

7

Township 7 South, Range 32 East

<u>File No.</u>	<u>Name of Owner</u>	<u>Name of Operator</u>	<u>First</u>	<u>Second</u>	<u>Third</u>	<u>Returned</u>
554	Heinrich, Gladys E.	Krone, P. R.	2/15/46	2/4/46	3/25/46	
549	Herman, Albert	Herman, Albert	2/15/46	3/4/46		3/15/46
550-551						
553-552	Indian	Krone, P. R.	2/15/46			
1096	Indian	Krone, P. R.				
555	Indian	Spotted, Wm.	Not Sent			
860	Indian	Robin, Iron				
548	Indian	Wolf, Charles	2/15/46			3/18/46
547	Wolf, Charles E.	Wolf, Charles E.	2/15/46	3/4/46		3/18/46

J

CONTENTS OF THIS FOLDER

<u>Code No.</u>	<u>Name of Owner</u>	<u>Name of Operator</u>
34 B	Anderson, Carl H.	Anderson, C. H. & T.
27 B	Chatham, John	Chatham, John
34 A	Chatham, Luther	Chatham, John
34 C, 35 B	Indian	Chatham, Luther
26 B, 35 A	Indian	Sherman, Sue
23 A, 26 C, 27 A, 24 D, 25 A, 26 A	Indian	Standish, Dell
33 A	Jefferson, Carl	Jefferson, Carl
12 A, 13 A, 24 A, 24 C	Smith, Mrs. Jeck & Indian	Faddis-Kennedy Cattle Co.
26 D	Spotted Horse, Martin	Spotted Horse, Martin
24 B	Standish, Dell	Standish, Dell

J. L. R. 33E

CONTENTS OF THIS FOLDER

<u>Code No.</u>	<u>Name of Owner</u>	<u>Name of Operator</u>
1 B	Brott, Neva Pearl	Clawson, John O.
1 C	Esp, Henry	
7 A, 18 A, 19 A	Faddis-Kennedy Cattle Co.	Faddis-Kennedy Cattle Co.
15 A	Gripp, Verlie	Layton, Lonnie
1 E, 15 B,		
16 A, 22 A	Indian	Clawson, John O.
11 C	Indian	Miller, R. J.
16 C, 21 A	Indian	Esp, Henry
6 C, 1 C	Indian	Mocassin, Gabriel
12 B, 13 A	Indian	Reservation Ranchers
12 C, 13 B	Indian	Tschirgi, M. H.
11 A, 12 A	Indian	Walker, Stephen E.
11 B, 14 A	Indian	Miller, L. J.
21 B	Miller, R. J.	
16 B, 20 A,		
29 A	Miller, W. A.	Miller, W. A.
29 B, 31 A,		
32 A	Nutting, Ruth and Indian	Graham, Joseph and Carroll
1 A, 6 A	Sharp, Harry	

CONTENTS OF THIS FOLDER

<u>Code No.</u>	<u>Name of Owner</u>	<u>Name of Operator</u>
22 A, 23 A	Heinrich, Gladys E.	Krone, P. R.
11 B, 12 A	Herman, Albert	Herman, Albert
14 A, 14 B, 22 C, 22 B, 23 B	Indian	Krone, P. R.
8 B, 9 A, 17 A, 16 A,	Indian	Krone, P. R.
11 C	Indian	Spotted, Wm.
4 A, 5 A, 8 A	Indian	Robin, Iron
1 B, 2 B, 11 A	Indian	Wolf, Charles
1 A, 2 A	Wolf, Charles E.	Wolf, Chas. E.

*See index for photo for
J. P. R. 33 & 34 E.*

Township 7S Range 34E County Big Horn

75

Range

34

County

Big Horn

[illegible]

STATE OF MONTANA
State Engineer's Office
WATER RESOURCES SURVEY

Township 7 S Range 34 E County Big Horn

167A	6	5	4	3	2	1
167A						
167A						
167A						
167A	7	8	9	10	11	12
166 164A						
166 164A						
166 164A						
166 164A	13	17	16	15	14	13
164A						
164A						
164A						
164A	19	20	21 168 101 168 101 168 101	22 168 101 168 101	23	24
	30	29	28	27	26	25
	31	32	33	34	35	36

Township _____ Range _____

75

Range 33

County Big Horn

[illegible]

STATE OF MONTANA
STATE ENGINEER'S OFFICE
 WATER RESOURCES SURVEY

Township 7.5 Range 33 E County Big Horn

6	5	4	3	2	1
7	8	9	10	11	12
18	17	16	15	14	13 165 164
19	20	21	22	23	24 164
30	29	28	27 229 362.6	26	25
31	32	33	34 362.6 209 362.6	35	36

Township..... Range.....

[illegible]

STATE OF MONTANA
STATE ENGINEER'S OFFICE
 WATER RESOURCES SURVEY

Township 75 Range 32E County Big Horn

					162A 162B	160 160A 161 161A 160B 160C 161 161A	160 160A 161 161A 160B 160C 161 161A	160 160A 161 161A 160B 160C 161 161A	162A
6	5	4	3			2			
					162A 162B				
7	8	9	10			11			12
					162B				
18	17	16	15			14			13
					163 163 163 163	163 163 163 163		87	
19	20	21	22						24
					163 163 163 163	163 163 163 163			
30	29	28			163 163 163 163	163 163 163 163			25
					163 163 163 163	163 163 163 163			
31	32	33			163 163 163 163	163 163 163 163			36
					163 163 163 163	163 163 163 163			

Township..... Range.....



1096
STATE OF MONTANA
STATE ENGINEERS OFFICE
Water Resources Survey

WR-1-10M 6-46
Code No. 13, 24, 17, 16, 17
County Big Horn
T. 7 S. R. 32 E.

Name of Land Owner Indian Address _____
Name of Operator Krone, P. R. Address St. Xavier, Mont.

Part A

TO BE FILED BY THOSE OBTAINING IRRIGATION WATER FROM
A DITCH COMPANY OR IRRIGATION DISTRICT

1. Water is delivered by: Carl Lieder Ditch & Parkate Ditch
Name of Ditch, Ditch Company or District supplying water
2. State the number of acres you irrigate under this system 100 Shares you hold _____
3. If you obtain water from more than one Company, give the number of shares, acres irrigated and the name of the Company under "Remarks." If you obtain water from a Ditch Company and also have a private system fill in both Part A and Part B.

Part B

TO BE FILED BY THOSE WHO HAVE A PRIVATE DITCH, PUMP OR IRRIGATION SYSTEM
or those who have a private water right under a Ditch Company

4. In what year was this land first irrigated? Date Do not know
5. Give the name of the original appropriator (first user): Carl Lieder
6. Give the date appropriated _____ Amount filed on: Miners Inches _____ C. F. S. _____
7. State the total number of acres irrigated under this system: _____
8. Give the point of diversion: SW 1/4 SW 1/4 Section 11 Township 7 S. Range 32 E.

Part C

TO BE FILED BY ALL WATER USERS IN ADDITION TO PART A OR PART B

9. Source of Water: West Fork of Soap Creek
Name of stream or lake from which water is originally diverted
10. Water is obtained by: (Check one) Gravity ☒ Pumping _____ Other _____
11. What is the greatest number of acres you have irrigated? 100 Date 1940
12. How many acres did you irrigate in 1945? (Crop and pasture) 100
13. State the total number of additional acres that could be irrigated by increasing the water supply, land leveling, etc. 40.4 This land is under what ditch? Same
14. How many acres of seeped land do you have which could be drained and put into production? 0
15. What is the condition of your irrigation system? Good
16. Is your water supply adequate? Yes ☒ No _____ Explain enough in spring & early summer
17. REMARKS: _____

Ridged in fall of grass, much clean water supply only a decrease in spring or wet years,

OVER

NOTE: The foregoing questions apply only to irrigated land shown on this plat.

DESCRIPTION AND MAP OF FARM

18. Legal Description of this Farm S², NW⁴, sec. 9, W² SE⁴, W² NE⁴ SE NW⁴, sec. 8
E² E², sec. 17, all sec. 16

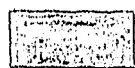

IRRIGATED LAND

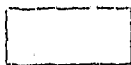

NON-IRRIGATED LAND

NORTH

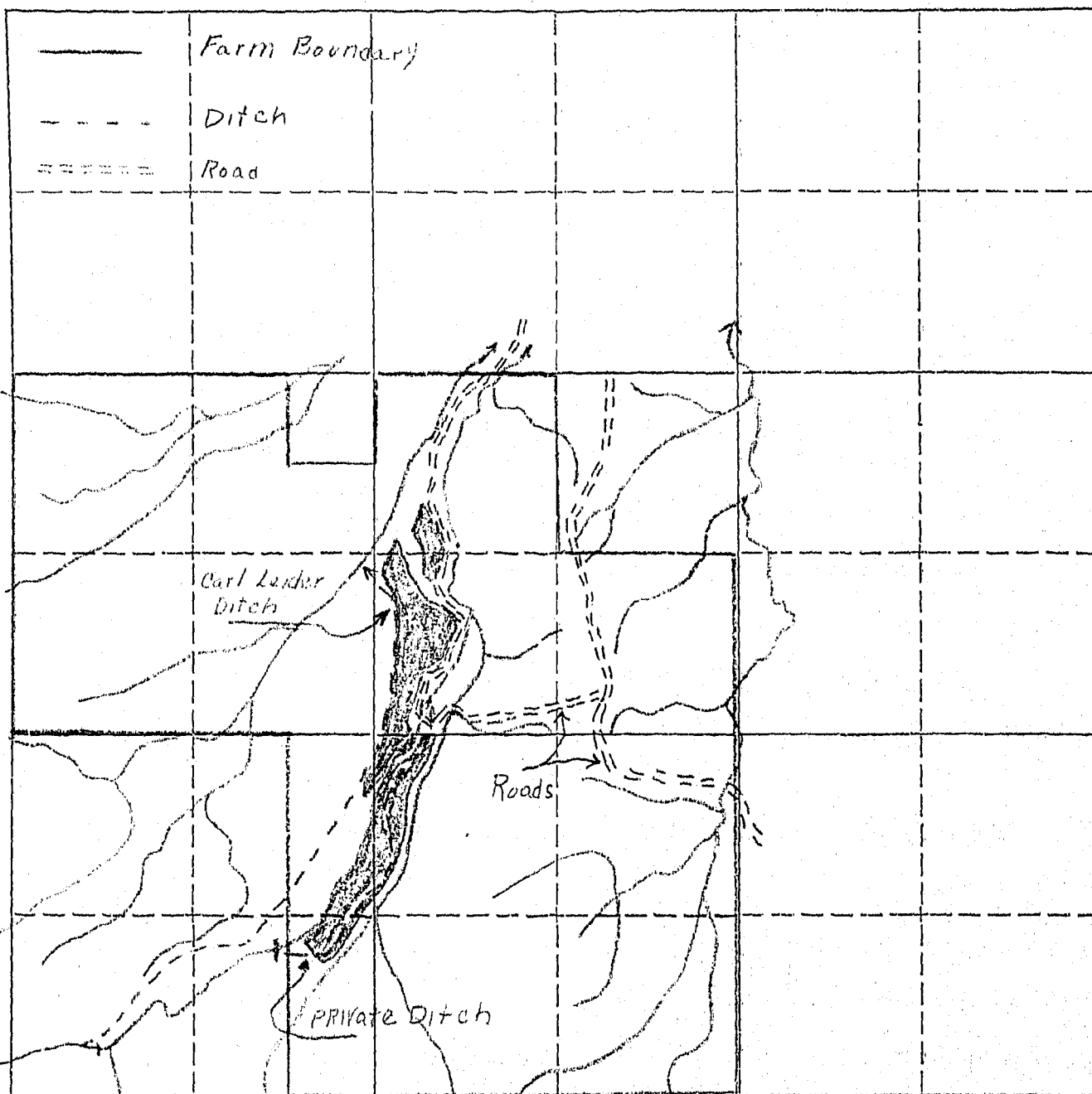

19. If the above land is irrigated from more than one ditch please give the acreage under each ditch in 19A and indicate the location of the land irrigated from each on the above map.

19A. Ditch: Carl Leider Ditch Acres: 100

Ditch: _____ Acres: _____

Information supplied by:

Name Dave Field check Address _____ Date 9/23/46

REMARKS: _____

If you cannot answer all of the questions on this form answer as many as you can and return the form to us as soon as possible.

STATE ENGINEERS OFFICE
Water Resources Survey

COUNTY Big Horn

FILE NO. 1096

Owner Indian Address _____

AAA Owner _____ Address _____

Operator Kramer, P.R. Address St. Xavier, Mont

New Owner _____ Address _____

New Operator _____ Address _____

Assessment Record _____

Assessed Acreage _____

Legal Description of This Farm S² NW⁴, sec 9, W², SE⁴, NW² NE⁴, SE NW⁴, sec 8
S² E², sec 17 all sec 16

Total Acres in Farm 1840

Code Number 9A, 8B, 17A, 16A

Photo No. 240-59

AAA Contract No. _____

AAA Total Cropland Acreage 149

App. No. _____

Decree No. _____

Land is located in

Twp. 7sa Rge. 33E Twp. _____ Rge. _____

Twp. _____ Rge. _____ Twp. _____ Rge. _____

Filed in Twp. _____ Rge. _____

Remarks _____

Farm Map

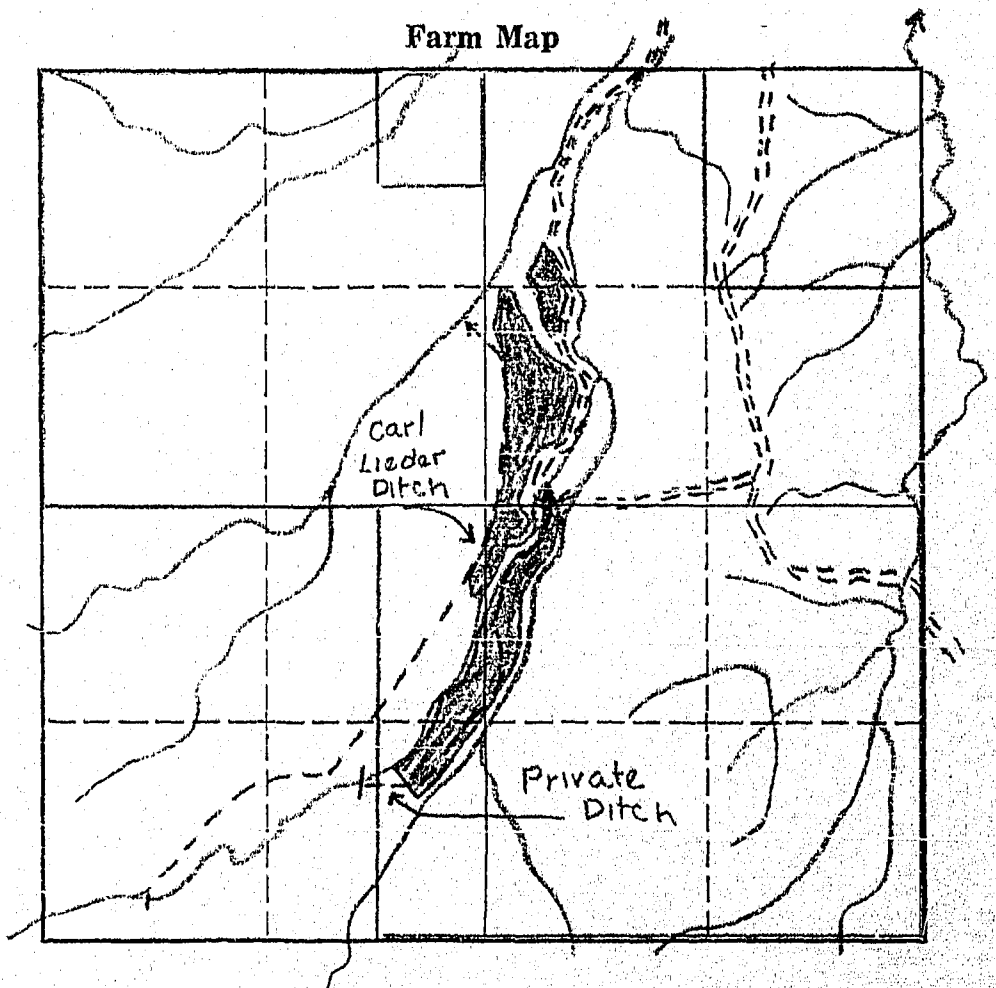



547
STATE OF MONTANA
STATE ENGINEERS OFFICE
Water Resources Survey

Form WRS-1--10M 8-45

Code No. 1 A, 2 A ✓
County Big Horn
T. 7 S. R. 32 E.

Name of Land Owner Wolf, Charles E. Address St. Xavier, Montana
Name of Operator Wolf, Chas. E. & Indian Address

Part A

**TO BE FILED BY THOSE OBTAINING IRRIGATION WATER FROM
A DITCH COMPANY OR IRRIGATION DISTRICT**

1. Water is delivered by: Private Ditch
Name of Ditch, Ditch Company or District supplying water
2. State the number of acres you irrigate under this system 0 Shares you hold
3. If you obtain water from more than one Company, give the number of shares, acres irrigated and the name of the Company under "Remarks." If you obtain water from a Ditch Company and also have a private system fill in both Part A and Part B.

Part B

**TO BE FILED BY THOSE WHO HAVE A PRIVATE DITCH, PUMP OR IRRIGATION SYSTEM
or those who have a private water right under a Ditch Company**

4. In what year was this land first irrigated? Date about 1900
5. Give the name of the original appropriator (first user): Joseph Cooper
6. Give the date appropriated Amount filed on: Miners Inches C. F. S.
7. State the total number of acres irrigated under this system:
8. Give the point of diversion: NE 1/4 of SW 1/4 Section 2 Township 7 S Range 32 E

Part C

TO BE FILED BY ALL WATER USERS IN ADDITION TO PART A OR PART B

9. Source of Water: Soap Creek
Name of stream or lake from which water is originally diverted
10. Water is obtained by: (Check one) Gravity ☒ Pumping ☒ Other
11. What is the greatest number of acres you have irrigated? 35 Date 1940
12. How many acres did you irrigate in 1945? (Crop and pasture) none
13. State the total number of additional acres that could be irrigated by increasing the water supply, land leveling, etc. 35.0 This land is under what ditch? Private
14. How many acres of seeped land do you have which could be drained and put into production?
15. What is the condition of your irrigation system? bad because of gopher's
16. Is your water supply adequate? Yes ☒ No Explain
17. REMARKS: I could irrigate 250 acres on bench in NW 1/4 of Section 2 if the Indian Irrigation did not have a larger water appropriated than the Soap Creek runs in summer. They use this water on the Big Horn. It does not pay me to develop the ditches needed because the Indian Irrigation has 1st water right.

NOTE: The foregoing conditions apply only to irrigated land shown on this plat.

DESCRIPTION AND MAP OF FARM

18. Legal Description of this Farm.....N¹/₄, NWSW¹/₄, Sec. 1 - NE¹/₄, SW¹/₄, S¹/₂NW¹/₄, NWNW¹/₄, N¹/₂SE¹/₄, SWSE¹/₄, Sec. 2 -
Twp. 7 S., Rge. 32 E.

IRRIGATED LAND		NON-IRRIGATED LAND	
<p>----- Farm boundary.</p> <p>NORTH</p> <p>↑</p> <p>This map is according to our records. Please change it if it is not correct. That is, if we show more irrigated land than you have, X it out; if we have not enough, draw it in.</p>			

19. If the above land is irrigated from more than one ditch please give the acreage under each ditch in 19A and indicate the location of the land irrigated from each on the above map.

19A. Ditch: Private Lower Ditch Acres: 35.0

Ditch: _____ Acres: _____

Information supplied by:

Name Chas E Wolf Address St Xavier Date March 10/1946

REMARKS: These 35 acres were first irrigated by the Indian allottee since 1900 and water was appropriated for him by the Indian Agent and has been irrigated most of the time since then.

If you cannot answer all of the questions on this form answer as many as you can and return the form to us as soon as possible.

Appropriations:

According to our records the following notices of appropriations were filed on and cover your land.

On August 14, 1915, James M. Kibben and Calvin G. Kibben filed for 200 miners inches from Soap Creek, recorded in Miscellaneous Records, Book 1, Page 226, Big Horn County; (160)

On August 14, 1915, James M. Kibben and Calvin G. Kibben filed for 80 miners inches from Soap Creek, recorded in Miscellaneous Records, Book 1, Page 227, Big Horn County; (160 A)

On August 24, 1916, James M. Kibben and Calvin G. Kibben filed for 280 miners inches from Soap Creek, recorded in Miscellaneous Records, Book 1, Page 294, Big Horn County; (161)

On March 11, 1915, the United States, through Mr. Evan W. Estep, Supt. and Special Disbursing Officer for the Crow Reservation, filed for 8 19/40 cubic feet per second from Soap Creek, recorded in Miscellaneous Records, Book 1, Page 193, Big Horn County; (162 A)

On March 11, 1915, the United States, through Mr. Evan W. Estep, Supt. and Special Disbursing Officer for the Crow Reservation, filed for 12 6/40 cubic feet per second from Soap Creek, recorded in Miscellaneous Records, Book 1, Page 192, Big Horn County. (162 B)

Are these appropriations now in use? If they are not, mark them "No", and if they are, mark them "Yes".

none of these appropriations are in use

STATE ENGINEERS OFFICE
Water Resources Survey

COUNTY Big Horn

FILE NO. 547

Owner Wolf, Charles E

Address St Xavier, Mont

AAA Owner Wolf, Charles E

Address

Operator

Address

New Owner

Address

New Operator

Address

Assessment Record lots 3+4, S²NW⁴, Sec. 1 lots 1, 2, 4, S²NE⁴ NESE⁴
S²NW⁴, SW⁴, NW⁴SE⁴ Sec. 2 750-32 E

Assessed Acreage 30.0

Legal Description of This Farm N², NWSW⁴, Sec. 1 - NE⁴, SW⁴, S²NW⁴, NWNW⁴
N²SE⁴, SWSE⁴ Sec. 2, 750-32 E.

Total Acres in Farm

Code Number 1A-2A

Photo No. 240-13

AAA Contract No. 1540

AAA Total Cropland Acreage 175

App. No. 160-161-160A-162A-162B

Decree No.

Land is located in

Twp. 750 Rge. 32E Twp. Rge.

Twp. Rge. Twp. Rge.

Filed in Twp. 750 Rge. 32E

Remarks

Farm Map

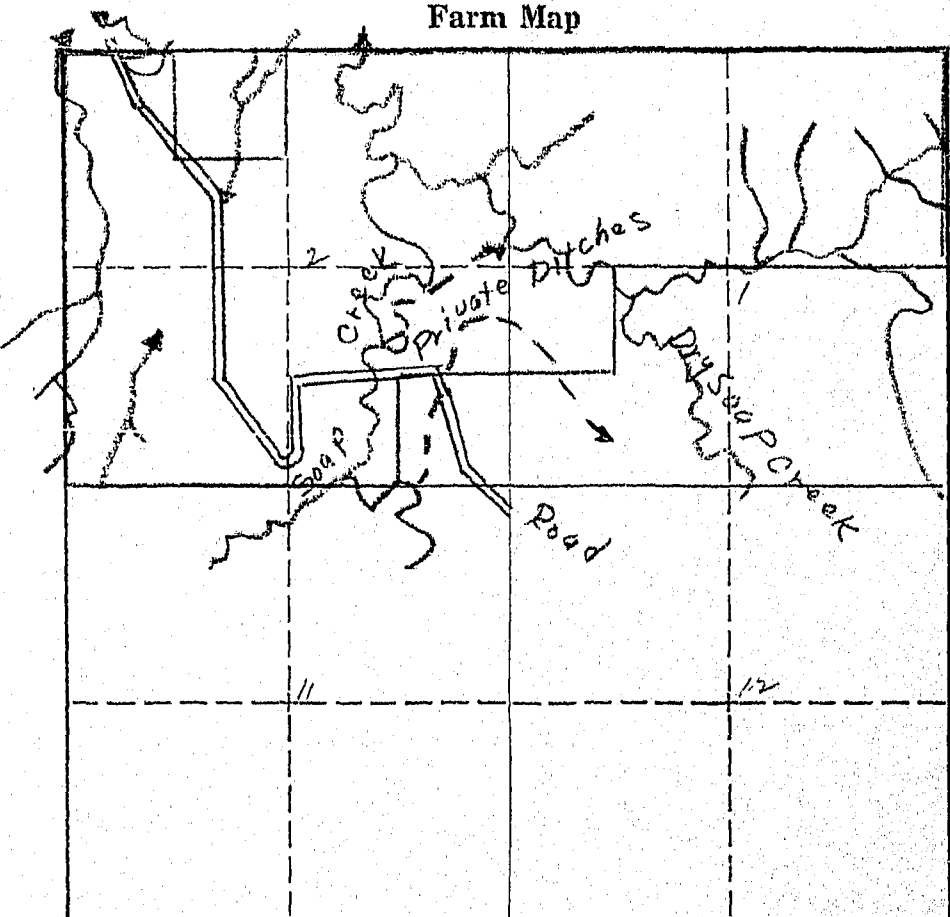

#547

Appropriations:

According to our records the following notices of appropriations were filed on and cover your land.

On August 14, 1915, James M. Kibben and Calvin G. Kibben filed for 200 miners inches from Soap Creek, recorded in Miscellaneous Records, Book 1, Page 226, Big Horn County; (160)

On August 14, 1915, James M. Kibben and Calvin G. Kibben filed for 80 miners inches from Soap Creek, recorded in Miscellaneous Records, Book 1, Page 227, Big Horn County; (160 A)

On August 24, 1916, James M. Kibben and Calvin G. Kibben filed for 280 miners inches from Soap Creek, recorded in Miscellaneous Records, Book 1, Page 294, Big Horn County; (161)

On March 11, 1915, the United States, through Mr. Evan W. Estep, Supt. and Special Disbursing Officer for the Crow Reservation, filed for 8 19/40 cubic feet per second from Soap Creek, recorded in Miscellaneous Records, Book 1, Page 193, Big Horn County; (162 A)

On March 11, 1915, the United States, through Mr. Evan W. Estep, Supt. and Special Disbursing Officer for the Crow Reservation, filed for 12 6/40 cubic feet per second from Soap Creek, recorded in Miscellaneous Records, Book 1, Page 192, Big Horn County. (162 B)

Are these appropriations now in use? If they are not, mark them "No", and if they are, mark them "Yes".

February 15, 1946

Mr. Charles Wolf
St. Xavier, Montana

Dear Mr. Wolf:

March 4, 1946

Mr. Charles E. Wolf
St. Xavier, Montana

Dear Mr. Wolf:

On February 15, 1946, this office sent you forms and a letter asking for information pertaining to your irrigated land in Big Horn County.

To date we have not heard from you. With the vast water development program now being planned on the Big Horn River by Federal Agencies, it is essential that we have this information in order to show the extent of our water use and our water rights in the Big Horn Basin in Montana. This information is necessary and vital if we are to protect our present water users and the rights they have against future irrigation, navigation, power, and flood control enterprises in this area. We are asking you for this information because we feel it is the democratic way. We also feel that you are more qualified to give us this information about your irrigated land than anyone else because it is part of your business. It may be that you were busy with your farm work, or some unforeseen thing happened at the time our first letter was received and you put it aside to be answered at some other time and have forgotten all about it. All information received by us is strictly confidential, and is only used to record and tabulate the water use in the Big Horn area.

Water is as necessary to the farmer as the soil in which he plants. Without it no crops will grow - no living thing can survive. It is your water that we are trying to protect so that you will have plenty now and in the future. We must keep Montana's water in Montana. The only way we can do this is by having the support of each and every water user so that we have 100% representation of all water users. Remember - "United we stand, divided we fall."

In order to facilitate this work, a branch office of the State Engineer has been established in Billings and is located in the Roosevelt School Building on Twenty-third Street and Fourth Avenue, North. Any time you are in Billings, we will appreciate your calling on us.

Hoping to hear from you in the very near future, I am

Yours very truly,

Gerald J. Oravetz
Ass't State Engineer

GJO:pw

P.S. If you cannot supply us with the information requested, it may be that you can tell us of someone who can.

FORM SM-1

A STUDY OF MONTANA'S WATER RESOURCES

County Big Horn Source of Information Mr. C. E. Wolf

1. Water User Wolf, C. E. Address St. Xavier, Mont.

2. Stream Sage Creek Tributary to Big Horn Basin Yellowstone

3. Point of Diversion $\frac{1}{4}$ $\frac{1}{4}$ Section Township Range

4. Description of System Ditch originally made Cooper, Joe (Crow Indian) About 1907

5. Type of Irrigation

6. Original Appropriator Address

7. First Use: about Year 1907 Acres Irrigated 5 acres

8. Maximum Use: Year Acres Irrigated

9. Present Use: Year 1941 Acres Irrigated 35 acres (about 200 ditched and used

10. Last Use: Year Why Abandoned Some for flood irrigation when water is available

11. Condition of System Good

12. Land Description , T 7S, R 32E

Remarks: 35 acres

all that has been
used in past several years.

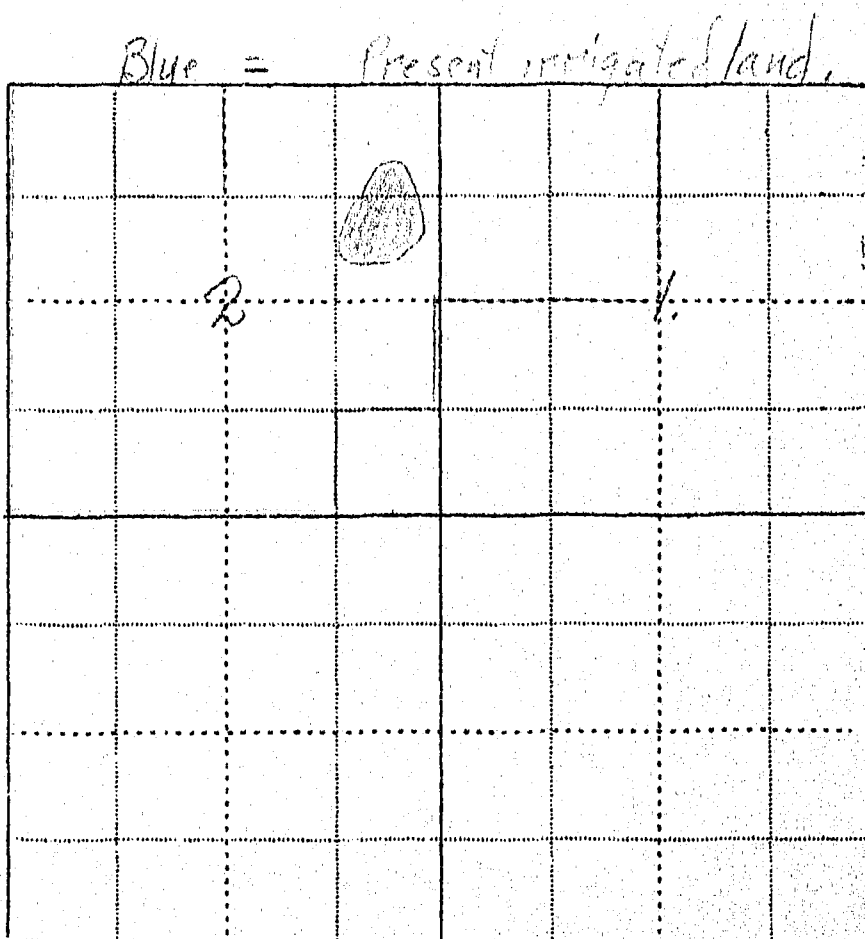

WITNESS: Information by Chas E Wolf

Place

App. 160 + 161

1. Water User	Address
1. [illegible]	[illegible]

2. Stream Sagehen Creek Tributary to Big Horn Basin

3. Point of Diversion $22\frac{1}{2}$ $42\frac{1}{2}$ Section 1 Township 7S Range 3-12

4. Description of System *Power Law - 2.22*

5. Type of Irrigation

6. Original Appropriator	Address

7. First Use:	Year	Acres Irrigated
---------------	------	-----------------

8. Maximum Use: Year Acres Irrigated

9. Present Use; Year	Acres Irrigated
1950	100
1951	100
1952	100
1953	100
1954	100
1955	100
1956	100
1957	100
1958	100
1959	100
1960	100
1961	100
1962	100
1963	100
1964	100
1965	100
1966	100
1967	100
1968	100
1969	100
1970	100
1971	100
1972	100
1973	100
1974	100
1975	100
1976	100
1977	100
1978	100
1979	100
1980	100
1981	100
1982	100
1983	100
1984	100
1985	100
1986	100
1987	100
1988	100
1989	100
1990	100
1991	100
1992	100
1993	100
1994	100
1995	100
1996	100
1997	100
1998	100
1999	100
2000	100
2001	100
2002	100
2003	100
2004	100
2005	100
2006	100
2007	100
2008	100
2009	100
2010	100
2011	100
2012	100
2013	100
2014	100
2015	100
2016	100
2017	100
2018	100
2019	100
2020	100
2021	100
2022	100
2023	100
2024	100
2025	100
2026	100
2027	100
2028	100
2029	100
2030	100
2031	100
2032	100
2033	100
2034	100
2035	100
2036	100
2037	100
2038	100
2039	100
2040	100
2041	100
2042	100
2043	100
2044	100
2045	100
2046	100
2047	100
2048	100
2049	100
2050	100
2051	100
2052	100
2053	100
2054	100
2055	100
2056	100
2057	100
2058	100
2059	100
2060	100
2061	100
2062	100
2063	100
2064	100
2065	100
2066	100
2067	100
2068	100
2069	100
2070	100
2071	100
2072	100
2073	100
2074	100
2075	100
2076	100
2077	100
2078	100
2079	100
2080	100
2081	100
2082	100
2083	100
2084	100
2085	100
2086	100
2087	100
2088	100
2089	100
2090	100
2091	100
2092	100
2093	100
2094	100
2095	100
2096	100
2097	100
2098	100
2099	100
2100	100

10. Last Use:	Year	Why Abandoned
---------------	------	---------------

11. Condition of System

12. Land Description . T 9 S , R 32

Remarks:

Let's find out how many 400's

A hand-drawn sketch on a grid background showing a profile of a person's head and neck. The sketch is labeled "Kibbo's Profile" and includes a vertical line indicating the "Kibbo's Profile" and a horizontal line indicating the "Kibbo's Profile".

WITNESS: Information by

Place _____

STATE ENGINEERS OFFICE
Water Resources Survey

Notice of Appropriation

1. County Big Horn Book 1 Page 226 Record Misc 160
 2. Name of Appropriator Kibben Bros. Address _____
 3. Date Appropriated 8-10-15 Date Filed 8-11-15
 Amount Appropriated, Miners Inches 200, Cubic Feet per second _____
 4. Name of Stream Scarp Creek Tributary _____ Basin _____
 5. Point of Diversion _____
in the NE corner of NWSE" of
 Sec. 14 Twp. 15 Rge. 32E Bank of Stream right

6. Purpose Irrigation & domestic
 7. Description of System a 4 to ditch running NE

8. Land Description of Intended Place of Use NW" sec 1 7S-32E
part lying E of Scarp Cr. NE" " 2 " "

9. Remarks (Pertaining to Use, etc.) _____

Decree

10. Case No. _____ Date _____ Amt. Decreed: M. I. _____ C. F. S. _____
 11. To Whom Decreed _____ Address _____
 12. Name of Ditch _____ Maximum Capacity (C. F. S.) _____
 13. Date of Priority _____ Purpose _____
 14. Land Description of Place of Use as Decreed _____

15. Remarks (Present Use Status, etc.) _____

STATE ENGINEERS OFFICE
Water Resources Survey

Notice of Appropriation

160-A

1. County Big Horn Book 1 Page 227 Record Misc.
2. Name of Appropriator Jas. W. & Calvin Kibben Address _____
3. Date Appropriated 8-10-15 Date Filed 8-14-15
Amount Appropriated, Miners Inches 80, Cubic Feet per second _____
4. Name of Stream _____ Tributary _____ Basin _____
5. Point of Diversion _____
at a point in
Sec. 14 Twp. 7S Rge. 32E Bank of Stream Left
6. Purpose Irrigation & domestic
7. Description of System 4 ft. ditch running north
8. Land Description of Intended Place of Use NE⁴ sec. 2, 7S-42E
part lying W. of Soap Creek
9. Remarks (Pertaining to Use, etc.) _____

Decree

10. Case No. _____ Date _____ Amt. Decreed: M. I. _____ C. F. S. _____
11. To Whom Decreed _____ Address _____
12. Name of Ditch _____ Maximum Capacity (C. F. S.) _____
13. Date of Priority _____ Purpose _____
14. Land Description of Place of Use as Decreed _____
15. Remarks (Present Use Status, etc.) _____

STATE ENGINEERS OFFICE
Water Resources Survey

Notice of Appropriation

1. County Big Horn Book 1 Page 296 Record Misc
2. Name of Appropriator Jas. M. Quinn Kibben Address _____
3. Date Appropriated 8-24-16 Date Filed 8-24-16
Amount Appropriated, Miners Inches 280, Cubic Feet per second _____
4. Name of Stream Loah Creek Tributary _____ Basin _____
5. Point of Diversion _____
a dam in the NENE of
Sec. 11 Twp. 7S Rge. 3RE Bank of Stream right
6. Purpose _____
7. Description of System _____
8. Land Description of Intended Place of Use NW 1/4 sec 1 7S-32E
NE 1/4 " 2 " "
9. Remarks (Pertaining to Use, etc.) _____

Decree

10. Case No. _____ Date _____ Amt. Decreed: M. I. _____ C. F. S. _____
11. To Whom Decreed _____ Address _____
12. Name of Ditch _____ Maximum Capacity (C. F. S.) _____
13. Date of Priority _____ Purpose _____
14. Land Description of Place of Use as Decreed _____
15. Remarks (Present Use Status, etc.) _____

STATE ENGINEERS OFFICE
Water Resources Survey

Notice of Appropriation

1. County Big Horn Book 1 Page 193 Record Misc.
2. Name of Appropriator U. S. A. Address _____
3. Date Appropriated 3-4-14 Date Filed 3-11-15
Amount Appropriated, Miners Inches 340, Cubic Feet per second _____
4. Name of Stream Soap Creek Tributary _____ Basin _____
5. Point of Diversion in the NE corner of N.W.S.E. of

Sec. 14 Twp. 7 S Rge. 32 E Bank of Stream right

6. Purpose Irrigation & domestic
7. Description of System _____

8. Land Description of Intended Place of Use In sec. 1-2-11, 7 S-32 E

9. Remarks (Pertaining to Use, etc.) _____

Decree

10. Case No. _____ Date _____ Amt. Decreed: M. I. _____ C. F. S. _____
11. To Whom Decreed _____ Address _____
12. Name of Ditch _____ Maximum Capacity (C. F. S.) _____
13. Date of Priority _____ Purpose _____
14. Land Description of Place of Use as Decreed _____
15. Remarks (Present Use Status, etc.) _____



548
STATE OF MONTANA
STATE ENGINEERS OFFICE
Water Resources Survey

Form WR-1--10M 3-45

Code No. 10-2B-115
County Big Horn
T. 7 S. R. 32 E.

Name of Land Owner Indian Address _____
Name of Operator Wolf, Charles Address St. Xavier, Montana

Part A

TO BE FILED BY THOSE OBTAINING IRRIGATION WATER FROM
A DITCH COMPANY OR IRRIGATION DISTRICT

1. Water is delivered by Private Ditch, filed on by J. H. Cooper
Name of Ditch, Ditch Company or District supplying water _____
2. State the number of acres you irrigate under this system. 0 Shares you hold _____
3. If you obtain water from more than one Company, give the number of shares, acres irrigated and the name of the Company under "Remarks." If you obtain water from a Ditch Company and also have a private system fill in both Part A and Part B.

Part B

TO BE FILED BY THOSE WHO HAVE A PRIVATE DITCH, PUMP OR IRRIGATION SYSTEM
or those who have a private water right under a Ditch Company

4. In what year was this land first irrigated? Date _____
5. Give the name of the original appropriator (first user): _____
6. Give the date appropriated. _____ Amount filed on: Miners Inches _____ C. F. S. _____
7. State the total number of acres irrigated under this system: _____
8. Give the point of diversion: 1/4 Section _____ Township _____ Range _____

Part C

TO BE FILED BY ALL WATER USERS IN ADDITION TO PART A OR PART B

9. Source of Water: Soap Creek
Name of stream or lake from which water is originally diverted _____
10. Water is obtained by: (Check one) Gravity ☒ Pumping _____ Other _____
11. What is the greatest number of acres you have irrigated? _____ Date _____
12. How many acres did you irrigate in 1945? (Crop and pasture) 0
13. State the total number of additional acres that could be irrigated by increasing the water supply, land leveling, etc. 5.0 acres This land is under what ditch? Private Ditch
14. How many acres of seeped land do you have which could be drained and put into production? _____
15. What is the condition of your irrigation system? Needs a dam for diverting water
16. Is your water supply adequate? Yes ☒ No _____ Explain _____
17. REMARKS: This ditch was built and filed on by J. H. Cooper

OVER

NOTE: The foregoing questions apply only to irrigated land shown on this plat.

DESCRIPTION AND MAP OF FARM

18. Legal Description of this Farm.....SWSW¹/₄, Sec. 1 - SESE¹/₄, Sec. 2 - NENE¹/₄, Sec. 11 -
Twp. 7 S., Rge. 32 E.

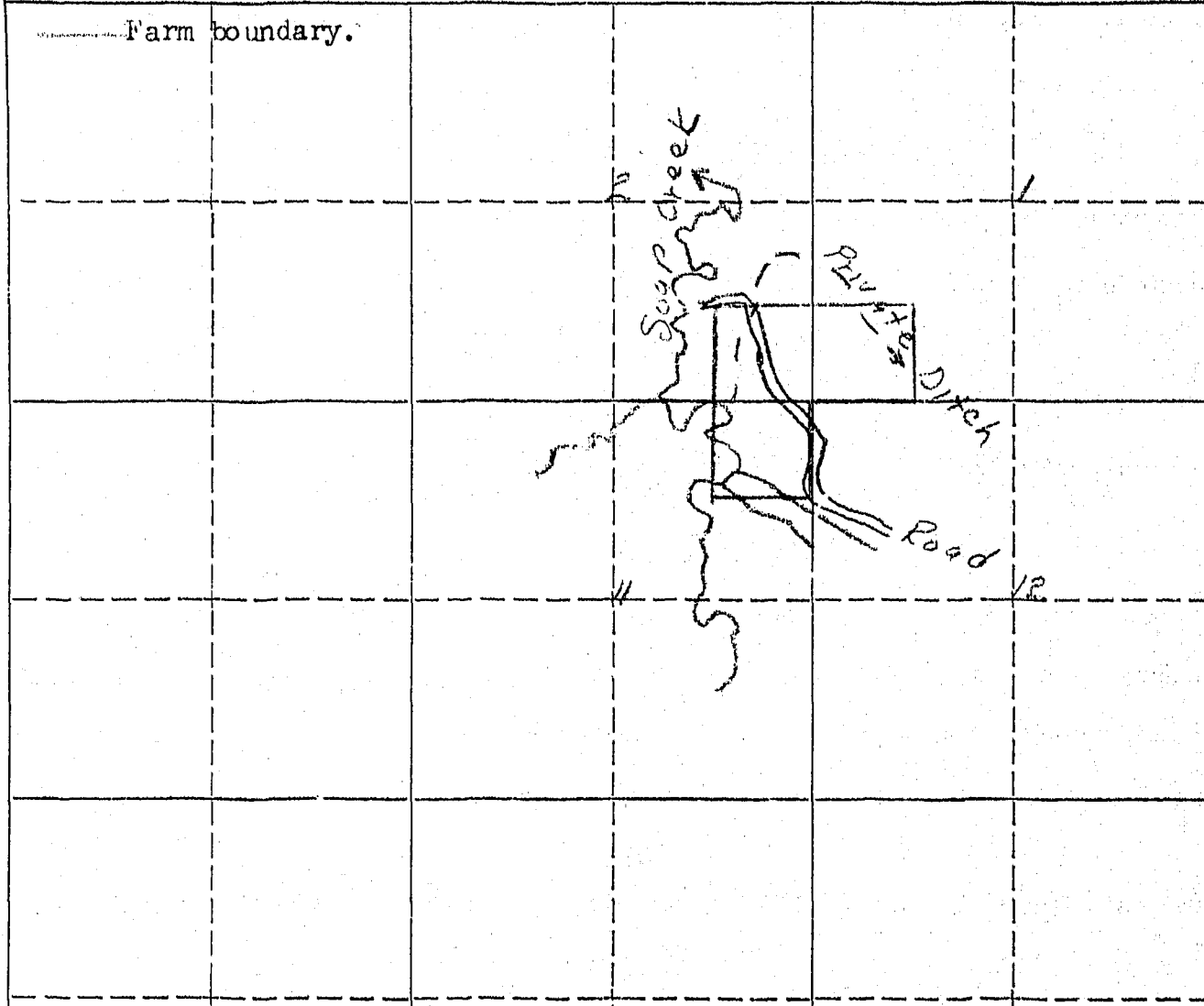
	IRRIGATED LAND	NON-IRRIGATED LAND
<p>NORTH</p> 	<p>Farm boundary.</p> 	
	<p>This map is according to our records. Please change it if it is not correct. That is, if we show more irrigated land than you have, X it out; if we have not enough, draw it in.</p>	

19. If the above land is irrigated from more than one ditch please give the acreage under each ditch in 19A and indicate the location of the land irrigated from each on the above map.

19A. Ditch: Private Ditch Acres: 0

Ditch: _____ Acres: _____

Information supplied by:

Name Field check & planimeter figures Address _____ Date 3-18-46
and farm section by the Wolf

REMARKS: _____

If you cannot answer all of the questions on this form answer as many as you can and return the form to us as soon as possible.

STATE ENGINEERS OFFICE
Water Resources Survey

COUNTY Big Horn

FILE NO. 548

Owner Indian Address

AAA Owner Indian Address

Operator Wolf, Charles Address St. Xavier Mont.

New Owner Address

New Operator Address

Assessment Record

Assessed Acreage 0

Legal Description of This Farm SWSW⁴ Sec. 1 - SESE⁴ Sec. 2 - NENE⁴ Sec. 11

7S0-32E

Total Acres in Farm 120

Code Number 1B-2B-11A-

Farm Map

Photo No. 240-13

AAA Contract No. 5048

AAA Total Cropland Acreage 69

App. No. 162A-162B

Decree No.

Land is located in

Twp. 7S0 Rge. 32E Twp. Rge.

Twp. Rge. Twp. Rge.

Filed in Twp. 7S0 Rge. 32E

Remarks

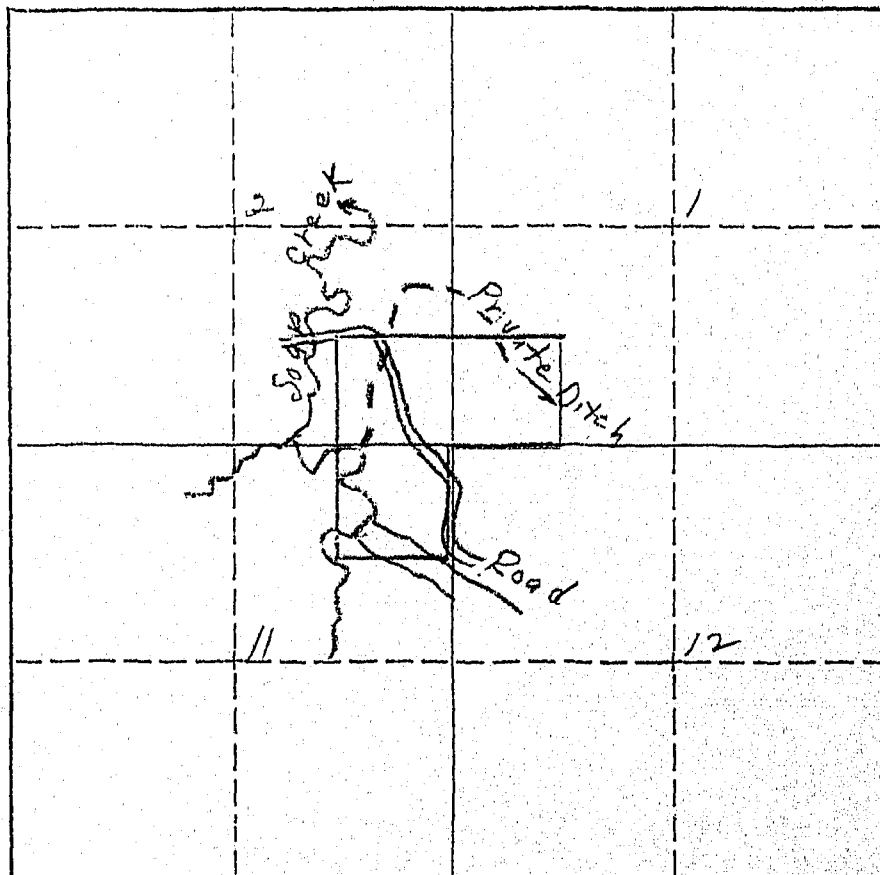

As this land is owned by the Indians it will not be necessary for you to give us any information pertaining to water rights, but as an operator of this land we would like to have you give us the number of acres you irrigated in 1945 in Question 12, under Part C, on the enclosed form.

February 15, 1946

Mr. Charles Wolf
St. Xavier, Montana

Dear Mr. Wolf:

SPECIAL NOTICE TO OPERATOR OF THE INDIAN LAND SHOWN ON THE ENCLOSED FORM.

As it is possible that you also operate other lands than those shown on our map, we are interested in the amount of land that you have irrigated only on the land that we have mapped, and not other lands that you may operate under different ownership. The reason for this is that, if lands have white owners, we contact them directly.

#547

Appropriations:

According to our records the following notices of appropriations were filed on and cover your land.

On August 14, 1915, James M. Kibben and Calvin G. Kibben filed for 200 miners inches from Soap Creek, recorded in Miscellaneous Records, Book 1, Page 226, Big Horn County; (160)

On August 14, 1915, James M. Kibben and Calvin G. Kibben filed for 80 miners inches from Soap Creek, recorded in Miscellaneous Records, Book 1, Page 227, Big Horn County; (160 A)

On August 24, 1916, James M. Kibben and Calvin G. Kibben filed for 280 miners inches from Soap Creek, recorded in Miscellaneous Records, Book 1, Page 294, Big Horn County; (161)

✓ On March 11, 1915, the United States, through Mr. Evan W. Estep, Supt. and Special Disbursing Officer for the Crow Reservation, filed for 8 19/40 cubic feet per second from Soap Creek, recorded in Miscellaneous Records, Book 1, Page 193, Big Horn County; (162 A)

✓ On March 11, 1915, the United States, through Mr. Evan W. Estep, Supt. and Special Disbursing Officer for the Crow Reservation, filed for 12 6/40 cubic feet per second from Soap Creek, recorded in Miscellaneous Records, Book 1, Page 192, Big Horn County. (162 B)

Are these appropriations now in use? If they are not, mark them "No", and if they are, mark them "Yes".

FORM SM-1

A STUDY OF MONTANA'S WATER RESOURCES

1-B
2-B
11-B

County Big Horn Source of Information OK #1055 24 24 24

1. Water User VS ID Address _____

2. Stream Big Horn Tributary to Big Horn Basin _____

3. Point of Diversion 1/2 1/2 Section 11 Township 15 Range 32 E

4. Description of System Wagon Ditch

5. Type of Irrigation _____

6. Original Appropriator Cooper (Indian) Address Rebuilt 4 feet 6 inches 1916

7. First Use: Year 1907 Acres Irrigated _____

8. Maximum Use: Year _____ Acres Irrigated _____

9. Present Use: Year 1939 Acres Irrigated 7 (Photo) (Very small irrigated)

10. Last Use: Year _____ Why Abandoned _____

11. Condition of System _____

12. Land Description _____ T 15 R 32 E

Remarks:

Mr. Donald C. Cooper

24 24 24

WITNESS:

Information by

Place



550 - 551 - 552 - 552
STATE OF MONTANA
STATE ENGINEERS OFFICE
Water Resources Survey

Form WR-1--10M-8-15
Code No. 14A - 14B- 22C
County Big Horn 22B
T. 7 S. R. 32 E. 23B

Name of Land Owner Indian Address
Name of Operator Krone, P. R. Address St. Xavier, Montana

Part A

TO BE FILED BY THOSE OBTAINING IRRIGATION WATER FROM
A DITCH COMPANY OR IRRIGATION DISTRICT

1. Water is delivered by: Laura Green Ditch Private
Name of Ditch, Ditch Company or District supplying water
2. State the number of acres you irrigate under this system 34.2 Shares you hold
3. If you obtain water from more than one Company, give the number of shares, acres irrigated and the name of the Company under "Remarks." If you obtain water from a Ditch Company and also have a private system fill in both Part A and Part B.

Part B

TO BE FILED BY THOSE WHO HAVE A PRIVATE DITCH, PUMP OR IRRIGATION SYSTEM
or those who have a private water right under a Ditch Company

4. In what year was this land first irrigated? Date
5. Give the name of the original appropriator (first user): Laura Green
6. Give the date appropriated 5-16-1904 Amount filed on: Miners Inches C. F. S. 36
7. State the total number of acres irrigated under this system: 147
8. Give the point of diversion: SW 1/4 SE 1/4 Section 22 Township 7 S Range 32 E

Part C

TO BE FILED BY ALL WATER USERS IN ADDITION TO PART A OR PART B

9. Source of Water: Snap Creek
Name of stream or lake from which water is originally diverted
10. Water is obtained by: (Check one) Gravity ☒ Pumping ☐ Other ☐
11. What is the greatest number of acres you have irrigated? Date
12. How many acres did you irrigate in 1945? (Crop and pasture) 34.2
13. State the total number of additional acres that could be irrigated by increasing the water supply, land leveling, etc. 0 This land is under what ditch?
14. How many acres of seeped land do you have which could be drained and put into production?
15. What is the condition of your irrigation system? Good
16. Is your water supply adequate? Yes ☒ No ☐ Explain
17. REMARKS:

NOTE: The foregoing questions apply only to irrigated land shown on this plat.

DESCRIPTION AND MAP OF FARM

18. Legal Description of this Farm... $W\frac{1}{2}NE\frac{1}{4}$, $E\frac{1}{2}SW\frac{1}{4}$, $E\frac{1}{2}NE\frac{1}{4}$, $SE\frac{1}{4}$, $W\frac{1}{2}SW\frac{1}{4}$, Sec. 14; $SE\frac{1}{4}$, Sec. 22; -

$W\frac{1}{2}NE\frac{1}{4}$, Sec. 22

$W\frac{1}{2}NWSW\frac{1}{4}$, Sec. 23; - T. 7So. - R. 32E.

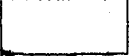
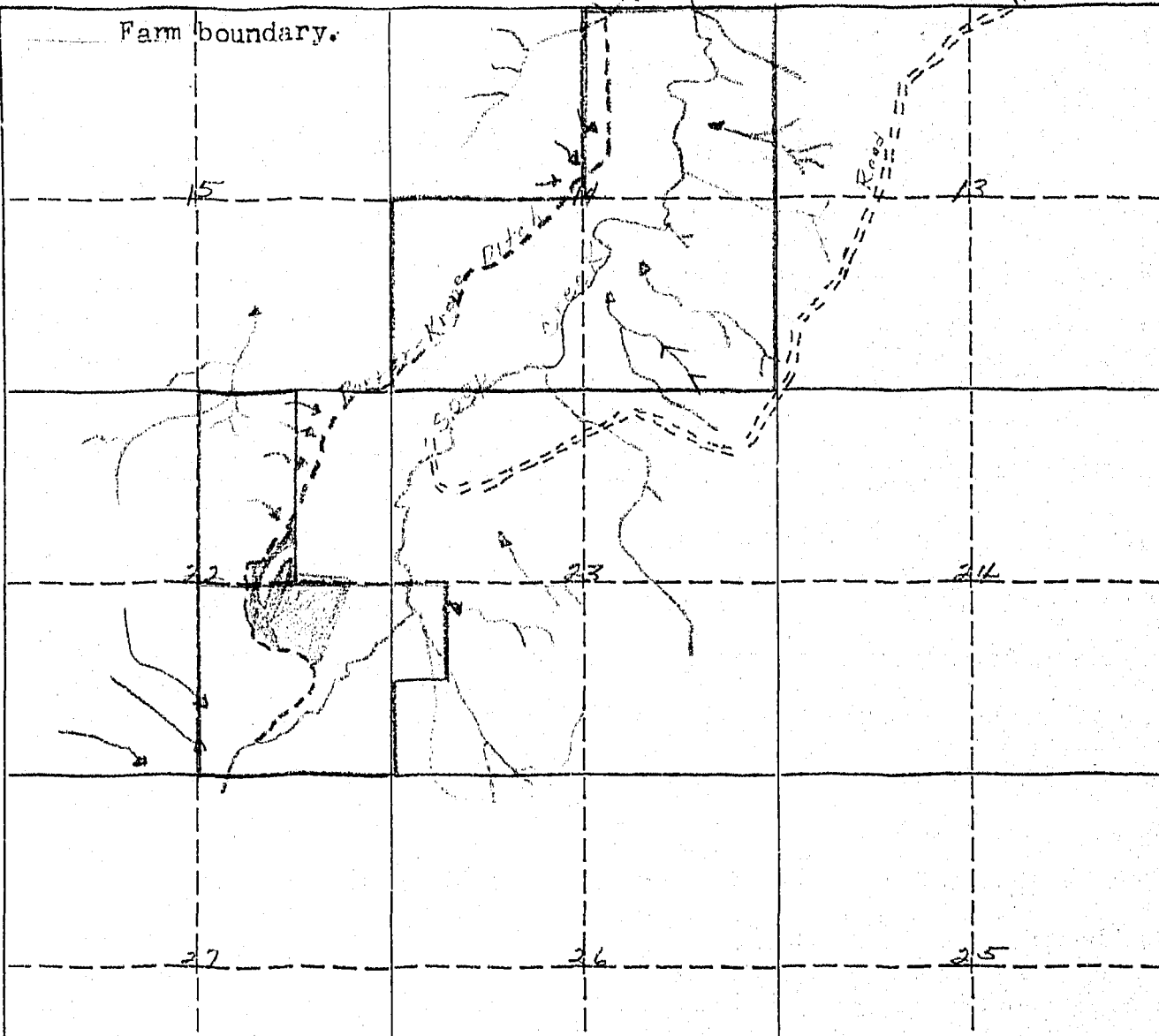
 IRRIGATED LAND		 NON-IRRIGATED LAND	
<p>Farm boundary.</p>			
			
<p>This map is according to our records. Please change it if it is not correct. That is, if we show more irrigated land than you have, X it out; if we have not enough, draw it in.</p>			

19. If the above land is irrigated from more than one ditch please give the acreage under each ditch in 19A and indicate the location of the land irrigated from each on the above map.

19A. Ditch: Laura Green Ditch Acres: 34.2

Ditch: _____ Acres: _____

Information supplied by: Field Check

Name: Dave Address: _____ Date: 9/23-46

REMARKS: _____

If you cannot answer all of the questions on this form answer as many as you can and return the form to us as soon as possible.

STATE ENGINEERS OFFICE
Water Resources Survey

COUNTY Big Horn

FILE NO. 550

Owner Indian Address _____

AAA Owner Indian Address _____

Operator Krone, P. R. Address St. Xavier

New Owner _____ Address _____

New Operator _____ Address _____

Assessment Record _____

Assessed Acreage 0

Legal Description of This Farm W*NE*, E*SW*, Sec. 14 - 750 - 32 E.

Total Acres in Farm 160

Code Number 14 A

Photo No. 240-16

AAA Contract No. 2068 A

AAA Total Cropland Acreage 52.8

App. No. 162 A - 162 B - 163

Decree No. _____

Land is located in

Twp. 750 Rge. 32 E Twp. _____ Rge. _____

Twp. _____ Rge. _____ Twp. _____ Rge. _____

Filed in Twp. 14 Rge. 32 E

Remarks _____

Farm Map

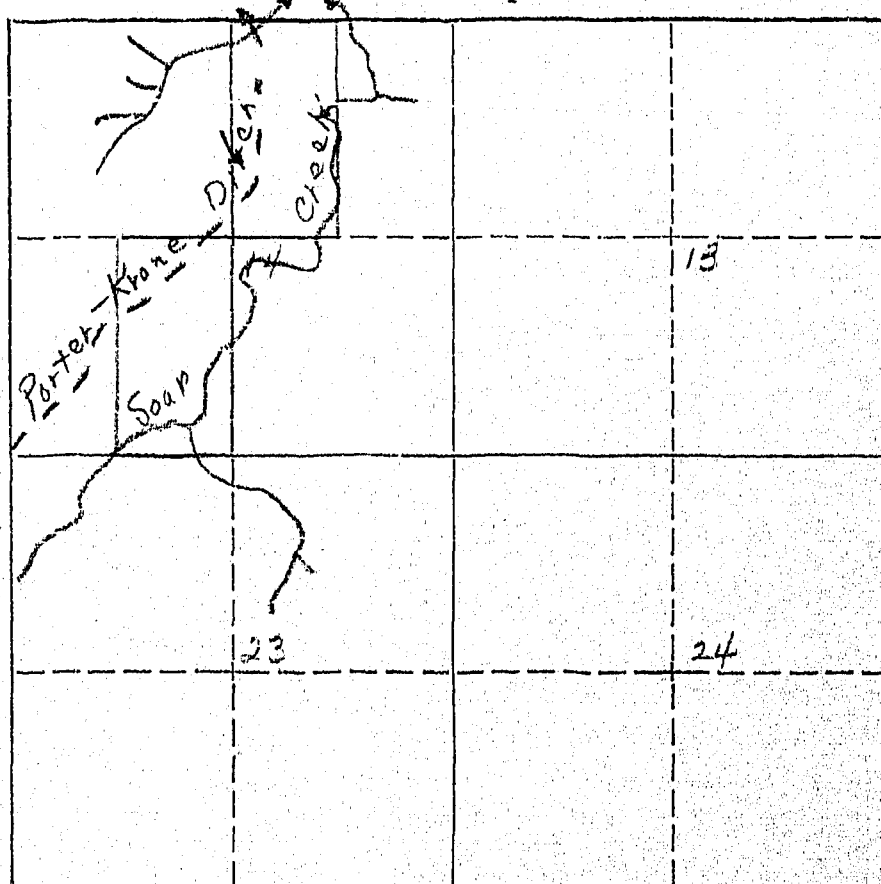

As this land is owned by the Indians it will not be necessary for you to give us any information pertaining to water rights, but as an operator of this land we would like to have you give us the number of acres you irrigated in 1945 in Question 12, under Part C, on the enclosed form.

February 15, 1946

Mr. P. R. Krone
St. Xavier, Montana

Dear Mr. Krone:

On March 11, 1915, the United States, through Mr. Evan W. Estep, Supt. and Special Disbursing Officer for the Crow Reservation, filed for 8 19/40 cubic feet per second from Soap Creek, recorded in Misc. Records, Book 1, Page 193, Big Horn County (162 A)

On March 11, 1915, the United States, through Mr. Evan W. Estep, Supt. and Special Disbursing Officer for the Crow Reservation, filed for 12 6/40 cubic feet per second from Soap Creek, recorded in Misc. Records, Book 1, Page 192, Big Horn County (162 B)

On May 19, 1904 Laura and A. F. C. Green filed for 36 cubic feet per second from Soap Creek, recorded in Book A, Page 419 of Misc. Records, Big Horn County (163)

STATE ENGINEERS OFFICE
Water Resources Survey

COUNTY Big Horn

FILE NO. 551

Owner Indian Address _____

AAA Owner Indian Address _____

Operator Krone, P. R. Address St. Xavier, Mont

New Owner _____ Address _____

New Operator _____ Address _____

Assessment Record _____

Assessed Acreage _____

Legal Description of This Farm E 1/4 NE 1/4, SE 1/4, NW 1/4, Sec. 14 - T. 56 - R. 32 E

Total Acres in Farm 320

Code Number 14B- dry land not shown
Farm Map

Photo No. 240-16

AAA Contract No. 8696

AAA Total Cropland Acreage 29.1

App. No. 0

Decree No. _____

Land is located in

Twp. 750 Rge. 32E Twp. _____ Rge. _____

Twp. _____ Rge. _____ Twp. _____ Rge. _____

Filed in Twp. 750 Rge. 32E

Remarks _____

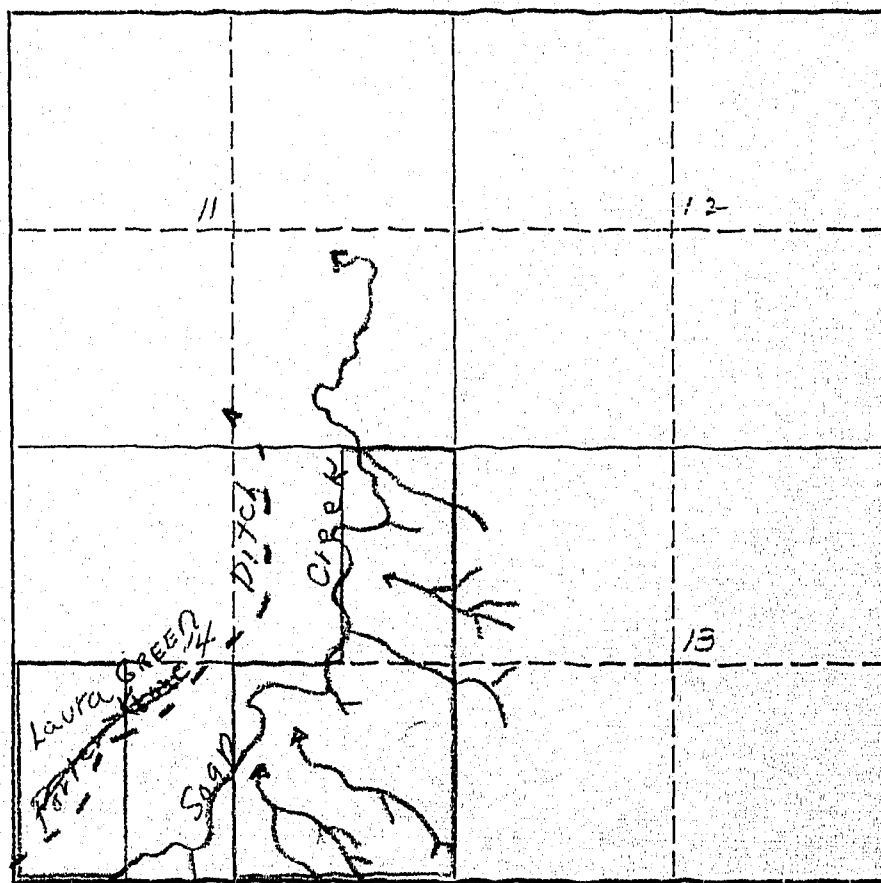

STATE ENGINEERS OFFICE
Water Resources Survey

COUNTY Big Horn

FILE NO. 553

Owner Indian Address _____

AAA Owner " Address _____

Operator Krone, P.R. Address St. Xavier, Mont.

New Owner _____ Address _____

New Operator _____ Address _____

Assessment Record _____

Assessed Acreage _____

Legal Description of This Farm SE 1/4, Sec. 22 750-32 E

W 1/2 NE 1/4, Sec. 22 W 1/2 NW 1/4, Sec. 23

Total Acres in Farm 260

Code Number 22C-22B

Photo No. 240-17

AAA Contract No. 1490 + 8855-9255

AAA Total Cropland Acreage 62

App. No. 163

Decree No. _____

Land is located in

Twp. 750 Rge. 32 E Twp. _____ Rge. _____

Twp. _____ Rge. _____ Twp. _____ Rge. _____

Filed in Twp. 750 Rge. 32 E

Remarks _____

Farm Map

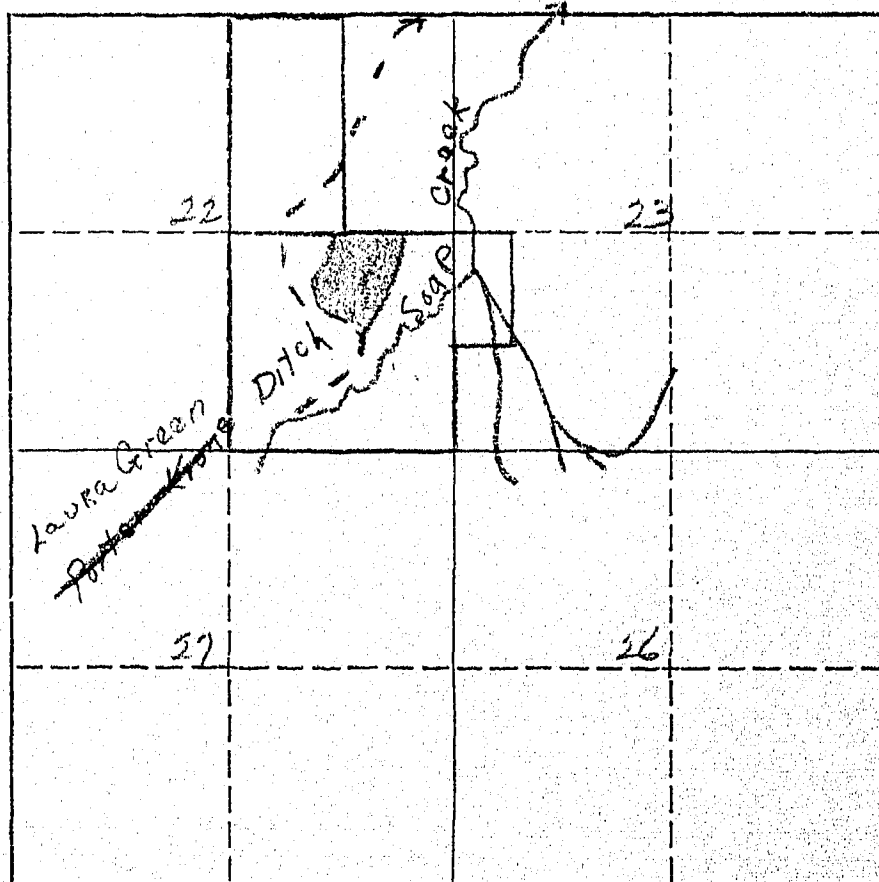

As this land is owned by the Indians it will not be necessary for you to give us any information pertaining to water rights, but as an operator of this land we would like to have you give us the number of acres you irrigated in 1945 in Question 12, under Part C, on the enclosed form.

Dear Mr. Krone:

SPECIAL NOTICE TO OPERATOR OF THE INDIAN LAND SHOWN ON ONE OF THE ENCLOSED FORMS:

As it is possible that you also operate other lands than those shown on our map, we are interested in the amount of land that you have irrigated only on the land that we have mapped, and not other lands that you may operate under different ownership. The reason for this is that, if lands have white owners, we contact them directly.

W.P. 3116
No. _____

A Study of Montana's Water Resources

Form WR-4

Record of a Farm under A.A.A. Program Having Irrigated Land

A.A.A. Contract No. 1490 County Big Horn Twp. South Rng. East

Name of Owner U.S. Indian Post (Dead Monument, # 1745) Address Crow Agency Mont.

Name of Operator Trone PR Address St Xavier Mont.

Total Number of Acres in Farm 160 ✓ Number of Acres Irrigated in 1940 37 ⁶

Outline on the plat below in red pencil the boundaries of the farm unit. If possible, show in blue pencil the location of the irrigated land. The section number (s) should be clearly indicated. Obtain the legal description from county ownership records and correct boundaries if necessary.

Legal Description E²SW⁴NE⁴, E²SE⁴, E²W²SE⁴, 22 W²NW⁴SW⁴, 23-75-32E

A 5x5 grid with solid vertical lines and dashed horizontal lines. The grid is divided into four horizontal sections by three dashed lines. The second section from the top is further divided by a solid vertical line into two columns. The number '22' is handwritten in the first column of the second section. The number '23' is handwritten in the second column of the second section. A shaded rectangular area is located in the first column of the second section, overlapping the horizontal dashed line. The shaded area is roughly rectangular with irregular edges, and the number '22' is written inside it.

See A-1
Greene

STATE ENGINEERS OFFICE
Water Resources Survey

Notice of Appropriation

162 A

1. County Big Horn Book 1 Page 193 Record Misc.
2. Name of Appropriator U. S. A. Address _____
3. Date Appropriated 3-4-14 Date Filed 5-11-15
Amount Appropriated, Miners Inches 340, Cubic Feet per second _____
4. Name of Stream Donp Creek Tributary _____ Basin _____
5. Point of Diversion _____
in
Sec. 16 Twp. 7S Rge. 32E Bank of Stream right
6. Purpose Irrigation & domestic
7. Description of System ditch
8. Land Description of Intended Place of Use Sec. 1-2-11 7S-32E
9. Remarks (Pertaining to Use, etc.) _____

Decree

10. Case No. _____ Date _____ Amt. Decreed: M. I. _____ C. F. S. _____
11. To Whom Decreed _____ Address _____
12. Name of Ditch _____ Maximum Capacity (C. F. S.) _____
13. Date of Priority _____ Purpose _____
14. Land Description of Place of Use as Decreed _____
15. Remarks (Present Use Status, etc.) _____

STATE ENGINEERS OFFICE
Water Resources Survey

Notice of Appropriation

163

1. County Big Horn Book A Page 419 Record 7mcc
2. Name of Appropriator J. C. Haines Green Address _____
3. Date Appropriated 5-16-04 Date Filed 5-19-04
- Amount Appropriated, Miners Inches 1440, Cubic Feet per second _____
4. Name of Stream Loops Creek Tributary _____ Basin _____
5. Point of Diversion _____

Sec. _____ Twp. _____ Rge. _____ Bank of Stream _____

6. Purpose Irrigation & other
7. Description of System ditch & ditch

8. Land Description of Intended Place of Use

<u>E²</u>	<u>sec 22</u>	<u>7.5-32E</u>
<u>W²</u>	<u>sec 23</u>	<u>" "</u>
<u>W²</u>	<u>sec 26</u>	<u>" "</u>
<u>SW⁴</u>	<u>sec 27</u>	<u>" "</u>

9. Remarks (Pertaining to Use, etc.) _____

Decree

10. Case No. _____ Date _____ Amt. Decreed: M. I. _____ C. F. S. _____
11. To Whom Decreed _____ Address _____
12. Name of Ditch _____ Maximum Capacity (C. F. S.) _____
13. Date of Priority _____ Purpose _____
14. Land Description of Place of Use as Decreed _____
15. Remarks (Present Use Status, etc.) _____



554

Form WR-1--10M 8-45

STATE OF MONTANA
STATE ENGINEERS OFFICE
Water Resources Survey

Code No. 22A - 23A

County Big Horn

T. 7 So. R. 32 E.

Name of Land Owner Heinrich, Gladys E. Address Missoula, Montana
Name of Operator Krone, P. R. Address St. Xavier, Montana

Part A**TO BE FILED BY THOSE OBTAINING IRRIGATION WATER FROM
A DITCH COMPANY OR IRRIGATION DISTRICT**

1. Water is delivered by: Laura Green Ditch Private
Name of Ditch, Ditch Company or District supplying water
2. State the number of acres you irrigate under this system. 60 Shares you hold —
3. If you obtain water from more than one Company, give the number of shares, acres irrigated and the name of the Company under "Remarks." If you obtain water from a Ditch Company and also have a private system fill in both Part A and Part B.

Part B**TO BE FILED BY THOSE WHO HAVE A PRIVATE DITCH, PUMP OR IRRIGATION SYSTEM
or those who have a private water right under a Ditch Company**

4. In what year was this land first irrigated? Date
5. Give the name of the original appropriator (first user): Laura Green
6. Give the date appropriated 5-16-1904 Amount filed on: Miners Inches C. F. S. 36
7. State the total number of acres irrigated under this system: 149
8. Give the point of diversion: SW 1/4 SE 1/4 Section 22 Township 7 So Range 32 E

Part C**TO BE FILED BY ALL WATER USERS IN ADDITION TO PART A OR PART B**

9. Source of Water: Seep Creek
Name of stream or lake from which water is originally diverted
10. Water is obtained by: (Check one) Gravity ☒ Pumping ☐ Other ☐
11. What is the greatest number of acres you have irrigated? Date
12. How many acres did you irrigate in 1945? (Crop and pasture) 60
13. State the total number of additional acres that could be irrigated by increasing the water supply, land leveling, etc. 20 This land is under what ditch? Laura Green Ditch
14. How many acres of seeped land do you have which could be drained and put into production?
15. What is the condition of your irrigation system? Good
16. Is your water supply adequate? Yes ☒ No ☐ Explain
17. REMARKS:

OVER

NOTE: The foregoing questions apply only to irrigated land shown on this plat.

DESCRIPTION AND MAP OF FARM

18. Legal Description of this Farm LAND, sec. 22 - NW 1/4, S 1/4, T 7 N, R 33 E, Sec. 23

Twp. 7 So., Rge. 33 E.



IRRIGATED LAND



NON-IRRIGATED LAND

NORTH

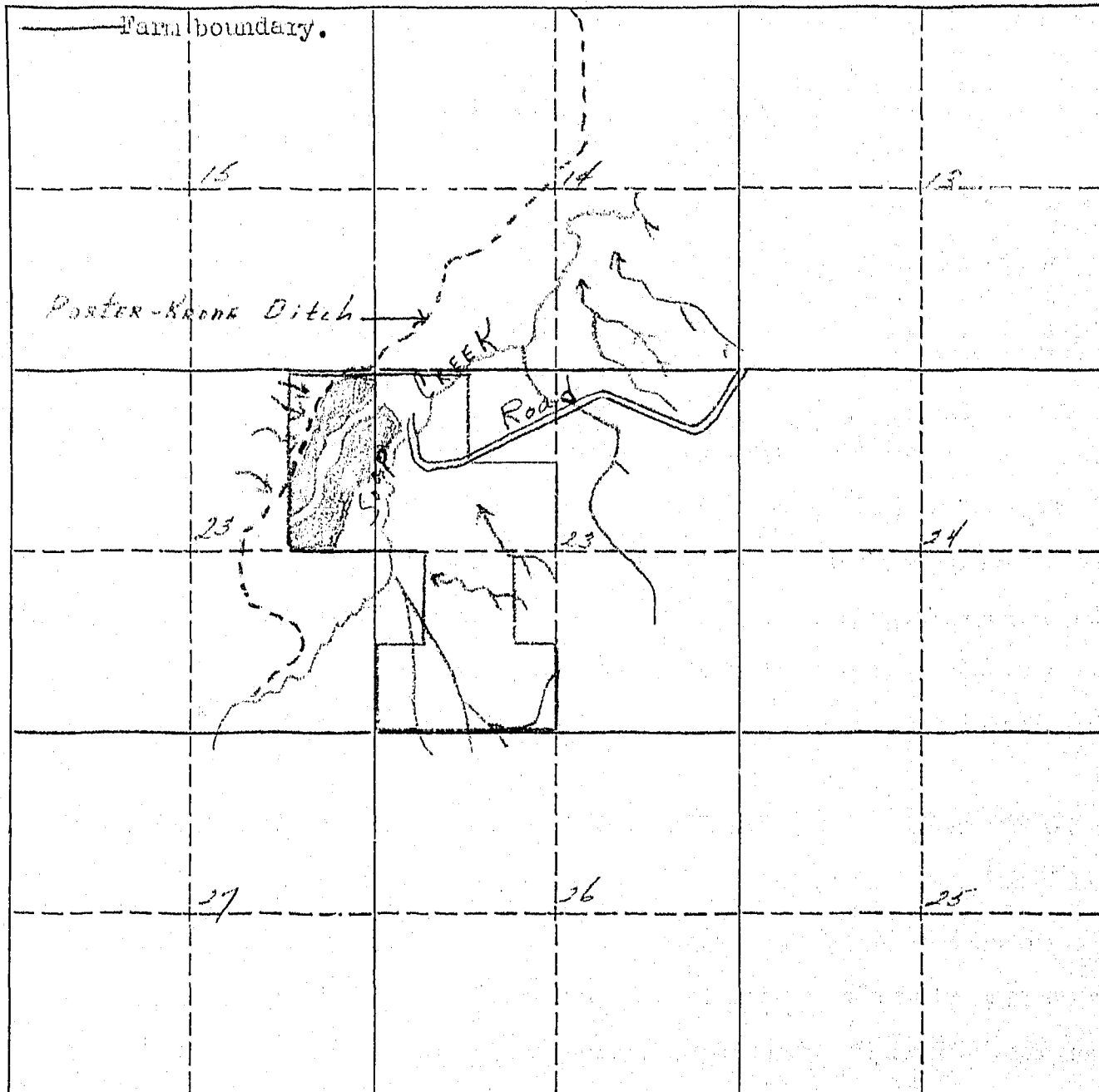

19. If the above land is irrigated from more than one ditch please give the acreage under each ditch in 19A and indicate the location of the land irrigated from each on the above map.

19A. Ditch: Laura Green Ditch Acres: 60

Ditch: _____ Acres: _____

Information supplied by: Field Check

Name: Anna Address: _____ Date: 9-23-46

REMARKS: _____

If you cannot answer all of the questions on this form answer as many as you can and return the form to us as soon as possible.

STATE ENGINEERS OFFICE
Water Resources SurveyCOUNTY Big HornFILE NO. 554Owner Heinrich, Gladys E. Address Missoula, Mont.AAA Owner " Address "Operator Krone, P.R. Address St. Vrain, Mont.New Owner " Address "New Operator " Address "Assessment Record E*NE* Sec 22 - NW*NW* S*NW* S*SW* E*NE*SW*
W*NE*SW* Sec 23 - 750 - 32 EAssessed Acreage 80.0Legal Description of This Farm Same as above.Total Acres in Farm 4.00Code Number 22A-23APhoto No. 210-17AAA Contract No. 1296AAA Total Cropland Acreage 82.1App. No. 163Decree No. "

Land is located in

Twp. 750 Rge. 32E Twp. " Rge. "Twp. " Rge. " Twp. " Rge. "Filed in Twp. 28 Rge. 32ERemarks Send to Operator

Farm Map

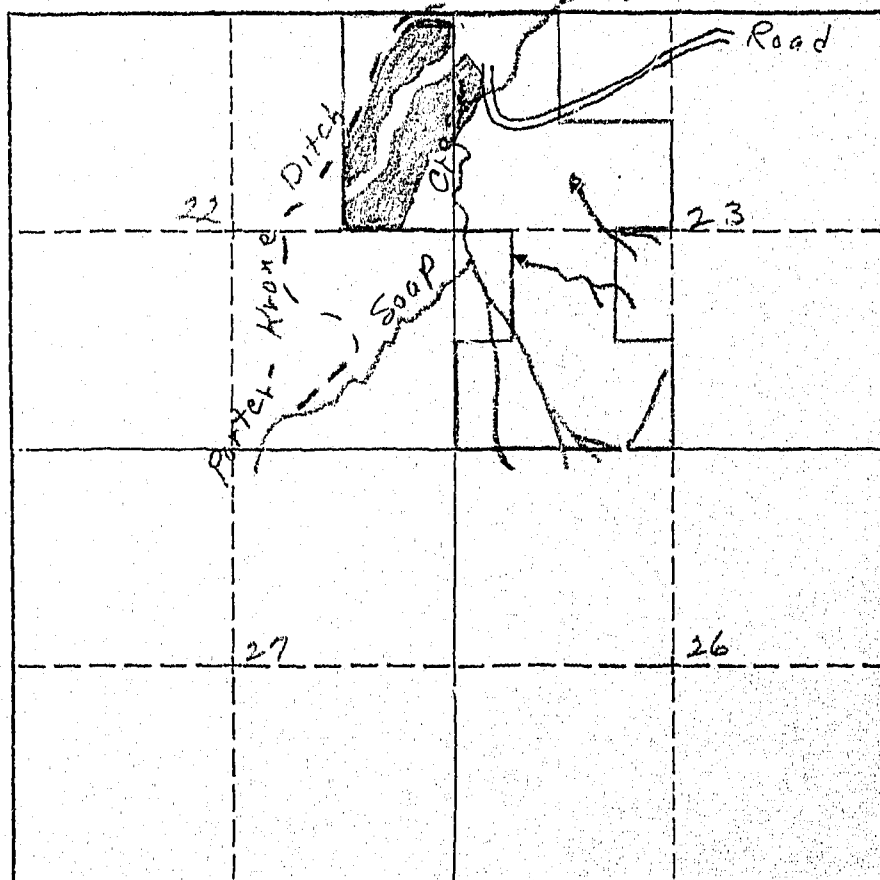

February 15, 1948

Mr. P. R. Krone
St. Xavier, Montana

Dear Mr. Krone:

#15

Appropriations: (Township 6 South, Range 32 East)

According to our records the following notices of appropriations were filed on and cover your land.

On September 7, 1905, S. G. Reynolds, Agent in behalf of the Crow Indians, filed for 31,535 miners inches from the Big Horn River, recorded in Miscellaneous Records, Book A, Page 426, Big Horn County; (211 F)

On March 15, 1912, John J. Harris and Edward Lawlor filed for 300 cubic feet per second from Big Horn River, recorded in Miscellaneous Records, Book A, Page 554, Big Horn County; (341 A)

On May 9, 1919, F. M. Heinrich filed for 160 miners inches from West Soap Creek, recorded in Miscellaneous Records, Book 1, Page 544, Big Horn County; (101 A)

On May 19, 1909, Ary Scott and children filed for 300 miners inches from Soap Creek, recorded in Miscellaneous Records, Book A, Page 496, Big Horn County; (102)

Appropriation: (Township 7 South, Range 32 East) #554

On May 19, 1904, A. F. Green & Laura filed for 36 cubic feet per second from Soap Creek, recorded in Miscellaneous Records, Book A, Page 419, Big Horn County. (163)

Are these appropriations now in use? If they are not, mark them "No", and if they are, mark them "Yes".

March 25, 1946

Mr. F. R. Krons
St. Xavier, Montana

Dear Mr. Krons:

On February 15, 1946 we sent you a letter asking for certain information pertaining to your irrigated land in Big Horn County. On March 4, 1946 we sent you another letter asking you to submit the information we had requested to us as soon as possible. To date we have not heard from you regarding this matter.

"It is hereby declared to be a policy of the state and necessary for the welfare of the state and its citizens, that the waters of this state, and especially interstate streams arising out of this state, be investigated. The State Engineer shall, either before or after the bringing of such actions (to adjudicate the waters of any stream and its tributaries in any county traversed by said stream), upon the direction of the State Water Conservation Board, or upon the directions of the court, do all things, make all surveys, and perform all services required by said board in the securing of all necessary information and make the same available to said board or others who may be interested therein, including the courts of this state."

In order to protect the water rights of the water users in this state, it is mandatory that the State Engineer have the information that we have asked you to submit to this office. If you have sold the piece of land about which we wrote you, will you please give us the name and address of the new owner.

We expect to hear from you in the very near future.

Very truly yours,

Gerald J. Oravetz
Ass't State Engineer

GJO:PM

W.P. 3116
No. _____

A Study of Montana's Water Resources

Form WK-4

Record of a Farm under A.A.A. Program Having Irrigated Land

A.A.A. Contract No. 1296 County Big Horn Twp. 7 South Rng. 82 East

Name of Owner Knowles, Gladys Heinrich address Big Horn, Mont.

Name of Operator Krone P.R. address St. Xavier Mont.

Total Number of Acres in Farm 24 Number of Acres Irrigated in 1940 592 ✓

Outline on the plat below in red pencil the boundaries of the farm unit.
If possible, show in blue pencil the location of the irrigated land. The
section number (s) should be clearly indicated. Obtain the legal descrip-
tion from county ownership records and correct boundaries if necessary.

Legal Description _____

X 22 A+B D-1
11 CDE I-1

See A-1
Greene

STATE ENGINEERS OFFICE
Water Resources Survey

Notice of Appropriation

1. County Big Horn Book A Page 419 Record Misc 163
2. Name of Appropriator J. C. & Laura Green Address _____
3. Date Appropriated 5-16-04 Date Filed 5-19-04
- Amount Appropriated, Miners Inches 1440, Cubic Feet per second _____
4. Name of Stream Loop Creek Tributary _____ Basin _____
5. Point of Diversion _____

Sec. _____ Twp. _____ Rge. _____ Bank of Stream _____

6. Purpose Irrigation & other
7. Description of System _____

8. Land Description of Intended Place of Use E², sec 22 75-32E
- | | | | | |
|-----------------------|----------|-----------|----------|----------|
| <u>W²</u> | <u>"</u> | <u>23</u> | <u>"</u> | <u>"</u> |
| <u>W²</u> | <u>"</u> | <u>26</u> | <u>"</u> | <u>"</u> |
| <u>SW⁴</u> | <u>"</u> | <u>27</u> | <u>"</u> | <u>"</u> |

9. Remarks (Pertaining to Use, etc.) _____

Decree

10. Case No. _____ Date _____ Amt. Decreed: M. I. _____ C. F. S. _____
11. To Whom Decreed _____ Address _____
12. Name of Ditch _____ Maximum Capacity (C. F. S.) _____
13. Date of Priority _____ Purpose _____
14. Land Description of Place of Use as Decreed _____
15. Remarks (Present Use Status, etc.) _____



549
STATE OF MONTANA
STATE ENGINEERS OFFICE
Water Resources Survey

Form No. 1-1-1001 8-45

Code No. 11B, 12A

County Big Horn

T. 7. S. R. 32. E.

Name of Land Owner Herman, Albert Address St. Xavier, Montana

Name of Operator Herman, Albert Address St. Xavier, Montana

Part A

TO BE FILED BY THOSE OBTAINING IRRIGATION WATER FROM
A DITCH COMPANY OR IRRIGATION DISTRICT

1. Water is delivered by: *Ditch built by J. H. Cooke Private*
Name of Ditch, Ditch Company or District supplying water
2. State the number of acres you irrigate under this system 0 Shares you hold
3. If you obtain water from more than one Company, give the number of shares, acres irrigated and the name of the Company under "Remarks." If you obtain water from a Ditch Company and also have a private system fill in both Part A and Part C.

Part B

TO BE FILED BY THOSE WHO HAVE A PRIVATE DITCH, PUMP OR IRRIGATION SYSTEM
or those who have a private water right under a Ditch Company

4. In what year was this land first irrigated? Date
5. Give the name of the original appropriator (first user):
6. Give the date appropriated Amount filed on: Miners Inches C. F. S.
7. State the total number of acres irrigated under this system:
8. Give the point of diversion: 1/4 1/4 Section Township Range

Part C

TO BE FILED BY ALL WATER USERS IN ADDITION TO PART A OR PART B

9. Source of Water: *Log Creek*
Name of stream or lake from which water is originally diverted
10. Water is obtained by: (Check one) Gravity ☒ Pumping Other
11. What is the greatest number of acres you have irrigated? Date
12. How many acres did you irrigate in 1945? (Crop and pasture) 0
13. State the total number of additional acres that could be irrigated by increasing the water supply, land leveling, etc. *25 acres* This land is under what ditch? *Private Ditch*
14. How many acres of seeped land do you have which could be drained and put into production?
15. What is the condition of your irrigation system?
16. Is your water supply adequate? Yes No Explain
17. REMARKS: *This ditch hasn't been in use and has to be started and completed before there can be any irrigation. Well checked and found correct*

OVER

NOTE: The foregoing questions apply only to irrigated land shown on this plat.

DESCRIPTION AND MAP OF FARM

18. Legal Description of this Farm $N\frac{1}{2}NW\frac{1}{4}$, $W\frac{1}{2}NE\frac{1}{4}$, $SE\frac{1}{4}NE\frac{1}{4}$, Sec. 11 - $S\frac{1}{2}NW\frac{1}{4}$, Sec. 12 -
Twp. 7 S., Rge. 32 E.



IRRIGATED LAND



NON-IRRIGATED LAND

NORTH

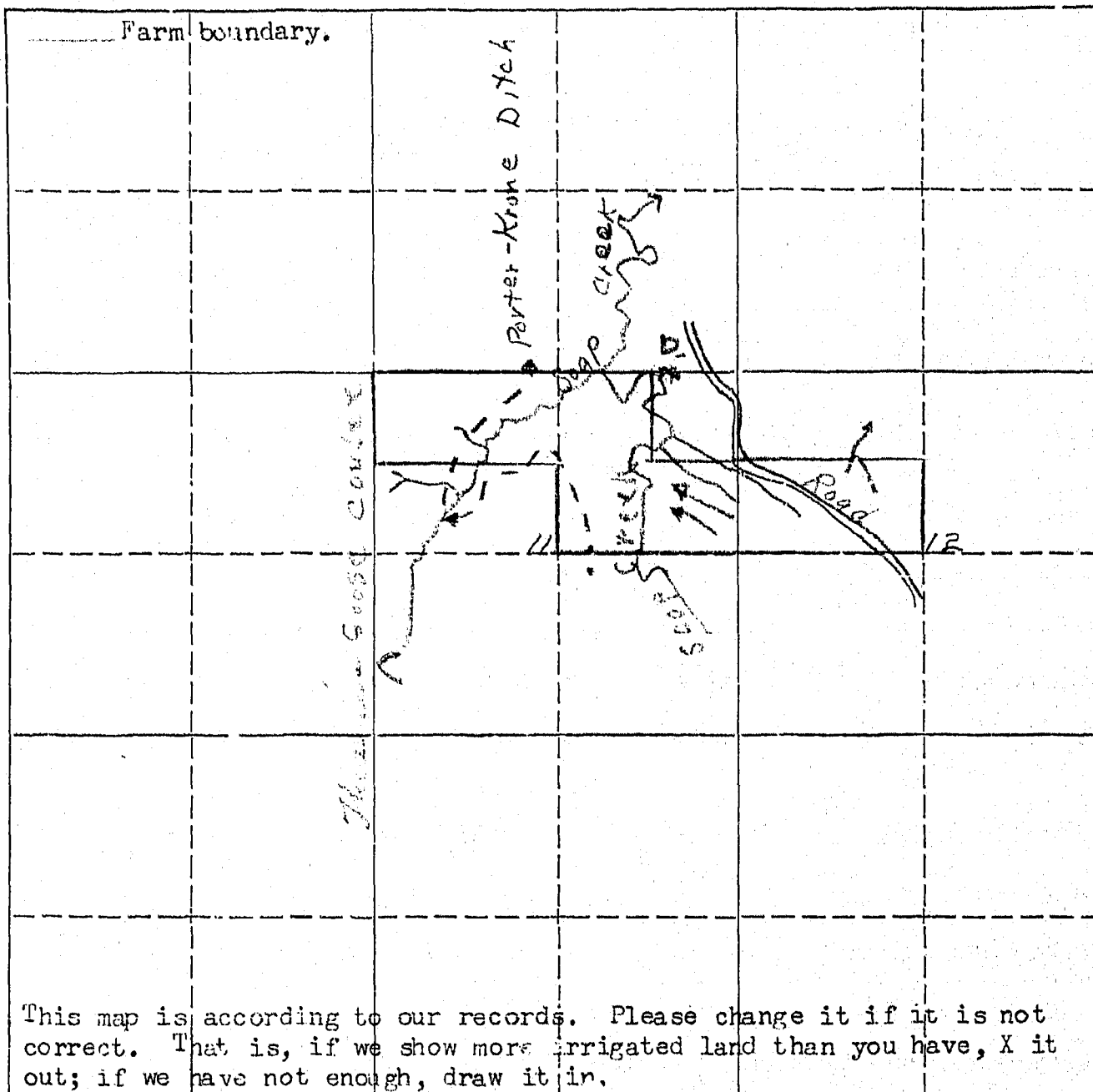

19. If the above land is irrigated from more than one ditch please give the acreage under each ditch in 19A and indicate the location of the land irrigated from each on the above map.

19A. Ditch: _____ Acres: 0

Ditch: _____ Acres: _____

Information supplied by:

Name Albert W. Herman Address Box 225 St Xavier Date Mar 4 1946

REMARKS: Refer to letter.

If you cannot answer all of the questions on this form answer as many as you can and return the form to us as soon as possible.

549

St. Xavier Montana
March 4th 1946

Mrs. Gerald J. Cravetz
Asst. State Engineer
Box 873
Billings, Montana

Dear Mr. Cravetz

Yours of February 15, 1946 relative to Irrigation Waters on Soap Creek received and contents noted.

I have compared appropriations with those listed in my abstract and find they agree. Abstract page 7 covers 162^A. The point of diversion however is off this place and running in a northerly direction would not serve this place. I have placed a D at the point of diversion on your map. More specific NE $\frac{1}{4}$, NE $\frac{1}{4}$ Sec. 11 T. 75 R. 32 East. 162 B series Sections 14, 11, and 2 T. 75 Range 32 E and is listed on page 6 of my Abstract. Point of diversion is on left bank. The United States of America is the name of the appropriator and claims right to maintain ditch carrying said water. I have never seen either end of this ditch but this place ~~has~~ the honor of being occupied by the Middle designated as the Porter Krone Ditch. It is not known by that

549

Mr Gerald J. Pravez
Asst State Engineer.

Name or any name that I know of. I am mentioning as a matter of record and not to make light of your information. This ditch is not in use.

The whole truth is that I do not know what water rights I do have if any. What rights would I have under item 162 B if any?

It has been quite rainy in this locality during the growing season for several years and no one irrigates much. I haven't at all. But should it turn dry I may want to. I could irrigate 25 acres easily by mounting a pump on tractor and back up to the creek most any where and start in.

And I'd like that right to do just that. This place can average 50 hd of cows per yr by cross fencing. I have feed fed from 200 to 400 on three different winters and I'd want that right to water stock.

Naturally we all want our water rights protected. When a stream flows thru ones place he takes it for granted that it is there when he needs it even though he

544

may not be using it to capacity at present. If I have no rights what procedure must I follow to secure adequate water for whatever needs I may have?

I have not attempted to fill in the Form of Water Resources Survey for reasons stated. In summary also I can say is that 25 Acres could easily be irrigated and by flood control more could if the need should so arise. None has been irrigated since I bought this place but I may want to. I want to cooperate & protect our water resources but do not know if I have any rights or can secure rights if I have none.

Farm map is very good. I have penciled in a small correction. Water way thru Porter & Bone ditch is known as Gosse Coulee. Penciling can be easily erased.

Should you ever make a survey here would appreciate a call. Hoping I may have rendered some help I am

Yours respectfully
Albert M. Herman

Answered by H. J. C. from Minneapolis - March 22 - 1946

February 15, 1946

Mr. Albert Herman
St. Xavier, Montana

Dear Mr. Herman:

Appropriations:

According to our records the following notices of appropriations were filed on
and cover your land.

On March 11, 1915, the United States, through Mr. Evan W. Estep, Supt. and Special
Disbursing Officer for the Crow Reservation, filed for 8 19/40 cubic feet per
second from Soap Creek, recorded in Miscellaneous Records, Book 1, Page 193, Big
Horn County; (162 A) *For use in sections 11, 1 and 2 T. 7 S. R. 32 E. sec. 11*
point of diversion marked on map on State map (see map)
On March 11, 1915, the United States, through Mr. Evan W. Estep, Supt. and Special
Disbursing Officer for the Crow Reservation, filed for 12 6/40 cubic feet per
second from Soap Creek, recorded in Miscellaneous Records, Book 1, Page 192, Big
Horn County. (162 B) *For domestic use in sections 11, 1 and 2 T. 7 S. R. 32 E. sec. 11*
on map and State map

Are these appropriations now in use? If they are not, mark them "No", and if
they are, mark them "Yes".

STATE ENGINEERS OFFICE
Water Resources Survey

COUNTY Big Horn

FILE NO. 549

Owner..... Address.....

AAA Owner Herman, Albert Address St. Xavier, Mont.

Operator..... Address.....

New Owner..... Address.....

New Operator..... Address.....

Assessment Record.....

Assessed Acreage 0

Legal Description of This Farm N²NW¹, W²NE⁴, SENE⁴, Sec. 11 - S²NW⁴, Sec. 12

7 So. 32 E

Total Acres in Farm.....

Code Number 11B-12A-

Photo No. 240-14

AAA Contract No. 5026

AAA Total Cropland Acreage 61.7

App. No. 162A-162B

Decree No.....

Land is located in

Twp. 7 So. Rge. 32 E Twp..... Rge.....

Twp..... Rge..... Twp..... Rge.....

Filed in Twp. 7 So. Rge. 32 E

Remarks.....

Farm Map

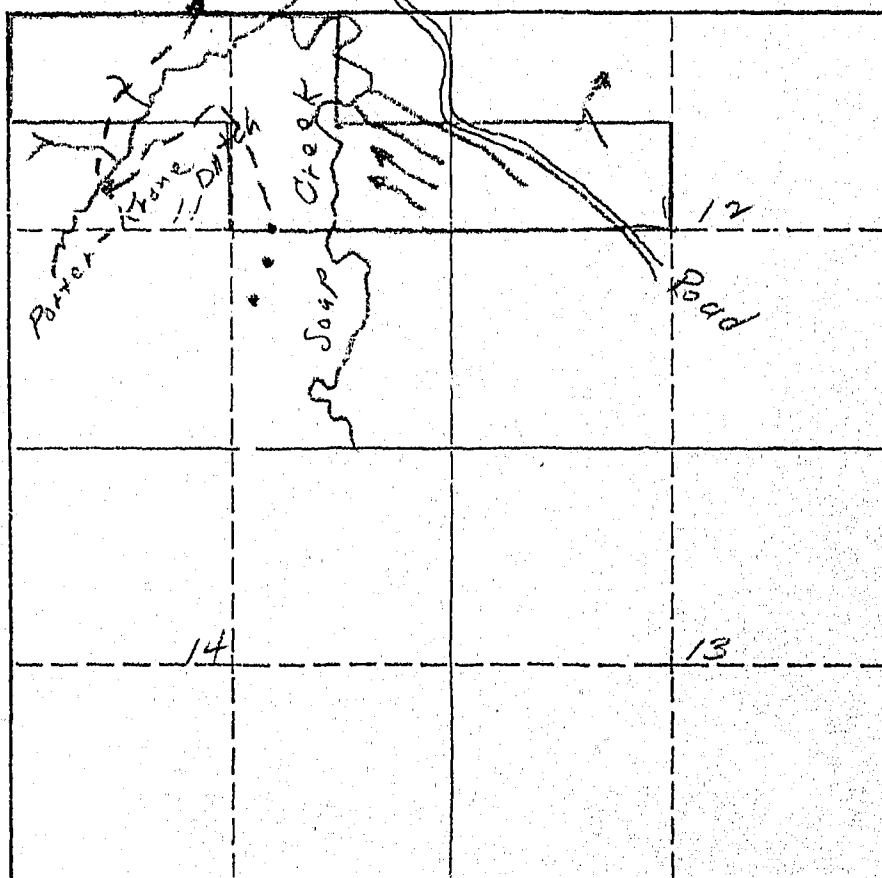

March 4, 1946

Mr. Albert Herman
St. Xavier, Montana

Dear Mr. Herman:

On February 15, 1946, this office sent you forms and a letter asking for information pertaining to your irrigated land in Big Horn County.

To date we have not heard from you. With the vast water development program now being planned on the Big Horn River by Federal Agencies, it is essential that we have this information in order to show the extent of our water use and our water rights in the Big Horn Basin in Montana. This information is necessary and vital if we are to protect our present water users and the rights they have against future irrigation, navigation, power, and flood control enterprises in this area. We are asking you for this information because we feel it is the democratic way. We also feel that you are more qualified to give us this information about your irrigated land than anyone else because it is part of your business. It may be that you were busy with your farm work, or some unforeseen thing happened at the time our first letter was received and you put it aside to be answered at some other time and have forgotten all about it. All information received by us is strictly confidential, and is only used to record and tabulate the water use in the Big Horn area.

Water is as necessary to the farmer as the soil in which he plants. Without it no crops will grow - no living thing can survive. It is your water that we are trying to protect so that you will have plenty now and in the future. We must keep Montana's water in Montana. The only way we can do this is by having the support of each and every water user so that we have 100% representation of all water users. Remember - "United we stand, divided we fall."

In order to facilitate this work, a branch office of the State Engineer has been established in Billings and is located in the Roosevelt School Building on Twenty-third Street and Fourth Avenue, North. Any time you are in Billings, we will appreciate your calling on us.

Hoping to hear from you in the very near future, I am

Yours very truly,

Gerald J. Oravetz
Ass't State Engineer

GJO:pw

P.S. If you cannot supply us with the information requested, it may be that you can tell us of someone who can.

W.P. 5116.
No. _____

A Study of Montana's Water Resources

Form WR-4

Record of a Farm under A.A.A. Program Having Irrigated Land

7/3-1941

A.A.A. Contract No. 5026 County Big Horn Twp. 1 South Rng. 32 East

Name of Owner Steil, August Address Sheridan Wyo.

Name of Operator Herman, Albert Address St Xavier Mont.

Total Number of Acres in Farm 280 Number of Acres Irrigated in 1940 17⁰ (Photo)

Outline on the plat below in red pencil the boundaries of the farm unit. If possible, show in blue pencil the location of the irrigated land. The section number (s) should be clearly indicated. Obtain the legal description from county ownership records and correct boundaries if necessary.

Legal Description NW¹ NE¹ S² NE¹ N² NW¹ 11, S² NW¹ 12-7S-32E

Probably some irrigated.

Diagram showing a 6x6 grid with section numbers 11 and 12 indicated. Section 11 is in the center, and Section 12 is to its right. The irrigated area is outlined in red pencil, showing a small portion of Section 11 and a larger portion of Section 12.

STATE ENGINEERS OFFICE
Water Resources Survey

Notice of Appropriation

1. County Big Horn Book 1 Page 173 Record None
2. Name of Appropriator W. B. A. Address
3. Date Appropriated 3-4-14 Date Filed 3-11-15
Amount Appropriated, Miners Inches 340, Cubic Feet per second
4. Name of Stream Soap Creek Tributary Basin
5. Point of Diversion

1000
Sec. 16 Twp. 7 S Rge. 3 E Bank of Stream right

6. Purpose Irrigation & domestic
7. Description of System ditch

8. Land Description of Intended Place of Use Sec. 1, 2, 11, 7 S-32 E

9. Remarks (Pertaining to Use, etc.)

Decree

10. Case No. Date Amt. Decreed: M. I. C. F. S.
11. To Whom Decreed Address
12. Name of Ditch Maximum Capacity (C. F. S.)
13. Date of Priority Purpose
14. Land Description of Place of Use as Decreed
15. Remarks (Present Use Status, etc.)

STATE ENGINEERS OFFICE
Water Resources Survey

Notice of Appropriation

142-14

1. County Logan Book 1 Page 192 Record
2. Name of Appropriator W. S. A. Address
3. Date Appropriated 3-4-15 Date Filed 3-11-15
- Amount Appropriated, Miners Inches 426, Cubic Feet per second
4. Name of Stream Soap Creek Tributary Basin
5. Point of Diversion
- Sec. 14 Twp. 7 S Rge. 32 Bank of Stream Left
6. Purpose Irrigation + domestic
7. Description of System ditch 4 ft wide runs north 3 miles through sec. 14, 11, 2
8. Land Description of Intended Place of Use sections 2, 11, 14, 7S-32E
9. Remarks (Pertaining to Use, etc.)

Decree

10. Case No. Date Amt. Decreed: M. I. C. F. S.
11. To Whom Decreed Address
12. Name of Ditch Maximum Capacity (C. F. S.)
13. Date of Priority Purpose
14. Land Description of Place of Use as Decreed.....
.....
.....
.....
.....
15. Remarks (Present Use Status, etc.)



555
STATE OF MONTANA
STATE ENGINEERS OFFICE
Water Resources Survey

Form WR-1-10M 8-45

Code No. 11C

County Big Horn

T. 7 S. R. 32 E.

Name of Land Owner Indian Address _____

Name of Operator Spotted, Wm. Address _____

Part A

**TO BE FILED BY THOSE OBTAINING IRRIGATION WATER FROM
A DITCH COMPANY OR IRRIGATION DISTRICT**

1. Water is delivered by: Laura Green Ditch Private
Name of Ditch, Ditch Company or District supplying water
2. State the number of acres you irrigate under this system 2 Shares you hold _____
3. If you obtain water from more than one Company, give the number of shares, acres irrigated and the name of the Company under "Remarks." If you obtain water from a Ditch Company and also have a private system fill in both Part A and Part B.

Part B

**TO BE FILED BY THOSE WHO HAVE A PRIVATE DITCH, PUMP OR IRRIGATION SYSTEM
or those who have a private water right under a Ditch Company**

4. In what year was this land first irrigated? Date _____
5. Give the name of the original appropriator (first user): _____
6. Give the date appropriated _____ Amount filed on: Miners Inches _____ C. F. S. _____
7. State the total number of acres irrigated under this system: _____
8. Give the point of diversion: 1/4 Section _____ Township _____ Range _____

Part C

TO BE FILED BY ALL WATER USERS IN ADDITION TO PART A OR PART B

9. Source of Water: Soap Creek
Name of stream or lake from which water is originally diverted
10. Water is obtained by: (Check one) Gravity ☒ Pumping _____ Other _____
11. What is the greatest number of acres you have irrigated? _____ Date _____
12. How many acres did you irrigate in 1945? (Crop and pasture) 0
13. State the total number of additional acres that could be irrigated by increasing the water supply, land leveling, etc. 51.6 This land is under what ditch? _____
14. How many acres of seeped land do you have which could be drained and put into production? _____
15. What is the condition of your irrigation system? _____
16. Is your water supply adequate? Yes _____ No - Explain Not enough water. Ditch not complete
17. REMARKS: _____

