

13-A
30-B

W.P. 3118
No. _____

A Study of Montana's Water Resources

Form WR-1

Record of a Farm under A.A.A. Program Having Irrigated Land

A.A.A. Contract No. _____ County Big Horn Twp. 7 South Rng. 39 East

Name of Owner Young, Albert E. et al Address Kirby Mont.

Name of Operator _____ Address _____

Total Number of Acres in Farm 472.18 Number of Acres Irrigated in 1940 _____

Cutline on the plat below in red pencil the boundaries of the farm unit. If possible, show in blue pencil the location of the irrigated land. The section number (s) should be clearly indicated. Obtain the legal description from county ownership records and correct boundaries if necessary.

Legal Description Lot 1, E^{1/2}W^{1/2}SE^{1/4}19, N²NE⁴SW⁴NE⁴30-7S-39E
possibly some irrigated land.

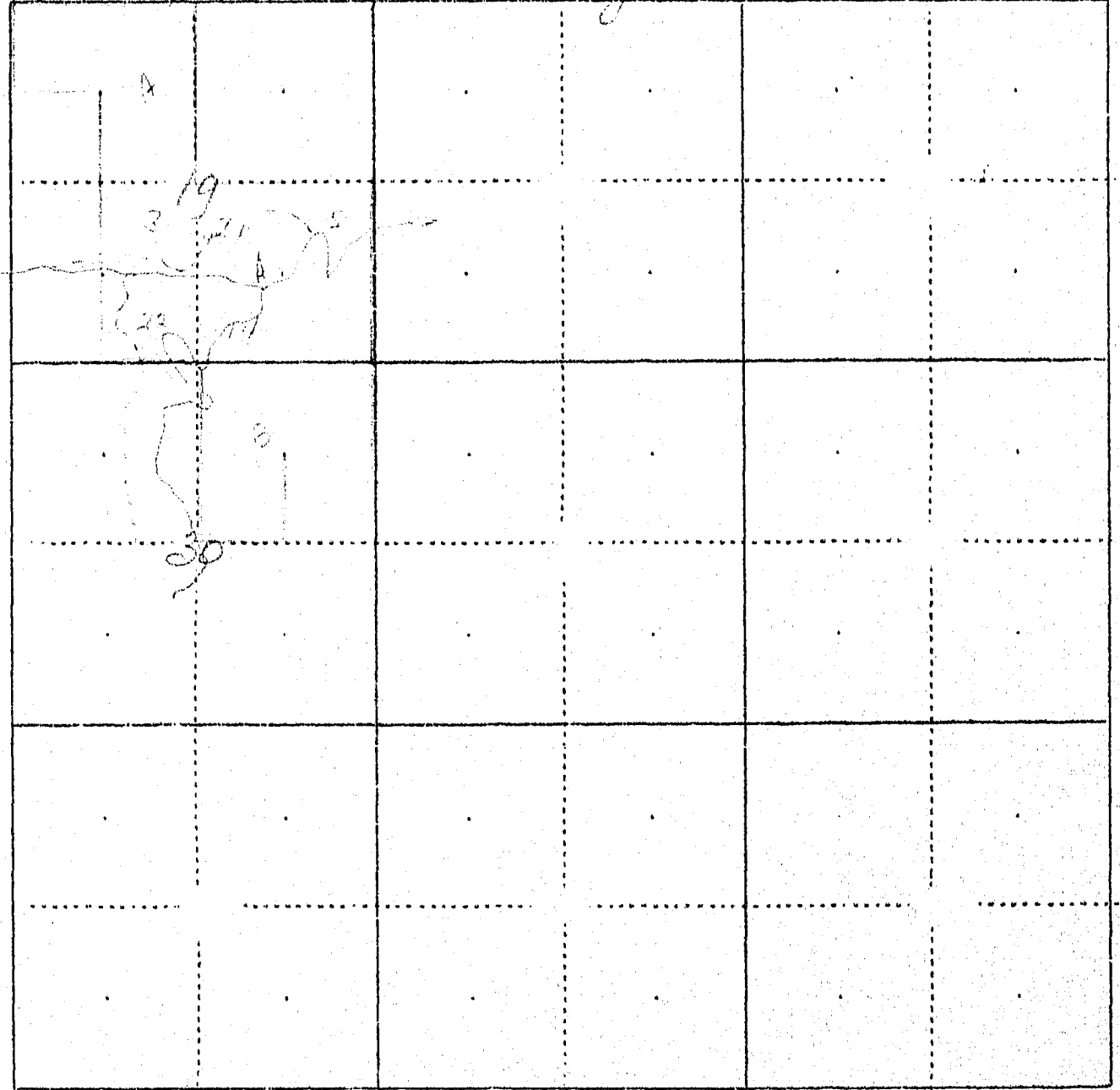

SM-1
A-1
Pres 0
Past 65
LC-65A (19)

App. 189

County _____ Code No. _____

1. Water User Robert E. Young Address Kulasa

2. Stream North of Orchard Tributary _____

3. Point of Diversion SW Section 19 Township 7 Range 39

4. Description of System Dam + Outlets

5. Original Appropriator Al Young Address _____ Date _____

6. First Use: Date 1897 No. Acres Irrigated 30

Other Use Stockwater Date _____

7. Maximum Use: Date 1918 No. Acres Irrigated 35

Other Use Stockwater Date _____

8. Present Use and Condition of System _____

1940 Crops	No. Acres
a	_____
b	_____
c	_____
d	_____
e	_____
f	_____
TOTAL	_____

Other Use (1940) _____

9. Potential Irrigable Lands Under this System No others

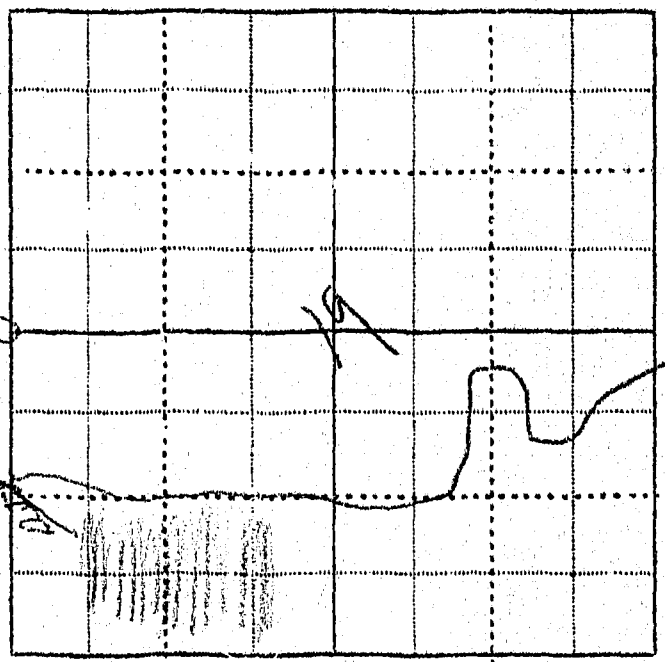

10. Remarks No appropriation ever made for this

11. The above statements are true and accurate to the best of my knowledge and belief: Al Young

(Signed)

WITNESS _____

(Place)

(Date)

County Big Horn Code No. _____

1. Water User Albert E. Young Address Fairley

2. Stream Swan River Tributary _____

3. Point of Diversion 1/4 Section 1/4 Township _____ Range _____

4. Description of System Dam & Ditches

5. Original Appropriator John A. Smith Address Rockwell Date 7/9/1904

6. First Use: Date 1905 No. Acres Irrigated _____

Other Use _____ Date _____

7. Maximum Use: Date _____ No. Acres Irrigated 200

Other Use _____ Date _____

8. Present Use and Condition of System _____

1940 Crops	No. Acres
a	_____
b	_____
c	_____
d	_____
e	_____
f	_____
TOTAL	_____

Other Use (1940) _____

9. Potential Irrigable Lands Under this System _____

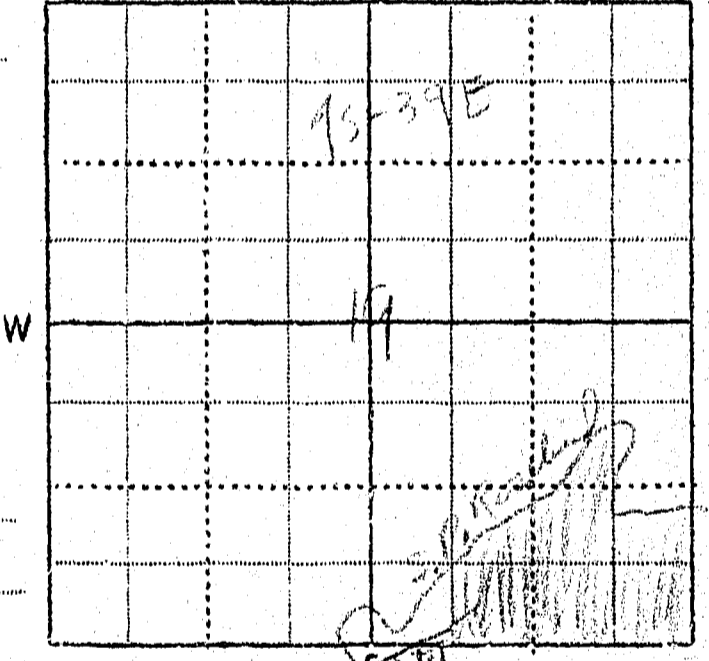

10. Remarks _____

11. The above statements are true and accurate to the best of my knowledge and belief: Albert E. Young (Signed)

WITNESS _____ (Place) _____ (Date)

W.P. 3116
No. _____

A Study of Montana's Water Resources

Form WR-4

Record of a Farm under A.A.A. Program Having Irrigated Land

A.A.A. Contract No. _____ County Big Horn Twp. 7 South Rng. 39 East

Name of Owner Rugg, C.C. Address Wirby Mont.

Name of Operator _____ Address _____

Total Number of Acres in Farm 640 Number of Acres Irrigated in 1940 _____

Cutline on the plat below in red pencil the boundaries of the farm unit. If possible, show in blue pencil the location of the irrigated land. The section number (s) should be clearly indicated. Obtain the legal description from county ownership records and correct boundaries if necessary.

Legal Description 1/4 16 - 75 - 39 E

Possibly some irrigated land

*L.C. San
Nat. Flood
129*

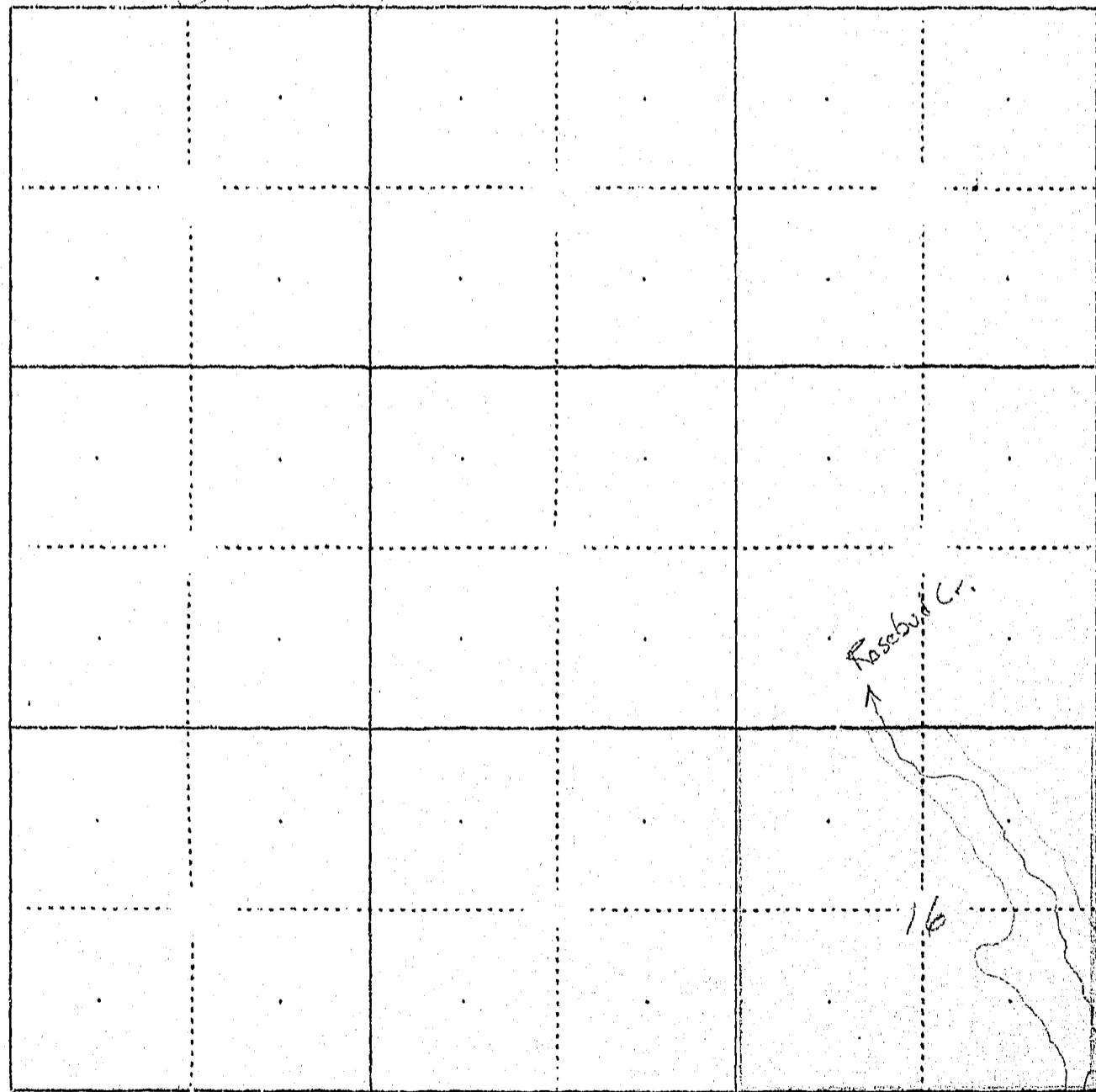



STATE OF MONTANA
STATE ENGINEERS OFFICE
Water Resources Survey

Form WR-1--10M 8-75

Code No. 36
County Blaine
T. 7 1/2 S. R. 41 E.

Name of Land Owner Thompson, S Address Blaine, Montana
Name of Operator _____ Address _____

Part A

TO BE FILED BY THOSE OBTAINING IRRIGATION WATER FROM A DITCH COMPANY OR IRRIGATION DISTRICT

1. Water is delivered by: _____
Name of Ditch, Ditch Company or District supplying water
2. State the number of acres you irrigate under this system _____ Shares you hold _____
3. If you obtain water from more than one Company, give the number of shares, acres irrigated and the name of the Company under "Remarks." If you obtain water from a Ditch Company and also have a private system fill in both Part A and Part B.

Part B

TO BE FILED BY THOSE WHO HAVE A PRIVATE DITCH, PUMP OR IRRIGATION SYSTEM or those who have a private water right under a Ditch Company

4. In what year was this land first irrigated? Date See Attached Water Rights
5. Give the name of the original appropriator (first user): _____
6. Give the date appropriated _____ Amount filed on: Miners Inches _____ C. F. S. _____
7. State the total number of acres irrigated under this system: _____
8. Give the point of diversion: _____ 1/4 _____ 1/4 Section _____ Township _____ Range _____

Part C

TO BE FILED BY ALL WATER USERS IN ADDITION TO PART A OR PART B

9. Source of Water: Tongue River
Name of stream or lake from which water is originally diverted
10. Water is obtained by: (Check one) Gravity Pumping _____ Other _____
11. What is the greatest number of acres you have irrigated? 7 Date _____
12. How many acres did you irrigate in 1949? (Crop and pasture) 80
13. State the total number of additional acres that could be irrigated by increasing the water supply, land leveling, etc. 0 This land is under what ditch? _____
14. How many acres of seeped land do you have which could be drained and put into production? None
15. What is the condition of your irrigation system? Good
16. Is your water supply adequate? Yes No _____ Explain Source of supply is
17. REMARKS: Tongue River

OVER

T. 7 1/2 S., R. 41 E.

NOTE: The foregoing questions apply only to irrigated land shown on this plat.

DESCRIPTION AND MAP OF FARM

18. Legal Description of this Farm

All sec 32 Twp 7/200 R41E



IRRIGATED LAND



NON-IRRIGATED LAND

NORTH

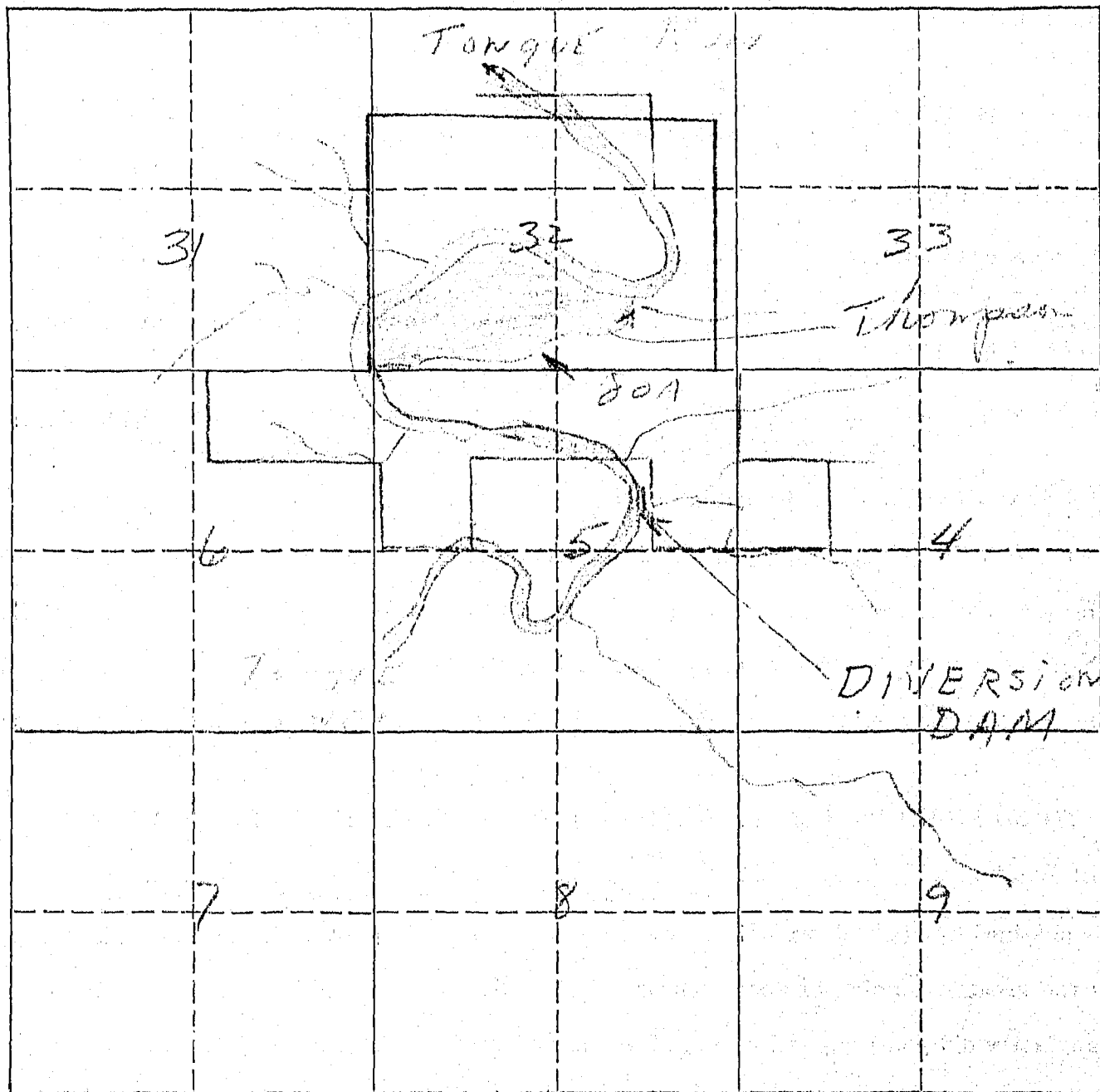

19. If the above land is irrigated from more than one ditch please give the acreage under each ditch in 19A and indicate the location of the land irrigated from each on the above map.

19A. Ditch: *Thompson Ditch* Acres: *80*

Ditch: _____ Acres: _____

Information supplied by:

Name _____ Address _____ Date *8/20/46*

REMARKS: *Interview & field check by Johnson & Bill*

If you cannot answer all of the questions on this form answer as many as you can and return the form to us as soon as possible.

(343) On April 19, 1937, the State Water Conservation Board by J. S. James appropriated all unappropriated waters of Tongue River. The notice of appropriation was filed April 21, 1937 in Book 7, Page 408 of Misc. Records.

(243-A) On Sept. 6, 1930 Henry H. Kistermann appropriated 400 miner's inches of water from Anderson Creek. The notice of appropriation was filed Sept. 6, 1930 in Book 6, Page 516 of Misc. Records.