



NOTICE
 These forms are the
 property of the State
 of Montana and must
 be returned.

STATE OF MONTANA
STATE ENGINEERS OFFICE

FORM WR-1-2M-12-67

Code No. 34A-35A

County Custer

T. 13N. R. 46E.

Water Resources Survey

Name of Land Owner Harry Lewis Lintoch Address Miles City, Mont

Name of Operator _____ Address _____

Part A

**TO BE FILED BY THOSE OBTAINING IRRIGATION WATER FROM
 A DITCH COMPANY OR IRRIGATION DISTRICT**

1. Water is delivered by: _____
 Name of Ditch, Ditch Company or District Supplying Water
2. State the number of acres you irrigate under this system _____ Shares you hold _____
3. If you obtain water from more than one Company, give the number of shares, acres irrigated and the name of the Company under "Remarks." If you obtain water from a Ditch Company and also have a private system fill in both Part A and Part B.

Part B

**TO BE FILED BY THOSE WHO HAVE A PRIVATE DITCH, PUMP OR IRRIGATION SYSTEM
 or those who have a private water right under a Ditch Company.**

4. In what year was this land first irrigated? Date _____
5. Give the name of the original appropriator (first user): Margaret E. Covel
6. Give the date appropriated June 1, 1912 Amount filed on: Miners Inches _____ C. F. S. 1 1/2
7. State the total number of acres irrigated under this system: Potential
8. Give the point of diversion: _____ 1/4 _____ 1/4 Sect. 28 Township 13N Range 46E

Part C

TO BE FILED BY ALL WATER USERS IN ADDITION TO PART A OR PART B

9. Source of Water: Custer Creek
 Name of stream or lake from which water is originally diverted
10. Water is obtained by: (Check one) Gravity Pumping _____ Other flood irrigation
11. What is the greatest number of acres you have irrigated? 34.6 Date P
12. How many acres did you irrigate in 1947? (Crop and pasture) None
13. State the total number of additional acres that could be irrigated by increasing the water supply, land leveling, etc. 34.6 This land is under what ditch? Private flood ditches
14. How many acres of seeped land do you have which could be drained and put into production? None
15. What is the condition of your irrigation system? not in order
16. Is your water supply adequate? Yes _____ No Explain Flood irrigation
17. REMARKS: _____

Old ditches not now in use

Over

T. 13N., R. 46E.

✓
NOTE: The foregoing questions apply only to irrigated land shown on this plat.

DESCRIPTION AND MAP OF FARM

18. Legal Description of this Farm Section 34, 35, Twp 13 N, Rge 46 E

IRRIGATED LAND
(None at Present)

NON-IRRIGATED LAND

North

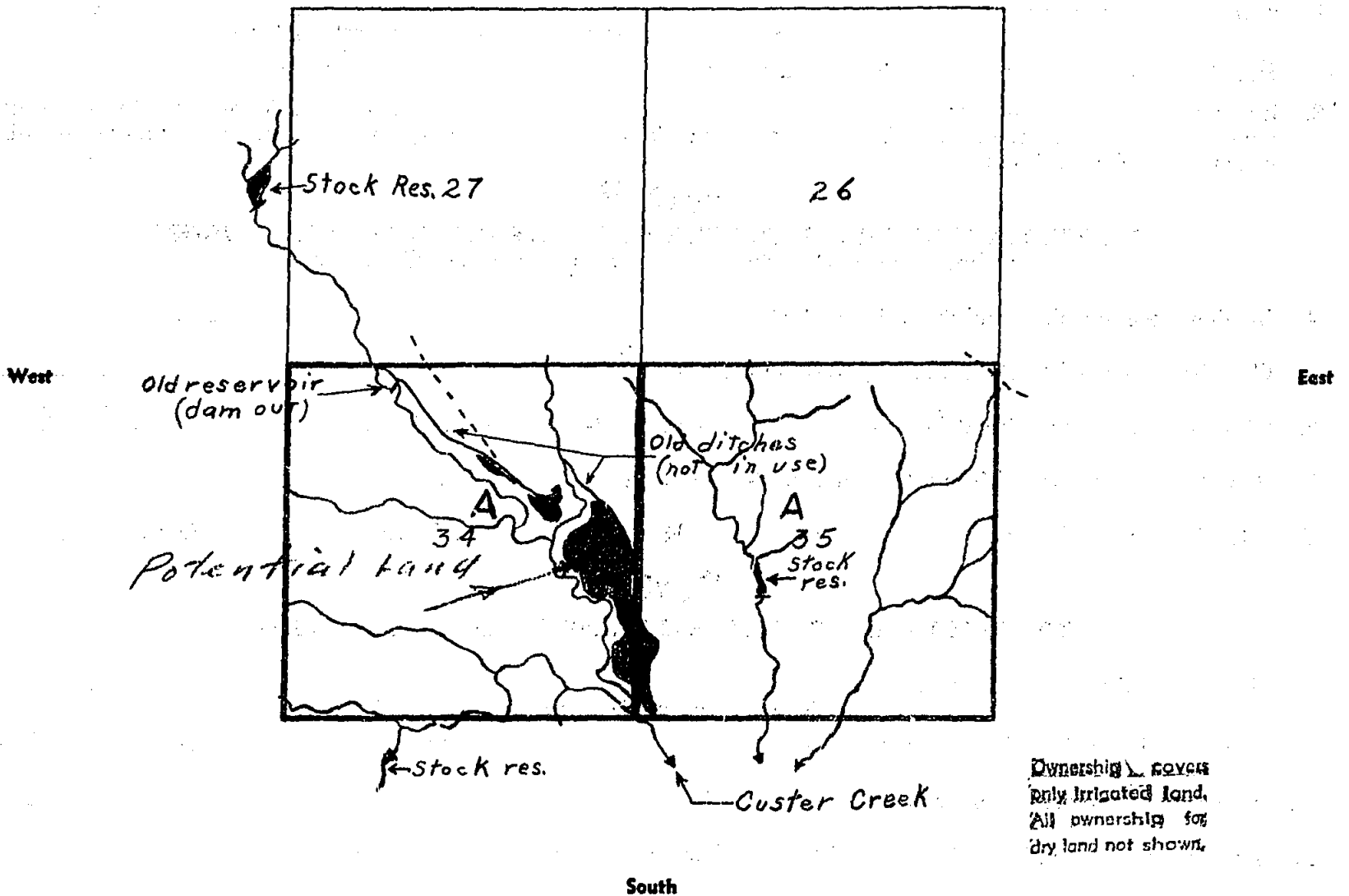

19. If the above land is irrigated from more than one ditch please give the acreage under each ditch in 19A and indicate the location of the land irrigated from each on the above map.

19A. Ditch: Private flood ditches Acres: 0

Ditch: _____ Acres: _____

Information supplied by:

Name Field Check Address _____ Date July 30-47

REMARKS: A. C. Johnson asst. Eng.
Joe Rantist

If you cannot answer all of the questions on this form answer as many as you can and return the form to us as soon as possible.

STATE ENGINEERS OFFICE
Water Resources Survey

COUNTY Custer

FILE NO. 2 13 N - 46 E -

Owner Haughians Livestock Co. Address Miles City, Mont

AAA Owner _____ Address _____

Operator _____ Address _____

New Owner _____ Address _____

New Operator _____ Address _____

Assessment Record None

Assessed Acreage _____

Legal Description of This Farm Sec. 34, T. 13 N., R. 46 E.

Total Acres in Farm _____

Code Number 34A - 35A

Photo No. MA-21-58

AAA Contract No. _____

AAA Total Cropland Acreage _____

App. No. 664

Decree No. _____

Land is located in

Twp. 13 Rge. 46 Twp. _____ Rge. old reservoir (dam out)

Twp. _____ Rge. _____ Twp. _____ Rge. _____

Filed in Twp. 10 N Rge. 48 E

Remarks App. 664 is for Finley Cr

Tributary of Custer Place of

Intend Use. Div.

34A - Haughians Livestock Co

35A - N.P.R.R

(Yellowstone Basin)

Farm Map

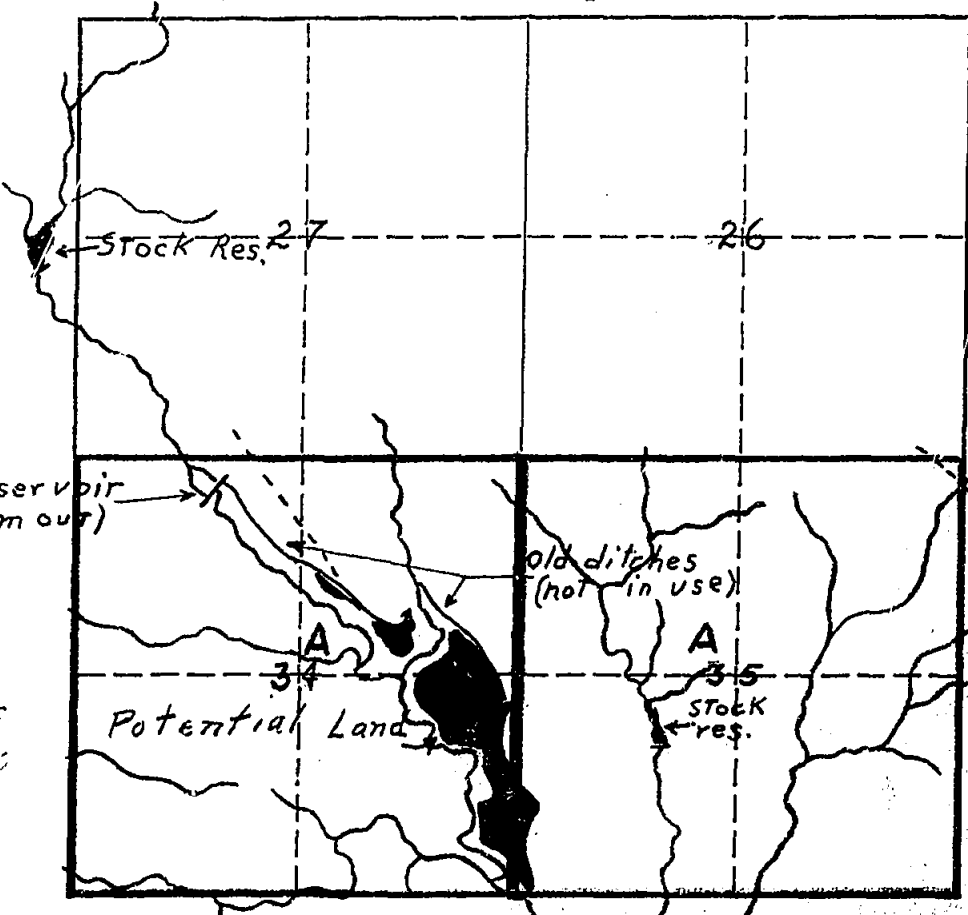

Stock res. Ownership covers only irrigated land. All ownership for Custer Creek dry land not shown.