



These forms are the property of the State of Montana and must be returned.

STATE OF MONTANA STATE ENGINEERS OFFICE

Water Resources Survey

FORM WR-1-2M 12-47
Code No. 34A-35A
County Custer
T. 13N R. 46E

Name of Land Owner H. B. and James Limestone Address Miles City, Mont
Name of Operator _____ Address _____

Part A

TO BE FILED BY THOSE OBTAINING IRRIGATION WATER FROM
A DITCH COMPANY OR IRRIGATION DISTRICT

1. Water is delivered by: _____
Name of Ditch, Ditch Company or District Supplying Water
2. State the number of acres you irrigate under this system _____ Shares you hold _____
3. If you obtain water from more than one Company, give the number of shares, acres irrigated and the name of the Company under "Remarks." If you obtain water from a Ditch Company and also have a private system fill in both Part A and Part B.

Part B

TO BE FILED BY THOSE WHO HAVE A PRIVATE DITCH, PUMP OR IRRIGATION SYSTEM
or those who have a private water right under a Ditch Company

4. In what year was this land first irrigated? Date _____
5. Give the name of the original appropriator (first user): Margaret E. Curl
6. Give the date appropriated June 4, 1912 Amount filed on: Miners Inches _____ C. F. S. 12 1/2
7. State the total number of acres irrigated under this system: Potential
8. Give the point of diversion: _____ 1/4 _____ 1/4 Section 28 Township 13N Range 46E

Part C

TO BE FILED BY ALL WATER USERS IN ADDITION TO PART A OR PART B

9. Source of Water: Custer Creek
Name of stream or lake from which water is originally diverted
10. Water is obtained by: (Check one) Gravity ☒ Pumping _____ Other flood
11. What is the greatest number of acres you have irrigated? 34.6 Date ?
12. How many acres did you irrigate in 1947? (Crop and pasture) None
13. State the total number of additional acres that could be irrigated by increasing the water supply, land leveling, etc. 34.6 This land is under what ditch? Private flood ditches
14. How many acres of seeped land do you have which could be drained and put into production? None
15. What is the condition of your irrigation system? not in order
16. Is your water supply adequate? Yes _____ No ☒ Explain Flood irrigation
17. REMARKS: Old ditches not now in use

Over: _____

T. 13N., R. 46E.

NOTE: The foregoing questions apply only to irrigated land shown on this plat.

DESCRIPTION AND MAP OF FARM

18. Legal Description of this Farm

Sections 34, 35, Twp 13-N, Rge 46-E

IRRIGATED LAND

NON-IRRIGATED LAND

(None at Present)

North

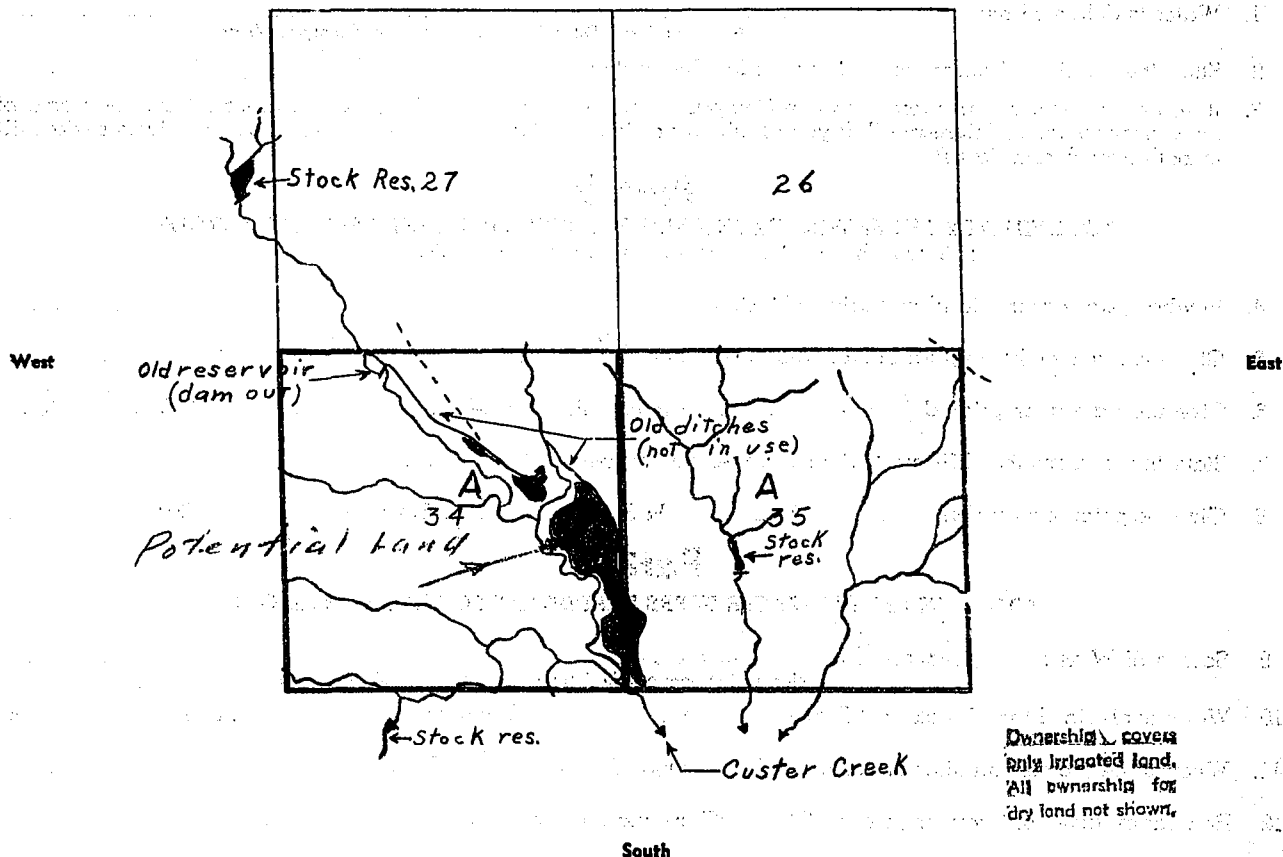

19. If the above land is irrigated from more than one ditch please give the acreage under each ditch in 19A and indicate the location of the land irrigated from each on the above map.

19A. Ditch: Private flood ditches Acres: 0

Ditch: _____ Acres: _____

Information supplied by:

Name Field Clerk Address _____ Date July 30-47

REMARKS: A. C. Johnson asst. Eng.

Joe Rantist

If you cannot answer all of the questions on this form answer as many as you can and return the form to us as soon as possible.

STATE ENGINEERS OFFICE
Water Resources SurveyCOUNTY CusterFILE NO. 2 13 N - 46 E -Owner Haughnians Livestock Co. Address Miles City, Mont

AAA Owner _____ Address _____

Operator _____ Address _____

New Owner _____ Address _____

New Operator _____ Address _____

Assessment Record NoneAssessed Acreage —Legal Description of This Farm Sec. 34, T. 13 N., R. 46 E.

Total Acres in Farm _____

Code Number 34 A - 35 A.Photo No. MA-21-58

AAA Contract No. _____

AAA Total Cropland Acreage —App. No. 664Decree No. —

Land is located in

Twp. 13 Rge. 46 Twp. _____ Rge. old reservoir
(dam out)

Twp. _____ Rge. _____ Twp. _____ Rge. _____

Filed in Twp. 10 N Rge. 48 ERemarks App. 664 is for Finley Cr.
Tributary of Custer Place of
Intend Use. O.K.34 A - Haughnians Livestock Co
35 A - N.P.R.R

(Yellowstone Basin)

Farm Map

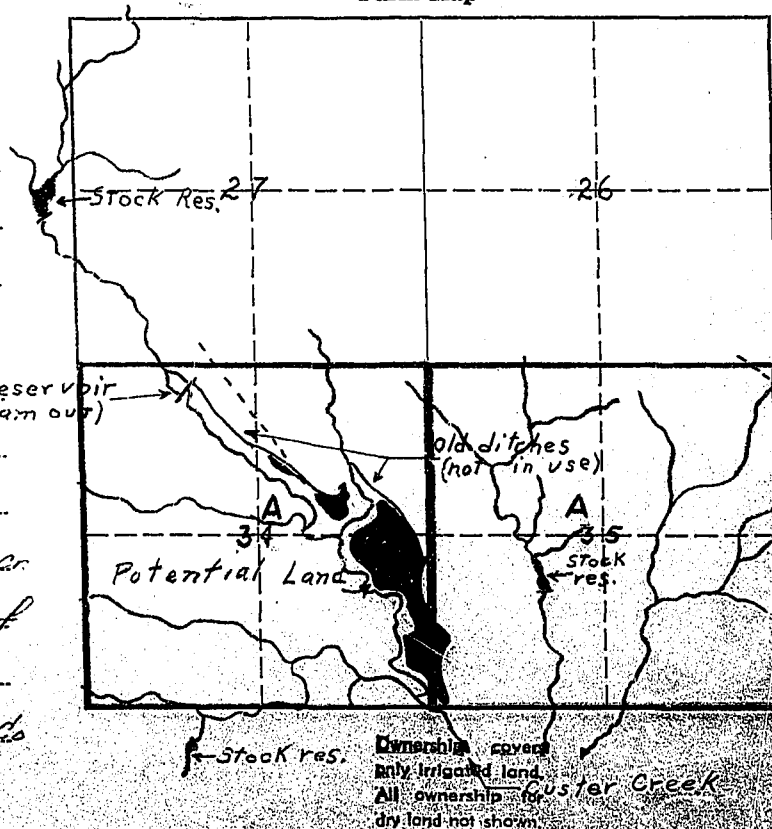

STATE ENGINEERS OFFICE
Water Resources Survey

664

Notice of Appropriation

1. County Custer Book D Page 580 Record Water Right
2. Name of Appropriator Margaret E. Carl Address Custer Co. Mont.
3. Date Appropriated June 1, 1912 Date Filed Apr. 15, 1913
- Amount Appropriated, Miners Inches....., Cubic Feet per second 12 1/2
4. Name of Stream Custer Creek Tributary " Basin Yellowstone
5. Point of Diversion About 450 ft. W + 125 ft. S of the N.E. Corner of the S.E.
- Sec. 28 Twp. 13 N Rge. 46 E Bank of Stream —

6. Purpose For Irrigation + other purposes
7. Description of System A dam of sufficient size to hold the storm + flood waters of said Creek.
8. Land Description of Intended Place of Use
SE 4 NE 4, E 4 SE 4, Sec 34 Twp. 13 N Rge 46 E
SW 4 SE 4, " " "
9. Remarks (Pertaining to Use, etc.)
System not in use July 30, 1947

Decree

10. Case No. Date Amt. Decreed: M. I. C. F. S.
11. To Whom Decreed Address
12. Name of Ditch Maximum Capacity (C. F. S.)
13. Date of Priority Purpose
14. Land Description of Place of Use as Decreed
15. Remarks (Present Use Status, etc.)

STATE OF MONTANA
STATE ENGINEER'S OFFICE
 WATER RESOURCES SURVEY

Township 13N Range 46E County Custer

6	5	4	3	2	1
7	8	9	10	11	12
18	17	16	15	14	13
19	20	21	22	23	24
30	29	28	Ownership covers only irrigated land. All ownership for dry land not shown.	26	25
31	32	33	34 664	35 A?	36

Township 13N Range 46E

Township 13 North

Range 46 East

Custer County

<u>Index No.</u>	<u>Name of Appropriator</u>	<u>Stream</u>	<u>Date App.</u>	<u>Date Filed</u>	<u>M.I.</u>
664	Margaret E. Curl	Finley Creek	6-1-12	4-15-13	500

Township 13 North

Range 46 East

Custer County

STATE OF MONTANA
STATE ENGINEER'S OFFICE
 WATER RESOURCES SURVEY

Township 12N Range 46E County Custer

6	5	4	3	2	1
7	8	9	10	11	12
18	17	16	15	14	13
19	20	21	22	23	Ownership ²⁴ covers only irrigated land. All ownership for dry land not shown.
30	29	28	27	26	A 25 B
31	32	33	34	35	36

no app.

Township 12N Range 46E

[illegible]



NOTICE
These forms are the
property of the State
of Montana and must
be returned.

STATE OF MONTANA
STATE ENGINEERS OFFICE
Water Resources Survey

Code No. 30 A

County Custer

T. 12 N R. 47 E

Name of Land Owner Hamlick, Myra Jay Address Miles City, Mont.

Name of Operator _____ Address _____

Part A

TO BE FILED BY THOSE OBTAINING IRRIGATION WATER FROM
A DITCH COMPANY OR IRRIGATION DISTRICT

1. Water is delivered by: _____
Name of Ditch, Ditch Company or District Supplying Water
2. State the number of acres you irrigate under this system _____ Shares you hold _____
3. If you obtain water from more than one Company, give the number of shares, acres irrigated and the name of the Company under "Remarks." If you obtain water from a Ditch Company and also have a private system fill in both Part A and Part B.

Part B

TO BE FILED BY THOSE WHO HAVE A PRIVATE DITCH, PUMP OR IRRIGATION SYSTEM
or those who have a private water right under a Ditch Company

4. In what year was this land first irrigated? Date 1911
5. Give the name of the original appropriator (first user): Frank Hamlick
6. Give the date appropriated 12-15-11 Amount filed on: Miners Inches 200 C. F. S.
7. State the total number of acres irrigated under this system: none
8. Give the point of diversion: 1/4 Section 30 Township 12 N Range 47 E

Part C

TO BE FILED BY ALL WATER USERS IN ADDITION TO PART A OR PART B

9. Source of Water: Bachelor Creek
Name of stream or lake from which water is originally diverted
10. Water is obtained by: (Check one) Gravity ☒ Pumping _____ Other Spring Flooding
11. What is the greatest number of acres you have irrigated? 55 Date 1912
12. How many acres did you irrigate in 1947? (Crop and pasture) none
13. State the total number of additional acres that could be irrigated by increasing the water supply, land leveling, etc. 55 This land is under what ditch? flood irrigation
14. How many acres of seeped land do you have which could be drained and put into production? none
15. What is the condition of your irrigation system? not used since about 1912
16. Is your water supply adequate? Yes _____ No ☒ Explain flood irrigation
17. REMARKS:

Hamlick desert Claim ditch

T. 12 N, R. 47 E

NOTE: The foregoing questions apply only to irrigated land shown on this plat.

DESCRIPTION AND MAP OF FARM

18. Legal Description of this Farm

Sec. 30, Twp 12 N. Rge 4 E.



IRRIGATED LAND



NON-IRRIGATED LAND

North

West
Hamlick Res. & desert
Claim ditch, last used
about 1912

Bachelor Cr.

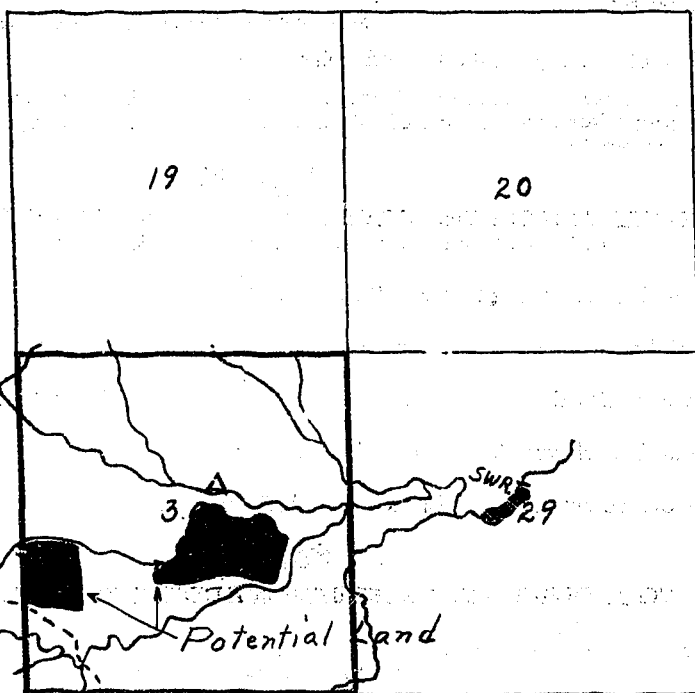

East

South

Ownership covers
only irrigated land.
All ownership for
dry land not shown

19. If the above land is irrigated from more than one ditch please give the acreage under each ditch in 19A and indicate the location of the land irrigated from each on the above map.

19A. Ditch: *Desert Claim ditches* Acres: *None*

Ditch: _____ Acres: _____

Information supplied by:

Name *Field Club* Address _____ Date *July 30, 47*

REMARKS: *A. C. Johnson*

Joe Paulist

Information from owner & survey

If you cannot answer all of the questions on this form answer as many as you can and return the form to us as soon as possible.

STATE ENGINEERS OFFICE
Water Resources SurveyCOUNTY CusterFILE NO. 3-T.12N-R.47EOwner Harnick, Myra JayAddress Miles City

AAA Owner

Address

Operator

Address

New Owner

Address

New Operator

Address

Assessment Record

Assessed Acreage NoneLegal Description of This Farm Sec. 30 T.12N-R.47E

Total Acres in Farm

Code Number 30APhoto No. MA-21-55

AAA Contract No.

AAA Total Cropland Acreage

App. No. 60

Decree No.

Land is located in

Twp. 12N Rge. 47E Twp. Rge.

Twp. Rge. Twp. Rge.

Filed in Twp. 12N Rge. 47E

Remarks

Bachelor Creek
Yellowstone Basin

Farm Map

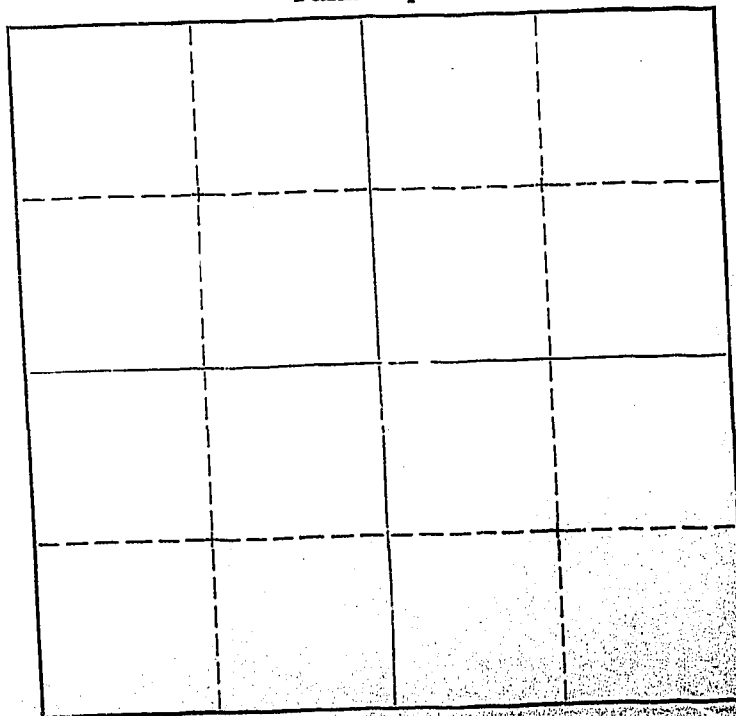
Ownership covers
only irrigated land.
All ownership for
dry land not shown.

STATE ENGINEERS OFFICE
Water Resources Survey

Notice of Appropriation

1. County Custer Book F Page 25 Record Water Right
2. Name of Appropriator Frank Hamlich Address Wilder City, Mont.
3. Date Appropriated 12/15/11 Date Filed 12/28/1911
Amount Appropriated, Miners Inches 200, Cubic Feet per second
4. Name of Stream Bachelor Creek Tributary Custer Creek Basin Yellowstone
5. Point of Diversion About 40 Chrs. West of the 1/4 Sec. Cor.
on the Westside of
Sec. 30 Twp. 12N Rge. 47E Bank of Stream east

6. Purpose For Irrigation, stock, domestic + other uses
7. Description of System A dam, reservoir + ditch. Said
ditch being 30" x 60" in size which carries +
conducts said amount of water to land.
8. Land Description of Intended Place of Use

N2 SW4, N2 SE4, Sec. 30 Twp 12N Rge 47E,

9. Remarks (Pertaining to Use, etc.)

Not in use since about 1912 desert
claim ditcher.

Decree

10. Case No. Date Amt. Decreed: M. I. C. F. S.
11. To Whom Decreed Address
12. Name of Ditch Maximum Capacity (C. F. S.)
13. Date of Priority Purpose
14. Land Description of Place of Use as Decreed
15. Remarks (Present Use Status, etc.)

STATE OF MONTANA
STATE ENGINEER'S OFFICE
 WATER RESOURCES SURVEY

Township 12N Range 47E County Custer

6	5	4	3	2	1
7	8	9	10	11	12
18	17	16	15	14	13
19	20	21	22	Ownership covers only irrigated land. All ownership for dry land not shown. 23	442 24 A
26 A	29	28	27	25 A	25 A
				441	
31	32	33	34	35	36

Township 12N Range 47E

County Cluster

Referrals

Township 12 North

Range 47 East

Custer County

<u>Index No.</u>	<u>Name of Appropriator</u>	<u>Stream</u>	<u>Date App.</u>	<u>Date Filed</u>	<u>M.T.</u>
60	Frank Hamlick	Bachelor Creek	12-15-11	12-28-14	200
441	H. M. Gilmore	Custer Creek	6-20-08	7-14-08	1,160,150 gals.
442	Frank Shaffer	Custer Creek	5-1-34	10-13-34	480

Township 12 North

Range 47 East

Custer County

STATE ENGINEERS OFFICE
Water Resources SurveyCOUNTY Custer Co.

FILE NO. _____

Owner Shaffer Frank Address Wilder City

AAA Owner _____ Address _____

Operator _____ Address _____

New Owner _____ Address _____

New Operator _____ Address _____

Assessment Record _____

Assessed Acreage _____

Legal Description of This Farm _____

Total Acres in Farm _____

Code Number _____

Farm Map

Photo No. _____

AAA Contract No. _____

AAA Total Cropland Acreage _____

App. No. _____

Decree No. _____

Land is located in

Twp. _____ Rge. _____ Twp. _____ Rge. _____

Twp. _____ Rge. _____ Twp. _____ Rge. _____

Filed in Twp. 12N Rge. 47ERemarks No 3



NOTICE
These forms are the
property of the State
of Montana and must
be returned.

STATE OF MONTANA
STATE ENGINEERS OFFICE

Water Resources Survey

FORM WR-12-24-47
24A-26A-12N-47E
Code No. 19A 30A

County Custer

T. 12 N R. 48 E

Name of Land Owner Frank Schaeffer Address Miller City, Mont.

Name of Operator _____ Address _____

Part A

TO BE FILED BY THOSE OBTAINING IRRIGATION WATER FROM
A DITCH COMPANY OR IRRIGATION DISTRICT

1. Water is delivered by: _____
Name of Ditch, Ditch Company or District Supplying Water
2. State the number of acres you irrigate under this system _____ Shares you hold _____
3. If you obtain water from more than one Company, give the number of shares, acres irrigated and the name of the Company under "Remarks." If you obtain water from a Ditch Company and also have a private system fill in both Part A and Part B.

Part B

TO BE FILED BY THOSE WHO HAVE A PRIVATE DITCH, PUMP OR IRRIGATION SYSTEM
or those who have a private water right under a Ditch Company

4. In what year was this land first irrigated? Date see attached forms
5. Give the name of the original appropriator (first user): _____
6. Give the date appropriated _____ Amount filed on: Miners Inches _____ C. F. S. _____
7. State the total number of acres irrigated under this system: _____
8. Give the point of diversion: $\frac{1}{4}$ $\frac{1}{4}$ Section _____ Township _____ Range _____

Part C

TO BE FILED BY ALL WATER USERS IN ADDITION TO PART A OR PART B

9. Source of Water: Custer Creek, Rock Creek & Coulson
Name of stream or lake from which water is originally diverted
10. Water is obtained by: (Check one) Gravity ☒ Pumping ☒ Other Flood irrigation
11. What is the greatest number of acres you have irrigated? 8 Date _____
12. How many acres did you irrigate in 1947? (Crop and pasture) 111.5
13. State the total number of additional acres that could be irrigated by increasing the water supply, land leveling, etc. _____ This land is under what ditch? _____
14. How many acres of seeped land do you have which could be drained and put into production? _____
15. What is the condition of your irrigation system? Fair
16. Is your water supply adequate? Yes ☒ No ☒ Explain Flood irrigation
17. REMARKS: Frank Schaeffer has rock dam and ditches on Custer Creek. Has just completed new ditches.

Over _____ If you check any of the questions on this form as having been answered by another form, please so indicate.

NOTE: The foregoing questions apply only to irrigated land shown on this plat.

DESCRIPTION AND MAP OF FARM

18. Legal Description of this Farm

Sec. 24, 25, Twp 12 N R 47 E Sec
19, NW 4 Sec 30 Twp 12 N R 48 E.



IRRIGATED LAND



NON-IRRIGATED LAND

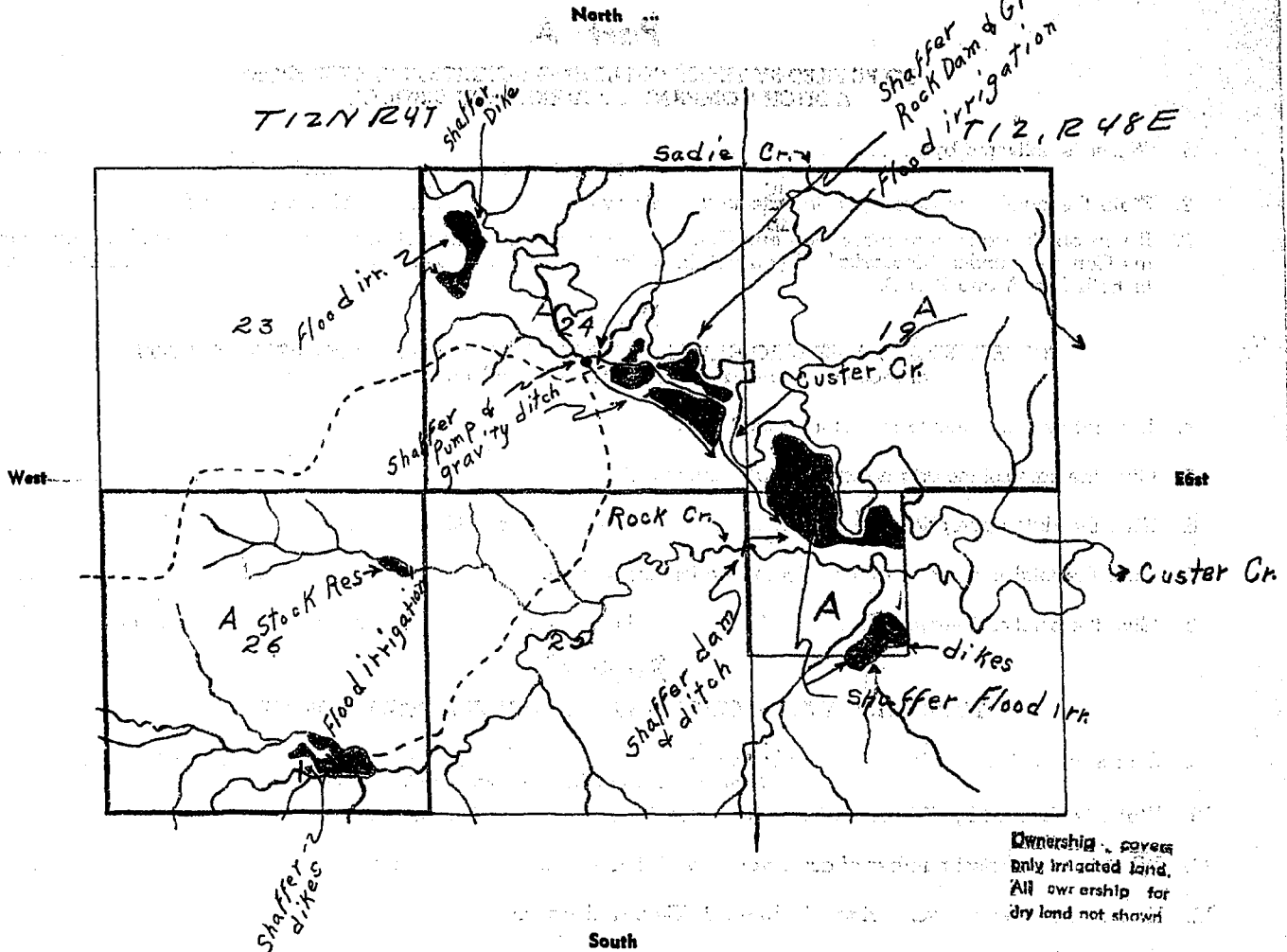

19. If the above land is irrigated from more than one ditch please give the acreage under each ditch in 19A and indicate the location of the land irrigated from each on the above map.

19A. Ditch: Flood Irrigation by private irrigation Acres: 1.5

Ditch: by means of ditches, ditches & pumpage Acres: 1.5

Information supplied by: Owner & Field

Name Owner & Field

Address

Date

July 30, 47

REMARKS: Survey by C. C. Johnson
for Plaintiff

If you cannot answer all of the questions on this form answer as many as you can and return the form to us as soon as possible.

STATE ENGINEERS OFFICE
Water Resources SurveyCOUNTY ClusterFILE NO. 3 - T. 12N - R. 47E
4 - T. 12N - R. 48EOwner Shaffer, FrankAddress Miles City

AAA Owner

Address

Operator

Address

New Owner

Address

New Operator

Address

Assessment Record NoneAssessed Acreage 0Legal Description of This Farm Sec. 24 & 26; T. 12N - R. 47ESec. 19, & NW 1/4 Sec. 20; T. 12N - R. 48ETotal Acres in Farm ✓Code Number 24A, 26A, T. 12N - R. 4719A, 30A - T. 12N - R. 48EPhoto No. MA-18-166, MA-21-28

Farm Map

AAA Contract No.

AAA Total Cropland Acreage

App. No. 441 - 442 - 1474

Decree No.

Land is located in

Twp. 12N Rge. 47E Twp. Rge.Twp. 12N Rge. 48E Twp. Rge.Filed in Twp. 12N Rge. 47E

Remarks

Cluster Creek
Rock "
Yellowstone BasinOwnership covers
only irrigated land.
All ownership for
dry land not shown.

STATE ENGINEERS OFFICE
Water Resources Survey

Notice of Appropriation

1. County Auster Book E Page 511 Record Water Right
2. Name of Appropriator Frank Shaffer Address Kinsley, Mont.
3. Date Appropriated Oct. 12, 1934 Date Filed Oct. 13, 1934
- Amount Appropriated, Miners Inches 480, Cubic Feet per second _____
4. Name of Stream Auster Creek Tributary Yellowstone Basin Yellowstone
5. Point of Diversion _____
- Sec. _____ Twp. _____ Rge. _____ Bank of Stream Right
6. Purpose for irrigation, stock, domestic + other uses
7. Description of System A dam with a ditch 5 ft x 4 ft in size, which carries + conducts said amount of water to lands
8. Land Description of Intended Place of Use _____
- In Section 24, Twp. 12 N. Rge. 47 E.
9. Remarks (Pertaining to Use, etc.) _____
- In use July 1947

Decree

10. Case No. _____ Date _____ Amt. Decreed: M. I. _____ C. F. S. _____
11. To Whom Decreed _____ Address _____
12. Name of Ditch _____ Maximum Capacity (C. F. S.) _____
13. Date of Priority _____ Purpose _____
14. Land Description of Place of Use as Decreed _____
15. Remarks (Present Use Status, etc.) _____

STATE ENGINEERS OFFICE
Water Resources Survey

441

Notice of Appropriation

1. County Custer Book D Page 46 Record Water Right
2. Name of Appropriator H. M. Gilmore Address P
3. Date Appropriated June 29, 1908 Date Filed July 14, 1908
Amount Appropriated, ^{gallon-} ~~Meters~~ Inches 1,160,150, Cubic Feet per second
4. Name of Stream Custer Creek Tributary Yel. River Basin Yellowstone
5. Point of Diversion At Red Hill Spring in
SE4, SE4,
- Sec. 26 Twp. 12 N Rgc. 47 E Bank of Stream —

6. Purpose For stock Res. + other purposes
7. Description of System A dam built on a fork of
Custer Creek for a stock Reservoir to hold
+ maintain described water
8. Land Description of Intended Place of Use
SE4, SE4, Sec 26, Twp 12 N Rgc 47 E

9. Remarks (Pertaining to Use, etc.)
A fork of Custer Creek known as
Red Hill Spring. In use July 1947

Decree

10. Case No. Date Amt. Decreed: M. I. C. F. S.
11. To Whom Decreed Address
12. Name of Ditch Maximum Capacity (C. F. S.)
13. Date of Priority Purpose
14. Land Description of Place of Use as Decreed
15. Remarks (Present Use Status, etc.)

STATE ENGINEERS OFFICE
Water Resources Survey

1474

Notice of Appropriation

1. County Custer Book 71 Page 40 Record Water Right
2. Name of Appropriator Josephine Woodcock Address Custer Co. Mont.
3. Date Appropriated May 25, 1915 Date Filed May 25, 1915
Amount Appropriated, Miners Inches 5000, Cubic Feet per second
4. Name of Stream Rock Creek Tributary Custer Co. Basin Yell. B.
5. Point of Diversion Dam no. 1, in the NW 1/4 of sec 30,
Dam No. 2 in Spt 3, sec 30,
Sec. 30 Twp 12N Rge 48E Bank of Stream ✓
6. Purpose For irrigation, stock, + domestic uses
7. Description of System 2 dams + ditches. Said to build
of earth + stone, ditches to carry + conduct
said water
8. Land Description of Intended Place of Use
E 2 NW 1/4, NE 1/4 SW 1/4, Sec 30 Twp 12N Rge 48E,
Spts 1, 2, 3,
9. Remarks (Pertaining to Use, etc.)
In use July 1947

Decree

10. Case No. Date Amt. Decreed: M. I. C. F. S.
11. To Whom Decreed Address
12. Name of Ditch Maximum Capacity (C. F. S.)
13. Date of Priority Purpose
14. Land Description of Place of Use as Decreed
15. Remarks (Present Use Status, etc.)

STATE OF MONTANA
STATE ENGINEER'S OFFICE
 WATER RESOURCES SURVEY

Township 12N Range 48E County Custer

6	5	4	3	2	1
7	8	9	10	11	12
18	17	16	15	14	13
19 ^A	Ownership: cows only irrigated land. All ownership for dry land not shown. 20	21	22 ^{23/0}	23	24
1474 ^A	30 ^B	29	28	27	26
C					25
31	32	33	34	35	36

Township 12N Range 48E

[illegible]

Township 12 North

Range 48 East

Custer County

<u>Index No.</u>	<u>Name of Appropriator</u>	<u>Stream</u>	<u>Date App.</u>	<u>Date Filed</u>	<u>M.I.</u>
1474	Josephine Woodcock	Rock Creek	5-1-15	5-25-15	5000
2310	Chas. G. Clarke	Dry Water Course	4-22-11	4-24-11	500

Township 12 North

Range 48 East

Custer County



NOTICE

These forms are the property of the State of Montana and must be returned.

STATE OF MONTANA
STATE ENGINEERS OFFICE

Water Resources Survey

Code No. 36A

County: Custer

T. 11 N R. 48 E

Name of Land Owner State of Montana Address Helena

Name of Operator Haughan Limestone Co. Address Wilder City, Mont

Part A

TO BE FILED BY THOSE OBTAINING IRRIGATION WATER FROM
A DITCH COMPANY OR IRRIGATION DISTRICT

1. Water is delivered by: _____
Name of Ditch, Ditch Company or District Supplying Water
2. State the number of acres you irrigate under this system _____ Shares you hold _____
3. If you obtain water from more than one Company, give the number of shares, acres irrigated and the name of the Company under "Remarks." If you obtain water from a Ditch Company and also have a private system fill in both Part A and Part B.

Part B

TO BE FILED BY THOSE WHO HAVE A PRIVATE DITCH, PUMP OR IRRIGATION SYSTEM
or those who have a private water right under a Ditch Company

4. In what year was this land first irrigated? Date See attached filing
5. Give the name of the original appropriator (first user): _____
6. Give the date appropriated _____ Amount filed on: Miners Inches _____ C. F. S. _____
7. State the total number of acres irrigated under this system: _____
8. Give the point of diversion: _____ $\frac{1}{4}$ _____ $\frac{1}{4}$ Section _____ Township _____ Range _____

Part C

TO BE FILED BY ALL WATER USERS IN ADDITION TO PART A OR PART B

9. Source of Water: Cabin Creek
Name of stream or lake from which water is originally diverted
10. Water is obtained by: (Check one) Gravity ☒ Pumping _____ Other _____
11. What is the greatest number of acres you have irrigated? ? Date _____
12. How many acres did you irrigate in 1947? (Crop and pasture) 55.0
13. State the total number of additional acres that could be irrigated by increasing the water supply, land leveling, etc. 0 This land is under what ditch? _____
14. How many acres of seeped land do you have which could be drained and put into production? 0
15. What is the condition of your irrigation system? Fair
16. Is your water supply adequate? Yes _____ No ☒ Explain I had no
17. REMARKS: _____

NOTE: The foregoing questions apply only to irrigated land shown on this plan.

DESCRIPTION AND MAP OF FARM

18. Legal Description of this Farm

Water Resources Survey



IRRIGATED LAND

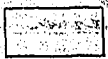

NON-IRRIGATED LAND

North

NOTE: If you cannot answer all the questions on this form answer as many as you can and return the form to us as soon as possible.

See attached
WR form

West

East

South

Ownership of land
Only irrigated land,
All ownership for
dry land not shown.

19. If the above land is irrigated from more than one ditch please give the acreage under each ditch in 19A and indicate the location of the land irrigated from each on the above map.

19A. Ditch: Cabin Creek flood U.S. Acres: 55.0

Ditch: _____ Acres: _____

Information supplied by:

Name Field Survey Address _____ Date 5/7/47

REMARKS: Johnson & Paulist

See attached form

If you cannot answer all of the questions on this form answer as many as you can and return the form to us as soon as possible.

STATE ENGINEERS OFFICE
Water Resources SurveyCOUNTY CusterFILE NO. 6A-T-11-R-48EOwner Montana, State of Address Helena, Montana

AAA Owner _____ Address _____

Operator Haughian Livestock Co Address Miles City, Montana

New Owner _____ Address _____

New Operator _____ Address _____

Assessment Record NoneAssessed Acreage 0Legal Description of This Farm all of sec. 36; T. 11N-R. 48ETotal Acres in Farm 640?Code Number 36APhoto No. MA 26-205

AAA Contract No. _____

AAA Total Cropland Acreage _____

App. No. 256

Decree No. _____

Land is located in

Twp. 11N Rge. 48E Twp. _____ Rge. _____

Twp. _____ Rge. _____ Twp. _____ Rge. _____

Filed in Twp. 10N Rge. 48ERemarks See form forHaughian Livestock Co.

Farm Map

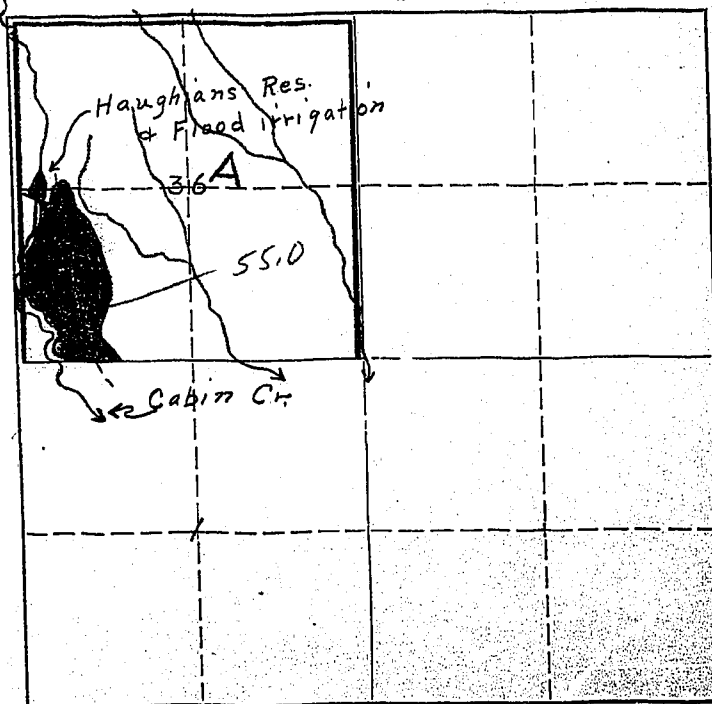
Ownership covers
only irrigated land.
All ownership for
dry land not shown.

Yellowstone River Basin

portion of 36-11N-48E

FORM F-1 - GAZETTE 1967-2M-1-4

1A - 10 N. - 4FE

Code No. 68-10N-49e

County Custer

County Custer

10 N 4 FE
10 N 4 FE

T. 102 R. 47E Sec. 11E

✓ 11N 480

Photo No. _____

Address _____

Address Miles City

Federal Project _____ Pres. _____ Pot. _____

Ditch Company _____ Pres. _____ Pot. _____

Irrigation District _____ Pres. _____ Pot. _____

Private System 1-100 d Pres. 55.0 Pot. 0

Totals	
1	1
2	2
3	3
4	4
5	5
6	6
7	7
8	8
9	9
10	10
11	11
12	12
13	13
14	14
15	15
16	16
17	17
18	18
19	19
20	20
21	21
22	22
23	23
24	24
25	25
26	26
27	27
28	28
29	29
30	30
31	31
32	32
33	33
34	34
35	35
36	36
37	37
38	38
39	39
40	40
41	41
42	42
43	43
44	44
45	45
46	46
47	47
48	48
49	49
50	50
51	51
52	52
53	53
54	54
55	55
56	56
57	57
58	58
59	59
60	60
61	61
62	62
63	63
64	64
65	65
66	66
67	67
68	68
69	69
70	70
71	71
72	72
73	73
74	74
75	75
76	76
77	77
78	78
79	79
80	80
81	81
82	82
83	83
84	84
85	85
86	86
87	87
88	88
89	89
90	90
91	91
92	92
93	93
94	94
95	95
96	96
97	97
98	98
99	99
100	100

Flood _____ Pump _____ Reservoir _____ Gravity _____

Size and Capacity, Pump, etc.

Original Appropriator, Company _____ App. No. _____

Original Appropriator, Private _____ App. No. 256

(Show date of appropriation under Remarks)

Is the system an extension of another system? Yes _____ No ✓

Is all land irrigated from one system? Yes ✓ No

(If No, show break down on map)

Source of Water. Cabin Cr.

Acres Irrigated 19 76

Potential Acres 0 Seeped 0

Explain _____

Condition of System Good mostly new

Adequate Supply Yes..... No.....

Explain Flood only

Topography Bad lands slope

Information From Haughian

Remarks _____

COPY

also filed in 10N.-48E.
10N.-49E.

4FE 49E

3E

Diagram showing a 10x10 grid with handwritten labels and symbols. The labels '4FE' and '49E' are at the top, '3E' is on the left, and various symbols (slashes, arrows, dots) are scattered across the grid.