

A STUDY OF MONTANA'S WATER RESOURCES

10-B

- County Custer Source of Information _____
1. Water User Sherman Chasen Address _____
2. Stream Longue Tributary to _____ Basin _____
3. Point of Diversion 1 1/2 Section _____ Township _____ Range _____
4. Description of System SH Cattle Co. Ditch
5. Type of Irrigation _____
6. Original Appropriator _____ Address _____
7. First Use: Year _____ Acres Irrigated _____
8. Maximum Use: Year 1920 Acres Irrigated 0
9. Present Use: Year _____ Acres Irrigated _____
10. Last Use: Year _____ Why Abandoned _____
11. Condition of System _____
12. Land Description Sec 10, T 2N, R 45E

Remarks: SH Cattle Co. Ditch 428 irrigates (1920)

33
44
55

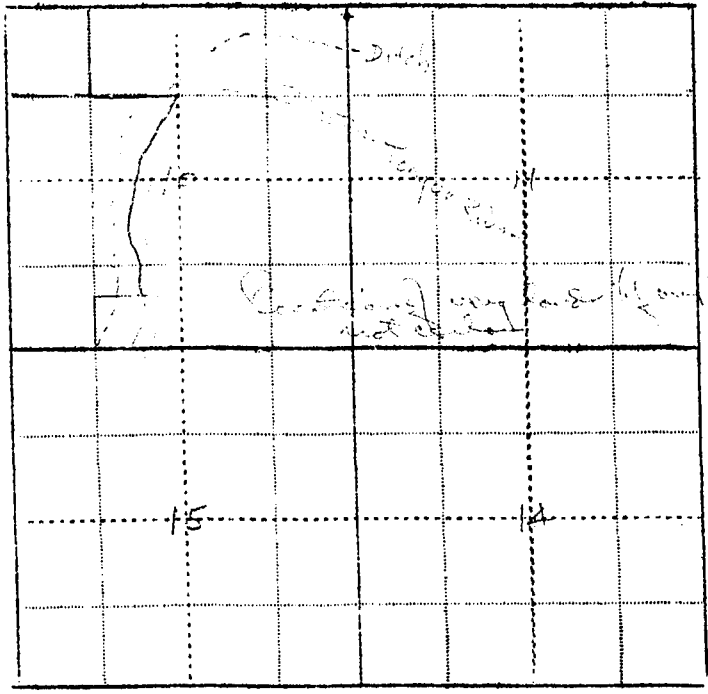

WITNESS: _____ Information by _____

Place _____

Irrigated land not shown in Land Class Book

W.P. 3116
No. _____

A Study of Montana's Water Resources

Form WR-4

Record of a Farm under A.A.A. Program Having Irrigated Land

A.A.A. Contract No. ✓ _____ County Auster 10/ Twp. 277 Rng. 456

Name of Owner Sherman Chegan Address _____

Name of Operator ✓ _____ Address _____

OB. Total Number of Acres in Farm 234.7 Number of Acres Irrigated in 1940 488

Outline on the plat below in red pencil the boundaries of the farm unit. If possible, show in blue pencil the location of the irrigated land. The section number (s) should be clearly indicated. Obtain the legal description from county ownership records and correct boundaries if necessary.

Legal Description Out of lot 6

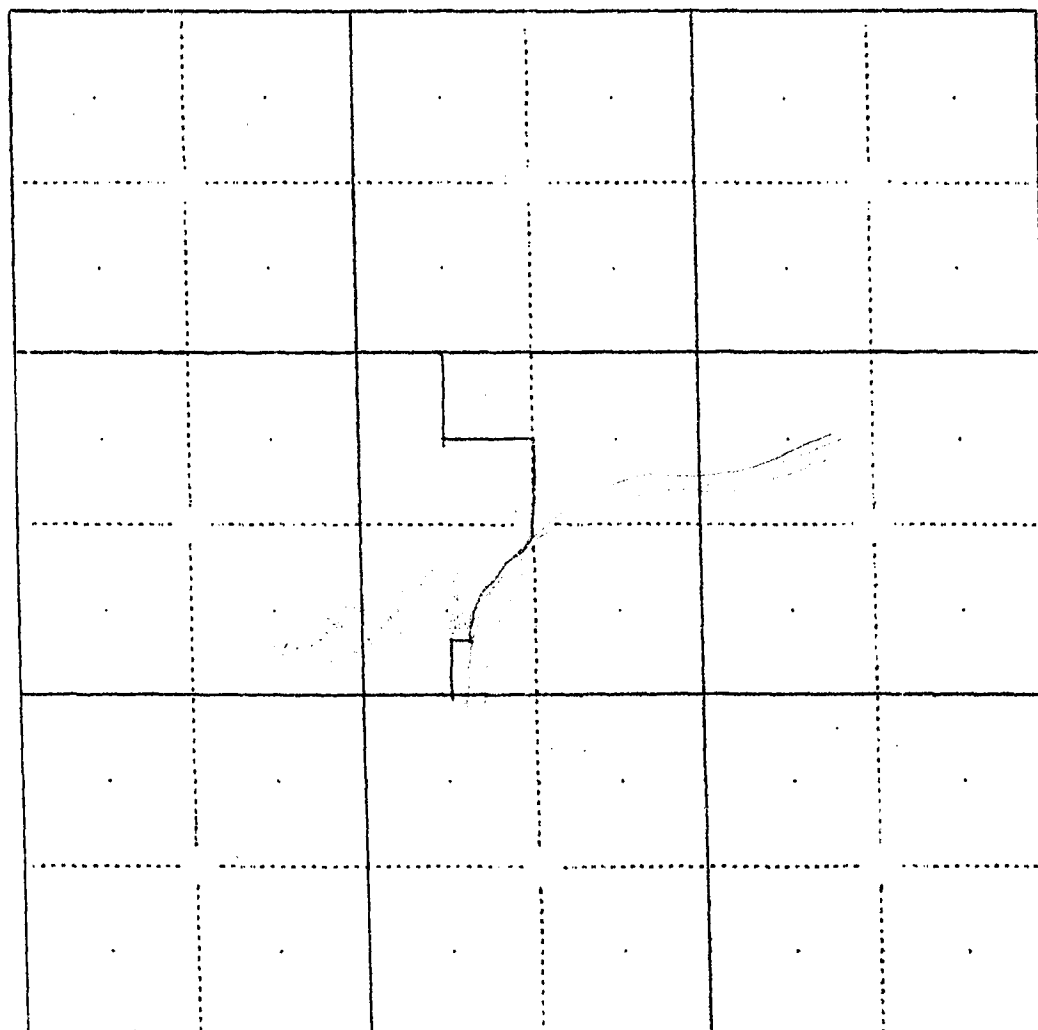

County	Source of Information
Custer	

1. Water User	Address
W. H. Hether, H. O.	

2. Stream Tributary to Basin

3. Point of Diversion	$\frac{1}{4}$	$\frac{1}{4}$	Section	Township	Range
-----------------------	---------------	---------------	---------	----------	-------

4. Description of System

5. Type of Irrigation

6. Original Appropriator	Address

7. First Use:	Year	Acres Irrigated

8. Maximum Use: Year 1970 Acres Irrigated 47

9. Present Use; Year	Acres Irrigated
1950	100
1951	100
1952	100
1953	100
1954	100
1955	100
1956	100
1957	100
1958	100
1959	100
1960	100
1961	100
1962	100
1963	100
1964	100
1965	100
1966	100
1967	100
1968	100
1969	100
1970	100
1971	100
1972	100
1973	100
1974	100
1975	100
1976	100
1977	100
1978	100
1979	100
1980	100
1981	100
1982	100
1983	100
1984	100
1985	100
1986	100
1987	100
1988	100
1989	100
1990	100
1991	100
1992	100
1993	100
1994	100
1995	100
1996	100
1997	100
1998	100
1999	100
2000	100
2001	100
2002	100
2003	100
2004	100
2005	100
2006	100
2007	100
2008	100
2009	100
2010	100
2011	100
2012	100
2013	100
2014	100
2015	100
2016	100
2017	100
2018	100
2019	100
2020	100
2021	100
2022	100
2023	100
2024	100
2025	100
2026	100
2027	100
2028	100
2029	100
2030	100
2031	100
2032	100
2033	100
2034	100
2035	100
2036	100
2037	100
2038	100
2039	100
2040	100
2041	100
2042	100
2043	100
2044	100
2045	100
2046	100
2047	100
2048	100
2049	100
2050	100
2051	100
2052	100
2053	100
2054	100
2055	100
2056	100
2057	100
2058	100
2059	100
2060	100
2061	100
2062	100
2063	100
2064	100
2065	100
2066	100
2067	100
2068	100
2069	100
2070	100
2071	100
2072	100
2073	100
2074	100
2075	100
2076	100
2077	100
2078	100
2079	100
2080	100
2081	100
2082	100
2083	100
2084	100
2085	100
2086	100
2087	100
2088	100
2089	100
2090	100
2091	100
2092	100
2093	100
2094	100
2095	100
2096	100
2097	100
2098	100
2099	100
2100	100

10. Last Use:	Year	Why Abandoned

11. Condition of System

12. Land Description Lot 6, Sec 19, T 2N, R 45E

Remarks:

2. Δ^1 sense - 100%

WITNESS:

Information by _____

Place _____

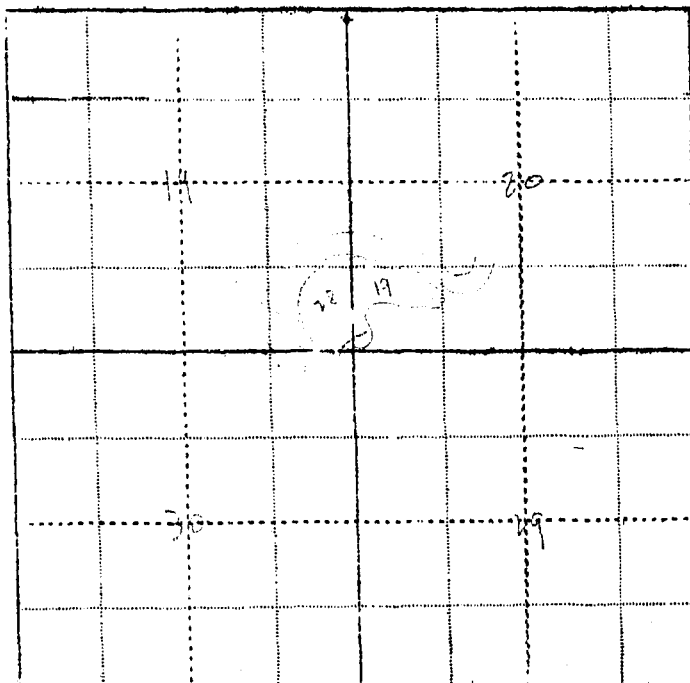

Irrigated land not shown in Land Clear Book

W.P. 3116
No. _____

A Study of Montana's Water Resources

Form WR-4

Record of a Farm under A.A.A. Program Having Irrigated Land

A.A.A. Contract No. ✓ _____ County Custer 20 Twp. 2 N Rng. 45 E

Name of Owner H. B. Hillier Address _____

Name of Operator ✓ _____ Address _____

Total Number of Acres in Farm 260 Number of Acres Irrigated in 1940 19

Outline on the plat below in red pencil the boundaries of the farm unit. If possible, show in blue pencil the location of the irrigated land. The section number (s) should be clearly indicated. Obtain the legal description from county ownership records and correct boundaries if necessary.

Legal Description Lots 5, 6, 7, 9 - N 2 E 4 -

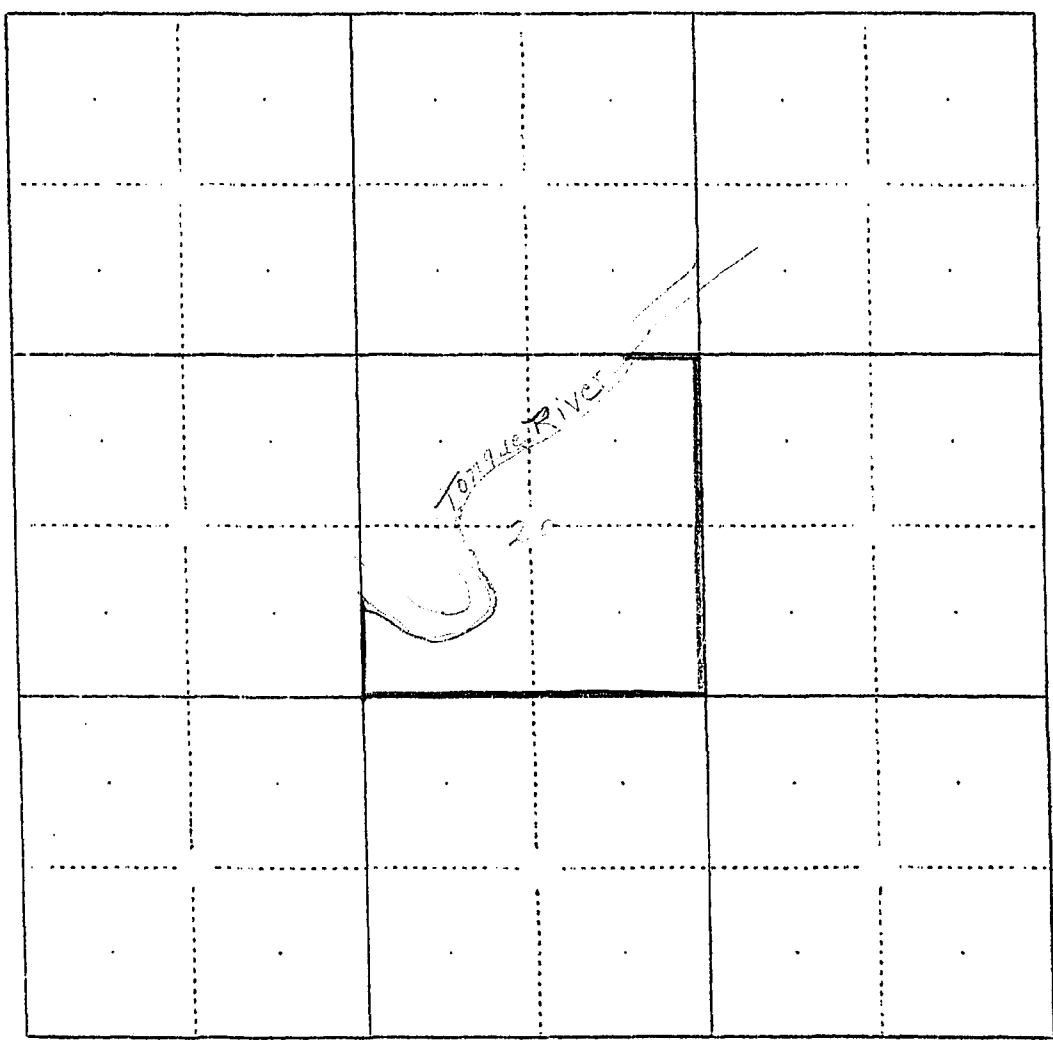

A STUDY OF MONTANA'S WATER RESOURCES

County Custer Source of Information Paul Carson Road

1. Water User _____ Address _____

2. Stream _____ Tributary to _____ Basin _____

3. Point of Diversion 1 1 Section _____ Township _____ Range _____

4. Description of System _____

5. Type of Irrigation _____

6. Original Appropriator _____ Address _____

7. First Use: Year _____ Acres Irrigated _____

8. Maximum Use: Year 1920 Acres Irrigated 11

9. Present Use: Year _____ Acres Irrigated _____

10. Last Use: Year _____ Why Abandoned _____

11. Condition of System _____

12. Land Description _____, T 2N, R 18E

Remarks: _____

Paul Carson Road
1920
1000
11
1920

WITNESS: _____ Information by _____

Place _____

C

Center

Source of Information Lead from General

- 134

1. What is the purpose of the experiment?
 2. What are the variables in the experiment?
 3. What is the hypothesis of the experiment?
 4. What are the materials and equipment used?
 5. What is the procedure of the experiment?
 6. What are the results of the experiment?
 7. What are the conclusions of the experiment?
 8. What are the limitations of the experiment?
 9. What are the sources of error in the experiment?
 10. What are the applications of the experiment?

27

16

31

Information by

Place

10-A

12. Land Description *Sec 12, T6N, R10E, N2S, W1/2, NW1/4, Sec 10, T 2 N, R 10 E*

Lasson (1942) shows 28 cases

[illegible]

Information by Paul Clark Second
Place Under City

Irrigated land not shown in Land Class Book

W.P. 3116
No. _____

A Study of Montana's Water Resources

Form WR-4

Record of a Farm under A.A.A. Program Having Irrigated Land

A.A.A. Contract No. 1 County Beaver Twp. 2 N Rng. 45 E

Name of Owner S. H. Cattle Co Address _____

Name of Operator _____ Address _____

OB. Total Number of Acres in Farm 363 Number of Acres Irrigated in 1940 28

Outline on the plat below in red pencil the boundaries of the farm unit.
If possible, show in blue pencil the location of the irrigated land. The
section number (s) should be clearly indicated. Obtain the legal descrip-
tion from county ownership records and correct boundaries if necessary.

Legal Description late 1-2-4. 7.6. S2 S4 NE4 S4 N2 NE4 NE NE5-

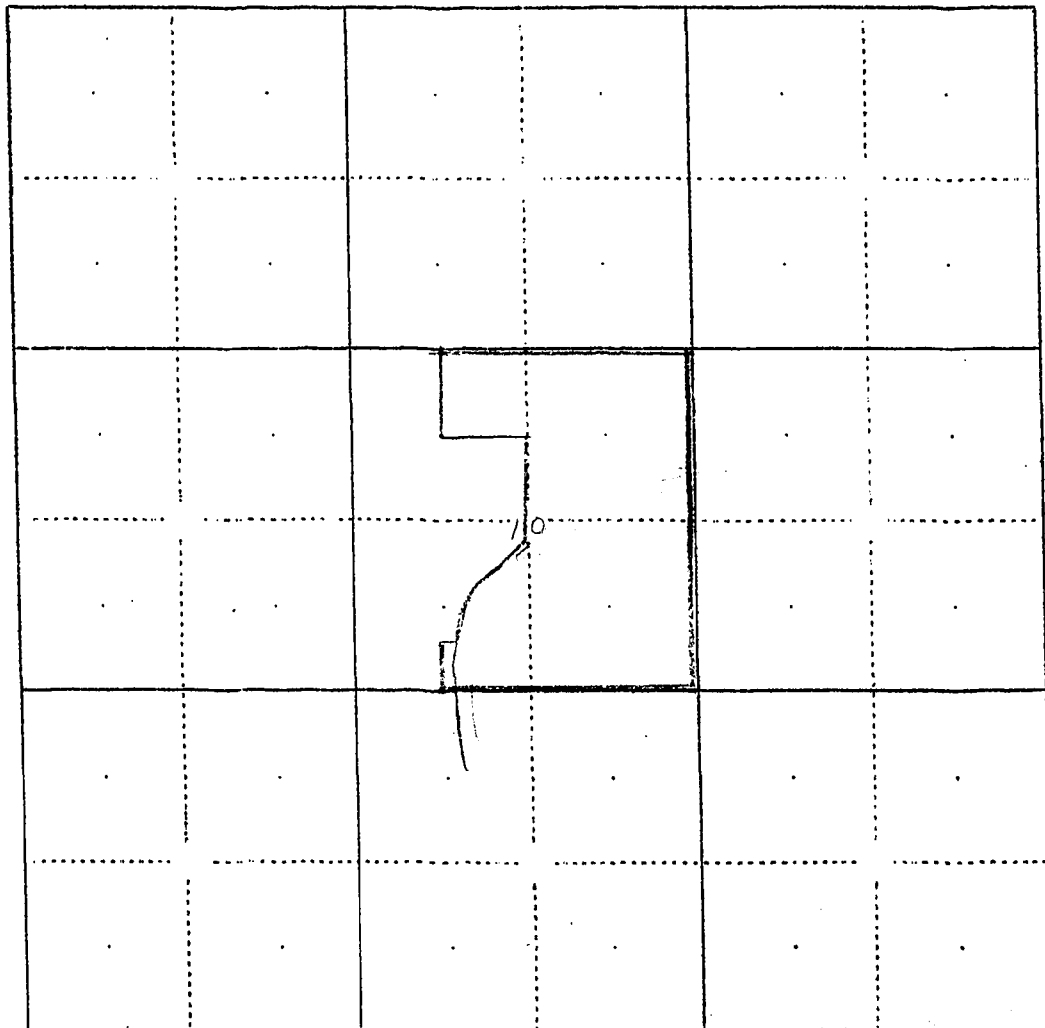

Sheet No. _____

Township 2N Range 2SE of Sheets

[illegible]



NOTICE
These forms and the
property of the State
of Montana and must
be returned.

STATE OF MONTANA
STATE ENGINEERS OFFICE
Water Resources Survey

FORM WR-1-1M 12-47

Code No. 24A 25A
County Chouteau
T. 2N R. 4E

Name of Land Owner Bessie Carey Address Valberg, Mont.
Name of Operator _____ Address _____

Part A

**TO BE FILED BY THOSE OBTAINING IRRIGATION WATER FROM
A DITCH COMPANY OR IRRIGATION DISTRICT**

1. Water is delivered by: _____
Name of Ditch, Ditch Company or District Supplying Water
2. State the number of acres you irrigate under this system. _____ Shares you hold _____
3. If you obtain water from more than one Company, give the number of shares, acres irrigated and the name of the Company under "Remarks." If you obtain water from a Ditch Company and also have a private system fill in both Part A and Part B.

Part B

**TO BE FILED BY THOSE WHO HAVE A PRIVATE DITCH, PUMP OR IRRIGATION SYSTEM
or those who have a private water right under a Ditch Company**

4. In what year was this land first irrigated? Date No. data
5. Give the name of the original appropriator (first user): See attached letter
6. Give the date appropriated _____ Amount filed on: Miners Inches _____ C. F. S. _____
7. State the total number of acres irrigated under this system: _____
8. Give the point of diversion: _____ $\frac{1}{4}$ _____ $\frac{1}{4}$ Section _____ Township _____ Range _____

Part C

TO BE FILED BY ALL WATER USERS IN ADDITION TO PART A OR PART B

9. Source of Water: N. H. Foster Creek
Name of stream or lake from which water is originally diverted
10. Water is obtained by: (Check one) Gravity ☒ Pumping _____ Other _____
11. What is the greatest number of acres you have irrigated? P Date P
12. How many acres did you irrigate in 1947 (Crop and pasture) 56.0
13. State the total number of additional acres that could be irrigated by increasing the water supply, land leveling, etc. 0 This land is under what ditch? _____
14. How many acres of seeped land do you have which could be drained and put into production? 0
15. What is the condition of your irrigation system? Fair
16. Is your water supply adequate? Yes _____ No ☒ Explain Flood War
17. REMARKS: _____

Information as to flood facilities from
ranch hand checked with records on
the spot.

Over

NOTE: The foregoing questions apply only to irrigated land shown on this plat.

DESCRIPTION AND MAP OF FARM

18. Legal Description of this Farm

Sec 24, 25,

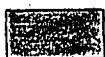

IRRIGATED LAND



NON-IRRIGATED LAND

North

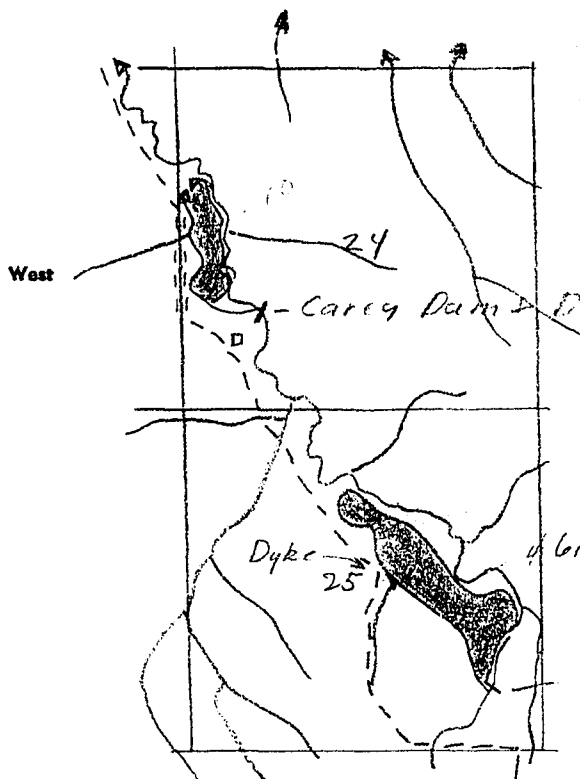

*Ira S. Carey
filed on Foster Cr
Sept 27, 1913 for
1000 inches,*

for lands in

Sec 2, T1N, R47E,

*possible connection
between their
land & that.*

carey Dams Ditch

Ownership covers
only irrigated land.
All ownership for
dry land not shown.

19. If the above land is irrigated from more than one ditch please give the acreage under each ditch in 19A and indicate the location of the land irrigated from each on the above map.

19A. Ditch: Carey Flood - N.E. Foster Cr Acres: 56.0

Ditch: _____ Acres: _____

Information supplied by:

Name Field Survey Address _____ Date July 23-47

REMARKS: Johnson & J. Paulist

If you cannot answer all of the questions on this form answer as many as you can and return the form to us as soon as possible.

STATE ENGINEERS OFFICE
Water Resources SurveyCOUNTY CusterFILE NO. 67-T.2N-R.47EOwner Carey, BessieAddress Valburg, Montana?

AAA Owner

Address

Operator PAddress P

New Owner

Address

New Operator

Address

Assessment Record NoneAssessed Acreage 0Legal Description of This Farm all of Sections 24 & 25, T.2N-R.47ETotal Acres in Farm ✓Code Number 24A, 25APhoto No. Ma. 13-170

AAA Contract No.

AAA Total Cropland Acreage

App. No. No Record by Discript.

Decree No.

Land is located in

Twp. 2N Rge. 47E Twp. Rge.

Twp. Rge. Twp. Rge.

Filed in Twp. 2N Rge. 47E

Remarks

Farm Map

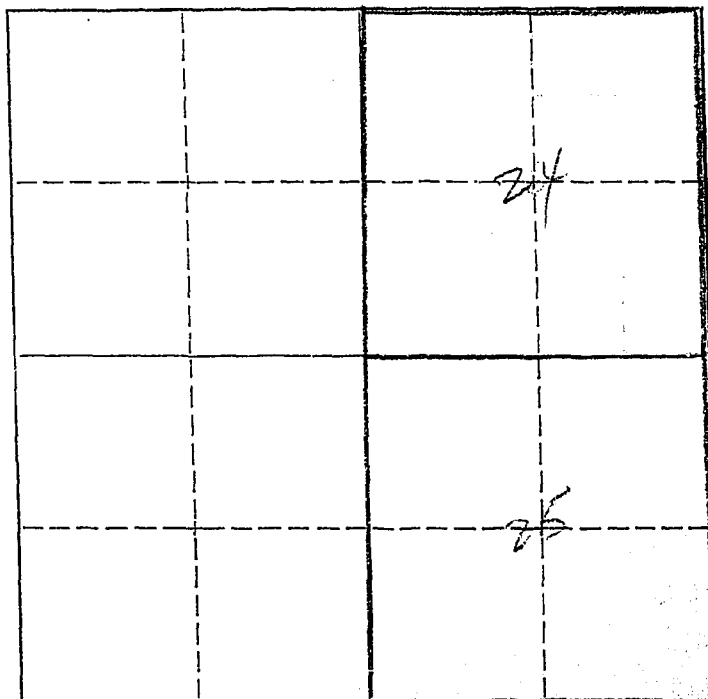
Ownership covers
only irrigated land.
All ownership for
dry land not shown.Tongue River Basin

Dear Sir
There has never been, to my knowledge, a filing
made on either the dam in ^{secs} 25 or 24.
The dam in sec. 24 was put in in 1936 by W.P.A.
labor under the S.C.S. on the site previously occupied
by a stock water ~~se~~ reservoir built about 10 yrs.
previous to that date.

The dam in sec 25 was built in 1943
and approved for payment under the AAA program.
From your letter you do not make it clear whether
or not a recorded water filing is necessary or advisable
for these dams. I do ~~not~~ know that there is no cause
for claims from existent water claimants below us
but I am not well informed about what any future
claimants could do. If it is at all possible I ~~would~~
should like for you advise me in this respect and
enlighten ^{me} on the probable result of your investigation
on water users on this creek.

Yours truly
Bessie Carey Bridge
by Del Carey
(Operator)

ACLS
JUN 20



STATE OF MONTANA

STATE ENGINEER

FRED E. BUNK, STATE ENGINEER
GERALD J. ORAVETZ, ASSISTANT

BILLINGS, MONTANA

February 12, 1948

Bessie Carey
Volberg, Montana

Re: Flood Irrigation N.F. Foster Creek

Dear Madam:

In accordance with the 1939 Session Law (Section 349.68 Montana Session Laws) requiring the State Engineer to investigate and prepare a complete record of all water rights in Montana, the State Engineer has been conducting a water resources survey in Custer County.

We are unable to find a recorded water filing for the land that you irrigate in Sections 24, 25, T. 2N., R. 47E. If a filing was made for this land we would like to have you send us the name of the appropriator, the date filed on, and the number of inches filed on. If no recorded filing was made we would like to have you send us the name of the first user and the date, or the approximate date, that the land was first irrigated so that we may establish a date of priority for this land.

We would like to have you make this a first on your agenda and send this information to us as soon as possible in the enclosed, stamped, self-addressed envelope.

Very truly yours,

Gerald J. Oravetz
Gerald J. Oravetz
Assistant State Engineer

GJO/a
enc.

(over)

March 3, 1948

Mr. Del Carey
Volberg, Montana

Dear Sir:

I have your letter in regard to your water rights on the North Fork of Foster Creek. I wish to advise that any and all use of water within the State should be recorded in your county courthouse for your protection and for the protection of those who will come after you.

It is not necessary to make this filing to have a legal water right, but if a filing is made it is much easier to prove your claim in case of dispute for the water that you are using. I would suggest that you make the proper recordings in your county courthouse.

Very truly yours,

Gerald J. Cravetz
Assistant State Engineer

GJO/a



NOTICE
These forms are the
property of the State
of Montana and must
be returned.

STATE OF MONTANA
STATE ENGINEERS OFFICE

Water Resources Survey

FORM WR-1-2M (2-47)

Code No. 14A

County Quinn

T. 2N R. 47

Name of Land Owner William H. Heape Address Valley View

Name of Operator _____ Address _____

Part A

TO BE FILED BY THOSE OBTAINING IRRIGATION WATER FROM
A DITCH COMPANY OR IRRIGATION DISTRICT

1. Water is delivered by: _____
Name of Ditch, Ditch Company or District Supplying Water
2. State the number of acres you irrigate under this system _____ Shares you hold _____
3. If you obtain water from more than one Company, give the number of shares, acres irrigated and the name of the Company under "Remarks." If you obtain water from a Ditch Company and also have a private system fill in both Part A and Part B.

Part B

TO BE FILED BY THOSE WHO HAVE A PRIVATE DITCH, PUMP OR IRRIGATION SYSTEM
or those who have a private water right under a Ditch Company

4. In what year was this land first irrigated? Date No data
5. Give the name of the original appropriator (first user): See attached letter
6. Give the date appropriated _____ Amount filed on: Miners Inches _____ C. F. S. _____
7. State the total number of acres irrigated under this system: _____
8. Give the point of diversion: _____ $\frac{1}{4}$ _____ $\frac{1}{4}$ Section _____ Township _____ Range _____

Part C

TO BE FILED BY ALL WATER USERS IN ADDITION TO PART A OR PART B

9. Source of Water: N. Fork Foster Creek
Name of stream or lake from which water is originally diverted
10. Water is obtained by: (Check one) Gravity ☒ Pumping _____ Other _____
11. What is the greatest number of acres you have irrigated? ? Date ?
12. How many acres did you irrigate in 1947? (Crop and pasture) 20.0
13. State the total number of additional acres that could be irrigated by increasing the water supply, land leveling, etc. 6 This land is under what ditch? _____
14. How many acres of seeped land do you have which could be drained and put into production? 0
15. What is the condition of your irrigation system? Fair
16. Is your water supply adequate? Yes _____ No ☒ Explain I have no
17. REMARKS: _____

unable to find a filings covering
Heape land.

Over

NOTE: The foregoing questions apply only to irrigated land shown on this plat.

DESCRIPTION AND MAP OF FARM

18. Legal Description of this Farm

Sec. 14

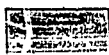

IRRIGATED LAND



NON-IRRIGATED LAND

North

West

East

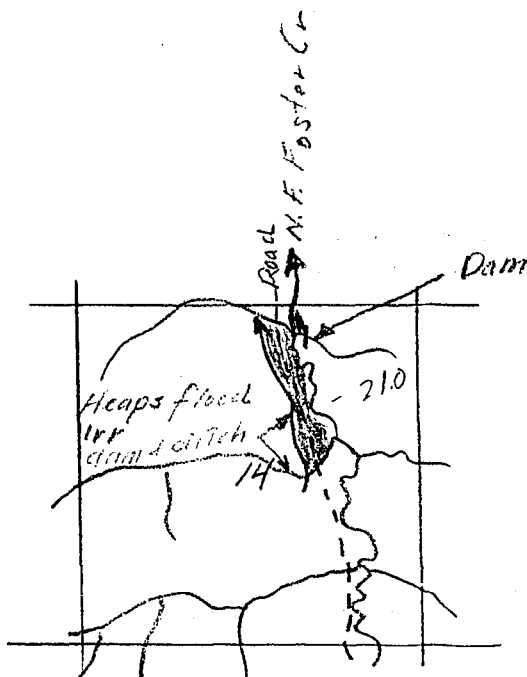

South

Ownership, shown
only irrigated land.
All ownership for
dry land not shown.

19. If the above land is irrigated from more than one ditch please give the acreage under each ditch in 19A and indicate the location of the land irrigated from each on the above map.

19A. Ditch: *Heaps flood irr.* Acres: *21.0*

Ditch: _____ Acres: _____

Information supplied by:

Name *Heaps to* Address _____ Date *July 23-47*

REMARKS: *Johnson + J Paulist*

If you cannot answer all of the questions on this form answer as many as you can and return the form to us as soon as possible.

STATE ENGINEERS OFFICE
Water Resources SurveyCOUNTY CusterFILE NO. 67-T.2N-R.47EOwner Herman Willard Address Valhalla, Montana

AAA Owner Address

Operator " " Address " "

New Owner Address

New Operator Address

Assessment Record NoneAssessed Acreage 0Legal Description of This Farm all of Sec. 14; T.2N-R.47ETotal Acres in Farm ✓Code Number 14APhoto No. Ma 13-171

AAA Contract No.

AAA Total Cropland Acreage

App. No. No Record by Discript

Decree No.

Land is located in

Twp. 2N Rge. 47E Twp. Rge.

Twp. Rge. Twp. Rge.

Filed in Twp. 2N Rge. 47E

Remarks

Farm Map

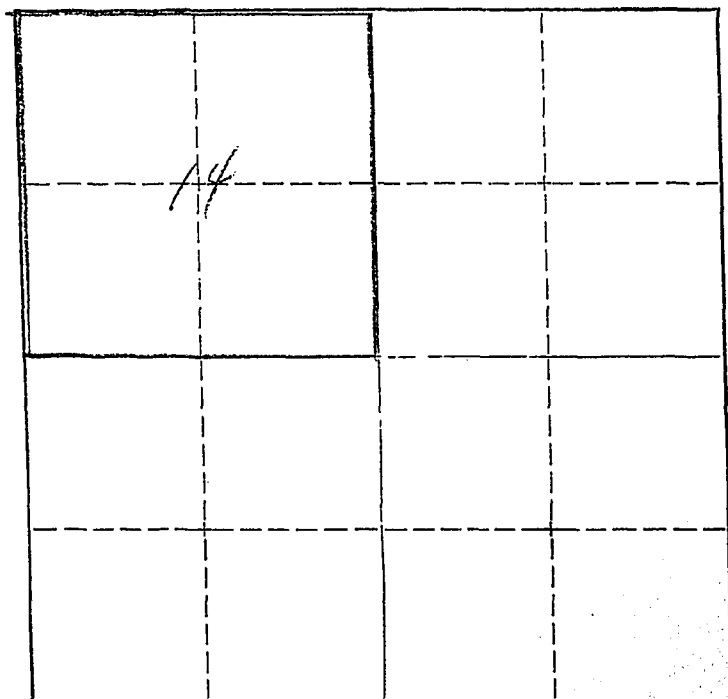
Ownership covers
only irrigated land.
All ownership for
dry land not shown.

Tongue River Basin

February 20, 1948

Mr. Willard Heaps
Volberg, Montana

Dear Mr. Heaps:

I have your letter regarding your water rights on the North Fork of Foster Creek, in which you state you would like to make a water filing of your rights.

We are enclosing herewith a Notice of Appropriation blank which you can fill out and take to the Courthouse in Miles City, from which they can record your water rights.

Hoping this information is sufficient, I am

Very truly yours,

Gerald J. Oravetz
Assistant State Engineer

GJO/a
enc.

217-41
Dear Sir:

Rece your letter
Concerning irrigation
I have one down in main creek
and one in side draw but havent
been able to hold water
on ground

one was put in the fall
of 1944 and one was put in
the fall of 1945

and the first user is my self
Willard Heaps

I havent find any water right
but would like to Right Away
would you please send me
any information I might
need

Yours Very Truly
Willard Heaps

Ret
2/21

February 12, 1948

Mr. Willard Heaps
Volborg, Montana
Dear Sir:

Re: Flood Irrigation N. Fork Foster Creek

Custer

Section 14, T. 2N., R. 4E.



NOTICE
These forms are the property of the State of Montana and should be returned.

**STATE OF MONTANA
STATE ENGINEERS OFFICE**

Water Resources Survey

FORM WR-1-2M 12-47

Code No. 6B-8B

County Butte

T. 2N R. 4E

Name of Land Owner E. J. Olson Address Garland Mont.

Name of Operator W. E. Shy Address Garland, Mont.
(Sam E. Shy)
Brother

Part A

**TO BE FILED BY THOSE OBTAINING IRRIGATION WATER FROM
A DITCH COMPANY OR IRRIGATION DISTRICT**

1. Water is delivered by: _____ Name of Ditch, Ditch Company or District Supplying Water _____
2. State the number of acres you irrigate under this system _____ Shares you hold _____
3. If you obtain water from more than one Company, give the number of shares, acres irrigated and the name of the Company under "Remarks." If you obtain water from a Ditch Company and also have a private system fill in both Part A and Part B.

Part B

**TO BE FILED BY THOSE WHO HAVE A PRIVATE DITCH, PUMP OR IRRIGATION SYSTEM
or those who have a private water right under a Ditch Company**

4. In what year was this land first irrigated? Date See attached app.
5. Give the name of the original appropriator (first user): _____
6. Give the date appropriated _____ Amount filed on: Miners Inches _____ C. F. S. _____
7. State the total number of acres irrigated under this system: _____
8. Give the point of diversion: _____ $\frac{1}{4}$ _____ $\frac{1}{4}$ Section _____ Township _____ Range _____

Part C

TO BE FILED BY ALL WATER USERS IN ADDITION TO PART A OR PART B

9. Source of Water: Foster Creek
Name of stream or lake from which water is originally diverted
10. Water is obtained by: (Check one) Gravity ☒ Pumping _____ Other _____
11. What is the greatest number of acres you have irrigated? 7 Date _____
12. How many acres did you irrigate in 1947? (Crop and pasture) 35.0
13. State the total number of additional acres that could be irrigated by increasing the water supply, land leveling, etc. 0 This land is under what ditch? _____
14. How many acres of seeped land do you have which could be drained and put into production? 0
15. What is the condition of your irrigation system? Fair
16. Is your water supply adequate? Yes _____ No ☒ Explain Shad only
17. REMARKS: _____

Ownership shown E. J. Olson as owner
Shy said it was his + his wife land

NOTE: The foregoing questions apply only to irrigated land shown on this plat.

DESCRIPTION AND MAP OF FARM

18. Legal Description of this Farm N2NE4, SE1NE4, E2SE4, Sec 6
W2NW4, NW5W, Sec 8

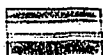

IRRIGATED LAND

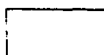

NON-IRRIGATED LAND

North

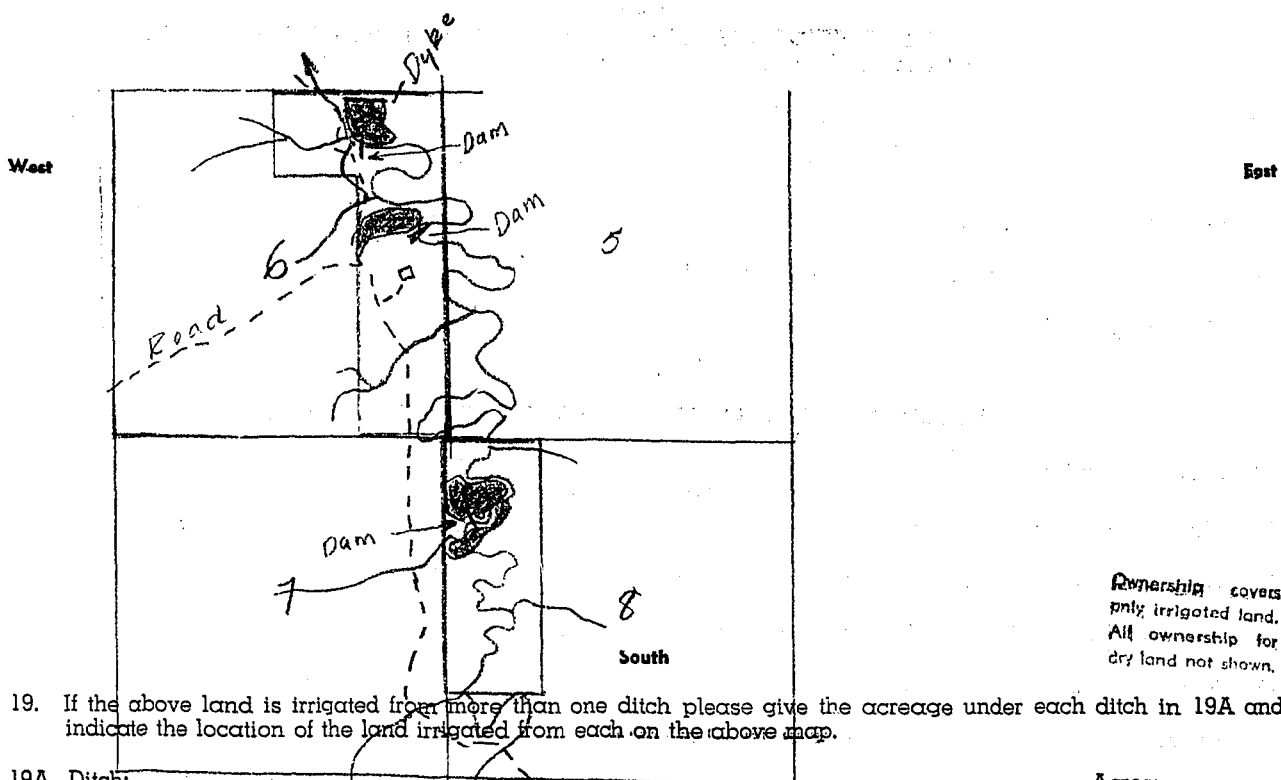

Ownership covers only irrigated land. All ownership for dry land not shown.

19. If the above land is irrigated from more than one ditch please give the acreage under each ditch in 19A and indicate the location of the land irrigated from each on the above map.

19A. Ditch: _____ Acres: _____

Ditch: The Sky Flood Ditch Acres: 36.0

Information supplied by:

Name The Sky to Address _____ Date July 23-47

REMARKS: Johnson & Paulist

All information as to lands irrigated
from The Sky - All Flood Ditch.

If you cannot answer all of the questions on this form answer as many as you can and return the form to us as soon as possible.

STATE ENGINEERS OFFICE
Water Resources SurveyCOUNTY ClusterFILE NO. 67-T.2N-R.47EOwner Olson, E. J. Address _____

AAA Owner _____ Address _____

Operator Shy, Ike ? Address Garland, Montana

New Owner _____ Address _____

New Operator _____ Address _____

Assessment Record NoneAssessed Acreage 0Legal Description of This Farm N²NE⁴, SE⁴NE⁴, E²SE⁴, Sec. 6; W²NW⁴,
NW⁴SW⁴, Sec. 8; T.2N-R.47ETotal Acres in Farm ✓Code Number 6B, 8BPhoto No. Ma 13-201

AAA Contract No. _____

AAA Total Cropland Acreage _____

App. No. 715; 724; 730

Decree No. _____

Land is located in

Twp. 2N Rge. 47E Twp. _____ Rge. _____

Twp. _____ Rge. _____ Twp. _____ Rge. _____

Filed in Twp. 2N Rge. 47E

Remarks _____

Farm Map

Ownership covers
only irrigated land.
All ownership for
dry land not shown.

Tongue River Basin

STATE ENGINEERS OFFICE
Water Resources Survey

Notice of Appropriation

1. County Custer Book D Page 250 Record Water Right
2. Name of Appropriator Thos. C. Bagby Address Garland, Custer County
(12)
3. Date Appropriated August 17, 1909 Date renewed August 18, 1909
- Amount Appropriated, Miners Inches 400, Cubic Feet per second 10
4. Name of Stream Foster Creek Tributary Basin
5. Point of Diversion About 20 chains NE of SW corner of

Sec. 8 Twp. 2N. Rge. 47E Bank of Stream West

6. Purpose Irrigating and other purposes
7. Description of System A ditch 48" X 24" in size which carries and conducts water
from said Foster Creek and runs thence in a northwesterly direction, thence
over and upon said land.
8. Land Description of Intended Place of Use
W $\frac{1}{4}$ NW $\frac{1}{4}$, NW $\frac{1}{4}$ SW $\frac{1}{4}$ Sec. 8-2N-47E, 120 acres, Fredrick S. Bannister, St. Paul, Minn.
9. Remarks (Pertaining to Use, etc.)

Decree

10. Case No. Date Amt. Decreed: M. I. C. F. S.
11. To Whom Decreed Address
12. Name of Ditch Maximum Capacity (C. F. S.)
13. Date of Priority Purpose
14. Land Description of Place of Use as Decreed
15. Remarks (Present Use Status, etc.)

724

STATE ENGINEERS OFFICE
Water Resources Survey
Notice of Appropriation

1. County Custer Book C Page 390 Record W.R.
 2. Name of Appropriator Robert A. Lantis Address Custer Co., Montana
 3. Date Appropriated Aug. 21, 1907 Date Filed Aug. 27, 1907
 Amount Appropriated, Miners Inches _____, Cubic Feet per second 22
 4. Name of Stream Foster Creek Tributary Tongue River Basin _____
 5. Point of Diversion About 300 ft. S. of 1/4 S.C. on east side of

Sec. 6 Twp. 2N. Rge. 47E. Bank of Stream _____

The following well known objects and permanent monuments are distant as follows, to-wit:

- The 1/4 S.C. on east side of said Sec. 6 is distant about 300 ft. in a northerly direction and the SE corner of said Sec. is distant about 900 ft. in a southerly direction
6. Purpose For domestic, irrigation and other useful and beneficial purposes.
7. Description of System Dam and ditch. Said ditch to be 5 ft. wide on bottom, 6 ft. wide on top and 2 ft. deep.
8. Land Description of Intended Place of Use
Lots 1, 2, SE 1/4 NE 1/4, E 1/4 SE 1/4 Sec. 6-2N-47E, 207.85 acres, Frederick J. Banister, St. Paul
Lots 5, 6, 7, E 1/4 NW 1/4, E 1/4 SW 1/4, W 1/4 SE 1/4 Sec. 6-2N-47E, 316.02 acres, Jesse C. Miller, Kelsey, Cal.
Balance of Section 6-2N-47E, 126.12 acres, U. S. A.

9. Remarks (Pertaining to Use, etc.) _____

Decree

10. Case No. _____ Date _____ Amt. Decreed: M. I. _____ C. F. S. _____
 11. To Whom Decreed _____ Address _____
 12. Name of Ditch _____ Maximum Capacity (C. F. S.) _____
 13. Date of Priority _____ Purpose _____
 14. Land Description of Place of Use as Decreed _____

 15. Remarks (Present Use Status, etc.) _____

STATE ENGINEERS OFFICE
Water Resources Survey

Notice of Appropriation

1. County Custer Book D Page 263 Record W.R.
2. Name of Appropriator Annie Bagby Address Garland, Custer Co.
Aug. 20, 1909
3. Date Appropriated Sept. 2, 1909 Date Filed Sept. 3, 1909
- Amount Appropriated, Minor Inches 200, Cubic Feet per second 5
4. Name of Stream Four Mile Creek Tributary Foster Creek Basin
5. Point of Diversion About 20 chains NW of SE corner of

Sec. 6 Twp. 2N Rge. 47E Bank of Stream East

6. Purpose Irrigating and other purposes
7. Description of System A ditch 36" X 18" in size which said ditch diverts the water from said stream and runs thence in a northerly direction, thence over and upon said land.
8. Land Description of Intended Place of Use
E $\frac{1}{2}$ SE $\frac{1}{4}$, Lot 2 Sec. 6-2N-47E, 122.45 acres, Custer County
SE $\frac{1}{4}$ NE $\frac{1}{4}$, Lot 1 Sec. 6-2N-47E, 82.42 acres, Not assessed.
9. Remarks (Pertaining to Use, etc.)

Decree

10. Case No. Date Amt. Decreed: M. I. C. F. S.
11. To Whom Decreed Address
12. Name of Ditch Maximum Capacity (C. F. S.)
13. Date of Priority Purpose
14. Land Description of Place of Use as Decreed
15. Remarks (Present Use Status, etc.)



NOTICE
These forms are the
property of the State
of Montana and must
be returned.

STATE OF MONTANA
STATE ENGINEERS OFFICE

Water Resources Survey

Code No. 2A

County Custer

T. 2N R. 47E

Name of Land Owner Sam E. Shy Address Garland, Mont.

Name of Operator _____ Address _____

Part A

TO BE FILED BY THOSE OBTAINING IRRIGATION WATER FROM
A DITCH COMPANY OR IRRIGATION DISTRICT

1. Water is delivered by: _____
Name of Ditch, Ditch Company or District Supplying Water
2. State the number of acres you irrigate under this system _____ Shares you hold _____
3. If you obtain water from more than one Company, give the number of shares, acres irrigated and the name of the Company under "Remarks." If you obtain water from a Ditch Company and also have a private system fill in both Part A and Part B.

Part B

TO BE FILED BY THOSE WHO HAVE A PRIVATE DITCH, PUMP OR IRRIGATION SYSTEM
or those who have a private water right under a Ditch Company

4. In what year was this land first irrigated? Date 1923
5. Give the name of the original appropriator (first user): Sam E. Shy
6. Give the date appropriated 6/1/23 Amount filed on: Miners Inches 500 C. F. S.
7. State the total number of acres irrigated under this system: 2
8. Give the point of diversion: Flooded $\frac{1}{4}$ Section 3E Township 2N Range 47

Part C

TO BE FILED BY ALL WATER USERS IN ADDITION TO PART A OR PART B

9. Source of Water: North Fork Foster Creek
Name of stream or lake from which water is originally diverted
10. Water is obtained by: (Check one) Gravity _____ Pumping _____ Other _____
11. What is the greatest number of acres you have irrigated? ? Date _____
12. How many acres did you irrigate in 1947 (Crop and pasture) 20.0
13. State the total number of additional acres that could be irrigated by increasing the water supply, land leveling, etc. 0 This land is under what ditch? _____
14. How many acres of seeped land do you have which could be drained and put into production? 0
15. What is the condition of your irrigation system? Fair
16. Is your water supply adequate? Yes _____ No 7 Explain Flooded
17. REMARKS: Sam Shy right filed in 1923 calls for South half of Sec. 34, 2N 47E he is using right on sec 2, 2N 47E.

Over

NOTE: The foregoing questions apply only to irrigated land shown on this plat.

DESCRIPTION AND MAP OF FARM

18. Legal Description of this Farm

Sec. 2

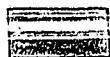

IRRIGATED LAND



NON-IRRIGATED LAND

North

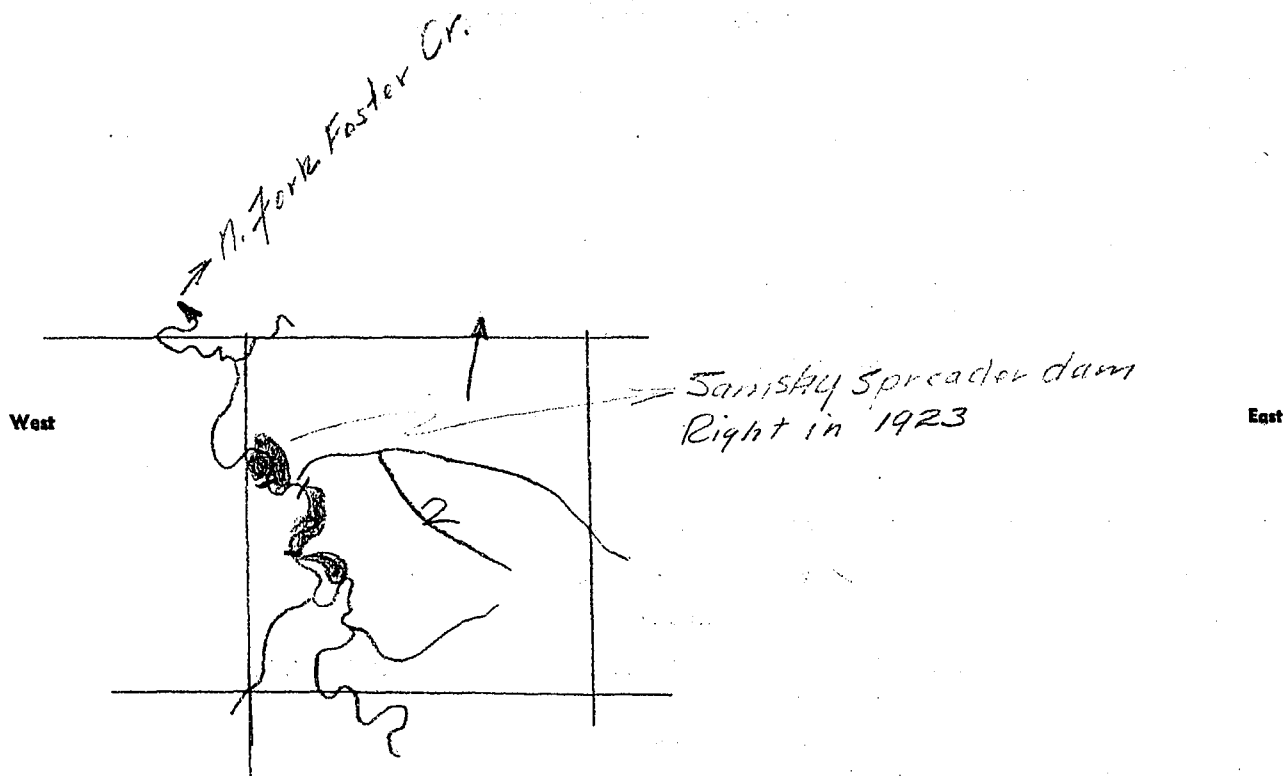

Ownership covers only irrigated land. All ownership for dry land not shown.

South

19. If the above land is irrigated from more than one ditch please give the acreage under each ditch in 19A and indicate the location of the land irrigated from each on the above map.

19A. Ditch: Sam Shy Flood Ch Acres: 20.0

Ditch: _____ Acres: _____

Information supplied by:

Name Sam Shy to Address _____ Date July 23-47

REMARKS:

Johnson & J Pauliant

If you cannot answer all of the questions on this form answer as many as you can and return the form to us as soon as possible.

STATE ENGINEERS OFFICE
Water Resources Survey

COUNTY Custer

FILE NO. 67-T.2N-R.47E

Owner Al. J. J. J. Address Garland, Montana

AAA Owner _____ Address _____

Operator " Address "

New Owner _____ Address _____

New Operator _____ Address _____

Assessment Record None

Assessed Acreage 0

Legal Description of This Farm all of Sec. 2, T.2N-R.47E

Total Acres in Farm 1

Code Number 2A

Photo No. Ma 13-172

AAA Contract No. _____

AAA Total Cropland Acreage _____

App. No. ? Right in 1923

Decree No. _____

Land is located in

Twp. 2N Rge. 17E Twp. 3N Rge. 17E

Twp. _____ Rge. _____ Twp. _____ Rge. _____

Filed in Twp. 2N Rge. 17E

Remarks also has some land

in T.3N-47E

Farm Map

Ownership covers
only irrigated land.
All ownership for
dry land not shown.

Tongue River Basin

STATE OF MONTANA
STATE ENGINEER'S OFFICE
 WATER RESOURCES SURVEY

Township 2N Range 47E County Custer

724 A 6 B	5	4	3	2 A	1
7	75 B 8 C A	9	10 Ownership covers only irrigated land. All ownership for dry land not shown.	11	12
18	17	16	15	14 A	13
19	20	21	22	23	24 A
30	29	28	27	26	25 A
31	32	33	34	35	36

Township 2N Range 47E

Township 2 North

Range 47 East

Custer County

<u>Index No.</u>	<u>Name of Appropriator</u>	<u>Stream</u>	<u>Date App.</u>	<u>Date Filed</u>	<u>M.I.</u>
715	Thomas C. Bagby	Foster Creek	8-12-09	8-13-09	400
724	Robert A. Lantis	Foster Creek	8-21-07	8-27-07	1000
730	Annie Bagby	Four Mile Creek	8-20-09	9-3-09	200

Township 2 North

Range 47 East

Custer County



NOTICE
These forms are the
property of the State
of Montana and must
be returned.

STATE OF MONTANA
STATE ENGINEERS OFFICE

Water Resources Survey

64-32B
FORM WR-1-2M (2-47)
(32B-214-49)
Code No. 6A(1N49)
County Custer
T. 2N R. 49
1N 49

Name of Land Owner Charles M. Allen Address Beebe, Montana

Name of Operator _____ Address _____

Part A

TO BE FILED BY THOSE OBTAINING IRRIGATION WATER FROM
A DITCH COMPANY OR IRRIGATION DISTRICT

1. Water is delivered by: _____
Name of Ditch, Ditch Company or District Supplying Water
2. State the number of acres you irrigate under this system. _____ Shares you hold _____
3. If you obtain water from more than one Company, give the number of shares, acres irrigated and the name of the Company under "Remarks." If you obtain water from a Ditch Company and also have a private system fill in both Part A and Part B.

Part B

TO BE FILED BY THOSE WHO HAVE A PRIVATE DITCH, PUMP OR IRRIGATION SYSTEM
or those who have a private water right under a Ditch Company

4. In what year was this land first irrigated? Date No data
5. Give the name of the original appropriator (first user): (see attached letter)
6. Give the date appropriated _____ Amount filed on: Miners Inches _____ C. F. S. _____
7. State the total number of acres irrigated under this system: _____
8. Give the point of diversion: _____ $\frac{1}{4}$ _____ $\frac{1}{4}$ Section _____ Township _____ Range _____

Part C

TO BE FILED BY ALL WATER USERS IN ADDITION TO PART A OR PART B

9. Source of Water: Pumpkin Creek & Culeer
Name of stream or lake from which water is originally diverted
10. Water is obtained by: (Check one) Gravity ☒ Pumping _____ Other _____
11. What is the greatest number of acres you have irrigated? 76 Date ?
12. How many acres did you irrigate in 1947? (Crop and pasture) 31.0
13. State the total number of additional acres that could be irrigated by increasing the water supply, land leveling, etc. 45.0 This land is under what ditch? Flood flow
14. How many acres of seeped land do you have which could be drained and put into production? 0
15. What is the condition of your irrigation system? Part in use and part out.
16. Is your water supply adequate? Yes _____ No ☒ Explain Flood flow,
17. REMARKS: _____

Irrigated by means of dams, Res, & dykes
dams and plug dams in creek bottom

Over

NOTE: The foregoing questions apply only to irrigated land shown on this plat.

DESCRIPTION AND MAP OF FARM

18. Legal Description of this Farm



IRRIGATED LAND

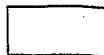

NON-IRRIGATED LAND



Potential Land

North

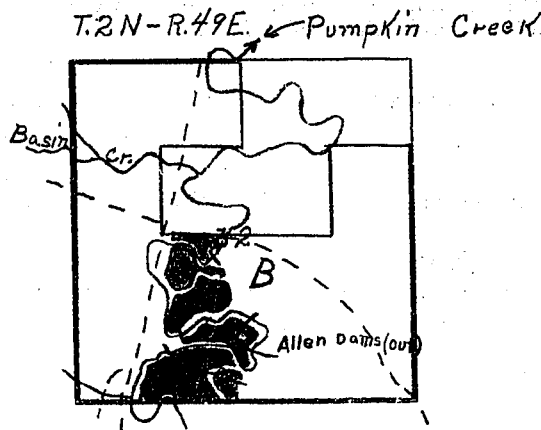

West

East

T.1N-R.49E.

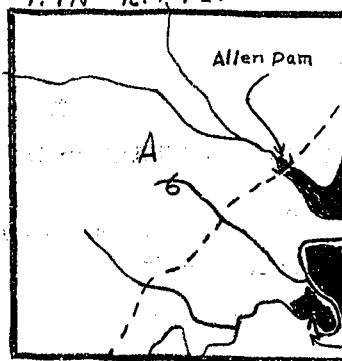

South

Ownership covers
only irrigated land.
All ownership for
dry land not shown.

19. If the above land is irrigated from more than one ditch please give the acreage under each ditch in 19A and indicate the location of the land irrigated from each on the above map.

19A. Ditch: Pumpkin Cr. Flood Cr. Acres: 36.0

Ditch: _____ Acres: _____

Information supplied by:

Name Chas Allen to Address _____ Date July 23, 1947

REMARKS: Johnson & Paulist

19 acres present in 32B, 35 acres - potential
12 acres present in 6A, 10 acres potential

If you cannot answer all of the questions on this form answer as many as you can and return the form to us as soon as possible.

STATE ENGINEERS OFFICE
Water Resources Survey

COUNTY Custer

FILE NO. 69-T.2N-R.49E

Owner Allen, Charles M

Address Beebe, Montana

AAA Owner

Address

Operator

Address

New Owner

Address

New Operator

Address

Assessment Record None

Assessed Acreage 0

Legal Description of This Farm N²NW⁴, SW⁴NW⁴, SE⁴NE⁴, S² Sec. 32 T.2N-R.49E

Total Acres in Farm ✓

Code Number 32B

Photo No. MA 12-69

AAA Contract No.

AAA Total Cropland Acreage

App. No. No record by Discript.

Decree No.

Land is located in

Twp. 2N Rge. 49E Twp. Rge.

Twp. Rge. Twp. Rge.

Filed in Twp. 2N Rge. 49E

Remarks Discript. same

Land in T.2N-R.50E
(with Elmer O.)

+ T.1N-R.49E

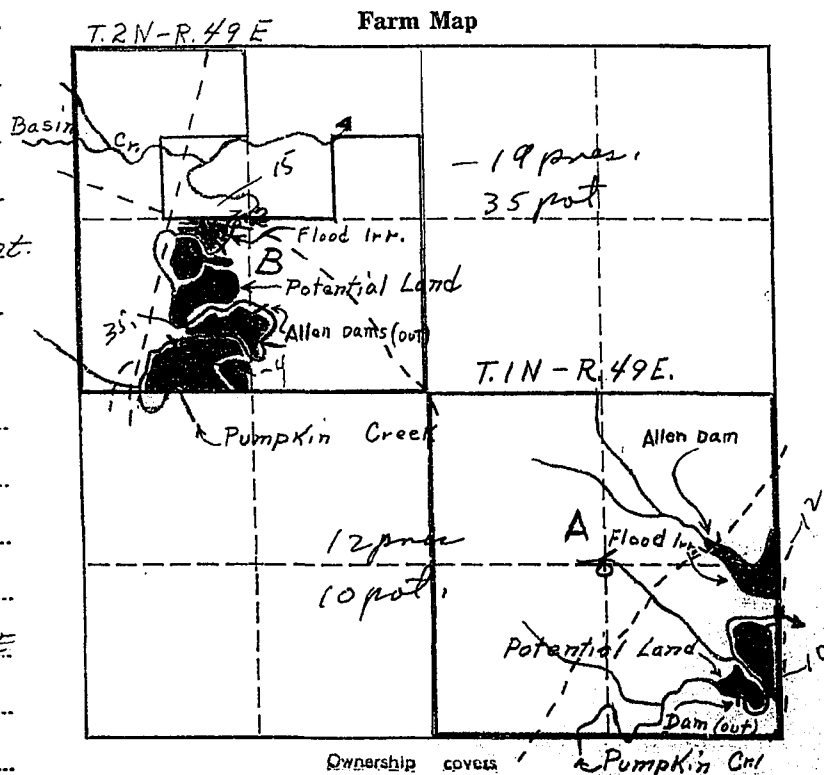

Tongue River Basin

February 16, 1948

Mr. C. M. Allen
Sheriff
Miles City, Montana

Dear Mr. Allen:

In reply to your letter, dated February 14, 1948, according to State law any and all use of water must be covered with a water right. This, however, does not mean that this right has to be recorded in the county records, but in case it is not recorded then it is up to the water user to prove prior use, which in most cases is very difficult and expensive. I, therefore, would advise you to make the necessary recording in your county for your land on Pumpkin Creek. May I advise in making your filing that you show the earliest possible date of first use as the date of priority, and the date of filing would be whatever date you make said filing. In doing this your right will be protected in the future.

Very truly yours,

Gerald J. Oravetz
Assistant State Engineer

GJO/a

OFFICERS

G. W. Spear - - - - - Clerk of Court
J. F. Doyle - - - - - County Clerk
Mary W. Cooley - - - - - Treasurer
Ernest N. Sorenson - - - - - Assessor
C. M. Allen - - - - - Sheriff
Hugh J. Lemire - - - - - Attorney
Mary Fulton St. John - Supt. of Schools
F. H. Walden - - - - - Public Administrator
Ralph Bray - - - - - Coroner



MILES CITY

**BOARD OF COUNTY
COMMISSIONERS**

Claude Woodruff - - - - - Chairman
F. A. Spears - - - - - Member
W. F. Murray - - - - - Member

February 14, 1948

Mr. Gerald J. Oravetz
Assistant State Engineer
Billings, Montana

Dear Mr. Oravetz;

In reply to your letter of February 12,
inquiring about flood irrigation and my water right on
Pumpkin Creek. I wish to advise you that I have never
made application to file a water right on Pumpkin Creek.

I did not know that it was necessary to have a water
right in such cases as ours.

The dams we build for our flood irrigation are just
dirt and temporary. They either wash out or we cut them
every year or two because if left permanent the water would
cut new channels across the meadows.

I have been experimenting with such dams in Pumpkin Creek
for thirty years.

Please advise me if it is necessary that I should file
a water right under such conditions. If it is I would
like to do it immediately.

C M Allen

Yours very truly

9.2N-R-49E

February 12, 1948

Mr. Charles M. Allen
Beebe, Montana

Re: Flood Irrigation Pumpkin Creek

Dear Sir:

Letter Ret. 2/16

Custer

the $N\frac{1}{2}NW\frac{1}{4}$, $SW\frac{1}{2}NW\frac{1}{4}$, $SE\frac{1}{2}NE\frac{1}{4}$, $S\frac{1}{2}$ Sec. 32, T. 2N., R. 49E.



NOTICE

These forms are the property of the State of Montana and must be returned.

STATE OF MONTANA
STATE ENGINEERS OFFICE

Water Resources Survey

FORM WB-1-2M 12-47

Code No. 17A-29432ACounty CusterT. 2N R. 49Name of Land Owner Don & Mary Ellen

Name of Operator _____ Address _____

Part A

TO BE FILED BY THOSE OBTAINING IRRIGATION WATER FROM
A DITCH COMPANY OR IRRIGATION DISTRICT

1. Water is delivered by: _____
Name of Ditch, Ditch Company or District Supplying Water
2. State the number of acres you irrigate under this system _____ Shares you hold _____
3. If you obtain water from more than one Company, give the number of shares, acres irrigated and the name of the Company under "Remarks." If you obtain water from a Ditch Company and also have a private system fill in both Part A and Part B.

Part B

TO BE FILED BY THOSE WHO HAVE A PRIVATE DITCH, PUMP OR IRRIGATION SYSTEM
or those who have a private water right under a Ditch Company

4. In what year was this land first irrigated? Date (No data)
5. Give the name of the original appropriator (first user): See attached letter
6. Give the date appropriated _____ Amount filed on: Miners Inches _____ C. F. S. _____
7. State the total number of acres irrigated under this system: _____
8. Give the point of diversion: _____ $\frac{1}{4}$ _____ $\frac{1}{4}$ Section _____ Township _____ Range _____

Part C

TO BE FILED BY ALL WATER USERS IN ADDITION TO PART A OR PART B

9. Source of Water: Pumpkin & Broughton Creeks
Name of stream or lake from which water is originally diverted
10. Water is obtained by: (Check one) Gravity ☒ Pumping _____ Other _____
11. What is the greatest number of acres you have irrigated? ? Date _____
12. How many acres did you irrigate in 1947? (Crop and pasture) 81.2
13. State the total number of additional acres that could be irrigated by increasing the water supply, land leveling, etc. 0 This land is under what ditch? _____
14. How many acres of seeped land do you have which could be drained and put into production? 0
15. What is the condition of your irrigation system? Poor
16. Is your water supply adequate? Yes _____ No ☒ Explain Flood Dam
17. REMARKS: _____

Water used for irrigation when available.

Over _____

NOTE: The foregoing questions apply only to irrigated land shown on this plat.

DESCRIPTION AND MAP OF FARM

18. Legal Description of this Farm

Sec. 17 & 29, N24E, S4NE,
SE NW, Sec 32, T 2N, 49E,

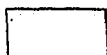

IRRIGATED LAND

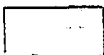

NON-IRRIGATED LAND

North

West

East

see attached
map

South

Ownership covers
only irrigated land.
All ownership for
dry land not shown.

19. If the above land is irrigated from more than one ditch please give the acreage under each ditch in 19A and indicate the location of the land irrigated from each on the above map.

19A. Ditch: Pumphin & Broughton Co. Flood Irr Acres: 81.2

Ditch: _____ Acres: _____

Information supplied by:

Name Elmer O. Allen to Address _____ Date July-23-47

REMARKS: Johnson & Pauline
All flood Irr.

If you cannot answer all of the questions on this form answer as many as you can and return the form to us as soon as possible.

T. 2 North - R. 49 East

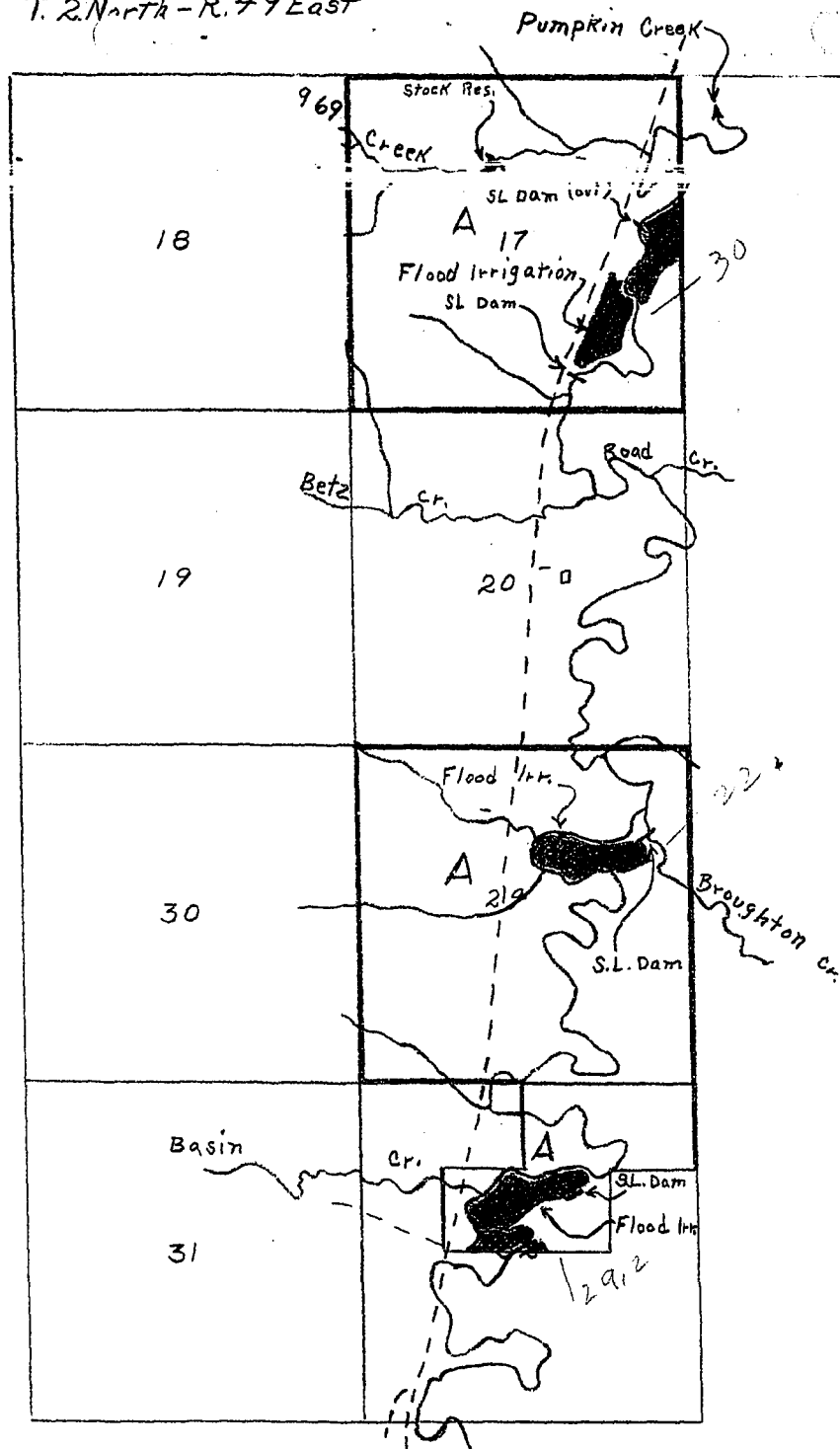

30
22
29.2
81.2

STATE ENGINEERS OFFICE
Water Resources Survey

COUNTY Cluster

FILE NO. 69-T.2N-R.49E

Owner Ellis, Blanche D.

Address Boabe Montana

AAA Owner..... Address.....

Operator..... Address.....

New Owner..... Address.....

New Operator..... Address.....

Assessment Record Nine

Assessed Acreage 0

Legal Description of This Farm all of Sections 17, 29, N²NE⁴, SW⁴NE⁴,
SE⁴NW⁴, Sec. 32 T.2N-R.49E

Total Acres in Farm ✓

Code Number 17A, 29A, 32A

Photo No. MA 12-67
MA 12-68, MA 12-69

AAA Contract No.....

AAA Total Cropland Acreage.....

App. No. No record by Discript

Decree No.....

Land is located in

Twp. 2N Rge. 49E Twp..... Rge.....

Twp..... Rge..... Twp..... Rge.....

Filed in Twp. 2N Rge. 49E

Remarks Blanche D. Ellis also

owns some land in

T. 1N-R. 49E



Farm Map

Ownership covers
only irrigated land.
All ownership for
dry land not shown.

Tongue River Basin

WR-1

T.1 North - R.49 East

-  Irrigated Land
-  Potential Land
-  Non-Irrigated Land

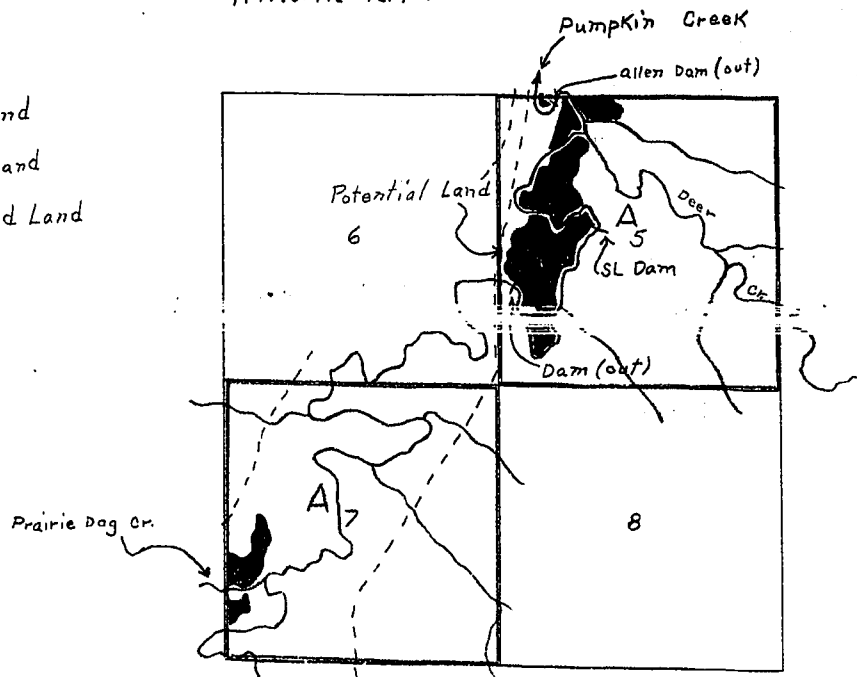

T.2 North - R.49 East

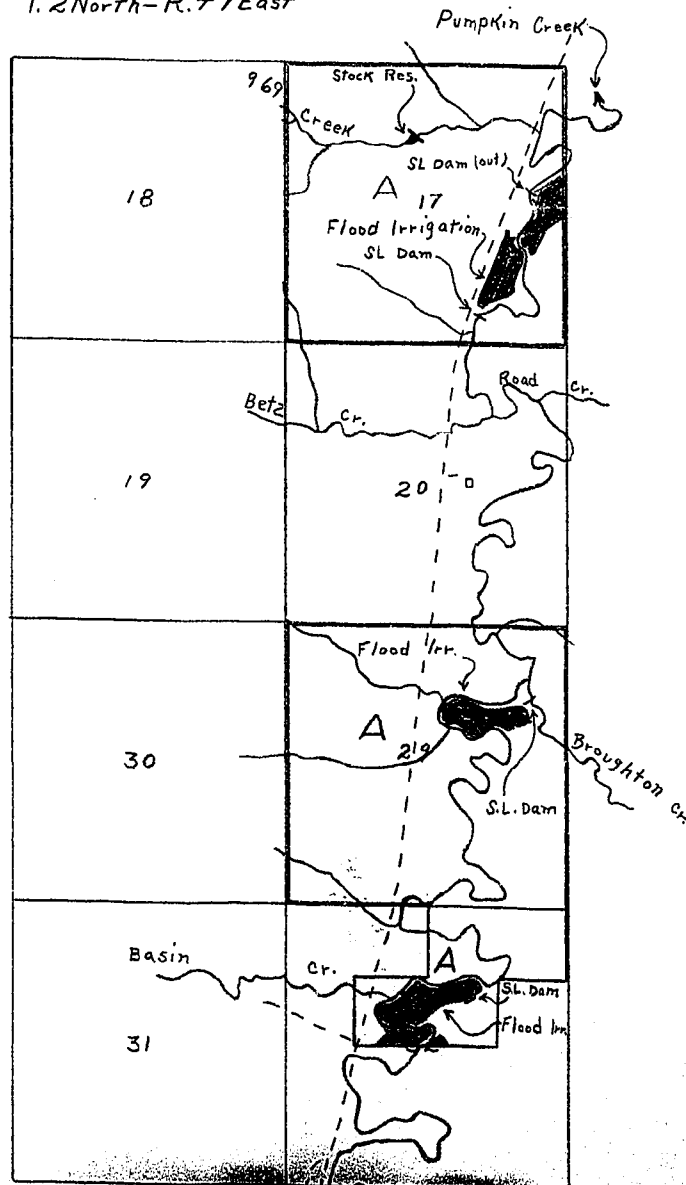

February 20, 1948

Mr. Jesse Harris, Ranch Foreman
c/o Broadus Stage
Miles City, Montana

Dear Mr. Harris:

I have your letter regarding your water rights on Pumpkin and Broughton Creeks, in T. 2N., R. 49E., in which you state you would like to make a water filing of your rights.

We are enclosing herewith a Notice of Appropriation blank which you can fill out and take to the Courthouse in Miles City, from which they can record your water rights.

Hoping this information is sufficient, I am

Very truly yours,

Gerald J. Oravetz
Assistant State Engineer

GJO/a
enc.

Miles City, Montana
Feb 14 1948

Mr. Gerald J. Cravety
Billings, Montana

Dear Sir:

In reply to your letter
written to Blanche D. Ellis about
water rights.

There is a filing made in Sec. 17
29, 32 T 2 N R 48 E.

I am sure that there must
have been a mistake ⁱⁿ the copying
they should have seen Range 49 instead
of R. 48.

In the sections mentioned in Range
48. there would be no water. The creeks
named are all in Range 48. 2, 1 & 2, N

I am at a loss to know what to say
about the irregularities. I have only been
here a short time as Ranch foreman

I am sending your letter to
Dr. R. H. Ellis & Mrs (Blanche D.) Ellis.

Would it be possible to get water rights on
these sections in R. 49E.

I would appreciate any information
you can give on any of them.

Yours very truly

Jesse Harris, Ranch Foreman
Miles City, Mont.
40 Brooks Stge

February 12, 1948

Rt
2/21

Blanche D. Ellis
Beebe, Montana

Re: Flood Irrigation Pumpkin & Broughton Creeks

Dear Madam:

Custer

Sec. 17, 29, N $\frac{1}{2}$ NE $\frac{1}{4}$, SW $\frac{1}{4}$ NE $\frac{1}{4}$, SE $\frac{1}{4}$ NW $\frac{1}{4}$ Sec. 32 - T. 2N., R. 49E.

Feb 27, 1942 Shaw Island Wash
Gerard J. Orovotz 2N-49
~~Dear Sir~~

Your letter addressed to
Frank Day Ellis - forwarded
to you here (our country office)
I have personally used the
water on land you describe for
20 years & it may use be
by previous owners for an indefinite
period there to you.

As soon as reference will
try to get this straight
we were supposed to have
seen it this water years
ago - undoubtedly a wrong
description or part of
attorney who did the
job for us.

Thank you for your
letter. Sincerely yours

Robert H. Ellis
(over)

Home address
Ltr 1701st St. ~~SE~~
545 MED. ARTS BLDG.
PORTLAND 5
OREGON



NOTE:
These forms are the
property of the State
of Montana, and must
be returned.

STATE OF MONTANA
STATE ENGINEERS OFFICE

Water Resources Survey

Code No. 4A-9A

County Custer

T. 2N R. 49E

Name of Land Owner Helder G. Tonn Address Wilhemina Tonn
Name of Operator (see annexes) Address Beebe, Mont.

Part A

TO BE FILED BY THOSE OBTAINING IRRIGATION WATER FROM
A DITCH COMPANY OR IRRIGATION DISTRICT

1. Water is delivered by: _____
Name of Ditch, Ditch Company or District Supplying Water
2. State the number of acres you irrigate under this system _____ Shares you hold _____
3. If you obtain water from more than one Company, give the number of shares, acres irrigated and the name of the Company under "Remarks." If you obtain water from a Ditch Company and also have a private system fill in both Part A and Part B.

Part B

TO BE FILED BY THOSE WHO HAVE A PRIVATE DITCH, PUMP OR IRRIGATION SYSTEM
or those who have a private water right under a Ditch Company

4. In what year was this land first irrigated? Date See attached filings
5. Give the name of the original appropriator (first user): _____
6. Give the date appropriated _____ Amount filed on: Miners Inches _____ C. F. S. _____
7. State the total number of acres irrigated under this system: _____
8. Give the point of diversion: _____ $\frac{1}{4}$ _____ $\frac{1}{4}$ Section _____ Township _____ Range _____

Part C

TO BE FILED BY ALL WATER USERS IN ADDITION TO PART A OR PART B

9. Source of Water: Pumpkin Creek & side unnamed Coulee
Name of stream or lake from which water is originally diverted
10. Water is obtained by: (Check one) Gravity ☒ Pumping ☐ Other ☐
11. What is the greatest number of acres you have irrigated? ? Date _____
12. How many acres did you irrigate in 1947? (Crop and pasture) 223.0
13. State the total number of additional acres that could be irrigated by increasing the water supply, land leveling, etc. 0 This land is under what ditch? _____
14. How many acres of seeped land do you have which could be drained and put into production? 0
15. What is the condition of your irrigation system? Good
16. Is your water supply adequate? Yes ☐ No ☒ Explain Flood loss
17. REMARKS: All flood in spring of year
16 elder and Wilhemina Tonn lands
combined as it is operated as Tonn Ranch

Over

NOTE: The foregoing questions apply only to irrigated land shown on this plat.

DESCRIPTION AND MAP OF FARM

18. Legal Description of this Farm

Sec. 3, 4, 9, 10, 2N R49E
See WR² form for ownership breakdown



IRRIGATED LAND

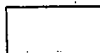

NON-IRRIGATED LAND

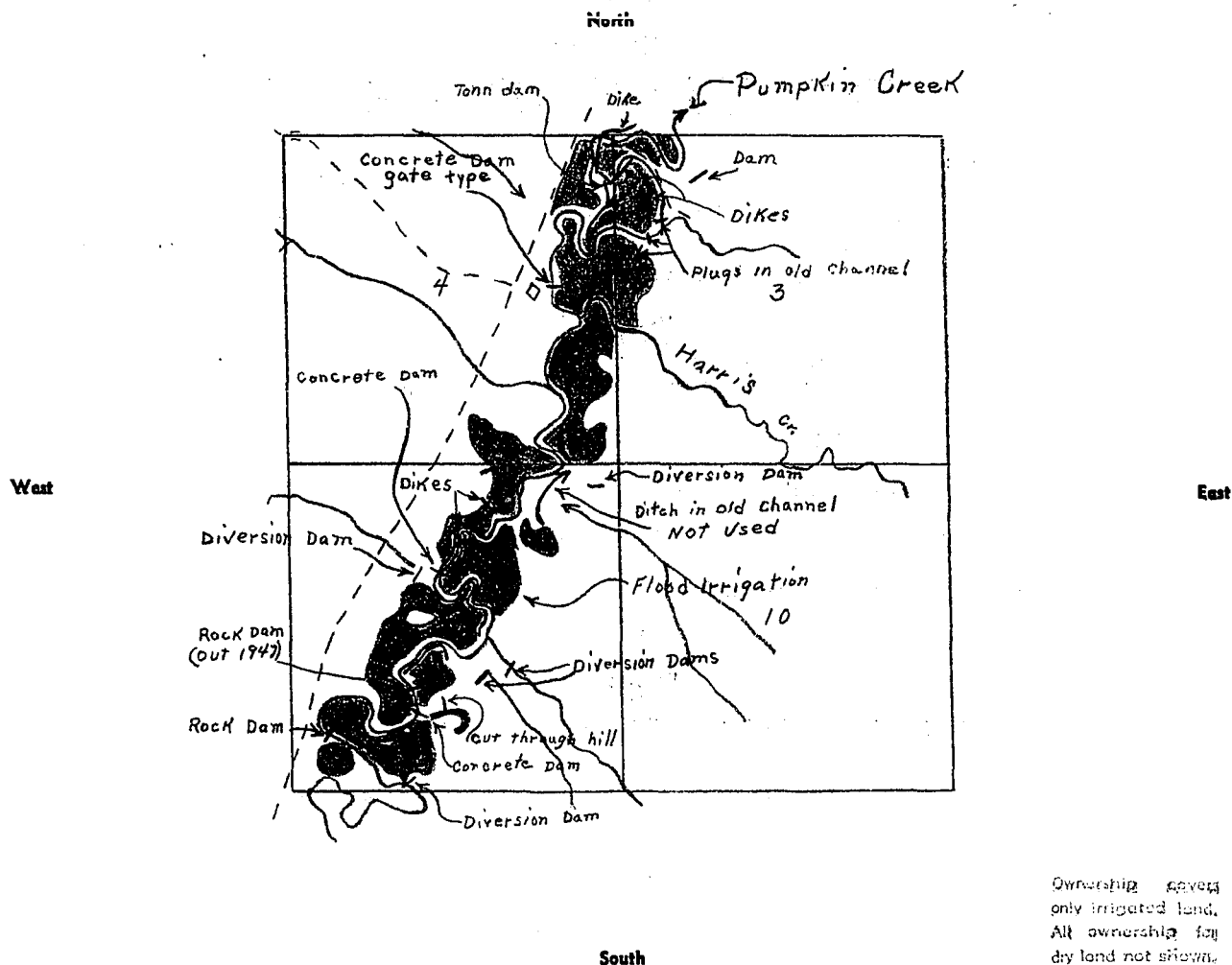

Ownership covers
only irrigated land.
All ownership for
dry land not shown.

19. If the above land is irrigated from more than one ditch please give the acreage under each ditch in 19A and indicate the location of the land irrigated from each on the above map.

19A. Ditch: Pumpkin & Side Canals Flood Irr Acres: 223.0

Ditch: _____ Acres: _____

Information supplied by:

Name Welder B. Tonn Address _____ Date July 31-47

REMARKS:

to Johnson & Paulist
Concrete dams, dikes - large amount of
work on place - Irrigation for Hay

If you cannot answer all of the questions on this form answer as many as you can and return the form to us as soon as possible.

STATE ENGINEERS OFFICE
Water Resources SurveyCOUNTY ClusterFILE NO. 69-T.2N-R.49ETony, With TimeAddress Boobe, Montana

AAA Owner..... Address.....

Operator..... Address.....

New Owner..... Address.....

New Operator..... Address.....

Assessment Record NoneAssessed Acreage 0Legal Description of This Farm all of Section 3 & 9 T.2N-R.49Ealso Section 4 T.2N-R.49ETotal Acres in Farm ✓Code Number 3A, 9A-4APhoto No. MA12-67, MA17-94

AAA Contract No.....

AAA Total Cropland Acreage.....

App. No. 1411, 1412, 2503, 2504

Decree No.....

Land is located in

Twp. 2N Rge. 49E Twp. Rge.

Twp. Rge. Twp. Rge.

Filed in Twp. 2N Rge. 49ERemarks Find operator

Farm Map

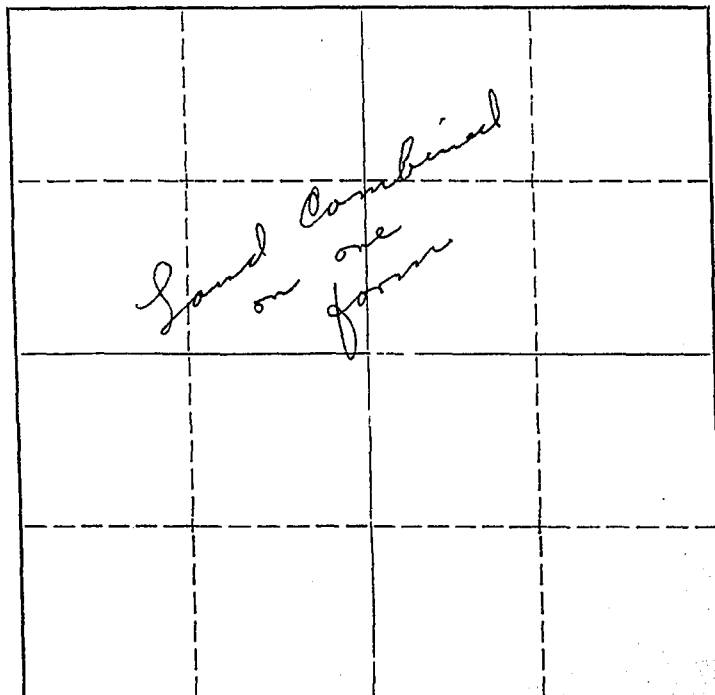
Ownership covers
only irrigated land.
All ownership for
dry land not shown.

Tongue River Basin

STATE ENGINEERS OFFICE
Water Resources Survey

COUNTY Custer

FILE NO. 69-T.2N-R.49E

Owner Farm, Helder G. Address Reebs, Montana

AAA Owner Address

Operator Address

New Owner Address

New Operator Address

Assessment Record None

Assessed Acreage 0

Legal Description of This Farm all of Section 4; T.2N-R.49E

Total Acres in Farm ✓

Code Number AA Farm Map Pumpkin Cr.

Photo No. MA 12-67

AAA Contract No.

AAA Total Cropland Acreage

App. No. 1396, 1711, 2503

Decree No.

Land is located in

Twp. 2N Rge. 49E Twp. Rge.

Twp. Rge. Twp. Rge. diversion

Filed in Twp. 2N Rge. 49E

Remarks Find Operator

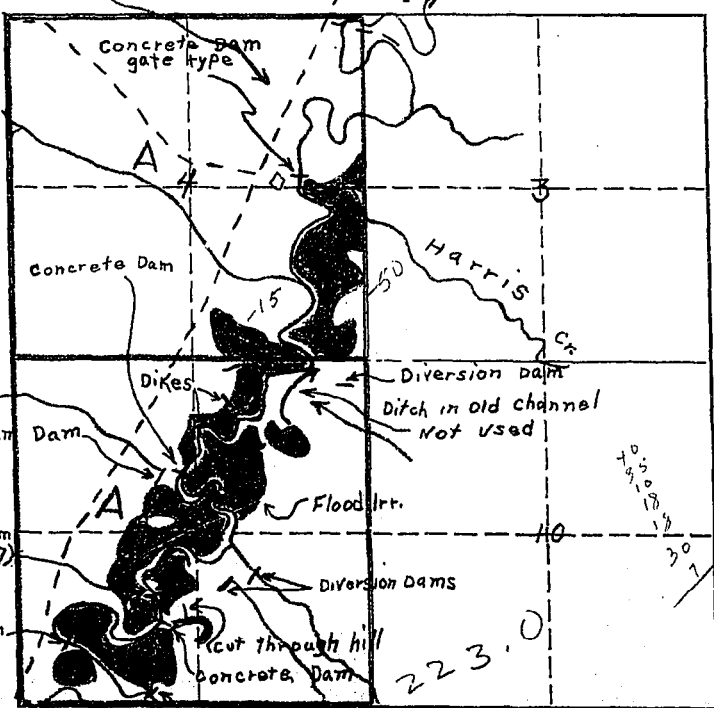

Tongue River Basin

15. Remarks (Present Use Status, etc.) _____

STATE ENGINEERS OFFICE
Water Resources Survey

Notice of Appropriation

1412

1. County Custer Book F Page 140 Record W.R.
2. Name of Appropriator Wilhelmina Tonn Address Miles City, Montana
3. Date Appropriated June 3, 1940 Date Filed June 25, 1940
Amount Appropriated, Miners Inches _____, Cubic Feet per second 1.5
4. Name of Stream Pumpkin Creek Tributary _____ Basin _____
5. Point of Diversion 1265 ft. in a northwesterly direction from the 1/4 corner of the
Section line between Sections 16 & 9 in Twp. 2N., Rge. 49E. Said spillway being 30 ft.
immediately east of said dam.
Sec. 16 & 9 Twp. 2N. Rge. 49E. Bank of Stream East or West
6. Purpose For raising of hay and other agricultural crops, for stock purposes and to
prevent the erosion of the channel and banks of said Pumpkin Creek
7. Description of System A dirt, log and rock dam with a spillway capable of placing said
amount of water on said lands. Said water runs from said point of diversion, thence
in a northwesterly direction following the lay of the land and on to and upon said lands.
8. Land Description of Intended Place of Use _____
W1/4 Frl. less H/W Sec. 9-2N-49E, 628.70 acres, Wilhelmina Tonn, Miles City, Montana
9. Remarks (Pertaining to Use, etc.) _____

Decree

10. Case No. _____ Date _____ Amt. Decreed: M. I. _____ C. F. S. _____
11. To Whom Decreed _____ Address _____
12. Name of Ditch _____ Maximum Capacity (C. F. S.) _____
13. Date of Priority _____ Purpose _____
14. Land Description of Place of Use as Decreed _____
15. Remarks (Present Use Status, etc.) _____

STATE ENGINEERS OFFICE
Water Resources Survey

Notice of Appropriation

- 2503
1. County..... Custer..... Book..... F..... Page..... 139..... Record..... W.R.....
 2. Name of Appropriator..... Wilhelmina Tonn..... Address..... Broadus Stage, Miles City.....
 3. Date Appropriated..... June 8, 1940..... Date Filed..... June 8, 1940.....
Amount Appropriated, Miners Inches....., Cubic Feet per second.....
 4. Name of Stream..... Pumpkin Creek..... Tributary..... Basin.....
 5. Point of Diversion..... Dam across creek at a point 863' NW from quarter corner.....
on Section line between.....
Sec..... 3 & 4..... Twp..... 2N..... Rge..... 49E..... Bank of Stream.....
 6. Purpose..... Irrigation and stock purposes.....
 7. Description of System..... Dam and spillway.....
 8. Land Description of Intended Place of Use..... NE $\frac{1}{4}$ Sec. 4, NW $\frac{1}{4}$ Sec. 3, N $\frac{1}{2}$ SE $\frac{1}{4}$ Sec. 4, N $\frac{1}{2}$ SW $\frac{1}{4}$ Sec. 3-2N-49E.....
 9. Remarks (Pertaining to Use, etc.).....

Decree

10. Case No..... Date..... Amt. Decreed: M. I..... C. F. S.....
11. To Whom Decreed..... Address.....
12. Name of Ditch..... Maximum Capacity (C. F. S.).....
13. Date of Priority..... Purpose.....
14. Land Description of Place of Use as Decreed.....
15. Remarks (Present Use Status, etc.).....

STATE ENGINEERS OFFICE
Water Resources Survey

Notice of Appropriation

2504

1. County Custer Book F Page 140 Record W.R.
2. Name of Appropriator Wilhelmina Tonn Address Broadus Stage, Miles City
3. Date of Appropriation June 8, 1946 Date Filed June 25, 1946
- Amount Appropriated, Miners Inches _____, Cubic Feet per second 175
4. Name of Stream Pumpkin Creek Tributary _____ Basin _____
5. Point of Diversion 30' east of dam on eastern bank of Pumpkin Creek - Dam 1265'
NW from quarter corner between
Sec. 16 & 9 Twp. 2 Rge. 49E Bank of Stream
6. Purpose Irrigation and stock purposes
7. Description of System Dam and spillway
8. Land Description of Intended Place of Use N¹/₂SW¹/₄, NW¹/₄, NE¹/₄ Sec. 9-2N-49E
9. Remarks (Pertaining to Use, etc.) _____

Decree

10. Case No. _____ Date _____ Amt. Decreed: M. I. _____ C. F. S. _____
11. To Whom Decreed _____ Address _____
12. Name of Ditch _____ Maximum Capacity (C. F. S.) _____
13. Date of Priority _____ Purpose _____
14. Land Description of Place of Use as Decreed _____
15. Remarks (Present Use Status, etc.) _____