

1026

STATE ENGINEERS OFFICE
Water Resources Survey
Notice of Appropriation

1. County Custer Book E Page 89 Record W.R.
2. Name of Appropriator Nona Todd Address Beebe, Montana
 Est. 15, 1908
3. Date Appropriated Mar. 14, 1911 Date Filed March 15, 1910
 Amount Appropriated, Miners Inches 400, Cubic Feet per second _____
4. Name of Stream North Lone Tree Creek and all tributaries Basin _____
5. Point of Diversion 59 yds. E. of 1/4 Sec. corner on N. side of said

 Sec. 34 Twp. 4N. Rge. 51E. Bank of Stream ? & South

6. Purpose For irrigation, watering stock and domestic purposes.
7. Description of System A dam and ditch 60" X 24" in size, which carries and conducts
said amount of water from said creek and runs thence in a southerly and easterly
direction.
8. Land Description of Intended Place of Use _____
NE 1/4, N 1/2 SE 1/4, SW 1/4 SE 1/4 Sec. 34-4N-51E, 280 acres.
Ownership Book shows: NE 1/4, NE 1/4 SE 1/4 Sec. 34-4N-51E, 200 acres, Nona Todd, Misspah, Montana

9. Remarks (Pertaining to Use, etc.) Nona Todd through Calvin Todd.

Decree

10. Case No. _____ Date _____ Amt. Decreed: M. I. _____ C. F. S. _____
11. To Whom Decreed _____ Address _____
12. Name of Ditch _____ Maximum Capacity (C. F. S.) _____
13. Date of Priority _____ Purpose _____
14. Land Description of Place of Use as Decreed _____

15. Remarks (Present Use Status, etc.) _____

STATE ENGINEERS OFFICE
Water Resources Survey

Notice of Appropriation

- 2219
1. County Custer Book C Page 370 Record W.R.
 2. Name of Appropriator Nona Todd Address Custer County, Montana
 3. Date Appropriated June 25, 1907 Date Filed July 5, 1907
 Amount Appropriated, Miners Inches _____, Cubic Feet per second 25
 4. Name of Stream Unnamed Coulee Tributary _____ Basin _____
 5. Point of Diversion Said creek on west side of the Mizpah Creek heading on the divide between Pumpkin Creek and Mizpah Creek and running in an easterly direction into Mizpah at a point about or near the center of Sec. 34-4N-51E and measured from said point of Sec. 34 Twp. 4N. Rge. 51E. Bank of Stream West.
diversion as an initial point, the following well known natural objects and permanent monuments are distant as follows, to wit: the NW corner of Dawson fence, the 1/4 SC on N. side of Sec. 34-4N-51E, is distant 80 in a due south direction and is distant 20 chains in an easterly direction.
 6. Purpose For irrigation and other useful and beneficial purposes.
 7. Description of System Dam and ditch and reservoir. Said ditch to be 4 ft. wide on bottom and 6 ft. wide on top, and 3 ft. deep.
 8. Land Description of Intended Place of Use _____
NE 1/4, NE 1/4 Sec. 34-4N-51E, 200 acres, Nona Todd, Mizpah, Montana
Balance of Sec. 34-4N-51E, 429.68 acres, U.S.A., Mizpah, Montana
 9. Remarks (Pertaining to Use, etc.) _____

Decree

10. Case No. _____ Date _____ Amt. Decreed: M. I. _____ C. F. S. _____
11. To Whom Decreed _____ Address _____
12. Name of Ditch _____ Maximum Capacity (C. F. S.) _____
13. Date of Priority _____ Purpose _____
14. Land Description of Place of Use as Decreed _____
15. Remarks (Present Use Status, etc.) _____

STATE OF MONTANA
STATE ENGINEER'S OFFICE
 WATER RESOURCES SURVEY

22 Township 4 N Range 51 E County Custer

303 B						
6A	5A	4A	3A	2A	1A	
7A	8A	9A	10A	11A	12A 616 1681 616 304	
					B	
A 13B C	17A	16A	15A	14A	13A	
19A	20A	21A	22A	23A	24B	
30A	29A	28A	27A	26A B C	25A	
31A	32A	33A	34A 2219 1026 2219 B 1472	35A	36A	

Township 4 N Range 51 E

26
27
51
81
212
20

Township 4 North

Range 51 East

Custer County, Montana

<u>Index No.</u>	<u>Name of Appropriator</u>	<u>Stream</u>	<u>Date App.</u>	<u>Date Filed</u>	<u>Inches</u>
303	Sol E. Herren	Correl Creek	5-29-11	5-29-11	400
616	Charles C. Kimball	East Second Creek	8-10-08	8-25-08	1000
1026	Nona Todd	Lone Tree Creek	10-15-08	3-15-10	400
1472	George E. Sandal	Rock Creek	12-15-08	12-15-09	3000
1681	John Tarr	Short Creek	8-17-15	8-18-15	1000
1904	John M. Tarr	Tomathy Creek	8-17-15	8-17-15	1000
2219	Nona Todd	Coulee (No name)	6-25-07	7-5-07	1000

Water Rights - Township 4 North

Range 51 East

Custer County, Montana



NOTICE
These forms are the
property of the State
of Montana and must
be returned.

STATE OF MONTANA
STATE ENGINEERS OFFICE
Water Resources Survey

Code No. 36A

County Custer

T. 4N R. 53

Name of Land Owner Orville Campbell Address Minneapolis, Minn
Name of Operator _____ Address _____

Part A

**TO BE FILED BY THOSE OBTAINING IRRIGATION WATER FROM
A DITCH COMPANY OR IRRIGATION DISTRICT**

1. Water is delivered by: _____
Name of Ditch, Ditch Company or District Supplying Water
2. State the number of acres you irrigate under this system _____ Shares you hold _____
3. If you obtain water from more than one Company, give the number of shares, acres irrigated and the name of the Company under "Remarks." If you obtain water from a Ditch Company and also have a private system fill in both Part A and Part B.

Part B

**TO BE FILED BY THOSE WHO HAVE A PRIVATE DITCH, PUMP OR IRRIGATION SYSTEM
or those who have a private water right under a Ditch Company**

4. In what year was this land first irrigated? Date 1905 (see attached filing)
5. Give the name of the original appropriator (first user): Orville Campbell
6. Give the date appropriated _____ Amount filed on: Miners Inches _____ C. F. S. _____
7. State the total number of acres irrigated under this system: _____
8. Give the point of diversion: _____ $\frac{1}{4}$ _____ $\frac{1}{4}$ Section _____ Township _____ Range _____

Part C

TO BE FILED BY ALL WATER USERS IN ADDITION TO PART A OR PART B

9. Source of Water: Powder River
Name of stream or lake from which water is originally diverted
10. Water is obtained by: (Check one) Gravity _____ Pumping ☒ Other _____
11. What is the greatest number of acres you have irrigated? 1800 Date 1905
12. How many acres did you irrigate in 1947? (Crop and pasture) 2310
13. State the total number of additional acres that could be irrigated by increasing the water supply, land leveling, etc. 0 This land is under what ditch? _____
14. How many acres of seeped land do you have which could be drained and put into production? 0
15. What is the condition of your irrigation system? Fair
16. Is your water supply adequate? Yes ☒ No ☐ Explain If water is clear
17. REMARKS: Can operate pump if silty cannot
use water right 1316

Over

NOTE: The foregoing questions apply only to irrigated land shown on this plat.

DESCRIPTION AND MAP OF FARM

18. Legal Description of this Farm

Sec 36, T4N R53E

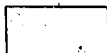

IRRIGATED LAND



NON-IRRIGATED LAND

North

West

East

see attached
map
main Campbell
ranch map
filed in 3N 54

South

Ownership covers
only irrigated land.
Dry land not shown.

19. If the above land is irrigated from more than one ditch please give the acreage under each ditch in 19A and indicate the location of the land irrigated from each on the above map.

19A. Ditch: Campbell Pump ditch Acres: 23.0

Ditch: from Power R. Acres:

Information supplied by:

Name Field Survey Address Date July 10-47

REMARKS: Johnson & Paulist

If you cannot answer all of the questions on this form answer as many as you can and return the form to us as soon as possible.

T. 4N-R 53E

25

36^A

Powder River

23.0

STATE ENGINEERS OFFICE
Water Resources SurveyCOUNTY ClusterFILE NO. 55-T4N-R53EOwner U.S.A. Address —AAA Owner Campbell, Orville Address —Operator — Address —New Owner — Address —New Operator — Address —Assessment Record NoneAssessed Acreage 0Legal Description of This Farm all of Sec 36 T4N-R53ETotal Acres in Farm 640Code Number 36APhoto No. MA 24-50AAA Contract No. —AAA Total Cropland Acreage —App. No. 1916Decree No. —

Land is located in

Twp. 4N Rge. 53E Twp. — Rge. —Twp. — Rge. — Twp. — Rge. —Filed in Twp. 3N Rge. 54ERemarks See Form forOrville Campbell - Operatesland in T. 3N-R54E

Farm Map

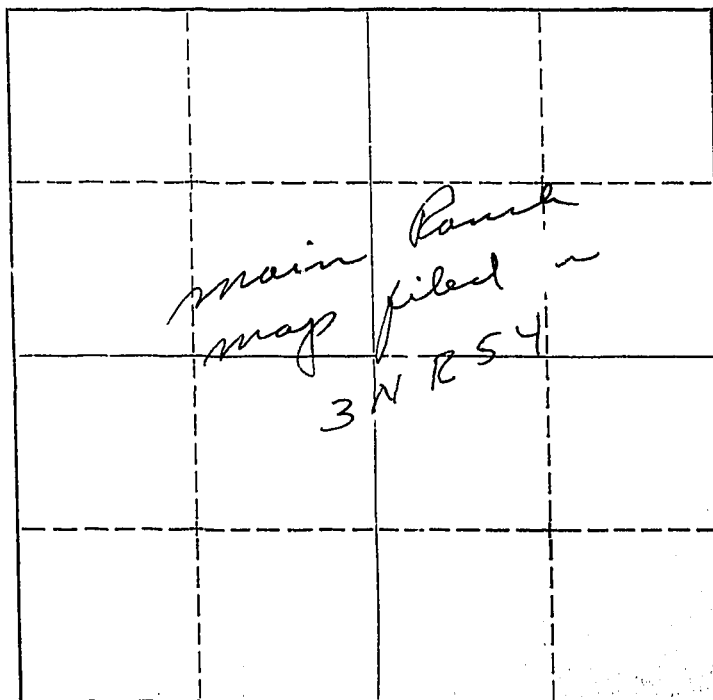

Powder River Basin

Ownership covers
only irrigated land.
All ownership for
dry land not shown.

1316

STATE ENGINEERS OFFICE
Water Resources Survey
Notice of Appropriation

1. County Custer Book E Page 508 Record W.R.
2. Name of Appropriator Orvel Campbell Address Mizzpah, Montana
 May 8, 1934
3. Date Appropriated Aug. 24, 1934 Date Filed Aug. 24, 1934
 Amount Appropriated, Miners Inches 2000 or , Cubic Feet per second 50
4. Name of Stream Powder River Tributary Basin
5. Point of Diversion Near the intersection of the S. line of

 Sec. 7 Twp. 3N. Rge. 54E. Bank of Stream Right
6. Purpose For irrigation, watering stock, domestic and other purposes.
7. Description of System A pump run by a gasoline engine and two ditches 48" X 60" in size,
which carries and conducts said amount of water from said river and runs thence in a
northerly and northwesterly direction.
8. Land Description of Intended Place of Use
In Sec. 36-4N-53E, 571.02 acres, U.S.A.
All Frl. Sec. 6-3N-54E, 550.52 acres, Eva & Orvil Campbell, Mizpah, Montana
Lots 2,3,6,7, Sec. 7-3N-53E, 175.21 acres, Frankler C. Davis, Mizpah, Montana
Lots 1,4,5,8, E&E Sec. 7-3N-53E, 352.72 acres, Eva L. Campbell, Mizpah, Montana
Lots 1,2,3,4,8, N. Sec. 25-3N-53E, 438.73 acres, Federal Land Bank, c/o Geo. Dagnall,
Lots 5,6,7, Sec. 25-3N-53E, 113.08 acres, N.P. Ry. Co. Mizpah
9. Remarks (Pertaining to Use, etc.)

Decree

10. Case No. Date Amt. Decreed: M. I. C. F. S.
11. To Whom Decreed Address
12. Name of Ditch Maximum Capacity (C. F. S.)
13. Date of Priority Purpose
14. Land Description of Place of Use as Decreed
15. Remarks (Present Use Status, etc.)



NOTICE
These forms are the
property of the State
of Montana and must
be returned.

STATE OF MONTANA
STATE ENGINEERS OFFICE

Water Resources Survey

FORM WR-2M (12-47)

Code No. 25A

County Custer

T. 4N R. 53E

Name of Land Owner George Dagnall Address Miller City, Mont.

Name of Operator _____ Address _____

Part A

TO BE FILED BY THOSE OBTAINING IRRIGATION WATER FROM
A DITCH COMPANY OR IRRIGATION DISTRICT

1. Water is delivered by: _____
Name of Ditch, Ditch Company or District Supplying Water
2. State the number of acres you irrigate under this system _____ Shares you hold _____
3. If you obtain water from more than one Company, give the number of shares, acres irrigated and the name of the Company under "Remarks." If you obtain water from a Ditch Company and also have a private system fill in both Part A and Part B.

Part B

TO BE FILED BY THOSE WHO HAVE A PRIVATE DITCH, PUMP OR IRRIGATION SYSTEM
or those who have a private water right under a Ditch Company

4. In what year was this land first irrigated? Date (see attached filings)
5. Give the name of the original appropriator (first user): George & Luke R. Dagnall
6. Give the date appropriated _____ Amount filed on: Miners Inches _____ C. F. S. _____
7. State the total number of acres irrigated under this system: _____
8. Give the point of diversion: _____ $\frac{1}{4}$ _____ $\frac{1}{2}$ Section _____ Township _____ Range _____

Part C

TO BE FILED BY ALL WATER USERS IN ADDITION TO PART A OR PART B

9. Source of Water: Little Teepee Creek (trib to Powder River)
Name of stream or lake from which water is originally diverted
10. Water is obtained by: (Check one) Gravity ☒ Pumping _____ Other _____
11. What is the greatest number of acres you have irrigated? ? Date _____
12. How many acres did you irrigate in 1947? (Crop and pasture) 90.0
13. State the total number of additional acres that could be irrigated by increasing the water supply, land leveling, etc. 0 This land is under what ditch? _____
14. How many acres of seeped land do you have which could be drained and put into production? 0
15. What is the condition of your irrigation system? Fair
16. Is your water supply adequate? Yes _____ No ☒ Explain Flood on
17. REMARKS: _____

System consists of flood ditch
& ditches,

Over

NOTE: The foregoing questions apply only to irrigated land shown on this plat.

DESCRIPTION AND MAP OF FARM

18. Legal Description of this Farm

Sec. 25, N of the Powder River
T4N R53E



IRRIGATED LAND

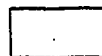

NON-IRRIGATED LAND



Potential Land

North

West

East

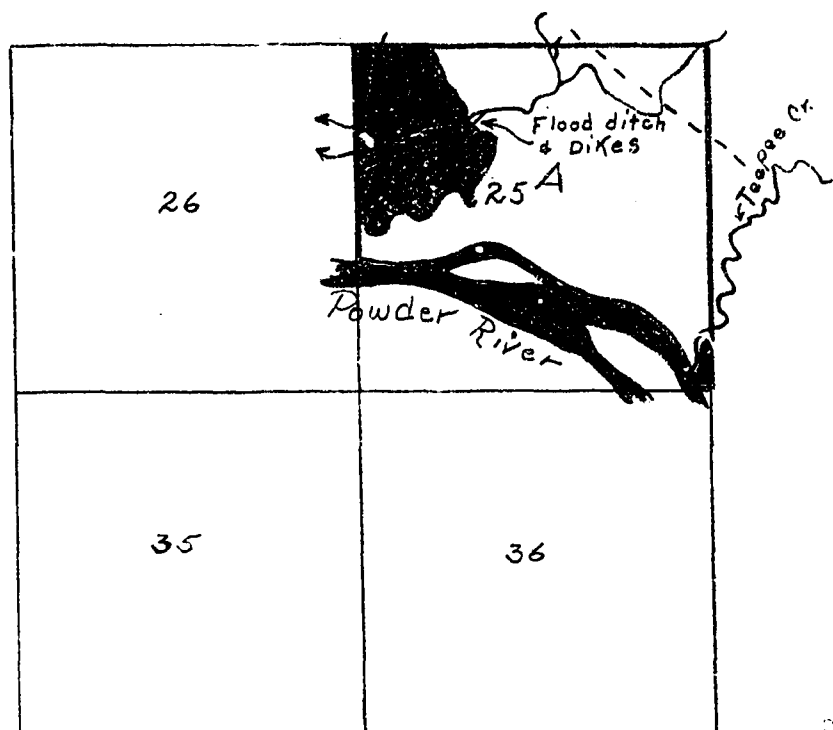

South

Overlapping areas
only irrigated land.
All ownership for
dry land not shown.

19. If the above land is irrigated from more than one ditch please give the acreage under each ditch in 19A and indicate the location of the land irrigated from each on the above map.

19A. Ditch:

Little Teepee Creek flood ditch Acres: *90.0*

Ditch:

Acres:

Information supplied by:

Name

Field Survey

Address

Date

July 10-47

REMARKS:

Johnson & Pantier

If you cannot answer all of the questions on this form answer as many as you can and return the form to us as soon as possible.

STATE ENGINEERS OFFICE
Water Resources SurveyCOUNTY ClusterFILE NO. 55-T4N-R53EOwner Dagnall, George Address Miles City?

AAA Owner Address

Operator Address

New Owner Address

New Operator Address

Assessment Record NoneAssessed Acreage 0Legal Description of This Farm N²; lots 1, 2, 3, 4, 8, Sec. 25 T.4N-R53ETotal Acres in Farm ✓Code Number 25APhoto No. Ma-24-50

AAA Contract No.

AAA Total Cropland Acreage

App. No. 1316, 2489, 2490

Decree No.

Land is located in

Twp. 4N Rge. 53E Twp. Rge.

Twp. Rge. Twp. Rge.

Filed in Twp. 4N Rge. 53E

Remarks

Farm Map

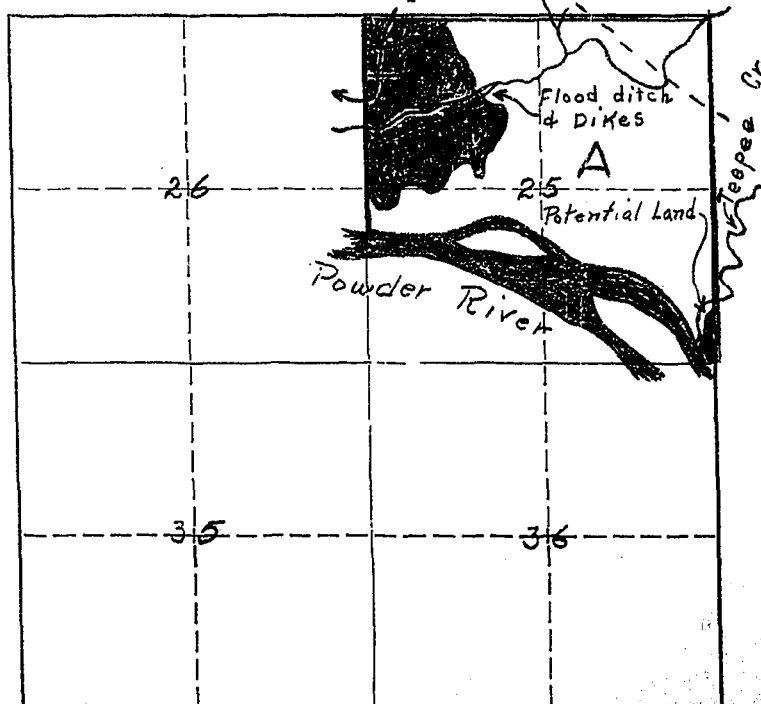
Ownership covers
only irrigated land.
All ownership for
dry land not shown.Powder River Basin

STATE ENGINEERS OFFICE Water Resources Survey

Notice of Appropriation

1. County Custer Book E Page 508 Record W.R.
2. Name of Appropriator Orvil Campbell Address Mizpah, Montana
May 8, 1934
3. Date Appropriated Aug. 24, 1934 Date Filed Aug. 24, 1934
Amount Appropriated, Miners Inches 2000 or, Cubic Feet per second 50
4. Name of Stream Powder River Tributary Basin
5. Point of Diversion Near the intersection of the S. line of

Sec. 7 Twp. 3N. Rge. 54E. Bank of Stream Right
6. Purpose For irrigation, watering stock, domestic and other purposes.
7. Description of System A pump run by a gasoline engine and two ditches 48" X 60" in size, which carries and conducts said amount of water from said river and runs thence in a northerly and northwesterly direction.
8. Land Description of Intended Place of Use
In Sec. 36-4N-53E, 571.02 acres, U.S.A.
All Frl. Sec. 6-3N-54E, 550.52 acres, Eva & Orvil Campbell, Mizpah, Montana
Lots 2,3,6,7, Sec. 7-3N-53E, 175.24 acres, Frasier C. Davis, Mizpah, Montana
Lots 1,4,5,8, 1/2 Sec. 7-3N-53E, 352.72 acres, Eva L. Campbell, Mizpah, Montana
Lots 1,2,3,4,8, N 1/2 Sec. 25-3N-53E, 438.73 acres, Federal Land Bank, c/o Geo. Dagnall, Mizpah
Lots 5,6,7, Sec. 25-3N-53E, 113.08 acres, N.P. Ry. Co.
9. Remarks (Pertaining to Use, etc.)

Decree

10. Case No. Date Amt. Decreed: M. I. C. F. S.
11. To Whom Decreed Address
12. Name of Ditch Maximum Capacity (C. F. S.)
13. Date of Priority Purpose
14. Land Description of Place of Use as Decreed
15. Remarks (Present Use Status, etc.)

STATE ENGINEERS OFFICE
Water Resources Survey

Notice of Appropriation

1. County Custer Book F Page 143 Record W.R.
2. Name of Appropriator George & Luke R. Dagnall Address Custer County, Montana
3. Date Appropriated May 1, 1929 Date Filed March 23, 1942
- Amount Appropriated, Miners Inches 2400, Cubic Feet per second _____
4. Name of Stream Little Teepee Creek Tributary _____ Basin _____
5. Point of Diversion Point in SW $\frac{1}{4}$ Sec.
- Sec. 24 Twp. 4N. Rge. 53E. Bank of Stream _____
6. Purpose Irrigation and watering livestock
7. Description of System Natural ending of defined channel, controlled by spreader dikes.
8. Land Description of Intended Place of Use NW $\frac{1}{4}$ Sec. 25, S $\frac{1}{2}$ NE $\frac{1}{4}$ Sec. 26-4N-53E.
9. Remarks (Pertaining to Use, etc.) _____

Decree

10. Case No. _____ Date _____ Amt. Decreed: M. I. _____ C. F. S. _____
11. To Whom Decreed _____ Address _____
12. Name of Ditch _____ Maximum Capacity (C. F. S.) _____
13. Date of Priority _____ Purpose _____
14. Land Description of Place of Use as Decreed _____
15. Remarks (Present Use Status, etc.) _____

STATE ENGINEERS OFFICE
Water Resources Survey

Notice of Appropriation

1. County Custer Book F Page 145 Record W.R.
2. Name of Appropriator George & Luke R. Dagnall Address Custer County, Montana
3. Date Appropriated March 1, 1942 Date Filed March 23, 1942
Amount Appropriated, Miners Inches Not given, Cubic Feet per second
4. Name of Stream Teepee Creek Tributary Powder River Basin
5. Point of Diversion Dam in lot 8 of Sec.

Sec. 25 Twp. 4N. Rge. 53E. Bank of Stream
6. Purpose Irrigation and watering stock
7. Description of System Diversion dam 180' long, 14' high, wing dam 450' long.
8. Land Description of Intended Place of Use Sec. 24-4N-53E.
9. Remarks (Pertaining to Use, etc.) Appropriate all waters of Teepee Creek.

Decree

10. Case No. Date Amt. Decreed: M. I. C. F. S.
11. To Whom Decreed Address
12. Name of Ditch Maximum Capacity (C. F. S.)
13. Date of Priority Purpose
14. Land Description of Place of Use as Decreed
15. Remarks (Present Use Status, etc.)



NOTICE
These forms are the
property of the State
of Montana and must
be returned.

STATE OF MONTANA
STATE ENGINEERS OFFICE

Water Resources Survey

Code No. 268

County Quintana

T. 4N R. 53E

Name of Land Owner Luke Dagnall Address Miller City

Name of Operator _____ Address _____

Part A

TO BE FILED BY THOSE OBTAINING IRRIGATION WATER FROM
A DITCH COMPANY OR IRRIGATION DISTRICT

1. Water is delivered by: _____
Name of Ditch, Ditch Company or District Supplying Water
2. State the number of acres you irrigate under this system _____ Shares you hold _____
3. If you obtain water from more than one Company, give the number of shares, acres irrigated and the name of the Company under "Remarks." If you obtain water from a Ditch Company and also have a private system fill in both Part A and Part B.

Part B

TO BE FILED BY THOSE WHO HAVE A PRIVATE DITCH, PUMP OR IRRIGATION SYSTEM
or those who have a private water right under a Ditch Company: (see attached app)

4. In what year was this land first irrigated? Date 1908
5. Give the name of the original appropriator (first user): Samuel Date
6. Give the date appropriated 1/14/08 Amount filed on: Miners inches 1000 C. F. S.
7. State the total number of acres irrigated under this system: 20.6
8. Give the point of diversion: Flood $\frac{1}{4}$ Section 26 Township 4N Range 53

Part C

TO BE FILED BY ALL WATER USERS IN ADDITION TO PART A OR PART B

9. Source of Water: Little Teepee Creek
Name of stream or lake from which water is originally diverted
10. Water is obtained by: (Check one) Gravity ☒ Pumping _____ Other _____
11. What is the greatest number of acres you have irrigated? ? Date 1908
12. How many acres did you irrigate in 1947? (Crop and pasture) 20.6
13. State the total number of additional acres that could be irrigated by increasing the water supply, land leveling, etc. 0 This land is under what ditch? _____
14. How many acres of seeped land do you have which could be drained and put into production? 0
15. What is the condition of your irrigation system? Fair
16. Is your water supply adequate? Yes _____ No ☒ Explain Flood ch
17. REMARKS: _____

First irrigated by Samuel Date
later filed on by George and Luke
R. Dagnall (5-1-29) and (3-1-42)

Over

NOTE: The foregoing questions apply only to irrigated land shown on this plat.

DESCRIPTION AND MAP OF FARM

18. Legal Description of this Farm

See attached form



IRRIGATED LAND

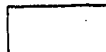

NON-IRRIGATED LAND

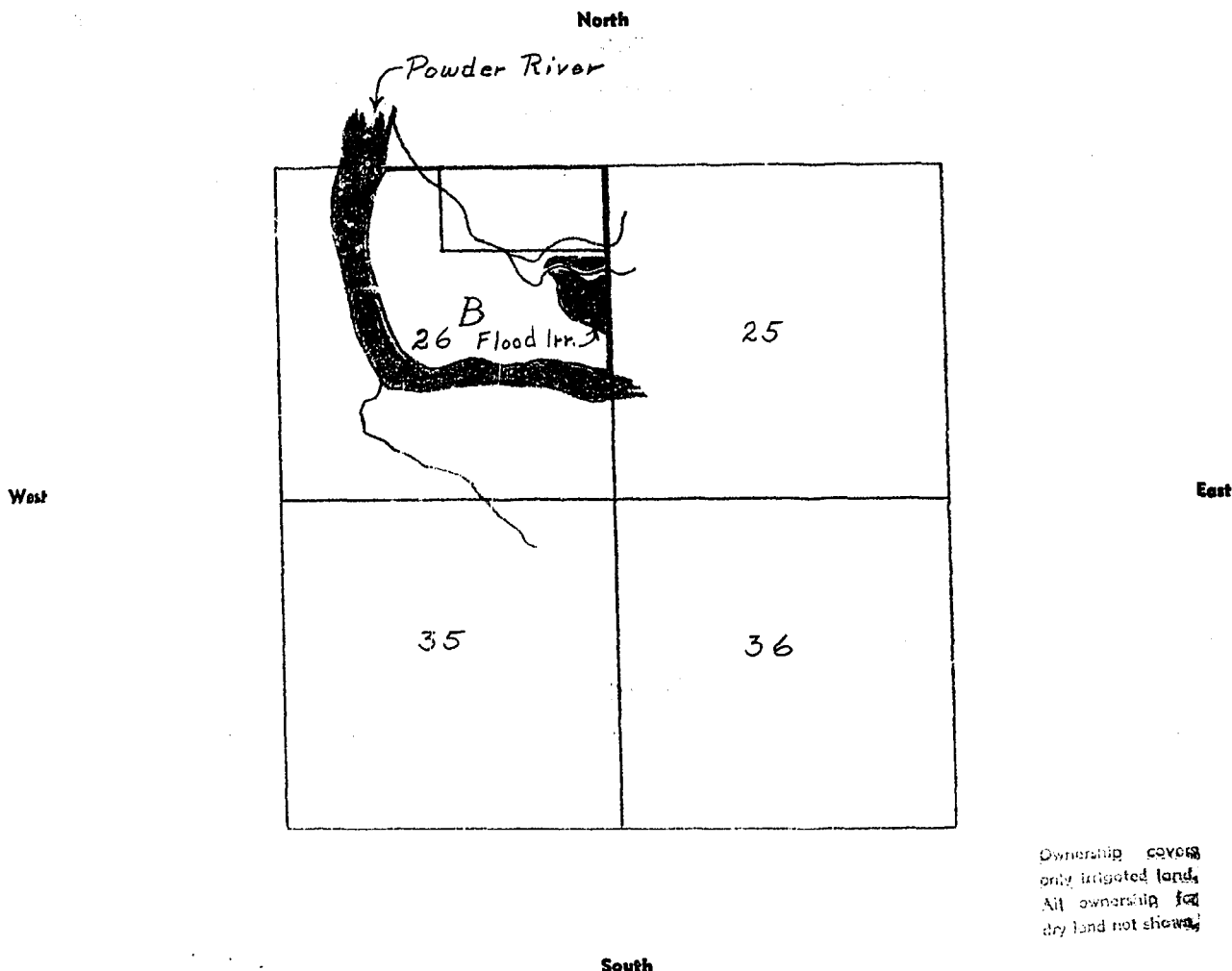

19. If the above land is irrigated from more than one ditch please give the acreage under each ditch in 19A and indicate the location of the land irrigated from each on the above map.

19A. Ditch: *Little Tiesee Creek flood Irr.* Acres: *20.6*

Ditch: _____ Acres: _____

Information supplied by:

Name *Field Survey* Address _____ Date *July 9-47*

REMARKS: *Johnson & Paulist*

If you cannot answer all of the questions on this form answer as many as you can and return the form to us as soon as possible.

STATE ENGINEERS OFFICE
Water Resources Survey

COUNTY Custer

FILE NO. 55-T.4N-R.53E

Owner Dagnall, Luke Address Miles City?

AAA Owner Address

Operator Address

New Owner Address

New Operator Address

Assessment Record None

Assessed Acreage 0

Legal Description of This Farm S2 NE4, 1/4 sec, E2 NW, & N2 SE,
& NENE, Sec 26, 4 N R 53 E.

Code Number 26B

Photo No. MA 24-50

AAA Contract No.

AAA Total Cropland Acreage

App. No. 2489, 1859

Decree No.

Land is located in

Twp. 4N Rge. 53E Twp. Rge.

Twp. Rge. Twp. Rge.

Filed in Twp. 4N Rge. 53E

Remarks

Powder River
Total Acres in Farm ✓

Farm Map

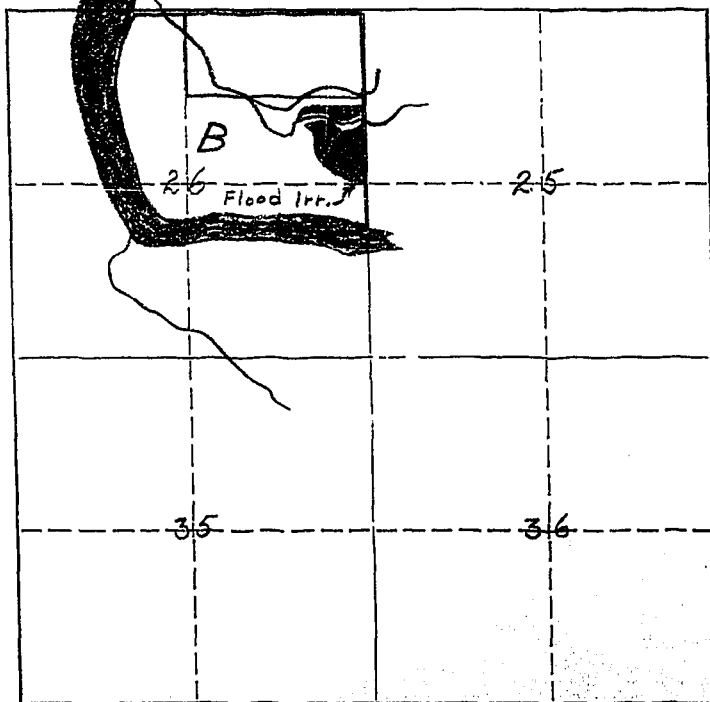

(Powder River Basin)

Ownership covers
only irrigated land.
All ownership for
dry land not shown.

STATE ENGINEERS OFFICE Water Resources Survey

Notice of Appropriation

- 1859
- County Custer Book C Page 490 Record W.R.
 - Name of Appropriator Samuel Date Address Hocket, Montana
 - Date Appropriated Jan. 14, 1908 Date Filed Jan. 16, 1908
Amount Appropriated, Miners Inches 1000 or , Cubic Feet per second 25
 - Name of Stream Little Teepee Tributary Basin
 - Point of Diversion About 400 ft. NE of Sec. corner at the NE corner

Sec. 26 Twp. 4N. Rge. 53E. Bank of Stream
 - Purpose For irrigating and other purposes.
 - Description of System Dam and ditch. Said ditch is 30 X 120 in. in size, which carries
and conducts said inches of water from said creek and runs thence in a southwesterly
direction, thence over and upon said land.
 - Land Description of Intended Place of Use
Lots 1,4,5,6,7, SE 1/4 Sec. 26-4N-53E, 183.78 acres, Samuel Date, Miles City
 - Remarks (Pertaining to Use, etc.)

Decree

- Case No. Date Amt. Decreed: M. I. C. F. S.
- To Whom Decreed Address
- Name of Ditch Maximum Capacity (C. F. S.)
- Date of Priority Purpose
- Land Description of Place of Use as Decreed
- Remarks (Present Use Status, etc.)

STATE ENGINEERS OFFICE
Water Resources Survey
Notice of Appropriation

1. County Custer Book F Page 143 Record W.R.
2. Name of Appropriator George & Luke R. Dagnall Address Custer County, Montana
3. Date Appropriated May 1, 1929 Date Filed March 23, 1942
Amount Appropriated, Miners Inches 2400, Cubic Feet per second
4. Name of Stream Little Teepee Creek Tributary Basin
5. Point of Diversion Point in SW 1/4 Sec.
Sec. 24 Twp. 4N Rge. 53E Bank of Stream
6. Purpose Irrigation and watering livestock
7. Description of System Natural ending of defined channel, controlled by spreader dikes.
8. Land Description of Intended Place of Use NW 1/4 Sec. 25, S 1/4 NE 1/4 Sec. 26-4N-53E.
9. Remarks (Pertaining to Use, etc.)

Decree

10. Case No. Date Amt. Decreed: M. I. C. F. S.
11. To Whom Decreed Address
12. Name of Ditch Maximum Capacity (C. F. S.)
13. Date of Priority Purpose
14. Land Description of Place of Use as Decreed
15. Remarks (Present Use Status, etc.)



NOTICE
These forms are the
property of the State
of Montana and must
be returned.

STATE OF MONTANA
STATE ENGINEERS OFFICE
Water Resources Survey

FORM WR-1-2M (2-47)
Code No. 4A-5A
County Custer
T. 4N R. 53

Name of Land Owner: Ernest Dignan Address Miller City
Name of Operator: _____ Address to Jim Rayburn
Box 304

Part A

TO BE FILED BY THOSE OBTAINING IRRIGATION WATER FROM
A DITCH COMPANY OR IRRIGATION DISTRICT

1. Water is delivered by: _____ Name of Ditch, Ditch Company or District Supplying Water
2. State the number of acres you irrigate under this system _____ Shares you hold _____
3. If you obtain water from more than one Company, give the number of shares, acres irrigated and the name of the Company under "Remarks." If you obtain water from a Ditch Company and also have a private system fill in both Part A and Part B.

Part B

TO BE FILED BY THOSE WHO HAVE A PRIVATE DITCH, PUMP OR IRRIGATION SYSTEM
or those who have a private water right under a Ditch Company

4. In what year was this land first irrigated? Date see attached filings
5. Give the name of the original appropriator (first user): _____
6. Give the date appropriated _____ Amount filed on: Miners Inches _____ C. F. S. _____
7. State the total number of acres irrigated under this system: _____
8. Give the point of diversion: _____ $\frac{1}{4}$ _____ $\frac{1}{4}$ Section _____ Township _____ Range _____

Part C

TO BE FILED BY ALL WATER USERS IN ADDITION TO PART A OR PART B

9. Source of Water: Coulter & Kimbal Creek
Name of stream or lake from which water is originally diverted
10. Water is obtained by: (Check one) Gravity ☒ Pumping _____ Other _____
11. What is the greatest number of acres you have irrigated? ? Date _____
12. How many acres did you irrigate in 1947? (Crop and pasture) 240.0
13. State the total number of additional acres that could be irrigated by increasing the water supply, land leveling, etc. None This land is under what ditch? _____
14. How many acres of seeped land do you have which could be drained and put into production? None
15. What is the condition of your irrigation system? Good flood system
16. Is your water supply adequate? Yes _____ No ☒ Explain I flood low
17. REMARKS: All flood low from side Coulter and Kimbal Creek - ditches, dams & ditches

Over

NOTE: The foregoing questions apply only to irrigated land shown on this plat.

DESCRIPTION AND MAP OF FARM

18. Legal Description of this Farm

See attached form & Map



IRRIGATED LAND

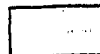

NON-IRRIGATED LAND

North

West

East

South

Shading, showing
only irrigated land.
All ownership for
dry land not shown.

19. If the above land is irrigated from more than one ditch please give the acreage under each ditch in 19A and indicate the location of the land irrigated from each on the above map.

19A. Ditch: *Kimball Creek & Conleer* Acres: *240.0*

Ditch: *(Figure includes 15 acres of N. P. land)* Acres: *in sec 5,*

Information supplied by:

Name *Jim Paykorn to* Address _____ Date *July 9-47*

REMARKS: *Johnson & Paulint*
(Acreage for N. P. land in 5 B included in figure
as it is operated as a part of McCreary Ranch,

If you cannot answer all of the questions on this form answer as many as you can and return the form to us as soon as possible.

T. 4 North - R. 53 East

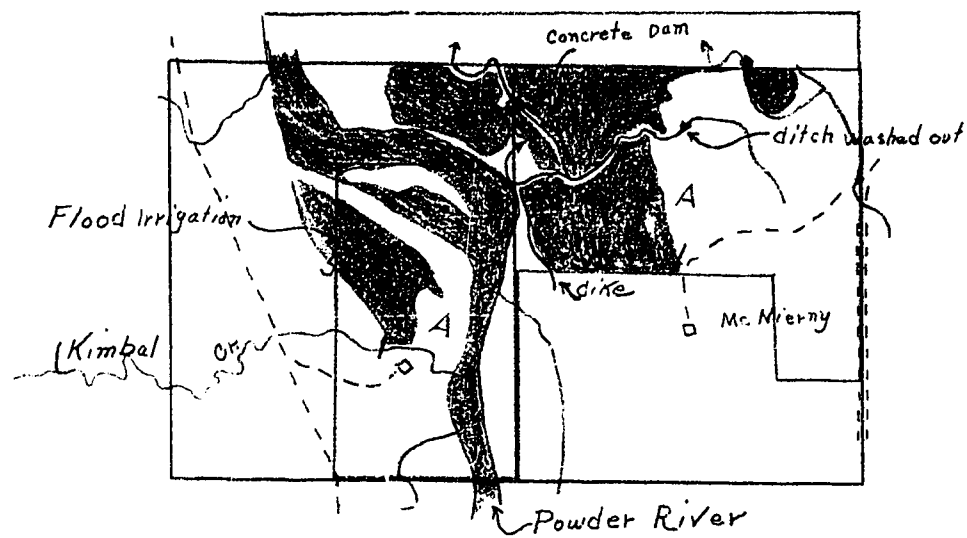

STATE ENGINEERS OFFICE
Water Resources SurveyCOUNTY ClusterFILE NO. 55-T. 4N-R. 53EOwner Digman, Emmett Address Miles CityAAA Owner Yelina Rayburn Address Box 304, Miles City

Operator _____ Address _____

New Owner _____ Address _____

New Operator _____ Address _____

Assessment Record NoneAssessed Acreage 0Legal Description of This Farm Lots 1, 2, 3, 4; N², NE⁴ SE⁴ Sec. 4Lots 1, 2, 7, 8, 9, 10, 11, 12, 13, 14, & 15; W² SE⁴ Sec. 5T. 4N-R. 53ETotal Acres in Farm ✓Code Number 4A, 5A

Farm Map

Photo No. MA. 24-39

AAA Contract No. _____

AAA Total Cropland Acreage _____

App. No. No. Record of Decree

Decree No. _____

Land is located in

Twp. 4N Rge. 53E Twp. 7N Rge. 51ETwp. 3N Rge. 54E Twp. 2N Rge. 54E
5N 52E 6N 51EFiled in Twp. 7N Rge. 51ERemarks Unable to findappropriation recordon this landAlso operates land in T. 3N-R. 54E
and T. 2N-R. 54E; T. 1N-R. 51E
(Powder River Basin)Ownership covers
only irrigated land.
All ownership for
dry land not shown.

STATE ENGINEERS OFFICE
Water Resources SurveyCOUNTY ClusterFILE NO. 55-T4N-53EOwner N. P. R. R. Address —

AAA Owner Address

Operator Digman, Emmett? Address Box 304, Miles CityNew Owner Go Jim Rayburn - Address

New Operator Address

Assessment Record NoneAssessed Acreage 0Legal Description of This Farm Lots 1, 5, 6, 7, 8, S²NW⁴, SW⁴ Sec 5, T.4N-R.5315 acres flooded included on forms 4A-5A
attachedTotal Acres in Farm ✓Code Number 5B

Farm Map

Photo No. MA 24-39

AAA Contract No.

AAA Total Cropland Acreage

App. No. No Record of Disa

Decree No.

Land is located in

Twp. 7N Rge. 51E Twp. Rge.

Twp. Rge. Twp. Rge.

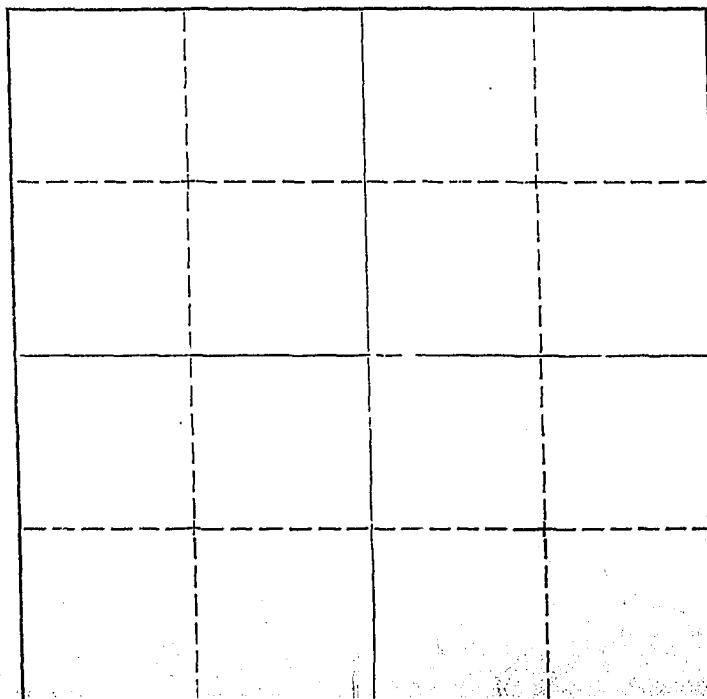
Filed in Twp. 4N Rge. 53ERemarks Probably leased byEmmett DigmanOwnership covers
only irrigated land.
All ownership for
dry land not shown.

(Powder River Basin)



NOTE
These forms are the
property of the State
of Montana and must
be returned.

STATE OF MONTANA
STATE ENGINEERS OFFICE

Water Resources Survey

Code No. 4B
County Custer
T. 4N R. 53E

Name of Land Owner Charles A. + Esther E. Miller Address Miller, Custer
Name of Operator _____ Address _____

Part A

TO BE FILED BY THOSE OBTAINING IRRIGATION WATER FROM
A DITCH COMPANY OR IRRIGATION DISTRICT

1. Water is delivered by: _____ Name of Ditch, Ditch Company or District Supplying Water _____
2. State the number of acres you irrigate under this system _____ Shares you hold _____
3. If you obtain water from more than one Company, give the number of shares, acres irrigated and the name of the Company under "Remarks." If you obtain water from a Ditch Company and also have a private system fill in both Part A and Part B.

Part B

TO BE FILED BY THOSE WHO HAVE A PRIVATE DITCH, PUMP OR IRRIGATION SYSTEM
or those who have a private water right under a Ditch Company

4. In what year was this land first irrigated? Date 1908
5. Give the name of the original appropriator (first user): Code Stoner
6. Give the date appropriated: 2/21/08 Amount filed on: Miners Inches 500 C. F. S. _____
7. State the total number of acres irrigated under this system: _____
8. Give the point of diversion: Flood In $\frac{1}{4}$ Section 4 Township 4N Range 53

Part C

TO BE FILED BY ALL WATER USERS IN ADDITION TO PART A OR PART B

9. Source of Water: No name Creek, (trib to Powder River)
Name of stream or lake from which water is originally diverted
10. Water is obtained by: (Check one) Gravity ☒ Pumping _____ Other _____
11. What is the greatest number of acres you have irrigated? 7 Date _____
12. How many acres did you irrigate in 1947? (Crop and pasture) 54.0
13. State the total number of additional acres that could be irrigated by increasing the water supply, land leveling, etc. 0 This land is under what ditch? _____
14. How many acres of seeped land do you have which could be drained and put into production? 0
15. What is the condition of your irrigation system? Good Fair
16. Is your water supply adequate? Yes _____ No ☒ Explain Flood In
17. REMARKS: Irrigated by means of ditches on dry wash, water in spring & front of wash of lands

Over

NOTE: The foregoing sections apply only to irrigated land shown on this plat.

DESCRIPTION AND MAP OF FARM

18. Legal Description of this Farm

SW 1/4 NWSE 1/4, S2SE 1/4, Sec 4
T.4N, R.53E.



IRRIGATED LAND

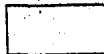

NON-IRRIGATED LAND

North

West

East

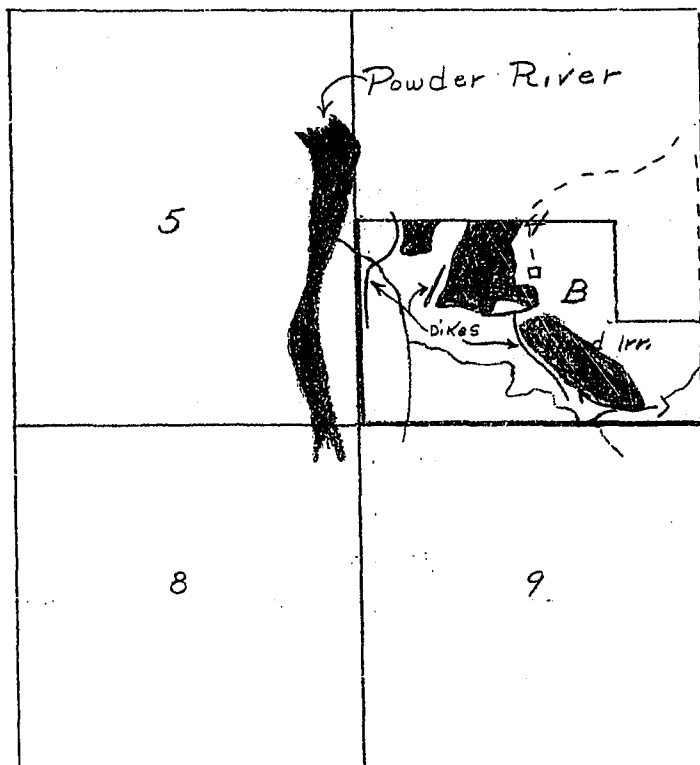

South

Ownership: cover
only irrigated land.
All ownership for
dry land not shown.

19. If the above land is irrigated from more than one ditch please give the acreage under each ditch in 19A and indicate the location of the land irrigated from each on the above map.

19A. Ditch: No name Creek (trib to Powder R.) Acres: 54.0

Ditch: _____ Acres: _____

Information supplied by:

Name Jim Rayburn to Address _____ Date July 9-47

REMARKS: Johnson & Paulist
while making field survey.

If you cannot answer all of the questions on this form answer as many as you can and return the form to us as soon as possible.

STATE ENGINEERS OFFICE
Water Resources SurveyCOUNTY ClusterFILE NO. 55-T 4N-R 53EOwner Niles, Charles A & Esther Address Miles City

AAA Owner..... Address.....

Operator..... Address.....

New Owner..... Address.....

New Operator..... Address.....

Assessment Record NoneAssessed Acreage 0Legal Description of This Farm SW 1/4, NW 1/4, SE 1/4, S 23E 4 Sec 4 T 4N-R 53ETotal Acres in Farm ✓Code Number ABPhoto No. MA 24-39

AAA Contract No.....

AAA Total Cropland Acreage.....

App. No. 2207

Decree No.....

Land is located in

Twp. 4N Rge. 53E Twp..... Rge.....

Twp..... Rge..... Twp..... Rge.....

Filed in Twp. 4N Rge. 53E

Remarks.....

Farm Map

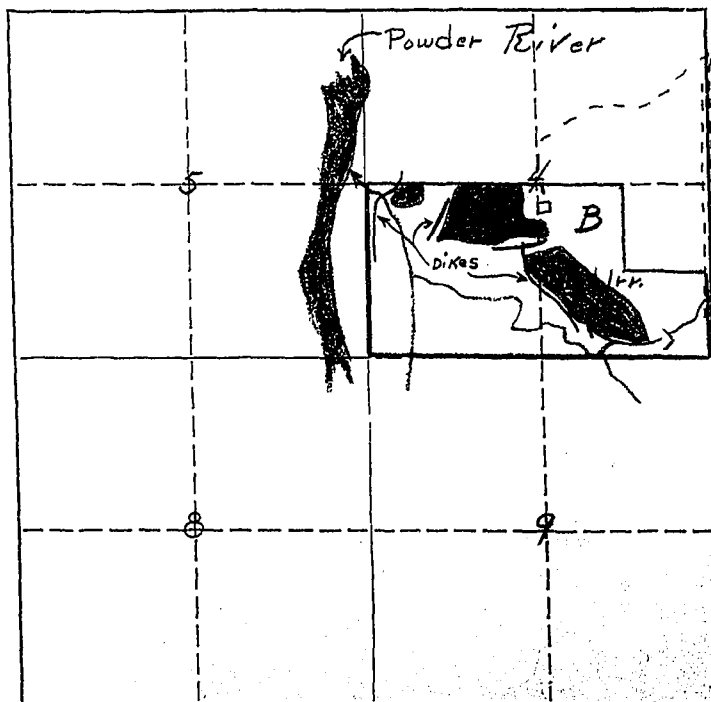
Ownership shown
only irrigated land.
All ownership for
dry land not shown.

(Powder River Basin)

STATE ENGINEERS OFFICE

Water Resources Survey

Notice of Appropriation

1. County Custer Book C Page 551 Record W.R.
2. Name of Appropriator Code Stoner Address Miles City, Montana
(21)
3. Date Appropriated Feb. 19, 1908 Date Filed Feb. 21, 1908
Amount Appropriated, Miners Inches 500 or 12 1/2 Cubic Feet per second 12 1/2
4. Name of Stream Unknown Creek Tributary Basin
5. Point of Diversion Near the center of the SE 1/4 of Section
Sec. 4 Twp. 4N. Rge. 53E. Bank of Stream
6. Purpose For irrigating, watering livestock and for domestic purposes.
7. Description of System Dam and ditch. Said dam to be about 200 ft. in length and about 20 ft. in height. The water is to be conveyed from said dam over and upon said land by means of a headgate located in the eastern part of dam, to be approximately 1' X 1' in size and by means of such ditches and flumes as the nature of the soil and country may require, being of sufficient size to carry said amount of water.
8. Land Description of Intended Place of Use N 1/4 SW 1/4, SE 1/4 SW 1/4, NW 1/4 SE 1/4 Sec. 4-4N-53E, lying on the east side of Powder River, Eda M. Miles, O'Neil, Montana
9. Remarks (Pertaining to Use, etc.)

Decree

10. Case No. Date Amt. Decreed: M. I. C. F. S.
11. To Whom Decreed Address
12. Name of Ditch Maximum Capacity (C. F. S.)
13. Date of Priority Purpose
14. Land Description of Place of Use as Decreed
15. Remarks (Present Use Status, etc.)

STATE OF MONTANA

STATE ENGINEER'S OFFICE

WATER RESOURCES SURVEY

Township 4N Range 53E County Custer

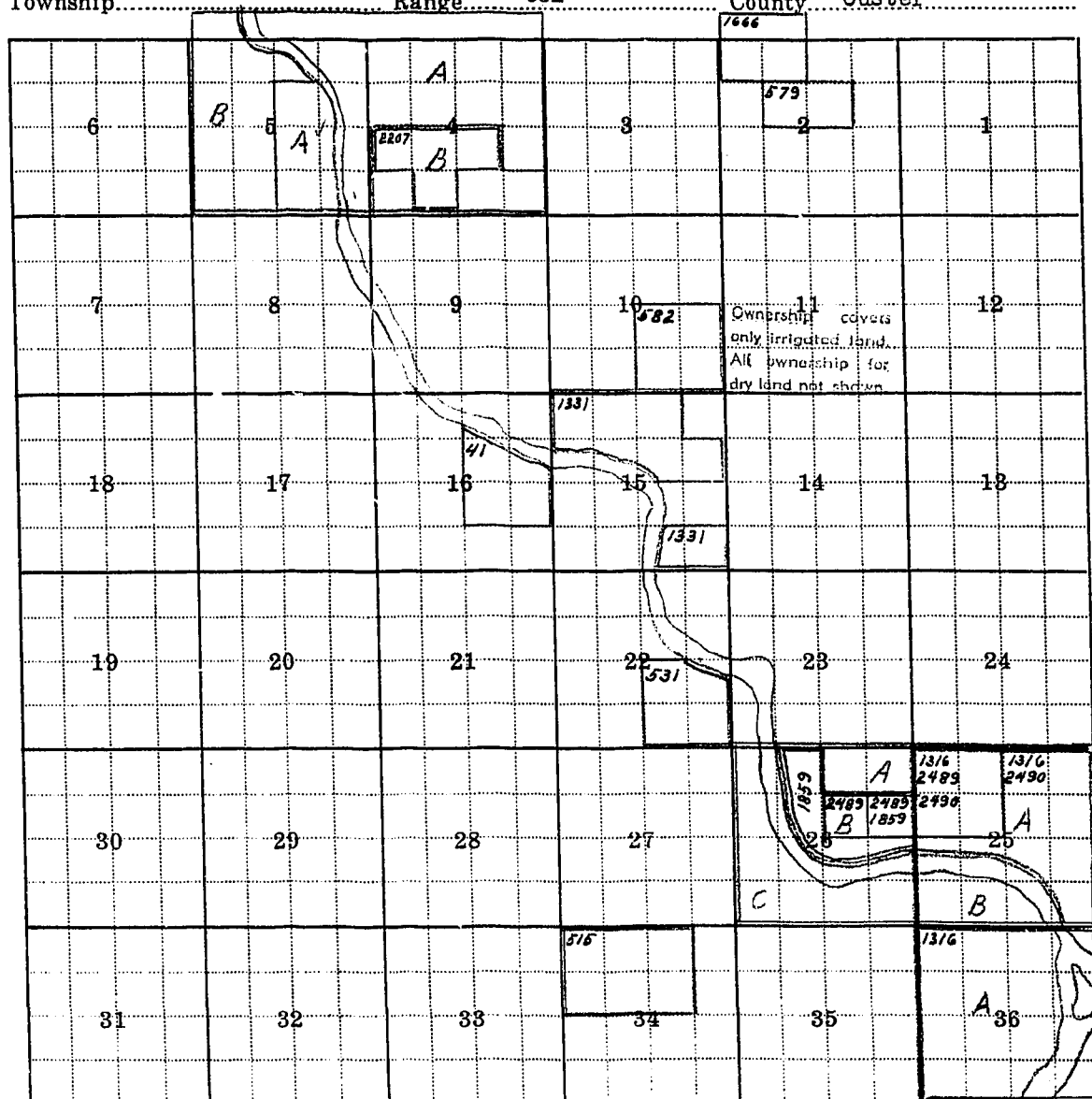

Township 4N Range 53E

Township 4 North

Range 53 East

Custer County

<u>Index No.</u>	<u>Name of Appropriator</u>	<u>Stream</u>	<u>Date App.</u>	<u>Date Filed</u>	<u>M.I.</u>
41	S. E. Kimball	Ash Creek	3-30-03	3-30-03	800
515	Bertha L. Grant	Dry Creek	6-21-10	6-21-10	500
531	John I. Kimball	Dry Creek	9-18-05	9-18-05	200
579	H. H. Crosby	Dry Gulch	2-25-10	2-25-10	500
582	Ferne Iona Kimball	Dry Gulch	8-28-14	8-29-14	1000
1316	Orvel Campbell	Powder River	5-8-34	8-24-34	2000
1331	C. C. Kimball	Powder River	8-7-35	8-8-35	1000
1666	H. H. Crosby	Short Creek	2-25-10	2-25-10	500
1859	Samuel Date	Little Teepee Creek	1-14-08	1-16-08	1000
2207	Code Stoner	No Name Creek	2-21-08	2-21-08	500
2489	George and Luke R. Dagnall	Little Teepee Creek	5-1-29	3-23-42	2400
2490	George and Luke R. Dagnall	Little Teepee Creek	3-1-42	3-23-42	----

Township 4 North

Range 53 East

Custer County

(Township 4 North, Range 53 East)

Campbell, Orville

Dagnall, George

Dagnall, Luke

Digman, Emmet

Niles, Charles A. & Esther E.

(Township 4 North, Range 54 East)

Campbell, Orvil

COUNTY

Custer

Sheet No.

Two

4N

Rgc

57

Letters

[illegible]



NOTICE
These forms are the
property of the State
of Montana and must
be returned.

STATE OF MONTANA
STATE ENGINEERS OFFICE

Water Resources Survey

Code No. 30A-31A

County Custer

T. 4N R. 54

Name of Land Owner Orville Campbell Address Wynah, Mont
Name of Operator _____ Address _____

Part A

TO BE FILED BY THOSE OBTAINING IRRIGATION WATER FROM
A DITCH COMPANY OR IRRIGATION DISTRICT

1. Water is delivered by: _____
Name of Ditch, Ditch Company or District Supplying Water
2. State the number of acres you irrigate under this system _____ Shares you hold _____
3. If you obtain water from more than one Company, give the number of shares, acres irrigated and the name of the Company under "Remarks." If you obtain water from a Ditch Company and also have a private system fill in both Part A and Part B.

Part B

TO BE FILED BY THOSE WHO HAVE A PRIVATE DITCH, PUMP OR IRRIGATION SYSTEM
or those who have a private water right under a Ditch Company

4. In what year was this land first irrigated? Date See Remarks
5. Give the name of the original appropriator (first user): Orville Campbell
6. Give the date appropriated _____ Amount filed on: Miners Inches _____ C. F. S. _____
7. State the total number of acres irrigated under this system: _____
8. Give the point of diversion: _____ $\frac{1}{4}$ Section _____ Township _____ Range _____

Part C

TO BE FILED BY ALL WATER USERS IN ADDITION TO PART A OR PART B

9. Source of Water: Powder River, Dry Creek & Couleer
Name of stream or lake from which water is originally diverted
10. Water is obtained by: (Check one) Gravity ☒ Pumping ☒ Other _____
11. What is the greatest number of acres you have irrigated? 202 Date ?
12. How many acres did you irrigate in 1947? (Crop and pasture) 105
13. State the total number of additional acres that could be irrigated by increasing the water supply, land leveling, etc. 97 This land is under what ditch? no name Couleer Flood Irr.
14. How many acres of seeped land do you have which could be drained and put into production? _____
15. What is the condition of your irrigation system? Fair
16. Is your water supply adequate? Yes ☒ No ☒ Explain No on flood irr.
17. REMARKS: Water most of time in Powder River - silt is bigger factor than water as it cuts out Pumps. No filings on this land - see filings 498-499 & 1316 made in sec 6 & 7
Over T3N R 5E

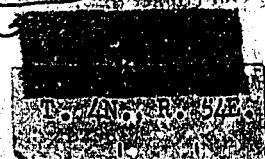

NOTE: The foregoing questions apply only to irrigated land shown on this plat.

DESCRIPTION AND MAP OF FARM

18. Legal Description of this Farm

Sec 30 & 31, T 4N R 54E

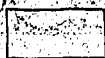

IRRIGATED LAND



NON-IRRIGATED LAND

North

PLAT OF THE LANDS OF THE UNITED STATES
FOR THE PURPOSE OF THE RECLAMATION ACT OF 1902

*see attached
map*

West

East

South

Ownership covers
only irrigated land.
All ownership for
dry land not shown.

19. If the above land is irrigated from more than one ditch please give the acreage under each ditch in 19A and indicate the location of the land irrigated from each on the above map.

19A. Ditch: Campbell Pump ditch (From Powder R.) Acres: 10.0

Ditch: Flood ditch from Dry Creek & Canaan Acres: 95.0

Information supplied by:

Name Field Survey Co Address _____ Date July 10-47

REMARKS: Johnson + Paulint

If you cannot answer all of the questions on this form answer as many as you can and return the form to us as soon as possible.

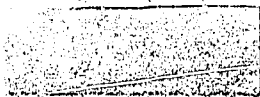

T. 4N-R. 54E



Orville
Campbell

STATE ENGINEERS OFFICE
Water Resources Survey

COUNTY CusterFILE NO. 56-T4N-R54EOwner Campbell, OrvilleAddress Mizpah, Mont

AAA Owner

Address

Operator

Address

New Owner

Address

New Operator

Address

Assessment Record NoneAssessed Acreage 0Legal Description of This Farm lots 2, 4 & 5, E² Sec. 30; all of Sec. 31Total Acres in Farm ✓Code Number 30A, 31APhoto No. MA 24-50

AAA Contract No.

AAA Total Cropland Acreage

App. No. No Record of Disc

Decree No.

Land is located in

Twp. 1N Rge. 54E Twp. Rge.

Twp. Rge. Twp. Rge.

Filed in Twp. 3N Rge. 54ERemarks Orville Campbell alsoowns or operates land inT. 4N-R. 53E, T. 3N-R. 53Eand T. 3N-R. 54E

Farm Map

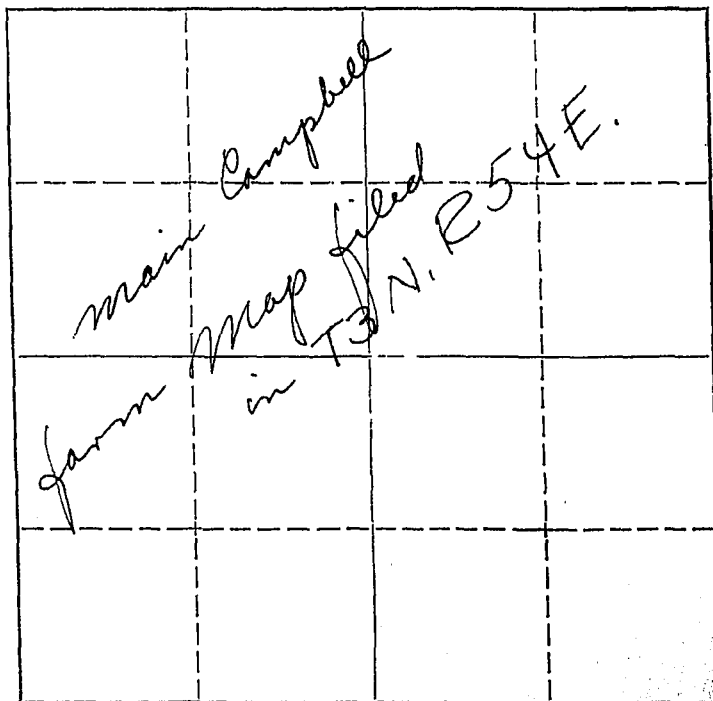

Ownership covers
 only irrigated land.
 All ownership for
 dry land not shown.

(Powder River Basin)

STATE OF MONTANA
STATE ENGINEER'S OFFICE
 WATER RESOURCES SURVEY

Township 4N Range 54E County Custer

6	5	4	3	2	1
7	8	9	10	11	12
18	17	16	15	14	13
19	20	21	22	23	24
B	Ownership covers only irrigated land. All ownership for dry land not shown.		28	27	26
30 A	29				25
31 A	32	33	34	35	36

Township 4N Range 54E

