



STATE OF MONTANA
STATE ENGINEERS OFFICE

Water Resources Survey

FORM WR-1-2M 12-47.

Code No. 364

County Curlew

T. 54 R. 45

Name of Land Owner John A. Whit Address Helena

Name of Operator Emil T. Alander Address Whiter City, Montana

Part A

TO BE FILED BY THOSE OBTAINING IRRIGATION WATER FROM
A DITCH COMPANY OR IRRIGATION DISTRICT

1. Water is delivered by: _____
Name of Ditch, Ditch Company or District Supplying Water
2. State the number of acres you irrigate under this system. _____ Shares you hold _____
3. If you obtain water from more than one Company, give the number of shares, acres irrigated and the name of the Company under "Remarks." If you obtain water from a Ditch Company and also have a private system fill in both Part A and Part B.

Part B

TO BE FILED BY THOSE WHO HAVE A PRIVATE DITCH, PUMP OR IRRIGATION SYSTEM
or those who have a private water right under a Ditch Company

4. In what year was this land first irrigated? Date No date
5. Give the name of the original appropriator (first user): Possibly 1881/1883
6. Give the date appropriated _____ Amount filed on: Miners Inches _____ C. F. S. _____
7. State the total number of acres irrigated under this system: (see Part A)
8. Give the point of diversion: _____ $\frac{1}{4}$ _____ $\frac{1}{4}$ Section _____ Township _____ Range _____

Part C

TO BE FILED BY ALL WATER USERS IN ADDITION TO PART A OR PART B

9. Source of Water: Hay Creek + Tribes
Name of stream or lake from which water is originally diverted
10. Water is obtained by: (Check one) Gravity ☒ Pumping _____ Other Flood
11. What is the greatest number of acres you have irrigated? 46.2 Date _____
12. How many acres did you irrigate in 1947? (Crop and pasture) 37.2
13. State the total number of additional acres that could be irrigated by increasing the water supply, land leveling, etc. 7.0 This land is under what ditch? trib to Hay Creek
14. How many acres of seeped land do you have which could be drained and put into production? _____
15. What is the condition of your irrigation system? Fair
16. Is your water supply adequate? Yes _____ No Yes Explain Flood line
17. REMARKS: _____

NOTE: The foregoing questions apply only to irrigated land shown on this plat.

DESCRIPTION AND MAP OF FARM

18. Legal Description of this Farm all sec 36

372
9
462



IRRIGATED LAND

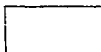

NON-IRRIGATED LAND



Potential Land

North

West

East

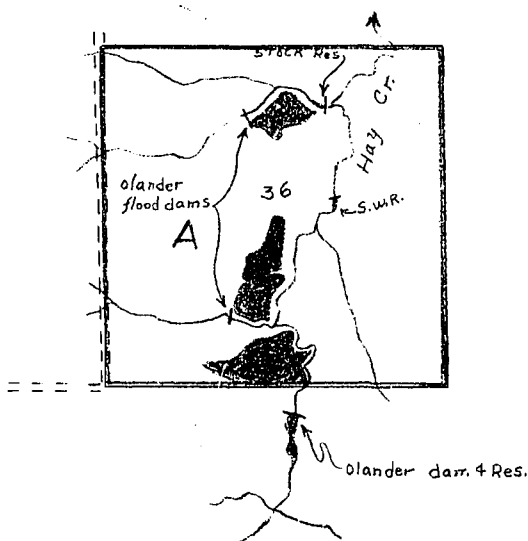

South

Dividing line
between
irrigated and
non-irrigated
land

19. If the above land is irrigated from more than one ditch please give the acreage under each ditch in 19A and indicate the location of the land irrigated from each on the above map.

19A. Ditch: Flood Hay Creek Acres: 19.2

Ditch: Flood side Canals tribut to Hay Cr. Acres: 18.0

Information supplied by:

Name Field Survey Address _____ Date 8/1/47

REMARKS: Johnson & J. Paulist

If you cannot answer all of the questions on this form answer as many as you can and return the form to us as soon as possible.

STATE ENGINEER'S OFFICE
WATER RESOURCES SURVEY

COUNTY Custer

FILE NO. 40A-T.5N-R.45E

Owner Montana, State of Address Helena, Mont.

AAA Owner Address

Operator Olander, Emil T. Address Mesa Creek Stage, Miles City

New Owner Address

New Operator Address

Assessment Record None

Assessed Acreage 0

Legal Description of This Farm all of Sec 36; T.5N-R.45E

Total Acres in Farm ✓

Code Number 36A

Photo No. Mo 23-08

AAA Contract No.

AAA Total Cropland Acreage

App. No. ?

Decree No.

Land is located in

Twp. 5N Rge. 45E Twp. Rge.

Twp. Rge. Twp. Rge.

Filed in Twp. 5N Rge. 45E

Remarks Emil T. Olander also

owns 21.25 acres land in

T.5N-R.46 & T.4N-R.46E

Yellowstone River Basin

Ownership covers
only irrigated land.
All ownership for
dry land not shown.

41

TRIANGLE H-L RANCH

MILES CITY, MONTANA

May, 4, 1948.

Mr. Gerald J. Gravetz
Assistant State Engineer.
Billings, Montana.

Dear Sir,

In regard to Flood Irrigation on my land located on Hay Creek and Moon Creek.

Section 36, 5N., R. 45E, I built two dams in 1941, and three dams in 1942, but made no water filing, if there is a runoff of enough water could flood irrigate about eighty acres.

Section 32, T. 5N., R. 46E built one dam in 1941 and on in 1942 and will irrigate twenty five acres more or less, and I made no water filing on these either.

Section 31, T. 5N., R. 46E, I built one dam in 1941, and 1942 and will irrigate about twenty acres and I made no water filing on these.

Section 5, T. 4N., R. 46E, built one dam in 1942 and will flood irrigate about thirty five acres and there is no water filing on this one.

Section 3, T. 4N., R. 46E., I built one dam in 1941 and one in 1945, and they will spread water on about fifteen acres of land. There is no water filing on these.

For the last ten years out side of an early spring run off we have not had much water down these two creeks, the sod is very heavy and we have given the grass lots of protection and so it seems to hold most of the rainfall and it is only when the ground is frozen that water gets away to the creeks.

Hoping this report will be satisfactory, I am sorry I didn't get it to you sooner.

Yours truly,

Emil J. Olander

P.S. I understand that your department is publishing in book form a complete series of charts on the water resources of each county, could you inform me if it would be possible to get one containing the water resources of Custer County?



STATE OF MONTANA
STATE ENGINEERS OFFICE
Water Resources Survey

FORM WR-1-2M 12-47

Code No. 2013

County Custer

T. 5N R. 46E

Name of Land Owner Wm. Stube Address Glyde Park, Mont

Name of Operator Emil T. Olander Address Wilder City, "

Part A

**TO BE FILED BY THOSE OBTAINING IRRIGATION WATER FROM
A DITCH COMPANY OR IRRIGATION DISTRICT**

1. Water is delivered by: _____
Name of Ditch, Ditch Company or District Supplying Water
2. State the number of acres you irrigate under this system _____ Shares you hold _____
3. If you obtain water from more than one Company, give the number of shares, acres irrigated and the name of the Company under "Remarks." If you obtain water from a Ditch Company and also have a private system fill in both Part A and Part B.

Part B

**TO BE FILED BY THOSE WHO HAVE A PRIVATE DITCH, PUMP OR IRRIGATION SYSTEM
or those who have a private water right under a Ditch Company**

4. In what year was this land first irrigated? Date See attached filing
5. Give the name of the original appropriator (first user): _____
6. Give the date appropriated _____ Amount filed on: Miners Inches _____ C. F. S. _____
7. State the total number of acres irrigated under this system: _____
8. Give the point of diversion: _____ $\frac{1}{4}$ _____ $\frac{1}{4}$ Section _____ Township _____ Range _____

Part C

TO BE FILED BY ALL WATER USERS IN ADDITION TO PART A OR PART B

9. Source of Water: Moore Creek
Name of stream or lake from which water is originally diverted
10. Water is obtained by: (Check one) Gravity _____ Pumping _____ Other Pump
11. What is the greatest number of acres you have irrigated? 27.0 Date _____
12. How many acres did you irrigate in 1947? (Crop and pasture) 0
13. State the total number of additional acres that could be irrigated by increasing the water supply, land leveling, etc. 27.0 This land is under what ditch? Private Moore Cr
14. How many acres of seeped land do you have which could be drained and put into production? 0
15. What is the condition of your irrigation system? Good
16. Is your water supply adequate? Yes _____ No X Explain It could be
17. REMARKS: _____

Over

NOTE: The foregoing questions apply only to irrigated land shown on this plat.

DESCRIPTION AND MAP OF FARM

13. Legal Description of this Farm S2 NE4, E28414, S24, Sec 20

☐ None At Present
IRRIGATED LAND

☐ NON-IRRIGATED LAND

☐ Potential Land

North

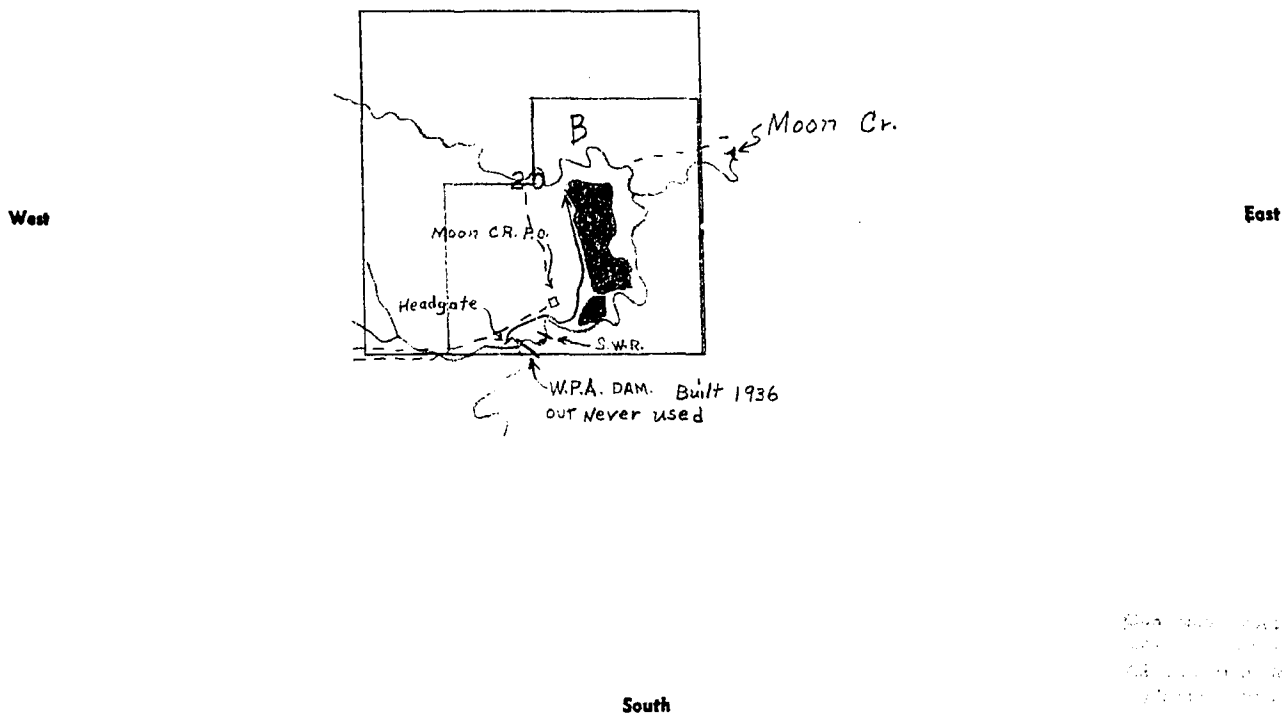

19. If the above land is irrigated from more than one ditch please give the acreage under each ditch in 19A and indicate the location of the land irrigated from each on the above map.

19A. Ditch: Moon Creek Point Flood Acres: 2

Ditch: _____ Acres: _____

Information supplied by:

Name Field Survey Address _____ Date 8/1/47

REMARKS: Johnson & J. Paulist

If you cannot answer all of the questions on this form answer as many as you can and return the form to us as soon as possible.

STATE ENGINEER'S OFFICE
WATER RESOURCES SURVEY

COUNTY CusterFILE NO. 40-T.5N-R.46EOwner Stoebe, Wm Address Clyde Park, Mont

AAA Owner Address

Operator Olander, Emil T. Address Moan Creek Stage, Miles City

New Owner Address

New Operator Address

Assessment Record NoneAssessed Acreage 0Legal Description of This Farm S²NE⁴, E²SW⁴, SE⁴, Sec. 20; T. 5N-R. 46ETotal Acres in Farm ✓Code Number 22BPhoto No. Mo 23-08

AAA Contract No.

AAA Total Cropland Acreage

App. No. 1113

Decree No.

Land is located in

Twp. 5N Rge. 46E Twp. Rge.

Twp. Rge. Twp. Rge.

Filed in Twp. 5N Rge. 46ERemarks Emil T. Olanderalso owns co operatorland in Sec. 20; T. 5N-R. 46E

2 Sections 34 & 35; T. 4N-R. 46E
and in Sections 31 & 32; T. 5N-R. 46E
Yellowstone River Basin

Ownership covers
 only irrigated land.
 All ownership for
 dry land not shown.

STATE ENGINEERS OFFICE
Water Resources Survey

Notice of Appropriation

1. County Custer Book D Page 18 Record W.R.
2. Name of Appropriator Samuel Stoebe Address Custer Co.
May 23, 1908
3. Date Appropriated June 15, 1908 Date Filed June 15, 1908
Amount Appropriated, Miners Inches 2000, Cubic Feet per second 50
4. Name of Stream Moon Creek Tributary Yellowstone Basin
5. Point of Diversion 1/2 mile from said land and at the mouth of Hay Creek which flows into said Moon Creek
Sec. _____ Twp. _____ Rge. _____ Bank of Stream _____
6. Purpose Irrigation, agricultural and grazing
7. Description of System A dam 100 ft. long and 6 ft. high, also by ditches running therefrom, which shall be approximately 6 ft. wide on the bottom and 2 ft. deep and by such other dams, ditches, flumes, reservoirs and dikes as the nature of the soil and country may require.
8. Land Description of Intended Place of Use
SE 1/4, S 1/4, E 1/4 Sec. 20-5N-46E, 320 acres, Wm. Stoebe, Moon Creek
N 1/4, N 1/4, E 1/4 Sec. 20-5N-46E, 320 acres, Dan Goodfellow, Miles City, Montana
All Sec. 21-5N-46E, 640 acres, C. H. Matt Ranch Co., Miles City
All Sec. 20-5N-46E, 640 acres, Wm. Stoebe, Moon Creek
9. Remarks (Pertaining to Use, etc.)

Decree

10. Case No. _____ Date _____ Amt. Decreed: M. I. _____ C. F. S. _____
11. To Whom Decreed _____ Address _____
12. Name of Ditch _____ Maximum Capacity (C. F. S.) _____
13. Date of Priority _____ Purpose _____
14. Land Description of Place of Use as Decreed _____
15. Remarks (Present Use Status, etc.)



NOTICE
These forms are the
property of the State
of Montana and must
be returned.

STATE OF MONTANA
STATE ENGINEERS OFFICE
Water Resources Survey

FORM WR-1-2M 12-47

Code No. 31A
County Custer
T. 5N R. 46E

Name of Land Owner Northwestern Trust Co Address Merchant Bank Bldg St. Paul
Name of Operator Emil T. Olander Address Wilder City, Mont

Part A

**TO BE FILED BY THOSE OBTAINING IRRIGATION WATER FROM
A DITCH COMPANY OR IRRIGATION DISTRICT**

1. Water is delivered by: _____
Name of Ditch, Ditch Company or District Supplying Water
2. State the number of acres you irrigate under this system _____ Shares you hold _____
3. If you obtain water from more than one Company, give the number of shares, acres irrigated and the name of the Company under "Remarks." If you obtain water from a Ditch Company and also have a private system fill in both Part A and Part B.

Part B

**TO BE FILED BY THOSE WHO HAVE A PRIVATE DITCH, PUMP OR IRRIGATION SYSTEM
or those who have a private water right under a Ditch Company**

4. In what year was this land first irrigated? Date Ms later
5. Give the name of the original appropriator (first user): Emil T. Olander
6. Give the date appropriated _____ Amount filed on: Miners Inches _____ C. F. S. _____
7. State the total number of acres irrigated under this system: _____
8. Give the point of diversion: _____ $\frac{1}{4}$ _____ $\frac{1}{4}$ Section _____ Township _____ Range _____

Part C

TO BE FILED BY ALL WATER USERS IN ADDITION TO PART A OR PART B

9. Source of Water: Trib to Hay Creek
Name of stream or lake from which water is originally diverted
10. Water is obtained by: (Check one) Gravity _____ Pumping _____ Other _____
11. What is the greatest number of acres you have irrigated? 13.0 Date _____
12. How many acres did you irrigate in 1947? (Crop and pasture) 13.0
13. State the total number of additional acres that could be irrigated by increasing the water supply, land leveling, etc. 0 This land is under what ditch? 0
14. How many acres of seeped land do you have which could be drained and put into production? 0
15. What is the condition of your irrigation system? Flood dam
16. Is your water supply adequate? Yes _____ No X Explain Flood water
17. REMARKS: _____

Over

NOTE: The foregoing questions apply only to irrigated land shown on this plat.

DESCRIPTION AND MAP OF FARM

18. Legal Description of this Farm

All Sec. 31

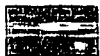

IRRIGATED LAND



NON-IRRIGATED LAND

North

West

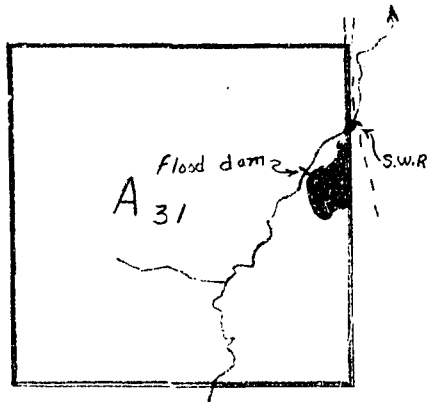

East

South

19. If the above land is irrigated from more than one ditch please give the acreage under each ditch in 19A and indicate the location of the land irrigated from each on the above map.

19A. Ditch: *Flood Dam* Acres: *13.0*

Ditch: _____ Acres: _____

Information supplied by:

Name *Field Survey* Address _____ Date *8/1/47*

REMARKS: *Johnson J G Paulist*

How Creek dam in creek

If you cannot answer all of the questions on this form answer as many as you can and return the form to us as soon as possible.

STATE ENGINEER'S OFFICE
WATER RESOURCES SURVEY

COUNTY CusterFILE NO. 40-T.5N-R.46EOwner Northwestern Trust Co. Address Merchant Bank Bldg. ^{5th} PaulAAA Owner Go Olander, Emil T. Address Mean Creek Stage, Miles CityOperator " Address "New Owner " Address "New Operator " Address "Assessment Record None-Assessed Acreage 0Legal Description of This Farm all of Sec. 31; T.5N-R.46ETotal Acres in Farm ✓Code Number 31APhoto No. Mar 23-01AAA Contract No. "AAA Total Cropland Acreage "App. No. Not recorded by descriptionDecree No. "

Land is located in

Twp. 5N Rge. 46E Twp. " Rge. "Twp. " Rge. " Twp. " Rge. "Filed in Twp. 5N Rge. 46ERemarks Emil T. Olander also ownsand operates land inSec. 20-T.5N-R.46ESec. 31-T.5N-R.46ESec. 34-T.4N-R.46ESec. 32-T.5N-R.46EYellowstone River Basin

Ownership covers
only irrigated land.
All ownership for
dry land not shown.



STATE OF MONTANA
STATE ENGINEERS OFFICE

Water Resources Survey

FORM WR-1-2M (2-47)

Code No. 324

County Butte

T. 5N R. 4E

Name of Land Owner Blana Holmberg Address Hallgrens Calif.

Name of Operator Emil A. Blander Address Wilton City, Mont.

Part A

**TO BE FILED BY THOSE OBTAINING IRRIGATION WATER FROM
A DITCH COMPANY OR IRRIGATION DISTRICT**

1. Water is delivered by: _____
Name of Ditch, Ditch Company or District Supplying Water
2. State the number of acres you irrigate under this system _____ Shares you hold _____
3. If you obtain water from more than one Company, give the number of shares, acres irrigated and the name of the Company under "Remarks." If you obtain water from a Ditch Company and also have a private system fill in both Part A and Part B.

Part B

**TO BE FILED BY THOSE WHO HAVE A PRIVATE DITCH, PUMP OR IRRIGATION SYSTEM
or those who have a private water right under a Ditch Company**

4. In what year was this land first irrigated? Date No date
5. Give the name of the original appropriator (first user): _____
6. Give the date appropriated _____ Amount filed on: Miners Inches _____ C. F. S. _____
7. State the total number of acres irrigated under this system: _____
8. Give the point of diversion: _____ $\frac{1}{4}$ _____ $\frac{1}{4}$ Section _____ Township _____ Range _____

Part C

TO BE FILED BY ALL WATER USERS IN ADDITION TO PART A OR PART B

9. Source of Water: Little to Wilson Creek
Name of stream or lake from which water is originally diverted
10. Water is obtained by: (Check one) Gravity _____ Pumping _____ Other Hand
11. What is the greatest number of acres you have irrigated? _____ Date _____
12. How many acres did you irrigate in 1942? (Crop and pasture) 4.2
13. State the total number of additional acres that could be irrigated by increasing the water supply, land leveling, etc. _____ This land is under what ditch? _____
14. How many acres of seeped land do you have which could be drained and put into production? 0
15. What is the condition of your irrigation system? Good
16. Is your water supply adequate? Yes _____ No Yes Explain Hand
17. REMARKS: _____

NOTE: The foregoing questions apply only to irrigated land shown on this plat.

DESCRIPTION AND MAP OF FARM

18. Legal Description of this Farm N², Sec 32



IRRIGATED LAND



NON-IRRIGATED LAND

North

West

East

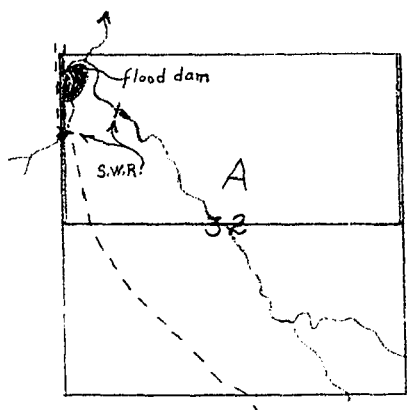

South

Surveyor's note:
only the land shown
on this map is
subject to claim.

19. If the above land is irrigated from more than one ditch please give the acreage under each ditch in 19A and indicate the location of the land irrigated from each on the above map.

19A. Ditch: Private flood trib to Moon's Acres: 4.0

Ditch: _____ Acres: _____

Information supplied by:

Name Field Survey Address _____ Date 3/1/47

REMARKS: Johnson & J. Pontiel

If you cannot answer all of the questions on this form answer as many as you can and return the form to us as soon as possible.

STATE ENGINEER'S OFFICE
WATER RESOURCES SURVEY

COUNTY Custer

FILE NO. 40-T.5N-R.46E

Owner Halaberg, Clara Address 1212 N. 25th Vista Blvd, Hollywood (CA) 90028

AAA Owner Address

Operator Olender, Emil T. Address Moon Creek Stage, Miles City

New Owner Address

New Operator Address

Assessment Record None

Assessed Acreage 0

Legal Description of This Farm N² Sec. 32; T.5N-R.46E

Total Acres in Farm ✓

Code Number 32A

Photo No. Ma 23-08

AAA Contract No.

AAA Total Cropland Acreage

App. No. No Record by Description

Decree No.

Land is located in

Twp. 5N Rge. 46E Twp. Rge.

Twp. Rge. Twp. Rge.

Filed in Twp. 5N Rge. 46E

Remarks Emil T. Olender also

owns or operates land in

Sec. 20; - T. 5N-R. 46E

Sec. 36; - T. 5N-R. 46E

Sec. 32.5; - T. 4N-R. 46E

Sec. 31; - T. 5N-R. 46E

Yellowstone River Basin

Ownership covers
only irrigated land.
All ownership for
dry land not shown.



STATE OF MONTANA
STATE ENGINEERS OFFICE

Code No 26B-35A

County Quint

T. 5N R. 47

Water Resources Survey

Name of Land Owner Leo Sumner

Address Miller City, Mont

Name of Operator

Address

Part A

TO BE FILED BY THOSE OBTAINING IRRIGATION WATER FROM
A DITCH COMPANY OR IRRIGATION DISTRICT

1. Water is delivered by: _____
Name of Ditch, Ditch Company or District Supplying Water
2. State the number of acres you irrigate under this system _____ Shares you hold _____
3. If you obtain water from more than one Company, give the number of shares, acres irrigated and the name of the Company under "Remarks." If you obtain water from a Ditch Company and also have a private system fill in both Part A and Part B.

Part B

TO BE FILED BY THOSE WHO HAVE A PRIVATE DITCH, PUMP OR IRRIGATION SYSTEM
or those who have a private water right under a Ditch Company

4. In what year was this land first irrigated? Date No data
5. Give the name of the original appropriator (first user): _____
6. Give the date appropriated _____ Amount filed on: Miners Inches _____ C. F. S. _____
7. State the total number of acres irrigated under this system: _____
8. Give the point of diversion: _____ $\frac{1}{4}$ _____ $\frac{1}{4}$ Section _____ Township _____ Range _____

Part C

TO BE FILED BY ALL WATER USERS IN ADDITION TO PART A OR PART B

9. Source of Water: Tongue River & Thorpe Cr.
Name of stream or lake from which water is originally diverted
10. Water is obtained by: (Check one) Gravity ☒ Pumping ☒ Other _____
11. What is the greatest number of acres you have irrigated? 162.0 Date _____
12. How many acres did you irrigate in 1947? (Crop and pasture) 78
13. State the total number of additional acres that could be irrigated by increasing the water supply, land leveling, etc. 35, side couler 7-Tongue River
40.0 This land is under what ditch? Thorpe Creek
14. How many acres of seeped land do you have which could be drained and put into production? 0
15. What is the condition of your irrigation system? Part in use
16. Is your water supply adequate? Yes ☒ No ☒ Explain None on Thorpe Creek
17. REMARKS: Good most of time on Tongue River
Stored water available

NOTE: The foregoing questions apply only to irrigated land shown on this plat.

DESCRIPTION AND MAP OF FARM

18. Legal Description of this Farm..... See attached CD K 2

IRRIGATED LAND

NON-IRRIGATED LAND

Potential Land

North

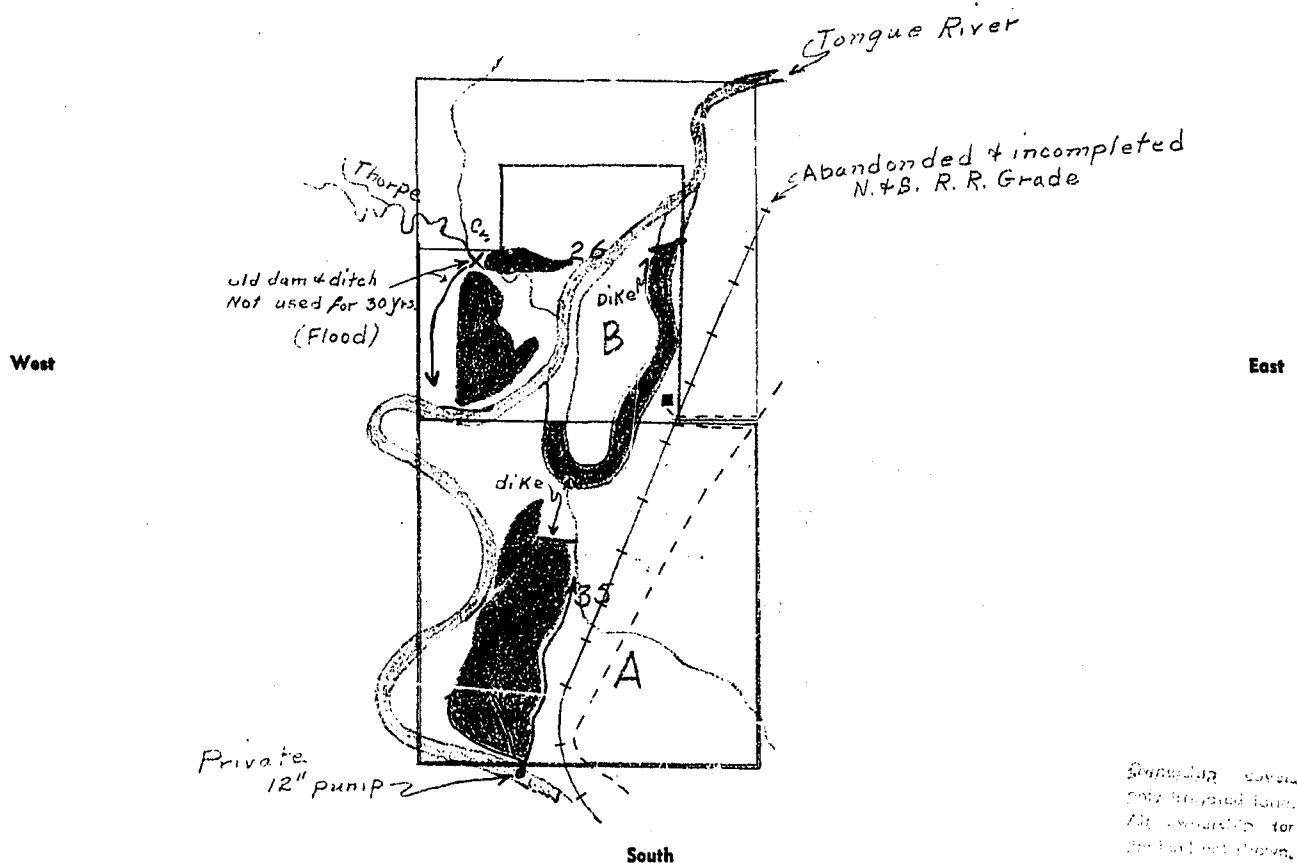

19. If the above land is irrigated from more than one ditch please give the acreage under each ditch in 19A and indicate the location of the land irrigated from each on the above map.

19A. Ditch: Private Crossed Tongue River Acres: 78.0

Ditch: Acres:

Information supplied by:

Name See attached form Address _____ Date _____

REMARKS: _____

If you cannot answer all of the questions on this form answer as many as you can and return the form to us as soon as possible.

STATE ENGINEER'S OFFICE
WATER RESOURCES SURVEYCOUNTY ClusterFILE NO. 41-T.5N-R.47EOwner Sumner, Leo Address Miles City, Montana

AAA Owner Address

Operator " " Address " "

New Owner Address

New Operator Address

Assessment Record NoneAssessed Acreage 0Legal Description of This Farm 9E¹ NW¹, SW¹, SW¹ NE¹, E² SE¹, Sec. 26;
all of Section 35; T.5N-R.47ETotal Acres in Farm. ✓Code Number 26B-35APhoto No. Ma 13-177, Ma 13-178

AAA Contract No.

AAA Total Cropland Acreage

App. No. No Record by Description

Decree No.

Land is located in

Twp. 5N Rge. 47E Twp. Rge.

Twp. Rge. Twp. Rge.

Filed in Twp. 5N Rge. 47E

Remarks

Tongue River BasinOwnership covers
only irrigated land.
All ownership for
dry land not shown.

[illegible]

April 16, 1948

Mr. Leo Sumer
Miles City, Montana

Re: Flood Irrigation Thorpe Creek

Dear Sir:

Custer

SE 1/4, SW 1/4, NE 1/4, E 1/2 Sec. 26, Section 35, T. 5N., R. 47E.



STATE OF MONTANA
STATE ENGINEERS OFFICE

Water Resources Survey

Code No. 25A

County Custer

T. 5N R. 47

Name of Land Owner Walter H. Lunn Address T.R. 5, Miles City

Name of Operator _____ Address _____

Part A

TO BE FILED BY THOSE OBTAINING IRRIGATION WATER FROM
A DITCH COMPANY OR IRRIGATION DISTRICT

1. Water is delivered by: _____
Name of Ditch, Ditch Company or District Supplying Water
2. State the number of acres you irrigate under this system _____ Shares you hold _____
3. If you obtain water from more than one Company, give the number of shares, acres irrigated and the name of the Company under "Remarks." If you obtain water from a Ditch Company and also have a private system fill in both Part A and Part B.

Part B

TO BE FILED BY THOSE WHO HAVE A PRIVATE DITCH, PUMP OR IRRIGATION SYSTEM
or those who have a private water right under a Ditch Company

4. In what year was this land first irrigated? Date No data See App. No. 1150
5. Give the name of the original appropriator (first user): _____
6. Give the date appropriated _____ Amount filed on: Miners Inches _____ C. F. S. _____
7. State the total number of acres irrigated under this system: _____
8. Give the point of diversion: _____ 1/4 _____ 1/4 Section _____ Township _____ Range _____

Part C

TO BE FILED BY ALL WATER USERS IN ADDITION TO PART A OR PART B

9. Source of Water: Nelson Creek & Coulees
Name of stream or lake from which water is originally diverted
10. Water is obtained by: (Check one) Gravity ☒ Pumping _____ Other Flood
11. What is the greatest number of acres you have irrigated? 64.0 Date _____
12. How many acres did you irrigate in 1947? (Crop and pasture) 64.0
13. State the total number of additional acres that could be irrigated by increasing the water supply, land leveling, etc. 0 This land is under what ditch? 0
14. How many acres of seeped land do you have which could be drained and put into production? 0
15. What is the condition of your irrigation system? Fair
16. Is your water supply adequate? Yes _____ No ☒ Explain Flood Irr
17. REMARKS: _____

NOTE: The foregoing questions apply only to irrigated land shown on this plat.

DESCRIPTION AND MAP OF FARM

18. Legal Description of this Farm

all of sec 25



IRRIGATED LAND



NON-IRRIGATED LAND

North

West

East

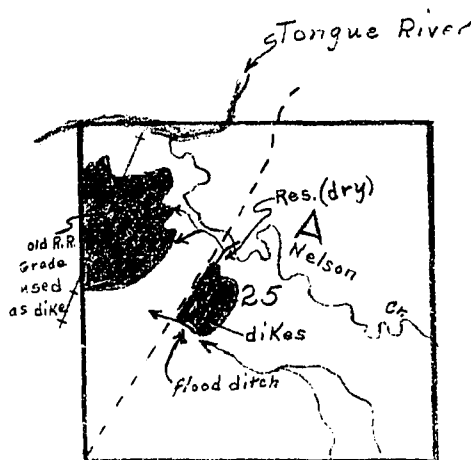

South

Ownership - Acres
1/2 sec 25, T. 1 N., R. 1 E., S. 1
Ad. Ownership for
1/2 sec 25, T. 1 N., R. 1 E., S. 1

19. If the above land is irrigated from more than one ditch please give the acreage under each ditch in 19A and indicate the location of the land irrigated from each on the above map.

19A. Ditch: *Nelson Creek Flood Ditch* Acres: *50.0*

Ditch: *Candlee Flood Ditch* Acres: *14.0*

Information supplied by:

Name *Field Survey* Address _____ Date *6/5/47*

REMARKS: *John I. D. Paulist*

If you cannot answer all of the questions on this form answer as many as you can and return the form to us as soon as possible.

STATE ENGINEER'S OFFICE
WATER RESOURCES SURVEY

COUNTY CusterFILE NO. 41-T.5N-R.47EOwner Sumner, Walter F. Address T.R. Stage, Miles City

AAA Owner Address

Operator " " Address " "

New Owner Address

New Operator Address

Assessment Record NoneAssessed Acreage 2Legal Description of This Farm all of Section 25, T.5N-R.47ETotal Acres in Farm ✓Code Number 25APhoto No. Ma 12-178

AAA Contract No.

AAA Total Cropland Acreage

App. No. No Record by Descript

Decree No.

Land is located in

Twp. 5N Rge. 47E Twp. Rge.

Twp. Rge. Twp. Rge.

Filed in Twp. 5N Rge. 47E

Remarks

Tongue River Basin

Own ship covers
only irrigated land.
All ownership for
dry land not shown.

No. 1150 -

Ex. 11

Miles City Mont
May - 8 - 48

Mr C. J. Oravetz
Assistant State Engineer
P.O. Box 873
Billings Mont

In regard to your letter about not
being able to find a water right on
Nelson Creek to Ingate sec
25. T. 5 N. R. 47. E.

I will say that this right
was filed in the recorder's office
at miles city in Nov. 1908

in the ~~name~~ name of Rudolph Sumner
the water has been used ever since
that date but is now being used
by my self

If the recorder at miles City refuses
to look this up for you let me know
and I will look it up.

Yours Truly
Walter F. Sumner

April 16, 1948

Mr. Walter F. Sumner
Tongue River Stage
Miles City, Montana

Re: Flood Irrigation Nelson Creek

Dear Sir:

Custer

Section 25, T. 5N., R. 47E.



NOTICE
These forms are the
property of the State
of Montana and must
be returned.

STATE OF MONTANA
STATE ENGINEERS OFFICE
Water Resources Survey

FORM WR-1-2M 12-47
Code No. 34A
County: Custer
T. 5N R. 47

Name of Land Owner William C. Sumner Address Wilder City, Mont
Name of Operator _____ Address _____

Part A

TO BE FILED BY THOSE OBTAINING IRRIGATION WATER FROM
A DITCH COMPANY OR IRRIGATION DISTRICT

1. Water is delivered by: _____
Name of Ditch, Ditch Company or District Supplying Water
2. State the number of acres you irrigate under this system _____ Shares you hold _____
3. If you obtain water from more than one Company, give the number of shares, acres irrigated and the name of the Company under "Remarks." If you obtain water from a Ditch Company and also have a private system fill in both Part A and Part B.

Part B

TO BE FILED BY THOSE WHO HAVE A PRIVATE DITCH, PUMP OR IRRIGATION SYSTEM
or those who have a private water right under a Ditch Company

4. In what year was this land first irrigated? Date No data
5. Give the name of the original appropriator (first user): _____
6. Give the date appropriated _____ Amount filed on: Miners Inches _____ C. F. S. _____
7. State the total number of acres irrigated under this system: _____
8. Give the point of diversion: _____ $\frac{1}{4}$ _____ $\frac{1}{4}$ Section _____ Township _____ Range _____

Part C

TO BE FILED BY ALL WATER USERS IN ADDITION TO PART A OR PART B

9. Source of Water: Side Couleer of Tongue River
Name of stream or lake from which water is originally diverted
10. Water is obtained by: (Check one) Gravity ☒ Pumping _____ Other _____
11. What is the greatest number of acres you have irrigated? 23.0 Date _____
12. How many acres did you irrigate in 1947? (Crop and pasture) 23.0
13. State the total number of additional acres that could be irrigated by increasing the water supply, land leveling, etc. 0 This land is under what ditch? 0
14. How many acres of seeped land do you have which could be drained and put into production? 0
15. What is the condition of your irrigation system? Fair
16. Is your water supply adequate? Yes _____ No ☒ Explain I had it
17. REMARKS: _____

NOTE: The foregoing questions apply only to irrigated land shown on this plat.

DESCRIPTION AND MAP OF FARM

18. Legal Description of this Farm All sec. 34,

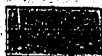

IRRIGATED LAND

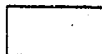

NON-IRRIGATED LAND

North

West

East

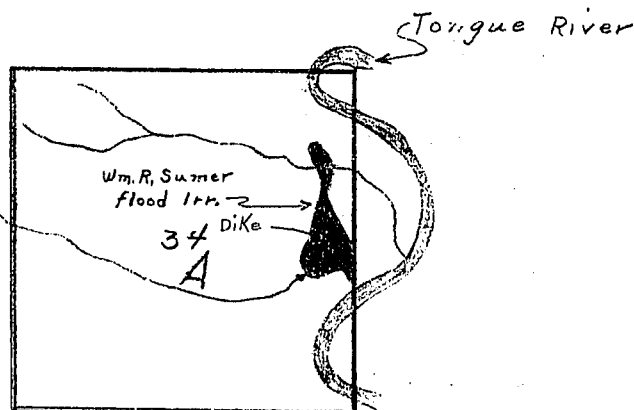

South

2-3-50-000-00000
Only irrigated land.
DMS. Some lines for
any line shown.

19. If the above land is irrigated from more than one ditch please give the acreage under each ditch in 19A and indicate the location of the land irrigated from each on the above map.

19A. Ditch: Flood Irr. Tongue River Side Canals Acres: 23.0

Ditch: _____ Acres: _____

Information supplied by:

Name Field Survey Address _____ Date 6/5/47

REMARKS: Cash + D Paulist

If you cannot answer all of the questions on this form answer as many as you can and return the form to us as soon as possible.

STATE ENGINEER'S OFFICE
WATER RESOURCES SURVEYCOUNTY ClusterFILE NO. 41-T. 5N-R. 47EOwner Sumer, William R. Address Miles City, Montana

AAA Owner Address

Operator " " Address " "

New Owner Address

New Operator Address

Assessment Record NoneAssessed Acreage 0Legal Description of This Farm 211 of Section 34; T. 5N-R. 47ETotal Acres in Farm ✓Code Number 34APhoto No. Mo 13-177

AAA Contract No.

AAA Total Cropland Acreage

App. No. No Record by Descript.

Decree No.

Land is located in

Twp. 5N Rge. 47E Twp. 4N Rge. 48E

Twp. Rge. Twp. Rge.

Filed in Twp. 5N Rge. 47E

Remarks

Tongue River Basin



NOTICE
These forms are the
property of the State
of Montana and must
be returned.

STATE OF MONTANA
STATE ENGINEERS OFFICE
Water Resources Survey

Code No. 24A
County Custer
T. 5N R. 47

Name of Land Owner Ellen M. Adams Address _____

Name of Operator J. Stanton, Edith Address Wilder City, Mont

Part A

**TO BE FILED BY THOSE OBTAINING IRRIGATION WATER FROM
A DITCH COMPANY OR IRRIGATION DISTRICT**

1. Water is delivered by: _____
Name of Ditch, Ditch Company or District Supplying Water
2. State the number of acres you irrigate under this system _____ Shares you hold _____
3. If you obtain water from more than one Company, give the number of shares, acres irrigated and the name of the Company under "Remarks." If you obtain water from a Ditch Company and also have a private system fill in both Part A and Part B.

Part B

**TO BE FILED BY THOSE WHO HAVE A PRIVATE DITCH, PUMP OR IRRIGATION SYSTEM
or those who have a private water right under a Ditch Company**

4. In what year was this land first irrigated? Date See attached filing
5. Give the name of the original appropriator (first user): _____
6. Give the date appropriated _____ Amount filed on: Miners Inches _____ C. F. S. _____
7. State the total number of acres irrigated under this system: _____
8. Give the point of diversion: _____ $\frac{1}{4}$ Section _____ Township _____ Range _____

Part C

TO BE FILED BY ALL WATER USERS IN ADDITION TO PART A OR PART B

9. Source of Water: Tongue River
Name of stream or lake from which water is originally diverted
10. Water is obtained by: (Check one) Gravity _____ Pumping ☒ Other _____
11. What is the greatest number of acres you have irrigated? 7.0 Date _____
12. How many acres did you irrigate in 1947 (Crop and pasture) 0
13. State the total number of additional acres that could be irrigated by increasing the water supply, land leveling, etc. 7.0 This land is under what ditch? Private ditch
14. How many acres of seeped land do you have which could be drained and put into production? _____
15. What is the condition of your irrigation system? Out of use
16. Is your water supply adequate? Yes ☒ No _____ Explain _____
17. REMARKS: _____
No more old pumps

Over

NOTE: The foregoing questions apply only to irrigated land shown on this plat.

DESCRIPTION AND MAP OF FARM

18. Legal Description of this Farm

N2NW4, SW4NW4, NW4SW4,

Sec 24



None At Present
IRRIGATED LAND



NON-IRRIGATED LAND



Potential Land

North

West

East

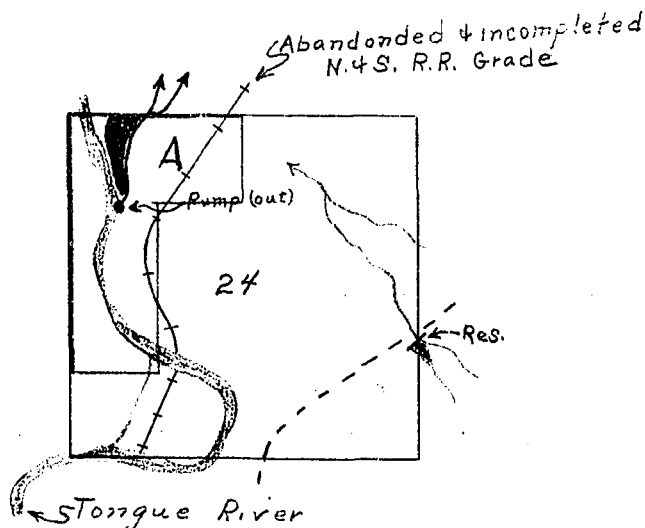

South

Ownership covers only irrigated land. All acreage for potential land.

19. If the above land is irrigated from more than one ditch please give the acreage under each ditch in 19A and indicate the location of the land irrigated from each on the above map.

19A. Ditch: *Tongue Private Pump ditch* Acres: *0*

Ditch: _____ Acres: _____

Information supplied by:

Name *Field Survey* Address _____ Date *6/5/47*

REMARKS: *Good & D. Paulsen*

If you cannot answer all of the questions on this form answer as many as you can and return the form to us as soon as possible.

STATE ENGINEER'S OFFICE
WATER RESOURCES SURVEYCOUNTY CustFILE NO. 41-T.5N-R.47EOwner Adams, Ellen M. Address T.R. Stage, Miles CityAAA Owner 90 Stanton, Edith Address " " " "Operator " " Address " "New Owner " " Address " "New Operator " " Address " "Assessment Record None -Assessed Acreage 0Legal Description of This Farm N²NW⁴, SW⁴NW⁴, NW⁴SW⁴, Sec. 24; T.5N-R.47ETotal Acres in Farm ✓Code Number 24APhoto No. MA 12-178AAA Contract No. " "AAA Total Cropland Acreage " "App. No. 1686Decree No. " "

Land is located in

Twp. " " Rge. " " Twp. " " Rge. " "Twp. " " Rge. " " Twp. " " Rge. " "Filed in Twp. " " Rge. " "Remarks Edith Stantonalso operates some landin Sec. 18; T.5N-R.48E

Tongue River Basin

Ownership covers
only irrigated land.
All ownership for
dry land not shown.

STATE ENGINEERS OFFICE
Water Resources Survey

Notice of Appropriation

1. County Custer Book D Page 471 Record W.R.
2. Name of Appropriator Edith Morrison Address Custer County
3. Date Appropriated Nov. 16, 1910 Date Filed Dec. 14, 1910
- Amount Appropriated, Miners Inches _____, Cubic Feet per second 25
4. Name of Stream Short Coulee Tributary _____ Basin _____
5. Point of Diversion 992 ft. east from SE corner of

Sec. 24 Twp. 5N. Rge. 47E. Bank of Stream _____

6. Purpose Irrigation and other purposes.

7. Description of System A dirt and brush dam across Short Coulee, said dam being from SE corner of Sec. 24-5N-47E, N 72° 15' E. 992 ft. and a headgate built wide enough on the bottom and of sufficient height to allow the free passage of 1000 M.I. of the flood waters of Short Coulee to flow thru. Also a ditch of sufficient size to carry and conduct the above described water, with such necessary flumes, sills and ditches as the needs of the soil and the country may require.

8. Land Description of Intended Place of Use _____

W/ Sec. 24-5N-47E, 320 acres, Ellen M. & Kirk S. Adams, c/o Eugene Stanton, Miles City

9. Remarks (Pertaining to Use, etc.) _____

Decree

10. Case No. _____ Date _____ Amt. Decreed: M. I. _____ C. F. S. _____
11. To Whom Decreed _____ Address _____
12. Name of Ditch _____ Maximum Capacity (C. F. S.) _____
13. Date of Priority _____ Purpose _____
14. Land Description of Place of Use as Decreed _____
15. Remarks (Present Use Status, etc.) _____



NOTICE
These forms are the
property of the State
of Montana and must
be returned.

STATE OF MONTANA
STATE ENGINEERS OFFICE
Water Resources Survey

FORM WR-2M-12-47
13A-23B-14A
Code No. _____
County Custer
T. 5N R. 47E

Name of Land Owner J. E. Anderson Address Buttersville, Mont
Name of Operator H. W. Hickey Address Wiles, Wyo

Part A

TO BE FILED BY THOSE OBTAINING IRRIGATION WATER FROM
A DITCH COMPANY OR IRRIGATION DISTRICT

1. Water is delivered by: _____
Name of Ditch, Ditch Company or District Supplying Water
2. State the number of acres you irrigate under this system _____ Shares you hold _____
3. If you obtain water from more than one Company, give the number of shares, acres irrigated and the name of the Company under "Remarks." If you obtain water from a Ditch Company and also have a private system fill in both Part A and Part B.

Part B

TO BE FILED BY THOSE WHO HAVE A PRIVATE DITCH, PUMP OR IRRIGATION SYSTEM
or those who have a private water right under a Ditch Company

4. In what year was this land first irrigated? Date See attached
5. Give the name of the original appropriator (first user): _____
6. Give the date appropriated _____ Amount filed on: Miners Inches _____ C. F. S. _____
7. State the total number of acres irrigated under this system: _____
8. Give the point of diversion: _____ $\frac{1}{4}$ _____ $\frac{1}{4}$ Section _____ Township _____ Range _____

Part C

TO BE FILED BY ALL WATER USERS IN ADDITION TO PART A OR PART B

9. Source of Water: Circle L. Creek + Tongue River
Name of stream or lake from which water is originally diverted
10. Water is obtained by: (Check one) Gravity ☒ Pumping ☒ Other _____
11. What is the greatest number of acres you have irrigated? _____ Date _____
12. How many acres did you irrigate in 1947? (Crop and pasture) 83.0
13. State the total number of additional acres that could be irrigated by increasing the water supply, land level-
ing, etc. 29.0 This land is under what ditch? Pump Tongue River
Flowed Circle L. Creek
14. How many acres of seeped land do you have which could be drained and put into production? 0
15. What is the condition of your irrigation system? Not too good
16. Is your water supply adequate? Yes ☒ No ☒ Explain Flood from
17. REMARKS: Circle L. Creek

In appropriation on pump

NOTE: The foregoing questions apply only to irrigated land shown on this plat.

DESCRIPTION AND MAP OF FARM

18. Legal Description of this Farm

See attached WR-2

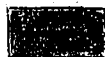

IRRIGATED LAND

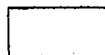

NON-IRRIGATED LAND

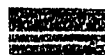

Potential Land

North

West

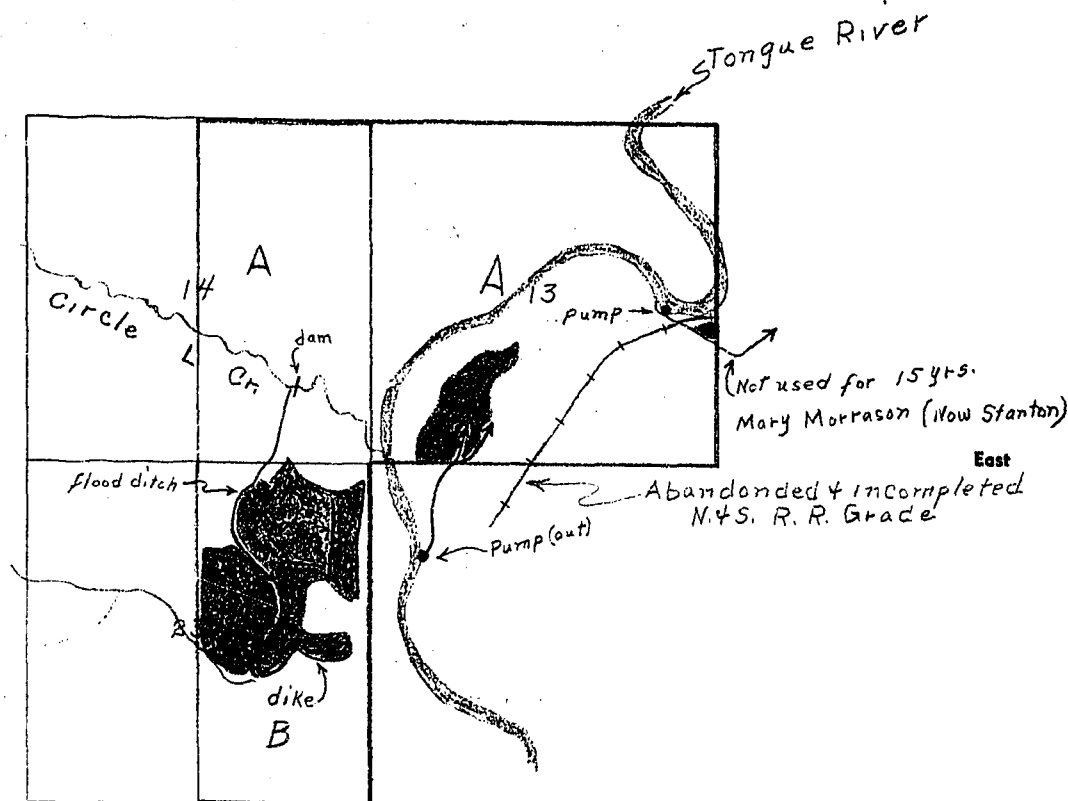

Continuation of Form No. 1
U. S. Department of Agriculture
Bureau of Reclamation
Washington, D. C.

19. If the above land is irrigated from more than one ditch please give the acreage under each ditch in 19A and indicate the location of the land irrigated from each on the above map.

19A. Ditch: *Circle L. Creek Flood* Acres: *83.0*

Ditch: _____ Acres: _____

Information supplied by:

Name *See attached form* Address _____ Date _____

REMARKS: _____

If you cannot answer all of the questions on this form answer as many as you can and return the form to us as soon as possible.

STATE ENGINEER'S OFFICE
WATER RESOURCES SURVEYCOUNTY CusterFILE NO. 41-T.5N-R.47EOwner Anderson, G. E. Address Cartersville, Montana

AAA Owner _____ Address _____

Operator Hickel, H. W. Address T. R. Stage, Miles City

New Owner _____ Address _____

New Operator _____ Address _____

Assessment Record None -Assessed Acreage 0Legal Description of This Farm All of Sec. 13; E², Sec. 23; T. 5N-R. 47Ealso E², Sec. 14; T. 5N-R. 47E (Dry Land)Total Acres in Farm ✓Code Number 15A-23B, 14A
(Dry Land)Photo No. Ma 13-178, Ma 13-179

AAA Contract No. _____

AAA Total Cropland Acreage _____

App. No. 2189

Decree No. _____

Land is located in

Twp. 5N Rge. 47E Twp. _____ Rge. _____

Twp. _____ Rge. _____ Twp. _____ Rge. _____

Filed in Twp. 5N Rge. 47E

Remarks _____

Ownership covers
only irrigated land.
All ownership for
dry land not shown.Tongue River Basin

Farm Checked

By Joe, Jim

Area Tongue River

Date 6/6/47

Legal Land Owner Anderson, G. E.

Operator Hickel H.W.

Water is delivered by:

STATE OF MONTANA

STATE ENGINEER'S OFFICE

WATER RESOURCES SURVEY

Code No. 12A/3A.14A.23B

Code No. 12A, 13A, 14A, 23B

County Custer

T. 5N R. 47E Sec. 19 & 23

Photo No. MA-13 178 & 179

Address Carterville Mont.

..Address Tongue Riv Stage

Federal Project _____ Pres. _____ Pot. _____

Ditch Company _____ Pres. _____ Pot. _____

Irrigation District _____ Pres. _____ Pot. _____

Private System ☒ Pres. 83 Pot. 164

Totals _____

Flood ☒ Pump ☒ Reservoir _____ Gravity _____

Size and Capacity, Pump, etc. 10 in Husham, 12' lift, Tractor

Original Appropriator, Company _____ App. No. _____

Original Appropriator, Private Support. no App. shown for water from Tongue Rapp. No 2189
(Show date of appropriation under Remarks)

Is the system an extension of another system? Yes _____ No ✓

Is all land irrigated from one system? Yes _____ No ✓

(If No, show break down on map)

Source of Water: Circle 6 No. 1000 Crk for flood, Tongue River for pump system

Acres Irrigated 19.46, 83 acres Flood none pump

Potential Acres 8 pump 164 flood Seeped 0

Explain pump not used yet, intends to dyke 164 a. more to flood

Condition of System flood good, pump ditches need repairing

Adequate Supply — Yes ✓ No ✓

Explain a degenerate for pump system

Topography river bottom & ^{Circle L Vrk.} ~~No Name~~ Valley

Information From Edward G. Heckel

Remarks Could pump water to 32 acres more by ext. ditches
& leveling. - or total of 40 acres

2189-9/6/24

[illegible]

Total private under pump about 40 acres (potential)

Total acres present flood irrigation, 83 acres

No works on the 164 acres of pot. flood yet. Needs to be dyked

STATE ENGINEERS' OFFICE
Water Resources Survey

Notice of Appropriation

1. County Custer Book F Page 99 Record W.R.
2. Name of Appropriator Fred Lippert Address Miles City, Montana
3. Date Appropriated Sept. 6, 1921 Date Filled Sept. 6, 1921
- Amount Appropriated, Miners Inches 500 or 12½, Cubic Feet per second 12½
4. Name of Stream Unnamed Creek Tributary Basin
5. Point of Diversion 60 ft. S. and 140 ft. east of the corner stone at the NW corner of the SE¼SE¼ of
- Sec. 14 Twp. 5N. Rge. 47E. Bank of Stream South
6. Purpose For irrigation, domestic and other purposes.
7. Description of System A dam 80 ft. wide at base X 120 ft. in length with a main ditch 20 ft. X 8 ft., which carries and conducts said amount of water from said creek and runs thence in a general southerly direction a distance of about 75 rods onto the E½ of said Sec. 23; T. 5N.; R. 47E.; the place of intended use.
8. Land Description of Intended Place of Use
- | | | |
|---|----------|----------|
| <u>SE¼SE¼ Sec. 14-5N-47E, 40 acres, Minnie Lippert, Miles City, Tongue R. Stage</u> | | |
| <u>E½ Sec. 23-5N-47E, 320 acres.</u> | <u>"</u> | <u>"</u> |
| <u>All Sec. 13-5N-4, 640 acres</u> | <u>"</u> | <u>"</u> |
9. Remarks (Pertaining to Use, etc.) He claims the waters of a certain unnamed creek and its tributaries, extending across the S½ of Section 14, T. 5N., R. 47E., The said creek rising with its tributaries west of the said S½ of Sec. 14-5N-47E, and flowing eastward across the SE¼SE¼ of the said Sec. 14 into Section 13, said Twp. & Rge.

Decree

10. Case No. Date Amt. Decreed: M. I. C. F. S.
11. To Whom Decreed Address
12. Name of Ditch Maximum Capacity (C. F. S.)
13. Date of Priority Purpose
14. Land Description of Place of Use as Decreed
-
-
-
15. Remarks (Present Use Status, etc.)
-
-
-



NOTICE
These forms are the
property of the State
of Montana and must
be returned.

STATE OF MONTANA
STATE ENGINEERS OFFICE
Water Resources Survey

Code No. 5A-6A

County Quinn

T. 5N R. 48

Name of Land Owner Campbell Ranch Co Address Miller City,

Name of Operator C. H. Trimbore Address "

Part A

**TO BE FILED BY THOSE OBTAINING IRRIGATION WATER FROM
A DITCH COMPANY OR IRRIGATION DISTRICT**

1. Water is delivered by: _____
Name of Ditch, Ditch Company or District Supplying Water
2. State the number of acres you irrigate under this system _____ Shares you hold _____
3. If you obtain water from more than one Company, give the number of shares, acres irrigated and the name of the Company under "Remarks." If you obtain water from a Ditch Company and also have a private system fill in both Part A and Part B.

Part B

**TO BE FILED BY THOSE WHO HAVE A PRIVATE DITCH, PUMP OR IRRIGATION SYSTEM
or those who have a private water right under a Ditch Company**

4. In what year was this land first irrigated? Date See attached filings
5. Give the name of the original appropriator (first user): None on Tongue
6. Give the date appropriated _____ Amount filed on: Miners Inches _____ C. F. S. _____
7. State the total number of acres irrigated under this system: See attached letter
8. Give the point of diversion: _____ $\frac{1}{4}$ _____ $\frac{1}{4}$ Section _____ Township _____ Range _____

Part C

TO BE FILED BY ALL WATER USERS IN ADDITION TO PART A OR PART B

9. Source of Water: Tongue River
Name of stream or lake from which water is originally diverted
10. Water is obtained by: (Check one) Gravity _____ Pumping ☒ Other _____
11. What is the greatest number of acres you have irrigated? 180.0 Date _____
12. How many acres did you irrigate in 1947? (Crop and pasture) 160.0
13. State the total number of additional acres that could be irrigated by increasing the water supply, land leveling, etc. 20.0 This land is under what ditch? 10 inch pump ditch
14. How many acres of seeped land do you have which could be drained and put into production? _____
15. What is the condition of your irrigation system? Part in use part not
16. Is your water supply adequate? Yes ☒ No _____ Explain _____
17. REMARKS: _____

Tongue River dry in 1934

NOTE: The foregoing questions apply only to irrigated land shown on this plat.

DESCRIPTION AND MAP OF FARM

18. Legal Description of this Farm all sec. 5-6

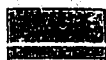

IRRIGATED LAND

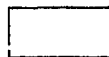

NON-IRRIGATED LAND

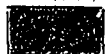

Potential Land

North

West

East

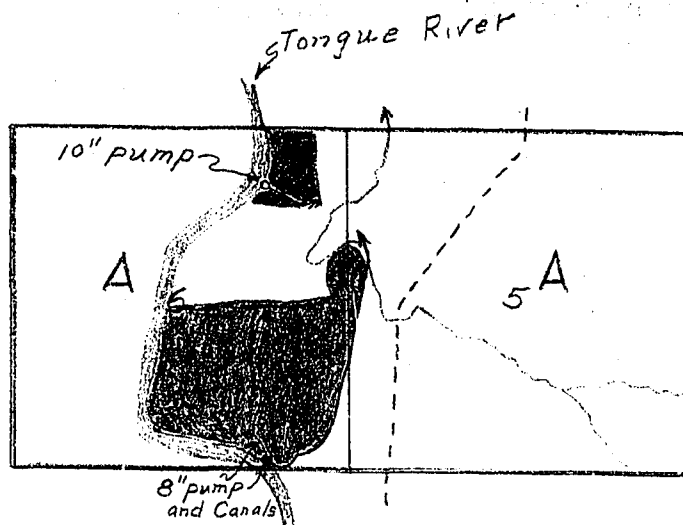

South

Shading indicates
only irrigated land.
All ownership for
dry land not shown.

19. If the above land is irrigated from more than one ditch please give the acreage under each ditch in 19A and indicate the location of the land irrigated from each on the above map.

19A. Ditch: Campbell 8 in pump Tongue R. Acres: 1600

Ditch: Campbell 10 in " " " Acres: 0

Information supplied by:

Name Johnson & J Paulist Address _____ Date 6/12/47

REMARKS: see attached form

If you cannot answer all of the questions on this form answer as many as you can and return the form to us as soon as possible.

STATE ENGINEER'S OFFICE
WATER RESOURCES SURVEYCOUNTY CusterFILE NO. 42-T.5N-R.48Owner Campbell Ranch Co. Address Miles City, MontanaAAA Owner Private (Pump) AddressOperator Trimborn, C.H. Address " "

New Owner Address

New Operator Address

Assessment Record None - Pump (Private Ditch)Assessed Acreage 0Legal Description of This Farm all of Sections 5-6; T.5N-R.48ETotal Acres in Farm ✓Code Number 5A-6APhoto No. Ma-12-88

AAA Contract No.

AAA Total Cropland Acreage

App. No. 527

Decree No.

Land is located in

Twp. 5N Rge. 48E Twp. 6N Rge. 48E

Twp. Rge. Twp. Rge.

Filed in Twp. 5N Rge. 48E

Remarks

Tongue River BasinOwnership covers
only irrigated land.
All ownership for
dry land not shown.

Miles City, Montana
June 25, 1948.

Gerald J. Oravetz
Assistant State Engineer
Billings, Montana

Dear Mr. Oravetz:

In reply to your inquiry of May 3rd and also your letter of May 13 I have the following information.

I have not been able to contact Mr. Johanson with regards to his irrigation activities while in possession of the property I now have. However one of the old time neighbors informs me that Mr. Johanson used a small pump on the site that was used by the Campbell Ranch Company and was not too successful. He then planned to use part of the N. & G. railway grade as a base for a dam and the cut leading to the north as a channel to divert water from the Dry Creek onto the land that would fall below the level of this channel discharge. It appears that none of this work was completed and water never diverted. This project would have covered land primarily in section 6, T5N, R48E.

In 1945 the Campbell Ranch Co. purchased the 8" pump mounted on skids and irrigated lands in sections 5&6 T5N, R48E and that portion of sec. 31, T6N, R48E lying east of Tongue River.

I have purchased and installed two 18" pumps to cover the above described lands and in addition the NW 1/4, sec 32, T6N, R48E. I have enclosed a sketch of my plans which shows location of the pumps. I will use the two pumps on the main place this year and plan to build a grade ditch so that I can use the main pump for all of the land if practicable or if necessary install the one on the NW sec 32. Then I would obtain a pump for relief purposes to be installed as soon as the present highway were abandoned for the purpose of irrigating that portion that lies above my present ditch and the present road that is suitable for irrigation.

On June 11th, 1948 I appropriated water on June 15th. Filed and recorded water right on 31.15 cubic feet per second. This right is recorded in Custer County Court House.

In making my installation I raised the water about 2 ft. higher than the Campbell ditch in order to bring the ditch closer to the point from which I intend to relief.

It is my understanding that you have accurate maps with which to determine the acreage so that I will not attempt to estimate the same. I would like to state tho that some of this land would appear to be quite broken and might not seem to be hardly feasible to irrigate but when the type of soil is taken into account I think that it ~~is~~ warrants the cost of leveling. This is just my personal opinion and would suggest you use your judgment in classifying this land.

If you require any further information in preparing your report feel free call for same at any time.

Sincerely Yours,

Hugo Muggli

Hugo Muggli
Tongue River Stage
Miles City, Montana

to be installed 1948

after 1948

31

32

18" pump
12000 g.p.m.

T 6 NR 48 E

6

relift pump
Proposed

5

Helipad

Double Suction pump
14000 g.p.m. rated cap.

T 5 NR 48 E

May 13, 1948

Mr. Hugo Harrell
Tongue River Stage
Miles City, Montana

Dear Sir:

In answer to your letter of May 11, 1948 we are enclosing herewith a copy of the title to the lands in Sections 5 and 6 both irrigated and potential in Township 5 North, Range 48 East. Both the potential and irrigated lands are irrigated by water from the ~~Logan~~ River. The only filing that we have pertaining to these two sections is a filing made by Jess C. Johnson, giving the date of priority as of October 23, 1937 and the date of filing November 4, 1937, on 1600 miner's inches from a stream called Bear Creek, with the point of diversion about 500 feet westerly from the Southeast corner of Section 6, Township 5 North, Range 48 East on the west bank of the stream. This notice of appropriation is filed in the District Engineer's office in Book 2, Page 17 of Water Right records.

Any and all information that you may be able to give us regarding the title to Sections 5 and 6, as to first use, will be greatly appreciated.

Very truly yours,

Very truly yours,

Gerald J. Gravetz
Assistant State Engineer

GT/s
enc.

Miles City, Montana
May 11, 1948.

Mr. Gerald J. Gravetz
Assistant State Engineer
Billings, Montana

Dear Mr. Gravetz:

I have at hand your letter of May 3rd. requesting information on the irrigation history of lands in Sec. 31, T. 6N., R. 48E.

I have just recently purchased that portion of this section that lies east of Tongue River and also the following property which joins the above tract. All of Sec. 5, T. 5N., R. 48E., part of which has been irrigated. All of Sec. 6, T. 5N., R. 48E., lying east of Tongue River and Sec. 32, T. 6N., R. 48E., " " " " " "

It is my opinion that the portion of Sec. 31 lying in the SW 1/4 was first irrigated by Jess C. Johanson in about the year 1904, however I would want to authenticate this statement by speaking to Mr. Johanson. I will contact him in the near future.

For information on that portion Sec. 31, T. 6N., R. 48E. lying west of Tongue River I would suggest you contact Mr. E. J. Brant, 702 N. Prairie Ave, Miles City, Mont.

I am wondering if it would be practical for you to furnish me with that information you have on Sec. 5, & Sec. 6, T. 5N., R. 48E. on the irrigation history and potential lands therein. If you could furnish a small map or drawing of this property I could more clearly and accurately supply information on this property.

I had the opportunity of inspecting the survey prepared on the Signora River which you sent my father. After the Tongue River survey is completed and if this report is available to the public I would like to obtain a copy.

As soon as I can get accurate information I will forward same to you.

Sincerely yours,

Hugo Maggi
Tongue River Stage
Miles City, Montana

Hugo Maggi

Farm Checked

STATE OF MONTANA

Code No. 5A, 6A.By Collins & Joe

STATE ENGINEER'S OFFICE

County CusterArea Tongue

WATER RESOURCES SURVEY

T. 5N R. 48E Sec. 5, 6Date 6/12/47

CHECK OWNERSHIP

Photo No. MA12-EELegal Land Owner Campbell Ranch Co.Address Miles CityOperator Trimborn, C. H.Address Miles City

Water is delivered by:

Federal Project _____ Pres. _____ Pot. _____

Ditch Company _____ Pres. _____ Pot. _____

Irrigation District _____ Pres. 160.0 Pot. 70Private System pump Pres. 175 Pot. about 400

Totals _____

Flood _____ Pump ✓ Reservoir _____ Gravity _____Size and Capacity, Pump, etc. 1-8" Cent. - 25' lift 75 H.P. stationery: 1-10" Cent. - 14' lift tractor power

Original Appropriator, Company _____ App. No. _____

Original Appropriator, Private. (Show date of appropriation under Remarks) _____ App. No. _____

Is the system an extension of another system? Yes _____ No ✓Is all land irrigated from one system? Yes _____ No ✓

(If No, show break down on map)

Source of Water Tongue RiverAcres Irrigated 1946 175 160.0Potential Acres 100.20 Seeped _____Explain potential under 10" pumpCondition of System goodAdequate Supply _____ Yes ✓ No _____

Explain _____

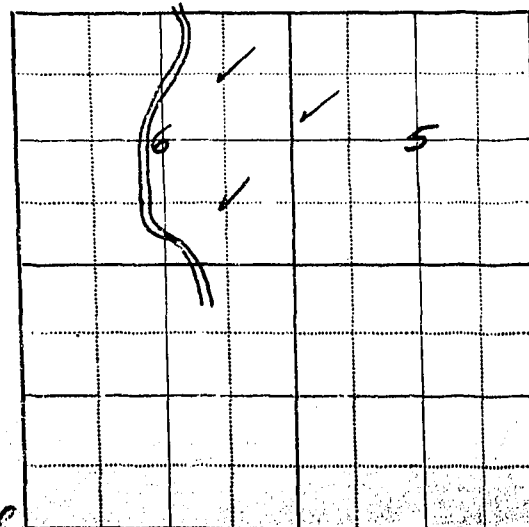
Topography bottomInformation From TrimbornRemarks 100 acres by extending ditch Sept. 1946 - no potential under present Sept. 1946

STATE ENGINEERS OFFICE

Water Resources Survey

Notice of Appropriation

1. County Custer Book E Page 517 Record W.R.
2. Name of Appropriator Jess C. Johansen Address Miles City, Montana
3. Date Appropriated October 23, 1937 Date Filed October 25, 1937
- Amount Appropriated, Miners Inches 1600 or , Cubic Feet per second 40
4. Name of Stream Dry Creek Tributary Basin
5. Point of Diversion Is about 600 ft. westerly from the SE corner of
-
- Sec. 6 Twp. 5N. Rge. 48E. Bank of Stream Right
-
6. Purpose For irrigation, watering stock, domestic purposes and other purposes
7. Description of System A ditch 60" X 60" in size, which carries and conducts said amount of water from said creek and runs thence in a westerly and northerly direction, thence in a northeasterly direction, thence over and upon said land (or mining claim)
8. Land Description of Intended Place of Use
- In Sec. 5-5N-48E, 641.51, Evaline Wolfshorn, Miles City
- In Sec. 6-5N-48E, 631.76 acres, " " " c/o Bradus Stage
9. Remarks (Pertaining to Use, etc.) Said appropriator intends to construct a suitable dam for the storage and diversion of water.

Decree

10. Case No. Date Amt. Decreed: M. I. C. F. S.
11. To Whom Decreed Address
12. Name of Ditch Maximum Capacity (C. F. S.)
13. Date of Priority Purpose
14. Land Description of Place of Use as Decreed
-
-
15. Remarks (Present Use Status, etc.)
-
-



NOTICE
These forms and the
property of the State
of Montana and must
be returned.

STATE OF MONTANA
STATE ENGINEERS OFFICE

Water Resources Survey

Code No. 18A
County Custer
T. 5N R. 48E

Name of Land Owner Mrs Mary J. Morrison et Address Widen City, Mont

Name of Operator Jo Edith Stanton Address _____

Part A

TO BE FILED BY THOSE OBTAINING IRRIGATION WATER FROM
A DITCH COMPANY OR IRRIGATION DISTRICT

1. Water is delivered by: _____
Name of Ditch, Ditch Company or District Supplying Water
2. State the number of acres you irrigate under this system _____ Shares you hold _____
3. If you obtain water from more than one Company, give the number of shares, acres irrigated and the name of the Company under "Remarks." If you obtain water from a Ditch Company and also have a private system fill in both Part A and Part B.

Part B

TO BE FILED BY THOSE WHO HAVE A PRIVATE DITCH, PUMP OR IRRIGATION SYSTEM
or those who have a private water right under a Ditch Company

4. In what year was this land first irrigated? Date No data
5. Give the name of the original appropriator (first user): _____
6. Give the date appropriated _____ Amount filed on: Miners Inches _____ C. F. S. _____
7. State the total number of acres irrigated under this system: _____
8. Give the point of diversion: _____ $\frac{1}{4}$ _____ $\frac{1}{4}$ Section _____ Township _____ Range _____

Part C

TO BE FILED BY ALL WATER USERS IN ADDITION TO PART A OR PART B

9. Source of Water: Longue River
Name of stream or lake from which water is originally diverted
10. Water is obtained by: (Check one) Gravity _____ Pumping ☒ Other _____
11. What is the greatest number of acres you have irrigated? 33.0 Date _____
12. How many acres did you irrigate in 1947 (Crop and pasture) 0
13. State the total number of additional acres that could be irrigated by increasing the water supply, land leveling, etc. 33.0 This land is under what ditch? Same
14. How many acres of seeped land do you have which could be drained and put into production? 0
15. What is the condition of your irrigation system? Out of use
16. Is your water supply adequate? Yes ☒ No _____ Explain _____
17. REMARKS: If stored water is purchased

Over

NOTE: The foregoing questions apply only to irrigated land shown on this plat.

DESCRIPTION AND MAP OF FARM

18. Legal Description of this Farm W⁴W², Sec 18

☐ None At Present
IRRIGATED LAND

☐ NON-IRRIGATED LAND

☒ Potential Land

North

West

East

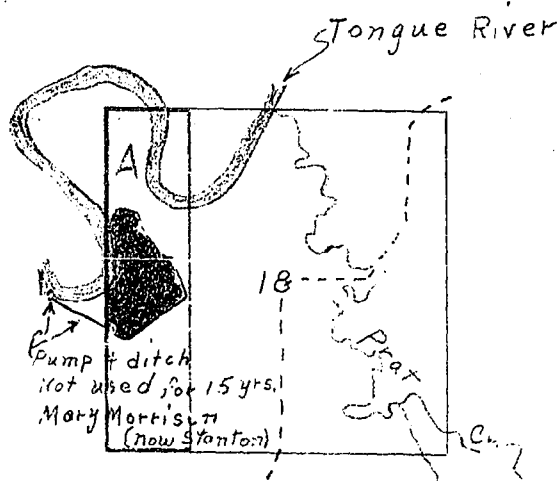

South

Shaded area represents
only irrigated land.
All area shown for
potential irrigation.

19. If the above land is irrigated from more than one ditch please give the acreage under each ditch in 19A and indicate the location of the land irrigated from each on the above map.

19A. Ditch: Private Pump ditch Tongue River Acres: 0

Ditch: _____ Acres: _____

Information supplied by:

Name Field Survey Address _____ Date 8/7/47

REMARKS: Flork & D. Paulist

If you cannot answer all of the questions on this form answer as many as you can and return the form to us as soon as possible.

STATE ENGINEER'S OFFICE
WATER RESOURCES SURVEYCOUNTY CusterFILE NO. 42-T-5N-R-48EOwner Messing, M. M. & J. I. (Est.) Address Tongue River State, Miles CityAAA Owner Stanton, Edith Address

Operator " " Address " " "

New Owner Address

New Operator Address

Assessment Record NoneAssessed Acreage 0Legal Description of This Farm W 1/2 W 2 Sec 18; T 5N-R 48ETotal Acres in Farm ✓Code Number 18APhoto No. Ma 12-87

AAA Contract No.

AAA Total Cropland Acreage

App. No. No Record by Description
2189?

Decree No.

Land is located in

Twp. 5N Rge. 48E Twp. Rge.

Twp. Rge. Twp. Rge.

Filed in Twp. 5N Rge. 48ERemarks Edith Stanton alsooperates some land inSec 24, T 5N-R 47ETongue River BasinOwnership covers
only irrigated land.
All ownership for
dry land not shown.



NOTICE
Persons desiring any form
of the State Engineer
or State Surveyor
may obtain same
on application.

STATE OF MONTANA
STATE ENGINEERS OFFICE
Water Resources Survey

Code No. 7A
County Custer
T. 5N R. 48

Name of Land Owner N. P. R. R. Address _____

Name of Operator _____ Address _____

Part A

**TO BE FILED BY THOSE OBTAINING IRRIGATION WATER FROM
A DITCH COMPANY OR IRRIGATION DISTRICT**

1. Water is delivered by: _____
Name of Ditch, Ditch Company or District Supplying Water
2. State the number of acres you irrigate under this system _____ Shares you hold _____
3. If you obtain water from more than one Company, give the number of shares, acres irrigated and the name of the Company under "Remarks." If you obtain water from a Ditch Company and also have a private system fill in both Part A and Part B.

Part B

**TO BE FILED BY THOSE WHO HAVE A PRIVATE DITCH, PUMP OR IRRIGATION SYSTEM
or those who have a private water right under a Ditch Company**

4. In what year was this land first irrigated? Date No data
5. Give the name of the original appropriator (first user): _____
6. Give the date appropriated _____ Amount filed on: Miners Inches _____ C. F. S. _____
7. State the total number of acres irrigated under this system: _____
8. Give the point of diversion: _____ $\frac{1}{4}$ _____ $\frac{1}{4}$ Section _____ Township _____ Range _____

Part C

TO BE FILED BY ALL WATER USERS IN ADDITION TO PART A OR PART B

9. Source of Water: Tongue River + Wolf Creek
Name of stream or lake from which water is originally diverted
10. Water is obtained by: (Check one) Gravity ☒ Pumping ☒ Other _____
11. What is the greatest number of acres you have irrigated? 91.0 Date _____
12. How many acres did you irrigate in 1947 (Crop and pasture) 1.0
13. State the total number of additional acres that could be irrigated by increasing the water supply, land leveling, etc. 90 This land is under what ditch? Wolf Cr. Flood System
14. How many acres of seeped land do you have which could be drained and put into production? _____
15. What is the condition of your irrigation system? Wolf Creek out of use
16. Is your water supply adequate? Yes ☒ No ☒ Explain _____
17. REMARKS: No on Wolf Creek, yes on Tongue River

Over

NOTE: The foregoing questions apply only to irrigated land shown on this plat.

DESCRIPTION AND MAP OF FARM

18. Legal Description of this Farm

all sec 7



IRRIGATED LAND



NON-IRRIGATED LAND



Potential Land

North

West

East

South

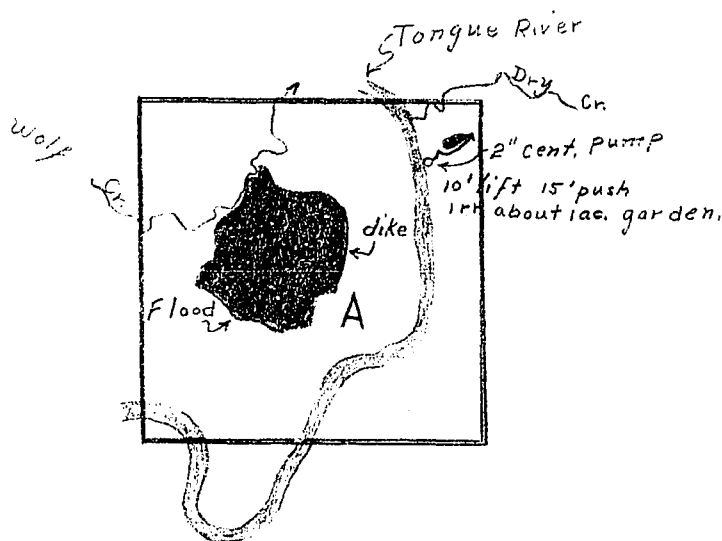

19. If the above land is irrigated from more than one ditch please give the acreage under each ditch in 19A and indicate the location of the land irrigated from each on the above map.

19A. Ditch: *Tongue River Pump ditch* Acres: *1.0*
Ditch: *Wolf Creek Flood ditch* Acres: *0*

Information supplied by:

Name *Field Survey* Address _____ Date *8/6/47*

REMARKS: *J. Cash + D. Paulist*

If you cannot answer all of the questions on this form answer as many as you can and return the form to us as soon as possible.

STATE ENGINEER'S OFFICE
WATER RESOURCES SURVEYCOUNTY CusterFILE NO. 42-T.5N-R.48EOwner N.P.R.R. Address

AAA Owner Address

Operator P Address P

New Owner Address

New Operator Address

Assessment Record Name -Assessed Acreage 0Legal Description of This Farm all of Section 7; T.5N-R.48ETotal Acres in Farm ✓Code Number 7APhoto No. MA 12-87

AAA Contract No.

AAA Total Cropland Acreage

App. No. No Record by Description

Decree No.

Land is located in

Twp. 5N Rge. 4E Twp. Rge.

Twp. Rge. Twp. Rge.

Filed in Twp. 5N Rge. 4E

Remarks

Tongue River BasinOwnership covers
only irrigated land.
All ownership for
dry land not shown.

STATE OF MONTANA

STATE ENGINEER'S OFFICE

WATER RESOURCES SURVEY

19 Township 5 North Range 48 East County Custer

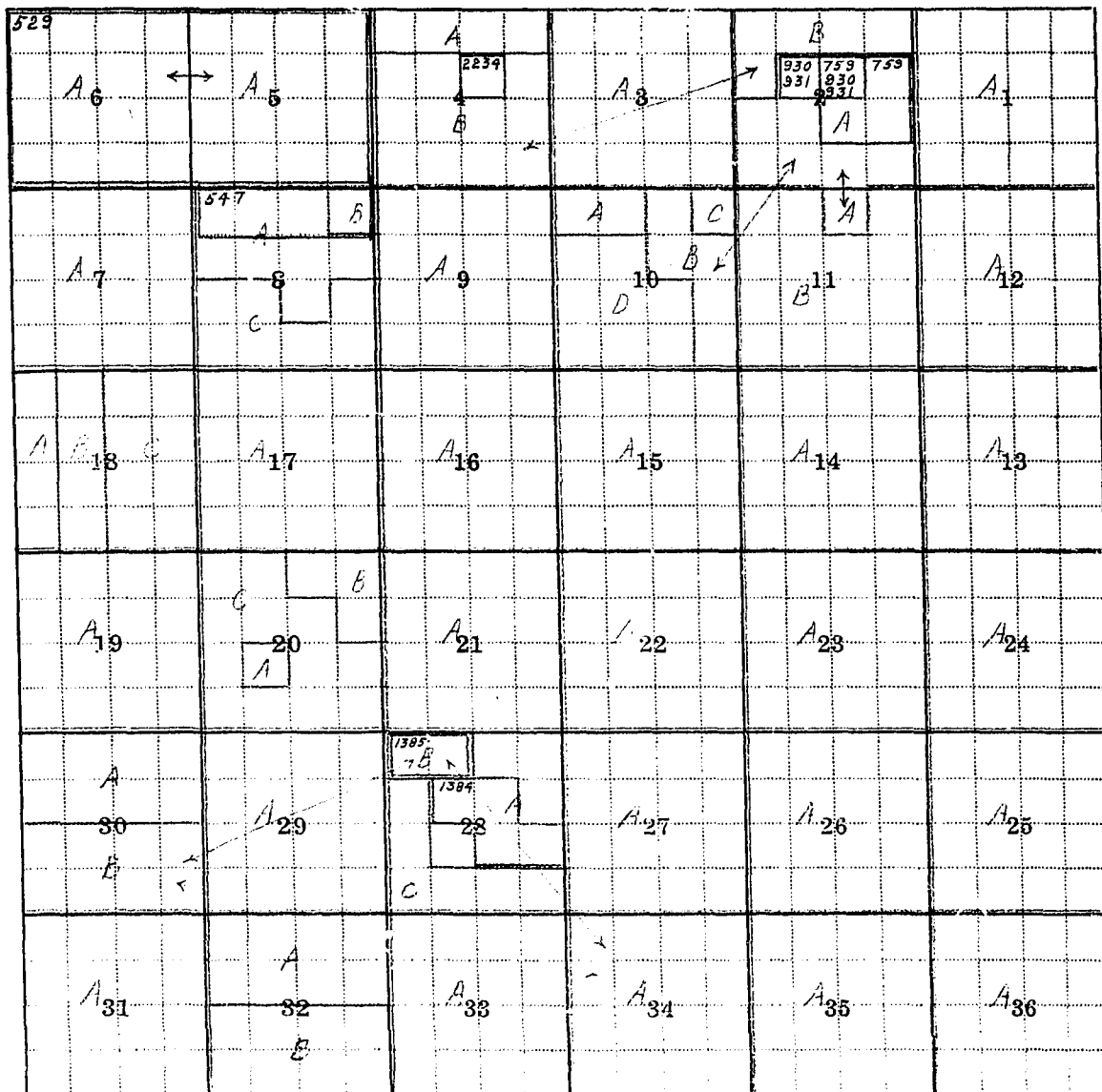

19 Township 5 North Range 48 East

Township 5 North Range 48 East County Custer

Parcel Number	Name of Owner	Address
8E, 8C, 10D,	U. S. A.	
12A, 14A, 20A,	" " "	
20B, 22A, 24A,	" " "	
26A, 28C, 32A	" " "	
1A, 3A, 7A, ✓	N. P. Ry.	
11B, 13A, 15A,	" " "	
17A, 19A, 21A,	" " "	
23A, 25A, 27A,	" " "	
29A, 33A, 35A	" " "	
2B, 4B	Frank S. Derm	Broadus Stage, Miles City
2A, 10P, 11A	John & Chas. Rogers	Broadus Stage, Miles City
4A	U. S. Rubber Co.	F. O. Box 12, Station G., New York City
16A, 36A	State	
5A, 6A ✓	Conrad & Sons, Inc. Violet Siets, c/o Eva Meltsberg	Tongue River Stage, Miles City
8A, 9A	N. P. Ry., c/o Rogers Bros.	Broadus Stage, Miles City
10A	Ed Block	1350 Westheimer, Houston, Tex.
10C	Custer County	
18C	E. G. and Norma Coon	Tongue River Stage, Miles City
18B	Edith M. Stanton	Tongue River Stage, Miles City
18A ✓	Mrs. M. J. Morrison Est., c/o Edith Stanton - T. R. Stage,	Miles City
20C	Milo & Katherine Bernard	Rt. 2, Box 44, Billings
30A	Walter F. Sumer	Tongue R. Stage
22A, 30B, 34A	E. J. Olson, c/o Merchants Bank Bldg.	St. Paul, Minn.
31A	Geo. J. Johnson	210 So. Montana Ave., Miles City
32B	Bruce Orcutt	Broadus Stage, Miles City
26B	H. E. McGuire	Tongue R. Stage