



These forms and the  
property of the state  
of Montana and must  
be returned.

# STATE OF MONTANA STATE ENGINEERS OFFICE

## Water Resources Survey

FORM WR-1—2M 12-47

Code No. 24B-24E

County Custer

T. 5N R. 51E

Name of Land Owner R.R. & Laura M. Crosby Address Missoula, Montana

Name of Operator \_\_\_\_\_ Address \_\_\_\_\_

## Part A

### TO BE FILED BY THOSE OBTAINING IRRIGATION WATER FROM A DITCH COMPANY OR IRRIGATION DISTRICT

1. Water is delivered by: \_\_\_\_\_  
Name of Ditch, Ditch Company or District Supplying Water
2. State the number of acres you irrigate under this system. \_\_\_\_\_ Shares you hold \_\_\_\_\_
3. If you obtain water from more than one Company, give the number of shares, acres irrigated and the name of the Company under "Remarks." If you obtain water from a Ditch Company and also have a private system fill in both Part A and Part B.

## Part B

### TO BE FILED BY THOSE WHO HAVE A PRIVATE DITCH, PUMP OR IRRIGATION SYSTEM or those who have a private water right under a Ditch Company

4. In what year was this land first irrigated? Date See attached filing
5. Give the name of the original appropriator (first user): \_\_\_\_\_
6. Give the date appropriated \_\_\_\_\_ Amount filed on: Miners Inches \_\_\_\_\_ C. F. S. \_\_\_\_\_
7. State the total number of acres irrigated under this system: \_\_\_\_\_
8. Give the point of diversion: \_\_\_\_\_  $\frac{1}{4}$  \_\_\_\_\_  $\frac{1}{4}$  Section \_\_\_\_\_ Township \_\_\_\_\_ Range \_\_\_\_\_

## Part C

### TO BE FILED BY ALL WATER USERS IN ADDITION TO PART A OR PART B

9. Source of Water: Russell Creek & Side Coulee  
Name of stream or lake from which water is originally diverted
10. Water is obtained by: (Check one) Gravity ☒ Pumping \_\_\_\_\_ Other Flood
11. What is the greatest number of acres you have irrigated? 27.0 Date \_\_\_\_\_
12. How many acres did you irrigate in 1977? (Crop and pasture) 27.0
13. State the total number of additional acres that could be irrigated by increasing the water supply, land leveling, etc. 0 This land is under what ditch? 0
14. How many acres of seeped land do you have which could be drained and put into production? 0
15. What is the condition of your irrigation system? Fair
16. Is your water supply adequate? Yes \_\_\_\_\_ No ☒ Explain Flood line
17. REMARKS: \_\_\_\_\_  
\_\_\_\_\_  
\_\_\_\_\_  
\_\_\_\_\_

NOTE: The foregoing questions apply only to irrigated land shown on this plat.

### DESCRIPTION AND MAP OF FARM

18. Legal Description of this Farm

NW 1/4, E 2 ME 4, M 28 E 4, SE 4 SE 4

Sec 24

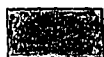

IRRIGATED LAND



NON-IRRIGATED LAND

North

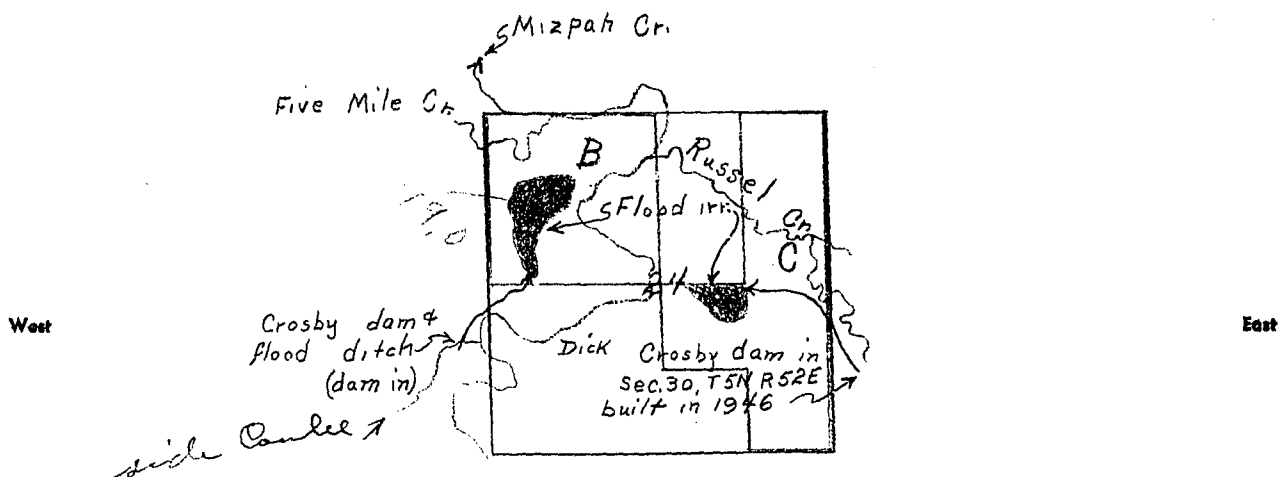

South

Ownership covers  
only irrigated land.  
All ownership for  
dry land not shown.

19. If the above land is irrigated from more than one ditch please give the acreage under each ditch in 19A and indicate the location of the land irrigated from each on the above map.

19A. Ditch: Side Coulee Acres: 19.0

Ditch: Russell Creek & Res. Acres: 8.0

Information supplied by:

Name Field Survey Address \_\_\_\_\_ Date 7/22/47

REMARKS: J. Johnson & Paulist

If you cannot answer all of the questions on this form answer as many as you can and return the form to us as soon as possible.

STATE ENGINEER'S OFFICE  
WATER RESOURCES SURVEY

COUNTY Cluster

FILE NO. 45-T-5N-R-51E

Owner Crosby, Laura M. & R.R. Address Mizpah, Montana?

AAA Owner Address

Operator " " " " " "

New Owner Address

New Operator Address

Assessment Record None

Assessed Acreage 0

Legal Description of This Farm NW 1/4, E 2 NE 1/4, N 2 SE 1/4, SE 1/4 SE 1/4 Sec. 24;

T. 5N-R. 51E

Total Acres in Farm ✓

Code Number 24B, 24C

Photo No. M. 23-83

AAA Contract No.

AAA Total Cropland Acreage

App. No. 672

Decree No.

Land is located in

Twp. 5N Rge. 51E Twp. Rge.

Twp. Rge. Twp. Rge.

Filed in Twp. 5N Rge. 51E

Remarks R.R. Crosby may

have NW 1/4 NE 1/4 (24E) Sec. 24

T. 5N-R. 51E which is

U.S.A. Land

Powder River Basin

Ownership covers  
only irrigated land.  
All ownership for  
dry land not shown.

679

**STATE ENGINEERS OFFICE**  
**Water Resources Survey**  
**Notice of Appropriation**

1. County Custer Book D Page 555 Record W.R.
2. Name of Appropriator Anton Chnek Address Mizpah, Montana
3. Date Appropriated Oct. 31, 1912 Date Filed Oct. 31, 1912  
 Amount Appropriated, Miners Inches 400 or 10, Cubic Feet per second
4. Name of Stream Five Mile Creek Tributary Basin
5. Point of Diversion See Question 7
- Sec.        Twp.        Rge.        Bank of Stream N. & S.
6. Purpose For irrigation and other purposes.
7. Description of System A dam and ditch 40" X 60" in size, which carries and conducts 400 miners inches of water from said stream at a point upon its north and south banks about 3/4 mile due west from the N.W. corner of said Sec. 24-5N-51E and runs thence in an easterly direction thence over and upon said lands.
8. Land Description of Intended Place of Use
9. Remarks (Pertaining to Use, etc.)

**Decree**

10. Case No.        Date        Amt. Decreed: M. I.        C. F. S.
11. To Whom Decreed        Address
12. Name of Ditch        Maximum Capacity (C. F. S.)
13. Date of Priority        Purpose
14. Land Description of Place of Use as Decreed
15. Remarks (Present Use Status, etc.)



NOTICE  
These forms and the  
property of the State  
of Montana and must  
be returned.

STATE OF MONTANA  
STATE ENGINEERS OFFICE

Water Resources Survey

FORM WR-1-2M 12-47

Code No. 35 B

County Custer

T. 5 N. R. 5 E

Name of Land Owner M. P. R. P. Address St. Paul, Minn

Name of Operator \_\_\_\_\_ Address \_\_\_\_\_

**Part A**

**TO BE FILED BY THOSE OBTAINING IRRIGATION WATER FROM  
A DITCH COMPANY OR IRRIGATION DISTRICT**

1. Water is delivered by: \_\_\_\_\_  
Name of Ditch, Ditch Company or District Supplying Water
2. State the number of acres you irrigate under this system \_\_\_\_\_ Shares you hold \_\_\_\_\_
3. If you obtain water from more than one Company, give the number of shares, acres irrigated and the name of the Company under "Remarks." If you obtain water from a Ditch Company and also have a private system fill in both Part A and Part B.

**Part B**

**TO BE FILED BY THOSE WHO HAVE A PRIVATE DITCH, PUMP OR IRRIGATION SYSTEM  
or those who have a private water right under a Ditch Company**

4. In what year was this land first irrigated? Date No data
5. Give the name of the original appropriator (first user): \_\_\_\_\_
6. Give the date appropriated \_\_\_\_\_ Amount filed on: Miners Inches \_\_\_\_\_ C. F. S. \_\_\_\_\_
7. State the total number of acres irrigated under this system: \_\_\_\_\_
8. Give the point of diversion: \_\_\_\_\_  $\frac{1}{4}$  \_\_\_\_\_  $\frac{1}{4}$  Section \_\_\_\_\_ Township \_\_\_\_\_ Range \_\_\_\_\_

**Part C**

**TO BE FILED BY ALL WATER USERS IN ADDITION TO PART A OR PART B**

9. Source of Water: Double Coral Creek  
Name of stream or lake from which water is originally diverted
10. Water is obtained by: (Check one) Gravity \_\_\_\_\_ Pumping \_\_\_\_\_ Other Flood
11. What is the greatest number of acres you have irrigated? 20.0 Date \_\_\_\_\_
12. How many acres did you irrigate in 1947 (Crop and pasture) 0
13. State the total number of additional acres that could be irrigated by increasing the water supply, land leveling, etc. 20.0 This land is under what ditch? Old Flood ditch
14. How many acres of seeped land do you have which could be drained and put into production? 0
15. What is the condition of your irrigation system? Out of use
16. Is your water supply adequate? Yes \_\_\_\_\_ No ✓ Explain Flood
17. REMARKS: \_\_\_\_\_  
\_\_\_\_\_  
\_\_\_\_\_  
\_\_\_\_\_

Over

NOTE: The foregoing questions apply only to irrigated land shown on this plat.

### DESCRIPTION AND MAP OF FARM

18. Legal Description of this Farm NW 1/4, E 2 NE 1/4, Lots 1, 4, 5, 6, 7, 8, 9, 10,  
11, 12, Sec 35

☐ None at Present  
IRRIGATED LAND

☐ NON-IRRIGATED LAND

☒ Potential Land

North

West

East

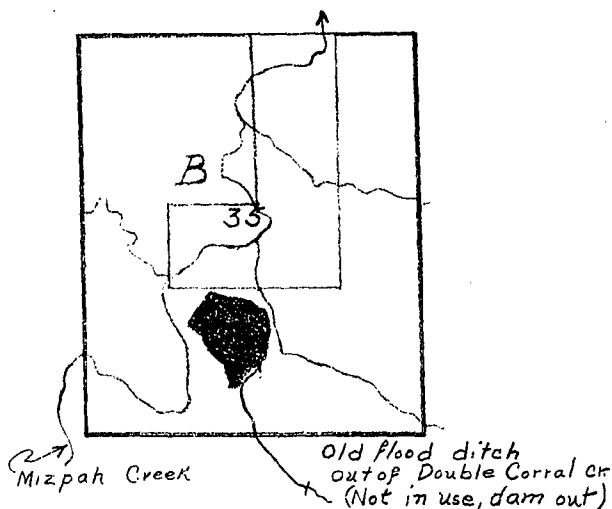

Shading covers  
only irrigated land.  
All ownership, the  
dry land not shown.

South

19. If the above land is irrigated from more than one ditch please give the acreage under each ditch in 19A and indicate the location of the land irrigated from each on the above map.

19A. Ditch: Double Corral Cr. Flood Cr. Acres: 0

Ditch: \_\_\_\_\_ Acres: \_\_\_\_\_

Information supplied by:

Name Johnson & Pauline Address \_\_\_\_\_ Date 7/22/47

REMARKS: Field survey.  
Old ditch not in use.

If you cannot answer all of the questions on this form answer as many as you can and return the form to us as soon as possible.

STATE ENGINEER'S OFFICE  
WATER RESOURCES SURVEYCOUNTY ClusterFILE NO. 45-T.5N-R.51EOwner N.P.R.R. Address St. Paul, Minn.

AAA Owner Address

Operator P Address P

New Owner Address

New Operator Address

Assessment Record NewAssessed Acreage 0Legal Description of This Farm NW 1/4, E 1/4 NE 1/4, Lots 1-2-5-6-7-8-9-10-11-12, Sec. 35T.5N-R.51ETotal Acres in Farm VCode Number 35BPhoto No. Ma 32-37

AAA Contract No.

AAA Total Cropland Acreage

App. No. No Record by Transcript

Decree No.

Land is located in

Twp. 5N Rge. 51E Twp. Rge.

Twp. Rge. Twp. Rge.

Filed in Twp. Rge.

Remarks Unable to findoperator of this landPowder River BasinOwnership covers  
only irrigated land.  
All ownership for  
dry land not shown.



NOTICE  
These forms are the  
property of the State  
of Montana and must  
be returned.

STATE OF MONTANA  
STATE ENGINEERS OFFICE  
Water Resources Survey

FORM WR-1-2M 12-47

Code No. 24E  
County Center  
T. 5N R. 5E

Name of Land Owner U.S.A. Address \_\_\_\_\_  
Name of Operator \_\_\_\_\_ Address \_\_\_\_\_

**Part A**

**TO BE FILED BY THOSE OBTAINING IRRIGATION WATER FROM  
A DITCH COMPANY OR IRRIGATION DISTRICT**

1. Water is delivered by: \_\_\_\_\_  
Name of Ditch, Ditch Company or District Supplying Water
2. State the number of acres you irrigate under this system. \_\_\_\_\_ Shares you hold \_\_\_\_\_
3. If you obtain water from more than one Company, give the number of shares, acres irrigated and the name of the Company under "Remarks." If you obtain water from a Ditch Company and also have a private system fill in both Part A and Part B.

**Part B**

**TO BE FILED BY THOSE WHO HAVE A PRIVATE DITCH, PUMP OR IRRIGATION SYSTEM  
or those who have a private water right under a Ditch Company**

4. In what year was this land first irrigated? Date No data
5. Give the name of the original appropriator (first user): \_\_\_\_\_
6. Give the date appropriated \_\_\_\_\_ Amount filed on: Miners Inches \_\_\_\_\_ C. F. S. \_\_\_\_\_
7. State the total number of acres irrigated under this system: \_\_\_\_\_
8. Give the point of diversion: \_\_\_\_\_  $\frac{1}{4}$  \_\_\_\_\_  $\frac{1}{4}$  Section \_\_\_\_\_ Township \_\_\_\_\_ Range \_\_\_\_\_

**Part C**

**TO BE FILED BY ALL WATER USERS IN ADDITION TO PART A OR PART B**

9. Source of Water: Russell Creek  
Name of stream or lake from which water is originally diverted
10. Water is obtained by: (Check one) Gravity ☒ Pumping \_\_\_\_\_ Other Reservoir
11. What is the greatest number of acres you have irrigated? 6.0 Date \_\_\_\_\_
12. How many acres did you irrigate in 1947 (Crop and pasture) 6.0
13. State the total number of additional acres that could be irrigated by increasing the water supply, land leveling, etc. ✓ This land is under what ditch? ✓
14. How many acres of seeped land do you have which could be drained and put into production? ✓
15. What is the condition of your irrigation system? Fair
16. Is your water supply adequate? Yes \_\_\_\_\_ No ☒ Explain I have less
17. REMARKS: \_\_\_\_\_  
\_\_\_\_\_  
\_\_\_\_\_  
\_\_\_\_\_

Over



NOTE: The foregoing questions apply only to irrigated land shown on this plat.

### DESCRIPTION AND MAP OF FARM

18. Legal Description of this Farm W2NE4, Sec 24



IRRIGATED LAND



NON-IRRIGATED LAND

North

West

East

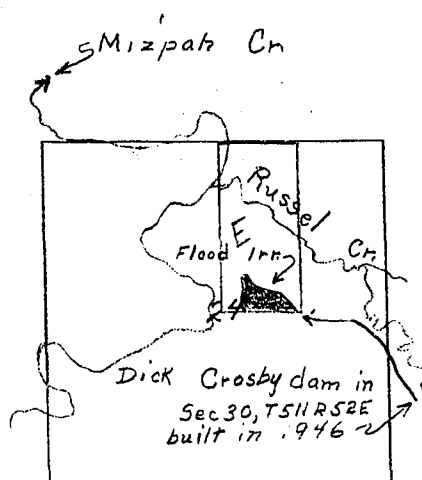

South

Ownership shows  
only irrigated land.  
All ownership for  
dry land not shown.

19. If the above land is irrigated from more than one ditch please give the acreage under each ditch in 19A and indicate the location of the land irrigated from each on the above map.

19A. Ditch: Private Acres: 6.0

Ditch: \_\_\_\_\_ Acres: \_\_\_\_\_

Information supplied by:

Name Johnson & J. Pantel Address \_\_\_\_\_ Date 7/22/47

REMARKS: Field Survey

If you cannot answer all of the questions on this form answer as many as you can and return the form to us as soon as possible.

STATE ENGINEER'S OFFICE  
WATER RESOURCES SURVEY

COUNTY Custer

FILE NO. 45-T.5N-R.51E

Owner U.S.A. Address Miles City, Montana

AAA Owner Address

Operator Crosby, R.R.? Address Mizpah, Montana

New Owner Address

New Operator Address

Assessment Record None

Assessed Acreage 0

Legal Description of This Farm W 1/2 NE 1/4 Sec 24, T.5N-R.51E

Total Acres in Farm ✓

Code Number 29E

Photo No. Ma 23-83

AAA Contract No.

AAA Total Cropland Acreage

App. No. No Record by Discrept

Decree No.

Land is located in

Twp. 5N Rge. 51E Twp. Rge.

Twp. Rge. Twp. Rge.

Filed in Twp. 5N Rge. 51E

Remarks R.R. Crosby gave title

to this land

Powder River Basin

Ownership covers  
only irrigated land.  
All ownership for  
dry land not shown.

(Township 5 North, Range 51 East)

Crosby, R. R. & Laura

N. P. R. R.

U. S. A.

(Township 5 North, Range 52 East)

Digman, Emmett

Kemp, Margaret B. (part of) R. R. (part of)

Wiley, Charles

(Township 5 North, Range 53 East)

McKenzie, Thomas Royal

Montana, State of

O'Neill, Robert

STATE OF MONTANA  
**STATE ENGINEER'S OFFICE**  
 WATER RESOURCES SURVEY

Township.....5N..... Range.....51E..... County.....Custer.....

6	5	4	3	2 302	1
7	8	9	10	11	12 617 617
18	17	16	15	14 Containing 1/4 sec. only, unpatented land. All township for any land not shown.	13 A
19	20	21	22	23	679 B E C A D
30	29	28	27	26 1021	25
31	32	33	34	B A 35	36

Township.....5N..... Range.....51E.....

[illegible]

Township 5 North

Range 51 East

Custer County

<u>Index No.</u>	<u>Name of Appropriator</u>	<u>Stream</u>	<u>Date App.</u>	<u>Date Filed</u>	<u>M.I.</u>
302	John Ogren	Center Creek	10-11-15	10-11-15	1000
617	Lula F. Ogren	East Second Creek	3-18-09	3-20-09	2000
679	Anton Chnek	Five Mile Creek	10-31-12	10-31-12	400
1091	Lillian Campbell	Mizpah Creek	8-15-10	5-25-11	500





NOTICE  
These forms are the  
property of the State  
of Montana and must  
be returned

STATE OF MONTANA  
STATE ENGINEERS OFFICE

Water Resources Survey

FORM WR-1-2M 12-47

Code No. 4A-14A

County Quemont

T. 5N R. 52E

Name of Land Owner Emmett Dugman Address Wilder City, Mont.

Name of Operator To Jim Rayburn Address Box 304 Wilder City

Part A

TO BE FILED BY THOSE OBTAINING IRRIGATION WATER FROM  
A DITCH COMPANY OR IRRIGATION DISTRICT

1. Water is delivered by: \_\_\_\_\_  
Name of Ditch, Ditch Company or District Supplying Water
2. State the number of acres you irrigate under this system. \_\_\_\_\_ Shares you hold \_\_\_\_\_
3. If you obtain water from more than one Company, give the number of shares, acres irrigated and the name of the Company under "Remarks." If you obtain water from a Ditch Company and also have a private system fill in both Part A and Part B.

Part B

TO BE FILED BY THOSE WHO HAVE A PRIVATE DITCH, PUMP OR IRRIGATION SYSTEM  
or those who have a private water right under a Ditch Company

4. In what year was this land first irrigated? Date See attached filings
5. Give the name of the original appropriator (first user): \_\_\_\_\_
6. Give the date appropriated. \_\_\_\_\_ Amount filed on: Miners Inches \_\_\_\_\_ C. F. S. \_\_\_\_\_
7. State the total number of acres irrigated under this system: \_\_\_\_\_
8. Give the point of diversion: \_\_\_\_\_  $\frac{1}{4}$  \_\_\_\_\_  $\frac{1}{4}$  Section \_\_\_\_\_ Township \_\_\_\_\_ Range \_\_\_\_\_

Part C

TO BE FILED BY ALL WATER USERS IN ADDITION TO PART A OR PART B

9. Source of Water: Powder River & Cottonwood Creek  
Name of stream or lake from which water is originally diverted
10. Water is obtained by: (Check one) Gravity ☒ Pumping ☒ Other \_\_\_\_\_
11. What is the greatest number of acres you have irrigated? 150 Date 1915
12. How many acres did you irrigate in 1947? (Crop and pasture) 0
13. State the total number of additional acres that could be irrigated by increasing the water supply, land leveling, etc. 150 This land is under what ditch? 120 acres powder River Pump  
30 acres Cottonwood Cr. Flood
14. How many acres of seeped land do you have which could be drained and put into production? \_\_\_\_\_
15. What is the condition of your irrigation system? Out of use
16. Is your water supply adequate? Yes \_\_\_\_\_ No ☒ Explain \_\_\_\_\_
17. REMARKS: Old O'Neill desert claim ditch out of  
cottonwood not in use, Pump on Powder River  
not in use in water supply. Most information  
from Jim Rayburn

Over



NOTE: The foregoing questions apply only to irrigated land shown on this plat.

### DESCRIPTION AND MAP OF FARM

18. Legal Description of this Farm W<sup>2</sup>, SW<sup>4</sup> SE<sup>4</sup>, Sec 4, Lots, 3, 4, 5, 6, W<sup>2</sup> NW<sup>4</sup>, SE<sup>4</sup> NW<sup>4</sup>, SW<sup>4</sup>, W<sup>2</sup> SE<sup>4</sup>, SE<sup>4</sup> SE<sup>4</sup>, Sec 14, T5N R52E

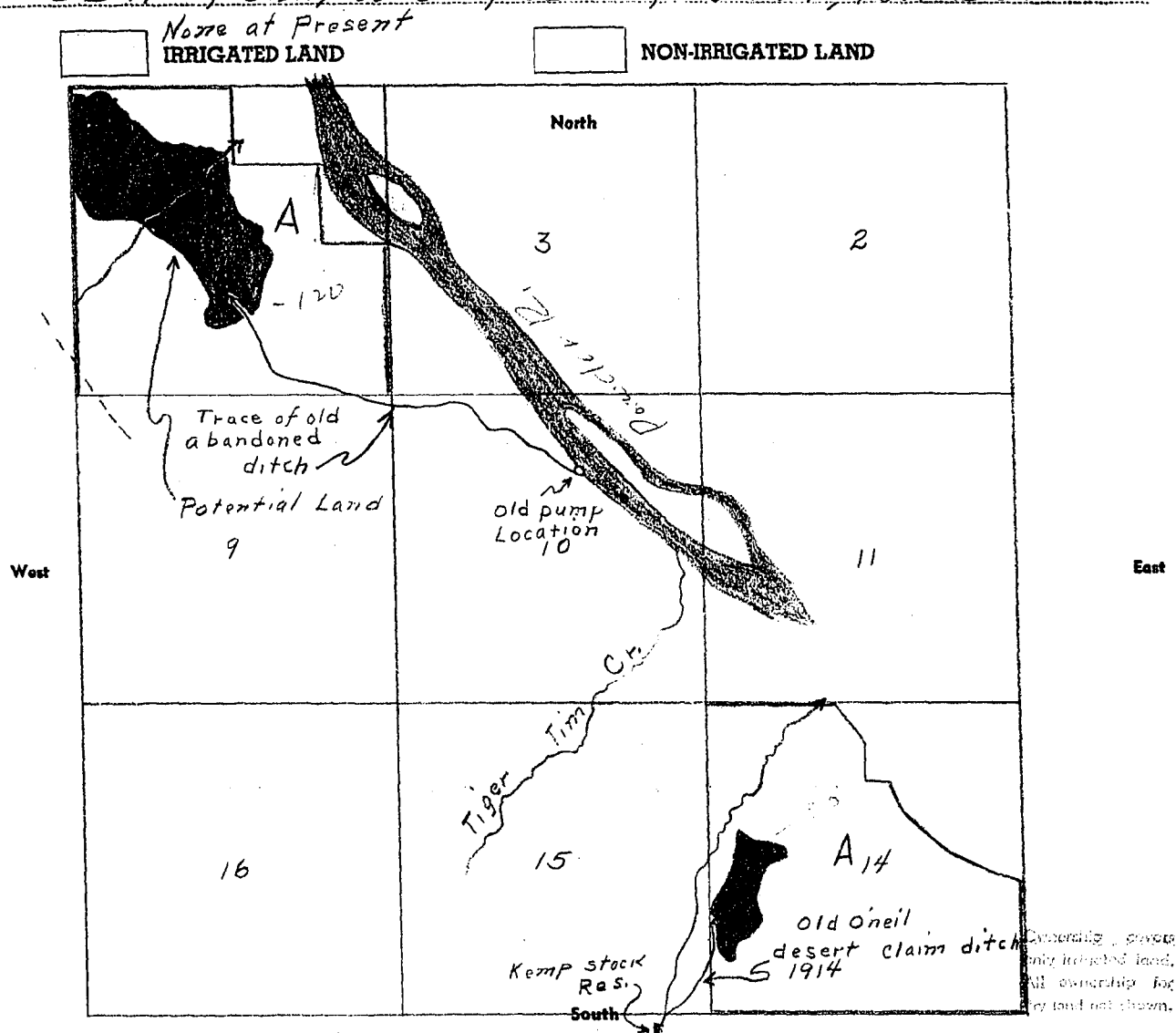

19. If the above land is irrigated from more than one ditch please give the acreage under each ditch in 19A and indicate the location of the land irrigated from each on the above map.

19A. Ditch: Cottonwood Creek flood Acres: 0

Ditch: Powder River Pump Acres: 0

Information supplied by:

Name Bob O'Neill to Address \_\_\_\_\_ Date July 16-47

REMARKS: Johnson & Paulist Field Survey

If you cannot answer all of the questions on this form answer as many as you can and return the form to us as soon as possible.

STATE ENGINEER'S OFFICE  
WATER RESOURCES SURVEY

COUNTY Custer

FILE NO. 46-T.5N-R.52E

Owner Digman, Emmett Address Miles City, Montana

AAA Owner Co Jim Rayburn Address Box 304, Miles City

Operator " Address "

New Owner Address

New Operator Address

Assessment Record None

Assessed Acreage 0

Legal Description of This Farm W<sup>2</sup>, SW<sup>4</sup> SE<sup>4</sup> Sec. 1, Lots 3, 4, 5, 6, N<sup>2</sup> NW<sup>4</sup>,  
SE<sup>4</sup> NW<sup>4</sup>, SW<sup>4</sup>, W<sup>2</sup> SE<sup>4</sup>, SE<sup>4</sup> SE<sup>4</sup> Sec. 14, T. 5N-R. 52E

Total Acres in Farm ✓

Code Number 4A, 14A

Photo No. Ma 23-83, Ma 24-41

AAA Contract No.

AAA Total Cropland Acreage

App. No. 731, 1318, 386,

Decree No.

Land is located in

Twp. 5N Rge. 53E Twp. 2N Rge. 54E

Twp. 3N Rge. 54E Twp. 1N Rge. 53E  
7N-51E 6N 51E

Filed in Twp. 5N Rge. 53E

Remarks

*See attached map for WR 1*

Powder River Basin

Ownership covers  
only irrigated land.  
All ownership for  
dry land not shown.

**STATE ENGINEERS OFFICE**  
**Water Resources Survey**

**Notice of Appropriation**

- 386
1. County Custer Book D Page 137 Record W.R.
  2. Name of Appropriator Ina M. O'Neill Address Custer County
  3. Date Appropriated Dec. 26, 1908 Date Filed Jan. 4, 1909  
Amount Appropriated, Miners Inches \_\_\_\_\_, Cubic Feet per second 30
  4. Name of Stream Cottonwood Creek Tributary Powder River Basin \_\_\_\_\_
  5. Point of Diversion 1/2 mile West of the SW corner of  
\_\_\_\_\_  
Sec. 14 Twp. 5N. Rge. 52E. Bank of Stream \_\_\_\_\_  
\_\_\_\_\_  
\_\_\_\_\_
  6. Purpose Watering of all kinds of livestock
  7. Description of System A dam across said creek to be about 100 feet long and about 15  
feet high. Said water is to be conveyed from said tributary and said dam to,  
over and upon said lands by means of a ditch approximately 4 ft. wide and 2 ft. deep.
  8. Land Description of Intended Place of Use \_\_\_\_\_  
W $\frac{1}{2}$  Sec. 14-5N-52E; NW $\frac{1}{4}$  Sec. 14-5N-52E, S $\frac{1}{2}$  NW $\frac{1}{4}$ , SW $\frac{1}{4}$ , Lot 3 Sec. 14-5N-52E, 317.17 acres, Frederick J.  
Bannister, St. Paul, Minn.
  9. Remarks (Pertaining to Use, etc.) \_\_\_\_\_  
\_\_\_\_\_  
\_\_\_\_\_  
\_\_\_\_\_

**Decree**

10. Case No. \_\_\_\_\_ Date \_\_\_\_\_ Amt. Decreed: M. I. \_\_\_\_\_ C. F. S. \_\_\_\_\_
11. To Whom Decreed \_\_\_\_\_ Address \_\_\_\_\_
12. Name of Ditch \_\_\_\_\_ Maximum Capacity (C. F. S.) \_\_\_\_\_
13. Date of Priority \_\_\_\_\_ Purpose \_\_\_\_\_
14. Land Description of Place of Use as Decreed \_\_\_\_\_  
\_\_\_\_\_  
\_\_\_\_\_  
\_\_\_\_\_  
\_\_\_\_\_
15. Remarks (Present Use Status, etc.) \_\_\_\_\_  
\_\_\_\_\_  
\_\_\_\_\_  
\_\_\_\_\_

STATE ENGINEERS OFFICE  
Water Resources Survey

Notice of Appropriation

1. County Custer Book C Page 549 Record W.R.

2. Name of Appropriator Martha J. Crosby Address Custer Co., Montana  
April 1, 1906

3. Date Appropriated Feb. 15, 1908 Date Filed Feb. 20, 1908

Amount Appropriated, Miners Inches....., Cubic Feet per second 5

4. Name of Stream Fourth Creek Tributary Powder R. Basin.....

5. Point of Diversion at or near the SW corner of the SE $\frac{1}{4}$ SW $\frac{1}{4}$

Sec. 4 Twp. 5N. Rge. 52E. Bank of Stream.....

6. Purpose For irrigation, reclaim land and raise crops.

7. Description of System A dam across said creek creating a storage reservoir of sufficient size to maintain and hold the storm and flood waters of said creek and thence by means of ditches and laterals on either side of said creek of sufficient capacity; said waters are to be conducted and carried over and upon the land described; the said diversion may also be aided by natural channels, depressions or by dykes as the circumstances will allow

8. Land Description of Intended Place of Use.....  
NW $\frac{1}{4}$ , NE $\frac{1}{4}$ SW $\frac{1}{4}$ , SE $\frac{1}{4}$ SW $\frac{1}{4}$ , SW $\frac{1}{4}$ SE $\frac{1}{4}$  Sec. 4-5N-52E. (See page 164)

9. Remarks (Pertaining to Use, etc.).....  
In question No. 4: The location of said Fourth Creek is as follows: Said Fourth Creek is a tributary to Powder River and being the 4th creek flowing into said Powder River from West above the mouth of the Mizpah Cr.

Decree

10. Case No..... Date..... Amt. Decreed: M. I. .... C. F. S.....

11. To Whom Decreed..... Address.....

12. Name of Ditch..... Maximum Capacity (C. F. S.).....

13. Date of Priority..... Purpose.....

14. Land Description of Place of Use as Decreed.....

15. Remarks (Present Use Status, etc.).....

STATE ENGINEERS OFFICE  
Water Resources Survey

Notice of Appropriation

- 1318
1. County Custer Book C Page 164 Record W.R.
2. Name of Appropriator Martha J. Crosby Address Miles City, Montana
3. Date Appropriated Nov. 2, 1905 Date Filed Nov. 4, 1905
- Amount Appropriated, Miners Inches 4000, Cubic Feet per second
4. Name of Stream Powder River Tributary  Basin
5. Point of Diversion 1600 ft. above or south of the meander corner common to  
Sec. 3, 4, Twp. 5N., Rge. 52E., Bank of Stream Left or West
6. Purpose For irrigating and other purposes.
7. Description of System Pump and ditch, said pump is run by an engine and will lift said  
4000 inches of water from said creek and into said ditch which will carry it to and  
upon said land.
8. Land Description of Intended Place of Use Sec. 4-5N-52E.  
Lots 1, 4, 5, NE-SE-1, SE-NE-1 Sec. 32-6N-52E, 132.89 acres, Henry Fricke, Miles City  
SE-SE-1, NW-SE-1 Sec. 32-6N-52E, 132.89 acres, Wm. R. Sincok, Mizpah, Montana  
Lot 1 Sec. 32-6N-52E, 18.18 acres, Frederick J. Banvister, St. Paul  
SW-SE-1, NW-SE-1, SE-SE-1 Sec. 32-6N-52E, 160 acres, "  
Lots 3, 4, SW-NE-1, NE-SE-1 Sec. 32-6N-52E, 200.16 acres, Clyde V. Brown, "  
SW-NE-1, NW-SE-1, SE-SE-1 Sec. 32-6N-52E, 160 acres, Federal Land Bank, c/o Clyde V. Brown  
Bal. of Sec. U.S.A.
9. Remarks (Pertaining to Use, etc.)

Decree

10. Case No.  Date  Amt. Decreed: M. I.  C. F. S.
11. To Whom Decreed  Address
12. Name of Ditch  Maximum Capacity (C. F. S.)
13. Date of Priority  Purpose
14. Land Description of Place of Use as Decreed
15. Remarks (Present Use Status, etc.)



NOTICE  
 When forms are filed,  
 receipt of the State  
 of Montana and must  
 be returned.

# STATE OF MONTANA STATE ENGINEERS OFFICE

## Water Resources Survey

FORM WR-1-2M 12-47

Code No. 23A-24A

County Custer

T: 5N R: 52E

Name of Land Owner Margaret B. Kemp Address Minpah, Mont  
 Name of Operator \_\_\_\_\_ Address \_\_\_\_\_

## Part A

### TO BE FILED BY THOSE OBTAINING IRRIGATION WATER FROM A DITCH COMPANY OR IRRIGATION DISTRICT

1. Water is delivered by: \_\_\_\_\_  
 Name of Ditch, Ditch Company or District Supplying Water
2. State the number of acres you irrigate under this system \_\_\_\_\_ Shares you hold \_\_\_\_\_
3. If you obtain water from more than one Company, give the number of shares, acres irrigated and the name of the Company under "Remarks." If you obtain water from a Ditch Company and also have a private system fill in both Part A and Part B.

## Part B

### TO BE FILED BY THOSE WHO HAVE A PRIVATE DITCH, PUMP OR IRRIGATION SYSTEM or those who have a private water right under a Ditch Company

4. In what year was this land first irrigated? Date See attached filings
5. Give the name of the original appropriator (first user): \_\_\_\_\_
6. Give the date appropriated \_\_\_\_\_ Amount filed on: Miners Inches \_\_\_\_\_ C. F. S. \_\_\_\_\_
7. State the total number of acres irrigated under this system: \_\_\_\_\_
8. Give the point of diversion: 1/4 Section \_\_\_\_\_ Township \_\_\_\_\_ Range \_\_\_\_\_

## Part C

### TO BE FILED BY ALL WATER USERS IN ADDITION TO PART A OR PART B

9. Source of Water: Mason Creek & Windham R.  
 Name of stream or lake from which water is originally diverted
10. Water is obtained by: (Check one) Gravity ☒ Pumping \_\_\_\_\_ Other Flood
11. What is the greatest number of acres you have irrigated? ? Date \_\_\_\_\_
12. How many acres did you irrigate in 1947? (Crop and pasture) 249.0
13. State the total number of additional acres that could be irrigated by increasing the water supply, land leveling, etc. 0 This land is under what ditch? \_\_\_\_\_
14. How many acres of seeped land do you have which could be drained and put into production? 0
15. What is the condition of your irrigation system? Fair

16. Is your water supply adequate? Yes \_\_\_\_\_ No ☒ Explain I had no
17. REMARKS: Has pump on the Powder River

& ditch but has not been used since 1934 also has pump in Sec. 24 but it has not been used since 1936, both out of  
Powder River 10-27-1966 Over A-1318A M.B. Cunningham H-1-57  
1400 ME Pumps on 300 ac.

NOTE: The foregoing questions apply only to irrigated land shown on this plat.

### DESCRIPTION AND MAP OF FARM

18. Legal Description of this Farm Lots, 2, 3, 6 & 7, W<sup>2</sup>N<sup>2</sup>, SE<sup>4</sup>SW<sup>4</sup>, Sec 24  
all sec 23, T5N R52E



IRRIGATED LAND



NON-IRRIGATED LAND

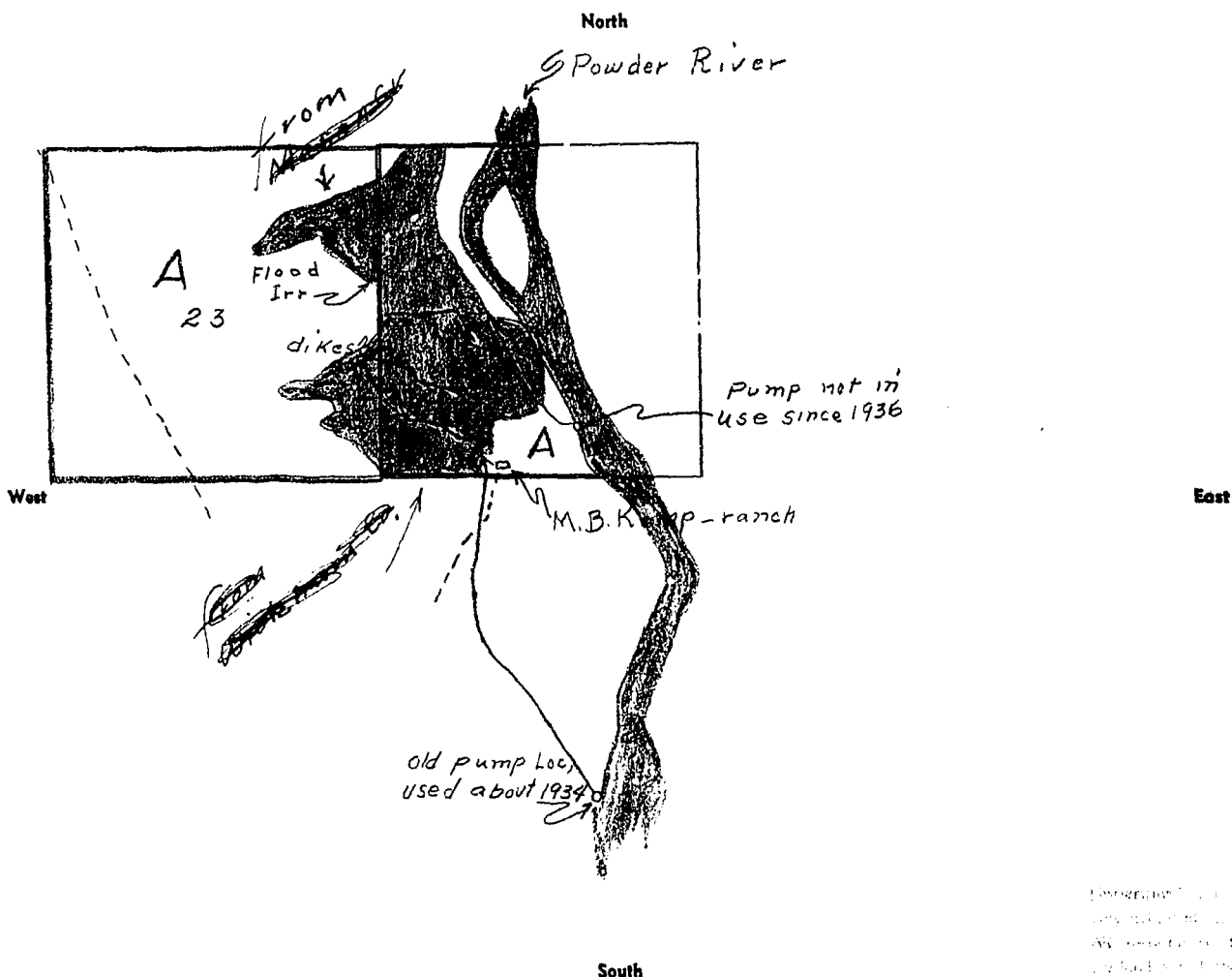

19. If the above land is irrigated from more than one ditch please give the acreage under each ditch in 19A and indicate the location of the land irrigated from each on the above map.

19A. Ditch: M. B. Kemp flood Irr from Kemp Cr. Acres: 249.0  
Ditch: \_\_\_\_\_ Acres: \_\_\_\_\_

Information supplied by:

Name M. B. Kemp Jr Address \_\_\_\_\_ Date July 15-47

REMARKS: Johnson & Paulist

If you cannot answer all of the questions on this form answer as many as you can and return the form to us as soon as possible.

STATE ENGINEER'S OFFICE  
WATER RESOURCES SURVEYCOUNTY ClusterFILE NO. 71-T5N-R52EOwner Kemp, Margaret B Address Mizpah, Montana

AAA Owner Address

Operator Address

New Owner Address

New Operator Address

Assessment Record NONEAssessed Acreage 0Legal Description of This Farm Lots 2, 3, 6, & 7, W<sup>2</sup>W<sup>2</sup>, SE<sup>4</sup>SW<sup>4</sup> Sec 24all SW, 23T.5N R.52ETotal Acres in Farm 4Code Number 21A - 23APhoto No. Margaret

AAA Contract No.

AAA Total Cropland Acreage

App. No. 1951-2205

Decree No.

Land is located in

Twp 5N Rge 52E Twp. Rge.

Twp. Rge. Twp. Rge.

Filed in Twp 5N Rge 52E

Remarks

Powder River BasinOwnership covers  
only irrigated land.  
All ownership for  
dry land not shown



**STATE ENGINEERS OFFICE**  
**Water Resources Survey**

**Notice of Appropriation**

1. County Custer Book E Page 521 Record W.R.
2. Name of Appropriator Alax Sabluckles Address Knowlton, Montana
3. Date Appropriated Sept. 8, 1938 Date Filed Sept. 8, 1938
- Amount Appropriated, Miners Inches 120 or         , Cubic Feet per second 3
4. Name of Stream Mason Creek Tributary          Basin
5. Point of Diversion

Sec.          Twp.          Rge.          Bank of Stream Left

6. Purpose For irrigation
7. Description of System A dam, or ditch 36" X 60" in size, which carries and conducts  
said amount of water fr m said creek and runs thence southwesterly according to  
the lay of the ground, thence over and upon said land.
8. Land Description of Intended Place of Use           
NE Sec. 24-5N-52E, 320 acres, Frederick J. Banister, St. Paul
9. Remarks (Pertaining to Use, etc.)

**Decree**

10. Case No.          Date          Amt. Decreed: M. I.          C. F. S.
11. To Whom Decreed          Address
12. Name of Ditch          Maximum Capacity (C. F. S.)
13. Date of Priority          Purpose
14. Land Description of Place of Use as Decreed
15. Remarks (Present Use Status, etc.)

**STATE ENGINEERS OFFICE**  
**Water Resources Survey**

**Notice of Appropriation**

1. County Custer Book C Page 318 Record W.R.
2. Name of Appropriator Arthur Stacy Address Powderville, Montana
3. Date Appropriated Mar. 21, 1907 Date Filed Mar. 21, 1907
- Amount Appropriated, Miners Inches 500 Cubic Feet per second \_\_\_\_\_
4. Name of Stream Nameless Creek Tributary \_\_\_\_\_ Basin \_\_\_\_\_
5. Point of Diversion About the center of the S $\frac{1}{2}$  of

Sec. 23 Twp. 5N. Rge. 52E. Bank of Stream South

6. Purpose For irrigating and other purposes.
7. Description of System Dam and ditch. Said ditch is 36" X 36" in size, which carries and conducts said 200 in. of water and runs thence in a southeasterly direction.

8. Land Description of Intended Place of Use \_\_\_\_\_  
W $\frac{1}{2}$ SW $\frac{1}{4}$ , SE $\frac{1}{4}$ SW $\frac{1}{4}$ , Lot 6, lot 7 Sec. 24-5N-52E, Margaret B. & Eva & Agnes Kemp, Mizpah,  
Montana

9. Remarks (Pertaining to Use, etc.) \_\_\_\_\_

**Decree**

10. Case No. \_\_\_\_\_ Date \_\_\_\_\_ Amt. Decreed: M. I. \_\_\_\_\_ C. F. S. \_\_\_\_\_
11. To Whom Decreed \_\_\_\_\_ Address \_\_\_\_\_
12. Name of Ditch \_\_\_\_\_ Maximum Capacity (C. F. S.) \_\_\_\_\_
13. Date of Priority \_\_\_\_\_ Purpose \_\_\_\_\_
14. Land Description of Place of Use as Decreed \_\_\_\_\_
15. Remarks (Present Use Status, etc.) \_\_\_\_\_



NOTICE  
These forms are the  
property of the State  
of Montana and must  
be returned.

STATE OF MONTANA  
STATE ENGINEERS OFFICE

Water Resources Survey

FORM WR-1-2M 12-47

Code No. 18A

County Ouster

T. 5N R. 52

Name of Land Owner Charles Wiley Address Wiley City, Mont

Name of Operator \_\_\_\_\_ Address \_\_\_\_\_

Part A

TO BE FILED BY THOSE OBTAINING IRRIGATION WATER FROM  
A DITCH COMPANY OR IRRIGATION DISTRICT

1. Water is delivered by: \_\_\_\_\_  
Name of Ditch, Ditch Company or District Supplying Water
2. State the number of acres you irrigate under this system \_\_\_\_\_ Shares you hold \_\_\_\_\_
3. If you obtain water from more than one Company, give the number of shares, acres irrigated and the name of the Company under "Remarks." If you obtain water from a Ditch Company and also have a private system fill in both Part A and Part B.

Part B

TO BE FILED BY THOSE WHO HAVE A PRIVATE DITCH, PUMP OR IRRIGATION SYSTEM  
or those who have a private water right under a Ditch Company

4. In what year was this land first irrigated? Date \_\_\_\_\_
5. Give the name of the original appropriator (first user): Milo S. Hill
6. Give the date appropriated 12/12/06 Amount filed on: Miners Inches 500 C. F. S.
7. State the total number of acres irrigated under this system: 30.0
8. Give the point of diversion: NE 1/4 1/4 Section 18 Township 5N Range 52

Part C

TO BE FILED BY ALL WATER USERS IN ADDITION TO PART A OR PART B

9. Source of Water: Pass Creek  
Name of stream or lake from which water is originally diverted
10. Water is obtained by: (Check one) Gravity ☒ Pumping \_\_\_\_\_ Other \_\_\_\_\_
11. What is the greatest number of acres you have irrigated? 2 Date \_\_\_\_\_
12. How many acres did you irrigate in 1947? (Crop and pasture) 30.0
13. State the total number of additional acres that could be irrigated by increasing the water supply, land leveling, etc. 0 This land is under what ditch? \_\_\_\_\_
14. How many acres of seeped land do you have which could be drained and put into production? 0
15. What is the condition of your irrigation system? New
16. Is your water supply adequate? Yes \_\_\_\_\_ No ☒ Explain I had slow
17. REMARKS: Has new dam and flood ditch constructed in 1946

Over

NOTE: The foregoing questions apply only to irrigated land shown on this plat.

### DESCRIPTION AND MAP OF FARM

18. Legal Description of this Farm W2, SE4, E2ME4, Sec 18, T5N R52E.



IRRIGATED LAND



NON-IRRIGATED LAND

North

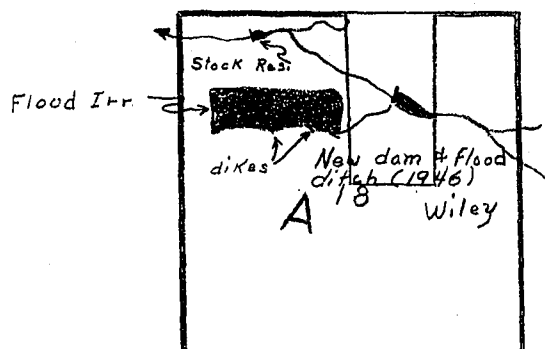

West

East

South

Ownership covers  
only irrigated land.  
All ownership for  
dry land not shown.

19. If the above land is irrigated from more than one ditch please give the acreage under each ditch in 19A and indicate the location of the land irrigated from each on the above map.

19A. Ditch: Wiley Flood ditch from Pass Creek Acres: 30.0

Ditch: \_\_\_\_\_ Acres: \_\_\_\_\_

Information supplied by:

Name Wiley to Address \_\_\_\_\_ Date July 15-47

REMARKS: Johnson & Paulist

If you cannot answer all of the questions on this form answer as many as you can and return the form to us as soon as possible.

STATE ENGINEER'S OFFICE  
WATER RESOURCES SURVEYCOUNTY CusterFILE NO. 46-T.5N-R.52EOwner Wiley, Charles (Estate) Address Miles City, Mont.

AAA Owner ..... Address .....

Operator ..... Address .....

New Owner ..... Address .....

New Operator None ..... Address .....

Assessment Record .....

Assessed Acreage 0Legal Description of This Farm W<sup>1</sup>, SE<sup>4</sup>, E<sup>2</sup> NE<sup>4</sup>, Sec 18, T.5N-R.52ETotal Acres in Farm ✓Code Number 18APhoto No. Ma-23-83

AAA Contract No. ....

AAA Total Cropland Acreage .....

App. No. 1226

Decree No. ....

Land is located in

Twp. 5N Rge. 52E Twp. 1N Rge. 52E

Twp. .... Rge. .... Twp. .... Rge. ....

Filed in Twp. 5N Rge. 52E

Remarks .....

Powder River BasinOwnership covers  
only irrigated land.  
All ownership for  
dry land not shown.

STATE ENGINEERS OFFICE  
Water Resources Survey

Notice of Appropriation

1. County Custer Book C Page 302 Record W.R.
2. Name of Appropriator Milo S. Hill Address Miles City, Montana  
(12)
3. Date Appropriated Dec. 15, 1906 Date Filed Dec. 15, 1906  
Amount Appropriated, Miners Inches 500, Cubic Feet per second
4. Name of Stream Pass Creek Tributary Basin
5. Point of Diversion About 20 chains SE of the 1/4 S.3. on the north side of  
Sec. 18 Twp. 5N Rge. 52E Bank of Stream Left
6. Purpose For irrigating and other purposes
7. Description of System Dam and ditch, said ditch is 40" X 36" in size, which carries and  
conducts said 500 inches of water from said creek, at said bank of stream and said point  
of diversion and runs thence in a westerly direction thence over and upon said land,  
(or mining claim).
8. Land Description of Intended Place of Use  
BLM, NE1/4, Lots 1,2,3, Sec. 18-5N-52E, 235.72 acres, Federal Land Bank, Spokane
9. Remarks (Pertaining to Use, etc.)

Decree

10. Case No. Date Amt. Decreed: M. I. C. F. S.
11. To Whom Decreed Address
12. Name of Ditch Maximum Capacity (C. F. S.)
13. Date of Priority Purpose
14. Land Description of Place of Use as Decreed
15. Remarks (Present Use Status, etc.)

STATE OF MONTANA  
**STATE ENGINEER'S OFFICE**  
 WATER RESOURCES SURVEY

Township 5N Range 52E County Custer

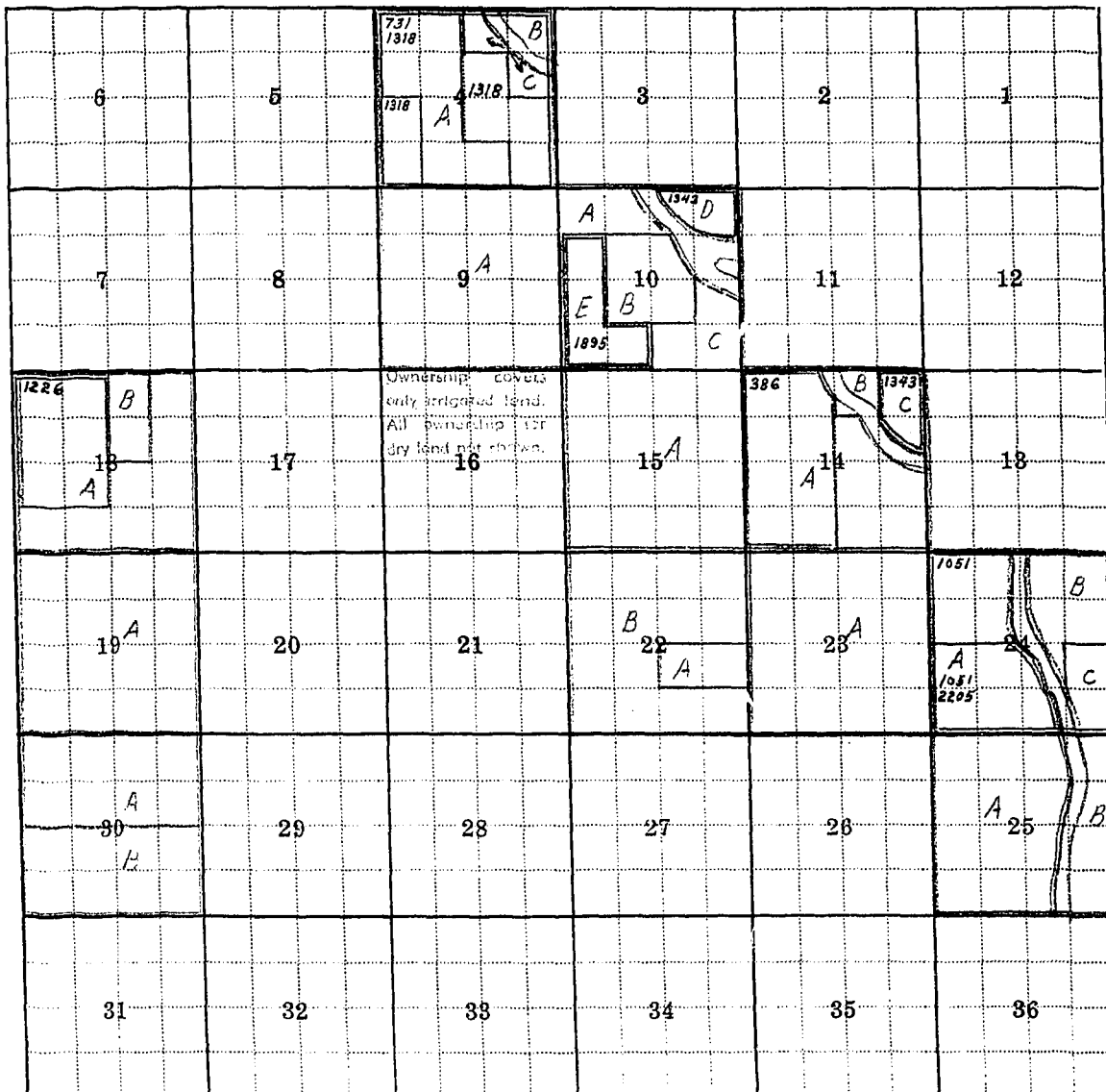

Township 5N Range 52E

Custer[illegible]



Township 5 North

Range 52 East

Custer County

<u>Index No.</u>	<u>Name of Appropriator</u>	<u>Stream</u>	<u>Date App.</u>	<u>Date Filed</u>	<u>M.I.</u>
386	Ina M. O'Neill	Cottonwood Creek	12-26-08	1-4-09	1200
731	Martha J. Crosby	Fourth Creek	4-1-06	2-20-08	200
1051	Alax Sabluckles	Mason Creek	9-8-38	9-8-38	120
1226	Milo S. Hill	Pass Creek	12-12-06	12-15-06	500
1318	Martha J. Crosby	Powder River	11-3-05	11-4-05	4000
1343	John Selway	Powder River	8-28-09	9-9-09	2000
1895	Mont. Crosby	Tiger Tim Creek	3-12-08	3-14-08	500
2205	George A. Lane	Wickham Creek	12-18-02	1-13-02	280

Township 5 North

Range 52 East

Custer County

STATE OF MONTANA  
**STATE ENGINEER'S OFFICE**  
 WATER RESOURCES SURVEY

Township 5N Range 53E County Custer

						6	5	4	3	2	1
						7	8	9	10	11	12
						18	17	16	15	14	13
						19	20	21	22	23	24
A	5	4	3	2	1	Ownership covers only irrigated land. All ownership for dry land is shown.					
7	8	9	10	11	12	30	29	28	27	26	25
13	17	B	16	15	14	13					
19	20	21	22	23	24						
6	5	4	3	2	1						
7	8	9	10	11	12	31	32	33	34	35	36
13	17	B	16	15	14	13					
19	20	21	22	23	24	458	508				

Township 5N Range 53E



Township 5 North

Range 53 East

Custer County

<u>Index No.</u>	<u>Name of Appropriator</u>	<u>Stream</u>	<u>Date App.</u>	<u>Date Filed</u>	<u>M.I.</u>
508	Mont Crosby	Dry Creek	5-26-15	5-26-15	120

Township 5 North

Range 53 East

Custer County





NOTICE  
These forms are the  
property of the State  
of Montana and must  
be returned.

STATE OF MONTANA  
STATE ENGINEERS OFFICE

FORM WR-1-24 12-47

Code No. 306

County Ouster

T. 5N R. 53E

Water Resources Survey

Name of Land Owner

Thomas Royal McKenzie

Address

O'Neill Montana

Name of Operator

Address

Part A

TO BE FILED BY THOSE OBTAINING IRRIGATION WATER FROM  
A DITCH COMPANY OR IRRIGATION DISTRICT

1. Water is delivered by: \_\_\_\_\_  
Name of Ditch, Ditch Company or District Supplying Water
2. State the number of acres you irrigate under this system. \_\_\_\_\_ Shares you hold \_\_\_\_\_
3. If you obtain water from more than one Company, give the number of shares, acres irrigated and the name of the Company under "Remarks." If you obtain water from a Ditch Company and also have a private system fill in both Part A and Part B.

Part B

TO BE FILED BY THOSE WHO HAVE A PRIVATE DITCH, PUMP OR IRRIGATION SYSTEM  
or those who have a private water right under a Ditch Company

4. In what year was this land first irrigated? Date see attached filing
5. Give the name of the original appropriator (first user): \_\_\_\_\_
6. Give the date appropriated. \_\_\_\_\_ Amount filed on: Miners Inches \_\_\_\_\_ C. F. S. \_\_\_\_\_
7. State the total number of acres irrigated under this system: \_\_\_\_\_
8. Give the point of diversion: \_\_\_\_\_  $\frac{1}{4}$  \_\_\_\_\_  $\frac{1}{4}$  Section \_\_\_\_\_ Township \_\_\_\_\_ Range \_\_\_\_\_

Part C

TO BE FILED BY ALL WATER USERS IN ADDITION TO PART A OR PART B

9. Source of Water: Trail Creek  
Name of stream or lake from which water is originally diverted
10. Water is obtained by: (Check one) Gravity ☒ Pumping \_\_\_\_\_ Other \_\_\_\_\_
11. What is the greatest number of acres you have irrigated? ? Date \_\_\_\_\_
12. How many acres did you irrigate in 1947? (Crop and pasture) 60.0
13. State the total number of additional acres that could be irrigated by increasing the water supply, land leveling, etc. 0 This land is under what ditch? 0
14. How many acres of seeped land do you have which could be drained and put into production? 0
15. What is the condition of your irrigation system? Fair
16. Is your water supply adequate? Yes \_\_\_\_\_ No ☒ Explain I have good water
17. REMARKS: irrigation only, through O'Neill flood ditch

Over

NOTE: The foregoing questions apply only to irrigated land shown on this plat.

### DESCRIPTION AND MAP OF FARM

18. Legal Description of this Farm Lots - 3, 4, 5, 8, 9, 10, 14, 15, 16, 17, 18, 19,  
20, 21, 22, 23. Sec 30, T5N R53E



IRRIGATED LAND



NON-IRRIGATED LAND

North

West

East

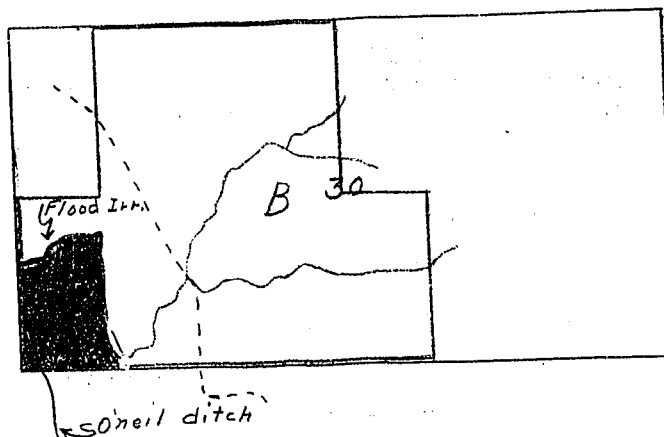

*possibly under Mary E. O'Neill  
right from trail  
creek*

South

Ownership, shows  
only irrigated land.  
All ownership for  
dry land not shown.

19. If the above land is irrigated from more than one ditch please give the acreage under each ditch in 19A and indicate the location of the land irrigated from each on the above map.

19A. Ditch: O'Neill Flood ditch Acres: 60.0

Ditch: \_\_\_\_\_ Acres: \_\_\_\_\_

Information supplied by:

Name Bob O'Neill Address \_\_\_\_\_ Date July 10-47

REMARKS: To Johnson & Paulist

If you cannot answer all of the questions on this form answer as many as you can and return the form to us as soon as possible.

STATE ENGINEER'S OFFICE  
WATER RESOURCES SURVEYCOUNTY ClusterFILE NO. 47-T.5N-R.53EOwner McKenzie, Thomas Royal Address O'Neill, Montana

AAA Owner ..... Address .....

Operator ? Address ?

New Owner ..... Address .....

New Operator ..... Address .....

Assessment Record NoneAssessed Acreage 0Legal Description of This Farm lots - 3-4-5-8-9-10-14-15-16-17-18-19-20-21-22-23, Sec. 30,T.5N-R.53ETotal Acres in Farm ✓Code Number 30BPhoto No. Ma. 23-82

AAA Contract No. ....

AAA Total Cropland Acreage .....

App. No. 1958

Decree No. ....

Land is located in

Twp. 5N Rge. 53E Twp. .... Rge. ....

Twp. .... Rge. .... Twp. .... Rge. ....

Filed in Twp. 5N Rge. 53ERemarks This land may beoperated Robert O'Neill?Powder River BasinOwnership covers  
only irrigated land.  
All ownership for  
dry land not shown.



## Notice of Appropriation

10. Case No..... Date..... Amt. Decreed: M. I..... C. F. S.....
11. To Whom Decreed ..... Address.....
12. Name of Ditch..... Maximum Capacity (C. F. S.).....
13. Date of Priority ..... Purpose.....
14. Land Description of Place of Use as Decreed.....  
.....  
.....  
.....  
.....
15. Remarks (Present Use Status, etc.).....

Amt. Decr

10. Case No..... Date..... Amt. Decreed: M. I..... C. F. S.....
11. To Whom Decreed..... Address.....
12. Name of Ditch..... Maximum Capacity (C. F. S.).....
13. Date of Priority..... Purpose.....
14. Land Description of Place of Use as Decreed.....  
.....  
.....  
.....  
.....
15. Remarks (Present Use Status, etc.).....  
.....  
.....



NOTICE  
These forms are the  
property of the State  
of Montana and must  
be returned.

STATE OF MONTANA  
STATE ENGINEERS OFFICE  
Water Resources Survey

Code No. 313  
County Custer  
T. 5N R. 53E

Name of Land Owner State of Montana Address Helena, Mont  
Name of Operator Robert O'neil Address O'Neill, Mont

**Part A**

(old post office?)

TO BE FILED BY THOSE OBTAINING IRRIGATION WATER FROM  
A DITCH COMPANY OR IRRIGATION DISTRICT

1. Water is delivered by: \_\_\_\_\_  
Name of Ditch, Ditch Company or District Supplying Water
2. State the number of acres you irrigate under this system \_\_\_\_\_ Shares you hold \_\_\_\_\_
3. If you obtain water from more than one Company, give the number of shares, acres irrigated and the name of the Company under "Remarks." If you obtain water from a Ditch Company and also have a private system fill in both Part A and Part B.

**Part B**

TO BE FILED BY THOSE WHO HAVE A PRIVATE DITCH, PUMP OR IRRIGATION SYSTEM  
or those who have a private water right under a Ditch Company

4. In what year was this land first irrigated? Date No data
5. Give the name of the original appropriator (first-user): Mary E. O'Neill
6. Give the date appropriated 4/22/07 Amount filed on: Miners Inches 1000 C. F. S. \_\_\_\_\_
7. State the total number of acres irrigated under this system: \_\_\_\_\_
8. Give the point of diversion: \_\_\_\_\_  $\frac{1}{4}$  Section \_\_\_\_\_ Township \_\_\_\_\_ Range \_\_\_\_\_

**Part C**

TO BE FILED BY ALL WATER USERS IN ADDITION TO PART A OR PART B

9. Source of Water: Trail Creek  
Name of stream or lake from which water is originally diverted
10. Water is obtained by: (Check one) Gravity ☒ Pumping \_\_\_\_\_ Other \_\_\_\_\_
11. What is the greatest number of acres you have irrigated? ? Date \_\_\_\_\_
12. How many acres did you irrigate in 1947? (Crop and pasture) 176.0
13. State the total number of additional acres that could be irrigated by increasing the water supply, land leveling, etc. 0 This land is under what ditch? \_\_\_\_\_
14. How many acres of seeped land do you have which could be drained and put into production? 0
15. What is the condition of your irrigation system? Fair
16. Is your water supply adequate? Yes \_\_\_\_\_ No ☒ Explain Flood line
17. REMARKS: \_\_\_\_\_

Only irrigated when water is available

Over

NOTE: The foregoing questions apply only to irrigated land shown on this plat.

### DESCRIPTION AND MAP OF FARM

18. Legal Description of this Farm Lots 13, 14, 15, 16, 17, 18, 19, 20, 21, 22,  
23, 24, S<sup>2</sup>SE<sup>4</sup>, Sec 31 - T5N R53E



IRRIGATED LAND



NON-IRRIGATED LAND

North

West

East

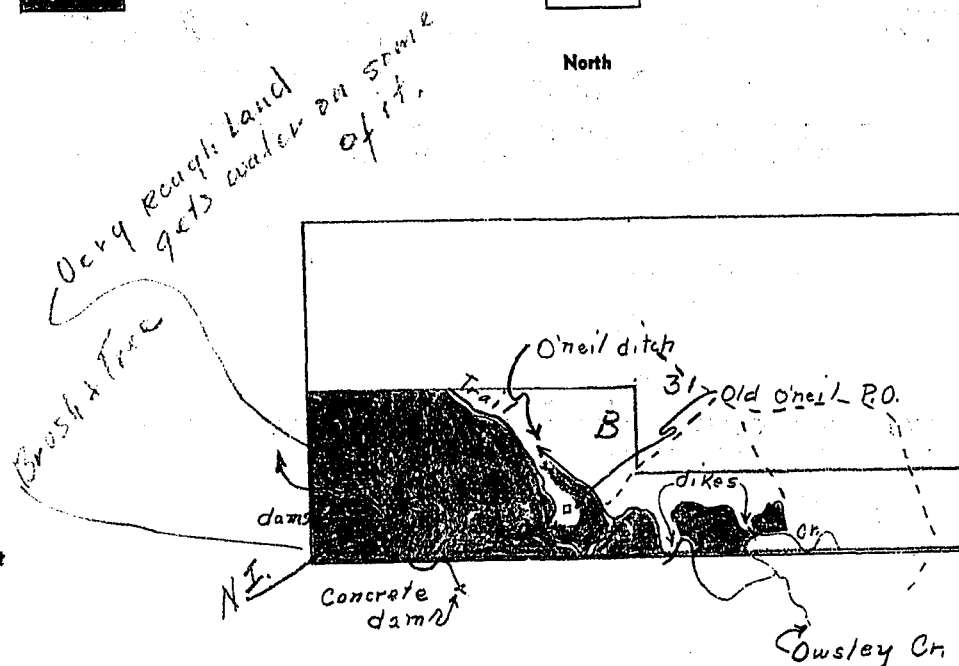

Land tied up in Mortgage  
title not clear  
has been in O. Neill  
family for years

South

Shading covers  
only irrigated land.  
All ownership for  
dry land not shown.

19. If the above land is irrigated from more than one ditch please give the acreage under each ditch in 19A and indicate the location of the land irrigated from each on the above map.

19A. Ditch: O' Neill Flood ditch Acres: 176.0

Ditch: from trail Creek Acres:       

Information supplied by:

Name Bob O. Neill Address                      Date July-10-47

REMARKS: To Johnson & Pauliat  
Mary E. O. Neill made filing in  
1907

If you cannot answer all of the questions on this form answer as many as you can and return the form to us as soon as possible.

STATE ENGINEER'S OFFICE  
WATER RESOURCES SURVEYCOUNTY CusterFILE NO. 47-T.5N-R.53EOwner Montana, State of Address Helena, Montana

AAA Owner Address

Operator Robert ? Oneil Address Miles? City - R.R.

New Owner Address

New Operator Address

Assessment Record NoneAssessed Acreage 0Legal Description of This Farm Lots 13-14-15-16-17-18-19-20-21-22-23-24, S<sup>2</sup>SE<sup>4</sup> Sec. 31;T.5N-R.53ETotal Acres in Farm ✓Code Number 31BPhoto No. Ma 23-82

AAA Contract No.

AAA Total Cropland Acreage

App. No. 1955

Decree No.

Land is located in

Twp. 5N Rge. 53E Twp. Rge.

Twp. Rge. Twp. Rge.

Filed in Twp. 5N Rge. 53E

Remarks

35.

30.

34.

16.

10.

8.

9.

40.

176

See attached  
map

Powder River Basin

Ownership covers  
only irrigated land.  
All ownership for  
dry land not shown.

February 12, 1948

Mr. Robert O'Neill  
O'Neill, Montana

Re: Flood Irrigation Trail Creek

Dear Sir:

Custer

12 13 14 15 16 17 18 19 20 21 22 23 24. S4SE Sec. 31. T.5N., R.53E.

**STATE ENGINEERS OFFICE**  
**Water Resources Survey**

**Notice of Appropriation**

1958

1. County Custer Book C Page 332 Record W.R.
2. Name of Appropriator Mary E. O'Neill Address Custer Co., Montana  
(22)
3. Date Appropriated April 25, 1907 Date Filed April 26, 1907 (Not filed)  
Amount Appropriated, Miners Inches \_\_\_\_\_, Cubic Feet per second 25
4. Name of Stream Trail Creek Tributary Powder River Basin \_\_\_\_\_
5. Point of Diversion at or near the NE corner of Section  
\_\_\_\_\_  
Sec. 4 Twp. 4N. Rge. 53E. Bank of Stream North  
\_\_\_\_\_  
\_\_\_\_\_
6. Purpose For irrigating and domestic purposes.
7. Description of System A ditch in dimensions about 5 feet wide and 2 feet deep and so constructed as to be capable of carrying said amount of water from said point of diversion to, upon and across the above described lands to any requested point of final discharge. The water from said creek is to be diverted and controlled by means of a suitable headgate and a dam if necessary.
8. Land Description of Intended Place of Use  
See Question 9  
\_\_\_\_\_  
\_\_\_\_\_  
\_\_\_\_\_
9. Remarks (Pertaining to Use, etc.) The claimants homestead, consisting of 160 acres of unsurveyed land lying on Powder River in T. 5N., R. 53E. (and supposed to be in Section 31) said land being adjoined on the south by the lands of the Open Range Sheep Co) and to irrigate other lands adjoining and lying northerly of said homestead; and also for domestic purposes and the watering of stock in and upon said lands.  
**Decree**
10. Case No. \_\_\_\_\_ Date \_\_\_\_\_ Amt. Decreed: M. I. \_\_\_\_\_ C. F. S. \_\_\_\_\_
11. To Whom Decreed \_\_\_\_\_ Address \_\_\_\_\_
12. Name of Ditch \_\_\_\_\_ Maximum Capacity (C. F. S.) \_\_\_\_\_
13. Date of Priority \_\_\_\_\_ Purpose \_\_\_\_\_
14. Land Description of Place of Use as Decreed  
\_\_\_\_\_  
\_\_\_\_\_  
\_\_\_\_\_  
\_\_\_\_\_  
\_\_\_\_\_
15. Remarks (Present Use Status, etc.)  
\_\_\_\_\_  
\_\_\_\_\_  
\_\_\_\_\_  
\_\_\_\_\_  
\_\_\_\_\_

May 27, 1948

Mr. Robert O'Neill  
#221  
Stevenson, Washington

Dear Mr. O'Neill:

This is in answer to your letter of May 24, 1948.

Since your water right, filed by Mary E. O'Neill, has been in use since the date of filing I wish to advise that it is not necessary to take any further action in regard to bringing this water right up-to-date. Because of its previous use and present use it is now in an active state.

Very truly yours,

Gerald J. Oravetz  
Assistant State Engineer

GJO/a

May 24, 1948

1011 Pleasant  
Miles City, Mont.

Serald J. Cravitz,  
Billings, Mont.

Dear Sir:

This letter has been misdirected due to the fact that O'Neill, Montana has been discontinued as a postoffice. I recently received this request.

Water right was filed by Mary E. O'Neill on April 25, 1907 - W. R. # 332. Patent to the land, namely, lots 16, 17, 20, 21 - Sec. 31 - R. 53 E. N. P. M. granted March - 1914 ~~May 2, 1916~~ under Patent # 394762 and noted on Abstract <sup>May 5, 1916</sup> ~~of that date~~ made out by Custer Abstract Co. - Abstract # 1788 in Custer County. This water right was deeded with the land to my father, Frank. D. O'Neill and I, by inheritance and purchase now own it,





FRED E. BUCK, STATE ENGINEER  
GERALD J. ORAVETZ, ASSISTANT

# STATE OF MONTANA

## STATE ENGINEER

BILLINGS, MONTANA

February 12, 1948

Mr. Robert O'Neill  
O'Neill, Montana

Re: Flood Irrigation Trail Creek

Dear Sir:

In accordance with the 1939 Session Law (Section 349.68 Montana Session Laws) requiring the State Engineer to investigate and prepare a complete record of all water rights in Montana, the State Engineer has been conducting a water resources survey in Custer County.

We are unable to find a recorded water filing for the land that you irrigate in Lots 13,14,15,16,17,18,19,20,21,22,23,24, S $\frac{1}{2}$ SE $\frac{1}{4}$  Sec. 31, T.5N.,R.53E. If a filing was made for this land we would like to have you send us the name of the appropriator, the date filed on, and the number of inches filed on. If no recorded filing was made we would like to have you send us the name of the first user and the date, or the approximate date, that the land was first irrigated so that we may establish a date of priority for this land.

We would like to have you make this a first on your agenda and send this information to us as soon as possible in the enclosed, stamped, self-addressed envelope.

Very truly yours,

*Gerald J. Oravetz*  
Gerald J. Oravetz  
Assistant State Engineer

GJO/a  
enc.

(Over)

E. W. CLARKSON, VICE PRESIDENT  
F. M. CLARKSON, VICE PRESIDENT

H. W. CLARKSON, PRESIDENT

A. J. BIEWER, EXECUTIVE VICE PRESIDENT  
R. L. WILCOX, CASHIER

## **MILES CITY BANK**

MEMBER FEDERAL DEPOSIT INSURANCE CORP.  
MEMBER FEDERAL RESERVE SYSTEM

MILES CITY, MONTANA

in conjunction with my brother,  
Thomas M. O'Neill, who has a  $\frac{1}{9}$  interest.

I would greatly appreciate it if  
you will advise me of any action nec-  
essary to bring this water-right up  
to date. It has been actively used by us  
for irrigation all the ensuing years  
since filing. Original claim was for  
25 Cubic Feet.

Sincerely,

Robert O'Neill  
# 221

Stevenson, Wash.  
(Permanent address)



NOTICE  
These forms are the  
property of the State  
of Montana and must  
be returned.

STATE OF MONTANA  
STATE ENGINEERS OFFICE

Water Resources Survey

FORM WR-1-2M 12-47

Code No. 31C

County Custer

T. 5N R. 53

Name of Land Owner Robert O'Neill Address O'Neill, Mont.

Name of Operator \_\_\_\_\_ Address \_\_\_\_\_

**Part A**

**TO BE FILED BY THOSE OBTAINING IRRIGATION WATER FROM  
A DITCH COMPANY OR IRRIGATION DISTRICT**

1. Water is delivered by: \_\_\_\_\_  
Name of Ditch, Ditch Company or District Supplying Water
2. State the number of acres you irrigate under this system. \_\_\_\_\_ Shares you hold \_\_\_\_\_
3. If you obtain water from more than one Company, give the number of shares, acres irrigated and the name of the Company under "Remarks." If you obtain water from a Ditch Company and also have a private system fill in both Part A and Part B.

**Part B**

**TO BE FILED BY THOSE WHO HAVE A PRIVATE DITCH, PUMP OR IRRIGATION SYSTEM  
or those who have a private water right under a Ditch Company**

4. In what year was this land first irrigated? Date See attached filing
5. Give the name of the original appropriator (first user): \_\_\_\_\_
6. Give the date appropriated \_\_\_\_\_ Amount filed on: Miners Inches \_\_\_\_\_ C. F. S. \_\_\_\_\_
7. State the total number of acres irrigated under this system: \_\_\_\_\_
8. Give the point of diversion: \_\_\_\_\_  $\frac{1}{4}$  \_\_\_\_\_  $\frac{1}{4}$  Section \_\_\_\_\_ Township \_\_\_\_\_ Range \_\_\_\_\_

**Part C**

**TO BE FILED BY ALL WATER USERS IN ADDITION TO PART A OR PART B**

9. Source of Water: Trail Creek  
Name of stream or lake from which water is originally diverted
10. Water is obtained by: (Check one) Gravity ☒ Pumping \_\_\_\_\_ Other \_\_\_\_\_
11. What is the greatest number of acres you have irrigated? ? Date \_\_\_\_\_
12. How many acres did you irrigate in 1947? (Crop and pasture) 830
13. State the total number of additional acres that could be irrigated by increasing the water supply, land leveling, etc. 0 This land is under what ditch? \_\_\_\_\_
14. How many acres of seeped land do you have which could be drained and put into production? 0
15. What is the condition of your irrigation system? Fair
16. Is your water supply adequate? Yes \_\_\_\_\_ No ☒ Explain Flood Irr Only
17. REMARKS: irrigated when water is available

NOTE: The foregoing sections apply only to irrigated land shown on this plat.

### DESCRIPTION AND MAP OF FARM

18. Legal Description of this Farm Lots, 2, 3, 4, 5, 6, 7, 8, 9, 10

Sec 31, T5N R53E



IRRIGATED LAND



NON-IRRIGATED LAND

North

West

East

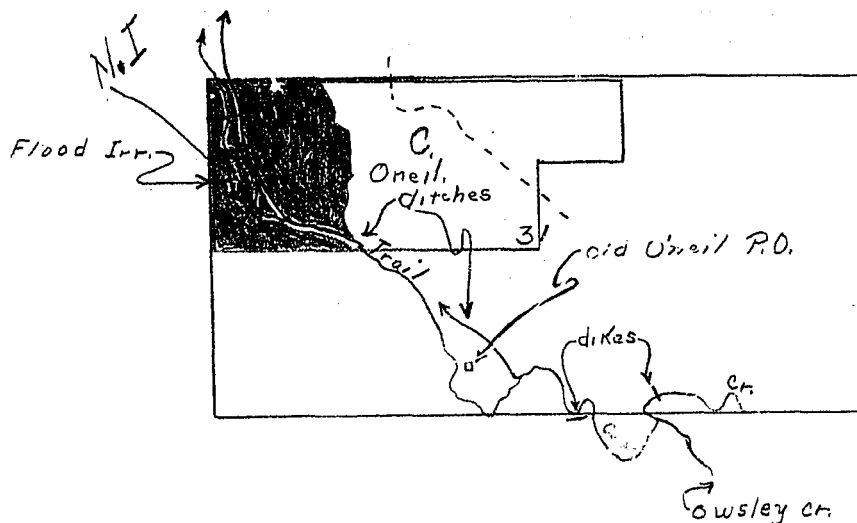

Covered by Mary E. O'Neill  
filing  
from Trail Creek

South

Ownership covers  
only irrigated land.  
All ownership for  
dry land not shown.

19. If the above land is irrigated from more than one ditch please give the acreage under each ditch in 19A and indicate the location of the land irrigated from each on the above map.

19A. Ditch: O'Neill Flood ditch Acres: 83.0

Ditch: from Trail Creek Acres:       

Information supplied by:

Name Bob O'Neill Address        Date July 10-47

REMARKS: To Johnson & Paulist

If you cannot answer all of the questions on this form answer as many as you can and return the form to us as soon as possible.

STATE ENGINEER'S OFFICE  
WATER RESOURCES SURVEYCOUNTY CusterFILE NO. 47-T.5N-R.53EOwner O'Neill, Robert Address O'Neill, Montana

AAA Owner Address

Operator " " Address " "

New Owner Address

New Operator Address

Assessment Record NeneAssessed Acreage 0Legal Description of This Farm Lots 2-3-4-5-6-7-8-9-10 Sec 31 T.5N-R.53ETotal Acres in Farm ✓Code Number 310Photo No. M.R. 23-82

AAA Contract No.

AAA Total Cropland Acreage

App. No. 1958

Decree No.

Land is located in

Twp. 5N Rge. 53E Twp. Rge.

Twp. Rge. Twp. Rge.

Filed in Twp. 5N Rge. 53E

Remarks

Powder River BasinOwnership covers  
only irrigated land.  
All ownership for  
dry land not shown.

1958

**STATE ENGINEERS OFFICE**  
**Water Resources Survey**  
**Notice of Appropriation**

1. County Custer Book C Page 332 Record W.R.
2. Name of Appropriator Mary E. O'Neill Address Custer Co., Montana  
(22)
3. Date Appropriated April 25, 1907 Date Filed April 26, 1907 (Not filed)  
Amount Appropriated, Miners Inches \_\_\_\_\_, Cubic Feet per second 25
4. Name of Stream Trail Creek Tributary Powder River Basin \_\_\_\_\_
5. Point of Diversion at or near the NE corner of Section  
\_\_\_\_\_  
Sec. 4 Twp. 4N. Rge. 53E. Bank of Stream North  
\_\_\_\_\_  
\_\_\_\_\_
6. Purpose For irrigating and domestic purposes.
7. Description of System A ditch in dimensions about 5 feet wide and 2 feet deep and so constructed as to be capable of carrying said amount of water from said point of diversion to, upon and across the above described lands to any requested point of final discharge. The water from said creek is to be diverted and controlled by means of a suitable headgate and siphon if necessary.
8. Land Description of Intended Place of Use  
See Question 9  
\_\_\_\_\_  
\_\_\_\_\_
9. Remarks (Pertaining to Use, etc.) The claimants homestead, consisting of 160 acres of unsurveyed land lying on Powder River in T. 5N., R. 53E (and supposed to be in Section 31) said land being adjoined on the south by the lands of the Open Range Sheep Co) and to irrigate other lands adjoining and lying northerly of said homestead; and also for domestic purposes and the watering of stock in and upon said lands.  
**Decree**
10. Case No. \_\_\_\_\_ Date \_\_\_\_\_ Amt. Decreed: M. I. \_\_\_\_\_ C. F. S. \_\_\_\_\_
11. To Whom Decreed \_\_\_\_\_ Address \_\_\_\_\_
12. Name of Ditch \_\_\_\_\_ Maximum Capacity (C. F. S.) \_\_\_\_\_
13. Date of Priority \_\_\_\_\_ Purpose \_\_\_\_\_
14. Land Description of Place of Use as Decreed  
\_\_\_\_\_  
\_\_\_\_\_  
\_\_\_\_\_  
\_\_\_\_\_  
\_\_\_\_\_
15. Remarks (Present Use Status, etc.)  
\_\_\_\_\_  
\_\_\_\_\_  
\_\_\_\_\_  
\_\_\_\_\_  
\_\_\_\_\_