



NOTICE  
These forms are the property of the State of Montana and must be returned.

STATE OF MONTANA  
STATE ENGINEERS' OFFICE  
Water Resources Survey

Code No. 1B-12B-14A

County: Custer

T. 6N R. 51E

Name of Land Owner: Digman, Emmett Address: Miles City, Montana  
Name of Operator: Go Jim Payburn Address: Box 304, Miles City

**Part A**

TO BE FILED BY THOSE OBTAINING IRRIGATION WATER FROM  
A DITCH COMPANY OR IRRIGATION DISTRICT

1. Water is delivered by: \_\_\_\_\_ Name of Ditch, Ditch Company or District Supplying Water \_\_\_\_\_
2. State the number of acres you irrigate under this system \_\_\_\_\_ Shares you hold \_\_\_\_\_
3. If you obtain water from more than one Company, give the number of shares, acres irrigated and the name of the Company under "Remarks." If you obtain water from a Ditch Company and also have a private system fill in both Part A and Part B.

**Part B**

TO BE FILED BY THOSE WHO HAVE A PRIVATE DITCH, PUMP OR IRRIGATION SYSTEM  
or those who have a private water right under a Ditch Company

4. In what year was this land first irrigated? Date: See attached filings
5. Give the name of the original appropriator (first user): \_\_\_\_\_
6. Give the date appropriated \_\_\_\_\_ Amount filed on: Miners Inches \_\_\_\_\_ C. F. S. \_\_\_\_\_
7. State the total number of acres irrigated under this system: \_\_\_\_\_
8. Give the point of diversion: \_\_\_\_\_  $\frac{1}{4}$  \_\_\_\_\_  $\frac{1}{4}$  Section \_\_\_\_\_ Township \_\_\_\_\_ Range \_\_\_\_\_

**Part C**

TO BE FILED BY ALL WATER USERS IN ADDITION TO PART A OR PART B

9. Source of Water: Powder River & Mizpah Creek  
Name of stream or lake from which water is originally diverted
10. Water is obtained by: (Check one) Gravity ☒ Pumping ☒ Other \_\_\_\_\_
11. What is the greatest number of acres you have irrigated? 176.0 Date: 1905
12. How many acres did you irrigate in 1947? (Crop and pasture) 1.0 by pump
13. State the total number of additional acres that could be irrigated by increasing the water supply, land leveling, etc. 176.0 This land is under what ditch? 121.0 Powder River pump  
55.0 Sandy Branch ditch  
From Mizpah Creek
14. How many acres of seeped land do you have which could be drained and put into production? ✓
15. What is the condition of your irrigation system? Pump in use - gravity, artificial
16. Is your water supply adequate? Yes ☒ No ☒ Explain \_\_\_\_\_
17. REMARKS: Potential used - Sandy gravity ditch  
not used since about 1905. Irrigate  
one acre by pump from Mizpah Creek  
at present July 9, 47 - Potential also under  
pump ditch from Powder River not in

T. 6N R. 51E

NOTE: The foregoing questions apply only to irrigated land shown on this plat.

### DESCRIPTION AND MAP OF FARM

18. Legal Description of this Farm Lots 3-4-5-8-9, Sec 1, T4N, R4W, S4, Sec 1,  
Lots 2-3, W 1/4, Sec 12, Lots 3-5-6, W 1/4, S4, Sec 24



IRRIGATED LAND



NON-IRRIGATED LAND

North

*See attached map*

West

East

South

Ownership covers  
only irrigated land.  
All acreage for  
dry land not shown.

19. If the above land is irrigated from more than one ditch please give the acreage under each ditch in 19A and indicate the location of the land irrigated from each on the above map.

19A. Ditch: Private pump on Mingah Creek Acres: 1.0  
Ditch: \_\_\_\_\_ Acres: \_\_\_\_\_

Information supplied by:

Name Jim Rayburn Address \_\_\_\_\_ Date 7/9/47

REMARKS: to Johnson & Joe Paulist

If you cannot answer all of the questions on this form answer as many as you can and return the form to us as soon as possible.

T.6N-R.51E

 Irrigated Land

 Non-Irrigated Land

 Potential Land

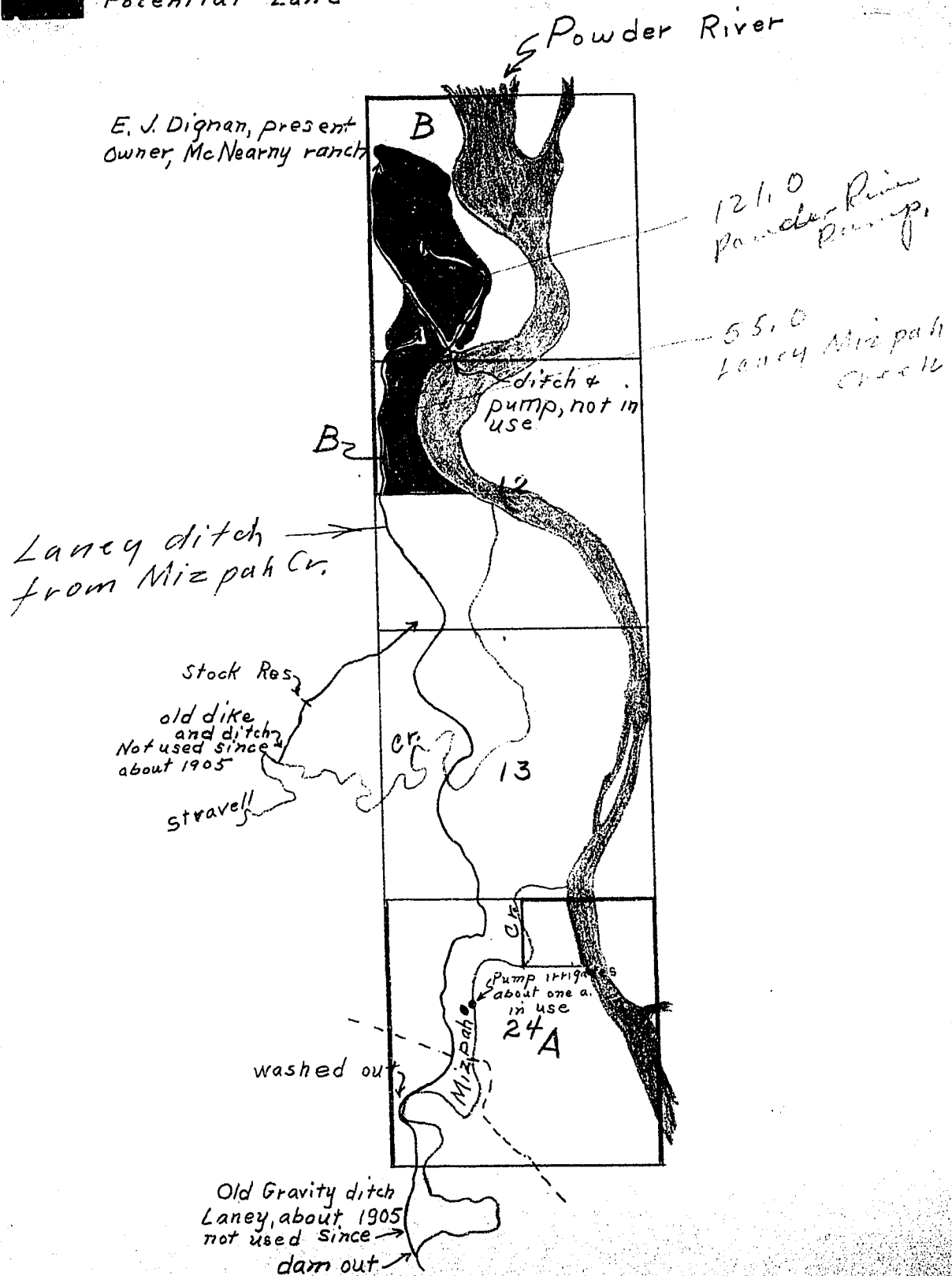

STATE ENGINEER'S OFFICE  
WATER RESOURCES SURVEYCOUNTY ClusterFILE NO. 36-T.6N-R.51EOwner Digman, Emmett Address Miles City, MontanaAAA Owner Go Jim Rayburn Address Box 304, Miles CityOperator " Address "

New Owner Address

New Operator Address

Assessment Record NoneAssessed Acreage 0Legal Description of This Farm lots 3-4-5-8-9, 5<sup>th</sup> NW, 4<sup>th</sup> W<sup>2</sup> SW, 4<sup>th</sup> Sec. 1;lots 2-3, W<sup>2</sup> NW, 4<sup>th</sup> Sec. 12; lots 3-5-6, W<sup>2</sup> SE, 4<sup>th</sup> W<sup>2</sup> Sec. 24;T. 6N-R. 51ETotal Acres in Farm ✓Code Number 1B, 12B, 24APhoto No. Ma. 23-86; Ma. 23-85

AAA Contract No.

AAA Total Cropland Acreage

App. No. 2174-1102-1133

Decree No.

Land is located in

Twp. 6N Rge. 51E Twp. 5N Rge. 52ETwp. 7N Rge. 51E Twp. 1N Rge. 52E3N 54E 2N 54EFiled in Twp. 6N Rge. 51E

Remarks

Powder River BasinOwnership covers  
only irrigated land.  
All ownership for  
dry land not shown.

# STATE ENGINEERS OFFICE Water Resources Survey

## Notice of Appropriation

1. County Custer Book B Page 69 Record W.R.
2. Name of Appropriator Franklin J. Murphy Address Mizpah, Montana  
Mar. 1, 1901
3. Date Appropriated Mar. 29, 1901 Date Filed Mar. 30, 1901
- Amount Appropriated, Miners Inches 500, Cubic Feet per second \_\_\_\_\_
4. Name of Stream Mizpah Creek Tributary \_\_\_\_\_ Basin \_\_\_\_\_
5. Point of Diversion Being 1320 ft. north of corner of Sections  
\_\_\_\_\_  
\_\_\_\_\_  
Sec 25, 26, 35, 36 Twp. 6N. Rge. 51E. Bank of Stream. West  
\_\_\_\_\_  
\_\_\_\_\_
6. Purpose Irrigation
7. Description of System A ditch 4 1/2 ft. X 4 ft. in size, which diverts the water from said point and runs thence northwest to irrigate said Sec. 24.  
\_\_\_\_\_  
\_\_\_\_\_
8. Land Description of Intended Place of Use Sec. 24-6N-51E.  
\_\_\_\_\_  
\_\_\_\_\_  
\_\_\_\_\_
9. Remarks (Pertaining to Use, etc.) That I also hereby claim said ditch and the right-of-way therefore, and for said water by it conveyed, or to be conveyed from said point of appropriation to said land or on point of final discharge, and also the right of location upon any lands of any dams, flumes, reservoirs, constructed or to be constructed, by me in appropriating, and in using said water. That I also claim the right to keep in repair and to enlarge said means of water appropriation at any time, and the right to dispose of the said right, water, ditch or said appurtenances in part or whole, at any time.
10. Case No. \_\_\_\_\_ Date \_\_\_\_\_ Amt. Decreed: M. I. C. F. S.
11. To Whom Decreed \_\_\_\_\_ Address \_\_\_\_\_
12. Name of Ditch \_\_\_\_\_ Maximum Capacity (C. F. S.) \_\_\_\_\_
13. Date of Priority \_\_\_\_\_ Purpose \_\_\_\_\_
14. Land Description of Place of Use as Decreed \_\_\_\_\_  
\_\_\_\_\_  
\_\_\_\_\_  
\_\_\_\_\_
15. Remarks (Present Use Status, etc.) \_\_\_\_\_  
\_\_\_\_\_  
\_\_\_\_\_  
\_\_\_\_\_

1133

STATE ENGINEERS OFFICE  
Water Resources Survey

Notice of Appropriation

1. County Custer Book E Page 159 Record W.R.
2. Name of Appropriator Karl John Mahlum Address Capitol, Montana  
(18)
3. Date Appropriated Aug. 19, 1911 Date Filed Aug. 30, 1911  
Amount Appropriated, Miners Inches 500, Cubic Feet per second \_\_\_\_\_
4. Name of Stream Musk Rat Creek Tributary \_\_\_\_\_ Basin \_\_\_\_\_
5. Point of Diversion At or near the supposed SE corner of SW  $\frac{1}{4}$ SW  $\frac{1}{4}$

Sec. 22 Twp. 4S. Rge. 57E. Bank of Stream North

6. Purpose For irrigation and domestic purposes.
7. Description of System Preposed dam and a ditch 60" X 12" in size, which carries and conducts said 500 in. of water from said water-course and runs thence in a north-westerly course; thence over and upon said land.
8. Land Description of Intended Place of Use  
SE  $\frac{1}{4}$ SE  $\frac{1}{4}$  Sec. 21, SW  $\frac{1}{4}$ SW  $\frac{1}{4}$  Sec. 22, NE  $\frac{1}{4}$ NE  $\frac{1}{4}$  Sec. 28, NW  $\frac{1}{4}$ NW  $\frac{1}{4}$  Sec. 27-4S-57E, 160 acres

9. Remarks (Pertaining to Use, etc.) \_\_\_\_\_

Decree

10. Case No. \_\_\_\_\_ Date \_\_\_\_\_ Amt. Decreed: M. I. \_\_\_\_\_ C. F. S. \_\_\_\_\_
11. To Whom Decreed \_\_\_\_\_ Address \_\_\_\_\_
12. Name of Ditch \_\_\_\_\_ Maximum Capacity (C. F. S.) \_\_\_\_\_
13. Date of Priority \_\_\_\_\_ Purpose \_\_\_\_\_
14. Land Description of Place of Use as Decreed \_\_\_\_\_
15. Remarks (Present Use Status, etc.) \_\_\_\_\_



STATE ENGINEERS OFFICE  
Water Resources Survey

Notice of Appropriation

2174

1. County Custer Book D Page 6 Record W.R.  
2. Name of Appropriator J. S. Howe Address Miles City, Custer Co.  
May 4, '08  
3. Date Appropriated May 12, 1908 Date Filed May 13, 1908

Amount Appropriated, Miners Inches 1000, Cubic Feet per second

4. Name of Stream Unnamed Tributary of Tributary Powder River Basin

5. Point of Diversion 1000 ft. NW from the South quarter corner of

Sec. 11 Twp. 6N. Rge. 51E. Bank of Stream

6. Purpose Irrigation and watering all kinds of livestock

7. Description of System A dam about 200 ft. long and 5 ft. high, said water is to be diverted and conveyed from said tributary and said dam to, over and upon said land by means of a series of overflow and spreading ditches leaving said dam on either side thereof and flumes such as the nature of the soil and country may require being of sufficient size in the aggregate to carry, convey and spread the aforesaid amount of water over and upon the lands

8. Land Description of Intended Place of Use above described.

E<sup>1</sup> Sec. 11, NW<sup>1</sup> Sec. 12-6N-51E, Ed Love, Miles City

9. Remarks (Pertaining to Use, etc.)

Decree

10. Case No. Date Amt. Decreed: M. I. C. F. S.

11. To Whom Decreed Address

12. Name of Ditch Maximum Capacity (C. F. S.)

13. Date of Priority Purpose

14. Land Description of Place of Use as Decreed

15. Remarks (Present Use Status, etc.)



NOTICE  
These forms and the  
property of the State  
of Montana and must  
be returned.

STATE OF MONTANA  
STATE ENGINEERS OFFICE

Water Resources Survey

Code No. 12 C

County Custer

T. 6 N R. 5 E

Name of Land Owner Joseph A. Janutis Address Minneapolis, Mont.

Name of Operator \_\_\_\_\_ Address \_\_\_\_\_

Part A

TO BE FILED BY THOSE OBTAINING IRRIGATION WATER FROM  
A DITCH COMPANY OR IRRIGATION DISTRICT

1. Water is delivered by: \_\_\_\_\_  
Name of Ditch, Ditch Company or District Supplying Water
2. State the number of acres you irrigate under this system \_\_\_\_\_ Shares you hold \_\_\_\_\_
3. If you obtain water from more than one Company, give the number of shares, acres irrigated and the name of the Company under "Remarks." If you obtain water from a Ditch Company and also have a private system fill in both Part A and Part B.

Part B

TO BE FILED BY THOSE WHO HAVE A PRIVATE DITCH, PUMP OR IRRIGATION SYSTEM  
or those who have a private water right under a Ditch Company

4. In what year was this land first irrigated? Date 10-19-86
5. Give the name of the original appropriator (first user): George W. Myers
6. Give the date appropriated \_\_\_\_\_ Amount filed on: Miners Inches / 500 C. F. S.
7. State the total number of acres irrigated under this system: (see attached filing)
8. Give the point of diversion: \_\_\_\_\_  $\frac{1}{4}$  \_\_\_\_\_  $\frac{1}{4}$  Section \_\_\_\_\_ Township \_\_\_\_\_ Range \_\_\_\_\_

Part C

TO BE FILED BY ALL WATER USERS IN ADDITION TO PART A OR PART B

9. Source of Water: Minneapolis Creek  
Name of stream or lake from which water is originally diverted
10. Water is obtained by: (Check one) Gravity ☒ Pumping \_\_\_\_\_ Other Flood
11. What is the greatest number of acres you have irrigated? 38.0 Date \_\_\_\_\_
12. How many acres did you irrigate in 1947? (Crop and pasture) 0
13. State the total number of additional acres that could be irrigated by increasing the water supply, land leveling, etc. 38.0 This land is under what ditch? Laney ditch
14. How many acres of seeped land do you have which could be drained and put into production? \_\_\_\_\_
15. What is the condition of your irrigation system? Out of use
16. Is your water supply adequate? Yes \_\_\_\_\_ No ☒ Explain \_\_\_\_\_
17. REMARKS: \_\_\_\_\_

Erratic supply in Minneapolis



NOTE: The foregoing questions apply only to irrigated land shown on this plat.

### DESCRIPTION AND MAP OF FARM

18. Legal Description of this Farm lots 5-6, 7 & 8, W2SW4, SE4SW4 Sec 12

☐ None at Present  
IRRIGATED LAND

☐ Potential Land

☐ NON-IRRIGATED LAND

North

West

East

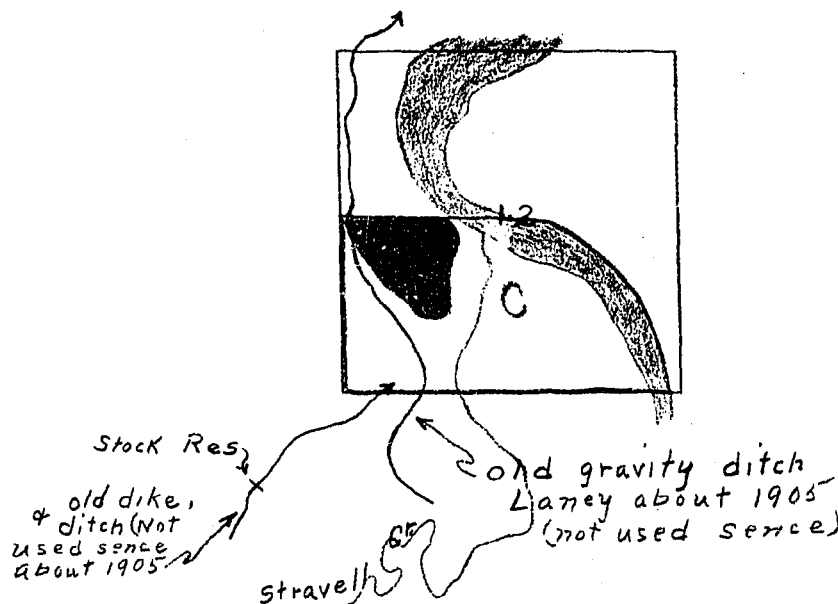

South

Ownership covers  
only irrigated land.  
All ownership for  
dry land not shown.

19. If the above land is irrigated from more than one ditch please give the acreage under each ditch in 19A and indicate the location of the land irrigated from each on the above map.

19A. Ditch: Laney ditch from Mizpah Acres: 0

Ditch: \_\_\_\_\_ Acres: \_\_\_\_\_

Information supplied by:

Name Jim Rayburn Address \_\_\_\_\_ Date 7/9/47

REMARKS: to Johnson + J Paulist

If you cannot answer all of the questions on this form answer as many as you can and return the form to us as soon as possible.

STATE ENGINEER'S OFFICE  
WATER RESOURCES SURVEY

COUNTY Cluster

FILE NO. 36-T.6N-R.51E

Owner Janutis, Joseph A. Address Mizpah, Montana?

AAA Owner Address

Operator " " P Address " " ?

New Owner Address

New Operator Address

Assessment Record None

Assessed Acreage 0

Legal Description of This Farm lots 6, 7, & 8, 41<sup>st</sup> SW, 4<sup>th</sup> SE, 34<sup>th</sup> SW, Sec. 12, T. 6N-R. 51E

Total Acres in Farm ✓

Code Number 120

Photo No. Ma 23-86

AAA Contract No.

AAA Total Cropland Acreage

App. No. 1323

Decree No.

Land is located in

Twp. 6N Rge. 51E Twp. Rge.

Twp. Rge. Twp. Rge.

Filed in Twp. 6N Rge. 51E

Remarks

Powder River Basin

Ownership covers  
only irrigated land.  
All ownership for  
dry land not shown.

1333

**STATE ENGINEERS OFFICE**  
**Water Resources Survey**  
**Notice of Appropriation**

1. County Custer Book 4 Page 40 Record W.R.
2. Name of Appropriator Geo. M. Myers Address Miles City, Montana
3. Date Appropriated Oct. 12, 1886 Date Filed Oct. 25, 1886  
Amount Appropriated, Miners Inches 1500, Cubic Feet per second
4. Name of Stream Powder River Tributary            Basin
5. Point of Diversion On West bank of said river where there is a grove of cottonwood trees  
about 300 ft. above the first road crossing on said river above the mouth of Mizpah Creek  
Sec.            Twp.            Rge.            Bank of Stream
6. Purpose Irrigating desert land and other purposes.
7. Description of System A ditch with a general course of north, said ditch at the head 6 ft.  
at bottom by 5 1/6 ft. deep for the first 2500 ft. of length, and from eight feet to  
nothing at the end of the ditch.
8. Land Description of Intended Place of Use             
Lots 1, 2, 3, 4, Sec. 24-6N-51E, 140.72 acres, Ed. Love, Miles City, Montana  
WSE 1/4, Lots 5, 6, Sec. 12-6N-51E, 143.76 acres, " " "  
and neighboring land in said county
9. Remarks (Pertaining to Use, etc.) Agricultural and other useful and beneficial purposes.

-      **Decree**

10. Case No.            Date            Amt. Decreed: M. I.            C. F. S.
11. To Whom Decreed            Address
12. Name of Ditch            Maximum Capacity (C. F. S.)
13. Date of Priority            Purpose
14. Land Description of Place of Use as Decreed
15. Remarks (Present Use Status, etc.)



NOTICE  
These forms are the  
property of the State  
of Montana and must  
be returned.

STATE OF MONTANA  
STATE ENGINEERS OFFICE

Water Resources Survey

Code No. 1A

County Beaumont

T. T. 6 N. R. R. 5 E.

Name of Land Owner Charles Wiley (Est.) Address Miller City, Mont.

Name of Operator \_\_\_\_\_ Address \_\_\_\_\_

Part A

TO BE FILED BY THOSE OBTAINING IRRIGATION WATER FROM  
A DITCH COMPANY OR IRRIGATION DISTRICT

1. Water is delivered by: \_\_\_\_\_  
Name of Ditch, Ditch Company or District Supplying Water
2. State the number of acres you irrigate under this system \_\_\_\_\_ Shares you hold \_\_\_\_\_
3. If you obtain water from more than one Company, give the number of shares, acres irrigated and the name of the Company under "Remarks." If you obtain water from a Ditch Company and also have a private system fill in both Part A and Part B.

Part B

TO BE FILED BY THOSE WHO HAVE A PRIVATE DITCH, PUMP OR IRRIGATION SYSTEM  
or those who have a private water right under a Ditch Company

4. In what year was this land first irrigated? Date See attached filing
5. Give the name of the original appropriator (first user): \_\_\_\_\_
6. Give the date appropriated \_\_\_\_\_ Amount filed on: Miners Inches \_\_\_\_\_ C. F. S. \_\_\_\_\_
7. State the total number of acres irrigated under this system: \_\_\_\_\_
8. Give the point of diversion: \_\_\_\_\_  $\frac{1}{4}$  \_\_\_\_\_  $\frac{1}{4}$  Section \_\_\_\_\_ Township \_\_\_\_\_ Range \_\_\_\_\_

Part C

TO BE FILED BY ALL WATER USERS IN ADDITION TO PART A OR PART B

9. Source of Water: Sheep Creek  
Name of stream or lake from which water is originally diverted
10. Water is obtained by: (Check one) Gravity ☒ Pumping \_\_\_\_\_ Other \_\_\_\_\_
11. What is the greatest number of acres you have irrigated? 12.0 Date \_\_\_\_\_
12. How many acres did you irrigate in 1947 (Crop and pasture) 0
13. State the total number of additional acres that could be irrigated by increasing the water supply, land leveling, etc. 12.0 This land is under what ditch? Sheep Creek flood
14. How many acres of seeped land do you have which could be drained and put into production? \_\_\_\_\_
15. What is the condition of your irrigation system? Out of use
16. Is your water supply adequate? Yes \_\_\_\_\_ No ☒ Explain I had no
17. REMARKS: \_\_\_\_\_

Brown flood ditch from sheep  
creek used in use 7/9/47

Over \_\_\_\_\_

NOTE: The foregoing questions apply only to irrigated land shown on this plat.

## DESCRIPTION AND MAP OF FARM

18. Legal Description of this Farm 1-2-6-7-10, 2E4NE4, E24E4, Sec 1

☐ None at Present  
IRRIGATED LAND

☐ NON-IRRIGATED LAND

☐ Potential Land

North

West

East

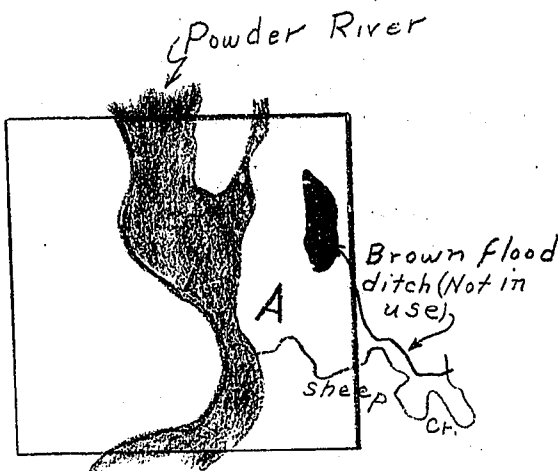

South

Ownership covers  
only irrigated land.  
All ownership for  
dry land not shown.

19. If the above land is irrigated from more than one ditch please give the acreage under each ditch in 19A and indicate the location of the land irrigated from each on the above map.

19A. Ditch: Brown flood ditch Acres: 0

Ditch: \_\_\_\_\_ Acres: \_\_\_\_\_

Information supplied by:

Name Jim Rayburn Address \_\_\_\_\_ Date 7/9/47

REMARKS: C. Johnson & J. Paulist

If you cannot answer all of the questions on this form answer as many as you can and return the form to us as soon as possible.

STATE ENGINEER'S OFFICE  
WATER RESOURCES SURVEYCOUNTY ClusterFILE NO. 36-T-6N-R-51EOwner Wiley, Charles (Estate) Address Miles City, Montana

AAA Owner ..... Address .....

Operator Brown? Address ?

New Owner ..... Address .....

New Operator ..... Address .....

Assessment Record NoneAssessed Acreage 0Legal Description of This Farm Lots 1-2-6-7-10, SE<sup>4</sup>NE<sup>4</sup>, E<sup>2</sup>SE<sup>4</sup> Sec. 1;T. 6N-R. 51ETotal Acres in Farm ✓Code Number 1APhoto No. Ma 23-86

AAA Contract No. ....

AAA Total Cropland Acreage .....

App. No. 1637

Decree No. ....

Land is located in

Twp. 6N Rge. 51E Twp. 1N Rge. 52ETwp. 5N Rge. 52E Twp. .... Rge. ....Filed in Twp. 6N Rge. 51E

Remarks .....

Powder River BasinOwnership shown  
only irrigated land.  
All ownership for  
dry land not shown.

# STATE ENGINEERS OFFICE

## Water Resources Survey

### Notice of Appropriation

1. County Custer Book C Page 221 Record W.R.
2. Name of Appropriator Brown & Brown Address Mizpah, Custer Co.
3. Date Appropriated Mar. 10, 1906 Date Filed Mar. 27, 1906
- Amount Appropriated, Miners Inches \_\_\_\_\_, Cubic Feet per second 25
4. Name of Stream Sheep Creek Tributary \_\_\_\_\_ Basin \_\_\_\_\_
5. Point of Diversion \_\_\_\_\_
- Sec. \_\_\_\_\_ Twp. \_\_\_\_\_ Rge. \_\_\_\_\_ Bank of Stream North
6. Purpose For irrigating and other purposes.
7. Description of System A ditch 3 ft. on the bottom and 2 ft. deep in size, which carries and conducts said water from said creek at said point and runs thence over and upon NW $\frac{1}{4}$ SW $\frac{1}{4}$  Sec. 6-6N-52E, thence over NE $\frac{1}{4}$ NE $\frac{1}{4}$  Sec. 1-6N-51E, thence over SE $\frac{1}{4}$ SE $\frac{1}{4}$  Sec. 36-7N-51E, thence over and upon W $\frac{1}{4}$ NE $\frac{1}{4}$  SE $\frac{1}{4}$ NE $\frac{1}{4}$  Sec. 36-6N-51E, thence over and upon said land (or mining claim.)
8. Land Description of Intended Place of Use \_\_\_\_\_  
W $\frac{1}{4}$ NW $\frac{1}{4}$ , NW $\frac{1}{4}$ SW $\frac{1}{4}$  Sec. 6-6N-52E, 120 acres, F. D. Ovirt, Knowlton, Montana  
W $\frac{1}{4}$ NE $\frac{1}{4}$ , NW $\frac{1}{4}$ SE $\frac{1}{4}$ , SE $\frac{1}{4}$ NE $\frac{1}{4}$  Sec. 36-7N-51E, 160 acres, Merrimack Co Savings Bank, Concord, N.H.
9. Remarks (Pertaining to Use, etc.) \_\_\_\_\_

### Decree

10. Case No. \_\_\_\_\_ Date \_\_\_\_\_ Amt. Decreed: M. I. \_\_\_\_\_ C. F. S. \_\_\_\_\_
11. To Whom Decreed \_\_\_\_\_ Address \_\_\_\_\_
12. Name of Ditch \_\_\_\_\_ Maximum Capacity (C. F. S.) \_\_\_\_\_
13. Date of Priority \_\_\_\_\_ Purpose \_\_\_\_\_
14. Land Description of Place of Use as Decreed \_\_\_\_\_
15. Remarks (Present Use Status, etc.) \_\_\_\_\_



Township 6 North

Range 51 East

Custer County

<u>Index No.</u>	<u>Name of Appropriator</u>	<u>Stream</u>	<u>Date App.</u>	<u>Date Filed</u>	<u>M.I.</u>
577	Ernest E. Blanchard	Dry Gulch	11-23-12	11-23-12	1000
672	Dick E. Blanchard	First Creek	5-29-15	6-11-15	500
1102	Franklin J. Murphy	Mizpah Creek	3-11-01	3-30-01	500
1133	Karl John Mahlum	Muskrat Creek	8-18-11	8-30-11	500
1333	George W. Myers	Powder River	10-19-86	10-25-86	1500
1807	Frank Stephenson	Stephenson Creek	3-16-08	3-17-08	600
1817	Paul Speck	Strevell Creek	10-20-07	12-4-07	500
1818	Paul Speck	Strevell Creek	10-20-07	12-4-07	500
1819	O. A. Nickerson	South Strevell Cr.	5-24-09	5-24-09	1000
1820	K. Sanner	South Strevell Cr.	9-17-10	10-7-10	300
1821	Sidney Sanner	South Strevell Cr.	9-17-10	10-7-10	300
1822	Sidney Sanner	South Strevell Cr.	5-15-11	5-19-10	480
2174	J. S. Howe	No Name Creek	5-4-08	5-13-08	1000
2372	Franklin J. Murphy	Dry Water Course	4-15-10	4-20-10	300

Township 6 North

Range 51 East

Custer County

STATE OF MONTANA  
STATE ENGINEER'S OFFICE  
WATER RESOURCES SURVEY

Township.....6N.....Range.....51E.....County.....Custer.....

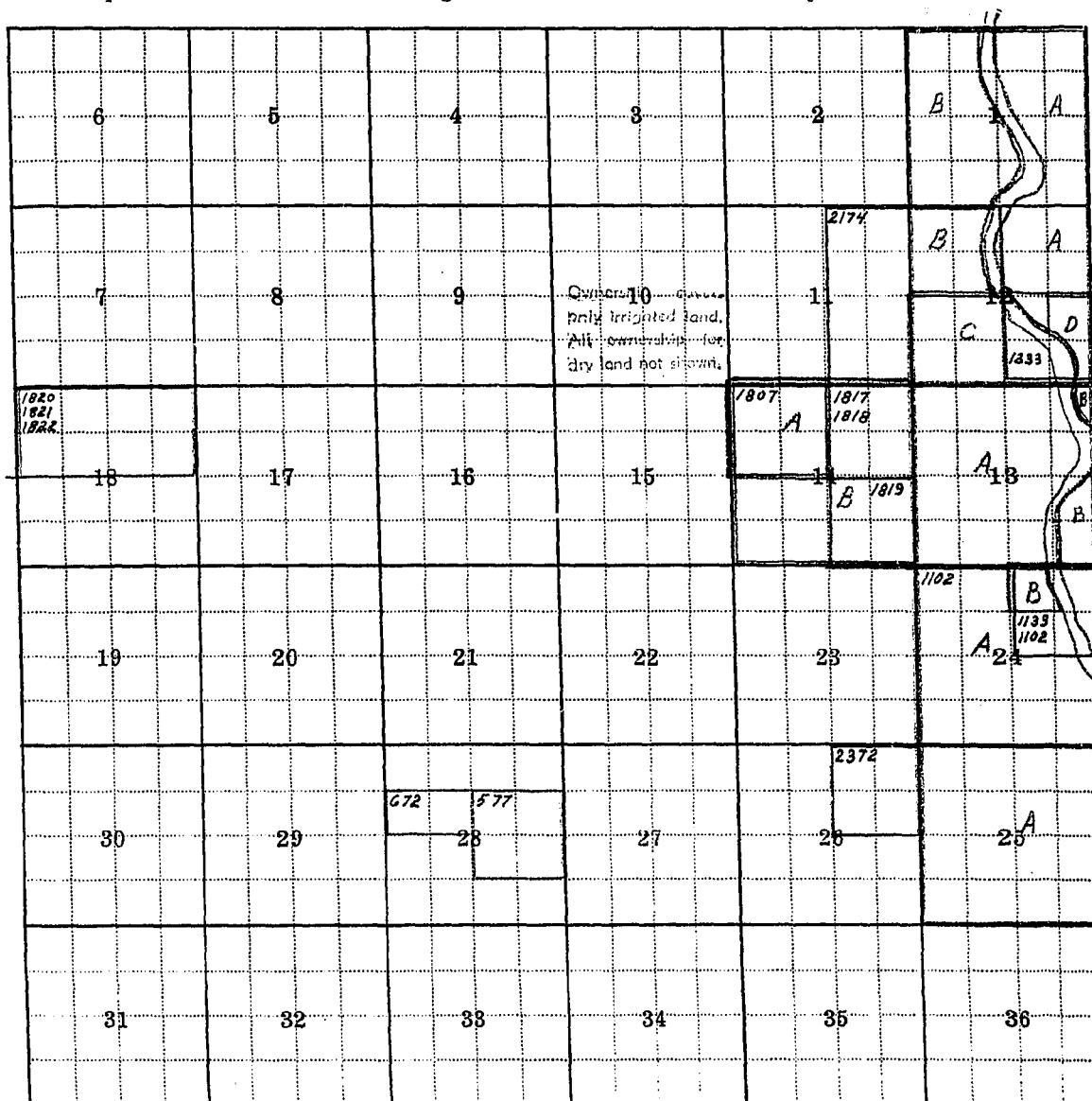

Township.....6N.....Range.....51E.....

Township 6N Range 51E County Custer

[illegible]



NOTICE

These forms are the property of the State of Montana and must be returned.

STATE OF MONTANA  
STATE ENGINEERS OFFICE

Water Resources Survey

Code No. 4A-9A

County Quinn

T. 6N R. 52

Name of Land Owner

Colin + Sylvia Gilman

Address

, Missoula, Mont

Name of Operator

Address

Part A

TO BE FILED BY THOSE OBTAINING IRRIGATION WATER FROM  
A DITCH COMPANY OR IRRIGATION DISTRICT

1. Water is delivered by: \_\_\_\_\_ Name of Ditch, Ditch Company or District Supplying Water \_\_\_\_\_
2. State the number of acres you irrigate under this system \_\_\_\_\_ Shares you hold \_\_\_\_\_
3. If you obtain water from more than one Company, give the number of shares, acres irrigated and the name of the Company under "Remarks." If you obtain water from a Ditch Company and also have a private system fill in both Part A and Part B.

Part B

TO BE FILED BY THOSE WHO HAVE A PRIVATE DITCH, PUMP OR IRRIGATION SYSTEM  
or those who have a private water right under a Ditch Company

4. In what year was this land first irrigated? Date no date
5. Give the name of the original appropriator (first user): \_\_\_\_\_
6. Give the date appropriated \_\_\_\_\_ Amount filed on: Miners Inches \_\_\_\_\_ C. F. S. \_\_\_\_\_
7. State the total number of acres irrigated under this system: \_\_\_\_\_
8. Give the point of diversion: \_\_\_\_\_  $\frac{1}{4}$  \_\_\_\_\_  $\frac{1}{4}$  Section \_\_\_\_\_ Township \_\_\_\_\_ Range \_\_\_\_\_

Part C

TO BE FILED BY ALL WATER USERS IN ADDITION TO PART A OR PART B

9. Source of Water: Sheep Creek  
Name of stream or lake from which water is originally diverted
10. Water is obtained by: (Check one) Gravity ☒ Pumping \_\_\_\_\_ Other \_\_\_\_\_
11. What is the greatest number of acres you have irrigated? 0 Date \_\_\_\_\_
12. How many acres did you irrigate in 1947? (Crop and pasture) 21.0
13. State the total number of additional acres that could be irrigated by increasing the water supply, land leveling, etc. ☒ This land is under what ditch? ☒
14. How many acres of seeped land do you have which could be drained and put into production? ☒
15. What is the condition of your irrigation system? Flood dam in use
16. Is your water supply adequate? Yes \_\_\_\_\_ No ☒ Explain Flood dam
17. REMARKS: \_\_\_\_\_

Over

NOTE: The foregoing questions apply only to irrigated land shown on this plat.

## DESCRIPTION AND MAP OF FARM

18. Legal Description of this Farm

*S<sup>2</sup>, Sec 4, all of Sec 9,*



IRRIGATED LAND



NON-IRRIGATED LAND

North

West

East

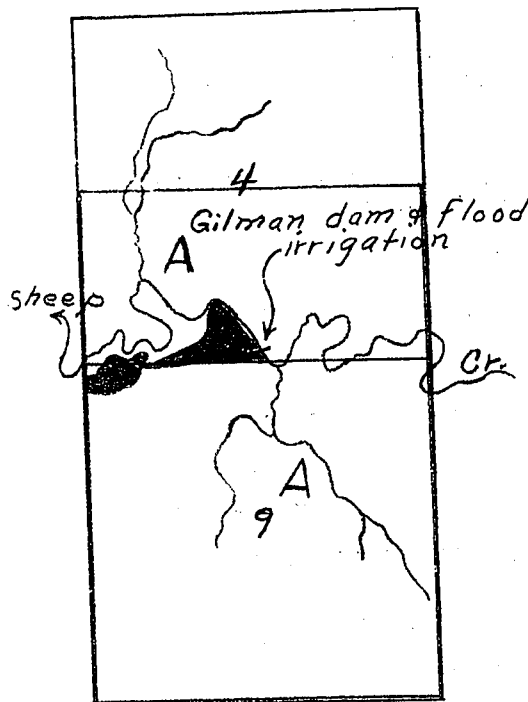

South

Ownership covers  
only irrigated land.  
All ownership for  
dry land not shown.

19. If the above land is irrigated from more than one ditch please give the acreage under each ditch in 19A and indicate the location of the land irrigated from each on the above map.

19A. Ditch: *Gilman Flood Irr* Acres: *21.0*

Ditch: \_\_\_\_\_

Acres: \_\_\_\_\_

Information supplied by:

Name

*Gilman to*

Address

Date

*July 17-47*

REMARKS:

*Johnson & J. Pauline*

If you cannot answer all of the questions on this form answer as many as you can and return the form to us as soon as possible.

STATE ENGINEER'S OFFICE  
WATER RESOURCES SURVEYCOUNTY CusterFILE NO. 37-T.6N-R.52EOwner Gilman, Colin & Sylvia Address Mizpah, Montana

AAA Owner Address

Operator " Address

New Owner Address

New Operator Address

Assessment Record NoneAssessed Acreage 0Legal Description of This Farm S<sup>2</sup> Sec 4; all of Sec 9; T.6N-R.52ETotal Acres in Farm ✓Code Number 4A, 9APhoto No. Ma-23-86

AAA Contract No.

AAA Total Cropland Acreage

App. No. No Record by Descript

Decree No.

Land is located in

Twp. 6N Rge. 52E Twp. 6N Rge. 53E

Twp. Rge. Twp. Rge.

Filed in Twp. 6N Rge. 52E

Remarks

Ownership covers  
only irrigated land.  
All ownership for  
dry land not shown.

Powder River Basin

February 26, 1948

Colin & Sylvia Gilman  
Mizpah, Montana

Re: Flood Irrigation on Sheep Creek

Dear Sir:

Custer

the S $\frac{1}{2}$  of Section 4; all of Section 9, Township 6N., R. 52E.





These forms are the property of the State of Montana and must be returned.

**STATE OF MONTANA**  
**STATE ENGINEERS OFFICE**  
**Water Resources Survey**

Code No. 19A-29A-30A

County Quinter

T. 6N R. 52

Name of Land Owner Ignatz Ostendorf Address Mizpah, Mont  
Name of Operator \_\_\_\_\_ Address \_\_\_\_\_

**Part A**

**TO BE FILED BY THOSE OBTAINING IRRIGATION WATER FROM A DITCH COMPANY OR IRRIGATION DISTRICT**

1. Water is delivered by: \_\_\_\_\_ Name of Ditch, Ditch Company or District Supplying Water \_\_\_\_\_
2. State the number of acres you irrigate under this system \_\_\_\_\_ Shares you hold \_\_\_\_\_
3. If you obtain water from more than one Company, give the number of shares, acres irrigated and the name of the Company under "Remarks." If you obtain water from a Ditch Company and also have a private system fill in both Part A and Part B.

**Part B**

**TO BE FILED BY THOSE WHO HAVE A PRIVATE DITCH, PUMP OR IRRIGATION SYSTEM or those who have a private water right under a Ditch Company**

4. In what year was this land first irrigated? Date See attached filings
5. Give the name of the original appropriator (first user): \_\_\_\_\_
6. Give the date appropriated \_\_\_\_\_ Amount filed on: Miners Inches \_\_\_\_\_ C. F. S. \_\_\_\_\_
7. State the total number of acres irrigated under this system: \_\_\_\_\_
8. Give the point of diversion: \_\_\_\_\_  $\frac{1}{4}$  \_\_\_\_\_  $\frac{1}{4}$  Section \_\_\_\_\_ Township \_\_\_\_\_ Range \_\_\_\_\_

**Part C**

**TO BE FILED BY ALL WATER USERS IN ADDITION TO PART A OR PART B**

9. Source of Water: Hay Creek & Powder River  
Name of stream or lake from which water is originally diverted
10. Water is obtained by: (Check one) Gravity ☒ Pumping ☒ Other \_\_\_\_\_
11. What is the greatest number of acres you have irrigated? 205.0 Date ?
12. How many acres did you irrigate in 1947? (Crop and pasture) 185.0
13. State the total number of additional acres that could be irrigated by increasing the water supply, land leveling, etc. 20.0 This land is under what ditch? Powder River Pump ditch
14. How many acres of seeped land do you have which could be drained and put into production? 0
15. What is the condition of your irrigation system? Leak
16. Is your water supply adequate? Yes ☒ No ☒ Explain I had under 1 Hay
17. REMARKS: Crack 185. acres when water is available - 20 acres from Powder River by pump usually water

NOTE: The foregoing questions apply only to irrigated land shown on this plat.

### DESCRIPTION AND MAP OF FARM

18. Legal Description of this Farm all of sections 19 + 29; Lots 1, 5, 16  
+ 12, NW<sup>4</sup> NE<sup>4</sup>, E<sup>2</sup> NE<sup>4</sup> Sec 30

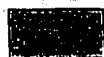

IRRIGATED LAND



NON-IRRIGATED LAND



Potential Land

North

West

East

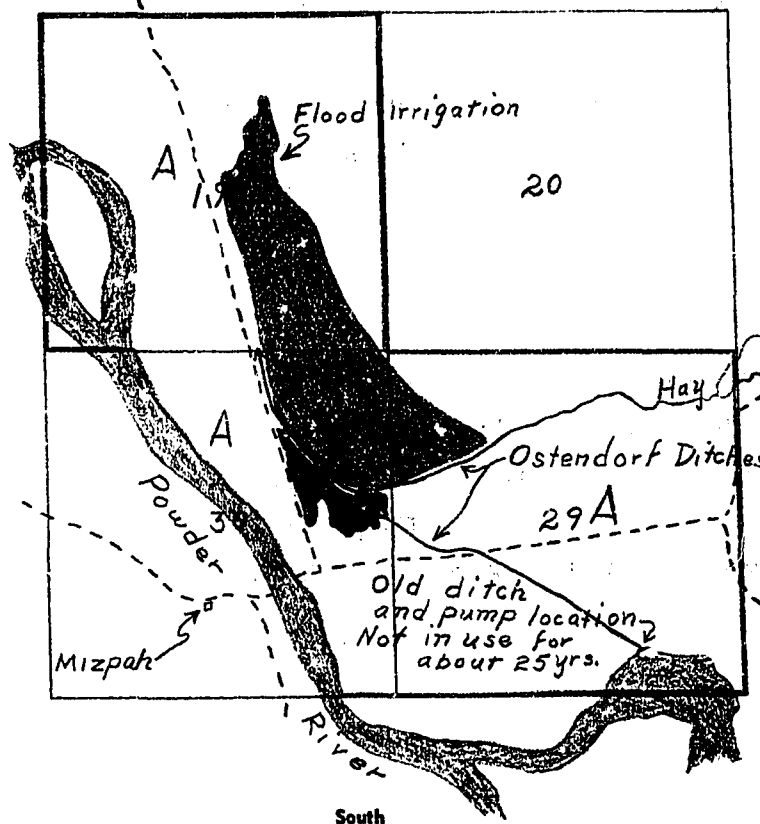

Ownership: covered  
only irrigated land.  
All ownerships for  
dry land not shown.

19. If the above land is irrigated from more than one ditch please give the acreage under each ditch in 19A and indicate the location of the land irrigated from each on the above map.

19A. Ditch: Ostendorf flood from Hay Creek Acres: 185.0

Ditch: 20 potential from P. R. pump Acres: 0

Information supplied by:

Name Ostendorf to Address \_\_\_\_\_ Date 7/17/47

REMARKS: Johnson + J. Poulin

If you cannot answer all of the questions on this form answer as many as you can and return the form to us as soon as possible.

STATE ENGINEER'S OFFICE  
WATER RESOURCES SURVEYCOUNTY CusterFILE NO. 37-T.6N-R.52EOwner Ostendarf, IgnatzAddress M. zpah, Montana

AAA Owner

Address

Operator

Address

New Owner

Address

New Operator

Address

Assessment Record NoneAssessed Acreage 0Legal Description of This Farm all of Sections 19 & 29; Lots 1, 5, 6, & 12  
NW 1/4 NE 1/4, E 1/2 NE 1/4, Sec. 30; T. 6N-R. 52ETotal Acres in Farm ✓Code Number 19A, 29A, 30APhoto No. Ma 23-85

AAA Contract No.

AAA Total Cropland Acreage

App. No. 820, 821, 952, 1343

Decree No.

Land is located in

Twp. 6N Rge. 52E Twp. Rge.

Twp. Rge. Twp. Rge.

Filed in Twp. 6N Rge. 52E

Remarks

Powder River BasinOwnership covers  
only irrigated land.  
All ownership for  
dry land not shown.

**STATE ENGINEERS OFFICE**  
Water Resources Survey

**Notice of Appropriation**

1. County Custer Book B Page 218 Record W. R.

2. Name of Appropriator James M. Johnson Address Custer Co., Montana  
July 12, 1902

3. Date Appropriated July 8, 1902 Date Filed July 14, 1902

Amount Appropriated, Miners Inches 1000 or \_\_\_\_\_, Cubic Feet per second 25 of 187 gals.  
per sec.

4. Name of Stream Hay Creek Tributary \_\_\_\_\_ Basin \_\_\_\_\_

5. Point of Diversion Nineteen chains west and 16 chains So. of the SE corner of

Sec. 20 Twp. 6S. Rge. 52E. Bank of Stream \_\_\_\_\_

6. Purpose For irrigating, watering of livestock, domestic and other purposes.

7. Description of System A dam across the bed of said creek 6 ft. high and about 30 ft.  
long composed of earth, wood, and rocks. Also a ditch 10 ft. wide on the bottom and  
2 ft. deep running therefrom in a northwesterly direction on the real estate herein  
described, and with such necessary flumes as the nature of the country and soil may require.

8. Land Description of Intended Place of Use \_\_\_\_\_  
W $\frac{1}{2}$ SW $\frac{1}{4}$ , SE $\frac{1}{4}$ SW $\frac{1}{4}$ , SW $\frac{1}{4}$ SE $\frac{1}{4}$  Sec. 20-6N-52E, E $\frac{1}{2}$ NE $\frac{1}{4}$ , Lots 5, 6, 7, 8 Sec. 30-6N-52E.

9. Remarks (Pertaining to Use, etc.) \_\_\_\_\_

**Decree**

10. Case No. \_\_\_\_\_ Date \_\_\_\_\_ Amt. Decreed: M. I. \_\_\_\_\_ C. F. S. \_\_\_\_\_

11. To Whom Decreed \_\_\_\_\_ Address \_\_\_\_\_

12. Name of Ditch \_\_\_\_\_ Maximum Capacity (C. F. S.) \_\_\_\_\_

13. Date of Priority \_\_\_\_\_ Purpose \_\_\_\_\_

14. Land Description of Place of Use as Decreed \_\_\_\_\_

15. Remarks (Present Use Status, etc.) \_\_\_\_\_

**STATE ENGINEERS OFFICE**  
**Water Resources Survey**

**Notice of Appropriation**

1. County Guster Book B Page 30 Record W.R.
2. Name of Appropriator James M. Johnson Address Mizpah, Montana
3. Date Appropriated October 18, 1900 Date Filed October 18, 1900  
 Amount Appropriated, Miners Inches 400, Cubic Feet per second \_\_\_\_\_
4. Name of Stream Hay Creek Tributary \_\_\_\_\_ Basin \_\_\_\_\_
5. Point of Diversion A dam at the mouth of said creek  
 \_\_\_\_\_  
 \_\_\_\_\_  
 \_\_\_\_\_  
 Sec. \_\_\_\_\_ Twp. \_\_\_\_\_ Rge. \_\_\_\_\_ Bank of Stream \_\_\_\_\_
6. Purpose Irrigating and other purposes.
7. Description of System A dam 75 ft. long by 10 ft. high. Said dam being at said point  
on said creek and said water flows on said land right at the dam, which said water  
flows out thence over and upon said land.
8. Land Description of Intended Place of Use \_\_\_\_\_  
Sec. 30-6N-52E, 163.55 acres, First National Bank, Miles City  
Lot 5 and 32.85 acres of Lot 6, 12 acres of Lot 6, Ignace Ostendorf, Mizpah, Montana
9. Remarks (Pertaining to Use, etc.) That I also hereby claim said ditch and the right-of-way  
therefore and for said water by it conveyed or to be conveyed from point of appropriation  
to said land or point of final discharge and also the right of location upon any lands of  
any dams, flumes or reservoirs constructed or to be constructed by me in appropriating and  
in using said water. That I also claim the right to keep in repair and to enlarge said  
means of water appropriation at any time and the right to dispose of the said right, water,  
ditch or said appurtenance in part or whole  
at any time.
10. Case No. \_\_\_\_\_ Date \_\_\_\_\_ Amt. Decreed: M. I. C. F. S. \_\_\_\_\_
11. To Whom Decreed \_\_\_\_\_ Address \_\_\_\_\_
12. Name of Ditch \_\_\_\_\_ Maximum Capacity (C. F. S.) \_\_\_\_\_
13. Date of Priority \_\_\_\_\_ Purpose \_\_\_\_\_
14. Land Description of Place of Use as Decreed \_\_\_\_\_  
 \_\_\_\_\_  
 \_\_\_\_\_  
 \_\_\_\_\_
15. Remarks (Present Use Status, etc.) \_\_\_\_\_  
 \_\_\_\_\_  
 \_\_\_\_\_

**Decree**

**STATE ENGINEERS OFFICE**  
**Water Resources Survey**

**Notice of Appropriation**

1. County Custer Book F Page 71 Record W.R.
2. Name of Appropriator John L. Selway Address Mizpah, Montana
3. Date Appropriated April 14, 1917 Date Filed April 18, 1917  
 Amount Appropriated, Miners Inches 2000 or 50 Cubic Feet per second
4. Name of Stream Johnson Creek (Dry Creek) Tributary Powder River Basin
5. Point of Diversion About 80 rods SW of the NE corner on  
Sec. 29 Twp. 6N. Rge. 52E. Bank of Stream
6. Purpose Irrigation and other useful purposes.
7. Description of System A ditch of sufficient size and capacity to divert the said  
water from said creek, said ditch runs thence in a southwesterly direction to, over  
and upon said Sec. 30 and thence in a northwesterly direction over and upon said Sec.  
19, and by a side ditch taken from the main ditch at a point not far from where  
the said waters have been diverted and running in a northwesterly direction across  
(over)
8. Land Description of Intended Place of Use NW 1/4 SW 1/4, S 1/2 SW 1/4, SW 1/4 SE 1/4 Sec. 20, E 1/2 NE 1/4, NW 1/4 E 1/4, Lots 1, 5, 6, Sec. 30-6N-52E, 372.26 ac.  
First National Bank of Miles City, Miles City, Montana  
All Sec. 19-6N-52E, Northern Pacific Ry. Co., St. Paul, Minn.
9. Remarks (Pertaining to Use, etc.) Said Johnson Creek runs into said Powder River from  
the east at a point near the west line of Section 29-6N-52E.

**Decree**

10. Case No. .... Date ..... Amt. Decreed: M. I. .... C. F. S. ....
11. To Whom Decreed ..... Address .....
12. Name of Ditch ..... Maximum Capacity (C. F. S.) .....
13. Date of Priority ..... Purpose .....
14. Land Description of Place of Use as Decreed .....
15. Remarks (Present Use Status, etc.) .....

OFFICE OF THE ATTORNEY GENERAL  
STATE OF TEXAS  
NOTARIAL PUBLIC TO COMMISSION

the NW $\frac{1}{4}$ NE $\frac{1}{4}$  and said Sec. 29 to over and upon Sec. 20 and crossing the SW $\frac{1}{4}$ SE $\frac{1}{4}$  of the said Sec. 20 and continuing thence in a northwesterly direction across the SW $\frac{1}{4}$  of the said section to, over and upon the said Sec. 19, said ditches conveying the storm and flood waters of the said Dry Creek or Johnson Creek, to, over and upon the lands above described and forming a flood water system for irrigating the same.



15. Remarks (Present Use Status, etc.).....

# STATE OF MONTANA

## STATE ENGINEER'S OFFICE

### WATER RESOURCES SURVEY

Township 6N Range 52E County Custer

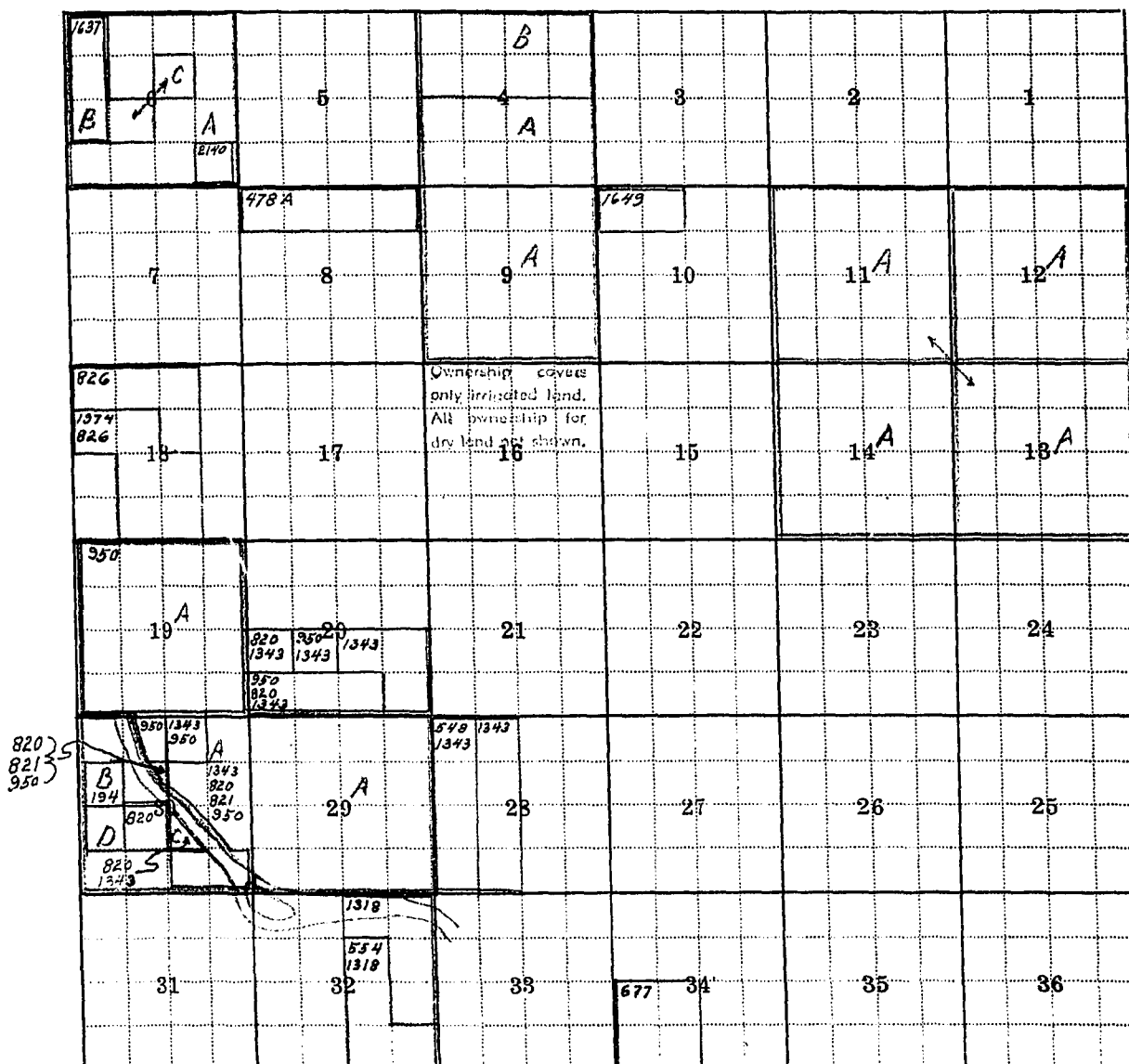

Township 6N Range 52E

Township 6N Range 52E County Custer

[illegible]

Township 6 North

Range 52 East

Custer County

<u>Index No.</u>	<u>Name of Appropriator</u>	<u>Stream</u>	<u>Date App.</u>	<u>Date Filed</u>	<u>M.I.</u>
194	Max Knell	Bridge Coulee	10-18-11	10-19-11	500
478 A	Harry G. Woolsey	Dog Gulch	11-18-12	11-18-12	500
548	John M. C. Raner	Dry Creek	3-8-06	3-8-06	250
554	Wm. R. Sincock	Dry Creek	5-1-03	5-1-03	500
677	Geo. W. Pennock	First Creek	10-26-14	11-2-14	500
820	James M. Johnson	Hay Creek	7-12-02	7-14-02	1000
821	James M. Johnson	Hay Creek	10-18-00	10-18-00	400
826	Mary E. Myers	Hay Creek	5-16-98	-----	400
950	John L. Selway	Johnson Creek	4-14-17	4-18-17	2000
1318	Martha J. Crosby	Powder River	11-3-05	11-4-05	4000
1343	John Selway	Powder River	8-28-09	9-9-09	2000
1637	Brown & Brown	Sheep Creek	3-10-06	3-27-06	1000
1649	Fred W. Woolsey	Sheep Creek	12-30-15	1-4-16	120
1974	Geo. W. Myers	Twin Butte Creek	2-1-09	2-5-09	500
2140	C. S. Babcock	No Name Creek	1-26-12	1-26-12	100

Township 6 North

Range 52 East

Custer County

(Township 6 N., R. 52 East)

Gilman, Colin & Sylvia

Ostendorf. Ignatz

(Township 6 North, Range 53 East)

Gilman, Colin & Sylvia



NOTICE  
These forms are the  
property of the State  
of Montana and must  
be returned.

STATE OF MONTANA  
STATE ENGINEERS OFFICE

Water Resources Survey

18A-19A-20A-21A  
Code No.

County: Custer

T. 6N R. 53E

Name of Land Owner: Colin & Sylvia Gilman Address: Mizzpah, Montana  
Name of Operator: \_\_\_\_\_ Address: \_\_\_\_\_

Part A

TO BE FILED BY THOSE OBTAINING IRRIGATION WATER FROM  
A DITCH COMPANY OR IRRIGATION DISTRICT

1. Water is delivered by: \_\_\_\_\_  
Name of Ditch, Ditch Company or District Supplying Water
2. State the number of acres you irrigate under this system: \_\_\_\_\_ Shares you hold: \_\_\_\_\_
3. If you obtain water from more than one Company, give the number of shares, acres irrigated and the name of the Company under "Remarks." If you obtain water from a Ditch Company and also have a private system, fill in both Part A and Part B.

Part B

TO BE FILED BY THOSE WHO HAVE A PRIVATE DITCH, PUMP OR IRRIGATION SYSTEM  
or those who have a private water right under a Ditch Company

4. In what year was this land first irrigated? Date: See attached filings
5. Give the name of the original appropriator (first user): \_\_\_\_\_
6. Give the date appropriated: \_\_\_\_\_ Amount filed on: Miners Inches: \_\_\_\_\_ C. F. S.: \_\_\_\_\_
7. State the total number of acres irrigated under this system: \_\_\_\_\_
8. Give the point of diversion: 1/4 Section \_\_\_\_\_ Township: \_\_\_\_\_ Range: \_\_\_\_\_

Part C

TO BE FILED BY ALL WATER USERS IN ADDITION TO PART A OR PART B

9. Source of Water: Sheep Creek  
Name of stream or lake from which water is originally diverted
10. Water is obtained by: (Check one) Gravity ☒ Pumping \_\_\_\_\_ Cher \_\_\_\_\_
11. What is the greatest number of acres you have irrigated? 7 Date: \_\_\_\_\_
12. How many acres did you irrigate in 1947? (Crop and pasture) 394.0
13. State the total number of additional acres that could be irrigated by increasing the water supply, land leveling, etc. 0. This land is under what ditch? 0
14. How many acres of seeped land do you have which could be drained and put into production? 0
15. What is the condition of your irrigation system? Good
16. Is your water supply adequate? Yes \_\_\_\_\_ No ☒ Explain: Flood & Spring
17. REMARKS: run off irrigation means of ditched ditches, dams and reservoirs?

Over

T. 6N R. 53E

NOTE: The foregoing questions apply only to irrigated land shown on this plat.

## DESCRIPTION AND MAP OF FARM

18. Legal Description of this Farm \_\_\_\_\_



IRRIGATED LAND



NON-IRRIGATED LAND

North

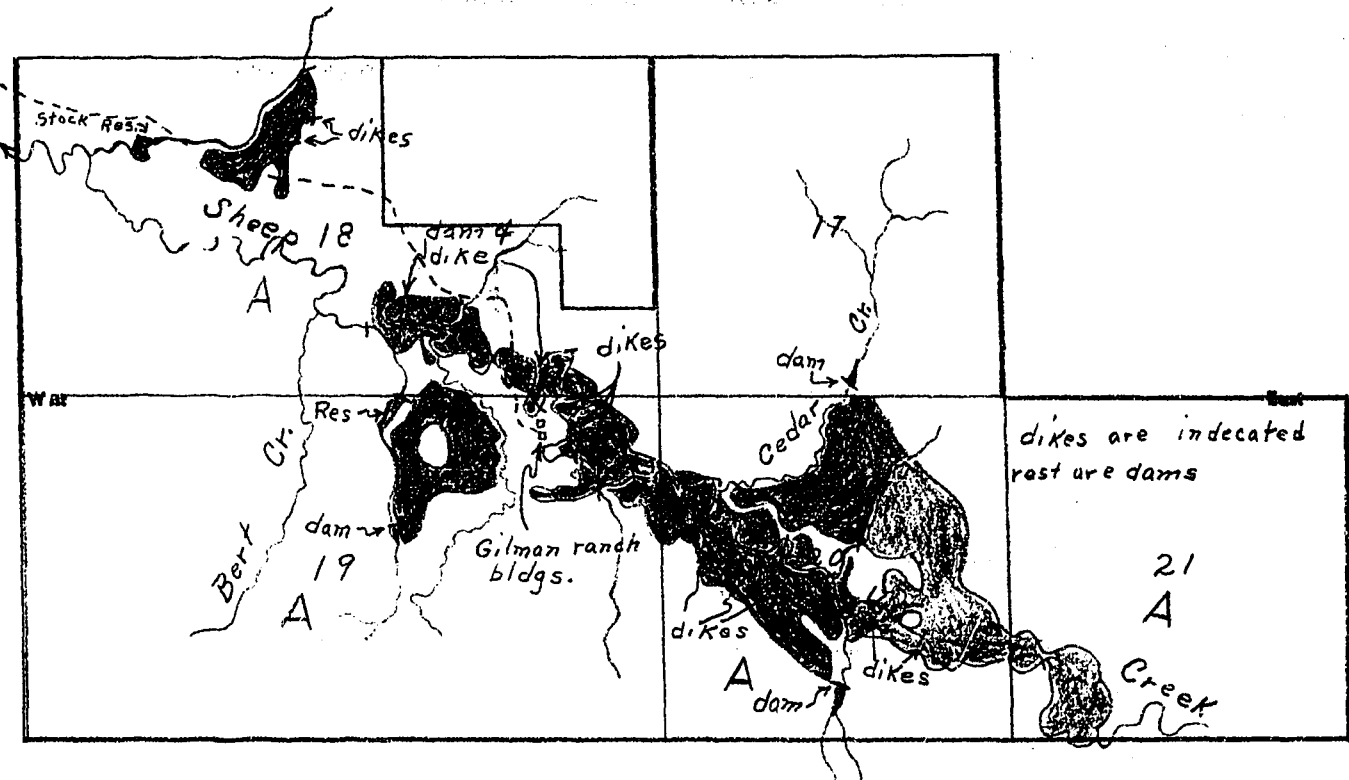

South

19. If the above land is irrigated from more than one ditch please give the acreage under each ditch in 19A and indicate the location of the land irrigated from each on the above map.

19A. Ditch: \_\_\_\_\_ Acres: \_\_\_\_\_

Ditch: \_\_\_\_\_ Acres: \_\_\_\_\_

Information supplied by:

Name \_\_\_\_\_ Address \_\_\_\_\_ Date \_\_\_\_\_

REMARKS: \_\_\_\_\_

If you cannot answer all of the questions on this form answer as many as you can and return the form to us as soon as possible.



STATE ENGINEER'S OFFICE  
WATER RESOURCES SURVEYCOUNTY CusterFILE NO. 38-T.6N-R.53EOwner Gilman, Colin & Sylvia Address Mizpah, Montana?

AAA Owner Address

Operator " " " " " "

New Owner Address

New Operator Address

Assessment Record NoneAssessed Acreage 0Legal Description of This Farm lots 2, 3, 4, 5, 6, 7, 8, 9, 10, 11, 12, 14, 15, 16, 17, 18, 19, 20, 21, 22, 23, 24, W<sup>2</sup>SE<sup>4</sup>, SE<sup>4</sup>SE<sup>4</sup>, Sec. 18; all of Sections 17, 19, 20, 21.T.6N-R.53ETotal Acres in Farm ✓Code Number 18A, 19A, 20A, 21APhoto No. Ma-20-83; Ma-20-71

AAA Contract No.

AAA Total Cropland Acreage

App. No. 398, 868, 1060, 1122, 2247

Decree No.

Land is located in

Twp. 6N Rge. 53E Twp. 6N Rge. 52E

Twp. Rge. Twp. Rge.

Filed in Twp. 6N Rge. 53

Remarks

Ownership covers  
only irrigated land.  
All ownership for  
dry land not shown.Powder River Basin

## STATE ENGINEERS OFFICE

## Water Resources Survey

## Notice of Appropriation

1. County Custer Book D Page 13 Record Water Right
2. Name of Appropriator Dan H. Bowman Address Knowlton, Custer County
3. Date Appropriated April 29, 1908 Date Filed May 25, 1908
- Amount Appropriated, Miners Inches 100, Cubic Feet per second
4. Name of Stream Cow Creek Tributary Basin
5. Point of Diversion 400 yds. east of Mud Butte

Sec. Twp. Rge. Bank of Stream Both

6. Purpose Irrigation and stock purposes.
7. Description of System Said dam is 3 ft. high by 10 ft. on top and 18 ft. on the bottom and 40 ft. long. Said ditch is 18" deep by 36" wide on the bottom in size, which carries and conducts 100 miners inches of water of said creek, which said ditch or ditches and dam diverts the water from said stream and runs thence in a northerly direction over and upon said lands discharging said
8. Land Description of Intended Place of Use water into said Sheep Creek.
- S $\frac{1}{2}$ NE $\frac{1}{4}$ , N $\frac{1}{2}$ SW $\frac{1}{4}$ , NW $\frac{1}{4}$ SE $\frac{1}{4}$ , S $\frac{1}{2}$ NE $\frac{1}{4}$ , Lot 9, Lots 12-8-13-6-15 Sec. 18-6N-53E.
- Lot 9 owned by Gaylord C. Bowman, Mizpah, Montana and Lots 12-8-13-6-15 by Portland Trust and Savings Bank, Portland, Ore.
9. Remarks (Pertaining to Use, etc.) On land lying on the South side of Sheep Creek and East from the mouth of Monkey Wrench Creek about  $1\frac{1}{2}$  of a mile. Said land in unsurveyed.

## Decree

10. Case No. Date Amt. Decreed: M. I. C. F. S.
11. To Whom Decreed Address
12. Name of Ditch Maximum Capacity (C. F. S.)
13. Date of Priority Purpose
14. Land Description of Place of Use as Decreed
15. Remarks (Present Use Status, etc.)

STATE ENGINEERS OFFICE  
Water Resources Survey

## Notice of Appropriation

1. County Custer Book C Page 585 Record W.R.2. Name of Appropriator Lillian M. Bowman Address Knowlton, Montana  
July 1, 19073. Date Appropriated July 1, 1907 Date Filed Mar. 24, 1908Amount Appropriated, Miners Inches 100, Cubic Feet per second4. Name of Stream Home Creek Tributary Basin5. Point of Diversion Near the center of the SE  $\frac{1}{4}$  NW  $\frac{1}{4}$ Sec. 20 Twp. 6N. Rge. 53E. Bank of Stream6. Purpose For irrigation and other useful purposes.7. Description of System A dam and two ditches each of said ditches are 2 ft. on the bottom by 12 in. deep in size. The dam is 12 ft. deep by 90 ft. long, said dam is 12 ft. on top and 30 ft. wide at base, said ditches carry and conduct said 100 in. of water from said creek and runs thence in a northwesterly and northeasterly direction to the south line of said land, thence over and upon said land.

8. Land Description of Intended Place of Use

W  $\frac{1}{2}$  NW  $\frac{1}{4}$ , SE  $\frac{1}{2}$  NW  $\frac{1}{4}$  Sec. 20-6N-53E, 120 acres, Portland Trust and Savings Bank, Portland,  
NE  $\frac{1}{2}$  NW  $\frac{1}{4}$  Sec. 20-6N-53E, 40 acres, Dan Bowman, Knowlton, Montana

9. Remarks (Pertaining to Use, etc.)

## Decree

10. Case No. Date Amt. Decreed: M. I. C. F. S.

11. To Whom Decreed Address

12. Name of Ditch Maximum Capacity (C. F. S.)

13. Date of Priority Purpose

14. Land Description of Place of Use as Decreed

15. Remarks (Present Use Status, etc.)

**STATE ENGINEERS OFFICE**  
Water Resources Survey

**Notice of Appropriation**

1. County Guster Book C Page 581 Record W.R.

2. Name of Appropriator Lillian M. Bowman Address Knowlton, Montana

July 1, 1907  
3. Date Appropriated March 24, 1908 Date Filed March 24, 1908

Amount Appropriated, Miners Inches 100, Cubic Feet per second

4. Name of Stream Meadow Creek Tributary Basin

5. Point of Diversion About 100 ft. west of the center of the NW $\frac{1}{4}$

Sec. 20 Twp. 6N. Rge. 52E. Bank of Stream

6. Purpose For irrigation and other useful purposes.

7. Description of System A dam, and ditches and a system of dykes, said dykes are  
eighteen inches high and eighteen inches on top by 3 ft. at the base. The dam is  
2 ft. high X 50 ft. long and 3 ft. on top and 6 ft. at the base. The said ditch is 2  
ft. on the bottom X 12 inches deep in size, said ditches and dykes carries and conducts  
8. Land Description of Intended Place of Use said 100 in. of water from said creek and runs thence  
in a westerly direction over and upon said land.

W $\frac{1}{2}$ NE $\frac{1}{4}$  Sec. 20-6N-53E, 80 acres, Dan Bowman, Knowlton, Montana

9. Remarks (Pertaining to Use, etc.)

**Decree**

10. Case No. Date Amt. Decreed: M. I. C. F. S.

11. To Whom Decreed Address

12. Name of Ditch Maximum Capacity (C. F. S.)

13. Date of Priority Purpose

14. Land Description of Place of Use as Decreed

15. Remarks (Present Use Status, etc.)

**STATE ENGINEERS OFFICE**  
**Water Resources Survey**

**Notice of Appropriation**

1. County Custer Book D Page 15 Record W.R.
2. Name of Appropriator Dan H. Bowman Address Knowlton, Custer County
3. Date Appropriated April 29, 1908 Date Filed May 25, 1908
- Amount Appropriated, Miners Inches 100, Cubic Feet per second \_\_\_\_\_
4. Name of Stream Mud Creek Tributary Sheep Creek Basin \_\_\_\_\_
5. Point of Diversion about 100 vds. above a cut bank on East side of said stream
- Sec. \_\_\_\_\_ Twp. \_\_\_\_\_ Rge. \_\_\_\_\_ Bank of Stream Right
6. Purpose Irrigation, stock and other useful purposes.
7. Description of System The dam is 4 ft. high by 50 ft. long and is 10 ft. on top by 20 ft. on the bottom in size, which carries and conducts 100 inches of water of said creek, which said ditch and dam diverts the water from said stream and runs thence in a southwesterly direction over and upon said lands discharging said water into Sheep Creek at a point about 600 ft. east of the mouth of Monkey Wrench Creek, the point of final discharge.
8. Land Description of Intended Place of Use  
Lots 3,4,5, Sec. 18-6N-53E, 136.22 acres, Gaylord C. Bowman, Mizpah, Montana  
Lots 6,7,8, Sec. 18-6N-53E, 136.27 acres, Portland Trust & Sav. Bank, Portland, Oregon
9. Remarks (Pertaining to Use, etc.) \_\_\_\_\_

**Decree**

10. Case No. \_\_\_\_\_ Date \_\_\_\_\_ Amt. Decreed: M. I. \_\_\_\_\_ C. F. S. \_\_\_\_\_
11. To Whom Decreed \_\_\_\_\_ Address \_\_\_\_\_
12. Name of Ditch \_\_\_\_\_ Maximum Capacity (C. F. S.) \_\_\_\_\_
13. Date of Priority \_\_\_\_\_ Purpose \_\_\_\_\_
14. Land Description of Place of Use as Decreed \_\_\_\_\_
15. Remarks (Present Use Status, etc.) \_\_\_\_\_

**STATE ENGINEERS OFFICE**  
Water Resources Survey

**Notice of Appropriation**

1. County Custer Book C Page 583 Record W.R.
2. Name of Appropriator Lillian M. Bowman Address Knowlton, Montana  
July 1, 1907
3. Date Appropriated Mar. 24, 1908 Date Filed Mar. 24, 1908
- Amount Appropriated, Miners Inches 100, Cubic Feet per second \_\_\_\_\_
4. Name of Stream Pond Draw Tributary \_\_\_\_\_ Basin \_\_\_\_\_
5. Point of Diversion Near the center of the E $\frac{1}{2}$ SE $\frac{1}{4}$

Sec. 20 Twp. 6N. Rge. 53E. Bank of Stream \_\_\_\_\_

6. Purpose For irrigation and other useful purposes.
7. Description of System A dam, ditch and system of dykes. Said ditch is 24 in. on the bottom and 18 in. deep in size, which carries and conducts 100" of water from said creek, said dykes are all 24" high and 4 ft. wide on the bottom and will conduct said 100" of water from said stream, said dam is 3 $\frac{1}{2}$  ft. high by 3 ft. on top and 12 ft. at the base; which said dykes, dams and ditches, divert the water from said stream and runs in a north-
8. Land Description of Intended Place of Use westerly direction over and upon said land.

N $\frac{1}{2}$ SE $\frac{1}{4}$  Sec. 20-6N-53E, 80 acres, Dan Bowman, Knowlton, Montana

9. Remarks (Pertaining to Use, etc.) \_\_\_\_\_

**Decree**

10. Case No. \_\_\_\_\_ Date \_\_\_\_\_ Amt. Decreed: M. I. \_\_\_\_\_ C. F. S. \_\_\_\_\_
11. To Whom Decreed \_\_\_\_\_ Address \_\_\_\_\_
12. Name of Ditch \_\_\_\_\_ Maximum Capacity (C. F. S.) \_\_\_\_\_
13. Date of Priority \_\_\_\_\_ Purpose \_\_\_\_\_
14. Land Description of Place of Use as Decreed \_\_\_\_\_
15. Remarks (Present Use Status, etc.) \_\_\_\_\_

# STATE OF MONTANA

## STATE ENGINEER'S OFFICE

### WATER RESOURCES SURVEY

Township.....6N..... Range.....53E..... County.....Custer.....

	6	5	4	3	2	1
	A <sub>7</sub>	8	9	10	11	12
398 1122 398	A	B 1122	17 A	15	14	13
	A	19	20 A 2249	21 A	22	23
	30	29	28	27	26	25
	31	32	33	34	35	36

Ownership: covers only irrigated land. All ownership for dry land set down.

164

868

1060

Township.....6N..... Range.....53E.....





Township 6 North

Range 53 East

Custer County

<u>Index No.</u>	<u>Name of Appropriator</u>	<u>Stream</u>	<u>Date App.</u>	<u>Date Filed</u>	<u>M.I.</u>
398	Dan H. Bowman	Cow Creek	4-29-08	5-25-08	100
164	Woolsey, Harry	Dog Gulch	11-13-12	11-13-12	500
868	Lillian M. Bowman	Home Creek	7-1-07	3-24-08	100
1060	Lillian Bowman	Meadow Creek	7-1-07	3-24-08	100
1122	Dan H. Bowman	Mud Creek	4-29-08	5-25-08	100
2249	Lillian M. Bowman	Pond Draw	7-1-07	3-24-08	100

Township 6 North

Range 53 East

Custer County