



These forms are the property of the State of Montana and must be returned.

STATE OF MONTANA
STATE ENGINEERS OFFICE

Water Resources Survey

Code No. 22B
County Quatern
T. 7N R. 45E

Name of Land Owner Leon E. Bracht Address Sheffield, Mont
Name of Operator Olaf Nelson Address " "

Part A

TO BE FILED BY THOSE OBTAINING IRRIGATION WATER FROM
A DITCH COMPANY OR IRRIGATION DISTRICT

1. Water is delivered by: _____
Name of Ditch, Ditch Company or District Supplying Water
2. State the number of acres you irrigate under this system _____ Shares you hold _____
3. If you obtain water from more than one Company, give the number of shares, acres irrigated and the name of the Company under "Remarks." If you obtain water from a Ditch Company and also have a private system fill in both Part A and Part B.

Part B

TO BE FILED BY THOSE WHO HAVE A PRIVATE DITCH, PUMP OR IRRIGATION SYSTEM
or those who have a private water right under a Ditch Company

4. In what year was this land first irrigated? Date see attached filings
5. Give the name of the original appropriator (first user): _____
6. Give the date appropriated _____ Amount filed on: Miners Inches _____ C. F. S. _____
7. State the total number of acres irrigated under this system: _____
8. Give the point of diversion: _____ $\frac{1}{4}$ _____ $\frac{1}{4}$ Section _____ Township _____ Range _____

Part C

TO BE FILED BY ALL WATER USERS IN ADDITION TO PART A OR PART B

9. Source of Water: Waste Water Yellowstone River
Name of stream or lake from which water is originally diverted
10. Water is obtained by: (Check one) Gravity _____ Pumping ☒ Other _____
11. What is the greatest number of acres you have irrigated? 26.0 Date _____
12. How many acres did you irrigate in 1977 (Crop and pasture) 0
13. State the total number of additional acres that could be irrigated by increasing the water supply, land leveling, etc. 26.0 This land is under what ditch? 0
14. How many acres of seeped land do you have which could be drained and put into production? 0
15. What is the condition of your irrigation system? Fair
16. Is your water supply adequate? Yes _____ No ☒ Explain _____
17. REMARKS: Uses waste water from Sheffield Pump system. None available this year

NOTE: The foregoing questions apply only to irrigated land shown on this plat.

DESCRIPTION AND MAP OF FARM

18. Legal Description of this Farm

MEY, Sec 22



None At Present
IRRIGATED LAND

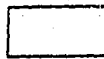

NON-IRRIGATED LAND



Potential Land

North

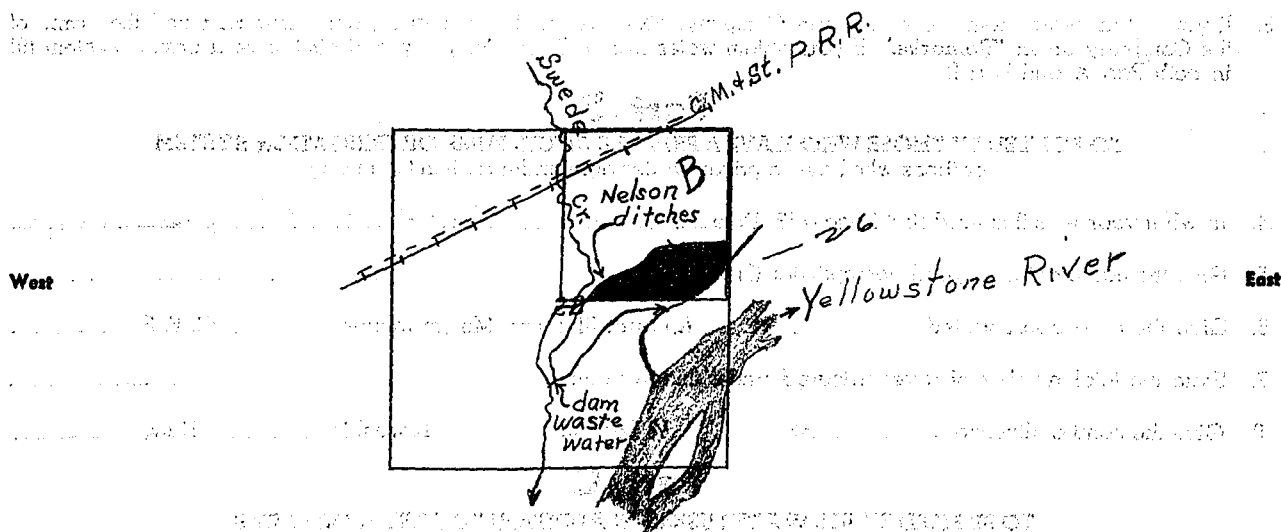

Ownership covers
only irrigated land.
All ownership for
dry land not shown.

19. If the above land is irrigated from more than one ditch please give the acreage under each ditch in 19A and indicate the location of the land irrigated from each on the above map.

19A. Ditch: Nelson Private Pump ditch Acres: 26.0
Ditch: _____ Acres: _____
(potential)

Information supplied by:

Name See field form Address _____ Date _____

REMARKS: attached to 220-22E Olaf Nelson op.

If you cannot answer all of the questions on this form answer as many as you can and return the form to us as soon as possible.

STATE ENGINEER'S OFFICE
WATER RESOURCES SURVEYCOUNTY ClusterFILE NO. 24-T. 7N-R. 45EOwner Bracht, Leon E Address Sheffield, Montana

AAA Owner Address

Operator Nelson, Olaf Address " "

New Owner Address

New Operator Address

Assessment Record NameAssessed Acreage 0Legal Description of This Farm NE⁴, Sec. 22; T. 7N-R. 45ETotal Acres in Farm ✓Code Number 22BPhoto No. Ma 22-156

AAA Contract No.

AAA Total Cropland Acreage

App. No. 2266-2057?

Decree No.

Land is located in

Twp. 7N Rge. 45E Twp. Rge.

Twp. Rge. Twp. Rge.

Filed in Twp. 7N Rge. 45ERemarks Olaf Nelson alsooperates some land southof this place - owned by(22D) Salma Nelson & Howard BaylonYellowstone River BasinOwnership covers
only irrigated land.
All ownership for
dry land not shown.



NOTICE
These forms are the
property of the State
of Montana and must
be returned.

STATE OF MONTANA
STATE ENGINEERS OFFICE

Water Resources Survey

Code No. 12C
County Beaumont
T. 7N R. 45

Name of Land Owner

J. W. Bullard et al

Address

Box 85 - Sinton Texas

Name of Operator

Address

Part A

TO BE FILED BY THOSE OBTAINING IRRIGATION WATER FROM
A DITCH COMPANY OR IRRIGATION DISTRICT

1. Water is delivered by: _____
Name of Ditch, Ditch Company or District Supplying Water
2. State the number of acres you irrigate under this system _____ Shares you hold _____
3. If you obtain water from more than one Company, give the number of shares, acres irrigated and the name of the Company under "Remarks." If you obtain water from a Ditch Company and also have a private system fill in both Part A and Part B.

Part B

TO BE FILED BY THOSE WHO HAVE A PRIVATE DITCH, PUMP OR IRRIGATION SYSTEM
or those who have a private water right under a Ditch Company

4. In what year was this land first irrigated? Date No data
5. Give the name of the original appropriator (first user): _____
6. Give the date appropriated _____ Amount filed on: Miners Inches _____ C. F. S. _____
7. State the total number of acres irrigated under this system: _____
8. Give the point of diversion: _____ $\frac{1}{4}$ Section _____ Township _____ Range _____

Part C

TO BE FILED BY ALL WATER USERS IN ADDITION TO PART A OR PART B

9. Source of Water: trib to Stager Creek
Name of stream or lake from which water is originally diverted
10. Water is obtained by: (Check one) Gravity ☒ Pumping _____ Other Flowed
11. What is the greatest number of acres you have irrigated? 22.0 Date _____
12. How many acres did you irrigate in 1947 (Crop and pasture) 0
13. State the total number of additional acres that could be irrigated by increasing the water supply, land leveling, etc. 22.0 This land is under what ditch? Old Bonanza ditch
14. How many acres of seeped land do you have which could be drained and put into production? 0
15. What is the condition of your irrigation system? Out of use
16. Is your water supply adequate? Yes _____ No ☒ Explain Flowed
17. REMARKS: _____

COPIES OF THIS REPORT MUST BE FILED IN THE OFFICE OF THE STATE ENGINEER, BOZEMAN, MONTANA

NOTE: The foregoing questions apply only to irrigated land shown on this plat.

DESCRIPTION AND MAP OF FARM

18. Legal Description of this Farm

N 2 SW 4, Sec 12
T4N R10W S12W

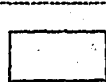

None At Present
IRRIGATED LAND

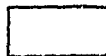

NON-IRRIGATED LAND



Potential Land

North

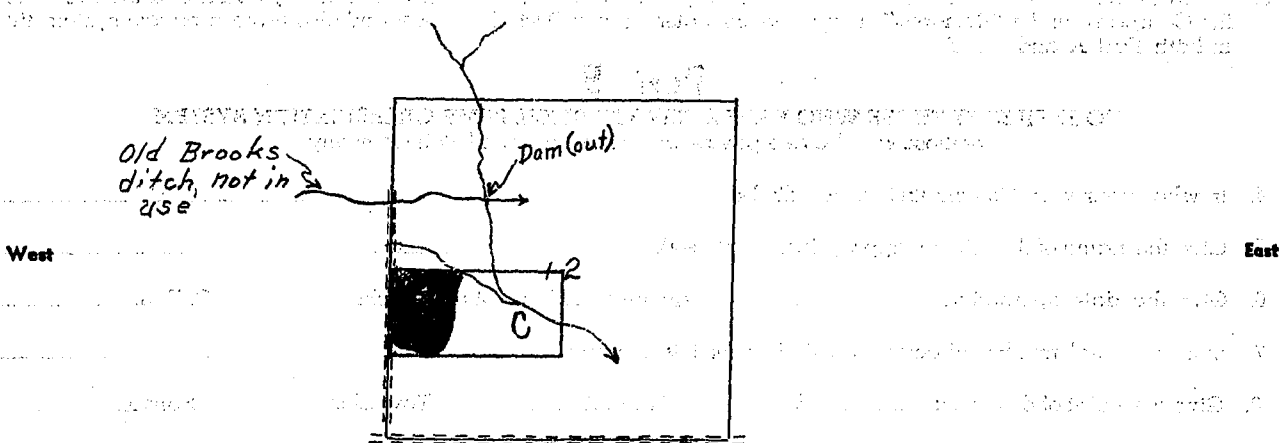

Ownership covers only irrigated land. All ownership for dry land not shown.

19. If the above land is irrigated from more than one ditch please give the acreage under each ditch in 19A and indicate the location of the land irrigated from each on the above map.

19A. Ditch: *Old Brooks ditch* Acres: *0*

Ditch: _____ Acres: _____

Information supplied by:

Name *Field Survey* Address _____ Date *5/15/47*

REMARKS: *Johnson & J. Pauline*

If you cannot answer all of the questions on this form answer as many as you can and return the form to us as soon as possible.

STATE ENGINEER'S OFFICE
WATER RESOURCES SURVEYCOUNTY CusterFILE NO. 24-T.7N-R.45EOwner Bullard, J.W. (Est.) Address Box 85 - Sinton, Texas

AAA Owner Address

Operator ? Address ?

New Owner Address

New Operator Address

Assessment Record NoneAssessed Acreage 0Legal Description of This Farm N²SW⁴ Sec. 12; T. 7N-R. 45ETotal Acres in Farm ✓Code Number 12CPhoto No. Ma 23-01

AAA Contract No.

AAA Total Cropland Acreage

App. No. No. Record by Description

Decree No.

Land is located in

Twp. 7N Rge. 45E Twp. Rge.

Twp. Rge. Twp. Rge.

Filed in Twp. 7N Rge. 45E

Remarks

Ownership shown
only irrigated land.
All ownership for
dry land not shown.Yellowstone River Basin



NOTICE
These forms are the
property of the State
of Montana and must
be returned.

STATE OF MONTANA
STATE ENGINEERS OFFICE

Water Resources Survey

Code No. 18B

County Custer

T. 7N R. 45E

Name of Land Owner Della Eyeland Address Sheffield, Mont

Name of Operator _____ Address _____

Part A

TO BE FILED BY THOSE OBTAINING IRRIGATION WATER FROM
A DITCH COMPANY OR IRRIGATION DISTRICT

1. Water is delivered by: _____
Name of Ditch, Ditch Company or District Supplying Water
2. State the number of acres you irrigate under this system. _____ Shares you hold _____
3. If you obtain water from more than one Company, give the number of shares, acres irrigated and the name of the Company under "Remarks." If you obtain water from a Ditch Company and also have a private system fill in both Part A and Part B.

Part B

TO BE FILED BY THOSE WHO HAVE A PRIVATE DITCH, PUMP OR IRRIGATION SYSTEM
or those who have a private water right under a Ditch Company

4. In what year was this land first irrigated? Date See attached filings
5. Give the name of the original appropriator (first user): _____
6. Give the date appropriated _____ Amount filed on: Miners Inches _____ C. F. S. _____
7. State the total number of acres irrigated under this system: _____
8. Give the point of diversion: _____ $\frac{1}{4}$ _____ $\frac{1}{4}$ Section _____ Township _____ Range _____

Part C

TO BE FILED BY ALL WATER USERS IN ADDITION TO PART A OR PART B

9. Source of Water: Whitetail Creek
Name of stream or lake from which water is originally diverted
10. Water is obtained by: (Check one) Gravity ☒ Pumping _____ Other Flood
11. What is the greatest number of acres you have irrigated? 65.0 Date _____
12. How many acres did you irrigate in 1948 (Crop and pasture) 65.0
13. State the total number of additional acres that could be irrigated by increasing the water supply, land leveling, etc. 0 This land is under what ditch? 0
14. How many acres of seeped land do you have which could be drained and put into production? 0
15. What is the condition of your irrigation system? Good
16. Is your water supply adequate? Yes _____ No ☒ Explain Flood Water
17. REMARKS: _____

NOTE: The foregoing questions apply only to irrigated land shown on this plat.

DESCRIPTION AND MAP OF FARM

18. Legal Description of this Farm

E 27 1/2 SECTION 18

T 27 N R 10 W



IRRIGATED LAND



NON-IRRIGATED LAND

North

West

East

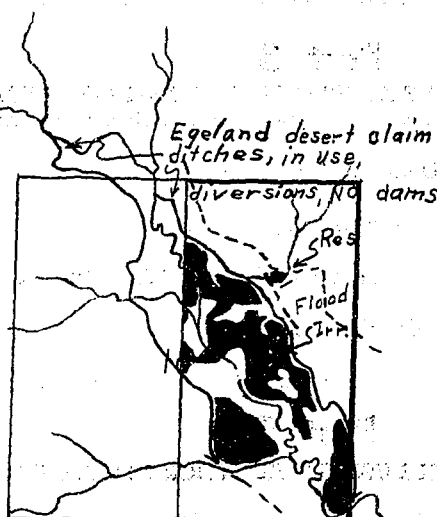

South

Ownership covers only irrigated land. All ownership for dry land not shown.

19. If the above land is irrigated from more than one ditch please give the acreage under each ditch in 19A and indicate the location of the land irrigated from each on the above map.

19A. Ditch: Flood Irr Whitetail Creek Acres: 65.0

Ditch: _____ Acres: _____

Information supplied by:

Name See attached form Address _____ Date 5/14/47

REMARKS: _____

If you cannot answer all of the questions on this form answer as many as you can and return the form to us as soon as possible.

STATE ENGINEER'S OFFICE
WATER RESOURCES SURVEY

COUNTY Custer

FILE NO. 24-T.7N-R.45E

Owner Egeland, Della Address Sheffield, Montana

AAA Owner Address

Operator " " Address " "

New Owner Address

New Operator Address

Assessment Record None

Assessed Acreage 0

Legal Description of This Farm E² Sec. 18; T. 7N-R. 45E

Total Acres in Farm 1

Code Number 18B

Photo No. MA 22-153

AAA Contract No.

AAA Total Cropland Acreage.

App. No. 1998-1999-2000

Decree No.

Land is located in

Twp. 7N Rge. 45E Twp. Rge.

Twp. Rge. Twp. Rge.

Filed in Twp. 7N Rge. 45E

Remarks

Yellowstone River Basin

Ownership covers
only irrigated land.
All ownership for
dry land not shown.

Farm Checked

STATE OF MONTANA

Code No. 158

By Johnson & Doe

STATE ENGINEER'S OFFICE

County Custer

Area Miles City - Sheffield

WATER RESOURCES SURVEY

T. 7N. R. 45E Sec. 15

Date 5/14/47

Photo No. MA 22-150

Legal Land Owner Egeland, Della

Address Sheffield

Operator SDMC

Address

Water is delivered by:

Federal Project _____ Pres. _____ Pot _____

Ditch Company _____ Pres. _____ Pot. _____

Irrigation District _____ Pres. _____ Pot. _____

Private System Private Flood ditches Pres. (25.0) Pot.

Totals

Flood ☒ Pump _____ Reservoir _____ Gravity ☒

Size and Capacity, Pump, etc.

Original Appropriator, Company.

App. No. 19 of 1999-2000

Original Appropriator, Private.

Packer 1907 to 1911

App. No. 2-55-111

(Show date of appropriation under Remarks)

Is the system an extension of another system?

Yes _____ No/ ☒

Is all land irrigated from one system?

Yes A No

(If No, show break down on map)

Source of Water. White Tail

Acres Irrigated 19 47 63.0

Potential Acres 0 Seeped 0

Explain _____

Condition of System good

Adequate Supply Yes..... No.....

Explain Flood only

Topography Creek bottom

Information From Ege/94d

Remarks Says that his desert claim
right is tied to the land & the
best right on the Creek



NOTICE
These forms and the
property of the State
of Montana and must
be returned.

Information on the Montana Water Resources Survey is available from the Montana State Engineers Office.

STATE OF MONTANA
STATE ENGINEERS OFFICE

Water Resources Survey

Code No. 12E
County Carbon
T. 7N R. 45E

Name of Land Owner Louise Faber Address 603 W. Lawrence St.
Name of Operator _____ Address Bozeman, Mont

Part A

TO BE FILED BY THOSE OBTAINING IRRIGATION WATER FROM
A DITCH COMPANY OR IRRIGATION DISTRICT

1. Water is delivered by: _____ Name of Ditch, Ditch Company or District Supplying Water _____
2. State the number of acres you irrigate under this system _____ Shares you hold _____
3. If you obtain water from more than one Company, give the number of shares, acres irrigated and the name of the Company under "Remarks." If you obtain water from a Ditch Company and also have a private system fill in both Part A and Part B.

Part B

TO BE FILED BY THOSE WHO HAVE A PRIVATE DITCH, PUMP OR IRRIGATION SYSTEM
or those who have a private water right under a Ditch Company

4. In what year was this land first irrigated? Date See attached filing
5. Give the name of the original appropriator (first user): _____
6. Give the date appropriated _____ Amount filed on: Miners Inches _____ C. F. S. _____
7. State the total number of acres irrigated under this system: _____
8. Give the point of diversion: _____ $\frac{1}{4}$ _____ $\frac{1}{4}$ Section _____ Township _____ Range _____

Part C

TO BE FILED BY ALL WATER USERS IN ADDITION TO PART A OR PART B

9. Source of Water: No Name Available
Name of stream or lake from which water is originally diverted _____
10. Water is obtained by: (Check one) Gravity ☒ Pumping _____ Other: Flood
11. What is the greatest number of acres you have irrigated? 60.0 Date _____
12. How many acres did you irrigate in 1947 (Crop and pasture) 0
13. State the total number of additional acres that could be irrigated by increasing the water supply, land leveling, etc. 60.0 This land is under what ditch? Faber dyke system
14. How many acres of seeped land do you have which could be drained and put into production? 0
15. What is the condition of your irrigation system? Good
16. Is your water supply adequate? Yes _____ No ☒ Explain Good water
17. REMARKS: _____

Over _____

NOTE: The foregoing questions apply only to irrigated land shown on this plot.

DESCRIPTION AND MAP OF FARM

18. Legal Description of this Farm

SE 1/4 Sec 12
Yuma County Arizona



None At Present
IRRIGATED LAND

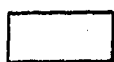

NON-IRRIGATED LAND



Potential Land

North

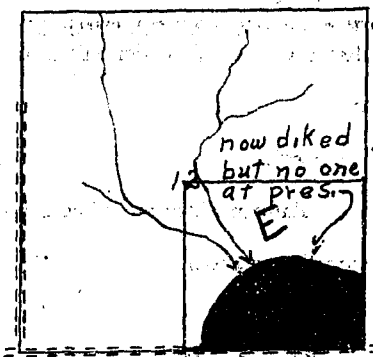

West

East

South

Ownership, covers
only irrigated land.
All ownership for
dry land not shown.

19. If the above land is irrigated from more than one ditch please give the acreage under each ditch in 19A and indicate the location of the land irrigated from each on the above map.

19A. Ditch: Private Flood System Acres: 0

Ditch: _____ Acres: _____

Information supplied by:

Name Lick Sinner Address _____ Date 5/5/71

REMARKS: see attached form

If you cannot answer all of the questions on this form answer as many as you can and return the form to us as soon as possible.

STATE ENGINEER'S OFFICE
WATER RESOURCES SURVEY

COUNTY Cluster

FILE NO. 24-T.7N-R.45E

Owner Faber, Louise Address 603 W. Lamma St., Bozeman, Mont.

AAA Owner _____ Address _____

Operator ? Address ?

New Owner _____ Address _____

New Operator _____ Address _____

Assessment Record None

Assessed Acreage 0

Legal Description of This Farm SE⁴ Sec. 12; T. 7N-R. 45E

Total Acres in Farm ✓

Code Number 12E

Photo No. Ma. 23-01

AAA Contract No. _____

AAA Total Cropland Acreage _____

App. No. 1803

Decree No. _____

Land is located in

Twp. 7N Rge. 45E Twp. _____ Rge. _____

Twp. _____ Rge. _____ Twp. _____ Rge. _____

Filed in Twp. 7N Rge. 45E

Remarks _____

Yellowstone River Basin

Ownership shown
only irrigated land
All ownership for
dry land not shown

Farm Checked

STATE OF MONTANA

Code No. 12E

By Doc & Collins

STATE ENGINEER'S OFFICE

County Custer

Area Miles - Sheffield

WATER RESOURCES SURVEY

T. 7N. R. 45E. Sec. 12

Date 5/15/47

Photo No. MA 23-02

Legal Land Owner. Faber, Louise

Address Bozeman

Operator.

Address

Water is delivered by:

Federal Project _____ Pres _____ Pot _____

Ditch Company _____ Pres. _____ Pot _____

Irrigation District _____ Pres. _____ Pot _____

Private System Flood Dir. 1959 Pres. 0 Pot.

Planim.

Totals

Flood Pump Reservoir Gravity

Size and Capacity, Pump, etc.

Original Appropriator, Company_____App. No. _____

Original Appropriator, Private Susan Ligen 1913 App. No. 1803

(Show date of appropriation under Remarks)

Is the system an extension of another system?

Yes_____No_____

Is all land irrigated from one system?

Yes_____No_____

(If No, show break down on map)

Source of Water No Name Coves

Acres Irrigated 19 46 0

Potential Acres 7 Seeped 0

Explain

Condition of System good

Adequate Supply Yes No ✓

Explain ✓ food only

Topography 2nd Terrace

Information From Bracey, Glen

Remarks No one on the place at
present, probably has been sold.

(over)

A 10x10 grid with a thick border. The number '12' is handwritten in the center. A checkmark is drawn in the bottom right corner.

There is no operator on this place but the dike system is in perfect condition and operates itself. Good crop of Hay on the land but probably will not be cut.

STATE INQUIRY OFFICE

TITLE OF REPORT



NOTICE

These forms are the property of the State of Montana and must be returned.

STATE OF MONTANA
STATE ENGINEERS OFFICE

Water Resources Survey

Code No. 18A

County Quinter

T. 7N R. 45

Name of Land Owner J. H. Harris Address Sheffield, Mont

Name of Operator _____ Address _____

Part A

TO BE FILED BY THOSE OBTAINING IRRIGATION WATER FROM
A DITCH COMPANY OR IRRIGATION DISTRICT

1. Water is delivered by: _____
Name of Ditch, Ditch Company or District Supplying Water
2. State the number of acres you irrigate under this system. _____ Shares you hold _____
3. If you obtain water from more than one Company, give the number of shares, acres irrigated and the name of the Company under "Remarks." If you obtain water from a Ditch Company and also have a private system fill in both Part A. and Part B.

Part B

TO BE FILED BY THOSE WHO HAVE A PRIVATE DITCH, PUMP OR IRRIGATION SYSTEM
or those who have a private water right under a Ditch Company

4. In what year was this land first irrigated? Date See attached filing
5. Give the name of the original appropriator (first user): _____
6. Give the date appropriated _____ Amount filed on: Miners Inches _____ C. F. S. _____
7. State the total number of acres irrigated under this system: _____
8. Give the point of diversion: _____ $\frac{1}{4}$ _____ $\frac{1}{4}$ Section _____ Township _____ Range _____

Part C

TO BE FILED BY ALL WATER USERS IN ADDITION TO PART A OR PART B

9. Source of Water: Whitetail Creek
Name of stream or lake from which water is originally diverted
10. Water is obtained by: (Check one) Gravity ☒ Pumping _____ Other Flowed
11. What is the greatest number of acres you have irrigated? 260 Date _____
12. How many acres did you irrigate in 1947 (Crop and pasture) 260
13. State the total number of additional acres that could be irrigated by increasing the water supply, land leveling, etc. 0 This land is under what ditch? 0
14. How many acres of seeped land do you have which could be drained and put into production? 0
15. What is the condition of your irrigation system? Sand
16. Is your water supply adequate? Yes _____ No ☒ Explain Flowed only
17. REMARKS: _____

NOTE: The foregoing questions apply only to irrigated land shown on this plat.

DESCRIPTION AND MAP OF FARM

18. Legal Description of this Farm

E. M. W. 18



IRRIGATED LAND

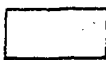

NON-IRRIGATED LAND

North

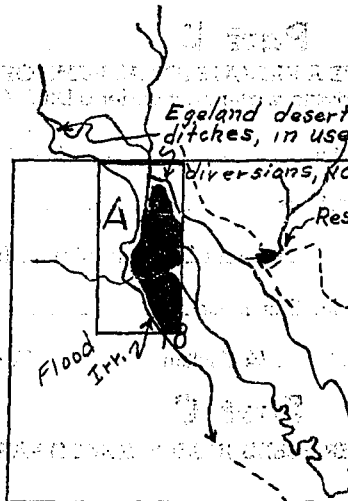

West

East

South

Ownership covers
only irrigated land.
All ownership for
dry land not shown.

19. If the above land is irrigated from more than one ditch please give the acreage under each ditch in 19A and indicate the location of the land irrigated from each on the above map.

19A. Ditch: Flood Whitetail Creek Acres: 26.0

Ditch: _____ Acres: _____

Information supplied by:

Name Mela Jensen Address _____ Date 5/14/47

REMARKS: Johnson & J. Paulist

If you cannot answer all of the questions on this form answer as many as you can and return the form to us as soon as possible.

STATE ENGINEER'S OFFICE
WATER RESOURCES SURVEY

COUNTY Cluster

FILE NO. 24-T.7N-R.45E

Owner Harris, Fred Address Sheffield, Montana

AAA Owner Address

Operator " " Address " "

New Owner Address

New Operator Address

Assessment Record None

Assessed Acreage 0

Legal Description of This Farm E² NW⁴, Sec. 18; T. 7N-R. 45E

Total Acres in Farm ✓

Code Number 18A

Photo No. M. 22-150

AAA Contract No.

AAA Total Cropland Acreage

App. No. 2000

Decree No.

Land is located in

Twp. 7N Rge. 45E Twp. Rge.

Twp. Rge. Twp. Rge.

Filed in Twp. 7N Rge. 45E

Remarks

Yellowstone River Basin

Ownership covers
only irrigated land.
All ownership for
dry land not shown.



NOTICE
These forms are the property of the State of Montana and must be returned.

STATE OF MONTANA
STATE ENGINEERS OFFICE

Water Resources Survey

Code No. 14D

County Custer

T. 7N R. 45

Name of Land Owner Clarence Johnson Address Sheffield, Mont

Name of Operator _____ Address _____

Part A

TO BE FILED BY THOSE OBTAINING IRRIGATION WATER FROM
A DITCH COMPANY OR IRRIGATION DISTRICT

1. Water is delivered by: _____ Name of Ditch, Ditch Company or District Supplying Water
2. State the number of acres you irrigate under this system _____ Shares you hold _____
3. If you obtain water from more than one Company, give the number of shares, acres irrigated and the name of the Company under "Remarks." If you obtain water from a Ditch Company and also have a private system fill in both Part A and Part B.

Part B

TO BE FILED BY THOSE WHO HAVE A PRIVATE DITCH, PUMP OR IRRIGATION SYSTEM
or those who have a private water right under a Ditch Company

4. In what year was this land first irrigated? Date No data
5. Give the name of the original appropriator (first user): See attached letter
6. Give the date appropriated _____ Amount filed on: Miners Inches _____ C. F. S. _____
7. State the total number of acres irrigated under this system: _____
8. Give the point of diversion: _____ $\frac{1}{4}$ _____ $\frac{1}{2}$ Section _____ Township _____ Range _____

Part C

TO BE FILED BY ALL WATER USERS IN ADDITION TO PART A OR PART B

9. Source of Water: Yellowstone River
Name of stream or lake from which water is originally diverted
10. Water is obtained by: (Check one) Gravity _____ Pumping ☒ Other _____
11. What is the greatest number of acres you have irrigated? 75.0 Date _____
12. How many acres did you irrigate in 1947? (Crop and pasture) 60.0
13. State the total number of additional acres that could be irrigated by increasing the water supply, land leveling, etc. 15.0 This land is under what ditch? Same
14. How many acres of seeped land do you have which could be drained and put into production? 0
15. What is the condition of your irrigation system? Good
16. Is your water supply adequate? Yes ☒ No _____ Explain _____
17. REMARKS: _____

Check an all correct and proper data and any an report as to Over and all no knowledge as to the accuracy of the data furnished by the irrigator

NOTE: The foregoing questions apply only to irrigated land shown on this plat.

DESCRIPTION AND MAP OF FARM

18. Legal Description of this Farm

Section 2, Township 2N, Range 2E, 18th Meridian, Yellowstone County, Montana



IRRIGATED LAND



NON-IRRIGATED LAND



Potential Land

North

West

East

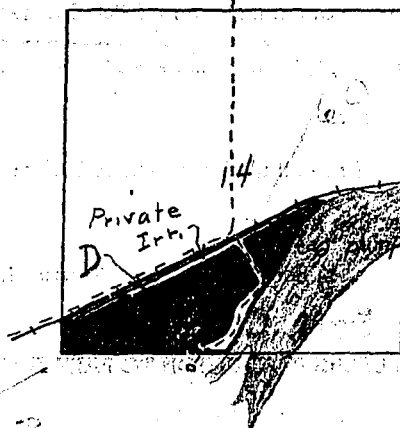

G.M. & St. P.R.R.

Yellowstone River

South

Ownership covers only irrigated land. All ownership for dry land not shown.

19. If the above land is irrigated from more than one ditch please give the acreage under each ditch in 19A and indicate the location of the land irrigated from each on the above map.

19A. Ditch: Private Irrig. Ditch Acres: 60.0

Ditch:

Acres:

Information supplied by:

Name

See attached form

Address

Date

REMARKS:

If you cannot answer all of the questions on this form answer as many as you can and return the form to us as soon as possible.

STATE ENGINEER'S OFFICE
WATER RESOURCES SURVEYCOUNTY CusterFILE NO. 24-T. 7N-R. 45EOwner Johnson, Clarence Address Sheffield, Montana

AAA Owner Address

Operator " " Address " "

New Owner Address

New Operator Address

Assessment Record None -Assessed Acreage 0Legal Description of This Farm all of the SW⁴ south of R.R. R/W;
and part of SE⁴ South of R.R. R/W and North of
Yellowstone River in Sec. 14; T. 7N-R. 45ETotal Acres in Farm ✓Code Number 14DPhoto No. Ma 22-157

AAA Contract No.

AAA Total Cropland Acreage

App. No. No. filing at present time
5/14/47

Decree No.

Land is located in

Twp. 7N Rge. 45E Twp. Rge.

Twp. Rge. Twp. Rge.

Filed in Twp. 7N Rge. 45ERemarks Clarence Johnson alsooperates some land adjoiningthis place, which is ownedby Fred Warwick (Rade Nat Co)Yellowstone River BasinOwnership shown
only irrigated land.
All ownership for
dry land not shown.

Farm Checked

STATE OF MONTANA

Code No. 14DBy Johnson & Joe

STATE ENGINEER'S OFFICE

County CusterArea Miles City-Sheffield

WATER RESOURCES SURVEY

T. 7N R. 45E Sec. 14Date 5/14/47Photo No. MA-22-157Legal Land Owner Johnson, Clarence (change ownership) Address SheffieldOperator Same Address _____

Water is delivered by:

Federal Project _____ Pres. _____ Pot. _____

Ditch Company _____ Pres. _____ Pot. _____

Irrigation District _____ Pres. _____ Pot. _____

Private System pump & ditches Pres. 60 Pot. 30

Totals _____

Flood _____ Pump ☒ Reservoir _____ Gravity ☒Size and Capacity, Pump, etc. 6" cent. Tractor power

Original Appropriator, Company _____ App. No. _____

Original Appropriator, Private No filing yet App. No. _____
(Show date of appropriation under Remarks)Is the system an extension of another system? Yes _____ No ☒Is all land irrigated from one system? Yes ☒ No _____

(If No, show break down on map)

Source of Water YellowstoneAcres Irrigated 19 46 60Potential Acres 3015 Seeped 0

Explain _____

Condition of System goodAdequate Supply Yes ☒ No _____

Explain _____

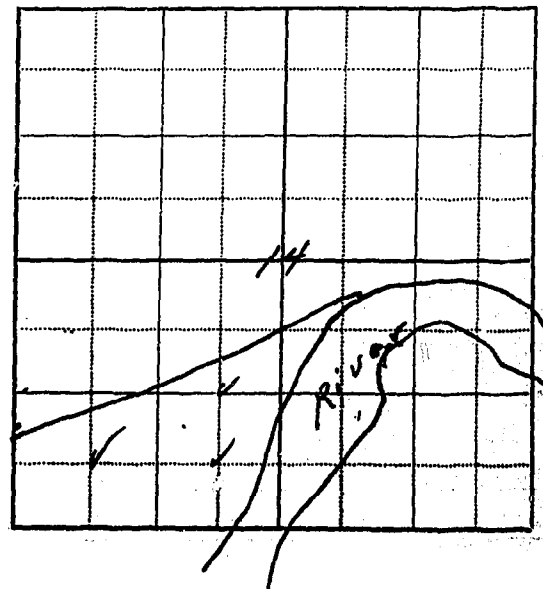
Topography bottom 1st. terraceInformation From Johnson, ClarenceRemarks First use in 1935

REGISTERED HEREFORDS

Clarence Johnson

SHEFFIELD, MONTANA

Mr. Gerald J. Aravitz
Assistant State Engineer
Billings Mont.

7N-45

Dear Sir,

In regard to your letter on
Irrigation, Yellowstone River,
I did not file a water right on
SW 1/4 S. R/W., SE 1/4 S. R/W Section 14, T. 7N
R. 45E, Custer County.

This land was irrigated
by pumping from the Yellowstone
River for the first time in
May 1935 by Clarence Johnson
and Alf Nelson, and has
been irrigated each year since

Yours truly,
Clarence Johnson



NOTICE
These forms are the
property of the State
of Montana and must
be returned.

STATE OF MONTANA
STATE ENGINEERS OFFICE

Water Resources Survey

Code No. 29A-290

County: Butte

T. 7N R. 4S

Name of Land Owner: Nels Jensen

Address: Sheffield, Mont

Name of Operator: _____

Address: _____

Part A

TO BE FILED BY THOSE OBTAINING IRRIGATION WATER FROM
A DITCH COMPANY OR IRRIGATION DISTRICT

1. Water is delivered by: _____ Name of Ditch, Ditch Company or District Supplying Water _____ Shares you hold _____
2. State the number of acres you irrigate under this system _____
3. If you obtain water from more than one Company, give the number of shares, acres irrigated and the name of the Company under "Remarks." If you obtain water from a Ditch Company and also have a private system fill in both Part A and Part B.

Part B

TO BE FILED BY THOSE WHO HAVE A PRIVATE DITCH, PUMP OR IRRIGATION SYSTEM
or those who have a private water right under a Ditch Company

4. In what year was this land first irrigated? Date: See attached filings
5. Give the name of the original appropriator (first user): _____
6. Give the date appropriated: _____ Amount filed on: Miners Inches _____ C. F. S. _____
7. State the total number of acres irrigated under this system: _____
8. Give the point of diversion: _____ $\frac{1}{4}$ Section _____ Township _____ Range _____

Part C

TO BE FILED BY ALL WATER USERS IN ADDITION TO PART A OR PART B

9. Source of Water: Whitetail Creek Name of stream or lake from which water is originally diverted _____
10. Water is obtained by: (Check one) Gravity ☒ Pumping _____ Other Flood
11. What is the greatest number of acres you have irrigated? 62.0 Date _____
12. How many acres did you irrigate in 1947 (Crop and pasture) 62.0
13. State the total number of additional acres that could be irrigated by increasing the water supply, land leveling, etc. 0 This land is under what ditch? 0
14. How many acres of seeped land do you have which could be drained and put into production? 0
15. What is the condition of your irrigation system? Fair
16. Is your water supply adequate? Yes _____ No X Explain Flood water only
17. REMARKS: _____

NOTE: The foregoing questions apply only to irrigated land shown on this plat.

DESCRIPTION AND MAP OF FARM

18. Legal Description of this Farm

N2 NW4, SW4 NE4 Sec 29



IRRIGATED LAND

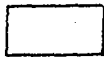

NON-IRRIGATED LAND

North

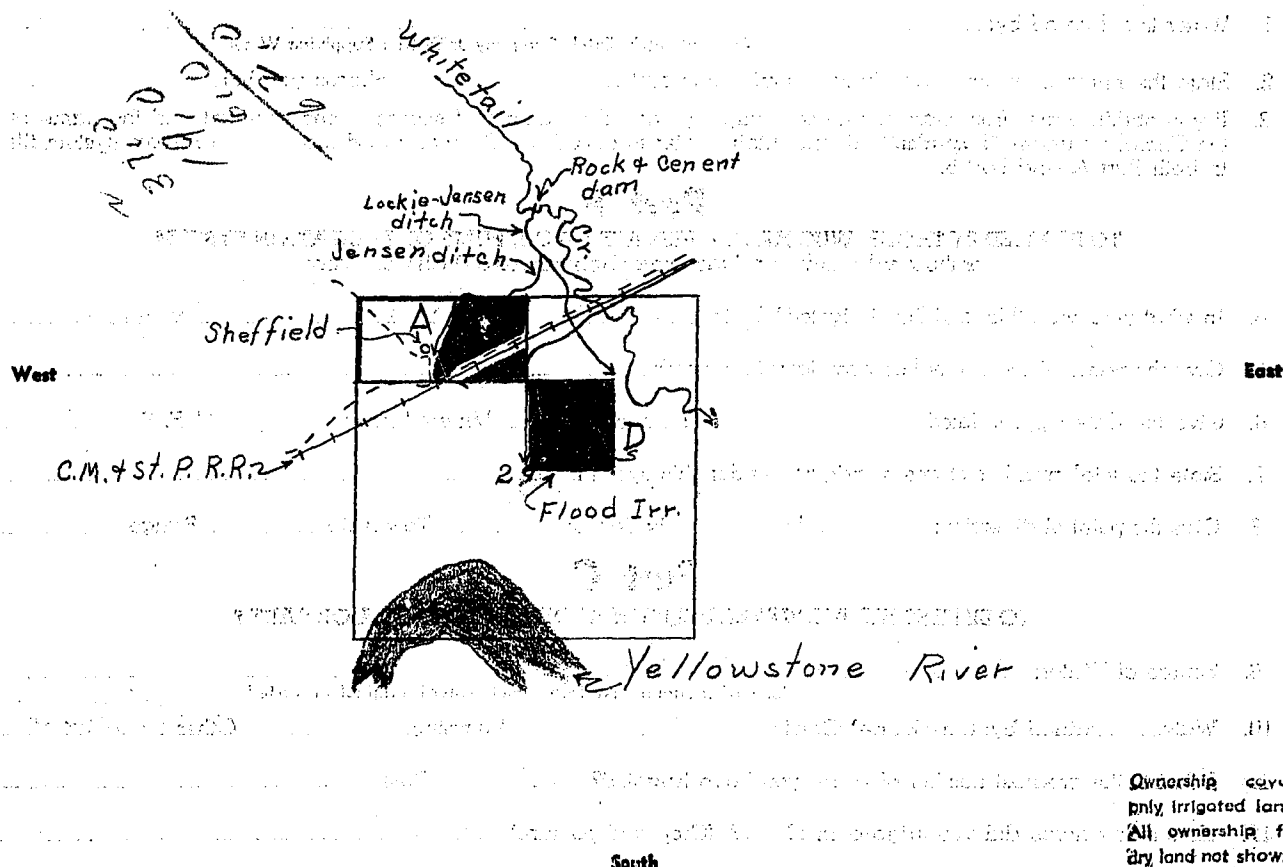

19. If the above land is irrigated from more than one ditch please give the acreage under each ditch in 19A and indicate the location of the land irrigated from each on the above map.

19A. Ditch: Flood Irr. Whitetail Creek Acres: 62.0

Ditch: _____ Acres: _____

Information supplied by:

Name See attached form Address _____ Date 5/14/47

REMARKS: _____

If you cannot answer all of the questions on this form answer as many as you can and return the form to us as soon as possible.

STATE ENGINEER'S OFFICE
WATER RESOURCES SURVEY

COUNTY Custer

FILE NO. 24-T.7N-R.45E

Owner Jensen, Nels Address Sheffield, Mont.

AAA Owner Address

Operator " " Address " "

New Owner Address

New Operator Address

Assessment Record None

Assessed Acreage 0

Legal Description of This Farm N²NW⁴, SW⁴NE⁴, Sec. 29; T. 7N-R. 45E

Total Acres in Farm ✓

Code Number 29A-29D

Photo No. Ma 22-156

AAA Contract No.

AAA Total Cropland Acreage

App. No. 1990-2486

Source No. 2001?-2055?

Land is located in

Twp. 7N Rge. 45E Twp. Rge.

Twp. Rge. Twp. Rge.

Filed in Twp. 7N Rge. 45E

Remarks

Yellowstone River Basin

Ownership
Only irrigated land
All ownership for
dry land not shown

Farm Checked

STATE OF MONTANA

Code No. 20A, 29A, 0

By Johnson & Doe

STATE ENGINEER'S OFFICE

County Custer

Area Miles City - Sheffield

WATER RESOURCES SURVEY

T. 7N. R. 45E Sec. 20 & 29

Date 3/14/47

Photo No. MA 22-156

Legal Land Owner Jensen, No 13

Address Sheffield

Operator same

Address _____

Water is delivered by:

Federal Project _____ Pres. _____ Pot. _____

Ditch Company _____ Pres. _____ Pot. _____

Irrigation District _____ Pres. _____ Pot. _____

Private System Flood Ditch Pres. ^{Flaming.} 62.0 Pot.

Totals _____

Flood ☒ Pump ☐ Reservoir ☐ Gravity ☒

Size and Capacity, Pump, etc. _____

Original Appropriator, Company _____ App. No. _____

Original Appropriator, Private Nels M. Anderson App. No. 1990 2486
(Show date of appropriation under Remarks)

Is the system an extension of another system? Yes _____ No _____

Is all land irrigated from one system? Yes No

(If No, show break down on map)

Source of Water Whitetail Cr.

Acres Irrigated 19 46, 762.0

Potential Acres 0 Seeped 0

Explain _____

Condition of System fair

Adequate Supply --- Yes _____ No ✓

Explain flood only

Topography Bottom

Information From Nels Venson

Remarks App. 1901

A 10x10 grid with handwritten numbers. The number '28' is written in the 5th column and 8th row. The number '29' is written in the 6th column and 8th row. There are also some small horizontal dashes in the 5th and 6th columns of the 7th row.

#2456 should be in the name of Jensen.
it is the same app. as #1970 but was
re-filed on as protection. He bought the
Andersen right in about 1911, has deed for it.

THE LA. WORKSHEET BOOK



These forms are the property of the State of Montana and must be returned.

STATE OF MONTANA
STATE ENGINEERS OFFICE

Water Resources Survey

130-74F-22F-23B
Code No. 24A-26A-27A
County: Custer
T. 7N R. 45

Name of Land Owner: Nels Kildahl Address: Box 247, Miles City
Name of Operator: _____ Address: _____

Part A

TO BE FILED BY THOSE OBTAINING IRRIGATION WATER FROM
A DITCH COMPANY OR IRRIGATION DISTRICT

1. Water is delivered by: _____
Name of Ditch, Ditch Company or District Supplying Water
2. State the number of acres you irrigate under this system: _____ Shares you hold: _____
3. If you obtain water from more than one Company, give the number of shares, acres irrigated and the name of the Company under "Remarks." If you obtain water from a Ditch Company and also have a private system fill in both Part A and Part B.

Part B

TO BE FILED BY THOSE WHO HAVE A PRIVATE DITCH, PUMP OR IRRIGATION SYSTEM
or those who have a private water right under a Ditch Company

4. In what year was this land first irrigated? Date: See attached filings
5. Give the name of the original appropriator (first user): _____
6. Give the date appropriated: _____ Amount filed on: Miners Inches: _____ C. F. S.: _____
7. State the total number of acres irrigated under this system: _____
8. Give the point of diversion: _____ $\frac{1}{4}$ _____ $\frac{1}{4}$ Section _____ Township _____ Range _____

Part C

TO BE FILED BY ALL WATER USERS IN ADDITION TO PART A OR PART B

9. Source of Water: Yellowstone River
Name of stream or lake from which water is originally diverted
10. Water is obtained by: (Check one) Gravity _____ Pumping X Other _____
11. What is the greatest number of acres you have irrigated? 208.0 Date _____
12. How many acres did you irrigate in 1947 (Crop and pasture) 208.0
13. State the total number of additional acres that could be irrigated by increasing the water supply, land leveling, etc. 190.0 This land is under what ditch? Same
14. How many acres of seeped land do you have which could be drained and put into production? 0
15. What is the condition of your irrigation system? Good
16. Is your water supply adequate? Yes X No _____ Explain _____
17. REMARKS: _____

NOTE: The foregoing questions apply only to irrigated land shown on this plat.

DESCRIPTION AND MAP OF FARM

18. Legal Description of this Farm

See WC-2 attached



IRRIGATED LAND



NON-IRRIGATED LAND



Potential Land

North

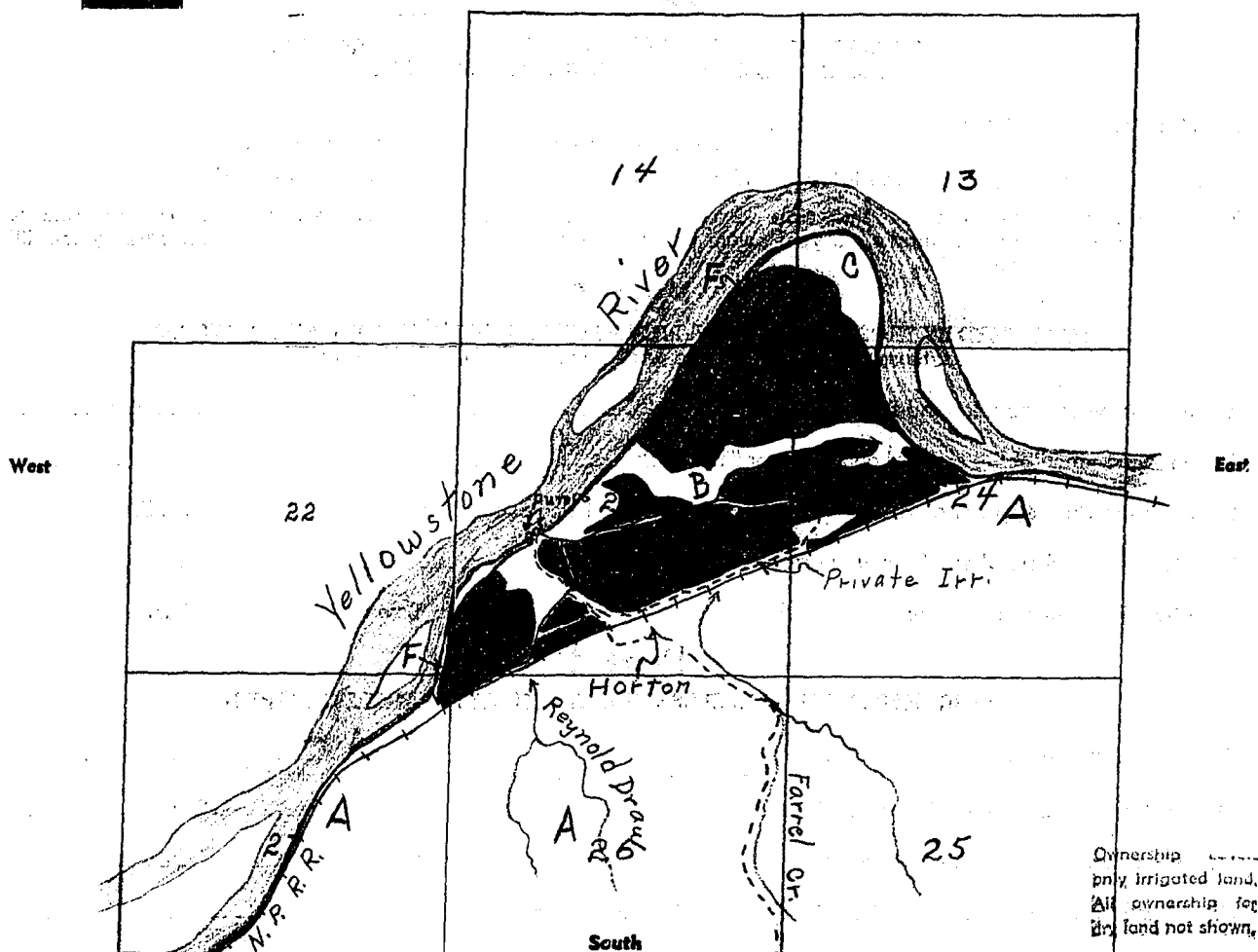

Ownership of land shown only irrigated land. All ownership for dry land not shown.

19. If the above land is irrigated from more than one ditch please give the acreage under each ditch in 19A and indicate the location of the land irrigated from each on the above map.

19A. Ditch: *(Horton) Private Pump ditch* Acres: *208.0*
Ditch: *Kildal Pump from Yel. River* Acres: _____

Information supplied by:

Name *See attached form* Address _____ Date _____

REMARKS: _____

If you cannot answer all of the questions on this form answer as many as you can and return the form to us as soon as possible.

STATE ENGINEER'S OFFICE
WATER RESOURCES SURVEY

COUNTY Cluster

FILE NO. 24-T 7N-R 45E

Owner Kildahl, Nels Address Box 247 - Miles City

AAA Owner Address

Operator Kildahl, E.W. Address Sheffield, Mont?

New Owner Address

New Operator Address

Assessment Record None

Assessed Acreage 0

Legal Description of This Farm Lot 4, Sec. 13; Lot 4, Sec. 14; Lot 4, Sec. 22;
Lots 1-5-6-7, SE¹NE¹SE¹SW¹SE¹ Sec. 23; Lots 3-4-5-6-9;
NW¹SW¹S²SW¹S²SE¹ Sec. 24; all of Sec. 26; Lots 1-4-5-7,
NE¹SE²S²SE¹ Sec. 27; T. 7N-R. 45E Total Acres in Farm ✓

Code Number 23B-24A-26A-27A
1130-14F-22F

Photo No. Ma 23-02; Ma 22-157;
Ma 22-156;

AAA Contract No.

AAA Total Cropland Acreage
(In Use) + (2066)

App. No. 2067-2057-2250-490-A
530-643-2159

Deed No.

Land is located in

Twp. 7N Rge. 45E Twp. Rge.

Twp. Rge. Twp. Rge.

Filed in Twp. 7N Rge. 45E

Remarks

Yellowstone River Basin

208
190
298

Ownership covers
only irrigated land.
All ownership for
dry land not shown.

FORM F-1 • GAZETTE 1668-2M-1-4

Code No. 22E, 23B, 24A, 25A

County Custer

STATE ENGINEER'S OFFICE

WATER RESOURCES SURVEY

T. 7N R. 45E Sec.

Photo No. MA 22-156, MA 23-02

Address Box 247 Miles City

Address

Federal Project_____ **Pres**_____ **Pot**_____

Ditch Company _____ Pres. _____ Pot. _____

Irrigation District _____ Pres. _____ Pot. _____

Private System pumps & canals Pres. 252-200 Pot. 200

Totals _____

Flood _____ Pump _____ Reservoir _____ Gravity _____

Flood _____ Pump _____ Reservoir _____ Gravity _____
 18" cant. 14' lift, steam powered 55 H. P.
 Size and Capacity, Pump, etc. 14" submerged pump, 14' lift - diesel 50 H. P.

Original Appropriator, Company _____ App. No. _____

Original Appropriator, Private Nils Kildahl 1934 App. No. 2067

(Show date of appropriation under Remarks)

Is the system an extension of another system? Yes _____ No ✓

Is all land irrigated from one system? Yes ✓ No

(If No, show break down on map)

Source of Water Yellowstone River

Acres Irrigated 19 46 208

Potential Acres 200 190 Seeped 0

Explain potential by clearing & leveling

Condition of System good

Adequate Supply Yes No

Explain _____

Topography 1st. terrace

Information From Nils Kildahl

Remarks _____

Peter Nevitt, operated a horse powered pump
in about 1884 to irrigate a small piece of this
place.

Steam pump not used since 1935, diesel handles same
land.

Mr. Kildahl came here in 1892, house he is living
in was built in 1876, still has gun ports in
walls



NOTICE
These forms are the
property of the State
of Montana and must
be returned.

STATE OF MONTANA
STATE ENGINEERS OFFICE

Water Resources Survey

29E-29F-30C-30D-32A

Code No. 30E-30E3/A

County Custer

T. 7N R. 45

Name of Land Owner Louise Bern Swint Address Sheffield, Mont

Name of Operator _____ Address _____

Part A

TO BE FILED BY THOSE OBTAINING IRRIGATION WATER FROM
A DITCH COMPANY OR IRRIGATION DISTRICT

1. Water is delivered by: _____
Name of Ditch, Ditch Company or District Supplying Water
2. State the number of acres you irrigate under this system _____ Shares you hold _____
3. If you obtain water from more than one Company, give the number of shares, acres irrigated and the name of the Company under "Remarks." If you obtain water from a Ditch Company and also have a private system fill in both Part A and Part B.

Part B

TO BE FILED BY THOSE WHO HAVE A PRIVATE DITCH, PUMP OR IRRIGATION SYSTEM
or those who have a private water right under a Ditch Company

4. In what year was this land first irrigated? Date See attached filings
5. Give the name of the original appropriator (first user): _____
6. Give the date appropriated _____ Amount filed on: Miners Inches _____ C. F. S. _____
7. State the total number of acres irrigated under this system: _____
8. Give the point of diversion: _____ $\frac{1}{4}$ _____ $\frac{1}{4}$ Section _____ Township _____ Range _____

Part C

TO BE FILED BY ALL WATER USERS IN ADDITION TO PART A OR PART B

9. Source of Water: Yellowstone River + Whitetail Creek
Name of stream or lake from which water is originally diverted
10. Water is obtained by: (Check one) Gravity ☒ Pumping _____ Other Flood
11. What is the greatest number of acres you have irrigated? 648.0 Date _____
12. How many acres did you irrigate in 1947 (Crop and pasture) 648.0
13. State the total number of additional acres that could be irrigated by increasing the water supply, land leveling, etc. 0 This land is under what ditch? 0
14. How many acres of seeped land do you have which could be drained and put into production? 0
15. What is the condition of your irrigation system? Not too good
16. Is your water supply adequate? Yes _____ No ☒ Explain Flood water only
17. REMARKS: _____

See attached form
Pumps not in use 1947

NOTE: The foregoing questions apply only to irrigated land shown on this plat.

DESCRIPTION AND MAP OF FARM

18. Legal Description of this Farm

see WR-2



IRRIGATED LAND



NON-IRRIGATED LAND

North

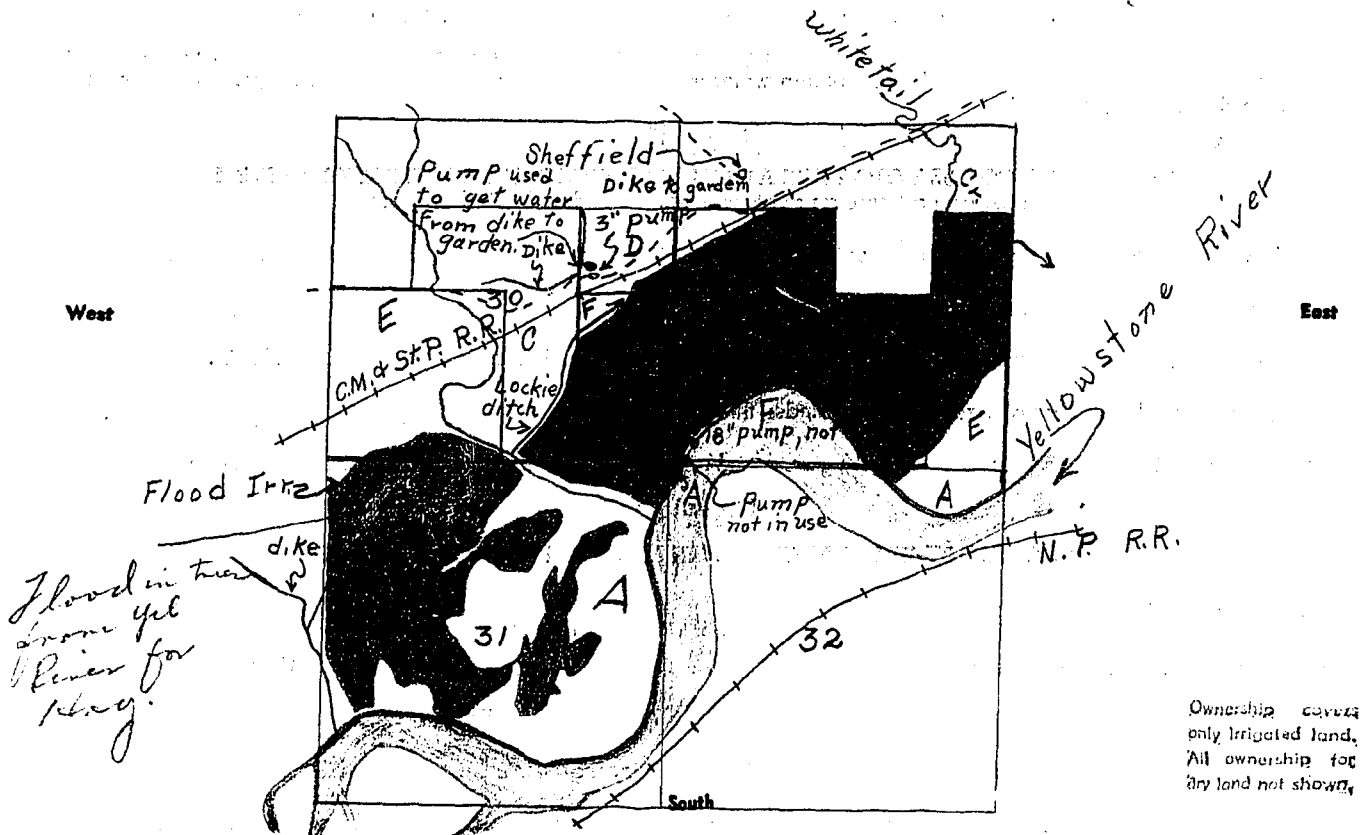

19. If the above land is irrigated from more than one ditch please give the acreage under each ditch in 19A and indicate the location of the land irrigated from each on the above map.

19A. Ditch: Lockie Yellowstone River Flood Area Acres: 560.0

Ditch: Lockie Whitetail Creek Flood Area Acres: 88.0

Information supplied by:

Name Field Survey Address _____ Date 5/14/47

REMARKS: Johnson & Joe

If you cannot answer all of the questions on this form answer as many as you can and return the form to us as soon as possible.

STATE ENGINEER'S OFFICE
WATER RESOURCES SURVEY

COUNTY Custer

FILE NO. 24-T.7N-R.45E

Owner Lockie Bros. Livestock Co. Address Sheffield, Montana

AAA Owner Address

Operator Address

New Owner Address.....

New Operator Address

Assessment Record None

Assessed Acreage.....0.....

Legal Description of This Farm *S²NW¹, S², S²E⁴NE⁴, Sec. 29; SE⁴NW⁴, S², S²NE⁴,
Sec. 30; Lot 1-2-3-4-5-6-7-8, E²NW⁴, NW⁴NE⁴ Sec. 31; Lots
1-2-3, Sec. 32; T. 7N-R. 45E*

Total Acres in Farm.....

Code Number 29E-29F-30C-30D
30E-30F-31A-32A

Photo No. Ma 22-152; Ma 22-156

AAA Contract No. _____

AAA Total Cropland Acreage.....

App. No. 1995-2001-2055
2218?

Decree No.....

Land i: located in

Twp. 1N Rge. 45E Twp. Rge.

Twp..... Rge..... Twp..... Rge.....

Filed in Twp. 7N Rge. 45E

Remarks

$$\begin{array}{r} 560 \\ 88 \\ \hline 648 \end{array}$$

Ownership covers
only irrigated land.
All ownership for
dry land not shown.

Yellowstone River Basin

Lockies now own all Dunlap land as shown also
have acquired water rights. rights listed were all
recognized by Mr. Lockie.

all land is flooded by their system but
the only part considered crop is where they
can get a mower between the trees.



NOTICE
These forms are the
property of the State
of Montana and must
be returned.

STATE OF MONTANA
STATE ENGINEERS OFFICE

Code No. 220-22E

County Custer

T. 7N R. 45E

Water Resources Survey

Name of Land Owner see attached WR-2 Address _____

Name of Operator Olaf Nelson Address Sheffield, Mont

Part A

TO BE FILED BY THOSE OBTAINING IRRIGATION WATER FROM
A DITCH COMPANY OR IRRIGATION DISTRICT

1. Water is delivered by: _____
Name of Ditch, Ditch Company or District Supplying Water
2. State the number of acres you irrigate under this system _____ Shares you hold _____
3. If you obtain water from more than one Company, give the number of shares, acres irrigated and the name of the Company under "Remarks." If you obtain water from a Ditch Company and also have a private system fill in both Part A and Part B.

Part B

TO BE FILED BY THOSE WHO HAVE A PRIVATE DITCH, PUMP OR IRRIGATION SYSTEM
or those who have a private water right under a Ditch Company

4. In what year was this land first irrigated? Date see attached filing
5. Give the name of the original appropriator (first user): _____
6. Give the date appropriated _____ Amount filed on: Miners Inches _____ C. F. S. _____
7. State the total number of acres irrigated under this system: _____
8. Give the point of diversion: _____ $\frac{1}{4}$ _____ $\frac{1}{2}$ Section _____ Township _____ Range _____

Part C

TO BE FILED BY ALL WATER USERS IN ADDITION TO PART A OR PART B

9. Source of Water: Waste water Yellowstone River
Name of stream or lake from which water is originally diverted
10. Water is obtained by: (Check one) Gravity _____ Pumping ☒ Other _____
11. What is the greatest number of acres you have irrigated? 14.0 Date _____
12. How many acres did you irrigate in 1947? (Crop and pasture) 0
13. State the total number of additional acres that could be irrigated by increasing the water supply, land leveling, etc. 14.0 This land is under what ditch? Same
14. How many acres of seeped land do you have which could be drained and put into production? 0
15. What is the condition of your irrigation system? Fair
16. Is your water supply adequate? Yes _____ No ☒ Explain depends on waste
17. REMARKS: water from Sheffield system

DO NOT WRITE IN THESE SPACES

NOTE: The foregoing questions apply only to irrigated land shown on this plat.

DESCRIPTION AND MAP OF FARM

18. Legal Description of this Farm

See attached WR-2

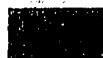

IRRIGATED LAND

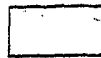

NON-IRRIGATED LAND



Potential Land

North

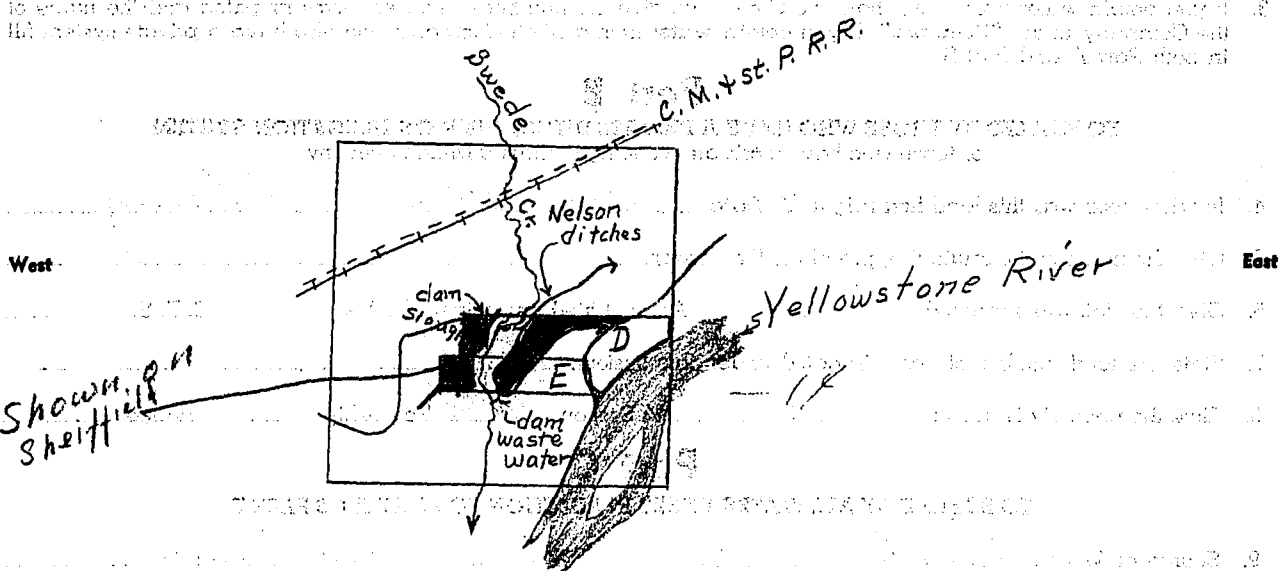

Ownership covers only irrigated land. All ownership for dry land not shown.

19. If the above land is irrigated from more than one ditch please give the acreage under each ditch in 19A and indicate the location of the land irrigated from each on the above map.

19A. Ditch: *Nelson Pump ditch* Acres: *2*

Ditch: _____ Acres: _____

Information supplied by:

Name *See attached* Address _____ Date _____

REMARKS: *form*

If you cannot answer all of the questions on this form answer as many as you can and return the form to us as soon as possible.

STATE ENGINEER'S OFFICE
WATER RESOURCES SURVEYCOUNTY CusterFILE NO. 24-T.7N-R.45E
1845-92654Owner { Nelson, Selma (22D)

Address

AAA Owner { Boylan, Howard (22E)

Address

Operator Nelson, Olaf

Address

New Owner

Address

New Operator

Address

Assessment Record NoneAssessed Acreage 0 (Code 22D)Legal Description of This Farm Part of NW⁴ SE⁴, Part of NE⁴ SW⁴, Sec. 22;
Part of NW⁴ SE⁴, Part NE⁴ SW⁴, Sec. 22; T. 7N-R. 45E
(Code 22E)Total Acres in Farm ✓Code Number 22D-22EPhoto No. Ma 22-156

AAA Contract No.

AAA Total Cropland Acreage

App. No. 2266

Decree No.

Land is located in

Twp. 7N Rge. 45E Twp. Rge.

Twp. Rge. Twp. Rge.

Filed in Twp. 7N Rge. 45ERemarks Olaf Nelson also operates
some land north & east of
this place - owned by
Leop. E. Bracht (Code 22B)
(See form)Yellowstone River BasinOwnership covers
only irrigated land.
All ownership for
dry land not shown.

Farm Checked

STATE OF MONTANA

Code No. 22 D. E - BBy Joe & Collins

STATE ENGINEER'S OFFICE

County CusterArea Mike City - Sheffield

WATER RESOURCES SURVEY

T. 7N. R. 45E Sec. 22Date 5/15/47Photo No. MA 22-156

Legal Land Owner

Nelson, Selma & Boylan, Howard Address Riverside Calif

Operator

Nelson, OlatAddress Sheffield

Water is delivered by:

Federal Project _____ Pres. _____ Pot. _____

Ditch Company _____ Pres. _____ Pot. _____

Irrigation District _____ Pres. _____ Pot. _____

Private System ditches from waste on Sheffield Pres. 0 Pot. 40dam in slough & ditch

Totals _____

Flood _____ Pump _____ Reservoir _____ Gravity ☒

Size and Capacity, Pump, etc. _____

Original Appropriator, Company _____ App. No. _____

Original Appropriator, Private Nelson, Selma See over App. No. 2266
(Show date of appropriation under Remarks)Is the system an extension of another system? Yes _____ No ☒Is all land irrigated from one system? Yes _____ No ☒

(If No, show break down on map)

Source of Water Waste & SloughAcres Irrigated 19 46 0Potential Acres 40 Seeped _____

Explain _____

Condition of System fairAdequate Supply _____ Yes _____ No ☒Explain Good only when Sheffield is pumping.Topography 1st. terrace

Information From _____

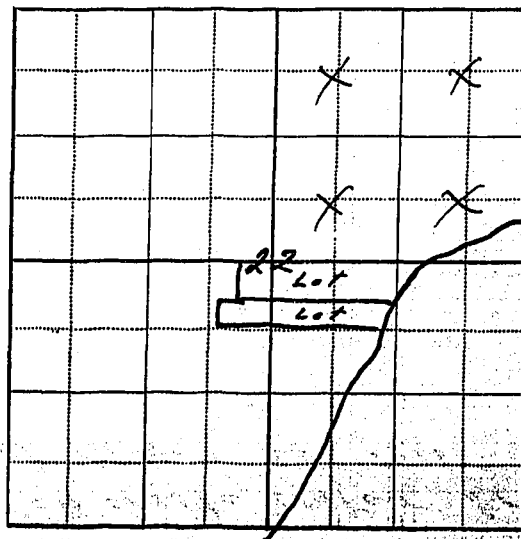
Remarks 2266-1924

Selma Nelson also filed on waste water from
Sheffield Ranch in about 1922 or 23 1925



NOTICE
These forms are the
property of the State
of Montana and must
be returned.

STATE OF MONTANA
STATE ENGINEERS OFFICE

Water Resources Survey

Code No. 11A-13B

County Deer

T. 7N R. 45

Name of Land Owner Chen Land & Co. Address Sheffield, Mont

Name of Operator _____ Address _____

Part A

TO BE FILED BY THOSE OBTAINING IRRIGATION WATER FROM
A DITCH COMPANY OR IRRIGATION DISTRICT

1. Water is delivered by: _____
Name of Ditch, Ditch Company or District Supplying Water
2. State the number of acres you irrigate under this system _____ Shares you hold _____
3. If you obtain water from more than one Company, give the number of shares, acres irrigated and the name of the Company under "Remarks." If you obtain water from a Ditch Company and also have a private system fill in both Part A and Part B.

Part B

TO BE FILED BY THOSE WHO HAVE A PRIVATE DITCH, PUMP OR IRRIGATION SYSTEM
or those who have a private water right under a Ditch Company

4. In what year was this land first irrigated? Date See attached filings
5. Give the name of the original appropriator (first user): _____
6. Give the date appropriated _____ Amount filed on: Miners Inches _____ C. F. S. _____
7. State the total number of acres irrigated under this system: _____
8. Give the point of diversion: _____ $\frac{1}{4}$ Section _____ Township _____ Range _____

Part C

TO BE FILED BY ALL WATER USERS IN ADDITION TO PART A OR PART B

9. Source of Water: Yellowstone River + Stager Creek Trib
Name of stream or lake from which water is originally diverted
10. Water is obtained by: (Check one) Gravity ☒ Pumping ☒ Other Flood
11. What is the greatest number of acres you have irrigated? 479.0 Date 0
12. How many acres did you irrigate in 1947? (Crop and pasture) 308.0 by pump
13. State the total number of additional acres that could be irrigated by increasing the water supply, land leveling, etc. 171.0 This land is under what ditch? 100 flood Stager Creek
71 Yellow pumps yell. R.
14. How many acres of seeped land do you have which could be drained and put into production? 0
15. What is the condition of your irrigation system? Good
16. Is your water supply adequate? Yes ☒ No ☒ Explain No on Stager Creek
17. REMARKS: tributary

NOTE: The foregoing questions apply only to irrigated land shown on this plat.

DESCRIPTION AND MAP OF FARM

18. Legal Description of this Farm

All in 11, all Sec 13 less 1/4 &

SW 1/4, S of River



IRRIGATED LAND

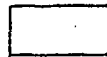

NON-IRRIGATED LAND



Potential Land

North

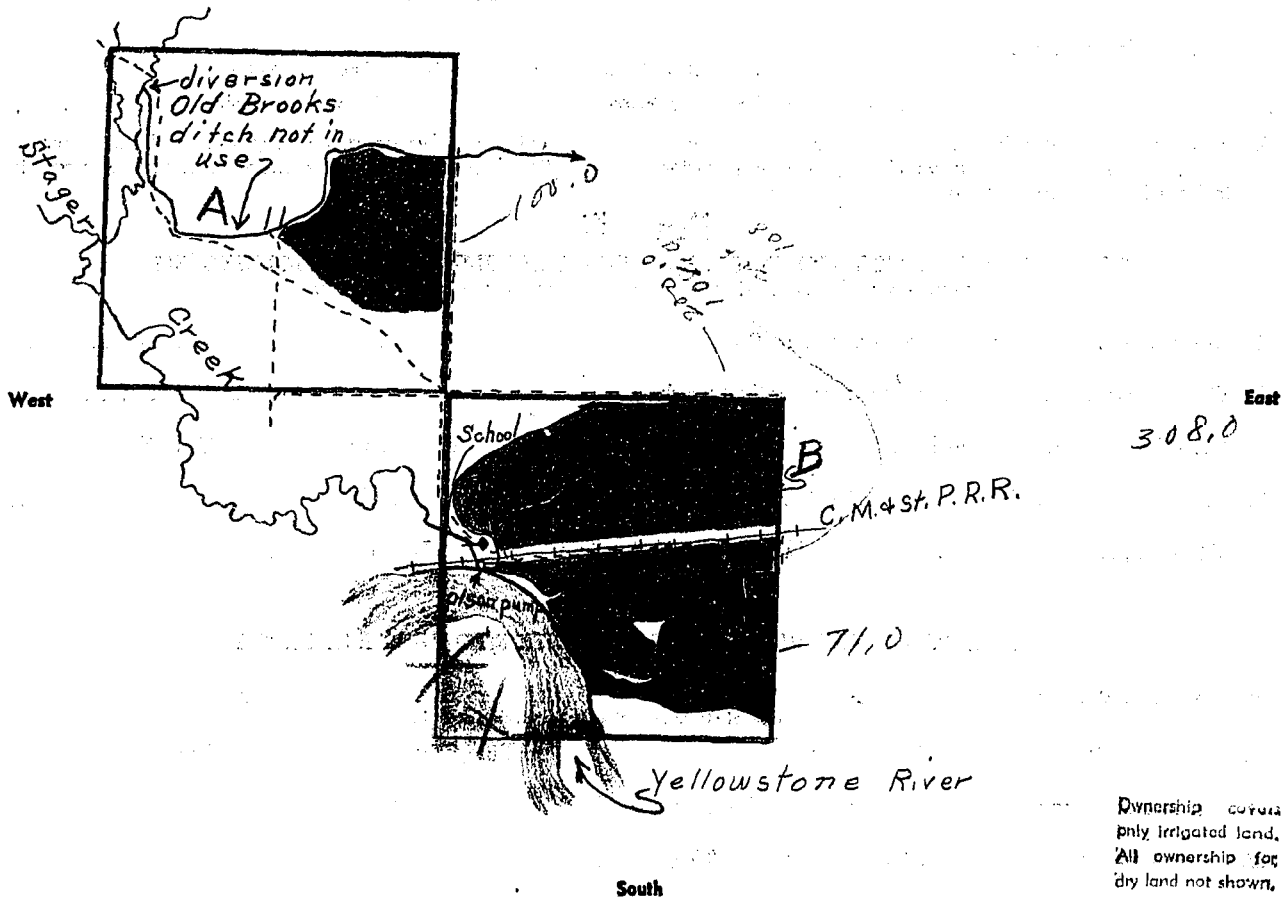

19. If the above land is irrigated from more than one ditch please give the acreage under each ditch in 19A and indicate the location of the land irrigated from each on the above map.

19A. Ditch: Olson Private Pump Acres: 308.0

Ditch: Stager Cr. Trib 100 ft - pump 21 ft. Acres: 0

Information supplied by:

Name Glenn Braluy Address _____ Date 5/15/47

REMARKS: to Johnson & J. Paulist

If you cannot answer all of the questions on this form answer as many as you can and return the form to us as soon as possible.

STATE ENGINEER'S OFFICE
WATER RESOURCES SURVEY

COUNTY Custer

FILE NO. 24-T.7N-R.45E

Owner Olsen Land Development Co Address Sheffield, Montana

AAA Owner Address.....

Operator " " " " Address " "

New Owner Address.....

New Operator Address.....

Assessment Record None

Assessed Acreage 0

Legal Description of This Farm all of Sections 11-13; T. 7N-R. 45E

Total Acres in Farm ✓

Code Number 11A-~~12A~~-13B

Photo No.....

AAA Contract No.....

AAA Total Cropland Acreage.....

App. No. 2063-2499

Decree No.....

Land is located in

Twp. 7N Rge. 45E Twp. 7N Rge. 46E

Twp..... Rge..... Twp..... Rge.....

Filed in Twp. 7N Rge. 45E

Remarks

308
100
71
479

Yellowstone River Basin

Ownership covers
only irrigated land.
All ownership for
dry land not shown.

A hand-drawn sketch of a 5x5 grid. The top row is divided into two sections by a vertical line. The left section is labeled "#5E" and the right section is labeled "46E".

Below the labels, there are handwritten marks in the first row of the grid:

- Under "#5E": A checkmark (✓) in the first column, the number "13" in the second column, and a checkmark (✓) in the third column.
- Under "46E": A checkmark (✓) in the fourth column, the number "15" in the fifth column, and a checkmark (✓) in the sixth column.

A curved line is drawn across the first two columns of the grid, starting from the top row and ending in the second row.



NOT
These forms are the
property of the State
of Montana and must
be returned.

STATE OF MONTANA
STATE ENGINEERS OFFICE

Water Resources Survey

200-218-244-210
Code No. 27B-284-29B
County: Center
T. 7N R. 45E

Name of Land Owner Sheffield Ranch Co. Address _____

Name of Operator Marble + Jones Address 316, Treasure St Bldg

R. B. Jones

Part A

Billingham

7. 11/1 Marble TO BE FILED BY THOSE OBTAINING IRRIGATION WATER FROM
A DITCH COMPANY OR IRRIGATION DISTRICT
purchased land in 1945

1. Water is delivered by: _____ Name of Ditch, Ditch Company or District Supplying Water _____
2. State the number of acres you irrigate under this system _____ Shares you hold _____
3. If you obtain water from more than one Company, give the number of shares, acres irrigated and the name of the Company under "Remarks." If you obtain water from a Ditch Company and also have a private system fill in both Part A and Part B.

Part B

TO BE FILED BY THOSE WHO HAVE A PRIVATE DITCH, PUMP OR IRRIGATION SYSTEM
or those who have a private water right under a Ditch Company

4. In what year was this land first irrigated? Date See attached filings
5. Give the name of the original appropriator (first user): _____
6. Give the date appropriated _____ Amount filed on: Miners Inches _____ C. F. S. _____
7. State the total number of acres irrigated under this system: _____
8. Give the point of diversion: _____ 1/4 _____ 1/4 Section _____ Township _____ Range _____

Part C

TO BE FILED BY ALL WATER USERS IN ADDITION TO PART A OR PART B

9. Source of Water: Yellowstone River
Name of stream or lake from which water is originally diverted
10. Water is obtained by: (Check one) Gravity _____ Pumping X Other _____
11. What is the greatest number of acres you have irrigated? 800.0 Date _____
12. How many acres did you irrigate in 1947? (Crop and pasture) 800.0
13. State the total number of additional acres that could be irrigated by increasing the water supply, land leveling, etc. 35.0. This land is under what ditch? Same
14. How many acres of seeped land do you have which could be drained and put into production? 0
15. What is the condition of your irrigation system? Fair
16. Is your water supply adequate? Yes X No _____ Explain _____
17. REMARKS: _____

NOTE: The foregoing questions apply only to irrigated land shown on this plat.

DESCRIPTION AND MAP OF FARM

18. Legal Description of this Farm

See attached WR-2



IRRIGATED LAND



NON-IRRIGATED LAND

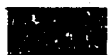

Potential Land

North

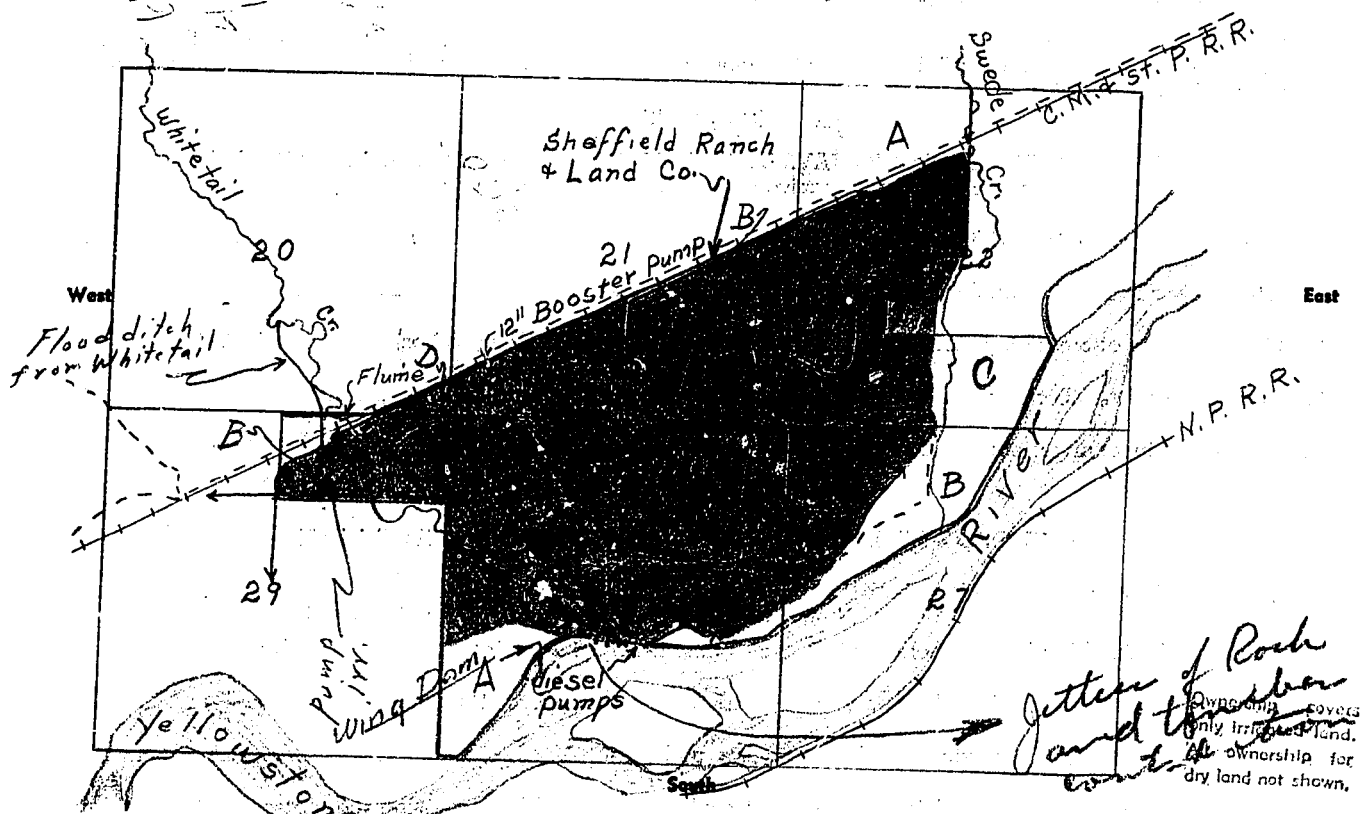

19. If the above land is irrigated from more than one ditch please give the acreage under each ditch in 19A and indicate the location of the land irrigated from each on the above map.

19A. Ditch:

Sheffield Ranch to System

Acres:

800.0

Ditch:

Acres:

Information supplied by:

Name

Field Survey

Address

Date

REMARKS:

see attached form

If you cannot answer all of the questions on this form answer as many as you can and return the form to us as soon as possible.

STATE ENGINEER'S OFFICE
WATER RESOURCES SURVEY

COUNTY Cluster

FILE NO. 24-T-7N-R-45E

Owner Sheffield Ranch Co. Address _____

AAA Owner Marble and Jones (owners) Address 316 Treasure St. Bldg;

Operator George McGhean Address Billings, Montana
(Manager)

New Owner _____ Address _____

New Operator _____ Address _____

Assessment Record yes - all South of C.M. Ry. Co. in Sec. 21; out of
the W² less 6.20 Acres, out of lat. 3, out of SW⁴, Sec. 22; Sec. 21 - 196.00
lots 2-3-6, W² NW⁴ Sec. 27; all of Sec. 28; T. 7N-R. 45E Sec. 22 - 171.00
Assessed Acreage. Sec. 27 - 118.00
Sec. 28 - 257.00

Legal Description of This Farm Part of SE⁴ SE⁴ South of R.R. R. Sec. 20; all south of the
C.M. Ry. Co. in Sec. 21; NW⁴, W² SW⁴ SE⁴ SW⁴, Part of NE⁴ SW⁴ SW⁴ SE⁴,
Sec. 22; all North of Yellowstone R. in Sec. 27; all North of Yellowstone
River in Sec. 28; N² NE⁴ in Sec. 29; T. 7N-R. 45E Total Acres in Farm. ✓
20D-21B-22A-22C

Code Number 27B-28A-29B

Photo No. Ma 22-15 1/2

AAA Contract No. _____

AAA Total Cropland Acreage. _____

App. No. 2057-2074

Deed No. _____

Land is located in

Twp. 7N Rge. 45E Twp. _____ Rge. _____

Twp. _____ Rge. _____ Twp. _____ Rge. _____

Filed in Twp. 7N Rge. 45E

Remarks No Assessments

For Irrigated land in

Sec. 20 (Code 22D) & in Sec. 29,

(Code 22B)

Yellowstone River Basin

Ownership covers
only irrigated land.
All ownership for
dry land not shown.

Farm Checked

STATE OF MONTANA

FORM 7-12 GAZETTE 1985-24-54
200 21B, 22A, 22C, 27B, 28A
Code No. 29B, 29C

By Johnson & Doe

STATE ENGINEER'S OFFICE

County Custer

Area Miles City Sheffield

WATER RESOURCES SURVEY

T. 7N. R. 45E Sec.

Date 5/14/47

Photo No. MA 22-156

Legal Land Owner Sheffield Ranch Co.

Address 4045 25th. Ave. So.

Operator Marble & Jones - New owners

Address Minneapolis 6, Minn.
316 Treasure State
Billings

Water is delivered by:

Federal Project _____ Pres. _____ Pot. _____

Ditch Company _____ Pres. _____ Pot. _____

Irrigation District _____ Pres. _____ Pot. _____

Private System pumps & ditches Pres. AAA Pot. 35

Totals _____

Flood _____ Pump ✓ Reservoir _____ Gravity _____

Size and Capacity, Pump, etc. 24" cent. - diesel 100 H.P. 10" cent. - diesel 60 H.P.
12" boiler, cent. - tractor power

Original Appropriator, Company _____ App. No. _____

Original Appropriator, Private Sheffield, B.B. App. No. _____
(Show date of appropriation under Remarks)

Is the system an extension of another system? Yes _____ No ✓

Is all land irrigated from one system? Yes _____ No _____

(If No, show break down on map)

Source of Water Yellowstone River

Acres Irrigated 19 46 800

Potential Acres 35 Seeped 0

Explain _____

Condition of System good

Adequate Supply _____ Yes ✓ No _____

Explain _____

Topography bottom & 1st. terrace

Information From Geo. MacLean - Manager

Remarks _____

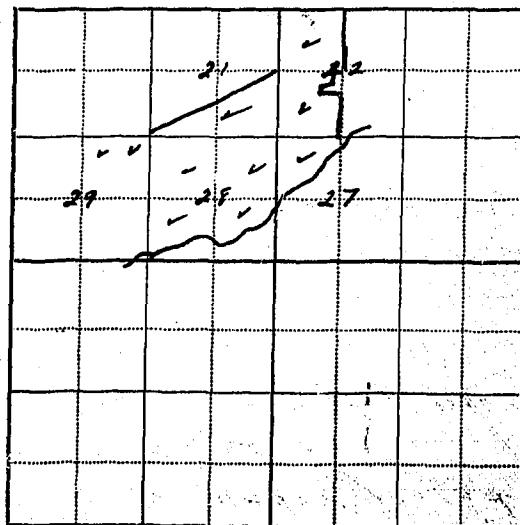

40" wood pipe about $\frac{1}{2}$ mi. long underground
from pump to distribution headgate.
1 40" intake from river. Concrete pump house,
2 pumps each with diesel motor,
10,000 gallon diesel fuel tank
River has been threatening to take pump
house, Contractor just completing riprap

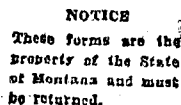

Water Resources Survey

Code No. 14C

(County) Yuba

T. 71 R. 45

Name of Land Owner Fred Warwick Address Box 612, Miles City
Name of Operator Clarence Johnson Address Sheffield, Mont

Part A

**TO BE FILED BY THOSE OBTAINING IRRIGATION WATER FROM
A DITCH COMPANY OR IRRIGATION DISTRICT**

1. Water is delivered by: _____
Name of Ditch, Ditch Company or District Supplying Water
2. State the number of acres you irrigate under this system _____ Shares you hold _____
3. If you obtain water from more than one Company, give the number of shares, acres irrigated and the name of the Company under "Remarks." If you obtain water from a Ditch Company and also have a private system fill in both Part A and Part B.

Part B

TO BE FILED BY THOSE WHO HAVE A PRIVATE DITCH, PUMP OR IRRIGATION SYSTEM
or those who have a private water right under a Ditch Company

4. In what year was this land first irrigated? Date See attached filings
5. Give the name of the original appropriator (first user): _____
6. Give the date appropriated _____ Amount filed on: Miners Inches _____ C. F. S. _____
7. State the total number of acres irrigated under this system: _____
8. Give the point of diversion: _____ $\frac{1}{4}$ _____ $\frac{1}{4}$ Section _____ Township _____ Range _____

Part C

TO BE FILED BY ALL WATER USERS IN ADDITION TO PART A OR PART B

9. Source of Water: Spring Creek
Name of stream or lake from which water is originally diverted
10. Water is obtained by: (Check one) Gravity ☒ Pumping _____ Other Flood
11. What is the greatest number of acres you have irrigated? 13.0 Date _____
12. How many acres did you irrigate in 1947? (Crop and pasture) 43.0
13. State the total number of additional acres that could be irrigated by increasing the water supply, land leveling, etc. 0 This land is under what ditch? 0
14. How many acres of seeped land do you have which could be drained and put into production? 0
15. What is the condition of your irrigation system? Said to Poor
16. Is your water supply adequate? Yes _____ No ☒ Explain Land only
17. REMARKS: _____

11-10-68

NOTE: The foregoing questions apply only to irrigated land shown on this plat.

DESCRIPTION AND MAP OF FARM

18. Legal Description of this Farm

See WR-2 attached



IRRIGATED LAND

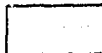

NON-IRRIGATED LAND

North

West

East

South

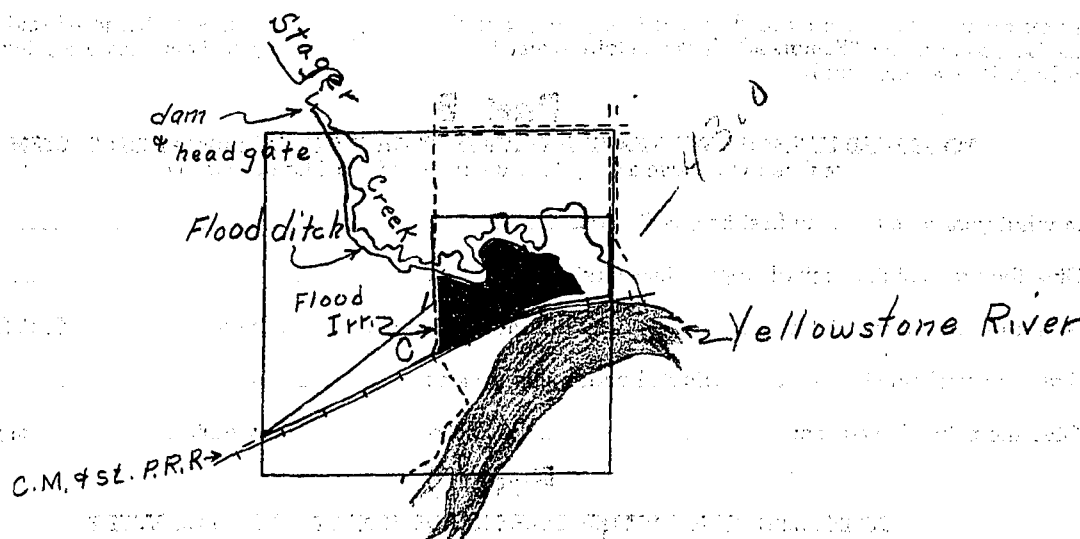

Ownership covers
only irrigated land.
All ownership for
dry land not shown.

19. If the above land is irrigated from more than one ditch please give the acreage under each ditch in 19A and indicate the location of the land irrigated from each on the above map.

19A. Ditch: *Private Flood ditch Stagers Cr* Acres: *43.0*

Ditch: _____ Acres: _____

Information supplied by:

Name *See attached form* Address _____ Date _____

REMARKS: _____

If you cannot answer all of the questions on this form answer as many as you can and return the form to us as soon as possible.

STATE ENGINEER'S OFFICE
WATER RESOURCES SURVEYCOUNTY CusterFILE NO. 24-T.7N-R.45E

Owner Warwick, Fred Address Box 618, Miles City
 AAA Owner _____ Address _____
 Operator Johanson, Clarence Address Sheffield, Mont
 New Owner _____ Address _____
 New Operator _____ Address _____

Assessment Record NoneAssessed Acreage 0

Legal Description of This Farm S²NE⁴ and all of SE⁴ North of R/W
and part of SW⁴ North of R/W in Sec. 14; T. 7N-R. 45E

Total Acres in Farm ✓Code Number 14CPhoto No. Ma 22-157

AAA Contract No. _____

AAA Total Cropland Acreage _____

App. No. 1800-1805

Decree No. _____

Land is located in

Twp. 7N Rge. 45E Twp. _____ Rge. _____

Twp. _____ Rge. _____ Twp. _____ Rge. _____

Filed in Twp. 7N Rge. 45ERemarks Clarence Johanson ownsSame land adjoining thisplace (Code No. 14D)Yellowstone River Basin

Ownership covers
only irrigated land.
All ownership for
dry land not shown.

Farm Checked

STATE OF MONTANA

FORM F-1 - GAZETTE 1988-LM-147

By Johnson & Co.

STATE ENGINEER'S OFFICE

Code No. 14 C, E.

Area Miles City-Sheffield WATER RESOURCES SURVEY

County Custer

Date 5/14/4

T. 7N R. 45E Sec. 14

Photo No. MA 22-157

Legal Land Owner Warwick, Fred

Address Sheffield

Operator Johnson, Clarence

Address

Water is delivered by:

Federal Project

Pres.

Pot.

Ditch Company

Pres.

Pot.

Irrigation District

Pres. 43.0

Pot. 0

Private System Flood ditch & dam

Pres. 60

Pot. 0

Totals

Flood ☒

Pump

Reservoir

Gravity ☒

Size and Capacity, Pump, etc.

Original Appropriator, Company

App. No.

Original Appropriator, Private (Show date of appropriation under Remarks)

App. No. 1800-1805

Is the system an extension of another system?

Yes

No

Is all land irrigated from one system?

Yes

No

(If No, show break down on map)

Source of Water Stager Cr.

Acres Irrigated 19 46

60-43.0

Potential Acres 0

Seeped 0

Explain

Condition of System poor

Adequate Supply

Yes

No ☒

Explain Flood only

Topography bottom 1st. terrace

Information From Clarence Johnson

Remarks

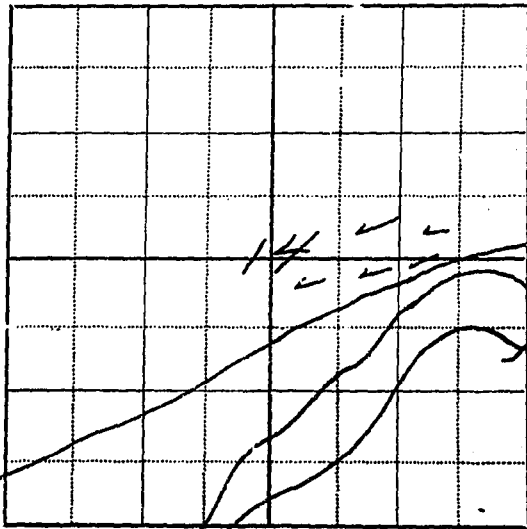



NOTICE
These forms are the property of the State of Montana and must be returned.

STATE OF MONTANA
STATE ENGINEERS OFFICE
Water Resources Survey

Code No. 124
County Carbon
T. 7N R. 45E

Name of Land Owner Ben H. Woodcock Address Miles City, Mont
Name of Operator _____ Address _____

Part A

TO BE FILED BY THOSE OBTAINING IRRIGATION WATER FROM
A DITCH COMPANY OR IRRIGATION DISTRICT

1. Water is delivered by: _____ Name of Ditch, Ditch Company or District Supplying Water _____ Shares you hold _____
2. State the number of acres you irrigate under this system _____
3. If you obtain water from more than one Company _____ the number of shares, acres irrigated and the name of the Company under "Remarks." If you obtain water from a Ditch Company and also have a private system fill in both Part A and Part B.

Part B

TO BE FILED BY THOSE WHO HAVE A PRIVATE DITCH, PUMP OR IRRIGATION SYSTEM
or those who have a private water right under a Ditch Company

4. In what year was this land first irrigated? Date No data
5. Give the name of the original appropriator (first user): _____
6. Give the date appropriated _____ Amount filed on: Miners Inches _____ C. F. S. _____
7. State the total number of acres irrigated under this system: _____
8. Give the point of diversion: _____ $\frac{1}{4}$ Section _____ Township _____ Range _____

Part C

TO BE FILED BY ALL WATER USERS IN ADDITION TO PART A OR PART B

9. Source of Water: Trib to Stager Creek Name of stream or lake from which water is originally diverted _____
10. Water is obtained by: (Check one) Gravity ☒ Pumping _____ Other Flood
11. What is the greatest number of acres you have irrigated? 20.0 Date _____
12. How many acres did you irrigate in 1948 (Crop and pasture) 0
13. State the total number of additional acres that could be irrigated by increasing the water supply, land leveling, etc. 30.0. This land is under what ditch? Private Flood ditch
14. How many acres of seeped land do you have which could be drained and put into production? 0
15. What is the condition of your irrigation system? Out of use
16. Is your water supply adequate? Yes _____ No ☒ Explain Flood water
17. REMARKS: only Old Brooks ditch

NOTE: The foregoing questions apply only to irrigated land shown on this plot.

DESCRIPTION AND MAP OF FARM

18. Legal Description of this Farm

Water Resources Survey

☐ None At Present
IRRIGATED LAND

☐ NON-IRRIGATED LAND

☒ Potential Land

North

TO BE FILLED BY THE OPERATOR OF THE DITCH COMPANY OR IRRIGATION DISTRICT
TO BE FILLED BY THE OPERATOR OF THE DITCH COMPANY OR IRRIGATION DISTRICT

State the number of acres of water which are irrigated by the ditch shown on this map. If you have more than one ditch, give the number of acres irrigated by each ditch. If you have more than one ditch, give the number of acres irrigated by each ditch. If you have more than one ditch, give the number of acres irrigated by each ditch.

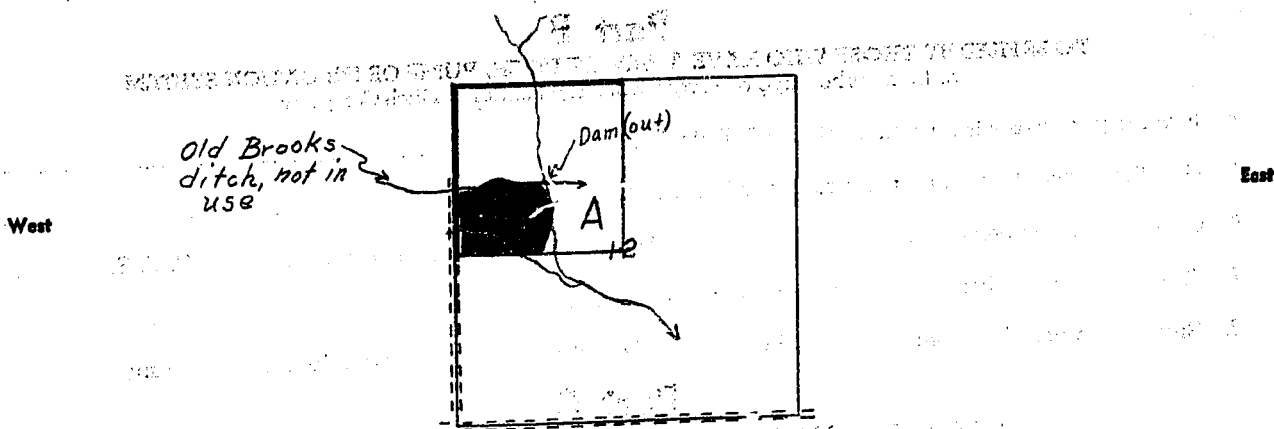

Ownership covers only irrigated land. All ownership for dry land not shown.

South

19. If the above land is irrigated from more than one ditch please give the acreage under each ditch in 19A and indicate the location of the land irrigated from each on the above map.

19A. Ditch: trib to Slager Creek Channel Acres: 0

Ditch: _____

Information supplied by:

Name Will Surrency Address _____ Date 5/15/47

REMARKS: John + J. Par. lent

If you cannot answer all of the questions on this form answer as many as you can and return the form to us as soon as possible.

STATE ENGINEER'S OFFICE
WATER RESOURCES SURVEYCOUNTY CusterFILE NO. 24-T-7N-R-45EOwner Woodcock, Ben H.Address Miles City, Mont.

AAA Owner

Address

Operator

Address

New Owner

Address

New Operator

Address

Assessment Record NoneAssessed Acreage 0Legal Description of This Farm NW 4 Sec. 12; T. 7N-R-45ETotal Acres in Farm ✓Code Number 12APhoto No. Mo 23-01

AAA Contract No.

AAA Total Cropland Acreage

App. No. No Record by Description

Decree No.

Land is located in

Twp. 7N Rge. 45E Twp. 7N Rge. 46E

Twp. Rge. Twp. Rge.

Filed in Twp. 7N Rge. 45E

Remarks

Yellowstone River Basin

Could not find area
in the B. M. -
ditch - ap-5-48

Ownership covers
only irrigated land.
All ownership for
dry land not shown.

(Township 7 North, Range 45 East)

Brackt, Leon E.

Bullard, J. W.

Egeland, Della

Fater, Louise

Harris, Fred

Johnson, Clarence

Jensen, Nels

Kildahl, Nels

Lockie Bros. Livestock Co.

Nelson, Selma

Olsen Land Del. Co.

Sheffield Ranch Co.

Warwick, Fred

Woodcock, Ben H.

COUNTY _____

Sheet No.

Twp. 7N Rge. 45E

Letters

[illegible]



These forms and the
property to the State
of Montana and must
be returned.

STATE OF MONTANA
STATE ENGINEERS OFFICE

Water Resources Survey

FORM WR-1-2M (1-47)
Code No. 22B
County Custer
T. 7N R. 45E

Name of Land Owner Leon E. Brackett Address Sheffield, Mont
Name of Operator Olaf Nelson Address " "

Part A

**TO BE FILED BY THOSE OBTAINING IRRIGATION WATER FROM
A DITCH COMPANY OR IRRIGATION DISTRICT**

1. Water is delivered by: _____
Name of Ditch, Ditch Company or District Supplying Water
2. State the number of acres you irrigate under this system _____ Shares you hold _____
3. If you obtain water from more than one Company, give the number of shares, acres irrigated and the name of the Company under "Remarks." If you obtain water from a Ditch Company and also have a private system fill in both Part A and Part B.

Part B

**TO BE FILED BY THOSE WHO HAVE A PRIVATE DITCH, PUMP OR IRRIGATION SYSTEM
or those who have a private water right under a Ditch Company**

4. In what year was this land first irrigated? Date see attached filings
5. Give the name of the original appropriator (first user): _____
6. Give the date appropriated _____ Amount filed on: Miners Inches _____ C. F. S. _____
7. State the total number of acres irrigated under this system: _____
8. Give the point of diversion: _____ $\frac{1}{4}$ _____ $\frac{1}{4}$ Section _____ Township _____ Range _____

Part C

TO BE FILED BY ALL WATER USERS IN ADDITION TO PART A OR PART B

9. Source of Water: Waste Water Yellowstone River
Name of stream or lake from which water is originally diverted
10. Water is obtained by: (Check one) Gravity _____ Pumping X Other _____
11. What is the greatest number of acres you have irrigated? 26.0 Date _____
12. How many acres did you irrigate in 1947 (Crop and pasture) 0
13. State the total number of additional acres that could be irrigated by increasing the water supply, land leveling, etc. 26.0 This land is under what ditch? ?
14. How many acres of seeped land do you have which could be drained and put into production? 0
15. What is the condition of your irrigation system? Fair
16. Is your water supply adequate? Yes _____ No X Explain _____
17. REMARKS: Uses waste water from
sheffield Pump system. None
available this year

Over

NOTE: The foregoing questions apply only to irrigated land shown on this plot.

DESCRIPTION AND MAP OF FARM

18. Legal Description of this Farm

ME4, Sec 22

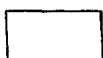

None At Present
IRRIGATED LAND

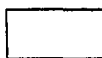

NON-IRRIGATED LAND



Potential Land

North

West

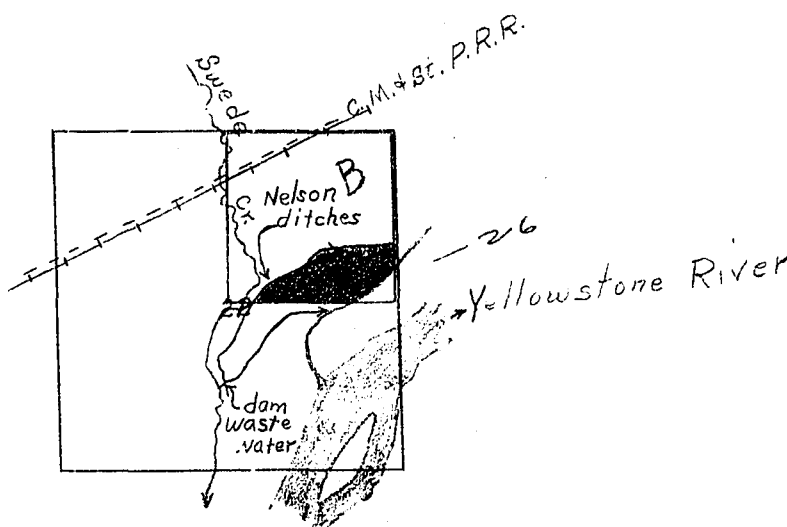

East

South

Ownership - owner
only irrigated land.
All ownership fee
by line not shown.

19. If the above land is irrigated from more than one ditch please give the acreage under each ditch in 19A and indicate the location of the land irrigated from each on the above map.

19A. Ditch: Nelson Private Pump ditch Acres: (26.0)
Ditch: _____ Acres: (potential)

Information supplied by:

Name See field form Address _____ Date _____

REMARKS: attached to 22D-22E Olaf Nelson op.

If you cannot answer all of the questions on this form answer as many as you can and return the form to us as soon as possible.

STATE ENGINEER'S OFFICE
WATER RESOURCES SURVEY

COUNTY Custer

FILE NO. 24-T-7N-R-45E

Owner Bracht, Leon E Address Sheffield, Montana

AAA Owner Address

Operator Nelson, Olaf Address " "

New Owner Address

New Operator Address

Assessment Record Nice

8

Assessed Acreage 0

Legal Description of This Farm NE 1/4 Sec. 22; T. 7N-R. 45E

Total Acres in Farm ✓

Code Number 22B

Photo No. Ma 22-156

AAA Contract No.

AAA Total Cropland Acreage

App. No. 2266-2057?

Decree No.

Land is located in

Twp. 7N Rge. 45E Twp. Rge.

Twp. Rge. Twp. Rge.

Filed in Twp. 7N Rge. 45E

Remarks Olaf Nelson also

operates some land south

of this place - owned by

(22D) Salma Nelson & Howard Bayler

(22E)

Yellowstone River Basin

Ownership covers
only irrigated land.
All ownership for
dry land not shown.

STATE ENGINEERS OFFICE

Water Resources Survey

B. B. Sheffield of Minneapolis,
Minn.

Notice of Appropriation

1. County Custer Book F. Page 88 Record W.R.2. Name of Appropriator A. J. Cumming et al Address Miles City, Montana

June 20, 1919

3. Date Appropriated Aug. 14, 1919 Date Filed Aug. 21, 1919Amount Appropriated, Miners Inches 1000 or , Cubic Feet per second 254. Name of Stream Yellowstone River Tributary Basin 5. Point of Diversion At or about the place where the section line between SectionsSec. 27 & 28 Twp. 7N. Rge. 45E. Bank of Stream Northintersects with north bank of said river.6. Purpose For irrigation, watering livestock, domestic and for developing power and all other purposes.7. Description of System A pump or pumps, or other means of elevating said water from said river into the ditch or flume constructed and to be of sufficient size and capacity to elevate and conduct said water from said river and from this point there will be a ditch or ditches leading onto the said lands. Said ditch will be about 8 ft. in width and about 1 1/2 feet in depth.

8. Land Description of Intended Place of Use

All S. of C.M.Ry. R/W Sec. 21-7N-45E, 200.50 acres, Sheffield Ranch Co., Sheffield, Mont.
Out of W. SW 1/4 Sec. 22-7N-45E, 332.33 acres, Sheffield Ranch Co., Sheffield, Montana
Lots 2,3,6, W 1/4 Sec. 27-7N-45E, 226.12 acres, Sheffield Ranch Co., Sheffield, Montana
All Fr. Sec. 28-7N-45E, Sheffield Ranch Co.

9. Remarks (Pertaining to Use, etc.)

Appropriators are A. J. Cumming and B. B. Sheffield.

Decree

10. Case No. Date Amt. Decreed: M. I. C. F. S. 11. To Whom Decreed Address 12. Name of Ditch Maximum Capacity (C. F. S.) 13. Date of Priority Purpose

14. Land Description of Place of Use as Decreed

Same lands water from the right

15. Remarks (Present Use Status, etc.)

2266

STATE ENGINEERS OFFICE
Water Resources Survey
Notice of Appropriation

1. County Custer Book F Page 112 Record W.R.
2. Name of Appropriator Selma Nelson Address Calahar, Montana
3. Date Appropriated Oct. 23, 1926 Date Filed Oct. 23, 1926
- Amount Appropriated, Miners Inches 500 or _____, Cubic Feet per second 12½
4. Name of Stream Unnamed Draw Tributary _____ Basin _____
5. Point of Diversion 2.1 ft. west of the center of said
- Sec. 22 Twp. 7N. Rge. 45E. Bank of Stream _____
6. Purpose For irrigation and other purposes.
7. Description of System A dam and a ditch 48" X 36" in size, which carries and conducts said amount of water from said creek and runs thence southeast about 240 ft. thence easterly about 125 ft. from thence diverted into such ditches and laterals as may be necessary for the proper irrigation of the said thence over and upon said land (or mining claim.) Said dam is about 75 ft. long and 5 ft. high and about 10 ft. wide at the bottom
8. Land Description of Intended Place of Use _____ and 3 ft. wide on top.
- Out of Lots 2, 3, 5 and SW¼ Sec. 22-7N-45E. 41.91 acres. Selma Nelson, Riverside, Cal.
9. Remarks (Pertaining to Use, etc.) _____
- Ref. to page further*

Decree

10. Case No. _____ Date _____ Amt. Decreed: M. I. _____ C. F. S. _____
11. To Whom Decreed _____ Address _____
12. Name of Ditch _____ Maximum Capacity (C. F. S.) _____
13. Date of Priority _____ Purpose _____
14. Land Description of Place of Use as Decreed _____
15. Remarks (Present Use Status, etc.) _____



NOTICE
These forms are the
property of the State
of Montana and must
be returned.

STATE OF MONTANA
STATE ENGINEERS OFFICE

Water Resources Survey

FORM WR-24-2M-12-47

Code No. 12 C

County: Quarter

T. 74 R. 45

Name of Land Owner J. W. Bullard et al Address Box 85 - Section 74

Name of Operator _____ Address _____

Part A

TO BE FILED BY THOSE OBTAINING IRRIGATION WATER FROM
A DITCH COMPANY OR IRRIGATION DISTRICT

1. Water is delivered by: _____
Name of Ditch, Ditch Company or District Supplying Water
2. State the number of acres you irrigate under this system _____ Shares you hold _____
3. If you obtain water from more than one Company, give the number of shares, acres irrigated and the name of the Company under "Remarks." If you obtain water from a Ditch Company and also have a private system fill in both Part A and Part B.

Part B

TO BE FILED BY THOSE WHO HAVE A PRIVATE DITCH, PUMP OR IRRIGATION SYSTEM
or those who have a private water right under a Ditch Company

4. In what year was this land first irrigated? Date 11/1/1910
5. Give the name of the original appropriator (first user): _____
6. Give the date appropriated _____ Amount filed on: Miners Inches _____ C. F. S. _____
7. State the total number of acres irrigated under this system: _____
8. Give the point of diversion: _____ $\frac{1}{4}$ _____ $\frac{1}{4}$ Section _____ Township _____ Range _____

Part C

TO BE FILED BY ALL WATER USERS IN ADDITION TO PART A OR PART B

9. Source of Water: Quiver Creek
Name of stream or lake from which water is originally diverted
10. Water is obtained by: (Check one) Gravity ☒ Pumping _____ Other Wind
11. What is the greatest number of acres you have irrigated? 220 Date _____
12. How many acres did you irrigate in 19 47 (Crop and pasture) 0
13. State the total number of additional acres that could be irrigated by increasing the water supply, land leveling, etc. 200 This land is under what ditch? Old Quiver ditch
14. How many acres of seeped land do you have which could be drained and put into production? _____
15. What is the condition of your irrigation system? Good
16. Is your water supply adequate? Yes _____ No ☒ Explain Good
17. REMARKS: _____

Over:

NOTE: The foregoing questions apply only to irrigated land shown on this plat.

DESCRIPTION AND MAP OF FARM

18. Legal Description of this Farm

N2SW4, Sec 12

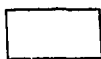

None At Present
IRRIGATED LAND



NON-IRRIGATED LAND



Potential Land

North

West

East

*Old Brooks
ditch, not in
use*

Dam (out)

12

C

South

Do not
only irrigated land.
All ownership for
any land not shown.

19. If the above land is irrigated from more than one ditch please give the acreage under each ditch in 19A and indicate the location of the land irrigated from each on the above map.

19A. Ditch: *Old Brooks ditch* Acres: *0*

Ditch: _____ Acres: _____

Information supplied by:

Name *Willie L. Lanning* Address _____ Date *5/15/47*

REMARKS: *Willie L. Lanning*

If you cannot answer all of the questions on this form answer as many as you can and return the form to us as soon as possible.

STATE ENGINEER'S OFFICE
WATER RESOURCES SURVEYCOUNTY ClusterFILE NO. 24-T-7N-R-45EOwner Bullard, J.W. (Est.) Address Box 85 - Sinton, Texas

AAA Owner Address

Operator ? Address ?

New Owner Address

New Operator Address

Assessment Record NoneAssessed Acreage 0Legal Description of This Farm N²SW⁴ Sec 18; T. 7N-R. 45ETotal Acres in Farm ✓Code Number 12CPhoto No. Ma 23-01

AAA Contract No.

AAA Total Cropland Acreage

App. No. No Record by Description

Decree No.

Land is located in

Twp. 7N Rge. 45E Twp. Rge.

Twp. Rge. Twp. Rge.

Filed in Twp. 7N Rge. 45E

Remarks

Yellowstone River BasinOwnership covers
only irrigated land.
All ownership for
dry land not shown.



NOTICE
These forms are the
property of the State
of Montana and must
be returned.

STATE OF MONTANA
STATE ENGINEERS OFFICE
Water Resources Survey

FORM WR-1-2M 12-67

Code No. 18B
County Custer
T. 7N R. 45E

Name of Land Owner Della Eyeland Address Sheffield, Mont
Name of Operator _____ Address _____

Part A

TO BE FILED BY THOSE OBTAINING IRRIGATION WATER FROM
A DITCH COMPANY OR IRRIGATION DISTRICT

1. Water is delivered by: _____
Name of Ditch, Ditch Company or District Supplying Water
2. State the number of acres you irrigate under this system _____ Shares you hold _____
3. If you obtain water from more than one Company, give the number of shares, acres irrigated and the name of the Company under "Remarks." If you obtain water from a Ditch Company and also have a private system fill in both Part A and Part B.

Part B

TO BE FILED BY THOSE WHO HAVE A PRIVATE DITCH, PUMP OR IRRIGATION SYSTEM
or those who have a private water right under a Ditch Company

4. In what year was this land first irrigated? Date See attached filings
5. Give the name of the original appropriator (first user): _____
6. Give the date appropriated _____ Amount filed on: Miners Inches _____ C. F. S. _____
7. State the total number of acres irrigated under this system: _____
8. Give the point of diversion: _____ $\frac{1}{4}$ _____ $\frac{1}{4}$ Section _____ Township _____ Range _____

Part C

TO BE FILED BY ALL WATER USERS IN ADDITION TO PART A OR PART B

9. Source of Water: Wet tail Creek
Name of stream or lake from which water is originally diverted
10. Water is obtained by: (Check one) Gravity ☒ Pumping _____ Other Good
11. What is the greatest number of acres you have irrigated? 650 Date _____
12. How many acres did you irrigate in 1948 (Crop and pasture) 650
13. State the total number of additional acres that could be irrigated by increasing the water supply, land leveling, etc. 0 This land is under what ditch? 0
14. How many acres of seeped land do you have which could be drained and put into production? 0
15. What is the condition of your irrigation system? Good
16. Is your water supply adequate? Yes _____ No ☒ Explain Good Water
17. REMARKS: _____

NOTE: The foregoing questions apply only to irrigated land shown on this plat.

DESCRIPTION AND MAP OF FARM

18. Legal Description of this Farm

E 2, Sec 18



IRRIGATED LAND



NON-IRRIGATED LAND

North

West

East

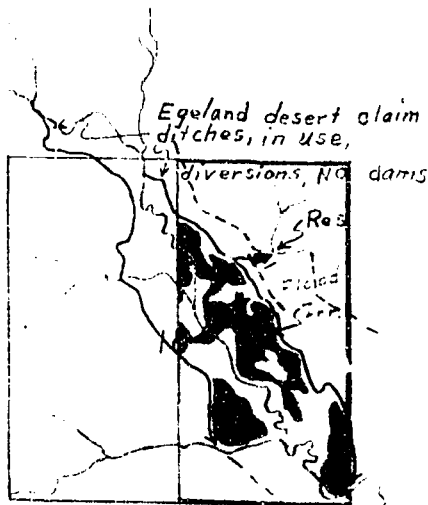

South

19. If the above land is irrigated from more than one ditch please give the acreage under each ditch in 19A and indicate the location of the land irrigated from each on the above map.

19A. Ditch: Flood from Whitetail Creek Acres: 165.0

Ditch: _____ Acres: _____

Information supplied by:

Name See attached form Address _____ Date 5/14/47

REMARKS: _____

If you cannot answer all of the questions on this form answer as many as you can and return the form to us as soon as possible.

STATE ENGINEER'S OFFICE
WATER RESOURCES SURVEYCOUNTY CusterFILE NO. 24-T. 7N-R. 45EOwner Egeland, Della Address Sheffield, Montana

AAA Owner Address

Operator " " Address " "

New Owner Address

New Operator Address

Assessment Record NoneAssessed Acreage 0Legal Description of This Farm E² Sec. 18; T. 7N-R. 45ETotal Acres in Farm ✓Code Number 18BPhoto No. Mo. 22-150

AAA Contract No.

AAA Total Cropland Acreage

App. No. 1998-1999-2000

Decree No.

Land is located in

Twp. 7N Rge. 45E Twp. Rge.

Twp. Rge. Twp. Rge.

Filed in Twp. 7N Rge. 45E

Remarks

Ownership covers
only irrigated land.
All ownership for
dry land not shown.Yellowstone River Basin

Farm Checked

STATE OF MONTANA

Code No. 188By Johnson & Doe

STATE ENGINEER'S OFFICE

County CusterArea Miles City - Sheffield

WATER RESOURCES SURVEY

T. 7N. R. 45E Sec. 18Date 5/14/47Phc. No. MA 22-150Legal Land Owner Egeland, DellaAddress SheffieldOperator Same

Address

Water is delivered by:

Federal Project _____ Pres. _____ Pot. _____

Ditch Company _____ Pres. _____ Pot. _____

Irrigation District _____ Pres. _____ Pot. _____

Private System private Flood ditches Pres. plains Pot. _____

Totals _____

Flood ☒ Pump _____ Reservoir _____ Gravity ☒

Size and Capacity, Pump, etc. _____

Original Appropriator, Company _____ App. No. _____

Original Appropriator, Private Packer 1907 & 1911 App. No. 1885-1997-2000
(Show date of appropriation under Remarks)Is the system an extension of another system? Yes _____ No ☒Is all land irrigated from one system? Yes ☒ No _____

(If No, show break down on map)

Source of Water White TailAcres Irrigated 19 47 650Potential Acres 0 Seeped 0

Explain _____

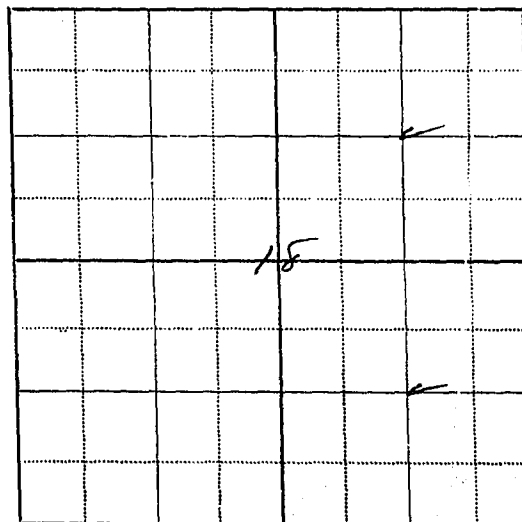
Condition of System goodAdequate Supply Yes _____ No ☒Explain Flood onlyTopography Creek bottomInformation From EgelandRemarks Says that his desert claim right is tied to the land & the best right on the Creek

STATE ENGINEERS OFFICE
Water Resources Survey

Notice of Appropriation

1. County Custer Book E Page 235 Record W.R.
2. Name of Appropriator Arthur J. Packer Address Calabar, Montana
3. Date Appropriated July 31, 1911 Date Filed July 25, 1912
Amount Appropriated, Miners Inches 500 or 12 1/2, Cubic Feet per second 12 1/2
4. Name of Stream White Tail Creek Tributary Basin
5. Point of Diversion 350 yds. west in 1/4 Sec. corner on E. side of

Sec. 18 Twp. 7N. Rge. 45E. Bank of Stream East
6. Purpose For irrigation, watering stock, domestic and other purposes.
7. Description of System A dam and a ditch 18" X 36" in size, which carries and conducts
said amount of water from said creek and runs thence in a southerly direction,
thence over and upon said land.
8. Land Description of Intended Place of Use
S 1/4 Sec. 18-7N-45E, 240 acres, Della Edgeland, Sheffield, Montana
9. Remarks (Pertaining to Use, etc.)

Decree

10. Case No. Date Amt. Decreed: M. I. C. F. S.
11. To Whom Decreed Address
12. Name of Ditch Maximum Capacity (C. F. S.)
13. Date of Priority Purpose
14. Land Description of Place of Use as Decreed
15. Remarks (Present Use Status, etc.)

STATE ENGINEERS OFFICE
Water Resources Survey

Notice of Appropriation

1. County Custer Book E Page 236 Record W.R.
2. Name of Appropriator Arthur J. Packer Address Calabar, Montana
3. Date Appropriated July 3, 1911 Date Filed July 15, 1912
- Amount Appropriated, Miners Inches 5000, Cubic Feet per second
4. Name of Stream White Tail Creek Tributary Basin
5. Point of Diversion 838 ft. N. 31° E. of NW corner

Sec. 18 Twp. 7N. Rge. 45E. Bank of Stream West

6. Purpose For irrigation, watering stock, domestic and other purposes.
7. Description of System A dam and a ditch 18" X 36" in size, which carries and conducts said amount of water from said creek and runs thence in a easterly direction.
8. Land Description of Intended Place of Use
S-SE-1/4, S-NE-1/4, N-SE-1/4 Sec. 18-7N-45E, 240 acres, Della Edgeland, Sheffield, Montana
9. Remarks (Pertaining to Use, etc.)

Decree

10. Case No. Date Amt. Decreed: M. I. C. F. S.
11. To Whom Decreed Address
12. Name of Ditch Maximum Capacity (C. F. S.)
13. Date of Priority Purpose
14. Land Description of Place of Use as Decreed
15. Remarks (Present Use Status, etc.)

STATE ENGINEERS OFFICE
Water Resources Survey

That Elizabeth Ellen Packer

in behalf of her son, Chas. J. Packer, deceased)

Notice of Appropriation

1. County Custer Book C Page 433 Record W.R.
2. Name of Appropriator Charles J. Packer (Deceased) Address Custer Co., Montana
3. Date Appropriated Nov. 8, 1907 Date Filed Nov. 9, 1907
- Amount Appropriated, Miners Inches 120, Cubic Feet per second
4. Name of Stream Whitetail Creek Tributary Basin
5. Point of Diversion About 450 ft. southwesterly from the 1/4 Section corner on N. side

Sec. 18 Twp. Rge. Bank of Stream Both

6. Purpose For irrigation and other purposes.
7. Description of System Ditches 36" wide X 12" deep, which carries and conducts 10 cu. ft. of water from said Whitetail Creek and runs thence in a southerly direction on both sides of the creek over and upon said desert claim.
8. Land Description of Intended Place of Use
- E¹ Sec. 18-7N-45E, 320 acres, Della England, Sheffield, Montana
- E¹ Sec. 18-7N-45E, 30 acres, Fred Harris, Sheffield, Montana
- Lots 1,2,3,4, E¹SW¹ Sec. 18-7N-45E, 226.40 acres, Anna L. and F.C. McCauley, M. City
9. Remarks (Pertaining to Use, etc.)

Decree

10. Case No. Date Amt. Decreed: M. I. C. F. S.
11. To Whom Decreed Address
12. Name of Ditch Maximum Capacity (C. F. S.)
13. Date of Priority Purpose
14. Land Description of Place of Use as Decreed
15. Remarks (Present Use Status, etc.)



STATE OF MONTANA
STATE ENGINEERS OFFICE
Water Resources Survey

FORM WS-1-12-47
Code No. 12E
County Beaverhead
T. 2N R. 45E

Name of Land Owner Louise Faber Address 603 W. Lawrence St.
Name of Operator _____ Address Bozeman, Mont

Part A

**TO BE FILED BY THOSE OBTAINING IRRIGATION WATER FROM
A DITCH COMPANY OR IRRIGATION DISTRICT**

1. Water is delivered by: _____
Name of Ditch, Ditch Company or District Supplying Water
2. State the number of acres you irrigate under this system _____ Shares you hold _____
3. If you obtain water from more than one Company, give the number of shares, acres irrigated and the name of the Company under "Remarks." If you obtain water from a Ditch Company and also have a private system fill in both Part A and Part B.

Part B

**TO BE FILED BY THOSE WHO HAVE A PRIVATE DITCH, PUMP OR IRRIGATION SYSTEM
or those who have a private water right under a Ditch Company**

4. In what year was this land first irrigated? Date 1911
5. Give the name of the original appropriator (first user): _____
6. Give the date appropriated _____ Amount filed on: Miners Inches _____ C. F. S. _____
7. State the total number of acres irrigated under this system: _____
8. Give the point of diversion: _____ $\frac{1}{4}$ _____ $\frac{1}{4}$ Section _____ Township _____ Range _____

Part C

TO BE FILED BY ALL WATER USERS IN ADDITION TO PART A OR PART B

9. Source of Water: Old Lawrence Ditch
Name of stream or lake from which water is originally diverted
10. Water is obtained by: (Check one) Gravity ☒ Pumping _____ Other Hand
11. What is the greatest number of acres you have irrigated? 600 Date _____
12. How many acres did you irrigate in 19 47 (Crop and pasture) 0
13. State the total number of additional acres that could be irrigated by increasing the water supply, land leveling, etc. 600 This land is under what ditch? The Lawrence Ditch System
14. How many acres of seeped land do you have which could be drained and put into production? 0
15. What is the condition of your irrigation system? Good
16. Is your water supply adequate? Yes _____ No ☒ Explain It is not adequate
17. REMARKS: _____

Over _____

NOTE: The foregoing questions apply only to irrigated land shown on this plot.

DESCRIPTION AND MAP OF FARM

18. Legal Description of this Farm

SE 1/4, Sec 12



None At Present
IRRIGATED LAND



NON-IRRIGATED LAND



Potential Land

North

West

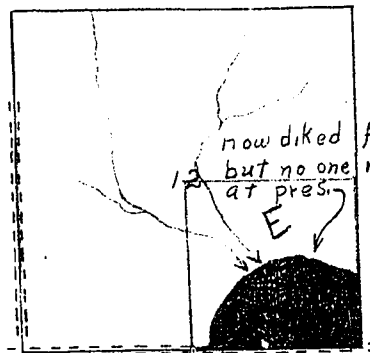

East

South

Shading covers
only irrigated land.
No ownership for
dry land not shown.

19. If the above land is irrigated from more than one ditch please give the acreage under each ditch in 19A and indicate the location of the land irrigated from each on the above map.

19A. Ditch: Panhandle Canal System Acres: 0

Ditch: _____ Acres: _____

Information supplied by:

Name Self Address _____ Date 5/15/41

REMARKS: See adjacent farm

If you cannot answer all of the questions on this form answer as many as you can and return the form to us as soon as possible.

STATE ENGINEER'S OFFICE
WATER RESOURCES SURVEYCOUNTY CusterFILE NO. 24-T.7N-R.45EOwner Faber, Louise Address 603 U. Hamm St., Bozeman, Mont.

• AAA Owner Address

Operator P Address P

New Owner Address

New Operator Address

Assessment Record NoneAssessed Acreage 0Legal Description of This Farm SE⁴ Sec. 12; T. 7N-R. 45ETotal Acres in Farm ✓Code Number 12EPhoto No. Ma 23-01

AAA Contract No.

AAA Total Cropland Acreage

App. No. 1883

Decree No.

Land is located in

Twp. 7N Rge. 45E Twp. Rge.

Twp. Rge. Twp. Rge.

Filed in Twp. 7N Rge. 45E

Remarks

Yellowstone River BasinOwnership covers
only irrigated land.
All ownership for
dry land not shown.

Farm Checked

STATE OF MONTANA

Code No. 12EBy Joe & Collins

STATE ENGINEER'S OFFICE

County CusterArea Miles - Sheffield

WATER RESOURCES SURVEY

T. 7N R. 45E Sec. 12Date 5/15/47Photo No. MA 23-02Legal Land Owner Faber, LouiseAddress Bozeman

Operator _____

Address _____

Water is delivered by:

Federal Project _____ Pres. _____ Pot. _____

Ditch Company _____ Pres. _____ Pot. _____

Irrigation District _____ Pres. _____ Pot. _____

Private System Flood dikes Pres. 0 Pot. planning

Totals _____

Flood ☒ Pump _____ Reservoir _____ Gravity _____

Size and Capacity, Pump, etc. _____

Original Appropriator, Company _____ App. No. _____

Original Appropriator, Private Susan Ilgen 1913 App. No. 1803

(Show date of appropriation under Remarks)

Is the system an extension of another system? Yes _____ No ☒Is all land irrigated from one system? Yes ☒ No _____

(If No, show break down on map)

Source of Water No Name CouleesAcres Irrigated 19 46 0Potential Acres ? Seeped 0

Explain _____

Condition of System goodAdequate Supply Yes _____ No ☒Explain Flood onlyTopography 2nd terraceInformation From Bracey, GlenRemarks No one on the place at present, probably has been sold.

(over)

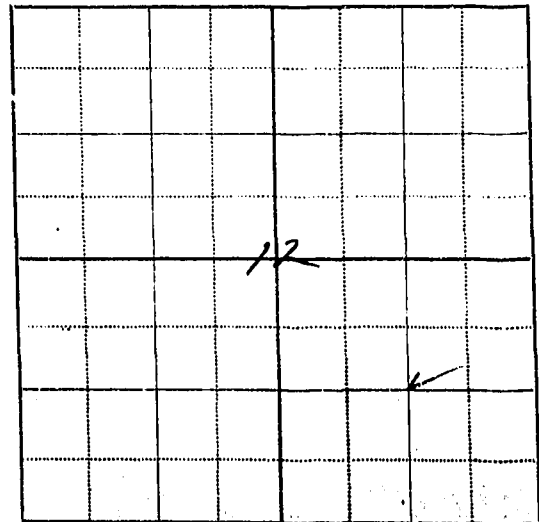

There is no operator on this place but the
dike system is in perfect condition and
operates itself. Good crop of Hay on the
land but probably will not be cut.

STATE ENGINEERS OFFICE
Water Resources Survey
Notice of Appropriation

1803

1. County Custer Book E Page 309 Record M.R.
2. Name of Appropriator Mrs. Susan T. Igen Address Miles City, Montana
3. Date Appropriated Sept. 11, 1913 Date Filed Sept. 11, 1913
- Amount Appropriated, Miners Inches 3000 C.F.S. 50
4. Name of Stream Steiger Creek Tributary Basin
5. Point of Diversion A dam on Steiger's Creek at the point of intersection and said prongs in the NW 1/4
Sec. 11 Twp. 7N. Rge. 45E. Bank of Stream East
6. Purpose For irrigation
7. Description of System A dam and a ditch sufficient in size to carry and conduct said amount of water to and upon the said lands, said ditch runs in a southeasterly direction from point of appropriation and enters the above-described land a point on the NW corner through a natural course, said ditch was constructed during the early part of the year of 1913.
8. Land Description of Intended Place of Use SE 1/4 Sec. 12-7N-45E, 40 acres, Sec. A. Lower "Est.", Sheffield, Montana
9. Remarks (Pertaining to Use, etc.) The two main prongs of Steiger Creek and tributaries of said prongs.

Decree

10. Case No. Date Amt. Decreed: M. I. C. F. S.
11. To Whom Decreed Address
12. Name of Ditch Maximum Capacity (C. F. S.)
13. Date of Priority Purpose
14. Land Description of Place of Use as Decreed
15. Remarks (Present Use Status, etc.)



These Indians are the
property of the State
of Florida and must
be returned.

STATE OF MONTANA
STATE ENGINEERS OFFICE
Water Resources Survey

Code No.

County Greene

T. 7, Y R. 45

Name of Land Owner Fred Harris

Address

Name of Operator _____

Address

Part A

**TO BE FILED BY THOSE OBTAINING IRRIGATION WATER FROM
A DITCH COMPANY OR IRRIGATION DISTRICT**

1. Water is delivered by:.....
Name of Ditch, Ditch Company or District Supplying Water
2. State the number of acres you irrigate under this system..... Shares you hold.....
3. If you obtain water from more than one Company, give the number of shares, acres irrigated and the name of the Company under "Remarks." If you obtain water from a Ditch Company and also have a private system fill in both Part A and Part B.

Part B

TO BE FILED BY THOSE WHO HAVE A PRIVATE DITCH, PUMP OR IRRIGATION SYSTEM
or those who have a private water right under a Ditch Company

4. In what year was this land first irrigated? Date See attached plat
5. Give the name of the original appropriator (first user): _____
6. Give the date appropriated _____ Amount filed on: Miners Inches _____ C. F. S. _____
7. State the total number of acres irrigated under this system: _____
8. Give the point of diversion: _____ $\frac{1}{4}$ _____ $\frac{1}{4}$ Section _____ Township _____ Range _____

Part C

TO BE FILED BY ALL WATER USERS IN ADDITION TO PART A OR PART B

9. Source of Water: San Joaquin River
Name of stream or lake from which water is originally diverted
10. Water is obtained by: (Check one) Gravity ☒ Pumping ☐ Other ☐
11. What is the greatest number of acres you have irrigated? 260 Date 1960
12. How many acres did you irrigate in 1960? (Crop and pasture) 260
13. State the total number of additional acres that could be irrigated by increasing the water supply, land leveling, etc. 0 This land is under what ditch? 0
14. How many acres of seeped land do you have which could be drained and put into production? 0
15. What is the condition of your irrigation system? Good
16. Is your water supply adequate? Yes ☐ No ☒ Explain Flowed only
17. REMARKS: _____

Overall

NOTE: The foregoing questions apply only to irrigated land shown on this plot.

DESCRIPTION AND MAP OF FARM

18. Legal Description of this Farm

E² NW⁴, Sec 18



IRRIGATED LAND

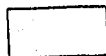

NON-IRRIGATED LAND

North

West

East

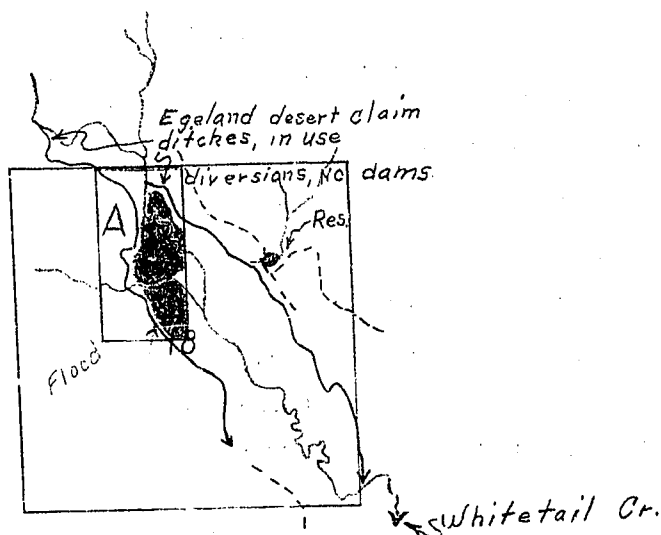

South

Ownership shown
only irrigated land.
All ownership for
dry land not shown.

19. If the above land is irrigated from more than one ditch please give the acreage under each ditch in 19A and indicate the location of the land irrigated from each on the above map.

19A. Ditch: *Flood Whitetail Creek* Acres: *26.0*

Ditch: _____ Acres: _____

Information supplied by:

Name: *Mels Jensen* Address: _____ Date: *5/14/47*

REMARKS: *Johnson & J Paulist*

If you cannot answer all of the questions on this form answer as many as you can and return the form to us as soon as possible.

STATE ENGINEER'S OFFICE
WATER RESOURCES SURVEYCOUNTY CusterFILE NO. 24-T.7N-R.45EOwner Harris, Fred Address Sheffield, Montana

AAA Owner Address

Operator " " Address " "

New Owner Address

New Operator Address

Assessment Record NoneAssessed Acreage 0Legal Description of This Farm E² NW¹, Sec. 18; T. 7N-R. 45ETotal Acres in Farm ✓Code Number 18APhoto No. Ma 22-150

AAA Contract No.

AAA Total Cropland Acreage

App. No. 2000

Decree No.

Land is located in

Twp. 7N Rge. 45E Twp. Rge.

Twp. Rge. Twp. Rge.

Filed in Twp. 7N Rge. 45E

Remarks

Ownership covers
only irrigated land.
All ownership for
dry land not shown.Yellowstone River Basin

STATE ENGINEERS OFFICE

Water Resources Survey

That Elizabeth Ellen Packer
in behalf of her son, Chas. J.
Packer, deceased)

Notice of Appropriation

1. County Custer Book C Page 433 Record W.R.
2. Name of Appropriator Charles J. Packer (Deceased) Address Custer Co., Montana
3. Date Appropriated Nov. 8, 1907 Date Filed Nov. 9, 1907
Amount Appropriated, Miners Inches 120 Cubic Feet per second
4. Name of Stream Whitetail Creek Tributary Basin
5. Point of Diversion About 450 ft. southwesterly from the 1/4 Section corner on N. side
Sec. 18 Twp. Rge. Bank of Stream Both
6. Purpose For irrigation and other purposes.
7. Description of System Ditches 36" wide X 12" deep, which carries and conducts 10 cu. ft.
of water from said Whitetail Creek and runs thence in a southerly direction on both
sides of the creek over and upon said desert claim.
8. Land Description of Intended Place of Use
E $\frac{1}{2}$ Sec. 18-7N-45E, 320 acres, Della Egeland, Sheffield, Montana
E $\frac{1}{2}$ N $\frac{1}{2}$ Sec. 18-7N-45E, 80 acres, Fred Harris, Sheffield, Montana
Lots 1,2,3,4, E $\frac{1}{2}$ SW $\frac{1}{4}$ Sec. 18-7N-45E, 226.40 acres, Anna T. and F.C. McCauley, M. City
9. Remarks (Pertaining to Use, etc.)

Decree

10. Case No. Date Amt. Decreed: M. I. C. F. S.
11. To Whom Decreed Address
12. Name of Ditch Maximum Capacity (C. F. S.)
13. Date of Priority Purpose
14. Land Description of Place of Use as Decreed
15. Remarks (Present Use Status, etc.)



NOTICE
These forms and the
property of the State
of Montana and shall
be returned.

STATE OF MONTANA
STATE ENGINEERS OFFICE
Water Resources Survey

FORM WR-1-2M 12-47
Code No. 1430
County Custer
T. 7.14 R. 45

Name of Land Owner Clarence Johnson Address Sheffield, Mont

Name of Operator _____ Address _____

Part A

**TO BE FILED BY THOSE OBTAINING IRRIGATION WATER FROM
A DITCH COMPANY OR IRRIGATION DISTRICT**

1. Water is delivered by: _____
Name of Ditch, Ditch Company or District Supplying Water
2. State the number of acres you irrigate under this system _____ Shares you hold _____
3. If you obtain water from more than one Company, give the number of shares, acres irrigated and the name of the Company under "Remarks." If you obtain water from a Ditch Company and also have a private system fill in both Part A and Part B.

Part B

**TO BE FILED BY THOSE WHO HAVE A PRIVATE DITCH, PUMP OR IRRIGATION SYSTEM
or those who have a private water right under a Ditch Company**

4. In what year was this land first irrigated? Date No data
5. Give the name of the original appropriator (first user): _____
6. Give the date appropriated _____ Amount filed on: Miners Inches _____ C. F. S. _____
7. State the total number of acres irrigated under this system: _____
8. Give the point of diversion: _____ $\frac{1}{4}$ _____ $\frac{1}{4}$ Section _____ Township _____ Range _____

Part C

TO BE FILED BY ALL WATER USERS IN ADDITION TO PART A OR PART B

9. Source of Water: Yellowstone River
Name of stream or lake from which water is originally diverted
10. Water is obtained by: (Check one) Gravity _____ Pumping ☒ Other _____
11. What is the greatest number of acres you have irrigated? 750 Date _____
12. How many acres did you irrigate in 1947? (Crop and pasture) 600
13. State the total number of additional acres that could be irrigated by increasing the water supply, land leveling, etc. 150 This land is under what ditch? Same
14. How many acres of seeped land do you have which could be drained and put into production? 0
15. What is the condition of your irrigation system? Good
16. Is your water supply adequate? Yes ☒ No _____ Explain _____
17. REMARKS: _____

Over _____

NOTE: The foregoing questions apply only to irrigated land shown on this plat.

DESCRIPTION AND MAP OF FARM

18. Legal Description of this Farm

Sec 14 in NW 1/4 WP-2



IRRIGATED LAND



NON-IRRIGATED LAND



Potential Land

North

West

East

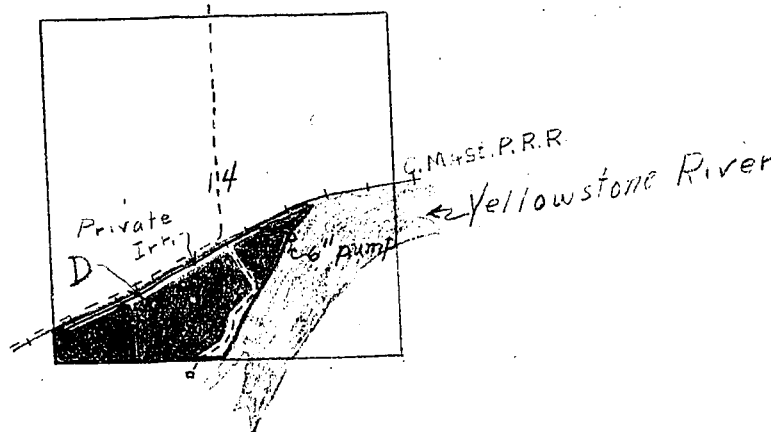

South

Ownership shown
only irrigated land.
All ownership for
dry land not shown.

19. If the above land is irrigated from more than one ditch please give the acreage under each ditch in 19A and indicate the location of the land irrigated from each on the above map.

19A. Ditch: *Private Pump ditch of (P)* Acres: *60.0*

Ditch: _____

Acres: _____

Information supplied by:

Name *J. H. Smith*

Address _____

Date _____

REMARKS: _____

If you cannot answer all of the questions on this form answer as many as you can and return the form to us as soon as possible.

STATE ENGINEER'S OFFICE
WATER RESOURCES SURVEYCOUNTY CusterFILE NO. 24-T.7N-R.45EOwner Johnson, Clarence Address Sheffield, Montana

AAA Owner _____ Address _____

Operator " Address "

New Owner _____ Address _____

New Operator _____ Address _____

Assessment Record None -Assessed Acreage 0Legal Description of This Farm all of the SW¹/₄ south of R.R. Rfwr;
and part of SE¹/₄ South of R.R. Rfwr and North of
Yellowstone River in Sec. 14; T. 7N-R. 45ETotal Acres in Farm ✓Code Number 14DPhoto No. Ma 22-157

AAA Contract No. _____

AAA Total Cropland Acreage _____

App. No. No filing at present timeDecree No. 5/14/47

Land is located in

Twp. 7N Rge. 45E Twp. _____ Rge. _____

Twp. _____ Rge. _____ Twp. _____ Rge. _____

Filed in Twp. 7N Rge. 45ERemarks Clarence Johnson alsoowns some land adjoiningthis place, which is ownedby Fred Wasmick (Cede No. 14C)Yellowstone River BasinOwnership covers
only irrigated land.
All ownership for
dry land not shown.

Farm Checked

STATE OF MONTANA

Code No. 14DBy Johnson & Joe

STATE ENGINEER'S OFFICE

County CusterArea Miles City-Sheffield

WATER RESOURCES SURVEY

T. 7N R. 45E Sec. 14Date 5/14/47Photo No. MA-22-157Legal Land Owner Johnson, Clarence (change ownership) Address SheffieldOperator Same Address _____

Water is delivered by:

Federal Project _____ Pres. _____ Pot. _____

Ditch Company _____ Pres. _____ Pot. _____

Irrigation District _____ Pres. _____ Pot. _____

Private System pump & ditches Pres. 60 Pot. 30

Totals _____

Flood _____ Pump ☒ Reservoir _____ Gravity ☒Size and Capacity, Pump, etc. 6" cent. Tractor power

Original Appropriator, Company _____ App. No. _____

Original Appropriator, Private No filing yet App. No. _____
(Show date of appropriation under Remarks)Is the system an extension of another system? Yes _____ No ☒Is all land irrigated from one system? Yes ☒ No _____

(If No, show break down on map)

Source of Water YellowstoneAcres Irrigated 19 46 60Potential Acres 30 Seeped 0

Explain _____

Condition of System goodAdequate Supply Yes ☒ No _____

Explain _____

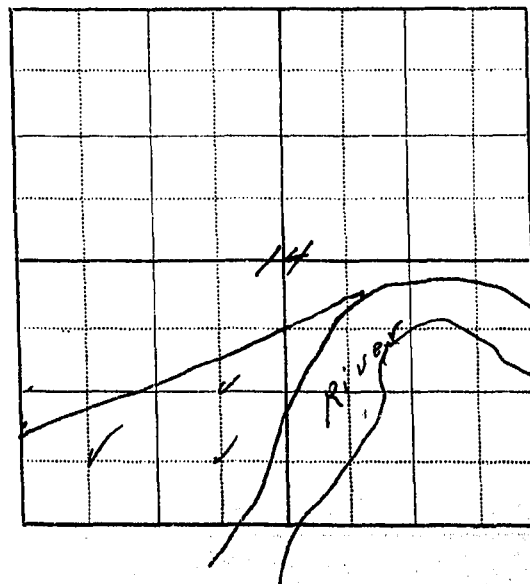
Topography bottom 1st terraceInformation From Johnson, ClarenceRemarks First use in 1935

REGISTERED HEREFORDS

Clarence Johnson

SHEFFIELD, MONTANA

14-40
Mr. Gerald J. Grantz
Assistant State Engineer
Billings Mont.

Dear Sir,

In regard to your letter re
Kend Irrigation, Yellowstone River,
I did not file a water right on
SW 1/4 S. R/W., SE 1/4 S. R/W Section 14, T. 7 N
R. 45 E., Carter County.

This land was irrigated
by pumping from the Yellowstone
River for the first time in
May 1935 by Clarence Johnson
and Glay Nelson, and has
been irrigated each year since

Yours truly,
Clarence Johnson

April 16, 1948

Mr. Clarence Johnson
Sheffield, Montana

Re: Flood Irrigation, Yellowstone River

Dear Sir:

Custor

SW $\frac{1}{4}$ S. R/W., SE $\frac{1}{4}$ S. R/W Section 17, T. 7N., R. 45E.



NOTICE
These forms are the
property of the State
of Montana and must
be returned.

STATE OF MONTANA
STATE ENGINEERS OFFICE
Water Resources Survey

FORM-WA-1-2M-12-47

Code No. 29A-290
County Quiver
T. 7N R. 45

Name of Land Owner Nels Jensen Address Sheffield, Mont
Name of Operator _____ Address _____

Part A

**TO BE FILED BY THOSE OBTAINING IRRIGATION WATER FROM
A DITCH COMPANY OR IRRIGATION DISTRICT**

1. Water is delivered by: _____
Name of Ditch, Ditch Company or District Supplying Water
2. State the number of acres you irrigate under this system _____ Shares you hold _____
3. If you obtain water from more than one Company, give the number of shares, acres irrigated and the name of the Company under "Remarks." If you obtain water from a Ditch Company and also have a private system fill in both Part A and Part B.

Part B

**TO BE FILED BY THOSE WHO HAVE A PRIVATE DITCH, PUMP OR IRRIGATION SYSTEM
or those who have a private water right under a Ditch Company**

4. In what year was this land first irrigated? Date See attached filings
5. Give the name of the original appropriator (first user): _____
6. Give the date appropriated _____ Amount filed on: Miners Inches _____ C. F. S. _____
7. State the total number of acres irrigated under this system: _____
8. Give the point of diversion: _____ $\frac{1}{4}$ _____ $\frac{1}{4}$ Section _____ Township _____ Range _____

Part C

TO BE FILED BY ALL WATER USERS IN ADDITION TO PART A OR PART B

9. Source of Water: Whitetail Creek
Name of stream or lake from which water is originally diverted
10. Water is obtained by: (Check one) Gravity ☒ Pumping _____ Other Flood
11. What is the greatest number of acres you have irrigated? 62.0 Date _____
12. How many acres did you irrigate in 1947? (Crop and pasture) 62.0
13. State the total number of additional acres that could be irrigated by increasing the water supply, land leveling, etc. 0 This land is under what ditch? 0
14. How many acres of seeped land do you have which could be drained and put into production? 0
15. What is the condition of your irrigation system? Fair
16. Is your water supply adequate? Yes _____ No ☒ Explain I flood water only
17. REMARKS: _____

Over _____

NOTE: The foregoing questions apply only to irrigated land shown on this plat.

DESCRIPTION AND MAP OF FARM

18. Legal Description of this Farm

N2 NW4, SW4 NE4 Sec 29



IRRIGATED LAND

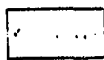

NON IRRIGATED LAND

North

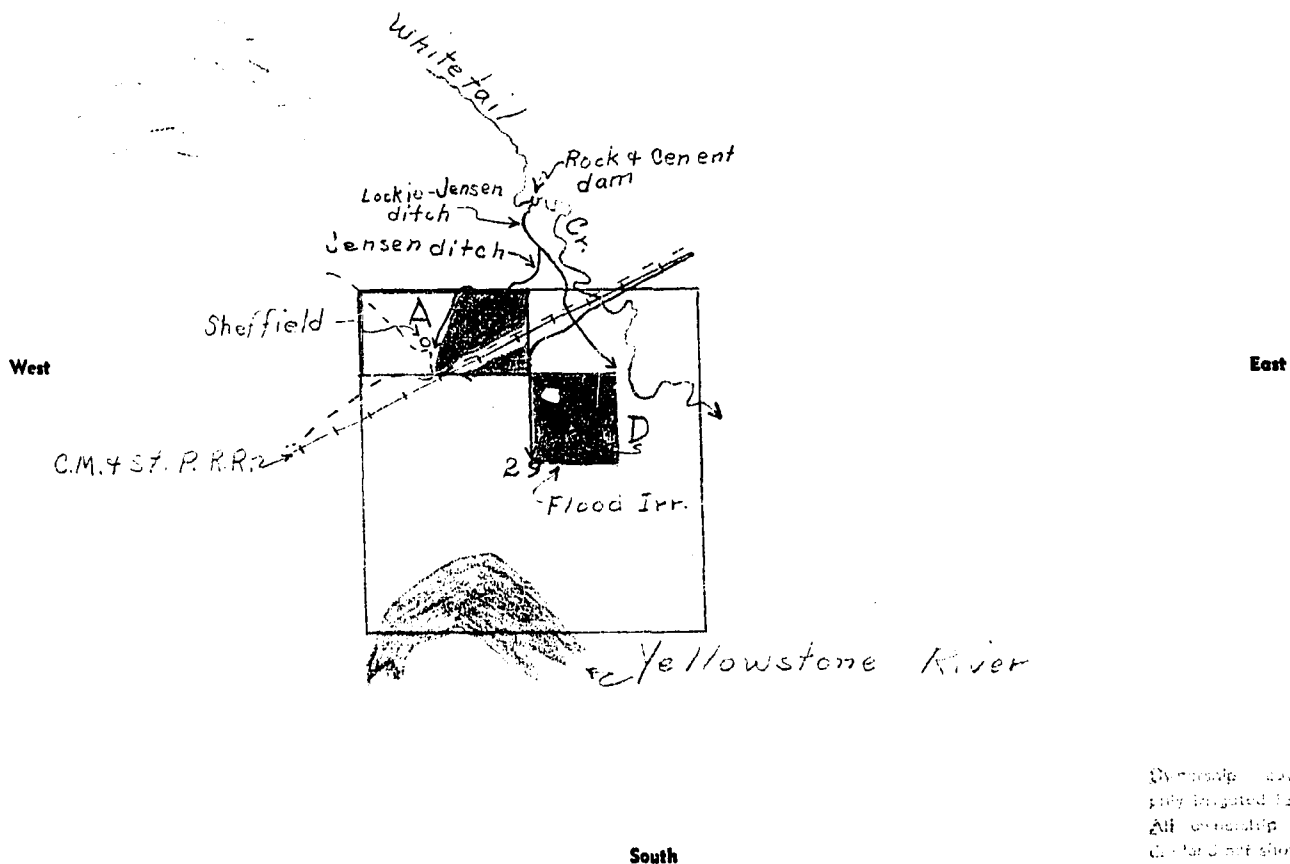

Shading shows
only irrigated land
All ownership in
ditch is not shown

19. If the above land is irrigated from more than one ditch please give the acreage under each ditch in 19A and indicate the location of the land irrigated from each on the above map.

19A. Ditch: Flood Irr. Whitetail Creek Acres: 62.0

Ditch: _____ Acres: _____

Information supplied by:

Name See attached form Address _____ Date 5/14/47

REMARKS: _____

If you cannot answer all of the questions on this form answer as many as you can and return the form to us as soon as possible.

STATE ENGINEER'S OFFICE
WATER RESOURCES SURVEYCOUNTY CusterFILE NO. 24-T 7N-R 45EOwner Jensen, Nels Address Sheffield, Mont

AAA Owner Address

Operator " " Address " "

New Owner Address

New Operator Address

Assessment Record NoneAssessed Acreage 0Legal Description of This Farm N² NW⁴, SW⁴ NE², Sec 29, T. 7N-R. 45ETotal Acres in Farm ✓Code Number 29A-293Photo No. Ma 22-156

AAA Contract No.

AAA Total Cropland Acreage

App. No. 1242-2486Decree No. 20511-20557

Land is located in

Twp. 7N Rge. 45E Twp. Rge.

Twp. Rge. Twp. Rge.

Filed in Twp. 7N Rge. 45E

Remarks

Yellowstone River BasinOwnership
only irrigated land
All ownership for
dry land not shown

STATE OF MONTANA

Code No. 20A, 29A, 0

STATE ENGINEER'S OFFICE

County Custer

Area Miles City - Sheffield

WATER RESOURCES SURVEY

T. 7N. R. 45E Sec. 20 & 29

Date 5/14/47

Photo No. MA 22-156

Legal Land Owner. C. Hansen, No 15

Address Sheffield

Operator Same

Address

Water is delivered by:

Federal Project _____ Pres. _____ Pot. _____

Ditch Company _____ Pres. _____ Pot. _____

Irrigation District _____ Pres. _____ Pot. _____

Private System Flood ditch Pres. ^{planning} 6210 Pot. _____

Totals _____

Flood ☒ Pump _____ Reservoir _____ Gravity ☒

Size and Capacity, Pump, etc. _____

Original Appropriator, Company _____ App. No. _____

Original Appropriator, Private Nels M. Anderson App. No. 1990 2486
(Show date of appropriation under Remarks)

Is the system an extension of another system? Yes _____ No _____

Is all land irrigated from one system? Yes No

(If No, show break down on map)

Source of Water: White Tail Cr.

Acres Irrigated 19.46 2 62.0

Potential Acres 6 Seeped 2

Explain

Condition of System FairAdequate Supply Yes No ☒

Explain flow only

Topography bottom

Information From Nels Venson

Remarks App. 1901

A 10x10 grid with a thick horizontal line across the middle. The number '26' is handwritten in the 4th column and 6th row from the top. The number '29' is handwritten in the 8th column and 2nd row from the bottom. There are also some small, faint marks in the grid.

#2456 should be in the name of Jensen.
it is the same app. as #1990 but was
re-filed on as protection. He bought the
Anderson right in about 1911, has deed for it.

1990

STATE ENGINEERS OFFICE
Water Resources Survey
Notice of Appropriation

1. County Custer Book B Page 96 Record W.R.
2. Name of Appropriator Nels M. Anderson Address Sadie, Montana
3. Date Appropriated June 5, 1901 Date Filed June 5, 1901
Amount Appropriated, Miners Inches 500, Cubic Feet per second
4. Name of Stream White Tail Creek Tributary Basin
5. Point of Diversion about 100 ft. up said Creek from a cut bank thereon and near the
center of the south line of Section 20 of said Twp. & Rge.
Sec. 20 Twp. Rge. Bank of Stream Left Bank

6. Purpose For irrigating and for other useful purposes.

7. Description of System A dam and ditch, said ditch starting at said point of diversion,
thence running in a southeasterly direction to and upon the said described land and through
said land to a point near the southwest corner of said described land and there discharge
into a swale or low piece of ground that conducts said water or the surplus that is not
absorbed by said land bank into said creek, the point of final discharge, the size of said

8. Land Description of Intended Place of Use (over)

SW 1/4 Sec. 20-7E-45E, 40 acres, Nels Jensen, Sheffield, Montana

9. Remarks (Pertaining to Use, etc.) and I do hereby claim the right to change the place of
diversion of said waters at any time, and to extend the ditches, flumes, piles and
aqueducts by which said diversion is made from time to time to any place other than where
first used and to use the said waters for other useful purposes than that for which it
was first appropriated, and I also claim all the right of way for ditches, flumes,

Decree (over)

10. Case No. Date Amt. Decreed: M. I. C. F. S.

11. To Whom Decreed Address

12. Name of Ditch Maximum Capacity (C. F. S.)

13. Date of Priority Purpose

14. Land Description of Place of Use as Decreed

15. Remarks (Present Use Status, etc.)

No. 7 - ditch is two feet deep by three feet wide on the bottom by six feet wide on top, the size of said dam is about forty feet long by six feet high by forty feet wide on the bottom and six feet wide on top.

No. 9 - aqueducts and reservoirs, dykes and canals, over and across the lands through which they are constructed and the right to enlarge the same from time to time and also all rights, easements, privileges and appurtenances thereunto belonging or granted under and by virtue of all laws relating to water rights both state and national.

2001

STATE ENGINEERS OFFICE
Water Resources Survey
Notice of Appropriation

1. County Custer Book A Page 129 Record W.R.
2. Name of Appropriator Rasmus Sporup Address Sadie, Custer Co.
3. Date Appropriated May, 1888 Date Filed March 19, 1892
Amount Appropriated, Miners Inches 500, Cubic Feet per second
4. Name of Stream White Tail Creek Tributary Basin
5. Point of Diversion At a point about 250 yds. north east of the half section stake and monument of the section line dividing sections 20 and 29 of said Twp. & Rge., and about 300 yds. due north of the present county road to Miles City.
Sec. 29 Twp. 7N Rge. 45E Bank of Stream West
6. Purpose Irrigation of land.
7. Description of System A dam now built across said creek and described as the point of diversion and a ditch 1 1/2 ft. wide at the bottom and 4 ft. wide at the top, diverging in size, depth and width according to the slope of the ground traversed.
8. Land Description of Intended Place of Use
SW 1/4 Sec. 29-7N-45E, 40 acres, Nelsa Hansen, Sheffield, Montana
SE 1/4 Sec. 29-7N-45E, 40 acres, Jas. Dunlap Est. Sheffield, Montana
9. Remarks (Pertaining to Use, etc.) Occupied and owned by the said Rasmus sporup.

Decree

10. Case No. Date Amt. Decreed: M. I. C. F. S.
11. To Whom Decreed Address
12. Name of Ditch Maximum Capacity (C. F. S.)
13. Date of Priority Purpose
14. Land Description of Place of Use as Decreed
15. Remarks (Present Use Status, etc.)

STATE ENGINEERS OFFICE
Water Resources Survey
Notice of Appropriation

1. County Custer Book A Page 310 Record W.R.

2. Name of Appropriator Chas. L. Carter Address Custer County
June 22, 1896

3. Date Appropriated June 25, 1896 Date Filed June 26, 1896

Amount Appropriated, Minors Inches 5000 Cubic Feet per second 1

4. Name of Stream Yellowstone River Tributary Basin

5. Point of Diversion About 100 yds. upstream from West line fence of

Sec. 31 Twp. 7N. Rge. 45E. Bank of Stream North

6. Purpose Irrigating the following described lands.

7. Description of System An open surface ditch of sufficient in size to carry 5000 in. of water.

8. Land Description of Intended Place of Use.
E1SE1/4, SW1/4 Sec. 30, 120 acres, S1/4, SW1/4 Sec. 29, 120 acres, W1SE1/4 Sec. 29, 80 acres,
Lots 1,2,3,4,5,6,7,8, and the NW1/4, E1NE1/4 Sec. 31, all of said above mentioned lands
being in Twp. 7N., R. 45E., 417 acres, Lockie Bros., Livestock Co.

9. Remarks (Pertaining to Use, etc.)

Decree

10. Case No. Date Amt. Decreed: M. I. C. F. S.

11. To Whom Decreed Address

12. Name of Ditch Maximum Capacity (C. F. S.)

13. Date of Priority Purpose

14. Land Description of Place of Use as Decreed

15. Remarks (Present Use Status, etc.)

STATE ENGINEERS OFFICE
Water Resources Survey

Notice of Appropriation

1. County Custer Book F Page 154 Record W.R.
2. Name of Appropriator Wils M. Anderson Address Sadie, Custer County
3. Date Appropriated June 5, 1901 Date Filed June 5, 1901
Recorded - Sept. 20, 1940
Amount Appropriated, Miners Inches 500, Cubic Feet per second
4. Name of Stream White Tail Creek Tributary Basin
5. Point of Diversion At a point near the center of the south line of Sec.
Sec. 20 Twp. 7N. Rge. 45E. Bank of Stream
6. Purpose Irrigation
7. Description of System Dam and ditch - Dam 40' long, 6' high, 40' wide at base and 6' wide at top.
8. Land Description of Intended Place of Use
SW 1/4 Sec. 20-7N-45E.
9. Remarks (Pertaining to Use, etc.)

Decree

10. Case No. Date Amt. Decreed: M. I. C. F. S.
11. To Whom Decreed Address
12. Name of Ditch Maximum Capacity (C. F. S.)
13. Date of Priority Purpose
14. Land Description of Place of Use as Decreed
15. Remarks (Present Use Status, etc.)



These forms are the property of the State of Montana and must be returned.

STATE OF MONTANA
STATE ENGINEERS OFFICE
Water Resources Survey

FORM WR-1-24, 12-4-77
13C-1-F-22F 23B
Code No. 24A-26A-27A
County Custer
T. 7N R. 45

Name of Land Owner Nels Kildahl Address Box 247, Miles City
Name of Operator _____ Address _____

Part A

**TO BE FILED BY THOSE OBTAINING IRRIGATION WATER FROM
A DITCH COMPANY OR IRRIGATION DISTRICT**

- Water is delivered by: _____
Name of Ditch, Ditch Company or District Supplying Water
- State the number of acres you irrigate under this system. _____ Shares you hold _____
- If you obtain water from more than one Company, give the number of shares, acres irrigated and the name of the Company under "Remarks." If you obtain water from a Ditch Company and also have a private system fill in both Part A and Part B.

Part B

**TO BE FILED BY THOSE WHO HAVE A PRIVATE DITCH, PUMP OR IRRIGATION SYSTEM
or those who have a private water right under a Ditch Company**

- In what year was this land first irrigated? Date See attached filings
- Give the name of the original appropriator (first user): _____
- Give the date appropriated _____ Amount filed on: Miners Inches _____ C. F. S. _____
- State the total number of acres irrigated under this system: _____
- Give the point of diversion: _____ $\frac{1}{4}$ _____ $\frac{1}{4}$ Section _____ Township _____ Range _____

Part C

TO BE FILED BY ALL WATER USERS IN ADDITION TO PART A OR PART B

- Source of Water: Yellowstone River
Name of stream or lake from which water is originally diverted
- Water is obtained by: (Check one) Gravity _____ Pumping X Other _____
- What is the greatest number of acres you have irrigated? 208.0 Date _____
- How many acres did you irrigate in 1947 (Crop and pasture) 208.0
- State the total number of additional acres that could be irrigated by increasing the water supply, land leveling, etc. 190.0 This land is under what ditch? Same
- How many acres of seeped land do you have which could be drained and put into production? 0
- What is the condition of your irrigation system? Good
- Is your water supply adequate? Yes X No _____ Explain _____
- REMARKS: _____

Over

NOTE: The foregoing actions apply only to irrigated land shown on this plat.

DESCRIPTION AND MAP OF FARM

18. Legal Description of this Farm

See WC-2 attached



IRRIGATED LAND



NON-IRRIGATED LAND



Potential Land

North

West

East

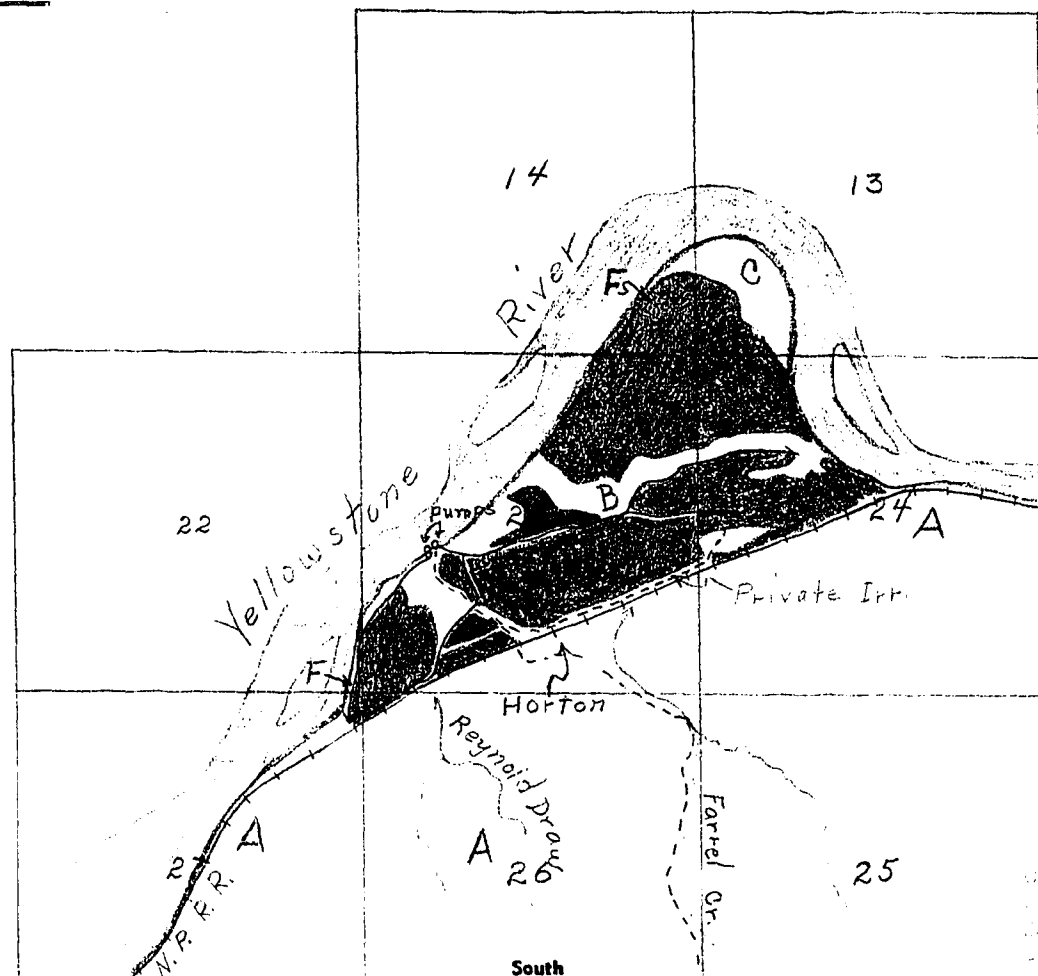

19. If the above land is irrigated from more than one ditch please give the acreage under each ditch in 19A and indicate the location of the land irrigated from each on the above map.

19A. Ditch: *(Horton) Private Pump ditch* Acres: *208.0*

Ditch: *Calder Pump from Gel. River* Acres: _____

Information supplied by:

Name *See attached form* Address _____ Date _____

REMARKS: _____

If you cannot answer all of the questions on this form answer as many as you can and return the form to us as soon as possible.

STATE ENGINEER'S OFFICE
WATER RESOURCES SURVEYCOUNTY ClusterFILE NO. 24-T.7N-R.45EOwner Kildahl, Nels Address Box 247 - Miles City

AAA Owner Address

Operator Kildahl, E.W. Address Sheffield, Mont.?

New Owner Address

New Operator Address

Assessment Record NoneAssessed Acreage 2Legal Description of This Farm lot 4, Sec. 13; lot 4, Sec. 14; lot 4, Sec. 22;lots 1-5-6-7, SE¹NE¹, SE¹SW¹, SE¹, Sec. 23; lots 3-4-5-6-7,NW¹SW¹, SE¹SW¹, SE¹SE¹, Sec. 24; all of Sec. 26; lots 1-4-5-7,NE¹SE¹, SE¹SE¹, Sec. 27; T.7N-R.45E Total Acres in Farm 2Code Number 23E-24A-26A-27APhoto No. 22-154

AAA Contract No.

AAA Total Cropland Acreage

App. No. 2067-2057-2250-440-A

Decree No.

Land is located in

Twp. 7N Rge. 45E Twp. Rge.

Twp. Rge. Twp. Rge.

Filed in Twp. 7N Rge. 45E

Remarks

Yellowstone River Basin208
190
298Ownership covers
only irrigated land.
All ownership for
dry land not shown.

peter Nevitt, operated a horse powered pump
in about 1884 to irrigate a small piece of this
place.

Steam pump not used since 1935, diesel handles same
land.

Mr. Kildahl came here in 1892, house he is living
in was built in 1876, still has gun ports in
walls

490-7

STATE ENGINEERS OFFICE
Water Resources Survey
Notice of Appropriation

1. County Custer Book F Page 114 Record W.R.
2. Name of Appropriator Nils Kildahl Address Horton, Montana
(2)
3. Date Appropriated Jan. 6, 1928 Date Filed January 6, 1928
Amount Appropriated, Miners Inches 500 or, Cubic Feet per second 12 1/2
4. Name of Stream Drontle Coulee Tributary Basin
5. Point of Diversion
Sec. Twp. Rge. Bank of Stream Right
6. Purpose For irrigation and other purposes.
7. Description of System A pipe which carries and conducts said amount of water from
said coulee and runs thence in an easterly direction and crosses the N.P. Ry. track,
through pipes now existing thence over and upon said land (or mining claim.)
8. Land Description of Intended Place of Use
Out of Lots 2,3, Out of Lot 4, NW 1/4 Sec. 24-7N-45E, 89.59 acres, Nils Kildahl,
Horton, Montana
9. Remarks (Pertaining to Use, etc.) The waters of said Drontle Coulee originate on Sec. 25,
Twp. 7N., Rge. 45E. and emptying on Section 24, same Twp. and Rge.

Decree

10. Case No. Date Amt. Decreed: M. I. C. F. S.
11. To Whom Decreed Address
12. Name of Ditch Maximum Capacity (C. F. S.)
13. Date of Priority Purpose
14. Land Description of Place of Use as Decreed
15. Remarks (Present Use Status, etc.)

STATE ENGINEERS OFFICE
Water Resources Survey

Notice of Appropriation

530

1. County Custer Book D Page 420 Record W.R.
2. Name of Appropriator Nils Kildahl Address Hathaway, Custer Co.
3. Date Appropriated June 6, 1910 Date Filed June 9, 1910
Amount Appropriated, Miners Inches 1000 , Cubic Feet per second 25
4. Name of Stream Dry Creek Tributary Yellowstone Basin
5. Point of Diversion About 10 chains, SW from $\frac{1}{4}$ Sec. corner on E. side of said
Sec. 23 Twp. 7N. Rge. 45E. Bank of Stream East
6. Purpose Irrigation
7. Description of System A 4" X 60" in size, which said dam diverts the water from
said stream and runs thence in a northerly direction, thence over and upon said land.
8. Land Description of Intended Place of Use
Lands in Sec. 23:
Part of SE $\frac{1}{4}$ Sec. 23, Twp. 7N., Rge. 45E., 332.85 acres, Nils
Kildahl, Horton, Montana; Lots 2, 3, 4, Sec. 23-7N-45E, 81.24 acres, Johnson and Nelson,
Sheffield, Montana.
9. Remarks (Pertaining to Use, etc.)

Decree

10. Case No. Date Amt. Decreed: M. I. C. F. S.
11. To Whom Decreed Address
12. Name of Ditch Maximum Capacity (C. F. S.)
13. Date of Priority Purpose
14. Land Description of Place of Use as Decreed
15. Remarks (Present Use Status, etc.)

STATE ENGINEERS OFFICE
Water Resources Survey

Notice of Appropriation

643

1. County Custer Book F. Page 100 Record Water Right
2. Name of Appropriator Nils Kildahl Address Horton, Montana
3. Date Appropriated March 6, 1925 Date Filed March 6, 1925
- Amount Appropriated, Miners Inches 1500 or , Cubic Feet per second 37 1/2
4. Name of Stream Farrell Draw Tributary Basin
5. Point of Diversion

Sec. Twp. Rge. Bank of Stream Left

6. Purpose For irrigation and other purposes.
7. Description of System A ditch 50" X 100" in size, which carries and conducts said amount of water from said stream and runs thence in a northerly direction over Sec. 23 crossing the N.P. track by means of a culvert under the said track, thence runs over and upon said land (or mining claim)
8. Land Description of Intended Place of Use In Sec. 23-7N-45E.
North of N.P. R.R. right of way
(see page 101) Sec. 23-7N-45E, 332.85 acres, Nils Kildahl, Horton, Montana
Part of SE 1/4, SW 1/4, SW 1/4, Lots 1, 5, 6, 7
9. Remarks (Pertaining to Use, etc.)

Decree

10. Case No. Date Amt. Decreed: M. I. C. F. S.
11. To Whom Decreed Address
12. Name of Ditch Maximum Capacity (C. F. S.)
13. Date of Priority Purpose
14. Land Description of Place of Use as Decreed
15. Remarks (Present Use Status, etc.)

2067

STATE ENGINEERS OFFICE
Water Resources Survey
Notice of Appropriation

1. County Custer Book E Page 510 Record W.R.

2. Name of Appropriator Nils Kildahl Address Horton, Montana

July 18, 1934
3. Date Appropriated Sept. 4, 1934 Date Filed Sept. 18, 1934

Amount Appropriated, Miners Inches 920.00, Cubic Feet per second 23

4. Name of Stream Yellowstone R. Tributary Basin

5. Point of Diversion

Sec. Twp. Rge. Bank of Stream South

6. Purpose For irrigation.

7. Description of System A pump plant. Said pump is 18" X 18" and carries and conducts said amount of water from said river and runs thence in a southeast and westerly direction over and upon said lands; all surplus water in the form of seepage or overflow returns to the said Yellowstone River. (Said pump is placed on a concrete foundation).

8. Land Description of Intended Place of Use

(over)

9. Remarks (Pertaining to Use, etc.)

Decree

10. Case No. Date Amt. Decreed: M. I. C. F. S.

11. To Whom Decreed Address

12. Name of Ditch Maximum Capacity (C. F. S.)

13. Date of Priority Purpose

14. Land Description of Place of Use as Decreed

15. Remarks (Present Use Status, etc.)

Part of SE $\frac{1}{4}$, SW $\frac{1}{4}$ Sec. 23, 7N-45E, 70.80 acres, N.P.R.R. Co., St. Paul

Part of SE $\frac{1}{4}$ and lots 1,5,6,7, Sec. 23-7N-45E, 332.85 acres, Nils Kildahl, Horton, Montana

Lots 2,3,4, Sec. 23-7N-45E, 81.24 acres, Johnson & Nelson, Sheffield, Montana

Part W $\frac{1}{2}$ SW $\frac{1}{4}$, Part of Lot 4 Sec. 24-7N-45E, 45.60 acres, N.P. R.R. Co., St. Paul

Lot 1 Sec. 24-7N-45E, 59.72 acres, Corlett & Ray, Joliet, Ill.

Lots 2,3, Out of Lot 4 Sec. 24-7N-45E, Out of NW $\frac{1}{4}$ SW $\frac{1}{4}$ Sec. 24-7N-45E, 89.59 acres, Nils
Kildahl, Horton, Montana

Lots 5,6, less 24 ac. R/W, S $\frac{1}{2}$ S $\frac{1}{2}$ less 45.60 ac., Out of Lot 4, Out of NW $\frac{1}{4}$ SW $\frac{1}{4}$ Sec. 24-7N-45E,
252.09 acres, Fred Drouette, Horton, Montana

STATE ENGINEERS OFFICE
Water Resources Survey

Notice of Appropriation

1. County Custer Book A Page 534 Record W.R.

2. Name of Appropriator John W. Ellis Address Custer County
 Feb. 4, 1899

3. Date Appropriated Feb. 21, 1899 Date Filed _____

Amount Appropriated, Miners Inches. 10, Cubic Feet per second _____
 Unnamed water course on SE $\frac{1}{4}$,

4. Name of Stream NE $\frac{1}{4}$ Sec. 26-7N-45E. Tributary _____ Basin _____

5. Point of Diversion About 15 yds. from the East line of
SE $\frac{1}{4}$ (See question 9)

Sec. 26 Twp. 7N Rge. 45E Bank of Stream Southerly

6. Purpose Irrigation and agriculture.

7. Description of System A ditch sufficient to carry the quantity of water claimed into a
reservoir, thence it will be raised by a windmill into a flume of sufficient size to carry
the water to the place of use. The ditch being and to be 12 inches wide and 6 inches deep
and the flume being and to be 4 in. wide and 4 in. deep.

8. Land Description of Intended Place of Use _____
SE $\frac{1}{4}$ Sec. 26-7N-45E.

9. Remarks (Pertaining to Use, etc.) The same being part of my Homestead Entry and the place
of its intended use on said land being in a southwesterly direction from the point of
diversion of said water.

Decree

10. Case No. _____ Date _____ Amt. Decreed: M. I. _____ C. F. S. _____

11. To Whom Decreed _____ Address _____

12. Name of Ditch _____ Maximum Capacity (C. F. S.) _____

13. Date of Priority _____ Purpose _____

14. Land Description of Place of Use as Decreed _____

15. Remarks (Present Use Status, etc.) _____

STATE ENGINEERS OFFICE
Water Resources Survey

Notice of Appropriation

1. County Custer Book F Page 101 Record W.R.
2. Name of Appropriator Nils Kildahl Address Horton, Montana
3. Date Appropriated Mar. 6, 1925 Date Filed Mar. 6, 1925
- Amount Appropriated, Miners Inches 1000 or , Cubic Feet per second 25
4. Name of Stream Reynolds Draw Tributary Basin
5. Point of Diversion
- Sec. Twp. Rge. Bank of Stream Right
6. Purpose For irrigation and other purposes.
7. Description of System A ditch 40" X 60" in size, which carries and conducts said amount of water from said creek and runs thence in a northerly direction, crossing the N.P. track by means of a culvert under said track, and extending over Sec. 23, thence over and upon said land (or mining claim)
8. Land Description of Intended Place of Use Part of SE 1/4, SW 1/4, SE 1/4, Twp. 1, S. 5, R. 7, Sec. 23-7N-45E, 332.85 acres, Nils Kildahl, Horton, Montana
9. Remarks (Pertaining to Use, etc.)

Decree

10. Case No. Date Ant. Decreed: M. I. C. F. S.
11. To Whom Decreed Address
12. Name of Ditch Maximum Capacity (C. F. S.)
13. Date of Priority Purpose
14. Land Description of Place of Use as Decreed
15. Remarks (Present Use Status, etc.)



There shall be no
recording of the
of Montana and may
be returned.

STATE OF MONTANA
STATE ENGINEERS OFFICE
Water Resources Survey

FORM WR-1-AM-12-47
29E-29F-30C-30D-32A
Code No. 3.0E-3.0F.3.1A

County Custer
T. 7N R. 45

Name of Land Owner Larkin Bros. Limited Address Shipfield, Mont
Name of Operator _____ Address _____

Part A

TO BE FILED BY THOSE OBTAINING IRRIGATION WATER FROM
A DITCH COMPANY OR IRRIGATION DISTRICT

1. Water is delivered by: _____
Name of Ditch, Ditch Company or District Supplying Water
2. State the number of acres you irrigate under this system _____ Shares you hold _____
3. If you obtain water from more than one Company, give the number of shares, acres irrigated and the name of the Company under "Remarks." If you obtain water from a Ditch Company and also have a private system fill in both Part A and Part B.

Part B

TO BE FILED BY THOSE WHO HAVE A PRIVATE DITCH, PUMP OR IRRIGATION SYSTEM
or those who have a private water right under a Ditch Company

4. In what year was this land first irrigated? Date See attached filings
5. Give the name of the original appropriator (first user): _____
6. Give the date appropriated _____ Amount filed on: Miners Inches _____ C. F. S. _____
7. State the total number of acres irrigated under this system: _____
8. Give the point of diversion: _____ $\frac{1}{4}$ _____ $\frac{1}{4}$ Section _____ Township _____ Range _____

Part C

TO BE FILED BY ALL WATER USERS IN ADDITION TO PART A OR PART B

9. Source of Water: Yellowstone River + Whitetail Creek
Name of stream or lake from which water is originally diverted
10. Water is obtained by: (Check one) Gravity ☒ Pumping _____ Other Flow
11. What is the greatest number of acres you have irrigated? 648.0 Date _____
12. How many acres did you irrigate in 19 17 (Crop and pasture) 648.0
13. State the total number of additional acres that could be irrigated by increasing the water supply, land leveling, etc. 0 This land is under what ditch? 0
14. How many acres of seeped land do you have which could be drained and put into production? 0
15. What is the condition of your irrigation system? Not too good
16. Is your water supply adequate? Yes _____ No 2 Explain Flow water only
17. REMARKS: _____

See attached form
Response to Pump not in use 1947

Over

NOTE: The foregoing questions apply only to irrigated land shown on this plat.

DESCRIPTION AND MAP OF FARM

18. Legal Description of this Farm

Sec 18-2



IRRIGATED LAND



NON-IRRIGATED LAND

North

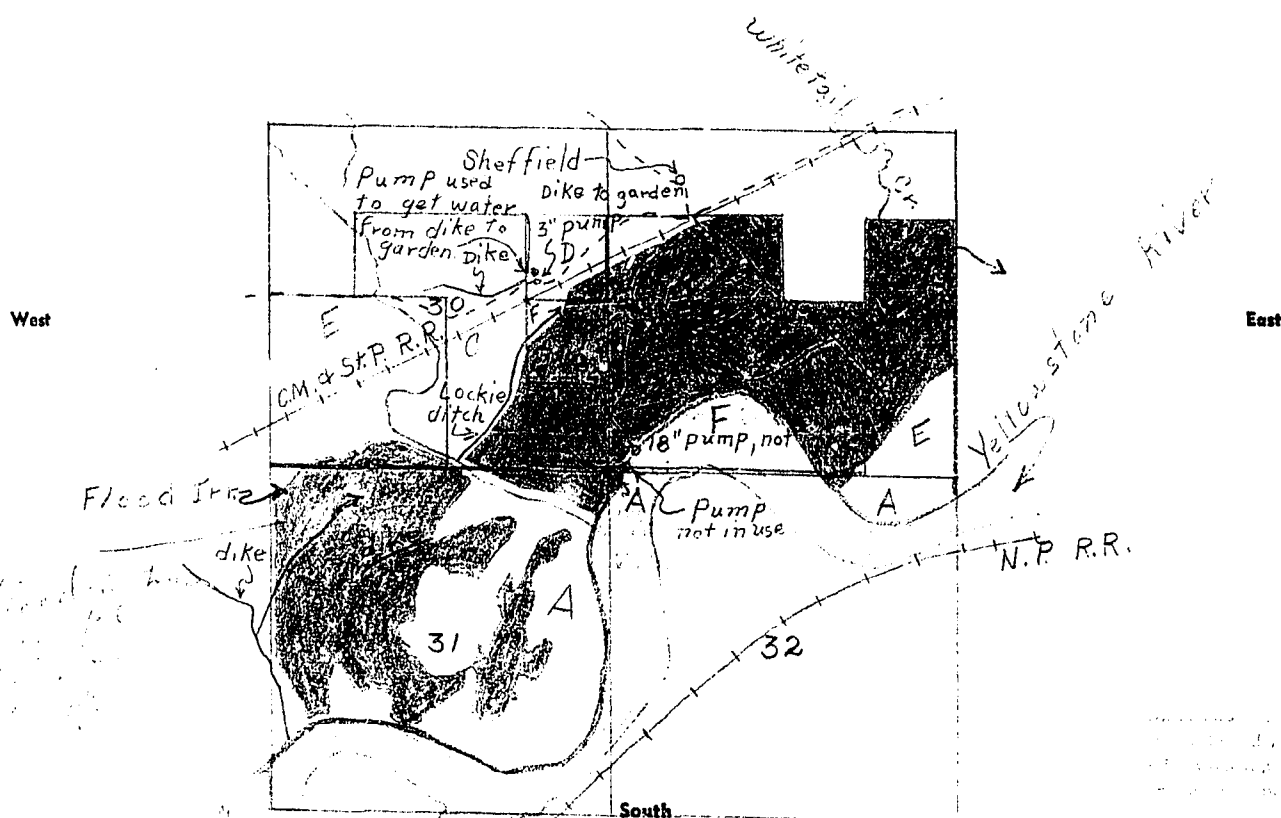

19. If the above land is irrigated from more than one ditch please give the acreage under each ditch in 19A and indicate the location of the land irrigated from each on the above map.

19A. Ditch: *Lockie Yellowstone River Flood Irrig* Acres: *560.0*

Ditch: *Lockie Whitetail Creek Flood Irrig* Acres: *88.0*

Information supplied by:

Name *Field Survey* Address _____ Date *5/14/41*

REMARKS: *Johnson & Jane*

If you cannot answer all of the questions on this form answer as many as you can and return the form to us as soon as possible.

STATE ENGINEER'S OFFICE
WATER RESOURCES SURVEY

COUNTY Custer

FILE NO. 24-T.7N-R.45E

Owner Lockie Bros. Livestock Co. Address Sheffield, Montana

AAA Owner Address

Operator Address

New Owner Address

New Operator Address

Assessment Record None

Assessed Acreage 0

Legal Description of This Farm S²NW⁴, S²SE⁴NE⁴ Sec. 29; SE⁴NW⁴, S², S²NE⁴,
Sec. 30; Lot 1-2-3-4-5-6-7-8, E²NW⁴, NW⁴NE⁴ Sec. 31; Lots
1-2-3, Sec. 32; T. 7N-R. 45E

Total Acres in Farm ✓

Code Number 21E-21F-30C-30D
30E-30F-31A-32A

Photo No. Ma 22-152; Ma 22-156

AAA Contract No.

AAA Total Cropland Acreage

App. No. 1775-2661-2055

Decree No. 2218?

Land is located in

Twp. 21N Rge. 21E Twp. Rge.

Twp. Rge. Twp. Rge.

Filed in Twp. 21N Rge. 21E

Remarks

560
88
648

Ownership covers
only irrigated land.
All ownership for
dry land not shown.

Yellowstone River Basin

Lockies now own all Dunlap land as shown also
have acquired water rights. rights listed were all
recognized by Mr. Lockie.

all land is flooded by their system but
the only part considered crop is where they
can get a mow between the trees.