

(Township 7 North, Range 51 East)

Bixler, Albert & Stanley

Digman, Emmett J.

(Township 7 North, Range 53 East)

Anderson, M. Elver

Woodruff, Claude

Woodruff, Claude & Harry

Woodruff, Harry A.

(Township 7 North, Range 54 East)

Woodruff, Harry A.

Township 7 North

Range 51 East

Custer County

<u>Index No.</u>	<u>Name of Appropriator</u>	<u>Stream</u>	<u>Date App.</u>	<u>Date Filed</u>	<u>M.I.</u>
127A	Flora Howe (N. Fork)	Big Coulee	11-5-15	11-5-15	1000
127B	Flora Howe (Middle Fork)	Big Coulee	(None given)		
1063	Charles G. Burk	Meyers Creek	4-14-10	4-14-10	2000
1064	Charles Burk	Meyers Creek	6-17-13	4-2-14	2000
1344	C. J. Smith	Powder River	7-1-02	11-4-14	1000
1345	Mabel P. Smith	Fowder River	6-1-14	6-1-14	250
1567	Earl W. Howe	Sage Brush Cr.	9-8-10	9-8-10	1000
1637	Brown & Brown	Sheep Cr.	3-10-06	3-27-06	1000
1673	Lora B. Holt	Short Creek	7-24-13	8-14-13	1000
1675	J. S. Howe	Short Creek	5-4-08	5-13-08	1000
1676	J. S. Howe	Short Creek	5-4-08	5-13-08	1000
1885	John Bergerson	Tie Creek	2-4-02	3-5-02	200
2301	Jessie E. Burk	Dry Water Course	2-11-10	2-11-10	600

Township 7 North

Range 51 East

Custer County

Custer

Sheet No.

Twil.

7N

Rge.

51E

Letters

File No.

Name

1st

2nd

3rd

Ret.

Name _____

1st

2nd

Degman, Emmett J.
Baker, Albert & Stanley

Not sent
Not sent



NOTES
These forms are the
property of the State
of Montana and must
be returned.

STATE OF MONTANA
STATE ENGINEERS OFFICE
Water Resources Survey

FORM WR-1 (2-28-47)
2A-3A-14A-10A-11A

Code No. _____

County Custer

T. 7N R. 5E

Name of Land Owner Albert + Stanley Address Locate, Mont.

Name of Operator Bixler Address _____

Part A

TO BE FILED BY THOSE OBTAINING IRRIGATION WATER FROM
A DITCH COMPANY OR IRRIGATION DISTRICT

1. Water is delivered by: _____ Name of Ditch, Ditch Company or District Supplying Water _____
2. State the number of acres you irrigate under this system _____ Shares you hold _____
3. If you obtain water from more than one Company, give the number of shares, acres irrigated and the name of the Company under "Remarks." If you obtain water from a Ditch Company and also have a private system fill in both Part A and Part B.

Part B

TO BE FILED BY THOSE WHO HAVE A PRIVATE DITCH, PUMP OR IRRIGATION SYSTEM
or those who have a private water right under a Ditch Company

4. In what year was this land first irrigated? Date See attached filings
5. Give the name of the original appropriator (first user): _____
6. Give the date appropriated _____ Amount filed on: Miners Inches _____ C. F. S. _____
7. State the total number of acres irrigated under this system: _____
8. Give the point of diversion: _____ 1/4 _____ 1/4 Section _____ Township _____ Range _____

Part C

TO BE FILED BY ALL WATER USERS IN ADDITION TO PART A OR PART B

9. Source of Water: Myers Creek + Coulson
Name of stream or lake from which water is originally diverted
10. Water is obtained by: (Check one) Gravity ☒ Pumping _____ Other _____
11. What is the greatest number of acres you have irrigated? 537 Date _____
12. How many acres did you irrigate in 1947? (Crop and pasture) 545
13. State the total number of additional acres that could be irrigated by increasing the water supply, land leveling, etc. 12 This land is under what ditch? Holms flood Ditch
14. How many acres of seeped land do you have which could be drained and put into production? None
15. What is the condition of your irrigation system? Fair flood System
16. Is your water supply adequate? Yes _____ No ☒ Explain Flood Irr.
17. REMARKS: Water from Myers Creek + unnamed Coulson, 1 Old Steam pump on Powder R which has not been used for about 20 years

NOTE: The foregoing questions apply only to irrigated land shown on this plat.

DESCRIPTION AND MAP OF FARM

18. Legal Description of this Farm

See W.R. form attached



IRRIGATED LAND



NON-IRRIGATED LAND

North

Map attached

West

East

South

Ownership, covered
only irrigated land,
Full ownership for
dry land not shown

19. If the above land is irrigated from more than one ditch please give the acreage under each ditch in 19A and indicate the location of the land irrigated from each on the above map.

19A. Ditch: *Myers Creek & Paulie flood Irr* Acres: *545.0*

Ditch: _____ Acres: _____

Information supplied by:

Name *A. M. Holmes* Address _____ Date *July 8-47*

REMARKS: *to Johnson & Paulist*
on field survey

If you cannot answer all of the questions on this form answer as many as you can and return the form to us as soon as possible.

120
 40
 25
 205

205
 110
 80
 60
 45
 145
 545

T7N R51 - center

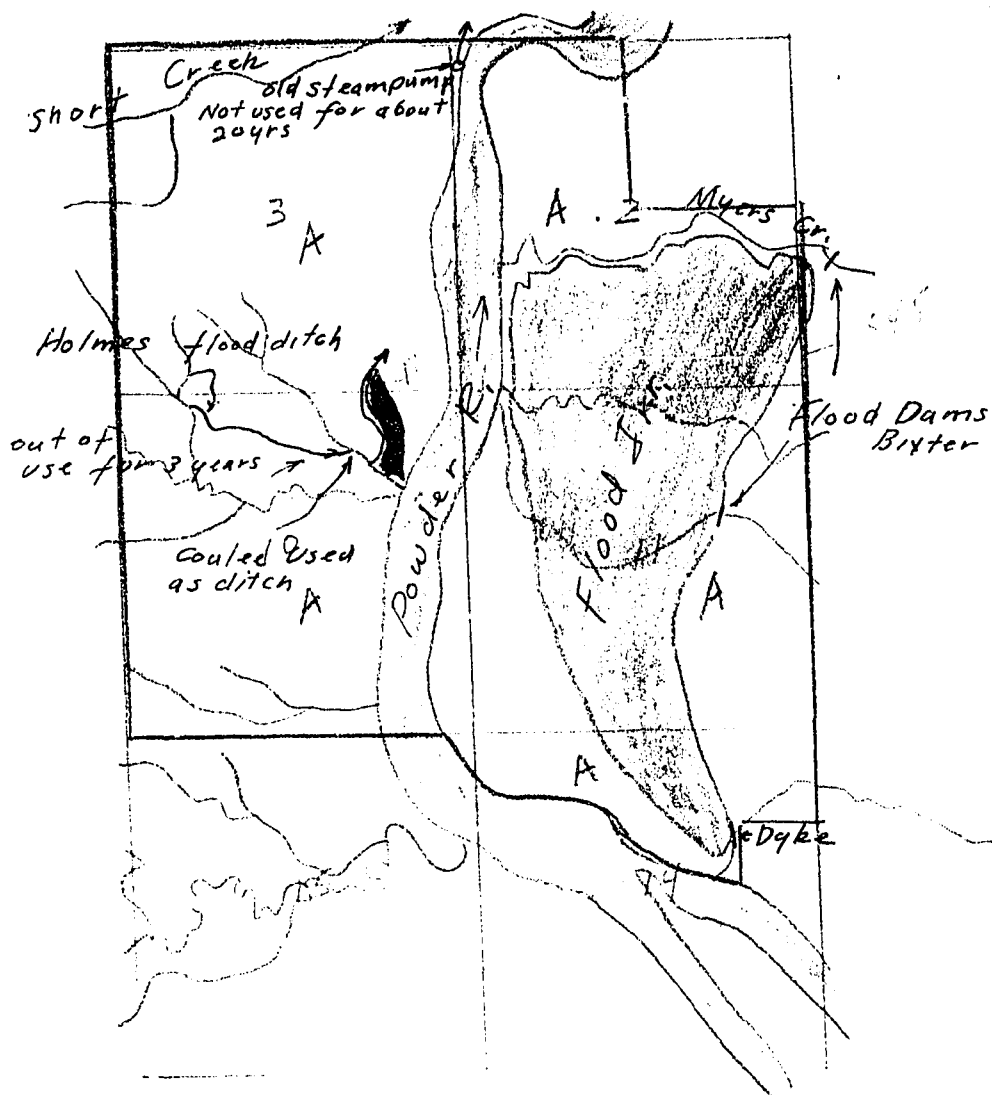

STATE ENGINEERS OFFICE
Water Resources Survey

COUNTY Cluster

FILE NO. 30-T.7N-R.51E

Owner Bixler, Stanley & Albert Address Locate, Montana

AAA Owner..... Address.....

Operator..... Address.....

New Owner..... Address.....

New Operator..... Address.....

Assessment Record None

Assessed Acreage 0

Legal Description of This Farm all of Sec. 3; W², SE², Sec. 2; lots 2, 3, 4, N² NE⁴ Sec. 14; all of Sec. 10 & 11 T.8N-R.51E

Total Acres in Farm ✓

Code Number 2A, 3A, 14A, 10A, 11A,

Photo No. MA 33-14, MA 33-43

AAA Contract No.....

AAA Total Cropland Acreage.....

App. No. 1063, 1064, 1344, 1345,

Decree No.....

Land is located in

Twp. 7N Rge. 4E Twp. 8N Rge. 5E

Twp. Rge. Twp. Rge.

Filed in Twp. Rge.

Remarks also operate land in T.8N-R.51E. Find operator.

Farm Map

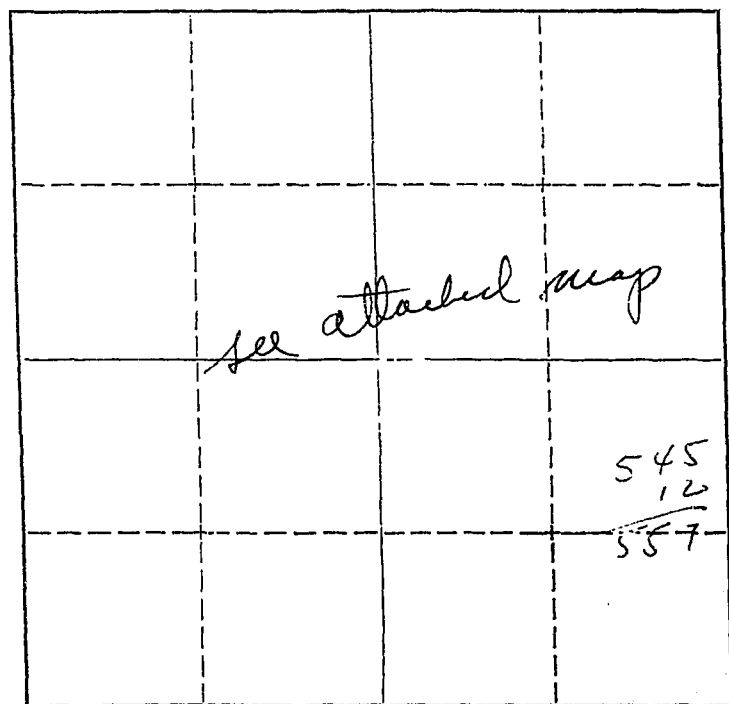

Powder River Basin

Ownership, taxes, only irrigated land, All ownership for dry land not shown.

STATE ENGINEERS OFFICE
Water Resources Survey

Notice of Appropriation

1. County Custer Book D Page 366 Record W.R.
2. Name of Appropriator Charles G. Burk Address Knowlton, Custer County
3. Date Appropriated April 14, 1910 Date Filed April 14, 1910
Amount Appropriated, Miners Inches 2000, Cubic Feet per second _____
4. Name of Stream Mevers Creek Tributary _____ Basin _____
5. Point of Diversion Approximately in the center of

Sec. 1 Twp. 7N. Rge. 51E. Bank of Stream Both

6. Purpose Irrigating and other purposes.
7. Description of System A dam across said Myers Creek, thence to be conducted by means of ditches sufficient in size to conduct said amount of water from both banks, running in a westerly direction to and upon the lands hereinbefore described.
8. Land Description of Intended Place of Use _____
Lots 1 & 2, S½ Sec. 2-7N-51E, 160.64 acres, A. E. Treadway, Knowlton, Montana
Fr. parts of NW¼, SW¼ Sec. 2-7N-51E, 177.35 acres, Essie Cummings, Locate, Montana

9. Remarks (Pertaining to Use, etc.) _____

Decree

10. Case No. _____ Date _____ Amt. Decreed: M. I. _____ C. F. S. _____
11. To Whom Decreed _____ Address _____
12. Name of Ditch _____ Maximum Capacity (C. F. S.) _____
13. Date of Priority _____ Purpose _____
14. Land Description of Place of Use as Decreed _____

15. Remarks (Present Use Status, etc.) _____

STATE ENGINEERS OFFICE

Water Resources Survey

Notice of Appropriation

1. County Custer Book E Page 338 Record W.R.
2. Name of Appropriator Chas. Burk Address Sutherland, Montana
June 17, 1913
3. Date Appropriated Mar. 31, 1914 Date Filed April 2, 1914
Amount Appropriated, Miners Inches 2000, Cubic Feet per second _____
4. Name of Stream Meyers Creek Tributary Powder River Basin _____
5. Point of Diversion One reservoir is located at dam in Meyers Creek at approximately the center of the SW 1/4 Sec. 6-7N-52E. The second reservoir is on line of ditch 300 yds. below the 3rd reservoir is on line of ditch 250 yds. S. of the center of Sec. 1-7N-51E.
Sec. _____ Twp. _____ Rge. _____ Bank of Stream North
6. Purpose For filling three reservoirs and for irrigation.
7. Description of System A dam and a ditch 24" X 14" wide in size, which carries and conducts said amount of water from said creek and reservoirs and runs thence West 1/2 mile, thence diagonally across Sec. 1 to a point 700 yds. S. of the NW corner of Sec. 1, T. 7N, 51E. The reservoir at dam is also supplied between floods by springs located along the S. line of Sec. 6 about 500 yds. SE of dam, thence over and upon said land.
8. Land Description of Intended Place of Use (or mining claim)
Lots 1, 2, S 1/4 Sec. 2-7N-51E, 160.64 acres, A. E. Tredway, Knowlton, Montana
Lots 3, 5, 6, 7, 8, E 1/4 Sec. 2-7N-51E, 222.83 acres, Essie Cummings, Locate, Montana
Lot 4 Sec. 2-7N-51E, 34.52 acres, Madge I. Holmes, Locate, Montana
9. Remarks (Pertaining to Use, etc.) _____

Decree

10. Case No. _____ Date _____ Amt. Decreed: M. I. _____ C. F. S. _____
11. To Whom Decreed _____ Address _____
12. Name of Ditch _____ Maximum Capacity (C. F. S.) _____
13. Date of Priority _____ Purpose _____
14. Land Description of Place of Use as Decreed _____

15. Remarks (Present Use Status, etc.) _____

STATE ENGINEERS OFFICE
Water Resources Survey

Notice of Appropriation

- 1344
1. County Custer Book E Page 376 Record K.R.
 2. Name of Appropriator C. J. Smith Address Mizpah, Montana
 July 1, 1902
 Date Appropriated Nov. 4, 1914 Date Filed Nov. 4, 1914
 Amount Appropriated, Miners Inches 1000, Cubic Feet per second _____
 4. Name of Stream Powder River Tributary _____ Basin _____
 5. Point of Diversion About 150 yds. east or northeast from where the west line of Lot 4,
Sec. 2-7N-51E intersects with Powder River.
 Sec. 2 Twp. 7N Rge. 51E Bank of Stream West
 6. Purpose For irrigation
 7. Description of System A steam pump and plant with ditch sufficient in size, which
carries and conducts said amount of water from said Powder River and runs thence over
and upon said land (or mining claim)
 8. Land Description of Intended Place of Use
Lot 4, Sec. 2-7N-51E, 34.50 acres, Madge I. Holmes, Locato, Montana
Lots 1,4,5,8, SE 1/4, E 1/2 Sec. 35-8N-51E, 238.25 acres, N.P. Ry., St. Paul
Lots 2,3,6,7, NW 1/4, W 1/2 Sec. 35-8N-51E, 337.25 acres, Madge I. Holmes, Locato
 9. Remarks (Pertaining to Use, etc.) _____

Decree

10. Case No. _____ Date _____ Amt. Decreed: M. I. _____ C. F. S. _____
11. To Whom Decreed _____ Address _____
12. Name of Ditch _____ Maximum Capacity (C. F. S.) _____
13. Date of Priority _____ Purpose _____
14. Land Description of Place of Use as Decreed _____
15. Remarks (Present Use Status, etc.) _____



NOTICE
Where forms are the property of the State of Montana and must be returned.

**STATE OF MONTANA
STATE ENGINEERS OFFICE**

Water Resources Survey

14B-14C-15A-22A-23A-27A
FORM WR-1-2ND 12-47
Code No. 26A-34A-35A

County Custer
T. 7N R. 51E

Name of Land Owner Emmett J. Rejman Address Wilder City

Name of Operator _____ Address To Jim Rejman

Part A

**TO BE FILED BY THOSE OBTAINING IRRIGATION WATER FROM
A DITCH COMPANY OR IRRIGATION DISTRICT**

1. Water is delivered by: _____
Name of Ditch, Ditch Company or District Supplying Water
2. State the number of acres you irrigate under this system _____ Shares you hold _____
3. If you obtain water from more than one Company, give the number of shares, acres irrigated and the name of the Company under "Remarks." If you obtain water from a Ditch Company and also have a private system fill in both Part A and Part B.

Part B

**TO BE FILED BY THOSE WHO HAVE A PRIVATE DITCH, PUMP OR IRRIGATION SYSTEM
or those who have a private water right under a Ditch Company**

4. In what year was this land first irrigated? Date See attached filings
5. Give the name of the original appropriator (first user): _____
6. Give the date appropriated _____ Amount filed on: Miners Inches _____ C. F. S. _____
7. State the total number of acres irrigated under this system: _____
8. Give the point of diversion: _____ $\frac{1}{4}$ _____ $\frac{1}{4}$ Section _____ Township _____ Range _____

Part C

TO BE FILED BY ALL WATER USERS IN ADDITION TO PART A OR PART B

9. Source of Water: South Laney Creek & Powder River
Name of stream or lake from which water is originally diverted
10. Water is obtained by: (Check one) Gravity ☒ Pumping ☒ Other _____
11. What is the greatest number of acres you have irrigated? _____ Date _____
12. How many acres did you irrigate in 1947? (Crop and pasture) 271.0
13. State the total number of additional acres that could be irrigated by increasing the water supply, land leveling, etc. 215 This land is under what ditch? Hawes Ditch
14. How many acres of seeped land do you have which could be drained and put into production? _____
15. What is the condition of your irrigation system? Part in use Part out of use
16. Is your water supply adequate? Yes _____ No ☒ Explain Floods etc.
17. REMARKS: Old Hawes ditches were pump ditches out of the Powder River and are not now in use - 215 acres of Potential under these 2 ditches

Over

NOTE: The foregoing questions apply only to irrigated land shown on this plat.

DESCRIPTION AND MAP OF FARM

18. Legal Description of this Farm

See attached form

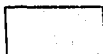

IRRIGATED LAND



NON-IRRIGATED LAND

North

see attached map

West

East

South

Ownership shown
only irrigated land.
All ownership for
dry land not shown

19. If the above land is irrigated from more than one ditch please give the acreage under each ditch in 19A and indicate the location of the land irrigated from each on the above map.

19A. Ditch: *South Laney Creek Flood Irr.* Acres: *271.0*

Ditch: _____ Acres: _____

Information supplied by:

Name *Jan Rayburn* Address _____ Date *July 9-47*

REMARKS: *to Johnson & Pauline*

If you cannot answer all of the questions on this form answer as many as you can and return the form to us as soon as possible.

ge No. _____ County _____

WR-2

T.7 North - R.51 East

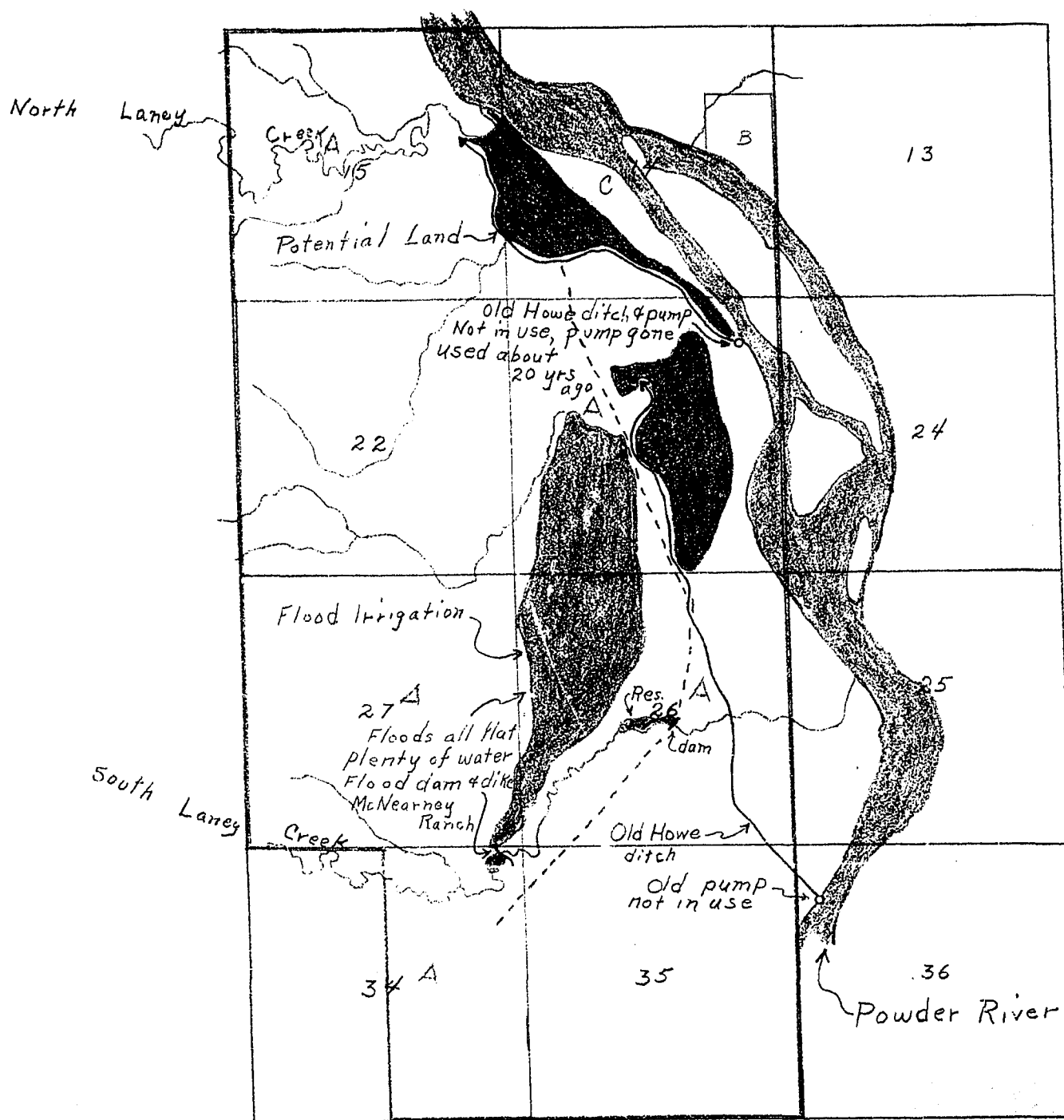

STATE ENGINEERS OFFICE
Water Resources SurveyCOUNTY ClusterFILE NO. 30-T.7N-R.51EOwner Digman, Emmett J Address Miles City

AAA Owner..... Address.....

Operator..... Address.....

New Owner..... Address.....

New Operator..... Address.....

Assessment Record NoneAssessed Acreage 0Legal Description of This Farm lot 1, 5, 6, 7, E¹ 50⁴, 5E⁴ 50⁴, Sec. 14; all of sections 15, 22, 23, 26, 27, & 35; E² Sec. 34; T. 7N-R. 51ETotal Acres in Farm ✓Code Number 26A, 27A, 34A, 35A
19C, 19B, 15A, 22A, 23APhoto No. MA 33-43, MA 33-42

AAA Contract No.....

AAA Total Cropland Acreage.....

App. No. 1567 1885, 2301 '696
1673, 1675

Decree No.....

Land is located in

Twp. 7N Rge. 51E Twp. 2N Rge. 54Twp. 3N Rge. 54E Twp. 4N Rge. 53
5N 52E 6N 51E

Filed in Twp..... Rge.....

Remarks.....

Farm Map

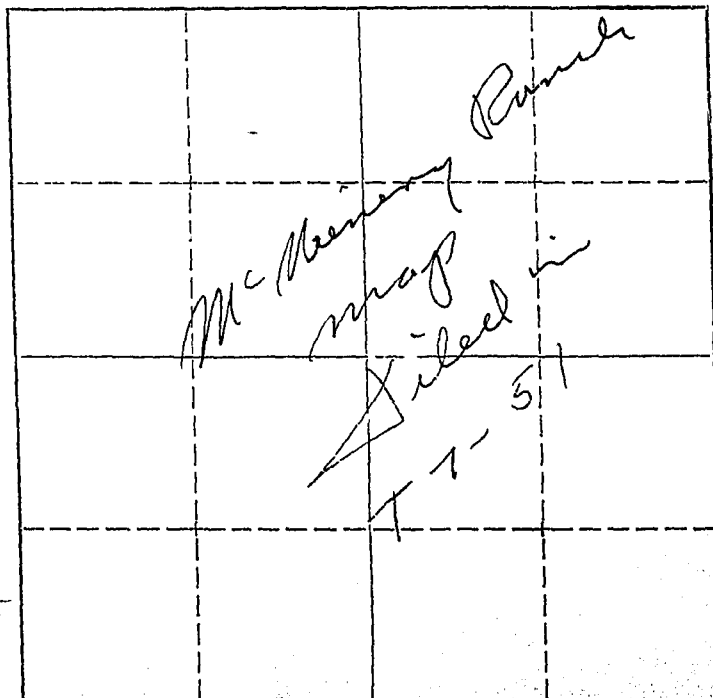
Ownership covers
only irrigated land.
All ownership for
dry land not shown.Powder River Basin

WR-1

T. 7 North - R. 51 East

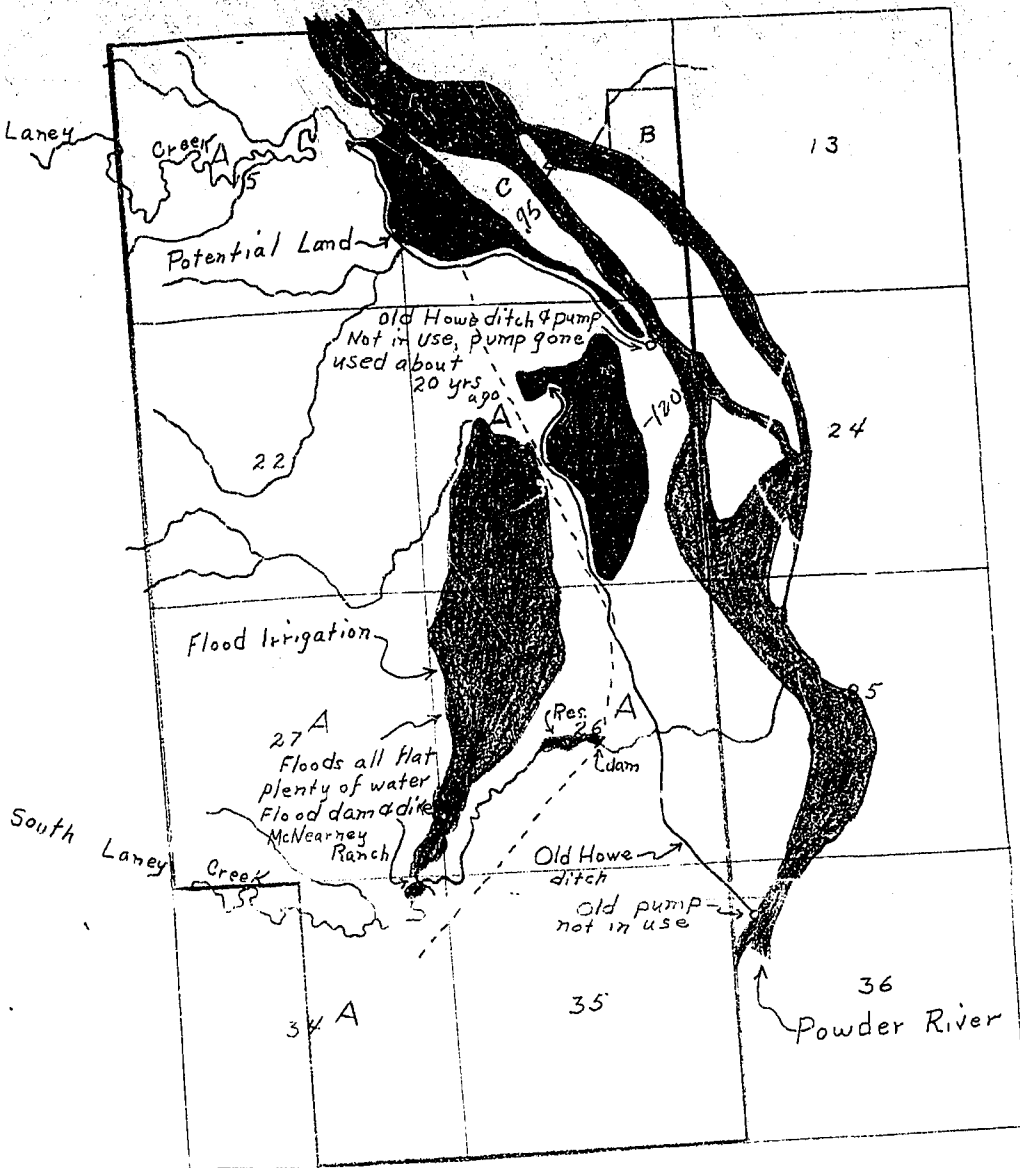

50
40
20
18
32
21

0000000000
435215
305

WR 1 former
made for
this part
of McNearney Ranch
Jun 15-48

T. 4 North - R. 53 East

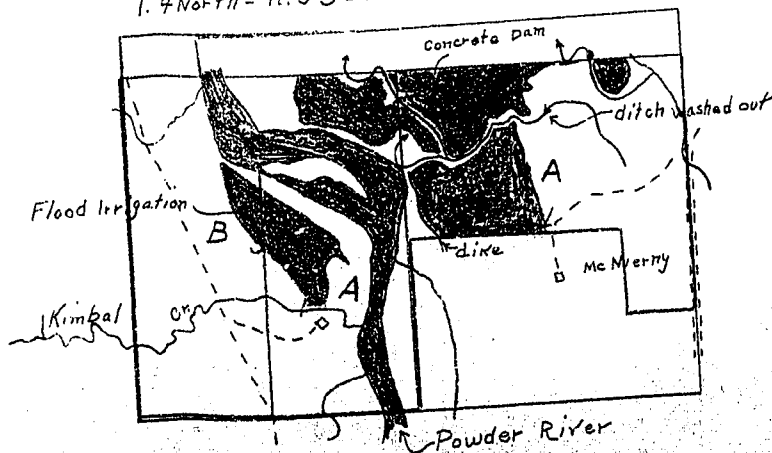

190
50
240

T. 7 North

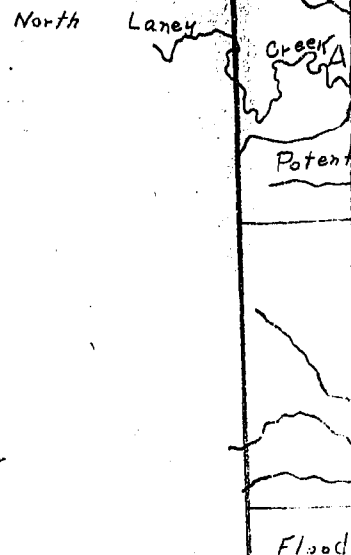

South Laney Creek

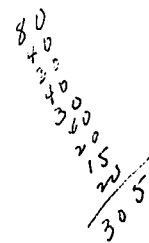

T. 4 Nov

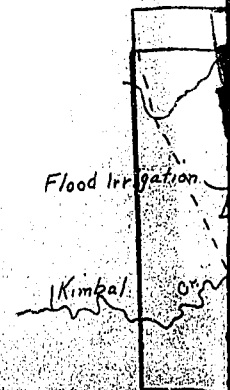

STATE ENGINEERS OFFICE
Water Resources Survey

Notice of Appropriation

1673

1. County Custer Book D Page 591 Record W.R.

2. Name of Appropriator Lora B. Holt Address Custer Co., Montana
July 22, 1913

3. Date Appropriated Aug. 5, 1913 Date Filed Aug. 14, 1913

Amount Appropriated, Miners Inches 1000 or , Cubic Feet per second 25

4. Name of Stream Prong of Short Creek Tributary Basin

5. Point of Diversion See Question #7

Sec. Twp. Rge. Bank of Stream

6. Purpose For irrigation and other purposes.

7. Description of System A dam 400 ft. long, 12 ft. high, forming a large reservoir in
prong of Short Creek in the NE-NE-1/4 Sec. 28-7N-51E. The said dam being constructed due
south 383 ft. west, 12 ft. from 1/4 corner on East line of Sec. 28-7N-51E, and a
(over)

8. Land Description of Intended Place of Use SW-1/4 Sec. 26-7N-51E, 160 acres, Lora B. Holt, Seattle, Washington

9. Remarks (Pertaining to Use, etc.)

Decree

10. Case No. Date Amt. Decreed: M. I. C. F. S.

11. To Whom Decreed Address

12. Name of Ditch Maximum Capacity (C. F. S.)

13. Date of Priority Purpose

14. Land Description of Place of Use as Decreed

15. Remarks (Present Use Status, etc.)

headgate and ditch built wide enough on the bottom and of sufficient height to allow the free passage of 1000 miners inches of the flood waters of Prong of Short Creek to flow through and also a ditch of sufficient size to carry and conduct the above described water with such necessary flumes, pipes, etc. as needed.

STATE ENGINEERS OFFICE
Water Resources Survey

Notice of Appropriation

1675

1. County Custer Book D Page 4 Record W.R.
2. Name of Appropriator J. S. Howe Address Miles City, Custer Co.
May 4, 1908
3. Date Appropriated May 12, 1908 Date Filed May 13, 1908
Amount Appropriated, Miners Inches 1000, Cubic Feet per second _____
4. Name of Stream Short Creek Tributary _____ Basin _____
5. Point of Diversion 1000 ft. northwesterly from NW corner of
Sec. 34 Twp. 7N Rge. 51E Bank of Stream _____
6. Purpose Watering all kinds of livestock and irrigation.
7. Description of System A dam to be about 20 ft. long and 6 ft. high. A headgate located at the easterly side of said dam 24 X 24 inches in size and so constructed to divert the aforesaid amount of water and by means of a ditch averaging 6 ft. in width and 2 ft. in depth extending to the E&NW of said Sec. 34, where it empties said water into a reservoir there constructed and thence by means of such further ditches, flumes and laterals so constructed as to carry, divert and spread the aforesaid amount of water.
8. Land Description of Intended Place of Use _____
Sec. (E22) Sec. 34-7N-51E, 320 acres, Ed Love, Miles City
9. Remarks (Pertaining to Use, etc.) _____

Decree

10. Case No. _____ Date _____ Amt. Decreed: M. I. _____ C. F. S. _____
11. To Whom Decreed _____ Address _____
12. Name of Ditch _____ Maximum Capacity (C. F. S.) _____
13. Date of Priority _____ Purpose _____
14. Land Description of Place of Use as Decreed _____
15. Remarks (Present Use Status, etc.) _____

STATE ENGINEERS OFFICE
Water Resources Survey

Notice of Appropriation

1676

1. County Custer Book D Page 5 Record M.R.
2. Name of Appropriator J. S. Howe Address Miles City, Custer Co.
May 4, 1908
3. Date Appropriated May 12, 1908 Date Filed May 13, 1908
- Amount Appropriated, Miners Inches 1000 or 25 Cubic Feet per second
4. Name of Stream Short Creek Tributary Basin
5. Point of Diversion 1000 ft. W. of the E. quarter corner of
Sec. 26 Twp. 7N. Rge. 51E. Bank of Stream.
6. Purpose Irrigating and watering livestock
7. Description of System A dam across said Creek 400 ft. long and 6 ft. high and said water
is to be diverted and conveyed from said creek and from said dam to, over and upon said
land by means of spreading ditches and flumes and being of sufficient character and size
in the aggregate to carry, convey and spread said water upon the above described land.
8. Land Description of Intended Place of Use
W&W Sec. 25-7N-51E, 174.86 acres, Ed Love, Miles City, Montana
E&E Sec. 26-7N-51E, 160 acres, N. P. Ry. Co., St. Paul
9. Remarks (Pertaining to Use, etc.)
Said water to be used on and on said lands and such other lands as may now
be owned or which may hereafter be acquired by the appropriator.

Decree

10. Case No. Date Amt. Decreed: M. I. C. F. S.
11. To Whom Decreed Address
12. Name of Ditch Maximum Capacity (C. F. S.)
13. Date of Priority Purpose
14. Land Description of Place of Use as Decreed

15. Remarks (Present Use Status, etc.)

STATE ENGINEERS OFFICE
Water Resources Survey

Notice of Appropriation

1885

1. County Custer Book B Page 179 Record W.R.
2. Name of Appropriator John Bergerson Address Capitol, Montana
3. Date Appropriated Feb. 4, 1902 Date Filed Mar. 5, 1902
- Amount Appropriated, Miners Inches 200 or 5 Cubic Feet per second
4. Name of Stream Tie Creek Tributary Basin
5. Point of Diversion At or near the section corner common to sections 14, 15, 22, 23
in said Twp. & Rge.
Sec. Twp. Rge. Bank of Stream Right Hand
6. Purpose For irrigation and domestic purposes.
7. Description of System Dam and ditch from point of diversion a ditch of sufficient size to
conduct said 200 inches of water to run to and upon said land.
8. Land Description of Intended Place of Use
Lots 1, 2 Sec. 23-15-62E.
Carroll Co
9. Remarks (Pertaining to Use, etc.)

Decree

10. Case No. Date Amt. Decreed: M. I. C. F. S.
11. To Whom Decreed Address
12. Name of Ditch Maximum Capacity (C. F. S.)
13. Date of Priority Purpose
14. Land Description of Place of Use as Decreed
15. Remarks (Present Use Status, etc.)

STATE ENGINEERS' OFFICE
Water Resources Survey

Notice of Appropriation

- 1301
1. County Custer Book D Page 316 Reco: L W.R.
 2. Name of Appropriator Jesse F. Burk Address Knowlton, Custer Co.
 3. Date Appropriated Feb. 11, 1910 Date Filed Feb. 11, 1910
Amount Appropriated, Miners Inches 600, Cubic Feet per second
 4. Name of Stream Unnamed Dry Creek Tributary Basin
 5. Point of Diversion About 300 ft. east of west line of said
SW 1
Sec. 22 Twp. 7N Rge. 51E Bank of Stream
 6. Purpose Irrigating and other purposes.
 7. Description of System A dam across said Dry Creek, said water to be conveyed to and upon the lands hereinabove described by means of ditches, sufficient in size to carry and conduct the amount of water now the right of the owner at the time in said SW 1 of Sec. 22-7N-51E, thence over and upon said land (or mining claim).
 8. Land Description of Intended Place of Use SW Sec. 22-7N-51E, 160 acres, Custer County
 9. Remarks (Pertaining to Use, etc.)

Decree

10. Case No. Date Amt. Decreed: M. I. C. F. S.
11. To Whom Decreed Address
12. Name of Pitch Maximum Capacity (C. F. S.)
13. Date of Priority Purpose
14. Land Description of Place of Use as Decreed
15. Remarks (Present Use Status, etc.)

STATE OF MONTANA
STATE ENGINEER'S OFFICE
 WATER RESOURCES SURVEY

Township.....7N.....Range.....51E.....County.....Custer

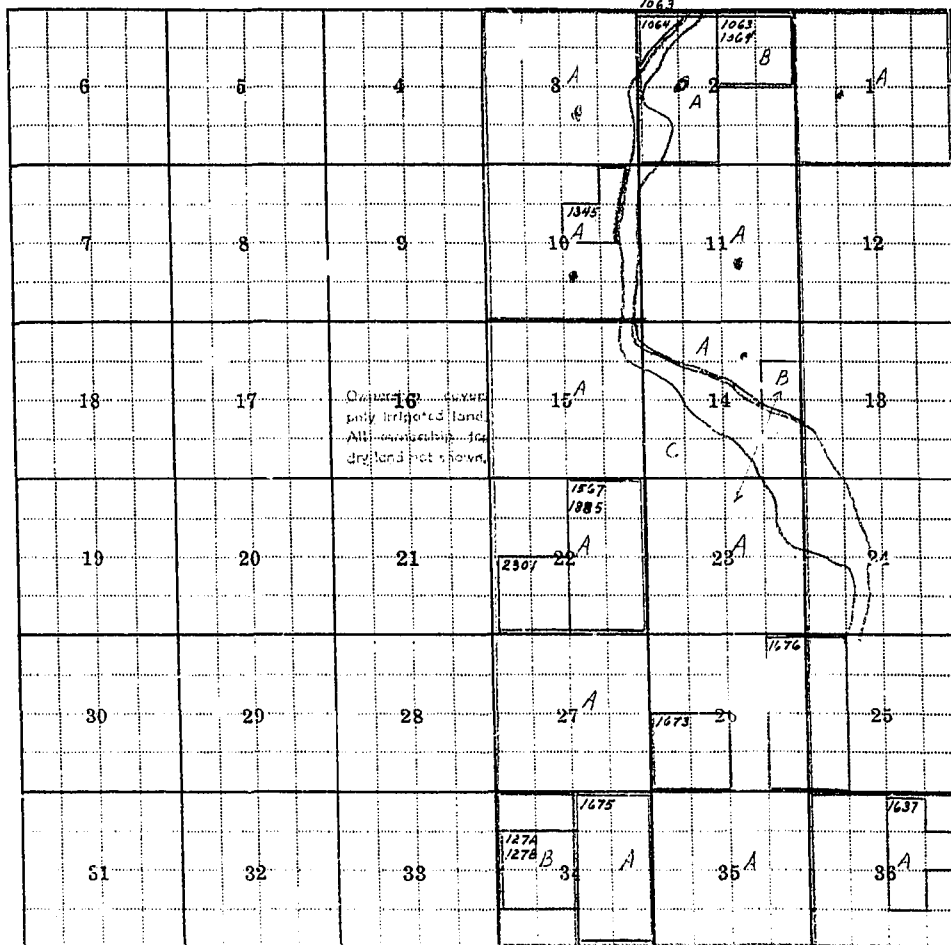

Township.....7N.....Range.....51E.....

COUNTY

Custer

Sheet No. _____

Twp.

7N

Rge.

53E

Letters

File No.

Name

1st

2nd

3rd

Ret.

Name

1st

2nd

Anderson, M. Elmer7/20Hoodruff, Harry A.7/20Filed Also in 7N-54EHoodruff, Claude & Harry7/20Hoodruff, Claude7/20



NOTICE
Blank forms are the
property of the State
of Montana and must
be returned.

STATE OF MONTANA
STATE ENGINEERS OFFICE

Water Resources Survey

Code No. 22.3

County Custer

T. 71N R. 53

Name of Land Owner M. E. Lee Anderson Address Kimberly, Montana

Name of Operator _____ Address Locate, Montana

Part A

TO BE FILED BY THOSE OBTAINING IRRIGATION WATER FROM
A DITCH COMPANY OR IRRIGATION DISTRICT

1. Water is delivered by: _____
Name of Ditch, Ditch Company or District Supplying Water
2. State the number of acres you irrigate under this system _____ Shares you hold _____
3. If you obtain water from more than one Company, give the number of shares, acres irrigated and the name of the Company under "Remarks." If you obtain water from a Ditch Company and also have a private system fill in both Part A and Part B.

Part B

TO BE FILED BY THOSE WHO HAVE A PRIVATE DITCH, PUMP OR IRRIGATION SYSTEM
or those who have a private water right under a Ditch Company

4. In what year was this land first irrigated? Date _____
5. Give the name of the original appropriator (first user): _____
6. Give the date appropriated _____ Amount filed on: Miners Inches _____ C. F. S. _____
7. State the total number of acres irrigated under this system: _____
8. Give the point of diversion: _____ $\frac{1}{4}$ _____ $\frac{1}{4}$ Section _____ Township _____ Range _____

Part C

TO BE FILED BY ALL WATER USERS IN ADDITION TO PART A OR PART B

9. Source of Water: West Fork of Locate Creek
Name of stream or lake from which water is originally diverted
10. Water is obtained by: (Check one) Gravity _____ Pumping _____ Other _____
11. What is the greatest number of acres you have irrigated? ? Date _____
12. How many acres did you irrigate in 1947? (Crop and pasture) 4.0
13. State the total number of additional acres that could be irrigated by increasing the water supply, land leveling, etc. 0 This land is under what ditch? _____
14. How many acres of seeped land do you have which could be drained and put into production? 0
15. What is the condition of your irrigation system? Fair
16. Is your water supply adequate? Yes _____ No ✓ Explain I had no
17. REMARKS: _____

Over

NOTE: The foregoing questions apply only to irrigated land shown on this plat.

DESCRIPTION AND MAP OF FARM

18. Legal Description of this Farm

SE 1/4, E 2 SW 1/4, Sec 22,



IRRIGATED LAND

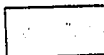

NON-IRRIGATED LAND

North

West

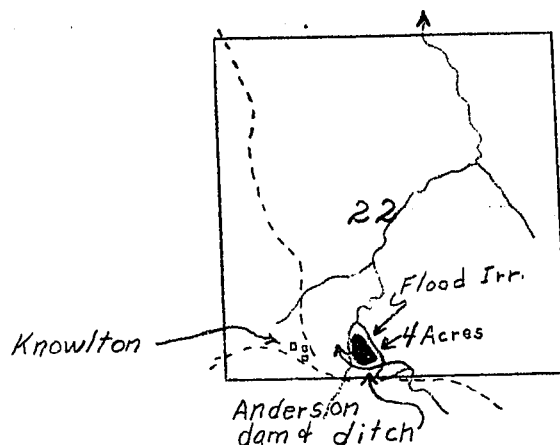

East

South

Ownership covers
only irrigated land.
All ownership for
dry land not shown

19. If the above land is irrigated from more than one ditch please give the acreage under each ditch in 19A and indicate the location of the land irrigated from each on the above map.

19A. Ditch: Anderson Private Flood Irr Acres: 4.0

Ditch: _____ Acres: _____

Information supplied by:

Name Field Survey Address _____ Date 7/17/47

REMARKS: Johnson & Paulist

If you cannot answer all of the questions on this form answer as many as you can and return the form to us as soon as possible.

STATE ENGINEER'S OFFICE
WATER RESOURCES SURVEY

COUNTY CusterFILE NO. 31-T.7N-R.53EOwner Anderson, M. Elver Address Knawilton, Montana

AAA Owner Address

Operator Address

New Owner Address

New Operator Address

Assessment Record NoneAssessed Acreage 0Legal Description of This Farm SE⁴, E²SW⁴, Section 22; T.7N-R.53ETotal Acres in Farm ✓Code Number 22BPhoto No. Ma 20-86

AAA Contract No.

AAA Total Cropland Acreage

App. No. No. Recently Discript

Decree No.

Land is located in

Twp. 7N Rge. 53E Twp. Rge.

Twp. Rge. Twp. Rge.

Filed in Twp. 7N Rge. 53E

Remarks

Powder River Basin

Ownership covers
only irrigated land.
All ownership for
dry land not shown.

February 20, 1948

Mr. N. Elver Anderson
R.F.D., Locate P.O.
Miles City, Montana

Re: Water Rights on Locate Creek

Dear Sir:

Custer

the SE $\frac{1}{4}$, E $\frac{1}{2}$ SW $\frac{1}{4}$ Section 22, T. 7N., R. 53E.



NOTICE
These forms are the
property of the State
of Montana and must
be returned.

STATE OF MONTANA
STATE ENGINEERS OFFICE
Water Resources Survey

FORM: WR-1-2M 12-47
Code No. 13A-24A
County Custer
T. 71Y R. 53E

Name of Land Owner Claude Woodruff Address Knappa, Mont
Name of Operator R. P. D. Address Locate, Mont

Part A

**TO BE FILED BY THOSE OBTAINING IRRIGATION WATER FROM
A DITCH COMPANY OR IRRIGATION DISTRICT**

1. Water is delivered by: _____
Name of Ditch, Ditch Company or District Supplying Water
2. State the number of acres you irrigate under this system: _____ Shares you hold: _____
3. If you obtain water from more than one Company, give the number of shares, acres irrigated and the name of the Company under "Remarks." If you obtain water from a Ditch Company and also have a private system fill in both Part A and Part B.

Part B

**TO BE FILED BY THOSE WHO HAVE A PRIVATE DITCH, PUMP OR IRRIGATION SYSTEM
or those who have a private water right under a Ditch Company**

- No data -
4. In what year was this land first irrigated? Date: _____
 5. Give the name of the original appropriator (first user): _____
 6. Give the date appropriated: _____ Amount filed on: Miners Inches: _____ C. F. S.: _____
 7. State the total number of acres irrigated under this system: _____
 8. Give the point of diversion: _____ $\frac{1}{4}$ Section _____ Township _____ Range _____

Part C

TO BE FILED BY ALL WATER USERS IN ADDITION TO PART A OR PART B

9. Source of Water: Locate Creek
Name of stream or lake from which water is originally diverted
10. Water is obtained by: (Check one) Gravity ☒ Pumping _____ Other _____
11. What is the greatest number of acres you have irrigated? ? Date: _____
12. How many acres did you irrigate in 1947? (Crop and pasture) 27.0
13. State the total number of additional acres that could be irrigated by increasing the water supply, land leveling, etc. 0 This land is under what ditch? _____
14. How many acres of seeped land do you have which could be drained and put into production? 0
15. What is the condition of your irrigation system? I had in use
16. Is your water supply adequate? Yes _____ No ☒ Explain I had in
17. REMARKS: _____

Over

NOTE: The foregoing questions apply only to irrigated land shown on this plat.

DESCRIPTION AND MAP OF FARM

18. Legal Description of this Farm.....



IRRIGATED LAND



NON-IRRIGATED LAND

North

West

East

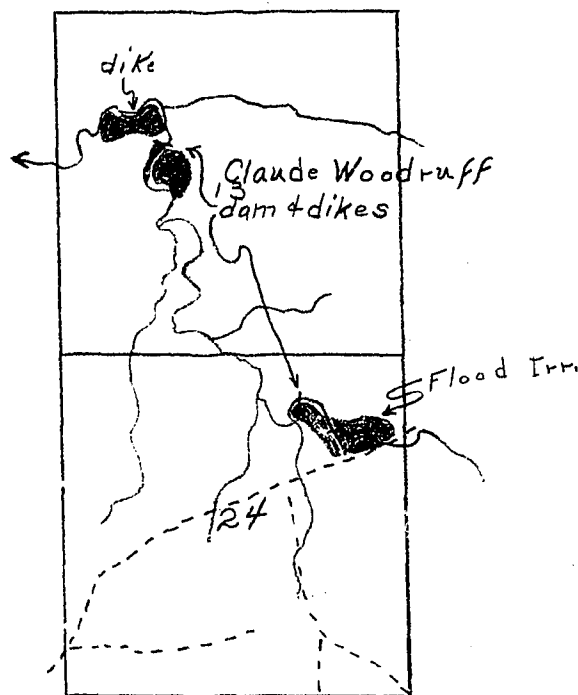

South

Ownership of property
only irrigated land.
All ownership for
dry land not shown.

19. If the above land is irrigated from more than one ditch please give the acreage under each ditch in 19A and indicate the location of the land irrigated from each on the above map.

19A. Ditch: Woodruff Private Flood Irr. Acres: 27.0

Ditch: _____ Acres: _____

Information supplied by:

Name Field Survey Address _____ Date July 17-47

REMARKS: Johnson & J. Paulist

If you cannot answer all of the questions on this form answer as many as you can and return the form to us as soon as possible.

**STATE ENGINEER'S OFFICE
WATER RESOURCES SURVEY**

COUNTY CusterFILE NO. 31-T.7N-R.53EOwner Woodruff, Claude Address Krawltan, Montana

AAA Owner Address.....

Operator " Address "

New Owner Address.....

New Operator Address.....

Assessment Record NoneAssessed Acreage 0Legal Description of This Farm all of Section 13; NE⁴, NE⁴NW⁴, NE⁴SW⁴, Sec. 24;
T.7N-R.53ETotal Acres in Farm ✓Code Number 13A, 24A, 24B^(dry land)Photo No. Ma 20-128

AAA Contract No.

AAA Total Cropland Acreage.....

App. No. No Record by Description

Decree No.....

Land is located in

Twp. 7N Rge. 53E Twp. Rge.

Twp. Rge. Twp. Rge.

Filed in Twp. 7N Rge. 53E

Remarks

Powder River Basin

Ownership covers
only irrigated land.
All ownership for
dry land not shown.

February 20, 1948

Mr. Claude Woodruff
R.F.D., Locate P.O.
Miles City, Montana

Re: Water Rights on Locate Creek

Dear Sir:

Custer

Section 13; NE $\frac{1}{4}$, NE $\frac{1}{4}$ NW $\frac{1}{4}$, NE $\frac{1}{4}$ SW $\frac{1}{4}$ Sec. 24, T. 7N., R. 53E.



STATE OF MONTANA

STATE ENGINEER

FRED E. BUCK, STATE ENGINEER
GERALD J. ORAVETZ, ASSISTANT

BILLINGS, MONTANA

February 20, 1948

Mr. Claude Woodruff
R.F.D., Locate P.O.
Miles City, Montana

Re: Water Rights on Locate Creek

Dear Sir:

In accordance with the 1939 Session Law (Section 349.68 Montana Session Laws) requiring the State Engineer to investigate and prepare a complete record of all water rights in Montana, the State Engineer has been conducting a water resources survey in Custer County.

We are unable to find a recorded water filing for the land that you irrigate in Section 13; NE $\frac{1}{4}$, NE $\frac{1}{4}$ NW $\frac{1}{4}$, NE $\frac{1}{4}$ SW $\frac{1}{4}$ Sec. 24, T. 7N., R. 53E. If a filing was made for this land we would like to have you send us the name of the appropriator, the date filed on, and the number of inches filed on. If no recorded filing was made we would like to have you send us the name of the first user and the date, or the approximate date, that the land was first irrigated so that we may establish a date of priority for this land.

We would like to have you make this a first on your agenda and send this information to us as soon as possible in the enclosed, stamped, self-addressed envelope.

Very truly yours,

Gerald J. Oravetz
Assistant State Engineer

GJO/a
enc.



NOTICE
These forms are the
property of the State
of Montana and must
be returned.

STATE OF MONTANA
STATE ENGINEERS OFFICE

Water Resources Survey

Code No. _____

County _____

T. _____ R. _____

Name of Land Owner _____

Address _____

Locate, Mont

Name of Operator _____

Address _____

R.F.D.

Wilder City,

Part A

TO BE FILED BY THOSE OBTAINING IRRIGATION WATER FROM
A DITCH COMPANY OR IRRIGATION DISTRICT

1. Water is delivered by: _____
Name of Ditch, Ditch Company or District Supplying Water
2. State the number of acres you irrigate under this system _____ Shares you hold _____
3. If you obtain water from more than one Company, give the number of shares, acres irrigated and the name of the Company under "Remarks." If you obtain water from a Ditch Company and also have a private system fill in both Part A and Part B.

Part B

TO BE FILED BY THOSE WHO HAVE A PRIVATE DITCH, PUMP OR IRRIGATION SYSTEM
or those who have a private water right under a Ditch Company

4. In what year was this land first irrigated? Date _____
5. Give the name of the original appropriator (first user): _____
6. Give the date appropriated _____ Amount filed on: Miners Inches _____ C. F. S. _____
7. State the total number of acres irrigated under this system: _____
8. Give the point of diversion: _____ $\frac{1}{4}$ _____ $\frac{1}{4}$ Section _____ Township _____ Range _____

Part C

TO BE FILED BY ALL WATER USERS IN ADDITION TO PART A OR PART B

9. Source of Water: *Locate Creek*
Name of stream or lake from which water is originally diverted
10. Water is obtained by: (Check one) Gravity ☒ Pumping _____ Other _____
11. What is the greatest number of acres you have irrigated? *?* Date _____
12. How many acres did you irrigate in 19*47*? (Crop and pasture) *30.0*
13. State the total number of additional acres that could be irrigated by increasing the water supply, land leveling, etc. *0* This land is under what ditch? _____
14. How many acres of seeped land do you have which could be drained and put into production? *0*
15. What is the condition of your irrigation system? *Good*
16. Is your water supply adequate? Yes _____ No ☒ Explain *I flood it*
17. REMARKS: _____

Over

NOTE: The foregoing questions apply only to irrigated land shown on this plat.

DESCRIPTION AND MAP OF FARM

18. Legal Description of this Farm

all of sec 3, T13S



IRRIGATED LAND



NON-IRRIGATED LAND

No th

West

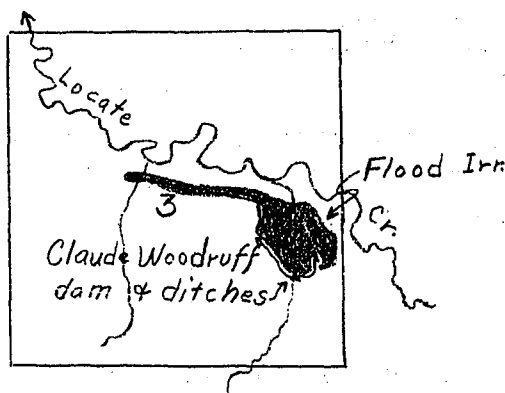

East

South

Ownership covers
only irrigated land.
All ownership for
dry land not shown.

19. If the above land is irrigated from more than one ditch please give the acreage under each ditch in 19A and indicate the location of the land irrigated from each on the above map.

19A. Ditch: *Claude Woodruff Private flood* Acres: *30.0*

Ditch: _____ Acres: _____

Information supplied by:

Name *Field Survey* Address _____ Date *July 17-47*

REMARKS: *Johnson & J Paulant*

If you cannot answer all of the questions on this form answer as many as you can and return the form to us as soon as possible.

STATE ENGINEER'S OFFICE
WATER RESOURCES SURVEY

COUNTY Custer

FILE NO. 31-T. 7N-R. 53E

Owner Woodruff, Claude & Harry Address Kawilton, Montana

AAA Owner _____ Address _____

Operator " " " Address " "

New Owner _____ Address _____

New Operator _____ Address _____

Assessment Record None

Assessed Acreage 0

Legal Description of This Farm all of Section 3; T. 7N-R. 53E

Total Acres in Farm ✓

Code Number 3A

Photo No. Ma 29-59

AAA Contract No. _____

AAA Total Cropland Acreage _____

App. No. No Record by Discript

Decree No. _____

Land is located in

Twp. 7N Rge. 53E Twp. _____ Rge. _____

Twp. _____ Rge. _____ Twp. _____ Rge. _____

Filed in Twp. 7N Rge. 53E

Remarks _____

Powder River Basin

Ownership covers
only irrigated land.
All ownership for
dry land not shown.



FRED E. BUCK, STATE ENGINEER
GERALD J. ORAVETZ, ASSISTANT

STATE OF MONTANA

STATE ENGINEER

BILLINGS, MONTANA

February 20, 1948

Claude & Harry Woodruff
R.F.D. Locate P.O.
Miles City, Montana

Re: Water Rights on Locate Creek

Gentlemen:

In accordance with the 1939 Session Law (Section 349.68 Montana Session Laws) requiring the State Engineer to investigate and prepare a complete record of all water rights in Montana, the State Engineer has been conducting a water resources survey in Custer County.

We are unable to find a recorded water filing for the land that you irrigate in Section 3, T. 7N., R. 53E.

If a filing was made for this land we would like to have you send us the name of the appropriator, the date filed on, and the number of inches filed on. If no recorded filing was made we would like to have you send us the name of the first user and the date, or the approximate date, that the land was first irrigated so that we may establish a date of priority for this land.

We would like to have you make this a first on your agenda and send this information to us as soon as possible in the enclosed, stamped, self-addressed envelope.

See Bill to Wood in 1941 Very truly yours,

Gerald J. Oravetz
Gerald J. Oravetz
Assistant State Engineer

GJO/a
enc.

February 20, 1948

Claude & Harry Woodruff
R.F.D. Locate P.O.
Miles City, Montana

Re: Water Rights on Locate Creek

Gentlemen:

Custer

Section 3, T. 7N., R. 53E.



NOTICE
These forms are the
property of the State
of Montana and must
be returned.

STATE OF MONTANA
STATE ENGINEERS OFFICE

Water Resources Survey

Code No. 25A

County Custer

T. 7N R. 53

Name of Land Owner Woodruff, Harry A. Address Knowlton Mont

Name of Operator _____ Address (Locate)

Part A

TO BE FILED BY THOSE OBTAINING IRRIGATION WATER FROM
A DITCH COMPANY OR IRRIGATION DISTRICT

1. Water is delivered by: _____ Name of Ditch, Ditch Company or District Supplying Water _____
2. State the number of acres you irrigate under this system _____ Shares you hold _____
3. If you obtain water from more than one Company, give the number of shares, acres irrigated and the name of the Company under "Remarks." If you obtain water from a Ditch Company and also have a private system fill in both Part A and Part B.

Part B

TO BE FILED BY THOSE WHO HAVE A PRIVATE DITCH, PUMP OR IRRIGATION SYSTEM
or those who have a private water right under a Ditch Company

4. In what year was this land first irrigated? Date no date
5. Give the name of the original appropriator (first user): _____
6. Give the date appropriated _____ Amount filed on: Miners Inches _____ C. F. S. _____
7. State the total number of acres irrigated under this system: _____
8. Give the point of diversion: _____ 1/4 _____ 1/4 Section _____ Township _____ Range _____

Part C

TO BE FILED BY ALL WATER USERS IN ADDITION TO PART A OR PART B

9. Source of Water: Locate Creek
Name of stream or lake from which water is originally diverted _____
10. Water is obtained by: (Check one) Gravity ☒ Pumping _____ Other _____
11. What is the greatest number of acres you have irrigated? ? Date _____
12. How many acres did you irrigate in 19 47? (Crop and pasture) 22,0
13. State the total number of additional acres that could be irrigated by increasing the water supply, land leveling, etc. 0 This land is under what ditch? _____
14. How many acres of seeped land do you have which could be drained and put into production? 0
15. What is the condition of your irrigation system? fair
16. Is your water supply adequate? Yes _____ No ☒ Explain Flood line
17. REMARKS: _____

NOTE: The foregoing questions apply only to irrigated land shown on this plat.

DESCRIPTION AND MAP OF FARM

18. Legal Description of this Farm All sec. 25, T1N R53E, E2 Sec 30
T1N R54E.



IRRIGATED LAND

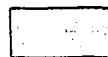

NON-IRRIGATED LAND

North

West

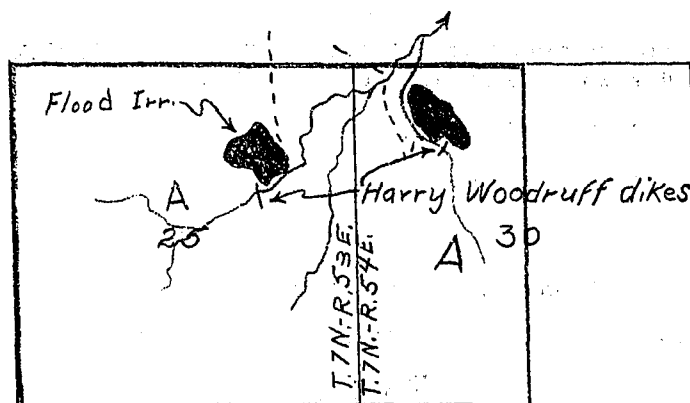

East

South

Ownership covers
only irrigated land.
All ownership for
dry land not shown.

19. If the above land is irrigated from more than one ditch please give the acreage under each ditch in 19A and indicate the location of the land irrigated from each on the above map.

19A. Ditch: Harry Woodruff private flood Acres: 22.0
Ditch: _____ Acres: _____

Information supplied by:

Name Field Survey Address _____ Date 7/17/47

REMARKS: Johnson & Pauline, Dane

If you cannot answer all of the questions on this form answer as many as you can and return the form to us as soon as possible.

STATE ENGINEER'S OFFICE
WATER RESOURCES SURVEYCOUNTY CusterFILE NO. 31-T.7N-R.53EOwner Woodruff, Harry A Address Keewilton, Montana

AAA Owner Address

Operator Address

New Owner Address

New Operator Address

Assessment Record NoneAssessed Acreage 0Legal Description of This Farm All of Section 25; T.7N-R.53ETotal Acres in Farm ✓Code Number 25APhoto No. Ma 20-128

AAA Contract No.

AAA Total Cropland Acreage

App. No. No Record by DISSEPT.

Decree No.

Land is located in

Twp. 7N Rge. 53E Twp. 7N Rge. 54E

Twp. Rge. Twp. Rge.

Filed in Twp. 7N Rge. 54ERemarks also has someland in T.7N-R.54EPowder River BasinOwnership covers
only irrigated land.
All ownership for
dry land not shown.

STATE OF MONTANA

STATE ENGINEER'S OFFICE

WATER RESOURCES SURVEY

Township.....7N..... Range.....55E..... County.....Custer.....

			2022		
6	5	4	3A	2B A	1
7	8	9	10	11	12
867			only irrigated land. All township - for dry, and not shown.		
18	17	16	15	14	13A
			A		A
19	20	21	22B C	23	24B C
896	30	29	28	27	26
31	32	33	34	35	36

Township.....7N..... Range.....55E.....

Township 7N Range 53E County Custer

[illegible]

Township 7 North

Range 53 East

Custer County

<u>Index No.</u>	<u>Name of Appropriator</u>	<u>Stream</u>	<u>Date App.</u>	<u>Date Filed</u>	<u>M.I.</u>
886	Patrick Doran	Horse Creek	3-15-02	3-12-02	200
867	Jesse G. Black	Hogen Creek	8-21-01	8-21-01	200
2022	Frank Sum	Windy Creek	8-29-01	-----	200

Township 7 North

Range 53 East

Custer County

STATE ENGINEER'S OFFICE
WATER RESOURCES SURVEYCOUNTY ClusterFILE NO. 32-T.7N-R.54EOwner Woodruff, Harry A Address Kawilton, Mont

AAA Owner Address

Operator " " Address " "

New Owner Address

New Operator Address

Assessment Record NoneAssessed Acreage 0Legal Description of This Farm W², Section 30; T.7N-R.54ETotal Acres in Farm ✓Code Number 30APhoto No. Ma 24-128

AAA Contract No.

AAA Total Cropland Acreage

App. No. No Record by Description

Decree No.

Land is located in

Twp. 7N Rge. 54E Twp. 7N Rge. 53

Twp. Rge. Twp. Rge.

Filed in Twp. 7N Rge. 54E

Remarks

*See Map & Form in
Twp. 7N-R. 53E*Powder River BasinOwnership covers
only irrigated land.
All ownership (or
not shown)

STATE OF MONTANA
STATE ENGINEER'S OFFICE
 WATER RESOURCES SURVEY

Township 7N Range 54E County Custer

6	5	4	3	2	1
7	8	9	10	11	12
13	17	16	15	14	13
19	20	21	22	23	24
A 30 B	29	28	27	26	25
31	32	33	34	35	36

Ownership covers only irrigated land. All ownership for dry land not shown.

Township 7N Range 54E

71

Range

54H

County

Customer

[illegible]