



NOTICE
These forms are the
property of the State
of Montana and must
be returned.

STATE OF MONTANA
STATE ENGINEERS OFFICE

FORM IWR-2 (12-47)

Code No. 23A-26A-35A

County Custer

T. 8N R. 51E

Water Resources Survey

Name of Land Owner Albert & Stanley Bixler Address Locater, Mont.
Name of Operator A. M. Holman Address Locater, Mont.

Part A

TO BE FILED BY THOSE OBTAINING IRRIGATION WATER FROM
A DITCH COMPANY OR IRRIGATION DISTRICT

1. Water is delivered by: _____
Name of Ditch, Ditch Company or District Supplying Water
2. State the number of acres you irrigate under this system _____ Shares you hold _____
3. If you obtain water from more than one Company, give the number of shares, acres irrigated and the name of the Company under "Remarks." If you obtain water from a Ditch Company and also have a private system fill in both Part A and Part B.

Part B

TO BE FILED BY THOSE WHO HAVE A PRIVATE DITCH, PUMP OR IRRIGATION SYSTEM
or those who have a private water right under a Ditch Company

4. In what year was this land first irrigated? Date 1902 (see attached filings)
5. Give the name of the original appropriator (first user): C. J. Smith
6. Give the date appropriated 7/1/02 Amount filed on: Miners Inches 1000 C. F. S. _____
7. State the total number of acres irrigated under this system: None - 160 acres potential
8. Give the point of diversion: SW 1/4 SW 1/4 Section 35 Township 8N Range 51E

Part C

TO BE FILED BY ALL WATER USERS IN ADDITION TO PART A OR PART B

9. Source of Water: 44 Creek on flood Powder on Pump
Name of stream or lake from which water is originally diverted
10. Water is obtained by: (Check one) Gravity Pumping Other _____
11. What is the greatest number of acres you have irrigated? 433 Date 1906
12. How many acres did you irrigate in 1947? (Crop and pasture) 273.0
13. State the total number of additional acres that could be irrigated by increasing the water supply, land leveling, etc. 160.0 This land is under what ditch? Powder River Pump ditch
Charlie Smith Pump ditch
14. How many acres of seeped land do you have which could be drained and put into production? _____
15. What is the condition of your irrigation system? out of use on pump - other flood
16. Is your water supply adequate? Yes _____ No Explain flood irr
17. REMARKS: Charlie Smith pump ditch from Powder River not used for about 20 years - was steam operated pump, tractor pump not used for about 10 years, both on same ditches

T. 8N R. 51E

NOTE: The foregoing questions apply only to irrigated land shown on this plat

DESCRIPTION AND MAP OF FARM

18. Legal Description of this Farm See attached WR

IRRIGATED LAND

NON-IRRIGATED LAND

North

See attached map -

West

East

South

Demeritis covers only irrigated land. Full ownership for dry land not shown.

19. If the above land is irrigated from more than one ditch please give the acreage under each ditch in 19A and indicate the location of the land irrigated from each on the above map.

19A. Ditch: 44 Creek flood Irr + Coulee, Acres: 273.0
Ditch: _____ Acres: _____

Information supplied by:

Name A. M. Holmes Address _____ Date July 9-47

REMARKS: to Johnson + Paulist,
have ditches in use on 44 Creek + Coulee
for flood water.

If you cannot answer all of the questions on this form answer as many as you can and return the form to us as soon as possible.



WR-1

T.8N-R51E

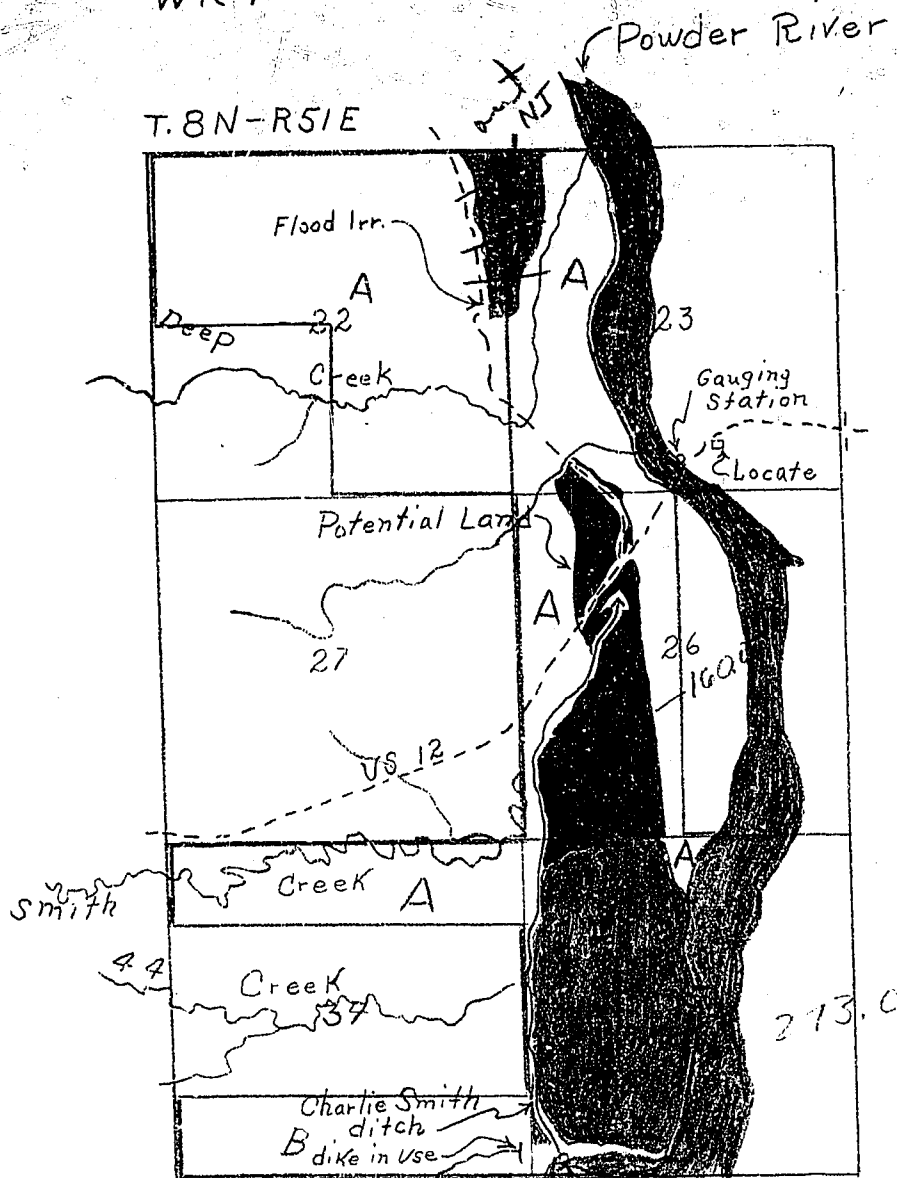

old steam pump
not used for about
20 years
(very large pump)

Albert Bixter present
owner

A.M. Holmes, Operator

Tractor pump
not used for 10 years
Josephine Denny

273
160
433

STATE ENGINEERS OFFICE
Water Resources Survey

COUNTY Custer
FILE NO. 21-T.8N-R.51E

Owner Bixler, Stanley & Albert Address Locate, Mont
AAA Owner _____ Address _____
Operator Holmes, A.M. Address Locate, Montana
New Owner _____ Address _____
New Operator _____ Address _____

Assessment Record None
Assessed Acreage 0

Legal Description of This Farm NW⁴ E² Sec. 22; Lots 2, 3, 6, 7 Sec. 23;
W², Lots 2, 3, 6, 7, Sec. 26; N²N² S²S² Sec. 34; Lots 2, 3,
6, 7, NW⁴ W²SW⁴ Sec. 35 T.8N-R.51E

Total Acres in Farm ✓

Code Number 22A, 23A, 26A
34A, 34B, 35A
Photo No. MA 33-45
AAA Contract No. _____
AAA Total Cropland Acreage _____
App. No. 1721, 1344
Decree No. _____

Farm Map

Land is located in
Twp. 8N Rge. 51E Twp. _____ Rge. _____
Twp. _____ Rge. _____ Twp. _____ Rge. _____
Filed in Twp. 8N Rge. 51E

Remarks Holmes only operates
front of this land.
Find out how much is
operated by Holmes and by Bixler
Also operate land in T.7N-R.51E
Powder River Basin

Ownership covers
only irrigated land.
All ownership for
dry land not shown.

WR-2

T.8N-R51E

Powder River

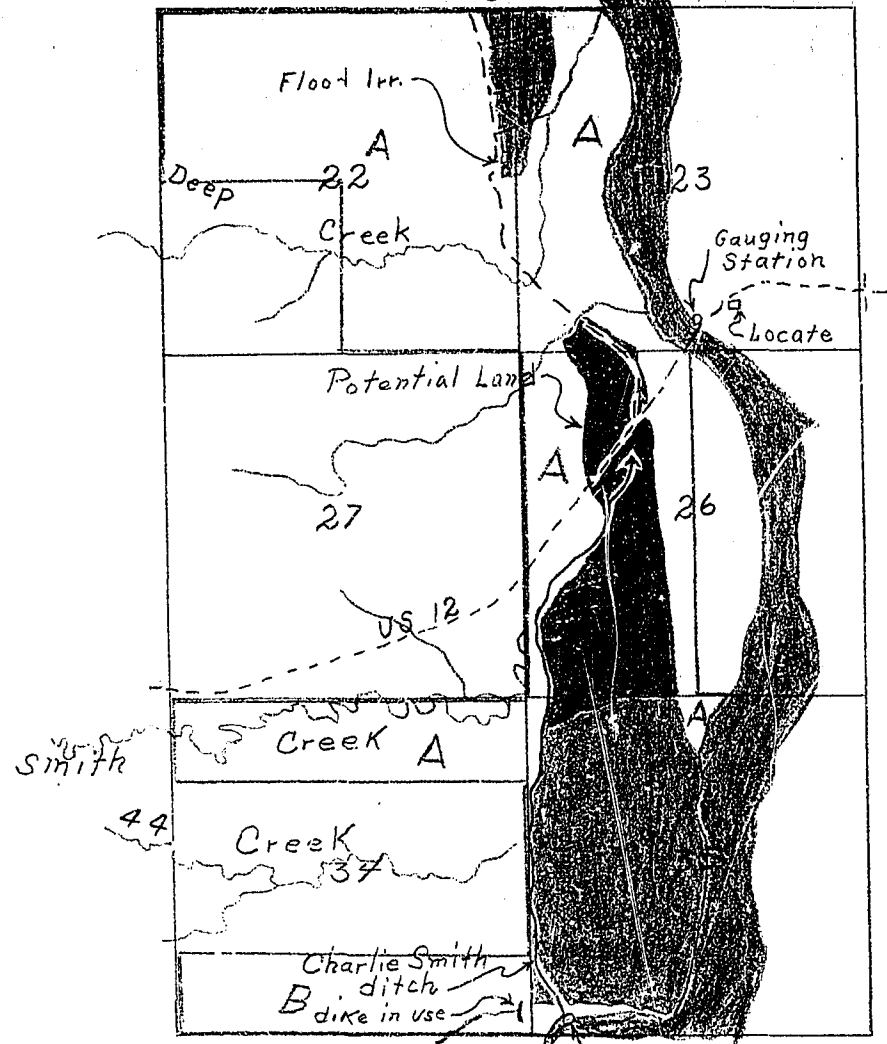

old steam pump
 not used for about
 20 years
 (very large pump)

Tractor pump
 not used for 10 years
 Josephine Denny

Albert Bixter present
 Owner
 A.M. Holmes, Operator

1349

STATE ENGINEERS OFFICE
Water Resources Survey
Notice of Appropriation

1. County Custer Book E Page 376 Record W.R.

2. Name of Appropriator C. J. Smith Address Mizpah, Montana
July 1, 1902

3. Date Appropriated Nov. 4, 1914 Date Filed Nov. 4, 1914

Amount Appropriated, Miners Inches 1000, Cubic Feet per second

4. Name of Stream Powder River Tributary Basin

5. Point of Diversion About 150 yds. east or northeast from where the west line of Lot 4, Sec. 2-7N-51E intersects with Powder River.

Sec. 2 Twp. 7N Rge. 51E Bank of Stream West

6. Purpose For irrigation

7. Description of System A steam pump and plant with ditch sufficient in size, which carries and conducts said amount of water from said Powder River and runs thence over and upon said land (or mining claim)

8. Land Description of Intended Place of Use

Lot 4, Sec. 2-7N-51E, 34.52 acres, Madge I. Holmes, Locate, Montana
Lots 1, 4, 5, 8, SW1/4, E1/2 Sec. 35-8N-51E, 238.25 acres, N.P. Ry., St. Paul
Lots 2, 3, 6, 7, NW1/4, W1/2 Sec. 35-8N-51E, 337.28 acres, Madge I. Holmes, Locate

9. Remarks (Pertaining to Use, etc.)

Decree

10. Case No. Date Amt. Decreed: M. I. C. F. S.

11. To Whom Decreed Address

12. Name of Ditch Maximum Capacity (C. F. S.)

13. Date of Priority Purpose

14. Land Description of Place of Use as Decreed

15. Remarks (Present Use Status, etc.)

1721

STATE ENGINEERS OFFICE
Water Resources Survey
Notice of Appropriation

- 1. County Custer Book E Page 491 Record W.R.
- 2. Name of Appropriator Andrew S. Holmes Address Mizpah, Montana
- 3. Date Appropriated April 7, 1931 Date Filed April 7, 1931
- 4. Amount Appropriated, Miners Inches 1000 or , Cubic Feet per second 25
- 5. Name of Stream Smith Creek Tributary Basin
- 5. Point of Diversion

Sec. Twp. Rge. Bank of Stream

6. Purpose For irrigation

7. Description of System The water naturally overflows the land.

8. Land Description of Intended Place of Use Certain land in (being in the NW $\frac{1}{4}$) Sec. 26-8N-51E, 149.61 acres, Madge I. Holmes, Locate, Montana

9. Remarks (Pertaining to Use, etc.) Said Smith Creek enters and overflows in west half of Sec. 26-8N-51E.

Decree

10. Case No. Date Amt. Decreed: M. I. C. F. S.

11. To Whom Decreed Address

12. Name of Ditch Maximum Capacity (C. F. S.)

13. Date of Priority Purpose

14. Land Description of Place of Use as Decreed

15. Remarks (Present Use Status, etc.)



NOTICE
These forms are the property of the State of Montana and must be returned.

**STATE OF MONTANA
STATE ENGINEERS OFFICE**

FORM WR-2M (2-24)

Code No. _____

County _____

T. _____ R. _____

Water Resources Survey

Name of Land Owner _____ Address _____

Name of Operator _____ Address _____

Dryland

Part A

TO BE FILED BY THOSE OBTAINING IRRIGATION WATER FROM A DITCH COMPANY OR IRRIGATION DISTRICT

1. Water is delivered by: _____
Name of Ditch, Ditch Company or District Supplying Water
2. State the number of acres you irrigate under this system _____ Shares you hold _____
3. If you obtain water from more than one Company, give the number of shares, acres irrigated and the name of the Company under "Remarks." If you obtain water from a Ditch Company and also have a private system fill in both Part A and Part B.

Part B

TO BE FILED BY THOSE WHO HAVE A PRIVATE DITCH, PUMP OR IRRIGATION SYSTEM or those who have a private water right under a Ditch Company

4. In what year was this land first irrigated? Date _____
5. Give the name of the original appropriator (first user): _____
6. Give the date appropriated _____ Amount filed on: Miners Inches _____ C. F. S. _____
7. State the total number of acres irrigated under this system: _____
8. Give the point of diversion: _____ ¼ _____ ¼ Section _____ Township _____ Range _____

Part C

TO BE FILED BY ALL WATER USERS IN ADDITION TO PART A OR PART B

9. Source of Water: _____
Name of stream or lake from which water is originally diverted
10. Water is obtained by: (Check one) Gravity _____ Pumping _____ Other _____
11. What is the greatest number of acres you have irrigated? _____ Date _____
12. How many acres did you irrigate in 19____? (Crop and pasture) _____
13. State the total number of additional acres that could be irrigated by increasing the water supply, land leveling, etc. _____ This land is under what ditch? _____
14. How many acres of seeped land do you have which could be drained and put into production? _____
15. What is the condition of your irrigation system? _____
16. Is your water supply adequate? Yes _____ No _____ Explain _____
17. REMARKS: _____

NOTE: The foregoing questions apply only to irrigated land shown on this plat.

DESCRIPTION AND MAP OF FARM

18. Legal Description of this Farm: _____



IRRIGATED LAND



NON-IRRIGATED LAND

North

West

East

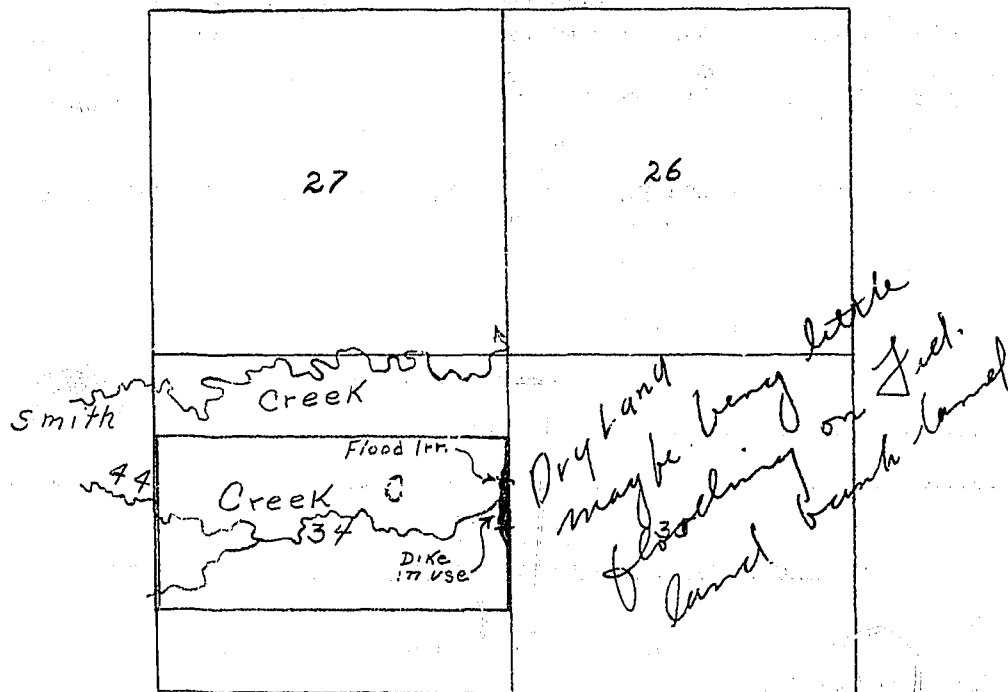

South

Ownership covers only irrigated land. All ownership for dry land not shown.

19. If the above land is irrigated from more than one ditch please give the acreage under each ditch in 19A and indicate the location of the land irrigated from each on the above map.

19A. Ditch: _____ Acres: _____

Ditch: _____ Acres: _____

Information supplied by:

Name _____ Address _____ Date _____

REMARKS: _____

If you cannot answer all of the questions on this form answer as many as you can and return the form to us as soon as possible.

STATE ENGINEERS OFFICE
Water Resources Survey

COUNTY Custer
FILE NO. 21-T8N-R.51E

Owner Federal Land Bank Address Spokane, WA
AAA Owner _____ Address _____
Operator Holmes, A.M. ? Address Locate, Montana
Bixler, Albert ? Address _____
New Owner _____ Address _____
New Operator _____ Address _____

Assessment Record None

Assessed Acreage 0

Legal Description of This Farm S²N², N²S², Sec. 34; T8N-R.51E

Total Acres in Farm ✓

Code Number 34C

Photo No. MA 33-45

AAA Contract No. _____

AAA Total Cropland Acreage _____

App. No. No record by Disrupt.

Decree No. _____

Land is located in

Twp. 8N Rge. 51E Twp. _____ Rge. _____

Twp. _____ Rge. _____ Twp. _____ Rge. _____

Filed in Twp. 8N Rge. 51E

Remarks Probably leased by
Stanley & Albert Bixler
(Find operator) Holmes or
Bixler?

Farm Map

Ownership covers
only irrigated land.
All ownership for
dry land not shown.

Powder River Basin



NOTICE
These forms are the property of the State of Montana and must be returned.

STATE OF MONTANA
STATE ENGINEERS OFFICE

Code No. 20

County Carbon

T. 8N R. 51E

Name of Land Owner M. P. R. R. Address St. Paul, Minn
Name of Operator _____ Address _____

Part A

TO BE FILED BY THOSE WHO OBTAIN IRRIGATION WATER FROM A DITCH COMPANY OR IRRIGATION DISTRICT

1. Water is delivered by: _____ Name of Ditch, Ditch Company or District Supplying Water _____
2. State the number of acres you irrigate under this system _____ Shares you hold _____
3. If you obtain water from more than one Company, give the number of shares, acres irrigated and the name of the Company under "Remarks." If you obtain water from a Ditch Company and also have a private system fill in both Part A and Part B.

Part B

TO BE FILED BY THOSE WHO HAVE A PRIVATE DITCH, PUMP OR IRRIGATION SYSTEM or those who have a private water right under a Ditch Company

4. In what year was this land first irrigated? Date 1910
5. Give the name of the original appropriator (first user): Newman, Carlston
6. Give the date appropriated 3/6/16 Amount filed on: Miners Inches 300 C. F. S. _____
7. State the total number of acres irrigated under this system: _____
8. Give the point of diversion: NW 1/4 SE 1/4 Section 2 Township 8N Range 51

Part C

TO BE FILED BY ALL WATER USERS IN ADDITION TO PART A OR PART B

9. Source of Water: Powder River Name of stream or lake from which water is originally diverted _____
10. Water is obtained by: (Check one) Gravity _____ Pumping Other _____
11. What is the greatest number of acres you have irrigated? 11 Date 1910
12. How many acres did you irrigate in 1947? (Crop and pasture) 0
13. State the total number of additional acres that could be irrigated by increasing the water supply, land leveling, etc. 11 This land is under what ditch? Newman ditch
14. How many acres of seeped land do you have which could be drained and put into production? _____
15. What is the condition of your irrigation system? out of use
16. Is your water supply adequate? Yes _____ No Explain Excessive Supply
17. REMARKS: Newman steam pump was put in, in about 1910, used until 1920. No app. covering this part of land under ditch, but appropriation for land from same ditch on land lower on old ditch.

NOTE: The foregoing questions apply only to irrigated land shown on this plat.

DESCRIPTION AND MAP OF FARM

18. Legal Description of this Farm

Sec 2, 8N R 51E

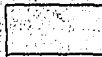

IRRIGATED LAND



NON-IRRIGATED LAND

North

Powder River

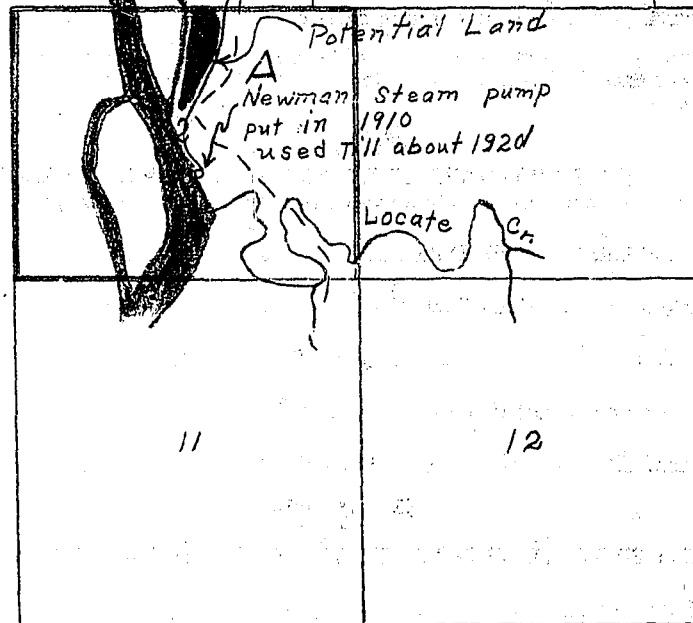

West

East

South

Ownership covers only irrigated land. All ownership for dry land not shown.

19. If the above land is irrigated from more than one ditch please give the acreage under each ditch in 19A and indicate the location of the land irrigated from each on the above map.

19A. Ditch: *None present* Acres: _____

Ditch: _____ Acres: _____

Information supplied by:

Name *Field Survey* Address _____ Date *July 9, 1917*

REMARKS: *Johnson & Paulist*

If you cannot answer all of the questions on this form answer as many as you can and return the form to us as soon as possible.

STATE ENGINEERS OFFICE
Water Resources Survey

COUNTY Custer

FILE NO. 21-T.8N-R.51E

Owner N.P.R.R. Address St. Paul, Minn.

AAA Owner _____ Address _____

Operator _____ Address _____

New Owner _____ Address _____

New Operator _____ Address _____

Assessment Record None

Assessed Acreage 0

Legal Description of This Farm all of sec 2 T.8N-R.51E

Total Acres in Farm 4

Code Number 2A

Farm Map

Photo No. MA 20-32

AAA Contract No. _____

AAA Total Cropland Acreage _____

App. No. 2034-1336

Decree No. _____

Land is located in

Twp. 8N Rge. 51E Twp. _____ Rge. _____

Twp. _____ Rge. _____ Twp. _____ Rge. _____

Filed in Twp. 8N Rge. 51E

Remarks Potential dry pumping

Irrigated by pumping in

1910-1920. Not so since

since 1920.

Ownership covers
only irrigated land.
All ownership for
dry land not shown.

Powder River Basin

STATE ENGINEERS OFFICE

Water Resources Survey

Notice of Appropriation

1. County Custer Book E Page 446 Record W.R.

2. Name of Appropriator Carlton Neumann Address Sutherland, Montana

3. Date Appropriated March 6, 1916 Date Filed March 7, 1916

Amount Appropriated, Miners Inches 300, Cubic Feet per second

4. Name of Stream Powder River Tributary Basin

5. Point of Diversion In lot 2 of said

Sec. 2 Twp. 8N. Rge. 51E. Bank of Stream East

6. Purpose For irrigation

7. Description of System A pipe 12 in. circumference, which carries and conducts said amount of water from said river and runs thence from a point 2250 ft. south of the N. line of Sec. 2-8N-51E, thence running north and westerly across Sec. 33-9N-51E, to the proposed ditch running along the east line of Lots 1, 4, 5, Sec. 32-9N-51E.

8. Land Description of Intended Place of Use Lots 1, 4, 5, Sec. 32-9N-51E, 83.53 acres, U.S.A.

9. Remarks (Pertaining to Use, etc.) This land does not appear on ownership book and is not being taxed.

Decree

10. Case No. Date Amt. Decreed: M. I. C. F. S.

11. To Whom Decreed Address

12. Name of Ditch Maximum Capacity (C. F. S.)

13. Date of Priority Purpose

14. Land Description of Place of Use as Decreed

15. Remarks (Present Use Status, etc.)

STATE ENGINEERS OFFICE
Water Resources Survey

Notice of Appropriation

1. County Custer Book F. Page 83 Record W.R.

2. Name of Appropriator Austin B. Middleton Address Custer Co., Montana
Nov. 30, 1917

3. Date Appropriated Dec. 5, 1917 Date Filed Dec. 5, 1917

Amount Appropriated, Miners Inches 2000 or _____, Cubic Feet per second 50

4. Name of Stream Wolf Creek Tributary Powder River Basin _____

5. Point of Diversion A dam across main Wolf Creek 20 ft. downstream from the inter-
section point of the N. & S. prongs of said Wolf Creek in Section

Sec. 3 Twp. 8N. Rge. 51E. Bank of Stream _____

6. Purpose For irrigation, watering of livestock, domestic and other purposes.

7. Description of System A dirt dam and water is diverted from said dam by means of a wide
shallow ditch with a 4 ft. dyke built up on the lower bank of said ditch with a bottom
of sufficient height to allow free passage of said amount of water to flow through, and
also a ditch of sufficient size to carry and conduct said amount of water to, over and
upon said lands.

8. Land Description of Intended Place of Use _____

Lots 3, 4, 5, 8, Sec. 2-8N-51E, 146.50 acres, Bradshaw Land & Cattle Co., Mizpah, Montana

9. Remarks (Pertaining to Use, etc.) _____

Decree

10. Case No. _____ Date _____ Amt. Decreed: M. I. _____ C. F. S. _____

11. To Whom Decreed _____ Address _____

12. Name of Ditch _____ Maximum Capacity (C. F. S.) _____

13. Date of Priority _____ Purpose _____

14. Land Description of Place of Use as Decreed _____

15. Remarks (Present Use Status, etc.) _____



NOTICE
These forms are the
property of the State
of Montana and must
be returned.

STATE OF MONTANA
STATE ENGINEERS OFFICE
Water Resources Survey

FORM WR-1-2H 12-47
Code No. 9A-10A-15A
County Cluster
T. 8N R. 51E

Name of Land Owner Odegaard, Andrew Address for 10A
Name of Operator N.P.R.R Address _____
% Odegaard for 9A-15A,
Part A

TO BE FILED BY THOSE OBTAINING IRRIGATION WATER FROM
A DITCH COMPANY OR IRRIGATION DISTRICT

- Water is delivered by: _____ Name of Ditch, Ditch Company or District Supplying Water _____
- State the number of acres you irrigate under this system _____ Shares you hold _____
- If you obtain water from more than one Company, give the number of shares, acres irrigated and the name of the Company under "Remarks." If you obtain water from a Ditch Company and also have a private system fill in both Part A and Part B.

Part B

TO BE FILED BY THOSE WHO HAVE A PRIVATE DITCH, PUMP OR IRRIGATION SYSTEM
or those who have a private water right under a Ditch Company

- In what year was this land first irrigated? Date See attached filings
- Give the name of the original appropriator (first user): _____
- Give the date appropriated _____ Amount filed on: Miners Inches _____ C. F. S. _____
- State the total number of acres irrigated under this system: _____
- Give the point of diversion: _____ $\frac{1}{4}$ Section _____ Township _____ Range _____

Part C

TO BE FILED BY ALL WATER USERS IN ADDITION TO PART A OR PART B

- Source of Water: Wolf Creek Coulee flood Irr
Name of stream or lake from which water is originally diverted
- Water is obtained by: (Check or e) Gravity Pumping _____ Other _____
- What is the greatest number of acres you have irrigated? ? Date _____
- How many acres did you irrigate in 1947? (Crop and pasture) 664.0
- State the total number of additional acres that could be irrigated by increasing the water supply, land leveling, etc. 0 This land is under what ditch? _____
- How many acres of seeped land do you have which could be drained and put into production? 0
- What is the condition of your irrigation system? Flood system fair
- Is your water supply adequate? Yes _____ No Explain Flood Irr
- REMARKS: Flood Irr by means of Res, dykes, dam & ditches.

Odegaard owner see 10, operator N.P. Land

Over

NOTE: The foregoing questions apply only to irrigated land shown on this plat.

DESCRIPTION AND MAP OF FARM

18. Legal Description of this Farm Sec. 9, 10, 15, T8N, E51E.



IRRIGATED LAND



NON-IRRIGATED LAND

Flood Irrigation

North

Sec 10, owned by Andrew Adegard

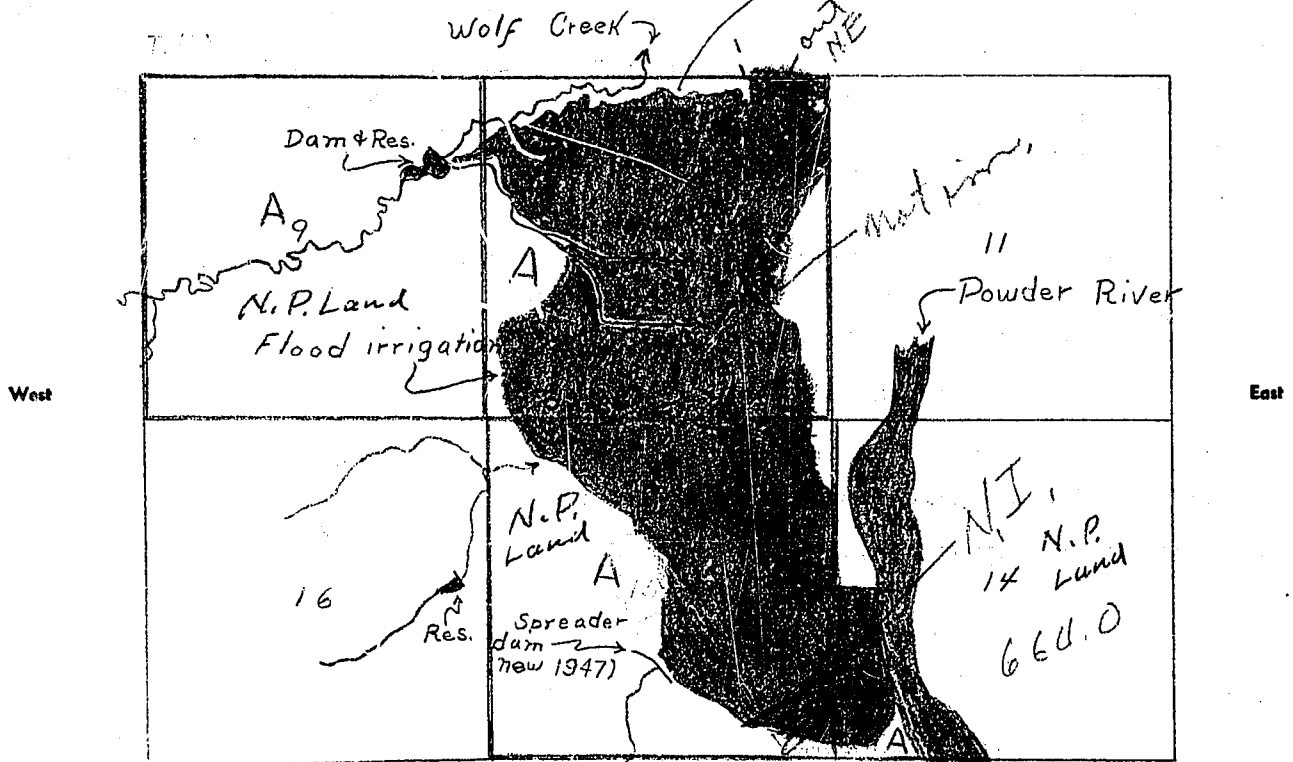

Land shown is approx land that has been flooded in maximum years of run off.

Shading covers only irrigated land. All ownership for dry land not shown.

19. If the above land is irrigated from more than one ditch please give the acreage under each ditch in 19A and indicate the location of the land irrigated from each on the above map.

19A. Ditch: Wolf Creek & Coulee Flood Irr. Acres: 664.0

Ditch: _____ Acres: _____

Information supplied by:

Name Field Survey Address _____ Date July 9-47

REMARKS: Johnson & Paulist

Land not flooded every year only when they have heavy rain or good spring run off

If you cannot answer all of the questions on this form answer as many as you can and return the form to us as soon as possible.

STATE ENGINEERS OFFICE
Water Resources Survey

COUNTY Custer

FILE NO. 21-T.8N-R.51E

Owner (9A, 11B, 14A, 15A) N.P.R.R. Co. Odegaard, Andrew Address Locate, Montana

~~AAA~~ Owner Odegaard, Andrew (10A) Address _____

Operator Odegaard, Andrew Address _____

New Owner _____ Address _____

New Operator _____ Address _____

Assessment Record None

Assessed Acreage 0

Legal Description of This Farm all of sec. 9+15; E², lots 1, 4, 5, 8, Sec. 11; lots 6, 7 Sec. 14; (N.P.R.R.) all of Sec. 10; T. 8N-R. 51E

Total Acres in Farm ✓

Code Number 9A, 11B, 14A, 15A, (N.P.R.R.)
10A (Odegaard, A.)

Farm Map

Photo No. MA 33-46

AAA Contract No. _____

AAA Total Cropland Acreage _____

App. No. 578, 1222, 2026, 2032

Decree No. _____

Land is located in

Twp. 8N Rge. 51E Twp. _____ Rge. _____

Twp. _____ Rge. _____ Twp. _____ Rge. _____

Filed in Twp. 8N Rge. 51E

Remarks operator of this

land uncertain. Probably

Andrew Odegaard

Owning only irrigated land. All ownership for dry land not shown.

Powder River Basin

STATE ENGINEERS OFFICE
Water Resources Survey

Notice of Appropriation

1. County Custer Book E Page 98 Record W.R.

2. Name of Appropriator Pat. Boyle Address Sutherland, Montana
(24)

3. Date Appropriated Mar. 25, 1911 Date Filed March 25, 1911

Amount Appropriated, Miners Inches 300, Cubic Feet per second

4. Name of Stream Dry Gulch or Coulee Tributary Basin

5. Point of Diversion In the SW corner of the NE $\frac{1}{4}$ NE $\frac{1}{4}$ of

Sec. 15 Twp. 8N. Rge. 51E. Bank of Stream North

6. Purpose For irrigation

7. Description of System A dam and ditch 24" X 48" in size, which carries and conducts
said amount of water from said gulch or coulee and runs thence in a northerly
direction to and upon said land.

8. Land Description of Intended Place of Use E $\frac{1}{2}$ SE $\frac{1}{4}$, SE $\frac{1}{4}$ NE $\frac{1}{4}$ Sec. 10-8N-51E. 120 acres,
Andrew Odegaard, Locate, Montana

9. Remarks (Pertaining to Use, etc.)

Decree

10. Case No. Date Amt. Decreed: M. I. C. F. S.

11. To Whom Decreed Address

12. Name of Ditch Maximum Capacity (C. F. S.)

13. Date of Priority Purpose

14. Land Description of Place of Use as Decreed

15. Remarks (Present Use Status, etc.)

STATE ENGINEERS' OFFICE
Water Resources Survey
Notice of Appropriation

1. County Custer Book D Page 482 Record W.R.
 2. Name of Appropriator Lucy A. & Ruby J. Hill Address Custer Co.
 3. Date Appropriated Mar. 28, 1911 Date Filed Mar. 28, 1911
 Amount Appropriated, Miners Inches _____, Cubic Feet per second 12
 4. Name of Stream Paddy Gulch Tributary _____ Basin _____
 5. Point of Diversion _____ (See question #7)

 Sec. 16 Twp. _____ SN. _____ Rge. 51E. Bank of Stream _____

6. Purpose Irrigating and other purposes

7. Description of System A dam across said gulch and near the mouth thereof, which dam shall be approximately 425 ft. long, 24 ft. high and 75 ft. wide at the bottom, and connected with said dam a ditch of approximately 6 ft. wide and 4 ft. deep to convey the said waters to and upon the lands above described thereto be aided by such laterals as may be necessary.

8. Land Description of Intended Place of Use _____
SE 1/4, NE 1/4, S 1/2, NW 1/4, SW 1/4 Sec. 10-8N-51E, 320 acres, Andrew Odegaard, Locate
SW 1/4, SE 1/4, NE 1/4, NW 1/4 Sec. 10-8N-51E, Mrs. Smith White, Los Angeles, Cal.

9. Remarks (Pertaining to Use, etc.) _____

Decree

10. Case No. _____ Date _____ Amt. Decreed: M. I. _____ C. F. S. _____
 11. To Whom Decreed _____ Address _____
 12. Name of Ditch _____ Maximum Capacity (C. F. S.) _____
 13. Date of Priority _____ Purpose _____
 14. Land Description of Place of Use as Decreed _____

 15. Remarks (Present Use Status, etc.) _____

STATE ENGINEERS OFFICE
Water Resources Survey

Notice of Appropriation

1. County Custer Book B Page 473 Record W.R.

2. Name of Appropriator Neil Boyle Address Custer Co., Montana
Nov. 25, 1903

3. Date Appropriated Dec. 14, 1903 Date Filed Dec. 14, 1903

Amount Appropriated, Miners Inches 500 or , Cubic Feet per second 12 1/2

4. Name of Stream Wolf Creek Tributary Powder River Basin

5. Point of Diversion In the
E 1/2
Sec. 9 Twp. 8N. Rge. 51E. Bank of Stream

6. Purpose For irrigating, watering stock and other purposes.

7. Description of System A dam and a ditch, said dam to be about 100 feet long and about 4 ft. high and said ditch from said dam running to the SE 1/4 of said Sec. 10, over and across the SW 1/4 Sec. 10, said ditch to be about 1 1/4 miles long and sufficient in size to conduct amount of water herein appropriated.

8. Land Description of Intended Place of Use
SE 1/4 NE 1/4, E 1/2 SW 1/4 Sec. 10-8N-51E, 160 acres, Andrew Odagaard, Locate, Montana

9. Remarks (Pertaining to Use, etc.)

Decree

10. Case No. Date Amt. Decreed: M. I. C. F. S.

11. To Whom Decreed Address

12. Name of Ditch Maximum Capacity (C. F. S.)

13. Date of Priority Purpose

14. Land Description of Place of Use as Decreed

15. Remarks (Present Use Status, etc.)

STATE ENGINEERS OFFICE
Water Resources Survey
Notice of Appropriation

1. County Custer Book D Page 208 Record W.R.

2. Name of Appropriator Lucy A. and Ruby Hill Address Custer Co.

3. Date Appropriated May 15, 1909 Date Filed May 17, 1909

Amount Appropriated, Miners Inches....., Cubic Feet per second 25

4. Name of Stream Wolf Creek Tributary..... Basin.....

5. Point of Diversion..... In or near the SE $\frac{1}{4}$ N $\frac{1}{4}$

Sec. 9 Twp. 8N. Rge. 51E. Bank of Stream.....

6. Purpose Irrigation and watering stock

7. Description of System..... A dam across said creek which dam shall be 150 feet long, 15 to 20 feet deep, 30 ft. wide on the bottom, 10 ft. wide at the top and so constructed as to impound and store the waters of said creek in a reservoir, thence to be diverted by means of a ditch or ditches of sufficient size and capacity to carry and convey said waters to and upon the lands above described.

8. Land Description of Intended Place of Use.....

SE $\frac{1}{4}$ NW $\frac{1}{4}$, NE $\frac{1}{4}$ SW $\frac{1}{4}$ Sec. 10-8N-51E, 80 acres, Mrs. Smith White, 2124 W. 24th St., Los Angeles, Cal.
SW $\frac{1}{4}$ NW $\frac{1}{4}$, NW $\frac{1}{4}$ SW $\frac{1}{4}$ Sec. 10-8N-51E, 80 acres, Andrew Odegaard

9. Remarks (Pertaining to Use, etc.)..... Also the following lands of Lucy A. Hill: W $\frac{1}{2}$ SW $\frac{1}{4}$, SE $\frac{1}{4}$ SW $\frac{1}{4}$, SW $\frac{1}{4}$ NW $\frac{1}{4}$ of the same Section 10, T. 8N., R. 51E, and so much of Sec. 3-8N-51E, as lies below the course of said Wolf Creek, in all about 480 acres.

Decree

10. Case No..... Date..... Amt. Decreed: M. I..... C. F. S.....

11. To Whom Decreed..... Address.....

12. Name of Ditch..... Maximum Capacity (C. F. S.).....

13. Date of Priority..... Purpose.....

14. Land Description of Place of Use as Decreed.....

15. Remarks (Present Use Status, etc.).....

Farm Checked

By Collins & Joe

Area Locate

Date 7/8/47

Legal Land Owner

Operator

Water is delivered by:

Federal Project _____ Pres. _____ Pot. _____

Ditch Company _____ Pres. _____ Pot. _____

Irrigation District _____ Pres. _____ Pot. _____

Private System Private Flood Pres. _____ Pot. _____

Totals _____

Flood Pump _____ Reservoir Gravity _____

Size and Capacity, Pump, etc.

Original Appropriator, Company _____ App. No. _____

Original Appropriator, Private _____ (Show date of appropriation under Remarks) App. No. _____

Is the system an extension of another system? Yes _____ No _____

Is all land irrigated from one system? Yes _____ No _____

(If No, show break down on map)

Source of Water Spreader dams and ditches from Reservoir on Wolf Cr.

Acres Irrigated 19 _____

Potential Acres _____ Seeped _____

Explain _____

Condition of System _____

Adequate Supply _____ Yes _____ No _____

Explain _____

Topography _____

Information From _____

Remarks Could not contact

any one about land

at operator's right

Code No. _____

County Custer

T. 8N R. 51E Sec. _____

Photo No. 33-46

Address _____

Address _____

Pres. _____ Pot. _____

Pres. _____ Pot. _____

Pres. _____ Pot. _____

Pres. _____ Pot. _____

Totals _____

Gravity _____

App. No. _____

App. No. _____

Yes _____ No _____

Yes _____ No _____



NOTICE
These forms are the property of the State of Montana and must be returned.

STATE OF MONTANA
STATE ENGINEERS' OFFICE
Water Resources Survey

Code No. _____
County _____
T. _____ R. _____

Name of Land Owner USA Address _____

Name of Operator Wray Land Address _____

Part A
TO BE FILED BY THOSE OBTAINING IRRIGATION WATER FROM
A DITCH COMPANY OR IRRIGATION DISTRICT

1. Water is delivered by: _____ Name of Ditch, Ditch Company or District Supplying Water _____
2. State the number of acres you irrigate under this system _____ Shares you hold _____
3. If you obtain water from more than one Company, give the number of shares, acres irrigated and the name of the Company under "Remarks." If you obtain water from a Ditch Company and also have a private system fill in both Part A and Part B.

Part B
TO BE FILED BY THOSE WHO HAVE A PRIVATE DITCH, PUMP OR IRRIGATION SYSTEM
or those who have a private water right under a Ditch Company

4. In what year was this land first irrigated? Date _____
5. Give the name of the original appropriator (first user): _____
6. Give the date appropriated _____ Amount filed on: Miners Inches _____ C. F. S. _____
7. State the total number of acres irrigated under this system: _____
8. Give the point of diversion: _____ 1/4 Section _____ Township _____ Range _____

Part C
TO BE FILED BY ALL WATER USERS IN ADDITION TO PART A OR PART B

9. Source of Water: _____ Name of stream or lake from which water is originally diverted _____
10. Water is obtained by: (Check one) Gravity _____ Pumping _____ Other _____
11. What is the greatest number of acres you have irrigated? _____ Date _____
12. How many acres did you irrigate in 19____? (Crop and pasture) _____
13. State the total number of additional acres that could be irrigated by increasing the water supply, land leveling, etc. _____ This land is under what ditch? _____
14. How many acres of seeped land do you have which could be drained and put into production? _____
15. What is the condition of your irrigation system? _____
16. Is your water supply adequate? Yes _____ No _____ Explain _____
17. REMARKS: _____

Over _____

NOTE: The foregoing questions apply only to irrigated land shown on this plat.

DESCRIPTION AND MAP OF FARM

18. Legal Description of this Farm



IRRIGATED LAND



NON-IRRIGATED LAND

North

West

East

South

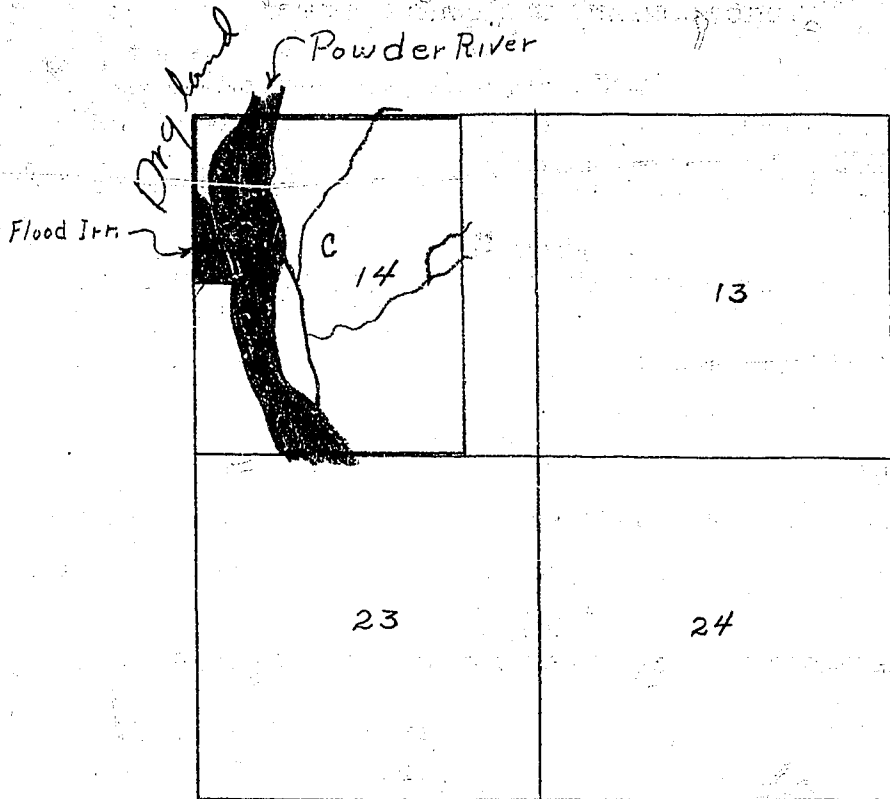

Ownership covers only irrigated land. All ownership for dry land not shown.

19. If the above land is irrigated from more than one ditch please give the acreage under each ditch in 19A and indicate the location of the land irrigated from each on the above map.

19A. Ditch: Dry Canal Acres: _____

Ditch: _____ Acres: _____

Information supplied by:

Name Field Club Address _____ Date July 9-47

REMARKS: _____

If you cannot answer all of the questions on this form answer as many as you can and return the form to us as soon as possible.

STATE ENGINEERS OFFICE
Water Resources Survey

COUNTY Cluster

FILE NO. 21-7.8N-R.51E

Owner U.S.A Address Miles City

AAA Owner Address

Operator ? Address

New Owner Address

New Operator Address

Assessment Record None

Assessed Acreage 0

Legal Description of This Farm lots 1, 2, 3, 4, 5, 8; W 2 E 2 Sec 14 T. 8N-R. 51E

Total Acres in Farm ✓

Code Number 14C

Farm Map

Photo No. MA 23-46

AAA Contract No.

AAA Total Cropland Acreage

App. No. 1312

Decree No.

Land is located in

Twp. 8N Rge. 51E Twp. Rge.

Twp. Rge. Twp. Rge.

Filed in Twp. 8N Rge. 51E

Remarks (Find operator)

Ownership covers
only irrigated land.
All ownership for
dry land not shown.

Powder River Basin

STATE OF MONTANA
STATE ENGINEER'S OFFICE
 WATER RESOURCES SURVEY

Township 8N Range 51E County Custer

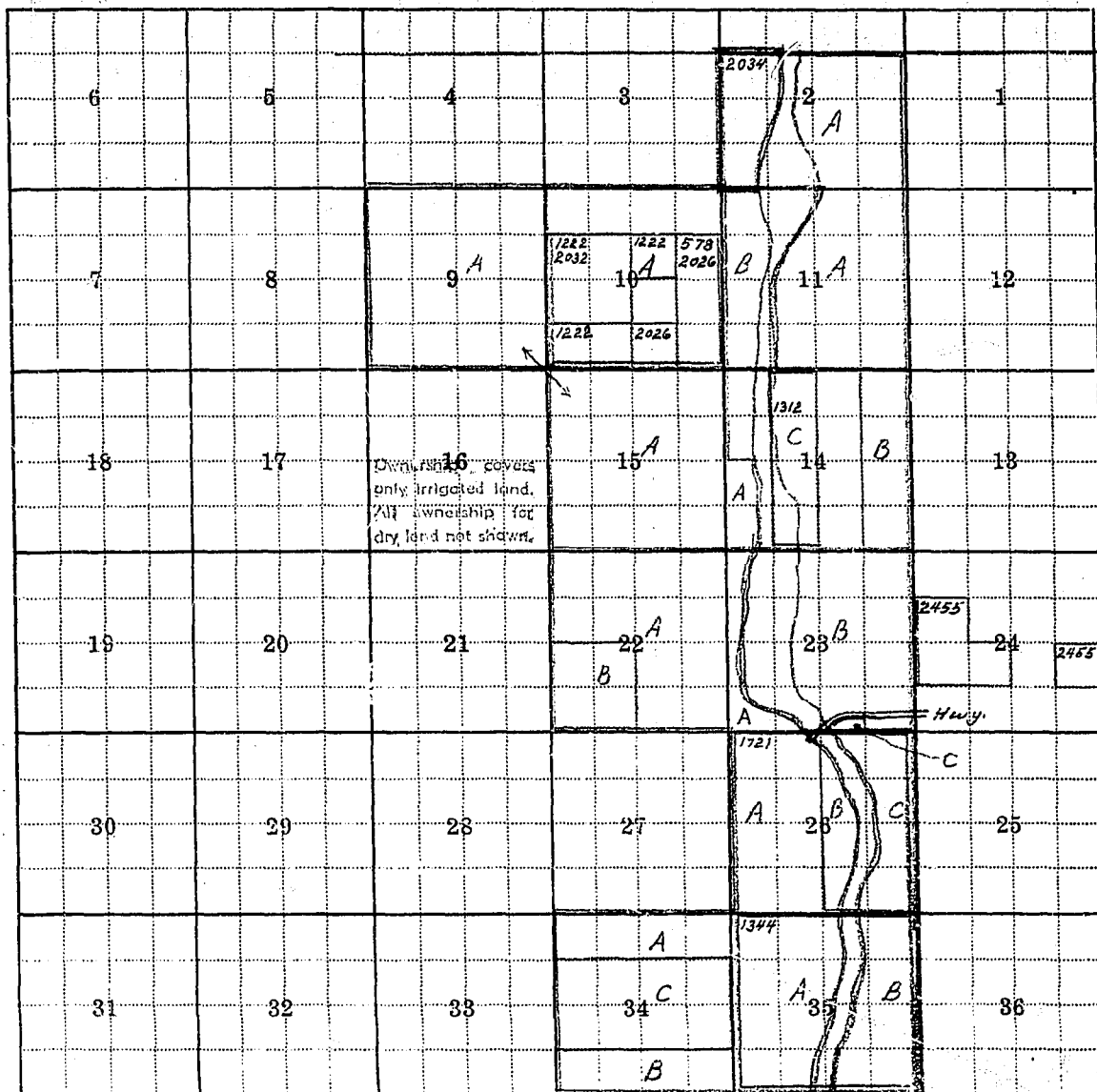

Township 8N Range 51E

Township 8 North

Range 51 East

Custer County

<u>Index No.</u>	<u>Name of Appropriator</u>	<u>Stream</u>	<u>Date App.</u>	<u>Date Filed</u>	<u>M.I.</u>
578	Pat Boyle	Dry Gulch	3-24-11	3-25-11	300
1222	Lucy & Ruby Hill	Paddy Gulch	3-23-11	3-28-11	480
1312	Lillian M. Baldwin	Powder River	4-17-16	4-19-16	2000
1344	C. J. Smith	Powder River	7-1-02	11-4-14	1000
1721	Andrew S. Holmes	Smith Creek	4-7-31	4-7-31	1000
2026	Neil Boyle	Wolf Creek	11-25-03	12-14-03	500
2032	Lucy & Ruby Hill	Wolf Creek	5-15-09	5-17-09	1000
2034	Austin B. Middleton	Wolf Creek	11-30-17	12-5-17	2000
2455	P. F. Metz (E. H. Knutson)	Cox Springs	10-19-35	10-19-35	40

Township 8 North

Range 51 East

Custer County



NOTICE
These forms are the
property of the State
of Montana and must
be returned.

STATE OF MONTANA
STATE ENGINEERS OFFICE
Water Resources Survey

FORM WR-24 (2-47)
Code No. 20A-21A
County Custer
T. 8N R. 52E

Name of Land Owner A. W. Bradshaw Address Vanaway, Mont.
Name of Operator _____ Address _____

Part A

**TO BE FILED BY THOSE OBTAINING IRRIGATION WATER FROM
A DITCH COMPANY OR IRRIGATION DISTRICT**

1. Water is delivered by: _____ Name of Ditch, Ditch Company or District Supplying Water _____
2. State the number of acres you irrigate under this system _____ Shares you hold _____
3. If you obtain water from more than one Company, give the number of shares, acres irrigated and the name of the Company under "Remarks." If you obtain water from a Ditch Company and also have a private system fill in both Part A and Part B.

Part B

**TO BE FILED BY THOSE WHO HAVE A PRIVATE DITCH, PUMP OR IRRIGATION SYSTEM
or those who have a private water right under a Ditch Company**

4. In what year was this land first irrigated? Date 1912 (see attached data)
5. Give the name of the original appropriator (first user): Jos. R. Abbigde
6. Give the date appropriated 5/16/12 Amount filed on: Miners Inches 500 C. F. S. _____
7. State the total number of acres irrigated under this system: 98
8. Give the point of diversion: Flood $\frac{1}{4}$ Section _____ Township _____ Range _____

Part C

TO BE FILED BY ALL WATER USERS IN ADDITION TO PART A OR PART B

9. Source of Water: Locate Creek
Name of stream or lake from which water is originally diverted _____
10. Water is obtained by: (Check one) Gravity Pumping _____ Other _____
11. What is the greatest number of acres you have irrigated? _____ Date _____
12. How many acres did you irrigate in 1947? (Crop and pasture) 98
13. State the total number of additional acres that could be irrigated by increasing the water supply, land leveling, etc. 0 This land is under what ditch? _____
14. How many acres of seeped land do you have which could be drained and put into production? 0
15. What is the condition of your irrigation system? Flood
16. Is your water supply adequate? Yes _____ No Explain A flood in
17. REMARKS: Irrigated by means of dams & ditches when water is available

NOTE: The foregoing questions apply only to irrigated land shown on this plat.

DESCRIPTION AND MAP OF FARM

18. Legal Description of this Farm M2, SW4, Sec 20, T21N, R57E
in sec 21, 8N, R57E.



IRRIGATED LAND



NON-IRRIGATED LAND

North

West

East

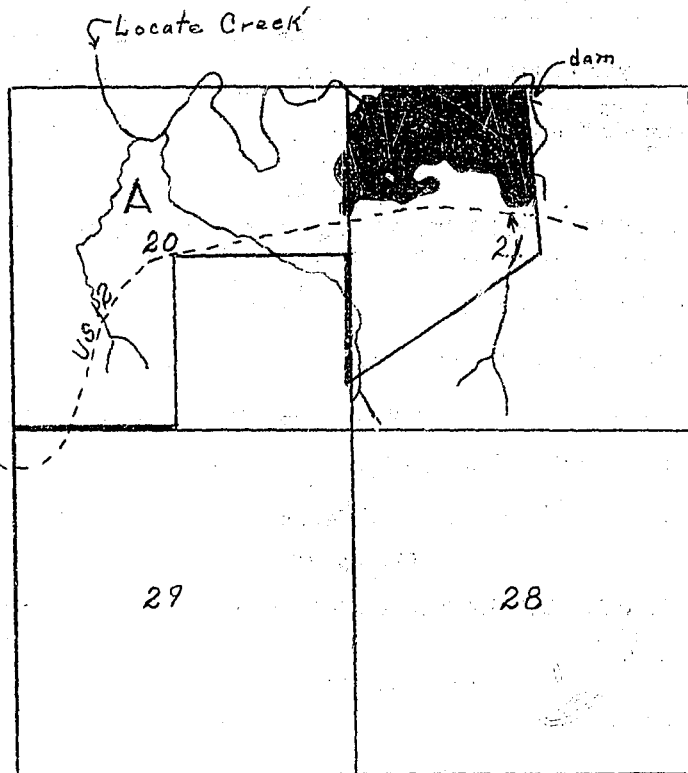

South

Ownership covers only irrigated land. All ownership for dry land not shown.

19. If the above land is irrigated from more than one ditch please give the acreage under each ditch in 19A and indicate the location of the land irrigated from each on the above map.

19A. Ditch: Locate Creek flood ch Acres: 98.0

Ditch: _____ Acres: _____

Information supplied by:

Name Bradshaw to Address _____ Date July 17-47

REMARKS: Johnson & Paulist
Bradshaw R ranch will buy bottom land

If you cannot answer all of the questions on this form answer as many as you can and return the form to us as soon as possible.

STATE ENGINEERS OFFICE
Water Resources Survey

COUNTY Custer
FILE NO. 22-T-8N-R-52E

Owner Bradshaw, Al Address Isnia, Montana
AAA Owner _____ Address _____
Operator 7 Address _____
New Owner _____ Address _____
New Operator _____ Address _____

Assessment Record None
Assessed Acreage 0

Legal Description of This Farm (NW part of Sec 21 meets & bounds) N² Sec 20
T. 8N-R. 52E

Total Acres in Farm ✓

Code Number 20A, 21A
Photo No. MA 20-37
AAA Contract No. _____
AAA Total Cropland Acreage _____
App. No. 1008
Decree No. _____
Land is located in
Twp. 8N Rge. 52E Twp. _____ Rge. _____
Twp. _____ Rge. _____ Twp. _____ Rge. _____
Filed in Twp. 8N Rge. 52E
Remarks a new ownership for
this land. Find new owner
and operator

Locate Cr.

Farm Map

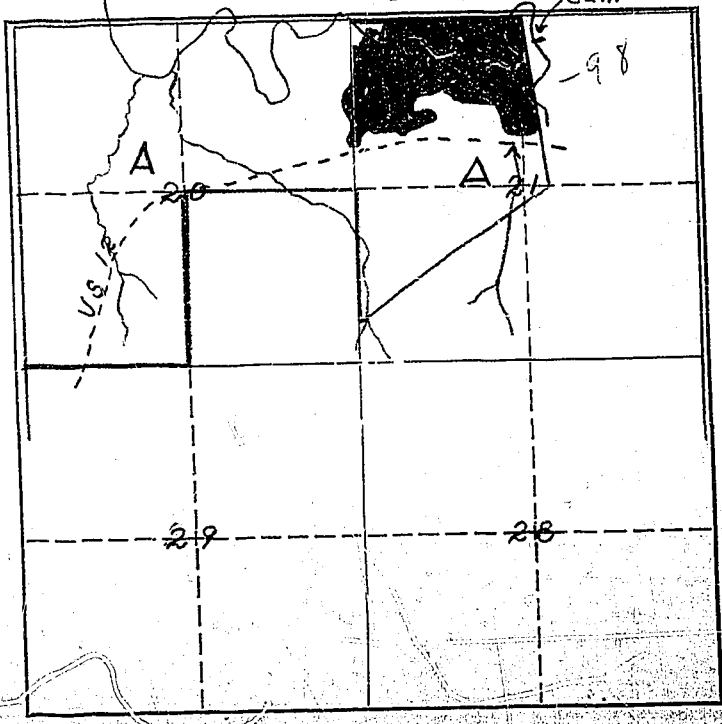



Ownership covers
only irrigated land.
All ownership for
dry land not shown.

Powder River Basin

NOTE: The foregoing questions apply only to irrigated land shown on this plat.

DESCRIPTION AND MAP OF FARM

18. Legal Description of this Farm Mt. & bounds in sec 21, all
227 8 N, 52 E.

 IRRIGATED LAND  NON-IRRIGATED LAND

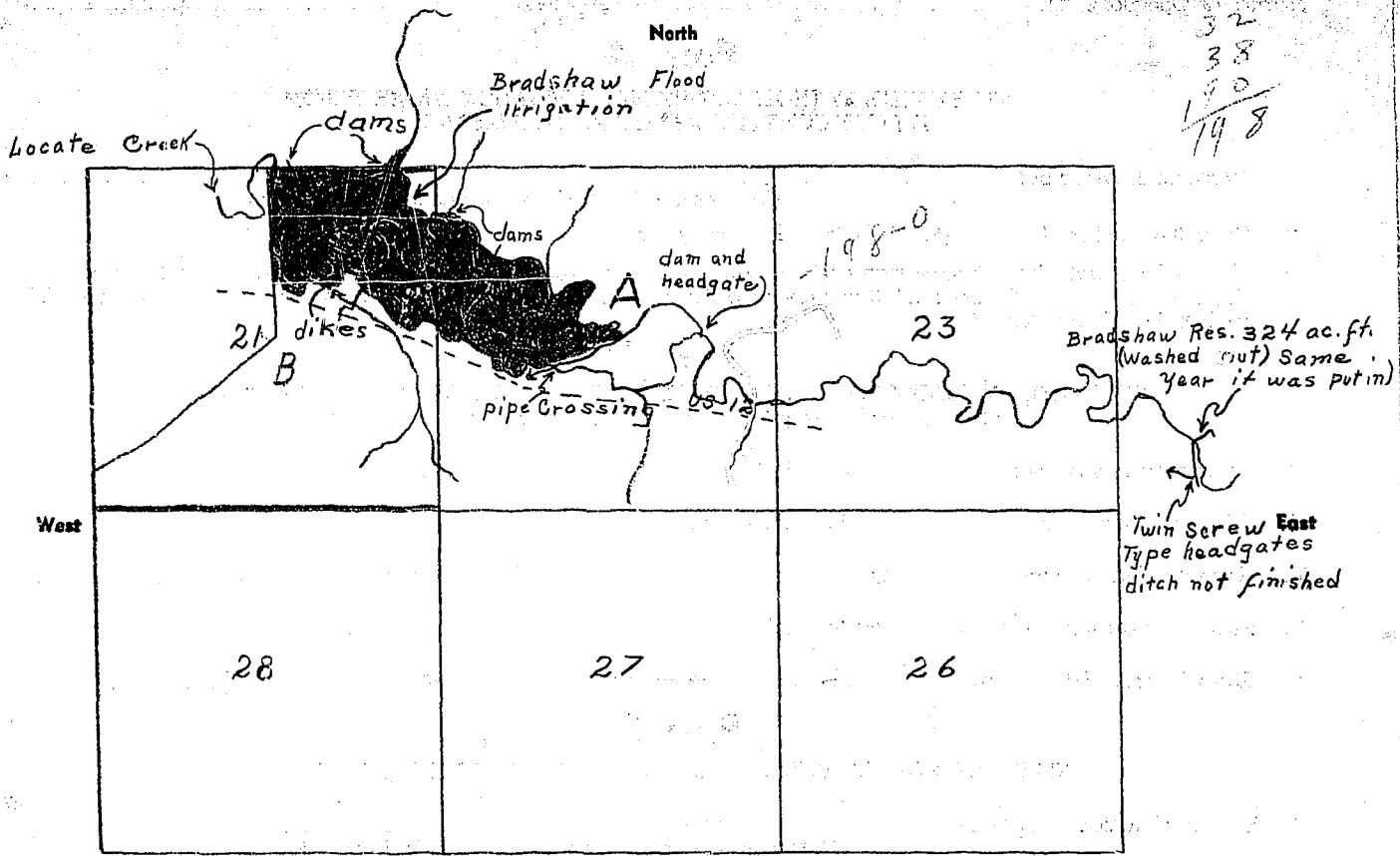

8
32
38
100
178

19. If the above land is irrigated from more than one ditch please give the acreage under each ditch in 19A and indicate the location of the land irrigated from each on the above map.

19A. Ditch: Locate Creek (Bradshaw flood) Acres: 198.0
Ditch: _____ Acres: _____

Information supplied by:
Name Bradshaw to Address _____ Date July 17-47

REMARKS: Johnson & Paulist

If you cannot answer all of the questions on this form answer as many as you can and return the form to us as soon as possible.



NOTICE
 These books are the property of the State of Montana and must be returned.

STATE OF MONTANA
STATE ENGINEERS OFFICE
Water Resources Survey

Code No. 216-22A
 County Quinn
 T. 8N R. 52

Name of Land Owner J. R. Bradshaw Address Usney Mount
 Name of Operator _____ Address _____

Part A

TO BE FILED BY THOSE OBTAINING IRRIGATION WATER FROM A DITCH COMPANY OR IRRIGATION DISTRICT

1. Water is delivered by: _____ Name of Ditch, Ditch Company or District Supplying Water
2. State the number of acres you irrigate under this system _____ Shares you hold _____
3. If you obtain water from more than one Company, give the number of shares, acres irrigated and the name of the Company under "Remarks." If you obtain water from a Ditch Company and also have a private system fill in both Part A and Part B.

Part B

TO BE FILED BY THOSE WHO HAVE A PRIVATE DITCH, PUMP OR IRRIGATION SYSTEM or those who have a private water right under a Ditch Company

4. In what year was this land first irrigated? Date see remarks
5. Give the name of the original appropriator (first user): _____
6. Give the date appropriated _____ Amount filed on: Miners Inches _____ C. F. S. _____
7. State the total number of acres irrigated under this system: _____
8. Give the point of diversion: _____ $\frac{1}{4}$ _____ $\frac{1}{4}$ Section _____ Township _____ Range _____

Part C

TO BE FILED BY ALL WATER USERS IN ADDITION TO PART A OR PART B

9. Source of Water: Treaty Creek Name of stream or lake from which water is originally diverted
10. Water is obtained by: (Check one) Gravity Pumping _____ Other _____
11. What is the greatest number of acres you have irrigated? ? Date _____
12. How many acres did you irrigate in 1947? (Crop and pasture) 198.0
13. State the total number of additional acres that could be irrigated by increasing the water supply, land leveling, etc. 0 This land is under what ditch? _____
14. How many acres of seeped land do you have which could be drained and put into production? 0
15. What is the condition of your irrigation system? Fair
16. Is your water supply adequate? Yes _____ No Explain Flood line
17. REMARKS: _____

J. R. & A. W. Bradshaw lands operated as one unit, possibility of Jase Cabbage right covering all land.

Bradshaw Reservoir in Sec. 24, 8N R5E
a straight storage dam of earth fill 500'
long, 26' high. Storage Capacity 344
acre feet, irrigable area 300 acres
submerged area 48.2 acres, drainage 6.2
square miles, Cost \$11,569. Water from dam
is delivered through outlet pipe to creek channel
about a mile below the dam. Bradshaw
brothers constructed a rock dam to
divert water onto their meadows, Dam
washed out next year after construction.

STATE ENGINEERS OFFICE
Water Resources Survey

COUNTY Custer

FILE NO. 22-T-8N-R-52E

Owner Bradshaw, J.R. Address T. Smay, Montana
 AAA Owner _____ Address _____
 Operator _____ Address _____
 New Owner _____ Address _____
 New Operator _____ Address _____

Assessment Record None

Assessed Acreage 0

Legal Description of This Farm South part of Sec 21 (units & bds) all of Sec 22, T. 8N-R. 52E

Code Number 21B, 22A
 Photo No. MA 20-37
 AAA Contract No. _____
 AAA Total Cropland Acreage _____
 App. No. Perm - 1008
No record by desc. pt.
 Decree No. _____

Land is located in
 Twp. 8N Rge. 52E Twp. _____ Rge. _____
 Twp. _____ Rge. _____ Twp. _____ Rge. _____
 Filed in Twp. 8N Rge. 52E

Remarks A new ownership for this land. Find new owner & operator.

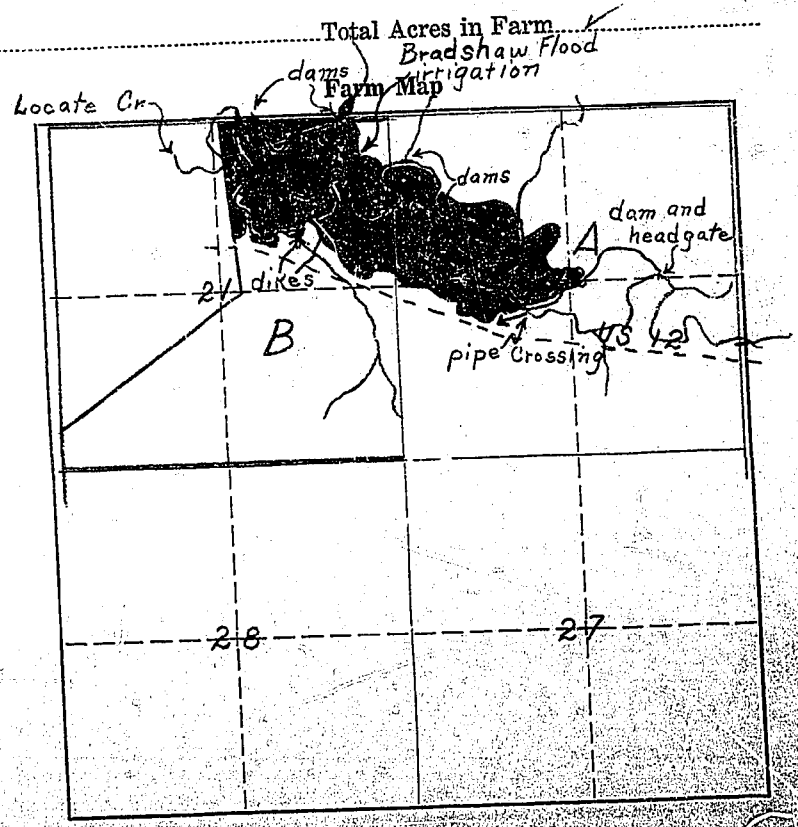

Powder River Basin

(over)

Ownership covers only irrigated land. All ownership for dry land not shown.



NOTE:
These forms are the
property of the State
of Montana and must
be returned.

STATE OF MONTANA
STATE ENGINEERS OFFICE

Water Resources Survey

FORM WR-2 (12-47)
Code No. 16A
County Custer
T. 5N R. 52E

Name of Land Owner State of Montana Address Helena, Mont.
Name of Operator J. L. Bradshaw Address Idamay, Mont.

Part A

TO BE FILED BY THOSE OBTAINING IRRIGATION WATER FROM
A DITCH COMPANY OR IRRIGATION DISTRICT

1. Water is delivered by: _____ Name of Ditch, Ditch Company or District Supplying Water _____
2. State the number of acres you irrigate under this system _____ Shares you hold _____
3. If you obtain water from more than one Company, give the number of shares, acres irrigated and the name of the Company under "Remarks." If you obtain water from a Ditch Company and also have a private system fill in both Part A and Part B.

Part B

TO BE FILED BY THOSE WHO HAVE A PRIVATE DITCH, PUMP OR IRRIGATION SYSTEM
or those who have a private water right under a Ditch Company

4. In what year was this land first irrigated? Date No date
5. Give the name of the original appropriator (first user): _____
6. Give the date appropriated _____ Amount filed on: Miners Inches _____ C. F. S. _____
7. State the total number of acres irrigated under this system: _____
8. Give the point of diversion: _____ $\frac{1}{4}$ _____ $\frac{1}{4}$ Section _____ Township _____ Range _____

Part C

TO BE FILED BY ALL WATER USERS IN ADDITION TO PART A OR PART B

9. Source of Water: Locate Creek
Name of stream or lake from which water is originally diverted
10. Water is obtained by: (Check one) Gravity Pumping _____ Other _____
11. What is the greatest number of acres you have irrigated? 10.0 Date _____
12. How many acres did you irrigate in 1947 (Crop and pasture) 10.0
13. State the total number of additional acres that could be irrigated by increasing the water supply, land leveling, etc. 0 This land is under what ditch? _____
14. How many acres of seeped land do you have which could be drained and put into production? 0
15. What is the condition of your irrigation system? Flood
16. Is your water supply adequate? Yes _____ No Explain Flooded
17. REMARKS: No works on State land but flooded from Bradshaw works on his land

Sec. 16, T. 8N, R. 5E



IRRIGATED LAND

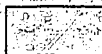

NON-IRRIGATED LAND

North

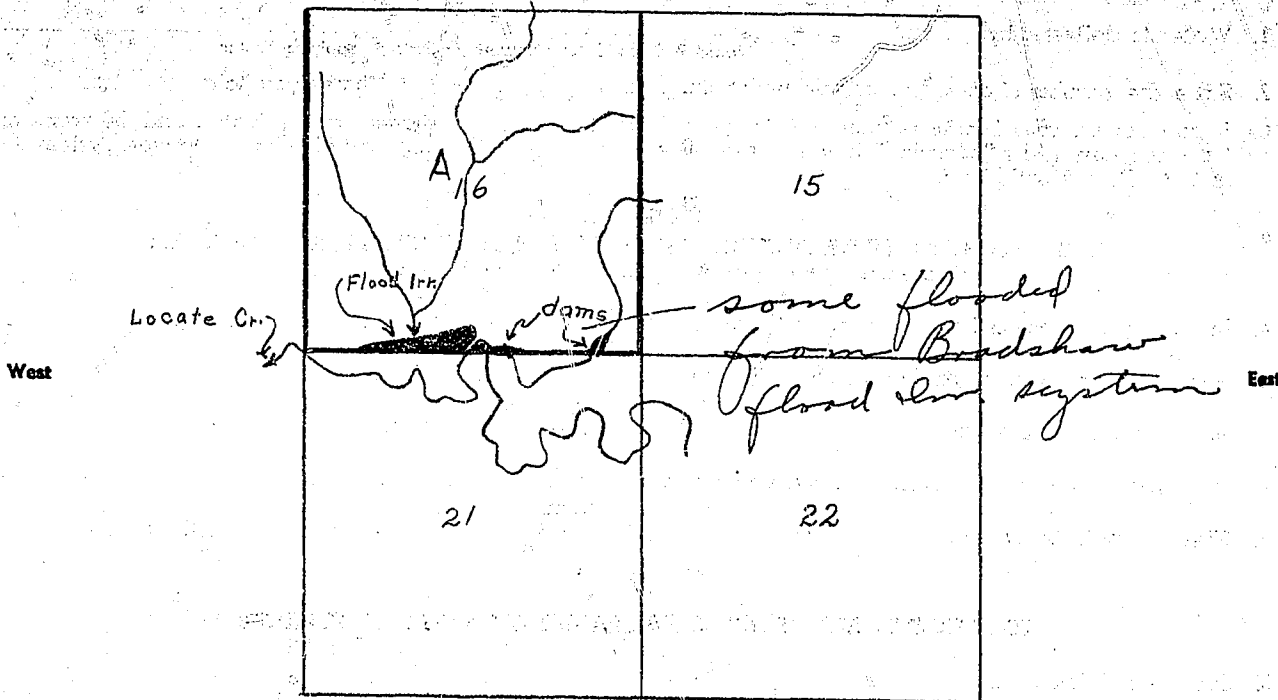

Ownership covers only irrigated land. All ownership for dry land not shown.

South

19. If the above land is irrigated from more than one ditch please give the acreage under each ditch in 19A and indicate the location of the land irrigated from each on the above map.

19A. Ditch: Locate Creek flood irr Acres: 10.0
 Ditch: _____ Acres: _____

Information supplied by:

Name Field Survey Address _____ Date July 17-47

REMARKS: Johnson & Pauliat

If you cannot answer all of the questions on this form answer as many as you can and return the form to us as soon as possible.

STATE ENGINEERS OFFICE
Water Resources Survey

COUNTY Custer
FILE NO 22-T-8N-R-52E

Owner Montana, State of Address Helena, Montana

AAA Owner _____ Address _____

Operator _____ Address _____

New Owner _____ Address _____

New Operator _____ Address _____

Assessment Record None

Assessed Acreage 0

Legal Description of This Farm all of Sec 16; T. 8N-R. 52E

Total Acres in Farm ✓

Code Number 16A

Farm Map

Photo No. MA 20-38

AAA Contract No. _____

AAA Total Cropland Acreage _____

App. No. No record by Discript

Decree No. _____

Land is located in

Twp. 8N Rge. 52E Twp. _____ Rge. _____

Twp. _____ Rge. _____ Twp. _____ Rge. _____

Filed in Twp. 8N Rge. 52E

Remarks This land is probably
leased by Bradshaw

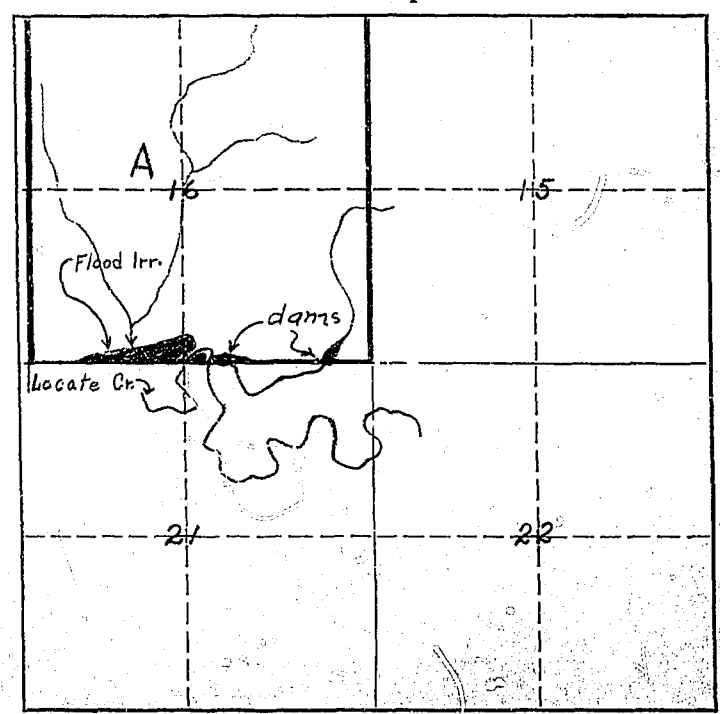

Powder River Basin

Ismay, Montana.
March 12, 1948.

Mr. G. J. Oravetz,
Asst. State Engineer,
P. O. Box 873,
Billings, Montana.

Dear Sir: Re: Flood Irrigation Locate Creek.

This is in answer to your letter of February 12th addressed to my brother J. R. Bradshaw. J. R. Bradshaw passed away here last April, and I am the executor of his estate.

To my knowledge there has never been a water right filed on Locate Creek in the vicinity of the sections that you have mentioned in your letter. On Section 24-8N-52, the W.P.A. put in a dam in the Winter of 1938-1939. They had an easement on that property, and some sort of a water right that is connected with those projects. Of course you would be able to get the dope from the office in Helena.

To give you a little history of the sections that you have mentioned in your letter, my father built up a ranch on Section 22 along about 1889 and homesteaded on this section some time later on, and lived there until his death in 1935. The balance of these lands were of course acquired subsequent to the homestead. To my knowledge the first irrigation out of the creek was started along about 1900, of course on a small scale along about that time, and in fact we are still developing hay meadows along these bottoms.

We own ten or twelve miles of Locate Creek, and six or seven miles of country on a creek called Coal Creek in Township 9N-52, and we are very much interested in getting a water right established within our holdings here on both creeks, but I am at a loss to know how to go about getting them. Therefore would appreciate hearing from you as to the proper method of procedure.

I hope that I have given you the desired information in this letter, and if I can be of any further assistance do not hesitate to call on me.

Sincerely yours,

A. W. Bradshaw

AWB:n

March 16, 1948

Mr. A. W. Bradshaw
Ismay, Montana

Dear Mr. Bradshaw:

I have your letter relative to the lands on Locate and Coal Creeks and wish to advise that the information contained therein is sufficient for our purpose.

In order to file water rights on these lands it will be necessary for you to accord your water rights in the Custer County courthouse, giving the date of first use and the approximate number of acres irrigated at that time, and also the acreage irrigated now. By doing this you will establish a date of priority with the date of filing being whatever date you make the recording. In a case of this kind it will be advisable to have a witness so as to further substantiate your date of first use. We are enclosing a Notice of Appropriation blank which is similar to the form that you will have to fill out and record in the courthouse. The part marked "decree" you may disregard because this pertains to a water right that has been adjudicated by the courts.

Hoping this information is sufficient for you to make out the proper recordings, I am

Very truly yours,

Gerald J. Cravetz
Assistant State Engineer

GJO/a
enc.

1008

STATE ENGINEERS OFFICE
Water Resources Survey
Notice of Appropriation

- 1. County Custer Book E Page 220 Record W.R.
- 2. Name of Appropriator James Rabidge Address Sutherland, Montana
- 3. Date Appropriated May 16, 1912 Date Filed May 16, 1912
- Amount Appropriated, Miners Inches 500 or _____, Cubic Feet per second 12 1/2
- 4. Name of Stream Locate Creek Tributary _____ Basin _____
- 5. Point of Diversion _____

Sec. _____ Twp. _____ Rge. _____ Bank of Stream West

- 6. Purpose For irrigation
- 7. Description of System A ditch and headgate of sufficient size, which carries and conducts said amount of water from said creek and runs thence in a westerly direction, conducted and conveyed by means of such dams, dykes, ditches, flumes as may be necessary for the proper irrigation of the said land.
- 8. Land Description of Intended Place of Use _____

N 1/4 Sec. 20-8N-52E, 160 acres, Mary Ann Cunningham, Miles City.
S 1/4 Sec. 20-8N-52E, Bradshaw Land & Cattle Co., Locate, Montana

- 9. Remarks (Pertaining to Use, etc.) Locate Creek runs in a westerly direction through the N 1/4 of Sec. 20-8N-52E.

Decree

- 10. Case No. _____ Date _____ Amt. Decreed: M. I. _____ C. F. S. _____
- 11. To Whom Decreed _____ Address _____
- 12. Name of Ditch _____ Maximum Capacity (C. F. S.) _____
- 13. Date of Priority _____ Purpose _____
- 14. Land Description of Place of Use as Decreed _____

- 15. Remarks (Present Use Status, etc.) _____

February 12, 1948

Mr. J. R. Bradshaw
Ismay, Montana

Re: Flood Irrigation Locate Creek

Dear Sir:

Custer

Township 8 North

Range 52 East

Custer County, Montana

<u>Index No.</u>	<u>Name of Appropriator</u>	<u>Stream</u>	<u>Date App.</u>	<u>Date Filed</u>	<u>Inches</u>
1008	Jas. Rabbidge	Locate Creek	5-16-12	5-16-12	500

Township 8 North

Range 52 East

Custer County, Montana

STATE OF MONTANA
STATE ENGINEER'S OFFICE
WATER RESOURCES SURVEY

11 Township 8 North Range 52 East County Custer

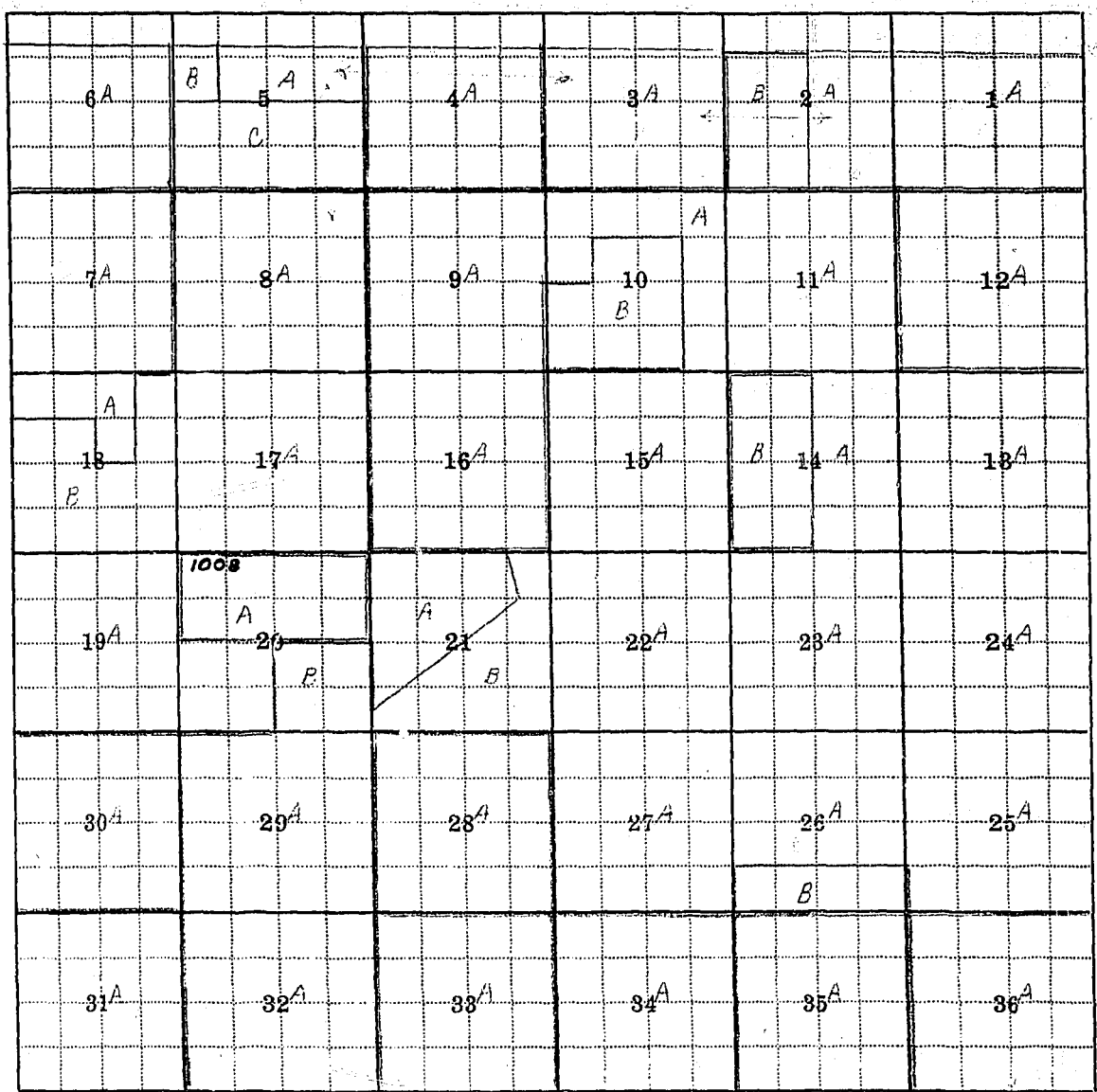

Township 8 North Range 52 East

