

Water

—of

— sheets.

Letters

T. 9N., R. 47E.

STATE ENGINEER'S OFFICE
WATER RESOURCES SURVEYCOUNTY CusterFILE NO. 11-T. 9N-R. 47EOwner Campbell, Fred L. & Bessie M Address Kinsey, Montana
(Kinsey Unit)

AAA Owner Address

Operator " " " Address " "

New Owner Address

New Operator Address

Assessment Record yes - Unit No. 3Assessed Acreage 81.0Legal Description of This Farm Unit No. 3 (Meets & Bounded) Sec. 13, T. 9N-R. 47ETotal Acres in Farm 372.80Code Number Unit No. 3Photo No. Ma-18-175

AAA Contract No.

AAA Total Cropland Acreage

App. No. 2123; 2124

Decree No.

Land is located in

Twp. 9N Rge. 77E Twp. Rge.

Twp. Rge. Twp. Rge.

Filed in Twp. 9N Rge. 48E

Remarks

Yellowstone River BasinOwnership covers
only irrigated land.
All ownership for
dry land not shown.



NOTICE
These forms are the
property of the State
of Montana and must
be returned.

STATE OF MONTANA
STATE ENGINEERS OFFICE

Water Resources Survey

Code No. 240

County Custer

T. 9N R. 47E

Name of Land Owner George A. & Katherine Hall

Address Miller City,

Name of Operator _____

Address _____

Part A

TO BE FILED BY THOSE OBTAINING IRRIGATION WATER FROM
A DITCH COMPANY OR IRRIGATION DISTRICT

1. Water is delivered by: _____
Name of Ditch, Ditch Company or District Supplying Water
2. State the number of acres you irrigate under this system. _____ Shares you hold _____
3. If you obtain water from more than one Company, give the number of shares, acres irrigated and the name of the Company under "Remarks." If you obtain water from a Ditch Company and also have a private system fill in both Part A and Part B.

Part B

TO BE FILED BY THOSE WHO HAVE A PRIVATE DITCH, PUMP OR IRRIGATION SYSTEM
or those who have a private water right under a Ditch Company

4. In what year was this land first irrigated? Date See attached filings
5. Give the name of the original appropriator (first user): _____
6. Give the date appropriated _____ Amount filed on: Miners Inches _____ C. F. S. _____
7. State the total number of acres irrigated under this system: _____
8. Give the point of diversion: _____ $\frac{1}{4}$ _____ $\frac{1}{4}$ Section _____ Township _____ Range _____

Part C

TO BE FILED BY ALL WATER USERS IN ADDITION TO PART A OR PART B

9. Source of Water: House Creek
Name of stream or lake from which water is originally diverted
10. Water is obtained by: (Check one) Gravity ☒ Pumping _____ Other _____
11. What is the greatest number of acres you have irrigated? 20. Date ?
12. How many acres did you irrigate in 1947 (Crop and pasture) 0
13. State the total number of additional acres that could be irrigated by increasing the water supply, land leveling, etc. 20.0 This land is under what ditch? Same
14. How many acres of seeped land do you have which could be drained and put into production? _____
15. What is the condition of your irrigation system? Out of use
16. Is your water supply adequate? Yes _____ No ☒ Explain I flood
17. REMARKS: _____

NOTE: The foregoing questions apply only to irrigated land shown on this plot.

DESCRIPTION AND MAP OF FARM

18. Legal Description of this Farm S2SW1/4 Sec. 24, T9N R47E

☐ None at Present
IRRIGATED LAND

☐ NON-IRRIGATED LAND

North

West

East

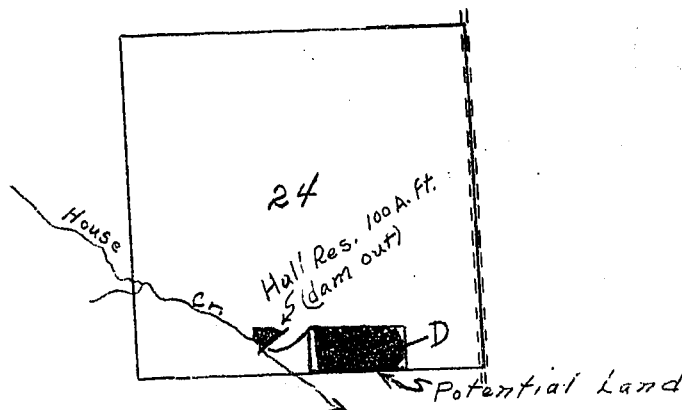

South

Ownership covers
only irrigated land.
All ownership for
dry land not shown.

19. If the above land is irrigated from more than one ditch please give the acreage under each ditch in 19A and indicate the location of the land irrigated from each on the above map.

19A. Ditch: S Road Acres: 0

Ditch: _____ Acres: _____

Information supplied by:

Name See attached form Address _____ Date _____

REMARKS: _____

If you cannot answer all of the questions on this form answer as many as you can and return the form to us as soon as possible.

Farm Checked

By Dave, Jim

Area Kinsey

Date 5/14/47

Legal Land Owner Hall, Katherine & George W

Operator Same

Water is delivered by:

STATE OF MONTANA

STATE ENGINEER'S OFFICE

WATER RESOURCES SURVEY

Code No. 24 D

County Custer, Co

T. 9 N R. 47E Sec. 24

Photo No. 18-176

Address miles City Kinsey Star Rte

Address _____

Federal Project _____ Pres. _____ Pot. _____

Ditch Company _____ Pres. _____ For _____

Irrigation District _____ Pres. _____

Private System ✓ Pres. 0 Pot. 20

Totals 0 20

Flood _____ Pump _____ Reservoir ☒ Gravity ☒

Size and Capacity, Pump, etc. _____

Original Appropriator, Company Chick Foose, App. No. _____

Original Appropriator, Private Clark Tozer, 1893, Miller (136) App. No. 2038
(Show date of appropriation under Remarks)

Is the system an extension of another system? Yes _____ No ☒

Is all land irrigated from one system? Yes ✓ No

(If No, show break down on map)

Source of Water: Reservoir on Woodlief or House Creek 100 Acre Foot Cap. Dam is out

Acres Irrigated 19-47, 0

Potential Acres 20 a. Seeped 0

Explain

Condition of System Dam out, system not used for 2 years

Adequate Supply ----- Yes ✓ ----- No ✓ -----

Explain Dam out

Topography 2nd Terrace

Information From NY 100-1049

Remarks _____

A 10x10 grid with handwritten text "sec 24 T9N R47E" at the top and "24" in the center. The grid is divided into four quadrants by a horizontal and vertical line. The text "sec 24 T9N R47E" is written across the top edge, and "24" is written in the center of the grid.

Dam built by WPA and water used 1 year by Mr. Hoffer
which Dam washed out and system not used since 1945. System
(Dam) large enough to irrigate about 160 acres.

Martin (Miles City) owns Tazew Water Right

According to Mr. Hall the State Water Conservation Board
was to either repair the dam within one year if it went out
or the water right which he had turned over to the board
was to be given back to him; this condition was in
his contract.

160 acres that could be irrigated includes land belonging
to two neighbors. Hall intends to form partnership with neighbors
to restore dam if and when he can get back control of water
rights

STATE ENGINEER'S OFFICE
WATER RESOURCES SURVEYCOUNTY CusterFILE NO. 11-T9N-R.47EOwner Hall, Katherine & George W. Address Kinsey Star Rte., Miles City

AAA Owner Address

Operator " " Address " "

New Owner Address

New Operator Address

Assessment Record NoneAssessed Acreage 0Legal Description of This Farm S²SW⁴SE⁴, Sec. 29; T. 9N-R. 47ETotal Acres in Farm ✓Code Number 24DPhoto No. Ma 18-176

AAA Contract No.

AAA Total Cropland Acreage

App. No. 714-2038

Decree No.

Land is located in

Twp. 9N Rge. 47E Twp. Rge.

Twp. Rge. Twp. Rge.

Filed in Twp. 9N Rge. 47E

Remarks

.....

.....

.....

Yellowstone River BasinOwnership covers
only irrigated land.
All ownership for
dry land not shown.

914

STATE ENGINEERS OFFICE
Water Resources Survey

Notice of Appropriation

1. County.....Custer.....Book.....F.....Page.....124.....Record.....W.R.....
2. Name of Appropriator.....State Water Con. Board of Mont.....Address.....
3. Date Appropriated.....Aug. 19, 1936.....Date Filed.....Aug. 21, 1936.....
Amount Appropriated, Miners Inches....., Cubic Feet per second.....
4. Name of Stream.....House Creek.....Tributary.....Basin.....
5. Point of Diversion.....
.....
.....
Sec.....Twp.....Rge.....Bank of Stream.....
.....
.....
6. Purpose.....For Irrigation.....
7. Description of System.....Storage.....
.....
.....
8. Land Description of Intended Place of Use.....
S $\frac{1}{2}$ Sec. 24-9N-47E, Custer County c/o Catherine Hall, Miles City, 320 acres
NE $\frac{1}{4}$ Sec. 24-9N-47E, 160 acres, Alex Noble, Miles City
NW $\frac{1}{4}$ Sec. 24-9N-47E, 160 acres, Custer County
9. Remarks (Pertaining to Use, etc.).....
.....
.....

Decree

10. Case No.....Date.....Amt. Decreed: M. I.....C. F. S.....
11. To Whom Decreed.....Address.....
12. Name of Ditch.....Maximum Capacity (C. F. S.).....
13. Date of Priority.....Purpose.....
14. Land Description of Place of Use as Decreed.....
.....
.....
15. Remarks (Present Use Status, etc.).....
.....
.....

STATE ENGINEERS OFFICE
Water Resources Survey

Notice of Appropriation

- 2038
1. County Custer Book A Page 157 Record W.R.
 2. Name of Appropriator Clark Tozer Address Miles City, Custer Co.
 3. Date Appropriated 6th day of, 1893 Date Filed 9-8-1893
Amount Appropriated, Miners Inches 300 Cubic Feet per second _____
 4. Name of Stream Woodlief's Creek Tributary _____ Basin _____
 5. Point of Diversion At a point on its left bank, thence running northeasterly direction

Sec. _____ Twp. _____ Rge. _____ Bank of Stream Left

 6. Purpose Irrigating and other purposes.
 7. Description of System A ditch 30 in. by 10 in. in size, and carries or conducts 300 in.
of water. _____

 8. Land Description of Intended Place of Use _____
SE 1/4 Sec. 24-2N-47E., 160 acres, Custer County, c/o Katherine Hall, Miles City

 9. Remarks (Pertaining to Use, etc.) That he also hereby claims said ditch and the right of way,
therefor and for said water by it conveyed or to be conveyed from said point of appropri-
ation to said land or point of final discharge and also the right of location upon any
lands of any dams, flumes, reservoirs, constructed or to be constructed by him in appro-
priating and using said water. That he also claims the right to keep in repair, and to
enlarge said means of water appropriation at any time and the right to dispose of said
right, water, ditch, or said appurtenances in part or in whole at any time.
- Decree**
10. Case No. _____ Date _____ Amt. Decreed: M. I. _____ C. F. S. _____
 11. To Whom Decreed _____ Address _____
 12. Name of Ditch _____ Maximum Capacity (C. F. S.) _____
 13. Date of Priority _____ Purpose _____
 14. Land Description of Place of Use as Decreed _____

 15. Remarks (Present Use Status, etc.) _____



NOTICE
These forms are the
property of the State
of Montana and must
be returned.

STATE OF MONTANA
STATE ENGINEERS OFFICE
Water Resources Survey

FORM WR-1-2M, 12-47
Code No. 36A
County Butte
T. 9N R. 47E

Name of Land Owner State of Montana Address Helena, Mont.
Name of Operator _____ Address _____

Part A

**TO BE FILED BY THOSE OBTAINING IRRIGATION WATER FROM
A DITCH COMPANY OR IRRIGATION DISTRICT**

1. Water is delivered by: Tongue R. Yellowstone Irr. Dist.
Name of Ditch, Ditch Company or District Supplying Water
2. State the number of acres you irrigate under this system 0 Shares you hold _____
3. If you obtain water from more than one Company, give the number of shares, acres irrigated and the name of the Company under "Remarks." If you obtain water from a Ditch Company and also have a private system fill in both Part A and Part B.

Part B

**TO BE FILED BY THOSE WHO HAVE A PRIVATE DITCH, PUMP OR IRRIGATION SYSTEM
or those who have a private water right under a Ditch Company**

4. In what year was this land first irrigated? Date _____
5. Give the name of the original appropriator (first user): _____
6. Give the date appropriated _____ Amount filed on: Miners Inches _____ C. F. S. _____
7. State the total number of acres irrigated under this system: _____
8. Give the point of diversion: _____ $\frac{1}{4}$ _____ $\frac{1}{4}$ Section _____ Township _____ Range _____

Part C

TO BE FILED BY ALL WATER USERS IN ADDITION TO PART A OR PART B

9. Source of Water: Tongue River
Name of stream or lake from which water is originally diverted
10. Water is obtained by: (Check one) Gravity ☒ Pumping _____ Other _____
11. What is the greatest number of acres you have irrigated? 0 Date _____
12. How many acres did you irrigate in 1947? (Crop and pasture) 0
13. State the total number of additional acres that could be irrigated by increasing the water supply, land leveling, etc. 125.95 This land is under what ditch? T. R. Y. Irr. dist.
14. How many acres of seeped land do you have which could be drained and put into production? _____
15. What is the condition of your irrigation system? No system
16. Is your water supply adequate? Yes ☒ No _____ Explain _____
17. REMARKS: _____

Not now irrigated potential land.

Over

NOTE: The foregoing questions apply only to irrigated land shown on this plat.

DESCRIPTION AND MAP OF FARM

18. Legal Description of this Farm

all of Sec. 36, T9N, R48E

☐ *None at Present*
IRRIGATED LAND

☐ NON-IRRIGATED LAND

North

West

East

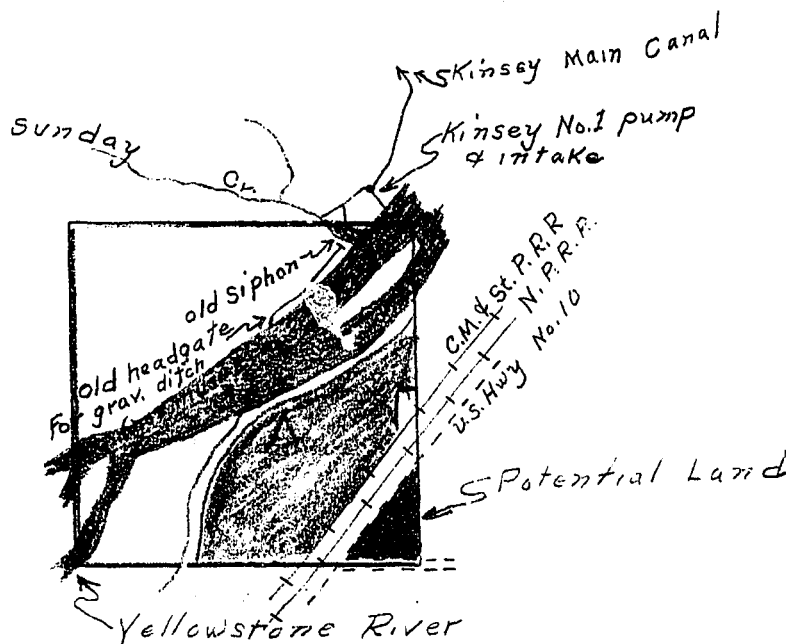

South

Ownership covers
only irrigated land.
All ownership for
dry land not shown.

19. If the above land is irrigated from more than one ditch please give the acreage under each ditch in 19A and indicate the location of the land irrigated from each on the above map.

19A. Ditch: *Tongue R. Yell. Irr. ditch* Acres: *0*

Ditch: _____ Acres: _____

Information supplied by:

Name *Field Survey* Address _____ Date *June 13-47*

REMARKS: _____

W. Paulist & J. Cook

If you cannot answer all of the questions on this form answer as many as you can and return the form to us as soon as possible.

STATE ENGINEER'S OFFICE WATER RESOURCES SURVEY

COUNTY ClusterFILE NO. 11-T.9N-R.47EOwner Montana, State of Address Helena, Montana

AAA Owner Address

Operator " " " Address " "

New Owner Address

New Operator Address

Assessment Record yesAssessed Acreage Sec. 36 - 125.85
Ac.Legal Description of This Farm all of Sec. 36; T. 9N-R. 48ECode Number 36APhoto No. Ma 18-177

AAA Contract No.

AAA Total Cropland Acreage

App. No. No Record by Description
2119-2120?

Decree No.

Land is located in

Twp. 9N Rge. 47E Twp. Rge.

Twp. Rge. Twp. Rge.

Filed in Twp. 9N Rge. 47E

Remarks

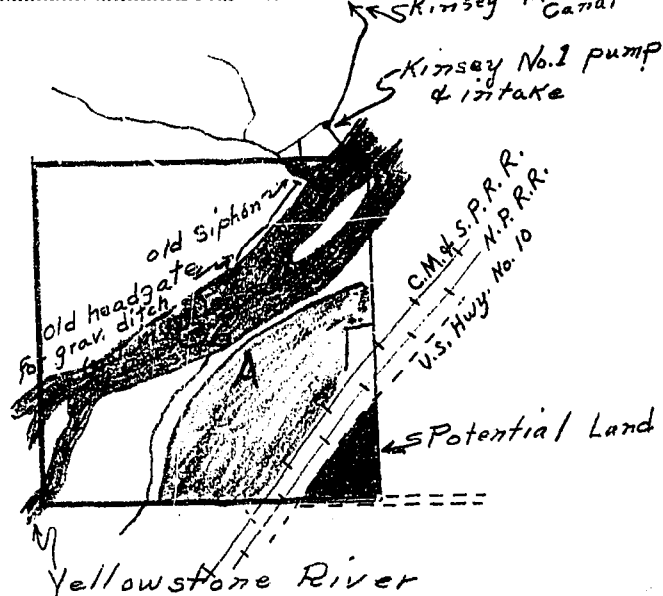
Total Acres in Farm ✓Tongue River Basin?

Ownership covers
only irrigated land
All ownership
any land not shown

47E

A STUDY OF MONTANA'S WATER RESOURCES--WPA
 Location of Irrigated Lands
 (Supplemental Sheet)

Section 36... Township 9N Range 47E County Custer

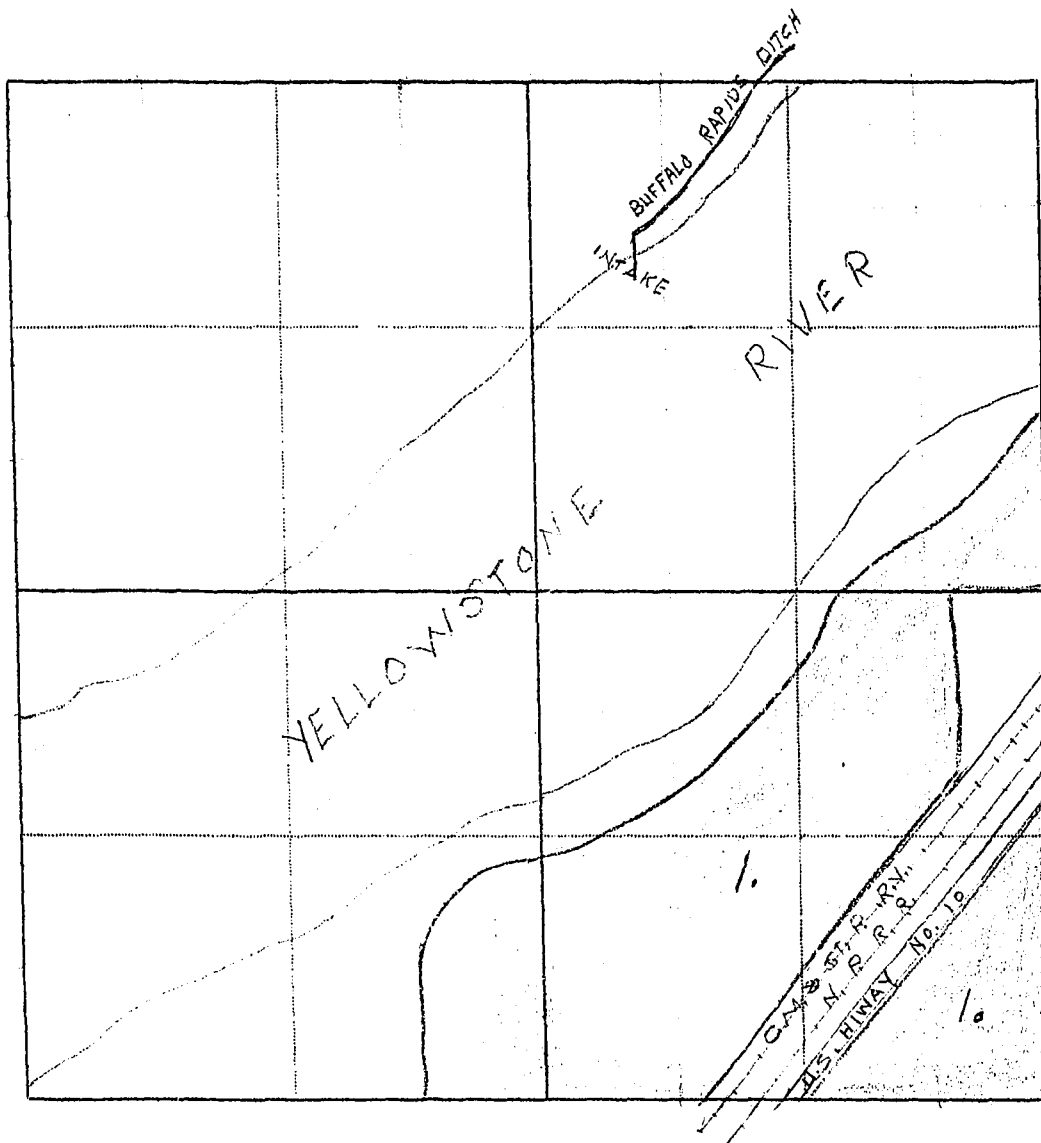

*Not assessed as irrigated land,
 but classified as irrigable land in
 the land classification books*

Section 36... Township 9N Range 47E

59.

36. - 9. - 47.

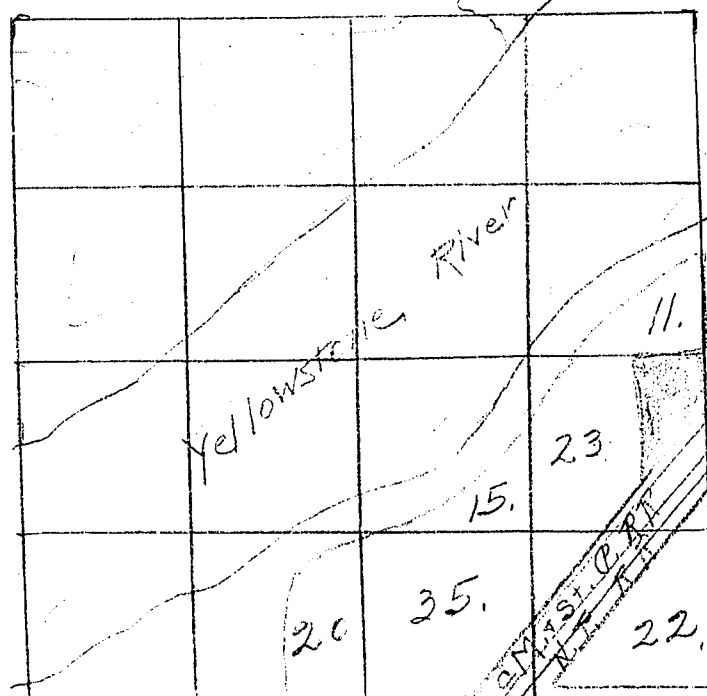

Total = 125.

Low-12K same No Divig = St. L. Land

A STUDY OF MONTANA'S WATER RESOURCES

County Custer Source of Information _____1. Water User State of Montana Address _____

2. Stream _____ Tributary to _____ Basin _____

3. Point of Diversion $\frac{1}{4}$ $\frac{1}{4}$ Section _____ Township _____ Range _____

4. Description of System _____

5. Type of Irrigation _____

6. Original Appropriator _____ Address _____

7. First Use: Year _____ Acres Irrigated _____

8. Maximum Use: Year _____ Acres Irrigated _____

9. Present Use: Year _____ Acres Irrigated _____

10. Last Use: Year _____ Why Abandoned _____

11. Condition of System _____

12. Land Description Cell Section 36, T 9N, R 1E

Remarks: _____

T 9N 12510

10.15" DB 12510
 22.25" DB 12510
 22.00" DB 12510
 24.77" DB 12510
 19.11" DB 12510
 15.02" DB 12510
 12.51"



WITNESS: _____ Information by _____

Place _____

FORM D-1

A STUDY OF MONTANA'S WATER RESOURCES--WPA
Location of Irrigated Lands

Township 9 N Range 47 E County Custer

6	5	4	3	2	1
7	8	9	10	11	12
18	17	16	15	14	13
19	20	21	22	23	24
30	29	28	27	26	25
31	32	33	34	35	36

YELLOWSTONE

Township 9 N Range 47 E

STATE ENGINEER'S OFFICE
WATER RESOURCES SURVEYCOUNTY ClusterFILE NO. 11-T 9N-R 47EOwner Noble, Alex Address Kinsey Star Rte, Miles City

AAA Owner Address

Operator " " Address " "

New Owner Address

New Operator Address

Assessment Record NoneAssessed Acreage 0Legal Description of This Farm all of Sec. 13 (less part of E² NE⁴); NE⁴ Sec. 24;T. 9N-R 47ETotal Acres in Farm ✓Code Number 13B, 24CPhoto No. MA 18-175; MA 18-176

AAA Contract No.

AAA Total Cropl and Acreage

App. No. 914-1967

Decree No.

Land is located in

Twp. 9N Rge. 47E Twp. 9N Rge. 48E

Twp. Rge. Twp. Rge.

Filed in Twp. 9N Rge. 48E

Remarks

Ownership covers
only irrigated land.
All ownership for
dry land not shown.

Yellowstone River Basin

STATE ENGINEER'S OFFICE
WATER RESOURCES SURVEYCOUNTY CusterFILE NO. 11-T.9N-R.47EOwner Scanlon, Harold & Ruby Address Kinsey, Montana
(Kinsey Unit)

AAA Owner Address

Operator Address

New Owner Address

New Operator Address

Assessment Record 483-Unit 7Assessed Acreage 64.0Legal Description of This Farm Unit No. 7 (Meets & Bounds) Sec. 12, T.9N-R.47ETotal Acres in Farm 70.95Code Number Unit No. 7Photo No. Ma-18-175

AAA Contract No.

AAA Total Cropland Acreage

App. No. 2123, 2124-1587
1957-1965-1966-1968

Decree No.

Land is located in

Twp. 2N Rge. 77E Twp. Rge.

Twp. Rge. Twp. Rge.

Filed in Twp. 2N Rge. 78E

Remarks

Yellowstone River BasinOwnership covers
only irrigated land.
All ownership for
dry land not shown.



NOTICE
These forms are the
property of the State
of Montana and must
be returned.

STATE OF MONTANA
STATE ENGINEERS OFFICE
Water Resources Survey

FORM WR-1-24 (12-47)

Code No. 33A-32C

County Quentin

T. 9N R. 47E

Name of Land Owner A. L. Taylor Address Baker Ranch
Name of Operator _____ Address Miller City

Part A

TO BE FILED BY THOSE OBTAINING IRRIGATION WATER FROM
A DITCH COMPANY OR IRRIGATION DISTRICT

1. Water is delivered by: _____
Name of Ditch, Ditch Company or District Supplying Water
2. State the number of acres you irrigate under this system. _____ Shares you hold _____
3. If you obtain water from more than one Company, give the number of shares, acres irrigated and the name of the Company under "Remarks." If you obtain water from a Ditch Company and also have a private system fill in both Part A and Part B.

Part B

TO BE FILED BY THOSE WHO HAVE A PRIVATE DITCH, PUMP OR IRRIGATION SYSTEM
or those who have a private water right under a Ditch Company

4. In what year was this land first irrigated? Date See attached filings
5. Give the name of the original appropriator (first user): _____
6. Give the date appropriated. _____ Amount filed on: Miners Inches _____ C. F. S. _____
7. State the total number of acres irrigated under this system: _____
8. Give the point of diversion: _____ $\frac{1}{4}$ _____ $\frac{1}{4}$ Section _____ Township _____ Range _____

Part C

TO BE FILED BY ALL WATER USERS IN ADDITION TO PART A OR PART B

9. Source of Water: Sunday Creek
Name of stream or lake from which water is originally diverted
10. Water is obtained by: (Check one) Gravity ☒ Pumping ☒ Other _____
11. What is the greatest number of acres you have irrigated? 200.0 Date _____
12. How many acres did you irrigate in 1947? (Crop and pasture) 0
13. State the total number of additional acres that could be irrigated by increasing the water supply, land leveling, etc. 200.0 This land is under what ditch? Taylor Flood ditch
14. How many acres of seeped land do you have which could be drained and put into production? _____
15. What is the condition of your irrigation system? Not in use
16. Is your water supply adequate? Yes ☒ No _____ Explain Flood water
17. REMARKS: See attached form

NOTE: The foregoing questions apply only to irrigated land shown on this plat.

DESCRIPTION AND MAP OF FARM

18. Legal Description of this Farm All of Sec. 33, E2, R2NW4, N2SW4,
Sec. 32, T9N, R48E

☐ None at Present
IRRIGATED LAND

☐ NON-IRRIGATED LAND

North

West

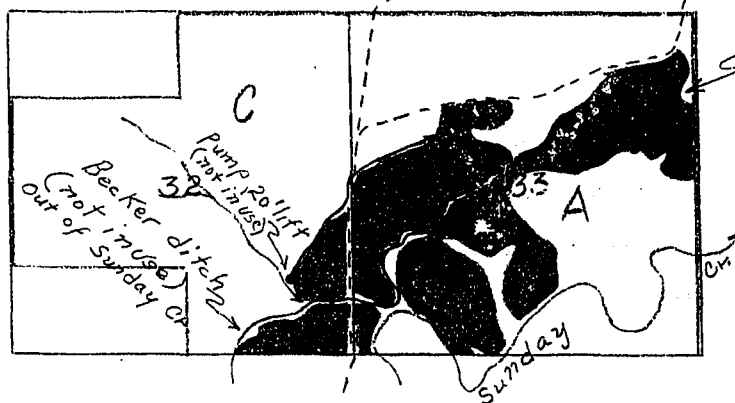

East

South

Ownership covers
only irrigated land.
All ownership for
dry land not shown.

19. If the above land is irrigated from more than one ditch please give the acreage under each ditch in 19A and indicate the location of the land irrigated from each on the above map.

19A. Ditch: Taylor Road Acres: 0
Ditch: _____ Acres: _____

Information supplied by:

Name See attached form Address _____ Date _____

REMARKS: _____

If you cannot answer all of the questions on this form answer as many as you can and return the form to us as soon as possible.

STATE ENGINEER'S OFFICE
WATER RESOURCES SURVEYCOUNTY CusterFILE NO. 11-T.9N-R.47EOwner Taylor, A. L. Address Becker Ranch, Miles City

AAA Owner Address

Operator " " Address " "

New Owner Address

New Operator Address

Assessment Record NoneAssessed Acreage 0Legal Description of This Farm all of Sec. 33; E² S² NW, N² SW, Sec. 32;T. 9N-R. 48ETotal Acres in Farm ✓Code Number 33A, 32CPhoto No. Ma 21-39

AAA Contract No.

AAA Total Cropland Acreage

App. No. 1828-1830-1832

Decree No.

Land is located in

Twp. 9N Rge. 27E Twp. 8N Rge. 27E

Twp. Rge. Twp. Rge.

Filed in Twp. 9N Rge. 27E

Remarks

Ownership covers
only irrigated land.
All ownership for
dry land not shown.Yellowstone River Basin

Farm Checked

STATE OF MONTANA

FORM F-1 - GAZETTE 1968-AM-1-17

By Jim + Dave

STATE ENGINEER'S OFFICE
WATER RESOURCES SURVEY

Code No. 32C, 33A, 28, 34

Area Sunday Creek

County Custer

Date 5/11/47

T. 9N R. 47E Sec. 33

Legal Land Owner Taylor, AL

Address Miles City, Kinsey Rte

Operator Same

Address

Water is delivered by:

Federal Project _____ Pres. _____ Pot. _____

Ditch Company _____ Pres. _____ Pot. _____

Irrigation District _____ Pres. _____ Pot. _____

Private System ✓ Pres. 0 Pot. 7141m. 200285

Totals _____

Flood _____ Pump ✓ Reservoir ✓ Gravity _____

Size and Capacity, Pump, etc. Booster pump, Double 10hp, 20 ft lift not in use

Original Appropriator, Company _____ App. No. _____

Original Appropriator, Private Becker Hugh Wells App. No. 1832, 1828
(Show date of appropriation under Remarks)

Is the system an extension of another system? Yes _____ No ✓

Is all land irrigated from one system? Yes ✓ No _____

(If No, show break down on map)

Source of Water Sunday Creek

Acres Irrigated 1947 none

Potential Acres 285 Seeped 0

Explain _____

Condition of System Run Down

Adequate Supply Yes _____ No ✓

Explain Date out, System Not in use

Topography _____

Information From A. L. Taylor

Remarks Wells App. 4/28/15, Becker App. 4/13/17

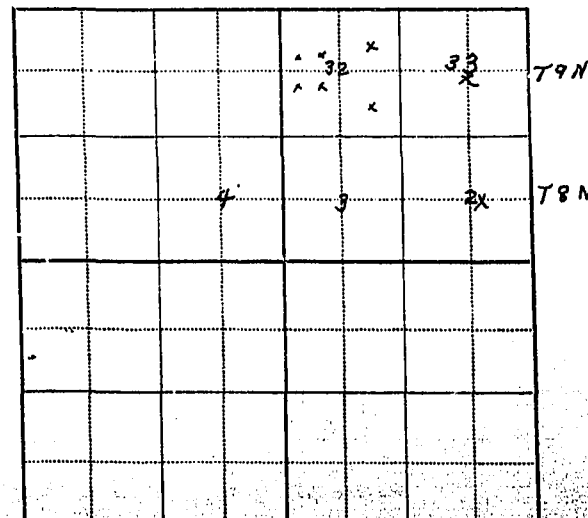

Made fillings on Cow Creek & Coal Creek for flood irr. system
not yet in filling made in October 1946

Irrigation system (concrete dam in Sunday Creek and
extensive ditches, 1 main gravity canal and double pump
lift of about 20 ft. for higher secondary canal) was built
originally by Becker to irrigate about 200 acres of
hayland. Taylor who now owns the land and water rights
does not intend to use the main canal but does
intend to flood irrigate hay land using the high ditch
to carry the water diverted into it from coulees
which it crosses

According to Mr. Mayo (lives ~~just~~^{one} mile north of junction North & South Sunday Crks
original Becker system was only used 2 years about 1917 till
concrete dam went out then given up.

Notice of Appropriation

9. Remarks (Pertaining to Use, etc.).....
.....
.....

Decree

15. Remarks (Present Use Status, etc.).....

STATE ENGINEERS OFFICE
Water Resources Survey
Notice of Appropriation

1830

1. County Custer Book B Page 623 Record W.R.
2. Name of Appropriator Sunday Creek Canal & Irr. Co Address Miles City, Montana
3. Date Appropriated Oct. 31, 1904 Date Filed Oct. 31, 1904
- Amount Appropriated, Miners Inches 15,000 or , Cubic Feet per second 375
4. Name of Stream Sunday Creek Tributary Basin
5. Point of Diversion Within the SE 1/4 of

Sec. 8 Twp. 8N. Rge. 47E. Bank of Stream North

6. Purpose For agricultural and grazing purposes.
7. Description of System A dam will be constructed of rock and cribbage and to be approximately 5 ft. in height and 150 ft. in length, not including an embankment on the westerly side of said creek extending in length probably 150 yds. It is further intended that at said dam there will be constructed a headgate in dimensions approximately 10 (ten) ft. square. When headgate will open into a ditch, to be constructed in width from 5 to 10 ft. at the bottom, which said ditch will be extended in an easterly direction on the northerly
8. Land Description of Intended Place of Use side of said creek upon or near the land hereinbefore

(over)

9. Remarks (Pertaining to Use, etc.)

Decree

10. Case No. Date Amt. Decreed: M. I. C. F. S.
11. To Whom Decreed Address
12. Name of Ditch Maximum Capacity (C. F. S.)
13. Date of Priority Purpose
14. Land Description of Place of Use as Decreed
15. Remarks (Present Use Status, etc.)

No. 2 cont'd.

The appropriators are: Christen Arneberg, and Cornelius H. Porter, also known as the Sunday Creek canal and Irrigating Co.

No. 7 cont'd.

described. It is further intended that such other dams and ditches and such flumes reservoirs and dykes will be constructed and employed in appropriating and in using of said water as the nature of the soil and contry may require.

All Sec. 8-8N-47E, 640 acres, Nils & Carl Lindeberg, Miles City

All Sec. 9-8N-47E, 640 acres, Ervin C. Bayer, Graham, Wash.

Lots 1,2, S $\frac{1}{2}$ NE $\frac{1}{4}$, SE $\frac{1}{4}$ Sec. 4-8N-47E, 321.13 acres, Nils & Carl Lindeberg, Miles City

Lots 3,4, S $\frac{1}{2}$ NW $\frac{1}{4}$, SW $\frac{1}{4}$, 321.45 acres, Sec. 4-8N-47E, Columbian Co., St. Paul, Minn.

All Frl. Sec. 3-8N-47E, 640.97 acres, Chappel Bros., Inc., Miles City

SE $\frac{1}{4}$ Sec. 32-9N-47E, 160 acres, Chappel Bros., Inc., Miles City

N $\frac{1}{2}$ NE $\frac{1}{4}$, S $\frac{1}{2}$ N $\frac{1}{2}$, N $\frac{1}{2}$ SW $\frac{1}{4}$ Sec. 32-9N-47E, 320 acres, C. W. Wood, Volberg, Montana

Balance Sec. 32-9N-47E, 160 acres, U. S. A.

All Sec. 33-9N-47E, 640 acres, Chappel Bros., Inc., Miles City

All Sec. 34-9N-47E, 640 acres, Custer County, Miles City

All Frl. Sec. 35-9N-47E, 531.53 acres, N. P. Ry. Co., St. Paul, Minn.

&
NW $\frac{1}{4}$ SW $\frac{1}{4}$, 320 acres, Sec. 25-9N-47E, Chappel Bros., Inc., Miles City

Bal. of Sec. 25-9N-47E, Custer County

All Frl. less 83.67 acres (Lot 1) Sec. 25-9N-47E, 540 acres, N.P. Ry. Co.

Lot 1, or 83.67 acres, Sec. 25-9N-47E, U.S.A.

STATE ENGINEERS OFFICE
Water Resources Survey

Notice of Appropriation

1. County Custer Book F Page 51 Record W.R.
 2. Name of Appropriator Hugh R. Wells Address Miles City, Montana
April 28, 1915 Date Filed Oct. 6, 1915
 3. Date Appropriated June 11, 1915
 Amount Appropriated, Miners Inches 500 or 12 1/2 Cubic Feet per second
 4. Name of Stream Sunday Creek Tributary Yellowstone R. Basin
 5. Point of Diversion 300 ft. E. of the SW corner on the S. line of said
Sec. 33 Twp. 9N. Rge. 47E. Bank of Stream North
 6. Purpose For irrigation, watering stock, domestic and other purposes.
 7. Description of System A pumping plant and a ditch 30" X 60" in size, which carries and
conducts said amount of water from said creek and runs thence northerly-easterly
and southerly direction, thence over and upon said lands.
 8. Land Description of Intended Place of Use
S 1/2 Sec. 33-9N-47E, 320 acres, Chappel Bros., Inc., Miles City
 9. Remarks (Pertaining to Use, etc.)

Decree

10. Case No. Date Amt. Decreed: M. I. C. F. S.
 11. To Whom Decreed Address
 12. Name of Ditch Maximum Capacity (C. F. S.)
 13. Date of Priority Purpose
 14. Land Description of Place of Use as Decreed
 15. Remarks (Present Use Status, etc.)



NOTICE
These forms are the
property of the State
of Montana and must
be returned.

STATE OF MONTANA
STATE ENGINEERS OFFICE
Water Resources Survey

FORM WR-1-24 (12-27)

Code No. 340

County Custer

T. 9N R. 47

Name of Land Owner: Joe Wahlgenant Address Box 524, Miles City

Name of Operator: _____ Address _____

Part A

**TO BE FILED BY THOSE OBTAINING IRRIGATION WATER FROM
A DITCH COMPANY OR IRRIGATION DISTRICT**

1. Water is delivered by: _____ Name of Ditch, Ditch Company or District Supplying Water _____ Shares you hold _____
2. State the number of acres you irrigate under this system _____
3. If you obtain water from more than one Company, give the number of shares, acres irrigated and the name of the Company under "Remarks." If you obtain water from a Ditch Company and also have a private system fill in both Part A and Part B.

Part B

**TO BE FILED BY THOSE WHO HAVE A PRIVATE DITCH, PUMP OR IRRIGATION SYSTEM
or those who have a private water right under a Ditch Company**

4. In what year was this land first irrigated? Date See attached filings
5. Give the name of the original appropriator (first user): _____
6. Give the date appropriated _____ Amount filed on: Miners Inches _____ C. F. S. _____
7. State the total number of acres irrigated under this system: _____
8. Give the point of diversion: _____ $\frac{1}{4}$ _____ $\frac{1}{4}$ Section _____ Township _____ Range _____

Part C

TO BE FILED BY ALL WATER USERS IN ADDITION TO PART A OR PART B

9. Source of Water: Sunday Creek Name of stream or lake from which water is originally diverted _____
10. Water is obtained by: (Check one) Gravity ☒ Pumping ☒ Other _____
11. What is the greatest number of acres you have irrigated? 0 Date _____
12. How many acres did you irrigate in 1947? (Crop and pasture) 115
13. State the total number of additional acres that could be irrigated by increasing the water supply, land leveling, etc. 40.0 This land is under what ditch? Same
14. How many acres of seeped land do you have which could be drained and put into production? _____
15. What is the condition of your irrigation system? Good
16. Is your water supply adequate? Yes _____ No ☒ Explain _____
17. REMARKS: _____

NOTE: The foregoing questions apply only to irrigated land shown on this plat.

DESCRIPTION AND MAP OF FARM

18. Legal Description of this Farm

*S292, N282, S2867 SE4SW4
Sec. 34, T9N-R48E*



IRRIGATED LAND



NON-IRRIGATED LAND

North

West

East

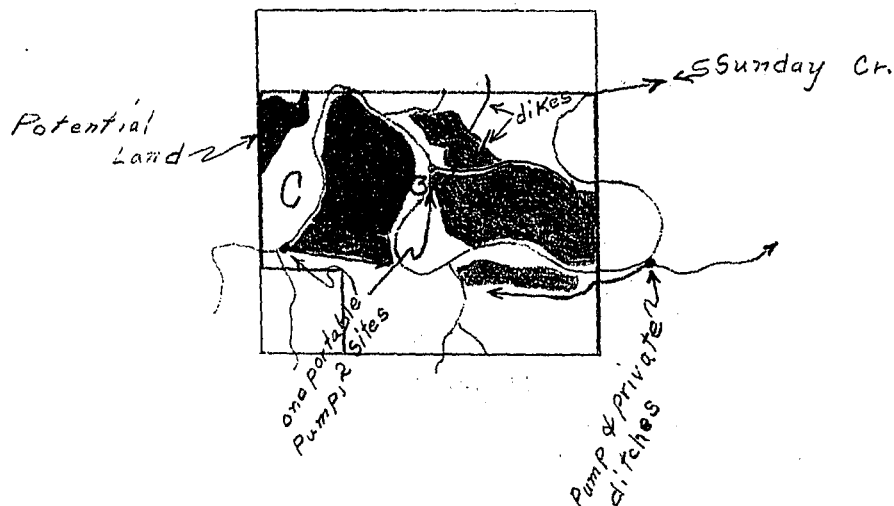

South

Ownership covers
only irrigated land.
All ownership for
dry land not shown.

19. If the above land is irrigated from more than one ditch please give the acreage under each ditch in 19A and indicate the location of the land irrigated from each on the above map.

19A. Ditch: *Sunday Creek Private* Acres: *115*

Ditch: _____ Acres: _____

Information supplied by:

Name *See Attached form* Address _____ Date _____

REMARKS: _____

If you cannot answer all of the questions on this form answer as many as you can and return the form to us as soon as possible.

Farm Checked

STATE OF MONTANA

Code No. 34CBy Dave & Jim

STATE ENGINEER'S OFFICE

County CusterArea lower Sunday Creek

WATER RESOURCES SURVEY

T. 9N R. 47E Sec. 34Date 5/14/47Photo No. MA 21-39Legal Land Owner Wohlgenant, JoeAddress Miles City, Kinsey Stage RdOperator Same

Address

Water is delivered by:

Federal Project _____ Pres. _____ Pot. _____

Ditch Company _____ Pres. _____ Pot. _____

Irrigation District _____ Pres. _____ Pot. _____

Private System ☒ Pres. 15 flood
100 Pot. 40Totals 115 40Flood ☒ Pump ☒ Reservoir _____ Gravity _____Size and Capacity, Pump, etc. 1 Portable pump Tractor power
Farmer pump, 17 ft lift Tractor power

Original Appropriator, Company _____ App. No. _____

Original Appropriator, Private Joe Wohlgenant (1946) Townsend, Theron App. No. 1831 & 2508
(Show date of appropriation under Remarks)Is the system an extension of another system? Yes _____ No ☒Is all land irrigated from one system? Yes _____ No ☒

(If No, show break down on map)

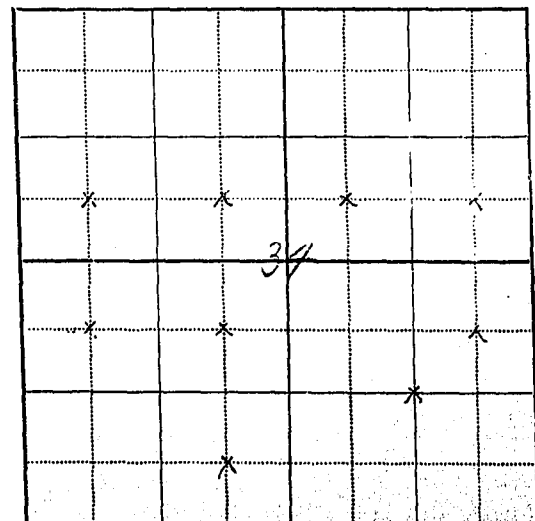
Source of Water Sunday Creek, side CouleesAcres Irrigated 19.47 115Potential Acres 40 Seeped 0Explain about 40 acres need clearing, leveling and ditches.Condition of System GoodAdequate Supply Yes ☒ No ☒Explain Plenty for hay, not sufficient in dry yearsTopography Sunday Creek bottom landInformation From Joe WohlgenantRemarks Theron H. Townsend - 1914, Joe Wohlgenant
1946,

15 acres hay hand flood irrigated. has one permer
type pump, large, and one small portable which he moves
between 2 ditch systems. Irrigates 12 acres from his
fathers' system (Carl Wohlgemant)

STATE ENGINEER'S OFFICE
WATER RESOURCES SURVEYCOUNTY CusterFILE NO. 11-T9N-R97EOwner Wahlgrenant, Joe Address Box 524, Miles City

AAA Owner Address

Operator " " Address " "

New Owner Address

New Operator Address

Assessment Record NoneAssessed Acreage 0Legal Description of This Farm S²N², N²S², S²SE⁴, SE⁴SW⁴, Sec. 34, T9N-R97ETotal Acres in Farm ✓Code Number 340Photo No. Ma 21-39

AAA Contract No.

AAA Total Cropland Acreage

App. No. 705-1830-1831-2508

Decree No.

Land is located in

Twp. 9N Rge. 97E Twp. Rge.

Twp. Rge. Twp. Rge.

Filed in Twp. 9N Rge. 97E

Remarks

Yellowstone River BasinOwnership covers
only irrigated land
All ownership for
dry land not shown

STATE ENGINEERS OFFICE
Water Resources Survey

Notice of Appropriation

1. County Custer Book C Page 18 Record W.R.
2. Name of Appropriator Eva Townsend Address Miles City, Montana
3. Date Appropriated Jan. 17, 1905 Date Filed Jan. 18, 1905
- Amount Appropriated, Miners Inches 500 or 12 1/2, Cubic Feet per second 12 1/2
4. Name of Stream Cow Creek Tributary Basin
5. Point of Diversion In the SW 1/4
- Sec. 28 Twp. 9N. Rge. 47E. Bank of Stream
6. Purpose To irrigate lands for agricultural and grazing purposes.
7. Description of System A dam and ditch said dam to be approximately 60 ft. long and 6 ft. high and 10 ft. through on the bottom; and said ditch running therefrom which ditch will be about 3 ft. wide at the bottom and about 1 1/2 ft. deep and by such other ditches, dams, flumes, reservoirs and dykes as the nature of the
8. Land Description of Intended Place of Use soil and country may require.
S 1/4 NW 1/4, S 1/4 NW 1/4, NW 1/4 SE 1/4 Sec. 1-9N-47E, 200 acres, W.P.R.R., c/o Chappel Bros., Miles City,
N 1/4 SW 1/4 Sec. 34-9N-47E, 200 acres, Custer County, Miles City.
9. Remarks (Pertaining to Use, etc.)

Decree

10. Case No. Date Amt. Decreed: M. I. C. F. S.
11. To Whom Decreed Address
12. Name of Ditch Maximum Capacity (C. F. S.)
13. Date of Priority Purpose
14. Land Description of Place of Use as Decreed
15. Remarks (Present Use Status, etc.)

STATE ENGINEERS OFFICE
Water Resources Survey

Notice of Appropriation

1. County Custer Book B Page 623 Record W.R.
(over)
2. Name of Appropriator Sunday Creek Canal & Irr. Co Address Missoula City, Montana
3. Date Appropriated Oct. 31, 1904 Date Filed Oct. 31, 1904
- Amount Appropriated, Miners Inches 15,000 or, Cubic Feet per second 375
4. Name of Stream Sunday Creek Tributary _____ Basin _____
5. Point of Diversion Within the SE 1/4 of

Sec. 8 Twp. 8N. Rge. 47E. Bank of Stream North

6. Purpose For agricultural and grazing purposes.
7. Description of System A dam will be constructed of rock and cribbage and to be approximately 5 ft. in height and 150 ft. in length, not including an embankment on the westerly side of said creek extending in length probably 150 yds. It is further intended that at said dam there will be constructed a headgate in dimensions approximately 10 (ten) ft. square, which headgate will open into a ditch to be constructed in width from 5 to 10 ft. at the bottom, which said ditch will be extended in an easterly direction on the northerly side of said creek upon or near the land hereinbefore
8. Land Description of Intended Place of Use side of said creek upon or near the land hereinbefore

(over)

9. Remarks (Pertaining to Use, etc.) _____

Decree

10. Case No. _____ Date _____ Amt. Decreed: M. I. _____ C. F. S. _____
11. To Whom Decreed _____ Address _____
12. Name of Ditch _____ Maximum Capacity (C. F. S.) _____
13. Date of Priority _____ Purpose _____
14. Land Description of Place of Use as Decreed _____
15. Remarks (Present Use Status, etc.) _____

No. 2 cont'd.

The appropriators are: Christen Arneberg, and Cornelius H. Porter, also known as the Sunday Creek canal and Irrigating Co.

No. 7 cont'd.

described. It is further intended that such other dams and ditches and such flumes reservoirs and dykes will be constructed and employed in appropriating and in using of said water as the nature of the soil and country may require.

All Sec. 8-8N-47E, 640 acres, Nils & Carl Lindeberg, Miles City

All Sec. 9-8N-47E, 640 acres, Ervin C. Bayer, Graham, Wash.

Lots 1,2, S½NE¼, SE¼ Sec. 4-8N-47E, 321.13 acres, Nils & Carl Lindeberg, Miles City

Lots 3,4, S½NE¼, SW¼, 321.45 acres, Sec. 4-8N-47E, Columbian Co., St. Paul, Minn.

All Frl. Sec. 3-8N-47E, 640.97 acres, Chappel Bros., Inc., Miles City

SE¼ Sec. 32-9N-47E, 160 acres, Chappel Bros., Inc., Miles City

N½NE¼, S½NE¼, N½SW¼ Sec. 32-9N-47E, 320 acres, C. W. Wood, Volberg, Montana

Balance Sec. 32-9N-47E, 160 acres, U. S. A.

All Sec. 33-9N-47E, 640 acres, Chappel Bros., Inc., Miles City

All Sec. 34-9N-47E, 640 acres, Custer County, Miles City

All Frl. Sec. 35-9N-47E, 581.53 acres, N. P. Ry. Co., St. Paul, Minn.

&
N½SE¼, 320 acres, Sec. 26-9N-47E, Chappel Bros., Inc., Miles City

Bal. of Sec. 26-9N-47E, Custer County

All Frl. less 83.67 acres (Lot 1) Sec. 25-9N-47E, 540 acres, N.P. Ry. Co.

Lot 1, cr 83.67 acres, Sec. 25-9N-47E, U.S.A.

1831

STATE ENGINEERS OFFICE
Water Resources Survey
Notice of Appropriation

1. County Custer Book F Page 23 Record W.R.
2. Name of Appropriator Theron H. Townsend Address Miles City, Montana
 (19)
3. Date Appropriated Dec. 22, 1914 Date Filed Dec. 22, 1914
- Amount Appropriated, Miners Inches 500 or, Cubic Feet per second 12½
4. Name of Stream Sunday Creek Tributary Yellowstone R. Basin
5. Point of Diversion at or near the center of the NW¼ of

Sec. 34 Twp. 9N. Rge. 47E. Bank of Stream

6. Purpose To irrigate lands for agricultural purposes.
7. Description of System A pump and an engine and a ditch. Said pump will have at least a 5 in. intake and a 4 in. discharge. Said ditch will be approximately 3 ft. on the bottom and 1½ ft. in depth, which runs thence over and upon said lands.
8. Land Description of Intended Place of Use
S½SW¼, SE¼SW¼ Sec. 34-9N-47E, 80 acres, Custer County
9. Remarks (Pertaining to Use, etc.)

Decree

10. Case No. Date Amt. Decreed: M. I. C. F. S.
11. To Whom Decreed Address
12. Name of Ditch Maximum Capacity (C. F. S.)
13. Date of Priority Purpose
14. Land Description of Place of Use as Decreed
15. Remarks (Present Use Status, etc.)

2508

STATE ENGINEERS OFFICE
Water Resources Survey
Notice of Appropriation

1. County Custer Book F Page 155 Record W.R.
2. Name of Appropriator Joe Wohlgenant Address Miles City
3. Date Appropriated January 26, 1946 Date Filed January 28, 1946
- Amount Appropriated, Miners Inches 250, Cubic Feet per second
4. Name of Stream Sunday Creek Tributary Yellowstone R. Basin
5. Point of Diversion Location of Pumping sites 4 points along bank of creek S¹
- Sec. 34 Twp. 9 Rge. 47E Bank of Stream
6. Purpose Irrigation and watering livestock
7. Description of System Portable pump
8. Land Description of Intended Place of Use S¹N¹, S¹ Sec. 34-9N-47E.
9. Remarks (Pertaining to Use, etc.)

Decree

10. Case No. Date Amt. Decreed: M. I. C. F. S.
11. To Whom Decreed Address
12. Name of Ditch Maximum Capacity (C. F. S.)
13. Date of Priority Purpose
14. Land Description of Place of Use as Decreed
15. Remarks (Present Use Status, etc.)



NOTICE
These forms are the
property of the State
of Montana and must
be returned.

STATE OF MONTANA
STATE ENGINEERS OFFICE
Water Resources Survey

Code No. 35A
County Quinn
T. 9N R. 47E

Name of Land Owner Carl Wahlgrenant Address Box 524, Miles City,
Name of Operator _____ Address _____

Part A

TO BE FILED BY THOSE OBTAINING IRRIGATION WATER FROM
A DITCH COMPANY OR IRRIGATION DISTRICT

1. Water is delivered by: _____
Name of Ditch, Ditch Company or District Supplying Water
2. State the number of acres you irrigate under this system _____ Shares you hold _____
3. If you obtain water from more than one Company, give the number of shares, acres irrigated and the name of the Company under "Remarks." If you obtain water from a Ditch Company and also have a private system fill in both Part A and Part B.

Part B

TO BE FILED BY THOSE WHO HAVE A PRIVATE DITCH, PUMP OR IRRIGATION SYSTEM
or those who have a private water right under a Ditch Company

4. In what year was this land first irrigated? Date (Check)
5. Give the name of the original appropriator (first user): Carl Wahlgrenant
6. Give the date appropriated 1942 Amount filed on: Miners Inches 115.0 C. F. S. 2.0
7. State the total number of acres irrigated under this system: 2.0 - no recorded filing
8. Give the point of diversion: _____ $\frac{1}{4}$ Section _____ Township _____ Range _____

Part C

TO BE FILED BY ALL WATER USERS IN ADDITION TO PART A OR PART B

9. Source of Water: Sunday Creek & Yellowstone River
Name of stream or lake from which water is originally diverted
10. Water is obtained by: (Check one) Gravity _____ Pumping ☒ Other _____
11. What is the greatest number of acres you have irrigated? 2.0 Date ?
12. How many acres did you irrigate in 1942 (Crop and pasture) 2.0 115.0
13. State the total number of additional acres that could be irrigated by increasing the water supply, land leveling, etc. 75 This land is under what ditch? Same
14. How many acres of seeped land do you have which could be drained and put into production? _____
15. What is the condition of your irrigation system? Good
16. Is your water supply adequate? Yes ☒ No ☒ Explain See attached form
17. REMARKS: _____

NOTE: The foregoing questions apply only to irrigated land shown on this plat.

DESCRIPTION AND MAP OF FARM

18. Legal Description of this Farm All of Sec. 35, T 9 N - R 4 E.



IRRIGATED LAND

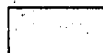

NON-IRRIGATED LAND

North

West

East

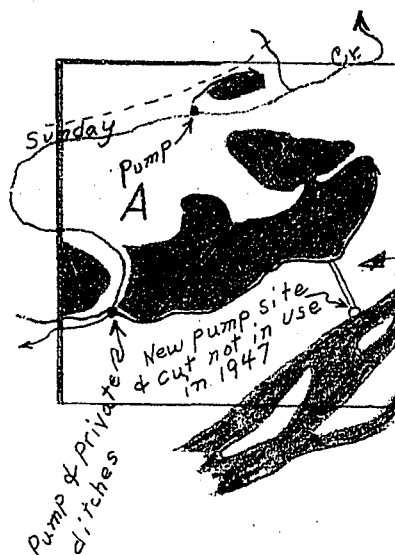

Is working on
cut thru hill from
yell. River to ditch when
completed will use
yell. River water on ^{working} ~~land~~
some project for ^{only irrigated land,} ~~one~~
individual ^{All ownership for}
^{or land not shown.}

19. If the above land is irrigated from more than one ditch please give the acreage under each ditch in 19A and indicate the location of the land irrigated from each on the above map.

19A. Ditch: Wahlgrenant Private system Acres: 115.6

Ditch: _____ Acres: _____

Information supplied by:

Name See attached form Address _____ Date _____

REMARKS: _____

If you cannot answer all of the questions on this form answer as many as you can and return the form to us as soon as possible.

STATE ENGINEER'S OFFICE
WATER RESOURCES SURVEY

COUNTY CusterFILE NO. 11-T 9N-R 47EOwner Wahlgenant, Carl Address Box 524, Miles City

AAA Owner Address

Operator " " Address " "

New Owner Address

New Operator Address

Assessment Record NoneAssessed Acreage 0Legal Description of This Farm all of Sec. 35; T 9N-R 48ETotal Acres in Farm ✓Code Number 35APhoto No. MA 21-29

AAA Contract No.

AAA Total Cropland Acreage

App. No. 1830

Decree No.

Land is located in

Twp. 9N Rge. 47E Twp. Rge.

Twp. Rge. Twp. Rge.

Filed in Twp. 9N Rge. 47E

Remarks

Ownership covered
only irrigated land.
All ownership for
dry land not shown.

Yellowstone River Basin

Farm Checked

STATE OF MONTANA

Code No. 214, 234, 242 35ABy Dave & Jim

STATE ENGINEER'S OFFICE

County CusterArea ^{Lower} Sunday Creek

WATER RESOURCES SURVEY

T. 9 N R. 47 E Sec. 35Date 5/14/47Photo No. MA 21-39Legal Land Owner Wahlgrenant, CarlAddress Miles City Kinsey Stage RdOperator Jame

Address

Water is delivered by:

Federal Project _____ Pres. _____ Pot. _____

Ditch Company _____ Pres. _____ Pot. _____

Irrigation District _____ Pres. _____ Pot. _____

Private System ☒ _____ Pres. 115 Pot. 75Totals 115 75Flood _____ Pump ☒ _____ Reservoir _____ Gravity _____Size and Capacity, Pump, etc. 2 small pumps tractor power 75 ft. Lifts out of Sunday Crk
6-8 Centrifugal 45 ft lift out of Yellowstone tractor power.

Original Appropriator, Company _____ App. No. _____

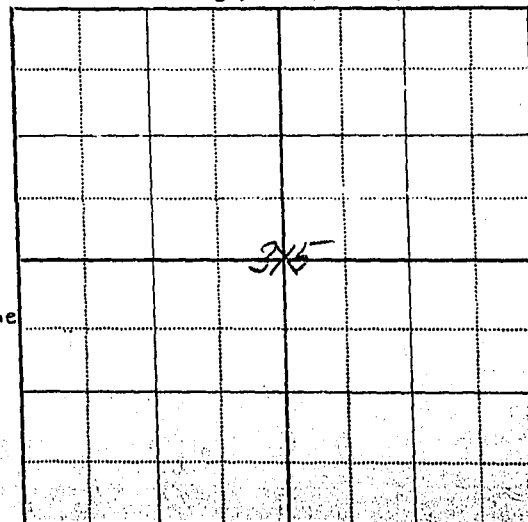
Original Appropriator, Private C. Wahlgrenant, 1942 no filing App. No. _____
(Show date of appropriation under Remarks)Is the system an extension of another system? Yes _____ No ☒Is all land irrigated from one system? Yes _____ No ☒(If No, show break down on map) see pic. MA 21-39Source of Water Sunday Creek 2 pumps about 4 in and 8 in. Yellowstone Riversec 35 T9N R47EAcres Irrigated 19.47 115Potential Acres 75 A. _____ Seeped 0Explain has about 75 acres that could be reached by waterCondition of System GoodAdequate Supply _____ Yes ☒ _____ No _____Explain Water from Sunday Creek supplemented by system from YellowstoneTopography 1st & 2nd Terrace Sunday CreekInformation From Carl WahlgrenantRemarks owns other lands beside sec 35 but allirrigation is in sec 35

has some potential land which he doesn't expect to
develop for irrig. for some time. Has irrigated 5 years No
~~more~~ filing made. My Wohlgenant is making out and putting
in pump to get water from Yellowstone now will be in use
this summer

April 16, 1948

Mr. Carl Wahlgenant
Box 524
Miles City, Montana

Re: Flood Irrigation on Sunday Creek

Dear Sir:

Custer

Section 35, T. 9N., R. 48E.

STATE ENGINEERS OFFICE
Water Resources Survey

Notice of Appropriation

1. County Custer Book B Page 623 Record M.R.
(over)
2. Name of Appropriator Sunday Creek Canal & Irr. Co. Address Miles City, Montana
3. Date Appropriated Oct. 31, 1904 Date Filed Oct. 31, 1904
- Amount Appropriated, Miners Inches 15,000 or _____, Cubic Feet per second 375
4. Name of Stream Sunday Creek Tributary _____ Basin _____
5. Point of Diversion Within the SE¹ of

Sec. 8 Twp. 8N. Rge. 4E. Bank of Stream North

6. Purpose For agricultural and grazing purposes.
7. Description of System A dam will be constructed of rock and cribbage and to be approximately 5 ft. in height and 150 ft. in length, not including an embankment on the westerly side of said creek extending in length probably 150 yds. It is further intended that at said dam there will be constructed a headgate in dimensions approximately 10 (ten) ftl square, which headgate will open into a ditch, to be constructed in width from 5 to 10 ft. at the bottom, which said ditch will be extended in an easterly direction on the northerly
8. Land Description of Intended Place of Use side of said creek upon or near the land hereinbefore
(over)

9. Remarks (Pertaining to Use, etc.) _____

Decree

10. Case No. _____ Date _____ Amt. Decreed: M. I. _____ C. F. S. _____
11. To Whom Decreed _____ Address _____
12. Name of Ditch _____ Maximum Capacity (C. F. S.) _____
13. Date of Priority _____ Purpose _____
14. Land Description of Place of Use as Decreed _____
15. Remarks (Present Use Status, etc.) _____

No. 2 cont'd.

The appropriators are: Christen Arneberg, and Cornelius H. Porter, also known as the Sunday Creek canal and Irrigating Co.

No. 7 cont'd.

described. It is further intended that such other dams and ditches and such flumes reservoirs and dykes will be constructed and employed in appropriating and in using of said water as the nature of the soil and contry may require.

All Sec. 8-8N-47E, 640 acres, Nils & Carl Lindeberg, Miles City

All Sec. 9-8N-47E, 640 acres, Ervin C. Bayer, Graham, Wash.

Lots 1,2, S $\frac{1}{2}$ NE $\frac{1}{4}$, SE $\frac{1}{4}$ Sec. 4-8N-47E, 321.13 acres, Nils & Carl Lindeberg, Miles City

Lots 3,4, S $\frac{1}{2}$ NE $\frac{1}{4}$, SW $\frac{1}{4}$, 321.45 acres, Sec. 4-8N-47E, Columbian Co., St. Paul, Minn.

All Frl. Sec. 3-8N-47E, 640.97 acres, Chappel Bros., Inc., Miles City

SE $\frac{1}{4}$ Sec. 32-9N-47E, 160 acres, Chappel Bros., Inc., Miles City

N $\frac{1}{2}$ NE $\frac{1}{4}$, S $\frac{1}{2}$ NE $\frac{1}{4}$, N $\frac{1}{2}$ SW $\frac{1}{4}$ Sec. 32-9N-47E, 320 acres, C. W. Wood, Volberg, Montana

Balance Sec. 32-9N-47E, 160 acres, U. S. A.

All Sec. 33-9N-47E, 640 acres, Chappel Bros., Inc., Miles City

All Sec. 34-9N-47E, 640 acres, Custer County, Miles City

All Frl. Sec. 35-9N-47E, 581.53 acres, N. P. Ry. Co., St. Paul, Minn.

&
NW $\frac{1}{4}$ SE $\frac{1}{4}$, 320 acres, Sec. 26-9N-47E, Chappel Bros., Inc., Miles City

Bal. of Sec. 26-9N-47E, Custer County

All Frl. less 83.67 acres (Lot 1) Sec. 25-9N-47E, 540 acres, N.P. Ry. Co.

Lot 1, or 83.67 acres, Sec. 25-9N-47E, U.S.A.

County Custer Sheet No. 1
Township 9N Range 27E of Sheets

[illegible]

5. Township 9 North Range 47 East

Township 9 North Range 47 East County Custer

Parcel Number	Name of Owner	Address
2C, 10B, 12C,	U. S. A.	
13A, 24A, 25A,	" " "	
26A, 26B, 28A,	" " "	
32A, 32B, 34A,	" " "	
34B	" " "	
1A	H. P. Ry.	
2A, 4B, 12A,	Custer County	
15A, 18B, 22A,	" "	
24B	" "	
2B	Fred, Edw. & Lena Noack	341 $\frac{1}{2}$ W. 65th St., Los Angeles 3, Cal.
3A, 4A, 5A, 6A,	A. L. Taylor	Becker Ranch, Miles City, Mont.
7A, 8A, 9A,	" "	
10A, 11A, 14A,	" "	
17A, 18A, 19A,	" "	
20A, 29A, 30A,	" "	
31A, 33A	" "	
16A, 36A	State	
6B	Grace W. Camp	704 Frisco, Monett, Mo.
6C	John W. Moore	Jordan Stage, Miles City, Mont.
10C	W. H. Holdeman, c/o Grace Rayburn	Sparta Road, R.R. 5, St. Joseph, Mo.
12B	John Dwyer, c/o Mabel Ryan	Wakonda, South Dakota
8B	C. E. Retallick	Box 358, Miles City, Montana
13B, 24C	Alex Noble	Box 308, Miles City, Montana
21A, 23A, 26C,	Carl Wahlgenant	Box 524, Miles City, Montana
26D, 27A, 35A	" "	
24D	K. Hall	Box 155, Miles City, Montana
20B	Earl S. Cherry, Est., c/o Mildred F. Elder - Strawn, Texas	
30B	Henry & Marian Stein, c/o H. E. Herrick	Miles City, Montana
28B	Fay H. Williamson	520 Yellowstone Avenue, Miles City, Mont.
32C	Helen Jeske, c/o Mack Jeske A. L. Taylor	Box 772, Miles City, Montana
34C	Joe Wahlgenant	Box 524, Miles City, Montana

Township 9 North

Range 47 East

Custer County, Montana

<u>Index No.</u>	<u>Name of Appropriator</u>	<u>Stream</u>	<u>Date App.</u>	<u>Date Filed</u>	<u>Inches</u>
405	Eva Townsend	Cow Creek	1-17-05	1-18-05	500
914	State Water Cons. Board	House Creek	8-9-36	8-21-36	---
1967	Charles G. Wilder	Tree Creek	4-7-11	4-13-11	6000
2038	Clark Tozer	Woodlief Creek	-93	9-8-93	300
673	Barney Collieran	First Creek	10-6-13	10-7-13	500
1830	Sunday Creek Canal & Irr. Co.	Sunday Creek	10-31-04	10-31-04	15,000
1828	Abraham Becker	Sunday Creek	6-13-17	6-13-17	1000
1832	Hugh R. Wells	Sunday Creek	4-28-15	10-6-15	500
2508	Joe Wohlgenant	Sunday Creek	1-26-46	1-28-46	250
405	Eva Townsend	Cow Creek	1-17-05	1-18-05	500
2507	Ed Whitbeck	Jim Creek	3-28-41	3-28-41	5000
1831	Theron H. Townsend	Sunday Creek	12-19-14	12-22-14	500
1580	W. H. Hill & Chas. G. Wilder	Sand Creek	1-8-06	3-18-13	---
1591	Charles G. Wilder	Sand Creek	4-3-30	4-5-30	3000
1814	Mary Ellen Wilder	Stone Shack Coulee	7-19-11	8-16-11	800

Township 9 North

Range 47 East

Custer County, Montana

(Township 9 North, Range 48 East)

Aastom, Carl & Clara
Beckman, Alick & Mabel
Bender, Mark & Violet
Burnside, Oscar R. & Ellen
Carey, Victor & Anna
Campbell, Fred L. & Bessie M.
Carter, Daniel & Grace
Christensen, Andrew & Pearl
Cleveland, Frank G. & Ruth
Cole, Robert F.
Crist, Milton G. & Margaret K.
Dolby, Glenn & Hazel
Edmonds, Wayne R. & Vera
Edwards, Vay N. & Daisy B.
Everson, Raymond & Glenn
Ferris, N. DeVere & Opal
General American Life Ins. Co.
George, Henry H. & Ethel
Gresser, Adam & Mabel
Gulden, Don
Hanson, Bernard & Betty
Hanson, Bernt & Ona M.
Haun, Richard & Elizabeth
Hillier, Earl S. & Ruth
Holzwarth, Elmer & Jennie
Ingraham, Geo. O. & Martin
Irving, Rolland H. & Ruth K.
Janutis, Tony & Mary
Job, Dominic S. & Theresa
Kinsey Irrigation Co.
Kirkpatrick, Richard & Dorothy
Lenning, Henry
Lund, Laurids & Nora K.
Mastin, C. O. & Edna
Mathison, Carl T. & Lillian
Morton, Edward & Bertha M.
Mugeli, Joe & Barbara
Myran, Otto H. & Rosalie
Myran, Wayne L. & Isabella
Nile, Cecil C. & Doris
Noble, Alex
Orthman, Carl
Parent, Alex J. & Ellen
Rebhahn, George & Frieda
Reinhardt, Rudolph & Rose
Scanlan, Harold & Ruby
Scheid, Martin and Hulda
Schmidt, Albert and Edna

Schmidt, Otto & Dorothy
Shook, Harold & Annie
Viall, Howard L. & Myril
Watts, Harold & Mary
Wolfe, C. D. & Dorothea
Wombolt, Fred Jr.
Wright, Jack & Mildred
Zabel, Henry W. & Bertha
Zabel, Walter C. & Helen
Ziebarth, Joseph N. & Nellie C.

COUNTY

Custer

Sheet No.

Twp.

9N

Rgc.

48E

Unit

Letters

File No.	Name	1st	2nd	3rd	Ret.	Name	1st
54	Gastorn, Carl & Clara	2/11			2/16		
58	Beckman, Alice & Mabel	2/11			2/20		
15	Gynder, Mark & Violet	2/10			2/16		
13	Burnside, Oscar B. & Ellen	2/11			3/11		
3	Campbell, Fred L. & Bernice M.	2/11			2/11		
63	Carey, Victor & Anna				2/26	Filed in 10N-48E	
5	Carter, Daniel & Grace				2/8		
56	Christensen, Andrew & Pearl				2/16		
61	Cleveland, Frank G. & Ruth				2/5		
11	Crist, Milton G. & Margaret				2/26		
10	Dalby, Glenn & Edgel	2/10			2/16		
35	Edmonds, Mary R. & Vera				2/20		
7	Edwards, Vay M. & Daisy B.	2/9			2/16		
6	Emerson, Raymond & Eleanor						
2	Ferris, M. De Vere & Opal				3/12		
51	George, Henry L. & Ethel				2/16		
	Gen. Inv. Refs. Ins. Co.						
49	Gresser, Adam & Mabel				2/16		
	Gulden, William E.				2/19		
59	Hanson, Bernard & Betty				2/24		
16	Hanson, Bernt & Anna M.				11		
14	Haux, Richard & Edg.	2/10			2/16		
	Hill, A. D.						
28	Hellier, Earl S. & Ruth	2/10			2/17		
36	Holguarth, Edmund & Jennie	2/10			2/16		
26	Ingram, Geo. O. & Marian				2/26		
37	Jones, Roland H. & Ruth K.				2/5		
18	Janutis, Tony & Mary				2/19		

COUNTY _____

Sheet No. _____

Twp. _____ Rge. _____

Letters

File No.	Name	1st	2nd	3rd	Ret.	Name	1st
30	Job, Dominie S. & Theresa	2/10			2/14		
55	Kinsley Innig. Co.	2/11			2/18		
47	Lickpatrick, Richard & Dorothy	2/11			2/16		
33	Lund, Lauride & Nora L.	2/11			2/27		
42	Martin, C.O. & Edna	2/11			2/25		
1	Mathison, Carl T. & Lillian	2/11			2/18		
70	Morton, Edward & Bertha	2/10				Filed in 10N-49E	
	Muggli, Joe & Barbara	2/11			2/16		
24	Mysan, Otto H. & Rosalie	2/11					
57	Mysan, Wayne & Isabella	2/11					
9	Nile, Cecil C. & Doris	2/11			2/9		
	Nobel, Alice	2/11					
25	Parent, Alice J. & Ellen	2/11			2/1		
53	Reblahn, Les. & Frieda	2/11			2/18		
17	Reinhardt, Rudolph & Rose	2/11			2/27		
4	Reynolds, Harold & Ruby	2/11					
60	Scheid, Martin & Hulda	2/11					
52	Schmidt, Otto & Dorothy	2/11			2/16		
33	Shook, Harold & Annie	2/11					
19	Viall, Edward L. & Myril	2/11			2/18		
12	Wakefield, Tony & Marion	2/11			2/18		
32	Watts, Harold & Mary	2/11				Filed in 10N-48E	
	Wolfe, C.D. & Sarah Ann	2/11					
50	Wombolt, Fred J.	2/11			2/16		
48	Wright, Jack & Mildred	2/11			2/18		
29	Zabel, Walter C. & Helen	2/11					
62	Zabel, Henry W. & Bertha	2/11			2/24		

Twp._____ **Rge.**_____

Letters

[illegible]



NOTICE
These forms are the
property of the State
of Montana and should
be returned.

STATE OF MONTANA
STATE ENGINEERS OFFICE
Water Resources Survey

FORM:WR-2M-12-47
Code No. Unit No. 54
County Custer
T. 9N. R. 48E.

Name of Land Owner Aastom, Carl & Clara Address Unit No. 54, Kinsey, Montana
Name of Operator Carl Aastrom Address Kinsey Rte. Kinsey
Mont.

Part A

TO BE FILED BY THOSE OBTAINING IRRIGATION WATER FROM
A DITCH COMPANY OR IRRIGATION DISTRICT

- Water is delivered by: Kinsey Irrigation Co.
Name of Ditch, Ditch Company or District Supplying Water
- State the number of acres you irrigate under this system: 75 Shares you hold 85 acres
- If you obtain water from more than one Company, give the number of shares, acres irrigated and the name of the Company under "Remarks." If you obtain water from a Ditch Company and also have a private system fill in both Part A and Part B.

Part B

TO BE FILED BY THOSE WHO HAVE A PRIVATE DITCH, PUMP OR IRRIGATION SYSTEM
or those who have a private water right under a Ditch Company

- In what year was this land first irrigated? Date Jan. 1946
- Give the name of the original appropriator (first user):
- Give the date appropriated: Amount filed on: Miners Inches: C. F. S.
- State the total number of acres irrigated under this system:
- Give the point of diversion: $\frac{1}{4}$ $\frac{1}{4}$ Section Township Range

Part C

TO BE FILED BY ALL WATER USERS IN ADDITION TO PART A OR PART B

- Source of Water: Yellowstone River
Name of stream or lake from which water is originally diverted
- Water is obtained by: (Check one) Gravity _____ Pumping ☒ Other _____
- What is the greatest number of acres you have irrigated? 85 Date 1946
- How many acres did you irrigate in 1947? (Crop and pasture) 75
- State the total number of additional acres that could be irrigated by increasing the water supply, land leveling, etc. This land is under what ditch?
- How many acres of seeped land do you have which could be drained and put into production? 10
- What is the condition of your irrigation system? Fair
- Is your water supply adequate? Yes ☒ No _____ Explain _____
- REMARKS: 10 acres of seeped land as soon as S.C.S. recommends location of required drain

NOTE: The foregoing questions apply only to irrigated land shown on this plat.

DESCRIPTION AND MAP OF FARM

18. Legal Description of this Farm Unit No. 54 - Sec. 2, 3, 10, 11, T. 9N., R. 48E.



IRRIGATED LAND



NON-IRRIGATED LAND

North

West

East

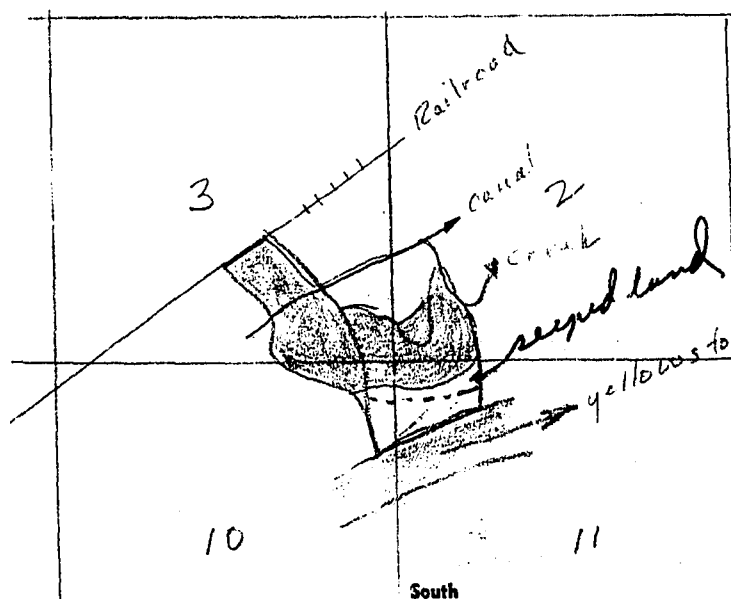

Shading covers only irrigated land. All ownership for dry land not shown.

19. If the above land is irrigated from more than one ditch please give the acreage under each ditch in 19A and indicate the location of the land irrigated from each on the above map.

19A. Ditch: _____ Acres: _____

Ditch: _____ Acres: _____

Information supplied by:

Name Carl Astrom Address Kinsey Mont Date 2-14-48

REMARKS: _____

If you cannot answer all of the questions on this form answer as many as you can and return the form to us as soon as possible.

STATE ENGINEERS OFFICE
Water Resources Survey

Rel. 2/16

COUNTY Custer

FILE NO. 12-T-9N-R-48E

Owner Aastam, Carl + Clara Address Kinsey, Montana
(Kinsey Unit)

AAA Owner Address

Operator " " Address " "

New Owner Address

New Operator Address

Assessment Record yes - Unit No. 54

Assessed Acreage 77.0

Legal Description of This Farm Unit No. 54 (Nestor Bounds) Sec. 2, 3, 10, 11, T. 9N-R. 48E

Total Acres in Farm 168.24

Code Number Unit No. 54

Photo No. Ma 26-208

AAA Contract No.

AAA Total Cropland Acreage

App. No. 2123; 2124

Decree No.

Land is located in

Twp. 2N Rge. 7SE Twp. Rge.

Twp. Rge. Twp. Rge.

Filed in Twp. 2N Rge. 7SE

Remarks

Farm Map

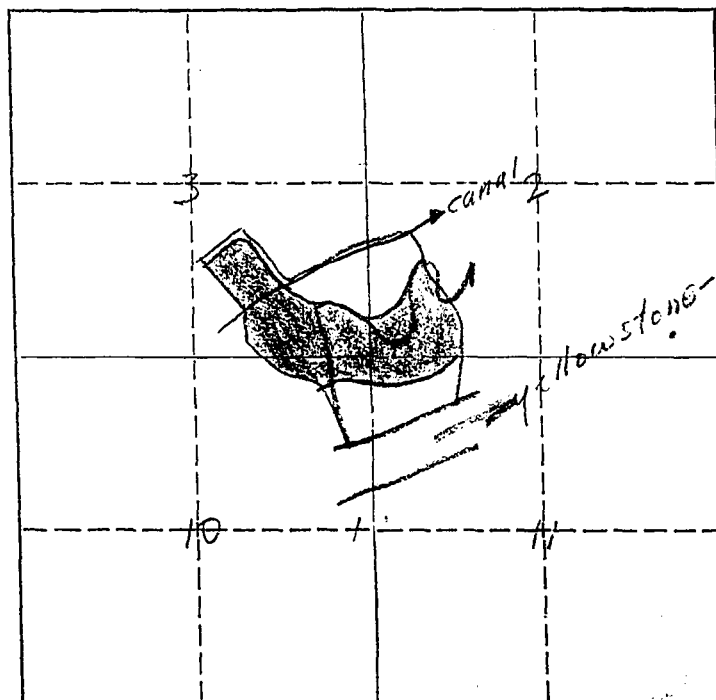

Ownership shown
only irrigated land,
All ownership for
dry land not shown.

yellowstone River Basin



NOTICE
These forms are the
property of the State
of Montana and must
be returned.

STATE OF MONTANA
STATE ENGINEERS OFFICE
Water Resources Survey

FORM WR-1-2M 12-47

Code No. Unit No. 58
County Custer
T. 9N. R. 48E.

Name of Land Owner Beckman, Alick & Mabel Address Kinsey Unit No. 58, Kinsey, Montana
Name of Operator ALICK BECKMAN Address KINSEY, MONT.

Part A

TO BE FILED BY THOSE OBTAINING IRRIGATION WATER FROM
A DITCH COMPANY OR IRRIGATION DISTRICT

1. Water is delivered by: KINSEY IRRIGATION CO.
Name of Ditch, Ditch Company or District Supplying Water
2. State the number of acres you irrigate under this system 71 Shares you hold
3. If you obtain water from more than one Company, give the number of shares, acres irrigated and the name of the Company under "Remarks." If you obtain water from a Ditch Company and also have a private system fill in both Part A and Part B.

Part B

TO BE FILED BY THOSE WHO HAVE A PRIVATE DITCH, PUMP OR IRRIGATION SYSTEM
or those who have a private water right under a Ditch Company

4. In what year was this land first irrigated? Date 1941
5. Give the name of the original appropriator (first user):
6. Give the date appropriated Amount filed on: Miners Inches C. F. S.
7. State the total number of acres irrigated under this system:
8. Give the point of diversion: 1/4 1/4 Section Township Range

Part C

TO BE FILED BY ALL WATER USERS IN ADDITION TO PART A OR PART B

9. Source of Water: YELLOWSTONE RIVER
Name of stream or lake from which water is originally diverted
10. Water is obtained by: (Check one) Gravity Pumping X Other
11. What is the greatest number of acres you have irrigated? 70 Date 1941
12. How many acres did you irrigate in 1947? (Crop and pasture) 60 A
13. State the total number of additional acres that could be irrigated by increasing the water supply, land leveling, etc. NONE This land is under what ditch? LOWER CANAL
14. How many acres of seeped land do you have which could be drained and put into production? 12 A
15. What is the condition of your irrigation system? FAIR
16. Is your water supply adequate? Yes No X Explain THE DITCH IS
17. REMARKS: NOT LARGE ENOUGH.

Over

NOTE: The foregoing questions apply only to irrigated land shown on this plat.

DESCRIPTION AND MAP OF FARM

18. Legal Description of this Farm Unit No. 58, Sec. 2 & 11, T. 9N., R. 48E.



IRRIGATED LAND

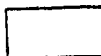

NON-IRRIGATED LAND

— unit Boundary

North

West

East

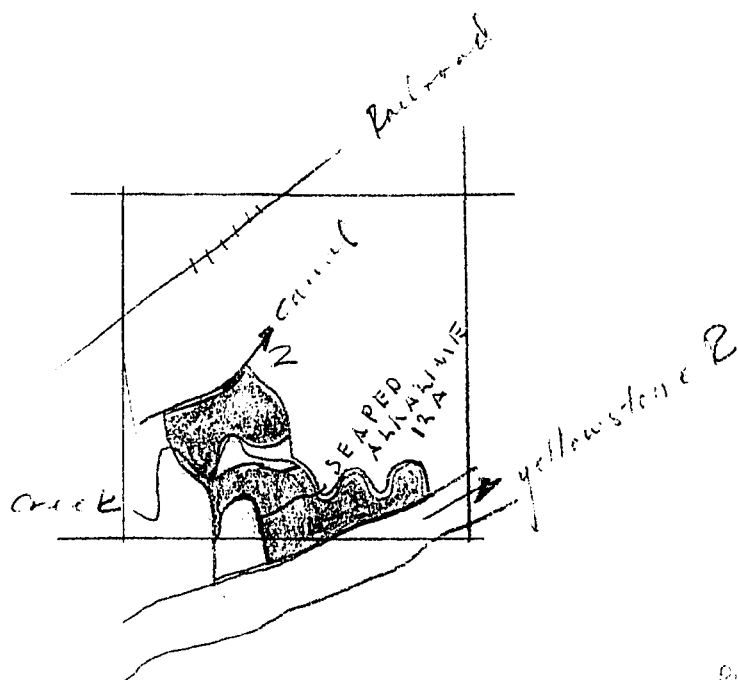

South

Shaded areas
only irrigated land.
All expansion of
ditch not shown.

19. If the above land is irrigated from more than one ditch please give the acreage under each ditch in 19A and indicate the location of the land irrigated from each on the above map.

19A. Ditch: _____ Acres: _____

Ditch: _____ Acres: _____

Information supplied by:

Name Wick Beckman Address Linsey Date Feb. 19-48

REMARKS: _____

If you cannot answer all of the questions on this form answer as many as you can and return the form to us as soon as possible.

STATE ENGINEERS OFFICE
Water Resources Survey

COUNTY Cluster

FILE NO. 12-T.9N-R.48E

Owner Beckman, Alice & Mabel Address Hiasey, Montana
(Kinsey Unit)

AAA Owner Address

Operator " " Address " "

New Owner Address

New Operator Address

Assessment Record yes Unit No. 58

Assessed Acreage 81.0

Legal Description of This Farm Unit No. 58 (Meets & Bounds) Sec. 24.11; T.9N-R.48E

Total Acres in Farm 135.83

Code Number Unit No. 58

Photo No. Ma 26-208

AAA Contract No.

AAA Total Cropland Acreage

App. No. 2123; 2124-323-1140

Decree No. 141-1142

Land is located in

Twp. 9N Rge. 28E Twp. Rge.

Twp. Rge. Twp. Rge.

Filed in Twp. 20 Rge. 28E

Remarks

Farm Map

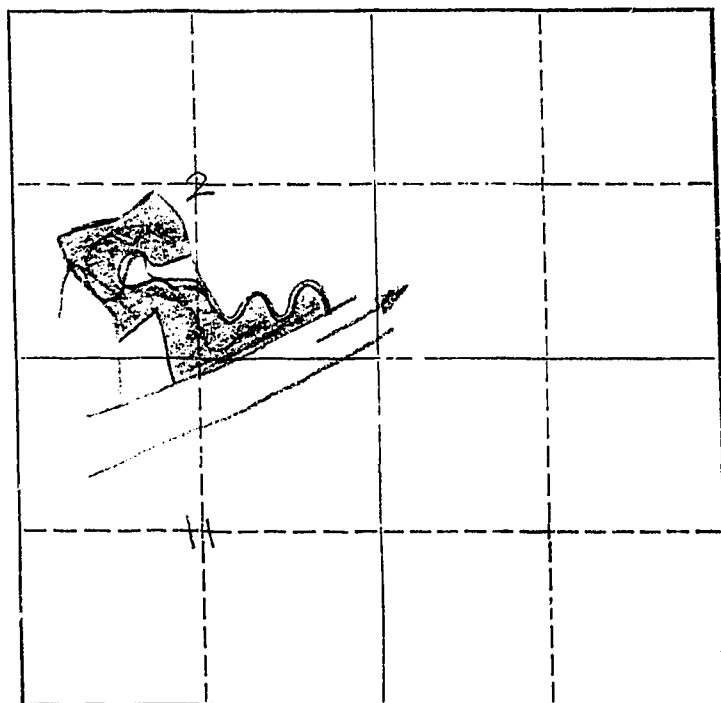

Ownership covers
only irrigated land,
All ownership for
dry land not shown

Yellowstone River Basin