

(Township 9 North, Range 51 East)

Meedinger, Edwin & Ann

Morton, Edward & Bertha M.

(Township 9 North, Range 51 East)

Dynes, T. A.

McCoy, Margaret

N. P. R. R.

U. S. A.

Young, Paul E.

STATE ENGINEERS OFFICE  
Water Resources Survey

L.S.  
(See 10N-44)  
P.R. 5

COUNTY Cluster

FILE NO. 12A-T. 9N-R. 49E

Owner McDermott, Edwin L. Don Address Kinsley, Montana

AAA Owner \_\_\_\_\_ Address \_\_\_\_\_

Operator \_\_\_\_\_ Address \_\_\_\_\_

New Owner \_\_\_\_\_ Address \_\_\_\_\_

New Operator \_\_\_\_\_ Address \_\_\_\_\_

Assessment Record Yes - Unit No. 67

Assessed Acreage 76.0

Legal Description of This Farm Unit No. 67 (Meets & Bounds) Sec. 31, T. 10N-R. 49E

Sec. 6; T. 9N-R. 49E

Total Acres in Farm 159.27

Code Number Unit No. 67

Photo No. Ma 17-116

AAA Contract No. \_\_\_\_\_

AAA Total Cropland Acreage \_\_\_\_\_

App. No. 2123; 2124

Decree No. \_\_\_\_\_

Land is located in

Twp. 10N Rge. 49E Twp. 9N Rge. 49E

Twp. \_\_\_\_\_ Rge. \_\_\_\_\_ Twp. \_\_\_\_\_ Rge. \_\_\_\_\_

Filed in Twp. 10N Rge. 49E

Remarks \_\_\_\_\_

Farm Map

Ownership covers  
only irrigated land.  
All ownership for  
dry land not shown.

Yellowstone River Basin

Owner Montana

AAA Owner \_\_\_\_\_

Operator \_\_\_\_\_

New Owner \_\_\_\_\_

New Operator \_\_\_\_\_

Assessment Record \_\_\_\_\_

Legal Description of

Sec. 31; T.

Code Number Ma

Photo No. Ma 17

AAA Contract No. \_\_\_\_\_

AAA Total Cropland \_\_\_\_\_

App. No. 2123

Decree No. \_\_\_\_\_

Land is located in

Twp. 10N Rge. 49E

Twp. 9N Rge. 49E

Filed in Twp. 10N

Remarks This

is located

Yellowstone

STATE ENGINEERS OFFICE  
Water Resources Survey

L.B.  
(Rev. 10N-49E)  
L.R.-2/14

COUNTY Custer

FILE NO. 12A-T.9N-R.99E

Owner Monte Edward & Bertha M. Address Kinsey, Montana

Address

Address

Address

Address

Assessment Record yes - Unit No. 70

Assessed Acreage 102.0

Legal Description of This Farm Unit No. 70 (Neeta & Bauda) Sec. 36, T.10N-R.98E, Sec. 31, T.10N-R.98E, Sec. 1, T.9N-R.98E, Sec. 6, T.9N-R.98E

Total Acres in Farm 132.26

Unit Number Unit No. 70

Photo No. Ma 17-116, Ma 17-207, Ma 17-208

AA Contract No.

AA Total Cropland Acreage

pp. No. 2123, 2124

acres No.

and is located in

wp. 20N Rge. 28E Twp. 10N Rge. 99E

wp. 20N Rge. 28E Twp. 20N Rge. 99E

iled in Twp. 10N Rge. 99E

emarks This Unit No. 70 is

located on front of

Stone River Basin

Farm Map

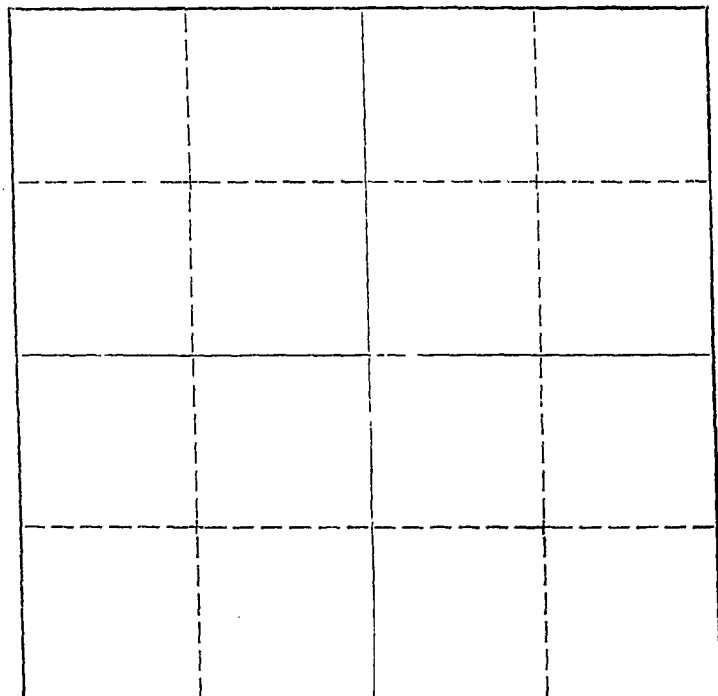

Ownership showing  
only irrigated land.  
All ownership for  
dry land not shown.

Township 9 North

Range 51 East

Custer County

<u>Index No.</u>	<u>Name of Appropriator</u>	<u>Stream</u>	<u>Date App.</u>	<u>Date Filed</u>	<u>M.I.</u>
453	W. R. Bowling	Deep Creek	4-5-35	4-5-35	800
587	Winifred Sutherland	Dry Gulch	6-1-14	7-27-16	500
1336	Carlton Neumann	Powder River	3-6-16	3-7-16	300

Township 9 North

Range 51 East

Custer County

Township 9N Range 51E County Custer

[illegible]

STATE OF MONTANA  
**STATE ENGINEER'S OFFICE**  
 WATER RESOURCES SURVEY

Township.....9N..... Range.....51E..... County.....Custer.....

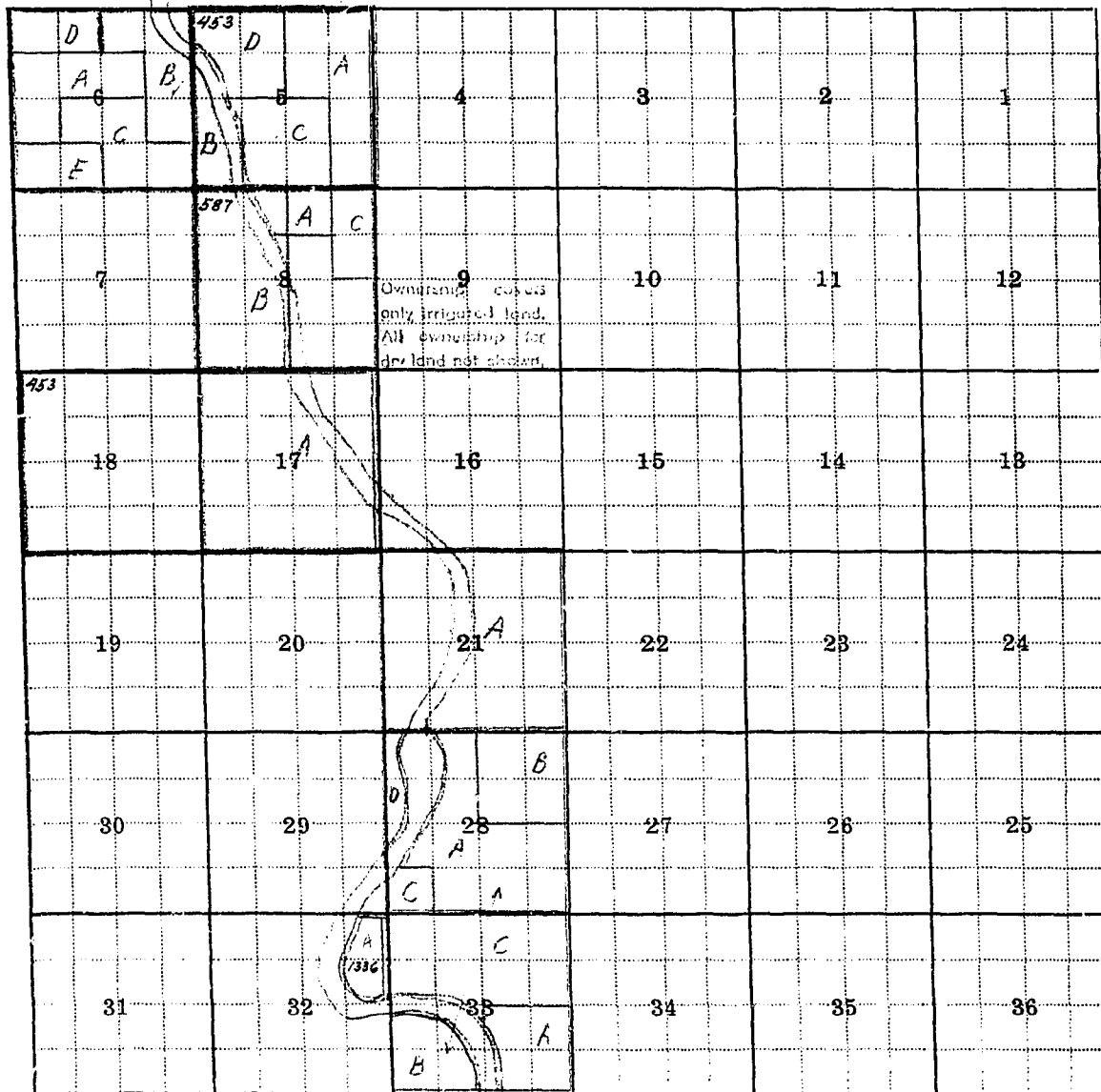

.....  
 .....  
 .....  
 .....

Township.....9N..... Range.....51E.....



NOTICE  
These forms are the  
property of the State  
of Montana and must  
be returned.

STATE OF MONTANA  
STATE ENGINEERS OFFICE  
Water Resources Survey

FORM WR-1-2M (2-47)  
Code No. 28A  
County Custer  
T. 9N R. 51E

Name of Land Owner T. A. Dwyer Address ?  
Name of Operator \_\_\_\_\_ Address \_\_\_\_\_

Part A

TO BE FILED BY THOSE OBTAINING IRRIGATION WATER FROM  
A DITCH COMPANY OR IRRIGATION DISTRICT

1. Water is delivered by: \_\_\_\_\_  
Name of Ditch, Ditch Company or District Supplying Water
2. State the number of acres you irrigate under this system: \_\_\_\_\_ Shares you hold: \_\_\_\_\_
3. If you obtain water from more than one Company, give the number of shares, acres irrigated and the name of the Company under "Remarks." If you obtain water from a Ditch Company and also have a private system fill in both Part A and Part B.

Part B

TO BE FILED BY THOSE WHO HAVE A PRIVATE DITCH, PUMP OR IRRIGATION SYSTEM  
or those who have a private water right under a Ditch Company

4. In what year was this land first irrigated? Date See attached filings
5. Give the name of the original appropriator (first user): \_\_\_\_\_
6. Give the date appropriated: \_\_\_\_\_ Amount filed on: Miners Inches \_\_\_\_\_ C. F. S. \_\_\_\_\_
7. State the total number of acres irrigated under this system: \_\_\_\_\_
8. Give the point of diversion: \_\_\_\_\_  $\frac{1}{4}$  \_\_\_\_\_  $\frac{1}{4}$  Section \_\_\_\_\_ Township \_\_\_\_\_ Range \_\_\_\_\_

Part C

TO BE FILED BY ALL WATER USERS IN ADDITION TO PART A OR PART B

9. Source of Water: Powder River & Snow Creek  
Name of stream or lake from which water is originally diverted
10. Water is obtained by: (Check one) Gravity \_\_\_\_\_ Pumping ☒ Other flood irrigation
11. What is the greatest number of acres you have irrigated? 109.7 Date about 1912
12. How many acres did you irrigate in 1912? (Crop and pasture) none
13. State the total number of additional acres that could be irrigated by increasing the water supply, land leveling, etc. 109.7 This land is under what ditch? Holbrook pump ditch - 19.1  
snow flood ditch 32.6  
Newman pump ditch 58.0
14. How many acres of seeped land do you have which could be drained and put into production? \_\_\_\_\_
15. What is the condition of your irrigation system? out of use
16. Is your water supply adequate? Yes \_\_\_\_\_ No ☒ Explain Constant supply
17. REMARKS: Holbrook pump ditch 1912 to 1920  
Holbrook snow Creek flood ditch 1910-1912  
Newman pump ditch 1910 to 1930  
approx use dates

Over

T. 9N., R. 51E.

NOTE: The foregoing questions apply only to irrigated land shown on this plat.

### DESCRIPTION AND MAP OF FARM

18. Legal Description of this Farm SE4, E2SW4, NW5W4 Sec River,  
E2NW4 Sec River, Sec 28, Twp 9N, Rge 51E

☐ IRRIGATED LAND

☐ NON-IRRIGATED LAND

☐ Potential Land

North

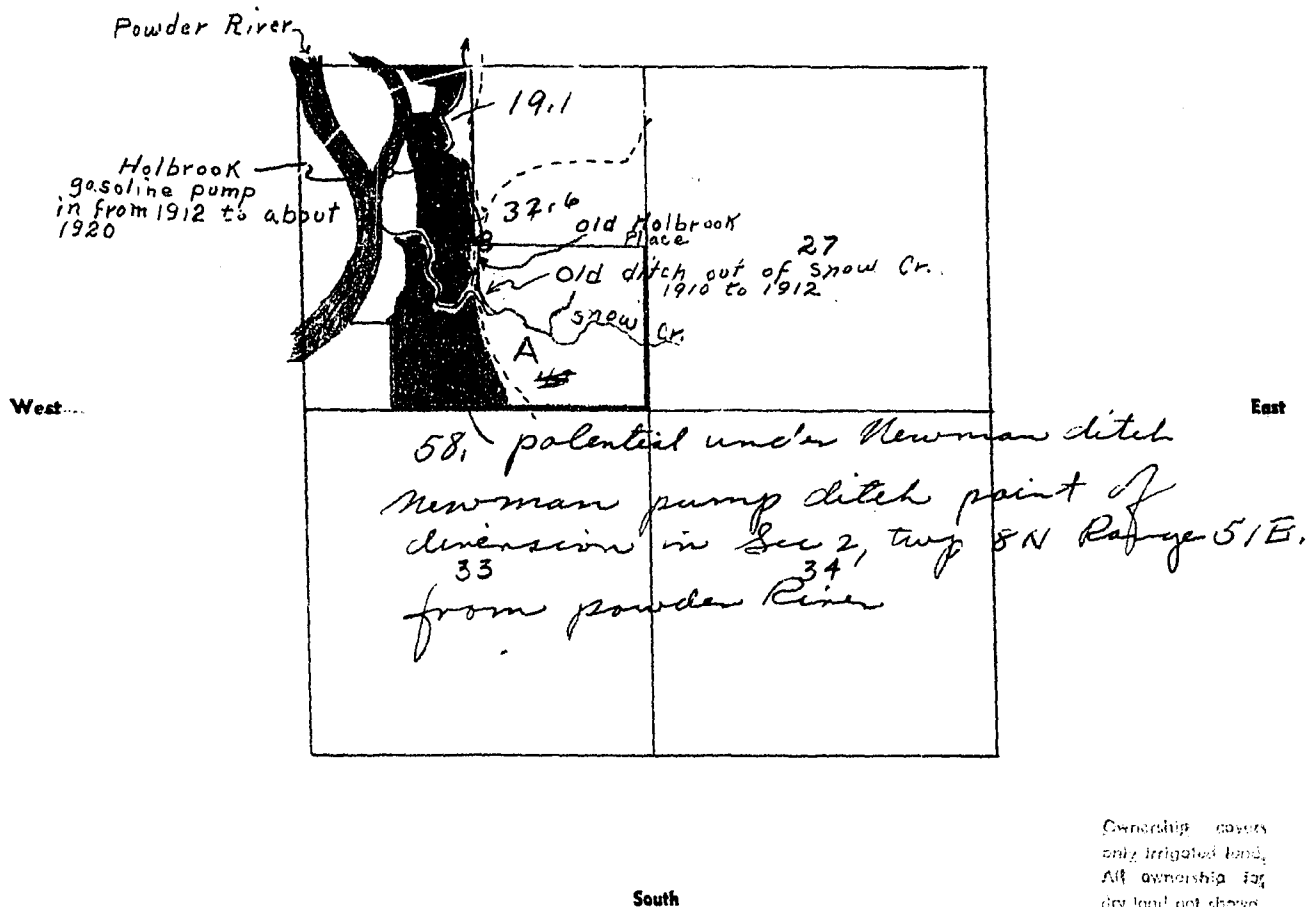

19. If the above land is irrigated from more than one ditch please give the acreage under each ditch in 19A and indicate the location of the land irrigated from each on the above map.

19A. Ditch: Holbrook pump ditch Acres: 0  
snow flood ditch Acres: 0  
Ditch: Newman ditch Acres: 0

Information supplied by:

Name Field Survey Address: \_\_\_\_\_ Date July 15-47

REMARKS: Johnson & Paulist

If you cannot answer all of the questions on this form answer as many as you can and return the form to us as soon as possible.



STATE ENGINEERS OFFICE  
Water Resources Survey

COUNTY Custer

FILE NO. 13-T9N-R.51E

Owner Dynes, T. A. Address 2

AAA Owner..... Address.....

Operator..... Address.....

New Owner..... Address.....

New Operator..... Address.....

Assessment Record None

Assessed Acreage 0

Legal Description of This Farm lots 1, 6, 7, SE 1/4, SE 1/4, Sec. 28; T9N-R.51E  
lots 3, 4, Sec. 33 T9N-R.51E

Total Acres in Farm ✓

Code Number 28A, 33B

Farm Map

Photo No. MA 20-31

AAA Contract No.....

AAA Total Cropland Acreage.....

App. No. No record by Dispt.

Decree No.....

Land is located in

Twp. 9N Rge. 51E Twp..... Rge.....

Twp..... Rge..... Twp..... Rge.....

Filed in Twp. 9N Rge. 51E

Remarks Unable to locate

appropriation for this land

Possible that new man ditch was filed on by E. S. Newman 4/12/25 no discription			

Ownership covers  
only irrigated land,  
All ownership for  
dry land not shown.

Powder River Basin



NOTICE  
These forms are the  
property of the State  
of Montana and must  
be returned.

STATE OF MONTANA  
STATE ENGINEERS OFFICE  
Water Resources Survey

FORM WR-1-2M 12-47

Code No. 32A  
County Custer  
T. 9N R. 51E

Name of Land Owner Margaret McCoy Address Chicago, Ill.  
Name of Operator \_\_\_\_\_ Address \_\_\_\_\_

**Part A**

**TO BE FILED BY THOSE OBTAINING IRRIGATION WATER FROM  
A DITCH COMPANY OR IRRIGATION DISTRICT**

1. Water is delivered by: \_\_\_\_\_  
Name of Ditch, Ditch Company or District Supplying Water
2. State the number of acres you irrigate under this system \_\_\_\_\_ Shares you hold \_\_\_\_\_
3. If you obtain water from more than one Company, give the number of shares, acres irrigated and the name of the Company under "Remarks." If you obtain water from a Ditch Company and also have a private system fill in both Part A and Part B.

**Part B**

**TO BE FILED BY THOSE WHO HAVE A PRIVATE DITCH, PUMP OR IRRIGATION SYSTEM  
or those who have a private water right under a Ditch Company**

4. In what year was this land first irrigated? Date 3/6/16
5. Give the name of the original appropriator (first user): Carlton Newman
6. Give the date appropriated 3/6/16 Amount filed on: Miners Inches 300 C. F. S. \_\_\_\_\_
7. State the total number of acres irrigated under this system: None
8. Give the point of diversion: NW 1/4 SE 1/4 Section 2 Township 8N Range 51

**Part C**

**TO BE FILED BY ALL WATER USERS IN ADDITION TO PART A OR PART B**

9. Source of Water: Powder River  
Name of stream or lake from which water is originally diverted
10. Water is obtained by: (Check one) Gravity \_\_\_\_\_ Pumping ☒ Other \_\_\_\_\_
11. What is the greatest number of acres you have irrigated? 51.2 Date 1916
12. How many acres did you irrigate in 1947? (Crop and pasture) none
13. State the total number of additional acres that could be irrigated by increasing the water supply, land leveling, etc. 51.2 This land is under what ditch? Newman
14. How many acres of seeped land do you have which could be drained and put into production? —
15. What is the condition of your irrigation system? out of use
16. Is your water supply adequate? Yes \_\_\_\_\_ No ☒ Explain Excessive Supply
17. REMARKS: Newman Steam Pump put in about 1910 filed in 1916 used till about 1920, With the completion of Moorhead Dam ditch could be put to use. River now full of silt that cuts out pumps,

NOTE: The foregoing questions apply only to irrigated land shown on this plat.

### DESCRIPTION AND MAP OF FARM

18. Legal Description of this Farm

*NE 1/4 Sec River, NE 1/4 Sec  
River township 9N Range 51E*

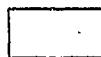

IRRIGATED LAND



NON-IRRIGATED LAND

North

West

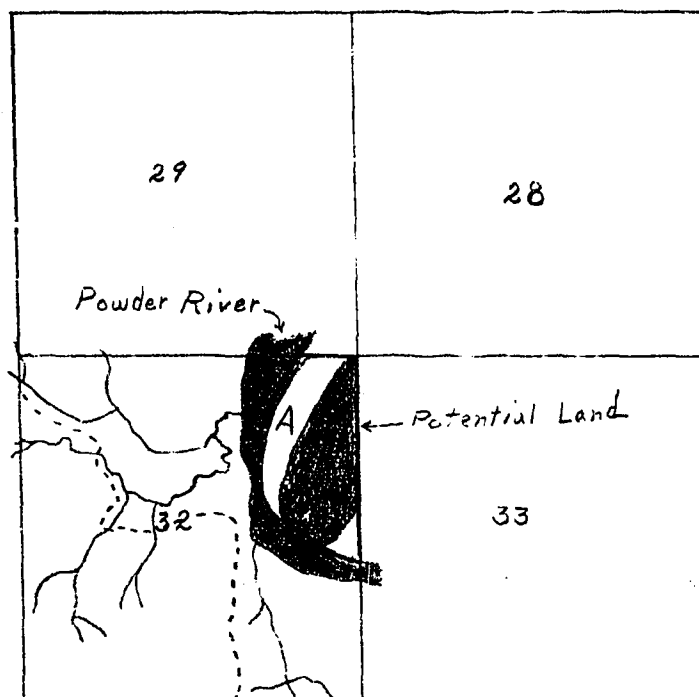

East

South

Shaded area is  
only irrigated land  
All other land  
dry land not shown

19. If the above land is irrigated from more than one ditch please give the acreage under each ditch in 19A and indicate the location of the land irrigated from each on the above map.

19A. Ditch: *Newman ditch* Acres: *2*

Ditch: \_\_\_\_\_ Acres: \_\_\_\_\_

Information supplied by:

Name *Lied Survey* Address \_\_\_\_\_ Date *July 15-47*

REMARKS: *Johnson & Paulist*

If you cannot answer all of the questions on this form answer as many as you can and return the form to us as soon as possible.

# STATE ENGINEERS OFFICE

## Water Resources Survey

COUNTY CusterFILE NO. 13-T9N-51EOwner M<sup>rs</sup> Coy, MargaretAddress Chicago, Ill

AAA Owner

Address

Operator

Address

New Owner

Address

New Operator

Address

Assessment Record NoneAssessed Acreage 0

Legal Description of This Farm

E 2 N 51 Sec 32 T9N-R 51ETotal Acres in Farm ✓Code Number 32A

### Farm Map

Photo No. MA 20-31

AAA Contract No.

AAA Total Cropland Acreage

App. No. 1336

Decree No.

Land is located in

Twp. 9N Rge. 51E Twp. Rge.

Twp. Rge. Twp. Rge.

Filed in Twp. 9N Rge. 51Remarks Owner's slip notup to date (1937)

Ownership shown  
only irrigated land.  
All ownership for  
dry land not shown.

(Powder River Basin)

**STATE ENGINEERS OFFICE**  
**Water Resources Survey**  
**Notice of Appropriation**

1. County Custer Book E Page 446 Record
2. Name of Appropriator Carlton Neumann Address Sutherland, Montana
3. Date Appropriated March 6, 1916 Date Filed March 7, 1916
- Amount Appropriated, Miners Inches 300, Cubic Feet per second
4. Name of Stream Powder River Tributary        Basin
5. Point of Diversion In lot 2 of said
- 
- Sec. 2 Twp. 8N. Rge. 51E. Bank of Stream East
- 
6. Purpose For irrigation
7. Description of System A pipe 12 in. circumference, which carries and conducts said  
amount of water from said river and runs thence from a point 2250 ft. south of the N.  
line of Sec. 2-8N-51E, thence running north and westerly across Sec. 32-9N-51E, to  
the proposed ditch running along the east line of Lots 1, 4, 5, Sec. 32-9N-51E.
8. Land Description of Intended Place of Use         
Lots 1, 4, 5, Sec. 32-9N-51E, 82.53 acres, U.S.A.
- 
9. Remarks (Pertaining to Use, etc.) This land does not appear on ownership book and  
is not being taxed.
- 
- 

**Decree**

10. Case No.        Date        Amt. Decreed: M. I.        C. F. S.
11. To Whom Decreed        Address
12. Name of Ditch        Maximum Capacity (C. F. S.)
13. Date of Priority        Purpose
14. Land Description of Place of Use as Decreed
15. Remarks (Present Use Status, etc.)



These forms are the property of the State of Montana and must be returned.

STATE OF MONTANA  
STATE ENGINEERS OFFICE  
Water Resources Survey

Code No. SB. 21A-33C  
County Custer  
T. 9N. R. 51E

Name of Land Owner N. P. R. R. Address St. Paul, Minn.  
Name of Operator \_\_\_\_\_ Address \_\_\_\_\_

### Part A

TO BE FILED BY THOSE OBTAINING IRRIGATION WATER FROM  
A DITCH COMPANY OR IRRIGATION DISTRICT

1. Water is delivered by: \_\_\_\_\_  
Name of Ditch, Ditch Company or District Supplying Water
2. State the number of acres you irrigate under this system \_\_\_\_\_ Shares you hold \_\_\_\_\_
3. If you obtain water from more than one Company, give the number of shares, acres irrigated and the name of the Company under "Remarks." If you obtain water from a Ditch Company and also have a private system fill in both Part A and Part B.

### Part B

TO BE FILED BY THOSE WHO HAVE A PRIVATE DITCH, PUMP OR IRRIGATION SYSTEM  
or those who have a private water right under a Ditch Company

4. In what year was this land first irrigated? Date \_\_\_\_\_
5. Give the name of the original appropriator (first user): see remarks
6. Give the date appropriated \_\_\_\_\_ Amount filed on: Miners Inches \_\_\_\_\_ C. F. S. \_\_\_\_\_
7. State the total number of acres irrigated under this system: \_\_\_\_\_
8. Give the point of diversion: \_\_\_\_\_  $\frac{1}{4}$  \_\_\_\_\_  $\frac{1}{4}$  Section \_\_\_\_\_ Township \_\_\_\_\_ Range \_\_\_\_\_

### Part C

TO BE FILED BY ALL WATER USERS IN ADDITION TO PART A OR PART B

9. Source of Water: Powder River + Swede Creek  
Name of stream or lake from which water is originally diverted
10. Water is obtained by: (Check one) Gravity ☒ Pumping ☒ Other Flood in
11. What is the greatest number of acres you have irrigated? 229.6 Date 1910-1912 to 1920
12. How many acres did you irrigate in 1947? (Crop and pasture) none
13. State the total number of additional acres that could be irrigated by increasing the water supply, land leveling, etc. 229.6 This land is under what ditch? see remarks
14. How many acres of seeped land do you have which could be drained and put into production? \_\_\_\_\_
15. What is the condition of your irrigation system? Out of use
16. Is your water supply adequate? Yes \_\_\_\_\_ No ☒ Explain irrigative water supply
17. REMARKS: Newman ditch used from 1910 to 1920 - 164 acres  
Holbrook Gasline Pump ditch from 1912 to 1920 - 61.5 acres  
Rosenow ditch, not used since 1923 no acres  
Sorenson pump - 1909 to 1910  
old ditch from Swede Creek not used for 30 years

NOTE: The foregoing questions apply only to irrigated land shown on this plat.

### DESCRIPTION AND MAP OF FARM

18. Legal Description of this Farm

*Part of Sec 5, West of River, Sec 21,  
N 2 Sec 33, Twp 9 N Rge 57 E.*

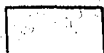

IRRIGATED LAND

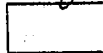

NON-IRRIGATED LAND

North

*See attached  
twp Plat,*

West

East

South

Do not fill in, except  
only irrigated land.  
All ownership for  
dry land not shown.

19. If the above land is irrigated from more than one ditch please give the acreage under each ditch in 19A and indicate the location of the land irrigated from each on the above map.

19A. Ditch: *Not in use* Acres: \_\_\_\_\_

Ditch: \_\_\_\_\_ Acres: \_\_\_\_\_

Information supplied by:

Name *Field Survey* Address \_\_\_\_\_ Date *July 15, 1947*

REMARKS: \_\_\_\_\_

*Johnson  
Paulist*

*All old ditches not now in use*

If you cannot answer all of the questions on this form answer as many as you can and return the form to us as soon as possible.



STATE ENGINEERS OFFICE  
Water Resources SurveyCOUNTY ClusterFILE NO. 13-T9N-R51EOwner N.P.R.R. Address \_\_\_\_\_

AAA Owner \_\_\_\_\_ Address \_\_\_\_\_

Operator \_\_\_\_\_ Address \_\_\_\_\_

New Owner \_\_\_\_\_ Address \_\_\_\_\_

New Operator \_\_\_\_\_ Address \_\_\_\_\_

Assessment Record None \_\_\_\_\_Assessed Acreage 0Legal Description of This Farm Part of the W<sup>2</sup> sec 4; part of the SW<sup>4</sup> sec 4;  
Sec 5; all of sec 21; N<sup>2</sup> sec 33; T9N-R51ETotal Acres in Farm ✓Code Number 5B, 21A, 33C

## Farm Map

Photo No. MA 20-29; MA 20-31

AAA Contract No. \_\_\_\_\_

AAA Total Cropland Acreage \_\_\_\_\_

App. No. 453

Decree No. \_\_\_\_\_

Land is located in

Twp. 9N Rge. 51E Twp. \_\_\_\_\_ Rge. \_\_\_\_\_

Twp. \_\_\_\_\_ Rge. \_\_\_\_\_ Twp. \_\_\_\_\_ Rge. \_\_\_\_\_

Filed in Twp. 9N Rge. 51ERemarks 21A & 33C haveno record of appropriation  
by description

Ownership covers  
only irrigated land.  
All ownership for  
dry land not shown.

Powder River Basin



STATE ENGINEERS OFFICE  
Water Resources Survey  
Notice of Appropriation

1. County Custer Book E Page 512 Record W.R.
2. Name of Appropriator W. R. Bowling Address Sutherland, Montana.
3. Date Appropriated April 5, 1935 Date Filed April 5, 1935
- Amount Appropriated, Miners Inches 800 or, Cubic Feet per second 20
4. Name of Stream Deep Creek Tributary  Basin
5. Point of Diversion
- Sec.  Twp.  Rge.  Bank of Stream Right
6. Purpose For irrigation, for watering stock, domestic purposes
7. Description of System A ditch 36" X 96" in size which carries and conducts said amount of water from said creek and runs thence in a northwesterly direction, thence over and upon said land (or mining claim)
8. Land Description of Intended Place of Use In Sec. 17-9N-51E, 583.24 acres, N.P.R.R. Co., St. Paul; Land in Sec. 2, T.10N-51E; E½ Sec. 18-9N-51E, 320 acres, State Land, Helena; Lots 1,2,3,4, E½ Sec. 18-9N-51E, 315.40 acres, Wm. H. Moss, St. Cloud, Minn; Lots 5,8,9, 1,2, S½NE¼, E½SE¼ Sec. 5-9N-51E, 291.46 acres, N.P. Ry. Co., Lots 7 & 10, W½SE¼ Sec. 5-9N-51E, 157.13 acres, Robert G. Earley; Lots 3,4,6, Sec. 5-9N-51E, 128.85 acres, U. S. A.
9. Remarks (Pertaining to Use, etc.)

### Decree

10. Case No.  Date  Amt. Decreed: M. I.  C. F. S.
11. To Whom Decreed  Address
12. Name of Ditch  Maximum Capacity (C. F. S.)
13. Date of Priority  Purpose
14. Land Description of Place of Use as Decreed
15. Remarks (Present Use Status, etc.)

T. 9 North R. 51 East Custer

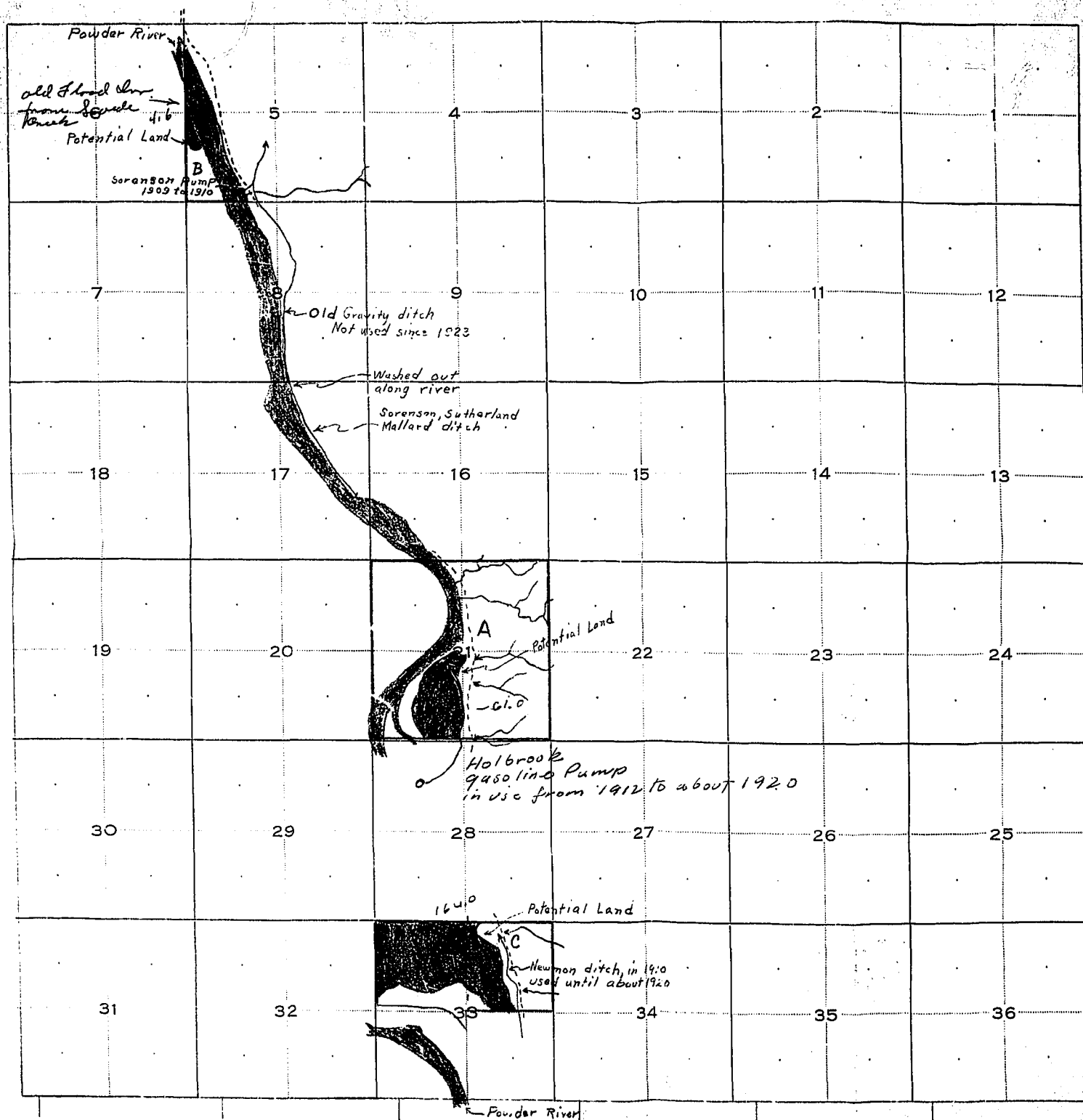



NOTICE  
These forms are the  
property of the State  
of Montana and must  
be returned.

STATE OF MONTANA  
STATE ENGINEERS' OFFICE  
Water Resources Survey

Code No. 50-28C-33A  
County Custer  
T. 9N. R. 51E

Name of Land Owner U. S. A. Address \_\_\_\_\_  
Name of Operator \_\_\_\_\_ Address \_\_\_\_\_

**Part A**

**TO BE FILED BY THOSE OBTAINING IRRIGATION WATER FROM  
A DITCH COMPANY OR IRRIGATION DISTRICT**

1. Water is delivered by: \_\_\_\_\_  
Name of Ditch, Ditch Company or District Supplying Water
2. State the number of acres you irrigate under this system \_\_\_\_\_ Shares you hold \_\_\_\_\_
3. If you obtain water from more than one Company, give the number of shares, acres irrigated and the name of the Company under "Remarks." If you obtain water from a Ditch Company and also have a private system fill in both Part A and Part B.

**Part B**

**TO BE FILED BY THOSE WHO HAVE A PRIVATE DITCH, PUMP OR IRRIGATION SYSTEM  
or those who have a private water right under a Ditch Company**

4. In what year was this land first irrigated? Date See attached Sheet
5. Give the name of the original appropriator (first user): See remarks
6. Give the date appropriated \_\_\_\_\_ Amount filed on: Miners Inches \_\_\_\_\_ C. F. S. \_\_\_\_\_
7. State the total number of acres irrigated under this system: \_\_\_\_\_
8. Give the point of diversion: \_\_\_\_\_  $\frac{1}{4}$  \_\_\_\_\_  $\frac{1}{4}$  Section \_\_\_\_\_ Township \_\_\_\_\_ Range \_\_\_\_\_

**Part C**

**TO BE FILED BY ALL WATER USERS IN ADDITION TO PART A OR PART B**

9. Source of Water: Powder River  
Name of stream or lake from which water is originally diverted
10. Water is obtained by: (Check one) Gravity ☒ Pumping ☒ Other Over
11. What is the greatest number of acres you have irrigated? 104.5 Date approx - 1910
12. How many acres did you irrigate in 1947 (Crop and pasture) none
13. State the total number of additional acres that could be irrigated by increasing the water supply, land leveling, etc. 104.5 This land is under what ditch? rehabilitate system
14. How many acres of seeped land do you have which could be drained and put into production? \_\_\_\_\_
15. What is the condition of your irrigation system? out of use
16. Is your water supply adequate? Yes \_\_\_\_\_ No ☒ Explain I flood the
17. REMARKS: Sorenson, Sutherland & Mallard ditch  
not used since 1923. Newman ditch  
Const. about 1910 used till 1920

NOTE: The foregoing questions apply only to irrigated land shown on this plat.

### DESCRIPTION AND MAP OF FARM

18. Legal Description of this Farm

*NW 1/4 Sec 5, 5454, Sec 5, 5454, Sec 5, 5454*  
*see 28, SE 4, Sec 33 Twp 9 N Rge. 51 E*



IRRIGATED LAND



NON-IRRIGATED LAND

North

*see attached  
maps*

West

East

South

Ownership ☒ owner  
only irrigated land.  
All ownership for  
the land not shown.

19. If the above land is irrigated from more than one ditch please give the acreage under each ditch in 19A and indicate the location of the land irrigated from each on the above map.

19A. Ditch: *Private ditches* Acres: *None*

Ditch: \_\_\_\_\_ Acres: \_\_\_\_\_

Information supplied by:

Name *Field Survey* Address \_\_\_\_\_ Date *July 17-47*

REMARKS: *Johnson & Paulist.*

*All ditches not now in use*

If you cannot answer all of the questions on this form answer as many as you can and return the form to us as soon as possible.

STATE ENGINEERS OFFICE  
Water Resources SurveyCOUNTY CusterFILE NO. 13-T.9N-R.51EOwner U.S.A. Address —

AAA Owner Address

Operator Address

New Owner Address

New Operator Address

Assessment Record NoneAssessed Acreage 0Legal Description of This Farm E<sup>2</sup> NW<sup>4</sup>, NW<sup>4</sup> NW<sup>4</sup> part of the SW<sup>4</sup> NW<sup>4</sup> Sec 5  
SW<sup>4</sup> SW<sup>4</sup> Sec 28; SE<sup>4</sup> Sec 33 T.9N-R.51ETotal Acres in Farm ✓Code Number 5D, 28C, 33A

## Farm Map

Photo No. MA 20-29, MA 20-31AAA Contract No. 453

AAA Total Cropland Acreage

App. No. 453 for 5D

Decree No.

Land is located in

Twp. 9N Rge. 51E Twp. Rge.

Twp. Rge. Twp. Rge.

Filed in Twp. 9N Rge. 51ERemarks 28C & 33A Hasno records of appropriationby description

Ownership covers  
only irrigated land.  
All ownership for  
dry land not shown.

Powder River Basin

**STATE ENGINEERS OFFICE**  
Water Resources Survey

**Notice of Appropriation**

1. County Custer Book E Page 512 Record W.R.
2. Name of Appropriator W. R. Bowling Address Sutherland, Montana.
3. Date Appropriated April 5, 1935 Date Filed April 5, 1935
- Amount Appropriated, Miners Inches 800 or, Cubic Feet per second 20
4. Name of Stream Deen Creek Tributary \_\_\_\_\_ Basin \_\_\_\_\_
5. Point of Diversion \_\_\_\_\_
- Sec. \_\_\_\_\_ Twp. \_\_\_\_\_ Rge. \_\_\_\_\_ Bank of Stream Right
6. Purpose For irrigation, for watering stock, domestic purposes
7. Description of System A ditch 36" X 96" in size which carries and conducts said amount of water from said creek and runs thence in a northwesterly direction, thence over and upon said land (or mining claim)
8. Land Description of Intended Place of Use  
In Sec. 17-2N-51E, 583.24 acres, N.P.R.R. Co., St. Paul; Land in Sec. 7, T.10N-51E, E. Sec. 18-2N-51E, 320 acres, State Land, Helena; Lots 1,2,3,4, E. Sec. 18-2N-51E, 315.40 acres, Wm. H. Moss, St. Cloud, Minn; Lots 5,6,9, 1,2, S. Sec. 1, E. Sec. 5-2N-51E, 291.46 acres, N.P. Ry. Co., Lots 7 & 10, W. Sec. 5-2N-51E, 157.13 acres, Robert C. Farley; Lots 3,4,6, Sec. 5-2N-51E, 128.85 acres, U. S. A.
9. Remarks (Pertaining to Use, etc.) \_\_\_\_\_

**Decree**

10. Case No. \_\_\_\_\_ Date \_\_\_\_\_ Amt. Decreed: M. I. \_\_\_\_\_ C. F. S. \_\_\_\_\_
11. To Whom Decreed \_\_\_\_\_ Address \_\_\_\_\_
12. Name of Ditch \_\_\_\_\_ Maximum Capacity (C. F. S.) \_\_\_\_\_
13. Date of Priority \_\_\_\_\_ Purpose \_\_\_\_\_
14. Land Description of Place of Use as Decreed \_\_\_\_\_
15. Remarks (Present Use Status, etc.) \_\_\_\_\_

Powder River

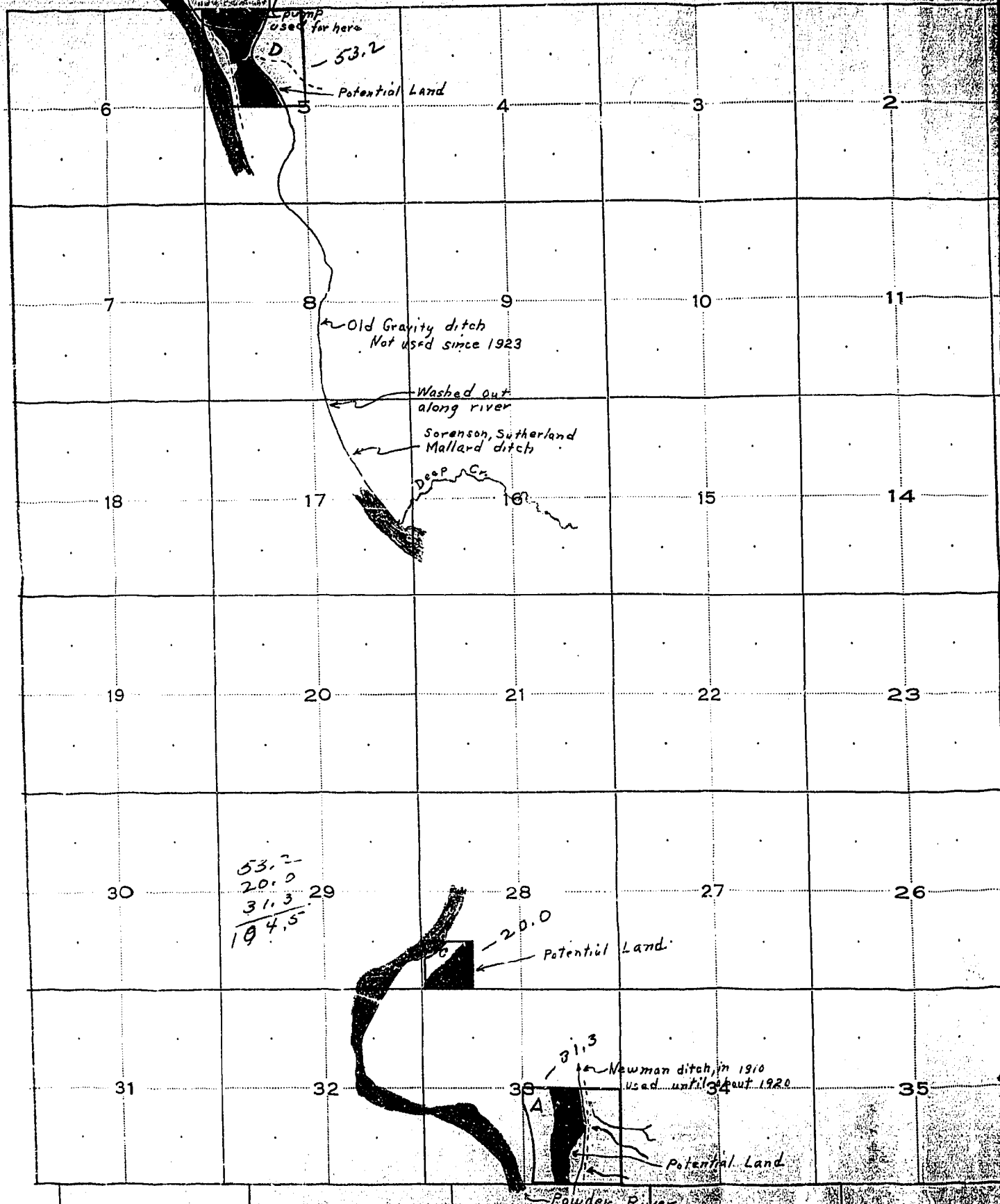

53.2  
20.0  
31.3  
194.5

Potential Land

Newman ditch, in 1910  
used until about 1920

Potential Land

Powder River





NOTICE  
These forms and the  
property of the State  
of Montana and must  
be returned.

STATE OF MONTANA  
STATE ENGINEERS OFFICE

Water Resources Survey

Code No. 63-5C

County Custer

T. 9N R. 51E

Name of Land Owner

Paul E. Young

Address

Timber, Mont.

Name of Operator

Address

Part A

TO BE FILED BY THOSE OBTAINING IRRIGATION WATER FROM  
A DITCH COMPANY OR IRRIGATION DISTRICT

1. Water is delivered by: \_\_\_\_\_  
Name of Ditch, Ditch Company, or District Supplying Water
2. State the number of acres you irrigate under this system \_\_\_\_\_ Shares you hold \_\_\_\_\_
3. If you obtain water from more than one Company, give the number of shares, acres irrigated and the name of the Company under "Remarks." If you obtain water from a Ditch Company and also have a private system fill in both Part A and Part B.

Part B

TO BE FILED BY THOSE WHO HAVE A PRIVATE DITCH, PUMP OR IRRIGATION SYSTEM  
or those who have a private water right under a Ditch Company

4. In what year was this land first irrigated? Date \_\_\_\_\_
5. Give the name of the original appropriator (first user): See attached filings
6. Give the date appropriated \_\_\_\_\_ Amount filed on: Miners Inches \_\_\_\_\_ C. F. S. \_\_\_\_\_
7. State the total number of acres irrigated under this system: \_\_\_\_\_
8. Give the point of diversion: \_\_\_\_\_  $\frac{1}{4}$  \_\_\_\_\_  $\frac{1}{4}$  Section \_\_\_\_\_ Township \_\_\_\_\_ Range \_\_\_\_\_

Part C

TO BE FILED BY ALL WATER USERS IN ADDITION TO PART A OR PART B

9. Source of Water: Powder River + Swede Creek  
Name of stream or lake from which water is originally diverted
10. Water is obtained by: (Check one) Gravity \_\_\_\_\_ Pumping ☒ Other Flood
11. What is the greatest number of acres you have irrigated? 58.8 Date about 1910
12. How many acres did you irrigate in 1947? (Crop and pasture) none
13. State the total number of additional acres that could be irrigated by increasing the water supply, land leveling, etc. 58.8 This land is under what ditch? 23.6 Swede Creek  
35.2 Swenson ditch
14. How many acres of seeped land do you have which could be drained and put into production? \_\_\_\_\_
15. What is the condition of your irrigation system? Out of use
16. Is your water supply adequate? Yes \_\_\_\_\_ No ☒ Explain Excessive supply
17. REMARKS:

Swede Creek flood ditch not used for  
30 years Swenson pump ditch used  
from 1909 to 1910  
10-31-1966 By Hansel Rane  
A-1353A PAUL E. YOUNG POWDER RIVER 4-27-61 7000 AC.  
Pumps on 330 acres (Yellowstone River Control)



18. Legal Description of this Farm

W<sup>2</sup>SE<sup>4</sup> E<sup>2</sup>SW<sup>4</sup> Sec 5  
 W<sup>2</sup>NE<sup>4</sup> Sec 6, SENE<sup>4</sup>, NESE<sup>4</sup>, Sec 6-9N5E

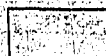

IRRIGATED LAND



NON-IRRIGATED LAND

North

West

East

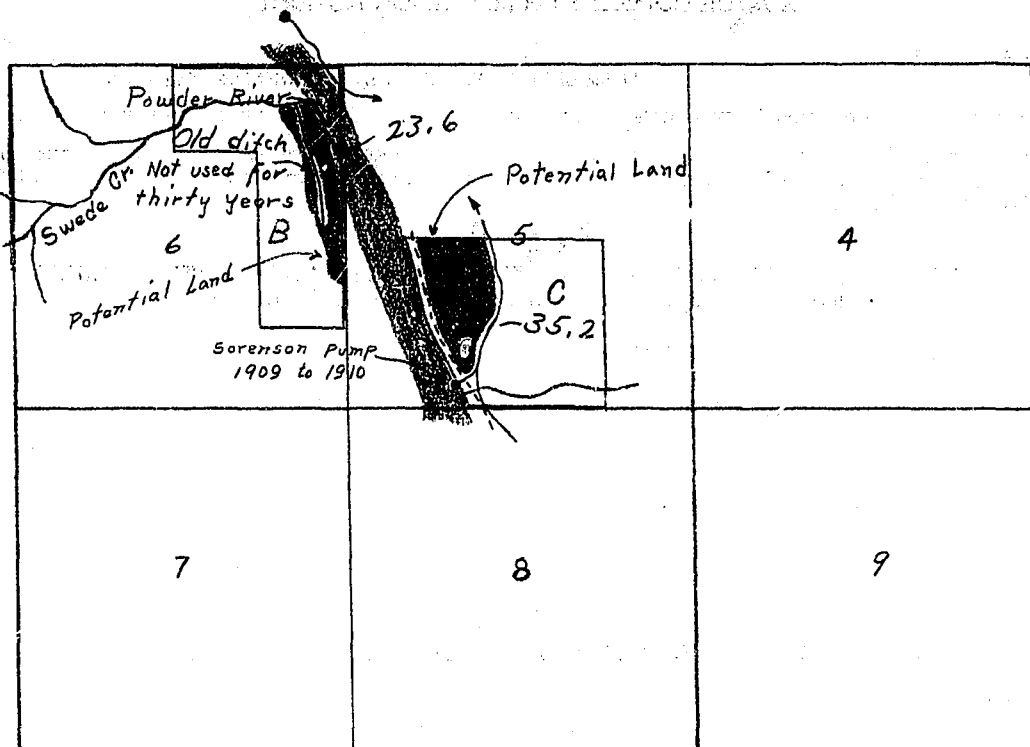

South

Ownership covers  
 only irrigated land.  
 All ownership for  
 dry land not shown.

19. If the above land is irrigated from more than one ditch please give the acreage under each ditch in 19A and indicate the location of the land irrigated from each on the above map.

19A. Ditch: Sweede Creek Flood ditch Acres: 0

Ditch: Sorensen Pump ditch Acres: 0

Information supplied by:

Name Field Survey Address \_\_\_\_\_ Date July 15-47

REMARKS: Johnson & Paulist

If you cannot answer all of the questions on this form answer as many as you can and return the form to us as soon as possible.

STATE ENGINEERS' OFFICE  
Water Resources SurveyCOUNTY CusterFILE NO. 13-T. 9N-R. 51EOwner Young, Paul E

Address

Tenny, Mont

AAA Owner

Address

Operator

Address

New Owner

Address

New Operator

Address

Assessment Record NoneAssessed Acreage 0

Legal Description of This Farm W<sup>2</sup>SE<sup>4</sup>; E<sup>2</sup>SW<sup>4</sup> + Part of NW<sup>4</sup>SW<sup>4</sup> Sec. 5;  
E<sup>2</sup>NE<sup>4</sup>; NW<sup>4</sup>NE<sup>4</sup>; NE<sup>2</sup>SE<sup>4</sup> Sec. 6; S<sup>2</sup>; S<sup>2</sup>NW<sup>4</sup>; NW<sup>4</sup>NW<sup>4</sup>;  
and part of NE<sup>4</sup>NW<sup>4</sup>; SW<sup>4</sup>NE<sup>4</sup> Sec. 8 T. 9N-R. 51E

Total Acres in Farm ✓Code Number 50-6B-8B

## Farm Map

Photo No. MA 20-29

AAA Contract No.

AAA Total Cropland Acreage

App. No. 453-587

Decree No.

Land is located in

Twp. 9N Rge. 51E Twp. Rge.

Twp. Rge. Twp. Rge.

Filed in Twp. 9N Rge. 51ERemarks Old ditch out ofSwede Cr. not used for 30 yrs.No appropriation by description

Ownership covers  
only irrigated land.  
All ownership for  
dry land not shown.

Powder River Basin

Water Resources Survey  
Notice of Appropriation

1. County..... Custer..... Book..... E..... Page..... 112..... Record..... W.R.1.....
2. Name of Appropriator..... W. R. Bowling..... Address..... Sutherland, Montana.....
3. Date Appropriated..... April 5, 1935..... Date Filed..... April 5, 1935.....  
Amount Appropriated, Miners Inches..... 800 or....., Cubic Feet per second..... 20.....
4. Name of Stream..... Deep Creek..... Tributary..... Basin.....
5. Point of Diversion.....  
.....  
.....  
Sec..... Twp..... Rge..... Bank of Stream..... Right.....  
.....  
.....
6. Purpose..... For irrigation, for watering stock, domestic purposes.....
7. Description of System..... A ditch 36" X 96" in size which carries and conducts said amount of water from said creek and runs thence in a northwesterly direction, thence over and upon said land (or mining claim).....
8. Land Description of Intended Place of Use.....  
In Sec. 17-9N-51E, 583.24 acres, N.P.R.R. Co., St. Paul; Land in Sec. 7, T.10N-51E; E½ Sec. 18-9N-51E, 320 acres, State Land, Helena; Lots 1,2,3,4, E½ Sec. 18-9N-51E, 315.40 acres, Wm. H. Moss, St. Cloud, Minn; Lots 5,8,9, 1,2, S½ Sec. 5-9N-51E, 291.46 acres, N.P. Ry. Co., Lots 7 & 10, W½ Sec. 5-9N-51E, 157.13 acres, Robert G. Earley; Lots 3,4,6, Sec. 5-9N-51E, 123.85 acres, U. S. A.
9. Remarks (Pertaining to Use, etc.).....  
.....  
.....

Decree

10. Case No..... Date..... Amt Decreed: M. I..... C. F. S.....
11. To Whom Decreed..... Address.....
12. Name of Ditch..... Maximum Capacity (C. F. S.).....
13. Date of Priority..... Purpose.....
14. Land Description of Place of Use as Decreed.....  
.....  
.....  
.....
15. Remarks (Present Use Status, etc.).....  
.....  
.....

# Notice of Appropriation

1. County Custer Book E Page 450 Record W.R.
2. Name of Appropriator Winifred M. Sutherland Address Sutherland, Montana  
(June 1, 1914)
3. Date Appropriated July 15, 1916 Date Filed July 27, 1916  
Amount Appropriated, Miners Inches 500 or, Cubic Feet per second 12 1/2
4. Name of Stream Unnamed Dry Gulch Tributary Basin
5. Point of Diversion

Sec.            Twp.            Rge.            Bank of Stream East

6. Purpose For irrigation, livestock and farming purposes.
7. Description of System A dam and a ditch and a gate. Said ditch is 12 inches X 14 inches in size, which carries and conducts said amount of water from said gulch and runs thence East and a little south a distance of 200 yards through the east half of Section 7, Twp. 9N., R. 51E.
8. Land Description of Intended Place of Use  
W 1/2 Sec. 8-9N-51E:

Lots 2 & 3 Sec. 8-9N-51E, 109.28 acres, Paul Young, Terry  
Lots 6 & 7 " " 53.87 " "

9. Remarks (Pertaining to Use, etc.)

## Decree

10. Case No.            Date            Amt. Decreed: M. I.            C. F. S.
11. To Whom Decreed            Address
12. Name of Ditch            Maximum Capacity (C. F. S.)
13. Date of Priority            Purpose
14. Land Description of Place of Use as Decreed
15. Remarks (Present Use Status, etc.)

(Township 9 North, Range 53 East)

Shumaker, P. J.

U. S. A.

(Township 9 North, Range 55 East)

Mackay, Donald

Shumaker, P. J.



NOTICE  
These forms are the  
property of the State  
of Montana and must  
be returned.

STATE OF MONTANA  
STATE ENGINEERS OFFICE  
Water Resources Survey

FORM WR-1-2M 12-47

Code No. 13A  
County Custer  
T. 9N R. 53E

Name of Land Owner Shumaker, P. J. Address Ismay, Mont.  
Name of Operator \_\_\_\_\_ Address \_\_\_\_\_

**Part A**

**TO BE FILED BY THOSE OBTAINING IRRIGATION WATER FROM  
A DITCH COMPANY OR IRRIGATION DISTRICT**

1. Water is delivered by: \_\_\_\_\_  
Name of Ditch, Ditch Company or District Supplying Water
2. State the number of acres you irrigate under this system \_\_\_\_\_ Shares you hold \_\_\_\_\_
3. If you obtain water from more than one Company, give the number of shares, acres irrigated and the name of the Company under "Remarks." If you obtain water from a Ditch Company and also have a private system fill in both Part A and Part B.

**Part B**

**TO BE FILED BY THOSE WHO HAVE A PRIVATE DITCH, PUMP OR IRRIGATION SYSTEM  
or those who have a private water right under a Ditch Company**

4. In what year was this land first irrigated? Date (see attached letter)
5. Give the name of the original appropriator (first user): No record
6. Give the date appropriated \_\_\_\_\_ Amount filed on: Miners Inches \_\_\_\_\_ C. F. S. \_\_\_\_\_
7. State the total number of acres irrigated under this system: \_\_\_\_\_
8. Give the point of diversion: \_\_\_\_\_  $\frac{1}{4}$  \_\_\_\_\_  $\frac{1}{4}$  Section \_\_\_\_\_ Township \_\_\_\_\_ Range \_\_\_\_\_

**Part C**

**TO BE FILED BY ALL WATER USERS IN ADDITION TO PART A OR PART B**

9. Source of Water: Whitney Creek  
Name of stream or lake from which water is originally diverted
10. Water is obtained by: (Check one) Gravity ☒ Pumping \_\_\_\_\_ Other Flood Irrigation
11. What is the greatest number of acres you have irrigated? 14.6 Date ?
12. How many acres did you irrigate in 1947? (Crop and pasture) none
13. State the total number of additional acres that could be irrigated by increasing the water supply, land leveling, etc. 14.6 This land is under what ditch? Shumaker dam & dike
14. How many acres of seeped land do you have which could be drained and put into production? none
15. What is the condition of your irrigation system? Not in use July 47
16. Is your water supply adequate? Yes \_\_\_\_\_ No ☒ Explain Flood Irrigation
17. REMARKS: \_\_\_\_\_

Intends to use dam and dike,  
unable to find a recorded filing for this  
project.

Over \_\_\_\_\_

NOTE: The foregoing questions apply only to irrigated land shown on this plat.

### DESCRIPTION AND MAP OF FARM

18. Legal Description of this Farm Sec. 13, T9N, R53E

 IRRIGATED LAND

 NON-IRRIGATED LAND

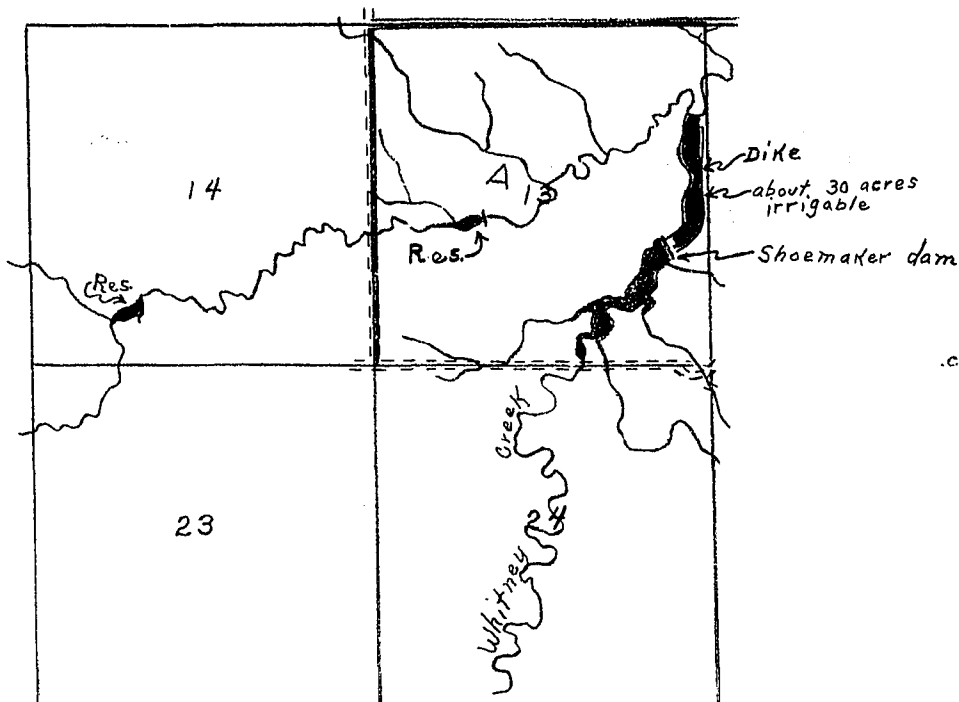

Ownership covering  
only irrigated land.  
All ownership for  
dry land not shown.

South

19. If the above land is irrigated from more than one ditch please give the acreage under each ditch in 19A and indicate the location of the land irrigated from each on the above map.

19A. Ditch: Private Works Acres: 0

Ditch: \_\_\_\_\_ Acres: \_\_\_\_\_

Information supplied by:

Name from Owner & Address \_\_\_\_\_ Date July 1947

REMARKS: Field Survey  
Johnson & J. Paulist,

If you cannot answer all of the questions on this form answer as many as you can and return the form to us as soon as possible.

# STATE ENGINEERS OFFICE

## Water Resources Survey

COUNTY ClusterFILE NO. 14-T.9N-R.53EOwner Shumaker, P.J. Address Ismay, Montana

AAA Owner \_\_\_\_\_ Address \_\_\_\_\_

Operator \_\_\_\_\_ Address \_\_\_\_\_

New Owner \_\_\_\_\_ Address \_\_\_\_\_

New Operator \_\_\_\_\_ Address \_\_\_\_\_

Assessment Record NoneAssessed Acreage 0

Legal Description of This Farm Sec 13; W<sup>2</sup>; N<sup>2</sup>NE<sup>4</sup>; SW<sup>4</sup>NE<sup>4</sup>; NW<sup>4</sup>SE<sup>4</sup> Sec 24;  
4 SE<sup>4</sup> Sec 28 T.9N-R.53E

Total Acres in Farm ✓Code Number 13A-24A-28DPhoto No. MA-20-109; MA-20-20

AAA Contract No. \_\_\_\_\_

AAA Total Cropland Acreage \_\_\_\_\_

App. No. Not covered by Discript

Decree No. \_\_\_\_\_

Land is located in

Twp. 9N Rge. 53E Twp. \_\_\_\_\_ Rge. \_\_\_\_\_

Twp. \_\_\_\_\_ Rge. \_\_\_\_\_ Twp. \_\_\_\_\_ Rge. \_\_\_\_\_

Filed in Twp. 9N Rge. 53E

Remarks \_\_\_\_\_

Whitney Creek.  
Yellowstone Basin

Farm Map PRAIRIE COUNTY

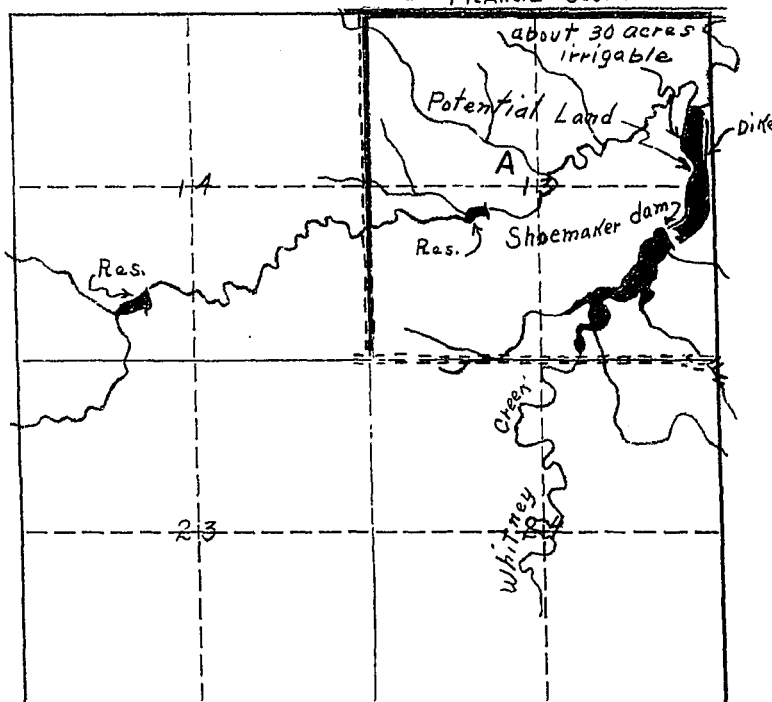

Ownership covers  
 only irrigated land.  
 All ownership for  
 dry land not shown.



February 12, 1948

Mr. P. J. Shumaker  
Ismay, Montana

Re: Flood Irrigation Whitney Creek

Dear Sir:

Custer

Sec. 13,  $W\frac{1}{2}$ ,  $N\frac{1}{2}NE\frac{1}{4}$ ,  $SW\frac{1}{4}NE\frac{1}{4}$ ,  $NW\frac{1}{4}SE\frac{1}{4}$  Sec. 24,  $SE\frac{1}{4}$  Sec. 28, T. 9N., R. 53E.



# STATE OF MONTANA

## STATE ENGINEER

GERALD J. CRAVETZ, ASSISTANT

BILLINGS, MONTANA

February 12, 1948

Mr. P. J. Shumaker  
Ismay, Montana

Re: Flood Irrigation Whitney Creek

Dear Sir:

In accordance with the 1939 Session Law (Section 349.68 Montana Session Laws) requiring the State Engineer to investigate and prepare a complete record of all water rights in Montana, the State Engineer has been conducting a water resources survey in Custer County.

We are unable to find a recorded water filing for the land that you irrigate in Sec. 13,  $W\frac{1}{2}$ ,  $N\frac{1}{2}$ NE $\frac{1}{4}$ , SW $\frac{1}{4}$ NE $\frac{1}{4}$ , NW $\frac{1}{4}$ SE $\frac{1}{4}$  Sec. 24, SE $\frac{1}{4}$  Sec. 28, T. 9N., R. 53E. If a filing was made for this land we would like to have you send us the name of the appropriator, the date filed on, and the number of inches filed on. If no recorded filing was made we would like to have you send us the name of the first user and the date, or the approximate date, that the land was first irrigated so that we may establish a date of priority for this land.

We would like to have you make this a first on your agenda and send this information to us as soon as possible in the enclosed, stamped, self-addressed envelope.

Very truly yours,

*Gerald J. Cravetz*  
Gerald J. Cravetz  
Assistant State Engineer

GJO/a  
enc.

*I cant under stand this letter. I have never irrigated any of this land. I have a reservoir on SE  $\frac{1}{4}$  of Section 13 T 9 N R 53 which I thought I might use water out of to irrigate some time*  
*P J Shumaker*



NOTICE  
These forms are the  
property of the State  
of Montana and must  
be returned.

STATE OF MONTANA  
STATE ENGINEERS OFFICE  
Water Resources Survey

FORM WR-1-2M 12-47

Code No. 26A  
County Center  
T. 9N R. 53E

Name of Land Owner V. S. A. Address \_\_\_\_\_  
Name of Operator Lytle Perkins Address Manay, Mont.

**Part A**

TO BE FILED BY THOSE OBTAINING IRRIGATION WATER FROM  
A DITCH COMPANY OR IRRIGATION DISTRICT

- Water is delivered by: \_\_\_\_\_ Name of Ditch, Ditch Company or District Supplying Water \_\_\_\_\_
- State the number of acres you irrigate under this system \_\_\_\_\_ Shares you hold \_\_\_\_\_
- If you obtain water from more than one Company, give the number of shares, acres irrigated and the name of the Company under "Remarks." If you obtain water from a Ditch Company and also have a private system fill in both Part A and Part B.

**Part B**

TO BE FILED BY THOSE WHO HAVE A PRIVATE DITCH, PUMP OR IRRIGATION SYSTEM  
or those who have a private water right under a Ditch Company

- In what year was this land first irrigated? Date 1/14/24
- Give the name of the original appropriator (first user): Oscar Bruchett
- Give the date appropriated 1/14/24 Amount filed on: Miners Inches 500 C. F. S. \_\_\_\_\_
- State the total number of acres irrigated under this system: none
- Give the point of diversion: SW 1/4 SE 1/4 Section 914 Township 53E Range (26)

**Part C**

TO BE FILED BY ALL WATER USERS IN ADDITION TO PART A OR PART B

- Source of Water: Whitney Creek  
Name of stream or lake from which water is originally diverted \_\_\_\_\_
- Water is obtained by: (Check one) Gravity \_\_\_\_\_ Pumping \_\_\_\_\_ Other Flood
- What is the greatest number of acres you have irrigated? 35.4 Date \_\_\_\_\_
- How many acres did you irrigate in 1947? (Crop and pasture) none
- State the total number of additional acres that could be irrigated by increasing the water supply, land leveling, etc. 35.4 This land is under what ditch? Smith Res. works
- How many acres of seeped land do you have which could be drained and put into production? \_\_\_\_\_
- What is the condition of your irrigation system? Not in use for now
- Is your water supply adequate? Yes \_\_\_\_\_ No X Explain Flood Irrigation
- REMARKS: The storage dam is of earth fill 135' long 26' high. Impounding 251 acres just was built to serve 82 acres. Drainage is 7 square miles. Siphon where spill way crosses ditch. Rip rap was placed to guard against erosion (Smith project 455)

**NOTE: The foregoing estimations apply only to irrigated land shown on this plat.**

## DESCRIPTION AND MAP OF FARM

18. Legal Description of this Farm.

Sec 26, Twp. 9N Rge 53E

11

## IRRIGATED LAND

4

### NON-IRRIGATED LAND

1. *Journal of the American Medical Association*, 1997; 277: 1033-1038.

Foientinai Laine

## North

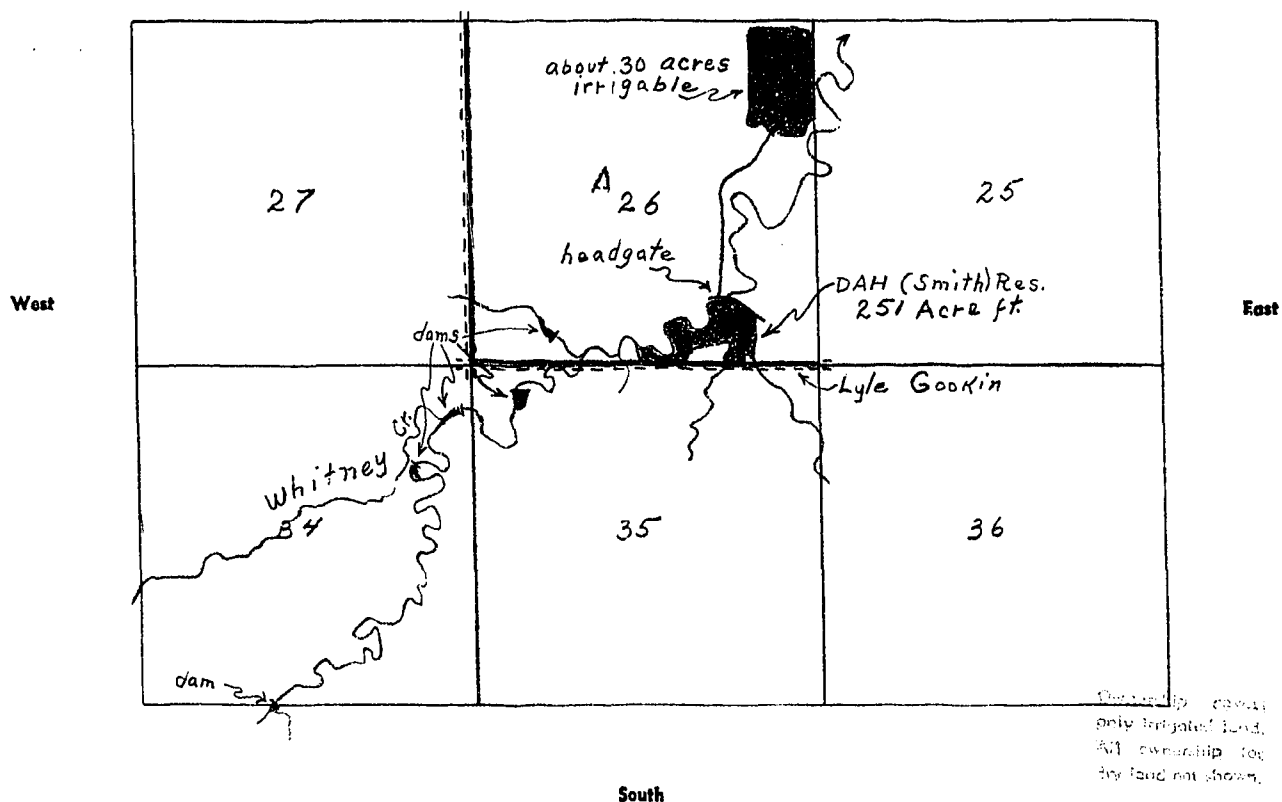

19. If the above land is irrigated from more than one ditch please give the acreage under each ditch in 19A and indicate the location of the land irrigated from each on the above map.

19A. Ditch: Private ditch from Res Acres: 0

Ditch: \_\_\_\_\_ Acres: \_\_\_\_\_

Information supplied by:

Name Lyle Graham in \_\_\_\_\_ Address \_\_\_\_\_ Date July 17, 1947

REMARKS: Field survey Johnson + Culbert  
Sober does not intend to use for emigration.

If you cannot answer all of the questions on this form answer as many as you can and return the form to us as soon as possible.

**STATE ENGINEERS OFFICE**  
**Water Resources Survey**

COUNTY CusterFILE NO. 14-T. 2N-R. 53E

AAA Owner..... Address.....

Operator Gookin, Kyle Address Ismay, Montana

New Owner..... Address.....

New Operator..... Address.....

Assessment Record NoneAssessed Acreage 2Legal Description of This Farm Sec. 22; All of Sec. 23, 25, 26 T2N-R. 53ETotal Acres in Farm ✓Code Number 22A, 23A, 25A, 26APhoto No. Ma-20-107, Ma-20-108

AAA Contract No.....

AAA Total Cropland Acreage.....

App. No. 2002

Decree No.....

Land is located in

Twp. 2N Rge. 53E Twp. .... Rge. ....

Twp. .... Rge. .... Twp. .... Rge. ....

Filed in Twp. 2N Rge. 53ERemarks Smith ReservoirRes. Cap. 251 Ac. ft.S.W.C.B. No. 755Whitney Creek  
Yellowstone Basin

Farm Map

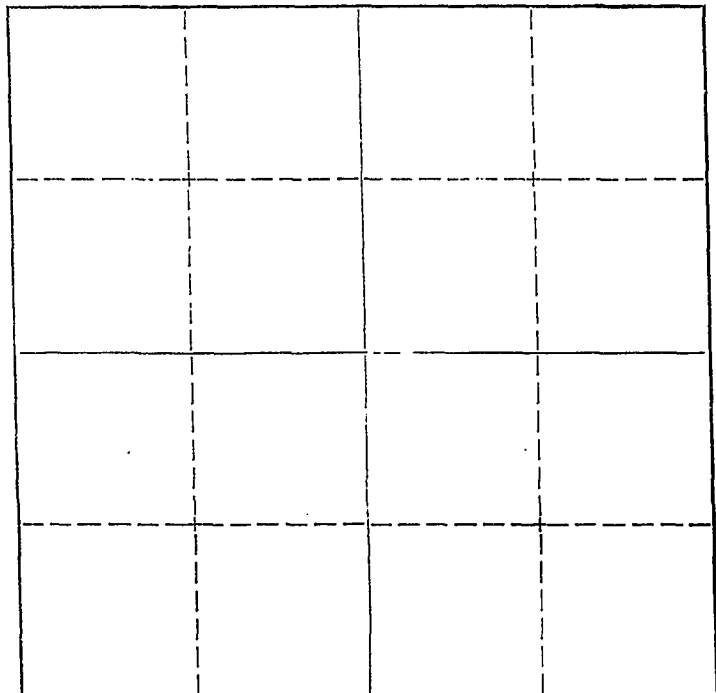

Ownership covers  
 only irrigated land.  
 All ownership for  
 dry land not shown.

**STATE ENGINEERS OFFICE**  
**Water Resources Survey**

**Notice of Appropriation**

- 2002
1. County Custer Book B Page 492 Record W.R.
  2. Name of Appropriator Oscar Brackett Address Custer Co., Montana
  3. Date Appropriated Jan. 14, 1904 Date Filed Jan. 15, 1904  
Amount Appropriated, Miners Inches 500 or       , Cubic Feet per second
  4. Name of Stream Whitney Creek Tributary Fallon Creek Basin
  5. Point of Diversion about 70 rods up said creek from its point of intersection with the south line of the NE $\frac{1}{4}$  of said section. Also a dam is to be constructed across said creek at its point of intersection with the south line of the NE $\frac{1}{4}$  of said section, also 2 counter dams are to be constructed on said creek, between the two aforesaid dams.  
Sec.        Twp.        Rge.        Bank of Stream
  6. Purpose For irrigating lands, watering stock and other purposes.
  7. Description of System Dams and ditches, said dam to be about 10 rods long, about 12 ft. high at the highest point, another dam as before mentioned or (Dam No. 2) will be about 50 ft. long. Also the other two dams as aforementioned, which are between these first two, each dam is to be excavated to such extent as may be practical to form reservoirs for the conserving of flood waters, and also such flumes and ditches of requisite size,
  8. Land Description of Intended Place of Use and dikes as can be practically utilized in the (over)

Blm $\frac{1}{4}$ , N $\frac{1}{2}$ Sec. 26-2N-53E, 160 acres, U.S.A.

9. Remarks (Pertaining to Use, etc.)

**Decree**

10. Case No.        Date        Amt. Decreed: M. I.        C. F. S.
11. To Whom Decreed        Address
12. Name of Ditch        Maximum Capacity (C. F. S.)
13. Date of Priority        Purpose
14. Land Description of Place of Use as Decreed
15. Remarks (Present Use Status, etc.)

turning of said waters upon and over said lands, and such other means as the nature of  
the business may require.

STATE OF MONTANA  
STATE ENGINEER'S OFFICE  
WATER RESOURCES SURVEY

7. Township 9 North Range 53 East County Custer

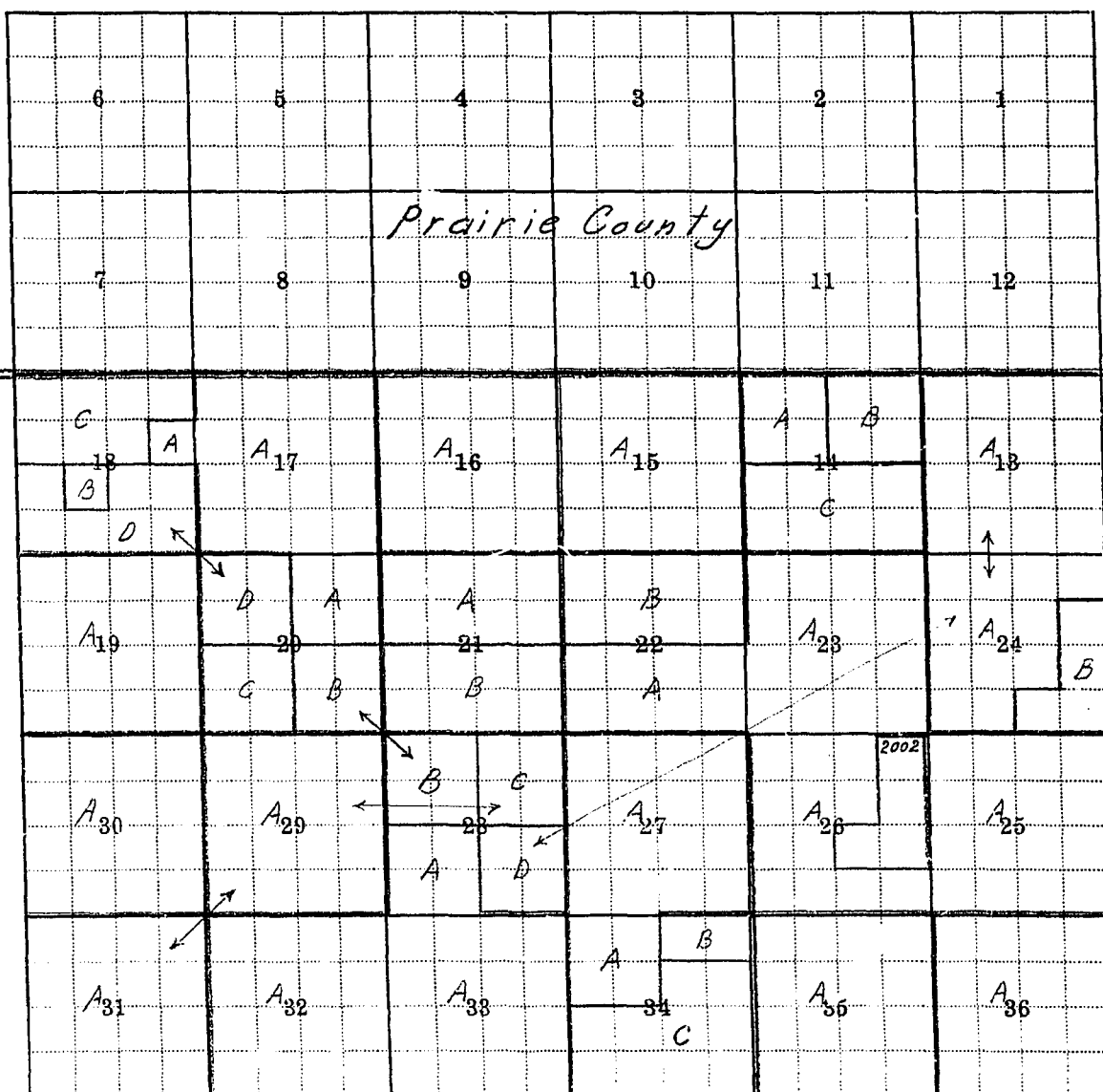

7. Township 9 North Range 53 East



[illegible]

Township 9 North

Range 53 East

Custer County, Montana

<u>Index No.</u>	<u>Name of Appropriator</u>	<u>Stream</u>	<u>Date App.</u>	<u>Date Filed</u>	<u>Inches</u>
2002	Oscar Brackett	Whitney Creek	1-14-04	1-15-04	500

Township 9 North

Range 53 East

Custer County, Montana

COUNTY

Custer

Sheet No. \_\_\_\_\_

Twp.

9N

Rgc.

53E

File No.

Name

1st

2nd

3rd

Ret.

Name

1st

2nd

Shumaker, P. J.  
U. S. A.2/12  
-3/1Not sent



NO. 28  
These forms are the  
property of the State  
of Montana and must  
be returned.

STATE OF MONTANA  
STATE ENGINEERS OFFICE  
Water Resources Survey

FORM WR-1-2M 12-47

Code No. 348

County Custer

T. 9N R. 55E

Name of Land Owner Machray, Donald Address Chadwick, Ill

Name of Operator \_\_\_\_\_ Address \_\_\_\_\_

Part A

TO BE FILED BY THOSE OBTAINING IRRIGATION WATER FROM  
A DITCH COMPANY OR IRRIGATION DISTRICT

1. Water is delivered by: \_\_\_\_\_  
Name of Ditch, Ditch Company or District Supplying Water
2. State the number of acres you irrigate under this system. \_\_\_\_\_ Shares you hold \_\_\_\_\_
3. If you obtain water from more than one Company, give the number of shares, acres irrigated and the name of the Company under "Remarks." If you obtain water from a Ditch Company and also have a private system fill in both Part A and Part B.

Part B

TO BE FILED BY THOSE WHO HAVE A PRIVATE DITCH, PUMP OR IRRIGATION SYSTEM  
or those who have a private water right under a Ditch Company

4. In what year was this land first irrigated? Date See attached sheets
5. Give the name of the original appropriator (first user): \_\_\_\_\_
6. Give the date appropriated \_\_\_\_\_ Amount filed on: Miners Inches \_\_\_\_\_ C. F. S. \_\_\_\_\_
7. State the total number of acres irrigated under this system: \_\_\_\_\_
8. Give the point of diversion:  $\frac{1}{4}$   $\frac{1}{4}$  Section \_\_\_\_\_ Township \_\_\_\_\_ Range \_\_\_\_\_

Part C

TO BE FILED BY ALL WATER USERS IN ADDITION TO PART A OR PART B

9. Source of Water: O'Fallon Creek & Coulee  
Name of stream or lake from which water is originally diverted
10. Water is obtained by: (Check one) Gravity ☒ Pumping \_\_\_\_\_ Other \_\_\_\_\_
11. What is the greatest number of acres you have irrigated? ? Date \_\_\_\_\_
12. How many acres did you irrigate in 1947? (Crop and pasture) 14.9
13. State the total number of additional acres that could be irrigated by increasing the water supply, land leveling, etc. 1.0 This land is under what ditch? old ditch out of O'Fallon Cr.
14. How many acres of seeped land do you have which could be drained and put into production? \_\_\_\_\_
15. What is the condition of your irrigation system? Fair
16. Is your water supply adequate? Yes \_\_\_\_\_ No ☒ Explain Flood flow
17. REMARKS: \_\_\_\_\_

Main ditch not in use, irrigates now  
from Res on Coulee, flood water only

Over

T. 9N., R. 55E.

NOTE: The foregoing questions apply only to irrigated land shown on this plat.

### DESCRIPTION AND MAP OF FARM

18. Legal Description of this Farm W2, SW4NE4, NW4SE4, S2SE4,  
Sec. 34 Twp 9N. Rge. 55E.



IRRIGATED LAND



NON-IRRIGATED LAND



POTENTIAL LAND

North

West

East

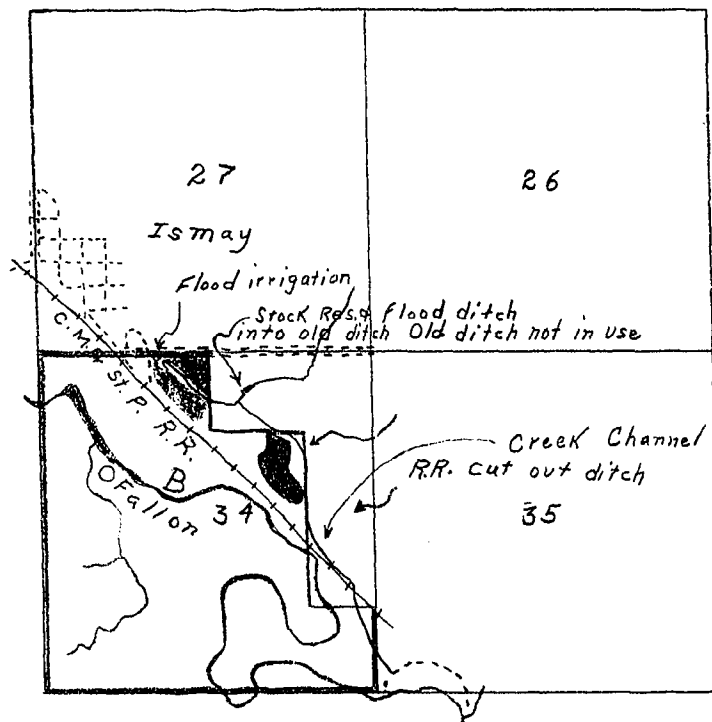

South

Ownership shown  
only irrigated land.  
All ownership for  
dry land not shown.

19. If the above land is irrigated from more than one ditch please give the acreage under each ditch in 19A and indicate the location of the land irrigated from each on the above map.

19A. Ditch: Private ditch from Canby + Res (Flood Irr.) Acres: 14.9

Ditch: \_\_\_\_\_ Acres: \_\_\_\_\_

Information supplied by:

Name Field Check on land Address \_\_\_\_\_ Date July 17, 1947

REMARKS: Buy Johansson + J. Pauliat  
old ditch out of use by R. R. Right-of-way has  
not been in use for long time.

If you cannot answer all of the questions on this form answer as many as you can and return the form to us as soon as possible.

STATE ENGINEERS OFFICE  
Water Resources Survey

COUNTY Custer

FILE NO. 15-T2N-R55E

Owner Mackay, Donald Address Chadwick, Ill

AAA Owner Address

Operator Address

New Owner Address

New Operator Address

Assessment Record None

Assessed Acreage 0

Legal Description of This Farm W2, SW1/4 NE1/4, W2 SE1/4, SE1/4 SE1/4, Sec. 34

T2N-R55E

Total Acres in Farm ✓

Code Number 34B

Photo No. MA 28-90

AAA Contract No.

AAA Total Cropland Acreage

App. No. 1175, 1593

Decree No.

Land is located in

Twp. 2N Rge. 55E Twp. Rge.

Twp. Rge. Twp. Rge.

Filed in Twp. 2N Rge. 55E

Remarks

Farm Map

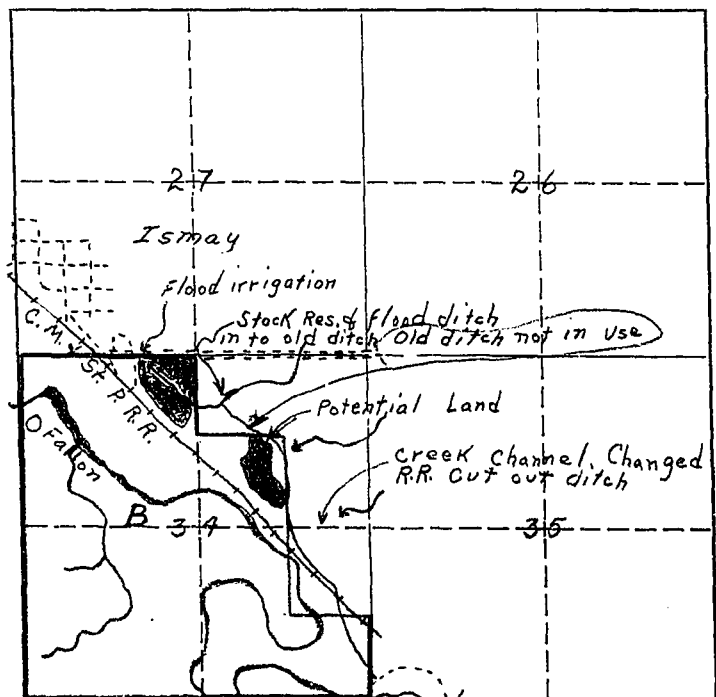

Ownership covers  
only irrigated land.  
All ownership for  
dry land not shown.

(Yellowstone Basin)

**STATE ENGINEERS OFFICE**  
**Water Resources Survey**

**Notice of Appropriation**

- 1175
- County Custer Book C Page 121 Record W.R.
  - Name of Appropriator John W. Stith Address Terry, Montana
  - Date Appropriated Aug. 15, 1905 Date Filed Aug. 15, 1905  
Amount Appropriated, Miners Inches 600 Cubic Feet per second
  - Name of Stream O'Fallon Creek Tributary Basin
  - Point of Diversion Question 9 seems to be the point of diversion  
Sec. Twp. Rge. Bank of Stream East
  - Purpose For irrigating and other purposes.
  - Description of System Ditch, said ditch of sufficient size which carries and conducts said 600 in. of water from said point which said ditch thence runs over said land.
  - Land Description of Intended Place of Use  
NW 1/4 less 27 acres, Sec. 34-9N-55E, 123. acres, Donald MacKay  
SW 1/4, W 1/2 SE 1/4, SE 1/4, less 8.80 R/W Sec. 34-9N-55E, 151.20 acres, Donald MacKay  
Balance of NW 1/4, SE 1/4 U.S.A.
  - Remarks (Pertaining to Use, etc.) That the purpose for which water is claimed and the place of intended use is 500 ft. in an easterly direction from the SE corner of Sec. 34-9N-55E, said purpose of water right is for irrigating the following described land in question 8.

**Decree**

- Case No. Date Amt. Decreed: M. I. C. F. S.
- To Whom Decreed Address
- Name of Ditch Maximum Capacity (C. F. S.)
- Date of Priority Purpose
- Land Description of Place of Use as Decreed
- Remarks (Present Use Status, etc.)

**STATE ENGINEERS OFFICE**  
**Water Resources Survey**

**Notice of Appropriation**

- 1593
1. County Custer Book B Page 423 Record W.R.
  2. Name of Appropriator Geo. W. Burt Address Custer Co.  
Sept. 11, 1903
  3. Date Appropriated Sept. 22, 1903 Date Filed Sept. 22, 1903  
Amount Appropriated, Miners Inches 15
  4. Name of Stream Sandstone Creek Tributary  Basin
  5. Point of Diversion 2320 ft. east and 55 ft. N. of the SW corner of Section  
Sec. 35 Twp. 9N. Rge. 55E. Bank of Stream West bank
  6. Purpose To irrigate and water agricultural, hay and grass land.
  7. Description of System A dam and a ditch, said dam to be 6 ft. high from water level and shall extend across said stream, and is to have in connection therewith a ditch 6 ft. wide on the bottom and 2 ft. deep, which said ditch shall be of sufficient size and capacity and length to carry the said 15 cu. ft. of water to and upon described land, and which said ditch is to run from said dam in a general northwesterly direction to and upon said
  8. Land Description of Intended Place of Use land herein before described.  
SW $\frac{1}{4}$  Sec. 35-9N-55E, 40 acres, SE $\frac{1}{4}$  NW $\frac{1}{4}$  SEC. 34, 320 acres, SW $\frac{1}{4}$  Sec. 27-9N-55E, State Bank of Terry, Terry, Mont., NE $\frac{1}{4}$  SE $\frac{1}{4}$  less R/W - Margaret Phillippi, Ismay, Mont. All SW $\frac{1}{4}$  Sec. 34, 16 acres out of NE $\frac{1}{4}$  SE $\frac{1}{4}$  Sec. 34, NW $\frac{1}{4}$  less 27 acres Sec. 34, W $\frac{1}{2}$  SE $\frac{1}{4}$  Sec. 34-9N-55E, Donald MacKay, Chadwick, Illinois
  9. Remarks (Pertaining to Use, etc.)

**Decree**

10. Case No.  Date  Amt. Decreed: M. I.  C. F. S.
11. To Whom Decreed  Address
12. Name of Ditch  Maximum Capacity (C. F. S.)
13. Date of Priority  Purpose
14. Land Description of Place of Use as Decreed
15. Remarks (Present Use Status, etc.)





NOTICE  
These forms are the  
property of the State  
of Montana and must  
be returned.

STATE OF MONTANA  
STATE ENGINEERS OFFICE  
Water Resources Survey

FORM WR-1-2M 12-47  
NOTICE Code No. 8A  
These forms are the  
property of the State  
of Montana and must  
be returned. X T. 9N R. 55E

Name of Land Owner Shumaker, P. J. Address Usamay, Montana  
Address \_\_\_\_\_

Part A

TO BE FILED BY THOSE OBTAINING IRRIGATION WATER FROM  
A DITCH COMPANY OR IRRIGATION DISTRICT

1. Water is delivered by: \_\_\_\_\_  
Name of Ditch, Ditch Company or District Supplying Water
2. State the number of acres you irrigate under this system \_\_\_\_\_ Shares you hold \_\_\_\_\_
3. If you obtain water from more than one Company, give the number of shares, acres irrigated and the name of the Company under "Remarks." If you obtain water from a Ditch Company and also have a private system fill in both Part A and Part B.

Part B

TO BE FILED BY THOSE WHO HAVE A PRIVATE DITCH, PUMP OR IRRIGATION SYSTEM  
or those who have a private water right under a Ditch Company

4. In what year was this land first irrigated? Date See attached sheets
5. Give the name of the original appropriator (first user): Anna Wagerstall
6. Give the date appropriated July 18, 1908 Amount filed on: Miners Inches 1000 C. F. S. \_\_\_\_\_
7. State the total number of acres irrigated under this system: 55.8
8. Give the point of diversion: SE 1/4 SE 1/4 Section 8 Township 9N Range 55E

Part C

TO BE FILED BY ALL WATER USERS IN ADDITION TO PART A OR PART B

- Source of Water: Dry Creek  
Name of stream or lake from which water is originally diverted
9. Water is obtained by: (Check one) Gravity ☒ Pumping ☒ Flood ☒ Other Irrigation
  10. What is the greatest number of acres you have irrigated? \_\_\_\_\_ Date \_\_\_\_\_
  11. How many acres did you irrigate in 1947? (Crop and pasture) 55.8
  12. State the total number of additional acres that could be irrigated by increasing the water supply, land leveling, etc. None This land is under what ditch? \_\_\_\_\_
  13. How many acres of seeped land do you have which could be drained and put into production? None
- What is the condition of your irrigation system? fair
- Is your water supply adequate? Yes \_\_\_\_\_ No ☒ Explain Flood Irrigation
- REMARKS: Has Reservoir + flood ditch

NOTE: The foregoing questions apply only to irrigated land shown on this plat.

### DESCRIPTION AND MAP OF FARM

18. Legal Description of this Farm Sec 8, Twp-9N Rge-55E



IRRIGATED LAND



NON-IRRIGATED LAND

North

Shading indicates  
only irrigated land.  
All ownership for  
dry land not shown.

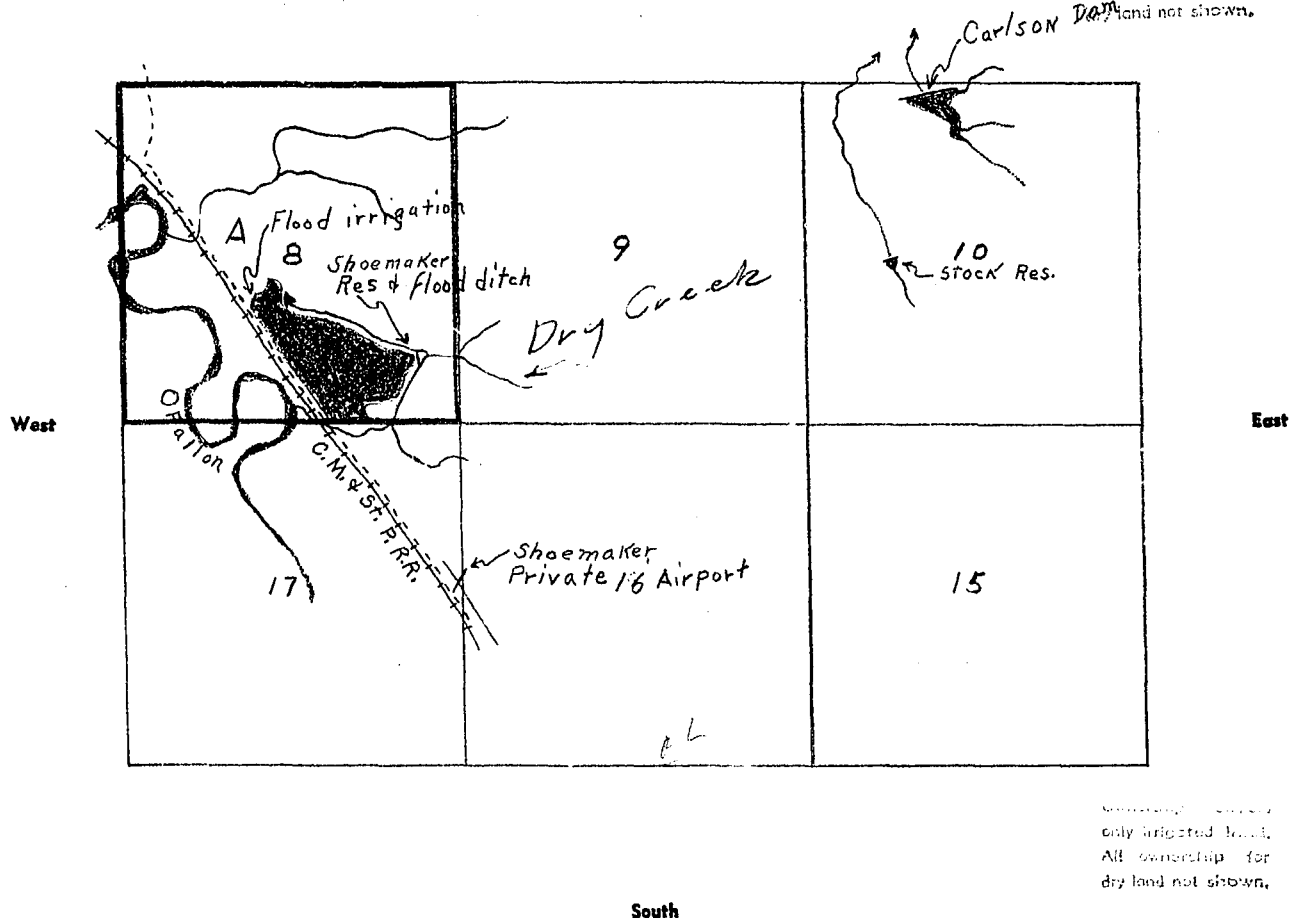

Shading indicates  
only irrigated land.  
All ownership for  
dry land not shown.

South

19. If the above land is irrigated from more than one ditch please give the acreage under each ditch in 19A and indicate the location of the land irrigated from each on the above map.

19A. Ditch: Private Flood ditch & Res. Acres: 55.8

Ditch: \_\_\_\_\_ Acres: \_\_\_\_\_

Information supplied by:

Name Owner & Field Address \_\_\_\_\_ Date July 17-47

REMARKS: Surveys Johnson & Paulist

If you cannot answer all of the questions on this form answer as many as you can and return the form to us as soon as possible.

STATE ENGINEERS OFFICE  
Water Resources Survey

COUNTY Cluster

FILE NO. 15-T.9N-R.55

Owner Shumaker, P.D. Address Ismay, Montana

AAA Owner \_\_\_\_\_ Address \_\_\_\_\_

Operator \_\_\_\_\_ Address \_\_\_\_\_

New Owner \_\_\_\_\_ Address \_\_\_\_\_

New Operator \_\_\_\_\_ Address \_\_\_\_\_

Assessment Record None

Assessed Acreage 0

Legal Description of This Farm all of Sec. 8 T.9N-R.55E

Total Acres in Farm 640

Code Number 8A

Photo No. MA 10-126

AAA Contract No. \_\_\_\_\_

AAA Total Cropland Acreage \_\_\_\_\_

App. No. 562, 561

Decree No. \_\_\_\_\_

Land is located in

Twp. 9N Rge. 55E Twp. \_\_\_\_\_ Rge. \_\_\_\_\_

Twp. \_\_\_\_\_ Rge. \_\_\_\_\_ Twp. \_\_\_\_\_ Rge. \_\_\_\_\_

Filed in Twp. 9N Rge. 55E

Remarks \_\_\_\_\_

Farm Map

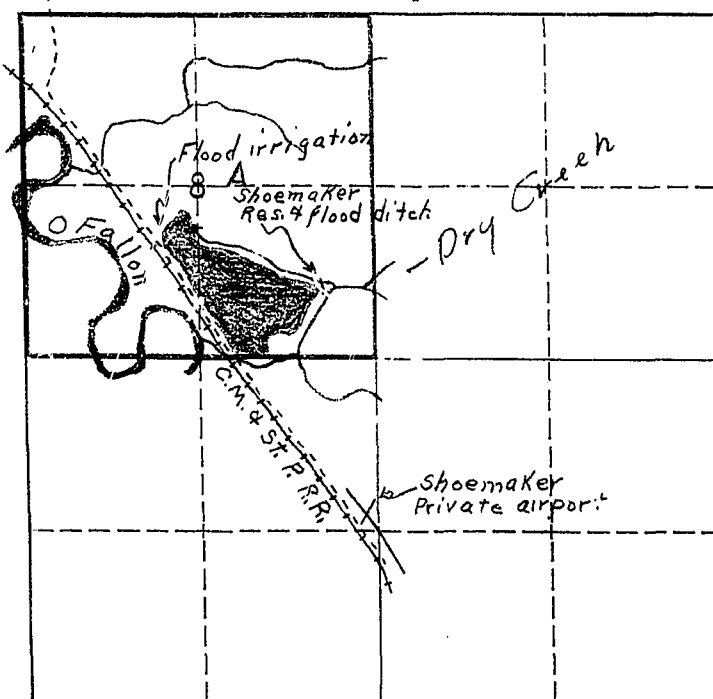

Ownership shown  
only irrigated land.  
All ownership for  
dry land not shown.

Yellowstone Basin

**STATE ENGINEERS OFFICE**  
**Water Resources Survey**

**Notice of Appropriation**

1. County Custer Book D Page 55 Record W. R.
2. Name of Appropriator Anna Meyerstall Address Ismay, Custer County
3. Date Appropriated July 18, 1908 Date Filed July 29, 1908  
Amount Appropriated, Miners Inches 1000, Cubic Feet per second
4. Name of Stream Dry Creek Tributary O'Fallon Creek Basin
5. Point of Diversion The point of intersection of the N. & E. boundary lines of the  
SE  $\frac{1}{4}$  NW  $\frac{1}{4}$   
Sec. 8 Twp. Rge. Bank of Stream  
which said point is further described as being near and in close proximity to a certain  
small butte.
6. Purpose Irrigation
7. Description of System A dam about 300 ft. long and 10 ft. high, and so constructed  
as to retain the flood waters of said creek and by ditches and laterals having a  
maximum width at the top of about 3 feet and a maximum width at the bottom of about  
2 ft. and a maximum depth of about 15". Said ditch or ditches to run thence to and
8. Land Description of Intended Place of Use through a small butte, thence to and through said  
described lands to any requisite point of final  
discharge.  
NW  $\frac{1}{4}$  Sec. 8-2N-55E, 80 acres, Rayton J. Shumaker, Ismay, Montana.  
SE  $\frac{1}{4}$  NW  $\frac{1}{4}$  Sec. 8-2N-55E, 120 acres, Frederick J. Banister, St. Paul
9. Remarks (Pertaining to Use, etc.)

**Decree**

10. Case No. Date Amt. Decreed: M. I. C. F. S.
11. To Whom Decreed Address
12. Name of Ditch Maximum Capacity (C. F. S.)
13. Date of Priority Purpose
14. Land Description of Place of Use as Decreed
15. Remarks (Present Use Status, etc.)

STATE ENGINEERS OFFICE  
Water Resources Survey  
Notice of Appropriation

1. County Custer Book D Page 56 Record W.R.
2. Name of Appropriator Anna Weyerstall Address Ismay, Custer Co.
3. Date Appropriated July 18, 1908 Date Filed July 29, 1908  
Amount Appropriated, minors inches 1000 3.14 East not surround
4. Name of Stream Dry Creek Tributary O'Fallon Creek Basin
5. Point of Diversion Where said creek crosses the East boundary line of said Section 8,  
which said point is further described as being near and in close proximity to the  
point where said creek divides into two prongs or forks.  
Sec. 8 Twp. Rge. Bank of Stream
6. Purpose Irrigation
7. Description of System A dam about 200 ft. long and 8 ft. high and by ditches and  
laterals having a maximum width at the top of about 3 ft. at the bottom of about 2 ft.  
and a maximum depth of about 15". Said ditch or ditches to run thence to and through  
said described lands to any requisite point of final discharge.
8. Land Description of Intended Place of Use  
S $\frac{1}{2}$ SE $\frac{1}{4}$  Sec. 8-9N-55E, Frederick J. Banister, St. Paul  
E $\frac{1}{2}$ SW $\frac{1}{4}$ , S $\frac{1}{2}$ NW $\frac{1}{4}$  Sec. 8-9N-55E, " "  
NW $\frac{1}{4}$ NE $\frac{1}{4}$  Sec. 8-9N-55E, Payton J. Shumaker, Ismay, Montana
9. Remarks (Pertaining to Use, etc.)

Decree

10. Case No. Date Amt. Decreed: M. I. C. F. S.
11. To Whom Decreed Address
12. Name of Ditch Maximum Capacity (C. F. S.)
13. Date of Priority Purpose
14. Land Description of Place of Use as Decreed
15. Remarks (Present Use Status, etc.)

# STATE OF MONTANA

## STATE ENGINEER'S OFFICE

### WATER RESOURCES SURVEY

Township 9N Range 55E County Custer

1842					
6	5	4	3	2	1
7	561 562 A	9	10	11	12
	562				
18	17	16	15	14	13
19	1056	Ownership covers only irrigated land. All ownership for dry land is shown.	21	22	23
20					
30	29	28	1593 27	26	25
31	32	33	1175 1593 B	1175 1593 A	35
			1593 1175	1593	36
				1593	

Township 9N Range 55E

Township 9N Range 55E County Custer

[illegible]

Township 9 North

Range 55 East

Custer County

<u>Index No.</u>	<u>Name of Appropriator</u>	<u>Stream</u>	<u>Date App.</u>	<u>Date Filed</u>	<u>M.I.</u>
561	Anna Weyerstall	Dry Creek	7-18-08	7-29-08	1000
562	Anna Weyerstall	Dry Creek	7-18-08	7-29-08	1000
1056	Charles McKay	McKay Creek	8-25-13	8-27-13	1000
1175	John W. Stith	O'Fallon Creek	8-15-05	8-15-05	600
1242	Peter M. Paulson	Pennell Creek	4-1-10	4-2-10	160
1593	George W. Burt	Sandstone Creek	9-11-03	9-22-03	600

Township 9 North

Range 55 East

Custer County