

T. 6 N - R. 19 E

DO NOT WRITE
IN SPACE BELOW

Code No.	14B	System	Old Flood Ditch (Pump)	Source of Water	Fish Creek
Basin	Musselshell River	Present	0	Potential	1.3
				Maximum	1.3
				R	F <input checked="" type="checkbox"/> P <input checked="" type="checkbox"/> G <input checked="" type="checkbox"/> S
Code No.		System		Source of Water	
Basin		Present		Potential	
				Maximum	
				R	F P G S
Code No.		System		Source of Water	
Basin		Present		Potential	
				Maximum	
				R	F P G S
Code No.		System		Source of Water	
Basin		Present		Potential	
				Maximum	
				R	F P G S

If under Ditch Company, Irrigation District, or Government Project, state the number of shares or inches, acre feet, as the case may be in said system.

NOTE: R—Denotes Regular Irrigation. F—Flood Irrigation. P—Water diverted by means of pumping. G—Water diverted by gravity. S—Stored Water.

Information from H. L. B. Date 6-13-49

Farm Checked

STATE OF MONTANA

Code No. 14 B

By J.E.C.

STATE ENGINEER'S OFFICE

County Golden Valley

Area Fish Creek

WATER RESOURCES SURVEY

T. 6N R. 19E Sec. 14

Date 8/20/78

Photo No. 44-6 145

Legal Land Owner Scott, Frank & Emily Bigelow 7900 So. State St. Chicago
Address

Operator Keiser, J. Address Ryegate

Water is delivered by:

Federal Project _____ Pres. _____ Pot. _____

Ditch Company _____ Pres. _____ Pot. _____

Irrigation District _____ Pres. _____ Pot. _____

Private System ☒ Pres. 0 Pot. 1.3

[illegible]

Flood ☒ Pump ☒ Reservoir ☐ Gravity ☒

Size and Capacity, Pump, etc. _____

Original Appropriator, Company _____ App. No. _____

Original Appropriator, Private Snyder, Chas E, Ward, Laura App. No. 142; 146

Is the system an extension of another system? Yes _____ No ✓

Is all land irrigated from one system? Yes ✓ No

(If No, show break down on map)

Source of Water Fish Creek

Acres Irrigated 19 48 0

Potential Acres 1.3 Seeped 0

Explain pump has not been used for 5 years

Condition of System out not in use

Adequate Supply --- Yes _____ No ✓

Explain depended on rainfall

Topography Creek bottom & bench

Information From Field Survey

Remarks _____

Sec 14 T6 N R19E

A coordinate grid with x and y axes ranging from -5 to 5. A point is plotted at (-3, 4) and labeled with the letter 'B'.

STATE ENGINEERS OFFICE
Water Resources Survey
Notice of Appropriation

1. County G.V. (Tel.) (Mehl) Book 22 (S) (C-2) Page 391 (549) (272) Record Misc. 142
2. Name of Appropriator Charles E. Snyder Address _____
3. Date Appropriated 8-19-07 Date Filed 8-27-07
- Amount Appropriated, Miners Inches 3000, Cubic Feet per second 75
4. Name of Stream Fish Creek Tributary Mchl. R. Basin No. 2.
5. Point of Diversion at a point on its north bank about the center of the SE 1/4 of Sec. 18-6-19, which said point of diversion is about 100 yards east of an abrupt sand rock point
 Sec. _____ Twp. _____ Rge. _____ Bank of Stream north
of a bluff; said ditch to run from said point of diversion in an easterly direction
to and over said land to be irrigated above described.
6. Purpose Irrigation, domestic use and other useful and beneficial purposes.
7. Description of System Dam and ditch, a dam to be constructed of dirt, stone and timber
about 10 ft. high, about 80 ft. long, about 80 ft. wide at the bottom and about 20 ft.
wide at the top; and a ditch which is to be about 15 ft. wide and 3 ft. deep.
8. Land Description of Intended Place of Use _____
Secs. 13, 14, 15, 16, 17-6-19 and
Secs. 17, 18, 19, 20-6-20 (See reverse side for different owners)
9. Remarks (Pertaining to Use, etc.) _____

Decree

10. Case No. _____ Date _____ Amt. Decreed: M. I. _____ C. F. S. _____
11. To Whom Decreed _____ Address _____
12. Name of Ditch _____ Maximum Capacity (C. F. S.) _____
13. Date of Priority _____ Purpose _____
14. Land Description of Place of Use as Decreed _____
15. Remarks (Present Use Status, etc.) _____

Page 1.

WT. 22-391 G.V.

WT. 22-396 G.V.

1940 Owners as follows:

W¹/₂ 13-6-19 - 320 Ac. - Will H. Northey, Ryegate, Mont.

E¹/₂ 13-6-19 - 320 Ac. - Emma Powell, Ryegate, Mont.

NW¹/₂ 14-6-19 - 160 Ac. - W. H. Northey, Ryegate, Mont.

NW¹/₂ 14-6-19 - 160 Ac. - Frank W. Scott, % East 80th St., Chicago, Ill.

SE¹/₂ 14-6-19 - 160 Ac. - Will H. Northey, Ryegate, Mont. & Josephine Northey, Ryegate, Mont.

NE¹/₂ 14-6-19 - 160 Ac. - Will H. Northey, Ryegate, Mont.

All Sec. 15-6-19 - 640 Ac. - Edgar M. Adams, 501 American Bank Building, Portland, Oreg.

All Sec. 16-6-19 - 640 Ac. - State Land.

All of Sec. 17-6-19 - 640 Ac. - Anna Linquist, Barber, Mont.

Sec. 17-6-20 - 640 Ac. - 1st Nat'l Bank, Fargo, No. Dak.

SW¹/₂ NE¹/₂, SE¹/₂ NE¹/₂, NW¹/₂ SE¹/₂ of 18-6-20 - 160 Ac. - Minnie Kellerstrass,

517 Archer St., Peoria, Ill.

W¹/₂ SW¹/₂, SE¹/₂ SW¹/₂, SE¹/₂ SE¹/₂ of Sec. 18-6-20 - 145 Ac. - Minnie Kellerstrass, Peoria, Ill.

N¹/₂ NW¹/₂, SE¹/₂ NW¹/₂, NW¹/₂ NE¹/₂ except 3.97 Ac. H. Ac in NE¹/₂ NE¹/₂ Sec. 18-6-20 - 147 Ac. -
Ford Garfield, Ryegate, Mont.

NE¹/₂ less h-Ac. in NE¹/₂ NE¹/₂

3.97 Ac in NE¹/₂ NE¹/₂ 18-6-20 - 160 Ac. - 1st Nat'l Bank, Fargo, No. Dak.

SE¹/₂ 19-6-20 - 160 Ac - Emma R. Cole, Wabasha, Minnesota

NW¹/₂ 19-6-20 - 145 Ac. - C. H. Ebenreiter, Gillett, Wis.

NE¹/₂ 19-6-20 - 160 Ac. - Anna W. Grunden, % 1st Nat'l Bank, Fargo, No. Dak.

SW¹/₂ 20-6-20 - 160 Ac. - Ernest Rediske & Herman Rediske, Ryegate, Mont.

SE¹/₂ 20-6-20 - 160 Ac. - Security Grazing Assoc., Ryegate, Mont.

NE¹/₂ 20-6-20 - 160 Ac. - Byron E. Wells, 174 So. Cloverly, Temple City, Calif.

NW¹/₂ 20-6-20 - 160 Ac. - E. S. Kemp Est. & Mrs. Maude Kemp, Temple City, Calif.

SE¹/₂ 19-6-20 - 160 Ac. - Federal Farm Mtg. Co. % Albert Ice, Henry Harrell and
W. H. Northey, Ryegate, Mont.

DEPT. OF AGRICULTURE

UNITED STATES GOVERNMENT
BUREAU OF LAND MANAGEMENT

STATE ENGINEERS OFFICE
Water Resources Survey

Notice of Appropriation

1. County G.V. (Yel) (Mshl.) Book 22 (E) (C-2) Page 371 (114) (221) Record Misc. 146
2. Name of Appropriator Laura Ward Address Shawmut, Mont.
3. Date Appropriated 11-18-05 Date Filed 11-21-03
- Amount Appropriated, Miners Inches 200 Cubic Feet per second 5
4. Name of Stream Fish Creek Tributary Mshl. R. Basin Mo. R.
5. Point of Diversion At a point upon its both banks at or near the NW 1/4 of
- Sec. 22 Twp. 6 Rge. 19 Bank of Stream both
6. Purpose irrigating and other purposes
7. Description of System Dam and ditches, which said ditches will be 12" by 30" in
size and carry and conduct 5 cu. ft. of water from said stream.
8. Land Description of Intended Place of Use
N 1/2 SE 1/4 and N 1/2 SW 1/4 Sec. 14-6-19 - 160 Ac., W. H. Northey, Ryegate, Mont.
9. Remarks (Pertaining to Use, etc.) Wrt. is dated 11-18-05, verified, subscribed and
sworn to 11-18-05. Filed for record 11-21-03. I believe this error was made in
transcribing.

Decree

10. Case No. _____ Date _____ Amt. Decreed: M. I. _____ C. F. S. _____
11. To Whom Decreed _____ Address _____
12. Name of Ditch _____ Maximum Capacity (C. F. S.) _____
13. Date of Priority _____ Purpose _____
14. Land Description of Place of Use as Decreed _____
15. Remarks (Present Use Status, etc.) _____

County Golden Valley

Farm Checked: Date 8-20-48

By J.E.C

Legal Land Owner.....Ira Witt.....

Operator.

Water is delivered by:— (1) Private System;

STATE OF MONTANA
STATE ENGINEERS OFFICE
Water Resources Survey

T 6N R 19E Plat No 22

Photo No. 6-145

Address.

Address.

2. Ditch Company;

3. State Project;

4. Federal Project;

5. Irrigation District

[illegible]

NOTE: R—Denotes Regular Irrigation. F—Flood Irrigation.

Adequate Supply: Yes..... No..xx Explain..depends on rainfall

Remarks.

River Basin.

Also in: Plat No.....	Twp.....	Rge.....	Plat No.....	Twp.....	Rge.....	Plat No.....	Twp.....	Rge.....
Plat No.....	Twp.....	Rge.....	Plat No.....	Twp.....	Rge.....	Plat No.....	Twp.....	Rge.....

Information From:

Ira Witt

100
 200
 300
 400
 500
 600
 700
 800
 900
 1000
 1100
 1200
 1300
 1400
 1500
 1600
 1700
 1800
 1900
 2000
 2100
 2200
 2300
 2400
 2500
 2600
 2700
 2800
 2900
 3000
 3100
 3200
 3300
 3400
 3500
 3600
 3700
 3800
 3900
 4000
 4100
 4200
 4300
 4400
 4500
 4600
 4700
 4800
 4900
 5000
 5100
 5200
 5300
 5400
 5500
 5600
 5700
 5800
 5900
 6000
 6100
 6200
 6300
 6400
 6500
 6600
 6700
 6800
 6900
 7000
 7100
 7200
 7300
 7400
 7500
 7600
 7700
 7800
 7900
 8000
 8100
 8200
 8300
 8400
 8500
 8600
 8700
 8800
 8900
 9000
 9100
 9200
 9300
 9400
 9500
 9600
 9700
 9800
 9900
 10000

1	2	3	4	5	6
7	8	9	10	11	12
13	14	15	16	17	18
19	20	21	22	23	24
25	26	27	28	29	30
31	32	33	34	35	36

Land Ownership.....

.....

.....

.....

.....

.....

.....

.....

.....

.....

.....

.....

.....

NOTICE
These forms are the
property of the State
of Montana and must
be returned.

STATE OF MONTANA
State Engineer's Office
WATER RESOURCES SURVEY
WATER RIGHT DATA

County Golden Valley
Code No. 20A

Name of Land Owner Ira Witt Address _____
Name of Operator _____ Address _____
Legal Description NE $\frac{1}{4}$, N $\frac{1}{2}$ NW $\frac{1}{4}$ Sec. 20, Twp. 6N., Rge. 19E

1. Our records show that the following water rights were filed on the above described land:

Code	Name of Appropriator	Stream	Land Description	Date App.	Date Filed	Miner's Inches Filed On
138	Thomas M. Powell	Fish Cr.	S $\frac{1}{2}$ NE $\frac{1}{4}$, NW $\frac{1}{4}$ NE $\frac{1}{4}$, N $\frac{1}{2}$ NW $\frac{1}{4}$ Sec. 20-6-19	11-18-05	11-21-05	200

2. Are these filings in use: _____ Yes _____ No. Explain _____
3. Have any of the above filings or any part of them been sold: _____ Yes _____ No. If yes, give amount of inches sold and to whom transferred and from what original filing _____

4. I have the following water rights that the State Engineer's Office have not shown in the above list:

Name of Appropriator	Stream	Land Description	Date App.	Date Filed	Miner's Inches Filed On

5. In addition, I have an irrigation system on which no recorded filing was ever made.

Name of First User	Date of First Use	Stream	Place of Use

6. Do you buy supplemental water? ☐ Yes. ☐ No. If yes, from whom and how many inches, C.F.S., Acre Feet, as the case may be? _____

7. Give any other information that you think should be included for the protection of your water right _____

Information from _____ Date _____

State Engineer's Office

WATER RESOURCES SURVEY

FARM MAP

Twp. 6N Rge. 19E
Twp. _____ Rge. _____
Twp. _____ Rge. _____
Ownership covers
only irrigated land.
All ownership for
dry land not shown.

Name of Land Owner. Ira Witt Address. _____

Name of Operator. _____ Address. _____

Legal Description. NE 1/4 NW 1/4 Sec. 20, Twp. 6N., Rge. 19E

☒ Irrigated Land ☐ Non-Irrigated Land ☒ Potential Land Under Existing Facilities

North

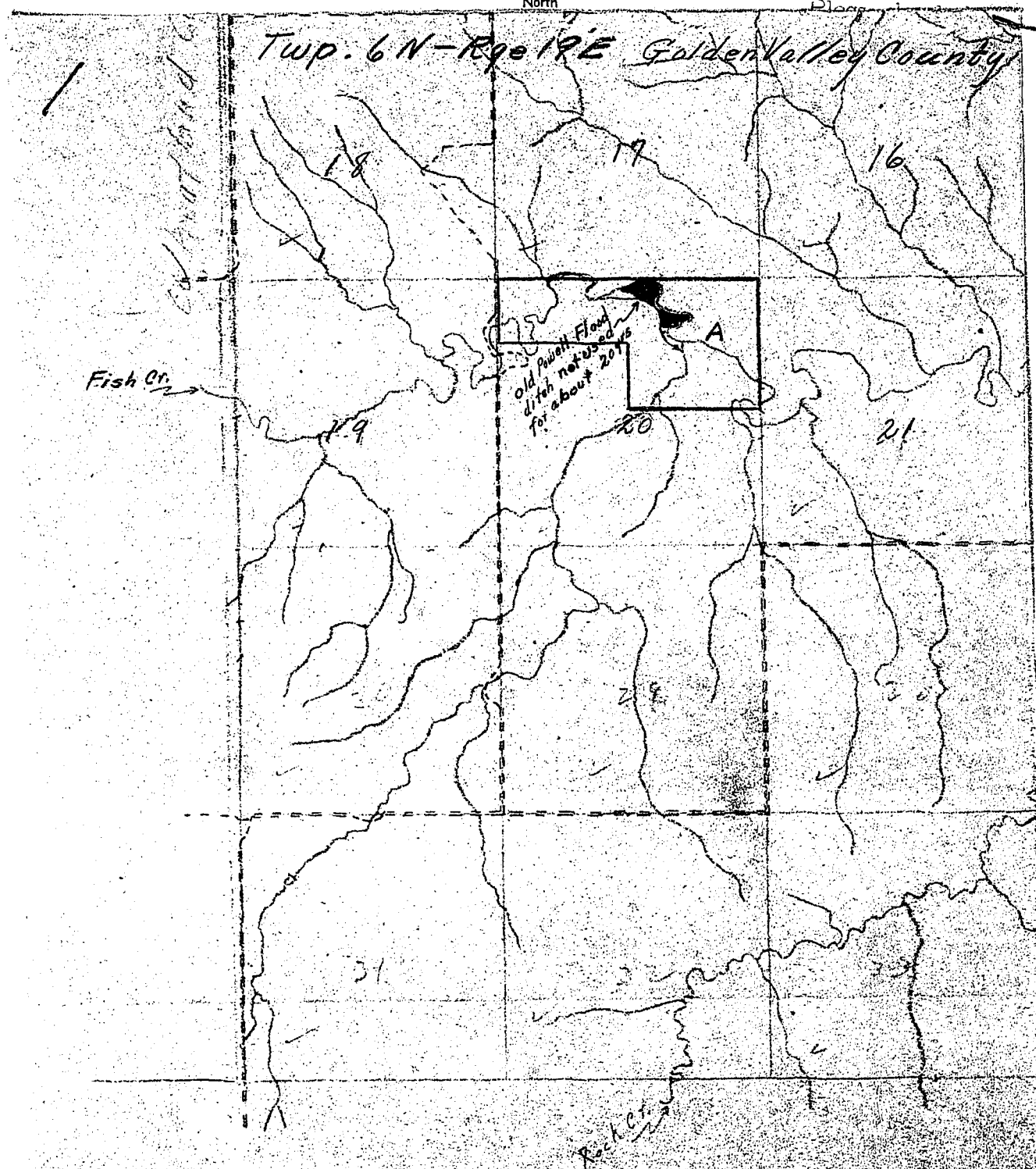

+ ☒ Potential Irrigation



DO NOT WRITE
IN SPACE BELOW

T. 6 N - R. 19 E

Code No. <u>20A</u>	System <u>Old Powell Flood Ditch</u>	Source of Water <u>Fish Creek</u>
Basin <u>Musselshell River</u>	Present <u>0</u>	Potential <u>7.0</u> Maximum <u>7.0</u> R <u> </u> F <u> </u> P <u> </u> G <u> </u> S <u> </u>
Code No. _____	System _____	Source of Water _____
Basin _____	Present _____	Potential _____ Maximum _____ R <u> </u> F <u> </u> P <u> </u> G <u> </u> S <u> </u>
Code No. _____	System _____	Source of Water _____
Basin _____	Present _____	Potential _____ Maximum _____ R <u> </u> F <u> </u> P <u> </u> G <u> </u> S <u> </u>
Code No. _____	System _____	Source of Water _____
Basin _____	Present _____	Potential _____ Maximum _____ R <u> </u> F <u> </u> P <u> </u> G <u> </u> S <u> </u>

If under Ditch Company, Irrigation District, or Government Project, state the number of shares or inches, acre feet, as the case may be in said system.

NOTE: R—Denotes Regular Irrigation. F—Flood Irrigation. P—Water diverted by means of pumping. G—Water diverted by gravity. S—Stored Water.

Information from H. L. B. Date 6-13-49

STATE ENGINEERS OFFICE
Water Resources Survey

Notice of Appropriation

1. County G.V. (Yel.) (Mshl.) Book 22 (E) (C-2) Page 372 (115) (222) Record Misc. 138
2. Name of Appropriator Thomas M. Powell Address Shawmut, Mont.
3. Date Appropriated 11-18-05 Date Filed 11-21-05
- Amount Appropriated, Miners Inches 200, Cubic Feet per second 5
4. Name of Stream Fish Creek Tributary Mshl. R. Basin Mo. R.
5. Point of Diversion At a point upon its northerly bank at or near the SW $\frac{1}{4}$ of
- Sec. 19 Twp. 6 Rge. 19 Bank of Stream northerly
6. Purpose irrigating, and other purposes
7. Description of System dam and ditch, which said ditch will be 12" by 48" in size and
carries and conducts 5 cu.ft. of water from said stream.
8. Land Description of Intended Place of Use
S $\frac{1}{2}$ NE $\frac{1}{4}$, NW $\frac{1}{4}$, N $\frac{1}{2}$ NW $\frac{1}{4}$ Sec. 20-6-19 - 200 Ac., Federal Land Bank, & Ira & Agnes Witt,
Barber, Mont.
9. Remarks (Pertaining to Use, etc.)

Decree

10. Case No. _____ Date _____ Amt. Decreed: M. I. _____ C. F. S. _____
11. To Whom Decreed _____ Address _____
12. Name of Ditch _____ Maximum Capacity (C. F. S.) _____
13. Date of Priority _____ Purpose _____
14. Land Description of Place of Use as Decreed _____
15. Remarks (Present Use Status, etc.) _____

Township 6 North, Range 20 East

Code	Owner	Operator
4F	W. K. Broderson	Same
1C, 2A	John & Ethel Broderson	Same
1A, 5A, 6A, 6B	Andrew E. Dale	Same
6A, 6TA, 6TB, 18A	D.E. & Helen Keefer	
5F	John & Amelia Kinsey	Alex Landice
4B, 4D, 5D	Ida Landice	
Lots 3-9, Incl.	Louis Lundy	Same
Lots 1,2,3,4,5,6	Jacob, Richard & Levi, Aaron McDonald	Same
5TG	McLaren	Same
5TA	John Milne	
6TF	Milwauke Ry.	Not known
5TB	Earl Osse	Same
Lots 1 & 2, 7,8,9,10,11,12	Harry I Reimers	Same
5TW	Beers	
5TV	Bukoskey	
3A,4A,5TU	Ford W. Garfield	
5TZ	Taber	
5TY	Todd	
5TE, 5TR, 5TS	Lois M. & Isabel Wolff	
5TX	Nick Schanz	
5E	Mrs. J. J. Schladweiler	
6C	Chris & Mary Willems	Same
Lots 3.4.7.8.9	Neva & Noah Walters	Same
1B, 2E	John Osse	Same

STATE OF MONTANA

STATE ENGINEER'S OFFICE

WATER RESOURCES SURVEY

Township 6 North

Range 20 East

County

Golden Valley

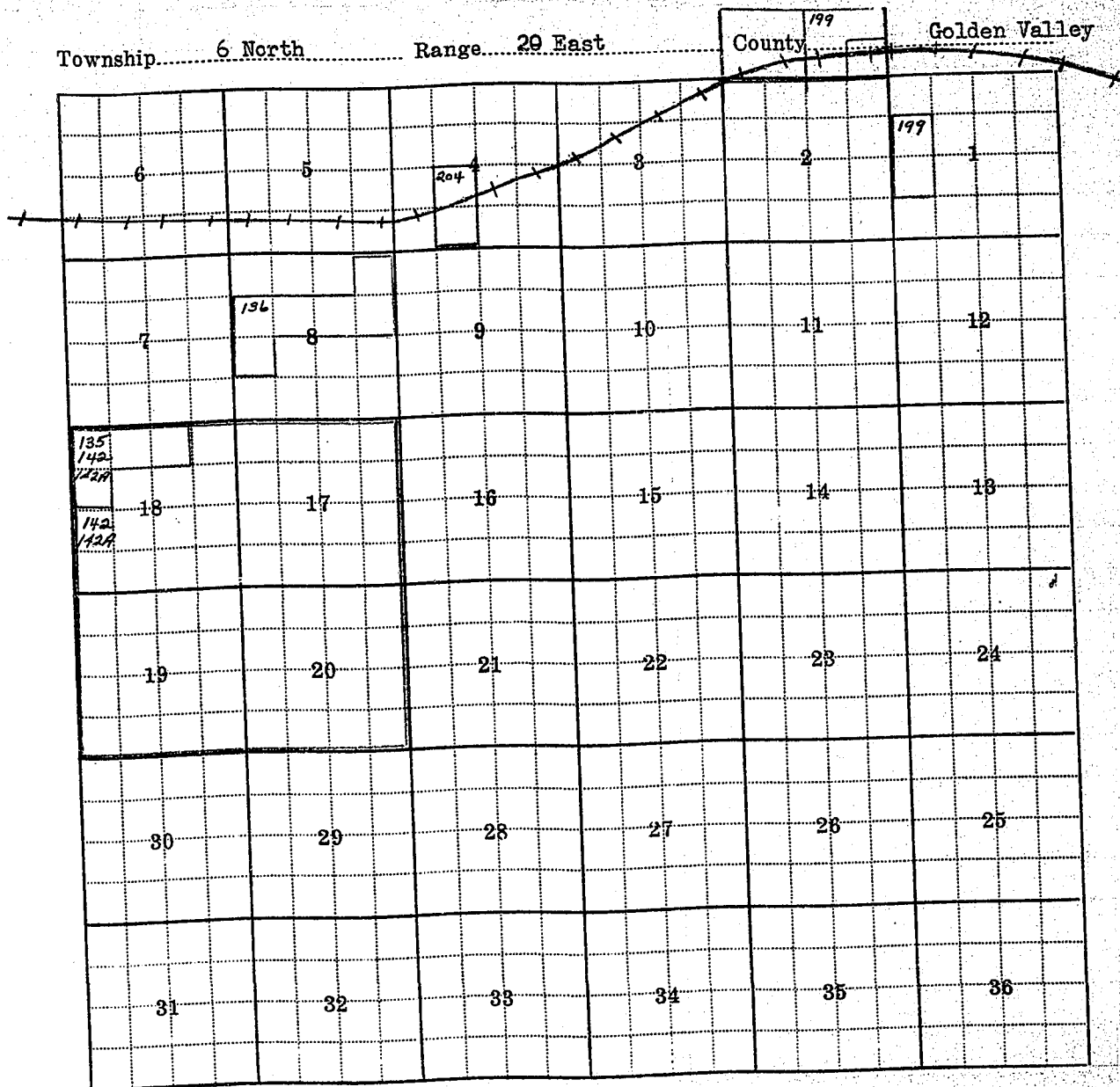

Township 6 North Range 20 East

Township 6 North, Range 20 East

<u>No.</u>	<u>Name of Appropriator</u>	<u>Name of Stream</u>	<u>Date App.</u>	<u>Date Filed</u>	<u>M.I.</u>
135	Hale, Wm. F.	Fish Creek	11-18-05	11-21-05	200
136	Jenizen, Jeanette	Fish Creek	11-18-05	11-21-05	300
142	Snyder, Chas. E.	Fish Creek	8-19-07	8-27-07	3000
142A	Snyder, Chas. E.	Fish Creek	10-1-07	10-17-07	3000
199	Broderson, Ethel	Musselshell River	6-1-32	11-1-33	300
204	Gregg, J. B. and Landice, Ida	Musselshell River	6-1-26	5-3-27	1000

County Golden Valley

Farm Checked: Date 6-24-48

By A.C.S.

Legal Land Owner..... W. K. Broderson

Operator.....

STATE OF MONTANA
STATE ENGINEERS OFFICE
Water Resources Survey

T 6N R 20E Plat No. 23

Photo No. 6-103

Address..... Ryegate

Address.....

[illegible][illegible]

NOTE: R—Denotes Regular Irrigation. F—Flood Irrigation.

Adequate Supply: Yes xx No..... Explain..... buys stored water
Remarks.....

.....River Basin

Information From:

W. K. Broderson

Also in: Plat No.	Twp.	Rge.	Plat No.	Twp.	Rge.	Plat No.	Twp.	Rge.
Plat No.	Twp.	Rge.	Plat No.	Twp.	Rge.	Plat No.	Twp.	Rge.

5	6	7	8	9	10	11	12
13	14	15	16	17	18	19	20
21	22	23	24	25	26	27	28
29	30	31	32	33	34	35	36

Land Ownership.....

.....

.....

These forms are the
property of the State
of Montana and must
be returned.

STATE OF MONTANA

State Engineer's Office

WATER RESOURCES SURVEY WATER RIGHT DATA

County Golden Valley
De No. 4F

Name of Land Owner W. K. Broderson Address Ryegate, Montana
Name of Operator Same Address _____
Legal Description SE 1/4 Sec. 4, Twp. 6N., Rge. 20E

We are asking you to help us protect your water right because in our records we are unable to find a recorded water right covering the above described land. We, therefore, would like to have you give us the information asked for in the following questions:

1. Was a water right filing ever made for this land.....Yes.....No. If yes, give us the following information:

Name of Appropriator	Stream	Land Description	Date App.	Date Filed	Miner's Inches Filed On
<u>John Hillman</u>	<u>Fish Creek</u>	<u>Sec. 20 and 6-20</u>	<u>12-10-83</u>	<u>12-24-83</u>	<u>120</u>
<u>John Hillman</u>	<u>Snake River</u>	<u>Fish in Box "T" page 14 Meagher County as original the 1884 Sec 5-6-20</u>	<u>Sept-1883</u>	<u>4-19-84</u>	<u>500</u>

If no, can you give us the following information:

Name of First User	Date of First Use	Stream	Place of Use
<u>Joseph Sims</u>	<u>June 15, 1895</u>	<u>Moun. R.</u>	<u>All lands under Sims Ditch System</u>

2. Or is this land covered by a water right that was purchased from another water right.....Yes.....No.....

If yes, give us the amount of the inches purchased, from what original filing, and if possible the date of purchase and from whom purchased.

3. If this land is under an incorporated ditch company, mutual ditch company, irrigation district, federal project, or state project, give us the following information:

Name of Ditch System	Shares of Stock	Miner's Inches	Acre Feet	Assessed Acres	Type of System Pumping Gravity

4. Do you buy supplemental water.....Yes.....No. If yes, from whom and how many inches, Cubic Feet Per Second, Acre Feet, as the case may be? 15 acres from Central Re. M. and 112
from N. and 1, 1946 - one from 15 + one from 50 acres from

5. Give any other information that you think should be included for the protection of your water right.....

Information from Walter K. Broderson Date _____

State Engineer's Office

County Golden Valley

Twp. 6N. Rge. 20E

Twp. _____ Rge. _____ Ownership covers
Twp. _____ Rge. _____ only irrigated land,
Twp. _____ Rge. _____ All ownership for
dry land not shown.

WATER RESOURCES SURVEY FARM MAP

Code No. 4F

Name of Land Owner W. K. Broderson

Address Reigate, Montana

Name of Operator Same

Address _____

Legal Description SE $\frac{1}{4}$ Sec. 4, Twp. 6N., Rge. 20E



Irrigated Land



Non-Irrigated Land



Potential Land Under Existing Facilities

North

Please check the
ownership outline
of this land.

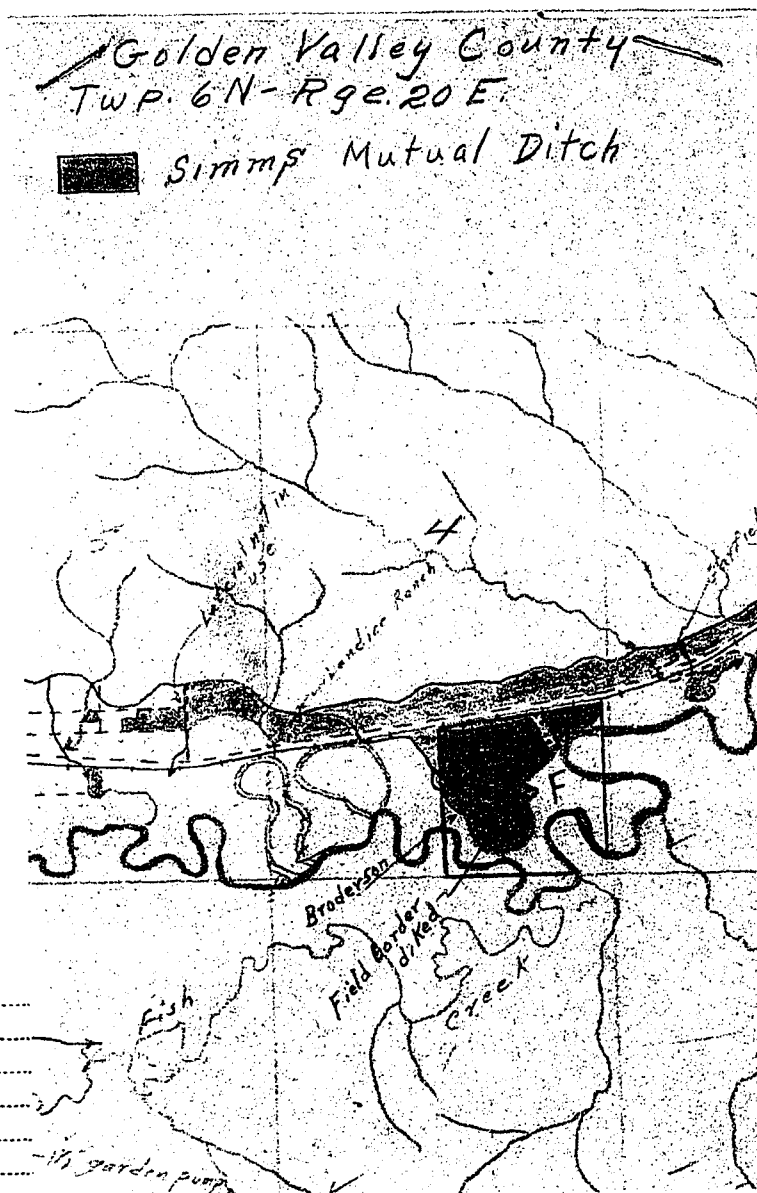

Code No. _____

Basin. _____

Code No. _____

Basin. _____

Code No. _____

Basin. _____

Code No. _____

Basin. _____

Water. _____

R. F. P. G. S.

Water. _____

R. F. P. G. S.

Water. _____

R. F. P. G. S.

Source of Water. _____

Basin. _____ Present _____ Potential _____ Maximum _____ R. F. P. G. S.

If under Ditch Company, Irrigation District, or Government Project, state the number of shares or inches, acre feet, as the case may be in said system.

NOTE: R—Denotes Regular Irrigation. F—Flood Irrigation. P—Water diverted by means of pumping. G—Water diverted by gravity. S—Stored Water.

Information from _____ Date _____

Farm Checked

STATE OF MONTANA

Code No. 4FBy A-C-S

STATE ENGINEER'S OFFICE

County Golden ValleyArea Ryegate

WATER RESOURCES SURVEY

T. 6N. R. 20E. Sec. 4Date 6/24/48Photo No. 6-103Legal Land Owner Broderon, W. K. Address Ryegate

Operator _____ Address _____

Water is delivered by:

Federal Project _____ Pres. _____ Pot. _____

Ditch Company _____ Pres. _____ Pot. _____

Irrigation District _____ Pres. _____ Pot. _____

Private System Mutua / (Simms) Pres. 110 Pot. 0

Totals _____

Flood _____ Pump _____ Reservoir ☒ Gravity ☒

Size and Capacity, Pump, etc. _____

Original Appropriator, Company _____ App. No. _____

Original Appropriator, Private _____ (Show date of appropriation under Remarks) App. No. None shown on form (see over)Is the system an extension of another system? Yes _____ No ☒Is all land irrigated from one system? Yes ☒ No _____

(If No, show break down on map)

Source of Water Musselshell R.Acres Irrigated 19 48 110Potential Acres 0 Seeped 0

Explain _____

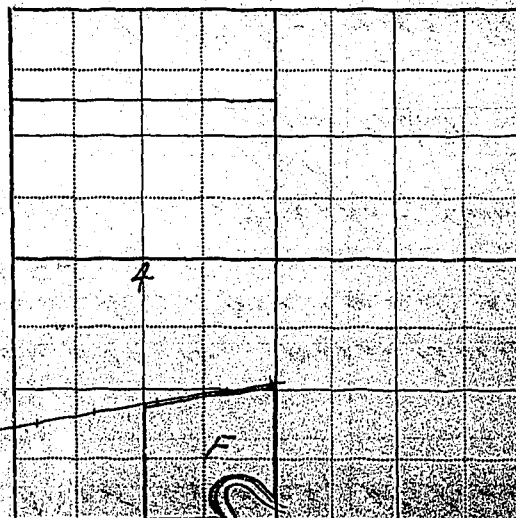
Condition of System goodAdequate Supply Yes ☒ No _____Explain buys stored waterTopography R. Bottom + terraceInformation From W. K. BroderonRemarks 1/3 of Mutua

May install pump where River crosses W. line
of SE 4

Buys 75 A.F. from Basin

Wm. Wilkins filed on 500 in. Musselshell
in S.W. Cor. Sec. 5. Owned this land at
the time. April 19 1884

Book T P. 257 of Records Meagher County

trans. 1 D 11

Yell.

trans. 2 2 11

Musselshell

This land also once part of Simms Ranch
Will get further information on this mutual
system at a later date, not included
in our present working area but contacted
this man at his fathers ranch farther
down the River.

ELVIS ENGINEERS OFFICE

April 19, 1949

Mr. W. K. Broderson
Ryegate, Montana

Dear Mr. Broderson:

In 1939 the State Legislature passed a law authorizing the State Engineer to investigate and compile a complete record of all water rights and water use in the State. In compliance with this law the State Engineer is now working in Golden Valley County compiling these data.

Enclosed herewith we are sending you two forms. The first one shows the ownership boundary of your land, with the irrigated portion colored orange. We would like to have you check this map and make any corrections that you may deem necessary. As we do not have a record of a water filing covering this land we are sending you Form WR-D, which we would like to have you fill out in its entirety, and also give us any and all information you can regarding the Simms Mutual Ditch and its operations.

Remember, this is your water and your water rights that we are trying to help you with.

Very truly yours,

Gerald J. Oravets
Assistant State Engineer

GJO/a
enc.

Twp. 6N Rge. 20E

Twp. _____ Rge. _____

Twp. _____ Rge. _____

State Engineer's Office
WATER RESOURCES SURVEY
FARM MAPT. 6N-R. 20EName of Land Owner Braderson, W.K. Address Ryegate

Name of Operator _____ Address _____

Legal Description _____



Irrigated Land



Non-Irrigated Land



Potential Land Under Existing Facilities

North

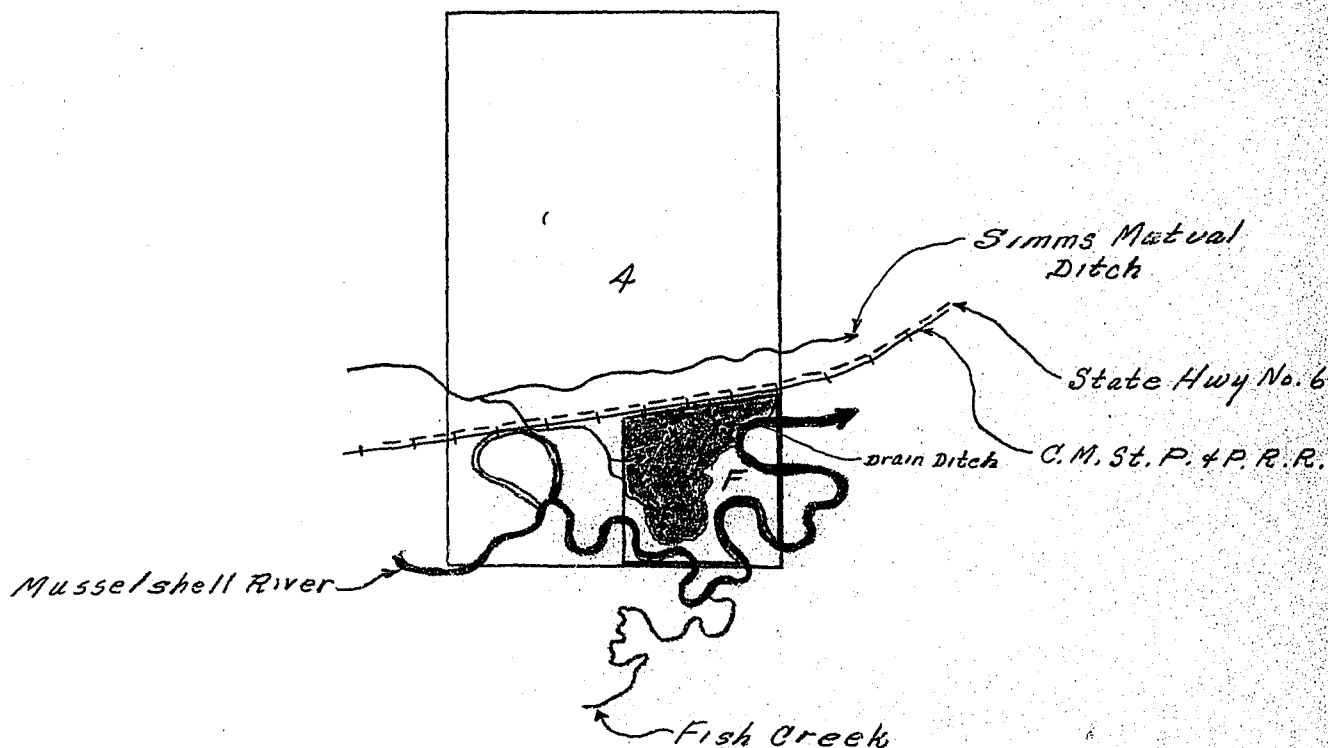
T. 6N-R. 20E

Code No. <u>FF</u>	System <u>Simms Mutual Ditch</u>	Source of Water <u>Musselshell River</u>
Basin <u>Musselshell River</u>	Present <u>110</u>	Potential <u>0</u> Maximum <u>110</u>
Code No. _____	System _____	Source of Water _____
Basin _____	Present _____	Potential _____ Maximum _____
Code No. _____	System _____	Source of Water _____
Basin _____	Present _____	Potential _____ Maximum _____
Code No. _____	System _____	Source of Water _____
Basin _____	Present _____	Potential _____ Maximum _____

If under Ditch Company, Irrigation District, or Government Project, state the number of shares or inches, acre feet, as the case may be, in said system.

NOTE: R—Denotes Regular Irrigation. F—Flood Irrigation. P—Water diverted by means of pumping. G—Water diverted by gravity. S—Stored Water.

Information from W.L.B.Date 6-14-49

STATE ENGINEERS OFFICE
Water Resources Survey

Notice of Appropriation

1. County G.V. (Yel) (Mshl) Book 22 (D) (C-2) Page 315 (10) (111) Record Misc. 147
2. Name of Appropriator Wm. Wilkins Address _____
3. Date Appropriated 12-10-83 Date Filed 12-24-83
Amount Appropriated, Miners Inches 220 Cubic Feet per second _____
spring runs into Fish Creek
4. Name of Stream Spring in Twp. 6-20, said Tributary _____ Basin _____
5. Point of Diversion from the south side water was diverted from the channel of said
stream near the head of the same believed to be in Sec. 20
Sec. _____ Twp. _____ Rge. _____ Bank of Stream _____
6. Purpose Irrigating and other useful purposes
7. Description of System No desc. shown
8. Land Description of Intended Place of Use _____
No Desc. given
9. Remarks (Pertaining to Use, etc.) It appears that Wm. Wilkins transferred this WR to
Joseph Sims by deed transcribed to Book 22, p. 323 G.V. but the transfer mentions
500 inches while this WR calls for only 220 inches.

Decree

10. Case No. _____ Date _____ Amt. Decreed: M. I. _____ C. F. S. _____
11. To Whom Decreed _____ Address _____
12. Name of Ditch _____ Maximum Capacity (C. F. S.) _____
13. Date of Priority _____ Purpose _____
14. Land Description of Place of Use as Decreed _____
15. Remarks (Present Use Status, etc.) _____

STATE ENGINEERS OFFICE
Water Resources Survey

Notice of Appropriation

1. County G.V. (Yel) (Mshl) Book 22 (D) (C-2) Page 315 (11) (111) Record Misc. 214
2. Name of Appropriator William Wilkins Address Olden, Montana
1883
3. Date Appropriated During or before Sept. Date Filed 4-19-84
Amount Appropriated, Miners Inches 500, Cubic Feet per second _____
4. Name of Stream Musselshell River Tributary _____ Basin Mo. R.
5. Point of Diversion from the channel of said Musselshell River at or near the S.W. corner
of
Sec. 5 Twp. 6 Rge. 20 Bank of Stream _____

6. Purpose Irrigating and other useful purposes
7. Description of System No desc. shown

8. Land Description of Intended Place of Use No Desc. given
Desc. incomplete on WR so have taken desc. from other source, desc. as follows:
Lot 13 - Sec. 3-6-20
SE 1/4 Sec. 4-6-20
E 1/4 SW 1/4 Sec. 4-6-20
9. Remarks (Pertaining to Use, etc.) This WR assigned to Joseph Sims 4-29-85. See Book 22,
p. 323 G.V.

Decree

10. Case No. _____ Date _____ Amt. Decreed: M. I. _____ C. F. S. _____
11. To Whom Decreed _____ Address _____
12. Name of Ditch _____ Maximum Capacity (C. F. S.) _____
13. Date of Priority _____ Purpose _____
14. Land Description of Place of Use as Decreed _____

15. Remarks (Present Use Status, etc.) _____

County.....Golden Valley.....

Farm Checked: Date 6-23-48

By.....A.C.J.

STATE OF MONTANA
STATE ENGINEERS OFFICE
Water Resources Survey

T 6N R 20E Plat No. 23

Photo No. 6-82

Legal Land Owner..... John & Ethel M. Broderick..... Address..... Ryegate.....

Operator Address

Water is delivered by:— (1) Private System; 2. Ditch Company; 3. State Project; 4. Federal Project; 5. Irrigation District

[illegible]

NOTE: R—Denotes Regular Irrigation. F—Flood Irrigation.

Adequate Supply: Yes **xx** No..... Explain..... buys stored water

[illegible]

...River Basin

Also in: Plat No.....	Twp.....	Rge.....	Plat No.....	Twp.....	Rge.....	Plat No.....	Twp.....	Rge.....
Plat No.....	Twp.....	Rge.....	Plat No.....	Twp.....	Rge.....	Plat No.....	Twp.....	Rge.....

Information From:

Broderick

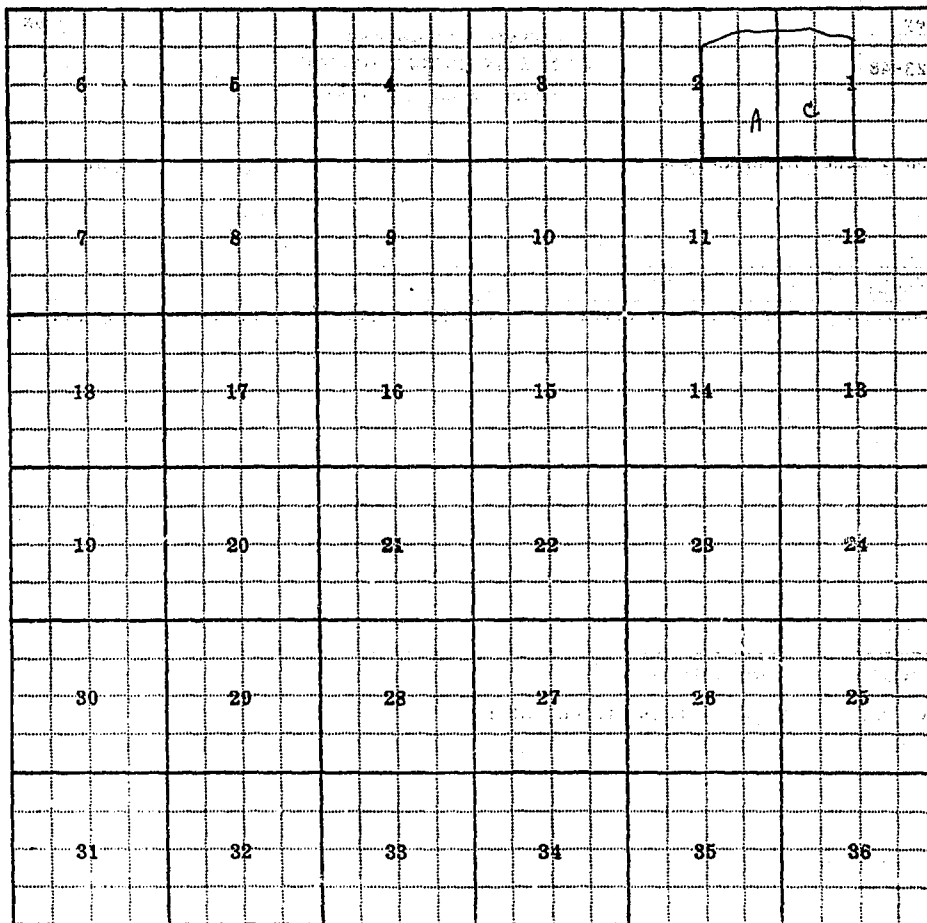

Land Ownership.....

.....

.....

NOTICE
These forms are the
property of the State
of Montana and must
be returned.

STATE OF MONTANA
State Engineer's Office
WATER RESOURCES SURVEY
WATER RIGHT DATA

County Golden Valley
Code No. 1C, 2A

Name of Land Owner John & Ethel Broderson Address Ryegate, Montana
Name of Operator Same Address _____
Legal Description W $\frac{1}{2}$ Sec. 1 and E $\frac{1}{2}$ Sec. 2 So. of R.R., Twp. 6N., Rge. 20E

1. Our records show that the following water rights were filed on the above described land:

Code	Name of Appropriator	Stream	Land Description	Date App.	Date Filed	Miner's Inches Filed On
199	Ethel M. Broderson	Mshl. River	No. of R.R. & South of River included in Lots 3 & 4 and So. of R/W in Lots 5 & 6 of Sec. 1 and Lots 1, 2, 7 Sec. 2 in 6-20	6-1-32	11-1-33	300

2. Are these filings in use: Yes ☒ No. Explain _____

3. Have any of the above filings or any part of them been sold: Yes ☒ No. If yes, give amount of inches sold and to whom transferred and from what original filing _____

4. I have the following water rights that the State Engineer's Office have not shown in the above list:

Name of Appropriator	Stream	Land Description	Date App.	Date Filed	Miner's Inches Filed On
<u>None</u>					

5. In addition, I have an irrigation system on which no recorded filing was ever made.

Name of First User	Date of First Use	Stream	Place of Use

6. Do you buy supplemental water? ☒ Yes ☐ No. If yes, from whom and how many inches, C.F.S., Acre Feet, as the case may be? 60 acre feet from Bear River Basin

7. Give any other information that you think should be included for the protection of your water right _____

Information from John & Ethel Broderson Date Aug 11, 1949

STATE OF MONTANA

State Engineer's Office
WATER RESOURCES SURVEY
FARM MAP

County Golden Valley
Code No. 10, 2A

Twp. 6N. Rge. 20E

Twp. _____ Rge. _____ Ownership covers
Twp. _____ Rge. _____ only irrigated land.
Twp. _____ Rge. _____ All ownership for
dry land not shown.

Name of Land Owner John & Ethel Broderson

Address Ryegate, Montana

Name of Operator Same

Address _____

Legal Description W 1/2 Sec. 1 and E 1/2 Sec. 2 So. of R.R., Twp. 6N., Rge. 20E



Irrigated Land



Non-Irrigated Land



Potential Land Under Existing Facilities

North

Right of way for Broderson Pump Site, dated April 11, 1927

Please check the ownership outline of this land.

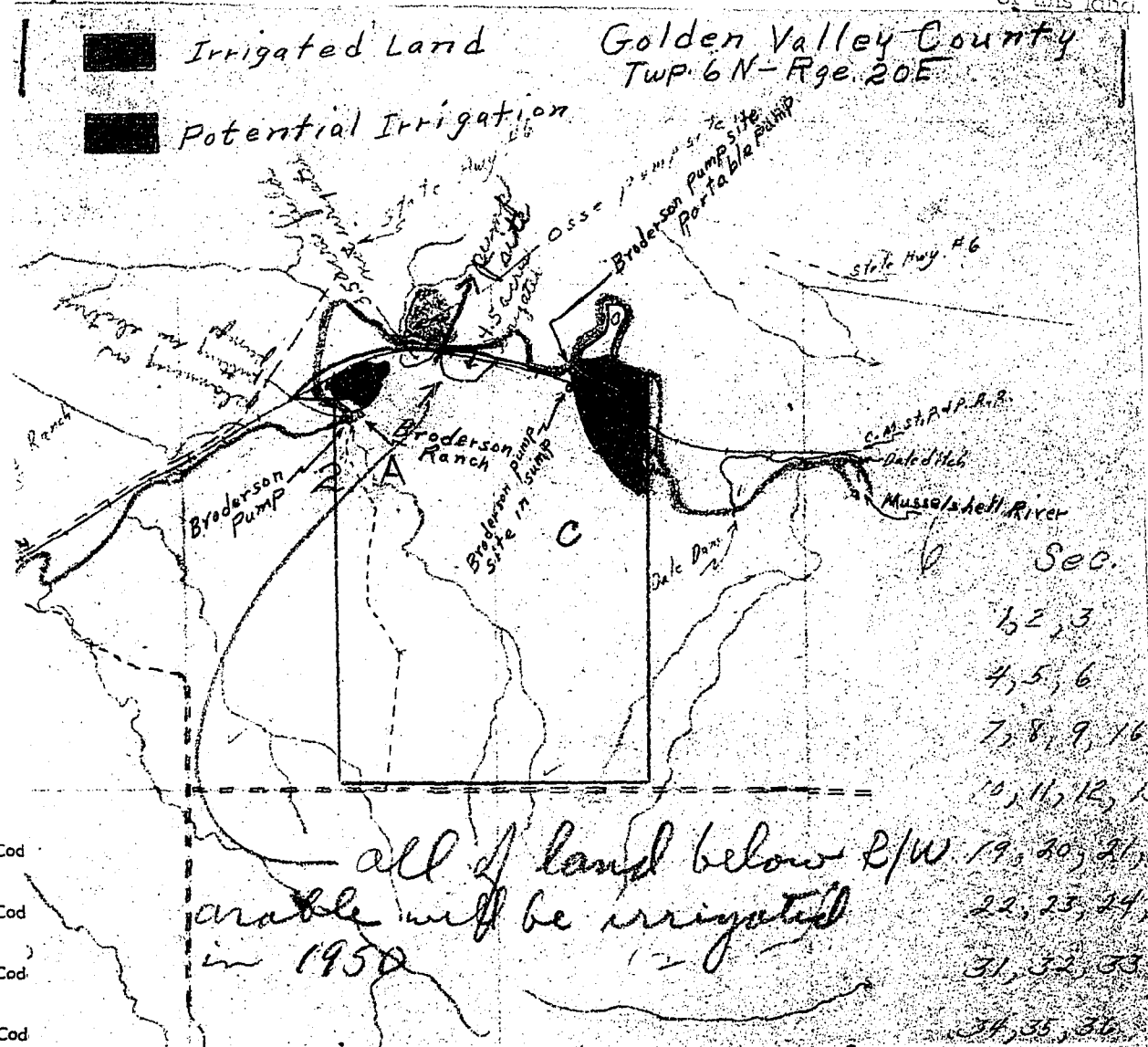

Basin _____ Present _____ Potential _____ Maximum _____ R _____ F _____ P _____ G _____ S _____

If under Ditch Company, Irrigation District, or Government Project, state the number of shares or inches, acre feet, as the case may be in said system.

NOTE: R—Denotes Regular Irrigation. F—Flood Irrigation. P—Water diverted by means of pumping. G—Water diverted by gravity. S—Stored Water.

Information from _____ Date _____

Farm Checked

STATE OF MONTANA

Code No. 2A, 1CBy A.C.P.

STATE ENGINEER'S OFFICE

County Golden ValleyArea Ryegate

WATER RESOURCES SURVEY

T. 6N. R. 20E. Sec. 1, 2Date 6/23/48Photo No. 6-82Legal Land Owner Broderon, John & Ethel M.Address Ryegate

Operator _____

Address _____

Water is delivered by:

Federal Project _____ Pres. _____ Pot. _____

Ditch Company _____ Pres. _____ Pot. _____

Irrigation District _____ Pres. _____ Pot. _____

Private System ☒ Pres. 20 Pot. 26

Totals _____

Flood _____ Pump ☒ Reservoir ☒ Gravity _____Size and Capacity, Pump, etc. parma 6" Tractor power 10' lift

Original Appropriator, Company _____ App. No. _____

Original Appropriator, Private _____ App. No. 199Is the system an extension of another system? Yes _____ No ☒Is all land irrigated from one system? Yes _____ No ☒

(If No, show break down on map)

Source of Water Musselshell R.Acres Irrigated 1948 20.0Potential Acres 26.0 Seeped 0

Explain _____

Condition of System FairAdequate Supply _____ Yes ☒ No _____Explain buys stored waterTopography R. bottomInformation From Broderon

Remarks _____

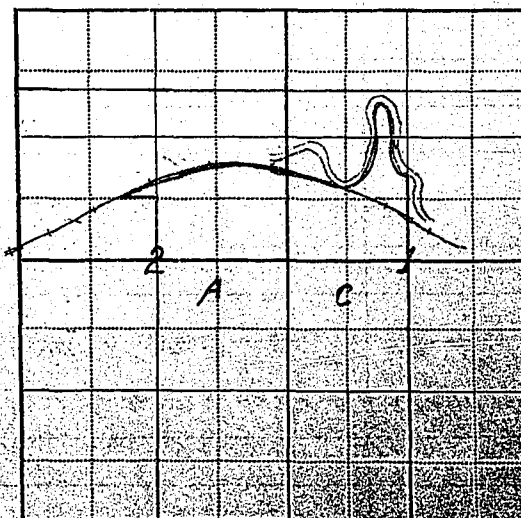

buys 60 A.F. from Basin

leveling field S. of tracks in sec. 1, will try
to pump from sump (now in) if not workable will
put culvert thru R.R. from pump site on N.
side.

STATE ENGINEER'S OFFICE

DIVISION OF HIGHWAYS

April 19, 1949

Mr. John M. Broderson
Ryegate, Montana

Dear Mr. Broderson:

In 1939 the State Legislature passed a law authorizing the State Engineer to investigate and compile a complete record of all water rights and water use in the State. In compliance with this law the State Engineer is now working in Golden Valley County compiling these data.

Enclosed herewith we are sending you two forms. The first one shows the ownership boundary of your land, with the irrigated and potential irrigable area designated by color. We would like to have you check this map very carefully—especially the ownership line which we have shown along the Musselshell River. We think we have this correct but we are not certain.

On the Form WR-A we have listed the one water filing that we have a record of. We would like to know whether or not this is the filing that is being used in relationship to your pumping operation. In addition, we would like to have you complete the remainder of this form so that we may have a complete record of your water rights and water use.

Remember, this is your water and your water rights that we are trying to help you with.

Very truly yours,

Gerald J. Oravets
Assistant State Engineer

GJO/a
enc.

State Engineer's Office

WATER RESOURCES SURVEY

FARM MAP

County Golden Valley

Code No. 102A

T. 6N-R. 20E

Twp. 6N Rge. 20E

Twp. _____ Rge. _____

Twp. _____ Rge. _____

Name of Land Owner Broderick, John & Ethel M. Address Rye Gate

Name of Operator _____ Address _____

Legal Description _____



Irrigated Land



Non-Irrigated Land



Potential Land Under Existing Facilities

North

State Hwy. No. 6

Osse pumpsite

Broderick Pumpsite
(Portable Pump)

C. M. St. P. & P. R. R.

Dale Ditch

Musselshell
River

Dale Dam

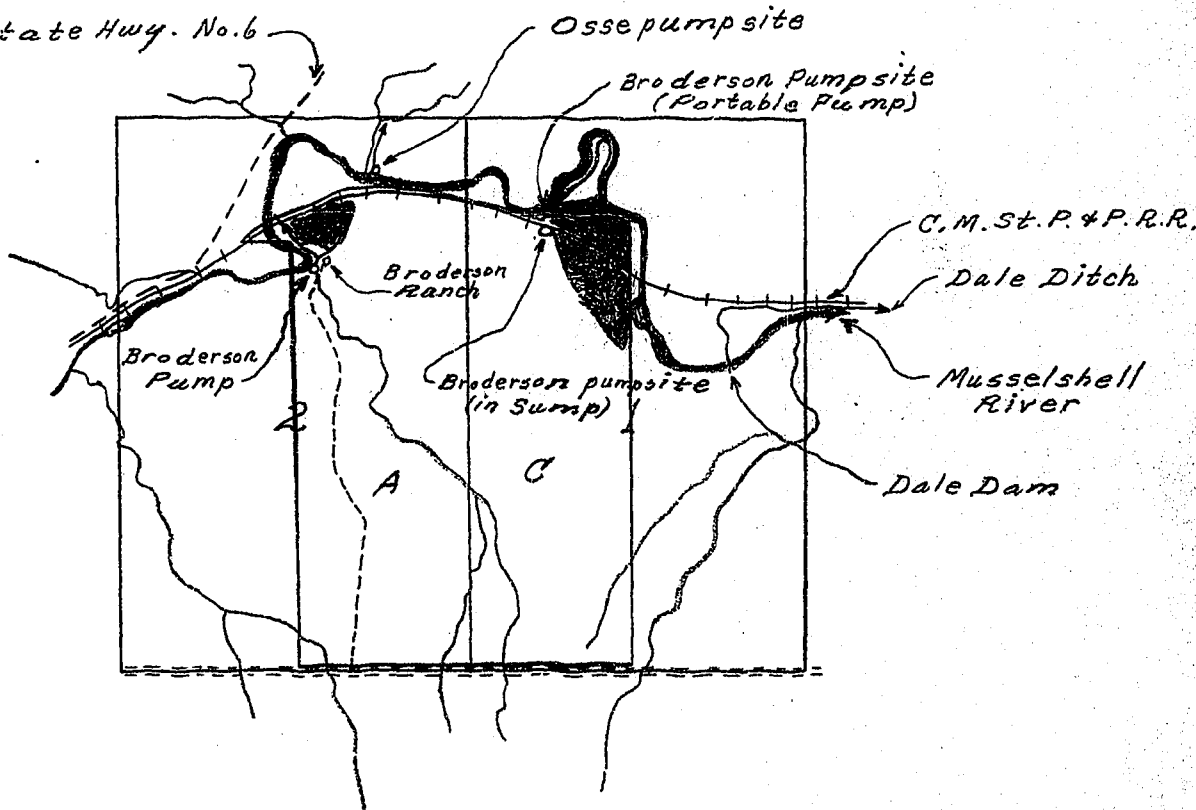

T. 6N-R. 20E

Code No. 102A System Broderick (Pump) Ditch Source of Water Musselshell R.

Basin Musselshell River Present 20.0 Potential 26.0 Maximum 46.0 R. F. P. G. S.

Code No. _____ System _____ Source of Water _____

Basin _____ Present _____ Potential _____ Maximum _____ R. F. P. G. S.

Code No. _____ System _____ Source of Water _____

Basin _____ Present _____ Potential _____ Maximum _____ R. F. P. G. S.

Code No. _____ System _____ Source of Water _____

Basin _____ Present _____ Potential _____ Maximum _____ R. F. P. G. S.

If under Ditch Company, Irrigation District, or Government Project, state the number of shares or inches, acre feet, as the case may be in said system.

NOTE: R—Denotes Regular Irrigation. F—Flood Irrigation. P—Water diverted by means of pumping. G—Water diverted by gravity. S—Stored Water.

Information from H. L. B.

Date 6-14-49

STATE ENGINEERS OFFICE
Water Resources Survey

Notice of Appropriation

1. County Golden Valley Book 3 Page 313 Record WR 199
 (Signature is Ethel Broderson only)
2. Name of Appropriator Ethel M. Broderson Address Ryegate, Mont.
3. Date Appropriated 6-1-32 Date Filed 11-1-33
 Amount Appropriated, Miners Inches 300, Cubic Feet per second 7 1/2
4. Name of Stream Musselshell River Tributary Basin Mo. River
5. Point of Diversion at a point upon its south bank in the NW corner of Lot 7 of Sec. 2-6-20,
where the water is first started by a certain pump drawing the water from the bottom
 Sec. Twp. Rge. Bank of Stream
of said river on to its bank and into said ditch, thence running in a northerly
direction to the R/W of C.M. St. P. & P. Ry. thence east and also on the south of the
bank
(See #9 below)
6. Purpose Irrigate, domestic and other purposes
7. Description of System Pump and ditches, which said ditch is 48" by 30" in size and
carries or conducts 300" or 7 1/2 cu. ft. of water from said river.
8. Land Description of Intended Place of Use
North of the C.M. St. P. & P. Ry. and South of Mshl. River, included in lots 3 & 4
and south of the R/W of said R.R. in Lots 5 & 6 of Sec. 1 and lots 1, 2, & 7 of
Section 2-6-20, and south of the R/W of C.M. St. P. & P. R.R. tracks. (OVER)
9. Remarks (Pertaining to Use, etc.)
said river on the north side of the C.M. St. P. & P. Ry. on Lot 4, Sec. 1-6-20, and into
ditch for said north side.

Decree

10. Case No. Date Amt. Decreed: M. I. C. F. S.
11. To Whom Decreed Address
12. Name of Ditch Maximum Capacity (C. F. S.)
13. Date of Priority Purpose
14. Land Description of Place of Use as Decreed
15. Remarks (Present Use Status, etc.)

Lot 3 North of River

Lot 4 North of Ry. in 1-6-20 - 82 Ac.- Dina Maria Van Der Voort, Hedgesville, Mont.

Lots 5, 6, 11, 12, 13, 14; SW $\frac{1}{4}$;

Lots 4 So. of Ry.- 20 Ac. in 1-6-20

Lot 3 South of River less R/W of 1-6-20 - 427 Ac.- Ethel M. Broderson, Ryegate, Mont.

Lot 7--- Sec. 2-6-20 - 40 Ac.- Ethel Broderson, Ryegate, Mont.

All that part of Govt. Lots 1, 2, 3 lying south of R/W and 1 ac Road North of Ry
in Lot 3 Sec. 2-6-20 - 21 Ac.- $\frac{7}{8}$ Ethel Broderson, Ryegate, Mont.

2-27-35

TO HAVE AND TO HOLD unto the said Ethel M. Broderson, the heirs, assigns and assigns forever, all that part of Govt. Lots 1, 2, 3 lying south of R/W and 1 ac Road North of Ry in Lot 3 Sec. 2-6-20 - 21 Ac. - $\frac{7}{8}$ Ethel Broderson, Ryegate, Mont.

TO HAVE AND TO HOLD unto the said Ethel M. Broderson, the heirs, assigns and assigns forever, all that part of Govt. Lots 1, 2, 3 lying south of R/W and 1 ac Road North of Ry in Lot 3 Sec. 2-6-20 - 21 Ac. - $\frac{7}{8}$ Ethel Broderson, Ryegate, Mont.

TO HAVE AND TO HOLD unto the said Ethel M. Broderson, the heirs, assigns and assigns forever, all that part of Govt. Lots 1, 2, 3 lying south of R/W and 1 ac Road North of Ry in Lot 3 Sec. 2-6-20 - 21 Ac. - $\frac{7}{8}$ Ethel Broderson, Ryegate, Mont.

TO HAVE AND TO HOLD unto the said Ethel M. Broderson, the heirs, assigns and assigns forever, all that part of Govt. Lots 1, 2, 3 lying south of R/W and 1 ac Road North of Ry in Lot 3 Sec. 2-6-20 - 21 Ac. - $\frac{7}{8}$ Ethel Broderson, Ryegate, Mont.

TO HAVE AND TO HOLD unto the said Ethel M. Broderson, the heirs, assigns and assigns forever, all that part of Govt. Lots 1, 2, 3 lying south of R/W and 1 ac Road North of Ry in Lot 3 Sec. 2-6-20 - 21 Ac. - $\frac{7}{8}$ Ethel Broderson, Ryegate, Mont.

Office of the Commissioner

County Golden Valley

Farm Checked: Date 6-23-48

By A.C.J.

Legal Land Owner..... Andrew E. Dale

Operator.....

STATE OF MONTANA
STATE ENGINEERS OFFICE
Water Resources Survey

T. 6N R. 20E Plat No. 23.

Photo No. 6-82, 58

Address Ryegate

Address

Water is delivered by:— (1) Private System; 2. Ditch Company; 3. State Project; 4. Federal Project; 5. Irrigation District

[illegible]

NOTE: R—Denotes Regular Irrigation. F—Flood Irrigation.

Adequate Supply: Yes. **xx** No..... Explain..... buys stored water
Remarks.....

[illegible]

...River Basin

Also in:	Plat No.....	Twp.....	Rge.....	Plat No.....	Twp.....	Rge.....	Plat No.....	Twp.....	Rge.....
	Plat No.....	Twp.....	Rge.....	Plat No.....	Twp.....	Rge.....	Plat No.....	Twp.....	Rge.....

Information From:
A.E. Dale

6	5	4	3	2	1
7	8	9	10	11	12
13	14	15	16	17	18
19	20	21	22	23	24
25	26	27	28	29	30
31	32	33	34	35	36

Land Ownership.....

.....

.....

Form WR-A
Reporter 17392 1M 2-49

NOTICE
These forms are the
property of the State
of Montana and must
be returned.

STATE OF MONTANA
State Engineer's Office
WATER RESOURCES SURVEY
WATER RIGHT DATA

County Golden Valley
Code No. 1A, 5A, 6A, 6B

3/24

Name of Land Owner Andrew E. Dale Address Reigate, Montana
Name of Operator Same Address _____
Legal Description E 1/2 Sec. 1, Twp. 6N., Rge. 20E; All Sec. 6 and Sec. 5 North of R.R., Twp. 6N., Rge. 21E

1. Our records show that the following water rights were filed on the above described land:

Code	Name of Appropriator	Stream	Land Description	Date App.	Date Filed	Miner's Inches Filed On
200	Andrew E. Dale	Mshl. River	Lots 6,7,8 in Sec. 6-6-21	1-22-12	1-23-12	320

2. Are these filings in use:.....Yes.....No. Explain.....

3. Have any of the above filings or any part of them been sold:.....Yes Yes.....No. if yes, give amount of inches sold and to whom transferred and from what original filing.....

4. I have the following water rights that the State Engineer's Office have not shown in the above list:

Name of Appropriator	Stream	Land Description	Date App.	Date Filed	Miner's Inches Filed On
<u>Andrew E. Dale</u>	<u>Fish Creek</u>	<u>Book 5 Page 329</u>	<u>Dec 4-1947</u>	<u>Same</u>	<u>320</u>
<u>State has water out at any dam in</u>					
<u>21</u>					

5. In addition, I have an irrigation system on which no recorded filing was ever made.

Name of First User	Date of First Use	Stream	Place of Use
			<u>Sec 1-2-3-6-7-8-11-12</u>
			<u>Sec 1-Township 6-Range 21</u>

6. Do you buy supplemental water? ☒ Yes. ☐ No. If yes, from whom and how many inches, C.F.S., Acres Feet, as the case may be?
I also have 70 acres. Purchase State water Board at Dickinson
Basin

7. Give any other information that you think should be included for the protection of your water right.....

Information from..... Date.....

Twp. 6N. Rge. 20E Owner up only irrigated land.
Twp. Rge. All ownership for
Twp. Rge. dry land not shown.

State Engineer's Office

WATER RESOURCES SURVEY

FARM MAP

Code No. 1A

Name of Land Owner. Andrew E. Dale Address. Regato, Montana

Name of Operator. Same Address.

Legal Description. E¹/₂ of Sec. 1, Twp. 6N., Rge. 20E



Irrigated Land



Non-Irrigated Land



Potential Land Under Existing Facilities

North

Please check the
ownership outline
of this land.

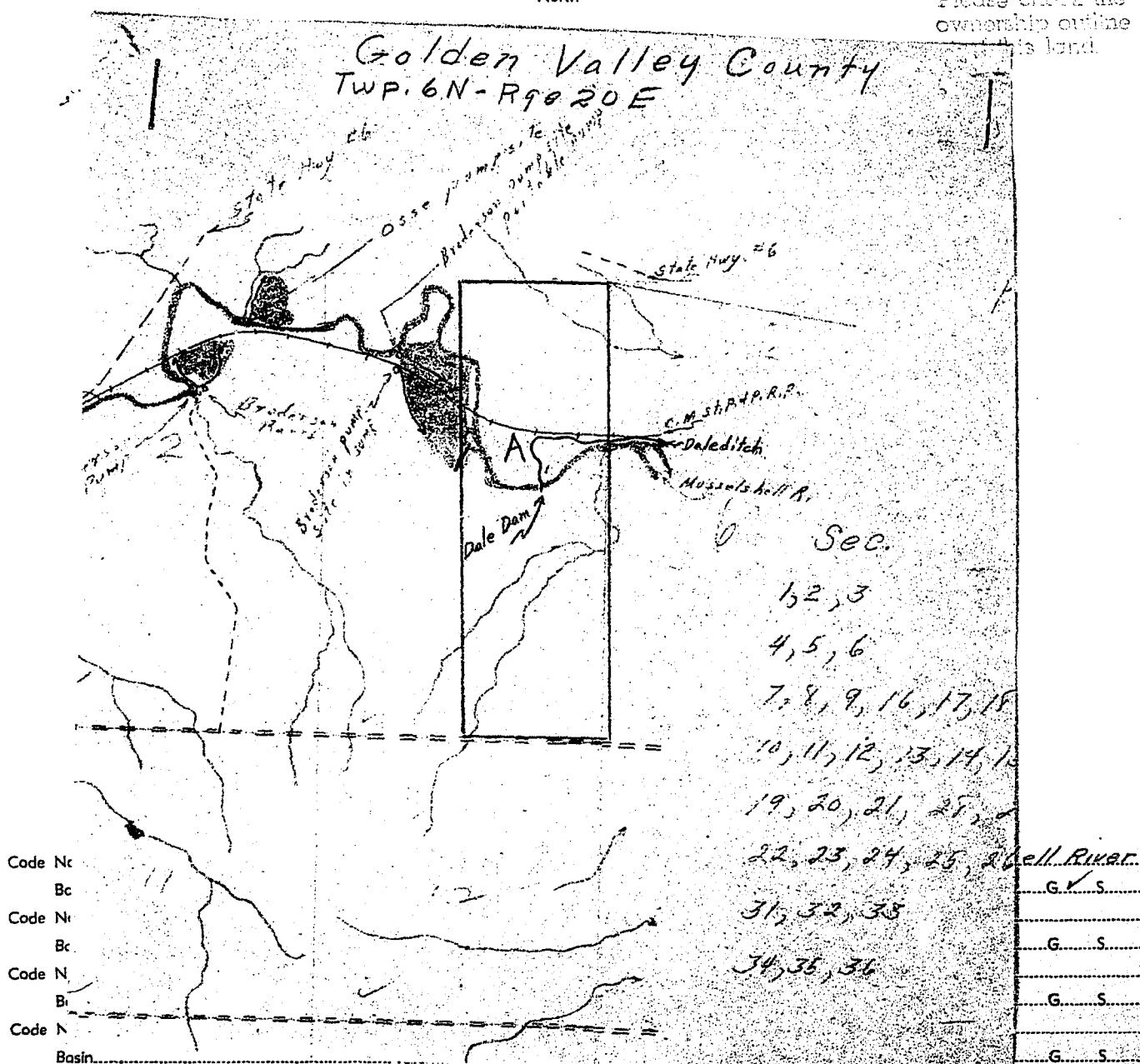

Code No

Bc

Code No

Bc

Code No

Bc

Code No

Bc

Basin

If under Ditch Company, Irrigation District, or Government Project, state the number of shares or inches, acre feet, as the case may be in said system.

NOTE: R—Denotes Regular Irrigation. F—Flood Irrigation. P—Water diverted by means of pumping. G—Water diverted by gravity. S—Stored Water.

Information from H. L. B. Date 6-13-49

Twp. 6N
 Twp.
 Twp.
 Name of Land
 Name of Oper
 Legal Descript

V

ck the
 outline
 land

DO NOT WRITE
IN SPACE BELOW

Code No. 1A T. 6N-R. 20E System Dale Ditch (in this twp) Source of Water Musselshell River
 Basin Musselshell River Present 0 Potential 0 Maximum 0 R ☒ F ☐ P ☐ G ☒ S ☐
 Code No. System Source of Water
 Basin Present Potential Maximum R ☐ F ☐ P ☐ G ☐ S ☐
 Code No. System Source of Water
 Basin Present Potential Maximum R ☐ F ☐ P ☐ G ☐ S ☐
 Code No. System Source of Water
 Basin Present Potential Maximum R ☐ F ☐ P ☐ G ☐ S ☐

If under Ditch Company, Irrigation District, or Government Project, state the number of shares or inches, acre feet as the case may be in said system.

NOTE: R—Denotes Regular Irrigation. F—Flood Irrigation. P—Water diverted by means of pumping. G—Water diverted by gravity. S—Stored Water.

Information from H. L. B. Date 6-13-47

State Engineer's Office

WATER RESOURCES SURVEY

FARM MAP

County Golden Valley

Code No. 5A, 6A, 6B

Twp. 6N. Rge. 21E

Twp. _____ Rge. _____

Twp. _____ Rge. _____

Owning _____
only irrigated land.
All ownership for
dry land not shown.

Name of Land Owner. Andrew E. Dale

Address. Ryegate, Montana

Name of Operator. Same

Address. _____

Legal Description. All Sec. 6 and Sec. 5 North of R.R. in Twp. 6N., Rge. 21E



Irrigated Land



Non-Irrigated Land

North



Potential Land Under Existing Facilities

Please show the
ownership of the land.

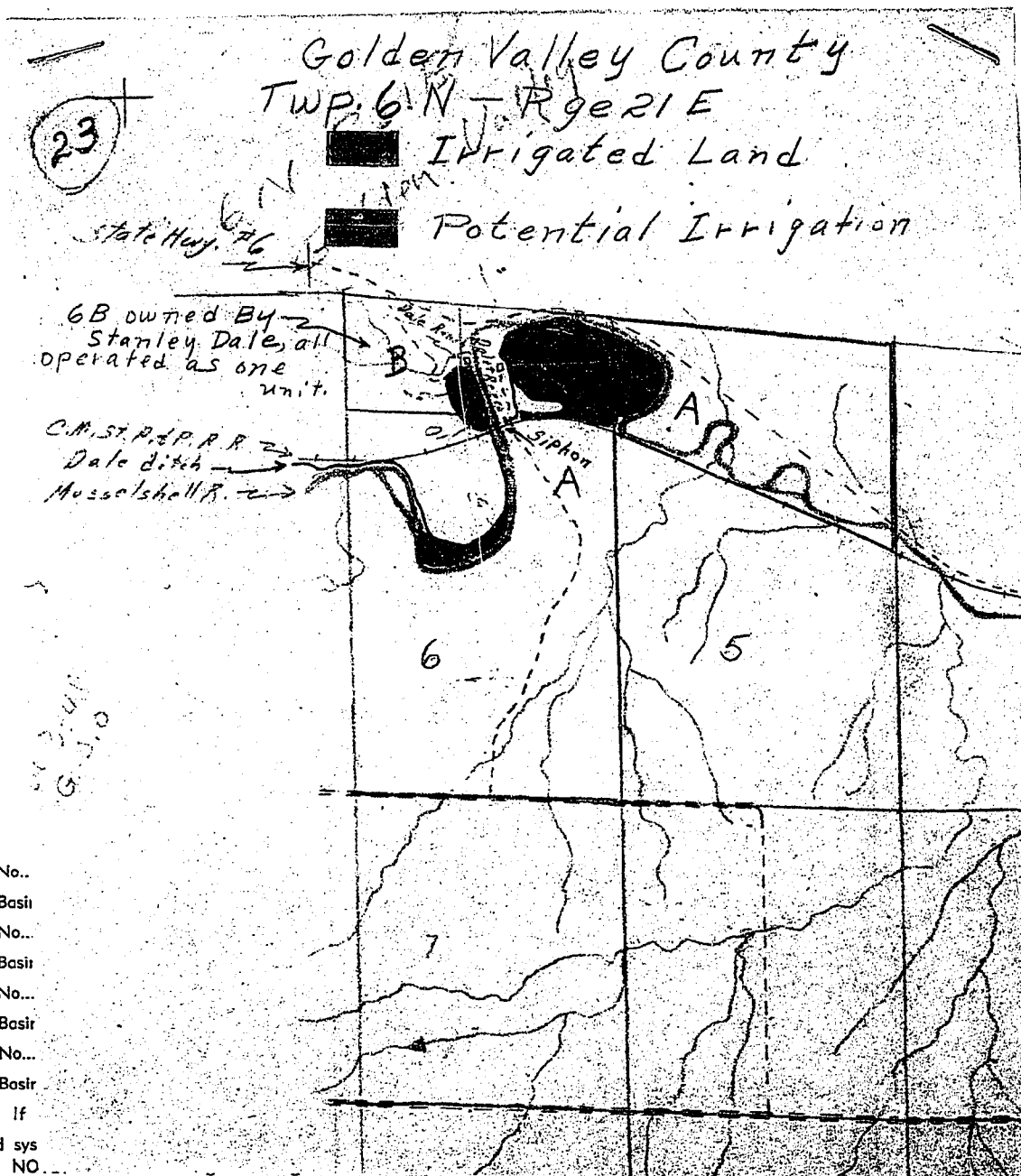

Code No..

Basir

Code No..

Basir

Code No..

Basir

Code No..

Basir

If

in said sys

NO...

S—Stored Water.

Information from

A. L. B.

Date

6-13-49

Tw
Tw
Tw

Name
Name
Legal



6A, 6B

Check the
ship outline
this land.

DO NOT WRITE
IN SPACE BELOW

(Andrew Dale)
Code No. 5A, 6A, T. 6N-R. 21E System Dale Ditch Source of Water Musselshell River
Basin Musselshell River Present 71.0 Potential 35.0 Maximum 106.0 R ☒ F ☐ P ☐ G ☐ S ☐
Code No. 6B (Stanley Dale 3rd) System Dale Ditch Source of Water Musselshell River
Basin Musselshell River Present 5.0 Potential 0 Maximum 5.0 R ☒ F ☐ P ☐ G ☐ S ☐
Code No. _____ System _____ Source of Water _____
Basin _____ Present _____ Potential _____ Maximum _____ R ☐ F ☐ P ☐ G ☐ S ☐
Code No. _____ System _____ Source of Water _____
Basin _____ Present _____ Potential _____ Maximum _____ R ☐ F ☐ P ☐ G ☐ S ☐
If under Ditch Company, Irrigation District, or Government Project, state the number of shares or inches, acre feet, as the case may be
in said system.
NOTE: R—Denotes Regular Irrigation. F—Flood Irrigation. P—Water diverted by means of pumping. G—Water diverted by gravity.
S—Stored Water.
Information from A. L. B. Date 6-13-49

FORM F-1 - GAZETTE 1665-2M.1-4

Code No. 5A, 6A, 6B

County Golden Valley

T. G. N. R. 21E Gr. 6

Photo No. 6-82, 6-5

Address Ryegate

Address _____

Ditch Company _____ Pres. _____ Pot. _____

Irrigation District _____ Pres. _____ Pot. _____

Private System ☒ Pres. 11 Pot. 36 (by f)

Totals_____

Flood _____ Pump _____ Reservoir _____ Gravity _____

Size and Capacity, Pump, etc. _____

Original Appropriator, Company _____ App. No. _____

Original Appropriator, Private Owner App. No. 200

(Show date of appropriation under Remarks)

Is the system an extension of another system? Yes _____ No ✓

Is all land irrigated from one system? Yes ✓ No

(If No, show break down on map)

Source of Water: Musselshell R.

Acres Irrigated 19 48, 71

Potential Acres 35 Seeped 0

Explain By pump

Condition of System Fair

Adequate Supply Yes No

Explain buys stored water

Topography R. 60 Horn

Information From A. E. Dale

Remarks Rock dam put in about 1944

replaces old dam

A large grid of 10 columns and 10 rows. The bottom-right cell (row 10, column 10) is shaded.

buys 70 A.F. from water board
Mr. Dale is Water Master for "Dead Man's
Basin Water Users Assn."

PAUL H. HARRIS, JR.
CIVIL ENGINEER
STATE OF MONTANA

Farm Checked

By A. C. J.Area Slayton

Date _____

Legal Land Owner _____

Operator _____

Water is delivered by:

Federal Project _____ Pres. _____ Pot. _____

Ditch Company _____ Pres. _____ Pot. _____

Irrigation District _____ Pres. _____ Pot. _____

Private System _____ Pres. _____ Pot. _____

Totals _____

Flood _____ Pump _____ Reservoir _____ Gravity _____

Size and Capacity, Pump, etc. _____

Original Appropriator, Company _____ App. No. _____

Original Appropriator, Private _____ App. No. _____

Is the system an extension of another system? Yes _____ No _____

Is all land irrigated from one system? Yes _____ No _____

(If No, show break down on map)

Source of Water _____

Acres Irrigated 19 _____

Potential Acres _____ Seeped _____

Explain _____

Condition of System _____

Adequate Supply _____ Yes _____ No _____

Explain _____

Topography _____

Information From _____

Remarks _____

STATE OF MONTANA
STATE ENGINEER'S OFFICE
 WATER RESOURCES SURVEY

Code No. 5A, 6A, 6BCounty Bolden ValleyT. 6 N. R. 21 E. Sec. 5, 6Photo No. 6-5F, 82

6B owned by Stanley Dale, son of
 Andrew all operated as one unit

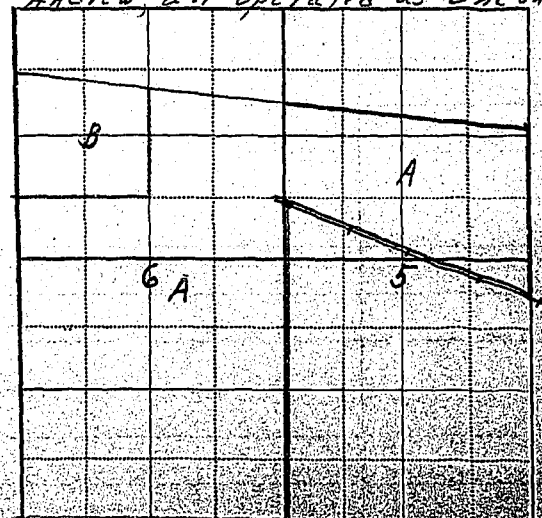

Farm Checked

By

Area

Date

Legal Land Owner

Operator

Water is delivered by:

Federal Project

Pres.

Pot.

Ditch Company

Pres.

Pot.

Irrigation District

Pres.

Pot.

Private System

Pres.

Pot.

Totals

Flood

Pump

Reservoir

Gravity

Size and Capacity, Pump, etc.

Original Appropriator, Company

App. No.

Original Appropriator, Private

App. No.

Is the system an extension of another system?

Yes

No

Is all land irrigated from one system?

Yes

No

(If No, show break down on map)

Source of Water

Acres Irrigated 19

Potential Acres

Seeped

Explain

Condition of System

Adequate Supply

Yes

No

Explain

Topography

Information From

Remarks

STATE OF MONTANA

State Engineer's Office

WATER RESOURCES SURVEY

FORM F-1 REPORTER 1M 3-49 17580

Code No.

County

T

Photo No.

Address

Address

22
22

1A

Golden Valley

6 N. R. 20 E. Sec. 1

Musselshell River

C.M. St. P. & P.R.R.

Dale, dam & ditch

A



STATE OF MONTANA

STATE ENGINEER

FREDE. BUCK, STATE ENGINEER
GERALD J. ORAVETZ, ASSISTANT

BILLINGS, MONTANA

April 19, 1949

Mr. Andrew E. Dale
Ryegate, Montana

Dear Mr. Dale:

In 1939 the State Legislature passed a law authorizing the State Engineer to investigate and compile a complete record of all water rights and water use in the State. In compliance with this law the State Engineer is now working in Golden Valley County compiling these data.

Enclosed herewith we are sending you two forms. One shows the ownership boundary of your land in Twp. 6N., Rge. 20E., and Twp. 6N., Rge. 21E., with the irrigated and irri_able portions designated by color. On the map for Twp. 6N., Rge. 21E., Section 6, you will note that we have marked parcel "B" as being owned by Stanley Dale and operated by you. For this parcel we would like to know whether or not he still owns it, and if so do you operate it at the present time. We would like to have you check these maps very carefully and make any corrections you may deem necessary.

On Form WR-A we have listed the one water right that we have a record of pertaining to these lands. This we would like to have you check also and fill in the remainder of the form, answering the parts that apply to your land.

Very truly yours,

Gerald J. Oravetz
Gerald J. Oravetz
Assistant State Engineer

GJO/a
enc

*enc. Stanley Dale own sat 3-4 As you have it
Stanley Dale and H. E. Dale work this as one unit
Hoping this is OK
H. E. Dale
yours truly*

April 19, 1949

Mr. Andrew E. Dale
Ryegate, Montana

Dear Mr. Dale:

In 1939 the State Legislature passed a law authorizing the State Engineer to investigate and compile a complete record of all water rights and water use in the State. In compliance with this law the State Engineer is now working in Golden Valley County compiling these data.

Enclosed herewith we are sending you two forms. One shows the ownership boundary of your land in Twp. 6N., Rge. 20E., and Twp. 6N., Rge. 21E., with the irrigated and irrigable portions designated by color. On the map for Twp. 6N., Rge. 21E., Section 6, you will note that we have marked parcel "B" as being owned by Stanley Dale and operated by you. For this parcel we would like to know whether or not he still owns it, and if so do you operate it at the present time. We would like to have you check these maps very carefully and make any corrections you may deem necessary.

On Form WR-A we have listed the one water right that we have a record of pertaining to these lands. This we would like to have you check also and fill in the remainder of the form, answering the parts that apply to your land.

Very truly yours,

Gerald J. Oravetz
Assistant State Engineer

GJO/a
enc.

STATE ENGINEERS OFFICE
Water Resources Survey

Notice of Appropriation

1. County G.V. (Mshl) Book 3 (13) Page 172 (32) Record WR 200
2. Name of Appropriator Andrew E. Dale Address Ryegata, Mont.
3. Date Appropriated 1-22-12 Date Filed 1-23-12
Amount Appropriated, Miners Inches 320, Cubic Feet per second 8
4. Name of Stream Mshl. River Tributary _____ Basin Mn. R.
5. Point of Diversion At a point upon its east bank and west bank of said river on th
above described land (See desc. below #8)
Sec. _____ Twp. _____ Rge. _____ Bank of Stream East and west
6. Purpose Irrigating and other purposes
7. Description of System Ditch, which said ditch is _____ by _____ inches in size and carries
or conducts 8 Cu. Ft. of water from said river.
8. Land Description of Intended Place of Use
Lots 6, 7, & 8 in Sec. 6-6-21
Lots 1-2; 5-15 incl.,
S $\frac{1}{2}$ less hiway less min reserve on
Lots 1 and 2 Sec. 6-6-21 - 779 Ac. - Andrew E. Dale, Ryegate, Mont.
9. Remarks (Pertaining to Use, etc.) _____

Decree

10. Case No. _____ Date _____ Amt. Decreed: M. I. _____ C. F. S. _____
11. To Whom Decreed _____ Address _____
12. Name of Ditch _____ Maximum Capacity (C. F. S.) _____
13. Date of Priority _____ Purpose _____
14. Land Description of Place of Use as Decreed _____

15. Remarks (Present Use Status, etc.) _____

State Engineer's Office

WATER RESOURCES SURVEY

FARM MAP

County

Code No.

Twp. 6N Rge. 20E

Twp. Rge.

Twp. Rge.

6TA 18A

Name of Land Owner D. E. & Helen Keefer Address 20

Name of Operator Address

Legal Description



Irrigated Land



Non-Irrigated Land



Potential Land Under Existing Facilities

North

See Master Map in Group 6N-Rge-19E
Folder No. 21

T. 6N-R. 20E

Code No. 6A, 6TA, 6TB System Simms Mutual Ditch Source of Water Musselshell RiverBasin Musselshell River Present 156.0 Potential 0 Maximum 156.0 R ✓ F ✓ P ✓ G ✓ S ✓Code No. 18A System Keefer Ditch Source of Water Side Coulee Trib Fish Cr & SpringsBasin Musselshell River Present 30.0 Potential 28.0 Maximum 58.0 R ✓ F ✓ P ✓ G ✓ S ✓

Code No. System Source of Water

Basin Present Potential Maximum R F P G S

Code No. System Source of Water

Basin Present Potential Maximum R F P G S

It under Ditch Company, Irrigation District, or Government Project, state the number of shares or inches, acre feet, as the case may be in said system.

NOTE: R—Denotes Regular Irrigation. F—Flood Irrigation. P—Water diverted by means of pumping. G—Water diverted by gravity. S—Stored Water.

Information from Date

ntv. Golden Valley

m Checked: Date.....

Hans

STATE OF MONTANA
STATE ENGINEERS OFFICE
Water Resources Survey

T 6N R 20E Plat No.23

Photo No. 6-103

Legal Land Owner. John & Amelia Kinsey Address.

Operator	Address
...	...

Water is delivered by:— 1. Private System; 2. Ditch Company; 3. State Project; 4. Federal Project; 5. Irrigation District

[illegible]

OTE: R—Denotes Regular Irrigation. F—Flood Irrigation.

adequate Supply: Yes** No..... Explain..... system in poor condition.....

Remarks.....

River Basin.

Also in: Plat No.....	Twp.....	Rge.....	Plat No.....	Twp.....	Rge.....	Plat No.....	Twp.....	Rge.....
Plat No.....	Twp.....	Rge.....	Plat No.....	Twp.....	Rge.....	Plat No.....	Twp.....	Rge.....

Information From:
Field Survey

6	5	4	3	2	1
7	8	9	10	11	12
13	14	15	16	17	18
19	20	21	22	23	24
25	26	27	28	29	30
31	32	33	34	35	36

Land Ownership.....

.....

.....

Farm Checked

STATE OF MONTANA

Code No. 5E

By H. L. B.

STATE ENGINEER'S OFFICE

County Golden Valley

Area Pycagote

WATER RESOURCES SURVEY

County Golden Valley

T. 6N R. 20E Sec. 5

Date_____

Photo No. _____

Legal Land Owner Kinsey, John & Amelia Address _____

Operator _____ Address _____

Water is delivered by:

Federal Project _____ Pres. _____ Pot _____

Ditch Company Mutual Sims (Mutual) Ditch Pres. Pot. ☒

Irrigation District _____ Pres. _____ Pot. _____

Private System ☒ Pres. _____ Pot. _____

Totals	
100	100

Flood _____ Pump _____ Reservoir _____ Gravity 

Size and Capacity, Pump, etc. _____

Original Appropriator, Company _____ App. No. _____

Original Appropriator, Private Joseph Sims? App. No. ?

Is the system an extension of another system? Yes. _____ No. _____

Is all land irrigated from one system? Yes_____No_____

(If No, show break down on map)

Source of Water: Musselshell River

Acres Irrigated 19

Potential Acres 1 Seeped

Explain _____

Condition of System PoorAdequate Supply Yes No

Explain System in Poor Condition

Topography Hilling (could be leveled)

Information From Field Survey

Remarks _____

A blank 10x10 grid for graphing, consisting of 10 columns and 10 rows of squares. The grid is used for plotting the graph of the function $y = \sin(x)$ for $0 \leq x \leq 2\pi$.

State Engineer's Office

County Golden Valley

Code No. 5F

Twp. 6N Rge. 20E

Twp. _____ Rge. _____

Twp. _____ Rge. _____

Ownership covers
only irrigated land.
All ownership for
dry land not shown.

WATER RESOURCES SURVEY FARM MAP

Name of Land Owner Hinsey, John & Amelia Address _____

Name of Operator _____ Address _____

Legal Description _____



Irrigated Land



Non-Irrigated Land

North



Potential Land Under Existing Facilities

Please check the
ownership outline
of this land.

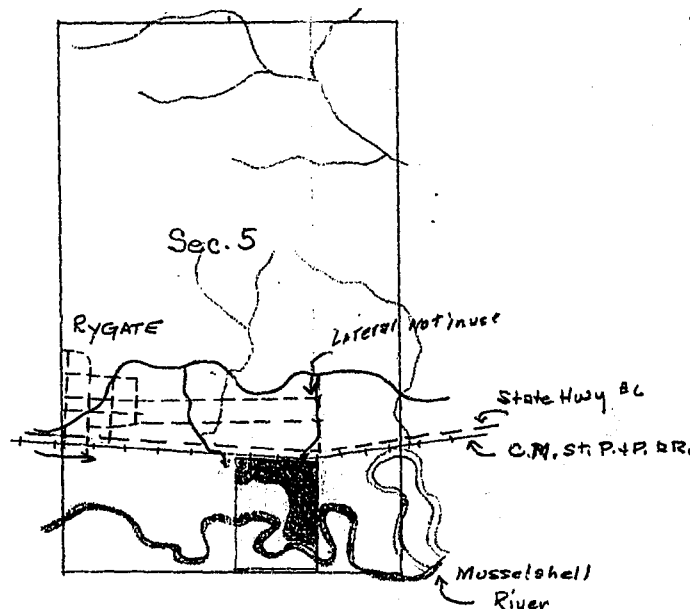

DO NOT WRITE
IN SPACE BELOW

T.6N-R.20E

Code No. <u>5F</u>	System <u>Sims (Mutual) Ditch</u>	Source of Water <u>Musselshell R.</u>
Basin <u>Mshl</u>	Present <u>0</u> Potential <u>14.0</u> Maximum <u>19.0</u>	R <u>✓</u> F <u>✓</u> P <u>✓</u> G <u>✓</u> S <u>✓</u>
Code No. _____	System _____	Source of Water _____
Basin _____	Present _____ Potential _____ Maximum _____	R _____ F _____ P _____ G _____ S _____
Code No. _____	System _____	Source of Water _____
Basin _____	Present _____ Potential _____ Maximum _____	R _____ F _____ P _____ G _____ S _____
Code No. _____	System _____	Source of Water _____
Basin _____	Present _____ Potential _____ Maximum _____	R _____ F _____ P _____ G _____ S _____

If under Ditch Company, Irrigation District, or Government Project, state the number of shares or inches, acre-feet, as the case may be in said system.

NOTE: R—Denotes Regular Irrigation. F—Flood Irrigation. P—Water diverted by means of pumping. G—Water diverted by gravity. S—Stored Water.

Information from H. L. B.

Date 9/22/79

Information From:
Landice

In 1926 the ditch was all filled in and not in use so Ida Sandier and J. B. Gregg cleaned out the ditch and filed on the water right on opp. side. Alex Sandier cleaned out all of the ditch to his place at that time.

This ditch system now not satisfactory as upper users use all water but do not do any maintenance. Which makes hardships all around especially the lower users.

Irrigator about 50 acres in his land and land he leases.

Have had plenty of water in 1948 did not buy any in 1948.

Need to make an arrangement of some kind with people in town.

Ditch system not now organized trays have been made with no attempt.

In 1947 all of ditch cleaned by dray line at cost of 200 dollars.

All users paid in accordance to the number of acres they irrigated.

Had a W.P.A. log dam it is now washed out - Have to have new dam for low water period.

Some seepage in ditch system at times fills basements of homes in Pygate.

Ditch now called Simms Mutual Ditch. ditch originally constructed by Simms - who had owned all of this land.

Form WR-A
Reporter 17382 1M 2-49

These forms are the
property of the State
of Montana and must
be returned.

STATE OF MONTANA

State Engineer's Office

WATER RESOURCES SURVEY

WATER RIGHT DATA

County Golden Valley

Code No. 4B, 4D, 5D

Name of Land Owner Ida Landice Address Bygate, Montana
Name of Operator Alex Landice Address "
Legal Description SW 1/4 Sec. 4, A parcel in the SE 1/4 of Sec. 5 So. of Ditch and No. of R.R., Twp. 6N., Rge. 20E

1. Our records show that the following water rights were filed on the above described land:

Code	Name of Appropriator	Stream	Land Description	Date App.	Date Filed	Miner's Inches Filed On
204	J. B. Gregg and Ida Landice	Mshl. River	E 1/4 SW 1/4, & part NE 1/4 SW 1/4 lying & being North of R.R. in Sec. 4-6-20 Sec. 5 in 6-20 (other description not appurtenant)	6-1-26	5-3-27	1000
<u>Also made old Seins water right.</u>						

2. Are these filings in use? ☒ Yes ☐ No. Explain Now in use

3. Have any of the above filings or any part of them been sold? ☐ Yes ☒ No. If yes, give amount of inches sold and to whom transferred and from what original filing.

4. I have the following water rights that the State Engineer's Office have not shown in the above list:

Name of Appropriator	Stream	Land Description	Date App.	Date Filed	Miner's Inches Filed On

5. In addition, I have an irrigation system on which no recorded filing was ever made.

Name of First User	Date of First Use	Stream	Place of Use
<u>Seins</u>	<u>?</u>	<u>Musand River</u>	

6. Do you buy supplemental water? ☒ Yes ☐ No. If yes, from whom and how many inches, C.F.S., Acre Feet, as the case may be?

40 acre feet from the Water Board.

7. Give any other information that you think should be included for the protection of your water right.

Over

Information from Alex Landice Date May 2, 1949

Form WR-2
Reborter 17362 1st-2-40

STATE OF MONTANA

State Engineer's Office

WATER RESOURCES SURVEY

FARM MAP

County Golden Valley

Code No. 4B, 4D, 5D

Twp. 6N Rge. 20E

Twp. Rge. Ownership

Twp. Rge. only irrigated land

Twp. Rge. All ownership for

Name of Land Owner Ida Landice Address Ryegate, Montana

Name of Operator Alex Landice Address "

Legal Description SW 1/4 Sec. 4, 1/2 parcel in the SE 1/4 of Sec. 5, So. of Ditch and No. of R.R., Twp. 6N., Rge. 20E



Irrigated Land



Non-Irrigated Land

North



Potential Land Under Existing Facilities

Please check the
ownership outline
of this land.

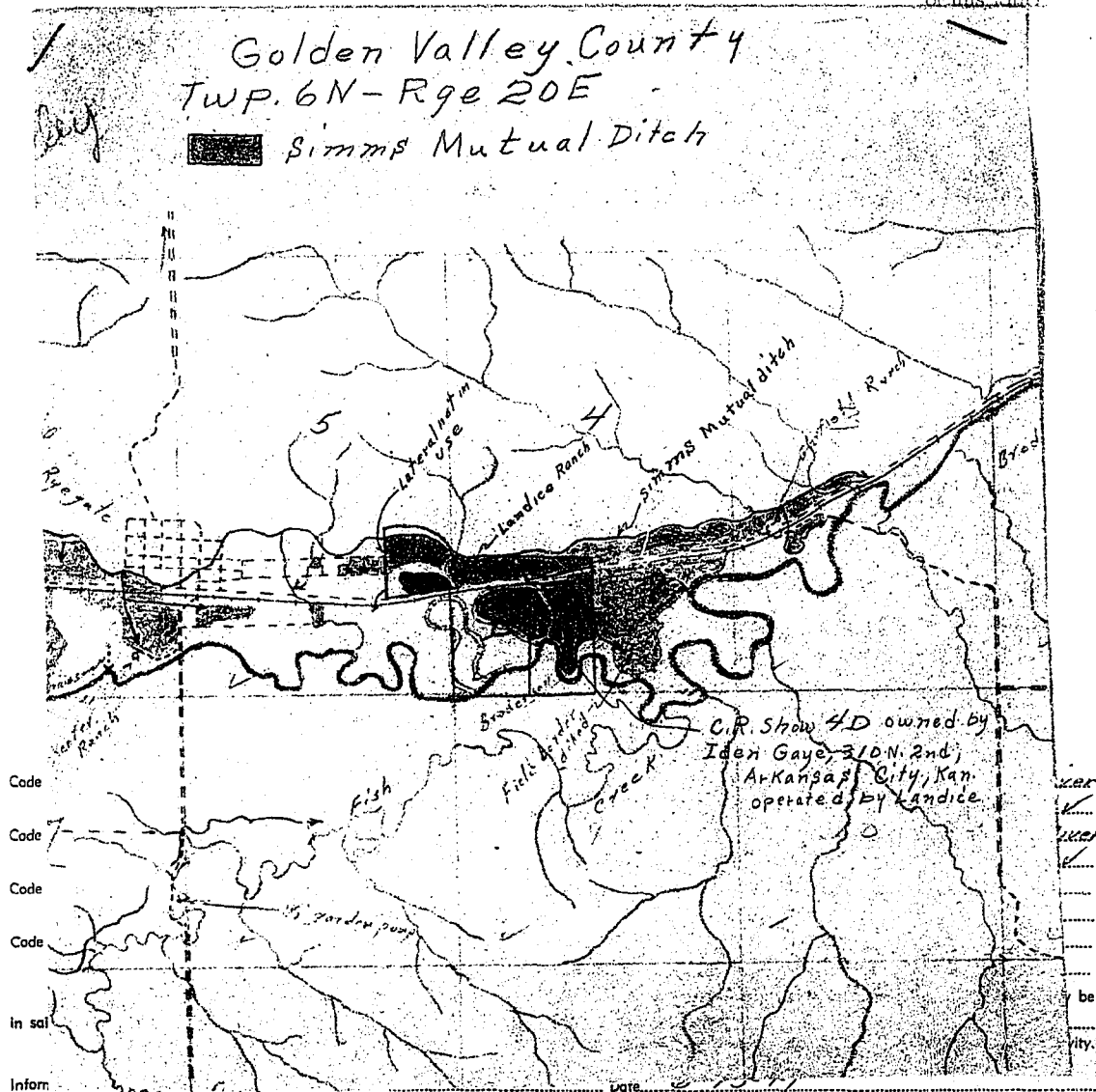

No
No
Let

7

DO NOT WRITE
IN SPACE BELOW.

* Correction for
Potential Acreage

T. 6 N - R. 20 E

Code No. 1-B, 5-D (Idaho) System Simms Mutual Ditch Source of Water Musselshell River
Basin Musselshell River Present 45.0 Potential 20.0 * Maximum 65.0 R. ☒ F. ☐ P. ☐ G. ☒ S. ☒
Code No. 1-D (Idaho) System Simms Mutual Ditch Source of Water Musselshell River
Basin Musselshell River Present 5.0 Potential 30.0 * Maximum 35.0 R. ☒ F. ☐ P. ☐ G. ☒ S. ☒
Code No. _____ System _____ Source of Water _____
Basin _____ Present _____ Potential _____ Maximum _____ R. ☐ F. ☐ P. ☐ G. ☐ S. ☐
Code No. _____ System _____ Source of Water _____
Basin _____ Present _____ Potential _____ Maximum _____ R. ☐ F. ☐ P. ☐ G. ☐ S. ☐

If under Ditch Company, Irrigation District, or Government Project, state the number of shares or inches, acre feet, as the case may be
in said system.

NOTE: R—Denotes Regular Irrigation. F—Flood Irrigation. P—Water diverted by means of pumping. G—Water diverted by gravity.
S—Stored Water.

Information from H. L. B. Date 6-13-49