

[illegible]

Farm Checked

By A-C-S.

Area Ryegate

Date 7/27/48

Legal Land Owner Landice, Alex Ida

Operator Landice, Alex

Water is delivered by:

Federal Project _____ Pres. _____ Pot. _____
Ditch Company Mutual Pres. 2 Pot. _____
Irrigation District _____ Pres. _____ Pot. _____
Private System Simms Ditch Pres. 50.0 Pot. 0
Totals _____
Flood _____ Pump _____ Reservoir ☒ Gravity ☒

Size and Capacity, Pump, etc.

Original Appropriator, Company Simms Ranch App. No. _____

Original Appropriator, Private supplemental thru same ditch App. No. 204
(Show date of appropriation under Remarks)

Is the system an extension of another system? Yes _____ No ☒

Is all land irrigated from one system? Yes ☒ No _____

(If No, show break down on map)

Source of Water Musselshell River

Acres Irrigated 1948 50.0

Potential Acres 0 Seeped 0

Explain _____

Condition of System Fair

Adequate Supply Yes ☒ No _____

Explain buys stored water

Topography Terrace to R. bottom

Information From Landice

Remarks _____

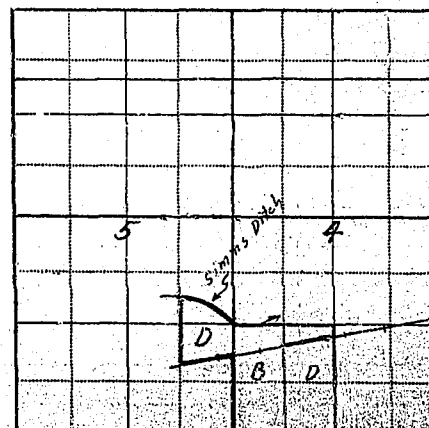

O.R. show 40 owned by Elder Baye, 3101 N. 2nd, Arkansas City, Kan. operated by Landice.

April 19, 1949

Mr. Alex Landice
Ryegate, Montana

Dear Mr. Landice:

In 1939 the State Legislature passed a law authorizing the State Engineer to investigate and compile a complete record of all water rights and water use in the State. In compliance with this law the State Engineer is now working in Golden Valley County compiling these data.

Enclosed herewith we are sending you two forms. The first one shows the ownership boundary of your land, with the irrigated portion colored orange. On this map you will note we have marked Parcel "D" as being owned by Iden Gaye. For this parcel we would like to know whether or not you are operating it or have purchased it.

On Form WR-A we have listed the one water right that we have a record of covering this land. This we would like to have you check, and also fill in the remainder of this form, giving us any and all information you can in regard to the Simms Mutual Ditch.

Remember, this is your water and your water rights that we are trying to help you with.

Very truly yours,

Gerald J. Oravetz
Assistant State Engineer

GJO/a
enc.

STATE ENGINEERS OFFICE
Water Resources Survey

Notice of Appropriation

1. County Golden Valley Book 3 Page 281 Record WR 204
2. Name of Appropriator J. B. Gregg & Ida Landice Address Ryegate, Mont.
3. Date Appropriated 6-1-26 Date Filed 5-3-27
 Amount Appropriated, Miners Inches 1000, Cubic Feet per second 25
4. Name of Stream Mshl. R. & its tributaries Tributary Basin Mo. R.
5. Point of Diversion at a point on its north bank at or near the east line of
Sec. 2 Twp. 6 Rge. 19 Bank of Stream where said line intersects said
Mshl. River, thence runs in an easterly direction north of the right of way of
C.M. St. P. & P. Ry. through Sec. 1-6-19, and across sections 6, 5, 4, 3, all in 6-20;
6. Purpose Irrigation, Domestic, water stock and other purposes.
7. Description of System dam and ditch which said ditch now is of carrying capacity, 8 to 10 ft.
wide at the top and 3 ft. wide at the bottom and 3 or more feet deep in size and carries
and capable of carrying 25 cu. ft. of water from said river
8. Land Description of Intended Place of Use
Lots 9, 10, 11, 12 & 13, Block 1
Lots 7-8 Block 2, Addn. to Ryegate
E 1/4 & part NE 1/4 SW 1/4 lying & being north of C.M. & St. P. Ry. R/W all in 6-20 (OVER)
9. Remarks (Pertaining to Use, etc.)

Decree

10. Case No. _____ Date _____ Amt. Decreed: M. I. _____ C. F. S. _____
11. To Whom Decreed _____ Address _____
12. Name of Ditch _____ Maximum Capacity (C. F. S.) _____
13. Date of Priority _____ Purpose _____
14. Land Description of Place of Use as Decreed _____

15. Remarks (Present Use Status, etc.) _____

and also for the surplus of said waters, if any, to such owners or those in possession of certain lands under the said ditch hereinafter described, as may contribute to the expense, construction, maintenance and up keep, or other expense, and particularly in Sec. 1-6-19 East, and Sections 6-5-4- and 3 in 6-20E., as may come under and susceptible of irrigation under said ditch, and who may apply and pay their share of the said expense and costs.

1940 Owners.

That part of E $\frac{1}{2}$ SW $\frac{1}{4}$ So of Ry 4-6-20 - 68 Ac - Gaye Iden, 310 No. 2nd, Arkansas City, Kansas
All less R/W Sec. 3-6-20 - 985 Ac.- Henton & Johnson, Ryegate, Montana.

Lots 9-10; N $\frac{1}{2}$ of Lots 11-12 of Sec. 5-6-20 - 120 Ac.- Kathlyn Henton, Ryegate, Montana
SE $\frac{1}{4}$ SW $\frac{1}{4}$ less 2 Ac Sec. 5-6-20 -38 Ac.- Sam Clark, Ryegate, Montana
Lot 16, So of Rimrock, all NE $\frac{1}{4}$ SE $\frac{1}{4}$ no of Ry Sec.5-6-20 - 40 Ac- A. C. Myers,
% George P. Arnold, Florence Station, Illinois.

SW $\frac{1}{4}$ SE $\frac{1}{4}$ Sec. 5-6-20 - 40 Ac- First State Bank, Albany, Minn.
That part of Lot 16 No of rim Sec. 5-6-20 - 14 Ac- Kathlyn Henton, Ryegate, Mont.
2 acres adjoining Ryegate Sec. 5-6-20 - 2 Ac.- Sam Clark, Ryegate, Mont.
Lots 1-8 incl. Sec. 5-6-20 -389.96 Ac.- Harry Henton, Ryegate, Mont.
SE $\frac{1}{4}$ SE $\frac{1}{4}$, So.12 Acres of NE $\frac{1}{4}$ SE $\frac{1}{4}$ Sec. 5-6-20 -52.90 Ac- Mrs. J. J. Schladweiler, Ryegate, Mont

Lots 14-15-18; Lot 17 So.of Ry. E $\frac{1}{2}$ SW $\frac{1}{4}$, W $\frac{1}{2}$ SE $\frac{1}{4}$, less R/W Sec.6-6-20 - 286 Ac-
Dan H. Corcoran, Ryegate, Montana
N $\frac{1}{2}$ Lot 9 Sec.6-6-6-20 - 20 Ac.- Laura A. Barta, Ryegate, Montana
Lots 5, 6, 7, 8 - Sec. 6-6-20 - 156 Ac.- Laura A. Barta, Ryegate, Montana
Lots 2, 3, 4 Sec. 6-6-20 - 166.69 Ac.- Laura A. Barta, Ryegate, Montana
Lot 1 Sec. 6-6-20 - 57.56 Ac- G.V. Co.
Lots 10, 11, 12, 13; that part of Lot 17 No of Ry less highway of Sec.6-6-20 -
162 Ac.- R. L. Bruner, Ryegate, Montana

All SE $\frac{1}{4}$ so of Ty; E $\frac{1}{2}$ SW $\frac{1}{4}$, So of Ry Sec.1-16-19 - 194 Ac.- Montana Land Agency,
Great Falls, Montana.
Part of NE $\frac{1}{4}$ SE $\frac{1}{4}$ No of Ry less highway; and So 15.60 Ac of Lot 16 of Sec.1-T.6-19E -
25.85 Ac.- R. L. Bruner, Ryegate, Montana
SW $\frac{1}{4}$ SW $\frac{1}{4}$, that part of NW $\frac{1}{4}$ SW $\frac{1}{4}$ So of Ry Sec.1-6-19 - 55 Ac.- Mrs. Clara C. Card-Skordahl.
Ryegate, Montana
Lots 1 to 15 incl, No 25.40 acres in lot 16; and all No of highway in N $\frac{1}{2}$ SW $\frac{1}{4}$,
and NW $\frac{1}{4}$ SE $\frac{1}{4}$ of 1-6-19 - 712.79 Ac- Federal Land Bank, Spokane, Wash.

OFFICE OF THE ENGINEER
RIVER ENGINEERING OFFICE

6	5	4	3	2	1
7	8	9	10	11	12
13	17	16	15	14	13
19	20	21	22	23	24
30	29	28	27	26	25
31	32	33	34	35	36

Third Hand Addition

Land Ownership.....

.....

.....

County.....Golden Valley.....

Farm Checked: Date 7-27-48

By A.C.J.

STATE OF MONTANA
STATE ENGINEERS OFFICE
Water Resources Survey

T 6N R 20E Plat No. 23

Photo No. 6-103

Legal Land Owner Louis Lundy Address Ryegate

Operator _____ Address _____

Water is delivered by:-- (1) Private System; (2) Ditch Company; 3. State Project; 4. Federal Project; 5. Irrigation District

[illegible]

NOTE: R—Denotes Regular Irrigation. F—Flood Irrigation.

Adequate Supply: Yes..xx.. No..... Explain.....buys stored water
Remarks.....

[illegible]

River Basin

Also in: Plat No.	Twp.	Rge.	Plat No.	Twp.	Rge.	Plat No.	Twp.	Rge.
Plat No.	Twp.	Rge.	Plat No.	Twp.	Rge.	Plat No.	Twp.	Rge.

Information From:

Louis Lundy

This form is the
property of the State
of Montana and must
be returned.

STATE OF MONTANA

State Engineer's Office

WATER RESOURCES SURVEY
WATER RIGHT DATA

County Golden Valley

Code No. Lots 3 to 9

Incl. 13

Name of Land Owner Louis Lundy Address Ryegate, Montana
Name of Operator Same Address _____
Legal Description Lots 3 to 9 inclusive in Third Farm Addition Sec. 5, Twp. 6N., Rge. 20E

We are asking you to help us protect your water right because in our records we are unable to find a recorded water right covering the above described land. We, therefore, would like to have you give us the information asked for in the following questions:

1. Was a water right filing ever made for this land.....Yes.....No. If yes, give us the following information:

Name of Appropriator	Stream	Land Description	Date App.	Date Filed	Miner's Inches Filed On

If no, can you give us the following information:

Name of First User	Date of First Use	Stream	Place of Use

2. Or is this land covered by a water right that was purchased from another water right.....Yes.....No.....

If yes, give us the amount of the inches purchased, from what original filing, and if possible the date of purchase and from whom purchased.

3. If this land is under an incorporated ditch company, mutual ditch company, irrigation district, federal project, or state project, give us the following information:

Name of Ditch System	Shares of Stock	Miner's Inches	Acre Feet	Assessed Acres	Type of System Pumping	Groovy

4. Do you buy supplemental water.....Yes.....No. If yes, from whom and how many inches, Cubic Feet Per Second, Acre Feet, as the case may be?

5. Give any other information that you think should be included for the protection of your water right.....

Information from..... Date.....

Twp. 6N Rge. 20E
Twp. _____ Rge. _____
Twp. _____ Rge. _____

State Engineer's Office
WATER RESOURCES SURVEY
FARM MAP

Name of Land Owner Louis Lundy Address Ryegate
Name of Operator Same Address _____
Legal Description Lots 3 to 9 inclusive in Third Farm Addition Sec. 5, Twp. 6N., Rge. 20E

☒ Irrigated Land ☐ Non-Irrigated Land ☐ Potential Land Under Existing Facilities

Simp Mutual Ditch North

Please show the
ownership outline
of the land.

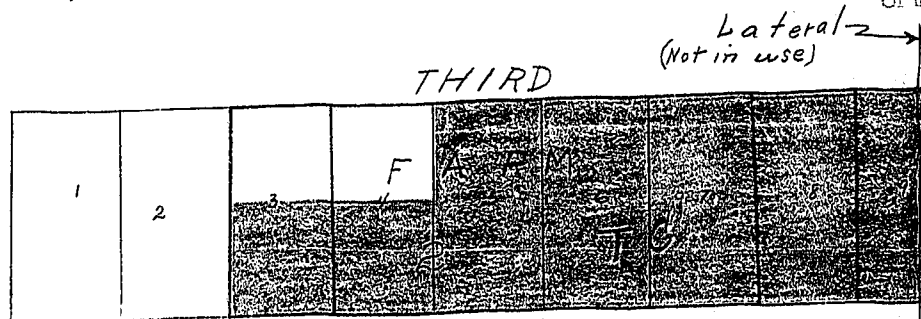

Scale 1"=200ft

DO NOT WRITE
IN SPACE BELOW

Code No. 5TC System Simp Mutual Ditch Source of Water Musselshell River
Basin Musselshell River Present 5.50 Potential 0 Maximum 5.50 R ✓ F ✓ P ✓ G ✓ S ✓
Code No. _____ System _____ Source of Water _____
Basin _____ Present _____ Potential _____ Maximum _____ R _____ F _____ P _____ G _____ S _____
Code No. _____ System _____ Source of Water _____
Basin _____ Present _____ Potential _____ Maximum _____ R _____ F _____ P _____ G _____ S _____
Code No. _____ System _____ Source of Water _____
Basin _____ Present _____ Potential _____ Maximum _____ R _____ F _____ P _____ G _____ S _____

If under Ditch Company, Irrigation District, or Government Project, state the number of shares or inches, acre feet, as the case may be in said system.

NOTE: R—Denotes Regular Irrigation. F—Flood Irrigation. P—Water diverted by means of pumping. G—Water diverted by gravity. S—Stored Water.

Information from A. L. B. Date 6-13-49

22
3

FORM F-1 - GAZETTE 1668-1M-1-47

Farm Checked

STATE OF MONTANA

Code No. 5 TC

By A-C.S.

STATE ENGINEER'S OFFICE

County Golden Valley

Area Ryegate

WATER RESOURCES SURVEY

T. 6N. R. 20E. Sec. 5

Date 7/27/45

Photo No. 6-103

Legal Land Owner Louis Lundy

Address Ryegate

Operator

Address

Water is delivered by:

Federal Project Pres. Pot.

Ditch Company Simms Ditch Pres. 5.50 Pot. 0

Irrigation District Pres. Pot.

Private System ☒ Pres. about 9 Pot.

Totals

Flood Pump Reservoir ☒ Gravity ☒

Size and Capacity, Pump, etc.

Original Appropriator, Company App. No.

Original Appropriator, Private (Show date of appropriation under Remarks) App. No. None shown

Is the system an extension of another system? Yes No ☒

Is all land irrigated from one system? Yes ☒ No

(If No, show break down on map)

Source of Water Musselshell River

Acres Irrigated 1948 5.50

Potential Acres 0 Seeped 0

Explain

Condition of System good

Adequate Supply Yes ☒ No

Explain ster buys stored water

Topography Terrace

Information From Louis Lundy

Remarks

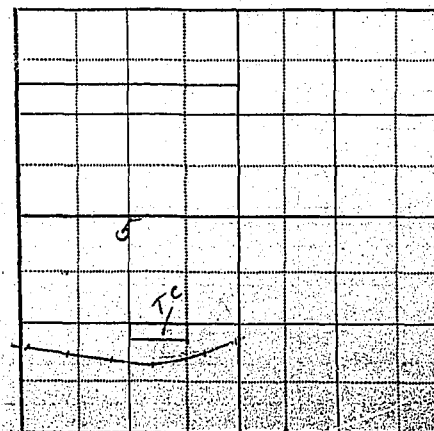



FRED E. BUCK, STATE ENGINEER
GERALD J. ORAVETZ, ASSISTANT

STATE OF MONTANA

STATE ENGINEER

BILLINGS, MONTANA

April 19, 1949

Mr. Louis Lundy
Ryegate, Montana

Dear Mr. Lundy:

In 1939 the State Legislature passed a law authorizing the State Engineer to investigate and compile a complete record of all water rights and water use in the State. In compliance with this law the State Engineer is now working in Golden Valley County compiling these data.

Enclosed herewith we are sending you two forms. The first one shows the ownership boundary of your land, with the lots that we show as irrigated colored in orange. We would like to have you check this map very carefully and make any corrections you may deem necessary.

As we do not have a water right covering this land we are sending you Form WR-D, which we would like to have you fill out in its entirety, and also give us any and all information you can regarding the Simms Mutual Ditch.

Remember, this is your water and your water rights that we are trying to help you with.

Very truly yours,

Gerald J. Oravetz
Gerald J. Oravetz
Assistant State Engineer

GJO/a
enc.

In reference to above letter in regard to water and water rights will say, I have a contract No. 17 for 20 acre feet of water under the Deadman basin project. As far as this Dimes ditch is concerned it was here a long time before I came in possession of this land, and was fixed and cleaned out by the WPA for rehabilitation, before I had my water contract bought, however this land had been irrigated from this ditch in years gone by as the head gate shows. I understand of the others that this ditch was filed on in White Sulphur Springs when this country was in Mahr County. I suppose by since I pay my water to the Musselshell Water Users Assn. at Roundup, Mont.
Louis Lundy

April 19, 1949

Mr. Louis Lundy
Ryegate, Montana

Dear Mr. Lundy:

In 1939 the State Legislature passed a law authorizing the State Engineer to investigate and compile a complete record of all water rights and water use in the State. In compliance with this law the State Engineer is now working in Golden Valley County compiling these data.

Enclosed herewith we are sending you two forms. The first one shows the ownership boundary of your land, with the lots that we show as irrigated colored in orange. We would like to have you check this map very carefully and make any corrections you may deem necessary.

As we do not have a water right covering this land we are sending you Form WR-D, which we would like to have you fill out in its entirety, and also give us any and all information you can regarding the Simms Mutual Ditch.

Remember, this is your water and your water rights that we are trying to help you with.

Very truly yours,

Gerald J. Oravetz
Assistant State Engineer

GJO/a
enc.

County.....Golden Valley

Farm Checked: Date 7-27-48

By A.C.J.

Legal Land Owner..... Aaron, Jacob & Richard McDonald

Operator.....

Water is delivered by:— 1. Private System; 2. Ditch Company; 3. State Project; 4. Federal Project; 5. Irrigation Dis

T 6N R 20E Plat No.

Photo No. 6-103

Address Ryegate

Address.....

[illegible]

NOTE: R—Denotes Regular Irrigation. F—Flood Irrigation.

Adequate Supply: Yes xx No xx Explain stored water available

Remarks.....

...River Basin

Also in: Plat No.....	Twp.....	Rge.....	Plat No.....	Twp.....	Rge.....	Plat No.....	Twp.....	Rge.....
Plat No.....	Twp.....	Rge.....	Plat No.....	Twp.....	Rge.....	Plat No.....	Twp.....	Rge.....

Information From:
Field Survey

6 <i>Black, Red, Yellow</i> □	5	4	3	2	1
7	8	9	10	11	12
13	17	16	15	14	13
19	20	21	22	23	24
30	29	28	27	26	25
31	32	33	34	35	36

Land Ownership _____

NOTICE
The forms are the property of the State of Montana and must be returned.

STATE OF MONTANA

State Engineer's Office

**WATER RESOURCES SURVEY
WATER RIGHT DATA**

County Golden Valley

Code No. See Lots listed below

53

Name of Land Owner Aaron, Jacob, Richard & Levi Address _____
Name of Operator Same McDonald Address Reigate, Montana
Legal Description Lots 1,2,3, South of Sims-McDonald Ditch, and also Lots 4,5,6 in Block 36, Twp. 6N., Rge. 20E

We are asking you to help us protect your water right because in our records we are unable to find a recorded water right covering the above described land. We, therefore, would like to have you give us the information asked for in the following questions:

1. Was a water right filing ever made for this land.....Yes.....No. If yes, give us the following information:

Name of Appropriator	Stream	Land Description	Date App.	Date Filed	Miner's Inches Filled On

If no, can you give us the following information:

Name of First User	Date of First Use	Stream	Place of Use

2. Or is this land covered by a water right that was purchased from another water right.....Yes.....No.....

If yes, give us the amount of the inches purchased, from what original filing, and if possible the date of purchase and from whom purchased.

3. If this land is under an incorporated ditch company, mutual ditch company, irrigation district, federal project, or state project, give us the following information:

Name of Ditch System	Shares of Stock	Miner's Inches	Acre Feet	Assessed Acres	Type of System Pumping Gravity

4. Do you buy supplemental water.....Yes.....No. If yes, from whom and how many inches, Cubic Feet Per Second, Acre Feet, as the case may be?

5. Give any other information that you think should be included for the protection of your water right.....

Information from..... Date.....

Form WR-2
Reporter 17362 1M-2-48

STATE OF MONTANA

County Golden Valley

State Engineer's Office

Code No. 6 TE

WATER RESOURCES SURVEY

FARM MAP

Twp. 6 N Rge. 20 E
Ownership covers
Twp. Rge. only irrigated land,
Twp. Rge. All ownership for
dry land not shown.

Name of Land Owner McDonald, Aaron, Jacob, Richard & Levi Address Rye gate

Name of Operator Same

Legal Description Lots 1, 2, 3, South of Sims Mutual Ditch, and also Lots 4, 5, 6 in Block 36,
Twp. 6N., Rge. 20E



Irrigated Land



Non-Irrigated Land



Potential Land Under Existing Facilities

Please check the
ownership outline
of this land.

Sims Mutual Ditch

Located in Block 36, Sec. 6

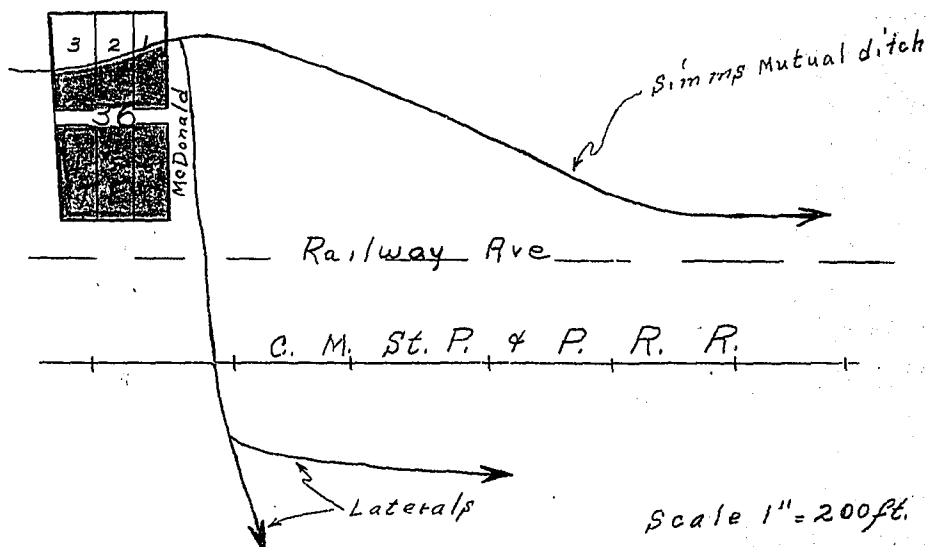

DO NOT WRITE
IN SPACE BELOW

Code No. 6 T.E. T. 6 N. R. 20 E. System Sims Mutual Ditch Source of Water Musselshell River
Basin Musselshell River Present 75 Potential 0 Maximum 25 R. F. P. G. S. V.
Code No. System Potential Maximum R. F. P. G. S.
Basin System Source of Water
Code No. Present Potential Maximum R. F. P. G. S.
Basin System Source of Water
Code No. Present Potential Maximum R. F. P. G. S.
Basin System Source of Water

If under Ditch Company, Irrigation District, or Government Project, state the number of shares or inches, acre feet, as the case may be
in said system.

NOTE: R—Denotes Regular Irrigation. F—Flood Irrigation. P—Water diverted by means of pumping. G—Water diverted by gravity.
S—Stored Water.

Information from H. L. B. Date 6-13-49

53

FORM P-1 - GAZETTE 1965-24-1-47

Farm Checked

STATE OF MONTANA

Code No. 6TE

By A. C. L.

STATE ENGINEER'S OFFICE
WATER RESOURCES SURVEY

County Golden Valley

Area Ryegate

T. 6N R. 20E Sec. 6

Date 7/27/48

Photo No. 6-103

Legal Land Owner McDonald, Aaron, Jacob & Richard Address Ryegate

Operator _____ Address _____

Water is delivered by:

Federal Project _____ Pres. _____ Pot. _____

Ditch Company Simms Mutual Pres. 78 Pot. 0

Irrigation District _____ Pres. _____ Pot. _____

Private System _____ Pres. _____ Pot. _____

Totals _____

Flood _____ Pump _____ Reservoir _____ Gravity ☒

Size and Capacity, Pump, etc. _____

Original Appropriator, Company _____ App. No. _____

Original Appropriator, Private _____ App. No. None Shown

Is the system an extension of another system? Yes _____ No ☒

Is all land irrigated from one system? Yes ☒ No _____

(If No, show break down on map)

Source of Water Musselshell R.

Acres Irrigated 19. 48 78

Potential Acres 0 Seeped 0

Explain _____

Condition of System good

Adequate Supply Yes ☒ No ☒

Explain stored water available

Topography Terrace

Information From field check

Remarks _____

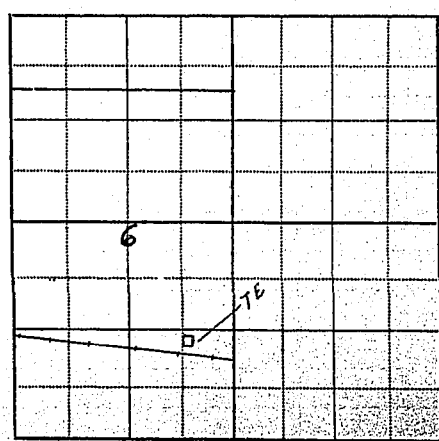

April 19, 1949

Aaron, Jacob & Richard McDonald
Ryegate, Montana

Gentlemen:

In 1939 the State Legislature passed a law authorizing the State Engineer to investigate and compile a complete record of all water rights and water use in the State. In compliance with this law the State Engineer is now working in Golden Valley County compiling these data.

Enclosed herewith we are sending you two forms. The first one shows the ownership boundary of your land, with the lots that we show as irrigated colored in orange. We would like to have you check this map very carefully and make any corrections you may deem necessary.

As we do not have a water right covering this land we are sending you Form WR-D, which we would like to have you fill out in its entirety, and also give us any and all information you can regarding the Simms Mutual Ditch.

Remember, this is your water and your water rights that we are trying to help you with.

Very truly yours,

Gerald J. Oravetz
Assistant State Engineer

GJO/a
enc.

Field Survey

6	<input type="checkbox"/> Saw Mill Lumber Co	4	8	2	1
7	8	9	10	11	12
18	17	16	15	14	13
19	20	21	22	23	24
30	29	28	27	26	25
31	32	33	34	35	36

Land Ownership _____

Farm Checked

By H. L. B.

Area Pyrogate

Date _____

Legal Land Owner McLaren

Operator _____

Water is delivered by:

Federal Project _____ Pres. _____ Pot. _____

(Mutual)
Ditch Company Sims (Mutual) Ditch Pres. ☒ Pot. _____

Irrigation District _____ Pres. _____ Pot. _____

Private System ☒ Pres. _____ Pot. _____

Totals _____

Flood _____ Pump _____ Reservoir _____ Gravity ☒

Size and Capacity, Pump, etc. _____

Original Appropriator, Company _____ App. No. _____

Original Appropriator, Private Joseph Sims ? App. No. ?

Is the system an extension of another system? Yes _____ No _____

Is all land irrigated from one system? Yes _____ No _____

(If No, show break down on map)

Source of Water Musselshell River

Acres Irrigated 19 V

Potential Acres _____ Seeped _____

Explain Irrigated Alfalfa

Condition of System _____

Adequate Supply Yes ☒ No _____

Explain Town lots (Alfalfa Hay)

Topography _____

Information From Field Survey

Remarks _____

STATE OF MONTANA
STATE ENGINEER'S OFFICE
WATER RESOURCES SURVEY

Code No. 5TG

County Golden Valley

T. 6N R. 20E Sec. 5

Photo No. _____

Address _____

Address _____

Form WR-B
Reporter 17302 1M-2-40

STATE OF MONTANA

State Engineer's Office
WATER RESOURCES SURVEY
FARM MAP

County Golden Valley
Code No. 575

Twp. 6N Rge. 20E Ownership covered
only irrigated land.
Twp. _____ Rge. _____ All ownership for
dry land not shown.

Name of Land Owner McLaren

Address _____

Name of Operator _____

Address _____

Legal Description _____



Irrigated Land



Non-Irrigated Land
North



Potential Land Under Existing Facilities

Please check the
ownership outline
of this land.



SIMMS MUTUAL DITCH

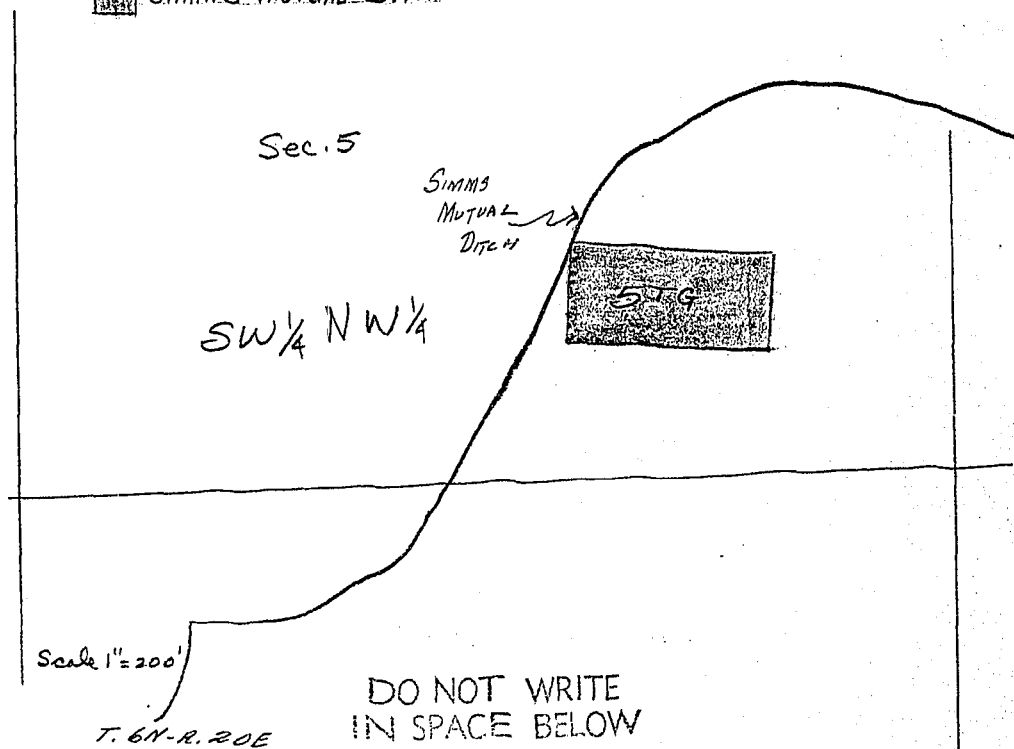

DO NOT WRITE
IN SPACE BELOW

Code No. <u>575</u>	System <u>Simms (Mutual) Ditch</u>	Source of Water <u>Musselshell R</u>
Basin <u>Mshl</u>	Present <u>2.0</u>	Potential <u>0</u> Maximum <u>2.0</u> R <u>✓</u> F <u>✓</u> P <u>✓</u> G <u>✓</u> S <u>✓</u>
Code No. _____	System _____	Source of Water _____
Basin _____	Present _____	Potential _____ Maximum _____ R _____ F _____ P _____ G _____ S _____
Code No. _____	System _____	Source of Water _____
Basin _____	Present _____	Potential _____ Maximum _____ R _____ F _____ P _____ G _____ S _____
Code No. _____	System _____	Source of Water _____
Basin _____	Present _____	Potential _____ Maximum _____ R _____ F _____ P _____ G _____ S _____

If under Ditch Company, Irrigation District, or Government Project, state the number of shares or inches, acre feet, as the case may be in said system.

NOTE: R—Denotes Regular Irrigation. F—Flood Irrigation. P—Water diverted by means of pumping. G—Water diverted by gravity. S—Stored Water.

Information from H. L. B.

Date 6/22/49

County.....Golden Valley.....

Farm Checked: Date 7-27-47

By A.C.J.

Legal Land Owner..... John Milne

Operator.....

STATE OF MONTANA
STATE ENGINEERS OFFICE
Water Resources Survey

T 6N R 20E Plat No. 23

Photo No. 6-103

Address.....Ryegate

Address.

Water is delivered by:— 1. Private System; 2. Ditch Company; 3. State Project; 4. Federal Project; 5. Irrigation District

[illegible]

NOTE: R—Denotes Regular Irrigation. F—Flood Irrigation.

Adequate Supply: Yes xx No xx Explain stored water available

Remarks.

...River Basin.

Also in: Plat No.....	Twp.....	Rge.....	Plat No.....	Twp.....	Rge.....	Plat No.....	Twp.....	Rge.....
Plat No.....	Twp.....	Rge.....	Plat No.....	Twp.....	Rge.....	Plat No.....	Twp.....	Rge.....

Information From:
Field Check

6	7th St SW 1st Ave SW		4	8	2	1
7	8	9	10	11	12	
18	17	16	15	14	13	
19	20	21	22	23	24	
30	29	28	27	26	25	
31	32	33	34	35	36	

Land Ownership _____

Form W-1-D
Reporter 17383 1M 2-45

NOTICE
The forms are the
property of the State
of Montana and must
be returned.

STATE OF MONTANA

State Engineer's Office

WATER RESOURCES SURVEY

WATER RIGHT DATA

County Golden Valley

Code No. 5 TA

T. 6 N - R. 20 E

53

Name of Land Owner John Milne Address Ryegate, Montana
Name of Operator Same Address _____
Legal Description A parcel in the NW 1/4 Sec. 5, Twp. 6N., Rge. 20E

We are asking you to help us protect your water right because in our records we are unable to find a recorded water right covering the above described land. We, therefore, would like to have you give us the information asked for in the following questions:

1. Was a water right filing ever made for this land.....Yes.....No. If yes, give us the following information:

Name of Appropriator	Stream	Land Description	Date App.	Date Filed	Miner's Inches Filed On

If no, can you give us the following information:

Name of First User	Date of First Use	Stream	Place of Use

2. Or is this land covered by a water right that was purchased from another water right.....Yes.....No.....

If yes, give us the amount of the inches purchased, from what original filing, and if possible the date of purchase and from whom purchased.

3. If this land is under an incorporated ditch company, mutual ditch company, irrigation district, federal project, or state project, give us the following information:

Name of Ditch System	Shares of Stock	Miner's Inches	Acre Feet	Assessed Acres	Type of System Pumping Gravity

4. Do you buy supplemental water.....Yes.....No. If yes, from whom and how many inches, Cubic Feet Per Second, Acre Feet, as the case may be?

5. Give any other information that you think should be included for the protection of your water right.....

Information from..... Date.....

Form WR-B
Reporter 17382 1M-2-48

STATE OF MONTANA

State Engineer's Office

WATER RESOURCES SURVEY

FARM MAP

County Golden Valley

Code No. 5TA

Twp. 6N Rge. 20E

Twp. _____ Rge. _____ Ownership covers

Twp. _____ Rge. _____ only irrigated land.

Twp. _____ Rge. _____ All ownership for

Name of Land Owner Milne, John Address Rye gate

Name of Operator Same Address _____

Legal Description A parcel in the NW 1/4 Sec. 5, Twp. 6N., Rge. 20E



Irrigated Land



Non-Irrigated Land



Potential Land Under Existing Facilities

Simms Mutual Ditch

North

Please check the
ownership outline
of this land.

PARK

C. M. St. & P. R. R.

Simms Mutual ditch Lateral



Scale 1" = 200

T. 6N-R. 20E

DO NOT WRITE
IN SPACE BELOW

* Correction in Pat.

Code No.	System	Source of Water
<u>5TA</u>	<u>Simms Mutual Ditch</u>	<u>Musselshell River</u>
Basin	<u>Present</u>	<u>Potential</u>
<u>5.56</u>	<u>3.26</u>	<u>8.82</u>
Code No.	System	Source of Water
Basin	Present	Potential
Code No.	System	Source of Water
Basin	Present	Potential
Code No.	System	Source of Water
Basin	Present	Potential

If under Ditch Company, Irrigation District, or Government Project, state the number of shares or inches, acre feet, as the case may be in said system.

NOTE: R—Denotes Regular Irrigation. F—Flood Irrigation. P—Water diverted by means of pumping. G—Water diverted by gravity. S—Stored Water.

Information from W. L. B. Date 6-13-49

Farm Checked

By A.C.J.

Area Ryegate

Date 7/27/47

Legal Land Owner Milne, John

Operator _____

Water is delivered by:

Federal Project _____ Pres. _____ Pot. _____

Ditch Company Simms Mutual Pres. 5.56 Pot. 0

Irrigation District _____ Pres. _____ Pot. _____

Private System _____ Pres. _____ Pot. _____

Totals _____

Flood _____ Pump _____ Reservoir _____ Gravity ☒

Size and Capacity, Pump, etc. _____

Original Appropriator, Company _____ App. No. _____

Original Appropriator, Private _____ App. No. _____

Is the system an extension of another system? Yes _____ No ☒

Is all land irrigated from one system? Yes ☒ No _____

(If No, show break down on map)

Source of Water Musselshell R.

Acres Irrigated 1948 5.56

Potential Acres 0 Seeped 0

Explain _____

Condition of System good

Adequate Supply Yes ☒ No ☒

Explain stored water available

Topography Terrace

Information From Field check

Remarks _____

STATE OF MONTANA

STATE ENGINEER'S OFFICE

WATER RESOURCES SURVEY

Code No. 5TA

County Golden Valley

T. 6N. R. 20E. Sec. 5

Photo No. 6-103

Address Ryegate

Address _____

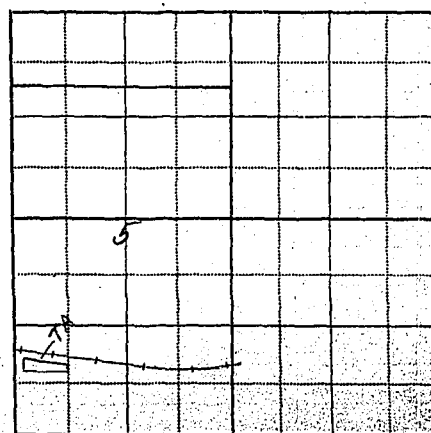

Byegate of 20 49

Gerald F. Stavetz
Billings

Dear Sir:

I received your letter
this A.M. in regard to the water
rights around here. All of this
land has been irrigated from
the Simms former water rights
most of the farmers along
the ditch have bought water
from the Dead man Basin
Every year I have paid my share
of \$10 for cleaning the ditch
I had to clean out my own
ditch to cover the land you
have marked. The culverts &
work cost me \$90 that is a lot
of money to irrigate three acres.
Two weeks ago I had it all leveled
with Harry all cost \$131 with
one

with one thing & another the
land comes high as it was a
wet year. I only used the water
twice. I had intended to buy
5¹/₂ ac feet from the D.M.B. water
last year. I spoke to one engineer
that was in the Court House
He told me there was plenty
of water. You can let me
know about getting the water
D.M.B. the old ditch I use was
old ditch re-surveyed last spring
by engineers from Roundup
up to last year there was more
or less quarreling along the
ditch. As most of the land
holders along the Big ditch have
bought more or less water at
least they all use it when they
can.

Yours very truly

John Milne

Description right

April 19, 1949

Mr. John Milne
Ryegate, Montana

Dear Mr. Milne:

In 1939 the State Legislature passed a law authorizing the State Engineer to investigate and compile a complete record of all water rights and water use in the State. In compliance with this law the State Engineer is now working in Golden Valley County compiling these data.

Enclosed herewith we are sending you two forms. The first one shows the ownership boundary of your land, with the lots that we show as irrigated colored in orange. We would like to have you check this map very carefully and make any corrections you may deem necessary.

As we do not have a water right covering this land we are sending you Form WR-D, which we would like to have you fill out in its entirety, and also give us any and all information you can regarding the Simms Mutual Ditch.

Remember, this is your water and your water rights that we are trying to help you with.

Very truly yours,

Gerald J. Gravetz
Assistant State Engineer

GJO/a
enc.

Farm Checked

By A.C.J.

Area Ryegate

Date 7/27/48

Legal Land Owner Millwaukee RR. & ~~Mont. State of~~

Operator not known

Water is delivered by:

Federal Project _____ Pres. _____ Pot. _____

Ditch Company Simms Ditch Pres. 2.50 Pot. 0

Irrigation District _____ Pres. _____ Pot. _____

Private System _____ Pres. _____ Pot. _____

Totals _____

Flood _____ Pump _____ Reservoir _____ Gravity ☒

Size and Capacity, Pump, etc. _____

Original Appropriator, Company _____ App. No. _____

Original Appropriator, Private _____ App. No. _____

Is the system an extension of another system? Yes _____ No ☒

Is all land irrigated from one system? Yes ☒ No _____

(If No, show break down on map)

Source of Water Musselshell R.

Acres Irrigated 19 48, 2.50

Potential Acres 0 Seeped 0

Explain _____

Condition of System good

Adequate Supply Yes ☒ No ☒

Explain stored water available

Topography Terrace

Information From field check

Remarks _____

STATE OF MONTANA
STATE ENGINEER'S OFFICE
WATER RESOURCES SURVEY

FORM 7-1 - GAZETTE 1938-24-1-42

Code No. 6TF

County Golden Valley

T. 6N. R. 20E. Sec. 6

Photo No. 6-103

Address _____

Address _____

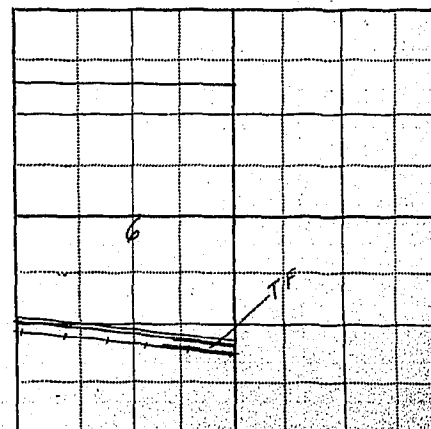

Form WR-3
Reporter 17362 1M-2-49

STATE OF MONTANA

County Golden Valley

State Engineer's Office

Code No. 6TF

Twp. 6N Rge. 20E Ownership covers
Twp. Rge. only irrigated land,
Twp. Rge. All ownership for
dry land not shown.

WATER RESOURCES SURVEY FARM MAP

Name of Land Owner Millwaukee, R.R. or Mont. State of

Name of Operator Not Known Address

Legal Description R.R. Right of Way in Sec. 6, Twp. 6N., Rge. 20E



Irrigated Land



Non-Irrigated Land



Potential Land Under Existing Facilities

Simms Mutual Ditch

North

Please check the
ownership outline
of this land.

Railroad Right of Way, Sec. 6

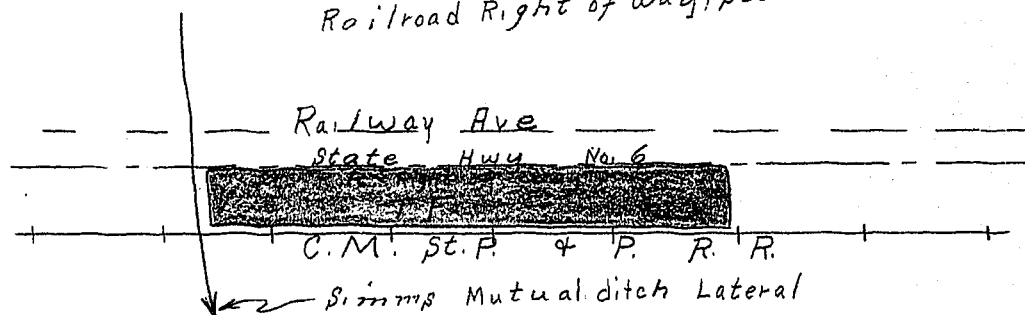

Scale 1" = 200ft.

DO NOT WRITE
IN SPACE BELOW

T. 6N-R. 20E
Code No. 6TF System Simms Mutual Ditch Source of Water Musselshell R.
Basin Musselshell River Present 2.50 Potential 0 Maximum 2.50 R. F. P. G. S. V.
Code No. System Source of Water
Basin Present Potential Maximum R. F. P. G. S.
Code No. System Source of Water
Basin Present Potential Maximum R. F. P. G. S.
Code No. System Source of Water
Basin Present Potential Maximum R. F. P. G. S.

If under Ditch Company, Irrigation District, or Government Project, state the number of shares or inches, acre feet, as the case may be in said system.

NOTE: R—Denotes Regular Irrigation. F—Flood Irrigation. P—Water diverted by means of pumping. G—Water diverted by gravity. S—Stored Water.

Information from W. L. B.

Date 6-13-49

County.....Golden Valley.....

Farm Checked: Date 7-27-48

By A. C. J.

Legal Land Owner.....Earl Osse

Operator.

Water is delivered by:— 1. Private System;

STATE OF MONTANA
STATE ENGINEERS OFFICE
Water Resources Survey

T 6N R 20E Plat No. 2

Photo No. 6-103

Address..... Ryegate

Address.

3. State Project;

4. Federal Project;

5. Irrigation Dist

[illegible]

NOTE: R—Denotes Regular Irrigation. F—Flood Irrigation.

Adequate Supply: Yes ☒ No ☒ Explain stored water available

Remarks.

...River Basin.

Also in: Plat No.....	Twp.....	Rge.....	Plat No.....	Twp.....	Rge.....	Plat No.....	Twp.....	Rge.....
Plat No.....	Twp.....	Rge.....	Plat No.....	Twp.....	Rge.....	Plat No.....	Twp.....	Rge.....

Information From:

Mrs. Osse

Land Ownership _____

These forms are the
property of the State
of Montana and must
be returned.

STATE OF MONTANA

State Engineer's Office

WATER RESOURCES SURVEY

WATER RIGHT DATA

County Golden Valley

Code No. 5 TB

Name of Land Owner Earl Osse Address Ryegate, Montana
Name of Operator Same Address _____
Legal Description Portion of NE 1/4 SW 1/4 and SE 1/4 SW 1/4 Sec. 5, Twp. 6N., Rge. 20E

We are asking you to help us protect your water right because in our records we are unable to find a recorded water right covering the above described land. We, therefore, would like to have you give us the information asked for in the following questions:

1. Was a water right filing ever made for this land.....Yes.....No. If yes, give us the following information:

Name of Appropriator	Stream	Land Description	Date App.	Date Filed	Miner's Inches Filed On

If no, can you give us the following information:

Name of First User	Date of First Use	Stream	Place of Use
<u>Joseph L. Linn</u>	<u>1893</u>		

2. Or is this land covered by a water right that was purchased from another water right.....Yes.....No X
If yes, give us the amount of the inches purchased, from what original filing, and if possible the date of purchase and from whom purchased.

3. If this land is under an incorporated ditch company, mutual ditch company, irrigation district, federal project, or state project, give us the following information: Mutual

Name of Ditch System	Shares of Stock	Miner's Inches	Acre Feet	Assessed Acres	Type of System Pumping Gravity
<u>No Name</u>					

4. Do you buy supplemental water.....X.....Yes.....No. If yes, from whom and how many Inches, Cubic Feet Per Second, Acre Feet, as the case may be?

5. Give any other information that you think should be included for the protection of your water right.
I irrigate 2 acres from the Mutual Ditch

Information from Earl Osse Date 4-23-49

Golden Valley County
Twp. 6 N - Rge. 20 E

■ Simms Mutual Ditch

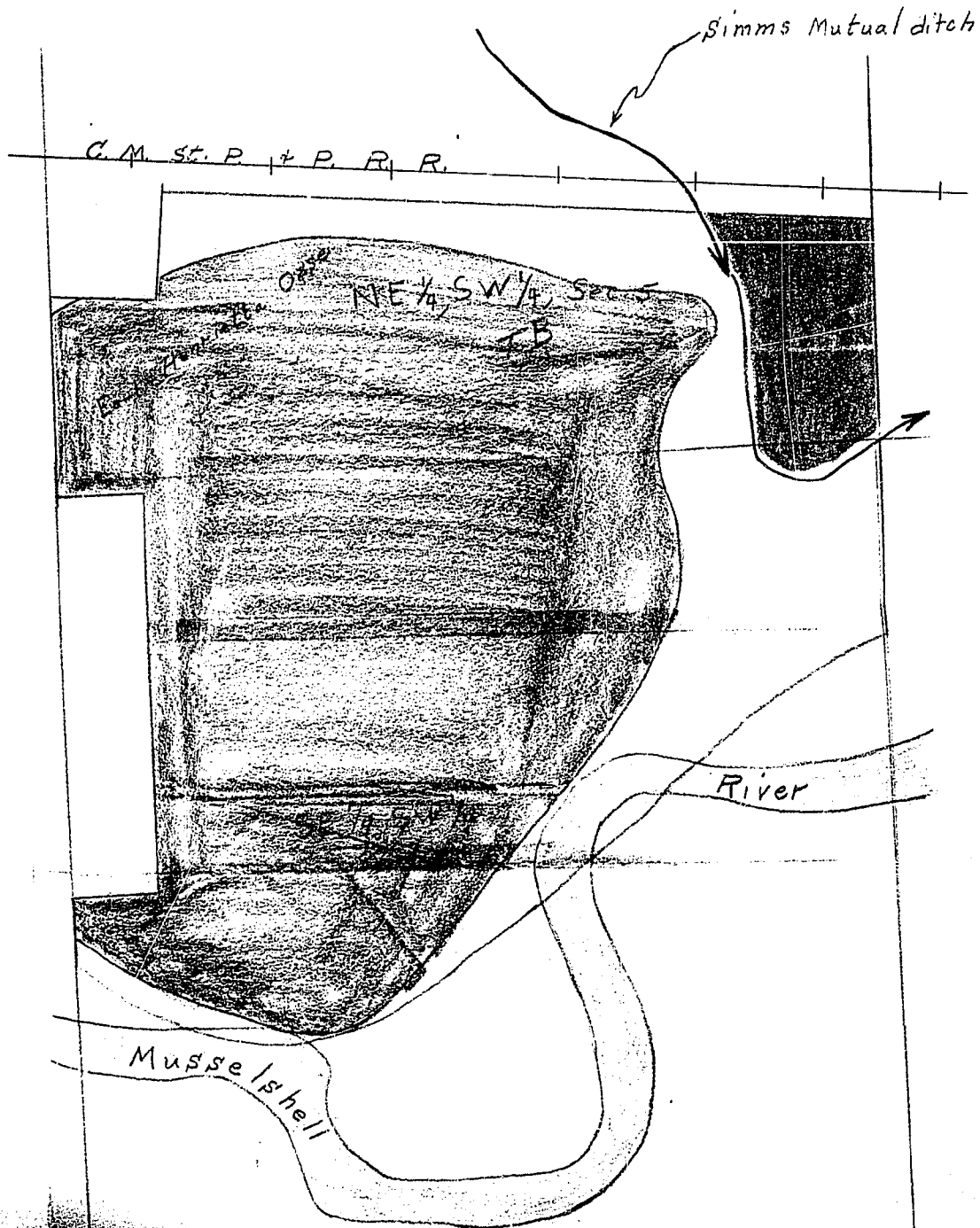

Scale 1" = 200

Form WR-2
Reporter 17322 124-2-49

STATE OF MONTANA

County Golden Valley

Twp. 6N Rge. 20E

State Engineer's Office

Code No. 5 TB

Ownership covers
Twp. Rge. only irrigated land.
Twp. Rge. All ownership for
dry land not shown.

**WATER RESOURCES SURVEY
FARM MAP**

Name of Land Owner Earl Osse Address Ryegate, Montana

Name of Operator Same Address _____

Legal Description Portion of NE 1/4 SW 1/4 AND SE 1/4 SW 1/4 Sec. 5, Twp. 6N., Rge. 20E



Irrigated Land



Non-Irrigated Land
North



Potential Land Under Existing Facilities

Please check the
ownership outline
of this land.

DO NOT WRITE
IN SPACE BELOW

* Correction for
Potential Acreage

T. 6N-R. 20E

Code No. 5 TB System Simms Mutual Ditch Source of Water Musselshell R.
Basin Musselshell River Present 1.64 Potential 23.0 Maximum 24.64 R. F. P. G. S. V. K
Code No. _____ System _____ Source of Water _____
Basin _____ Present _____ Potential _____ Maximum _____ R. F. P. G. S.
Code No. _____ System _____ Source of Water _____
Basin _____ Present _____ Potential _____ Maximum _____ R. F. P. G. S.
Code No. _____ System _____ Source of Water _____
Basin _____ Present _____ Potential _____ Maximum _____ R. F. P. G. S.

If under Ditch Company, Irrigation District, or Government Project, state the number of shares or inches, acre feet, as the case may be in said system.

NOTE: R—Denotes Regular Irrigation. F—Flood Irrigation. P—Water diverted by means of pumping. G—Water diverted by gravity. S—Stored Water.

Information from W. P. B. Date 6-13-49

Farm Checked

STATE OF MONTANA

FORM F-1 - GAZETTE (659-28-1-47)

By A-G-J

STATE ENGINEER'S OFFICE
WATER RESOURCES SURVEY

Code No. 57B

Area Ryegate

County Golden Valley

Date 7/27/48

T. 6N. R. 20E. Sec. 5

Photo No. C-103

Legal Land Owner O. S. S. Co., Earl Address Ryegate

Operator _____ Address _____

Water is delivered by:

Federal Project _____ Pres. _____ Pot. _____

Ditch Company Simms Ditch Pres. 7.64 Pot. 0

Irrigation District _____ Pres. _____ Pot. _____

Private System _____ Pres. _____ Pot. _____

Totals _____

Flood _____ Pump _____ Reservoir _____ Gravity ☒

Size and Capacity, Pump, etc. _____

Original Appropriator, Company _____ App. No. _____

Original Appropriator, Private _____ (Show date of appropriation under Remarks) App. No. _____

Is the system an extension of another system? Yes _____ No ☒

Is all land irrigated from one system? Yes ☒ No _____

(If No, show break down on map)

Source of Water Musselshell, River

Acres Irrigated 19 48 1.64

Potential Acres 0 Seeped 0

Explain _____

Condition of System good

Adequate Supply _____ Yes ☒ No ☒

Explain stored water available

Topography Terrace

Information From Mrs. O. S. S.

Remarks _____

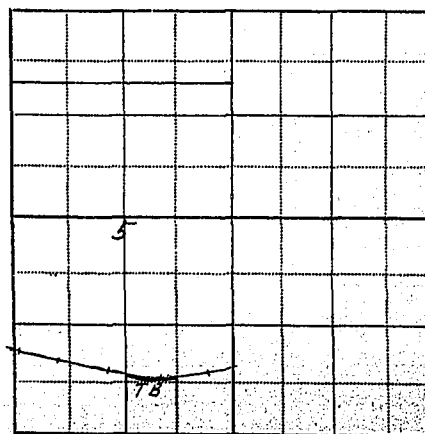

This water Right was filed in Meagher County by one Joseph Simms in or about 1893--when we were later embraced within Yellowstone, Fergus and Musselshell Counties.

No transcript was made of this record so when Golden Valley County was created, there was no County record. An action was as instituted in about 1913 or 1914 in the District Court. It was appealed and then restored and it was held to be a valid ditch as to receive water when available.

Simms sold to the Enterprise Land Co. who in turn sold to Whurlock and Whurlock who sold this land, under this ditch, in parcels, and their conveyance allocated 1/1500 of the water right--to this land conveyed to each acre sold that was then irrigated or susceptible of irrigation.

April 19, 1949

Mr. Earl Osse
Ryegate, Montana

Dear Mr. Osse:

In 1939 the State Legislature passed a law authorizing the State Engineer to investigate and compile a complete record of all water rights and water use in the State. In compliance with this law the State Engineer is now working in Golden Valley County compiling these data.

Enclosed herewith we are sending you two forms. One shows the ownership boundary of your land, with the irrigated portion colored orange. We would like to have you check this map very carefully and make any corrections that you may deem necessary.

As we do not have a record of any water rights covering this land we are sending you Form WR-D, which we would like to have you fill out in its entirety, answering any parts that pertain to your land. In addition, we would like to have you give us any information you can regarding the Simms Mutual Ditch.

Remember, this is your water and your water rights that we are trying to help you with.

Very truly yours,

Gerald J. Oravetz
Assistant State Engineer

GJO/a
enc.

Plot 23, 24 to 1, 2, 7, 8, 9, 10, 11, 12

1	2	3	4	5	6	7	8	9	10	11	12
13	14	15	16	17	18	19	20	21	22	23	24
25	26	27	28	29	30	31	32	33	34	35	36

Land Ownership _____

NOTICE
TAKEN forms are the
property of the State
of Montana and must
be returned.

STATE OF MONTANA
State Engineer's Office
WATER RESOURCES SURVEY
WATER RIGHT DATA

County Golden Valley
Code No. See lots listed
below

T. 6N-R. 20E

23

Name of Land Owner Harry I. Reimers Address Ryegate, Montana
Name of Operator Same Address _____
Legal Description Lots 1 & 2 South of Sims Mutual Ditch; Lots 7, 8, 9, 10, 11, 12 in Block 23,
Twp. 6N., Rge. 20E

We are asking you to help us protect your water right because in our records we are unable to find a recorded water right covering the above described land. We, therefore, would like to have you give us the information asked for in the following questions:

1. Was a water right filing ever made for this land.....Yes.....No. If yes, give us the following information:

Name of Appropriator	Stream	Land Description	Date App.	Date Filed	Miner's Inches Filed On

If no, can you give us the following information:

Name of First User	Date of First Use	Stream	Place of Use

2. Or is this land covered by a water right that was purchased from another water right.....Yes.....No.....

If yes, give us the amount of the inches purchased, from what original filing, and if possible the date of purchase and from whom purchased.

3. If this land is under an incorporated ditch company, mutual ditch company, irrigation district, federal project, or state project, give us the following information:

Name of Ditch System	Shares of Stock	Miner's Inches	Acre Feet	Assessed Acres	Type of System Pumping Gravity

4. Do you buy supplemental water.....Yes.....No. If yes, from whom and how many inches, Cubic Feet Per Second, Acre Feet, as the case may be?

5. Give any other information that you think should be included for the protection of your water right.....

Information from _____ Date _____

State Engineer's Office

WATER RESOURCES SURVEY

FARM MAP

County Golden Valley

Code No. 6 TD

Twp. 6N Rge. 20E

Twp. _____ Rge. _____

Twp. _____ Rge. _____

Ownership cover
only irrigated land.
All ownership for
dry land not shown.

Name of Land Owner Reimers, Harry T. Address Ryegate

Name of Operator Same Address _____

Legal Description Lots 1 & 2 south of Simms Mutual Ditch; Lots 7, 8, 9, 10, 11, 12 in Block 23,
4 Lots 5 & 6 south of ditch

Twp. 6N, Rge. 20E



Irrigated Land



Non-Irrigated Land



Potential Land Under Existing Facilities

Simms Mutual Ditch

North

Please check the
ownership outline
of this land.

Located in Block 23, Sec. 6

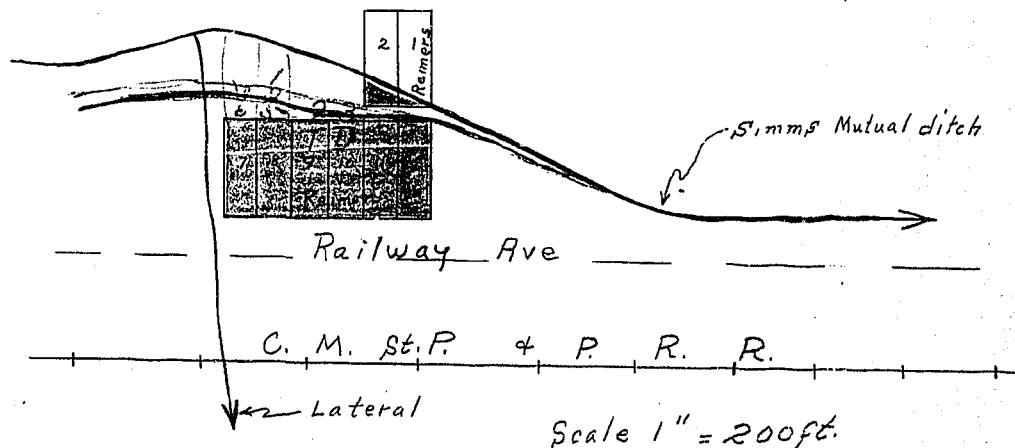

DO NOT WRITE
IN SPACE BELOW

Code No. 6 TD, T. 6 N. - R. 20 E. System Simms Mutual Ditch Source of Water Musselshell River
Basin Musselshell River Present 1.16 Potential 0 Maximum 1.16 R. F. P. G. S. ✓
Code No. _____ System _____ Source of Water _____
Basin _____ Present _____ Potential _____ Maximum _____ R. F. P. G. S. _____
Code No. _____ System _____ Source of Water _____
Basin _____ Present _____ Potential _____ Maximum _____ R. F. P. G. S. _____
Code No. _____ System _____ Source of Water _____
Basin _____ Present _____ Potential _____ Maximum _____ R. F. P. G. S. _____

If under Ditch Company, Irrigation District, or Government Project, state the number of shares or inches, acre feet, as the case may be in said system.

NOTE: R—Denotes Regular Irrigation. F—Flood Irrigation. P—Water diverted by means of pumping. G—Water diverted by gravity. S—Stored Water.

Information from H. L. B. Date 6-12-49

Farm Checked

By W.C.J.

Area Ryegate

Date 7/27/48

Legal Land Owner Reimers, Harry I.

Operator _____

Water is delivered by:

Federal Project _____ Pres _____ Pot _____

Ditch Company Simms Mutual Ditch Pres 1.16 Pot 0

Irrigation District _____ Pres _____ Pot _____

Private System _____ Pres _____ Pot _____

Totals _____

Flood _____ Pump _____ Reservoir _____ Gravity ☒

Size and Capacity, Pump, etc. _____

Original Appropriator, Company _____ App. No. _____

Original Appropriator, Private _____ App. No. None shown

Is the system an extension of another system? Yes _____ No ☒

Is all land irrigated from one system? Yes ☒ No _____

(If No, show break down on map)

Source of Water Musselshell R.

Acres Irrigated 19 48 1.16

Potential Acres 0 Seeped 0

Explain _____

Condition of System good

Adequate Supply Yes ☒ No ☒

Explain store & water available

Topography Terrace

Information From field check

Remarks _____

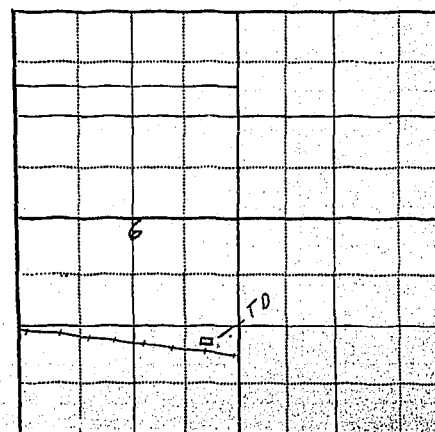



STATE OF MONTANA
STATE ENGINEER

FRED E. BUCH, STATE ENGINEER
GERALD J. CRAVETZ, ASSISTANT

BILLINGS, MONTANA

April 19, 1949

Mr. Harry I. Reimers
Ryegate, Montana

Dear Mr. Reimers:

In 1939 the State Legislature passed a law authorizing the State Engineer to investigate and compile a complete record of all water rights and water use in the State. In compliance with this law the State Engineer is now working in Golden Valley County compiling these data.

Enclosed herewith we are sending you two forms. The first one shows the ownership boundary of your land, with the lots that we show as irrigated colored orange. We would like to have you check this map very carefully and make any corrections you may deem necessary.

As we do not have a water right covering this land we are sending you Form WR-D, which we would like to have you fill out in its entirety, and also give us any and all information you can regarding the Simms Mutual Ditch.

Remember, this is your water and your water rights that we are trying to help you with.

Very truly yours,

Gerald J. Cravetz
Gerald J. Cravetz
Assistant State Engineer

GJ/a
enc.

Dear Sir:

I'll explain here as much as I know
in regarding the Simms mutual ditch
In 1893 Meagher County was where the ditch was
filed for a water right Transfer was made by
to Simms to Enterprise land Co. they to Wheelock
& Wheelock and they to present ^{owner}
a suit was held in 1913 or 1914 when Supreme
Court it was a valid ditch no Transcript
was made from Meagher County to the Counties
Created later It was filed in Meagher County
afterwards incorporated in Fergus later in
Yellowstone then to Musselshell then into
Golden Valley County. But the filing was
never transferable. Probably you already know
of this of what I have written.
You will notice I have changed the ditch
line of which you had mapped out. I have
a portion of 5 to which is under the ditch
If there is any information I have given which you
would like to know, please write again.

Harry C. Reimers

April 19, 1949

Mr. Harry I. Reimers
Ryegate, Montana

Dear Mr. Reimers:

In 1939 the State Legislature passed a law authorizing the State Engineer to investigate and compile a complete record of all water rights and water use in the State. In compliance with this law the State Engineer is now working in Golden Valley County compiling these data.

Enclosed herewith we are sending you two forms. The first one shows the ownership boundary of your land, with the lots that we show as irrigated colored orange. We would like to have you check this map very carefully and make any corrections you may deem necessary.

As we do not have a water right covering this land we are sending you Form WR-D, which we would like to have you fill out in its entirety, and also give us any and all information you can regarding the Simms Mutual Ditch.

Remember, this is your water and your water rights that we are trying to help you with.

Very truly yours,

Gerald J. Oravets
Assistant State Engineer

GJ/a
enc.

County.....Golden Valley

Farm Checked: Date.....

By Hans

Legal Land Owner.....**Beers**.....

Operator.....

Water is delivered by:— (1) Private System;

STATE OF MONTANA
STATE ENGINEERS OFFICE
Water Resources Survey

T. 6N R. 20E Plat No. 23

Photo No. 6-103

Address.....

Address.....

3. State Project; 4. Federal Project; 5. Irrigation District

[illegible]

NOTE: R—Denotes Regular Irrigation. F—Flood Irrigation.

Adequate Sup'ly: Yes xx No..... Explain town lot, yard & garden

Remarks:

.....River Basin.

Also in: Plat No.....	Twp.....	Rge.....	Plat No.....	Twp.....	Rge.....	Plat No.....	Twp.....	Rge.....
Plat No.....	Twp.....	Rge.....	Plat No.....	Twp.....	Rge.....	Plat No.....	Twp.....	Rge.....

Information From:
Field Survey

*2nd Town Addition
Lots 1 thru 12
City of Rochester*

6	5	4	3	2	1
7	8	9	10	11	12
18	17	16	15	14	13
19	20	21	22	23	24
30	29	28	27	26	25
31	32	33	34	35	36

Land Ownership _____

FORM F-1 - GAZETTE 1665.2M.1-4

Code No. 57W

County Gelder Valley

T. 6N R. 20E Sec. 5

Photo No. _____

Address _____

Operator _____ Address _____

Water is delivered by:

Federal Project _____ **Pres** _____ **Pot** _____

Ditch Company Sims (Mutual) Ditch Pres. _____ Pot. ☒

Irrigation District _____ Pres. _____ Pot. _____

Private System ☒ Pres. _____ Pot. _____

[illegible]

Flood _____ Pump _____ Reservoir _____ Gravity 

Size and Capacity, Pump, etc. _____

Original Appropriator, Company _____ App. No. _____

Original Appropriator, Private Joseph Sims? App. No. 7

Is the system an extension of another system? Yes_____No_____

Is all land irrigated from one system? Yes_____No_____

(If No, show break down on map)

Source of Water: Musselshell River

Acres Irrigated 19.....

Potential Acres ✓ 11.0 Seeped

Explain _____

Condition of System.....

Adequate Supply Yes ☒ No ☐

Explain Town lot (yard & Garden)

Topography

Information From Field Survey

Remarks _____

Form WR-B
Reporter 17362 1M-2-49

STATE OF MONTANA

Twp. 6N Rge. 20E
Twp. _____ Rge. _____
Twp. _____ Rge. _____

Ownership cover
only irrigated land.
All ownership for
dry land not shown.

State Engineer's Office
WATER RESOURCES SURVEY
FARM MAP

County Golden Valley
Code No. 5TW

Name of Land Owner Bears

Address _____

Name of Operator _____

Address _____

Legal Description _____



Irrigated Land



Non-Irrigated Land
North



Potential Land Under Existing Facilities

Please check the
ownership outline
of this land.

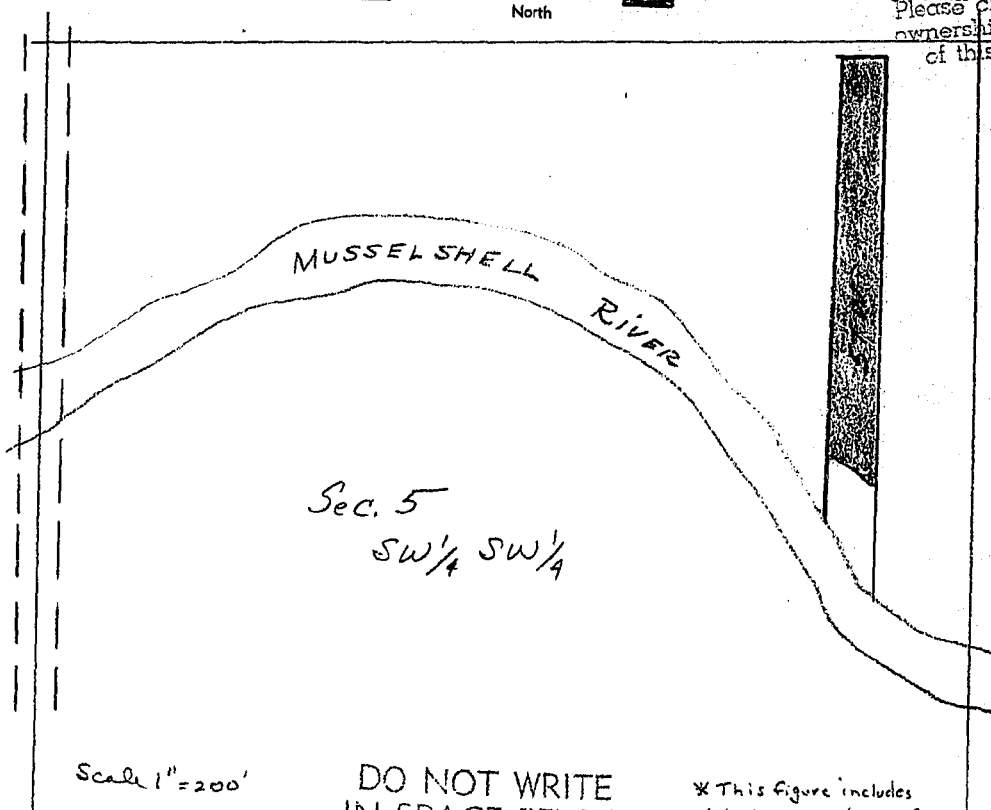

Scale 1" = 200'

DO NOT WRITE
IN SPACE BELOW

* This figure includes
Lots 1-12 in SW 1/4 SW 1/4 of Sec. 5
And STA in SE 1/4 SW 1/4 Sec. 5
LOCATED IN CITY OF RYOGATE.
Source of Water Musselshell River

Code No. 5TW System SURS (Mutual) Ditch
Basin Mchl Present ~ Potential ~ Maximum ~ R ✓ F ~ P ~ G ✓ S ~
* Code No. 5TW, 514, 515, 516, 517, 518, 519, 520, 521, 522, 523, 524, 525 System SURS (Mutual) Ditch Source of Water Mchl River
Basin Mchl R. Present 0 Potential 11.0 Maximum 11.0 R ✓ F ~ P ~ G ✓ S ~
Code No. _____ System _____ Source of Water _____
Basin _____ Present _____ Potential _____ Maximum _____ R ~ F ~ P ~ G ~ S ~
Code No. _____ System _____ Source of Water _____
Basin _____ Present _____ Potential _____ Maximum _____ R ~ F ~ P ~ G ~ S ~

If under Ditch Company, Irrigation District, or Government Project, state the number of shares or inches, acre feet, as the case may be in said system.

NOTE: R—Denotes Regular Irrigation. F—Flood Irrigation. P—Water diverted by means of pumping. G—Water diverted by gravity.
S—Stored Water.

Information from H. R. R.

Date 9/22/49

Information From:
Field Survey

6	5	4	3	2	1	
	II					
7	8	9	10	11	12	
13	17	16	15	14	13	
19	20	21	22	23	24	
30	29	28	27	26	25	
31	32	33	34	35	36	

Land Ownership _____

Code No. 5TV

Code No. 5TV

County Golden Valley

T. 6N R. 20E Sec. 5

Address _____

Address _____

Federal Project _____ Pres. _____ Pot. _____

Ditch Company Sims (Mutual) Pres. _____ Pot. ☒

Irrigation District _____ Pres. _____ Pot. _____

Private System ☒ Pres. _____ Pot. _____

[illegible]

Flood _____ Pump _____ Reservoir _____ Gravity ☒

Original Appropriator, Company _____ App. No. _____

Original Appropriator, Private Joseph Sims? App. No. ?

Is the system an extension of another system? Yes_____No_____

Is all land irrigated from one system? Yes _____ No _____

(If No, show break down on map)

Source of Water. Musselshell River

Acres Irrigated 19

Potential Acres 1 Seeped

Explain Town hot

Condition of System _____

Adequate Supply Yes ☒ No ☐

Explain (yard & garden)

Topography

Information From Field Survey

Remarks _____

Form WR-3
Reporter 17362 1M-2-49

STATE OF MONTANA

State Engineer's Office

WATER RESOURCES SURVEY

FARM MAP

County Golden Valley
Code No. 5TV

Twp. 6N Rge. 20E

Twp. _____ Rge. _____

Twp. _____ Rge. _____

Ownership covers
only irrigated land.
All ownership for
dry land not shown.

Name of Land Owner Bukaskey

Address _____

Name of Operator _____

Address _____

Legal Description _____



Irrigated Land



Non-Irrigated Land

North



Potential Land Under Existing Facilities

Please check the
ownership outline
of his land.

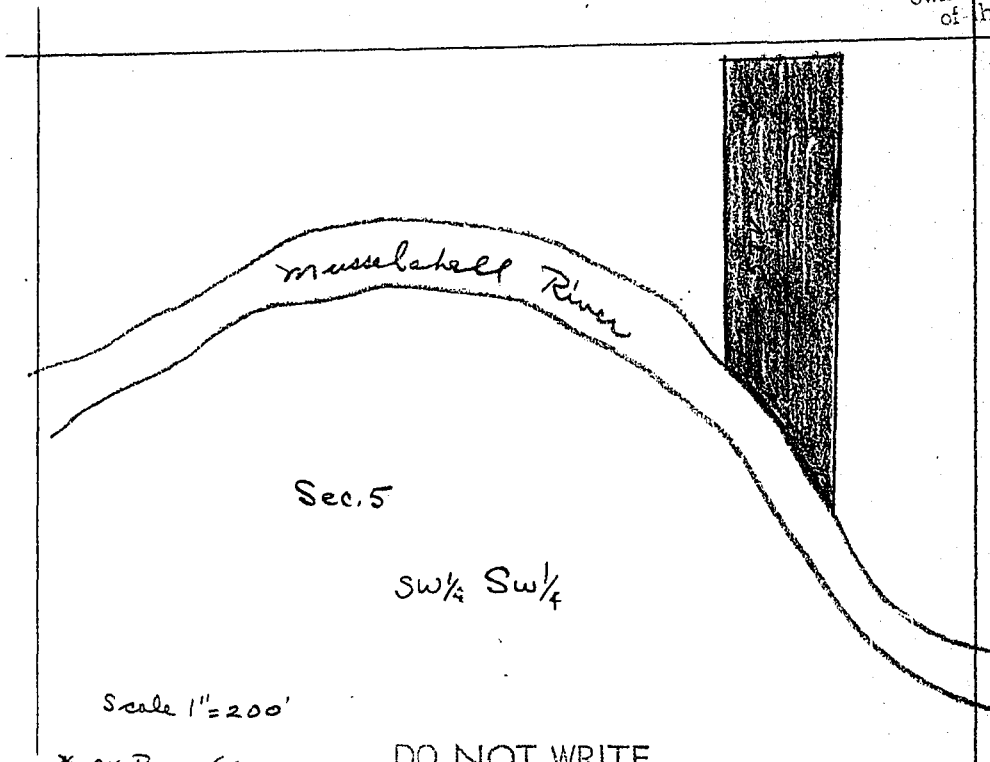

* ON Bee's farm.

T. 6N-R. 20E

DO NOT WRITE
IN SPACE BELOW

* Code No. <u>5TV</u>	System <u>Sims (Mutual) Ditch</u>	Source of Water <u>Musselshell R.</u>
Basin <u>Mshl</u>	Present _____ Potential _____ Maximum _____	R. <u>✓</u> F. _____ P. _____ G. <u>✓</u> S. _____
Code No. _____	System _____	Source of Water _____
Basin _____	Present _____ Potential _____ Maximum _____	R. _____ F. _____ P. _____ G. _____ S. _____
Code No. _____	System _____	Source of Water _____
Basin _____	Present _____ Potential _____ Maximum _____	R. _____ F. _____ P. _____ G. _____ S. _____
Code No. _____	System _____	Source of Water _____
Basin _____	Present _____ Potential _____ Maximum _____	R. _____ F. _____ P. _____ G. _____ S. _____

If under Ditch Company, Irrigation District, or Government Project, state the number of shares or inches acre feet, as the case may be in said system.

NOTE: R—Denotes Regular Irrigation. F—Flood Irrigation. P—Water diverted by means of pumping. G—Water diverted by gravity. S—Stored Water.

Information from H. L. B.

Date 9/22/49

Information From:
Ford Garfield

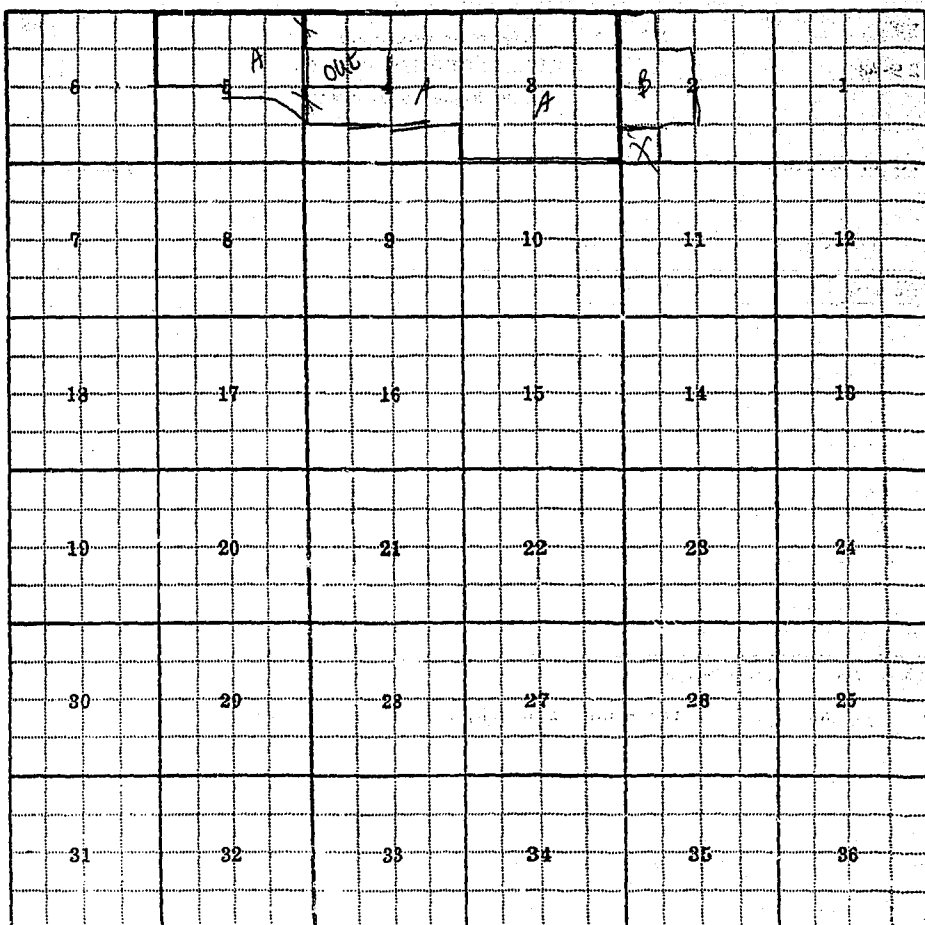
rigable
ACRES

Land Ownership.....