

NOTICE
These forms are the
property of the State
of Montana and must
be returned.

STATE OF MONTANA

State Engineer's Office

WATER RESOURCES SURVEY

WATER RIGHT DATA

County Golden Valley

Code No. 3A, 4A

Name of Land Owner Ford C. Garfield Address Ryegate, Montana
Name of Operator Same Address _____
Legal Description All Sec. 3, All Sec. 4 North of R.R., Twp. 6N., Rge. 20E

We are asking you to help us protect your water right because in our records we are unable to find a recorded water right covering the above described land. We, therefore, would like to have you give us the information asked for in the following questions:

1. Was a water right filing ever made for this land? Yes _____ No _____ If yes, give us the following information:

Name of Appropriator	Stream	Land Description	Date App.	Date Filed	Miner's Inches Filed On

If no, can you give us the following information:

Name of First User	Date of First Use	Stream	Place of Use

2. Or is this land covered by a water right that was purchased from another water right? Yes _____ No _____

If yes, give us the amount of the inches purchased, from what original filing, and if possible the date of purchase and from whom purchased.

3. If this land is under an incorporated ditch company, mutual ditch company, irrigation district, federal project, or state project, give us the following information:

Name of Ditch System	Shares of Stock	Miner's Inches	Acre Feet	Assessed Acres	Type of System Pumping Gravity

4. Do you buy supplemental water? Yes _____ No _____ If yes, from whom and how many inches, Cubic Feet Per Second, Acre Feet, as the case may be? _____

5. Give any other information that you think should be included for the protection of your water right.

This ranch was the headquarters of the original Big Horn ranch as my land has the same status as the other lands under the Big Horn ditch. My abstract refers to the ditch & right of way but I have never been able to find out as the records were never transported to this county from Big Horn while Big Horn was in Big Horn or before it was moved to this county. This land was in at the time the water right was filed. Ford C. Garfield

Form WR-B
Reporter 17362 1M-2-49

STATE OF MONTANA

State Engineer's Office

WATER RESOURCES SURVEY

FARM MAP

County Golden Valley

Code No. 3A, 4A

Twp. 6N. Rge. 20E

Twp. _____ Rge. _____

Twp. _____ Rge. _____

Name of Land Owner Ford C. Garfield

Address Reigate, Montana

Name of Operator Same

Address _____

Legal Description All Sec. 3, All Sec. 4 North of R.R., Twp. 6N., Rge. 20E



Irrigated Land



Non-Irrigated Land



Potential Land Under Existing Facilities

North

Disc. Check the
outline
of land.

Golden Valley County
Twp. 6N - Rge. 20E
Simms Mutual Ditch

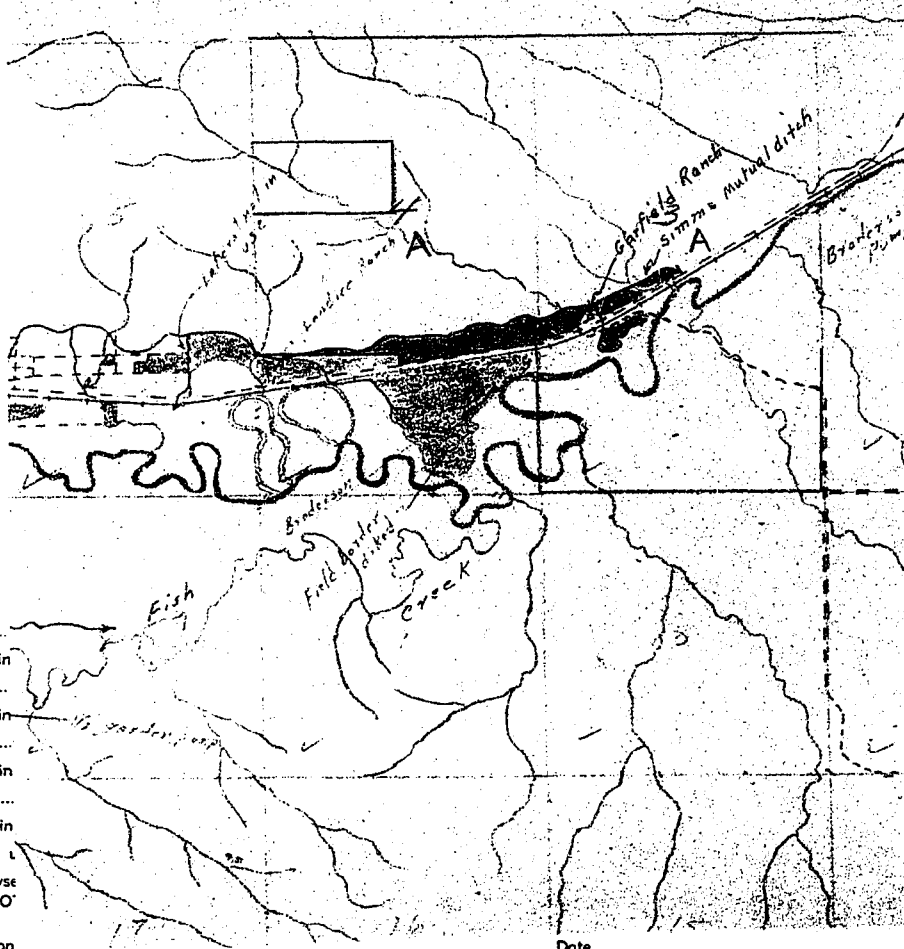

Code No. _____

Basin _____

Code No. _____

Basin _____

Code No. _____

Basin _____

Code No. _____

Basin _____

If _____

in said syse

NO

Information _____

G. S. _____

G. S. _____

G. S. _____

G. S. _____

the case may be

verted by gravity.

Date _____

Form Checked

By H-C-J.

Area Ryeate

Date 7/29/45

Legal Land Owner Garfield, Ford C.

Operator

Water is delivered by:

Federal Project Pres. Pot.

Ditch Company Simms Ditch Pres. 60.0 Pot. 0

Irrigation District Pres. Pot.

Private System Pres. Pot.

Totals

Flood Pump Reservoir ☒ Gravity ☒

Size and Capacity, Pump, etc.

Original Appropriator, Company App. No.

Original Appropriator, Private App. No. 204?

(Show date of appropriation under Remarks)

Is the system an extension of another system? Yes No ☒

Is all land irrigated from one system? Yes ☒ No

(If No, show break down on map)

Source of Water Musselshell R.

Acres Irrigated 19 48 60.0

Potential Acres 0 Seeped 0

Explain

Condition of System good

Adequate Supply Yes ☒ No ☒

Explain tail end of ditch

Explain buys stored water

Topography Terrace & bottom

Information From Ford Garfield

Remarks

STATE OF MONTANA
STATE ENGINEER'S OFFICE
WATER RESOURCES SURVEY

Code No. 79, 4A, 5TU

County Golden Valley

T. 6N. R. 20E. Sec. 3, 4

Photo No. 6-82, 6-103

Address Ryeate

Address

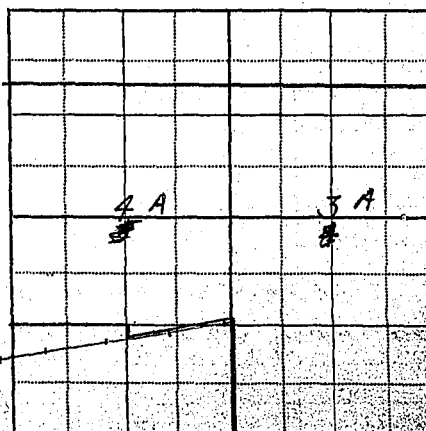

Buys 40 A.F. from Basin

If water rights on this ditch can be found, Garfield would appreciate a copy.

April 19, 1949

Mr. Ford C. Garfield
Ryegate, Montana

Dear Mr. Garfield:

In 1939 the State Legislature passed a law authorizing the State Engineer to investigate and compile a complete record of all water rights and water use in the State. In compliance with this law the State Engineer is now working in Golden Valley compiling these data.

Enclosed herewith we are sending you two forms. The first one shows the ownership of your land and the part that covers the irrigated area colored in orange. We would like to have you check this map very carefully and make any additions that you may deem necessary.

As we do not have a record of a water filing covering this land we are sending you Form WR-D, which we would like to have you fill out in its entirety and give us any and all information you can in regard to the Simms Mutual Ditch Company.

Remember, this is your water and your water rights that we are trying to help you with.

Very truly yours,

Gerald J. Oravetz
Assistant State Engineer

GJO/a
enc.

Form WR-B
Reporter 17362 1M-2-40

STATE OF MONTANA

State Engineer's Office

WATER RESOURCES SURVEY

FARM MAP

County Golden Valley

Code No. 2B, 3A, 4A, 5A

T. 6N-R. 20E

Twp. 6N Rge. 20E

Twp. _____ Rge. _____

Twp. _____ Rge. _____

Name of Land Owner Garfield, Ford C Address Rye Gate

Name of Operator _____ Address _____

Legal Description _____



Irrigated Land



Non-Irrigated Land



Potential Land Under Existing Facilities

North

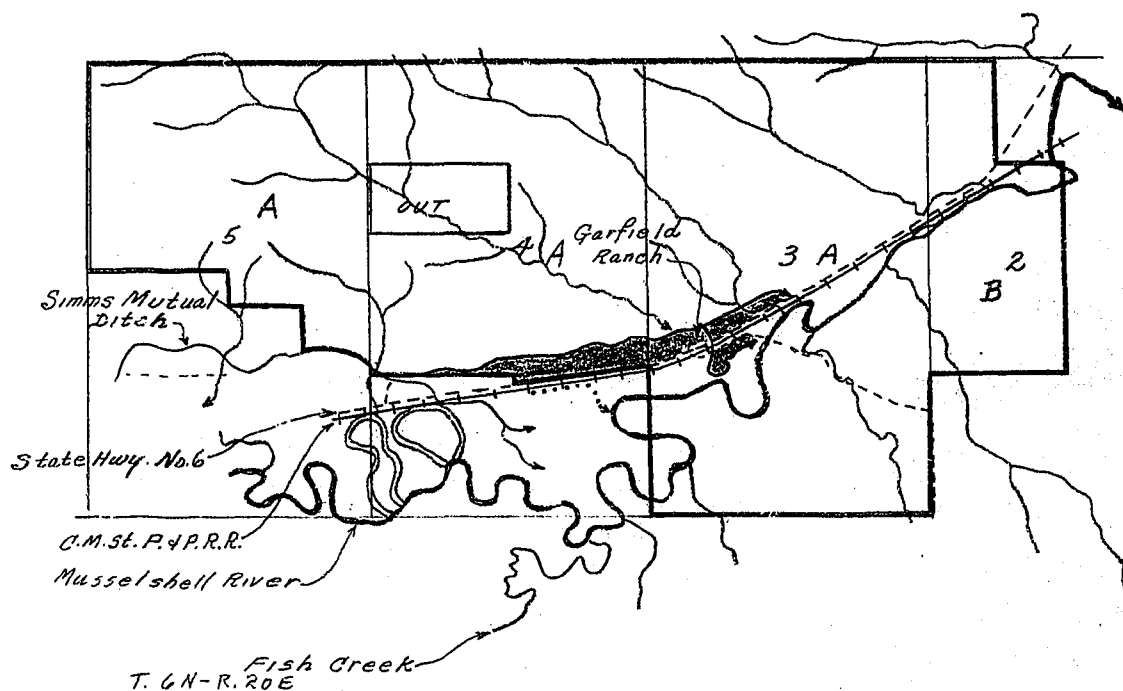

Code No. 3A, 4A System Simms Mutual Ditch Source of Water Musselshell River

Basin Musselshell River Present 60.0 Potential 0 Maximum 60.0 R. ✓ F. ✓ P. ✓ G. ✓ S. ✓

Code No. _____ System _____ Source of Water _____

Basin _____ Present _____ Potential _____ Maximum _____ R. _____ F. _____ P. _____ G. _____ S. _____

Code No. _____ System _____ Source of Water _____

Basin _____ Present _____ Potential _____ Maximum _____ R. _____ F. _____ P. _____ G. _____ S. _____

Code No. _____ System _____ Source of Water _____

Basin _____ Present _____ Potential _____ Maximum _____ R. _____ F. _____ P. _____ G. _____ S. _____

If under Ditch Company, Irrigation District, or Government Project, state the number of shares or inches, acre feet, as the case may be in said system.

NOTE: R—Denotes Regular Irrigation. F—Flood Irrigation. P—Water diverted by means of pumping. G—Water diverted by gravity. S—Stored Water.

Information from R. L. B. Date 6-14-49

State Engineer's Office
WATER RESOURCES SURVEY
FARM MAP

County _____
Code No. _____

Twp. _____ Rge. _____
Twp. _____ Rge. _____
Twp. _____ Rge. _____
Ownership covers only irrigated land.
All ownership for dry land not shown.

Name of Land Owner _____ Address _____
Name of Operator _____ Address _____
Legal Description _____

☒ Irrigated Land ☐ Non-Irrigated Land, North ☒ Potential Land Under Existing Facilities

Please check the ownership outline of this land.

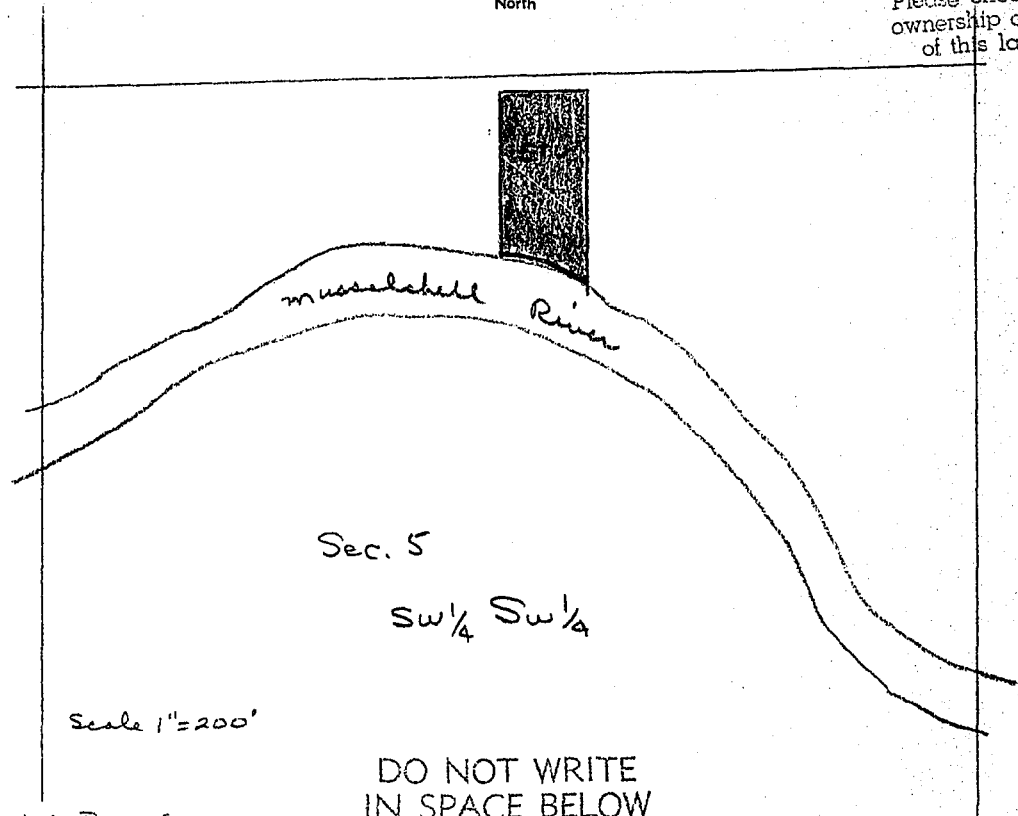

DO NOT WRITE
IN SPACE BELOW

* On Beers form.

* Code No. 511 T. 16 N. R. 24 E. System SUMMIT MUTUAL DITCH Source of Water MUSHEL RIVER
Basin MUSHEL Present _____ Potential _____ Maximum _____ R. F. P. G. S. ✓
Code No. _____ System _____ Source of Water _____
Basin _____ Present _____ Potential _____ Maximum _____ R. F. P. G. S. _____
Code No. _____ System _____ Source of Water _____
Basin _____ Present _____ Potential _____ Maximum _____ R. F. P. G. S. _____
Code No. _____ System _____ Source of Water _____
Basin _____ Present _____ Potential _____ Maximum _____ R. F. P. G. S. _____

If under Ditch Company, Irrigation District, or Government Project, state the number of shares or inches, acre feet, as the case may be in said system.

NOTE: R—Denotes Regular Irrigation. F—Flood Irrigation. P—Water diverted by means of pumping. G—Water diverted by gravity. S—Stored Water.

Information from _____ Date _____

County.....Golden Valley.....

Farm Checked: Date 9-22-49

By Hans

Legal Land Owner.....**Taber**.....

Operator.....

STATE OF MONTANA
STATE ENGINEERS OFFICE
Water Resources Survey

T 6N R 20E Plat No. 23

Photo No. 6-103

Water is delivered by:— (1) Private System; (2) Ditch Company; 3. State Project; 4. Federal Project; 5. Irrigation District

[illegible]

NOTE: R—Denotes Regular Irrigation. F—Flood Irrigation.

Adequate Supply: Yes. xx No..... Explain..... no water shortage, system in poor condition: town lot

Remarks.....

...River Basin

Also in: Plat No.....	Twp.....	Rge.....	Plat No.....	Twp.....	Rge.....	Plat No.....	Twp.....	Rge.....
Plat No.....	Twp.....	Rge.....	Plat No.....	Twp.....	Rge.....	Plat No.....	Twp.....	Rge.....

Information From:
Field Survey

6	5	4	3	2	1
7	8	9	10	11	12
18	17	16	15	14	13
19	20	21	22	23	24
30	29	28	27	26	25
31	32	33	34	35	36

Land Ownership

Form WR-3
Reporter 17382 1M-2-40

STATE OF MONTANA

State Engineer's Office

County Golden Valley
Code No. 572

Twp. 4N Rge. 20E
Twp. _____ Rge. _____
Twp. _____ Rge. _____

Ownership covers
only irrigated land.
All ownership for
dry land not shown.

WATER RESOURCES SURVEY
FARM MAP

Name of Land Owner Taker Address _____
Name of Operator _____ Address _____
Legal Description _____



Irrigated Land



Non-Irrigated Land
North



Potential Land Under Existing Facilities

Please check the
ownership outline
of this land.

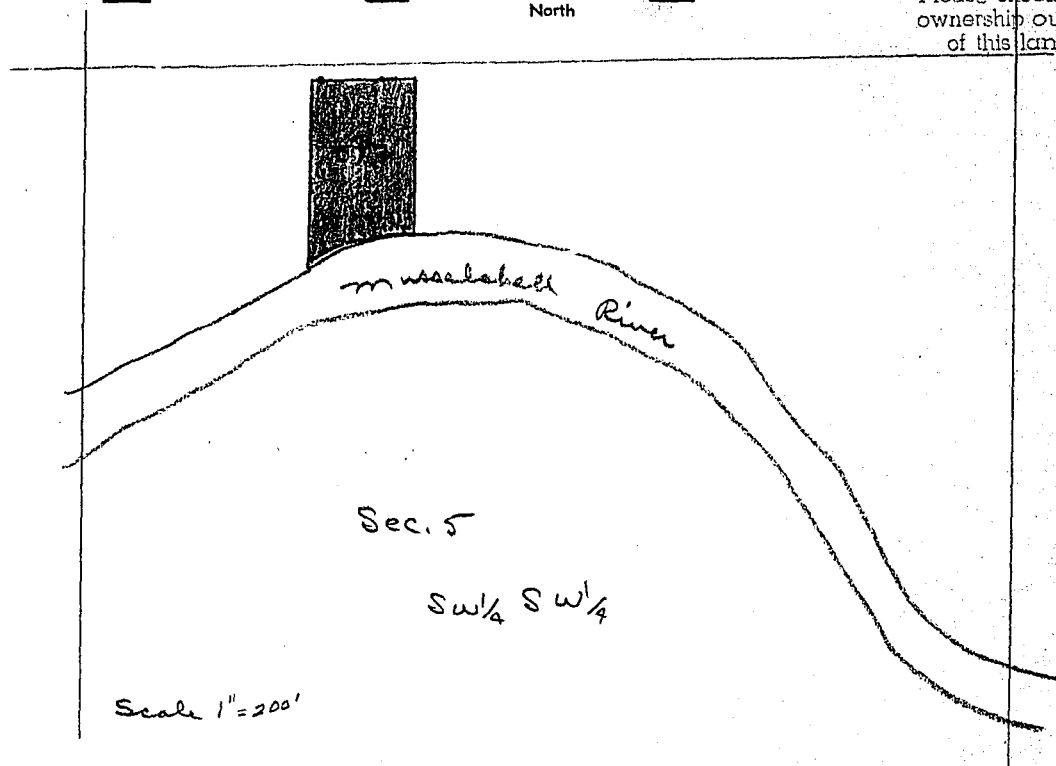

* On Beers form,

DO NOT WRITE
IN SPACE BELOW

Code No. <u>572</u>	System <u>Time (Mutual) Ditch</u>	Source of Water <u>Musselshell R.</u>
Basin <u>M561</u>	Present _____ Potential _____ Maximum _____	R <input checked="" type="checkbox"/> F _____ P _____ G <input checked="" type="checkbox"/> S _____
Code No. _____	System _____	Source of Water _____
Basin _____	Present _____ Potential _____ Maximum _____	R _____ F _____ P _____ G _____ S _____
Code No. _____	System _____	Source of Water _____
Basin _____	Present _____ Potential _____ Maximum _____	R _____ F _____ P _____ G _____ S _____
Code No. _____	System _____	Source of Water _____
Basin _____	Present _____ Potential _____ Maximum _____	R _____ F _____ P _____ G _____ S _____

If under Ditch Company, Irrigation District, or Government Project, state the number of shares or inches, acre feet, as the case may be in said system.

NOTE: R—Denotes Regular Irrigation. F—Flood Irrigation. P—Water diverted by means of pumping. G—Water diverted by gravity. S—Stored Water.

Information from H. L. B. Date 9/22/49

County Golden Valley

Farm Checked: Date. 9-22-49

By Hans

Legal Land Owner.....Todd.....

Operator.....

Water is delivered by:— (1) Private System;

STATE OF MONTANA
STATE ENGINEERS OFFICE
Water Resources Survey

T 6N R 20E Plat. No. 23

Photo No. 6-103

Address.....

Address.....

3. State Project; 4. Federal Project; 5. Irrigation District

[illegible]

NOTE: R—Denotes Regular Irrigation. F—Flood Irrigation.

Adequate Supply: Yes..xx No..... Explain..... Town lot, yard & garden.....

Remarks.

River Basin

Also in: Plat No.....	Twp.....	Rge.....	Plat No.....	Twp.....	Rge.....	Plat No.....	Twp.....	Rge.....
Plat No.....	Twp.....	Rge.....	Plat No.....	Twp.....	Rge.....	Plat No.....	Twp.....	Rge.....

Information From:
Field Survey

6	5	4	3	2	1
7	8	9	10	11	12
13	17	16	15	14	13
19	20	21	22	23	24
29	29	28	27	26	25
31	32	33	34	35	36

Land Ownership.....

.....

.....

Farm Checked

By H.L.B.

Area Rye Gate

Date 9/22/49

Legal Land Owner Todd

Operator _____

Water is delivered by:

Federal Project _____ Pres. _____ Pot. _____

Ditch Company (Mutual) Sims (Mutual) Ditch Pres. _____ Pot. ☒

Irrigation District _____ Pres. _____ Pot. _____

Private System ☒ _____ Pres. _____ Pot. _____

Totals _____

Flood _____ Pump _____ Reservoir _____ Gravity ☒

Size and Capacity, Pump, etc. _____

Original Appropriator, Company _____ App. No. _____

Original Appropriator, Private Joseph Sims? App. No. ?

Is the system an extension of another system? Yes _____ No _____

Is all land irrigated from one system? Yes _____ No _____

(If No, show break down on map)

Source of Water Musselshell River

Acres Irrigated 19 _____

Potential Acres ☒ _____ Seeped _____

Explain _____

Condition of System _____

Adequate Supply Yes ☒ No _____

Explain Town Lot (yard + Garden)

Topography _____

Information From Field Survey

Remarks _____

STATE OF MONTANA
STATE ENGINEER'S OFFICE
WATER RESOURCES SURVEY

Code No. 5TY

County Golden Valley

T. 6N R. 20 Sec. 5

Photo No. _____

Address _____

Address _____

FORM F-1 - GAZETTE 1989-24-1-47

Form WR-B
Reporter 17322 1M-2-49

STATE OF MONTANA

Twp. 6N Rge. 20E

Twp. _____ Rge. _____

Twp. _____ Rge. _____

Ownership covers
only irrigated land.
All ownership for
dry land not shown.

State Engineer's Office
WATER RESOURCES SURVEY
FARM MAP

County Golden Valley

Code No. 5TY

Name of Land Owner Todd

Address _____

Name of Operator _____

Address _____

Legal Description _____



Irrigated Land



Non-Irrigated Land
North



Potential Land Under Existing Facilities

Please check the
ownership outline
of this land.

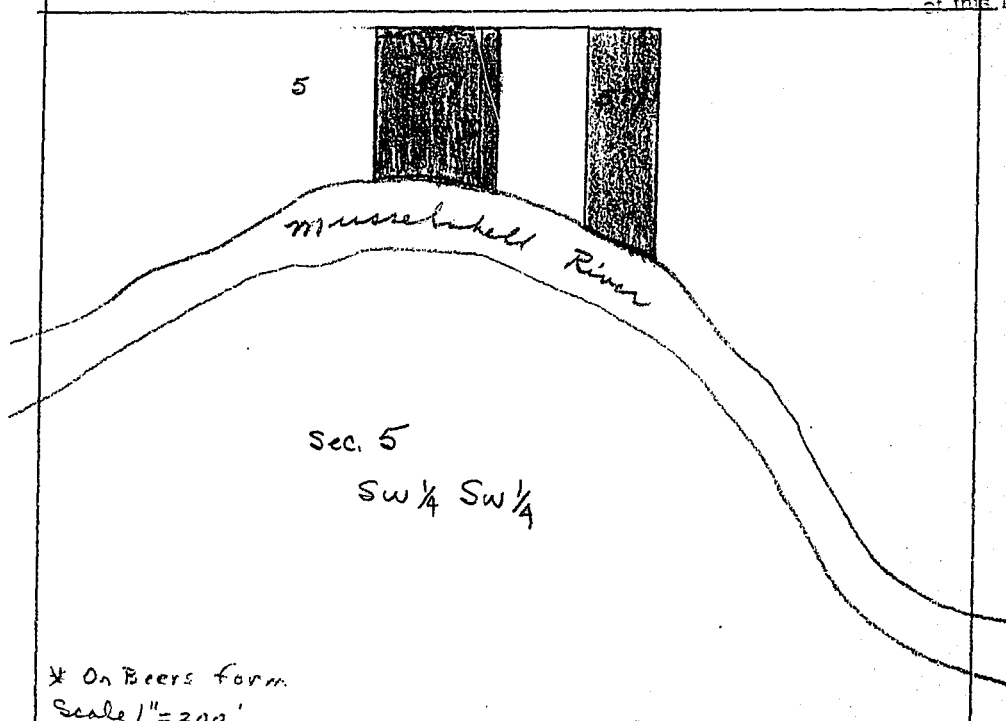

* On Beers form
Scale 1"=200'

T. 6N-R. 20E

DO NOT WRITE
IN SPACE BELOW

* Code No. <u>5TY</u>	System <u>Sims (natural) Ditch</u>	Source of Water <u>Mustelshell River</u>
Basin <u>Nichl</u>	Present _____ Potential _____ Maximum _____	R <u>X</u> F _____ P _____ G <u>X</u> S _____
Code No. _____	System _____	Source of Water _____
Basin _____	Present _____ Potential _____ Maximum _____	R _____ F _____ P _____ G _____ S _____
Code No. _____	System _____	Source of Water _____
Basin _____	Present _____ Potential _____ Maximum _____	R _____ F _____ P _____ G _____ S _____
Code No. _____	System _____	Source of Water _____
Basin _____	Present _____ Potential _____ Maximum _____	R _____ F _____ P _____ G _____ S _____

If under Ditch Company, Irrigation District, or Government Project, state the number of shares or inches, acre feet, as the case may be, in said system.

NOTE: R—Denotes Regular Irrigation. F—Flood Irrigation. P—Water diverted by means of pumping. G—Water diverted by gravity. S—Stored Water.

Information from H. P. R.

Date 9/22/49

County Golden Valley

Farm Checked: Date 7-27-48

By A.C.J.

STATE OF MONTANA
STATE ENGINEERS OFFICE
Water Resources Survey

T 6N R 20E Plat No. 23

Photo No. 6-103

Legal Land Owner.....Lois M. or Isabel Wolff.....Address.....Ryegate.....

Operator..... Address.....

Water is delivered by:— 1. Private System; 2. Ditch Company; 3. State Project; 4. Federal Project; 5. Irrigation District

[illegible]

NOTE: R—Denotes Regular Irrigation. F—Flood Irrigation.

Adequate Supply: Yes ☒ No ☒ Explain... stored water available

Remarks.....

River Basin.

...River Basin

Also in: Plat No.....	Twp.....	Rge.....	Plat No.....	Twp.....	Rge.....	Plat No.....	Twp.....	Rge.....
Plat No.....	Twp.....	Rge.....	Plat No.....	Twp.....	Rge.....	Plat No.....	Twp.....	Rge.....

Information From:
Field Survey & Louis Lundy

Land Ownership.....

Farm Checked

By A. C. R.

Area Ryegate

Date 7/27/48

Legal Land Owner Wolff, Lois M. or Isabel

Operator _____

Water is delivered by:

Federal Project _____ Pres. _____ Pot. _____

Ditch Company Simms Mutual Pres. .75 Pot. 0

Irrigation District _____ Pres. _____ Pot. _____

Private System _____ Pres. _____ Pot. _____

Totals _____

Flood _____ Pump _____ Reservoir _____ Gravity ☒

Size and Capacity, Pump, etc. _____

Original Appropriator, Company _____ App. No. _____

Original Appropriator, Private _____ App. No. None Shown

Is the system an extension of another system? Yes _____ No ☒

Is all land irrigated from one system? Yes ☒ No _____

(If No, show break down on map)

Source of Water Musselshell R.

Acres Irrigated 19 48 .75

Potential Acres. 0 Seeped 0

Explain _____

Condition of System Good

Adequate Supply _____ Yes ☒ No ☒

Explain stored water available

Topography Terrace

Information From Field check & Louis Lundy

Remarks _____

STATE OF MONTANA

STATE ENGINEER'S OFFICE

WATER RESOURCES SURVEY

Code No. 5 TE, 5 TR, 5 TS

County Golden Valley

T. 6 N. R. 20 E Sec. 5

Photo No. 6-103

Address Ryegate

Address _____

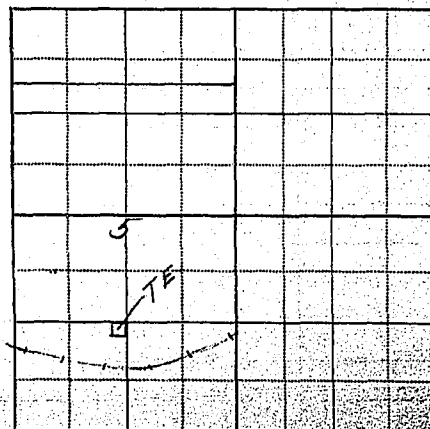

April 19, 1949

Lois M. Wolff
Ryegate, Montana

Dear Madam:

In 1939 the State Legislature passed a law authorizing the State Engineer to investigate and compile a complete record of all water rights and water use in the State. In compliance with this law the State Engineer is now working in Golden Valley County compiling these data.

Enclosed herewith we are sending you two forms. The first one shows the ownership boundary of your land, with the lots that we show as irrigated colored in orange. We would like to have you check this map very carefully and make any corrections you may deem necessary.

As we do not have a water right covering this land we are sending you Form WR-D, which we would like to have you fill out in its entirety, and also give us any and all information you can regarding the Simms Mutual Ditch.

Remember, this is your water and your water rights that we are trying to help you with.

Very truly yours,

Gerald J. Oravetz
Assistant State Engineer

GJO/a
enc.

STATE OF MONTANA

State Engineer's Office
WATER RESOURCES SURVEY
FARM MAP

County Golden Valley
Code No. TE

Twp. 6N Rge. 20E

Twp. _____ Rge. _____

Twp. _____ Rge. _____

T. 6N-R. 20E

Name of Land Owner Wolff, Lewis M. or Isabell Address R. 4. 9. gate

Name of Operator _____ Address _____

Legal Description _____



Irrigated Land



Non-Irrigated Land



Potential Land Under Existing Facilities

North

*Simms
Mutual
Ditch*

*Sec. 5
Twp 6N-R. 20E*

*First
Farm
Addition
Block(2)*

6	7	TE 8	9

Scale 1" = 200'

T. 6N-R. 20E
Code No. 5TE System Simms Mutual Ditch Source of Water Musselshell River
Basin Musselshell River Present 75 Potential 0 Maximum 75 R ✓ F ✓ P ✓ G ✓ S ✓
Code No. _____ System _____ Source of Water _____
Basin _____ Present _____ Potential _____ Maximum _____ R _____ F _____ P _____ G _____ S _____
Code No. _____ System _____ Source of Water _____
Basin _____ Present _____ Potential _____ Maximum _____ R _____ F _____ P _____ G _____ S _____
Code No. _____ System _____ Source of Water _____
Basin _____ Present _____ Potential _____ Maximum _____ R _____ F _____ P _____ G _____ S _____

If under Ditch Company, Irrigation District, or Government Project, state the number of shares or inches, acre feet, as the case may be in said system.

NOTE: R—Denotes Regular Irrigation. F—Flood Irrigation. P—Water diverted by means of pumping. G—Water diverted by gravity. S—Stored Water.

Information from H. L. B. Date 6-14-49

Form WR-3
Reporter 17362 11A-2-49

STATE OF MONTANA

State Engineer's Office

WATER RESOURCES SURVEY

FARM MAP

County GOLDEN VALLEY

Code No. 57R, 57S

LN-20E

Sec. 5

Twp. _____ Rge. _____

Twp. _____ Rge. _____

Twp. _____ Rge. _____

Ownership covers
only irrigated land.
All ownership for
dry land not shown.

Name of Land Owner Wolff, Lois M., et Isabel Address R. 1, GATE

Name of Operator _____ Address _____

Legal Description _____



Irrigated Land



Non-Irrigated Land



Potential Land Under Existing Facilities

Please check the
ownership outline
of this land.

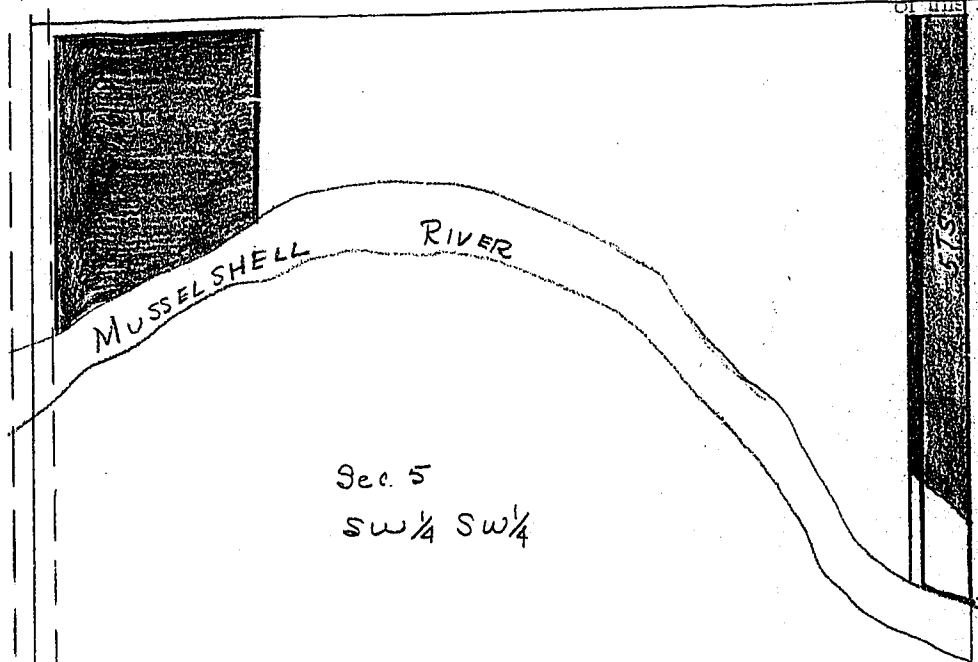

Scale 1"=200'

* On Bear's form,
T. 6N-R. 20E

DO NOT WRITE
IN SPACE BELOW

* Code No. <u>57R, 57S</u>	System <u>Simms Mutual Ditch</u>	Source of Water <u>Mussell River</u>
Basin <u>Musell</u>	Present _____ Potential _____ Maximum _____	R <input checked="" type="checkbox"/> F _____ P _____ G <input checked="" type="checkbox"/> S <input checked="" type="checkbox"/>
Code No. _____	System _____	Source of Water _____
Basin _____	Present _____ Potential _____ Maximum _____	R _____ F _____ P _____ G _____ S _____
Code No. _____	System _____	Source of Water _____
Basin _____	Present _____ Potential _____ Maximum _____	R _____ F _____ P _____ G _____ S _____
Code No. _____	System _____	Source of Water _____
Basin _____	Present _____ Potential _____ Maximum _____	R _____ F _____ P _____ G _____ S _____

If under Ditch Company, Irrigation District, or Government Project, state the number of shares or inches, acre feet, as the case may be in said system.

NOTE: R—Denotes Regular Irrigation. F—Flood Irrigation. P—Water diverted by means of pumping. G—Water diverted by gravity. S—Stored Water.

Information from _____ Date _____

County Golden Valley

Farm Checked: Date 9-22-49

By **Hans**

Legal Land Owner Nick Schanz

Operator _____

Water is delivered by:— 1 Private System:

② Ditch Company:

3. State Project:

4. Federal Project:

5. Irrigation District

[illegible]

NOTE: R Denotes Regular Irrigation E Flood Irrigation

Adequate Supply: Yes. xx No..... Explain..... town lot: yard & Garden

Discussion

River Basin

Also in: Plat No.....	Twp.....	Rge.....	Plat No.....	Twp.....	Rge.....	Plat No.....	Twp.....	Rge.....
Plat No.....	Twp.....	Rge.....	Plat No.....	Twp.....	Rge.....	Plat No.....	Twp.....	Rge.....

Information From:
Field Survey

6	5 <i>beaver hole</i>	4	3	2	1
7	8	9	10	11	12
18	17	16	15	14	13
10	20	21	22	23	24
30	29	28	27	26	25
31	32	33	34	35	36

Land Ownership.....

Farm Checked

By H. L. B.

Area Rye gate

Date 9/22/49

Legal Land Owner Nick Schanz

Operator _____

Water is delivered by:

Federal Project _____ Pres. _____ Pot. _____

Ditch Company Sims (mutual) Ditch Pres. _____ Pot. ☒

Irrigation District _____ Pres. _____ Pot. _____

Private System ☒ Pres. _____ Pot. _____

Totals _____

Flood _____ Pump _____ Reservoir _____ Gravity ☒

Size and Capacity, Pump, etc. _____

Original Appropriator, Company Joseph Sims ? App. No. ?

Original Appropriator, Private _____ App. No. _____

Is the system an extension of another system? Yes _____ No _____

Is all land irrigated from one system? Yes _____ No _____

(If No, show break down on map)

Source of Water Musselshell River

Acres Irrigated 19 _____

Potential Acres _____ Seeped _____

Explain _____

Condition of System _____

Adequate Supply _____ Yes ☒ _____ No _____

Explain Town lot (yard & garden)

Topography _____

Information From _____

Remarks _____

FORM 9-1 - GAZETTE 1948-24-1-17

Code No. 5TX

County Golden Valley

T. 6N R. 20E Sec. 5

Photo No. _____

Address _____

Address _____

Information From:
Field Survey

6	5	4	3	2	1
7	8	9	10	11	12
13	14	15	16	17	18
19	20	21	22	23	24
25	26	27	28	29	30
31	32	33	34	35	36

Land Ownership _____

Farm Checked

By H. L. B.

Area Pyegate

Date 9/22/49

Legal Land Owner Schladweiler, Mrs. J. J.

Operator

Water is delivered by:

Federal Project Pres. Pot.

Ditch Company Mutual Sims (Mutual) Ditch Pres. Pot. ☒

Irrigation District Pres. Pot.

Private System ☒ Pres. Pot.

Totals

Flood Pump Reservoir Gravity ☒

Size and Capacity, Pump, etc.

Original Appropriator, Company App. No.

Original Appropriator, Private Joseph Sims? App. No. ?

Is the system an extension of another system? Yes No

Is all land irrigated from one system? Yes ☒ No

(If No, show break down on map)

Source of Water Musselshell River

Acres Irrigated 19

Potential Acres ☒ Seeped

Explain Rolling land (could be leveled)

Condition of System Poor

Adequate Supply Yes ☒ No

Explain System in poor repair

Topography Rolling

Information From Field Survey

Remarks

STATE OF MONTANA
STATE ENGINEER'S OFFICE
WATER RESOURCES SURVEY

Code No. 5E

County Golden Valley

T 6N R 20E Sec 5

Photo No.

Address

Address

Totals

Gravity ☒

App. No.

App. No. ?

Yes No

Yes ☒ No

Acres Irrigated 19

Potential Acres ☒ Seeped

Explain Rolling land (could be leveled)

Condition of System Poor

Adequate Supply Yes ☒ No

Explain System in poor repair

Topography Rolling

Information From Field Survey

Remarks

Form WR-3
Reporter 17382 1M-2-49

STATE OF MONTANA

State Engineer's Office

WATER RESOURCES SURVEY
FARM MAP

County Golden Valley
Code No. 5E

Twp. 6N Rge. 20E Ownership covers
Twp. _____ Rge. _____ only irrigated land,
Twp. _____ Rge. _____ All ownership tag
dry land not shown.

Name of Land Owner Schladowiler, Mrs. J. J. Address _____
Name of Operator _____ Address _____
Legal Description _____

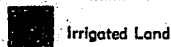

Potential Land Under Existing Facilities

Please check the
ownership outline
of this land.

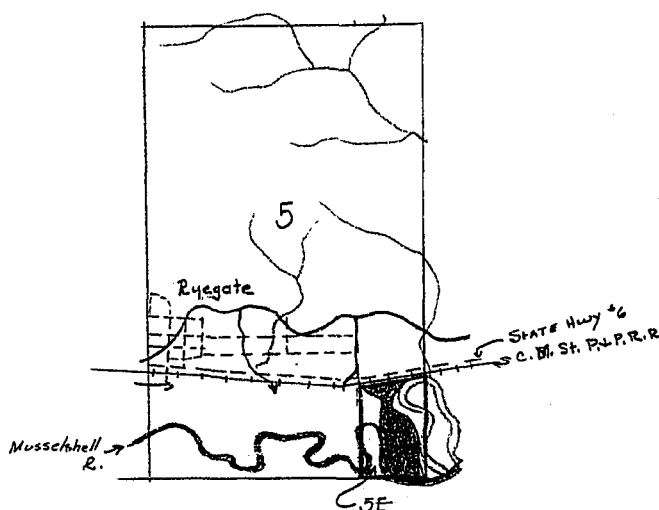

DO NOT WRITE
IN SPACE BELOW

T. 6N-R. 20E

Code No. <u>5E</u>	System <u>Sims (Mutual) Ditch</u>	Source of Water <u>Musselshell R.</u>
Basin <u>MSB1</u>	Present <u>0</u>	Potential <u>22.0</u> Maximum <u>22.0</u> R <u>✓</u> F <u>✓</u> P <u>✓</u> G <u>✓</u> S <u>✓</u>
Code No. _____	System _____	Source of Water _____
Basin _____	Present _____	Potential _____ Maximum _____ R _____ F _____ P _____ G _____ S _____
Code No. _____	System _____	Source of Water _____
Basin _____	Present _____	Potential _____ Maximum _____ R _____ F _____ P _____ G _____ S _____
Code No. _____	System _____	Source of Water _____
Basin _____	Present _____	Potential _____ Maximum _____ R _____ F _____ P _____ G _____ S _____

If under Ditch Company, Irrigation District, or Government Project, state the number of shares or inches, acre feet, as the case may be in said system.

NOTE: R—Denotes Regular Irrigation. F—Flood Irrigation. P—Water diverted by means of pumping. G—Water diverted by gravity. S—Stored Water.

Information from H. L. B.

Date 6/22/49

County.....Golden Valley.....

Farm Checked: Date.....7-27-48.....

By A.C.J.

STATE OF MONTANA
STATE ENGINEERS OFFICE
Water Resources Survey

T 6N R 20E Plat No 23

Photo No. 6-103

Legal Land Owner..... Chris & Mary Willems Address..... Ryegate

Operator..... Address.....

Water is delivered by:— 1. Private System; (2) Ditch Company; 3. State Project; 4. Federal Project; 5. Irrigation District.

[illegible]

NOTE: R—Denotes Regular Irrigation. F—Flood Irrigation.

Adequate Supply: Yes ☒ No ☒ Explain. stored water available

Remarks:

...River Basin.

Also in: Plat No.....	Twp.....	Rge.....	Plat No.....	Twp.....	Rge.....	Plat No.....	Twp.....	Rge.....
Plat No.....	Twp.....	Rge.....	Plat No.....	Twp.....	Rge.....	Plat No.....	Twp.....	Rge.....

Information From:
Keefer & Field Survey

C	6	5	4	3	2	1
7	8	9	10	11	12	
13	17	16	15	14	13	
19	20	21	22	23	24	
30	29	28	27	26	25	
31	32	33	34	35	36	

Land Ownership.....

.....

.....

.....

These forms are the
property of the State
of Montana and must
be returned.

STATE OF MONTANA

State Engineer's Office

WATER RESOURCES SURVEY

WATER RIGHT DATA

A150 in No. 17 T. 7N-R. 20E

County Golden Valley

Code No. 6C

23

Name of Land Owner Chris & Mary Willems Address Rvegate, Montana
Name of Operator Same Address _____
Legal Description All Sec. 6 North of R.R. except EASE Sec. 6., Twp. 6N., Rge. 20E

We are asking you to help us protect your water right because in our records we are unable to find a recorded water right covering the above described land. We, therefore, would like to have you give us the information asked for in the following questions:

1. Was a water right filing ever made for this land.....Yes.....No. If yes, give us the following information:

Name of Appropriator	Stream	Land Description	Date App.	Date Filed	Miner's Inches Filed On
<i>I can not answer these question till I study abstracts</i>					

If no, can you give us the following information:

Name of First User	Date of First Use	Stream	Place of Use

2. Or is this land covered by a water right that was purchased from another water right.....Yes.....No.....

If yes, give us the amount of the inches purchased, from what original filing, and if possible the date of purchase and from whom purchased.

3. If this land is under an incorporated ditch company, mutual ditch company, irrigation district, federal project, or state project, give us the following information:

Name of Ditch System	Shares of Stock	Miner's Inches	Acre Feet	Assessed Acres	Type of System Pumping Gravity
<i>applied for</i>		<i>70</i>	<i>70</i>		<i>66</i>
<i>applied for</i>			<i>30</i>	<i>25</i>	
<i>are working on land above ditch, Ditch isn't</i>					
<i>sewered pit</i>					

4. Do you buy supplemental water.....Yes.....No. If yes, from whom and how many Inches, Cubic Feet Per Second, Acre Feet, as the case may be?

5. Give any other information that you think should be included for the protection of your water right. *In 20th ditch that go thru my land belong to said land and were not signed over our field by MPA I have a water right on 1 1/4 MWS in Ditch*
Information from Chris m. Willems Date _____

Name of
Name of
Legal De

check the
ship outline
this land.

DO NOT WRITE
IN SPACE BELOW

T. 6 N - R. 20 E

Code No. 6.0 System Simms Mutual Ditch Source of Water Musselshell R.
Basin Musselshell River Present 65.0 Potential 0 Maximum 65.0 R X F P G X S X
Code No. System Source of Water
Basin Present Potential Maximum R F P G S
Code No. System Source of Water
Basin Present Potential Maximum R F P G S
Code No. System Source of Water
Basin Present Potential Maximum R F P G S
If under Ditch Company, Irrigation District, or Government Project, state the number of shares or inches, acre feet, as the case may be
in said system.
NOTE: R—Denotes Regular Irrigation. F—Flood Irrigation. P—Water diverted by means of pumping. G—Water diverted by gravity.
S—Stored Water.
Information from H. L. B. Date 6-13-49

Farm Checked

By A. C. J.

Area Ryegate

Date 7/27/48

Legal Land Owner Willems, Chris & Mary (C.R.)

Operator _____

Water is delivered by:

Federal Project _____ Pres. _____ Pot. _____

Ditch Company Simms Mutual Pres. 165 Pot. 0

Irrigation District _____ Pres. _____ Pot. _____

Private System _____ Pres. _____ Pot. _____

Totals _____

Flood _____ Pump _____ Reservoir * Gravity ✓

Size and Capacity, Pump, etc. _____

Original Appropriator, Company _____ App. No. _____

Original Appropriator, Private _____ App. No. _____

Is the system an extension of another system? Yes _____ No ✓

Is all land irrigated from one system? Yes ✓ No _____

(If No, show break down on map)

Source of Water Musselshell R.

Acres Irrigated 19 48, 65

Potential Acres 0 Seeped 0

Explain _____

Condition of System good

Adequate Supply Yes ✓ No ✓

Explain stored water available?

Topography Terrace

Information From Keeper & field check

Remarks _____

STATE OF MONTANA

STATE ENGINEER'S OFFICE

WATER RESOURCES SURVEY

Code No. 6 C

County Golden Valley

T. 6 N. R. 20 E. Sec. 6

Photo No. 6-103

Address Ryegate

Address _____

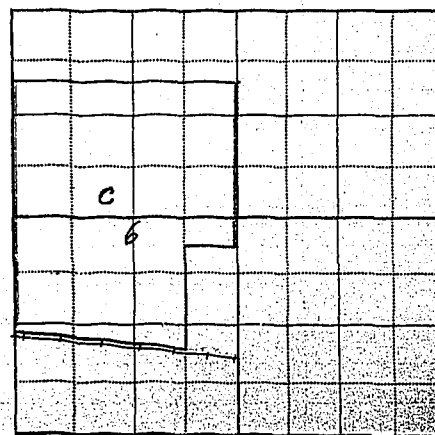

April 19, 1949

Mr. Chris Willems
Ryegate, Montana

Dear Mr. Willems:

In 1939 the State Legislature passed a law authorizing the State Engineer to investigate and compile a complete record of all water rights and water use in the State. In compliance with this law the State Engineer is now working in Golden Valley County compiling these data.

Enclosed herewith we are sending you two forms. The first one shows the ownership of your land, with the irrigated portion colored orange. We would like to have you check this map very carefully and make any and all corrections you may deem necessary.

As we do not have a water filing for this land we are sending you Form WR-D, which we would like to have you fill out in its entirety, and also give us any and all information you can regarding the Simms Mutual Ditch.

Remember, this is your water and your water rights that we are trying to help you with.

Very truly yours,

Gerald J. Oravetz
Assistant State Engineer

GJO/a
enc.

County Golden Valley

Farm Checked: Date.....7-27-48.....

By A.C.J.

STATE OF MONTANA
STATE ENGINEERS OFFICE
Water Resources Survey

T 6N R 20E Plat No.23

Photo No. 6-103.....

Legal Land Owner.....Neva & Noah Walters.....Address.....Ryegeat

Operator..... Address.....

Water is delivered by:— 1. Private System; 2. Ditch Company; 3. State Project; 4. Federal Project; 5. Irrigation District .

[illegible]

NOTE: R—Denotes Regular Irrigation. F—Flood Irrigation.

Adequate Supply: Yes. ☒ No. ☒ Explain..... stored water available

Remarks

[illegible]

...River Basin

Also in: Plat No.....	Twp.....	Rge.....	Plat No.....	Twp.....	Rge.....	Plat No.....	Twp.....	Rge.....
Plat No.....	Twp.....	Rge.....	Plat No.....	Twp.....	Rge.....	Plat No.....	Twp.....	Rge.....

Information From:

Field Survey

Block 21 Lots 3, 4, 5, 6, 7, 8, 9	5	4	8	2	1
7	8	9	10	11	12
18	17	16	15	14	13
19	20	21	22	23	24
30	29	28	27	26	25
31	32	33	34	35	36

Land Ownership.....

STATE OF MONTANA

State Engineer's Office

County Golden Valley
Code No. 6 TC

Twp. 6N Rge. 20E
Twp. _____ Rge. _____
Twp. _____ Rge. _____

Owning only irrigated land.
All ownership for dry land not shown.

WATER RESOURCES SURVEY
FARM MAP

Name of Land Owner Walters, Neva & Noah Address Py-gate
Name of Operator Same Address _____
Legal Description Lots 3,4,7,8,9 in Block 24, Sec. 6, Twp. 6N., Rge. 20E



Irrigated Land



Non-Irrigated Land



Potential Land Under Existing Facilities

Simms Mutual Ditch North

Please check the ownership outline of this land.

Located in Block 24, Sec. 6

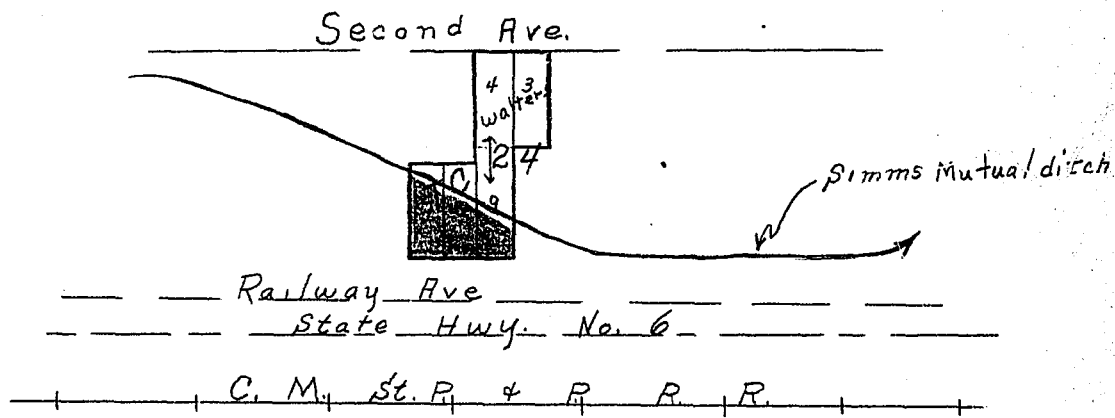

Scale 1" = 200ft.

DO NOT WRITE
IN SPACE BELOW

T. 6N-R. 20E
Code No. 6 TC System Simms Mutual Ditch Source of Water Musselshell R.
Basin Musselshell River Present 1.0 Potential 0 Maximum 1.0 R. X F. P. G. X S. ✓
Code No. _____ System _____ Source of Water _____
Basin _____ Present _____ Potential _____ Maximum _____ R. F. P. G. S.
Code No. _____ System _____ Source of Water _____
Basin _____ Present _____ Potential _____ Maximum _____ R. F. P. G. S.
Code No. _____ System _____ Source of Water _____
Basin _____ Present _____ Potential _____ Maximum _____ R. F. P. G. S.

If under Ditch Company, Irrigation District, or Government Project, state the number of shares or inches, acre feet, as the case may be in said system.

NOTE: R—Denotes Regular Irrigation. F—Flood Irrigation. P—Water diverted by means of pumping. G—Water diverted by gravity. S—Stored Water.

Information from A. L. B. Date 6-13-49

Form WR-D
Reporter 17383 IM 2-49

NOTICE
These forms are the
property of the State
of Montana and must
be returned.

STATE OF MONTANA

State Engineer's Office

WATER RESOURCES SURVEY

WATER RIGHT DATA

County Golden Valley
Code No. Lots 3,4,7,8,9

Name of Land Owner Neva & Noah Walters Address Ryegate, Montana
Name of Operator Same Address _____
Legal Description Lots 3,4,7,8,9 in Block 24, Sec. 6, Twp. 6N., Rge. 20E

We are asking you to help us protect your water right because in our records we are unable to find a recorded water right covering the above described land. We, therefore, would like to have you give us the information asked for in the following questions:

1. Was a water right filing ever made for this land.....Yes.....No. If yes, give us the following information:

Name of Appropriator	Stream	Land Description	Date App.	Date Filed	Miner's Inches Filed On

If no, can you give us the following information:

Name of First User	Date of First Use	Stream	Place of Use

2. Or is this land covered by a water right that was purchased from another water right.....Yes.....No.....

If yes, give us the amount of the inches purchased, from what original filing, and if possible the date of purchase and from whom purchased.

3. If this land is under an incorporated ditch company, mutual ditch company, irrigation district, federal project, or state project, give us the following information:

Name of Ditch System	Shares of Stock	Miner's Inches	Acre Feet	Assessed Acres	Type of System Pumping Gravity

4. Do you buy supplemental water... noYes.....No. If yes, from whom and how many inches, Cubic Feet Per Second, Acre Feet, as the case may be?

5. Give any other information that you think should be included for the protection of your water right. We are unable to answer much of the above - it is our understand that the Simms Ditch was a water right to all the land along the ditch, we use very little water, what is used is pumped out of the ditch by a small water pump.

Information from Noah Walters Date May 19th 1949

Farm Checked

By A. C. R.

Area Ryegate

Date 7/27/48

Legal Land Owner Walters, Neva & Noah

Operator _____

Water is delivered by:

Federal Project _____ Pres _____ Pot _____

Ditch Company Simms Mutual Pres 1.0 Pot 0

Irrigation District _____ Pres _____ Pot _____

Private System _____ Pres _____ Pot _____

Totals _____

Flood _____ Pump _____ Reservoir _____ Gravity ☒

Size and Capacity, Pump, etc. _____

Original Appropriator, Company _____ App. No. _____

Original Appropriator, Private _____ App. No. _____

Is the system an extension of another system? Yes _____ No ☒

Is all land irrigated from one system? Yes ☒ No _____

(If No, show break down on map)

Source of Water Muscle Shell R.

Acres Irrigated 19 48 1.0

Potential Acres 0 Seeped 0

Explain _____

Condition of System good

Adequate Supply Yes ☒ No ☒

Explain stored water available

Topography Terrace

Information From Field check

Remarks _____

STATE OF MONTANA

STATE ENGINEER'S OFFICE
WATER RESOURCES SURVEY

Code No. 6 TC

County Golden Valley

T. 6 N. R. 20 E. Sec. 6

Photo No. 6-103

Address Ryegate

Address _____

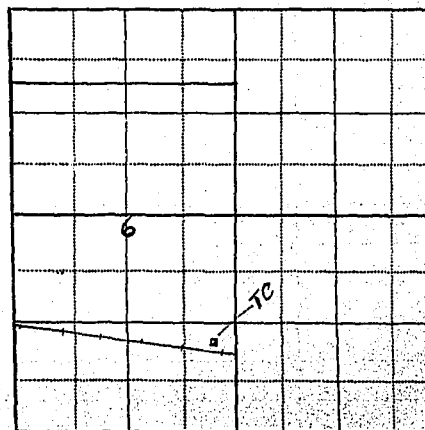

April 19, 1949

Neva & Noah Walters
Ryegate, Montana

Dear Sir:

In 1939 the State Legislature passed a law authorizing the State Engineer to investigate and compile a complete record of all water rights and water use in the State. In compliance with this law the State Engineer is now working in Golden Valley County compiling these data.

Enclosed herewith we are sending you two forms. The first one shows the ownership boundary of your land, with the lots that we show as irrigated colored in orange. We would like to have you check this map very carefully and make any corrections you may deem necessary.

As we do not have a water right covering this land we are sending you Form WR-D, which we would like to have you fill out in its entirety, and also give us any and all information you can regarding the Simms Mutual Ditch.

Remember, this is your water and your water rights that we are trying to help you with.

Very truly yours,

Gerald J. Oravetz
Assistant State Engineer

GJO/a
enc.

County Golden Valley

Farm Checked: Date.....6-23-48

By..... A.C.J.

Legal Land Owner..... John Osse

Operator

Water is delivered by:— (1.) Private System;

STATE OF MONTANA
STATE ENGINEERS OFFICE
Water Resources Survey

T 6N R 20E Plat No 23

Photo No. 6-82

Address

Address

4. Federal Project:

5. Irrigation District

2. Ditch Company:

3. State Project:

[illegible]

NOTE: R—Denotes Regular Irrigation. F—Flood Irrigation.

Adequate Supply: Yes. xx No. xx Explain... stored water available

Remarks.

River Basin

Information From:

Mrs. Osse

Also in: Plat No.....	Twp.....	Rge.....	Plat No.....	Twp.....	Rge.....	Plat No.....	Twp.....	Rge.....
Plat No.....	Twp.....	Rge.....	Plat No.....	Twp.....	Rge.....	Plat No.....	Twp.....	Rge.....

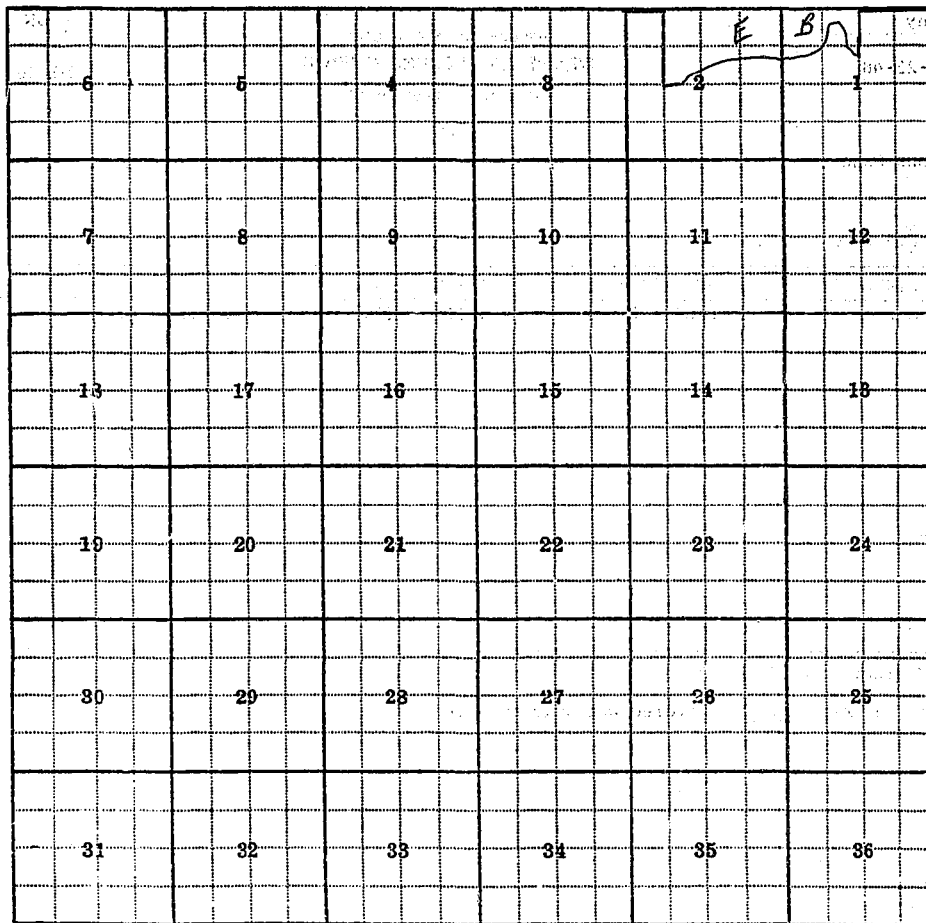

Land Ownership.....
.....
.....

Form WR-A
Reporter 17383 1M 2-49

These forms are the
property of the State
of Montana and must
be returned.

STATE OF MONTANA
State Engineer's Office
WATER RESOURCES SURVEY
WATER RIGHT DATA

County Golden Valley
Code No. 1B, 2E

Name of Land Owner John Osse Address Bygate, Montana
Name of Operator Same Address _____
Legal Description Lot 4 Sec. 1, Lots 1, 2, 3, Sec. 2, Twp. 6N., Rge. 20E

1. Our records show that the following water rights were filed on the above described land:

Code	Name of Appropriator	Stream	Land Description	Date App.	Date Filed	Miner's Inches Filed On
199	Ethel M. Broderson	Mshl. River	North of the R.R. & South of River Lots 3, 4 & So. of R/W in Lots 5 & 6 in Sec. 1; Lots 1, 2, 7 Sec. 2 in 6-20	6-1-32	11-1-33	300

2. Are these filings in use? Yes. No. Explain.

3. Have any of the above filings or any part of them been sold? Yes. No. If yes, give amount of inches sold and to whom transferred and from what original filing.

4. I have the following water rights that the State Engineer's Office have not shown in the above list:

Name of Appropriator	Stream	Land Description	Date App.	Date Filed	Miner's Inches Filed On

5. In addition, I have an irrigation system on which no recorded filing was ever made.

Name of First User	Date of First Use	Stream	Place of Use

6. Do you buy supplemental water? ☐ Yes. ☐ No. If yes, from whom and how many inches, C.F.S., Acre Feet, as the case may be?

7. Give any other information that you think should be included for the protection of your water right.

Information from _____ Date _____

STATE OF MONTANA

State Engineer's Office

WATER RESOURCES SURVEY
FARM MAP

Golden Valley

Code No. 1B, 2E

Twp 6N. Rge. 20E

Twp. _____ Rge. _____ Ownership covering
only irrigated land.
Twp. _____ Rge. _____ All ownership for
dry land in place.

Name of Land Owner.....John Osse.....Address.....Ryegate, Montana.....

Name of Operator..... Same

Address

Name of Operator..... Address.....
 Legal Description..... Lot 4 Sec.1, Lots 1,2,3 Sec. 2, Twp. 6N., Rge. 20E



Irrigated Land



Non-Irrigated Land



Potential Land Under Existing Facilities

Please check the ownership outline of this land.

Golden Valley County
Twp. 6N-Rge 20E

Potential Irrigation

Proj. 

Sec.

1, 2, 3

4, 5, 6

7, 8, 9, 16, 17, 18

10, 11, 12, 13, 14, 15

19, 20, 21, 25, 29, 30

22, 23, 24, 25, 26, 27

31, 32, 33, 34

34, 35, 36

in said sysem.

NOTE: R—Denotes Regular Irrigation. F—Flood Irrigation. P—Water diverted by means of pumping. G—Water diverted by gravity.
S—Stored Water.

Information from

4 L B

Date 6-13-49

DO NOT WRITE
IN SPACE BELOW

Code No. 2 E. T. G. N. - R. 20 E System 0.35c Pump Ditch Source of Water Musselshell River
 Basin Musselshell River Present 0 Potential 12.0 Maximum 12.0 R. ✓ F. ✓ P. ✓ G. ✓ S. ✓
 Code No. _____ System _____ Source of Water _____
 Basin _____ Present _____ Potential _____ Maximum _____ R. _____ F. _____ P. _____ G. _____ S. _____
 Code No. _____ System _____ Source of Water _____
 Basin _____ Present _____ Potential _____ Maximum _____ R. _____ F. _____ P. _____ G. _____ S. _____
 Code No. _____ System _____ Source of Water _____
 Basin _____ Present _____ Potential _____ Maximum _____ R. _____ F. _____ P. _____ G. _____ S. _____
 If under Ditch Company, Irrigation District, or Government Project, state the number of shares or inches, acre feet, as the case may be
 in said system.
 NOTE: R—Denotes Regular Irrigation. F—Flood Irrigation. P—Water diverted by means of pumping. G—Water diverted by gravity.
 S—Stored Water.
 Information from H. L. B. Date 6-13-49

Farm Checked

STATE OF MONTANA

FORM P-1 - GAZETTE (1963-24-1-47)

By A-C-J.

STATE ENGINEER'S OFFICE

Code No. 1B, 2E

Area Ryegate

WATER RESOURCES SURVEY

County Golden Valley

Date 6/23/48

T. 6N. R. 20E Sec. 2, 1

Photo No. 6-52

Legal Land Owner Osse, John

Address Ryegate

Operator Lot 4 - Sec. 8 - Lot 1-2-3

Address 2

Water is delivered by:

Federal Project _____ Pres. _____ Pot. _____

Ditch Company _____ Pres. _____ Pot. _____

Irrigation District _____ Pres. _____ Pot. _____

Private System ☒ Pres. 0 Pot. 12

Totals _____

Flood _____ Pump ☒ Reservoir _____ Gravity _____

Size and Capacity, Pump, etc. no pump, not irrigated for 6 yrs.

Original Appropriator, Company _____ App. No. _____

Original Appropriator, Private might be Braderson App. No. 179
(Show date of appropriation under Remarks)

Is the system an extension of another system? Yes _____ No ☒

Is all land irrigated from one system? Yes ☒ No _____

(If No, show break down on map)

Source of Water Musselshell R.

Acres Irrigated 19 47 0

Potential Acres 12.0 Seeped 0

Explain _____

Condition of System no pump at present

Adequate Supply _____ Yes ☒ No ☒

Explain stored water available

Topography R. bottom

Information From Mrs. Osse

Remarks No water Board water

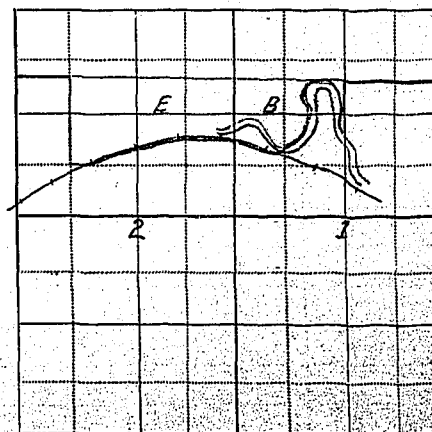



FRED E. BUCK, STATE ENGINEER
GERALD J. ORAVETZ, ASSISTANT

STATE OF MONTANA

STATE ENGINEER

BILLINGS, MONTANA

April 19, 1949

Mr. John Osse
Ryegate, Montana

Dear Mr. Osse:

In 1939 the State Legislature passed a law authorizing the State Engineer to investigate and compile a complete record of all water rights and water use in the State. In compliance with this law the State Engineer is now working in Golden Valley County compiling these data.

Enclosed herewith we are sending you two forms. The first one shows the part of your ownership that covers the potential irrigable land. For this land we would like to know whether or not you intend to irrigate it in the future.

On Form WR-A we are listing the one water filing that we have a record of. This we would like to have you check and tell us whether or not it applies to this land, and also fill in the remainder of the form, giving us any and all information you can so that we may have a complete record of your water rights and water use for your protection now and in the future.

Remember, this is your water and your water rights that we are trying to help you with.

Very truly yours,

*Ryegate, Mont.
May 18.*

Gerald J. Oravetz
Assistant State Engineer

GJO/a
enc.

Dear sir:

*In looking over my abstract,
I can not see that there are any
water rights with this ranch. I have
irrigated a garden with a small centrifugal
pump operated by an electric motor.
Otherwise I have used no irrigating water.
Sincerely, John Osse*

April 19, 1949

Mr. John Osse
Ryegate, Montana

Dear Mr. Osse:

In 1939 the State Legislature passed a law authorizing the State Engineer to investigate and compile a complete record of all water rights and water use in the State. In compliance with this law the State Engineer is now working in Golden Valley County compiling these data.

Enclosed herewith we are sending you two forms. The first one shows the part of your ownership that covers the potential irrigable land. For this land we would like to know whether or not you intend to irrigate it in the future.

On Form WR-1 we are listing the one water filing that we have a record of. This we would like to have you check and tell us whether or not it applies to this land, and also fill in the remainder of the form, giving us any and all information you can so that we may have a complete record of your water rights and water use for your protection now and in the future.

Remember, this is your water and your water rights that we are trying to help you with.

Very truly yours,

Gerald J. Oravet,
Assistant State Engineer

GJO/a
enc.

STATE ENGINEERS OFFICE
Water Resources Survey

Notice of Appropriation

1. County Golden Valley Book 3 Page 313 Record WR 199
(Signature is Ethel Broderson only)
2. Name of Appropriator Ethel M. Broderson Address Ryegate, Mont.
3. Date Appropriated 6-1-32 Date Filed 11-1-33
Amount Appropriated, Miners Inches 300, Cubic Feet per second 7 1/2
4. Name of Stream Musselshell River Tributary _____ Basin Mo. River
5. Point of Diversion at a point upon its south bank in the NW corner of Lot 7 of Sec. 2-6-20,
where the water is first started by a certain pump drawing the water from the bottom
Sec. _____ Twp. _____ Rge. _____ Bank of Stream _____
of said river on to its bank and into said ditch, thence running in a northerly
direction to the R/W of C.M. St. P. & P. Ry. thence east and also on the south bank
(See #9 below)
6. Purpose Irrigate, domestic and other purposes
7. Description of System Pump and ditches, which said ditch is 48" by 30" in size and
carries or conducts 300" or 7 1/2 cu. ft. of water from said river.
8. Land Description of Intended Place of Use _____
North of the C.M. St. P. & P. Ry. and South of Mahl. River, included in lots 3 & 4
and south of the R/W of said R.R. in lots 5 & 6 of Sec. 1 and lots 1, 2, & 7 of
Section 2-6-20, and south of the R/W of C.M. St. P. & P. R.R. tracks. (OVER)
9. Remarks (Pertaining to Use, etc.) _____
said river on the north side of the C.M. St. P. & P. Ry. on Lot 4, Sec. 1-6-20, and into
ditch for said north side.

Decree

10. Case No. _____ Date _____ Amt. Decreed: M. I. _____ C. F. S. _____
11. To Whom Decreed _____ Address _____
12. Name of Ditch _____ Maximum Capacity (C. F. S.) _____
13. Date of Priority _____ Purpose _____
14. Land Description of Place of Use as Decreed _____

15. Remarks (Present Use Status, etc.) _____

Lot 3 North of River

Lot 4 North of Ry. in 1-6-20 - 82 Ac.- Dina Maria Van Der Voort, Hedgesville, Mont.

Lots 5, 6, 11, 12, 13, 14; SW $\frac{1}{4}$;

Lot 4 So. of Ry.- 20 Ac. in 1-6-20

Lot 3 South of River less R/W of 1-6-20 - 427 Ac.- Ethel M. Broderson, Ryegate, Mont.

Lot 7--- Sec. 2-6-20 - 40 Ac.- Ethel Broderson, Ryegate, Mont.

All that part of Govt. Lots 1, 2, 3 lying south of R/W and 1 ac Road North of Ry
in Lot 3 Sec. 2-6-20 - 21 Ac.- ~~7/8~~ Ethel Broderson, Ryegate, Mont.

Office of Administration

National Insurance Policy

ATTLE ENGINEERING OFFICE

Township 6 North, Range 21 East

Code	Owner	Operator
1A	G.H. & Don Belcher	Same
2B	John Beslanowitch	Same
23A	Geo. C. Banning	No operator
5A, 6A	Andrew E. Dale	
2A	E. D. Forsyth	Same
23B	Axel Johnson	Same
22A	Jno. B. Lammers & Alex N. Munn	Same
21A, 29A, 30A, 31A	Harry Van DerVoort	Same

STATE OF MONTANA

STATE ENGINEER'S OFFICE

WATER RESOURCES SURVEY

Township 130 200 Range 6 North 21 East County Golden Valley

6	5	4	3	215	205	202
7	8	9	10	11	12	
18	17	16	15	14	13	
19	20	21	22	23	24	
30	29	28	27	26	25	
31	32	33	34	35	36	

Township 6 North Range 21 East

No.

80

81

84

85

86

93

97

98

99

100

130

200

202

205

215

424 yll

Township 6 North, Range 21 East

<u>No.</u>	<u>Name of Appropriator</u>	<u>Name of Stream</u>	<u>Date App.</u>	<u>Date Filed</u>	<u>M.I.</u>
80	Dolve, Elmer J.	(Big) Coulee Creek	11-22-24	11-22-24	500
81	Dolve, Nels N.	(Big) Coulee Creek	7-20-09	7-21-09	100
84	Fifield, Wm. F.	(Big) Coulee Creek	7-10-09	7-12-09	40
85	Fratt, David	(Big) Coulee Creek	12-11-00	12-12-00	500
86	Fratt, David	(Big) Coulee Creek	12-10-00	12-12-00	500
93	Johnson, Axel	(Big) Coulee Creek	9-22-30	9-22-30	250
97	Olson, John A.	(Big) Coulee Creek	6-11-26	6-17-26	300
98	Rasmussen, Anton	(Big) Coulee Creek	3-18-08	3-20-08	320
99	Rasmussen, Anton	(Big) Coulee Creek	12-13-09	12-15-09	All
100	Rasmussen, Anton	(Big) Coulee Creek	12-11-25	12-12-25	320
130	Dale, Andrew E.	Fish Creek	12-4-37	12-4-37	320
200	Dale, Andrew E.	Musselshell River	1-22-12	1-23-12	320
202	Fratt, David (Same as #132 M.I. C.) (#1461. Mungler)	Musselshell River	7-17-84	10-21-85	1000
205	Hanson, Alfred	Musselshell River	6- -08	8-22-31	300
215	Garfield, Ruth Soule	Nine Mile Creek	1-6-31	1-22-31	---
424 yll	Sundbuth, Wm. H.	(Big) Coulee Creek	4-21-02	5-1-02	1000

County.....Golden Valley

Farm Checked: Date 8-26-48

By J.E.C.

STATE OF MONTANA
STATE ENGINEERS OFFICE
Water Resources Survey

T 6N R 21E Plat No 24

Photo No. 6-59

Legal Land Owner. George C. Banning Address. Columbus, Ohio

Operator..... Address.....

Water is delivered by:— ① Private System; 2. Ditch Company; 3. State Project; 4. Federal Project; 5. Irrigation District

[illegible]

NOTE: R—Denotes Regular Irrigation. F—Flood Irrigation.

Adequate Supply: Yes..... No ☒ Explain depends partly on rainfall.....

Remarks:

...River Basin.

Also in: Plat No.....	Twp.....	Rge.....	Plat No.....	Twp.....	Rge.....	Plat No.....	Twp.....	Rge.....
Plat No.....	Twp.....	Rge.....	Plat No.....	Twp.....	Rge.....	Plat No.....	Twp.....	Rge.....

Information From:
Field Survey

6	5	4	3	2	1
7	8	9	10	11	12
13	14	15	16	17	18
19	20	21	22	23	24
25	26	27	28	29	30
31	32	33	34	35	36

Land Ownership _____

Form WR-A
Report No. 47382 UM 2-49

These forms are the
property of the State
of Montana and must
be returned.

STATE OF MONTANA
State Engineer's Office
WATER RESOURCES SURVEY
WATER RIGHT DATA

County Golden Valley
Code No. 23A
g4

Name of Land Owner George C. Banning Address 1924 Bedford Rd., Columbia, Ohio
Name of Operator No Operator Address _____
Legal Description W $\frac{1}{2}$ Sec. 23, Twp. 6N., Rge. 21E

1. Our records show that the following water rights were filed on the above described land:

Code	Name of Appropriator	Stream	Land Description	Date App.	Date Filed	Miner's Inches Filed On
97	John A. Olson	Big Coulee Creek	NW $\frac{1}{4}$ Sec. 23 in 6-21	6-11-26	6-17-26	300

2. Are these filings in use:.....Yes.....No. Explain.....
.....
3. Have any of the above filings or any part of them been sold:.....Yes.....No. If yes, give amount of inches sold and to whom trans-
ferred and from what original filing.....
.....

4. I have the following water rights that the State Engineer's Office have not shown in the above list:

Name of Appropriator	Stream	Land Description	Date App.	Date Filed	Miner's Inches Filed On

5. In addition, I have an irrigation system on which no recorded filing was ever made.

Name of First User	Date of First Use	Stream	Place of Use

6. Do you buy supplemental water? ☐ Yes. ☐ No. If yes, from whom and how many inches, C.F.S., Acre Feet, as the case may be?.....
.....
7. Give any other information that you think should be included for the protection of your water right.....
.....

Information from..... Date.....

Form WR-B
Reporter 17362 1M-2-40

STATE OF MONTANA

State Engineer's Office

County Golden Valley

Twp. 6N. Rge. 21E

Code No. 23A

Twp. Rge.

WATER RESOURCES SURVEY

Twp. Rge.

FARM MAP

Name of Land Owner George C. Banning

Address 1924 Bedford Rd., Columbia, Ohio

Name of Operator No Operator

Address

Legal Description W. Sec. 23, Twp. 6N., Rge. 21E



Irrigated Land



Non-Irrigated Land



Potential Land Under Existing Facilities

North

Please check all
land.

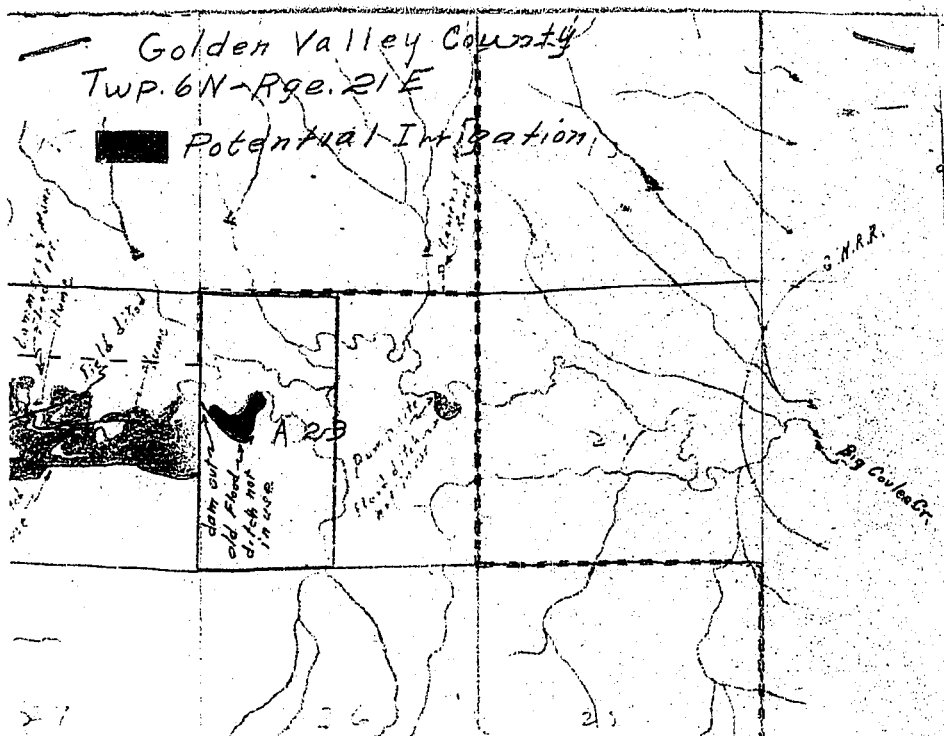

DO NOT WRITE
IN SPACES BELOW

T. 6N-R. 21E
Code No. 23A System Old Flood Ditch (water use) Source of Water Big Coulee Creek
Basin Musselshell River Present 0 Potential 10.0 Maximum 10.0 R. F P. G S. S
Code No. System Source of Water
Basin Present Potential Maximum R. F P. G S. S
Code No. System Source of Water
Basin Present Potential Maximum R. F P. G S. S
Code No. System Source of Water
Basin Present Potential Maximum R. F P. G S. S

If under Ditch Company, Irrigation District, or Government Project, state the number of shares or inches, acre feet, as the case may be in said system.

NOTE: R—Denotes Regular Irrigation. F—Flood Irrigation. P—Water diverted by means of pumping. G—Water diverted by gravity.
S—Stored Water.

Information from H. L. B.

Date 6-14-49

Farm Checked

STATE OF MONTANA

Code No. 23A

By JEC

STATE ENGINEER'S OFFICE
WATER RESOURCES SURVEY

County Golden Valley

Area Cushman

County Golden Valley

Date ~~FF~~ 8/26/48

T. 6N R. 21E S. 23

Photo No. MA-659

Legal Land Owner Banning, George C.

Address 1924 Bedford Rd., Columbus, Ohio

Operator no op.

Address

Water is delivered by:

Federal Project _____ Pres. _____ Pot. _____

Ditch Company _____ Pres. _____ Pot. _____

Irrigation District _____ Pres. _____ Pot. _____

Private System ☒ Pres. 0 Pot. 10.0

[illegible]

Flood ☒ Pump _____ Reservoir _____ Gravity _____

Size and Capacity, Pump, etc.

Original Appropriator, Company _____ App. No. _____

Original Appropriator, Private Olsen, John A. App. No. 97

Is the system an extension of another system? Yes _____ No ☒ _____

Is all land irrigated from one system? Yes ☒ No ☐

(If No, show break down on map)

Source of Water. Big Coulee Creek

Acres Irrigated 1948 0

Potential Acres 10.0 Seeped _____

Explain _____

Condition of System run down, not used for many year

Adequate Supply . . . Yes _____ No ☒

Explain depended on rainfall partly

Topography Creek bottom

Information From Field Survey

Remarks _____

Sec 23 T6N R21E

[illegible]