

12N-8E

FORM D-1 - GAZETTE 1964-24-1-47

STATE OF MONTANA
STATE ENGINEER'S OFFICE
WATER RESOURCES SURVEY

20

Township 12 North Range 8 East County Meagher

				1789 ✓ 1829 ✓		
6	5	4	3	2	1	
7	8	9	10	11	12	
18	17	16	15	14	13	
19	20	21	22	23	24	
30	29	28	27	26	25	
291 ✓ 1761 ✓						
31	32	33	34	35	36	

Township 12 North Range 8 East

Township 12 North, Range 3 East

<u>No.</u>	<u>Name of Appropriator</u>	<u>Name of Stream</u>	<u>Date App.</u>	<u>Date Filed</u>	<u>M.I.</u>
291	Bonine, Elwood	Bonine Creek	6- 1918	9-16-19	100
1761	Bonine, Elwood A.	Sheep Creek	6-10-19	9-16-19	100
1789	U. S. A.	Sheep Creek	4-26-39	4-26-39	40
2829	U. S. A.	Unnamed Spring	4-26-39	4-26-39	40

2 ditches out of Bonine Creek were filed on by Alward Bonine
Filing on Sheep Creek was never proved upon.

Bonine built 1 ditch out of Ranch Creek but did not file
on a water right. Mr. Russel intends to file on this soon.
The ditch was probably built about 1935 by Bonine

some of the land on Ranch Creek has ^{been} subdivided and sold as
Cabin site lots. Water is taken from Ranch Cr. by means of 3"
pipe to supply Cabins

191	Bonine, Alward	Bonine creek	6 - 1918	100
1761	" "	Sheep creek	6-10-19	100

STATE OF MONTANA
State Engineer's Office
WATER RESOURCES SURVEY

Township 12 N Range 8 E County Meagher

6	5	4	3	2	1
7	8	9	10	11	12
18	17	16	15	14	13
19	20	21	22	23	24
30	29	28	27	26	25
31	32	33	34	35	36

E. Bonine - Forest Green Resort - Now Stanley Russell ow-op

See Forest Service map for ownership

Township 12 N Range 8 E

State Engineer's Office
WATER RESOURCES SURVEY
FARM MAP

County Meagher

Code No. 31A, 32A

Twp. 12N Rge. 8E # 20
Twp. _____ Rge. _____
Twp. _____ Rge. _____

Name of Land Owner.....Address.....
Name of Operator.....Address.....
Legal Description.....

Irrigated Land Non-Irrigated Land Potential Land Under Existing Facilities
North

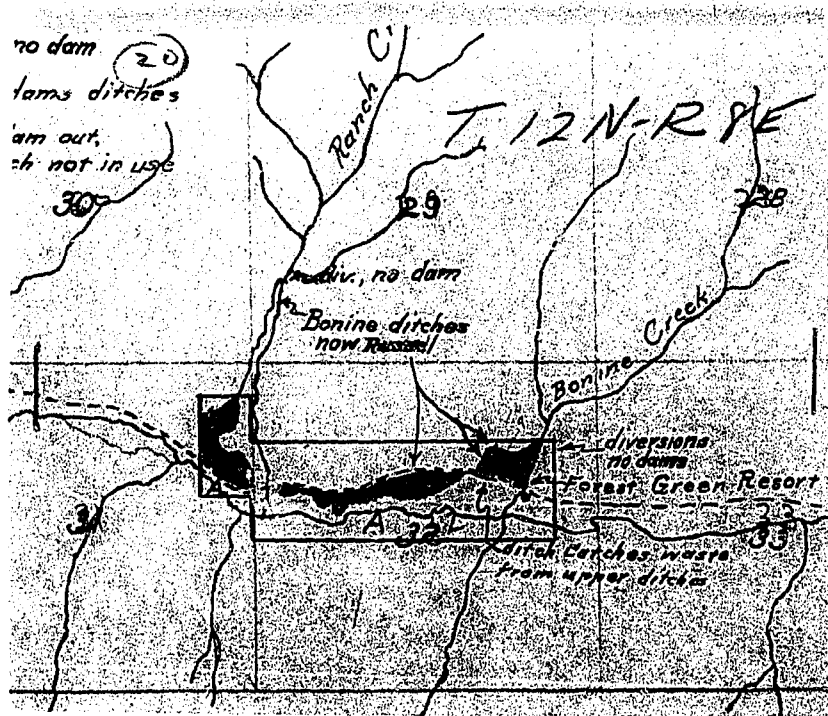

Code No. 31A System Bonine Ditch (Now Russell) Source of Water Ranch Creek
Basin Smith River Present 13.0 Potential 0 Maximum 13.0 R. F P. G V. S
Code No. 32A System Bonine Ditches (Now Russell) Source of Water Bonine Creek
Basin Smith River Present 23.0 Potential 0 Maximum 23.0 R. F P. G V. S
Code No. _____ System _____ Source of Water _____
Basin _____ Present _____ Potential _____ Maximum _____ R. F P. G V. S
Code No. _____ System _____ Source of Water _____
Basin _____ Present _____ Potential _____ Maximum _____ R. F P. G V. S

If under Ditch Company, Irrigation District, or Government Project, state the number of shares or inches, acre feet, as the case may be in said system.

NOTE: R—Denotes Regular Irrigation. F—Flood Irrigation. P—Water diverted by means of pumping. G—Water diverted by gravity. S—Stored Water.

Information from H. L. B.

Date 5/24/50

#20

Farm Checked

FORM F-1 REPORTER IM 3-49 17380

By J.E.C.

STATE OF MONTANA

Code No. _____

State Engineer's Office

County Meagher & Cascade Co.

Area Sheep Creek

WATER RESOURCES SURVEY

T. 12N R. 8E Sec. 2 & 3

Date Sept. 22, 1949

Photo No. MA-38-172 (not in field)

Legal Land Owner U.S.A.

Address _____

Operator Forest Service

Address _____

Water is delivered by:

Federal Project _____ Pres. _____ Pot. _____

Ditch Company _____ Pres. _____ Pot. _____

Irrigation District _____ Pres. _____ Pot. _____

Private System _____ Pres. _____ Pot. _____

Totals _____

Flood _____ Pump Reservoir Gravity

Size and Capacity, Pump, etc. hydraulic ram f

Original Appropriator, Company _____ App. No. _____

Original Appropriator, Private U.S. App. No. 1789, 2829

Is the system an extension of another system? Yes _____ No

Is all land irrigated from one system? Yes _____ No

(If No, show break down on map)

Source of Water Sheep Creek & unnamed Spring

Acres Irrigated 19 _____, for domestic use only

Potential Acres _____ Seeped _____

Explain _____

Condition of System _____

Adequate Supply Yes _____ No _____

Explain _____

Topography _____

Information From _____

Remarks This system consists of dam near head of

Sheep Cr. to catch water from Spring. Water operates hydraulic ram which raises water to Campground at top of Kings Hill pass. Water is raised 189 ft. to storage tanks.

no map

needed

Started
 Mumbree ~~filed~~ Sheep to Newlan Supply Canal
 Cleared Right of way but never started the ditch
 It was filed on by Mumbree, ^{A.B. Cook} ~~Wm~~, and later
 by Axel Holstrom who finished the ditch

1789	U.S.A.	Sheep lev.	4-26-39	40
2829	"	Unnamed lev.	"	40

State Engineer's Office

County Meagher

Twp 12N Rge 8E 20V

Code No. 2, 3

Twp _____ Rge _____

WATER RESOURCES SURVEY

Twp _____ Rge _____

FARM MAP

Name of Land Owner U.S. (Forest Service) Address _____

Name of Operator _____ Address _____

Legal Description _____

Irrigated Land

Non-Irrigated Land
North

Potential Land Under Existing Facilities

No Map Needed

Code No. _____ System _____ Source of Water _____

Basin _____ Present _____ Potential _____ Maximum _____ R F P G S

Code No. _____ System _____ Source of Water _____

Basin _____ Present _____ Potential _____ Maximum _____ R F P G S

Code No. _____ System _____ Source of Water _____

Basin _____ Present _____ Potential _____ Maximum _____ R F P G S

Code No. _____ System _____ Source of Water _____

Basin _____ Present _____ Potential _____ Maximum _____ R F P G S

Code No. _____ System _____ Source of Water _____

Basin _____ Present _____ Potential _____ Maximum _____ R F P G S

Code No. _____ System _____ Source of Water _____

Basin _____ Present _____ Potential _____ Maximum _____ R F P G S

Code No. _____ System _____ Source of Water _____

Basin _____ Present _____ Potential _____ Maximum _____ R F P G S

Code No. _____ System _____ Source of Water _____

Basin _____ Present _____ Potential _____ Maximum _____ R F P G S

If under Ditch Company, Irrigation District, or Government Project, state the number of shares or inches, acre feet, as the case may be in said system.

NOTE: R—Denotes Regular Irrigation. F—Flood Irrigation. P—Water diverted by means of pumping. G—Water diverted by gravity. S—Stored Water

Information from _____ Date _____

State Engineer's Office
WATER RESOURCES SURVEY
FARM MAP

County Meagher
Code No. 1A, 2A, 12A

Twp. 11N Rge. 2E
Twp. 11N Rge. 3E
Twp. _____ Rge. _____

Name of Land Owner Lind, Lydia Address White Sulphur Springs
Name of Operator Same Address " " "
Legal Description _____



Irrigated Land



Non-Irrigated Land
North



Potential Land Under Existing Facilities

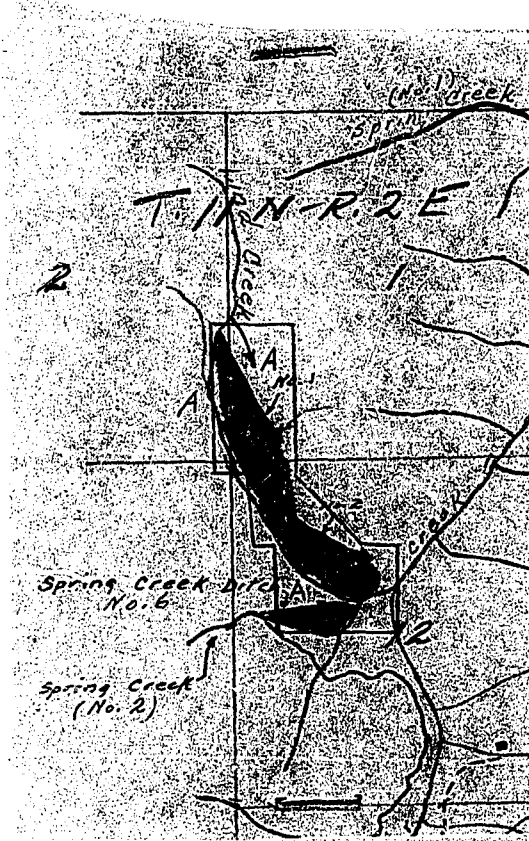

See Master Map, T 11N-R. 3E # 22

Code No. <u>1A, 2A, 12A</u>	System <u>Lind Ditch No. 1</u>	Source of Water <u>Lind Creek</u>
Basin <u>Smith River</u>	Present <u>33.0</u> Potential <u>0</u> Maximum <u>33.0</u>	R <u>✓</u> F <u>✓</u> P <u>✓</u> G <u>✓</u> S <u>✓</u>
Code No. <u>12A</u>	System <u>Lind Ditch No. 2</u>	Source of Water <u>Lind Creek</u>
Basin <u>Smith River</u>	Present <u>25.0</u> Potential <u>0</u> Maximum <u>25.0</u>	R <u>✓</u> F <u>✓</u> P <u>✓</u> G <u>✓</u> S <u>✓</u>
Code No. <u>12A</u>	System <u>Spring Creek Ditch (No. 2)</u>	Source of Water <u>Spring Creek (No. 2)</u>
Basin <u>Smith River</u>	Present <u>7.0</u> Potential <u>0</u> Maximum <u>7.0</u>	R <u>✓</u> F <u>✓</u> P <u>✓</u> G <u>✓</u> S <u>✓</u>
Code No. _____	System _____	Source of Water _____
Basin _____	Present _____ Potential _____ Maximum _____	R <u>✓</u> F <u>✓</u> P <u>✓</u> G <u>✓</u> S <u>✓</u>

If under Ditch Company, Irrigation District, or Government Project, state the number of shares or inches, acre feet, as the case may be in said system.

NOTE: R—Denotes Regular Irrigation. F—Flood Irrigation. P—Water diverted by means of pumping. G—Water diverted by gravity. S—Stored Water.

Information from H. L. B.

Date 5/24/50

Farm Checked

STATE OF MONTANA

Code No. 1A-2A-12A

By Dave & Joe
Beaver Creek
Area 7/13/49

STATE ENGINEER'S OFFICE
WATER RESOURCES SURVEY

County MERCER

T. 11N R. 2E Sec. 1, 2, 12

Date 7/13/49

Photo No. 16A-155

Legal Land Owner Kind, Lydia

Address White Sulphur

Operator Same

Address " "

Water is delivered by:

Federal Project _____ Pres. _____ Pot. _____

Ditch Company _____ Pres. _____ Pot. _____

Irrigation District _____ Pres. _____ Pot. _____

Private System Gravity ditches Pres. _____ Pot. _____

Totals _____

Flood _____ Pump _____ Reservoir _____ Gravity

Size and Capacity, Pump, etc. _____

Original Appropriator, Company _____ App. No. _____

Original Appropriator, Private _____ App. No. _____

Is the system an extension of another system? Yes _____ No _____

Is all land irrigated from one system? Yes _____ No _____

(If No, show break down on map)

Source of Water Kind Creek,

Acres Irrigated 19 _____

Potential Acres _____ Seeped _____

Explain _____

Condition of System _____

Adequate Supply Yes _____ No _____

Explain _____

Topography _____

Information From _____

Remarks No. 1 Ditch and No. 2 Ditch

T11N - R.2E

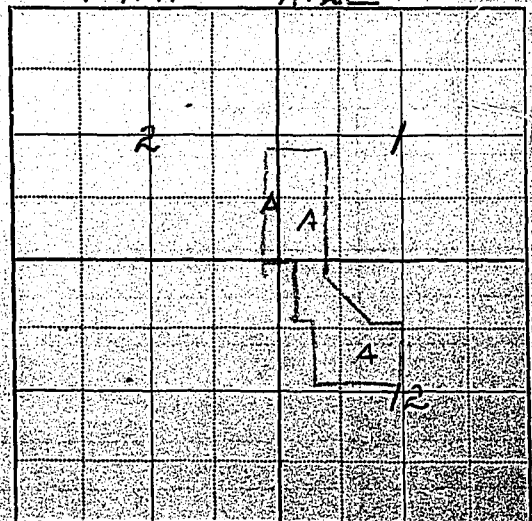

State Engineer's Office
WATER RESOURCES SURVEY
FARM MAP

County Meagher
Code No. 6A, 7B

Twp. 11N Rge. 3E
Twp. 11N Rge. 2E
Twp. _____ Rge. _____

Name of Land Owner Lind, Lyda Address White Sulphur Springs
Name of Operator Same Address " " "
Legal Description _____

Irrigated Land Non-Irrigated Land Potential Land Under Existing Facilities
North

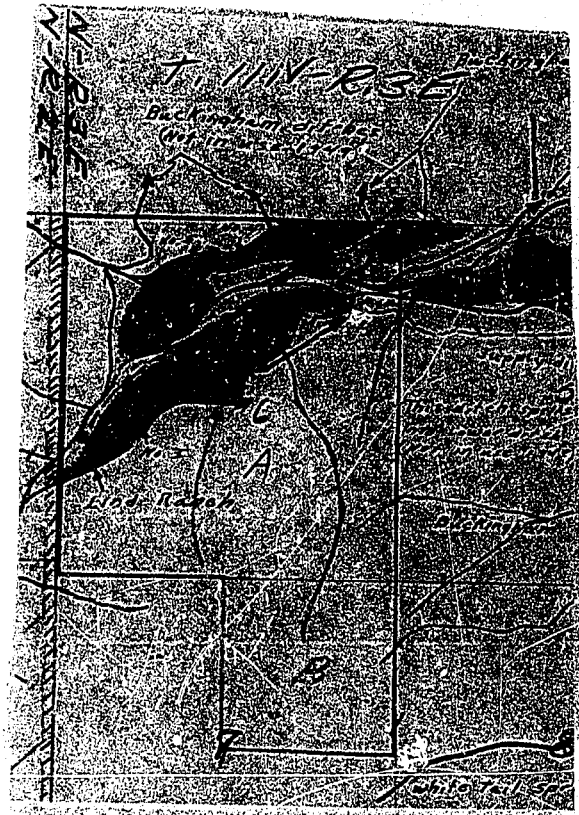

Code No. <u>6A</u>	System <u>Lind Ditch No. 3</u>	Source of Water <u>Beaver Creek</u>
Basin <u>Smith River</u>	Present <u>82.0</u> Potential <u>0</u> Maximum <u>82.0</u>	R. _____ F. <input checked="" type="checkbox"/> P. _____ G. <input checked="" type="checkbox"/> S. _____
Code No. <u>6A</u>	System <u>Lind Ditch No. 4</u>	Source of Water <u>Spring Cr. & Beaver Cr.</u>
Basin <u>Smith River</u>	Present <u>45.0</u> Potential <u>0</u> Maximum <u>45.0</u>	R. _____ F. <input checked="" type="checkbox"/> P. _____ G. <input checked="" type="checkbox"/> S. _____
Code No. <u>6A</u>	System <u>Lind Ditch No. 5</u>	Source of Water <u>Spring Cr. & Beaver Cr.</u>
Basin <u>Smith River</u>	Present <u>9.0</u> Potential <u>0</u> Maximum <u>9.0</u>	R. _____ F. <input checked="" type="checkbox"/> P. _____ G. <input checked="" type="checkbox"/> S. _____
Code No. <u>6A</u>	System <u>Lind Ditch ? (Number)</u>	Source of Water <u>Beaver Creek</u>
Basin <u>Smith River</u>	Present <u>4.5</u> Potential <u>0</u> Maximum <u>4.5</u>	R. _____ F. <input checked="" type="checkbox"/> P. _____ G. <input checked="" type="checkbox"/> S. _____

If under Ditch Company, Irrigation District, or Government Project, state the number of shares or inches, acre feet, as the case may be in said system.

NOTE: R—Denotes Regular Irrigation. F—Flood Irrigation. P—Water diverted by means of pumping. G—Water diverted by gravity. S—Stored Water.

Information from A. L. B. Date 5/24/50

STATE OF MONTANA

State Engineer's Office

WATER RESOURCES SURVEY

FARM MAP

County Moore

Code No. 6A, 7B

Twp. 11N Rge. 3E
Twp. 11N Rge. 2E
Twp. _____ Rge. _____

Owner Lind, Lyda Address White Sulphur Springs
Same Address " " "

Non-Irrigated Land
North

Potential Land Under Existing Facilities

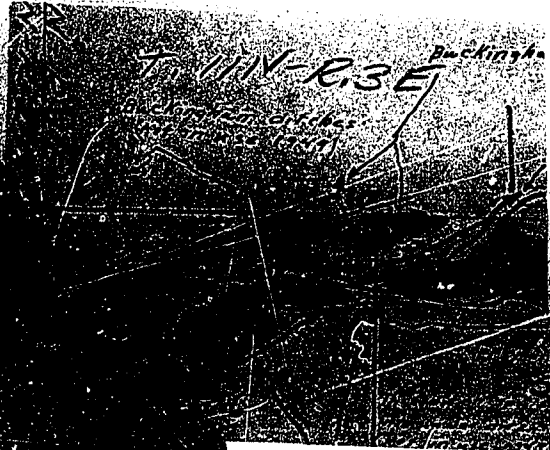

Code No. 6A System Buckingham Ditch Source of Water Beaver Creek
 Basin Smith River Present 5.0 Potential 0 Maximum 5.0 R. ✓ F. ✓ P. ✓ G. ✓ S. ✓

Code No. _____ System _____ Source of Water _____
 Basin _____ Present _____ Potential _____ Maximum _____ R. _____ F. _____ P. _____ G. _____ S. _____

Code No. _____ System _____ Source of Water _____
 Basin _____ Present _____ Potential _____ Maximum _____ R. _____ F. _____ P. _____ G. _____ S. _____

Code No. _____ System _____ Source of Water _____
 Basin _____ Present _____ Potential _____ Maximum _____ R. _____ F. _____ P. _____ G. _____ S. _____

If under Ditch Company, Irrigation District, or Government Project, state the number of shares or inches, acre feet, as the case may be in said system.

NOTE: R—Denotes Regular Irrigation. F—Flood Irrigation. P—Water diverted by means of pumping. G—Water diverted by gravity. S—Stored Water.

Information from H. L. B. Date 5/24/50

Watson Spread) - Top 11N-Rge 3E - ~~11N-Rge 3E~~
 Deer Gulch - Two ditches take out of
 Sec 20 - Follow hillside one ditch on each
 side of Gulch. To irrigate hay.
 App. - No. 725 Sec. 20, 21. APPROX. 15 ac. Dunbar
160 NT

Lambing Camp Creek
 Two ditches sec. 20 out of Lambing Camp Cr.
 App. - No 1226 - One ditch on each side of
 creek - irrigates about 35 acres. A. H. Watson - 160 NT

Beaver Dam Creek.
 In Sec. ~~20~~ - no App. shown.
 One ditch not used for many years
 needs cleaning. ^{To} irrigates pasture.

Benton Gulch
 upper ditch - Out of sec. 32 old ditch now out of
 use partly cut out by gold dredge and
 county road. Potential about 45 ac.
 See Benton Gulch decree.
 lower ditch - heads in sec. 33 - ditch in fair
 condition - irrigates about 70 acres.

Vermont Creek. App. 2200 - 2199
 High and low ditch out of sec 28 and turns
 into sec 33. ~~potential~~ ^(Potential) about 10 to 15 ac. Hay
 and pasture. Also ditch sec 32 - not in use.
 (Note) - Present acreage on farm of approx 300 ac.
 is total of all Watson irrigation
 Potential of 250 acres is proposed by
 clearing of some timber for Hay land.

2199	Watson, A. H.	Vermont Creek	7-20-89	8-29-10	250
2200	Watson, Sarah A.	" "	2-20-03	4-1-07	160

White Tail Spring - SE $\frac{1}{4}$, Sec 8 - 11N - R. 3E
Watson says he filed on it between
1917 and 1920. We didn't find a filing
on it. - Says it was filed under Watson Bros.
July - 12, 49.

Additional information from Elmer Watson
Cottonwood Creek - Sec. 18, 17, 8 - Two ditches
One ditch heads in sec. 17 - The other in
Sec. 18. irrigates Hay & pasture.

App. No. 639 - Alexander Nelson Cottonwood Cr. 1-16-04 M.I.
200

Unnamed Spring - App. No. 2768 Sec. 15 -
Spring house and ditch half mile long
Elmer Watson & another fellow dug ditch
by hand - Time ditch was dug year
Frisco Earthquake. Lulla Nelson 4-14-03 150 M.I.

Cottonwood Creek.

unnamed spring - App. No. 2765 - sec. 17.
Main house uses water from spring.
Also land south of road irrigated.
from spring. Alexander Watson 3-10-04 4-1-07 150 M.I.

Form Checked

FORM F-1 REPORTER 1M 3-49 17380

By Dave & Joe

Code No. _____

Area Watson P.O.

STATE OF MONTANA
State Engineer's Office
WATER RESOURCES SURVEY

County Meagher

Date 7/8/49

T. 11 N. R. 3 E. Sec. 17, 18, 8

Photo No. 16A-196

Legal Land Owner Watson, Art

Address White Sulphur

Operator Same

Address " "

Water is delivered by:

Federal Project _____ Pres. _____ Pot. _____

Ditch Company _____ Pres. _____ Pot. _____

Irrigation District _____ Pres. _____ Pot. _____

Private System Gravity ditches Pres. _____ Pot. _____

Totals _____

Flood Pump _____ Reservoir _____ Gravity

Size and Capacity, Pump, etc. _____

Original Appropriator, Company _____ App. No. 639

Original Appropriator, Private _____ App. No. _____

Is the system an extension of another system? Yes _____ No _____

Is all land irrigated from one system? Yes _____ No _____

(If No, show break down on map)

Source of Water Cottonwood Creek and Springs

Acres Irrigated 1949

Potential Acres _____ Seeped _____

Explain _____

Condition of System Good

Adequate Supply Yes No _____

Explain Large part of area is spring feed

Topography Slope & Creek bottom

Information From _____

Remarks Land south of road into main house irr. by spreader ditches from creek and big spring near house.

See Master Form.

Farm Checked

FORM F-1 REPORTER IN 3-49 17380

STATE OF MONTANA

State Engineer's Office

WATER RESOURCES SURVEY

By Dave & Joe

Code No

Area Watson P.O.

County Meagher

Date 7/8/49

T. 11N R. 3E Sec. 20, 21

Photo No. 16A-196

Legal Land Owner Watson, Art.

Address White Sulphur

Operator Same

Address " "

Water is delivered by:

Federal Project _____ Pres. _____ Pot. _____

Ditch Company _____ Pres. _____ Pot. _____

Irrigation District _____ Pres. _____ Pot. _____

Private System Gravity ditches Pres. _____ Pot. _____

Totals _____

Flood Pump _____ Reservoir _____ Gravity

Size and Capacity, Pump, etc. _____

Original Appropriator, Company _____ App. No. _____

Original Appropriator, Private _____ App. No. 725

Is the system an extension of another system? Yes _____ No _____

Is all land irrigated from one system? Yes _____ No _____

(If No, show break down on map)

Source of Water: Deer Creek

Acres Irrigated 19 49, Approx 15 acres

Potential Acres _____ Seeped _____

Explain _____

Condition of System Good

Adequate Supply..... Yes No _____

Explain Enough for his hay most years

Topography Slope

Information From _____

Remarks _____

See Master Form.

Farm Checked

FORM F-1 REPORTER IM 3-49 17360

STATE OF MONTANA

State Engineer's Office

WATER RESOURCES SURVEY

By Dave & Joe

Code No. _____

Area Watson P.O.

County Meagher

Date 7/8/49

T. 11N R. 3E Sec 20

Legal Land Owner Watson, Art

Photo No. 16A-196

Address White Sulphur

Operator same

Address " "

Water is delivered by:

Federal Project _____ Pres. _____ Pot. _____

Ditch Company _____ Pres. _____ Pot. _____

Irrigation District _____ Pres. _____ Pot. _____

Private System Gravity ditches Pres. _____ Pot. _____

Totals _____

Flood Pump _____ Reservoir _____ Gravity

Size and Capacity, Pump, etc. _____

Original Appropriator, Company _____ App. No. _____

Original Appropriator, Private _____ App. No. 1226

Is the system an extension of another system? Yes _____ No _____

Is all land irrigated from one system? Yes _____ No _____

(If No, show break down on map)

Source of Water Lambing Camp Creek

Acres Irrigated 1949, Approx 35 acres

Potential Acres _____ Seeped _____

Explain _____

Condition of System good

Adequate Supply..... Yes No _____

Explain Most years

Topography Slope & creek bottom

Information From _____

Remarks _____

See Master Form.

STATE OF MONTANA

State Engineer's Office

WATER RESOURCES SURVEY

Township 11 N Range 3 E County Meagher

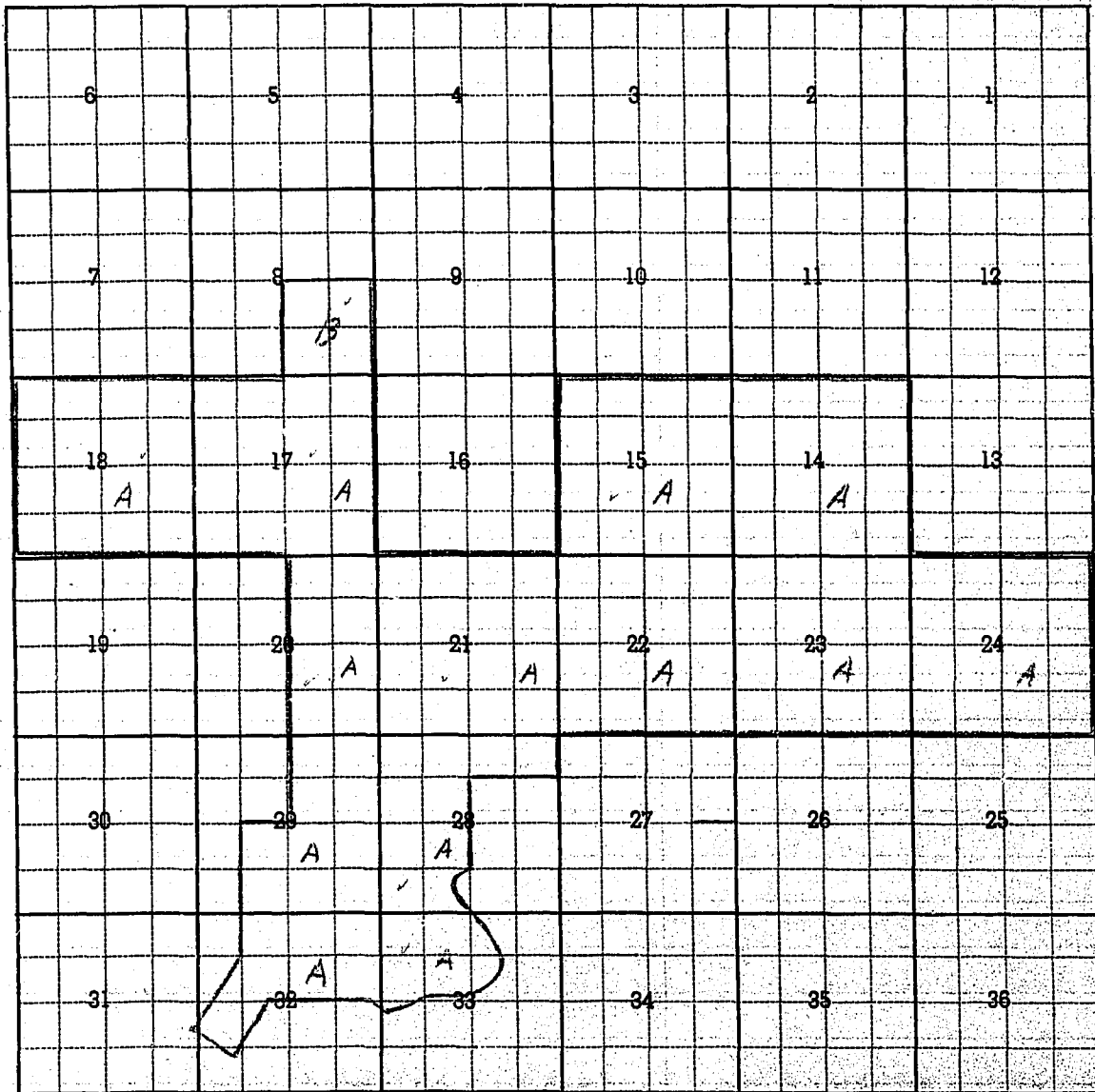

Township 11 N Range 3 E



Form WR-B
Revised 12/22 1962-2-49

STATE OF MONTANA
State Engineer's Office
WATER RESOURCES SURVEY
FARM MAP

County Missoula
Code No. 17A 12A-2B
TA 20A 21A 22A
23A 24A 25A 26A
27A 28A

Twp. 7 Rge. 3E
Twp. Rge.
Twp. Rge.

Name of Land Owner White Family Farms Address White Family Farms
Name of Operator Address
Legal Description

 Irrigated Land  Non-Irrigated Land  Potential Land Under Existing Facilities
North

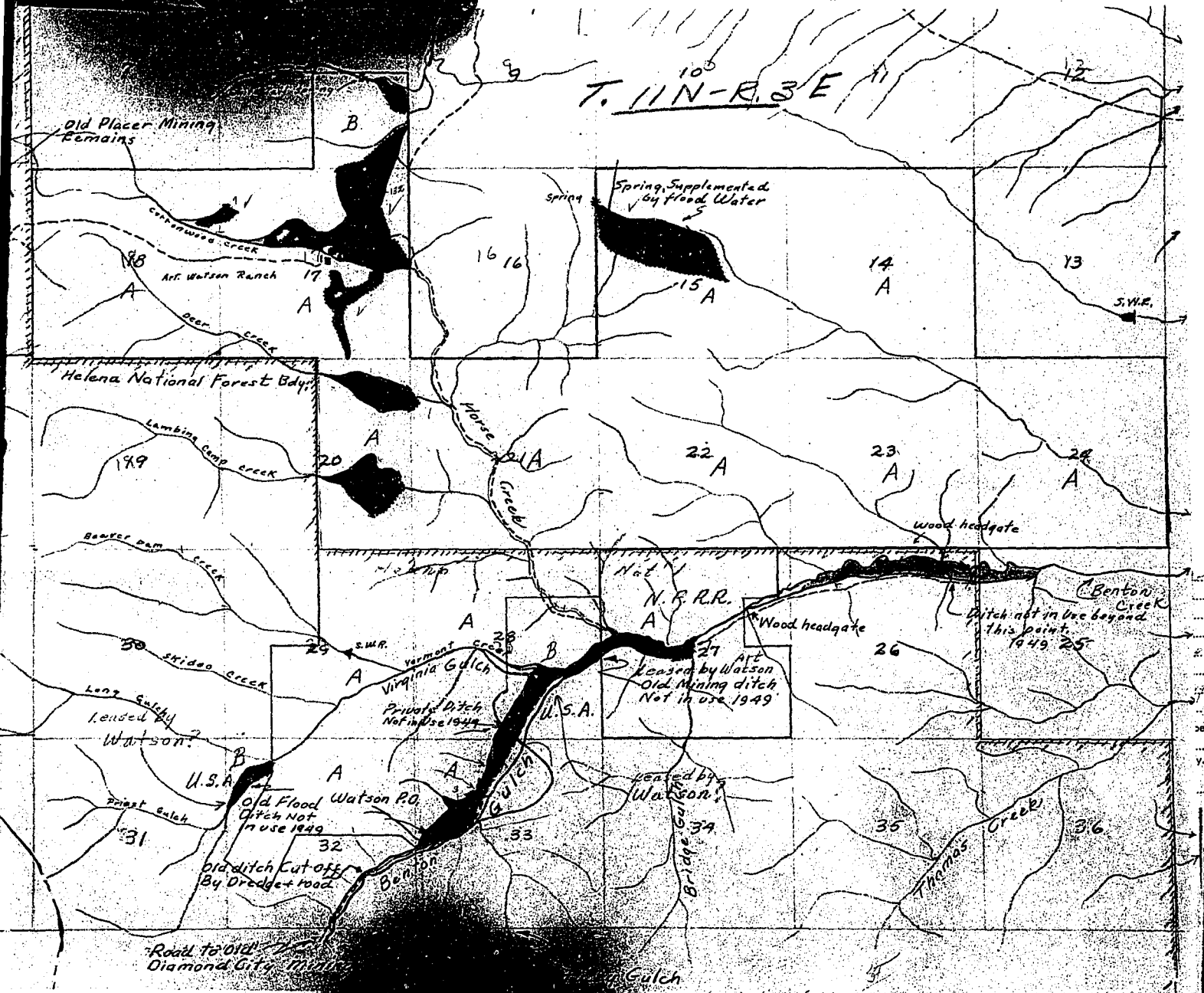

STATE OF MONTANA

State Engineer's Office

WATER RESOURCES SURVEY
FARM MAP

County Meagher

Code No. 17A, 18A, 20B

14A, 15A, 20A, 21A, 22A
33A, 29A, 22A, 23A
24A, 32A

Twp. 11N Rge. 3E

Twp. _____ Rge. _____

Twp. _____ Rge. _____

Name of Land Owner Watson, Arthur Address White Sulphur Springs

Name of Operator Same Address " " "

Legal Description _____



Irrigated Land



Non-Irrigated Land
North



Potential Land Under Existing Facilities

Code No. 8B, 17A, 18A System Watson Flood Ditches Source of Water Croftwood Creek and Springs
 Basin Smith River Present 163.0 Potential 0 Maximum 163.0 R ✓ F ✓ P ✓ G ✓ S ✓

Code No. 33A System Watson Flood Ditch Source of Water Benton Gulch
 Basin Smith River Present 6.0 Potential 0 Maximum 6.0 R ✓ F ✓ P ✓ G ✓ S ✓

Code No. 15A System Watson Flood Ditch Source of Water Unnamed Spring
 Basin Smith River Present 90.0 Potential 0 Maximum 90.0 R ✓ F ✓ P ✓ G ✓ S ✓

Code No. 8B System Watson Flood Ditch Source of Water White Tail Spring
 Basin Smith River Present 10.0 Potential 0 Maximum 10.0 R ✓ F ✓ P ✓ G ✓ S ✓

If under Ditch Company, Irrigation District, or Government Project, state the number of shares or inches, acre feet, as the case may be in said system.

NOTE: R—Denotes Regular Irrigation F—Flood Irrigation P—Water diverted by means of pumping G—Water diverted by gravity S—Stored Water

Information from A. L. B.

Date 5/24/50

State Engineer's Office

County Moagher

Code No. _____

Twp. 11N Rge. 3E

Twp. _____ Rge. _____

Twp. _____ Rge. _____

WATER RESOURCES SURVEY

FARM MAP

Name of Land Owner Watson, Arthur Address White Sulphur Springs

Name of Operator Same Address " " "

Legal Description _____

Irrigated Land

Non-irrigated Land
North

Potential Land Under Existing Facilities

Code No. 20A, 21A System Watson Flood Ditch Source of Water Deer Creek

Basin Smith River Present 33.0 Potential 0 Maximum 33.0 R ✓ F ✓ P ✓ G ✓ S ✓

Code No. 20A System Watson Flood Ditch Source of Water Lambing Camp Cr.

Basin Smith River Present 42.0 Potential 0 Maximum 42.0 R ✓ F ✓ P ✓ G ✓ S ✓

Code No. 28A, 33A System Watson Flood Ditch Source of Water Vermont Creek

Basin Smith River Present 0 Potential 19.0 Maximum 19.0 R ✓ F ✓ P ✓ G ✓ S ✓

Code No. 33A System Old Watson Flood Ditch Source of Water Beaton Gulch

Basin Smith River Present 0 Potential 20.0 Maximum 20.0 R ✓ F ✓ P ✓ G ✓ S ✓

If under Ditch Company, Irrigation District, or Government Project, state the number of shares or inches, acre feet, as the case may be

FARM MAP

Address White Sulphur Springs
 Address " " "

Potential Land Under Existing Facilities

Code No.	<u>27A (N.P.R.R.)</u>	System	<u>old Mining Ditch</u>	Source of Water	<u>Benton Gulch</u>
Basin	<u>Smith River</u>	Present	<u>0</u>	Potential	<u>22.0</u> Maximum <u>22.0</u> R. F. <input checked="" type="checkbox"/> P. G. V. S.
Code No.	<u>28B (U.S.A.)</u>	System	<u>Watson Flood Ditches</u>	Source of Water	<u>Vermont Creek</u>
Basin	<u>Smith River</u>	Present	<u>0</u>	Potential	<u>35.0</u> Maximum <u>35.0</u> R. F. <input checked="" type="checkbox"/> P. G. V. S.
Code No.	<u>32B (U.S.A.)</u>	System	<u>old Flood Ditch</u>	Source of Water	<u>Priest Gulch</u>
Basin	<u>Smith River</u>	Present	<u>0</u>	Potential	<u>11.0</u> Maximum <u>11.0</u> R. F. <input checked="" type="checkbox"/> P. G. V. S.
Code No.	<u>EB</u>	System	<u>Watson Flood ditch</u>	Source of Water	<u>White Sulphur Springs</u>
Basin	<u>Smith River</u>	Present		Potential	Maximum R. F. <input checked="" type="checkbox"/> P. G. V. S.

If under Ditch Company, Irrigation District, or Government Project, state the number of shares or inches, acre feet, as the case may be in said system.

NOTE: R—Denotes Regular Irrigation. F—Flood Irrigation. P—Water diverted by means of pumping. G—Water diverted by gravity. S—Stored Water.

Information from H. L. B. Date 5/24/50

11N-2E

FORM D-1 - GAZETTE 1964-2M-1-47

STATE OF MONTANA

STATE ENGINEER'S OFFICE

21

WATER RESOURCES SURVEY

Township 11 North Range 2 East County Meagher

6	5	4	3	2	1
7	8	9	10	11	12
18	17	16	15	14	13
19	20	21	22	23	24
30	29	28	27	26	25
31	32	33	34	35	36

172

Township 11 North Range 2 East

Township 11 North, Range 2 East

<u>No.</u>	<u>Name of Appropriator</u>	<u>Name of Stream</u>	<u>Date App.</u>	<u>Date Filed</u>	<u>M.I.</u>
I72	U. S. A.	Beaver Creek	7-1-30	9-1-31	20

6	5	4	3	2	1
7	8	9	10	11	12
13	14	15	16	17	18
19	20	21	22	23	24
25	26	27	28	29	30
31	32	33	34	35	36

Land Ownership

F-1-A

County Meagher

T. 10N R. 10E Plat No. 42

Farm Checked: Date 8-2-49

MONTANA WATER RESOURCES BOARD
Water Resources Survey

Photo No. 40-123

By Jim Cook - George Meyers

Legal Land Owner John H. Bleiker

Address Martinsdale

Operator

Address

Water is delivered by:— 1. Private System; 2. Ditch Company; 3. State Project; 4. Federal Project; 5. Irrigation District

App. No. Decree No.	NAME OF APPROPRIATOR TO WHOM DECREED	NAME OF STREAM	Date App. Date Priority	Miner's Inches	In Use	NAME OF DITCH (Water Delivered By)	No.		Present Irr. Acres	Irrigable Acres
							R	F		
D-191	Joseph Bleiker	Twin Spring Creek	7-1-1876	40	Yes	Bleiker Ditch	1	R	4	0
		Spring Creek	5-1-1913	16	No	Bleiker Ditch	1	R	0	8
1-198	F.M. Cook	Trail Creek	8-31-1895	200	No					
2-314	F.M. Cook	Whitetail Creek	6-10-1896	504	No					
3-2497M	F.M. & G.R. Cook	White tail Creek	9-2-1901	500	No (R)					
5-170	F.M. Cook & Elizabeth Simon	White tail Creek	2-7-1910	400	No					

NOTE: R—Denotes Regular Irrigation. F—Flood Irrigation.

Adequate Supply: Yes No Explain

Remarks

River Basin Musselshell

Also in: Plat No. <u>44</u> Twp. <u>10N</u> Rge. <u>9E</u>	Plat No. Twp. Rge.	Plat No. Twp. Rge.	Plat No. Twp. Rge.
Plat No. Twp. Rge.	Plat No. Twp. Rge.	Plat No. Twp. Rge.	Plat No. Twp. Rge.

Information From: Sanford Holliday

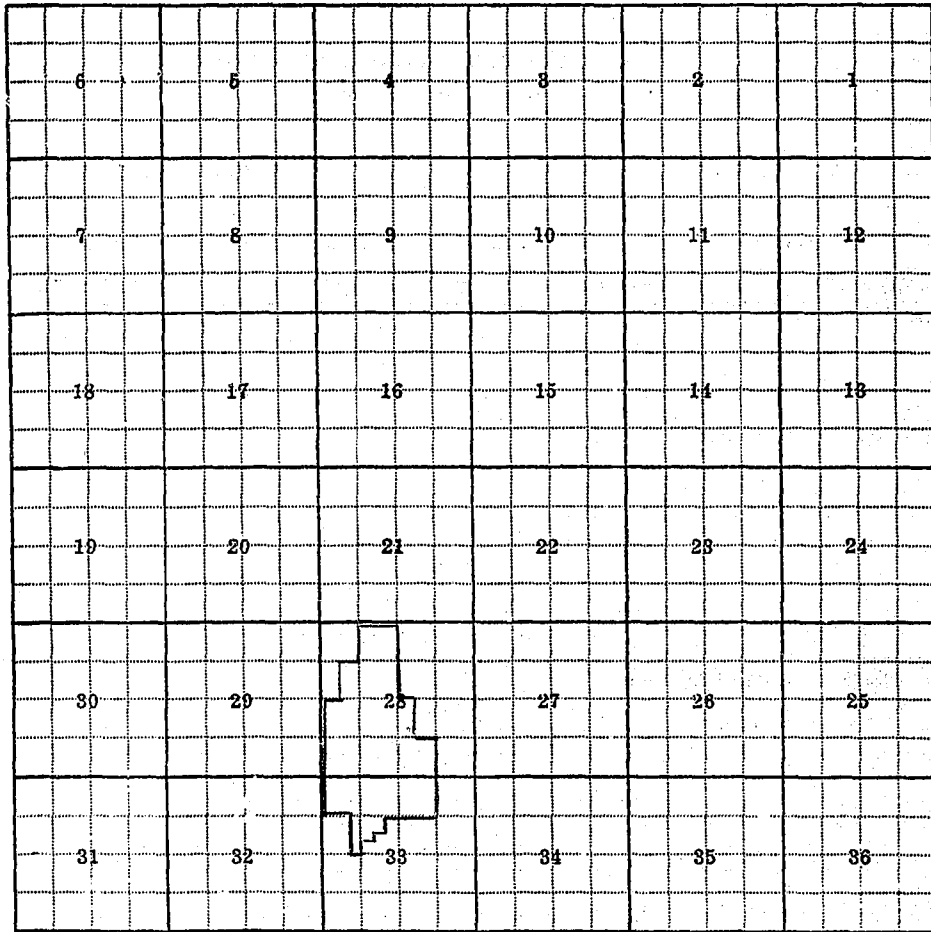

Land Ownership.....

.....

.....

Township 11 North, Range 6 East

<u>No.</u>	<u>Name of Appropriator</u>	<u>Name of Stream</u>	<u>Date App.</u>	<u>Date Filed</u>	<u>M.I.</u>
1962	Hammons, Nellie	Spring Creek	1-29-06	1-30-06	50
2024	Chapin, Frank C.	Little Spring Creek	8-6-12	8-16-12	160
2026	Hammond, Alvin	Little Spring Creek	1-29-06	1-30-06	50
2027	Snyder, Samuel	Little Spring Creek	4-16-02	4-18-02	100

11N-6E

FORM D-1 - GAZETTE 1864:2M-1-47

STATE OF MONTANA

STATE ENGINEER'S OFFICE

WATER RESOURCES SURVEY

25

Township 11 North Range 6 East County Meagher

6	5	4	3	2	1
7	8	9	10	11	12
18	17	16	15	14	13
19	20	21	22	23	24
30	29	28	27	26	25
31	32	33	34	35	36

Handwritten annotations on the grid:

- Section 28: A small square area containing the numbers 2024, 2025, 2026, and 2027.
- Section 26: A larger rectangular area containing the year 1962.

Township 11 North Range 6 East

State Engineer's Office

WATER RESOURCES SURVEY

Township 11 N Range 3 E County Meagher

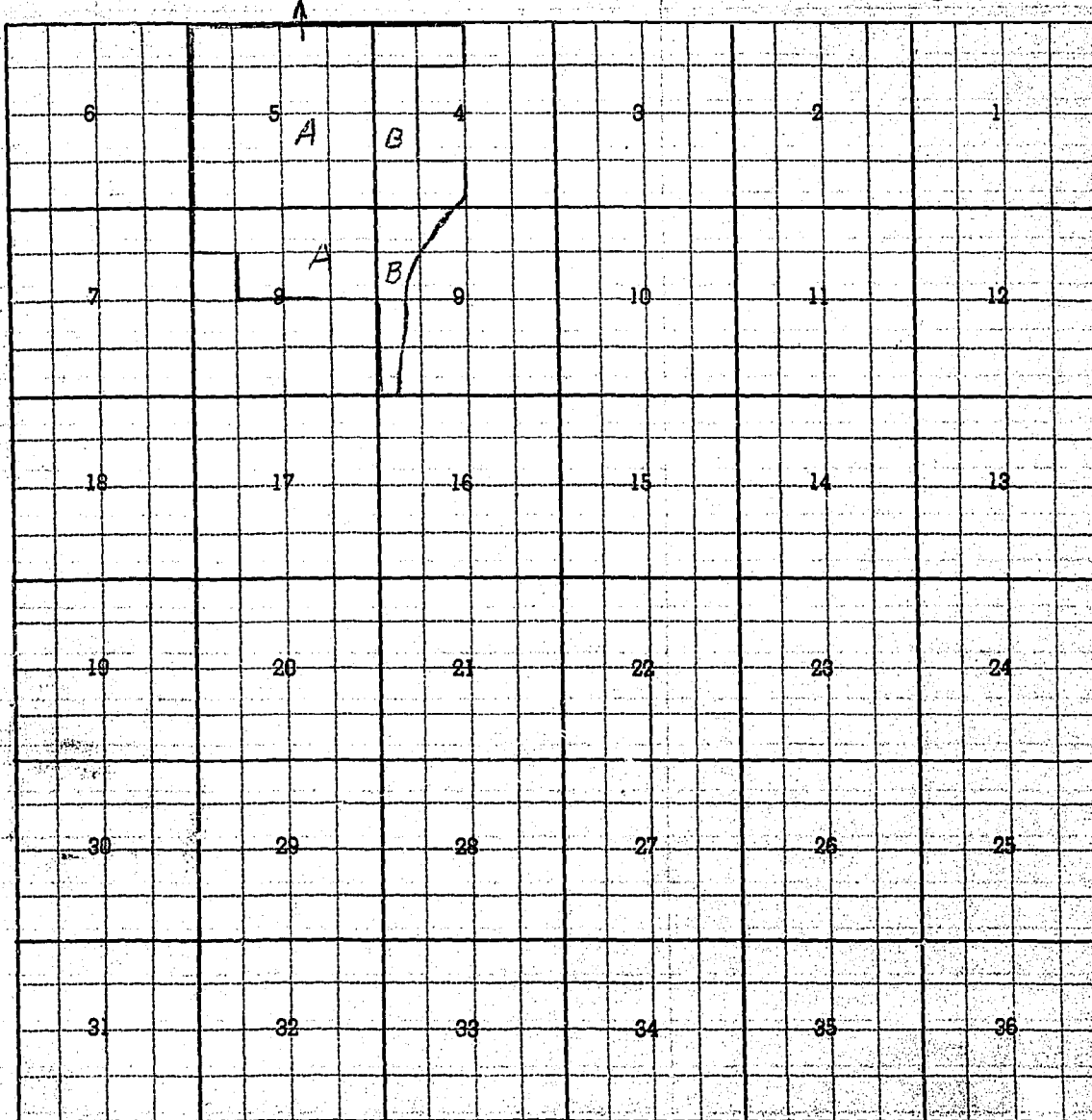

Township 11 N Range 3 E

#25

FORM F-1 - GAZETTE 1968-24-1-47

Farm Checked

STATE OF MONTANA

Code No. 2A

By Dave & Joe

STATE ENGINEER'S OFFICE

County Meagher

Area Butte Creek

WATER RESOURCES SURVEY

T. 11N R. 6E Sec. 2

Date 9/1/49

Photo No. 14A-166

Legal Land Owner Buckingham, J.T. & W.A.

Address White Sulphur

Operator Joseph T. Buckingham

Address " "

Water is delivered by:

Federal Project _____ Pres. _____ Pot. _____

Ditch Company _____ Pres. _____ Pot. _____

Irrigation District _____ Pres. _____ Pot. _____

Private System Buckingham Ditch Pres. 0 Pot. PII

Totals _____

Flood _____ Pump _____ Reservoir _____ Gravity

Size and Capacity, Pump, etc. _____

Original Appropriator, Company _____ App. No. _____

Original Appropriator, Private _____ App. No. _____

Is the system an extension of another system? Yes _____ No _____

Is all land irrigated from one system? Yes _____ No _____

(If No, show break down on map)

Source of Water Butte Creek

Acres Irrigated 19 49 None

Potential Acres PII Seeped _____

Explain _____

Condition of System Trace of old ditch (not in use)

Adequate Supply Yes _____ No _____

Explain _____

Topography _____

Information From J.T. Buckingham

Remarks _____

T. 11N R. 6E

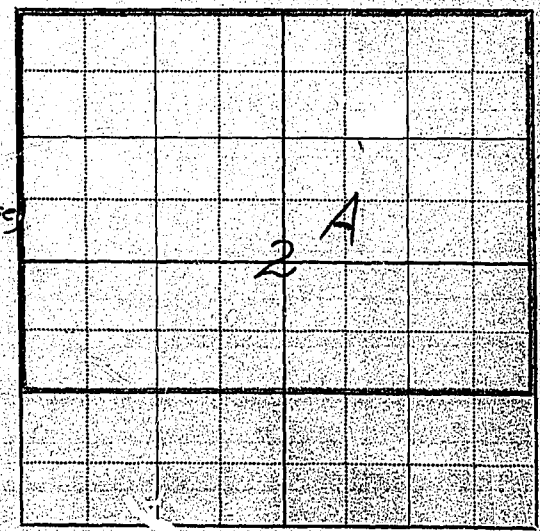

See Master Map in T10N-R6E #34

State Engineer's Office

WATER RESOURCES SURVEY

FARM MAP

County Meagher
Code No. 2A

Twp 11N Rge 6E
Twp 10N Rge 6E
Twp _____ Rge _____

Name of Land Owner Buckingham, J.T. & W.A. Address White Sulphur Springs
Name of Operator Joseph T. Buckingham Address " "
Legal Description _____



Irrigated Land



Non-Irrigated Land

North



Potential Land Under Existing Facilities

See Master Map in T. 10N-R6E

(NO IRRIGATION)

Code No. _____	System _____	Source of Water _____
Basin _____	Present _____ Potential _____	Maximum _____ R _____ F _____ P _____ G _____ S _____
Code No. _____	System _____	Source of Water _____
Basin _____	Present _____ Potential _____	Maximum _____ R _____ F _____ P _____ G _____ S _____
Code No. _____	System _____	Source of Water _____
Basin _____	Present _____ Potential _____	Maximum _____ R _____ F _____ P _____ G _____ S _____
Code No. _____	System _____	Source of Water _____
Basin _____	Present _____ Potential _____	Maximum _____ R _____ F _____ P _____ G _____ S _____

If under Ditch Company, Irrigation District, or Government Project, state the number of shares or inches, acre feet, as the case may be in said system.

NOTE: R—Denotes Regular Irrigation. F—Flood Irrigation. P—Water diverted by means of pumping. G—Water diverted by gravity. S—Stored Water.

Information from _____ Date _____

Township 11 North - Range 7 East

Code No.	Owner	Operator
31a, 32a	Butler, John C.	
9c, 10a, 11a	Chapman, Forest & Esther	
4a, 9a	Hanson, Alonzo & Bertha	
20a, 21b, 29b, c, d, e, 30c	Mesmer, Alfred	
16a, 21a	Skelton, Bill	
9b, 9c	U.S.A.	Forest Service

11N-7E

STATE ENGINEER'S OFFICE

WATER RESOURCES SURVEY

26

Township 11 North Range 7 East County Meagher

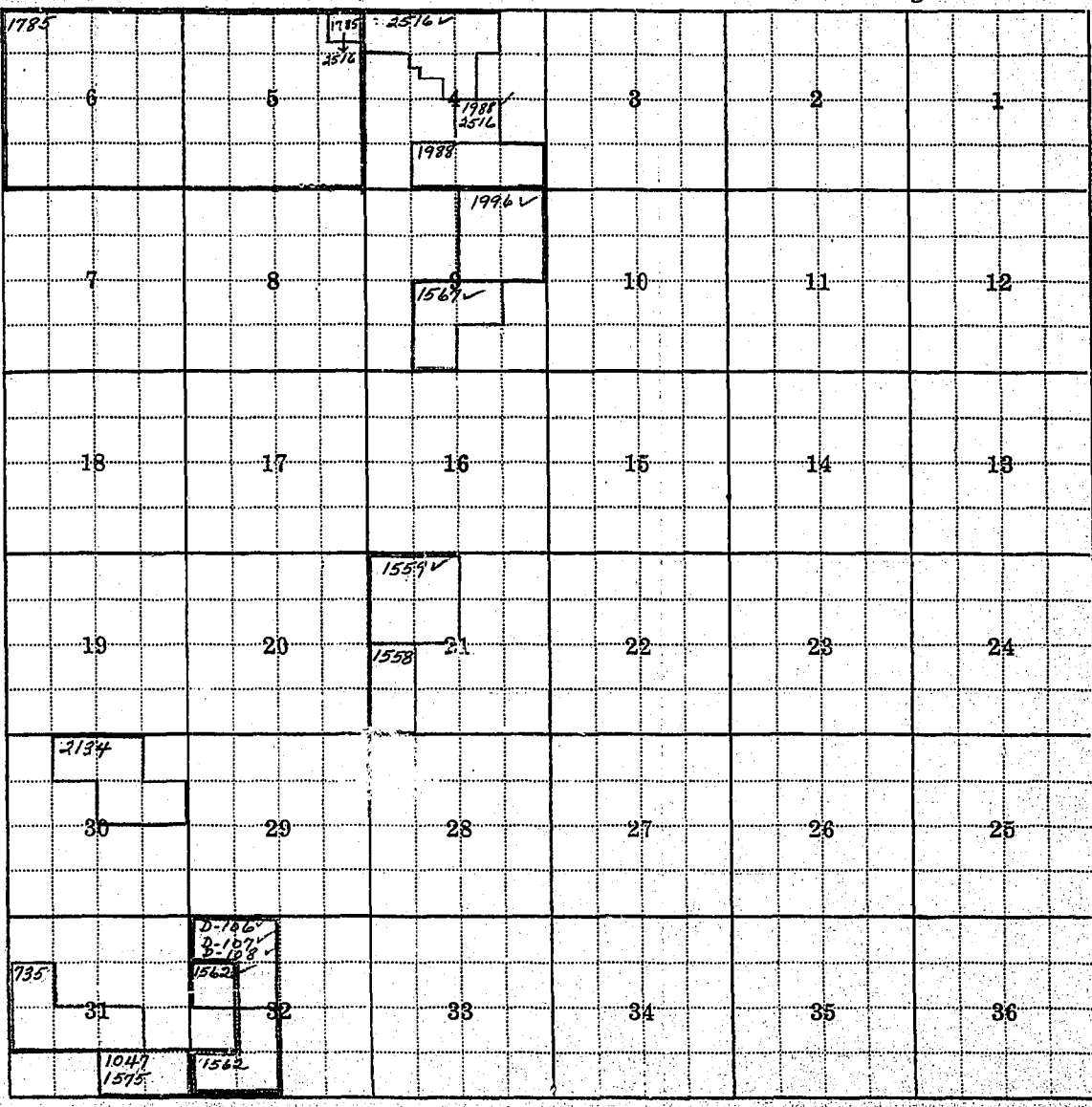

Township 11 North Range 7 East

Township 11 North, Range 8 East

<u>No.</u>	<u>Name of Appropriator</u>	<u>Name of Stream</u>	<u>Date App.</u>	<u>Date Filed</u>	<u>M.I.</u>
735	Kinyon, Emma S. 5-427	Divide Creek	7-31-86	7-31-86	200
1047	Smith, Cora L.	Gulch Creek	9-1-05	7-31-06	50
✓1558	Allen, Edgar L. 5-22	Newlan Creek	9-15-05	9-25-06	50
⊗1559	Black, Wm. G. 7-11	Newlan Creek	10-15-20	12-14-36	160
✓1562⊗	Butler, John <u>Verd 2-286</u>	Newlan Creek	5- -91	12-24-95	150
⊗1567	Hanson, Norman 5-138	Newlan Creek	6-15-06	8-23-09	120
1575	Smith, Cora L. 5-15	Newlan Creek	3-18-03	7-31-06	50
1785	Mumbrue, Eliza, Wm., Dan & Wm. H. 2-415	Sheep Creek	5-10-01	5-17-01	800
⊗1988	Seary, William ✓	Spring Creek	4-7-97	4-7-97	100
1996	U. S. A.	Spring Creek	4-26-39	4-26-39	40
2134	Corkill, Wm. J.	Trail Creek	6-15-07	8-29-08	100
⊗2516	Short, Bertha M. ✓	Newlan Spring	5-23-11	5-23-11	100
✓D-106⊗	Butler, John	Newlan Creek	9- 1888		60
✓D-107⊗	Butler, John	Newlan Creek	5- 1891		90
✓D-108⊗	Butler, John	Newlan Creek	9- 1891		75

726

Also in

Farm Checked

FORM F-1 REPORTER 1M 3-49 17380

STATE OF MONTANA

By J.E.C.

Code No. 31A, 32A

State Engineer's Office

County Meagher

Area Newlan Creek

WATER RESOURCES SURVEY

T. 11N R. 7E Sec. 31, 32

Date Sept 21, 1949

Photo No. MA-14A-156

Legal Land Owner John C. Butler

Address White Sulphur Springs

Operator _____ Address _____

Water is delivered by:

Federal Project _____ Pres. _____ Pot. _____

Ditch Company _____ Pres. _____ Pot. _____

Irrigation District _____ Pres. _____ Pot. _____

Private System Pres. 53.5 Pot. 0

Totals _____

Flood _____ Pump _____ Reservoir _____ Gravity

Size and Capacity, Pump, etc. _____

Original Appropriator, Company _____ App. No. _____

Original Appropriator, Private John Butler's App. No. 1562, D-106, D107, D-108

Is the system an extension of another system? Yes _____ No

Is all land irrigated from one system? Yes _____ No

(If No, show break down on map)

Source of Water Newlan Cr

Acres Irrigated 1949, 53.5'

Potential Acres 0 Seeped _____

Explain _____

Condition of System Fair

Adequate Supply..... Yes No

Explain Newlan Cr 1st Right?

Topography Creek bottom

Information From Field Survey

Remarks _____

have another ranch
See at Mathis Market

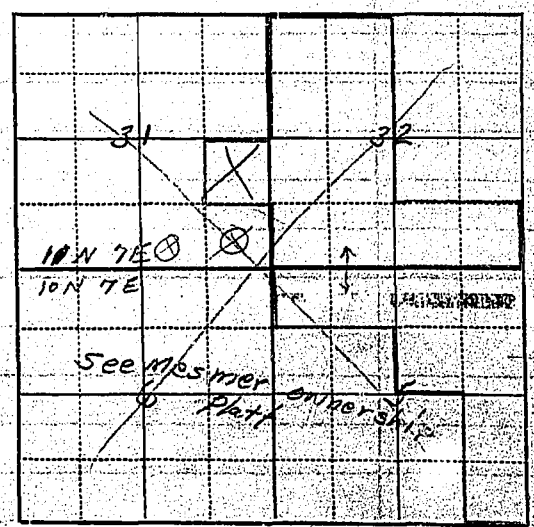

see attached on plat
ownership changed

State Engineer's Office

WATER RESOURCES SURVEY

Township 11 N Range 7 E County Meagher

6	5	4	3	2	1
7	8	9	10	11	12
18	17	16	15	14	13
19	20	21	22	23	24
30	29	28	27	26	25
31	32	33	34	35	36
<input type="checkbox"/> A	A				

*John C. Butler - bought or being bought by Miller
(Miller not contacted)*

Township 11 N Range 7 E

State Engineer's Office
WATER RESOURCES SURVEY
FARM MAP

County Meagher
Code No. 32A, 31A

Twp. 11N Rge. 7E #26 ✓
Twp. _____ Rge. _____
Twp. _____ Rge. _____

Name of Land Owner. John C. Butler (Contract to Miller) Address. White Sulphur Springs
Name of Operator. Miller Address. _____
Legal Description. _____

Irrigated Land Non-Irrigated Land Potential Land Under Existing Facilities
North

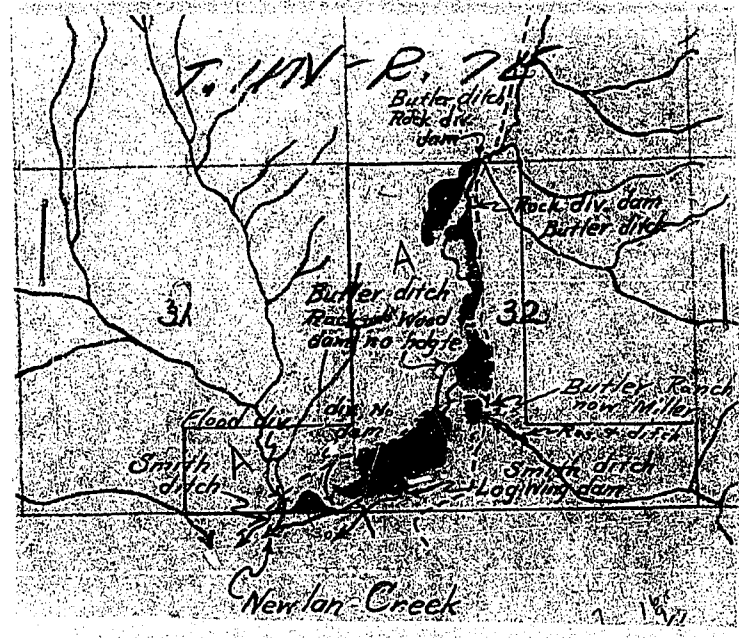

Code No. <u>31A, 32A</u>	System. <u>Butler Ditches</u>	Source of Water. <u>Newlan Creek</u>
Basin. <u>Smith River</u>	Present. <u>49.0</u> Potential. <u>0</u> Maximum. <u>49.0</u>	R. <input checked="" type="checkbox"/> F. <input type="checkbox"/> P. <input type="checkbox"/> G. <input checked="" type="checkbox"/> S. <input type="checkbox"/>
Code No. <u>32A</u>	System. <u>Butler Ditch (Res.)</u>	Source of Water. <u>Unnamed Course Trib. to Newlan Creek</u>
Basin. <u>Smith River</u>	Present. <u>1.5</u> Potential. <u>0</u> Maximum. <u>1.5</u>	R. <input checked="" type="checkbox"/> F. <input type="checkbox"/> P. <input type="checkbox"/> G. <input checked="" type="checkbox"/> S. <input checked="" type="checkbox"/>
Code No. <u>31A</u>	System. <u>Smith Ditch</u>	Source of Water. <u>Newlan Creek</u>
Basin. <u>Smith</u>	Present. <u>3.0</u> Potential. <u>0</u> Maximum. <u>3.0</u>	R. <input checked="" type="checkbox"/> F. <input type="checkbox"/> P. <input type="checkbox"/> G. <input checked="" type="checkbox"/> S. <input type="checkbox"/>
Code No. _____	System. _____	Source of Water. _____
Basin. _____	Present. _____ Potential. _____ Maximum. _____	R. <input type="checkbox"/> F. <input type="checkbox"/> P. <input type="checkbox"/> G. <input type="checkbox"/> S. <input type="checkbox"/>

If under Ditch Company, Irrigation District, or Government Project, state the number of shares or inches, acre feet, as the case may be in said system. _____

NOTE: R—Denotes Regular Irrigation, F—Flood Irrigation, P—Water diverted by means of pumping, G—Water diverted by gravity, S—Stored Water.

Information from H. L. B. Date 5/26/50

Also in 44

#26

Farm Checked Com.

FORM F-1 REPORTER 1M 3-49 17380

STATE OF MONTANA

By J. E. C.

Code No. 9C, 10A, 11A

State Engineer's Office

County Meagher

Area Newlan Creek

WATER RESOURCES SURVEY

T. 11N R. 7E Sec. 10, 11

Date Sept 20, 1949

Photo No. MA-14A-155

Legal Land Owner Forest & Esther Chapman
ownership conveyed

Address White Sulphur Springs

Operator Same

Address _____

Water is delivered by:

Federal Project _____ Pres. _____ Pot. _____

Ditch Company _____ Pres. _____ Pot. _____

Irrigation District _____ Pres. _____ Pot. _____

Private System _____ Pres. 3.5 Pot. 15.5

Totals _____

Flood _____ Pump _____ Reservoir _____ Gravity

Size and Capacity, Pump, etc. _____

Original Appropriator, Company _____ App. No. _____

Original Appropriator, Private No Filings shown App. No. _____

Is the system an extension of another system? Yes _____ No

Is all land irrigated from one system? Yes _____ No

(If No, show break down on map)

Source of Water East Fork Newlan Cr., Pistol Creek, Spruce Gulch
Sec. 10 T11N R7E

Acres Irrigated 1949, 3.5

Potential Acres 15.5 Seeped _____

Explain _____

Condition of System See other side

Adequate Supply..... Yes No _____

Explain Enough for small amount irrigated.

Topography Creek bottom & Valley Slope

Information From Mr. Chapman

Remarks _____

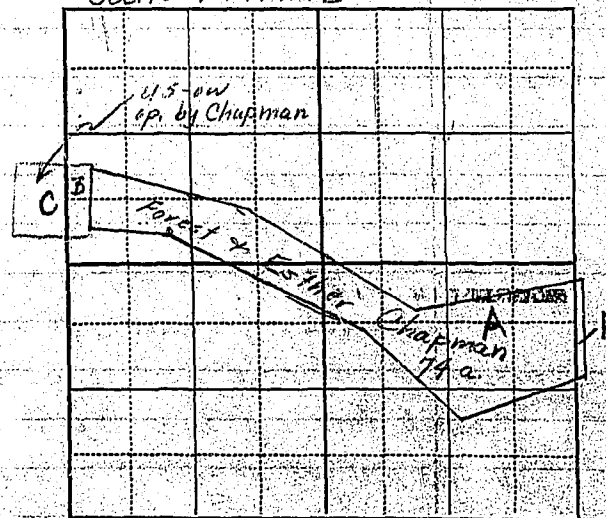

6.
/
de
y.

Two ditches out of Pistol Creek on E. side of Sec. 10 (11N-7E)
look as if they haven't been used for a good many years
but ^{Chapman} ~~Hanson~~ says he used both one year ago and he intends
to use them again when he can get them cleaned

Ditch out of E. Fork Newlan Crk in the center of sec 10.
was used two years ago and will be used again.

Ditch out of Spruce Gulch is in use at present. It is
on land leased by ^{Chapman} ~~Hanson~~.

^{Chapman} ~~Hanson~~ says all these ditches were built before he got
the place, probably over 30 yrs ago

No filings shown for these ditches. Probably built by Albright

State Engineer's Office

County Meagher
Code No. 9C, 10A, 11A

Twp. 11N Rge. 7E #26
Twp. _____ Rge. _____
Twp. _____ Rge. _____

WATER RESOURCES SURVEY
FARM MAP

Name of Land Owner. Forest & Esther Chapman Address. White Sulphur Springs
Name of Operator. _____ Address. _____
Legal Description. _____

Irrigated Land Non-Irrigated Land Potential Land Under Existing Facilities
North

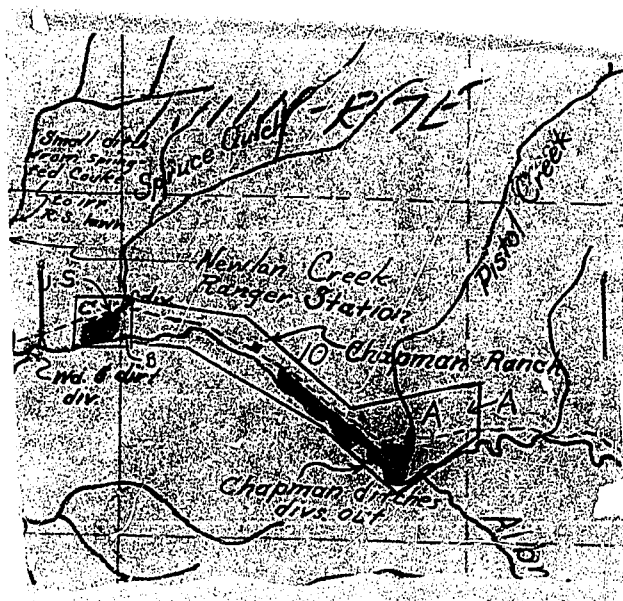

Code No. 10A System Chapman Ditches Source of Water Pistol Creek
Basin Smith River Present 0 Potential 8.5 Maximum 8.5 R. ✓ F. ✓ P. ✓ G. ✓ S. ✓
Code No. 10A System Chapman Ditch Source of Water East Fk. Newton C.
Basin Smith River Present 0 Potential 2.0 Maximum 2.0 R. ✓ F. ✓ P. ✓ G. ✓ S. ✓
Code No. 9C (U.S.A.) System Chapman Ditch Source of Water Spruce Gulch
Basin Smith River Present 3.5 Potential 0 Maximum 3.5 R. ✓ F. ✓ P. ✓ G. ✓ S. ✓
Code No. _____ System _____ Source of Water _____
Basin _____ Present _____ Potential _____ Maximum _____ R. ✓ F. ✓ P. ✓ G. ✓ S. ✓

If under Ditch Company, Irrigation District, or Government Project, state the number of shares or inches, acre feet, as the case may be in said system.

NOTE: R—Denotes Regular Irrigation. F—Flood Irrigation. P—Water diverted by means of pumping. G—Water diverted by gravity. S—Stored Water.

Information from H. L. B. Date 5/26/50