

14N-5E

STATE OF MONTANA

STATE ENGINEER'S OFFICE

WATER RESOURCES SURVEY

5

Township 14 North Range 5 East County Meagher

| | | | | | |
|---|---|----|----|----|----|
| 6 | 5 | 4 | 3 | 2 | 1 |
| 7 | 8 | 9 | 10 | 11 | 12 |
| 18 | 17 | 16 | 15 | 14 | 13 |
| 19 | 20 | 21 | 22 | 23 | 24 |
| <div style="border: 1px solid black; padding: 2px;"> 691 ✓ 1248 691 ✓ 1348 2077 </div> 30 | 29 | 28 | 27 | 26 | 25 |
| 31 | <div style="border: 1px solid black; padding: 2px;"> 2074 ✓ </div> 32 | 33 | 34 | 35 | 36 |

.....
.....
.....

Township 14 North Range 5 East

Township 14 North, Range 5 East

| <u>No.</u> | <u>Name of Appropriator</u> | <u>Name of Stream</u> | <u>Date App.</u> | <u>Date Filed</u> | <u>M.I.</u> |
|------------|-----------------------------|-----------------------|------------------|-------------------|-------------|
| 691 ✓ | Mongar, George | Dead Man Creek | 5-15-00 | 5-28-01 | 75 |
| 1348 | Mongar, George | Mongar Creek | 5-20-03 | 6-22-03 | 100 |
| 2074 ✓ | Good, Reed | Tenderfoot Creek | 11-17-98 | 11-17-98 | 320 |
| 2077 | Vineyard, Mantle | Tenderfoot Creek | 4-1-35 | 4-20-35 | 600 |

no ditches mapped

FORM F-1 - GAZETTE 1665-2M-1-47

Farm Checked

STATE OF MONTANA

Code No. 31A

By _____

STATE ENGINEER'S OFFICE

County Meagher

Area _____

WATER RESOURCES SURVEY

T. 14N R. 5E Sec. 31

Date _____

Photo No. MA-15A-27

Legal Land Owner Bair Co Address _____

Operator " " Address _____

Water is delivered by:

Federal Project _____ Pres. _____ Pot. _____

Ditch Company _____ Pres. _____ Pot. _____

Irrigation District _____ Pres. _____ Pot. _____

Private System _____ Pres. _____ Pot. _____

Totals _____

Flood _____ Pump _____ Reservoir _____ Gravity _____

Size and Capacity, Pump, etc. _____

Original Appropriator, Company _____ App. No. _____

Original Appropriator, Private _____ App. No. _____

Is the system an extension of another system? Yes _____ No _____

Is all land irrigated from one system? Yes _____ No _____

(If No, show break down on map)

Source of Water _____

Acres Irrigated 19 _____

Potential Acres _____ Seeped _____

Explain _____

Condition of System _____

Adequate Supply _____ Yes _____ No _____

Explain _____

Topography _____

Information From _____

Remarks _____

| | | | | | | | |
|--|--|--|--|--|--|--|--|
| | | | | | | | |
| | | | | | | | |
| | | | | | | | |
| | | | | | | | |
| | | | | | | | |
| | | | | | | | |
| | | | | | | | |
| | | | | | | | |
| | | | | | | | |
| | | | | | | | |
| | | | | | | | |

14N-5E

15A-27

STATE ENGINEER'S OFFICE

WATER RESOURCES SURVEY

Township 14 N Range 5 E County _____

| | | | | | |
|---------|----|----|----|----|----|
| 6 | 5 | 4 | 3 | 2 | 1 |
| 7 | 8 | 9 | 10 | 11 | 12 |
| 18 | 17 | 16 | 15 | 14 | 13 |
| 19 | 20 | 21 | 22 | 23 | 24 |
| 30 | 29 | 28 | 27 | 26 | 25 |
| A 31 | 32 | 33 | 34 | 35 | 36 |

Bair Co own-OP
Sec 31 - less 40 acres

no appropriations listed

Township 14 N Range 5 E

State Engineer's Office

WATER RESOURCES SURVEY

WATER RIGHT DATA

Name of Land Owner..... Conway, George Address..... White Sulphur Springs
 Name of Operator..... L. Ralph Cahoon Address..... " " "
 Legal Description..... See Map

1. Our records show that the following water rights were filed on the above described land:

| Code | Name of Appropriator | Stream | Land Description | Date App. | Date Filed | Miner's Inches Filed On |
|------|----------------------|----------------|---|-----------|------------|-------------------------|
| 666 | Mrs. Annie Mongar | Daisy Cr. | SE $\frac{1}{4}$ Sec. 24-14N-4E | 7-15-02 | 6-28-05 | 100 |
| 691 | Geo. Mongar | Dead Man Cr. | Sec. 30-14N-5E | 5-15-00 | 5-28-01 | 75 |
| 2074 | Reed Good | Tenderfoot Cr. | W $\frac{1}{2}$ W $\frac{1}{2}$, E $\frac{1}{2}$ NW $\frac{1}{4}$, N $\frac{1}{2}$ NE $\frac{1}{4}$ | 11-17-98 | 11-17-98 | 320 |
| 2075 | " " | " " | I.D. | 10-5-99 | 4-2-00 | 200 |
| | | | | | | |
| | | | | | | |

2. Are these filings in use:.....Yes.....No. Explain.....

3. Have any of the above filings or any part of them been sold:.....Yes.....No. If yes, give amount of inches sold and to whom transferred and from what original filing.....

4. I have the following water rights that the State Engineer's Office have not shown in the above list:

| Name of Appropriator | Stream | Land Description | Date App. | Date Filed | Miner's Inches Filed On |
|----------------------|--------|------------------|-----------|------------|-------------------------|
| | | | | | |
| | | | | | |
| | | | | | |

5. In addition, I have an irrigation system on which no recorded filing was ever made.

| Name of First User | Date of First Use | Stream | Place of Use |
|--------------------|-------------------|--------|--------------|
| | | | |
| | | | |

6. Do you buy supplemental water? Yes. No. If yes, from whom and how many Inches, C.F.S., Acre Feet, as the case may be?.....

7. Give any other information that you think should be included for the protection of your water right.....

Information from..... Date.....

Also in T.14N-R.4E

#5 FORM F-1 REPORTER 1M 3-49 17380

Farm Checked

STATE OF MONTANA

By Dave & Joe

State Engineer's Office

Code No. 19A, 30A

Area Tenderfoot Creek

WATER RESOURCES SURVEY

County Meagher

14N-4E-24
T. 14N R. 5E Sec. 31, 32, 29, 30

Date 8/3/49

Photo No. 15A-94-27 ^{sec. 19}

Legal Land Owner Conway, George

Address White Sulphur

Operator L. Ralph Cahoon

Address " "

Water is delivered by:

Federal Project _____ Pres. _____ Pot. _____

Ditch Company _____ Pres. _____ Pot. _____

Irrigation District Conway Ditches Pres. _____ Pot. _____

Private System Gravity Ditches Pres. 174.0 Pl. Pot. 133.0 Pl.

Totals _____

Flood _____ Pump _____ Reservoir _____ Gravity

Size and Capacity, Pump, etc. _____

Original Appropriator, Company Reed Good App. No. 2074-2075

Original Appropriator, Private Geo. Mongar App. No. 691
Mrs. Annie Mongar App. No. 666

Is the system an extension of another system? Yes _____ No _____

Is all land irrigated from one system? Yes _____ No _____

(If No, show break down on map)

Source of Water So. Fork Tenderfoot, Deadman Cr., Daisy Cr.

Acres Irrigated 1949, 174.0 for all farms

Potential Acres 133.0 Seeped _____

Explain _____

Condition of System Good Fair

Adequate Supply..... Yes _____ No

Explain Creeks do not run as much as he needs.

Topography Slope & Creek bottom

Information From L. Ralph Cahoon

Remarks Has started to clean ditch in Deadman Creek.

| | | | | |
|--|--|--|--|--|
| | | | | |
| | | | | |
| | | | | |
| | | | | |
| | | | | |
| | | | | |
| | | | | |
| | | | | |
| | | | | |
| | | | | |

See Attached Map

Deadman Creek.

Old ditch Has not been in use for several years.
is cleaning ditch now.

South Fork Tenderfoot.

Two ditches - Twp. 13N Rge. 5E, Sec. 4 & Head.
~~irrigate~~ Low ditch irrigates land in Sec. 31 & 32
in T. 14N - R. 5E.

High ditch irrigates land in Sec. 29, 30, 31, 32
in T. 14N - R. 5E.

Filing by - Reed Good - App. No. 2074 - date filed 11/17/98
for MI 320. Aard - App. No. 2075 - date 4/2/0
for MI 200. Both in use - good condition

Deadman Creek.

Two ditches - Filing by - Geo Mongar
App. No. 691 - date filed 5/28/01 - for MI 75
Sec. 31 - T. 14N - R. 5E - Short ditch in use.

Daisy Creek.

Filing by - Mrs. Annie Mongar - App. No. 666
date filed 6/28/05 for MI 100 - T. R.

Covers land in T. 14N - R. 4E - SE $\frac{1}{4}$, Sec 24.
~~The~~ ditch not in use at present plans
to clean and use.

E. FK. of So. FK. Tenderfoot.

contacted
8/24/49

Mr. Conway says he plans a dam or reservoir to
supplyment water from East Fork.
Says it has good storage site.

Deadmans Creek:

Short ditch heads on sec. line between 31 & 32 - T14N-R.5E extending north a little more than quarter mile.

This ditch he was just cleaning, he didn't have the ditch job finished as he had to stop to start his haying.

Ditch takes out in SE $\frac{1}{4}$, Sec 31. - This is the old Mongar ditch, it extends through Sec. 31 crossing Kid Creek to some hay meadows in Sec. 30 - This ditch has not been used for several years.

Conway says creek does not flow as much as it use to, and he thinks earthquakes have slowed the flow.

For water filings see Master farm.

State Engineer's Office

WATER RESOURCES SURVEY

Township 14 North Range 5 East County Meagher

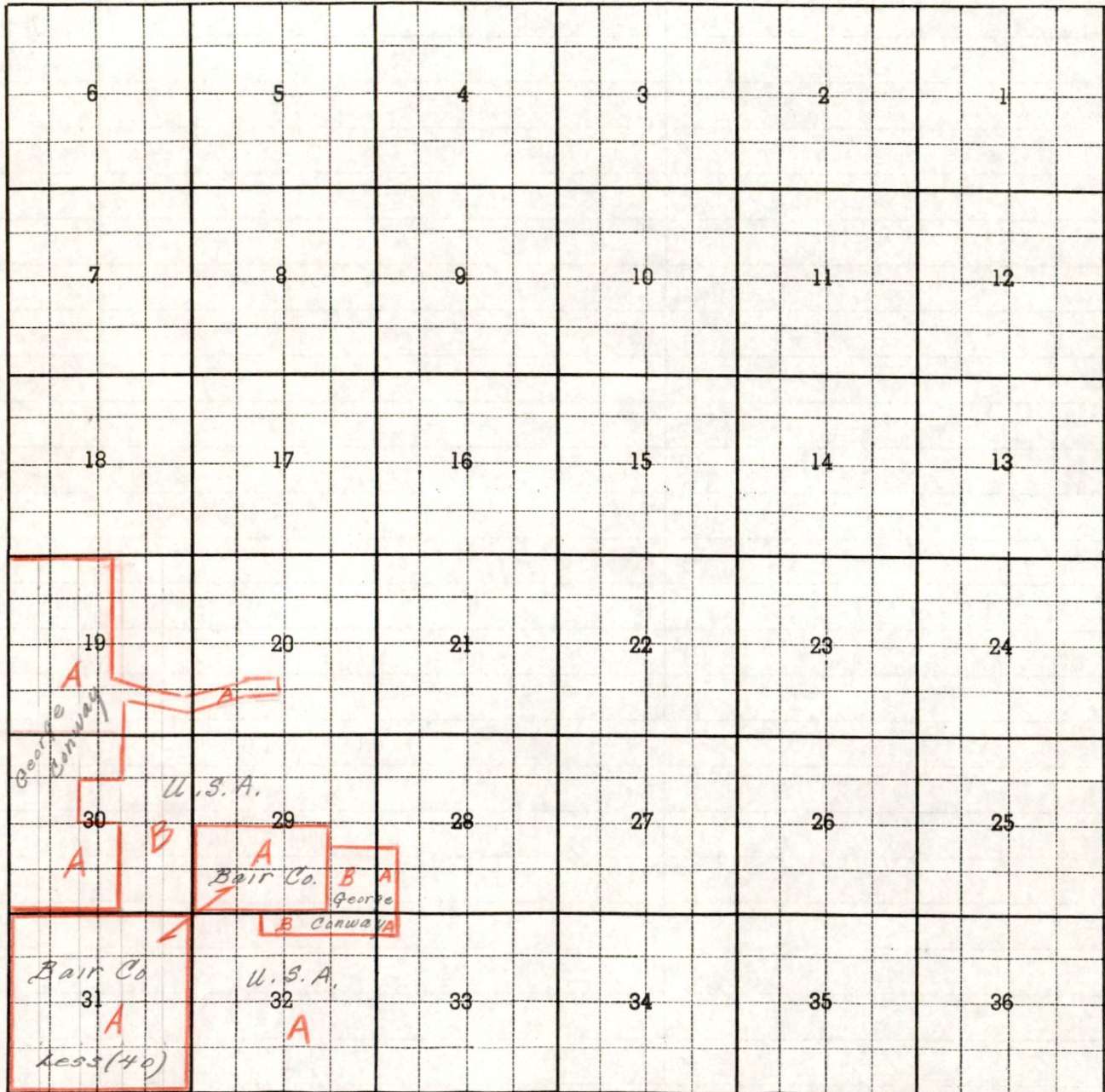

Note: Survey shows irrigation for Conway in
 Sec. 30 B and 32 A no ownership shown maybe Government
 also Conway house is located near SW, NW $\frac{1}{4}$, sec. 32.
 In sec. 31 Conway irr. show Bair Co. ow-op (less 40 ac.)
 And South half sec. 29 - may have bought or lease.

T. 14N. - R. 5E

Bear Gulch

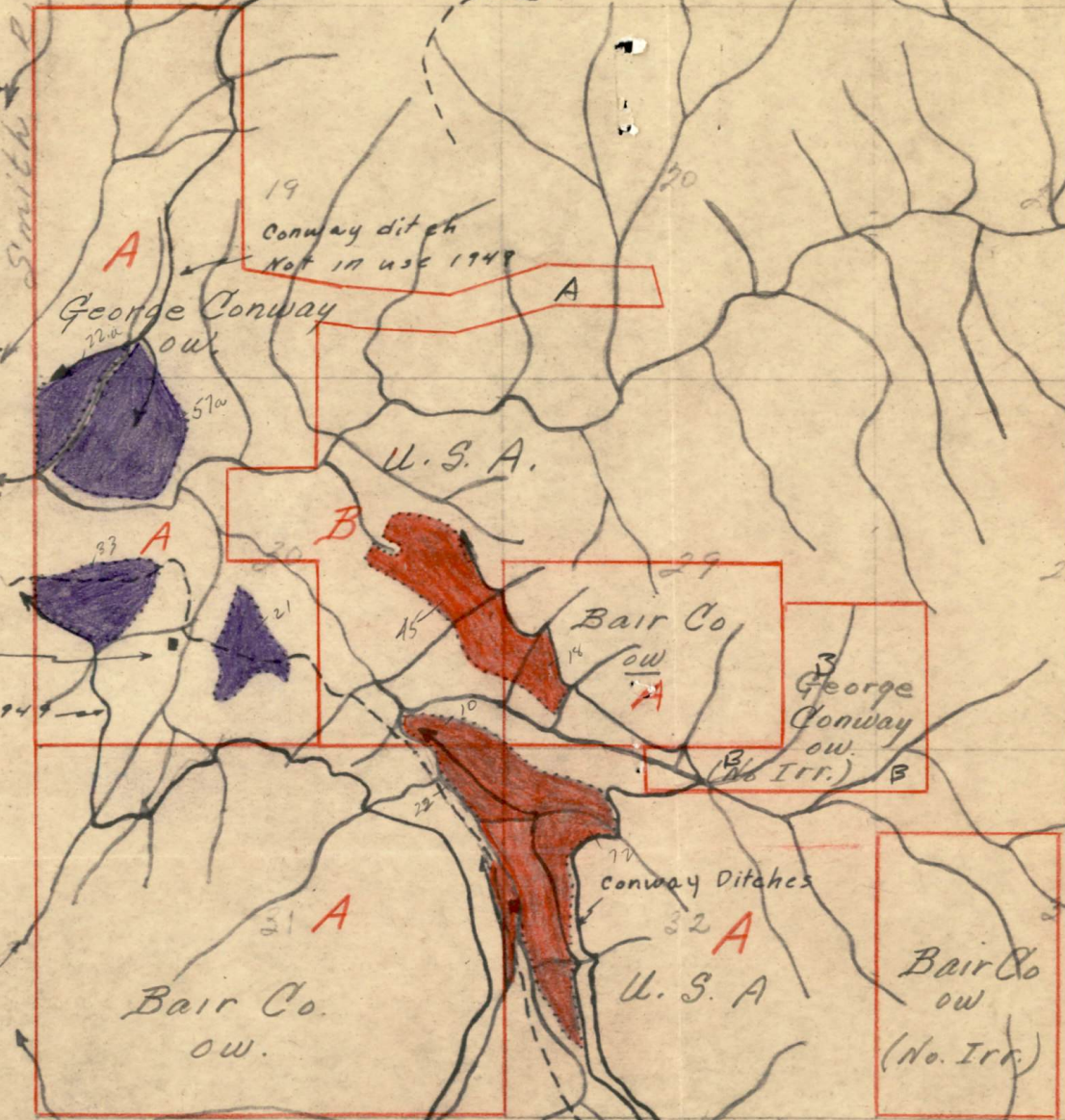

Daisy Creek.

Tenderfoot Creek

old Mongar Place

of old ditch Not in use 1949

Kid Creek

Dead Man's Creek

South FK tenderfoot Creek

A

A

A

B

A

A

B

George Conway ow.

U. S. A.

Bair Co ow.

George Conway ow. (No Irr.)

Bair Co. ow.

U. S. A

Bair Co ow (No. Irr.)

19

20

51⁰⁰

33

30

21

15

29

22

31

32

conway Ditches

Conway ditch Not in use 1949

(No Irr.)

Smith River

State Engineer's Office

WATER RESOURCES SURVEY

FARM MAP

County Meagher

Code No. 19A, 30A

30B, 29A, 31A

32A

Twp. 14N Rge. 5E

Twp. 14N Rge. 4E

Twp. _____ Rge. _____

Name of Land Owner Conway, George Address White Sulphur Springs

Name of Operator L. Ralph Cahoon Address " " "

Legal Description _____



Irrigated Land



Non-Irrigated Land



Potential Land Under Existing Facilities

North

Also in
T. 14N-R4E

Also in T. 14N-R. 4E

| | | |
|-------------------------------------|--|--|
| Code No. <u>19A, 30A</u> | System <u>Conway Flood Ditch</u> ^(Not in Use) | Source of Water <u>Daisy Creek</u> |
| Basin <u>Smith River (Missouri)</u> | Present <u>0</u> Potential <u>79.0</u> Maximum <u>79.0</u> | R. <u>F</u> P. <u>G</u> S. <u>S</u> |
| Code No. <u>30A</u> | System <u>old Flood Ditch</u> ^(Not in Use) | Source of Water <u>Deadman's Creek</u> |
| Basin <u>Smith River (Missouri)</u> | Present <u>0</u> Potential <u>54.0</u> Maximum <u>54.0</u> | R. <u>F</u> P. <u>G</u> S. <u>S</u> |
| Code No. <u>29A, 31A (Bair Co)</u> | System <u>Conway Ditch</u> | Source of Water <u>So. Fork Tenderfoot Cr.</u> |
| Basin <u>Smith River</u> | Present <u>40.0</u> Potential <u>0</u> Maximum <u>40.0</u> | R. <u>F</u> P. <u>G</u> S. <u>S</u> |
| Code No. <u>31A (Bair Co)</u> | System <u>Conway Ditch</u> | Source of Water <u>Deadman's Creek</u> |
| Basin <u>Smith River</u> | Present <u>2.0</u> Potential <u>0</u> Maximum <u>2.0</u> | R. <u>F</u> P. <u>G</u> S. <u>S</u> |

If under Ditch Company, Irrigation District, or Government Project, state the number of shares or inches, acre feet, as the case may be in said system.

NOTE: R—Denotes Regular Irrigation. F—Flood Irrigation. P—Water diverted by means of pumping. G—Water diverted by gravity. S—Stored Water.

Information from _____ Date _____

over

DO NOT WRITE
IN SPACE BELOW

✓ Code No. 32A (U.S.A.) System Conway Ditch Source of Water Deadman's Cr.
Basin Smith River Present 5.0 Potential 0 Maximum 5.0 R F P G S
Code No. 30B, 32A (U.S.A.) System Conway Ditch Source of Water Sa. Fk. Tenderfoot Cr.
Basin Smith River Present 127.0 Potential 0 Maximum 127.0 R F P G S
Code No. _____ System _____ Source of Water _____
Basin _____ Present _____ Potential _____ Maximum _____ R F P G S
Code No. _____ System _____ Source of Water _____
Basin _____ Present _____ Potential _____ Maximum _____ R F P G S

If under Ditch Company, Irrigation District, or Government Project, state the number of shares or inches, acre feet, as the case may be in said system.

NOTE: R—Denotes Regular Irrigation. F—Flood Irrigation. P—Water diverted by means of pumping. G—Water diverted by gravity.
S—Stored Water.

Information from H. L. B. Date 5/19/50