

State Engineer's Office

WATER RESOURCES SURVEY

FARM MAP

County _____

Code No. _____

Twp. _____ Rge. _____

Twp. _____ Rge. _____

Twp. _____ Rge. _____

Name of Land Owner..... Address.....

Name of Operator..... Address.....

Legal Description.....



Irrigated Land



Non-Irrigated Land



Potential Land Under Existing Facilities

North

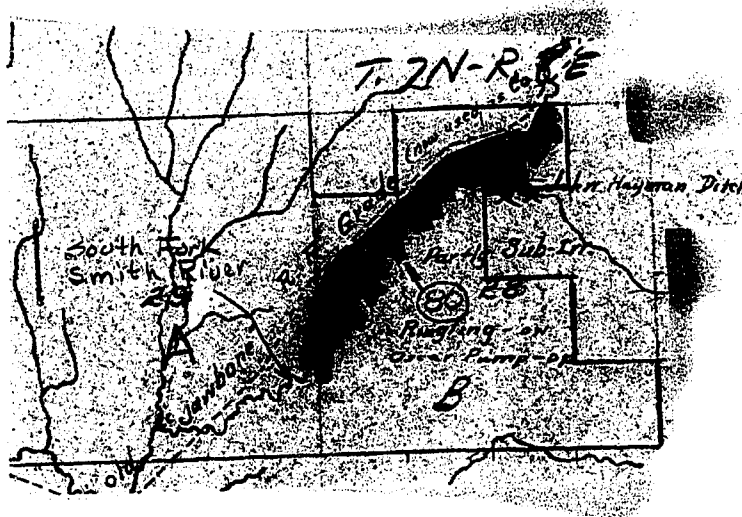

Code No. 28 B, 29 A System JOHN HAYMAN DITCH Source of Water S.F.K. SMITH RIVER

Basin S.F.R. SMITH RIVER Present 80 Potential 0 Maximum 80 R ✓ F ✓ P ✓ G ✓ S ✓

Code No. _____ System _____ Source of Water _____

Basin _____ Present _____ Potential _____ Maximum _____ R _____ F _____ P _____ G _____ S _____

Code No. _____ System _____ Source of Water _____

Basin _____ Present _____ Potential _____ Maximum _____ R _____ F _____ P _____ G _____ S _____

Code No. _____ System _____ Source of Water _____

Basin _____ Present _____ Potential _____ Maximum _____ R _____ F _____ P _____ G _____ S _____

If under Ditch Company, Irrigation District, or Government Project, state the number of shares or inches, acre feet, as the case may be in said system.....

NOTE: R—Denotes Regular Irrigation. F—Flood Irrigation. P—Water diverted by means of pumping. G—Water diverted by gravity. S—Stored Water.

Information from _____ Date.....

Farm Checked

STATE OF MONTANA

Code No. 34A, 35A, 26A

By Dave & Joe

STATE ENGINEER'S OFFICE

County Meagher

Area Ringling

WATER RESOURCES SURVEY

T. 7N R. 8E Sec. _____

Date 8/29/50

Photo No. MA-38-186

Legal Land Owner Potter & Meyer

Address _____

Operator Higgins Bros.

Address Ringling

Water is delivered by:

Federal Project _____ Pres. _____ Pot. _____

Ditch Company _____ Pres. _____ Pot. _____

Irrigation District _____ Pres. _____ Pot. _____

Private System _____ Pres. _____ Pot. _____

Totals _____

Flood _____ Pump _____ Reservoir _____ Gravity Regular

Size and Capacity, Pump, etc. _____

Original Appropriator, Company _____ App. No. _____

Original Appropriator, Private _____ App. No. 784

Is the system an extension of another system? Yes _____ No

Is all land irrigated from one system? Yes No _____

(If No, show break down on map)

Source of Water Durst Creek

Acres Irrigated 1950 none

Potential Acres none Seeped _____

Explain Trace of old ditch

Condition of System Poor needs repair

Adequate Supply _____ Yes No _____

Explain (Not in use)

Topography _____

Information From Mr. Higgins

Remarks _____

60 see over

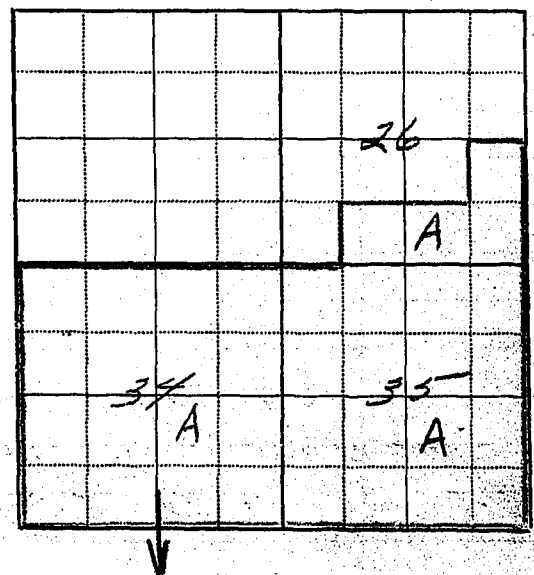

Durst Creek:

Trace of Ditch heads in the SE, NE 1/4, Sec. 34
on west bank, extends for about
3/4 mile in southwest direction.
Not in use, needs repair.

784	Redmond, Horse	Durst Creek	6-21-12	50
-----	----------------	-------------	---------	----

STATE OF MONTANA
State Engineer's Office
WATER RESOURCES SURVEY
FARM MAP

County Meagher
Code No. 34A-35A-26A

Twp. 7N Rge. 8E
Twp. _____ Rge. _____
Twp. _____ Rge. _____

Name of Land Owner Potter & Meyer Address _____
Name of Operator Higgins Bros. Address Ringling Mont.
Legal Description _____

Irrigated Land Non-Irrigated Land Potential Land Under Existing Facilities
North

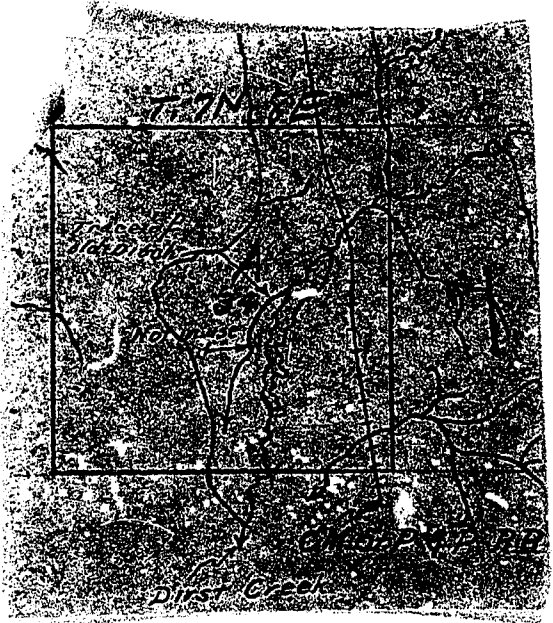

No Irrigation

Code No. 34A System TRACE of OLD DITCH Source of Water DUST CREEK
Basin SIXTEEN MILE CR. Present 0 Potential 0 Maximum 0 R 0 F 0 P 0 G 0 S 0
Code No. _____ System _____ Source of Water _____
Basin _____ Present _____ Potential _____ Maximum _____ R _____ F _____ P _____ G _____ S _____
Code No. _____ System _____ Source of Water _____
Basin _____ Present _____ Potential _____ Maximum _____ R _____ F _____ P _____ G _____ S _____
Code No. _____ System _____ Source of Water _____
Basin _____ Present _____ Potential _____ Maximum _____ R _____ F _____ P _____ G _____ S _____
If under Ditch Company, Irrigation District, or Government Project, state the number of shares or inches, acre feet, as the case may be in said system. _____
NOTE: R—Denotes Regular Irrigation. F—Flood Irrigation. P—Water diverted by means of pumping. G—Water diverted by gravity.
S—Stored Water.
Information from _____ Date _____

#60

Farm Checked

Also In No. 59 - T. 7N - R. 7E
No. 61 - T. 7N - R. 9E
STATE OF MONTANA

FORM F-1 REPORTER, IM 3-49 17380

By Oravetz-Rille

State Engineer's Office

Code No. 1A; 2C

Area Warm Springs Cr.

WATER RESOURCES SURVEY

County Meagher

Date 7/24/50

T. 7N R. 8E Sec. 1, 2, 3

Photo No. MA-38-184

Legal Land Owner Rostad, Olaf

Address White Sulph Spgs,

Operator Rostad, Carl

Address

Water is delivered by:

Federal Project _____ Pres. _____ Pot. _____

Ditch Company _____ Pres. _____ Pot. _____

Irrigation District _____ Pres. _____ Pot. _____

Private System yes _____ Pres. _____ Pot. _____

Totals _____

Flood _____ Pump _____ Reservoir _____ Gravity

Size and Capacity, Pump, etc. _____

Original Appropriator, Company _____ App. No. _____

Original Appropriator, Private See Other Side _____ App. No. _____

Is the system an extension of another system? Yes _____ No

Is all land irrigated from one system? Yes _____ No

(If No, show break down on map)

Source of Water Warm Springs Creek, Saw Mill Creek

Checkerboard Creek

Acres Irrigated 19 _____

Potential Acres _____ Seeped None

Explain _____

Condition of System Good

Adequate Supply..... Yes No _____

Explain _____

Topography Rolling Hills

Information From Carl Rostad

Remarks Picks up Abren Waste Water

from Reynolds Cr.

See Attached
MAPS

App. No	Name of App	Name of Stream	Date	No. of Inches
2224	Henry W. Glasser	Warm Spring Creek	4-28-89	500
2240	Andrew Morrison	" " "	9-1-02	150
2242	Maria & Olaf Rostad	" " "	9-26-06	400
2219	David Doucett	" " "	7-29-01	200
2220	Mary Doucett	" " "	5-30-03	200
529	Ed Thorsen	Checkerboard Creek (Desert Claim)	4-1-03	800 No
1747	Andrew Erickson	Saw Mill Creek	7-26-18	200 No
1748	Mrs. A. F. Erickson	" " "	6-12-12	100 No

Rostad Ditches - Warm Spring Creek

Point Diversion - One Ditch takes out on North Side of Creek in SW¹/₄ Sec 35, T8N-R.8E and Irrigates land Section (1) T.7N - 8E & Section (6) T.7N-R.9E

Another Ditch takes out on the South Side of Creek in SE¹/₄ of Section 34 T8N-R.8E and Irrigates land in Sections 1 & 2, T.7N-R.8E.

Rostad Also has 3 Old Ditches out of Saw Mill Creek which are not in Use. Section 1 Twp 7N-R.7E

In Twp. 9N-R.9E, Checkerboard Creek there is a ditch & some Irrigation. Other Field part of this & Farm should be completed.

Other Appropriations on Rostad Land which are listed below:

App No.	Name of App	Name of Stream	Date	No. Inches
688	Mary J. Doucett	Dead Horse Creek	6-10-05	40
2090	W. E. Sherman	Thompson's Creek	10-4-98	120

STATE OF MONTANA
State Engineer's Office
 WATER RESOURCES SURVEY

Township **7N**

Range **8E**

County **Meagher**

6	5	4	3 ✓ A	<table border="1"> <tr> <td>MARIE ROSTAD own A</td> <td>✓ C</td> </tr> <tr> <td>CARL B ROSTAD-own</td> <td></td> </tr> </table>	MARIE ROSTAD own A	✓ C	CARL B ROSTAD-own		11 ✓ A
MARIE ROSTAD own A	✓ C								
CARL B ROSTAD-own									
7	8	9 ✓ A	10 ✓ A	11 ✓ A	12				
18	17	16	15	14	13				
19	20	21	22	23	24				
30	29	28	27	26	25				
31	32	33	34	35	36				

Township

Range

STATE OF MONTANA

State Engineer's Office

WATER RESOURCES SURVEY

Township 7 N Range 9 E County Meagher

C	6	5	4	3	2	1
B						
7	8	9	10	11	12	
18	17	16	15	14	13	
19	20	21	22	23	24	
30	29	28	27	26	25	
31	32	33	34	35	36	

Township Range

STATE ENGINEER'S OFFICE

WATER RESOURCES SURVEY

Township 7N Range 7E County Meagher

6	5	4	3	2	1A
7	8	9	10	11	12
18	17	16	15	14	13
19	20	21	22	23	24
30	29	28	27	26	25
31	32	33	34	35	36

Township 7North Range 7East

STATE OF MONTANA
State Engineer's Office
WATER RESOURCES SURVEY
FARM MAP

County Meagher
Code No. 1A-2C

Twp. 7N Rge. 8E
Twp. _____ Rge. _____
Twp. _____ Rge. _____

Name of Land Owner Rostad, Olaf Address White Sulphur
Name of Operator Rostad, Carl Address " "
Legal Description _____

Irrigated Land Non-Irrigated Land Potential Land Under Existing Facilities
North

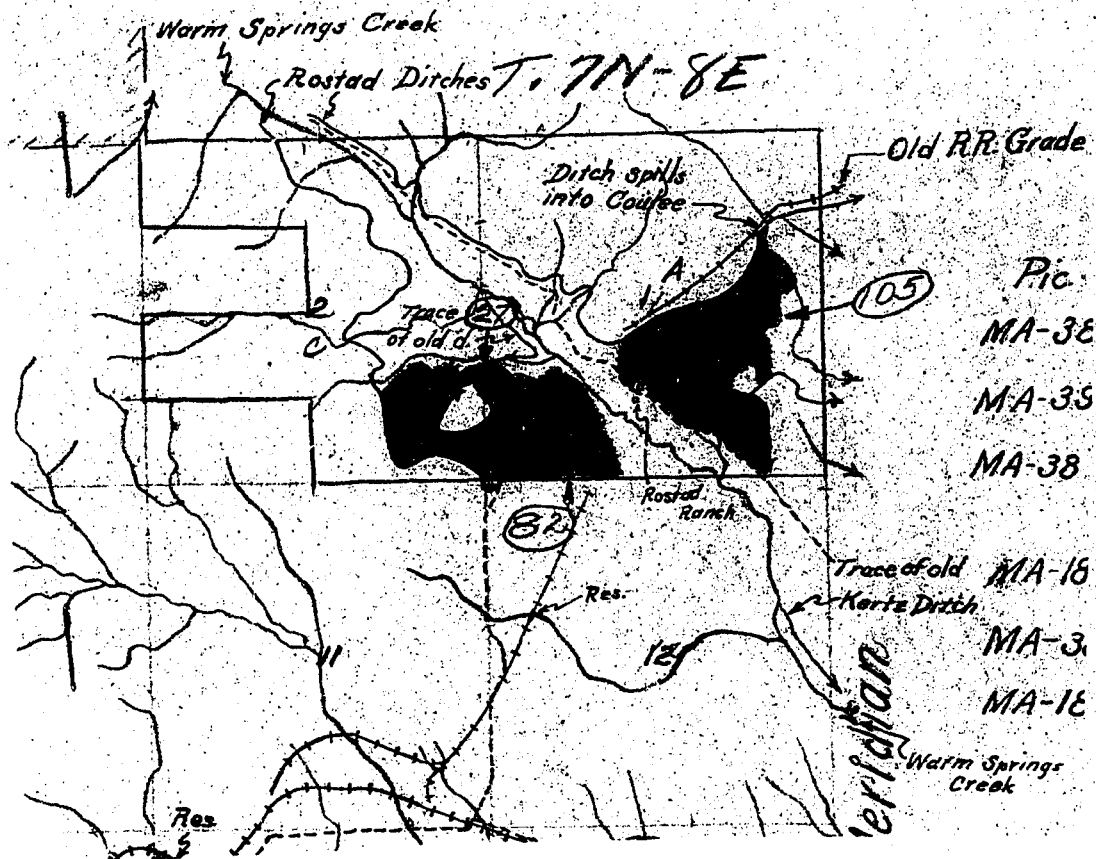

Pic.
MA-3E
MA-3S
MA-3B
MA-1B
MA-3
MA-1E

Code No. 1A, 2C System ROSTAD DITCHES Source of Water WARM SPRINGS CR.
Basin S.F. Musselshell R. Present 187 Potential 27 Maximum 219 R. F. P. G. S.
Code No. 1A System TRACE OF OLD DITCH Source of Water WARM SPRS. CR.
Basin S.F. Musselshell R. Present 0 Potential 0 Maximum 0 R. F. P. G. S.
Code No. _____ System _____ Source of Water _____
Basin _____ Present _____ Potential _____ Maximum _____ R. _____ F. _____ P. _____ G. _____ S. _____
Code No. _____ System _____ Source of Water _____
Basin _____ Present _____ Potential _____ Maximum _____ R. _____ F. _____ P. _____ G. _____ S. _____

If under Ditch Company, Irrigation District, or Government Project, state the number of shares or inches, acre feet, as the case may be in said system.

NOTE: R—Denotes Regular Irrigation. F—Flood Irrigation. P—Water diverted by means of pumping. G—Water diverted by gravity. S—Stored Water.

Information from _____ Date _____

Township 7 North. - Range 9 East

Code No.	Owner	Operator
7a,8a,18b,(18a State)	Grande Ranch Co.	
2a,5a,6a,8b,11a,12a,13a, 14b.	Hereim, Clarence	
3a,4a	Hoyem, Morris B.	
9a,10a,15a,15b, 16a,16b,21a	Rostad, Olaf	Orville Rostad
6b,6c	Rostad, Olaf & Marie	Carl Rostad
21b,22b,27a,28b,33a,34a	Smith Bros. Sheep Co.	
1a	Voldseth, Mina	Voldseth Bros.

25
-81

ict
table
eres

2

6	5	4	3	2	1
7	8	9	10	11	12
13	17	16	15	14	13
19	20	21	22	23	24
30	29	28	27	26	25
31	32	33	34	35	36

Land Ownership.....
.....
.....

6	5	4	3	2	1
7	8	9	10	11	12
13	17	16	15	14	13
19	20	21	22	23	24
30	29	28	27	26	25
31	32	33	34	35	36

Land Ownership _____

6	5	4	3	2	1
7	8	9	10	11	12
13	17	16	15	14	13
19	20	21	22	23	24
30	29	28	27	26	25
31	32	33	34	35	36

Land Ownership.....

.....

.....

6	5	4	3	2	1
7	8	9	10	11	12
13	14	15	16	17	18
19	20	21	22	23	24
25	26	27	28	29	30
31	32	33	34	35	36

Land Ownership.....

6	5	4	3	2	1
7	8	9	10	11	12
13	14	15	16	17	18
19	20	21	22	23	24
25	26	27	28	29	30
31	32	33	34	35	36

Land Ownership.....

able
res

6	5	4	3	2	1
7	8	9	10	11	12
13	17	16	15	14	13
10	20	21	22	23	24
30	29	28	27	26	25
31	32	33	34	35	36

Land Ownership.....

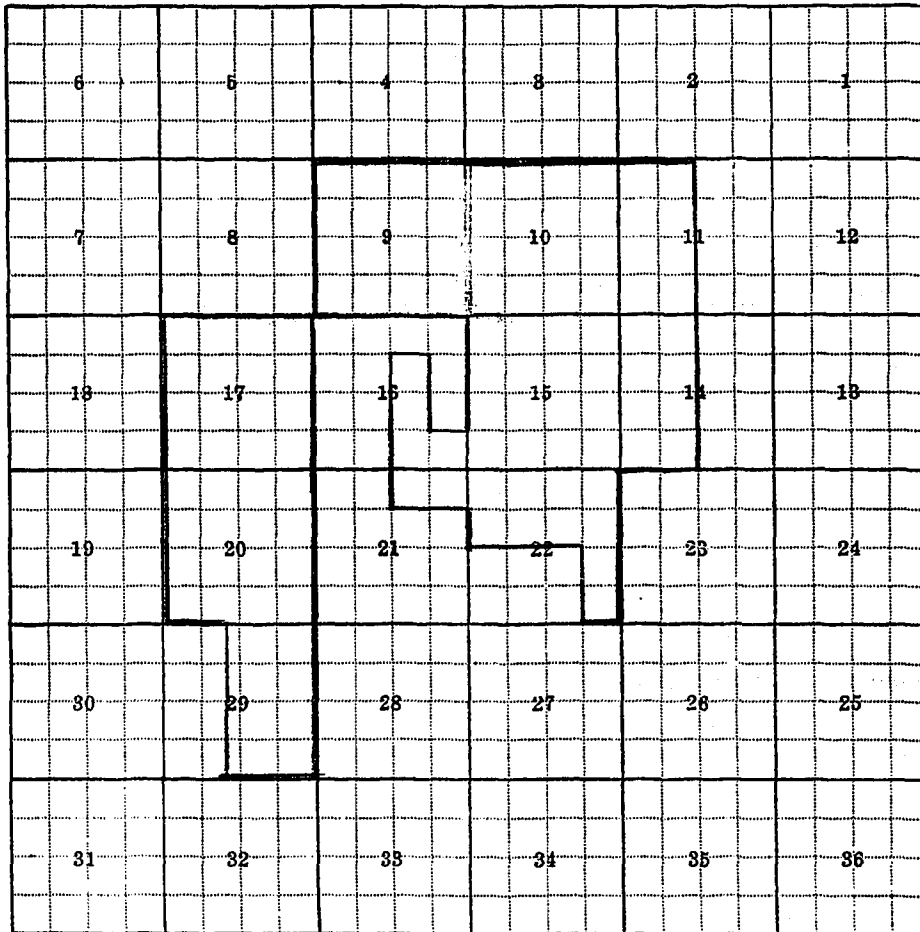

Land Ownership.....

F-1-A
 Cou
 Far
 By
 Leg
 Of
 Wa
 A
 De
 2-
 2-
 1-1
 2-1
 5-
 NO
 Ad
 Re

 [

	6	5	4	3	2	1
7	8	9	10	11	12	
13	17	16	15	14	13	
19	20	21	22	23	24	
30	29	28	27	26	25	
31	32	33	34	35	36	

Land Ownership.....

5

ct

able
res

6	5	4	3	2	1
7	8	9	10	11	12
13	14	15	16	17	18
19	20	21	22	23	24
25	26	27	28	29	30
31	32	33	34	35	36

Land Ownership.....

.....

.....

6	5	4	3	2	1
7	8	9	10	11	12
13	17	16	15	14	13
19	20	21	22	23	24
30	29	28	27	26	25
31	32	33	34	35	36

Land Ownership.....

5

ct

able
res

3

6	5	4	3	2	1
7	8	9	10	11	12
13	17	16	15	14	13
19	20	21	22	23	24
29	29	28	27	26	25
31	32	33	34	35	36

20/2

Land Ownership _____

7N-9E

STATE OF MONTANA
STATE ENGINEER'S OFFICE
WATER RESOURCES SURVEY

61

Township 7 North Range 9 East County Meagher

Plotted wrong
in TANK 9E
should be
in TN 9E

	1833 2237	2236 2237	2236			1482	1482 1483	1415		
					331 1482 1204			1486 1485 1486		
2248 2249 2220 2224 2240	6		5		1832					1
					331	331 1753				
(2232)		2242		1504 2242	328					
		1834 2237 2242				1750				12
	7				9					
	2210				327 328			1747		
2087										
646 1036 2092	18 MTHA Voidsath		17		16			14		13
	19		20			1046 1154 1801	1046			
					1156	21				
						1046 1154 1156 1801	22		23	24
2306										645
	30		29		28			27	26	25
2769			1951				1649			
	31		32		33				35	36

Marten
Brecke

Alfred E
Davis

Quinn
Harris

Township 7 North Range 9 East

Township 7 North, Range 9 East

<u>No.</u>	<u>Name of Appropriator</u>	<u>Name of Stream</u>	<u>Date App.</u>	<u>Date Filed</u>	<u>M.I.</u>
327✓	Freeman, J. H. and Ripley, John D.	Bozeman Fork	9-30-85	9-30-85	500
328✓	Freeman, J. H. & J. P.	Bozeman Fork	5-1-88	5-14-89	500
331✓	More, Ed and Jay	Bozeman Fork	5-20-91	6-15-91	320
640.	Wilson, Agnes	Cottonwood Creek	5-10-10	8-15-12	50
645.	Hereim, Helmert	(Little Cottonwood	5-25-18	7-22-18	100
724✓ 724A	Hoyem, Sivert ✓ Hoyem, Andrew & Sivert	Deer Creek " "	4- -95	3-27-96 6-1-91	200 250
1036.	Wilson, Agnes J.	Grande Creek	5-10-10	8-15-12	100
1046.	Brown, Wm. M.	Grouse Creek	6-1-11	11-12-14	20
1154..	Brown, William M.	Indian Creek	6-1-11	11-12-14	100
1156..	Hoyem, George	Indian Creek	11-8-37	11-27-37	160
1415✓	Arthur, John	Musselshell River	8-28-91	8-31-91	500
1482✓	Hoyem, Andrew and More Bros.	Musselshell River	4-19-95	5-7-95	320
1483✓	Hoyem, Andrew & Sivert ✓	Musselshell River	5-14-92	6-6-06	360
1486✓	Jackson, Henry	Musselshell River	9-6-94	9-8-94	160
1504✓.	More, Ed and Jay ✓	Musselshell River	6-18-88	7-5-88	320
1649.	Freeman, John P.	Quaking Asp Creek	5-15-01	1-24-07	75
1749✓	Hoyem, Andrew	Saw Mill Creek	9-15-97	6-14-99	120
1750.	Hoyem, Gertrude	Saw Mill Creek	6-20-04	9-28-04	250
1753✓	More, Ed V.	Saw Mill Creek	5-15-91	6-15-91	40
1801..	Brown, Wm. M.	Sill Creek	6-1-11	11-12-14	40
1832✓	Hebnes, Andrew L.	Slaughter House Creek	7-1-07	3-11-12	160
1833✓	More, Jay ✓	Slaughter House Creek	6-10-03	6-15-03	80
1834✓	More, Jay ✓	Slaughter House Creek	6-11-07	7-24-07	160
1951	Dahl, Eng.	Spring Creek	6-6-11	6-14-11	100
2057.	Utness, John	Summit Gulch	4-11-12	4-13-12	160

Township 7 North, Range 9 East

<u>No.</u>	<u>Name of Appropriator</u>	<u>Name of Stream</u>	<u>Date App.</u>	<u>Date Filed</u>	<u>M.I.</u>
2092.	Wilson, Agnes J.	Thompson's Creek	5-10-10	8-15-12	100
2210	Alseth, Stengrim	Warm Spring Creek	5-17-15	5-20-15	100
2232 1/2	Kelly, John S.	" " "	4-17-95		200
2236 1/2	More, Jay ✓	Warm Spring Creek	6-11-03	6-15-03	400
2237 1/2	More, Jay and Josephine ✓	Warm Spring Creek	6-11-03	7-24-07	400
2242 1/2	Rostad, Marie & Olaf	Warm Spring Creek	9-26-06	9-26-06	400
2306.	Siegfried, Alma	Willow Spring Creek	7-24-01	7-25-01	160
2769.	Wells, Cyrus J.	Unnamed Spring	1-4-17	1-5-17	60
2219 1/2	Doucett, David	Warm Springs Creek	7-29-01		200
2220 1/2	Doucett, Mary	" " "	5-30-03		200
2224 1/2	Glasser, Henry H.	" " "	4-28-89		500
2240 1/2	Morrison, Andrew	" " "	9-1-02		150

61

Also in T. 8N-R. 9E (master Form)

" " T. 8N-R. 10E

" " T. 8N-R. 8E

FORM 7-1 - GAZETTE 1685-24-1-47

(state)

Farm Checked

STATE OF MONTANA

Code No. 7A, 8A, 18A, 18B

By Oravetz-Bille

STATE ENGINEER'S OFFICE

County Meagher

Area Kennep

WATER RESOURCES SURVEY

T. 7N R. 9E Sec. 7

Date 7/27/50

Photo No. Ma-38-185

Legal Land Owner Grande Ranch Co. Address _____

Operator _____ Address _____

Water is delivered by:

Federal Project _____ Pres. _____ Pot. _____

Ditch Company _____ Pres. _____ Pot. _____

Irrigation District _____ Pres. _____ Pot. _____

Private System _____ Pres. _____ Pot. _____

Totals _____

Flood _____ Pump _____ Reservoir _____ Gravity _____

Size and Capacity, Pump, etc. _____

Original Appropriator, Company _____ App. No. _____

Original Appropriator, Private _____ App. No. _____

Is the system an extension of another system? Yes _____ No _____

Is all land irrigated from one system? Yes _____ No _____

(If No, show break down on map)

Source of Water Warm Spring Creek

Acres Irrigated 19 _____

Potential Acres _____ Seeped _____

Explain _____

Condition of System _____

Adequate Supply Yes _____ No _____

Explain _____

Topography _____

Information From _____

Remarks _____

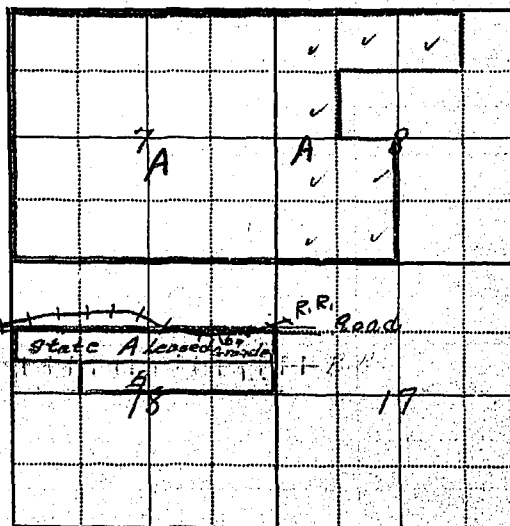

Master Form No 54
T. 8N-R. 9E

See

STATE OF MONTANA

State Engineer's Office
WATER RESOURCES SURVEY
FARM MAP

County _____

Code No. _____

Twp. _____ Rge. _____

Twp. _____ Rge. _____

Twp. _____ Rge. _____

Name of Land Owner.....Address.....

Name of Operator.....Address.....

Legal Description.....



Irrigated Land



Non-Irrigated Land



Potential Land Under Existing Facilities

North

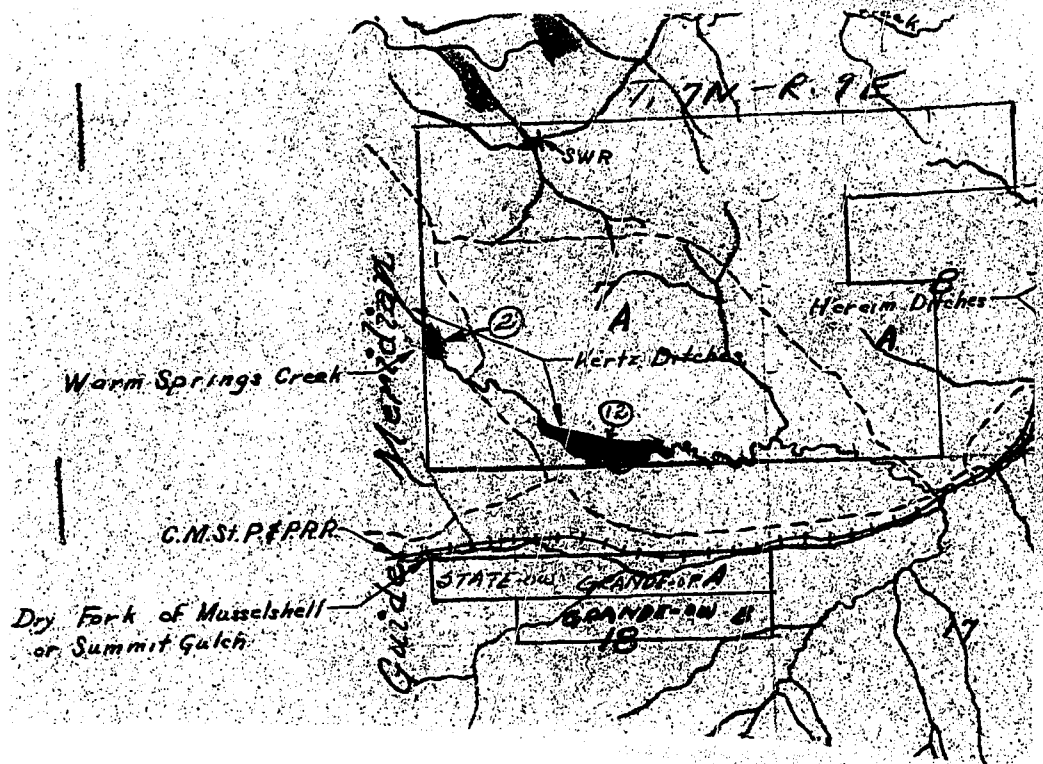

Code No. 7A System KERTZ DITCHES (NOT IN USE) Source of Water WARM SPRINGS CR.
 Basin D.F. Musselshell R. Present 0 Potential 14 Maximum 14 R. L F. P G. S
 Code No. _____ System _____ Source of Water _____
 Basin _____ Present _____ Potential _____ Maximum _____ R. _____ F. _____ P. _____ G. _____ S. _____
 Code No. _____ System _____ Source of Water _____
 Basin _____ Present _____ Potential _____ Maximum _____ R. _____ F. _____ P. _____ G. _____ S. _____
 Code No. _____ System _____ Source of Water _____
 Basin _____ Present _____ Potential _____ Maximum _____ R. _____ F. _____ P. _____ G. _____ S. _____

If under Ditch Company, Irrigation District, or Government Project, state the number of shares or inches, acre feet, as the case may be in said system.

NOTE: R—Denotes Regular Irrigation. F—Flood Irrigation. P—Water diverted by means of pumping. G—Water diverted by gravity. S—Stored Water.

Information from _____ Date _____

Deer Creek:

Ditch heads in the SW, SW $\frac{1}{4}$, Sec. 12
For hay meadow.

One ditch in SE, SE $\frac{1}{4}$, Sec. 2 Narrow strip
of hay meadow.

Short ditch in the NW, NE $\frac{1}{4}$, Sec. 2
For narrow strip hay meadow.

South Fork Musselshell R. cr:

Old ditch heads in the NW, NE $\frac{1}{4}$, Sec 17

This ditch was cut off by
Railroad and changed course of creek
Would have been for use in
river bottom in sec. 8

(Not in use) for several yrs.

Bozeman Fk. Creek:

Ditch heads in center of west line
of Sec. 9 (Not in use)

STATE ENGINEER'S OFFICE

WATER RESOURCES SURVEY

Township 7 North Range 9 East County Meagher

6	5	4	3	2	1
A	A			A	
7	8	9	10	11	12
	B			A	A
18	17	16	15	14	13
				B	A
19	20	21	22	23	24
30	29	28	27	26	25
31	32	33	34	35	36

Herein, Clarence

Township _____ Range _____

6A,
2A,
13.

State Engineer's Office
WATER RESOURCES SURVEY
FARM MAP

County MEAGHER

Code No. _____

6A-5A-8B-

2A-11A-12A-13A-

14B

Twp. 2N Rge. 2E

Twp. _____ Rge. _____

Twp. _____ Rge. _____

Name of Land Owner. Hereim Clarence Address Martinsdale

Name of Operator. None Address _____

Legal Description _____

 Irrigated Land  Non-Irrigated Land  Potential Land Under Existing Facilities

E.T.
Dec 5, 1950

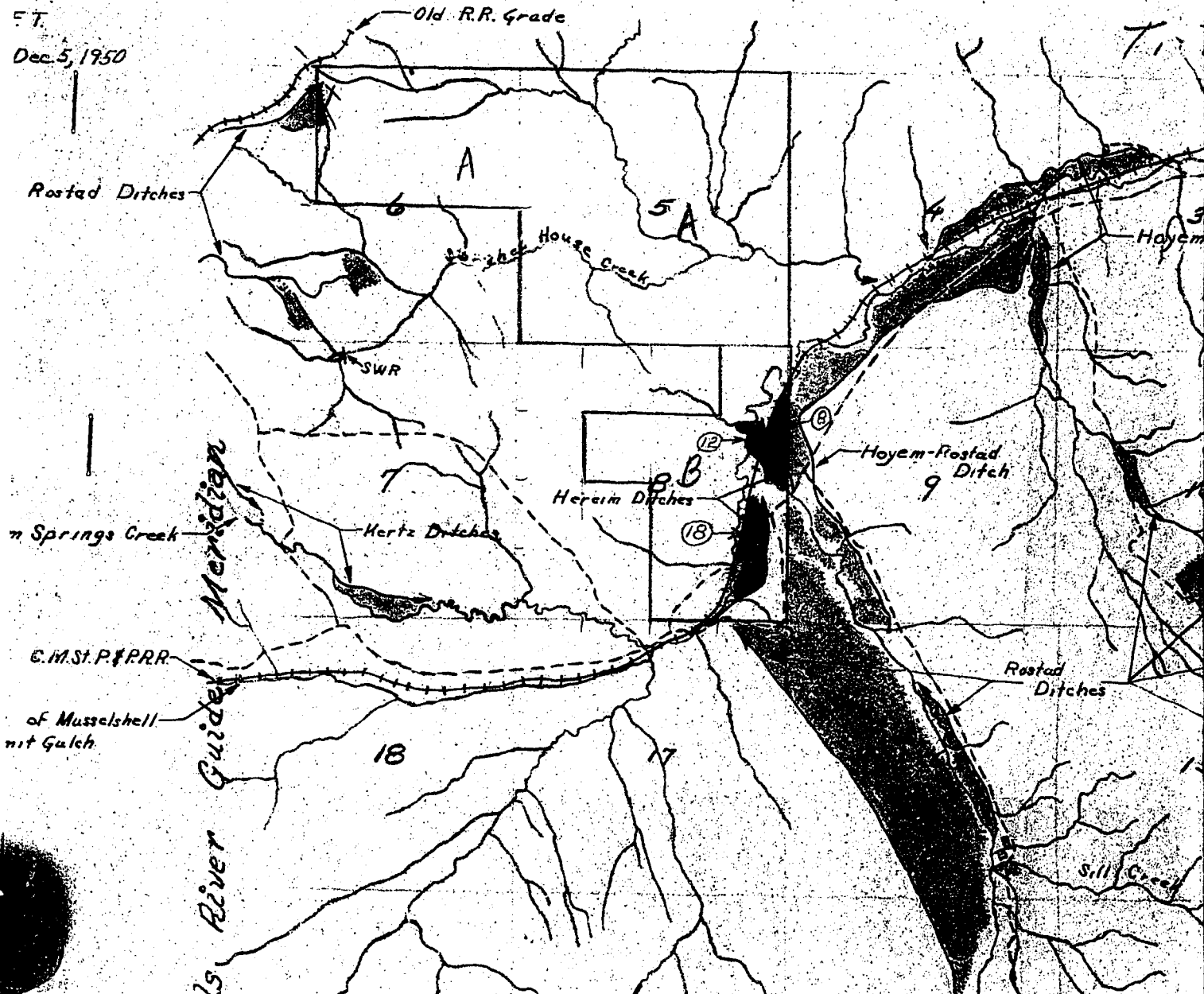

Basin S.F. Musselshell R. Present _____ Potential 10 Maximum 10 K. E. F. _____

If under Ditch Company, Irrigation District, or Government Project, state the number of shares or inches, acre feet, as the case may be in said system. _____

NOTE: R—Denotes Regular Irrigation. F—Flood Irrigation. P—Water diverted by means of pumping. G—Water diverted by gravity. S—Stored Water.

Information from _____ Date _____

A
Office
RVEY

County MEAGHER
Code No. 6A-5A-8B-
2A-11A-12A-13A-
14C

Martinsdale
.....
.....
.....

 Potential Land Under Existing Facilities

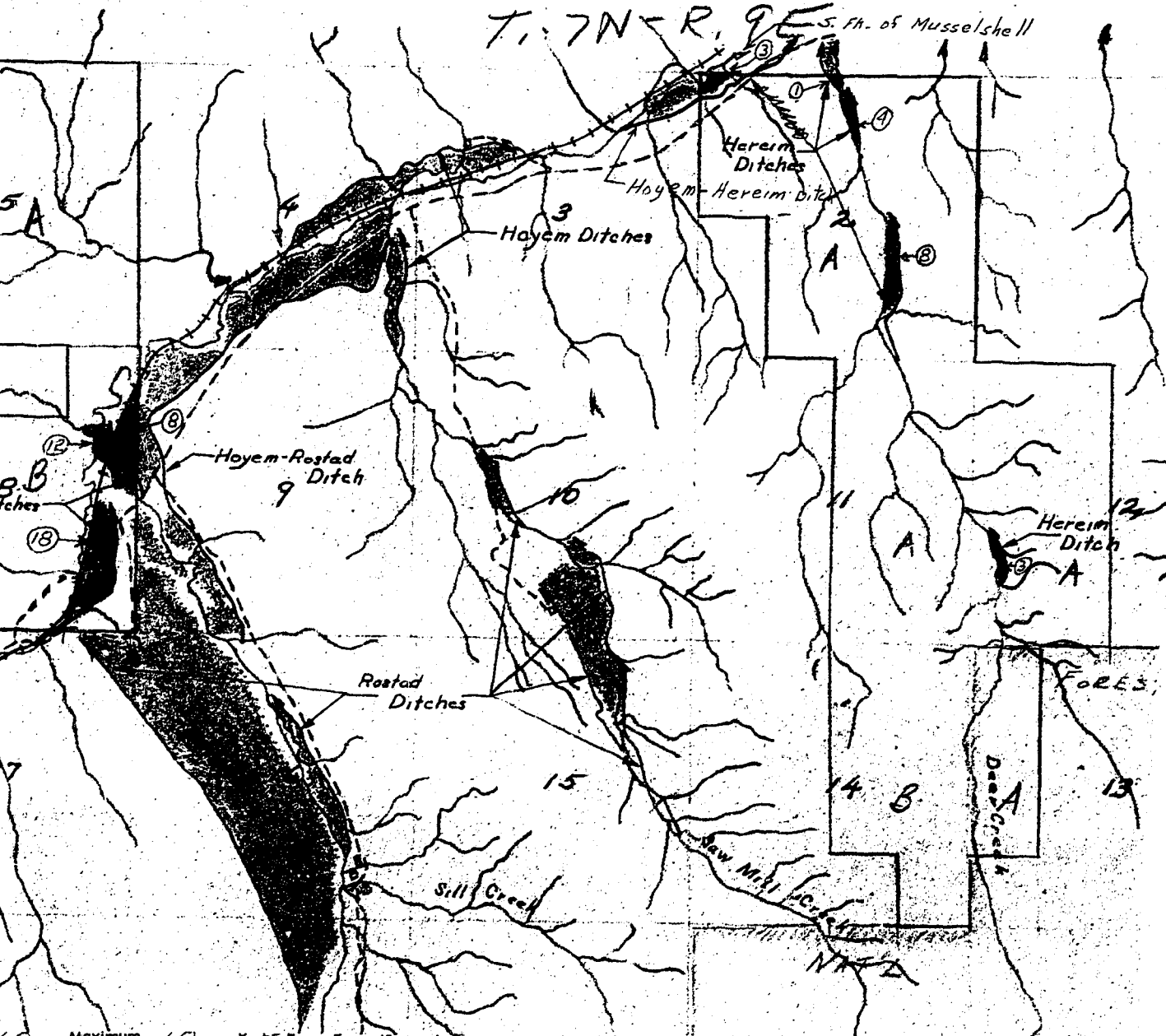

Maximum.....
the number of shares or inches, acre feet, as the case may be
diverted by means of pumping. G—Water diverted by gravity.
Date.....

Twp. 2N Rge. 4E
Twp. _____ Rge. _____
Twp. _____ Rge. _____

State Engineer's Office

WATER RESOURCES SURVEY

FARM MAP

Code No. 6A-57-85
2A-11A-12A-13A-
14B

Name of Land Owner Hereim, Clarence Address Martinsdale
Name of Operator same Address "
Legal Description _____

Irrigated Land _____ Land Potential Land Under Existing Facilities



Code No. 2A, 10A System HEREIM DITCHES Source of Water DEER CREEK
Basin S. FK. Musselshell R. Present 16 Potential 1 Maximum 16 R. F. P. G. S.
Code No. 2A System HOYEM-HEREIM DITCH Source of Water S. FK. Musselshell R.
Basin S. FK. Musselshell R. Present 3 Potential 0 Maximum 3 R. F. P. G. S.
Code No. 8B System HEREIM DITCH (NOT IN USE) Source of Water BOZEMAN FORK CR.
Basin S. FK. Musselshell R. Present 0 Potential 12 Maximum 12 R. F. P. G. S.
Code No. 8B System HEREIM DITCH (NOT IN USE) Source of Water S. FK. Musselshell R.
Basin S. FK. Musselshell R. Present 1 Potential 1E Maximum 1B R. F. P. G. S.

If under Ditch Company, Irrigation District, or Government Project, state the number of shares or inches, acre feet, as the case may be in said system _____
NOTE: R—Denotes Regular Irrigation. F—Flood Irrigation. P—Water diverted by means of pumping. G—Water diverted by gravity. S—Stored Water.
Information from _____ Date _____

STATE ENGINEER
 WATER RESOURCES SURVEY
 FARM MAP

GA-30
 2A-11A-123-13A-
 14E

Clarence Address Martinsdale
 Address

 Potential Land Under Existing Facilities

Code No. BB System Hayes Rooted Ditch Source of Water Unnamed Trib. to Reizenbach Creek
 Basin S. S. Vandenberg R. Present 0 Potential 8 Maximum 8 R. V F. P. G S. V
 Code No. _____ System _____ Source of Water _____
 Basin _____ Present _____ Potential _____ Maximum _____ R. _____ F. _____ P. _____ G. _____ S. _____
 Code No. _____ System _____ Source of Water _____
 Basin _____ Present _____ Potential _____ Maximum _____ R. _____ F. _____ P. _____ G. _____ S. _____
 Code No. _____ System _____ Source of Water _____
 Basin _____ Present _____ Potential _____ Maximum _____ R. _____ F. _____ P. _____ G. _____ S. _____

If under Ditch Company, Irrigation District, or Government Project, state the number of shares or inches, acre feet, as the case may be in said system.

NOTE: R—Denotes Regular Irrigation. F—Flood Irrigation. P—Water diverted by means of pumping. G—Water diverted by gravity. S—Stored Water.

Information from _____

Saw Mill Creek!

Ditch heads in the NE, NE $\frac{1}{4}$, Sec. 9
on east bank, for meadow in Sec. 4.

South Fork Musselshell River
Ditch heads in the NW, SE $\frac{1}{4}$, Sec. 4
on north bank, extends northeasterly
by bottoms in Sec. 3 & 4

Bozeman Fork Creek:

Ditch heads on east side in the
NE, NW $\frac{1}{4}$, Sec. 16.

For additional information see
Posted form on Hayem-Posted
Ditch. Irrigates land in Sec. 4.

331	Mose, Ed + Jay	Bozeman Fork	5-20-91	320
1482	Hayem, Andrew + more Bros.	Musselshell R.	4-19-95	320
1483	Hayem, Andrew + Sixent	" "	5-14-92	360
1504	Mose, Ed + Jay	" "	6-18-98	320
1753	Mose, Ed V.	Saw-mill Crv.	5-15-91	40
1832	Hebrnes, Andrew-L.	Slaughter House Crv.	7-1-07	160

STATE OF MONTANA

State Engineer's Office

WATER RESOURCES SURVEY

FARM MAP

County Meagher

Code No. _____

3A-4A

Twp. 7N Rge. 9E

Twp. _____ Rge. _____

Twp. _____ Rge. _____

Name of Land Owner Hoyem, Morris B. Address Martinsdale

Name of Operator Same Address "

Legal Description _____

Irrigated Land Non-Irrigated Land Potential Land Under Existing Facilities

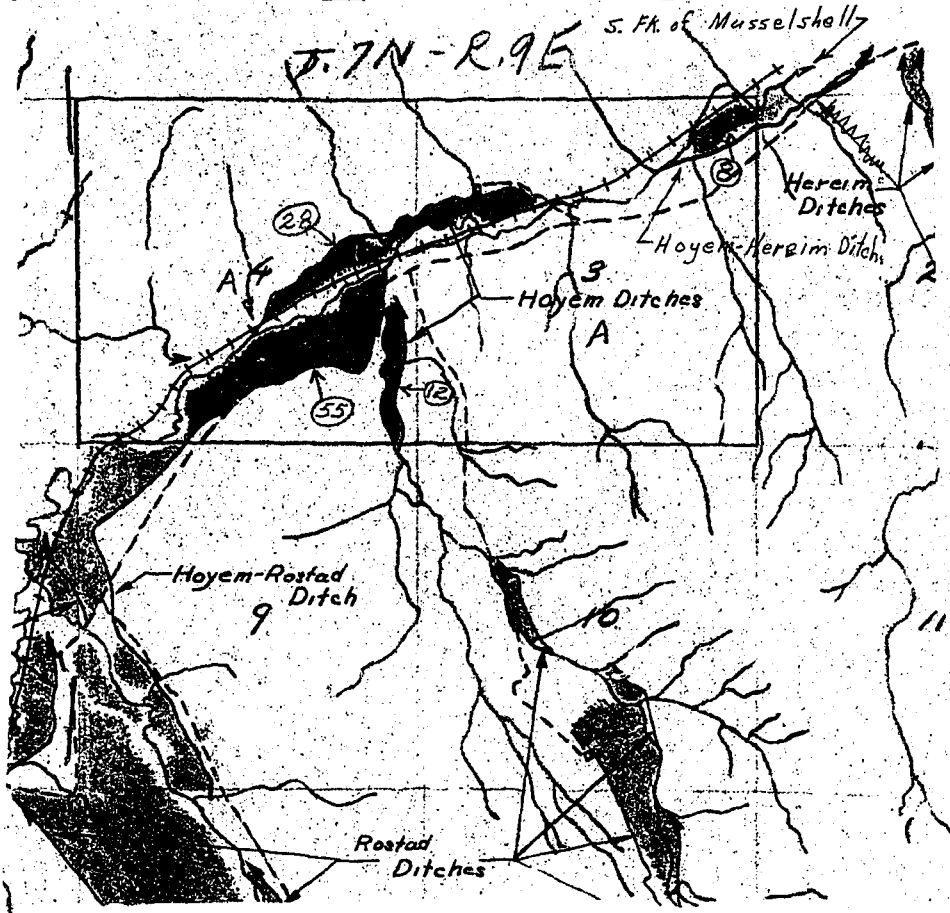

Code No. <u>3A</u>	System <u>HOYEM-HEREIM DITCH</u>	Source of Water <u>S. Fr. Musselshell R.</u>
Basin <u>S. Fr. Musselshell R.</u>	Present <u>8</u> Potential <u>0</u> Maximum <u>8</u>	R <input checked="" type="checkbox"/> F <input type="checkbox"/> P <input type="checkbox"/> G <input checked="" type="checkbox"/> S <input type="checkbox"/>
Code No. <u>3A, 4A</u>	System <u>HOYEM DITCH</u>	Source of Water <u>S. Fr. Musselshell R.</u>
Basin <u>S. Fr. Musselshell R.</u>	Present <u>2.6</u> Potential <u>0</u> Maximum <u>2.8</u>	R <input checked="" type="checkbox"/> F <input type="checkbox"/> P <input type="checkbox"/> G <input checked="" type="checkbox"/> S <input type="checkbox"/>
Code No. <u>4A</u>	System <u>HOYEM DITCH</u>	Source of Water <u>SAW MILL CREEK</u>
Basin <u>S. Fr. Musselshell R.</u>	Present <u>12</u> Potential <u>0</u> Maximum <u>12</u>	R <input checked="" type="checkbox"/> F <input type="checkbox"/> P <input type="checkbox"/> G <input checked="" type="checkbox"/> S <input type="checkbox"/>
Code No. <u>7A</u>	System <u>HOYEM-ROSTAD DITCH</u>	Source of Water <u>UNNAMED CREEK TRIBUTARY TO BAZZMAN FORK CR.</u>
Basin <u>S. Fr. Musselshell R.</u>	Present <u>55</u> Potential <u>0</u> Maximum <u>55</u>	R <input checked="" type="checkbox"/> F <input type="checkbox"/> P <input type="checkbox"/> G <input checked="" type="checkbox"/> S <input type="checkbox"/>

If under Ditch Company, Irrigation District, or Government Project, state the number of shares or inches, acre feet, as the case may be in said system.

NOTE: R—Denotes Regular Irrigation. F—Flood Irrigation. P—Water diverted by means of pumping. G—Water diverted by gravity. S—Stored Water.

Information from _____ Date _____

Bozeman Fork Creek:

Ditch heads on west side of creek, near south line of Sec. 21 extending north west, irrigates in Sec. 21, 16, 17 & 9.

Has treated Plank headgate.
East Side ditch in the SE, SE $\frac{1}{4}$, Sec. 16 extending north west, for creek bottom in Sec. 16.

Hoyem & Postad Ditch:

Ditch heads on east side in the NE, NW $\frac{1}{4}$, Sec. 16. extending northwest into Sec. 9 then north east into Sec. 4.
Ditch was built by Postad and Hoyem's fathers, ditch has grown up with willows and has caused to much seepage. Irr. in Sec. 9, some pot. land NW $\frac{1}{4}$.
Postad plans to build higher ditch to avoid seepage and to put more land under irrigation in Sec. 9 —
Then will not use Hoyem-Postad Ditch himself.
Sawmill Creek: (Flood)

A series of spreader ditches from Creek. irrigates Creek bottoms in Sec. 15 & 10.

Sill Creek:

Short ditch heads in SE, SE $\frac{1}{4}$, Sec. 16 for small pasture.

Indian Creek:

Waters from creek intermingle with Bozeman Fork Creek irrigation.

STATE ENGINEER'S OFFICE

WATER RESOURCES SURVEY

Township 7 North Range 9 East County Meagher

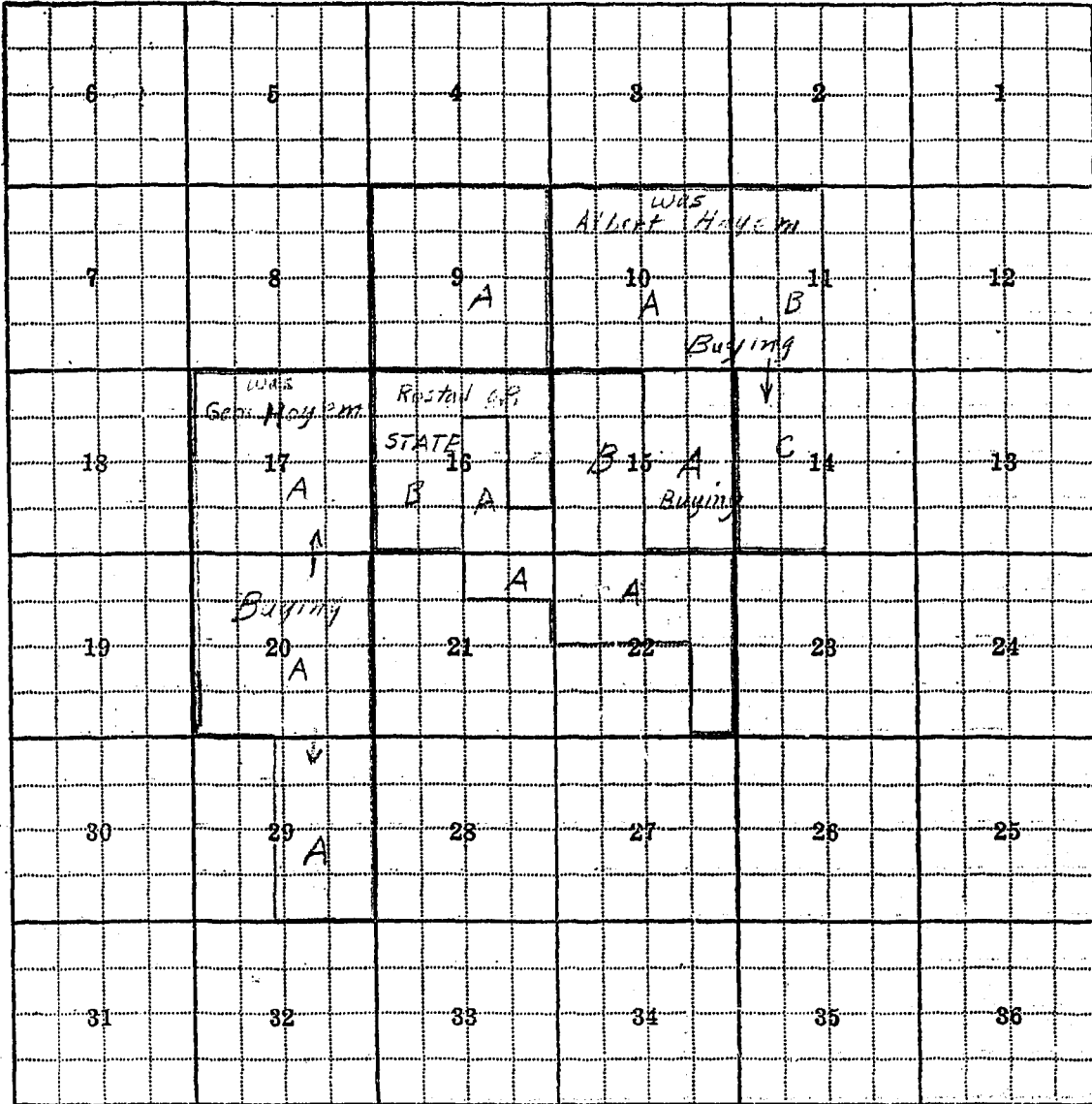

Rostad, Orville

Township _____ Range _____

Township 7 North Range 9 East County Meagher

Parcel Number	Name of Owner	Address
21A, 16A, 16B	Eostad, Orville	Martinsdale
9A, 15A, 15B	" "	"
10A	" "	"
327	Prennan, J.H. & Ripley, John E.	Boggs creek lev. 9-30-85 500
328	" " & J.P.	" " 5-1-88 500
331	More, Ed & Jaly	" " 5-20-91 320
1154	Brown, William M.	Indian creek 6-1-11 100
1156	Hoyem, George	" " 11-8-37 160
1749	Hoyem, Andrew	Saw mill lev. 9-15-97 120
1750	Hoyem, Gertrude	" " " 6-20-04 250
1753	More, Ed V.	" " " 5-15-91 40
1801	Brown, Wm. M.	Sill creek 6-1-11 40

STATE OF MONTANA
State Engineer's Office
WATER RESOURCES SURVEY
FARM MAP

County Meagher
Code No. 21A-16A-16B-1
9A-15A-15B-10A

Twp. 7N Rge. 9E
Twp. _____ Rge. _____
Twp. _____ Rge. _____

Name of Land Owner Rostad, Orville Address Martinsdale
Name of Operator Same Address 11
Legal Description _____

150 to Dec. 5, 1950.

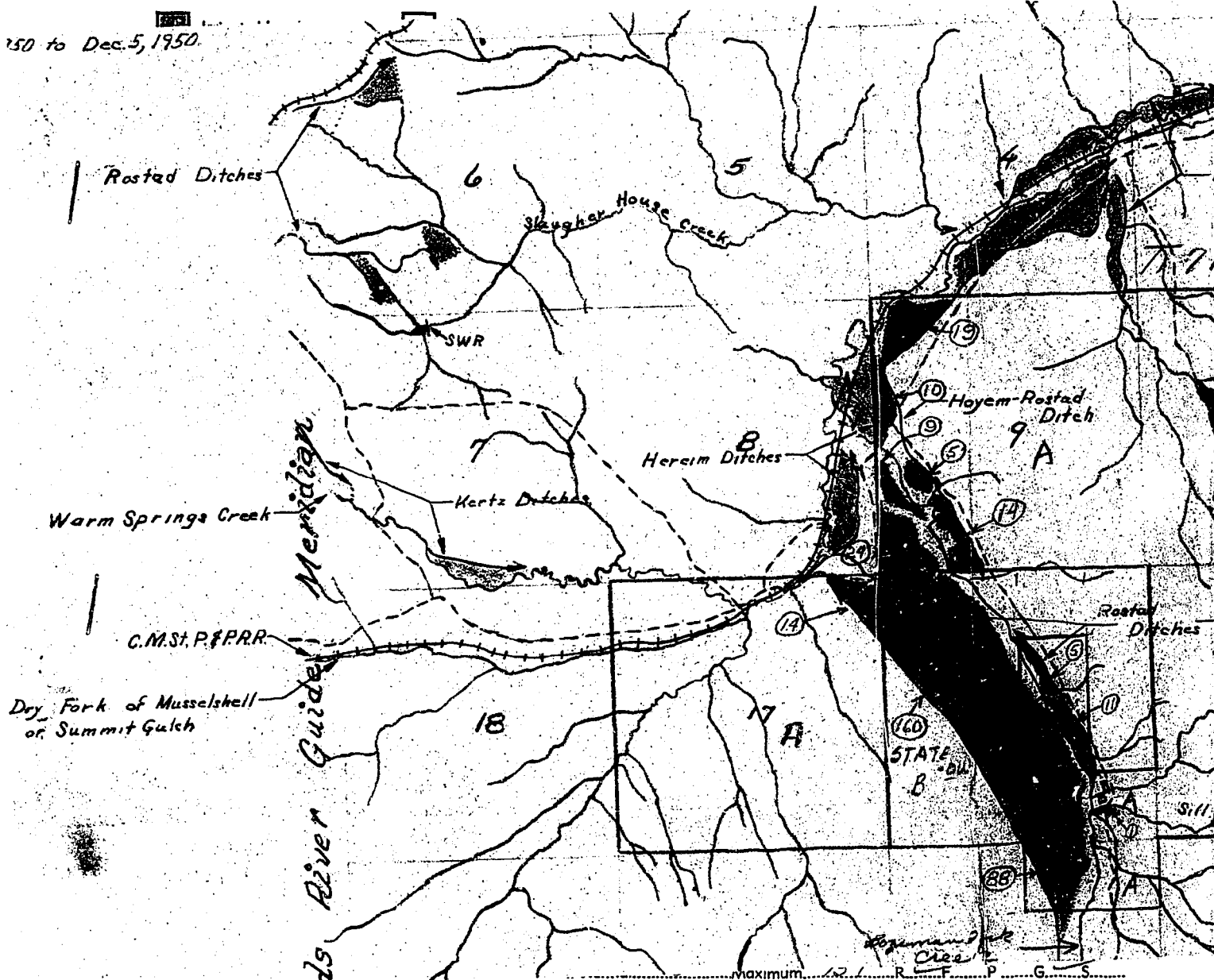

Code No. 16B (STATE-DW) System ROSTAD DITCHES Source of Water BOZEMAN FORK CR.
Basin: S.F.M. Musselshell R. Present 160 Potential 0 Maximum 160 R F P G S
Code No. 10A, 15A System ROSTAD DITCHES Source of Water SAN MILE CR.
Basin: S.F.M. Musselshell R. Present 59 Potential 0 Maximum 59 R F P G S

If under Ditch Company, Irrigation District, or Government Project, state the number of shares or inches, acre feet, as the case may be in said system.

NOTE: R—Denotes Regular Irrigation. F—Flood Irrigation. P—Water diverted by means of pumping. G—Water diverted by gravity. S—Stored Water.

Information from _____ Date _____

STATE OF MONTANA

Engineer's Office

RESOURCES SURVEY

FARM MAP

County Meagher

Code No. _____

21A-16A-16B-

4A-15A-15B-10A

Address Madison

Address _____

ber
B-
10A

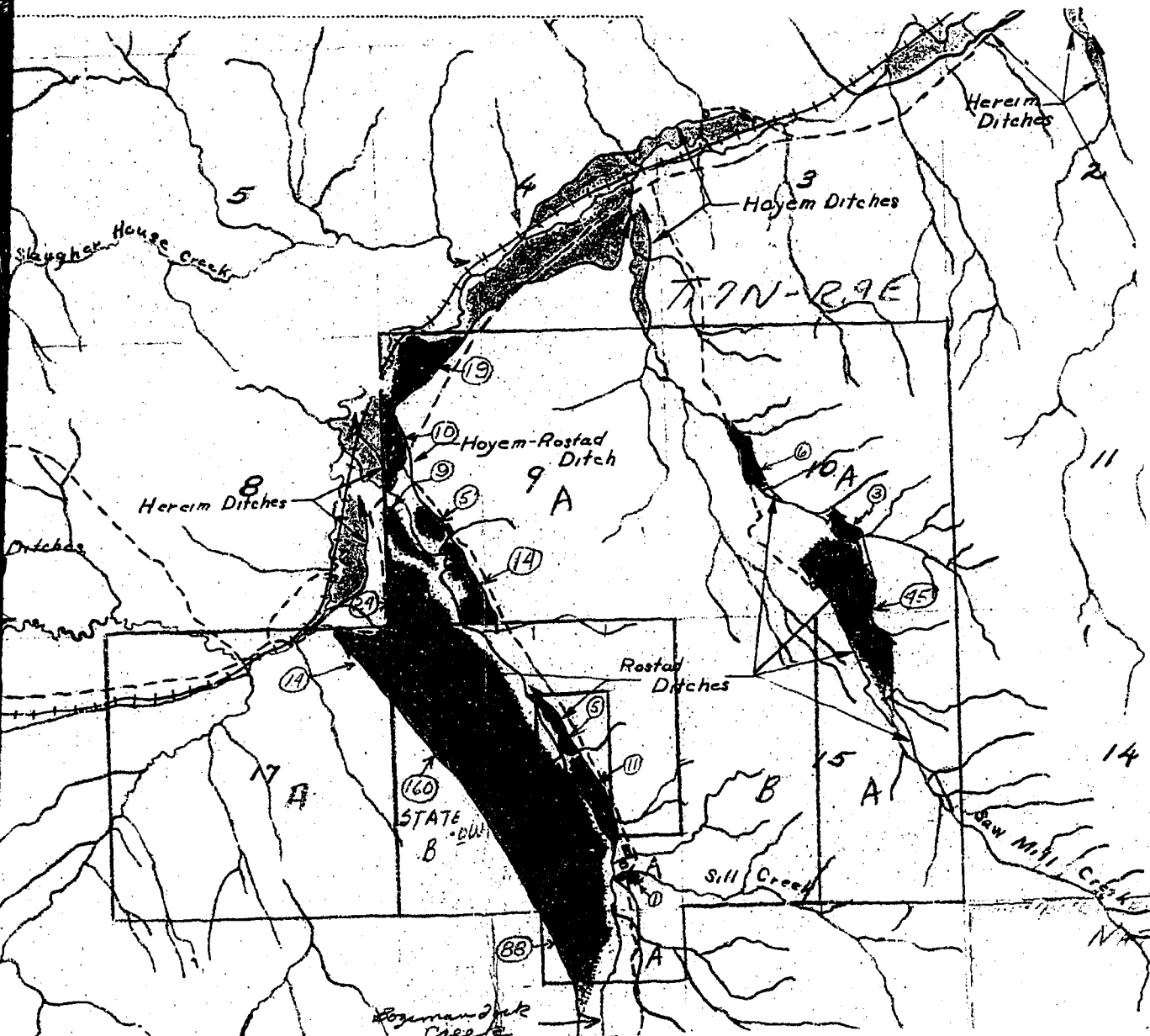

..... maximum..... R..... F..... P..... G..... S.....
 ROSTAD DITCHES Source of Water BERKMAN Fork Cr.
 Potential..... Maximum..... R..... F..... P..... G..... S.....
 ROSTAD DITCHES Source of Water Saw Mill Cr.
 Potential..... Maximum..... R..... F..... P..... G..... S.....
 Government Project, state the number of shares or inches, acre feet, as the case may be
 Irrigation. P—Water diverted by means of pumping. G—Water diverted by gravity.

Date _____

FARM MAP

Name of Land Owner Rostad, Orville Address Martinsdale

Name of Operator Same Address 11

ities

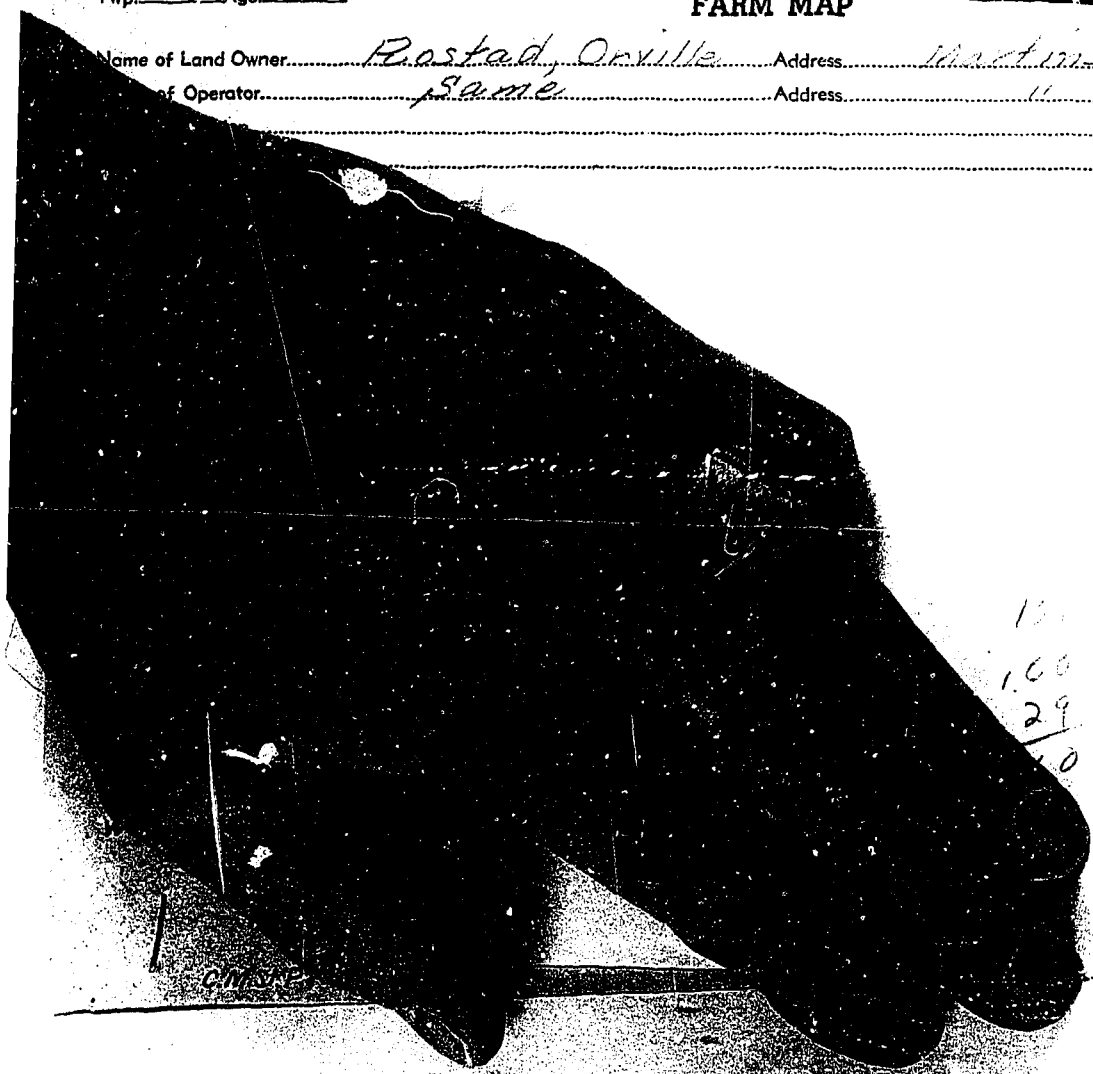

10
100
29
10

- Code No. 9A System HOVEM-ROSTAD DITCH Source of Water Unnamed Canal Exhibit
Basin 3 Fr. Musselshell R. Present 20 Potential 19 Maximum 48 R. F. P. G. S.
- Code No. 9A, 16A, 17A, 21A System ROSTAD DITCHES Source of Water ROZEMAN Fork CR.
Basin 3 Fr. Musselshell R. Present 151 Potential 0 Maximum 151 R. F. P. G. S.
- Code No. 16B (STATE-OW) System ROSTAD DITCHES Source of Water ROZEMAN Fork CR.
Basin 3 Fr. Musselshell R. Present 160 Potential 0 Maximum 160 R. F. P. G. S.
- Code No. 10A, 15A System ROSTAD DITCHES Source of Water SAN MILL CR.
Basin 3 Fr. Musselshell R. Present 59 Potential 0 Maximum 59 R. F. P. G. S.

If under Ditch Company, Irrigation District, or Government Project, state the number of shares or inches, acre feet, as the case may be in said system.

NOTE: R—Denotes Regular Irrigation. F—Flood Irrigation. P—Water diverted by means of pumping. G—Water diverted by gravity. S—Stored Water.

Information from _____ Date _____

Rge.

FARM MAP

Roostad, Orville
Same

Address: ...
Address: ...

ities

Code No. 16 A System SMALL DITCH Source of Water SILK CREEK
 Basin S. F. Nusselshell R. Present 1 Potential 0 Maximum 1 R. --- F. --- P. --- G. --- S. ---
 Code No. _____ System _____ Source of Water _____
 Basin _____ Present _____ Potential _____ Maximum _____ R. _____ F. _____ P. _____ G. _____ S. _____
 Code No. _____ System _____ Source of Water _____
 Basin _____ Present _____ Potential _____ Maximum _____ R. _____ F. _____ P. _____ G. _____ S. _____
 Code No. _____ System _____ Source of Water _____
 Basin _____ Present _____ Potential _____ Maximum _____ R. _____ F. _____ P. _____ G. _____ S. _____

If under Ditch Company, Irrigation District, or Government Project, state the number of shares or inches, acre feet, as the case may be in said system.

NOTE: R—Denotes Regular Irrigation F—Flood Irrigation P—Water diverted by means of pumping. G—Water diverted by gravity S—Stored Water.

Information from