

Land Ownership.....

6	5	4	3	2	1
7	8	9	10	11	12
18	17	16	15	14	13
19	20	21	22	23	24
30	29	28	27	26	25
31	32	33	34	35	36

2000
2100

Land Ownership.....

6	5	4	3	2	1
7	8	9	10	11	12
13	14	15	16	17	18
19	20	21	22	23	24
25	26	27	28	29	30
31	32	33	34	35	36

Land Ownership

.....

.....

6	5	4	3	2	1
7	8	9	10	11	12
13	14	15	16	17	18
19	20	21	22	23	24
25	26	27	28	29	30
31	32	33	34	35	36

1-12-11
1911

WILSON COUNTY, MISSISSIPPI
N. H. A.

Land Ownership.....
.....
.....

6	5	4	3	2	1
7	8	9	10	11	12
13	14	15	16	17	18
19	20	21	22	23	24
25	26	27	28	29	30
31	32	33	34	35	36

101
A33

W. R. R.

Land Ownership.....

.....

.....

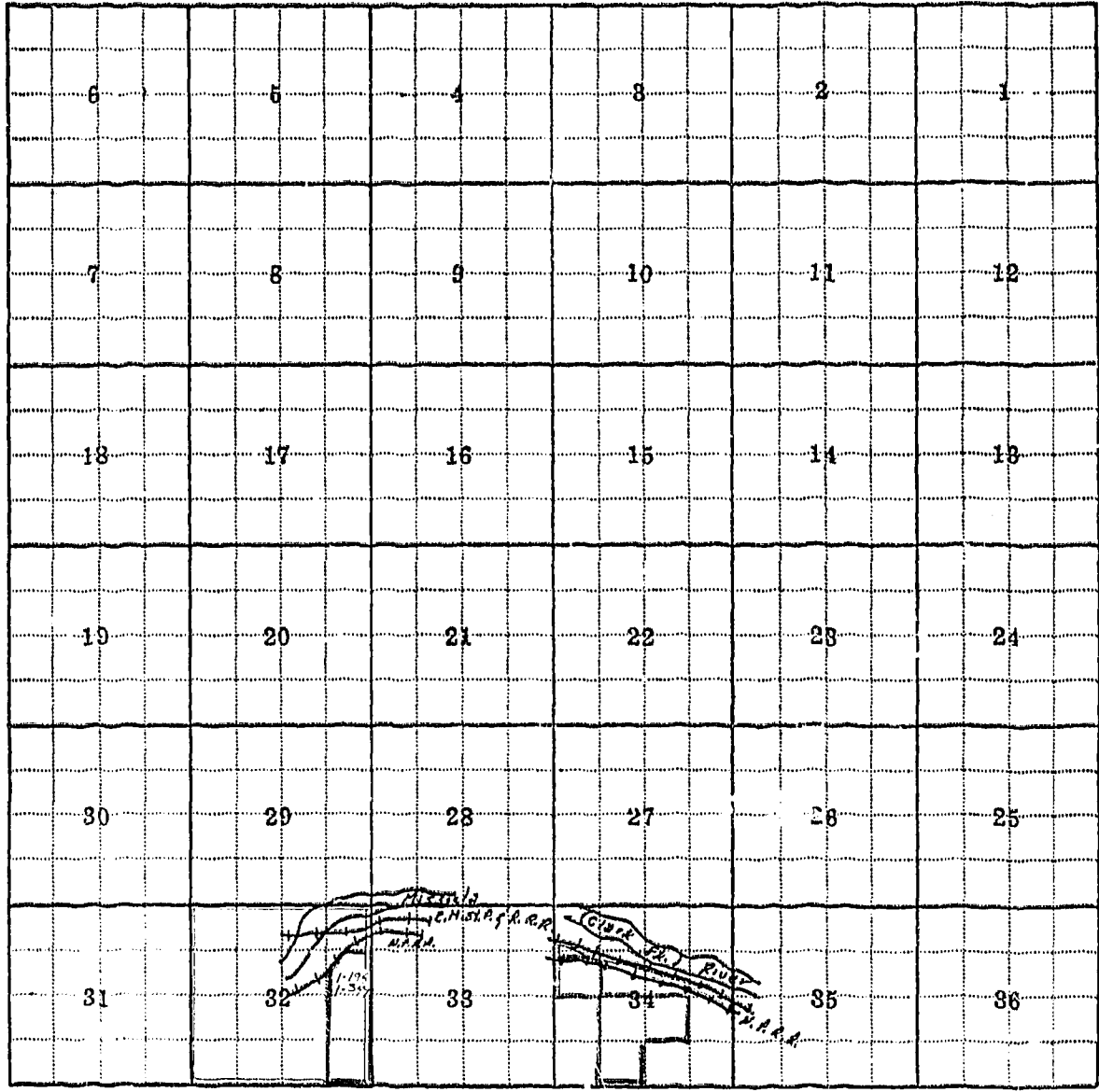

Land Ownership.....

.....

.....

6	5	4	3	2	1
7	8	9	10	11	12
13	14	15	16	17	18
19	20	21	22	23	24
25	26	27	28	29	30
31	32	33	34	35	36

MISSOURI & NORTH PACIFIC R.R.
 U.S. R.R.

Land Ownership

.....

.....

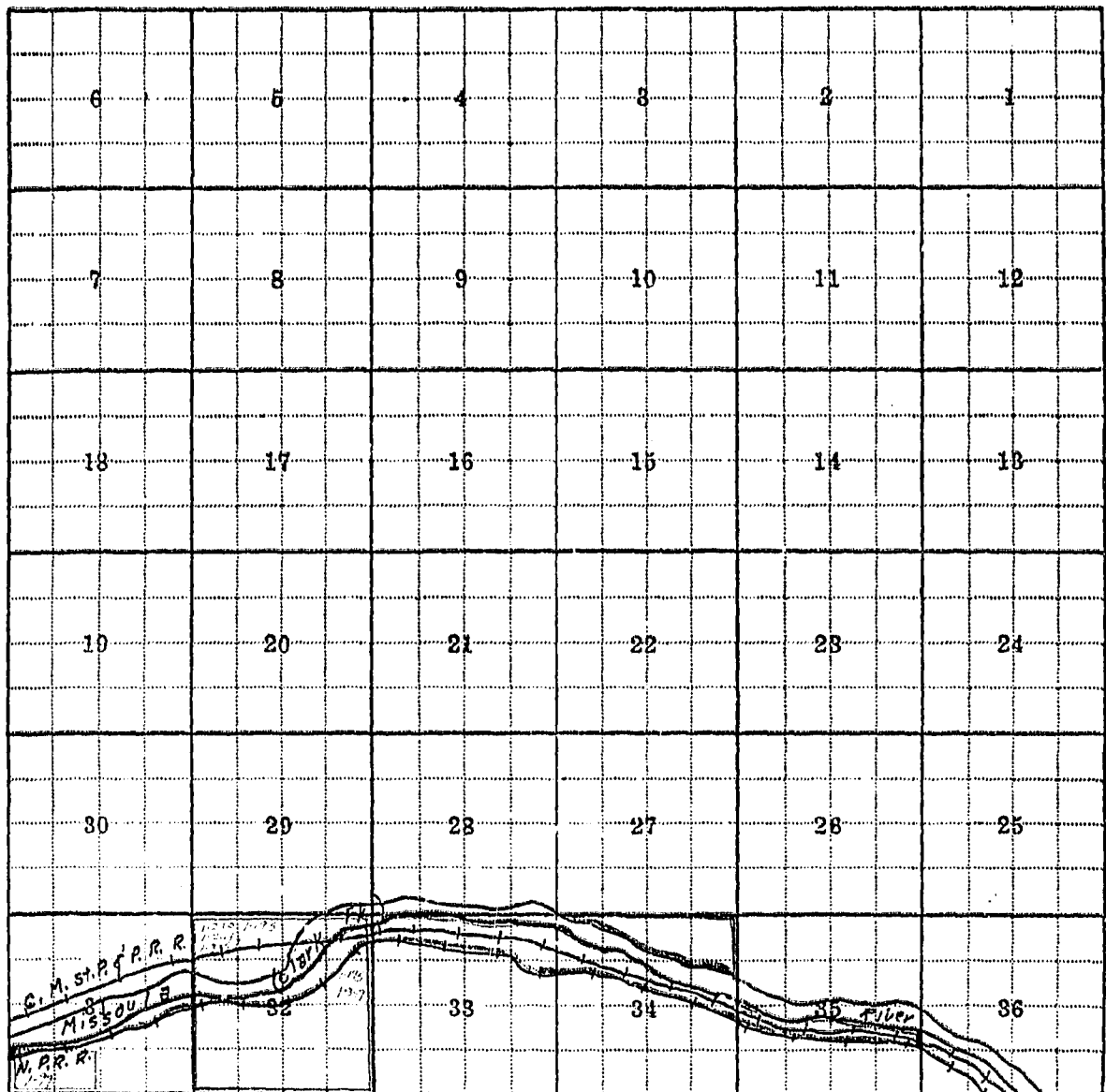

Land Ownership.....

.....

.....

C.M. ST. P. & P.R.R.
N.P.R.R.

	6		5		4		3		2		1
	7		8		9		10		11		12
	13		14		15		16		17		18
	19		20		21		22		23		24
	25		26		27		28		29		30
	31		32		33		34		35		36

Land Ownership

.....

.....

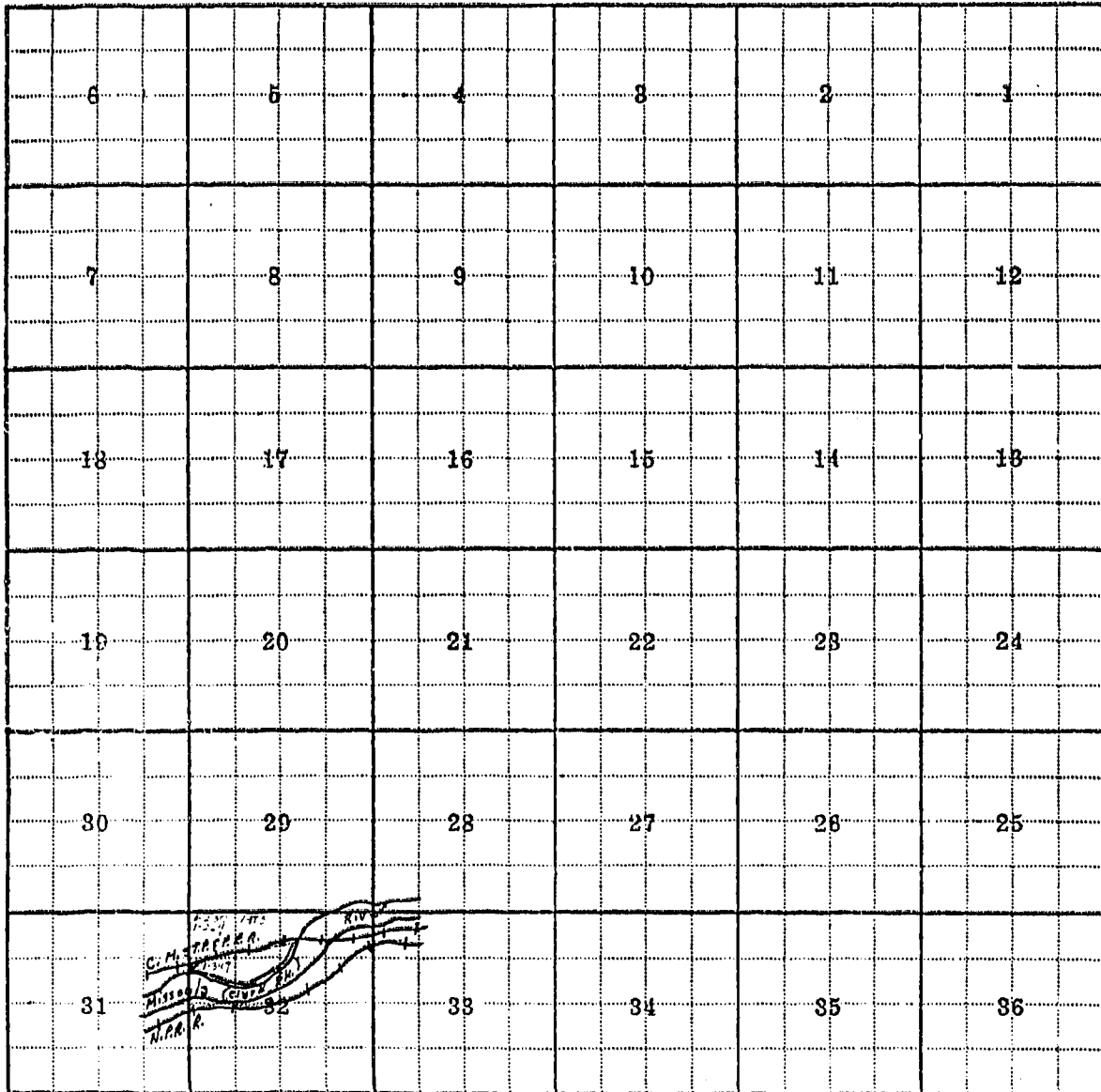

Land Ownership

.....

.....

6	5	4	3	2	1
7	8	9	10	11	12
13	14	15	16	17	18
19	20	21	22	23	24
25	26	27	28	29	30
31	32	33	34	35	36

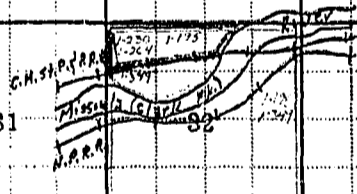

Land Ownership.....

.....

.....

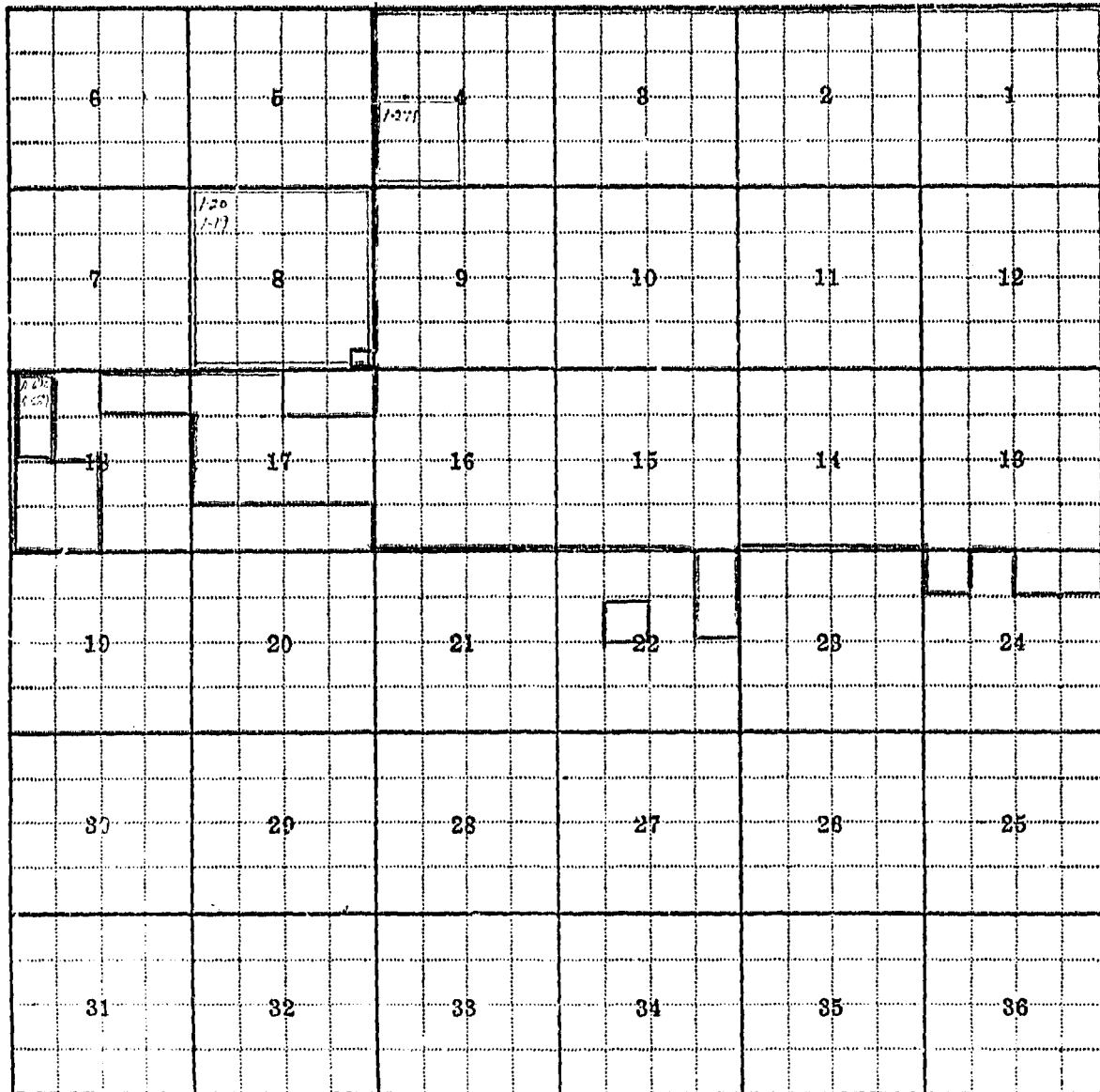

Land Ownership.....

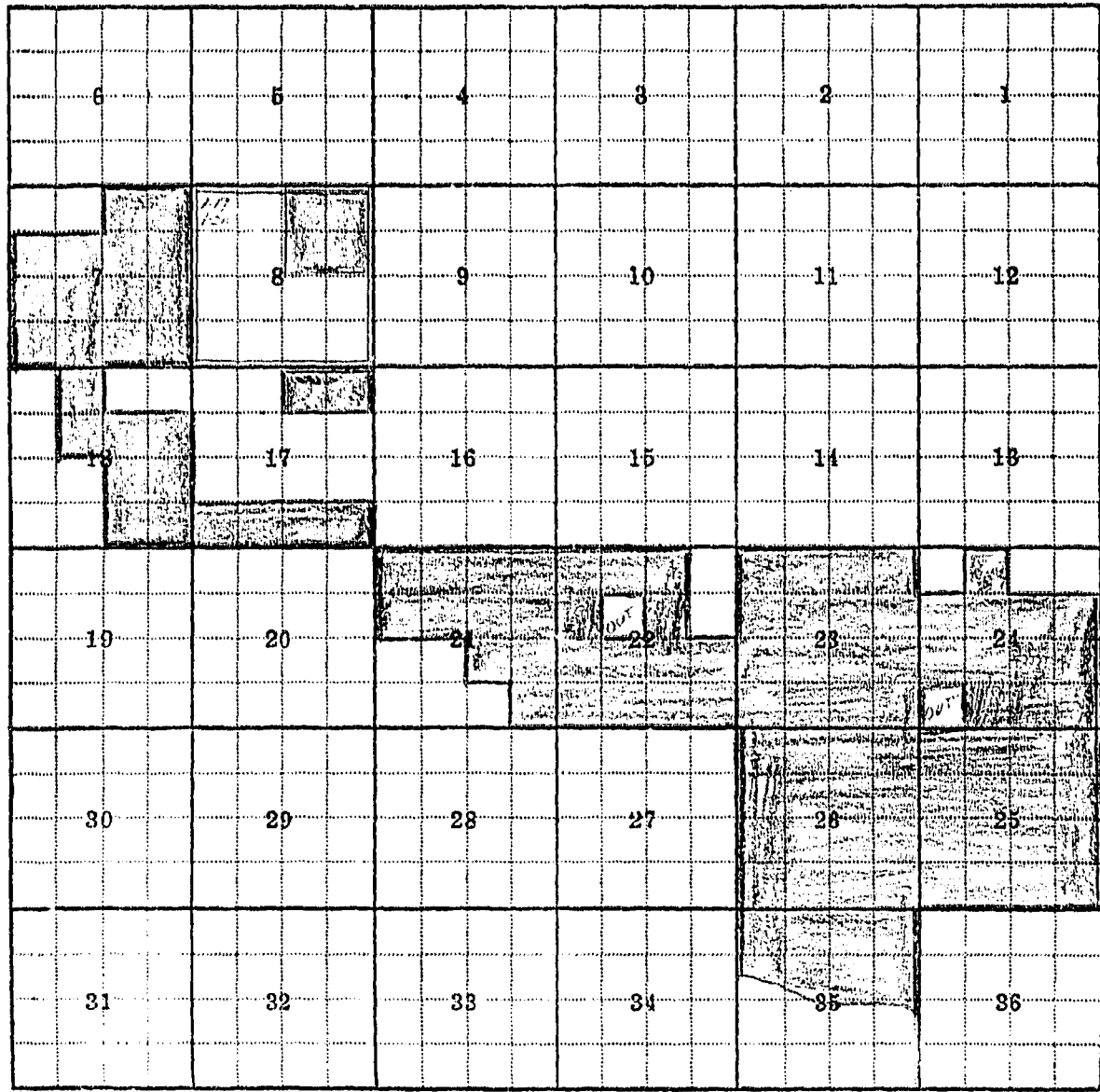

Land Ownership

.....

.....

6	5	4	3	2	1
7	8 <i>100 1-17</i>	9	10	11	12
13	17	16	15	14	13
19	20	21	22	23	24
29	29	28	27	26	25
31	32	33	34	35	36

Land Ownership.....

6	5	4	3	2	1
7	8	9	10	11	12
13	14	15	16	17	18
19	20	21	22	23	24
25	26	27	28	29	30
31	32	33	34	35	36

1-129
N-337

AMERICAN COLLEGE OF SURVEYING
1111 17th St. N.W.
Washington, D.C. 20036

Land Ownership.....
.....
.....

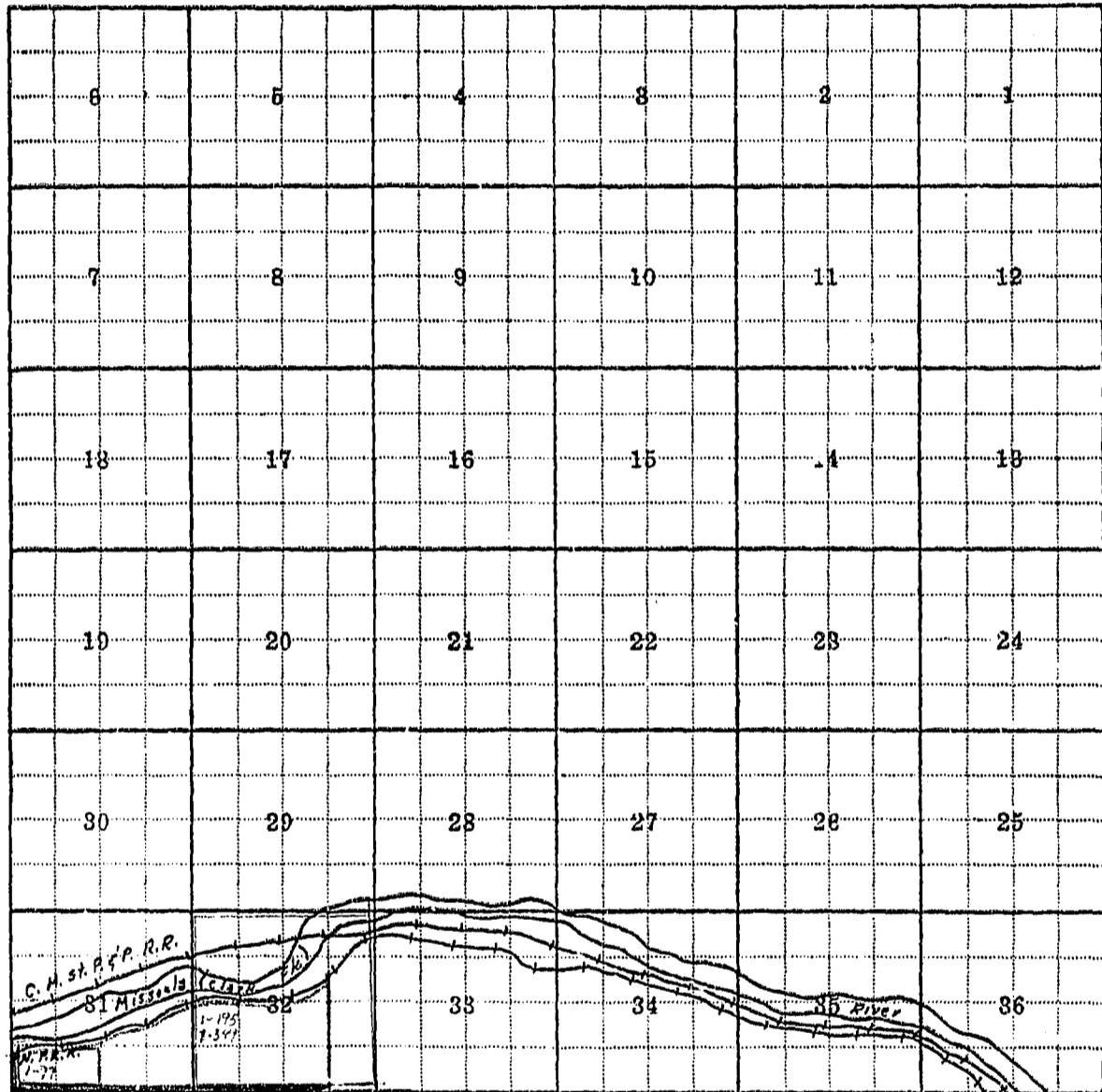

Land Ownership

.....

.....

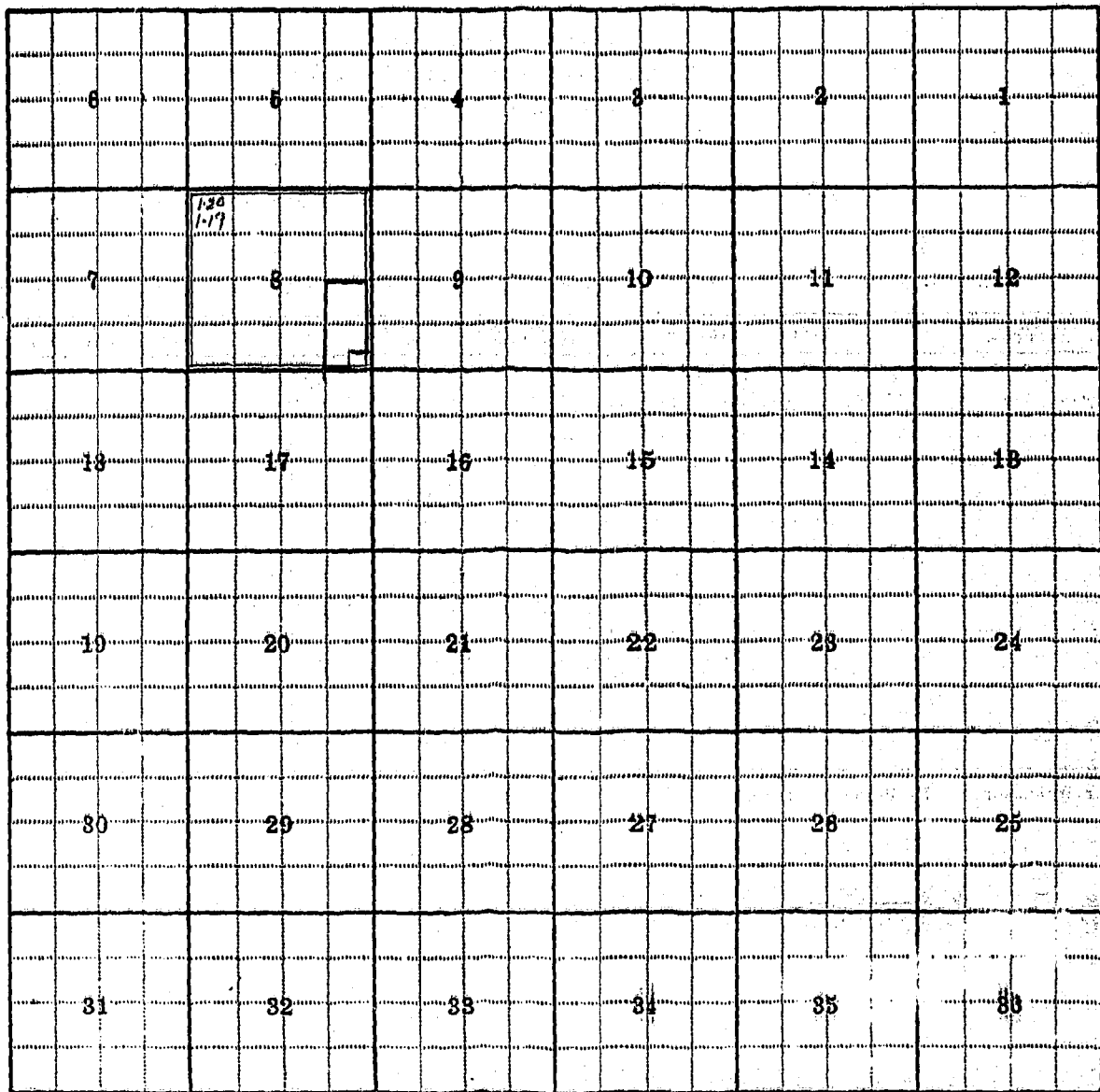

Land Ownership.....

6	8	4	8	2	1
7	8	9	10	11	12
13	17	18	15	14	13
19	20	21	22	23	24
30	29	28	27	26	25
31	32	33	34	35	36

A-690
A-689

Land Ownership.....
.....
.....

6	5	4	3	2	1
7	8	9	10	11	12
13	17	16	15	14	13
19	20	21	22	23	24
30	29	28	27	26	25
31	32	33	34	35	36

Land Ownership

.....

.....

.....

.....

.....

.....

.....

.....

.....

.....

.....

.....

.....

6	6	4	8	2	1
7	8	9	10	11	12
13	17	16	15	14	13
19	20	21	22	23	24
30	29	28	27	26	25
31	32	33	34	35	36

1/12/20
1/13/20

WYOMING GOVT. LAND OFFICE
LARAMIE, WYOMING

Land Ownership

.....

.....

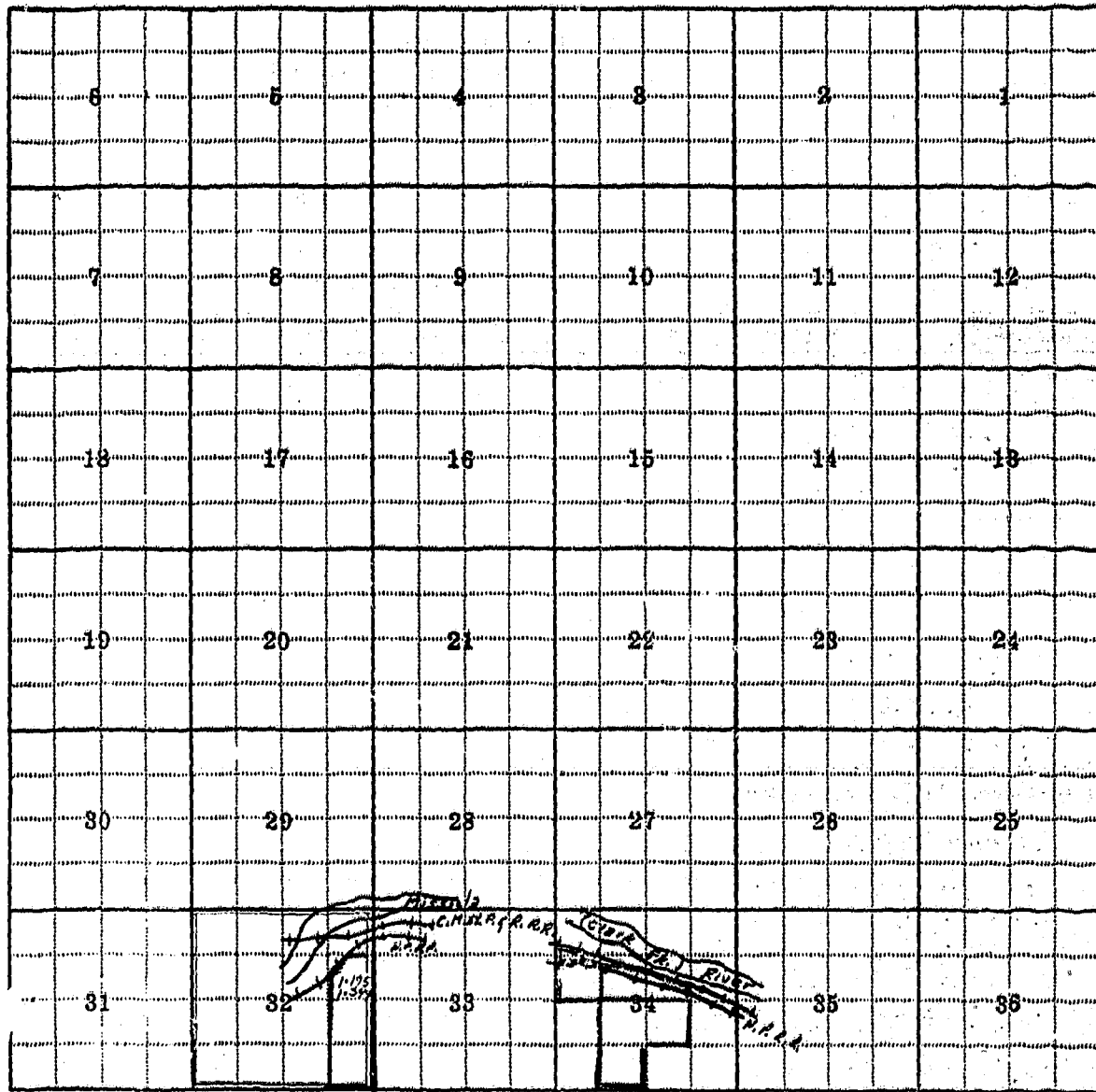

Land Ownership.....

.....

.....

6	5	4	3	2	1
7	8	9	10	11	12
13	14	15	16	17	18
19	20	21	22	23	24
25	26	27	28	29	30
31	32	33	34	35	36

RECEIVED
 CLERK
 U.S. DEPT. OF AGRICULTURE
 WASHINGTON, D.C.

Land Ownership.....

.....

.....

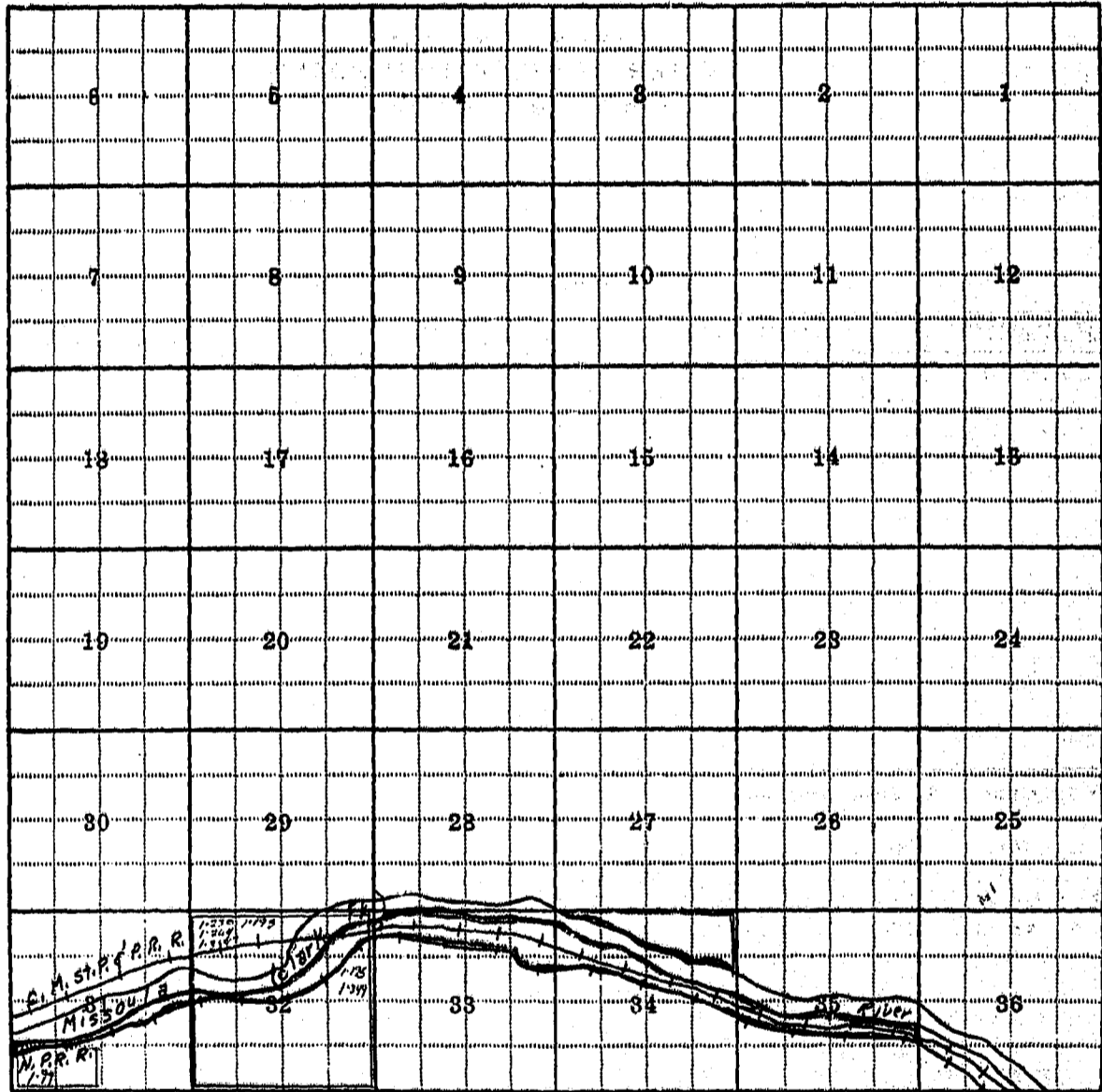

Land Ownership.....

.....

.....

.....

.....

.....

.....

.....

.....

.....

.....

.....

.....

.....

.....

6	5	4	3	2	1
7	8	9	10	11	12
13	17	16	15	14	13
19	20	21	22	23	24
30	29	28	27	26	25
31	32	33	34	35	36

FEB 24 1975
 C. M. STARR
 MISSISSIPPI
 N.C.R.R.

Land Ownership.....

.....

COUNTY OF ...
 STATE OF ...
 ...
 ...

Also on file in ...
 ...

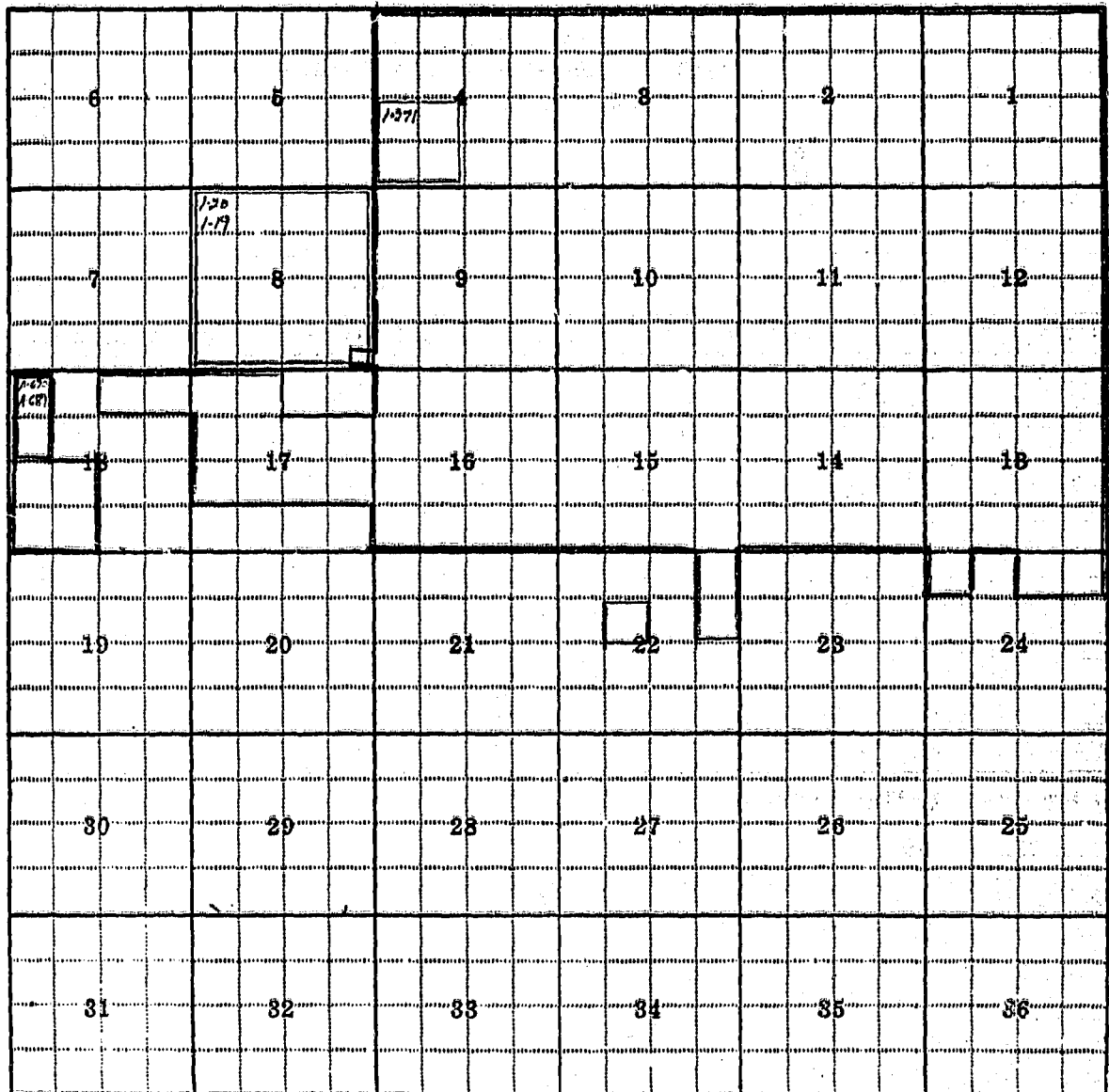

Land Ownership.....

.....

.....

.....

.....

.....

.....

.....

.....

.....

.....

.....

.....

.....

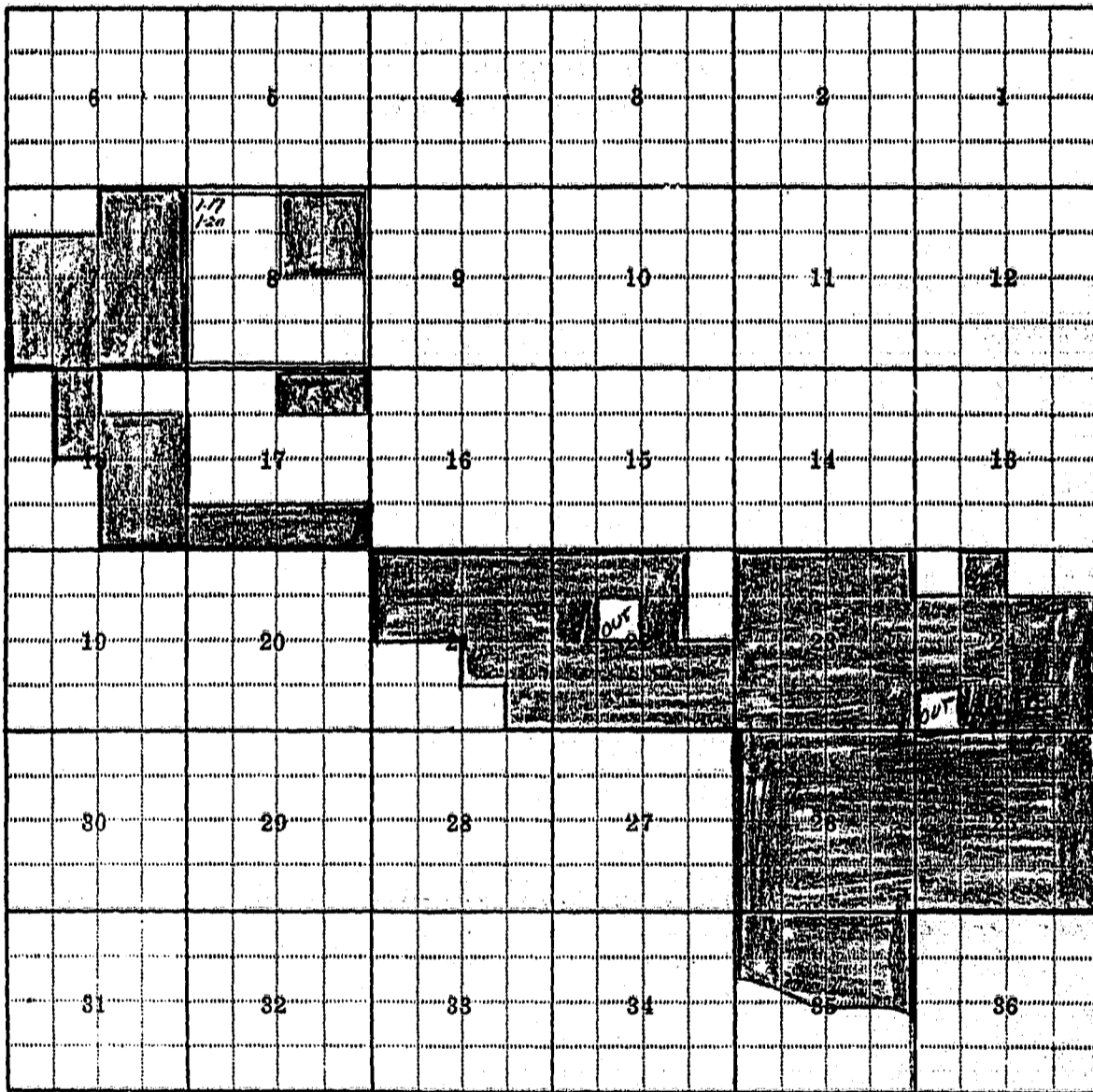

Land Ownership.....

.....

.....

.....

.....

.....

.....

.....

.....

.....

.....

.....

.....

.....

6	5	4	3	2	1
7	8	9	10	11	12
13	14	15	16	17	18
19	20	21	22	23	24
25	26	27	28	29	30
31	32	33	34	35	36

ADL 100
 1-124
 0-339

LAND OFFICE
 DEPARTMENT OF THE INTERIOR
 BUREAU OF LAND MANAGEMENT

Land Ownership.....

.....

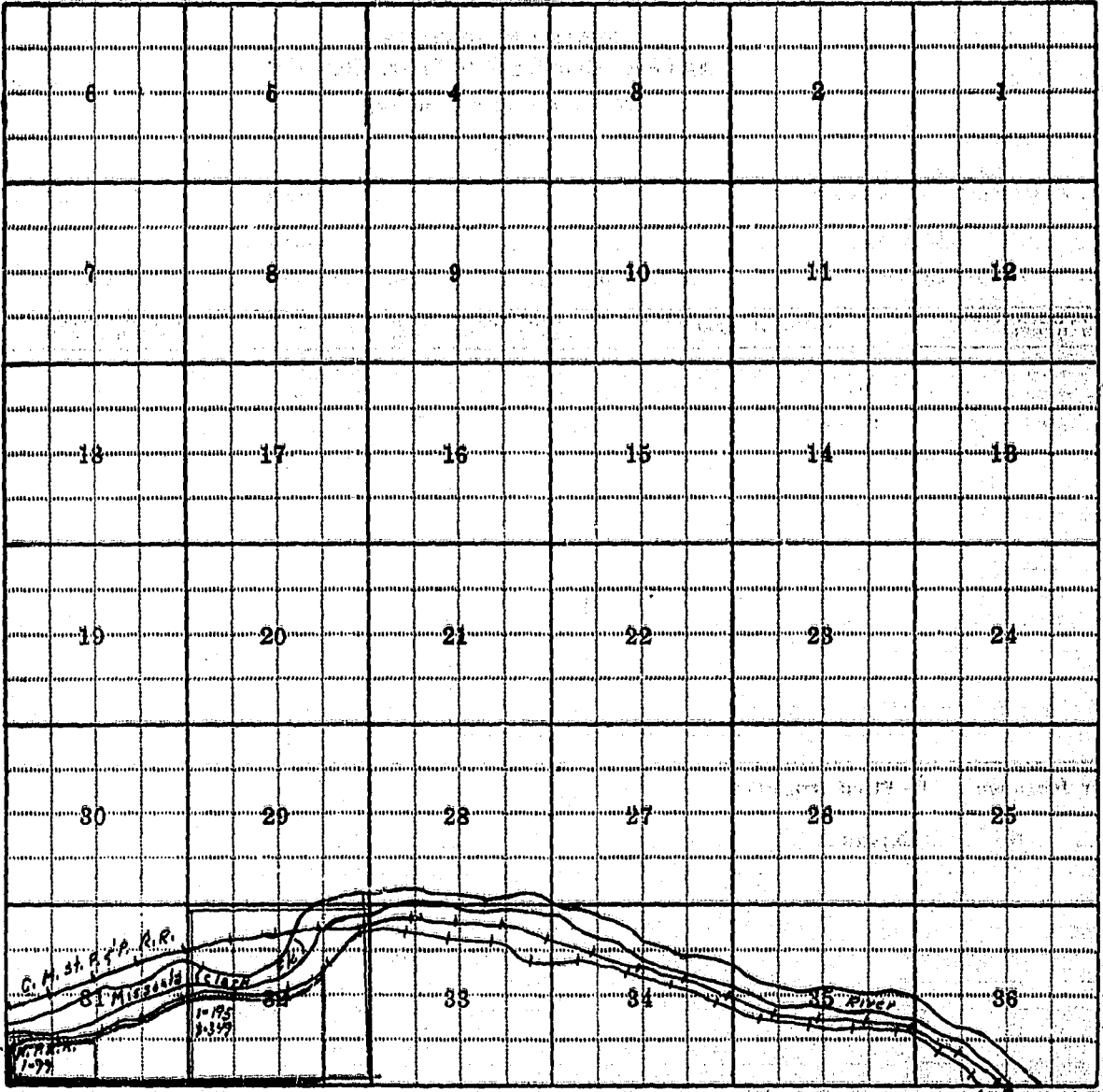

Land Ownership.....

Faint, illegible text on the right side of the page, possibly bleed-through from the reverse side of the document.