

F-1-A

County Missoula

Farm Checked: Date Oct 2 1955

By S. R. Leonard

Legal Land Owner James M. Scott & Sons

Operator James M. Scott & Sons

Water is delivered by:-- 1. Private System; 2. Ditch Company; 3. State Project; 4. Federal Project; 5. Irrigation District

STATE OF MONTANA
WATER CONSERVATION BOARD
Water Resources Survey

T. 34N R. 5W Plat No. E

Photo No. 115-10000000

R.T. 78
Address Wallace Idaho

Address Wallace Idaho

App. No. Decree No.	NAME OF APPROPRIATOR TO WHOM DECREED	NAME OF STREAM	Date App. Date Priority	Miner's Inches	In Use	NAME OF DITCH (Water Delivered By)	No.	R/F	Present Irr. Acres	Irrigable Acres
<u>Missoula E-2021</u>	<u>LOREN, Vian</u>	<u>N. 75' balance of North Fork of Walla Walla at Packer Creek</u>	<u>6-1-55</u>	<u>350</u>	<u>Minor #</u>					

NOTE: R--Denotes Regular Irrigation. F--Flood Irrigation.

Adequate Supply: Yes No Explain

Remarks
* This is a portion of the Lost Chance Mines which has long since been taken over by the State. The mines are now being worked by a group of individuals. It is intended to build a dam on the Snake River. The dam will be a concrete dam and will be the largest dam in the State.

River Basin Columbia

Also in Plat No. <u> </u> Twp. <u> </u> Rge. <u> </u>	Plat No. <u> </u> Twp. <u> </u> Rge. <u> </u>	Plat No. <u> </u> Twp. <u> </u> Rge. <u> </u>	Plat No. <u> </u> Twp. <u> </u> Rge. <u> </u>
Plat No. <u> </u> Twp. <u> </u> Rge. <u> </u>	Plat No. <u> </u> Twp. <u> </u> Rge. <u> </u>	Plat No. <u> </u> Twp. <u> </u> Rge. <u> </u>	Plat No. <u> </u> Twp. <u> </u> Rge. <u> </u>

Information From: W. R. Pats

6	5	4	3	2	1
7	8	9	10	11	12
13	14	15	16	17	18
19	20	21	22	23	24
25	26	27	28	29	30
31	32	33	34	35	36

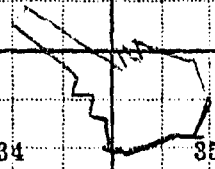

Land Ownership: *The Mining claim plotted is just the
 Lost State Mining claim, not the entire
 Tupper Tupper Co.*

F-1-A

County MINERAL

Farm Checked: Date Oct 3, 1940

By J. H. ...

Legal Land Owner TARBOX MINING COMPANY * See below

Operator Jupiter Corporation

Water is delivered by:— 1. Private System; 2. Ditch Company; 3. State Project; 4. Federal Project; 5. Irrigation District

STATE OF MONTANA
WATER CONSERVATION BOARD
Water Resources Survey

T. 20NR 31W1 Plat No. B

Photo No. No. Photostats

App. No. Decree No.	NAME OF APPROPRIATOR TO WHOM DECREED	NAME OF STREAM	Date App. Date Priority	Miner's Inches	In Use	NAME OF DITCH (Water Delivered By)	No.	R/F	Present Irr. Acres	Irrigable Acres
R 275	LARSON, Lewis F.	Packer Creek	8-8-1900	8,000	No					
A-521	TARBOX Mining Company by Maurice Everett	Packer Creek	5-19-03	1600	No					

NOTE: R—Denotes Regular Irrigation. F—Flood Irrigation.

Adequate Supply: Yes No Explain

Remarks
* These rights were filed specifically for the TARBOX Mining Company which supposedly still exists. It is not in operation at the present time but upon interview of CHARLES GUNS he stated that operation will be in the near future at this mine. There is no record in the court house that the land where this property was patented and all maps the field investigator has seen from the county show it as a patented mining claim as shown on the reverse side.

River Basin Columbia

Also in: Plat No. Twp. Rge.	Plat No. Twp. Rge.	Plat No. Twp. Rge.	Plat No. Twp. Rge.
Plat No. Twp. Rge.	Plat No. Twp. Rge.	Plat No. Twp. Rge.	Plat No. Twp. Rge.

Information From:
Charles Guns, Field Survey
(MINER)

6	5	4	3	2	1
7	8	9	10	11	12
13	14	15	16	17	18
19	20	21	22	23	24
25	26	27	28	29	30
31	32	33	34	35	36

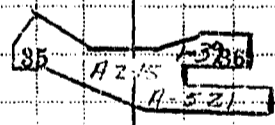

Land Ownership *Approximate location of mining claim on the*
Traverse No. 21

F-1-A

County Mineral

Farm Checked: Date Oct 1, 1967

By J. Noewood

Legal Land Owner U.S.A.

Operator Forest Service

Water is delivered by: 1. Private System;

2. Ditch Company;

3. State Project;

4. Federal Project;

5. Irrigation District

STATE OF MONTANA
WATER CONSERVATION BOARD
Water Resources Survey

T. 20N R. 31W Plat No. 8

Photo No. None

Lolo National Forest
Tinley, January 1963

Address Washington, D.C.

Address SAME

App. No. Decree No.	NAME OF APPROPRIATOR TO WHOM DECREED	NAME OF STREAM	Date App. Date Priority	Miner's Inches	In Use	NAME OF DITCH (Water Delivered By)	No.	R/F	Present Irr. Acres	Irrigable Acres
1-209	MINERAL KING MINING Co.	Packer Creek East of West fork	7-1-40	60	No (F)					
A-413	LAMAR, J. J.	Packer Creek North fork	1-19-95	400	No (F)					
A-439	CHAMPAGNE, J. J.	Packer Creek North fork of West fork	1-19-95	500	No (F)					
A-333	Various Miners Consumed by	Packer Creek	10-11-03	500	No (F)					
A-410	CHAMPAGNE, J. J.	Packer Creek	1-19-95	300	No (F)					
1-39	DIXON, Richard	East fork of Packer Creek	6-3-16	500	No (F)					
A-521	MINERAL KING	Packer Creek	5-19-03	1,600	No (F)					
A-573	DIXON, Richard	Packer Creek	5-1-06	10,000	No (F)					
A-575	DIXON, Richard	Packer Creek	10-11-03	10,000	No (F)					
A-578	DIXON, Richard	Packer Creek	6-25-05	10,000	No (F)					
A-587	DIXON, Richard	Packer Creek	5-9-05	10,000	No (F)					
A-589	DIXON, Richard	Packer Creek	5-9-09	10,000	No (F)					
A-601	BELL, Frank	Packer Creek North fork of West fork	4-5-07	500	No (F)					
F-60	MINERAL KING	Packer Creek	10-11-03	500	No (F)					

NOTE: R—Denotes Regular Irrigation. F—Flood Irrigation.

Adequate Supply: Yes No Explain

Remarks

* These two water rights were listed only in the Township & Range
All rights are changing hands

River Basin Columbia

Also in: Plat No. Twp. Rge	Plat No. Twp. Rge	Plat No. Twp. Rge	Plat No. Twp. Rge
Plat No. Twp. Rge	Plat No. Twp. Rge	Plat No. Twp. Rge	Plat No. Twp. Rge

Information From:

FIELD SURVEY J. Noewood
also from Forest Service Engineers

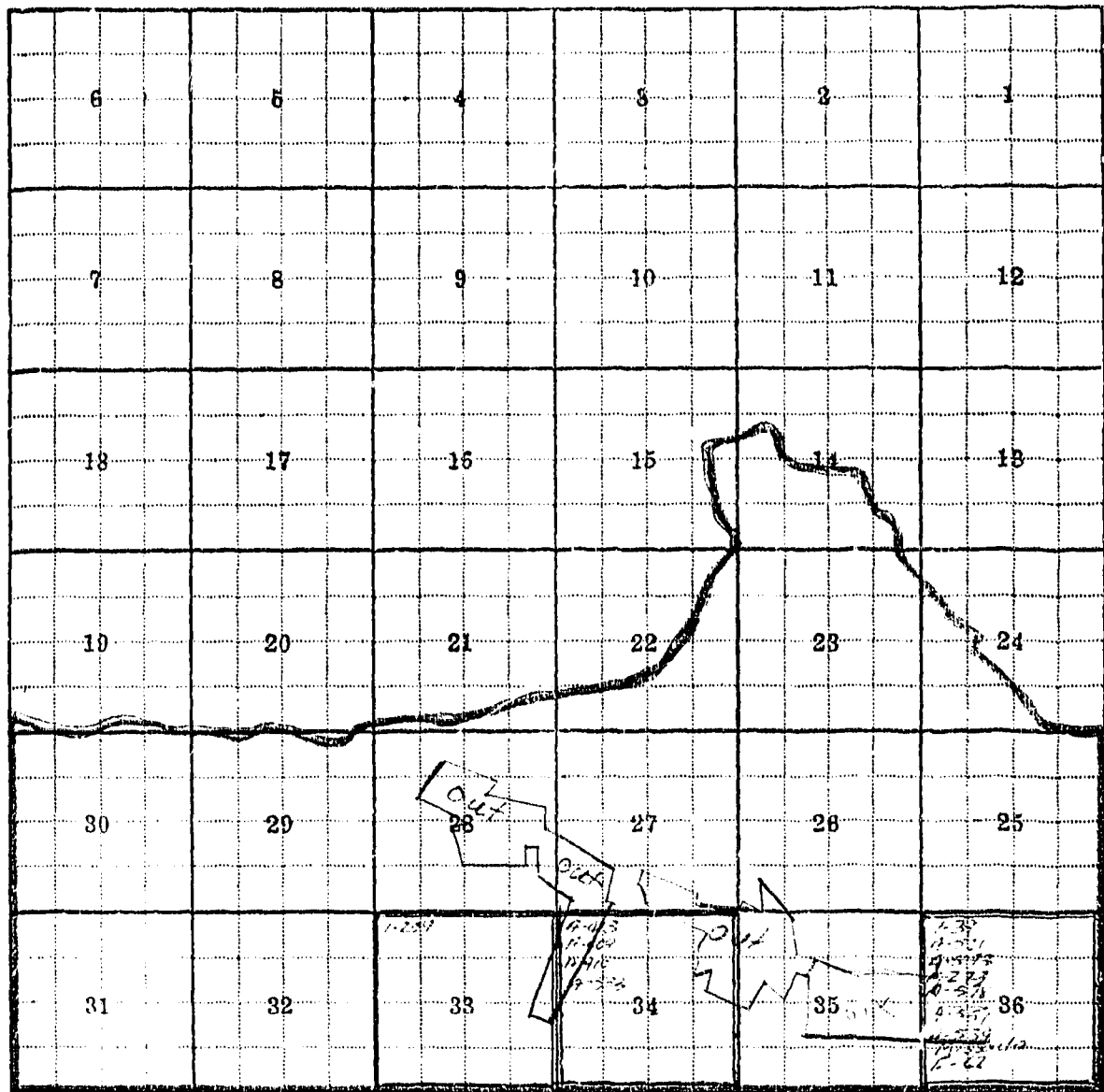

Land Ownership Tracts marked out all the approximate locations of
 Bayan Mining claim, Tambora Mining claim & Last Chance Mining
 claim. The balance of the land in the Township is U.S.A.
 Filed in 11-257 11-413 11-404 11-414 9-222 10-1 1-30 11-701 11-512 11-273 10-521 11-257 11-238 11-239 11-62
 P-601 } Listed only in Township & Range

F-1-A

County Columbia

Farm Checked: Date Oct 1, 1968

By J. Norman

Legal Land Owner Sunshine Mining Co 3/4 Interest MR. R.T. Scott 1/4 Interest Address Wallace, Idaho

Operator Charles Puls et al * Address Salt Lake, Montana

Water is delivered by:— 1. Private System; 2. Ditch Company; 3. State Project; 4. Federal Project; 5. Irrigation District

STATE OF MONTANA
WATER CONSERVATION BOARD
Water Resources Survey

T. 201R 31W Plat No. B

Photo No. No. Photos

Solo National Forest
Timber Inventory 1960

App. No. Decree No.	NAME OF APPROPRIATOR TO WHOM DECREED	NAME OF STREAM	Date App. Date Priority	Miner's Inches	In Use	NAME OF DITCH (Water Delivered By)	No.	R/F	Present Irr. Acres	Irrigable Acres
1-207	Mineral King Mining Co	Packer Creek East Branch	7-1-90	60	Mining (F)					
17-913	Lanning, Joseph	Packer Creek North Branch	5-21-95	700	Mining (F)					
17-909	Jones, William, J.T. Smith, II	Packer Creek North Branch	1-14-95	500	Mining (F)					
1-553	Charles Puls et al	Packer Creek	10-1-05	500	Mining (F)					
4-910	Chambliss, George Jones, William, J.T. Smith, II	Packer Creek	1-19-95	300	Mining (F)					

NOTE: R—Denotes Regular Irrigation. F—Flood Irrigation.

Adequate Supply: Yes No Explain

Remarks
* There are two fallows awaiting these mines at the present time, however by Oct 7, 1968 plans have been made for a Sunshine Mining Company, Wallace, Idaho to begin mining building at this time.

River Basin Columbia

Also in: Plat No. Twp. Rge.	Plat No. Twp. Rge.	Plat No. Twp. Rge.
Plat No. Twp. Rge.	Plat No. Twp. Rge.	Plat No. Twp. Rge.

Information From:
MRS. R.T. Scott - Salt Lake Mont.
Charles Puls - Salt Lake, Mont.

6	5	4	3	2	1
7	8	9	10	11	12
18	17	16	15	14	13
19	20	21	22	23	24
30	29	28	27	26	25
31	32	33	34	35	36

Land Ownership *Ownership is plotted on attached sheets 31W-N*

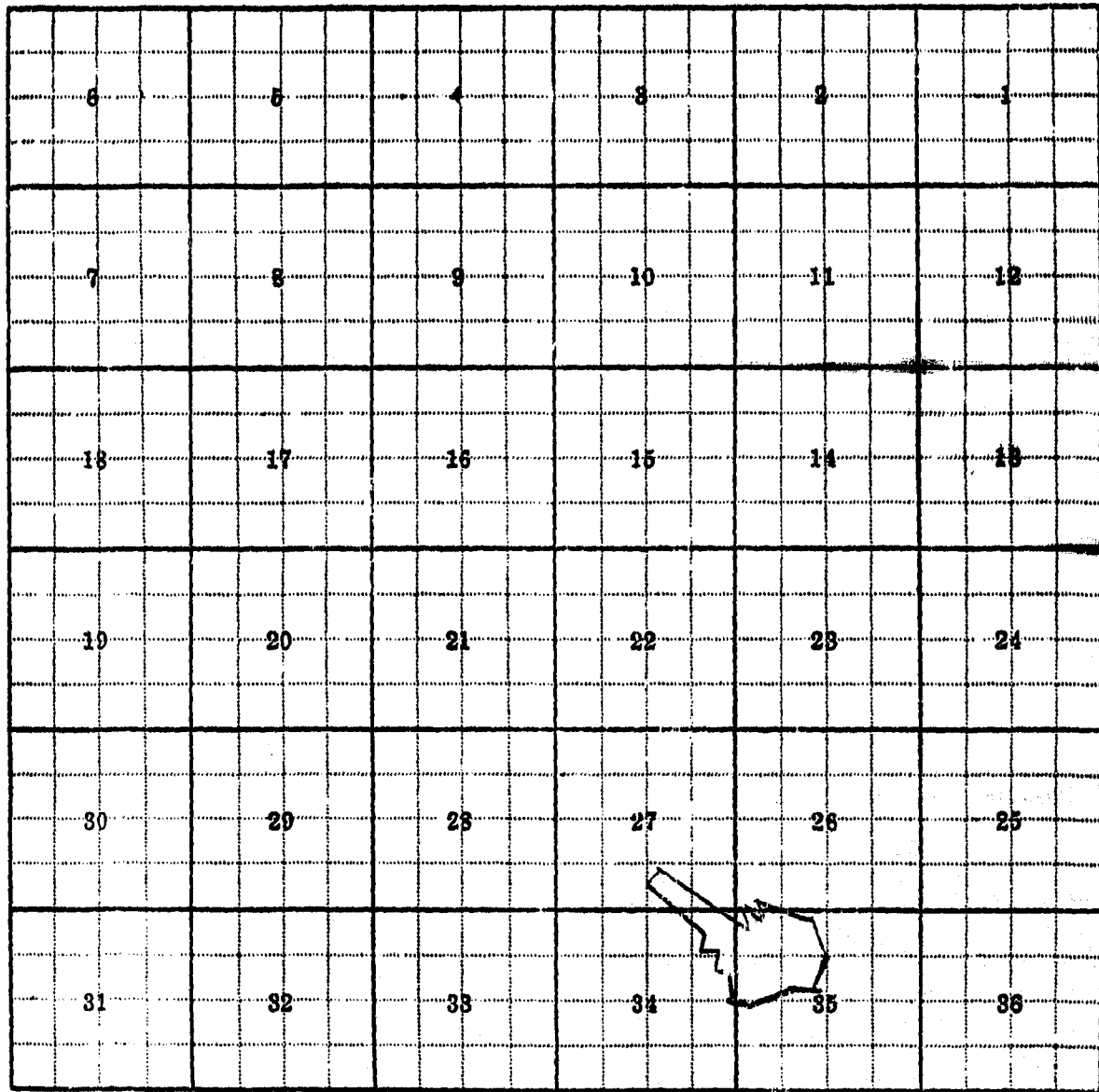

Land Ownership. *The Mining Claim platted is just the
 Last Chance Mining Claim, not the ENTIRE
 Jupiter Corporation*

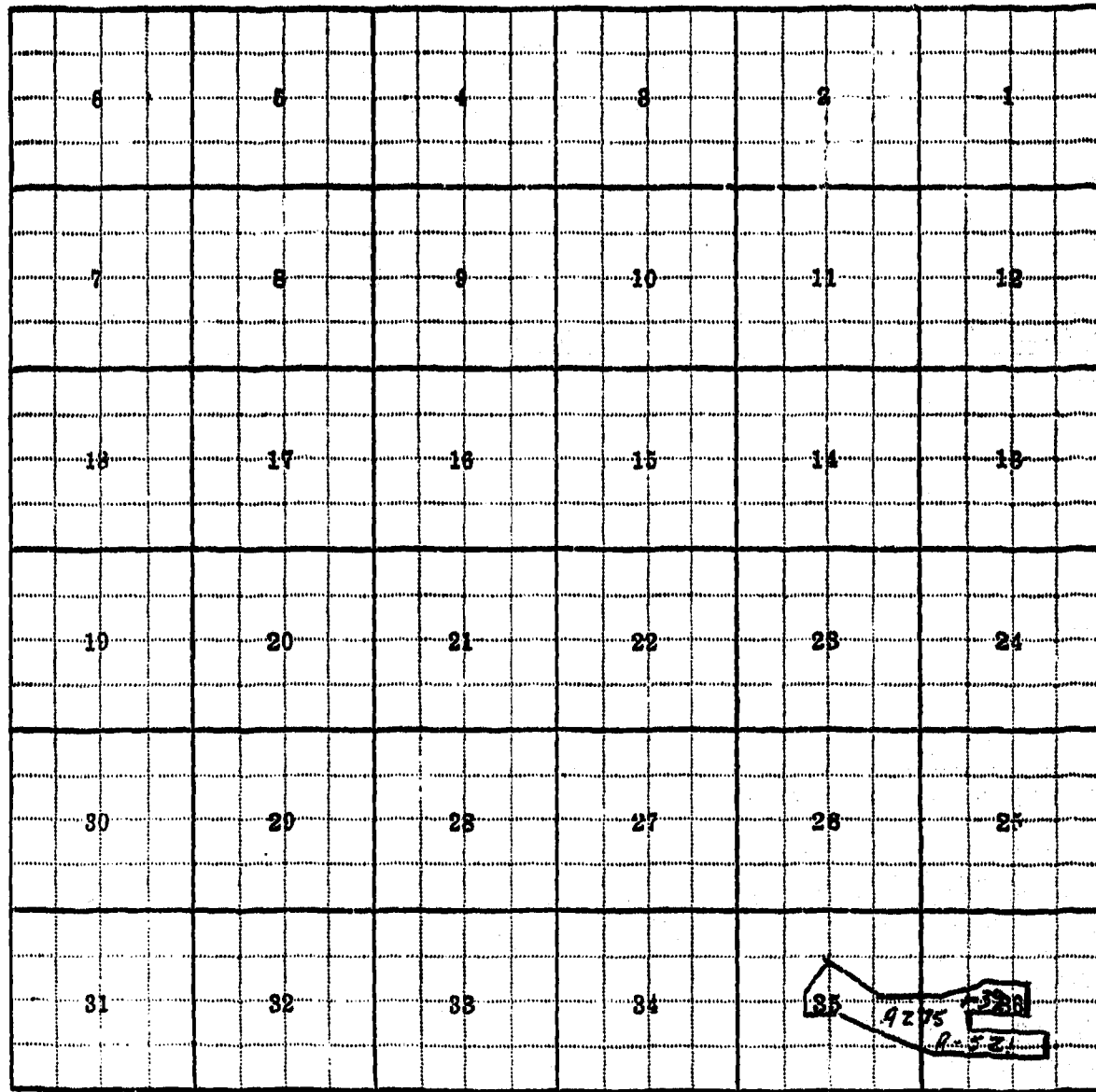

Land Ownership APPROXIMATE location of mining claim for the
TARBOR MINING COMPANY

F-1-A

County MINERAL

Form Checked: Date Oct 1, 1968

By J. Norwood

Legal Land Owner U.S.A.

Operator FOREST SERVICE

Water is delivered by: — 1. Private System; 2. Ditch Company; 3. State Project; 4. Federal Project; 5. Irrigation District

STATE OF MONTANA
WATER CONSERVATION BOARD
Water Resources Survey

T. 20N.R. 31W. Plat No. B

Photo No. NONE

Lolo National Forest
Timber Inventory 1960

Address Washington D.C.

Address SAME

App. No. Decree No.	NAME OF APPROPRIATOR TO WHOM DECREED	NAME OF STREAM	Date App. Date Priority	Miner's Inches	In Use	NAME OF DITCH (Water Delivered By)	No.	R/F	Present Irr. Acres	Irrigable Acres
1-209	MINERAL King Mining Company	Packer Creek East Fork	7-1-40	60	No (d)					
A-413	LAUDREY, Joseph	Packer Creek North Fork of West Fork S-218		400	No (d)					
A-409	James Whelan, J.T. Sawhill	Packer Creek North Fork of West Fork	1-14-95	500	No (d)					
A-533	Varlox Mining Company by Maurice Everett	Packer Creek	10-11-03	500	No (d)					
A-410	Champagne George James, J.T.	Packer Creek	1-14-95	300	No (d)					
1-39	DAXON, Richard	East Fork of Packer Creek	6-3-16	500	No (d)					
A-52	Maurice Everett	Packer Creek	5-14-03	1,600	No (d)					
A-575	DAXON, Richard	Packer Creek	5-1-06	10,000	No (d)					
E-373	DAXON, Richard	Packer Creek	12-17-07	10,000	No (d)					
A-578	DAXON, Richard	Packer Creek	6-25-06	10,000	No (d)					
A-557	DAXON, Richard	Packer Creek	5-9-05	10,000	No (d)					
A-539	DAXON, Richard	Packer Creek	5-9-09	10,000	No (d)					
E-237	LOREAN, VIAN	Packer Creek North Fork of West Fork	6-1-95	400	No (d)					
A-601	Bell, Frank	Packer Creek North Fork of West Fork	4-5-07	500	No (d)					
E-62	MAURICE EVERETT	Packer Creek	10-11-03	500	No (d)					

NOTE: R—Denotes Regular Irrigation. F—Flood Irrigation.

Adequate Supply: Yes..... No..... Explain.....

Remarks.....

* These two water rights were listed only in the Township & Range.
All rights are Mining Rights.

River Basin Columbia

Also in: Plat No..... Twp..... Rge.....	Plat No..... Twp..... Rge.....	Plat No..... Twp..... Rge.....
Plat No..... Twp..... Rge.....	Plat No..... Twp..... Rge.....	Plat No..... Twp..... Rge.....

Information From:

Field Survey 1968
Also from Forest Service employees

F-1-A

County MINERAL

Farm Checked: Date Oct 1, 1968

By J. NORWOOD

Legal Land Owner JUPITER MINING CO. 3/8 Interest MRS. R.T. SCOTT 1/8 Interest Address Wallace, Idaho

Operator CHARLE BULLS ET AL * Address SALTSEE, MONTANA

Water is delivered by: - 1. Private System; 2. Ditch Company; 3. State Project; 4. Federal Project; 5. Irrigation District

STATE OF MONTANA
WATER CONSERVATION BOARD
Water Resources Survey

T. 20N R. 31W Plat No. B

Photo No. No Photos

Lolo National Forest
TIMBER INVENTORY #60

App. No. Decree No.	NAME OF APPROPRIATOR TO WHOM DECREED	NAME OF STREAM	Date App. Date Priority	Miner's Inches	In Use	NAME OF DITCH (Water Delivered By)	No.	R/F	Present Irr. Acres	Irrigable Acres
1-209	MINERAL KING MINING CO.	PACKER CREEK EAST BRANCH	7-1-90	60	Mining (pt)					
A-913	LAUNDRY, JOSEPH	PACKER CREEK NORTH EAST OF WARD FORD	5-21-95	400	Mining (pt)					
A-909	JAMES WHELAN, J.T. SAWHILL	PACKER CREEK NORTH EAST OF WARD FORD	1-14-95	500	Mining (pt)					
A-533	TRABON MINING CO. BY WARRANT	PACKER CREEK	10-11-03	500	Mining (pt)					
A-910	CHAMPAGNE, GEORGE JAMES WHELAN, J.T. SAWHILL	PACKER CREEK	1-19-95	300	Mining (pt)					

NOTE: R—Denotes Regular Irrigation. F—Flood Irrigation.

Adequate Supply: Yes No Explain

Remarks
* THERE ARE TWO FELLOWS WORKING THESE MINES AT THE PRESENT TIME, HOWEVER BY OCT 7, 1968 PLANS HAVE BEEN MADE FOR A SUNSHINE MINING COMPANY, WALLACE, IDAHO TO BEGIN DIAMOND DRILLING AT THIS TIME.

River Basin Columbia

Also in: Plat No. Twp. Rge.	Plat No. Twp. Rge.	Plat No. Twp. Rge.	Plat No. Twp. Rge.
Plat No. Twp. Rge.	Plat No. Twp. Rge.	Plat No. Twp. Rge.	Plat No. Twp. Rge.

Information From:
MRS. R.T. SCOTT - Saltsee Mont.
Charle Bulls - Saltsee, Mont.

6	5	4	3	2	1
7	8	9	10	11	12
13	14	15	16	17	18
19	20	21	22	23	24
25	26	27	28	29	30
31	32	33	34	35	36

Land Ownership Ownership is plotted on attached sheets J.W.N