

APP. No. - Name - Stream - Date APP. - FILED - M.I.

837 Wm McCurdy - Goose CR. - 6/30/08 - 9/20/12-160

X1073 MATILDA J. BRUFFEY - MISSION CR. - 8/13/92 - 8/13/92-200

X1074 " " - " " - 3/23/00 - 3/23/00-ALL

^{stock} 1845 GEO. BRUFFEY - UNNAMED SPRING - 8/6/17 - 8/6/17-40

^{Domestic & Stock Water} 1947 CHRIST LARSON - UNNAMED SPRING - 12/2/12 - 12/2/12-10

WYLLIE W. HARRIS, CLERK

RIVER FRONTIER CANON

RECEIVED NOV 14 1912

STATE OF MONTANA

STATE ENGINEER'S OFFICE

WATER RESOURCES SURVEY

Township 25 Range 11 E County Park

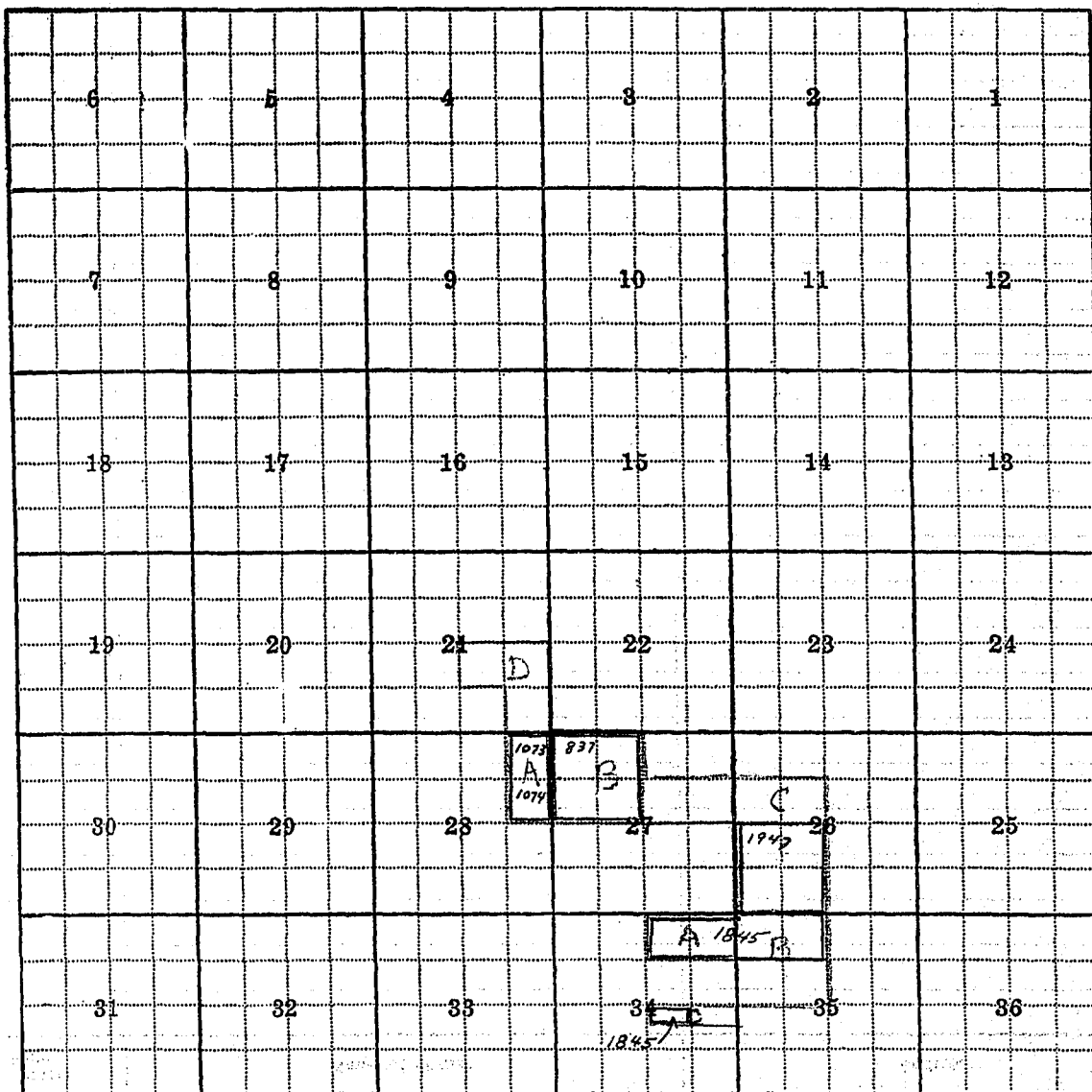

Oliver Tendeland ow-op

25

11 E

(27)

By J.E. Cook

Area Mission Cr.

Date May 25, 1951

Legal Land Owner WA

Operator _____

Water is delivered by:

Federal Project _____ Pres. _____ Pot. _____

Ditch Company Pres. Pot.

Irrigation District _____ Pres. _____ Pot. _____

Private System _____ Pres. _____ Pot. _____

[illegible]

Flood _____ Pump _____ Reservoir _____ Gravity _____

Size and Capacity, Pump, etc. _____

Original Appropriator, Company _____ App. No. _____

Original Appropriator, Private SEE OTHER SIDE App. No. _____

Is the system an extension of another system? Yes_____No_____

Is all land irrigated from one system? Yes_____No_____

(If No, show break down on map)

Source of Water Yellowstone River, Mission Creek

Acres Irrigated 19_____

Potential Acres _____ Seeped _____

Explain _____

Condition of System.....

Adequate Supply --- Yes ☒ No ☐

Explain

Topography Creek & River bottoms Terrace & bench land

Information From Mr. A.E. Walborn & others

Remarks Aubrey & Paul Hodors supplied most of

inf. on W. Rights for this ranch.

SEE ATTACHED
SHEET

APP No. —	Name	Stream	Date APP. —	FILED —	M.I.
OK 1094E	MARY J. MILES	MISSION CR.	5/29/99	6/1/99	325
OK 1089	D. J. KENNELLEY	MISSION CR.	4/7/85	4/7/85	1000
OK 1091	"	"	4/27/8	5/5/85	1000
OK 1094F	STERLING MILES	MISSION CR.	5/27/99	6/1/99	325
OK 1072	ROBERT D. BROWNER	"	7/5/07	7/5/07	320
X 1081	SARAH FLANNIGAN	"	9/4/06	9/4/06	320
X 1086	OLE JACKSON	"	5/27/91	5/27/91	160
OK Miles d. 132	WINFIELD S. WORK	BEAVER CR.	5/24/99	5/24/99	160
OK Miles d. 1095	HELEN SMITH	MISSION CR.	2/13/05	2/13/05	160
OK Miles d. 1100	WINFIELD S. WORK	MISSION CR.	5/20/99	5/20/99	160
OK Miles d. 1098	JOHN F. WORK	"	12/12/11	12/12/11	40
OK 1933	Wm. M. KEARNS	UNNAMED SPRING	10/4/05	11/4/05	80
OK 1991	GRACE G. RICHARDSON	"	11/26/09	11/27/09	40
OK 1810	Wm. H. ADAMS	"	12/1/17	12/4/17	ALL
X 650	W. F. DAVIS	BASIN LAKE	11/13/97	11/13/97	160
No. J. 656	ARTHUR HUFFER	"	1/14/97	1/14/97	160
No. d. 1592	ROBERT W. POLK	SPRING CREEK	8/7/09	8/12/09	160
No. ditch found 918	JAMES LAUILLE	HUFFER CREEK	5/31/10	5/31/10	120
No. ditch found 1565	ARTHUR J. HUFFER	SPRING CREEK	5/3/05	5/3/05	120
No. d. 2120	"	WORK CREEK	2/26/96	2/26/96	40
No. filing	Hicks	Mission Creek			
	Hicks ditch now used as lateral of Cady or Little Mission ditch				

Mission Creek

- ① ^{or miles} Kennelley ditch (see inf & description on field form for T15-R11E)
- ② Walhorn has small amount of land under Hodges (Tunnelli) Ditch, in sec 6 T25R11E, but has no w.r. in this ditch
- ③ Kennelley ditch was intended to be used to supply water to prove on desert claims on bench land w. of Mission Creek. The ditch was tried one year but kept breaking out where it went along the rocky slope out of Mission Creek so attempts to use it were given up. Kennelly made the first filings on the ditch, then others made filings in order to prove on des. claims. Mr. Walhorn says he may try to rebuild the ditch to irrigate the bench land w. of Mission Creek

STATE ENGINEER'S OFFICE

WATER RESOURCES SURVEY

Township 25 Range 11E County Park

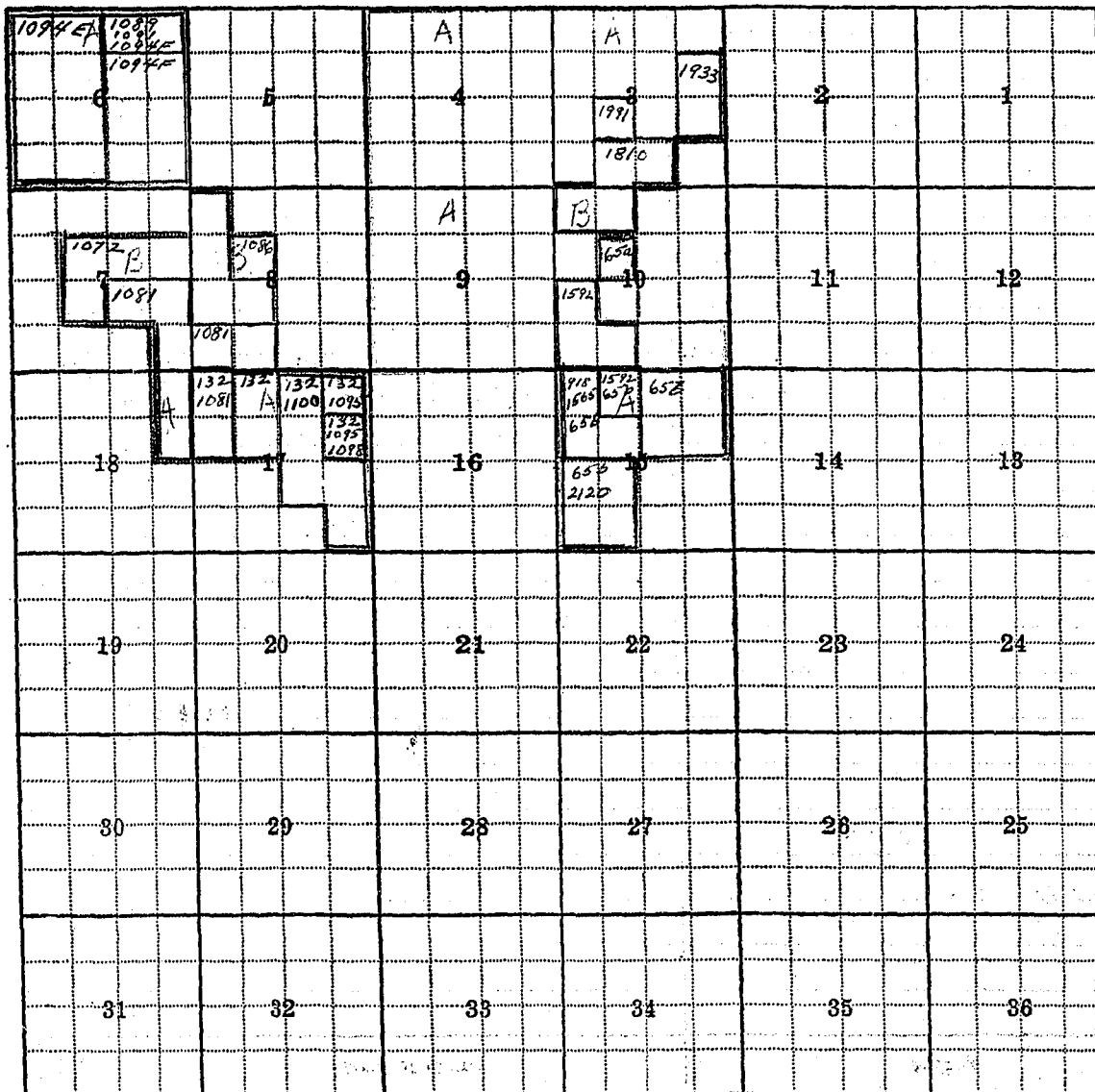

A. E. Walborn own-op

STATE OF MONTANA

State Engineer's Office
WATER RESOURCES SURVEY
FARM MAP

County Park
Code No. 3A, 4A, 6A, 7B, 8B
9A, 10B, 15A, 17A, 18A

Twp. 25 Rge. 11E
Twp. _____ Rge. _____
Twp. _____ Rge. _____

Name of Land Owner A. E. Walborn Address Mission Ranch, Livingston
Name of Operator _____ Address _____
Legal Description _____

☐ Irrigated Land ☐ Non-Irrigated Land ☐ Potential Land Under Existing Facilities
North

Code No. 6A System Hodges Ditch Source of Water Mission Creek
Basin Yellowstone River Present 0 Potential 25 Maximum 25 R ✓ F ✓ P ✓ G ✓ S ✓
Code No. _____ System _____ Source of Water _____
Basin _____ Present _____ Potential _____ Maximum _____ R _____ F _____ P _____ G _____ S _____
Code No. _____ System _____ Source of Water _____
Basin _____ Present _____ Potential _____ Maximum _____ R _____ F _____ P _____ G _____ S _____
Code No. _____ System _____ Source of Water _____
Basin _____ Present _____ Potential _____ Maximum _____ R _____ F _____ P _____ G _____ S _____

If under Ditch Company, Irrigation District, or Government Project, state the number of shares or inches, acre feet, as the case may be in said system.

NOTE: R—Denotes Regular Irrigation. F—Flood Irrigation. P—Water diverted by means of pumping. G—Water diverted by gravity.
S—Stored Water.

Information from J. E. Cook Date 1/30/50

By J.E. Cook

Area Beaver Creek

Date July 19, 1951

Legal Land Owner. JOE WEISS

Operator Same

Water is delivered by:

Federal Project _____ Pres. _____ Pot. _____

Ditch Company _____ Pres. _____ Pot. _____

Irrigation District _____ Pres. _____ Pot. _____

Private System ☒ 2 ditches Pres. _____ Pot. _____

[illegible]

Flood _____ Pump _____ Reservoir _____ Gravity ☒ _____

Size and Capacity, Pump, etc. _____

Original Appropriator, Company _____ App. No. _____

Original Appropriator, Private _____ App. No. _____

Is the system an extension of another system? Yes _____ No _____

Is all land irrigated from one system? Yes_____No_____

(If No, show break down on map)

Source of Water. BEAVER CREEK

Acres Irrigated 19.57, _____

Potential Acres _____ Seeped _____

Explain _____

Condition of System Good

Adequate Supply Yes ✓ No ✓

Explain Enough in early summer, not in late summer

Topography Valley side (steep) & bottom

Information From JOE WEISS

Remarks _____

[illegible]

OK. 115 Jacob Graf - BEAVER Creek - 5/25/95 - 5/25/95 - 160

^{STOCK WATER}
OK 2047 Max Weiss - UNNAMED SPRING - 7/17/07 - 7/17/07 - 100

Also App No 130 For this land

130 Max Weiss - Beaver Creek - 2/14/03 - 2/14/03 - 160

Beaver Creek

① Ditch diverts on left bank at the EW $\frac{1}{2}$ sec line and runs NE about $\frac{1}{2}$ mile. Irrigates steep valley slope on NW side of Cr. Ditch built by Jacob Graf, uses App No 115

② Small ditch diverts on R bank of Cr. near diversion at ditch above and irrigates about 1.5 acre of Creek bottom. Built by Max Weiss, Sr. uses app. No 130

STATE OF MONTANA
STATE ENGINEER'S OFFICE
 WATER RESOURCES SURVEY

Township 2 S Range 11 E County Park

6	5	4	3	2	1
7	8	9	10	11	12
18	17	16	15	14	13
19	<div style="border: 2px solid black; padding: 2px; display: inline-block;"> 115 2047 </div>	21	22	23	24
30	29	28	27	26	25
31	32	33	34	35	36

JOE WEISS - owner

Township 2 S Range 11 E

STATE OF MONTANA

State Engineer's Office

WATER RESOURCES SURVEY

FARM MAP

County Park

Code No. 20 D

Twp. 28 S Rge. 11 E

Twp. _____ Rge. _____

Twp. _____ Rge. _____

Name of Land Owner Joe Weiss

Address Box 471, Livingston

Name of Operator _____

Address _____

Legal Description _____

☐ Irrigated Land

☐ Non-Irrigated Land
North

☐ Potential Land Under Existing Facilities

Code No. 20 D System Weiss Ditches Source of Water Beaver Cr. (Trib to Mission Creek)

Basin Yellowstone River Present 12 Potential 0 Maximum 12 R ☒ F ☐ P ☐ G ☒ S ☐

Code No. _____ System _____ Source of Water _____

Basin _____ Present _____ Potential _____ Maximum _____ R ☐ F ☐ P ☐ G ☐ S ☐

Code No. _____ System _____ Source of Water _____

Basin _____ Present _____ Potential _____ Maximum _____ R ☐ F ☐ P ☐ G ☐ S ☐

Code No. _____ System _____ Source of Water _____

Basin _____ Present _____ Potential _____ Maximum _____ R ☐ F ☐ P ☐ G ☐ S ☐

If under Ditch Company, Irrigation District, or Government Project, state the number of shares or inches, acre feet, as the case may be in said system.

NOTE: R—Denotes Regular Irrigation. F—Flood Irrigation. P—Water diverted by means of pumping. G—Water diverted by gravity. S—Stored Water.

Information from J. C. Cook

Date 1/30/52

APP. No. -	Name	Stream	Date APP.	FILED - M.T.
stock water OK 2009	EDWARD SCHULTZ	UNNAMED SPRING	7/8/13	7/11/13-20
Joe Weiss 130	Max Weiss	BEAVER CREEK	2/14/03	2/14/03-160
OK 131	Max Weiss	" "	5/26/19	6/19/19-120
des (lawn (no ditch now) 132	Winfield Work	" "	5/24/99	5/24/99-160
Joe Weiss 115	Jacob Graf	" "	5/25/95	5/25/95-160
stock water OK 1978	Margaret Penman	UNNAMED SPRING	11/25/03	11/25/03-100
stock water 2047	Max Weiss	" "	7/17/07	7/17/07-100
No ditch 1083	James M. Graveley	Mission Creek	9/26/04	9/26/04-175
Not on this land 1073	Matilda L. Bruffey	MISSION CREEK	8/13/92	8/13/92-200
Not on Weisland 1074	" "	" "	3/23/00	3/23/00-ALL

Beaver Creek

- ① Ditch diverts from E bank of Stream in the NE $\frac{1}{4}$ SE $\frac{1}{4}$ sec 19 runs N. to irr. small area of Garden & lawn. about 100 yards long
App. No 131 is water right used

The rest of the apps. are for stock water.

Poison Creek

- ② There is a trace of a ditch diverting on W bank of Poison Creek in the NE $\frac{1}{4}$ SW $\frac{1}{4}$ sec 19 and running N about $\frac{1}{8}$ mile. No filing shown for this ditch.

STATE OF MONTANA
STATE ENGINEER'S OFFICE
 WATER RESOURCES SURVEY

Township 25 Range 11E County Park

6	5	4	3	2	1
7	8	9	10	11	12
18	17	16	15	14	13
19	20	21	22	23	24
30	29	28	27	26	25
31	32	33	34	35	36

Handwritten annotations on the grid:

- Section 17: 132, C
- Section 20: 131, 130, 131, B
- Section 19: A
- Section 20: 1978, 2009, C
- Section 20: E

Max Weiss

Township 25 Range 11E

State Engineer's Office

WATER RESOURCES SURVEY

FARM MAP

County Park

Code No. 179, 180, 19A

208

Twp. 25 Rge. 11E

Twp. _____ Rge. _____

Twp. _____ Rge. _____

Name of Land Owner Max Weiss, Jr

Address Swingley Route

Name of Operator Same

Address _____

Legal Description _____

☐

Irrigated Land

☐

Non-Irrigated Land
North

☐

Potential Land Under Existing Facilities

Code No. 19A System Weiss Ditch Source of Water Paison Creek

Basin Yellowstone River Present 12 Potential 12 Maximum 12 R. F P. G S. S

Code No. _____ System _____ Source of Water _____

Basin _____ Present _____ Potential _____ Maximum _____ R. _____ F. _____ P. _____ G. _____ S. _____

Code No. _____ System _____ Source of Water _____

Basin _____ Present _____ Potential _____ Maximum _____ R. _____ F. _____ P. _____ G. _____ S. _____

Code No. _____ System _____ Source of Water _____

Basin _____ Present _____ Potential _____ Maximum _____ R. _____ F. _____ P. _____ G. _____ S. _____

If under Ditch Company, Irrigation District, or Government Project, state the number of shares or inches, acre feet, as the case may be in said system.

NOTE: R—Denotes Regular Irrigation. F—Flood Irrigation. P—Water diverted by means of pumping. G—Water diverted by gravity. S—Stored Water.

Information from J. P. Cook

Date 1/31/52

OK	Stock Jones	110
	1947	
	not in use	

CHEIST LARSON - UNNAMED SPRING - 12/2/12 - 12/2/12 - 10

[illegible]

STATE ENGINEER'S OFFICE

WATER RESOURCES SURVEY

Township 25 Range 11 E County Park

6	5	4	3	2	1
7	8	9	10	11	12
13	14	15	16	17	18
19	20	21	22	23	24
25	26	27	28	29	30
31	32	33	34	35	36

1997 A

Dewey Wolf own-op

STATE OF MONTANA

State Engineer's Office

WATER RESOURCES SURVEY

Township 25 Range 12E County Park

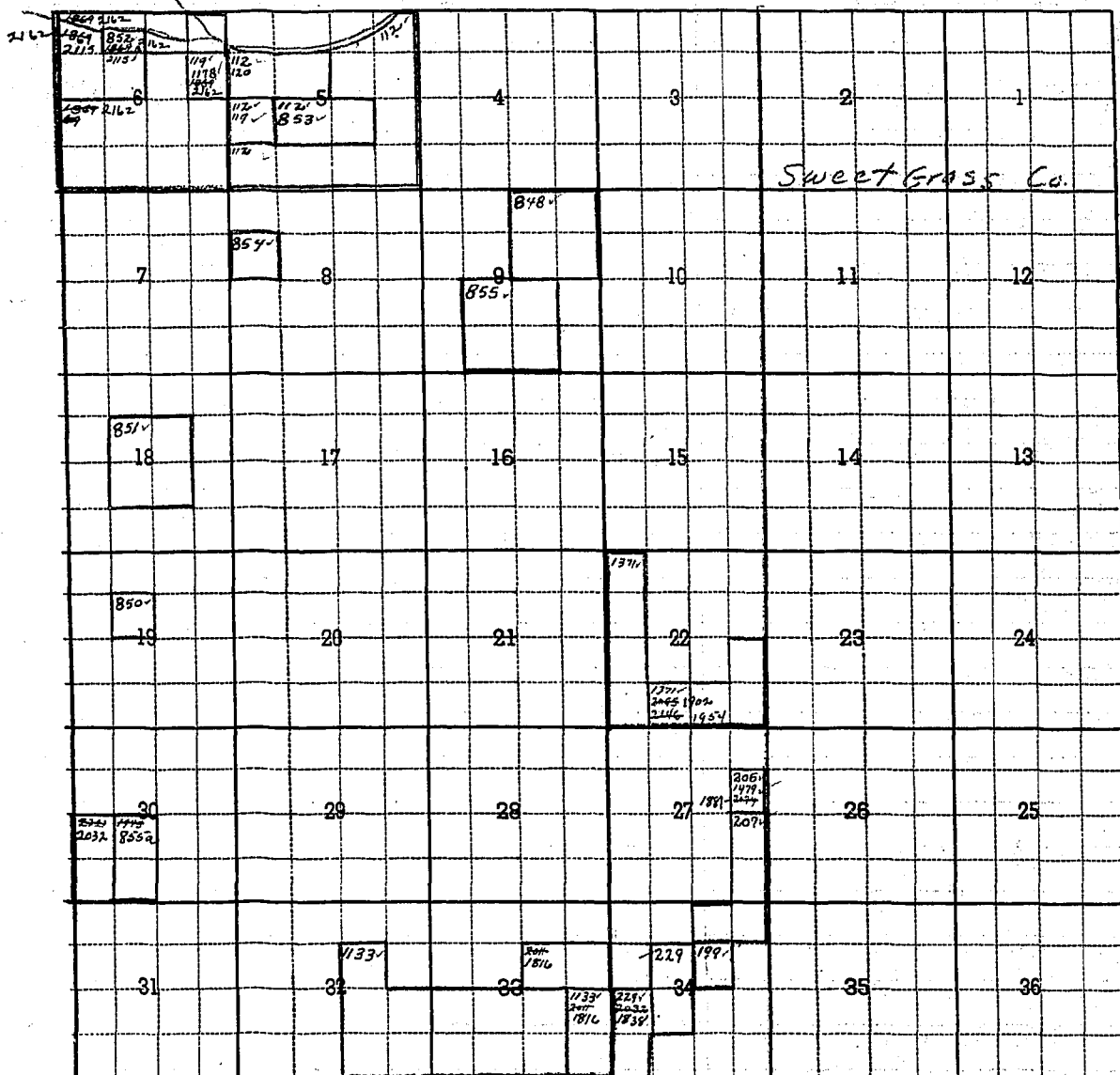

Township 25 Range 12E

Township 2 S Range 12 E County Park

Parcel Number	Name of Owner	Stream	Address	Filed	MI
Peterson 112 ✓	Bartlett, H. G.	Beaver Cr.	5-12-82	5-15-82	111
Peterson 119 ✓	Peterson, Andrew	"	8-3-93	8-4-93	80
Peterson 120 ✓	"	"	8-3-93	8-4-94	150
199 ✓	Burmester, H.	Boulder Cr.	1-3-06	1-3-06	40
206 ✓	Elges, Emma	"	8-16-18	8-16-18	80
207 ✓	Elges, Wm A.	"	5-29-00	5-29-00	200
229 ✓	Wood, John B.	"	11-13-96	11-13-96	300
No ditch dec. Ch. Gow 848 ✓	Cady, C. L.	Greeley Cr.	3-3-94	3-3-94	160
849 ✓	Clark, Chas. P.	"	8-6-07	8-6-07	80
Gow 850 ✓	Gilbert, Geo. F.	"	10-24-12	10-24-12	40
Gow 851 ✓	Hodges, John S.	"	1-3-94	1-3-94	160
L.W. Swanson 852 ✓	Payne, Harry	"	7-13-31	7-13-31	125
Peterson 853 ✓	Peterson, Andrew	"	5-26-02	5-26-02	80
Peterson 854 ✓	Peterson, Martha A.	"	6-23-05	6-23-05	50
Tyson Wood 855 ✓	Wood, John J.	"	2-27-15	2-27-15	160
P 1133 ✓	Swanson, Edward	Muttal Cr.	6-28-19	6-30-19	250
on Peterson Ranch 1178 ✓	Mc Ewan, George	Greeley Cr. or Peterson Cr.	3-2-36	3-2-36	40
1371 ✓	Hodges, Aubrey P.	Second Cr.	9-5-17	9-5-17	25
1479 ✓	Elges, Emma M.	Sick Em Cr.	8-16-18	8-16-18	40
L.W. Swanson 216 ✓	Hurzeler, Mrs. Sarah	Yellowstone R.	5-20-39	5-27-39	300
no ditch W 1975 ✓	Trautman, Adam Allen, George W.	Greeley Springs	10-24-08	10-24-08	50
1816 2011 ✓	Anderson, Enrich	Unnamed Sp.	5-11-15	5-12-15	111
1838 2038 ✓	Brening, Susie C.	"	11-4-08	11-5-08	80
1891 2074 ✓	Elges, Emma M.	"	8-16-18	8-16-18	20
1902 2085 ✓	Hall, C.S. + Shutte, Wesley	"	11-12-13	12-1-13	40
L.W. Swanson 1112 2115 ✓	Hurzeler, Fred W.	"	10-11-13	10-11-13	100
1154 2146 ✓	Lorenz, Wm	"	11-7-13	11-7-13	100
2032 2221 ✓	Trautman, Adam	"	8-17-04	8-17-04	1411

RECORD OF DEEDS

STATE OF MONTANA

State Engineer's Office

WATER RESOURCES SURVEY

Township 2 S Range 12 E County Park

6	5	4	3	2	1
7	8	9	10	11	12
18	17	16	15	14	13
19	20	21	22	23	24
30	29	28	27	26	25
31	32	33	34	35	36

Diagram showing a 6x6 grid with a 3x3 sub-grid in the top-left corner. The sub-grid is labeled "IN TIS 12E". A small square is marked with "407" in the center of the grid.

Township 2 S Range 12 E

28

125

Park

[illegible]

By J. E. Cook

STATE ENGINEER'S OFFICE

Area

Date _____

Legal Land Owner H. S. Stevenson

Address _____

Operator John Lee

Address Stinson Lake

Water is delivered by:

Federal Project _____ Pres. _____ Pot. _____

Ditch Company _____ Pres. _____ Pot. _____

Irrigation District _____ Pres. _____ Pot. _____

Private System _____ Pres. _____ Pot. _____

Totals

Flood _____ Pump _____ Reservoir _____ Gravity _____

Size and Capacity, Pump, etc. _____

Original Appropriator, Company _____ App. No. _____

Original Appropriator, Private _____ App. No. _____

Is the system an extension of another system? Yes_____No_____

Is all land irrigated from one system? Yes _____ No _____

(If No, show break down on map)

Source of Water _____

Acres Irrigated 19_____

Potential Acres _____ Seeped _____

Explain _____

Condition of System _____

Adequate Supply --- Yes _____ No _____

Explain

Topography

Information From Donald & Clifford Larkin & Co.

Remarks No ditches. No irr

A full-page view of a blank sheet of graph paper. The grid consists of small squares formed by thin black lines. A thicker vertical line runs down the left side, creating a margin. A thicker horizontal line runs across the middle, dividing the page into two equal halves. There are no markings or text on the grid.

[illegible]

STATE OF MONTANA

STATE ENGINEER'S OFFICE

WATER RESOURCES SURVEY

Township 2 S Range 12 E County Park

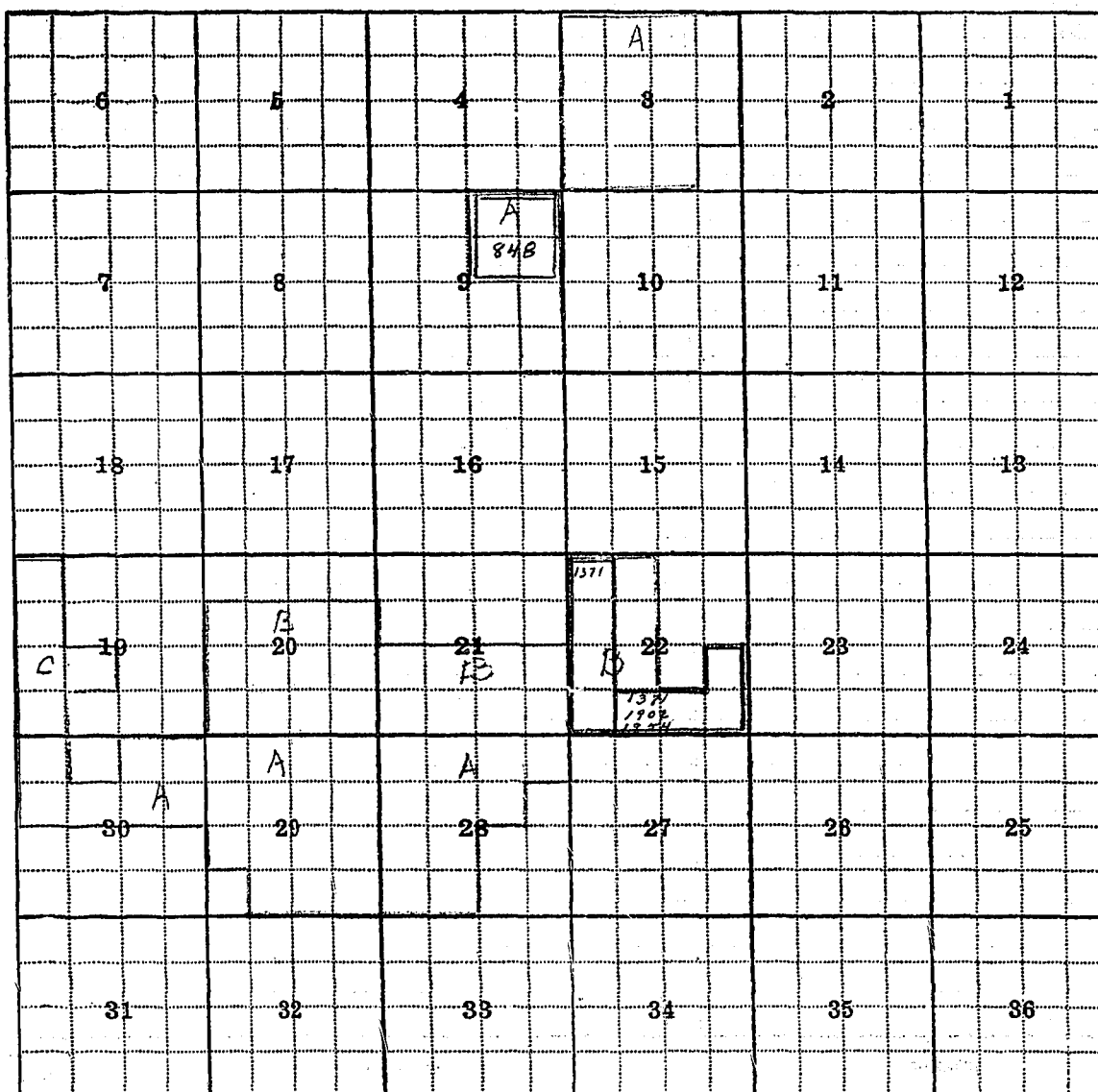

W. S. Stevenson & John Lee on op

2 S

12 E

(30)

Farm Checked

STATE OF MONTANA

Code No.

By

J. Cook

STATE ENGINEER'S OFFICE

County

Park

Area

West boulder

WATER RESOURCES SURVEY

T. 25

R. 12E

Sec. 34

Date

Aug. 6-51

Photo No.

MA15A163

Legal Land Owner

Wm. Clayton

Address

Operator

Address

Water is delivered by:

Federal Project

Pres.

Pot.

Ditch Company

Pres.

Pot.

Irrigation District

Pres.

Pot.

Private System

☒ old ditch, Not in use

Pres.

Pot.

Totals

Flood

Pump

No

Reservoir

Gravity

☒

Size and Capacity, Pump, etc.

Original Appropriator, Company

App. No.

Original Appropriator, Private

App. No.

Is the system an extension of another system?

Yes

No

Is all land irrigated from one system?

Yes

No

(If No, show break down on map)

Source of Water

West Boulder

Acres Irrigated 19

Potential Acres

Seeped

Explain

Condition of System

Adequate Supply

Yes

No

Explain

Topography

Information From

Field Survey

Remarks

Old ditch crosses this land but
has not been in use for many years

No Water right shown

Sec 34

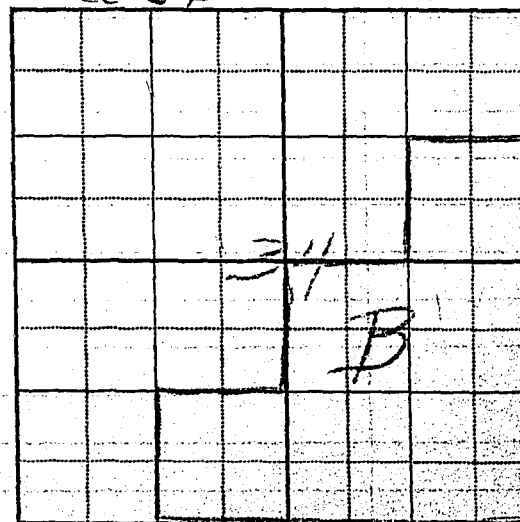

Farm Checked

STATE OF MONTANA

Code No. 3B-10A

By C. E. Cook

STATE ENGINEER'S OFFICE

County Park

Area Mendonhall Cr.

WATER RESOURCES SURVEY

T. 25 R. 12E Sec. 3-10

Date May 15, 1951

Photo No. MA-15A-161

Legal Land Owner. Bart Wood

Address Springdale

Operator.

Address

Water is delivered by:

Federal Project _____ Pres. _____ Pot. _____

Ditch Company _____ Pres. _____ Pot. _____

Irrigation District _____ Pres. _____ Pot. _____

Private System no ditch Pres. _____ Pot. _____

Totals _____

Flood Pump Reservoir Gravity

Size and Capacity, Pump, etc. _____

Original Appropriator, Company _____ App. No. _____

Original Appropriator, Private_____App. No._____

Is the system an extension of another system? Yes_____No_____

Is all land irrigated from one system? Yes _____ No _____

(If No, show break down on map)

Source of Water: _____

Acres Irrigated 19_____

Potential Acres _____ Seeped _____

Explain _____

Condition of System _____

Adequate Supply ... Yes _____ No _____

Explain _____

Topography

Information From Bert Wood

Remarks Mr. Wood says the only ditch used is to irrigate a small garden near the house

[illegible]



FORM D-1— WESTERN LITHO, BILLINGS

STATE OF MONTANA

STATE ENGINEER'S OFFICE

WATER RESOURCES SURVEY

Township 25 Range 12 E County Park

6	5	4	3	2	1
			B		
			A		
7	8	9	10	11	12
18	17	16	15	14	13
19	20	21	22	23	24
30	29	28	27	26	25
31	32	33	34	35	36

Bert Wood on

25

12 E

(30)

WESTERN
١٢٣٤

By J. E. Cook

Area Springdale

Date May 11, 1951

Legal Land Owner. Art

Operator _____

Water is delivered by:

Federal Project _____ Pres. _____ Pot. _____

Ditch Company. _____ Pres. _____ Pot. _____

Irrigation District _____ Pres. _____ Pot. _____

Private System ☒ Pres. _____ Pot. _____

[illegible]

Flood Pump Reservoir Gravity

Size and Capacity, Pump, etc. _____

Original Appropriator, Company _____ App. No. _____

Original Appropriator, Private _____ App. No. _____

Is the system an extension of another system? Yes _____ No _____

Is all land irrigated from one system? Yes _____ No _____

(If No, show break down on map)

Source of Water _____

Acres Irrigated 19_____

Potential Acres _____ Seeped _____

Explain _____

Condition of System _____

Adequate Supply Yes No

Explain

Topography

Information From Mrs Peterson & Field Service

Remarks No irr.

[illegible]

[illegible]

ALL INFORMATION CONTAINED HEREIN IS UNCLASSIFIED

[illegible][illegible]



FORM D-1 WESTERN LITRO, BILLINGS

STATE OF MONTANA

STATE ENGINEER'S OFFICE

WATER RESOURCES SURVEY

Township 2S Range 12E County Park

6	5	4	3	2	1
7	8	9	10	11	12
18	17	16	15	14	13
B					
B FSO 10	20	21	22	23	24
30	D	29	28	27	26
	B				
	B				
31	32	33	34	35	36

Arthur P. Your own op

2S

12E

(30)

[illegible]



FORM D-1— WESTERN LITHO. BILLINGS

STATE OF MONTANA

STATE ENGINEER'S OFFICE

WATER RESOURCES SURVEY

Township 2 S Range 12 E County Park

6	5	4	3	2	1
7	8	9	10	11	12
13	14	15	16	17	18
19	20	21	22	23	24
25	26	27	28	29	30
31	32	33	34	35	36

2012
F33A
B

Minnie & Marie Francis

Farm Checked

By J. E. Cook

Area _____

Date _____

Legal Land Owner Ronald E Wood

Operator _____

Water is delivered by:

Federal Project _____ Pres. _____ Pot. _____

Ditch Company _____ Pres. _____ Pot. _____

Irrigation District _____ Pres. _____ Pot. _____

Private System _____ Pres. _____ Pot. _____

Totals	
1	1
2	2
3	3
4	4
5	5
6	6
7	7
8	8
9	9
10	10
11	11
12	12
13	13
14	14
15	15
16	16
17	17
18	18
19	19
20	20
21	21
22	22
23	23
24	24
25	25
26	26
27	27
28	28
29	29
30	30
31	31
32	32
33	33
34	34
35	35
36	36
37	37
38	38
39	39
40	40
41	41
42	42
43	43
44	44
45	45
46	46
47	47
48	48
49	49
50	50
51	51
52	52
53	53
54	54
55	55
56	56
57	57
58	58
59	59
60	60
61	61
62	62
63	63
64	64
65	65
66	66
67	67
68	68
69	69
70	70
71	71
72	72
73	73
74	74
75	75
76	76
77	77
78	78
79	79
80	80
81	81
82	82
83	83
84	84
85	85
86	86
87	87
88	88
89	89
90	90
91	91
92	92
93	93
94	94
95	95
96	96
97	97
98	98
99	99
100	100

Flood Pump Reservoir Gravity

Size and Capacity, Pump, etc. _____

Original Appropriator, Company _____ App. No. _____

Original Appropriator, Private _____ App. No. _____

Is the system an extension of another system? Yes_____No_____

Is all land irrigated from one system? Yes_____No_____

(If No, show break down on map)

Source of Water. _____

Acres Irrigated 19_____

Potential Acres _____ Seeped _____

Explain _____

Condition of System _____

Adequate Supply --- Yes_____ No_____

Explain _____

Topography _____

Information From _____

Remarks No Irr. on this place

The Bartlett filing is owned by Peterson Ranch.

[illegible]

[illegible]

STATE OF MONTANA

STATE ENGINEER'S OFFICE

WATER RESOURCES SURVEY

Township 2 S Range 12 E County Park

Yellowstone R

6	5	4	3	2	1
7	8	9	10	11	12
13	14	15	16	17	18
19	20	21	22	23	24
25	26	27	28	29	30
31	32	33	34	35	36

Handwritten notes on grid: "Yellowstone R" with an arrow pointing to the top-left section. "11 R" and "A" are written near the top-left corner of the grid.

Ronald E Wood

APP.

OK 199	H. Buurmaster	W. Boulder Cr.	1-3-06	1-3-06	40	MI
OK ^{lower ditch} 206	Emma Elges	" "	8-16-18	8-16-18	80	"
OK 207	W. A. Elges	" "	5-29-00	5-29-00	200	"
OK 229	John B. Wood	" "	11-13-96	11-13-96	300	"
X 1133	Swainson Edward	Nuttall Cr.	6-28-19	6-30-19	250	"
OK 1479	Emma Elges M. Dick	Em Cr.	8-16-18	8-16-18	40	"
OK 1816	Enoch Anderson	unnamed spl.	5-11-15	5-12-15	all	
? 1838	Lussie C. Brening	" "	11-4-08	11-5-08	80	"
OK 1881	Emma Elges	" "	8-16-18	8-16-18	20	"

① Elges ditch diverted in NE corner of sec 4 T3S R1E on N bank West Boulder River ran NE across sec 34 and into SE corner sec 27 T3S R1E. not in use for many years Elges intend to rebuild and use this ditch.

② Ditch diverted on N bank of W. Boulder River in the NE 1/4 SW 1/4 sec 34, ran NE into SE corner sec 27. not in use. Elges plan to clean and use this ditch also.

③ Small ditch diverts on N bank Elges Creek. is used to irrigate small pasture N of Cr. in SE 1/4 sec 27.

④ ditch diverted on N bank Elges Creek near sec line between secs 26 and 27. Ditch picked up water from W. Boulder ditches not in use.

STATE ENGINEER'S OFFICE

WATER RESOURCES SURVEY

Township 25 Range 12 E County Park

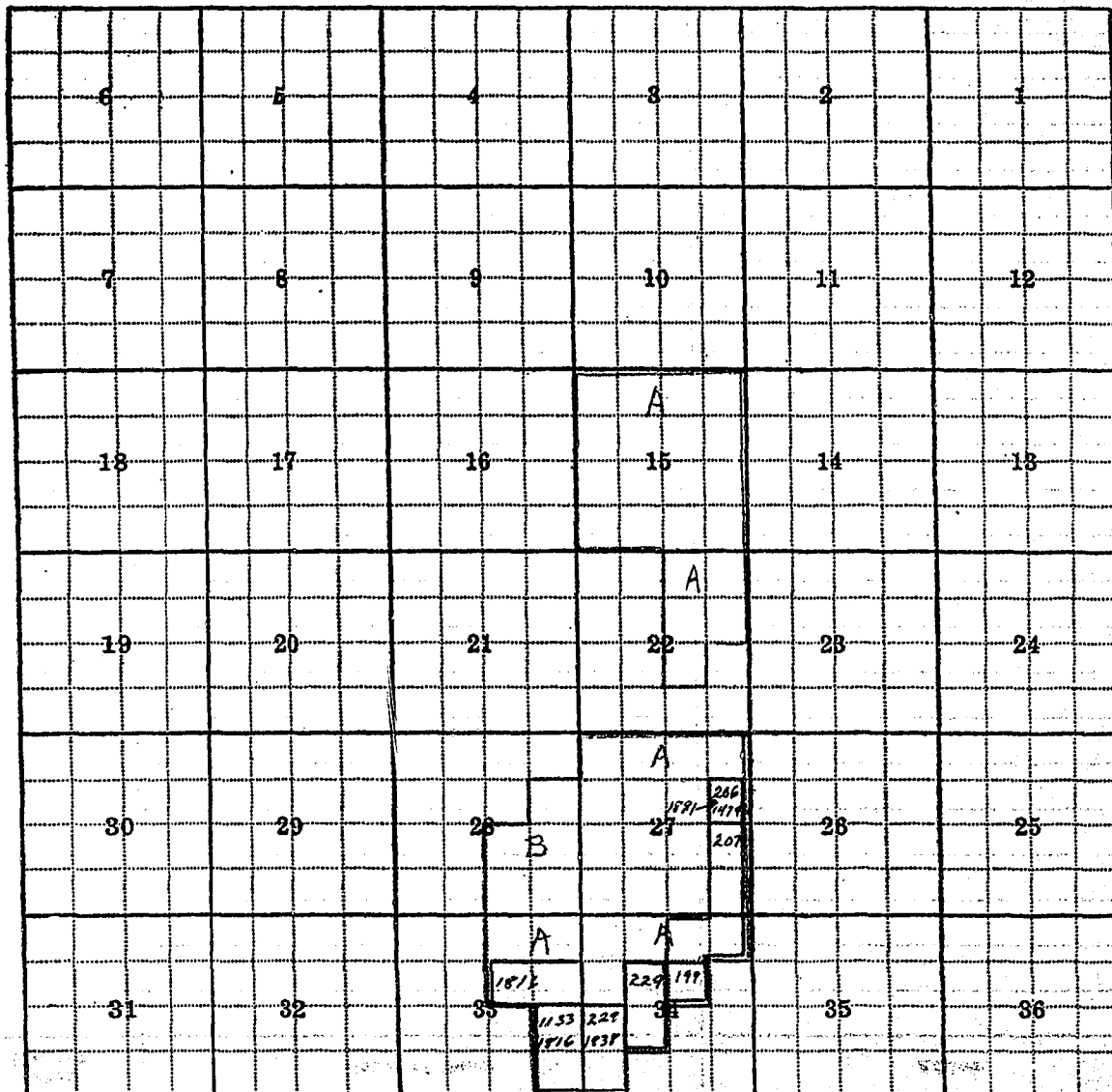

Emma Elges OW-SP

State Engineer's Office
WATER RESOURCES SURVEY
FARM MAP

County Park
Code No. 15A, 22A, 27A
28B, 33A, 34A

Twp. 25 Rge. 12E
Twp. _____ Rge. _____
Twp. _____ Rge. _____

Name of Land Owner Emma Elges Address McLeod
Name of Operator _____ Address _____
Legal Description _____

☐

Irrigated Land

☐

Non-Irrigated Land
North

☐

Potential Land Under Existing Facilities

Code No. 27A, 34A System Elges Ditches Source of Water West Boulder River
Basin Boulder River Present 0 Potential 114 Maximum 114 R ✓ F ✓ P ✓ G ✓ S ✓
Code No. 27A System Elges Ditches Source of Water Elges Creek
Basin Boulder River Present 3 Potential 3 Maximum 3 R ✓ F ✓ P ✓ G ✓ S ✓
Code No. _____ System _____ Source of Water _____
Basin _____ Present _____ Potential _____ Maximum _____ R _____ F _____ P _____ G _____ S _____
Code No. _____ System _____ Source of Water _____
Basin _____ Present _____ Potential _____ Maximum _____ R _____ F _____ P _____ G _____ S _____

If under Ditch Company, Irrigation District, or Government Project, state the number of shares or inches, acre feet, as the case may be in said system.

NOTE: R—Denotes Regular Irrigation. F—Flood Irrigation. P—Water diverted by means of pumping. G—Water diverted by gravity.
S—Stored Water.

Information from J. E. Cook

Date 1/29/52

Farm Checked

STATE OF MONTANA

Code No. 5B-6C-7A-8A-9C
18A-17A-19A-20ABy J. E. Cook

STATE ENGINEER'S OFFICE

County ParkArea Springdale

WATER RESOURCES SURVEY

T. 2 S R. 12 E Sec. 4Date May 15, 1951Photo No. MA-10A-15416Legal Land Owner Martha A. PetersonAddress MA-10A-15416Operator Same

Address

Water is delivered by:

Federal Project _____ Pres. _____ Pot. _____

Ditch Company _____ Pres. _____ Pot. _____

Irrigation District _____ Pres. _____ Pot. _____

Private System ☒ _____ Pres. _____ Pot. _____

Totals _____

Flood _____ Pump _____ Reservoir _____ Gravity ☒

Size and Capacity, Pump, etc. _____

Original Appropriator, Company _____ App. No. _____

Original Appropriator, Private _____ App. No. _____

Is the system an extension of another system? Yes _____ No _____

Is all land irrigated from one system? Yes _____ No _____

(If No, show break down on map)

Source of Water Greeley or Peterson Creek (originally Beaver Creek)

Acres Irrigated 19 _____

Potential Acres _____ Seeped _____

Explain _____

Condition of System _____

Adequate Supply _____ Yes ☒ _____ No _____Explain Small amount irrigatedTopography Valley bottoms & sidesInformation From Mrs. Peterson & Mrs. McEwan

Remarks _____

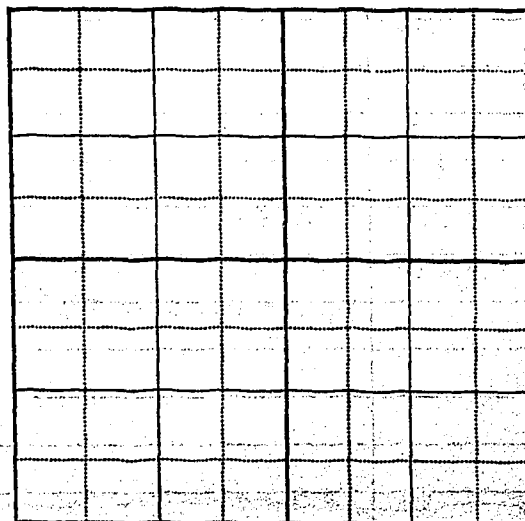

Deerced

~~208~~ ~~Bartlett H. G. Beaver Cr.~~ ~~5-12-82~~ ~~5-15-82~~ ~~80~~ ~~MI~~

APP.

OK 5112	Bartlett H. G.	Beaver Cr.	now called Peterson Creek	5-12-82	5-15-82	all	
OK 418	Peterson, Andrew	"	"	8-3-93	8-4-93	80 MI	
OK 120	"	"	"	"	"	150 "	
OK 853	"	"	Greeley Cr.	now called Peterson Creek	5-26-02	5-26-02	80 "
OK 1178	Geo. McEwen	Peterson Cr.		3-2-36	3-2-36	40 "	
2162	Sarah Hargis	Yellowstone R.		5-20-39	5-27-39	300 "	
OK 851	John S. Hodges	Greeley Cr.	(Nov. 1, 1993)	1-3-94	1-3-94	160 "	
OK 854	Martha A. Peterson	"	"	6-23-05	6-23-05	50 "	

Peterson Creek

- ① Ditch diverts on N bank in NE 1/4 SE 1/4 sec 5, runs W ditch is in use.
- ② Ditch diverts ^{from Greeley Cr (W bank)} in NW 1/4 SW 1/4 sec 5, runs a short distance W. This ditch was extended by Payne to irr. land in SE 1/4 NE 1/4 sec 6, but has not been used for many years.
- ③ Trace of ditch diverted on E bank Greeley Creek in NE 1/4 SW 1/4 sec 5 ran N about 75 yds not in use.
- ④ Trace of ditch diverted from Greeley or Peterson Creek (E bank) in the SW 1/4 NW 1/4 sec 5, ran N and E irrigated land N of highway & railroad in N 1/4 sec 5 Not in use for many years put off by highway.
- ⑤ Trace of ditch diverting from Greeley Creek W bank near the center of section 18 not in use. App 551

STATE ENGINEER'S OFFICE

WATER RESOURCES SURVEY

Township 2 S Range 12 E County Park

6	119 1178 2162 112 112 2162 112 112	209 112 112 112 112 112 112 112	4	8	2	1
A	A	C				
7	854	8	9	10	11	12
A	A					
851	18	17	16	15	14	13
S						
19	A	20	21	22	23	24
30	29	28	27	26	25	
31	32	33	34	35	36	

Marsha Peterson Civi-Eng

STATE OF MONTANA

State Engineer's Office

WATER RESOURCES SURVEY

FARM MAP

County Park

Code No. 57

Twp. 25 Rge. 12E

Twp. _____ Rge. _____

Twp. _____ Rge. _____

Name of Land Owner Martha Peterson Address Springdale

Name of Operator _____ Address _____

Legal Description _____

☐ Irrigated Land

☐ Non-Irrigated Land
North

☐ Potential Land Under Existing Facilities

Code No. 5B System Peterson Ditches Source of Water Peterson Creek
Basin Yellowstone River Present 14 Potential 0 Maximum 14 R ✓ F ✓ P ✓ G ✓ S ✓
Code No. 5B System Peterson Ditch Source of Water Greeley Creek
Basin Yellowstone River Present 0 Potential 16 Maximum 16 R ✓ F ✓ P ✓ G ✓ S ✓
Code No. 5B, 6C System Payne Ditch Source of Water Greeley Creek
Basin Yellowstone River Present 2 Potential 10 Maximum 12 R ✓ F ✓ P ✓ G ✓ S ✓
Code No. _____ System _____ Source of Water _____
Basin _____ Present _____ Potential _____ Maximum _____ R _____ F _____ P _____ G _____ S _____

If under Ditch Company, Irrigation District, or Government Project, state the number of shares or inches, acre feet, as the case may be in said system.

NOTE: R—Denotes Regular Irrigation. F—Flood Irrigation. P—Water diverted by means of pumping. G—Water diverted by gravity.
S—Stored Water.

Information from J. E. Link Date 1/29/52

Area Spingdale

Date May 15, 1951

Legal Land Owner L. W. Harrison

Operator Ross

Water is delivered by:

Federal Project _____ Pres. _____ Pot. _____

Ditch Company _____ Pres. _____ Pot. _____

Irrigation District _____ Pres. _____ Pot. _____

Private System ☒ _____ Pres. _____ Pot. _____

Totals _____

Flood _____ Pump 2 _____ Reservoir _____ Gravity _____

Size and Capacity, Pump, etc. 6" p.d.y.m.a., 100 H.P. Ford using natural gas, 22' lift

Original Appropriator, Company _____ App. No. _____

Original Appropriator, Private _____ App. No. _____

Is the system an extension of another system? Yes_____No_____

Is all land irrigated from one system? Yes _____ No _____

(If No, show break down on map)

Source of Water: Yellowstone River Greasy Creek

Acres Irrigated 19 51 85

Pot. or Bal. Acres _____ Seeped _____

Explain _____

Condition of System Good

Adequate Supply Yes ☒ No ☐

Explain _____

Topography River Bottom Terrace

Information From Mr. L.W. Swanson

Remarks

1992, 1993, 1994, 1995, 1996, 1997, 1998, 1999, 2000, 2001, 2002, 2003, 2004, 2005, 2006, 2007, 2008, 2009, 2010, 2011, 2012, 2013, 2014, 2015, 2016, 2017, 2018, 2019, 2020, 2021, 2022, 2023, 2024, 2025, 2026, 2027, 2028, 2029, 2030, 2031, 2032, 2033, 2034, 2035, 2036, 2037, 2038, 2039, 2040, 2041, 2042, 2043, 2044, 2045, 2046, 2047, 2048, 2049, 2050, 2051, 2052, 2053, 2054, 2055, 2056, 2057, 2058, 2059, 2060, 2061, 2062, 2063, 2064, 2065, 2066, 2067, 2068, 2069, 2070, 2071, 2072, 2073, 2074, 2075, 2076, 2077, 2078, 2079, 2080, 2081, 2082, 2083, 2084, 2085, 2086, 2087, 2088, 2089, 2090, 2091, 2092, 2093, 2094, 2095, 2096, 2097, 2098, 2099, 2100, 2101, 2102, 2103, 2104, 2105, 2106, 2107, 2108, 2109, 2110, 2111, 2112, 2113, 2114, 2115, 2116, 2117, 2118, 2119, 2120, 2121, 2122, 2123, 2124, 2125, 2126, 2127, 2128, 2129, 2130, 2131, 2132, 2133, 2134, 2135, 2136, 2137, 2138, 2139, 2140, 2141, 2142, 2143, 2144, 2145, 2146, 2147, 2148, 2149, 2150, 2151, 2152, 2153, 2154, 2155, 2156, 2157, 2158, 2159, 2160, 2161, 2162, 2163, 2164, 2165, 2166, 2167, 2168, 2169, 2170, 2171, 2172, 2173, 2174, 2175, 2176, 2177, 2178, 2179, 2180, 2181, 2182, 2183, 2184, 2185, 2186, 2187, 2188, 2189, 2190, 2191, 2192, 2193, 2194, 2195, 2196, 2197, 2198, 2199, 2200, 2201, 2202, 2203, 2204, 2205, 2206, 2207, 2208, 2209, 2210, 2211, 2212, 2213, 2214, 2215, 2216, 2217, 2218, 2219, 2220, 2221, 2222, 2223, 2224, 2225, 2226, 2227, 2228, 2229, 2230, 2231, 2232, 2233, 2234, 2235, 2236, 2237, 2238, 2239, 2240, 2241, 2242, 2243, 2244, 2245, 2246, 2247, 2248, 2249, 2250, 2251, 2252, 2253, 2254, 2255, 2256, 2257, 2258, 2259, 2260, 2261, 2262, 2263, 2264, 2265, 2266, 2267, 2268, 2269, 2270, 2271, 2272, 2273, 2274, 2275, 2276, 2277, 2278, 2279, 2280, 2281, 2282, 2283, 2284, 2285, 2286, 2287, 2288, 2289, 2290, 2291, 2292, 2293, 2294, 2295, 2296, 2297, 2298, 2299, 2300, 2301, 2302, 2303, 2304, 2305, 2306, 2307, 2308, 2309, 2310, 2311, 2312, 2313, 2314, 2315, 2316, 2317, 2318, 2319, 2320, 2321, 2322, 2323, 2324, 2325, 2326, 2327, 2328, 2329, 2330, 2331, 2332, 2333, 2334, 2335, 2336, 2337, 2338, 2339, 2340, 2341, 2342, 2343, 2344, 2345, 2346, 2347, 2348, 2349, 2350, 2351, 2352, 2353, 2354, 2355, 2356, 2357, 2358, 2359, 2360, 2361, 2362, 2363, 2364, 2365, 2366, 2367, 2368, 2369, 2370, 2371, 2372, 2373, 2374, 2375, 2376, 2377, 2378, 2379, 2380, 2381, 2382, 2383, 2384, 2385, 2386, 2387, 2388, 2389, 2390, 2391, 2392, 2393, 2394, 2395, 2396, 2397, 2398, 2399, 2400, 2401, 2402, 2403, 2404, 2405, 2406, 2407, 2408, 2409, 2410, 2411, 2412, 2413, 2414, 2415, 2416, 2417, 2418, 2419, 2420, 2421, 2422, 2423, 2424, 2425, 2426, 2427, 2428, 2429, 2430, 2431, 2432, 2433, 2434, 2435, 2436, 2437, 2438, 2439, 2440, 2441, 2442, 2443, 2444, 2445, 2446, 2447, 2448, 2449, 2450, 2451, 2452, 2453, 2454, 2455, 2456, 2457, 2458, 2459, 2460, 2461, 2462, 2463, 2464, 2465, 2466, 2467, 2468, 2469, 2470, 2471, 2472, 2473, 2474, 2475, 2476, 2477, 2478, 2479, 2480, 2481, 2482, 2483, 2484, 2485, 2486, 2487, 2488, 2489, 2490, 2491, 2492, 2493, 2494, 2495, 2496, 2497, 2498, 2499, 2500, 2501, 2502, 2503, 2504, 2505, 2506, 2507, 2508, 2509, 2510, 2511, 2512, 2513, 2514, 2515, 2516, 2517, 2518, 2519, 2520, 2521, 2522, 2523, 2524, 2525, 2526, 2527, 2528, 2529, 2530, 2531, 2532, 2533, 2534, 2535, 2536, 2537, 2538, 2539, 2540, 2541, 2542, 2543, 2544, 2545, 2546, 2547, 2548, 2549, 2550, 2551, 2552, 2553, 2554, 2555, 2556, 2557, 2558, 2559, 2560, 2561, 2562, 2563, 2564, 2565, 2566, 2567, 2568, 2569, 2570, 2571, 2572, 2573, 2574, 2575, 2576, 2577, 2578, 2579, 2580, 2581, 2582, 2583, 2584, 2585, 2586, 2587, 2588, 2589, 2590, 2591, 2592, 2593, 2594, 2595, 2596, 2597, 2598, 2599, 2600, 2601, 2602, 2603, 2604, 2605, 2606, 2607, 2608, 2609, 2610, 2611, 2612, 2613, 2614, 2615, 2616, 2617, 2618, 2619, 2620, 2621, 2622, 2623, 2624, 2625, 2626, 2627, 2628, 2629, 2630, 2631, 2632, 2633, 2634, 2635, 2636, 2637, 2638, 2639, 2640, 2641, 2642, 2643, 2644, 2645, 2646, 2647, 2648, 2649, 2650, 2651, 2652, 2653, 2654, 2655, 2656, 2657, 2658, 2659, 2660, 2661, 2662, 2663, 2664, 2665, 2666, 2667, 2668, 2669, 2670, 2671, 2672, 2673, 26

Code No. 6B-19D-30B

County Pike

T. 2 S. R. 12 E. Sec.

Photo No. MA-10A-15-16

Address Springdale

Address _____

Pres. _____ Pot. _____

Pres. _____ Pot. _____

Pres. _____ Pot. _____

Pres. _____ Pot. _____

Totals_____[illegible]

App. No. _____

App. No. _____

1. 2. 3. 4. 5. 6. 7. 8. 9. 10. 11. 12. 13. 14. 15. 16. 17. 18. 19. 20. 21. 22. 23. 24. 25. 26. 27. 28. 29. 30. 31. 32. 33. 34. 35. 36. 37. 38. 39. 40. 41. 42. 43. 44. 45. 46. 47. 48. 49. 50. 51. 52. 53. 54. 55. 56. 57. 58. 59. 60. 61. 62. 63. 64. 65. 66. 67. 68. 69. 70. 71. 72. 73. 74. 75. 76. 77. 78. 79. 80. 81. 82. 83. 84. 85. 86. 87. 88. 89. 90. 91. 92. 93. 94. 95. 96. 97. 98. 99. 100. 101. 102. 103. 104. 105. 106. 107. 108. 109. 110. 111. 112. 113. 114. 115. 116. 117. 118. 119. 120. 121. 122. 123. 124. 125. 126. 127. 128. 129. 130. 131. 132. 133. 134. 135. 136. 137. 138. 139. 140. 141. 142. 143. 144. 145. 146. 147. 148. 149. 150. 151. 152. 153. 154. 155. 156. 157. 158. 159. 160. 161. 162. 163. 164. 165. 166. 167. 168. 169. 170. 171. 172. 173. 174. 175. 176. 177. 178. 179. 180. 181. 182. 183. 184. 185. 186. 187. 188. 189. 190. 191. 192. 193. 194. 195. 196. 197. 198. 199. 200. 201. 202. 203. 204. 205. 206. 207. 208. 209. 210. 211. 212. 213. 214. 215. 216. 217. 218. 219. 220. 221. 222. 223. 224. 225. 226. 227. 228. 229. 230. 231. 232. 233. 234. 235. 236. 237. 238. 239. 240. 241. 242. 243. 244. 245. 246. 247. 248. 249. 250. 251. 252. 253. 254. 255. 256. 257. 258. 259. 260. 261. 262. 263. 264. 265. 266. 267. 268. 269. 270. 271. 272. 273. 274. 275. 276. 277. 278. 279. 280. 281. 282. 283. 284. 285. 286. 287. 288. 289. 290. 291. 292. 293. 294. 295. 296. 297. 298. 299. 300. 301. 302. 303. 304. 305. 306. 307. 308. 309. 310. 311. 312. 313. 314. 315. 316. 317. 318. 319. 320. 321. 322. 323. 324. 325. 326. 327. 328. 329. 330. 331. 332. 333. 334. 335. 336. 337. 338. 339. 340. 341. 342. 343. 344. 345. 346. 347. 348. 349. 350. 351. 352. 353. 354. 355. 356. 357. 358. 359. 360. 361. 362. 363. 364. 365. 366. 367. 368. 369. 370. 371. 372. 373. 374. 375. 376. 377. 378. 379. 380. 381. 382. 383. 384. 385. 386. 387. 388. 389. 390. 391. 392. 393. 394. 395. 396. 397. 398. 399. 400. 401. 402. 403. 404. 405. 406. 407. 408. 409. 410. 411. 412. 413. 414. 415. 416. 417. 418. 419. 420. 421. 422. 423. 424. 425. 426. 427. 428. 429. 430. 431. 432. 433. 434. 435. 436. 437. 438. 439. 440. 441. 442. 443. 444. 445. 446. 447. 448. 449. 450. 451. 452. 453. 454. 455. 456. 457. 458. 459. 460. 461. 462. 463. 464. 465. 466. 467. 468. 469. 470. 471. 472. 473. 474. 475. 476. 477. 478. 479. 480. 481. 482. 483. 484. 485. 486. 487. 488. 489. 490. 491. 492. 493. 494. 495. 496. 497. 498. 499. 500. 501. 502. 503. 504. 505. 506. 507. 508. 509. 510. 511. 512. 513. 514. 515. 516. 517. 518. 519. 520. 521. 522. 523. 524. 525. 526. 527. 528. 529. 530. 531. 532. 533. 534. 535. 536. 537. 538. 539. 540. 541. 542. 543. 544. 545. 546. 547. 548. 549. 550. 551. 552. 553. 554. 555. 556. 557. 558. 559. 560. 561. 562. 563. 564. 565. 566. 567. 568. 569. 570. 571. 572. 573. 574. 575. 576. 577. 578. 579. 580. 581. 582. 583. 584. 585. 586. 587. 588. 589. 590. 591. 592. 593. 594. 595. 596. 597. 598. 599. 600. 601. 602. 603. 604. 605. 606. 607. 608. 609. 610. 611. 612. 613. 614. 615. 616. 617. 618. 619. 620. 621. 622. 623. 624. 625. 626. 627. 628. 629. 630. 631. 632. 633. 634. 635. 636. 637. 638. 639. 640. 641. 642. 643. 644. 645. 646. 647. 648. 649. 650. 651. 652. 653. 654. 655. 656. 657. 658. 659. 660. 661. 662. 663. 664. 665. 666. 667. 668. 669. 670. 671. 672. 673. 674. 675. 676. 677. 678. 679. 680. 681. 682. 683. 684. 685. 686. 687. 688. 689. 690. 691. 692. 693. 694. 695. 696. 697. 698. 699. 700. 701. 702. 703. 704. 705. 706. 707. 708. 709. 710. 711. 712. 713. 714. 715. 716. 717. 718. 719. 720. 721. 722. 723. 724. 725. 726. 727. 728. 729. 730. 731. 732. 733. 734. 735. 736. 737. 738. 739. 740. 741. 742. 743. 744. 745. 746. 747. 748. 749. 750. 751. 752. 753. 754. 755. 756. 757. 758. 759. 760. 761. 762. 763. 764. 765. 766. 767. 768. 769. 770. 771. 772. 773. 774. 775. 776. 777. 778. 779. 780. 781. 782. 783. 784. 785. 786. 787. 788. 789. 790. 791. 792. 793. 794. 795. 796. 797. 798. 799. 800. 801. 802. 803. 804. 805. 806. 807. 808. 809. 810. 811. 812. 813. 814. 815. 816. 817. 818. 819. 820. 821. 822. 823. 824. 825. 826. 827. 828. 829. 830. 831. 832. 833. 834. 835. 836. 837. 838. 839. 840. 84

[illegible]

A large grid of graph paper with 10 columns and 10 rows, used for drawing a diagram.

| | | | | | |
|---------------------------------------|----------------|----------------|----------|----------|--------|
| OK 852 | Harry Payne | Maechy Cr. | 7-13-31 | 7-13-31 | 125 MI |
| OK 1983
2115 | Fred M. Hurler | unmanned | 10-11-13 | 10-11-13 | 100 " |
| OK 2162 | Larch | Yellowstone R. | 5-20-39 | 5-27-39 | 300 " |

① Pump is located on the S bank of the Yellowstone R. in the NW 1/4 NW 1/4 sec. 1 T2S-R11E. Water is pumped to foot of bench and ditches run E to SE 1/4 NE 1/4 sec 6 T2S-R12E and W to the W side of lot 2 sec. 1 T2S-R11E - App. No 2162

② Payne Ditch diverts from Greeley Creek, W bank, in the NW 1/4 SW 1/4 sec 5 T2S-R11E. This ditch is used by the Peterson Ranch to irr yard & garden in the NW 1/4 SW 1/4 sec 5, but has not been used beyond there for several years. This ditch was probably extended by Payne to his place from a ditch built by Peterson.

Swanson says the Fred Hurler filing must have been for stock water

STATE OF MONTANA

STATE ENGINEER'S OFFICE

WATER RESOURCES SURVEY

Township 25 Range 12 E County Park

2162
852
2115

| | | | | | | | | | | | |
|------|------|------|----|----|----|---|--|--|--|--|--|
| 2162 | 2115 | 2162 | | | | | | | | | |
| 2115 | 6 | 5 | 4 | 3 | 2 | 1 | | | | | |
| 2162 | B | | | | | | | | | | |
| | | | | | | | | | | | |
| 7 | 8 | 9 | 10 | 11 | 12 | | | | | | |
| | | | | | | | | | | | |
| 18 | 17 | 16 | 15 | 14 | 13 | | | | | | |
| | | | | | | | | | | | |
| 19 | 20 | 21 | 22 | 23 | 24 | | | | | | |
| D | | | | | | | | | | | |
| B | | | | | | | | | | | |
| 30 | 29 | 28 | 27 | 26 | 25 | | | | | | |
| | | | | | | | | | | | |
| 31 | 32 | 33 | 34 | 35 | 36 | | | | | | |
| | | | | | | | | | | | |

L. W. DICKERSON OW

25

12 E

30

STATE OF MONTANA

State Engineer's Office
WATER RESOURCES SURVEY
FARM MAP

County Park

Code No. 6B

Twp. 25 Rge. 12E

Twp. _____ Rge. _____

Twp. _____ Rge. _____

Name of Land Owner. L.W. SWANSON

Address Springdale

Name of Operator. _____

Address _____

Legal Description. _____



Irrigated Land



Non-Irrigated Land
North



Potential Land Under Existing Facilities

Code No. 6B System Swanson Pump Ditch Source of Water Yellowstone River
Basin Yellowstone Present 53 Potential 0 Maximum 53 R ✓ F ✓ P ✓ G ✓ S ✓
Code No. _____ System _____ Source of Water _____
Basin _____ Present _____ Potential _____ Maximum _____ R _____ F _____ P _____ G _____ S _____
Code No. _____ System _____ Source of Water _____
Basin _____ Present _____ Potential _____ Maximum _____ R _____ F _____ P _____ G _____ S _____
Code No. _____ System _____ Source of Water _____
Basin _____ Present _____ Potential _____ Maximum _____ R _____ F _____ P _____ G _____ S _____

If under Ditch Company, Irrigation District, or Government Project, state the number of shares or inches, acre feet, as the case may be in said system.

NOTE: R—Denotes Regular Irrigation. F—Flood Irrigation. P—Water diverted by means of pumping. G—Water diverted by gravity.
S—Stored Water.

Information from SWANSON

Date 1/29/52

FORM F-1 WESTERN LITHO, BILLINGS

Farm Checked

By S E Cook

Area West Boulder

Date July 25, 1951

Legal Land Owner. J. P. Wilson

Operator Tony E Ferguson

Water is delivered by:

Federal Project _____ Pres. _____ Pot. _____

Ditch Company _____ Pres. _____ Pot. _____

Irrigation District _____ Pres. _____ Pot. _____

Private System ☒ 5 Flood ditches Pres. _____ Pot. _____

| Totals | |
|--------|-----|
| 100 | 100 |

Flood ☒ Pump _____ Reservoir _____ Gravity _____

Size and Capacity, Pump, etc. _____

Original Appropriator, Company _____ App. No. _____

Original Appropriator, Private _____ App. No. _____

Is the system an extension of another system? Yes _____ No _____

Is all land irrigated from one system? Yes _____ No _____

(If No, show break down on map)

Source of Water. Nuttall Creek

Acres Irrigated 19 51 _____

Potential Acres _____ Seeded _____

Explain

Condition of System Good to Fair

Adequate Supply . . . Yes _____ No ☒

Explain Artesian & Springs get low in late summer

Topography Valley bottom & slope

Information From Tony E. Ferguson

Remarks _____

[illegible]

1133 Edward Swinson Nuttall Cr. 6-28-19 6-30-19 250 MI

Nuttall Creek (P)

① System consists of a small Res and four ditches, three ditches diverting on the left bank and one on the right bank in the S $\frac{1}{2}$ of the SW $\frac{1}{4}$ of Sec 33 T 25 R 12 E. irrigates land in S $\frac{1}{2}$ SW $\frac{1}{4}$ and SW $\frac{1}{4}$ SE $\frac{1}{4}$ sec 33

Ferguson also has a small garden ditch near E line in sec 32.

STATE ENGINEER'S OFFICE

WATER RESOURCES SURVEY

Township 2S Range 12 E County Park

| | | | | | |
|----|----|----|----|----|----|
| 6 | 5 | 4 | 3 | 2 | 1 |
| 7 | 8 | 9 | 10 | 11 | 12 |
| 18 | 17 | 16 | 15 | 14 | 13 |
| 19 | 20 | 21 | 22 | 23 | 24 |
| 30 | 29 | 28 | 27 | 26 | 25 |
| 31 | 32 | 33 | 34 | 35 | 36 |

Handwritten notes on the grid:

- Section 20: "NP" (National Park)
- Section 21: "Village 301" and "Porch"
- Section 28: "Elbow"
- Section 32: "A"
- Section 33: "B"
- Section 33: "1133"
- Section 33: "NP 301"

J. P. Wilson ow-op

STATE OF MONTANA

State Engineer's Office

WATER RESOURCES SURVEY

FARM MAP

County Park

Code No. 31A, 32A, 33B

Twp. 28 Rge. 12E

Twp. _____ Rge. _____

Twp. _____ Rge. _____

Name of Land Owner L. P. Wilson

Address McCleod

Name of Operator _____

Address _____

Legal Description _____

☐

Irrigated Land

☐

Non-Irrigated Land

North

☐

Potential Land Under Existing Facilities

Code No. 33B System Wilson Ditch Source of Water Muttal Creek
Basin Boulder River Present 46 Potential 0 Maximum 46 R ✓ F ✓ P ✓ G ✓ S ✓
Code No. _____ System _____ Source of Water _____
Basin _____ Present _____ Potential _____ Maximum _____ R _____ F _____ P _____ G _____ S _____
Code No. _____ System _____ Source of Water _____
Basin _____ Present _____ Potential _____ Maximum _____ R _____ F _____ P _____ G _____ S _____
Code No. _____ System _____ Source of Water _____
Basin _____ Present _____ Potential _____ Maximum _____ R _____ F _____ P _____ G _____ S _____

If under Ditch Company, Irrigation District, or Government Project, state the number of shares or inches, acre feet, as the case may be in said system.

NOTE: R—Denotes Regular Irrigation. F—Flood Irrigation. P—Water diverted by means of pumping. G—Water diverted by gravity. S—Stored Water.

Information from J. E. Cook

Date 1/29/52

Farm Checked

By J. E. Cook

STATE OF MONTANA

Code No. 4B-913-21A

Area Peterson Cr.

STATE ENGINEER'S OFFICE
WATER RESOURCES SURVEY

County Park

T. 2 S R 12 E Sec. 4-9-21

Date May 15, 1950

Photo No. MA-15A-161 & 162

Legal Land Owner Tyron J. Ward

Address Springdale

Operator Same

Address _____

Water is delivered by:

Federal Project_____ **Pres.**_____ **Pot.**_____

Ditch Company _____ Pres. _____ Pot. _____

Irrigation District _____ Pres. _____ Pot. _____

Private System 2 ditches Pres. _____ Pot. _____

Totals _____

Flood _____ Pump _____ Reservoir _____ Gravity $\frac{1}{2}$ _____

Size and Capacity, Pump, etc. _____

Original Appropriator, Company_____App. No._____

Original Appropriator, Private _____ App. No. _____

Is the system an extension of another system? Yes _____ No _____

Is all land irrigated from one system? Yes _____ No _____

(If No, show break down on map)

Source of Water Peterson or Grayley Creek (also Beaver Cr)

Acres Irrigated 1954, _____

Potential Acres _____ Seeped _____

Explain

Condition of System Good

Adequate Supply --- Yes ☒ No ☐

Explain Small amount irrigated

Topography Valley bottom & slope

Information From Tyson Wood

Remarks _____

A large grid of 10 columns and 10 rows, intended for drawing a picture. The grid is composed of thin black lines forming a 10x10 array of squares.

OK. 855 John J. Wood Hoeing Cr. 2-27-15 2-27-15 160 ME

APPROVED BY

APPROVED BY

APPROVED BY

(1) Ditch diverts from E side of Cr. (E fork in sec 9) in NW 1/4 SE 1/4 of sec 9 and runs N about 1/4 mile. Irrigates land in valley bottom.

(2) Ditch diverts from W branch of Creek in sec 9 on the W side of the Cr. in the SW 1/4 SE 1/4 sec 9.

Tyson Wood uses App No 855 for both ditches

The filing states that water was first used Feb. 20, 1911

855- John J. Wood Hoeing Cr. 2-27-15 2-27-15 160 ME

APP.



FORM D-1— WESTERN LITHO, BILLINGS

STATE OF MONTANA

STATE ENGINEER'S OFFICE

WATER RESOURCES SURVEY

Township 2S Range 12E County Park

| | | | | | |
|----|----|----|----|----|----|
| 6 | 5 | 4 | 3 | 2 | 1 |
| 7 | 8 | 9 | 10 | 11 | 12 |
| 13 | 17 | 16 | 15 | 14 | 13 |
| 19 | 20 | 21 | 22 | 23 | 24 |
| 30 | 29 | 28 | 27 | 26 | 25 |
| 31 | 32 | 33 | 34 | 35 | 36 |

Tyson J. Wood ow

25

12E

(30)

STATE OF MONTANA

State Engineer's Office
WATER RESOURCES SURVEY
FARM MAP

County Park
Code No. 9B, 4B, 21A

Twp. 2S Rge. 1E
Twp. _____ Rge. _____
Twp. _____ Rge. _____

Name of Land Owner Tyson Wood Address Springdale
Name of Operator _____ Address _____
Legal Description _____

☐ Irrigated Land ☐ Non-Irrigated Land ☐ Potential Land Under Existing Facilities
North

Code No. 9B System Wood Ditches Source of Water Peterson Creek
Basin Yellowstone River Present 12 Potential 0 Maximum 12 R ✓ F ✓ P ✓ G ✓ S ✓
Code No. _____ System _____ Source of Water _____
Basin _____ Present _____ Potential _____ Maximum _____ R _____ F _____ P _____ G _____ S _____
Code No. _____ System _____ Source of Water _____
Basin _____ Present _____ Potential _____ Maximum _____ R _____ F _____ P _____ G _____ S _____
Code No. _____ System _____ Source of Water _____
Basin _____ Present _____ Potential _____ Maximum _____ R _____ F _____ P _____ G _____ S _____

If under Ditch Company, Irrigation District, or Government Project, state the number of shares or inches, acre feet, as the case may be in said system.

NOTE: R—Denotes Regular Irrigation. F—Flood Irrigation. P—Water diverted by means of pumping. G—Water diverted by gravity.
S—Stored Water.

Information from J. E. Cook Date 1/29/52