

[illegible]



FORM D-1- WESTERN LITHO, BILLINGS

STATE OF MONTANA

STATE ENGINEER'S OFFICE

WATER RESOURCES SURVEY

Township 2 S. Range 12 E. County Park

6	5	4	3	2	1
7	8	9	10	11	12
18	17	16	15	14	13
19	20	21	22	23	24
30	29	28	27	26	25
31	32	33	34	35	36

Sweet Grass

County

1342
1938
8

John J. Clark - ow
note this is 1938 ownership. Field
check for present ownership

2 S.

12 E.

(36)

[illegible]



FORM D-1— WESTERN LITHO, BILLINGS

STATE OF MONTANA

STATE ENGINEER'S OFFICE

WATER RESOURCES SURVEY

Township 2 S. Range 12 E County Park

6	5	4	3	2	1
7	8	9	10	11	12
13	14	15	16	17	18
19	20	21	22	23	24
25	26	27	28	29	30
31	32	33	34	35	36

Handwritten notes on the grid:

- Section 11: *Sweet Grass*
- Section 23: *County*
- Section 28: *1392*
1938
C
28
us
- Section 34: *424*
727
us 2037
34
2038B

U. S. A. - aw
Note: This 1938 ownership. Field check
for present ownership.

*3 S.**12 E.**36*

Farm Checked

STATE OF MONTANA

Code No. 8A

By J.E. Cook & G. Bender

STATE ENGINEER'S OFFICE

County Park

Area W. Boulder R.

WATER RESOURCES SURVEY

T. 3 S. R. 12 E. Sec. 8

Date July 26, 1951

Photo No. MA-10A-18

Legal Land Owner. Johnson

Address

Operator Ole Tower

Address Milford

Water is delivered by:

Federal Project _____ Pres. _____ Pot. _____

Ditch Company _____ Pres. _____ Pot. _____

Irrigation District _____ Pres. _____ Pot. _____

Private System _____ Pres. _____ Pot. _____

Totals

Flood _____ Pump _____ Reservoir _____ Gravity _____

Size and Capacity, Pump, etc.

Original Appropriator, Company _____ App. No. _____

Original Appropriator, Private _____ App. No. _____

Is the system an extension of another system? Yes_____No_____

Is all land irrigated from one system? Yes_____No_____

(If No, show break down on map)

Source of Water: W. Boulder River & Springs

Acres Irrigated 19_____, _____

Potential Acres _____ Seeped _____

Explain

Condition of System Not in use for many years

Adequate Supply Yes *from W. Section* No *from Springs of Cot.*

Explain

Topography

Information From Ole Tower

Remarks _____

[illegible]

STATE ENGINEER'S OFFICE

WATER RESOURCES SURVEY

Township 3 S. Range 12 E County Park

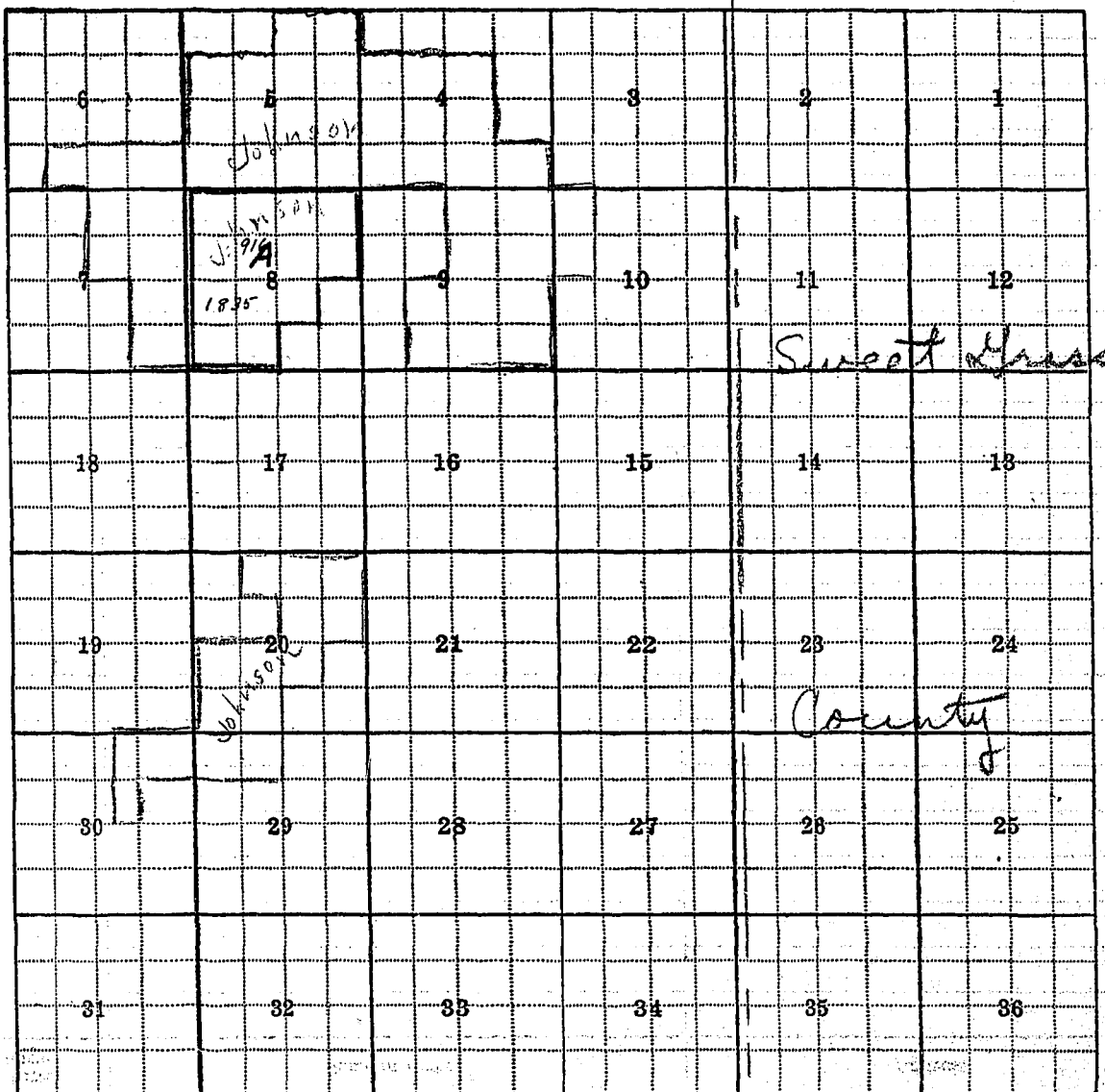

Frank B. Costa, et al - owner

note:

This is 1938 ownership. Field check for present ownership.

3 S.

12 E

(36)

Farm Checked

STATE OF MONTANA

Code No. 5B

By Cook & Bender

STATE ENGINEER'S OFFICE

County Clark

Area W. Boulder

WATER RESOURCES SURVEY

T. 3 S R. 12 E Sec. 3

Date July 26, 1951

Photo No. MA-10A-17

Legal Land Owner Johnson

Address

Operator O/c Tower

Address McLeod

Water is delivered by:

Federal Project _____ Pres. _____ Pot. _____

Ditch Company _____ Pres. _____ Pot. _____

Irrigation District _____ Pres. _____ Pot. _____

Private System _____ Pres. _____ Pot. _____

Totals _____

Flood Pump Reservoir Gravity

Size and Capacity, Pump, etc.

Original Appropriator, Company _____ App. No. _____

Original Appropriator, Private _____ App. No. _____

Is the system an extension of another system? Yes _____ No _____

Is all land irrigated from one system? Yes_____No_____

(If No, show break down on map)

Source of Water _____

Acres Irrigated 19_____

Potential Acres _____ Seeped _____

Explain _____

Condition of System _____

Adequate Supply: Yes No

Explain

Topography

Information From Ole Tower

Remarks _____

A large grid of graph paper. It consists of a main 10x10 grid of squares. Each of these squares is further divided into a 2x2 sub-grid of smaller squares, creating a total of 40x40 small squares. The grid lines are thin and black, set against a white background.

[illegible]

STATE ENGINEER'S OFFICE

WATER RESOURCES SURVEY

Township 3 S. Range 12 E. County Park

6	5	4	3	2	1
	1698 1904				
7	8	9	10	11	12
				Sweet Grass	
18	17	16	15	14	13
19	20	21	22	23	24
				County	
30	29	28	27	26	25
31	32	33	34	35	36

Ebert Sheep Co. - now to H. A. Windsor

Note: This 1938 ownership. 2 old checks for present ownership.

3 S.

12 E

(36)

Farm Checked

By J. E. Cook

Area West Boulder R.

Date July 25, 1951

Legal Land Owner W.D. Wolf & Johnson (Old Tower - op

Operator ole Tower

Water is delivered by:

Federal Project _____ Pres. _____ Pot. _____

Ditch Company _____ Pres. _____ Pot. _____

Irrigation District _____ Pres. _____ Pot. _____

Private System _____ Pres. _____ Pot. _____

[illegible]

Flood _____ Pump NB Reservoir _____ Gravity _____

Size and Capacity, Pump, etc.

Original Appropriator, Company _____ App. No. _____

Original Appropriator, Private _____ App. No. _____

Is the system an extension of another system? Yes_____No_____

Is all land irrigated from one system? Yes_____No_____

(If No, show break down on map)

Source of Water: _____

Acres Irrigated 19____, _____

Potential Acres _____ Seeped _____

Explain

Condition of System _____

Adequate Supply --- Yes _____ No _____

Explain

Topography

Information From John Tedrick

Remarks Filings are for stock water from

Springs

1. *Journal of Management Studies*, 1996, 33, 1, 1-14.

10. *Journal of the American Medical Association*, 277:1033-1034, 1997

1998, 1999, 2000, 2001, 2002, 2003, 2004, 2005, 2006, 2007, 2008, 2009, 2010, 2011, 2012, 2013, 2014, 2015, 2016, 2017, 2018, 2019, 2020, 2021, 2022, 2023, 2024, 2025, 2026, 2027, 2028, 2029, 2030, 2031, 2032, 2033, 2034, 2035, 2036, 2037, 2038, 2039, 2040, 2041, 2042, 2043, 2044, 2045, 2046, 2047, 2048, 2049, 2050, 2051, 2052, 2053, 2054, 2055, 2056, 2057, 2058, 2059, 2060, 2061, 2062, 2063, 2064, 2065, 2066, 2067, 2068, 2069, 2070, 2071, 2072, 2073, 2074, 2075, 2076, 2077, 2078, 2079, 2080, 2081, 2082, 2083, 2084, 2085, 2086, 2087, 2088, 2089, 2090, 2091, 2092, 2093, 2094, 2095, 2096, 2097, 2098, 2099, 2100, 2101, 2102, 2103, 2104, 2105, 2106, 2107, 2108, 2109, 2110, 2111, 2112, 2113, 2114, 2115, 2116, 2117, 2118, 2119, 2120, 2121, 2122, 2123, 2124, 2125, 2126, 2127, 2128, 2129, 2130, 2131, 2132, 2133, 2134, 2135, 2136, 2137, 2138, 2139, 2140, 2141, 2142, 2143, 2144, 2145, 2146, 2147, 2148, 2149, 2150, 2151, 2152, 2153, 2154, 2155, 2156, 2157, 2158, 2159, 2160, 2161, 2162, 2163, 2164, 2165, 2166, 2167, 2168, 2169, 2170, 2171, 2172, 2173, 2174, 2175, 2176, 2177, 2178, 2179, 2180, 2181, 2182, 2183, 2184, 2185, 2186, 2187, 2188, 2189, 2190, 2191, 2192, 2193, 2194, 2195, 2196, 2197, 2198, 2199, 2200, 2201, 2202, 2203, 2204, 2205, 2206, 2207, 2208, 2209, 2210, 2211, 2212, 2213, 2214, 2215, 2216, 2217, 2218, 2219, 2220, 2221, 2222, 2223, 2224, 2225, 2226, 2227, 2228, 2229, 2230, 2231, 2232, 2233, 2234, 2235, 2236, 2237, 2238, 2239, 2240, 2241, 2242, 2243, 2244, 2245, 2246, 2247, 2248, 2249, 2250, 2251, 2252, 2253, 2254, 2255, 2256, 2257, 2258, 2259, 2260, 2261, 2262, 2263, 2264, 2265, 2266, 2267, 2268, 2269, 2270, 2271, 2272, 2273, 2274, 2275, 2276, 2277, 2278, 2279, 2280, 2281, 2282, 2283, 2284, 2285, 2286, 2287, 2288, 2289, 2290, 2291, 2292, 2293, 2294, 2295, 2296, 2297, 2298, 2299, 2300, 2301, 2302, 2303, 2304, 2305, 2306, 2307, 2308, 2309, 2310, 2311, 2312, 2313, 2314, 2315, 2316, 2317, 2318, 2319, 2320, 2321, 2322, 2323, 2324, 2325, 2326, 2327, 2328, 2329, 2330, 2331, 2332, 2333, 2334, 2335, 2336, 2337, 2338, 2339, 2340, 2341, 2342, 2343, 2344, 2345, 2346, 2347, 2348, 2349, 2350, 2351, 2352, 2353, 2354, 2355, 2356, 2357, 2358, 2359, 2360, 2361, 2362, 2363, 2364, 2365, 2366, 2367, 2368, 2369, 2370, 2371, 2372, 2373, 2374, 2375, 2376, 2377, 2378, 2379, 2380, 2381, 2382, 2383, 2384, 2385, 2386, 2387, 2388, 2389, 2390, 2391, 2392, 2393, 2394, 2395, 2396, 2397, 2398, 2399, 2400, 2401, 2402, 2403, 2404, 2405, 2406, 2407, 2408, 2409, 2410, 2411, 2412, 2413, 2414, 2415, 2416, 2417, 2418, 2419, 2420, 2421, 2422, 2423, 2424, 2425, 2426, 2427, 2428, 2429, 2430, 2431, 2432, 2433, 2434, 2435, 2436, 2437, 2438, 2439, 2440, 2441, 2442, 2443, 2444, 2445, 2446, 2447, 2448, 2449, 2450, 2451, 2452, 2453, 2454, 2455, 2456, 2457, 2458, 2459, 2460, 2461, 2462, 2463, 2464, 2465, 2466, 2467, 2468, 2469, 2470, 2471, 2472, 2473, 2474, 2475, 2476, 2477, 2478, 2479, 2480, 2481, 2482, 2483, 2484, 2485, 2486, 2487, 2488, 2489, 2490, 2491, 2492, 2493, 2494, 2495, 2496, 2497, 2498, 2499, 2500, 2501, 2502, 2503, 2504, 2505, 2506, 2507, 2508, 2509, 2510, 2511, 2512, 2513, 2514, 2515, 2516, 2517, 2518, 2519, 2520, 2521, 2522, 2523, 2524, 2525, 2526, 2527, 2528, 2529, 2530, 2531, 2532, 2533, 2534, 2535, 2536, 2537, 2538, 2539, 2540, 2541, 2542, 2543, 2544, 2545, 2546, 2547, 2548, 2549, 2550, 2551, 2552, 2553, 2554, 2555, 2556, 2557, 2558, 2559, 2560, 2561, 2562, 2563, 2564, 2565, 2566, 2567, 2568, 2569, 2570, 2571, 2572, 2573, 2574, 2575, 2576, 2577, 2578, 2579, 2580, 2581, 2582, 2583, 2584, 2585, 2586, 2587, 2588, 2589, 2590, 2591, 2592, 2593, 2594, 2595, 2596, 2597, 2598, 2599, 2600, 2601, 2602, 2603, 2604, 2605, 2606, 2607, 2608, 2609, 2610, 2611, 2612, 2613, 2614, 2615, 2616, 2617, 2618, 2619, 2620, 2621, 2622, 2623, 2624, 2625, 2626, 2627, 2628, 2629, 2630, 2631, 2632, 2633, 2634, 2635, 2636, 2637, 2638, 2639, 2640, 2641, 2642, 2643, 2644, 2645, 2646, 2647, 2648, 2649, 2650, 2651, 2652, 2653, 2654, 2655, 2656, 2657, 2658, 2659, 2660, 2661, 2662, 2663, 2664, 2665, 2666, 2667, 2668, 2669, 2670, 2671, 2672, 2673, 2674, 2675, 2676, 2677, 2678, 2679, 26

the 1990s, the number of people in the world who are under 15 years of age is expected to increase by 1.5 billion, from 1.1 billion in 1990 to 2.6 billion in 2010. The number of people aged 65 and over is expected to increase by 1.1 billion, from 350 million in 1990 to 1.4 billion in 2010. The number of people aged 15-64 is expected to increase by 1.5 billion, from 2.5 billion in 1990 to 4.0 billion in 2010. The number of people aged 65 and over is expected to increase by 1.1 billion, from 350 million in 1990 to 1.4 billion in 2010. The number of people aged 15-64 is expected to increase by 1.5 billion, from 2.5 billion in 1990 to 4.0 billion in 2010.

STATE OF MONTANA
STATE ENGINEER'S OFFICE
WATER RESOURCES SURVEY

Code No. 5C-6A-7A

County Park

T. 35 R. 12E Sec. 5-6-7

Photo No. MA-10A-17 +15

Address Swingley Route

Address _____

Totals _____

App. No. _____

App. No. _____

Yes_____No_____

Yes_____No_____

[illegible]

STATE OF MONTANA

STATE ENGINEER'S OFFICE

WATER RESOURCES SURVEY

Township 3 S. Range 12 E County Park

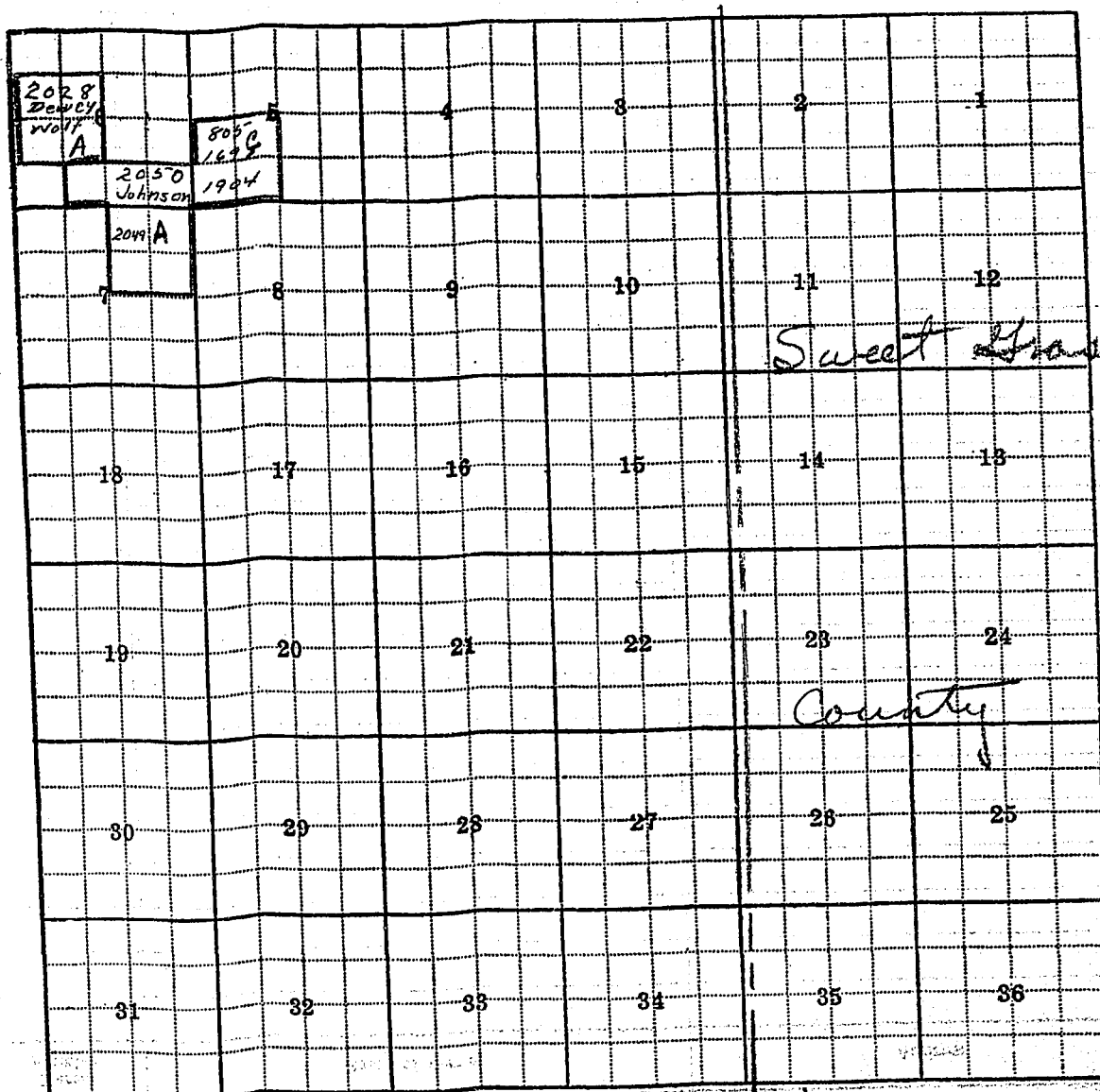

Union Trust Co. over to John W. & James A. Hart
 note: This is 1938 ownership. Field checks for present
 ownership.

3 S.

12 E

(36)

Farm Checked

STATE OF MONTANA

Code No. 4B-5A-9A-20A

By _____

STATE ENGINEER'S OFFICE

WATER RESOURCES SURVEY

County Park

Area _____

T. 35 R. 12E Sec.

Date _____

T. 35 R. 12E Sec. MA-10A-17 & 18

Photo No. ~~44-157-1634-164~~

Legal Land Owner Johnson Address _____

Operator _____ Address _____

Water is delivered by:

Federal Project _____ Pres. _____ Pot. _____

Ditch Company _____ Pres. _____ Pot. _____

Irrigation District _____ Pres. _____ Pot. _____

Private System _____ Pres. _____ Pot. _____

[illegible]

Flood Pump Reservoir Gravity

Size and Capacity, Pump, etc......

Original Appropriator, Company _____ App. No. _____

Original Appropriator, Private _____ App. No. _____

Is the system an extension of another system? Yes _____ No _____

Is all land irrigated from one system? Yes_____No_____

(If No, show break down on map)

Source of Water. _____

Acres Irrigated 19_____

Potential Acres _____ Seeped _____

Explain

Condition of System _____

Adequate Supply _____ Yes _____ No _____

Explain.

Topography

Information From: Ole Tower

Remarks _____

A large grid of graph paper with 10 columns and 10 rows of squares. The grid is composed of thin black lines forming a uniform pattern of squares. The grid is used for drawing or writing.

OK 211	M. H. Hough et al	W.B. Boulder cr.	5-4-07	5-7-07	600
OK 221	Robert Noone	"	9-2-99	9-2-99	200
222	"	"	9-6-99	9-6-99	100
OK 1698	Tom Holand	Tahoe Cr.	9-24-36	9-24-36	100
OK 1904	"	unnamed spr.	5-10-37	5-10-37	50
OK 1562	"	Spring Cr.	9-2-31	9-5-31	500
OK 1588	Robert Noone	"	9-6-99	9-6-99	100
<div style="text-align: center;"> <p>ADVIS: RESPONDER SERIAL</p> <p>CIVIL ENGINEER'S OFFICE</p> <p>STATE OF MONTANA</p> </div>					



FORM D-1- WESTERN LITHO, BILLINGS

STATE OF MONTANA

STATE ENGINEER'S OFFICE

WATER RESOURCES SURVEY

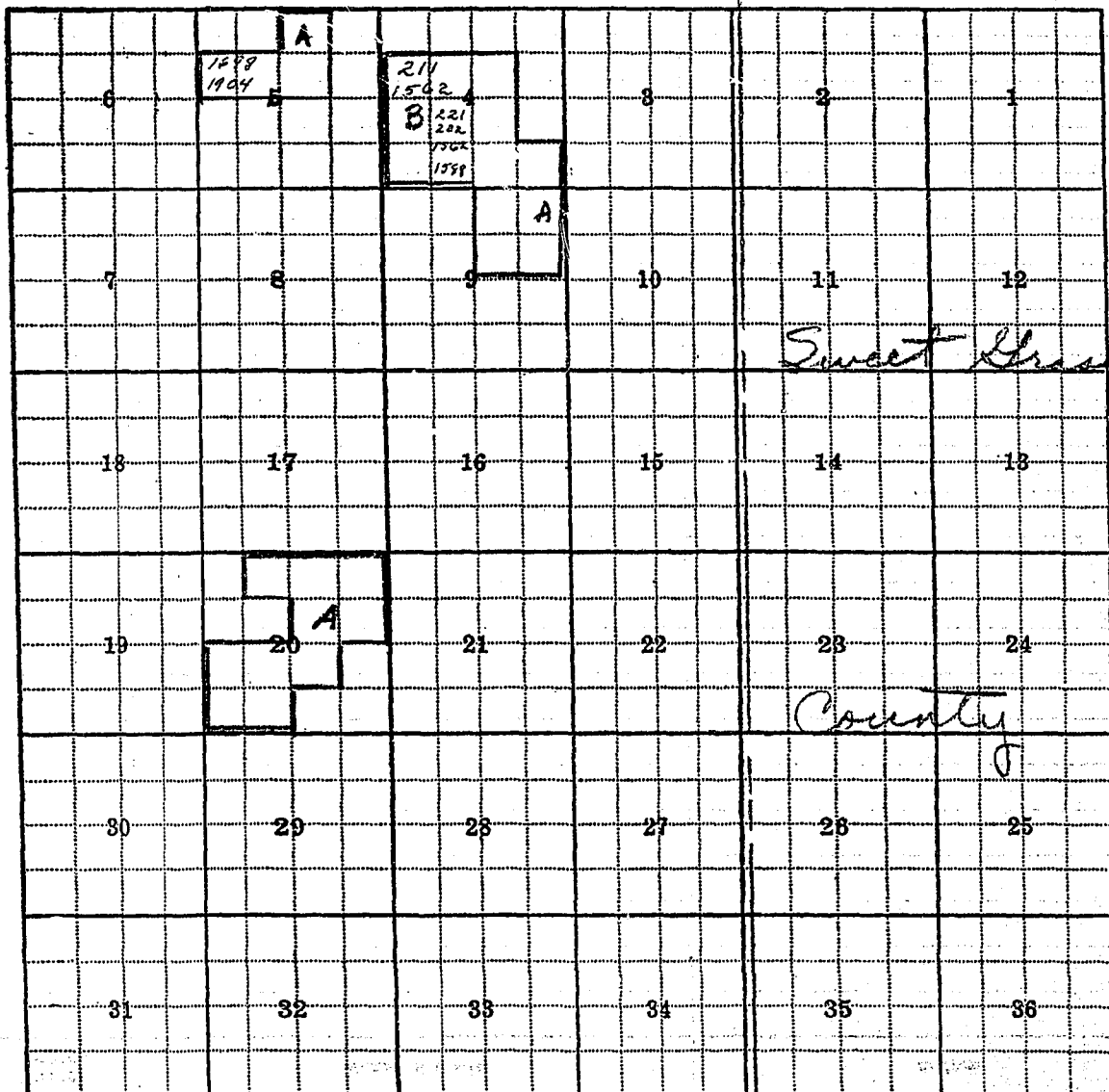
Township 3 S. Range 12 E County Park

Tom Hailand - owner

Note: This is 1938 ownership. Field check for
present ownership.

3 S.

12 E

36

STATE OF MONTANA

State Engineer's Office
WATER RESOURCES SURVEY
FARM MAP

County Park
Code No. 4A, 5A, 6A, 7A, 8A
9A, 10A

Twp 35 Rge 12E
Twp _____ Rge _____
Twp _____ Rge _____

Name of Land Owner _____ Address _____
Name of Operator _____ Address _____
Legal Description _____

☐ Irrigated Land ☐ Non-Irrigated Land ☐ Potential Land Under Existing Facilities
North

Code No. 4A System Near Ditch Source of Water Springs (Tribs to West Boulder River)
Basin Boulder River Present 0 Potential 11 Maximum 11 R ☒ F ☐ P ☐ G ☒ S ☐
Code No. _____ System _____ Source of Water _____
Basin _____ Present _____ Potential _____ Maximum _____ R ☐ F ☐ P ☐ G ☐ S ☐
Code No. _____ System _____ Source of Water _____
Basin _____ Present _____ Potential _____ Maximum _____ R ☐ F ☐ P ☐ G ☐ S ☐
Code No. _____ System _____ Source of Water _____
Basin _____ Present _____ Potential _____ Maximum _____ R ☐ F ☐ P ☐ G ☐ S ☐

If under Ditch Company, Irrigation District, or Government Project, state the number of shares or inches, acre feet, as the case may be in said system.

NOTE: R—Denotes Regular Irrigation. F—Flood Irrigation. P—Water diverted by means of pumping. G—Water diverted by gravity.
S—Stored Water

Information from J. E. Cook Date 1/29/52