



# STATE OF MONTANA

## STATE ENGINEER

FRED E. BUCK, STATE ENGINEER  
GERALD J. ORAVETZ, ASSISTANT

BILLINGS, MONTANA

November 5, 1951

Mr. Austin Swandal  
Wilsall, Montana

Dear Mr. Swandal:

The 1939 Session of the Montana Legislature enacted a law (Sec. 349.68 Montana Session Laws) requiring the State Engineer to investigate and prepare a complete record of all water rights in the State. In compliance with this law all water users are being requested to supply information regarding their decreed water rights. Will you please list all of your decreed water rights or a part of any right that you might have. Our records show a decree to Harry Hathorn as of July 3, 1897 for 200 miner's inches and also one on July 10, 1902 for 450 miner's inches. Will you please advise us as to which of the foregoing priority dates the 100 miner's inches was purchased by you from W. W. Pepper.

We would greatly appreciate your cooperation in this matter, and in order that we might complete our water right records we would like to have you return this information to us by November 20th.

Very truly yours,

*Hans L. Bille*

Hans L. Bille  
Assistant State Engineer

To Whom Decreed	Name of Stream	Date of Priority	Miner's Inches
1. <i>Liquor &amp; Swandal in Shida River</i>		<i>July 10<sup>th</sup> 1902.</i>	<i>100.</i>
2.			
3.			
4.			
5.			
6.			
7.			
8.			

STATE OF MONTANA  
**State Engineer's Office**  
WATER RESOURCES SURVEY  
FARM MAP

County PARK  
Code No. \_\_\_\_\_  
\_\_\_\_\_  
\_\_\_\_\_

Twp. 5N Rge. 9E  
Twp. \_\_\_\_\_ Rge. \_\_\_\_\_  
Twp. \_\_\_\_\_ Rge. \_\_\_\_\_

Name of Land Owner. \_\_\_\_\_ Address. \_\_\_\_\_  
Name of Operator. \_\_\_\_\_ Address. \_\_\_\_\_  
Legal Description. \_\_\_\_\_  
\_\_\_\_\_

☒ Irrigated Land      ☐ Non-Irrigated Land      ☒ Potential Land Under Existing Facilities  
North

Code No. 21A, 28A System SHIELDS RANCH CO. DITCH Source of Water KAYANAUGH CREEK  
Basin SHIELDS RIVER Present 23.0 Potential 0 Maximum 23.0 R ✓ F ✓ P ✓ G ✓ S ✓  
Code No. 28A System W.W. PEPPER-SHIELDS RANCH CO. (Mingled water) DITCH Source of Water SHIELDS RIVER  
Basin SHIELDS RIVER Present 95.0 Potential 0 Maximum 95.0 R ✓ F ✓ P ✓ G ✓ S ✓  
Code No. \_\_\_\_\_ System \_\_\_\_\_ Source of Water \_\_\_\_\_  
Basin \_\_\_\_\_ Present \_\_\_\_\_ Potential \_\_\_\_\_ Maximum \_\_\_\_\_ R \_\_\_\_\_ F \_\_\_\_\_ P \_\_\_\_\_ G \_\_\_\_\_ S \_\_\_\_\_  
Code No. \_\_\_\_\_ System \_\_\_\_\_ Source of Water \_\_\_\_\_  
Basin \_\_\_\_\_ Present \_\_\_\_\_ Potential \_\_\_\_\_ Maximum \_\_\_\_\_ R \_\_\_\_\_ F \_\_\_\_\_ P \_\_\_\_\_ G \_\_\_\_\_ S \_\_\_\_\_

If under Ditch Company, Irrigation District, or Government Project, state the number of shares or inches, acre-feet, as the case may be in said system.

NOTE: R—Denotes Regular Irrigation. F—Flood Irrigation. P—Water diverted by means of pumping. G—Water diverted by gravity.  
S—Stored Water.

Information from Joe Paulist Date 1/25/56

Farm Checked

STATE OF MONTANA

FORM F-1 - GAZETTE 1965-24-1-47

By Gordon & Joe

**STATE ENGINEER'S OFFICE**

Code No. 22A, 34A

Area Wilsall

WATER RESOURCES SURVEY

County Park

Date 6/8/51

T. 5N R. 9E Sec.

MA-38 98

Photo No. MA-38 97

Legal Land Owner Swindland, Hans & Gladys

Address

Operator Same

Address

Water is delivered by:

Federal Project

Pres.

Pot.

Ditch Company

Pres.

Pot.

Irrigation District

Pres.

Pot.

Private System Shields Ranch Cor. W.W. Pepper ditch

Pres.

Pot.

Totals

Flood

Pump

Reservoir

Gravity

Size and Capacity, Pump, etc.

Original Appropriator, Company

App. No.

Original Appropriator, Private See attached sheet

App. No.

Is the system an extension of another system?

Yes

No

Is all land irrigated from one system?

Yes

No

(If No, show break down on map)

Source of Water Shields River, Smith Creek, Spring Creek, E. Fk. Spring Cr., unnamed Springs

Acres Irrigated 19 51

Potential Acres

Seeped

Explain

Condition of System Good

Adequate Supply

Yes

No

Explain

Topography Slight slope to River Bottom

Information From Hans Swindland

Remarks

(2)

# SHIELDS RIVER

Ditch diverts on north bank in the  
SW. NW  $\frac{1}{4}$ , Sec. 26 - T. 5 - R. 9 E - extends in a  
southeasterly direction, irrigates land in  
NW  $\frac{1}{2}$ , Sec. 27 W.W. Pepper (owner)  
leased by Hans Sundland.  
Also irrigates the NW  $\frac{1}{4}$ , Sec. 34.

Also ditch out of Spring Creek SW  $\frac{1}{4}$ , Sec. 22  
(Not in use)

Short ditch out of Spring in the SW  $\frac{1}{4}$   
Sec. 22 (Not in use)

Township \_\_\_\_\_ Range \_\_\_\_\_ County \_\_\_\_\_

A 6x6 grid map of the Los Angeles area, with cells numbered 1 through 36. The grid is oriented with 1 at the top right and 36 at the bottom right. A rectangular area is highlighted in the center, spanning cells 21, 22, 27, and 28. This area contains handwritten notes and dates. The notes include '1571', '1571 2037 717', 'A', '1377 1967', '1571', '1399 1404 1409 1962', '1404 1409 1962', '1404', and '1404'.

Swindland, Hans & Gladys

Township 5N Range 9E



Form WR-B  
Reporter 20188 2M 11-49

STATE OF MONTANA

State Engineer's Office

WATER RESOURCES SURVEY

FARM MAP

County PARK

Code No. \_\_\_\_\_

Twp. 5N Rge. 9E

Twp. \_\_\_\_\_ Rge. \_\_\_\_\_

Twp. \_\_\_\_\_ Rge. \_\_\_\_\_

Name of Land Owner \_\_\_\_\_ Address \_\_\_\_\_

Name of Operator \_\_\_\_\_ Address \_\_\_\_\_

Legal Description \_\_\_\_\_



Irrigated Land



Non-Irrigated Land



Potential Land Under Existing Facilities

North

Code No. 34A - System W.W. PEPPER - SHIELDS RANCH CO. DITCH Source of Water SHIELDS RIVER  
Basin SHIELDS RIVER Present 119.0 Potential 0 Maximum 119.0 R ✓ F ✓ P ✓ G ✓ S ✓  
Code No. 22A - System SWINDAL DITCHES (Flood) Source of Water SPRING CR. & SPRING  
Basin SHIELDS RIVER Present 0 Potential 25.0 Maximum 25.0 R ✓ F ✓ P ✓ G ✓ S ✓  
Code No. \_\_\_\_\_ System \_\_\_\_\_ Source of Water \_\_\_\_\_  
Basin \_\_\_\_\_ Present \_\_\_\_\_ Potential \_\_\_\_\_ Maximum \_\_\_\_\_ R \_\_\_\_\_ F \_\_\_\_\_ P \_\_\_\_\_ G \_\_\_\_\_ S \_\_\_\_\_  
Code No. \_\_\_\_\_ System \_\_\_\_\_ Source of Water \_\_\_\_\_  
Basin \_\_\_\_\_ Present \_\_\_\_\_ Potential \_\_\_\_\_ Maximum \_\_\_\_\_ R \_\_\_\_\_ F \_\_\_\_\_ P \_\_\_\_\_ G \_\_\_\_\_ S \_\_\_\_\_

If under Ditch Company, Irrigation District, or Government Project, state the number of shares or inches, acre feet, as the case may be in said system.

NOTE: R—Denotes Regular Irrigation. F—Flood Irrigation. P—Water diverted by means of pumping. G—Water diverted by gravity.  
S—Stored Water.

Information from

Joe Paulist

Date

1/24/52

Form Checked

FORM F-1 REPORTER IM 3-49 17380

By Gordon E. Tor

STATE OF MONTANA

**State Engineer's Office**

**WATER RESOURCES SURVEY**

Code No. 20B

County Park

Area W. Hall

T. 5N R. 9E Sec.

Date 6/6/51

Photo No. MA38-98

Legal Land Owner U.S.A.

Address

Operator

Address

Water is delivered by:

Federal Project Pres. Pot.

Ditch Company Pres. Pot.

Irrigation District Pres. Pot.

Private System No Irrigation Pres. Pot.

Totals

Flood Pump Reservoir Gravity

Size and Capacity, Pump, etc.

Original Appropriator, Company App. No.

Original Appropriator, Private App. No.

Is the system an extension of another system? Yes No

Is all land irrigated from one system? Yes No

(If No, show break down on map)

Source of Water Hand-to-hand

Acres Irrigated 19

Potential Acres Seeped

Explain

Condition of System

Adequate Supply Yes No

Explain

Topography Range Land

Information From

Remarks

(2)



[illegible]



FORM D-1— WESTERN LITHO, BILLINGS

STATE OF MONTANA

# STATE ENGINEER'S OFFICE

## WATER RESOURCES SURVEY

Township 5N Range 9E County Park

6	5	4	3	2	1
7	8	9	10	11	12
18	17	16	15	14	13
19	20	21	22	23	24
30	29	28	27	26	25
31	32	33	34	35	36

U.S.A.

Farm Checked

STATE OF MONTANA

Code No. 24 BBy Gordon & Joe

## STATE ENGINEER'S OFFICE

County ParkArea Willisall

WATER RESOURCES SURVEY

T. 5N R 9E Sec. 24Date May 25-51Photo No. MA-11A-75Legal Land Owner Wilson, Fred & VictoriaAddress WillisallOperator Same

Address

Water is delivered by:

Federal Project \_\_\_\_\_ Pres. \_\_\_\_\_ Pot. \_\_\_\_\_

Ditch Company \_\_\_\_\_ Pres. \_\_\_\_\_ Pot. \_\_\_\_\_

Irrigation District \_\_\_\_\_ Pres. \_\_\_\_\_ Pot. \_\_\_\_\_

Private System Hamilton ditch Pres. \_\_\_\_\_ Pot. \_\_\_\_\_

Totals \_\_\_\_\_

Flood \_\_\_\_\_ Pump \_\_\_\_\_ Reservoir \_\_\_\_\_ Gravity ☒

Size and Capacity, Pump, etc. \_\_\_\_\_

Original Appropriator, Company \_\_\_\_\_ App. No. \_\_\_\_\_

Original Appropriator, Private \_\_\_\_\_ App. No. \_\_\_\_\_

Is the system an extension of another system? Yes \_\_\_\_\_ No \_\_\_\_\_

Is all land irrigated from one system? Yes \_\_\_\_\_ No \_\_\_\_\_

(If No show break down on map)

Note! has only 40 acres in Sec. 24

Source of Water Shiela River, Smith CreekAcres Irrigated 19 51

Potential Acres \_\_\_\_\_ Seeped \_\_\_\_\_

Explain \_\_\_\_\_

Condition of System \_\_\_\_\_

Adequate Supply \_\_\_\_\_ Yes \_\_\_\_\_ No \_\_\_\_\_

Explain \_\_\_\_\_

Topography \_\_\_\_\_

Information From Fred WilsonRemarks See over

Sec 24 T5N R9E

				673	1510 673 B
					1412 660 373

② Also in T.5N-R.10E

W.R. No.	Appropriator	Stream	Date App.	Date Filed	A M.I.		
1412	Brown, Wm. T.	Shields R	1-12-06	4-6-06	160		
1510	Hamilton, Patrick	Smith Cr.	5-29-96	5-29-96	250		
	Decreed to		Date of priority	Date of Decree			
D-660	Chas. Brown & Chas. Brown, Administrators Estate of Wm. T. Brown	Shields River	5-15-01	3-3-11	90		
also sec 5N10E-D-673	Hamilton, Wm. Patrick & Jas.	Smith Cr. trib. Shields R.	6-1-90	3-3-11	235		

### Smith Creek

D673 Hamilton ditch, only ditch used on this land. See Fredx Victoria Wilson form. In T.5N-R10E.

No rights from other sources.

### Smith Creek:

Hamilton ditch, Point of diversion,  $\frac{1}{2}$  mile north of the North boundary line of Sec. 18-T.5N-R.10E in Sec. 7 of T.6N-R.10E (Meagher County) Extending in a south westerly direction, part of old original ditch used for (flood only) Main ditch now used for regular irrigation, hay meadows in Sec. 18-13-24

original Hamilton Ditch extending through the SE SE  $\frac{1}{4}$ , Sec. 13 used for (flood only) This part of 13 belongs to Interstate Holding Corp - But Wilson gets hay under ditch in Sec. 13-

Twp. 5N Rge. 9E

Twp. \_\_\_\_\_ Rge. \_\_\_\_\_

Twp. \_\_\_\_\_ Rge. \_\_\_\_\_

STATE OF MONTANA

State Engineer's Office

WATER RESOURCES SURVEY

FARM MAP

County PARK

Code No. \_\_\_\_\_

Name of Land Owner \_\_\_\_\_ Address \_\_\_\_\_

Name of Operator \_\_\_\_\_ Address \_\_\_\_\_

Legal Description \_\_\_\_\_



Irrigated Land



Non-Irrigated Land

North



Potential Land Under Existing Facilities

Code No. 2412- System HAMILTON DITCH Source of Water SMITH CREEK  
Basin SHIELDS RIVER Present 9.0 Potential 0 Maximum 9.0 R. ✓ F. ✓ P. ✓ G. ✓ S. ✓  
Code No. 24B- System HAMILTON DITCH Source of Water SMITH CREEK  
Basin SHIELDS RIVER Present 17.0 Potential 0 Maximum 17.0 R. ✓ F. ✓ P. ✓ G. ✓ S. ✓  
Code No. \_\_\_\_\_ System \_\_\_\_\_ Source of Water \_\_\_\_\_  
Basin \_\_\_\_\_ Present \_\_\_\_\_ Potential \_\_\_\_\_ Maximum \_\_\_\_\_ R. \_\_\_\_\_ F. \_\_\_\_\_ P. \_\_\_\_\_ G. \_\_\_\_\_ S. \_\_\_\_\_  
Code No. \_\_\_\_\_ System \_\_\_\_\_ Source of Water \_\_\_\_\_  
Basin \_\_\_\_\_ Present \_\_\_\_\_ Potential \_\_\_\_\_ Maximum \_\_\_\_\_ R. \_\_\_\_\_ F. \_\_\_\_\_ P. \_\_\_\_\_ G. \_\_\_\_\_ S. \_\_\_\_\_

If under Ditch Company, Irrigation District, or Government Project, state the number of shares or inches, acre feet, as the case may be in said system.

NOTE: R—Denotes Regular Irrigation. F—Flood Irrigation. P—Water diverted by means of pumping. G—Water diverted by gravity.  
S—Stored Water.

Information from Joe Paulot Date 1/24/53

CONTENTS OF THIS BOOK

T.5N-R.1OE

Name of Owner

Name of Operator

BECKER, Eaton, et al

GRAFTON, Harold

NEEDENS, Wm. (buying)

HEREIN, Elias

INTERSTATE HOLDING CO.

PEPPER, Ralph W., et al

PUMP, Henry, Jr.

SMITH BROS. SHEEP CO.

VAN DYCK, Christina

WESTLING, John

WILSON, Fred

WILSON, Fred & Victoria

T. 5N—R. 10E

6	5	4	3	2	1
7	8	9	10	11	12
673-	MEAGHER COUNTY				
Fred & Leta Wilson	17	16	15	14	13
28- 673- 27A-	20	21	22	7149- 105 169- 696 B thru L 537 B 312-6 105 108 596 thru 7148 537 537 537 696 696 696 169 169 169 169 169 169	Henry Pump Jr SMITH Bros SHEEP
29- Eaton Beck 27A-	28- Interstate Holding Corp.				24
30 I. S. H. Corp. 1655-	29	28 Int. State H. Corp. Elias Harvino	27	26	679- Henry Pump Jr 23
31	32 John Westling	33	676- Christina Vanduyck 257- Not for Appx 398- " " 676- E. VANDUYCK 257- For T. 4N-R. 10E 398- Not for this land C. VANDUYCK	35	36

Fred & Leta Wilson - (about 2000 Sec. 14)

↑ No Irr.

STATE OF MONTANA  
STATE ENGINEER'S OFFICE  
WATER RESOURCES SURVEY

Township 57N Range 10E County Park

6	5	4	3	2	1
7	8	9	10	11	12
18	17	16	15	14	13
19	20	21	22	23	24
30	29	28	27	26	25
31	32	33	34	35	36

*Handwritten notes on grid:*  
 - Section 9: *Water Right*  
 - Section 11: *Water Right*  
 - Section 23: *169 105 106 105 169 169*  
 - Section 28: *169*  
 - Section 34: *257 257 257*  
 - Section 32: *702*  
 - Section 31: *123*  
 - Section 18: *673*  
 - Section 19: *29 673*  
 - Section 20: *28*  
 - Section 21: *67*  
 - Section 22: *676*  
 - Section 23: *679*

*Davis* Township 57N Range 10E



Township 5 N. Range 10 E County Park

Parcel Number	Name of Owner	Stream	Date of Address	Date of Deed	M.I.
28	David + Earnest McChute	Basin in Meadow Cr.	6-1-03	3-3-11	160
29	James + William McChute	" " "	5-10-90	3-3-11	200
		" " "	6-20-98	"	185
		" " "	6-10-00	"	55
105	Shields River Park Ranch	Shields River	6-1-87	3-3-11	715
(Moose)		Coole Creek	7-1-88	"	230
37-8E		" "	9-15-06	"	50
37-9F		" "	"	"	"
37-10E		Pumpkin Creek	11-9-03	"	106
47-8E		Shields River	7-1-85	"	50
47-9E		" "	4-25-83	"	150
		" "	6-1-89	"	100
		Flathead Creek	6-1-86	"	110
		Shields River	6-15-86	"	100
		" "	6-1-84	"	150
		" "	6-1-91	"	40
		" "	6-1-84	"	65
		" "	6-1-84	"	30
		" "	5-25-09	"	150
		" "	6-1-84	"	1460
		" "	10-19-98	"	3315
169	Arthur Dennis E. E. L. Withers Hobson	Spring Lake Cr.	7-15-93	3-3-11	240
		Spring Cr.	6-20-92	"	70
257	Robert D. Dumas	North Fork Creek	6-27-?	3-3-1	150
		" "	6-15-86	"	130
		" "	6-15-00	"	70
		Lena Creek	6-15-00	"	30
		North Fork Creek	6-15-00	"	170
		North Fork Lena Creek	6-12-90	"	10
		South Fork	6-12-90	"	10

Deigen  
Page 2

570.

106

Ad. A.

44.9E

54

10E

Township 5N Range 10E

54

10 E

97.4

000	000	000	000
-----	-----	-----	-----

Farm Checked

STATE OF MONTANA

Code No. 19ABy Gordon & Joe

## STATE ENGINEER'S OFFICE

County ParkArea Willisall

WATER RESOURCES SURVEY

T. 5N R. 10E Sec.Date May 25 - 1951Photo No. MA-11A-75Legal Land Owner Becker, Eaton, et al

Address \_\_\_\_\_

Operator Farmer

Address \_\_\_\_\_

Water is delivered by:

Federal Project \_\_\_\_\_ Pres. \_\_\_\_\_ Pot. \_\_\_\_\_

Ditch Company \_\_\_\_\_ Pres. \_\_\_\_\_ Pot. \_\_\_\_\_

Irrigation District \_\_\_\_\_ Pres. \_\_\_\_\_ Pot. \_\_\_\_\_

Private System ☒ \_\_\_\_\_ Pres. \_\_\_\_\_ Pot. \_\_\_\_\_

Totals \_\_\_\_\_

Flood \_\_\_\_\_ Pump \_\_\_\_\_ Reservoir \_\_\_\_\_ Gravity ☒ \_\_\_\_\_

Size and Capacity, Pump, etc. \_\_\_\_\_

Original Appropriator, Company \_\_\_\_\_ App. No. \_\_\_\_\_

Original Appropriator, Private See other side App. No. \_\_\_\_\_Is the system an extension of another system? Yes \_\_\_\_\_ No ☒ \_\_\_\_\_Is all land irrigated from one system? Yes \_\_\_\_\_ No ☒ \_\_\_\_\_

(If No, show break down on map)

Source of Water Basin or Meadow Creek, Smith CreekAcres Irrigated 19 51 \_\_\_\_\_

Potential Acres \_\_\_\_\_ Seeped \_\_\_\_\_

Explain \_\_\_\_\_

Condition of System Good \_\_\_\_\_Adequate Supply \_\_\_\_\_ Yes ☒ \_\_\_\_\_ No \_\_\_\_\_Explain Except in late summer, May be low \_\_\_\_\_Topography Slope to creek bottom \_\_\_\_\_Information From Mr. Eaton Becker \_\_\_\_\_Remarks Note! Mr. Becker has all of sec. 19 \_\_\_\_\_except about 20 ac. in the NW 1/4

Sec. 19 T5N R10E

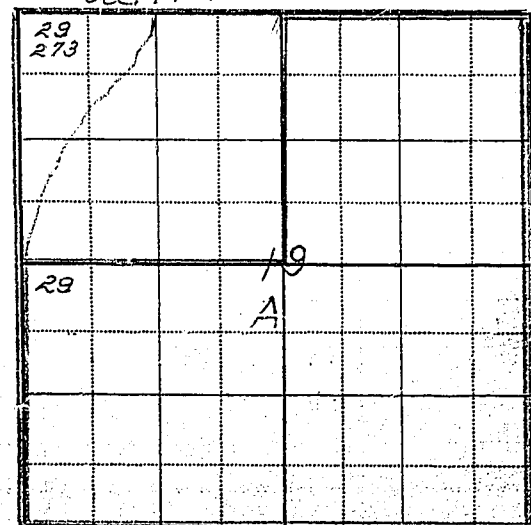

WR No.	Decreed to	Stream	Date of Priority	Date of Decree	M.I.	
D-29	McClarty, Jas. & Wm.	Basin & Meadow Cr.	5-10-90	3-3-11	200	OK
	" " "	" " "	6-20-90	3-3-11	185	OK
	" " "	" " "	6-10-00	3-3-11	55	OK
<del>D-673</del>	<del>Hamilton, Wm., Deitch, &amp; Co.</del>	<del>Smith Cr., White Shields</del>	<del>6-1-90</del>	<del>5-6-11</del>	<del>235</del>	

### Meadow Creek

D29 Point of diversion, on South bank near East Line Sec. 19 in the N.W.  $\frac{1}{4}$  Sec. 20 extending Westely for hay meadow of sec. 19.

Spring in the N.W. S.E.  $\frac{1}{4}$  Sec. 18 as ditch extending along North Line Sec. 19 irr. little meadow Sec. 19 "No app. shown."

ditch, Point of diversion in NE of NE  $\frac{1}{4}$  Sec. 19, Branch of meadow creek, irr. hay meadow Sec. 19

has no water right in Smith creek.

STATE OF MONTANA  
**State Engineer's Office**  
WATER RESOURCES SURVEY  
FARM MAP

County PART  
Code No. \_\_\_\_\_

Twp. 5 N Rge. 10 E  
Twp. \_\_\_\_\_ Rge. \_\_\_\_\_  
Twp. \_\_\_\_\_ Rge. \_\_\_\_\_

Name of Land Owner \_\_\_\_\_ Address \_\_\_\_\_  
Name of Operator \_\_\_\_\_ Address \_\_\_\_\_  
Legal Description \_\_\_\_\_



Irrigated Land



Non-Irrigated Land  
North



Potential Land Under Existing Facilities

Code No. 11A System BECKER DITCHES Source of Water MEADOW CREEK  
Basin SHIELDS RIVER Present 287.0 Potential 0 Maximum 287.0 R ✓ F ✓ P ✓ G ✓ S ✓  
Code No. \_\_\_\_\_ System \_\_\_\_\_ Source of Water \_\_\_\_\_  
Basin \_\_\_\_\_ Present \_\_\_\_\_ Potential \_\_\_\_\_ Maximum \_\_\_\_\_ R \_\_\_\_\_ F \_\_\_\_\_ P \_\_\_\_\_ G \_\_\_\_\_ S \_\_\_\_\_  
Code No. \_\_\_\_\_ System \_\_\_\_\_ Source of Water \_\_\_\_\_  
Basin \_\_\_\_\_ Present \_\_\_\_\_ Potential \_\_\_\_\_ Maximum \_\_\_\_\_ R \_\_\_\_\_ F \_\_\_\_\_ P \_\_\_\_\_ G \_\_\_\_\_ S \_\_\_\_\_  
Code No. \_\_\_\_\_ System \_\_\_\_\_ Source of Water \_\_\_\_\_  
Basin \_\_\_\_\_ Present \_\_\_\_\_ Potential \_\_\_\_\_ Maximum \_\_\_\_\_ R \_\_\_\_\_ F \_\_\_\_\_ P \_\_\_\_\_ G \_\_\_\_\_ S \_\_\_\_\_

If under Ditch Company, Irrigation District, or Government Project, state the number of shares or inches, acre feet, as the case may be in said system.

NOTE: R—Denotes Regular Irrigation. F—Flood Irrigation. P—Water diverted by means of pumping. G—Water diverted by gravity.  
S—Stored Water.

Information from Joe Furbush Date 1/28/52

**Farm Checked**

STATE OF MONTANA

Code No. 31a

By Gordon & Joe

# STATE ENGINEER'S OFFICE

County PARK

Area Highall

WATER RESOURCES SURVEY

T. 5N R. 10E Sec.

Date 6/8/57

Photo No. MA 114-71

Legal Land Owner Grafton, Harold Needs 4000

Address Hillsall

**Operator.**

**Address**

Water is delivered by:

Federal Project \_\_\_\_\_ Pres. \_\_\_\_\_ Pot. \_\_\_\_\_

Ditch Company Pres. Pot.

Irrigation District \_\_\_\_\_ Pres. \_\_\_\_\_ Pot. \_\_\_\_\_

Private System No 14192102 Pres. \_\_\_\_\_ Pot. \_\_\_\_\_

**Totals** \_\_\_\_\_

Flood \_\_\_\_\_ Pump \_\_\_\_\_ Reservoir \_\_\_\_\_ Gravity \_\_\_\_\_

Size and Capacity, Pump, etc. \_\_\_\_\_

Original Appropriator, Company \_\_\_\_\_ App. No. \_\_\_\_\_

Original Appropriator, Private \_\_\_\_\_ App. No. \_\_\_\_\_

Is the system an extension of another system? Yes\_\_\_\_\_No\_\_\_\_\_

Is all land irrigated from one system? Yes\_\_\_\_\_No\_\_\_\_\_

(If No, show break down on map)

Source of Water: Shields River

Acres Irrigated 19.....

Potential Acres \_\_\_\_\_ Seeped \_\_\_\_\_

### Explain

Condition of System \_\_\_\_\_

Adequate Supply .... Yes..... No.....

**Explain** \_\_\_\_\_

## Topography

Information From Harold Grafton

Remarks \_\_\_\_\_

\_\_\_\_\_

3

[illegible]



# STATE ENGINEER'S OFFICE

## WATER RESOURCES SURVEY

Township 5 Range 10E County Park

6	5	4	3	2	1
7	8	9	10	11	12
18	17	16	15	14	13
19	20	21	22	23	24
30	29	28	27	26	25
31	32	33	34	35	36

*Harold Grafton* owner

Township 5N Range 10E



Farm Checked

STATE OF MONTANA

Code No. 19B, 22B, 28BBy Gordon & Joe

## STATE ENGINEER'S OFFICE

County ParkArea Wilsall

## WATER RESOURCES SURVEY

T. 5N R. 10E Sec. MA-11A-74Date 6/8/51Photo No. MA-38 71Legal Land Owner Hercim, Elias

Address \_\_\_\_\_

Operator \_\_\_\_\_

Address \_\_\_\_\_

Water is delivered by:

Federal Project \_\_\_\_\_ Pres. \_\_\_\_\_ Pot. \_\_\_\_\_

Ditch Company \_\_\_\_\_ Pres. \_\_\_\_\_ Pot. \_\_\_\_\_

Irrigation District \_\_\_\_\_ Pres. \_\_\_\_\_ Pot. \_\_\_\_\_

Private System No irrigation Pres. \_\_\_\_\_ Pot. \_\_\_\_\_

Totals \_\_\_\_\_

Flood \_\_\_\_\_ Pump \_\_\_\_\_ Reservoir \_\_\_\_\_ Gravity \_\_\_\_\_

Size and Capacity, Pump, etc. \_\_\_\_\_

Original Appropriator, Company \_\_\_\_\_ App. No. \_\_\_\_\_

Original Appropriator, Private \_\_\_\_\_ App. No. \_\_\_\_\_

Is the system an extension of another system? Yes \_\_\_\_\_ No \_\_\_\_\_

Is all land irrigated from one system? Yes \_\_\_\_\_ No \_\_\_\_\_

(If No, show break down on map)

Source of Water \_\_\_\_\_

Acres Irrigated 19 \_\_\_\_\_

Potential Acres \_\_\_\_\_ Seeped \_\_\_\_\_

Explain \_\_\_\_\_

Condition of System \_\_\_\_\_

Adequate Supply \_\_\_\_\_ Yes \_\_\_\_\_ No \_\_\_\_\_

Explain \_\_\_\_\_

Topography \_\_\_\_\_

Information From \_\_\_\_\_

Remarks Party at Innersate Ranch

③ said they didn't believe other owner in Sec. 28 had any right in ditches from S. of R. Shields River.

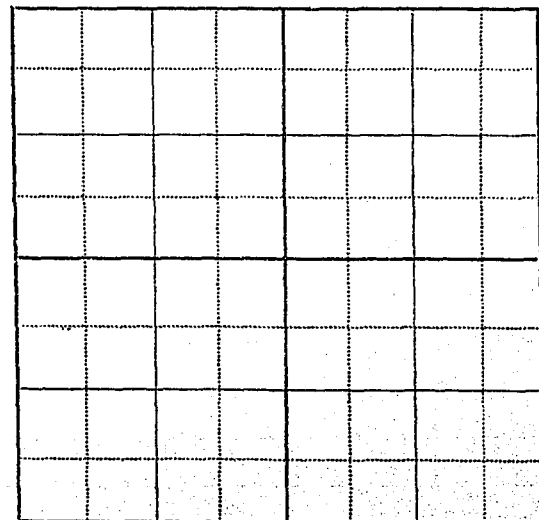

# STATE ENGINEER'S OFFICE

## WATER RESOURCES SURVEY

Township 5 N Range R 10 E County Park

6	5	4	3	2	1
7	8	9	10	11	12
13	17	16	15	14 1426 1541	13
19	20	21	22	23	24
30	29	28 1444 1446 1441	27	26	25
31	32	33	34	35	36

Herein, Elias - ow

Township 5 N Range 10 E

Farm Checked

FORM F-1 - GAZETTE 1665:24-1-47

By Gordon & Joe

STATE OF MONTANA

Code No. 17A, 20A, 21A, 28A, 29A, 30A

**STATE ENGINEER'S OFFICE**

County Park

**WATER RESOURCES SURVEY**

T. 5N R. 10E Sec.

Area Wilsall

MA-11A-77 & 75

Date 5/29/51

Photo No. MA-38-71

Legal Land Owner Interstate Holding Co. Address

Operator Corbett, Harold Address Wilsall

Water is delivered by:

Federal Project  Pres.  Pot.

Ditch Company Ditch No. 3 Pres.  Pot.

Irrigation District  Pres.  Pot.

Private System  Pres.  Pot.

Totals

Flood  Pump  Reservoir  Gravity X

Size and Capacity, Pump, etc.

Original Appropriator, Company  App. No.

Original Appropriator, Private See attached sheet App. No.

Is the system an extension of another system? Yes  No X

Is all land irrigated from one system? Yes  No X

(If No, show break down on map)

Source of Water Shields River, So. Fl. Shields River, Basin or Meadow Creek, Swamp

Acres Irrigated 19 50

Potential Acres  Seeped

Explain

Condition of System Good

Adequate Supply  Yes X No

Explain

Topography Slight slope to River Bottom.

Information From

Remarks

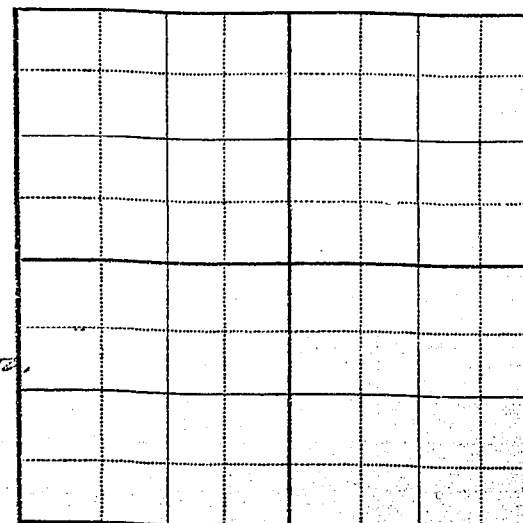

## Shields River

Ditch No. 3 - Point of diversion, ~~at~~ Near the center of Sec. 30 - T. 5 N - R. 10 E, on north bank, extending in a N.W. direction. Irr. 1794 Meadow in Sec. 30 also in Sec. 24 & 25 T. 5 N - R. 9 E.

Also short pump ditch from slough or spring in the NW  $\frac{1}{4}$ , Sec. 30 for land in 30.

Also ditch heading in about the NW  $\frac{1}{4}$  SW, NE  $\frac{1}{4}$ , Sec. 29 irr. in the NW  $\frac{1}{4}$ , Sec. 29 and NW, Sec. 30.

### (MEADOW CREEK)

Trace of old ditch not in use for many years.

Ditch heads near north line in NE  $\frac{1}{4}$ , Sec. 20 (Third Right) Not enough water left for this land. Said they have enough irr. meadow anyway.

### South Fork SHIELDS River

Ditch heads in about the SW, SE  $\frac{1}{4}$ , Sec. 34 extending to irrigate in the NE  $\frac{1}{4}$ , Sec. 28 and again in Sec. 29.

Ditch divides in the NW  $\frac{1}{4}$ , Sec. 34 - T. 5 N - R. 10 E and laterals into NE, Sec. 28 - T. 5 N - R. 10 E

## STATE ENGINEER'S OFFICE

## WATER RESOURCES SURVEY

Township 5N Range 10E County Park

6	5	4	3	2	1
7	8	9	10	11	12
18	17	16	15	14	13
19	28 64	20 389	21	22	24
1425 1441	1441	688 668A	23	26	25
30	29	1441 1441 689	27	28	25
1405 655 1426 1441		1441			
31	32	33	34	35	36

Interstate Holding Co. - owHarold Gratton - op.Township 5N Range 10E





STATE OF MONTANA  
**State Engineer's Office**  
WATER RESOURCES SURVEY  
FARM MAP

County PARK  
Code No. \_\_\_\_\_

Twp. 5N Rge. 10E  
Twp. \_\_\_\_\_ Rge. \_\_\_\_\_  
Twp. \_\_\_\_\_ Rge. \_\_\_\_\_

Name of Land Owner. \_\_\_\_\_ Address. \_\_\_\_\_  
Name of Operator. \_\_\_\_\_ Address. \_\_\_\_\_  
Legal Description. \_\_\_\_\_



Irrigated Land



Non-Irrigated Land  
North



Potential Land Under Existing Facilities

Code No. 29A, 30A- System Interstate Holding Corp. <sup>Ditches</sup> Source of Water SHIELDS RIVER  
Basin SHIELDS RIVER Present 297.0 Potential 0 Maximum 297.0 R X F   P   G X S    
Code No. 28A, 29A System I. S. H. Corp. Ditch Source of Water SE. FK. SHIELDS RIVER  
Basin SHIELDS RIVER Present 115.0 Potential 0 Maximum 115.0 R X F   P   G X S    
Code No. \_\_\_\_\_ System \_\_\_\_\_ Source of Water \_\_\_\_\_  
Basin \_\_\_\_\_ Present \_\_\_\_\_ Potential \_\_\_\_\_ Maximum \_\_\_\_\_ R   F   P   G   S    
Code No. \_\_\_\_\_ System \_\_\_\_\_ Source of Water \_\_\_\_\_  
Basin \_\_\_\_\_ Present \_\_\_\_\_ Potential \_\_\_\_\_ Maximum \_\_\_\_\_ R   F   P   G   S  

If under Ditch Company, Irrigation District, or Government Project, state the number of shares or inches, acre feet, as the case may be in said system.

NOTE: R—Denotes Regular Irrigation. F—Flood Irrigation. P—Water diverted by means of pumping. G—Water diverted by gravity.  
S—Stored Water.

Information from Joe Fouchst Date 1/28/52

Farm Checked

STATE OF MONTANA

Code No. 31b, 32aBy Gordon & Joe

## STATE ENGINEER'S OFFICE

County PARKArea Wilsall

## WATER RESOURCES SURVEY

T. 5N R. 10E Sec. \_\_\_\_\_Date 5/29/51

Photo No. \_\_\_\_\_

Legal Land Owner Pepper, Ralph W. et alAddress Wilsall

Operator \_\_\_\_\_

Address \_\_\_\_\_

Water is delivered by:

Federal Project \_\_\_\_\_

Pres. \_\_\_\_\_

Pot. \_\_\_\_\_

Ditch Company \_\_\_\_\_

Pres. \_\_\_\_\_

Pot. \_\_\_\_\_

Irrigation District \_\_\_\_\_

Pres. \_\_\_\_\_

Pot. \_\_\_\_\_

Private System No Irrigation

Pres. \_\_\_\_\_

Pot. \_\_\_\_\_

Totals \_\_\_\_\_

Flood \_\_\_\_\_

Pump \_\_\_\_\_

Reservoir \_\_\_\_\_

Gravity \_\_\_\_\_

Size and Capacity, Pump, etc \_\_\_\_\_

Original Appropriator, Company \_\_\_\_\_

App. No. \_\_\_\_\_

Original Appropriator, Private \_\_\_\_\_

App. No. \_\_\_\_\_

Is the system an extension of another system?

Yes \_\_\_\_\_

No \_\_\_\_\_

Is all land irrigated from one system?

Yes \_\_\_\_\_

No \_\_\_\_\_

(If No, show break down on map)

Source of Water Shields River,

Acres Irrigated 19 \_\_\_\_\_

Potential Acres \_\_\_\_\_

Seeped \_\_\_\_\_

Explain \_\_\_\_\_

Condition of System \_\_\_\_\_

Adequate Supply \_\_\_\_\_

Yes \_\_\_\_\_

No \_\_\_\_\_

Explain \_\_\_\_\_

Topography RangeInformation From Field Survey

Remarks \_\_\_\_\_

③

## STATE ENGINEER'S OFFICE

## WATER RESOURCES SURVEY

Township 5N Range 10E County Park

6	5	4	3	2	1
7	8	9	10	11	12
18	17	16	15	14	13
19	20	21	22	23	24
30	29	28	27	26	25
31	32	33	34	35	36

144 A

144 B

Ralph Peterson on-pp

Township 5N Range 10E

Township 5N Range 10E County PARK

[illegible]

Farm Checked

STATE OF MONTANA

FORM F-1 - GAZETTE 1965-2N-5-47

By P. H. W. T. Co.

**STATE ENGINEER'S OFFICE**

Code No. 18A, 19A, 22A, 23A, 24A, 25A, 26A, 27A

Area Wiltsall

**WATER RESOURCES SURVEY**

County Park

Date 6/12/51

T. 5N R. 10E Sec.

Photo No. MA-38-70 & 71

Legal Land Owner Pump, Henry Jr.

Address Harlowton

Operator Same

Address

Water is delivered by:

Federal Project  Pres.  Pot.

Ditch Company  Pres.  Pot.

Irrigation District  Pres.  Pot.

Private System No Irrigation Pres.  Pot.

Totals

Flood  Pump  Reservoir  Gravity

Size and Capacity, Pump, etc.

Original Appropriator, Company  App. No.

Original Appropriator, Private  App. No.

Is the system an extension of another system? Yes  No

Is all land irrigated from one system? Yes  No

(If No, show break down on map)

Source of Water Bennett Creek, Crandall Creek, Deep Creek, Spring Creek, Flathead Creek, Porcupine Creek, Gole Creek, Shields River

Acres Irrigated 19

Potential Acres  Seeped

Explain

Condition of System No sign of ditches

Adequate Supply  Yes  No

Explain Use here at present would be for stock water - only -

Topography

Information From Field Survey

Remarks

③

STATE OF MONTANA

# State Engineer's Office

## WATER RESOURCES SURVEY

Township 5N Range 10E County Park

[illegible]

Henry Pump, Jr. - ow - op.

Township 5N Range 10E

Township 5 N Range 10 E County Park

Parcel Number	Name of Owner	Stream	Date App.	Date filed	MI	
<i>W.R. No</i>	<i>Appropriator</i>	<i>Stream</i>	<i>Date App.</i>	<i>Date filed</i>	<i>MI</i>	
133	Serrett, Helen	Bennett Cr.	7-9-03	7-6-03	350	
134	Staley, Fred	" "	11-27-05	12-2-05	200	
426	Hudson, Wilbur J.	Crandall Cr.	11-1-02	11-1-02	300	
505	Hurst, Cassius	Deep Creek	11-27-05	12-2-05	800	
1441	Interstate Holding Corp.	Shields Creek	7-26-33	7-26-33	20,000	
1561	Hudson, Wilbur J.	Spring Creek	11-1-02	11-1-02	150	
	<i>Decreed to</i>	<i>Stream</i>	<i>Priority</i>	<i>Date of Decree</i>	<i>MI</i>	
D-105	Shields Riv. Park Ranch	Shields River	6-1-87	3-3-11	715	No Part in use here
		Flat Creek	7-1-88	"	230	" "
		" "	9-15-06	"	50	" "
		Perompin Creek	11-9-03	"	106	" "
		Shields River	7-1-85	"	50	Not in use here
		" "	4-25-83	"	150	Not in use here
		" "	6-1-89	"	100	" " "
		Flathead Creek	6-1-86	"	110	" " "
D-105		Shields River	6-15-86	"	100	" " "
		" "	6-1-84	"	150	" " "
		" "	6-1-91	"	40	" " "
		" "	6-1-84	"	65	" " "
		" "	6-1-84	"	30	" " "
		" "	5-25-09	"	150	" " "
		" "	6-1-84	"	1460	" " "
		" "	10-19-98	"	3315	" " "
D-169	<sup>Wilbur Hudson</sup> Davis, Arthur, Ex. Est of	Crandall Creek	7-15-93	3-3-11	240	Not in use
		Spring Creek	6-20-92	"	70	" " "
D-679	Hoff, J. W.	Shields River	7-6-00	"	40	" " "
		" "	7-1-07	"	100	" " "

[illegible]



By B. H. & J. J.

## STATE OF MONTANA

Code No. 15A, 23B, 35A

# STATE ENGINEER'S OFFICE

County Park

Area Wilsall

## WATER RESOURCES SURVEY

T 5N3 10E Sec \_\_\_\_\_

Date 6/2/57

Photo No. MA-38-70 & 71

Legal Land Owner. Smith Bros. Sheep Co.

Address \_\_\_\_\_

Operator Same

Address \_\_\_\_\_

**Water is delivered by:**

Federal Project \_\_\_\_\_ Pres. \_\_\_\_\_ Pot. \_\_\_\_\_

Ditch Company \_\_\_\_\_ Pres. \_\_\_\_\_ Pot. \_\_\_\_\_

Irrigation District \_\_\_\_\_ Pres. \_\_\_\_\_ Pot. \_\_\_\_\_

Private System 44 Excitation Pres. \_\_\_\_\_ Pot. \_\_\_\_\_

[illegible]

Flood \_\_\_\_\_ Pump \_\_\_\_\_ Reservoir \_\_\_\_\_ Gravity \_\_\_\_\_

Size and Capacity, Pump, etc. \_\_\_\_\_

Original Appropriator, Company \_\_\_\_\_ App. No. \_\_\_\_\_

Original Appropriator, Private \_\_\_\_\_ App. No. \_\_\_\_\_

Is the system an extension of another system? Yes\_\_\_\_\_No\_\_\_\_\_

Is all land irrigated from one system? Yes\_\_\_\_\_No\_\_\_\_\_

(If No, show break down on map)

Source of Water Shields River, Spring Cr., Cole Creek, Porcupine Creek, Flathead Creek  
Crandall Creek

Acres Irrigated 19 \_\_\_\_\_

Potential Acres \_\_\_\_\_ Seeped \_\_\_\_\_

### Explain

Condition of System Found no changes for Sec 2

Adequate Supply ..... Yes..... No.....

Explain

### Topography

Information From Field Survey

Remarks \_\_\_\_\_

STATE OF MONTANA

State Engineer's Office

WATER RESOURCES SURVEY

Township 5 N Range 10 E County Park

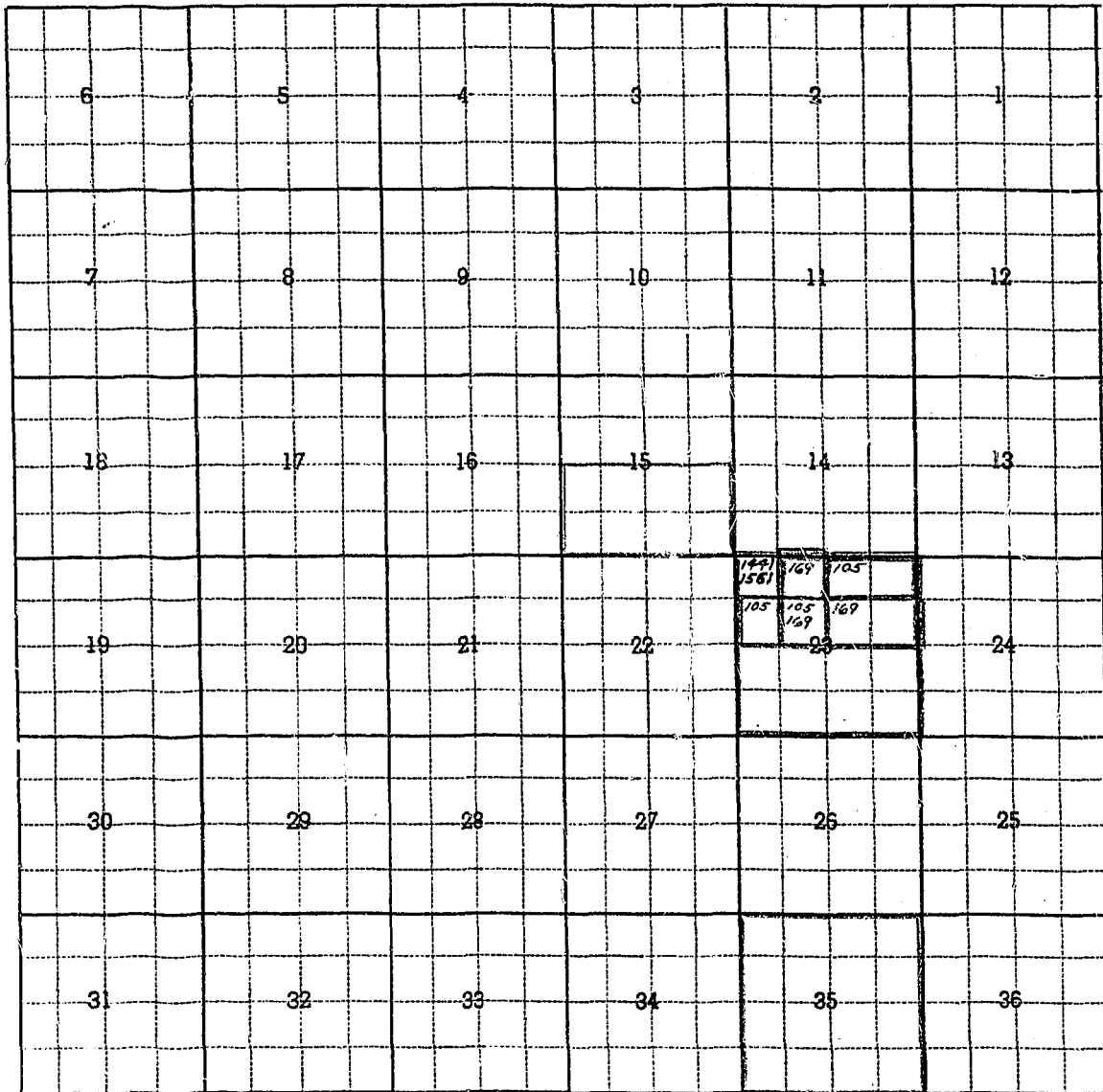

Smith Bros. Sheep Co.

Township 5 N Range 10 E

54

10 E

Park

Parcel Number	Name of Owner		Address		
W.P. No.	Appropriator	Stream	Date app.	Date filed	M.I.
1441	Interstate Holding Corp	Shields River	7-26-33	7-26-33	20,000
1561	Hudson, Wilbur L.	Spring Creek	11-1-02	11-1-02	150
	Decreed to		Date of Priority	Date of Decree	
D-105	Shields River Park Ranch	Shields River	6-1-87	3-3-11	715
		Belt Creek	7-1-88	"	230
		"	7-15-86	"	30
		Porcupine Creek	11-9-83	"	106
		Flathead Creek	6-1-86	"	110
		Shields River	7-1-85	"	50
		" "	4-25-83	"	150
		" "	6-1-89	"	100
		" "	6-15-86	"	100
		" "	6-1-84	"	150
		" "	6-1-91	"	20
		" "	6-1-84	"	65
		" "	6-1-84	"	30
		" "	5-25-89	"	150
		" "	4-1-87	"	1460
		" "	10-19-98	"	3315
D-169	Wilbur Hudson Davis, Arthur, Et Al of	Crandall Creek	7-15-93	"	240
		Spring Creek	6-20-92	"	70

SHEEP

71

CATTLE

RANCH CO.

MARTINSDALE, MONTANA

November 18, 1951

Mr. Hans L. Billie,  
Ass't. State Engineer,  
P. O. Box 873,  
Billings, Montana.

Dear Sir:

I am replying to your letter addressed to Mr.  
W. D. Farr, Greeley, Colo., with reference to the  
water rights of the 71 Ranch Company in Park County.

The 71 Ranch Company does not have any water rights  
in connection with their land holdings in Park County  
to my knowledge, the majority of the lands were pur-  
chased from the N. P. Railway Company.

The Company does own one parcel of land in Section  
23 R. 5 N. 10E, which was a homestead and purchased  
from Minnie Wendt. I have checked this deed and  
there is no water right on this deed.

I trust this is the information that you wish.

Truly yours,

71 Ranch Company

cc  
WM-WDF

*F. J. Shaw*  
F. J. Shaw

STATE OF MONTANA

Code No. 33a, 34a

# STATE ENGINEER'S OFFICE

County Park

Area Hillsall

## WATER RESOURCES SURVEY

T. 5N R. 10E Sec

Date 5/29/51

Photo No. MA 11A-74, MA 38-70

Legal Land Owner. Van Dyck, Christina

**Address.**

**Operator.**

**Address**

**Water is delivered by:**

Federal Project \_\_\_\_\_ Pres. \_\_\_\_\_ Pot. \_\_\_\_\_

Ditch Company \_\_\_\_\_ Pres. \_\_\_\_\_ Pot. \_\_\_\_\_

Irrigation District \_\_\_\_\_ Pres. \_\_\_\_\_ Pot. \_\_\_\_\_

Private System No. 1419081021 Pres. \_\_\_\_\_ Pot. \_\_\_\_\_

**Totals**

Flood \_\_\_\_\_ Pump \_\_\_\_\_ Reservoir \_\_\_\_\_ Gravity \_\_\_\_\_

### Size and Capacity, Pump, etc..

Original Appropriator, Company \_\_\_\_\_ App. No. \_\_\_\_\_

Original Appropriator, Private \_\_\_\_\_ App. No. \_\_\_\_\_

Is the system an extension of another system? Yes\_\_\_\_\_No\_\_\_\_\_

Is all land irrigated from one system? Yes\_\_\_\_\_No\_\_\_\_\_

(If No, show break down on map)

Source of Water. Shields River, No. Fk. Elk Cr., So. Fk. Shields R., Lena Cr., No. & So. Fks. Lena Cr.

Acres Irrigated 19.....

Potential Acres \_\_\_\_\_ Seeped \_\_\_\_\_

**Explain** \_\_\_\_\_

Condition of System \_\_\_\_\_

Adequate Supply ----- Yes ----- No -----

Explain

### Topography

Information From Field Survey

Remarks Ditches extending through  
Sec. 33 & 34, but no irrigation  
in these sections -

# STATE ENGINEER'S OFFICE

## WATER RESOURCES SURVEY

Township 5N Range 10E County Park

6	5	4	3	2	1
7	8	9	10	11	12
13	17	16	15	14	13
19	20	21	22	23	24
20	29	28	27	28	25
31	32	33	<div style="border: 1px solid black; padding: 2px;"> <div style="border: 1px solid black; padding: 2px;"> 1441 1446 </div> <div style="border: 1px solid black; padding: 2px;"> 1436 040 676 258 676 257 </div> </div>	35	36

Christina Van Dyke, owner

Township 5N Range 10E

Township 5N Range 10E County Park

Parcel Number	Name of Owner	Address
APPROPRIATIONS		
1436	Helgeson, Ivor	Shields R. 9-16-03 9-24-03 200
1441	Inter-State Holding Corp.	" " 7-26-33 7-26-33 20,000
1446	Jordan, W. B.	" " 9-13-06 9-14-06 300
DECREES		
		Date of Priority Decree Date of M.I.
257	Nevils, Robert	No. Fk. Elk Cr. 6-27-? 3-3-1 150
	" "	6-15-86 " 130
	" "	6-15-00 " 70
	Lena Cr.	6-15-00 " 20
	No. Fk. Elk Cr.	6-15-00 " 170
	No. Fk. Lena Cr.	6-12-90 " 10
	So. Fk. Lena Cr.	6-12-90 " 10
676	Helgeson, Ivor	So. Fk. Shields R. 7-3-1905 3-3-1911 110 (NOT in Use) 121 Sec. 34

Farm Checked

STATE OF MONTANA

Code No. 32bBy Gordon & Joe

## STATE ENGINEER'S OFFICE

County PARKArea Wilsall

WATER RESOURCES SURVEY

T. 5N R. 10E Sec. Date 7/25/51Photo No. MA 11A-74Legal Land Owner Westling, JohnAddress WilsallOperator Address 

Water is delivered by:

Federal Project  Pres.  Pot. Ditch Company  Pres.  Pot. Irrigation District  Pres.  Pot. Private System Westling ditch Pres.  Pot. Totals Flood  Pump  Reservoir  Gravity ✓Size and Capacity, Pump, etc. Original Appropriator, Company  App. No. Original Appropriator, Private See Attached Sheet App. No. Is the system an extension of another system? Yes  No ✓Is all land irrigated from one system? Yes ✓ No 

(If No, show break down on map)

Source of Water Ponchaque Cr., Shields R., So. Ft. Shields RiverAcres Irrigated 19 51Potential Acres  Seeped Explain Condition of System goodAdequate Supply  Yes ✓ No Explain most yearsTopography Slight SlopeInformation From Mr WestlingRemarks over

(3)

F in Use  
Sec. 34



Bo. Fork Shields River:

Westling ditch heads in about the SW  $\frac{1}{4}$  Sec. 34 T. 5N-R. 10E - extends in a North-westerly direction into Sec. 33 & 32. Ditch spills into a couple draws, where it is picked up for irrigation in the SE  $\frac{1}{4}$ , Sec. 32.

# STATE ENGINEER'S OFFICE

## WATER RESOURCES SURVEY

Township 5N Range 10E County Park

6	5	4	3	2	1
7	8	9	10	11	12
13	14	15	16	17	18
19	20	21	22	23	24
25	26	27	28	29	30
31	32	33	34	35	36

32  
B  
1250  
1474  
1474

*John Westling-sw-op, Wilkall*

Township 5N Range 10E

Township

5M

Range

LOE

County

PARK

Parcel Number	Name of Owner	Address		
APPROPRIATIONS				
1230	Corr. Michael	Forcubine Cr.	7-21-88	7-25-88 150
1441	Inter-State Holding Corp.	Shields E.	7-25-33	7-26-33 20,000
1474	Westling, John	"	7-10-25	7-10-25 160
DECREE				
702	Westling, John	So. E. Shields R.	6-15-1907	3-3-1911 125 0/4

STATE OF MONTANA

# State Engineer's Office

WATER RESOURCES SURVEY

## FARM MAP

County PARK

Code No. \_\_\_\_\_

Twp. 5N Rge. 10E

Twp. \_\_\_\_\_ Rge. \_\_\_\_\_

Twp. \_\_\_\_\_ Rge. \_\_\_\_\_

Name of Land Owner \_\_\_\_\_ Address \_\_\_\_\_

Name of Operator \_\_\_\_\_ Address \_\_\_\_\_

Legal Description \_\_\_\_\_

☐ Irrigated Land

☐ Non-Irrigated Land  
North

☐ Potential Land Under Existing Facilities

Code No. 3203 System Westling DITCHES Source of Water SO. FK. SHIELDS RIVER

Basin SHIELDS RIVER Present 35.0 Potential 0 Maximum 35.0 R ✓ F ✓ P ✓ G ✓ S ✓

Code No. \_\_\_\_\_ System \_\_\_\_\_ Source of Water \_\_\_\_\_

Basin \_\_\_\_\_ Present \_\_\_\_\_ Potential \_\_\_\_\_ Maximum \_\_\_\_\_ R \_\_\_\_\_ F \_\_\_\_\_ P \_\_\_\_\_ G \_\_\_\_\_ S \_\_\_\_\_

Code No. \_\_\_\_\_ System \_\_\_\_\_ Source of Water \_\_\_\_\_

Basin \_\_\_\_\_ Present \_\_\_\_\_ Potential \_\_\_\_\_ Maximum \_\_\_\_\_ R \_\_\_\_\_ F \_\_\_\_\_ P \_\_\_\_\_ G \_\_\_\_\_ S \_\_\_\_\_

Code No. \_\_\_\_\_ System \_\_\_\_\_ Source of Water \_\_\_\_\_

Basin \_\_\_\_\_ Present \_\_\_\_\_ Potential \_\_\_\_\_ Maximum \_\_\_\_\_ R \_\_\_\_\_ F \_\_\_\_\_ P \_\_\_\_\_ G \_\_\_\_\_ S \_\_\_\_\_

If under Ditch Company, Irrigation District, or Government Project, state the number of shares or inches, acre feet, as the case may be in said system.

NOTE: R—Denotes Regular Irrigation. F—Flood Irrigation. P—Water diverted by means of pumping. G—Water diverted by gravity.  
S—Stored Water.

Information from Joe Paulist Date 1/28/52

FORM F-1 REPORTER 1M 3-49 17380

STATE OF MONTANA

Code No. 18A 19E

# State Engineer's Office

County Franklin

WATER RESOURCES SURVEY

T. 5 N R. 10 E Sec

Photo No. MAA-25

**Operator.**

Address 72-1-2-11

**Address**

**Address**

Federal Project \_\_\_\_\_ Pres. \_\_\_\_\_ Pot \_\_\_\_\_

Pres. \_\_\_\_\_ Pot. \_\_\_\_\_

Ditch Company \_\_\_\_\_ Pres. \_\_\_\_\_ Pot \_\_\_\_\_

Pres. \_\_\_\_\_ Pot \_\_\_\_\_

Irrigation District \_\_\_\_\_ Pres. \_\_\_\_\_ Pot \_\_\_\_\_

Pres. \_\_\_\_\_ Pot \_\_\_\_\_

Private System Hamilton ditch Pres. \_\_\_\_\_ Flor. \_\_\_\_\_

Pres. \_\_\_\_\_ Flot \_\_\_\_\_

**Totals**

Flood \_\_\_\_\_ Pump \_\_\_\_\_ Reservoir \_\_\_\_\_ Gravity \_\_\_\_\_

Flood \_\_\_\_\_ Pump \_\_\_\_\_ Reservoir \_\_\_\_\_ Gravity \_\_\_\_\_

Size and Capacity, Pump, etc..

Original Appropriator, Company \_\_\_\_\_ App. No. \_\_\_\_\_

Original Appropriator, Private \_\_\_\_\_ App. No. \_\_\_\_\_

Is the system an extension of another system? Yes \_\_\_\_\_ No \_\_\_\_\_

is all land irrigated from one system? Yes\_\_\_\_\_No\_\_\_\_\_

(If No, show break down on map)

Source of Water Shenandoah River in Maryland

Acres Irrigated 19\_\_\_\_

Potential: Acres \_\_\_\_\_ Seeped \_\_\_\_\_

**Explain** \_\_\_\_\_

Condition of System\_\_\_\_\_

Adequate Supply..... Yes\_\_\_\_\_ No\_\_\_\_\_

**Explain** \_\_\_\_\_

### Topography

Information From \_\_\_\_\_

Remarks for information on ditch see

Fred & Victoria Wilson form

[illegible]

5

D-24	John + Wm. McElroy	Basin on Main Street	5-10-90	3-3-11	185-
	"	"	6-20-98	"	185-
	"	"	6-10-10	"	185-
D-673	Wm. Patrick on base Hamilton Smith base.		6-1-1890	3-6-11	235-
Sept. 15/10	Patrick Hamilton	Smith base	5-29-91	5-29-91	250-

STATE OF MONTANA

# STATE ENGINEER'S OFFICE

WATER RESOURCES SURVEY

Township 5 N Range 16 E County Park

6	5	4	3	2	1
7	8	9	10	11	12
18 <i>ASD</i>	17	16	15	14	13
19 <i>ASD</i>	20	21	22	23	24
30	29	28	27	26	25
31	32	33	34	35	36

*Liberty, Park*

Farm Checked

STATE OF MONTANA

Code No. MA/8 B, 198By Gordon & Joe

## STATE ENGINEER'S OFFICE

County ParkArea Willisall

WATER RESOURCES SURVEY

T. 5N R. 10E Sec. \_\_\_\_\_Date May 25-51Photo No. MA-11A-75Legal Land Owner Wilson, Fred & VictoriaAddress Willisall

Operator \_\_\_\_\_

Address \_\_\_\_\_

Water is delivered by:

Federal Project \_\_\_\_\_

Pres. \_\_\_\_\_

Pot. \_\_\_\_\_

Ditch Company \_\_\_\_\_

Pres. \_\_\_\_\_

Pot. \_\_\_\_\_

Irrigation District \_\_\_\_\_

Pres. \_\_\_\_\_

Pot. \_\_\_\_\_

Private System Hamilton Ditch

Pres. \_\_\_\_\_

Pot. \_\_\_\_\_

Totals \_\_\_\_\_

Flood \_\_\_\_\_

Pump \_\_\_\_\_

Reservoir \_\_\_\_\_

Gravity ☒

Size and Capacity, Pump, etc. \_\_\_\_\_

Original Appropriator, Company \_\_\_\_\_

App. No. \_\_\_\_\_

Original Appropriator, Private See attached sheet

App. No. \_\_\_\_\_

Is the system an extension of another system?

Yes \_\_\_\_\_

No ☒

Is all land irrigated from one system?

Yes ☒

No \_\_\_\_\_

(If No, show break down on map)

Source of Water Smith Creek, Basin or Meadow CreekAcres Irrigated 19.51

Potential Acres \_\_\_\_\_

Seeped \_\_\_\_\_

Explain \_\_\_\_\_

Condition of System Good

Adequate Supply \_\_\_\_\_

Yes ☒

No \_\_\_\_\_

Explain \_\_\_\_\_

Topography Very slight slopeInformation From Mr. Fred Wilson

Remarks \_\_\_\_\_

(3)

Also in T. 5N - R. 9E

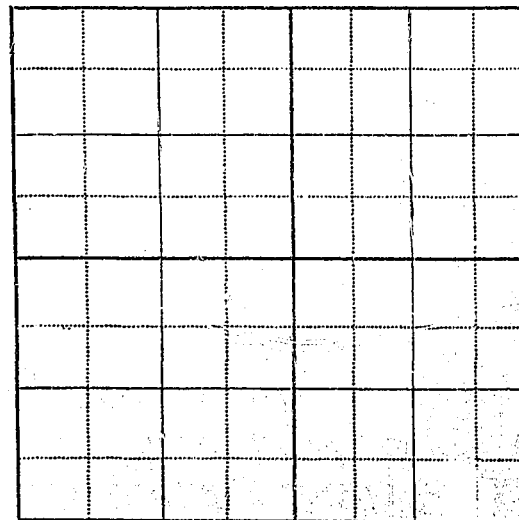



Smith Creek

D673 Hamilton ditch, Point of diversion,  $\frac{1}{2}$  Mile North of the  
North boundary line of Sec. 18, T. 5 N. - R. 10 E.  
In Sec. 7 of T. 6 N. - R. 10 E. Meagher County.  
Extending in a South West direction, part of  
ditch now used for flood only.  
another part of ditch used as regular irr.  
hay meadow in Sec. 18-13-24.

Also has short ditch from Spring, Sec. 18 - South  $\frac{1}{2}$ .  
irrigates little meadow along ditch.

No irrigation from meadow creek, no decree.

# STATE ENGINEER'S OFFICE

## WATER RESOURCES SURVEY

Township \_\_\_\_\_ Range \_\_\_\_\_ County \_\_\_\_\_

6	5	4	3	2	1
7	8	9	10	11	12
13	14	15	16	17	18
19	20	21	22	23	24
25	26	27	28	29	30
31	32	33	34	35	36

*has only 20 ac. in Sec. 19 along creek,*

*Wilson, Fred and Victoria*

Township 5N Range 10E

County.

[illegible]

Form WR-B  
Reporter 30168 2M 12-49

Twp. 5N Rge. 10E  
Twp. \_\_\_\_\_ Rge. \_\_\_\_\_  
Twp. \_\_\_\_\_ Rge. \_\_\_\_\_

STATE OF MONTANA  
**State Engineer's Office**  
WATER RESOURCES SURVEY  
FARM MAP

County PARK  
Code No. \_\_\_\_\_

Name of Land Owner \_\_\_\_\_ Address \_\_\_\_\_  
Name of Operator \_\_\_\_\_ Address \_\_\_\_\_  
Legal Description \_\_\_\_\_



Irrigated Land



Non-Irrigated Land  
North



Potential Land Under Existing Facilities

Code No. 18B, 19B System HAMILTON DITCH Source of Water SMITH CREEK & SPRING  
Basin SHIELDS RIVER Present 65.0 Potential 0 Maximum 65.0 R — F — P — G — S —  
Code No. 18B System HAMILTON DITCH Source of Water SMITH CREEK  
Basin SHIELDS RIVER Present 11.0 (Flood) Potential 0 Maximum 11.0 R — F — P — G — S —  
Code No. \_\_\_\_\_ System \_\_\_\_\_ Source of Water \_\_\_\_\_  
Basin \_\_\_\_\_ Present \_\_\_\_\_ Potential \_\_\_\_\_ Maximum \_\_\_\_\_ R \_\_\_\_\_ F \_\_\_\_\_ P \_\_\_\_\_ G \_\_\_\_\_ S \_\_\_\_\_  
Code No. \_\_\_\_\_ System \_\_\_\_\_ Source of Water \_\_\_\_\_  
Basin \_\_\_\_\_ Present \_\_\_\_\_ Potential \_\_\_\_\_ Maximum \_\_\_\_\_ R \_\_\_\_\_ F \_\_\_\_\_ P \_\_\_\_\_ G \_\_\_\_\_ S \_\_\_\_\_

If under Ditch Company, Irrigation District, or Government Project, state the number of shares or inches, acre feet, as the case may be in said system.

NOTE: R—Denotes Regular Irrigation. F—Flood Irrigation. P—Water diverted by means of pumping. G—Water diverted by gravity.  
S—Stored Water.

Information from Joe Paulson Date 1/25/52