

D-210	Samuel Bailey	Donahue, Wm.	6-19-82	8-11-17	56
D-211	Mabel Z...				
D-212					
D-213					
D-214					
D-215					
D-216					
D-217					
D-218					
D-219					
D-220					
D-221					
D-222					
D-223					
D-224					
D-225					
D-226					
D-227					
D-228					
D-229					
D-230					
D-231					
D-232					
D-233					
D-234					
D-235					
D-236					
D-237					
D-238					
D-239					
D-240					
D-241					
D-242					
D-243					
D-244					
D-245					
D-246					
D-247					
D-248					
D-249					
D-250					
D-251					
D-252					
D-253					
D-254					
D-255					
D-256					
D-257					
D-258					
D-259					
D-260					
D-261					
D-262					
D-263					
D-264					
D-265					
D-266					
D-267					
D-268					
D-269					
D-270					
D-271					
D-272					
D-273					
D-274					
D-275					
D-276					
D-277					
D-278					
D-279					
D-280					
D-281					
D-282					
D-283					
D-284					
D-285					
D-286					
D-287					
D-288					
D-289					
D-290					
D-291					
D-292					
D-293					
D-294					
D-295					
D-296					
D-297					
D-298					
D-299					
D-300					

old ditches out of donahue & Little donahue creeks.
Near The North Line of Sec. 4. [Not in use.]

ATLANTA HERALD-EXCHANGE PUBLISHED
CIVIL ENGINEERING OFFICE
CHIEF OF ENGINEERING

WATER RESOURCES SURVEY

Township 7A Range 7E County Wark

1946
A
210
211

6	5		8	2	1
7	8	9	10	11	12
13	14	15	16	17	18
19	20	21	22	23	24
25	26	27	28	29	30
31	32	33	34	35	36

710200 included
Potatoes &
white bread
where things are
as the P. & O.
is much right

21 also included
lots 2 & 3. Above
applies to these
lots, also.

Harold Dailey - owner

State Engineer's Office
WATER RESOURCES SURVEY
FARM MAP

County _____

Code No. _____

Twp. _____ Rge. _____
Twp. _____ Rge. _____
Twp. _____ Rge. _____

Name of Land Owner _____ Address _____
Name of Operator _____ Address _____
Legal Description _____

☐ Irrigated Land

☐ Non-Irrigated Land
North

☐ Potential Land Under Existing Facilities

Code No. 4A System Dailey Ditches Source of Water Donahoo Creek
Basin Y.R. Present 0 Potential 15 Maximum 15 R ✓ F ✓ P ✓ G ✓ S ✓
Code No. _____ System _____ Source of Water _____
Basin _____ Present _____ Potential _____ Maximum _____ R ✓ F ✓ P ✓ G ✓ S ✓
Code No. _____ System _____ Source of Water _____
Basin _____ Present _____ Potential _____ Maximum _____ R ✓ F ✓ P ✓ G ✓ S ✓
Code No. _____ System _____ Source of Water _____
Basin _____ Present _____ Potential _____ Maximum _____ R ✓ F ✓ P ✓ G ✓ S ✓

If under Ditch Company, Irrigation District, or Government Project, state the number of shares or inches, acre feet, as the case may be in said system.

NOTE: R—Denotes Regular Irrigation. F—Flood Irrigation. P—Water diverted by means of pumping. G—Water diverted by gravity.
S—Stored Water.

Information from Rare Date 2-5-52

Farm Checked

STATE OF MONTANA

Code No. 4D-5X, 7A, 18A, 3CBy Clare

STATE ENGINEER'S OFFICE

County ParkArea Emigrant

WATER RESOURCES SURVEY

T. 7S R. 7E Sec.Date 6-7-57Photo No. MA19A-23Legal Land Owner Hookham, Claude

Address

Operator

Address

Water is delivered by:

Federal Project

Pres.

Pot.

Ditch Company

Pres.

Pot.

Irrigation District

Pres.

Pot.

Private System ☒Pres. 60-80

Pot.

Totals

Flood ☒

Pump

Reservoir

Gravity ☒

Size and Capacity, Pump, etc.

Original Appropriator, Company

App. No.

Original Appropriator, Private DecreeSec. oneApp. No. D 211

Is the system an extension of another system?

Yes

No

Is all land irrigated from one system?

Yes

No

(If No, show break down on map)

Source of Water

Rock box, unnamed by Donahoe Cr.

Acres Irrigated 19

Potential Acres

Seeped

Explain

Condition of System Flood

Adequate Supply

Yes ☒

No

Explain

Topography Rolling ValleyInformation From Claude Hookham

Remarks

37

[illegible]



FORM D-1 - WESTERN LITHO, BILLINGS

STATE OF MONTANA

STATE ENGINEER'S OFFICE

WATER RESOURCES SURVEY

Township 7 S. Range 7 E County Park

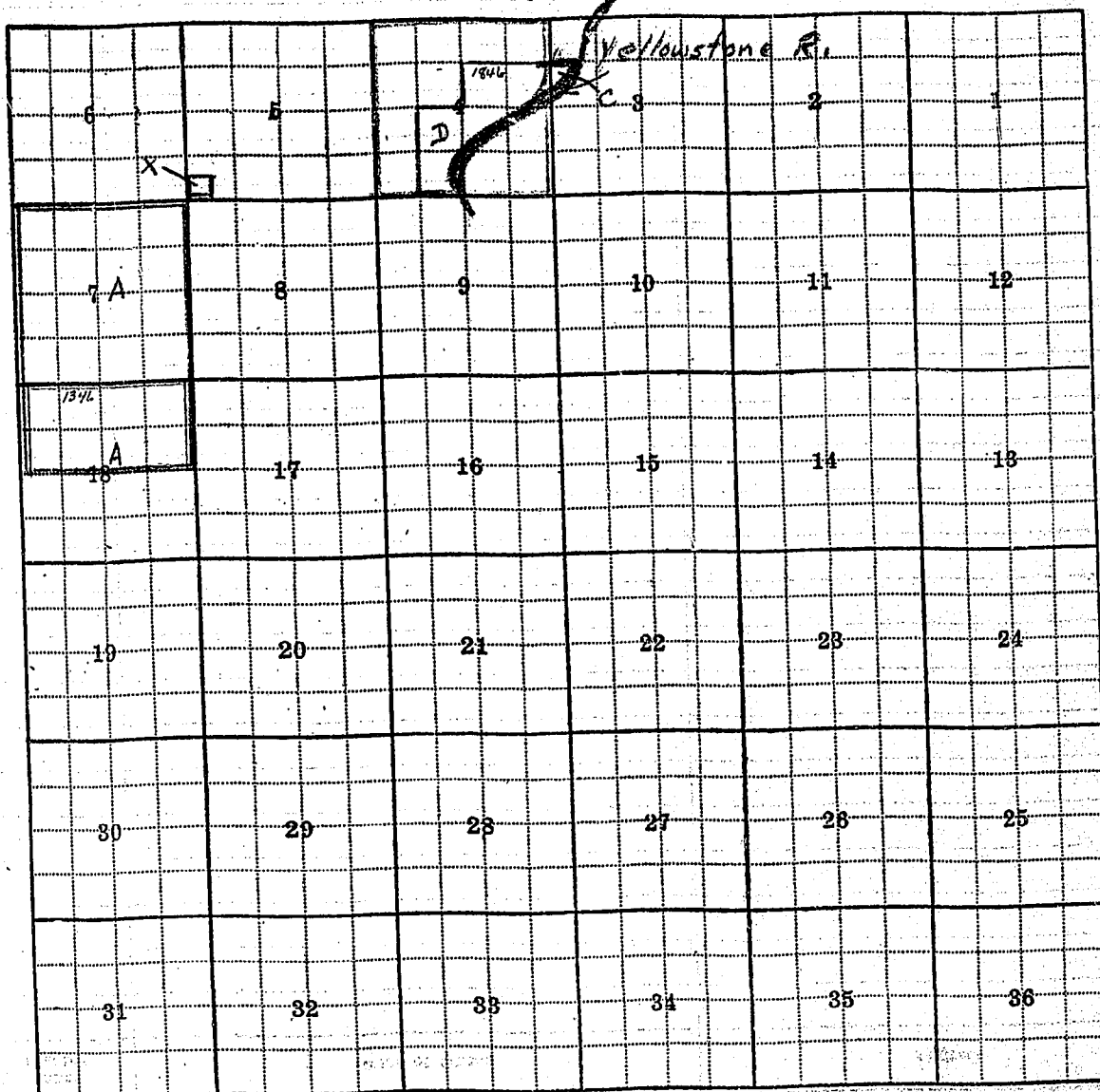

Claude Hookham - owner

State Engineer's Office

WATER RESOURCES SURVEY

FARM MAP

County

Code No.

Twp. Rge.

Twp. Rge.

Twp. Rge.

Name of Land Owner.

Address.

Name of Operator.

Address.

Legal Description.

☐ Irrigated Land

☐ Non-Irrigated Land
North

☐ Potential Land Under Existing Facilities

Code No. 3C, 4D System HOOKHAM DITCH Source of Water Danahoo Creek
Basin Y.R. Present 22 Potential 0 Maximum 22 R 1 F 0 P 0 G 0 S 0
Code No. System Source of Water
Basin Present Potential Maximum R F P G S
Code No. System Source of Water
Basin Present Potential Maximum R F P G S
Code No. System Source of Water
Basin Present Potential Maximum R F P G S

If under Ditch Company, Irrigation District, or Government Project, state the number of shares or inches, acre-feet, as the case may be in said system.

NOTE: R—Denotes Regular Irrigation. F—Flood Irrigation. P—Water diverted by means of pumping. G—Water diverted by gravity. S—Stored Water.

Information from

Date 2-5-52

Farm Checked

STATE OF MONTANA

Code No.

By

STATE ENGINEER'S OFFICE

County

Area

WATER RESOURCES SURVEY

T.

R.

Sec.

Date

Photo No.

Legal Land Owner

Address

Operator

Address

Water is delivered by:

Federal Project

Pres.

Pot.

Ditch Company

Pres.

Pot.

Irrigation District

Pres.

Pot.

Private System

Pres.

Pot.

Totals

Flood

Pump

Reservoir

Gravity

Size and Capacity, Pump, etc.

Original Appropriator, Company

App. No.

Original Appropriator, Private

App. No.

Is the system an extension of another system?

Yes

No

Is all land irrigated from one system?

Yes

No

(If No, show break down on map)

Source of Water

Unnamed Spring

Acres Irrigated 19.51

5

Potential Acres

0

Seeped

Explain

Condition of System

Good

Adequate Supply

Yes

No

Explain

Topography

River Bench

Information From

D'Ewart

Remarks

[illegible]



FORM D-1 WESTERN LITHO, BILLINGS

STATE OF MONTANA

STATE ENGINEER'S OFFICE

WATER RESOURCES SURVEY

Township

7S

Range

7E

County

Park

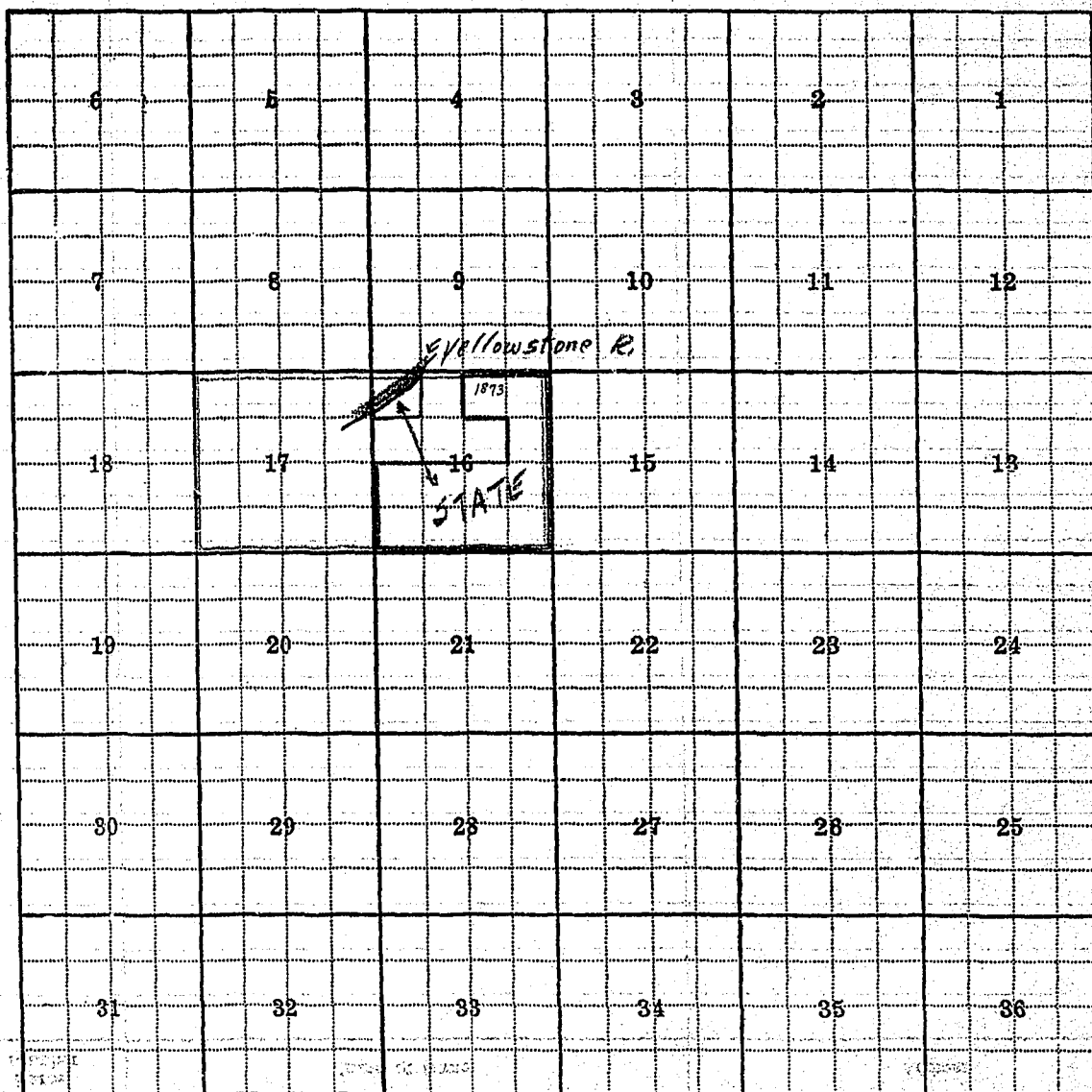

State of Montana - ow

DRAWN BY

CHECKED BY

APPROVED BY

570

STATE OF MONTANA

State Engineer's Office

WATER RESOURCES SURVEY

FARM MAP

County _____

Code No. _____

Twp _____ Rge _____

Twp _____ Rge _____

Twp _____ Rge _____

Name of Land Owner _____

Address _____

Name of Operator _____

Address _____

Legal Description _____



Irrigated Land



Non-Irrigated Land

North



Potential Land Under Existing Facilities

Code No. 16B System D'Ewart Ditch Source of Water Unnamed Spring

Basin Y.R. Present S Potential 2 Maximum 5 R ✓ F ✓ P ✓ G ✓ S ✓

Code No. _____ System _____ Source of Water _____

Basin _____ Present _____ Potential _____ Maximum R F P G S

Code No. _____ System _____ Source of Water _____

Basin _____ Present _____ Potential _____ Maximum R F P G S

Code No. _____ System _____ Source of Water _____

Basin _____ Present _____ Potential _____ Maximum R F P G S

If under Ditch Company, Irrigation District, or Government Project, state the number of shares or inches, acre feet, as the case may be in said system.

NOTE: R—Denotes Regular Irrigation. F—Flood Irrigation. P—Water diverted by means of pumping. G—Water diverted by gravity. S—Stored Water.

Information from _____

Date 2-5-52

Form Checked

STATE OF MONTANA

FORM F-1 WESTERN LITHO. BILLINGS

By Dave

STATE ENGINEER'S OFFICE

Code No. 1A, 2A, 3B, 11A

Area Daily Lake

WATER RESOURCES SURVEY

County Park

Date 5-13-57

T. 7S R. 7E Sec.

Photo No. MA-18A-138

Legal Land Owner Rigler, David & Frank

Address Pray

Operator

Address

Water is delivered by:

Federal Project

Pres.

Pot.

Ditch Company

Pres.

Pot.

Irrigation District

Pres.

Pot.

Private System ✓

Pres. 110

Pot. 0

Totals

Flood

Pump

Reservoir

Gravity ✓

Size and Capacity, Pump, etc.

Original Appropriator, Company

App. No.

Original Appropriator, Private

App. No.

Is the system an extension of another system?

Yes

No

Is all land irrigated from one system?

Yes

No

(If No, show break down on map)

Source of Water

Daily Lake, Hardin Cr., Sheep Cr., Unnamed Spr., Big Mtn Cr.,
Paper Cr.

Acres Irrigated 19 51 110

Potential Acres 0

Seeped

Explain

Condition of System

Adequate Supply

Yes ✓

No

Explain Most years

Topography Crater Valley

Information From David Rigler

Remarks

50

D-173	Chas. Eaton	Daily Cr.	6-1-80	11-19-09	40
D-334	Andrew J. Bailey	Garden Cr.	6-1-80	10-29-09	120
825	R. J. Bailey				
1386	Strickland, N. J.	Garden Cr.	5-27-93	5-27-93	160
1387	" " "	Sheep Cr.	"	"	160
1487	Andrew J. Bailey	" "	6-19-13	6-30-13	160
1700	" " "	Six mile Cr.	9-12-05	9-13-05	600
2024	R. E. Butler	Franklin Cr.	4-22-20	4-24-20	60
	Frank Strickland	Unmanned Abq.	4-7-02	4-7-02	25

STATE ENGINEER'S OFFICE

WATER RESOURCES SURVEY

Township 2S Range 7E County Park

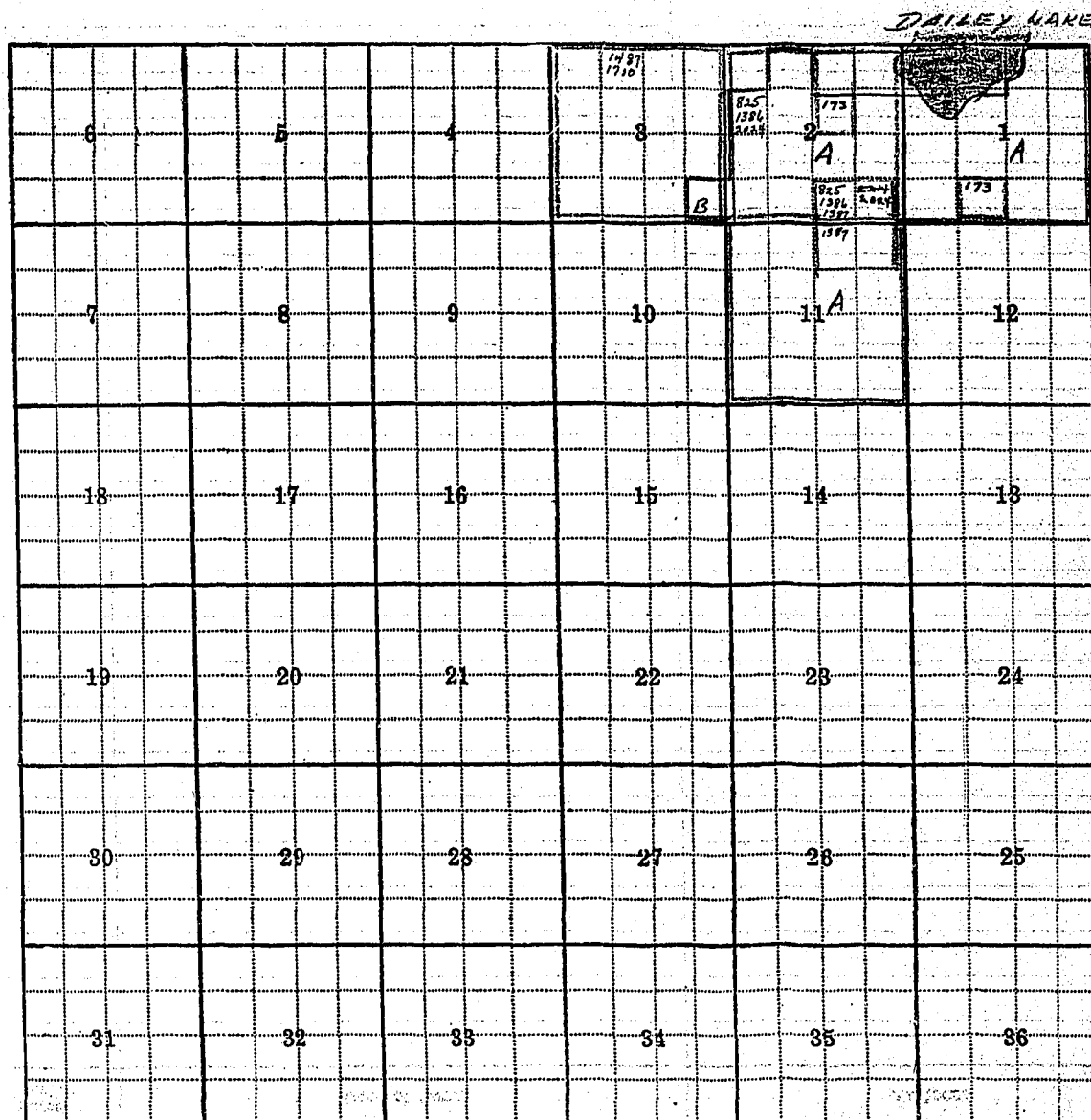

David & Frank Rigler - own op

50

State Engineer's Office
WATER RESOURCES SURVEY
FARM MAP

County _____

Code No. _____

Twp. _____ Rge. _____

Twp. _____ Rge. _____

Twp. _____ Rge. _____

Name of Land Owner _____

Address _____

Name of Operator _____

Address _____

Legal Description _____

☐

Irrigated Land

☐

Non-Irrigated Land
North

☐

Potential Land Under Existing Facilities

Code No. 2A System Rigler Ditches Source of Water Sheep-Danley-Garden Cr.
Basin Y.R. Present 110 Potential 0 Maximum 110 R X F P G S
Code No. _____ System _____ Source of Water _____
Basin _____ Present _____ Potential _____ Maximum _____ R F P G S
Code No. _____ System _____ Source of Water _____
Basin _____ Present _____ Potential _____ Maximum _____ R F P G S
Code No. _____ System _____ Source of Water _____
Basin _____ Present _____ Potential _____ Maximum _____ R F P G S

If under Ditch Company, Irrigation District, or Government Project, state the number of shares or inches, acre feet, as the case may be, in said system.

NOTE: R—Denotes Regular Irrigation. F—Flood Irrigation. P—Water diverted by means of pumping. G—Water diverted by gravity.
S—Stored Water.

Information from _____

Date 2-4-52

Farm Checked

STATE OF MONTANA

Code No. 29C-31C-32BBy Name

STATE ENGINEER'S OFFICE

County ParkArea Miner

WATER RESOURCES SURVEY

T. 7S R. 7E SecDate 6-7-57Photo No. MA-19A-22

Legal Land Owner

Rush, H.L.

Address

Miner

Operator

W.L. Kelly (Buyers)

Address

"

Water is delivered by:

Federal Project

Pres.

Pot.

Ditch Company

Pres.

Pot.

Irrigation District

Pres.

Pot.

Private System ☒

Pres.

Pot.

Totals

Flood

Pump

Reservoir

Gravity ☒

Size and Capacity, Pump, etc.

Original Appropriator, Company

App. No.

Original Appropriator, Private

App. No. D 467

Is the system an extension of another system?

Yes

No ☒

Is all land irrigated from one system?

Yes ☒

No

(If No, show break down on map)

Source of Water

Miner CreekAcres Irrigated 19.57

Potential Acres

Seeped

Explain

Condition of System

Being Reprimed

Adequate Supply

Yes ☒

No

Explain

Topography

Run Bottom

Information From

Mrs. W.L. Kelly

Remarks



FORM D-1— WESTERN LITHO, BILLINGS

STATE OF MONTANA

STATE ENGINEER'S OFFICE

WATER RESOURCES SURVEY

Township 7S. Range 7E County Park

6	5	4	3	2	1
7	8	9	10	11	12
18	17	16	15	14	13
19	20	21	22	23	24
30	29	28	27	26	25
31	32	33	34	35	36

Handwritten diagram in section 32 showing a polygon with vertices labeled 3, 1068, and 32. An arrow points to the vertex labeled 3.

H. L. Rust - owner

LOWEY

BINGO

COWLEY

650

State Engineer's Office
WATER RESOURCES SURVEY
FARM MAP

County _____

Code No. _____

Twp _____ Rge _____

Twp _____ Rge _____

Twp _____ Rge _____

Name of Land Owner _____ Address _____

Name of Operator _____ Address _____

Legal Description _____

☐ Irrigated Land

☐ Non-Irrigated Land

☐ Potential Land Under Existing Facilities

North

Code No. 31C-32B System Rust Ditch Source of Water Minor Creek
Basin Y.R. Present 22 Potential 0 Maximum 22 R ✓ F ✓ P ✓ G ✓ S ✓
Code No. _____ System _____ Source of Water _____
Basin _____ Present _____ Potential _____ Maximum _____ R _____ F _____ P _____ G _____ S _____
Code No. _____ System _____ Source of Water _____
Basin _____ Present _____ Potential _____ Maximum _____ R _____ F _____ P _____ G _____ S _____
Code No. _____ System _____ Source of Water _____
Basin _____ Present _____ Potential _____ Maximum _____ R _____ F _____ P _____ G _____ S _____

If under Ditch Company, Irrigation District, or Government Project, state the number of shares or inches, acre feet, as the case may be in said system.

NOTE: R—Denotes Regular Irrigation. F—Flood Irrigation. P—Water diverted by means of pumping. G—Water diverted by gravity.
S—Stored Water.

Information from Name Date 2-4-52

Farm Checked

By Alone

Area Minor

Date 6-7-57

Legal Land Owner Stewart, Jas. + Robt.

Operator

Water is delivered by:

Federal Project

Pres.

Pot.

Ditch Company

Pres.

Pot.

Irrigation District

Pres.

Pot.

Private System ☒

Pres.

Pot.

Totals

Flood

Pump

Reservoir

Gravity ☒

Size and Capacity, Pump, etc.

Original Appropriator, Company

App. No.

Original Appropriator, Private

App. No. 1341-1342

Is the system an extension of another system?

Yes

No ☒

Is all land irrigated from one system?

Yes

No ☒

(If No, show break down on map)

Source of Water Rock lev.

Acres Irrigated 19

Potential Acres

Seeped

Explain

Condition of System Good

Adequate Supply

Yes ☒

No

Explain

Topography Roll Bottom

Information From James Stewart

Remarks

50

Handwritten scribbles at top right corner.

D-460	Anna Amalasing, Adm.	77 Mins. Per.	7-1-79	4-9-58	40
1341	"	"	7-1-86	"	50
1342	"	"	7-1-96	"	90
1343	"	"	7-1-11	"	40

Apprx. #

1341	Alexander Stewart	Rock Per.	10-28-04	10-28-04	
1342	"	"	1-2-20	1-2-20	200

Rock Creek A. Tech Roads in SW. NW sec 19 T. 7S-R. 16
 on north Bank part of ditch flows Rock Creek for
 a line 8 ft sec 19.
 between ditch & railroad North of Rock Creek.

WYLER KENNEDY CORP
 2110 BROADWAY
 NEW YORK, N.Y. 10007

STATE ENGINEER'S OFFICE

WATER RESOURCES SURVEY

Township

7 S.

Range

7 E

County

Park

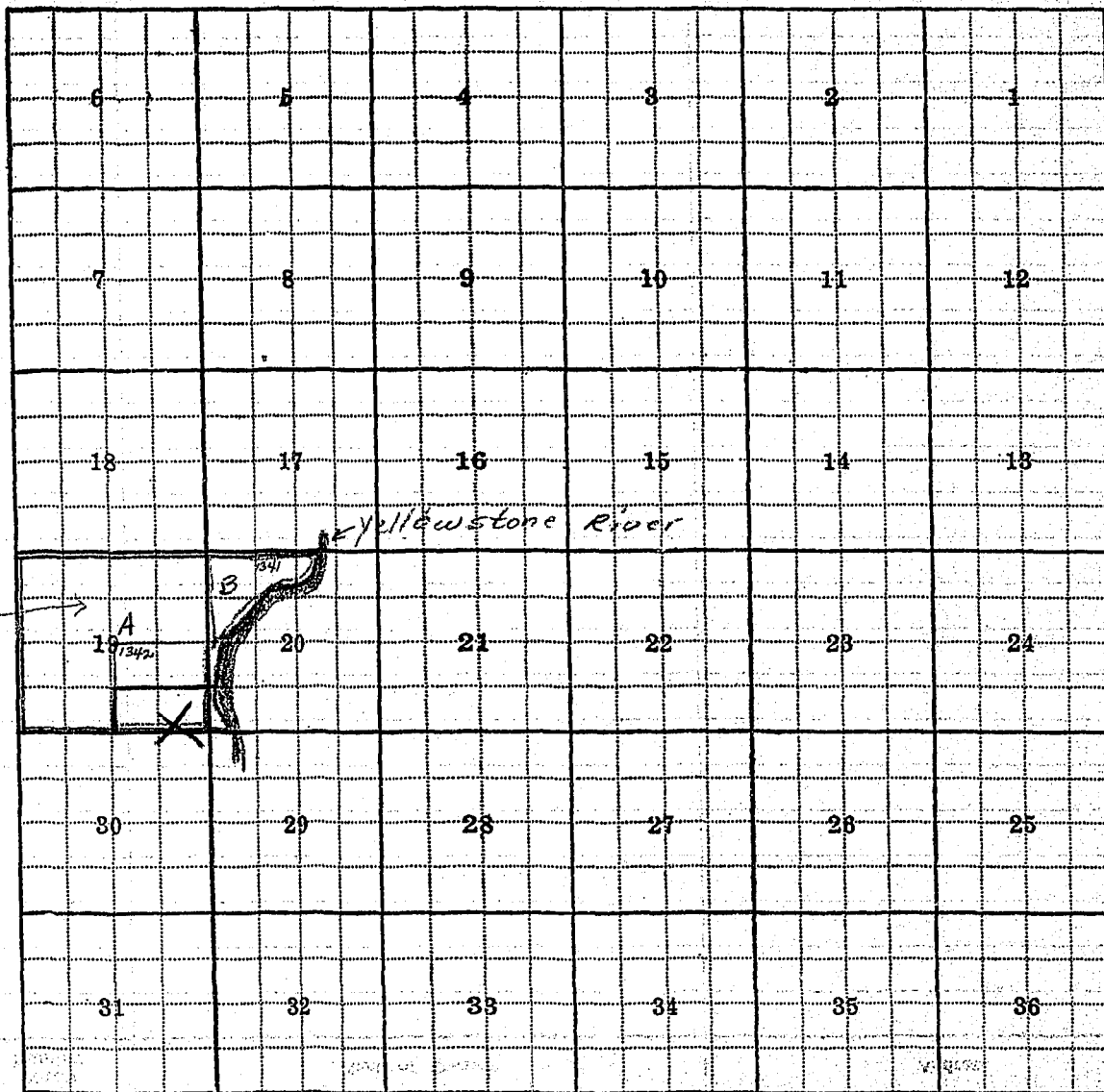

gas. & Robert Stewart - our op.

STATE OF MONTANA

State Engineer's Office
WATER RESOURCES SURVEY
FARM MAP

County _____
Code No. _____

Twp _____ Rge _____
Twp _____ Rge _____
Twp _____ Rge _____

Name of Land Owner _____ Address _____
Name of Operator _____ Address _____
Legal Description _____

☐

Irrigated Land

☐

Non-Irrigated Land

North

☐

Potential Land Under Existing Facilities

Code No. 19A System Stewart Ditches Source of Water Rock Creek
Basin Y.R. Present 42 Potential 0 Maximum 42 R ✓ F ✓ P ✓ G ✓ S ✓
Code No. _____ System _____ Source of Water _____
Basin _____ Present _____ Potential _____ Maximum _____ R ✓ F ✓ P ✓ G ✓ S ✓
Code No. _____ System _____ Source of Water _____
Basin _____ Present _____ Potential _____ Maximum _____ R ✓ F ✓ P ✓ G ✓ S ✓
Code No. _____ System _____ Source of Water _____
Basin _____ Present _____ Potential _____ Maximum _____ R ✓ F ✓ P ✓ G ✓ S ✓

If under Ditch Company, Irrigation District, or Government Project, state the number of shares or inches, acre feet, as the case may be in said system.

NOTE: R—Denotes Regular Irrigation. F—Flood Irrigation. P—Water diverted by means of pumping. G—Water diverted by gravity.
S—Stored Water.

Information from None Date 2-5-52

CONTENTS OF THIS BOOK

T.8S - R.6E - 8S-7E - 8S-8E

NAME OF OWNER

NAME OF OPERATOR

UNITED STATES OF AMERICA

MERRELL, Ellery

JACKSON, Jos. E.

MARTIN, John

NORMAN, Millard

SIMONSON, Waldermar

SMITH, Francis

WARD, Wm. B.

RIGLER, David & Frank

8S-7E

CUTLER, Manley

CUTLER, Harriett

STERMITZ, Bert & Geo.

SIMONSON, W. W.

NAEGELI, Lothair

MCDONALD, John A.

HEIST, Jos. W.

HEIST, Mary E.

ARMSTRONG, Ray

KONCILYA, Anten

STYERS, Walter

U. S. A.

8S-8E

ROSS, Lena B.

ARMSTRONG, Roy

BROGAN, W. E.

LIBBY, C. T.

LUSTRICK, Mary

GEDEL, Luthur

WARD, Wm. B. (Buying)

MERRELL, Ellery (buying)

BEEDLE, Lloyd (buying)

CUTLER, Manley

HEIST, J. E.

CUTLER, Manley

MALCOLM, O. R.

MICKOLICH, Charles

(See reverse side)

RIGLER, David & Frank

U. S. A.

FOREST SERVICE

Township 8 S Range 6 E County Park

Parcel Number	Name of Owner	Stream	Date of Acquisition	Date of Disposal	Ac.
(also see 780-66) 355	J. E. Jackson	Horse Creek	6-1-98	4-9-38	60
		" "	6-15-01	"	50
		" "	5-15-02	"	100
366	Alex. F. Martin	Horse Cr. (Tom mine ditch)	7-1-94	4-9-38	75
		" "	7-1-19	"	10
372	Millard F. Norman	Horse Cr. (Davis & Norman ditch)	7-1-94	4-9-38	20
375	Charles F. Pfohl	Horse Creek	6-1-91	4-9-38	35
		" "	7-2-01	"	60
		" "	7-1-10	"	130
376	Charles F. Pfohl	Horse Cr. (Bull & Pfohl ditch)	7-1-02	"	75
(also see 780-66) 377	Adelaide Scott	Horse Cr. (Scott ditch)	6-1-85	4-9-38	40
		" "	7-1-92	"	60
378	John Smith Jr.	Horse Cr. (Smith-Pfohl)	5-15-02	"	115
		" "	6-1-01	"	40
393	John Smith Jr.	Lee Cr. (Smith ditch)	6-1-15	4-9-38	5
394	Muntle M. Stewart	Lee Cr. (So. bank)	6-1-96	"	40
		" " (N. bank)	"	"	20
409	Charles F. Pfohl	Middle Creek	6-1-91	4-9-38	45
462	Bernard D. Bailey, Ex. Ad. of Geo. C. Bailey	Minor Creek	6-1-36	4-9-38	100
463	" " " " " "	" " So. bk	6-1-98	"	25
(also see 780-66) 466	J. E. Jackson	Minor Cr. (Tom mine)	7-1-19	4-9-38	72
473	Millard F. Norman	Minor Cr. (Mines ditch)	7-1-19	4-9-38	63
476	Adelaide Scott	Gulch Creek	6-1-05	4-9-38	100
477	" "	" " (Tom mine)	7-1-19	4-9-38	60
		" "	6-1-92	"	32
479	John Smith Jr.	Minor Creek	7-1-19	4-9-38	18
522	Charles Light	Pine Creek	5-15-05	2-24-10	120
522A	M. H. Link	Pine Creek	5-15-05	4-9-38	120
526	Richard Reed	Pine Creek	4-24-94	4-9-38	100

STATE OF MONTANA

Deerles - Page 2

82

6 E

Park

(also see
75-6E)

(also see
75-6E)

Township

Q 3

Range

6 E

STATE OF MONTANA
State Engineer's Office
WATER RESOURCES SURVEY

Township **8 S** Range **6 E** County **Park**

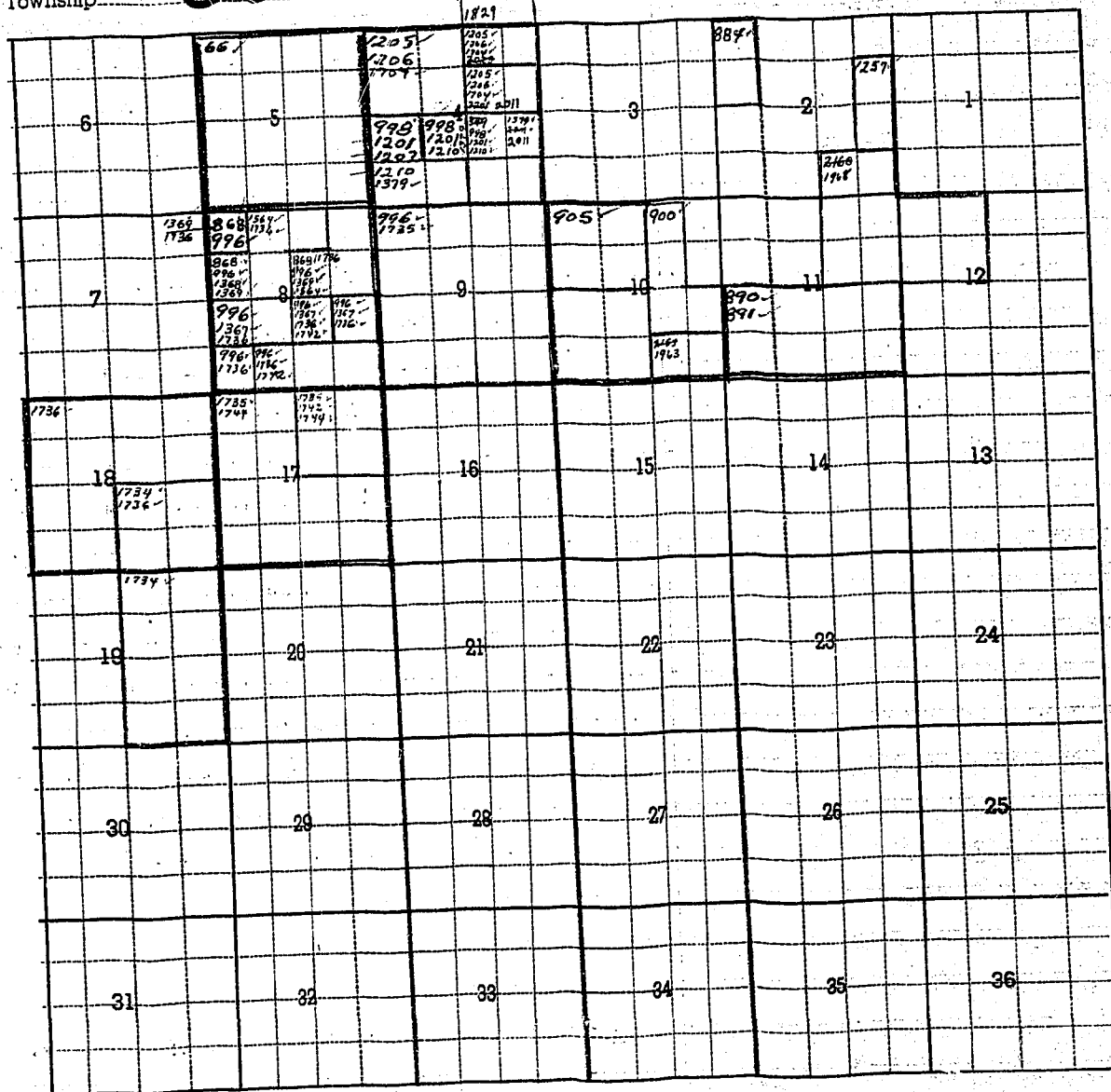

Township **8 S** Range **6 E**

Township

Range

County

Parcel Number	Name of Owner	Stream	Address	App	Filed	MT
661	Colence, Frank	Basset Cr.	8-14-89	8-17-89	160	
868	Strong, Morgan	Haskins Cr.	4-7-03	4-7-03	200	
884	Clark, Wallace M.	Horse Cr.	2-17-09	2-17-09	80	
890	George, Henry J.	" "	11-15-04	11-15-04	160	
891	" "	" "	11-15-04	11-15-04	160	
900	Martin, Alexander	" "	5-5-09	5-5-09	160	
905	Norman, Millard	" "	5-5-09	5-5-09	160	
996	Hoppe, Hugo B.	Middle Cr.	5-15-08	5-16-08	100	
998	Strong, Maude B.	" "	4-8-03	4-8-03	150	
1201	Light, Samuel N.	Pine Cr.	7-18-05	7-18-05	200	
1202	" "	" "	12-28-10	12-28-10	120	
1205	Sharpe, Wm R.	" "	11-27-03	11-27-03	200	
1206	" "	" "	6-30-05	6-30-05	200	
1210	Strong, Maude B.	" "	4-7-03	4-7-03	200	
1257	Smith, John Jr.	Reeder Cr.	6-9-06	6-11-06	80	
1367	Hoppe, Albert U.	Sculley Cr.	4-7-03	4-7-03	200	
1368	Hoppe, Hugo B.	" "	12-22-10	12-23-10	120	
1369	Strong, Morgan	" "	4-8-03	4-8-03	200	
1379	Strong, Maude B.	Sharp Cr.	4-8-03	4-8-03	50	
1564	Hoppe, Hugo B.	Spring Cr.	12-22-10	12-23-10	40	
1704	Sharpe, Wm R.	Tie Cr.	11-27-03	11-27-03	160	
1734	Davis, Geo. O.	Tom Miner Cr.	4-7-10	4-7-10	All	
1735	Hoppe, Albert & Strong, Morgan	" " "	4-8-03	4-8-03	800	
1736	" " " "	" " "	4-8-03	4-8-03	200	
1742	Scott, Charles B.	" " "	10-22-09	10-27-09	250	
1744	Styers, W. I.	" " "	8-16-02	8-16-02	320	
1829 2023	Beley, A. J.	Unnamed Spring	3-8-12	3-8-12	80	
1963 2155	Martin, Alexander F.	" "	5-11-08	5-12-08	50	
1968 2162	Morrison, James	" "	6-16-19	6-24-19	120	

CHIEF OF POLICE

STATE OF MONTANA

State Engineer's Office

WATER RESOURCES SURVEY

Township _____ Range _____ County _____

6		5		4		3		2		1
7		8		9		10		11		12
18		17		16		15		14		13
19		20		21		22		23		24
30		29		28		27		26		25
31		32		33		34		35		36

Township _____ Range _____

Farm Checked

STATE OF MONTANA

Code No. 18B3C

By _____

STATE ENGINEER'S OFFICE

County Park

Area _____

WATER RESOURCES SURVEY

T. 85 R. 6E Sec. 18

Date _____

Photo No. MA-19A-85

Legal Land Owner, United States of America

Address _____

Operator.

Address _____

Water is delivered by:

Federal Project _____ Pres. _____ Pot. _____

Ditch Company _____ Pres. _____ Pot. _____

Irrigation District _____ Pres. _____ Pot. _____

Private System 1.1 GN Pres. Pot.

Totals _____

Flood _____ Pump _____ Reservoir _____ Gravity _____

Size and Capacity, Pump, etc. _____

Original Appropriator, Company _____ App. No. _____

Original Appropriator, Private _____ App. No. _____

Is the system an extension of another system? Yes _____ No _____

Is all land irrigated from one system? Yes _____ No _____

(If No, show break down on map)

Source of Water _____

Acres Irrigated 19_____

Potential Acres _____ Seeped _____

Explain _____

Condition of System.....

Adequate Supply — Yes — No

Explain _____

Topography _____

Information From _____

Remarks _____

A full-page view of a blank sheet of graph paper. The grid consists of solid black lines forming large squares, with dashed lines further subdividing each large square into four smaller ones. The entire page is covered by this grid pattern.

Appropriation

1736

Strong, Morgan &
Hoppe, Albert

Tom Miner Co.

4-8-03

4-8-03

303

10-10-68

THE UNIVERSITY OF CHICAGO

STATE ENGINEER'S OFFICE

WATER RESOURCES SURVEY

Township 88 Range 6E County Park

6	5	4	3	2	1
7	1736	8	9	10	11
18	1736	17	16	15	14
19	20	21	22	23	24
30	29	28	27	26	25
31	32	33	34	35	36

U.S. G. - over

Farm Checked

STATE OF MONTANA

Code No. 9C

By _____

STATE ENGINEER'S OFFICE
WATER RESOURCES SURVEY

County Lark

Area _____

T. 85 R. 6E Sec. 9

Date _____

Photo No. W4-18A-51

Legal Land Owner.

Ellery Marshall

Address

Operator

Address

Water is delivered by:

Federal Project _____ Pres. _____ Pot. _____

Ditch Company _____ Pres. _____ Pot. _____

Irrigation District _____ Pres. _____ Pot. _____

Private System _____ Pres. _____ Pot. _____

No I R R I

[illegible]

Flood _____ Pump _____ Reservoir _____ Gravity _____

Size and Capacity, Pump, etc. _____

Original Appropriator, Company _____ App. No. _____

Original Appropriator, Private _____ App. No. _____

Is the system an extension of another system? Yes_____No_____

Is all land irrigated from one system? Yes _____ No _____

(If No, show break down on map)

Source of Water _____

Acres Irrigated 19_____

Potential Acres _____ Seeped _____

Explain

Condition of System

Adequate Supply Yes No

Explain

Topography

Information From _____

Remarks

[illegible]

STATE ENGINEER'S OFFICE

WATER RESOURCES SURVEY

Township 8 S. Range 6 E County Park

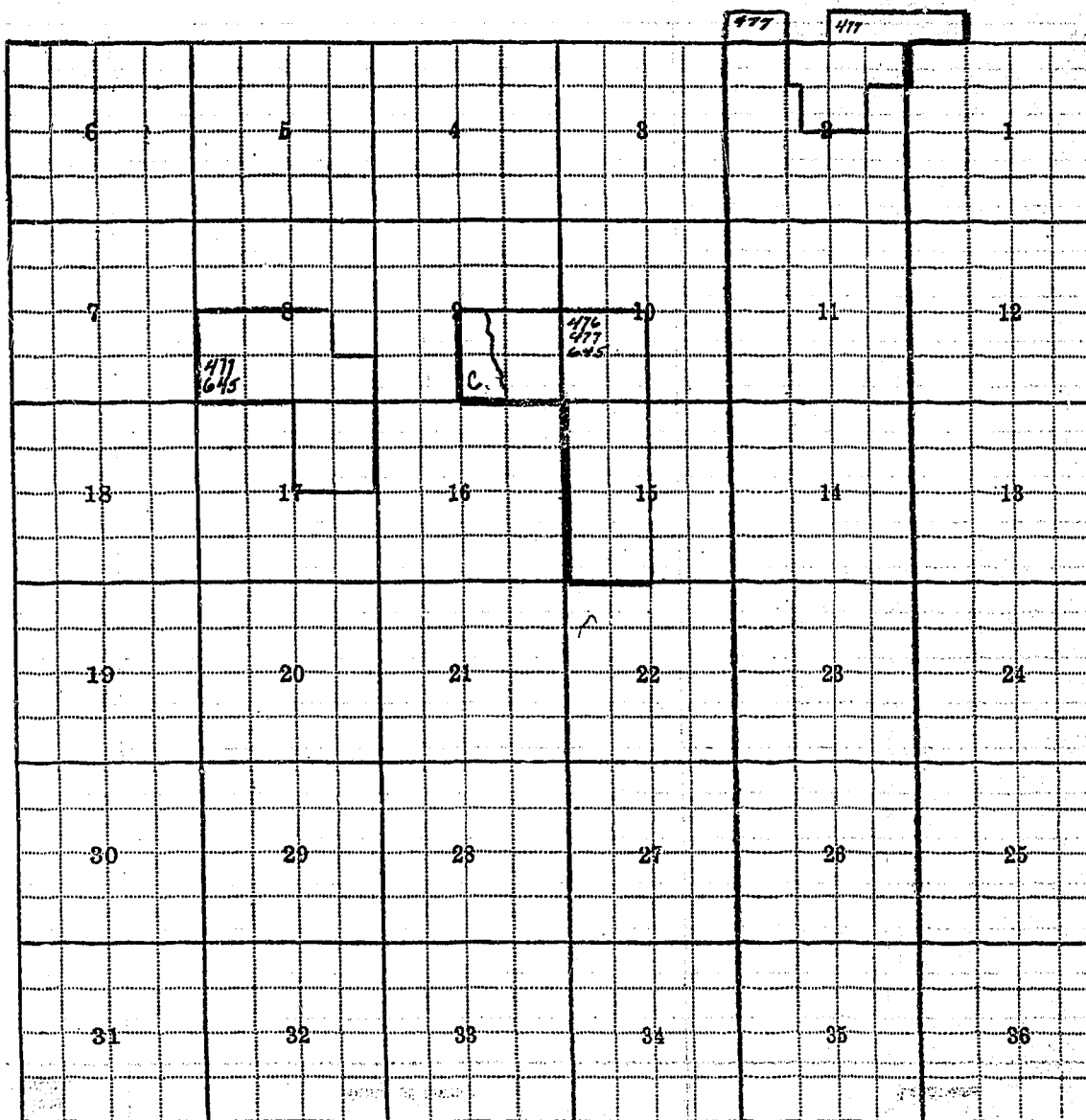

Ellery Marshall - owner

Farm Checked

STATE OF MONTANA

Code No. 1A, 2B, 11A

By.

STATE ENGINEER'S OFFICE

County Frank

Area

WATER RESOURCES SURVEY

T. 85 R. 66 Sec. 12 11

Date _____

Photo No. W4-19A-51

Legal Land Owner

Address W. J. ...

Operator.

Address

Water is delivered by:

Federal Project _____ Pres. _____ Pot. _____

Ditch Company _____ Pres. _____ Pot. _____

Irrigation District _____ Pres. _____ Pot. _____

Private System ☒ Pres. _____ Pot. _____

[illegible]

Flood _____ Pump _____ Reservoir _____ Gravity 2 _____

Size and Capacity, Pump, etc. _____

Original Appropriator, Company _____ App. No. _____

Original Appropriator, Private _____ App. No. 2355

Is the system an extension of another system? Yes _____ No _____

Is all land irrigated from one system? Yes _____ No _____

(If No, show break down on map)

Source of Water. Horse Cr., Tom Miner Cr., Lee Cr., Reeder Cr.

Acres Irrigated 19.....

Potential Acres _____ Seeped _____

Explain

Condition of System Island

Adequate Supply ----- Yes ☒ No ☐

Explain

Topography Mountain Valley over 7000'

Information From Don C Jackson

[illegible]

LIFE SALES						
355	J. E. Jackson	Horse Cr.	{	6-1-98	4-9-38	60
				6-1-901	4-9-38	50
				5-15-02	4-9-38	100
372	Adeline Scott	Horse Cr. (Sally D.)	{	6-1-98	4-9-38	70
	(Wards)			7-1-92	4-9-38	60
394	Myrtle M. Stuart	Lee Cr. (So bank)	{	6-1-96	4-9-38	40
	Jackson	(No bank)		6-1-96	4-9-38	30
466	J. E. Jackson	Miner Cr. (Tom Miner D.)	{	7-1-19	4-9-38	73
477	Adeline Scott	Miner Cr. (Tom Miner D.)	{	7-1-19	4-9-38	60 Ward
		" " "		6-1-92	4-9-38	32 Ward
485	Adelaide Scott	Sally Cr.	{	6-1-97	4-9-38	184 "
				5-1-89	4-9-38	114 "

[illegible]

STATE ENGINEER'S OFFICE

WATER RESOURCES SURVEY

Township 85 Range 6E County Park

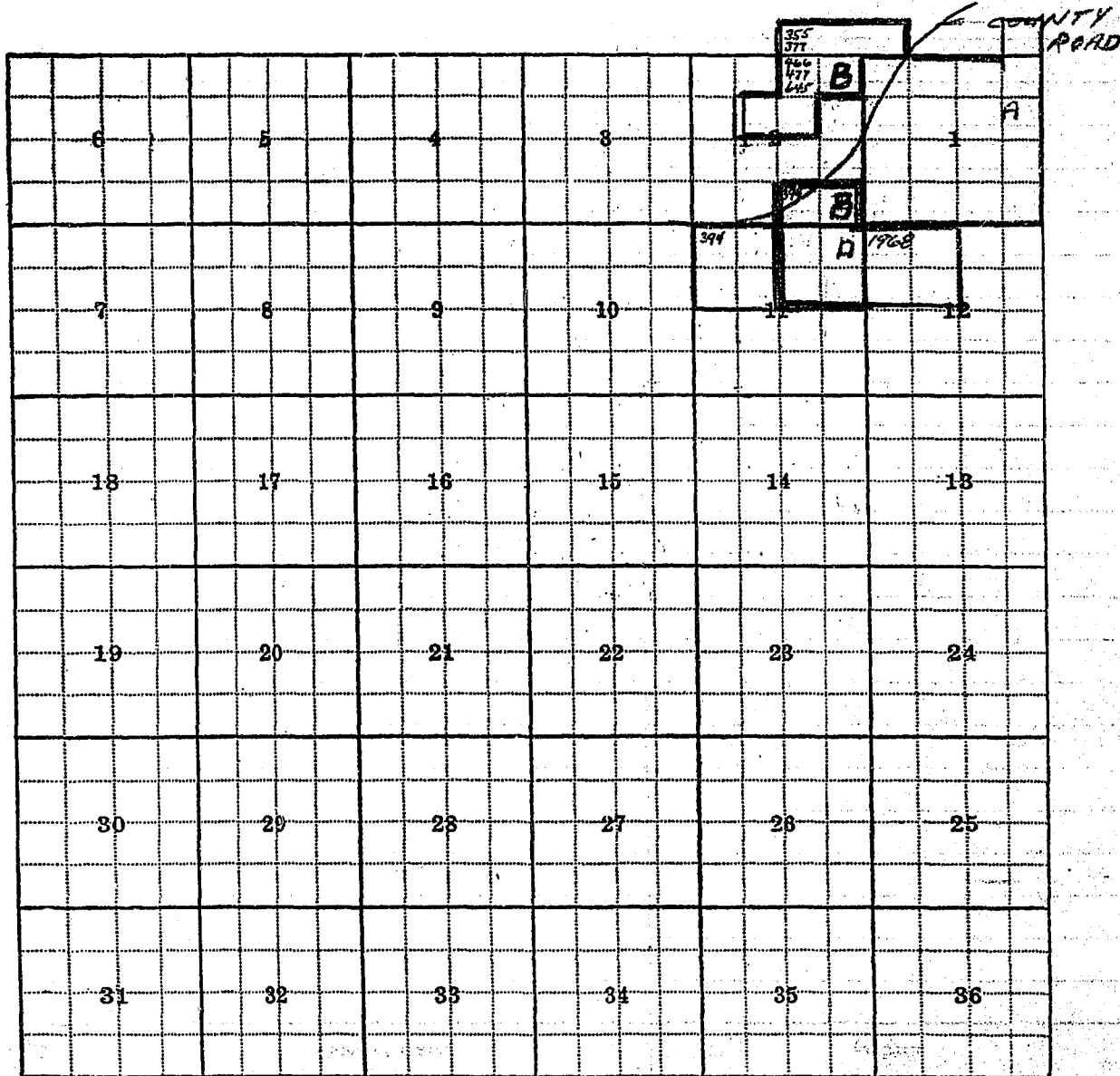

Joe. E. Jackson aw-210-

STATE OF MONTANA

State Engineer's Office
WATER RESOURCES SURVEY
FARM MAP

County _____

Code No. _____

Twp _____ Rge _____

Twp _____ Rge _____

Twp _____ Rge _____

Name of Land Owner _____ Address _____

Name of Operator _____ Address _____

Legal Description _____

☐ Irrigated Land

☐ Non-Irrigated Land
North

☐ Potential Land Under Existing Facilities

Code No. 1A-2B System Jackson-Merrell Ditch Source of Water Tam Miner Creek
Basin Y.R. Present 75 Potential 0 Maximum 75 R ✓ F ✓ P ✓ G ✓ S ✓
Code No. 1A-2B System Jackson Ditch Source of Water Lee Creek
Basin Y.R. Present 64 Potential 0 Maximum 64 R ✓ F ✓ P ✓ G ✓ S ✓
Code No. 2B-11A System Smith Peab Ditch Source of Water Horse Creek
Basin Y.R. Present 38 Potential 0 Maximum 38 R ✓ F ✓ P ✓ G ✓ S ✓
Code No. 11A System Slackson Ditch Source of Water Reeder Creek
Basin Y.R. Present 10 Potential 0 Maximum 10 R ✓ F ✓ P ✓ G ✓ S ✓

If under Ditch Company, Irrigation District, or Government Project, state the number of shares or inches, acre feet, as the case may be in said system.

NOTE: R—Denotes Regular Irrigation. F—Flood Irrigation. P—Water diverted by means of pumping. G—Water diverted by gravity. S—Stored Water.

Information from _____

Date 2-5-52

FORM F-1 REPORTER 1M 3-49 17380

STATE OF MONTANA

Code No. 3D10B 12A 15A

State Engineer's Office

County Park

WATER RESOURCES SURVEY

T. 85 R. 6E Sec. 15

Photo No. W4-19A-51

Address Miner

Address _____

Federal Project _____ Pres. _____ Pot. _____

Ditch Company _____ Pres. _____ Pot. _____

Irrigation District _____ Pres. _____ Pot. _____

Private System _____ Pres. _____ Pot. _____

[illegible]

Flood _____ Pump _____ Reservoir _____ Gravity _____

Size and Capacity, Pump, etc. _____

Original Appropriator, Company _____ App. No. _____

Original Appropriator, Private _____ App. No. D 366

Is the system an extension of another system? Yes _____ No _____

Is all land irrigated from one system? Yes _____ No _____

(If No, show break down on map)

Source of Water: Homes Co. Tom Miner Cr.

Acres Irrigated 19 37 _____

Potential Acres Seeped

Explain _____

Condition of System Good

Adequate Supply..... Yes ✓ No _____

Explain _____

Topography. Mountain Valley

Information From: Lutheran Social

Remarks _____

A full-page view of a blank sheet of graph paper. The page features a uniform grid of small squares formed by thin black lines. A thicker vertical line runs down the left side, creating a margin. There are also thicker horizontal lines near the top and bottom edges, defining header and footer areas. The paper appears slightly aged or off-white.

Decree					
366	Alex F. Martin	Horse Cr (Martin-Norman D)	7-1-94	4-9-38	75
		Miler C. T.M.D	7-1-19	4-9-38	10

Appropriations					
1963	Martin, Alexander F.	Unnamed Spring	5-11-08	5-12-08	50
1968	Morrison, James	Unnamed Spring	6-16-19	6-24-19	120

ENTER RESOURCES HERE

ENTER COMMENTS & NOTES

ENTER DATE OF ENTRY

ENTER DATE OF ENTRY

ENTER DATE OF ENTRY



FORM D-1—WESTERN LITHO. BILLINGS

STATE OF MONTANA

STATE ENGINEER'S OFFICE

WATER RESOURCES SURVEY

Township 8 S. Range 6 E. County Park

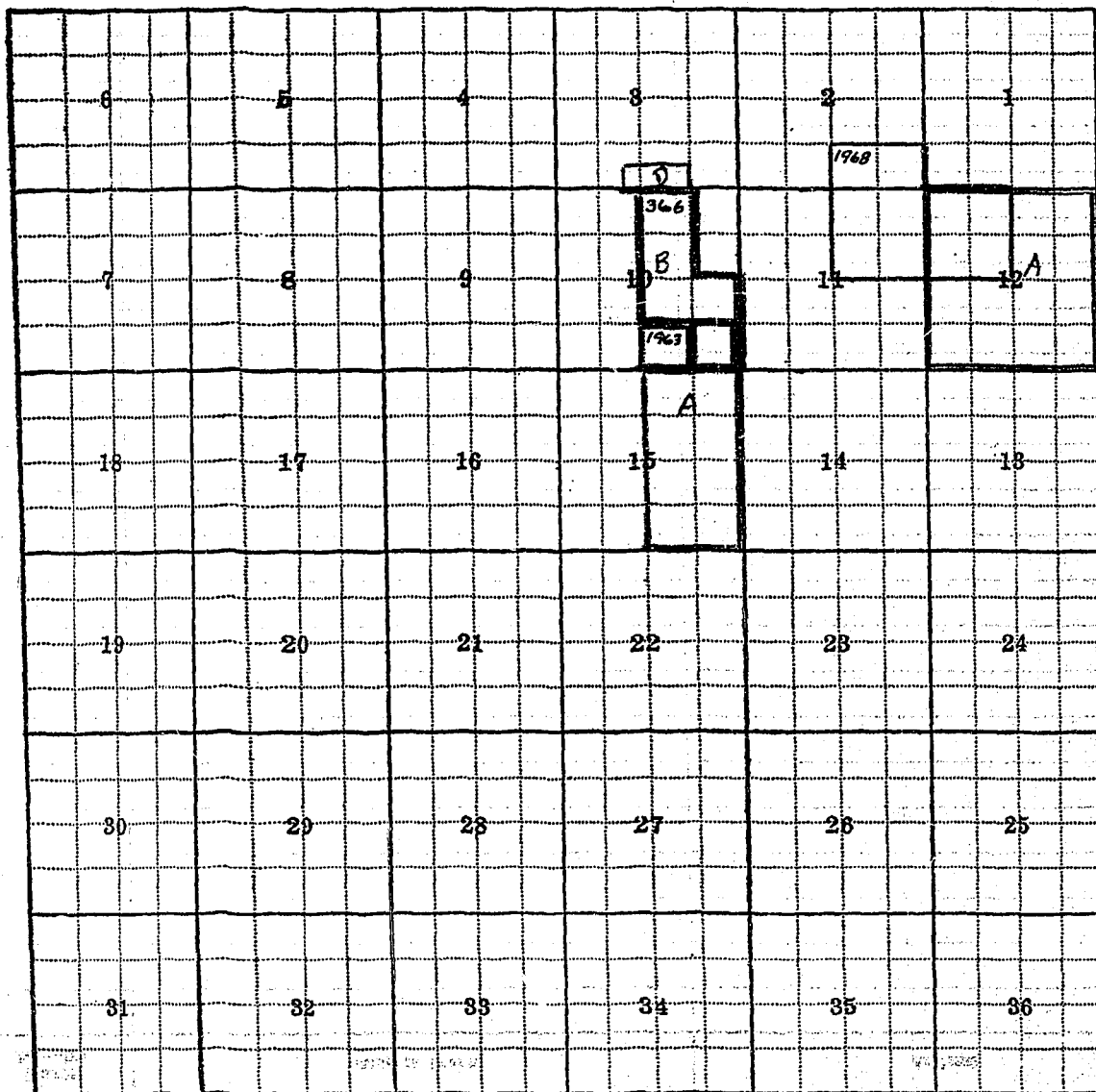

John Martin - ow ap

1. LOCATION

2. DATE

3. COMMENT

52

State Engineer's Office
WATER RESOURCES SURVEY
FARM MAP

County _____
Code No. _____

Twp. _____ Rge. _____
Twp. _____ Rge. _____
Twp. _____ Rge. _____

Name of Land Owner _____ Address _____
Name of Operator _____ Address _____
Legal Description _____

☐ Irrigated Land ☐ Non-Irrigated Land ☐ Potential Land Under Existing Facilities
North

Code No. 3D System Town Minor Ditch Source of Water Town Minor Cr.
Basin Y.R. Present 12 Potential 0 Maximum 12 R F P G S
Code No. 3D-14B System Ward-Norman-Martin Ditch Source of Water Horse Creek
Basin Y.R. Present 12 Potential 0 Maximum 12 R F P G S
Code No. 3D-10B System Martin-Norman Ditch Source of Water Horse Creek
Basin Y.R. Present 43 Potential 0 Maximum 43 R F P G S
Code No. _____ System _____ Source of Water _____
Basin _____ Present _____ Potential _____ Maximum _____ R F P G S

If under Ditch Company, Irrigation District, or Government Project, state the number of shares or inches, acre feet, as the case may be in said system.

NOTE: R—Denotes Regular Irrigation. F—Flood Irrigation. P—Water diverted by means of pumping. G—Water diverted by gravity.
S—Stored Water.

Information from Narc Date 2-5-62

Dec 1965

[illegible]

STATE ENGINEER'S OFFICE

WATER RESOURCES SURVEY

Township 8 S Range 6 E County Park

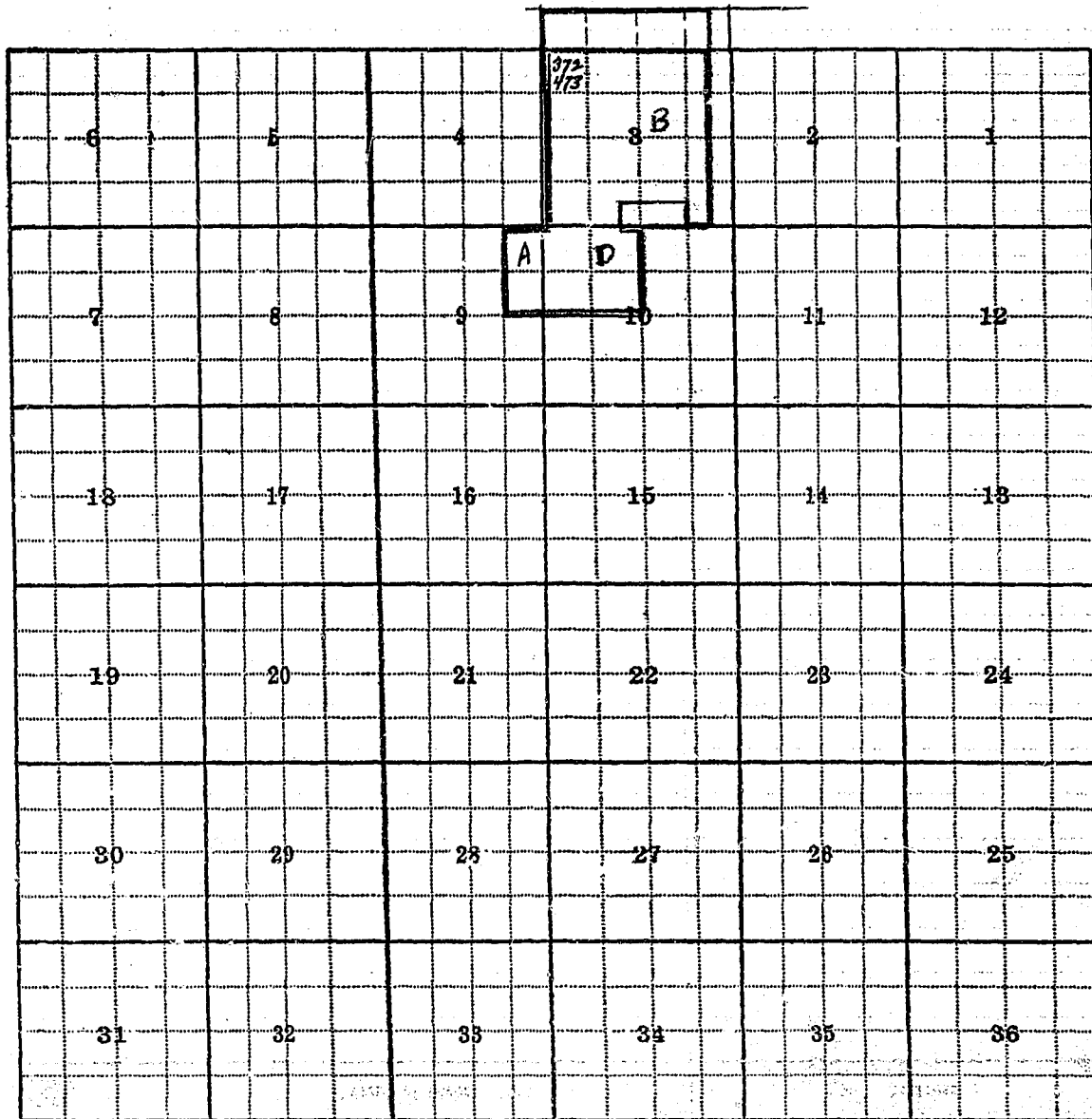

Millard Norman - surveyor

Surveyor

Witness

County

STATE OF MONTANA

State Engineer's Office
WATER RESOURCES SURVEY
FARM MAP

County _____

Code No. _____

Twp. _____ Rge. _____

Twp. _____ Rge. _____

Twp. _____ Rge. _____

Name of Land Owner _____ Address _____

Name of Operator _____ Address _____

Legal Description _____

☐ Irrigated Land

☐ Non-Irrigated Land
North

☐ Potential Land Under Existing Facilities

Code No. <u>9A-10D</u>	System <u>Ward Ditch</u>	Source of Water <u>Gulch Creek</u>
Basin <u>Y.R.</u>	Present <u>12</u> Potential <u>0</u> Maximum <u>12</u>	R F P G S
Code No. <u>10D</u>	System <u>Martin-Norman Ditch</u>	Source of Water <u>Horse Creek</u>
Basin <u>Y.R.</u>	Present <u>60</u> Potential <u>0</u> Maximum <u>60</u>	R F P G S
Code No. <u>3B</u>	System <u>Ward-Martin-Norman Ditch</u>	Source of Water <u>Horse Creek</u>
Basin <u>Y.R.</u>	Present <u>96</u> Potential <u>0</u> Maximum <u>96</u>	R F P G S
Code No. <u>3B-10D</u>	System <u>Tom Miner Ditch</u>	Source of Water <u>Tom Miner Creek</u>
Basin <u>Y.R.</u>	Present <u>63</u> Potential <u>0</u> Maximum <u>63</u>	R F P G S

If under Ditch Company, Irrigation District, or Government Project, state the number of shares or inches, acre feet, as the case may be in said system.

NOTE: R—Denotes Regular Irrigation. F—Flood Irrigation. P—Water diverted by means of pumping. G—Water diverted by gravity.
S—Stored Water.

Information from Dave Date 2-5-52

Farm Checked

STATE OF MONTANA

Code No. 44

By Alan

STATE ENGINEER'S OFFICE

County Lark

Area Harver Basin

WATER RESOURCES SURVEY

T 85 R 6E Sec 4

Date 6-5-51

Photo No. MA-19A-50

Legal Land Owner.

Waldemar Simpson

Address Mined

Operator

Ellery Merrell (Benjamin)

Address:

Water is delivered by:

Federal Project _____ Pres. _____ Fot. _____

Ditch Company _____ Pres. _____ Pot. _____

Irrigation District _____ Pres. _____ Pot. _____

Private System 1 Pres. Pot.

Totals _____

Flood _____ Pump _____ Reservoir _____ Gravity Low

Size and Capacity, Pump, etc. _____

Original Appropriator, Company _____ App. No. _____

Original Appropriator, Private _____ App. No. 0529 05224

Is the system an extension of another system? Yes_____No_____

Is all land irrigated from one system? Yes_____No_____

(If No, show break down on map)

Source of Water Pine Creek, Tie or Sharp Creek, Middle Co. ^{trip of Pine}

Acres Irrigated 1957, _____

Potential Acres _____ Seeped _____

Explain _____

Condition of System Good

Adequate Supply Yes No

Explain most years.

Topography Mountain peaks

Information From 6/2/68 [Signature]

Remarks _____

[illegible]

Decrees

522	Samuel Light	Pine Creek	5-15-05	4-9-38	12.0
522A	M.H. Link	Pine Creek	5-15-05	4-9-38	12.0
527	W.B. Sharpe	Pine Cr.	7-1-06	4-9-38	30
529	Wm (or Waldo) Simonsen	Pine Cr.	7-1-06	4-9-38	200
		Tie or Sharp Cr.	5-1-30	4-9-38	30

Appropriations

998	Strong, Maude B.	Middle Cr.	1-8-03	4-8-03	150
1829	Beley, A.J.	Unnamed Spring	3-8-12	3-8-12	80
2011	Sharpe, Wm.R.	Unnamed Spring	12-22-09	12-22-09	80

STATE ENGINEER'S OFFICE

WATER RESOURCES SURVEY

Township 8 S. Range 6 E County Park

<div style="border: 2px solid black; padding: 5px; display: inline-block;"> <p>539 1829</p> <p>537 539</p> <p>537</p> <p>532 537 539 539</p> <p>532 537 539 539</p> <p>532 537 539 539</p> <p>532 537 539 539</p> </div>						
6	7	8	9	10	11	12
13	14	15	16	17	18	19
20	21	22	23	24	25	26
27	28	29	30	31	32	33
34	35	36	37	38	39	40

Waldemar Simonson - owner

53

STATE OF MONTANA

State Engineer's Office
WATER RESOURCES SURVEY
FARM MAP

County _____

Code No. _____

Twp. _____ Rge. _____

Twp. _____ Rge. _____

Twp. _____ Rge. _____

Name of Land Owner _____

Address _____

Name of Operator _____

Address _____

Legal Description _____

☐

Irrigated Land

☐

Non-Irrigated Land
North

☐

Potential Land Under Existing Facilities

Code No. 4A System Merrill Ditches Source of Water Sharpe Creek
Basin Y.R. Present 62 Potential 0 Maximum 62 R ✓ F ✓ P ✓ G ✓ S ✓
Code No. 4A System Merrill Ditch Source of Water Pine Creek
Basin Y.R. Present 85 Potential 0 Maximum 85 R ✓ F ✓ P ✓ G ✓ S ✓
Code No. 4A System Merrill Ditches Source of Water Middle Creek
Basin Y.R. Present 22 Potential 0 Maximum 22 R ✓ F ✓ P ✓ G ✓ S ✓
Code No. _____ System _____ Source of Water _____
Basin _____ Present _____ Potential _____ Maximum _____ R ✓ F ✓ P ✓ G ✓ S ✓

If under Ditch Company, Irrigation District, or Government Project, state the number of shares or inches, acre feet, as the case may be in said system.

NOTE: R—Denotes Regular Irrigation. F—Flood Irrigation. P—Water diverted by means of pumping. G—Water diverted by gravity.
S—Stored Water.

Information from _____

Name

Date

2-5-52

Farm Checked

STATE OF MONTANA

Code No. 2A-3A

By Hane

STATE ENGINEER'S OFFICE
WATER RESOURCES SURVEY

County Park

Area Mixer Basin

T. 85 R. 6E Sec. 2-3

Date 5-6-51

Photo No. MPA-19A-50

Legal Land Owner.

Francis Smith

Address Miner

Operator

Lloyd Beedle (Buying)

Address

Water is delivered by:

Federal Project _____ **Pres.** _____ **Pot.** _____

Ditch Company _____ Pres. _____ Pot. _____

Irrigation District _____ Pres. _____ Put. _____

Private System ☒ Pres. _____ Pot. _____

[illegible]

Flood _____ Pump _____ Reservoir _____ Gravity ☒

Size and Capacity, Pump, etc. _____

Original **Appropriator, Company** _____ **App. No.** _____

Original Appropriator, Private _____ App. No. 2378

Is the **system** an extension of another system? Yes. _____ No. _____

Is all land irrigated from one system? Yes _____ No _____ 539

(If No, show break down on map)

Source of Water Horse Cr., Reader Cr., Miner Cr.

Acres Irrigated 19 57 _____

Potential Acres _____ Seeped _____

Explain _____

Condition of System Good

Adequate Supply --- Yes ✓ No _____

Explain

Topography Mountain Villes

Information From Hand Beedle

Remarks _____



FORM D-1— WESTERN LITHO. BILLINGS

STATE OF MONTANA

STATE ENGINEER'S OFFICE

WATER RESOURCES SURVEY

Township

7S

Range

6E

County

Park

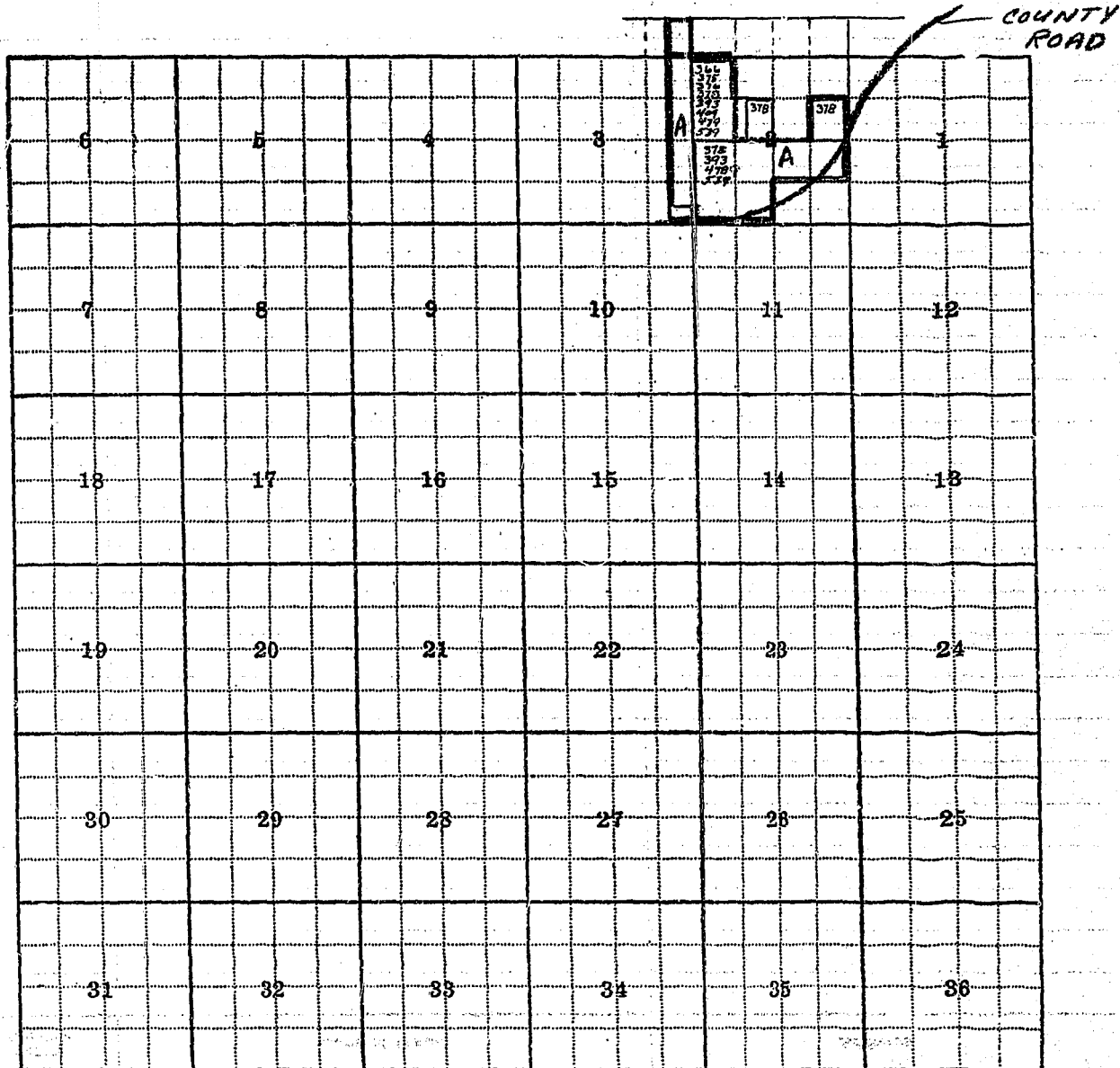

Francis Smith - owner

(52)

STATE OF MONTANA

State Engineer's Office
WATER RESOURCES SURVEY
FARM MAP

County

Code No.

Twp. Rge.

Twp. Rge.

Twp. Rge.

Name of Land Owner. Address.

Name of Operator. Address.

Legal Description.

☐ Irrigated Land

☐ Non-Irrigated Land
North

☐ Potential Land Under Existing Facilities

Code No. <u>2A-</u>	System <u>Smith-Pfehl Ditch</u>	Source of Water <u>Horse Creek</u>
Basin <u>Y.R</u>	Present <u>94</u> Potential <u>0</u> Maximum <u>94</u>	<u>R</u> <u>F</u> <u>P</u> <u>G</u> <u>S</u>
Code No. <u>2A-3A</u>	System <u>Smith Ditch</u>	Source of Water <u>Horse Creek</u>
Basin <u>Y.R</u>	Present <u>12</u> Potential <u>0</u> Maximum <u>12</u>	<u>R</u> <u>F</u> <u>P</u> <u>G</u> <u>S</u>
Code No. <u>3A</u>	System <u>Tom Miner Ditch</u>	Source of Water <u>Tom Miner Cr.</u>
Basin <u>Y.R</u>	Present <u>5</u> Potential <u>0</u> Maximum <u>5</u>	<u>R</u> <u>F</u> <u>P</u> <u>G</u> <u>S</u>
Code No. _____	System _____	Source of Water _____
Basin _____	Present _____ Potential _____ Maximum _____	<u>R</u> <u>F</u> <u>P</u> <u>G</u> <u>S</u>

If under Ditch Company, Irrigation District, or Government Project, state the number of shares or inches, acre feet, as the case may be in said system.

NOTE: R—Denotes Regular Irrigation. F—Flood Irrigation. P—Water diverted by means of pumping. G—Water diverted by gravity.
S—Stored Water.

Information from

Date 2-5-52

Township

8 S

Range

7 E

County

Park

Parcel Number	Name of Owner	Stream	Address	Filed	MT
306	^{Cutler} Gutter, Harriett E.	Cedar Cr.	1-13-09	7-12-09	80
308	Cutler, Robert E.	" "	12-20-03	12-22-03	150
311	Gilmore, Anna W.	" "	6-25-17	6-25-17	320
315	Randall, Richard	" "	12-27-03	6-27-03	300
520	Heist, Salomon	Dixon Cr.	1-10-22	7-10-22	80
521	^{Andrew} Pisch	" "	9-30-03	10-7-03	300
522	Selony, John	" "	4-23-17	4-23-17	160
524	Stimutz, Joseph	" "	10-10-08	10-10-08	40
875	Tastaurnik, Louis	Hoffman Cr.	11-6-16	11-6-16	40
879	Lehman, J.C.	Hoppe Cr.	4-22-91	4-22-91	150
*1003	Bailey, Joseph	Mill Cr.	8-18-00	8-22-00	160
1031	Roll, M.W.	" "	11-29-01	11-29-01	100
1032	" "	" "	11-29-01	11-29-01	100
1119	Badine, Alban	Mulherin Cr.	5-31-21	5-31-21	400
1120	Jewett, H.C.	" "	1-26-89	2-9-89	150
1128	Van Dyck, L.H.	" "	12-10-03	12-10-03	160
1577	Kloun, Louis	Spring Cr.	7-3-16	7-3-16	40
1761	1925 Northern Pacific Ry. Co.	Unnamed Cr.	9-2-97	9-4-97	5
1800	^{Cutler} 1946 Gutter, Robert E.	Unnamed Lake	12-12-08	12-17-08	200
1802	1948 George, James (Yankee Jim)	" "	11-24-85	11-24-85	911
1805	1951 Miller, P.J. & Swift, C.R.	" "	3-26-86	4-23-86	60
344	1962 Jones, E. & Wright, F.	Clear Water Spgs.	5-28-04	6-18-16	30
1926	2728 Kloun, Louis	Unnamed Spring	2-26-15	2-26-15	111
949a	Miller, P.J. et al	Lake Creek	3-26-86	4-23-86	60
1860-A	Cutler, Manley R.	unnamed Spring	5- -32	6-26-30	14
980	J.C. Bassett	Leon Hollow Cr.	8-10-97	8-17-97	160
981	M.G. & W.H. North	" "	9-29-98	9-30-98	160

DATE OF ENTRY