

STATE OF MONTANA
STATE ENGINEERS OFFICE
Water Resources Survey

T. 6S R. 46E Plat No. 52
Photo No. 29-75

Water is delivered by:—^x 1. Private System; 2. Ditch Company; 3. State Project; 4. Federal Project; 5. Irrigation District

If under Ditch Company, Irrigation District, or Government Project, state the number of shares or inches, acre feet, as the case may be in said system

[illegible]

NOTE: R—Denotes Regular Irrigation. F—Flood Irrigation. P—Water diverted by means of pumping. G—Water diverted by gravity. S—Stored Water.

Condition of System Fair Topography Valley River Basin Yellowstone
Adequate Supply: Yes ☐ No ☒ Explain _____
Remarks _____

Also in: Plat No..... Twp..... Rge.....	Plat No..... Twp..... Rge.....	Plat No..... Twp..... Rge.....
Plat No..... Twp..... Rge.....	Plat No..... Twp..... Rge.....	Plat No..... Twp..... Rge.....

Information From:
Anne Thex Bull

County Powder River

Farm Checked: Date...9-26-60

By George Brandt

STATE OF MONTANA
STATE ENGINEERS OFFICE
Water Resources Survey

T. 6S.....R. 46E..... Plat No. 52.....

Photo No. 29-75, 76, 77

Legal Land Owner United States of America Address

Operator	Address
<code>ADD R1, #1</code>	<code>0x00000001</code>
<code>MUL R2, R1, R2</code>	<code>0x00000002</code>
<code>SUB R3, R2, R1</code>	<code>0x00000003</code>
<code>MOV R4, R3</code>	<code>0x00000004</code>
<code>AND R5, R4, #0xFF</code>	<code>0x00000005</code>
<code>OR R6, R5, #0xFF</code>	<code>0x00000006</code>
<code>XOR R7, R6, #0xFF</code>	<code>0x00000007</code>
<code>LDR R8, [R7]</code>	<code>0x00000008</code>
<code>STR R8, [R7]</code>	<code>0x00000009</code>
<code>BLZ R9, R8, #0</code>	<code>0x0000000A</code>
<code>BPLZ R10, R9, #0</code>	<code>0x0000000B</code>
<code>BEQZ R11, R10, #0</code>	<code>0x0000000C</code>
<code>BTBZ R12, R11, #0</code>	<code>0x0000000D</code>
<code>BRZ R13, R12, #0</code>	<code>0x0000000E</code>
<code>BRNZ R14, R13, #0</code>	<code>0x0000000F</code>
<code>BRGTZ R15, R14, #0</code>	<code>0x00000010</code>
<code>BRGTEZ R16, R15, #0</code>	<code>0x00000011</code>
<code>BRLTZ R17, R16, #0</code>	<code>0x00000012</code>
<code>BRLTEZ R18, R17, #0</code>	<code>0x00000013</code>
<code>BRGEZ R19, R18, #0</code>	<code>0x00000014</code>
<code>BRGEGEZ R20, R19, #0</code>	<code>0x00000015</code>
<code>BRLEZ R21, R20, #0</code>	<code>0x00000016</code>
<code>BRLTLEZ R22, R21, #0</code>	<code>0x00000017</code>
<code>BRGTEZ R23, R22, #0</code>	<code>0x00000018</code>
<code>BRGTLEZ R24, R23, #0</code>	<code>0x00000019</code>
<code>BRLEZ R25, R24, #0</code>	<code>0x0000001A</code>
<code>BRLTLEZ R26, R25, #0</code>	<code>0x0000001B</code>
<code>BRGTEZ R27, R26, #0</code>	<code>0x0000001C</code>
<code>BRGTLEZ R28, R27, #0</code>	<code>0x0000001D</code>
<code>BRLEZ R29, R28, #0</code>	<code>0x0000001E</code>
<code>BRLTLEZ R30, R29, #0</code>	<code>0x0000001F</code>
<code>BRGTEZ R31, R30, #0</code>	<code>0x00000020</code>
<code>BRGTLEZ R32, R31, #0</code>	<code>0x00000021</code>
<code>BRLEZ R33, R32, #0</code>	<code>0x00000022</code>
<code>BRLTLEZ R34, R33, #0</code>	<code>0x00000023</code>
<code>BRGTEZ R35, R34, #0</code>	<code>0x00000024</code>
<code>BRGTLEZ R36, R35, #0</code>	<code>0x00000025</code>
<code>BRLEZ R37, R36, #0</code>	<code>0x00000026</code>
<code>BRLTLEZ R38, R37, #0</code>	<code>0x00000027</code>
<code>BRGTEZ R39, R38, #0</code>	<code>0x00000028</code>
<code>BRGTLEZ R40, R39, #0</code>	<code>0x00000029</code>
<code>BRLEZ R41, R40, #0</code>	<code>0x0000002A</code>
<code>BRLTLEZ R42, R41, #0</code>	<code>0x0000002B</code>
<code>BRGTEZ R43, R42, #0</code>	<code>0x0000002C</code>
<code>BRGTLEZ R44, R43, #0</code>	<code>0x0000002D</code>
<code>BRLEZ R45, R44, #0</code>	<code>0x0000002E</code>
<code>BRLTLEZ R46, R45, #0</code>	<code>0x0000002F</code>
<code>BRGTEZ R47, R46, #0</code>	<code>0x00000030</code>
<code>BRGTLEZ R48, R47, #0</code>	<code>0x00000031</code>
<code>BRLEZ R49, R48, #0</code>	<code>0x00000032</code>
<code>BRLTLEZ R50, R49, #0</code>	<code>0x00000033</code>
<code>BRGTEZ R51, R50, #0</code>	<code>0x00000034</code>
<code>BRGTLEZ R52, R51, #0</code>	<code>0x00000035</code>
<code>BRLEZ R53, R52, #0</code>	<code>0x00000036</code>
<code>BRLTLEZ R54, R53, #0</code>	<code>0x00000037</code>
<code>BRGTEZ R55, R54, #0</code>	<code>0x00000038</code>
<code>BRGTLEZ R56, R55, #0</code>	<code>0x00000039</code>
<code>BRLEZ R57, R56, #0</code>	<code>0x0000003A</code>
<code>BRLTLEZ R58, R57, #0</code>	<code>0x0000003B</code>
<code>BRGTEZ R59, R58, #0</code>	<code>0x0000003C</code>
<code>BRGTLEZ R60, R59, #0</code>	<code>0x0000003D</code>
<code>BRLEZ R61, R60, #0</code>	<code>0x0000003E</code>
<code>BRLTLEZ R62, R61, #0</code>	<code>0x0000003F</code>
<code>BRGTEZ R63, R62, #0</code>	<code>0x00000040</code>
<code>BRGTLEZ R64, R63, #0</code>	<code>0x00000041</code>
<code>BRLEZ R65, R64, #0</code>	<code>0x00000042</code>
<code>BRLTLEZ R66, R65, #0</code>	<code>0x00000043</code>
<code>BRGTEZ R67, R66, #0</code>	<code>0x00000044</code>
<code>BRGTLEZ R68, R67, #0</code>	<code>0x00000045</code>
<code>BRLEZ R69, R68, #0</code>	<code>0x00000046</code>
<code>BRLTLEZ R70, R69, #0</code>	<code>0x00000047</code>
<code>BRGTEZ R71, R70, #0</code>	<code>0x00000048</code>
<code>BRGTLEZ R72, R71, #0</code>	<code>0x00000049</code>
<code>BRLEZ R73, R72, #0</code>	<code>0x0000004A</code>
<code>BRLTLEZ R74, R73, #0</code>	<code>0x0000004B</code>
<code>BRGTEZ R75, R74, #0</code>	<code>0x0000004C</code>
<code>BRGTLEZ R76, R75, #0</code>	<code>0x0000004D</code>
<code>BRLEZ R77, R76, #0</code>	<code>0x0000004E</code>
<code>BRLTLEZ R78, R77, #0</code>	<code>0x0000004F</code>
<code>BRGTEZ R79, R78, #0</code>	<code>0x00000050</code>
<code>BRGTLEZ R80, R79, #0</code>	<code>0x00000051</code>

Water is delivered by:— 1. Private System; 2. Ditch Company; 3. State Project; 4. Federal Project; 5. Irrigation District

If under Ditch Company, Irrigation District, or Government Project, state the number of shares or inches, acre feet, as the case may be in said system

[illegible]

NOTE: R—Denotes Regular Irrigation. F—Flood Irrigation. P—Water diverted by means of pumping. G—Water diverted by gravity. S—Stored Water.

Condition of System	Topography	River Basin	Yellowstone
Adequate Supply: Yes..... No.....	Explain		
Remarks			

[illegible]

Also in: Plat No.....	Twp.....	Rge.....	Plat No.....	Twp.....	Rge.....	Plat No.....	Twp.....	Rge.....
Plat No.....	Twp.....	Rge.....	Plat No.....	Twp.....	Rge.....	Plat No.....	Twp.....	Rge.....

Information From:
Field Survey & Neighbors

	6		5		4		3		2		1
	7		8		9		10		11		12
A	18		17		16		15		14		13
	19		20		21		22		23		24
	30		29		28		27		26		25
	31		32		33		34		35		36

18-A

NOTE: All U. S. A. ownership is not platted. Only that part where the appropriation is located. See ownership plat for any additional ownership required.

Mrs. Maude Carlat

6	5	4	3	2	1	A
7	8	9	10	11	12	A
13	17	16	15	14	13	
19	20	21	22	23	24	
29	29	23	27	28	25	
31	32	33	34	35	36	

1-A, 12-A, 27-B, 34-A, 35-B

Also in: Plat No.....	Twp.....	Rge.....	Plat No.....	Twp.....	Rge.....	Plat No.....	Twp.....	Rge.....
Plat No.....	Twp.....	Rge.....	Plat No.....	Twp.....	Rge.....	Plat No.....	Twp.....	Rge.....

	6		5		4		3		2		1	
	7		8		9		10		11		12	
	13		17		16		15		14		13	B
											B	
	19		20		21		22		23		24	
	30		29		28		27		26		25	
	31		32		33		34		35		36	

13-B, 24-B

If under Ditch Company, Irrigation District, or Government Project, state the number of shares or inches, acre feet, as the case may be in said system

Photo No. 23-36

Address

NOTE: R—Denotes Regular Irrigation. F—Flood Irrigation. P—Water diverted by means of pumping. G—Water diverted by gravity. S—Stored Water.

Adequate Supply: Yes..... No.....X... Explain

Remarks

Remarks

1 2 3 4 5 6 7 8 9 10 11 12 13 14 15 16 17 18 19 20 21 22 23 24 25 26 27 28 29 30 31 32 33 34 35 36 37 38 39 40 41 42 43 44 45 46 47 48 49 50 51 52 53 54 55 56 57 58 59 60 61 62 63 64 65 66 67 68 69 70 71 72 73 74 75 76 77 78 79 80 81 82 83 84 85 86 87 88 89 90 91 92 93 94 95 96 97 98 99 100 101 102 103 104 105 106 107 108 109 110 111 112 113 114 115 116 117 118 119 120 121 122 123 124 125 126 127 128 129 130 131 132 133 134 135 136 137 138 139 140 141 142 143 144 145 146 147 148 149 150 151 152 153 154 155 156 157 158 159 160 161 162 163 164 165 166 167 168 169 170 171 172 173 174 175 176 177 178 179 180 181 182 183 184 185 186 187 188 189 190 191 192 193 194 195 196 197 198 199 200 201 202 203 204 205 206 207 208 209 210 211 212 213 214 215 216 217 218 219 220 221 222 223 224 225 226 227 228 229 230 231 232 233 234 235 236 237 238 239 240 241 242 243 244 245 246 247 248 249 250 251 252 253 254 255 256 257 258 259 260 261 262 263 264 265 266 267 268 269 270 271 272 273 274 275 276 277 278 279 280 281 282 283 284 285 286 287 288 289 290 291 292 293 294 295 296 297 298 299 300 301 302 303 304 305 306 307 308 309 310 311 312 313 314 315 316 317 318 319 320 321 322 323 324 325 326 327 328 329 330 331 332 333 334 335 336 337 338 339 340 341 342 343 344 345 346 347 348 349 350 351 352 353 354 355 356 357 358 359 360 361 362 363 364 365 366 367 368 369 370 371 372 373 374 375 376 377 378 379 380 381 382 383 384 385 386 387 388 389 390 391 392 393 394 395 396 397 398 399 400 401 402 403 404 405 406 407 408 409 410 411 412 413 414 415 416 417 418 419 420 421 422 423 424 425 426 427 428 429 430 431 432 433 434 435 436 437 438 439 440 441 442 443 444 445 446 447 448 449 450 451 452 453 454 455 456 457 458 459 460 461 462 463 464 465 466 467 468 469 470 471 472 473 474 475 476 477 478 479 480 481 482 483 484 485 486 487 488 489 490 491 492 493 494 495 496 497 498 499 500 501 502 503 504 505 506 507 508 509 510 511 512 513 514 515 516 517 518 519 520 521 522 523 524 525 526 527 528 529 530 531 532 533 534 535 536 537 538 539 540 541 542 543 544 545 546 547 548 549 550 551 552 553 554 555 556 557 558 559 560 561 562 563 564 565 566 567 568 569 570 571 572 573 574 575 576 577 578 579 580 581 582 583 584 585 586 587 588 589 590 591 592 593 594 595 596 597 598 599 600 601 602 603 604 605 606 607 608 609 610 611 612 613 614 615 616 617 618 619 620 621 622 623 624 625 626 627 628 629 630 631 632 633 634 635 636 637 638 639 640 641 642 643 644 645 646 647 648 649 650 651 652 653 654 655 656 657 658 659 660 661 662 663 664 665 666 667 668 669 670 671 672 673 674 675 676 677 678 679 680 681 682 683 684 685 686 687 688 689 690 691 692 693 694 695 696 697 698 699 700 701 702 703 704 705 706 707 708 709 710 711 712 713 714 715 716 717 718 719 720 721 722 723 724 725 726 727 728 729 730 731 732 733 734 735 736 737 738 739 740 741 742 743 744 745 746 747 748 749 750 751 752 753 754 755 756 757 758 759 760 761 762 763 764 765 766 767 768 769 770 771 772 773 774 775 776 777 778 779 780 781 782 783 784 785 786 787 788 789 790 791 792 793 794 795 796 797 798 799 800 801 802 803 804 805 806 807 808 809 810 811 812 813 814 815 816 817 818 819 820 821 822 823 824 825 826 827 828 829 830 831 832 833 834 835 836 837 838 839 840 841 842 843 844 845 846 847 848 849 850 851 852 853 854 855 856 857 858 859 860 861 862 863 864 865 866 867 868 869 870 871 872 873 874 875 876 877 878 879 880 881 882 883 884 885 886 887 888 889 890 891 892 893 894 895 896 897 898 899 900 901 902 903 904 905 906 907 908 909 910 911 912 913 914 915 916 917 918 919 920 921 922 923 924 925 926 927 928 929 930 931 932 933 934 935 936 937 938 939 940 941 942 943 944 945 946 947 948 949 950 951 952 953 954 955 956 957 958 959 960 961 962 963 964 965 966 967 968 969 970 971 972 973 974 975 976 977 978 979 980 981 982 983 984 985 986 987 988 989 990 991 992 993 994 995 996 997 998 999 1000 1001 1002 1003 1004 1005 1006 1007 1008 1009 1010 1011 1012 1013 1014 1015 1016 1017 1018 1019 1020 1021 1022 1023 1024 1025 1026 1027 1028 1029 1030 1031 1032 1033 1034 1035 1036 1037 1038 1039 104

[illegible]

[Return to top](#)

.....

1 2 3 4 5 6 7 8 9 10 11 12 13 14 15 16 17 18 19 20 21 22 23 24 25 26 27 28 29 30 31 32 33 34 35 36 37 38 39 40 41 42 43 44 45 46 47 48 49 50 51 52 53 54 55 56 57 58 59 60 61 62 63 64 65 66 67 68 69 70 71 72 73 74 75 76 77 78 79 80 81 82 83 84 85 86 87 88 89 90 91 92 93 94 95 96 97 98 99 100 101 102 103 104 105 106 107 108 109 110 111 112 113 114 115 116 117 118 119 120 121 122 123 124 125 126 127 128 129 130 131 132 133 134 135 136 137 138 139 140 141 142 143 144 145 146 147 148 149 150 151 152 153 154 155 156 157 158 159 160 161 162 163 164 165 166 167 168 169 170 171 172 173 174 175 176 177 178 179 180 181 182 183 184 185 186 187 188 189 190 191 192 193 194 195 196 197 198 199 200 201 202 203 204 205 206 207 208 209 210 211 212 213 214 215 216 217 218 219 220 221 222 223 224 225 226 227 228 229 230 231 232 233 234 235 236 237 238 239 240 241 242 243 244 245 246 247 248 249 250 251 252 253 254 255 256 257 258 259 260 261 262 263 264 265 266 267 268 269 270 271 272 273 274 275 276 277 278 279 280 281 282 283 284 285 286 287 288 289 290 291 292 293 294 295 296 297 298 299 300 301 302 303 304 305 306 307 308 309 310 311 312 313 314 315 316 317 318 319 320 321 322 323 324 325 326 327 328 329 330 331 332 333 334 335 336 337 338 339 340 341 342 343 344 345 346 347 348 349 350 351 352 353 354 355 356 357 358 359 360 361 362 363 364 365 366 367 368 369 370 371 372 373 374 375 376 377 378 379 380 381 382 383 384 385 386 387 388 389 390 391 392 393 394 395 396 397 398 399 400 401 402 403 404 405 406 407 408 409 410 411 412 413 414 415 416 417 418 419 420 421 422 423 424 425 426 427 428 429 430 431 432 433 434 435 436 437 438 439 440 441 442 443 444 445 446 447 448 449 450 451 452 453 454 455 456 457 458 459 460 461 462 463 464 465 466 467 468 469 470 471 472 473 474 475 476 477 478 479 480 481 482 483 484 485 486 487 488 489 490 491 492 493 494 495 496 497 498 499 500 501 502 503 504 505 506 507 508 509 510 511 512 513 514 515 516 517 518 519 520 521 522 523 524 525 526 527 528 529 530 531 532 533 534 535 536 537 538 539 540 541 542 543 544 545 546 547 548 549 550 551 552 553 554 555 556 557 558 559 560 561 562 563 564 565 566 567 568 569 570 571 572 573 574 575 576 577 578 579 580 581 582 583 584 585 586 587 588 589 590 591 592 593 594 595 596 597 598 599 600 601 602 603 604 605 606 607 608 609 610 611 612 613 614 615 616 617 618 619 620 621 622 623 624 625 626 627 628 629 630 631 632 633 634 635 636 637 638 639 640 641 642 643 644 645 646 647 648 649 650 651 652 653 654 655 656 657 658 659 660 661 662 663 664 665 666 667 668 669 670 671 672 673 674 675 676 677 678 679 680 681 682 683 684 685 686 687 688 689 690 691 692 693 694 695 696 697 698 699 700 701 702 703 704 705 706 707 708 709 710 711 712 713 714 715 716 717 718 719 720 721 722 723 724 725 726 727 728 729 730 731 732 733 734 735 736 737 738 739 740 741 742 743 744 745 746 747 748 749 750 751 752 753 754 755 756 757 758 759 760 761 762 763 764 765 766 767 768 769 770 771 772 773 774 775 776 777 778 779 780 781 782 783 784 785 786 787 788 789 790 791 792 793 794 795 796 797 798 799 800 801 802 803 804 805 806 807 808 809 810 811 812 813 814 815 816 817 818 819 820 821 822 823 824 825 826 827 828 829 830 831 832 833 834 835 836 837 838 839 840 841 842 843 844 845 846 847 848 849 850 851 852 853 854 855 856 857 858 859 860 861 862 863 864 865 866 867 868 869 870 871 872 873 874 875 876 877 878 879 880 881 882 883 884 885 886 887 888 889 890 891 892 893 894 895 896 897 898 899 900 901 902 903 904 905 906 907 908 909 910 911 912 913 914 915 916 917 918 919 920 921 922 923 924 925 926 927 928 929 930 931 932 933 934 935 936 937 938 939 940 941 942 943 944 945 946 947 948 949 950 951 952 953 954 955 956 957 958 959 960 961 962 963 964 965 966 967 968 969 970 971 972 973 974 975 976 977 978 979 980 981 982 983 984 985 986 987 988 989 990 991 992 993 994 995 996 997 998 999 1000 1001 1002 1003 1004 1005 1006 1007 1008 1009 1010 1011 1012 1013 1014 1015 1016 1017 1018 1019 1020 1021 1022 1023 1024 1025 1026 1027 1028 1029 1030 1031 1032 1033 1034 1035 1036 1037 1038 1039 104

.....

.....

[\[Detailed description of the figure\]](#)

12345678910111213141516171819202122232425262728293031323334353637383940414243444546474849505152535455565758596061626364656667686970717273747576777879808182838485868788899091929394959697989910010110210310410510610710810911011111211311411511611711811912012112212312412512612712812913013113213313413513613713813914014114214314414514614714814915015115215315415515615715815916016116216316416516616716816917017117217317417517617717817918018118218318418518618718818919019119219319419519619719819920020120220320420520620720820921021121221321421521621721821922022122222322422522622722822923023123223323423523623723823924024124224324424524624724824925025125225325425525625725825926026126226326426526626726826927027127227327427527627727827928028128228328428528628728828929029129229329429529629729829930030130230330430530630730830931031131231331431531631731831932032132232332432532632732832933033133233333433533633733833934034134234334434534634734834935035135235335435535635735835936036136236336436536636736836937037137237337437537637737837938038138238338438538638738838939039139239339439539639739839940040140240340440540640740840941041141241341441541641741841942042142242342442542642742842943043143243343443543643743843944044144244344444544644744844945045145245345445545645745845946046146246346446546646746846947047147247347447547647747847948048148248348448548648748848949049149249349449549649749849950050150250350450550650750850951051151251351451551651751851952052152252352452552652752852953053153253353453553653753853954054154254354454554654754854955055155255355455555655755855956056156256356456556656756856957057157257357457557657757857958058158258358458558658758858959059159259359459559659759859960060160260360460560660760860961061161261361461561661761861962062162262362462562662762862963063163263363463563663763863964064164264364464564664764864965065165265365465565665765865966066166266366466566666766866967067167267367467567667767867968068168268368468568668768868969069169269369469569669769869970070170270370470570670770870971071171271371471571671771871972072172272372472572672772872973073173273373473573673773873974074174274374474574674774874975075175275375475575675775875976076176276376476576676776876977077177277377477577677777877978078178278378478578678778878979079179279379479579679779879980080180280380480580680780880981081181281381481581681781881982082182282382482582682782882983083183283383483583683783883984084184284384484584684784884985085185285385485585685785885986086186286386486586686786886987087187287387487587687787887988088188288388488588688788888989089189289389489589689789889990090190290390490590690790890991091191291391491591691791891992092192292392492592692792892993093193293393493593693793893994094194294394494594694794894995095195295395495595695795895996096196296396496596696796896997097197297397497597697797897998098198298398498598698798898999099199299399499599699799899910001001100210031004100510061007100810091010101110121013101410151016101710181019102010211022102310241025102610271028102910301031103210331034103510361037103810391040104110421043104410451046104710481049105010511052105310541055105610571058105910601061106210631064106510661067106810691070107110721073107410751076107710781079108010811082108310841085108610871088108910901091109210931094109510961097109810991100110111021103110411051106110711081109111011111112111311141115111611171118111911201121112211231124112511261127112811291130113111321133113411351136113711381139114011411142114311441145114611471148114911501151115211531154115511561157115811591160116111621163116411651166116711681169117011711172117311741175117611771178117911801181118211831184118511861187118811891190119111921193119411951196119711981199120012011202120312041205120612071208120912101211121212131214121512161217121812191220122112221223122412251226122712281229123012311232123312341235123612371238123912401241124212431244124512461247124812491250125112521253125412551256125712581259126012611262126312641265126612671268126912701271127212731274127512761277127812791280128112821283128412851286128712881289129012911292129312941295129612971298129913001

[Tegyük fel, hogy az alábbiakban leírtak egy új, még nem létező szót jelentenek. Milyen szó lehet ez? Írja meg a szó magánhangzóit és a szó végén álló betűket! A szó magánhangzóit a szó elején kell megírnia, a szó végén álló betűket pedig a szó végén!](#)

<u>Airway Plot No.</u>	<u>Turn</u>	<u>Race</u>	<u>Plot No.</u>	<u>Turn</u>	<u>Race</u>	<u>Plot No.</u>	<u>Turn</u>	<u>Race</u>	Information From:
------------------------	-------------	-------------	-----------------	-------------	-------------	-----------------	-------------	-------------	-------------------

Also in: Plat No. Twp. Age.			Plat No. Twp. Age.			Plat No. Twp. Age.		
Plat No.	Twp.	Age.	Plat No.	Twp.	Age.	Plat No.	Twp.	Age.

H. J. McCullough

Page 10 of 10

Information From:

H. J. McCullough

6	5	4	3	2	1
7	8	9	10	11	12
13	17	16	15	14	13
19	20	21	22	23	24
29	29	28	27	26	25
31	32	33	34	35	36

31-B

5

Information From:
Field Survey

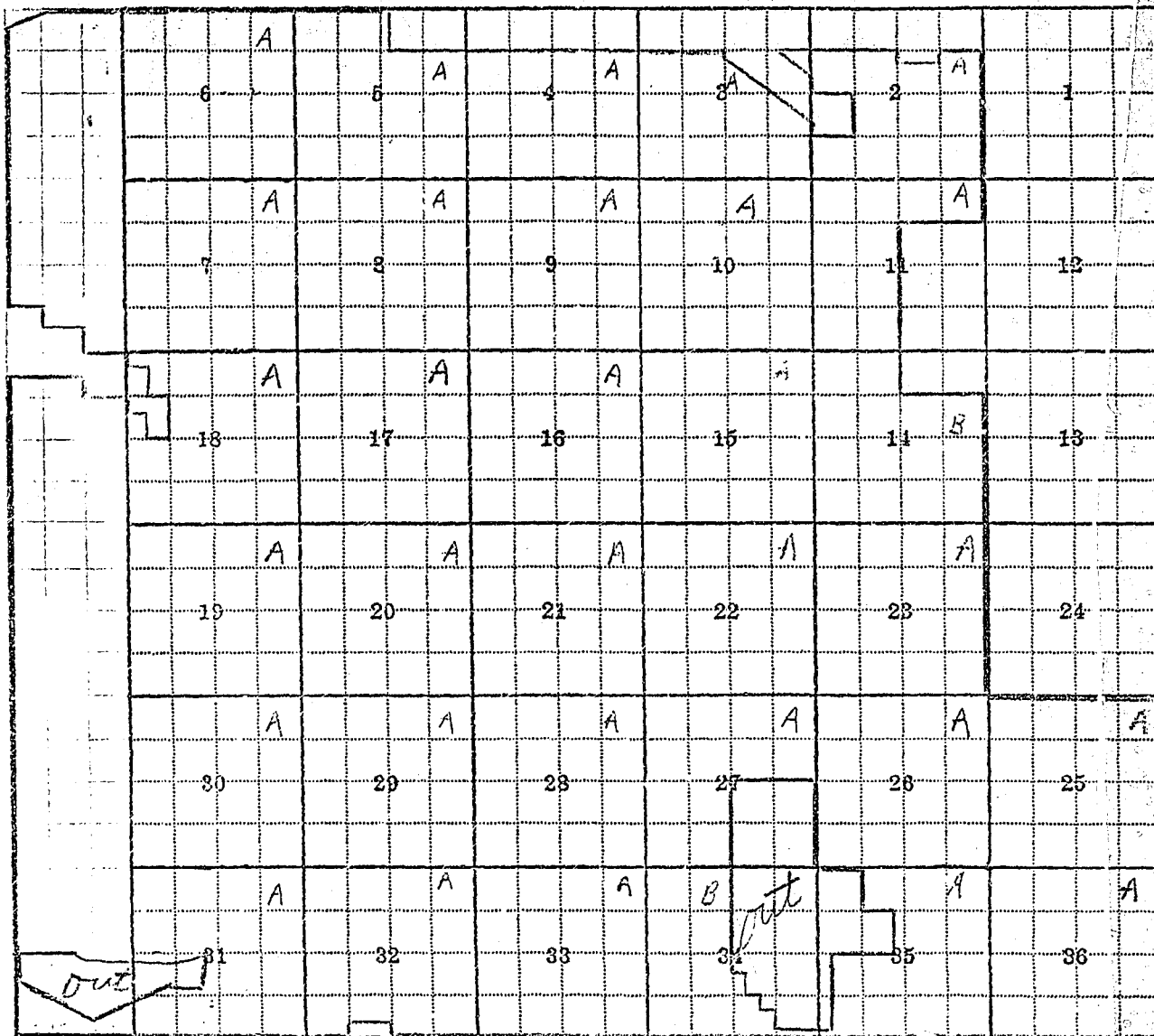

2-A, 3-A, 4-A, 5-A, 6-A, 7-A, 8-A, 9-A, 10-A, 11-A, 14-B, 15-A, 16-A, 17-A, 18-A,
 19-A, 20-A, 21-A, 22-A, 23-A, 25-A, 26-A, 27-A, 28-A, 29-A, 30-A, 31-A, 32-A, 33-A,
 34-B, 35-A, 36-A

County Powder River

Farm Checked: Date.....9-23-60

By George Brandt

STATE OF MONTANA
STATE ENGINEERS OFFICE
Water Resources Survey

T.. 3..48E.. Plat No...54.....

Photo No. 17-15

Legal Land Owner L. T. & Maude Carlat Address Sonnette & Kansas City, Missouri

Operator Ralph Carlat Address Sonnette

Water is delivered by:— 1. Private System; 2. Ditch Company; 3. State Project; 4. Federal Project; 5. Irrigation District

If under Ditch Company, Irrigation District, or Government Project, state the number of shares or inches, acre feet, as the case may be in said system

[illegible]

NOTE: R—Denotes Regular Irrigation. F—Flood Irrigation. P—Water diverted by means of pumping. G—Water diverted by gravity. S—Stored Water.

Condition of System Topography Mountains River Basin Yellowstone

Adequate Supply: Yes..... No..... Explain.....

Remarks	
---------	--

Also in: Plat No. 53 Twp. 65 Rge. 47E	Plat No. Twp. Rge.	Plat No. Twp. Rge.
Plat No. Twp. Rge.	Plat No. Twp. Rge.	Plat No. Twp. Rge.

Information From:

Mrs. M. Carlat

6	5	5	4	3	2	1
7	8	9	10	11	12	
13	17	16	15	14	13	
19	20	21	22	23	24	
29	29	28	27	26	25	
31	32	33	34	35	36	

5-B

By George Brandt

STATE OF MONTANA
STATE ENGINEERS OFFICE
Water Resources Survey

T. 6S R. 48E Plat No. 54

Photo No. 17-15, 17-51, 17-14

Legal Land Owner Eldon & Marvin Harris Address Sonnette

Operator: Same Address

Water is delivered by:— 1. Private System; 2. Ditch Company; 3. State Project; 4. Federal Project; 5. Irrigation District

If under Ditch Company, Irrigation District, or Government Project, state the number of shares or inches, acre feet, as the case may be in said system

[illegible]

NOTE: R—Denotes Regular Irrigation. F—Flood Irrigation. P—Water diverted by means of pumping. G—Water diverted by gravity. S—Stored Water.

Condition of System Topography Large Hills River Basin Yellowstone

Adequate Supply: Yes..... No ^X..... Explain

Remarks These fellows made the remark - "It must be one of those old scripts" when I talked to them.

12345678910111213141516171819202122232425262728293031323334353637383940414243444546474849505152535455565758596061626364656667686970717273747576777879808182838485868788899091929394959697989910010110210310410510610710810911011111211311411511611711811912012112212312412512612712812913013113213313413513613713813914014114214314414514614714814915015115215315415515615715815916016116216316416516616716816917017117217317417517617717817918018118218318418518618718818919019119219319419519619719819920020120220320420520620720820921021121221321421521621721821922022122222322422522622722822923023123223323423523623723823924024124224324424524624724824925025125225325425525625725825926026126226326426526626726826927027127227327427527627727827928028128228328428528628728828929029129229329429529629729829930030130230330430530630730830931031131231331431531631731831932032132232332432532632732832933033133233333433533633733833934034134234334434534634734834935035135235335435535635735835936036136236336436536636736836937037137237337437537637737837938038138238338438538638738838939039139239339439539639739839940040140240340440540640740840941041141241341441541641741841942042142242342442542642742842943043143243343443543643743843944044144244344444544644744844945045145245345445545645745845946046146246346446546646746846947047147247347447547647747847948048148248348448548648748848949049149249349449549649749849950050150250350450550650750850951051151251351451551651751851952052152252352452552652752852953053153253353453553653753853954054154254354454554654754854955055155255355455555655755855956056156256356456556656756856957057157257357457557657757857958058158258358458558658758858959059159259359459559659759859960060160260360460560660760860961061161261361461561661761861962062162262362462562662762862963063163263363463563663763863964064164264364464564664764864965065165265365465565665765865966066166266366466566666766866967067167267367467567667767867968068168268368468568668768868969069169269369469569669769869970070170270370470570670770870971071171271371471571671771871972072172272372472572672772872973073173273373473573673773873974074174274374474574674774874975075175275375475575675775875976076176276376476576676776876977077177277377477577677777877978078178278378478578678778878979079179279379479579679779879980080180280380480580680780880981081181281381481581681781881982082182282382482582682782882983083183283383483583683783883984084184284384484584684784884985085185285385485585685785885986086186286386486586686786886987087187287387487587687787887988088188288388488588688788888989089189289389489589689789889990090190290390490590690790890991091191291391491591691791891992092192292392492592692792892993093193293393493593693793893994094194294394494594694794894995095195295395495595695795895996096196296396496596696796896997097197297397497597697797897998098198298398498598698798898999099199299399499599699799899910001001100210031004100510061007100810091010101110121013101410151016101710181019102010211022102310241025102610271028102910301031103210331034103510361037103810391040104110421043104410451046104710481049105010511052105310541055105610571058105910601061106210631064106510661067106810691070107110721073107410751076107710781079108010811082108310841085108610871088108910901091109210931094109510961097109810991100110111021103110411051106110711081109111011111112111311141115111611171118111911201121112211231124112511261127112811291130113111321133113411351136113711381139114011411142114311441145114611471148114911501151115211531154115511561157115811591160116111621163116411651166116711681169117011711172117311741175117611771178117911801181118211831184118511861187118811891190119111921193119411951196119711981199120012011202120312041205120612071208120912101211121212131214121512161217121812191220122112221223122412251226122712281229123012311232123312341235123612371238123912401241124212431244124512461247124812491250125112521253125412551256125712581259126012611262126312641265126612671268126912701271127212731274127512761277127812791280128112821283128412851286128712881289129012911292129312941295129612971298129913001

12345678910111213141516171819202122232425262728293031323334353637383940414243444546474849505152535455565758596061626364656667686970717273747576777879808182838485868788899091929394959697989910010110210310410510610710810911011111211311411511611711811912012112212312412512612712812913013113213313413513613713813914014114214314414514614714814915015115215315415515615715815916016116216316416516616716816917017117217317417517617717817918018118218318418518618718818919019119219319419519619719819920020120220320420520620720820921021121221321421521621721821922022122222322422522622722822923023123223323423523623723823924024124224324424524624724824925025125225325425525625725825926026126226326426526626726826927027127227327427527627727827928028128228328428528628728828929029129229329429529629729829930030130230330430530630730830931031131231331431531631731831932032132232332432532632732832933033133233333433533633733833934034134234334434534634734834935035135235335435535635735835936036136236336436536636736836937037137237337437537637737837938038138238338438538638738838939039139239339439539639739839940040140240340440540640740840941041141241341441541641741841942042142242342442542642742842943043143243343443543643743843944044144244344444544644744844945045145245345445545645745845946046146246346446546646746846947047147247347447547647747847948048148248348448548648748848949049149249349449549649749849950050150250350450550650750850951051151251351451551651751851952052152252352452552652752852953053153253353453553653753853954054154254354454554654754854955055155255355455555655755855956056156256356456556656756856957057157257357457557657757857958058158258358458558658758858959059159259359459559659759859960060160260360460560660760860961061161261361461561661761861962062162262362462562662762862963063163263363463563663763863964064164264364464564664764864965065165265365465565665765865966066166266366466566666766866967067167267367467567667767867968068168268368468568668768868969069169269369469569669769869970070170270370470570670770870971071171271371471571671771871972072172272372472572672772872973073173273373473573673773873974074174274374474574674774874975075175275375475575675775875976076176276376476576676776876977077177277377477577677777877978078178278378478578678778878979079179279379479579679779879980080180280380480580680780880981081181281381481581681781881982082182282382482582682782882983083183283383483583683783883984084184284384484584684784884985085185285385485585685785885986086186286386486586686786886987087187287387487587687787887988088188288388488588688788888989089189289389489589689789889990090190290390490590690790890991091191291391491591691791891992092192292392492592692792892993093193293393493593693793893994094194294394494594694794894995095195295395495595695795895996096196296396496596696796896997097197297397497597697797897998098198298398498598698798898999099199299399499599699799899910001001100210031004100510061007100810091010101110121013101410151016101710181019102010211022102310241025102610271028102910301031103210331034103510361037103810391040104110421043104410451046104710481049105010511052105310541055105610571058105910601061106210631064106510661067106810691070107110721073107410751076107710781079108010811082108310841085108610871088108910901091109210931094109510961097109810991100110111021103110411051106110711081109111011111112111311141115111611171118111911201121112211231124112511261127112811291130113111321133113411351136113711381139114011411142114311441145114611471148114911501151115211531154115511561157115811591160116111621163116411651166116711681169117011711172117311741175117611771178117911801181118211831184118511861187118811891190119111921193119411951196119711981199120012011202120312041205120612071208120912101211121212131214121512161217121812191220122112221223122412251226122712281229123012311232123312341235123612371238123912401241124212431244124512461247124812491250125112521253125412551256125712581259126012611262126312641265126612671268126912701271127212731274127512761277127812791280128112821283128412851286128712881289129012911292129312941295129612971298129913001

© 2016 Pearson Education, Inc. or its affiliate(s). All rights reserved.

[illegible][illegible][illegible]

.....

12345678910111213141516171819202122232425262728293031323334353637383940414243444546474849505152535455565758596061626364656667686970717273747576777879808182838485868788899091929394959697989910010110210310410510610710810911011111211311411511611711811912012112212312412512612712812913013113213313413513613713813914014114214314414514614714814915015115215315415515615715815916016116216316416516616716816917017117217317417517617717817918018118218318418518618718818919019119219319419519619719819920020120220320420520620720820921021121221321421521621721821922022122222322422522622722822923023123223323423523623723823924024124224324424524624724824925025125225325425525625725825926026126226326426526626726826927027127227327427527627727827928028128228328428528628728828929029129229329429529629729829930030130230330430530630730830931031131231331431531631731831932032132232332432532632732832933033133233333433533633733833934034134234334434534634734834935035135235335435535635735835936036136236336436536636736836937037137237337437537637737837938038138238338438538638738838939039139239339439539639739839940040140240340440540640740840941041141241341441541641741841942042142242342442542642742842943043143243343443543643743843944044144244344444544644744844945045145245345445545645745845946046146246346446546646746846947047147247347447547647747847948048148248348448548648748848949049149249349449549649749849950050150250350450550650750850951051151251351451551651751851952052152252352452552652752852953053153253353453553653753853954054154254354454554654754854955055155255355455555655755855956056156256356456556656756856957057157257357457557657757857958058158258358458558658758858959059159259359459559659759859960060160260360460560660760860961061161261361461561661761861962062162262362462562662762862963063163263363463563663763863964064164264364464564664764864965065165265365465565665765865966066166266366466566666766866967067167267367467567667767867968068168268368468568668768868969069169269369469569669769869970070170270370470570670770870971071171271371471571671771871972072172272372472572672772872973073173273373473573673773873974074174274374474574674774874975075175275375475575675775875976076176276376476576676776876977077177277377477577677777877978078178278378478578678778878979079179279379479579679779879980080180280380480580680780880981081181281381481581681781881982082182282382482582682782882983083183283383483583683783883984084184284384484584684784884985085185285385485585685785885986086186286386486586686786886987087187287387487587687787887988088188288388488588688788888989089189289389489589689789889990090190290390490590690790890991091191291391491591691791891992092192292392492592692792892993093193293393493593693793893994094194294394494594694794894995095195295395495595695795895996096196296396496596696796896997097197297397497597697797897998098198298398498598698798898999099199299399499599699799899910001001100210031004100510061007100810091010101110121013101410151016101710181019102010211022102310241025102610271028102910301031103210331034103510361037103810391040104110421043104410451046104710481049105010511052105310541055105610571058105910601061106210631064106510661067106810691070107110721073107410751076107710781079108010811082108310841085108610871088108910901091109210931094109510961097109810991100110111021103110411051106110711081109111011111112111311141115111611171118111911201121112211231124112511261127112811291130113111321133113411351136113711381139114011411142114311441145114611471148114911501151115211531154115511561157115811591160116111621163116411651166116711681169117011711172117311741175117611771178117911801181118211831184118511861187118811891190119111921193119411951196119711981199120012011202120312041205120612071208120912101211121212131214121512161217121812191220122112221223122412251226122712281229123012311232123312341235123612371238123912401241124212431244124512461247124812491250125112521253125412551256125712581259126012611262126312641265126612671268126912701271127212731274127512761277127812791280128112821283128412851286128712881289129012911292129312941295129612971298129913001

1. 2. 3. 4. 5. 6. 7. 8. 9. 10. 11. 12. 13. 14. 15. 16. 17. 18. 19. 20. 21. 22. 23. 24. 25. 26. 27. 28. 29. 30. 31. 32. 33. 34. 35. 36. 37. 38. 39. 40. 41. 42. 43. 44. 45. 46. 47. 48. 49. 50. 51. 52. 53. 54. 55. 56. 57. 58. 59. 60. 61. 62. 63. 64. 65. 66. 67. 68. 69. 70. 71. 72. 73. 74. 75. 76. 77. 78. 79. 80. 81. 82. 83. 84. 85. 86. 87. 88. 89. 90. 91. 92. 93. 94. 95. 96. 97. 98. 99. 100. 101. 102. 103. 104. 105. 106. 107. 108. 109. 110. 111. 112. 113. 114. 115. 116. 117. 118. 119. 120. 121. 122. 123. 124. 125. 126. 127. 128. 129. 130. 131. 132. 133. 134. 135. 136. 137. 138. 139. 140. 141. 142. 143. 144. 145. 146. 147. 148. 149. 150. 151. 152. 153. 154. 155. 156. 157. 158. 159. 160. 161. 162. 163. 164. 165. 166. 167. 168. 169. 170. 171. 172. 173. 174. 175. 176. 177. 178. 179. 180. 181. 182. 183. 184. 185. 186. 187. 188. 189. 190. 191. 192. 193. 194. 195. 196. 197. 198. 199. 200. 201. 202. 203. 204. 205. 206. 207. 208. 209. 210. 211. 212. 213. 214. 215. 216. 217. 218. 219. 220. 221. 222. 223. 224. 225. 226. 227. 228. 229. 230. 231. 232. 233. 234. 235. 236. 237. 238. 239. 240. 241. 242. 243. 244. 245. 246. 247. 248. 249. 250. 251. 252. 253. 254. 255. 256. 257. 258. 259. 260. 261. 262. 263. 264. 265. 266. 267. 268. 269. 270. 271. 272. 273. 274. 275. 276. 277. 278. 279. 280. 281. 282. 283. 284. 285. 286. 287. 288. 289. 290. 291. 292. 293. 294. 295. 296. 297. 298. 299. 300. 301. 302. 303. 304. 305. 306. 307. 308. 309. 310. 311. 312. 313. 314. 315. 316. 317. 318. 319. 320. 321. 322. 323. 324. 325. 326. 327. 328. 329. 330. 331. 332. 333. 334. 335. 336. 337. 338. 339. 340. 341. 342. 343. 344. 345. 346. 347. 348. 349. 350. 351. 352. 353. 354. 355. 356. 357. 358. 359. 360. 361. 362. 363. 364. 365. 366. 367. 368. 369. 370. 371. 372. 373. 374. 375. 376. 377. 378. 379. 380. 381. 382. 383. 384. 385. 386. 387. 388. 389. 390. 391. 392. 393. 394. 395. 396. 397. 398. 399. 400. 401. 402. 403. 404. 405. 406. 407. 408. 409. 410. 411. 412. 413. 414. 415. 416. 417. 418. 419. 420. 421. 422. 423. 424. 425. 426. 427. 428. 429. 430. 431. 432. 433. 434. 435. 436. 437. 438. 439. 440. 441. 442. 443. 444. 445. 446. 447. 448. 449. 450. 451. 452. 453. 454. 455. 456. 457. 458. 459. 460. 461. 462. 463. 464. 465. 466. 467. 468. 469. 470. 471. 472. 473. 474. 475. 476. 477. 478. 479. 480. 481. 482. 483. 484. 485. 486. 487. 488. 489. 490. 491. 492. 493. 494. 495. 496. 497. 498. 499. 500. 501. 502. 503. 504. 505. 506. 507. 508. 509. 510. 511. 512. 513. 514. 515. 516. 517. 518. 519. 520. 521. 522. 523. 524. 525. 526. 527. 528. 529. 530. 531. 532. 533. 534. 535. 536. 537. 538. 539. 540. 541. 542. 543. 544. 545. 546. 547. 548. 549. 550. 551. 552. 553. 554. 555. 556. 557. 558. 559. 560. 561. 562. 563. 564. 565. 566. 567. 568. 569. 570. 571. 572. 573. 574. 575. 576. 577. 578. 579. 580. 581. 582. 583. 584. 585. 586. 587. 588. 589. 590. 591. 592. 593. 594. 595. 596. 597. 598. 599. 600. 601. 602. 603. 604. 605. 606. 607. 608. 609. 610. 611. 612. 613. 614. 615. 616. 617. 618. 619. 620. 621. 622. 623. 624. 625. 626. 627. 628. 629. 630. 631. 632. 633. 634. 635. 636. 637. 638. 639. 640. 641. 642. 643. 644. 645. 646. 647. 648. 649. 650. 651. 652. 653. 654. 655. 656. 657. 658. 659. 660. 661. 662. 663. 664. 665. 666. 667. 668. 669. 670. 671. 672. 673. 674. 675. 676. 677. 678. 679. 680. 681. 682. 683. 684. 685. 686. 687. 688. 689. 690. 691. 692. 693. 694. 695. 696. 697. 698. 699. 700. 701. 702. 703. 704. 705. 706. 707. 708. 709. 710. 711. 712. 713. 714. 715. 716. 717. 718. 719. 720. 721. 722. 723. 724. 725. 726. 727. 728. 729. 730. 731. 732. 733. 734. 735. 736. 737. 738. 739. 740. 741. 742. 743. 744. 745. 746. 747. 748. 749. 750. 751. 752. 753. 754. 755. 756. 757. 758. 759. 760. 761. 762. 763. 764. 765. 766. 767. 768. 769. 770. 771. 772. 773. 774. 775. 776. 777. 778. 779. 780. 781. 782. 783. 784. 785. 786. 787. 788. 789. 790. 791. 792. 793. 794. 795. 796. 797. 798. 799. 800. 801. 802. 803. 804. 805. 806. 807. 808. 809. 810. 811. 812. 813. 814. 815. 816. 817. 818. 819. 820. 821. 822. 823. 824. 825. 826. 827. 828. 829. 830. 831. 832. 833. 834. 835. 836. 837. 838. 839. 840.

[illegible]

| | | | | | | | | | |
|-----------------------|----------|----------|--------------|----------|----------|--------------|----------|----------|-------------------|
| Also in: Plat No..... | Twp..... | Rge..... | Plat No..... | Twp..... | Rge..... | Plat No..... | Twp..... | Rge..... | Information from: |
| Plat No..... | Twp..... | Rge..... | Plat No..... | Twp..... | Rge..... | Plat No..... | Twp..... | Rge..... | Information from: |

Plat No. Twp. Rge. Plat No. Twp. Rge. Plat No. Twp. Rge. Harris Bros.

Information From:

Harris Bros.

F-1-A Powder River

Farm Checked: Date...9-22-60

By George Brandt

Legal Land Owner Pierre V. & Mary LeVeque

OperatorSame.

Water is delivered by:— 1. Private System; 2. Ditch Company; 3. State Project; 4. Federal Project; 5. Irrigation District

If under Ditch Company, Irrigation District, or Government Project, state the number of shares or inches, acre feet, as the case may be in said system

[illegible]

NOTE: R—Denotes Regular Irrigation. F—Flood Irrigation. P—Water diverted by means of pumping. G—Water diverted by gravity. S—Stored Water.

Condition of System Topography Mountain Valley River Basin Yellowstone

Adequate Supply: Yes..... No. ^x Explain

Adequate Supply: Yes..... No. X..... Explain.....
Remarks See Plat #44 for irriogation of this party. (Township 5 south, Range 48 East)

| | | | | | | | | |
|----------------------|-----------|-----------|---------------|-----------|-----------|---------------|-----------|-----------|
| Also in: Plat No. 44 | Twp 5S | Rge 48E | Plat No. | Twp. | Rge. | Plat No. | Twp. | Rge. |
| Plat No. | Twp. | Rge. | Plat No. | Twp. | Rge. | Plat No. | Twp. | Rge. |

Information From:
Pierre LeVeque

If under Ditch Company, Irrigation District.

Photo No. 29-10, 29-09

4. Federal Project; 5. Irrigation District

Water is delivered by:— x 1. Private System; 2. Ditch Company; 3. State Project; 4. Federal Project; 5. Irrigation District

If under Ditch Company, Irrigation District, or Government Project, state the number of shares or inches, acre feet, as the case may be in said system _____

NOTE: R—Denotes Regular Irrigation. F—Flood Irrigation. P—Water diverted by means of pumping. G—Water diverted by gravity. S—Stored Water.

NOTE: R=Denotes Regular Irrigation.

Condition of System Good Topography Valley River Basin Yellowstone
Adequate Supply: Yes x No x Explain Only Fair
Remarks No recorded right, but Fred King had ditches in Otter Creek since 1944 known personally by Ted Fletcher.

Information From:
Ted Fletcher

| | | | | | | | | |
|----------------------|---------|----------|---------------|-----------|-----------|---------------|-----------|-----------|
| Also in: Plat No. 62 | Twp. 7S | Rge. 46E | Plct No. | Twp. | Rge. | Plat No. | Twp. | Rge. |
| Plat No. 52 | Twp. 6S | Rge. 46E | Plat No. | Twp. | Rge. | Plat No. | Twp. | Rge. |

| | | | | | | |
|----|----|----|----|----|----|--|
| 6 | 6 | 4 | 8 | 2 | 1 | |
| 7 | 8 | 9 | 10 | 11 | 12 | |
| 18 | 17 | 16 | 15 | 14 | 13 | |
| | | | | | E | |
| 19 | 20 | 21 | 22 | 23 | B | |
| | | | | | | |
| 30 | 29 | 28 | 27 | 26 | A | |
| | | | | | | |
| 31 | 32 | 33 | 34 | 35 | 36 | |

13-E, 24-B, 25-A

By George Brandt

STATE OF MONTANA
STATE ENGINEERS OFFICE
Water Resources Survey

T. 7S R. 45E Plat No. 61

Photo No. 29-10

Legal Land Owner Sarah V. Hagen Address

Operator Levi Howe Family - leasing Sec. 23 & 24 Address Utter, Montana

Water is delivered by:—^x 1. Private System; 2. Ditch Company; 3. State Project; 4. Federal Project; 5. Irrigation District

If under Ditch Company, Irrigation District, or Government Project, state the number of shares or inches, acre feet, as the case may be in said system

[illegible]

NOTE: R—Denotes Regular Irrigation. F—Flood Irrigation. P—Water diverted by means of pumping. G—Water diverted by gravity. S—Stored Water.

Condition of System Fair Topography Valley River Basin Yellowstone
 Adequate Supply: Yes..... No.....^x Explain
 Remarks

| | | |
|--|--------------------------------|--------------------------------|
| Also in: Plat No. 62..... Twp. 7S..... Rge. 46E..... | Plat No..... Twp..... Rge..... | Plat No..... Twp..... Rge..... |
| Plat No..... Twp..... Rge..... | Plat No..... Twp..... Rge..... | Plat No..... Twp..... Rge..... |

Information From:
Levi Howe

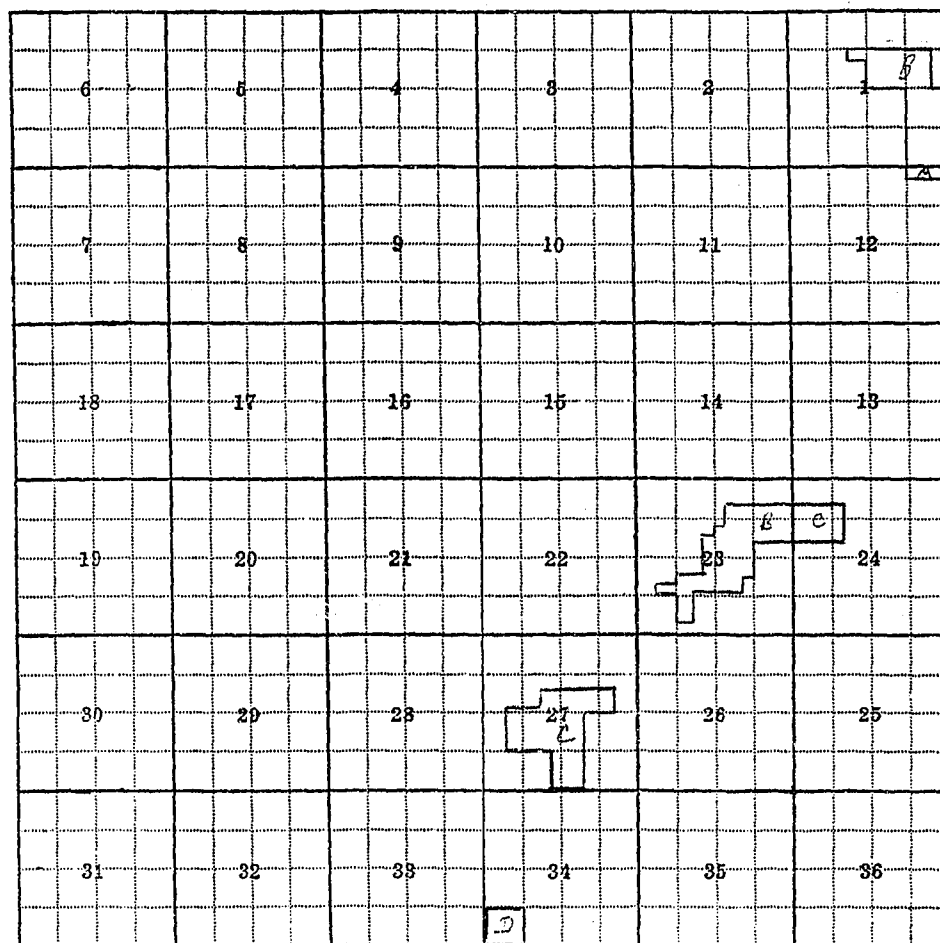

1-B, 12-A, 23-B, 24-C, 27-C, 34-D

F-1-A
County Powder River

Farm Checked: Date 9-24-60

By George Brandt

Legal Land Owner Gertrude H. Storm (Daughter).

Address

OperatorLevi Howes & Family.

Address City

Water is delivered by:—^X 1. Private System; 2. Ditch Company; 3. State Project; 4. Federal Project; 5. Irrigation District

If under Ditch Company, Irrigation District, or Government Project, state the number of shares or inches, acre feet, as the case may be in said system

[illegible]

NOTE: R—Denotes Regular Irrigation. F—Flood Irrigation. P—Water diverted by means of pumping. G—Water diverted by gravity. S—Stored Water.

Condition of System Topography Valley River Basin Yellowstone

4adequate Supply: Yes..... No. ^x..... Explain

| | |
|---------|--|
| Remarks | |
|---------|--|

.....

#####

#####

.....

[illegible]

SECRET

.....

.....

.....

.....

.....

Information From:

Also in: Plat No. Twp. Rge. Plat No. Twp. Rge. Plat No. Twp. Rge. INFORMATION FROM:

| | | | |
|--------------------------------|--------------------------------|--------------------------------|------------|
| Plat No..... Twp..... Rge..... | Plat No..... Twp..... Rge..... | Plat No..... Twp..... Rge..... | Levi Howes |
|--------------------------------|--------------------------------|--------------------------------|------------|

[illegible]

10. The following table shows the number of people who have been convicted of a crime in the United States since 1990. The data is presented in millions of people.

1. *Journal of Management Studies*, 1996, 33, 1, 1-14.

| | | | | | | | | |
|-----------------------|----------|----------|--------------|----------|----------|--------------|----------|----------|
| Also in: Plat No..... | Twp..... | Rge..... | Plat No..... | Twp..... | Rge..... | Plat No..... | Twp..... | Rge..... |
| Plat No..... | Twp..... | Rge..... | Plat No..... | Twp..... | Rge..... | Plat No..... | Twp..... | Rge..... |

Information From:

Levi Howes

| | | | | | | | | | | | |
|--|----|--|----|--|----|--|----|--|----|--|----|
| | 6 | | 5 | | 4 | | 3 | | 2 | | 1 |
| | 7 | | 8 | | 9 | | 10 | | 11 | | 12 |
| | 18 | | 17 | | 16 | | 15 | | 14 | | 13 |
| | 19 | | 20 | | 21 | | 22 | | 23 | | 24 |
| | 30 | | 29 | | 28 | | 27 | | 26 | | 25 |
| | | | | | | | D | | | | |
| | | | | | | | 8 | | | | |
| | 31 | | 32 | | 33 | | 34 | | 35 | | 36 |

27-D, 34-B

5. Irrigation District

Information From:
Anne Thex Bull, a sister

| | | | | | |
|----|----|----|----|----|---------|
| 6 | 5 | 4 | 3 | 2 | 1 |
| 7 | 8 | 9 | 10 | 11 | 12 |
| 13 | 17 | 16 | 15 | 14 | 13
D |
| 19 | 20 | 21 | 22 | 23 | 24 |
| 29 | 29 | 28 | 27 | 26 | 25 |
| 31 | 32 | 33 | 34 | 35 | 36 |

13-D

Information From:
Ted Fletcher

| | | | | | | | | | | | |
|---|----|--|----|--|----|--|----|--|----|--|----|
| | 6 | | 5 | | 4 | | 3 | | 2 | | 1 |
| | 7 | | 8 | | 9 | | 10 | | 11 | | 12 |
| | 13 | | 17 | | 16 | | 15 | | 14 | | 13 |
| | 19 | | 20 | | 21 | | 22 | | 23 | | 24 |
| B | 30 | | 20 | | 23 | | 27 | | 28 | | 25 |
| | 31 | | 32 | | 33 | | 34 | | 35 | | 36 |

30-B

F-1-A

County Powder RiverFarm Checked: Date 9-12-60By George BrandtLegal Land Owner F. T. Y Ranch Co.Operator SameWater is delivered by: ☒ 1. Private System; ☐ 2. Ditch Company; ☐ 3. State Project; ☐ 4. Federal Project; ☐ 5. Irrigation District

If under Ditch Company, Irrigation District, or Government Project, state the number of shares or inches, acre feet, as the case may be in said system

| App. No.
Decree No. | NAME OF APPROPRIATOR
TO WHOM DECREED | NAME OF STREAM | Date App.
Date Priority | Miner's
Inches | In Use | NAME OF DITCH
(Water Delivered By) | No. | R/F | P/G/S | Present
Irr. Acres | Irrigable
Acres |
|------------------------|--|--|----------------------------|-------------------|--------|---------------------------------------|-----|-----|-----------------|-----------------------|--------------------|
| A-820-C | Fred T. Jr., Lawrence
A. & Lillian A. | Yonkee | | | | | | | | | |
| | | Coal Draw a Trib. to
South Prong of Taylor
Creek | 9-1-60 | 500 | Flood | F. T. Y. Ranch System | 1 | F | R &
Ditch | | |
| A-820-D | Fred T. Jr., Lawrence
A. & Lillian A. | Yonkee | | | | | | | | | |
| | | Wilbur Draw A Trib. of
South Prong of
Taylor Creek | 9-1-60 | 500 | Flood | F. T. Y. Ranch System | 1 | F | Dike &
Ditch | | |
| A-820-A | Fred T. Jr., Lawrence
A. & Lillian A. | Yonkee | | | | | | | | | |
| | | South Prong of | CONTINUED ON NEXT PAGE | | | | | | | | |

NOTE: R—Denotes Regular Irrigation. F—Flood Irrigation. P—Water diverted by means of pumping. G—Water diverted by gravity. S—Stored Water.

Condition of System Topography Mountain Valleys River Basin Yellowstone
 Adequate Supply: Yes ☒ No ☐ Explain Use Flood Waters only.
 Remarks New rights filed as noted.

| | | |
|--|--|--|
| Also in: Plat No. <u>63</u> Twp. <u>7S</u> Rge. <u>47E</u> | Plat No. <u> </u> Twp. <u> </u> Rge. <u> </u> | Plat No. <u> </u> Twp. <u> </u> Rge. <u> </u> |
| Plat No. <u> </u> Twp. <u> </u> Rge. <u> </u> | Plat No. <u> </u> Twp. <u> </u> Rge. <u> </u> | Plat No. <u> </u> Twp. <u> </u> Rge. <u> </u> |

Information From:
Fred T. Yonkee Jr.

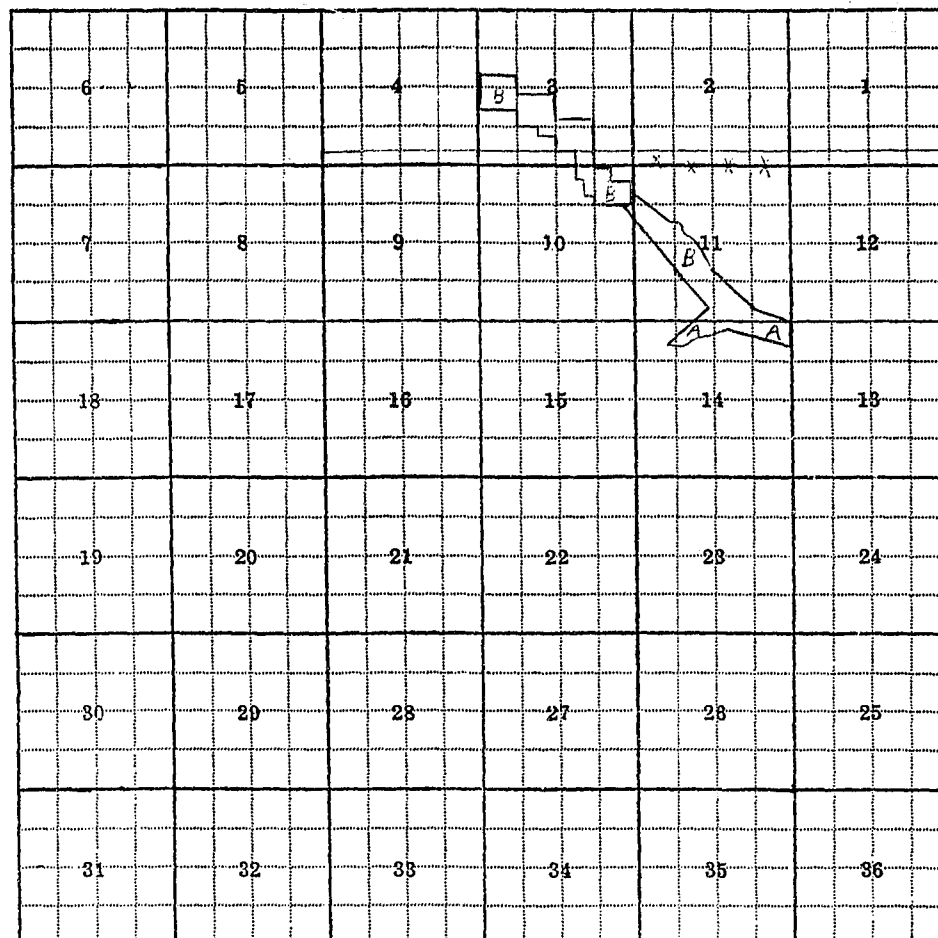

3-B, 10-B, 11-B, 14-A

If under Ditch Company, Irrigation District, or Government Project, state the number of shares or inches, acre feet, as the case may be in said system

Photo No.....

NOTE: R—Denotes Regular Irrigation. F—Flood Irrigation. P—Water diverted by means of pumping. G—Water diverted by gravity. S—Stored Water.

| | | |
|-----------------------------------|------------------|-------------------|
| Condition of System | Topography | River Basin |
| Adequate Supply: Yes..... No..... | Explain | |
| Remarks | | |

Information From:

If under Ditch Company, Irrigation District, or Government Project, state the number of shares or inches, acre feet, as the case may be in said system

Photo No. 29-11

Levi Howe

County Powder River

Farm Checked: Date 10-4-60

By George Brandt

STATE OF MONTANA
STATE ENGINEERS OFFICE
Water Resources Survey

T...7S....R...46E... Plat No...62.....

Photo No. 29-79

Legal Land Owner Charles H. Kraft Address

| Operator | Same | Address | Other |
|----------|------|---------|-------|
| | | | |

Water is delivered by:—^x 1. Private System; 2. Ditch Company; 3. State Project; 4. Federal Project; 5. Irrigation District

If under Ditch Company, Irrigation District, or Government Project, state the number of shares or inches, acre feet, as the case may be in said system

[illegible]

NOTE: R—Denotes Regular Irrigation. F—Flood Irrigation. P—Water diverted by means of pumping. G—Water diverted by gravity. S—Stored Water.

Condition of System Topography Valley River Basin Yellowstone

Adequate Supply: Yes..... No. ^x Explain

| Remarks |
|---------|
| |

1 2 3 4 5 6 7 8 9 10 11 12 13 14 15 16 17 18 19 20 21 22 23 24 25 26 27 28 29 30 31 32 33 34 35 36 37 38 39 40 41 42 43 44 45 46 47 48 49 50 51 52 53 54 55 56 57 58 59 60 61 62 63 64 65 66 67 68 69 70 71 72 73 74 75 76 77 78 79 80 81 82 83 84 85 86 87 88 89 90 91 92 93 94 95 96 97 98 99 100 101 102 103 104 105 106 107 108 109 110 111 112 113 114 115 116 117 118 119 120 121 122 123 124 125 126 127 128 129 130 131 132 133 134 135 136 137 138 139 140 141 142 143 144 145 146 147 148 149 150 151 152 153 154 155 156 157 158 159 160 161 162 163 164 165 166 167 168 169 170 171 172 173 174 175 176 177 178 179 180 181 182 183 184 185 186 187 188 189 190 191 192 193 194 195 196 197 198 199 200 201 202 203 204 205 206 207 208 209 210 211 212 213 214 215 216 217 218 219 220 221 222 223 224 225 226 227 228 229 230 231 232 233 234 235 236 237 238 239 240 241 242 243 244 245 246 247 248 249 250 251 252 253 254 255 256 257 258 259 260 261 262 263 264 265 266 267 268 269 270 271 272 273 274 275 276 277 278 279 280 281 282 283 284 285 286 287 288 289 290 291 292 293 294 295 296 297 298 299 300 301 302 303 304 305 306 307 308 309 310 311 312 313 314 315 316 317 318 319 320 321 322 323 324 325 326 327 328 329 330 331 332 333 334 335 336 337 338 339 340 341 342 343 344 345 346 347 348 349 350 351 352 353 354 355 356 357 358 359 360 361 362 363 364 365 366 367 368 369 370 371 372 373 374 375 376 377 378 379 380 381 382 383 384 385 386 387 388 389 390 391 392 393 394 395 396 397 398 399 400 401 402 403 404 405 406 407 408 409 410 411 412 413 414 415 416 417 418 419 420 421 422 423 424 425 426 427 428 429 430 431 432 433 434 435 436 437 438 439 440 441 442 443 444 445 446 447 448 449 450 451 452 453 454 455 456 457 458 459 460 461 462 463 464 465 466 467 468 469 470 471 472 473 474 475 476 477 478 479 480 481 482 483 484 485 486 487 488 489 490 491 492 493 494 495 496 497 498 499 500 501 502 503 504 505 506 507 508 509 510 511 512 513 514 515 516 517 518 519 520 521 522 523 524 525 526 527 528 529 530 531 532 533 534 535 536 537 538 539 540 541 542 543 544 545 546 547 548 549 550 551 552 553 554 555 556 557 558 559 560 561 562 563 564 565 566 567 568 569 570 571 572 573 574 575 576 577 578 579 580 581 582 583 584 585 586 587 588 589 590 591 592 593 594 595 596 597 598 599 600 601 602 603 604 605 606 607 608 609 610 611 612 613 614 615 616 617 618 619 620 621 622 623 624 625 626 627 628 629 630 631 632 633 634 635 636 637 638 639 640 641 642 643 644 645 646 647 648 649 650 651 652 653 654 655 656 657 658 659 660 661 662 663 664 665 666 667 668 669 670 671 672 673 674 675 676 677 678 679 680 681 682 683 684 685 686 687 688 689 690 691 692 693 694 695 696 697 698 699 700 701 702 703 704 705 706 707 708 709 710 711 712 713 714 715 716 717 718 719 720 721 722 723 724 725 726 727 728 729 730 731 732 733 734 735 736 737 738 739 740 741 742 743 744 745 746 747 748 749 750 751 752 753 754 755 756 757 758 759 760 761 762 763 764 765 766 767 768 769 770 771 772 773 774 775 776 777 778 779 780 781 782 783 784 785 786 787 788 789 790 791 792 793 794 795 796 797 798 799 800 801 802 803 804 805 806 807 808 809 810 811 812 813 814 815 816 817 818 819 820 821 822 823 824 825 826 827 828 829 830 831 832 833 834 835 836 837 838 839 840 841 842 843 844 845 846 847 848 849 850 851 852 853 854 855 856 857 858 859 860 861 862 863 864 865 866 867 868 869 870 871 872 873 874 875 876 877 878 879 880 881 882 883 884 885 886 887 888 889 890 891 892 893 894 895 896 897 898 899 900 901 902 903 904 905 906 907 908 909 910 911 912 913 914 915 916 917 918 919 920 921 922 923 924 925 926 927 928 929 930 931 932 933 934 935 936 937 938 939 940 941 942 943 944 945 946 947 948 949 950 951 952 953 954 955 956 957 958 959 960 961 962 963 964 965 966 967 968 969 970 971 972 973 974 975 976 977 978 979 980 981 982 983 984 985 986 987 988 989 990 991 992 993 994 995 996 997 998 999 1000 1001 1002 1003 1004 1005 1006 1007 1008 1009 1010 1011 1012 1013 1014 1015 1016 1017 1018 1019 1020 1021 1022 1023 1024 1025 1026 1027 1028 1029 1030 1031 1032 1033 1034 1035 1036 1037 1038 1039 104

[illegible]

[\[Detailed description of the figure\]](#)

[illegible][illegible][illegible]

12345678910111213141516171819202122232425262728293031323334353637383940414243444546474849505152535455565758596061626364656667686970717273747576777879808182838485868788899091929394959697989910010110210310410510610710810911011111211311411511611711811912012112212312412512612712812913013113213313413513613713813914014114214314414514614714814915015115215315415515615715815916016116216316416516616716816917017117217317417517617717817918018118218318418518618718818919019119219319419519619719819920020120220320420520620720820921021121221321421521621721821922022122222322422522622722822923023123223323423523623723823924024124224324424524624724824925025125225325425525625725825926026126226326426526626726826927027127227327427527627727827928028128228328428528628728828929029129229329429529629729829930030130230330430530630730830931031131231331431531631731831932032132232332432532632732832933033133233333433533633733833934034134234334434534634734834935035135235335435535635735835936036136236336436536636736836937037137237337437537637737837938038138238338438538638738838939039139239339439539639739839940040140240340440540640740840941041141241341441541641741841942042142242342442542642742842943043143243343443543643743843944044144244344444544644744844945045145245345445545645745845946046146246346446546646746846947047147247347447547647747847948048148248348448548648748848949049149249349449549649749849950050150250350450550650750850951051151251351451551651751851952052152252352452552652752852953053153253353453553653753853954054154254354454554654754854955055155255355455555655755855956056156256356456556656756856957057157257357457557657757857958058158258358458558658758858959059159259359459559659759859960060160260360460560660760860961061161261361461561661761861962062162262362462562662762862963063163263363463563663763863964064164264364464564664764864965065165265365465565665765865966066166266366466566666766866967067167267367467567667767867968068168268368468568668768868969069169269369469569669769869970070170270370470570670770870971071171271371471571671771871972072172272372472572672772872973073173273373473573673773873974074174274374474574674774874975075175275375475575675775875976076176276376476576676776876977077177277377477577677777877978078178278378478578678778878979079179279379479579679779879980080180280380480580680780880981081181281381481581681781881982082182282382482582682782882983083183283383483583683783883984084184284384484584684784884985085185285385485585685785885986086186286386486586686786886987087187287387487587687787887988088188288388488588688788888989089189289389489589689789889990090190290390490590690790890991091191291391491591691791891992092192292392492592692792892993093193293393493593693793893994094194294394494594694794894995095195295395495595695795895996096196296396496596696796896997097197297397497597697797897998098198298398498598698798898999099199299399499599699799899910001001100210031004100510061007100810091010101110121013101410151016101710181019102010211022102310241025102610271028102910301031103210331034103510361037103810391040104110421043104410451046104710481049105010511052105310541055105610571058105910601061106210631064106510661067106810691070107110721073107410751076107710781079108010811082108310841085108610871088108910901091109210931094109510961097109810991100110011100211003110041100511006110071100811009110101101111012110131101411015110161101711018110191102011021110221102311024110251102611027110281102911030110311103211033110341103511036110371103811039110401104111042110431104411045110461104711048110491105011051110521105311054110551105611057110581105911060110611106211063110641106511066110671106811069110701107111072110731107411075110761107711078110791108011081110821108311084110851108611087110881108911090110911109211093110941109511096110971109811099111001110011110021110031110041110051110061110071110081110091110101110111110121110131110141110151110161110171110181110191110201110211110221110231110241110251110261110271110281110291110301110311110321110331110341110351110361110371110381110391110401110411110421110431110441110451110461110471110481110491110501

js 1 2 3 4 5 6 7 8 9 10 11 12 13 14 15 16 17 18 19 20 21 22 23 24 25 26 27 28 29 30 31 32 33 34 35 36 37 38 39 40 41 42 43 44 45 46 47 48 49 50 51 52 53 54 55 56 57 58 59 60 61 62 63 64 65 66 67 68 69 70 71 72 73 74 75 76 77 78 79 80 81 82 83 84 85 86 87 88 89 90 91 92 93 94 95 96 97 98 99 100 101 102 103 104 105 106 107 108 109 110 111 112 113 114 115 116 117 118 119 120 121 122 123 124 125 126 127 128 129 130 131 132 133 134 135 136 137 138 139 140 141 142 143 144 145 146 147 148 149 150 151 152 153 154 155 156 157 158 159 160 161 162 163 164 165 166 167 168 169 170 171 172 173 174 175 176 177 178 179 180 181 182 183 184 185 186 187 188 189 190 191 192 193 194 195 196 197 198 199 200 201 202 203 204 205 206 207 208 209 210 211 212 213 214 215 216 217 218 219 220 221 222 223 224 225 226 227 228 229 230 231 232 233 234 235 236 237 238 239 240 241 242 243 244 245 246 247 248 249 250 251 252 253 254 255 256 257 258 259 260 261 262 263 264 265 266 267 268 269 270 271 272 273 274 275 276 277 278 279 280 281 282 283 284 285 286 287 288 289 290 291 292 293 294 295 296 297 298 299 300 301 302 303 304 305 306 307 308 309 310 311 312 313 314 315 316 317 318 319 320 321 322 323 324 325 326 327 328 329 330 331 332 333 334 335 336 337 338 339 340 341 342 343 344 345 346 347 348 349 350 351 352 353 354 355 356 357 358 359 360 361 362 363 364 365 366 367 368 369 370 371 372 373 374 375 376 377 378 379 380 381 382 383 384 385 386 387 388 389 390 391 392 393 394 395 396 397 398 399 400 401 402 403 404 405 406 407 408 409 410 411 412 413 414 415 416 417 418 419 420 421 422 423 424 425 426 427 428 429 430 431 432 433 434 435 436 437 438 439 440 441 442 443 444 445 446 447 448 449 450 451 452 453 454 455 456 457 458 459 460 461 462 463 464 465 466 467 468 469 470 471 472 473 474 475 476 477 478 479 480 481 482 483 484 485 486 487 488 489 490 491 492 493 494 495 496 497 498 499 500 501 502 503 504 505 506 507 508 509 510 511 512 513 514 515 516 517 518 519 520 521 522 523 524 525 526 527 528 529 530 531 532 533 534 535 536 537 538 539 540 541 542 543 544 545 546 547 548 549 550 551 552 553 554 555 556 557 558 559 560 561 562 563 564 565 566 567 568 569 570 571 572 573 574 575 576 577 578 579 580 581 582 583 584 585 586 587 588 589 590 591 592 593 594 595 596 597 598 599 600 601 602 603 604 605 606 607 608 609 610 611 612 613 614 615 616 617 618 619 620 621 622 623 624 625 626 627 628 629 630 631 632 633 634 635 636 637 638 639 640 641 642 643 644 645 646 647 648 649 650 651 652 653 654 655 656 657 658 659 660 661 662 663 664 665 666 667 668 669 670 671 672 673 674 675 676 677 678 679 680 681 682 683 684 685 686 687 688 689 690 691 692 693 694 695 696 697 698 699 700 701 702 703 704 705 706 707 708 709 710 711 712 713 714 715 716 717 718 719 720 721 722 723 724 725 726 727 728 729 730 731 732 733 734 735 736 737 738 739 740 741 742 743 744 745 746 747 748 749 750 751 752 753 754 755 756 757 758 759 760 761 762 763 764 765 766 767 768 769 770 771 772 773 774 775 776 777 778 779 780 781 782 783 784 785 786 787 788 789 790 791 792 793 794 795 796 797 798 799 800 801 802 803 804 805 806 807 808 809 810 811 812 813 814 815 816 817 818 819 820 821 822 823 824 825 826 827 828 829 830 831 832 833 834 835 836 837 838 839 840 841 842 843 844 845 846 847 848 849 850 851 852 853 854 855 856 857 858 859 860 861 862 863 864 865 866 867 868 869 870 871 872 873 874 875 876 877 878 879 880 881 882 883 884 885 886 887 888 889 890 891 892 893 894 895 896 897 898 899 900 901 902 903 904 905 906 907 908 909 910 911 912 913 914 915 916 917 918 919 920 921 922 923 924 925 926 927 928 929 930 931 932 933 934 935 936 937 938 939 940 941 942 943 944 945 946 947 948 949 950 951 952 953 954 955 956 957 958 959 960 961 962 963 964 965 966 967 968 969 970 971 972 973 974 975 976 977 978 979 980 981 982 983 984 985 986 987 988 989 990 991 992 993 994 995 996 997 998 999 1000 1001 1002 1003 1004 1005 1006 1007 1008 1009 1010 1011 1012 1013 1014 1015 1016 1017 1018 1019 1020 1021 1022 1023 1024 1025 1026 1027 1028 1029 1030 1031 1032 1033 1034 1035 1036 1037 1038 1039 1040

12345678910111213141516171819202122232425262728293031323334353637383940414243444546474849505152535455565758596061626364656667686970717273747576777879808182838485868788899091929394959697989910010110210310410510610710810911011111211311411511611711811912012112212312412512612712812913013113213313413513613713813914014114214314414514614714814915015115215315415515615715815916016116216316416516616716816917017117217317417517617717817918018118218318418518618718818919019119219319419519619719819920020120220320420520620720820921021121221321421521621721821922022122222322422522622722822923023123223323423523623723823924024124224324424524624724824925025125225325425525625725825926026126226326426526626726826927027127227327427527627727827928028128228328428528628728828929029129229329429529629729829930030130230330430530630730830931031131231331431531631731831932032132232332432532632732832933033133233333433533633733833934034134234334434534634734834935035135235335435535635735835936036136236336436536636736836937037137237337437537637737837938038138238338438538638738838939039139239339439539639739839940040140240340440540640740840941041141241341441541641741841942042142242342442542642742842943043143243343443543643743843944044144244344444544644744844945045145245345445545645745845946046146246346446546646746846947047147247347447547647747847948048148248348448548648748848949049149249349449549649749849950050150250350450550650750850951051151251351451551651751851952052152252352452552652752852953053153253353453553653753853954054154254354454554654754854955055155255355455555655755855956056156256356456556656756856957057157257357457557657757857958058158258358458558658758858959059159259359459559659759859960060160260360460560660760860961061161261361461561661761861962062162262362462562662762862963063163263363463563663763863964064164264364464564664764864965065165265365465565665765865966066166266366466566666766866967067167267367467567667767867968068168268368468568668768868969069169269369469569669769869970070170270370470570670770870971071171271371471571671771871972072172272372472572672772872973073173273373473573673773873974074174274374474574674774874975075175275375475575675775875976076176276376476576676776876977077177277377477577677777877978078178278378478578678778878979079179279379479579679779879980080180280380480580680780880981081181281381481581681781881982082182282382482582682782882983083183283383483583683783883984084184284384484584684784884985085185285385485585685785885986086186286386486586686786886987087187287387487587687787887988088188288388488588688788888989089189289389489589689789889990090190290390490590690790890991091191291391491591691791891992092192292392492592692792892993093193293393493593693793893994094194294394494594694794894995095195295395495595695795895996096196296396496596696796896997097197297397497597697797897998098198298398498598698798898999099199299399499599699799899910001001100210031004100510061007100810091010101110121013101410151016101710181019102010211022102310241025102610271028102910301031103210331034103510361037103810391040104110421043104410451046104710481049105010511052105310541055105610571058105910601061106210631064106510661067106810691070107110721073107410751076107710781079108010811082108310841085108610871088108910901091109210931094109510961097109810991100110111021103110411051106110711081109111011111112111311141115111611171118111911201121112211231124112511261127112811291130113111321133113411351136113711381139114011411142114311441145114611471148114911501151115211531154115511561157115811591160116111621163116411651166116711681169117011711172117311741175117611771178117911801181118211831184118511861187118811891190119111921193119411951196119711981199120012011202120312041205120612071208120912101211121212131214121512161217121812191220122112221223122412251226122712281229123012311232123312341235123612371238123912401241124212431244124512461247124812491250125112521253125412551256125712581259126012611262126312641265126612671268126912701271127212731274127512761277127812791280128112821283128412851286128712881289129012911292129312941295129612971298129913001

.....

| | | | | | | | | | |
|--------------------------|-------------|-------------|-----------------|-------------|-------------|-----------------|-------------|-------------|-------------------|
| <u>Block or Plat No.</u> | <u>Town</u> | <u>Rge.</u> | <u>Plat No.</u> | <u>Town</u> | <u>Rge.</u> | <u>Plat No.</u> | <u>Town</u> | <u>Rge.</u> | Information From: |
|--------------------------|-------------|-------------|-----------------|-------------|-------------|-----------------|-------------|-------------|-------------------|

| | | | | | | | | | |
|---|-----|-----|--------------------------------|-----|-----|--------------------------------|-----|-----|-------------|
| Also in: Plat No..... Twp..... Rge..... | | | Plat No..... Twp..... Rge..... | | | Plat No..... Twp..... Rge..... | | | Chas. Kraft |
| Plat No | Twp | Rge | Plat No | Twp | Rge | Plat No | Twp | Rge | |

Plat No. Twp. Rge. Plat No. Twp. Rge. Plat No. Twp. Rge. Chas. Kraft

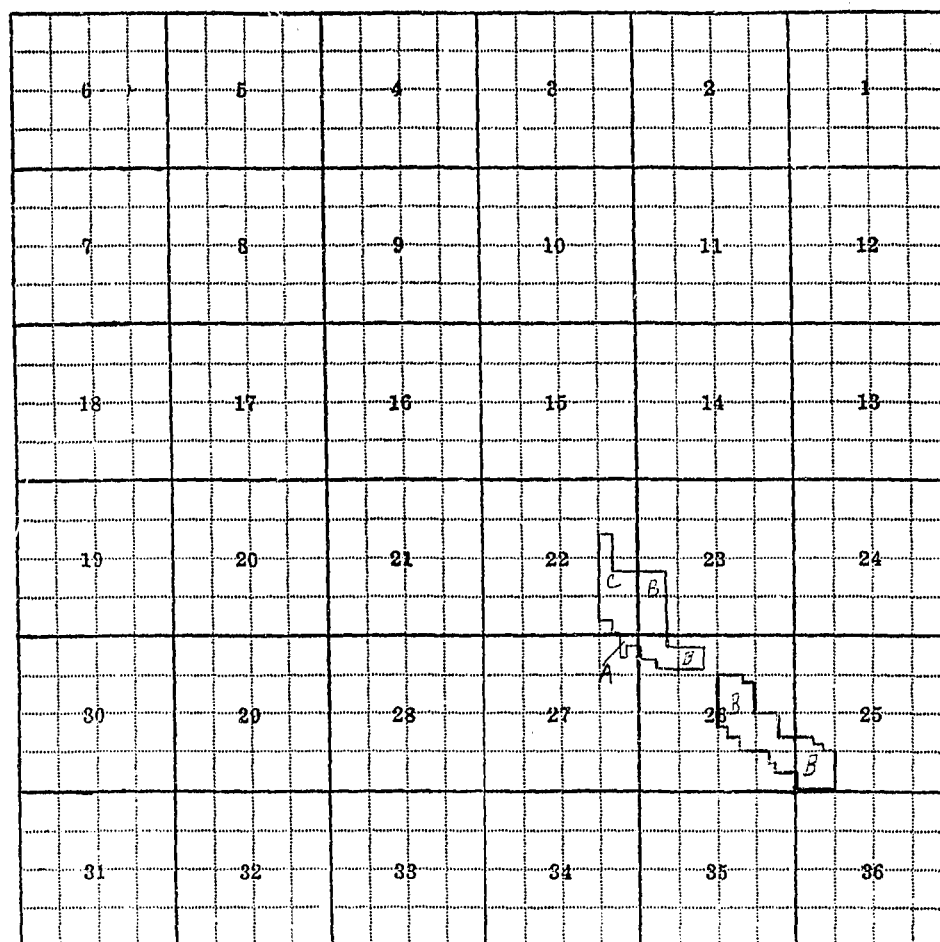

22-C, 23-B, 25-B, 26-B, 27-A
 25-B, & 26-B, in Clara May, Charles H. & Daniel R. Kraft name.

County Powder River

Farm Checked: Date.....9-28-60

By George Brandt

STATE OF MONTANA
STATE ENGINEERS OFFICE
Water Resources Survey

T. 7S R. 46E Plat No. 62

Photo No. 29-78, 79

Legal Land Owner Dorothy H. Stevens

Address

OperatorLevi S. Howe & Family.

Address Other

Water is delivered by:— 1. Private System; 2. Ditch Company; 3. State Project; 4. Federal Project; 5. Irrigation District

If under Ditch Company, Irrigation District, or Government Project, state the number of shares or inches, acre feet, as the case may be in said system

[illegible]

NOTE: R--Denotes Regular Irrigation. F--Flood Irrigation. P--Water diverted by means of pumping. G--Water diverted by gravity. S--Stored Water.

Condition of System Topography Indian Creek Valley River Basin Yellowstone

Remarks One of the nicest field of hay meadows in this area. All sub irrigated and good producers.

Also in: Plat No..... Twp..... Rge..... Plat No..... Twp..... Rge..... Plat No..... Twp..... Rge.....
Plat No..... Twp..... Rge..... Plat No..... Twp..... Rge..... Plat No..... Twp..... Rge.....

Information From:

Levi S. Howe

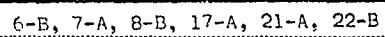

6-B, 7-A, 8-B, 17-A, 21-A, 22-B

If under Ditch Company, Irrigation District, or Government Project, state the number of shares or inches, acre feet, as the case may be in said system

Photo No. 23-37, 38, 39;
29-78, 79, 80

[illegible]

NOTE: R—Denotes Regular Irrigation. F—Flood Irrigation. P—Water diverted by means of pumping. G—Water diverted by gravity. S—Stored Water.

Condition of System Topography River Basin Yellowstone

Adequate Supply: Yes..... No..... Explain

| | |
|---------|--|
| Remarks | |
|---------|--|

| | | |
|---|--------------------------------|--------------------------------|
| Also in: Plat No..... Twp..... Rge..... | Plat No..... Twp..... Rge..... | Plat No..... Twp..... Rge..... |
| Plat No..... Twp..... Rge..... | Plat No..... Twp..... Rge..... | Plat No..... Twp..... Rge..... |

Information From:
Field Survey

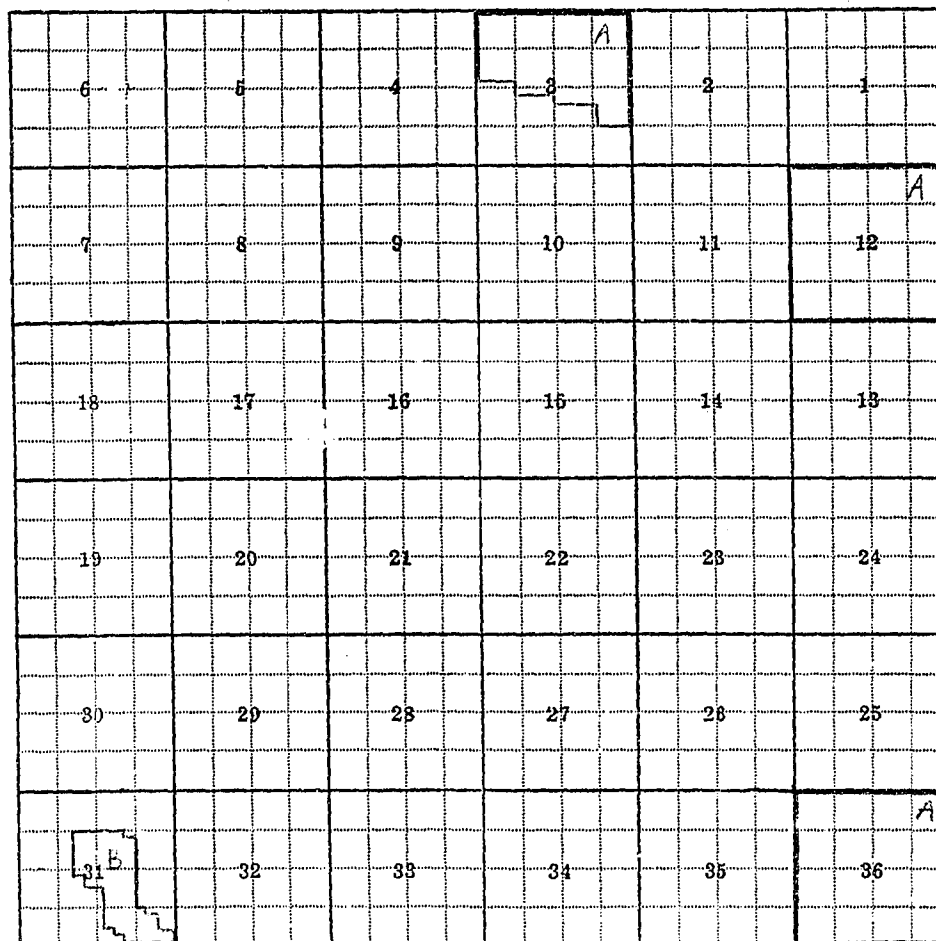

2-A, 12-A, 31-B, 36-A

NOTE: All U. S. A. ownership is not platted. Only that part where the appropriation is located. See ownership plat for any additional ownership required.

T. 7S R. 47E Plat No. 63

STATE OF MONTANA
STATE ENGINEERS OFFICE
Water Resources Survey

Photo No.....23-39

By George Brandt

Legal Land Owner F. I. V. Ranch Co. Address Other

| Operator | Same | Address |
|----------|------|---------|
| Operator | Same | Address |

Water is delivered by:—X 1. Private System; 2. Ditch Company; 3. State Project; 4. Federal Project; 5. Irrigation District

If under Ditch Company, Irrigation District, or Government Project, state the number of shares or inches, acre feet, as the case may be in said system

NOTE: R—Denotes Regular Irrigation. F—Flood Irrigation. P—Water diverted by means of pumping. G—Water diverted by gravity. S—Stored Water.

Condition of System Good Topography Valley River Basin Yellowstone
Adequate Supply: Yes..... No x Explain Only spring run off is used.
Remarks A-374A Newly filed water right.

| | | |
|---------------------------------------|-----------------------------------|-----------------------------------|
| Also in: Plat No. 62 Twp. 7S Rge. 46E | Plat No. Twp. Rge. | Plat No. Twp. Rge. |
| Plat No. Twp. Rge. | Plat No. Twp. Rge. | Plat No. Twp. Rge. |

Information From:
Fred Yonkee Jr.

| | | | | | | | | | | | |
|----|----|----|----|----|----|----|----|----|----|----|----|
| | 6 | | 6 | | 4 | | 3 | | 2 | | 1 |
| | 7 | | 8 | | 9 | | 10 | | 11 | | 12 |
| | 13 | | 14 | | 15 | | 16 | | 17 | | 18 |
| | 19 | | 20 | | 21 | | 22 | | 23 | | 24 |
| | 25 | | 26 | | 27 | | 28 | | 29 | | 30 |
| 31 | | 32 | | 33 | | 34 | | 35 | | 36 | |

31-B, 31-E, 32-C

County Powder River

Farm Checked: Date...9-13-60

By George Brandt

STATE OF MONTANA
STATE ENGINEERS OFFICE
Water Resources Survey

T. 7S.....R. 47E..... Plat No. 63

Photo No. 23-39

Legal Land Owner Ereta G. Kraft Address Otter

| Operator | Same | Address |
|----------|------|---------|
| Operator | Same | Address |

Water is delivered by:—^x 1. Private System; 2. Ditch Company; 3. State Project; 4. Federal Project; 5. Irrigation District

If under Ditch Company, Irrigation District, or Government Project, state the number of shares or inches, acre feet, as the case may be in said system

[illegible]

NOTE: R—Denotes Regular Irrigation. F—Flood Irrigation. P—Water diverted by means of pumping. G—Water diverted by gravity. S—Stored Water.

Condition of System Good Topography Valley River Basin Yellowstone

Adequate Supply: Yes..... No. ☒ Explain

| | | |
|------------------|---------------------|----|
| Adequate supply. | Yes | No |
| Remarks | Very small meadows. | |

| | | |
|--|--------------------------------|--------------------------------|
| Also in: Plat No.....73. Twp.....8S. Rge.....47E | Plat No..... Twp..... Rge..... | Plat No..... Twp..... Rge..... |
| Plat No..... Twp..... Rge..... | Plat No..... Twp..... Rge..... | Plat No..... Twp..... Rge..... |

Information From:
Chas. Kraft

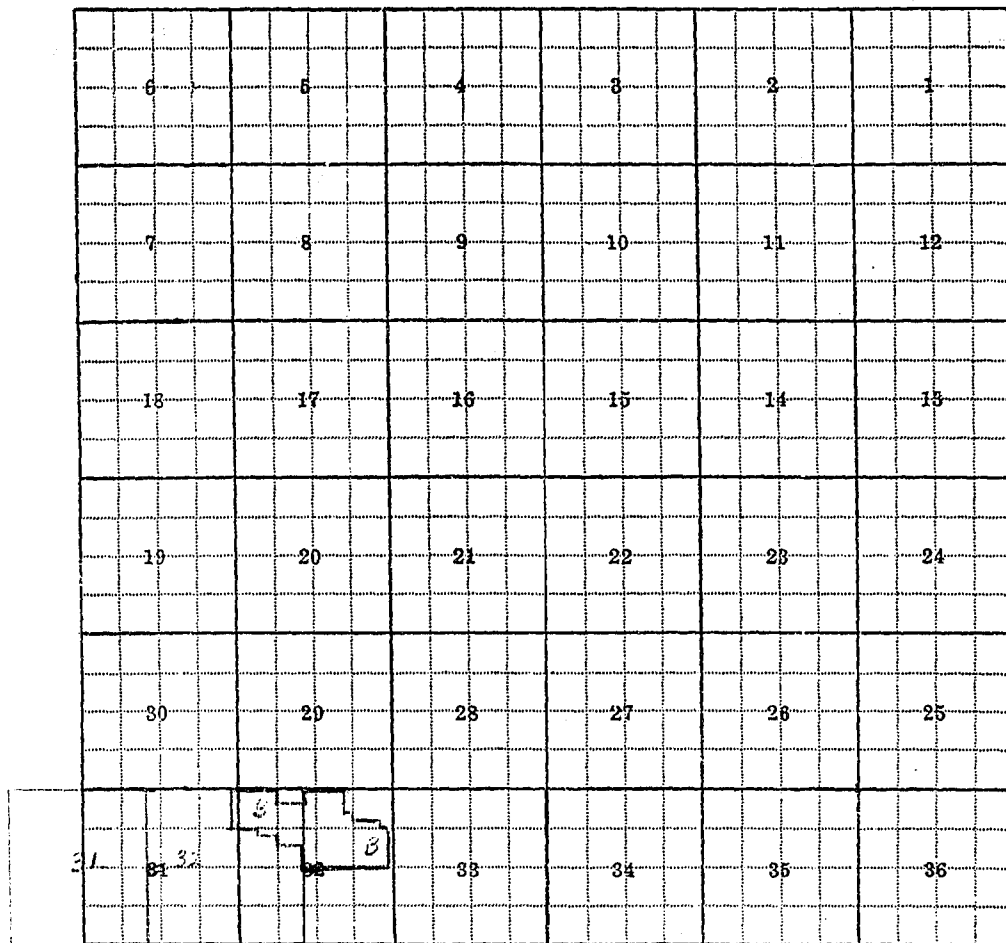

32-B, 33-B

section 33 is a wide section.

County.....Powder River.....

Farm Checked: Date.....9-20-60.....

By.....George Brandt.....

STATE OF MONTANA
WATER CONSERVATION BOARD
Water Resources Survey

T. 7S.....R. 47E..... Plat No. 63.....

Photo No. 23--38

Legal Land Owner.....John A. Kueffer.....Address.....Otter.....

| Operator | Same | Address |
|----------|------|---------|
| | | |

Water is delivered by:— 1. Private System; 2. Ditch Company; 3. State Project; 4. Federal Project; 5. Irrigation District

[illegible]

NOTE: R—Denotes Regular Irrigation. F—Flood Irrigation.

Adequate Supply: Yes..... No ☒ Explain.....
Remarks..... Started using water in 1959.....

NOTE: 820E is listed on this page but not in the book.

.....River Basin.....Yellowstone.

| | | | | | | | | |
|------------------------|-----------|-----------|---------------|-----------|-----------|---------------|-----------|-----------|
| Also in: Plat No. | Twp. | Rge. | Plat No. | Twp. | Rge. | Plat No. | Twp. | Rge. |
| Plat No. | Twp. | Rge. | Plat No. | Twp. | Rge. | Plat No. | Twp. | Rge. |

Information From:

John Kueffer

| | | | | | |
|----|----|----|----|----|----|
| 6 | 5 | 4 | 3 | 2 | 1 |
| 7 | 8 | 9 | 10 | 11 | 12 |
| 13 | 17 | 16 | 15 | 14 | 13 |
| 19 | 20 | 21 | 22 | 23 | 24 |
| 30 | 29 | 28 | 27 | 26 | 25 |
| 31 | 32 | 33 | 34 | 35 | 36 |

Land Ownership

.....

.....

By George Brandt

STATE OF MONTANA
STATE ENGINEERS OFFICE
Water Resources Survey

T7S.....R. 47E..... Plat No. 63

Photo No.....23-37, 38, 39,
17-54, 55, 56

Legal Land Owner United States of America

Address

Address

| Operator | Address |
|--|---------------|
| Water is delivered by:-- 1. Private System; 2. Ditch Company; 3. State Project; 4. Federal Project; 5. Irrigation District | |

If under Ditch Company, Irrigation District, or Government Project, state the number of shares or inches, acre feet, as the case may be in said system

[illegible]

NOTE: R—Denotes Regular Irrigation. F—Flood Irrigation. P—Water diverted by means of pumping. G—Water diverted by gravity. S—Stored Water.

Condition of System Topography River Basin Yellowstone

Adequate Supply: Yes..... No..... Explain

| | |
|---------|--|
| Remarks | |
|---------|--|

SECRET

[illegible]

.....

[illegible][illegible]

.....

.....

1 2 3 4 5 6 7 8 9 10 11 12 13 14 15 16 17 18 19 20 21 22 23 24 25 26 27 28 29 30 31 32 33 34 35 36 37 38 39 40 41 42 43 44 45 46 47 48 49 50 51 52 53 54 55 56 57 58 59 60 61 62 63 64 65 66 67 68 69 70 71 72 73 74 75 76 77 78 79 80 81 82 83 84 85 86 87 88 89 90 91 92 93 94 95 96 97 98 99 100 101 102 103 104 105 106 107 108 109 110 111 112 113 114 115 116 117 118 119 120 121 122 123 124 125 126 127 128 129 130 131 132 133 134 135 136 137 138 139 140 141 142 143 144 145 146 147 148 149 150 151 152 153 154 155 156 157 158 159 160 161 162 163 164 165 166 167 168 169 170 171 172 173 174 175 176 177 178 179 180 181 182 183 184 185 186 187 188 189 190 191 192 193 194 195 196 197 198 199 200 201 202 203 204 205 206 207 208 209 210 211 212 213 214 215 216 217 218 219 220 221 222 223 224 225 226 227 228 229 230 231 232 233 234 235 236 237 238 239 240 241 242 243 244 245 246 247 248 249 250 251 252 253 254 255 256 257 258 259 260 261 262 263 264 265 266 267 268 269 270 271 272 273 274 275 276 277 278 279 280 281 282 283 284 285 286 287 288 289 290 291 292 293 294 295 296 297 298 299 300 301 302 303 304 305 306 307 308 309 310 311 312 313 314 315 316 317 318 319 320 321 322 323 324 325 326 327 328 329 330 331 332 333 334 335 336 337 338 339 340 341 342 343 344 345 346 347 348 349 350 351 352 353 354 355 356 357 358 359 360 361 362 363 364 365 366 367 368 369 370 371 372 373 374 375 376 377 378 379 380 381 382 383 384 385 386 387 388 389 390 391 392 393 394 395 396 397 398 399 400 401 402 403 404 405 406 407 408 409 410 411 412 413 414 415 416 417 418 419 420 421 422 423 424 425 426 427 428 429 430 431 432 433 434 435 436 437 438 439 440 441 442 443 444 445 446 447 448 449 450 451 452 453 454 455 456 457 458 459 460 461 462 463 464 465 466 467 468 469 470 471 472 473 474 475 476 477 478 479 480 481 482 483 484 485 486 487 488 489 490 491 492 493 494 495 496 497 498 499 500 501 502 503 504 505 506 507 508 509 510 511 512 513 514 515 516 517 518 519 520 521 522 523 524 525 526 527 528 529 530 531 532 533 534 535 536 537 538 539 540 541 542 543 544 545 546 547 548 549 550 551 552 553 554 555 556 557 558 559 560 561 562 563 564 565 566 567 568 569 570 571 572 573 574 575 576 577 578 579 580 581 582 583 584 585 586 587 588 589 590 591 592 593 594 595 596 597 598 599 600 601 602 603 604 605 606 607 608 609 610 611 612 613 614 615 616 617 618 619 620 621 622 623 624 625 626 627 628 629 630 631 632 633 634 635 636 637 638 639 640 641 642 643 644 645 646 647 648 649 650 651 652 653 654 655 656 657 658 659 660 661 662 663 664 665 666 667 668 669 670 671 672 673 674 675 676 677 678 679 680 681 682 683 684 685 686 687 688 689 690 691 692 693 694 695 696 697 698 699 700 701 702 703 704 705 706 707 708 709 710 711 712 713 714 715 716 717 718 719 720 721 722 723 724 725 726 727 728 729 730 731 732 733 734 735 736 737 738 739 740 741 742 743 744 745 746 747 748 749 750 751 752 753 754 755 756 757 758 759 760 761 762 763 764 765 766 767 768 769 770 771 772 773 774 775 776 777 778 779 780 781 782 783 784 785 786 787 788 789 790 791 792 793 794 795 796 797 798 799 800 801 802 803 804 805 806 807 808 809 810 811 812 813 814 815 816 817 818 819 820 821 822 823 824 825 826 827 828 829 830 831 832 833 834 835 836 837 838 839 840 841 842 843 844 845 846 847 848 849 850 851 852 853 854 855 856 857 858 859 860 861 862 863 864 865 866 867 868 869 870 871 872 873 874 875 876 877 878 879 880 881 882 883 884 885 886 887 888 889 890 891 892 893 894 895 896 897 898 899 900 901 902 903 904 905 906 907 908 909 910 911 912 913 914 915 916 917 918 919 920 921 922 923 924 925 926 927 928 929 930 931 932 933 934 935 936 937 938 939 940 941 942 943 944 945 946 947 948 949 950 951 952 953 954 955 956 957 958 959 960 961 962 963 964 965 966 967 968 969 970 971 972 973 974 975 976 977 978 979 980 981 982 983 984 985 986 987 988 989 990 991 992 993 994 995 996 997 998 999 1000 1001 1002 1003 1004 1005 1006 1007 1008 1009 1010 1011 1012 1013 1014 1015 1016 1017 1018 1019 1020 1021 1022 1023 1024 1025 1026 1027 1028 1029 1030 1031 1032 1033 1034 1035 1036 1037 1038 1039 104

1 2 3 4 5 6 7 8 9 10 11 12 13 14 15 16 17 18 19 20 21 22 23 24 25 26 27 28 29 30 31 32 33 34 35 36 37 38 39 40 41 42 43 44 45 46 47 48 49 50 51 52 53 54 55 56 57 58 59 60 61 62 63 64 65 66 67 68 69 70 71 72 73 74 75 76 77 78 79 80 81 82 83 84 85 86 87 88 89 90 91 92 93 94 95 96 97 98 99 100 101 102 103 104 105 106 107 108 109 110 111 112 113 114 115 116 117 118 119 120 121 122 123 124 125 126 127 128 129 130 131 132 133 134 135 136 137 138 139 140 141 142 143 144 145 146 147 148 149 150 151 152 153 154 155 156 157 158 159 160 161 162 163 164 165 166 167 168 169 170 171 172 173 174 175 176 177 178 179 180 181 182 183 184 185 186 187 188 189 190 191 192 193 194 195 196 197 198 199 200 201 202 203 204 205 206 207 208 209 210 211 212 213 214 215 216 217 218 219 220 221 222 223 224 225 226 227 228 229 230 231 232 233 234 235 236 237 238 239 240 241 242 243 244 245 246 247 248 249 250 251 252 253 254 255 256 257 258 259 260 261 262 263 264 265 266 267 268 269 270 271 272 273 274 275 276 277 278 279 280 281 282 283 284 285 286 287 288 289 290 291 292 293 294 295 296 297 298 299 300 301 302 303 304 305 306 307 308 309 310 311 312 313 314 315 316 317 318 319 320 321 322 323 324 325 326 327 328 329 330 331 332 333 334 335 336 337 338 339 340 341 342 343 344 345 346 347 348 349 350 351 352 353 354 355 356 357 358 359 360 361 362 363 364 365 366 367 368 369 370 371 372 373 374 375 376 377 378 379 380 381 382 383 384 385 386 387 388 389 390 391 392 393 394 395 396 397 398 399 400 401 402 403 404 405 406 407 408 409 410 411 412 413 414 415 416 417 418 419 420 421 422 423 424 425 426 427 428 429 430 431 432 433 434 435 436 437 438 439 440 441 442 443 444 445 446 447 448 449 450 451 452 453 454 455 456 457 458 459 460 461 462 463 464 465 466 467 468 469 470 471 472 473 474 475 476 477 478 479 480 481 482 483 484 485 486 487 488 489 490 491 492 493 494 495 496 497 498 499 500 501 502 503 504 505 506 507 508 509 510 511 512 513 514 515 516 517 518 519 520 521 522 523 524 525 526 527 528 529 530 531 532 533 534 535 536 537 538 539 540 541 542 543 544 545 546 547 548 549 550 551 552 553 554 555 556 557 558 559 560 561 562 563 564 565 566 567 568 569 570 571 572 573 574 575 576 577 578 579 580 581 582 583 584 585 586 587 588 589 590 591 592 593 594 595 596 597 598 599 600 601 602 603 604 605 606 607 608 609 610 611 612 613 614 615 616 617 618 619 620 621 622 623 624 625 626 627 628 629 630 631 632 633 634 635 636 637 638 639 640 641 642 643 644 645 646 647 648 649 650 651 652 653 654 655 656 657 658 659 660 661 662 663 664 665 666 667 668 669 670 671 672 673 674 675 676 677 678 679 680 681 682 683 684 685 686 687 688 689 690 691 692 693 694 695 696 697 698 699 700 701 702 703 704 705 706 707 708 709 710 711 712 713 714 715 716 717 718 719 720 721 722 723 724 725 726 727 728 729 730 731 732 733 734 735 736 737 738 739 740 741 742 743 744 745 746 747 748 749 750 751 752 753 754 755 756 757 758 759 760 761 762 763 764 765 766 767 768 769 770 771 772 773 774 775 776 777 778 779 780 781 782 783 784 785 786 787 788 789 790 791 792 793 794 795 796 797 798 799 800 801 802 803 804 805 806 807 808 809 810 811 812 813 814 815 816 817 818 819 820 821 822 823 824 825 826 827 828 829 830 831 832 833 834 835 836 837 838 839 840 841 842 843 844 845 846 847 848 849 850 851 852 853 854 855 856 857 858 859 860 861 862 863 864 865 866 867 868 869 870 871 872 873 874 875 876 877 878 879 880 881 882 883 884 885 886 887 888 889 890 891 892 893 894 895 896 897 898 899 900 901 902 903 904 905 906 907 908 909 910 911 912 913 914 915 916 917 918 919 920 921 922 923 924 925 926 927 928 929 930 931 932 933 934 935 936 937 938 939 940 941 942 943 944 945 946 947 948 949 950 951 952 953 954 955 956 957 958 959 960 961 962 963 964 965 966 967 968 969 970 971 972 973 974 975 976 977 978 979 980 981 982 983 984 985 986 987 988 989 990 991 992 993 994 995 996 997 998 999 1000 1001 1002 1003 1004 1005 1006 1007 1008 1009 1010 1011 1012 1013 1014 1015 1016 1017 1018 1019 1020 1021 1022 1023 1024 1025 1026 1027 1028 1029 1030 1031 1032 1033 1034 1035 1036 1037 1038 1039 104

#####

| | | | | | | | | | | | | | | | | | | | | | | | | | | | | | | | | | | | | | | | | | | | | | | | | | | | | | | | | | | | | | | | | | | | | | | | | | | | | | | | | | | | | | | | | | | | | | | | | | | | | | | | | | | | | | | | | | | | | | | | | | | | | | | | | | | | | | | | | | | | | | | | | | | | | | | | | | | | | | | | | | | | | | | | | | | | | | | | | | | | | | | | | | | | | | | | | | | | | | | | | | | | | | | | | | | | | | | | | | | | | | | | | | | | | | | | | | | | | | | | | | | | | | | | | | | | | | | | | | | | | | | | | | | | | | | | | | | | | | | | | | | | | | | | | | | | | | | | | | | | | | | | | | | | | | | | | | | | | | | | | | | | | | | | | | | | | | | | | | | | | | | | | | | | | | | | | | | | | | | | | | | | | | | | | | | | | | | | | | | | | | | | | | | | | | | | | | | | | | | | | | | | | | | | | | | | | | | | | | | | | | | | | | | | | | | | | | | | | | | | | | | | | | | | | | | | | | | | | | | | | | | | | | |
|---|---|---|---|---|---|---|---|---|----|----|----|----|----|----|----|----|----|----|----|----|----|----|----|----|----|----|----|----|----|----|----|----|----|----|----|----|----|----|----|----|----|----|----|----|----|----|----|----|----|----|----|----|----|----|----|----|----|----|----|----|----|----|----|----|----|----|----|----|----|----|----|----|----|----|----|----|----|----|----|----|----|----|----|----|----|----|----|----|----|----|----|----|----|----|----|----|----|----|-----|-----|-----|-----|-----|-----|-----|-----|-----|-----|-----|-----|-----|-----|-----|-----|-----|-----|-----|-----|-----|-----|-----|-----|-----|-----|-----|-----|-----|-----|-----|-----|-----|-----|-----|-----|-----|-----|-----|-----|-----|-----|-----|-----|-----|-----|-----|-----|-----|-----|-----|-----|-----|-----|-----|-----|-----|-----|-----|-----|-----|-----|-----|-----|-----|-----|-----|-----|-----|-----|-----|-----|-----|-----|-----|-----|-----|-----|-----|-----|-----|-----|-----|-----|-----|-----|-----|-----|-----|-----|-----|-----|-----|-----|-----|-----|-----|-----|-----|-----|-----|-----|-----|-----|-----|-----|-----|-----|-----|-----|-----|-----|-----|-----|-----|-----|-----|-----|-----|-----|-----|-----|-----|-----|-----|-----|-----|-----|-----|-----|-----|-----|-----|-----|-----|-----|-----|-----|-----|-----|-----|-----|-----|-----|-----|-----|-----|-----|-----|-----|-----|-----|-----|-----|-----|-----|-----|-----|-----|-----|-----|-----|-----|-----|-----|-----|-----|-----|-----|-----|-----|-----|-----|-----|-----|-----|-----|-----|-----|-----|-----|-----|-----|-----|-----|-----|-----|-----|-----|-----|-----|-----|-----|-----|-----|-----|-----|-----|-----|-----|-----|-----|-----|-----|-----|-----|-----|-----|-----|-----|-----|-----|-----|-----|-----|-----|-----|-----|-----|-----|-----|-----|-----|-----|-----|-----|-----|-----|-----|-----|-----|-----|-----|-----|-----|-----|-----|-----|-----|-----|-----|-----|-----|-----|-----|-----|-----|-----|-----|-----|-----|-----|-----|-----|-----|-----|-----|-----|-----|-----|-----|-----|-----|-----|-----|-----|-----|-----|-----|-----|-----|-----|-----|-----|-----|-----|-----|-----|-----|-----|-----|-----|-----|-----|-----|-----|-----|-----|-----|-----|-----|-----|-----|-----|-----|-----|-----|-----|-----|-----|-----|-----|-----|-----|-----|-----|-----|-----|-----|-----|-----|-----|-----|-----|-----|-----|-----|-----|-----|-----|-----|-----|-----|-----|-----|-----|-----|-----|-----|-----|-----|-----|-----|-----|-----|-----|-----|-----|-----|-----|-----|-----|-----|-----|-----|-----|-----|-----|-----|-----|-----|-----|-----|-----|-----|-----|-----|-----|-----|-----|-----|-----|-----|-----|-----|-----|-----|
| 1 | 2 | 3 | 4 | 5 | 6 | 7 | 8 | 9 | 10 | 11 | 12 | 13 | 14 | 15 | 16 | 17 | 18 | 19 | 20 | 21 | 22 | 23 | 24 | 25 | 26 | 27 | 28 | 29 | 30 | 31 | 32 | 33 | 34 | 35 | 36 | 37 | 38 | 39 | 40 | 41 | 42 | 43 | 44 | 45 | 46 | 47 | 48 | 49 | 50 | 51 | 52 | 53 | 54 | 55 | 56 | 57 | 58 | 59 | 60 | 61 | 62 | 63 | 64 | 65 | 66 | 67 | 68 | 69 | 70 | 71 | 72 | 73 | 74 | 75 | 76 | 77 | 78 | 79 | 80 | 81 | 82 | 83 | 84 | 85 | 86 | 87 | 88 | 89 | 90 | 91 | 92 | 93 | 94 | 95 | 96 | 97 | 98 | 99 | 100 | 101 | 102 | 103 | 104 | 105 | 106 | 107 | 108 | 109 | 110 | 111 | 112 | 113 | 114 | 115 | 116 | 117 | 118 | 119 | 120 | 121 | 122 | 123 | 124 | 125 | 126 | 127 | 128 | 129 | 130 | 131 | 132 | 133 | 134 | 135 | 136 | 137 | 138 | 139 | 140 | 141 | 142 | 143 | 144 | 145 | 146 | 147 | 148 | 149 | 150 | 151 | 152 | 153 | 154 | 155 | 156 | 157 | 158 | 159 | 160 | 161 | 162 | 163 | 164 | 165 | 166 | 167 | 168 | 169 | 170 | 171 | 172 | 173 | 174 | 175 | 176 | 177 | 178 | 179 | 180 | 181 | 182 | 183 | 184 | 185 | 186 | 187 | 188 | 189 | 190 | 191 | 192 | 193 | 194 | 195 | 196 | 197 | 198 | 199 | 200 | 201 | 202 | 203 | 204 | 205 | 206 | 207 | 208 | 209 | 210 | 211 | 212 | 213 | 214 | 215 | 216 | 217 | 218 | 219 | 220 | 221 | 222 | 223 | 224 | 225 | 226 | 227 | 228 | 229 | 230 | 231 | 232 | 233 | 234 | 235 | 236 | 237 | 238 | 239 | 240 | 241 | 242 | 243 | 244 | 245 | 246 | 247 | 248 | 249 | 250 | 251 | 252 | 253 | 254 | 255 | 256 | 257 | 258 | 259 | 260 | 261 | 262 | 263 | 264 | 265 | 266 | 267 | 268 | 269 | 270 | 271 | 272 | 273 | 274 | 275 | 276 | 277 | 278 | 279 | 280 | 281 | 282 | 283 | 284 | 285 | 286 | 287 | 288 | 289 | 290 | 291 | 292 | 293 | 294 | 295 | 296 | 297 | 298 | 299 | 300 | 301 | 302 | 303 | 304 | 305 | 306 | 307 | 308 | 309 | 310 | 311 | 312 | 313 | 314 | 315 | 316 | 317 | 318 | 319 | 320 | 321 | 322 | 323 | 324 | 325 | 326 | 327 | 328 | 329 | 330 | 331 | 332 | 333 | 334 | 335 | 336 | 337 | 338 | 339 | 340 | 341 | 342 | 343 | 344 | 345 | 346 | 347 | 348 | 349 | 350 | 351 | 352 | 353 | 354 | 355 | 356 | 357 | 358 | 359 | 360 | 361 | 362 | 363 | 364 | 365 | 366 | 367 | 368 | 369 | 370 | 371 | 372 | 373 | 374 | 375 | 376 | 377 | 378 | 379 | 380 | 381 | 382 | 383 | 384 | 385 | 386 | 387 | 388 | 389 | 390 | 391 | 392 | 393 | 394 | 395 | 396 | 397 | 398 | 399 | 400 | 401 | 402 | 403 | 404 | 405 | 406 | 407 | 408 | 409 | 410 | 411 | 412 | 413 | 414 | 415 | 416 | 417 | 418 | 419 | 420 | 421 | 422 | 423 | 424 | 425 | 426 | 427 | 428 | 429 | 430 | 431 | 432 | 433 | 434 | 435 | 436 | 437 | 438 | 439 | 440 | 441 | 442 | 443 | 444 | 445 | 446 | 447 | 448 | 449 | 450 | 451 | 452 | 453 | 454 | 455 | 456 | 457 | 458 | 459 | 460 | 461 | 462 | 463 | 464 | 465 | 466 |
|---|---|---|---|---|---|---|---|---|----|----|----|----|----|----|----|----|----|----|----|----|----|----|----|----|----|----|----|----|----|----|----|----|----|----|----|----|----|----|----|----|----|----|----|----|----|----|----|----|----|----|----|----|----|----|----|----|----|----|----|----|----|----|----|----|----|----|----|----|----|----|----|----|----|----|----|----|----|----|----|----|----|----|----|----|----|----|----|----|----|----|----|----|----|----|----|----|----|----|-----|-----|-----|-----|-----|-----|-----|-----|-----|-----|-----|-----|-----|-----|-----|-----|-----|-----|-----|-----|-----|-----|-----|-----|-----|-----|-----|-----|-----|-----|-----|-----|-----|-----|-----|-----|-----|-----|-----|-----|-----|-----|-----|-----|-----|-----|-----|-----|-----|-----|-----|-----|-----|-----|-----|-----|-----|-----|-----|-----|-----|-----|-----|-----|-----|-----|-----|-----|-----|-----|-----|-----|-----|-----|-----|-----|-----|-----|-----|-----|-----|-----|-----|-----|-----|-----|-----|-----|-----|-----|-----|-----|-----|-----|-----|-----|-----|-----|-----|-----|-----|-----|-----|-----|-----|-----|-----|-----|-----|-----|-----|-----|-----|-----|-----|-----|-----|-----|-----|-----|-----|-----|-----|-----|-----|-----|-----|-----|-----|-----|-----|-----|-----|-----|-----|-----|-----|-----|-----|-----|-----|-----|-----|-----|-----|-----|-----|-----|-----|-----|-----|-----|-----|-----|-----|-----|-----|-----|-----|-----|-----|-----|-----|-----|-----|-----|-----|-----|-----|-----|-----|-----|-----|-----|-----|-----|-----|-----|-----|-----|-----|-----|-----|-----|-----|-----|-----|-----|-----|-----|-----|-----|-----|-----|-----|-----|-----|-----|-----|-----|-----|-----|-----|-----|-----|-----|-----|-----|-----|-----|-----|-----|-----|-----|-----|-----|-----|-----|-----|-----|-----|-----|-----|-----|-----|-----|-----|-----|-----|-----|-----|-----|-----|-----|-----|-----|-----|-----|-----|-----|-----|-----|-----|-----|-----|-----|-----|-----|-----|-----|-----|-----|-----|-----|-----|-----|-----|-----|-----|-----|-----|-----|-----|-----|-----|-----|-----|-----|-----|-----|-----|-----|-----|-----|-----|-----|-----|-----|-----|-----|-----|-----|-----|-----|-----|-----|-----|-----|-----|-----|-----|-----|-----|-----|-----|-----|-----|-----|-----|-----|-----|-----|-----|-----|-----|-----|-----|-----|-----|-----|-----|-----|-----|-----|-----|-----|-----|-----|-----|-----|-----|-----|-----|-----|-----|-----|-----|-----|-----|-----|-----|-----|-----|-----|-----|-----|-----|-----|-----|-----|-----|-----|-----|-----|-----|-----|-----|-----|-----|-----|-----|-----|-----|-----|-----|-----|-----|-----|-----|-----|-----|-----|-----|-----|-----|-----|-----|

| | | | | | | | | | |
|-----------------------|----------|----------|--------------|----------|----------|--------------|----------|----------|-------------------|
| Also in: Plat No..... | Twp..... | Rge..... | Plat No..... | Twp..... | Rge..... | Plat No..... | Twp..... | Rge..... | Information from: |
| Plat No..... | Twp..... | Rge..... | Plat No..... | Twp..... | Rge..... | Plat No..... | Twp..... | Rge..... | |

Plat No. Twp. Rge. || Plat No. Twp. Rge. || Plat No. Twp. Rge.

[illegible]

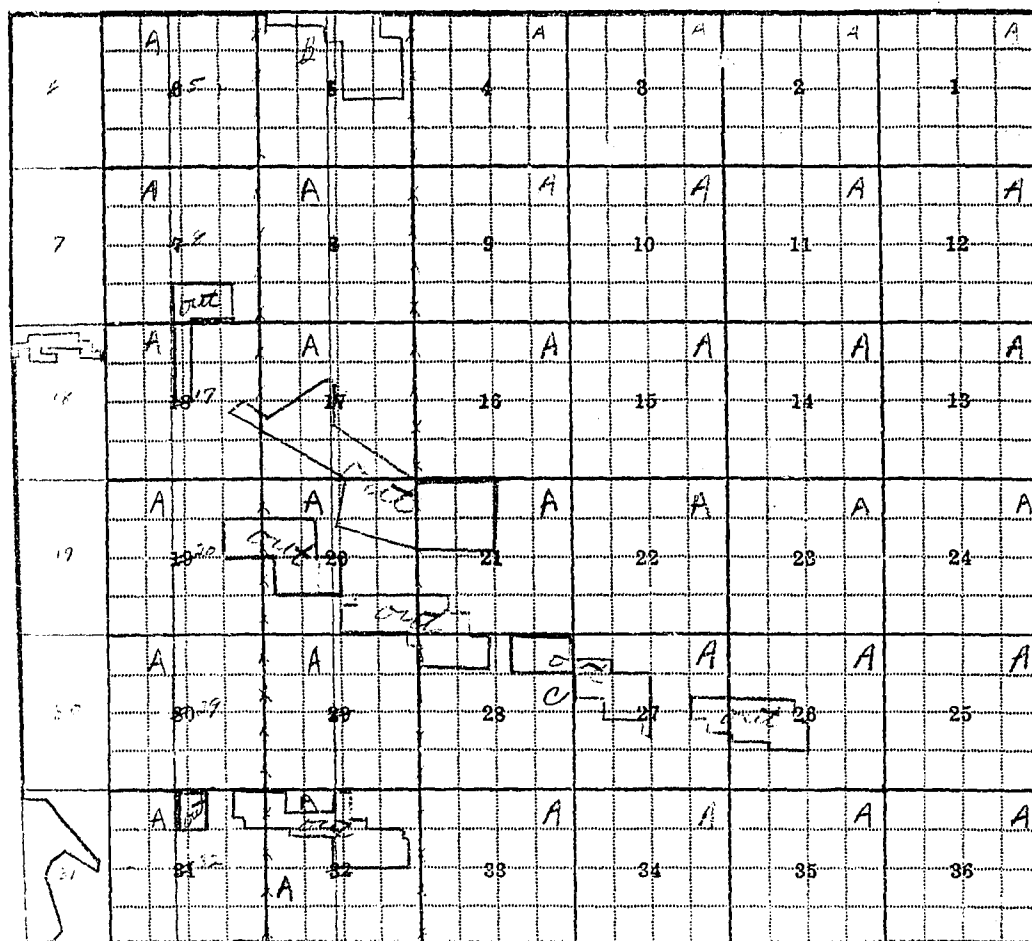

1-A, 2-A, 3-A, 4-A, 5-B, 6-A, 7-A, 8-A, 9-A, 10-A, 11-A, 12-A, 13-A, 14-A, 15-A, 16-A, 17-A, 18-A, 19-A, 20-A, 21-A, 22-A, 23-A, 24-A, 25-A, 26-A, 27-A, 28-C, 29-A, 30-A, 31-A, 32-A, 33-A, 34-A, 35-A, 36-A

If under Ditch Company, Irrigation District, or Government Project, state the number of shares or inches, acre feet, as the case may be in said system.

74
TBS
R45E
72

Photo No. 28-210, 28-211,
28-212, 29-07, 29-08

Address Otter

If under Ditch Company, Irrigation District, or Government Project, state the number of shares or inches, acre feet, as the case may be in said system.

NOTE: R—Denotes Regular Irrigation. F—Flood Irrigation. P—Water diverted by means of pumping. G—Water diverted by gravity. S—Stored Water.

Adequate Supply: Yes ☐ No ☒ Explain: This water was appropriated for a pump system, but was never used as such. It's now just a flood system.

Remarks Ints. water was appropriated for a pump system, but was never used as such. It's now just a flood system.

Information From:
Mark Tolliver - Foreman

F-1-A
County Powder River

Farm Checked: Date 9-12-60

By Georgia Brandt

Legal Land Owner Gerald T. Powers

STATE OF MONTANA
STATE ENGINEERS OFFICE
Water Resources Survey

T. 8S R. 45E Plat No. 71

Photo No. 29-06

Address Otter, Montana

Operator _____ Address _____

Water is delivered by: ☒ 1. Private System; ☐ 2. Ditch Company; ☐ 3. State Project; ☐ 4. Federal Project; ☐ 5. Irrigation District

If under Ditch Company, Irrigation District, or Government Project, state the number of shares or inches, acre feet, as the case may be in said system _____

| App. No.
Decree No. | NAME OF APPROPRIATOR
TO WHOM DECREE | NAME OF STREAM | Date App.
Date Priority | Miner's
Inches | In Use | NAME OF DITCH
(Water Delivered By) | No. | R/F | P/G/S | Present
Irr. Acres | Irrigable
Acres |
|------------------------|--|----------------|----------------------------|-------------------|--------|---------------------------------------|-----|-----|-----------|-----------------------|--------------------|
| A-46A | August E. Munn | Bear Creek | 11-6-05 | 2000 | Yes | Powers System | 1 | F | Diversion | | |
| A-47 | Roxa A. Powers | Bear Creek | 1-15-10 | 1000 | Yes | Powers System | 1 | F | Diversion | 105 | 0 |
| A-48 | Roy H. Powers | Bear Creek | 5-27-35 | All | | | | | | | |
| | | | | Unappropriated | | | | | | | |
| | | | | Water | Yes | Powers System | 1 | F | Diversion | | |
| | | | | | | | | | | | |
| A-867 | Phineas W. & Roxa
Powers | Vance Creek | 2-21-07 | 4000 | Yes | Powers System | 1 | F | Diversion | 15 | 0 |
| A-868 | Roxa C. Powers | Vance Creek | 11-8-34 | All | | | | | | | |
| | | | | Unappropriated | | | | | | | |
| | | | | Water | Yes | Powers System | 1 | F | Diversion | | |

NOTE: R—Denotes Regular Irrigation. F—Flood Irrigation. P—Water diverted by means of pumping. G—Water diverted by gravity. S—Stored Water.

Condition of System Good Topography Valley River Basin Yellowstone

Adequate Supply: Yes ☒ No ☒ Explain Adequate only in spring.

Remarks This man born and raised on this ranch. Excellent source of information on this area.

| | | |
|---|--------------------------------------|--------------------------------------|
| Also in: Plat No. _____ Twp. _____ Rge. _____ | Plat No. _____ Twp. _____ Rge. _____ | Plat No. _____ Twp. _____ Rge. _____ |
| Plat No. _____ Twp. _____ Rge. _____ | Plat No. _____ Twp. _____ Rge. _____ | Plat No. _____ Twp. _____ Rge. _____ |

Information From:
Gerald T. Powers

| | | | | | | | | | | | | |
|--|----|--|----|--|----|---|----|---|----|--|----|--|
| | 6 | | 5 | | 4 | | 3 | | 2 | | 1 | |
| | 7 | | 8 | | 9 | | 10 | | 11 | | 12 | |
| | 18 | | 17 | | 16 | | 15 | | 14 | | 13 | |
| | 19 | | 20 | | 21 | | 22 | | 23 | | 24 | |
| | 30 | | 29 | | 28 | | 27 | | 26 | | 25 | |
| | | | | | A | B | | A | C | | | |
| | 31 | | 32 | | 33 | | 34 | | 35 | | 36 | |

26-D, 27-B, 27-C, 33-A, 34-A, 34-B, 35-C

County Powder River

Farm Checked: Date.....9-9-60.....

By George Brandt

STATE OF MONTANA
WATER CONSERVATION BOARD
Water Resources Survey

T 8S R 45E Plat No. 71

Photo No. 28-212, 29-06

Legal Land Owner.....Mibra E. Lloyd.....Address.....Otter.....

| Operator | Same | Address |
|----------|------|---------|
| | | |

Water is delivered by:— 1. Private System; 2. Ditch Company; 3. State Project; 4. Federal Project; 5. Irrigation District.

[illegible]

NOTE: R—Denotes Regular Irrigation. F—Flood Irrigation.

Adequate Supply: Yes..... No X..... Explain.....
Remarks..... Some new work largely not tried......

1. The first step in the process of the scientific method is to ask a question. This question should be based on observation and should be specific and measurable. For example, "Does the amount of sunlight affect the growth of a plant?"

2. The second step is to form a hypothesis. A hypothesis is a statement that can be tested. It should be based on the question and should be a prediction of what will happen. For example, "If a plant receives more sunlight, then it will grow taller." This hypothesis is testable because it can be measured and compared.

3. The third step is to design an experiment. The experiment should be designed to test the hypothesis. It should include a control group and an experimental group. The control group is the group that does not receive the treatment being tested. The experimental group is the group that does receive the treatment. In this example, the control group would be plants that receive a normal amount of sunlight, and the experimental group would be plants that receive more sunlight.

4. The fourth step is to collect data. Data is the information that is gathered during the experiment. In this example, the data would be the height of the plants in both groups over a period of time.

5. The fifth step is to analyze the data. This step involves looking at the data and seeing if it supports the hypothesis. In this example, if the plants in the experimental group grew taller than the plants in the control group, then the hypothesis is supported.

6. The sixth step is to draw a conclusion. A conclusion is a statement that summarizes the results of the experiment. In this example, the conclusion would be that the amount of sunlight does affect the growth of a plant.

7. The final step is to communicate the results. This step involves sharing the results of the experiment with others. This can be done through a presentation, a paper, or a report.

.....River Basin.....Yellowstone

| | | | | | | | | |
|----------------------|-----------|-----------|---------------|-----------|-----------|---------------|-----------|-----------|
| Also in: Plat No. 81 | Twp. 9S | Rge. 45E | Plat No. | Twp. | Rge. | Plat No. | Twp. | Rge. |
| Plat No. | Twp. | Rge. | Plat No. | Twp. | Rge. | Plat No. | Twp. | Rge. |

Information From:

M. E. Lloyd

| | | | | | | | | | | | | |
|--|----|----------|----|----------|----------|----------|----|--|----|--|----|--|
| | 6 | | 6 | | 4 | | 8 | | 2 | | 1 | |
| | 7 | | 8 | | 9 | | 10 | | 11 | | 12 | |
| | 13 | | 17 | | 16 | | 15 | | 14 | | 13 | |
| | 19 | | 20 | | 21 | | 22 | | 23 | | 24 | |
| | 30 | | 29 | | 28 | | 27 | | 26 | | 25 | |
| | | <i>B</i> | | | | <i>L</i> | | | | | | |
| | | <i>A</i> | | <i>A</i> | <i>E</i> | | | | | | | |
| | 31 | | 32 | | 33 | | 34 | | 35 | | 36 | |

Land Ownership

.....

.....

Information From:
Robert T. Powers

| | | | | | |
|----|----|----|----|----|----|
| 6 | 5 | 4 | 3 | 2 | 1 |
| 7 | 8 | 9 | 10 | 11 | 12 |
| 18 | 17 | 16 | 15 | 14 | 13 |
| | | | | C | C |
| | | | A | B | A |
| 19 | 20 | 21 | B | 22 | 23 |
| | | | | | |
| | | | B | A | A |
| 20 | 20 | 28 | | 27 | 28 |
| | | | | | |
| 31 | 32 | 33 | 34 | 35 | 36 |

14-C, 15-C, 21-A, 21-B, 22-A, 22-B, 23-B, 26-C, 27-A, 28-A, 28-B.
 NOTE: Both Robert Thomas Powers and Robt. T. & Jennie A. Powers ownerships are
 operated as one unit.
 21-A, 22-B, & 28-B, in Robert Thomas Powers name.

If under Ditch Company, Irrigation District, or Government Project, state the number of shares or inches, acre feet, as the case may be in said system

Photo No. 29-08

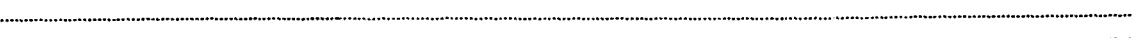

Information From:
John Witham

1-D, 2-C, 3-A, 4-B, 12-B, 14-D, 23-A, 24-C, 26-A

1-D, 2-C, 3-A, 4-B, 12-B, 14-D, 23-A, 24-C, 26-A

If under Ditch Company, Irrigation District.

Photo No. 29-82, 29-83

Address

Water is delivered by:—^x 1. Private System; 2. Ditch Company; 3. State Project; 4. Federal Project; 5. Irrigation District

If under Ditch Company, Irrigation District, or Government Project, state the number of shares or inches, acre feet, as the case may be in said system.

[illegible]

NOTE: R—Denotes Regular Irrigation. F—Flood Irrigation. P—Water diverted by means of pumping. G—Water diverted by gravity. S—Stored Water.

Condition of System Fair Topography Upper Creek Basin River Basin Yellowstone

Adequate Supply: Yes..... No.^x..... Explain

| | |
|---------|--|
| Remarks | Has tractor & Scraper which is in use most of the summer on dike work. |
|---------|--|

1 2 3 4 5 6 7 8 9 10 11 12 13 14 15 16 17 18 19 20 21 22 23 24 25 26 27 28 29 30 31 32 33 34 35 36 37 38 39 40 41 42 43 44 45 46 47 48 49 50 51 52 53 54 55 56 57 58 59 60 61 62 63 64 65 66 67 68 69 70 71 72 73 74 75 76 77 78 79 80 81 82 83 84 85 86 87 88 89 90 91 92 93 94 95 96 97 98 99 100 101 102 103 104 105 106 107 108 109 110 111 112 113 114 115 116 117 118 119 120 121 122 123 124 125 126 127 128 129 130 131 132 133 134 135 136 137 138 139 140 141 142 143 144 145 146 147 148 149 150 151 152 153 154 155 156 157 158 159 160 161 162 163 164 165 166 167 168 169 170 171 172 173 174 175 176 177 178 179 180 181 182 183 184 185 186 187 188 189 190 191 192 193 194 195 196 197 198 199 200 201 202 203 204 205 206 207 208 209 210 211 212 213 214 215 216 217 218 219 220 221 222 223 224 225 226 227 228 229 230 231 232 233 234 235 236 237 238 239 240 241 242 243 244 245 246 247 248 249 250 251 252 253 254 255 256 257 258 259 260 261 262 263 264 265 266 267 268 269 270 271 272 273 274 275 276 277 278 279 280 281 282 283 284 285 286 287 288 289 290 291 292 293 294 295 296 297 298 299 300 301 302 303 304 305 306 307 308 309 310 311 312 313 314 315 316 317 318 319 320 321 322 323 324 325 326 327 328 329 330 331 332 333 334 335 336 337 338 339 340 341 342 343 344 345 346 347 348 349 350 351 352 353 354 355 356 357 358 359 360 361 362 363 364 365 366 367 368 369 370 371 372 373 374 375 376 377 378 379 380 381 382 383 384 385 386 387 388 389 390 391 392 393 394 395 396 397 398 399 400 401 402 403 404 405 406 407 408 409 410 411 412 413 414 415 416 417 418 419 420 421 422 423 424 425 426 427 428 429 430 431 432 433 434 435 436 437 438 439 440 441 442 443 444 445 446 447 448 449 450 451 452 453 454 455 456 457 458 459 460 461 462 463 464 465 466 467 468 469 470 471 472 473 474 475 476 477 478 479 480 481 482 483 484 485 486 487 488 489 490 491 492 493 494 495 496 497 498 499 500 501 502 503 504 505 506 507 508 509 510 511 512 513 514 515 516 517 518 519 520 521 522 523 524 525 526 527 528 529 530 531 532 533 534 535 536 537 538 539 540 541 542 543 544 545 546 547 548 549 550 551 552 553 554 555 556 557 558 559 560 561 562 563 564 565 566 567 568 569 570 571 572 573 574 575 576 577 578 579 580 581 582 583 584 585 586 587 588 589 590 591 592 593 594 595 596 597 598 599 600 601 602 603 604 605 606 607 608 609 610 611 612 613 614 615 616 617 618 619 620 621 622 623 624 625 626 627 628 629 630 631 632 633 634 635 636 637 638 639 640 641 642 643 644 645 646 647 648 649 650 651 652 653 654 655 656 657 658 659 660 661 662 663 664 665 666 667 668 669 670 671 672 673 674 675 676 677 678 679 680 681 682 683 684 685 686 687 688 689 690 691 692 693 694 695 696 697 698 699 700 701 702 703 704 705 706 707 708 709 710 711 712 713 714 715 716 717 718 719 720 721 722 723 724 725 726 727 728 729 730 731 732 733 734 735 736 737 738 739 740 741 742 743 744 745 746 747 748 749 750 751 752 753 754 755 756 757 758 759 760 761 762 763 764 765 766 767 768 769 770 771 772 773 774 775 776 777 778 779 780 781 782 783 784 785 786 787 788 789 790 791 792 793 794 795 796 797 798 799 800 801 802 803 804 805 806 807 808 809 810 811 812 813 814 815 816 817 818 819 820 821 822 823 824 825 826 827 828 829 830 831 832 833 834 835 836 837 838 839 840 841 842 843 844 845 846 847 848 849 850 851 852 853 854 855 856 857 858 859 860 861 862 863 864 865 866 867 868 869 870 871 872 873 874 875 876 877 878 879 880 881 882 883 884 885 886 887 888 889 890 891 892 893 894 895 896 897 898 899 900 901 902 903 904 905 906 907 908 909 910 911 912 913 914 915 916 917 918 919 920 921 922 923 924 925 926 927 928 929 930 931 932 933 934 935 936 937 938 939 940 941 942 943 944 945 946 947 948 949 950 951 952 953 954 955 956 957 958 959 960 961 962 963 964 965 966 967 968 969 970 971 972 973 974 975 976 977 978 979 980 981 982 983 984 985 986 987 988 989 990 991 992 993 994 995 996 997 998 999 1000 1001 1002 1003 1004 1005 1006 1007 1008 1009 1010 1011 1012 1013 1014 1015 1016 1017 1018 1019 1020 1021 1022 1023 1024 1025 1026 1027 1028 1029 1030 1031 1032 1033 1034 1035 1036 1037 1038 1039 104

[illegible]

SECRET

[illegible][illegible][illegible]

12345678910111213141516171819202122232425262728293031323334353637383940414243444546474849505152535455565758596061626364656667686970717273747576777879808182838485868788899091929394959697989910010110210310410510610710810911011111211311411511611711811912012112212312412512612712812913013113213313413513613713813914014114214314414514614714814915015115215315415515615715815916016116216316416516616716816917017117217317417517617717817918018118218318418518618718818919019119219319419519619719819920020120220320420520620720820921021121221321421521621721821922022122222322422522622722822923023123223323423523623723823924024124224324424524624724824925025125225325425525625725825926026126226326426526626726826927027127227327427527627727827928028128228328428528628728828929029129229329429529629729829930030130230330430530630730830931031131231331431531631731831932032132232332432532632732832933033133233333433533633733833934034134234334434534634734834935035135235335435535635735835936036136236336436536636736836937037137237337437537637737837938038138238338438538638738838939039139239339439539639739839940040140240340440540640740840941041141241341441541641741841942042142242342442542642742842943043143243343443543643743843944044144244344444544644744844945045145245345445545645745845946046146246346446546646746846947047147247347447547647747847948048148248348448548648748848949049149249349449549649749849950050150250350450550650750850951051151251351451551651751851952052152252352452552652752852953053153253353453553653753853954054154254354454554654754854955055155255355455555655755855956056156256356456556656756856957057157257357457557657757857958058158258358458558658758858959059159259359459559659759859960060160260360460560660760860961061161261361461561661761861962062162262362462562662762862963063163263363463563663763863964064164264364464564664764864965065165265365465565665765865966066166266366466566666766866967067167267367467567667767867968068168268368468568668768868969069169269369469569669769869970070170270370470570670770870971071171271371471571671771871972072172272372472572672772872973073173273373473573673773873974074174274374474574674774874975075175275375475575675775875976076176276376476576676776876977077177277377477577677777877978078178278378478578678778878979079179279379479579679779879980080180280380480580680780880981081181281381481581681781881982082182282382482582682782882983083183283383483583683783883984084184284384484584684784884985085185285385485585685785885986086186286386486586686786886987087187287387487587687787887988088188288388488588688788888989089189289389489589689789889990090190290390490590690790890991091191291391491591691791891992092192292392492592692792892993093193293393493593693793893994094194294394494594694794894995095195295395495595695795895996096196296396496596696796896997097197297397497597697797897998098198298398498598698798898999099199299399499599699799899910001001100210031004100510061007100810091010101110121013101410151016101710181019102010211022102310241025102610271028102910301031103210331034103510361037103810391040104110421043104410451046104710481049105010511052105310541055105610571058105910601061106210631064106510661067106810691070107110721073107410751076107710781079108010811082108310841085108610871088108910901091109210931094109510961097109810991100110111021103110411051106110711081109111011111112111311141115111611171118111911201121112211231124112511261127112811291130113111321133113411351136113711381139114011411142114311441145114611471148114911501151115211531154115511561157115811591160116111621163116411651166116711681169117011711172117311741175117611771178117911801181118211831184118511861187118811891190119111921193119411951196119711981199120012011202120312041205120612071208120912101211121212131214121512161217121812191220122112221223122412251226122712281229123012311232123312341235123612371238123912401241124212431244124512461247124812491250125112521253125412551256125712581259126012611262126312641265126612671268126912701271127212731274127512761277127812791280128112821283128412851286128712881289129012911292129312941295129612971298129913

1 2 3 4 5 6 7 8 9 10 11 12 13 14 15 16 17 18 19 20 21 22 23 24 25 26 27 28 29 30 31 32 33 34 35 36 37 38 39 40 41 42 43 44 45 46 47 48 49 50 51 52 53 54 55 56 57 58 59 60 61 62 63 64 65 66 67 68 69 70 71 72 73 74 75 76 77 78 79 80 81 82 83 84 85 86 87 88 89 90 91 92 93 94 95 96 97 98 99 100 101 102 103 104 105 106 107 108 109 110 111 112 113 114 115 116 117 118 119 120 121 122 123 124 125 126 127 128 129 130 131 132 133 134 135 136 137 138 139 140 141 142 143 144 145 146 147 148 149 150 151 152 153 154 155 156 157 158 159 160 161 162 163 164 165 166 167 168 169 170 171 172 173 174 175 176 177 178 179 180 181 182 183 184 185 186 187 188 189 190 191 192 193 194 195 196 197 198 199 200 201 202 203 204 205 206 207 208 209 210 211 212 213 214 215 216 217 218 219 220 221 222 223 224 225 226 227 228 229 230 231 232 233 234 235 236 237 238 239 240 241 242 243 244 245 246 247 248 249 250 251 252 253 254 255 256 257 258 259 260 261 262 263 264 265 266 267 268 269 270 271 272 273 274 275 276 277 278 279 280 281 282 283 284 285 286 287 288 289 290 291 292 293 294 295 296 297 298 299 300 301 302 303 304 305 306 307 308 309 310 311 312 313 314 315 316 317 318 319 320 321 322 323 324 325 326 327 328 329 330 331 332 333 334 335 336 337 338 339 340 341 342 343 344 345 346 347 348 349 350 351 352 353 354 355 356 357 358 359 360 361 362 363 364 365 366 367 368 369 370 371 372 373 374 375 376 377 378 379 380 381 382 383 384 385 386 387 388 389 390 391 392 393 394 395 396 397 398 399 400 401 402 403 404 405 406 407 408 409 410 411 412 413 414 415 416 417 418 419 420 421 422 423 424 425 426 427 428 429 430 431 432 433 434 435 436 437 438 439 440 441 442 443 444 445 446 447 448 449 450 451 452 453 454 455 456 457 458 459 460 461 462 463 464 465 466 467 468 469 470 471 472 473 474 475 476 477 478 479 480 481 482 483 484 485 486 487 488 489 490 491 492 493 494 495 496 497 498 499 500 501 502 503 504 505 506 507 508 509 510 511 512 513 514 515 516 517 518 519 520 521 522 523 524 525 526 527 528 529 530 531 532 533 534 535 536 537 538 539 540 541 542 543 544 545 546 547 548 549 550 551 552 553 554 555 556 557 558 559 560 561 562 563 564 565 566 567 568 569 570 571 572 573 574 575 576 577 578 579 580 581 582 583 584 585 586 587 588 589 590 591 592 593 594 595 596 597 598 599 600 601 602 603 604 605 606 607 608 609 610 611 612 613 614 615 616 617 618 619 620 621 622 623 624 625 626 627 628 629 630 631 632 633 634 635 636 637 638 639 640 641 642 643 644 645 646 647 648 649 650 651 652 653 654 655 656 657 658 659 660 661 662 663 664 665 666 667 668 669 670 671 672 673 674 675 676 677 678 679 680 681 682 683 684 685 686 687 688 689 690 691 692 693 694 695 696 697 698 699 700 701 702 703 704 705 706 707 708 709 710 711 712 713 714 715 716 717 718 719 720 721 722 723 724 725 726 727 728 729 730 731 732 733 734 735 736 737 738 739 740 741 742 743 744 745 746 747 748 749 750 751 752 753 754 755 756 757 758 759 760 761 762 763 764 765 766 767 768 769 770 771 772 773 774 775 776 777 778 779 780 781 782 783 784 785 786 787 788 789 790 791 792 793 794 795 796 797 798 799 800 801 802 803 804 805 806 807 808 809 810 811 812 813 814 815 816 817 818 819 820 821 822 823 824 825 826 827 828 829 830 831 832 833 834 835 836 837 838 839 840 841 842 843 844 845 846 847 848 849 850 851 852 853 854 855 856 857 858 859 860 861 862 863 864 865 866 867 868 869 870 871 872 873 874 875 876 877 878 879 880 881 882 883 884 885 886 887 888 889 890 891 892 893 894 895 896 897 898 899 900 901 902 903 904 905 906 907 908 909 910 911 912 913 914 915 916 917 918 919 920 921 922 923 924 925 926 927 928 929 930 931 932 933 934 935 936 937 938 939 940 941 942 943 944 945 946 947 948 949 950 951 952 953 954 955 956 957 958 959 960 961 962 963 964 965 966 967 968 969 970 971 972 973 974 975 976 977 978 979 980 981 982 983 984 985 986 987 988 989 990 991 992 993 994 995 996 997 998 999 1000 1001 1002 1003 1004 1005 1006 1007 1008 1009 1010 1011 1012 1013 1014 1015 1016 1017 1018 1019 1020 1021 1022 1023 1024 1025 1026 1027 1028 1029 1030 1031 1032 1033 1034 1035 1036 1037 1038 1039 104

1 2 3 4 5 6 7 8 9 10 11 12 13 14 15 16 17 18 19 20 21 22 23 24 25 26 27 28 29 30 31 32 33 34 35 36 37 38 39 40 41 42 43 44 45 46 47 48 49 50 51 52 53 54 55 56 57 58 59 60 61 62 63 64 65 66 67 68 69 70 71 72 73 74 75 76 77 78 79 80 81 82 83 84 85 86 87 88 89 90 91 92 93 94 95 96 97 98 99 100 101 102 103 104 105 106 107 108 109 110 111 112 113 114 115 116 117 118 119 120 121 122 123 124 125 126 127 128 129 130 131 132 133 134 135 136 137 138 139 140 141 142 143 144 145 146 147 148 149 150 151 152 153 154 155 156 157 158 159 160 161 162 163 164 165 166 167 168 169 170 171 172 173 174 175 176 177 178 179 180 181 182 183 184 185 186 187 188 189 190 191 192 193 194 195 196 197 198 199 200 201 202 203 204 205 206 207 208 209 210 211 212 213 214 215 216 217 218 219 220 221 222 223 224 225 226 227 228 229 230 231 232 233 234 235 236 237 238 239 240 241 242 243 244 245 246 247 248 249 250 251 252 253 254 255 256 257 258 259 260 261 262 263 264 265 266 267 268 269 270 271 272 273 274 275 276 277 278 279 280 281 282 283 284 285 286 287 288 289 290 291 292 293 294 295 296 297 298 299 300 301 302 303 304 305 306 307 308 309 310 311 312 313 314 315 316 317 318 319 320 321 322 323 324 325 326 327 328 329 330 331 332 333 334 335 336 337 338 339 340 341 342 343 344 345 346 347 348 349 350 351 352 353 354 355 356 357 358 359 360 361 362 363 364 365 366 367 368 369 370 371 372 373 374 375 376 377 378 379 380 381 382 383 384 385 386 387 388 389 390 391 392 393 394 395 396 397 398 399 400 401 402 403 404 405 406 407 408 409 410 411 412 413 414 415 416 417 418 419 420 421 422 423 424 425 426 427 428 429 430 431 432 433 434 435 436 437 438 439 440 441 442 443 444 445 446 447 448 449 450 451 452 453 454 455 456 457 458 459 460 461 462 463 464 465 466 467 468 469 470 471 472 473 474 475 476 477 478 479 480 481 482 483 484 485 486 487 488 489 490 491 492 493 494 495 496 497 498 499 500 501 502 503 504 505 506 507 508 509 510 511 512 513 514 515 516 517 518 519 520 521 522 523 524 525 526 527 528 529 530 531 532 533 534 535 536 537 538 539 540 541 542 543 544 545 546 547 548 549 550 551 552 553 554 555 556 557 558 559 560 561 562 563 564 565 566 567 568 569 570 571 572 573 574 575 576 577 578 579 580 581 582 583 584 585 586 587 588 589 590 591 592 593 594 595 596 597 598 599 600 601 602 603 604 605 606 607 608 609 610 611 612 613 614 615 616 617 618 619 620 621 622 623 624 625 626 627 628 629 630 631 632 633 634 635 636 637 638 639 640 641 642 643 644 645 646 647 648 649 650 651 652 653 654 655 656 657 658 659 660 661 662 663 664 665 666 667 668 669 670 671 672 673 674 675 676 677 678 679 680 681 682 683 684 685 686 687 688 689 690 691 692 693 694 695 696 697 698 699 700 701 702 703 704 705 706 707 708 709 710 711 712 713 714 715 716 717 718 719 720 721 722 723 724 725 726 727 728 729 730 731 732 733 734 735 736 737 738 739 740 741 742 743 744 745 746 747 748 749 750 751 752 753 754 755 756 757 758 759 760 761 762 763 764 765 766 767 768 769 770 771 772 773 774 775 776 777 778 779 780 781 782 783 784 785 786 787 788 789 790 791 792 793 794 795 796 797 798 799 800 801 802 803 804 805 806 807 808 809 810 811 812 813 814 815 816 817 818 819 820 821 822 823 824 825 826 827 828 829 830 831 832 833 834 835 836 837 838 839 840 841 842 843 844 845 846 847 848 849 850 851 852 853 854 855 856 857 858 859 860 861 862 863 864 865 866 867 868 869 870 871 872 873 874 875 876 877 878 879 880 881 882 883 884 885 886 887 888 889 890 891 892 893 894 895 896 897 898 899 900 901 902 903 904 905 906 907 908 909 910 911 912 913 914 915 916 917 918 919 920 921 922 923 924 925 926 927 928 929 930 931 932 933 934 935 936 937 938 939 940 941 942 943 944 945 946 947 948 949 950 951 952 953 954 955 956 957 958 959 960 961 962 963 964 965 966 967 968 969 970 971 972 973 974 975 976 977 978 979 980 981 982 983 984 985 986 987 988 989 990 991 992 993 994 995 996 997 998 999 1000 1001 1002 1003 1004 1005 1006 1007 1008 1009 1010 1011 1012 1013 1014 1015 1016 1017 1018 1019 1020 1021 1022 1023 1024 1025 1026 1027 1028 1029 1030 1031 1032 1033 1034 1035 1036 1037 1038 1039 104

Information From:

| | | | | | | | | | |
|----------------------|---------|---------|---------------|-----------|-----------|---------------|-----------|-----------|-------------------|
| Also in: Plat No. 82 | Twp. 9S | Rge. 4E | Plat No. | Twp. | Rge. | Plat No. | Twp. | Rge. | Information from: |
| Plat No. 81 | Twp. 9S | Rge. 4E | Plat No. | Twp. | Rge. | Plat No. | Twp. | Rge. | Information from: |

| | | | |
|--------------------------------|--------------------|--------------------|--------------|
| Plat No. 81 Twp. 9S. Rge. 45E. | Plat No. Twp. Rge. | Plat No. Twp. Rge. | Walter Sales |
|--------------------------------|--------------------|--------------------|--------------|

.....

F-1-A Powder River
County

Farm Checked: Date.....9-22-60

By George Brandt

STATE OF MONTANA
STATE ENGINEERS OFFICE
Water Resources Survey

T. 8S R. 46E Plat No. 72

Photo No.....23-42

Legal Land Owner M. M. & Iva V. Crocker Address Otter

| Operator | Address |
|----------|---------|
| ... | ... |

Water is delivered by:— 1. Private System; 2. Ditch Company; 3. State Project; 4. Federal Project; 5. Irrigation District

If under Ditch Company, Irrigation District, or Government Project, state the number of shares or inches, acre feet, as the case may be in said system

[illegible]

NOTE: R—Denotes Regular Irrigation. F—Flood Irrigation. P—Water diverted by means of pumping. G—Water diverted by gravity. S—Stored Water.

Condition of System Topography River Basin Yellowstone
Adequate Supply: Yes..... No Explain
Remarks

| | | |
|--|-----------------------------------|-----------------------------------|
| Also in: Plat No. <u>73</u> Twp. <u>8S</u> Rge. <u>47E</u> | Plat No. Twp. Rge. | Plat No. Twp. Rge. |
| Plat No. Twp. Rge. | Plat No. Twp. Rge. | Plat No. Twp. Rge. |

Information From:
M. M. Crocker