

STATE ENGINEER'S OFFICE
WATER RESOURCES SURVEYCOUNTY RosebudFILE NO. 8 - 21BOwner Johnson, EdwardAddress Melstone, Montana

AAA Owner

Address

Operator N.O.

Address

New Owner

Address

New Operator

Address

Assessment Record No

Assessed Acreage

Legal Description of This Farm E. 1/2 E. of Mshl. River Sec. 21, T. 10N., R. 31E.

Pump from Musselshell

Check August 21, 1947

Total Acres in Farm

Code Number 21BPhoto No. MA-29-155

AAA Contract No.

AAA Total Cropland Acreage 20.4App. No. E. 274-2

Decree No.

Land is located in

Twp. 10N. Rge. 31E. Twp. Rge.

Twp. Rge. Twp. Rge.

Filed in Twp. 10N. Rge. 31E.

Remarks

M.R.B.

April 29, 1948

Mr. Edward Johnson
Melstone, Montana

Re: Old pump ditch from Musselshell River

Dear Sir:

Rosebud

Sec. 21, T.10N., R. 31E, (E₂E₂)

Tuesday May 18. 1948. Melstone, Mont

Mr G. J. Cravets

Dear Sir in reply to water filing on section
21. I never got any water rights as there
was no water in the River to get so I never
Purchased any

Yours Truly

E. J. Johnson

Melstone, Mont

Enc
one



STATE OF MONTANA

STATE ENGINEER

FRED E. BUCK, STATE ENGINEER
GERALD J. ORAVETZ, ASSISTANT

BILLINGS, MONTANA

April 29, 1948

Mr. Edward Johnson
Melstone, Montana

Re: Old pump ditch from Musselshell River

Dear Sir:

In accordance with the 1939 Session Law (Section 349.68 Montana Session Laws) requiring the State Engineer to investigate and prepare a complete record of all water rights in Montana, the State Engineer has been conducting a water resources survey in Rosebud County.

We are unable to find a recorded water filing for the land that you irrigate in Sec. 21, T.10N., R. 31E, (E₂E₂)
If a filing was made for this land we would like to have you send us the name of the appropriator, the date filed on, and the number of inches filed on. If no recorded filing was made we would like to have you send us the name of the first user and the date, or the approximate date, that the land was first irrigated so that we may establish a date of priority for this land.

We would like to have you make this a first on your agenda and send this information to us as soon as possible in the enclosed, stamped, self-addressed envelope.

Very truly yours,

Gerald J. Oravetz
Assistant State Engineer

GJO/a
enc.



NOTICE
This form and the
contents of the State
of Montana and must
be returned.

STATE OF MONTANA
STATE ENGINEERS OFFICE
Water Resources Survey

FORM WR-1-2M 12-47

8 Code No. 16A
County Rosebud
T. 10N. R. 31E.

Name of Land Owner Setzler, Otto Address c/o F. C. Butts, Melstone, Mont.
Name of Operator _____ Address _____

Part A

**TO BE FILED BY THOSE OBTAINING IRRIGATION WATER FROM
A DITCH COMPANY OR IRRIGATION DISTRICT**

1. Water is delivered by: _____ Name of Ditch, Ditch Company or District Supplying Water _____
2. State the number of acres you irrigate under this system _____ Shares you hold _____
3. If you obtain water from more than one Company, give the number of shares, acres irrigated and the name of the Company under "Remarks." If you obtain water from a Ditch Company and also have a private system fill in both Part A and Part B.

Part B

**TO BE FILED BY THOSE WHO HAVE A PRIVATE DITCH, PUMP OR IRRIGATION SYSTEM
or those who have a private water right under a Ditch Company**

4. In what year was this land first irrigated? Date See attached filings.
5. Give the name of the original appropriator (first user): _____
6. Give the date appropriated _____ Amount filed on: Miners Inches _____ C. F. S. _____
7. State the total number of acres irrigated under this system: _____
8. Give the point of diversion: $\frac{1}{4}$ $\frac{1}{4}$ Section _____ Township _____ Range _____

Part C

TO BE FILED BY ALL WATER USERS IN ADDITION TO PART A OR PART B

9. Source of Water: Musselshell River
Name of stream or lake from which water is originally diverted _____
10. Water is obtained by: (Check one) Gravity ☒ Pumping _____ Other _____
11. What is the greatest number of acres you have irrigated? 27 Date ??
12. How many acres did you irrigate in 1947? (Crop and pasture) 0
13. State the total number of additional acres that could be irrigated by increasing the water supply, land leveling, etc. 27 This land is under what ditch? old Gravity Ditch
14. How many acres of seeped land do you have which could be drained and put into production? 0
15. What is the condition of your irrigation system? poor
16. Is your water supply adequate? Yes _____ No ☒ Explain _____
17. REMARKS: _____

Over

NOTE: The foregoing questions apply only to irrigated land shown on this plat.

DESCRIPTION AND MAP OF FARM

18. Legal Description of this Farm See attached WR2.



IRRIGATED LAND

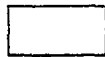

NON-IRRIGATED LAND



POTENTIAL

North

West

East

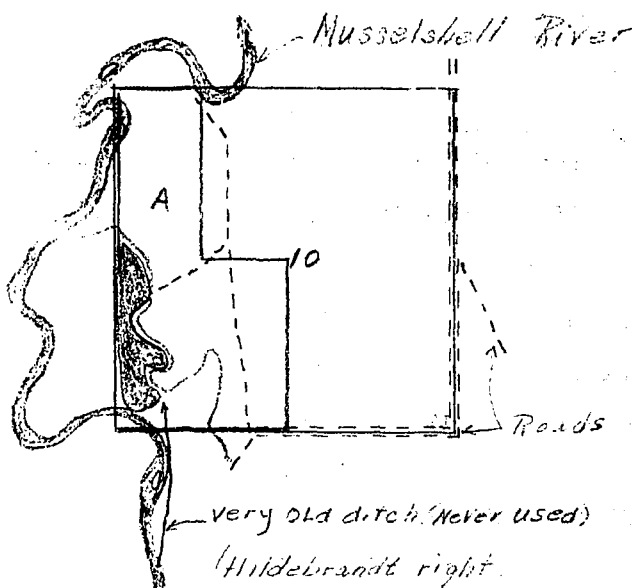

South

Ownership covers
only irrigated land.
All ownership for
dry land not shown.

19. If the above land is irrigated from more than one ditch please give the acreage under each ditch in 19A and indicate the location of the land irrigated from each on the above map.

19A. Ditch: _____ Acres: 0

Ditch: _____ Acres: _____

Information supplied by:

Name _____ Address _____ Date 8/21/47

REMARKS: Field check by Cook-Johnson

If you cannot answer all of the questions on this form answer as many as you can and return the form to us as soon as possible.

STATE ENGINEER'S OFFICE
WATER RESOURCES SURVEY

COUNTY Rosebud

FILE NO 8- 10A

Owner Setzler, Otto Address c/o F. C. Butts, Melstone, Montana

AAA Owner Address

Operator N.O. Address

New Owner Address

New Operator Address

Assessment Record Yes

County 50

Assessed Acreage

Legal Description of This Farm NW 1/4, SW 1/4 Sec. 10, T. 10N., R. 31E.

Gravity out of Musselshell

Checked August 21, 1947 Total Acres in Farm

Code Number 10A

Photo No. MA-29-156

AAA Contract No.

AAA Total Cropland Acreage 0

App. No. 438, 333

Decree No.

Land is located in

Twp. 10N. Rge. 31E. Twp. Rge.

Twp. Rge. Twp. Rge.

Filed in Twp. 10N. Rge. 31E.

Remarks

STATE ENGINEERS OFFICE
Water Resources Survey

Notice of Appropriation

333

1. County Rosebud Book 1 Page 418 Record Water Right
2. Name of Appropriator Wm. Hildebrandt Address Musselshell, Montana
3. Date Appropriated 6-1-1903 Date Filed 8-11-1904
Amount Appropriated, Miners Inches....., Cubic Feet per second 10
4. Name of Stream Home Creek Tributary Musselshell River Basin
5. Point of Diversion At a point upon its northerly bank in
Sec. 10 Twp. 10N. Rge. 31E. Bank of Stream North
6. Purpose Irrigation of agricultural lands
7. Description of System Dam and ditch - Open surface ditch of sufficient width, depth
and length to convey the said amount of water to the land of its intended use.
8. Land Description of Intended Place of Use.....
S $\frac{1}{2}$ SW $\frac{1}{4}$ Sec. 10, T. 10N., R. 31E.
1940 Book shows: W $\frac{1}{2}$ NW $\frac{1}{4}$, SW $\frac{1}{4}$ Sec. 10, T. 10N., R. 31E., 230 acres, Otto Setzler,
Melstone, Montana
9. Remarks (Pertaining to Use, etc.).....
Appropriation was made June 1, 1903.

Decree

10. Case No. Date Amt. Decreed: M. I. C. F. S.
11. To Whom Decreed Address
12. Name of Ditch Maximum Capacity (C. F. S.)
13. Date of Priority Purpose
14. Land Description of Place of Use as Decreed.....
.....
.....
.....
15. Remarks (Present Use Status, etc.).....
.....
.....
.....

STATE ENGINEERS OFFICE
Water Resources Survey

Notice of Appropriation

438

1. County Rosebud Book 1 Page 419 Record Water Rights
2. Name of Appropriator George Setzler Address Rosebud County
3. Date Appropriated 6-1-1903 Date Filed 8-11-1904
Amount Appropriated, Miners Inches 17, Cubic Feet per second _____
4. Name of Stream Musselshell River Tributary Missouri River Basin _____
5. Point of Diversion is marked by a stone monument upon the southerly bank of said stream
and situated at or about the north and south section line between sections
Sec. 15 & 16 Twp. 10N. Rge. _____ Bank of Stream _____

6. Purpose Irrigation of agricultural lands, gardens and yards and for ranch and
agricultural purposes.
7. Description of System _____
Dam and ditch of sufficient width, depth, and length to convey water
appropriated.
8. Land Description of Intended Place of Use _____
W $\frac{1}{2}$ NW $\frac{1}{4}$, N $\frac{1}{2}$ SW $\frac{1}{4}$ Sec. 10, T. 10N., R. 31E.,
1940 Book shows: W $\frac{1}{2}$ NW $\frac{1}{4}$, SW $\frac{1}{4}$ less rd. Sec. 10, T. 10N., R. 31E., 230 acres,
Otto Setzler, Melstone, Montana, 1940 Owner
9. Remarks (Pertaining to Use, etc.) _____
Appropriation was made June 1, 1903.

Decree

10. Case No. _____ Date _____ Amt. Decreed: M. I. _____ C. F. S. _____
11. To Whom Decreed _____ Address _____
12. Name of Ditch _____ Maximum Capacity (C. F. S.) _____
13. Date of Priority _____ Purpose _____
14. Land Description of Place of Use as Decreed _____

15. Remarks (Present Use Status, etc.) _____



NOTICE
These forms are the
property of the State
of Montana and must
be returned.

STATE OF MONTANA
STATE ENGINEERS OFFICE

Water Resources Survey

FORM WR-1-24 12-47
8 Code No. 3A
County Rosebud
T. 10N. R. 31E.

Name of Land Owner Smith, Jud & Ruby Address Melstone, Mont.

Name of Operator Address

Part A

TO BE FILED BY THOSE OBTAINING IRRIGATION WATER FROM
A DITCH COMPANY OR IRRIGATION DISTRICT

1. Water is delivered by: Name of Ditch, Ditch Company or District Supplying Water
2. State the number of acres you irrigate under this system Shares you hold
3. If you obtain water from more than one Company, give the number of shares, acres irrigated and the name of the Company under "Remarks." If you obtain water from a Ditch Company and also have a private system fill in both Part A and Part B.

Part B

TO BE FILED BY THOSE WHO HAVE A PRIVATE DITCH, PUMP OR IRRIGATION SYSTEM
or those who have a private water right under a Ditch Company

4. In what year was this land first irrigated? Date No data
5. Give the name of the original appropriator (first user):
6. Give the date appropriated Amount filed on: Miners Inches C. F. S.
7. State the total number of acres irrigated under this system:
8. Give the point of diversion: 1/4 1/4 Section Township Range

Part C

TO BE FILED BY ALL WATER USERS IN ADDITION TO PART A OR PART B

9. Source of Water: Musselshell River & side coulees.
Name of stream or lake from which water is originally diverted
10. Water is obtained by: (Check one) Gravity Pumping X Other FLOOD
11. What is the greatest number of acres you have irrigated? 28 Date ??
12. How many acres did you irrigate in 1947? (Crop and pasture) 9
13. State the total number of additional acres that could be irrigated by increasing the water supply, land leveling, etc. 19 This land is under what ditch? 10 by flood from side coulee
9 " pump from Musselshell
14. How many acres of seeped land do you have which could be drained and put into production? 0
15. What is the condition of your irrigation system? poor
16. Is your water supply adequate? Yes No X Explain
17. REMARKS:

Over

NOTE: The foregoing questions apply only to irrigated land shown on this plat.

DESCRIPTION AND MAP OF FARM

18. Legal Description of this Farm. See attached WR2.



IRRIGATED LAND

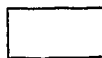

NON-IRRIGATED LAND

North

West

East

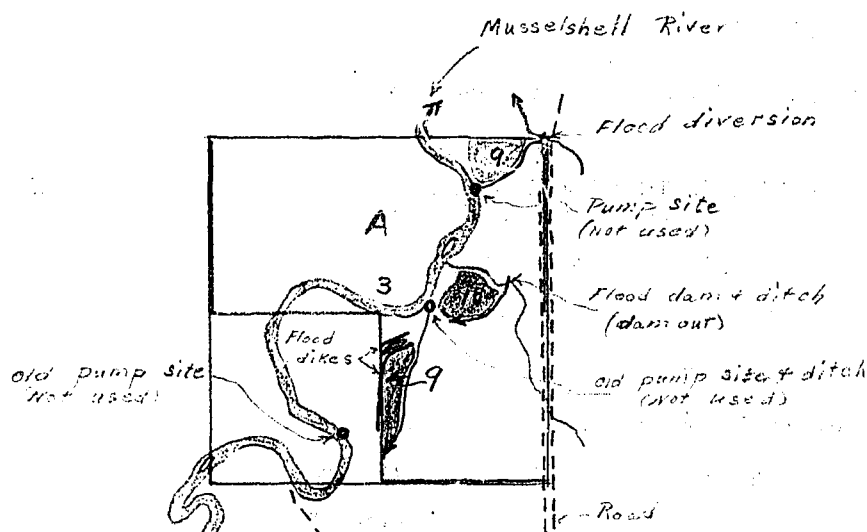

South

Ownership covers
only irrigated land.
All ownership for
dry land not shown.

19. If the above land is irrigated from more than one ditch please give the acreage under each ditch in 19A and indicate the location of the land irrigated from each on the above map.

19A. Ditch: flood from side coulees Acres: 9

Ditch: Acres:

Information supplied by:

Name Address Date

REMARKS: Field check by Cook-Johnson

If you cannot answer all of the questions on this form answer as many as you can and return the form to us as soon as possible.

STATE ENGINEER'S OFFICE
WATER RESOURCES SURVEY

COUNTY.....Rosebud.....

FILE NO.....8 - 3A.....

Owner.....Smith, Jud & Ruby.....Address.....Melstone, Montana.....

AAA Owner.....Address.....

Operator.....N.O.....Address.....

New Owner.....Address.....

New Operator.....Address.....

Assessment Record.....No.....

Assessed Acreage.....

Legal Description of This Farm.....Lots 1,2,3,4, S $\frac{1}{2}$ N $\frac{1}{2}$ E $\frac{1}{2}$, S $\frac{1}{2}$ N $\frac{1}{2}$ E $\frac{1}{2}$, SE $\frac{1}{4}$ Sec. 3, T. 10N., R. 31E.....

Flood from Unnamed Coulees.....Total Acres in Farm.....

Code Number.....3A.....

Photo No.....MA-29-156.....

AAA Contract No.....

AAA Total Cropland Acreage.....~~0~~ 117.9.....

App. No.....N.R.....

Decree No.....

Land is located in

Twp.....10N.....Rge.....31E.....Twp.....Rge.....

Twp.....Rge.....Twp.....Rge.....

Filed in Twp.....10N.....Rge.....31E.....

Remarks.....

M.R.B.

4/15

April 15, 1948

Jud & Ruby Smith
Melstone, Montana

Re: Flood Irrigation and Potential
Irrigable Land, Musselshell River

Dear Sir:

Rosebud

Lots 1,2,3,4, S₁NE₁, S₂NE₁, SE₁ Sec. 3, T. 10N., R. 31E.



STATE OF MONTANA

STATE ENGINEER

FRED E. BUCK, STATE ENGINEER
GERALD J. ORAVETZ, ASSISTANT

BILLINGS, MONTANA

April 15, 1948

Jud & Ruby Smith
Melstone, Montana

Re: Flood Irrigation and Potential
Irrigable Land, Musselshell River

Dear Sir:

In accordance with the 1939 Session Law (Section 349.68 Montana Session Laws) requiring the State Engineer to investigate and prepare a complete record of all water rights in Montana, the State Engineer has been conducting a water resources survey in Rosebud County.

We are unable to find a recorded water filing for the land that you irrigate in Lots 1,2,3,4, S $\frac{1}{2}$ NW $\frac{1}{4}$, S $\frac{1}{2}$ NE $\frac{1}{4}$, SE $\frac{1}{4}$ Sec. 3, T. 10N., R. 31E. If a filing was made for this land we would like to have you send us the name of the appropriator, the date filed on, and the number of inches filed on. If no recorded filing was made we would like to have you send us the name of the first user and the date, or the approximate date, that the land was first irrigated so that we may establish a date of priority for this land.

We would like to have you make this a first on your agenda and send this information to us as soon as possible in the enclosed, stamped, self-addressed envelope.

Very truly yours,

Gerald J. Oravetz
Gerald J. Oravetz
Assistant State Engineer

GJO/a
enc.

I have never irrigated any land since I have been here and don't think there is any water rights on the place however there are a few old ditches that was made made in the twenties or maybe early
Jud Smith



NOTICE
These forms are the
property of the State
of Montana and must
be returned.

STATE OF MONTANA
STATE ENGINEERS OFFICE
Water Resources Survey

FORM WR-1-2M 12-47

8

Code No. 28B

County Rosebud

T. 10N. R. 31E.

Name of Land Owner Stewart, William F. Address c/o V. C. Stevenson

Name of Operator Address

Part A

TO BE FILED BY THOSE OBTAINING IRRIGATION WATER FROM
A DITCH COMPANY OR IRRIGATION DISTRICT

1. Water is delivered by: Name of Ditch, Ditch Company or District Supplying Water
2. State the number of acres you irrigate under this system. Shares you hold
3. If you obtain water from more than one Company, give the number of shares, acres irrigated and the name of the Company under "Remarks." If you obtain water from a Ditch Company and also have a private system fill in both Part A and Part B.

Part B

TO BE FILED BY THOSE WHO HAVE A PRIVATE DITCH, PUMP OR IRRIGATION SYSTEM
or those who have a private water right under a Ditch Company

4. In what year was this land first irrigated? Date No recording.
5. Give the name of the original appropriator (first user):
6. Give the date appropriated. Amount filed on: Miners Inches. C. F. S.
7. State the total number of acres irrigated under this system:
8. Give the point of diversion: 1/4 1/4 Section Township Range

Part C

TO BE FILED BY ALL WATER USERS IN ADDITION TO PART A OR PART B

9. Source of Water: Musselshell River
Name of stream or lake from which water is originally diverted
10. Water is obtained by: (Check one) Gravity Pumping X Other
11. What is the greatest number of acres you have irrigated? 1.8 Date 1947
12. How many acres did you irrigate in 1947? (Crop and pasture) 1.8
13. State the total number of additional acres that could be irrigated by increasing the water supply, land leveling, etc. 0 This land is under what ditch?
14. How many acres of seeped land do you have which could be drained and put into production? 0
15. What is the condition of your irrigation system? fair
16. Is your water supply adequate? Yes X No Explain Sufficient for this small acreage.
17. REMARKS:

Over

NOTE: The foregoing questions apply only to irrigated land shown on this plat.

DESCRIPTION AND MAP OF FARM

18. Legal Description of this Farm See attached WR#2



IRRIGATED LAND



NON-IRRIGATED LAND

North

West

East

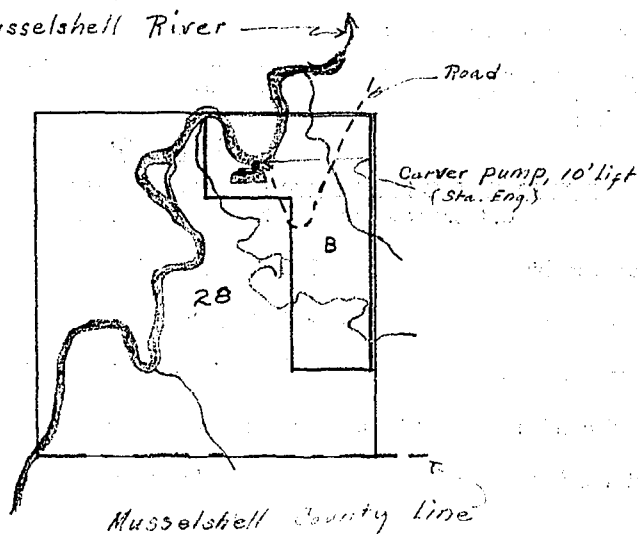

South

Ownership covers
only irrigated land.
All ownership for
dry land not shown.

19. If the above land is irrigated from more than one ditch please give the acreage under each ditch in 19A and indicate the location of the land irrigated from each on the above map.

19A. Ditch: Private pump Musselshell River Acres: 1.8

Ditch: _____ Acres: _____

Information supplied by:

Name _____ Address _____ Date 8/21/47

REMARKS: Field check by Cook-Johnson.

If you cannot answer all of the questions on this form answer as many as you can and return the form to us as soon as possible.

STATE ENGINEER'S OFFICE
WATER RESOURCES SURVEY

COUNTY Rosebud

FILE NO. 8 28B

Owner Stewart, William F. Address c/o V. C. Stevenson

AAA Owner Address

Operator N.O. Address

New Owner Address

New Operator Address

Assessment Record No

Assessed Acreage

Legal Description of This Farm N¹/₄NE¹/₄, S. & E. of River, SE¹/₄NE¹/₄, NE¹/₄SE¹/₄ Sec. 28, T. 10N., R. 31E

Checked August 21, 1947

Pump from Musselshell Total Acres in Farm

Code Number 28B

Photo No. MA-29-155

AAA Contract No.

AAA Total Cropland Acreage 0

App. No. N.R.

Decree No.

Land is located in

Twp. 10N. Rge. 31E. Twp. Rge.

Twp. Rge. Twp. Rge.

Filed in Twp. 10N. Rge. 31E.

Remarks

M.R.B.

4/15
April 15, 1948

Mr. William F. Stewart
c/o V. C. Stevenson
Melstone, Montana

Re: Flood Irrigation on Musselshell River

Dear Sir:

Rosebud

N $\frac{1}{2}$ NE $\frac{1}{4}$, S. & E. River, SE $\frac{1}{4}$ NE $\frac{1}{4}$, NE $\frac{1}{2}$ SE $\frac{1}{4}$ Sec. 28, T. 10N., R. 31E.

STATE OF MONTANA
STATE ENGINEER'S OFFICE
 WATER RESOURCES SURVEY

Township.....10N..... Range.....31E..... County.....Rosebud.....

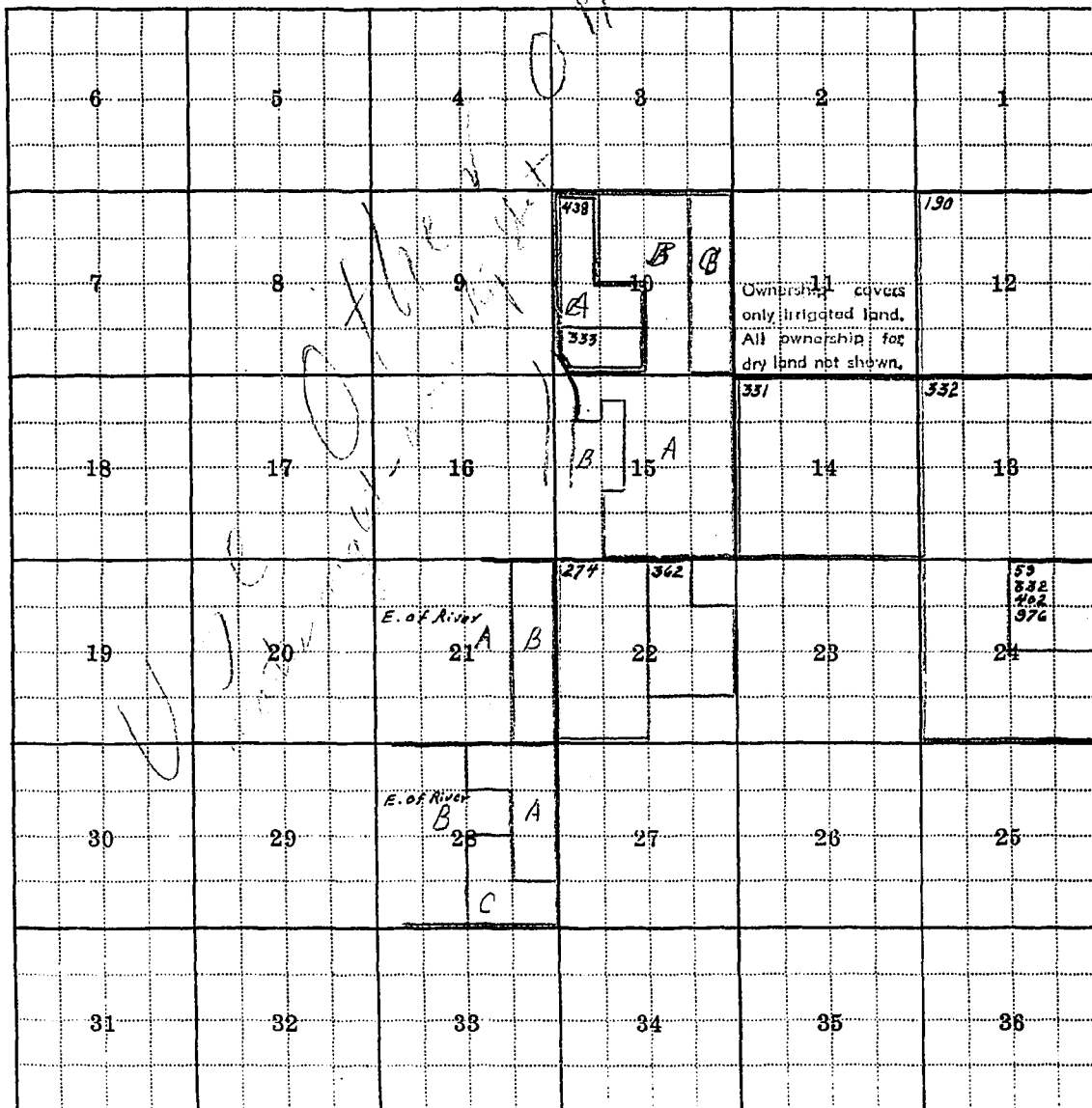

Township.....10N..... Range.....31E.....

Township 10N Range 31E County Rosebud

[illegible]

88

FORM D-1 - GAZETTE 1864, 2M-1-47

STATE OF MONTANA
STATE ENGINEER'S OFFICE
 WATER RESOURCES SURVEY

8# Township 10 N Range 31 E County Rosebud

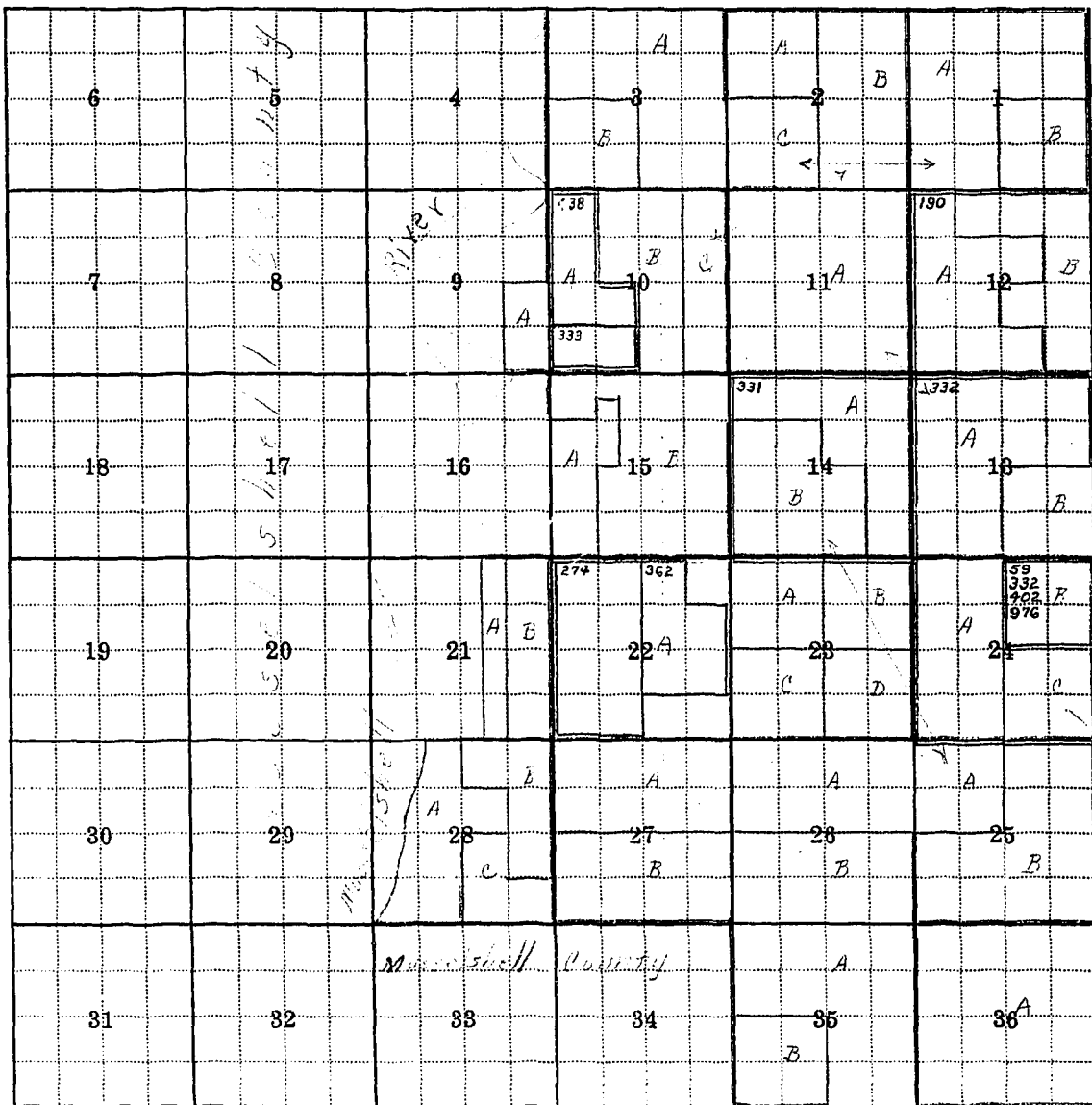

Township 10 N Range 31 E

Township 10 North Range 31 East County Rosebud

Parcel Number	Name of Owner	Address
21B	Edward Johnson	Melstone, Montana
14B, 25A, 26A	Harold Schroeder	Melstone, Montana
23B	Rosebud County	Forsyth, Montana
23A	H. T. McGuigen	412-414 Main St., Red Wing, Minn.
23C	Joe Majerus	Iona, Minn.
23D	Katherine Upton	207 E. Church St., Collinsville, Ill.
24A	Harold S. Confer	3048 1/2 E. St., San Bernardino, Calif.
24B	Cora McLoughlin	914 N. Benton Ave., Helena, Mont.
24C	Fred J. Adams	Melstone, Montana
25B	F. S. Renter	Mozeppa, Minn.
1A, 2C, 3A, 12B	Jud & Ruby Smith	Melstone, Montana
1B	Mary Tracy	Spring Valley, Minn.
2B, 10C	Claude L. Honey	2064 W. Superior, Duluth, Minn.
	State of Montana	Helena, Montana
3B	Barbara Butts	Melstone, Montana
9A, 10A	Otto Setzler	c/o F. C. Butts, Melstone, Mont.
10B, 14A, 15B	F. C. Butts	Melstone, Montana
11A, 13A	Aulden F. Sibley	White Sulphur Springs, Montana
12A	Pat J. Brennan	1105 Worden Ave., Missoula, Mont.
13B	Milwaukee Land Co.	St. Paul, Minn.
21A	Otto Stensvad	Melstone, Montana
25B	Stewart, Wm. F. To V. C. Stevenson	

Township 10N

Range 31E

Rosebud County

<u>Index No.</u>	<u>Name of Appropriator</u>	<u>Stream</u>	<u>Date App.</u>	<u>Date Filed</u>	<u>M.I.</u>
59	Andrew Holman	Basin Coulee	4-20-09	9-22-10	10,600
190	Chas. J. Andreas	Coulee Creek	12-15-06	12-18-07	600
274	Wm. A. Fredrickson	Fredrickson Coulee	9-1-10	9-9-10	320
331	H. L. Brockway	Home Creek	11-22-09	11-22-09	400
332	C.M.St. Paul Ry.	Home Creek	3-28-08	3-30-08	500
333	Wm. Hildebrandt	Home Creek	6-1-03	8-11-04	400
362	Edward Johnson	Johnson Coulee	9-8-10	9-9-10	160
402	Andrew Holman	Liffrig Coulee	9-11-15	9-16-15	10,000
438	George Setzler	Musselshell River	6-1-03	8-11-04	680
976	Harold Schroeder	Unnamed Coulee	11-10-43	11-10-43	200

Township 10 North

Range 31 East

Rosebud County

Township 10 North

Range 31 East

Rosebud County

<u>Index No.</u>	<u>Name of Appropriator</u>	<u>Stream</u>	<u>Date App.</u>	<u>Date Filed</u>	<u>Inches</u>
59	Andrew Holman	Basin Coulee	4-20-09	9-22-10	10,000
190	Chas. J. Andreas	Coulee Creek	12-15-06	12-18-07	600
274	Wm.A. Fredrickson	Fredrickson Coulee	9-1-10	9-9-10	320
331	H. L. Brockway	Home Creek	11-22-09	11-22-09	400
332	C. M. St. Paul Ry.	Home Creek	3-28-08	3-30-08	500
335	Hildebrandt, Wm.	Home Creek	6-1-03	8-11-04	400
362	Edward Johnson	Johnson Coulee	9-8-10	9-9-10	160
402	Andrew Holman	Liffrig Coulee	9-11-15	9-16-15	10,000
438	George Setzler,	Musselshell R.	6-1-03	8-11-04	680
976	Harold Schroeder	Home Creek	11-10-43	11-10-43	200

<u>Parcel Number</u>	<u>Name of Owner</u>	<u>Address</u>
22A, 26B, 27A,	Fred J. Adams	Melstone, Montana
27B, 28A, 28B,	" "	
28C, 35A	" "	
22A	W. C. Stevenson	Melstone, Montana
27B	Agnes Dorsey	Mozeppa, Minn.
28B	Wm. F. Stewart	c/o V. C. Stevenson, Melstone
28A	Catherine Kennedy	New Ulm, Minn.
28C	Clarice M. Drees	
35B	Susan Peters	Box 285, Chewelah, Wash.
2A, 15A, 56A	State of Montana	Helena, Montana

STATE ENGINEERS OFFICE
Water Resources Survey

Notice of Appropriation

1. County Rosebud Book 2 Page 171 Record Water Right
2. Name of Appropriator Wm. A. Fredrickson Address Rosebud County
3. Date Appropriated 9-8-1910 Date Filed 9-9-1910
- Amount Appropriated, Miners Inches 320, Cubic Feet per second _____
4. Name of Stream Fredrickson Coulee Tributary Musselshell River Basin
5. Point of Diversion At a point upon its east bank thence runs west and north over and upon
- Sec. 22 Twp. 10N. Rge. 31E. Bank of Stream East
6. Purpose Irrigating and other purposes
7. Description of System A ditch 60 X 12 inches in size, which carries and conducts 320 inches of water.
8. Land Description of Intended Place of Use _____
W $\frac{1}{2}$ Sec. 22, T. 10N., R. 31E., 310 acres, Jas. F. and Prudence Fredrickson, Peru, Indiana, 1940 Owner.
9. Remarks (Pertaining to Use, etc.) _____
Appropriation was made September 1, 1910.

Decree

10. Case No. _____ Date _____ Amt. Decreed: M. I. _____ C. F. S. _____
11. To Whom Decreed _____ Address _____
12. Name of Ditch _____ Maximum Capacity (C. F. S.) _____
13. Date of Priority _____ Purpose _____
14. Land Description of Place of Use as Decreed _____
15. Remarks (Present Use Status, etc.) _____

(Forms filed in Township 10 North, Range 33 East

Schleder, Arthur C.

Schleder, George

(Ownership & Appropriation Plats)

T. 10N., R. 33E.



NOTE: These forms are the property of the State of Montana and must be returned.

STATE OF MONTANA
STATE ENGINEERS OFFICE
Water Resources Survey

FORM WR-1-24 12-47
9 Code No. 28A
County Rosebud
T. 10N. R. 33E.

Name of Land Owner Schleder, Arthur C. Address Smatra, Mont.
Name of Operator _____ Address _____

Part A

**TO BE FILED BY THOSE OBTAINING IRRIGATION WATER FROM
A DITCH COMPANY OR IRRIGATION DISTRICT**

1. Water is delivered by: _____
Name of Ditch, Ditch Company or District Supplying Water _____
2. State the number of acres you irrigate under this system _____ Shares you hold _____
3. If you obtain water from more than one Company, give the number of shares, acres irrigated and the name of the Company under "Remarks." If you obtain water from a Ditch Company and also have a private system fill in both Part A and Part B.

Part B

**TO BE FILED BY THOSE WHO HAVE A PRIVATE DITCH, PUMP OR IRRIGATION SYSTEM
or those who have a private water right under a Ditch Company**

4. In what year was this land first irrigated? Date No Data
5. Give the name of the original appropriator (first user): _____
6. Give the date appropriated _____ Amount filed on: Miners Inches _____ C. F. S. _____
7. State the total number of acres irrigated under this system: _____
8. Give the point of diversion: 1/4 1/4 Section _____ Township _____ Range _____

Part C

TO BE FILED BY ALL WATER USERS IN ADDITION TO PART A OR PART B

9. Source of Water: Trib. of Muggins Cr.
Name of stream or lake from which water is originally diverted _____
10. Water is obtained by: (Check one) Gravity _____ Pumping _____ Other FLOOD
11. What is the greatest number of acres you have irrigated? 30 Date 1947
12. How many acres did you irrigate in 1947? (Crop and pasture) 30
13. State the total number of additional acres that could be irrigated by increasing the water supply, land leveling, etc. 0 This land is under what ditch? _____
14. How many acres of seeped land do you have which could be drained and put into production? 0
15. What is the condition of your irrigation system? fair
16. Is your water supply adequate? Yes _____ No X Explain Seasonal Flood only.
17. REMARKS: _____

Over _____

NOTE: The foregoing questions apply only to irrigated land shown on this plat.

DESCRIPTION AND MAP OF FARM

18. Legal Description of this Farm See attached WR2.



IRRIGATED LAND



NON-IRRIGATED LAND

North

West

East

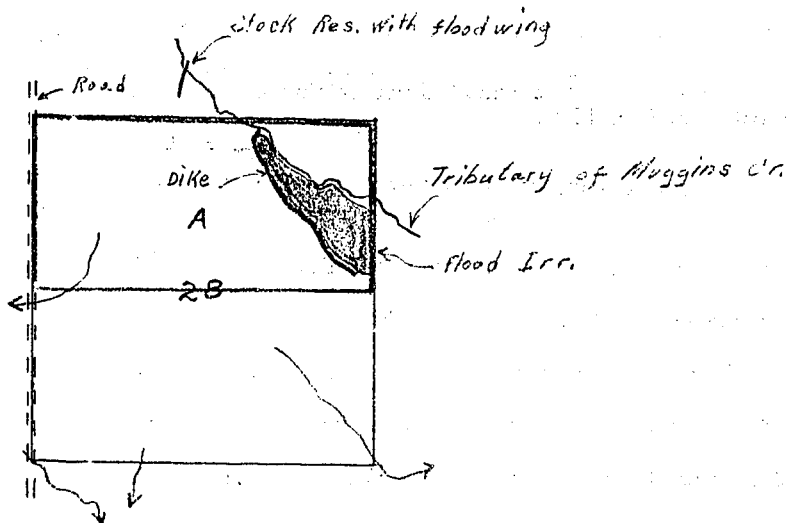

South

Ownership covers
only irrigated land.
All ownership for
dry land not shown.

19. If the above land is irrigated from more than one ditch please give the acreage under each ditch in 19A and indicate the location of the land irrigated from each on the above map.

19A. Ditch: Flood from Muggins Trib. Acres: 30

Ditch: _____ Acres: _____

Information supplied by:

Name _____ Address _____ Date 8/21/47

REMARKS: Field check by Cook-Johnson.

If you cannot answer all of the questions on this form answer as many as you can and return the form to us as soon as possible.

STATE ENGINEER'S OFFICE
WATER RESOURCES SURVEY

COUNTY.....Rosebud.....

FILE NO. 90 - 28A.....

Owner.....Schleder, Arthur C.....Address.....

AAA Owner.....Address.....

Operator.....N.O.....Address.....

New Owner.....Address.....

New Operator.....Address.....

Assessment Record.....No.....

Assessed Acreage.....

Legal Description of This Farm.....N¹/₂ Sec. 28, T. 10N., R. 33E.....

Checked August 21, 1947

Flood Irrigation from Muggins Tributary.....Total Acres in Farm.....

Code Number.....28A.....

Photo No.....MA-35-46.....

AAA Contract No.....

AAA Total Cropland Acreage.....0.....

App. No.....N.R.....

Decree No.....

Land is located in

Twp.....10N Rge. 33E. Twp..... Rge.....

Twp..... Rge..... Twp..... Rge.....

Filed in Twp.....10N. Rge. 33E.....

Remarks.....

Y.R.B.

4/15
April 15, 1948

Mr. Arthur C. Schleder
Sumatra, Montana

Re: Flood Irrigation on Muggins Creek

Dear Sir:

Rosebud

N $\frac{1}{2}$ Sec. 26, T. 10N., R. 33E.

104-338

San Jose Mont
April 16, 1948

Mr. H. J. Cravely.
Assistant State Engineer
Dear Sir:

In reply to your letter of April 15th.
I do not irrigate any land or intend to
on N $\frac{1}{2}$ sec. 28 T10. N~~10~~ R33E. I have one little
water dam on it for live stock only, and
it is dry $\frac{5}{6}$ of the year. *

My abstract ~~and~~ shows I ^{do} have the
water rights however. But I don't
care to irrigate. But I am going to
hold on to the water rights.

Yours truly
Arthur Schleder.



NOTICE
These forms are the
property of the State
of Montana and must
be returned.

STATE OF MONTANA
STATE ENGINEERS OFFICE

Water Resources Survey

FORM WR-1-2M 12-47

9 Code No. 21A
County Rosebud
T. 10N. R. 33E.

Name of Land Owner. Schleder, Geo. Address Sumatra, Mont.

Name of Operator. Address

Part A

TO BE FILED BY THOSE OBTAINING IRRIGATION WATER FROM
A DITCH COMPANY OR IRRIGATION DISTRICT

1. Water is delivered by: Name of Ditch, Ditch Company or District Supplying Water
2. State the number of acres you irrigate under this system. Shares you hold
3. If you obtain water from more than one Company, give the number of shares, acres irrigated and the name of the Company under "Remarks." If you obtain water from a Ditch Company and also have a private system fill in both Part A and Part B.

Part B

TO BE FILED BY THOSE WHO HAVE A PRIVATE DITCH, PUMP OR IRRIGATION SYSTEM
or those who have a private water right under a Ditch Company

4. In what year was this land first irrigated? Date No data
5. Give the name of the original appropriator (first user):
6. Give the date appropriated. Amount filed on: Miners Inches. C. F. S.
7. State the total number of acres irrigated under this system:
8. Give the point of diversion: $\frac{1}{4}$ $\frac{1}{4}$ Section Township Range

Part C

TO BE FILED BY ALL WATER USERS IN ADDITION TO PART A OR PART B

9. Source of Water: Trib. of Muggins Cr.
Name of stream or lake from which water is originally diverted
10. Water is obtained by: (Check one) Gravity Pumping Other FLOOD
11. What is the greatest number of acres you have irrigated? 5.5 Date 1947
12. How many acres did you irrigate in 1947? (Crop and pasture) 5.5
13. State the total number of additional acres that could be irrigated by increasing the water supply, land leveling, etc. 0. This land is under what ditch?
14. How many acres of seeped land do you have which could be drained and put into production? 0
15. What is the condition of your irrigation system? fair
16. Is your water supply adequate? Yes No X Explain Seasonal flood only.
17. REMARKS:

Over

NOTE: The foregoing questions apply only to irrigated land shown on this plat.

DESCRIPTION AND MAP OF FARM

18. Legal Description of this Farm. See attached WR2.



IRRIGATED LAND

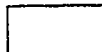

NON-IRRIGATED LAND

North

West

East

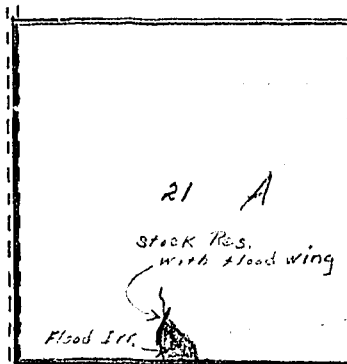

South

Ownership covers
only irrigated land.
All ownership of
dry land not shown.

19. If the above land is irrigated from more than one ditch please give the acreage under each ditch in 19A and indicate the location of the land irrigated from each on the above map.

19A. Ditch: Flood trib. Muggins Cr. Acres: 5.5

Ditch: Acres:

Information supplied by:

Name Address Date 8/21/47

REMARKS: Fied check by Cook-Johnson.

If you cannot answer all of the questions on this form answer as many as you can and return the form to us as soon as possible.

STATE ENGINEER'S OFFICE
WATER RESOURCES SURVEY

COUNTY Rosebud

FILE NO. 9 - 21A

Owner Schleder, George Address

AAA Owner Address

Operator N.O. Address

New Owner Address

New Operator Address

Assessment Record No.

Assessed Acreage

Legal Description of This Farm All Sec. 21, T. 10N., R. 33E.

Checked August 21, 1947

Flood from Muggins Tributary

Total Acres in Farm

Code Number 21A

Photo No. MA-35-46

AAA Contract No.

AAA Total Cropland Acreage 0

App. No. H.R.

Decree No.

Land is located in

Twp. 10N. Rge. 33E. Twp. Rge.

Twp. Rge. Twp. Rge.

Filed in Twp. 10N. Rge. 33E.

Remarks

Y.R.B.

4/15

April 15, 1948

Mr. Geo. Schleder
Sumatra, Montana

Re: Flood Irrigation on Muggins Creek

Dear Sir:

Rosabud

Sec. 21, T. 10N., R. 33E.

10N. 32E

Sumatra Montana

April 16, 1948

Mr. L. L. Orsutz:

Assistant State Engineer:

Dear Sir:

I'm reply to your letter of the 15th.
we have a stock water ~~reservoir~~
or Dam on ~~Sec. 28~~ Sec. 28, T. 10N, R. 33E. For
stock watering only. If it wouldn't be
for this dam or water our live stock
would thirst to death at times. we
built this dam only for stock water.
we have never irrigated any land,
what ever, and never intend to.

I want to know who told you ~~this~~ ^{that}
we irrigate.

(over)

Yours truly

~~Geo. Schleder~~ Geo. Schleder

This ^{Stock} water dam or reservoir has
been approved by the Soil Conservation
program. I invite you or any one to
come and look ~~it~~ ^{it} over; if not satisfied
with this letter.

STATE OF MONTANA

STATE ENGINEER'S OFFICE

WATER RESOURCES SURVEY

Township 10N Range 33E County Rosebud

6	5	4	3	2	1
7	8	9	10	11	12
18	17	16	15	14	13
19	20	21 ^A	22 ^B	23	24
			A		
30	29	28 ^A	27 ^A	26	25
		B			
31	32	33	34 ^A	35	36

Ownership covers only irrigated land. All ownership for dry land not shown.

426

Township 10N Range 33E

[illegible]

STATE OF MONTANA
State Engineer's Office
WATER RESOURCES SURVEY

Township 10 N Range 31 E County Rockbud

6	5	4	3	2	
7	8	9	10	11	12
			333		130
18	17	16	15	14	13
			274	362	
19	20	21	22	23	24
					59 405 376
30	29	28	27	26	25
			340		
31	32	33	34	35	36

part

Township _____ Range _____

[illegible]

STATE OF MONTANA
State Engineer's Office
WATER RESOURCES SURVEY

Township 10 N Range 32 E County Rosebud

6	5	4	3	2	
7	245 8	9	10	11	923 12
977	245			327	
18	17	16	15	14	13
	242		54 242 54	242	
19	20	21	22	23	24
30	29	28	27	26	25
			778		
31	32	33	34	35	36

Township _____ Range _____

[illegible]

STATE OF MONTANA
State Engineer's Office
WATER RESOURCES SURVEY

Township 10 N Range 33 E County Rosebud

6	5	4	3	2	1
7	8	9	10	11	12
18	17	16	15	14	13
19	20	21	22	23	24
30	29	28	27	26	25
31	32	33	34	35	36

Township _____ Range _____

County Rosebud[illegible]

Township 10N

Range 33E

Rosebud County

<u>Index No.</u>	<u>Name of Appropriator</u>	<u>Stream</u>	<u>Date App.</u>	<u>Date Filed</u>	<u>M.I.</u>
426	Minnie Herbold	Muggins Creek	1-20-12	1-27-12	1000

Township 10 North

Range 33 East

Rosebud County

STATE OF MONTANA
State Engineer's Office
WATER RESOURCES SURVEY

Township 10 N Range 34 E County Rosebud

6	5	4	3	2	1
7	8	9	10	11	12
18	17	16	15	14	13
19	20	21	22	23	24
30	29	28	27	26	25
31	32	33	34	35	36

Township _____ Range _____

STATE OF MONTANA
State Engineer's Office
WATER RESOURCES SURVEY

Township 10N Range 35E County Rosebud

6	5	4	3	2	1
7	8	9	10	11	12
18	17	16	15	14	13
19	20	21	22	23	24
30	29	28	27	26	25
31	32	33	34	35	36

Township _____ Range _____

[illegible]

STATE OF MONTANA
State Engineer's Office
WATER RESOURCES SURVEY

Township 10 N Range 36 E County Rosebud

6	5	4	3	2	1
7	8	9	10	11	12
18	17	16	15	14	13
19	20	21	22	23	24
30	29	28	27	26	25
31	32	33	34	35	36

Township _____ Range _____

Township 10N Range 36E County Rosebud

[illegible]

STATE OF MONTANA
State Engineer's Office
WATER RESOURCES SURVEY

Township 10 N Range 29 E County Rosebud

					103		
6	5	4	3	2	1		
7	8	9	10	11	12		
1499	18	17	16	15	14	13	
	19	20	21	22	23	24	
499	30	29	28	27	26	25	
	31	32	33	34	35	36	

Township _____ Range _____

[illegible]

<u>Parcel Number</u>	<u>Name of Owner</u>	<u>Address</u>
25A	Burt Hunnes	Ingomar, Montana
36A	State of Montana	Helena, Montana
30A	Ben G. Olson Thos. Gilbert	Vananda, Montana Vananda, Montana
22A, 26B, 27A	Lucille Hedges	Ingomar, Montana
22B	Mrs. Shelby Wright	
28B	Sherwood Schmill	1405 Campbell Avenue, Springfield, Mo.
34A, 35A	Lewis Starke	Forsyth, Montana
34B	Alex Masterday Est.	Ingomar, Montana
30B, 32A	U. S. Taylor Grazing	

35

FORM D-1 - GAZETTE 1964.2M-1-47

STATE OF MONTANA
STATE ENGINEER'S OFFICE
 WATER RESOURCES SURVEY

35 Township 10 N Range 36 E County Rosebud

A 6 B	5A	4A B	3A	2A	1A
7A A	8A	9A	10 B	11A	12A
18A	17A	16A	15A	14 B	13A
19A	20 B A	21A	A 22 B	23A	24 B A
A 30 B	29A	A 28 B	27A	A 26 B	25A
31A	A 32 B	33A	6/9 A B	34 B	35A
					36A

Township 10 N Range 36 E

Township 10 North Range 36 East County Rosebud

Parcel Number	Name of Owner	Address
	S. O. Mysse	Ingomar, Montana
4B	U. S. Taylor Grazing	
1A, 2A, 3A,	Cherry Creek Sheep Co.	Ingomar, Montana
4A, 5A, 6B	" " " "	
6A	State of Montana	Helena, Montana
18A, 19B, 11A	Wm. Magelssen	Billings, Montana
12A, 14A, 15A	" "	
10A	Theo. Birkrem	Ingomar, Montana
9A, 16A	State of Montana	Helena, Montana
14B	Elva R. Goodrich	1312 E. 11th Avenue, Winfield, Kansas
21A, 29A, 31A	Andrew Erickson	Ingomar, Montana
33A, 7A, 8A,	" "	
19A, 20A	" "	
17A	N. P. Railway	St. Paul, Minn.
20B	W. J. Johnston	1504 So. 4th St. W., Missoula, Montana
28A	Lawrence Kaiser	Madison, S. Dakota
32B	Donald Zcerb	7500 Maryland Ave., Clayton, Missouri
13A, 23A, 24B	Ed Luger	Ingomar, Montana
24A	K. B. Elliott	New England, North Dakota
26A	DeForrest C. Wood	Worcester, New York

STATE ENGINEERS OFFICE
Water Resources Survey

Notice of Appropriation

1. County Rosebud Book 2 Page 377 Record W. R.
2. Name of Appropriator Lewis C. Starke Address Miles City
3. Date Appropriated 11-7-12 Date Filed 12-2-12
- Amount Appropriated, Miners Inches 50, Cubic Feet per second
4. Name of Stream Bough Creek Tributary Basin
5. Point of Diversion on its east bank

Sec. Twp. Rge. Bank of Stream

6. Purpose Irrigation & other
7. Description of System dam, reservoir & ditch

8. Land Description of Intended Place of Use 30 Ac. on the W side of W²NW⁴ sec 34 - 12N - 3E

9. Remarks (Pertaining to Use, etc.)

Decree

10. Case No. Date Amt. Decreed: M. I. C. F. S.
11. To Whom Decreed Address
12. Name of Ditch Maximum Capacity (C. F. S.)
13. Date of Priority Purpose
14. Land Description of Place of Use as Decreed
15. Remarks (Present Use Status, etc.)

STATE ENGINEER'S OFFICE
WATER RESOURCES SURVEYCOUNTY RosebudFILE NO. 8 - 21BOwner Johnson, EdwardAddress Melstone, Montana

AAA Owner

Address

Operator M.O.

Address

New Owner

Address

New Operator

Address

Assessment Record Mc

Assessed Acreage

Legal Description of This Farm 1/4 E. of Mshl. River Sec. 21. T. 10N., R. 31E.Pump from MusselshellCheck August 21, 1947

Total Acres in Farm

Code Number 21BPhoto No. MA-29-155

AAA Contract No.

AAA Total Cropland Acreage 20.4App. No. M-274-2

Decree No.

Land is located in

Twp. 10N. Rge. 31E. Twp. Rge.

Twp. Rge. Twp. Rge.

Filed in Twp. 10N. Rge. 31E.

Remarks

M.R.B.

April 29, 1948

Mr. Edward Johnson
Melstone, Montana

Re: Old pump ditch from Musselshell River

Dear Sir:

Rosebud

Sec. 21, T.10N., R. 31E, (E¹/₄ E¹/₄)

Mr. G. J. Carver etc

Dear Sir in reply to water filing on on section
21. I never got any water rights as there
was no water in the River to get so I never

Permit me

James Farley

Ed. J. H. Moore

Walter's Mount

[illegible]

4030
4030



STATE OF MONTANA

STATE ENGINEER

FRED E. BUCK, STATE ENGINEER
GERALD J. ORAVETZ, ASSISTANT

BILLINGS, MONTANA

April 29, 1948

Mr. Edward Johnson
Melstone, Montana

Re: Old pump ditch from Musselshell River

Dear Sir:

In accordance with the 1939 Session Law (Section 349.68 Montana Session Laws) requiring the State Engineer to investigate and prepare a complete record of all water rights in Montana, the State Engineer has been conducting a water resources survey in Rosebud County.

We are unable to find a recorded water filing for the land that you irrigate in Sec. 21, T.10N., R. 31E, (E_{1/2}E₂)
If a filing was made for this land we would like to have you send us the name of the appropriator, the date filed on, and the number of inches filed on. If no recorded filing was made we would like to have you send us the name of the first user and the date, or the approximate date, that the land was first irrigated so that we may establish a date of priority for this land.

We would like to have you make this a first on your agenda and send this information to us as soon as possible in the enclosed, stamped, self-addressed envelope.

Very truly yours,

Gerald J. Oravetz
Assistant State Engineer

GJO/a
enc.



NOTES
This form and its
contents are the
property of the State
of Montana and should
be returned.

STATE OF MONTANA
STATE ENGINEERS OFFICE
Water Resources Survey

FORM WR-1-2M-12-47

8 Code No. 16A
County Rosebud
T. 10N. R. 31E.

Name of Land Owner Setzler, Otto Address c/o F. C. Butts, Melstone, Mont.

Name of Operator _____ Address _____

Part A

**TO BE FILED BY THOSE OBTAINING IRRIGATION WATER FROM
A DITCH COMPANY OR IRRIGATION DISTRICT**

1. Water is delivered by: _____
Name of Ditch, Ditch Company or District Supplying Water
2. State the number of acres you irrigate under this system: _____ Shares you hold _____
3. If you obtain water from more than one Company, give the number of shares, acres irrigated and the name of the Company under "Remarks." If you obtain water from a Ditch Company and also have a private system fill in both Part A and Part B.

Part B

**TO BE FILED BY THOSE WHO HAVE A PRIVATE DITCH, PUMP OR IRRIGATION SYSTEM
or those who have a private water right under a Ditch Company**

4. In what year was this land first irrigated? Date See attached filings.
5. Give the name of the original appropriator (first user): _____
6. Give the date appropriated _____ Amount filed on: Miners Inches _____ C. F. S. _____
7. State the total number of acres irrigated under this system: _____
8. Give the point of diversion: 1/4 1/4 Section _____ Township _____ Range _____

Part C

TO BE FILED BY ALL WATER USERS IN ADDITION TO PART A OR PART B

9. Source of Water: Musselshell River
Name of stream or lake from which water is originally diverted
10. Water is obtained by: (Check one) Gravity X Pumping _____ Other _____
11. What is the greatest number of acres you have irrigated? 27 Date ??
12. How many acres did you irrigate in 1947? (Crop and pasture) (0)
13. State the total number of additional acres that could be irrigated by increasing the water supply, land leveling, etc. 27 This land is under what ditch? old Gravity Ditch
14. How many acres of seeped land do you have which could be drained and put into production? 0
15. What is the condition of your irrigation system? poor
16. Is your water supply adequate? Yes _____ No X Explain _____
17. REMARKS: _____

Over

NOTE: The foregoing questions apply only to irrigated land shown on this plat.

DESCRIPTION AND MAP OF FARM

18. Legal Description of this Farm See attached WR2.



IRRIGATED LAND



NON-IRRIGATED LAND



POTENTIAL

North

West

East

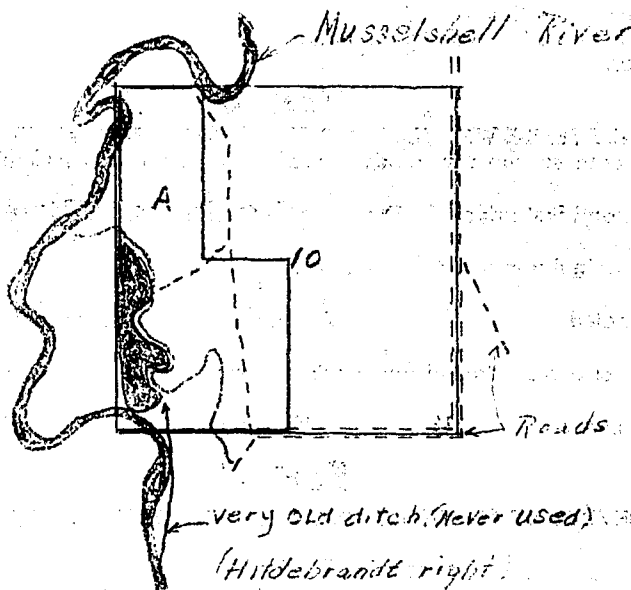

South

Ownership, crops
only irrigated land.
All ownership for
dry land not shown.

19. If the above land is irrigated from more than one ditch please give the acreage under each ditch in 19A and indicate the location of the land irrigated from each on the above map.

19A. Ditch: _____ Acres: 0

Ditch: _____ Acres: _____

Information supplied by:

Name _____ Address _____ Date 8/21/47

REMARKS: Field check by Cook-Johnson

If you cannot answer all of the questions on this form answer as many as you can and return the form to us as soon as possible.

STATE ENGINEER'S OFFICE
WATER RESOURCES SURVEY

COUNTY Rosebud

FILE NO. 8- 10A

Owner Setzler, Otto Address c/o F. C. Butts, Melstone, Montana

AAA Owner Address

Operator N.O. Address

New Owner Address

New Operator Address

Assessment Record Yes

County 50

Assessed Acreage

Legal Description of This Farm W $\frac{1}{2}$ NW $\frac{1}{4}$, SW $\frac{1}{4}$ Sec. 10, T. 10N., R. 31E.

Gravity out of Musselshell

Checked August 21, 1947

Total Acres in Farm

Code Number 10A

Photo No. MA-29-156

AAA Contract No.

AAA Total Cropland Acreage 0

App. No. 438, 333

Decree No.

Land is located in

Twp. 10N. Rge. 31E. Twp. Rge.

Twp. Rge. Twp. Rge.

Filed in Twp. 10N. Rge. 31E.

Remarks

STATE ENGINEERS OFFICE
Water Resources Survey

Notice of Appropriation

1. County Rosebud Book 1 Page 418 Record Water Right
2. Name of Appropriator Wm. Hildebrandt Address Musselshell, Montana
3. Date Appropriated 6-1-1903 Date Filed 8-11-1904
- Amount Appropriated, Miners Inches....., Cubic Feet per second 10
4. Name of Stream Home Creek Tributary Musselshell River Basin
5. Point of Diversion At a point upon its northerly bank in
- Sec. 10 Twp. 10N. Rge. 31E. Bank of Stream North
6. Purpose Irrigation of agricultural lands
7. Description of System Dam and ditch - Open surface ditch of sufficient width, depth
and length to convey the said amount of water to the land of its intended use.
8. Land Description of Intended Place of Use
S¹/₄ Sec. 10, T. 10N., R. 31E.
1940 Book shows: W¹/₄ NW¹/₄, S¹/₄ Sec. 10, T. 10N., R. 31E., 230 acres, Otto Setzler,
Melstone, Montana
9. Remarks (Pertaining to Use, etc.)
Appropriation was made June 1, 1903.

Decree

10. Case No. Date Amt. Decreed: M. I. C. F. S.
11. To Whom Decreed Address
12. Name of Ditch Maximum Capacity (C. F. S.)
13. Date of Priority Purpose
14. Land Description of Place of Use as Decreed
15. Remarks (Present Use Status, etc.)

STATE ENGINEERS OFFICE
Water Resources Survey

Notice of Appropriation

438

1. County Rosebud Book 1 Page 419 Record Water Rights
2. Name of Appropriator George Setzler Address Rosebud County
3. Date Appropriated 6-1-1903 Date Filed 8-11-1904
Amount Appropriated, Miners Inches 17, Cubic Feet per second
4. Name of Stream Musselshell River Tributary Missouri River Basin
5. Point of Diversion is marked by a stone monument upon the southerly bank of said stream
and situated at or about the north and south section line between sections
Sec. 15 & 16 Twp. 10N. Rge. Bank of Stream
6. Purpose Irrigation of agricultural lands, gardens and yards and for ranch and
agricultural purposes.
7. Description of System
Dam and ditch of sufficient width, derth. and length to convey water
appropriated.
8. Land Description of Intended Place of Use
W $\frac{1}{2}$ NW $\frac{1}{4}$, N $\frac{1}{2}$ SW $\frac{1}{4}$ Sec. 10, T. 10N., R. 31E.,
1940 Book shows: W $\frac{1}{2}$ NW $\frac{1}{4}$, SW $\frac{1}{4}$ less rd. Sec. 10, T. 10N., R. 31E., 230 acres,
Otto Setzler, Melstone, Montana, 1940 Owner
9. Remarks (Pertaining to Use, etc.)
Appropriation was made June 1, 1903.

Decree

10. Case No. Date Amt. Decreed: M. I. C. F. S.
11. To Whom Decreed Address
12. Name of Ditch Maximum Capacity (C. F. S.)
13. Date of Priority Purpose
14. Land Description of Place of Use as Decreed
15. Remarks (Present Use Status, etc.)



NOTICE
These forms are the
property of the State
of Montana and must
be returned.

STATE OF MONTANA
STATE ENGINEERS OFFICE

Water Resources Survey

FORM WR-1 1M 12-47
8 Code No. 3A
County Rosebud
T. 10N. R. 31E.

Name of Land Owner Smith, Jud & Ruby Address Melstone, Mont.

Name of Operator Address

Part A

TO BE FILED BY THOSE OBTAINING IRRIGATION WATER FROM
A DITCH COMPANY OR IRRIGATION DISTRICT

1. Water is delivered by: Name of Ditch, Ditch Company or District Supplying Water
2. State the number of acres you irrigate under this system Shares you hold
3. If you obtain water from more than one Company, give the number of shares, acres irrigated and the name of the Company under "Remarks." If you obtain water from a Ditch Company and also have a private system fill in both Part A and Part B.

Part B

TO BE FILED BY THOSE WHO HAVE A PRIVATE DITCH, PUMP OR IRRIGATION SYSTEM
or those who have a private water right under a Ditch Company

4. In what year was this land first irrigated? Date No data
5. Give the name of the original appropriator (first user):
6. Give the date appropriated Amount filed on: Miners Inches C. F. S.
7. State the total number of acres irrigated under this system:
8. Give the point of diversion: 1/4 1/4 Section Township Range

Part C

TO BE FILED BY ALL WATER USERS IN ADDITION TO PART A OR PART B

9. Source of Water: Musselshell River & side coulees.
Name of stream or lake from which water is originally diverted
10. Water is obtained by: (Check one) Gravity Pumping X Other FLOOD
11. What is the greatest number of acres you have irrigated? 28 Date ??
12. How many acres did you irrigate in 1947? (Crop and pasture) 9
13. State the total number of additional acres that could be irrigated by increasing the water supply, land leveling, etc. 19 This land is under what ditch? 9 " pump from Musselshell
14. How many acres of seeped land do you have which could be drained and put into production? 0
15. What is the condition of your irrigation system? poor
16. Is your water supply adequate? Yes No X Explain
17. REMARKS:

Over

NOTE: The foregoing questions apply only to irrigated land shown on this plat.

DESCRIPTION AND MAP OF FARM

18. Legal Description of this Farm See attached WR2.



IRRIGATED LAND

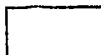

NON-IRRIGATED LAND

North

West

East

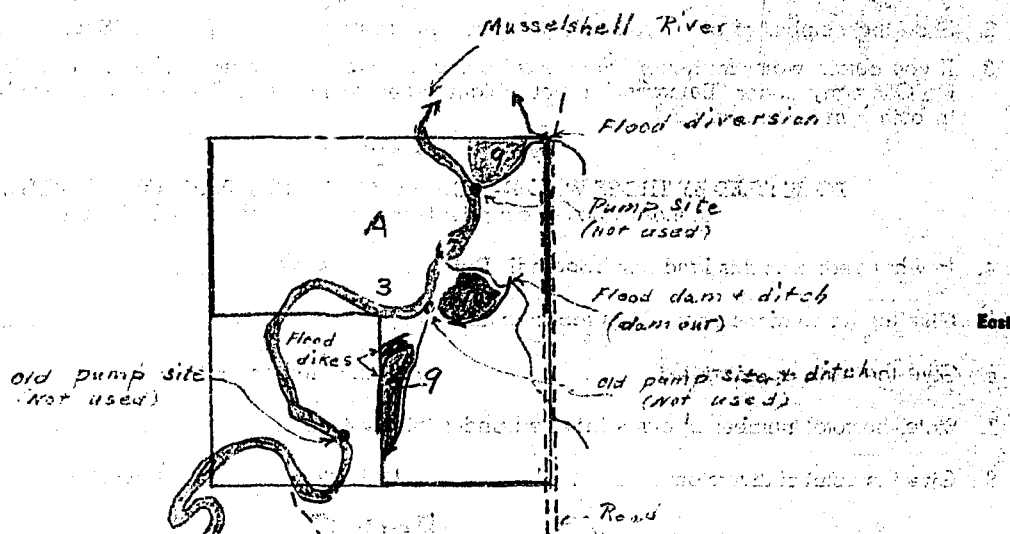

South

Ownership covers
only irrigated land.
All ownership for
dry land not shown.

19. If the above land is irrigated from more than one ditch please give the acreage under each ditch in 19A and indicate the location of the land irrigated from each on the above map.

19A. Ditch: flood from side coulee Acres: 9

Ditch: _____ Acres: _____

Information supplied by:

Name _____ Address _____ Date _____

REMARKS: Field check by Cook-Johnson

If you cannot answer all of the questions on this form answer as many as you can and return the form to us as soon as possible.

STATE ENGINEER'S OFFICE
WATER RESOURCES SURVEYCOUNTY RosebudFILE NO. 8 - 3AOwner Smith, Jud & RubyAddress Melstone, Montana

AAA Owner

Address

Operator N.C.

Address

New Owner

Address

New Operator

Address

Assessment Record No.

Assessed Acreage

Legal Description of This Farm Lots 1,2,3,4, S¹/₄NE¹/₄, S¹/₄NE¹/₄, SE¹/₄ Sec. 3, T. 10N., R. 31E.

Flood from Unnamed Coulees

Total Acres in Farm

Code Number 3APhoto No. MA-29-156

AAA Contract No.

AAA Total Cropland Acreage 117.9App. No. N.R.

Decree No.

Land is located in

Twp. 10N. Rge. 31E. Twp. Rge.

Twp. Rge. Twp. Rge.

Filed in Twp. 10N. Rge. 31E.

Remarks

M.R.B.

4/15
April 15, 1948

Jed & Ruby Smith
Melstone, Montana

Re: Flood Irrigation and Potential
Irrigable Land, Musselshell River

Dear Sir:

Rosebud

Lots 1,2,3,4, S $\frac{1}{2}$ NE $\frac{1}{4}$, S $\frac{1}{2}$ NE $\frac{1}{4}$, SE $\frac{1}{4}$ Sec. 3, T. 10N., R. 31E.



STATE OF MONTANA

STATE ENGINEER

FRED E. BUCK, STATE ENGINEER
GERALD J. ORAVETS, ASSISTANT

BILLINGS, MONTANA

April 15, 1948

Jud & Ruby Smith
Melstone, Montana

Re: Flood Irrigation and Potential
Irrigable Land, Musselshell River

Dear Sir:

In accordance with the 1939 Session Law (Section 349.58 Montana Session Laws) requiring the State Engineer to investigate and prepare a complete record of all water rights in Montana, the State Engineer has been conducting a water resources survey in Rosebud County.

We are unable to find a recorded water filing for the land that you irrigate in Lots 1, 2, 3, 4, S $\frac{1}{2}$ NW $\frac{1}{4}$, S $\frac{1}{2}$ NE $\frac{1}{4}$, SE $\frac{1}{4}$ Sec. 3, T. 10N., R. 31E. If a filing was made for this land we would like to have you send us the name of the appropriator, the date filed on, and the number of inches filed on. If no recorded filing was made we would like to have you send us the name of the first user and the date, or the approximate date, that the land was first irrigated so that we may establish a date of priority for this land.

We would like to have you make this a first on your agenda and send this information to us as soon as possible in the enclosed, stamped, self-addressed envelope.

Very truly yours,

Gerald J. Oravets
Gerald J. Oravets
Assistant State Engineer

GJO/a
enc.

*I have never irrigated any land since I have been here and don't think there is any water rights on the place however there are a few old ditches that was made in the twenties or maybe early
Jud Smith*



NOTICE
These forms and the
reports of the State
of Montana and must
be returned.

STATE OF MONTANA
STATE ENGINEERS OFFICE
Water Resources Survey

8

FORM WR-1-24 12-47

Code No. 28B

County Rosebud

T. 10N. R. 31E.

Name of Land Owner Stewart, William F. Address c/o V. C. Stevenson

Name of Operator Address

Part A

TO BE FILED BY THOSE OBTAINING IRRIGATION WATER FROM
A DITCH COMPANY OR IRRIGATION DISTRICT

1. Water is delivered by: Name of Ditch, Ditch Company or District Supplying Water
2. State the number of acres you irrigate under this system. Shares you hold
3. If you obtain water from more than one Company, give the number of shares, acres irrigated and the name of the Company under "Remarks." If you obtain water from a Ditch Company and also have a private system fill in both Part A and Part B.

Part B

TO BE FILED BY THOSE WHO HAVE A PRIVATE DITCH, PUMP OR IRRIGATION SYSTEM
or those who have a private water right under a Ditch Company

4. In what year was this land first irrigated? Date No recording.
5. Give the name of the original appropriator (first user):
6. Give the date appropriated. Amount filed on: Miners Inches C. F. S.
7. State the total number of acres irrigated under this system:
8. Give the point of diversion: $\frac{1}{4}$ $\frac{1}{4}$ Section Township Range

Part C

TO BE FILED BY ALL WATER USERS IN ADDITION TO PART A OR PART B

9. Source of Water: Musselshell River
Name of stream or lake from which water is originally diverted
10. Water is obtained by: (Check one) Gravity Pumping ☒ Other
11. What is the greatest number of acres you have irrigated? 1.8 Date 1947
12. How many acres did you irrigate in 1947? (Crop and pasture) 1.8
13. State the total number of additional acres that could be irrigated by increasing the water supply, land leveling, etc. 0 This land is under what ditch?
14. How many acres of seeped land do you have which could be drained and put into production? 0
15. What is the condition of your irrigation system? fair
16. Is your water supply adequate? Yes ☒ No Explain Sufficient for this small acreage.
17. REMARKS:

Over

NOTE: The foregoing questions apply only to irrigated land shown on this plat.

DESCRIPTION AND MAP OF FARM

18. Legal Description of this Farm See attached WR#2



IRRIGATED LAND



NON-IRRIGATED LAND

North

West

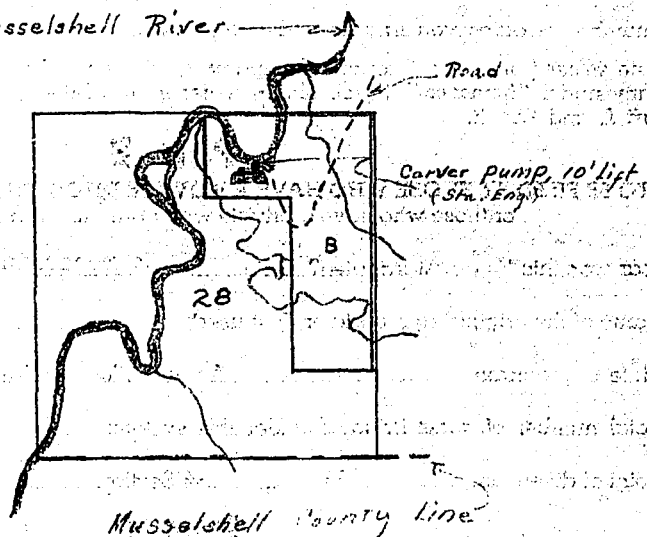

South

Ownership: correct
only irrigated land.
All ownership for
dry land not shown.

19. If the above land is irrigated from more than one ditch please give the acreage under each ditch in 19A and indicate the location of the land irrigated from each on the above map.

19A. Ditch: Private pump Musselshell River Acres: 1.8

Ditch: _____ Acres: _____

Information supplied by:

Name _____ Address _____ Date 8/21/47

REMARKS: Field check by Cook-Johnson.

If you cannot answer all of the questions on this form answer as many as you can and return the form to us as soon as possible.

STATE ENGINEER'S OFFICE
WATER RESOURCES SURVEY

COUNTY Rosebud

FILE NO. 8 - 28B

Owner Stewart, William F.

Address c/o V. C. Stevenson

AAA Owner

Address

Operator M.O.

Address

New Owner

Address

New Operator

Address

Assessment Record No

Assessed Acreage

Legal Description of This Farm N¹/₄NE¹/₄, S. & E. of River, SE¹/₄NE¹/₄, NE¹/₄SE¹/₄ Sec. 28, T. 10N., R. 31E

Checked August 21, 1947

Pump from Musselshell

Total Acres in Farm

Code Number 28B

Photo No. MA-29-155

AAA Contract No.

AAA Total Cropland Acreage 0

App. No. N.R.

Decree No.

Land is located in

Twp. 10N. Rge. 31E. Twp. Rge.

Twp. Rge. Twp. Rge.

Filed in Twp. 10N. Rge. 31E.

Remarks

M.R.B.

4/15
April 15, 1948

Mr. William F. Stewart
c/o V. C. Stevenson
Melstone, Montana

Re: Flood Irrigation on Musselshell River

Dear Sir:

Rosebud

N $\frac{1}{2}$ NE $\frac{1}{4}$, S. & E. River, SE $\frac{1}{4}$ NE $\frac{1}{4}$, NE $\frac{1}{4}$ SE $\frac{1}{4}$ Sec. 28, T. 10N., R. 31E.

STATE OF MONTANA
STATE ENGINEER'S OFFICE
 WATER RESOURCES SURVEY

Township 10N Range 31E County Rosebud

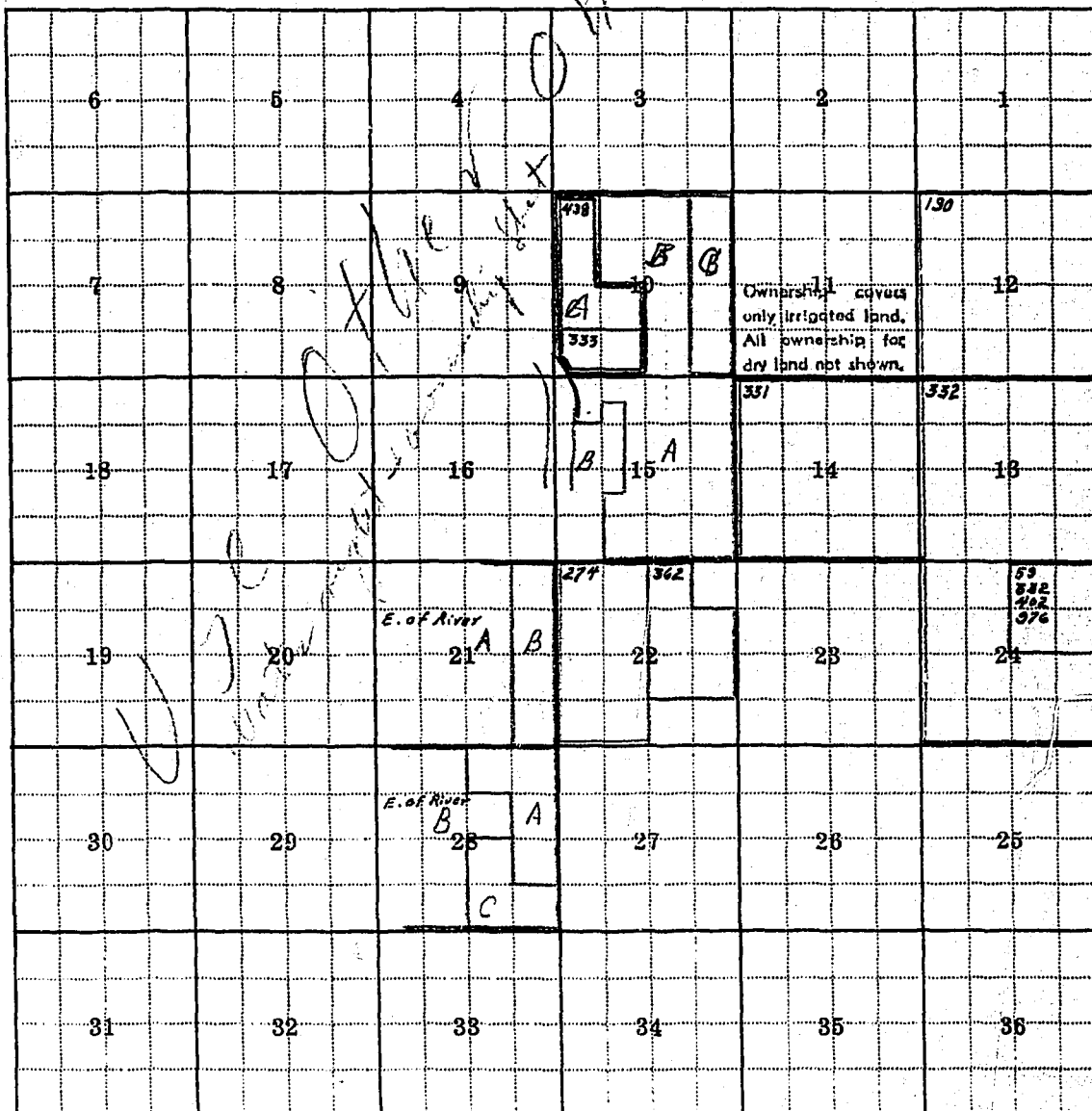

Township 10N Range 31E

[illegible]

85

FORM D-1 - GAZETTE 1964-24-1-47

STATE OF MONTANA
STATE ENGINEER'S OFFICE
WATER RESOURCES SURVEY

84 Township 10 N Range 31 E County Rosebud

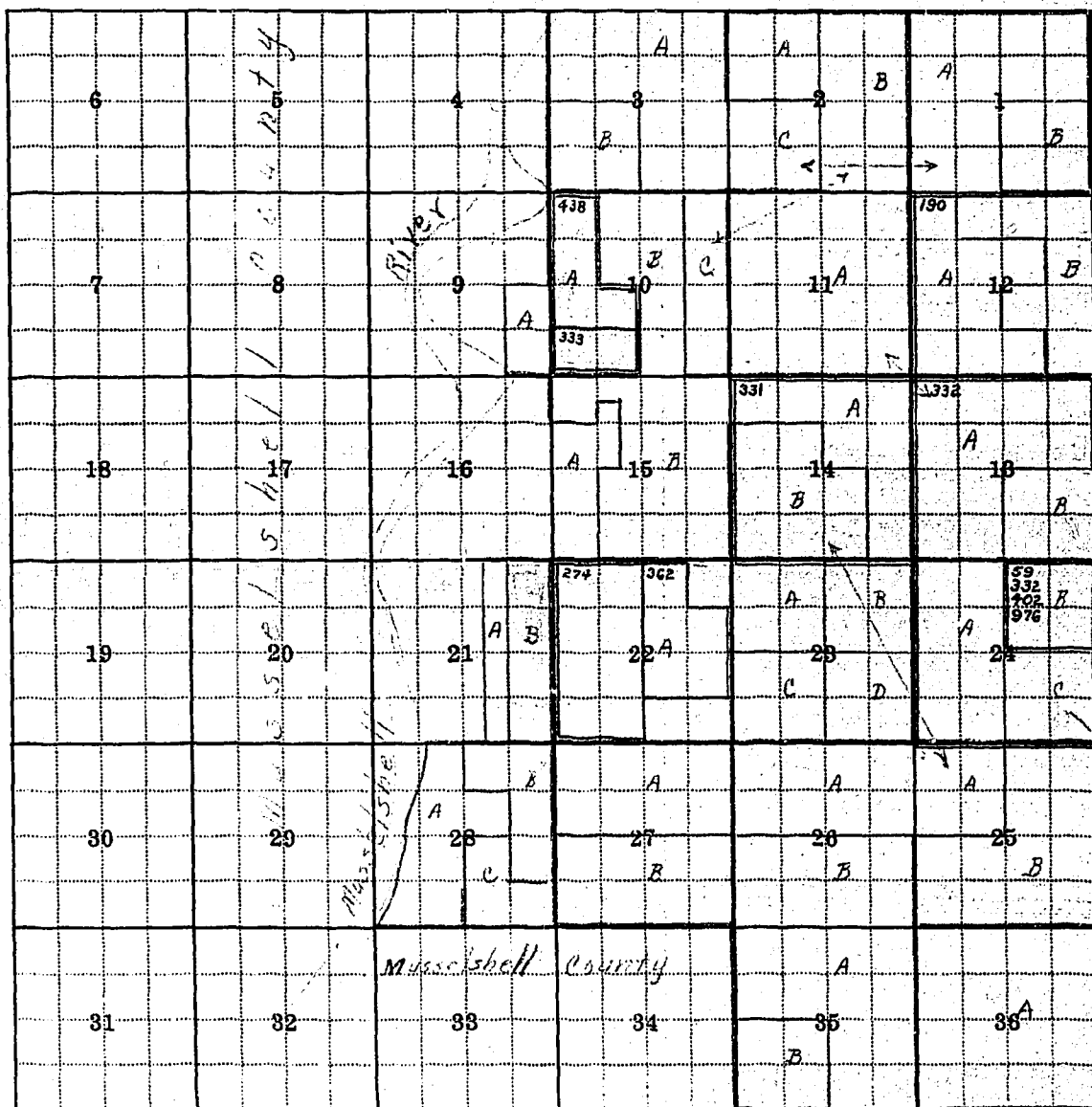

Township 10 N Range 31 E

Township 10 North Range 31 East County Rosebud

Parcel Number	Name of Owner	Address
21B	Edward Johnson	Melstone, Montana
14B, 25A, 26A	Harold Schroeder	Melstone, Montana
23B	Rosebud County	Forsyth, Montana
23A	H. T. McGuigen	412-414 Main St., Red Wing, Minn.
23C	Joe Majerus	Iona, Minn.
23D	Katherine Upton	207 E. Church St., Collinsville, Ill.
24A	Harold S. Confer	3048 1/2 N.E. St., San Bernardino, Calif.
24B	Cora McLoughlin	914 N. Benton Ave., Helena, Mont.
24C	Fred J. Adams	Melstone, Montana
25B	F. S. Renter	Mozeppa, Minn.
1A, 2C, 3A, 12B	Jud & Ruby Smith	Melstone, Montana
1B	Mary Tracy	Spring Valley, Minn.
2B, 10C	Glaude L. Honey	2064 W. Superior, Duluth, Minn.
	State of Montana	Helena, Montana
3B	Barbara Butts	Melstone, Montana
9A, 10A	Otto Setzler	c/o F. C. Butts, Melstone, Mont.
10B, 14A, 15B	F. C. Butts	Melstone, Montana
11A, 13A	Aulden F. Sibley	White Sulphur Springs, Montana
12A	Pat J. Brennan	1105 Worden Ave., Missoula, Mont.
13B	Milwaukee Land Co.	St. Paul, Minn.
21A	Otto Stensvad	Melstone, Montana
28B	Stewart, Wm. F. To V. C. Stevenson	

Township 10N

Range 31E

Rosebud County

<u>Index No.</u>	<u>Name of Appropriator</u>	<u>Stream</u>	<u>Date App.</u>	<u>Date Filed</u>	<u>M.I.</u>
59	Andrew Holman	Basin Coulee	4-20-09	9-22-10	10,000
190	Chas. J. Andreas	Coulee Creek	12-15-06	12-18-07	600
274	Wm. A. Fredrickson	Fredrickson Coulee	9-1-10	9-9-10	320
331	H. L. Brockway	Home Creek	11-22-09	11-22-09	400
332	C.M.St. Paul Ry.	Home Creek	3-28-08	3-30-08	500
333	Wm. Hildebrandt	Home Creek	6-1-03	8-11-04	400
362	Edward Johnson	Johnson Coulee	9-8-10	9-9-10	160
402	Andrew Holman	Liffirig Coulee	9-11-15	9-16-15	10,000
438	George Setzler	Musselshell River	6-1-03	8-11-04	680
976	Harold Schroeder	Unnamed Coulee	11-10-43	11-10-43	200

Township 10 North

Range 31 East

Rosebud County

Township 10 North

Range 31 East

Rosebud County

<u>Index No.</u>	<u>Name of Appropriator</u>	<u>Stream</u>	<u>Date App.</u>	<u>Date Filed</u>	<u>Inches</u>
59	Andrew Holman	Basin Coulee	4-20-09	9-22-10	10,000
190	Chas. J. Andreas	Coulee Creek	12-15-06	12-18-07	600
274	Wm. A. Fredrickson	Fredrickson Coulee	9-1-10	9-9-10	320
331	H. L. Brockway	Home Creek	11-22-09	11-22-09	400
332	C. M. St. Paul Ry.	Home Creek	3-28-08	3-30-08	500
333	Hildebrandt, Wm.	Home Creek	6-1-03	8-11-04	400
362	Edward Johnson	Johnson Coulee	9-8-10	9-9-10	160
402	Andrew Holman	Liffrig Coulee	9-11-15	9-16-15	10,000
438	George Setzler,	Musselshell R.	6-1-03	8-11-04	680
976	Harold Schroeder	Home Creek	11-10-45	11-10-45	200

Parcel
Number

Name of Owner

Address

22A, 26B, 27A,
27B, 28A, 28B,
28C, 35A
32A
27B
28B
28A
28C
35B
2A, 15A, 36A

Fred J. Adams
" "
" "
W. C. Stevenson
Agnes Dorcey
Wm. F. Stewart
Catherine Kennedy
Clarice M. Drees
Susan Peters
State of Montana

Melstone, Montana

Melstone, Montana
Mozeppa, Minn.
c/o V. C. Stevenson, Melstone
New Ulm, Minn.

Box 285, Chewalah, Wash.
Helena, Montana

STATE ENGINEERS OFFICE
Water Resources Survey

Notice of Appropriation

1. County Rosebud Book 2 Page 171 Record Water Right
2. Name of Appropriator Wm. A. Fredrickson Address Rosebud County
3. Date Appropriated 9-8-1910 Date Filed 9-9-1910
- Amount Appropriated, Miners Inches 320, Cubic Feet per second _____
4. Name of Stream Fredrickson Coulee Tributary Musselshell River Basin
5. Point of Diversion At a point upon its east bank thence runs west and north over and upon
- Sec. 22 Twp. 10N. Rge. 31E. Bank of Stream East
6. Purpose Irrigating and other purposes
7. Description of System A ditch 60 X 12 inches in size, which carries and conducts 320 inches of water.
8. Land Description of Intended Place of Use _____
W $\frac{1}{2}$ Sec. 22, T. 10N., R. 31E., 310 acres, Jas. F. and Prudence Fredrickson,
Peru, Indiana, 1940 Owner.
9. Remarks (Pertaining to Use, etc.) _____
Appropriation was made September 1, 1910.

Decree

10. Case No. _____ Date _____ Amt. Decreed: M. I. _____ C. F. S. _____
11. To Whom Decreed _____ Address _____
12. Name of Ditch _____ Maximum Capacity (C. F. S.) _____
13. Date of Priority _____ Purpose _____
14. Land Description of Place of Use as Decreed _____
15. Remarks (Present Use Status, etc.) _____

(Forms filed in Township 10 North, Range 33 East

Schleder, Arthur C.

Schleder, George

(Ownership & Appropriation Plats)

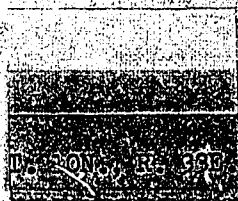



NOTICE
These forms are the
property of the State
of Montana and must
be returned.

STATE OF MONTANA
STATE ENGINEERS OFFICE
Water Resources Survey

9

Code No. 28A

County: Rosebud

T. 10N. R. 33E.

Name of Land Owner: Schleder, Arthur C. Address: Smatra, Mont.

Name of Operator: Address:

Part A

TO BE FILED BY THOSE OBTAINING IRRIGATION WATER FROM
A DITCH COMPANY OR IRRIGATION DISTRICT

1. Water is delivered by: Name of Ditch, Ditch Company or District Supplying Water
2. State the number of acres you irrigate under this system Shares you hold
3. If you obtain water from more than one Company, give the number of shares, acres irrigated and the name of the Company under "Remarks." If you obtain water from a Ditch Company and also have a private system fill in both Part A and Part B.

Part B

TO BE FILED BY THOSE WHO HAVE A PRIVATE DITCH, PUMP OR IRRIGATION SYSTEM
or those who have a private water right under a Ditch Company

4. In what year was this land first irrigated? Date: No Data
5. Give the name of the original appropriator (first user):
6. Give the date appropriated: Amount filed on: Miners Inches C. F. S.
7. State the total number of acres irrigated under this system:
8. Give the point of diversion: 1/4 1/4 Section Township Range

Part C

TO BE FILED BY ALL WATER USERS IN ADDITION TO PART A OR PART B

9. Source of Water: Trib. of Muggins Cr. Name of stream or lake from which water is originally diverted
10. Water is obtained by: (Check one) Gravity Pumping Other FLOOD
11. What is the greatest number of acres you have irrigated? 30 Date 1947
12. How many acres did you irrigate in 1947? (Crop and pasture) 30
13. State the total number of additional acres that could be irrigated by increasing the water supply, land leveling, etc. 0 This land is under what ditch?
14. How many acres of seeped land do you have which could be drained and put into production? 0
15. What is the condition of your irrigation system? fair
16. Is your water supply adequate? Yes No X Explain Seasonal Flood only
17. REMARKS:

Over

NOTE: The foregoing questions apply only to irrigated land shown on this plat.

DESCRIPTION AND MAP OF FARM

18. Legal Description of this Farm. See attached WR2.

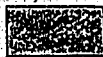

IRRIGATED LAND



NON-IRRIGATED LAND

North

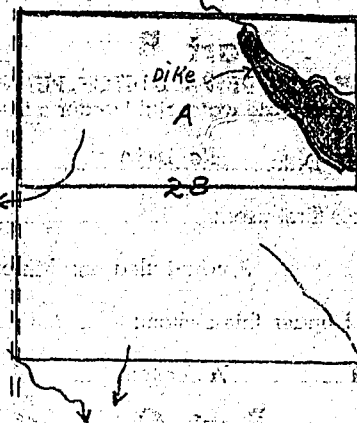

West

East

South

19. If the above land is irrigated from more than one ditch please give the acreage under each ditch in 19A and indicate the location of the land irrigated from each on the above map.

19A. Ditch: Flood from Miggins Trib. Acres: 30

Ditch: _____ Acres: _____

Information supplied by:

Name _____ Address _____ Date 8/21/47

REMARKS: Field check by Cook-Johnson.

If you cannot answer all of the questions on this form answer as many as you can and return the form to us as soon as possible.

STATE ENGINEER'S OFFICE
WATER RESOURCES SURVEYCOUNTY RosebudFILE NO. 9 - 28AOwner Schleder, Arthur C. Address _____

AAA Owner _____ Address _____

Operator N.O. Address _____

New Owner _____ Address _____

New Operator _____ Address _____

Assessment Record _____ No. _____

Assessed Acreage _____

Legal Description of This Farm N¹ Sec. 28, T. 10N., R. 33E.

Checked August 21, 1947

Flood Irrigation from Muggins Tributary

Total Acres in Farm _____

Code Number 28APhoto No. MA-35-46

AAA Contract No. _____

AAA Total Cropland Acreage 0App. No. N.R.

Decree No. _____

Land is located in

Twp. 10N Rge. 33E Twp. _____ Rge. _____

Twp. _____ Rge. _____ Twp. _____ Rge. _____

Filed in Twp. 10N Rge. 33E

Remarks _____

Y.R.B.

4/15
April 15, 1948

Mr. Arthur C. Schleder
Sumatra, Montana

Re: Flood Irrigation on Miggins Creek

Dear Sir:

Rosebud

N $\frac{1}{2}$ Sec. 28, T. 10N., R. 33E.

10N-33E

Sancho Inn

April 15, 1945

Mr. H. J. Cravely.
Assistant State Engineer
Dear Sir:

In reply to your letter of April 15th 44
I do not irrigate any land or intend to
on N $\frac{1}{2}$ sec. 28 T10N R33E. I have one little
water dam on it for live stock only. and
it is dry $\frac{5}{6}$ of the year.

My abstract ⁴ and shows I have the
water rights however. But I don't
care to irrigate. But I am going to
hold onto the water rights.

Yours truly
Arthur Leblond



NOTICE
These forms are the
property of the State
of Montana and must
be returned.

STATE OF MONTANA
STATE ENGINEERS OFFICE

Water Resources Survey

9

Code No. 21A

County Rosebud

T. 10N. R. 33E.

Name of Land Owner Schleder, Geo. Address Sumatra, Mont.

Name of Operator _____ Address _____

Part A

TO BE FILED BY THOSE OBTAINING IRRIGATION WATER FROM
A DITCH COMPANY OR IRRIGATION DISTRICT

1. Water is delivered by: _____
Name of Ditch, Ditch Company or District Supplying Water
2. State the number of acres you irrigate under this system _____ Shares you hold _____
3. If you obtain water from more than one Company, give the number of shares, acres irrigated and the name of the Company under "Remarks." If you obtain water from a Ditch Company and also have a private system fill in both Part A and Part B.

Part B

TO BE FILED BY THOSE WHO HAVE A PRIVATE DITCH, PUMP OR IRRIGATION SYSTEM
or those who have a private water right under a Ditch Company

4. In what year was this land first irrigated? Date No data
5. Give the name of the original appropriator (first user): _____
6. Give the date appropriated _____ Amount filed on: Miners Inches _____ C. F. S. _____
7. State the total number of acres irrigated under this system: _____
8. Give the point of diversion: _____ $\frac{1}{4}$ _____ $\frac{1}{4}$ Section _____ Township _____ Range _____

Part C

TO BE FILED BY ALL WATER USERS IN ADDITION TO PART A OR PART B

9. Source of Water: Trib. of Muggins Cr.
Name of stream or lake from which water is originally diverted
10. Water is obtained by: (Check one) Gravity _____ Pumping _____ Other FLOOD
11. What is the greatest number of acres you have irrigated? 5.5 Date 1947
12. How many acres did you irrigate in 1947? (Crop and pasture) 5.5
13. State the total number of additional acres that could be irrigated by increasing the water supply, land leveling, etc. 0 This land is under what ditch? _____
14. How many acres of seeped land do you have which could be drained and put into production? 0
15. What is the condition of your irrigation system? fair
16. Is your water supply adequate? Yes _____ No X Explain Seasonal flood only.
17. REMARKS: _____

Over

NOTE: The foregoing questions apply only to irrigated land shown on this plat.

DESCRIPTION AND MAP OF FARM

18. Legal Description of this Farm See attached WR2.



IRRIGATED LAND



NON-IRRIGATED LAND

North

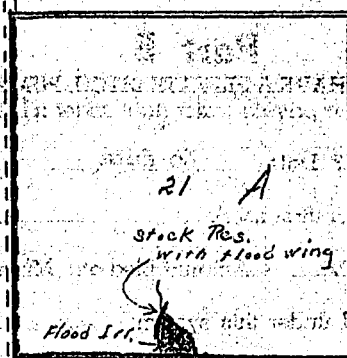

West

East

South

19. If the above land is irrigated from more than one ditch please give the acreage under each ditch in 19A and indicate the location of the land irrigated from each on the above map.

19A. Ditch: Flood trib. Muggins Cr. Acres: 5.5

Ditch: _____ Acres: _____

Information supplied by:

Name _____ Address _____ Date 8/21/47

REMARKS: Fied check by Cook-Johnson.

If you cannot answer all of the questions on this form answer as many as you can and return the form to us as soon as possible.

STATE ENGINEER'S OFFICE
WATER RESOURCES SURVEY

COUNTY Rosebud

FILE NO. 9 - 21A

Owner Schleder, George Address

AAA Owner Address

Operator N.O. Address

New Owner Address

New Operator Address

Assessment Record No.

Assessed Acreage

Legal Description of This Farm All Sec. 21, T. 10N., R. 33E.

Checked August 21, 1947

Flood from Muggins Tributary

Total Acres in Farm

Code Number 21A

Photo No. MA-35-46

AAA Contract No.

AAA Total Cropland Acreage 0

App. No. H.R.

Decree No.

Land is located in

Twp. 10N. Rge. 33E. Twp. Rge.

Twp. Rge. Twp. Rge.

Filed in Twp. 10N. Rge. 33E.

Remarks

Y.R.B.

4/15
April 15, 1948

Mr. Geo. Schleder
Sumatra, Montana

Re: Flood Irrigation on Muggins Creek

Dear Sir:

Rosebud

Sec. 21, T. 10N., R. 33E.

10 N. 33 E

Sumatra Montana

April 16, 1948

Mr. G. F. Orveth:

Assistant State Engineer:

Dear Sir:

I'm reply to your letter of the 15th.
we have a stock water ~~reservoir~~
or Dam on ~~Sec. 28~~ Sec. 28, T. 10N, R. 33E. For
stock watering only. If it wouldn't be
for this dam or water our live stock
would thirst to death at times. we
built this dam only for stock water.
we have never irrigated any land,
what ever, and never intend to.

I want to know who told you ~~that~~
we irrigate.

(over)

Yours truly

~~Geo. F. Orveth~~ Geo. F. Orveth

This ^{Stock} water dam or reservoir has
been approved by the Soil Conservation
program. I invite you or any one to
come and look ~~it~~ ^{it} over; if not satisfied
with this letter.

STATE OF MONTANA
STATE ENGINEER'S OFFICE
 WATER RESOURCES SURVEY

Township 10N Range 33E County Rosebud

6	5	4	3	2	1
7	8	9	10	11	12
18	17	16	15	14	13
19	20	21 ^A	22 ^B	23	24
			A		
30	29	28 ^A	27 ^A	26	25
		B			
31	32	33	34 ^A	35	36

Ownership covers only irrigated land. All ownership for dry land not shown.

426

Township 10N Range 33E

[illegible]

STATE OF MONTANA

State Engineer's Office

WATER RESOURCES SURVEY

Township 10N Range 31E County Rosebud

6	5	4	3	2	
7	8	9	10	11	12
			333		170
18	17	16	15	14	13
			277	362	59 402 976
19	20	21	22	23	24
30	29	28	27	26	25
			340		
31	32	33	34	35	36

part

Township _____ Range _____

[illegible]

STATE OF MONTANA

State Engineer's Office

WATER RESOURCES SURVEY

Township 10 N Range 32 E County Rosebud

6	5	4	3	2	
7	245	8	9	10	11
12	243	13	14	15	16
17	241	18	19	20	21
22	242	23	24	25	26
27	244	28	29	30	31
32	246	33	34	35	36

Township _____ Range _____

[illegible]

STATE OF MONTANA

State Engineer's Office

WATER RESOURCES SURVEY

Township 10 N Range 33 E County Rosebud

6	5	4	3	2	1
7	8	9	10	11	12
18	17	16	15	14	13
19	20	21	22	23	24
30	29	28	27	26	25
31	32	33	34	35	36

Township _____ Range _____

10 N

Range.

33 E

County

Roselva

[illegible]

Township 10N

Range 33E

Rosebud County

<u>Index No.</u>	<u>Name of Appropriator</u>	<u>Stream</u>	<u>Date App.</u>	<u>Date Filed</u>	<u>A.C.</u>
426	Minnie Herbold	Muggins Creek	1-20-12	1-27-12	1000

Township 10 North

Range 33 East

Rosebud County

STATE OF MONTANA

State Engineer's Office

WATER RESOURCES SURVEY

Township

10 N

Range

34 E

County

Rosebud

6	5	4	3	2	1
7	8	9	10	11	12
13	14	15	16	17	18
19	20	21	22	23	24 ^{7/3}
25	26	27	28	29	30
31	32	33	34	35	36

Township

Range

10N

34 E

Розетка

[illegible]

STATE OF MONTANA

State Engineer's Office

WATER RESOURCES SURVEY

Township 10N Range 35E County Rosebud

6	5	4	3	2	1
7	8	9	10	11	12
18	17	16	15	14	13
19	20	21	22	23	24
30	29	28	27	26	25
31	32	33	34	35	36

Township _____ Range _____

[illegible]

STATE OF MONTANA
State Engineer's Office
WATER RESOURCES SURVEY

Township 10 N Range 36 E County Rosebud

6	5	4	3	2	1
7	8	9	10	11	12
18	17	16	15	14	13
19	20	21	22	23	24
30	29	28	27	26	25
31	32	33	34	35	36

Township _____ Range _____

Township 10N Range 36E County Rosebud

[illegible]

STATE OF MONTANA

State Engineer's Office

WATER RESOURCES SURVEY

Township 10N Range 37E County Rosebud

					103	
6	5	4	3	2	1	
7	8	9	10	11	12	
18	17	16	15	14	13	
19	20	21	22	23	24	
499	29	28	27	26	25	
31	32	33	34	35	36	

Township _____ Range _____

[illegible]

2225-02 22250197

<u>Parcel Number</u>	<u>Name of Owner</u>	<u>Address</u>
25A	Burt Hunnes	Ingomar, Montana
36A	State of Montana	Helena, Montana
30A	Ben G. Olson Thos. Gilbert	Vananda, Montana Vananda, Montana
22A, 26B, 27A	Lucille Hedges	Ingomar, Montana
22B	Mrs. Shelby Wright	
28B	Sherwood Schmill	1405 Campbell Avenue, Springfield, Mo.
34A, 35A	Lewis Starke	Forsyth, Montana
34B	Alex Easterday Est.	Ingomar, Montana
30B, 32A	U. S. Taylor Grazing	

STATE OF MONTANA
STATE ENGINEER'S OFFICE
 WATER RESOURCES SURVEY

35 Township 10 N Range 36 E County Rosebud

A					
6	5A	4A	3A	2A	1A
B		B			
7A	8A	9A	10	11A	12A
A			B		
18A	17A	16A	15A	14	13A
				B	
19A	20	21A	A	22	23A
	B			B	24
	A				B
A				A	
30	29A	A	28	27A	26
B			B		B
31A	A	32	33A	34	35A
	B			B	36

Township 10 N Range 36 E

Township 10 North Range 36 East County Rosebud

Parcel Number	Name of Owner	Address
	S. O. Mysse	Ingomar, Montana
4B	U. S. Taylor Grazing	
1A, 2A, 3A,	Cherry Creek Sheep Co.	Ingomar, Montana
4A, 5A, 6B	" " " "	
6A	State of Montana	Helena, Montana
18A, 19B, 11A	Wm. Magelssen	Billings, Montana
12A, 14A, 15A	" "	
10A	Theo. Birkrem	Ingomar, Montana
9A, 16A	State of Montana	Helena, Montana
14B	Elvar. Goodrich	1312 E. 11th Avenue, Winfield, Kansas
21A, 29A, 31A,	Andrew Erickson	Ingomar, Montana
33A, 7A, 8A,	" "	
19A, 20A	" "	
17A	N. P. Railway	St. Paul, Minn.
20B	W. J. Johnston	1504 So. 4th St. W., Missoula, Montana
28A	Lawrence Kaiser	Madison, S. Dakota
32B	Donald Zoerb	7500 Maryland Ave., Clayton, Missouri
13A, 23A, 24B	Ed Luger	Ingomar, Montana
24A	K. E. Elliott	New England, North Dakota
26A	DeForrest C. Wood	Worcester, New York

STATE ENGINEERS OFFICE
Water Resources Survey

Notice of Appropriation

1. County Rosebud Book 2 Page 377 Record W. R.
 2. Name of Appropriator Louis C. Starker Address Miss City
 3. Date Appropriated 11-7-12 Date Filed 12-2-12
 Amount Appropriated, Miners Inches 50, Cubic Feet per second
 4. Name of Stream Roug Creek Tributary Basin
 5. Point of Diversion on its east bank
 Sec. Twp. Rge. Bank of Stream

6. Purpose Irrigation & other
 7. Description of System dam, reservoir, & ditch

8. Land Description of Intended Place of Use 30 AC. on the W side of W²NW⁴, sec. 34-10N-36E

9. Remarks (Pertaining to Use, etc.)

Decree

10. Case No. Date Amt. Decreed: M. I. C. F. S.
 11. To Whom Decreed Address
 12. Name of Ditch Maximum Capacity (C. F. S.)
 13. Date of Priority Purpose
 14. Land Description of Place of Use as Decreed
 15. Remarks (Present Use Status, etc.)