

Township 2 South, Range 41 East)

Bailey, Henry N.

Davidson, Elizabeth

Egan, Joe

McGregor, Mary L.

U. S. I. D.

U. S. A. Taylor Grazing

(Township 2 South, Range 44 East)

Anderson, Alfred

Nahon, Estella

U. S. I. D.

Welch, Claude E.

STATE OF MONTANA
STATE ENGINEER'S OFFICE
 WATER RESOURCES SURVEY

65 Township 2 S Range 41 E County Rosebud

184						
1			148	B		
2	5 A		H	B	2 A	1 A
	A			177	A	
7 A	8	411	9	10	11	12
		C2		D		
Cheyenne Indian Reservation Boundary						
18	17	A	16	A	15	14
		River				
19	20	A	21	A	22	23
		Rosebud				
30	29		28	27	26	25
					A	A
31	32		33	34	35	36
					A	

Township 2 S Range 41 E

Township 2 South Range 41 East County Rosebud

Parcel Number	Name of Owner	Address
8A, 9A, 10A	Joe Egan	Forsyth, Montana
10B	Taylor Grazing	
3B, 5A, 6A, 11A	Henry N. Bailey	Forsyth, Montana
4A	Elizabeth Davidson	Forsyth, Montana
12A	Perry G. Kelley	Lane Deer, Montana
1A, 2A, 3A	John & Minnie McKay	Forsyth, Montana
4B, 6B	Taylor Grazing	
7A, 8B	Mary L. MacGregor	Lane Deer, Montana
8C	John C. Hamilton	Forsyth, Montana
	H. H. Huffman	Forsyth, Montana
25A, 26A, 35A	Land on Reservation owned by Indians (James C. Burns)	

No. 65

Township 2 South

Range 41 East

Rosebud County, Montana

<u>Index No.</u>	<u>Name of Appropriator</u>	<u>Stream</u>	<u>Date App.</u>	<u>Date Filed</u>	<u>Inches</u>
184	Mrs. H. M. Bailey	Cottonwood Creek	11-17-10	11-23-10	500
411	John J. Mahony	Mahony Creek	12-14-98	12-16-98	300
148	Henry N. Bailey	Caswell Coulee	3-4-12	3-8-12	50
147	Henry N. Bailey	Caswell Coulee	3-4-12	3-8-12	50

STATE ENGINEER'S OFFICE

WATER RESOURCES SURVEY

66 Township 2 S Range 43 E County Rosebud

6 ^A	5 ^A	4 ^A	3 ^A	2 ^A	1 ^A 1 ^B
7	8	9	10	11	12 ^A
18	17	16	15	14	13
19	20	21	22	23	24
30	29	28	27	26	25
31	32	33	34	35	36

Township...2 S

OFFICE
RESOURCES SURVEY
Range..... *H. Y. E* County..... *Tongue R.*

STATE OF MONTANA

STATE ENGINEER'S OFFICE

WATER RESOURCES SURVEY

Township 25 Range 44 E County Longview

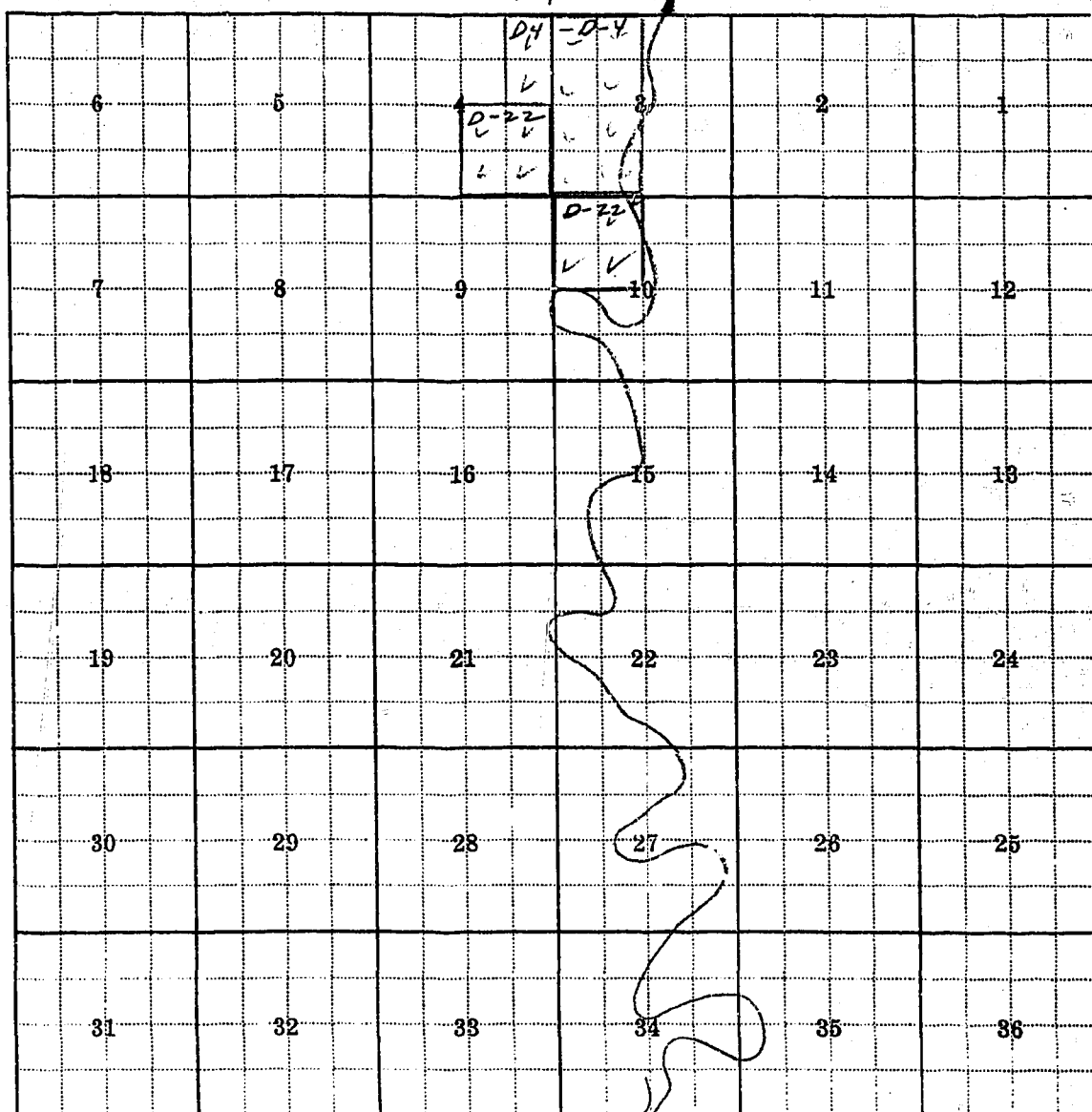

Longview River decrees

Township 25 Range 44 E

No. 67

Township 2 South

Range 44 East

Rosebud County, Montana

<u>Index No.</u>	<u>Name of Appropriator</u>	<u>Stream</u>	<u>Date App.</u>	<u>Date Filed</u>	<u>Inches</u>
460	Samuel O'Connell	Otter Creek	10-18-87	10-30-97	500
461	Samuel O'Connell	Otter Creek	1-17-99	1-18-99	500
747	John Barringer	Tongue River	3-30-92	3-30-82(?)	1500
756	Cheyenne Indians	Tongue River	3-16-09	3-24-09	6000
778	Walter A. Petrie	Tongue River	12-9-14	1-4-15	500

STATE OF MONTANA

STATE ENGINEER'S OFFICE

WATER RESOURCES SURVEY

67 Township 2S Range 44E County Rosebud

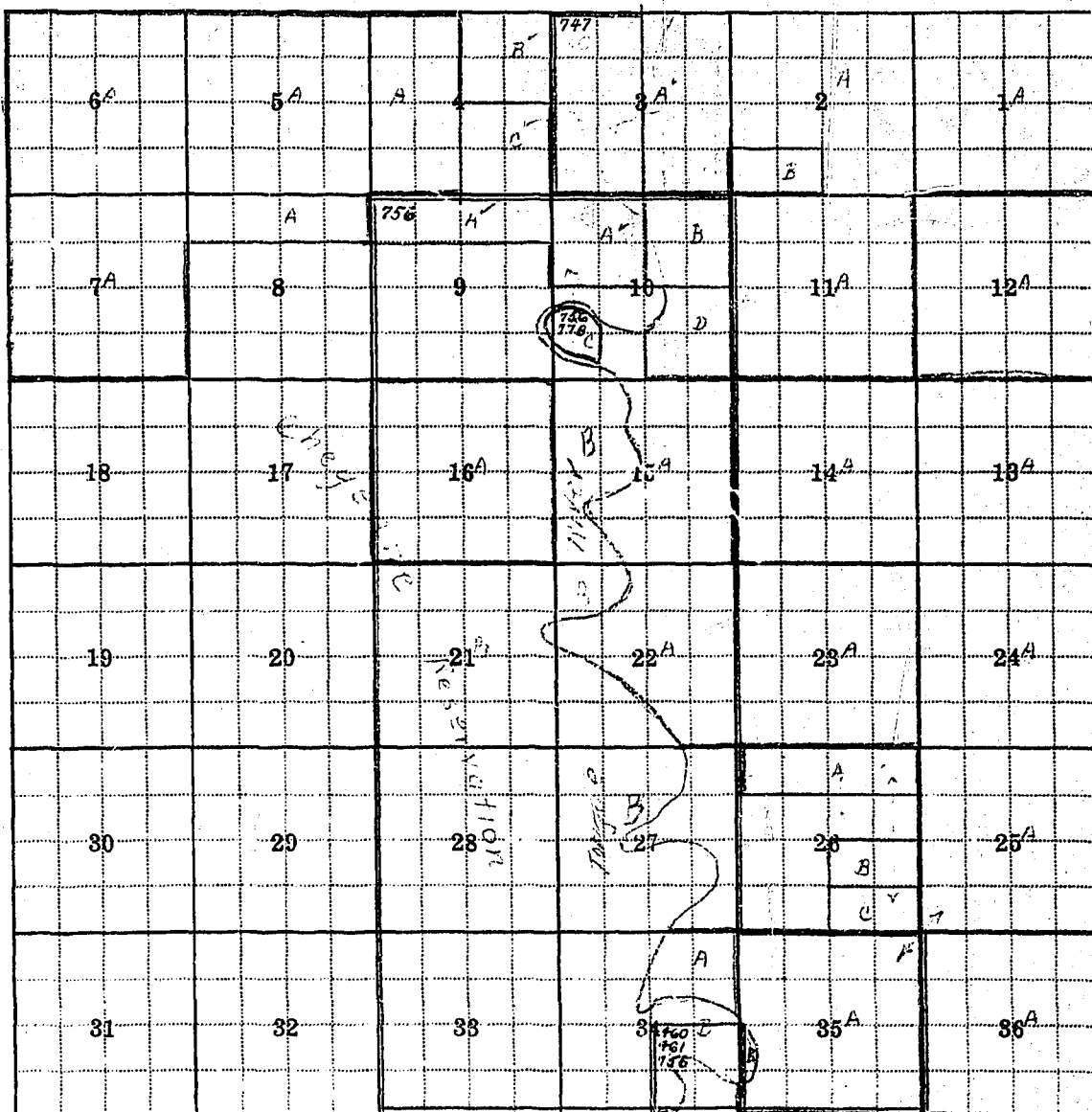

Township 2S Range 44E

Township 2 South Range 44 East County Rosebud

Parcel Number	Name of Owner	Address
	McRae Ranch Co.	Forsyth, Montana
4A, 5A, 6A, 7A, 8A	Greenleaf Land & Livestock Co.	c/c McRae
4C, 9A, 10A, 10B	Claude E. Welch	Forsyth, Montana
15A, 22A, 23A	" "	
10B	Mann & Dodds	Forsyth, Montana
10D	St. Labre Mission	Ashland, Montana
13A, 14A, 24A	Walter McLatchy	Ashland, Montana
25A, 35A	" "	
12A	Lucy Bello	c/o McLatchy
26A, 26C	St. Labre Mission	Ashland, Montana
34A	Estella Mahon	Ashland, Montana
16A, 36A	State of Montana	Helena, Montana
26B	Taylor Grazing	
34B	Roman Catholic Bishop	Great Falls, Montana
1A, 2A, 3A, 4B, 11A	Alfred Anderson	Ashland, Montana
2B	Taylor Grazing	

STATE OF MONTANA
STATE ENGINEER'S OFFICE
 WATER RESOURCES SURVEY

Township 35 Range 41 E County Rosebud

6	5	4	3 372	2	1
	539				
7	8	9	10	11	12
13	17	16	15	14	13
19	20	21	22	23	24
30	29	28	27	26	25
31	32	33	34	35	36

Township..... Range.....

51 52

Range.

41 E

County

Revised

[illegible]

STATE OF MONTANA

State Engineer's Office

WATER RESOURCES SURVEY

Township

35

Range.

44E

County

Rosebud

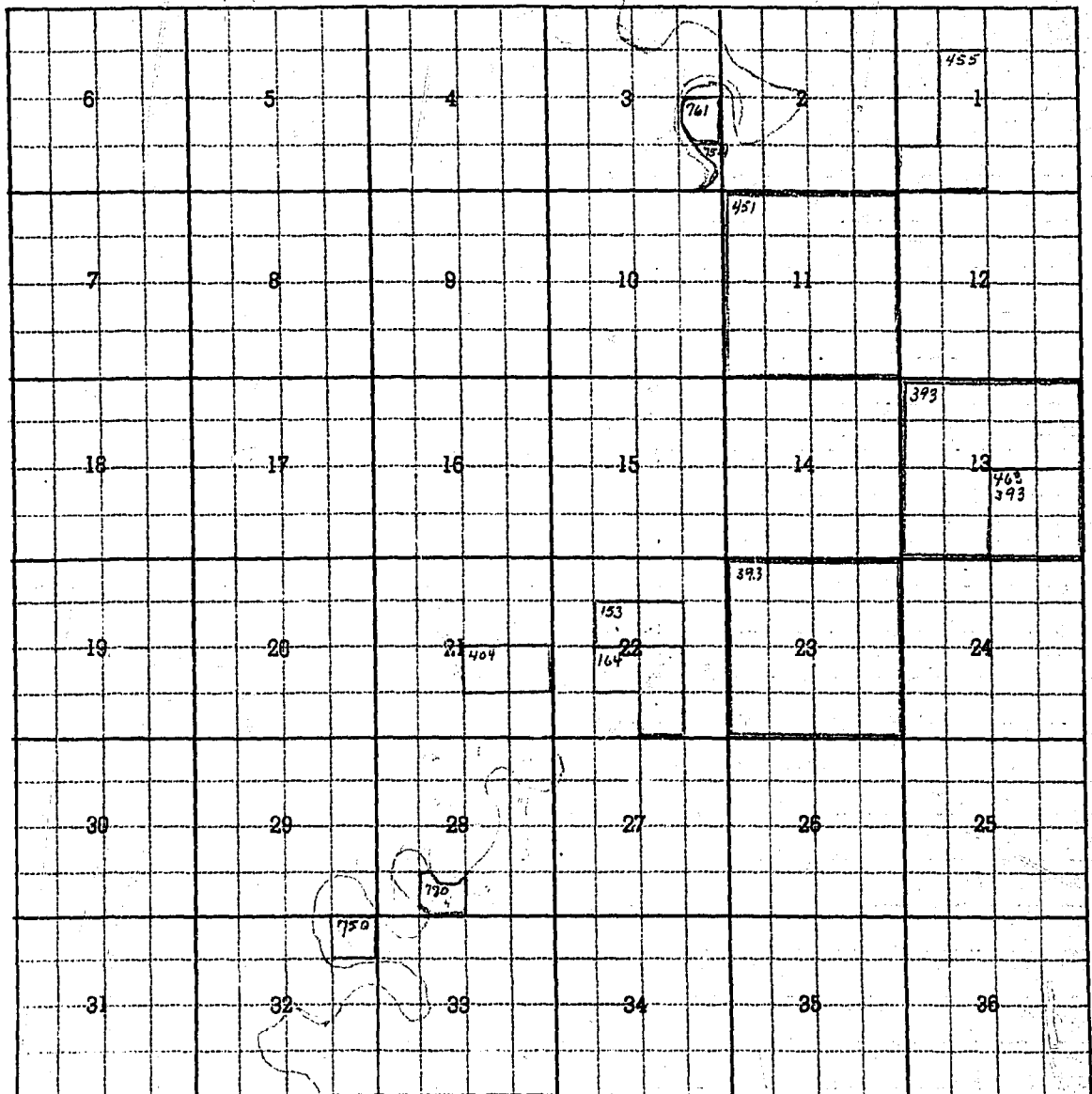

Township.

Range

Township

35

Range

44 E

County

Poudre

Parcel Number	Name of Owner	Address
↓ 153	McKee, Mary	Cedar Creek 5-3-16 5-6-16 160
↓ 164	McKee, Horatio	Cedar Creek 7-1-12 7-3-12 200
↓ 404	Wylie, Peter	Longue River 10-17-87 10-19-87 300
↓ 451	Beatty, James A.	Otter Creek 5-6-02 5-6-02 640
↓ 455	Cunningham, Fremont	Otter Creek 7-1-99 7-12-99 75
↓ 463	Winters, Matt	Otter Creek 6-28-94 6-28-94 1000
from Poudre 323 ↓ 462A	^{Trouser} Henderson, W. W.	Otter Creek 4-8-40 4-8-40 400
↓ 750	Borman, John	Longue River 1-30-10 2-10-10 250
754	Busalt, Francis	Longue River 3-3-28 3-20-28 400
↓ 761	Simone, Lloyd	Longue River 9-5-17 9-5-17 400
↓ 780	Simone, John	Longue River 5-21-13 6-12-13 200

[illegible]

Haley, Mark

Snodgrass, B. L.

U. S. I. D.

Township 3 South, Range 44 East

1 500 8-45 1 4-45

COUNTY.

Twp.

Rge.

Letters

No.

Name

1st

2nd

3rd

Ret.

Name

Halt, J.C. Est.

4/15

68

FORM D-1 - GAZETTE 1864.2M.1-47

STATE OF MONTANA

STATE ENGINEER'S OFFICE

WATER RESOURCES SURVEY

68

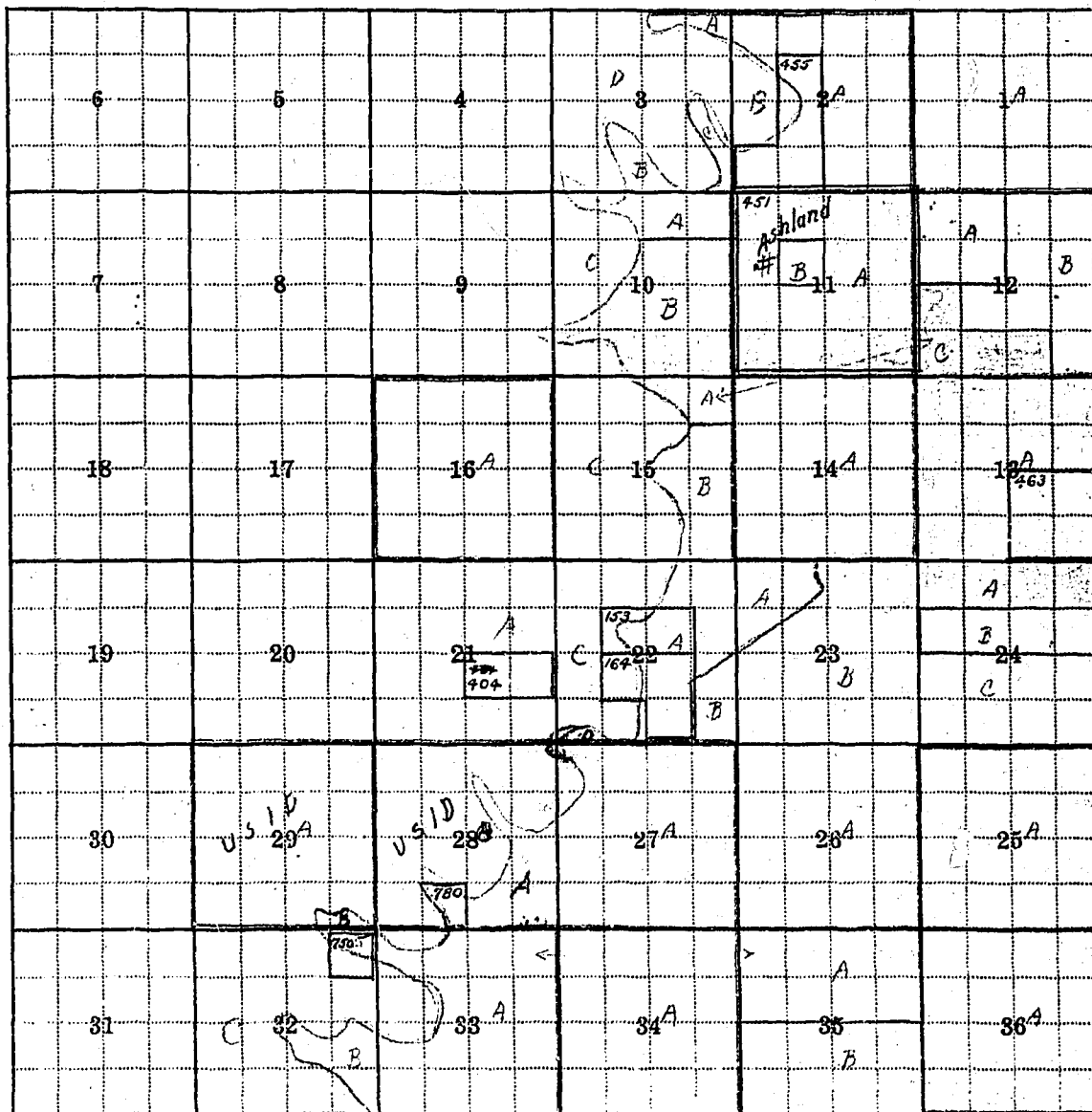
Township 3 SRange 44County RosebudTownship 3 S Range 44 E

Township 3 South Range 44 East County Rosebud

Parcel Number	Name of Owner	Address
1A	Walter McLatchy	Ashland, Montana
36A	State of Montana	Helena, Montana
2A, 3A, 3B, 3C	10A St. Labre Mission	Ashland, Montana
12A 12 C	Herbert ^{Marie E} T. Wagner	Ashland, Montana
12C, 15A	J. C. Holt Est.	c/o Wagner
10B 15A	C. C. Green	Ashland, Montana
	J. C. Holt Est.	c/o Wagner
14A	Robt. L. Rainey	Ashland, Montana
15B, 22A, 23A	Tug McKelvey	Ashland, Montana
13A, 22B, 23B	W. W. Trusler	Ashland, Montana
24A, 24C, 26A	" "	
27A, 28A	Henry Brey	Ashland, Montana
29 B	Day Brian	" "
32A, 32B, 33A	35A Mark Holey	Ashland, Montana
24B, 34A	Taylor Grazing	
11B, 25A	Chas. Thex	c/o Glenn Gentry, Ashland, Montana
12B	J. C. Holt Est. ^{Now} Herbert Wagner	c/o Wagner

12B

C. O. Wagner

Parcel
Number

Name of Owner

Address

11A

J. L. Snodgrass
~~N. P. Railway~~

Ashland
St. Paul, Minn.

29A

Earl & Faye Bryan

Ashland, Montana

35B

August C. Loom

Ashland, Montana

16A

State of Montana

Helena, Montana

No. 68

Township 3 South

Range 44 East

Rosebud County, Montana

<u>Index No.</u>	<u>Name of Appropriator</u>	<u>Stream</u>	<u>Date App.</u>	<u>Date Filed</u>	<u>Inches</u>
153	Mary McKelvey	Cedar Creek	5-3-16	5-6-16	160
164	Horatio McKelvey	Coal Creek	7-1-12	7-3-12	200
404	Peter Wyllie	Logging Creek	10-19-87	10-19-87	300
451	James A. Beatty	Otter Creek	5-6-02	5-6-02	640
455	Fremont Chuning	Otter Creek	7-1-99	7-12-99	75
463	Matt Winters	Otter Creek	6-28-94	6-28-94	1000
750	John Bowman	Tongue River	1-30-10	2-10-10	250
780	Jul. us Schaefer	Tongue River	5-31-13	6-12-13	200

Water Rights - Township 3 South, Range 44 East

Rosebud County, Montana

STATE OF MONTANA

State Engineer's Office

WATER RESOURCES SURVEY

Township 45 Range 43E County Rosebud

6	5	4	3	2	1
7	8	9	10	11	12
18	17	16	15	14	13
19	20	21	22	23	24
30	29	28	27	26	25
31	32	33	34	35	36

Township _____ Range _____

45

43E

Abraham Lincoln

10-000-27-23
24-06-00-37-14

FORM D-1
REPORTER IN 3-48 17373

STATE OF MONTANA

State Engineer's Office

WATER RESOURCES SURVEY

Township 45 Range 44 E County Rosebud

6	5	4	3	2	1
	650				
7	151 150	150	9	10	11
147 152 144 143 152 149 545 227 140 545 227	152 144 143 152 149 545 227 140 545 227	17	16	15	14
19	20	21	22	23	24
30	29	28	27	26	25
31	32	33	34	35	36

Township _____ Range _____

Township 45 Range 44E County Rosebud

Parcel Number	Name of Owner	Stream	Address App.	Filed	MI
✓ 151	King, Mrs. L. B.	Cedar Creek	11-18-10	12-2-10	1000
152	McKelvie, Gordon	Cedar Creek	8-15-10	10-2-10	1000
✓ 227	Beath, James G.	Dry Creek	10-11-06	10-11-06	3000
✓ 450	King, James	Second Creek	5-5-02	4-22-03	500
✓ 749	Beath, James G.	Tongue River	10-11-06	10-11-06	200
520, 2-3-4-015-16 21-2-2-15-29-31-32-33 from Custer	545 Cheyenne Indians	Tongue River	3-16-09	3-24-09	6000
	Penn, Nettie	Dry Creek	4-13-01	4-13-01	500

(Township 4 South, Range 43 East)

Brown Cattle Co.

Knoblock, John & Albert

U. S. I. D.

(Township 4 South, Range 44 East)

Perry, D. L.

Schaudel, Robert G.

Schaudel, RobertG.

U. S. I. D.

STATE OF MONTANA

STATE ENGINEER'S OFFICE

WATER RESOURCES SURVEY

69 Township 4 S 4 Range 43 E County Rosebud

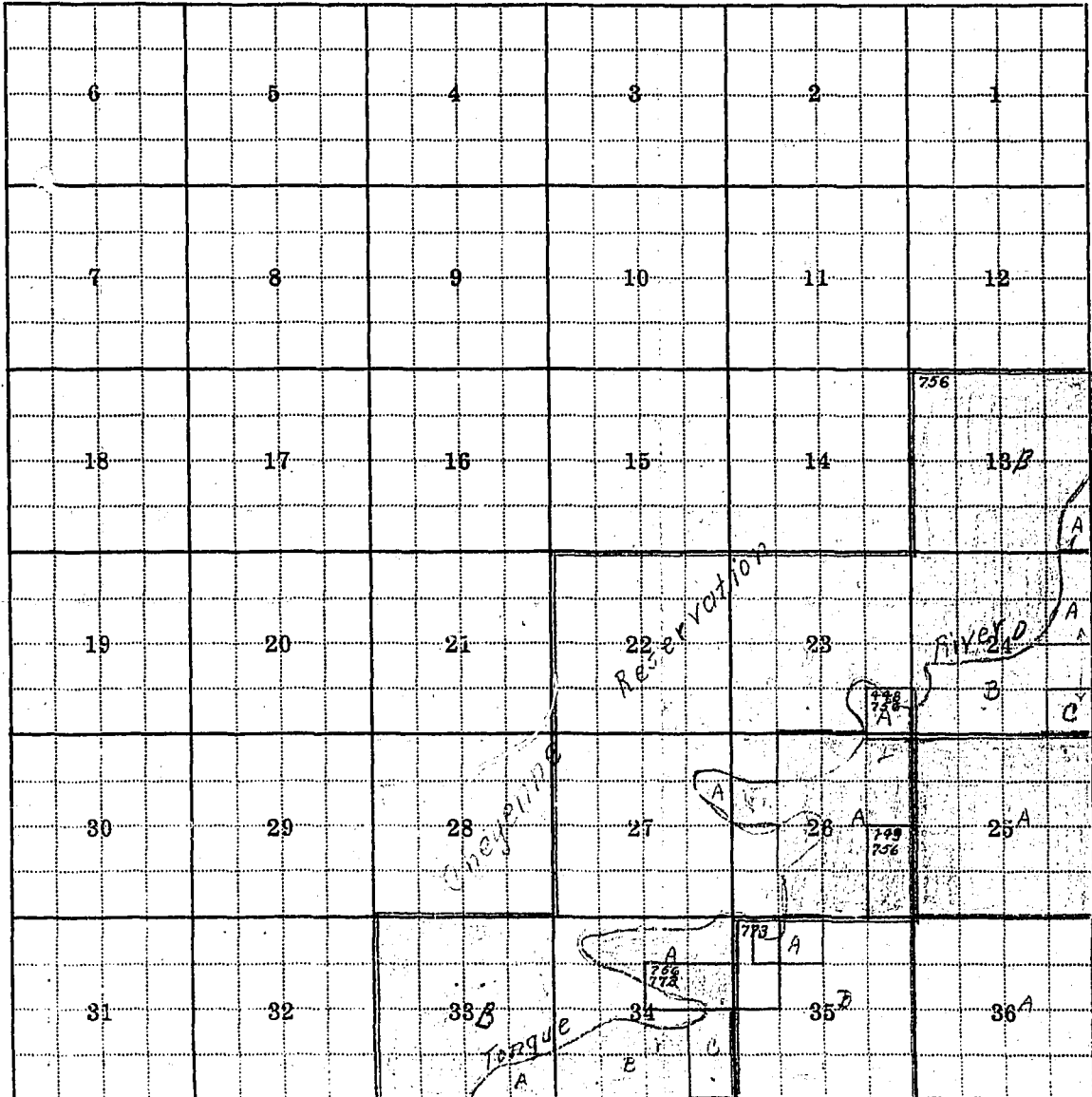

Township 4 S Range 43 E

Township 4 South Range 43 East County Rosebud

[illegible]

Township 4 South

Range 43 East

Rosebud County

No. 69

<u>Index No.</u>	<u>Name of Appropriator</u>	<u>Stream</u>	<u>Date App.</u>	<u>Date Filed</u>	<u>Inches</u>
448	Bird Konkrih	O'Dell Creek	4-16-06	4-16-06	80
449	Samuel McKelvey	O'Dell Creek	7-11-12	7-17-12	200
756	Cheyenne Indians	Tongue River	5-16-09	3-24-09	6000
773	H. W. McIntire	Tongue River	4-18-04	4-19-04	500

STATE OF MONTANA
STATE ENGINEER'S OFFICE
 WATER RESOURCES SURVEY

Township 45 Range 43 County Rosebud Co

6	5	4	3	2	1
7	8	9	10	11	12
18	17	16	15	14	13
19	20	21	22	23	24
30	29	28	27	26	25
31	32	33	34	35	36

Handwritten notes on grid:
 - Section 26: D 18, D 19, X, X
 - Section 34: D 18, D 19, X, X
 - Tongue R. (written vertically on the right side of the grid)

Tongue River Decrees
18 + 19 duplicate decrees

Township 45 Range 43 E

Township 4 South, Ranges 43 & 44 East

1 500 8-45 1 ~~432~~

COUNTY.

Sheet

Twp. 45

Rge. 44 E

Letters

[illegible]

STATE OF MONTANA
STATE ENGINEER'S OFFICE
WATER RESOURCES SURVEY

70 Township 4 S Range 44 E County Rosebud

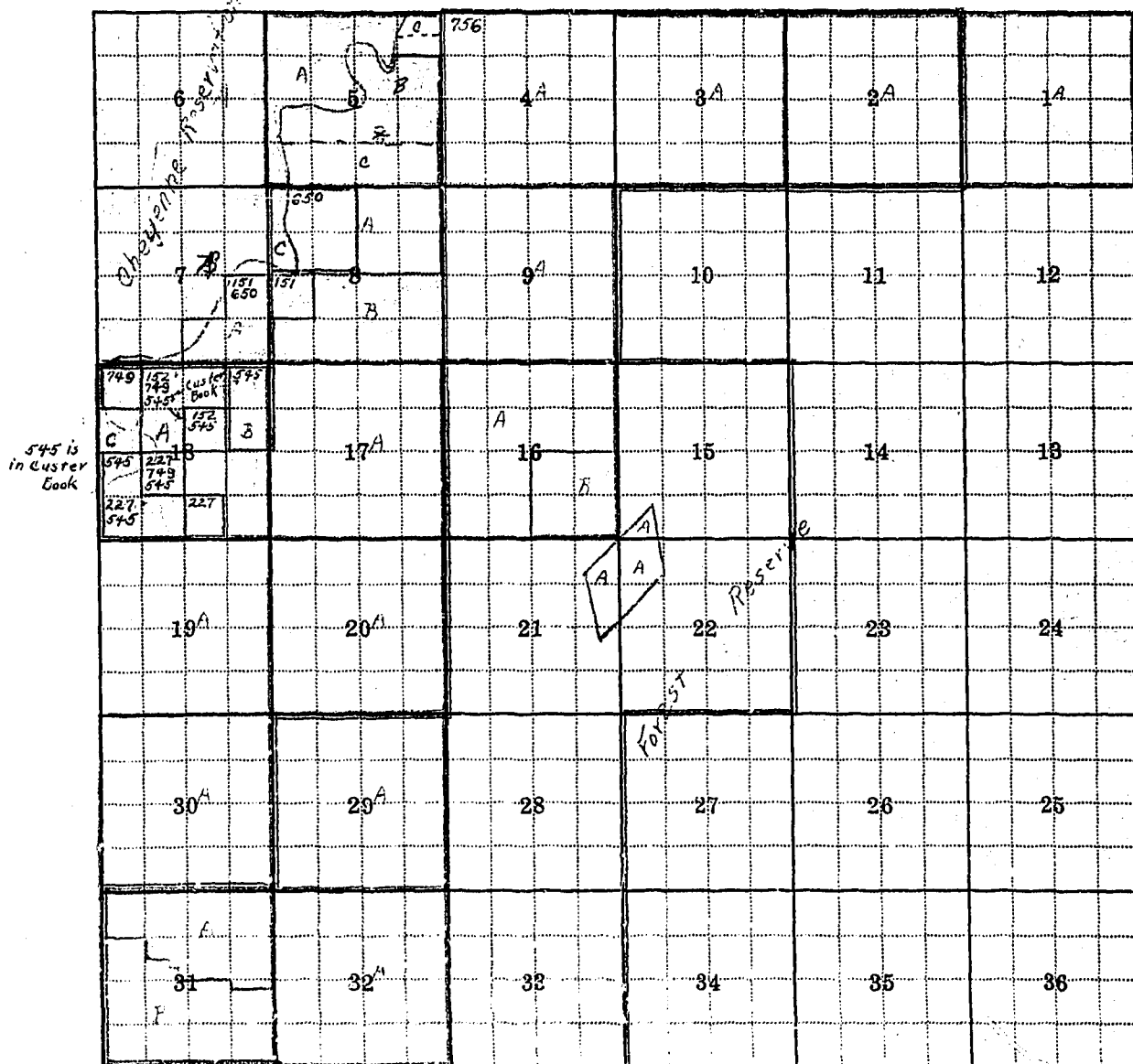

Township 4 S Range 44 E

Township 4 SouthRange 44 EastCounty Rosebud

Parcel Number	Name of Owner	Address
2A	Henry Brey	Ashland, Montana
3A, 4A, 5A	Mark Haley	Ashland, Montana
	Walter McLatchy	Ashland, Montana
16A	State of Montana	Helena, Montana
	Herbert T. Wagner	Ashland, Montana
	D. L. Perry	Ashland, Montana
	Brown Cattle Co.	Birney, Montana
	Knoblock Bros.	Birney, Montana
7A , 8B, 9A, 16B	Robt. G. Schandel	Ashland, Montana
15A, 21A, 22A	" "	
5B	Mark Haley	Ashland, Montana
8A 7A	Shirley, Haley	Ashland, Montana
18A, 18B, 17A	D. L. Perry	Ashland, Montana
19A, 29A	" "	
18A & B	now H. T. Wagner	
1A	N. P. Railway	St. Paul, Minn.
20A, 32A	Taylor Grazing	
30A	Frank M. Scott	7108 No. Pauline Ave., Chicago 26
31A, 31B	Knoblock Bros.	Birney, Montana

Township 4 South

Rosebud County

No. 70

Index

Name of

Date App.

Date Filed

Inches

31A, 31B

Knoblock Bros.

Birney, Montana

Township 4 South

Range 44 East

Rosebud County

No. 70

<u>Index No.</u>	<u>Name of Appropriator</u>	<u>Stream</u>	<u>Date App.</u>	<u>Date Filed</u>	<u>Inches</u>
151	Mrs. L. B. King	Cedar Creek	11-18-10	12-2-10	1000
152	Jordan McKelvey ✓	Cedar Creek	8-15-10	10-2-10	1000
227	James A. Beatty ✓	Dry Creek	10-11-06	10-11-06	3000
545(Custer)	Nettie Penn ✓	Dry Creek	4-13-01	4-13-01	500
650	James King	Second Creek	5-5-02	4-22-03	500
749	James A. Beatty ✓	Tongue River	10-11-06	10-11-06	200
756	Cheyenne Indians	Tongue River	3-16-09	3-24-09	6000

FORM D-1
REPORTER IM 5-48 17379

STATE OF MONTANA
State Engineer's Office
WATER RESOURCES SURVEY

Township 5 S Range 41 E County Roosveld

6	5	4	3	2	1
7	8	9	10	11	12
18	17	16	15	14	13
19	20	21	22	23	24
30	29	28	27	26	25
31	32	33	34	35	36

Township _____ Range _____

Township.

55

Range

41E

County

Rechnung

Parcel
Number

Name of Owner

Stream

Address

Acc

Filed

MI

129

Thompson, John W.

Bull Creek

1-18-30

2-3-30

520

174

Salisbury, S. H.

Cook Creek

6-19-07

6-17-07

1000

STATE ENGINEER'S OFFICE

WATER RESOURCES SURVEY

Township 55 Range 42 E County Rosebud

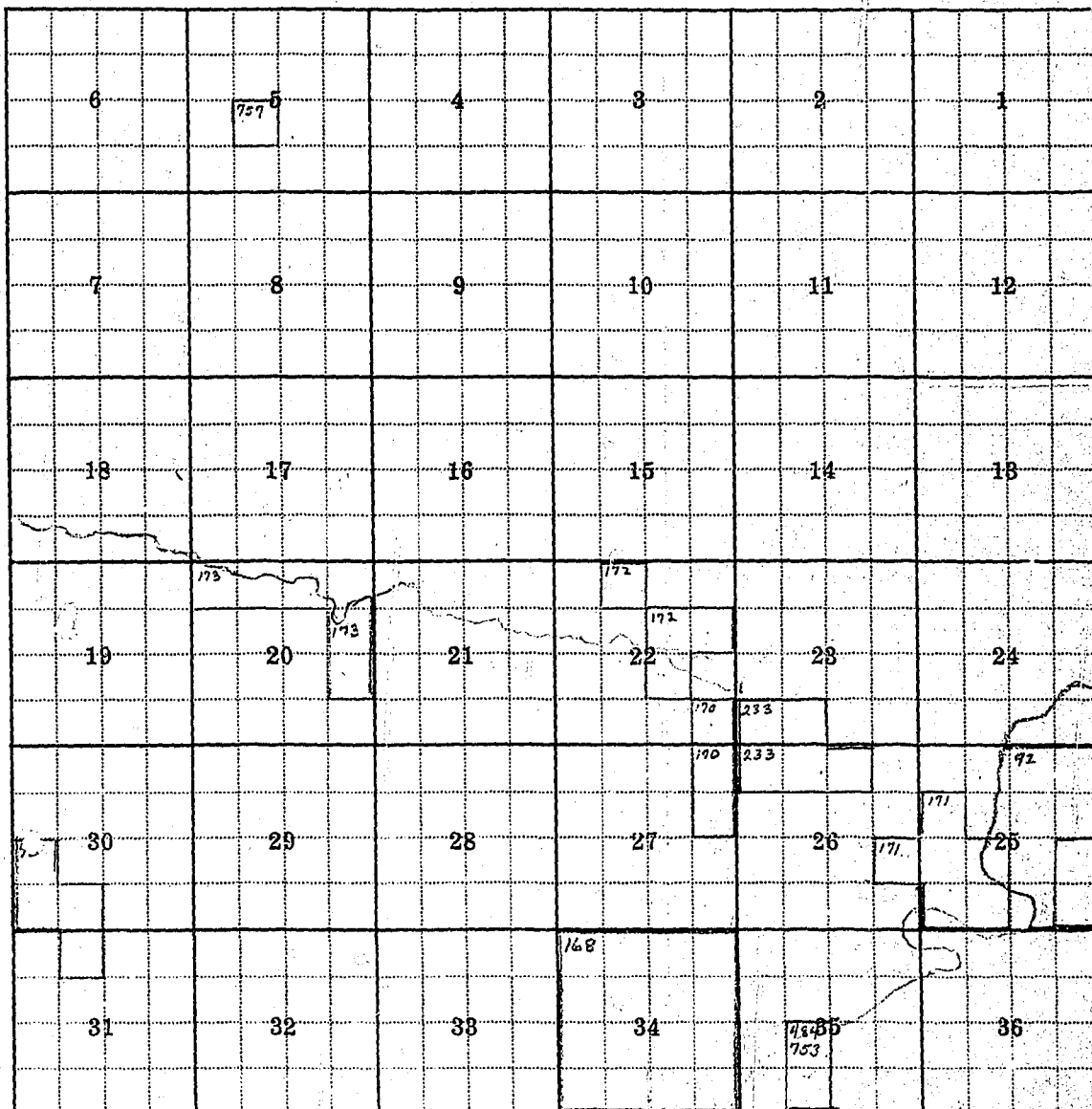

Township _____ Range _____

Township 5S Range 42E County Bozeman

[illegible]

STATE OF MONTANA

STATE ENGINEER'S OFFICE

WATER RESOURCES SURVEY

Township 5 S Range 43 E County Rosebud

6	5	4	3	2	1
7	8	9	10	11	12
18	17	16	15	14	13
19	20	21	22	23	24
30	29	28	27	26	25
31	32	33	34	35	36

Handwritten notes on the grid:

- Section 18: 486, 768
- Section 19: 768
- Section 19: 5+6, 6-10, 11

768 = sec. 19 - SE⁴, NW⁴, NE⁴

Township..... Range.....

Township 53 Range 43 County Prosser

Parcel Number	Name of Owner	Address	Filed	MI
from Rig H 481	Hunt, Thomas W.	St. Louis, Mo.	1-28-01	1-29-01 400
42	McMullen, Frank Y.	St. Louis, Mo.	5-1-10	5-3-13 500
in 523, 1-5-11-8 9-1-11-19 1756	Clayton, William	St. Louis, Mo.	3-15-09	3-24-09 6000
D 1768	Hunt, Thomas	St. Louis, Mo.	1-28-01	1-29-01 400

STATE ENGINEER'S OFFICE

WATER RESOURCES SURVEY

Township 55 Range 44 E County Rosebud

6	5	4	3	2	1
7	8	9	10	11	12
13	17	16	15	14	13
19	20	21	22	23	24
30	29	28	27	26	25
31	32	33	34	35	36

.....

.....

.....

.....

Township..... Range.....

Parcel Number	Name of Owner	Address	App	Filed	MI
765	Powere Albert J.	Unrecorded	5-6-16	5-13-16	5

Township 5 South

Range 42 East

County Rosebud

[illegible]

71

Township.....5 S.

Range.....42.....E

County Rosebud

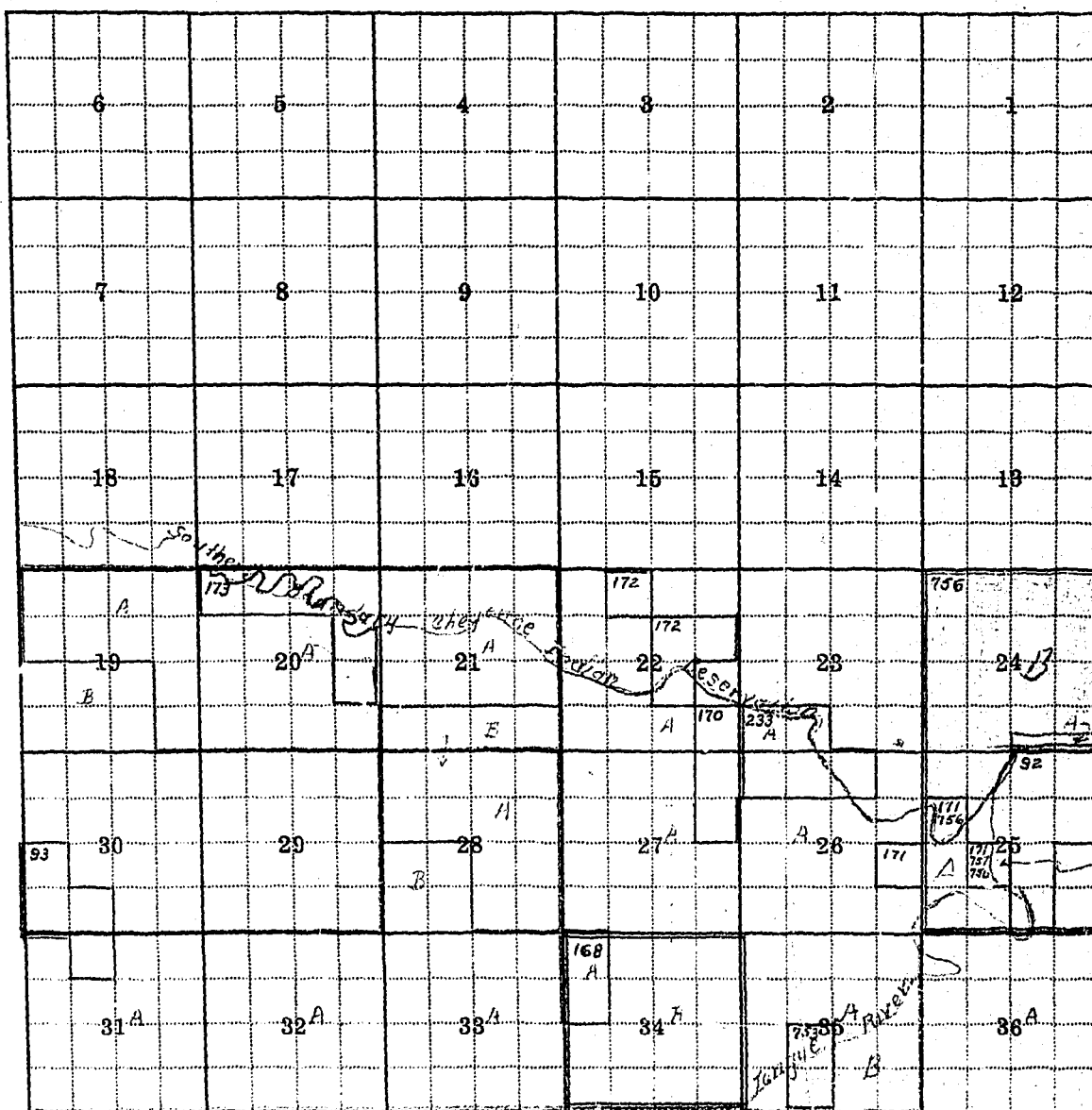

171
750
757
92

Township

Rosebud

[illegible]

STATE OF MONTANA
STATE ENGINEER'S OFFICE
WATER RESOURCES SURVEY

Township 55 Range 42 E County Rosebud

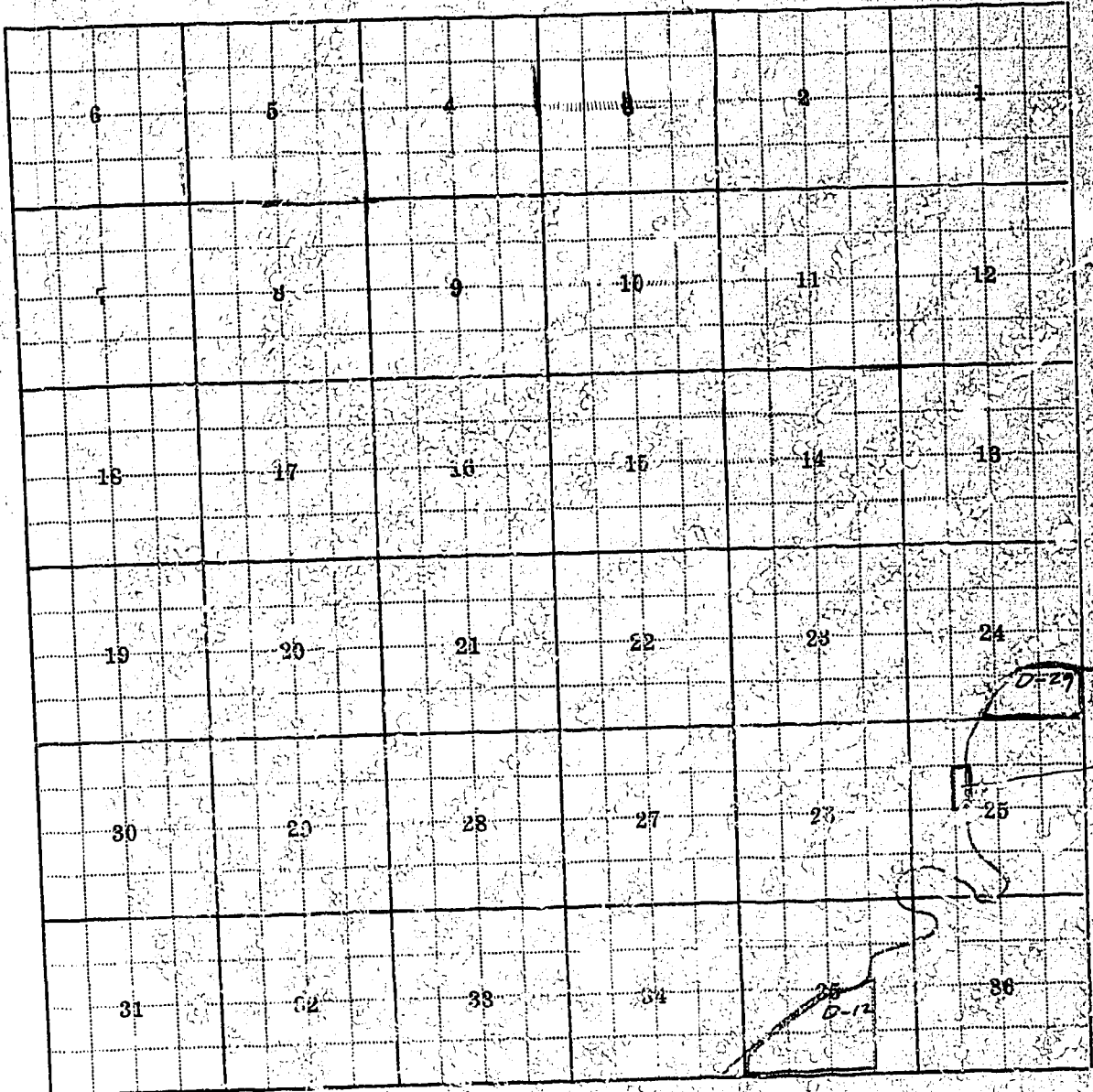

Tongue River decrees

Township 55

STATE ENGINEER'S OFFICE
WATER RESOURCES SURVEY

STATE OF MONTANA

(Township 5 South, Range 41 East)

Brewster, Warren G.

(Township 5 South, Range 42 East)

Brown Cattle Co.

U. S. I. D.

(Township 5 South, Range 43 East)

Brown Cattle Co

Lukins, Edwin

U. S. I. D.

STATE OF MONTANA

STATE ENGINEER'S OFFICE

WATER RESOURCES SURVEY

Township.....5S..... Range.....41E..... County.....Rosebud.....

6	5	4	3	2	1
7	8	9	10	11	12
18	17	16	15	14	13
19	20	21	22	23	24
			174		
30	29	28	27	26	25
31	32	33	34	35	36

Ownership covers only irrigated land. All ownership for dry land not shown.

129

Township.....5S..... Range.....41E.....

Township 53 Range 41E County Rosebud

[illegible]

Township 5 South

Range 41 East

Rosebud County

<u>Index No.</u>	<u>Name of Appropriator</u>	<u>Stream</u>	<u>Date App.</u>	<u>Date Filed</u>	<u>M.I.</u>
129	John W. Thompson	Bull Creek	1-18-30	2-3-30	500
174	S. H. Salveson	Cook Creek	6-19-07	6-19-07	1000

Township 5 South

Range 41 East

Rosebud County

No. 71

Township 5 South

Range 42 East

Rosebud County, Montana

<u>Index No.</u>	<u>Name of Appropriator</u>	<u>Stream</u>	<u>Date App.</u>	<u>Date Filed</u>	<u>Inches</u>
92	Jessie A. Foster	Black Eagle Creek	7-22-10	7-22-10	1000
93	Agnes F. Hanna	Black Eagle Creek	6-14-11	6-24-11	1000
168	John T. Brown, Jr.	Coal Bank Creek	4-1-13	6-21-16	200
170	Agnes Hanna	Cook Creek	4-17-15	4-26-16	500
171	John T. Logan	Cook Creek	4-22-96	4-22-96	1200
172	Marie F. Logan	Cook Creek	4-24-03	4-22-03	300
173	Charles Rice	Cook Creek	5-10-13	5-26-15	500
233	John T. Logan	Dry Creek	7-30-03	8-12-03	500
753	Joseph T. Brown	Tongue River	2-8-92	2-12-92	1000
756	Cheyenne Indians	Tongue River	3-16-09	3-24-09	6000
757	Cheyenne Indians (Northern)	Tongue River	9-3-15	9-10-13	6000

WATER RESOURCES SURVEY

Township.....55

Range.....43.....E

County Rosebud

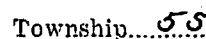

Range.....43 E

Township 5 South Range 48 East County Rosebud

Parcel Number	Name of Owner	Address
2A, 3A, 8A, 9D	Brown Cattle Co.	Birney, Montana
10A, 17A, 21A,	" "	
26A, 31A, 30A	" "	
16A	State of Montana	Helena, Montana
3B, 7A, 9A,	N. P. Railway	St. Paul, Minn.
9C, 17B, 18A	" "	
18B, 19B, 20A, 29A	Knoblock Bros.	Birney, Montana
19A	Edwin Lukens	
30B	Taylor Grazing	

OFFICE
SURVEY

3 E County Rosebud

1	2	3	4	5	6	7	8	9	10	11	12	13	14	15	16	17	18	19	20	21	22	23	24	25	26	27	28	29	30	31	32	33	34	35	36	37	38	39	40	41	42	43	44	45	46	47	48	49	50	51	52	53	54	55	56	57	58	59	60	61	62	63	64	65	66	67	68	69	70	71	72	73	74	75	76	77	78	79	80	81	82	83	84	85	86	87	88	89	90	91	92	93	94	95	96	97	98	99	100
---	---	---	---	---	---	---	---	---	----	----	----	----	----	----	----	----	----	----	----	----	----	----	----	----	----	----	----	----	----	----	----	----	----	----	----	----	----	----	----	----	----	----	----	----	----	----	----	----	----	----	----	----	----	----	----	----	----	----	----	----	----	----	----	----	----	----	----	----	----	----	----	----	----	----	----	----	----	----	----	----	----	----	----	----	----	----	----	----	----	----	----	----	----	----	----	----	----	----	-----

STATE OF MONTANA

STATE ENGINEER'S OFFICE

WATER RESOURCES SURVEY

Township 55 Range 43 E County Rosebud

6	5	4	3	2	1
7	8	9	10	11	12
18	17	16	15	14	13
19	20	21	22	23	24
30	29	28	27	26	25
31	32	33	34	35	36

Tongue River

Tongue River decrees with Legal description

Township 55 Range 43 E

Township 5 South

Range 43 East

Rosebud County

No. 72

<u>Index No.</u>	<u>Name of Appropriator</u>	<u>Stream</u>	<u>Date App.</u>	<u>Date Filed</u>	<u>Inches</u>
482	Neal G. McMullen	Poker Jim Creek	5-1-10	5-3-13	500
756	Cheyenne Indians	Tongue River	3-16-09	3-24-09	6000
768	Myron W. Hunt	Tongue River	1-28-01	1-29-01	400
1293 (Custer)	Geo. W. Humphreys	Poker Jim Creek	4-15-01	4-15-01	500
1294	" Geo. W. Humphreys	Poker Jim Creek	5-1-01	4-15-01	500
1295	" Frank Lambert	Poker Jim Creek	4-15-01	4-15-01	500

FORM D-1
REPORTER IM 3-49 17379

STATE OF MONTANA
State Engineer's Office
WATER RESOURCES SURVEY

Township 6S Range 44E County Rosebud

6	5	4	3	2	1
7	8	9	10	11	12
18	17	16	15	14	13
19	20	21	22	23	24
30	29	28	27	26	25
31	32	33	34	35	36

Township _____ Range _____

