

Township 3 North

Range 42 East

Rosebud County

<u>Index No.</u>	<u>Name of Appropriator</u>	<u>Stream</u>	<u>Date App.</u>	<u>Date Filed</u>	<u>M.I.</u>
670	W. W. McDonald	Sprague Creek	5-29-08	6-1-08	100
672	Myrtle Philbrick	Sprague Creek	12-12-06	12-19-06	200
673	Nellie A. Philbrick	Sprague Creek	4-14-00	5-4-00	100

Township 3 North

Range 42 East

Rosebud County

STATE OF MONTANA

STATE ENGINEER'S OFFICE

WATER RESOURCES SURVEY

Township.....3N..... Range.....42E..... County.....Rosebud.....

6	5	4	3	2	1
7	8	9	10	11	12
18	17	16	15	14	13
19	20	Ownership 21 covers only irrigated land. All ownership for dry land not shown.	22	23	24
30	29	A B	27	26	25
31	32	A	34	35	36

673 672 673 B 672 C

Township.....3N..... Range.....42E.....

(Forms filed in Township 3 North, Range 43 East)

Lange, Francis

McDonald, Lena

Philbrick L. & L. Co.

Philbrick, Newell G.

1

Sheet No.

Twp. 24 Rge. 42 E

Letters

[illegible]

No. 55

Township 3 North

Range 45 East

Rosebud County, Montana

<u>Index No.</u>	<u>Name of Appropriator</u>	<u>Stream</u>	<u>Date App.</u>	<u>Date Filed</u>	<u>Inches</u>
158	Herman Bollmeier	Cherry Creek	6-6-00	6-8-00	All
159	Herman Bollmeier	Cherry Creek	4-1-06	4-18-10	200
160	Freeman Philbrick	Cherry Creek	10-8-06	10-8-06	800
560	Wm. E. Goodwin	Rosebud River	3-26-95	5-6-95	160
592	Philbrick, E. C. & Bro.	Rosebud River	8-20-95	9-16-95	320
594	Freeman Philbrick	Rosebud River	10-8-06	10-8-06	600
671	Freeman Philbrick	Sprague Creek	2-15-06	2-15-06	800
675	George Batey	Spring Creek	5-2-14	5-2-14	160
814	Laurence M. Weaver	Udie Creek	4-23-37	4-23-37	400
883	Howard Sprague James Gallagher	Yellowstone R.	9-12-96	10-6-96	320
1496(Custer)	James Gallagher Howard Sprague	Rosebud River	9-12-96	10-6-96	320
2453(Custer)	Herman Bollmeier	Cherry Creek Spring 7	-87	6-8-00	3

STATE OF MONTANA
STATE ENGINEER'S OFFICE
 WATER RESOURCES SURVEY

55 Township 3 N Range 43 E County Rosebud

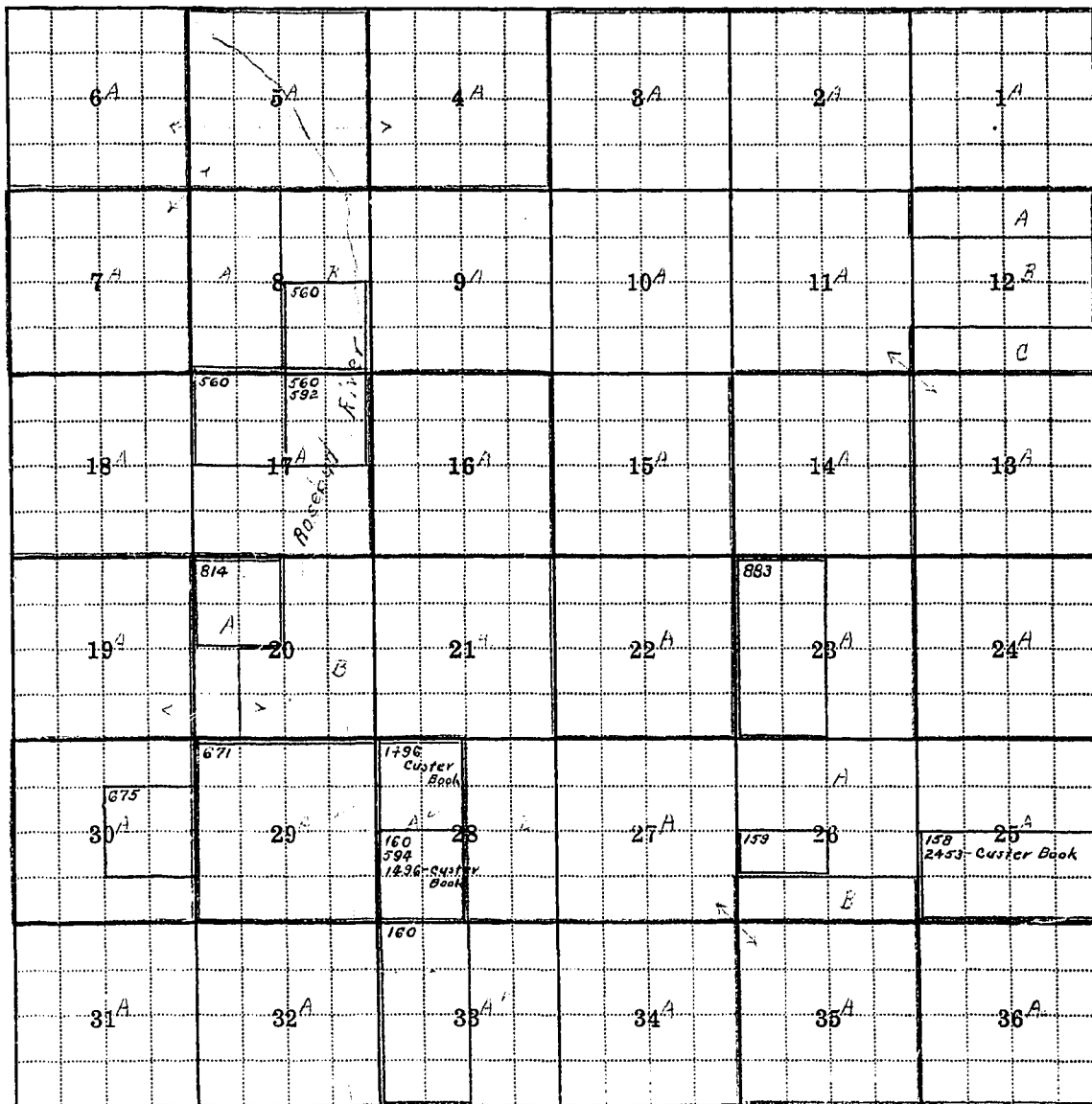

Township 3 N Range 43 E

Township 5 North Range 43 East County Rosebud

Parcel Number	Name of Owner	Address
4A, 6A	Sivert Sand	Forsyth, Montana
1A, 2A, 3A, 8B	Newell G. Philbrich	Forsyth, Montana
9A, 10A, 11A,	" "	
12B, 13A, 15A,	" "	
17A, 18A	" "	
8A	Dale Philbrich	Forsyth, Montana
12A, 12C, 14A, 24A	Taylor Grazing	
16A	State of Montana	Helena, Montana
	Duncan & John McDonald	Forsyth, Montana
5A, 7A	Lena MacDonald	Forsyth, Montana
19A, 20B, 21A, 23A,	Francis Large	Forsyth, Montana
25A, 26A, 27A, 28B,	" "	
35A	" "	
20A, 22A, 26B	Taylor Grazing	
36A	State of Montana	Helena, Montana
28A, 29A, 31A,	Philbrich Land & Livestock Co.	Forsyth, Montana
32A, 33A, 34A		
30A	George and Bernice Baty	Forsyth, Montana

STATE OF MONTANA
STATE ENGINEER'S OFFICE
 WATER RESOURCES SURVEY

Township 2 N Range 39 E County Rosebud

6 797	5	4	3	2 141	1 17 25
7	8	9	10	11 112 25	12 1621
18	17	16	15	14 482 223 537A	13
19	20	21	22 28	23	24
30	29	28	27	26	25
31	32	33	34	35	36

Township..... Range.....

22

39 E

Rosalia

[illegible]

STATE OF MONTANA
State Engineer's Office
WATER RESOURCES SURVEY

Township 2 N Range 40 E County Rosebud

6	5	4	3	2	1
7	8	9	10	11	12
18	17	16	15	14	13
19	20	21	22	23	24
30	29	28	27	26	25
31	32	33	34	35	36
	721				

2N

40 E

Roselynd

P. 1. 1.

T. 2 North, Range 43E.

2N

Range.

41 E

County

Rosemary

200

STATE OF MONTANA

STATE ENGINEER'S OFFICE

WATER RESOURCES SURVEY

Township 2 N Range 43 E County Rosebud

6	5	4 591	3	2	1
7	8	9 361	10	11	12
18	17	16 349 601	15	14	13
19	20	21	22	23	24
30 485	29	28	27	26	25
31	32 354 562 563	33	34	35	36

Township..... Range.....

T. 2 North, Range 43E.

T. 2 North, Range 43E.

Township.

2N

Range 43 E

County Rosebud

[illegible]

STATE OF MONTANA

STATE ENGINEER'S OFFICE

WATER RESOURCES SURVEY

Township 2 N Range 44 E County Rosebud

6	5	4	3	2	1
7	8	9	10	11	12
18	17	16	15	14	13
19	20	21	22	23	24
30	29	28	27	26	25
787			777		
31	32	33	34	35	36

.....

.....

.....

.....

Township..... Range.....

Township 2 N Range 44 E County Rosebud

[illegible]

(Forms filed in Township 2 North, Range 39 East)

N. P. R. R.

(Township 2 North, Ranges 41 and 43 East also filed in this folder)

Township 2 North

Range 39 East

Rosebud County

<u>Index No.</u>	<u>Name of Appropriator</u>	<u>Stream</u>	<u>Date App.</u>	<u>Date Filed</u>	<u>M.I.</u>
17	Fletcher Dailey	Armell's Creek	11-30-01	11-27-01	200
25	W. H. Hardy	Armell's Creek	7-28-07	8-13-07	1000
28	Alice C. Kimball	Armell's Creek	7-19-13	7-26-13	200
223	H. E. Buffington	Donnelly Creek	8-24-07	9-4-07	1000
537 A	Harvey E. Buffington	Roach Coulee	8-24-07	9-4-07	1000
797	Maude Robinson	Trail Creek	10-15-11	12-20-15	500
941	Lillie Spurlock	Unnamed Coulee	8-27-14	8-27-14	200
621	Frank M. Kimball	Rupurt Creek	3-23-09	4-19-09	400

Township 2 North

Range 39 East

Rosebud County

T. 2 North, Range 43E.

STATE OF MONTANA
STATE ENGINEER'S OFFICE
 WATER RESOURCES SURVEY

Township 2N Range 39E County Rosebud

6	5	4	3	2	1
7	8	9	10	11	12
18	17	16	15	14	13
19	20	21	22	23	24
30	29	28	27	26	25
31	32	33	34	35	36

Handwritten notes on the grid:

- Section 6: 797
- Section 2: 17/25, 3, 941, A
- Section 1: A
- Section 11: Ownership covers only irrigated land. All ownership for dry land not shown. 621
- Section 14: 223, 537A
- Section 22: 28, A

Township 2N Range 39E

T. 2 North, Range 43E.

Township 2 North Range 41 East County Rosebud

Parcel Number	Name of Owner	Address
1A	A. C. Lloyd	Forsyth, Montana
	Duncan & John MacDonald	Forsyth, Montana
19A	L. & L. Philbrick	Forsyth, Montana
	H. J. Kyhl	Colstrip, Montana
6A,	Gertrude Chilberg	Forsyth, Montana
32A,33A	N. W. I.	Colstrip, Montana
18B,30A	Arthur Mansfield	Colstrip, Montana
2A,3A,10A,11A,	Vern Wemer	Colstrip, Montana
12B,14A,24A	" "	
13A	N. P. Railroad	St. Paul, Minn.
36A	State of Montana	Helena, Montana
12A,21A,29A	L. & L. Philbrick Co.	Forsyth, Montana
25A	N. P. Railroad	St. Paul, Minn.
56A	State of Montana	Helena, Montana
4A	C. C. Edwards	Colstrip, Montana
4B	E. P. West	c/o Edwards, Colstrip, Mont.
4C	Olabell Duncan	c/o C. C. Edwards, Colstrip, Mont.
5A,7A,9A,17A	N. P. Railroad	St. Paul, Minn.
8B	The Barth Co.	Billings, Montana
8A	John Mahoney	Forsyth, Montana
16A	State of Montana	Helena, Montana
23A,26A,27A	N. W. I.	Colstrip, Montana

8A		
16A	State of Montana	Montana
23A, 26A, 27A	N. W. I.	Colstrip, Montana

<u>Parcel Number</u>	<u>Name of Owner</u>	<u>Address</u>
22A	Ray Henley	Colstrip, Montana
15A	N. P. Railroad	St. Paul, Minn.
28A	N. W. I.	Colstrip, Montana
20A	Edith MacDonald	Colstrip, Montana
28A, 31A	N. W. I.	Colstrip, Montana
18A	Eliz. Anshutz	Colstrip, Montana
33A, 34A, 35A	N. W. I.	Colstrip, Montana
28B	B. R. Lund	c/o Ray Henley, Colstrip, Mont.

No. 56

Township 2 North

Range 41 East

Rosebud County, Montana

<u>Index No.</u>	<u>Name of Appropriator</u>	<u>Stream</u>	<u>Date App.</u>	<u>Date Filed</u>	<u>Inches</u>
20	Olabelle Duncan	Armell's Creek	7-16-16	7-14-16	500
21	C. C. & E. Edwards	Armell's Creek	1-30-09	1-30-09	200
33	Eugenie G. Philbrick	Armell's Creek	12-18-15	12-27-15	200
34	Freeman Philbrick	Armell's Creek	2-12-06	2-15-06	800
35	Malcolm Philbrick	Armell's Creek	4-6-14	4-24-14	600
183	C. C. & Anna Edwards	Correll Creek	1-30-09	1-30-09	200

(Forms filed in Township 2 North, Range 43 East)

Goodwin, Arley

Philbrick, Mary & Malcolm

Philbrick, L. & L. Co.

T. 2 North, Range 43E.

ownship 2 North, Ranges 39, 41, & 43 East

1 500 8-45 1

COUNTY

Rosebud

Twp.

24

Rgc.

43E

Letters

No.

Name

1st

2nd

3rd

Ret.

N

Philbrick, Mary & Malcolm 4/15

No. 57

Township 2 North

Range 43 East

Rosebud County, Montana

<u>Index No.</u>	<u>Name of Appropriator</u>	<u>Stream</u>	<u>Date App.</u>	<u>Date Filed</u>	<u>Inches</u>
349	Geo. W. Snider	Howard Creek	12-23-90	12-23-90	1000
361	Freeman Philbrick	John Hen Creek	2-15-06	2-15-06	800
485	Robert Hupke	Pony Creek	9-5-12	9-9-12	200
554	Wallace Carpenter	Rosebud River	8-5-96	8-7-96	300
563	Harris, Wilson & Edson	Rosebud River	7-21-93	8-1-93	500
591	E. C. Philbrick	Rosebud River	4-6-91	4-21-91	600
601	Geo. W. Snider	Rosebud River	9-12-90	9-18-90	576

Township 2 N Range 43 E

Township 2 North Range 43 East County Rosebud

Parcel Number	Name of Owner	Address
1A, 2A, 3A, 4A,	Philbrick Land & Livestock Co.	Forsyth, Montana
5A, 6A, 7A, 9A,	" "	
10A, 11A, 12B,	" "	
13A, 28A, 29A,	" "	
31A, 32B, 33A	" "	
4B, 4C, 6C, 12A	Taylor Grazing	
6B	State of Montana	Helena, Montana
15B, 16B, 17B,	George Coon	Forsyth, Montana
18B, 22A	" "	
18A	Taylor Grazing	
20A, 28B	Leigh Sinkey	Forsyth, Montana
16C, 17C, 19A,	Mary & Malcolm Philbrick	Forsyth, Montana
21A, 23A, 24A,	" "	
25A, 26A, 27A,	" "	
30C, 31A, 35A	" "	
8B, 14A, 15A, 16A	Archie Goodwin	Forsyth, Montana
8A, 22B, 22C,	Taylor Grazing	
30A, 30B	" "	
17A	Siel Snyder	Forsyth, Montana
36A	State of Montana	Helena, Montana
32A	Bert Royal	Forsyth, Montana

STATE OF MONTANA
State Engineer's Office
WATER RESOURCES SURVEY

Township 1N Range 43 E County Rosebud

			734			
6	5	4		3	2	1
			934			
7	1485	8	9	10	11	12
18	17	16	15	14	13	
588	19	20	21	22	23	24
						588
30	29	28	27	26	25	
31	32	33	34	35	36	

Township _____ Range _____

STATE OF MONTANA

State Engineer's Office

WATER RESOURCES SURVEY

Township 1N Range 44E County Rosebud

[illegible]

Township _____ Range _____

Township

1N

Range

44E

County

Bozeman

Parcel Number	Name of Owner	Section	Address	Filed	MI
FROM CUSTOMER Decree D-41 395" 7-20-14	67 Wolff, William	Beaver Creek	12-7-91	12-30-91	700
✓ 68 Wolff, William	Beaver Creek	3-2-93	7-20-95	700	
✓ 220 McBowell, Fannie	Diamond Creek	4-20-08	4-20-08	600	
✓ 273 Geist, Mary A	Freda Creek	10-21-12	10-24-12	200	
✓ 285 Goodale, Henry C.	Goodale Creek	10-3-11	10-3-11	500	
✓ 286 Gerritt, A. H.	Goodale Creek	9-17-00	10-1-00	3000	
✓ 316 Hart, Harley H.	Hart Creek	11-30-10	12-15-10	500	
✓ 722 McBowell, W. C.	Wright Creek	4-17-07	4-18-07	500	
✓ 746 Cobb Ranch Co.	Tongue River	12-17-07	12-17-07	10,000	
✓ 762 Goodale, H. C.	Tongue River	11-25-10	11-25-10	500	
✓ 775 Miles, Geo. M.	Tongue River	3-7-07	3-8-07	1200	
7-23-14 Decree COUR DECREE Decree 7-23-14 49, 10"	✓ 789 Gerritt, J. H.	Tongue River	12-24-00	1-2-01	10,000
	✓ 789 Gerritt, J. H.	Tongue River	12-10-96	1-27-97	10,000
	✓ 846 Wolff, William W.	Wolff Creek	10-10-02	10-10-02	500
	✓ 962 McBowell, W. C.	Tongue River	4-1-92	4-23-10	40

(Township 1 North, Range 43 East)

Philbrick L. & L. Co.

Parkins, Geo. W.

(Township 1 North, Range 44 East)

Aldrich, W. A.

Dennis, Warren

Dennis, John A.

Flowers, John

Goodale, H. C. Est.

Hart, Rollo

Hunt, H. L.

Overgard, John

U. S. A. Taylor Grazing



of Montana and hereby
is authorized

STATE ENGINEERS OFFICE

Water Resources Survey

50 Code No 5A, 8A, 4A, 17A

County Rosebud

T. 1N. R. 43E.

Name of Land Owner Philbrick L. & L. Co? Address Forsyth, Mont.

Name of Operator _____ Address _____

Part A

R. C.
**TO BE FILED BY THOSE OBTAINING IRRIGATION WATER FROM
A DITCH COMPANY OR IRRIGATION DISTRICT**

1. Water is delivered by: _____
Name of Ditch, Ditch Company or District Supplying Water
2. State the number of acres you irrigate under this system _____ Shares you hold _____
3. If you obtain water from more than one Company, give the number of shares, acres irrigated and the name of the Company under "Remarks." If you obtain water from a Ditch Company and also have a private system fill in both Part A. and Part B.

Part B

**TO BE FILED BY THOSE WHO HAVE A PRIVATE DITCH, PUMP OR IRRIGATION SYSTEM
or those who have a private water right under a Ditch Company**

4. In what year was this land first irrigated? Date _____ See attached filings (70-542)
5. Give the name of the original appropriator (first user): _____
6. Give the date appropriated _____ Amount filed on: Miners Inches _____ C. F. S. _____
7. State the total number of acres irrigated under this system: _____
8. Give the point of diversion: _____ $\frac{1}{4}$ _____ $\frac{1}{4}$ Section _____ Township _____ Range _____

Part C

TO BE FILED BY ALL WATER USERS IN ADDITION TO PART A OR PART B

9. Source of Water: Rosebud River
Name of stream or lake from which water is originally diverted
10. Water is obtained by: (Check one) Gravity X Pumping _____ Other _____
11. What is the greatest number of acres you have irrigated? 191 Date ??
12. How many acres did you irrigate in 1947? (Crop and pasture) 0
13. State the total number of additional acres that could be irrigated by increasing the water supply, land leveling, etc. 191 This land is under what ditch? old gray ditch
14. How many acres of seeped land do you have which could be drained and put into production? 0
15. What is the condition of your irrigation system? poor, in abandoned condition.
16. Is your water supply adequate? Yes _____ No X Explain _____
17. REMARKS: _____

V

Over

18. Legal Description of this Farm See attached WB2

WATER RESOURCES SURVEY

COUNTY Rosebud

FILE NO. 50 - 5A,8A,4A,17A

Owner Philbrick L. & L. Co. Address Forsyth, Montana

AAA Owner Address

Operator N.O. Address

New Owner Address

New Operator Address

Assessment Record Yes

County 571
Assessed Acreage

Legal Description of This Farm W1/2 Sec. 4, All Sec. 5, N1/2, N1/2SW1/2, SE1/2SW1/2, W1/2SE1/2 Sec. 8;
All Sec. 17, T. 1N., R. 43E.

Gravity Rosebud R. Total Acres in Farm

Code Number 5A,8A,4A,17A

Photo No. MA-28-105

AAA Contract No.

AAA Total Cropland Acreage 443.7

App. No. 1485 Custer

Decree No.

Land is located in

Twp. 1N. Rge. 43E. Twp. 3N. Rge. 43E.

Twp. 2N. Rge. 43E. Twp. Rge.

Filed in Twp. 3N. Rge. 43E.

Remarks

Y.R.B.

Notice of Appropriation

1. County Custer Book A Page 494 Record Water Right
2. Name of Appropriator Elizabeth A. Bean Address Custer County
3. Date Appropriated November 3, 1898 Date Filed 11/4/98
Amount Appropriated, Miners Inches 40, Cubic Feet per second _____
4. Name of Stream Rosebud River Tributary _____ Basin _____
5. Point of Diversion About 300 yards So. of the Ranch House of Henry Ferguson and 50 yards west of a monument of stone standing in the said Fergusons pasture.
Sec. _____ Twp. _____ Rge. _____ Bank of Stream Right and East
6. Purpose Irrigation and other purposes.
7. Description of System _____
8. Land Description of Intended Place of Use _____
SE 1/4 Sec. 8-1N-43E.
9. Remarks (Pertaining to Use, etc.) _____

Decree

10. Case No. _____ Date _____ Amt. Decreed: M. I. _____ C. F. S. _____
11. To Whom Decreed _____ Address _____
12. Name of Ditch _____ Maximum Capacity (C. F. S.) _____
13. Date of Priority _____ Purpose _____
14. Land Description of Place of Use as Decreed _____
15. Remarks (Present Use Status, etc.) _____

May 8 - 1948
Rosebud River

May 3, 1948

Philbrick L. & L. Co.
Forsyth, Montana

Re: Potential Irrigable Lands along Rosebud River

Gentlemen:

Rosebud

Sections 4, 5, 8, 17, T. 1N., R. 43E.

your interest in the above described land was made on the Rosebud. At that time, as you may know, we were in Custer County. The above described land was irrigated, by Mr. Bean in 1887 or before. This appropriation was the second made on the Rosebud. As far as the number of acres appropriated, we can not say. Could you not, secure information, as to the date of the filing from our County (Rosebud) records, since there must have been a transcript of all records, when we were segregated from Custer County?

(J) Ranch -
May 8 - 1948 -
(Rosebud River)

Mr. Gerald J. Cravitz
Assistant State Engineer
Billings Montana - (Appropriation
No. 542)

Dear Mr. Cravitz -

This will acknowledge the receipt of
your letter of May 3, - 1948 - Concerning the
irrigated land in sections 4-5-8- N T-1n-
43 E - (which we now own) . As far as
we know - Mr. R. Q. Bean, filed a water
right - prior to 1887 - As to the number
of inches appropriated, we can not say -
This appropriation was the second
made on the Rosebud - At that time, as
you may know, we were in Custer County -
The above described land was
irrigated, by Mr. Bean in 1887 or before

Could you not, secure information,
as to the date of the filing - from our
County (Rosebud) - records - Since, there
must have been a transcript of all
records - when, we were segregated from
Custer County - ?

Mr. Gerald J. Tharrington
— This matter is very interesting to me.
Since we have rather extensive holdings
on the Rosebud — We have a copy of
a water right, 900 inches, filed, Sept. 8,
1887, — Rosebud River; Also a water
right, filed, Feb. 13, 1906, for 800 inches.
from Sprague Creek, and tributaries —
(Sprague Creek is a tributary of the
Rosebud)

We are in section 4-2-n 43 E —
— Home Ranch — Are sorry that we can not
give you the information, that you
really wish —

Very truly
Philbrick Land & Livestock Co
Mary H. Philbrick — Pres —

P.S. — Mr. Bean, may
have filed a water right
in 1885 — We
we just do not know —
Mrs Philbrick



STATE ENGINEERS OFFICE

Water Resources Survey

50 Code No. 19A
County Rosebud
T. 1N. R. 43E;

Name of Land Owner Parkins, Geo. W. Address Forsyth, Mont.
Name of Operator Address

Part A

TO BE FILED BY THOSE OBTAINING IRRIGATION WATER FROM
A DITCH COMPANY OR IRRIGATION DISTRICT

1. Water is delivered by: Name of Ditch, Ditch Company or District Supplying Water
2. State the number of acres you irrigate under this system Shares you hold
3. If you obtain water from more than one Company, give the number of shares, acres irrigated and the name of the Company under "Remarks." If you obtain water from a Ditch Company and also have a private system fill in both Part A and Part B.

Part B

TO BE FILED BY THOSE WHO HAVE A PRIVATE DITCH, PUMP OR IRRIGATION SYSTEM
or those who have a private water right under a Ditch Company

4. In what year was this land first irrigated? Date See attached filings.
5. Give the name of the original appropriator (first user):
6. Give the date appropriated Amount filed on: Miners Inches C. F. S.
7. State the total number of acres irrigated under this system:
8. Give the point of diversion: 1/4 1/4 Section Township Range

Part C

TO BE FILED BY ALL WATER USERS IN ADDITION TO PART A OR PART B

9. Source of Water: side coulees of Rosebud River
Name of stream or lake from which water is originally diverted
10. Water is obtained by: (Check one) Gravity Pumping Other FLOOD
11. What is the greatest number of acres you have irrigated? 42 Date 1947
12. How many acres did you irrigate in 1947? (Crop and pasture) 42
13. State the total number of additional acres that could be irrigated by increasing the water supply, land leveling, etc. 0 This land is under what ditch?
14. How many acres of seeped land do you have which could be drained and put into production? 0
15. What is the condition of your irrigation system? fair
16. Is your water supply adequate? Yes No X Explain Seasonal flood only
17. REMARKS:

Over

Address _____
Forsyth

Owner _____
Parkins, George W.

FILE NO. 50 - 19A

COUNTY _____
Rosebud

WATER RESOURCES SURVEY

See attached WR2

18. Legal Description of this Farm _____



IRRIGATED LAND



NON-IRRIGATED LAND

North

West

East

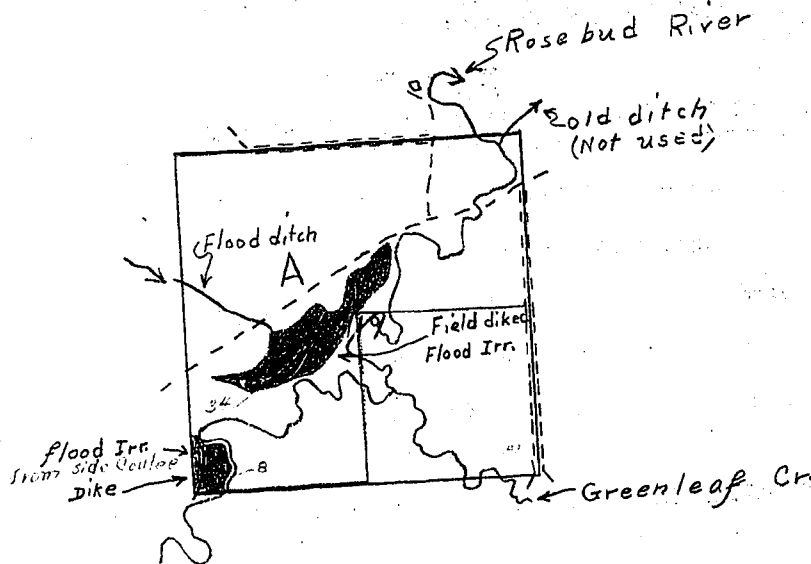

South

19. If the above land is irrigated from more than one ditch please give the acreage under each ditch in 19A and indicate the location of the land irrigated from each on the above map.

19A. Ditch: _____ Flood, side coulees _____ Acres: 42

Ditch: _____ Acres: _____

Information supplied by: _____

Name _____ Address _____ Date 8/14/47

REMARKS: _____ Field check by Cook - Johnson.

If you can

of the questions

return the form to us as soon



See attached WRS

18. Legal Description of this Farm

WATER RESOURCES SURVEY

COUNTY.....Rosebud

FILE NO.....50 - 19A

Owner.....Parkins, George W.

Address.....Forsyth

AAA Owner.....

Address.....

Operator.....N.O.

Address.....

New Owner.....

Address.....

New Operator.....

Address.....

Assessment Record.....Yes

County.....23

Assessed Acreage.....

Legal Description of This Farm.....N $\frac{1}{2}$, SW $\frac{1}{4}$, Sec. 19, T. 1N., R. 43E.

Flood Rosebud, Side Coulees

Total Acres in Farm.....

Code Number.....19A

Photo No.....MA-28-106

AAA Contract No.....

AAA Total Cropland Acreage.....214.3

App. No.....588

Decree No.....

Land is located in

Twp.....1N. Rge. 43E. Twp.....1N. Rge. 42E.

Twp..... Rge..... Twp..... Rge.....

Filed in Twp.....1N. Rge. 42E.

Remarks.....

Y.R.B.

Notice of Appropriation

1. County Rosebud (Custer) Book 1 Page 187 Record Water Rights
2. Name of Appropriator Mary R. Parkins Address Rosebud, Montana
3. Date Appropriated 8-29-1898 Date Filed 8-29-1898
 Amount Appropriated, Miners Inches 200, Cubic Feet per second _____
4. Name of Stream Rosebud River Tributary Yellowstone R. Basin _____
5. Point of Diversion (the right to enter upon any of the lands through which water right and ditch passes)
 Sec. _____ Twp. _____ Rge. _____ Bank of Stream _____
6. Purpose Watering, irrigating, farming, agricultural hay and grass lands.
7. Description of System A dam and ditch of sufficient size and capacity.
8. Land Description of Intended Place of Use
SE $\frac{1}{4}$ Sec. 24, T. 1N., R. 43E., 40 acres
S $\frac{1}{2}$ Sec. 19, T. 1N., R. 43E., 32 acres
SE $\frac{1}{4}$ Sec. 19, T. 1N., R. 43E., 158 acres, Hattie Bradley, Forsyth, Montana
N $\frac{1}{2}$, SW $\frac{1}{4}$ less 1 ac. 19, 1N., 43E., 472 ac., Geo. H. Parkins, Forsyth, Montana
NE $\frac{1}{4}$, N $\frac{1}{2}$ SE $\frac{1}{4}$, SE $\frac{1}{4}$ NW $\frac{1}{4}$, NE $\frac{1}{4}$ SW $\frac{1}{4}$ Sec. 24, 1N-43E, 320 acres, Rosebud County, Forsyth, Mont.
9. Remarks (Pertaining to Use, etc.)
N $\frac{1}{2}$ NW $\frac{1}{4}$, SW $\frac{1}{4}$ NW $\frac{1}{4}$, W $\frac{1}{2}$ SW $\frac{1}{4}$, SE $\frac{1}{4}$ SW $\frac{1}{4}$, S $\frac{1}{2}$ SE $\frac{1}{4}$ Sec. 24, 1N, 43E, 320 acres, Oscar C. Rainey (No address given)
Appropriation was made August 29, 1898.

Decree

10. Case No. _____ Date _____ Amt. Decreed: M. I. _____ C. F. S. _____
11. To Whom Decreed _____ Address _____
12. Name of Ditch _____ Maximum Capacity (C. F. S.) _____
13. Date of Priority _____ Purpose _____
14. Land Description of Place of Use as Decreed _____

15. Remarks (Present Use Status, etc.) _____

No. 59

Township 1 North

Range 43 East

Rosebud County, Montana

<u>Index No.</u>	<u>Name of Appropriator</u>	<u>Stream</u>	<u>Date App.</u>	<u>Date Filed</u>	<u>Inches</u>
934	Thos. Roberts Proj.	Coulee (No name)	10-19-36	10-21-36	Flood Waters
588	Mary R. Parkins	Rosebud River	8-29-98	8-29-98	200
1485 (Custer)	Elizabeth A. Bean	Rosebud River	11-3-98	11-4-98	40

Water Rights - Township 1 North, Range 43 East

Rosebud County, Montana

Parcel
Number

Name of Owner

Address

25A,27A,35A
36A

Harly Hart
State of Montana

Brandenburg, Montana
Helena, Montana

6B

Bertrom Royal

Forsyth, Montana

6A

Heirs Mahlon Vaught

c/o Norman Vaught,1044 Portland Ave
St. Paul 5, Wis.

20A

Clara Sprage

Forsyth, Montana

STATE ENGINEER'S OFFICE

WATER RESOURCES SURVEY

59 Township. 1 N Range. 43 E County. Rosebud

1 ^A	2 ^A	3 ^A	4 ^H	5 ^A	6 ^B
7 ^A	8 ^A	9 ^A	10 ^A	11 ^A	12 ^A
13 ^A	14 ^A	15 ^A	16 ^A	17 ^A	18 ^A
19 ^A	20 ^A	21 ^A	22 ^B	23 ^A	24 ^A
25 ^A	26 ^B	27 ^A	28 ^A	29 ^A	30 ^A
31 ^A	32 ^B	33 ^A	34 ^B	35 ^A	36 ^A

Township 1 N Range 43 E

Township 41 North Range 43 East County Rosebud

Parcel Number	Name of Owner	Address
1A, 2A	Mary & Malcolm Philbrick	Forsyth, Montana
	Leigh A. Sinkey	Forsyth, Montana
3A, 4B	Thomas & Clara Roberts	308 - 6th Avenue N.W., Puyallup, Wash.
4A	Philbrick Land & Livestock Co.	Forsyth, Montana
5A, 7A, 8A, 9A	Philbrick Land & Livestock Co.	Forsyth, Montana
10A, 11A, 12A, 17A	" "	
8B, 8C	Mrs. Chauncy Groom	Forsyth, Montana
16A	State of Montana	Helena, Montana
13A, 14A, 15A	Rollo Hart	Brandenberg, Montana
21A, 22B, 23A	" "	
24A, 25A	" "	
22A, 22C, 26B, 34B	Taylor Grazing	
18A	Donald Rash	Forsyth, Montana
19A, 34A	George W. Parkins	Forsyth, Montana
20B, 29A, 30B	J. P. McCuistion	Forsyth, Montana
31A, 32B, 33A	" "	
2A	Clara Sprague	Forsyth, Montana
19B, 28A, 30A	George W. Bradley	Forsyth, Montana
32A	Hugo Hanft	c/o Norman Vaught, 1044 Portland Ave. St. Paul 5, Wis.

County Rosebud

Snake River

STATE ENGINEER'S OFFICE

WATER RESOURCES SURVEY

Township 1N Range 44E County Rosebud

6	5	4	3	2	1	12
						D-2 D-2
7	8	9	10	11	12	12
				D-2 D-3 D-2	D-2 D-3	
18	17	16	15	14	13	18
			D-1	D-2 D-3		
19	20	21	22	23	24	24
			D-1	D-2 D-3		
30	29	28	27	26	25	25
			D-41	D-23		
31	32	33	34	35	36	36
		D-41				

Tongue River

Decrees - D-1 refer to decree book
decree no. 1, etc. for Tongue River

Township 1N Range 44E
(over)

STATE OF MONTANA

STATE ENGINEER'S OFFICE

WATER RESOURCES SURVEY

60 Township 1 N Range 44 E County Rosebud

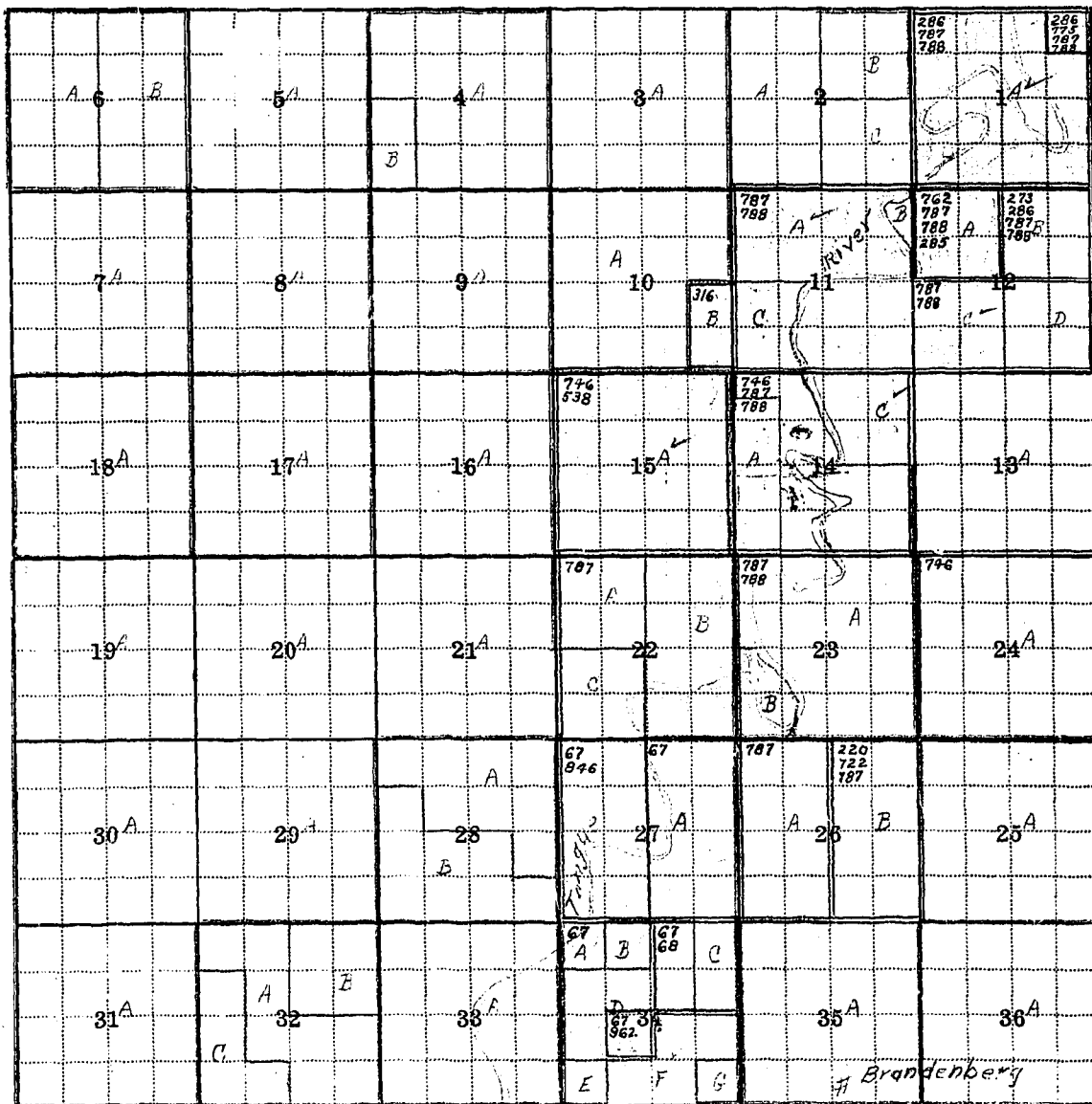

Township 1 N Range 44 E

Township 1 North Range 44 East County Rosebud

Parcel Number	Name of Owner	Address
1A, 2C, 3A, 9A	H. L. Hunt	Garland, Montana
11A, 12C, 13A	" "	
14C, 15A, 17A, 23A	" "	
16A	State of Montana	Helena, Montana
14B	Thomas Orr	Brandenberg, Montana
22B	W. A. Aldrich	Brandenberg, Montana
	Taylor Grazing	
23B	John Flowers	c/o Mabel Flowers, Brandenberg, Mont.
4A, 10A	Ralph Conley	Brandenberg, Montana
2A, 4B, 3A, 10B	Rollo Hart	Brandenberg, Montana
11C, 14A, 18A	" "	
2B	Taylor Grazing	
14B	Thomas Orr	Brandenberg, Montana
5A, 7A	Philbrick Land & Livestock Co.	Forsyth, Montana
6A	Harley Hart	Brandenberg, Montana
11B	Herbert Burlison	Brandenberg, Montana
12A, 12D	H. C. Goodale Est.	Brandenberg, Montana
19A, 20A, 21A	John Overgard	Brandenberg, Montana
22C, 27A, 29A	" "	
30A, 31A, 34A, 34C	" "	
24A	W. H. Aldrich	Brandenberg, Montana

FORM D-1 - GAZETTE 1664-2M.3-47

STATE OF MONTANA

STATE ENGINEER'S OFFICE

County Rosebud City

STATE OF MONTANA
STATE ENGINEER'S OFFICE
 WATER RESOURCES SURVEY

Township 2 N Range 44 County Rosebud Co

6	5	4	3	2	1
7	8	9	10	11	12
18	17	16	15	14	13
19	20	21	22	23	24
30	29	28	27	26	25
31	32	33	34	35	36

Dr 2

Tongue River Decrees

Township 2 N Range 44 E

Township 2 N Range 44 E County Kosciusko

Touque River decree

[illegible]

<u>Parcel Number</u>	<u>Name of Owner</u>	<u>Address</u>
25A, 26B, 34D , 35A 36A	John A. Dennis State of Montana	Brandenberg, Montana Helena, Montana
26A	Mabel Flowers	Brandenberg, Montana
28A	F. A. Briscoe	Brandenberg, Montana
33A, 34F	Warren Dennis	Brandenberg, Montana
32A	John Overgard	Brandenberg, Montana
6B, 22A, 28B, 32B, 32C, 34B, 34E, 34G	Taylor Grazing " "	
12B	Mary Giest	c/o Ben Geist, Ashland, Mont.

No. 60

Township 1 North

Range 44 East

Rosebud County, Montana

<u>Index No.</u>	<u>Name of Appropriator</u>	<u>Stream</u>	<u>Date App.</u>	<u>Date Filed</u>	<u>Inches</u>
67	William Wolff	Beaver Creek	12-9-91	12-30-91	700
68	William Wolff	Beaver Creek	3-2-93	7-20-95	700
220	Fannie McDowell	Diamond R. Creek	4-20-08	4-20-08	600
273	Mary A. Geist	Freda Creek	10-21-12	10-24-12	200
285	Henry C. Goodale	Goodale Creek	10-3-11	10-3-11	500
286	A. H. Terrett	Goodale Coulee	9-17-00	10-1-00	3000
316	Harley E. Hart	Hart Creek	11-30-10	12-15-10	500
538	W. H. Horton	Roe and Cooper Cr.	2-1-09	2-18-09	1200
722	W. C. McDowell	Straight Creek	4-17-07	4-18-07	500
746	Ball Ranch Co.	Tongue River	12-17-07	12-17-07	10,000
762	H. C. Goodale	Tongue River	11-25-10	11-25-10	500
775	George M. Miles	Tongue River	3-7-07	3-8-07	1200
787	A. H. Terrett	Tongue River	12-24-00	1-1-01	10,000
788	A. Hunter Terrett	Tongue River	1-10-96	1-27-97	10,000
846	William W. Wolff	Wolf Creek	10-10-08	10-12-08	500
962	W. C. McDowell	Spring (no name)	4-1-92	4-23-10	40

Township 1 North, Range 44 East

Rosebud County, Montana

Notice of Appropriation

1. County Rosebud - Custer Book 1 Page 64 Record Water Right

2. Name of Appropriator William Wolff Address Brandenburg, Montana

3. Date Appropriated 12-30-1891 Date Filed 12-30-1891

Amount Appropriated, Miners Inches 700, Cubic Feet per second

4. Name of Stream Beaver Creek Tributary Tongue River Basin

5. Point of Diversion At a point near the corner of the NW $\frac{1}{4}$ NE $\frac{1}{4}$ of

Sec. 34 Twp. 1N. Rge. 44E. Bank of Stream

6. Purpose Irrigation and other purposes.

7. Description of System Ditch and dam - Ditch is 3 ft. wide by 2 ft. deep, and carries
and converts 700 inches of water from Beaver Creek.

8. Land Description of Intended Place of Use
all Sec. 34, 27, T. 1N., R. 44E. (1940 Owner - John Overgard, Brandenburg, Mont.)
(1940 book shows) W $\frac{1}{2}$ NE $\frac{1}{4}$, SE $\frac{1}{4}$ NE $\frac{1}{4}$, N $\frac{1}{2}$ SW $\frac{1}{4}$ Lot 1, Sec. 34, T. 1N., R. 44E. . . C. McDowell,
Brandenburg, Montana 1940 Owner; N $\frac{1}{2}$ SE $\frac{1}{4}$, SW $\frac{1}{4}$ SE $\frac{1}{4}$, SE $\frac{1}{4}$ SW $\frac{1}{4}$ Sec. 34, T. 1N., R. 44E.
Fannie McDowell, Brandenburg, Montana 1940 Owner, E $\frac{1}{2}$ NE $\frac{1}{4}$, Lots 1, 2 Sec. 34, T. 1N., R.
1940 Owner, John Overgard, Brandenburg, Montana, N $\frac{1}{2}$ SE $\frac{1}{4}$, SW $\frac{1}{4}$ SE $\frac{1}{4}$, SE $\frac{1}{4}$ SW $\frac{1}{4}$ Sec. 34,

9. Remarks (Pertaining to Use, etc.) T. 1N., R. 44E., 8 acres total owned by the Rosebud R.E.
Hldg. Co. of Brandenburg

Appropriation was made Dec. 9, 1891

Decree

10. Case No..... Date..... Amt. Decreed: M. I..... C. F. S.....

11. To Whom Decreed Address.....

12. Name of Ditch..... Maximum Capacity (C. F. S.).....

13. Date of Priority Purpose.....

14. Land Description of Place of Use as Decreed.....
.....
.....
.....
.....

15. Remarks (Present Use Status, etc.).....

Township 3 North

Range 42 East

Rosebud County

<u>Index No.</u>	<u>Name of Appropriator</u>	<u>Stream</u>	<u>Date App.</u>	<u>Date Filed</u>	<u>M.I.</u>
670	W. W. McDonald	Sprague Creek	5-29-08	6-1-08	100
672	Myrtle Philbrick	Sprague Creek	12-12-06	12-19-06	200
673	Nellie A. Philbrick	Sprague Creek	4-14-00	5-4-00	100

Township 3 North

Range 42 East

Rosebud County

STATE OF MONTANA

STATE ENGINEER'S OFFICE

WATER RESOURCES SURVEY

Township 3E Range 42E County Rosebud

6 5 4 3 2 1

7 8 9 10 11 12

18 17 16 15 14 13

19 20 21 22 23 24

30 29 28 27 26 25

31 32 33 34 35 36

673 672 673 672 670

A B C D E F G H I J K L M N O P Q R S T U V W X Y Z

Township..... 01 Range..... 495

(Forms filed in Township 3 North, Range 43 East)

Lange, Francis

McDonald, Lena

Philbrick L. & L. Co.

Philbrick, Newell G.

North,

1-1 500 8-45 1-45

COUNTY

Revised

Sheet No. —

Twp. 24

Page. 402 E

Letters

No.

Name _____

1st

214

3rd

Ret.

Name _____

Mr Donald Lee

4/15

No. 55

Township 5 North

Range 40 East

Rosebud County, Montana

<u>Index No.</u>	<u>Name of Appropriator</u>	<u>Stream</u>	<u>Date App.</u>	<u>Date Filed</u>	<u>Inches</u>
158	Herman Bollmeier	Cherry Creek	6-6-00	6-8-00	All
159	Herman Bollmeier	Cherry Creek	4-1-06	4-18-10	200
160	Freeman Philbrick	Cherry Creek	10-8-06	10-8-06	800
560	Wm. A. Goodwin	Rosebud River	5-26-95	5-6-95	160
592	Philbrick, L. C. & Bro.	Rosebud River	8-20-95	9-16-95	320
594	Freeman Philbrick	Rosebud River	10-8-06	10-8-06	600
671	Freeman Philbrick	Sprague Creek	2-15-06	2-15-06	800
675	George W.	Spring Creek	5-2-14	5-2-14	160
814	Laurence L. Weaver	Udie Creek	4-23-37	4-23-37	400
880	Howard Sprague James Gallagher	Yellowstone R.	9-12-96	10-6-96	320
1496(Custer)	James Gallagher Howard Sprague	Rosebud River	9-12-96	10-6-96	320
2450(Custer)	Herman Bollmeier	Cherry Creek Spring 7	-87	6-8-00	3

Water Rights - Township 5 North, Range 40 East

Rosebud County, Montana

STATE OF MONTANA

STATE ENGINEER'S OFFICE

WATER RESOURCES SURVEY

55 Township 3 N Range 43 E County Rosebud

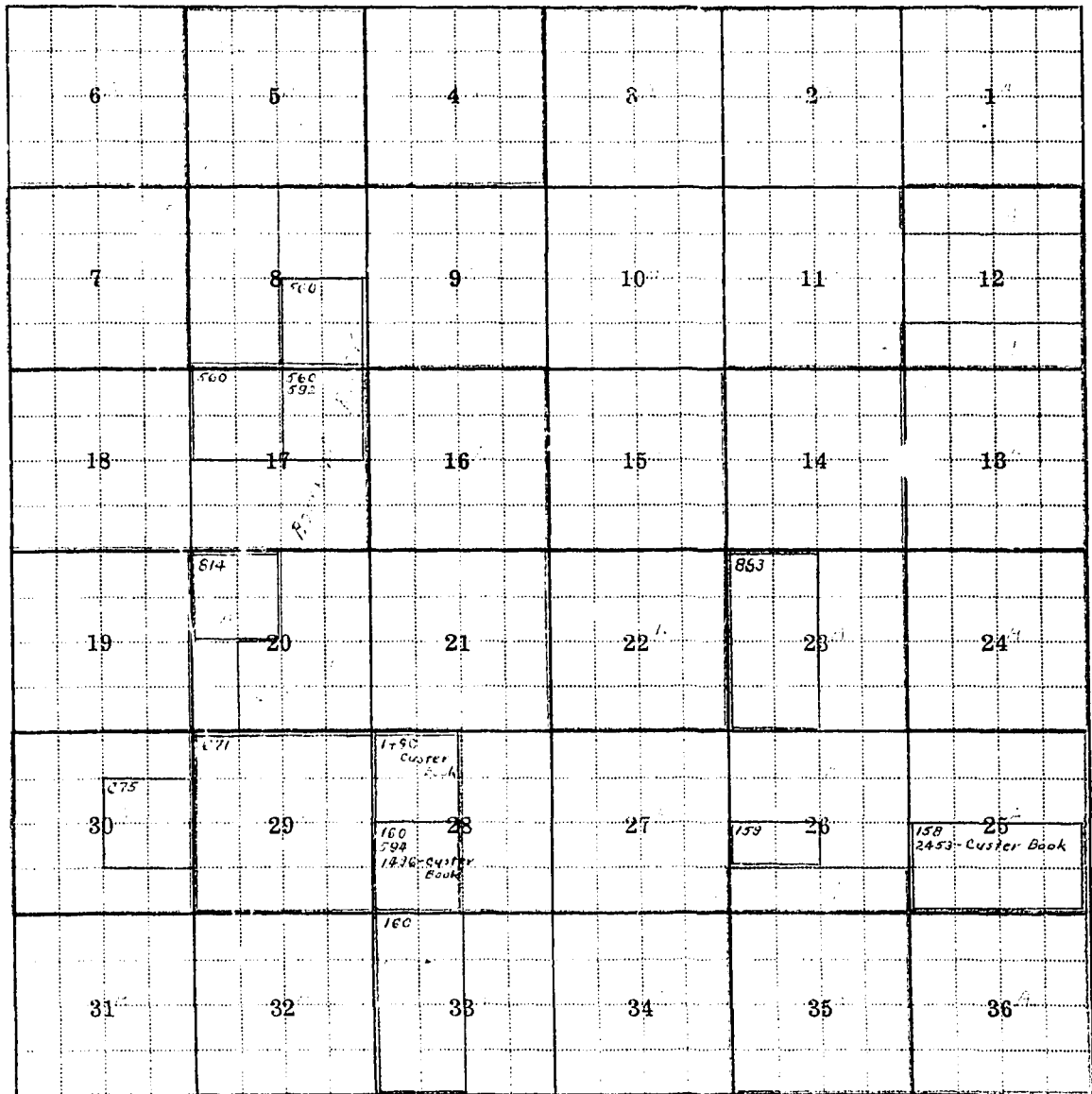

Township 3 N Range 43 E

Township 5 North Range 43 East County Rosebud

Parcel Number	Name of Owner	Address
4A, 6A	Sivert Sand	Forsyth, Montana
1A, 2A, 3A, 8B	Howell C. Philbrich	Forsyth, Montana
9A, 10A, 11A,	" "	
12B, 13A, 15A,	" "	
17A, 18A	" "	
8A	Dale Philbrich	Forsyth, Montana
12A, 13C, 14A, 24A	Taylor Grazing	
16A	State of Montana	Helena, Montana
	Duncan & John McDonald	Forsyth, Montana
5A, 7A	Lena McDonald	Forsyth, Montana
19A, 20B, 21A, 25A,	Francis Large	Forsyth, Montana
25A, 26A, 27A, 28B,	" "	
35A	" "	
30A, 22A, 26B	Taylor Grazing	
36A	State of Montana	Helena, Montana
28A, 29A, 31A	Philbrich Land & Livestock Co.	Forsyth, Montana
32A, 33A, 34A		
30A	George and Bernice Batey	Forsyth, Montana

STATE OF MONTANA
STATE ENGINEER'S OFFICE
WATER RESOURCES SURVEY

Township 2.1 Range 34E County Beaumont

6	5	4	3	2	1
7	8	9	10	11	12
18	17	16	15	14	13
19	20	21	22	23	24
30	29	28	27	26	25
31	32	33	34	35	36

.....
.....
.....
.....

Township..... Range.....

T. 2 North, Range 43E.

T. 2 North, Range 43E.

Township 211 Range 318 County Richard

Parcel Number	Name of Owner	Address	
1172	W. A.
1173
1174
1175
1176
1177
1178
1179
1180
1181
1182
1183
1184
1185
1186
1187
1188
1189
1190
1191
1192
1193
1194
1195
1196
1197
1198
1199
1200

STATE OF MONTANA
State Engineer's Office
WATER RESOURCES SURVEY

Township 2 N Range 43 E County Beaumont

6	5	4	3	2	1
7	8	9	10	11	12
18	17	16	15	14	13
19	20	21	22	23	24
30	29	28	27	26	25
31	32	33	34	35	36

Range

T. 2 North, Range 43E.

ownship 2 North, Ranges 39, 41, & 43 East

Township 2N Range 40E County Rockland

[illegible]County *Reverend*

STATE OF MONTANA
State Engineer's Office
WATER RESOURCES SURVEY

Township 2 N Range 41 E County Beaverhead

6	5	4	3	2	1
7	8	9	10	11	12
18	17	16	15	14	13
26	25	24	23	22	21
30	29	28	27	26	25
31	32	33	34	35	36

Township _____ Range _____

T. 2 North, Range 43E.

Arthur



STATE OF MONTANA
STATE ENGINEER'S OFFICE
 WATER RESOURCES SURVEY

Township 41N Range 43E County Beaumont

6	5	4	3	2	1
7	8	9	10	11	12
18	17	16	15	14	13
19	20	21	22	23	24
30	29	28	27	26	25
31	32	33	34	35	36

Township..... Range.....

T. 2 North, Range 41E.

T. 2 North, Range 43E.

Township 12 Range 14 County Rock

Parcel Number	Name of Owner	Address
349
350
351
352
353
354
355
356
357
358
359
360

County Alameda

STATE OF MONTANA
STATE ENGINEER'S OFFICE
 WATER RESOURCES SURVEY

Township 2N Range 43E County Beaumont

6	5	4	3	2	1
7	8	9	10	11	12
18	17	16	15	14	13
19	20	21	22	23	24
30	29	28	27	26	25
31	32	33	34	35	36

.....

.....

.....

.....

Township..... Range.....

T. 2 North, Range 43E.

T. 2 North, Range 43E.

(Forms filed in Township 2 North, Range 30 East)

N. P. R. R.

(Township 2 North, Ranges 41 and 43 East also filed in this folder)

T. 2 North, Range 42E.

T. 2 North, Range 43E.

Township 2 North

Range 39 East

Rosebud County

<u>Index No.</u>	<u>Name of Appropriator</u>	<u>Stream</u>	<u>Date App.</u>	<u>Date Filed</u>	<u>M.I.</u>
17	Fletcher Dailey	Arnell's Creek	11-30-01	11-27-01	200
25	W. H. Hardy	Arnell's Creek	7-28-07	8-13-07	1000
28	Alice C. Kimball	Arnell's Creek	7-19-13	7-26-13	200
223	H. E. Buffington	Donnelly Creek	8-24-07	9-4-07	1000
537 A	Harvey E. Buffington	Peach Coulee	8-24-07	9-4-07	1000
797	Kaude Robinson	Trail Creek	10-13-11	12-20-13	500
941	Lillie Spurlock	Unnamed Coulee	8-27-14	8-27-14	200
621	Frank L. Kimball	Rupert Creek	8-23-09	4-19-09	400

Township 2 North

Range 39 East

Rosebud County

T. 2 North, Range 43E.

T. 2 North, Range 43E.

STATE OF MONTANA
STATE ENGINEER'S OFFICE
 WATER RESOURCES SURVEY

Township 2N Range 39E County Rosebud

6	5	4	3	2	1
7	8	9	10	11	12
18	17	16	15	14	13
19	20	21	22	23	24
30	29	28	27	26	25
31	32	33	34	35	36

Handwritten notes on the grid:

- Section 6: 79.7
- Section 2: 17/25
- Section 1: A
- Section 11: Ownership: 621, only 1/2 of land, All ownership for 1/2 of land.
- Section 14: 223, 5374
- Section 22: 28

Township 2N Range 39E

T. 2 North, Range 41E.

T. 2 North, Range 43E.

STATE OF MONTANA

STATE ENGINEER'S OFFICE

WATER RESOURCES SURVEY

56 Township 2 N Range 41 E County Rosebud

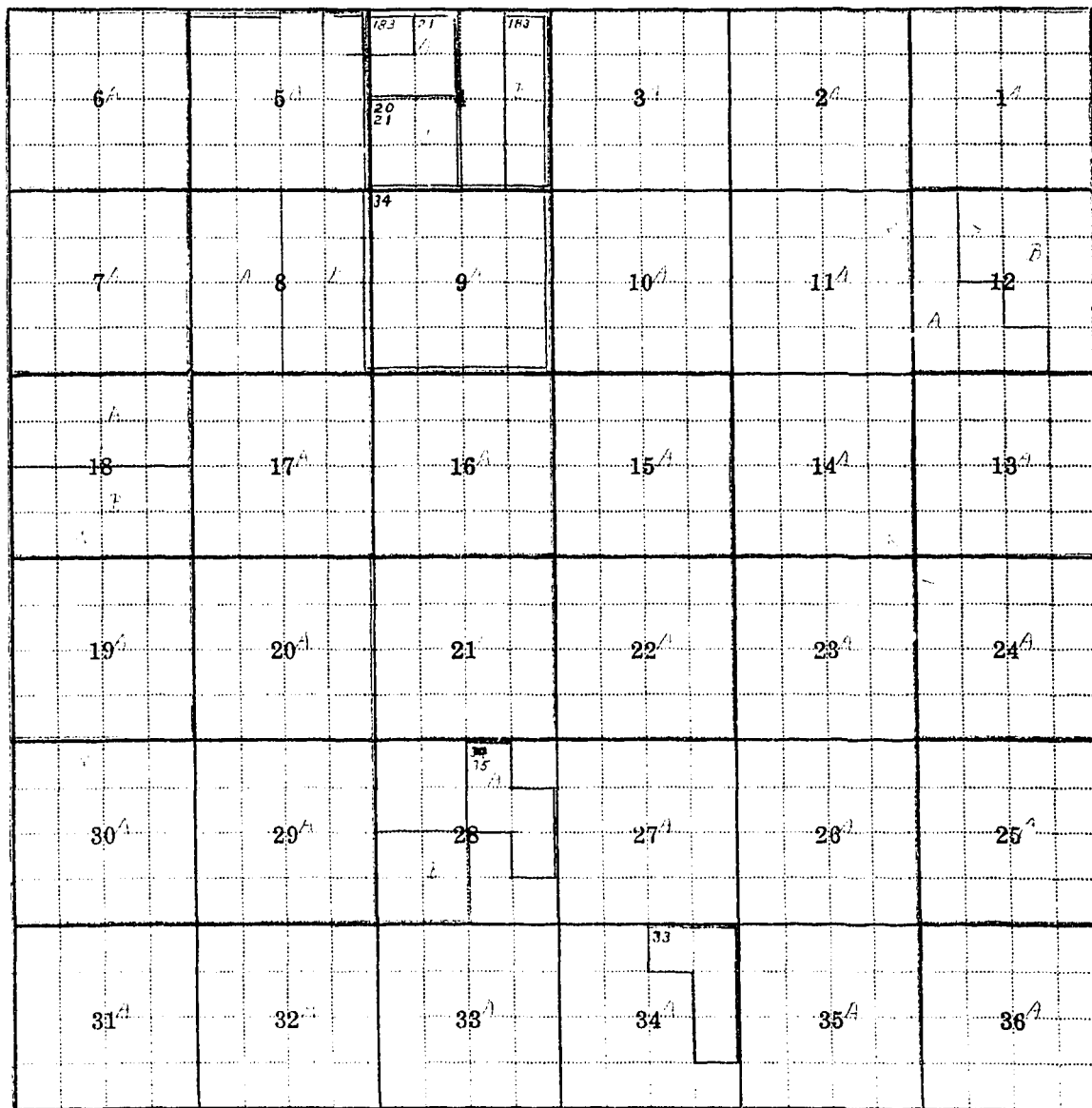

Township 2 N Range 41 E

T. 2 North, Range 41E.

T. 2 North, Range 43E.

Township 2 North Range 41 East County Rosebud

Parcel Number	Name of Owner	Address
1A	A. C. Lloyd	Forsyth, Montana
	Duncan & John MacDonald	Forsyth, Montana
19A	L. & L. Philbrick	Forsyth, Montana
	H. J. Kyhl	Colstrip, Montana
6A	Gertrude Chilberg	Forsyth, Montana
32A, 33A	N. W. I.	Colstrip, Montana
12B, 30A	Arthur Mansfield	Colstrip, Montana
2A, 3A, 10A, 11A	Vern Werner	Colstrip, Montana
12B, 14A, 24A	" "	
13A	N. P. Railroad	St. Paul, Minn.
36A	State of Montana	Helena, Montana
12A, 21A, 29A	L. & L. Philbrick Co.	Forsyth, Montana
25A	N. P. Railroad	St. Paul, Minn.
36A	State of Montana	Helena, Montana
4A	C. C. Edwards	Colstrip, Montana
4B	E. E. West	c/o Edwards, Colstrip, Mont.
4C	Olshbell Duncan	c/o C. C. Edwards, Colstrip, Mont.
5A, 7A, 9A, 17A	N. P. Railroad	St. Paul, Minn.
8E	The Barth Co.	Billings, Montana
8A	John Mahoney	Forsyth, Montana
16A	State of Montana	Helena, Montana
25A, 26A, 27A	N. W. I.	Colstrip, Montana

16A	State of Mont.	Colstrip, Montana
25A, 26A, 27A	N. W. I.	Colstrip, Montana

<u>Parcel Number</u>	<u>Name of Owner</u>	<u>Address</u>
22A	Ray Henley	Colstrip, Montana
15A	M. P. Railroad	St. Paul, Minn.
28A	N. W. I.	Colstrip, Montana
20A	Edith MacDonald	Colstrip, Montana
28A, 31A	N. W. I.	Colstrip, Montana
18A	Eliz. Anshutz	Colstrip, Montana
33A, 34A, 35A	N. W. I.	Colstrip, Montana
28B	P. R. Lund	c/o Ray Henley, Colstrip, Mont.

No. 86

Township 2 North

Range 41 East

Rosebud County, Montana

<u>Index No.</u>	<u>Name of Appropriator</u>	<u>Stream</u>	<u>Date App.</u>	<u>Date Filed</u>	<u>Inches</u>
20	Olabelle Duncan	Arnell's Creek	7-16-16	7-14-16	500
21	C. C. & A. Edwards	Arnell's Creek	1-30-09	1-30-09	200
33	Eugenie J. Philbrick	Arnell's Creek	12-18-15	12-27-15	200
34	Freeman Philbrick	Arnell's Creek	2-12-06	2-15-06	800
35	Malcolm Philbrick	Arnell's Creek	4-6-14	4-24-14	600
185	C. C. & Anna Edwards	Correll Creek	1-30-09	1-30-09	200

Water Rights - Township 2 North, Range 41 East

Rosebud County, Montana

T. 2 North, Range 43E.

(Forms filed in Township 2 North, Range 43 East)

Goodwin, Arley

Philbrick, Mary & Malcolm

Philbrick, L. & L. Co.

T. 2 North, Range 43E.

ownship 2 North, Ranges 39, 41, & 43 East

1 500 8-45 1

COUNTY

Rosebud

Twp.

2N

Rge.

43E

Letters

No.

Name

1st

2nd

3rd

Ret.

Philbrick, Mary & Malcolm

4/15

No. 57

Township 2 North

Range 48 East

Rosebud County, Montana

<u>Index No.</u>	<u>Name of Appropriator</u>	<u>Stream</u>	<u>Date App.</u>	<u>Date Filed</u>	<u>Inches</u>
349	Geo. W. Snider	Howard Creek	12-23-90	12-23-90	1000
361	Freeman Philbrick	John Don Creek	2-15-06	2-15-06	800
485	Robert Hupke	Lony Creek	9-5-12	9-9-12	200
554	Wallace Carpenter	Rosebud River	8-5-96	8-7-96	300
563	Harris, Wilson & Edson	Rosebud River	7-21-98	8-1-98	300
591	E. C. Philbrick	Rosebud River	4-6-91	4-21-91	600
601	Geo. W. Snider	Rosebud River	9-12-90	9-18-90	576

Water Rights - Township 2 North, Range 48 East

Rosebud County, Montana

Township 2 North, Ranges 39, 41, & 43 East

STATE OF MONTANA
STATE ENGINEER'S OFFICE
 WATER RESOURCES SURVEY

57 Township 2 N Range 43 E County Rosebud

6	5	4	3	2	1
7	8	9	10	11	12
18	17	16	15	14	13
19	20	21	22	23	24
30	29	28	27	26	25
31	32	33	34	35	36

Handwritten annotations on the grid include:
 - Section 4: 391
 - Section 9: 361
 - Section 16: 349, 301
 - Section 21: 485
 - Section 33: 354, 363
 - Various letters (A, B, C, E) and numbers (1, 2, 3, 4, 5, 6, 7, 8, 9, 10, 11, 12, 13, 14, 15, 16, 17, 18, 19, 20, 21, 22, 23, 24, 25, 26, 27, 28, 29, 30, 31, 32, 33, 34, 35, 36) are scattered throughout the grid cells.

Township 2 N Range 43 E

Township 2 North Range 48 East County Rosebud

Parcel Number	Name of Owner	Address
1A, 2A, 3A, 4A,	Philbrick Land & Livestock Co.	Forsyth, Montana
5A, 6A, 7A, 9A,	" "	
10A, 11A, 12B,	" "	
13A, 28A, 29A,	" "	
31A, 32B, 33A	" "	
4E, 4C, 6C, 12A	Taylor Grazing	
6B	State of Montana	Helena, Montana
15B, 16B, 17B,	George Coon	Forsyth, Montana
10B, 22A	" "	
18A	Taylor Grazing	
20A, 26B	Leigh Sinkey	Forsyth, Montana
16C, 17C, 19A,	Mary & Malcolm Philbrick	Forsyth, Montana
21A, 23A, 24A,	" "	
25A, 26A, 27A,	" "	
30C, 34A, 35A	" "	
3B, 14A, 15A, 16A	Archie Goodwin	Forsyth, Montana
8A, 22B, 22C,	Taylor Grazing	
30A, 30B	" "	
17A	Siel Snyder	Forsyth, Montana
36A	State of Montana	Helena, Montana
32A	Bert Royal	Forsyth, Montana

STATE OF MONTANA
State Engineer's Office
WATER RESOURCES SURVEY

Township 17N Range 4E County Richmond

			134		
6	5	4		3	2
			134		1
7	1485	8	9	10	11
					12
18	17	16	15	14	13
19	20	21	22	23	24
1578					288
30	29	28	27	26	25
31	32	33	34	35	36

Township _____ Range _____

STATE OF MONTANA

State Engineer's Office

WATER RESOURCES SURVEY

Township _____ Range _____ County _____

Township _____ Range _____

County

Parcel Number	Name of Owner	Address
100	Wm. J.
101
102
103
104
105
106
107
108
109
110
111
112
113
114
115
116
117
118
119
120

(Township 1 North, Range 43 East)

Philbrick L. & L. Co.

Parkins, Geo. W.

(Township 1 North, Range 44 East)

Aldrich, W. A.

Dennis, Warren

Dennis, John A.

Flowers, John

Goodale, H. C. Est.

Hart, Rollo

Hunt, H. L.

Overgard, John

U. S. A. Taylor Grazing



STATE OF MONTANA
STATE ENGINEERS OFFICE

Water Resources Survey

50 Code No 5A, 8A, 4A, 17A

County Rosebud

T. 1N. R. 43E.

Name of Land Owner Philbrick L. & L. Co. Address Forsyth, Mont.

Name of Operator _____ Address _____

Part A

**TO BE FILED BY THOSE OBTAINING IRRIGATION WATER FROM
A DITCH COMPANY OR IRRIGATION DISTRICT**

1. Water is delivered by: _____
Name of Ditch, Ditch Company or District Supplying Water
2. State the number of acres you irrigate under this system. _____ Shares you hold _____
3. If you obtain water from more than one Company, give the number of shares, acres irrigated and the name of the Company under "Remarks." If you obtain water from a Ditch Company and also have a private system fill in both Part A and Part B.

Part B

**TO BE FILED BY THOSE WHO HAVE A PRIVATE DITCH, PUMP OR IRRIGATION SYSTEM
or those who have a private water right under a Ditch Company**

4. In what year was this land first irrigated? Date _____ See attached filings (720.542)
5. Give the name of the original appropriator (first user): _____
6. Give the date appropriated _____ Amount filed on: Miners Inches _____ C. F. S. _____
7. State the total number of acres irrigated under this system: _____
8. Give the point of diversion: _____ $\frac{1}{4}$ _____ $\frac{1}{4}$ Section _____ Township _____ Range _____

Part C

TO BE FILED BY ALL WATER USERS IN ADDITION TO PART A OR PART B

9. Source of Water: Rosebud River
Name of stream or lake from which water is originally diverted
10. Water is obtained by: (Check one) Gravity ☒ Pumping _____ Other _____
11. What is the greatest number of acres you have irrigated? 191 Date _____ ??
12. How many acres did you irrigate in 1947...? (Crop and pasture) 0
13. State the total number of additional acres that could be irrigated by increasing the water supply, land leveling, etc. 191 This land is under what ditch? old grav. ditch
14. How many acres of seeped land do you have which could be drained and put into production? 0
15. What is the condition of your irrigation system? poor, in abandoned condition.
16. Is your water supply adequate? Yes _____ No X Explain _____
17. REMARKS: _____

Over

Operator _____
 AAA Owner _____
 Owner _____
 Philbrick L. I. Co.
 Address _____
 Address _____
 Address _____
 Forth, Montana
 FILE NO. 50 - 5A, 8A, 4A, 17A
 COUNTY Rosebud

WATER RESOURCES SURVEY

18. Legal Description of this Form See attached WR2

☐ None At Present
 IRRIGATED LAND

☐ NON-IRRIGATED LAND

☒ Potential Land

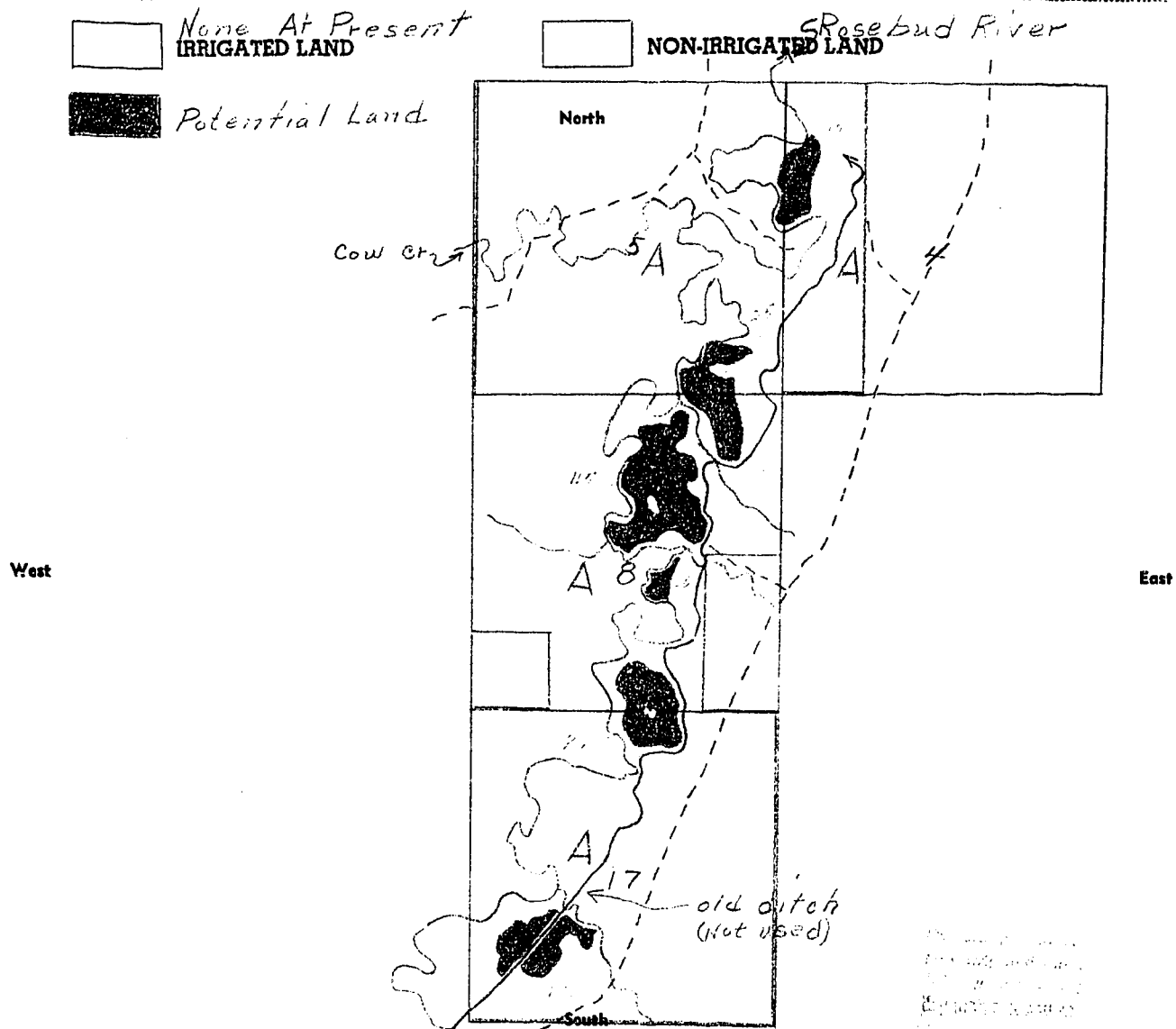

19. If the above land is irrigated from more than one ditch please give the acreage under each ditch in 19A and indicate the location of the land irrigated from each on the above map.

19A. Ditch: _____ Acres: 0

Ditch: _____ Acres: _____

Information supplied by:

Name _____ Address _____ Date 8/14/47

REMARKS: Field check by Cook - Johnson

If you cannot answer all of the questions, please answer as many as you can and return the form to us as soon as possible.

IRRIGATED LAND
None At Present
SPRING RIVER

18. Legal Description of this Farm See attached WRS

WATER RESOURCES SURVEY

COUNTY Rosebud

FILE NO. 50 - 5A, 8A, 4A, 17A

Owner Philbrick L. & L. Co. Address Forsyth, Montana

AAA Owner Address

Operator M.O. Address

New Owner Address

New Operator Address

Assessment Record Yes

County 571
Assessed Acreage

Legal Description of This Farm NW 1/4 Sec. 4, All Sec. 5, NE 1/4, NW 1/4, SE 1/4, W 1/2 Sec. 8;
All Sec. 17, T. 1N., R. 43E.

Gravity Rosebud R. Total Acres in Farm

Code Number 5A, 8A, 4A, 17A

Photo No. MA-28-105

AAA Contract No.

AAA Total Cropland Acreage 443.7

App. No. 1485 Custer

Decree No.

Land is located in

Twp. 1N. Rge. 43E. Twp. 3N. Rge. 43E.

Twp. 2N. Rge. 43E. Twp. Rge.

Filed in Twp. 3N. Rge. 43E.

Remarks

Y R.E.

Notice of Appropriation

1. County Custer Book A Page 494 Record Water Right
2. Name of Appropriator Elizabeth A. Bean Address Custer County
3. Date Appropriated November 3, 1898 Date Filed 11/1/98
Amount Appropriated, Miners Inches 40, Cubic Feet per second.....
4. Name of Stream Rosebud River Tributary..... Basin.....
5. Point of Diversion About 300 yards So. of the Ranch House of Henry Ferguson and 50 yards west of a monument of stone standing in the said Fergusons pasture.
Sec..... Twp..... Rge..... Bank of Stream Right and East
6. Purpose Irrigation and other purposes.
7. Description of System.....
8. Land Description of Intended Place of Use.....
SE 1/4 Sec. 8-1N-43E
9. Remarks (Pertaining to Use, etc.).....

Decree

10. Case No..... Date..... Amt. Decreed: M. I..... C. F. S.....
11. To Whom Decreed..... Address.....
12. Name of Ditch..... Maximum Capacity (C. F. S.).....
13. Date of Priority..... Purpose.....
14. Land Description of Place of Use as Decreed.....
15. Remarks (Present Use Status, etc.).....

May 3, 1948

Philbrick L. & L. Co.
Forsyth, Montana

Re: Potential Irrigable Lands along Rosebud River

Gentlemen:

Rosebud

Sections 4,5,8,17, T. 1N., R. 43E.

your interest in this appropriation was the second made on the Rosebud. At that time, as you may know, we were in Custer County. The above described land was irrigated, by Mr. Bean in 1887 or before. Could you not, secure information, as to the date of the filing - from our County (Rosebud) records - since there must have been a transcript of all records - when; we were segregated from Custer County - ?

✓ Ranch -
May 8 - 1948 -
Mr. Gerald J. Gravitz
Assistant State Engineer (Rosebud River)
Billings Montana - (Appropriation)
Dear Mr. Gravitz -

This will acknowledge the receipt of
your letter of May 3, - 1948 - Concerning the
irrigated land in sections 4-5-8-M T-1n-
43 E - (which we now own) . As far as
we know - Mr. R. Q. Bean, filed a water
right, prior to 1887 - As to the number
of inches appropriated, we can not say -
This appropriation was the second
made on the Rosebud - At that time, as
you may know, we were in Custer County -
The above described land was
irrigated, by Mr. Bean in 1887 or before

Could you not, secure information,
as to the date of the filing - from our
County (Rosebud) - records, since, there
must have been a transcript of all
records, when, we were segregated from
Custer County - ?

Mr. Gerald J. Tharitz —
— This matter is very interesting to me.
Since we have rather extensive holdings
on the Rosebud — We have a copy of
a water right, 900 inches, filed, Sept. 8,
1887, — Rosebud River; Also a water
right, filed, Feb. 13, 1906, for 800 inches.
from Sprague Creek, and tributaries —
(Sprague Creek is a tributary of the)
Rosebud —

We are in section 4-2-n 43 E —
— Home Ranch — Are sorry that we can not
give you the information, that you
really wish —

Very truly
Phillbrick Land & Livestock Co
Mary H. Phillbrick - Pres —

P.S. Mr. Bean, may
have filed a water right
in 1885 — — — well —
we just do not know —
Mr. Phillbrick



STATE ENGINEERS OFFICE
Water Resources Survey

50 Code No. 19A
County Rosebud
T. 1N. R. 43E;

Name of Land Owner Parkins, Geo. W. Address Forsyth, Mont.
Name of Operator Address

Part A

TO BE FILED BY THOSE OBTAINING IRRIGATION WATER FROM
A DITCH COMPANY OR IRRIGATION DISTRICT

1. Water is delivered by: Name of Ditch, Ditch Company or District Supplying Water
2. State the number of acres you irrigate under this system Shares you hold
3. If you obtain water from more than one Company, give the number of shares, acres irrigated and the name of the Company under "Remarks." If you obtain water from a Ditch Company and also have a private system fill in both Part A and Part B.

Part B

TO BE FILED BY THOSE WHO HAVE A PRIVATE DITCH, PUMP OR IRRIGATION SYSTEM
or those who have a private water right under a Ditch Company

4. In what year was this land first irrigated? Date See attached filings.
5. Give the name of the original appropriator (first user):
6. Give the date appropriated Amount filed on: Miners Inches C. F. S.
7. State the total number of acres irrigated under this system:
8. Give the point of diversion: $\frac{1}{4}$ $\frac{1}{4}$ Section Township Range

Part C

TO BE FILED BY ALL WATER USERS IN ADDITION TO PART A OR PART B

9. Source of Water: side coulees of Rosebud River
Name of stream or lake from which water is originally diverted
10. Water is obtained by: (Check one) Gravity Pumping Other FLOOD
11. What is the greatest number of acres you have irrigated? 42 Date 1947
12. How many acres did you irrigate in 1947? (Crop and pasture) 42
13. State the total number of additional acres that could be irrigated by increasing the water supply, land leveling, etc. 0 This land is under what ditch?
14. How many acres of seeped land do you have which could be drained and put into production? 0
15. What is the condition of your irrigation system? fair
16. Is your water supply adequate? Yes No X Explain Seasonal flood only
17. REMARKS:

Ove-

Owner

Parkins, George W.

Address

Forayth

FILE NO 50 - 19A

COUNTY Rosebud

WATER RESOURCES SURVEY

See attached WR2

18. Legal Description of this Farm



IRRIGATED LAND



NON-IRRIGATED LAND

North

West

East

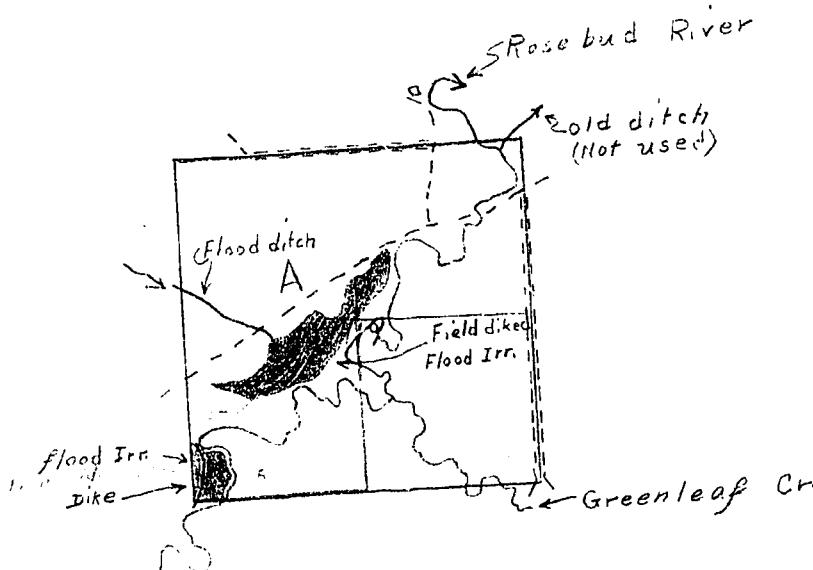

South

19. If the above land is irrigated from more than one ditch please give the acreage under each ditch in 19A and indicate the location of the land irrigated from each on the above map.

19A. Ditch: Flood, side coulees Acres: 42

Ditch: _____ Acres: _____

Information supplied by:

Name _____ Address _____ Date 8/14/47

REMARKS: Field check by Cook - Johnson.

If you cannot answer any of the questions, please return the form to us as soon as possible.

WATER RESOURCES SURVEY

See attached WR2

18. Legal Description of this Farm

COUNTY Rosebud

FILE NO. 10 - 19A

Owner Parkins, George W. Address Forsyth

AAA Owner Address

Operator M.O. Address

New Owner Address

New Operator Address

Assessment Record Yes

County 23
Assessed Acreage

Legal Description of This Farm NE 1/4, SW 1/4 Sec. 19, T. 1N., R. 43E.

Flood Rosebud, Side Coulees Total Acres in Farm

Code Number 19A

Photo No. WA-28-106

AAA Contract No.

AAA Total Cropland Acreage 214.3

App. No. 528

Decree No.

Land is located in

Twp. 1N. Rge. 43E. Twp. 1N. Rge. 42E.

Twp. Rge. Twp. Rge.

Filed in Twp. 1N. Rge. 42E.

Remarks

Y.P.B.

Notice of Appropriation

1. County Rosebud (Custer) Book 1 Page 187 Record Water Rights
2. Name of Appropriator Mary R. Parkins Address Rosebud, Montana
3. Date Appropriated 8-29-1898 Date Filed 8-29-1898
Amount Appropriated, Miners Inches 200, Cubic Feet per second
4. Name of Stream Rosebud River Tributary Yellowstone R. Basin
5. Point of Diversion (the right to enter upon any of the lands through which water right and ditch passes)
Sec. Twp. Rge. Bank of Stream
6. Purpose Watering, irrigation, farming, agricultural hay and grass lands.
7. Description of System A dam and ditch of sufficient size and capacity.
8. Land Description of Intended Place of Use
SE 1/4 Sec. 24, T. 1N., R. 43E., 40 acres
SE 1/4 Sec. 19, T. 1N., R. 43E., 320 acres
SE 1/4 Sec. 19, T. 1N., R. 43E., 158 acres, Hattie Bradley, Forsyth, Montana
N 1/2, SW 1/4 less 1 ac. 19, 1N., 43E., 472 ac., Geo. R. Parkins, Forsyth, Montana
NE 1/4, SE 1/4, SW 1/4, NW 1/4 Sec. 24, 1N-43E, 320 acres, Rosebud County, Forsyth, Mont.
9. Remarks (Pertaining to Use, etc.)
N 1/2, SW 1/4, NW 1/4, SE 1/4 Sec. 24, 1N, 43E, 320 acres, Oscar C. Rainey (No address given)
Appropriation was made August 29, 1898

Decree

10. Case No. Date Amt. Decreed: M. I. C. F. S.
11. To Whom Decreed Address
12. Name of Ditch Maximum Capacity (C. F. S.)
13. Date of Priority Purpose
14. Land Description of Place of Use as Decreed
15. Remarks (Present Use Status, etc.)

No. 59

Township 1 North

Range 40 East

Rosebud County, Montana

<u>Index No.</u>	<u>Name of Appropriator</u>	<u>Stream</u>	<u>Date App.</u>	<u>Date Filed</u>	<u>Inches</u>
934	Thos. Roberts Proj.	Coulee (No name)	10-19-36	10-21-36	Flood
582	Mary R. Perkins	Rosebud River	8-29-98	8-29-98	Waters
1485 (Custer)	Elizabeth A. Bean	Rosebud River	11-3-98	11-4-98	200
					40

Water Rights - Township 1 North, Range 40 East

Rosebud County, Montana

Parcel
Number

Name of Owner

Address

25A,27A,35A
36A

Harly Hart
State of Montana

Brandenburg, Montana
Helena, Montana

6B

Bertron Royal

Forsyth, Montana

6A

Heirs Lehlou Vaught

c/o Norman Vaught, 1044 Portland Av
St. Paul 5, Wis.

20A

Clara Sprage

Forsyth, Montana

STATE OF MONTANA
STATE ENGINEER'S OFFICE
 WATER RESOURCES SURVEY

59 Township 1 N Range 43 E County Rosebud

6	5	4	3	2	1
7	8	9	10	11	12
18	17	16	15	14	13
19	20	21	22	23	24
30	29	28	27	26	25
31	32	33	34	35	36

Township 1 N Range 43 E

Township 1 North Range 40 East County Rosebud

Parcel Number	Name of Owner	Address
1A, 2A	Mary & Malcolm Philbrick	Forsyth, Montana
	Leigh A. Sinkey	Forsyth, Montana
3A, 4B	Thomas & Clara Roberts	308 - 6th Avenue N.W., Puyallup, Wash.
4A	Philbrick Land & Livestock Co.	Forsyth, Montana
5A, 7A, 8A, 9A	Philbrick Land & Livestock Co.	Forsyth, Montana
10A, 11A, 12A, 17A	" "	
8B, 8C	Mrs. Chauncy Groom	Forsyth, Montana
16A	State of Montana	Helena, Montana
13A, 14A, 15A	Rollo Hart	Brandenberg, Montana
21A, 22B, 23A	" "	
24A, 25A	" "	
22A, 22C, 26B, 34B	Taylor Grazing	
18A	Donald Rash	Forsyth, Montana
19A, 34A	George W. Perkins	Forsyth, Montana
20B, 29A, 30B	J. P. McCuiston	Forsyth, Montana
31A, 32B, 33A	" "	
2A	Clara Brague	Forsyth, Montana
19B, 28A, 30A	George W. Bradley	Forsyth, Montana
32A	Hugo Hanft	c/o Norman Vaught, 1044 Portland Ave. St. Paul 5, Wis.

County Rosebud

ogue River

STATE OF MONTANA
STATE ENGINEER'S OFFICE
WATER RESOURCES SURVEY

Township 1N Range 44E County Rosebud

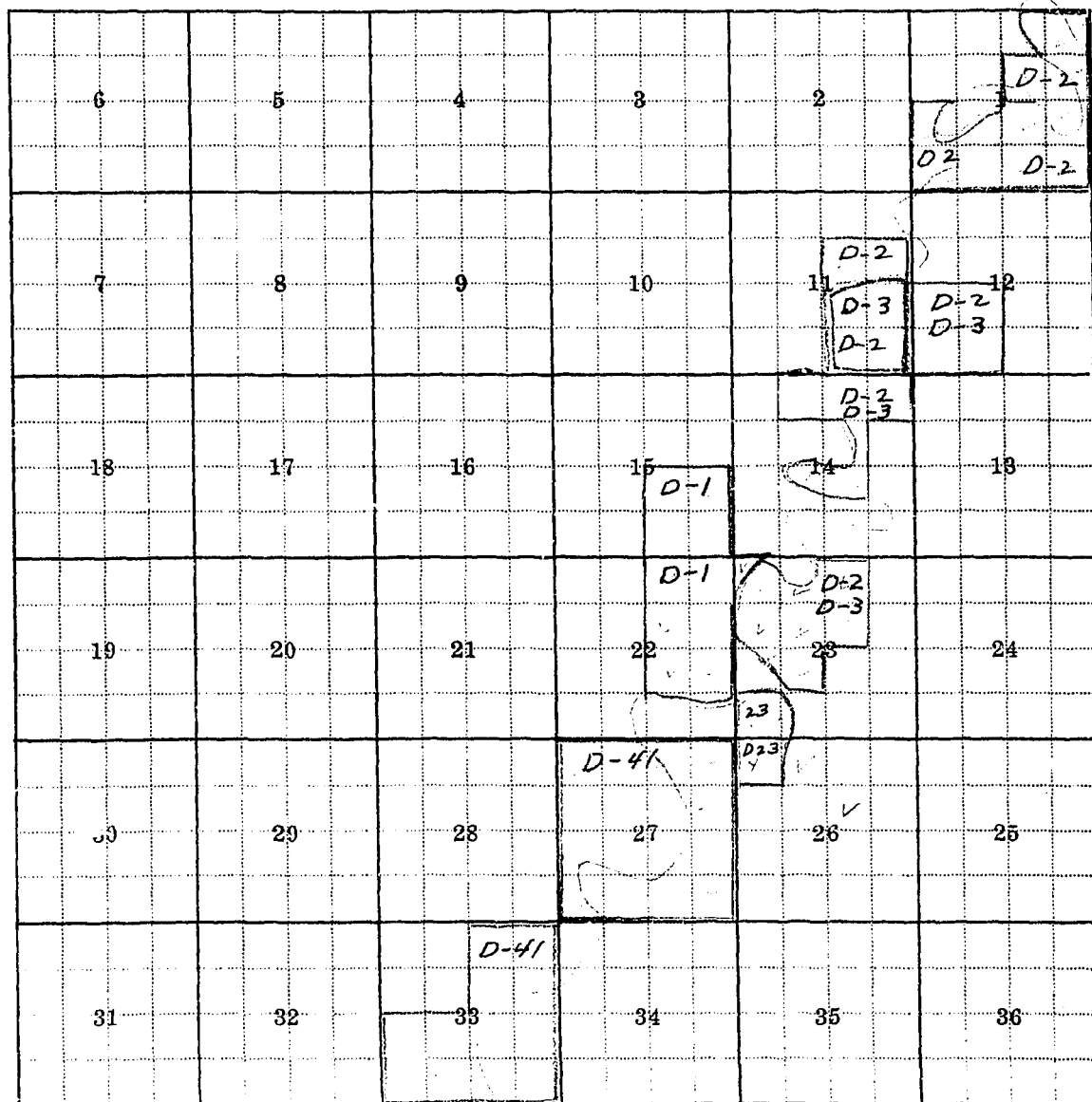

Decrees - D-1 refers to decree book
decree no 1, etc. for Tongue River

Township 1N Range 44E
(over)

Tongue River

Township 1N Range 44E County Rosebud

List of decreed water rights in Township & to whom decreed

Parcel Number	Name of Owner decreed	date of Admission Priority	Inches Decreed
D-1	Ball Ranch Co	12-17-08	314.45
D-2	" " "	12-17-08	1163.75
D-3	" " "	1-27-97	676.45
D-41	William, Wolff	12-10-02	395.0
D-23	John L. Flowers	1-27-97	49.70

County Rosebud

STATE OF MONTANA

STATE ENGINEER'S OFFICE

WATER RESOURCES SURVEY

60 Township 1 N Range 44 E County Rosebud

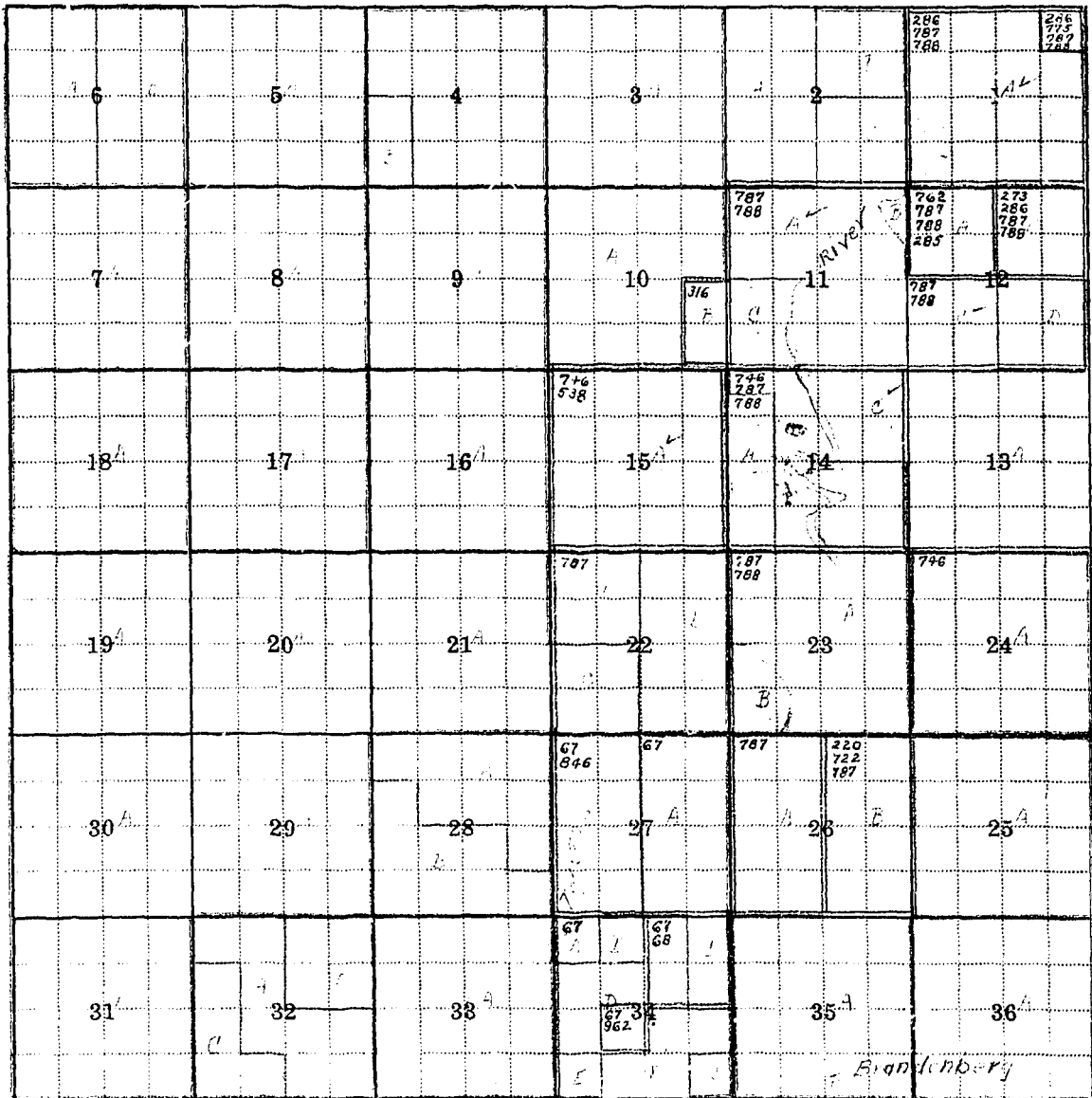

Township 1 N Range 44 E

Township 1 North Range 44 East County Rosebud

Parcel Number	Name of Owner	Address
1A, 2C, 3A, 3A	H. L. Hunt	Helena, Montana
11A, 12C, 13A	" "	
14C, 15A, 17A, 23A	" "	
16A	State of Montana	Helena, Montana
14B	Thomas Orr	Brandenburg, Montana
22B	W. A. Aldrich	Brandenburg, Montana
	Taylor Grazing	
23B	John Flowers	c/o John L. Flowers, Brandenburg, Mont.
4A, 10A	Ralph Conley	Brandenburg, Montana
2A, 4B, 8A, 10B	Rollie Hart	Brandenburg, Montana
11C, 14A, 18A	" "	
2B	Taylor Grazing	
14B	Thomas Orr	Brandenburg, Montana
5A, 7A	Philbrick Land & Livestock Co.	Forsyth, Montana
6A	Harley Hart	Brandenburg, Montana
11B	Herbert Burlison	Brandenburg, Montana
12A, 12D	H. C. Goodale Est.	Brandenburg, Montana
19A, 20A, 31A	John Overgard	Brandenburg, Montana
22C, 27A, 29A	" "	
30A, 31A, 34A, 34C	" "	
24A	W. A. Aldrich	Brandenburg, Montana

FORM D-1 - GAZETTE 1964-2M-1-47

STATE OF MONTANA

STATE ENGINEER'S OFFICE

County Rosebud Co

2					
---	--	--	--	--	--

STATE OF MONTANA
STATE ENGINEER'S OFFICE
WATER RESOURCES SURVEY

Township 2 N Range 44 County Rosebud Co

6	5	4	3	2	1
7	8	9	10	11	12
18	17	16	15	14	13
19	20	21	22	23	24
30	29	28	27	26	25
31	32	33	34	35	36

4-2

Tongue River Decrees

.....

.....

.....

Township 2 N Range 44 E

Township 2 N Range 44 E County Bozbad

Tongue River decree

[illegible]

Parcel
Number

Name of Owner

Address

25A, 26B, 34D, 55A
36A

John A. Dennis
State of Montana

Brandenberg, Montana
Helena, Montana

26A

Mabel Flowers

Brandenberg, Montana

28A

F. A. Briscoe

Brandenberg, Montana

33A, 34F

Warren Dennis

Brandenberg, Montana

33A

John Overgard

Brandenberg, Montana

6B, 22A, 28B, 32B,
32C, 34B, 34E, 34G

Taylor Grazing
" "

12B

Mary Giest

c/o Ben Geist, Ashland, Mont.

No. 60

Township 1 North

Range 44 East

Rosebud County, Montana

<u>Index No.</u>	<u>Name of Appropriator</u>	<u>Stream</u>	<u>Date App.</u>	<u>Date Filed</u>	<u>Inches</u>
67	William Wolff	Beaver Creek	12-9-91	12-30-91	700
68	William Wolff	Beaver Creek	3-2-98	7-20-95	700
220	Fannie McDowell	Diamond H. Creek	4-20-08	4-20-08	600
272	Mary A. Geist	Freda Creek	10-21-12	10-24-12	200
285	Henry C. Goodale	Goodale Creek	10-3-11	10-3-11	500
286	A. H. Terrett	Goodale Coulee	9-17-00	10-1-00	3000
516	Harley H. Hart	Hart Creek	11-30-10	12-15-10	500
538	W. H. Horton	Roe and Cooper Cr.	2-1-09	2-18-09	1200
722	W. C. McDowell	Straight Creek	4-17-07	4-18-07	500
746	Ball Ranch Co.	Tongue River	12-17-07	12-17-07	10,000
762	H. C. Goodale	Tongue River	11-25-10	11-25-10	500
775	George M. Miles	Tongue River	3-7-07	3-8-07	1200
787	A. H. Terrett	Tongue River	12-24-00	1-2-01	10,000
788	A. Hunter Terrett	Tongue River	12-10-96	1-27-97	10,000
846	William M. Wolff	Wolff Creek	10-10-08	10-12-08	500
962	W. C. McDowell	Spring (no name)	4-1-92	4-23-10	40

Township 1 North, Range 44 East

Rosebud County, Montana

Notice of Appropriation

1. County Rosebud - Chester Book 1 Page 64 Record Water Right
2. Name of Appropriator William Wolff Address Brandenburg, Montana
3. Date Appropriated 12-30-1891 Date Filed 12-30-1891
Amount Appropriated, Miners Inches 700, Cubic Feet per second
4. Name of Stream Beaver Creek Tributary Tongue River Basin
5. Point of Diversion At a point near the corner of the NE 1/4 of
Sec. 34 Twp. 1N. Rge. 44E. Bank of Stream
6. Purpose Irrigation and other purposes.
7. Description of System Ditch and dam - Ditch is 3 ft. wide by 2 ft. deep, and carries
and converts 700 inches of water from Beaver Creek.
8. Land Description of Intended Place of Use
All Sec. 34, 27, T. 1N., R. 44E. (1940 Owner - John Overgard, Brandenburg, Mont)
(1940 book shows) W 1/2 NE 1/4, SE 1/4 NW 1/4, N 1/2 SW 1/4 Lot 1, Sec. 34, T. 1N., R. 44E. W. C. McDowell,
Brandenburg, Montana 1940 Owner; N 1/2 SE 1/4, SW 1/4 SE 1/4 Sec. 34, T. 1N., R. 44E.
Fannie McDowell, Brandenburg, Montana 1940 Owner, E 1/2 NE 1/4, Lots 1, 2 Sec. 34, T. 1N., R.
1940 Owner, John Overgard, Brandenburg, Montana, N 1/2 SE 1/4, SW 1/4 SE 1/4 Sec.
9. Remarks (Pertaining to Use, etc.) T. 1N. R. 44E. 8 acres total owned by the Rosebud R.R.
Hldg. Co. of Brandenbu

Appropriation was made Dec. 9, 1891

Decree

10. Case No. Date Amt. Decreed M. I. C. F. S.
11. To Whom Decreed Address
12. Name of Ditch Maximum Capacity (C. F. S.)
13. Date of Priority Purpose
14. Land Description of Place of Use as Decreed
15. Remarks (Present Use Status, etc.)