



NOTICE
These forms are the
property of the State
of Montana and must
be returned.

STATE OF MONTANA
STATE ENGINEERS OFFICE
Water Resources Survey

FORM WR-1-28 12-47

Code No. 22A-23A

County Bozeman

T. 6N R. 40

Name of Land Owner Anna C. Arnold Address Faraguth, Mont

Name of Operator _____ Address _____

Part A

**TO BE FILED BY THOSE OBTAINING IRRIGATION WATER FROM
A DITCH COMPANY OR IRRIGATION DISTRICT**

1. Water is delivered by: _____
Name of Ditch, Ditch Company or District Supplying Water
2. State the number of acres you irrigate under this system: _____ Shares you hold _____
3. If you obtain water from more than one Company, give the number of shares, acres irrigated and the name of the Company under "Remarks." If you obtain water from a Ditch Company and also have a private system fill in both Part A and Part B.

Part B

**TO BE FILED BY THOSE WHO HAVE A PRIVATE DITCH, PUMP OR IRRIGATION SYSTEM
or those who have a private water right under a Ditch Company**

4. In what year was this land first irrigated? Date No filing made on Gill. R.
5. Give the name of the original appropriator (first user): _____
6. Give the date appropriated: _____ Amount filed on: Miners Inches _____ C. F. S. _____
7. State the total number of acres irrigated under this system: _____
8. Give the point of diversion: _____ $\frac{1}{4}$ _____ $\frac{1}{4}$ Section _____ Township _____ Range _____

Part C

TO BE FILED BY ALL WATER USERS IN ADDITION TO PART A OR PART B

9. Source of Water: Yellowstone River
Name of stream or lake from which water is originally diverted
10. Water is obtained by: (Check one) Gravity _____ Pumping X Other _____
11. What is the greatest number of acres you have irrigated? _____ Date _____
12. How many acres did you irrigate in 1947 (Crop and pasture) 85
13. State the total number of additional acres that could be irrigated by increasing the water supply, land leveling, etc. 0 This land is under what ditch? 0
14. How many acres of seeped land do you have which could be drained and put into production? 0
15. What is the condition of your irrigation system? 2
16. Is your water supply adequate? Yes _____ No X Explain _____
17. REMARKS: See attached

Over

NOTE: The foregoing questions apply only to irrigated land shown on this plat.

DESCRIPTION AND MAP OF FARM

18. Legal Description of this Farm all S of River Less Lot, 5 Sec 22,
Part of Sec 23 So of R/W



IRRIGATED LAND



NON-IRRIGATED LAND

North

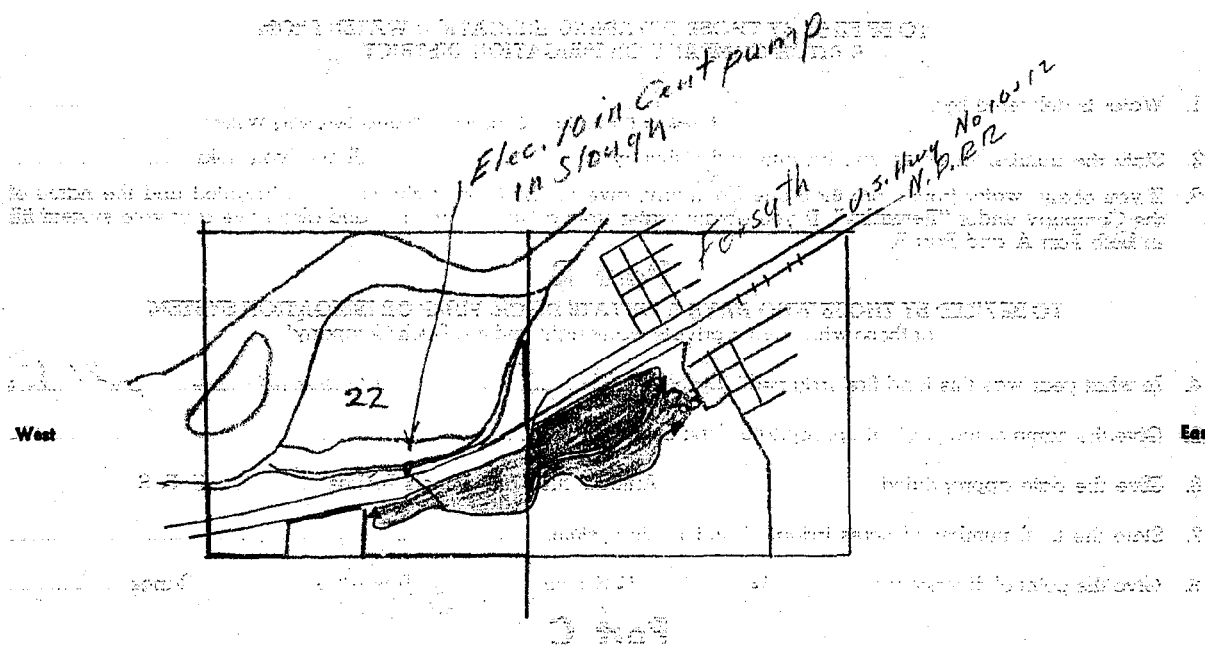

West

East

South

Ownership covers
only irrigated land.
All ownership for
dry land not shown.

19. If the above land is irrigated from more than one ditch please give the acreage under each ditch in 19A and indicate the location of the land irrigated from each on the above map.

19A. Ditch: Arnold private pump Acres: 85.0

Ditch: _____ Acres: _____

Information supplied by:

Name See attached farm Address _____ Date _____

REMARKS: _____

If you cannot answer all of the questions on this form answer as many as you can and return the form to us as soon as possible.

i.c. e.j.

STATE ENGINEER'S OFFICE
WATER RESOURCES SURVEYCOUNTY RosebudFILE NO. (29) 22A, 23AOwner Arnold, Anna C. Address Forayth

AAA Owner Address

Operator Address

New Owner Address

New Operator Address

Assessment Record SESE, Lots 6, 7, 4, Pt. 5 N. of R/W sec. 22; SW⁴,SE NW, Lot 3 so. of R/W sec. 23 T. 6N. - R. 40E.County 47
Assessed Acreage

Legal Description of This Farm

Priv. Pump, Slough of Yell. R. Total Acres in FarmCode Number 22A, 23APhoto No. MA 16-163

AAA Contract No.

AAA Total Cropland Acreage

App. No. 875

Decree No.

Land is located in

Twp. 6N. Rge. 40E. Twp. Rge.

Twp. Rge. Twp. Rge.

Filed in Twp. 6N. Rge. 40E.

Remarks

Y.R.B.

Farm Checked

STATE OF MONTANA

STATE ENGINEER'S OFFICE
WATER RESOURCES SURVEY

Code No. 22B, 22D, 23A

County Rosebud

T. 6 N R. 40 E Sec. 22 & 23

Photo No. MA 16-163

By Dave Jim

Area Forsyth

Date 7/17/47

Legal Land Owner Ben Arnold

Address Forsyth

Operator Martin Gloderman

Address Forsyth

Water is delivered by:

Federal Project	Pres.	Pot.
Ditch Company	Pres.	Pot.
Irrigation District	Pres.	Pot.
Private System <input checked="" type="checkbox"/>	Pres. <u>85</u>	Pot. <u>0</u>
Totals	<u>85</u>	<u>0</u>

Flood _____ Pump ☒ Reservoir _____ Gravity _____

Size and Capacity, Pump, etc. 10" Cent. pump (20 HP Elec. motor 21' lift, 360 push)

Original Appropriator, Company _____ App. No. _____

Original Appropriator, Private no filing App. No. _____
(Show date of Appropriation under Remarks)

Is the system an extension of another system? Yes _____ No ☒

Is all land irrigated from one system? Yes ☒ No _____

(If No, show break down on map)

Source of Water slough out of Yellowstone River

Acres Irrigated 1947 85

Potential Acres 0 Seeped 0

Explain all possible land under ditch is irrigated

Condition of System good

Adequate supply Yes ☒ No _____

Explain except when River is low

Topography Valley side

Information From Ben Arnold

Remarks _____

System has been in use 25 years

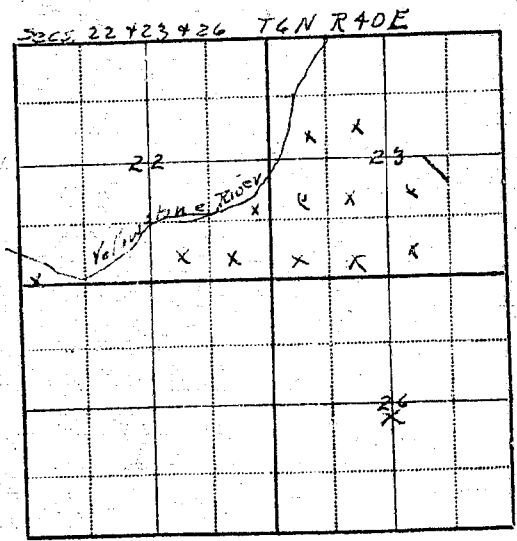



These forms are the property of the State of Montana and must be returned.

STATE OF MONTANA
STATE ENGINEERS OFFICE

Water Resources Survey

Code No. 8A

County Bozeman

T. 6N R. 40E

Name of Land Owner J. M. & Edith Booth Address Forseyth, Mont
Name of Operator James McGraw Address " "

Part A

TO BE FILED BY THOSE OBTAINING IRRIGATION WATER FROM
A DITCH COMPANY OR IRRIGATION DISTRICT

- Water is delivered by: Hammond Irr Ditch
Name of Ditch, Ditch Company or District Supplying Water
- State the number of acres you irrigate under this system 27.6 Shares you hold
- If you obtain water from more than one Company, give the number of shares, acres irrigated and the name of the Company under "Remarks." If you obtain water from a Ditch Company and also have a private system fill in both Part A and Part B.

Part B

TO BE FILED BY THOSE WHO HAVE A PRIVATE DITCH, PUMP OR IRRIGATION SYSTEM
or those who have a private water right under a Ditch Company

- In what year was this land first irrigated? Date
- Give the name of the original appropriator (first user):
- Give the date appropriated Amount filed on: Miners Inches C. F. S.
- State the total number of acres irrigated under this system:
- Give the point of diversion: $\frac{1}{4}$ $\frac{1}{4}$ Section Township Range

Part C

TO BE FILED BY ALL WATER USERS IN ADDITION TO PART A OR PART B

- Source of Water: Yellowstone River
Name of stream or lake from which water is originally diverted
- Water is obtained by: (Check one) Gravity Pumping ☒ Other
- What is the greatest number of acres you have irrigated? ✓ Date
- How many acres did you irrigate in 1947 (Crop and pasture) 27.6
- State the total number of additional acres that could be irrigated by increasing the water supply, land leveling, etc. 0 This land is under what ditch? 0
- How many acres of seeped land do you have which could be drained and put into production? 0
- What is the condition of your irrigation system? Fair
- Is your water supply adequate? Yes ☒ No ☒ Explain If not all users
- REMARKS: are using water sometimes
have to rotate

Over

NOTE: The foregoing questions apply only to irrigated land shown on this plat.

DESCRIPTION AND MAP OF FARM

18. Legal Description of this Farm W²SW⁴, SE⁴SW⁴, SW⁴SE⁴, Sec 8

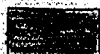

IRRIGATED LAND



NON-IRRIGATED LAND

North

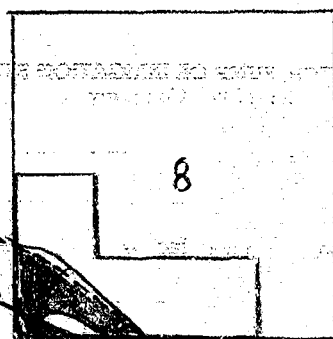

East

South

Ownership covers
only irrigated land.
All ownership for
dry land not shown.

19. If the above land is irrigated from more than one ditch please give the acreage under each ditch in 19A and indicate the location of the land irrigated from each on the above map.

19A. Ditch: Hammond Irr. Ditch Acres: 27.6

Ditch: _____ Acres: _____

Information supplied by:

Name Field Survey Address _____ Date July 3-47

REMARKS: Jr. Cash & Dave Paulist

If you cannot answer all of the questions on this form answer as many as you can and return the form to us as soon as possible.

STATE ENGINEER'S OFFICE
WATER RESOURCES SURVEYCOUNTY RosebudFILE NO. (29) 8AOwner Booth, F. M. & EdithAddress Forsyth

AAA Owner

Address

Operator McGraw, JamesAddress Forsyth

New Owner

Address

New Operator

Address

Assessment Record W²SW⁴, SESE, SWSE, 622 R/WCounty 35.6
Assessed Acreage 27.6

Legal Description of This Farm

Hammond Irr. DistTotal Acres in Farm 149Code Number 8A

Photo No.

AAA Contract No. 25,500AAA Total Cropland Acreage 25,500App. No. 861, 866

Decree No.

Land is located in

Twp. 6N. Rge. 40E. Twp. Rge.

Twp. Rge. Twp. Rge.

Filed in Twp. 6N. Rge. 40E.

Remarks

YRB.



NOTICE
These forms are the
property of the State
of Montana and must
be returned.

STATE OF MONTANA
STATE ENGINEERS OFFICE

Water Resources Survey

FORM WS-15-2N TENY
Code No. 18C-19A
County Bozeman
T. 6 N R. 40

Name of Land Owner Harold L. Boyer Address Forsyth, Mont

Name of Operator _____ Address _____

Part A

TO BE FILED BY THOSE OBTAINING IRRIGATION WATER FROM
A DITCH COMPANY OR IRRIGATION DISTRICT

1. Water is delivered by: _____
Name of Ditch, Ditch Company or District Supplying Water
2. State the number of acres you irrigate under this system _____ Shares you hold _____
3. If you obtain water from more than one Company, give the number of shares, acres irrigated and the name of the Company under "Remarks." If you obtain water from a Ditch Company and also have a private system fill in both Part A and Part B.

Part B

TO BE FILED BY THOSE WHO HAVE A PRIVATE DITCH, PUMP OR IRRIGATION SYSTEM
or those who have a private water right under a Ditch Company

4. In what year was this land first irrigated? Date 1906 - no date
5. Give the name of the original appropriator (first user): See attached date
6. Give the date appropriated _____ Amount filed on: Miners Inches _____ C. F. S. _____
7. State the total number of acres irrigated under this system: _____
8. Give the point of diversion: _____ $\frac{1}{4}$ _____ $\frac{1}{4}$ Section _____ Township _____ Range _____

Part C

TO BE FILED BY ALL WATER USERS IN ADDITION TO PART A OR PART B

9. Source of Water: Yellowstone River
Name of stream or lake from which water is originally diverted
10. Water is obtained by: (Check one) Gravity _____ Pumping X Other _____
11. What is the greatest number of acres you have irrigated? _____ Date _____
12. How many acres did you irrigate in 1947 (Crop and pasture) 100
13. State the total number of additional acres that could be irrigated by increasing the water supply, land leveling, etc. 20 This land is under what ditch? Same
14. How many acres of seeped land do you have which could be drained and put into production? 0
15. What is the condition of your irrigation system? Good
16. Is your water supply adequate? Yes X No _____ Explain _____
17. REMARKS: _____

NOTE: The foregoing questions apply only to irrigated land shown on this plat.

DESCRIPTION AND MAP OF FARM

18. Legal Description of this Farm Four 1/2 of River Sec 18, Town
North of R/W Sec 19

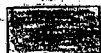

IRRIGATED LAND



NON-IRRIGATED LAND

potential

North

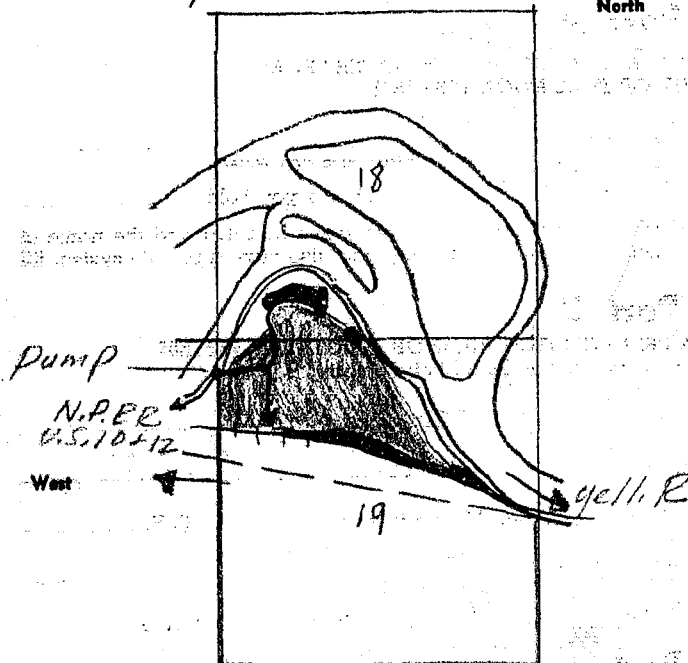

East

South

For more information
see the map of the
farm ownership for
the land not shown.

19. If the above land is irrigated from more than one ditch please give the acreage under each ditch in 19A and indicate the location of the land irrigated from each on the above map.

19A. Ditch: Boyer Private Pump ditch Acres: 100
Ditch: _____ Acres: _____

Information supplied by:

Name See attached form Address _____ Date _____

REMARKS: _____

If you cannot answer all of the questions on this form answer as many as you can and return the form to us as soon as possible.

STATE ENGINEER'S OFFICE
WATER RESOURCES SURVEYCOUNTY RosebudFILE NO. (29) 18C, 19AOwner Bayer, Harold L. Address Forsyth

AAA Owner Address

Operator Address

New Owner Address

New Operator Address

Assessment Record Lots 4, 8, 9, 10 sec. 15; all Fract. sec. 19 T. 6N. - R. 40E.County 71.0
Assessed Acreage

Legal Description of This Farm

Private Pump

Total Acres in Farm

Code Number 18C, 19APhoto No. MA 16-127 + 128

AAA Contract No.

AAA Total Cropland Acreage

App. No. 873

Decree No.

Land is located in

Twp. 6N. Rge. 40E Twp. 6N Rge. 39E

Twp. Rge. Twp. Rge.

Filed in Twp. 6N Rge. 40E

Remarks

R.B.

Farm Checked

STATE OF MONTANA

Code No.

By Jim Collins

STATE ENGINEER'S OFFICE

County RosebudArea Forsythe West

WATER RESOURCES SURVEY

T. 6N. R. 40E Sec. 19, 24Date 4/25/47Photo No. MA 16-127, 128Legal Land Owner Boyer, Harold L.Address ForsytheOperator Same

Address

Water is delivered by:

Federal Project _____ Pres. _____ Pot. _____

Ditch Company _____ Pres. _____ Pot. _____

Irrigation District _____ Pres. _____ Pot. _____

Private System private pump Pres. 100 Pot. 20

Totals _____

Flood _____ Pump ✓ Reservoir _____ Gravity _____Size and Capacity, Pump, etc. 5" Parma 1500 Gal. P.M. Tractor power

Original Appropriator, Company _____ App. No. _____

Original Appropriator, Private _____ App. No. _____

(Show date of appropriation under Remarks)

Is the system an extension of another system? Yes _____ No ✓Is all land irrigated from one system? Yes ✓ No _____

(If No, show break down on map)

Source of Water Yellowstone River

COPY

also filed in 6N.39E

Acres Irrigated 19 46 100Potential Acres 20 Seeped 0Explain potential by clearing & levelingCondition of System pump new, ditches poorAdequate Supply — Yes ✓ No _____

Explain _____

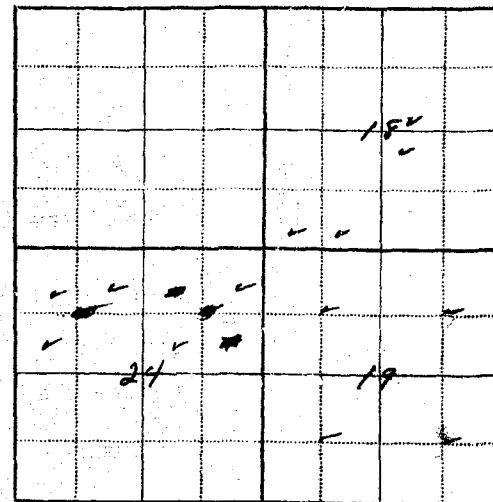
Topography River BottomInformation From Harold L. BoyerRemarks original filing 1901, 10A. in head of river could be irrigated with another pump, not included in potential

[illegible]

10 acres shown in 6439 making total irrigated land 110 acres for the entire farm project.

State of Montana
State Engineer

6N-40E

Longsight Mont.
April 16, 1948

Dear Sir:

I am writing in regards to the information that you have requested. Concerning the filing of water rights for the irrigation of Lots 4, 8, 9 10 sec. 18. 19, T. 6 N., R. 40 E.

It was filed Dec. 20, 1919 at 2:30 PM. Recorded in Book 3 of Water Rights, page 15. The amount is (4) four Cubic feet per second of the waters of the Certain Arm of the Yellowstone River.

The appropriators were J. H. Longley and C. E. Longley. and was notarized by Henry V. Beeman, Abstractor.

Hoping this is the information that you want.

Sincerely yours.

Harold L. Boyer.



NOTICE
These forms are the
property of the State
of Montana and must
be returned.

STATE OF MONTANA
STATE ENGINEERS OFFICE

FORM WR-10-2M 12-49
Code No. 16A
County Rosebud
T. 6N R. 40E

Boyd, G.F. Water Resources Survey Forsyth

Name of Land Owner Fed. Land Bank Address _____

Name of Operator J. C. C. Edgell Address Forsyth, Mont

Part A

**TO BE FILED BY THOSE OBTAINING IRRIGATION WATER FROM
A DITCH COMPANY OR IRRIGATION DISTRICT**

1. Water is delivered by: Hammond Irr dist
Name of Ditch, Ditch Company or District Supplying Water
2. State the number of acres you irrigate under this system. 100.0 Shares you hold _____
3. If you obtain water from more than one Company, give the number of shares, acres irrigated and the name of the Company under "Remarks." If you obtain water from a Ditch Company and also have a private system fill in both Part A and Part B.

Part B

**TO BE FILED BY THOSE WHO HAVE A PRIVATE DITCH, PUMP OR IRRIGATION SYSTEM
or those who have a private water right under a Ditch Company**

4. In what year was this land first irrigated? Date _____
5. Give the name of the original appropriator (first user): _____
6. Give the date appropriated _____ Amount filed on: Miners Inches _____ C. F. S. _____
7. State the total number of acres irrigated under this system: _____
8. Give the point of diversion: _____ $\frac{1}{4}$ _____ $\frac{1}{4}$ Section _____ Township _____ Range _____

Part C

TO BE FILED BY ALL WATER USERS IN ADDITION TO PART A OR PART B

9. Source of Water: Yellowstone River
Name of stream or lake from which water is originally diverted
10. Water is obtained by: (Check one) Gravity _____ Pumping ☒ Other _____
11. What is the greatest number of acres you have irrigated? _____ Date _____
12. How many acres did you irrigate in 1947 (Crop and pasture) 100.0
13. State the total number of additional acres that could be irrigated by increasing the water supply, land leveling, etc. _____ This land is under what ditch? _____
14. How many acres of seeped land do you have which could be drained and put into production? _____
15. What is the condition of your irrigation system? fair
16. Is your water supply adequate? Yes ☒ No ☐ Explain _____
17. REMARKS: Sometimes are short of water

Discrepancy in Ownership - Both Owners shown as above.

Over

NOTE: The foregoing questions apply only to irrigated land shown on this plat.

DESCRIPTION AND MAP OF FARM

18. Legal Description of this Farm

NW 1/4, Sec 16



IRRIGATED LAND



NON-IRRIGATED LAND

North

West

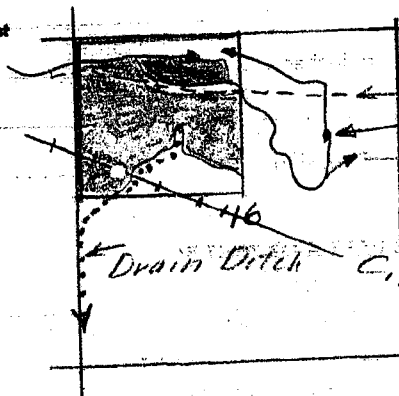

state Hwy 4.
pump

Hammond Main Canal

Drain Ditch

C. M. & P. R. R.

East

South

Ownership covers
only irrigated land.
All ownership for
dry land not shown.

19. If the above land is irrigated from more than one ditch please give the acreage under each ditch in 19A and indicate the location of the land irrigated from each on the above map.

19A. Ditch: Hammond Irr. Ditch Acres: 100.0

Ditch:

Information supplied by:

Name Field Survey Address _____ Date July 3-47

REMARKS: J. Conk & Dave Paulist

If you cannot answer all of the questions on this form answer as many as you can and return the form to us as soon as possible.

STATE ENGINEER'S OFFICE
WATER RESOURCES SURVEYCOUNTY RosebudFILE NO. (29) 16AOwner Boyd, G. F.Address ForsythAAA Owner Ditch Co. Shaver

Address

Operator Fed. Land Bank

Address

New Owner To C. C. EdgellAddress Forsyth Mont.New Operator as Owner

Address

Assessment Record NW 1/4 Sec. 16 T. 6N. - R. 40E.County 116
Assessed Acreage 100

Legal Description of This Farm

Hammond Irr. Dist.

Total Acres in Farm

Code Number 16APhoto No. MA 16 - 127

AAA Contract No.

AAA Total Cropland Acreage

App. No. 861

Decree No.

Land is located in

Twp. 6N. Rge. 40E Twp. Rge.

Twp. Rge. Twp. Rge.

Filed in Twp. 6N. Rge. 40E

Remarks

Y. R. B.



These forms are the property of the State of Montana and must be returned.

STATE OF MONTANA
STATE ENGINEERS OFFICE

Water Resources Survey

FORM WR-1-2M-18-67

Code No. 17B
County Rosebud
T. 6N R. 40E

Name of Land Owner W. M. Christoph Address Forsyth, Mont
Name of Operator Henry Fahrenbruch Address " "

Part A

TO BE FILED BY THOSE OBTAINING IRRIGATION WATER FROM
A DITCH COMPANY OR IRRIGATION DISTRICT

1. Water is delivered by: Hammond Irr Dist
Name of Ditch, Ditch Company or District Supplying Water
2. State the number of acres you irrigate under this system 2.0 Shares you hold _____
3. If you obtain water from more than one Company, give the number of shares, acres irrigated and the name of the Company under "Remarks." If you obtain water from a Ditch Company and also have a private system fill in both Part A and Part B.

Part B

TO BE FILED BY THOSE WHO HAVE A PRIVATE DITCH, PUMP OR IRRIGATION SYSTEM
or those who have a private water right under a Ditch Company

4. In what year was this land first irrigated? Date _____
5. Give the name of the original appropriator (first user): _____
6. Give the date appropriated _____ Amount filed on: Miners Inches _____ C. F. S. _____
7. State the total number of acres irrigated under this system: _____
8. Give the point of diversion: $\frac{1}{4}$ $\frac{1}{4}$ Section _____ Township _____ Range _____

Part C

TO BE FILED BY ALL WATER USERS IN ADDITION TO PART A OR PART B

9. Source of Water: Yellowstone River
Name of stream or lake from which water is originally diverted
10. Water is obtained by: (Check one) Gravity _____ Pumping ☒ Other _____
11. What is the greatest number of acres you have irrigated? _____ Date _____
12. How many acres did you irrigate in 1947 (Crop and pasture) 2.0
13. State the total number of additional acres that could be irrigated by increasing the water supply, land leveling, etc. 32.6 This land is under what ditch? Same
14. How many acres of seeped land do you have which could be drained and put into production? 32.6
15. What is the condition of your irrigation system? Bad all seeped but 2 a.
16. Is your water supply adequate? Yes ☒ No _____ Explain _____
17. REMARKS: If pumps are operating correctly and power is not too low

DESCRIPTION AND MAP OF FARM

NE NE 1/4 R/W Sec 17

NON-IRRIGATED LAND

potential Seeped

North

West

East

South

Ownership covered
only irrigated land.
All ownership for
dry land not shown.

19. If the above land is irrigated from more than one ditch please give the acreage under each ditch in 19A and indicate the location of the land irrigated from each on the above map.

19A. Ditch: Hammond Cr. Dist.

Acres: 2.0

Ditch:

Actes:

Information supplied by:

Name _____

Information supplied by: Field Survey

Address

Date _____

~~July 3-47~~

REMARKS:

J. Cash & Dave Paulini

If you cannot answer all of the questions on this form answer as many as you can and return the form to us as soon as possible. 3

STATE ENGINEER'S OFFICE
WATER RESOURCES SURVEYCOUNTY RosebudFILE NO. (29) 17BOwner Christoph, Wm. Address ForeythAAA Owner Fahrenbruck, Henry Address "

Operator _____ Address _____

New Owner _____ Address _____

New Operator _____ Address _____

Assessment Record NENE, pt NWNE, pt SENE lying N.R.R.County 49.0
Assessed Acreage 49.7

Legal Description of This Farm _____

2.0
47.7Hammond Irr. Dist. Total Acres in Farm _____Code Number 17BPhoto No. MA16-127

AAA Contract No. _____

AAA Total Cropland Acreage 34.6App. No. 861 2.0
32.6

Decree No. _____

Land is located in

Twp. 6N. Rge. 40E. Twp. _____ Rge. _____

Twp. _____ Rge. _____ Twp. _____ Rge. _____

Filed in Twp. 6N. Rge. 40E.

Remarks _____

Y.R.B.



NOTICE
These forms are the
property of the State
of Montana and must
be returned.

STATE OF MONTANA
STATE ENGINEERS OFFICE
Water Resources Survey

FORM WR-1-2M 12-47

Code No. 183
County Rosebud
T. 6N R. 40

Name of Land Owner Pat Flanagan Address Forayth, Mont
Name of Operator _____ Address _____

Part A

**TO BE FILED BY THOSE OBTAINING IRRIGATION WATER FROM
A DITCH COMPANY OR IRRIGATION DISTRICT**

1. Water is delivered by: Hammond Irr Dist
Name of Ditch, Ditch Company or District Supplying Water
2. State the number of acres you irrigate under this system 1000 Shares you hold _____
3. If you obtain water from more than one Company, give the number of shares, acres irrigated and the name of the Company under "Remarks." If you obtain water from a Ditch Company and also have a private system fill in both Part A and Part B.

Part B

**TO BE FILED BY THOSE WHO HAVE A PRIVATE DITCH, PUMP OR IRRIGATION SYSTEM
or those who have a private water right under a Ditch Company**

4. In what year was this land first irrigated? Date _____
5. Give the name of the original appropriator (first user): _____
6. Give the date appropriated _____ Amount filed on: Miners Inches _____ C. F. S. _____
7. State the total number of acres irrigated under this system: _____
8. Give the point of diversion: $\frac{1}{4}$ $\frac{1}{4}$ Section _____ Township _____ Range _____

Part C

TO BE FILED BY ALL WATER USERS IN ADDITION TO PART A OR PART B

9. Source of Water: Yellowstone River
Name of stream or lake from which water is originally diverted
10. Water is obtained by: (Check one) Gravity _____ Pumping ☒ Other _____
11. What is the greatest number of acres you have irrigated? 7 Date _____
12. How many acres did you irrigate in 1947 (Crop and pasture) 10
13. State the total number of additional acres that could be irrigated by increasing the water supply, land leveling, etc. 10 This land is under what ditch? Same Pump in Shingle
14. How many acres of seeped land do you have which could be drained and put into production? _____
15. What is the condition of your irrigation system? Good
16. Is your water supply adequate? Yes ☒ No _____ Explain _____
17. REMARKS:
Land Potential under Pumping in Shingle
could also be irrigated by the Hammond Dist.

NOTE: The foregoing questions apply only to irrigated land shown on this plat.

DESCRIPTION AND MAP OF FARM

18. Legal Description of this Farm S 2 N 2, No. of River Sec 18



IRRIGATED LAND



NON-IRRIGATED LAND

*potential either by private pump or Hammond
ir. ditch. Rough land needs leveling*

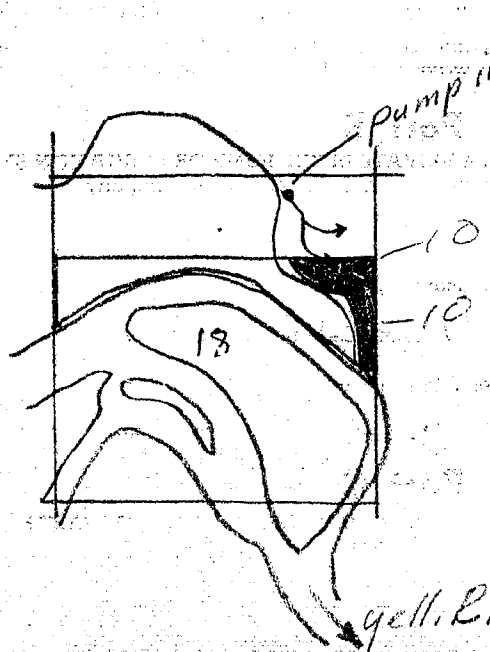

Ownership shown
only irrigated land.
All ownership for
dry land not shown.

19. If the above land is irrigated from more than one ditch please give the acreage under each ditch in 19A and indicate the location of the land irrigated from each on the above map.

19A. Ditch: Hammond ir. ditch Acres: 10.0

Ditch: _____ Acres: _____

Information supplied by:

Name Field Survey Address _____ Date July 3-47

REMARKS: J. Clark & D. Pauline

If you cannot answer all of the questions on this form answer as many as you can and return the form to us as soon as possible.

STATE ENGINEER'S OFFICE
WATER RESOURCES SURVEYCOUNTY RosebudFILE NO. (29) 18BOwner Flanagan, Pat Address Forsyth

AAA Owner Address

Operator Address

New Owner Address

New Operator Address

Assessment Record lots 2, 5, 6, 7, 11 sec. 18 T. 6N. - R. 40E.Dist. Ass. to A.F. Hilliard 16A. in lot 6 sec. 18 T. 6N. -
R. 40E. County 16.
Assessed Acreage 16.

Legal Description of This Farm

Hammond Dist. & private pump Total Acres in FarmCode Number 18BPhoto No. MA 16-127

AAA Contract No.

AAA Total Cropland Acreage

App. No. 873

Decree No.

Land is located in

Twp. 6N. Rge. 40E. Twp. Rge.

Twp. Rge. Twp. Rge.

Filed in Twp. 6N. Rge. 40E.

Remarks

V.R.B.



NOTICE
These forms are the
property of the State
of Montana and must
be returned.

STATE OF MONTANA
STATE ENGINEERS OFFICE

Water Resources Survey

Code No. 7A-17C-17A

County Rosebud

T. 6N R. 40E

Name of Land Owner Hamm Brewing Co Address Minneapolis Minn

Name of Operator James C. Kelly Address _____

Part A

TO BE FILED BY THOSE OBTAINING IRRIGATION WATER FROM
A DITCH COMPANY OR IRRIGATION DISTRICT

1. Water is delivered by: Hammond Irr Dist
Name of Ditch, Ditch Company or District Supplying Water
2. State the number of acres you irrigate under this system 491.2 Shares you hold _____
3. If you obtain water from more than one Company, give the number of shares, acres irrigated and the name of the Company under "Remarks." If you obtain water from a Ditch Company and also have a private system fill in both Part A and Part B.

Part B

TO BE FILED BY THOSE WHO HAVE A PRIVATE DITCH, PUMP OR IRRIGATION SYSTEM
or those who have a private water right under a Ditch Company

4. In what year was this land first irrigated? Date _____
5. Give the name of the original appropriator (first user): _____
6. Give the date appropriated _____ Amount filed on: Miners Inches _____ C. F. S. _____
7. State the total number of acres irrigated under this system: _____
8. Give the point of diversion: 1/4 Section _____ Township _____ Range _____

Part C

TO BE FILED BY ALL WATER USERS IN ADDITION TO PART A OR PART B

9. Source of Water: Yellowstone River
Name of stream or lake from which water is originally diverted
10. Water is obtained by: (Check one) Gravity _____ Pumping X Other _____
11. What is the greatest number of acres you have irrigated? _____ Date _____
12. How many acres did you irrigate in 19 47 (Crop and pasture) 491.2
13. State the total number of additional acres that could be irrigated by increasing the water supply, land leveling, etc. 7.3 This land is under what ditch? Same
14. How many acres of seeped land do you have which could be drained and put into production? 7.3
15. What is the condition of your irrigation system? Fair
16. Is your water supply adequate? Yes X No _____ Explain _____
17. REMARKS: Have to rotate water at times
Poor pump system - partly washed out
very old dam. Thinking of changing
to electric system,
Over

NOTE: The foregoing questions apply only to irrigated land shown on this plat.

DESCRIPTION AND MAP OF FARM

18. Legal Description of this Farm Sec 7, all sec 17 Twp 41E & M.
of R/W Sec 17.



IRRIGATED LAND



NON-IRRIGATED LAND

potential seep

North

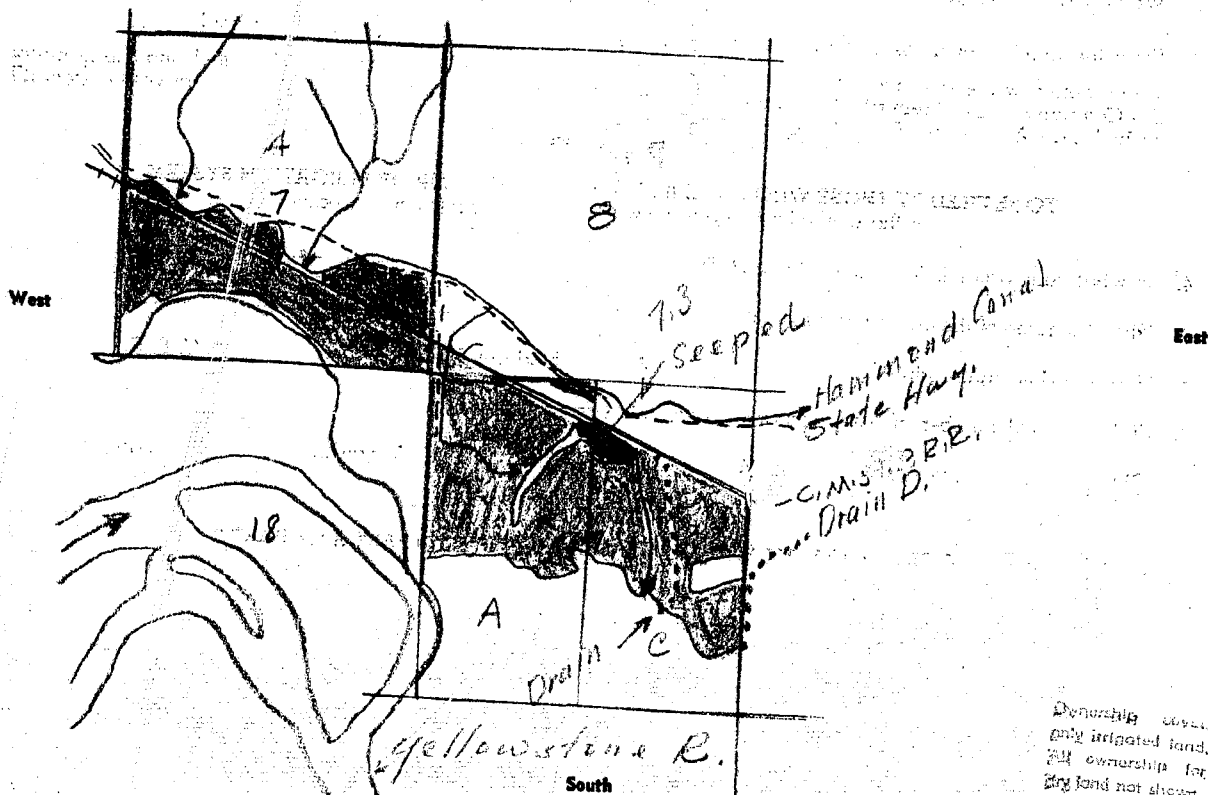

19. If the above land is irrigated from more than one ditch please give the acreage under each ditch in 19A and indicate the location of the land irrigated from each on the above map.

19A. Ditch: Hammond Irr ditch

Acres: 491.2

Ditch:

Acres:

Information supplied by:

Name

Field Survey

Address

Date

July 3-1947

REMARKS:

J. Cook & Dave Paulson

If you cannot answer all of the questions on this form answer as many as you can and return the form to us as soon as possible.

STATE ENGINEER'S OFFICE
WATER RESOURCES SURVEYCOUNTY RosebudFILE NO. (29) 7A, 17C, 17AOwner Hamm Brewing Co. AddressAAA Owner To James E. Kelly Address Minneapolis, Minn.Operator Fahrenbrock, Henry operates 7A Address ForsythNew Owner Cole, Harold operates 17C AddressNew Operator Fadhl, Geo. J. " 17A AddressAssessment Record County - all fractl. sec. 7; SW⁴ sec. 17;
District - N^WNE, SENE, NENW, SUNE, NWNW, SENW, SWNW, NESE, NWSE,
NE²W, NW²W sec. 17; NESE, NWSE, SESE, SWSE, NESW,
SESW, lot 3, lot 4 sec. 7 T. 6N - R. - 40E County 252.00
Assessed Acreage 491.2

Legal Description of This Farm

Hammond Irr. Dist. Total Acres in FarmCode Number 7A, 17C, 17APhoto No. MAK-127

AAA Contract No.

AAA Total Cropland Acreage 400.4App. No. 861, 862

Decree No.

Land is located in

Twp. 6N Rge. 40E Twp. Rge.

Twp. Rge. Twp. Rge.

Filed in Twp. 6N Rge. 40E

Remarks

*See attached
map.*

Y.R.B.



NOTICE
These forms are the
property of the State
of Montana and must
be returned.

STATE OF MONTANA
STATE ENGINEERS OFFICE
Water Resources Survey

FORM WRS-1 2M-12-57
Code No. 18A
County Rosebud
T. 6N R. 40E

Name of Land Owner Anna McClure Address _____
Name of Operator Jo Elmer Larson Address Jessyth, Mont

Part A

TO BE FILED BY THOSE OBTAINING IRRIGATION WATER FROM
A DITCH COMPANY OR IRRIGATION DISTRICT

1. Water is delivered by: Hammond Ditch
Name of Ditch, Ditch Company or District Supplying Water
2. State the number of acres you irrigate under this system 10.0 Shares you hold _____
3. If you obtain water from more than one Company, give the number of shares, acres irrigated and the name of the Company under "Remarks." If you obtain water from a Ditch Company and also have a private system fill in both Part A and Part B.

Part B

TO BE FILED BY THOSE WHO HAVE A PRIVATE DITCH, PUMP OR IRRIGATION SYSTEM
or those who have a private water right under a Ditch Company

4. In what year was this land first irrigated? Date _____
5. Give the name of the original appropriator (first user): _____
6. Give the date appropriated _____ Amount filed on: Miners Inches _____ C. F. S. _____
7. State the total number of acres irrigated under this system: _____
8. Give the point of diversion: $\frac{1}{4}$ $\frac{1}{4}$ Section _____ Township _____ Range _____

Part C

TO BE FILED BY ALL WATER USERS IN ADDITION TO PART A OR PART B

9. Source of Water: Yellowstone River
Name of stream or lake from which water is originally diverted
10. Water is obtained by: (Check one) Gravity ☒ Pumping ☒ Other _____
11. What is the greatest number of acres you have irrigated? _____ Date _____
12. How many acres did you irrigate in 19 47 (Crop and pasture) 10
13. State the total number of additional acres that could be irrigated by increasing the water supply, land leveling, etc. 34.0 This land is under what ditch? Hammond or private
14. How many acres of seeped land do you have which could be drained and put into production? _____
15. What is the condition of your irrigation system? fair
16. Is your water supply adequate? Yes ☒ No _____ Explain _____
17. REMARKS: Sand that is potential Can be irrigated by private pumps from slough or Hammond ditch.

NOTE: The foregoing questions apply only to irrigated land shown on this plot.

DESCRIPTION AND MAP OF FARM

18. Legal Description of this Farm

N²W², Sec 18



IRRIGATED LAND

potential



NON-IRRIGATED LAND

North

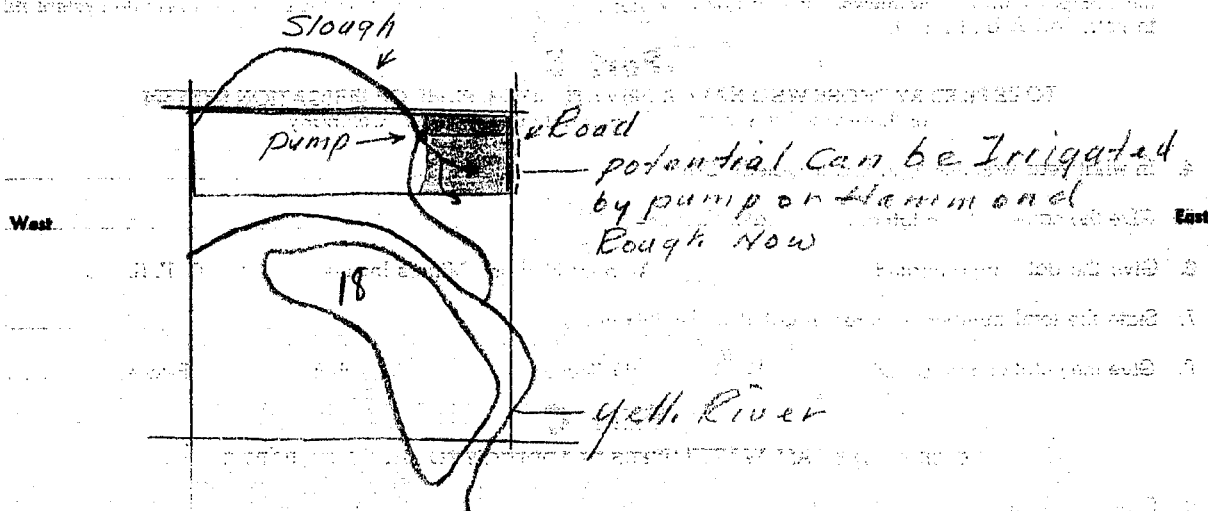

Ownership covers
only irrigated land.
All ownership for
dry land not shown.

South

19. If the above land is irrigated from more than one ditch please give the acreage under each ditch in 19A and indicate the location of the land irrigated from each on the above map.

19A. Ditch: *Hammond Irr ditch* Acres: *10.0*

Ditch: _____ Acres: _____

Information supplied by:

Name *Field Survey* Address _____ Date _____

REMARKS: *See attached form*

If you cannot answer all of the questions on this form answer as many as you can and return the form to us as soon as possible.

STATE ENGINEER'S OFFICE
WATER RESOURCES SURVEYCOUNTY RosbudFILE NO. (29) 18AOwner McClure, Anna Address _____~~AAA Owner~~ To Elmer Larsen Address Forsyth

Operator _____ Address _____

New Owner _____ Address _____

New Operator _____ Address _____

Assessment Record N²NE⁴, NENW, lot 1 sec. 18 T. 6N. - R. 40E.county 80
Assessed Acreage 40.0

Legal Description of This Farm _____

Hammond Dist. & Private Pump Total Acres in Farm 155.Code Number 18APhoto No. MA 16-127

AAA Contract No. _____

AAA Total Cropland Acreage 79.3App. No. N.R.

Decree No. _____

Land is located in

Twp. 6N. Rge. 40E Twp. _____ Rge. _____

Twp. _____ Rge. _____ Twp. _____ Rge. _____

Filed in Twp. 6N. Rge. 40E.

Remarks _____

V.R.B.

FORM F-1 - GAZETTE 1685-ZM-T-47

Code No. 18A

County Rosebud

T. CN R. 40E Sec. 18

Photo No. MA 16-127

Address (deceased)

Address Forsyth

Federal Project _____

Dist. Company Hammond Inc. et

Disc. Company Hammond Iron Cast Pres. 10 Pot. 0

Indigene District Private pump from Slough Pres. 30. Pot. 4.0

Private System ☒ Pres. 12 a. 10 17

Private can be served by
(Hammond dist also, _____ Totals _____

Flood _____ Pump ✓ Reservoir _____ Gravity _____

Size and Capacity, Pump, etc. 8" intake, 4" discharge Cent. pump 6' lift. Tractor power

Original Appropriator, Company ✓ _____ App. No. _____

Original Appropriator, Private. ✓

(Show date of appropriation under Remarks)

Is the system an extension of another system? Yes _____ No ☒

Is all land irrigated from one system? Yes ✓ No

(If No, show break down on map)

Source of Water: Slough out of Yellowstone River

Acres Irrigated 19 47 40.0

Potential Acres 34 Seeped 0

Explain needs to have ditch raised about 9"

Condition of System good

Adequate Supply — Yes ☒ No ☐

Explain _____

Topography 1st Terrace or river bottom

Information From C. M. L.

Remarks barsen thinks there is a water right

Could not find it and none is shown in our records

sec 18 T6N R40E

x x x x

18

by raising the present ditch about 9" all
the land in crop could be irrigated or an additional
4 acres



NOTICE
These forms are the
property of the State
of Montana and must
be returned.

STATE OF MONTANA
STATE ENGINEERS OFFICE
Water Resources Survey

FORM WR-1-2M 12-47

Code No. 15A-16B-2/A

County Rockwell

T. 6N R. 40E

Name of Land Owner R. D. Mountain Address Billings, Mont.

Name of Operator _____ Address _____

Part A

**TO BE FILED BY THOSE OBTAINING IRRIGATION WATER FROM
A DITCH COMPANY OR IRRIGATION DISTRICT**

1. Water is delivered by: Hammond Irr. Dist.
Name of Ditch, Ditch Company or District Supplying Water
2. State the number of acres you irrigate under this system 346.70 Shares you hold _____
3. If you obtain water from more than one Company, give the number of shares, acres irrigated and the name of the Company under "Remarks." If you obtain water from a Ditch Company and also have a private system fill in both Part A and Part B.

Part B

**TO BE FILED BY THOSE WHO HAVE A PRIVATE DITCH, PUMP OR IRRIGATION SYSTEM
or those who have a private water right under a Ditch Company**

4. In what year was this land first irrigated? Date _____
5. Give the name of the original appropriator (first user): _____
6. Give the date appropriated _____ Amount filed on: Miners Inches _____ C. F. S. _____
7. State the total number of acres irrigated under this system: _____
8. Give the point of diversion: _____ $\frac{1}{4}$ _____ $\frac{1}{4}$ Section _____ Township _____ Range _____

Part C

TO BE FILED BY ALL WATER USERS IN ADDITION TO PART A OR PART B

9. Source of Water: Yellowstone River
Name of stream or lake from which water is originally diverted
10. Water is obtained by: (Check one) Gravity _____ Pumping ☒ Other _____
11. What is the greatest number of acres you have irrigated? _____ Date _____
12. How many acres did you irrigate in 1947 (Crop and pasture) 346.70
13. State the total number of additional acres that could be irrigated by increasing the water supply, land leveling, etc. 68.70 This land is under what ditch? Same
14. How many acres of seeped land do you have which could be drained and put into production? 20.0
15. What is the condition of your irrigation system? Fair
16. Is your water supply adequate? Yes ☒ No _____ Explain _____
17. REMARKS: _____

Over

NOTE: The foregoing questions apply only to irrigated land shown on this plat.

DESCRIPTION AND MAP OF FARM

18. Legal Description of this Farm

NW 1/4 Sec 15, NE 1/4, S2, T16N
N2 1/2 of River Sec 21



IRRIGATED LAND



NON-IRRIGATED LAND



potential Land

North

MOST IRRIGATED PORTION OF THIS FARM IS LOCATED IN THE
 NORTHWEST CORNER OF THIS FARM

19. If the above land is irrigated from more than one ditch please give the acreage under each ditch in 19A and indicate the location of the land irrigated from each on the above map.

West

East

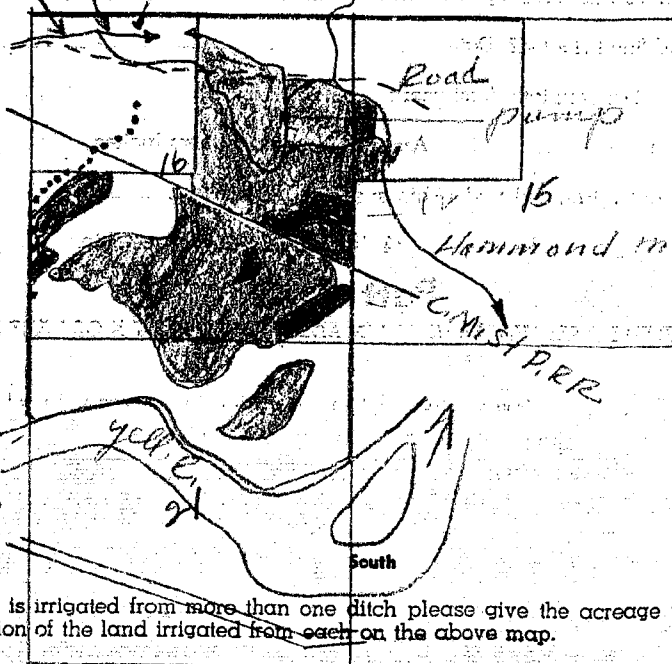

Ownership shown
 only irrigated land.
 All ownership for
 dry land not shown.

19A. Ditch:

Acres:

Ditch:

Hammond Irr ditch

Acres: 346.70

Information supplied by:

Name

Field Survey

Address

Date

July 3-47

REMARKS:

J. Cook & D. Paulist

If you cannot answer all of the questions on this form answer as many as you can and return the form to us as soon as possible.

STATE ENGINEER'S OFFICE
WATER RESOURCES SURVEYCOUNTY RosebudFILE NO (29) 15A, 16B, 21AOwner Mountain, R. D. Address Billings, Mont.

AAA Owner _____ Address _____

Operator Rangel, Victor operates 16B, 21A Address Forsyth

New Owner _____ Address _____

New Operator _____ Address _____

Assessment Record NW⁴ sec. 15; E², SW⁴ sec. 16; Lots 1, 2, 3, 4,
N³NE⁴, NENW sec. 21 T. 6N. - R. 40E.County 281
Assessed Acreage 435

Legal Description of This Farm _____

Hammond Irr. Dist. & Pump

Total Acres in Farm _____

Code Number 15A, 16B, 21APhoto No. MA 16-164, 127, 128

AAA Contract No. _____

AAA Total Cropland Acreage _____

App. No. 861

Decree No. _____

Land is located in

Twp. 6N. Rge. 40E Twp. _____ Rge. _____

Twp. _____ Rge. _____ Twp. _____ Rge. _____

Filed in Twp. 6N. Rge. 40E

Remarks _____

V.R.B.

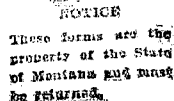

Water Resources Survey

T. 64 R. 40

Address

Address

**TO BE FILED BY THOSE OBTAINING IRRIGATION WATER FROM
A DITCH COMPANY OR IRRIGATION DISTRICT**

1. Water is delivered by: _____
Name of Ditch, Ditch Company or District Supplying Water
2. State the number of acres you irrigate under this system _____ Shares you hold _____
3. If you obtain water from more than one Company, give the number of shares, acres irrigated and the name of the Company under "Remarks." If you obtain water from a Ditch Company and also have a private system fill in both Part A and Part B.

TO BE FILED BY THOSE WHO HAVE A PRIVATE DITCH, PUMP OR IRRIGATION SYSTEM
or those who have a private water right under a Ditch Company

4. In what year was this land first irrigated? Date No Data
5. Give the name of the original appropriator (first user): (see attached title)
6. Give the date appropriated _____ Amount filed on: Miners Inches _____ C. F. S. _____
7. State the total number of acres irrigated under this system: _____
8. Give the point of diversion: _____ $\frac{1}{4}$ _____ $\frac{1}{4}$ Section _____ Township _____ Range _____

TO BE FILED BY ALL WATER USERS IN ADDITION TO PART A OR PART B

9. Source of Water: Yellowstone River
Name of stream or lake from which water is originally diverted
10. Water is obtained by: (Check one) Gravity _____ Pumping ☒ Other _____
11. What is the greatest number of acres you have irrigated? _____ Date _____
12. How many acres did you irrigate in 1947? (Crop and pasture) 12.5
13. State the total number of additional acres that could be irrigated by increasing the water supply, land leveling, etc. 10 This land is under what ditch? Same
14. How many acres of seeped land do you have which could be drained and put into production? 0
15. What is the condition of your irrigation system? Good
16. Is your water supply adequate? Yes ☒ No _____ Explain _____
17. REMARKS: _____

OVER

NOTE: The foregoing questions apply only to irrigated land shown on this plat.

DESCRIPTION AND MAP OF FARM

18. Legal Description of this Farm

S 2 S 2, NE 4 E 4, Tract between
R/W + Lines See 20.



IRRIGATED LAND



NON-IRRIGATED LAND

potential land

North

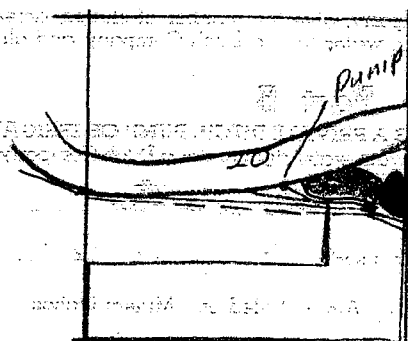

West

East

South

Shading covers
only irrigated land.
All ownership for
dry land not shown.

19. If the above land is irrigated from more than one ditch please give the acreage under each ditch in 19A and indicate the location of the land irrigated from each on the above map.

19A. Ditch: Rock private Pump Acres: 12.5

Ditch: _____ Acres: _____

Information supplied by:

Name See attached form Address _____ Date _____

REMARKS: _____

If you cannot answer all of the questions on this form answer as many as you can and return the form to us as soon as possible.

Send C.J.

STATE ENGINEER'S OFFICE
WATER RESOURCES SURVEY

COUNTY *Rosebud*FILE NO. *(29) 20A*Owner *Rock, Oliver*Address *Forsyth*

AAA Owner

Address

Operator

Address

New Owner

Address

New Operator

Address

Assessment Record *None*

Assessed Acreage

Legal Description of This Farm *S²S², NESE, 10+8 sec. 20 T. 6N. - R. 40E**Show all irrigation on this for regardless of ownership boundary.**Private Pump in Yell*

Total Acres in Farm

Code Number *20A*Photo No. *MA 16-128*

AAA Contract No.

AAA Total Cropland Acreage

App. No. *N.R.*

Decree No.

Land is located in

Twp. *6N* Rge. *40E* Twp. Rge.

Twp. Rge. Twp. Rge.

Filed in Twp. *6N* Rge. *40E*

Remarks

V.R.B.

6N-40
Forsyth, Montana
April 21, 1948

State of Montana
State Engineer
Billings, Montana

Dear Sir:

In reply to your letter of the 15th requesting information regarding a water right for the land I am now irrigating, namely ~~S1/4, NE1/4~~, Lot 8, Sec. 20, T.6N., R. 40E. in Rosebud County, I wish to state that as far as I know a water right has never been requested.

However Wilson Westaby homesteaded lot 8 April 25, 1912 then containing seventy nine Forty-One-Hundredths acres according to the Official Plat of the Survey of the said land. At that time or shortly after he began irrigating by pumping water from the river using steam for power. The old engine is now in the river and visible when the river is low.

At present I am irrigating only the land which I have leveled in good shape which consists of about 25 acres, but plan to bring another 15 or 20 acres under the ditch as soon as possible.

following

You didn't request this information but will include it in case you might. I have leased lots 5, 6, 7, & 8 of Sec. 21, T.6N., R. 40E from the Northern Pacific R.R. I would like to irrigate part of this land either as farm land or pasture. At present they do not wish to sell this land but if at a later date they changed their mind I have a verbal promise of first change. I would then like to have a water right.

Hoping this information is satisfactory, I remain,

Sincerely yours,

Oliver F. Rock
Oliver F. Rock



NOTICE
These forms are the
property of the State
of Montana and must
be returned.

STATE OF MONTANA
STATE ENGINEERS OFFICE
Water Resources Survey

FORM WR-1-24 12-47
Code No. 15C-22E
County Rosebud
T. 6N R. 40E

Name of Land Owner Joseph Istithykei Address Forayth, Mont
Name of Operator _____ Address _____

Part A

**TO BE FILED BY THOSE OBTAINING IRRIGATION WATER FROM
A DITCH COMPANY OR IRRIGATION DISTRICT**

1. Water is delivered by: Hammond Irr dist
Name of Ditch, Ditch Company or District Supplying Water
2. State the number of acres you irrigate under this system. 22.0 Shares you hold
3. If you obtain water from more than one Company, give the number of shares, acres irrigated and the name of the Company under "Remarks." If you obtain water from a Ditch Company and also have a private system fill in both Part A and Part B.

Part B

**TO BE FILED BY THOSE WHO HAVE A PRIVATE DITCH, PUMP OR IRRIGATION SYSTEM
or those who have a private water right under a Ditch Company**

4. In what year was this land first irrigated? Date _____
5. Give the name of the original appropriator (first user): _____
6. Give the date appropriated _____ Amount filed on: Miners Inches _____ C. F. S. _____
7. State the total number of acres irrigated under this system: _____
8. Give the point of diversion: _____ $\frac{1}{4}$ _____ $\frac{1}{4}$ Section _____ Township _____ Range _____

Part C

TO BE FILED BY ALL WATER USERS IN ADDITION TO PART A OR PART B

9. Source of Water: Yellowstone River
Name of stream or lake from which water is originally diverted
10. Water is obtained by: (Check one) Gravity _____ Pumping ☒ Other _____
11. What is the greatest number of acres you have irrigated? _____ Date _____
12. How many acres did you irrigate in 19 47 (Crop and pasture) 22.0
13. State the total number of additional acres that could be irrigated by increasing the water supply, land leveling, etc. 0 This land is under what ditch? 0
14. How many acres of seeped land do you have which could be drained and put into production? 0
15. What is the condition of your irrigation system? fair
16. Is your water supply adequate? Yes ☒ No _____ Explain _____
17. REMARKS: Land on Sec 3, T 6N 39E cont.
for vegetation information

Over

NOTE: The foregoing questions apply only to irrigated land shown on this plat.

DESCRIPTION AND MAP OF FARM

18. Legal Description of this Farm S.W. 1/4, Sec. 15 N. 24 W. 1/4 of
Range 22



IRRIGATED LAND



NON-IRRIGATED LAND

North

MOST OF THE LAND DESCRIBED ABOVE IS OWNED BY
JAMES H. HARRISON, JR. OF THE CITY OF

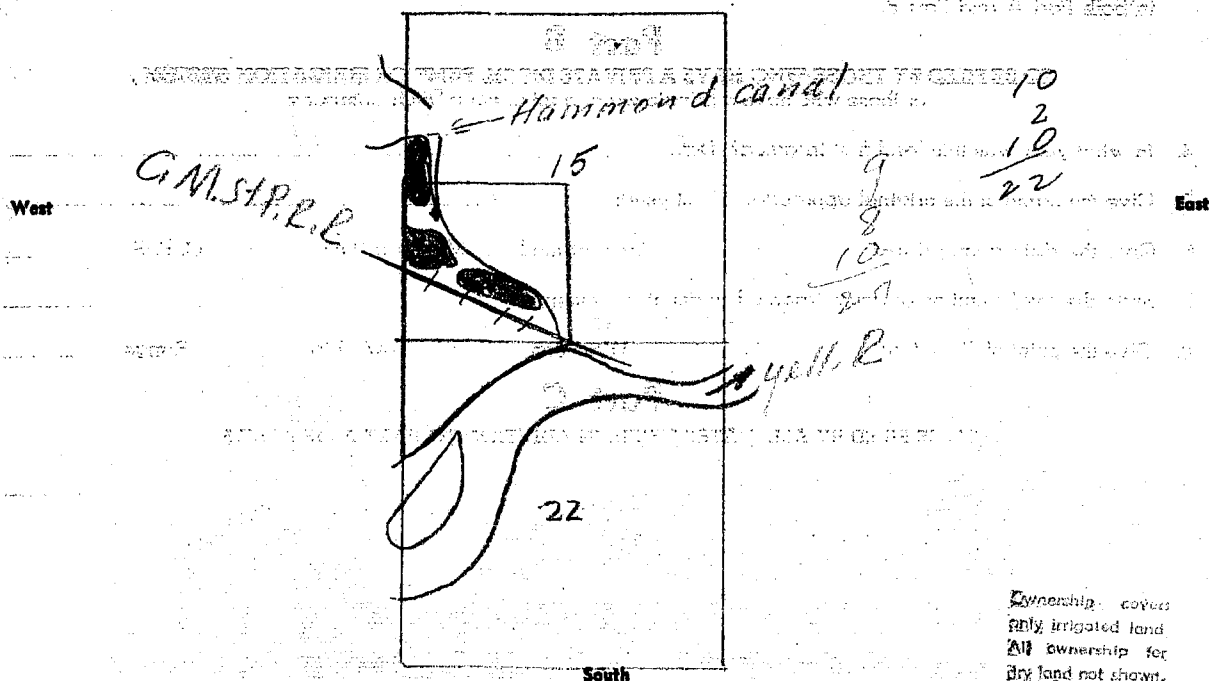

19. If the above land is irrigated from more than one ditch please give the acreage under each ditch in 19A and indicate the location of the land irrigated from each on the above map.

22.0

19A. Ditch: Hammond Can. Ditch Acres: 22.0

Ditch: _____ Acres: _____

Information supplied by:

Name Field Survey Address _____ Date July 3-47

REMARKS: J. Cook & D. Paulist

If you cannot answer all of the questions on this form answer as many as you can and return the form to us as soon as possible.

STATE ENGINEER'S OFFICE
WATER RESOURCES SURVEYCOUNTY RosebudFILE NO. (29) 15C, 22EOwner Tillitzki, JosephAddress Forsyth

AAA Owner

Address

Operator

Address

New Owner

Address

New Operator

Address

Assessment Record W²SW⁴ Sec. 15 T. 6N. - R. 40ECounty 37.0
Assessed Acreage 37.6

Legal Description of This Farm

Hammond Irr. Dist.Total Acres in Farm 231Code Number 15C, 22EPhoto No. MA 16-163, 164

AAA Contract No.

AAA Total Cropland Acreage 132.9App. No. 861

Decree No.

Land is located in

Twp. 6N. Rge. 40E Twp. 6N. Rge. 39E

Twp. Rge. Twp. Rge.

Filed in Twp. 6N. Rge. 39E

Remarks

Y.R.B.