



These forms are the property of the State of Montana and must be retained.

STATE OF MONTANA
STATE ENGINEERS OFFICE

Water Resources Survey

Code No. 30 - 1B

County Rosebud

T. 6N. R. 41E

Name of Land Owner Clark, Willis Ivan Address Lodge Grass, Montana
Name of Operator Cable, Alex Fred Halmer Address Rosebud, Montana

Part A

TO BE FILED BY THOSE OBTAINING IRRIGATION WATER FROM
A DITCH COMPANY OR IRRIGATION DISTRICT

1. Water is delivered by: CARTERSVILLE Irrigation Dist.
Name of Ditch, Ditch Company or District Supplying Water
2. State the number of acres you irrigate under this system 78.8 Shares you hold Don't Know.
3. If you obtain water from more than one Company, give the number of shares, acres irrigated and the name of the Company under "Remarks." If you obtain water from a Ditch Company and also have a private system fill in both Part A and Part B.

Part B

TO BE FILED BY THOSE WHO HAVE A PRIVATE DITCH, PUMP OR IRRIGATION SYSTEM
or those who have a private water right under a Ditch Company

4. In what year was this land first irrigated? Date
5. Give the name of the original appropriator (first user):
6. Give the date appropriated Amount filed on: Miners Inches C. F. S.
7. State the total number of acres irrigated under this system:
8. Give the point of diversion: 1/4 1/4 Section Township Range

Part C

TO BE FILED BY ALL WATER USERS IN ADDITION TO PART A OR PART B

9. Source of Water: YELLOWSTONE RIVER
Name of stream or lake from which water is originally diverted.
10. Water is obtained by: (Check one) Gravity ☒ Pumping Other
11. What is the greatest number of acres you have irrigated? 78.8 Date 1944
12. How many acres did you irrigate in 1947? (Crop and pasture) Supposedly 78.8
13. State the total number of additional acres that could be irrigated by increasing the water supply, land leveling, etc. 7A This land is under what ditch? CARTERSVILLE DITCH CO.
14. How many acres of seeped land do you have which could be drained and put into production? none
15. What is the condition of your irrigation system? Good.
16. Is your water supply adequate? Yes ☒ No Explain
17. REMARKS:

NOTE: The foregoing questions apply only to irrigated land shown on this plat.

DESCRIPTION AND MAP OF FARM

18. Legal Description of this Farm Lot 1, Pt. Lot 7 & 8, SE $\frac{1}{4}$ NE $\frac{1}{4}$, Pt. SW $\frac{1}{4}$ NE $\frac{1}{4}$ E. of Horse Cr. Rd.,
Pt. NE $\frac{1}{4}$ SE $\frac{1}{4}$ E. of Horse Cr. Rd., Sec. 1, T. 6N., R. 41E.



IRRIGATED LAND



NON-IRRIGATED LAND



Potentially Irrigable Land North

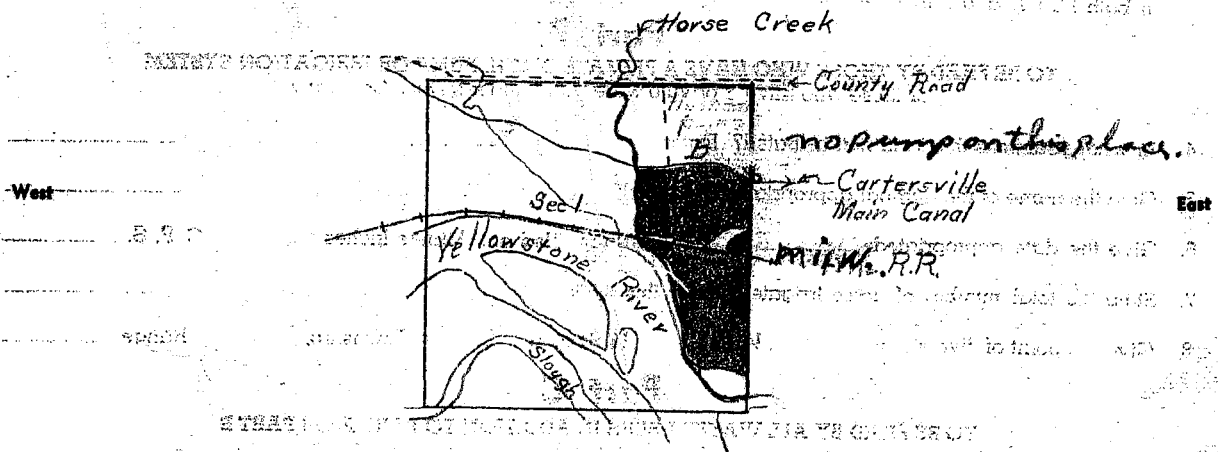

Ownership covers
only irrigated land.
All ownership for
any land not shown.

19. If the above land is irrigated from more than one ditch please give the acreage under each ditch in 19A and indicate the location of the land irrigated from each on the above map.

19A. Ditch: _____ Acres: _____

Ditch: _____ Acres: _____

Information supplied by:

Name Walter Ivan Clark Address Lodgepole Date March 25

REMARKS: _____

If you cannot answer all of the questions on this form answer as many as you can and return the form to us as soon as possible.

**STATE ENGINEER'S OFFICE
WATER RESOURCES SURVEY**

L.S.
Rt #129

COUNTY RosebudFILE NO. (30) 1BOwner Clark, Willis IvanAddress Lodge Grass, Mont.

AAA Owner

Address

Operator Goble, AlexAddress Forsyth

New Owner

Address

New Operator

Address

Assessment Record Lot 1, pt. lot 7 & 8, SENE, pt. SWNE E. of Horse Cr Rd., pt. NESE E. of Horse Cr. Rd. Sec. 1 T. 6N. - R. 41E.

County 99.00
Assessed Acreage 107.04

Legal Description of This Farm

Cartersville Dist.

Total Acres in Farm

Code Number 1BPhoto No. WY 3A-02

AAA Contract No.

AAA Total Cropland Acreage

App. No. 502

Decree No.

Land is located in

Twp. 6N. Rge. 41E. Twp. Rge.

Twp. Rge. Twp. Rge.

Filed in Twp. 6N. Rge. 41E.

Remarks

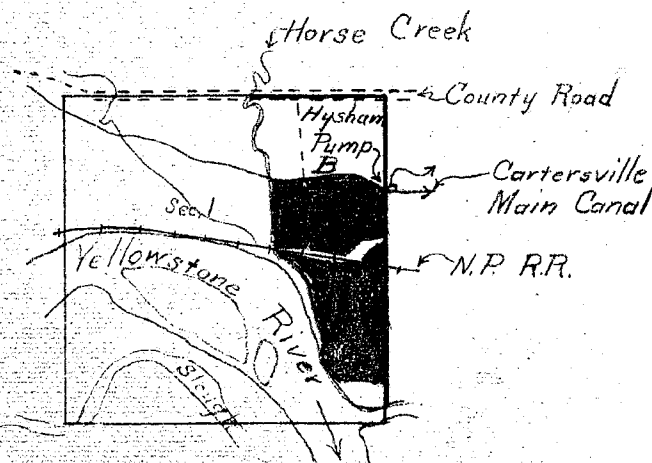

Y.R.B.



NOTICE
These forms are the
property of the State
of Montana and should
be retained.

STATE OF MONTANA
STATE ENGINEERS OFFICE

Water Resources Survey

Code No.

County

T. 7N

R. 4E

Name of Land Owner F. V. H. Collins Co Address Forsyth, Mont.

Name of Operator _____ Address _____

Part A

TO BE FILED BY THOSE OBTAINING IRRIGATION WATER FROM
A DITCH COMPANY OR IRRIGATION DISTRICT

1. Water is delivered by: Casterville Ditch Co.
Name of Ditch, Ditch Company or District Supplying Water
2. State the number of acres you irrigate under this system 1,320.60 Shares you hold _____
3. If you obtain water from more than one Company, give the number of shares, acres irrigated and the name of the Company under "Remarks." If you obtain water from a Ditch Company and also have a private system fill in both Part A and Part B.

Part B

TO BE FILED BY THOSE WHO HAVE A PRIVATE DITCH, PUMP OR IRRIGATION SYSTEM
or those who have a private water right under a Ditch Company

4. In what year was this land first irrigated? Date _____
5. Give the name of the original appropriator (first user): _____
6. Give the date appropriated _____ Amount filed on: Miners Inches _____ C. F. S. _____
7. State the total number of acres irrigated under this system: _____
8. Give the point of diversion: $\frac{1}{4}$ _____ $\frac{1}{4}$ Section _____ Township _____ Range _____

Part C

TO BE FILED BY ALL WATER USERS IN ADDITION TO PART A OR PART B

9. Source of Water: Yellowstone River
Name of stream or lake from which water is originally diverted
10. Water is obtained by: (Check one) Gravity ☒ Pumping _____ Other _____
11. What is the greatest number of acres you have irrigated? _____ Date _____
12. How many acres did you irrigate in 1947? (Crop and pasture) 1,320.60
13. State the total number of additional acres that could be irrigated by increasing the water supply, land leveling, etc. 195.40 This land is under what ditch? Same
14. How many acres of seeped land do you have which could be drained and put into production? _____
15. What is the condition of your irrigation system? Fair
16. Is your water supply adequate? Yes ☒ No _____ Explain _____
17. REMARKS: This acreage for all land shown on attached map - some may be under contract or sold to private individuals - poor county records - Collins Co does not pay water charges for land near head of main canal

NOTE: The foregoing questions apply only to irrigated land shown on this plat.

DESCRIPTION AND MAP OF FARM

18. Legal Description of this Farm

See attached description



IRRIGATED LAND



NON-IRRIGATED LAND

North

see attached map

West

*Porcupine Ranch to operate all except 7B-8B-6N41E.
Toniguchi, Masoni ops - W²NW⁴, Sec 11, 6N43
Agushi, Tom Jr, SESE-6N43
Land in 6N43 not included on this form*

East

South

Ownership covers
Only irrigated land.
All ownership for
Dry land not shown.

19. If the above land is irrigated from more than one ditch please give the acreage under each ditch in 19A and indicate the location of the land irrigated from each on the above map.

19A. Ditch: *Casternville Dr. Dist* Acres: *1,320.60*

Ditch: _____ Acres: _____

Information supplied by:

Name *Mr. J.V.H. Collins* Address _____ Date _____

REMARKS: *To Paulist & Co. see attached form*

If you cannot answer all of the questions on this form answer as many as you can and return the form to us as soon as possible.

STATE ENGINEER'S OFFICE
WATER RESOURCES SURVEY

COUNTY Rosebud
FILE NO. (30) 1A, 2A, 3A, 4A, 7A, 8A, 9A, 10A, 11A, 18A, 7B, 8B.

Owner Collins, F.V.H. Co. Address Forsyth

AAA Owner Address

Porcupine Ranch Co. operates all except
Operator 7A + 8A Address Forsyth

New Owner Address

New Operator Address

Assessment Record See Attached

County 985.00
Assessed Acreage 888.50

Legal Description of This Farm

See Jim's diary, June 18

Cartersville Dist. + Pump Total Acres in Farm

1A, 2A, 3A, 4A, 7A, 7B, 8A,
Code Number 8B, 9A, 10A, 11A, 18A

Photo No. WY 3A-02, 03 MA 16-164,
MA 16-166

AAA Contract No.

AAA Total Cropland Acreage

App. No. 502, 736, 886, 959, 954,
955, 479

Decree No.

Land is located in

Twp. 6N. Rge. 41E. Twp. 6N. Rge. 43E.

Twp. 7N. Rge. 41E. Twp. Rge.

Filed in Twp. 6N. Rge. 41E.

Remarks

V.R.B.

ASSESSMENT RECORD

County Record:

Collins, F. V. H. Co. - Forsyth, Montana

Pt. Lot 2 West of Horse Cr., Lots 3,4,5, Pt. Lot 7, Pt. Lot 8,
Pt. SW $\frac{1}{4}$ NE $\frac{1}{4}$, Pt. NE $\frac{1}{4}$ SE $\frac{1}{4}$ All West of Horse Creek Rd., SE $\frac{1}{4}$ NW $\frac{1}{4}$, Section 1;
Lots 1,2,3,5,7,8, S $\frac{1}{2}$ NE $\frac{1}{4}$, S $\frac{1}{2}$ NW $\frac{1}{4}$, W $\frac{1}{2}$ SW $\frac{1}{4}$, Pt. NE $\frac{1}{4}$ SW $\frac{1}{4}$ Section 2;
Lot 1, Pt. SE $\frac{1}{4}$ SW $\frac{1}{4}$ So. R/W, S $\frac{1}{2}$ SW $\frac{1}{4}$ SW $\frac{1}{4}$ So. R/W, NW $\frac{1}{4}$ SE $\frac{1}{4}$, NE $\frac{1}{4}$ SE $\frac{1}{4}$,
SW $\frac{1}{4}$ SE $\frac{1}{4}$, SE $\frac{1}{4}$ SE $\frac{1}{4}$, SE $\frac{1}{4}$ NE $\frac{1}{4}$ Section 3;
Lots 8, 9, NE $\frac{1}{4}$ SE $\frac{1}{4}$, SE $\frac{1}{4}$ SE $\frac{1}{4}$, SW $\frac{1}{4}$ SE $\frac{1}{4}$ Section 7;
Lot 1, NE $\frac{1}{4}$ NE $\frac{1}{4}$, SW $\frac{1}{4}$ NE $\frac{1}{4}$, S $\frac{1}{2}$ SE $\frac{1}{4}$ NW $\frac{1}{4}$, S $\frac{1}{2}$ NW $\frac{1}{4}$ SW $\frac{1}{4}$, Lots 2,3,4, So. C.M.St. P. R.R.
Section 8;
NW $\frac{1}{4}$ NW $\frac{1}{4}$ Section 9;
Lots 2,3,4, NW $\frac{1}{4}$ NE $\frac{1}{4}$, NW $\frac{1}{4}$ NW $\frac{1}{4}$, NE $\frac{1}{4}$ NW $\frac{1}{4}$, NE $\frac{1}{4}$ NE $\frac{1}{4}$ Section 10; All in Township 6N-41E

Cartersville Irrigation District Assessment Record:

Chicago, Mil. & St. P. Ry. - Chicago, Ill.

Pt. NE $\frac{1}{4}$ NE $\frac{1}{4}$, Pt. NW $\frac{1}{4}$ NE $\frac{1}{4}$, Pt. Lot 1 Section 9;

Collins, F. V. H. Co., c/o Armour & Lee, Forsyth, Montana

Pt. SW $\frac{1}{4}$ NE $\frac{1}{4}$, Pt. Lot 7, SE $\frac{1}{4}$ NW $\frac{1}{4}$, Lot 3,4,5, Pt. NE $\frac{1}{4}$ SE $\frac{1}{4}$ Section 1;
NE $\frac{1}{4}$ SW $\frac{1}{4}$, Lots 1,2,3,5,7, SW $\frac{1}{4}$ NE $\frac{1}{4}$, SE $\frac{1}{4}$ NE $\frac{1}{4}$, SW $\frac{1}{4}$ NW $\frac{1}{4}$, SW $\frac{1}{4}$ SW $\frac{1}{4}$, SE $\frac{1}{4}$ NW $\frac{1}{4}$, NW $\frac{1}{4}$ SW $\frac{1}{4}$ Section 2;
SE $\frac{1}{4}$ NE $\frac{1}{4}$, NE $\frac{1}{4}$ SE $\frac{1}{4}$, NW $\frac{1}{4}$ SE $\frac{1}{4}$, SW $\frac{1}{4}$ SE $\frac{1}{4}$, SE $\frac{1}{4}$ SE $\frac{1}{4}$, SE $\frac{1}{4}$ SW $\frac{1}{4}$, SW $\frac{1}{4}$ SW $\frac{1}{4}$ Section 3;
SW $\frac{1}{4}$ SE $\frac{1}{4}$ Section 4
NE $\frac{1}{4}$ NE $\frac{1}{4}$, NW $\frac{1}{4}$ NE $\frac{1}{4}$, NE $\frac{1}{4}$ NW $\frac{1}{4}$, NW $\frac{1}{4}$ NW $\frac{1}{4}$, Lots 3 & 4 Section 9;
NE $\frac{1}{4}$ NE $\frac{1}{4}$, NW $\frac{1}{4}$ NE $\frac{1}{4}$, Lot 2, NE $\frac{1}{4}$ NW $\frac{1}{4}$, Lots 3,4, NW $\frac{1}{4}$ NW $\frac{1}{4}$, Lot 1 Section 10;
Lot 8, Section 11, also NW $\frac{1}{4}$ NW $\frac{1}{4}$ Section 11

Cartersville Irrigation District Lands:

Lot 2 Section 9

All in Township 6N., R. 41E.

Wilson, C. C. - Cartersville, Montana

Lot 1, Blk. 3 Section 9 in T. 6N., R. 41E.

Pump & gravity diversions combined
no attempt to make break down of
pump & gravity average, At other
time this Company owned all of the
land under the Patterson Irr. & G. S. system, For this reason they have
right of way right in ditch system.

195,40

0

Township 41 North Range 41 East

■ Irrigated Land
 ■ Potentially Irrigable Land

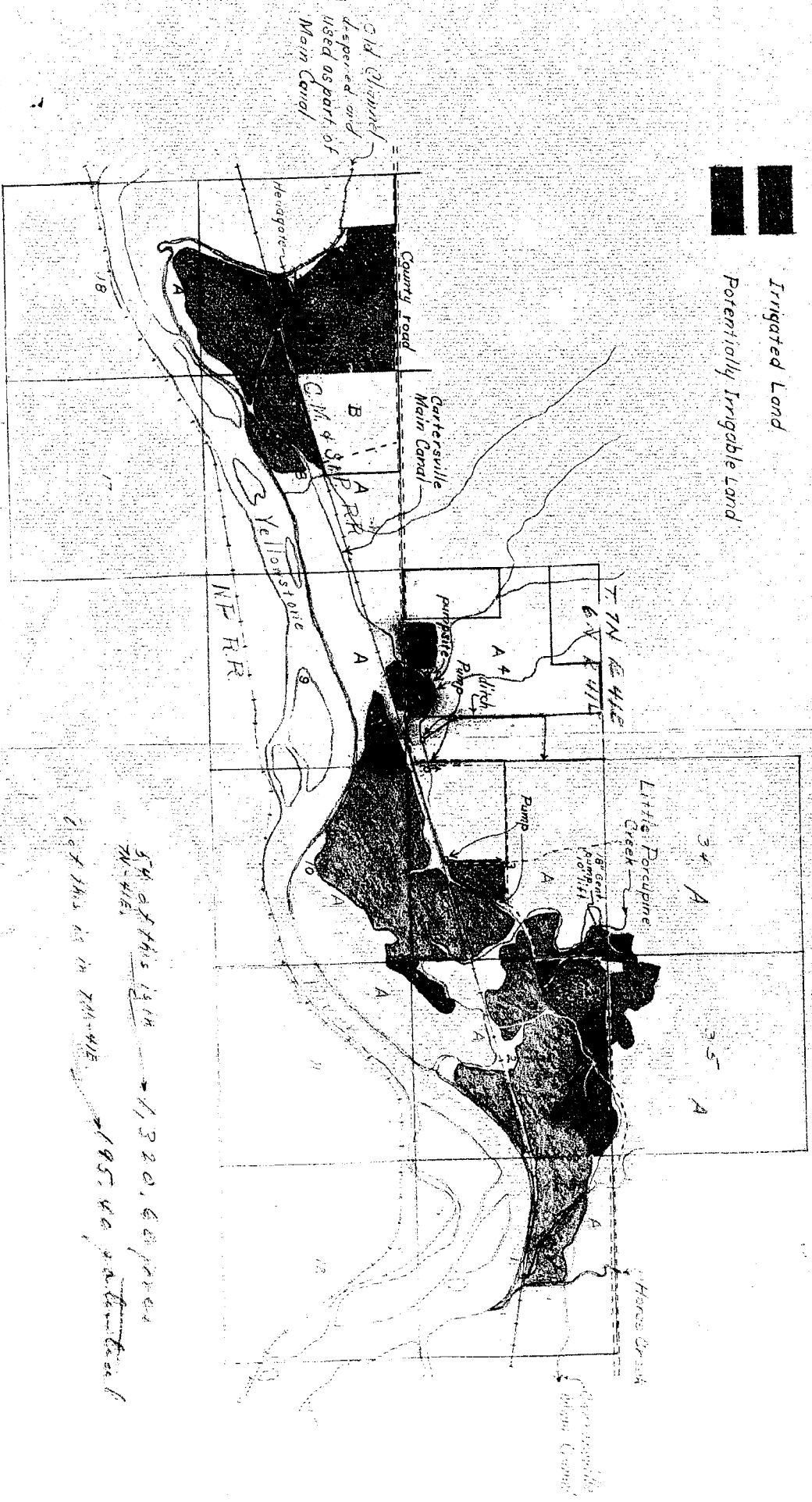

34 at this is in 1320.60 per acre
 7N-41E
 195.40 per acre



NOTICE
These forms are the
property of the State
of Montana and must
be returned.

STATE OF MONTANA
STATE ENGINEERS OFFICE

Water Resources Survey

Code No. 128

County: Rosebud

T. 6N R. 41E

Name of Land Owner: Elizabeth Kennedy Address: Rosebud, Mont

Name of Operator: Gordon McRae Address: Forsyth, Mont

Part A

TO BE FILED BY THOSE OBTAINING IRRIGATION WATER FROM
A DITCH COMPANY OR IRRIGATION DISTRICT

1. Water is delivered by: _____
Name of Ditch, Ditch Company or District Supplying Water
2. State the number of acres you irrigate under this system _____ Shares you hold _____
3. If you obtain water from more than one Company, give the number of shares, acres irrigated and the name of the Company under "Remarks." If you obtain water from a Ditch Company and also have a private system fill in both Part A and Part B.

Part B

TO BE FILED BY THOSE WHO HAVE A PRIVATE DITCH, PUMP OR IRRIGATION SYSTEM
or those who have a private water-right under a Ditch Company

4. In what year was this land first irrigated? Date: No filing made
5. Give the name of the original appropriator (first user): _____
6. Give the date appropriated _____ Amount filed on: Miners Inches _____ C. F. S. _____
7. State the total number of acres irrigated under this system: _____
8. Give the point of diversion: _____ $\frac{1}{4}$ Section _____ Township _____ Range _____

Part C

TO BE FILED BY ALL WATER USERS IN ADDITION TO PART A OR PART B

9. Source of Water: Yellowstone River
Name of stream or lake from which water is originally diverted
10. Water is obtained by (Check one) Gravity _____ Pumping ☒ Other _____
11. What is the greatest number of acres you have irrigated? _____ Date _____
12. How many acres did you irrigate in 1947 (Crop and pasture) 46.0
13. State the total number of additional acres that could be irrigated by increasing the water supply, land leveling, etc. ☒ This land is under what ditch? _____
14. How many acres of seeped land do you have which could be drained and put into production? ☒
15. What is the condition of your irrigation system? ☒
16. Is your water supply adequate? Yes ☒ No _____ Explain _____
17. REMARKS: See attached form

Over

NOTE: The foregoing questions apply only to irrigated land shown on this plat.

DESCRIPTION AND MAP OF FARM

18. Legal Description of this Farm

Lots 11 & 12 Sec 1, Lots 2, 3, 4, 5, 6, 7, 8² NW 4, SW 4, W² SE 4 Sec 12



IRRIGATED LAND



NON-IRRIGATED LAND

North

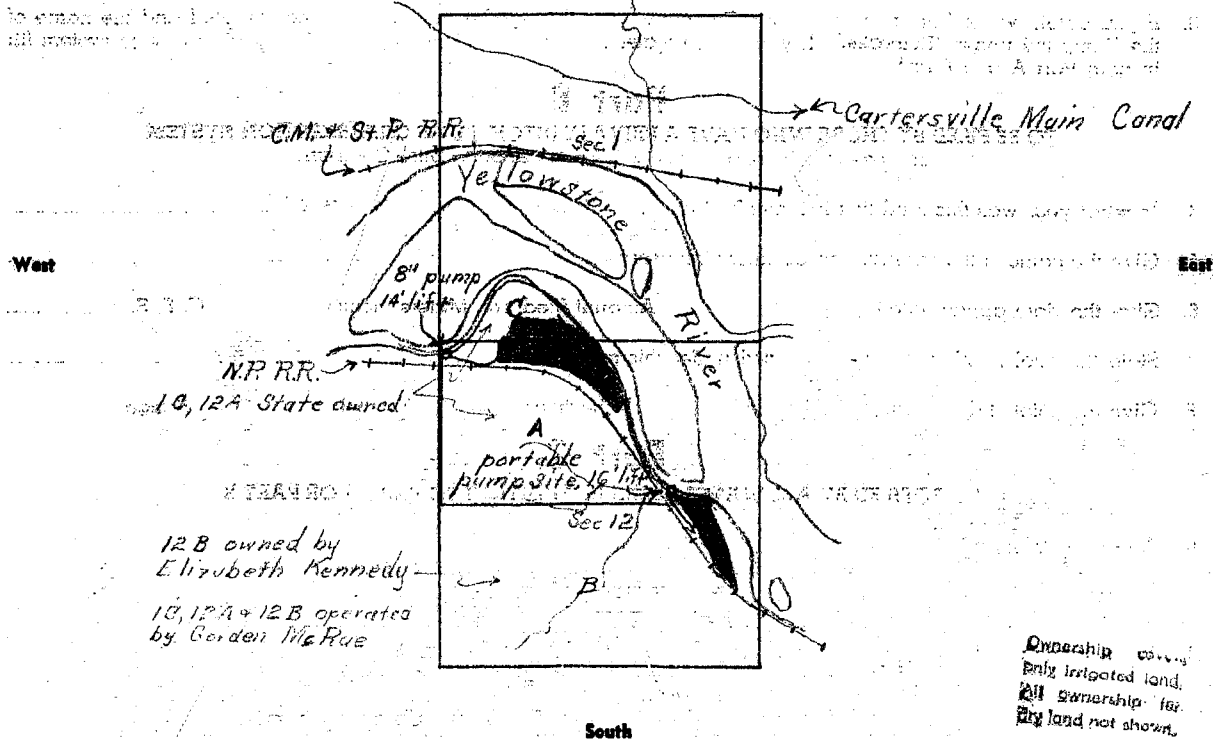

19. If the above land is irrigated from more than one ditch please give the acreage under each ditch in 19A and indicate the location of the land irrigated from each on the above map.

19A. Ditch: *McRae Private Pump* Acres: *46.0*

Ditch: _____ Acres: _____

Information supplied by:

Name _____ Address _____ Date _____

REMARKS: *See attached form*

If you cannot answer all of the questions on this form answer as many as you can and return the form to us as soon as possible.

STATE ENGINEER'S OFFICE
WATER RESOURCES SURVEYCOUNTY RosebudFILE NO. (30) 1C, 12AOwner State of Montana Address Helena

AAA Owner _____ Address _____

Operator McRae, Gordon Address Forsyth

New Owner _____ Address _____

New Operator _____ Address _____

Assessment Record NoneAssessed Acreage 0Legal Description of This Farm Lot 11 sec. 1; Lots 2, 3, 4, 5, S² NW sec. 12 T. 6N. - R. 41E.Private by Pump Total Acres in Farm _____Code Number 1C, 12APhoto No. WY 3A-02

AAA Contract No. _____

AAA Total Cropland Acreage _____

App. No. 502

Decree No. _____

Land is located in

Twp. 6N. Rge. 41E Twp. 6N. Rge. 38ETwp. 6N. Rge. 42E Twp. _____ Rge. _____Filed in Twp. 6N. Rge. 38E.

Remarks _____

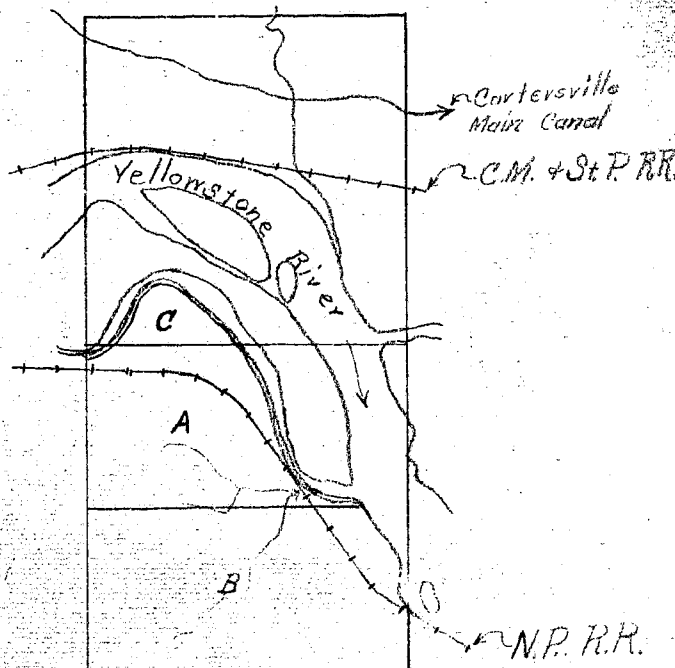
See master plan

Y.R.B.

STATE ENGINEER'S OFFICE
WATER RESOURCES SURVEYCOUNTY RosebudFILE NO. (30) 12BOwner Kennedy, Eliz.Address Rosebud~~Owner~~ McRae, GordonAddress Forsyth

Operator

Address

New Owner

Address

New Operator

Address

Assessment Record SWSE, Lots 2, 5, 6, 7 Sec. 12 T. 6N. - R. 41ECounty 23
Assessed Acreage

Legal Description of This Farm

Private by pump

Total Acres in Farm

Code Number 12BPhoto No. WY 3A-02

AAA Contract No.

AAA Total Cropland Acreage

App. No. N.R.

Decree No.

Land is located in

Twp. 6N. Rge. 41E Twp. Rge.

Twp. Rge. Twp. Rge.

Filed in Twp. 6N. Rge. 41E

Remarks

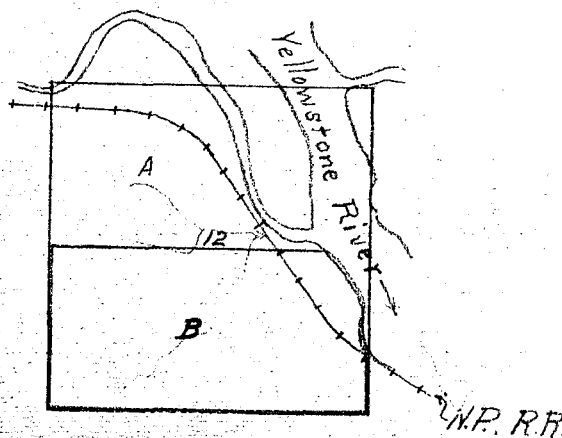
See water gauge
attached -

Y.R.B.

Farm Checked

STATE OF MONTANA

Code No. 1D, 12ABy Dava, Jim

STATE ENGINEER'S OFFICE

County RosebudArea Rosebud

WATER RESOURCES SURVEY

T. 4N R 41E Sec. 1, 12, 2Date 7/8/47Photo No. WV 3A-02Legal Land Owner Gordon McRaeAddress RosebudOperator Same

Address

Water is delivered by:

Federal Project

Pres.

Pot.

Ditch Company

Pres.

Pot.

Irrigation District

Pres.

Pot.

Private System ☒Pres. 46

Pot.

Totals 46

Flood

Pump ☒

Reservoir

Gravity

Size and Capacity, Pump, etc.

6" water lifter Tractor power 8' & 14" lift

Original Appropriator, Company

App. No.

Original Appropriator, Private no filing

(Show date of appropriation under Remarks)

App. No. ☒

Is the system an extension of another system?

Yes

No ☒

Is all land irrigated from one system?

Yes

No ☒

(If No, show break down on map)

Source of Water

Yellowstone River 2 pump sitesAcres Irrigated 1947Potential Acres none at presentsee other sideSeeped 0

Explain

Condition of System Good

Adequate Supply

Yes ☒

No

Explain

Topography 1st terrageInformation From Gordon McRae

Remarks

T6N R41E

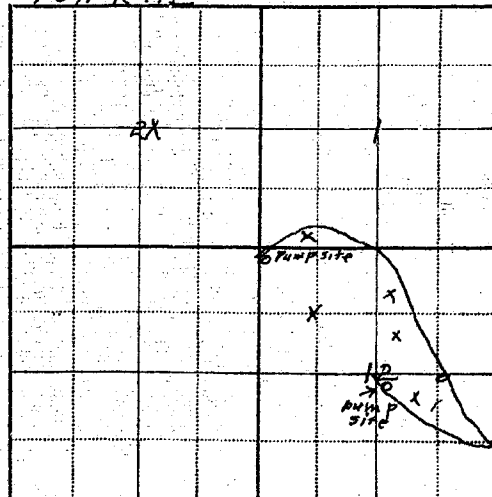

McRae Can irr. about 60 acres more on island
by leveling and putting in ditches



NOTICE
These forms are the
property of the State
of Montana and must
be returned.

STATE OF MONTANA
STATE ENGINEERS OFFICE

Water Resources Survey

Code No. 8C-98-12A

County Carbon

T. 6N R. 41

Name of Land Owner H. E. Patterson Address Forayth, Mont.
Name of Operator _____ Address _____

Part A

**TO BE FILED BY THOSE OBTAINING IRRIGATION WATER FROM
A DITCH COMPANY OR IRRIGATION DISTRICT**

1. Water is delivered by: _____ Name of Ditch, Ditch Company or District Supplying Water _____
2. State the number of acres you irrigate under this system _____ Shares you hold _____
3. If you obtain water from more than one Company, give the number of shares, acres irrigated and the name of the Company under "Remarks." If you obtain water from a Ditch Company and also have a private system fill in both Part A and Part B.

Part B

**TO BE FILED BY THOSE WHO HAVE A PRIVATE DITCH, PUMP OR IRRIGATION SYSTEM
or those who have a private water right under a Ditch Company**

4. In what year was this land first irrigated? Date See attached filings
5. Give the name of the original appropriator (first user): _____
6. Give the date appropriated _____ Amount filed on: Miners Inches _____ C. F. S. _____
7. State the total number of acres irrigated under this system: _____
8. Give the point of diversion: _____ $\frac{1}{4}$ _____ $\frac{1}{4}$ Section _____ Township _____ Range _____

Part C

TO BE FILED BY ALL WATER USERS IN ADDITION TO PART A OR PART B

9. Source of Water: Yellowstone River
Name of stream or lake from which water is originally diverted
10. Water is obtained by: (Check one) Gravity _____ Pumping ☒ Other _____
11. What is the greatest number of acres you have irrigated? 130.0 Date _____
12. How many acres did you irrigate in 1947? (Crop and pasture) 130.0
13. State the total number of additional acres that could be irrigated by increasing the water supply, land leveling, etc. 18.0 This land is under what ditch? Same
14. How many acres of seeped land do you have which could be drained and put into production? X
15. What is the condition of your irrigation system? Good
16. Is your water supply adequate? Yes ☒ No _____ Explain _____
17. REMARKS: See attached form

NOTE: The foregoing questions apply only to irrigated land shown on this plat.

DESCRIPTION AND MAP OF FARM

18. Legal Description of this Farm

*S² south of line Sec 9, S² SE
part Sec of line Sec 8, N² Sec 17 Lura R/W + line*



IRRIGATED LAND



NON-IRRIGATED LAND



Potentially Irrigable Land

North

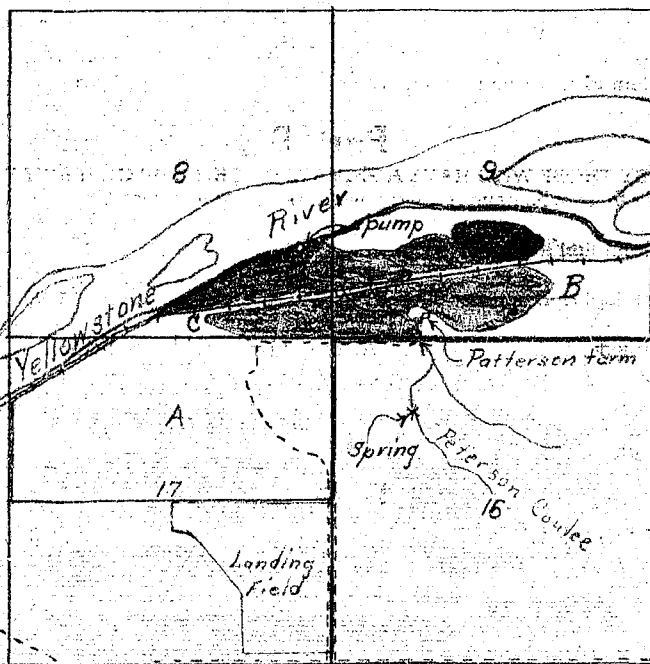

U.S. Hwy 10 + 12

South

Ownership covers
only irrigated land.
All ownership for
dry land not shown.

19. If the above land is irrigated from more than one ditch please give the acreage under each ditch in 19A and indicate the location of the land irrigated from each on the above map.

19A. Ditch: *Patterson Private Pump ditch* Acres: *130.0*

Ditch: _____ Acres: _____

Information supplied by:

Name _____ Address _____ Date _____

REMARKS: *See attached form*

If you cannot answer all of the questions on this form answer as many as you can and return the form to us as soon as possible.

STATE ENGINEER'S OFFICE
WATER RESOURCES SURVEYCOUNTY RosebudFILE NO. (30) FC, 9B, 17AOwner Patterson, H. E.Address Forsyth

AAA Owner

Address

Operator

Address

New Owner

Address

New Operator

Address

Assessment Record pt lot 6 N. of R/W, Lot 5, 6, less R/W sec. 8;
SESW, SWSE, Lots 5, 6, 7, 8 less R/W sec. 9 T. 6N. - R. 41E.
County 75
Assessed AcreageLegal Description of This Farm lots S. of River (numbers not known) sec. 8;
lots 5, 6, 7, 8, SESW, SWSE sec. 9; N² sec. 12 T. 6N. -
R. 41E. Note: map small pc. in sec. 16 under this ownership.
private Pump

Total Acres in Farm

Code Number FC, 9B, 17APhoto No. MA16-166

AAA Contract No.

AAA Total Cropland Acreage

App. No. 479, 586

Decree No.

Land is located in

Twp. 6N. Rge. 41E. Twp. Rge.

Twp. Rge. Twp. Rge.

Filed in Twp. 6N. Rge. 41E.

Remarks

V.R.B.

Farm Checked

STATE OF MONTANA

Code No.

By Dave, Jim, Joe

STATE ENGINEER'S OFFICE

County

Area Forsyth

WATER RESOURCES SURVEY

T. 6 N R. 41 E Sec.Date 7/2/47Photo No. 16-166Legal Land Owner H. E. PetersonAddress Forsyth MontanaOperator Same

Address

Water is delivered by:

Federal Project

Pres.

Pot.

Ditch Company

Pres.

Pot.

Irrigation District

Pres.

Pot.

Private System

Private Pump & coulee spring

Pres.

Pot.

Totals

130

Flood

Pump ☒

Reservoir

Gravity ☒

Size and Capacity, Pump, etc.

15-30 stationary engine - cent primer & 10' to 18' lift.

Original Appropriator, Company

App. No.

Original Appropriator, Private

H. P. Peterson

App. No.

479

(Show date of appropriation under Remarks)

Is the system an extension of another system?

Yes

No ☒

Is all land irrigated from one system?

Yes ☒

No

(If No, show break down on map)

Source of Water Yellowstone river and Peterson Coulee, spring and pipe to house & lawn.

Acres Irrigated 1946

130

Potential Acres

18.0Seeped 0

Explain

Condition of System

good

Adequate Supply

Yes ☒

No

Explain

Topography

River Bottom

Information From

M. & M. Peterson

Remarks

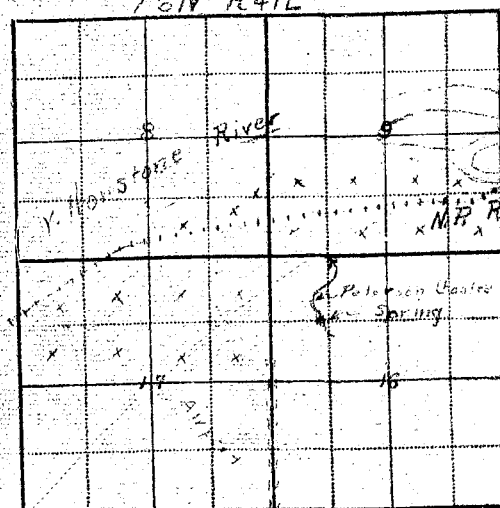
See over

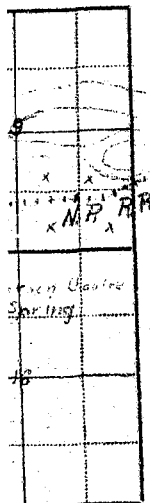
L
 Sec.
 16
 Montana
 Plan
 18.0
 Cent.
 Spring

An island is forming above pump house
 caused by a cottonwood tree, which
 in time may cut off present pump
 location.

And pumping plant may have to be
 moved.

According to Mr. Patterson, the pump was first
 used in 1909. It was ~~put~~^{set} up by Barney Blum
 for Rheim Shorey. System has been used by
 Mr. Patterson since 1927.



NOTICE
These forms are the
property of the State
of Montana and must
be preserved.

STATE OF MONTANA
STATE ENGINEERS OFFICE

Water Resources Survey

FORM WR-1-2M-12-42
Code No. (27) 3B, 4B
County Rosebud
T. 6N. R. 4E.

Name of Land Owner Wenholz, C. L. Address Forsyth, Montana

Name of Operator _____ Address _____

Part A

TO BE FILED BY THOSE OBTAINING IRRIGATION WATER FROM
A DITCH COMPANY OR IRRIGATION DISTRICT

1. Water is delivered by: Cartersville Irrigation Ditch
Name of Ditch, Ditch Company or District Supplying Water
2. State the number of acres you irrigate under this system. 164 Shares you hold none
3. If you obtain water from more than one Company, give the number of shares, acres irrigated and the name of the Company under "Remarks." If you obtain water from a Ditch Company and also have a private system fill in both Part A and Part B.

Part B

TO BE FILED BY THOSE WHO HAVE A PRIVATE DITCH, PUMP OR IRRIGATION SYSTEM
or those who have a private water right under a Ditch Company

4. In what year was this land first irrigated? Date _____
5. Give the name of the original appropriator (first user): _____
6. Give the date appropriated _____ Amount filed on: Miners Inches _____ C. F. S. _____
7. State the total number of acres irrigated under this system: _____
8. Give the point of diversion: 1/4 1/4 Section _____ Township _____ Range _____

Part C

TO BE FILED BY ALL WATER USERS IN ADDITION TO PART A OR PART B

9. Source of Water: Yellowstone River
Name of stream or lake from which water is originally diverted
10. Water is obtained by: (Check one) Gravity _____ Pumping ☒ Other _____
11. What is the greatest number of acres you have irrigated? 164 Date 1938 - to 1947 Inc.
12. How many acres did you irrigate in 1947? (Crop and pasture) 164
13. State the total number of additional acres that could be irrigated by increasing the water supply, land leveling, etc. 100 This land is under what ditch? Cartersville Irrigation Ditch
14. How many acres of seeped land do you have which could be drained and put into production? 5A
15. What is the condition of your irrigation system? very good
16. Is your water supply adequate? Yes ☒ No _____ Explain _____
17. REMARKS: I am buying on contract 1/2 of 1/2 sec 4 T6 R4 E
I am renting that irrigated section shown on
the map in SW 1/4 sec 3
I began in 1900 + 10 ft. to bed exp.

Over

NOTE: The foregoing questions apply only to irrigated land shown on this plat.

DESCRIPTION AND MAP OF FARM

18. Legal Description of this Farm SW 1/4 No. R/W Sec. 3; E 1/2 less Rd. & R/W Sec. 4, T. 6N., R. 41E

Description of



IRRIGATED LAND



NON-IRRIGATED LAND



Potentially irrigable land

North

Map showing the location of the farm and the irrigation system.

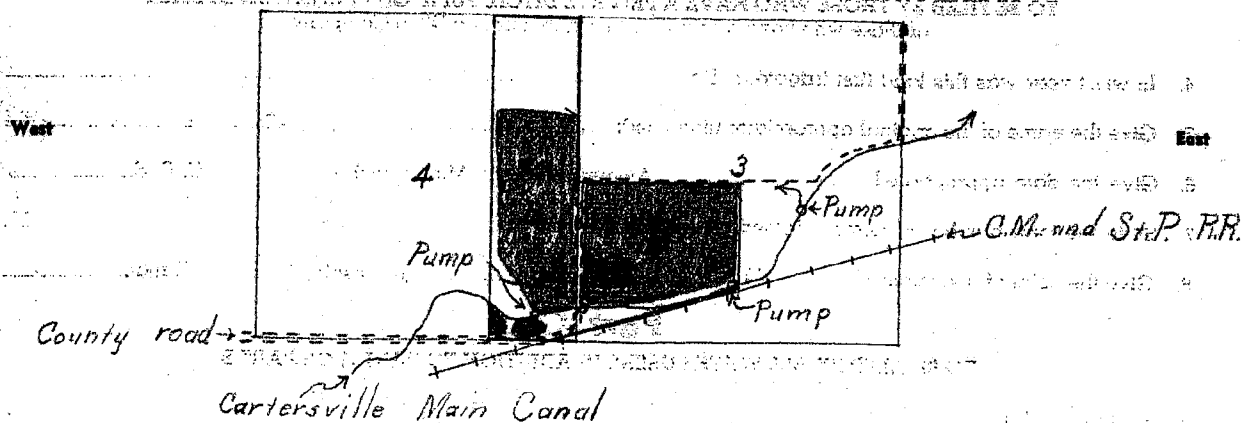

Shading covers
only irrigated land.
All ownership for
dry land not shown.

19. If the above land is irrigated from more than one ditch please give the acreage under each ditch in 19A and indicate the location of the land irrigated from each on the above map.

19A. Ditch: Cartersville In ditch Acres: 190.0

Ditch: Potential Deeped Acres: 20.0

Information supplied by:

Name C. L. W. W. W. W. Address Farm 13, 1948

REMARKS: Removable Water Lifter type, lift is 8 ft.

If you cannot answer all of the questions on this form answer as many as you can and return the form to us as soon as possible.

STATE ENGINEER'S OFFICE
WATER RESOURCES SURVEYCOUNTY RosebudFILE NO. (30) 3B, 4BOwner Wenholz, C. L.Address Forsyth

AAA Owner

Address

Operator

Address

New Owner

Address

New Operator

Address

Assessment Record SW⁴ No. R/W sec. 3; E²E² less Rd. & R/W sec. 4
T. 6N. - R. 41E.County 130.00
Assessed Acreage 5.55

Legal Description of This Farm

Cartersville & Pump

Total Acres in Farm

Code Number 3B, 4BPhoto No. MAH 166

AAA Contract No.

AAA Total Cropland Acreage

App. No. 886, 954, 959

Decree No.

Land is located in

Twp. 6N. Rge. 41E Twp. Rge.

Twp. Rge. Twp. Rge.

Filed in Twp. 6N. Rge. 41E

Remarks

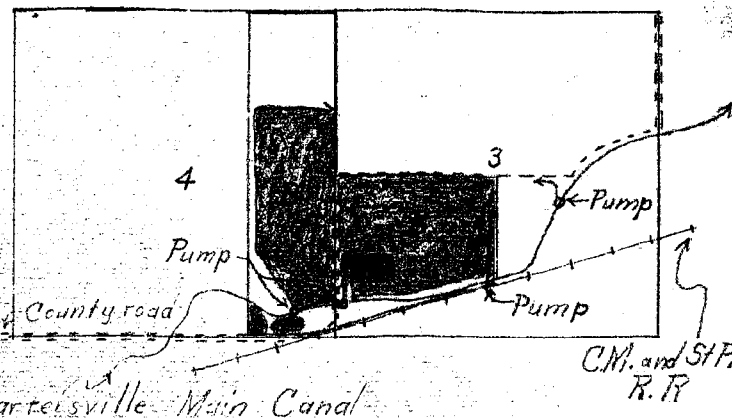

Y.R.B.