

NOTE: The foregoing questions apply only to irrigated land shown on this plat.

DESCRIPTION AND MAP OF FARM

18. Legal Description

is Farm

All sec 30 - 6 N - 44



IRRIGATED LAND

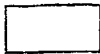

NON-IRRIGATED LAND



Potentially Irrigable Land

North

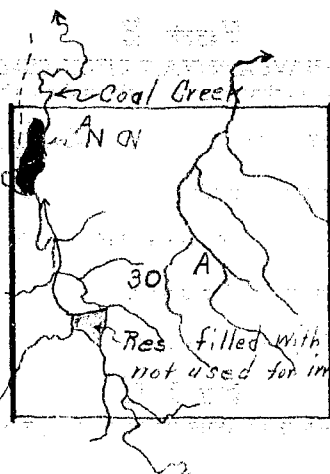

West

East

South

One acre = 43,560 sq ft
Irrigated land
All ownership for
dry land not shown

19. If the above land is irrigated from more than one ditch please give the acreage under each ditch in 19A and indicate the location of the land irrigated from each on the above map.

19A. Ditch:

Acres:

Ditch:

Acres:

Information supplied by:

Name

Paul Sweeney

Address

Date

7/1/47

REMARKS:

D. Paulist & J. E. Cook

If you cannot answer all of the questions on this form answer as many as you can and return the form to us as soon as possible.

**STATE ENGINEER'S OFFICE
WATER RESOURCES SURVEY**

COUNTY RosebudFILE NO. 33 - 30AOwner N.P.R.R. Address St. Paul, Minn.

AAA Owner Address

Operator N.O. Address

New Owner Address

New Operator Address

Assessment Record No

Assessed Acreage

Legal Description of This Farm All Sec. 30, T. 6N., R. 44E.Private Flood Cool Creek Total Acres in FarmCode Number 30APhoto No. MA-32-55

AAA Contract No.

AAA Total Cropland Acreage 0App. No. 166

Decree No.

Land is located in

Twp. 6N. Rge. 44E. Twp. 6N. Rge. 42E.

Twp. Rge. Twp. Rge.

Filed in Twp. 6N. Rge. 42E.

Remarks



SEAL OF THE STATE OF MONTANA
DEPARTMENT OF THE STATE ENGINEER
BUTTE, MONTANA

STATE OF MONTANA
STATE ENGINEERS OFFICE
Water Resources Survey

FORM WR-1-28 12-67

Code No. 7B-18C

County Rosebud

T. 6N R. 44

Name of Land Owner Northwest Trust Co Address St Paul, Minn

Name of Operator See W.R. 2 Address _____

Part A

**TO BE FILED BY THOSE OBTAINING IRRIGATION WATER FROM
A DITCH COMPANY OR IRRIGATION DISTRICT**

1. Water is delivered by: Gustavus Smith Irr. Dist
Name of Ditch, Ditch Company or District Supplying Water
2. State the number of acres you irrigate under this system 231.0 Shares you hold 193.71
3. If you obtain water from more than one Company, give the number of shares, acres irrigated and the name of the Company under "Remarks." If you obtain water from a Ditch Company and also have a private system fill in both Part A and Part B.

Part B

**TO BE FILED BY THOSE WHO HAVE A PRIVATE DITCH, PUMP OR IRRIGATION SYSTEM
or those who have a private water right under a Ditch Company**

4. In what year was this land first irrigated? Date _____
5. Give the name of the original appropriator (first user): _____
6. Give the date appropriated _____ Amount filed on: Miners Inches _____ C. F. S. _____
7. State the total number of acres irrigated under this system: _____
8. Give the point of diversion: _____ $\frac{1}{4}$ _____ $\frac{1}{4}$ Section _____ Township _____ Range _____

Part C

TO BE FILED BY ALL WATER USERS IN ADDITION TO PART A OR PART B

9. Source of Water: Yellowstone River
Name of stream or lake from which water is originally diverted
10. Water is obtained by: (Check one) Gravity ☒ Pumping _____ Other _____
11. What is the greatest number of acres you have irrigated? 231.0 Date _____
12. How many acres did you irrigate in 1947 (Crop and pasture) 231.0
13. State the total number of additional acres that could be irrigated by increasing the water supply, land leveling, etc. 0 This land is under what ditch? C
14. How many acres of seeped land do you have which could be drained and put into production? C
15. What is the condition of your irrigation system? Fair
16. Is your water supply adequate? Yes ☒ No _____ Explain _____
17. REMARKS: _____

Over

NOTE: The foregoing questions apply only to irrigated land shown on this plat.

DESCRIPTION AND MAP OF FARM

18. Legal Description of this Farm

See attached WK-2



IRRIGATED LAND



NON-IRRIGATED LAND



Potentially Irrigable Land

North

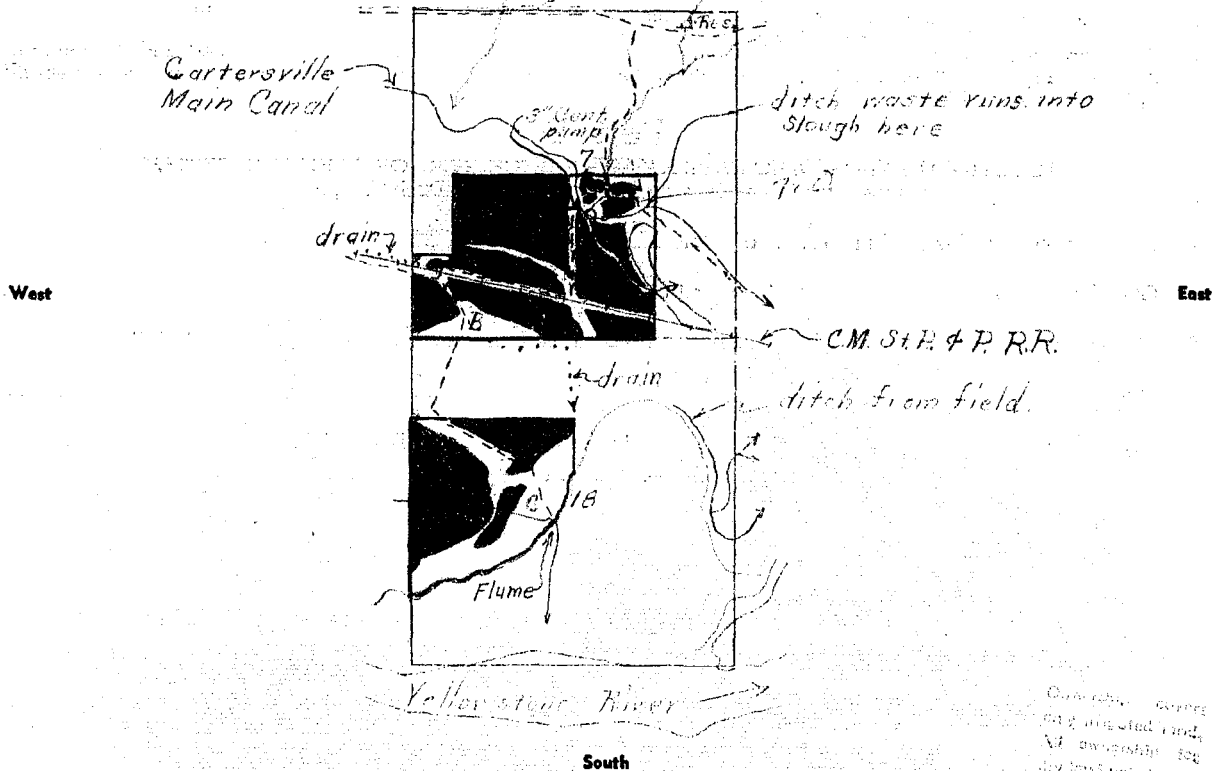

19. If the above land is irrigated from more than one ditch please give the acreage under each ditch in 19A and indicate the location of the land irrigated from each on the above map.

19A. Ditch: *Cartersville Orr dist (Pump)* Acres: *7.0*
Ditch: *"* *"* *Gravity* Acres: *224.0*
231.0

Information supplied by:

Name *Field Survey* Address _____ Date *6/16/47*

REMARKS:

Some wet spots

If you cannot answer all of the questions on this form answer as many as you can and return the form to us as soon as possible.

STATE ENGINEER'S OFFICE

WATER RESOURCES SURVEY

COUNTY RosebudFILE NO. 33 - TR. 18C, 7BOwner Northwest Trust Co.Address St. Paul, Minn.AAA Owner Shand, B. F.Address Rosebud, MontanaOperator Satake, Samuel I.
Wilson, C. C.Address Rosebud, Montana
Cartersville, Mont.

New Owner

Address

New Operator

Address

Assessment Record YesCounty 145Assessed Acreage 193.71Legal Description of This Farm E. 1/2 Lot 3, Lot 4, 5, 8, E. 1/2 Sec. 7; Lot 2, 3, 7, Sec. 18,
T. 6N., R. 14E.Cartersville Irrigation District and Pump

Total Acres in Farm

Code Number 7B, 18CPhoto No. MA-32-54

AAA Contract No.

AAA Total Cropland Acreage 251.60App. No. H.R.

Decree No.

Land is located in

Twp. 6N. Rge. 44E. Twp. Rge.

Twp. Rge. Twp. Rge.

Filed in Twp. 6N. Rge. 44E.

Remarks

Y.R.B.



These forms are the
property of the State
of Montana and must
be returned.

STATE OF MONTANA
STATE ENGINEERS OFFICE

Water Resources Survey

FORM WR-1--2N 12-47

Code No. 18A

County Rosebud

T. 6 N. R. 44 E

Name of Land Owner Gavin Robertson Address Rosebud, Mont

Name of Operator Samuel J. Satake Address " "

Part A

TO BE FILED BY THOSE OBTAINING IRRIGATION WATER FROM
A DITCH COMPANY OR IRRIGATION DISTRICT

1. Water is delivered by: Rosebud Irr. Dist.
Name of Ditch, Ditch Company or District Supplying Water
2. State the number of acres you irrigate under this system 42.0 Shares you hold 70.80
3. If you obtain water from more than one Company, give the number of shares, acres irrigated and the name of the Company under "Remarks." If you obtain water from a Ditch Company and also have a private system fill in both Part A and Part B.

Part B

TO BE FILED BY THOSE WHO HAVE A PRIVATE DITCH, PUMP OR IRRIGATION SYSTEM
or those who have a private water right under a Ditch Company

4. In what year was this land first irrigated? Date
5. Give the name of the original appropriator (first user):
6. Give the date appropriated Amount filed on: Miners Inches C. F. S.
7. State the total number of acres irrigated under this system:
8. Give the point of diversion: 1/4 1/4 Section Township Range

Part C

TO BE FILED BY ALL WATER USERS IN ADDITION TO PART A OR PART B

9. Source of Water: Yellowstone River
Name of stream or lake from which water is originally diverted
10. Water is obtained by: (Check one) Gravity ☒ Pumping ☐ Other ☐
11. What is the greatest number of acres you have irrigated? 50.0 Date
12. How many acres did you irrigate in 1947 (Crop and pasture) 42
13. State the total number of additional acres that could be irrigated by increasing the water supply, land leveling, etc. 8.0 This land is under what ditch? Same
14. How many acres of seeped land do you have which could be drained and put into production? 8.0
15. What is the condition of your irrigation system? Fair
16. Is your water supply adequate? Yes ☒ No ☐ Explain
17. REMARKS:

Over

NOTE: The foregoing questions apply only to irrigated land shown on this plat.

DESCRIPTION AND MAP OF FARM

18. Legal Description of this Farm

Lot 1, NE4 NW4, Sec 18



IRRIGATED LAND



NON-IRRIGATED LAND



Potentially Irrigable Land

North

West

East

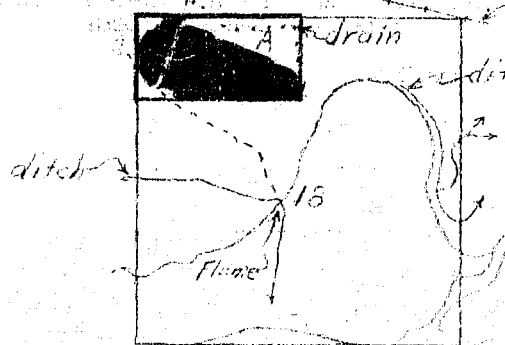

South

19. If the above land is irrigated from more than one ditch please give the acreage under each ditch in 19A and indicate the location of the land irrigated from each on the above map.

19A. Ditch:

Carterville Irr ditch

Acres: *42.0*

Ditch:

Acres:

Information supplied by:

Name

Field Survey

Address

Date

6/18/17

REMARKS:

Flume to Dore Pauline

If you cannot answer all of the questions on this form answer as many as you can and return the form to us as soon as possible.

STATE ENGINEER'S OFFICE
WATER RESOURCES SURVEY

COUNTY RosebudFILE NO. 33 -18AOwner Robertson, Gavin Address Rosebud, Montana

AAA Owner Address

Operator Satake, Samuel I. Address Rosebud, Montana

New Owner Address

New Operator Address

Assessment Record Yes

County 0
Assessed Acreage 70.80

Legal Description of This Farm: Lot 1, NE 1/4 Sec. 18, T. 6N., R. 44E.Cartersville Irrigation District

Total Acres in Farm

Code Number 18APhoto No. MA-32-54

AAA Contract No.

AAA Total Cropland Acreage 57.5App. No. N.R.

Decree No.

Land is located in

Twp. 6N. Rge. 44E. Twp. 6N. Rge. 43E.

Twp. Rge. Twp. Rge.

Filed in Twp. 6N. Rge. 43E.

Remarks

Y.R.B.



These forms and the
contents of the State
of Montana and land
to be produced.

STATE OF MONTANA
STATE ENGINEERS OFFICE
Water Resources Survey

FORM WR-1-2M 12-67

Code No. 18B-18D

County Rosebud

T. 6N R. 44

Name of Land Owner B. F. Shand Address Rosebud, Mont

Name of Operator Address

Part A

TO BE FILED BY THOSE OBTAINING IRRIGATION WATER FROM
A DITCH COMPANY OR IRRIGATION DISTRICT

1. Water is delivered by: Cartersville Irr. dist
Name of Ditch, Ditch Company or District Supplying Water
2. State the number of acres you irrigate under this system 99.0 Shares you hold 93.16
3. If you obtain water from more than one Company, give the number of shares, acres irrigated and the name of the Company under "Remarks." If you obtain water from a Ditch Company and also have a private system fill in both Part A and Part B.

Part B

TO BE FILED BY THOSE WHO HAVE A PRIVATE DITCH, PUMP OR IRRIGATION SYSTEM
or those who have a private water right under a Ditch Company

4. In what year was this land first irrigated? Date
5. Give the name of the original appropriator (first user):
6. Give the date appropriated Amount filed on: Miners Inches C. F. S.
7. State the total number of acres irrigated under this system:
8. Give the point of diversion: $\frac{1}{4}$ $\frac{1}{4}$ Section Township Range

Part C

TO BE FILED BY ALL WATER USERS IN ADDITION TO PART A OR PART B

9. Source of Water: Yellowstone River
Name of stream or lake from which water is originally diverted
10. Water is obtained by: (Check one) Gravity ☒ Pumping ☐ Other ☐
11. What is the greatest number of acres you have irrigated? 99.0 Date
12. How many acres did you irrigate in 1947 (Crop and pasture) 99.0
13. State the total number of additional acres that could be irrigated by increasing the water supply, land leveling, etc. 0 This land is under what ditch? 0
14. How many acres of seeped land do you have which could be drained and put into production? 0
15. What is the condition of your irrigation system? Fair
16. Is your water supply adequate? Yes ☒ No ☐ Explain
17. REMARKS:

Over

NOTE: The foregoing questions apply only to irrigated land shown on this plat.

DESCRIPTION AND MAP OF FARM

18. Legal Description of this Farm Lots 8, 9, 4, 5, 6, 10, 11, 12, 13, 14, NE 1/4 Sec 18



IRRIGATED LAND



NON-IRRIGATED LAND

North

West

East

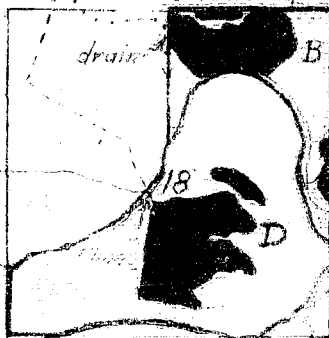

South

19. If the above land is irrigated from more than one ditch please give the acreage under each ditch in 19A and indicate the location of the land irrigated from each on the above map.

19A. Ditch: Westerville Ditch Acres: 99.0

Ditch: _____ Acres: _____

Information supplied by:

Name Smith Address _____ Date 6/26/47

REMARKS: Good & clean

If you cannot answer all of the questions on this form answer as many as you can and return the form to us as soon as possible.

STATE ENGINEER'S OFFICE
WATER RESOURCES SURVEY

COUNTY Rosebud

FILE NO. 33 - 18B, 18D

Owner Shand, B. F. Address Rosebud, Montana

AAA Owner Address

Operator N.O. Address

New Owner Address

New Operator Address

Assessment Record Yes

County 18

Assessed Acreage 93.16

Legal Description of This Farm Lots 8, 9, 4, 5, 6, 10, 11, 12, 13, 14, NE 1/4 Sec. 18,

T. 6N., R. 44E.

Cartersville Irrigation District Total Acres in Farm

Code Number 18B, 18D

Photo No. MA-32-54

AAA Contract No.

AAA Total Cropland Acreage 89.55

App. No. N.R.

Decree No.

Land is located in

Twp. 6N. Rge. 44E. Twp. 7N. Rge. 44E.

Twp. Rge. Twp. Rge.

Filed in Twp. 6N. Rge. 44E.

Remarks

Y.R.B.



These forms are the
property of the State
and should be kept
in good condition.

STATE OF MONTANA
STATE ENGINEERS OFFICE

Water Resources Survey

FORM WR-1-2M 12-47

Code No. 1A
County Bozeman
T. 6N R. 44E

Name of Land Owner

Poy Sader

Address

Hathaway, Mont

Name of Operator

Address

Part A

TO BE FILED BY THOSE OBTAINING IRRIGATION WATER FROM
A DITCH COMPANY OR IRRIGATION DISTRICT

1. Water is delivered by: _____ Name of Ditch, Ditch Company or District Supplying Water _____ Shares you hold _____
2. State the number of acres you irrigate under this system _____
3. If you obtain water from more than one Company, give the number of shares, acres irrigated and the name of the Company under "Remarks." If you obtain water from a Ditch Company and also have a private system fill in both Part A and Part B.

Part B

TO BE FILED BY THOSE WHO HAVE A PRIVATE DITCH, PUMP OR IRRIGATION SYSTEM
or those who have a private water right under a Ditch Company

4. In what year was this land first irrigated? Date No data
5. Give the name of the original appropriator (first user): _____
6. Give the date appropriated _____ Amount filed on: Miners Inches _____ C. F. S. _____
7. State the total number of acres irrigated under this system: _____
8. Give the point of diversion: _____ $\frac{1}{4}$ _____ $\frac{1}{4}$ Section _____ Township _____ Range _____

Part C

TO BE FILED BY ALL WATER USERS IN ADDITION TO PART A OR PART B

9. Source of Water: Gallatin River Name of stream or lake from which water is originally diverted _____
10. Water is obtained by: (Check one) Gravity _____ Pumping X Other _____
11. What is the greatest number of acres you have irrigated? 15.0 Date _____
12. How many acres did you irrigate in 1947 (Crop and pasture) 15.0
13. State the total number of additional acres that could be irrigated by increasing the water supply, land leveling, etc. 0 This land is under what ditch? 0
14. How many acres of seeped land do you have which could be drained and put into production? 0
15. What is the condition of your irrigation system? Fair
16. Is your water supply adequate? Yes _____ No X Explain Only in high water
17. REMARKS: See attached forms

Over

NOTE: The foregoing questions apply only to irrigated land shown on this plat.

DESCRIPTION AND MAP OF FARM

18. Legal Description of this Farm Pt. Lot, 8, 9, 10 Sec 1



IRRIGATED LAND



NON-IRRIGATED LAND

North

West

East

South

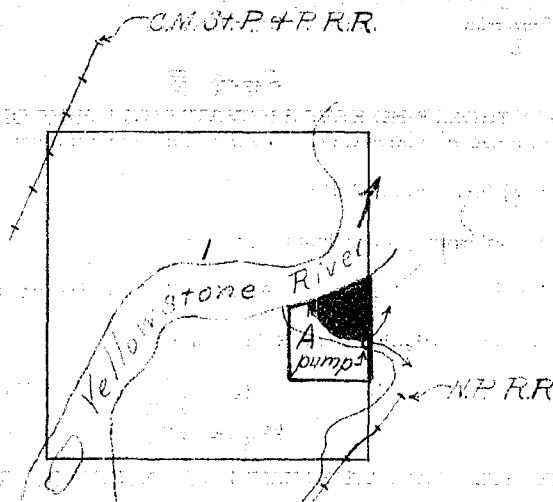

Shading
only irrigated land.
All ownership for
the land not shown.

19. If the above land is irrigated from more than one ditch please give the acreage under each ditch in 19A and indicate the location of the land irrigated from each on the above map.

19A. Ditch: Private Pump & High Yell. River Acres: 15.0
Ditch: _____ Acres: _____

Information supplied by:

Name Field Survey Address _____ Date 5/16/47

REMARKS: Johnson & J. Paulist

If you cannot answer all of the questions on this form answer as many as you can and return the form to us as soon as possible.

STATE ENGINEER'S OFFICE

WATER RESOURCES SURVEY

COUNTY RosebudFILE NO. 33 - 1AOwner Sadler, Roy Address Hathaway, Montana

AAA Owner Address

Operator N.C. Address

New Owner Address

New Operator Address

Assessment Record No

Assessed Acreage

Legal Description of This Farm Parts Lots 8,9,10 Section 1, T. 6N., R. 44E.(Extends into Custer County)Private Pump Yellowstone Total Acres in FarmCode Number 1APhoto No. MA-22-153

AAA Contract No.

AAA Total Cropland Acreage 0App. No. N.R.

Decree No.

Land is located in

Twp. 6N. Rge. 44E. Twp. Rge.

Twp. Rge. Twp. Rge.

Filed in Twp. 6N. Rge. 44E.

Remarks

Farm Checked

STATE OF MONTANA

Code No.

By Doc & Collins

STATE ENGINEER'S OFFICE

County

Area Miles City - West

WATER RESOURCES SURVEY

T. 6N.

R. 45E.

Sec. 6

Date 5/16/47

Photo No.

MA 22-152Legal Land Owner Saddler, R. J.

Address

Hathaway

Operator

same

Address

Water is delivered by:

Federal Project

Pres.

Pot.

Ditch Company

Pres.

Pot.

Irrigation District

Pres.

Pot.

Private System

pump & ditches - flood ditches

Pres.

90

Pot.

Totals

Flood

☒

Pump

☒

Reservoir

Gravity

Size and Capacity, Pump, etc.

6-8 cent. - 15' lift - tractor power

Original Appropriator, Company

App. No.

Original Appropriator, Private

pump Snell or Lakin Bros.Snell & Theade about 35 ac. filing
(Show date of appropriation under Remarks)

App. No.

Is the system an extension of another system?

Yes

No

Is all land irrigated from one system?

Yes

No

(If No, show break down on map)

Source of Water

Snell Cr., Theade Cr., Slough of the Yellowstone

Acres Irrigated 19

4690

Potential Acres

0

Seeped

0

Explain

Condition of System

fair

Adequate Supply

Yes

No

Explain

Flood only on the creeks, high water only on the slough

Topography

1st. Terrace

Information From

Saddler

Remarks

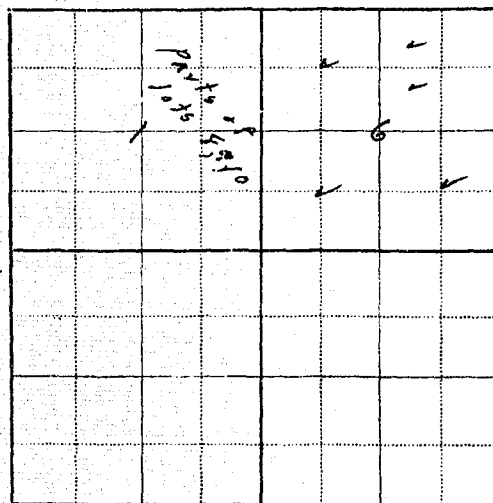
Floods & pumps on same ground, about 20 acres flood only

TE
also filed in
T. 6N-45E.
R. 45E.
Sec. 6
Custer



These forms and the
records of the State
of Montana are to be
retained.

STATE OF MONTANA
STATE ENGINEERS OFFICE

Water Resources Survey

FORM WR-1-2M 18-47

Code No. 21A

County Rosebud

T. _____ R. _____

Name of Land Owner Orlando Suffice Address Moravia, Iowa

Name of Operator _____ Address _____

Part A

TO BE FILED BY THOSE OBTAINING IRRIGATION WATER FROM
A DITCH COMPANY OR IRRIGATION DISTRICT

1. Water is delivered by: _____
Name of Ditch, Ditch Company or District Supplying Water
2. State the number of acres you irrigate under this system _____ Shares you hold _____
3. If you obtain water from more than one Company, give the number of shares, acres irrigated and the name of the Company under "Remarks." If you obtain water from a Ditch Company and also have a private system fill in both Part A and Part B.

Part B

TO BE FILED BY THOSE WHO HAVE A PRIVATE DITCH, PUMP OR IRRIGATION SYSTEM
or those who have a private water right under a Ditch Company

4. In what year was this land first irrigated? Date No date
5. Give the name of the original appropriator (first user): _____
6. Give the date appropriated _____ Amount filed on: Miners Inches _____ C. F. S. _____
7. State the total number of acres irrigated under this system: _____
8. Give the point of diversion: _____ $\frac{1}{4}$ _____ $\frac{1}{4}$ Section _____ Township _____ Range _____

Part C

TO BE FILED BY ALL WATER USERS IN ADDITION TO PART A OR PART B

9. Source of Water: Union Jaw Creek
Name of stream or lake from which water is originally diverted
10. Water is obtained by: (Check one) Gravity ☒ Pumping _____ Other Flood
11. What is the greatest number of acres you have irrigated? 191.0 Date _____
12. How many acres did you irrigate in 1947 (Crop and pasture) 191.0
13. State the total number of additional acres that could be irrigated by increasing the water supply, land leveling, etc. 0 This land is under what ditch? 0
14. How many acres of seeped land do you have which could be drained and put into production? 0
15. What is the condition of your irrigation system? Good
16. Is your water supply adequate? Yec _____ No ☒ Explain Only flood waters
17. REMARKS: _____

Over

NOTE: The foregoing sections apply only to irrigated land shown on this plat.

DESCRIPTION AND MAP OF FARM

18. Legal Description of this Farm All sec 21,



IRRIGATED LAND



NON-IRRIGATED LAND

North

West

East

South

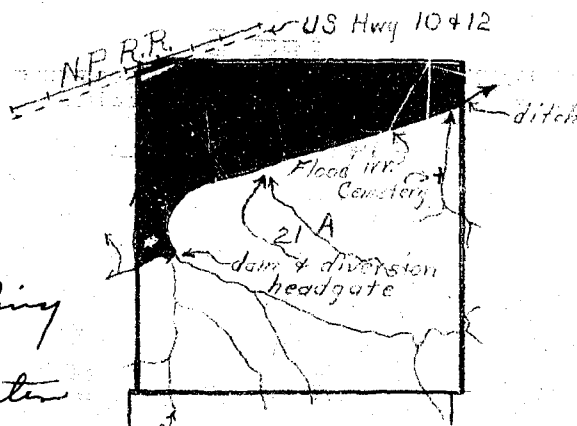

Considerable
natural flooding
ditch used to
distribute water

all land could be irrigated by the Banning Pump System
Land used to produce Hay

Considerable
only irrigated land,
At ownership for
dry land now shown

19. If the above land is irrigated from more than one ditch please give the acreage under each ditch in 19A and indicate the location of the land irrigated from each on the above map.

19A. Ditch: Private ditch across Jaw Cr. Flood Acres: 191.0

Ditch: _____ Acres: _____

Information supplied by:

Name Field Survey Address _____ Date 6/30/47

REMARKS: J. Cook & D. Paulin

If you cannot answer all of the questions on this form answer as many as you can and return the form to us as soon as possible.

STATE ENGINEER'S OFFICE
WATER RESOURCES SURVEYCOUNTY RosebudFILE NO. 33 - 21AOwner Sufficool, Orlando Address Moravia, Iowa

AAA Owner Address

Operator N.O. Address

New Owner Address

New Operator Address

Assessment Record YesCounty 240
Assessed AcreageLegal Description of This Farm All Sec. 21, T. 6N., R. 44E.

Private Flood Total Acres in Farm

Code Number 21APhoto No. MA-22-41

AAA Contract No.

AAA Total Cropland Acreage 248.1App. No. N.R.

Decree No.

Land is located in

Twp. 6N. Rge. 44E. Twp. Rge.

Twp. Rge. Twp. Rge.

Filed in Twp. 6N. Rge. 44E.

Remarks



These forms are for
recording of the State
of Montana and must
be returned.

STATE OF MONTANA
STATE ENGINEERS OFFICE

Water Resources Survey

FORM WAR-1-2M 12-47

Code No. 11A-14A

County Rosebud

T. 6N R. 44

Name of Land Owner Frank Turner Address Rosebud, Mont

Name of Operator _____ Address _____

Part A

TO BE FILED BY THOSE OBTAINING IRRIGATION WATER FROM
A DITCH COMPANY OR IRRIGATION DISTRICT

1. Water is delivered by: _____
Name of Ditch, Ditch Company or District Supplying Water
2. State the number of acres you irrigate under this system _____ Shares you hold _____
3. If you obtain water from more than one Company, give the number of shares, acres irrigated and the name of the Company under "Remarks." If you obtain water from a Ditch Company and also have a private system fill in both Part A and Part B.

Part B

TO BE FILED BY THOSE WHO HAVE A PRIVATE DITCH, PUMP OR IRRIGATION SYSTEM
or those who have a private water right under a Ditch Company

4. In what year was this land first irrigated? Date See attached filings
5. Give the name of the original appropriator (first user): _____
6. Give the date appropriated _____ Amount filed on: Miners Inches _____ C. F. S. _____
7. State the total number of acres irrigated under this system: _____
8. Give the point of diversion: _____ $\frac{1}{4}$ _____ $\frac{1}{4}$ Section _____ Township _____ Range _____

Part C

TO BE FILED BY ALL WATER USERS IN ADDITION TO PART A OR PART B

9. Source of Water: Branchyard Creek
Name of stream or lake from which water is originally diverted
10. Water is obtained by: (Check one) Gravity ☒ Pumping _____ Other _____
11. What is the greatest number of acres you have irrigated? 130.0 Date _____
12. How many acres did you irrigate in 1947 (Crop and pasture) 130.
13. State the total number of additional acres that could be irrigated by increasing the water supply, land leveling, etc. 2.0 This land is under what ditch? Flowed from Branchyard Creek
14. How many acres of seeped land do you have which could be drained and put into production? _____
15. What is the condition of your irrigation system? Fair
16. Is your water supply adequate? Yes _____ No ☒ Explain I have water
17. REMARKS: _____

Over

NOTE: The foregoing questions apply only to irrigated land shown on this plat.

DESCRIPTION AND MAP OF FARM

18. Legal Description of this Farm

See attached WC-2



IRRIGATED LAND

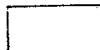

NON-IRRIGATED LAND



Potentially Irrigable Land

North

West

East

South

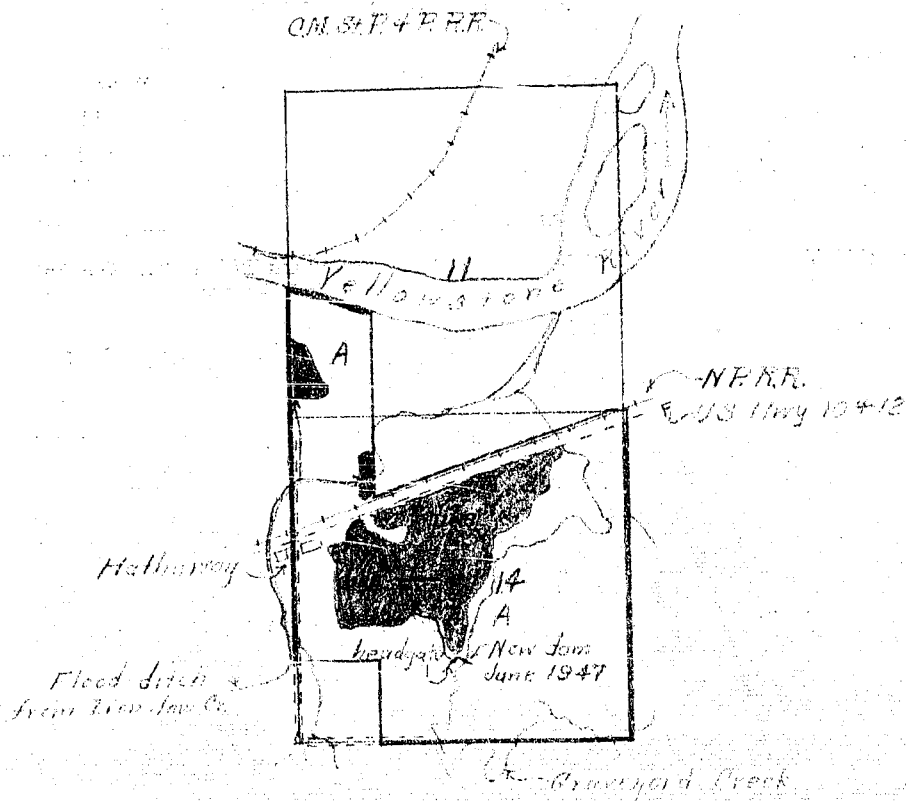

19. If the above land is irrigated from more than one ditch please give the acreage under each ditch in 19A and indicate the location of the land irrigated from each on the above map.

19A. Ditch: *Flood in Holloway Creek* Acres: *130.0*

Ditch: *12 acres Potential Brown Jan. Creek* Acres: _____

Information supplied by:

Name *See attached form* Address _____ Date _____

REMARKS:

If you cannot answer all of the questions on this form answer as many as you can and return the form to us as soon as possible.

STATE ENGINEER'S OFFICE
WATER RESOURCES SURVEY

COUNTY Rosebud

FILE NO. 33 - 11A, 14A

Owner Turner, Frank Address Rosebud, Montana
AAA Owner Address
Operator N.O. Address
New Owner Address
New Operator Address

Assessment Record No

Assessed Acreage

Legal Description of This Farm Lots 6,7, Sec. 11; Lot 3, Sec. 1, E1/4, N1/4, S1/4, S1/4, NE1/4, NE1/4 SO. of R/W, and Lots 1,2 So. of R/W Sec. 14,
T. 6N., R. 44E.

Private flood and private pump Total Acres in Farm

Code Number 11A, 14A

Photo No. MA-22-153

AAA Contract No.

AAA Total Cropland Acreage 120.9

App. No. 447, 288, 928

Decree No.

Land is located in

Twp. 6N. Rge. 44E. Twp. Rge.

Twp. Rge. Twp. Rge.

Filed in Twp. 6N. Rge. 44E.

Remarks

Y.R.B.

Farm Checked

STATE OF MONTANA

Code No. 14B, 11ABy Dave, Jim, Joe

STATE ENGINEER'S OFFICE

County RosebudArea Hathaway

WATER RESOURCES SURVEY

T. 6N R. 44E Sec. 14Date 6/26/47Photo No. 22-153Legal Land Owner Frank TurnerAddress Rosebud Mont.Operator Same

Address

Water is delivered by:

Federal Project

Pres.

Pot.

Ditch Company

Pres.

Pot.

Irrigation District

Pres.

Pot.

Private System Private FloodPres. 30.0

Planum

Pot. 0

Totals

Flood. ☒

Pump

Reservoir ☒

Gravity

Size and Capacity, Pump, etc.

Original Appropriator, Company

App. No.

Original Appropriator, Private Mrs. K.A. LottApp. No. 288

(Show date of appropriation under Remarks)

Is the system an extension of another system?

Yes ☐ No ☐

Is all land irrigated from one system?

Yes ☒ No ☐

(If No, show break down on map)

Source of Water Graveyard CreekAcres Irrigated 19 47 130Potential Acres none Seeped 0

Explain

Condition of System good

Adequate Supply

Yes ☐No ☐Explain Adequate only in wet seasonTopography Valley bottomInformation From Mrs. Frank Turner

Remarks

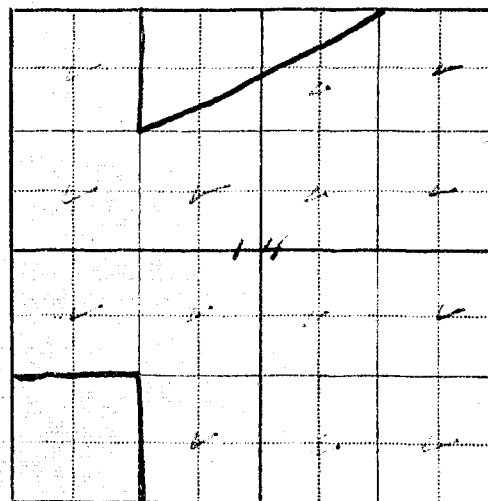
See other side

Irrigation by dikes and ditches, new
dirt reservoir & dam completed June, 23, 1947.
Dam has headgate to ditch.
Constructed in Graveyard Creek.



NOTICE
These forms are the
property of the State
of Montana and must
be returned.

STATE OF MONTANA
STATE ENGINEERS OFFICE

Water Resources Survey

FORM WR-1-2M 12-47

Code No. 22A

County Carbon

T. 6N R. 44E

Name of Land Owner Esther Van Den Biesen Address Hysham, Mont

Name of Operator James Beebe Address Hysham, Mont

Part A

TO BE FILED BY THOSE OBTAINING IRRIGATION WATER FROM
A DITCH COMPANY OR IRRIGATION DISTRICT

1. Water is delivered by: _____
Name of Ditch, Ditch Company or District Supplying Water
2. State the number of acres you irrigate under this system _____ Shares you hold _____
3. If you obtain water from more than one Company, give the number of shares, acres irrigated and the name of the Company under "Remarks." If you obtain water from a Ditch Company and also have a private system fill in both Part A and Part B.

Part B

TO BE FILED BY THOSE WHO HAVE A PRIVATE DITCH, PUMP OR IRRIGATION SYSTEM
or those who have a private water right under a Ditch Company

4. In what year was this land first irrigated? Date see attached filings
5. Give the name of the original appropriator (first user): _____
6. Give the date appropriated _____ Amount filed on: Miners Inches _____ C. F. S. _____
7. State the total number of acres irrigated under this system: _____
8. Give the point of diversion: _____ $\frac{1}{4}$ _____ $\frac{1}{4}$ Section _____ Township _____ Range _____

Part C

TO BE FILED BY ALL WATER USERS IN ADDITION TO PART A OR PART B

9. Source of Water: Upon Jaw Creek
Name of stream or lake from which water is originally diverted
10. Water is obtained by: (Check one) Gravity ☒ Pumping _____ Other Flood
11. What is the greatest number of acres you have irrigated? 8.0 Date _____
12. How many acres did you irrigate in 1947 (Crop and pasture) 8.0
13. State the total number of additional acres that could be irrigated by increasing the water supply, land leveling, etc. 0 This land is under what ditch? 0
14. How many acres of seeped land do you have which could be drained and put into production? 0
15. What is the condition of your irrigation system? Fair
16. Is your water supply adequate? Yes _____ No x Explain Flood loss
17. REMARKS: _____

Over

NOTE: The foregoing questions apply only to irrigated land shown on this plat.

DESCRIPTION AND MAP OF FARM

18. Legal Description of this Form

MEY, M² NW⁴, Sec 22

IRRIGATED LAND

NON-IRRIGATED LAND

North

1. 在 1990 年 12 月 31 日，A 公司有一项可供出售金融资产，其公允价值为 100 万元，账面价值为 80 万元。2001 年 1 月 1 日，A 公司将其出售，取得价款 110 万元。A 公司应确认的损益为（ ）万元。

 A. 20 B. 30 C. 10 D. 0

2. 在 1990 年 12 月 31 日，A 公司有一项可供出售金融资产，其公允价值为 100 万元，账面价值为 80 万元。2001 年 1 月 1 日，A 公司将其出售，取得价款 110 万元。A 公司应确认的损益为（ ）万元。

 A. 20 B. 30 C. 10 D. 0

3. 在 1990 年 12 月 31 日，A 公司有一项可供出售金融资产，其公允价值为 100 万元，账面价值为 80 万元。2001 年 1 月 1 日，A 公司将其出售，取得价款 110 万元。A 公司应确认的损益为（ ）万元。

 A. 20 B. 30 C. 10 D. 0

4. 在 1990 年 12 月 31 日，A 公司有一项可供出售金融资产，其公允价值为 100 万元，账面价值为 80 万元。2001 年 1 月 1 日，A 公司将其出售，取得价款 110 万元。A 公司应确认的损益为（ ）万元。

 A. 20 B. 30 C. 10 D. 0

5. 在 1990 年 12 月 31 日，A 公司有一项可供出售金融资产，其公允价值为 100 万元，账面价值为 80 万元。2001 年 1 月 1 日，A 公司将其出售，取得价款 110 万元。A 公司应确认的损益为（ ）万元。

 A. 20 B. 30 C. 10 D. 0

6. 在 1990 年 12 月 31 日，A 公司有一项可供出售金融资产，其公允价值为 100 万元，账面价值为 80 万元。2001 年 1 月 1 日，A 公司将其出售，取得价款 110 万元。A 公司应确认的损益为（ ）万元。

 A. 20 B. 30 C. 10 D. 0

7. 在 1990 年 12 月 31 日，A 公司有一项可供出售金融资产，其公允价值为 100 万元，账面价值为 80 万元。2001 年 1 月 1 日，A 公司将其出售，取得价款 110 万元。A 公司应确认的损益为（ ）万元。

 A. 20 B. 30 C. 10 D. 0

8. 在 1990 年 12 月 31 日，A 公司有一项可供出售金融资产，其公允价值为 100 万元，账面价值为 80 万元。2001 年 1 月 1 日，A 公司将其出售，取得价款 110 万元。A 公司应确认的损益为（ ）万元。

 A. 20 B. 30 C. 10 D. 0

9. 在 1990 年 12 月 31 日，A 公司有一项可供出售金融资产，其公允价值为 100 万元，账面价值为 80 万元。2001 年 1 月 1 日，A 公司将其出售，取得价款 110 万元。A 公司应确认的损益为（ ）万元。

 A. 20 B. 30 C. 10 D. 0

10. 在 1990 年 12 月 31 日，A 公司有一项可供出售金融资产，其公允价值为 100 万元，账面价值为 80 万元。2001 年 1 月 1 日，A 公司将其出售，取得价款 110 万元。A 公司应确认的损益为（ ）万元。

 A. 20 B. 30 C. 10 D. 0

West

East

South

Ownership, ~~status~~
only included land.
All ownership for
for land not shown

19. If the above land is irrigated from more than one ditch please give the acreage under each ditch in 19A and indicate the location of the land irrigated from each on the above map.

19A. Ditch: Flood Irr from Moon Jaw Creek Acres: 8.0

Information supplied by:

Name Field Survey Address _____ Date 7/1/47

REMARKS: Looked over Panel

If you cannot answer all of the questions on this form answer as many as you can and return the form to us as soon as possible.

**STATE ENGINEER'S OFFICE
WATER RESOURCES SURVEY**

COUNTY RosebudFILE NO. 33 - 22AOwner Van Den Biesen, EstherAddress Hysham, Montana

AAA Owner

Address

Operator Beebe, JamesAddress Hathaway, Montana

New Owner

Address

New Operator

Address

Assessment Record YesCounty 180

Assessed Acreage

Legal Description of This Farm NE¹/₄, N¹/₂N¹/₂ Sec. 22, T. 6N., R. 44E.

Private Flood

Total Acres in Farm

Code Number 22APhoto No. MA-29-41

AAA Contract No.

AAA Total Cropland Acreage 132.2App. No. 225, 356

Decree No.

Land is located in

Twp. 6N. Rge. 44E. Twp. Rge.

Twp. Rge. Twp. Rge.

Filed in Twp. 6N. Rge. 44E.

Remarks



DEPARTMENT
NATURAL RESOURCES AND CONSERVATION
PROPERTY OF THE STATE
OF MONTANA AND NOT
TO BE LOANED

STATE OF MONTANA
STATE ENGINEERS OFFICE
Water Resources Survey

FORM WR-1-5M 12-57
Code No. JD
County Bozeman
T. 6N R. 44E

Name of Land Owner C. C. Wilson Address Bozemanville, Mont
Name of Operator _____ Address _____

Part A

TO BE FILED BY THOSE OBTAINING IRRIGATION WATER FROM
A DITCH COMPANY OR IRRIGATION DISTRICT

1. Water is delivered by: Bozemanville On dirt
Name of Ditch, Ditch Company or District Supplying Water
2. State the number of acres you irrigate under this system 24.0 Shares you hold 11.50
3. If you obtain water from more than one Company, give the number of shares, acres irrigated and the name of the Company under "Remarks." If you obtain water from a Ditch Company and also have a private system fill in both Part A and Part B.

Part B

TO BE FILED BY THOSE WHO HAVE A PRIVATE DITCH, PUMP OR IRRIGATION SYSTEM
or those who have a private water right under a Ditch Company

4. In what year was this land first irrigated? Date _____
5. Give the name of the original appropriator (first user): _____
6. Give the date appropriated _____ Amount filed on: Miners Inches _____ C. F. S. _____
7. State the total number of acres irrigated under this system: _____
8. Give the point of diversion: $\frac{1}{4}$ $\frac{1}{4}$ Section _____ Township _____ Range _____

Part C

TO BE FILED BY ALL WATER USERS IN ADDITION TO PART A OR PART B

9. Source of Water: Gallatin River
Name of stream or lake from which water is originally diverted
10. Water is obtained by: (Check one) Gravity ☒ Pumping _____ Other _____
11. What is the greatest number of acres you have irrigated? 24.0 Date _____
12. How many acres did you irrigate in 1947 (Crop and pasture) 24.0
13. State the total number of additional acres that could be irrigated by increasing the water supply, land leveling, etc. 0 This land is under what ditch? 0
14. How many acres of seeped land do you have which could be drained and put into production? 0
15. What is the condition of your irrigation system? 0
16. Is your water supply adequate? Yes ☒ No _____ Explain _____
17. REMARKS:
Have riparian access through in lateral

NOTE: The foregoing questions apply only to irrigated land shown on this plat.

DESCRIPTION AND MAP OF FARM

18. Legal Description of this Farm Tracts 6, 7, Sec 7



IRRIGATED LAND

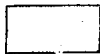

NON-IRRIGATED LAND

North

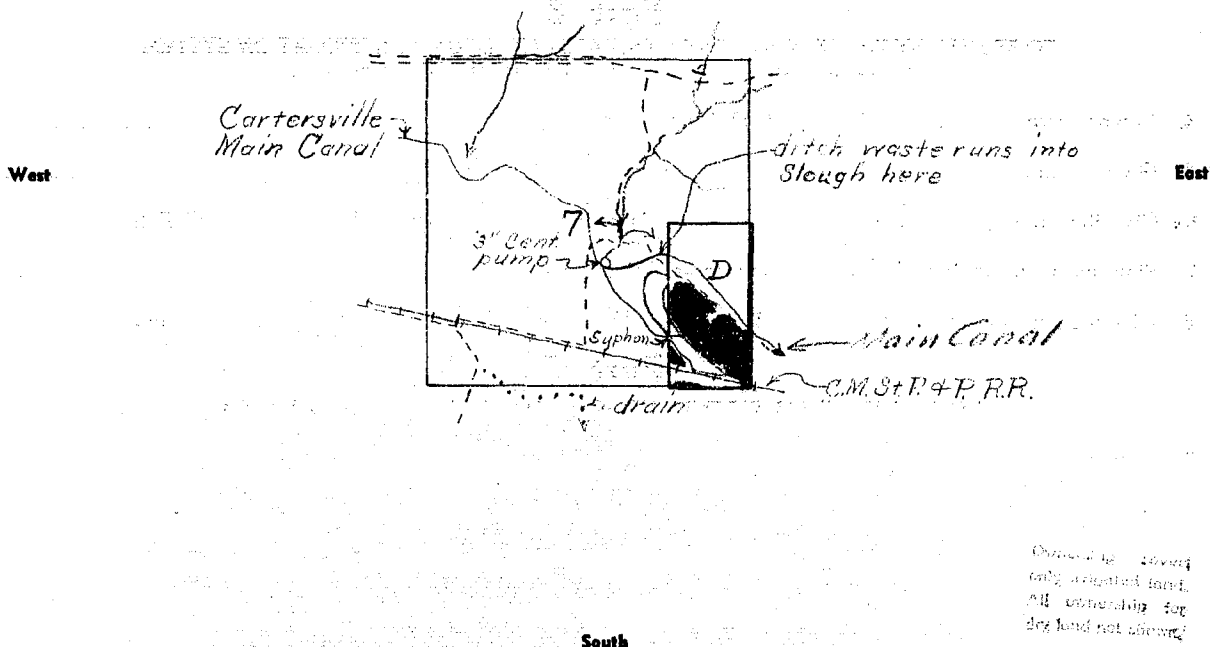

19. If the above land is irrigated from more than one ditch please give the acreage under each ditch in 19A and indicate the location of the land irrigated from each on the above map.

19A. Ditch: Cartersville Irr ditch Acres: 24.0

Ditch: _____ Acres: _____

Information supplied by:

Name Field Survey Address _____ Date 6/16/47

REMARKS: Frank & D Paulant

If you cannot answer all of the questions on this form answer as many as you can and return the form to us as soon as possible.

STATE ENGINEER'S OFFICE

WATER RESOURCES SURVEY

COUNTY RosebudFILE NO. 33 - 7DOwner Wilson, C. C. Address Cartersville, Montana

AAA Owner Address

Operator N.O. Address

New Owner Address

New Operator Address

Assessment Record YesCounty 6
Assessed Acreage 11.50Legal Description of This Farm Lots 6, 7, Sec. 7, T. 6N., R. 44E.Cartersville Irrigation District Total Acres in FarmCode Number 7DPhoto No. MA-32-54

AAA Contract No.

AAA Total Cropland Acreage 17.8App. No. N.R.

Decree No.

Land is located in

Twp. 6N. Rge. 44E. Twp. Rge.

Twp. Rge. Twp. Rge.

Filed in Twp. 6N. Rge. 44E.

Remarks

Y.R.B.



These forms and the property of the State of Montana and must be returned.

STATE OF MONTANA
STATE ENGINEERS OFFICE

Water Resources Survey

FORM WR-12-AN 12-47

Corie No. 16 B

County Rosebud

T. 6 N R. 44 E

Name of Land Owner Irvin Barringer Address Lathaway, Montana

Name of Operator _____ Address _____

Part A

TO BE FILED BY THOSE OBTAINING IRRIGATION WATER FROM
A DITCH COMPANY OR IRRIGATION DISTRICT

1. Water is delivered by: _____
Name of Ditch, Ditch Company or District Supplying Water
2. State the number of acres you irrigate under this system _____ Shares you hold _____
3. If you obtain water from more than one Company, give the number of shares, acres irrigated and the name of the Company under "Remarks." If you obtain water from a Ditch Company and also have a private system fill in both Part A and Part B.

Part B

TO BE FILED BY THOSE WHO HAVE A PRIVATE DITCH, PUMP OR IRRIGATION SYSTEM
or those who have a private water right under a Ditch Company

4. In what year was this land first irrigated? Date _____
5. Give the name of the original appropriator (first user): See attached filing
6. Give the date appropriated _____ Amount filed on: Miners Inches _____ C. F. S. _____
7. State the total number of acres irrigated under this system: _____
8. Give the point of diversion: _____ $\frac{1}{4}$ _____ $\frac{1}{4}$ Section _____ Township _____ Range _____

Part C

TO BE FILED BY ALL WATER USERS IN ADDITION TO PART A OR PART B

9. Source of Water: Yellowstone River
Name of stream or lake from which water is originally diverted
10. Water is obtained by: (Check one) Gravity _____ Pumping ☒ Other _____
11. What is the greatest number of acres you have irrigated? 147.0 Date _____
12. How many acres did you irrigate in 1947? (Crop and pasture) 147.0
13. State the total number of additional acres that could be irrigated by increasing the water supply, land leveling, etc. 0 This land is under what ditch? _____
14. How many acres of seeped land do you have which could be drained and put into production? 0
15. What is the condition of your irrigation system? Good
16. Is your water supply adequate? Yes ☒ No _____ Explain _____
17. REMARKS: _____

Over

NOTE: The foregoing questions apply only to irrigated land shown on this plat.

DESCRIPTION AND MAP OF FARM

18. Legal Description of this Farm

NE 4, Sec 16



IRRIGATED LAND



NON-IRRIGATED LAND

North

West

East

South

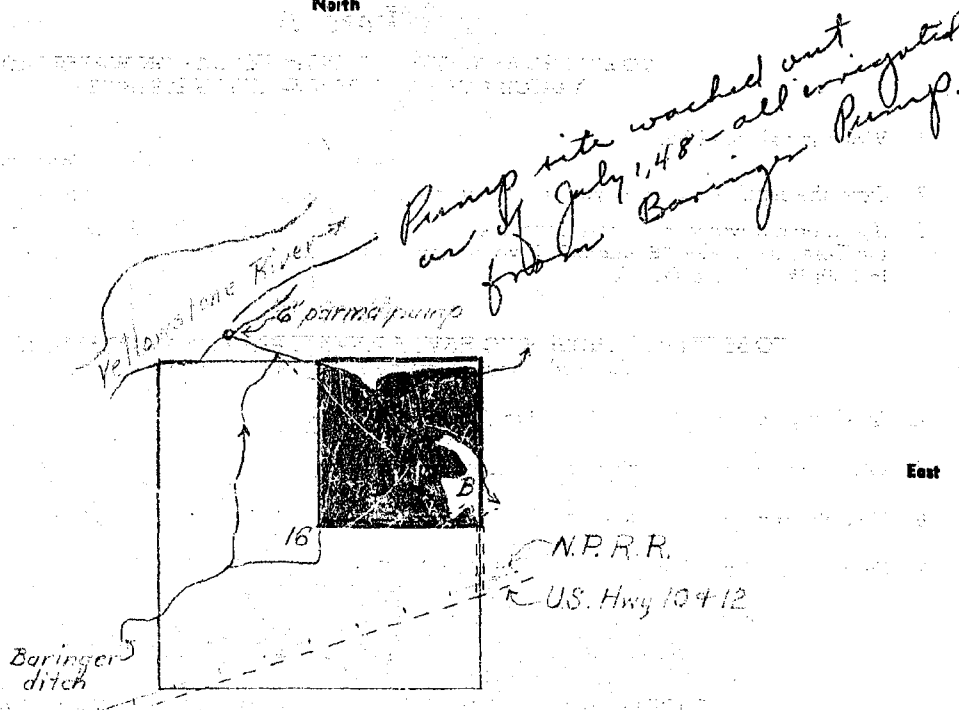

19. If the above land is irrigated from more than one ditch please give the acreage under each ditch in 19A and indicate the location of the land irrigated from each on the above map.

19A. Ditch: Baringer Pump System Acres: 147.0

Ditch: _____ Acres: _____

Information supplied by:

Name Field Survey Address _____ Date 6/30/47

REMARKS: Pen lot & Cash

If you cannot answer all of the questions on this form answer as many as you can and return the form to us as soon as possible.

STATE ENGINEER'S OFFICE
WATER RESOURCES SURVEY

COUNTY Rosebud

FILE NO. 33 - 16B

Owner Barringer, Fred Address Hathaway, Montana

AAA Owner Address

Operator Address

New Owner Address

New Operator H.O. Address

Assessment Record No

Assessed Acreage

Legal Description of This Farm NE 1/4 Sec. 16, T. 6N., R. 44E.

Private Pump Total Acres in Farm

Code Number 16B

Photo No. MA-32-53

AAA Contract No.

AAA Total Cropland Acreage 315.8

App. No. 888

Decree No.

Land is located in

Twp. 6N. Rge. 44E. Twp. Rge.

Twp. Rge. Twp. Rge.

Filed in Twp. 6N. Rge. 44E.

Remarks

Farm Checked

STATE OF MONTANA

Code No. 16B, E. 1/2 of W. 1/2 of 16ABy Dave, Jim, Joe

STATE ENGINEER'S OFFICE

County RosebudArea Hathaway

WATER RESOURCES SURVEY

T. 6N R. 44E Sec. 16Date 6/30/1947Photo No. MA-2253Legal Land Owner Fred Baringer Address HathawayOperator Same Address _____

Water is delivered by:

Federal Project _____ Pres. _____ Pot. _____

Ditch Company _____ Pres. _____ Pot. _____

Irrigation District _____ Pres. _____ Pot. _____

Private System ☒ lift Pres. 170 Pot. 50Totals 170 50Flood _____ Pump ☒ _____ Reservoir _____ Gravity _____Size and Capacity, Pump, etc. 6500 gals./min. Turbine, Elec. powered 15' lift.

Original Appropriator, Company _____ App. No. _____

Original Appropriator, Private Antilao Weber App. No. 888
(Show date of appropriation under Remarks)

Is the system an extension of another system? Yes _____ No _____

Is all land irrigated from one system? Yes ☒ No _____

(If No, show break down on map)

Source of Water Yellowstone RiverAcres Irrigated 1946 172 acresPotential Acres 50 Seeped 0Explain Needs levelingCondition of System GoodAdequate Supply Yes ☒ No _____

Explain _____

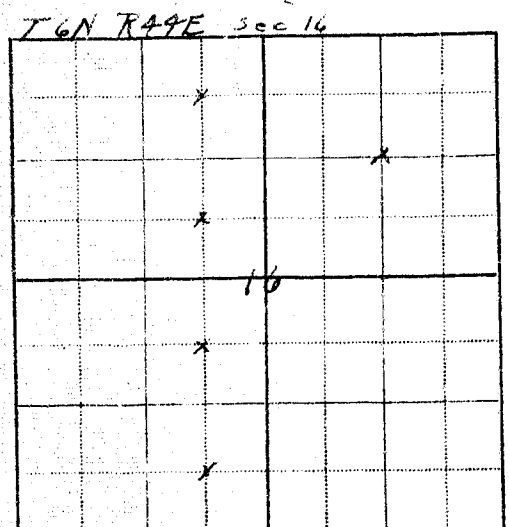
Topography River BottomInformation From Fred BaringerRemarks 888 - 9/10/20ownership in W. 1/2 of sec. now changing
to Fred Baringer



Since 1909 and 1911
Department of the State
of Montana and today
is required.

STATE OF MONTANA
STATE ENGINEERS OFFICE
Water Resources Survey

FORM WR-102-2M 12-57
Code No. 8A-17B-16A
County Rosebud
T. 6N R. 44

Name of Land Owner John F. Barringer Address Hathaway, Mont
Name of Operator _____ Address _____

Part A

**TO BE FILED BY THOSE OBTAINING IRRIGATION WATER FROM
A DITCH COMPANY OR IRRIGATION DISTRICT**

1. Water is delivered by: Cartersville Ditch
Name of Ditch, Ditch Company or District Supplying Water
2. State the number of acres you irrigate under this system 24.0 Shares you hold _____
3. If you obtain water from more than one Company, give the number of shares, acres irrigated and the name of the Company under "Remarks." If you obtain water from a Ditch Company and also have a private system fill in both Part A and Part B.

Part B

**TO BE FILED BY THOSE WHO HAVE A PRIVATE DITCH, PUMP OR IRRIGATION SYSTEM
or those who have a private water right under a Ditch Company**

4. In what year was this land first irrigated? Date See attached filing
5. Give the name of the original appropriator (first user): _____
6. Give the date appropriated _____ Amount filed on: Miners Inches _____ C. F. S. _____
7. State the total number of acres irrigated under this system: _____
8. Give the point of diversion: _____ $\frac{1}{4}$ Section _____ Township _____ Range _____

Part C

TO BE FILED BY ALL WATER USERS IN ADDITION TO PART A OR PART B

9. Source of Water: Yellowstone River + Brown Jaw Creek
Name of stream or lake from which water is originally diverted
10. Water is obtained by: (Check one) Gravity ☒ Pumping ☒ Other Flood
11. What is the greatest number of acres you have irrigated? _____ Date _____
12. How many acres did you irrigate in 19 47 (Crop and pasture) 33.0 see breakdown on reverse side
13. State the total number of additional acres that could be irrigated by increasing the water supply, land leveling, etc. 47.0 This land is under what ditch? Barringer Pump System
14. How many acres of seeped land do you have which could be drained and put into production? _____
15. What is the condition of your irrigation system? Good
16. Is your water supply adequate? Yes _____ No Yes Explain Yes Yellow C. M.
17. REMARKS: Yellow Jaw Creek
that water is in ownership from

Over

NOTE: The foregoing questions apply only to irrigated land shown on this plat.

DESCRIPTION AND MAP OF FARM

18. Legal Description of this Farm See attached WP-2

☒ IRRIGATED LAND (Carterville) ☐ NON-IRRIGATED LAND
☒ Privately Irrigated Land North
☒ Potentially Irrigable Land

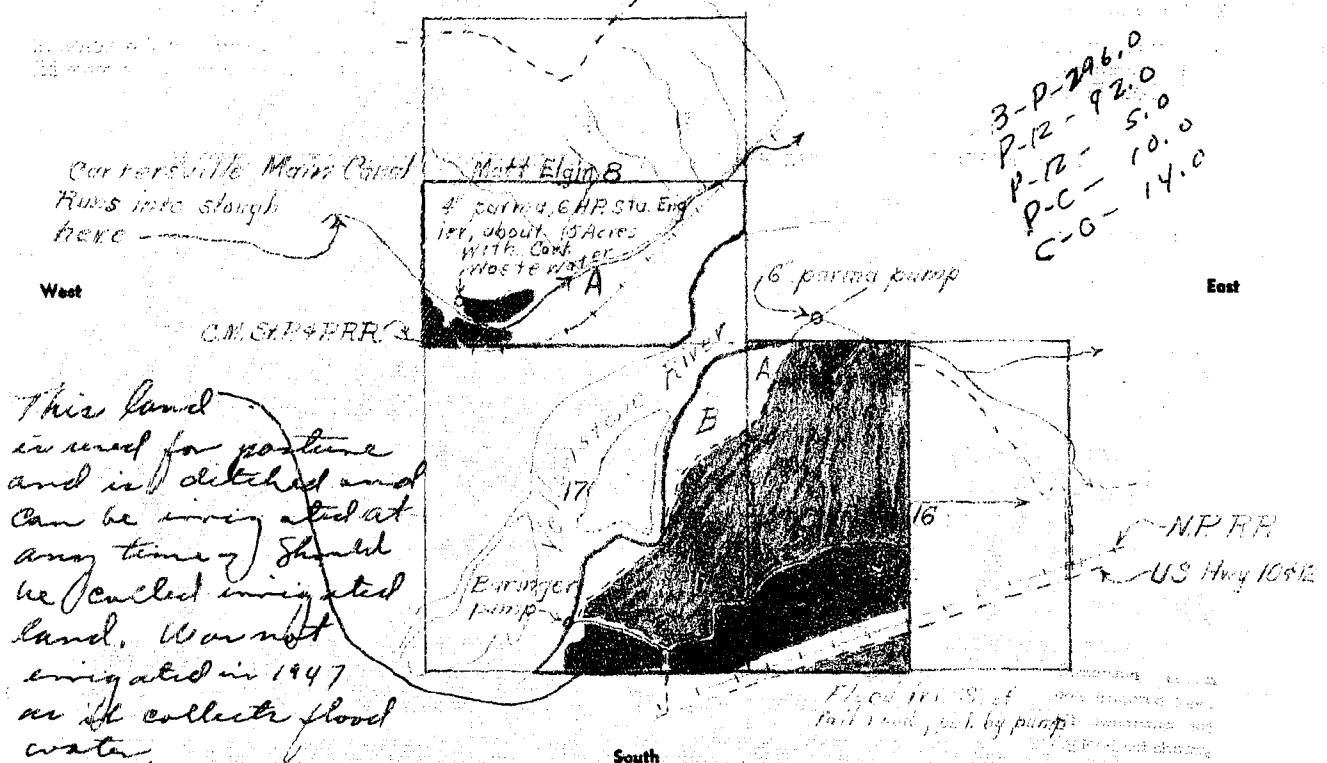

19. If the above land is irrigated from more than one ditch please give the acreage under each ditch in 19A and indicate the location of the land irrigated from each on the above map.

19A. Ditch: Baxinger Pump System Acres: 296.0
Flood from Gary Creek Acres: 11.0
 Ditch: Carterville Irr. ditch Acres: 10.0
(Pumps grants) Acres: 14.0
 Information supplied by: 331.0

Name Field Survey Address _____ Date 6/30/47

REMARKS: J. Cash + D. B. Baxinger

If you cannot answer all of the questions on this form answer as many as you can and return the form to us as soon as possible.

NOTE: The foregoing questions apply only to irrigated land shown on this plat.

DESCRIPTION AND MAP OF FARM

18. Legal Description of this Farm

See attached WP-2



IRRIGATED LAND

(Cartersville)



NON-IRRIGATED LAND



Privately Irrigated Land

North



Potentially Irrigable Land

*Cartersville Main Canal
Runs into slough
here*

West

C.M. S.P. & P.R.R.

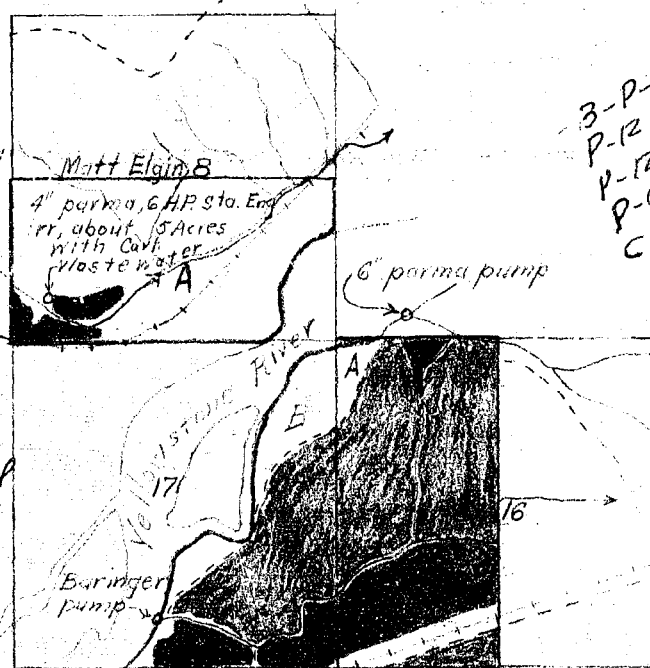

*3-P-296.0
P-R-92.0
P-R-5.0
P-C-10.0
C-G-14.0*

East

*This land
is used for pasture
and is ditched and
can be irrigated at
any time. Should
be called irrigated
land. Was not
irrigated in 1947
as it collects flood
water.*

South

19. If the above land is irrigated from more than one ditch please give the acreage under each ditch in 19A and indicate the location of the land irrigated from each on the above map.

19A. Ditch:

Baxinger Pump System

Acres:

296.0

Ditch:

Flood plain just west

Acres:

11.0

Information supplied by:

Cartersville Irr. Dist.

*(Pump
gram)*

Acres:

10.2

Name

Field Survey

Address

Date

6/30/47

REMARKS:

Frank & D. Parliant

If you cannot answer all of the questions on this form answer as many as you can and return the form to us as soon as possible.

Farm Checked

STATE OF MONTANA

Code No. 178, W. H. W. Sec 16By Dave, Jim, Joe

STATE ENGINEER'S OFFICE

County RosebudArea Hathaway

WATER RESOURCES SURVEY

T. 6N R. 44E Sec. 16 & 17Date 6/30/1947Photo No. 22-53Legal Land Owner John F. BaringerAddress HathawayOperator Same

Address

Water is delivered by:

Federal Project

Pres. Pot.

Ditch Company

Pres. Pot.

Irrigation District

Pres. Pot.

Private System ☒ (Figures do not include net of 100 gpm)Pres. 180 Pot. 50Totals 180 50

Flood

Pump K

Reservoir

Gravity

Size and Capacity, Pump, etc.

40 H.P. Turbine Electric powered 15' lift
6500 gals/min cap.

App. No.

Original Appropriator, Company

App. No. 888Original Appropriator, Private ☒ Arthur Heber

(Show date of appropriation under Remarks)

Is the system an extension of another system?

Yes No

Is all land irrigated from one system?

Yes ☒ No

(If No, show break down on map)

Source of Water

Yellowstone RiverAcres Irrigated 1947 180Potential Acres 50Seeped 0Explain Needs levelingCondition of System Good

Adequate Supply

Yes ☒

No

Explain

Topography River BottomInformation From John BaringerRemarks 888-4/16/47

T-6 N 44 E

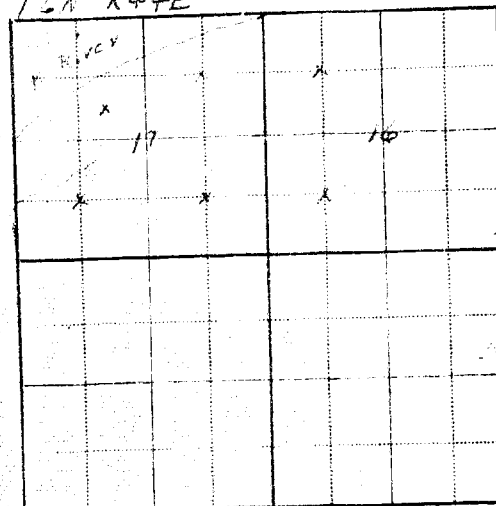

A and

as soon

STATE ENGINEER'S OFFICE
WATER RESOURCES SURVEY

COUNTY.....Rosebud.....

FILE NO.....33 - 8A, 17B.....

Owner.....Barringer, John E.....Address.....Hathaway, Montana.....

AAA Owner.....Address.....

Operator.....N.O.....Address.....

New Owner.....Address.....

New Operator.....Address.....

Assessment Record.....Yes.....

County.....127
Assessed Acreage.....0Legal Description of This Farm.....
(containing 52
Lots 2, 3, 4, NW 1/4 Sec. 8; Lots 1, 5, 6, SE 1/4, NE 1/4
Sec. 17, T. 6N., R. 44E.)Cartersville Irrigation District.....Total Acres in Farm.....
Cartersville by Pump in waste, Private by pump in Yellowstone
Code Number.....8A, 17B

Photo No.....MA-32-54

AAA Contract No.....

AAA Total Cropland Acreage.....15.5

App. No.....888

Decree No.....

Land is located in

Twp.....6N.. Rge.....44E.. Twp..... Rge.....

Twp..... Rge..... Twp..... Rge.....

Filed in Twp.....6N.. Rge.....44E..

Remarks.....

Y.R.B.

STATE ENGINEER'S OFFICE
WATER RESOURCES SURVEY

COUNTY Rosebud

FILE NO. 33 - 16A

Owner Montana, State of
c/o Barringer, John F.Address Helena, Montana
Hathaway, Montana

AAA Owner

Address

Operator

Address

New Owner

Address

New Operator Barringer, John F.

Address Hathaway, Montana

Assessment Record No.

County 0
Assessed Acreage 0

Legal Description of This Farm

~~Barbersville~~ Private pump & private flood

Total Acres in Farm

Code Number 16A

Photo No. MA-32-53

AAA Contract No.

AAA Total Cropland Acreage 0

App. No. N.R.

Decree No.

Land is located in

Twp. 6N. Rge. 44E. Twp. Rge.

Twp. Rge. Twp. Rge.

Filed in Twp. 6N. Rge. 44E.

Remarks

Y.R.E.

BARINGER PUMPING PROJECT

The first use of what is now known as the Baringer Pumping Project was made by M. W. Dickey, who, in 1905, installed a steam powered pumping plant in the location of the present Baringer diversion. According to Fred H. Baringer, "Dickey", the name by which he was commonly known to the "old-timers", did not make a recorded water filing but that water for irrigation has been diverted continuously, with the exception of possibly one year, by pumping from the Yellowstone River at or near the point of the original appropriation to and upon the lands in the Hathaway bottom, since 1905. No recorded filings were made until 1920.

According to a notice of appropriation filed in Book 3, Page 16 of Water Right Records in the Rosebud County Courthouse, J. E. Libby, on January 5, 1920, made the first recorded filing for 17.50 cubic feet of water to be diverted from the Yellowstone River. The point of diversion was described as a point in Section 9, Township 6 North, Range 44 East on the South bank of the river. The system was described as a pumping plant with ditches and structures extending from the pumping plant to the place of intended use. The land description of intended place of use was described as a portion of Sections 9 and 10, Township 6 North, Range 44 East.

This system and water right was later transferred to Carl Calvin, who, for a time, operated a diesel powered six inch Parma water lifter at the site of the original appropriation made by Libby. As this operation did not prove too successful the pumping operation was moved to the Fred H. Baringer location and the two ditch systems were incorporated under one pumping unit. The Calvin pump site has since been destroyed as a result of ice and high water.

On April 4, 1920 Antilace G. Nebber filed on 10 cubic feet of water to be diverted from the Yellowstone River at the same point of diversion as the original "Dickey" pumping plant location. The original steam plant was then replaced by a 30 horse power one cylinder Witt tractor fuel operated pump. The notice of appropriation is on file in Book 3, Page 17, of water right records in the Rosebud County Courthouse. The point of diversion was described as a point upon the southern bank of said river upon Lot 5 in Section 17, Township 6 North, Range 44 East. The purpose was for irrigation on agricultural lands. The system was described as a pumping plant which lifts the water from said river about 12 feet and discharges it into a canal 10 feet wide on the bottom. The land description of intended place of use was described as the NE 1/4, SW 1/4, and Lots 1, 5 and 6 in Section 17, Township 6 North, Range 44 East. This water right and system was later transferred to Fred H. Baringer, which, together with the Carl Calvin right and system was the basis for the creation of the Baringer Pumping Project. In 1945 a surplus pump and electric motor were purchased from the government project at Kinsey. After this, the following two agreements were entered into by the parties concerned. The first deals with the operation and maintenance of the pumping plant, and the second describes the use of the irrigation system.



NOTICE
This form is the
property of the State
of Montana and must
be returned.

STATE OF MONTANA
STATE ENGINEERS OFFICE

Water Resources Survey

FORM WR-1-24 12-47

Code No. 9A-10A-15A

County Bozeman

T. 6N R. 44E

Name of Land Owner Carl B. Calvin Address Wiley City, Mont

Name of Operator _____ Address _____

Part A

TO BE FILED BY THOSE OBTAINING IRRIGATION WATER FROM
A DITCH COMPANY OR IRRIGATION DISTRICT

1. Water is delivered by: Bainbridge Pump Mutual
Name of Ditch, Ditch Company or District Supplying Water
2. State the number of acres you irrigate under this system _____ Shares you hold _____
3. If you obtain water from more than one Company, give the number of shares, acres irrigated and the name of the Company under "Remarks." If you obtain water from a Ditch Company and also have a private system fill in both Part A and Part B.

Part B

TO BE FILED BY THOSE WHO HAVE A PRIVATE DITCH, PUMP OR IRRIGATION SYSTEM
or those who have a private water right under a Ditch Company

4. In what year was this land first irrigated? Date No data
5. Give the name of the original appropriator (first user): (see attached forms)
6. Give the date appropriated _____ Amount filed on: Miners Inches _____ C. F. S. _____
7. State the total number of acres irrigated under this system: _____
8. Give the point of diversion: _____ $\frac{1}{4}$ _____ $\frac{1}{4}$ Section _____ Township _____ Range _____

Part C

TO BE FILED BY ALL WATER USERS IN ADDITION TO PART A OR PART B

9. Source of Water: Yellowstone River & Brown Bear Creek
Name of stream or lake from which water is originally diverted
10. Water is obtained by: (Check one) Gravity X Pumping X Other Flood
11. What is the greatest number of acres you have irrigated? 5460 Date _____
12. How many acres did you irrigate in 1947? (Crop and pasture) 4560
13. State the total number of additional acres that could be irrigated by increasing the water supply, land leveling, etc. 860 This land is under what ditch? Bainbridge Pump System
14. How many acres of seeped land do you have which could be drained and put into production? 0
15. What is the condition of your irrigation system? Good
16. Is your water supply adequate? Yes _____ No _____ Explain _____
17. REMARKS: No seeped land in Brown Bear Creek flood

Over

DESCRIPTION AND MAP OF FARM

DESCRIPTION AND MAP
See WR-2

NON-IRRIGATED LAND

Potentially Irrigable Land North

This land was leased in 1947 and irrigated in 1948 for the first time.

Pump site washed
and July 1-48

West
End of July 1, 1948
all land formerly
irrigated by flood ditch
is being ditched from the
Bainbridge Pump Project.
New ditch was
constructed in the
spring of 1948
All flood
Railroad P
by pump
flood ditch

All flood S of
Railroad Pot.
by pump

Red ditch out of Iron Jaw Creek

$$\begin{array}{r} 73 \\ 5 \\ 8 \\ \hline 86.0 \text{ prot} \end{array}$$

$$\begin{array}{r} 162 \\ 14 \\ 98 \\ 50 \\ 134 \\ \hline 358.0 \end{array}$$

C.M.S.F. & F.R.R.

N.P.R.R.

US Hwy 10412

Hathaway

Only irrigated land.
All ownership for
dry land not shown.

19. If the above land is irrigated from more than one ditch please give the acreage under each ditch in 19A and indicate the location of the land irrigated from each on the above map.

19A. Ditch: Barometer Pump System Acres: 358.0

Ditch: Good Above Dry Creek Acres: 98.0

Information supplied by:

Name Michael J. ... Address ... Date 6/26/41

REMARKS: Good & healthy

If you cannot answer all of the questions on this form answer as many as you can and return the form to us as soon as possible.

STATE ENGINEER'S OFFICE

WATER RESOURCES SURVEY

COUNTY RosebudFILE NO. 33 - 9A, 10A, 15A

Owner Galvin, Carl B. Address Miles City, Montana
 AAA Owner _____ Address _____
 Operator N.O. Address _____
 New Owner _____ Address _____
 New Operator _____ Address _____
 Assessment Record No

Assessed Acreage _____

Legal Description of This Farm Lots 5, 6, 7, 8, 9, SE $\frac{1}{4}$ Sec. 9; Lots 5, 6, 7, 8, SE $\frac{1}{4}$, SW $\frac{1}{4}$ Sec. 10;
W $\frac{1}{2}$ Sec. 15, T. 6N., R. 44E.

Private flood and private pump _____

Total Acres in Farm _____

Code Number 9A, 10A, 15APhoto No. MA-32-53

AAA Contract No. _____

AAA Total Cropland Acreage 519.8App. No. N.R.

Decree No. _____

Land is located in

Twp. 6N. Rge. 44E. Twp. _____ Rge. _____

Twp. _____ Rge. _____ Twp. _____ Rge. _____

Filed in Twp. 6N. Rge. 44E.

Remarks _____

Y.R.B.

Farm Checked

STATE OF MONTANA

Code No. 9B, 10BBy Lewis, Jim Jones

STATE ENGINEER'S OFFICE

County BeaumontArea Hathaway

WATER RESOURCES SURVEY

T. 24N R. 44E Sec. 2-10Date 6/26/47Photo No. 22-53Legal Land Owner Carl B. CalvinAddress Miles City MontOperator Helmer Havik & Shep Vale

Address _____

Water is delivered by:

Federal Project _____ Pres. _____ Pot. _____

Ditch Company _____ Pres. _____ Pot. _____

Irrigation District _____ Pres. _____ Pot. _____

Private System Private Pump Pres. Planim Pot. _____

Totals _____

Flood _____ Pump ☒ Reservoir _____ Gravity _____Size and Capacity, Pump, etc. See Beringer System

Original Appropriator, Company _____ App. No. _____

Original Appropriator, Private _____ (Show date of appropriation under Remarks) App. No. _____

Is the system an extension of another system? Yes _____ No ☒Is all land irrigated from one system? Yes ☒ No _____

(If No, show break down on map)

Source of Water Beringer ditchAcres Irrigated 19 47 ☒Potential Acres ☒ Seeped _____

Explain _____

Condition of System goodAdequate Supply Yes ☒ No _____

Explain _____

Topography River BottomInformation From Lower Becks

Remarks _____

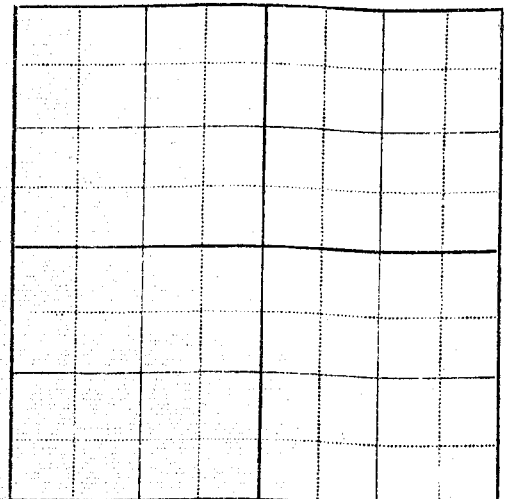

Farm Checked

STATE OF MONTANA

Code No. 15A,By Dave, Jim, Joe

STATE ENGINEER'S OFFICE

County RosebudArea Hathaway

WATER RESOURCES SURVEY

T. 6N R. 44E Sec. 15Date 6/26/47Photo No. 22-53Legal Land Owner Anton Nielsen - 15A family Address Hathaway Mont.
owned by Carl B. Calvin now by Anton Nielsen.

Operator _____ Address _____

Water is delivered by:

Federal Project _____ Pres. _____ Pot. _____

Ditch Company _____ Pres. _____ Pot. _____

Irrigation District _____ Pres. _____ Pot. _____

Private System Private pumps & Flood Pres. Planim Pot. 0

Totals _____

Flood ☒ Pump ☒ Reservoir _____ Gravity _____Size and Capacity, Pump, etc. see Baringer SystemOriginal Appropriator, Company _____ App. No. 700 inchesOriginal Appropriator, Private ☒ J. E. Lilly - 1-5-20 App. No. No Filing
(Show date of appropriation under Remarks)

Is the system an extension of another system? Yes _____ No _____

Is all land irrigated from one system? Yes ☒ No ☒

(If No, show break down on map)

Source of Water Yellowstone R. and Flood from Hamhorst system
out of 1107 Jaw. Sec. 15Acres Irrigated 19. 46.1Potential Acres none Seeped 0Explain ☒Condition of System GoodAdequate Supply Yes ☒ No _____

Explain _____

Topography River BottomInformation From J. Lilly

Remarks _____

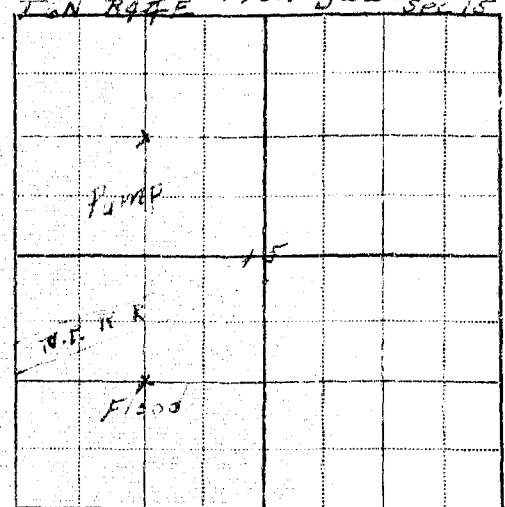

~~Ans~~ ~~10~~

Ans Jan. 5, 1910 J. E. Libby filed
on 700 minute inches of water
from the Yellowstone River to be
used in Sec. 9 & 10.

App number 872

DARINGER PUMPING PROJECT

The first use of what is now known as the Daringer Pumping Project was made by H. W. Dickey, who, in 1905, installed a steam powered pumping plant in the location of the present Daringer diversion. According to Fred H. Baringer, "Dickey", the name by which he was commonly known to the "old-timers", did not make a recorded water filing but that water for irrigation has been diverted continuously, with the exception of possibly one year, by pumping from the Yellowstone River at or near the point of the original appropriation to and upon the lands in the Hathaway bottom, since 1905. No recorded filings were made until 1920.

According to a notice of appropriation filed in Book 3, Page 15 of Water Right Records in the Rosebud County Courthouse, J. F. Libby, on January 5, 1920, made the first recorded filing for 17.5 cubic feet of water to be diverted from the Yellowstone River. The point of diversion was described as a point in Section 9, Township 6 North, Range 44 East on the South bank of the river. The system was described as a pumping plant with ditches and structures extending from the pumping plant to the place of intended use. The land description of intended place of use was described as a portion of Sections 9 and 10, Township 6 North, Range 44 East.

This system and water right was later transferred to Carl Calvin, who, for a time, operated a diesel powered six inch Larua water lifter at the site of the original appropriation made by Libby. As this operation did not prove too successful the pumping operation was moved to the Fred H. Baringer location and the two ditch systems were incorporated under one pumping unit. The Calvin pump site has since been destroyed as a result of ice and high water.

On April 4, 1920 Antilace G. Huber filed on 10 cubic feet of water to be diverted from the Yellowstone River at the same point of diversion as the original "Dickey" pumping plant location. The original steam plant was then replaced by a 30 horse power gas cylinder with tractor fuel operated pump. The notice of appropriation is on file in Book 3, Page 17, of water right records in the Rosebud County Courthouse. The point of diversion was described as a point upon the southern bank of said river upon Lot 5 in Section 17, Township 6 North, Range 44 East. The purpose was for irrigation on agricultural lands. The system was described as a pumping plant which lifts the water from said river about 12 feet and discharges it into a canal 10 foot wide on the bottom. The land description of intended place of use was described as the NE 1/4, NW 1/4, and Lots 1, 5 and 6 in Section 17, Township 6 North, Range 44 East. This water right and system was later transferred to Fred H. Baringer, which, together with the Carl Calvin right and system was the basis for the creation of the Baringer Pumping Project. In 1945 a surplus pump and electric motor were purchased from the government project at Kinsey. After which, the following two agreements were entered into by the parties concerned. The first dealing with the operation and maintenance of the pumping plant, and the second describing the use of the irrigation system.

Missoula City, Montana.
July 7, 1948.

Mr. Gerald J. Oravitz,
Assistant State Engineer,
Billings, Montana.

Dear sir;

Your letter of April 18th was duly received and should have been answered a long time ago.

When I purchased lots 5,6,7,8,9, Sec. 9; lots 5,6,7,8, SW 1/4 of section 10 and the west 1/4 of sec. 19T.6N., R 44E in Rosebud County I noted that no water right had been filed by the then owner or former owners except one filed by J. E. Libby on Jan. 20, 1920 in Book 3 of water rights at page 16 for 17 1/2 cubic feet per second to be pumped out of the Yellowstone river to irrigate all lands South of the Yellowstone in sections nine & ten. You would not have located this on the records unless you had gotten an abstract as Mr. Libby never had a deed to this land. On June 2, 1919, Henry E. and Marie Martin entered into a contract to sell the last above described land to Jesse E. Libby. Libby gave back to Martins a quitclaim deed dated Oct. 20, 1934. Both of these instruments are of record in Rosebud County.

Knowing that the Courts had held that the use of water for irrigation was paramount I secured an affidavit from Henry E. Martin and this affidavit is enclosed herewith. After I received your letter I had the same put of record in Rosebud County. I would like to have this returned to me after you have finished with it.

If there is any further information I can give or get for you re these lands please let me know.

Very truly yours,

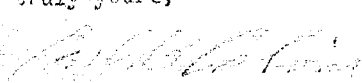
Carl E. Calvin
111 So. Jordan Ave.
Missoula City, Montana.

HENRY E. MARTIN, being duly sworn deposes and says that he has been a resident of Rosebud County, State of Montana since the year 1904;

That he has been familiar with the following described land since 1904; to-wit;

The Southeast quarter and lots five, six, seven, eight and nine in Section nine;

The Southwest quarter, the south one-half of the southeast quarter, and lots five, six, seven and eight of Section ten; and all of Section fifteen; all in township six, North of Range forty-four East of Montana Principal Meridian, State of Montana.

That he knows of his own knowledge that water was pumped on to said lands out of the Yellowstone River for irrigation purposes and to irrigate a portion of said lands in the year 1909;

That from and after the year 1909 there has been water pumped on some of said land each and every year up until this time;

That from the year 1909 to 1939 inclusive there was irrigated an average of about 200 acres per year and for the years of 1940 and 1941 there was irrigated at least 400 acres per year;

That the present pumping site was established about the year 1915 and that prior thereto the water was pumped from the Yellowstone River at two other locations on the above described land, excepting for the years from 1926 to 1933, when water was pumped from a point about one mile south west and up the river from the present pumping site;

IN WITNESS WHEREOF I have hereunto signed my name this 3rd day of February, 1942.

/s/ Henry E. Martin

STATE OF MONTANA)
COUNTY OF CUSTER) SS

On the 3rd day of February, 1942, before me, the undersigned, a Notary Public for the State of Montana, personally appeared Henry E. Martin, known to me to be the person whose name is subscribed to the within instrument and acknowledged to me that he executed the same.

IN WITNESS WHEREOF, I have hereunto set my hand and affixed by Notarial Seal the day and year first above written.

(SEAL)

My Commission expires February 10, 1943

/s/ W. E. Clark, Jr.
Notary Public for the State of Mont.
Residing at Miles City.



These forms are the property of the State of Montana and must be returned.

STATE OF MONTANA
STATE ENGINEERS OFFICE

Water Resources Survey

FORM WR-1-2M 12-47

Code No. 7C

County Rosebud

T. 6N R. 44

Name of Land Owner Matt Elgin Address Rosebud, Mont

Name of Operator _____ Address _____

Part A

TO BE FILED BY THOSE OBTAINING IRRIGATION WATER FROM
A DITCH COMPANY OR IRRIGATION DISTRICT

1. Water is delivered by: Cartersville Irr. dist
Name of Ditch, Ditch Company or District Supplying Water
2. State the number of acres you irrigate under this system 18.79 Shares you hold 18.79
3. If you obtain water from more than one Company, give the number of shares, acres irrigated and the name of the Company under "Remarks." If you obtain water from a Ditch Company and also have a private system fill in both Part A and Part B.

Part B

TO BE FILED BY THOSE WHO HAVE A PRIVATE DITCH, PUMP OR IRRIGATION SYSTEM
or those who have a private water right under a Ditch Company

4. In what year was this land first irrigated? Date _____
5. Give the name of the original appropriator (first user): _____
6. Give the date appropriated _____ Amount filed on: Miners Inches _____ C. F. S. _____
7. State the total number of acres irrigated under this system: _____
8. Give the point of diversion: _____ $\frac{1}{4}$ Section _____ Township _____ Range _____

Part C

TO BE FILED BY ALL WATER USERS IN ADDITION TO PART A OR PART B

9. Source of Water: Yellowstone River
Name of stream or lake from which water is originally diverted
10. Water is obtained by: (Check one) Gravity ☒ Pumping _____ Other _____
11. What is the greatest number of acres you have irrigated? 18.79 Date _____
12. How many acres did you irrigate in 1947? (Crop and pasture) 18.79
13. State the total number of additional acres that could be irrigated by increasing the water supply, land leveling, etc. 0 This land is under what ditch? 0
14. How many acres of seeped land do you have which could be drained and put into production? 0
15. What is the condition of your irrigation system? fair
16. Is your water supply adequate? Yes ☒ No _____ Explain _____
17. REMARKS: _____

Over

NOTE: The foregoing questions apply only to irrigated land shown on this plat.

DESCRIPTION AND MAP OF FARM

18. Legal Description of this Farm W² Lot 3, Sec 7



IRRIGATED LAND

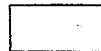

NON-IRRIGATED LAND

North

When shown, the following information shall be given to the best of the knowledge of the person furnishing the same:

1. The name of the person or persons who own the land, and the name of the person or persons who have the right to use the land for irrigation.

2. The name of the ditch or ditches which irrigate the land, and the location of the land irrigated from each ditch.

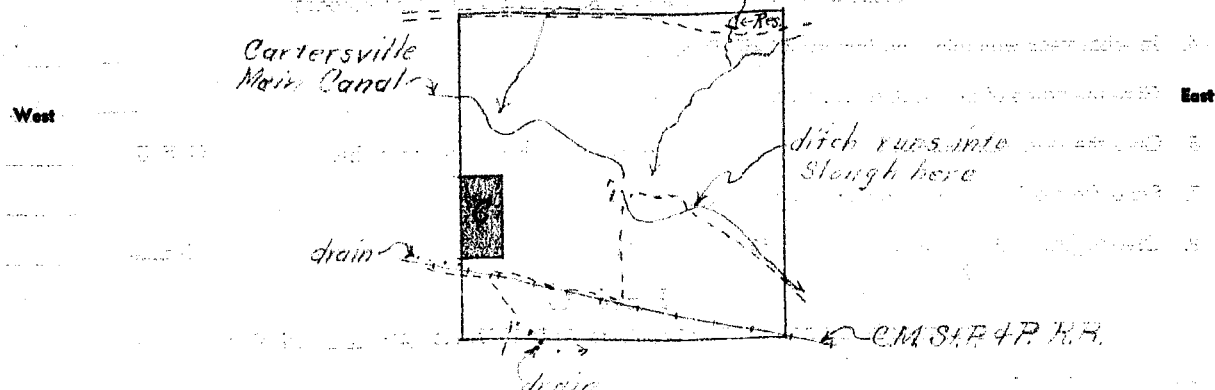

19. If the above land is irrigated from more than one ditch please give the acreage under each ditch in 19A and indicate the location of the land irrigated from each on the above map.

19A. Ditch: Cartersville Irr. ditch Acres: 18.79

Ditch: _____ Acres: _____

Information supplied by:

Name Field Survey Address _____ Date 6/19/47

REMARKS: John & D. Paulint

If you cannot answer all of the questions on this form answer as many as you can and return the form to us as soon as possible.

STATE ENGINEER'S OFFICE
WATER RESOURCES SURVEY

COUNTY Rosebud

FILE NO. 33 - 70

Owner Elgin, Matt Address Rosebud, Montana

AAA Owner Address

Operator Address

New Owner Address

New Operator Address

Assessment Record Yes

County 20
Assessed Acreage 18.79

Legal Description of This Farm W¹/₂ Lot 3, Sec. 7, T. 6N., R. 44E.

Cartersville Irrigation District Total Acres in Farm

Code Number 70

Photo No. MA-32-54

AAA Contract No.

AAA Total Cropland Acreage

App. No. N.R.

Decree No.

Land is located in

Twp. 6N. Rge. 44E. Twp. Rge.

Twp. Rge. Twp. Rge.

Filed in Twp. 6N. Rge. 44E.

Remarks



These forms are the
property of the State
of Montana and must
be returned.

STATE OF MONTANA
STATE ENGINEERS OFFICE

FORM WR-1-AM 12-67

Code No. 7A

County Rosebud

Water Resources Survey

T. 6N R. 4E

Name of Land Owner Ed. Sanderson Address Rosebud, Mont

Name of Operator _____ Address _____

Part A

TO BE FILED BY THOSE OBTAINING IRRIGATION WATER FROM
A DITCH COMPANY OR IRRIGATION DISTRICT

1. Water is delivered by: Cartersville Irr. Dist
Name of Ditch, Ditch Company or District Supplying Water
2. State the number of acres you irrigate under this system 35.32 Shares you hold 35.32
3. If you obtain water from more than one Company, give the number of shares, acres irrigated and the name of the Company under "Remarks." If you obtain water from a Ditch Company and also have a private system fill in both Part A and Part B.

Part B

TO BE FILED BY THOSE WHO HAVE A PRIVATE DITCH, PUMP OR IRRIGATION SYSTEM
or those who have a private water right under a Ditch Company

4. In what year was this land first irrigated? Date _____
5. Give the name of the original appropriator (first user): _____
6. Give the date appropriated _____ Amount filed on: Miners Inches _____ C. F. S. _____
7. State the total number of acres irrigated under this system: _____
8. Give the point of diversion: _____ $\frac{1}{4}$ _____ $\frac{1}{4}$ Section _____ Township _____ Range _____

Part C

TO BE FILED BY ALL WATER USERS IN ADDITION TO PART A OR PART B

9. Source of Water: Yellowstone River
Name of stream or lake from which water is originally diverted
10. Water is obtained by: (Check one) Gravity ☒ Pumping _____ Other _____
11. What is the greatest number of acres you have irrigated? 35.32 Date _____
12. How many acres did you irrigate in 1947 (Crop and pasture) 35.32
13. State the total number of additional acres that could be irrigated by increasing the water supply, land leveling, etc. 0 This land is under what ditch? 0
14. How many acres of seeped land do you have which could be drained and put into production? 0
15. What is the condition of your irrigation system? fair
16. Is your water supply adequate? Yes ☒ No _____ Explain _____
17. REMARKS: _____

Over

20
18.79

NOTE: The foregoing questions apply only to irrigated land shown on this plat.

DESCRIPTION AND MAP OF FARM

18. Legal Description of this Farm Lots 1, 2, E2 NW 1/4, Sec 7



IRRIGATED LAND



NON-IRRIGATED LAND

North

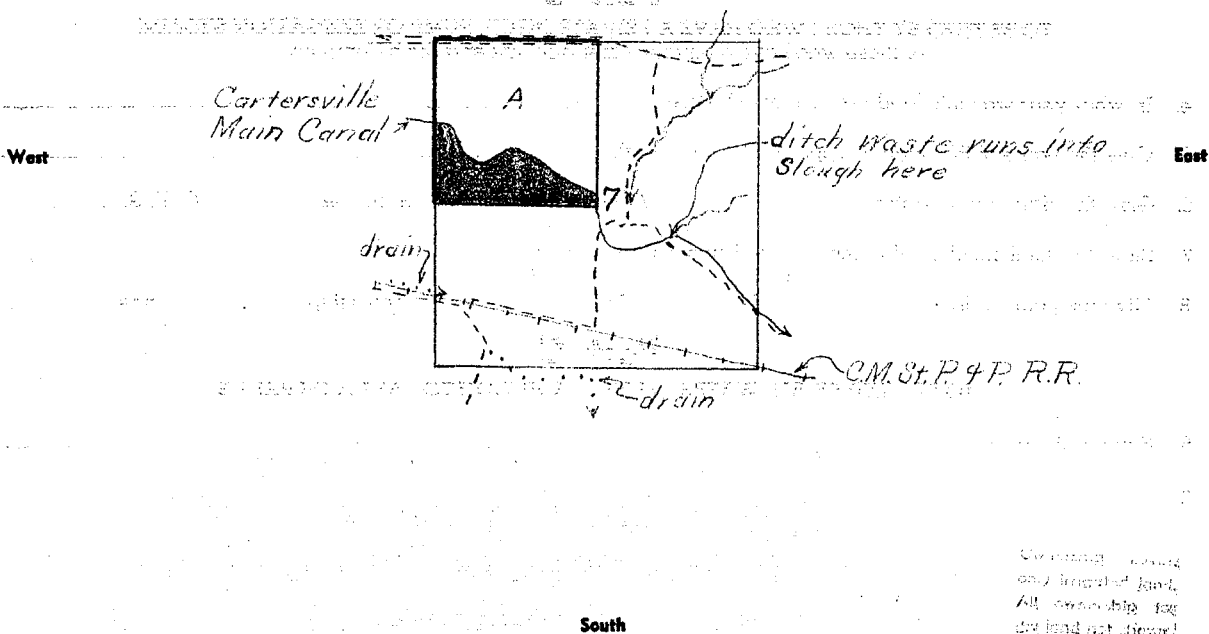

19. If the above land is irrigated from more than one ditch please give the acreage under each ditch in 19A and indicate the location of the land irrigated from each on the above map.

19A. Ditch: Cartersville Main Canal Acres: 35.32

Ditch: _____ Acres: _____

Information supplied by:

Name Field Survey Address _____ Date 6/16/47

REMARKS: Frank J. D. Paulson

If you cannot answer all of the questions on this form answer as many as you can and return the form to us as soon as possible.

STATE ENGINEER'S OFFICE
WATER RESOURCES SURVEY

COUNTY Rosebud

FILE NO. 33 - 7A

Owner Gunderson, Ed. Address Rosebud, Montana
AAA Owner Address
Operator N.O. Address
New Owner Address
New Operator Address

Assessment Record Yes

County 37
Assessed Acreage 35.32

Legal Description of This Farm Lot 1, 2, E 1/4 Sec. 7, T. 6N., R. 44E.

Cartersville Irrigation District Total Acres in Farm

Code Number 7A

Photo No. MA-32-54

AAA Contract No.

AAA Total Cropland Acreage 42.2

App. No. N.R.

Decree No.

Land is located in

Twp. 6N. Rge. 44E. Twp. Rge.

Twp. Rge. Twp. Rge.

Filed in Twp. 6N. Rge. 44E.

Remarks

Y.R.E.



NOTICE
These forms are the
property of the State
of Montana and must
be returned.

STATE OF MONTANA
STATE ENGINEERS OFFICE

Water Resources Survey

FORM WR-1-2N 12-67

Code No. LIB-12B

County Bozeman

T. 6N R. 44

Name of Land Owner John Heade Address Hathaway, Mont

Name of Operator Shan Stone Address "

Part A

TO BE FILED BY THOSE OBTAINING IRRIGATION WATER FROM
A DITCH COMPANY OR IRRIGATION DISTRICT

1. Water is delivered by: _____
Name of Ditch, Ditch Company or District Supplying Water
2. State the number of acres you irrigate under this system _____ Shares you hold _____
3. If you obtain water from more than one Company, give the number of shares, acres irrigated and the name of the Company under "Remarks." If you obtain water from a Ditch Company and also have a private system fill in both Part A and Part B.

Part B

TO BE FILED BY THOSE WHO HAVE A PRIVATE DITCH, PUMP OR IRRIGATION SYSTEM
or those who have a private water right under a Ditch Company

4. In what year was this land first irrigated? Date No data
5. Give the name of the original appropriator (first user): _____
6. Give the date appropriated _____ Amount filed on: Miners Inches _____ C. F. S. _____
7. State the total number of acres irrigated under this system: _____
8. Give the point of diversion: _____ $\frac{1}{4}$ _____ $\frac{1}{4}$ Section _____ Township _____ Range _____

Part C

TO BE FILED BY ALL WATER USERS IN ADDITION TO PART A OR PART B

9. Source of Water: Yellowstone River
Name of stream or lake from which water is originally diverted
10. Water is obtained by: (Check one) Gravity _____ Pumping ☒ Other _____
11. What is the greatest number of acres you have irrigated? _____ Date _____
12. How many acres did you irrigate in 1947? (Crop and pasture) 0
13. State the total number of additional acres that could be irrigated by increasing the water supply, land leveling, etc. 40.0 This land is under what ditch? Yell. River Pump
14. How many acres of seeped land do you have which could be drained and put into production? ✓
15. What is the condition of your irrigation system? Not in use
16. Is your water supply adequate? Yes ☒ No _____ Explain _____
17. REMARKS: _____

Over

NOTE: The foregoing questions apply only to irrigated land shown on this plat.

DESCRIPTION AND MAP OF FARM

18. Legal Description of this Farm

See WR-2



IRRIGATED LAND



NON-IRRIGATED LAND

North

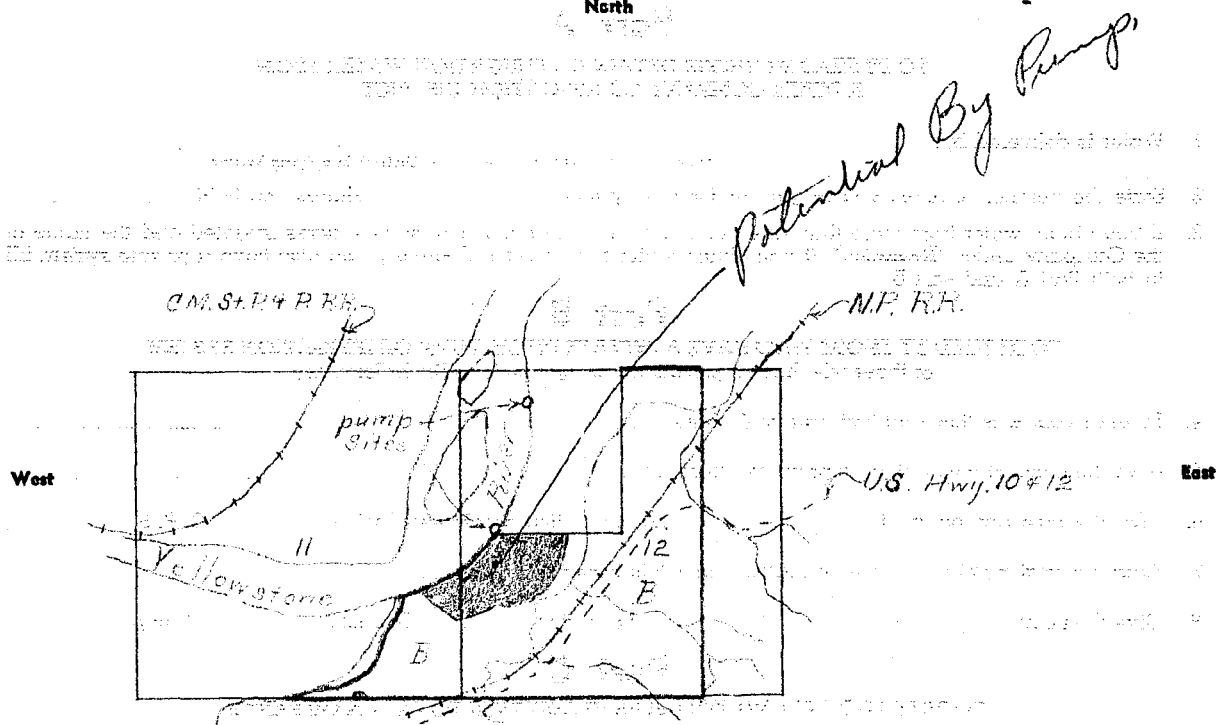

South

Ownership covers only irrigated land. All ownership for the land not shown.

19. If the above land is irrigated from more than one ditch please give the acreage under each ditch in 19A. and indicate the location of the land irrigated from each on the above map.

19A. Ditch: *Private Pump ditch Gll R* Acres: *0*

Ditch: _____ Acres: _____

Information supplied by:

Name *Field Survey* Address _____ Date *6/26/47*

REMARKS: *Water from Char Stone*

Dave & Jean Cook

If you cannot answer all of the questions on this form answer as many as you can. and return the form to us as soon as possible.

STATE ENGINEER'S OFFICE

WATER RESOURCES SURVEY

COUNTY RosebudFILE NO. 33 - 11B, 12BOwner Theade, John Address Hathaway, Montana

AAA Owner Address

Operator Stone, Charles Address Hathaway, Montana

New Owner Address

New Operator Address

Assessment Record YesCounty 117

Assessed Acreage

Legal Description of This Farm. Lots 1, 11, 12, Sec. 11; Lots 3, 4, 5, 6, 7, 8, 9, 10, 11, 12, Sec. 12, T. 6N., R. 44E.WSE1

Private Pump

Total Acres in Farm

Code Number 11B, 12APhoto No. MA-22-153

AAA Contract No.

AAA Total Cropland Acreage 99.6App. No. N.R.

Decree No.

Land is located in

Twp. 6N. Rge. 44E. Twp. Rge.

Twp. Rge. Twp. Rge.

Filed in Twp. 6N. Rge. 44E.

Remarks

Y.R.E.



NOTICE
These forms are the
property of the State
of Montana and must
be returned.

STATE OF MONTANA
STATE ENGINEERS OFFICE
Water Resources Survey

FORM WR-1-2N 12-47

Code No. 17A
County Rosebud
T. 6N R. 44

Name of Land Owner C. F. Kline Address Bloom City, Wis.
Name of Operator C. C. Wilson Address Castroville, Mont

Part A

**TO BE FILED BY THOSE OBTAINING IRRIGATION WATER FROM
A DITCH COMPANY OR IRRIGATION DISTRICT**

1. Water is delivered by: Castroville Irr dist
Name of Ditch, Ditch Company or District Supplying Water
2. State the number of acres you irrigate under this system 75.0 Shares you hold
3. If you obtain water from more than one Company, give the number of shares, acres irrigated and the name of the Company under "Remarks." If you obtain water from a Ditch Company and also have a private system fill in both Part A and Part B.

Part B

**TO BE FILED BY THOSE WHO HAVE A PRIVATE DITCH, PUMP OR IRRIGATION SYSTEM
or those who have a private water right under a Ditch Company**

4. In what year was this land first irrigated? Date
5. Give the name of the original appropriator (first user):
6. Give the date appropriated. Amount filed on: Miners Inches C. F. S.
7. State the total number of acres irrigated under this system:
8. Give the point of diversion: $\frac{1}{4}$ $\frac{1}{4}$ Section Township Range

Part C

TO BE FILED BY ALL WATER USERS IN ADDITION TO PART A OR PART B

9. Source of Water: Yellowstone River
Name of stream or lake from which water is originally diverted
10. Water is obtained by: (Check one) Gravity ☒ Pumping Other
11. What is the greatest number of acres you have irrigated? 15.0 Date
12. How many acres did you irrigate in 19 47 (Crop and pasture) 75.0
13. State the total number of additional acres that could be irrigated by increasing the water supply, land leveling, etc. 0 This land is under what ditch? 0
14. How many acres of seeped land do you have which could be drained and put into production? 0
15. What is the condition of your irrigation system? Good
16. Is your water supply adequate? Yes ☒ No Explain
17. REMARKS:

Over

NOTE: The foregoing questions apply only to irrigated land shown on this plat.

DESCRIPTION AND MAP OF FARM

18. Legal Description of this Farm Lots 2, 3, 4, W² NW⁴, NE⁴ NW⁴, Sec 17

 IRRIGATED LAND

 NON-IRRIGATED LAND

North

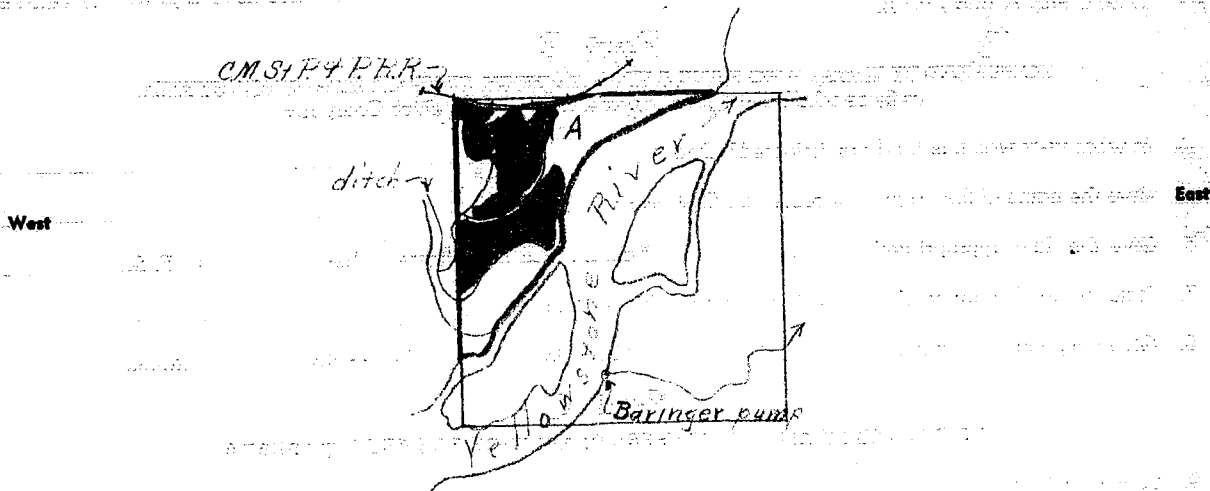

19. If the above land is irrigated from more than one ditch please give the acreage under each ditch in 19A and indicate the location of the land irrigated from each on the above map.

19A. Ditch: Cartersville Va ditch Acres: 75.0

Ditch: _____ Acres: _____

Information supplied by:

Name Field Survey Address _____ Date 6/30/47

REMARKS: Joshua D. Paulist

If you cannot answer all of the questions on this form answer as many as you can and return the form to us as soon as possible.

STATE ENGINEER'S OFFICE
WATER RESOURCES SURVEY

COUNTY Rosebud

FILE NO. 33 - 17A

Owner Kline, C. F.

Address Bloom City, Wis.

AAA Owner

Address

Operator Wilson, C. C.

Address Cartersville, Montana

New Owner

Address

New Operator

Address

Assessment Record ☒ Yes ☐ No

County 0

Assessed Acreage 0

Legal Description of This Farm Lots 2, 3, 4, W1/4 NE1/4 Sec. 17, T. 6N., R. 44E.

Cartersville Irrigation District Total Acres in Farm

Code Number 17A

Photo No. MA-32-54

AAA Contract No.

AAA Total Cropland Acreage 146.7

App. No. N.R.

Decree No.

Land is located in

Twp. 6N. Rge. 44E. Twp. Rge.

Twp. Rge. Twp. Rge.

Filed in Twp. 6N. Rge. 44E.

Remarks

Y.L.B.

See 17

East

19A and

15.0

30/47

15 GS 200N

3



NOTICE
These forms are the
property of the State
of Montana and must
be returned.

STATE OF MONTANA
STATE ENGINEERS OFFICE
Water Resources Survey

FORM WR-1-2M 12-57

Code No. 20A
County Rosebud
T. 6N R. 44E

Name of Land Owner Arthur Kambout Address Henry, Mont.
Name of Operator _____ Address _____

Part A

TO BE FILED BY THOSE OBTAINING IRRIGATION WATER FROM
A DITCH COMPANY OR IRRIGATION DISTRICT

1. Water is delivered by: _____ Name of Ditch, Ditch Com. or District Supplying Water _____ Shares you hold _____
2. State the number of acres you irrigate under this system _____
3. If you obtain water from more than one Company, give the number of shares, acres irrigated and the name of the Company under "Remarks." If you obtain water from a Ditch Company and also have a private system fill in both Part A and Part B.

Part B

TO BE FILED BY THOSE WHO HAVE A PRIVATE DITCH, PUMP OR IRRIGATION SYSTEM
or those who have a private water right under a Ditch Company

4. In what year was this land first irrigated? Date See attached filings
5. Give the name of the original appropriator (first user): _____
6. Give the date appropriated _____ Amount filed on: Miners Inches _____ C. F. S. _____
7. State the total number of acres irrigated under this system: _____
8. Give the point of diversion: $\frac{1}{4}$ $\frac{1}{4}$ Section _____ Township _____ Range _____

Part C

TO BE FILED BY ALL WATER USERS IN ADDITION TO PART A OR PART B

9. Source of Water: Lower Snow Jaw Creek
Name of stream or lake from which water is originally diverted
10. Water is obtained by: (Check one) Gravity ☒ Pumping _____ Other Flood
11. What is the greatest number of acres you have irrigated? 167.0 Date _____
12. How many acres did you irrigate in 1947? (Crop and pasture) 167.0
13. State the total number of additional acres that could be irrigated by increasing the water supply, land leveling, etc. 0 This land is under what ditch? _____
14. How many acres of seeped land do you have which could be drained and put into production? 0
15. What is the condition of your irrigation system? Said
16. Is your water supply adequate? Yes ☒ No ☐ Explain No under Thompson
17. REMARKS: All land will be irrigated from Barringer Pump - worked in from Yellowstone River

Over

NOTE: The foregoing questions apply only to irrigated land shown on this plat.

DESCRIPTION AND MAP OF FARM

18. Legal Description of this Farm

All sec 20, Less W²W²



IRRIGATED LAND



NON-IRRIGATED LAND

North

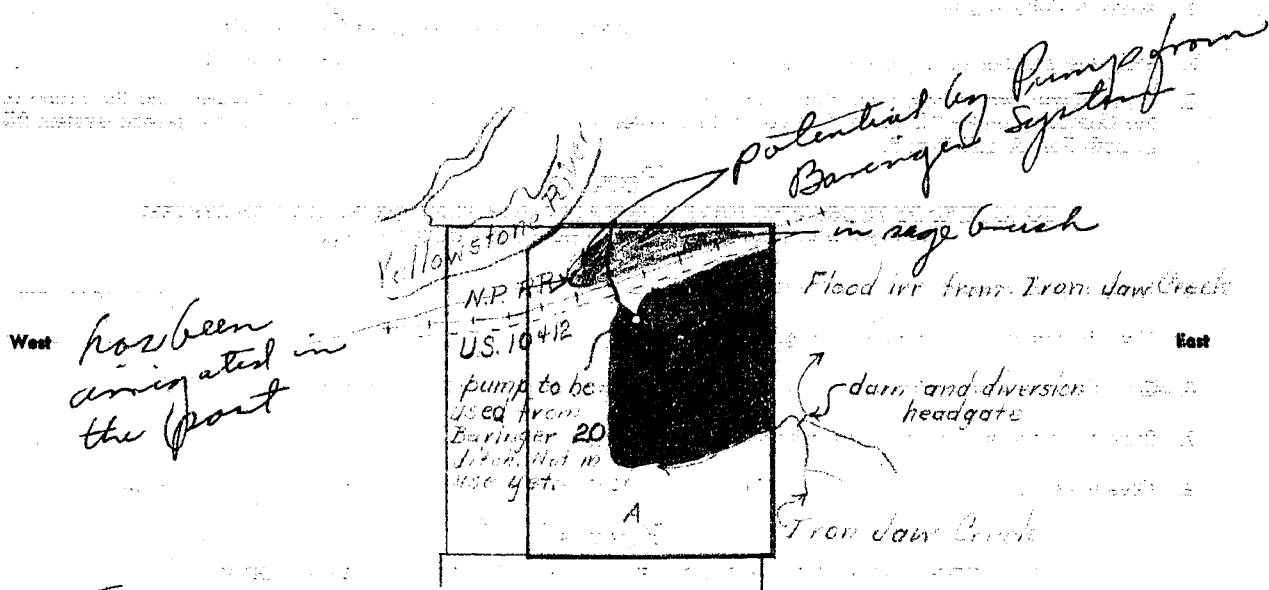

This land will be and can be irrigated from Baringer Pump. Has trouble with R.W. now system in. Ditch across R.W. does not have enough drop to operate efficiently as presently constructed

19. If the above land is irrigated from more than one ditch please give the acreage under each ditch in 19A and indicate the location of the land irrigated from each on the above map.

19A. Ditch: *Flood from Iron Jaw Creek* Acres: *167.0*

Ditch: _____ Acres: _____

Information supplied by:

Name *Field Survey* Address _____ Date *6/30/47*

REMARKS: *Pondist & Creek*

All flood now will be pumped on Pump & ditch constructed

If you cannot answer all of the questions on this form answer as many as you can and return the form to us as soon as possible.

Farm Checked

STATE OF MONTANA

Code No. 27A, 33A, 20B, 22C

By Dave, Joe, Jim

STATE ENGINEER'S OFFICE
WATER RESOURCES SURVEY

County Rosebud

Area Hathaway

T. 6N R. 44E Sec.

Date 6/30/47

Photo No. 32-54 + 29-41

Legal Land Owner Kamhoor

Address Hathaway, Forsyth

Operator Same

Address _____

Water is delivered by:

Pres. _____ Pot. _____

Federal Project _____

Pres. _____ Pot. _____

Ditch Company.

Pres. _____ Pot. _____

Irrigation District _____ *Planim* *Planim*

Pres. _____ Pot. _____

Private System ☒ Barringer not in use Pres. 167.0 Pot. 0
2 - Creek Flood

167.0 0

[illegible]

Flood ☒ Pump ☒ Reservoir _____ Gravity _____

Gravity_____

Size and Capacity, Pump, etc. Barringer pump and secondary lift

Original Appropriator, Company _____ App. No. _____

App. No. _____

Original Appropriator, Private. (Show date of appropriation under Remarks)

App. No. _____

Original Appropriator, Private (Show date of appropriation under Remarks)

Is the system an extension of another system? Yes _____ No _____

Is all land irrigated from one system? Yes _____ No _____

(If No, show break down on map) *66-1-100*

(If No, show break down on map)

Source of Water Yellowstone River flood from Iron Jaw Creek

Acres Irrigated 19 46[illegible]

Explain medans

Explain _____

Condition of System *flood okay, ^{secondary} pump system not working*

Adequate Supply — Yes _____ No ☒ _____

Explain _____

Topography Valley side

Information From Now all irrigated from

Information From John J. ...
Remarks From Saw Creek Road

Remarks Water from well
water no use of
pump system 6/30/41

[illegible]

STATE ENGINEER'S OFFICE
WATER RESOURCES SURVEYCOUNTY RosebudFILE NO. 33 - 20AOwner Kamhoot, ArthurAddress Forsyth, Montana

AAA Owner

Address

Operator N.O.

Address

New Owner

Address

New Operator

Address

Assessment Record No.

Assessed Acreage

Legal Description of This Farm E¹ Sec. 20, E¹ Sec. 20, T. 6N., R. 44E.

Private flood

Total Acres in Farm

Code Number 20APhoto No. MA-32-54

AAA Contract No.

AAA Total Cropland Acreage 244.0App. No. 355, 357

Decree No.

Land is located in

Twp. 6N. Rge. 44E. Twp. Rge.

Twp. Rge. Twp. Rge.

Filed in Twp. 6N. Rge. 44E.

Remarks

Y. R. E.



NOTICE
These forms and the
property of the State
of Montana and may
be secured.

STATE OF MONTANA
STATE ENGINEERS OFFICE
Water Resources Survey

FORM WA-1-24 12-27
Code No. 16 C
County Rosebud
T. 6 N. R. 44

Name of Land Owner Carl Lockard Address Box 427, Miland, Calif
Name of Operator _____ Address _____

Part A

TO BE FILED BY THOSE OBTAINING IRRIGATION WATER FROM
A DITCH COMPANY OR IRRIGATION DISTRICT

1. Water is delivered by: _____
Name of Ditch, Ditch Company or District Supplying Water
2. State the number of acres you irrigate under this system. _____ Shares you hold _____
3. If you obtain water from more than one Company, give the number of shares, acres irrigated and the name of the Company under "Remarks." If you obtain water from a Ditch Company and also have a private system fill in both Part A and Part B.

Part B

TO BE FILED BY THOSE WHO HAVE A PRIVATE DITCH, PUMP OR IRRIGATION SYSTEM
or those who have a private water right under a Ditch Company

4. In what year was this land first irrigated? Date see attached filing
5. Give the name of the original appropriator (first user): _____
6. Give the date appropriated _____ Amount filed on: Miners Inches _____ C. F. S. _____
7. State the total number of acres irrigated under this system: _____
8. Give the point of diversion: _____ 1/4 _____ 1/4 Section _____ Township _____ Range _____

Part C

TO BE FILED BY ALL WATER USERS IN ADDITION TO PART A OR PART B

9. Source of Water: Yellowstone River + Brown Jaw Creek
Name of stream or lake from which water is originally diverted
10. Water is obtained by: (Check one) Gravity ☒ Pumping ☒ Other _____
11. What is the greatest number of acres you have irrigated? 118 Date _____
12. How many acres did you irrigate in 1947 (Crop and pasture) 118.0
13. State the total number of additional acres that could be irrigated by increasing the water supply, land leveling, etc. 3.0 This land is under what ditch? Baringer Pump
14. How many acres of seeped land do you have which could be drained and put into production? 0
15. What is the condition of your irrigation system? Good
16. Is your water supply adequate? Yes ☒ No ☒ Explain Yes on Yellowstone
17. REMARKS: no on Brown Jaw Creek
Baringer Pump system is a private
partnership system. Cost \$1.90 cents to
install pump - 600 cfs per minute
Over

NOTE: The foregoing questions apply only to irrigated land shown on this plat.

DESCRIPTION AND MAP OF FARM

18. Legal Description of this Farm

SE 1, Sec 16



IRRIGATED LAND



NON-IRRIGATED LAND



Potentially Irrigable Land

North

NOTE: DRAWN TO SCALE. IN THIS CASE, 1" = 1/4 MILE. ALL DISTANCES ARE APPROXIMATE.

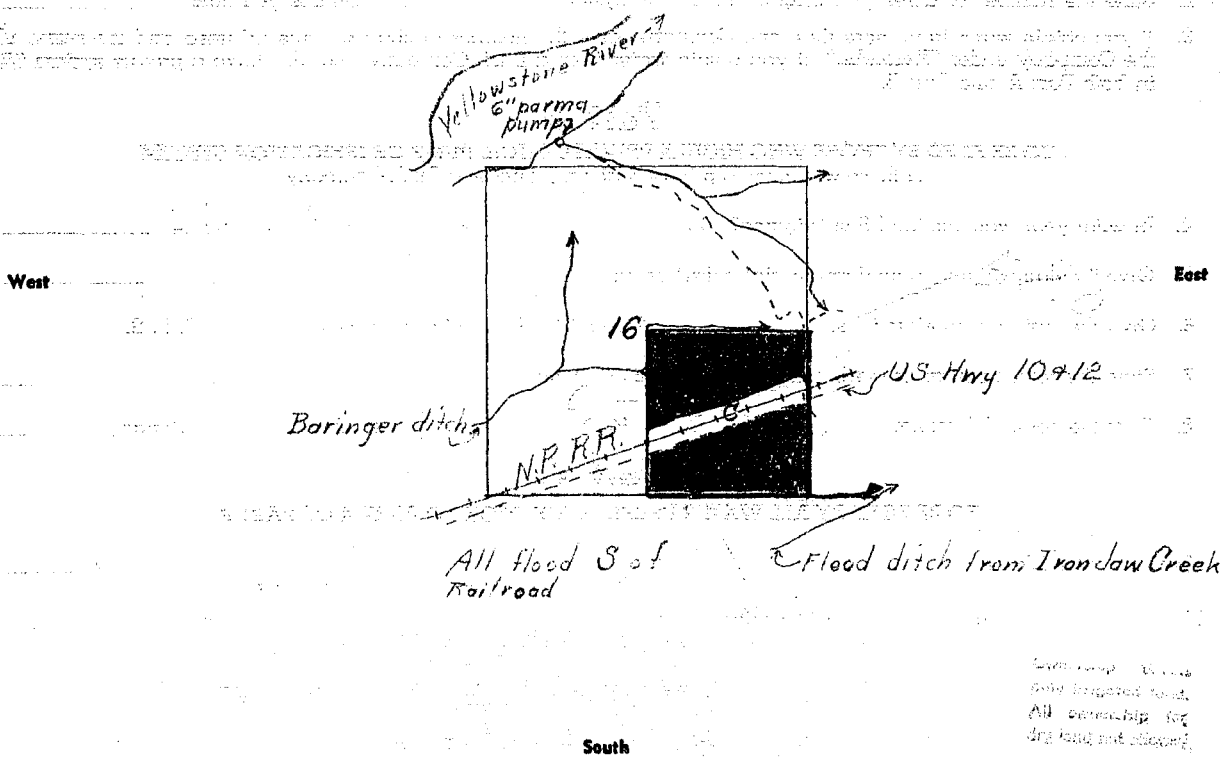

19. If the above land is irrigated from more than one ditch please give the acreage under each ditch in 19A and indicate the location of the land irrigated from each on the above map.

19A. Ditch: Baringer Pump ditch, Yell. River Acres: 58.0

Ditch: Private Iron Jaw Creek Flood Acres: 60.0

Information supplied by:

Name Baringer to Address _____ Date 6/30/47

REMARKS: J Cook + O Paulist

If you cannot answer all of the questions on this form answer as many as you can and return the form to us as soon as possible.

STATE ENGINEER'S OFFICE
WATER RESOURCES SURVEYCOUNTY RosebudFILE NO. 33 - 16COwner Lockard, Carl Address Box 427, Niland, California

AAA Owner Address

Operator N.O. Address

New Owner Address

New Operator Address

Assessment Record No

Assessed Acreage

Legal Description of This Farm SE 1/4 Sec. 16, T. 6N., R. 44E.

Private flood and private pump

Total Acres in Farm

Code Number 16CPhoto No. MA-32-53

AAA Contract No.

AAA Total Cropland Acreage 56.4App. No. 888

Decree No.

Land is located in

Twp. 6N. Rge. 44E. Twp. Rge.

Twp. Rge. Twp. Rge.

Filed in Twp. 6N. Rge. 44E.

Remarks

Y.R.B.

BARINGER PUMPING PROJECT

The first use of what is now known as the Baringer Pumping Project was made by M. W. Dickey, who, in 1905, installed a steam powered pumping plant in the location of the present Baringer diversion. According to Fred H. Baringer, "Dickey", the name by which he was commonly known to the "old-timers", did not make a recorded water filing but that water for irrigation has been diverted continuously, with the exception of possibly one year, by pumping from the Yellowstone River at or near the point of the original appropriation to and upon the lands in the Hathaway bottom, since 1905. No recorded filings were made until 1920.

According to a notice of appropriation filed in Book 3, Page 16 of Water Right Records in the Rosebud County Courthouse, J. E. Libby, on January 5, 1920, made the first recorded filing for 17.50 cubic feet of water to be diverted from the Yellowstone River. The point of diversion was described as a point in Section 9, Township 6 North, Range 44 East on the South bank of the river. The system was described as a pumping plant with ditches and structures extending from the pumping plant to the place of intended use. The land description of intended place of use was described as a portion of Sections 9 and 10, Township 6 North, Range 44 East.

This system and water right was later transferred to Carl Calvin, who, for a time, operated a diesel powered six inch Parma water lifter at the site of the original appropriation made by Libby. As this operation did not prove too successful the pumping operation was moved to the Fred H. Baringer location and the two ditch systems were incorporated under one pumping unit. The Calvin pump site has since been destroyed as a result of ice and high water.

On April 4, 1920 Antilace G. Webber filed on 10 cubic feet of water to be diverted from the Yellowstone River at the same point of diversion as the original "Dickey" pumping plant location. The original steam plant was then replaced by a 30 horse power one cylinder Witt tractor fuel operated pump. The notice of appropriation is on file in Book 3, Page 17, of water right records in the Rosebud County Courthouse. The point of diversion was described as a point upon the southern bank of said river upon Lot 5 in Section 17, Township 6 North, Range 44 East. The purpose was for irrigation on agricultural lands. The system was described as a pumping plant which lifts the water from said river about 12 feet and discharges it into a canal 10 feet wide on the bottom. The land description of intended place of use was described as the NE 1/4, SW 1/4, and Lots 1, 5 and 6 in Section 17, Township 6 North, Range 44 East. This water right and system was later transferred to Fred H. Baringer, which, together with the Carl Calvin right and system was the basis for the creation of the Baringer Pumping Project. In 1945 a surplus pump and electric motor were purchased from the government project at Kinsey. After this, the following two agreements were entered into by the parties concerned. The first deals with the operation and maintenance of the pumping plant, and the second describes the use of the irrigation system.



NOTICE
These forms are the
property of the State
of Montana and must
be returned.

STATE OF MONTANA
STATE ENGINEERS OFFICE
Water Resources Survey

FORM WR-1-2M 12-87
2A-3A-10B-11C
Code No.

County Rosebud
T. 6N R. 4E

Name of Land Owner Loekie Bros Address Sheffield, Mont

Name of Operator _____ Address _____

Part A

**TO BE FILED BY THOSE OBTAINING IRRIGATION WATER FROM
A DITCH COMPANY OR IRRIGATION DISTRICT**

1. Water is delivered by: _____
Name of Ditch, Ditch Company or District Supplying Water
2. State the number of acres you irrigate under this system _____ Shares you hold _____
3. If you obtain water from more than one Company, give the number of shares, acres irrigated and the name of the Company under "Remarks." If you obtain water from a Ditch Company and also have a private system fill in both Part A and Part B.

Part B

**TO BE FILED BY THOSE WHO HAVE A PRIVATE DITCH, PUMP OR IRRIGATION SYSTEM
or those who have a private water right under a Ditch Company**

4. In what year was this land first irrigated? Date See attached filings
5. Give the name of the original appropriator (first user): _____
6. Give the date appropriated _____ Amount filed on: Miners Inches _____ C. F. S. _____
7. State the total number of acres irrigated under this system: _____
8. Give the point of diversion: _____ $\frac{1}{4}$ _____ $\frac{1}{4}$ Section _____ Township _____ Range _____

Part C

TO BE FILED BY ALL WATER USERS IN ADDITION TO PART A OR PART B

9. Source of Water: Bull Creek
Name of stream or lake from which water is originally diverted
10. Water is obtained by: (Check one) Gravity ☒ Pumping _____ Other Flood
11. What is the greatest number of acres you have irrigated? _____ Date _____
12. How many acres did you irrigate in 1947 (Crop and pasture) 190.0
13. State the total number of additional acres that could be irrigated by increasing the water supply, land leveling, etc. 0 This land is under what ditch? 0
14. How many acres of seeped land do you have which could be drained and put into production? 0
15. What is the condition of your irrigation system? Fair
16. Is your water supply adequate? Yes _____ No ☒ Explain Flood Irrigation
17. REMARKS: _____

Over

NOTE: The foregoing questions apply only to irrigated land shown on this plat.

DESCRIPTION AND MAP OF FARM

18. Legal Description of this Farm See W.C. 2



North

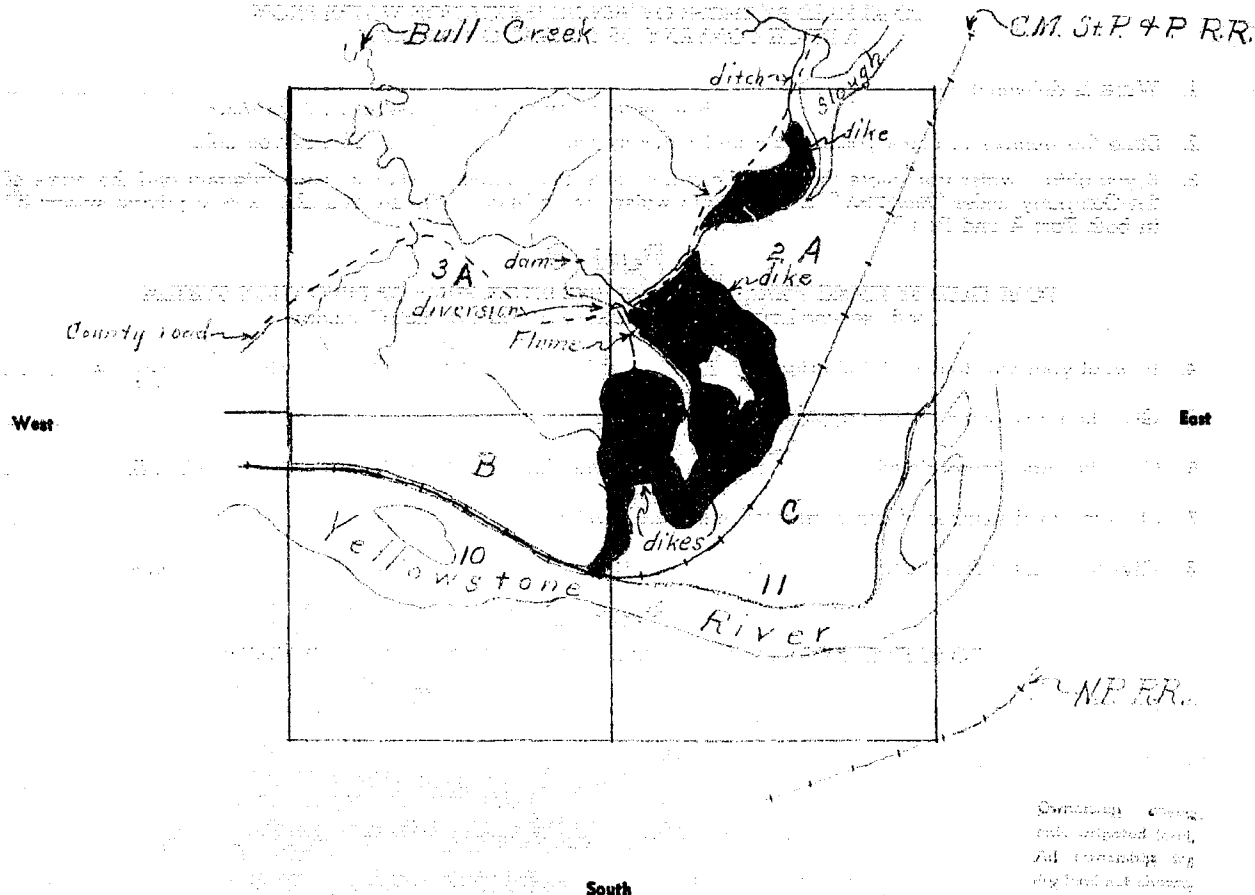

19. If the above land is irrigated from more than one ditch please give the acreage under each ditch in 19A and indicate the location of the land irrigated from each on the above map.

19A. Ditch: Bull Creek flood line Acres: 190.0

Ditch: _____ Acres: _____

Information supplied by:

Name Field Survey Address _____ Date 6/24/47

REMARKS: Cash & D. Paulist

from Iskhie Bros.

If you cannot answer all of the questions on this form answer as many as you can and return the form to us as soon as possible.

STATE ENGINEER'S OFFICE
WATER RESOURCES SURVEYCOUNTY RosebudFILE NO. 33 - 2A, 3A, 10F, 11COwner Lockie Bros.Address Sheffield, Montana

AAA Owner

Address

Operator N.O.

Address

New Owner

Address

New Operator

Address

Assessment Record No

Assessed Acreage

Legal Description of This Farm All Sec. 2, All Sec. 3, Lots 3, 4, 5, NW 1/4 Sec. 11;Lots 1, 2, 3, 4, NE 1/4 Sec. 10, T. 6N., R. 4E.

Private Flood Bull Creek

Total Acres in Farm

Code Number 2A, 3A, 10B, 11CPhoto No. MA-22-153, 32-53

AAA Contract No.

AAA Total Cropland Acreage 36.23App. No. 123, 120, 94, 124, 93

Decree No.

Land is located in

Twp. 6N. Rge. 4E. Twp. 6N. Rge. 42E.Twp. 8N. Rge. 42E. Twp. Rge.Filed in Twp. 6N. Rge. 42E.

Remarks

Y. R. B.



These forms are the
property of the State
of Montana and should
be returned.

STATE OF MONTANA
STATE ENGINEERS OFFICE

Water Resources Survey

FORM WR-1-24 12-67

Code No. 153
County Rosebud
T. 6N R. 44

Name of Land Owner

H. E. Martin

Address

Hathaway Mont

Name of Operator

L. Nielson, Jr.

Address

Part A

TO BE FILED BY THOSE OBTAINING IRRIGATION WATER FROM
A DITCH COMPANY OR IRRIGATION DISTRICT

1. Water is delivered by: Baringer Pump Mutual
Name of Ditch, Ditch Company or District Supplying Water
2. State the number of acres you irrigate under this system. _____ Shares you hold _____
3. If you obtain water from more than one Company, give the number of shares, acres irrigated and the name of the Company under "Remarks." If you obtain water from a Ditch Company and also have a private system fill in both Part A and Part B.

Part B

TO BE FILED BY THOSE WHO HAVE A PRIVATE DITCH, PUMP OR IRRIGATION SYSTEM
or those who have a private water right under a Ditch Company

4. In what year was this land first irrigated? Date no date
5. Give the name of the original appropriator (first user): (see attached letter)
6. Give the date appropriated. _____ Amount filed on: Miners Inches _____ C. F. S. _____
7. State the total number of acres irrigated under this system: _____
8. Give the point of diversion: _____ $\frac{1}{4}$ _____ $\frac{1}{4}$ Section _____ Township _____ Range _____

Part C

TO BE FILED BY ALL WATER USERS IN ADDITION TO PART A OR PART B

9. Source of Water: Yellowstone River from Saw Creek
Name of stream or lake from which water is originally diverted
10. Water is obtained by: (Check one) Gravity ☒ Pumping ☒ Other Flood
11. What is the greatest number of acres you have irrigated? 207.0 Date _____
12. How many acres did you irrigate in 1947 (Crop and pasture) 177.0
13. State the total number of additional acres that could be irrigated by increasing the water supply, land leveling, etc. 30.0 This land is under what ditch? Baringer Pump
14. How many acres of seeped land do you have which could be drained and put into production? 0
15. What is the condition of your irrigation system? Good
16. Is your water supply adequate? Yes ☒ No ☐ Explain _____
17. REMARKS: No more from Saw Creek

Over

NOTE: The foregoing questions apply only to irrigated land shown on this plat.

DESCRIPTION AND MAP OF FARM

18. Legal Description of this Farm

E 2 Sec 15



IRRIGATED LAND



NON-IRRIGATED LAND



Potentially Irrigable Land

North

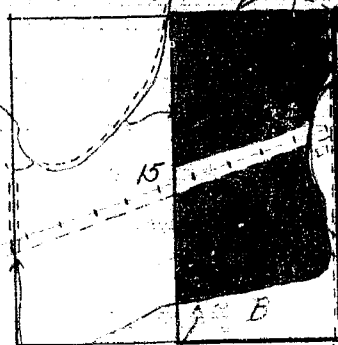

Flood ditch out of Iron Jaw Creek

As of July 1, 1948 all land is now under Baringer Pump Project - new ditch covering land formerly irrigated by flood from Iron Jaw creek was constructed in the spring of 1948

19. If the above land is irrigated from more than one ditch please give the acreage under each ditch in 19A and indicate the location of the land irrigated from each on the above map.

19A. Ditch: *Baringer Pump System* Acres: *80.0*

Ditch: *Iron Jaw Creek Flood* Acres: *97.0*

Information supplied by:

Name *Field Survey* Address _____ Date *6/26/47*

REMARKS: *J. C. B. D. B. B. B.*

If you cannot answer all of the questions on this form answer as many as you can and return the form to us as soon as possible.

STATE ENGINEER'S OFFICE
WATER RESOURCES SURVEYCOUNTY RosebudFILE NO. 33 - 15B

Owner Martin, H. E. Address c/o Nielson, Soren, Hathaway, Montana
 AAA Owner Address
 Operator Nielson, Soren Address Hathaway, Montana
 New Owner Address
 New Operator Address

Assessment Record No

Assessed Acreage

Legal Description of This Farm E¹ Sec. 15, T. 6N., R. 44E.

Private flood and private pump

Total Acres in Farm

Code Number 15BPhoto No. MA-32-53

AAA Contract No.

AAA Total Cropland Acreage 177.7App. No. N.R.

Decree No.

Land is located in

Twp. 6N. Rge. 44E. Twp. Rge.

Twp. Rge. Twp. Rge.

Filed in Twp. 6N. Rge. 44E.

Remarks

Y.R.P.

Farm Checked

STATE OF MONTANA

Code No. 15BBy Dave, Jim, Joe

STATE ENGINEER'S OFFICE

County RosebudArea Hathaway

WATER RESOURCES SURVEY

T. 4N R. 44E Sec. 15Date 6/26/47Photo No. 22-53Legal Land Owner Soren NielsenAddress Hathaway MontOperator same

Address

Water is delivered by:

Federal Project

Pres.

Pot.

Ditch Company

Pres.

Pot.

Irrigation District

Pres.

Pot.

Private System

Pres.

Planim

Pot.

Totals

Flood ☒Pump ☒

Reservoir

Gravity

Size and Capacity, Pump, etc. See Barger system write up.Original Appropriator, Company M.W. Dickey - Libby & Webber

App. No.

Original Appropriator, Private ☒ (Show date of appropriation under Remarks)App. No. Not filing shown

Is the system an extension of another system?

Yes ☐ No ☐

Is all land irrigated from one system?

Yes ☒ No ☒

(If No, show break down on map)

Source of Water Yellowstone River & Iron Jaw Crk.Acres Irrigated 1946 ☒PlanimPotential Acres ☒Seeped ☐

Explain

Condition of System Good

Adequate Supply

Yes ☒No ☒Explain pump supply adequate, flood only in rainy seasonsTopography flat valley side of River bottomInformation From J. Bacbo

Remarks

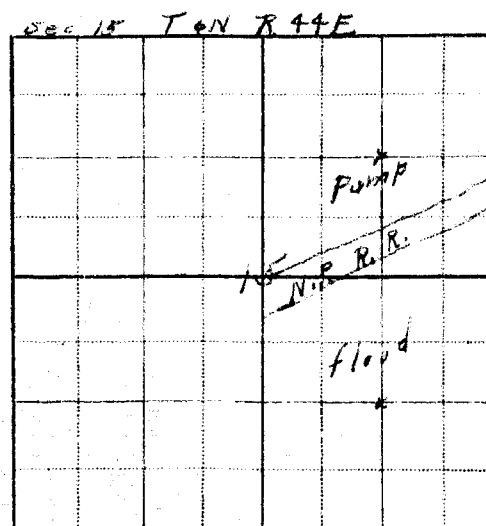

Hathaway, Montana,
Apr. 20, 1948 -

Mr. G. J. Gravetz,
Asst. St. Engineer,
Billings, Mont.

Dear Sir,

Recd at Sec. 15. Your letter was received in-
quiring about the water right on
E's Sec. 15 T. 6N R. 44E. This parcel of
land was put under irrigation
by Mr. M. W. Kieley in 1905. It has been
irrigated almost continuously since
that year. Yours truly

Yours truly,
Samuel Nickerson.

BARINGER PUMPING PROJECT

The first use of what is now known as the Baringer Pumping Project was made by M. W. Dickey, who, in 1905, installed a steam powered pumping plant in the location of the present Baringer diversion. According to Fred H. Baringer, "Dickey", the name by which he was commonly known to the "old-timers", did not make a recorded water filing but that water for irrigation has been diverted continuously, with the exception of possibly one year, by pumping from the Yellowstone River at or near the point of the original appropriation to and upon the lands in the Hathaway bottom, since 1905. No recorded filings were made until 1920.

According to a notice of appropriation filed in Book 3, Page 16 of Water Right Records in the Rosebud County Courthouse, J. R. Libby, on January 5, 1920, made the first recorded filing for 17.50 cubic feet of water to be diverted from the Yellowstone River. The point of diversion was described as a point in Section 9, Township 6 North, Range 44 East on the South bank of the river. The system was described as a pumping plant with ditches and structures extending from the pumping plant to the place of intended use. The land description of intended place of use was described as a portion of Sections 9 and 10, Township 6 North, Range 44 East.

This system and water right was later transferred to Carl Calvin, who, for a time, operated a diesel powered six inch Parma water lifter at the site of the original appropriation made by Libby. As this operation did not prove too successful the pumping operation was moved to the Fred H. Baringer location and the two ditch systems were incorporated under one pumping unit. The Calvin pump site has since been destroyed as a result of ice and high water.

On April 4, 1920 Antilace G. Webber filed on 10 cubic feet of water to be diverted from the Yellowstone River at the same point of diversion as the original "Dickey" pumping plant location. The original steam plant was then replaced by a 30 horse power one cylinder Witt tractor fuel operated pump. The notice of appropriation is on file in Book 3, Page 17, of water right records in the Rosebud County Courthouse. The point of diversion was described as a point upon the southern bank of said river upon Lot 5 in Section 17, Township 6 North, Range 44 East. The purpose was for irrigation on agricultural lands. The system was described as a pumping plant which lifts the water from said river about 12 feet and discharges it into a canal 10 feet wide on the bottom. The land description of intended place of use was described as the NE 1/4, SW 1/4, and Lots 1, 5 and 6 in Section 17, Township 6 North, Range 44 East. This water right and system was later transferred to Fred H. Baringer, which, together with the Carl Calvin right and system was the basis for the creation of the Baringer Pumping Project. In 1945 a surplus pump and electric motor were purchased from the government project at Kinsey. After this, the following two agreements were entered into by the parties concerned. The first deals with the operation and maintenance of the pumping plant, and the second describes the use of the irrigation system.



These forms are the
property of the State
of Montana and must
be returned.

STATE OF MONTANA
STATE ENGINEERS OFFICE

Water Resources Survey

FORM WR-14-27 (2-47)

Code No. 12.4

County Bozeman

T. 6N R. 44

Name of Land Owner Newton McFinnon Address Miller City, Mont

Name of Operator _____ Address _____

Part A

**TO BE FILED BY THOSE OBTAINING IRRIGATION WATER FROM
A DITCH COMPANY OR IRRIGATION DISTRICT**

1. Water is delivered by: _____
Name of Ditch, Ditch Company or District Supplying Water
2. State the number of acres you irrigate under this system. _____ Shares you hold _____
3. If you obtain water from more than one Company, give the number of shares, acres irrigated and the name of the Company under "Remarks." If you obtain water from a Ditch Company and also have a private system fill in both Part A and Part B.

Part B

**TO BE FILED BY THOSE WHO HAVE A PRIVATE DITCH, PUMP OR IRRIGATION SYSTEM
or those who have a private water right under a Ditch Company**

4. In what year was this land first irrigated? Date No data
5. Give the name of the original appropriator (first user): _____
6. Give the date appropriated _____ Amount filed on: Miners Inches _____ C. F. S. _____
7. State the total number of acres irrigated under this system: _____
8. Give the point of diversion: _____ $\frac{1}{4}$ _____ $\frac{1}{4}$ Section _____ Township _____ Range _____

Part C

TO BE FILED BY ALL WATER USERS IN ADDITION TO PART A OR PART B

9. Source of Water: Yellowstone River
Name of stream or lake from which water is originally diverted
10. Water is obtained by: (Check one) Gravity _____ Pumping X Other _____
11. What is the greatest number of acres you have irrigated? 50.0 Date _____
12. How many acres did you irrigate in 1947? (Crop and pasture) 50.0
13. State the total number of additional acres that could be irrigated by increasing the water supply, land leveling, etc. 0 This land is under what ditch? 0
14. How many acres of seeped land do you have which could be drained and put into production? 0
15. What is the condition of your irrigation system? Good
16. Is your water supply adequate? Yes ✓ No _____ Explain _____
17. REMARKS: _____

Over

NOTE: The foregoing questions apply only to irrigated land shown on this plat.

DESCRIPTION AND MAP OF FARM

18. Legal Description of this Farm

Tracts 4.5, 8, 11, 12, Sec 12



IRRIGATED LAND



NON-IRRIGATED LAND

North

West

East

South

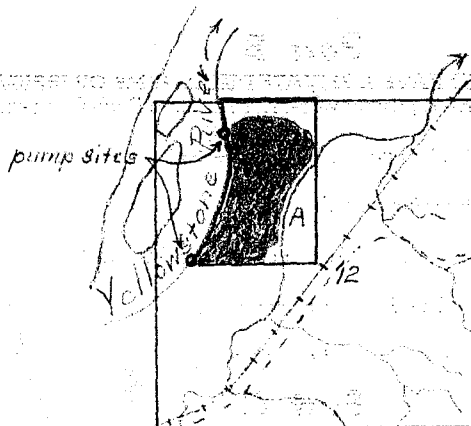

19. If the above land is irrigated from more than one ditch please give the acreage under each ditch in 19A and indicate the location of the land irrigated from each on the above map.

19A. Ditch: Private Pump Yell. R. Acres: 50.0

Ditch: _____ Acres: _____

Information supplied by:

Name See attached form Address _____ Date _____

REMARKS: _____

If you cannot answer all of the questions on this form answer as many as you can and return the form to us as soon as possible.

STATE ENGINEER'S OFFICE
WATER RESOURCES SURVEY

COUNTY Rosebud

FILE NO. 33, 12A

Owner McKinnon, Newton Address Miles City

AAA Owner Address

Operator Nace, Chas. Address Hathaway, Mont.

New Owner Address

New Operator Address

Assessment Record No

Assessed Acreage 0

Legal Description of This Farm SW 1/4, Lots 4, 5 Sec. 12, T. 6N. - R. 44E.

Pump Yell. R. Total Acres in Farm

Code Number 12A

Photo No. MA 22-153

AAA Contract No.

AAA Total Cropland Acreage 48.7

App. No. N.R.

Decree No.

Land is located in

Twp. 6N. Rge. 44E. Twp. Rge.

Twp. Rge. Twp. Rge.

Filed in Twp. 6N. Rge. 44E.

Remarks



NOTICE
These forms are the
property of the State
of Montana and must
be returned.

STATE OF MONTANA
STATE ENGINEERS OFFICE
Water Resources Survey

FORM WR-1-1-2-12-57

Code No. 14B
County Bozeman
T. 6N R. 4E

Name of Land Owner See D. Name Address Bozeman, Mont
(Name)
Name of Operator _____ Address _____

Part A

**TO BE FILED BY THOSE OBTAINING IRRIGATION WATER FROM
A DITCH COMPANY OR IRRIGATION DISTRICT**

1. Water is delivered by: _____
Name of Ditch, Ditch Company or District Supplying Water
2. State the number of acres you irrigate under this system. _____ Shares you hold _____
3. If you obtain water from more than one Company, give the number of shares, acres irrigated and the name of the Company under "Remarks." If you obtain water from a Ditch Company and also have a private system fill in both Part A and Part B.

Part B

**TO BE FILED BY THOSE WHO HAVE A PRIVATE DITCH, PUMP OR IRRIGATION SYSTEM
or those who have a private water right under a Ditch Company**

4. In what year was this land first irrigated? Date See attached filing
5. Give the name of the original appropriator (first user): _____
6. Give the date appropriated _____ Amount filed on: Miners Inches _____ C. F. S. _____
7. State the total number of acres irrigated under this system: _____
8. Give the point of diversion: _____ $\frac{1}{4}$ _____ $\frac{1}{4}$ Section _____ Township _____ Range _____

Part C

TO BE FILED BY ALL WATER USERS IN ADDITION TO PART A OR PART B

9. Source of Water: Yellowstone River & Graveyard Cr.
Name of stream or lake from which water is originally diverted
10. Water is obtained by: (Check one) Gravity ☒ Pumping ☒ Other Flood
11. What is the greatest number of acres you have irrigated? 32.2 Date _____
12. How many acres did you irrigate in 1947 (Crop and pasture) 32.2
13. State the total number of additional acres that could be irrigated by increasing the water supply, land leveling, etc. 0 This land is under what ditch? 0
14. How many acres of seeped land do you have which could be drained and put into production? 0
15. What is the condition of your irrigation system? Fair
16. Is your water supply adequate? Yes ☒ No _____ Explain _____
17. REMARKS: Some flooded from Graveyard Creek
that pumped out 1 1/2 inches of water

Over

NOTE: The foregoing questions apply only to irrigated land shown on this plat.

DESCRIPTION AND MAP OF FARM

18. Legal Description of this Farm

See attached WK-2

IRRIGATED LAND

NON-IRRIGATED LAND

Potentially Irrigable Land North

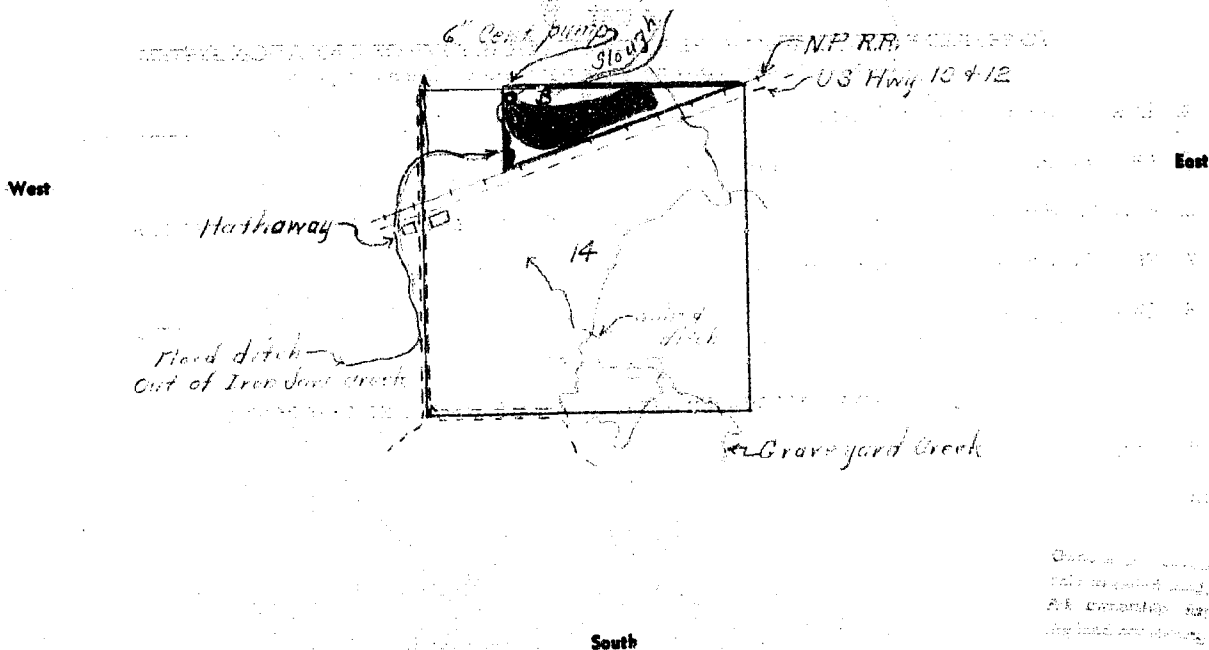

19. If the above land is irrigated from more than one ditch please give the acreage under each ditch in 19A and indicate the location of the land irrigated from each on the above map.

19A. Ditch: *Private Pump Yell River* Acres: *32.0*

Ditch: _____

Acres: _____

Information supplied by:

Name

Field Survey

Address _____

Date _____

REMARKS:

See attached form

If you cannot answer all of the questions on this form answer as many as you can and return the form to us as soon as possible.

**STATE ENGINEER'S OFFICE
WATER RESOURCES SURVEY**

COUNTY RosebudFILE NO. 33 - 14BOwner Nace, Geo. D. Address Hathaway, Montana

AAA Owner Address

Operator N.O. Address

New Owner Address

New Operator Address

Assessment Record YesCounty 30

Assessed Acreage

Legal Description of This Farm NE 1/4 NE 1/4 No. of R/W. Lots 1, 2, No. of R/W Sec. 14, T. 6N., R. 44E.

Private Flood

Total Acres in Farm

Code Number 14BPhoto No. MA-22-153

AAA Contract No.

AAA Total Cropland Acreage 58.8App. No. 447

Decree No.

Land is located in

Twp. 6N. Rge. 44E Twp. Rge.

Twp. Rge. Twp. Rge.

Filed in Twp. 6N. Rge. 44E.

Remarks

By Dave, Jim, Joe

Area Hathaway

Date 6/26/47

Legal Land Owner G. D. Nace

Operator Same

Water is delivered by:

Federal Project

Ditch Company.

Irrigation District

Private System. Private pump & flood

Flood ☒ Pump ☒ Reservoir _____ Gravity _____

Size and Capacity, Pump, etc. 6-8" Cent-Tractor 10' lift

Original Appropriator, Company.

Original Appropriator, Private. ☒

Is the system an extension of another system?

Is all land irrigated from one system?

(If No, show break down on map)

(If No, show break down on map)

Source of Water Pump from Slough Yellowstone River - flood Graveyard Cr.

Acres Irrigated 1947, 32.0

Potential Acres None Seeped 0

Explain.

Condition of System. Good

Adequate Supply — Yes ☒ No ☐

Explain

Topography River, Bottom

Information From Char H Nace

Remarks

STATE OF MONTANA

STATE ENGINEER'S OFFICE

WATER RESOURCES SURVEY

Code No. 14A

County Rosebud

T. 6N R. 44E Sec. 14

Photo No. 22-153

Address Hathaway

Address

Pres. _____ Pot. _____

Pres. _____ Pot. _____

Pres. _____ Pot. _____

Pres. Plasencia Pot. 0**Totals**

Yes _____ **No** _____

Yes ☐ No ☒

A 10x10 grid with a small triangle in the top right corner and the number 14 in the middle right.



STATE OF MONTANA

STATE ENGINEER

FRED E. BUCK, STATE ENGINEER
GERALD J. CRAVETZ, ASSISTANT

BILLINGS, MONTANA

May 3, 1948

Mr. Geo. D. Nance
Hathaway, Montana

Re: Private pump in Slough from Yellowstone River

Dear Sir:

In accordance with the 1939 Session Law (Section 349.68 Montana Session Laws) requiring the State Engineer to investigate and prepare a complete record of all water rights in Montana, the State Engineer has been conducting a water resources survey in Rosebud County.

We are unable to find a recorded water filing for the land that you irrigate in Sec. 14 North of R/W, T. 6N., R. 44E.

If a filing was made for this land we would like to have you send us the name of the appropriator, the date filed on, and the number of inches filed on. If no recorded filing was made we would like to have you send us the name of the first user and the date, or the approximate date, that the land was first irrigated so that we may establish a date of priority for this land.

We would like to have you make this a first on your agenda and send this information to us as soon as possible in the enclosed, stamped, self-addressed envelope.

Very truly yours,

Gerald J. Cravetz
Gerald J. Cravetz
Assistant State Engineer

GJO/a
enc.

May 8 - 48
Hathaway
mont

Dear Sir

There never was a water filling
on this land and as near as we know
we were the first to irrigate it and
as near as we can place the date,
July 1928, hope this will help

Geo. D. Nace
Hathaway
mont

2nd



NOTICE
These forms are the
property of the State
of Montana and must
be returned.

STATE OF MONTANA
STATE ENGINEERS OFFICE

Water Resources Survey

FORM WR-1-2M 12-47

Code No. 30A
County Rosebud
T. 6N R. 44

Name of Land Owner M.P.R.P. Address St. Paul, Minn
Name of Operator _____ Address _____

Part A

TO BE FILED BY THOSE OBTAINING IRRIGATION WATER FROM
A DITCH COMPANY OR IRRIGATION DISTRICT

1. Water is delivered by: _____ Name of Ditch, Ditch Company or District Supplying Water _____ Shares you hold _____
2. State the number of acres you irrigate under this system: _____
3. If you obtain water from more than one Company, give the number of shares, acres irrigated and the name of the Company under "Remarks." If you obtain water from a Ditch Company and also have a private system fill in both Part A and Part B.

Part B

TO BE FILED BY THOSE WHO HAVE A PRIVATE DITCH, PUMP OR IRRIGATION SYSTEM
or those who have a private water right under a Ditch Company

4. In what year was this land first irrigated? Date _____
5. Give the name of the original appropriator (first user): _____
6. Give the date appropriated _____ Amount filed on: Miners Inches _____ C. F. S. _____
7. State the total number of acres irrigated under this system: _____
8. Give the point of diversion: _____ $\frac{1}{4}$ _____ $\frac{1}{4}$ Section _____ Township _____ Range _____

Part C

TO BE FILED BY ALL WATER USERS IN ADDITION TO PART A OR PART B

9. Source of Water: Coal Creek Name of stream or lake from which water is originally diverted _____
10. Water is obtained by: (Check one) Gravity ☒ Pumping _____ Other Other
11. What is the greatest number of acres you have irrigated? 6.0 Date _____
12. How many acres did you irrigate in 1947 (Crop and pasture) 0
13. State the total number of additional acres that could be irrigated by increasing the water supply, land leveling, etc. 6.0 This land is under what ditch? Same
14. How many acres of seeped land do you have which could be drained and put into production? 0
15. What is the condition of your irrigation system? Out of use
16. Is your water supply adequate? (es. _____ No. ☒ Explain _____
17. REMARKS: _____

Over