



These forms are the property of the State of Montana and must be returned.

STATE OF MONTANA  
STATE ENGINEERS OFFICE

Sand Creek  
5A-8B-17A-20B-27A  
Code No. 32B  
County Roeland  
T. 7 N R. 43

Water Resources Survey

Name of Land Owner Barley Bros Address Roeland, Mont  
Name of Operator \_\_\_\_\_ Address \_\_\_\_\_

Part A

TO BE FILED BY THOSE OBTAINING IRRIGATION WATER FROM A DITCH COMPANY OR IRRIGATION DISTRICT

- Water is delivered by: Carterville Irr ditch  
Name of Ditch, Ditch Company or District Supplying Water
- State the number of acres you irrigate under this system 40.0 Shares you hold \_\_\_\_\_
- If you obtain water from more than one Company, give the number of shares, acres irrigated and the name of the Company under "Remarks." If you obtain water from a Ditch Company and also have a private system fill in both Part A and Part B.

Part B

TO BE FILED BY THOSE WHO HAVE A PRIVATE DITCH, PUMP OR IRRIGATION SYSTEM or those who have a private water right under a Ditch Company

- In what year was this land first irrigated? Date See attached filings
- Give the name of the original appropriator (first user): \_\_\_\_\_
- Give the date appropriated \_\_\_\_\_ Amount filed on: Miners Inches \_\_\_\_\_ C. F. S. \_\_\_\_\_
- State the total number of acres irrigated under this system: 228.0
- Give the point of diversion: \_\_\_\_\_ 1/4 \_\_\_\_\_ 1/4 Section \_\_\_\_\_ Township \_\_\_\_\_ Range \_\_\_\_\_

Part C

TO BE FILED BY ALL WATER USERS IN ADDITION TO PART A OR PART B



- Source of Water: Sand Creek & Yell. River  
Name of stream or lake from which water is originally diverted
- Water is obtained by: (Check one) Gravity  Pumping  out of main C. Canal Other \_\_\_\_\_
- What is the greatest number of acres you have irrigated? 268.0 Date \_\_\_\_\_
- How many acres did you irrigate in 1948? (Crop and pasture) 268.0
- State the total number of additional acres that could be irrigated by increasing the water supply, land leveling, etc. 12.0 This land is under what ditch? Carterville Irr ditch by pump
- How many acres of seeped land do you have which could be drained and put into production? 0
- What is the condition of your irrigation system? See above
- Is your water supply adequate? Yes \_\_\_\_\_ No \_\_\_\_\_ Explain See Sand Creek
- REMARKS: \_\_\_\_\_

12.0 acres potential under seeped area

NOTE: The foregoing questions apply only to irrigated land shown on this plot.

### DESCRIPTION AND MAP OF FARM

18. Legal Description of this Farm N<sup>2</sup> NW<sup>4</sup>, NE<sup>2</sup> NW<sup>4</sup>, N<sup>2</sup> SW<sup>4</sup>, S<sup>2</sup> NE<sup>4</sup>  
N<sup>2</sup> SE<sup>4</sup>, Sec 32 - SW<sup>2</sup> CR<sup>2</sup> for Sand Creek dis.

 IRRIGATED LAND       NON-IRRIGATED LAND

North  
A 179

QUESTIONS 17 AND 18 ARE TO BE ANSWERED ONLY BY THE OWNER OF THE LAND DESCRIBED HEREIN AND SHOULD BE KEPT A

QUESTIONS 19 AND 20 ARE TO BE ANSWERED ONLY BY THE OWNER OF THE LAND DESCRIBED HEREIN AND SHOULD BE KEPT A

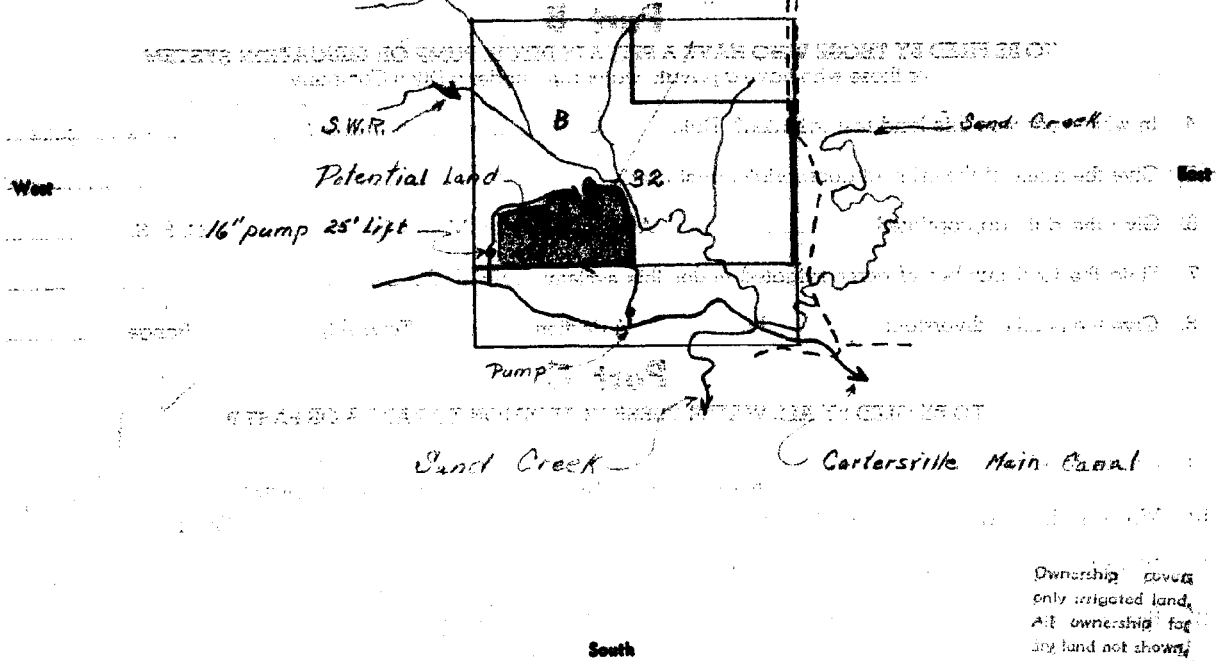

19. If the above land is irrigated from more than one ditch please give the acreage under each ditch in 19A and indicate the location of the land irrigated from each on the above map.

19A. Ditch: Cartersville br ditch Pump Acres: 40.0  
Ditch: Flood br Sand Creek + Side Canals Acres: 228.0

Information supplied by:  
Name Field Survey Address \_\_\_\_\_ Date 6/30/47

REMARKS: James D Paulist

If you cannot answer all of the questions on this form answer as many as you can and return the form to us as soon as possible.

**IRRIGATED LAND**

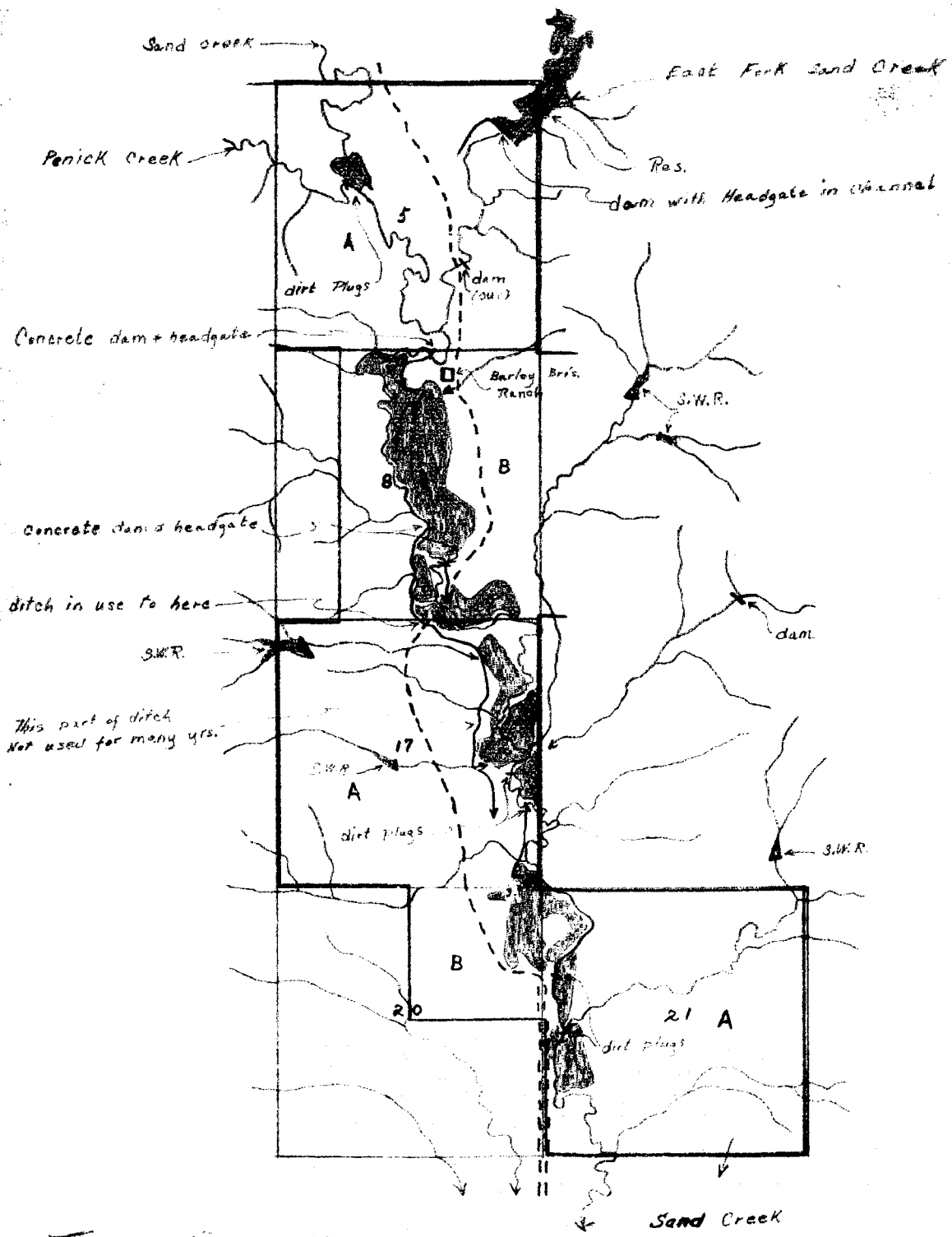

*T15 C1E  
Barley Br's*

*Sand Creek  
22 S. 0*

STATE ENGINEER'S OFFICE  
WATER RESOURCES SURVEY

COUNTY Rosebud  
FILE NO. 25 - 5A, 8B, 17A, 20B, 21A, 32B

Owner Barley Bros. Address Rosebud, Montana  
AAA Owner Address  
Operator N.O. Address  
New Owner Address  
New Operator Address

Assessment Record Yes

County 14  
Assessed Acreage 20

Legal Description of This Farm All of Sec. 5, E<sup>1</sup>/<sub>2</sub>, E<sup>1</sup>/<sub>2</sub> Sec. 8, All Sec. 17, NW<sup>1</sup>/<sub>4</sub> Sec. 20, All Sec. 21, NW<sup>1</sup>/<sub>4</sub>, N<sup>1</sup>/<sub>2</sub>S<sup>1</sup>/<sub>2</sub>, S<sup>1</sup>/<sub>2</sub>NE<sup>1</sup>/<sub>4</sub> Sec. 32, -75-043

Cartersville by pump and private Flood on Sand Creek Total Acres in Farm

Code Number 5A, 8B, 17A, 20B, 21A, 32B

Photo No. MA-27-97, MA-27-98, MA-27-99

AAA Contract No.

AAA Total Cropland Acreage 35.1

App. No. 627, 633, 630, 632

Decree No.

Land is located in

Twp. 7N. Rge. 43E. Twp. 7N. Rge. 43E.

Twp. Rge. Twp. Rge.

Filed in Twp. 7N. Rge. 43E.

Remarks



These forms are the property of the State of Montana and must be returned.

STATE OF MONTANA  
STATE ENGINEERS OFFICE

Water Resources Survey

FORM 10-17-48 (REV)

Code No. 318  
County Rosebud  
T. 7N R. 43

Name of Land Owner Walter Hawley Address Casterville, Mont  
Name of Operator \_\_\_\_\_ Address \_\_\_\_\_

Part A

TO BE FILED BY THOSE OBTAINING IRRIGATION WATER FROM  
A DITCH COMPANY OR IRRIGATION DISTRICT

- Water is delivered by: Casterville Irr. Dist.  
Name of Ditch, Ditch Company or District Supplying Water
- State the number of acres you irrigate under this system 6.0 Shares you hold 61.44
- If you obtain water from more than one Company, give the number of shares, acres irrigated and the name of the Company under "Remarks." If you obtain water from a Ditch Company and also have a private system fill in both Part A and Part B.

Part B

TO BE FILED BY THOSE WHO HAVE A PRIVATE DITCH, PUMP OR IRRIGATION SYSTEM  
or those who have a private water right under a Ditch Company

- In what year was this land first irrigated? Date \_\_\_\_\_
- Give the name of the original appropriator (first user): \_\_\_\_\_
- Give the date appropriated \_\_\_\_\_ Amount filed on: Miners Inches \_\_\_\_\_ C. F. S. \_\_\_\_\_
- State the total number of acres irrigated under this system: \_\_\_\_\_
- Give the point of diversion: 1/4 1/4 Section \_\_\_\_\_ Township \_\_\_\_\_ Range \_\_\_\_\_

Part C

TO BE FILED BY ALL WATER USERS IN ADDITION TO PART A OR PART B

- Source of Water: Yellowstone River  
Name of stream or lake from which water is originally diverted
- Water is obtained by: (Check one) Gravity  Pumping \_\_\_\_\_ Other \_\_\_\_\_
- What is the greatest number of acres you have irrigated? 56.0 Date \_\_\_\_\_
- How many acres did you irrigate in 1947? (Crop and pasture) 6.0
- State the total number of additional acres that could be irrigated by increasing the water supply, land leveling, etc. 50.0 This land is under what ditch? Same
- How many acres of seeped land do you have which could be drained and put into production? 50.0
- What is the condition of your irrigation system? Fair
- Is your water supply adequate? Yes  No \_\_\_\_\_ Explain \_\_\_\_\_
- REMARKS: \_\_\_\_\_

NOTE: The foregoing questions apply only to irrigated land shown on this plot.

### DESCRIPTION AND MAP OF FARM

18. Legal Description of this Farm S. 31, Sec 31



IRRIGATED LAND

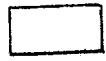

NON-IRRIGATED LAND

North

West

South

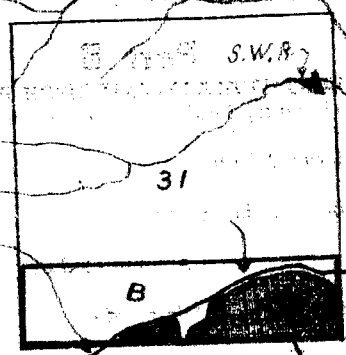

Ownership shown only irrigated land. All ownership for dry land not shown.

19. If the above land is irrigated from more than one ditch please give the acreage under each ditch in 19A and indicate the location of the land irrigated from each on the above map.

19A. Ditch: Cartersville Main Canal Acres: 6.0

Ditch: \_\_\_\_\_ Acres: \_\_\_\_\_

Information supplied by:

Name Field Survey Address \_\_\_\_\_ Date 6/20/47

REMARKS: Cook & D. Parlant

If you cannot answer all of the questions on this form answer as many as you can and return the form to us as soon as possible.

STATE ENGINEER'S OFFICE  
WATER RESOURCES SURVEY

COUNTY Rosebud

FILE NO. 25 - 31B

Owner Hawley, Walter

Address Cartersville, Montana

AAA Owner

Address

Operator N.O.

Address

New Owner

Address

New Operator

Address

Assessment Record Yes

County 0  
Assessed Acreage 61.44

Legal Description of This Farm S<sup>1</sup>SE<sup>1</sup>/<sub>4</sub>, SE<sup>1</sup>SW<sup>1</sup>/<sub>4</sub> Sec. 31, T. 7N., R. 43E.

Cartersville Irrigation District Total Acres in Farm

Code Number 31B

Photo No. MA-27-99

AAA Contract No.

AAA Total Cropland Acreage 135.8

App. No. N.R.

Decree No.

Land is located in

Twp. 7N. Rge. 43E. Twp. 6N. Rge. 43E.

Twp. Rge. Twp. Rge.

Filed in Twp. 6N. Rge. 43E.

Remarks



NO STATE  
These forms are the  
property of the State  
of Montana and must  
be returned.

STATE OF MONTANA  
STATE ENGINEERS OFFICE

Water Resources Survey

Code No. 16A  
County Roobush  
T. 7N R. 43

Name of Land Owner State of Mont. Address Helena, Mont.  
Name of Operator Barley Bros. Address Roobush, Mont.

**Part A**

**TO BE FILED BY THOSE OBTAINING IRRIGATION WATER FROM  
A DITCH COMPANY OR IRRIGATION DISTRICT**

1. Water is delivered by: \_\_\_\_\_  
Name of Ditch, Ditch Company or District Supplying Water
2. State the number of acres you irrigate under this system \_\_\_\_\_ Shares you hold \_\_\_\_\_
3. If you obtain water from more than one Company, give the number of shares, acres irrigated and the name of the Company under "Remarks." If you obtain water from a Ditch Company and also have a private system fill in both Part A and Part B.

**Part B**

**TO BE FILED BY THOSE WHO HAVE A PRIVATE DITCH, PUMP OR IRRIGATION SYSTEM  
or those who have a private water right under a Ditch Company**

4. In what year was this land first irrigated? Date filings on Barley Bros. form
5. Give the name of the original appropriator (first user): \_\_\_\_\_
6. Give the date appropriated \_\_\_\_\_ Amount filed on: Miners Inches \_\_\_\_\_ C. F. S. \_\_\_\_\_
7. State the total number of acres irrigated under this system: \_\_\_\_\_
8. Give the point of diversion: \_\_\_\_\_  $\frac{1}{4}$  \_\_\_\_\_  $\frac{1}{4}$  Section \_\_\_\_\_ Township \_\_\_\_\_ Range \_\_\_\_\_

**Part C**

**TO BE FILED BY ALL WATER USERS IN ADDITION TO PART A OR PART B**

9. Source of Water: Sand Creek  
Name of stream or lake from which water is originally diverted
10. Water is obtained by: (Check one) Gravity  Pumping \_\_\_\_\_ Other Flowed
11. What is the greatest number of acres you have irrigated? 4.0 Date \_\_\_\_\_
12. How many acres did you irrigate in 1947 (Crop and pasture) 4.0
13. State the total number of additional acres that could be irrigated by increasing the water supply, land leveling, etc. 0 This land is under what ditch? 0
14. How many acres of seeped land do you have which could be drained and put into production? 0
15. What is the condition of your irrigation system? Good
16. Is your water supply adequate? Yes \_\_\_\_\_ No  Explain Flowed
17. REMARKS: \_\_\_\_\_  
\_\_\_\_\_  
\_\_\_\_\_

Over



NOTE: The foregoing questions apply only to irrigated land shown on this plat.

### DESCRIPTION AND MAP OF FARM

18. Legal Description of this Farm

*All see 16,*



IRRIGATED LAND



NON-IRRIGATED LAND

North

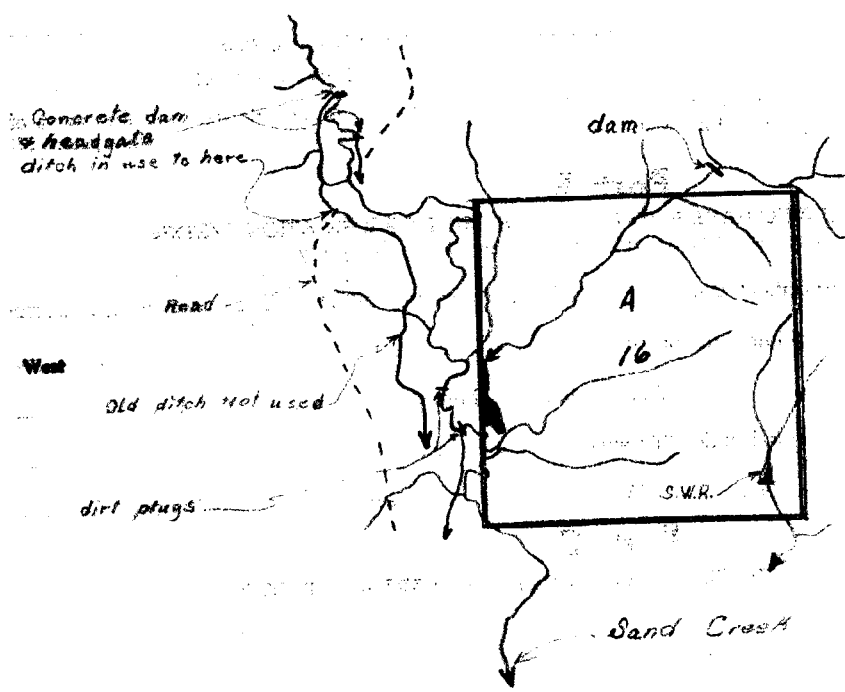

South

19. If the above land is irrigated from more than one ditch please give the acreage under each ditch in 19A and indicate the location of the land irrigated from each on the above map.

19A. Ditch: *Sand Creek Flood Box* Acres: *4.0*

Ditch: \_\_\_\_\_ Acres: \_\_\_\_\_

Information supplied by:

Name *Field Survey* Address \_\_\_\_\_ Date *6/30/47*

REMARKS: *Coal & Pan Coal*  
*The land flooded in Sec 16 is part of the*  
*Bushy Branch System that floods over in Westland*

If you cannot answer all of the questions on this form answer as many as you can and return the form to us as soon as possible.

STATE ENGINEER'S OFFICE  
WATER RESOURCES SURVEY

COUNTY Rosebud

FILE NO. 25 - 16A

Owner Montana, State of Address Helens, Montana

AAA Owner Address

Operator Barley Bros. Address Rosebud, Montana

New Owner Address

New Operator Address

Assessment Record No

Assessed Acreage

Legal Description of This Farm All Sec. 16, T. 7N., R. 43E.

Private Flood Sand Creek Total Acres in Farm

Code Number 16A

Photo No. MA-27-98

AAA Contract No.

AAA Total Cropland Acreage 0

App. No. H.R.

Decree No.

Land is located in

Twp. 7N. Rge. 43E. Twp. Rge.

Twp. Rge. Twp. Rge.

Filed in Twp. 7N. Rge. 43E.

Remarks

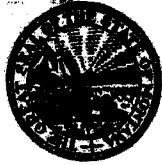

**NOTICE**  
These forms are the property of the State of Montana and must be returned.

**STATE OF MONTANA**  
**STATE ENGINEERS OFFICE**  
**Water Resources Survey**

Code No. 32C  
County Rosebud  
T. 7N R. 43

Name of Land Owner J. E. Robberson Address Rosebud, Montana  
Name of Operator \_\_\_\_\_ Address \_\_\_\_\_

**Part A**

**TO BE FILED BY THOSE OBTAINING IRRIGATION WATER FROM A DITCH COMPANY OR IRRIGATION DISTRICT**

1. Water is delivered by: Casterville Irr. Dist.  
Name of Ditch, Ditch Company or District Supplying Water
2. State the number of acres you irrigate under this system. 48.0 Shares you hold \_\_\_\_\_
3. If you obtain water from more than one Company, give the number of shares, acres irrigated and the name of the Company under "Remarks." If you obtain water from a Ditch Company and also have a private system fill in both Part A and Part B.

**Part B**

**TO BE FILED BY THOSE WHO HAVE A PRIVATE DITCH, PUMP OR IRRIGATION SYSTEM or those who have a private water right under a Ditch Company**

4. In what year was this land first irrigated? Date \_\_\_\_\_
5. Give the name of the original appropriator (first user): \_\_\_\_\_
6. Give the date appropriated \_\_\_\_\_ Amount filed on: Miners Inches \_\_\_\_\_ C. F. S. \_\_\_\_\_
7. State the total number of acres irrigated under this system: \_\_\_\_\_
8. Give the point of diversion: \_\_\_\_\_  $\frac{1}{4}$  \_\_\_\_\_  $\frac{1}{2}$  Section \_\_\_\_\_ Township \_\_\_\_\_ Range \_\_\_\_\_

**Part C**

**TO BE FILED BY ALL WATER USERS IN ADDITION TO PART A OR PART B**

9. Source of Water: Yellowstone River  
Name of stream or lake from which water is originally diverted
10. Water is obtained by: (Check one) Gravity  Pumping  out of main Canal Other \_\_\_\_\_
11. What is the greatest number of acres you have irrigated? 71.0 Date \_\_\_\_\_
12. How many acres did you irrigate in 1947? (Crop and pasture) 48.0
13. State the total number of additional acres that could be irrigated by increasing the water supply, land leveling, etc. 23.0 This land is under what ditch? Same
14. How many acres of seeped land do you have which could be drained and put into production? 23.0
15. What is the condition of your irrigation system? Fair
16. Is your water supply adequate? Yes  No \_\_\_\_\_ Explain \_\_\_\_\_
17. REMARKS: \_\_\_\_\_  
\_\_\_\_\_  
\_\_\_\_\_

Over

c  
 head  
 43  
 tana  
  
 he name of  
 e system fill  
  
 air Canal  
  
 ly, land level  
 23.0

NOTE: The foregoing questions apply only to irrigated land shown on this plot.

DESCRIPTION AND MAP OF FARM

18. Local Description of this Farm

*S. 28, Sec 32*



IRRIGATED LAND



NON-IRRIGATED LAND

North

NOTE: This map is a plan view of the land shown on this plot. It is not a true map of the land and should not be used for any other purpose.

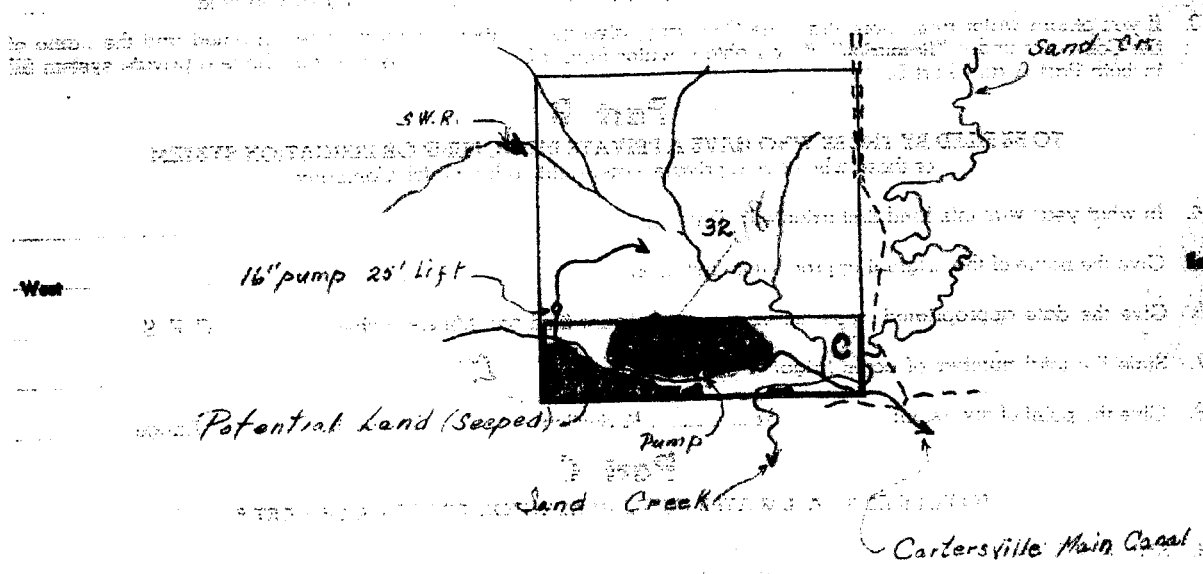

Ownership covers only irrigated land. All ownership for dry land not shown.

19. If the above land is irrigated from more than one ditch please give the acreage under each ditch in 19A and indicate the location of the land irrigated from each on the above map.

19A. Ditch: *Cartersville Or dist. Pump* Acres: *48.0*  
 Ditch: *23.0 potential by Gravity* Acres: \_\_\_\_\_

Information supplied by:  
 Name *Field Survey* Address \_\_\_\_\_ Date *6/30/47*

REMARKS: *Creek + Pond*

If you cannot answer all of the questions on this form answer as many as you can and return the form to us as soon as possible.

