



NOTICE  
These forms are the  
property of the State  
of Montana and must  
be returned.

STATE OF MONTANA  
STATE ENGINEERS OFFICE

20

Code No. 29A, 30A, 31A, 32A

County Rosebud

T. 8N. R. 43E.

Water Resources Survey

Name of Land Owner Barley Bros. Address Rosebud, Mont.

Name of Operator \_\_\_\_\_ Address \_\_\_\_\_

**Part A**

TO BE FILED BY THOSE OBTAINING IRRIGATION WATER FROM  
A DITCH COMPANY OR IRRIGATION DISTRICT

1. Water is delivered by: \_\_\_\_\_  
Name of Ditch, Ditch Company or District Supplying Water
2. State the number of acres you irrigate under this system \_\_\_\_\_ Shares you hold \_\_\_\_\_
3. If you obtain water from more than one Company, give the number of shares, acres irrigated and the name of the Company under "Remarks." If you obtain water from a Ditch Company and also have a private system fill in both Part A and Part B.

**Part B**

TO BE FILED BY THOSE WHO HAVE A PRIVATE DITCH, PUMP OR IRRIGATION SYSTEM  
or those who have a private water right under a Ditch Company

4. In what year was this land first irrigated? Date \_\_\_\_\_ See attached filings.
5. Give the name of the original appropriator (first user): \_\_\_\_\_
6. Give the date appropriated \_\_\_\_\_ Amount filed on: Miners Inches \_\_\_\_\_ C. F. S. \_\_\_\_\_
7. State the total number of acres irrigated under this system: \_\_\_\_\_
8. Give the point of diversion: \_\_\_\_\_  $\frac{1}{4}$  \_\_\_\_\_  $\frac{1}{4}$  Section \_\_\_\_\_ Township \_\_\_\_\_ Range \_\_\_\_\_

**Part C**

TO BE FILED BY ALL WATER USERS IN ADDITION TO PART A OR PART B

9. Source of Water: Sand Cr. & side coulees  
Name of stream or lake from which water is originally diverted
10. Water is obtained by: (Check one) Gravity \_\_\_\_\_ Pumping \_\_\_\_\_ Other Flood
11. What is the greatest number of acres you have irrigated? 134 Date 1947
12. How many acres did you irrigate in 1947? (Crop and pasture) 134
13. State the total number of additional acres that could be irrigated by increasing the water supply, land leveling, etc. 0 This land is under what ditch? \_\_\_\_\_
14. How many acres of seeped land do you have which could be drained and put into production? 0
15. What is the condition of your irrigation system? Good
16. Is your water supply adequate? Yes \_\_\_\_\_ No X Explain seasonal flood only.
17. REMARKS: \_\_\_\_\_  
\_\_\_\_\_  
\_\_\_\_\_

Over

NOTE: The descriptive conditions apply only to irrigated land shown on this plot.

### DESCRIPTION AND MAP OF FARM

18. Legal Description of this Farm See attached WR2.



IRRIGATED LAND



NON-IRRIGATED LAND

North

Sand Creek

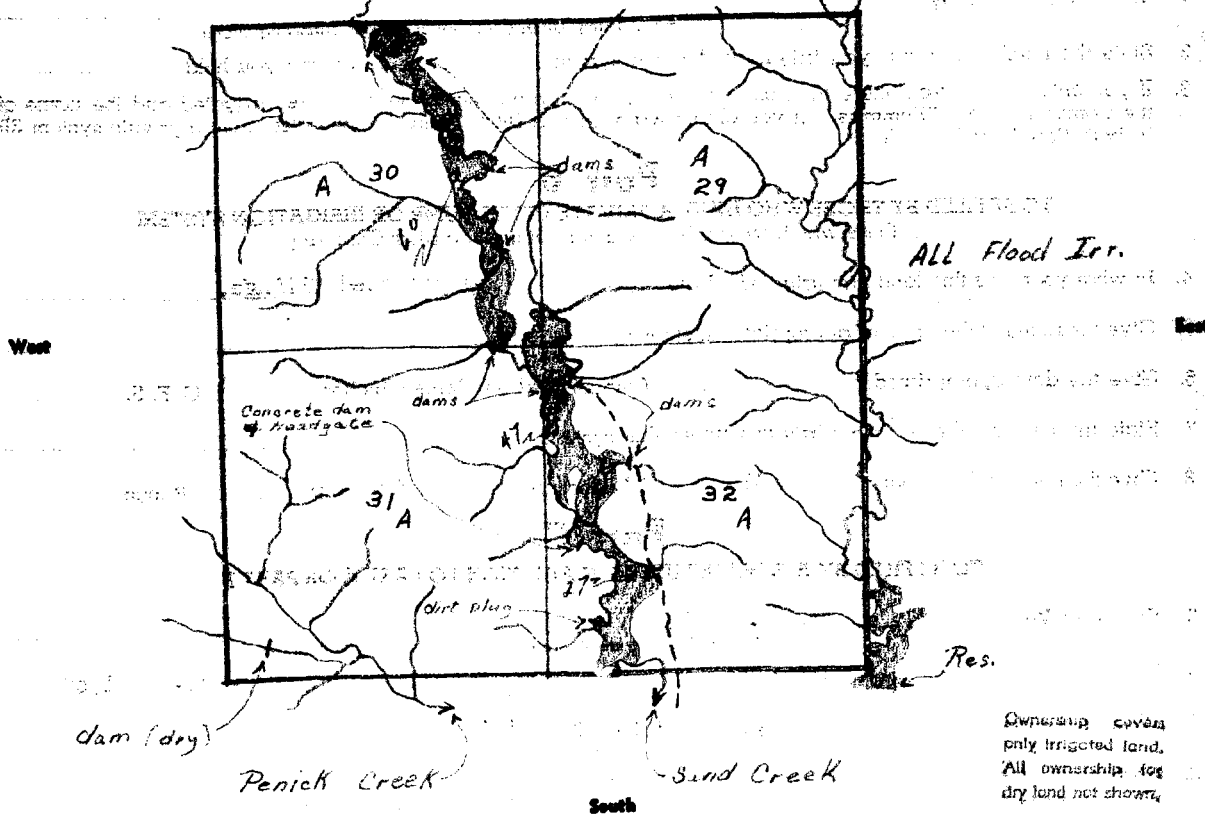

Ownership covers only irrigated land. All ownership for dry land not shown.

19. If the above land is irrigated from more than one ditch please give the acreage under each ditch in 19A and indicate the location of the land irrigated from each on the above map.

19A. Ditch: Flood dams in Sand Cr. & side coulees Acres: 134

Ditch: \_\_\_\_\_ Acres: \_\_\_\_\_

Information supplied by:

Name Barley Bros. Address \_\_\_\_\_ Date 8/12/47

REMARKS: Field check & interview by Cook - Johnson

If you cannot answer all of the questions on this form answer as many as you can and return the form to us as soon as possible.

STATE ENGINEER'S OFFICE  
WATER RESOURCES SURVEY

COUNTY Rosebud

FILE NO. 20 - 29A, 30A, 31A, 32A

Owner Barley Bros. Address Rosebud, Montana

AAA Owner ..... Address .....

Operator Same Address .....

New Owner ..... Address .....

New Operator ..... Address .....

Assessment Record No

Assessed Acreage

Legal Description of This Farm All Sec. 29, 30, 31, 32, T. 8N., R. 43E.

Checked August 12, 1947

Flood Sand Cr. & Side Coulees ..... Total Acres in Farm .....

Cor. Number 29A, 30A, 31A, 32A

Photo No. MA-27-96

AAA Contract No. ....

AAA Total Cropland Acreage 0

App. No. 624, 623, 625

Decree No. ....

Land is located in

Twp. 8N. Rge. 43E. Twp. 7N. Rge. 43E.

Twp. .... Rge. .... Twp. .... Rge. ....

Filed in Twp. 7N. Rge. 43E.

Remarks .....

Rosebud Mont May 1<sup>st</sup> 1948  
Mr. Gerald J. Oravetz

8N-43

Received your letter in regards to Water rights We are supposed to have Water rights for all our flood irrigation We had Mr William P Flynn of Miles city to do our surveying and get our Water rights We paid him for it but if he wrote the Water rights he never turned them over to us or put them on record sec 19-~~25~~ 8N-43 was put under flood irrigation Sept 1916. sec 17-7 N-43. in April 1917.  
We also flood irrigates W 1/2 sec 32. 8N-43. started in 1920 April sec 5. 7N-43. April 1917  
N 1/4 sec 9. 8N-43 1927. NE 1/4 sec 29 7N-43 Sept 1929  
sec 1-9-42. and part of sec 12. 9-42. Sept 1925-

During 1947 We did not have enough water for our Irrigation water never got to the mouth of sand Creek any other information you wish we will be glad to furnish upon request

Yours Very Truly

Barley Bros

By Joe Barley



NOTICE  
These forms are the property of the State of Montana and must be returned.

STATE OF MONTANA  
STATE ENGINEERS OFFICE  
Water Resources Survey

20

Code No. 19A

County Rosebud

T. 8N. R. 43E.

Name of Land Owner N.P.R.R. Address St. Paul, Minn.  
Name of Operator Barley Bros. Address Rosebud, Mont.

**Part A**

TO BE FILED BY THOSE OBTAINING IRRIGATION WATER FROM A DITCH COMPANY OR IRRIGATION DISTRICT

1. Water is delivered by: \_\_\_\_\_ Name of Ditch, Ditch Company or District Supplying Water \_\_\_\_\_  
2. State the number of acres you irrigate under this system \_\_\_\_\_ Shares you hold \_\_\_\_\_  
3. If you obtain water from more than one Company, give the number of shares, acres irrigated and the name of the Company under "Remarks." If you obtain water from a Ditch Company and also have a private system fill in both Part A and Part B.

**Part B**

TO BE FILED BY THOSE WHO HAVE A PRIVATE DITCH, PUMP OR IRRIGATION SYSTEM or those who have a private water right under a Ditch Company

4. In what year was this land first irrigated? Date See filings under Barley Bros.  
5. Give the name of the original appropriator (first user): \_\_\_\_\_  
6. Give the date appropriated \_\_\_\_\_ Amount filed on: Miners Inches \_\_\_\_\_ C. F. S. \_\_\_\_\_  
7. State the total number of acres irrigated under this system: \_\_\_\_\_  
8. Give the point of diversion: \_\_\_\_\_ 1/4 \_\_\_\_\_ 1/4 Section \_\_\_\_\_ Township \_\_\_\_\_ Range \_\_\_\_\_

**Part C**

TO BE FILED BY ALL WATER USERS IN ADDITION TO PART A OR PART B

9. Source of Water: Sand Cr. & side coulees.  
Name of stream or lake from which water is originally diverted \_\_\_\_\_  
10. Water is obtained by: (Check one) Gravity \_\_\_\_\_ Pumping \_\_\_\_\_ Other FLOOD  
11. What is the greatest number of acres you have irrigated? 31 Date 1947  
12. How many acres did you irrigate in 1947? (Crop and pasture) 31  
13. State the total number of additional acres that could be irrigated by increasing the water supply, land leveling, etc. 0 This land is under what ditch? \_\_\_\_\_  
14. How many acres of seeped land do you have which could be drained and put into production? 0  
15. What is the condition of your irrigation system? good  
16. Is your water supply adequate? Yes \_\_\_\_\_ No X Explain Seasonal flood only  
17. REMARKS: \_\_\_\_\_

Over

NOTE: The foregoing questions apply only to irrigated land shown on this plot.

### DESCRIPTION AND MAP OF FARM

18. Legal Description of this Farm See attached WB2.

 IRRIGATED LAND

 NON-IRRIGATED LAND

North

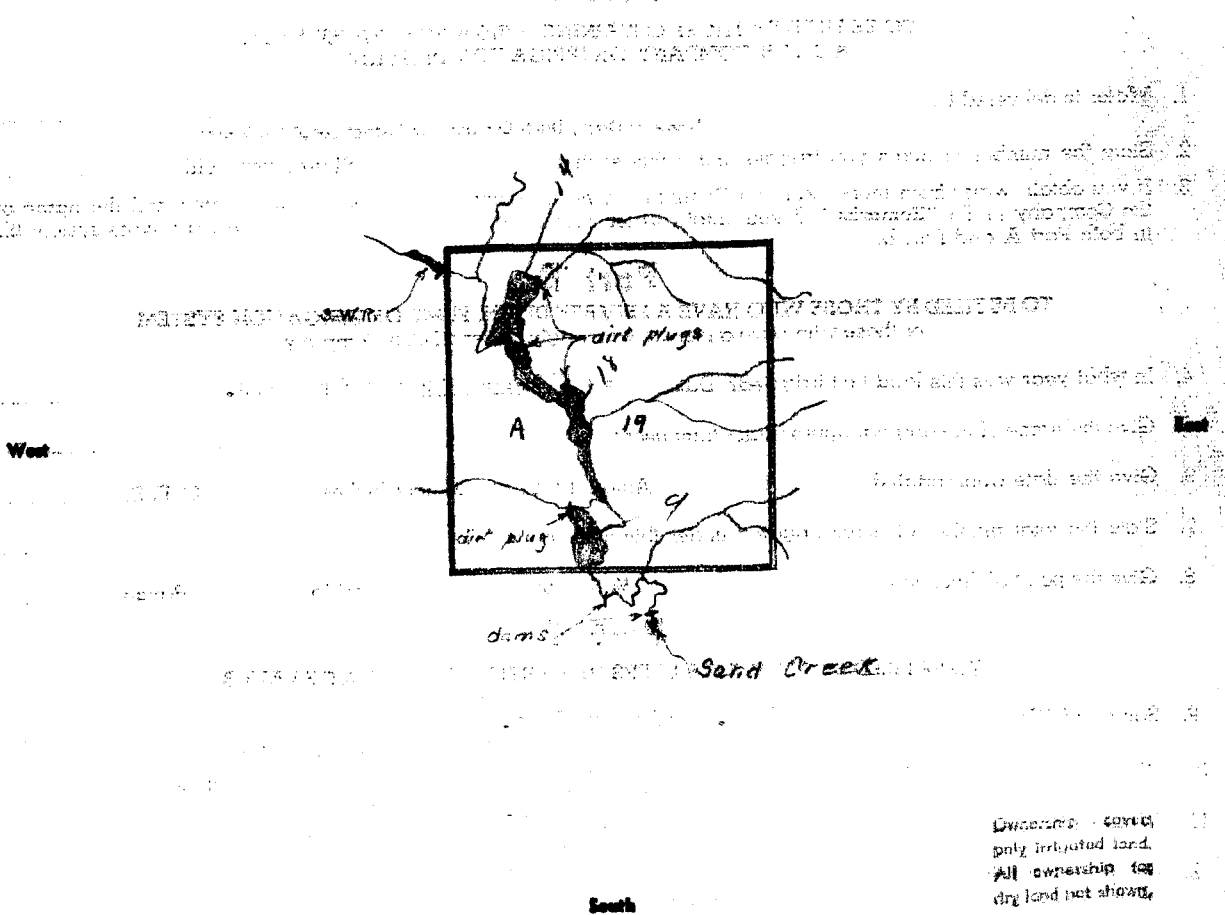

19. If the above land is irrigated from more than one ditch please give the acreage under each ditch in 19A and indicate the location of the land irrigated from each on the above map.

19A. Ditch: Flood dams in Sand Cr. & side coulees Acres: 31

Ditch: \_\_\_\_\_ Acres: \_\_\_\_\_

Information supplied by:

Name Barley Bros. Address \_\_\_\_\_ Date 8/12/47

REMARKS: Field check & interview by Cook - Johnson

If you cannot answer all of the questions on this form answer as many as you can and return the form to us as soon as possible.

STATE ENGINEER'S OFFICE  
WATER RESOURCES SURVEY

COUNTY Rosebud

FILE NO. 20 - 19A

Owner H. P. R. R. Address St. Paul, Minn.

AAA Owner \_\_\_\_\_ Address \_\_\_\_\_

Operator Barley Bros. Address Rosebud, Montana

New Owner \_\_\_\_\_ Address \_\_\_\_\_

New Operator \_\_\_\_\_ Address \_\_\_\_\_

Assessment Record No

Assessed Acreage \_\_\_\_\_

Legal Description of This Farm All Sec. 19, T. 8N., R. 43E.

Checked August 12, 1947

Flood Sand Cr. & Side Coulees Total Acres in Farm \_\_\_\_\_

Code Number 19A

Photo No. MA-27-95

AAA Contract No. \_\_\_\_\_

AAA Total Cropland Acreage 0

App. No. N.R. (See Barley Bros. form)

Decree No. \_\_\_\_\_

Land is located in Twp. 8N. Rge. 43E. Twp. 6N. Rge. 42E.

Twp. 6N. Rge. 44E. Twp. \_\_\_\_\_ Rge. \_\_\_\_\_

Filed in Twp. 8N. Rge. 43E.

Remarks \_\_\_\_\_

\_\_\_\_\_

\_\_\_\_\_

\_\_\_\_\_