

6	5	4	3	2	1
7	8	9	10	11	12
13	17	16	15	14	13
19	20	21	22	23	24
30	29	28	27	26	25
31	32	33	34	35	36

Land Ownership _____

County San Diego

Farm Checked: Date 8-29-68

Bv 228 E

Legal Land Owner.....

Operator.....

Water is delivered by:— 1. Private System:

STATE OF MONTANA
WATER CONSERVATION BOARD
Water Resources Survey

T-54 R-222 Plat No. 60

Photo No. 50-151 50-155

Address _____

Address: _____

Water is delivered by:— 1. Private System; 2. Ditch Company; 3. State Project; 4. Federal Project; 5. Irrigation District

[illegible]

NOTE: R—Denotes Regular Irrigation. F—Flood Irrigation.

Adequate Supply: Yes..... No..... Explain.....

Remarks:

CANT FIND

River Basin CCCATB

Also in: Plat No.....	Twp.....	Rge.....	Plat No.....	Twp.....	Rge.....	Plat No.....	Twp.....	Rge.....
Plat No.....	Twp.....	Rge.....	Plat No.....	Twp.....	Rge.....	Plat No.....	Twp.....	Rge.....

Information From:

11512-14885

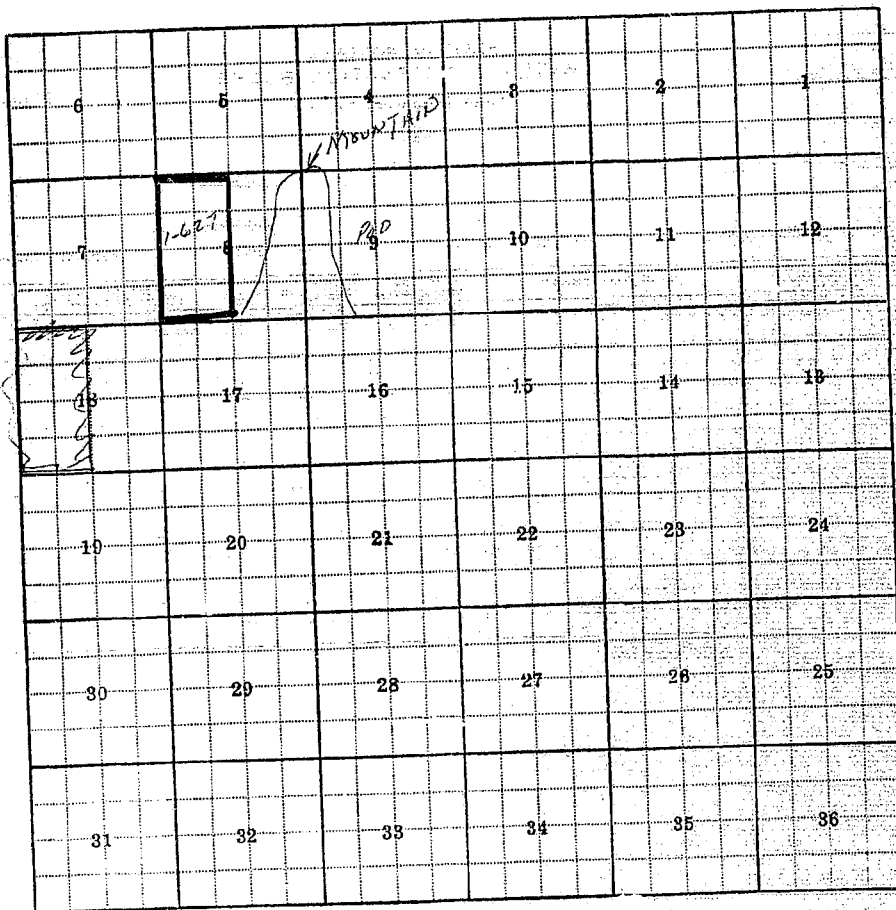

Land Ownership _____

County San Diego

Farm Checked: Date 3-20-68

By _____

Legal Land Owner Alfred Brown

Operator 5322

Water is delivered by:— 1. Private System;

CHARTER

T. R. Plat No. 20

Photo No. 50-738, 50-739.

100-24, 5112

Address _____

Address.....

Water is delivered by:— 1. Private System; 2. Ditch Company; 3. State Project; 4. Federal Project; 5. Irrigation District

[illegible]

NOTE: R—Denotes Regular Irrigation. F—Flood Irrigation.

Adequate Supply: Yes ☒ No ☐ Explain _____

Remarks _____

Remarks

[The following section contains extremely faint, illegible handwritten notes and mathematical symbols.]

[illegible]

[The following text is extremely faint and largely illegible due to low contrast and blurring. It appears to be a continuation of the document's content, possibly a list or a detailed description.]

[illegible]

[http://www.mindgarden.com/mindgarden.htm](#)

.....

[illegible]

..... River Basin:

Also in: Plat No. Twp. Rge. || Plat No. Twp. Rge. || Plat No. Twp. Rge. Information From:

Plat No. Twp. Rge.	Plat No. Twp. Rge.	Plat No. Twp. Rge.	22-5-1900
-----------------------------------	-----------------------------------	-----------------------------------	-----------

1. The first step in the process of identifying a problem is to recognize that a problem exists. This involves gathering information about the situation and identifying the specific issue that needs to be addressed. Once the problem is identified, the next step is to define the problem in clear, concise terms. This involves stating the problem in a way that is specific and measurable, and identifying the goals that need to be achieved in order to solve the problem. The third step in the process is to generate potential solutions. This involves brainstorming ideas and considering different approaches to solving the problem. The fourth step is to evaluate the potential solutions and select the best one. This involves comparing the solutions based on their feasibility, effectiveness, and cost, and selecting the solution that is most likely to achieve the desired goals. The final step in the process is to implement the selected solution and monitor its progress. This involves putting the solution into action and tracking its performance over time, making adjustments as needed to ensure that the problem is solved.

...the ...

1. The first step is to identify the problem. This involves understanding the current situation and what needs to be achieved. It is important to gather all relevant information and to define the scope of the problem.

1. The first part of the document is a list of references. The references are listed in a standard format, including the author's name, the title of the work, and the publisher. The references are as follows:

Author	Title	Publisher
1. A. A. A.	1. A. A. A.	1. A. A. A.
2. B. B. B.	2. B. B. B.	2. B. B. B.
3. C. C. C.	3. C. C. C.	3. C. C. C.
4. D. D. D.	4. D. D. D.	4. D. D. D.
5. E. E. E.	5. E. E. E.	5. E. E. E.
6. F. F. F.	6. F. F. F.	6. F. F. F.
7. G. G. G.	7. G. G. G.	7. G. G. G.
8. H. H. H.	8. H. H. H.	8. H. H. H.
9. I. I. I.	9. I. I. I.	9. I. I. I.
10. J. J. J.	10. J. J. J.	10. J. J. J.
11. K. K. K.	11. K. K. K.	11. K. K. K.
12. L. L. L.	12. L. L. L.	12. L. L. L.
13. M. M. M.	13. M. M. M.	13. M. M. M.
14. N. N. N.	14. N. N. N.	14. N. N. N.
15. O. O. O.	15. O. O. O.	15. O. O. O.
16. P. P. P.	16. P. P. P.	16. P. P. P.
17. Q. Q. Q.	17. Q. Q. Q.	17. Q. Q. Q.
18. R. R. R.	18. R. R. R.	18. R. R. R.
19. S. S. S.	19. S. S. S.	19. S. S. S.
20. T. T. T.	20. T. T. T.	20. T. T. T.
21. U. U. U.	21. U. U. U.	21. U. U. U.
22. V. V. V.	22. V. V. V.	22. V. V. V.
23. W. W. W.	23. W. W. W.	23. W. W. W.
24. X. X. X.	24. X. X. X.	24. X. X. X.
25. Y. Y. Y.	25. Y. Y. Y.	25. Y. Y. Y.
26. Z. Z. Z.	26. Z. Z. Z.	26. Z. Z. Z.
27. A. A. A.	27. A. A. A.	27. A. A. A.
28. B. B. B.	28. B. B. B.	28. B. B. B.
29. C. C. C.	29. C. C. C.	29. C. C. C.
30. D. D. D.	30. D. D. D.	30. D. D. D.
31. E. E. E.	31. E. E. E.	31. E. E. E.
32. F. F. F.	32. F. F. F.	32. F. F. F.
33. G. G. G.	33. G. G. G.	33. G. G. G.
34. H. H. H.	34. H. H. H.	34. H. H. H.
35. I. I. I.	35. I. I. I.	35. I. I. I.
36. J. J. J.	36. J. J. J.	36. J. J. J.
37. K. K. K.	37. K. K. K.	37. K. K. K.
38. L. L. L.	38. L. L. L.	38. L. L. L.
39. M. M. M.	39. M. M. M.	39. M. M. M.
40. N. N. N.	40. N. N. N.	40. N. N. N.
41. O. O. O.	41. O. O. O.	41. O. O. O.
42. P. P. P.	42. P. P. P.	42. P. P. P.
43. Q. Q. Q.	43. Q. Q. Q.	43. Q. Q. Q.
44. R. R. R.	44. R. R. R.	44. R. R. R.
45. S. S. S.	45. S. S. S.	45. S. S. S.
46. T. T. T.	46. T. T. T.	46. T. T. T.
47. U. U. U.	47. U. U. U.	47. U. U. U.
48. V. V. V.	48. V. V. V.	48. V. V. V.
49. W. W. W.	49. W. W. W.	49. W. W. W.
50. X. X. X.	50. X. X. X.	50. X. X. X.
51. Y. Y. Y.	51. Y. Y. Y.	51. Y. Y. Y.
52. Z. Z. Z.	52. Z. Z. Z.	52. Z. Z. Z.
53. A. A. A.	53. A. A. A.	53. A. A. A.
54. B. B. B.	54. B. B. B.	54. B. B. B.
55. C. C. C.	55. C. C. C.	55. C. C. C.
56. D. D. D.	56. D. D. D.	56. D. D. D.
57. E. E. E.	57. E. E. E.	57. E. E. E.
58. F. F. F.	58. F. F. F.	58. F. F. F.
59. G. G. G.	59. G. G. G.	59. G. G. G.
60. H. H. H.	60. H. H. H.	60. H. H. H.
61. I. I. I.	61. I. I. I.	61. I. I. I.
62. J. J. J.	62. J. J. J.	62. J. J. J.
63. K. K. K.	63. K. K. K.	63. K. K. K.
64. L. L. L.	64. L. L. L.	64. L. L. L.
65. M. M. M.	65. M. M. M.	65. M. M. M.
66. N. N. N.	66. N. N. N.	66. N. N. N.
67. O. O. O.	67. O. O. O.	67. O. O. O.
68. P. P. P.	68. P. P. P.	68. P. P. P.
69. Q. Q. Q.	69. Q. Q. Q.	69. Q. Q. Q.
70. R. R. R.	70. R. R. R.	70. R. R. R.
71. S. S. S.	71. S. S. S.	71. S. S. S.
72. T. T. T.	72. T. T. T.	72. T. T. T.
73. U. U. U.	73. U. U. U.	73. U. U. U.
74. V. V. V.	74. V. V. V.	74. V. V. V.
75. W. W. W.	75. W. W. W.	75. W. W. W.
76. X. X. X.	76. X. X. X.	76. X. X. X.
77. Y. Y. Y.	77. Y. Y. Y.	77. Y. Y. Y.
78. Z. Z. Z.	78. Z. Z. Z.	78. Z. Z. Z.
79. A. A. A.	79. A. A. A.	79. A. A. A.
80. B. B. B.	80. B. B. B.	80. B. B. B.
81. C. C. C.	81. C. C. C.	81. C. C. C.
82. D. D. D.	82. D. D. D.	82. D. D. D.
8		

1. The first part of the document is a letter from the author to the editor, dated 1995. The letter discusses the author's interest in the topic of the journal and the importance of the research. The author mentions that the research was conducted in 1994 and that the results are significant. The author also mentions that the research was conducted in a laboratory setting and that the results are consistent with previous research. The author concludes the letter by stating that the research is a contribution to the field and that the author is pleased to share the results with the journal.

[illegible][illegible]

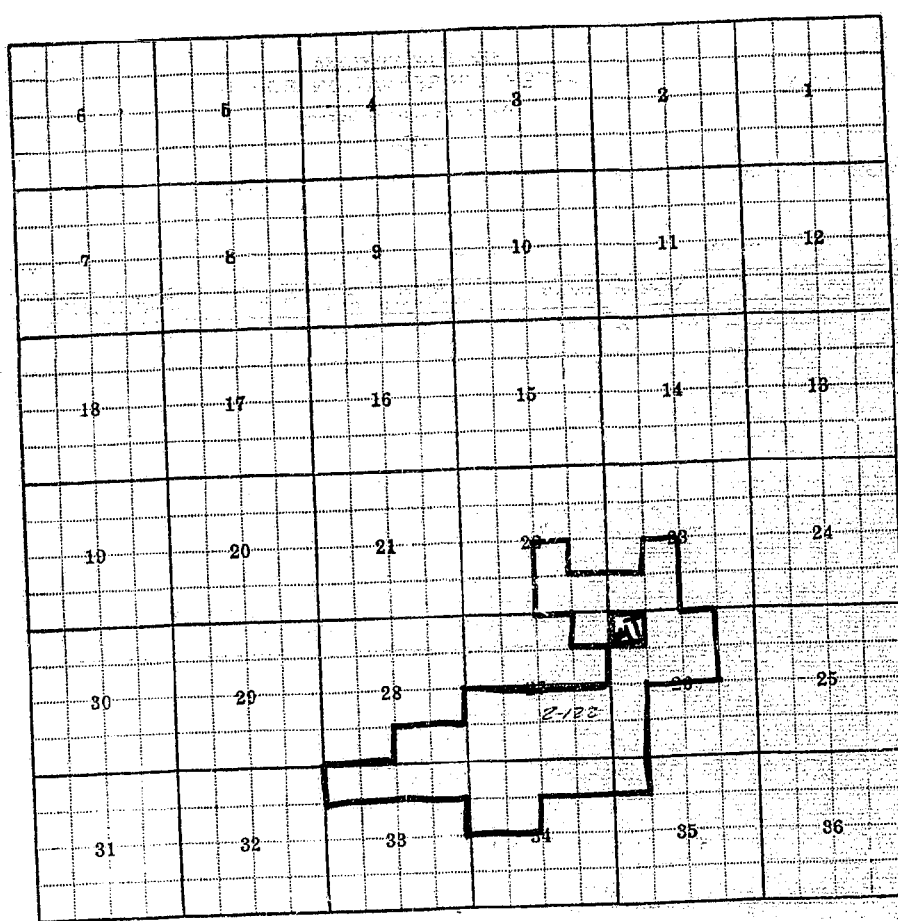

Land Ownership.....

County: SANDERS

Farm Checked: Date 8-21-68

By M. J. [illegible] (MRS)

Operator A. L. ATKINSON

Water is delivered by:— 1. Private System;

T200 R 220 Plat No. 60

Photo No. 52-140, 141, 142

4230

Address

Address Bozou

Water is delivered by:— 1. Private System; 2. Ditch Company; 3. State Project; 4. Federal Project; 5. Irrigation District

[illegible]

NOTE: R—Denotes Regular Irrigation. F—Flood Irrigation.

Adequate Supply: Yes ☒ No ☐ Explain
Remarks _____

Remarks.

Chicago Bureau and St. Louis

River Basin Colorado

Also in: Plat No. <u>64</u> Twp. <u>2</u> Rge. <u>2</u>	Plat No. <u> </u> Twp. <u> </u> Rge. <u> </u>	Plat No. <u> </u> Twp. <u> </u> Rge. <u> </u>
Plat No. <u> </u> Twp. <u> </u> Rge. <u> </u>	Plat No. <u> </u> Twp. <u> </u> Rge. <u> </u>	Plat No. <u> </u> Twp. <u> </u> Rge. <u> </u>

Information From:

A. C. ATKINSON

15022

Present	Irrigable

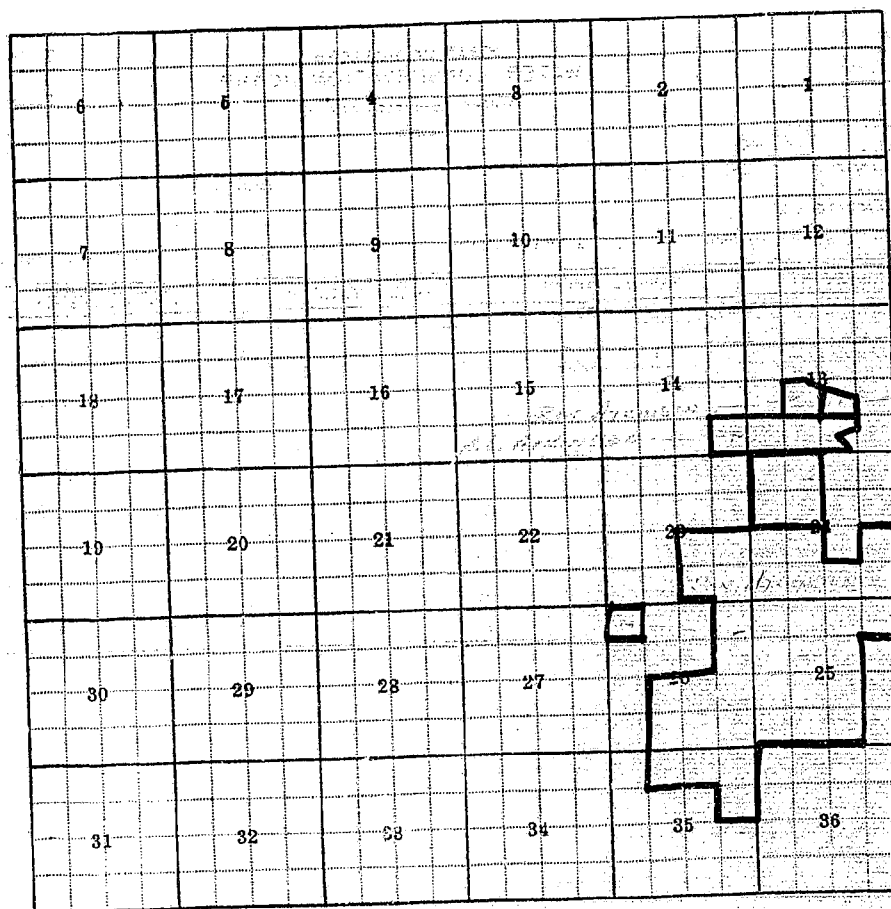
[illegible]

Land Ownership.

om :

500

County San Diego

Form Checked: Date 9-23-88

By 2015

SECRET

T-2-R-2-2 Plat No

Photo No. 15-4423

Legal Land Owner.....

Address: _____

Operator.....

Address _____

Water is delivered by:— 1. Private System; 2. Ditch Company; 3. State Project; 4. Federal Project; 5. Irrigation District

[illegible]

NOTE: R—Denotes Regular Irrigation. F—Flood Irrigation.

Adequate Supply: Yes ☒ No ☐ Explain _____

Remarks:	
----------	--

[Faint, illegible text from bleed-through]

for a long time

2025-10-18 14:00:00

[illegible]

#####

River Basin

Also in: Plat No.....	Twp.....	Rge.....	Plat No.....	Twp.....	Rge.....	Plat No.....	Twp.....	Rge.....
Plat No.....	Twp.....	Rge.....	Plat No.....	Twp.....	Rge.....	Plat No.....	Twp.....	Rge.....

Information From:

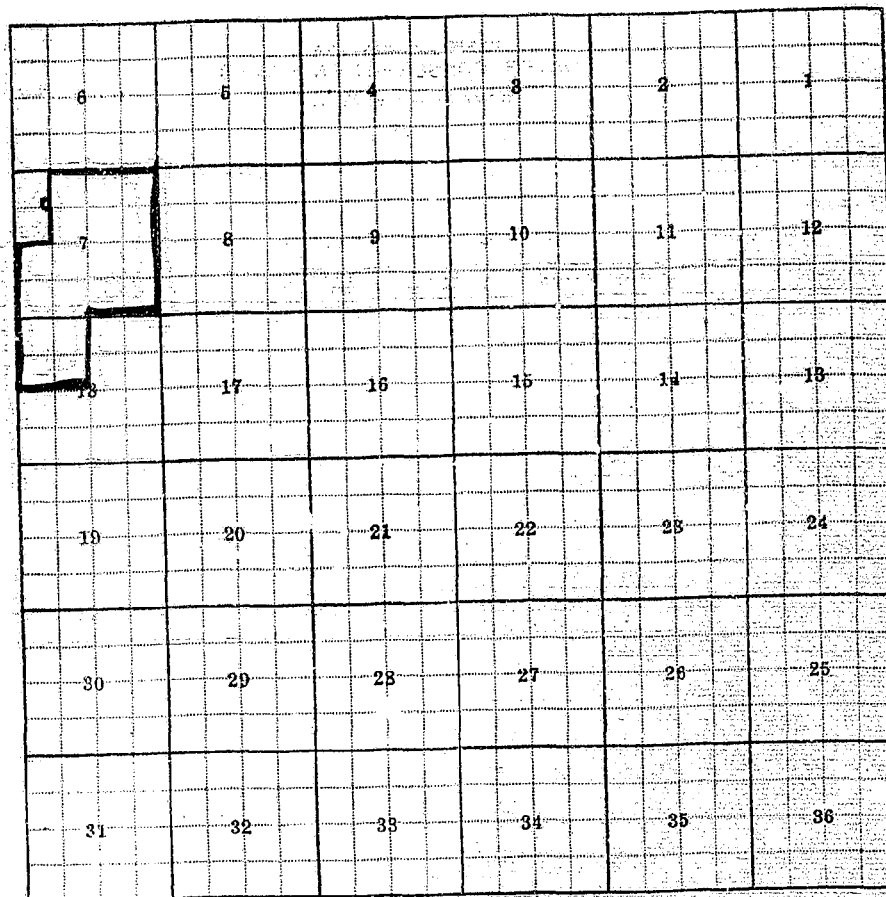

Land Ownership

.....

.....

.....

County _____

Farm Checked: Date 9-7-68

By _____

Legal Land Owner

Operator-

Water is delivered by:— 1. Private System; 2. Ditch Company; 3. State Project; 4. Federal Project; 5. Irrigation District

T. 77 R. 30 Plat No. 60

Photo No. 52-153

Address _____

Address

[illegible]

NOTE: R—Denotes Regular Irrigation. F—Flood Irrigation.

Adequate Supply: Yes..... No..... Explain.....

Remarks:

* FF 24752

River Basin (S. 44 N. 61 E.)

Also in: Plat No.	Twp.	Rge.	Plat No.	Twp.	Rge.	Plat No.	Twp.	Rge.
Plat No.	Twp.	Rge.	Plat No.	Twp.	Rge.	Plat No.	Twp.	Rge.

Information From:

DEAR MR. ANDERSON

3-753

B/F	Present	Irrigable
-----	---------	-----------

[illegible]

17. Approved.

6	5	4	3	2	1
7	8	9	10	11	12
13	17	16	15	14	18
19	20	21	22	23	24
25	29	28	27	26	25
31	32	33	34	35	36

Land Ownership.

County SANDERS

Farm Checked: Date 8-20-68

By Jack McRae

T-20N R-22W Plat No. 60

Photo No. 502-136 & 502-137

Legal Land Owner *Mr. & Mrs. Neil Patton*

Address

Operator % Leon Melton

Address Hot Springs, Montana

Water is delivered by:— 1. Private System; 2. Ditch Company; 3. State Project; 4. Federal Project; 5. Irrigation District

NOTE: R—Denotes Regular Irrigation. F—Flood Irrigation.

Adequate Supply: Yes..... No..... Explain.....
Remarks.....

River Basin *Columbia*

Also in: Plat No.	Twp.	Rge.	Plat No.	Twp.	Rge.	Plat No.	Twp.	Rge.
Plat No.	Twp.	Rge.	Plat No.	Twp.	Rge.	Plat No.	Twp.	Rge.

Information From:

Leon Kertson

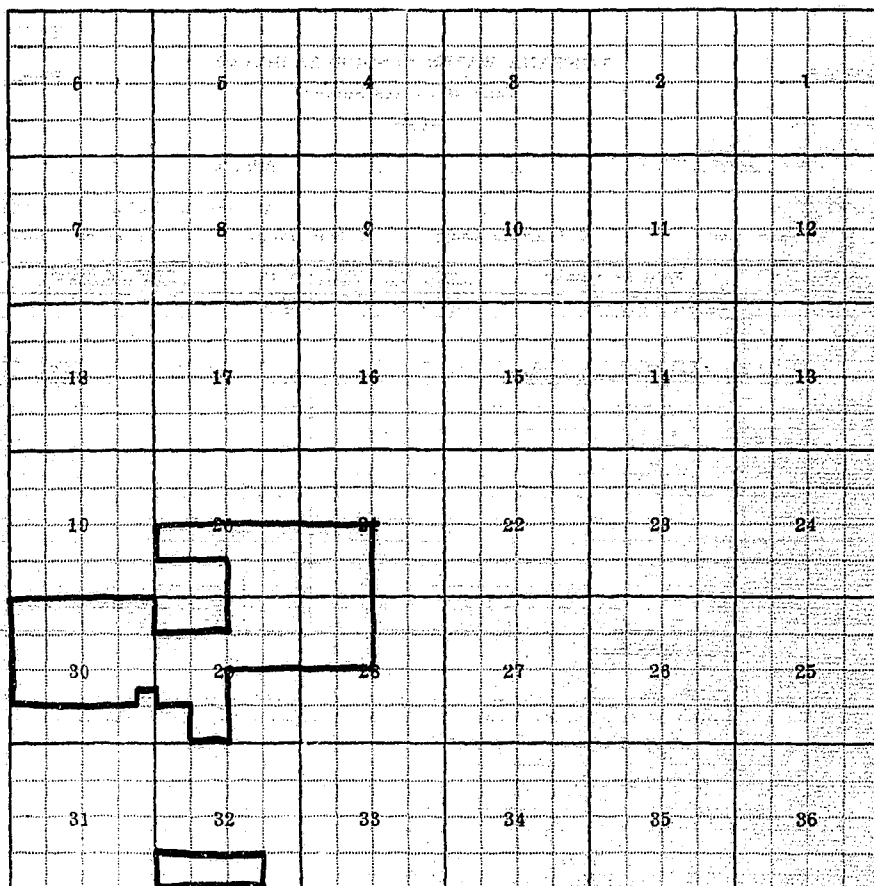

Land Ownership

County SANDERS

T 20N R 22W Plat No. 60

Farm Checked: Date 8-26-68

Water Resources Survey

Photo No. 66D-30

By Jack Mc Bee

Legal Land Owner Willard V & Fay E. Holmes

Address Hot Springs, Montana

Operator... *Price*

Address

Water is delivered by:— 1. Private System; 2. Ditch Company; 3. State Project; 4. Federal Project; 5. Irrigation District

NOTE: R—Denotes Regular Irrigation. F—Flood Irrigation.

Adequate Supply: Yes..... No..... Explain.

Remarks:

GW-236 Located 12 NW 1/4 Sec 31 south of House. 200 Gal. Per. Min.

River Basin *Columbia*

Information From:

W. V. Haynes

6	5	4	3	2	1
7	8	9	10	11	12
13	14	15	16	17	18
19	20	21	22	23	24
25	26	27	28	29	30
31	32	33	34	35	36

Land Ownership.....

County PAWERS

Farm Checked: Date 8-20-68

By Walter H. Roe

Legal Land Owner Leora N. Melton

Operator... *12724*

Water is delivered by:— (1) Private System;

ONTANA WATER RESOURCES BOARD
Water Resources Survey

T 20N R 23W Plat No. 60

Photo No 625-30, 500-136 E

500-137

Address Hot Springs, Montana

Address... *Same*

3. State Project;

4. Federal Project;

5. Irrigation District

[illegible]

NOTE: R—Denotes Regular Irrigation. F—Flood Irrigation.

Adequate Supply: Yes..... No..... Explain.....

Remarks.

River Basin *Columbia*

Also in: Plat No.....	Twp.....	Rge.....	Plat No.....	Twp.....	Rge.....	Plat No.....	Twp.....	Rge.....
Plat No.....	Twp.....	Rge.....	Plat No.....	Twp.....	Rge.....	Plat No.....	Twp.....	Rge.....

Information From:

Leon Meltzer

6	5	4	3	2	1
7	8	9	10	11	12
18	17	16	15	14	13
19	20	21	22	23	24
30	29	28	27	26	25
31	32	33	34	35	36

Land Ownership.....

County SANDERS

T. 2015 R. 234 Flat No. 60

MONTANA WATER RESOURCES BOARD

Photo No. 500-136

Water Resources Survey

Address _____

Address Hot Springs, Montana

Water is delivered by: ☒ 1. Private System; ☐ 2. Ditch Company; ☐ 3. State Project; ☐ 4. Federal Project; ☐ 5. Irrigation District

[illegible]

NOTE: R—Denotes Regular Irrigation. F—Flood Irrigation.

Adequate Supply: Yes..... No..... Explain.....

Remarks

River Basin *Columbia*

Also in: Plat No. Twp. Rge.	Plat No. Twp. Rge.	Plat No. Twp. Rge.
Plat No. Twp. Rge.	Plat No. Twp. Rge.	Plat No. Twp. Rge.

Information From:

Leah Helton

Flat No. 60

ation District

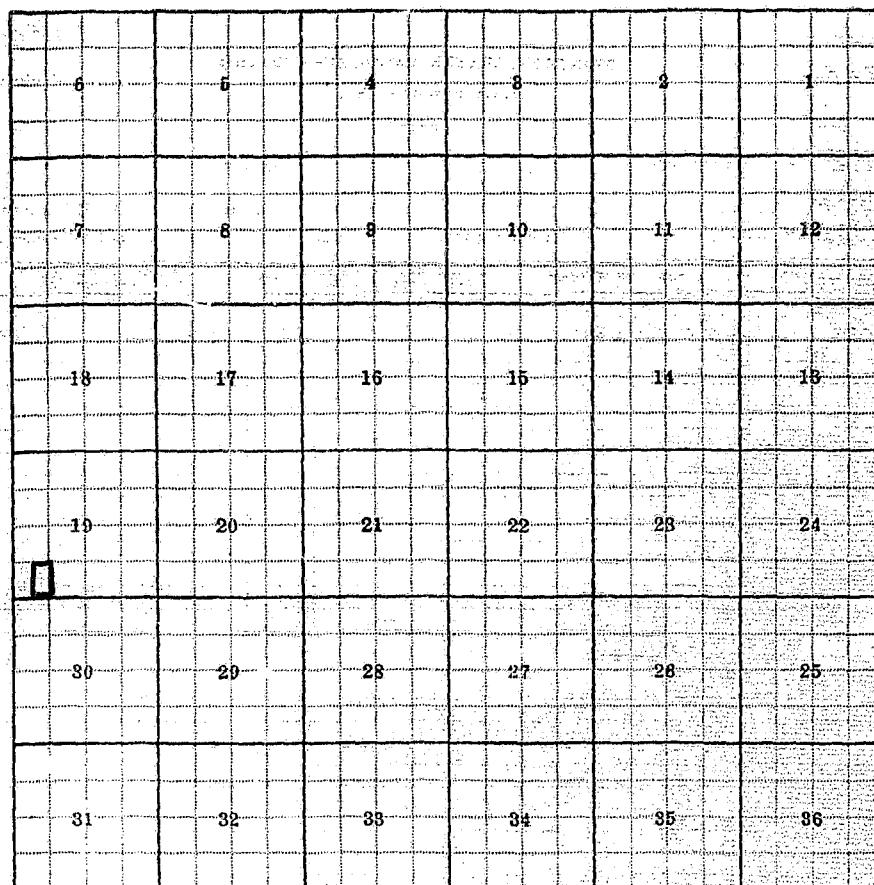
[illegible]

Land Ownership.

County Sevier

Farm Checked: Date 9-22-68

By _____

Legal Land Owner.....

Operator *02 22 22 22*

Water is delivered by— 1. Private System;

STATE OF MONTANA
WATER CONSERVATION BOARD
Water Resources Survey

T. R. Plat No. 42

Photo No. 3254

4-2197-20-25570-138

Address.....

Address

Water is delivered by:— 1. Private System; 2. Ditch Company; 3. State Project; 4. Federal Project; 5. Irrigation District

[illegible]

NOTE: R—Denotes Regular Irrigation. F—Flood Irrigation.

Adequate Supply: Yes ☒ No ☐ Explain.

Remarks

River Basin

Information From:

Also in: Plat No. <u>122</u> Twp. <u>19N</u> Rge. <u>22E</u>	Plat No. _____ Twp. _____ Rge. _____	Plat No. _____ Twp. _____ Rge. _____
Plat No. _____ Twp. _____ Rge. _____	Plat No. _____ Twp. _____ Rge. _____	Plat No. _____ Twp. _____ Rge. _____

