

Please Do Not Fill in Any Items on This Page

Notice of Appropriation

1. County Stillwater Book 4 Page 605 Record Misc.
2. Name of Appropriator James McBrady Address Reed Point, Montana
3. Date Appropriated June 8, 1903 Date Filed June 8, 1903
Amount Appropriated, Miners Inches 500, Cubic Feet per second _____
4. Name of Stream Spring in School House Canyon Tributary Basin _____
5. Point of Diversion at a point at its mouth of Gulch of said spring at the south line of
my said ranch and thence to and upon said land.
Sec. _____ Twp. _____ Rge. _____ Bank of Stream _____
6. Purpose Irrigation, domestic and other purposes.
7. Description of System A dam and ditch. Ditch 24 x 12 inches in size and carries all
waters from said spring.
8. Land Description of Intended Place of Use
Homestead claim in sections 31 & 32, Twp. 1 S., Rge. 18 E. Tot. Acr. 160
9. Remarks (Pertaining to Use, etc.)
not used and used

Decree

10. Case No. _____ Date _____ Amt. Decreed: M. I. _____ C. F. S. _____
11. To Whom Decreed _____ Address _____
12. Name of Ditch _____ Maximum Capacity (C. F. S.) _____
13. Date of Priority _____ Purpose _____
14. Land Description of Place of Use as Decreed _____

Code No. 563

Please Do Not Fill in Any Items on This Page

Notice of Appropriation

1. County Stillwater Book 1 Page 51 - 52 Record Misc.
2. Name of Appropriator Normark, Maria E. Address _____
3. Date Appropriated May 19, 1913 Date Filed May 20, 1913
Amount Appropriated, Miners Inches 160 or _____, Cubic Feet per second 4
4. Name of Stream Two springs on homestead Tributary _____ Basin _____
5. Point of Diversion a certain coulee fed by springs and flood water running in a NW direction thru the SW $\frac{1}{4}$ of Sec. 31, T. 1 S., R. 18 E. & the said springs themselves and measured from said point of diversion as an initial point. The following well known natural objects & permanent monuments are distance as follows. SE $\frac{1}{4}$ Sec. 4 31, 1 S., 18 E. is a distance of _____ Sec. _____ Twp. _____ Rge. _____ Bank of Stream _____
6. Purpose Irrigation, domestic & other purposes. 140 rds in a NW direction said point being about the center point of the N. line of SE $\frac{1}{4}$ Sec. 31, 1 S., 18 E.
7. Description of System Said water is to be converted or conveyed by means of a dam and ditch, said ditch to be 1 $\frac{1}{2}$ feet wide on bottom, 2 $\frac{1}{2}$ feet wide on top and one foot deep.

8. Land Description of Intended Place of Use SE $\frac{1}{4}$ of Sec. 31, Twp. 1 S., Rge. 18 E. Tot. Acr. 160 - 1940 Owner, Marie Normark, 1365 Prospect Ave., Long Beach, Calif.
9. Remarks (Pertaining to Use, etc.) And the undersigned claims right of way over all unappropriated lands of U. S. thru which said ditch shall pass, together with the right to repair and enlarge said ditch wherever and whenever the same may be necessary to carry the water hereby appropriated.

Transfers of Land Ownership - Marie E. Normark - SE $\frac{1}{4}$ of sec. 31, T. 1 S., Rge. 18 E.

not now in use.

Decree

10. Case No. _____ Date _____ Amt. Decreed: M. I. _____ C. F. S. _____
11. To Whom Decreed _____ Address _____
12. Name of Ditch _____ Maximum Capacity (C. F. S.) _____
13. Date of Priority _____ Purpose _____
14. Land Description of Place of Use as Decreed _____

Code No. 15

Please Do Not Fill in Any Items on This Page

Notice of Appropriation

1. County Stillwater Book 4 Page 615 Record Miss.
2. Name of Appropriator John S. Campbell Address Need Point, Montana
3. Date Appropriated Mar. 27, 1906 Date Filed Mar. 31, 1906
- Amount Appropriated, Miners Inches 40 or Cubic Feet per second 1
4. Name of Stream Thompson Canyon Tributary Basin
5. Point of Diversion at a point upon its left bank and near the line between SW¹/₄ - NW¹/₄SW¹/₄
of
- Sec. 32 Twp. 1 S. Rge. 18 E. Bank of Stream left.
thence running to and upon said land.
6. Purpose Domestic, agricultural, irrigation and other purposes.
7. Description of System By means of a pipe which is 1 inch in size.
8. Land Description of Intended Place of Use

Subdivision	Sec.	Twp.	Rge.	Tot. Acr.	1940 Owner	Address
<u>N¹/₄ - NW¹/₄NE¹/₄</u>	<u>32</u>	<u>1 S.</u>	<u>18 E.</u>	<u>116</u>		
<u>Lot 4</u>	<u>29</u>	<u>1 S.</u>	<u>18 E.</u>	<u>21.11</u>	<u>Joe Campbell</u>	<u>Absarokee, Mont</u>
9. Remarks (Pertaining to Use, etc.) not now in use

Decree

10. Case No. Date Amt. Decreed: M. I. C. F. S.
11. To Whom Decreed Address
12. Name of Ditch Maximum Capacity (C. F. S.)
13. Date of Priority Purpose
14. Land Description of Place of Use as Decreed

STATE ENGINEERS OFFICE
Water Resources Survey

Notice of Appropriation

1. County Stillwater Book 4 Page 425 Record Misc.
2. Name of Appropriator Hans P. Nelson et al Address Reed Point, Montana
3. Date Appropriated Oct. 23, 1893 Date Filed Nov. 19, 1893
- Amount Appropriated, Miners Inches 1000 Cubic Feet per second
4. Name of Stream Yellowstone River Tributary Basin
5. Point of Diversion at a point on its south bank about 2000 feet north, 60 west from the
N. P. Railroad mile post L. 56 and about 500 feet west to the cabin claimed by John H.
Dougherty and running thence in an easterly direction to and upon said land.
Sec. Twp. Rge. Bank of Stream south
6. Purpose Irrigation, stock use, domestic and other useful and beneficial purposes.
7. Description of System By means of a ditch which is 48 inches wide on bottom, 84 inches across
top, by 18 inches in depth.
8. Land Description of Intended Place of Use
Subdivision Sec. Twp. Rge. Tot. Acr. 1940 Owner Address
When surveyed will be in 1 S. 18 E.
9. Remarks (Pertaining to Use, etc.)
Hans P. Nelson and W. F. Hodgkins and L. E. Thompson are the appropriators of this
water right of Reed Point, Montana.

now in use
Decree

10. Case No. Date Amt. Decreed: M. I. C. F. S.
11. To Whom Decreed Address
12. Name of Ditch Maximum Capacity (C. F. S.)
13. Date of Priority Purpose
14. Land Description of Place of Use as Decreed
15. Remarks (Present Use Status, etc.)



STATE OF MONTANA
STATE ENGINEERS OFFICE
Water Resources Survey

212
Form WR-1-IM-11-41

Code No. 30 A, 31 B
County Stillwater
T. 1 S. R. 18 E.

Name of Land Owner Certrude McKeith

Address Reed Point

Name of Operator _____

Address _____

Part A

TO BE FILED BY THOSE OBTAINING IRRIGATION WATER FROM
A DITCH COMPANY OR IRRIGATION DISTRICT

1. Water is delivered by: Reed Point Ditch
Name of Ditch, Ditch Company or District supplying water
2. State the number of acres you irrigate under this system _____ Shares you hold _____
3. If you obtain water from more than one Company, give the number of shares, acres irrigated and the name of the Company under "Remarks". If you obtain water from a Ditch Company and also have a private system fill in both Part A and Part B.

Part B

TO BE FILED BY THOSE WHO HAVE A PRIVATE DITCH, PUMP OR IRRIGATION SYSTEM
or those who have a private water right under a Ditch Company

4. In what year was this land first irrigated? Date May 1894
5. Give the name of the original appropriator (first user): Porter Phipps
6. Give the date appropriated Oct 23, 1898 amount filed on: Miners Inches 333 C. F. S. _____
7. State the total number of acres irrigated under this system: about 45
8. Give the point of diversion: 1/4 Section 18 Township 18 Range 18 E
at a point two thousand feet W from mile Post 186.12 on

Part C

TO BE FILED BY ALL WATER USERS IN ADDITION TO PART A OR PART B

9. Source of Water: Yellowstone River
Name of stream or lake from which water is originally diverted
10. Water is obtained by: (Check one) Gravity _____ Pumping _____ Other _____
11. What is the greatest number of acres you have irrigated? 75 Date _____
12. How many acres did you irrigate in 1944? (Crop and pasture) 75
13. State the total number of additional acres that could be irrigated by increasing the water supply, land leveling, etc. 12 This land is under what ditch? Yellowstone River
14. How many acres of seeped land do you have which could be drained and put into production? _____
15. What is the condition of your irrigation system? _____
16. Is your water supply adequate? Yes W No _____ Explain _____
17. REMARKS: _____

OVER

NOTE: The foregoing questions apply only to irrigated land shown on this plat.

DESCRIPTION AND MAP OF FARM

18. Legal Description of this Farm Lots 9, 10, Sec. 30, T4W N2E, Sec. 31 - T4W N3E, Rge. 18 E.

75 A IRRIGATED LAND

26 A NON-IRRIGATED LAND

NORTH



This map is according to our records. Please change it if it is not correct. That is if we show more irrigated land than you have, X it out; if we have not enough, draw it in.

19. If the above land is irrigated from more than one ditch please give the acreage under each ditch in 19A and indicate the location of the land irrigated from each on the above map.

19A. Ditch: Road Point Ditch Acres: 75

Ditch: _____ Acres: _____

Information supplied by:

Name: _____ Address: _____ Date: _____

REMARKS: _____

If you cannot answer all of the questions on this form answer as many as you can and return the form to us as soon as possible.

THURDEN'S, HELENA

Our records show that you have an appropriation made by James McBrady, appropriated Nov. 16, 1906 and filed Nov. 16, 1906 from McPherson Spring for 100 miners inches.

also

Our records show that you have an appropriation made by James McBrady appropriated June 8, 1903 and filed June 8, 1903 from Waters of Thompson Canyon for 40 miners inches. Are these appropriations now in use?

*not in use
only stock water*

Dear Sir

*This ditch has four
shares and one half share for
five farms and has 1500 inches
of water Right Known as
Red Point Ditch Company*

FORM SM-1

A STUDY OF MONTANA'S WATER RESOURCES

County Montana Source of Information

1. Water User Robert J. Smith Address Red Butte

2. Stream Tributary to Basin

3. Total of Divisions 1 1 Section Township Range

4. Description of System

5. Type of Irrigation

6. Original Appropriator John Smith Address

7. First Use: Year Acres Irrigated

8. Maximum Use: Year Acres Irrigated

9. Present Use: Year Acres Irrigated

10. Last Use: Year Why Abandoned

11. Condition of System

12. Land Description Lot 1, Sec. 30, T. 14N, R. 18E

Remarks: Handed to John Smith

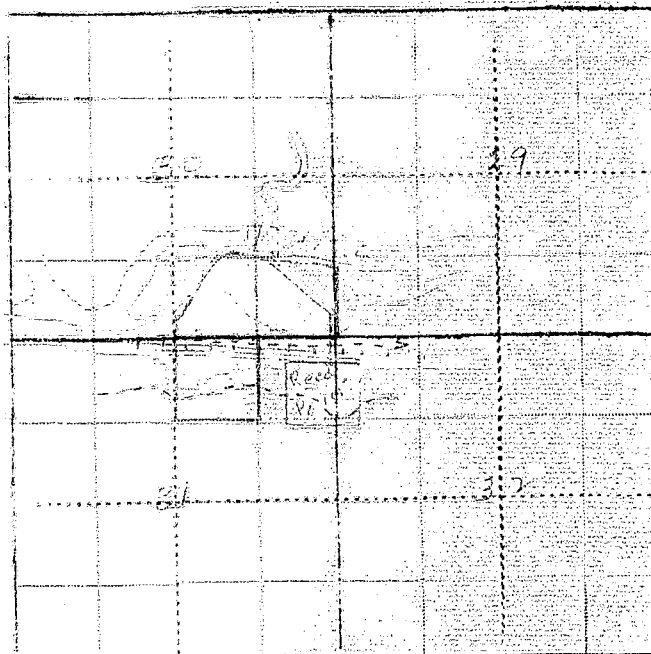

WITNESS:

Information by

Place

Our records show that you have an appropriation made by James McBrady, appropriated Nov. 16, 1906 and filed Nov. 16, 1906 from McPherson Spring for 100 miners inches.

also

Our records show that you have an appropriation made by James McBrady appropriated June 8, 1903 and filed June 8, 1903 from Waters of Thompson Canyon for 40 miners inches. Are these appropriations now in use?

Code No. 6

Please Do Not Fill in Any Items on This Page

Notice of Appropriation

1. County Stillwater Book 4 Page 617 Record Misc.
2. Name of Appropriator James McBrady Address Need Point, Montana
3. Date Appropriated Nov. 15, 1906 Date Filed Nov. 16, 1906
Amount Appropriated, Miners Inches 100 or all Cubic Feet per second _____
4. Name of Stream McPherson Spring Tributary _____ Basin _____
5. Point of Diversion at a point near where it emerges from the ground in

Sec. 6 Twp. 2 S. Rge. 18 E. Bank of Stream not given.
thence running to and upon said land.
6. Purpose Irrigation, domestic and other purposes.
7. Description of System By means of a dam and ditch, said ditch being 18 inches by 12 inches in size.

8. Land Description of Intended Place Partly in Section 31, Twp. 2 S., Rge. 18 E., and partly in Sec. 32, T. 1 S., R. 18 E.

9. Remarks (Pertaining to Use, etc.) not in use

Decree

10. Case No. _____ Date _____ Amt. Decreed: M. I. _____ C. F. S. _____
11. To Whom Decreed _____ Address _____
12. Name of Ditch _____ Maximum Capacity (C. F. S.) _____
13. Date of Priority _____ Purpose _____
14. Land Description of Place of Use as Decreed _____

Code No. 5

Please Do Not Fill in Any Items on This Page

Notice of Appropriation

557

1. County Stillwater Book 4 page 100 Sec. 1 Twp. 1 Rge. 18 E.
2. Name of Appropriator James McBrady Address Need Point, Montana
3. Date Appropriated June 8, 1903 Date Filed June 8, 1903
- Amount Appropriated, Miners Inches 500 Cubic Feet per second
4. Name of Stream Spring in School House Canyon Tributary Basin
5. Point of Diversion at a point at its mouth of Gulch of said spring at the south line of my said ranch and thence to and upon said land.
- Sec. Twp. Rge. Bank of Stream
6. Purpose Irrigation, domestic and other purposes.
7. Description of System a dam and ditch, ditch 24 x 12 inches in size and carries all waters from said spring.
8. Land Description of Intended Place of Use Homestead claim in secs. 31 & 32, Twp. 1 S., Rge. 18 E. Tot. Acr. 160
9. Remarks (Pertaining to Use, etc.)

Decree

10. Case No. Date Amt. Decreed: M. I. C. F. S.
11. To Whom Decreed Address
12. Name of Ditch Maximum Capacity (C. F. S.)
13. Date of Priority Purpose
14. Land Description of Place of Use as Decreed

STATE ENGINEERS OFFICE
Water Resources Survey

Notice of Appropriation

1. County Stillwater Book 4 Page 425 Record Misc.
2. Name of Appropriator Hans P. Nelson et al
3. Date Appropriated Oct. 23, 1893 Date Filed Nov. 19, 1893
Amount Appropriated, Miners Inches 1000, Cubic Feet per second
4. Name of Stream Yellowstone River Tributary Basin
5. Point of Diversion at a point on its south bank about 2000 feet north, 60 west from the N. P. Railroad mile post L. 56 and about 500 feet west to the cabin claimed by John H. Dougherty and running thence in an easterly direction to and upon said land.
Sec. Twp. Rge. Bank of Stream South.
6. Purpose Irrigation, stock use, domestic and other useful and beneficial purposes.
7. Description of System By means of a ditch which is 48 inches wide on bottom, 84 inches across top, by 18 inches in depth.
8. Land Description of Intended Place of Use
Subdivision Sec. Twp. Rge. Tot. Acr. 1940 Owner Address
When surveyed will be in 1 S. 18 E.
9. Remarks (Pertaining to Use, etc.)
Hans P. Nelson and W. F. Hodgkins and L. K. Thompson are the appropriators of this water right of Reed Point, Montana.

Decree

10. Case No. Date Amt. Decreed: M. I. C. F. S.
11. To Whom Decreed Address
12. Name of Ditch Maximum Capacity (C. F. S.)
13. Date of Priority Purpose
14. Land Description of Place of Use as Decreed
15. Remarks (Present Use Status, etc.)



STATE OF MONTANA
STATE ENGINEERS OFFICE
Water Resources Survey

Form WR-1-1M-11-41
Code No. 15 A, 22 A
County Stillwater
T. 1 S. R. 18 E.

Name of Land Owner Frank & Isaac Flatz Address Laurel
Name of Operator E. J. Ferruson Address Need Point, Montana

Part A

TO BE FILED BY THOSE OBTAINING IRRIGATION WATER FROM
A DITCH COMPANY OR IRRIGATION DISTRICT

1. Water is delivered by: P. D. Flatz & Son
Name of Ditch, Ditch Company or District supplying water
2. State the number of acres you irrigate under this system 100 Shares you hold
3. If you obtain water from more than one Company, give the number of shares, acres irrigated and the name of the Company under "Remarks". If you obtain water from a Ditch Company and also have a private system fill in both Part A and Part B.

Part B

TO BE FILED BY THOSE WHO HAVE A PRIVATE DITCH, PUMP OR IRRIGATION SYSTEM
or those who have a private water right under a Ditch Company

4. In what year was this land first irrigated? Date
5. Give the name of the original appropriator (first user): W. H. Smith
6. Give the date appropriated Feb 4, 1885 Amount filed on: Miners Inches 435 C. F. S.
7. State the total number of acres irrigated under this system: 100
8. Give the point of diversion: Between Sec. 15 & 23
1/4 Section Township 15 N Range 18 E

Part C

TO BE FILED BY ALL WATER USERS IN ADDITION TO PART A OR PART B

9. Source of Water: White Pine Creek
Name of stream or lake from which water is originally diverted
10. Water is obtained by: (Check one) Gravity ☒ Pumping ☐ Other ☐
11. What is the greatest number of acres you have irrigated? 100 Date
12. How many acres did you irrigate in 1944? (Crop and pasture) 100
13. State the total number of additional acres that could be irrigated by increasing the water supply, land leveling, etc. This land is under what ditch?
14. How many acres of seeped land do you have which could be drained and put into production?
15. What is the condition of your irrigation system? Good
16. Is your water supply adequate? Yes ☐ No ☒ Explain water is not adequate
17. REMARKS: This water has been taken from the White Pine Creek and used for the 1/4 section that I own off and a long time ago I had around 1000 acres irrigated

OVER

NOTE: The foregoing questions apply only to irrigated land shown on this plat.

DESCRIPTION AND MAP OF FARM

18. Legal Description of this Farm: All Sec. 15, T₁S., R₁₈E., S₁W, Sec. 22 - Twp. 1 S., Rge. 18 E.

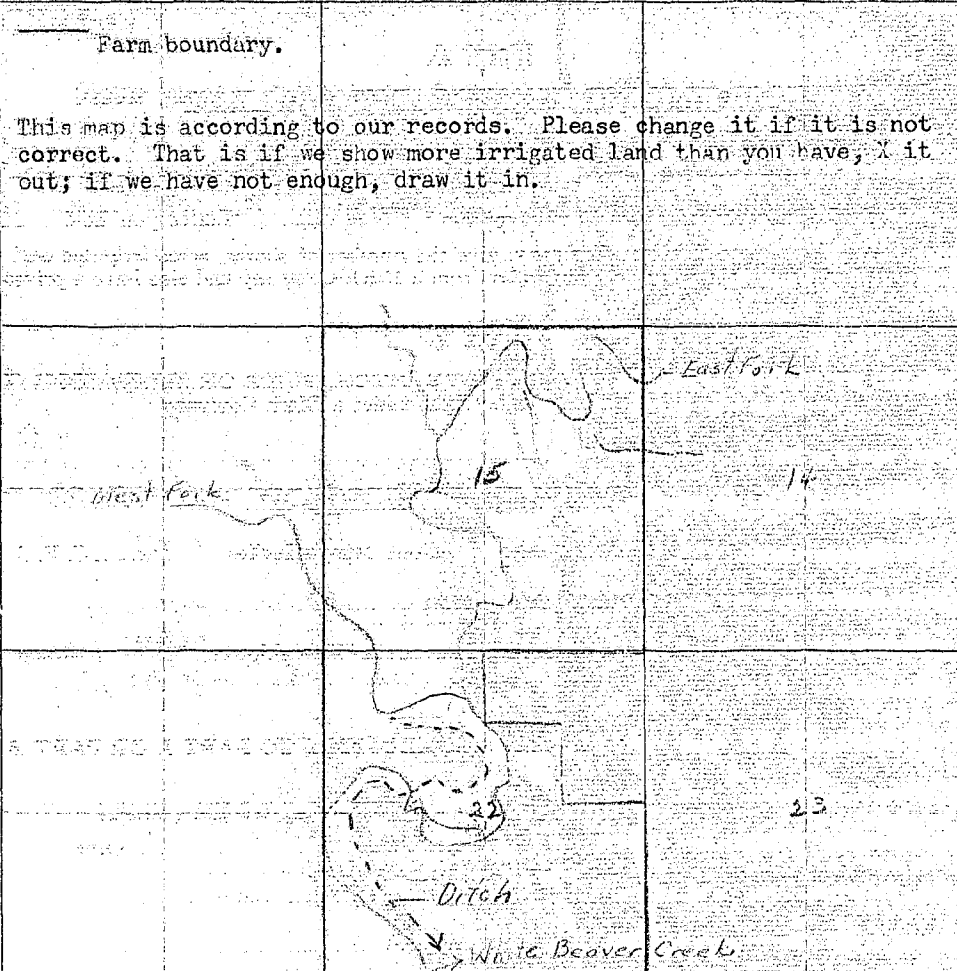
IRRIGATED LAND		NON-IRRIGATED LAND	
<p>— Farm boundary.</p> <p>This map is according to our records. Please change it if it is not correct. That is if we show more irrigated land than you have, X it out; if we have not enough, draw it in.</p> <p>NORTH</p> 			

19. If the above land is irrigated from more than one ditch please give the acreage under each ditch in 19A and indicate the location of the land irrigated from each on the above map.

19A. Ditch: Private Ditch Acres: 100

Ditch: _____ Acres: _____

Information supplied by:

Name: F. J. Jorgensen Address: Red Point Mont Date: Feb 3-45

REMARKS: _____

If you cannot answer all of the questions on this form answer as many as you can and return the form to us as soon as possible.

THURBER'S, HELENA

Our records show that you have an appropriation made by A. E. Parsons, appropriated April 10, 1899 and filed April 10, 1899 from White Beaver Creek for 75 miners inches.

also

Our records show that you have an appropriation made by P. A. Seeschrist, appropriated Sept. 4, 1885 and filed Sept. 4, 1885 from White Beaver Creek for 435 miners inches. Is this appropriation now in use?

15 M FORM SM-1

794

7-20-18 E

A STUDY OF MONTANA'S WATER RESOURCES

- County Yellowstone Source of Information Personal
1. Water User E. W. Parsons Address Bozeman
2. Stream Yellowstone Tributary to Yellowstone Basin Yellowstone
3. Point of Diversion 1 1 Section 1 Township 1 Range 1
4. Description of System
5. Type of Irrigation
6. Original Appropriator 601-604 Address
7. First Use: Year Acres Irrigated
8. Maximum Use: Year Acres Irrigated
9. Present Use: Year Acres Irrigated
10. Last Use: Year Why Abandoned
11. Condition of System
12. Land Description All Sec 15, 16, 17, 18, 19, 20, 21, 22, T 18 S, R 18 E.

Remarks: no record

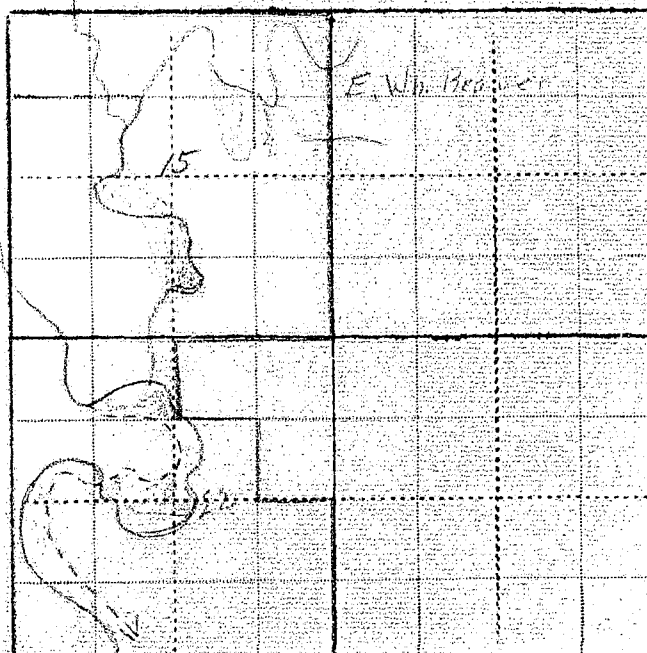

WITNESS:

Information by

Place

Please Do Not Fill in Any Items on This Page

Notice of Appropriation

1. County Stillwater Book 4 Page 572 Record Misc.
2. Name of Appropriator A. E. Parsons Address Merrill, Montana
3. Date Appropriated April 10, 1899 Date Filed April 10, 1899
Amount Appropriated, Miners Inches 75 Cubic Feet per second _____
4. Name of Stream White Beaver Creek Tributary _____ Basin _____
5. Point of Diversion at a point on its right bank 300 yards in a N direction from NW corner of NE $\frac{1}{4}$ of Sec. 22, T. 1 S., Rge. 18 E. on right bank of stream also on the right bank of the west fork of said creek $\frac{1}{2}$ mile in a NW direction from the NW corner of said Sec. 22, thence Sec. _____ Twp. _____ Rge. _____ Bank of Stream to and upon said land.
6. Purpose Irrigation, domestic, agriculture and other purposes.
7. Description of System By means of ditch and headgate, said headgate being 24 inches by 24 inches in size.

8. Land Description of Intended Place of Use

Subdivision	Sec.	Twp.	Rge.	Tot. Acr.	1940 Owner	Address
<u>SE$\frac{1}{4}$ - NE$\frac{1}{4}$SW$\frac{1}{4}$ - SW$\frac{1}{4}$NE$\frac{1}{4}$</u>	<u>22</u>	<u>1 S.</u>	<u>18 E.</u>	<u>160</u>	<u>Isaac Platz</u>	<u>Laurel, Mont.</u>
<u>and other lands in</u>	<u>22</u>	<u>1 S.</u>	<u>18 E.</u>			

9. Remarks (Pertaining to Use, etc.)

Transfers of Land Ownership.A. E. Parsons to Isaac Platz et alSE $\frac{1}{4}$ - NE $\frac{1}{4}$ SW $\frac{1}{4}$ - SW $\frac{1}{4}$ NE $\frac{1}{4}$ - Sec. 22 - Twp. 1 S., Rge. 18 E.now in use**Decree**

10. Case No. _____ Date _____ Amt. Decreed: M. I. _____ C. F. S. _____
11. To Whom Decreed _____ Address _____
12. Name of Ditch _____ Maximum Capacity (C. F. S.) _____
13. Date of Priority _____ Purpose _____
14. Land Description of Place of Use as Decreed _____

Please Do Not Fill in Any Items on This Page

Notice of Appropriation

604

1. County Stillwater Book 4 Page 417 Record 1100
2. Name of Appropriator Phillip A. Seechrist Address Sweet Grass P.O., Montana
3. Date Appropriated September 4, 1885 Date Filed Sept. 4, 1885
 A prior appropriation made on Aug. 1, 1885.
 Amount Appropriated, Miners Inches 435, Cubic Feet per second
4. Name of Stream White Beaver Creek Tributary Basin
5. Point of Diversion at a point upon its west bank on the section line dividing sections
15 & 22 Twp. 1 S., Rge. 13 E. on the west bank of stream about 1 mile e. of the W line
of said secs. or near the S. sec. corner of said sec. 15, on the S. & of said section 22 on
Sec. Twp. Rge. Bank of Stream the N. thence running to and
upon said land.
6. Purpose Irrigation and other legal and useful purposes.
7. Description of System By means of a ditch sufficiently large enough to carry 435 inches
of water.
8. Land Description of Intended Place of Use
W $\frac{1}{2}$ of Section 22, Twp. 1 S., Rge. 13 E. Tot. Acres 320 - 1940 Owner Isaac Platz,
Laurel, Mont.
9. Remarks (Pertaining to Use, etc.)
Transfers of Land ownership.
Phillip A. Seechrist to A. E. Parsons to Isaac Platz et al.
W $\frac{1}{2}$ - Sec. 22 - Twp. 1 S., Rge. 13 E.

Decree

10. Case No. _____ Date _____ Amt. Decreed: M. I. _____ C. F. S. _____
11. To Whom Decreed _____ Address _____
12. Name of Ditch _____ Maximum Capacity (C. F. S.) _____
13. Date of Priority _____ Purpose _____
14. Land Description of Place of Use as Decreed _____



STATE OF MONTANA
STATE ENGINEERS OFFICE
Water Resources Survey

214
Form WR-1-1M-11-44

Code No. 31 A

County Stillwater

T. 1 S. R. 18 E.

Name of Land Owner Reed Point Address _____

Name of Operator _____

Part A

TO BE FILED BY THOSE OBTAINING IRRIGATION WATER FROM
A DITCH COMPANY OR IRRIGATION DISTRICT

1. Water is delivered by: Reed Point ditch Company
Name of Ditch, Ditch Company or District supplying water
2. State the number of acres you irrigate under this system _____ Shares you hold _____
3. If you obtain water from more than one Company, give the number of shares, acres irrigated and the name of the Company under "Remarks". If you obtain water from a Ditch Company and also have a private system fill in both Part A and Part B.

Part B

TO BE FILED BY THOSE WHO HAVE A PRIVATE DITCH, PUMP OR IRRIGATION SYSTEM
or those who have a private water right under a Ditch Company

4. In what year was this land first irrigated? Date 1893
5. Give the name of the original appropriator (first user): W. F. Williams et al
6. Give the date appropriated Oct 23, 1893 Amount filed on: Miners Inches 1000 C. F. S. _____
7. State the total number of acres irrigated under this system: _____
8. Give the point of diversion: SE 1/4 SE 1/4 Section 26 Township 1 S. Range 17 E

Part C

TO BE FILED BY ALL WATER USERS IN ADDITION TO PART A OR PART B

9. Source of Water: Gallatin River
Name of stream or lake from which water is originally diverted
10. Water is obtained by: (Check one) Gravity ☒ Pumping _____ Other _____
11. What is the greatest number of acres you have irrigated? _____ Date _____
12. How many acres did you irrigate in 1944? (Crop and pasture) 10
13. State the total number of additional acres that could be irrigated by increasing the water supply, land leveling, etc. 10 This land is under what ditch? _____
14. How many acres of seeped land do you have which could be drained and put into production? _____
15. What is the condition of your irrigation system? need of new headgate
16. Is your water supply adequate? Yes _____ No ☒ Explain _____
17. REMARKS: Because of new headgate can only irrigate 10 acres of land.

NOTE: The foregoing questions apply only to irrigated land shown on this plat.

DESCRIPTION AND MAP OF FARM

18. Legal Description of this Farm. Frac. 13, Sec. 31 - Twp. 1 S., Rge. 18 E.

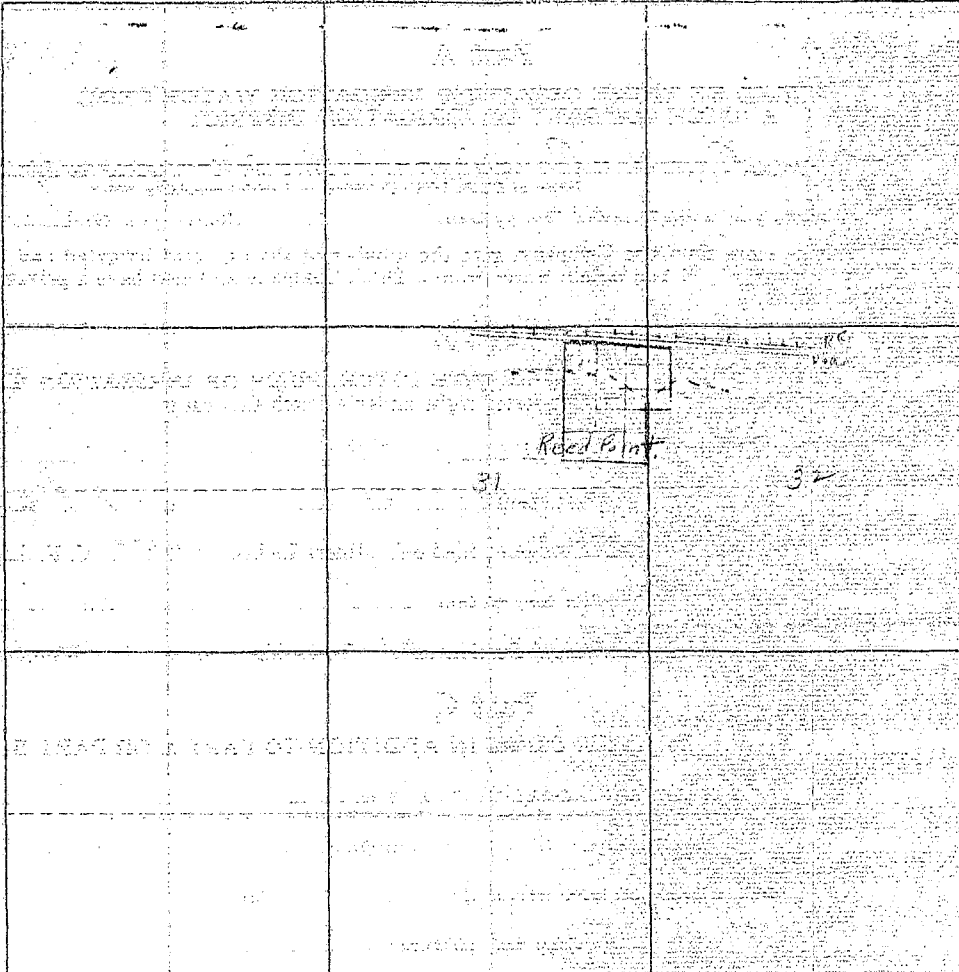
	IRRIGATED LAND	NON-IRRIGATED LAND
<p>NORTH</p> 		

19. If the above land is irrigated from more than one ditch please give the acreage under each ditch in 19A and indicate the location of the land irrigated from each on the above map.

19A. Ditch: Reed Point Ditch Co. Acres: 10

Ditch: _____ Acres: _____

Information supplied by:

Name: John S. McKeith Address: _____ Date: Apr. 17 - 45

REMARKS: Reed Point Ditch Co. has a 50 ft. deep well at Reed Point.

If you cannot answer all of the questions on this form answer as many as you can and return the form to us as soon as possible.

THURBER'S, HELENA

FORM SM-1

A STUDY OF MONTANA'S WATER RESOURCES

County Chouteau Source of Information _____

1. Water User West Point Address _____

2. Stream _____ Tributary to _____ Basin _____

3. Point of Diversion 1/4 1/4 Section _____ Township _____ Range _____

4. Description of System _____

5. Type of Irrigation _____

6. Original Appropriator D Address _____

7. First Use: Year _____ Acres Irrigated _____

8. Maximum Use: Year _____ Acres Irrigated _____

9. Present Use: Year _____ Acres Irrigated _____

10. Last Use: Year _____ Why Abandoned _____

11. Condition of System _____

12. Land Description Tract 764, Sec 31, T 12N, R 18E

Remarks: _____

WITNESS: _____ Information by _____

Place _____

STATE ENGINEERS OFFICE
Water Resources Survey

Notice of Appropriation

1. County Stillwater Book 4 Page 425 Record Misc.
2. Name of Appropriator Hans P. Nelson et al Address Reed Point, Montana
3. Date Appropriated Oct. 23, 1893 Date Filed Nov. 19, 1893
- Amount Appropriated, Miners Inches 1000, Cubic Feet per second
4. Name of Stream Yellowstone River Tributary Basin
5. Point of Diversion at a point on its south bank about 2000 feet north, 60 west from the N. P. Railroad mile post L. 56 and about 500 feet west to the cabin claimed by John H. Dougherty and running thence in an easterly direction to and upon said land.
Sec. Twp. Rge. Bank of Stream south.

6. Purpose Irrigation, stock use, domestic and other useful and beneficial purposes.
7. Description of System By means of a ditch which is 48 inches wide on bottom, 84 inches across top, by 18 inches in depth.

8. Land Description of Intended Place of Use
- | Subdivision | Sec. | Twp. | Rge. | Tot. Acr. | 1940 Owner | Address |
|--------------------------|------|-------|------|-----------|------------|---------|
| When surveyed will be in | 1 S. | 18 E. | | | | |

9. Remarks (Pertaining to Use, etc.)
- Hans P. Nelson and W. F. Hodgkins and L. E. Thompson are the appropriators of this this water right of Reed Point, Montana.

Decree

10. Case No. Date Amt. Decreed: M. I. C. F. S.
11. To Whom Decreed Address
12. Name of Ditch Maximum Capacity (C. F. S.)
13. Date of Priority Purpose
14. Land Description of Place of Use as Decreed
15. Remarks (Present Use Status, etc.)



STATE OF MONTANA
STATE ENGINEERS OFFICE
Water Resources Survey

193
Form WR-1-1M-11-41
Code No. 9 A, 10 A, 11 A, 12 A
County Stillwater 14 A
T. 13. R. 18 E.

Name of Land Owner Harry Schmitt Address Reed Point
Name of Operator Address

Part A

TO BE FILED BY THOSE OBTAINING IRRIGATION WATER FROM
A DITCH COMPANY OR IRRIGATION DISTRICT

1. Water is delivered by: Name of Ditch, Ditch Company or District supplying water
2. State the number of acres you irrigate under this system Shares you hold
3. If you obtain water from more than one Company, give the number of shares, acres irrigated and the name of the Company under "Remarks". If you obtain water from a Ditch Company and also have a private system fill in both Part A and Part B.

Part B

TO BE FILED BY THOSE WHO HAVE A PRIVATE DITCH, PUMP OR IRRIGATION SYSTEM
or those who have a private water right under a Ditch Company

4. In what year was this land first irrigated? Date about 1900
5. Give the name of the original appropriator (first user):
6. Give the date appropriated. I think it was 1897 from White River creek Amount filed on: Miners Inches 240 C. F. S.
7. State the total number of acres irrigated under this system: 70
8. Give the point of diversion: S W 1/4 Sec 12 Section 14 Township 1-S Range 18 E

Part C

TO BE FILED BY ALL WATER USERS IN ADDITION TO PART A OR PART B

9. Source of Water: White Beaver Creek & Spring Creek Name of stream or lake from which water is originally diverted
10. Water is obtained by: (Check one) Gravity ☒ Pumping ☒ Other
11. What is the greatest number of acres you have irrigated? 70 Date
12. How many acres did you irrigate in 1944? (Crop and pasture) None - due to lack of help
13. State the total number of additional acres that could be irrigated by increasing the water supply, land leveling, etc. 100 acres This land is under what ditch? private ditch of this place
14. How many acres of seeped land do you have which could be drained and put into production? None
15. What is the condition of your irrigation system? poor
16. Is your water supply adequate? Yes No Explain yes except in dry years
17. REMARKS: They have taken the boys away from me for raising and it is impossible for me to keep this irrigation system on the ground and what will have to be at wages I can afford to pay.

OVER

NOTE: The foregoing questions apply only to irrigated land shown on this plat.

DESCRIPTION AND MAP OF FARM

18. Legal Description of this Farm All Sec. 9 & 11, N₁, R₅W, Sec. 10 - NW₁, NE₁, Sec. 14
Twp. 1 S., Rge. 18 E.

	IRRIGATED LAND	NON-IRRIGATED LAND
<p>Farm boundary.</p> <p>This map is according to our records. Please change it if it is not correct. That is if we show more irrigated land than you have, X it out; if we have not enough, draw it in.</p> <p>NORTH</p>		

19. If the above land is irrigated from more than one ditch please give the acreage under each ditch in 19A and indicate the location of the land irrigated from each on the above map.

19A. Ditch: no 1 - covered 56 acres Acres: _____

Ditch: no 2 - covered 20 acres Acres: _____

Information supplied by:

Name Henry Schubert Address Reed Point, Mont Date Mar 25-15

REMARKS: I absolutely devote the time to go in and get the information correct as my abstracts are at the bank and I am left with 3 mins work to try to get done -

If you cannot answer all of the questions on this form answer as many as you can and return the form to us as soon as possible.

If you can't get along with this information let me know and I will take time to let you know

THUNDER'S, HELENA

2. 14
ge. 18 E.

Spring creek empties into White Beaver and that
way I went. Also one of our ditches crossed
Spring creek and that way used that water
came down Spring creek when this ditch was new

0000
not bought
160
0000

was
served

A and

- 25-45
1 get the
and 9

as soon

[illegible]

I that
water
covered

Our records show that you have an appropriation made by Samuel Andrews, appropriated April 7, 1902 and filed April 7, 1902 from Spring Creek for 100 miners inches. Is this appropriation now in use?

Billings,
XXXXXXX

March 15, 1945

Harry Schmitt
Reed Point, Montana

Dear Mr. Schmitt:

On February 3rd, this office sent you a letter asking for certain information pertaining to your irrigated land in township 1 south, range 18 east. To date we have not heard from you. With the vast post war water development in this area as now planned, it is essential that we have this information in order to show the extent of our water use in the Yellowstone Basin in Montana. This information is necessary to protect our present water users in the rights they have against future irrigation, navigation, power and flood control enterprises in this area. We are asking you for this information because we feel it is the democratic way; we also feel that you are more qualified to give us this information about your irrigated land than anyone else because it is part of your business. It may be that you were busy with your farm work or some unforeseen thing happened at the time our first letter was received, and you put it aside to be answered at some other time and have forgotten all about it. All information is strictly confidential and is only used to record and tabulate the water use in this area.

Water is as necessary to the farmer as the soil in which he plants. Without it no crops will grow; no living thing can survive. It is your water that we are trying to protect, so that you will have plenty now and in the future. We must keep Montana's water in Montana. The only way we can do this is by having the support of each and every water user so that we have a 100 percent representation of all water users. Remember: "United we stand, divided we fall".

In order to facilitate this work a branch office of the State Engineer has been established in Billings and is located in the Roosevelt School Building on 23rd Street and Fourth Avenue North. Anytime you are in Billings we would appreciate your calling on us.

Hoping to hear from you in the very near future, I am,

Very truly yours,

Gerald J. Oravetz
Assistant State Engineer

P.S. If you cannot supply us with the information requested, it may be that you can tell us of someone who can.

+ White
ver. C. H.

Code No. 496

Please Do Not Fill in Any Items on This Page

Notice of Appropriation

1. County Stillwater Book 4 Page 600 Record Misc.
2. Name of Appropriator Samuel Andrews Address Merrill, Montana
3. Date Appropriated April 5, 1902 Date Filed April 7, 1902
Amount Appropriated, Miners Inches 100 or all Cubic Feet per second _____
4. Name of Stream Spring Creek Tributary _____ Basin _____
5. Point of Diversion at a point on its west bank about 3/4 mile above the mouth of said creek
thence running to and upon said land.
Sec. _____ Twp. _____ Rge. _____ Bank of Stream _____
6. Purpose Domestic, irrigation and other purposes.
7. Description of System By means of a dam for reservoir and a ditch which said ditch is
24 inches by 12 inches in size.

8. Land Description of Intended Place of Use _____
Portion of Section 11, Twp. 1 S., Rge. 18 E. Tot. Acr. 640, 1940 Owner - Harry Schmitt
Reed Point, Mont.

9. Remarks (Pertaining to Use, etc.) Transfers of Land Ownership.
Samuel Andrews to Maggie Andrews to Merchants Trust Co., c/o John Volbrecht to
Harry Schmitt - Portion of Sec. 11, Twp. 1 S., Rge. 18 E.
APPROPRIATION

Decree

10. Case No. _____ Date _____ Amt. Decreed: M. I. _____ C. F. S. _____
11. To Whom Decreed _____ Address _____
12. Name of Ditch _____ Maximum Capacity (C. F. S.) _____
13. Date of Priority _____ Purpose _____
14. Land Description of Place of Use as Decreed _____



STATE OF MONTANA
STATE ENGINEERS OFFICE
Water Resources Survey

149

Form WR-1-1M-11-44

Code No. 5 A, 8 A

County Stillwater

T. 1 S. R. 18 E.

Name of Land Owner Federal Land Bank - Sec. 3 Address Spokane, Wash.

Name of Engineer Henry DePoe - buying on contract Address Reed Point, Montana

Part A

TO BE FILED BY THOSE OBTAINING IRRIGATION WATER FROM
A DITCH COMPANY OR IRRIGATION DISTRICT

1. Water is delivered by: Reed Point Ditch
Name of Ditch, Ditch Company or District supplying water
2. State the number of acres you irrigate under this system. _____ Shares you hold _____
3. If you obtain water from more than one Company, give the number of shares, acres irrigated and the name of the Company under "Remarks". If you obtain water from a Ditch Company and also have a private system fill in both Part A and Part B.

Part B

TO BE FILED BY THOSE WHO HAVE A PRIVATE DITCH, PUMP OR IRRIGATION SYSTEM
or those who have a private water right under a Ditch Company

4. In what year was this land first irrigated? Date Aug 2, 1889
5. Give the name of the original appropriator (first user): Samuel F. Hansen
6. Give the date appropriated Sept 22, 1890 Amount filed on: Miners Inches 200 C. F. S. _____
7. State the total number of acres irrigated under this system: _____
8. Give the point-of diversion: Sec 14 1/4 Section 6 Township 18 E Range 18 E

Part C



TO BE FILED BY ALL WATER USERS IN ADDITION TO PART A OR PART B

9. Source of Water: Reed Point Ditch
Name of stream or lake from which water is originally diverted
10. Water is obtained by: (Check one) Gravity ☒ Pumping _____ Other _____
11. What is the greatest number of acres you have irrigated? 155 Date _____
12. How many acres did you irrigate in 1944? (Crop and pasture) 0
13. State the total number of additional acres that could be irrigated by increasing the water supply, land leveling, etc. 155 This land is under what ditch? by constructing ditch & flume
14. How many acres of seeped land do you have which could be drained and put into production? _____
15. What is the condition of your irrigation system? not adequate
16. Is your water supply adequate? Yes _____ No ☒ Explain _____
17. REMARKS: Only a few water users in the area

NOTE: The foregoing questions apply only to irrigated land shown on this plat.

DESCRIPTION AND MAP OF FARM

18. Legal Description of this Farm All Sec. 5 - All Sec. 8 - Twp. 1 S., R. 18 E.

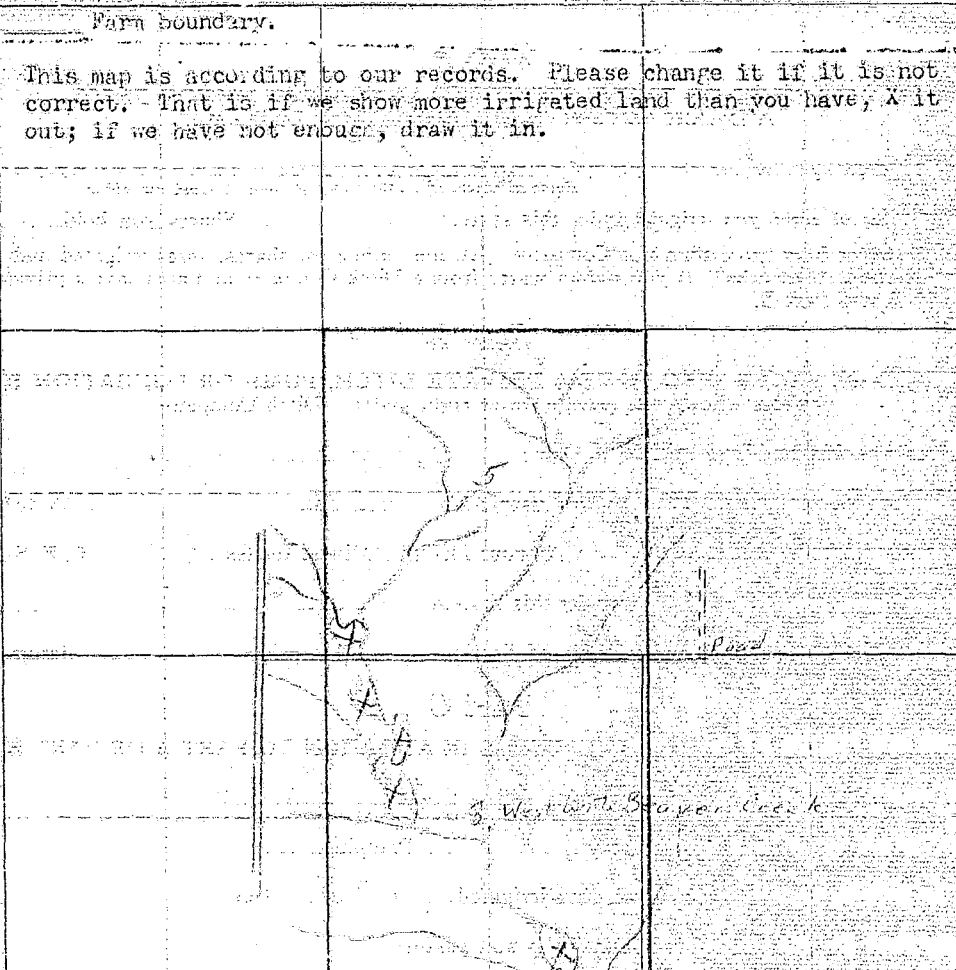
 IRRIGATED LAND	 NON-IRRIGATED LAND
Farm boundary.	
This map is according to our records. Please change it if it is not correct. That is if we show more irrigated land than you have, X it out; if we have not enough, draw it in.	
	

19. If the above land is irrigated from more than one ditch please give the acreage under each ditch in 19A and indicate the location of the land irrigated from each on the above map.

19A. Ditch: _____ Acres: _____

Ditch: _____ Acres: _____

Information supplied by:

Name Henry To Ruel Address _____ Date Apr-12-45

REMARKS: Information taken from Ranch of

Henry To Ruel by the way of Bill Lee

If you cannot answer all of the questions on this form answer as many as you can and return the form to us as soon as possible.

THURBER'S, HELENA 

Reed Print
mont

Dear Sir

I gave the map
and papers to Attorney
Parcells of Columbus to
check up on the water
rights, and as soon as he
does he will send them
on to you. Sorry about this
delay but he seems
awfully busy. So far as
I can ascertain I have
the first water right

Henry T. Poel

FORM SM-1

A STUDY OF MONTANA'S WATER RESOURCES

County St. Lawrence Source of Information St. Lawrence

1. Water User St. Lawrence Address St. Lawrence

2. Stream St. Lawrence Tributary to St. Lawrence Basin St. Lawrence

3. Point of Diversion 1 section 1 Township 1 Range 1

4. Description of System St. Lawrence

5. Type of Irrigation St. Lawrence

6. Original Appropriator St. Lawrence Address St. Lawrence

7. First Use: Year St. Lawrence Acres Irrigated St. Lawrence

8. Maximum Use: Year St. Lawrence Acres Irrigated St. Lawrence

9. Present Use: Year St. Lawrence Acres Irrigated St. Lawrence

10. Last Use: Year St. Lawrence Why Abandoned St. Lawrence

11. Condition of System St. Lawrence

12. Land Description St. Lawrence, T 1, R 18

Remarks: St. Lawrence

WITNESS: _____ Information by _____

Place _____

~~Billings,~~
~~Montana~~
-March 15, 1945

Henry Te Poel
Reed Point, Montana

Dear Mr. Te Poel:

On February 3rd, this office sent you a letter asking for certain information pertaining to your irrigated land in township 1 south, range 18 east. To date we have not heard from you. With the vast post war water development in this area as now planned, it is essential that we have this information in order to show the extent of our water use in the Yellowstone Basin in Montana. This information is necessary to protect our present water users in the rights they have against future irrigation, navigation, power and flood control enterprises in this area. We are asking you for this information because we feel it is the democratic way; we also feel that you are more qualified to give us this information about your irrigated land than anyone else because it is part of your business. It may be that you were busy with your farm work on some unforeseen thing happened at the time our first letter was received, and you put it aside to be answered at some other time and have forgotten all about it. All information is strictly confidential and is only used to record and tabulate the water use in this area.

Water is as necessary to the farmer as the soil in which he plants. Without it no crops will grow; no living thing can survive. It is your water that we are trying to protect, so that you will have plenty now and in the future. We must keep Montana's water in Montana. The only way we can do this is by having the support of each and every water user so that we have a 100 percent representation of all water users. Remember: "United we stand, divided we fall".

In order to facilitate this work a branch office of the State Engineer has been established in Billings and is located in the Roosevelt School Building on 23rd Street and Fourth Avenue North. Anytime you are in Billings we would appreciate your calling on us.

Hoping to hear from you in the very near future, I am,

Very truly yours,

Gerald J. Oravetz
Assistant State Engineer

P.S. If you cannot supply us with the information requested, it may be that you can tell us of someone who can.

Code No. 91

Please Do Not Fill in Any Items on This Page

Notice of Appropriation

1. County Stillwater Book 4 Page 421 Record Misc.
2. Name of Appropriator Samuel L. Davis Address Sweet Springs, W. V., Montana
3. Date Appropriated Sept. 23, 1890 Date Filed Sept. 27, 1890
4. prior water appropriation made by Samuel L. Davis on August 2, 1889.
- Amount Appropriated, Miners Inches 200, Cubic Feet per second
5. Name of Stream West White Beaver Creek Tributary Basin
6. Point of Diversion at a point upon its east bank thereon near the section line dividing

Sec. 5 & 6 Twp. 1 S. Rge. 18 E. Bank of Stream east.
 about 1/2 mile north of south line of said section or 1/2 mile north of sec. stake corner of Sec. 5, 6, 7 & 8.,
 6. Purpose Irrigation and other purposes. / thence running to and upon said
described land.

7. Description of System By means of ditch which is 24 inches
by 48 inches in size.

8. Land Description of Intended Place of Use
- | Subdivision | Sec. | Twp. | Rge. | Tot. Acr. | 1940 Owner | Address |
|-------------|------|------|-------|-----------|-------------------|----------------|
| NW 1/4 | 8 | 1 S. | 18 E. | 160 | Federal Land Bank | Spokane, Wash. |

9. Remarks (Pertaining to Use, etc.)

Decree

10. Case No. _____ Date _____ Amt. Decreed: M. I. _____ C. F. S. _____
11. To Whom Decreed _____ Address _____
12. Name of Ditch _____ Maximum Capacity (C. F. S.) _____
13. Date of Priority _____ Purpose _____

STATE ENGINEERS OFFICE

Water Resources Survey

Notice of Appropriation

607

1. County Jefferson Book 2 Page 403 Record 7100
2. Name of Appropriator Good H. Winchester Address Ray, Nevada
3. Date Appropriated Oct 14-1905 Date Filed Oct 25-1905
- Amount Appropriated, Miners Inches 5000, Cubic Feet per second
4. Name of Stream White River Tributary Basin
5. Point of Diversion on the NWNE 1/4

Sec. 1 Twp. 15 Rge. 12E Bank of Stream

6. Purpose Irrigation, domestic, and industrial use
7. Description of System dam, headgate, ditch, and extension

8. Land Description of Intended Place of Use S 1/4 NE 1/4 Sec 6 T 15 N R 12 E
S 1/4 NE 1/4 Sec 8 T 15 N R 12 E
N 1/4 NE 1/4 Sec 6 T 15 N R 12 E

9. Remarks (Pertaining to Use, etc.)

Decree

10. Case No. Date Amt. Decreed: M. I. C. F. S.
11. To Whom Decreed Address
12. Name of Ditch Maximum Capacity (C. F. S.)
13. Date of Priority Purpose
14. Land Description of Place of Use as Decreed
15. Remarks (Present Use Status, etc.)



STATE OF MONTANA
STATE ENGINEERS OFFICE
Water Resources Survey

Code No. 30 B, 31 CCounty StillwaterT. 1 S. R. 18 E.Name of Land Owner Jacob Wagner S. A. Witham Address Reed PointName of Operator S. A. Witham - buying on contract Address Reed Point**Part A**

**TO BE FILED BY THOSE OBTAINING IRRIGATION WATER FROM
 A DITCH COMPANY OR IRRIGATION DISTRICT**

1. Water is delivered by: Reed Point Ditch Co.
Name of Ditch, Ditch Company or District supplying water
2. State the number of acres you irrigate under this system 50 Shares you hold 1
3. If you obtain water from more than one Company, give the number of shares, acres irrigated and the name of the Company under "Remarks". If you obtain water from a Ditch Company and also have a private system fill in both Part A and Part B.

Part B

**TO BE FILED BY THOSE WHO HAVE A PRIVATE DITCH, PUMP OR IRRIGATION SYSTEM
 or those who have a private water right under a Ditch Company**

4. In what year was this land first irrigated? Date 1893
5. Give the name of the original appropriator (first user) W. H. Redburn
6. Give the date appropriated Oct 23 1893 Amount filed on: Miners Inches 1000 C. F. S.
7. State the total number of acres irrigated under this system: 50
8. Give the point of diversion: SE 1/4 SE 1/4 Section 26 Township 18 N Range 17 East

Part C

TO BE FILED BY ALL WATER USERS IN ADDITION TO PART A OR PART B

9. Source of Water: Yellowstone River
Name of stream or lake from which water is originally diverted
10. Water is obtained by: (Check one) Gravity ☐ Pumping ☐ Other ☐
11. What is the greatest number of acres you have irrigated? 50 Date 1944
12. How many acres did you irrigate in 1944? (Crop and pasture) 50
13. State the total number of additional acres that could be irrigated by increasing the water supply, land leveling, etc. 15 This land is under what ditch? pumped from Reed Point Ditch Co.
14. How many acres of seeped land do you have which could be drained and put into production? 2
15. What is the condition of your irrigation system? fair
16. Is your water supply adequate? Yes ☐ No ☒ Explain could use more water

17. REMARKS: Water is pumped from Reed Point Ditch Co. and used for irrigation. 1900-1911 - 40 m.s.

44

of
fall

ding,

229

✓

300

See 30 and be not in
31.

Verfahren 2007

Mr. A. B. C.

— 135 —

at Rock Point Hotel

31

Don't use your name the
first time you write.

19A. Ditch: Red River Ditch Co Acres: 50

19A. Ditch: Red River Ditch Co Acres: 50

Ditch: _____ **Acres:** _____

Name Mr. W. H. H. H. H. H. Address Red Point, Mont. Date Feb. 2, 1945.

REMARKS: Jack Wagner is not with this crew
and left Oct. 2, 1968.

THURBER'S, HELENA

Our records show that you have an appropriation made by James McBrady, appropriated Nov. 16, 1906 and filed Nov. 16, 1906 from McPherson Spring for 100 miners inches.

also

Our records show that you have an appropriation made by James McBrady, appropriated June 8, 1903 and filed June 8, 1903 from Spring in School House Canyon for 500 miners inches.

also

Our records show that you have an appropriation made by Jacob Wagner, appropriated Mar. 20, 1911 and filed Mar. 20, 1911 from Springs in Sec. 31 for 40 miners inches. Are these appropriations now in use? *Used for stock water.*

FORM SM-1

A STUDY OF MONTANA'S WATER RESOURCES

- County Stillwater Source of Information _____
1. Water User Robert Wagner Address Reed Point
Reed Point, Mont.
2. Stream _____ Tributary to _____ Basin _____
3. Point of Diversion 1/4 1/4 Section _____ Township _____ Range _____
4. Description of System _____
5. Type of Irrigation _____
6. Original Appropriator 14-187-573 Address _____
7. First Use: Year _____ Acres Irrigated _____
8. Maximum Use: Year _____ Acres Irrigated _____
9. Present Use: Year _____ Acres Irrigated _____
10. Last Use: Year _____ Why Abandoned _____
11. Condition of System _____
12. Land Description Lot 7, Sec. 30, T. 18 N., R. 18 E.

Remarks: _____

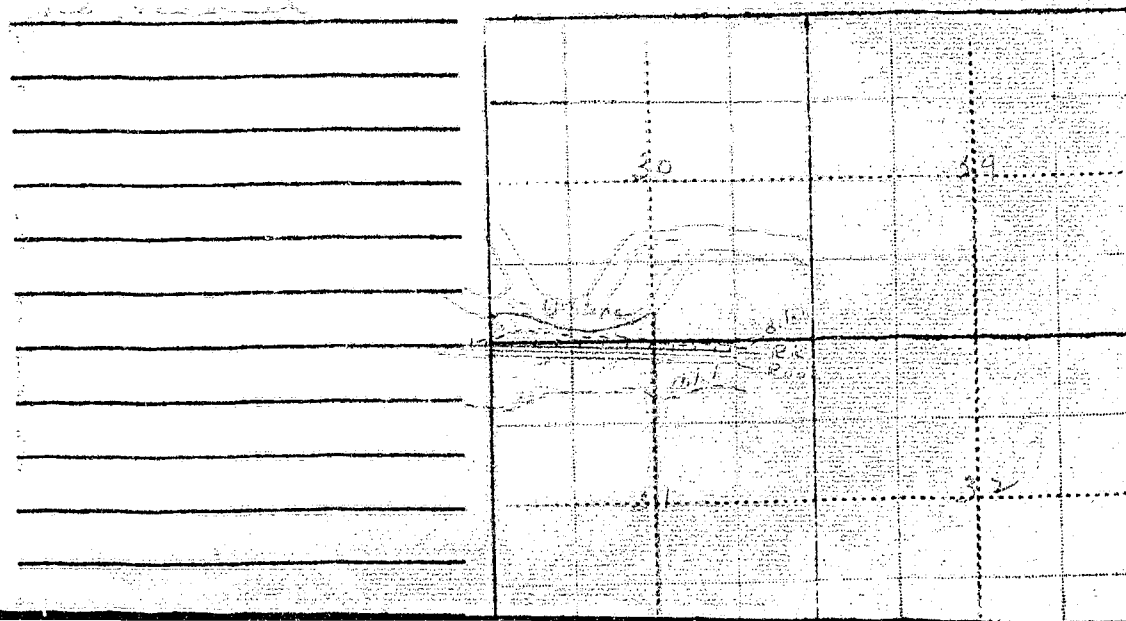

A and

0

7.1945

s soon

Our records show that you have an appropriation made by James McBrady, appropriated Nov. 16, 1906 and filed Nov. 16, 1906 from McPherson Spring for 100 miners inches.

also

Our records show that you have an appropriation made by James McBrady, appropriated June 8, 1903 and filed June 8, 1903 from Spring in School House Canyon for 500 miners inches.

Our records show that you have an appropriation made by Jacob Wagner, appropriated Mar. 20, 1911 and filed Mar. 20, 1911 from Springs in Sec. 31 for 40 miners inches. Are these appropriations now in use?

Code No. 46

Please Do Not Fill in Any Items on This Page

Notice of Appropriation

1. County Stillwater Book 4 Page 617 Record 4 Sec.
2. Name of Appropriator James McBrady Address Need Point, Montana
3. Date Appropriated Nov. 15, 1906 Date Filed Nov. 16, 1906
- Amount Appropriated, Miners Inches 100 or all Cubic Feet per second
4. Name of Stream McPherson Spring Tributary Basin
5. Point of Diversion at a point near where it emerges from the ground in
- Sec. 6 Twp. 2 S. Rge. 18 E. Bank of Stream not given.
thence running to and upon said land.
6. Purpose Irrigation, domestic and other purposes.
7. Description of System By means of a dam and ditch, said ditch being 16 inches by 12
inches in size.
8. Land Description of Intended Place of Use
Partly in Sec. 31, T. 1 S., Rge. 18 E. and partly in Sec. 32, T. 1 S., Rge. 18 E.
9. Remarks (Pertaining to Use, etc.)
Not in use

Decree

10. Case No. Date Amt. Decreed: M. I. C. F. S.
11. To Whom Decreed Address
12. Name of Ditch Maximum Capacity (C. F. S.)

Code No. 557

Please Do Not Fill in Any Items on This Page

Notice of Appropriation

1. County Stillwater Book 4 Page 605 Record Misc.
2. Name of Appropriator James McBrady Address Reed Point, Montana
3. Date Appropriated June 8, 1903 Date Filed June 8, 1903
Amount Appropriated, Miners Inches 500 Cubic Feet per second _____
4. Name of Stream Spring in School House Canyon Tributary Basin _____
5. Point of Diversion at a point at its mouth of Gulch of said spring at the south line of my said ranch and thence to and upon said land.
6. Purpose Irrigation, domestic and other purposes.
7. Description of System A dam and ditch, ditch 24 x 12 inches in size and carries all water's from said spring.
8. Land Description of Intended Place of Use
Homestead claim in section 31 & 32, Twp. 1 S., Rge. 18 E. Tot. Acr. 160.
9. Remarks (Pertaining to Use, etc.)
Not available

Decree

10. Case No. _____ Date _____ Amt. Decreed: M. I. _____ C. F. S. _____
11. To Whom Decreed _____ Address _____
12. Name of Ditch _____ Maximum Capacity (C. F. S.) _____
13. Date of Priority _____ Purpose _____
14. Land Description of Place of Use as Decreed _____

Code No. 573

Please Do Not Fill in Any Items on This Page

Notice of Appropriation

1. County Stillwater Book 4 Page 227 Record 150
2. Name of Appropriator Jacob Wagner Address Reed Point, Montana
3. Date Appropriated March 19, 1911 Date Filed March 20, 1911
- Amount Appropriated, Miners Inches 40 or 1 Cubic Feet per second
4. Name of Stream Springs Tributary Basin
5. Point of Diversion at a point on the bank on the SW $\frac{1}{4}$ of Sec. 31, T. 1 S., R. 18 E. on the east bank of the stream as a point of diversion for the first ditch, thence extending in a NE direction & second ditch will divert said water at a point on its west bank at a point on the SE $\frac{1}{4}$ SW $\frac{1}{4}$ of sec. 31, T. 1 S., R. 18 E. thence extending in a NW direction
- Sec. 31 Twp. 1 S. Rge. 18 E. Bank of Stream Basin
6. Purpose Watering livestock, household use, irrigation & running to & upon said land.
7. Description of System By means of a dam and ditches, said ditches to be each 16 inches by 12 inches in size and each to carry 20 inches of water.

8. Land Description of Intended Place of Use
- | Subdivision | Sec. | Twp. | Rge. | Tot. Acr. | 1940 Owner | Address |
|-----------------------------------|-----------|-------------|--------------|------------|---------------------|--------------------------------------|
| <u>SW$\frac{1}{4}$</u> | <u>31</u> | <u>1 S.</u> | <u>18 E.</u> | <u>160</u> | <u>Jacob Wagner</u> | <u>c/o S. A. Witham, Reed Point.</u> |

9. Remarks (Pertaining to Use, etc.)
- Transfers of Land Ownership.
- Jacob Wagner contracted to Jake Wagner back to Jacob Wagner c/o S. A. Witham
- SW $\frac{1}{4}$ - Sec. 31 - Twp. 1 S., Rge. 18 E.

Decree

10. Case No. _____ Date _____ Amt. Decreed: M. I. _____ C. F. S. _____
11. To Whom Decreed _____ Address _____
12. Name of Ditch _____ Maximum Capacity (C. F. S.) _____
13. Date of Priority _____ Purpose _____
14. Land Description of Place of Use as Decreed _____

1. Sheets

[illegible]

75

and the β -phase of the polymer. The β -phase is the more ordered phase and is characterized by a higher density and a higher melting point than the α -phase. The β -phase is also the more stable phase and is the one that is most commonly observed in nature. The α -phase is the less ordered phase and is characterized by a lower density and a lower melting point than the β -phase. The α -phase is also the less stable phase and is the one that is most commonly observed in nature.

22-1-12-10

[illegible]

STATE OF MONTANA
STATE ENGINEER'S OFFICE
 WATER RESOURCES SURVEY

Township 15 Range 18 County Beaverhead

6 <i>101</i>	5	4	3	2	1
7	8	9 <i>57</i>	10	11	12
18	17	16	15	14	13
19	20	21	22 <i>55</i>	23	24
30	29	28 <i>24</i>	27	26	25
31	32	33	34	35	36

Township _____ Range _____

Township 1 South, Range 19 East

<u>Code No.</u>	<u>Name of Owner</u>	<u>Name of Operator</u>
3 A, 4 A, 19 A,		
21 A, 22 A, 27 A,		
28 A, 29 A, 30 A,		
32 A, 33 A, 34 A	Guhrt, Elmer & Garritson, Robert	
5 B, 6 A, 30 B,		
51 A, 32 B	Nelson, Herbert & Emil	
4 A, 5 A, 6 A	Williams, Almon	



STATE OF MONTANA
STATE ENGINEERS OFFICE
Water Resources Survey

183
WR-1-1M-11-44
3 A. 4 A

Code No. 19A, 21A, 22A, 27A,
28A, 29A, 30A, 32A, 33A, 34A
County Stillwater

T. 1 S. R. 19 E.
2 S. 19 E.

Name of Land Owner Elmer Gahr & Robert Garritson Address Columbus

Name of Operator James E. & Hubert Address Columbus

Part A

TO BE FILED BY THOSE OBTAINING IRRIGATION WATER FROM
A DITCH COMPANY OR IRRIGATION DISTRICT

1. Water is delivered by: Murrell Ditch Co
Name of Ditch, Ditch Company or District supplying water
2. State the number of acres you irrigate under this system 150 Shares you hold 25
3. If you obtain water from more than one Company, give the number of shares, acres irrigated and the name of the Company under "Remarks". If you obtain water from a Ditch Company and also have a private system fill in both Part A and Part B.

Part B

TO BE FILED BY THOSE WHO HAVE A PRIVATE DITCH, PUMP OR IRRIGATION SYSTEM
or those who have a private water right under a Ditch Company

4. In what year was this land first irrigated? Date _____
5. Give the name of the original appropriator (first user): W. A. Lawrence, et al
6. Give the date appropriated 4-2-1883 Amount filed on: Miners Inches 1400 C. F. S. _____
7. State the total number of acres irrigated under this system: _____
8. Give the point of diversion: the water below Nelson Point 1/4 _____ 1/4 Section _____ Township _____ Range _____

Part C

TO BE FILED BY ALL WATER USERS IN ADDITION TO PART A OR PART B

9. Source of Water: Yellowstone River
Name of stream or lake from which water is originally diverted
10. Water is obtained by: (Check one) Gravity ☒ Pumping ☐ Other ☐
11. What is the greatest number of acres you have irrigated? 150 Date _____
12. How many acres did you irrigate in 1944? (Crop and pasture) 150
13. State the total number of additional acres that could be irrigated by increasing the water supply, land leveling, etc. None This land is under what ditch? Minell Ditch Co
14. How many acres of seeped land do you have which could be drained and put into production? None
15. What is the condition of your irrigation system? Good
16. Is your water supply adequate? Yes ☒ No ☐ Explain _____
17. REMARKS: _____

OVER

NOTE: The following questions apply only to irrigated land shown on this plat.

DESCRIPTION AND MAP OF FARM

18. Legal Description of this Farm All Sec. 19, 21, 22, 27, 28, 29, 34, N¹ Sec. 30, N¹, N¹ SE⁴, Sec. 32

all No. of River Sec. 33 - Twp. 1 S., R. 19 E. - Lot 1, 2, 3, 4, 5, 6, 10, S¹ Sec. 3
Lot 1, Sec. 4 - Twp. 2 S., R. 19 E.

IRRIGATED LAND

NON-IRRIGATED LAND

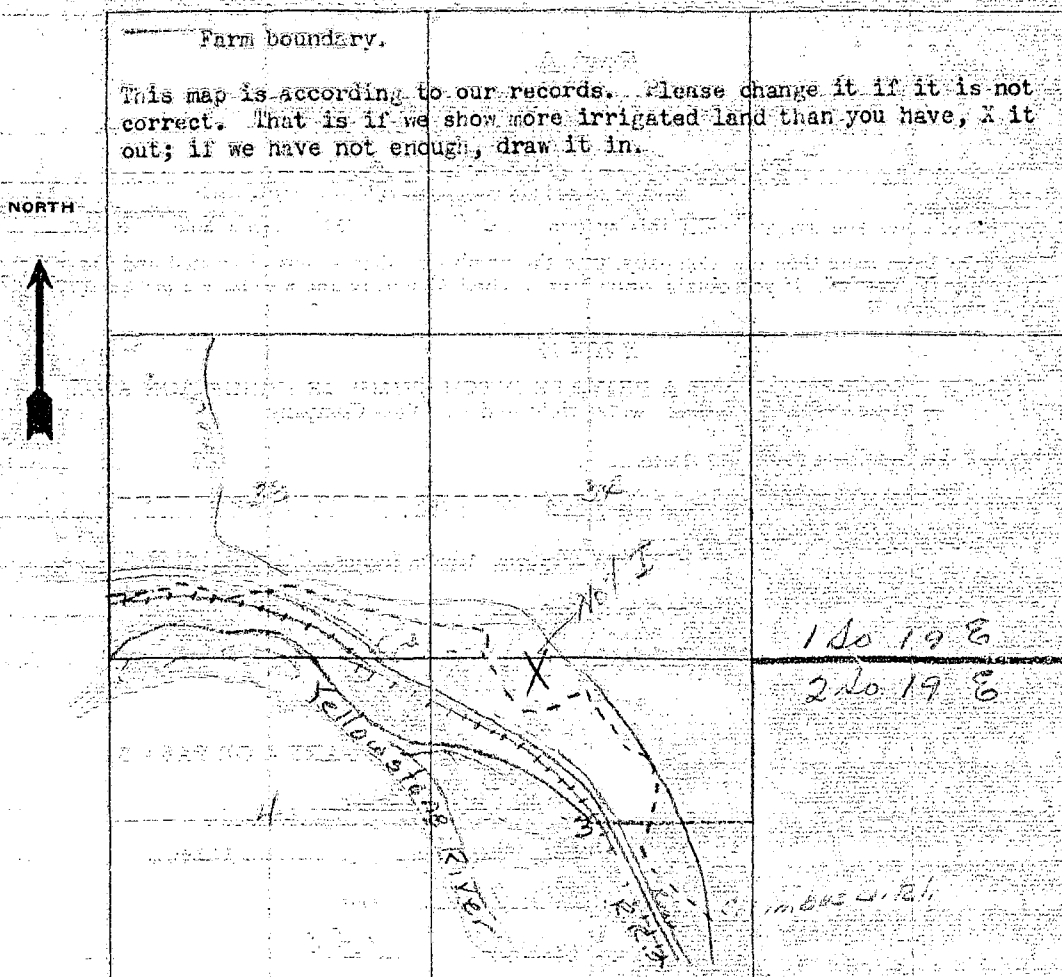

19. If the above land is irrigated from more than one ditch please give the acreage under each ditch in 19A and indicate the location of the land irrigated from each on the above map.

19A. Ditch: Merrill Ditch Acres: 150

Ditch: _____ Acres: _____

Information supplied by:

Name Edmund Suchit Address Columbus Date 3/15-45

REMARKS: land north of ditch has been irrigated at one time and can be irrigated again by installing a pump

If you cannot answer all of the questions on this form answer as many as you can and return the form to us as soon as possible.

TAUBER'S, HELENA

Our records show that you have an appropriation made by Constantine Loherty, appropriated Sept. 6, 1913 and filed Sept. 6, 1913 from Berry Creek for 40 miners inches. Is this appropriation now in use?

also

Our records show that you have an appropriation made by John O. Miller, appropriated May 27, 1911 and filed May 18, 1915 from Berry Creek for 240 miners inches. Is this appropriation now in use?

no

Our records show that you have an appropriation made by Constantine Doherty, appropriated September 6, 1913 and filed September 6, 1913 from Berry Creek for 40 minors inches. Is this appropriation now in use?

also

Our records show that you have an appropriation made by John O. Miller, appropriated May 27, 1911 and filed May 18, 1915 from Berry Creek for 240 minors inches. Is this appropriation now in use?

FORM SM-1

A STUDY OF MONTANA'S WATER RESOURCES

County Billings Source of Information Billings, Montana, Map

1. Water User Billings, Montana Address Billings, Montana

2. Stream Billings River Tributary to Billings River Basin Billings River

3. Point of Diversion 1/2 Section 1/2 Township 1/2 Range 1/2

4. Description of System Billings River

5. Type of Irrigation Billings River

6. Original Appropriator Billings, Montana Address Billings, Montana

7. First Use: Year 1913 Acres Irrigated 40

8. Maximum Use: Year 1913 Acres Irrigated 40

9. Present Use: Year 1913 Acres Irrigated 40

10. Last Use: Year 1913 Why Abandoned Billings River

11. Condition of System Billings River

12. Land Description Billings River, T. 1N, R. 17E

Remarks: Billings River

Billings River

Billings River

Billings River

Billings River

Billings River

Billings River

Billings River

Billings River

Billings River

Billings River

Billings River

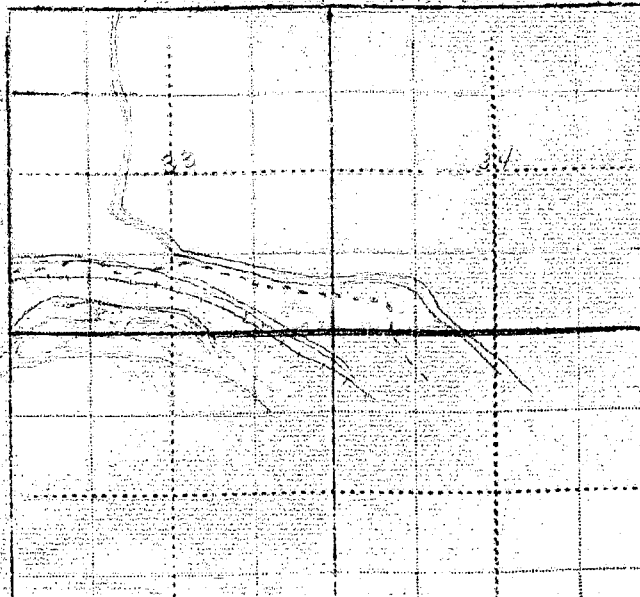

Billings,

February 21, 1945

Elsar Gahrt
Robert Garritson
Columbus, Montana

Dear Sirs:

On January 23rd, this office sent you a letter asking for certain information pertaining to your irrigated land in township 1 south, range 19 east and township 2 south, range 19 east. To date we have not heard from you. With the vast post war water development in this area as now planned, it is essential that we have this information in order to show the extent of our water use in the Yellowstone Basin in Montana. This information is necessary to protect our present water users in the rights they have against future irrigation, navigation, power and flood control enterprises in this area. We are asking you for this information because we feel it is the democratic way; we also feel that you are more qualified to give us this information about your irrigated land than anyone else because it is part of your business. It may be that you were busy with your farm work or some unforeseen thing happened at the time our first letter was received, and you put it aside to be answered at some other time and have forgotten all about it. All information is strictly confidential and is only used to record and tabulate the water use in this area.

Water is as necessary to the farmer as the soil in which he plants. Without it no crops will grow; no living thing can survive. It is your water that we are trying to protect, so that you will have plenty now and in the future. We must keep Montana's water in Montana. The only way we can do this is by having the support of each and every water user so that we have a 100 percent representation of all water users. Remember: "United we stand, divided we fall".

In order to facilitate this work a branch office of the State Engineer has been established in Billings and is located in the Roosevelt School Building on 23rd Street and Fourth Avenue North. Anytime you are in Billings we would appreciate your calling on us.

Hoping to hear from you in the very near future, I am,

Very truly yours,

Gerald J. Oravetz
Assistant State Engineer

P.S. If you cannot supply us with the information requested, it may be that you can tell us of someone who can.

Please Do Not Fill in Any Items on This Page

Notice of Appropriation

1. County Stillwater Book 1 Page 585 Record Misc.
2. Name of Appropriator John O. Miller Address Stillwater County
3. Date Appropriated May 27, 1911 Date Filed May 18, 1915
Amount Appropriated, Miners Inches 240 Cubic Feet per second river basin
4. Name of Stream Berry Creek Tributary Yellowstone Basin
5. Point of Diversion Starting at the initial point of diversion the well known natural objects & permanent monuments are distant as follows - (North line of Sec. 22 - Twp. 1 S., Rge. 19 E. is distant about 40 rods in a N direction; The E line of said sec. 22 is distant about 40 rods in an easterly direction.
Sec. 22 Twp. 1 S. Rge. 19 E. Bank of Stream
6. Purpose Domestic, irrigation and other useful and beneficial purposes.
7. Description of System Said water is diverted and conveyed to said place by means of a dam and ditch said ditch is 2 feet wide on bottom and 3 feet wide on top and one foot deep.
8. Land Description of Intended Place of Use
W¹/₂ of Section 22, Twp. 1 S., Rge. 19 E. Tot. Acr. 320, 1940 Owner Montana Life Ins. Co., Helena, Montana
9. Remarks (Pertaining to Use, etc.) That the undersigned did on the 27th day of May 1911, appropriate and claim six cubic feet per second of waters of Berry Creek, county of Stillwater, Mont. Transfers of Land Ownership, John O. Miller to L. B. Banks to Montana Life Ins. Co. W¹/₂ of Sec. 22, Twp. 1 S., Rge. 19 E.

Decree

10. Case No. _____ Date _____ Amt. Decreed: M. I. _____ C. F. S. _____
11. To Whom Decreed _____ Address _____
12. Name of Ditch _____ Maximum Capacity (C. F. S.) _____
13. Date of Priority _____ Purpose _____
14. Land Description of Place of Use as Decreed _____

Code No. 24

Please Do Not Fill in Any Items on This Page

Notice of Appropriation

1. County Stillwater Book 1 Page 103 Record Misc.

2. Name of Appropriator Constantine Doherty Address Unknown.

3. Date Appropriated Sept. 6, 1913 Date Filed Sept. 6, 1913

Amount Appropriated, Miners Inches 40 Cubic Feet per second

4. Name of Stream Berry Creek Tributary Basin

5. Point of Diversion a certain spring on Berry Creek, which is located near SE corner of

SE 1/4 SW 1/4 of Sec. 28 - T. 1 S., Rge. 19 E. The following well known natural objects &
permanent monuments are distant as follows SW 1/4 of Sec. 28 is distant about 150 rods, Sec. 28 is
Sec. Twp. Rge. Bank of Stream /distant about 30 rods in a
Southerly direction.

6. Purpose Domestic, irrigation, garden, & other purposes.

7. Description of System Dam and reservoir.

8. Land Description of Intended Place of Use

NE 1/4, NW 1/4 of Sec. 28 Twp. 1 S., Rge. 19 E. Tot. Acr. 160, 1910 Owner, Mont. Life Ins. Co
Helena.

9. Remarks (Pertaining to Use, etc.) Transfers of Land Ownership.

(Constantine Dougherty to Nellie Dennis to L. B. Banks & Janet Annin to Mont. Life Ins. Co
NE 1/4 - NW 1/4 - Sec. 28 - Twp. 1 S., Rge. 19 E.

not now in use.

Decree

10. Case No. Date Amt. Decreed: M. I. C. F. S.

11. To Whom Decreed Address

12. Name of Ditch Maximum Capacity (C. F. S.)

13. Date of Priority Purpose

14. Land Description of Place of Use as Decreed

STATE ENGINEERS OFFICE
Water Resources Survey

Code No. 624

Notice of Appropriation

1. County Stillwater Book 4 Page 271 Record Misc.
2. Name of Appropriator H. H. Clawson et al Address Stillwater Territory, Mont.
3. Date Appropriated Sept. 8, 1883 Date Filed Sept. 8, 1883
Amount Appropriated, Miners Inches 1400, Cubic Feet per second
4. Name of Stream Yellowstone River Tributary Basin
5. Point of Diversion at a point about 1/2 mile below Reed's Point.
Sec. Twp. Rge. Bank of Stream
6. Purpose Irrigation and other useful purposes.
7. Description of System By means of ditches. No dimensions given.
8. Land Description of Intended Place of Use
Lands occupied by us situated about 1/2 of a mile down the Yellowstone River from
Reeds Point. Unsurveyed.
9. Remarks (Pertaining to Use, etc.)
H. W. Clawson and Edward Cardwell, Olaf Laverson and S. W. Porter are the appropriators
of this water right.

Decree

10. Case No. Date Amt. Decreed: M. L. C. F. S.
11. To Whom Decreed Address
12. Name of Ditch Maximum Capacity (C. F. S.)
13. Date of Priority Purpose
14. Land Description of Place of Use as Decreed
15. Remarks (Present Use Status, etc.)



STATE OF MONTANA
STATE ENGINEERS OFFICE
Water Resources Survey

136
Form WR-1-1M-11-41
Code No. 5 B, 6 A, 30 B
31 A, 32 B.
County Stillwater
T. 1 S. R. 19 E.

Name of Land Owner: Herbert & Emil Nelson Address: Columbus, Montana

Name of Operator: Address:

Part A

TO BE FILED BY THOSE OBTAINING IRRIGATION WATER FROM
A DITCH COMPANY OR IRRIGATION DISTRICT

1. Water is delivered by: Merrill Ditch Company
Name of Ditch, Ditch Company or District supplying water
2. State the number of acres you irrigate under this system: 62 Shares you hold: 1-2-1/2
3. If you obtain water from more than one Company, give the number of shares, acres irrigated and the name of the Company under "Remarks". If you obtain water from a Ditch Company and also have a private system fill in both Part A and Part B.

Part B

TO BE FILED BY THOSE WHO HAVE A PRIVATE DITCH, PUMP OR IRRIGATION SYSTEM
or those who have a private water right under a Ditch Company

4. In what year was this land first irrigated? Date: 1944
5. Give the name of the original appropriator (first user): W. H. Johnson et al
6. Give the date appropriated: Sept 8-1923 Amount filed on: Miners Inches 1400 C. F. S.
7. State the total number of acres irrigated under this system: 62
8. Give the point of diversion: Yellowstone River 1/4 Section 1/4 Township 19 Range 19

Part C

TO BE FILED BY ALL WATER USERS IN ADDITION TO PART A OR PART B

9. Source of Water: Yellowstone River
Name of stream or lake from which water is originally diverted
10. Water is obtained by: (Check one) Gravity ☒ Pumping ☐ Other ☐
11. What is the greatest number of acres you have irrigated? 62 Date: 1944
12. How many acres did you irrigate in 1944? (Crop and pasture) 62
13. State the total number of additional acres that could be irrigated by increasing the water supply, land leveling, etc. 20 This land is under what ditch? Merrill Ditch Company
14. How many acres of seeped land do you have which could be drained and put into production? None
15. What is the condition of your irrigation system? Fair
16. Is your water supply adequate? Yes Yes No ☐ Explain
17. REMARKS:

NOTE: The following questions apply only to irrigated land shown on this plat.

DESCRIPTION AND MAP OF FARM

18. Legal Description of this Farm. All North of River Sec. 5 - E $\frac{1}{2}$ NW $\frac{1}{4}$, NE $\frac{1}{4}$, NE SE $\frac{1}{4}$, Frac SE SE $\frac{1}{4}$, Sec. 6
S $\frac{1}{2}$ Sec. 30, - All Sec. 31 - SW $\frac{1}{4}$, S $\frac{1}{2}$ SE $\frac{1}{4}$, Section 32 - Twp. 1 S., Rge. 19 E.

IRRIGATED LAND

NON-IRRIGATED LAND

NORTH

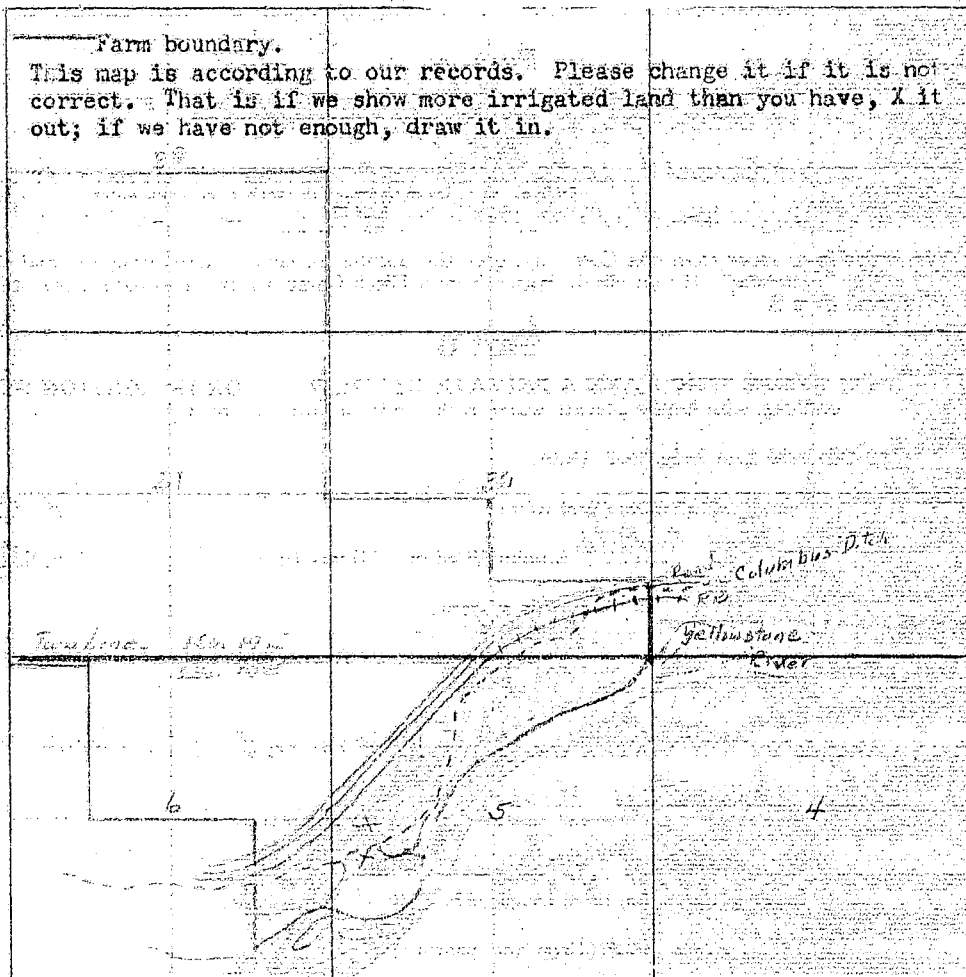

19. If the above land is irrigated from more than one ditch please give the acreage under each ditch in 19A and indicate the location of the land irrigated from each on the above map.

19A. Ditch: Yellowstone River Acres: 6.2

Ditch: _____ Acres: _____

Information supplied by:

Name _____ Address _____ Date _____

REMARKS: _____

If you cannot answer all of the questions on this form answer as many as you can and return the form to us as soon as possible.

THUNDER'S, HELENA



STATE OF MONTANA
STATE ENGINEERS OFFICE
Water Resources Survey

186
Form WR-2-1M-11-44
Code No. 13 A, 14 B, 21 A,
22 A, 23 A, 24 A,
County Stillwater
T. 2 S. R. 19 E.

Name of Land Owner Herbert & Emil Nelson Address Columbus, Montana
Name of Operator Address

Part A

TO BE FILED BY THOSE OBTAINING IRRIGATION WATER FROM
A DITCH COMPANY OR IRRIGATION DISTRICT

1. Water is delivered by: Merrill Ditch Company
Name of Ditch, Ditch Company or District supplying water.
2. State the number of acres you irrigate under this system. 128 Shares you hold 12 1/2
3. If you obtain water from more than one Company, give the number of shares, acres irrigated and the name of the Company under "Remarks". If you obtain water from a Ditch Company and also have a private system fill in both Part A and Part B.

Part B

TO BE FILED BY THOSE WHO HAVE A PRIVATE DITCH OR PUMP OR IRRIGATION SYSTEM
or those who have a private water right ditch Company

4. In what year was this land first irrigated? Date _____
5. Give the name of the original appropriator (first user): _____
6. Give the date appropriated _____ Amount filed on: Miners Inches _____ C. F. S. _____
7. State the total number of acres irrigated under this system: _____
8. Give the point of diversion: 1/4 Section _____ Township _____ Range _____

Part C

TO BE FILED BY ALL WATER USERS IN ADDITION TO PART A OR PART B

9. Source of Water: Yellowstone River
Name of stream or lake from which water is originally diverted
10. Water is obtained by: (Check one) Gravity ☒ Pumping _____ Other _____
11. What is the greatest number of acres you have irrigated? 128 Date _____
12. How many acres did you irrigate in 1944? (Crop and pasture) 128
13. State the total number of additional acres that could be irrigated by increasing the water supply, land leveling, etc. 36 This land is under what ditch? Merrill Ditch
14. How many acres of seeped land do you have which could be drained and put into production? none
15. What is the condition of your irrigation system? Fair
16. Is your water supply adequate? Yes yes No _____ Explain _____
17. REMARKS: _____

NOTE: The following questions apply only to irrigated land shown on this plat.

DESCRIPTION AND MAP OF FARM

18. Legal Description of this Farm. All Sec. 13, Lot 5, 9, 10, 11, $\frac{1}{2}$ SW $\frac{1}{4}$, SE SW $\frac{1}{4}$, Sec. 14

NE $\frac{1}{4}$ NW $\frac{1}{4}$, NW $\frac{1}{4}$ NE $\frac{1}{4}$, Sec. 24 - Lot 3, 4, SW NE $\frac{1}{4}$, NW SE $\frac{1}{4}$, NW $\frac{1}{4}$, NW SW $\frac{1}{4}$, Sec. 23 -

E $\frac{1}{2}$, E $\frac{1}{2}$ NW $\frac{1}{4}$, SW NW $\frac{1}{4}$, Sec. 22, S $\frac{1}{2}$ NE $\frac{1}{4}$, Sec. 21 - Twp. 2 S., Rge. 19 E.

IRRIGATED LAND

NON-IRRIGATED LAND

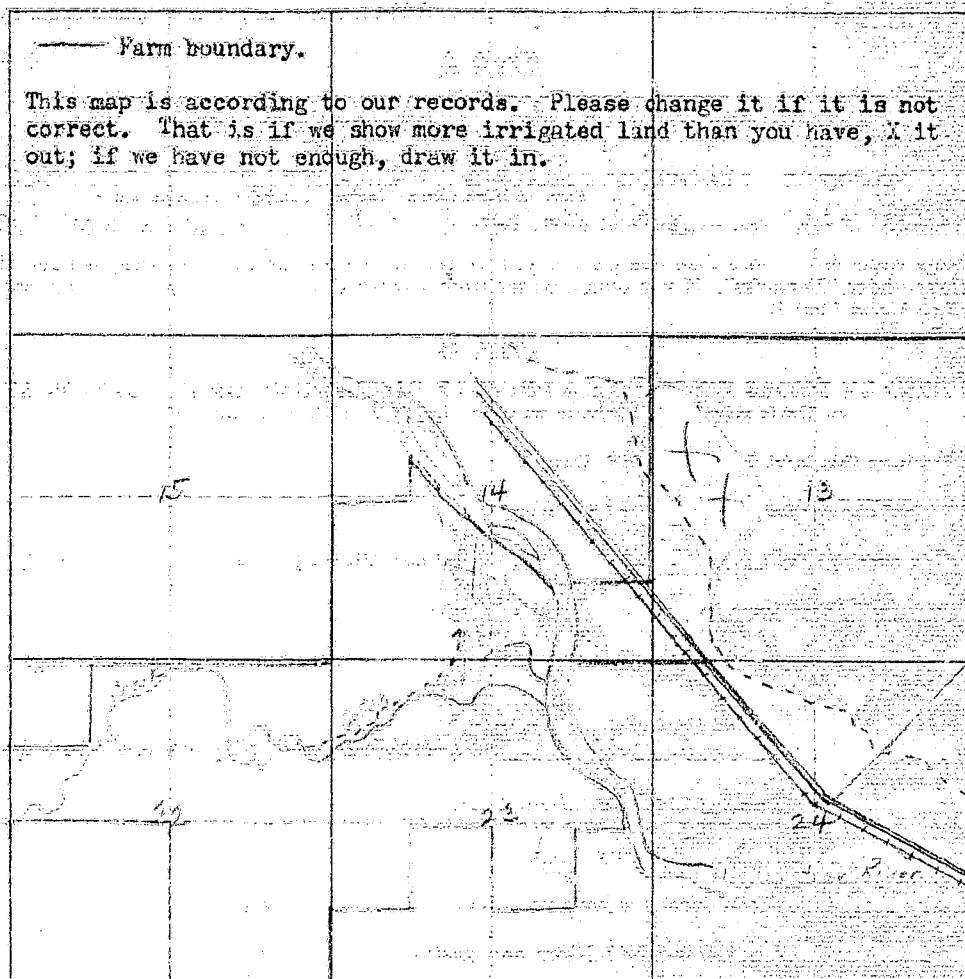

19. If the above land is irrigated from more than one ditch please give the acreage under each ditch in 19A and indicate the location of the land irrigated from each on the above map.

19A. Ditch: M. R. Ditch Acres: 1.5

Ditch: _____ Acres: _____

Information supplied by:

Name: _____ Address: _____ Date: _____

REMARKS: _____

If you cannot answer all of the questions on this form answer as many as you can and return the form to us as soon as possible.

THURBER'S, HELENA

12-173
24-185

Name of Water User Anthony J. Breda Address Belmont, Mass.

1. Do you own this land? Yes ___ No ___ If not give the owner's name below:
Owner's name _____ Address _____
2. Source of Water _____ Water delivered by _____
3. Give point of Diversion _____ Section _____ Township _____ Range _____
4. Water is obtained by: (Check one) Gravity _____ Pumping _____ Other _____
(Not for irrigation)
5. Who first used water on this land? _____ Address _____
6. In what year was this land first irrigated? _____ Approximate Acres _____
7. What is the greatest number of acres you have irrigated? _____ Date _____
8. Present Use: Year _____ Acres Irrigated _____
9. If this land is not irrigated now give date of last use _____
10. State the total number of acres that could be irrigated _____ acres.
11. What is the condition of your irrigation system? _____
12. Land Description: Sec 20, Twp 31 N., R. 31 E. Twp. 120 Range 17 E

Remarks:

Information by	Place	Date

STATE ENGINEERS OFFICE
Water Resources Survey

Code No. 624

Notice of Appropriation

1. County Stillwater Book 4 Page 271 Record Misc.
2. Name of Appropriator W. H. Clawson et al Address Stillwater Territory, Mont.
3. Date Appropriated Sept. 8, 1883 Date Filed Sept. 8, 1883
Amount Appropriated, Miners Inches 1400 Cubic Feet per second
4. Name of Stream Yellowstone River Tributary Basin
5. Point of Diversion at a point about 1/4 mile below Reed's Point.
Sec. Twp. Rge. Bank of Stream
6. Purpose Irrigation and other useful purposes.
7. Description of System By means of ditches. No dimensions given.
8. Land Description of Intended Place of Use
Lands occupied by us situated about 1/4 of a mile down the Yellowstone River from
Reed's Point. Unsurveyed.
9. Remarks (Pertaining to Use, etc.)
H. W. Clawson and Edward Cardwell, Olaf Laverson and S. W. Porter are the appropriators
of this water right.

Decree

10. Case No. Date Amt. Decreed: M. I. C. F. S.
11. To Whom Decreed Address
12. Name of Ditch Maximum Capacity (C. F. S.)
13. Date of Priority Purpose
14. Land Description of Place of Use as Decreed
15. Remarks (Present Use Status, etc.)

Rec'd
9-22
[Signature]

STATE OF MONTANA
STATE ENGINEERS OFFICE
Water Resources Survey

Code No. 4 A, 5 A, 6 ACounty StillwaterT. 1 S. R. 19 E.Name of Land Owner Almon Williams Address Reed Point, Montana

Name of Operator _____ Address _____

Part A

**TO BE FILED BY THOSE OBTAINING IRRIGATION WATER FROM
 A DITCH COMPANY OR IRRIGATION DISTRICT**

1. Water is delivered by: Reed Point Ditch Co. of Stillwater Ditch
Name of Ditch, Ditch Company or District supplying water
2. State the number of acres you irrigate under this system: _____ Shares you hold: _____
3. If you obtain water from more than one Company, give the number of shares, acres irrigated and the name of the Company under "Remarks". If you obtain water from a Ditch Company and also have a private system fill in both Part A and Part B.

This information is only for section four (4)
Part B

**TO BE FILED BY THOSE WHO HAVE A PRIVATE DITCH, PUMP OR IRRIGATION SYSTEM
 or those who have a private water right under a Ditch Company**

4. In what year was this land first irrigated? Date June 30, 1916
5. Give the name of the original appropriator (first user): Robert E. Jones
6. Give the date appropriated June 30, 1916 Amount filed on: Miners Inches 40 C. F. S. 1
7. State the total number of acres irrigated under this system: _____
8. Give the point of diversion: NW 1/4 Section 4 Township 15 Range 19 E

Part C

TO BE FILED BY ALL WATER USERS IN ADDITION TO PART A OR PART B

9. Source of Water: Reed Point Ditch Co. of Stillwater Ditch
Name of stream or lake from which water is originally diverted
10. Water is obtained by: (Check one) Gravity ☒ Pumping _____ Other _____
11. What is the greatest number of acres you have irrigated? 3 Date _____
12. How many acres did you irrigate in 1944? (Crop and pasture) 0
13. State the total number of additional acres that could be irrigated by increasing the water supply, land leveling, etc. 3 This land is under what ditch? _____
14. How many acres of seeped land do you have which could be drained and put into production? 0
15. What is the condition of your irrigation system? the ditch is in good condition
16. Is your water supply adequate? Yes _____ No ☒ Explain _____
17. REMARKS: Almon Williams, plaintiff, is the owner of the land in the NW 1/4 of Section 4, Township 15, Range 19 E. and is the owner of the Reed Point Ditch Co. of Stillwater Ditch.

OVER

1-1M-11-11

5 A, 6 A

water

19 E.

the name of
system fill

STEM

and leveling,

improved

plain

NOTE: The foregoing questions apply only to irrigated land shown on this plat.

DESCRIPTION AND MAP OF FARM

18. Legal Description of this Farm: N $\frac{1}{2}$ Section 4 - Twp. 1 S., Rge. 19 E. - all of Section 5,

Lot 1, SE NE $\frac{1}{4}$, E $\frac{1}{2}$ SE $\frac{1}{4}$, SW SE $\frac{1}{4}$, Section 6 - Twp. 1 S., Rge. 19 E.

	IRRIGATED LAND	NON-IRRIGATED LAND
<p>Farm boundary.</p> <p>NORTH</p>		

This map is according to our records. Please change it if it is not correct. That is if we show more irrigated land than you have, X it out; if we have not enough, draw it in.

19. If the above land is irrigated from more than one ditch please give the acreage under each ditch in 19A and indicate the location of the land irrigated from each on the above map.

19A. Ditch: _____ Acres: _____

Ditch: _____ Acres: _____

Information supplied by:

Name: Almon J. Williams Address: Reed Point Date: _____

REMARKS: _____

If you cannot answer all of the questions on this form answer as many as you can and return the form to us as soon as possible.

THUNDER'S, HELENA

Our records show that you have an appropriation made by Robert Rogers, appropriated June 30, 1916 and filed June 30, 1916 from Cottonwood Creek and Springs for 20 minors inches. Is this appropriation now in use?

190

Form WR-1-2M-11-41

STATE OF MONTANA
STATE ENGINEERS OFFICE
Water Resources Survey

Cable No. 6 B
County Stillwater
T. 1 S. R. 19 E.

Name of Land Owner Mr. C. Hills

Address Winona, Minnesota

Name of Operator Almon Williams

Address Head Point, Montana

Part A

TO BE FILED BY THOSE OBTAINING IRRIGATION WATER FROM
A DITCH COMPANY OR IRRIGATION DISTRICT

1. Water is delivered by: White Pine Creek
Name of Ditch, Ditch Company or District supplying water
2. State the number of acres you irrigate under this system _____ Shares you hold _____
3. If you obtain water from more than one Company, give the number of shares, acres irrigated and the name of the Company under "Remarks". If you obtain water from a Ditch Company and also have a private system fill in both Part A and Part B.

This information is only for section six (6)
Part B

TO BE FILED BY THOSE WHO HAVE A PRIVATE DITCH, PUMP OR IRRIGATION SYSTEM
or those who have a private water right under a Ditch Company

4. In what year was this land first irrigated? Date June 27, 1892
5. Give the name of the original appropriator (first user): Montana Cattle Co.
6. Give the date appropriated June 27, 1892 Amount filed on: Miners Inches 450 C. F. S. _____
7. State the total number of acres irrigated under this system: 115
8. Give the point of diversion: SE 1/4 Section 36 Township 1 N Range 18 E

Part C

TO BE FILED BY ALL WATER USERS IN ADDITION TO PART A OR PART B

9. Source of Water: White Pine Creek
Name of stream or lake from which water is originally diverted
10. Water is obtained by: (Check one) Gravity ☒ Pumping _____ Other _____
11. What is the greatest number of acres you have irrigated? 115 Date 1943
12. How many acres did you irrigate in 1944? (Crop and pasture) 5
13. State the total number of additional acres that could be irrigated by increasing the water supply, land leveling, etc. _____ This land is under what ditch? White Pine Creek
14. How many acres of seeped land do you have which could be drained and put into production? _____
15. What is the condition of your irrigation system? _____
16. Is your water supply adequate? Yes _____ No ☒ Explain Water is intermittent
17. REMARKS: Stream is intermittent and plans to build a dam to regulate flow and place a pipe to divert water to alfalfa and corn.

OVER

NOTE: The foregoing questions apply only to irrigated land shown on this plat.

DESCRIPTION AND MAP OF FARM

18. Legal Description of this Farm: Lots, 2, 3, 4, 5, SE 1/4, Section 6 - Twp. 1 S., Rge. 19 E.

IRRIGATED LAND	NON-IRRIGATED LAND
<p>Farm boundary.</p>	
<p>NORTH</p>	
<p>White Bear Creek</p>	
<p>Sec 4</p>	
<p>5</p>	
<p>This map is according to our records. Please change it if it is not correct. That is if we show more irrigated land than you have, X it out; if we have not enough, draw it in.</p>	

19. If the above land is irrigated from more than one ditch please give the acreage under each ditch in 19A and indicate the location of the land irrigated from each on the above map.

19A. Ditch: _____ Acres: _____

Ditch: _____ Acres: _____

Information supplied by:

Name: Almon J. Williams Address: Reed Point Date: _____

REMARKS: Also a filing by Steve Woods made

March 14, 1918 for 40 inches from the east fork of White
Bear Creek - Recorded Book 1 page 200, Stillwater Records.

If you cannot answer all of the questions on this form answer as many as you can and return the form to us as soon as possible.

Water use was first made Sept 30, 1911

THURMAN'S, BELLEVILLE