



STATE OF MONTANA
STATE ENGINEERS OFFICE
Water Resources Survey

Form WR-1-11-44

Code No. 6 C, 7 A
County Stillwater
T. 2 S. 19 E.

Name of Land Owner B. T. Deeney Address Head Point
Name of Operator B. T. Deeney Address _____

Part A

TO BE FILED BY THOSE OBTAINING IRRIGATION WATER FROM
A DITCH COMPANY OR IRRIGATION DISTRICT

1. Water is delivered by: Private system
Name of Ditch, Ditch Company or District supplying water
2. State the number of acres you irrigate under this system 25 Shares you hold _____
3. If you obtain water from more than one Company, give the number of shares, acres irrigated and the name of the Company under "Remarks". If you obtain water from a Ditch Company and also have a private system fill in both Part A and Part B.

Part B

TO BE FILED BY THOSE WHO HAVE A PRIVATE DITCH, PUMP OR IRRIGATION SYSTEM
or those who have a private water right under a Ditch Company

4. In what year was this land first irrigated? Date 1934 # 534
5. Give the name of the original appropriator (first user): B. T. Deeney
6. Give the date appropriated July 1934 Amount filed on: Miners Inches _____ C. F. S. _____
7. State the total number of acres irrigated under this system: 40
8. Give the point of diversion: 1/4 Section 1 Township 2 Range 18

Part C

TO BE FILED BY ALL WATER USERS IN ADDITION TO PART A OR PART B

9. Source of Water: Head Point
Name of stream or lake from which water is originally diverted.
10. Water is obtained by: (Check one) Gravity _____ Pumping _____ Other _____
11. What is the greatest number of acres you have irrigated? _____ Date _____
12. How many acres did you irrigate in 1944? (Crop and pasture) 0
13. State the total number of additional acres that could be irrigated by increasing the water supply, land leveling, etc. 0 This land is under what ditch? _____
14. How many acres of seeped land do you have which could be drained and put into production? _____
15. What is the condition of your irrigation system? _____
16. Is your water supply adequate? Yes _____ No _____ Explain _____
17. REMARKS: App not for land but for canal in
new system from head point to the river
across of pump, ditch, etc. water

NOTE: The foregoing questions apply only to irrigated land shown on this plat.

DESCRIPTION AND MAP OF FARM

18. Legal Description of this Farm Lots, 10, 11, Sec. 6 - Lots 1, 2, NE NW $\frac{1}{4}$, Sec. 7 - Twp. 2 S. - R. 19 E.

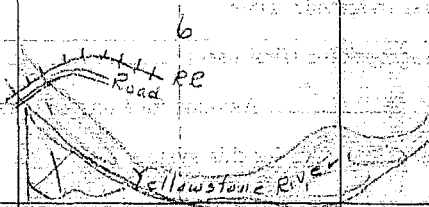
| | IRRIGATED LAND | NON-IRRIGATED LAND |
|--|---|--------------------|
| <p>NORTH</p>  | <p>Farm boundary</p> <p>This map is according to our records. Please change it if it is not correct. That is if we show more irrigated land than you have, X it out; if we have not enough, draw it in.</p> | |
| |  | |
| | | |
| | | |
| | | |

19. If the above land is irrigated from more than one ditch please give the acreage under each ditch in 19A and indicate the location of the land irrigated from each on the above map.

19A. Ditch: Private ditch Acres: 0

Ditch: _____ Acres: _____

Information supplied by:

Name: _____ Address: _____ Date: _____

REMARKS: _____

If you cannot answer all of the questions on this form answer as many as you can and return the form to us as soon as possible.

THURBER'S, HELENA 

6-c
7-A

229

County St. Albans

Source of Information

1. Water User A. J. Deussen

Address

2. Stream

Tributary to

Basin

3. Point of Diversion: $\frac{1}{4}$ $\frac{1}{4}$

Section

Township

Range

4. Description of System

5. Type of Irrigation

6. Original Appropriator 144

Address

7. First Use: Year _____ Acres Irrigated _____

Acres Irrigated

| 8. Maximum Use: Year | Acres Irrigated |
|----------------------|-----------------|
| 1950 | 100 |
| 1951 | 100 |
| 1952 | 100 |
| 1953 | 100 |
| 1954 | 100 |
| 1955 | 100 |
| 1956 | 100 |
| 1957 | 100 |
| 1958 | 100 |
| 1959 | 100 |
| 1960 | 100 |
| 1961 | 100 |
| 1962 | 100 |
| 1963 | 100 |
| 1964 | 100 |
| 1965 | 100 |
| 1966 | 100 |
| 1967 | 100 |
| 1968 | 100 |
| 1969 | 100 |
| 1970 | 100 |
| 1971 | 100 |
| 1972 | 100 |
| 1973 | 100 |
| 1974 | 100 |
| 1975 | 100 |
| 1976 | 100 |
| 1977 | 100 |
| 1978 | 100 |
| 1979 | 100 |
| 1980 | 100 |
| 1981 | 100 |
| 1982 | 100 |
| 1983 | 100 |
| 1984 | 100 |
| 1985 | 100 |
| 1986 | 100 |
| 1987 | 100 |
| 1988 | 100 |
| 1989 | 100 |
| 1990 | 100 |
| 1991 | 100 |
| 1992 | 100 |
| 1993 | 100 |
| 1994 | 100 |
| 1995 | 100 |
| 1996 | 100 |
| 1997 | 100 |
| 1998 | 100 |
| 1999 | 100 |
| 2000 | 100 |
| 2001 | 100 |
| 2002 | 100 |
| 2003 | 100 |
| 2004 | 100 |
| 2005 | 100 |
| 2006 | 100 |
| 2007 | 100 |
| 2008 | 100 |
| 2009 | 100 |
| 2010 | 100 |
| 2011 | 100 |
| 2012 | 100 |
| 2013 | 100 |
| 2014 | 100 |
| 2015 | 100 |
| 2016 | 100 |
| 2017 | 100 |
| 2018 | 100 |
| 2019 | 100 |
| 2020 | 100 |
| 2021 | 100 |
| 2022 | 100 |
| 2023 | 100 |
| 2024 | 100 |
| 2025 | 100 |
| 2026 | 100 |
| 2027 | 100 |
| 2028 | 100 |
| 2029 | 100 |
| 2030 | 100 |
| 2031 | 100 |
| 2032 | 100 |
| 2033 | 100 |
| 2034 | 100 |
| 2035 | 100 |
| 2036 | 100 |
| 2037 | 100 |
| 2038 | 100 |
| 2039 | 100 |
| 2040 | 100 |
| 2041 | 100 |
| 2042 | 100 |
| 2043 | 100 |
| 2044 | 100 |
| 2045 | 100 |
| 2046 | 100 |
| 2047 | 100 |
| 2048 | 100 |
| 2049 | 100 |
| 2050 | 100 |
| 2051 | 100 |
| 2052 | 100 |
| 2053 | 100 |
| 2054 | 100 |
| 2055 | 100 |
| 2056 | 100 |
| 2057 | 100 |
| 2058 | 100 |
| 2059 | 100 |
| 2060 | 100 |
| 2061 | 100 |
| 2062 | 100 |
| 2063 | 100 |
| 2064 | 100 |
| 2065 | 100 |
| 2066 | 100 |
| 2067 | 100 |
| 2068 | 100 |
| 2069 | 100 |
| 2070 | 100 |
| 2071 | 100 |
| 2072 | 100 |
| 2073 | 100 |
| 2074 | 100 |
| 2075 | 100 |
| 2076 | 100 |
| 2077 | 100 |
| 2078 | 100 |
| 2079 | 100 |
| 2080 | 100 |
| 2081 | 100 |
| 2082 | 100 |
| 2083 | 100 |
| 2084 | 100 |
| 2085 | 100 |
| 2086 | 100 |
| 2087 | 100 |
| 2088 | 100 |
| 2089 | 100 |
| 2090 | 100 |
| 2091 | 100 |
| 2092 | 100 |
| 2093 | 100 |
| 2094 | 100 |
| 2095 | 100 |
| 2096 | 100 |
| 2097 | 100 |
| 2098 | 100 |
| 2099 | 100 |
| 2100 | 100 |

Acres Irrigated

| 2. | Present Use: | Year | Acres Irrigated |
|----|--------------|------|-----------------|
| 1 | Wheat | 1950 | 100 |
| 2 | Wheat | 1951 | 100 |
| 3 | Wheat | 1952 | 100 |
| 4 | Wheat | 1953 | 100 |
| 5 | Wheat | 1954 | 100 |
| 6 | Wheat | 1955 | 100 |
| 7 | Wheat | 1956 | 100 |
| 8 | Wheat | 1957 | 100 |
| 9 | Wheat | 1958 | 100 |
| 10 | Wheat | 1959 | 100 |
| 11 | Wheat | 1960 | 100 |
| 12 | Wheat | 1961 | 100 |
| 13 | Wheat | 1962 | 100 |
| 14 | Wheat | 1963 | 100 |
| 15 | Wheat | 1964 | 100 |
| 16 | Wheat | 1965 | 100 |
| 17 | Wheat | 1966 | 100 |
| 18 | Wheat | 1967 | 100 |
| 19 | Wheat | 1968 | 100 |
| 20 | Wheat | 1969 | 100 |
| 21 | Wheat | 1970 | 100 |
| 22 | Wheat | 1971 | 100 |
| 23 | Wheat | 1972 | 100 |
| 24 | Wheat | 1973 | 100 |
| 25 | Wheat | 1974 | 100 |
| 26 | Wheat | 1975 | 100 |
| 27 | Wheat | 1976 | 100 |
| 28 | Wheat | 1977 | 100 |
| 29 | Wheat | 1978 | 100 |
| 30 | Wheat | 1979 | 100 |
| 31 | Wheat | 1980 | 100 |
| 32 | Wheat | 1981 | 100 |
| 33 | Wheat | 1982 | 100 |
| 34 | Wheat | 1983 | 100 |
| 35 | Wheat | 1984 | 100 |
| 36 | Wheat | 1985 | 100 |
| 37 | Wheat | 1986 | 100 |
| 38 | Wheat | 1987 | 100 |
| 39 | Wheat | 1988 | 100 |
| 40 | Wheat | 1989 | 100 |
| 41 | Wheat | 1990 | 100 |
| 42 | Wheat | 1991 | 100 |
| 43 | Wheat | 1992 | 100 |
| 44 | Wheat | 1993 | 100 |
| 45 | Wheat | 1994 | 100 |
| 46 | Wheat | 1995 | 100 |
| 47 | Wheat | 1996 | 100 |
| 48 | Wheat | 1997 | 100 |
| 49 | Wheat | 1998 | 100 |
| 50 | Wheat | 1999 | 100 |
| 51 | Wheat | 2000 | 100 |
| 52 | Wheat | 2001 | 100 |
| 53 | Wheat | 2002 | 100 |
| 54 | Wheat | 2003 | 100 |
| 55 | Wheat | 2004 | 100 |
| 56 | Wheat | 2005 | 100 |
| 57 | Wheat | 2006 | 100 |
| 58 | Wheat | 2007 | 100 |
| 59 | Wheat | 2008 | 100 |
| 60 | Wheat | 2009 | 100 |
| 61 | Wheat | 2010 | 100 |
| 62 | Wheat | 2011 | 100 |
| 63 | Wheat | 2012 | 100 |
| 64 | Wheat | 2013 | 100 |
| 65 | Wheat | 2014 | 100 |
| 66 | Wheat | 2015 | 100 |
| 67 | Wheat | 2016 | 100 |
| 68 | Wheat | 2017 | 100 |
| 69 | Wheat | 2018 | 100 |
| 70 | Wheat | 2019 | 100 |
| 71 | Wheat | 2020 | 100 |
| 72 | Wheat | 2021 | 100 |
| 73 | Wheat | 2022 | 100 |
| 74 | Wheat | 2023 | 100 |
| 75 | Wheat | 2024 | 100 |
| 76 | Wheat | 2025 | 100 |
| 77 | Wheat | 2026 | 100 |
| 78 | Wheat | 2027 | 100 |
| 79 | Wheat | 2028 | 100 |
| 80 | Wheat | 2029 | 100 |
| 81 | Wheat | 2030 | 100 |
| 82 | Wheat | 2031 | 100 |
| 83 | Wheat | 2032 | 100 |
| 84 | Wheat | 2033 | 100 |
| 85 | Wheat | 2034 | 100 |
| 86 | Wheat | 2035 | 100 |
| 87 | Wheat | 2036 | 100 |
| 88 | Wheat | 2037 | 100 |
| 89 | Wheat | 2038 | 100 |
| 90 | Wheat | 2039 | 100 |
| 91 | Wheat | 2040 | 100 |
| 92 | Wheat | 2041 | 100 |
| 93 | Wheat | 2042 | 100 |
| 94 | Wheat | 2043 | 100 |
| 95 | Wheat | 2044 | 100 |
| 96 | Wheat | 2045 | 100 |
| 97 | Wheat | | |

Acres Irrigated

| 10. Last Use: | Year | Why Abandoned |
|---------------|------|---------------|
| | | |

Why Abandoned

11. Condition of System

12. Land Description lots 10, 11, 12, 13, 14, 15, 16, 17, 18, 19, 20, 21, 22, 23, 24, 25, 26, 27, 28, 29, 30, 31, 32, 33, 34, 35, 36, 37, 38, 39, 40, 41, 42, 43, 44, 45, 46, 47, 48, 49, 50, 51, 52, 53, 54, 55, 56, 57, 58, 59, 60, 61, 62, 63, 64, 65, 66, 67, 68, 69, 70, 71, 72, 73, 74, 75, 76, 77, 78, 79, 80, 81, 82, 83, 84, 85, 86, 87, 88, 89, 90, 91, 92, 93, 94, 95, 96, 97, 98, 99, 100, T 24S, R 19E

Remarks: _____

Admission

1

1

WITNESS: _____

WITNESS:

Information by _____

Place

Please Do Not Fill in Any Items on This Page

Notice of Appropriation

Misc. File

1. County Stillwater Book No. 110955 Page none given Record Misc.
2. Name of Appropriator State Water Conservation Address Helena, Montana
3. Date Appropriated Sept. 1, 1937 Date Filed Sept. 7, 1937
waters.
- Amount Appropriated, Miners Inches All unappropriated Cubic Feet per second
4. Name of Stream Yellowstone River & trib. Tributary Basin
5. Point of Diversion
- Sec. 6 Twp. 2 S. Rge. 19 E. Bank of Stream not shown.
6. Purpose Irrigation (Declaration of intention to store, control and divert water)
7. Description of System Dam and canal.

8. Land Description of Intended Place of Use

| Subdivision | Sec. | Twp. | Rge. | Tot. Acr. | 1940 Owner | Address |
|-------------|------|------|-------|-----------|------------|---------|
| Lands in | 6 | 2 S. | 19 E. | | | |

9. Remarks (Pertaining to Use, etc.) All of the unappropriated waters of Yellowstone and tributaries, together with the return flow of all waters furnished or supplied by seeping or overflowing from the previous place of use of the above appropriated water;
This is filed but not recorded.

Decree

10. Case No. _____ Date _____ Amt. Decreed: M. I. _____ C. F. S. _____
11. To Whom Decreed _____ Address _____
12. Name of Ditch _____ Maximum Capacity (C. F. S.) _____
13. Date of Priority _____ Purpose _____
14. Land Description of Place of Use as Decreed _____
15. Remarks (Present Use Status, etc.) _____

STATE ENGINEERS OFFICE
Water Resources Survey

Notice of Appropriation

1. County Stillwater Book 9 Page 237 Record Misc.
2. Name of Appropriator Deaney, Bernard T. Address Reed Point, Montana
3. Date Appropriated June 1, 1915 Date Filed Aug. 30, 1920
Amount Appropriated, Miners Inches 60 or, Cubic Feet per second 2
4. Name of Stream Spring in Coulee Tributary Basin
5. Point of Diversion at a point on said coulee 200 feet SW of center point of NE 1/4 of
Sec. 12 Twp. 2 S. Rge. 18 E. Bank of Stream
and marked by a dam.
6. Purpose Domestic, irrigation and other useful and beneficial purposes.
7. Description of System By means of a dam, pipeline and ditch, said pipe line being 1 inch
in diameter and ditch to be 2 feet at top, 1 1/2 feet at bottom and 1 foot deep.
8. Land Description of Intended Place of Use.

| Subdivision | Sec. | Twp. | Rge. | Tot. Acr. | 1910 Owner | Address |
|-------------------------------------|------|------|-------|-----------|--------------------|---------------------|
| Lots 9, 10 & 11, SWSE 1/4, SESW 1/4 | 1 | 2 S. | 18 E. | 157.20 | Bernard T. Deaney, | Reed Point, Montana |
9. Remarks (Pertaining to Use, etc.) Transfers of Land Ownership.
1926 - Bernard T. Deaney leased to Barney Deaney
Lot 9 & 10 - SESW - SWSE - Sec. 1, Twp. 2 S., Rge. 18 E.
Bernard T. Deaney to Dan Dunlavy to Louise Dunlavy to Bernard T. Deaney
Lot 11 of Sec. 1 - Twp. 2 S., Rge. 18 E.

Decree
10. Case No. Date Amt. Decreed: M. I. C. F. S.
11. To Whom Decreed Address
12. Name of Ditch Maximum Capacity (C. F. S.)
13. Date of Priority Purpose
14. Land Description of Place of Use as Decreed
15. Remarks (Present Use Status, etc.)



STATE OF MONTANA
STATE ENGINEERS OFFICE
Water Resources Survey

185
Form WR-1-1M-11-44

Code No. 3 C, 4 B, 5 A, 8 A
County Stillwater
T. 2 S. R. 19 E.

Name of Land Owner Fannon Goddard Address Reed Point, Montana

Name of Operator _____ Address _____

Part A

TO BE FILED BY THOSE OBTAINING IRRIGATION WATER FROM
A DITCH COMPANY OR IRRIGATION DISTRICT

1. Water is delivered by: Private Ditch
Name of Ditch, Ditch Company or District supplying water _____
2. State the number of acres you irrigate under this system _____ Shares you hold _____
3. If you obtain water from more than one Company, give the number of shares, acres irrigated and the name of the Company under "Remarks". If you obtain water from a Ditch Company and also have a private system fill in both Part A and Part B.

Part B

TO BE FILED BY THOSE WHO HAVE A PRIVATE DITCH, PUMP OR IRRIGATION SYSTEM
or those who have a private water right under a Ditch Company

4. In what year was this land first irrigated? Date 1917
5. Give the name of the original appropriator (first user): Harlow M. Mullen
6. Give the date appropriated June 15, 1916 Amount filed on: Miners Inches 200 C. F. S. _____
7. State the total number of acres irrigated under this system: 175 acres
8. Give the point of diversion: Div 1/4 lot 5 - 1/4 Section 5 Township 2 N. Range 19 E.
Also 200 ins. Oct. 29 - 1927 - Harlow M. Mullen - same P. of S.

Part C

TO BE FILED BY ALL WATER USERS IN ADDITION TO PART A OR PART B

9. Source of Water: Yellowstone River
Name of stream or lake from which water is originally diverted _____
10. Water is obtained by: (Check one) Gravity _____ Pumping ☒ Other water wheel
11. What is the greatest number of acres you have irrigated? 175 Date 1938
12. How many acres did you irrigate in 1944? (Crop and pasture) None
13. State the total number of additional acres that could be irrigated by increasing the water supply, land leveling, etc. 200 acres This land is under what ditch? private ditch
14. How many acres of seeped land do you have which could be drained and put into production? _____
15. What is the condition of your irrigation system? Beyond repair.
16. Is your water supply adequate? Yes _____ No _____ Explain _____
17. REMARKS: _____

NOTE: The foregoing questions apply only to irrigated land shown on this plat.

DESCRIPTION AND MAP OF FARM

18. Legal Description of this Farm. Lot 11, Sec. 3 - Lot 3, 4, 5, 6, 7, SE SE $\frac{1}{4}$, W $\frac{1}{2}$ SE $\frac{1}{4}$, SW NE $\frac{1}{4}$, S $\frac{1}{2}$ NE $\frac{1}{4}$, SW $\frac{1}{4}$, Sec. 4 - Lot 3, SE NE $\frac{1}{4}$, SE $\frac{1}{4}$, Sec. 5 - N $\frac{1}{2}$ NE $\frac{1}{4}$, SW NE $\frac{1}{4}$, E $\frac{1}{2}$ NW $\frac{1}{4}$, Sec. 8 - T.2 S.19 E.



IRRIGATED LAND



NON-IRRIGATED LAND

NORTH

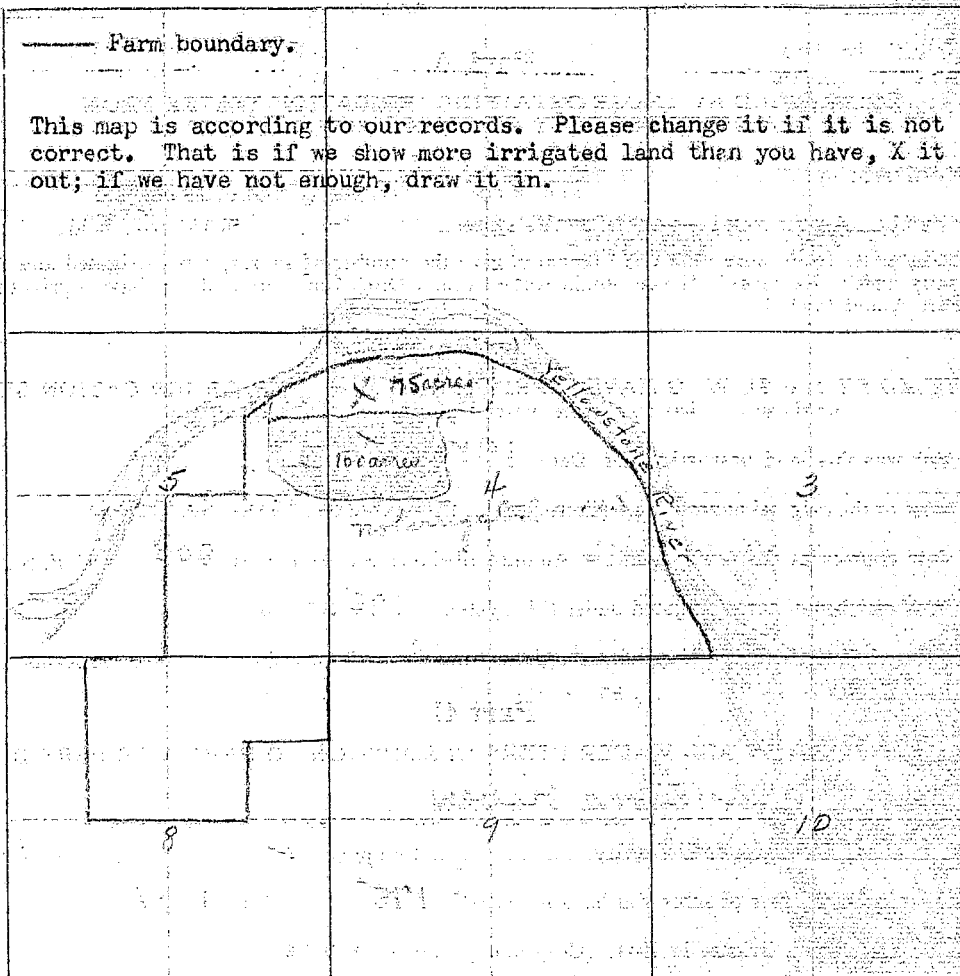

19. If the above land is irrigated from more than one ditch please give the acreage under each ditch in 19A. and indicate the location of the land irrigated from each on the above map.

19A. Ditch: one Acres: 75 of 1428
Ditch: two Acres: 100

Information supplied by:

Name: Mrs. Ganchon Goodard Address: Reed Point, Mont Date: Jan. 25, 1945

REMARKS: Since my father's death this land has not been irrigated on account of the war, but expect to use this water just as soon as we can get necessary machinery & material.

If you cannot answer all of the questions on this form answer as many as you can and return the form to us as soon as possible.

THURBER'S, HELENA

Our records show that you have an appropriation made by Harlon Milligan appropriated June 15, 1916 and filed December 6, 1916 from Yellowstone River for 200 minors inches. Is this appropriation now in use?

also

Our records show that you have an appropriation made by Harlon Milligan, appropriated October 29, 1937 and filed October 30, 1937 from Yellowstone River for 200 minors inches. Is this appropriation now in use.

Code No. 532

Please Do Not Fill in Any Items on This Page

Notice of Appropriation

1. County Stillwater Book 6 Page 180 Record Misc.
2. Name of Appropriator Milligan, Harlon Address Springtime, Montana
3. Date Appropriated June 15, 1916 Date Filed Dec. 6, 1916
- Amount Appropriated, Miners Inches 200 Cubic Feet per second _____
4. Name of Stream Yellowstone River Tributary _____ Basin _____
5. Point of Diversion at a point on its south bank at the southwest corner of Lot 8 of
Sec. 5 Twp. 2 S. Rge. 19 E. Bank of Stream south
6. Purpose Domestic, irrigation and other purposes.
7. Description of System By means of a pump 10 inches in diameter.
8. Land Description of Intended Place of Use

| Subdivision | Sec. | Twp. | Rge. | Tot. Acr. | 1940 Owner | Address |
|---------------------------------------|----------|-------------|--------------|--------------|------------------------|---------------------|
| <u>Lots 5 & 7 - S4SW4 - N1SE4</u> | <u>4</u> | <u>2 S.</u> | <u>19 E.</u> | | <u>Harlan Milligan</u> | <u>Logan, Mont.</u> |
| <u>N1SE4</u> | <u>4</u> | <u>2 S.</u> | <u>19 E.</u> | <u>227</u> | <u>Harlan Milligan</u> | <u>Logan, Mont.</u> |
| <u>Lot 8 - S4SW4</u> | <u>5</u> | <u>2 S.</u> | <u>19 E.</u> | <u>54.57</u> | <u>Harlan Milligan</u> | <u>Logan, Mont.</u> |
9. Remarks (Pertaining to Use, etc.) Transfers of Land Ownership.
Harlan Milligan
Lot 5 & 7 - S4SW4 - N1SW - NWSE - Sec. 4 - Twp. 2 S., Rge. 19 E.
Lot 8 - S4SW4 - Sec. 5 - Twp. 2 S., Rge. 19 E.

Decree

10. Case No. _____ Date _____ Amt. Decreed: M. I. _____ C. F. S. _____
11. To Whom Decreed _____ Address _____
12. Name of Ditch _____ Maximum Capacity (C. F. S.) _____
13. Date of Priority _____ Purpose _____
14. Land Description of Place of Use as Decreed _____

Please Do Not Fill in Any Items on This Page

Notice of Appropriation

1. County Stillwater Book 22 Page 196 Record 215C.
2. Name of Appropriator Milligan, Harlan Address Billings, Montana
3. Date Appropriated Oct. 23, 1937 Date Filed Oct. 30, 1937
- Amount Appropriated, Miners Inches 200 Cubic Feet per second _____
4. Name of Stream Yellowstone River Tributary _____ Basin _____
5. Point of Diversion at a point on its south bank at the SW corner of Lot 8 of Sec. 5,
Twp. 2 S., Rge. 19 E. on the south bank of the stream thence running to & upon said land.
- Sec. _____ Twp. _____ Rge. _____ Bank of Stream _____
6. Purpose Stock use, domestic, irrigation and other purposes.
7. Description of System By means of a water wheel, pump and ditch. Said ditch is 48 inches
by 24 inches in size.

8. Land Description of Intended Place of Use

| Subdivision | Sec. | Twp. | Rge. | Tot. Acr. | 1940 Owner | Address |
|----------------------------------|----------|-------------|--------------|------------|------------------------|---------------------|
| <u>Lots 3, 4 & 6 - SEANW</u> | <u>4</u> | <u>2 S.</u> | <u>19 E.</u> | | <u>Harlan Milligan</u> | <u>Logan, Mont.</u> |
| <u>SWNE</u> | <u>4</u> | <u>2 S.</u> | <u>19 E.</u> | <u>139</u> | <u>Harlan Milligan</u> | <u>Logan, Mont.</u> |

9. Remarks (Pertaining to Use, etc.) Transfers of Land Ownership.
Harlan Milligan contracted to Philester Morrison to Northland Securities Co. back to
Harlan Milligan - Lots 3, 4 and 6 - SEANW - SWNE - Section 4 - Twp. 2 S., Rge. 19 E.

Decree

10. Case No. _____ Date _____ Amt. Decreed: M. I. _____ C. F. S. _____
11. To Whom Decreed _____ Address _____
12. Name of Ditch _____ Maximum Capacity (C. F. S.) _____
13. Date of Priority _____ Purpose _____
14. Land Description of Place of Use as Decreed _____
15. Remarks (Present Use Status, etc.) _____

Address _____
Logan, Mont.
Logan, Mont.
Logan, Mont.

A STUDY OF MONTANA'S WATER RESOURCES

County Missoula Source of Information 1831. Water User Chas. E. Williams Address Columbia

2. Stream _____ Tributary to _____ Basin _____

3. Point of Diversion 1/4 1/4 Section _____ Township _____ Range _____

4. Description of System _____

5. Type of Irrigation _____

6. Original Appropriator _____ Address _____

7. First Use: Year _____ Acres Irrigated _____

8. Maximum Use: Year _____ Acres Irrigated _____

9. Present Use: Year _____ Acres Irrigated _____

10. Last Use: Year _____ Why Abandoned _____

11. Condition of System _____

12. Land Description Intersecting Section 3, T. 20, R. 19 E.

Remarks: _____

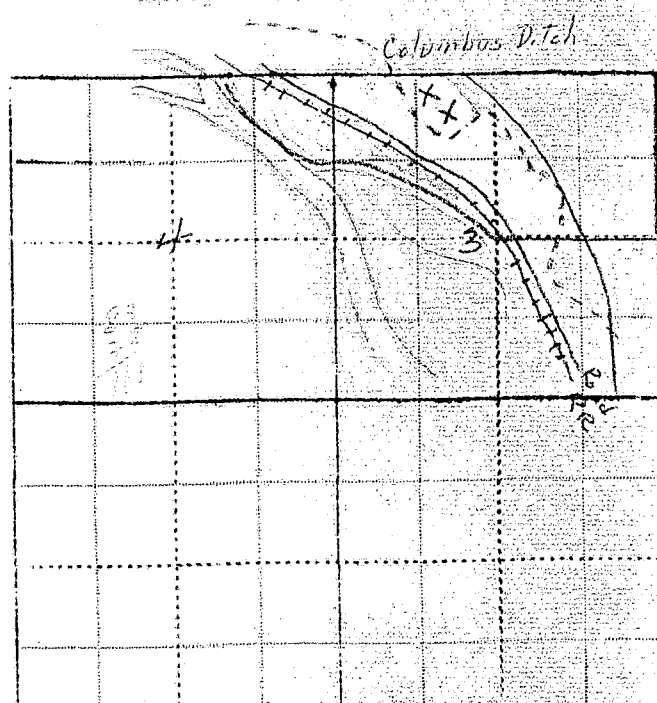
Sec 3, 4, 5, 6, 10, 12, 13, 14, 15, 16, 17, 18, 19, 20, 21, 22, 23, 24, 25, 26, 27, 28, 29, 30, 31, 32, 33, 34, 35, 36, 37, 38, 39, 40, 41, 42, 43, 44, 45, 46, 47, 48, 49, 50, 51, 52, 53, 54, 55, 56, 57, 58, 59, 60, 61, 62, 63, 64, 65, 66, 67, 68, 69, 70, 71, 72, 73, 74, 75, 76, 77, 78, 79, 80, 81, 82, 83, 84, 85, 86, 87, 88, 89, 90, 91, 92, 93, 94, 95, 96, 97, 98, 99, 100, 101, 102, 103, 104, 105, 106, 107, 108, 109, 110, 111, 112, 113, 114, 115, 116, 117, 118, 119, 120, 121, 122, 123, 124, 125, 126, 127, 128, 129, 130, 131, 132, 133, 134, 135, 136, 137, 138, 139, 140, 141, 142, 143, 144, 145, 146, 147, 148, 149, 150, 151, 152, 153, 154, 155, 156, 157, 158, 159, 160, 161, 162, 163, 164, 165, 166, 167, 168, 169, 170, 171, 172, 173, 174, 175, 176, 177, 178, 179, 180, 181, 182, 183, 184, 185, 186, 187, 188, 189, 190, 191, 192, 193, 194, 195, 196, 197, 198, 199, 200, 201, 202, 203, 204, 205, 206, 207, 208, 209, 210, 211, 212, 213, 214, 215, 216, 217, 218, 219, 220, 221, 222, 223, 224, 225, 226, 227, 228, 229, 230, 231, 232, 233, 234, 235, 236, 237, 238, 239, 240, 241, 242, 243, 244, 245, 246, 247, 248, 249, 250, 251, 252, 253, 254, 255, 256, 257, 258, 259, 260, 261, 262, 263, 264, 265, 266, 267, 268, 269, 270, 271, 272, 273, 274, 275, 276, 277, 278, 279, 280, 281, 282, 283, 284, 285, 286, 287, 288, 289, 290, 291, 292, 293, 294, 295, 296, 297, 298, 299, 300, 301, 302, 303, 304, 305, 306, 307, 308, 309, 310, 311, 312, 313, 314, 315, 316, 317, 318, 319, 320, 321, 322, 323, 324, 325, 326, 327, 328, 329, 330, 331, 332, 333, 334, 335, 336, 337, 338, 339, 340, 341, 342, 343, 344, 345, 346, 347, 348, 349, 350, 351, 352, 353, 354, 355, 356, 357, 358, 359, 360, 361, 362, 363, 364, 365, 366, 367, 368, 369, 370, 371, 372, 373, 374, 375, 376, 377, 378, 379, 380, 381, 382, 383, 384, 385, 386, 387, 388, 389, 390, 391, 392, 393, 394, 395, 396, 397, 398, 399, 400, 401, 402, 403, 404, 405, 406, 407, 408, 409, 410, 411, 412, 413, 414, 415, 416, 417, 418, 419, 420, 421, 422, 423, 424, 425, 426, 427, 428, 429, 430, 431, 432, 433, 434, 435, 436, 437, 438, 439, 440, 441, 442, 443, 444, 445, 446, 447, 448, 449, 450, 451, 452, 453, 454, 455, 456, 457, 458, 459, 460, 461, 462, 463, 464, 465, 466, 467, 468, 469, 470, 471, 472, 473, 474, 475, 476, 477, 478, 479, 480, 481, 482, 483, 484, 485, 486, 487, 488, 489, 490, 491, 492, 493, 494, 495, 496, 497, 498, 499, 500, 501, 502, 503, 504, 505, 506, 507, 508, 509, 510, 511, 512, 513, 514, 515, 516, 517, 518, 519, 520, 521, 522, 523, 524, 525, 526, 527, 528, 529, 530, 531, 532, 533, 534, 535, 536, 537, 538, 539, 540, 541, 542, 543, 544, 545, 546, 547, 548, 549, 550, 551, 552, 553, 554, 555, 556, 557, 558, 559, 560, 561, 562, 563, 564, 565, 566, 567, 568, 569, 570, 571, 572, 573, 574, 575, 576, 577, 578, 579, 580, 581, 582, 583, 584, 585, 586, 587, 588, 589, 590, 591, 592, 593, 594, 595, 596, 597, 598, 599, 600, 601, 602, 603, 604, 605, 606, 607, 608, 609, 610, 611, 612, 613, 614, 615, 616, 617, 618, 619, 620, 621, 622, 623, 624, 625, 626, 627, 628, 629, 630, 631, 632, 633, 634, 635, 636, 637, 638, 639, 640, 641, 642, 643, 644, 645, 646, 647, 648, 649, 650, 651, 652, 653, 654, 655, 656, 657, 658, 659, 660, 661, 662, 663, 664, 665, 666, 667, 668, 669, 670, 671, 672, 673, 674, 675, 676, 677, 678, 679, 680, 681, 682, 683, 684, 685, 686, 687, 688, 689, 690, 691, 692, 693, 694, 695, 696, 697, 698, 699, 700, 701, 702, 703, 704, 705, 706, 707, 708, 709, 710, 711, 712, 713, 714, 715, 716, 717, 718, 719, 720, 721, 722, 723, 724, 725, 726, 727, 728, 729, 730, 731, 732, 733, 734, 735, 736, 737, 738, 739, 740, 741, 742, 743, 744, 745, 746, 747, 748, 749, 750, 751, 752, 753, 754, 755, 756, 757, 758, 759, 760, 761, 762, 763, 764, 765, 766, 767, 768, 769, 770, 771, 772, 773, 774, 775, 776, 777, 778, 779, 780, 781, 782, 783, 784, 785, 786, 787, 788, 789, 790, 791, 792, 793, 794, 795, 796, 797, 798, 799, 800, 801, 802, 803, 804, 805, 806, 807, 808, 809, 810, 811, 812, 813, 814, 815, 816, 817, 818, 819, 820, 821, 822, 823, 824, 825, 826, 827, 828, 829, 830, 831, 832, 833, 834, 835, 836, 837, 838, 839, 840, 841, 842, 843, 844, 845, 846, 847, 848, 849, 850, 851, 852, 853, 854, 855, 856, 857, 858, 859, 860, 861, 862, 863, 864, 865, 866, 867, 868, 869, 870, 871, 872, 873, 874, 875, 876, 877, 878, 879, 880, 881, 882, 883, 884, 885, 886, 887, 888, 889, 890, 891, 892, 893, 894, 895, 896, 897, 898, 899, 900, 901, 902, 903, 904, 905, 906, 907, 908, 909, 910, 911, 912, 913, 914, 915, 916, 917, 918, 919, 920, 921, 922, 923, 924, 925, 926, 927, 928, 929, 930, 931, 932, 933, 934, 935, 936, 937, 938, 939, 940, 941, 942, 943, 944, 945, 946, 947, 948, 949, 950, 951, 952, 953, 954, 955, 956, 957, 958, 959, 960, 961, 962, 963, 964, 965, 966, 967, 968, 969, 970, 971, 972, 973, 974, 975, 976, 977, 978, 979, 980, 981, 982, 983, 984, 985, 986, 987, 988, 989, 990, 991, 992, 993, 994, 995, 996, 997, 998, 999, 1000Sec 3 - 73 AT - 196 TALot 1, Sec 4 - 32 AT - 28 TA2.20 19 EAll Sec 24 - All, exceptSec 33 - 70 AT - 50 TASec 44 - 80 AT - 64 TA1.20 19 ESection 19 19 E

WITNESS: _____

Information by _____

Place _____

March 8, 1945

Elmer Gahrt
Robert Garritson
Dolumbus, Montana

Dear Sirs:

We received your letter this morning stating that you did not receive a water resources form. We are sorry that this discrepancy occurred and are enclosing herewith a map of your farm as of our records which is on the form we would like to have filled out.

Yours truly,

Gerald J. Oravetz
Ass't State Engineer



STATE OF MONTANA

STATE ENGINEER

Billings,
MEXICO, MONTANA

February 21, 1945

Elmer Guhrt
Robert Garritson
Columbus, Montana

Dear Sirs:

On January 23rd, this office sent you a letter asking for certain information pertaining to your irrigated land in township 1 south, range 19 east and township 2 south, range 19 east. To date we have not heard from you. With the vast post war water development in this area as now planned, it is essential that we have this information in order to show the extent of our water use in the Yellowstone Basin in Montana. This information is necessary to protect our present water users in the rights they have against future irrigation, navigation, power and flood control enterprises in this area. We are asking you for this information because we feel it is the democratic way; we also feel that you are more qualified to give us this information about your irrigated land than anyone else because it is part of your business. It may be that you were busy with your farm work or some unforeseen thing happened at the time our first letter was received, and you put it aside to be answered at some other time and have forgotten all about it. All information is strictly confidential and is only used to record and tabulate the water use in this area.

Water is as necessary to the farmer as the soil in which he plants. Without it no crops will grow; no living thing can survive. It is your water that we are trying to protect, so that you will have plenty now and in the future. We must keep Montana's water in Montana. The only way we can do this is by having the support of each and every water user so that we have a 100 percent representation of all water users. Remember: "United we stand, divided we fall".

In order to facilitate this work a branch office of the State Engineer has been established in Billings and is located in the Roosevelt School Building on 23rd Street and Fourth Avenue North. Anytime you are in Billings we would appreciate your calling on us.

Hoping to hear from you in the very near future, I am,

Very truly yours,

Gerald J. Oravetz
Gerald J. Oravetz
Assistant State Engineer

P.S. If you cannot supply us with the information requested, it may be that you can tell us of someone who can.

Over

I do not recall receiving a request for any information
of this kind.

Elmer Guhrt



STATE OF MONTANA
STATE ENGINEERS OFFICE
Water Resources Survey

116
Form WR-1-1M-11-41

Code No. 25 A, 30 C

County Stillwater

T. 2 S. R. 19 E.
2 S. 20 E.

Name of Land Owner Henry Heicksen Address Columbus

Name of Operator Address

Part A

TO BE FILED BY THOSE OBTAINING IRRIGATION WATER FROM
A DITCH COMPANY OR IRRIGATION DISTRICT

1. Water is delivered by: Private Ditch
Name of Ditch, Ditch Company or District supplying water
2. State the number of acres you irrigate under this system _____ Shares you hold _____
3. If you obtain water from more than one Company, give the number of shares, acres irrigated and the name of the Company under "Remarks". If you obtain water from a Ditch Company and also have a private system fill in both Part A and Part B.

Part B

TO BE FILED BY THOSE WHO HAVE A PRIVATE DITCH, PUMP OR IRRIGATION SYSTEM
or those who have a private water right under a Ditch Company

4. In what year was this land first irrigated? Date 1911
5. Give the name of the original appropriator (first user): Grant Johnson
6. Give the date appropriated July 1895 Amount filed on: Miners Inches 1000 C. F. S. _____
7. State the total number of acres irrigated under this system: _____
1 1/2 miles from mouth of Stillwater
8. Give the point of diversion: _____ 1/4 _____ 1/4 Section _____ Township _____ Range _____

Part C

TO BE FILED BY ALL WATER USERS IN ADDITION TO PART A OR PART B

9. Source of Water: Stillwater River
Name of stream or lake from which water is originally diverted
10. Water is obtained by: (Check one) Gravity _____ Pumping _____ Other Ditch
11. What is the greatest number of acres you have irrigated? 15 1/2 Date 1911
12. How many acres did you irrigate in 1944? (Crop and pasture) Same
13. State the total number of additional acres that could be irrigated by increasing the water supply, land leveling, etc. None This land is under what ditch? Old Grant Johnson D.
14. How many acres of seeped land do you have which could be drained and put into production? None
15. What is the condition of your irrigation system? Lack of labor - poor
16. Is your water supply adequate? Yes X No _____ Explain _____
17. REMARKS: Water would be adequate if some work were done to keep ditch channels open.

OVER

NOTE: The foregoing questions apply only to irrigated land shown on this plat.

DESCRIPTION AND MAP OF FARM

Twp. 2S., 19E.

18. Legal Description of this Farm E $\frac{1}{2}$ NE $\frac{1}{4}$, SW NE $\frac{1}{4}$, NE SW $\frac{1}{4}$, NW SE $\frac{1}{4}$, S $\frac{1}{2}$ NE $\frac{1}{4}$, Fr. NWNE $\frac{1}{4}$, Sec. 25 -

Lot 6, Frac 7 & 8 Sec. 30 - Twp. 2 S., Rge. 20 E.

IRRIGATED LAND

NON-IRRIGATED LAND

NORTH

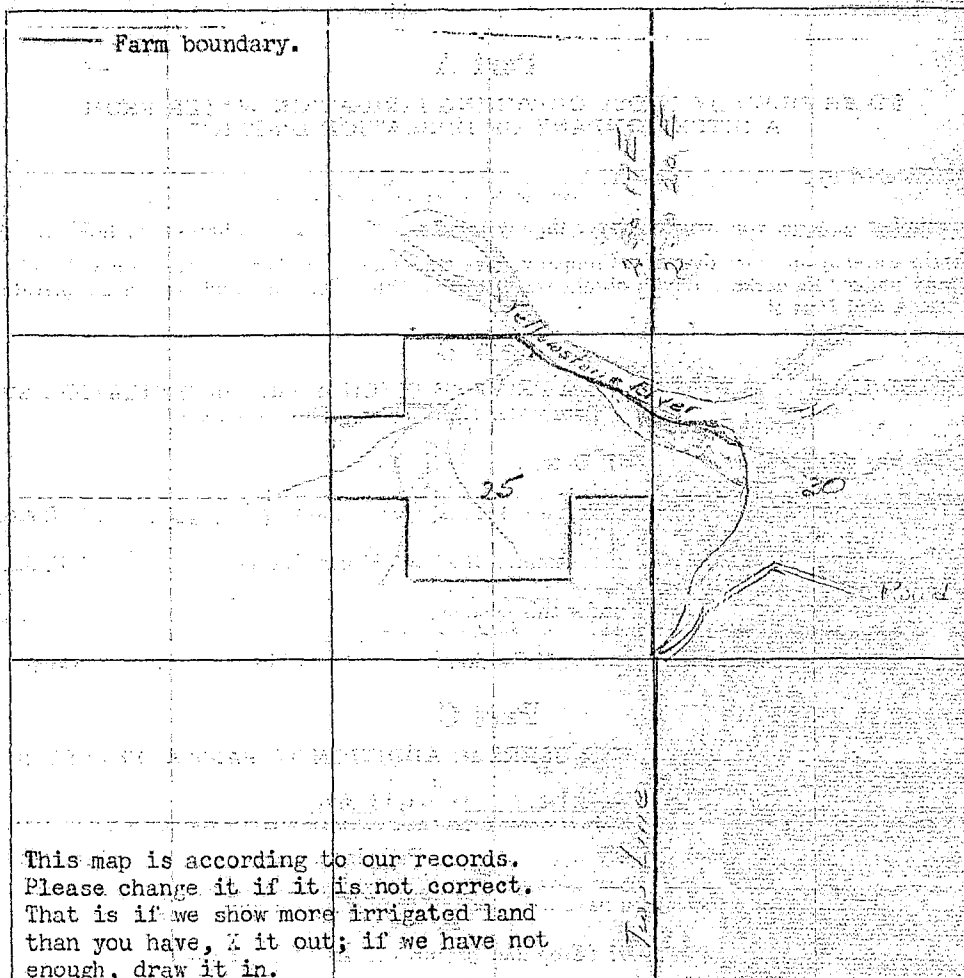

19. If the above land is irrigated from more than one ditch please give the acreage under each ditch in 19A and indicate the location of the land irrigated from each on the above map.

19A. Ditch: _____ Acres: 15 $\frac{1}{2}$

Ditch: _____ Acres: _____

Information supplied by:

Name Henry H. Beckman Address Columbus Date Feb. 3-45

REMARKS: _____

If you cannot answer all of the questions on this form answer as many as you can and return the form to us as soon as possible.

THUNDER'S, HELENA

STATE ENGINEERS OFFICE
Water Resources Survey

Code No. 436

Notice of Appropriation

1. County Stillwater Book 4 Page 562 Record Misc.
2. Name of Appropriator T. G. Irwin & Grant S. Irwin Address Columbus, Montana
3. Date Appropriated April 15, 1895 Date Filed Sept. 17, 1896
Amount Appropriated, Miners Inches 1000, Cubic Feet per second
4. Name of Stream Stillwater Creek Tributary Basin
5. Point of Diversion at a point on its left bank about 1½ miles from mouth of said
Stillwater Creek thence running in a northwesterly direction to and upon said land,
Sec. Twp. Rge. Bank of Stream left.
6. Purpose Irrigation, domestic and power and other useful purposes.
7. Description of System By means of a ditch which is 30 inches in depth and 42 inches wide
in size.
8. Land Description of Intended Place of Use.
Subdivision Sec. Twp. Rge. Tot. Acr. 1940 Owner Address
Situated in Secs. 29 & 30 2 S. 20 E.
9. Remarks (Pertaining to Use, etc.)
Appropriation filed in Sweetgrass shows date of appropriation as Mar. 13, 1896.

now in suit
Decree

10. Case No. Date Amt. Decreed: M. I. C. F. S.
11. To Whom Decreed Address
12. Name of Ditch Maximum Capacity (C. F. S.)
13. Date of Priority Purpose
14. Land Description of Place of Use as Decreed
15. Remarks (Present Use Status, etc.)



STATE OF MONTANA
STATE ENGINEERS OFFICE
Water Resources Survey

209

Form WR-1-IM-11-44

Code No. 11 A, 12 A, 14 A

County Stillwater

T. 2 S. R. 19 E.

Name of Land Owner John L. Holmgren Address Columbus

Name of Operator Address

Part A

TO BE FILED BY THOSE OBTAINING IRRIGATION WATER FROM
A DITCH COMPANY OR IRRIGATION DISTRICT

1. Water is delivered by: Merrill Ditch Co.
Name of Ditch, Ditch Company or District supplying water
2. State the number of acres you irrigate under this system 200 Shares you hold 25
3. If you obtain water from more than one Company, give the number of shares, acres irrigated and the name of the Company under "Remarks". If you obtain water from a Ditch Company and also have a private system fill in both Part A and Part B.

Part B

TO BE FILED BY THOSE WHO HAVE A PRIVATE DITCH, PUMP OR IRRIGATION SYSTEM
or those who have a private water right under a Ditch Company

4. In what year was this land first irrigated? Date 1904
5. Give the name of the original appropriator (first user): W. H. Hanson et al
6. Give the date appropriated Sept 5 1903 Amount filed on: Miners Inches 1400 C. F. S.
7. State the total number of acres irrigated under this system: 200
8. Give the point of diversion: 1/4 1/4 Section Township Range

Part C

TO BE FILED BY ALL WATER USERS IN ADDITION TO PART A OR PART B

9. Source of Water: Yellowstone River
Name of stream or lake from which water is originally diverted
10. Water is obtained by: (Check one) Gravity ☒ Pumping Other
11. What is the greatest number of acres you have irrigated? 200 Date
12. How many acres did you irrigate in 1944? (Crop and pasture) 200
13. State the total number of additional acres that could be irrigated by increasing the water supply, land leveling, etc. 30 This land is under what ditch? By pumping from the Merrill Ditch
14. How many acres of seeped land do you have which could be drained and put into production? None
15. What is the condition of your irrigation system? Good
16. Is your water supply adequate? Yes ☒ No Explain
17. REMARKS:

OVER

NOTE: The foregoing questions apply only to irrigated land shown on this plat.

DESCRIPTION AND MAP OF FARM

18. Legal Description of this Farm. SE 1/4, SW NE 1/4, W 1/2 SE 1/4, Sec. 11 - All Section 12,

lots 2, 3, 4, 6, N 1/2 NE 1/4, SE NE 1/4, Section 14 - Twp. 2 S., Rge. 19 E.

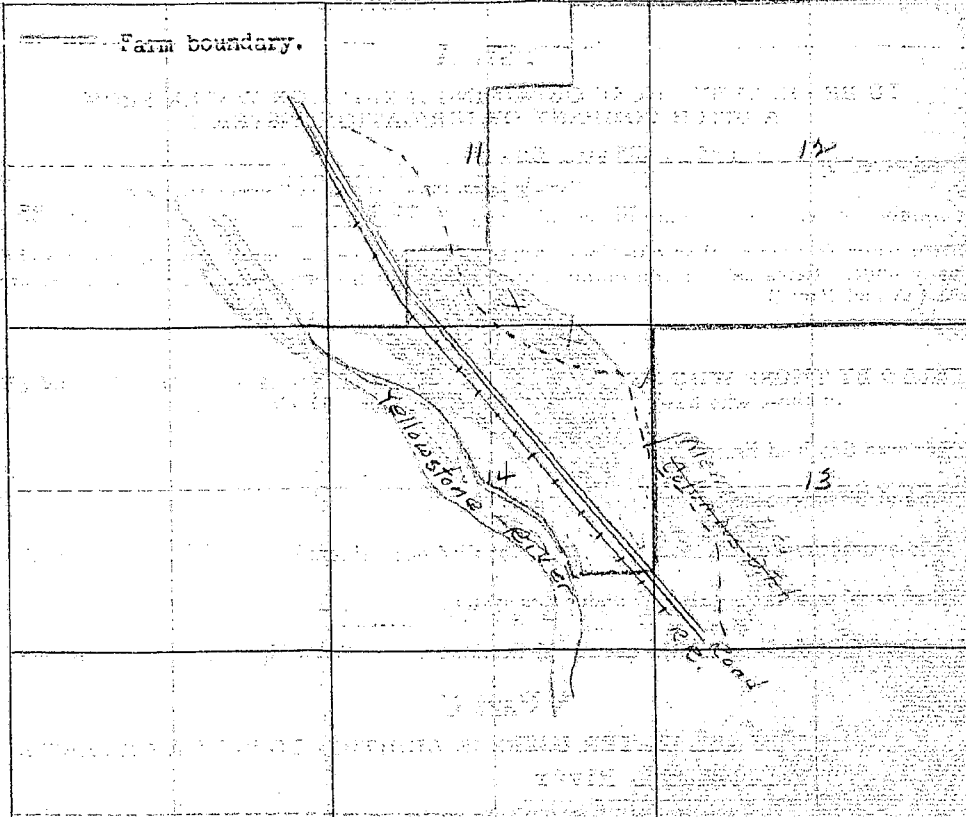
| | IRRIGATED LAND | NON-IRRIGATED LAND |
|---|----------------|--------------------|
| <p> NORTH</p>  <p>This map is according to our records. Please change it if it is not correct. That is if we show more irrigated land than you have, X it out; if we have not enough, draw it in.</p> | | |

19. If the above land is irrigated from more than one ditch please give the acreage under each ditch in 19A and indicate the location of the land irrigated from each on the above map.

19A. Ditch: Merrill Ditch Acres: 200

Ditch: _____ Acres: _____

Information supplied by:

Name: John Holmgren Jr. Address: Columbus, Mont. Date: March 5, 45

REMARKS: _____

If you cannot answer all of the questions on this form answer as many as you can and return the form to us as soon as possible.

THURBER'S, HELENA

FORM SM-1

A STUDY OF MONTANA'S WATER RESOURCES

County St. Charles Source of Information 1453

1. Water User John L. Kolman Address St. Louis, Mo.

2. Stream _____ Tributary to _____ Basin _____

3. Point of Diversion 1/2 1/2 Section Township Range

4. Description of System

5. Type of Irrigation _____

6. Original Appropriator 0 Address _____

| 7. First Use: | Year | Acres Irrigated |
|---------------|------|-----------------|
| | | |

8. Maximum Use: Year Acres Irrigated

| | | | | |
|-----------------|--|------|--|-----------------|
| 9. Present Use: | | Year | | Acres Irrigated |
|-----------------|--|------|--|-----------------|

| 10. Last Use: | Year | Why Abandoned |
|---------------|------|---------------|
| | | |

11. Condition of System

12. Land Description E 1/4 Sec 17, T 24N, R 10E, T 24, R 10E

Remarks:

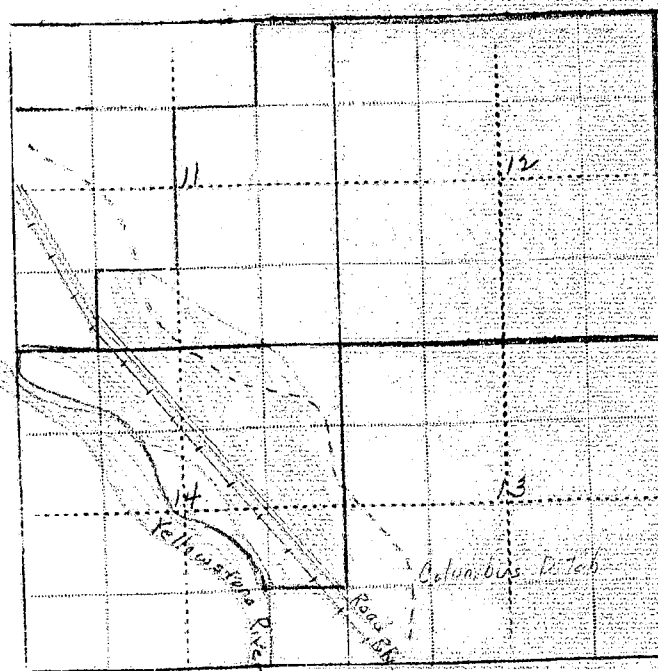

WITNESS: _____ Information by _____

Place _____

and

5.45

soon

Billings,
XXXXXXX

March 2, 1945

John L. Holagren
Columbus, Montana

Dear Mr. Holagren:

On January 23rd, this office sent you a letter asking for certain information pertaining to your irrigated land in township 2 south, 19 east. To date we have not heard from you. With the vast post war water development in this area as now planned, it is essential that we have this information in order to show the extent of our water use in the Yellowstone Basin in Montana. This information is necessary to protect our present water users in the rights they have against future irrigation, navigation, power and flood control enterprises in this area. We are asking you for this information because we feel it is the democratic way; we also feel that you are more qualified to give us this information about your irrigated land than anyone else because it is part of your business. It may be that you were busy with your farm work or some unforeseen thing happened at the time our first letter was received, and you put it aside to be answered at some other time and have forgotten all about it. All information is strictly confidential and is only used to record and tabulate the water use in this area.

Water is as necessary to the farmer as the soil in which he plants. Without it no crops will grow; no living thing can survive. It is your water that we are trying to protect, so that you will have plenty now and in the future. We must keep Montana's water in Montana. The only way we can do this is by having the support of each and every water user so that we have a 100 percent representation of all water users. Remember: "United we stand, divided we fall".

In order to facilitate this work a branch office of the State Engineer has been established in Billings and is located in the Roosevelt School Building on 23rd Street and Fourth Avenue North. Anytime you are in Billings we would appreciate your calling on us.

Hoping to hear from you in the very near future, I am,

Very truly yours,

Gerald J. Oravetz
Assistant State Engineer

P.S. If you cannot supply us with the information requested, it may be that you can tell us of someone who can.

STATE ENGINEERS OFFICE

Water Resources Survey

Co. No. 624

Notice of Appropriation

1. County Stillwater Book 4 Page 271 Record Misc.
2. Name of Appropriator W. H. Clawson et al Address Stillwater Territory, Mont.
3. Date Appropriated Sept. 8, 1883 Date Filed Sept. 8, 1883
Amount Appropriated, Miners Inches 1400, Cubic Feet per second _____
4. Name of Stream Yellowstone River Tributary _____ Basin _____
5. Point of Diversion at a point about 1 mile below Reed's Point

Sec. _____ Twp. _____ Rge. _____ Bank of Stream _____
6. Purpose Irrigation and other useful purposes.
7. Description of System By means of ditches. No dimensions given.

8. Land Description of Intended Place of Use _____
Lands occupied by us situated about 1/4 of a mile down the Yellowstone River from Reeds
Point. Unsurveyed.

9. Remarks (Pertaining to Use, etc.) _____
H. W. Clawson and Edward Cardwell, Olaf Laverson and S. W. Porter are the appropriators
of this water right.

Decree

10. Case No. _____ Date _____ Amt. Decreed: M. I. _____ C. F. S. _____
11. To Whom Decreed _____ Address _____
12. Name of Ditch _____ Maximum Capacity (C. F. S.) _____
13. Date of Priority _____ Purpose _____
14. Land Description of Place of Use as Decreed _____

15. Remarks (Present Use Status, etc.) _____

5-B

FORM SM-1

A STUDY OF MONTANA'S WATER RESOURCES

County St. Lawrence Source of Information 8-81. Water User Portals Canal, Tolson Address Calvin, Mont.

2. Stream _____ Tributary to _____ Basin _____

3. Point of Diversion 1/4 1/4 Section _____ Township _____ Range _____

4. Description of System _____

5. Type of Irrigation _____

6. Original Appropriator 6-1 Address _____

7. First Use; Year _____ Acres Irrigated _____

8. Maximum Use; Year _____ Acres Irrigated _____

9. Present Use; Year _____ Acres Irrigated _____

10. Last Use; Year _____ Why Abandoned _____

11. Condition of System _____

12. Land Description All Sec 13 - Lot 5, 9, 10, 11, 12, 13, 14, T 24 S, R 19 ERemarks: Sec 13 NE 1/4, Sec 13, T 24 S, R 19 E Lot 5, 9, 10, 11, 12, 13, 14, T 24 S, R 19 EFrom 6-1, Sec 14 - 251 25 TANE 1/4, Sec 13, T 24 S, R 19 EFrom 6-1, Sec 14 - 251 25 TASec 13 - 171 TAAll North 1/2 Sec 5 -E 1/2, NE 1/4, SE 1/4, Sec 5, T 24 S, R 19 ESec 13 - 171 TAMerrill Patch

WITNESS: _____ Information by _____

Place _____

Code No. 541

Please Do Not Fill in Any Items on This Page

Notice of Appropriation

Misc. File

1. County Stillwater Book No. 110955 Page none given. Record Misc.
2. Name of Appropriator State Water Conservation Bd. Address Helena, Montana
3. Date Appropriated Sept. 1, 1937 Date Filed Sept. 7, 1937
water.
- Amount Appropriated, Miners Inches All unappropriated/Cubic Feet per second
4. Name of Stream Yellowstone river & trib. Tributary Basin
5. Point of Diversion

Sec. 6 Twp. 2 S. Rge. 19 E. Bank of Stream not shown.

6. Purpose Irrigation (Declaration of intention to store, control and divert water)
7. Description of System Dam and canal.

8. Land Description of Intended Place of Use

| Subdivision | Sec. | Twp. | Rge. | Tot. Acr. | 1940 Owner | Address |
|-------------|------|------|-------|-----------|------------|---------|
| Lands in | 6 | 2 S. | 19 E. | | | |

9. Remarks (Pertaining to Use, etc.) All of the unappropriated waters of Yellowstone and tributaries together with the return flow of all waters furnished or supplied by seeping or over-flowing from the previous place of use of the above appropriated water.
This is filed but not recorded.

Decree

10. Case No. _____ Date _____ Amt. Decreed: M. I. _____ C. F. S. _____
11. To Whom Decreed _____ Address _____
12. Name of Ditch _____ Maximum Capacity (C. F. S.) _____
13. Date of Priority _____ Purpose _____
14. Land Description of Place of Use as Decreed _____
15. Remarks (Present Use Status, etc) _____

Our records show that you have an appropriation made by Margaret Quinn, appropriated Nov. 10, 1905 and filed Nov. 13, 1905 from Yellowstone River for 420 minors inches.

also *Not now in use the intake is destroyed*

Our records show that you have an appropriation made by Mary A. Clausen, appropriated Feb. 20, 1913 and filed Feb. 21, 1913 from Yellowstone River for 100 minors inches. Are these appropriations now in use?

only 70 inches now



STATE OF MONTANA
STATE ENGINEERS OFFICE
Water Resources Survey

89
Form WR-1-1M-11-41

Code No. 24 D, 25 B, 19 A
County Stillwater
T. 2 S. R. 19 E.
2 S. 20 E.

Name of Land Owner Swante Nyholt Address Columbus

Name of Operator Baerke Nyholt Address Columbus Mont

Part A

TO BE FILED BY THOSE OBTAINING IRRIGATION WATER FROM
A DITCH COMPANY OR IRRIGATION DISTRICT

1. Water is delivered by: Merrill Ditch Co
Name of Ditch, Ditch Company or District supplying water.
2. State the number of acres you irrigate under this system 80 Shares you hold 3 1/2
3. If you obtain water from more than one Company, give the number of shares, acres irrigated and the name of the Company under "Remarks". If you obtain water from a Ditch Company and also have a private system fill in both Part A and Part B.

Part B

TO BE FILED BY THOSE WHO HAVE A PRIVATE DITCH, PUMP OR IRRIGATION SYSTEM
or those who have a private water right under a Ditch Company

4. In what year was this land first irrigated? Date Do not know
5. Give the name of the original appropriator (first user): Blowson et al
6. Give the date appropriated Sept 1900 Amount filed on: Miners Inches 420 C. F. S.
7. State the total number of acres irrigated under this system: I think everything what is on the map.
8. Give the point of diversion: 1/4 Section 1/4 Township 19 Range 20

Part C

TO BE FILED BY ALL WATER USERS IN ADDITION TO PART A OR PART B

9. Source of Water: Yellowstone River
Name of stream or lake from which water is originally diverted
10. Water is obtained by: (Check one) Gravity L Pumping Other
11. What is the greatest number of acres you have irrigated? 80 Date 80
12. How many acres did you irrigate in 1944? (Crop and pasture) 80
13. State the total number of additional acres that could be irrigated by increasing the water supply, land leveling, etc. 55 This land is under what ditch? the same
14. How many acres of seeped land do you have which could be drained and put into production? 55
15. What is the condition of your irrigation system? fair
16. Is your water supply adequate? Yes L No Explain for those 80 acres
17. REMARKS:

NOTE: The foregoing questions apply only to irrigated land shown on this plat.

DESCRIPTION AND MAP OF FARM

18. Legal Description of this Farm Fr. NE $\frac{1}{4}$ Sec. 24, SE $\frac{1}{4}$ Sec. 24, FR. SW $\frac{1}{4}$ Sec. 24, SEC. 24, Lot 1, Sec. 25-T.23.S.19 E

Frac. S $\frac{1}{2}$ Sec 19 - Frac N $\frac{1}{2}$ Sec. 30 - Twp. 2 S., Rge. 20 E.

| <input type="checkbox"/> IRRIGATED LAND | <input type="checkbox"/> NON-IRRIGATED LAND |
|---|---|
| <p>Farm boundary.</p> <p>NORTH</p> <p>at A over water is taken out the main ditch B is badly seeped. but will be drained in 1946</p> <p>This map is according to our records. Please change it if it is not correct. That is if we show more irrigated land than you have, X it out; if we have not enough, draw it in.</p> | |

19. If the above land is irrigated from more than one ditch please give the acreage under each ditch in 19A and indicate the location of the land irrigated from each on the above map.

19A. Ditch: Merrill ditch Acres: 80

Ditch: _____ Acres: _____

Information supplied by:

Name Baerke Nyholt Address Columbus Date 3/11/45

REMARKS: _____

If you cannot answer all of the questions on this form answer as many as you can and return the form to us as soon as possible.

THURBER'S, HELENA

2-1-D
25B

FORM SM-1

A STUDY OF MONTANA'S WATER RESOURCES

County Stillwater Source of Information § 12

1. Water User Swante, Nyholt Address Columbus
2. Stream _____ Tributary to _____ Basin _____
3. Point of Diversion $\frac{1}{4}$ $\frac{1}{4}$ Section _____ Township _____ Range _____
4. Description of System _____
5. Type of Irrigation _____
6. Original Appropriator L. S. J. Address _____
7. First Use: Year _____ Acres Irrigated _____
8. Maximum Use: Year _____ Acres Irrigated _____
9. Present Use: Year _____ Acres Irrigated _____
10. Last Use: Year _____ Why Abandoned _____
11. Condition of System _____
12. Land Description Sec. 24, T. 24 N., R. 17 E.
Lot 1, Sec. 25

Remarks: 2-1-D

Sec. 24 - 1/4 AI - 177A

Sec. 24 - 1/4 AI - 177A

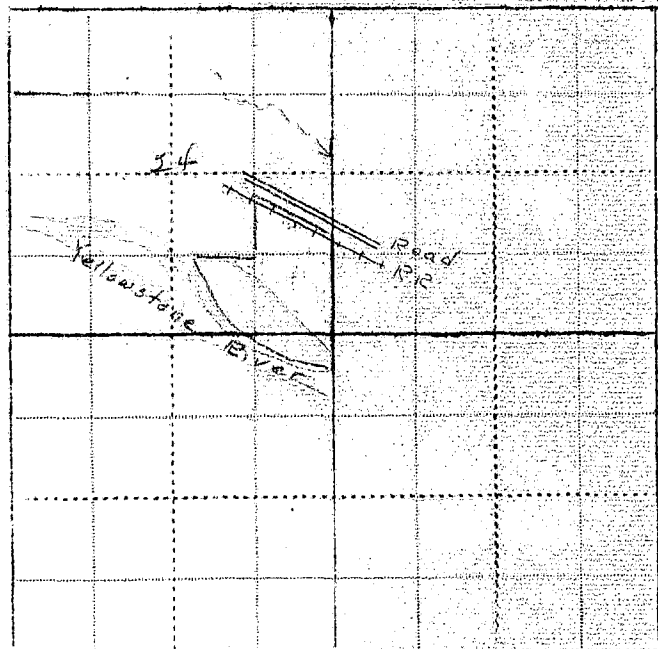

WITNESS: _____ Information by _____
Place _____

Billings,
XXXXXXX

March 2, 1945

Swante Nyholt
Columbus, Montana

Dear Mr. Nyholt:

On January 30th, this office sent you a letter asking for certain information pertaining to your irrigated land in Township 2 south, 19 east and township 2 south, 20 west. To date we have not heard from you. With the vast post war water development in this area as now planned, it is essential that we have this information in order to show the extent of our water use in the Yellowstone Basin in Montana. This information is necessary to protect our present water rights in the fights they have against future irrigation, navigation, power and flood control enterprises in this area. We are asking you for this information because we feel it is the democratic way; we also feel that you are more qualified to give us this information about your irrigated land than anyone else because it is part of your business. It may be that you were busy with your farm work or some unforeseen thing happened at the time our first letter was received, and you put it aside to be answered at some other time and have forgotten all about it. All information is strictly confidential and is only used to record and tabulate the water use in this area.

Water is as necessary to the farmer as the soil in which he plants. Without it no crops will grow; no living thing can survive. It is your water that we are trying to protect, so that you will have plenty now and in the future. We must keep Montana's water in Montana. The only way we can do this is by having the support of each and every water user so that we have a 100 percent representation of all water users. Remember: "United we stand, divided we fall".

In order to facilitate this work a branch office of the State Engineer has been established in Billings and is located in the Roosevelt School Building on 23rd Street and Fourth Avenue North. Anytime you are in Billings, we would appreciate your calling on us.

Hoping to hear from you in the very near future, I am,

Very truly yours,

Gerald J. Oravetz
Assistant State Engineer

P.S. If you cannot supply us with the information requested, it may be that you can tell us of someone who can.

Please Do Not Fill in Any Items on This Page

Notice of Appropriation

1. County Stillwater Book 4 Page 441 Record Misc.
2. Name of Appropriator Margaret Quinn, trustee et al Address Montana
3. Date Appropriated Nov. 10, 1905 Date Filed Nov. 13, 1905
- Amount Appropriated, Miner. Inches Cubic Feet per second 10.5
4. Name of Stream Yellowstone River Tributary Basin
5. Point of Diversion at a point on the N bank of said river near the center of the NW 1/4 of Sec. 14, 2 S., 19 E on the N bank of stream & measured from said point as the initial point the following well known natural objects and Permanent monuments are distant as follows: NW corner of Sec. 14, 2 S., 19 E. is distant about 600 yds in a NW direction. A high rocky bluff across Sec. 14, 2 S., 19 E. is distant about 600 yds in a westerly direction.
6. Purpose Irrigation, domestic and other purposes.
7. Description of System By means of a dam, ditch and headgate. Said ditch is 6 ft. wide on bottom, 7 1/2 feet wide on top and 1 1/2 feet deep on average.
8. Land Description of Intended Place of Use

| Subdivision | Sec. | Twp. | Rge. | Tot. Acr. | 1940 Owner | Address |
|------------------------------------|------|------|-------|-----------|----------------|---------|
| on | 24 | 2 S. | 19 E. | | See next page. | |
| & Secs. 19 & 30 | | 2 S. | 20 E. | | | |
| Christina Plemp & George Matovich. | | | | | | |
9. Remarks (Pertaining to Use, etc.)
Margaret Quinn trustee 2/3; J. R. & J. T. Holt 1/6; & W. H. Claussen are the appropriators of this water right.

Decree

10. Case No. _____ Date _____ Amt. Decreed: M. I. _____ C. F. S. _____
11. To Whom Decreed _____ Address _____
12. Name of Ditch _____ Maximum Capacity (C. F. S.) _____
13. Date of Priority _____ Purpose _____
14. Land Description of Place of Use as Decreed _____
15. Remarks (Present Use Status, etc) _____

Code No. 637

1940 Land Ownership.

Acres

523 - N - Lot 3, 5, 6, N $\frac{1}{2}$ SE $\frac{1}{4}$ - NW $\frac{1}{4}$ - Frac SESW - Sec. 19, T. 2 S., R. 20 E.,
Christina Plomp, Columbus, Montana
61 -- Lot 4 - S frac SSW - SW frac SWSE - Chas Sec. 19, T. 2 S., R. 20 E. Zwante Nyholt.
39.07 - Lot 1 and 2 - Section 30 - Twp. 2 S., Rge. 20 E. - Zwante Nyholt, Columbus, Mont.
80 - Lot 6 & 7 & 8 - Sec. 30 - T. 2 S., Rge. 20 E. - Henry Heicksen - Columbus
473.10 - SE $\frac{1}{4}$ - E $\frac{1}{2}$ SW $\frac{1}{4}$ - Lot 8 - SE fraction NW $\frac{1}{4}$ - Lots 3, 4, & 5
S $\frac{1}{2}$ NE $\frac{1}{4}$ - Section 30 - Twp. 2 S., Rge. 20 E. - George Matovich, Columbus, Mont.
200 - Frac. NW $\frac{1}{4}$ - Frac SWNE - Frac NWSE - Section 24, Twp. 2 S., Rge. 19 E.
Frac 1 to 3 north of R/W - Section 24 - Twp. 2 S., Rge. 19 E.
Frank Borek et ux, Columbus, Montana

STATE ENGINEERS OFFICE
Water Resources Survey

Notice of Appropriation

1. County Stillwater Book 4 Page 550 Record Misc.
2. Name of Appropriator Mary E. Claussen Address Montana
3. Date Appropriated Feb. 20, 1913 Date Filed Feb. 21, 1913
- Amount Appropriated, Miners Inches 100 or Cubic Feet per second 2 1/2
4. Name of Stream Yellowstone River Tributary Basin
5. Point of Diversion at a point on the bank of river 30 rods north of the west end of a certain island which said land is about center of
Sec. 14 Twp. 2 S. Rge. 19 E. Bank of Stream
6. Purpose Irrigation and other useful and beneficial purposes.
7. Description of System By means of a dam and ditch, said ditch being 6 feet wide at bottom, feet wide at top and 3 feet deep.
8. Land Description of Intended Place of Use
- | Subdivision | Sec. | Twp. | Rge. | Tot. Acr. | 1940 Owner | Address |
|-----------------------------------|------|------|-------|-----------|------------------|----------|
| Frac SE 1/4 - Frac E 1/2 SW 1/4 | 19 | 2 S. | 20 E. | 203 | Christina Plamp, | Columbus |
| S 1/2 | 19 | 2 S. | 20 E. | | | |
| Frac S 1/2 - Frac NWSW, S of R.R. | 19 | 2 S. | 20 E. | 65 | Zwante Nyholt, | Columbus |
9. Remarks (Pertaining to Use, etc.) Transfers of Land Ownership.
Mary E. Clausen to H. A. Appleby to Christina Plamp.
N 1/2 SE 1/4 - NESW - NWSW - Lot 5 & 6 - Frac SE 1/4 of Sec. 19, Lot 3 - 1/2 Sec. 19, T. 2 S., R. 20 E.
Mary E. Claussen to Frank Lawrence to Allie Farron to Zwante Nyholt
Frac Lot 4 - Frac SE 1/4 - Frac Lot 5 - Sec. 19, Twp. 2 S., Rge. 20 E.
- Decree**
10. Case No. Date Amt. Decreed: M. I. C. F. S.
11. To Whom Decreed Address
12. Name of Ditch Maximum Capacity (C. F. S.)
13. Date of Priority Purpose
14. Land Description of Place of Use as Decreed
15. Remarks (Present Use Status, etc.)

STATE ENGINEERS OFFICE
Water Resources Survey

Case No. 624

Notice of Appropriation

1. County Stillwater Book 4 Page 271 Record Misc.
 2. Name of Appropriator H. H. Clawson et al Address Stillwater Territory, Mont.
 3. Date Appropriated Sept. 8, 1883 Date Filed Sept. 8, 1883

Amount Appropriated, Miners Inches 1400, Cubic Feet per second

4. Name of Stream Yellowstone River Tributary Basin
 5. Point of Diversion at a point about 1/4 mile below Reed's Point

Sec. Tw. Rge. Bank of Stream

6. Purpose Irrigation and other useful purposes.
 7. Description of System By means of ditches. No dimensions given.

8. Land Description of Intended Place of Use
Lands occupied by us situated about 1/4 of a mile down the Yellowstone River from Reed's
Point. Unsurveyed.

9. Remarks (Pertaining to Use, etc.)
H. W. Clawson and Edward Cardwell, Olaf Laversen and S. W. Porter are the appropriators
of this water right.

Decree

10. Case No. Date Amt. Decreed: M. I. C. F. S.
 11. To Whom Decreed Address
 12. Name of Ditch Maximum Capacity (C. F. S.)
 13. Date of Priority Purpose
 14. Land Description of Place of Use as Decreed
 15. Remarks (Present Use Status, etc.)



STATE OF MONTANA
STATE ENGINEERS OFFICE
Water Resources Survey

184

Form WR-1-1M-11-41

Code No. 3 B, 10 A, 11B

County Stillwater

T. 2 S. R. 19 E.

Name of Land Owner F. C. Pierce

Address 201 Ave D., Billings, Montana

Name of Operator

Address

Part A

TO BE FILED BY THOSE OBTAINING IRRIGATION WATER FROM
A DITCH COMPANY OR IRRIGATION DISTRICT

1. Water is delivered by: Merrill Ditch Co.
Name of Ditch, Ditch Company or District supplying water
2. State the number of acres you irrigate under this system 400 Shares you hold 1/4 off, in ditch
3. If you obtain water from more than one Company, give the number of shares, acres irrigated and the name of the Company under "Remarks". If you obtain water from a Ditch Company and also have a private system fill in both Part A and Part B.

Part B

TO BE FILED BY THOSE WHO HAVE A PRIVATE DITCH, PUMP OR IRRIGATION SYSTEM
or those who have a private water right under a Ditch Company

4. In what year was this land first irrigated? Date 1904
5. Give the name of the original appropriator (first user): W. H. Blainard et al.
6. Give the date appropriated Sept 5, 02 Amount filed on: Miners Inches 1400 C. F. S.
7. State the total number of acres irrigated under this system: 400
8. Give the point of diversion: 1/4 Section 1/4 Township Range

Part C

TO BE FILED BY ALL WATER USERS IN ADDITION TO PART A OR PART B

9. Source of Water: Yellowstone River
Name of stream or lake from which water is originally diverted
10. Water is obtained by: (Check one) Gravity ☒ Pumping ☐ Other ☐
11. What is the greatest number of acres you have irrigated? 400 Date
12. How many acres did you irrigate in 1944? (Crop and pasture) 400
13. State the total number of additional acres that could be irrigated by increasing the water supply, land leveling, etc. This land is under what ditch? Merrill Ditch
14. How many acres of seeped land do you have which could be drained and put into production?
15. What is the condition of your irrigation system? Good
16. Is your water supply adequate? Yes ☒ No ☐ Explain
17. REMARKS:

OVER

NOTE: The foregoing questions apply only to irrigated land shown on this plat.

DESCRIPTION AND MAP OF FARM

18. Legal Description of this Farm Lot 1, 2, 3, 4, E $\frac{1}{2}$ NE $\frac{1}{4}$, Section 10 - Twp. 2 S./19 E. Rge.

NW NE $\frac{1}{4}$, NW $\frac{1}{4}$, NE $\frac{1}{4}$ Sec. 11 - Lots 7, 8, 9, E $\frac{1}{2}$ Sec. 3 - Twp. 2 S. Rge. 19 E.

IRRIGATED LAND

NON-IRRIGATED LAND

NORTH

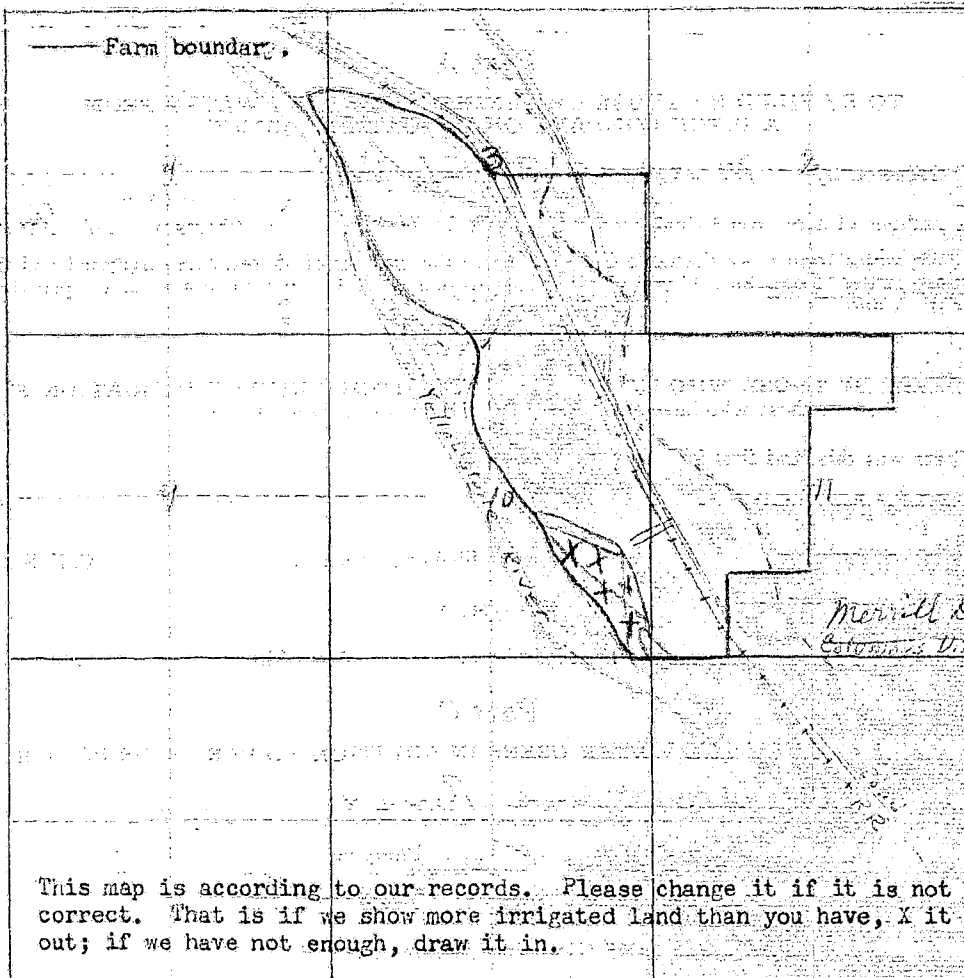

19. If the above land is irrigated from more than one ditch please give the acreage under each ditch in 19A and indicate the location of the land irrigated from each on the above map.

19A. Ditch:

Merrill Ditch

Acres: 4.00

Ditch:

Acres:

Information supplied by:

Name: Fred C Pierce

Address: Billings

Date: 2/1-1945

REMARKS:

If you cannot answer all of the questions on this form answer as many as you can and return the form to us as soon as possible.

THURBER'S, HELENA

FORM SM-1

A STUDY OF MONTANA'S WATER RESOURCES

County Billings Source of Information 1920

1. Water User J. C. Brown Address 1000 E. 10th

2. Stream Yellow River Tributary to Yellow River Basin Yellow River

3. Point of Diversion 1/4 1/4 Section 1 Township 1 Range 1

4. Description of System

5. Type of Irrigation

6. Original Appropriator 0 Address

7. First Use: Year Acres Irrigated

8. Maximum Use: Year Acres Irrigated

9. Present Use: Year Acres Irrigated

10. Last Use: Year Why Abandoned

11. Condition of System

12. Land Description 1/4 Sec 1, T. 1 S., R. 19 E.

Remarks: 2.50 17.5

1.50 2.50 3.50 4.50 5.50 6.50 7.50 8.50 9.50 10.50 11.50 12.50 13.50 14.50 15.50 16.50 17.50 18.50 19.50 20.50 21.50 22.50 23.50 24.50 25.50 26.50 27.50 28.50 29.50 30.50 31.50 32.50 33.50 34.50 35.50 36.50 37.50 38.50 39.50 40.50 41.50 42.50 43.50 44.50 45.50 46.50 47.50 48.50 49.50 50.50 51.50 52.50 53.50 54.50 55.50 56.50 57.50 58.50 59.50 60.50 61.50 62.50 63.50 64.50 65.50 66.50 67.50 68.50 69.50 70.50 71.50 72.50 73.50 74.50 75.50 76.50 77.50 78.50 79.50 80.50 81.50 82.50 83.50 84.50 85.50 86.50 87.50 88.50 89.50 90.50 91.50 92.50 93.50 94.50 95.50 96.50 97.50 98.50 99.50 100.50 101.50 102.50 103.50 104.50 105.50 106.50 107.50 108.50 109.50 110.50 111.50 112.50 113.50 114.50 115.50 116.50 117.50 118.50 119.50 120.50 121.50 122.50 123.50 124.50 125.50 126.50 127.50 128.50 129.50 130.50 131.50 132.50 133.50 134.50 135.50 136.50 137.50 138.50 139.50 140.50 141.50 142.50 143.50 144.50 145.50 146.50 147.50 148.50 149.50 150.50 151.50 152.50 153.50 154.50 155.50 156.50 157.50 158.50 159.50 160.50 161.50 162.50 163.50 164.50 165.50 166.50 167.50 168.50 169.50 170.50 171.50 172.50 173.50 174.50 175.50 176.50 177.50 178.50 179.50 180.50 181.50 182.50 183.50 184.50 185.50 186.50 187.50 188.50 189.50 190.50 191.50 192.50 193.50 194.50 195.50 196.50 197.50 198.50 199.50 200.50 201.50 202.50 203.50 204.50 205.50 206.50 207.50 208.50 209.50 210.50 211.50 212.50 213.50 214.50 215.50 216.50 217.50 218.50 219.50 220.50 221.50 222.50 223.50 224.50 225.50 226.50 227.50 228.50 229.50 230.50 231.50 232.50 233.50 234.50 235.50 236.50 237.50 238.50 239.50 240.50 241.50 242.50 243.50 244.50 245.50 246.50 247.50 248.50 249.50 250.50 251.50 252.50 253.50 254.50 255.50 256.50 257.50 258.50 259.50 260.50 261.50 262.50 263.50 264.50 265.50 266.50 267.50 268.50 269.50 270.50 271.50 272.50 273.50 274.50 275.50 276.50 277.50 278.50 279.50 280.50 281.50 282.50 283.50 284.50 285.50 286.50 287.50 288.50 289.50 290.50 291.50 292.50 293.50 294.50 295.50 296.50 297.50 298.50 299.50 300.50 301.50 302.50 303.50 304.50 305.50 306.50 307.50 308.50 309.50 310.50 311.50 312.50 313.50 314.50 315.50 316.50 317.50 318.50 319.50 320.50 321.50 322.50 323.50 324.50 325.50 326.50 327.50 328.50 329.50 330.50 331.50 332.50 333.50 334.50 335.50 336.50 337.50 338.50 339.50 340.50 341.50 342.50 343.50 344.50 345.50 346.50 347.50 348.50 349.50 350.50 351.50 352.50 353.50 354.50 355.50 356.50 357.50 358.50 359.50 360.50 361.50 362.50 363.50 364.50 365.50 366.50 367.50 368.50 369.50 370.50 371.50 372.50 373.50 374.50 375.50 376.50 377.50 378.50 379.50 380.50 381.50 382.50 383.50 384.50 385.50 386.50 387.50 388.50 389.50 390.50 391.50 392.50 393.50 394.50 395.50 396.50 397.50 398.50 399.50 400.50 401.50 402.50 403.50 404.50 405.50 406.50 407.50 408.50 409.50 410.50 411.50 412.50 413.50 414.50 415.50 416.50 417.50 418.50 419.50 420.50 421.50 422.50 423.50 424.50 425.50 426.50 427.50 428.50 429.50 430.50 431.50 432.50 433.50 434.50 435.50 436.50 437.50 438.50 439.50 440.50 441.50 442.50 443.50 444.50 445.50 446.50 447.50 448.50 449.50 450.50 451.50 452.50 453.50 454.50 455.50 456.50 457.50 458.50 459.50 460.50 461.50 462.50 463.50 464.50 465.50 466.50 467.50 468.50 469.50 470.50 471.50 472.50 473.50 474.50 475.50 476.50 477.50 478.50 479.50 480.50 481.50 482.50 483.50 484.50 485.50 486.50 487.50 488.50 489.50 490.50 491.50 492.50 493.50 494.50 495.50 496.50 497.50 498.50 499.50 500.50 501.50 502.50 503.50 504.50 505.50 506.50 507.50 508.50 509.50 510.50 511.50 512.50 513.50 514.50 515.50 516.50 517.50 518.50 519.50 520.50 521.50 522.50 523.50 524.50 525.50 526.50 527.50 528.50 529.50 530.50 531.50 532.50 533.50 534.50 535.50 536.50 537.50 538.50 539.50 540.50 541.50 542.50 543.50 544.50 545.50 546.50 547.50 548.50 549.50 550.50 551.50 552.50 553.50 554.50 555.50 556.50 557.50 558.50 559.50 560.50 561.50 562.50 563.50 564.50 565.50 566.50 567.50 568.50 569.50 570.50 571.50 572.50 573.50 574.50 575.50 576.50 577.50 578.50 579.50 580.50 581.50 582.50 583.50 584.50 585.50 586.50 587.50 588.50 589.50 590.50 591.50 592.50 593.50 594.50 595.50 596.50 597.50 598.50 599.50 600.50 601.50 602.50 603.50 604.50 605.50 606.50 607.50 608.50 609.50 610.50 611.50 612.50 613.50 614.50 615.50 616.50 617.50 618.50 619.50 620.50 621.50 622.50 623.50 624.50 625.50 626.50 627.50 628.50 629.50 630.50 631.50 632.50 633.50 634.50 635.50 636.50 637.50 638.50 639.50 640.50 641.50 642.50 643.50 644.50 645.50 646.50 647.50 648.50 649.50 650.50 651.50 652.50 653.50 654.50 655.50 656.50 657.50 658.50 659.50 660.50 661.50 662.50 663.50 664.50 665.50 666.50 667.50 668.50 669.50 670.50 671.50 672.50 673.50 674.50 675.50 676.50 677.50 678.50 679.50 680.50 681.50 682.50 683.50 684.50 685.50 686.50 687.50 688.50 689.50 690.50 691.50 692.50 693.50 694.50 695.50 696.50 697.50 698.50 699.50 700.50 701.50 702.50 703.50 704.50 705.50 706.50 707.50 708.50 709.50 710.50 711.50 712.50 713.50 714.50 715.50 716.50 717.50 718.50 719.50 720.50 721.50 722.50 723.50 724.50 725.50 726.50 727.50 728.50 729.50 730.50 731.50 732.50 733.50 734.50 735.50 736.50 737.50 738.50 739.50 740.50 741.50 742.50 743.50 744.50 745.50 746.50 747.50 748.50 749.50 750.50 751.50 752.50 753.50 754.50 755.50 756.50 757.50 758.50 759.50 760.50 761.50 762.50 763.50 764.50 765.50 766.50 767.50 768.50 769.50 770.50 771.50 772.50 773.50 774.50 775.50 776.50 777.50 778.50 779.50 780.50 781.50 782.50 783.50 784.50 785.50 786.50 787.50 788.50 789.50 790.50 791.50 792.50 793.50 794.50 795.50 796.50 797.50 798.50 799.50 800.50 801.50 802.50 803.50 804.50 805.50 806.50 807.50 808.50 809.50 810.50 811.50 812.50 813.50 814.50 815.50 816.50 817.50 818.50 819.50 820.50 821.50 822.50 823.50 824.50 825.50 826.50 827.50 828.50 829.50 830.50 831.50 832.50 833.50 834.50 835.50 836.50 837.50 838.50 839.50 840.50 841.50 842.50 843.50 844.50 845.50 846.50 847.50 848.50 849.50 850.50 851.50 852.50 853.50 854.50 855.50 856.50 857.50 858.50 859.50 860.50 861.50 862.50 863.50 864.50 865.50 866.50 867.50 868.50 869.50 870.50 871.50 872.50 873.50 874.50 875.50 876.50 877.50 878.50 879.50 880.50 881.50 882.50 883.50 884.50 885.50 886.50 887.50 888.50 889.50 890.50 891.50 892.50 893.50 894.50 895.50 896.50 897.50 898.50 899.50 900.50 901.50 902.50 903.50 904.50 905.50 906.50 907.50 908.50 909.50 910.50 911.50 912.50 913.50 914.50 915.50 916.50 917.50 918.50 919.50 920.50 921.50 922.50 923.50 924.50 925.50 926.50 927.50 928.50 929.50 930.50 931.50 932.50 933.50 934.50 935.50 936.50 937.50 938.50 939.50 940.50 941.50 942.50 943.50 944.50 945.50 946.50 947.50 948.50 949.50 950.50 951.50 952.50 953.50 954.50 955.50 956.50 957.50 958.50 959.50 960.50 961.50 962.50 963.50 964.50 965.50 966.50 967.50 968.50 969.50 970.50 971.50 972.50 973.50 974.50 975.50 976.50 977.50 978.50 979.50 980.50 981.50 982.50 983.50 984.50 985.50 986.50 987.50 988.50 989.50 990.50 991.50 992.50 993.50 994.50 995.50 996.50 997.50 998.50 999.50 1000.50 1001.50 1002.50 1003.50 1004.50 1005.50 1006.50 1007.50 1008.50 1009.50 1010.50 1011.50 1012.50 1013.50 1014.50 1015.50 1016.50 1017.50 1018.50 1019.50 1020.50 1021.50 1022.50 1023.50 1024.50 1025.50 1026.50 1027.50 1028.50 1029.50 1030.50 1031.50 1032.50 1033.50 1034.50 1035.50 1036.50 1037.50 1038.50 1039.50 1040.50 1041.50 1042.50 1043.50 1044.50 1045.50 1046.50 1047.50 1048.50 1049.50 1050.50 1051.50 1052.50 1053.50 1054.50 1055.50 1056.50 1057.50 1058.50 1059.50 1060.50 1061.50 1062.50 1063.50 1064.50 1065.50 1066.50 1067.50 1068.50 1069.50 1070.50 1071.50 1072.50 1073.50 1074.50 1075.50 1076.50 1077.50 1078.50 1079.50 1080.50 1081.50 1082.50 1083.50 1084.50 1085.50 1086.50 1087.50 1088.50 1089.50 1090.50 1091.50 1092.50 1093.50 1094.50 1095.50 1096.50 1097.50 1098.50 1099.50 1100.50 1101.50 1102.50 1103.50 1104.50 1105.50 1106.50 1107.50 1108.50 1109.50 1110.50 1111.50 1112.50 1113.50 1114.50 1115.50 1116.50 1117.50 1118.50 1119.50 1120.50 1121.50 1122.50 1123.50 1124.50 1125.50 1126.50 1127.50 1128.50 1129.50 1130.50 1131.50 1132.50 1133.50 1134.50 1135.50 1136.50 1137.50 1138.50 1139.50 1140.50 1141.50 1142.50 1143.50 1144.50 1145.50 1146.50 1147.50 1148.50 1149.50 1150.50 1151.50 1152.50 1153.50 1154.50 1155.50 1156.50 1157.50 1158.50 1159.50 1160.50 1161.50 1162.50 1163.50 1164.50 1165.50 1166.50 1167.50 1168.50 1169.50 1170.50 1171.50 1172.50 1173.50 1174.50 1175.50 1176.50 1177.50 1178.50 1179.50 1180.50 1181.50 1182.50 1183.50 1184.50 1185.50 1186.50 1187.50 1188.50 1189.50 1190.50 1191.50 1192.50 1193.50 1194.50 1195.50 1196.50 1197.50 1198.50 1199.50 1200.50 1201.50 1202.50 1203.50 1204.50 1205.50 1206.50 1207.50 1208.50 1209.50 1210.50 1211.50 1212.50 1213.50 1214.50 1215.50 1216.50 1217.50 1218.50 1219.50 1220.50 1221.50 1222.50 1223.50 1224.50 1225.50 1226.50 1227.50 1228.50 1229.50 1230.50 1231.50 1232.50 1233.50 1234.50 1235.50 1236.50 1237.50 1238.50 1239.50 1240.50 1241.50 1242.50 1243.50 1244.50 1245.50 1246.50 1247.50 1248.50 1249.50 1250.50 1251.50 1252.50 1253.50 1254.50 1255.50 1256.50 1257.50 1258.50 1259.50 1260.50 1261.50 1262.50 1263.50 1264.50 1265.50 1266.50 1267.50 1268.50 1269.50 1270.50 1271.50 1272.50 1273.50 1274.50 1275.50 1276.50 1277.50 1278.50 1279.50 1280.50 1281.50 1282.50 1283.50 1284.50 1285.50 1286.50 1287.50 1288.50 1289.50 1290.50 1291.50 1292.50 1293.50 1294.50 1295.50 1296.50 1297.50 1298.50 1299.50 1300.50 1301.50 1302.50 1303.50 1304.50 1305.50 1306.50 1307.50 1308.50 1309.50 1310.50 1311.50 1312.50 1313.50 1314.50 1315.50 1316.50 1317.50 1318.50 1319.50 1320.50 1321.50 1322.50 1323.50 1324.50 1325.50 1326.50 1327.50 1328.50 1329.50 1330.50 1331.50 1332.50 1333.50 1334.50 1335.50 1336.50 1337.50 1338.50 1339.50 1340.50 1341.50 1342.50 1343.50 1344.50 1345.50 1346.50 1347.50 1348.50 1349.50 1350.50 1351.50 1352.50 1353.50 1354.50 1355.50 1356.50 1357.50 1358.50 1359.50 1360.50 1361.50 1362.50 1363.50 1364.50 1365.50 1366.50 1367.50 1368.50 1369.50 1370.50 1371.50 1372.50 1373.50 1374.50 1375.50 1376.50 1377.50 1378.50 1379.50 1380.50 1381.50 1382.50 1383.50 1384.50 1385.50 1386.50 1387.50 1388.50 1389.50 1390.50 1391.50 1392.50 1393.50 1394.50 1395.50 1396.50 1397.50 1398.50 1399.50 1400.50 1401.50 1402.50 1403.50 1404.50 1405.50 1406.50 1407.50 1408.50 1409.50 1410.50 1411.50 1412.50 1413.50 1414.50 1415.50 1416.50 1417.50 1418.50 1419.50 1420.50 1421.50 1422.50 1423.50 1424.50 1425.50 1426.50 1427.50 1428.50 1429.50 1430.50 1431.50 1432.50 1433.50 1434.50 1435.50 1436.50 1437.50 1438.50 1439.50 1440.50 1441.50 1442.50 1443.50 1444.50 1445.50 1446.50 1447.50 1448.50 1449.50 1450.50 1451.50 1452.50 1453.50 1454.50 1455.50 1456.50 1457.50 1458.50 1459.50 1460.50 1461.50 1462.50 1463.50 1464.50 1465.50 1466.50 1467.50 1468.50 1469.50 1470.50 1471.50 1472.50 1473.50 1474.50 1475.50 1476.50 1477.50 1478.50 1479.50 1480.50 1481.50 1482.50 1483.50 1484.50 1485.50 1486.50 1487.50 1488.50 1489.50 1490.50 1491.50 1492.50 1493.50 1494.50 1495.50 1496.50 1497.50 1498.50 1499.50 1500.50 1501.50 1502.50 1503.50 1504.50 1505.50 1506.50 1507.50 1508.50 1509.50 1510.50 1511.50 1512.50 1513.50 1514.50 1515.50 1516.50 1517.50 1518.50 1519.50 1520.50 1521.50 1522.50 1523.50 1524.50 1525.50 1526.50 1527.50 1528.50 1529.50 1530.50 1531.50 1532.50 1533.50 1534.50 1535.50 1536.50 1537.50 1538.50 1539.50 1540.50 1541.50 1542.50 1543.50 1544.50 1545.50 1546.50 1547.50 1548.50 1549.50 1550.50 1551.50 1552.50 1553.50 1554.50 1555.50 1556.50 1557.50 1558.50 1559.50 1560.50 1561.50 1562.50 1563.50 1564.50 1565.50 1566.50 1567.50 1568.50 1569.50 1570.50

STATE ENGINEERS OFFICE
Water Resources Survey

Case No. 624

Notice of Appropriation

1. County Stillwater Book 4 Page 271 Record Misc.
2. Name of Appropriator W. H. Clawson et al Address Stillwater Territory, Mont.
3. Date Appropriated Sept. 8, 1883 Date Filed Sept. 8, 1883
Amount Appropriated, Miners Inches 1400 Cubic Feet per second
4. Name of Stream Yellowstone River Tributary Basin
5. Point of Diversion at a point about 1/2 mile below Reed's Point
Sec. Twp. Rge. Bank of Stream
6. Purpose Irrigation and other useful purposes.
7. Description of System By means of ditches. No dimensions given.
8. Land Description of Intended Place of Use
Lands occupied by us situated about 1/2 of a mile down the Yellowstone River from Reed's Point. Unsurveyed.
9. Remarks (Pertaining to Use, etc.)
H. H. Clawson and Edward Cardwell, Olaf Laverson and S. W. Porter are the appropriators of this water right.

Decree

10. Case No. Date Amt. Decreed: M. I. C. F. S.
11. To Whom Decreed Address
12. Name of Ditch Maximum Capacity (C. F. S.)
13. Date of Priority Purpose
14. Land Description of Place of Use as Decreed
15. Remarks (Present Use Status, etc.)



STATE OF MONTANA
STATE ENGINEERS OFFICE
Water Resources Survey

146
Form WR-1-1M-11-44

Code No. 24 C, 18 A, 19 C
County Stillwater
T. 2 S. - R. 19 E.
2 S. 20 E.

Name of Land Owner Christina Plomp Address Columbus
Name of Operator _____ Address _____

Part A

TO BE FILED BY THOSE OBTAINING IRRIGATION WATER FROM
A DITCH COMPANY OR IRRIGATION DISTRICT

1. Water is delivered by: Mountain Ditch Co.
Name of Ditch, Ditch Company or District supplying water
2. State the number of acres you irrigate under this system 60 Shares you hold 6
3. If you obtain water from more than one Company, give the number of shares, acres irrigated and the name of the Company under "Remarks". If you obtain water from a Ditch Company and also have a private system fill in both Part A and Part B.

Part B

TO BE FILED BY THOSE WHO HAVE A PRIVATE DITCH, PUMP OR IRRIGATION SYSTEM
or those who have a private water right under a Ditch Company.

4. In what year was this land first irrigated? Date _____
5. Give the name of the original appropriator (first user): W. H. Clausen et al
6. Give the date appropriated Sept 8-1893 Amount filed on: Miners Inches 1400 C. F. S. _____
7. State the total number of acres irrigated under this system: 60
8. Give the point of diversion: 1/4 mile below Black Point
1/4 Section _____ Township _____ Range _____

Part C

TO BE FILED BY ALL WATER USERS IN ADDITION TO PART A OR PART B

9. Source of Water: Yellowstone River
Name of stream or lake from which water is originally diverted
10. Water is obtained by: (Check one) Gravity _____ Pumping _____ Other _____
11. What is the greatest number of acres you have irrigated? _____ Date _____
12. How many acres did you irrigate in 1944? (Crop and pasture) 60
13. State the total number of additional acres that could be irrigated by increasing the water supply, land leveling, etc. 20 more This land is under what ditch? Mountain Ditch Co.
14. How many acres of seeped land do you have which could be drained and put into production? more
15. What is the condition of your irrigation system? Good
16. Is your water supply adequate? Yes ☒ No _____ Explain _____
17. REMARKS: _____

OVER

NOTE: The foregoing questions apply only to irrigated land shown on this plat.

DESCRIPTION AND MAP OF FARM

Twp. 2 S. Rge. 19 E.

18. Legal Description of this Farm SE NE $\frac{1}{4}$, Fr. SW NE $\frac{1}{4}$, Fr. NE NE $\frac{1}{4}$, Fr. N $\frac{1}{2}$ SE, No. of R.R. - Sec. 24

N $\frac{1}{2}$, Frac SE $\frac{1}{4}$, Frac E $\frac{1}{2}$ SW $\frac{1}{4}$, Fr. NW SW $\frac{1}{4}$, Sec. 19 - S $\frac{1}{2}$ SW $\frac{1}{4}$, N $\frac{1}{2}$ SE $\frac{1}{4}$, Sec. 18 - Twp. 2 S., Rge. 20 E.

| | IRRIGATED LAND | NON-IRRIGATED LAND |
|---|----------------|--------------------|
| <p>— Farm boundary.</p> <p>NORTH</p> <p>This map is according to our records. Please change it if it is not correct. That is if we show more irrigated land than you have, X it out; if we have not enough, draw it in.</p> | | |

19. If the above land is irrigated from more than one ditch please give the acreage under each ditch in 19A and indicate the location of the land irrigated from each on the above map.

19A. Ditch: Mound Ditch Acres: 2

Ditch: _____ Acres: _____

Information supplied by:

Name: Michael P. [Signature] Address: _____ Date: Nov. 5-45

REMARKS: _____

If you cannot answer all of the questions on this form answer as many as you can and return the form to us as soon as possible.

THURBER'S, HELENA

Our records show that you have an appropriation made by Margaret Quinn, appropriated November 10, 1905 and filed November 13, 1905 from Yellowstone River for 420 minors inches. Is this appropriation now in use?

also

Our records show that you have an appropriation made by Mary A. Claussen, appropriated February 20, 1913 and filed February 21, 1913 from Yellowstone River for 100 minors inches. Is this appropriation now in use?

FORM SM-1

A STUDY OF MONTANA'S WATER RESOURCES

- County Stillwater Source of Information 323
1. Water User Christina Kemp Address Columbus
2. Stream _____ Tributary to _____ Basin _____
3. Point of Diversion $\frac{1}{4}$ $\frac{1}{4}$ Section _____ Township _____ Range _____
4. Description of System _____
5. Type of Irrigation _____
6. Original Appropriator 637 Address _____
7. First Use: Year _____ Acres Irrigated _____
8. Maximum Use: Year _____ Acres Irrigated _____
9. Present Use: Year _____ Acres Irrigated _____
10. Last Use: Year _____ Why Abandoned _____
11. Condition of System _____
12. Land Description NE 1/4, 1/4 Sec 18, 54 N 23 E, T. 2 S, R. 19 E

Remarks: 2 Ac 19 E

1/4 Sec 18, 54 N 23 E, T. 2 S, R. 19 E
2 Ac 19 E
1/4 Sec 18, 54 N 23 E, T. 2 S, R. 19 E
2 Ac 19 E

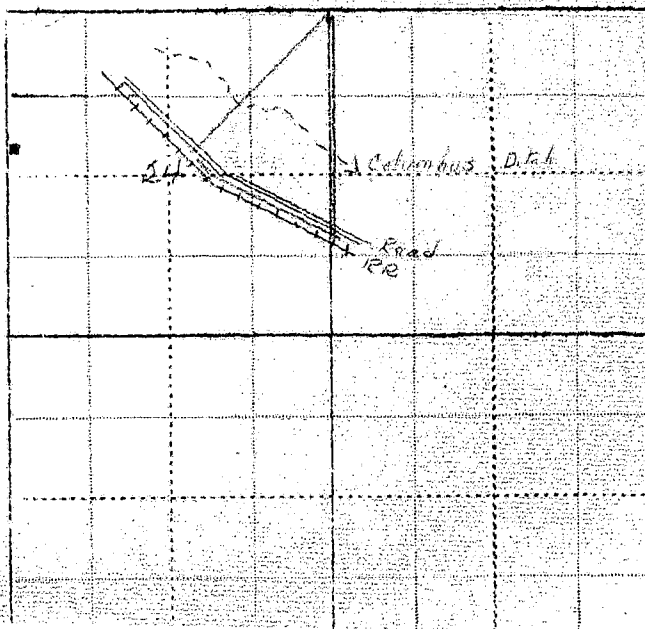

Billings,
~~XXXXXXXX~~

March 2, 1945

Christina Plemp
Columbus, Montana

Dear Madam:

On January 30th, this office sent you a letter asking for certain information pertaining to your irrigated land in township 2 south, 19 east and township 2 south, 20 east. To date we have not heard from you. With the vast post war water development in this area as now planned, it is essential that we have this information in order to show the extent of our water use in the Yellowstone Basin in Montana. This information is necessary to protect our present water users in the rights they have against future irrigation, navigation, power and flood control enterprises in this area. We are asking you for this information because we feel it is the democratic way; we also feel that you are more qualified to give us this information about your irrigated land than anyone else because it is part of your business. It may be that you were busy with your farm work or some unforeseen thing happened at the time our first letter was received, and you put it aside to be answered at some other time and have forgotten all about it. All information is strictly confidential and is only used to record and tabulate the water use in this area.

Water is as necessary to the farmer as the soil in which he plants. Without it no crops will grow; no living thing can survive. It is your water that we are trying to protect, so that you will have plenty now and in the future. We must keep Montana's water in Montana. The only way we can do this is by having the support of each and every water user so that we have a 100 percent representation of all water users. Remember: "United we stand, divided we fall".

In order to facilitate this work a branch office of the State Engineer has been established in Billings and is located in the Roosevelt School Building on 23rd Street and Fourth Avenue North. Anytime you are in Billings we would appreciate your calling on us.

Hoping to hear from you in the very near future, I am,

Very truly yours,

Gerald J. Gravetz
Assistant State Engineer

P.S. If you cannot supply us with the information requested, it may be that you can tell us of someone who can.

Please Do Not Fill in Any Items on This Page

Notice of Appropriation

1. County Stillwater Book 4 Page 441 Record Disc.
2. Name of Appropriator Margaret Quinn, trustee et al Address Montana
3. Date Appropriated Nov. 12, 1935 Date Filed Nov. 13, 1935
- Amount Appropriated, Miners Inches _____, Cubic Feet per second 10.5
4. Name of Stream Yellowstone River Tributary _____ Basin _____
5. Point of Diversion at a point on the north bank of said river near the center of the NW 1/4 of Sec. 14, 2 S., 19 E. on the north bank of stream & measured from said point as the initial point the following well known natural objects and permanent monuments are distant as follows: NW corner of Sec. 14, 2 S., 19 E. is distant about 600 yds in a NW direction. A high rocky bluff across of Sec. 14, 2 S., 19 E. is distant about 600 yds in a westerly direction.
6. Purpose Domestic, irrigation & other purposes.
7. Description of System _____
By means of a dam, ditch and headgate. Said ditch is 6 ft. wide on bottom, 7 1/2 feet wide on top and 1 1/2 feet deep on average.
8. Land Description of Intended Place of Use
- | Subdivision | Sec. | Twp. | Rge. | Tot. Acr. | 1940 Owner | Address |
|------------------------------------|------|------|-------|-----------|----------------|---------|
| on | 24 | 2 S. | 19 E. | | See next page. | |
| & Secs. 19 & 30 | | 2 S. | 20 E. | | | |
| Christina Plemp & George Matovich. | | | | | | |
9. Remarks (Pertaining to Use, etc.)
Margaret Quinn trustee 2/3; J. A. & J. T. Holt 1/6; W. H. Claussen are the appropriators of this water right.

*Not now in use.***Decree**

10. Case No. _____ Date _____ Amt. Decreed: M. I. _____ C. F. S. _____
11. To Whom Decreed _____ Address _____
12. Name of Ditch _____ Maximum Capacity (C. F. S.) _____
13. Date of Priority _____ Purpose _____
14. Land Description of Place of Use as Decreed _____

15. Remarks (Present Use Status, etc.)

1940 Land Ownership.

Acres

- 523 - N - Lot 3, 5, 6, N $\frac{1}{2}$ SW $\frac{1}{4}$ - NE $\frac{1}{4}$ - Frac S $\frac{1}{2}$ SW - Sec. 19, Twp. 2 S., Rge. 20 E.
Christina Plomp, Columbus, Montana
- 61 -- Lot 4 - S frac S $\frac{1}{2}$ SW - SW frac E $\frac{1}{2}$ SE - Section 19, Twp. 2 S., Rge. 20 E.,
Zwante Nyholt.
- 39.07 - Lot 1 and 2 - Section 30 - Twp. 2 S., Rge. 20 E. - Zwante Nyholt, Columbus.
- 80 - Lot 6 & 7 & 8 - Sec. 30 - Twp. 2 S., Rge. 20 E. - Henry Heicksen - Columbus
- 473.10 - S $\frac{1}{2}$ - E $\frac{1}{2}$ SW $\frac{1}{4}$ - Lot 8 - SE fraction N $\frac{1}{2}$ SW - Lots 3, 4, & 5
S $\frac{1}{2}$ NE $\frac{1}{4}$ - Section 30 - Twp. 2 S., Rge. 20 E. - George Matovich, Columbus, Mont.
- 200 - Frac. N $\frac{1}{2}$ - Frac S $\frac{1}{2}$ NE - Frac N $\frac{1}{2}$ SE - Section 24, Twp. 2 S., Rge. 19 E.
Frac 1 to 3 north of R/W - Section 24 - Twp. 2 S., Rge. 19 E.
Frank Borek et ux, Columbus, Montana.

STATE ENGINEERS OFFICE
Water Resources Survey

Notice of Appropriation

1. County Stillwater Book 4 Page 550 Record Misc.
2. Name of Appropriator Mary E. Claussen Address Montana
3. Date Appropriated Feb. 20, 1913 Date Filed Feb. 21, 1913
Amount Appropriated, Miners Inches 100 or , Cubic Feet per second 2 1/2
4. Name of Stream Yellowstone River Tributary Basin
5. Point of Diversion at a point on the bank of river 30 rods north of the west end of a
certain island which said land is about center of
Sec. 14 Twp. 2 S. Rge. 19 E. Bank of Stream
6. Purpose Irrigation and other useful and beneficial purposes.
7. Description of System By means of a dam and ditch, said ditch being 6 feet wide at bottom,
feet wide at top and 3 feet deep.
8. Land Description of Intended Place of Use

| Subdivision | Sec. | Twp. | Rge. | Tot. Acr. | 1940 Owner | Address |
|--------------------------------------|------|------|-------|-----------|------------------|----------|
| Frac S 2 1/2 - Frac E 1/2 SW 1/4 | 19 | 2 S. | 20 E. | 203 | Christina Plomp, | Columbus |
| S 1/2 | 19 | 2 S. | 20 E. | | | |
| Frac S 1/2 - Frac NWSW 1/4 S of R.R. | 19 | 2 S. | 20 E. | 65 | Zwante Nyholt, | Columbus |
9. Remarks (Pertaining to Use, etc.) Transfers of Land Ownership.
Mary E. Clausen to H. A. Appleby to Christina Plomp.
N 1/2 SW 1/4 - N 1/2 SW - Lot 5 & 6 - Frac SE 1/4 of Sec. 19, Lot 3 - 7 Sec. 19, T. 2 S., R. 20 E.
Mary E. Claussen to Frank Lawrence to Allie Farron to Zwante Nyholt
Frac Lot 4 - Frac SE 1/4 - Frac Lot 5 - Sec. 19, Twp. 2 S., Rge. 20 E.

Decree
10. Case No. Date Amt. Decreed: M. I. C. F. S.
11. To Whom Decreed Address
12. Name of Ditch Maximum Capacity (C. F. S.)
13. Date of Priority Purpose
14. Land Description of Place of Use as Decreed
15. Remarks (Present Use Status, etc.)



STATE OF MONTANA
STATE ENGINEERS OFFICE
Water Resources Survey

Code No. 93County 9T. 3 S. R. 10 E.Name of Land Owner Mr. James H. H. H. Address Box 100

Name of Operator _____ Address _____

Part A

**TO BE FILED BY THOSE OBTAINING IRRIGATION WATER FROM
 A DITCH COMPANY OR IRRIGATION DISTRICT**

1. Water is delivered by: Don't know
Name of Ditch, Ditch Company or District supplying water
2. State the number of acres you irrigate under this system _____ Shares you hold _____
3. If you obtain water from more than one Company, give the number of shares, acres irrigated and the name of the Company under "Remarks". If you obtain water from a Ditch Company and also have a private system fill in both Part A and Part B.

Part B

**TO BE FILED BY THOSE WHO HAVE A PRIVATE DITCH, PUMP OR IRRIGATION SYSTEM
 or those who have a private water right under a Ditch Company**

4. In what year was this land first irrigated? Date _____
5. Give the name of the original appropriator (first user): _____
6. Give the date appropriated _____ Amount filed on: Miners Inches _____ C. F. S. _____
7. State the total number of acres irrigated under this system: _____
8. Give the point of diversion: $\frac{1}{4}$ $\frac{1}{4}$ Section _____ Township _____ Range _____

Part C

TO BE FILED BY ALL WATER USERS IN ADDITION TO PART A OR PART B

9. Source of Water: _____
Name of stream or lake from which water is originally diverted
10. Water is obtained by: (Check one) Gravity _____ Pumping _____ Other _____
11. What is the greatest number of acres you have irrigated? _____ Date _____
12. How many acres did you irrigate in 1944? (Crop and pasture) _____
13. State the total number of additional acres that could be irrigated by increasing the water supply, land leveling, etc. _____ This land is under what ditch? _____
14. How many acres of seeped land do you have which could be drained and put into production? _____
15. What is the condition of your irrigation system? _____
16. Is your water supply adequate? Yes _____ No _____ Explain _____
17. REMARKS: _____

DESCRIPTION AND MAP OF FARM

9048-5-77-106

1950

NON-IRRIGATED LAND



19A. Ditch: _____ Acres: _____

Ditch: _____ Acres: _____

Information supplied by: 11655-1

If you cannot answer all of the questions on this form answer as many as you can and return the form to us as soon as possible.

form to us as soon

6-6

2 40 1980

FORM SM-1

A STUDY OF MONTANA'S WATER RESOURCES

County Montana Source of Information 1980

1. Water User Mr. John J. Johnson Address Helena, MT

2. Stream _____ Tributary to _____ Basin _____

3. Point of Diversion 1 1 Section _____ Township _____ Range _____

4. Description of System _____

5. Type of Irrigation _____

6. Original Appropriator John J. Johnson Address _____

7. First Use: Year _____ Acres Irrigated _____

8. Maximum Use: Year _____ Acres Irrigated _____

9. Present Use: Year _____ Acres Irrigated _____

10. Last Use: Year _____ Why Abandoned _____

11. Condition of System _____

12. Land Description lots 15, 16, 17, 18 Sec 6, T 2S, R 19E

Remarks: _____

no record

dry land

see letter attached

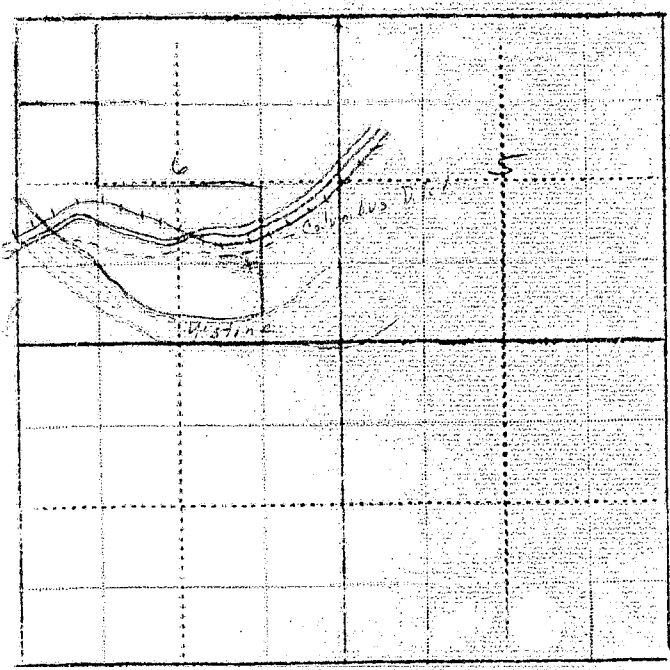

WITNESS: _____ Information by _____
Place _____

DA and

as soon

Billings,
XXXXXX

March 2, 1945

Mrs. Bessie Toothaker
Columbus, Montana

Dear Mrs. Toothaker:

On January 23rd, this office sent you a letter asking for certain information pertaining to your irrigated land in township 2 south, 19 east. To date we have not heard from you. With the vast post war water development in this area as now planned, it is essential that we have this information in order to show the extent of our water use in the Yellowstone Basin in Montana. This information is necessary to protect our present water users in the rights they have against future irrigation, navigation, power and flood control enterprises in this area. We are asking you for this information because we feel it is the democratic way; we also feel that you are more qualified to give us this information about your irrigated land than anyone else because it is part of your business. It may be that you were busy with your farm work or some unforeseen thing happened at the time our first letter was received, and you put it aside to be answered at some other time and have forgotten all about it. All information is strictly confidential and is only used to record and tabulate the water use in this area.

Water is as necessary to the farmer as the soil in which he plants. Without it no crops will grow; no living thing can survive. It is your water that we are trying to protect, so that you will have plenty now and in the future. We must keep Montana's water in Montana. The only way we can do this is by having the support of each and every water user so that we have a 100 percent representation of all water users. Remember: "United we stand, divided we fall".

In order to facilitate this work a branch office of the State Engineer has been established in Billings and is located in the Roosevelt School Building on 23rd Street and Fourth Avenue North. Anytime you are in Billings we would appreciate your calling on us.

Hoping to hear from you in the very near future, I am,

Very truly yours

Gerald J. Gravetz
Assistant State Engineer

P.S. If you cannot supply us with the information requested, it may be that you can tell us of someone who can.



STATE OF MONTANA

STATE ENGINEER

Billings,
~~IDEAL~~ MONTANA

March 2, 1945

Mrs. Bessie Toothaker
Columbus, Montana

Dear Mrs. Toothaker:

On January 23rd, this office sent you a letter asking for certain information pertaining to your irrigated land in township 2 south, 19 east. To date we have not heard from you. With the vast post war water development in this area as now planned, it is essential that we have this information in order to show the extent of our water use in the Yellowstone Basin in Montana. This information is necessary to protect our present water users in the rights they have against future irrigation, navigation, power and flood control enterprises in this area. We are asking you for this information because we feel it is the democratic way; we also feel that you are more qualified to give us this information about your irrigated land than anyone else because it is part of your business. It may be that you were busy with your farm work or some unforeseen thing happened at the time our first letter was received, and you put it aside to be answered at some other time and have forgotten all about it. All information is strictly confidential and is only used to record and tabulate the water use in this area.

Water is as necessary to the farmer as the soil in which he plants. Without it no crops will grow; no living thing can survive. It is your water that we are trying to protect, so that you will have plenty now and in the future. We must keep Montana's water in Montana. The only way we can do this is by having the support of each and every water user so that we have a 100 percent representation of all water users. Remember: "United we stand, divided we fall".

In order to facilitate this work a branch office of the State Engineer has been established in Billings and is located in the Roosevelt School Building on 23rd Street and Fourth Avenue North. Anytime you are in Billings we would appreciate your calling on us.

Hoping to hear from you in the very near future, I am,

Very truly yours,

Gerald J. Grayetz
Gerald J. Grayetz
Assistant State Engineer

P.S. If you cannot supply us with the information requested, it may be that you can tell us of someone who can.

over

Please Do Not Fill in Any Items on This Page

Notice of Appropriation

Misc. File

1. County Stillwater Book No. 110955 Page none given Record Misc.
2. Name of Appropriator State Water Conservation Bd. Address Helena, Montana
3. Date Appropriated Sept. 1, 1937 Date Filed Sept. 7, 1937
Amount Appropriated, All unappropriated/ Miners Inches water. Cubic Feet per second
4. Name of Stream Yellowstone River & trib. Tributary Basin
5. Point of Diversion

Sec. 6 Twp. 2 S. Rge. 19 E. Bank of Stream not shown.

6. Purpose Irrigation (Declaration of intention to store, control and divert water).
7. Description of System Dam and canal.

8. Land Description of Intended Place of Use

| Subdivision | Sec. | Twp. | Rge. | Lot. | Acr. | 1940 Owner | Address |
|-------------|------|------|-------|------|------|------------|---------|
| Lands in | 6 | 2 S. | 19 E. | | | | |

9. Remarks (Pertaining to Use, etc.) All of the unappropriated waters of Yellowstone and tributaries together with the return flow of all waters furnished or supplied by seeping or overflowing from the previous place of use of the above appropriated water.

This is filed but not recorded.

Decree

10. Case No. _____ Date _____ Amt. Decreed: M. I. _____ C. F. S. _____
11. To Whom Decreed _____ Address _____
12. Name of Ditch _____ Maximum Capacity (C. F. S.) _____
13. Date of Priority _____ Purpose _____
14. Land Description of Place of Use as Decreed _____
15. Remarks (Present Use Status, etc.) _____

Form PB-6-1
U. S. 3667

County Stillwater

Sheet No. 1

FORK PROJECTS ADMINISTRATION

Twp. 2 S.

Rge. 20 E.

Section 3

| No. | Name | 1st Set | 2nd Set | Age | Source of Water | | | Source of Information | | | | Type of Irrigation | | |
|-------|-----------------------|------------|------------|-----|-----------------|---------|--------|-----------------------|-------|-------|-------|--------------------|---------|-------|
| | | | | | Ditch | Stream | Other | AAA | Ditch | Owner | Other | Private | Company | Flood |
| 130 | Annin, Winifred ✓ | Jan. | 30-45 | | | 2-1 | | | | | | | | |
| 114 | Bare, C. G. ✓ | Jan. | 30-45 | | | 4-7 | 3-2-45 | | | | | | | |
| 110 | Bay, Lillian ✓ | Jan. | 30-45 | | | 3-10 | 3-2-45 | | | | | | | |
| 145 | Borek, Ollie ✓ | Jan. | 30-45 | | | 2-5 | | | | | | | | |
| 120 | Bothman, John ✓ | Jan. | 30-45 | | | 2-2 | 3-2-45 | | | | | | | |
| 99 | Bouma, Myrtle ✓ | Jan. | 30-45 | | | 4-7 | 3-2-45 | | | | | | | |
| 206 | Bruce, Ida M. ✓ | Jan. | 30-45 | | | 2-9-45 | | | | | | | | |
| 119 | Caldwell, H. M. ✓ | Jan. | 30-45 | | | 2-9-45 | | | | | | | | |
| 91 | Carr, Harry ✓ | Jan. | 30-45 | | | 4-7 | 3-2-45 | | | | | | | |
| 103 | Columbus, Town of ✓ | not set | | | | | | | | | | | | |
| 113 | Cvelbar, Rudolph ✓ | Jan. | 30-45 | | | 2-8-45 | 3-2-45 | | | | | | | |
| 96 | Davey, Mike ✓ | Jan. | 30-45 | | | 3-8-45 | | | | | | | | |
| 104 | Drain, Myrtle ✓ | Jan. | 30-45 | | | 4-7 | 3-2-45 | | | | | | | |
| 121 | Drain, Oliver ✓ | Jan. | 30-45 | | | 3-10-45 | | | | | | | | |
| 88 | Gates, W. N. ✓ | Jan. | 30-45 | | | 2-5 | | | | | | | | |
| 182 | Hamlet, Charles ✓ | Jan. | 30-45 | | | 3-10-45 | 3-2-45 | | | | | | | |
| 100 | Handy, Wes. ✓ | Jan. | 30-45 | | | 3-1 | | | | | | | | |
| 101 | Harris, Byron C. ✓ | Jan. | 30-45 | | | 4-3 | 3-2-45 | | | | | | | |
| 138 | Heckenlively, O. L. ✓ | Jan. | 30-45 | | | 2-2 | 3-2-45 | | | | | | | |
| 107 | Heicksen, Elsie ✓ | Jan. | 30-45 | | | 2-5 | 3-2-45 | | | | | | | |
| 116 | Heicksen, Henry ✓ | Jan. | 30-45 | | | 2-5 | 3-2-45 | | | | | | | |
| Total | | | | | | | | | | | | | | |

Handwritten notes at bottom right of page.

3 Sheets

[illegible]

[illegible]

Township 2 South, Range 20 East

| Code No. | Name of Owner | Name of Operator |
|------------------------|-----------------------|-------------------|
| 1 A, 36 E | Ammin, Winifred | Lofing, Conrad |
| 25 D, 33 A, 33 A | Bare, C. G. | |
| 28 D | Bay, William | |
| 19 B | Berek, Ollie | |
| 34 B | Bothman, John | |
| 21 F | Bouma, Myrtle | |
| 5 A, 8 B | Bruce, Ida M. | |
| 34 A | Caldwell, W. N. | Wagner, Adolph |
| 21 B, 23 D | Carr, Harry | |
| 21 C, 22 G, 27 E, 23 A | Columbus, Town of | |
| 29 C | Cvelbar, Mary | |
| 20 E | Davey, Mike | |
| 27 C, 27 D | Drain, Hugh | |
| 34 C | Drain, Oliver | Drain, Oliver |
| 16 A | Gates, W. N. | |
| 21 H | Hanlett, Charles | |
| 22 A, 27 A, 26 B | Handy, Wes. | |
| 34 F | Harris, Byron C. | Harris, Byron C. |
| 31 C | Heckenlively, O. I. | |
| 28 C, 29 A | Heicksen, Elise | Bernhart, Fred |
| 30 C | Heicksen, Henry | |
| 24 A, 25 A, 26 A | Helleren, Nels | |
| 20 D | Holt, Edna | Isakson, Leonard |
| 20 E | Isakson, Leonard | Same |
| 28 E | Jenkins, Lucy | |
| 1 D, 2 A, 35 A, 36 B | Kem, Oliver T. | |
| 3 A, 4 A, 8 A, 10 A | Kennedy, A. J. | |
| 21 E | Kiehl, Geo. | |
| 17 A, 20 A, 21 D | Kienitz, John | |
| 36 A | Kober, Alex | |
| 20 G | Kovanda, Joe | Kovando, Joe |
| 34 E, 35 D | Kyle, Mrs. W. L. | Huck, Phillip Jr. |
| 28 F | Larson, Lois | |
| 34 D | Lightfoot, Frank | Lightfoot, A. E. |
| 32 C | Line, Jacob E. | Wagner |
| 22 B | Mann, Lewis | Same |
| 27 E | Montana Life Ins. Co. | |
| 29 E, 30 B, 31 A | Matovich, Geo. | Matovich, Geo. |
| 36 D, 1 B | Stene, Elmer | |
| 36 C, 1 C | Stene, John | |
| 19 A, 30 A | Nyholt, Zwante | |
| 35 B, 2 D | Peterson, W. R. | |
| 18 A, 19 C | Flemp, Christina | |
| 32 B | Rudd, John | |
| 35 C, 2 E | Suddith, E. H. | |
| 21 C, 22 F | Twohy, Sarah | |
| 28 B | Witt, Adolph | Same |

Township

28

Range

10 E

County

Bellevue

| Parcel Number | Name of Owner | Section | Address | Filed | MT |
|---------------|---------------------------|-----------|----------|----------|------|
| 112 | Barnes, John H. | Section 1 | 7-1-12 | 7-1-12 | 50 |
| 213 | Walters, Edward F. | Section 1 | 7-1-13 | 7-1-13 | 100 |
| 214 | Quinn, Francis | Section 1 | 5-2-14 | 5-2-14 | 80 |
| 215 | Barto, Charles Edward | Section 1 | 11-12-22 | 7-12-21 | 300 |
| 216 | Crabtree, John H. | Section 1 | 11-12-21 | 4-2-21 | 100 |
| 217 | Christensen, Alexander S. | Section 1 | 5-1-23 | 4-29-21 | 1000 |
| 217 | Christensen, Alexander S. | Section 1 | 7-29-25 | 12-22-25 | 1200 |
| 218 | David, James W. & Edward | Section 1 | 11-19-29 | 10-21-21 | 500 |
| 219 | David, Alexander S. | Section 1 | 5-19-30 | 6-4-30 | 5 |
| 220 | Anderson, John W. | Section 1 | 11-27-22 | 12-32-25 | 300 |
| 221 | Barnes, John H. | Section 1 | 5-1-23 | 7-23-21 | 300 |
| 222 | Barnes, Francis | Section 1 | 3-1-23 | 7-23-21 | 288 |
| 223 | Walters, Robert C. | Section 1 | 7-34-27 | 7-34-27 | 500 |
| 224 | Harker, George | Section 1 | 7-1-25 | 7-1-25 | 50 |
| 225 | Walters, John H. | Section 1 | 11-26-22 | 10-27-22 | 1000 |
| 226 | Walters, John H. | Section 1 | 11-26-22 | 10-27-22 | 1000 |
| 227 | Columbiana Land Co. | Section 1 | 12-2-26 | 7-1-27 | 250 |
| 228 | Hedge, William L. | Section 1 | 3-15-27 | 12-21-25 | 100 |
| 229 | Walters, W.B. | Section 1 | 1-61-21 | 4-22-24 | 50 |
| 230 | Walters, W.B. | Section 1 | 1-61-21 | 1-21-26 | 200 |
| 231 | Walters, W.B. | Section 1 | 1-61-21 | 4-3-15 | 3000 |
| 232 | Walters, W.B. | Section 1 | 1-61-21 | 1-31-25 | 200 |
| 233 | White, John | Section 1 | 11-26-22 | 7-2-15 | 350 |
| 234 | Walters, John H. | Section 1 | 3-3-21 | 4-1-15 | 20 |
| 235 | Chapman, Mary H. | Section 1 | 5-60-19 | 1-3-1-12 | 100 |
| 236 | Columbiana Land Co. | Section 1 | 5-29-19 | 5-29-11 | 3460 |
| 237 | Christensen, Charles H. | Section 1 | 7-6-80 | 8-4-87 | 500 |
| 238 | Walters, W.B. | Section 1 | 6-12-31 | 6-12-31 | 100 |
| 239 | Walters, W.B. | Section 1 | 3-14-27 | 3-14-27 | 100 |
| 240 | Walters, W.B. | Section 1 | 1-30-25 | 1-31-25 | 200 |

STATE OF MONTANA

STATE ENGINEER'S OFFICE

WATER RESOURCES SURVEY

Township 25 Range 20E County Beaumont

| | | | | | |
|----|----|----|----|----|----|
| 6 | 5 | 4 | 3 | 2 | 1 |
| 7 | 8 | 9 | 10 | 11 | 12 |
| 18 | 17 | 16 | 15 | 14 | 13 |
| 19 | 20 | 21 | 22 | 23 | 24 |
| 30 | 29 | 28 | 27 | 26 | 25 |
| 31 | 32 | 33 | 34 | 35 | 36 |

Township..... Range.....

STATE OF MONTANA
STATE ENGINEERS OFFICE
Water Resources Survey

Code No. 1 A, 36 ECounty StillwaterT. 2 S. R. 20 E.
3 S. 20 E.Name of Land Owner Winifred Annin Address ColumbusName of Operator Conrad Jaffig Address same**Part A**

**TO BE FILED BY THOSE OBTAINING IRRIGATION WATER FROM
 A DITCH COMPANY OR IRRIGATION DISTRICT**

1. Water is delivered by: Shane Ditch Co
Name of Ditch, Ditch Company or District supplying water
2. State the number of acres you irrigate under this system 135 Shares you hold 2
3. If you obtain water from more than one Company, give the number of shares, acres irrigated and the name of the Company under "Remarks". If you obtain water from a Ditch Company and also have a private system fill in both Part A and Part B.

Part B

**TO BE FILED BY THOSE WHO HAVE A PRIVATE DITCH, PUMP OR IRRIGATION SYSTEM
 or those who have a private water right under a Ditch Company**

4. In what year was this land first irrigated? Date 1967
5. Give the name of the original appropriator (first user): John R. Smith
6. Give the date appropriated 1967 Amount filed on: Miners Inches 200 C. F. S. 2
7. State the total number of acres irrigated under this system: 135
8. Give the point-of-diversion: 1/4 Section 12 Township 20 Range 36

Part C

TO BE FILED BY ALL WATER USERS IN ADDITION TO PART A OR PART B

9. Source of Water: Shane Ditch Co
Name of stream or lake from which water is originally diverted.
10. Water is obtained by: (Check one) Gravity ☒ Pumping ☐ Other ☐
11. What is the greatest number of acres you have irrigated? 135 Date 1967
12. How many acres did you irrigate in 1944? (Crop and pasture) 135
13. State the total number of additional acres that could be irrigated by increasing the water supply, land leveling, etc. 0 This land is under what ditch? Shane Ditch Co
14. How many acres of seeped land do you have which could be drained and put into production? 0
15. What is the condition of your irrigation system? Good
16. Is your water supply adequate? Yes ☒ No ☐ Explain Yes
17. REMARKS:

NOTE: The foregoing questions apply only to irrigated land shown on this plat.

DESCRIPTION AND MAP OF FARM

18. Legal Description of this Farm: SE 32¹/₂, Frac NE 32¹/₂, Sec. 36 - Twp. 2 S., Rge. 20 E.

SE 32¹/₂, Frac NE 32¹/₂, Sec. 1 - Twp. 3 S., Rge. 20 E.

IRRIGATED LAND

NON-IRRIGATED LAND

NORTH



— Farm boundary.

This map is according to our records. Please change it if it is not correct. That is if we show more irrigated land than you have, X it out; if we have not enough, draw it in.

19. If the above land is irrigated from more than one ditch please give the acreage under each ditch in 19A and indicate the location of the land irrigated from each on the above map.

19A. Ditch: Shane Ditch Co Acres: 135

Ditch: _____ Acres: _____

Information supplied by:

Name: _____ Address: _____ Date: _____

REMARKS: _____

If you cannot answer all of the questions on this form answer as many as you can and return the form to us as soon as possible.

THUNDER B. HELINA

FORM SL-1

A STUDY OF MONTANA'S WATER RESOURCES

County Albuquerque Source of Information 177

1. Water User William L. Anderson Address Bellevue

2. Area Tributary to Basin

3. Point of Diversion 1 1 Section Township Range

4. Description of System

5. Type of Irrigation _____

6. Original Appropriator _____ Address _____

[illegible]

8. Maximum Use: Year _____ Acres Irrigated _____

9. Present Use: Year _____ Acres Irrigated _____

| 10. Last Use: | Year | Why Abandoned |
|---------------|------|---------------|
| | | |

11. Condition of System

12. Land Description 1000 Acres, T 1, R 1

Remarks: 4-2-5

1. 1990年12月，中共中央、国务院作出《关于实行党风廉政建设责任制的规定》，明确各级领导干部对职责范围内的党风廉政建设负全面领导责任。

11-20-44

[illegible][illegible]

[Faint handwritten notes and bleed-through from the reverse side of the page are visible.]

$\frac{d}{dt} \left(\frac{1}{r^2} \right) = -\frac{2}{r^3} \frac{dr}{dt}$

Figure 1. The effect of the concentration of the polymer on the swelling ratio of the hydrogel. The swelling ratio of the hydrogel increases with the increase of the concentration of the polymer. The swelling ratio of the hydrogel is 1.0 at 0.1 g/L, 1.5 at 0.2 g/L, 2.0 at 0.3 g/L, 2.5 at 0.4 g/L, 3.0 at 0.5 g/L, 3.5 at 0.6 g/L, 4.0 at 0.7 g/L, 4.5 at 0.8 g/L, 5.0 at 0.9 g/L, 5.5 at 1.0 g/L, 6.0 at 1.1 g/L, 6.5 at 1.2 g/L, 7.0 at 1.3 g/L, 7.5 at 1.4 g/L, 8.0 at 1.5 g/L, 8.5 at 1.6 g/L, 9.0 at 1.7 g/L, 9.5 at 1.8 g/L, 10.0 at 1.9 g/L, 10.5 at 2.0 g/L, 11.0 at 2.1 g/L, 11.5 at 2.2 g/L, 12.0 at 2.3 g/L, 12.5 at 2.4 g/L, 13.0 at 2.5 g/L, 13.5 at 2.6 g/L, 14.0 at 2.7 g/L, 14.5 at 2.8 g/L, 15.0 at 2.9 g/L, 15.5 at 3.0 g/L, 16.0 at 3.1 g/L, 16.5 at 3.2 g/L, 17.0 at 3.3 g/L, 17.5 at 3.4 g/L, 18.0 at 3.5 g/L, 18.5 at 3.6 g/L, 19.0 at 3.7 g/L, 19.5 at 3.8 g/L, 20.0 at 3.9 g/L, 20.5 at 4.0 g/L, 21.0 at 4.1 g/L, 21.5 at 4.2 g/L, 22.0 at 4.3 g/L, 22.5 at 4.4 g/L, 23.0 at 4.5 g/L, 23.5 at 4.6 g/L, 24.0 at 4.7 g/L, 24.5 at 4.8 g/L, 25.0 at 4.9 g/L, 25.5 at 5.0 g/L, 26.0 at 5.1 g/L, 26.5 at 5.2 g/L, 27.0 at 5.3 g/L, 27.5 at 5.4 g/L, 28.0 at 5.5 g/L, 28.5 at 5.6 g/L, 29.0 at 5.7 g/L, 29.5 at 5.8 g/L, 30.0 at 5.9 g/L, 30.5 at 6.0 g/L, 31.0 at 6.1 g/L, 31.5 at 6.2 g/L, 32.0 at 6.3 g/L, 32.5 at 6.4 g/L, 33.0 at 6.5 g/L, 33.5 at 6.6 g/L, 34.0 at 6.7 g/L, 34.5 at 6.8 g/L, 35.0 at 6.9 g/L, 35.5 at 7.0 g/L, 36.0 at 7.1 g/L, 36.5 at 7.2 g/L, 37.0 at 7.3 g/L, 37.5 at 7.4 g/L, 38.0 at 7.5 g/L, 38.5 at 7.6 g/L, 39.0 at 7.7 g/L, 39.5 at 7.8 g/L, 40.0 at 7.9 g/L, 40.5 at 8.0 g/L, 41.0 at 8.1 g/L, 41.5 at 8.2 g/L, 42.0 at 8.3 g/L, 42.5 at 8.4 g/L, 43.0 at 8.5 g/L, 43.5 at 8.6 g/L, 44.0 at 8.7 g/L, 44.5 at 8.8 g/L, 45.0 at 8.9 g/L, 45.5 at 9.0 g/L, 46.0 at 9.1 g/L, 46.5 at 9.2 g/L, 47.0 at 9.3 g/L, 47.5 at 9.4 g/L, 48.0 at 9.5 g/L, 48.5 at 9.6 g/L, 49.0 at 9.7 g/L, 49.5 at 9.8 g/L, 50.0 at 9.9 g/L, 50.5 at 10.0 g/L, 51.0 at 10.1 g/L, 51.5 at 10.2 g/L, 52.0 at 10.3 g/L, 52.5 at 10.4 g/L, 53.0 at 10.5 g/L, 53.5 at 10.6 g/L, 54.0 at 10.7 g/L, 54.5 at 10.8 g/L, 55.0 at 10.9 g/L, 55.5 at 11.0 g/L, 56.0 at 11.1 g/L, 56.5 at 11.2 g/L, 57.0 at 11.3 g/L, 57.5 at 11.4 g/L, 58.0 at 11.5 g/L, 58.5 at 11.6 g/L, 59.0 at 11.7 g/L, 59.5 at 11.8 g/L, 60.0 at 11.9 g/L, 60.5 at 12.0 g/L, 61.0 at 12.1 g/L, 61.5 at 12.2 g/L, 62.0 at 12.3 g/L, 62.5 at 12.4 g/L, 63.0 at 12.5 g/L, 63.5 at 12.6 g/L, 64.0 at 12.7 g/L, 64.5 at 12.8 g/L, 65.0 at 12.9 g/L, 65.5 at 13.0 g/L, 66.0 at 13.1 g/L, 66.5 at 13.2 g/L, 67.0 at 13.3 g/L, 67.5 at 13.4 g/L, 68.0 at 13.5 g/L, 68.5 at 13.6 g/L, 69.0 at 13.7 g/L, 69.5 at 13.8 g/L, 70.0 at 13.9 g/L, 70.5 at 14.0 g/L, 71.0 at 14.1 g/L, 71.5 at 14.2 g/L, 72.0 at 14.3 g/L, 72.5 at 14.4 g/L, 73.0 at 14.5 g/L, 73.5 at 14.6 g/L, 74.0 at 14.7 g/L, 74.5 at 14.8 g/L, 75.0 at 14.9 g/L, 75.5 at 15.0 g/L, 76.0 at 15.1 g/L, 76.5 at 15.2 g/L, 77.0 at 15.3 g/L, 77.5 at 15.4 g/L, 78.0 at 15.5 g/L, 78.5 at 15.6 g/L, 79.0 at 15.7 g/L, 79.5 at 15.8 g/L, 80.0 at 15.9 g/L, 80.5 at 16.0 g/L, 81.0 at 16.1 g/L, 81.5 at 16.2 g/L, 82.0 at 16.3 g/L, 82.5 at 16.4 g/L, 83.0 at 16.5 g/L, 83.5 at 16.6 g/L, 84.0 at 16.7 g/L, 84.5 at 16.8 g/L, 85.0 at 16.9 g/L, 85.5 at 17.0 g/L, 86.0 at 17.1 g/L, 86.5 at 17.2 g/L, 87.0 at 17.3 g/L, 87.5 at 17.4 g/L, 88.0 at 17.5 g/L, 88.5 at 17.6 g/L, 89.0 at 17.7 g/L, 89.5 at 17.8 g/L, 90.0 at 17.9 g/L, 90.5 at 18.0 g/L, 91.0 at 18.1 g/L, 91.5 at 18.2 g/L, 92.0 at 18.3 g/L, 92.5 at 18.4 g/L, 93.0 at 18.5 g/L, 93.5 at 18.6 g/L, 94.0 at 18.7 g/L, 94.5 at 18.8 g/L, 95.0 at 18.9 g/L, 95.5 at 19.0 g/L, 96.0 at 19.1 g/L, 96.5 at 19.2 g/L, 97.0 at 19.3 g/L, 97.5 at 19.4 g/L, 98.0 at 19.5 g/L, 98.5 at 19.6 g/L, 99.0 at 19.7 g/L, 99.5 at 19.8 g/L, 100.0 at 19.9 g/L, 100.5 at 20.0 g/L, 101.0 at 20.1 g/L, 101.5 at 20.2 g/L, 102.0 at 20.3 g/L, 102.5 at 20.4 g/L, 103.0 at 20.5 g/L, 103.5 at 20.6 g/L, 104.0 at 20.7 g/L, 104.5 at 20.8 g/L, 105.0 at 20.9 g/L, 105.5 at 21.0 g/L, 106.0 at 21.1 g/L, 106.5 at 21.2 g/L, 107.0 at 21.3 g/L, 107.5 at 21.4 g/L, 108.0 at 21.5 g/L, 108.5 at 21.6 g/L, 109.0 at 21.7 g/L, 109.5 at 21.8 g/L, 110.0 at 21.9 g/L, 110.5 at 22.0 g/L, 111.0 at 22.1 g/L, 111.5 at 22.2 g/L, 112.0 at 22.3 g/L, 112.5 at 22.4 g/L, 113.0 at 22.5 g/L, 113.5 at 22.6 g/L, 114.0 at 22.7 g/L, 114.5 at 22.8 g/L, 115.0 at 22.9 g/L, 115.5 at 23.0 g/L, 116.0 at 23.1 g/L, 116.5 at 23.2 g/L, 117.0 at 23.3 g/L, 117.5 at 23.4 g/L, 118.0 at 23.5 g/L, 118.5 at 23.6 g/L, 119.0 at 23.7 g/L, 119.5 at 23.8 g/L, 120.0 at 23.9 g/L, 120.5 at 24.0 g/L, 121.0 at 24.1 g/L, 121.5 at 24.2 g/L, 122.0 at 24.3 g/L, 122.5 at 24.4 g/L, 123.0 at 24.5 g/L, 123.5 at 24.6 g/L, 124.0 at 24.7 g/L, 124.5 at 24.8 g/L, 125.0 at 24.9 g/L, 125.5 at 25.0 g/L, 126.0 at 25.1 g/L, 126.5 at 25.2 g/L, 127.0 at 25.3 g/L, 127.5 at 25.4 g/L, 128.0 at 25.5 g/L, 128.5 at 25.6 g/L, 129.0 at 25.7 g/L, 129.5 at 25.8 g/L, 130.0 at 25.9 g/L, 130.5 at 26.0 g/L, 131.0 at 26.1 g/L, 131.5 at 26.2 g/L, 132.0 at 26.3 g/L, 132.5 at 26.4 g/L, 133.0 at 26.5 g/L, 133.5 at 26.6 g/L, 134.0 at 26.7 g/L, 134.5 at 26.8 g/L, 135.0 at 26.9 g/L, 135.5 at 27.0 g/L, 136.0 at 27.1 g/L, 136.5 at 27.2 g/L, 137.0 at 27.3 g/L, 137.5 at 27.4 g/L, 138.0 at 27.5 g/L, 138.5 at 27.6 g/L, 139.0 at 27.7 g/L, 139.5 at 27.8 g/L, 140.0 at 27.9 g/L, 140.5 at 28.0 g/L, 141.0 at 28.1 g/L, 141.5 at 28.2 g/L, 142.0 at 28.3 g/L, 142.5 at 28.4 g/L, 143.0 at 28.5 g/L, 143.5 at 28.6 g/L, 144.0 at 28.7 g/L, 144.5 at 28.8 g/L, 145.0 at 28.9 g/L, 145.5 at 29.0 g/L, 146.0 at 29.1

WITNESS: _____ Information by _____

Place

