

Please Do Not Fill in Any Items on This Page

Notice of Appropriation

1. County Stillwater Book 2 Page 18 Record Misc.
2. Name of Appropriator Charles Temple et al Address not shown.
(See next page.)
3. Date Appropriated Nov. 23, 1891 Date Filed Not due Nov. 24, 1891
Amount Appropriated, Miners Inches 3000, Cubic Feet per second _____
4. Name of Stream Yellowstone River Tributary _____ Basin _____
5. Point of Diversion Water is diverted 1/4 from a point upon its northerly bank about 230 feet from the center of the main track of the N. P. Ry. Co.'s railroad and about 300 feet W. from the residence of E. S. Tutt, situated on lot 5, Sec. 5, T. 3 S., R. 21 E. & running thence Sec. _____ Twp. _____ Rge. _____ Bank of Stream, northerly.
in a general easterly direction to over and upon the above described lands.
6. Purpose Irrigation, domestic and beneficial purposes.
7. Description of System By means of a dam and ditch; the said ditch is 108 inches in width on the bottom, thereof and 156 inches across the top, by 24 inches in depth.

8. Land Description of Intended Place of Use

Subdivision	Sec.	Twp.	Rge.	Tot. Acr.	1940 Owner	Address
N1/4 - lots 4 & 5, NW1/4	10	3 S.	21 E.		See next page.	
N1/4 - NW1/4 - NW1/4 - NW1/4	11					
NE1/4 - E1/4	11	3 S.	21 E.			
NW1/4 - NE1/4 - E1/4 - SW1/4	12	3 S.	21 E.			
SE1/4 - lots 2, 3, 4 & 5	7	3 S.	22 E.			
Part of NW1/4 of	8	3 S.	22 E.			
All of	5	3 S.	22 E.			
Lots 2, 3, 5 & 6	4	3 S.	22 E.			
SW1/4 - SE1/4	33	2 S.	22 E.			

Decree

For 9. Remarks - See next page. - now in use.

10. Case No. _____ Date _____ Amt. Decreed: M. I. _____ C. F. S. _____
11. To Whom Decreed _____ Address _____
12. Name of Ditch _____ Maximum Capacity (C. F. S.) _____
13. Date of Priority _____ Purpose _____
14. Land Description of Place of Use as Decreed _____

15. Remarks (Present Use Status, etc.) _____

9. Remarks (Pertaining to Use, etc.)

And we do further claim the right to change the point of diversion of said water at anytime and to extend the flumes, piles, ditches and aqueducts for which said diversion is made, from time to time to any place other than where first used and to use the water for other useful purposes and beneficial purposes than that for which it was first appropriated, we also claim the rights of way for dikes and canals over and across the lands through the same and the right to enlarge and to alter the same from time to time and also all rights, easements, privileges and appurtenances.

2. Name of appropriators:

Charles Temple et al; John Walsh, Charles R. Watkins, Andrew E. Parker, George R. Cummins, John W. Cummins, Stephen E. Wimsett, Sarah E. Wimsett, William W. Palmer and George C. Tilden.

1940 Land Ownership .

- 128 A - N $\frac{1}{2}$ NW $\frac{1}{4}$, Lots 4 & 5, Sec. 10, T. 3 S., R. 21 E. - Gerhard Waltermann, Columbus,
 160 A - NE $\frac{1}{4}$, Sec. 10, T. 3 S., R. 21 E., Douglas Annin, c/o L. B. Banks, Columbus, Mont.
 111 A - W $\frac{1}{2}$ NW $\frac{1}{4}$, NWSW - Sec. 11, T. 3 S., R. 21 E. - Jacob Henry, Park City, Mont.
 155 A - E $\frac{1}{2}$ NE $\frac{1}{4}$ - Lot 1, Sec. 11, T. 3 S., R. 21 E. - Charles & Alice Storer, Columbus,
 E Frac lot 2 - Sec. 11, T. 3 S., R. 21 E.
 E $\frac{1}{2}$ W $\frac{1}{2}$ NE $\frac{1}{4}$ - Sec. 11, T. 3 S., R. 21 E.
 183.78 - E $\frac{1}{2}$ NW $\frac{1}{4}$, NESW, W $\frac{1}{2}$ NWSE, Sec. 11, T. 3 S., R. 21 E. - Federal Land Bank.
 W $\frac{1}{2}$ W $\frac{1}{2}$ NE $\frac{1}{4}$ - Sec. 11, T. 3 S., R. 21 E. c/o Al Godneys, Hardin, Mont.
 164 - SE $\frac{1}{2}$ NW $\frac{1}{4}$ - Lot 2, 3, 4, 5 - Sec. 7, T. 3 S., R. 22 E - R. W. Whipple, Fishtail.
 80 - Lot 1 & 2, N $\frac{1}{2}$ NW - Sec. 8 - T. 3 S., R. 22 E. - Konrad Weschenfelder, Park City,
 222 - Frac E $\frac{1}{2}$ NW $\frac{1}{4}$ - W $\frac{1}{2}$ NW $\frac{1}{4}$
 NWSW - Frac NESW - Frac SWSW - Sec. 5, T. 3 S., R. 22 E. - Peter Yegen, Billings.
 105 - Frac SWSW - Lot 5 & 6, Sec. 5, T. 3 S., R. 22 E.
 SE corner NESW - SW frac NESW - Sec. 5 - T. 3 S., R. 22 E.
 Konrad Weschenfelder - Park City, Montana
 Acres? - Part of lot 2 & Frac of lot 3 - Sec. 5 - T. 3 S., R. 22 E.
 M. O. Rosden, Laurel, Montana
 40 A - Lot 1 - Sec. 5 - T. 3 S., R. 22 E. - Titus Mauk, Park City, Montana
 50.23 - Lot 7 - NE corner SWSE, Sec. 5, T. 3 S., R. 22 E. - M. O. Rosden, Laurel, Montana
 99.77 - Lot 5 & 6 - Frac SWNW - Sec. 4 - T. 3 S., R. 22 E.
 S $\frac{1}{2}$ N $\frac{1}{2}$ NW - Lot 2 - Sec. 4, T. 3 S., R. 22 E.
 19.67 - Fracs. of lot 3 - Sec. 4 - T. 3 S., R. 22 E - H. C. Crippen, Billings.
 143 - S $\frac{1}{2}$ SW $\frac{1}{4}$, NESW, Sec. 33, T. 2 S., R. 22 E.
 Frac NWSW, Frac SENW, Sec. 33, T. 2 S., R. 22 E.
 Frac SESW, Sec. 33, T. 2 S., R. 22 E. - H. C. Crippen, Billings, Montana
 68 - SWNW, Frac SENW, Sec. 33 - T. 2 S., R. 22 E. - M. O. Raysden, Laurel, Montana



STATE OF MONTANA
STATE ENGINEERS OFFICE
Water Resources Survey

76
Form WR-1-1M-11-41

Code No. 1 A, 2 A, 12 A

County Stillwater

T. 3 S. R. 21 E.

Name of Land Owner Anton Hajny Address Columbus, Montana

Name of Operator Anton Hajny Address Columbus, Montana

Part A

TO BE FILED BY THOSE OBTAINING IRRIGATION WATER FROM
A DITCH COMPANY OR IRRIGATION DISTRICT

1. Water is delivered by: The Yellowstone & Love Ditch
Name of Ditch, Ditch Company or District supplying water
2. State the number of acres you irrigate under this system 130 acres Shares you hold 30.57
3. If you obtain water from more than one Company, give the number of shares, acres irrigated and the name of the Company under "Remarks". If you obtain water from a Ditch Company and also have a private system fill in both Part A and Part B.
50 acres above ditch at

Part B

TO BE FILED BY THOSE WHO HAVE A PRIVATE DITCH, PUMP OR IRRIGATION SYSTEM
or those who have a private water right under a Ditch Company

4. In what year was this land first irrigated? Date I don't know but about 1892 or '93
5. Give the name of the original appropriator (first user): 3000 inches Blue Earth ditch
6. Give the date appropriated Nov 23-1891 Amount filed on: Miners Inches 3000 C. F. S. _____
7. State the total number of acres irrigated under this system: _____
8. Give the point of diversion: _____ $\frac{1}{4}$ _____ $\frac{1}{4}$ Section 5 Township 340 Range 21 E

Part C

TO BE FILED BY ALL WATER USERS IN ADDITION TO PART A OR PART B

9. Source of Water: Yellowstone River
Name of stream or lake from which water is originally diverted
10. Water is obtained by: (Check one) Gravity ☒ Pumping ☐ Other ☐
11. What is the greatest number of acres you have irrigated? _____ Date _____
12. How many acres did you irrigate in 1944? (Crop and pasture) 180
13. State the total number of additional acres that could be irrigated by increasing the water supply, land leveling, etc. _____ This land is under what ditch? ✓
14. How many acres of seeped land do you have which could be drained and put into production? _____
15. What is the condition of your irrigation system? Good
16. Is your water supply adequate? Yes ☒ No ☐ Explain _____
17. REMARKS: _____

50 acres pumped above ditch

OVER

NOTE: The foregoing questions apply only to irrigated land shown on this plat.

DESCRIPTION AND MAP OF FARM

18. Legal Description of this Farm. All Section 1, N $\frac{1}{2}$, NE SW $\frac{1}{4}$, N $\frac{1}{2}$ SE $\frac{1}{4}$, SE SE $\frac{1}{4}$, Sec. 2 - Twp. 3 S., Rge. 21 E.
NW $\frac{1}{4}$, N $\frac{1}{2}$ NE $\frac{1}{4}$, Lot 4, 8, 9, 10, 11, Section 12 - Twp. 3 S., Rge. 21 E.

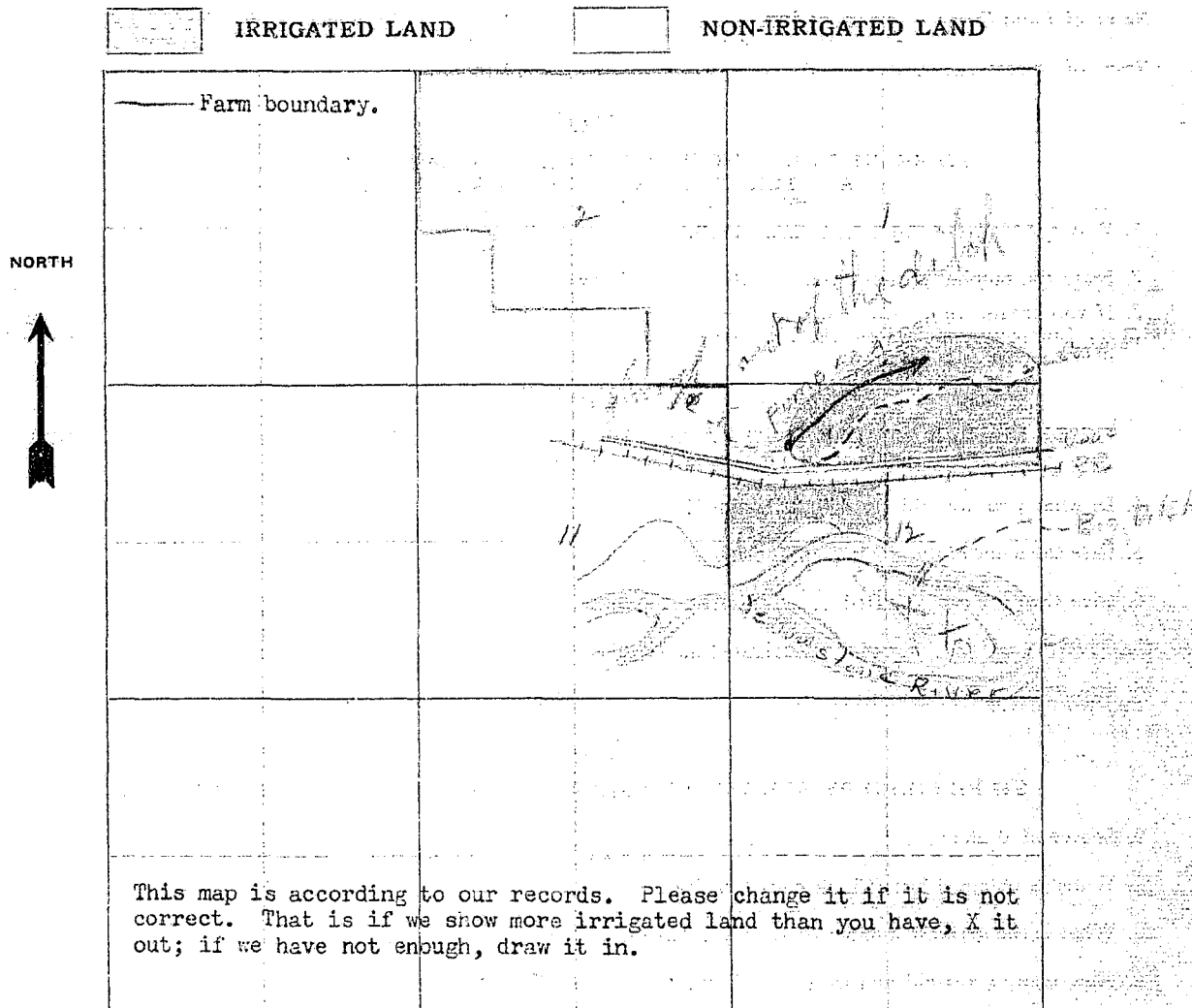
	IRRIGATED LAND	NON-IRRIGATED LAND
<p>— Farm boundary.</p> <p>NORTH</p> 		
<p>This map is according to our records. Please change it if it is not correct. That is if we show more irrigated land than you have, X it out; if we have not enough, draw it in.</p>		

19. If the above land is irrigated from more than one ditch please give the acreage under each ditch in 19A and indicate the location of the land irrigated from each on the above map.

19A. Ditch: Yellowstone Ditch Co. Acres: 10.0

Ditch: _____ Acres: _____

Information supplied by:

Name: Country Agency Address: Cochise County Date: Feb 6 1915

REMARKS: _____

If you cannot answer all of the questions on this form answer as many as you can and return the form to us as soon as possible.

THURBER'S, HELENA

Our records show that you have an appropriation made by George R. Cummins, appropriated November 23, 1891 and filed November 24, 1891 from Yellowstone River for 3000 minors inches. Is this appropriation now in use?

1-A
2-A
10-A
FORM SM-1

76
A STUDY OF MONTANA'S WATER RESOURCES

County Stillwater Source of Information SR-7510

1. Water User Antes Hagen Address Bellevue

2. Stream _____ Tributary to _____ Basin _____

3. Point of Diversion $\frac{1}{4}$ $\frac{1}{4}$ Section _____ Township _____ Range _____

4. Description of System _____

5. Type of Irrigation _____

6. Original Appropriator Antes Address _____

7. First Use: Year _____ Acres Irrigated _____

8. Maximum Use: Year _____ Acres Irrigated _____

9. Present Use: Year _____ Acres Irrigated _____

10. Last Use: Year _____ Why Abandoned _____

11. Condition of System _____

12. Land Description All Sec 1, 10, 20, 30, 40, 50, 60, 70, 80, 90, 100, 110, 120, 130, 140, 150, 160, 170, 180, 190, 200, 210, 220, 230, 240, 250, 260, 270, 280, 290, 300, 310, 320, 330, 340, 350, 360, 370, 380, 390, 400, 410, 420, 430, 440, 450, 460, 470, 480, 490, 500, 510, 520, 530, 540, 550, 560, 570, 580, 590, 600, 610, 620, 630, 640, 650, 660, 670, 680, 690, 700, 710, 720, 730, 740, 750, 760, 770, 780, 790, 800, 810, 820, 830, 840, 850, 860, 870, 880, 890, 900, 910, 920, 930, 940, 950, 960, 970, 980, 990, 1000, 1010, 1020, 1030, 1040, 1050, 1060, 1070, 1080, 1090, 1100, 1110, 1120, 1130, 1140, 1150, 1160, 1170, 1180, 1190, 1200, 1210, 1220, 1230, 1240, 1250, 1260, 1270, 1280, 1290, 1300, 1310, 1320, 1330, 1340, 1350, 1360, 1370, 1380, 1390, 1400, 1410, 1420, 1430, 1440, 1450, 1460, 1470, 1480, 1490, 1500, 1510, 1520, 1530, 1540, 1550, 1560, 1570, 1580, 1590, 1600, 1610, 1620, 1630, 1640, 1650, 1660, 1670, 1680, 1690, 1700, 1710, 1720, 1730, 1740, 1750, 1760, 1770, 1780, 1790, 1800, 1810, 1820, 1830, 1840, 1850, 1860, 1870, 1880, 1890, 1900, 1910, 1920, 1930, 1940, 1950, 1960, 1970, 1980, 1990, 2000, 2010, 2020, 2030, 2040, 2050, 2060, 2070, 2080, 2090, 2100, 2110, 2120, 2130, 2140, 2150, 2160, 2170, 2180, 2190, 2200, 2210, 2220, 2230, 2240, 2250, 2260, 2270, 2280, 2290, 2300, 2310, 2320, 2330, 2340, 2350, 2360, 2370, 2380, 2390, 2400, 2410, 2420, 2430, 2440, 2450, 2460, 2470, 2480, 2490, 2500, 2510, 2520, 2530, 2540, 2550, 2560, 2570, 2580, 2590, 2600, 2610, 2620, 2630, 2640, 2650, 2660, 2670, 2680, 2690, 2700, 2710, 2720, 2730, 2740, 2750, 2760, 2770, 2780, 2790, 2800, 2810, 2820, 2830, 2840, 2850, 2860, 2870, 2880, 2890, 2900, 2910, 2920, 2930, 2940, 2950, 2960, 2970, 2980, 2990, 3000, 3010, 3020, 3030, 3040, 3050, 3060, 3070, 3080, 3090, 3100, 3110, 3120, 3130, 3140, 3150, 3160, 3170, 3180, 3190, 3200, 3210, 3220, 3230, 3240, 3250, 3260, 3270, 3280, 3290, 3300, 3310, 3320, 3330, 3340, 3350, 3360, 3370, 3380, 3390, 3400, 3410, 3420, 3430, 3440, 3450, 3460, 3470, 3480, 3490, 3500, 3510, 3520, 3530, 3540, 3550, 3560, 3570, 3580, 3590, 3600, 3610, 3620, 3630, 3640, 3650, 3660, 3670, 3680, 3690, 3700, 3710, 3720, 3730, 3740, 3750, 3760, 3770, 3780, 3790, 3800, 3810, 3820, 3830, 3840, 3850, 3860, 3870, 3880, 3890, 3900, 3910, 3920, 3930, 3940, 3950, 3960, 3970, 3980, 3990, 4000, 4010, 4020, 4030, 4040, 4050, 4060, 4070, 4080, 4090, 4100, 4110, 4120, 4130, 4140, 4150, 4160, 4170, 4180, 4190, 4200, 4210, 4220, 4230, 4240, 4250, 4260, 4270, 4280, 4290, 4300, 4310, 4320, 4330, 4340, 4350, 4360, 4370, 4380, 4390, 4400, 4410, 4420, 4430, 4440, 4450, 4460, 4470, 4480, 4490, 4500, 4510, 4520, 4530, 4540, 4550, 4560, 4570, 4580, 4590, 4600, 4610, 4620, 4630, 4640, 4650, 4660, 4670, 4680, 4690, 4700, 4710, 4720, 4730, 4740, 4750, 4760, 4770, 4780, 4790, 4800, 4810, 4820, 4830, 4840, 4850, 4860, 4870, 4880, 4890, 4900, 4910, 4920, 4930, 4940, 4950, 4960, 4970, 4980, 4990, 5000, 5010, 5020, 5030, 5040, 5050, 5060, 5070, 5080, 5090, 5100, 5110, 5120, 5130, 5140, 5150, 5160, 5170, 5180, 5190, 5200, 5210, 5220, 5230, 5240, 5250, 5260, 5270, 5280, 5290, 5300, 5310, 5320, 5330, 5340, 5350, 5360, 5370, 5380, 5390, 5400, 5410, 5420, 5430, 5440, 5450, 5460, 5470, 5480, 5490, 5500, 5510, 5520, 5530, 5540, 5550, 5560, 5570, 5580, 5590, 5600, 5610, 5620, 5630, 5640, 5650, 5660, 5670, 5680, 5690, 5700, 5710, 5720, 5730, 5740, 5750, 5760, 5770, 5780, 5790, 5800, 5810, 5820, 5830, 5840, 5850, 5860, 5870, 5880, 5890, 5900, 5910, 5920, 5930, 5940, 5950, 5960, 5970, 5980, 5990, 6000, 6010, 6020, 6030, 6040, 6050, 6060, 6070, 6080, 6090, 6100, 6110, 6120, 6130, 6140, 6150, 6160, 6170, 6180, 6190, 6200, 6210, 6220, 6230, 6240, 6250, 6260, 6270, 6280, 6290, 6300, 6310, 6320, 6330, 6340, 6350, 6360, 6370, 6380, 6390, 6400, 6410, 6420, 6430, 6440, 6450, 6460, 6470, 6480, 6490, 6500, 6510, 6520, 6530, 6540, 6550, 6560, 6570, 6580, 6590, 6600, 6610, 6620, 6630, 6640, 6650, 6660, 6670, 6680, 6690, 6700, 6710, 6720, 6730, 6740, 6750, 6760, 6770, 6780, 6790, 6800, 6810, 6820, 6830, 6840, 6850, 6860, 6870, 6880, 6890, 6900, 6910, 6920, 6930, 6940, 6950, 6960, 6970, 6980, 6990, 7000, 7010, 7020, 7030, 7040, 7050, 7060, 7070, 7080, 7090, 7100, 7110, 7120, 7130, 7140, 7150, 7160, 7170, 7180, 7190, 7200, 7210, 7220, 7230, 7240, 7250, 7260, 7270, 7280, 7290, 7300, 7310, 7320, 7330, 7340, 7350, 7360, 7370, 7380, 7390, 7400, 7410, 7420, 7430, 7440, 7450, 7460, 7470, 7480, 7490, 7500, 7510, 7520, 7530, 7540, 7550, 7560, 7570, 7580, 7590, 7600, 7610, 7620, 7630, 7640, 7650, 7660, 7670, 7680, 7690, 7700, 7710, 7720, 7730, 7740, 7750, 7760, 7770, 7780, 7790, 7800, 7810, 7820, 7830, 7840, 7850, 7860, 7870, 7880, 7890, 7900, 7910, 7920, 7930, 7940, 7950, 7960, 7970, 7980, 7990, 8000, 8010, 8020, 8030, 8040, 8050, 8060, 8070, 8080, 8090, 8100, 8110, 8120, 8130, 8140, 8150, 8160, 8170, 8180, 8190, 8200, 8210, 8220, 8230, 8240, 8250, 8260, 8270, 8280, 8290, 8300, 8310, 8320, 8330, 8340, 8350, 8360, 8370, 8380, 8390, 8400, 8410, 8420, 8430, 8440, 8450, 8460, 8470, 8480, 8490, 8500, 8510, 8520, 8530, 8540, 8550, 8560, 8570, 8580, 8590, 8600, 8610, 8620, 8630, 8640, 8650, 8660, 8670, 8680, 8690, 8700, 8710, 8720, 8730, 8740, 8750, 8760, 8770, 8780, 8790, 8800, 8810, 8820, 8830, 8840, 8850, 8860, 8870, 8880, 8890, 8900, 8910, 8920, 8930, 8940, 8950, 8960, 8970, 8980, 8990, 9000, 9010, 9020, 9030, 9040, 9050, 9060, 9070, 9080, 9090, 9100, 9110, 9120, 9130, 9140, 9150, 9160, 9170, 9180, 9190, 9200, 9210, 9220, 9230, 9240, 9250, 9260, 9270, 9280, 9290, 9300, 9310, 9320, 9330, 9340, 9350, 9360, 9370, 9380, 9390, 9400, 9410, 9420, 9430, 9440, 9450, 9460, 9470, 9480, 9490, 9500, 9510, 9520, 9530, 9540, 9550, 9560, 9570, 9580, 9590, 9600, 9610, 9620, 9630, 9640, 9650, 9660, 9670, 9680, 9690, 9700, 9710, 9720, 9730, 9740, 9750, 9760, 9770, 9780, 9790, 9800, 9810, 9820, 9830, 9840, 9850, 9860, 9870, 9880, 9890, 9900, 9910, 9920, 9930, 9940, 9950, 9960, 9970, 9980, 9990, 10000, 10010, 10020, 10030, 10040, 10050, 10060, 10070, 10080, 10090, 10100, 10110, 10120, 10130, 10140, 10150, 10160, 10170, 10180, 10190, 10200, 10210, 10220, 10230, 10240, 10250, 10260, 10270, 10280, 10290, 10300, 10310, 10320, 10330, 10340, 10350, 10360, 10370, 10380, 10390, 10400, 10410, 10420, 10430, 10440, 10450, 10460, 10470, 10480, 10490, 10500, 10510, 10520, 10530, 10540, 10550, 10560, 10570, 10580, 10590, 10600, 10610, 10620, 10630, 10640, 10650, 10660, 10670, 10680, 10690, 10700, 10710, 10720, 10730, 10740, 10750, 10760, 10770, 10780, 10790, 10800, 10810, 10820, 10830, 10840, 10850, 10860, 10870, 10880, 10890, 10900, 10910, 10920, 10930, 10940, 10950, 10960, 10970, 10980, 10990, 11000, 11010, 11020, 11030, 11040, 11050, 11060, 11070, 11080, 11090, 11100, 11110, 11120, 11130, 11140, 11150, 11160, 11170, 11180, 11190, 11200, 11210, 11220, 11230, 11240, 11250, 11260, 11270, 11280, 11290, 11300, 11310, 11320, 11330, 11340, 11350, 11360, 11370, 11380, 11390, 11400, 11410, 11420, 11430, 11440, 11450, 11460, 11470, 11480, 11490, 11500, 11510, 11520, 11530, 11540, 11550, 11560, 11570, 11580, 11590, 11600, 11610, 11620, 11630, 11640, 11650, 11660, 11670, 11680, 11690, 11700, 11710, 11720, 11730, 11740, 11750, 11760, 11770, 11780, 11790, 11800, 11810, 11820, 11830, 11840, 11850, 11860, 11870, 11880, 11890, 11900, 11910, 11920, 11930, 11940, 11950, 11960, 11970, 11980, 11990, 12000, 12010, 12020, 12030, 12040, 12050, 12060, 12070, 12080, 12090, 12100, 12110, 12120, 12130, 12140, 12150, 12160, 12170, 12180, 12190, 12200, 12210, 12220, 12230, 12240, 12250, 12260, 12270, 12280, 12290, 12300, 12310, 12320, 12330, 12340, 12350, 12360, 12370, 12380, 12390, 12400, 12410, 12420, 12430, 12440, 12450, 12460, 12470, 12480, 12490, 12500, 12510, 12520, 12530, 12540, 12550, 12560, 12570, 12580, 12590, 12600, 12610, 12620, 12630, 12640, 12650, 12660, 12670, 12680, 12690, 12700, 12710, 12720, 12730, 12740, 12750, 12760, 12770, 12780, 12790, 12800, 12810, 12820, 12830, 12840, 12850, 12860, 12870, 12880, 12890, 12900, 12910, 12920, 12930, 12940, 12950, 12960, 12970, 12980, 12990, 13000, 13010, 13020, 13030, 13040, 13050, 13060, 13070, 13080, 13090, 13100, 13110, 13120, 13130, 13140, 13150, 13160, 13170, 13180, 13190, 13200, 13210, 13220, 13230, 13240, 13250, 13260, 13270, 13280, 13290, 13300, 13310, 13320, 13330, 13340, 13350, 13360, 13370, 13380, 13390, 13400, 13410, 13420, 13430, 13440, 13450, 13460, 13470, 13480, 13490, 13500, 13510, 13520, 13530, 13540, 13550, 13560, 13570, 13580, 13590, 13600, 13610, 13620, 13630, 13640, 13650, 13660, 13670, 13680, 13690, 13700, 13710, 13720, 13730, 13740, 13750, 13760, 13770, 13780, 13790, 13800, 13810, 13820, 13830, 13840, 13850, 13860, 13870, 13880, 13890, 13900, 13910, 13920, 13930, 13940, 13950, 13960, 13970, 13980, 13990, 14000, 14010, 14020, 14030, 14040, 14050, 14060, 14070, 14080, 14090, 14100, 14110, 14120, 14130, 14140, 14150, 14160, 14170, 14180, 14190, 14200, 14210, 14220, 14230, 14240, 14250, 14260, 14270, 14280, 14290, 14300, 14310, 14320, 14330, 14340, 14350, 14360, 14370, 14380, 14390, 14400, 14410, 14420, 14430, 14440, 14450, 14460, 14470, 14480, 14490, 14500, 14510, 14520, 14530, 14540, 14550, 14560, 14570, 14580, 14590, 14600, 14610, 14620, 14630, 14640, 14650, 14660, 14670, 14680, 14690, 14700, 14710, 14720, 14730, 14740, 14750, 14760, 14770, 14780, 14790, 14800, 14810, 14820, 14830, 14840, 14850, 14860, 14870, 14880, 14890, 14900, 14910, 14920, 14930, 14940, 14950, 14960, 14970, 14980, 14990, 15000, 15010, 15020, 15030, 15040, 15050, 15060, 15070, 15080, 15090, 15100, 15110, 15120, 15130, 15140, 15150, 15160, 15170, 15180, 15190, 15200, 15210, 15220, 15230, 15240, 15250, 15260, 15270, 15280, 15290, 15300, 15310, 15320, 15330, 15340, 15350, 15360, 15370, 15380, 15390, 15400, 15410, 15420, 15430, 15440, 15450, 15460, 15470, 15480, 15490, 15500, 15510, 15520, 15530, 15540, 15550, 15560, 15570, 15580, 15590, 15600, 15610, 15620, 15630, 15640, 15650, 15660, 15670, 15680, 15690, 15700, 15710, 15720, 15730, 15740, 15750, 15760, 15770, 15780, 15790, 15800, 15810, 15820, 15830, 15840, 15850, 15860, 15870, 15880, 15890, 15900, 15910, 15920, 15930, 15940, 15950, 15960, 15970, 15980, 15990, 16000, 16010, 16020, 16030, 16040, 16050, 16060, 16070, 16080, 16090, 16100, 16110, 16120, 16130, 16140, 16150, 16160, 16170, 16180, 16190, 16200, 16210, 16220, 16230, 16240, 16250, 16260, 16270, 16280, 16290, 16300, 16310, 16320, 16330, 16340, 16350, 16360, 16370, 16380, 16390, 16400, 16410, 16420, 16430, 16440, 16450, 16460, 16470, 16480, 16490, 16500, 16510, 16520, 16530, 16540, 16550, 16560, 16570, 16580, 16590, 16600, 16610, 16620, 16630, 16640, 16650, 16660, 16670, 16680, 16690, 16700, 16710, 16720, 16730, 16740, 16750, 16760, 16770, 16780, 16790, 16800, 16810, 16820, 16830, 16840, 16850, 16860, 16870, 16880, 16890, 16900, 16910, 16920, 16930, 16940, 16950, 16960, 16970, 16980, 16990, 17000, 17010, 17020, 17030, 17040, 17050, 17060, 17070, 17080, 17090, 17100, 17110, 17120, 17130, 17140, 17150, 17160, 17170, 17180, 17190, 17200, 17210, 17220, 17230, 17240, 17250, 17260, 17270, 17280, 17290, 17300, 17310, 17320, 17330, 17340, 17350, 17360, 17370, 17380, 17390, 17400, 17410, 17420, 17430, 17440, 17450, 17460, 17470, 17480, 17490, 17500, 17510, 17520, 17530, 17540, 17550, 17560, 17570, 17580, 17590, 17600, 17610, 17620, 17630, 17640, 17650, 17660, 17670, 17680, 17690, 17700, 17710, 17720, 17730, 17740, 17750, 17760, 17770, 17780, 17790, 17800, 17810, 17820, 17830, 17840, 17850, 17860, 17870, 17880, 17890, 17900, 17910, 17920, 17930, 17940, 17950, 17960, 17970, 17980, 17990, 18000, 18010, 18020, 18030, 18040, 18050, 18060, 18070, 18080, 18090, 18100, 18110, 18120, 181

Please Do Not Fill in Any Items on This Page

Notice of Appropriation

- County Stillwater Book 2 Page 18 Record Misc.
- Name of Appropriator Charles Temple et al Address not shown
(See next page.)
- Date Appropriated Nov. 23, 1891 Date Filed Not Dec Nov. 24, 1891
- Amount Appropriated, Miners Inches 3000 Cubic Feet per second
- Name of Stream Yellowstone River Tributary Basin
- Point of Diversion Water is diverted from a point upon its northerly bank about 230

feet from the center of the main track of the N. P. Ry. Co.'s railroad and about 300 feet from the residence of E. S. Tutt, situated on lot 5, Sec. 5, T. 3 S., R. 21 E. & running thence Sec. Twp. Rge. Bank of Stream northerly in a general easterly direction to over and upon the above described lands.

- Purpose Irrigation, domestic and beneficial purposes.
- Description of System By means of a dam and ditch; the said ditch is 100 inches in width on the bottom, thereof and 150 inches across the top, by 24 inches in depth.

2. Land Description of Intended Place of Use

Subdivision	Sec.	Twp.	Rge.	Lot.	Ac.	1910 Owner	Address
<u>Range - lots 4 & 5, N. 24</u>	<u>10</u>	<u>3 S.</u>	<u>21 E.</u>			<u>See next page.</u>	
<u>Range - Range - N. 24 - N. 25</u>	<u>11</u>						
<u>Range - Range</u>	<u>11</u>	<u>3 S.</u>	<u>21 E.</u>				
<u>Range - Range - Range - Range</u>	<u>12</u>	<u>3 S.</u>	<u>21 E.</u>				
<u>Range - lots 2, 3, 4 & 5</u>	<u>7</u>	<u>3 S.</u>	<u>22 E.</u>				
<u>Part of lot of</u>	<u>8</u>	<u>3 S.</u>	<u>22 E.</u>				
<u>All of</u>	<u>5</u>	<u>3 S.</u>	<u>22 E.</u>				
<u>Lots 2, 3, 5 & 6</u>	<u>4</u>	<u>3 S.</u>	<u>22 E.</u>				
<u>Sec - Sec</u>	<u>33</u>	<u>2 S.</u>	<u>22 E.</u>				

Decree

For 9. Remarks - See next page.

- Case No. Date Amt. Decreed: M. I. C. F. S.
- To Whom Decreed Address
- Name of Ditch Maximum Capacity (C. F. S.)
- Date of Priority Purpose
- Land Description of Place of Use as Decreed

15. Remarks (Present Use Status, etc)

9. Remarks (Pertaining to Use, etc.)

And we do further claim the right to change the point of diversion of said water at anytime and to extend the flumes, piles, ditches and aqueducts for which said diversion is made, from time to time to any place other than where first used and to use the water for other useful purposes and beneficial purposes than that for which it was first appropriated, we also claim the rights of way for dikes and canals over and across the lands through the same and the right to enlarge and to alter the same from time to time and also all rights, easements, privileges and appurtenances.

2. Name of appropriators:

Charles Temple et al; John Walsh, Charles R. Watkins, Andrew R. Parker, George R. Cummins, John W. Cummins, Stephen S. Wimsatt, Sarah A. Wimsatt, William W. Palmer and George C. Tilden.

1940 Land Ownership .

128 A - N1/4, Lots 4 & 5, Sec. 10, T. 3 S., R. 21 E. - Gerhard Waltermann, Columbus,
 160 A - NE1/4, Sec. 10, T. 3 S., R. 21 E., Douglas Annin, c/o L. B. Banks, Columbus, Mont.
 111 A - W1/4, NWSW - Sec. 11, T. 3 S., R. 21 E. - Jacob Henry, Park City, Mont.
 155 A - E1/4, Lot 1, Sec. 11, T. 3 S., R. 21 E. - Charles & Alice Storer, Columbus,
 E Frac lot 2 - Sec. 11, T. 3 S., R. 21 E.
 E1/4, NE1/4 - Sec. 11, T. 3 S., R. 21 E.
 183.78 - E1/4, NESW, W1/4, SE1/4, Sec. 11, T. 3 S., R. 21 E. - Federal Land Bank.
 W1/4, NE1/4 - Sec. 11, T. 3 S., R. 21 E. c/o Al Godneys, Hardin, Mont.
 164 - SE1/4 - Lot 2, 3, 4, 5 - Sec. 7, T. 3 S., R. 22 E. - E. W. Whipple, Fishtail.
 80 - Lot 1 & 2, N1/4 - Sec. 8 - T. 3 S., R. 22 E. - Konrad Weschenfelder, Park City,
 222 - Frac E1/4, NE1/4 - W1/4, NE1/4
 NWSW - Frac NESW - Frac SWSW - Sec. 5, T. 3 S., R. 22 E. - Peter Yegen, Billings.
 105 - Frac SWSW - Lot 5 & 6, Sec. 5, T. 3 S., R. 22 E.
 SE corner NESW - SW frac NESW - Sec. 5 - T. 3 S., R. 22 E.
 Konrad Weschenfelder - Park City, Montana
 Acres? - Part of lot 2 & Frac of lot 3 - Sec. 5 - T. 3 S., R. 22 E.
 M. O. Rosden, Laurel, Montana
 40 A - Lot 1 - Sec. 5 - T. 3 S., R. 22 E. - Titus Mauk, Park City, Montana
 50.23 - Lot 7 - NE corner SWSW, Sec. 5, T. 3 S., R. 22 E. - M. O. Rosden, Laurel, Montana
 99.77 - Lot 5 & 6 - Frac SWSW - Sec. 4 - T. 3 S., R. 22 E.
 SE1/4, NE1/4 - Lot 2 - Sec. 4, T. 3 S., R. 22 E.
 19.67 - Fracs. of lot 3 - Sec. 4 - T. 3 S., R. 22 E. - H. C. Crippen, Billings.
 143 - S1/4, NESW, Sec. 33, T. 2 S., R. 22 E.
 Frac NESW, Frac SE1/4, Sec. 33, T. 2 S., R. 22 E.
 Frac SESW, Sec. 33, T. 2 S., R. 22 E. - H. C. Crippen, Billings, Montana
 68 - SWSW, Frac SE1/4, Sec. 33 - T. 2 S., R. 22 E. - M. O. Rosden, Laurel, Montana



STATE OF MONTANA
STATE ENGINEERS OFFICE
Water Resources Survey

Form WB-1-1M-11-41

Code No. 2 B, 11 C
County Stillwater
T. 3 S. R. 21 E.

Name of Land Owner Leob Henry, Sr. Address Bozeman, Montana
Name of Operator _____ Address _____

Part A

TO BE FILED BY THOSE OBTAINING IRRIGATION WATER FROM
A DITCH COMPANY OR IRRIGATION DISTRICT

1. Water is delivered by: Cone Ditch Co. (Bozeman)
Name of Ditch, Ditch Company or District supplying water
2. State the number of acres you irrigate under this system: 90 Shares you hold: 14
3. If you obtain water from more than one Company, give the number of shares, acres irrigated and the name of the Company under "Remarks". If you obtain water from a Ditch Company and also have a private system fill in both Part A and Part B.

Part B

TO BE FILED BY THOSE WHO HAVE A PRIVATE DITCH, PUMP OR IRRIGATION SYSTEM
or those who have a private water right under a Ditch Company

4. In what year was this land first irrigated? Date: _____
5. Give the name of the original appropriator (first user): Charles Joseph Job
6. Give the date appropriated: 1902-1903 Amount filed on: Miners Inches 3000 C. F. S.
7. State the total number of acres irrigated under this system: _____
8. Give the point of diversion: _____ 1/4 Section _____ Township 3 N Range 21 E

Part C

TO BE FILED BY ALL WATER USERS IN ADDITION TO PART A OR PART B.

9. Source of Water: Yellowstone River
Name of stream or lake from which water is originally diverted
10. Water is obtained by: (Check one) Gravity _____ Pumping _____ Other _____
11. What is the greatest number of acres you have irrigated? 96 Date _____
12. How many acres did you irrigate in 1944? (Crop and pasture) 90
13. State the total number of additional acres that could be irrigated by increasing the water supply, land leveling, etc. 34 This land is under what ditch? Cone
14. How many acres of seeped land do you have which could be drained and put into production? 6
15. What is the condition of your irrigation system? _____
16. Is your water supply adequate? Yes _____ No ✓ Explain _____
17. REMARKS: It is on the part of the Ditch Company that it is not the ditch but the water on some of the higher ground.

OVER

NOTE: The foregoing questions apply only to irrigated land shown on this plat.

DESCRIPTION AND MAP OF FARM

18. Legal Description of this Farm SW 5/4, Section 2 - W 1/4 NW 1, Lot 4, Section 11 - Twp. 3 S., Rge. 21 E.

	IRRIGATED LAND	NON-IRRIGATED LAND
<p>— Farm boundary.</p> <p>This map is according to our records. Please change it if it is not correct. That is if we show more irrigated land than you have, X it out; if we have not enough, draw it in.</p> <p>NORTH</p>		

19. If the above land is irrigated from more than one ditch please give the acreage under each ditch in 19A and indicate the location of the land irrigated from each on the above map.

19A. Ditch: Cone Ditch Yellowstone Ditch Acres: 90

Ditch: _____ Acres: _____

Information supplied by:

Name: Laura Herring Address: Columbus Date: Mar 1-45

REMARKS: _____

If you cannot answer all of the questions on this form answer as many as you can and return the form to us as soon as possible.

FORM SM-1

A STUDY OF MONTANA'S WATER RESOURCES

County Billings Source of Information 559

1. Water User Jacob Henry Address 559

2. Stream Big Horn River Tributary to Basin

3. Point of Diversion 1/4 Section Township Range

4. Description of System

5. Type of Irrigation

6. Original Appropriator 644 Address

7. First Use: Year Acres Irrigated

8. Maximum Use: Year Acres Irrigated

9. Present Use: Year Acres Irrigated

10. Last Use: Year Why Abandoned

11. Condition of System

12. Land Description Section 4, T. 24 N., R. 21 E.

Remarks:

Section 4, T. 24 N., R. 21 E.

644 - 644

644 - 644

644 - 644

644 - 644

644 - 644

644 - 644

644 - 644

644 - 644

644 - 644

644 - 644

644 - 644

644 - 644

644 - 644

644 - 644

644 - 644

644 - 644

644 - 644

644 - 644

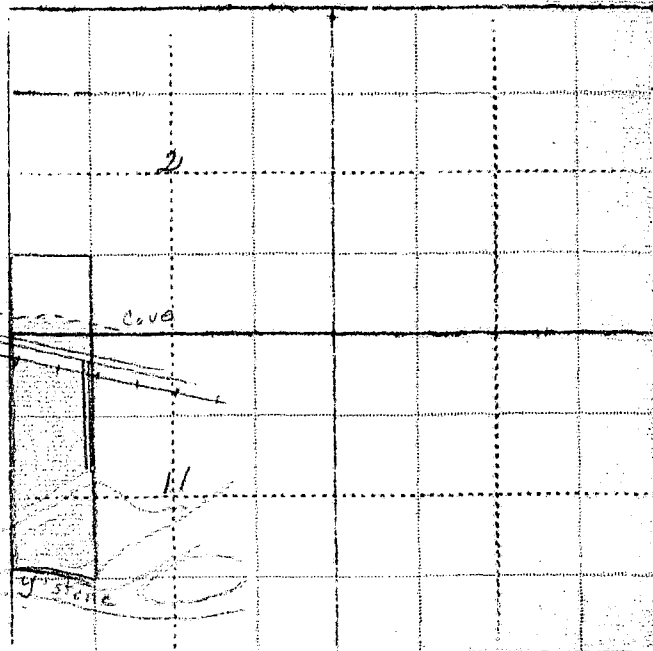

WITNESS: Information by

Place

DA and

201-95

as soon

Our records show that you have an appropriation made by George A. Cummins, appropriated November 23, 1891 and filed November 24, 1891 from Yellowstone River for 3000 minors inches. Is this appropriation now in use?

Billings,
MONTANA

February 21, 1945

Jacob Henry, Sr.
Park City, Montana

Dear Mr. Henry:

On January 22nd and January 26th, this office sent you letters asking for certain information pertaining to your irrigated land in township 2 south, range 21 east and township 2 south, range 23 east. To date we have not heard from you. With the vast post war water development in this area as now planned, it is essential that we have this information in order to show the extent of our water use in the Yellowstone Basin in Montana. This information is necessary to protect our present water users in the rights they have against future irrigation, navigation, power and flood control enterprises in this area. We are asking you for this information because we feel it is the democratic way; we also feel that you are more qualified to give us this information about your irrigated land than anyone else because it is part of your business. It may be that you were busy with your farm work or some unforeseen thing happened at the time our first letter was received, and you put it aside to be answered at some other time and have forgotten all about it. All information is strictly confidential and is only used to record and tabulate the water use in this area.

Water is as necessary to the farmer as the soil in which he plants. Without it no crops will grow; no living thing can survive. It is your water that we are trying to protect, so that you will have plenty now and in the future. We must keep Montana's water in Montana. The only way we can do this is by having the support of each and every water user so that we have a 100 percent representation of all water users. Remember: "United we stand, divided we fall".

In order to facilitate this work a branch office of the State Engineer has been established in Billings and is located in the Roosevelt School Building on 23rd Street and Fourth Avenue North. Anytime you are in Billings we would appreciate your calling on us.

Hoping to hear from you in the very near future, I am,

Very truly yours,

Gerald J. Oravetz
Assistant State Engineer

P.S. If you cannot supply us with the information requested, it may be that you can tell us of someone who can.

Please Do Not Fill in Any Items on This Page

Notice of Appropriation

1. County Stillwater Book 2 Page 18 Record Misc.
2. Name of Appropriator Charles Temple et al Address Not shown.
(See next page.)
3. Date Appropriated Nov. 23, 1891 Date Filed Nov. 24, 1891
- Amount Appropriated, Miners Inches 3000, Cubic Feet per second _____
4. Name of Stream Yellowstone River Tributary _____ Basin _____
5. Point of Diversion Water is diverted from a point upon its northerly bank about 230 feet from the center of the main track of the N. P. Ry. Co.'s railroad and about 300 feet n from the residence of E. S. Tutt, situated on lot 5, Sec. 5, T. 3 S., R. 21 E. & running thence Sec. _____ Twp. _____ Rge. _____ Bank of Stream northerly. in a general easterly direction to over and upon the above described lands.
6. Purpose Irrigation, domestic and beneficial purposes.
7. Description of System By means of a dam and ditch; the said ditch is 108 inches in width on the bottom, thereof and 156 inches across the top, by 24 inches in depth.

8. Land Description of Intended Place of Use

Subdivision	Sec.	Twp.	Rge.	Tot. Acr.	1940 Owner	Address
<u>N$\frac{1}{2}$N$\frac{1}{2}$W$\frac{1}{2}$ - lots 4 & 5, NE$\frac{1}{4}$</u>	<u>10</u>	<u>3 S.</u>	<u>21 E.</u>		<u>See next page.</u>	
<u>W$\frac{1}{2}$ - NW$\frac{1}{4}$SW$\frac{1}{4}$ - NE$\frac{1}{4}$ - N$\frac{1}{2}$SE$\frac{1}{4}$</u>	<u>11</u>					
<u>NE$\frac{1}{4}$SW$\frac{1}{4}$ - E$\frac{1}{2}$NW$\frac{1}{2}$</u>	<u>11</u>	<u>3 S.</u>	<u>21 E.</u>			
<u>NW$\frac{1}{4}$NE$\frac{1}{4}$, NE$\frac{1}{4}$NE$\frac{1}{4}$, E$\frac{1}{2}$NW$\frac{1}{2}$, SW$\frac{1}{4}$NW$\frac{1}{4}$</u>	<u>12</u>	<u>3 S.</u>	<u>21 E.</u>			
9. Remarks (Pertaining to Use, etc.)						
<u>SE$\frac{1}{4}$NW$\frac{1}{4}$ - lots 2, 3, 4 & 5</u>	<u>7</u>	<u>3 S.</u>	<u>22 E.</u>			
<u>Part of NW$\frac{1}{4}$ of</u>	<u>8</u>	<u>3 S.</u>	<u>22 E.</u>			
<u>All of</u>	<u>5</u>	<u>3 S.</u>	<u>22 E.</u>			
<u>Lots 2, 3, 5 & 6</u>	<u>4</u>	<u>3 S.</u>	<u>22 E.</u>			
<u>SW$\frac{1}{4}$ - SE$\frac{1}{4}$NW$\frac{1}{4}$</u>	<u>33</u>	<u>2 S.</u>	<u>22 E.</u>			

DecreeFor 9. Remarks - See next page. - now included.

10. Case No. _____ Date _____ Amt. Decreed: M. I. _____ C. F. S. _____
11. To Whom Decreed _____ Address _____
12. Name of Ditch _____ Maximum Capacity (C. F. S.) _____
13. Date of Priority _____ Purpose _____
14. Land Description of Place of Use as Decreed _____
15. Remarks (Present Use Status, etc.) _____

9. Remarks (Pertaining to Use, etc.)

And we do further claim the right to change the point of diversion of said water at anytime and to extend the flumes, piles, ditches and aqueducts for which said diversion is made, from time to time to any place other than where first used and to use the water for other useful purposes and beneficial purposes than that for which it was first appropriated, we also claim the rights of way for dikes and canals over and across the lands through the same and the right to enlarge and to alter the same from time to time and also all rights, easements, privileges and appurtenances.

2. Name of appropriators:

Charles Temple et al; John Walsh, Charles E. Watkins, Andrew E. Parker, George E. Cummins, John W. Cummins, Stephen E. Wimssett, Sarah E. Wimssett, William W. Palmer and George C. Tilden.

1940 Land Ownership.

128 A - N $\frac{1}{2}$ NW $\frac{1}{4}$, Lots 4 & 5, Sec. 10, T. 3 S., R. 21 E. - Gerhard Waltermann, Columbus, Mont.

160 A - NE $\frac{1}{4}$ - Sec. 10, T. 3 S., R. 21 E., Douglas Annin, c/o L. B. Banks, Columbus, Mont.

111 A - W $\frac{1}{2}$ NW $\frac{1}{4}$, NWSW - Sec. 11, T. 3 S., R. 21 E. - Jacob Henry, Park City, Montana

155 A. - E $\frac{1}{2}$ NE $\frac{1}{4}$ - Lot 1, Sec. 11, T. 3 S., R. 21 E. - Charles & Alice Storer, Columbus,

E Frac lot 2 - Sec. 11, T. 3 S., R. 21 E.

E $\frac{1}{2}$ W $\frac{1}{2}$ NE $\frac{1}{4}$ - Sec. 11, T. 3 S., Rge. 21 E.

183.78 - E $\frac{1}{2}$ NW, NESW, W $\frac{1}{2}$ NWSE, Sec. 11, T. 3 S., R. 21 E. - Federal Land Bank

W $\frac{1}{2}$ W $\frac{1}{2}$ NE $\frac{1}{4}$ - Sec. 11, T. 3 S., R. 21 E. c/o Al Codneys, Hardin, Montana

164 - SE $\frac{1}{2}$ NW $\frac{1}{4}$ - Lot 2, 3, 4, 5 - Sec. 7, Twp. 3 S., R. 22 E. - R. W. Whipple, Fishtail.

80 - Lot 1 & 2, NW $\frac{1}{2}$ - Sec. 8 - T. 3 S., Rge. 22 E. - Konrad Weschenfelder,
Park City, Montana

222 - Frac E $\frac{1}{2}$ NW $\frac{1}{4}$ - W $\frac{1}{2}$ NW $\frac{1}{4}$

NWSW - Frac NESW - Frac SWSW - Sec. 5 - T. 3 S., Rge. 22 E. - Peter Yegen, Billings

105 acres - Frac SWSW - Lot 5 & 6 - Sec. 5, T. 3 S., Rge. 22 E.

SE corner NESW - SW frac NESW - Sec. 5 - T. 3 S., R. 22 E.

Konrad Weschenfelder - Park City, Montana

Acres? - Part of lot 2 & Frac of lot 3 - Sec. 5 - T. 3 S., Rge. 22 E.

M. O. Rosden, Laurel, Montana

40 A - Lot 1 - Sec. 5 - T. 3 S., Rge. 22 E. - Titus Mauk, Park City, Montana

50.23 - Lot 7 - NE corner SWSE, Sec. 5, T. 3 S., R. 22 E., M. O. Rosden, Laurel, Mont.

99.77 - Lot 5 & 6 - Frac SW $\frac{1}{2}$ NW - Sec. 4 - T. 3 S., Rge. 22 E.

SE $\frac{1}{2}$ NW $\frac{1}{4}$ - Lot 2 - Sec. 4, T. 3 S., R. 22 E.

19.67 - Fracs. of lot 3 - Sec. 4 - T. 3 S., R. 22 E. - H. C. Crippen, Billings

143 - S $\frac{1}{2}$ SW $\frac{1}{4}$, NESW, Sec. 33, T. 2 S., R. 22 E.

Frac NWSW, Frac SENW, Sec. 33, T. 2 S., R. 22 E.

Frac SESW, Sec. 33, T. 2 S., R. 22 E., H. C. Crippen, Billings, Montana

68 - SW $\frac{1}{2}$ NW, Frac SENW, Sec. 33 - Twp. 2 S., Rge. 22 E. - M. O. Raysden, Laurel, Mont.



STATE OF MONTANA
STATE ENGINEERS OFFICE
Water Resources Survey

Form 82
WR-1-1M-11-41
Code No. 6 B, 7 B
County Stillwater
T. 3 S. R. 21 E.

Name of Land Owner Geo. Hersom & Laura Noelke Address 324 W. Columbia, Davenport, Iowa

Name of Operator Alex Schreiner Address Columbus, Montana

Part A

TO BE FILED BY THOSE OBTAINING IRRIGATION WATER FROM
A DITCH COMPANY OR IRRIGATION DISTRICT

1. Water is delivered by: Flakuty Flat Ditch Co
Name of Ditch, Ditch Company or District supplying water
2. State the number of acres you irrigate under this system 102 Shares you hold 2
3. If you obtain water from more than one Company, give the number of shares, acres irrigated and the name of the Company under "Remarks". If you obtain water from a Ditch Company and also have a private system fill in both Part A and Part B.

Part B

TO BE FILED BY THOSE WHO HAVE A PRIVATE DITCH, PUMP OR IRRIGATION SYSTEM
or those who have a private water right under a Ditch Company

4. In what year was this land first irrigated? Date 1943
5. Give the name of the original appropriator (first user): Joseph Pope et al
6. Give the date appropriated Jan 10 1896 Amount filed on: Miners Inches - C. F. S. -
7. State the total number of acres irrigated under this system: -
8. Give the point of diversion: 1/4 Section 34 Township 2 N Range 20 E

Part C

TO BE FILED BY ALL WATER USERS IN ADDITION TO PART A OR PART B



9. Source of Water: Yellowstone River
Name of stream or lake from which water is originally diverted
10. Water is obtained by: (Check one) Gravity ☒ Pumping ☐ Other ☐
11. What is the greatest number of acres you have irrigated? 120 Date 1943
12. How many acres did you irrigate in 1944? (Crop and pasture) 102
13. State the total number of additional acres that could be irrigated by increasing the water supply, land leveling, etc. 1960 This land is under what ditch? Flakuty Flat Ditch
14. How many acres of seeped land do you have which could be drained and put into production? 160
15. What is the condition of your irrigation system? Poor
16. Is your water supply adequate? Yes ☐ No ☒ Explain -
17. REMARKS: This ditch could supply enough water if it was handled right.

OVER

NOTE: The foregoing questions apply only to irrigated land shown on this plat.

DESCRIPTION AND MAP OF FARM

18. Legal Description of this Farm E2SW1/4, W2SW1/4, Lots 2, 5, 6, Sec. 6 - NWNE1/4, Sec. 7-Twp. 3 S., Rge. 21 E.

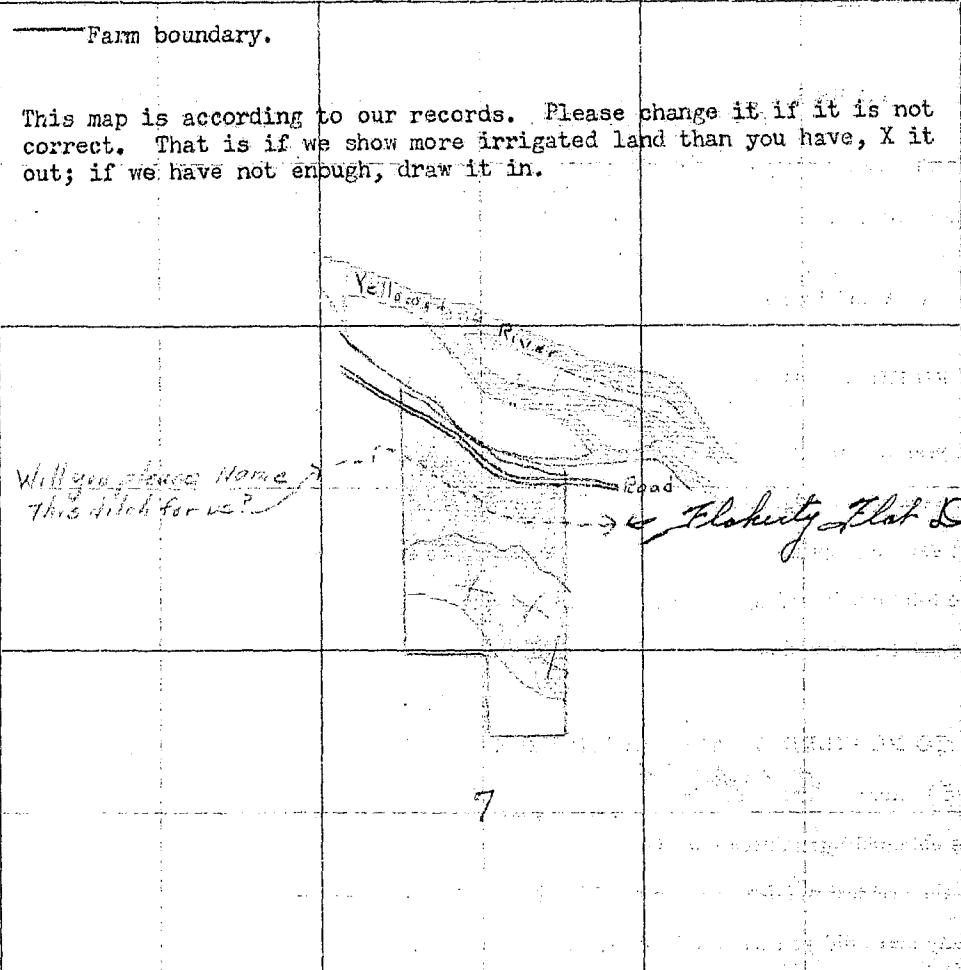
 IRRIGATED LAND	 NON-IRRIGATED LAND
<p>— Farm boundary.</p> <p>This map is according to our records. Please change it if it is not correct. That is if we show more irrigated land than you have, X it out; if we have not enough, draw it in.</p> <p>NORTH</p>  <p>Will you please Name This ditch for us?</p> <p>Florety Flat Ditch Co.</p> <p>7</p>	

19. If the above land is irrigated from more than one ditch please give the acreage under each ditch in 19A and indicate the location of the land irrigated from each on the above map.

19A. Ditch: Florety Flat ditch Acres: _____
Ditch: _____ Acres: _____

Information supplied by:

Name Alex Schreiner Address Columbus Date 10-2

REMARKS: _____

If you cannot answer all of the questions on this form answer as many as you can and return the form to us as soon as possible.

THURBER'S, HELENA

FORM SM-1

A STUDY OF MONTANA'S WATER RESOURCES

County Stillwater Source of Information 1913

1. Water User The Higgins & Lewis Mfg. Co. Address 324 W. Columbia, Beaumont, Texas
Sold to Alex. Robinson, operator Columbia, Mont.
2. Stream _____ Tributary to _____ Basin _____
3. Point of Diversion $\frac{1}{4}$ $\frac{1}{4}$ Section _____ Township _____ Range _____
4. Description of System _____
5. Type of Irrigation _____
6. Original Appropriator _____ Address _____
7. First Use: Year _____ Acres Irrigated _____
8. Maximum Use: Year _____ Acres Irrigated _____
9. Present Use: Year _____ Acres Irrigated _____
10. Last Use: Year _____ Why Abandoned _____
11. Condition of System _____
12. Land Description Section 2, 5, 6, 7, 8, 9, 10, 11, 12, 13, 14, 15, 16, 17, 18, 19, 20, 21, 22, 23, 24, 25, 26, 27, 28, 29, 30, 31, 32, 33, 34, 35, 36, 37, 38, 39, 40, 41, 42, 43, 44, 45, 46, 47, 48, 49, 50, 51, 52, 53, 54, 55, 56, 57, 58, 59, 60, 61, 62, 63, 64, 65, 66, 67, 68, 69, 70, 71, 72, 73, 74, 75, 76, 77, 78, 79, 80, 81, 82, 83, 84, 85, 86, 87, 88, 89, 90, 91, 92, 93, 94, 95, 96, 97, 98, 99, 100, 101, 102, 103, 104, 105, 106, 107, 108, 109, 110, 111, 112, 113, 114, 115, 116, 117, 118, 119, 120, 121, 122, 123, 124, 125, 126, 127, 128, 129, 130, 131, 132, 133, 134, 135, 136, 137, 138, 139, 140, 141, 142, 143, 144, 145, 146, 147, 148, 149, 150, 151, 152, 153, 154, 155, 156, 157, 158, 159, 160, 161, 162, 163, 164, 165, 166, 167, 168, 169, 170, 171, 172, 173, 174, 175, 176, 177, 178, 179, 180, 181, 182, 183, 184, 185, 186, 187, 188, 189, 190, 191, 192, 193, 194, 195, 196, 197, 198, 199, 200, 201, 202, 203, 204, 205, 206, 207, 208, 209, 210, 211, 212, 213, 214, 215, 216, 217, 218, 219, 220, 221, 222, 223, 224, 225, 226, 227, 228, 229, 230, 231, 232, 233, 234, 235, 236, 237, 238, 239, 240, 241, 242, 243, 244, 245, 246, 247, 248, 249, 250, 251, 252, 253, 254, 255, 256, 257, 258, 259, 260, 261, 262, 263, 264, 265, 266, 267, 268, 269, 270, 271, 272, 273, 274, 275, 276, 277, 278, 279, 280, 281, 282, 283, 284, 285, 286, 287, 288, 289, 290, 291, 292, 293, 294, 295, 296, 297, 298, 299, 300, 301, 302, 303, 304, 305, 306, 307, 308, 309, 310, 311, 312, 313, 314, 315, 316, 317, 318, 319, 320, 321, 322, 323, 324, 325, 326, 327, 328, 329, 330, 331, 332, 333, 334, 335, 336, 337, 338, 339, 340, 341, 342, 343, 344, 345, 346, 347, 348, 349, 350, 351, 352, 353, 354, 355, 356, 357, 358, 359, 360, 361, 362, 363, 364, 365, 366, 367, 368, 369, 370, 371, 372, 373, 374, 375, 376, 377, 378, 379, 380, 381, 382, 383, 384, 385, 386, 387, 388, 389, 390, 391, 392, 393, 394, 395, 396, 397, 398, 399, 400, 401, 402, 403, 404, 405, 406, 407, 408, 409, 410, 411, 412, 413, 414, 415, 416, 417, 418, 419, 420, 421, 422, 423, 424, 425, 426, 427, 428, 429, 430, 431, 432, 433, 434, 435, 436, 437, 438, 439, 440, 441, 442, 443, 444, 445, 446, 447, 448, 449, 450, 451, 452, 453, 454, 455, 456, 457, 458, 459, 460, 461, 462, 463, 464, 465, 466, 467, 468, 469, 470, 471, 472, 473, 474, 475, 476, 477, 478, 479, 480, 481, 482, 483, 484, 485, 486, 487, 488, 489, 490, 491, 492, 493, 494, 495, 496, 497, 498, 499, 500, 501, 502, 503, 504, 505, 506, 507, 508, 509, 510, 511, 512, 513, 514, 515, 516, 517, 518, 519, 520, 521, 522, 523, 524, 525, 526, 527, 528, 529, 530, 531, 532, 533, 534, 535, 536, 537, 538, 539, 540, 541, 542, 543, 544, 545, 546, 547, 548, 549, 550, 551, 552, 553, 554, 555, 556, 557, 558, 559, 560, 561, 562, 563, 564, 565, 566, 567, 568, 569, 570, 571, 572, 573, 574, 575, 576, 577, 578, 579, 580, 581, 582, 583, 584, 585, 586, 587, 588, 589, 590, 591, 592, 593, 594, 595, 596, 597, 598, 599, 600, 601, 602, 603, 604, 605, 606, 607, 608, 609, 610, 611, 612, 613, 614, 615, 616, 617, 618, 619, 620, 621, 622, 623, 624, 625, 626, 627, 628, 629, 630, 631, 632, 633, 634, 635, 636, 637, 638, 639, 640, 641, 642, 643, 644, 645, 646, 647, 648, 649, 650, 651, 652, 653, 654, 655, 656, 657, 658, 659, 660, 661, 662, 663, 664, 665, 666, 667, 668, 669, 670, 671, 672, 673, 674, 675, 676, 677, 678, 679, 680, 681, 682, 683, 684, 685, 686, 687, 688, 689, 690, 691, 692, 693, 694, 695, 696, 697, 698, 699, 700, 701, 702, 703, 704, 705, 706, 707, 708, 709, 710, 711, 712, 713, 714, 715, 716, 717, 718, 719, 720, 721, 722, 723, 724, 725, 726, 727, 728, 729, 730, 731, 732, 733, 734, 735, 736, 737, 738, 739, 740, 741, 742, 743, 744, 745, 746, 747, 748, 749, 750, 751, 752, 753, 754, 755, 756, 757, 758, 759, 760, 761, 762, 763, 764, 765, 766, 767, 768, 769, 770, 771, 772, 773, 774, 775, 776, 777, 778, 779, 780, 781, 782, 783, 784, 785, 786, 787, 788, 789, 790, 791, 792, 793, 794, 795, 796, 797, 798, 799, 800, 801, 802, 803, 804, 805, 806, 807, 808, 809, 810, 811, 812, 813, 814, 815, 816, 817, 818, 819, 820, 821, 822, 823, 824, 825, 826, 827, 828, 829, 830, 831, 832, 833, 834, 835, 836, 837, 838, 839, 840, 841, 842, 843, 844, 845, 846, 847, 848, 849, 850, 851, 852, 853, 854, 855, 856, 857, 858, 859, 860, 861, 862, 863, 864, 865, 866, 867, 868, 869, 870, 871, 872, 873, 874, 875, 876, 877, 878, 879, 880, 881, 882, 883, 884, 885, 886, 887, 888, 889, 890, 891, 892, 893, 894, 895, 896, 897, 898, 899, 900, 901, 902, 903, 904, 905, 906, 907, 908, 909, 910, 911, 912, 913, 914, 915, 916, 917, 918, 919, 920, 921, 922, 923, 924, 925, 926, 927, 928, 929, 930, 931, 932, 933, 934, 935, 936, 937, 938, 939, 940, 941, 942, 943, 944, 945, 946, 947, 948, 949, 950, 951, 952, 953, 954, 955, 956, 957, 958, 959, 960, 961, 962, 963, 964, 965, 966, 967, 968, 969, 970, 971, 972, 973, 974, 975, 976, 977, 978, 979, 980, 981, 982, 983, 984, 985, 986, 987, 988, 989, 990, 991, 992, 993, 994, 995, 996, 997, 998, 999, 1000, 1001, 1002, 1003, 1004, 1005, 1006, 1007, 1008, 1009, 1010, 1011, 1012, 1013, 1014, 1015, 1016, 1017, 1018, 1019, 1020, 1021, 1022, 1023, 1024, 1025, 1026, 1027, 1028, 1029, 1030, 1031, 1032, 1033, 1034, 1035, 1036, 1037, 1038, 1039, 1040, 1041, 1042, 1043, 1044, 1045, 1046, 1047, 1048, 1049, 1050, 1051, 1052, 1053, 1054, 1055, 1056, 1057, 1058, 1059, 1060, 1061, 1062, 1063, 1064, 1065, 1066, 1067, 1068, 1069, 1070, 1071, 1072, 1073, 1074, 1075, 1076, 1077, 1078, 1079, 1080, 1081, 1082, 1083, 1084, 1085, 1086, 1087, 1088, 1089, 1090, 1091, 1092, 1093, 1094, 1095, 1096, 1097, 1098, 1099, 1100, 1101, 1102, 1103, 1104, 1105, 1106, 1107, 1108, 1109, 1110, 1111, 1112, 1113, 1114, 1115, 1116, 1117, 1118, 1119, 1120, 1121, 1122, 1123, 1124, 1125, 1126, 1127, 1128, 1129, 1130, 1131, 1132, 1133, 1134, 1135, 1136, 1137, 1138, 1139, 1140, 1141, 1142, 1143, 1144, 1145, 1146, 1147, 1148, 1149, 1150, 1151, 1152, 1153, 1154, 1155, 1156, 1157, 1158, 1159, 1160, 1161, 1162, 1163, 1164, 1165, 1166, 1167, 1168, 1169, 1170, 1171, 1172, 1173, 1174, 1175, 1176, 1177, 1178, 1179, 1180, 1181, 1182, 1183, 1184, 1185, 1186, 1187, 1188, 1189, 1190, 1191, 1192, 1193, 1194, 1195, 1196, 1197, 1198, 1199, 1200, 1201, 1202, 1203, 1204, 1205, 1206, 1207, 1208, 1209, 1210, 1211, 1212, 1213, 1214, 1215, 1216, 1217, 1218, 1219, 1220, 1221, 1222, 1223, 1224, 1225, 1226, 1227, 1228, 1229, 1230, 1231, 1232, 1233, 1234, 1235, 1236, 1237, 1238, 1239, 1240, 1241, 1242, 1243, 1244, 1245, 1246, 1247, 1248, 1249, 1250, 1251, 1252, 1253, 1254, 1255, 1256, 1257, 1258, 1259, 1260, 1261, 1262, 1263, 1264, 1265, 1266, 1267, 1268, 1269, 1270, 1271, 1272, 1273, 1274, 1275, 1276, 1277, 1278, 1279, 1280, 1281, 1282, 1283, 1284, 1285, 1286, 1287, 1288, 1289, 1290, 1291, 1292, 1293, 1294, 1295, 1296, 1297, 1298, 1299, 1300, 1301, 1302, 1303, 1304, 1305, 1306, 1307, 1308, 1309, 1310, 1311, 1312, 1313, 1314, 1315, 1316, 1317, 1318, 1319, 1320, 1321, 1322, 1323, 1324, 1325, 1326, 1327, 1328, 1329, 1330, 1331, 1332, 1333, 1334, 1335, 1336, 1337, 1338, 1339, 1340, 1341, 1342, 1343, 1344, 1345, 1346, 1347, 1348, 1349, 1350, 1351, 1352, 1353, 1354, 1355, 1356, 1357, 1358, 1359, 1360, 1361, 1362, 1363, 1364, 1365, 1366, 1367, 1368, 1369, 1370, 1371, 1372, 1373, 1374, 1375, 1376, 1377, 1378, 1379, 1380, 1381, 1382, 1383, 1384, 1385, 1386, 1387, 1388, 1389, 1390, 1391, 1392, 1393, 1394, 1395, 1396, 1397, 1398, 1399, 1400, 1401, 1402, 1403, 1404, 1405, 1406, 1407, 1408, 1409, 1410, 1411, 1412, 1413, 1414, 1415, 1416, 1417, 1418, 1419, 1420, 1421, 1422, 1423, 1424, 1425, 1426, 1427, 1428, 1429, 1430, 1431, 1432, 1433, 1434, 1435, 1436, 1437, 1438, 1439, 1440, 1441, 1442, 1443, 1444, 1445, 1446, 1447, 1448, 1449, 1450, 1451, 1452, 1453, 1454, 1455, 1456, 1457, 1458, 1459, 1460, 1461, 1462, 1463, 1464, 1465, 1466, 1467, 1468, 1469, 1470, 1471, 1472, 1473, 1474, 1475, 1476, 1477, 1478, 1479, 1480, 1481, 1482, 1483, 1484, 1485, 1486, 1487, 1488, 1489, 1490, 1491, 1492, 1493, 1494, 1495, 1496, 1497, 1498, 1499, 1500, 1501, 1502, 1503, 1504, 1505, 1506, 1507, 1508, 1509, 1510, 1511, 1512, 1513, 1514, 1515, 1516, 1517, 1518, 1519, 1520, 1521, 1522, 1523, 1524, 1525, 1526, 1527, 1528, 1529, 1530, 1531, 1532, 1533, 1534, 1535, 1536, 1537, 1538, 1539, 1540, 1541, 1542, 1543, 1544, 1545, 1546, 1547, 1548, 1549, 1550, 1551, 1552, 1553, 1554, 1555, 1556, 1557, 1558, 1559, 1560, 1561, 1562, 1563, 1564, 1565, 1566, 1567, 1568, 1569, 1570, 1571, 1572, 1573, 1574, 1575, 1576, 1577, 1578, 1579, 1580, 1581, 1582, 1583, 1584, 1585, 1586, 1587, 1588, 1589, 1590, 1591, 1592, 1593, 1594, 1595, 1596, 1597, 1598, 1599, 1600, 1601, 1602, 1603, 1604, 1605, 1606, 1607, 1608, 1609, 1610, 1611, 1612, 1613, 1614, 1615, 1616, 1617, 1618, 1619, 1620, 1621, 1622, 1623, 1624, 1625, 1626, 1627, 1628, 1629, 1630, 1631, 1632, 1633, 1634, 1635, 1636, 1637, 1638, 1639, 1640, 1641, 1642, 1643, 1644, 1645, 1646, 1647, 1648, 1649, 1650, 1651, 1652, 1653, 1654, 1655, 1656, 1657, 1658, 1659, 1660, 1661, 1662, 1663, 1664, 1665, 1666, 1667, 1668, 1669, 1670, 1671, 1672, 1673, 1674, 1675, 1676, 1677, 1678, 1679, 1680, 1681, 1682, 1683, 1684, 1685, 1686, 1687, 1688, 1689, 1690, 1691, 1692, 1693, 1694, 1695, 1696, 1697, 1698, 1699, 1700, 1701, 1702, 1703, 1704, 1705, 1706, 1707, 1708, 1709, 1710, 1711, 1712, 1713, 1714, 1715, 1716, 1717, 1718, 1719, 1720, 1721, 1722, 1723, 1724, 1725, 1726, 1727, 1728, 1729, 1730, 1731, 1732, 1733, 1734, 1735, 1736, 1737, 1738, 1739, 1740, 1741, 1742, 1743, 1744, 1745, 1746, 1747, 1748, 1749, 1750, 1751, 1752, 1753, 1754, 1755, 1756, 1757, 1758, 1759, 1760, 1761, 1762, 1763, 1764, 1765, 1766, 1767, 1768, 1769, 1770, 1771, 1772, 1773, 1774, 1775, 1776, 1777, 1778, 1779, 1780, 1781, 1782, 1783, 1784, 1785, 1786, 1787, 1788, 1789, 1790, 1791, 1792, 1793, 1794, 1795, 1796, 1797, 1798, 1799, 1800, 1801, 1802, 1803, 1804, 1805, 1806, 1807, 1808, 1809, 1810, 1811, 1812, 1813, 1814, 1815, 1816, 1817, 1818, 1819, 1820, 1821, 1822, 1823, 1824, 1825, 1826, 1827, 1828, 1829, 1830, 1831, 1832, 1833, 1834, 1835, 1836, 1837, 1838, 1839, 1840, 1841, 1842, 1843, 1844, 1845, 1846, 1847, 1848, 1849, 1850, 1851, 1852, 1853, 1854, 1855, 1856, 1857, 1858, 1859, 1860, 1861, 1862, 1863, 1864, 1865, 1866, 1867, 1868, 1869, 1870, 1871, 1872, 1873, 1874, 1875, 1876, 1877, 1878, 1879, 1880, 1881, 1882, 1883, 1884, 1885, 1886, 1887, 1888, 1889, 1890, 1891, 1892, 1893, 1894, 1895, 1896, 1897, 1898, 1899, 1900, 1901, 1902, 1903, 1904, 1905, 1906, 1907, 1908, 1909, 1910, 1911, 1912, 1913, 1914, 1915, 1916, 1917, 1918, 1919, 1920, 1921, 1922, 1923, 1924, 1925, 1926, 1927, 1928, 1929, 1930, 1931, 1932, 1933, 1934, 1935, 1936, 1937, 1938, 1939, 1940, 1941, 1942, 1943, 1944, 1945, 1946, 1947, 1948, 1949, 1950, 1951, 1952, 1953, 1954, 1955, 1956, 1957, 1958, 1959, 1960, 1961, 1962, 1963, 1964, 1965, 1966, 1967, 1968, 1969, 1970, 1971, 1972, 1973, 1974, 1975, 1976, 1977, 1978, 1979, 1980, 1981, 1982, 1983, 1984, 1985, 1986, 1987, 1988, 1989, 1990, 1991, 1992, 1993, 1994, 1995, 1996, 1997, 1998, 1999, 2000, 2001, 2002, 2003, 2004, 2005, 2006, 2007, 2008, 2009, 2010, 2011, 2012, 2013, 2014, 2015, 2016, 2017, 2018, 2019, 2020, 2021, 2022, 2023, 2024, 2025, 2026, 2027, 2028, 2029, 2030, 2031, 2032, 2033, 2034, 2035, 2036, 2037, 2038, 2039, 2040, 2041, 2042, 2043, 2044, 2045, 2046, 2047, 2048, 2049, 2050, 2051, 2052, 2053, 2054, 2055, 2056, 2057, 2058, 2059, 2060, 2061, 2062, 2063, 2064, 2065, 2066, 2067, 2068, 2069, 2070, 2071, 2072, 2073, 2074, 2075, 2076, 2077, 2078, 2079, 2080, 2081, 2082, 2083, 2084, 2085, 2086, 2087, 2088, 2089, 2090, 2091, 2092, 2093, 2094, 2095, 2096, 2097, 2098, 2099, 2100, 2101, 2102, 2103, 2104, 2105, 2106, 2107, 2108, 2109, 2110, 2111, 2112, 2113, 2114, 2115, 2116, 2117, 2118, 2119, 2120, 2121, 2122, 2123, 2124, 2125, 2126, 2127, 2128, 2129, 2130, 2131, 2132, 2133, 2134, 2135, 2136, 2137, 2138, 2139, 2140, 2141, 2142, 2143, 2144, 2145, 2146, 2147, 2148, 2149, 2150, 2151, 2152, 2153, 2154, 2155, 2156, 2157, 2158, 2159, 2160, 2161, 2162, 2163, 2164, 2165, 2166, 2167, 2168, 2169, 2170, 2171, 2172, 2173, 2174, 2175, 2176, 2177, 2178, 2179, 2180, 2181,

Billings,
~~XXXXXX~~

February 21, 1945

Alex Schreiner
Columbus, Montana

Dear Mr. Schreiner:

On January 22nd, this office sent you a letter asking for certain information pertaining to your irrigated land in township 3 south, range 21 east. To date we have not heard from you. With the vast post war water development in this area as now planned, it is essential that we have this information in order to show the extent of our water use in the Yellowstone Basin in Montana. This information is necessary to protect our present water users in the rights they have against future irrigation, navigation, power and flood control enterprises in this area. We are asking you for this information because we feel it is the democratic way; we also feel that you are more qualified to give us this information about your irrigated land than anyone else because it is part of your business. It may be that you were busy with your farm work or some unforeseen thing happened at the time our first letter was received, and you put it aside to be answered at some other time and have forgotten all about it. All information is strictly confidential and is only used to record and tabulate the water use in this area.

Water is as necessary to the farmer as the soil in which he plants. Without it no crops will grow; no living thing can survive. It is your water that we are trying to protect, so that you will have plenty now and in the future. We must keep Montana's water in Montana. The only way we can do this is by having the support of each and every water user so that we have a 100 percent representation of all water users. Remember: "United we stand, divided we fall".

In order to facilitate this work a branch office of the State Engineer has been established in Billings and is located in the Roosevelt School Building on 23rd Street and Fourth Avenue North. Anytime you are in Billings we would appreciate your calling on us.

Hoping to hear from you in the very near future, I am,

Very truly yours,

Gerald J. Cravetz
Assistant State Engineer

P.S. If you cannot supply us with the information requested, it may be that you can tell us of someone who can.



STATE OF MONTANA
STATE ENGINEERS OFFICE
Water Resources Survey

Form WR-1-1M-11-41

Code No. 55-85

County Stillwater

T. 34 R. 20

Name of Land Owner Geo. Martin Address Chamberlain

Name of Operator _____ Address _____

Part A

TO BE FILED BY THOSE OBTAINING IRRIGATION WATER FROM
A DITCH COMPANY OR IRRIGATION DISTRICT

1. Water is delivered by: Shahely, J. E. Ditch Co.
Name of Ditch, Ditch Company or District supplying water
2. State the number of acres you irrigate under this system 50 Shares you hold 20
3. If you obtain water from more than one Company, give the number of shares, acres irrigated and the name of the Company under "Remarks". If you obtain water from a Ditch Company and also have a private system fill in both Part A and Part B.

Part B

TO BE FILED BY THOSE WHO HAVE A PRIVATE DITCH, PUMP OR IRRIGATION SYSTEM
or those who have a private water right under a Ditch Company

4. In what year was this land first irrigated? Date _____
5. Give the name of the original appropriator (first user): Joseph Pope et al.
6. Give the date appropriated Sept 10 - 1898 Amount filed on: Miners Inches _____ C. F. S. _____
7. State the total number of acres irrigated under this system: _____
8. Give the point of diversion: 1/4 71 Section 34 Township 34 Range 20

Part C

TO BE FILED BY ALL WATER USERS IN ADDITION TO PART A OR PART B

9. Source of Water: Yellowstone River
Name of stream or lake from which water is originally diverted
10. Water is obtained by: (Check one) Gravity ☒ Pumping _____ Other _____
11. What is the greatest number of acres you have irrigated? 50 Date _____
12. How many acres did you irrigate in 1944? (Crop and pasture) 50
13. State the total number of additional acres that could be irrigated by increasing the water supply, land leveling, etc. _____ This land is under what ditch? _____
14. How many acres of seeped land do you have which could be drained and put into production? 10
15. What is the condition of your irrigation system? Fair
16. Is your water supply adequate? Yes ☒ No _____ Explain _____
17. REMARKS: _____

18. Legal Description of this Farm. Section 5-18 North, Township 46, Range 1
18-18-18

From April 5-1987 thru Oct 1987

NORTH

19A. Ditch: Water, 4th Dist 23 Acres: 55

Ditch: _____ Acres: _____

Name Chas Thompson + C.B. Viach Address _____ Date Apr - 6 - 45

REMARKS: Also field check by Cook + [unclear]
and [unclear] [unclear]

THURDER'S, HELENA 

FORM SM-1

A STUDY OF MONTANA'S WATER RESOURCES

County Stillwater Source of Information 273
 1. Water User Alb. P. Johnson Address Glacier House, Glacier House, Mont. 59003
 2. Stream Big Lost River Tributary to Basin
 3. Point of Diversion 1/4 1/4 Section Township Range
 4. Description of System
 5. Type of Irrigation
 6. Original Appropriator 0 Address
 7. First Use: Year Acres Irrigated
 8. Maximum Use: Year Acres Irrigated
 9. Present Use: Year Acres Irrigated
 10. Last Use: Year Why Abandoned
 11. Condition of System
 12. Land Description Tract 100' x 100' S. 1/4 Sec 5, T 34N, R 21E

Remarks: See map, Sec 5, T. 34N, R. 21E

Tract 100' x 100' S. 1/4 Sec 5
Map 5, T. 34N, R. 21E - 1391-551A

* See map to Columbus, Mont.

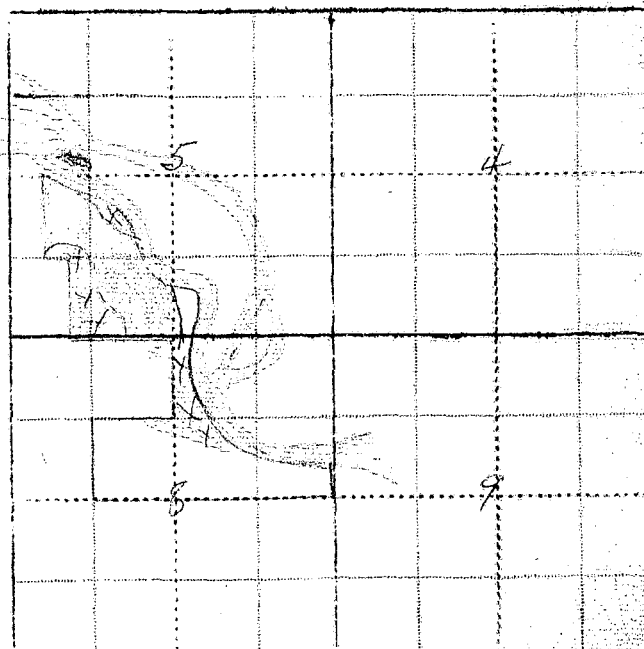

WITNESS:

Information by

Place

and

6-45

soon

Billings,
XXXXXXX

February 21, 1945

Ole P. Thomson
Columbus, Montana

Dear Mr. Thomson:

On January 22nd, this office sent you a letter asking for certain information pertaining to your irrigated land in township 3 south, range 21 east. To date we have not heard from you. With the vast post war water development in this area as now planned, it is essential that we have this information in order to show the extent of our water use in the Yellowstone Basin in Montana. This information is necessary to protect our present water users in the rights they have against future irrigation, navigation, power and flood control enterprises in this area. We are asking you for this information because we feel it is the democratic way; we also feel that you are more qualified to give us this information about your irrigated land than anyone else because it is part of your business. It may be that you were busy with your farm work or some unforeseen thing happened at the time our first letter was received, and you put it aside to be answered at some other time and have forgotten all about it. All information is strictly confidential and is only used to record and tabulate the water use in this area.

Water is as necessary to the farmer as the soil in which he plants. Without it no crops will grow; no living thing can survive. It is your water that we are trying to protect, so that you will have plenty now and in the future. We must keep Montana's water in Montana. The only way we can do this is by having the support of each and every water user so that we have a 100 percent representation of all water users. Remember: "United we stand, divided we fall".

In order to facilitate this work a branch office of the State Engineer has been established in Billings and is located in the Roosevelt School Building on 23rd Street and Fourth Avenue North. Anytime you are in Billings we would appreciate your calling on us.

Hoping to hear from you in the very near future, I am,

Very truly yours,

Gerald J. Oravetz
Assistant State Engineer

P.S. If you cannot supply us with the information requested, it may be that you can tell us of someone who can.

Billings,
XXXXXX

March 29, 1945

Ole P. Thomsen
Columbus, Montana

Dear Mr. Thomsen:

On January 22nd, we sent you a letter asking for certain information pertaining to your irrigated land in township 3 south, range 21 east. On February 21st, we sent you another letter asking you to submit the information to us as soon as possible. To date we have not heard from you regarding this matter.

It is hereby declared to be a policy of the State and necessary for the welfare of the State and its citizens, that the waters of this State, and especially interstate streams arising out of the State, be investigated. The State Engineer shall, either before or after the bringing of such action (to adjudicate the waters of any stream and its tributaries in any county traversed by said stream), upon the direction of the State Water Conservation Board, or upon the direction of the court, do all things, make all surveys and perform all services required by said board in the securing of all necessary information and make the same available to said board or others who may be interested therein, including the courts of this State.

In order to protect the water rights of the water users in this state it is mandatory that the State Engineer have the information that we have asked you to submit to this office. If you have sold the piece of land about which we wrote you, will you please give us the name and address of the new owner.

We expect to hear from you in the very near future.

Very truly yours,

Gerald J. Oravetz
Assistant State Engineer



STATE OF MONTANA
STATE ENGINEERS OFFICE
Water Resources Survey

200
Form WR-1-M-11-41
Code No. 2 C, 11 A
County Stillwater
T. 3 S. R. 21 E.

Name of Land Owner Chas. Storer Address Columbus

Name of Operator _____ Address _____

Part A

TO BE FILED BY THOSE OBTAINING IRRIGATION WATER FROM
A DITCH COMPANY OR IRRIGATION DISTRICT

1. Water is delivered by: Cove Ditch Co. Yellowstone Ditch
Name of Ditch, Ditch Company or District supplying water
2. State the number of acres you irrigate under this system 70 Shares you hold 12.51
3. If you obtain water from more than one Company, give the number of shares, acres irrigated and the name of the Company under "Remarks". If you obtain water from a Ditch Company and also have a private system fill in both Part A and Part B.

Part B

TO BE FILED BY THOSE WHO HAVE A PRIVATE DITCH, PUMP OR IRRIGATION SYSTEM
or those who have a private water right under a Ditch Company

4. In what year was this land first irrigated? Date _____
5. Give the name of the original appropriator (first user): Charles Temple Stah
6. Give the date appropriated Feb. 12, 1894 Amount filed on: Miners Inches 3000 C. F. S. _____
7. State the total number of acres irrigated under this system: _____
8. Give the point of diversion: _____ $\frac{1}{4}$ _____ $\frac{1}{4}$ Section 5 Township 240 Range 21 E

Part C

TO BE FILED BY ALL WATER USERS IN ADDITION TO PART A OR PART B

9. Source of Water: Yellowstone River
Name of stream or lake from which water is originally diverted
10. Water is obtained by: (Check one) Gravity ☒ Pumping _____ Other _____
11. What is the greatest number of acres you have irrigated? 70 Date 1944
12. How many acres did you irrigate in 1944? (Crop and pasture) 70 acres
13. State the total number of additional acres that could be irrigated by increasing the water supply, land leveling, etc. 20 This land is under what ditch? Cove Ditch
14. How many acres of seeped land do you have which could be drained and put into production? 20
15. What is the condition of your irrigation system? Fair
16. Is your water supply adequate? Yes _____ No ☒ Explain Difficult to get
17. REMARKS: water in late summer after
river gets low

OVER

NOTE: The foregoing questions apply only to irrigated land shown on this plat.

DESCRIPTION AND MAP OF FARM

18. Legal Description of this Farm SW $\frac{1}{4}$, SE $\frac{1}{4}$, Sec. 2 - Lot 1, Frac. Lot 2, Frac. NE $\frac{1}{4}$, Sec. 11

Twp. 3 S., Rge. 21 E.

☒ IRRIGATED LAND ☐ NON-IRRIGATED LAND

NORTH



— Farm boundary.

11

12

Yellowstone River

This map is according to our records. Please change it if it is not correct. That is if we show more irrigated land than you have, X it out; if we have not enough, draw it in.

19. If the above land is irrigated from more than one ditch please give the acreage under each ditch in 19A and indicate the location of the land irrigated from each on the above map.

19A. Ditch: Yellowstone Ditch Acres: 70

Ditch: _____ Acres: _____

Information supplied by:

Name Chas E. Stover Address Columbus Date 2-28-40

REMARKS: _____

If you cannot answer all of the questions on this form answer as many as you can and return the form to us as soon as possible.

THUNDER'S, HELENA

Our records show that you have an appropriation made by George R. Cummins, appropriated November 23, 1891 and filed November 24, 1891 from Yellowstone River for 3000 minors inches. Is this appropriation now in use? yes

2-5
FORM SM-1

A STUDY OF MONTANA'S WATER RESOURCES

County Billings Source of Information _____

1. Water User Chas. Storer Address Columbus

2. Stream _____ Tributary to _____ Basin _____

3. Point of Diversion 1/4 1/4 Section _____ Township _____ Range _____

4. Description of System _____

5. Type of Irrigation _____

6. Original Appropriator 644 Address _____

7. First Use: Year _____ Acres Irrigated _____

8. Maximum Use: Year _____ Acres Irrigated _____

9. Present Use: Year _____ Acres Irrigated _____

10. Last Use: Year _____ Why Abandoned _____

11. Condition of System _____

12. Land Description Sec 2, T 34 N, R 21 E

Remarks: _____

Lot 1, T. 34 N, R. 21 E, S. 11

340215-5547-1551A

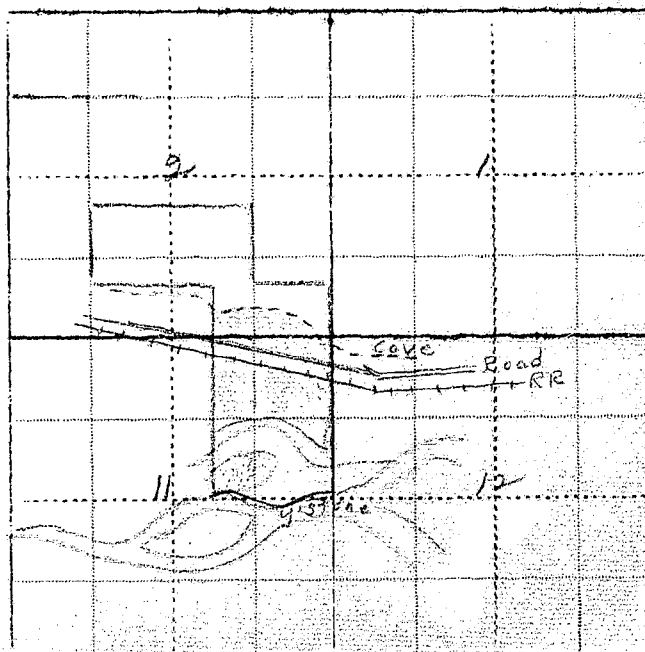

Our records show that you have an appropriation made by George R. Cummins, appropriated November 23, 1891 and filed November 24, 1891 from Yellowstone River for 3000 minors inches. Is this appropriation now in use?

Billings,
XXXXXX

February 21, 1945

Chas. Storer
Columbus, Montana

Dear Mr. Storer:

On January 22nd, this office sent you a letter asking for certain information pertaining to your irrigated land in township 3 south, range 21 east. To date we have not heard from you. With the vast post war water development in this area as now planned, it is essential that we have this information in order to show the extent of our water use in the Yellowstone Basin in Montana. This information is necessary to protect our present water users in the rights they have against future irrigation, navigation, power and flood control enterprises in this area. We are asking you for this information because we feel it is the democratic way; we also feel that you are more qualified to give us this information about your irrigated land than anyone else because it is part of your business. It may be that you were busy with your farm work or some unforeseen thing happened at the time our first letter was received, and you put it aside to be answered at some other time and have forgotten all about it. All information is strictly confidential and is only used to record and tabulate the water use in this area.

Water is as necessary to the farmer as the soil in which he plants. Without it no crops will grow; no living thing can survive. It is your water that we are trying to protect, so that you will have plenty now and in the future. We must keep Montana's water in Montana. The only way we can do this is by having the support of each and every water user so that we can have a 100 percent representation of all water users. Remember: "United we stand, divided we fall".

In order to facilitate this work a branch office of the State Engineer has been established in Billings and is located in the Roosevelt School Building on 23rd Street and Fourth Avenue North. Anytime you are in Billings we would appreciate your calling on us.

Hoping to hear from you in the very near future, I am,

Very truly yours,

Gerald J. Oravetz
Assistant State Engineer

P.S. If you cannot supply us with the information requested, it may be that you can tell us of someone who can.

Please Do Not Fill in Any Items on This Page

Notice of Appropriation

1. County Stillwater Book 2 Page 18 Record Disc.
2. Name of Appropriator Charles Temple et al Address Not shown.
(See next page.)
3. Date Appropriated Nov. 23, 1891 Date Filed Nov. 24, 1891
Amount Appropriated, Miners Inches 3000 Cubic Feet per second _____
4. Name of Stream Yellowstone River Tributary _____ Basin _____
5. Point of Diversion Water is diverted from a point upon its northerly bank about 230 feet from the center of the main track of the N. P. Ry. Co.'s railroad and about 300 feet W from the residence of E. S. Tutt, situated on lot 5, Sec. 5, T. 3 S., R. 21 E. & running thence
Sec. _____ Twp. _____ Rge. _____ Bank of Stream northerly.
in a general easterly direction to over and upon the above described lands.
6. Purpose Irrigation, domestic and beneficial purposes.
7. Description of System By means of a dam and ditch; the said ditch is 103 inches in width on the bottom, thereof and 156 inches across the top, by 2 1/4 inches in depth.

8. Land Description of Intended Place of Use

Subdivision	Sec.	Twp.	Rge.	Tot. Acr.	1940 Owner	Address
<u>N. 1/4 - lots 4 & 5, NW 1/4</u>	<u>10</u>	<u>3 S.</u>	<u>21 E.</u>			<u>See next page.</u>
<u>SW 1/4 - NW 1/4 - NW 1/4 - NW 1/4</u>	<u>11</u>					
<u>NW 1/4 - NW 1/4</u>	<u>11</u>	<u>3 S.</u>	<u>21 E.</u>			
<u>SW 1/4 - NW 1/4 - NW 1/4 - NW 1/4</u>	<u>12</u>	<u>3 S.</u>	<u>21 E.</u>			
<u>SE 1/4 - lots 2, 3, 4 & 5</u>	<u>7</u>	<u>3 S.</u>	<u>22 E.</u>			
<u>Part of NW 1/4 of</u>	<u>8</u>	<u>3 S.</u>	<u>22 E.</u>			
<u>All of</u>	<u>5</u>	<u>3 S.</u>	<u>22 E.</u>			
<u>Lots 2, 3, 5 & 6</u>	<u>4</u>	<u>3 S.</u>	<u>22 E.</u>			
<u>SW 1/4 - NW 1/4</u>	<u>33</u>	<u>2 S.</u>	<u>22 E.</u>			

Decree

For 9. Remarks - See next page.

10. Case No. _____ Date _____ Amt. Decreed: M. I. _____ C. F. S. _____
11. To Whom Decreed _____ Address _____
12. Name of Ditch _____ Maximum Capacity (C. F. S.) _____
13. Date of Priority _____ Purpose _____
14. Land Description of Place of Use as Decreed _____

15. Remarks (Present Use Status, etc.) _____

9. Remarks (Pertaining to Use, etc.)

And we do further claim the right to change the point of diversion of said water at anytime and to extend the flumes, piles, ditches and aqueducts for which said diversion is made, from time to time to any place other than where first used and to use the water for other useful purposes and beneficial purposes than that for which it was first appropriated, we also claim the rights of way for dikes and canals over and across the lands through the same and the right to enlarge and to alter the same from time to time and also all rights, easements, privileges and appurtenances.

2. Name of appropriators:

Charles Temple et al; John Walsh, Charles H. Watkins, Andrew M. Parker, George H. Cummins, John H. Cummins, Stephen E. Wimssett, Sarah E. Wimssett, William W. Palmer and George C. Tilden.

1940 Land Ownership.

- 128 A - NW¹/₄, Lots 4 & 5, Sec. 10, T. 3 S., R. 21 E. - Gerhard Waltermann, Columbus, Mont.
 160 A - NE¹/₄ - Sec. 10, T. 3 S., R. 21 E., Douglas Annin, c/o L. B. Banks, Columbus, Mont.
 111 A - NW¹/₄, NWSW - Sec. 11, T. 3 S., R. 21 E. - Jacob Henry, Park City, Montana
 155 A - NW¹/₄ - Lot 1, Sec. 11, T. 3 S., R. 21 E. - Charles & Alice Storer, Columbus,
 E Frac lot 2 - Sec. 11, T. 3 S., R. 21 E.
 E¹/₂ NW¹/₄ - Sec. 11, T. 3 S., Rge. 21 E.
 183.78 - E¹/₂ NW, NWSW, NW¹/₄ NWSE, Sec. 11, T. 3 S., R. 21 E. - Federal Land Bank
 NW¹/₄ NWSE - Sec. 11, T. 3 S., R. 21 E. c/o Al Codneys, Hardin, Montana
 164 - SE¹/₄ NW - Lot 2, 3, 4, 5 - Sec. 7, Twp. 3 S., R. 22 E. - R. W. Shipple, Fishtail.
 80 - Lot 1 & 2, R¹/₂ NW - Sec. 8 - T. 3 S., Rge. 22 E. - Konrad Meschenfelder,
 Park City, Montana
 222 - Frac E¹/₂ NW¹/₄ - NW¹/₄ NWSE
 NWSW - Frac NWSW - Frac SWSW - Sec. 5 - T. 3 S., Rge. 22 E. - Peter Yegen, Billings
 105 acres - Frac SWSW - Lot 5 & 6 - Sec. 5, T. 3 S., Rge. 22 E.
 SE corner NWSW - SW frac NWSW - Sec. 5 - T. 3 S., R. 22 E.
 Konrad Meschenfelder - Park City, Montana
 Acres? - Part of lot 2 & Frac of lot 3 - Sec. 5 - T. 3 S., Rge. 22 E.
 M. O. Rosden, Laurel, Montana
 40 A - Lot 1 - Sec. 5 - T. 3 S., Rge. 22 E. - Titus Mauk, Park City, Montana
 50.23 - Lot 7 - NE corner SWSW, Sec. 5, T. 3 S., R. 22 E., M. O. Rosden, Laurel, Mont.
 99.77 - Lot 5 & 6 - Frac SWSW - Sec. 4 - T. 3 S., Rge. 22 E.
 S¹/₂ NW¹/₄ - Lot 2 - Sec. 4, T. 3 S., R. 22 E.
 19.67 - Fracs. of lot 3 - Sec. 4 - T. 3 S., R. 22 E. - H. C. Crippen, Billings
 143 - S¹/₂ SW¹/₄, NWSW, Sec. 33, T. 2 S., R. 22 E.
 Frac NWSW, Frac SE¹/₄ NW, Sec. 33, T. 2 S., R. 22 E.
 Frac SWSW, Sec. 33, T. 2 S., R. 22 E., H. C. Crippen, Billings, Montana
 68 - SWSW, Frac SE¹/₄ NW, Sec. 33 - Twp. 2 S., Rge. 22 E. - M. O. Raysden, Laurel, Mont.



STATE OF MONTANA
STATE ENGINEERS OFFICE
Water Resources Survey

84
Form WR-1-1M-11-41

Code No. 6 D, 7 A, 8 C
County Stillwater
T. 3 S. R. 21 E.

Name of Land Owner Chris Thompson Address Columbus
Name of Operator _____ Address _____

Part A

TO BE FILED BY THOSE OBTAINING IRRIGATION WATER FROM
A DITCH COMPANY OR IRRIGATION DISTRICT

1. Water is delivered by: Flaherty Flat Ditch Company.
Name of Ditch, Ditch Company or District supplying water
2. State the number of acres you irrigate under this system. 80 Shares you hold 30
3. If you obtain water from more than one Company, give the number of shares, acres irrigated and the name of the Company under "Remarks". If you obtain water from a Ditch Company and also have a private system fill in both Part A and Part B.

Part B

TO BE FILED BY THOSE WHO HAVE A PRIVATE DITCH, PUMP OR IRRIGATION SYSTEM
or those who have a private water right under a Ditch Company

4. In what year was this land first irrigated? Date 1898
5. Give the name of the original appropriator (first user): Joseph W. Pope et al
6. Give the date appropriated Jan 10, 1898 Amount filed on: Miners Inches _____ C. F. S. _____
7. State the total number of acres irrigated under this system: _____
8. Give the point of diversion: 1/4 Section 34 Township 2S Range 20E

Part C

TO BE FILED BY ALL WATER USERS IN ADDITION TO PART A OR PART B

9. Source of Water: _____
Name of stream or lake from which water is originally diverted
10. Water is obtained by: (Check one) Gravity ☒ Pumping _____ Other _____
11. What is the greatest number of acres you have irrigated? 120 Date _____
12. How many acres did you irrigate in 1944? (Crop and pasture) 80
13. State the total number of additional acres that could be irrigated by increasing the water supply, land leveling, etc. 40 This land is under what ditch? Flaherty Flat Ditch
14. How many acres of seeped land do you have which could be drained and put into production? 100
15. What is the condition of your irrigation system? Poor
16. Is your water supply adequate? Yes _____ No ☒ Explain Ditch in Poor Condition

17. REMARKS: Some of the water is used in seeped and used for pasture only. It is seeped that should be put into production.
OVER

NOTE: The foregoing questions apply only to irrigated land shown on this plat.

DESCRIPTION AND MAP OF FARM

18. Legal Description of this Farm SE $\frac{1}{4}$ Section 6, E $\frac{1}{2}$ NE $\frac{1}{4}$ Section 7 - Twp. 3 S., Rge. 21 E.

W $\frac{1}{2}$ NW $\frac{1}{4}$ Frac NE NW $\frac{1}{4}$, SW $\frac{1}{4}$, S $\frac{1}{2}$ SE $\frac{1}{4}$, W $\frac{1}{2}$ SE $\frac{1}{4}$, Section 8 - Twp. 3 S., Rge. 21 E.

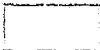
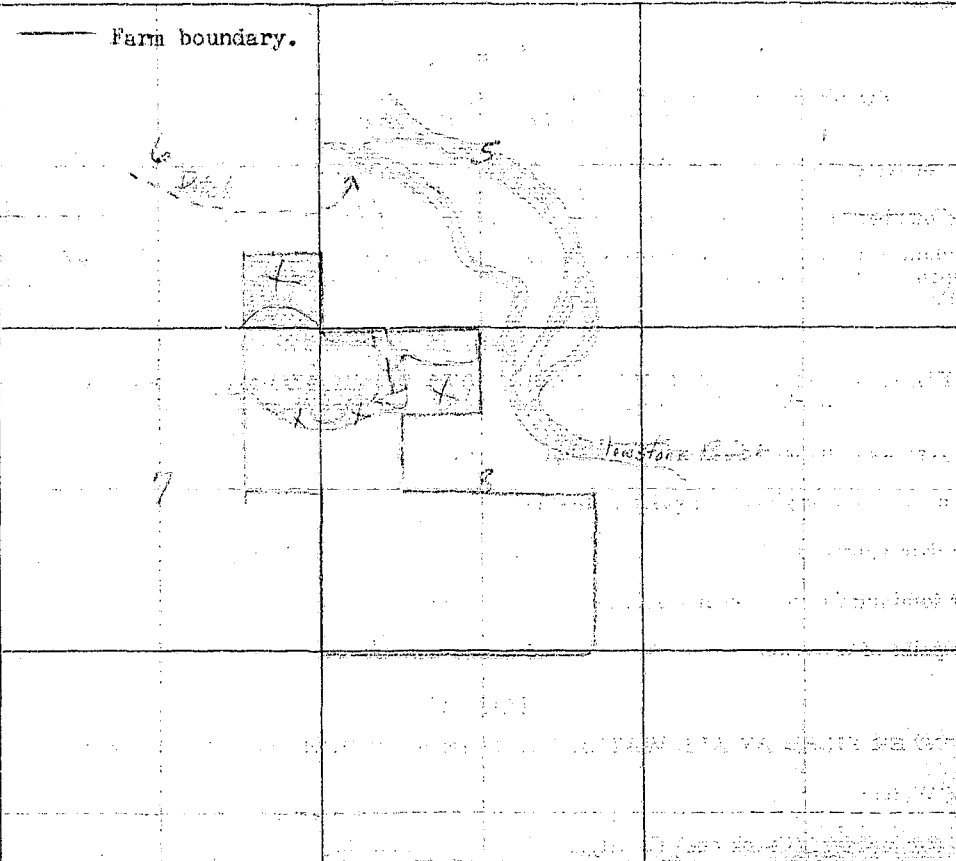
 IRRIGATED LAND	 NON-IRRIGATED LAND
<p>— Farm boundary.</p> <p>NORTH</p>  <p>This map is according to our records. Please change it if it is not correct. That is if we show more irrigated land than you have, X it out; if we have not enough, draw it in.</p>	

19. If the above land is irrigated from more than one ditch please give the acreage under each ditch in 19A and indicate the location of the land irrigated from each on the above map.

19A. Ditch: Liberty Flat Ditch Co. Acres: 80

Ditch: _____ Acres: _____

Information supplied by:

Name: _____ Address: _____ Date: _____

REMARKS: _____

If you cannot answer all of the questions on this form answer as many as you can and return the form to us as soon as possible.

THUNDERBOLT, HELENA

FORM SM-1

A STUDY OF MONTANA'S WATER RESOURCES

County Stillwater Source of Information 1134

1. Water User John Thompson Address Calumet

2. Stream _____ Tributary to _____ Basin _____

3. Point of Diversion 1/4 1/4 Section _____ Township _____ Range _____

4. Description of System _____

5. Type of Irrigation _____

6. Original Appropriator _____ Address _____

7. First Use: Year _____ Acres Irrigated _____

8. Maximum Use: Year _____ Acres Irrigated _____

9. Present Use: Year _____ Acres Irrigated _____

10. Last Use: Year _____ Why Abandoned _____

11. Condition of System _____

12. Land Description SE 1/4, Sec 6-5-7-24, Sec 7, T 3 N, R 21 E

Remarks:

Acres 1/4, 1/4, 1/4, 1/4, 1/4, 1/4, 1/4, 1/4

2000 TA

2000 TA

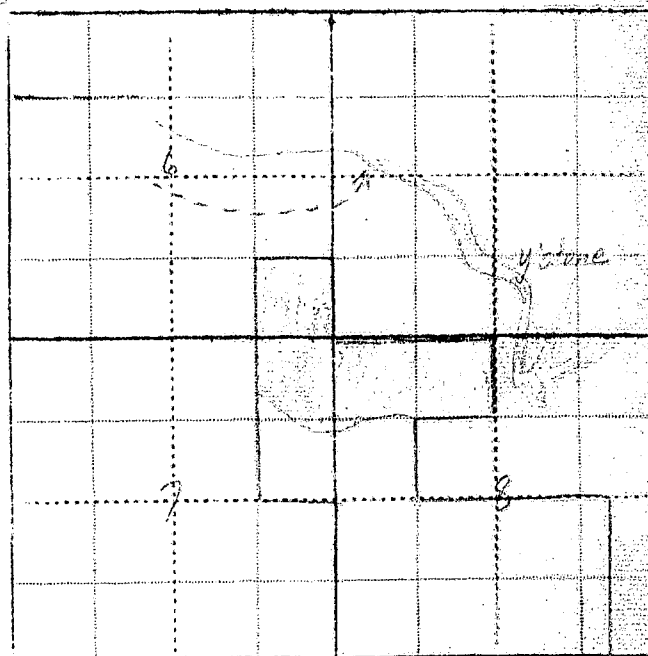

WITNESS:

Information by

Place



STATE OF MONTANA
STATE ENGINEERS OFFICE
Water Resources Survey

Form WR-1-1M-11-44

Code No. 65-100
County Yellowstone
T. 24 R. 25

Name of Land Owner Montana Central Lumber Co. Address Billings

Name of Operator _____ Address _____

Part A

TO BE FILED BY THOSE OBTAINING IRRIGATION WATER FROM
A DITCH COMPANY OR IRRIGATION DISTRICT

1. Water is delivered by: Mont. Irrigated
Name of Ditch, Ditch Company or District supplying water
2. State the number of acres you irrigate under this system _____ Shares you hold _____
3. If you obtain water from more than one Company, give the number of shares, acres irrigated and the name of the Company under "Remarks". If you obtain water from a Ditch Company and also have a private system fill in both Part A and Part B.

Part B

TO BE FILED BY THOSE WHO HAVE A PRIVATE DITCH, PUMP OR IRRIGATION SYSTEM
or those who have a private water right under a Ditch Company

4. In what year was this land first irrigated? Date _____
5. Give the name of the original appropriator (first user): _____
6. Give the date appropriated _____ Amount filed on: Miners Inches _____ C. F. S. _____
7. State the total number of acres irrigated under this system: _____
8. Give the point of diversion: _____ $\frac{1}{4}$ _____ $\frac{1}{4}$ Section _____ Township _____ Range _____

Part C

TO BE FILED BY ALL WATER USERS IN ADDITION TO PART A OR PART B

9. Source of Water: _____
Name of stream or lake from which water is originally diverted
10. Water is obtained by: (Check one) Gravity _____ Pumping _____ Other _____
11. What is the greatest number of acres you have irrigated? _____ Date _____
12. How many acres did you irrigate in 1944? (Crop and pasture) _____
13. State the total number of additional acres that could be irrigated by increasing the water supply, land leveling, etc. _____ This land is under what ditch? _____
14. How many acres of seeped land do you have which could be drained and put into production? _____
15. What is the condition of your irrigation system? _____
16. Is your water supply adequate? Yes _____ No _____ Explain _____
17. REMARKS: Mont. irrigated all wet land
Field Creek B. G. Hunt & Co. Billings
April 6, 1945 - Henry Hunt, also
has water on 100 acres

OVER

NOTE: The foregoing questions apply only to irrigated land shown on this plat.

DESCRIPTION AND MAP OF FARM

18. Legal Description of this Farm

IRRIGATED LAND

NON-IRRIGATED LAND



6

not integrated

7

19. If the above land is irrigated from more than one ditch please give the acreage under each ditch in 19A and indicate the location of the land irrigated from each on the above map.

19A. Ditch: _____ Acres: _____

Ditch: _____ Acres: _____

Information supplied by:

Name	Address	Date
------	---------	------

REMARKS:

If you cannot answer all of the questions on this form answer as many as you can and return the form to us as soon as possible.

THUNDERBOLT, HELENA

A STUDY OF MONTANA'S WATER RESOURCES

County	Source of Information
--------	-----------------------

1. Water User *John A. Smith, Highway 100, Box 100* Address *Golden, CO*

2. Stream Tributary to Basin

3. Point of Diversion $\frac{1}{4}$ $\frac{1}{4}$ Section Township Range

4. Description of System

5. Type of Irrigation _____

6. Original Appropriator	Address

7. First Use:	Year	Acres Irrigated
---------------	------	-----------------

8. Maximum Use: Year	Acres Irrigated
1950	100
1951	100
1952	100
1953	100
1954	100
1955	100
1956	100
1957	100
1958	100
1959	100
1960	100
1961	100
1962	100
1963	100
1964	100
1965	100
1966	100
1967	100
1968	100
1969	100
1970	100
1971	100
1972	100
1973	100
1974	100
1975	100
1976	100
1977	100
1978	100
1979	100
1980	100
1981	100
1982	100
1983	100
1984	100
1985	100
1986	100
1987	100
1988	100
1989	100
1990	100
1991	100
1992	100
1993	100
1994	100
1995	100
1996	100
1997	100
1998	100
1999	100
2000	100
2001	100
2002	100
2003	100
2004	100
2005	100
2006	100
2007	100
2008	100
2009	100
2010	100
2011	100
2012	100
2013	100
2014	100
2015	100
2016	100
2017	100
2018	100
2019	100
2020	100
2021	100
2022	100
2023	100
2024	100
2025	100
2026	100
2027	100
2028	100
2029	100
2030	100
2031	100
2032	100
2033	100
2034	100
2035	100
2036	100
2037	100
2038	100
2039	100
2040	100
2041	100
2042	100
2043	100
2044	100
2045	100
2046	100
2047	100
2048	100
2049	100
2050	100
2051	100
2052	100
2053	100
2054	100
2055	100
2056	100
2057	100
2058	100
2059	100
2060	100
2061	100
2062	100
2063	100
2064	100
2065	100
2066	100
2067	100
2068	100
2069	100
2070	100
2071	100
2072	100
2073	100
2074	100
2075	100
2076	100
2077	100
2078	100
2079	100
2080	100
2081	100
2082	100
2083	100
2084	100
2085	100
2086	100
2087	100
2088	100
2089	100
2090	100
2091	100
2092	100
2093	100
2094	100
2095	100
2096	100
2097	100
2098	100
2099	100
2100	100

9. Present Use; Year	Acres Irrigated
1. Alfalfa	
2. Corn	
3. Soybeans	
4. Wheat	
5. Other	
6. Total	
7. Total	
8. Total	

10. Last Use:	Year	Why Abandoned

11. Condition of System

12. Land Description *Lot 4, Sec 6-1st, T2N, R2E*, T *2N*, R *2E*

Remarks:

Note: Length changed

A 10x10 grid with handwritten numbers. The number '6' is written in the second column, fourth row. The number '7' is written in the second column, eighth row. There are also some faint, illegible markings in the top left corner.

WITNESS: _____ Information by _____

Place

A- and

as soon

Billings,
XXXXXXX

February 21, 1945

Don Richardson
Columbus, Montana

Dear Mr. Richardson:

On January 22nd, this office sent you a letter asking for certain information pertaining to your irrigated land in township 3 south, range 21 east. To date we have not heard from you. With the vast post war water development in this area as now planned, it is essential that we have this information in order to show the extent of our water use in the Yellowstone Basin in Montana. This information is necessary to protect our present water users in the rights they have against future irrigation, navigation, power and flood control enterprises in this area. We are asking you for this information because we feel it is the democratic way; we also feel that you are more qualified to give us this information about your irrigated land than anyone else because it is part of your business. It may be that you were busy with your farm work or some unforeseen thing happened at the time our first letter was received, and you put it aside to be answered at some other time and have forgotten all about it. All information is strictly confidential and is only used to record and tabulate the water use in this area.

Water is as necessary to the farmer as the soil in which he plants. Without it no crops will grow; no living thing can survive. It is your water that we are trying to protect, so that you will have plenty now and in the future. We must keep Montana's water in Montana. The only way we can do this is by having the support of each and every water user so that we have a 100 percent representation of all water users. Remember: "United we stand, divided we fall".

In order to facilitate this work a branch office of the State Engineer has been established in Billings and is located in the Roosevelt School Building on 23rd Street and Fourth Avenue North. Anytime you are in Billings we would appreciate your calling on us.

Hoping to hear from you in the very near future, I am,

Very truly yours,

Gerald J. Oravetz
Assistant State Engineer

P.S. If you cannot supply us with the information requested, it may be that you can tell us of someone who can.

Billings,
XXXXXXX

March 29, 1945

Don Richardson
Columbus, Montana

Dear Mr. Richardson:

On January 22nd, we sent you a letter asking for certain information pertaining to your irrigated land in township 3 south, range 21 east. On February 21st, we sent you another letter asking you to submit the information to us as soon as possible. To date we have not heard from you regarding this matter.

It is hereby declared to be a policy of the State and necessary for the welfare of the State and its citizens, that the waters of this State, and especially interstate streams arising out of the State be investigated. The State Engineer shall, either before or after the bringing of such action (to adjudicate the waters of any stream and its tributaries in any county traversed by said stream), upon the direction of the State Water Conservation Board, or upon the direction of the court, do all things, make all surveys, and perform all services required by said board in the securing of all necessary information and make the same available to said board or others who may be interested therein, including the courts of this State.

In order to protect the water rights of the water users in this state it is mandatory that the State Engineer have the information that we have asked you to submit to this office. If you have sold the piece of land about which we wrote you, will you please give us the name and address of the new owner.

We expect to hear from you in the very near future.

~~Billings, Montana~~

Gerald J. Oravetz
Ass't State Engineer



STATE OF MONTANA
STATE ENGINEERS OFFICE
Water Resources Survey

81
Form WR-1-1M-11-44
Code No. 5 C, 6 A
County Stillwater
T. 3 S. R. 21 E.

Name of Land Owner: C. B. Veach Address: Columbus
Name of Operator: _____ Address: _____

Part A

TO BE FILED BY THOSE OBTAINING IRRIGATION WATER FROM
A DITCH COMPANY OR IRRIGATION DISTRICT

- Water is delivered by: Liberty Flat Ditch
Name of Ditch, Ditch Company or District supplying water
- State the number of acres you irrigate under this system 65 Shares you hold 1
- If you obtain water from more than one Company, give the number of shares, acres irrigated and the name of the Company under "Remarks". If you obtain water from a Ditch Company and also have a private system fill in both Part A and Part B.

Part B

TO BE FILED BY THOSE WHO HAVE A PRIVATE DITCH, PUMP OR IRRIGATION SYSTEM
or those who have a private water right under a Ditch Company

- In what year was this land first irrigated? Date _____
- Give the name of the original appropriator (first user): Joseph Pope et al
- Give the date appropriated Jan-10-1898 Amount filed on: Miners Inches _____ C. F. S. _____
- State the total number of acres irrigated under this system: _____
- Give the point of diversion: 1/4 71 Section 34 Township 2 S Range 20 E

Part C

TO BE FILED BY ALL WATER USERS IN ADDITION TO PART A OR PART B

- Source of Water: Yellowstone River
Name of stream or lake from which water is originally diverted
- Water is obtained by: (Check one) Gravity _____ Pumping _____ Other Ditch
- What is the greatest number of acres you have irrigated? all Date _____
- How many acres did you irrigate in 1944? (Crop and pasture) 26
- State the total number of additional acres that could be irrigated by increasing the water supply, land leveling, etc. _____ This land is under what ditch? Liberty Flat
- How many acres of seeped land do you have which could be drained and put into production? 45
- What is the condition of your irrigation system? Poor
- Is your water supply adequate? Yes _____ No X Explain Ditch is not an good condition
- REMARKS: Land needs some leveling and ditch needs repairs

OVER

Total Potential 95 Acres

NOTE: The foregoing questions apply only to irrigated land shown on this plat.

DESCRIPTION AND MAP OF FARM

18. Legal Description of this Farm. Frac. W¹SW¹, Lot 11- Sec. 5, Lot 7, NE SE¹, Sec. 6 - Twp. 3 S. - Rge. 21 E.

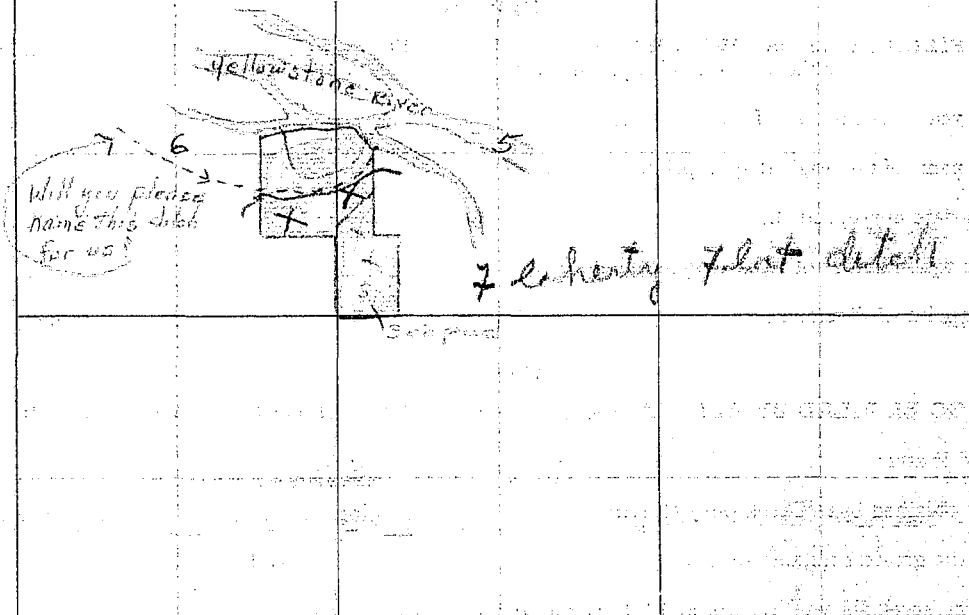
	IRRIGATED LAND	NON-IRRIGATED LAND
<p>NORTH</p> 	<p>— Farm boundary.</p> <p>This map is according to our records. Please change it if it is not correct. That is if we show more irrigated land than you have, X it out; if we have not enough, draw it in.</p>	
		

19. If the above land is irrigated from more than one ditch please give the acreage under each ditch in 19A and indicate the location of the land irrigated from each on the above map.

19A. Ditch: Flaherty Flat Ditch Acres: 25

Ditch: _____ Acres: _____

Information supplied by:

Name: W. B. Veach Address: Helena, Mont. Date: Jan. 16

REMARKS: _____

If you cannot answer all of the questions on this form answer as many as you can and return the form to us as soon as possible.

Checked in Office by M. E. K.

THURBER'S, HELENA

A STUDY OF MONTANA'S WATER RESOURCES

- County Stillwater Source of Information SPS
1. Water User B. B. Deach Address Columbus
2. Stream _____ Tributary to _____ Basin _____
3. Point of Diversion $\frac{1}{4}$ $\frac{1}{4}$ Section _____ Township _____ Range _____
4. Description of System _____
5. Type of Irrigation _____
6. Original Appropriator D Address _____
7. First Use: Year _____ Acres Irrigated _____
8. Maximum Use: Year _____ Acres Irrigated _____
9. Present Use: Year _____ Acres Irrigated _____
10. Last Use: Year _____ Why Abandoned _____
11. Condition of System _____
12. Land Description Sec. 11, T. 34 N., R. 21 E.

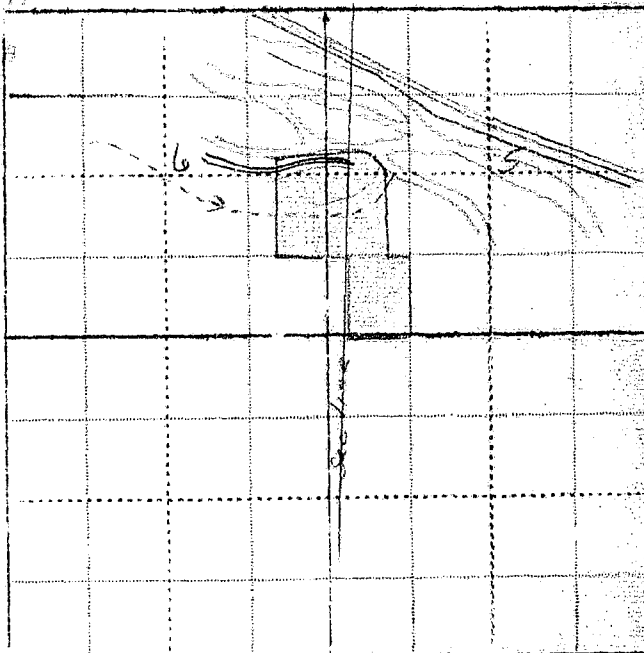
Remarks: Sec. 11, T. 34 N., R. 21 E.Lot 7, T. 34 N., R. 21 E.Lot 11, T. 34 N., R. 21 E.

WITNESS: _____ Information by _____
Place _____



STATE OF MONTANA
STATE ENGINEERS OFFICE
Water Resources Survey

Form WR-1-1M-11-41

Code No. 10 B
County Stillwater
T. 3 S. R. 21 E.

Name of Land Owner Gerhard Waltermann Address Columbus, Montana
Name of Operator _____ Address _____

Part A

TO BE FILED BY THOSE OBTAINING IRRIGATION WATER FROM
A DITCH COMPANY OR IRRIGATION DISTRICT

1. Water is delivered by: Yellowstone Ditch Co.
Name of Ditch, Ditch Company or District supplying water
2. State the number of acres you irrigate under this system 70 Shares you hold 942
3. If you obtain water from more than one Company, give the number of shares, acres irrigated and the name of the Company under "Remarks". If you obtain water from a Ditch Company and also have a private system fill in both Part A and Part B.

Part B

TO BE FILED BY THOSE WHO HAVE A PRIVATE DITCH, PUMP OR IRRIGATION SYSTEM
or those who have a private water right under a Ditch Company

4. In what year was this land first irrigated? Date _____
5. Give the name of the original appropriator (first user): Charles Temple et al.
6. Give the date appropriated Nov. 25-1891 Amount filed on: Miners Inches 5000 C. F. S. _____
7. State the total number of acres irrigated under this system: _____
8. Give the point of diversion: _____ $\frac{1}{4}$ _____ $\frac{1}{4}$ Section 5 Township 34S Range 21E

Part C

TO BE FILED BY ALL WATER USERS IN ADDITION TO PART A OR PART B

9. Source of Water: Yellowstone River
Name of stream or lake from which water is originally diverted
10. Water is obtained by: (Check one) Gravity ☒ Pumping _____ Other _____
11. What is the greatest number of acres you have irrigated? 70 Date 1944
12. How many acres did you irrigate in 1944? (Crop and pasture) 70
13. State the total number of additional acres that could be irrigated by increasing the water supply, land leveling, etc. 35 This land is under what ditch? Yellowstone Ditch - by pumping
14. How many acres of seeped land do you have which could be drained and put into production? None
15. What is the condition of your irrigation system? Good
16. Is your water supply adequate? Yes ☒ No _____ Explain _____
17. REMARKS: _____

NOTE: The foregoing questions apply only to irrigated land shown on this plat.

DESCRIPTION AND MAP OF FARM

18. Legal Description of this Farm N 1/4, Lots 4, 5, Section 10 - Twp. 3 S., Rge. 21 E.

	IRRIGATED LAND	NON-IRRIGATED LAND
<p>— Farm boundary.</p> <p>NORTH</p>		
<p>This map is according to our records. Please change it if it is not correct. That is if we show more irrigated land than you have, X it out; if we have not enough, draw it in.</p>		

19. If the above land is irrigated from more than one ditch please give the acreage under each ditch in 19A and indicate the location of the land irrigated from each on the above map.

19A. Ditch: Yellowstone Ditch Acres: 7.0

Ditch: _____ Acres: _____

Information supplied by:

Name Lehard Goltzmann Address Columbus Date 3/28-1945

REMARKS: _____

If you cannot answer all of the questions on this form answer as many as you can and return the form to us as soon as possible.

THURBER'S, HELENA

Yes

A STUDY OF MONTANA'S WATER RESOURCES

County	Source of Information
<i>[illegible]</i>	<i>[illegible]</i>

1. Water User Robert W. Witterman Address Bellevue, Va.

2. Stream _____ Tributary to _____ Basin _____

3. Point of Diversion 1/4 1/4 Section Township Range

4. Description of System

5. Type of Irrigation _____

6. Original Appropriator 64-1 Address _____

7. First Use: Year _____ Acres Irrigated _____

8. Maximum Use: Year _____ Acres Irrigated _____

9. Present Use: Year _____ Acres Irrigated _____

10. Last Use: Year _____ Why Abandoned _____

11. Condition of System

12. Land Description Tr 2nd, lot 45, Sec 10, T 34S, R 20E

Remarks: 1000000

1944-1945

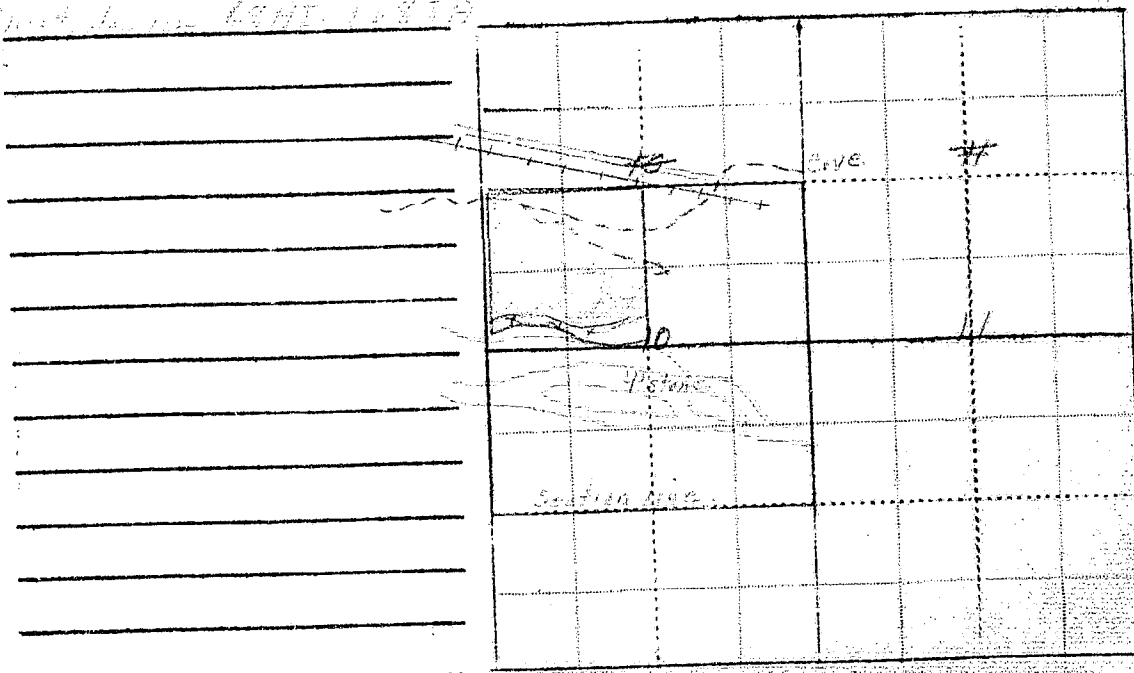

Information by

Billings,
~~XXXXXX~~

February 21, 1945

Gerhard Waltermann
Columbus, Montana

Dear Mr. Waltermann:

On January 22nd, this office sent you a letter asking for certain information pertaining to your irrigated land in township 3 south, range 21 east. To date we have not heard from you. With the vast post war water development in this area as now planned, it is essential that we have this information in order to show the extent of our water use in the Yellowstone Basin in Montana. This information is necessary to protect our present water users in the rights they have against future irrigation, navigation, power and flood control enterprises in this area. We are asking you for this information because we feel it is the democratic way; we also feel that you are more qualified to give us this information about your irrigated land than anyone else because it is part of your business. It may be that you were busy with your farm work or some unforeseen thing happened at the time our first letter was received, and you put it aside to be answered at some other time and have forgotten all about it. All information is strictly confidential and is only used to record and tabulate the water use in this area.

Water is as necessary to the farmer as the soil in which he plants. Without it no crops will grow; no living thing can survive. It is your water that we are trying to protect, so that you will have plenty now and in the future. We must keep Montana's water in Montana. The only way we can do this is by having the support of each and every water user so that we have a 100 percent representation of all water users. Remember: "United we stand, divided we fall".

In order to facilitate his work a branch office of the State Engineer has been established in Billings and is located in the Roosevelt School Building on 23rd Street and Fourth Avenue North. Anytime you are in Billings we would appreciate your calling on us.

Hoping to hear from you in the very near future, I am,

Very truly yours,

Gerald J. Oravetz
Assistant State Engineer

P.S. If you cannot supply us with the information requested, it may be that you can tell us of someone who can.

Please Do Not Fill in Any Items on This Page

Notice of Appropriation

1. County Stillwater Book 2 Page 19 Record Disc.
2. Name of Appropriator Charles Temple et al Address Not shown.
(See next page.)
3. Date Appropriated Nov. 23, 1891 Date Filed Nov. 24, 1891
Amount Appropriated, Miners Inches 3000 Cubic Feet per second _____
4. Name of Stream Yellowstone River Tributary _____ Basin _____
5. Point of Diversion Water is diverted from a point upon its northerly bank about 200 feet from the center of the main track of the N. P. Ry Co.'s railroad and about 300 feet from the residence of C. C. Tatt, situated on lot 5, Sec. 5, T. 3 N., R. 21 E. & running thence Sec. _____ Twp. _____ Rge. _____ Bank of Stream northerly.
in a general easterly direction to over and upon the above described lands.
6. Purpose Irrigation, domestic and beneficial purposes.
7. Description of System By means of a dam and ditch; the said ditch is 108 inches in width on the bottom, thereof and 150 inches across the top, by 24 inches in depth.

8. Land Description of Intended Place of Use

Subdivision	Sec.	Twp.	Rge.	Tot. Acr.	1900 Owner	Address
<u>Block - lots 4 & 5, sec.</u>	<u>20</u>	<u>3 N.</u>	<u>21 E.</u>		<u>See next page.</u>	
<u>Block - lots 6 & 7, sec.</u>	<u>11</u>					
<u>Block - lots 8 & 9, sec.</u>	<u>11</u>	<u>3 N.</u>	<u>21 E.</u>			
<u>Block - lots 10 & 11, sec.</u>	<u>12</u>	<u>3 N.</u>	<u>21 E.</u>			
<u>Block - lots 12, 13, 14 & 15, sec.</u>	<u>7</u>	<u>3 N.</u>	<u>22 E.</u>			
<u>Part of N. 1/2 of</u>	<u>6</u>	<u>3 N.</u>	<u>22 E.</u>			
<u>All of</u>	<u>5</u>	<u>3 N.</u>	<u>22 E.</u>			
<u>lots 2, 3, 5 & 6</u>	<u>4</u>	<u>3 N.</u>	<u>22 E.</u>			
<u>sec. - 22 E.</u>	<u>33</u>	<u>2 N.</u>	<u>22 E.</u>			

Decree

For 9. Remarks - See next page. -- Water in 1891

10. Case No. _____ Date _____ Amt. Decreed: M. I. _____ C. F. S. _____
11. To Whom Decreed _____ Address _____
12. Name of Ditch _____ Maximum Capacity (C. F. S.) _____
13. Date of Priority _____ Purpose _____
14. Land Description of Place of Use as Decreed _____
15. Remarks (Present Use Status, etc) _____

9. Remarks (Pertaining to Use, etc.)

And we do further claim the right to change the point of diversion of said water at anytime and to extend the flumes, piles, ditches and aqueducts for which said diversion is made, from time to time to any place other than where first used and to use the water for other useful purposes and beneficial purposes than that for which it was first appropriated, we also claim the rights of way for dikes and canals over and across the lands through the same and the right to enlarge and to alter the same from time to time and also all rights, easements, privileges and appurtenances.

2. Name of appropriators:

Charles Temple et al; John Ealen, Charles M. Watkins, Andrew E. Parker, George E. Cummins, John H. Cummins, Stephen E. Wimsatt, Sarah E. Wimsatt, William E. Palmer and George C. Tilden.

1940 Land Ownership.

128 A - NW 1/4, Lots 4 & 5, Sec. 10, T. 3 S., R. 21 E. - Gerhard Waltersan, Columbus, Mont.

160 A - NW 1/4 - Sec. 10, T. 3 S., R. 21 E., Douglas Annin, c/o L. B. Banks, Columbus, Mont.

111 A - NW 1/4, NE 1/4 - Sec. 11, T. 3 S., R. 21 E. - Jacob Henry, Park City, Montana

155 A - NW 1/4 - Lot 1, Sec. 11, T. 3 S., R. 21 E. - Charles & Alice Storer, Columbus,

& Frac lot 2 - Sec. 11, T. 3 S., R. 21 E.

NE 1/4 - Sec. 11, T. 3 S., R. 21 E.

183.78 - NW 1/4, NE 1/4, NW 1/4, Sec. 11, T. 3 S., R. 21 E. - Federal Land Bank

NE 1/4 - Sec. 11, T. 3 S., R. 21 E. c/o Al Godneys, Hardin, Montana

164 - SE 1/4 - Lot 2, 3, 4, 5 - Sec. 7, Twp. 3 S., R. 22 E. - R. E. Whipple, Fishtail.

80 - Lot 1 & 2, NW 1/4 - Sec. 8 - T. 3 S., R. 22 E. - Konrad Meschenfelder,
Park City, Montana

222 - Frac NW 1/4 - NW 1/4

NE 1/4 - Frac NE 1/4 - Frac SE 1/4 - Sec. 5 - T. 3 S., R. 22 E. - Peter Yegen, Billings

105 acres - Frac SE 1/4 - Lot 5 & 6 - Sec. 5, T. 3 S., R. 22 E.

SE corner NE 1/4 - SE frac NE 1/4 - Sec. 5 - T. 3 S., R. 22 E.

Konrad Meschenfelder - Park City, Montana

Acres? - Part of lot 2 & Frac of lot 3 - Sec. 5 - T. 3 S., R. 22 E.

M. O. Hoaden, Laurel, Montana

40 A - Lot 1 - Sec. 5 - T. 3 S., R. 22 E. - Titus Hauk, Park City, Montana

50.23 - Lot 7 - NE corner SE 1/4, Sec. 5, T. 3 S., R. 22 E., M. O. Hoaden, Laurel, Mont.

99.77 - Lot 5 & 6 - Frac SE 1/4 - Sec. 4 - T. 3 S., R. 22 E.

SE 1/4 - Lot 2 - Sec. 4, T. 3 S., R. 22 E.

19.67 - Fracs. of lot 3 - Sec. 4 - T. 3 S., R. 22 E. - H. C. Crippen, Billings

143 - SE 1/4, NE 1/4, Sec. 33, T. 2 S., R. 22 E.

Frac NE 1/4, Frac SE 1/4, Sec. 33, T. 2 S., R. 22 E.

Frac SE 1/4, Sec. 33, T. 2 S., R. 22 E., H. C. Crippen, Billings, Montana

68 - SE 1/4, Frac SE 1/4, Sec. 33 - Twp. 2 S., R. 22 E. - M. O. Hoaden, Laurel, Mont.

13A 27

FORM D-1 - GAZETTE 1952-53 1-47

STATE OF MONTANA
STATE ENGINEER'S OFFICE
WATER RESOURCES SURVEY

Township 27 Range 22 County St. Lawrence

6	5	4	3	2	1
7	8	9	10	11	12
18	17	16	15	14	13
19	20	21	22	23	24
30	29	28	27	26	25
31	32	33	34	35	36

Township _____ Range _____

Township 3 South, Range 22 East

<u>Code No.</u>	<u>Name of Owner</u>	<u>Name of Operator</u>
4 C	Crippen, H. C.	
7 A	Fox, Geo. Jr.	Same
4 B, 5 C	Reeder, J. L.	
32 B, 5 A	Hauk, Titus	
3 A, 4 A	Tilden, Clarence	
5 E, 8 A	Weschenfelder, Frederick	
5 B	Williams, Walt	
6 B, 7 B	Winsett, George	Same
5 D, 6 C	Yegen, Peter Jr.	Harding, Solomon

[illegible]

4-C
FORM SM-1

A STUDY OF MONTANA'S WATER RESOURCES

County Billings Source of Information 561
1. Water User H. G. Briggs Address Billings
2. Stream _____ Tributary to _____ Basin _____
3. Point of Diversion 1/4 1/4 Section _____ Township _____ Range _____
4. Description of System _____
5. Type of Irrigation _____
6. Original Appropriator 644 Address _____
7. First Use: Year _____ Acres Irrigated _____
8. Maximum Use: Year _____ Acres Irrigated _____
9. Present Use: Year _____ Acres Irrigated _____
10. Last Use: Year _____ Why Abandoned _____
11. Condition of System _____
12. Land Description Sec 75, R. 27, E. 2, S. 4, T 27, R 27, E

Remarks:

see sketch of
into 22 work sheet
Filed in 2. 27 E
Cave - 45 percent
0 pot

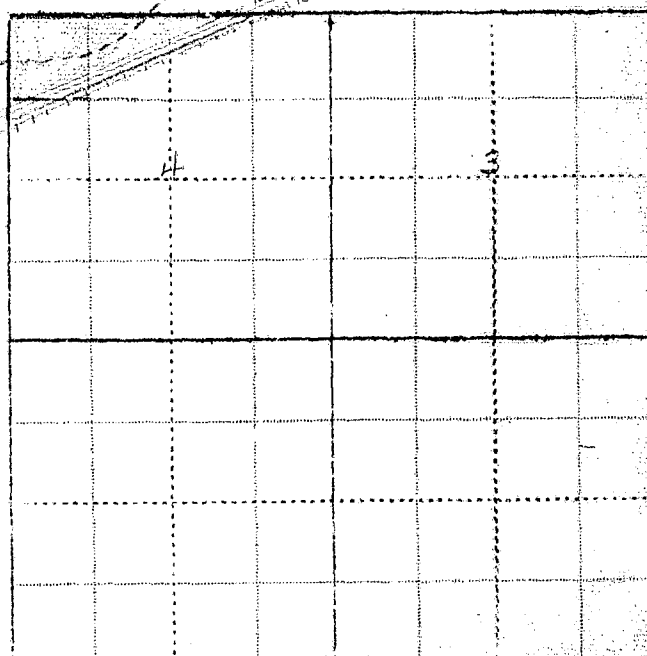

WITNESS:

Information by

Place

Our records show at you have an appropriation made by George R. Cummins, appropriated November 23, 1891 and filed November 24, 1891 from Yellowstone River for 3000 minors inches. Is this appropriation now in use?

Form Ap. 1--10M 8-

STATE ENGINEERS OFFICE
Water Resources Survey

Code No. 644

Notice of Appropriation

1. County Stillwater Book 2 Page 18 Record Misc.
2. Name of Appropriator Charles Temple et al Address not shown
(See next page.)
3. Date Appropriated Nov. 23, 1891 Date Filed Nov. 24, 1891
Amount Appropriated, Miners Inches 3000, Cubic Feet per second
4. Name of Stream Yellowstone River Tributary Basin
5. Point of Diversion Water is diverted from a point upon its N bank about 230 feet from the center of the main track of the Northern Pacific Railway Company's Railroad and about Sec. Twp. Rge. Bank of Stream northerly.
300 feet west from the residence of E. S. Tutt, situated on lot 5, Sec. 4 5, 3 S., 21 E. and running thence in a general E direction to over and upon the above described land.
6. Purpose Irrigation, domestic and beneficial purposes.
7. Description of System By means of a dam and ditch; the said ditch is 108 inches in width on the bottom, thereof and 156 inches across the top by 24 inches in depth.
8. Land Description of Intended Place of Use

Subdivision	Sec.	Twp.	Rge.	Tot. Acr.	1940 Owner	Address
<u>N$\frac{1}{2}$NW$\frac{1}{4}$ - lots 4 & 5 - NE$\frac{1}{4}$</u>	<u>10</u>	<u>3 S.</u>	<u>21 E.</u>		<u>See next page.</u>	
<u>W$\frac{1}{2}$NW$\frac{1}{4}$ - NW$\frac{1}{4}$SW$\frac{1}{4}$ - NE$\frac{1}{4}$, N$\frac{1}{2}$SE$\frac{1}{4}$</u>	<u>11</u>					
<u>NE$\frac{1}{4}$SW$\frac{1}{4}$, E$\frac{1}{2}$NW$\frac{1}{4}$</u>	<u>11</u>	<u>3 S.</u>	<u>21 E.</u>			
<u>NW$\frac{1}{4}$NE$\frac{1}{4}$, NE$\frac{1}{4}$NE$\frac{1}{4}$, E$\frac{1}{2}$NW$\frac{1}{4}$, SW$\frac{1}{4}$NW$\frac{1}{4}$</u>	<u>12</u>	<u>3 S.</u>	<u>21 E.</u>			
9. Remarks (Pertaining to Use, etc.)

	Sec.	Twp.	Rge.
<u>SE$\frac{1}{4}$NW$\frac{1}{4}$, lots 2, 3, 4 & 5</u>	<u>7</u>	<u>3 S.</u>	<u>22 E.</u>
<u>Part of NW$\frac{1}{4}$ of</u>	<u>8</u>	<u>3 S.</u>	<u>22 E.</u>
<u>All of</u>	<u>5</u>	<u>3 S.</u>	<u>22 E.</u>
<u>Lots 2, 3, 5 & 6</u>	<u>4</u>	<u>3 S.</u>	<u>22 E.</u>

Decree
10. Case No. SW $\frac{1}{4}$, S $\frac{1}{2}$ NW $\frac{1}{4}$ 33 2 S. 22 E. Amt. Decreed: M. I. C. F. S.
11. To Whom Decreed Address
12. Name of Ditch Maximum Capacity (C. F. S.)
13. Date of Priority Purpose
14. Land Description of Place of Use as Decreed
15. Remarks (Present Use Status, etc.)

9. Remarks (Pertaining to Use, etc.)

And we do further claim the right to change the point of diversion of said water at anytime and to extend the ~~fe~~ flumes, piles, ditches and aqueducts for which said diversion is made, from time to time to any place other than where first used and to use the water for other useful purposes and beneficial purposes than that for which it was first appropriated, we also claim the rights to enlarge and to alter the same from time to time and also all rights, easements, privileges and appurtenances.

2. Names of Appropriators:

Charles Temple ~~Y~~ et al; John Walsh, Charles R. Watkins, Andrew E. Parker, George R. Cummins, John W. Cummins, Stephen E. Wimsett, Sarah E. Wimsett, William W. Palmer and George C. Tilden.

1940 Land Ownership.

- 128 A - N $\frac{1}{2}$ NW $\frac{1}{4}$, lots 4 & 5, Sec. 10, T. 3 S., R. 21 E., Gerhard Waltherman, Columbus.
 160 A - NE $\frac{1}{4}$, Sec. 10, T. 3 S., R. 21 E., Douglas Annin, c/o L. B. Banks, Columbus
 111 A - W $\frac{1}{2}$ NW $\frac{1}{4}$, NWSW, Sec. 11, T. 3 S., R. 21 E. - Jacob Henry, Park City, Montana
 155 A - E $\frac{1}{2}$ NE $\frac{1}{4}$, lot 1, Sec. 11, T. 3 S., R. 21 E. - Charles & Alice Storer, Columbus.
 E Frac lot 2, Sec. 11, T. 3 S., R. 21 E.
 E $\frac{1}{2}$ W $\frac{1}{2}$ NE $\frac{1}{4}$, Sec. 11, T. 3 S., R. 21 E.
 183.78 - E $\frac{1}{2}$ NW, NESW, W $\frac{1}{2}$ NWSE, Sec. 11, T. 3 S., R. 21 E. - Federal Land Bank
 W $\frac{1}{2}$ W $\frac{1}{2}$ NE $\frac{1}{4}$, Sec. 11, T. 3 S., R. 21 E. - Federal Land Bank
 164 - SE $\frac{1}{2}$ NW $\frac{1}{4}$, Lot 2, 3, 4, 5 - Sec. 7, T. 3 S., R. 22 E. - R. W. Whipple, Fishtail
 80 A - Lot 1 & 2, NWNW, Sec. 8, T. 3 S., R. 22 E. Konrad Weschenfelder, Park City.
 222 - Frac E $\frac{1}{2}$ NW $\frac{1}{4}$, W $\frac{1}{2}$ NW $\frac{1}{4}$, NWSW, Frac NESW, Frac SWSW, Sec. 5, T. 3 S., R. 22 E.
 Peter Yegen, Billings, Mont.
 105 A - Frac SWSW, Lot 5 & 6, Sec. 5, T. 3 S., R. 22 E.
 SE corner NESW, SW frac NESW, Sec. 5, T. 3 S., R. 22 E.
 Konrad Weschenfelder, Park City, Montana
 Acres? - Part of lot 2 & Frac of lot 3, Sec. 5, T. 3 S., R. 22 E. M. O. Rosden, Laurel
 40 A - Lot 1, Sec. 5, T. 3 S., R. 22 E. - Titus Mauk, Park City, Montana
 50.23 - Lot 7, NE corner SWSE, Sec. 5, T. 3 S., R. 22 E. - M. O. Rosden, Laurel
 99.77 - Lot 5 & 6, Frac SWNW, Sec. 4, T. 3 S., R. 22 E.
 S $\frac{1}{2}$ NE $\frac{1}{2}$ NW, Lot 2, Sec. 4, T. 3 S., R. 22 E.
 19.67 - Fracs. of lot 3, Sec. 4, T. 3 S., R. 22 E. - H. C. Crippen, Billings
 143 - S $\frac{1}{2}$ SW $\frac{1}{4}$, NESW, Sec. 33 - T. 2 S., R. 22 E.
 Frac NWSW, Frac SENW, Sec. 33, T. 2 S., R. 22 E.
 Frac SESW, Sec. 33, T. 2 S., R. 22 E. - H. C. Crippen, Billings, Montana
 68 - SWNW, Frac SENW - Sec. 33, T. 2 S., R. 22 E. - M. O. Raysden, Laurel, Montana

STATE ENGINEERS OFFICE
Water Resources SurveyCode No. 644

Notice of Appropriation

1. County Stillwater Book 2 Page 18 Record Misc.
2. Name of Appropriator Charles Temple et al Address not shown
(See next page.)
3. Date Appropriated Nov. 23, 1891 Date Filed Nov. 24, 1891
Amount Appropriated, Miners Inches 3000, Cubic Feet per second
4. Name of Stream Yellowstone River Tributary Basin
5. Point of Diversion Water is diverted from a point upon its N. bank about 230 feet from the center of the main track of the Northern Pacific Railway Company's Railroad and about Sec. Twp. Rge. Bank of Stream northerly.
300 feet west from the residence of E. S. Tutt, situated on lot 5, Sec. 4, 3 S., 21 E. and running thence in a general E. direction to over and upon the above described land.
6. Purpose Irrigation, domestic and beneficial purposes.
7. Description of System By means of a dam and ditch; the said ditch is 108 inches in width on the bottom, thereof and 156 inches across the top by 24 inches in depth.
8. Land Description of Intended Place of Use
- | Subdivision | Sec. | Twp. | Rge. | Tot. Acr. | 1940 Owner | Address |
|--|------|------|-------|-----------|----------------|---------|
| N $\frac{1}{2}$ NW $\frac{1}{4}$ - lots 4 & 5 - NE $\frac{1}{4}$ | 10 | 3 S. | 21 E. | | See next page. | |
| W $\frac{1}{2}$ NW $\frac{1}{4}$ - NW $\frac{1}{4}$ SW $\frac{1}{4}$ - NE $\frac{1}{4}$, N $\frac{1}{2}$ SE $\frac{1}{4}$ | 11 | | | | | |
| NE $\frac{1}{4}$ SW $\frac{1}{4}$, E $\frac{1}{2}$ NW $\frac{1}{4}$ | 11 | 3 S. | 21 E. | | | |
| NW $\frac{1}{4}$ NE $\frac{1}{4}$, NE $\frac{1}{4}$ NE $\frac{1}{4}$, E $\frac{1}{2}$ NW $\frac{1}{4}$, SW $\frac{1}{4}$ NW $\frac{1}{4}$ | 12 | 3 S. | 21 E. | | | |
9. Remarks (Pertaining to Use, etc.)
- SE $\frac{1}{4}$ NW $\frac{1}{4}$, lots 2, 3, 4 & 5 7 3 S. 22 E.
- Part of NW $\frac{1}{4}$ of 8 3 S. 22 E.
- All of 5 3 S. 22 E.
- Lots 2, 3, 5 & 6 4 3 S. 22 E/
- Decree**
10. Case No. SW $\frac{1}{4}$, S $\frac{1}{2}$ NW $\frac{1}{4}$ Date 33 Amt. Decreed: M. I. 2 S. 22 E. C. F. S. now in use.
11. To Whom Decreed Address
12. Name of Ditch Maximum Capacity (C. F. S.)
13. Date of Priority Purpose
14. Land Description of Place of Use as Decreed
15. Remarks (Present Use Status, etc.)

9. Remarks (Pertaining to Use, etc.)

And we do further claim the right to change the point of diversion of said water at anytime and to extend the ~~to~~ flumes, piles, ditches and aqueducts for which said diversion is made, from time to time to any place other than where first used and to use the water for other useful purposes and beneficial purposes than that for which it was first appropriated, we also claim the rights to enlarge and to alter the same from time to time and also all rights, easements, privileges and appurtenances.

2. Names of Appropriators:

Charles Temple & et al; John Walsh, Charles R. Watkins, Andrew E. Parker, George R. Cummins, John W. Cummins, Stephen E. Wimssett, Sarah E. Wimssett, William W. Palmer and George C. Tilden.

1940 Land Ownership.

- 128 A - N~~W~~W~~4~~, lots 4 & 5, Sec. 10, T. 3 S., R. 21 E., Gerhard Waltersman, Columbus.
 160 A - NE~~4~~, Sec. 10, T. 3 S., R. 21 E., Douglas Annin, c/o L. B. Banks, Columbus
 111 A - W~~W~~W~~4~~, N~~W~~SW, Sec. 11, T. 3 S., R. 21 E. - Jacob Henry, Park City, Montana
 155 A - E~~NE~~W~~4~~, lot 1, Sec. 11, T. 3 S., R. 21 E. - Charles & Alice Storer, Columbus.
 E Frac lot 2, Sec. 11, T. 3 S., R. 21 E.
 E~~W~~W~~NE~~W~~4~~, Sec. 11, T. 3 S., R. 21 E.
 183.78 - E~~W~~W~~NE~~W~~4~~, N~~W~~SW, W~~W~~W~~NE~~W~~4~~, Sec. 11, T. 3 S., R. 21 E. - Federal Land Bank
 W~~W~~W~~NE~~W~~4~~, Sec. 11, T. 3 S., R. 21 E. - Federal Land Bank
 164 - SE~~W~~W~~4~~, Lot 2, 3, 4, 5 - Sec. 7, T. 3 S., R. 22 E. - R. W. Whipple, Fishtail
 80 A - Lot 1 & 2, N~~W~~W~~4~~, Sec. 8, T. 3 S., R. 22 E. Konrad Weschenfelder, Park City.
 222 - Frac E~~W~~W~~NE~~W~~4~~, W~~W~~W~~NE~~W~~4~~, N~~W~~SW, Frac NESW, Frac SWSW, Sec. 5, T. 3 S., R. 22 E.
 Peter Yegen, Billings, Mont.
 105 A - Frac SWSW, Lot 5 & 6, Sec. 5, T. 3 S., R. 22 E.
 SE corner NESW, SW frac NESW, Sec. 5, T. 3 S., R. 22 E.
 Konrad Weschenfelder, Park City, Montana
 Acres? - Part of lot 2 & Frac of lot 3, Sec. 5, T. 3 S., R. 22 E. M. O. Rosden, Laurel
 40 A - Lot 1, Sec. 5, T. 3 S., R. 22 E. - Titus Mauk, Park City, Montana
 50.23 - Lot 7, NE corner SWSE, Sec. 5, T. 3 S., R. 22 E. - M. O. Rosden, Laurel
 99.77 - Lot 5 & 6, Frac S~~W~~W~~4~~, Sec. 4, T. 3 S., R. 22 E.
 S~~W~~W~~NE~~W~~4~~, Lot 2, Sec. 4, T. 3 S., R. 22 E.
 19.67 - Fracs. of lot 3, Sec. 4, T. 3 S., R. 22 E. - H. C. Crippen, Billings
 143 - S~~W~~W~~NE~~W~~4~~, NESW, Sec. 33 - T. 2 S., R. 22 E.
 Frac NWSW, Frac SENW, Sec. 33, T. 2 S., R. 22 E.
 Frac SESW, Sec. 33, T. 2 S., R. 22 E. - H. C. Crippen, Billings, Montana
 68 - S~~W~~W~~4~~, Frac SENW - Sec. 33, T. 2 S., R. 22 E. - M. O. Raysden, Laurel, Montana



STATE OF MONTANA
STATE ENGINEERS OFFICE
Water Resources Survey

75
Form WR-1-1M-11-41

Code No. 626, 7 A
County Stillwater
T. 3 S. R. 22 E.

Name of Land Owner Geo. Fox, Jr. Address Park City, Montana
Name of Operator " Address "

Part A

TO BE FILED BY THOSE OBTAINING IRRIGATION WATER FROM
A DITCH COMPANY OR IRRIGATION DISTRICT

1. Water is delivered by: The Yellowstone Ditch Co.
Name of Ditch, Ditch Company or District supplying water
2. State the number of acres you irrigate under this system 809 Shares you hold 12
3. If you obtain water from more than one Company, give the number of shares, acres irrigated and the name of the Company under "Remarks". If you obtain water from a Ditch Company and also have a private system fill in both Part A and Part B.

Part B

TO BE FILED BY THOSE WHO HAVE A PRIVATE DITCH, PUMP OR IRRIGATION SYSTEM
or those who have a private water right under a Ditch Company

4. In what year was this land first irrigated? Date "
5. Give the name of the original appropriator (first user): Charles Temple, et al
6. Give the date appropriated Feb. 13-1891 Amount filed on: Miners Inches 3000 C. F. S. "
7. State the total number of acres irrigated under this system: "
8. Give the point of diversion: 1/4 Section 5 Township 30 N Range 21 E

Part C

TO BE FILED BY ALL WATER USERS IN ADDITION TO PART A OR PART B

9. Source of Water: Yellowstone River
Name of stream or lake from which water is originally diverted
10. Water is obtained by: (Check one) Gravity ☒ Pumping ☐ Other ☐
11. What is the greatest number of acres you have irrigated? 100 Date 1940
12. How many acres did you irrigate in 1944? (Crop and pasture) 75
13. State the total number of additional acres that could be irrigated by increasing the water supply, land leveling, etc. 100 This land is under what ditch? The Yellowstone Ditch Co
14. How many acres of seeped land do you have which could be drained and put into production? None
15. What is the condition of your irrigation system? Good
16. Is your water supply adequate? Yes ☒ No ☐ Explain "
17. REMARKS: "

NOTE: The foregoing questions apply only to irrigated land shown on this plat.

DESCRIPTION AND MAP OF FARM

18. Legal Description of this Farm S. Sec. 6 - Twp. 3 S., Rge. 22 E.

N. 1/2, Lot 5, Fr. Lot 6, Sec. 7 - Twp. 3 S., Rge. 22 E.

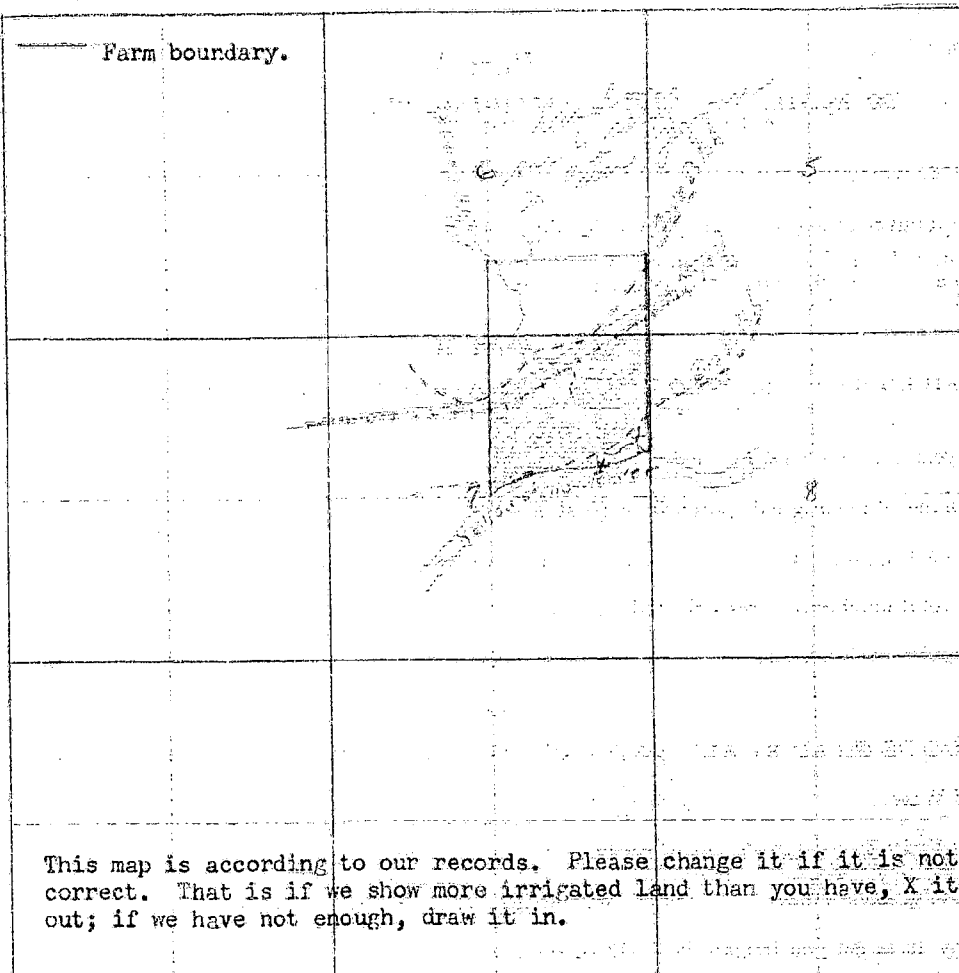
<input type="checkbox"/> IRRIGATED LAND	<input type="checkbox"/> NON-IRRIGATED LAND
<p>Farm boundary.</p>  <p>NORTH</p> <p>This map is according to our records. Please change it if it is not correct. That is if we show more irrigated land than you have, X it out; if we have not enough, draw it in.</p>	

19. If the above land is irrigated from more than one ditch please give the acreage under each ditch in 19A and indicate the location of the land irrigated from each on the above map.

19A. Ditch: Yellowstone Ditch Acres: 25

Ditch: _____ Acres: _____

Information supplied by:

Name: Mr. Fox Jr Address: Paul City Mont Date: Jan 20-1945

REMARKS: _____

If you cannot answer all of the questions on this form answer as many as you can and return the form to us as soon as possible.

THUNDER'S, HELENA

Our records show that you have an appropriation made by George R. Cummins, appropriated November 23, 1891 and filed November 24, 1891 from Yellowstone River for 3000 minors inches.

also

Our records show that you have an appropriation made by John Abbott, appropriated April 2, 1914 and filed April 2, 1914 from Stillwater River for 40 minors inches. Are these appropriations now in use?

FORM SM-1

A STUDY OF MONTANA'S WATER RESOURCES

County Stillwater Source of Information 615-6

1. Water User Geo. J. J. J. Address Proctor, Mont.

2. Stream _____ Tributary to _____ Basin _____

3. Point of Diversion 1/4 1/4 Section _____ Township _____ Range _____

4. Description of System _____

5. Type of Irrigation _____

6. Original Appropriator 644 - 347 Address _____

7. First Use: Year _____ Acres Irrigated _____

8. Maximum Use: Year _____ Acres Irrigated _____

9. Present Use: Year _____ Acres Irrigated _____

10. Last Use: Year _____ Why Abandoned _____

11. Condition of System _____

12. Land Description 1/4 Sec 16, T 2 N, R 2 W

Remarks: _____

1/4 Sec 16, T 2 N, R 2 W
1/4 Sec 16, T 2 N, R 2 W

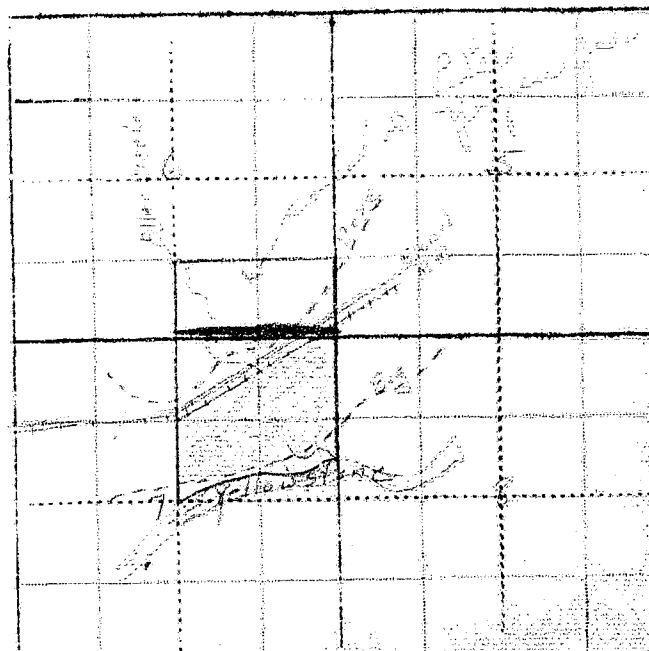

WITNESS: _____

Information by _____

Our records show that you have an appropriation made by George H. Diggins, appropriated November 23, 1891 and filed November 24, 1891 from Yellowstone river for 3000 minors inches.

also

Our records show that you have an appropriation made by John Abbott, appropriated April 2, 1914 and filed April 2, 1914 from Stillwater river for 40 minors inches. Are these appropriations now in use?

~~CONFIDENTIAL~~
~~RECEIVED~~

March 2, 1945

George Fox, Jr.
Park City, Montana

Dear Mr. Fox:

On January 22nd, this office sent you a letter asking for certain information pertaining to your irrigated land in township 3 south, R2 east. To date we have not heard from you. With the vast post war water development in this area as now planned, it is essential that we have this information in order to show the extent of our water use in the Yellowstone Basin in Montana. This information is necessary to protect our present water users in the rights they have against future irrigation, navigation, power and flood control enterprises in this area. We are asking you for this information because we feel it is the democratic way; we also feel that you are more qualified to give us this information about your irrigated land than anyone else because it is part of your business. It may be that you were busy with your business or some unforeseen thing happened at the time our first letter was received, and you put it aside to be answered at some other time and have forgotten all about it. All information is strictly confidential and is only used to record and tabulate the water use in this area.

Water is as necessary to the farmer as the soil in which he plants, without it no crops will grow; no living thing can survive. It is your water that we are trying to protect, so that you will have plenty now and in the future. We must keep Montana's water in Montana. The only way we can do this is by having the support of each and every water user so that we have a 100 percent representation of all water users. Remember: "United we stand, divided we fall".

In order to facilitate this work a branch office of the State Engineer has been established in Billings and is located in the Roosevelt School Building on 23rd Street and Fourth Avenue North. Anytime you are in Billings we would appreciate your calling on us.

Hoping to hear from you in the very near future, I am,

Very truly yours,

Gerald J. Oravetz
Assistant State Engineer

P.S. If you cannot supply us with the information requested, it may be that you can tell us of someone who can.

Please Do Not Fill in Any Items on This Page

Notice of Appropriation

1. County Stillwater Book 1 Page 213 Record Misc.
2. Name of Appropriator Abbott, John Address Columbus, Montana
3. Date Appropriated April 2, 1914 Date Filed April 2, 1914
- Amount Appropriated, Miners Inches 40 Cubic Feet per second
4. Name of Stream Stillwater River Tributary Bosin
5. Point of Diversion Ditch taps and diverts the water from said stream at a point upon its right bank NW $\frac{1}{4}$ of
- Sec. 22 Twp. 3 S. Rge. 19 E. Bank of Stream right.
 about $\frac{1}{2}$ mile below the mouth of Mexican Joe Creek, a tributary of Stillwater R. & running in a
6. Purpose Domestic, irrigation and other purposes. NE & North direction.
7. Description of System By means of McBride ditch which is four feet wide by three feet deep, and carries about 1200 inches of water from river.
8. Land Description of Intended Place of Use
- | Subdivision | Sec. | Twp. | Rge. | Tot. Acr. | 1940 Owner | Address |
|-----------------------------------|------|------|-------|-----------|---------------|----------------|
| SW $\frac{1}{4}$ NE $\frac{1}{4}$ | 7 | 3 S. | 22 E. | 29.89 | H. W. Whipple | Fishtail, Mont |
9. ~~Remarks (Pertaining to Use, etc.)~~ Transfers of Land Ownership.
1920 - John Abbot to Stephen Wimsett Est. to Ralph W. Whipple
SWNE - Sec. 7 - T. 3 S., Rge. 22 E.

Decree

10. Case No. _____ Date _____ Amt. Decreed: M. I. _____ C. F. S. _____
11. To Whom Decreed _____ Address _____
12. Name of Ditch _____ Maximum Capacity (C. F. S.) _____
13. Date of Priority _____ Purpose _____
14. Land Description of Place of Use as Decreed _____
15. Remarks (Present Use Status, etc) _____

FORM SM-1

A STUDY OF MONTANA'S WATER RESOURCES

County Missoula Source of Information 1937

1. Water User John J. J. J. Address 7000

2. Stream Tributary to Basin

3. Point of Diversion 1 1 Section Township Range

4. Description of System

5. Type of Irrigation

6. Original Appropriator Address

7. First Use: Year Acres Irrigated

8. Maximum Use: Year Acres Irrigated

9. Present Use: Year Acres Irrigated

10. Last Use: Year Why Abandoned

11. Condition of System

12. Land Description From Sec 11, T. 24N, R. 32E

Remarks:

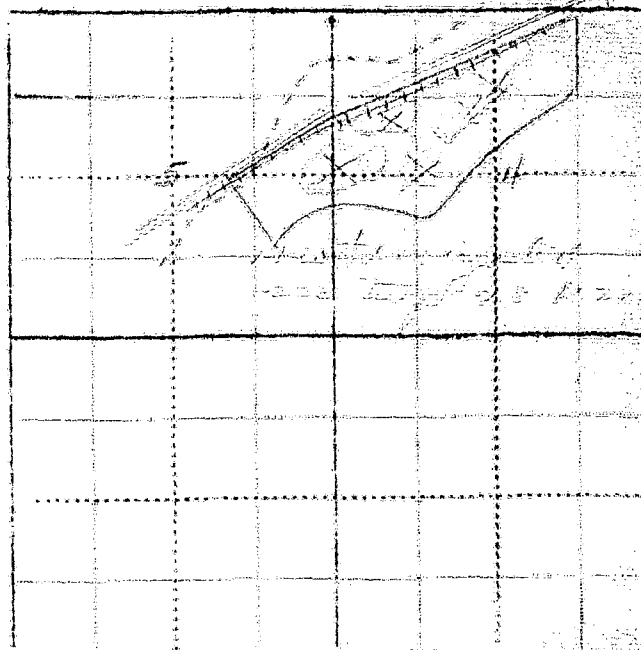

WITNESS: Information by

Place