

FORM D-1 • GAZETTE 1964-2M-1-47

STATE ENGINEER'S OFFICE

Township 45 Range 15 E County Sebastian

| | | | | | |
|----|----|----|----|----|----|
| 6 | 5 | 4 | 3 | 2 | 1 |
| 7 | 8 | 9 | 10 | 11 | 12 |
| 18 | 17 | 16 | 15 | 14 | 13 |
| 19 | 20 | 21 | 22 | 23 | 24 |
| 30 | 29 | 28 | 27 | 26 | 25 |
| 31 | 32 | 33 | 34 | 35 | 36 |

Township.....Range.....

Township.

45

Range

County

L. Buntin

| Parcel Number | Name of Owner | Stream | Address | Filed | MT |
|---------------|-------------------------------|------------------|----------|----------|-----|
| 54 | Jay, R.M. | Castle Creek | 6-1-11 | 10-17-05 | 25 |
| 54 | Holt, Willard | Castle Creek | 7-2-12 | 7-2-12 | 100 |
| 672 | Etchell, C.A. | Castle Creek | 8-15-37 | 5-17-41 | 100 |
| 58 | Goumany, Geo L. | Castle Creek | 7-2-14 | 7-11-18 | 100 |
| 62 | Wright, Harry W. | Castle Creek | 6-11-14 | 6-19-14 | 100 |
| 160 | Jay, R.M. & A. E. | Four Mile Creek | 6-7-99 | 10-17-05 | 500 |
| 161 | Jay, R.M. & A. E. | Four Mile Creek | 6-26-96 | 10-17-05 | 50 |
| 201 | Richardson, Arnold | Horseman Creek | 10-10-11 | 10-13-17 | 50 |
| 695 | Hudson, R. B. (in care) | Limestone Creek | 6-15-95 | 8-6-10 | 100 |
| 231 | Russell, Herbert | Lodge Pole Creek | 1-4-34 | 1-4-36 | 280 |
| 666 | Southworth, Fred & Frank | Lodge Pole Creek | — 1898 | 3-7-44 | 200 |
| 250 | Smith, Glenn A. | Magnus Creek | 12-5-12 | 5-8-13 | 40 |
| 275 | Jarvis, Geo. L. Jr. | Pickett's Creek | 10-6-17 | 5-31-18 | 160 |
| 462 | Jay, R.M. | Sheep Creek | 6-1-97 | 10-17-05 | 10 |
| 476 | Richard, Joseph | Sheep Creek | 6-1-12 | 6-14-14 | 75 |
| 379 | Fitzgerald, John & Lutz, Gene | Stillwater River | 12-16-14 | 12-17-14 | 480 |
| 385 | Holt, Willard (in care) | Stillwater River | 9-1-34 | 7-24-37 | 360 |
| 390 | Lutz, Gene F. | Stillwater River | 6-1-10 | 12-23-17 | 250 |

[illegible]

Township 4 South, Range 15 East

| <u>Code No.</u> | <u>Name of Owner</u> | <u>Name of Operator</u> |
|--------------------|------------------------|-------------------------|
| 29 E | Fender, Paul | |
| 29 F, 30 A | Giles, Wm. E. | |
| 26 A, 27 B, 32 B, | | |
| 33 E, 34 A, 35 A | Jones, Charles E. | Same |
| 17 B, 20 B | McKinsey, Clara Est. | McKinsey, Geo. E. |
| 30 B, 31 B | McTaggart, Mable | Holiness Bros. |
| 16 A, 17 A | Mulvihill, Tom | Same |
| 20 A, 23 B | Russell, Herbert | |
| 5 A, 6 A, 7 B, 8 C | Southworth, Ralph Est. | |
| 27 A, 28 A | Stafford, Wm. R. | |
| 28 C, 29 C, 31 A, | | |
| 32 A, 33 A | Stafford, C. A. & Mary | Same |
| 29 D | Torian, Geo. L. Jr. | Same |



STATE OF MONTANA
STATE ENGINEERS OFFICE
Water Resources Survey

Form WR-1-1M-11-41

Code No. 29 E
County Stillwater
T. 4 S. R. 15 E.

Name of Land Owner Paul Fender Address Limestone, Montana

Name of Operator Address

Part A

TO BE FILED BY THOSE OBTAINING IRRIGATION WATER FROM
A DITCH COMPANY OR IRRIGATION DISTRICT

1. Water is delivered by: Private Ditch
Name of Ditch, Ditch Company or District supplying water
2. State the number of acres you irrigate under this system. Shares you hold.
3. If you obtain water from more than one Company, give the number of shares, acres irrigated and the name of the Company under "Remarks". If you obtain water from a Ditch Company and also have a private system fill in both Part A and Part B.

Part B

TO BE FILED BY THOSE WHO HAVE A PRIVATE DITCH, PUMP OR IRRIGATION SYSTEM
or those who have a private water right under a Ditch Company

4. In what year was this land first irrigated? Date
5. Give the name of the original appropriator (first user):
6. Give the date appropriated. Amount filed on: Miners Inches C. F. S.
7. State the total number of acres irrigated under this system: 15
8. Give the point of diversion: $\frac{1}{4}$ $\frac{1}{4}$ Section Township Range

Part C

TO BE FILED BY ALL WATER USERS IN ADDITION TO PART A OR PART B

9. Source of Water: Cattle Creek
Name of stream or lake from which water is originally diverted
10. Water is obtained by: (Check one) Gravity ☒ Pumping Other
11. What is the greatest number of acres you have irrigated? 3 Date a number of years
12. How many acres did you irrigate in 1944? (Crop and pasture) 0
13. State the total number of additional acres that could be irrigated by increasing the water supply, land leveling, etc. 20 This land is under what ditch? Community ditch
14. How many acres of seeped land do you have which could be drained and put into production? 0
15. What is the condition of your irrigation system? Good
16. Is your water supply adequate? Yes No ☒ Explain stream too small
17. REMARKS: I have no water right in this ditch but have used it at different times

OVER

NOTE: The foregoing questions apply only to irrigated land shown on this plat.

DESCRIPTION AND MAP OF FARM

18. Legal Description of this Farm SW 1/4, Sec. 29 - Twp. 4 S., Rge. 15 E.



IRRIGATED LAND



NON-IRRIGATED LAND

— Farm boundary.

This map is according to our records. Please change it if it is not correct. That is if we show more irrigated land than you have, X it out; if we have not enough, draw it in.

NORTH

Ditch

Road creek

29

19. If the above land is irrigated from more than one ditch please give the acreage under each ditch in 19A and indicate the location of the land irrigated from each on the above map.

19A. Ditch: Herbert R. Marshall Acres: 15

Ditch: _____ Acres: _____

Information supplied by:

Name Ralph E. Bender Address Linington, Mont.

REMARKS: I have obtained water from the ditch on several occasions by reaching on the ditch.

If you cannot answer all of the questions on this form answer as many as you can and return the form to us as soon as possible.

THURBER'S, HELENA

12. Land Description: 54NH4, Sec 29, Twp. 14S, Range 15E

Our records show that you have an appropriation in Stillwater County, Book 22, Page 68, Record Misc., made by Willard Holt, appropriated Sept. 1, 1934 and filed July 24, 1937 from W. Fork Stillwater River for 360 miners inches. Is this appropriation now in use?

Form Ap. 1—10M-8-6

STATE ENGINEERS OFFICE
Water Resources Survey

Code No. 385

Notice of Appropriation

1. County Stillwater Book 22 Page 68 Record Misc.
2. Name of Appropriator Holt, Willard Address Limestone, Montana
3. Date Appropriated Sept. 1, 1934 Date Filed July 24, 1937
Amount Appropriated, Miners Inches 360, Cubic Feet per second _____
4. Name of Stream Stillwater River (W. Fork) Tributary _____ Basin _____
5. Point of Diversion at a point on its northwest bank at center NE $\frac{1}{4}$ of SW $\frac{1}{4}$ of
Sec. 32 Twp. 4 S. Rge. 15 E. Bank of Stream Northwest.
thence runs over and upon said land.
6. Purpose Irrigation and other purposes.
7. Description of System By means of a ditch, 36 inches by 48 inches in size and conducts
360 inches of water.
8. Land Description of Intended Place of Use
Subdivision _____ Sec. Twp. Rge. Tot. Acr.
On Secs. 32 & 29 4 S. 15 E.
9. Remarks (Pertaining to Use, etc.)
It now is in use.

Decree

10. Case No. _____ Date _____ Amt. Decreed: M. I. _____ C. F. S. _____
11. To Whom Decreed _____ Address _____
12. Name of Ditch _____ Maximum Capacity (C. F. S.) _____
13. Date of Priority _____ Purpose _____
14. Land Description of Place of Use as Decreed _____
15. Remarks (Present Use Status, etc.) _____



STATE OF MONTANA
STATE ENGINEERS OFFICE
Water Resources Survey

327
Form WR-1-IM-11-44
Code No. ~~10-11-12-1~~ 29F, 30A
County Stillwater
T. 4 S. R. 15 E.

Name of Land Owner Sam. E. Giles Address Limestone, Montana

Name of Operator _____ Address _____

Part A

TO BE FILED BY THOSE OBTAINING IRRIGATION WATER FROM
A DITCH COMPANY OR IRRIGATION DISTRICT

1. Water is delivered by: Private ditch
Name of Ditch, Ditch Company or District supplying water _____
2. State the number of acres you irrigate under this system _____ Shares you hold _____
3. If you obtain water from more than one Company, give the number of shares, acres irrigated and the name of the Company under "Remarks". If you obtain water from a Ditch Company and also have a private system fill in both Part A and Part B.

Part B

TO BE FILED BY THOSE WHO HAVE A PRIVATE DITCH, PUMP OR IRRIGATION SYSTEM
or those who have a private water right under a Ditch Company

4. In what year was this land first irrigated? Date (from cattle tracks)
5. Give the name of the original appropriator (first user): George & Torian
6. Give the date appropriated July 2, 1919 Amount filed on: Miners Inches 100 C. F. S. _____
7. State the total number of acres irrigated under this system: _____
8. Give the point of diversion: NW 1/4 SE 1/4 Section 30 Township 4 S Range 15 E

Part C

TO BE FILED BY ALL WATER USERS IN ADDITION TO PART A OR PART B

9. Source of Water: Cattle Creek & Rabbit Run Creek
Name of stream or lake from which water is originally diverted _____
10. Water is obtained by: (Check one) Gravity ☒ Pumping _____ Other _____
11. What is the greatest number of acres you have irrigated? 105 Date _____
12. How many acres did you irrigate in 1944? (Crop and pasture) 105
13. State the total number of additional acres that could be irrigated by increasing the water supply, land leveling, etc. _____ This land is under what ditch? _____
14. How many acres of seeped land do you have which could be drained and put into production? _____
15. What is the condition of your irrigation system? Good
16. Is your water supply adequate? Yes ☒ No _____ Explain _____

17. REMARKS: Have one small ditch out of Cattle Creek to irrigate
yards, also use water out of Torian ditch out of Rabbit
Run Creek and also use water out of Torian ditch
out of Cattle Creek.

OVER

See note on next form

NOTE: The foregoing questions apply only to irrigated land shown on this plat.

DESCRIPTION AND MAP OF FARM

18. Legal Description of this Farm SE 1/4, Sec. 16 - Twp. 4 S., Rge. 15 E.

NE 1/4, NW 1/4, Sec. 17 - Twp. 4 S., Rge. 15 E. NW 1/4, Sec. 29 - SE 1/4, E 1/2, Sec. 30
Twp. 4 S., Rge. 15 E.

☒ IRRIGATED LAND

☐ NON-IRRIGATED LAND

Farm boundary.

This map is according to our records. Please change it if it is not correct. That is if we show more irrigated land than you have, X it out; if we have not enough, draw it in.

NORTH

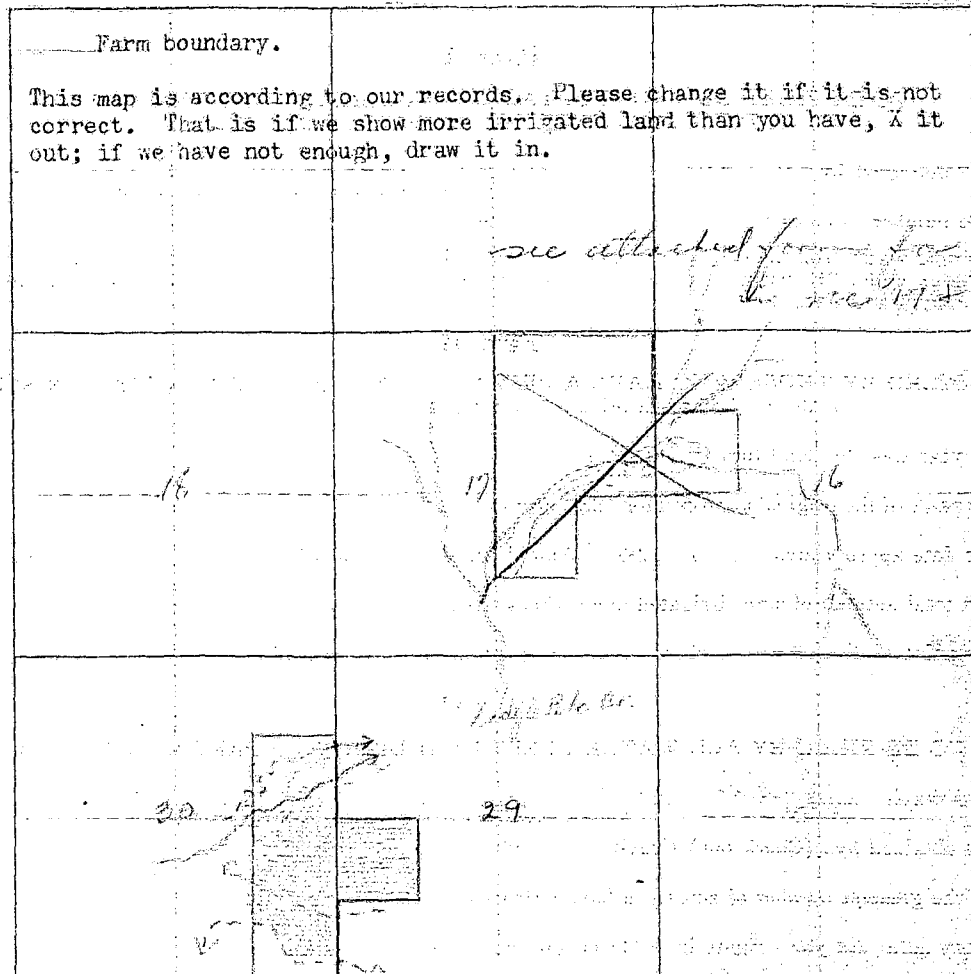

19. If the above land is irrigated from more than one ditch please give the acreage under each ditch in 19A and indicate the location of the land irrigated from each on the above map.

19A. Ditch: Private ditch Acres: 1.05

Ditch: _____ Acres: _____

Information supplied by:

Name Geo. L. Torian and Mrs. G. L. Torian Address at ranch by G. L. Torian Date Apr-26-48

REMARKS: also see above form Picket Post on ranch
check by Geo. L. Torian for 160 acres
app - 10-6-17

If you cannot answer all of the questions on this form answer as many as you can and return the form to us as soon as possible.

THURBER'S, MILWAUKEE

STATE OF MONTANA WATER RESOURCES SURVEY

County Stillwater Date _____

Name of Water User _____ Address _____

1. Do you own this land? Yes _____ No _____ If not give the owner's name below:

Owner's name W. E. Giles Address Limestone

2. Source of Water _____ Water delivered by _____

3. Give point of Diversion _____ Section _____ Township _____ Range _____

4. Water is obtained by: (Check one) Gravity _____ Pumping _____ Other _____

5. Who first used water on this land? 57 Address _____

6. In what year was this land first irrigated? _____ Approximate Acres _____

7. What is the greatest number of acres you have irrigated? _____ Date _____

8. Present Use: Year _____ acres Irrigated _____

9. If this land is not irrigated now give date of last use _____

10. State the total number of acres that could be irrigated _____ acres.

11. What is the condition of your irrigation system? _____

12. Land Description: W. 1/4 Sec 29, Twp. _____ Range _____Remarks: SameNW 1/4, Sec 29SENE, E 1/4 SE 1/4, Sec 30

Mrs. Giles
claims 200 inches
from Four Mile
Creek Approx.
John S. Hovis
Nov 1, 1900 filed for this ditch
March 26, 1907
in Stillwater Co
records - Book 4

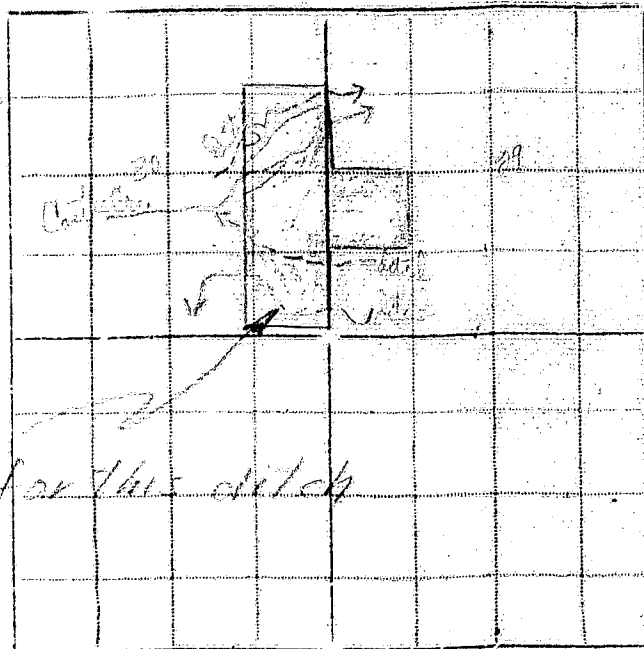
Page 811 - Code mo 162

Information by _____ Place _____ Date _____

Our records show that you have an appropriation in Stillwater County, Book 4, Page 439, Record Misc., made by R. M. Fry, appropriated June 1, 1897 and filed Oct. 17, 1905 from Castle Creek for 25 miners inches. Is this appropriation now in use?

Billings,
~~XXXXXX~~

March 27, 1945

Wm. E. Gales
Limestone, Montana

Dear Mr. Gales:

On March 7th, this office sent you a letter asking for certain information pertaining to your irrigated land in township 4 south, range 15 east. To date we have not heard from you. With the vast post war water development in this area as now planned, it is essential that we have this information in order to show the extent of our water use in the Yellowstone Basin in Montana. This information is necessary to protect our present water users in the rights they have against future irrigation, navigation, power and flood control enterprises in this area. We are asking you for this information because we feel it is the democratic way; we also feel that you are more qualified to give us this information about your irrigated land than anyone else because it is part of your business. It may be that you were busy with your farm work or some unforeseen thing happened at the time our first letter was received, and you put it aside to be answered at some other time and have forgotten all about it. All information is strictly confidential and is only used to record and tabulate the water use in this area.

Water is as necessary to the farmer as the soil in which he plants. Without it no crops will grow; no living thing can survive. It is your water that we are trying to protect, so that you will have plenty now and in the future. We must keep Montana's water in Montana. The only way we can do this is by having the support of each and every water user so that we have a 100 percent representation of all water users. Remember: "United we stand, divided we fall".

In order to facilitate this work a branch office of the State Engineer has been established in Billings and is located in the Roosevelt School Building on 23rd Street and Fourth Avenue North. Anytime you are in Billings we would appreciate your calling on us.

Hoping to hear from you in the very near future, I am,

Very truly yours,

Gerald J. Oravetz
Assistant State Engineer

P.S. If you cannot supply us with the information requested, it may be that you can tell us of someone who can.

Billings,
XXXXXXXXXX

April 10, 1945

Wm. E. Giles
Limestone, Montana

Dear Mr. Giles:

On March 7th we sent you a letter asking for certain information pertaining to your irrigated land in township 4 south range 15 east. On March 27th we sent you another letter asking you to submit the information to us as soon as possible. To date we have not heard from you regarding this matter.

It is hereby declared to be a policy of the State and necessary for the welfare of the State and its citizens, that the waters of this State, and especially interstate streams arising out of the State, be investigated. The State Engineer shall, either before or after the bringing of such action (to adjudicate the waters of any stream and its tributaries in any county traversed by said stream), upon the direction of the State Water Conservation Board, or upon the direction of the court, do all things, make all surveys, and perform all services required by said board in the securing of all necessary information and make the same available to said board or others who may be interested therein, including the courts of this State.

In order to protect the water rights of the water users in this state it is mandatory that the State Engineer have the information that we have asked you to submit to this office. If you have sold the piece of land about which we wrote you, will you please give us the name and address of the new owner.

We expect to hear from you in the very near future.

Very truly yours,

Gerald J. Oravetz
Assistant State Engineer

STATE ENGINEERS OFFICE
Water Resources Survey

Code No. 57

Notice of Appropriation

1. County Stillwater Book 4 Page 439 Record Misc.
2. Name of Appropriator R. M. Fry Address Nye, Montana
3. Date Appropriated June 1, 1897 Date Filed Oct. 17, 1905
Amount Appropriated, Miners Inches 25, Cubic Feet per second
4. Name of Stream Castle Creek Tributary Basin
5. Point of Diversion at a point upon its north bank about 100 yards below its junction with 4 miles check, thence running to and upon said described land.
Sec. Twp. Rge. Bank of Stream north.
6. Purpose Irrigating and other useful purposes.
7. Description of System By means of a ditch which is 12 inches by 3 inches in size & conducts 25 inches of water.
8. Land Description of Intended Place of Use

| Subdivision | Sec. | Twp. | Rge. | Tot. Acr. | 1940 Owner | Address |
|---|-----------|-------------|--------------|-----------|---------------------------|-----------------|
| <u>NE$\frac{1}{4}$SW$\frac{1}{4}$</u> | <u>30</u> | <u>4 S.</u> | <u>15 E.</u> | <u>40</u> | <u>Ray C. Battey</u> | <u>Dukmyer,</u> |
| | | | | | <u>c/o John McTaggart</u> | <u>Montana.</u> |
9. Remarks (Pertaining to Use, etc.) Transfer of Land Ownership.
R. M. Fry to Grace Fry to Ray C. Battey c/o John McTaggart
NE $\frac{1}{4}$ SW $\frac{1}{4}$ - Sec. 30 - Twp. 4 S., Rge. 15 E.
not used as such

Decree

10. Case No. Date Amt. Decreed: M. I. C. F. S.
11. To Whom Decreed Address
12. Name of Ditch Maximum Capacity (C. F. S.)
13. Date of Priority Purpose
14. Land Description of Place of Use as Decreed
15. Remarks (Present Use Status, etc.)

STATE ENGINEERS OFFICE
Water Resources Survey

Case No. 58

Notice of Appropriation

1. County Stillwater Book 8 Page 13 Record Misc.
2. Name of Appropriator Geo. L. Torian Address Limestone, Montana
3. Date Appropriated July 2, 1919 Date Filed July 11, 1919
Amount Appropriated, Miners Inches 100, Cubic Feet per second
4. Name of Stream Castle Creek Tributary Basin
5. Point of Diversion at a point on its south bank 13 rods south of center corner of
Sec. 30 Twp. 4 S. Rge. 15 E. Bank of Stream south.
thence running to and upon said land.
6. Purpose Irrigation and other purposes.
7. Description of System By means of a ditch which is 3 feet wide on bottom by 12 inches
in size and conducts 300 inches of water.
8. Land Description of Intended Place of Use

| Subdivision | Sec. | Twp. | Rge. | Tot. Acr. | 1940 Owner | Address |
|--|-----------|-------------|--------------|------------|-------------------------------|-------------------|
| <u>S₂SW₄, NESW₄, SENW₄</u> | <u>29</u> | <u>4 S.</u> | <u>15 E.</u> | <u>160</u> | <u>George L. Torian, Jr.,</u> | <u>Limestone.</u> |
9. Remarks (Pertaining to Use, etc.) Transfer of Land Ownership.
George L. Torian to - George L. Torian Jr.
S₂SW₄, NESW₄, SENW₄, Sec. 29 - Twp. 4 S., Rge. 15 E.
How in deed

Decree

10. Case No. _____ Date _____ Amt. Decreed: M. I. _____ C. F. S. _____
11. To Whom Decreed _____ Address _____
12. Name of Ditch _____ Maximum Capacity (C. F. S.) _____
13. Date of Priority _____ Purpose _____
14. Land Description of Place of Use as Decreed _____
15. Remarks (Present Use Status, etc.) _____

STATE ENGINEERS OFFICE
Water Resources Survey

Code No. 275

Notice of Appropriation

1. County Stillwater Book 7 Page 83 Record Misc.
2. Name of Appropriator Torian, Jr. Geo. L. Address Limestone, Montana
3. Date Appropriated Oct. 6, 1917 Date Filed May 31, 1918
Amount Appropriated, Miners Inches 160, Cubic Feet per second Picket Pine & Swamp Creek
4. Name of Stream Picket Piner & Swamper Tributary Basin
5. Point of Diversion at a point on its east bank running thence in a NE direction 1 mile to SW corner SW $\frac{1}{4}$ of
Sec. 29 Twp. 4 S. Rge. 15 E. Bank of Stream East.
thence running to and upon said land.
6. Purpose Domestic, irrigation and other purposes.
7. Description of System By means of a ditch which is 36 inches by 24 inches in size.
8. Land Description of Intended Place of Use
Subdivision SE $\frac{1}{4}$ NW $\frac{1}{4}$, E $\frac{1}{4}$ SW $\frac{1}{4}$, SW $\frac{1}{4}$ SW $\frac{1}{4}$ Sec. 29 Twp. 4 S. Rge. 15 E. Tot. Acr. 160 1940 Owner George L. Torian, Jr., Address Limestone, Mont.
9. Remarks (Pertaining to Use, etc.) Transfer of Land Ownership.
George L. Torian, Jr. - SE $\frac{1}{4}$ NW $\frac{1}{4}$ - SWSW $\frac{1}{4}$ - E $\frac{1}{4}$ SW $\frac{1}{4}$ - Sec. 29, T. 4 S., R. 15 E.

Decree

10. Case No. _____ Date _____ Amt. Decreed: M. I. _____ C. F. S. _____
11. To Whom Decreed _____ Address _____
12. Name of Ditch _____ Maximum Capacity (C. F. S.) _____
13. Date of Priority _____ Purpose _____
14. Land Description of Place of Use as Decreed _____
15. Remarks (Present Use Status, etc.) _____



STATE OF MONTANA
STATE ENGINEERS OFFICE
Water Resources Survey

330
Form WR-1-1M-11-41
Code No. 26A, 27B, 32B,
33B, 34A, 35A
County Stillwater
T. 4 S. R. 15 E.

Name of Land Owner Charles E. Jones Address Nye, Montana
Name of Operator Same Address _____

Part A

TO BE FILED BY THOSE OBTAINING IRRIGATION WATER FROM
A DITCH COMPANY OR IRRIGATION DISTRICT

1. Water is delivered by: Private Ditch from W. Fork, Stillwater River.
Name of Ditch, Ditch Company or District supplying water
2. State the number of acres you irrigate under this system est. 35A Shares you hold _____
3. If you obtain water from more than one Company, give the number of shares, acres irrigated and the name of the Company under "Remarks". If you obtain water from a Ditch Company and also have a private system fill in both Part A and Part B.

Part B

TO BE FILED BY THOSE WHO HAVE A PRIVATE DITCH, PUMP OR IRRIGATION SYSTEM
or those who have a private water right under a Ditch Company

4. In what year was this land first irrigated? Date unknown
5. Give the name of the original appropriator (first user): unknown *Lullack M. Edgerman*
6. Give the date appropriated March 1914 Amount filed on: Miners Inches 480 C. F. S. ---
7. State the total number of acres irrigated under this system: 35A. est.
8. Give the point of diversion: --- $\frac{1}{4}$ --- $\frac{1}{4}$ Section --- Township --- Range ---

Part C

TO BE FILED BY ALL WATER USERS IN ADDITION TO PART A OR PART B

9. Source of Water: W. Fork, Stillwater River.
Name of stream or lake from which water is originally diverted
10. Water is obtained by: (Check one) Gravity X Pumping _____ Other _____
11. What is the greatest number of acres you have irrigated? ? Date _____
12. How many acres did you irrigate in 1944? (Crop and pasture) none on this particular ranch
13. State the total number of additional acres that could be irrigated by increasing the water supply, land leveling, etc. 30 This land is under what ditch? private
14. How many acres of seeped land do you have which could be drained and put into production? ?
15. What is the condition of your irrigation system? just rebuilt
16. Is your water supply adequate? Yes X No _____ Explain _____
17. REMARKS: This land being plowed and irrigated this season, for 1st time in several years as used purely for grazing since ranch ownership in 1942.

Also - gave 3 little pigs - June 1970 - 25¢ each
Also Arnold & I bought - later 1971 - 6¢ each - 10 - same week

OVER

NOTE: The foregoing questions apply only to irrigated land shown on this plat.

DESCRIPTION AND MAP OF FARM

18. Legal Description of this Farm $S\frac{1}{2}SE\frac{1}{4}$, $SW\frac{1}{4}$, Sec. 26 - $SE\frac{1}{4}$, $S\frac{1}{2}SW\frac{1}{4}$, Sec. 27 - $E\frac{1}{2}SE\frac{1}{4}$, Sec. 32 - $S\frac{1}{2}$, $NE\frac{1}{4}$, $Frac S\frac{1}{2}NW\frac{1}{4}$, Sec. 33 - All Sec. 34 - $N\frac{1}{2}$, $N\frac{1}{2}S\frac{1}{2}$, Sec. 35 - Twp. 4 S., Rge. 15 E.

IRRIGATED LAND

NON-IRRIGATED LAND

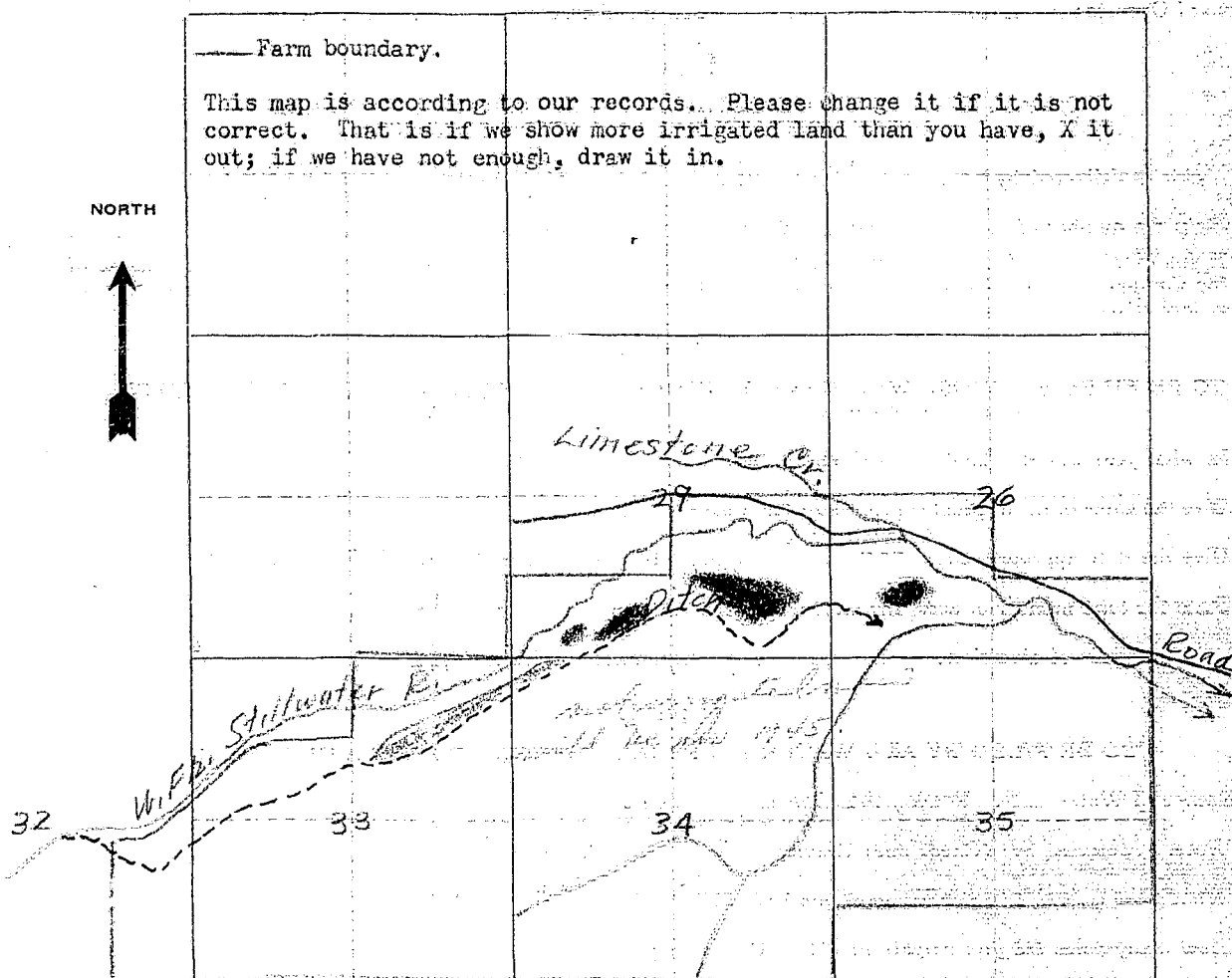

19. If the above land is irrigated from more than one ditch please give the acreage under each ditch in 19A and indicate the location of the land irrigated from each on the above map.

19A. Ditch: _____ Acres: _____

Ditch: _____ Acres: _____

Information supplied by:

Name: [Signature] Address: [Signature] Date: 3/1/45

REMARKS: _____

If you cannot answer all of the questions on this form answer as many as you can and return the form to us as soon as possible.

THURBER'S, HELENA

4575

Bellevue

Name of Water User

1. Do you own this land? Yes _____ No _____ If not give the owner's name below:

Owner's name Charles E. Jones Address Nga

2. Source of Water _____ Water delivered by _____

3. Give point of Diversion 1/4 1/4 Section Township Range

4. Water is obtained by: (Check one) Gravity _____ Pumping _____ Other _____

5. Who first used water on this land? 377-340-201 Address _____

6. In what year was this land first irrigated? _____ Approximate Acres _____

7. What is the greatest number of acres you have irrigated? _____ Date _____

| | | | |
|----|--------------|------|-----------------|
| 8. | Present Use: | Year | Acres Irrigated |
|----|--------------|------|-----------------|

9. If this land is not irrigated now give date of last use _____

10. State the total number of acres that could be irrigated _____ acres.

11. What is the condition of your irrigation system?

S²SE, S¹4, Sec 26, S²4, S²SW Sec 27 E²SE, Sec 32, S², NE⁴, Finc S²NW, Sec 33

12. Land Description: _____ Twp. _____ Range _____

all sec 34, 71st, 72nd, sec 35

Remarks:

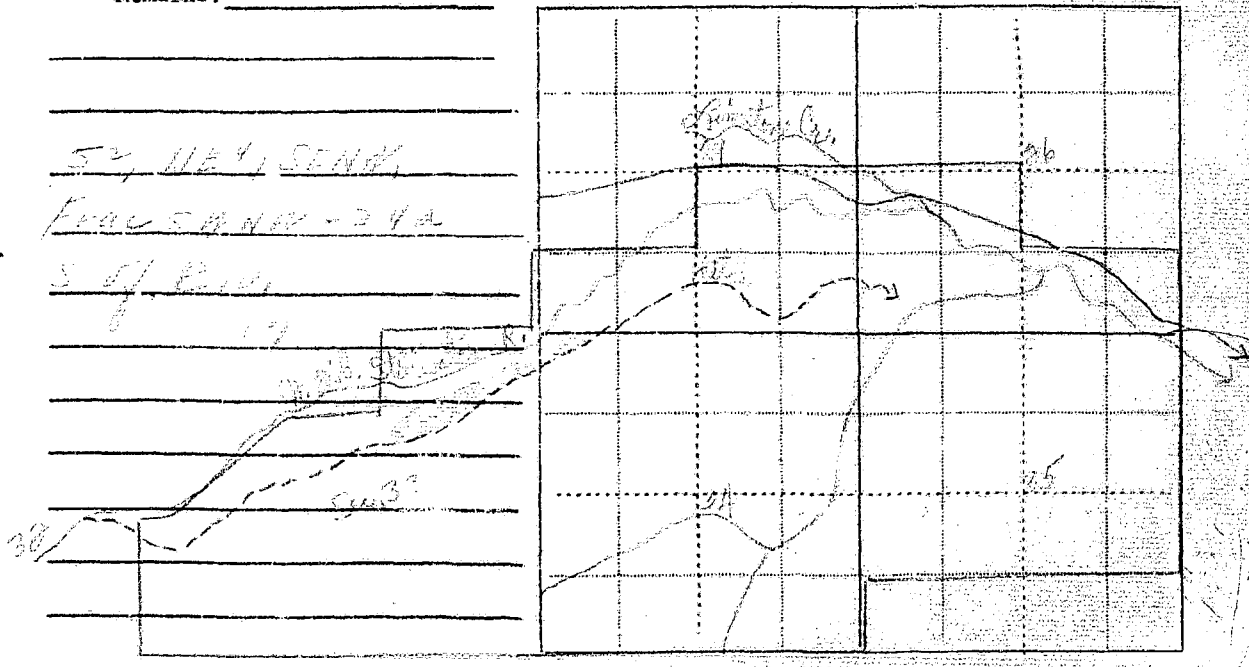
[illegible]

2-53

 Δ and

145

as soon

Our records show that you have an appropriation in Stillwater County, Book 1, Page 408, Record Misc., made by Salleck M. Fitzgerald, appropriated Dec. 16, 1914 and filed Dec. 17, 1914 and- from W. Fork of Stillwater for 480 miners inches.

also

Our records show that you have an appropriation in Stillwater County, Book 8, Page 289, Record Misc., made by Jane F. Lotta, appropriated June 1, 1910 and filed Dec. 23, 1919 from Stillwater River - W. Fork for 250 miners inches.

also

Our records show that you have an appropriation in Stillwater County, Book 19, Page 452, Record Water Rights, made by Arnold Richards, appropriated Oct. 10, 1911 and filed Oct. 13, 1911 from Horseman Creek for 50 miners inches.
Are these appropriations now in use?

YES.



STATE ENGINEERS OFFICE
Water Resources Survey

Code No. 379

Notice of Appropriation

1. County Stillwater Book 1 Page 408 Record Misc.
2. Name of Appropriator Fitzgerald, Selleck M. Address Nye, Montana
3. Date Appropriated Dec. 16, 1914 Date Filed Dec. 17, 1914
- Amount Appropriated, Miners Inches 480, Cubic Feet per second _____
4. Name of Stream West Fork of Stillwater Tributary _____ Basin _____
5. Point of Diversion at a point upon its right bank near the northwest corner of NW $\frac{1}{4}$ of SE $\frac{1}{4}$ of

Sec. 32 Twp. 4 S. Rge. 15 E. Bank of Stream right bank

6. Purpose For domestic and for irrigating and other purposes.
7. Description of System Dam, ditch, ditch is 12 inches by 36 inches in size and carries and conducts 480 inches of water / from said spring.

8. Land Description of Intended Place of Use

| Subdivision | Sec. | Twp. | Rge. | Tot. Acr. | 1940 Owner | Address |
|---|------|------|-------|-----------|----------------|---------|
| E $\frac{1}{2}$ NW $\frac{1}{4}$ - W $\frac{1}{2}$ NW $\frac{1}{4}$ | 33 | 4 S. | 15 E. | | See next page. | |
| N $\frac{1}{2}$ NE $\frac{1}{4}$ | 34 | 4 S. | 15 E. | | | |
| S $\frac{1}{2}$ SE $\frac{1}{4}$ | 27 | 4 S. | 15 E. | | | |
| S $\frac{1}{2}$ SW $\frac{1}{4}$, SWSE $\frac{1}{4}$ | 26 | 4 S. | 15 E. | | | |

9. Remarks (Pertaining to Use, etc.)

NW $\frac{1}{4}$ 35 4 S. 15 E.

2. Remarks - That we (Selleck M. Fitzgerald & Jane F. Latta) appropriated and took said water on June 23, 1908 by means of said dam and ditch.

Decree

10. Case No. _____ Date _____ Amt. Decreed: M. I. _____ C. F. S. _____

11. To Whom Decreed _____ Address _____

12. Name of Ditch _____ Maximum Capacity (C. F. S.) _____

13. Date of Priority _____ Purpose _____

14. Land Description of Place of Use as Decreed _____

15. Remarks (Present Use Status, etc.) _____

Code No. 379

1940 Land Ownership.

40 - NENW, Sec. 33, T. 4 S., R. 15 E. - John S. Currie, Pharma, Montana
120 - SENW - WANE, Sec. 33, T. 4 S., R. 15 E., Walter Lotta, Columbus, Montana
80 - NNE $\frac{1}{4}$, Sec. 34, T. 4 S., R. 15 E.
80 - S $\frac{1}{2}$ SE $\frac{1}{4}$, Sec. 27 - T. 4 S., R. 15 E.
120 - S $\frac{1}{2}$ SW $\frac{1}{4}$, SWSE, Sec. 26, T. 4 S., R. 15 E.

Transfers of Land Ownership.

S. M. Fitzgerald to Helen Wellington to Walter Lotta
WNE $\frac{1}{4}$, SENW $\frac{1}{4}$, Sec. 33, Twp. 4 S., Rge. 15 E.

S. M. Fitzgerald to Henry Fitzgerald to John S. Currie
NENW $\frac{1}{4}$, Sec. 33, Twp. 4 S., Rge. 15 E.

S. M. Fitzgerald to Jane Lotta to Helen Wellington to Walter Lotta
NNE $\frac{1}{4}$, Sec. 34 - Twp. 4 S., Rge. 15 E.
S $\frac{1}{2}$ SE $\frac{1}{4}$, Sec. 27 - Twp. 4 S., Rge. 15 E.
S $\frac{1}{2}$ SW $\frac{1}{4}$, SWSE, Sec. 26 - Twp. 4 S., Rge. 15 E.
NWNW $\frac{1}{4}$, Sec. 35 - Twp. 4 S., Rge. 15 E.

STATE ENGINEERS OFFICE
Water Resources Survey

Code No. 390

Notice of Appropriation

1. County Stillwater Book 8 Page 289 Record Misc.
2. Name of Appropriator Latta, Jane F. Address Nye, Montana
3. Date Appropriated June 1, 1910 Date Filed Dec. 23, 1919
Amount Appropriated, Miners Inches 250 Cubic Feet per second
4. Name of Stream Stillwater River (W. Fork) Tributary Basin
5. Point of Diversion at a point on its south bank where river crosses 1/2 sec. line NE 1/4 of
Sec. 32 Twp. 4 S. Rge. 15 E. Bank of Stream south
thence running to and upon said land.
6. Purpose Stock use, domestic, irrigation and other purposes.
7. Description of System By means of a ditch which is 36 inches by 18 inches in size.
8. Land Description of Intended Place of Use

| Subdivision | Sec. | Twp. | Rge. | Tot. Acr. | 1940 Owner | Address |
|---------------------------------------|------|------|-------|-----------|-------------------------|---------|
| N 1/2 SW 1/4, S 1/2 SW 1/4, SW SE 1/4 | 26 | 4 S. | 15 E. | 200 | Walter C. Lotta | |
| SE 1/4 | 27 | 4 S. | 15 E. | 160 | Walter C. Lotta | |
| N 1/2 NE 1/4 | 34 | 4 S. | 15 E. | 80 | Walter C. Lotta | |
| NW 1/4 NW 1/4 | 35 | 4 S. | 15 E. | 40 | Walter Lotta, Columbus. | |
9. Remarks (Pertaining to Use, etc.) Transfers of Land Ownership
Jane F. Lotts to Helen Wellington to Walter Lotta
SW 1/4, SW SE 1/4, Sec. 26 - Twp. 4 S., Rge. 15 E.
N 1/2 NE 1/4, SE 1/4, Sec. 27, Twp. 4 S., Rge. 15 E.
N 1/2 NE 1/4, Sec. 34 - Twp. 4 S., Rge. 15 E.
NWNW 1/4, Sec. 35, T. 4 S., R. 15 E. Decree *now in use*
10. Case No. Date Amt. Decreed: M. I. C. F. S.
11. To Whom Decreed Address
12. Name of Ditch Maximum Capacity (C. F. S.)
13. Date of Priority Purpose
14. Land Description of Place of Use as Decreed
15. Remarks (Present Use Status, etc.)

STATE ENGINEERS OFFICE
Water Resources Survey

Code No. 201

Notice of Appropriation

1. County Sweetgrass Book 19 Page 452 Record Water Rights
2. Name of Appropriator Arnold Richards Address Nye, Montana
3. Date Appropriated Oct. 10, 1911 Date Filed Oct. 13, 1911
Amount Appropriated, Miners Inches 50 or, Cubic Feet per second 1 $\frac{1}{2}$
4. Name of Stream Horsman Creek Tributary W. Fork Stillwater Basin
5. Point of Diversion at and on NE $\frac{1}{4}$ SE $\frac{1}{4}$
Sec. 34 Twp. 4 S. Rge. 15 E. Bank of Stream Right.
6. Purpose Household, agricultural, livestock, irrigating, etc.
7. Description of System Headgate and ditch, which said headgate and ditch will be 24 inches by 12 inches in size and will carry and conduct 1 $\frac{1}{2}$ cubic feet water from said stream.
8. Land Description of Intended Place of Use

| | | | | | | |
|------------------|------|------|-------|-----------|-------------------|---------|
| Subdivision | Sec. | Twp. | Rge. | Tot. Acr. | 1940 Owner | Address |
| SE $\frac{1}{4}$ | 34 | 4 S. | 15 E. | | Stillwater County | |
9. Remarks (Pertaining to Use, etc.)

Decree

10. Case No. Date Amt. Decreed: M. I. C. F. S.
11. To Whom Decreed Address
12. Name of Ditch Maximum Capacity (C. F. S.)
13. Date of Priority Purpose
14. Land Description of Place of Use as Decreed
15. Remarks (Present Use Status, etc.)



STATE OF MONTANA
STATE ENGINEERS OFFICE
Water Resources Survey

328
Form WR-1-1M-11-44

Code No. 17 B, 208

County Stillwater

T. 4 S. R. 15 E.

Name of Land Owner Clara McKinsey est. Address Limestone, Montana
Name of Operator Geo. E. McKinsey Address Limestone, Montana

Part A

TO BE FILED BY THOSE OBTAINING IRRIGATION WATER FROM
A DITCH COMPANY OR IRRIGATION DISTRICT

1. Water is delivered by: Private ditch
Name of Ditch, Ditch Company or District supplying water
2. State the number of acres you irrigate under this system _____ Shares you hold _____
3. If you obtain water from more than one Company, give the number of shares, acres irrigated and the name of the Company under "Remarks". If you obtain water from a Ditch Company and also have a private system fill in both Part A and Part B.

Part B

TO BE FILED BY THOSE WHO HAVE A PRIVATE DITCH, PUMP OR IRRIGATION SYSTEM
or those who have a private water right under a Ditch Company

4. In what year was this land first irrigated? Date Land has been irrigated since about 1909
5. Give the name of the original appropriator (first user): (No filings)
6. Give the date appropriated _____ Amount filed on: Miners Inches _____ C. F. S. _____
7. State the total number of acres irrigated under this system: _____
8. Give the point of diversion: _____ $\frac{1}{4}$ _____ $\frac{1}{4}$ Section _____ Township _____ Range _____

Part C

TO BE FILED BY ALL WATER USERS IN ADDITION TO PART A OR PART B

9. Source of Water: Lodge Pole Creek & Limestone Springs
Name of stream or lake from which water is originally diverted
10. Water is obtained by: (Check one) Gravity _____ Pumping _____ Other _____
11. What is the greatest number of acres you have irrigated? 22 Date _____
12. How many acres did you irrigate in 1944? (Crop and pasture) 0
13. State the total number of additional acres that could be irrigated by increasing the water supply, land leveling, etc. 0 This land is under what ditch? _____
14. How many acres of seeped land do you have which could be drained and put into production? 0
15. What is the condition of your irrigation system? fair
16. Is your water supply adequate? Yes ☒ No _____ Explain _____
17. REMARKS: Have a small ditch out of Lodge Pole Creek and a ditch out of Limestone Springs, one serving both and one serving the well irrigated pasture land.

OVER

NOTE: The foregoing questions apply only to irrigated land shown on this plat.

DESCRIPTION AND MAP OF FARM

18. Legal Description of this Farm E1NW4, W2NE4, N3SW4, N4SE4, Sec. 20, Twp. 4 S., Rge. 15 E.

S3SW4, S4SE4, Sec. 17 - Twp. 4 S., Rge. 15 E.

☒ IRRIGATED LAND ☐ NON-IRRIGATED LAND

Farm boundary.

This map is according to our records. Please change it if it is not correct. That is if we show more irrigated land than you have, A it out; if we have not enough, draw it in.

NORTH

19. If the above land is irrigated from more than one ditch please give the acreage under each ditch in 19A and indicate the location of the land irrigated from each on the above map.

19A. Ditch: Private ditch Acres: 0

Ditch: _____ Acres: _____

Information supplied by

Name Geo. E. McKinney Address _____ Date Apr. 26-45

REMARKS: Taken at Rancher's Office and Court
from Geo. E. McKinney who also operates?
the land at present.

If you cannot answer all of the questions on this form answer as many as you can and return the form to us as soon as possible.

THURBER'S, HELENA

STATE OF MONTANA WATER RESOURCES SURVEY

County Stillwater Date _____Name of Water User Geo. E. McKinsey Address Limestone

1. Do you own this land? Yes ___ No ___ If not give the owner's name below:

Owner's name Clara McKinsey et al Address Limestone

2. Source of Water _____ Water delivered by _____

3. Give point of Diversion _____ Section _____ Township _____ Range _____

4. Water is obtained by: (Check one) Gravity _____ Pumping _____ Other _____

5. Who first used water on this land? 0 Address _____

6. In what year was this land first irrigated? _____ Approximate Acres _____

7. What is the greatest number of acres you have irrigated? _____ Date _____

8. Present Use: Year _____ Acres Irrigated _____

9. If this land is not irrigated now give date of last use _____

10. State the total number of acres that could be irrigated _____ acres.

11. What is the condition of your irrigation system? _____

12. Land Description: 1/4 NW 1/4, W 1/2 NE 1/4, NE 1/4, NW 1/4, SE 1/4, SW 1/4, SW 1/4, SW 1/4 Twp. _____ Range _____Remarks: Same

NE 1/4, NE 1/4,
SE 1/4, SE 1/4, NE 1/4,
NW 1/4, NW 1/4,
SE 1/4, SE 1/4, SW 1/4

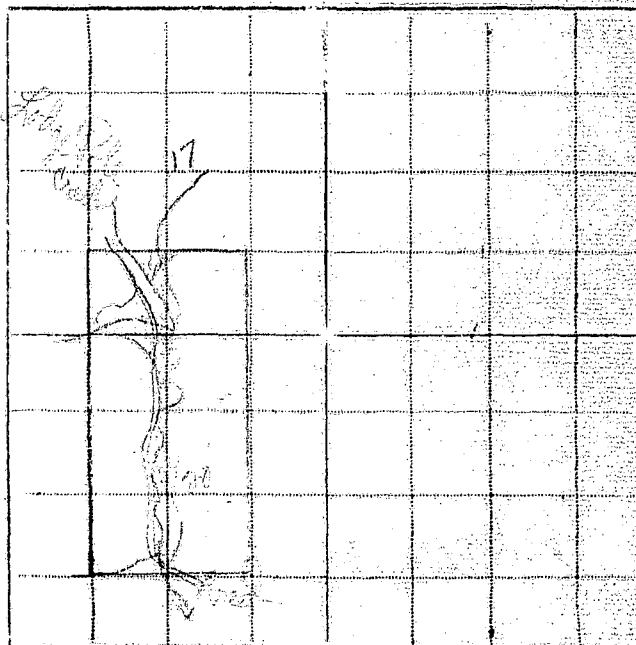

Information by _____ Place _____ Date _____

63-156

Billings,
~~Montana~~

March 27, 1945

Geo. E. McKinsey
Limestone, Montana

Dear Mr. McKinsey:

On March 7th, this office sent you a letter asking for certain information pertaining to your irrigated land in township 4 south, range 15 east. To date we have not heard from you. With the vast post war water development in this area as now planned, it is essential that we have this information in order to show the extent of our water use in the Yellowstone Basin in Montana. This information is necessary to protect our present water users in the rights they have against future irrigation, navigation, power and flood control enterprises in this area. We are asking you for this information because we feel it is the democratic way; we also feel that you are more qualified to give us this information about your irrigated land than anyone else because it is part of your business. It may be that you were busy with your farm work or some unforeseen thing happened at the time our first letter was received, and you put it aside to be answered at some other time and have forgotten all about it. All information is strictly confidential and is only used to record and tabulate the water use in this area.

Water is as necessary to the farmer as the soil in which he plants. Without it no crops will grow; no living thing can survive. It is your water that we are trying to protect, so that you will have plenty now and in the future. We must keep Montana's water in Montana. The only way we can do this is by having the support of each and every water user so that we have a 100 percent representation of all water users. Remember: "United we stand, divided we fall".

In order to facilitate this work a branch office of the State Engineer has been established in Billings and is located in the Roosevelt School Building on 23rd Street and Fourth Avenue North. Anytime you are in Billings we would appreciate your calling on us.

Hoping to hear from you in the very near future, I am,

Very truly yours,

Gerald J. Oravetz
Assistant State Engineer

P.S. If you cannot supply us with the information requested, it may be that you can tell us of someone who can.

Billings,
XXXXXXX

April 10, 1945

Geo. E. McKinsey
Limestone, Montana

Dear Mr. McKinsey:

On March 7th we sent you a letter asking for certain information pertaining to your irrigated land in township 4 south range 15 east. On March 27th we sent you another letter asking you to submit the information to us as soon as possible. To date we have not heard from you regarding this matter.

It is hereby declared to be a policy of the State and necessary for the welfare of the State and its citizens, that the waters of this State, and especially interstate streams arising out of the State, be investigated. The State Engineer shall, either before or after the bringing of such action (to adjudicate the waters of any stream and its tributaries in any county traversed by said stream), upon the direction of the State Water Conservation Board, or upon the direction of the court, do all things, make all surveys, and perform all services required by said board in the securing of all necessary information and make the same available to said board or others who may be interested therein, including the courts of this State.

In order to protect the water rights of the water users in this state it is mandatory that the State Engineer have the information that we have asked you to submit to this office. If you have sold the piece of land about which we wrote you, will you please give us the name and address of the new owner.

We expect to hear from you in the very near future.

Very truly yours,

Gerald J. Oravetz
Assistant State Engineer



STATE OF MONTANA
STATE ENGINEERS OFFICE
Water Resources Survey

336
Form WR-1-IM-11-44

Code No. 30 B, 31 B
County Stillwater
T. 4 S. R. 15 E.

Name of Land Owner Mable McTaggart Address Limestone, Montana
Name of Operator Hoiness Bros. Address Limestone, Montana

Part A

TO BE FILED BY THOSE OBTAINING IRRIGATION WATER FROM
A DITCH COMPANY OR IRRIGATION DISTRICT

1. Water is delivered by: Private ditch
Name of Ditch, Ditch Company or District supplying water
2. State the number of acres you irrigate under this system _____ Shares you hold _____
3. If you obtain water from more than one Company, give the number of shares, acres irrigated and the name of the Company under "Remarks". If you obtain water from a Ditch Company and also have a private system fill in both Part A and Part B.

Part B

TO BE FILED BY THOSE WHO HAVE A PRIVATE DITCH, PUMP OR IRRIGATION SYSTEM
or those who have a private water right under a Ditch Company

4. In what year was this land first irrigated? Date Code no 160 Stillwater
5. Give the name of the original appropriator (first user): R. M. Fry et al
6. Give the date appropriated June 26-96 Amount filed on: Miners Inches 50 C. F. S. 500
7. State the total number of acres irrigated under this system: June 7, 99
8. Give the point of diversion: 1/4 1/4 Section _____ Township _____ Range _____
(see back of letter for details of ditch)

Part C

TO BE FILED BY ALL WATER USERS IN ADDITION TO PART A OR PART B

9. Source of Water: Picket Run Creek
Name of stream or lake from which water is originally diverted
10. Water is obtained by: (Check one) Gravity ☒ Pumping ☐ Other ☐
11. What is the greatest number of acres you have irrigated? 119 Date _____
12. How many acres did you irrigate in 1944? (Crop and pasture) 119
13. State the total number of additional acres that could be irrigated by increasing the water supply, land leveling, etc. 120 This land is under what ditch? 80 under Tanager ditch and 40 under private
14. How many acres of seeped land do you have which could be drained and put into production? 0
15. What is the condition of your irrigation system? Good
16. Is your water supply adequate? Yes ☒ No ☐ Explain _____
17. REMARKS: Hoiness Bros. did not know anything about filing for their water right (checked) it was filed under name of 1900 all they had to do was file it.

OVER

NOTE: The foregoing questions apply only to irrigated land shown on this plat.

DESCRIPTION AND MAP OF FARM

18. Legal Description of this Farm W₂, W₃E₂, N₂E₂, Sec. 30 - Twp. 4 S., Rge. 15 E.

W₂, W₃E₂, SENE₂, NESE₂, Sec. 31 - Twp. 4 S., Rge. 15 E.



IRRIGATED LAND

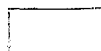

NON-IRRIGATED LAND

— Farm boundary.

This map is according to our records. Please change it if it is not correct. That is if we show more irrigated land than you have, X it out; if we have not enough, draw it in.

NORTH

50

Cast 5

19. If the above land is irrigated from more than one ditch please give the acreage under each ditch in 19A and indicate the location of the land irrigated from each on the above map.

19A. Ditch: Private ditch Acres 114

Ditch: _____ Acres _____

Information supplied by:

Name Homer B. B. Address _____ Date Apr. 26 - 1915

REMARKS: Taken by Bill and Homer at
mouth of Homer B. B. field
check.

If you cannot answer all of the questions on this form answer as many as you can and return the form to us as soon as possible.

THURBER'S, HELONA

FORM SM-1a

STATE OF MONTANA WATER RESOURCES SURVEY

9513E

308
312

County Stillwater Date _____

Name of Water User Heiness Bros Address Limestone

1. Do you own this land? Yes _____ No _____ If not give the owner's name below:

Owner's name Mable McQuinn Address Limestone

2. Source of Water _____ Water delivered by _____

3. Give point of Diversion _____ Section _____ Township _____ Range _____

4. Water is obtained by: (Check one) Gravity _____ Pumping _____ Other _____

5. Who first used water on this land? _____ Address _____

6. In what year was this land first irrigated? _____ Approximate Acres _____

7. What is the greatest number of acres you have irrigated? _____ Date _____

8. Present Use: Year _____ Acres Irrigated _____

9. If this land is not irrigated now give date of last use _____

10. State the total number of acres that could be irrigated _____ acres.

11. What is the condition of your irrigation system? _____

12. Land Description: _____, Twp. _____ Range _____

Remarks: Some

N^W, N²E², NE¹NE, Sec 30
N^W, N²E², SE¹NE, NE¹SE
Sec 31

(2.90)

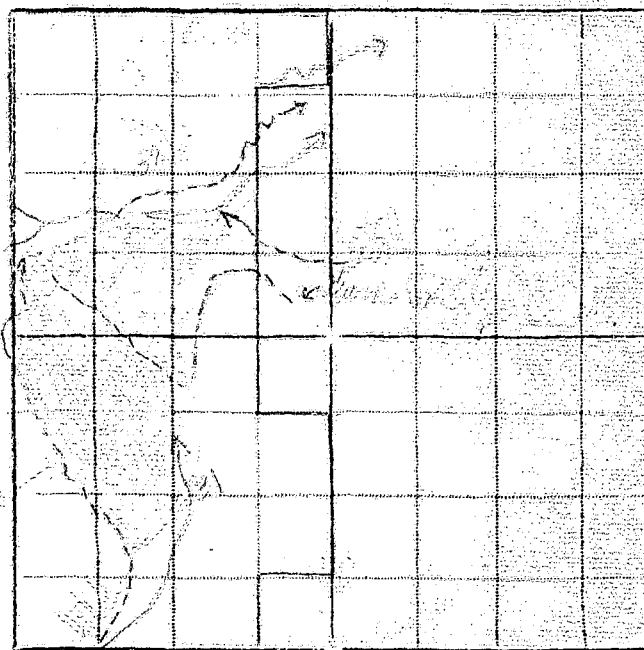

Information by _____ Place _____ Date _____

1518

9A. and

14

-26-1998

CS

as soon

IA

Billings,
Montana

March 27, 1945

Heiness Bros.
Limestone, Montana

Dear Sirs:

On March 7th, this office sent you a letter asking for certain information pertaining to your irrigated land in township 4 south, range 15 east. To date we have not heard from you. With the vast post war water development in this area as now planned, it is essential that we have this information in order to show the extent of our water use in the Yellowstone Basin in Montana. This information is necessary to protect our present water users in the rights they have against future irrigation, navigation, power and flood control enterprises in this area. We are asking you for this information because we feel it is the democratic way; we also feel that you were busy with your farm work or some unforeseen thing happened at the time our first letter was received, and you put it aside to be answered at some other time and have forgotten all about it. All information is strictly confidential and is only used to record and tabulate the water use in this area.

Water is as necessary to the farmer as the soil in which he plants. Without it no crops will grow; no living thing can survive. It is your water that we are trying to protect, so that you will have plenty now and in the future. We must keep Montana's water in Montana. The only way we can do this is by having the support of each and every water user so that we have a 100 percent representation of all water users. Remember: "United we stand, divided we fall".

In order to facilitate this work a branch office of the State Engineer has been established in Billings and is located in the Roosevelt School Building on 23rd Street and Fourth Avenue North. Anytime you are in Billings we would appreciate your calling on us.

Hoping to hear from you in the very near future, I am,

Very truly yours,

Gerald J. Oravetz
Assistant State Engineer

P.S. If you cannot supply us with the information requested, it may be that you can tell us of someone who can.

NOTE:

THIRD LETTER FILED IN 55.15E UNDER HEINESS BROS. LAND.

(Over)

Appropriation - E. M. Foy et al
app - June 26, 1896 filed Oct 17,
1905 for 50 acres from
Four Miles Creek area called
Robert Pann Creek.

E. M. Foy et al
app - June 7, 1899 filed Oct 17,
1905 for 50 acres from
Four Miles Creek area called
Robert Pann Creek.

both above filings for 1.00
lands in Twp. 45 - R. 1, E.
SW 7 Sec 30 + NW 1/4 Sec
31 - Coke 160 + 161 in
Stillwater County, Minn.

Billings,
XXXXXXXXXX

April 18, 1945

Mabel McTaggart
Limestone, Montana

Dear Madam:

In order that we in Montana will be able to present facts as to the amount of land we are now irrigating, protect our water rights, and keep Montana water in Montana, the 1939 Session of Montana State Legislature enacted a law (Sec. 349.68 Montana Session Laws) requiring the State Engineer to investigate and prepare a complete record of all water rights in the state. In compliance with this law all water users in the state are being requested to supply information regarding their use of water. We are therefore asking you to help us by answering the questions on the enclosed form which pertain to your land.

The adjoining states have already compiled records of their water use in this basin for the protection of their rights. It is therefore necessary that we do the same in Montana. We have completed our survey in Yellowstone and Carbon Counties and have had 100 percent cooperation from all of the water users in these counties, and I am sure we can expect the same support in Stillwater County. It might interest you to know that before we started our survey it was estimated that there were 162,000 acres of irrigated land in the two counties. We have found that there are 204,674.82 acres being irrigated and 49,422.61 acres of potential land under the existing works. This is a notable difference, and especially so in regard to the forthcoming division of water between states which the Congress of the United States has authorized.

We in Montana must be vigilant and do everything possible to protect the rights we have. These rights are being challenged by interests outside of the State of Montana, particularly the navigation interest of downstream states, and also the water users in the neighboring states through which our interstate streams flow. In order to protect these rights we must have a record of them and their present uses. The only way we can obtain this information is from the water user.

We are therefore depending on you to fill in the enclosed form and mail it to us in the enclosed self-addressed envelope at your earliest possible convenience. If any of the information we have compiled on the enclosed form is not correct we will greatly appreciate your making the necessary corrections.

In order to facilitate this work a branch office of the State Engineer has been established in Billings and is located in the Roosevelt School Building on 23rd Street and Fourth Avenue North. Anytime you are in Billings we would appreciate your calling on us. Our phone number is 3777.

Very truly yours,

Gerald J. Oravetz
Assistant State Engineer

STATE ENGINEERS OFFICE
Water Resources Survey

160

Notice of Appropriation

1. County Williston Book 4 Page 498 Record None
2. Name of Appropriator H.M. Gray et al Address Nye
3. Date Appropriated 6-7-99 Date Filed 10-12-05
Amount Appropriated, Miners Inches 500, Cubic Feet per second _____
4. Name of Stream Four Mile Creek Tributary _____ Basin _____
5. Point of Diversion at a point on its south bank two miles from its junction with Caselle Creek
Sec. _____ Twp. _____ Rge. _____ Bank of Stream _____

6. Purpose Irrigation & other
7. Description of System ditch 12' x 36"

8. Land Description of Intended Place of Use SW 1/4 Sec 30 45-15E
NW 1/4 Sec 31 45-15E

9. Remarks (Pertaining to Use, etc.) _____

Decree

10. Case No. _____ Date _____ Amt. Decreed: M. I. _____ C. F. S. _____
11. To Whom Decreed _____ Address _____
12. Name of Ditch _____ Maximum Capacity (C. F. S.) _____
13. Date of Priority _____ Purpose _____
14. Land Description of Place of Use as Decreed _____
15. Remarks (Present Use Status, etc.) _____

STATE ENGINEERS OFFICE
Water Resources Survey

Notice of Appropriation

161

1. County Stillwater Book 4 Page 437 Record None
2. Name of Appropriator R. M. Gray et al. Address _____
3. Date Appropriated 6-26-76 Date Filed 10-17-05
Amount Appropriated, Miners Inches 50, Cubic Feet per second _____
4. Name of Stream Four Mile Creek Tributary _____ Basin _____
5. Point of Diversion at a point on its south bank 100 yards above its junction with Castle Creek
Sec. _____ Twp. _____ Rge. _____ Bank of Stream _____
6. Purpose Irrigation & other
7. Description of System a ditch 6" x 10"
8. Land Description of Intended Place of Use SW⁴ sec 30, 4S-15E
NW⁴ sec 31, 4S-15E
9. Remarks (Pertaining to Use, etc.) _____

Decree

10. Case No. _____ Date _____ Amt. Decreed: M. I. _____ C. F. S. _____
11. To Whom Decreed _____ Address _____
12. Name of Ditch _____ Maximum Capacity (C. F. S.) _____
13. Date of Priority _____ Purpose _____
14. Land Description of Place of Use as Decreed _____
15. Remarks (Present Use Status, etc.) _____

STATE ENGINEERS OFFICE
Water Resources Survey

Notice of Appropriation

1. County Hillman Book A Page 439 Record 11222
2. Name of Appropriator H. M. Guy Address Tracy
3. Date Appropriated 6-1-99 Date Filed 12-17-95
Amount Appropriated, Miners Inches 25, Cubic Feet per second _____
4. Name of Stream Crook Creek Tributary _____ Basin _____
5. Point of Diversion at a point on its north bank 100 yds. below its
junction with Four Mile Creek
Sec. _____ Twp. _____ Rge. _____ Bank of Stream _____

6. Purpose Irrigation & other
7. Description of System a ditch 3" x 12"

8. Land Description of Intended Place of Use N.E.S.W. 1/4 Sec 30-45-15E

9. Remarks (Pertaining to Use, etc.) _____

Decree

10. Case No. _____ Date _____ Amt. Decreed: M. I. _____ C. F. S. _____
11. To Whom Decreed _____ Address _____
12. Name of Ditch _____ Maximum Capacity (C. F. S.) _____
13. Date of Priority _____ Purpose _____
14. Land Description of Place of Use as Decreed _____
15. Remarks (Present Use Status, etc.) _____

STATE ENGINEERS OFFICE

Water Resources Survey

Notice of Appropriation

1. County Willmar Book 4 Page 421 Record 7111
2. Name of Appropriator Hopper John W. Address _____
3. Date Appropriated Aug 22, 1904 Date Filed Jan 4-1905
Amount Appropriated, Miners Inches 120, Cubic Feet per second _____
4. Name of Stream Willmar River Tributary _____ Basin _____
5. Point of Diversion 1/2 mile east of County bridge across the
Willmar River
Sec. _____ Twp. _____ Rge. _____ Bank of Stream _____

6. Purpose Irrigation & water
7. Description of System dam & ditch 10 ft wide on bottom, 14 ft wide
on top, 3 ft deep
8. Land Description of Intended Place of Use W^{1/2} NW^{1/4} NE NW^{1/4} lots 4-9 & 10 sec 23-35-19E

9. Remarks (Pertaining to Use, etc.) _____

Decree

10. Case No. _____ Date _____ Amt. Decreed: M. I. _____ C. F. S. _____
11. To Whom Decreed _____ Address _____
12. Name of Ditch _____ Maximum Capacity (C. F. S.) _____
13. Date of Priority _____ Purpose _____
14. Land Description of Place of Use as Decreed _____
15. Remarks (Present Use Status, etc.) _____

STATE ENGINEERS OFFICE
Water Resources Survey

Notice of Appropriation

1. County Stillwater Book 3 Page 725 Record 1150
2. Name of Appropriator McDonald, K. J. Address 1000 1st St. S. Stillwater, Minn.
3. Date Appropriated July 14, 1945 Date Filed Aug. 21, 1945
Amount Appropriated, Miners Inches 600, Cubic Feet per second 1.0
4. Name of Stream Stillwater Creek Tributary Basin
5. Point of Diversion at a point one to right bank in the NW 1/4 of
Sec. 22 Twp. 35 Rge. 19E Bank of Stream right

6. Purpose Irrigation water
7. Description of System a ditch 18" x 72"

8. Land Description of Intended Place of Use N²NW² NWNE⁴ SEC. 23 35-19E
SWSE⁴ E⁴SE⁴ SEC. 14 " "
W²SW² NW² SEC. 12 " "

9. Remarks (Pertaining to Use, etc.)

Decree

10. Case No. Date Amt. Decreed: M. I. C. F. S.
11. To Whom Decreed Address
12. Name of Ditch Maximum Capacity (C. F. S.)
13. Date of Priority Purpose
14. Land Description of Place of Use as Decreed

15. Remarks (Present Use Status, etc.)

STATE ENGINEERS OFFICE
Water Resources Survey

Notice of Appropriation

1. County Stellwagen Book 4 Page 146 Record Free
2. Name of Appropriator E. M. Gump Address _____
3. Date Appropriated 4-1-27 Date Filed 10-17-25
Amount Appropriated, Miners Inches 10, Cubic Feet per second _____
4. Name of Stream Sharp Creek Tributary _____ Basin _____
5. Point of Diversion at a point on the east bank & about 150 yds
above its mouth
Sec. _____ Twp. _____ Rge. _____ Bank of Stream _____
6. Purpose Irrigation & other
7. Description of System a ditch 3" x 16"
8. Land Description of Intended Place of Use N.E. SW 1/4 Sec 30, T 4 S - R 15 E
9. Remarks (Pertaining to Use, etc.) _____

Decree

10. Case No. _____ Date _____ Amt. Decreed: M. I. _____ C. F. S. _____
11. To Whom Decreed _____ Address _____
12. Name of Ditch _____ Maximum Capacity (C. F. S.) _____
13. Date of Priority _____ Purpose _____
14. Land Description of Place of Use as Decreed _____
15. Remarks (Present Use Status, etc.) _____



STATE OF MONTANA
STATE ENGINEERS OFFICE

Water Resources Survey

Form WR-1-1M-11-11

Code No. 44-172

County Chouteau

T. 4.00 R. 15 E

Name of Land Owner Tom Hapvill Address Coleman

Name of Operator (New Owner) Address _____

Part A

TO BE FILED BY THOSE OBTAINING IRRIGATION WATER FROM
A DITCH COMPANY OR IRRIGATION DISTRICT

1. Water is delivered by: Chouteau Ditch
Name of Ditch, Ditch Company or District supplying water
2. State the number of acres you irrigate under this system _____ Shares you hold _____
3. If you obtain water from more than one Company, give the number of shares, acres irrigated and the name of the Company under "Remarks". If you obtain water from a Ditch Company and also have a private system fill in both Part A and Part B.

Part B

TO BE FILED BY THOSE WHO HAVE A PRIVATE DITCH, PUMP OR IRRIGATION SYSTEM
or those who have a private water right under a Ditch Company

4. In what year was this land first irrigated? Date 1911
5. Give the name of the original appropriator (first user): Frank J. Beni
6. Give the date appropriated 1908 Amount filed on: Miners Inches 0 C. F. S. _____
7. State the total number of acres irrigated under this system: _____
8. Give the point of diversion: 1/4 Section _____ Township _____ Range _____

Part C

TO BE FILED BY ALL WATER USERS IN ADDITION TO PART A OR PART B

9. Source of Water: Springs at Head of Beni Creek
Name of stream or lake from which water is originally diverted
10. Water is obtained by: (Check one) Gravity _____ Pumping _____ Other _____
11. What is the greatest number of acres you have irrigated? 0 Date _____
12. How many acres did you irrigate in 1944? (Crop and pasture) 20
13. State the total number of additional acres that could be irrigated by increasing the water supply, land leveling, etc. _____ This land is under what ditch? _____
14. How many acres of seeped land do you have which could be drained and put into production? _____
15. What is the condition of your irrigation system? Fair
16. Is your water supply adequate? Yes ✓ No _____ Explain _____
17. REMARKS: Information from S. E. McKinney

OVER

NOTE: The foregoing questions apply only to irrigated land shown on this plat.

DESCRIPTION AND MAP OF FARM

18. Legal Description of this Farm: _____

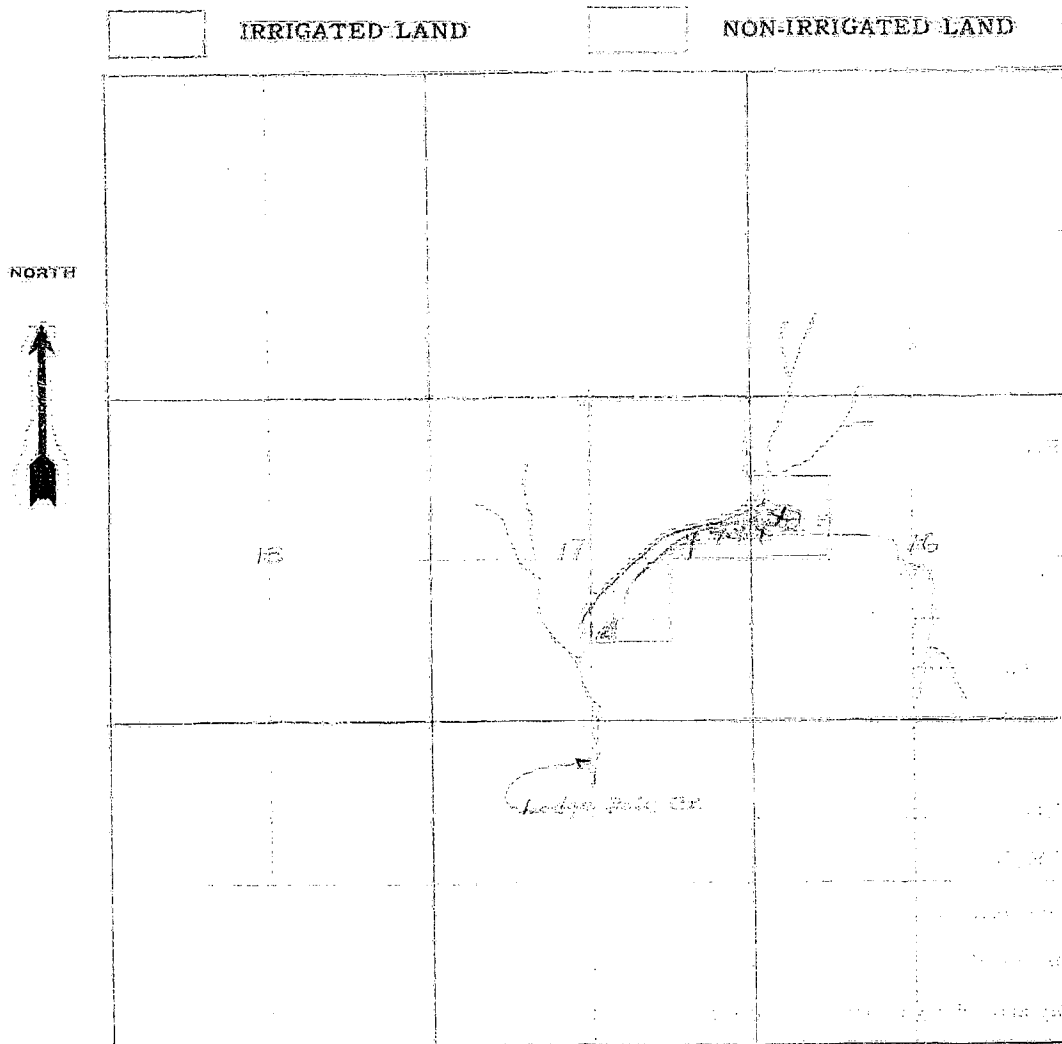
| <input type="checkbox"/> IRRIGATED LAND | <input type="checkbox"/> NON-IRRIGATED LAND |
|---|---|
|  | |

19. If the above land is irrigated from more than one ditch please give the acreage under each ditch in 19A and indicate the location of the land irrigated from each on the above map.

19A. Ditch: Reinhardt Ditch Acres: 200

Ditch: _____ Acres: _____

Information supplied by:

Name: E. J. Reinhardt Address: _____ Date: Apr-26-45

REMARKS: by letterhead and from the

100' Rebar, of going under the ditch

think that the Rebar is not in the ditch

If you cannot answer all of the questions on this form answer as many as you can and return the form to us as soon as possible.

THOMAS H. NELSON



STATE OF MONTANA
STATE ENGINEERS OFFICE
Water Resources Survey

325
Form WR-1-1M-11-44

Code No. 8 B, 7 A
County Stillwater
T. 4 S. R. 15 E.

Name of Land Owner Thomas Mulvihill Address Columbus, Montana
Name of Operator _____ Address _____

Part A

TO BE FILED BY THOSE OBTAINING IRRIGATION WATER FROM
A DITCH COMPANY OR IRRIGATION DISTRICT

1. Water is delivered by: Private ditch from Lodge Pole Creek
Name of Ditch, Ditch Company or District supplying water _____ Shares you hold _____
2. State the number of acres you irrigate under this system _____
3. If you obtain water from more than one Company, give the number of shares, acres irrigated and the name of the Company under "Remarks". If you obtain water from a Ditch Company and also have a private system fill in both Part A and Part B.

Part B

TO BE FILED BY THOSE WHO HAVE A PRIVATE DITCH, PUMP OR IRRIGATION SYSTEM
or those who have a private water right under a Ditch Company

4. In what year was this land first irrigated? Date 1898
5. Give the name of the original appropriator (first user): Frank A. Smith
6. Give the date appropriated 1898 Amount filed on: Miners Inches 200 C. F. S. _____
7. State the total number of acres irrigated under this system: _____
8. Give the point of diversion: _____ $\frac{1}{4}$ _____ $\frac{1}{4}$ Section _____ Township _____ Range _____

Part C

TO BE FILED BY ALL WATER USERS IN ADDITION TO PART A OR PART B

9. Source of Water: Lodge Pole Creek - Frank A. Smith
Name of stream or lake from which water is originally diverted _____
10. Water is obtained by: (Check one) Gravity ☒ Pumping _____ Other _____
11. What is the greatest number of acres you have irrigated? 10 Date _____
12. How many acres did you irrigate in 1944? (Crop and pasture) 10
13. State the total number of additional acres that could be irrigated by increasing the water supply, land leveling, etc. 0 This land is under what ditch? _____
14. How many acres of seeped land do you have which could be drained and put into production? 0
15. What is the condition of your irrigation system? fair
16. Is your water supply adequate? Yes ☒ No _____ Explain _____
17. REMARKS: _____



This land is irrigated from the
private ditch - Lodge Pole Creek
land was previously owned by Herman
Heppeler

OVER

NOTE: The foregoing questions apply only to irrigated land shown on this plat.

DESCRIPTION AND MAP OF FARM

18. Legal Description of this Farm Meets and bounds in Sec. 7 & 8, Twp. 4 S., Rge. 15 E.

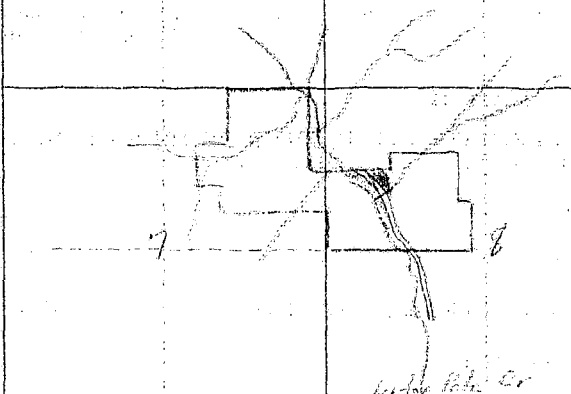
|  IRRIGATED LAND |  NON-IRRIGATED LAND |
|---|--|
| <p>Farm boundary.</p> <p>This map is according to our records. Please change it if it is not correct. That is if we show more irrigated land than you have, X it out; if we have not enough, draw it in.</p> <p>NORTH</p>  | |
| | |
| | |
| | |
| | |
| | |
| | |

19. If the above land is irrigated from more than one ditch please give the acreage under each ditch in 19A and indicate the location of the land irrigated from each on the above map.

19A. Ditch: Rocky Fork Acres: 10

Ditch: _____ Acres: _____

Information supplied by:

Name Tom Mulvihill Address _____ Date _____

REMARKS: ed ranch information taken by G. J. Smith
Apr. 26, 1945 - land at the top of field
All hay land

If you cannot answer all of the questions on this form answer as many as you can and return the form to us as soon as possible.

THURBER'S, HELENA



STATE OF MONTANA
STATE ENGINEERS OFFICE
Water Resources Survey

326
Form WR-1-12-11-41

Code No. 8 A, 17 C
County Stillwater
T. 4 S. R. 15 E.

Name of Land Owner Dudley White Address Limestone, Montana
Name of Operator Now owned by Address _____
Thomas Mulvihill Columbus, Mont

Part A

TO BE FILED BY THOSE OBTAINING IRRIGATION WATER FROM
A DITCH COMPANY OR IRRIGATION DISTRICT

1. Water is delivered by: Private delivery from Lodge Pole Co. + Myers Creek
Name of Ditch, Ditch Company or District supplying water
2. State the number of acres you irrigate under this system _____ Shares you hold _____
3. If you obtain water from more than one Company, give the number of shares, acres irrigated and the name of the Company under "Remarks". If you obtain water from a Ditch Company and also have a private system fill in both Part A and Part B.

Part B

TO BE FILED BY THOSE WHO HAVE A PRIVATE DITCH, PUMP OR IRRIGATION SYSTEM
or those who have a private water right under a Ditch Company

4. In what year was this land first irrigated? Date approx 1898
5. Give the name of the original appropriator (first user): Dudley White
6. Give the date appropriated _____ Amount filed on: Miners Inches 0 C. F. S. _____
7. State the total number of acres irrigated under this system: _____
8. Give the point of diversion: 1/4 Section _____ Township _____ Range _____

Part C

TO BE FILED BY ALL WATER USERS IN ADDITION TO PART A OR PART B

9. Source of Water: Lodge Pole Co. + Myers Creek - Tribe to Stillwater R.
Name of stream or lake from which water is originally diverted
10. Water is obtained by: (Check one) Gravity ☒ Pumping _____ Other _____
11. What is the greatest number of acres you have irrigated? 62 Date _____
12. How many acres did you irrigate in 1944? (Crop and pasture) 62
13. State the total number of additional acres that could be irrigated by increasing the water supply, land leveling, etc. 0 This land is under what ditch? _____
14. How many acres of seeped land do you have which could be drained and put into production? 0
15. What is the condition of your irrigation system? Fair
16. Is your water supply adequate? Yes ☒ No _____ Explain _____
17. REMARKS: _____

depends on amount in state, amount in high
and down and second for amount in irrigation
only in crop years irrigation helps dry
areas.

OVER

19A and

10

as soon

NOTE: The foregoing questions apply only to irrigated land shown on this plat.

DESCRIPTION AND MAP OF FARM

18. Legal Description of this Farm S1SW1/4, N2SW1/4, Sec. 8 - Twp. 4 S., Rge. 15 E.

N2E1/4, N2SW1/4, Sec. 17 - Twp. 4 S., Rge. 15 E.

IRRIGATED LAND

NON-IRRIGATED LAND

NORTH

Farm boundary.

This map is according to our records. Please change it if it is not correct. That is if we show more irrigated land than you have, X it out; if we have not enough, draw it in.

19. If the above land is irrigated from more than one ditch please give the acreage under each ditch in 19A and indicate the location of the land irrigated from each on the above map.

19A. Ditch: Private ditch from Lake side to Sec 8 Acres: 30

Ditch: Private ditch from Village Creek Acres: 32

Information supplied by:

Name Thomas Mulvihill Address _____ Date Apr-26-15

REMARKS: + Sec 17 is not irrigated by

G.J. Co. with a private ditch

Mulvihill did not have water right

If you cannot answer all of the questions on this form answer as many as you can and return the form to us as soon as possible.

other than that they were not irrigated in
about 1898

THURBER'S HELIX

STATE OF MONTANA WATER RESOURCES SURVEY

County Stillwater Date _____

Name of Water User _____ Address _____

1. Do you own this land? Yes ___ No ___ If not give the owner's name below:

Owner's name Dudley White Address Limestone

2. Source of Water _____ Water delivered by _____

3. Give point of Diversion
- 1/4
- 1/4
- Section _____ Township _____ Range _____

4. Water is obtained by: (Check one) Gravity _____ Pumping _____ Other _____

5. Who first used water on this land?
- 0
- Address _____

6. In what year was this land first irrigated? _____ Approximate Acres _____

7. What is the greatest number of acres you have irrigated? _____ Date _____

8. Present Use: Year _____ Acres Irrigated _____

9. If this land is not irrigated now give date of last use _____

10. State the total number of acres that could be irrigated _____ acres.

11. What is the condition of your irrigation system? _____

12. Land Description:
- 1/4 Sec 17, Twp. 20, Range 15E

Remarks: _____

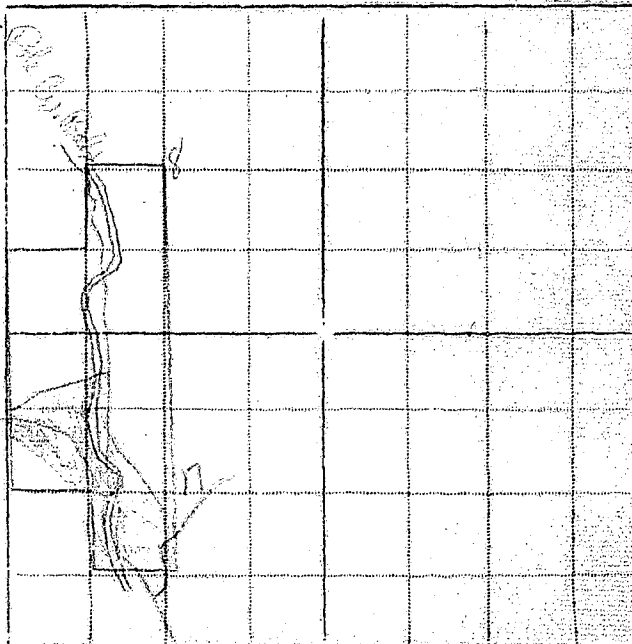
NNNW, SPARK NECHNE NW Sec 1745-15E63Land then given withRudley White from in45-16Eon this ground or up.

Information by _____ Place _____ Date _____

LB-155

Billings,
XXXXXXXXXX

March 27, 1945

Dudley White
Limestone, Montana

Dear Mr. White:

On March 7th, this office sent you a letter asking for certain information pertaining to your irrigated land in township 4 south, range 15 east, and township 4 south, range 16 east. To date we have not heard from you. With the vast post war water development in this area as now planned, it is essential that we have this information in order to show the extent of our water use in the Yellowstone Basin in Montana. This information is necessary to protect our present water users in the rights they have against future irrigation, navigation, power and flood control enterprises in this area. We are asking you for this information because we feel it is the democratic way; we also feel that you are more qualified to give us this information about your irrigated land than anyone else because it is part of your business. It may be that you were busy with your farm work or some unforeseen thing happened at the time our first letter was received, and you put it aside to be answered at some other time and have forgotten all about it. All information is strictly confidential and is only used to record and tabulate the water use in this area.

Water is as necessary to the farmer as the soil in which he plants. Without it no crops will grow; no living thing can survive. It is your water that we are trying to protect, so that you will have plenty now and in the future. We must keep Montana's water in Montana. The only way we can do this is by having the support of each and every water user so that we have a 100 percent representation of all water users. Remember: "United we stand, divided we fall".

In order to facilitate this work a branch office of the State Engineer has been established in Billings and is located in the Roosevelt School Building on 23rd Street and Fourth Avenue North. Anytime you are in Billings we would appreciate your calling on us.

Hoping to hear from you in the very near future, I am,

Very truly yours,

Gerald J. Oravetz
Assistant State Engineer

P.S. If you cannot supply us with the information requested, it may be that you can tell us of someone who can.

Billings,
XXXXXXX

April 10, 1945

Dudley White
Limestone, Montana

Dear Mr. White:

On March 7th we sent you a letter asking for certain information pertaining to your irrigated land in township 4 south range 15 east and in township 4 south range 16 east. On March 27th we sent you another letter asking you to submit the information to us as soon as possible. To date we have not heard from you regarding this matter.

It is hereby declared to be a policy of the State and necessary for the welfare of the State and its citizens, that the waters of this State, and especially interstate streams arising out of the State, be investigated. The State Engineer shall, either before or after the bringing of such action (to adjudicate the waters of any stream and its tributaries in any county traversed by said stream), upon the direction of the State Water Conservation Board, or upon the direction of the court, do all things, make all surveys, and perform all services required by said board in the securing of all necessary information and make the same available to said board or others who may be interested therein, including the courts of this State.

In order to protect the water rights of the water users in this state it is mandatory that the State Engineer have the information that we have asked you to submit to this office. If you have sold the piece of land about which we wrote you, will you please give us the name and address of the new owner.

We expect to hear from you in the very near future.

Very truly yours,

Gerald J. Oravets
Assistant State Engineer

STATE OF MONTANA WATER RESOURCES SURVEY

County Beaumont Date _____Name of Water User Thomas Marshall Address Columbia

1. Do you own this land? Yes _____ No _____ If not give the owner's name below:

Owner's name John S. Garcia Address Nye

2. Source of Water _____ Water delivered by _____

3. Give point of Diversion 1/2 1/2 Section _____ Township _____ Range _____

4. Water is obtained by: (Check one) Gravity _____ Pumping _____ Other _____

5. Who first used water on this land? 0 Address _____

6. In what year was this land first irrigated? _____ Approximate Acres _____

7. What is the greatest number of acres you have irrigated? _____ Date _____

8. Present Use: Year _____ Acres Irrigated _____

9. If this land is not irrigated now give date of last use _____

10. State the total number of acres that could be irrigated _____ acres.

11. What is the condition of your irrigation system? _____

12. Land Description: Wells in Sec 7 & Sec 8, 45-15E Twp. _____ Range _____

Remarks: _____

Final NPSR to be filed
Rd. sec. 627

(8)

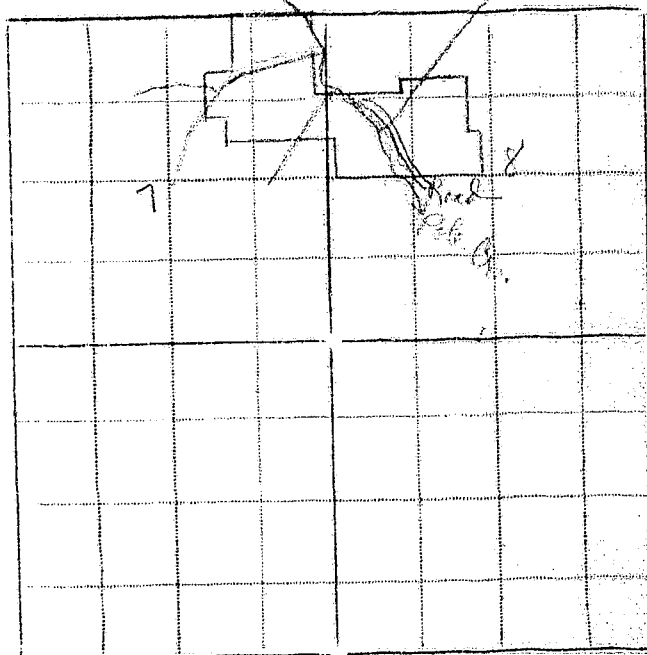

Information by _____ Place _____ Date _____



STATE OF MONTANA

STATE ENGINEER

Billings,
MONTANA

March 7, 1945

John S. Currie
Nye, Montana

Dear Mr. Currie:

In order that we in Montana will be able to present facts as to the amount of land we are now irrigating, protect our water rights, and keep Montana water in Montana, the 1939 Session of Montana State Legislature enacted a law (Sec. 349.68 Montana Session Laws) requiring the State Engineer to investigate and prepare a complete record of all water rights in the state. In compliance with this law all water users in the state are being requested to supply information regarding their use of water. We are therefore asking you to help us by answering the questions on the enclosed form which pertain to your land.

The adjoining states have already compiled records of their water use in this basin for the protection of their rights. It is therefore necessary that we do the same in Montana. We have completed our survey in Yellowstone and Carbon Counties and have had 100 percent cooperation from all of the water users in these counties, and I am sure we can expect the same support in Stillwater County. It might interest you to know that before we started our survey it was estimated that there were 162,000 acres of irrigated land in the two counties. We have found that there are 204,674.82 acres being irrigated and 49,422.61 acres of potential land under the existing works. This is a notable difference, and especially so in regard to the forthcoming division of water between states which the Congress of the United States has authorized.

We in Montana must be vigilant and do everything possible to protect the rights we have. These rights are being challenged by interests outside of the State of Montana, particularly the navigation interest of downstream states, and also the water users in the neighboring states through which our interstate streams flow. In order to protect these rights we must have a record of them and their present uses. The only way we can obtain this information is from the water user.

We are therefore depending on you to fill in the enclosed form and mail it to us in the enclosed self-addressed envelope at your earliest possible convenience. If any of the information we have compiled on the enclosed form is not correct we will greatly appreciate your making the necessary corrections.

In order to facilitate this work a branch office of the State Engineer has been established in Billings and is located in the Roosevelt School Building on 23rd Street and Fourth Avenue North. Any time you are in Billings we would appreciate your calling us. Our phone number is 3777.

This parcel of land is now owned by Thomas Mulvihill, Columbus, Mont.
Very truly yours,
Gerald J. Gravetz
Assistant State Engineer
GJO/rh
Please contact him. John S. Currie



STATE OF MONTANA
STATE ENGINEERS OFFICE
Water Resources Survey

325
Form WR-1-1M-11-44

Code No. S B, 1 A
County Stillwater
T. 4 S. R. 15 E.

Name of Land Owner John S. Currie Address Nye

Name of Operator _____ Address _____

Part A

TO BE FILED BY THOSE OBTAINING IRRIGATION WATER FROM
A DITCH COMPANY OR IRRIGATION DISTRICT

1. Water is delivered by: _____
Name of Ditch, Ditch Company or District supplying water
2. State the number of acres you irrigate under this system. _____ Shares you hold _____
3. If you obtain water from more than one Company, give the number of shares, acres irrigated and the name of the Company under "Remarks". If you obtain water from a Ditch Company and also have a private system fill in both Part A and Part B.

Part B

TO BE FILED BY THOSE WHO HAVE A PRIVATE DITCH, PUMP OR IRRIGATION SYSTEM
or those who have a private water right under a Ditch Company

4. In what year was this land first irrigated? Date _____
5. Give the name of the original appropriator (first user): _____
6. Give the date appropriated _____ Amount filed on: Miners Inches _____ C. F. S. _____
7. State the total number of acres irrigated under this system: _____
8. Give the point of diversion: _____ $\frac{1}{4}$ _____ $\frac{1}{4}$ Section _____ Township _____ Range _____

Part C

TO BE FILED BY ALL WATER USERS IN ADDITION TO PART A OR PART B



9. Source of Water: _____
Name of stream or lake from which water is originally diverted
10. Water is obtained by: (Check one) Gravity _____ Pumping _____ Other _____
11. What is the greatest number of acres you have irrigated? _____ Date _____
12. How many acres did you irrigate in 1944? (Crop and pasture) _____
13. State the total number of additional acres that could be irrigated by increasing the water supply, land leveling, etc. _____ This land is under what ditch? _____
14. How many acres of seeped land do you have which could be drained and put into production? _____
15. What is the condition of your irrigation system? _____
16. Is your water supply adequate? Yes _____ No _____ Explain _____
17. REMARKS: _____

OVER

NOTE: The foregoing questions apply only to irrigated land shown on this plat.

DESCRIPTION AND MAP OF FARM

18. Legal Description of this Farm Meets and bounds in Sections 7 and 8 - Twp. 4 S., Rge. 15 E.

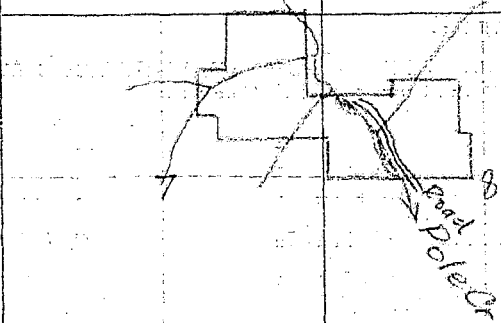
|  IRRIGATED LAND |  NON-IRRIGATED LAND |
|--|--|
| <p>— Farm boundary.</p> <p>This map is according to our records. Please change it if it is not correct. That is if we show more irrigated land than you have, X it out; if we have not enough, draw it in.</p> | |
| <p>NORTH</p>   | |

19. If the above land is irrigated from more than one ditch please give the acreage under each ditch in 19A and indicate the location of the land irrigated from each on the above map.

19A. Ditch: _____ Acres: _____

Ditch: _____ Acres: _____

Information supplied by:

Name: _____ Address: _____ Date: _____

REMARKS: _____

If you cannot answer all of the questions on this form answer as many as you can and return the form to us as soon as possible.

THURDEN'S, HELENA

Billings,
XXXXXXX

April 10, 1945

Thomas Mulvihill
Columbus, Montana

Dear Mr. Mulvihill:

On March 22nd this office sent you a letter asking for certain information pertaining to your irrigated land in township 4 south range 15 east. To date we have not heard from you. With the vast post war water development in this area as now planned, it is essential that we have this information in order to show the extent of our water use in the Yellowstone Basin in Montana. This information is necessary to protect our present water users in the rights they have against future irrigation, navigation, power and flood control enterprises in this area. We are asking you for this information because we feel it is the democratic way; we also feel that you are more qualified to give us this information about your irrigated land than anyone else because it is part of your business. It may be that you were busy with your farm work or some unforeseen thing happened at the time our first letter was received, and you put it aside to be answered at some other time and have forgotten all about it. All information is strictly confidential and is only used to record and tabulate the water use in this area.

Water is as necessary to the farmer as the soil in which he plants. Without it no crops will grow; no living thing can survive. It is your water that we are trying to protect, so that you will have plenty now and in the future. We must keep Montana's water in Montana. The only way we can do this is by having the support of each and every water user so that we have a 100 percent representation of all water users. Remember: "United we stand, divided we fall".

In order to facilitate this work a branch office of the State Engineer has been established in Billings and is located in the Roosevelt School Building on 23rd Street and Fourth Avenue North. Anytime you are in Billings we would appreciate your calling on us.

Hoping to hear from you in the very near future, I am,

Very truly yours,

Gerald J. Oravetz
Assistant State Engineer

P.S. If you cannot supply us with the information requested, it may be that you can tell us of someone who can.

Columbus, Montana

April 11; 1945

Mr. Gerald Oravetz
Asst. State Engineer
Helena, Montana

Dear Mr. Oravetz

As yet I am not well enough acquainted with this section to give you the information you want.

If you will write to Mr. Dudley White at Columbus, I am sure he will be able to.

Very truly yours,

Thos. P. Mulvihill
Thos. P. Mulvihill

April 13, 1945

Dudley White
Columbus, Montana

Dear Mr. White:

Mr. Thos. P. Mulvihill has requested us that we sent the enclosed form to you, as he said you were acquainted with the land described thereon. This land is located on Lodge Pole Creek, a tributary to Limestone Creek, between the Southworth and Dudley White original homesteads. We are interested to know the acreage irrigated and who first irrigated this land. As we have no record of recorded water right filings, we more or less have to depend on old timers like yourself to give us this information in order to just claim for the waters in this area. Any information that you can give us will be greatly appreciated. On our records we have three recorded water rights on Lodge Pole Creek. One taken out by George P. Oliver on what was known as the Myers Ranch, on Nov. 20th, 1901 for 150 inches. Another taken out by Herbert Russell on January 4, 1936 for 280 inches and another by Fred & Frank Southworth in 1898 for 200 inches. This information may help you recall some of the old timers in the area.

Very respectfully yours,

Gerald J. Oravetz
Assistant State Engineer

FORM SM-1a

STATE OF MONTANA WATER RESOURCES SURVEY

County Stillwater Date 1966

Name of Water User _____ Address _____

1. Do you own this land? Yes _____ No _____ If not give the owner's name below:

Owner's name W. E. Filer Address Lincoln

2. Source of Water _____ Water delivered by _____

3. Give point of Diversion 1 1 Section _____ Township _____ Range _____

4. Water is obtained by: (Check one) Gravity _____ Pumping _____ Other _____

5. Who first used water on this land? 0 Address _____

6. In what year was this land first irrigated? _____ Approximate Acres _____

7. What is the greatest number of acres you have irrigated? _____ Date _____

8. Present Use: Year _____ Acres Irrigated _____

9. If this land is not irrigated now give date of last use _____

10. State the total number of acres that could be irrigated _____ acres.

11. What is the condition of your irrigation system? _____

12. Land Description: _____, Twp. _____ Range _____

Remarks: Some

SW 1/4, Sec. 16
NE 1/4, NW 1/4, Sec. 17

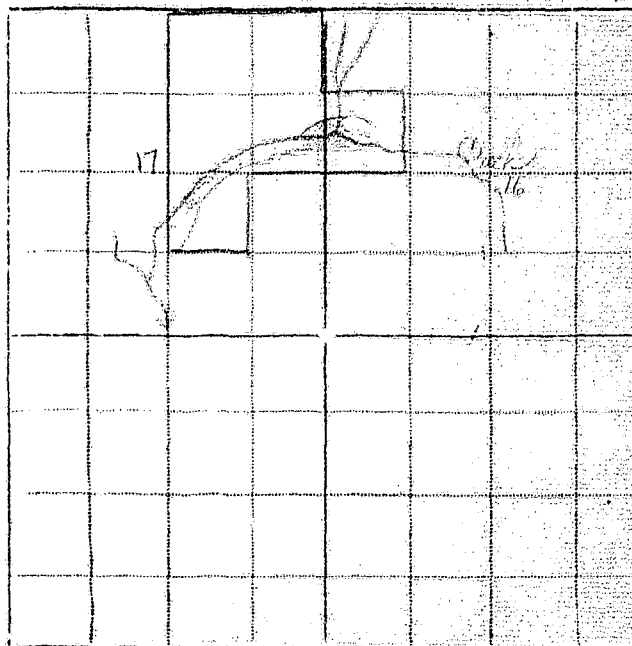

Information by _____ Place _____ Date _____

63-157 + 68-158

STATE ENGINEERS OFFICE
Water Resources Survey

Case No. 497

Notice of Appropriation

1. County Stillwater Book 4 Page 599 Record Misc.
2. Name of Appropriator Frank J. Bem Address Nye, Montana
3. Date Appropriated May 15, 1896 Date Filed Mar. 26, 1902
Amount Appropriated, Miners Inches 160, Cubic Feet per second
4. Name of Stream Spring Creek Tributary of Lodge Pole Cr. Basin
5. Point of Diversion at a point on its right bank near the east portion and eastern side
said ranch claim thence running to and upon said land.
Sec. Twp. Rge. Bank of Stream right.
6. Purpose Domestic, agricultural, irrigation and other purposes.
7. Description of System By means of a headgate and ditch which said ditch is 24 inches by
16 inches in size.
8. Land Description of Intended Place of Use
Sub
Land known as Bem Ranch claim $\frac{1}{4}$ mile above confluence of said creek. 1 mile long
easterly and westerly $\frac{1}{4}$ mile wide.
9. Remarks (Pertaining to Use, etc.)
now in ditch

Decree

10. Case No. Date Amt. Decreed: M. I. C. F. S.
11. To Whom Decreed Address
12. Name of Ditch Maximum Capacity (C. F. S.)
13. Date of Priority Purpose
14. Land Description of Place of Use as Decreed
15. Remarks (Present Use Status, etc.)

STATE ENGINEERS OFFICE
Water Resources Survey

Code No. 666

Notice of Appropriation

1. County Stillwater Book 25 Page 391 Record Misc.
G. Southworth
2. Name of Appropriator Fred R. Southworth & Frank Address Dean, Montana
3. Date Appropriated 1898 or 1899 Date Filed Mar. 7, 1944
- Amount Appropriated, Miners Inches 200, Cubic Feet per second
4. Name of Stream Lodge Pole Creek Tributary Basin
5. Point of Diversion at a point on its north bank.
- Sec. Twp. Rge. Bank of Stream
6. Purpose Stock, domestic, irrigation.
7. Description of System A flume and dam 12" x 72" which carries 200" of water from said stream to and upon said land or mining claim.
8. Land Description of Intended Place of Use.
- | Subdivision | Sec. | Twp. | Rge. | Tot. Acr. | 1940 Owner | Address |
|--|------|------|------|-----------|---|---------|
| N $\frac{1}{2}$ SW $\frac{1}{4}$ NWSW $\frac{1}{4}$, S $\frac{1}{2}$ SWNWSW $\frac{1}{4}$ | 5 | | | | NWNWSESE $\frac{1}{4}$, NENESWSE $\frac{1}{4}$ | |
| NWSWSW, W $\frac{1}{2}$ SWWSW $\frac{1}{4}$ | 5 | | | | S $\frac{1}{2}$ SENESE $\frac{1}{4}$, SESEWSE $\frac{1}{4}$ | |
| SESESESE $\frac{1}{4}$, N $\frac{1}{2}$ SESESE $\frac{1}{4}$ | | | | | W $\frac{1}{2}$ W $\frac{1}{2}$ NESE $\frac{1}{4}$, SWSWSENE $\frac{1}{4}$ | |
| NESESE, E $\frac{1}{2}$ NWSESE $\frac{1}{4}$ | | | | | SESWNE, E $\frac{1}{2}$ NWSE. | |
9. Remarks (Pertaining to Use, etc.)
- E $\frac{1}{2}$ W $\frac{1}{2}$ NWSE $\frac{1}{4}$, NWSWNWSE $\frac{1}{4}$
- W $\frac{1}{2}$ NWNWSE $\frac{1}{4}$, E $\frac{1}{2}$ NENESW $\frac{1}{4}$ of Sec. 6
- E $\frac{1}{2}$ E $\frac{1}{2}$ NENE - Sec. 7 - W $\frac{1}{2}$ NWNW - W $\frac{1}{2}$ SENNW, SWNENWNW $\frac{1}{4}$, Sec. 8 - T. 4 S., R. 15 E. containing 160 acres.

Decree

10. Case No. Date Amt. Decreed: M. I. C. F. S.
11. To Whom Decreed Address
12. Name of Ditch Maximum Capacity (C. F. S.)
13. Date of Priority Purpose
14. Land Description of Place of Use as Decreed
15. Remarks (Present Use Status, etc.) That Ralph Southworth (deceased) did by continuous use in 1898 or 1899 appropriate 200 miner's inches. All of the waters of Lodge Pole Creek and it's tributaries in said county and state.



STATE OF MONTANA
STATE ENGINEERS OFFICE
Water Resources Survey

Form 329
WR-1-IM-11-44

Code No. 20 A, 29 B
County Stillwater
T. 4 S. R. 15 E.

Name of Land Owner Herbert Russell Address Limestone, Montana
Name of Operator Address

Part A

TO BE FILED BY THOSE OBTAINING IRRIGATION WATER FROM
A DITCH COMPANY OR IRRIGATION DISTRICT

1. Water is delivered by: Private
Name of Ditch, Ditch Company or District supplying water
2. State the number of acres you irrigate under this system Shares you hold
3. If you obtain water from more than one Company, give the number of shares, acres irrigated and the name of the Company under "Remarks". If you obtain water from a Ditch Company and also have a private system fill in both Part A and Part B.

Part B 231-385

TO BE FILED BY THOSE WHO HAVE A PRIVATE DITCH, PUMP OR IRRIGATION SYSTEM
or those who have a private water right under a Ditch Company

4. In what year was this land first irrigated? Date 1936
5. Give the name of the original appropriator (first user): Milton Low
6. Give the date appropriated 1936 Amount filed on: Miners Inches 280 C. F. S.
7. State the total number of acres irrigated under this system: 50
8. Give the point of diversion: 1/4 Section Township Range

Part C

TO BE FILED BY ALL WATER USERS IN ADDITION TO PART A OR PART B

9. Source of Water: Snake River
Name of stream or lake from which water is originally diverted
10. Water is obtained by: (Check one) Gravity ☒ Pumping Other
11. What is the greatest number of acres you have irrigated? 150 Date
12. How many acres did you irrigate in 1944? (Crop and pasture) 110
13. State the total number of additional acres that could be irrigated by increasing the water supply, land leveling, etc. none 40 This land is under what ditch?
14. How many acres of seeped land do you have which could be drained and put into production? none
15. What is the condition of your irrigation system? Good
16. Is your water supply adequate? Yes ☒ No Explain
17. REMARKS:

OVER

NOTE: The foregoing questions apply only to irrigated land shown on this plat.

DESCRIPTION AND MAP OF FARM

18. Legal Description of this Farm. SWNW¹/₄, W¹/₂SW¹/₄, SE¹/₂SW¹/₄, SWS¹/₂E¹/₄, Sec. 20

NNW¹/₄, N¹/₂NW¹/₄, Sec. 29 - Twp. 4 S., Rge. 15 E.



IRRIGATED LAND

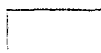

NON-IRRIGATED LAND

— Farm boundary.

This map is according to our records. Please change it if it is not correct. That is if we have not enough, draw it in; if we show more irrigated land than you have X it out.

NORTH

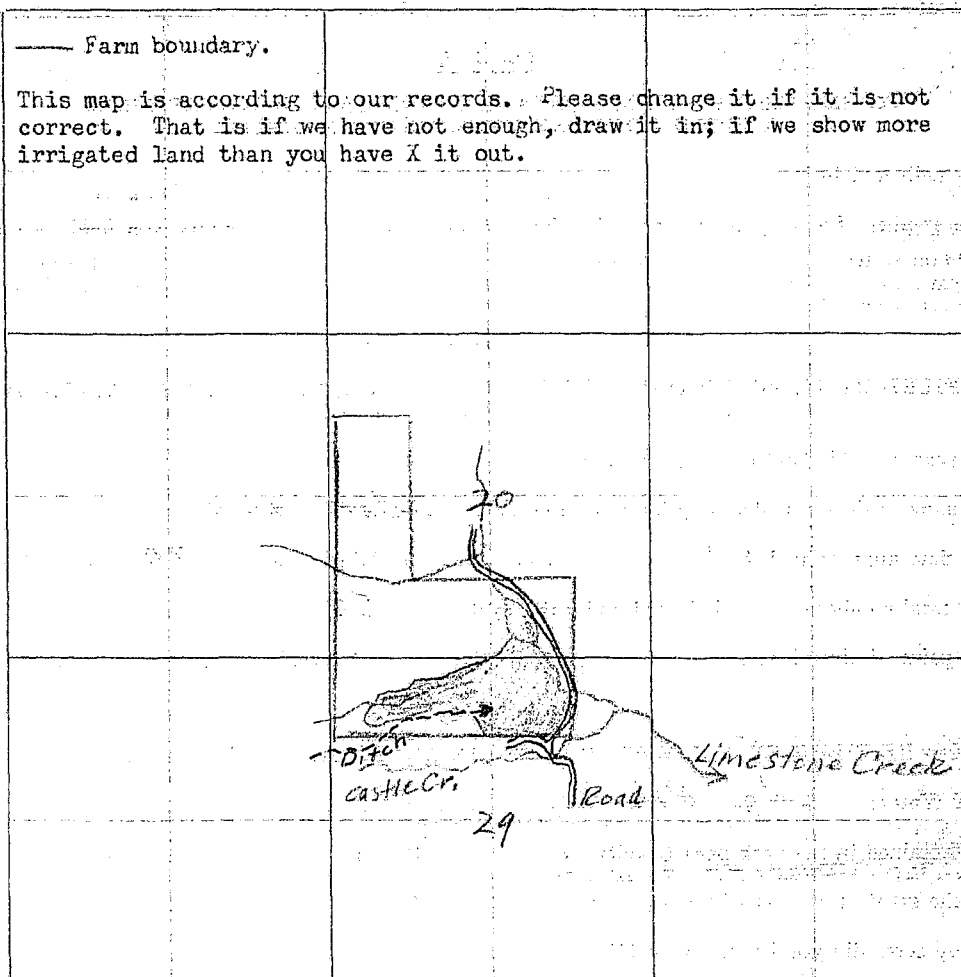

19. If the above land is irrigated from more than one ditch please give the acreage under each ditch in 19A and indicate the location of the land irrigated from each on the above map.

19A. Ditch: Castle Creek Ditch Acres: 110

Ditch: ~~Castle Creek~~ Acres: ~~40~~

Information supplied by:

Name Herbert Russell Address Limestone, Mont. Date 3/29/44

REMARKS: _____

If you cannot answer all of the questions on this form answer as many as you can and return the form to us as soon as possible.

THURBER'S, HELENA

Our records show that you have an appropriation in Stillwater County, Book 22, Page 68 Record Misc., made by Willard Holt, appropriated Sept. 1, 1934 and filed July 21, 1937 from Stillwater River - W. Fork for 360 miners inches. Is this appropriation now in use? no

also
Our records show that you have an appropriation in Stillwater County, Book 21, Page 390, Record Misc., made by Herbert Russell, appropriated Jan. 4, 1936 and filed Jan. 4, 1936 from Lodge Pole Creek for 280 miner's inches. Is this appropriation now in use? yes Lodge Pole

FORM SM-1a

STATE OF MONTANA WATER RESOURCES SURVEY

County Stillwater Date _____

Name of Water User _____ Address _____

1. Do you own this land? Yes _____ No _____ If not give the owner's name below:

Owner's name Herbert Russell Address Lincoln

2. Source of Water _____ Water delivered by _____

3. Give point of Diversion $\frac{1}{4}$ $\frac{1}{4}$ Section _____ Township _____ Range _____

4. Water is obtained by: (Check one) Gravity _____ Pumping _____ Other _____

5. Who first used water on this land? 385-231 Address _____

6. In what year was this land first irrigated? _____ Approximate Acres _____

7. What is the greatest number of acres you have irrigated? _____ Date _____

8. Present Use: Year _____ Acres Irrigated _____

9. If this land is not irrigated now give date of last use _____

10. State the total number of acres that could be irrigated _____ acres.

11. What is the condition of your irrigation system? _____

12. Land Description: _____, T.p. _____ Range _____

Remarks: same

SARNA, HPSM, SE 1/4

SW 1/4, Sec 20

NE 1/4, NW 1/4, Sec 24

43 B 15 E

72

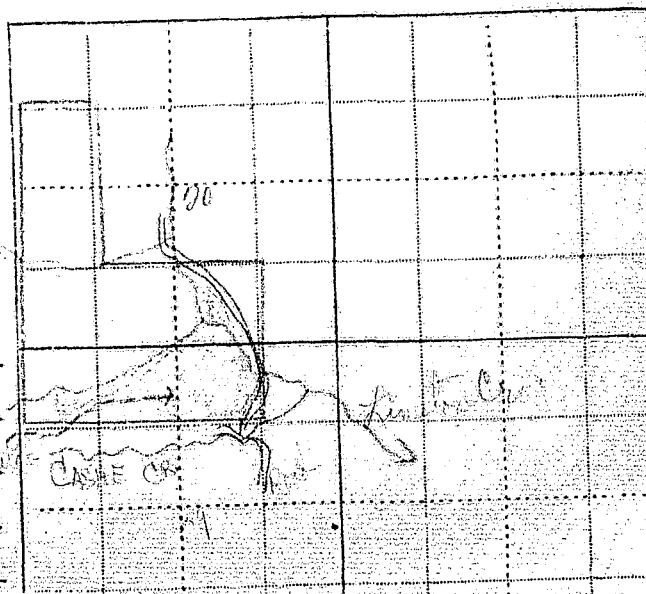

Our records show that you have an appropriation in Stillwater County, Book 22, Page 68 Record Misc., made by Willard Holt, appropriated Sept. 1, 1934 and filed July 21, 1937 from Stillwater River - W. Fork for 360 miners inches. Is this appropriation now in use?

also
Our records show that you have an appropriation in Stillwater County, Book 21, Page 390, Record Misc., made by Herbert Russell, appropriated Jan. 4, 1936 and filed Jan. 4, 1936 from Lodge Pole Creek for 280 miner's inches. Is this appropriation now in use?

March 27, 1945

Herbert Russell
Limestone, Montana

Dear Mr. Russell:

On March 7th, this office sent you a letter asking for certain information pertaining to your irrigated land in township 4 south, range 16 east. To date we have not heard from you. With the vast post war water development in this area as now planned, it is essential that we have this information in order to show the extent of our water use in the Yellowstone Basin in Montana. This information is necessary to protect our present water users in the rights they have against future irrigation, navigation, power and flood control enterprises in this area. We are asking you for this information because we feel it is the democratic way; we also feel that you are more qualified to give us this information about your irrigated land than anyone else because it is part of your business. It may be that you were busy with your farm work or some unforeseen thing happened at the time our first letter was received, and you put it aside to be answered at some other time and have forgotten all about it. All information is strictly confidential and is only used to record and tabulate the water use in this area.

Water is as necessary to the farmer as the soil in which he plants. Without it no crops will grow; no living thing can survive. It is your water that we are trying to protect, so that you will have plenty now and in the future. We must keep Montana's water in Montana. The only way we can do this is by having the support of each and every water user so that we have a 100 percent representation of all water users. Remember: "United we stand, divided we fall".

In order to facilitate this work a branch office of the State Engineer has been established in Billings and is located in the Roosevelt School Building on 23rd Street and Fourth Avenue North. Anytime you are in Billings we would appreciate your calling on us.

Hoping to hear from you in the very near future, I am,

Very truly yours,

Gerald J. Oravetz
Assistant State Engineer

P.S. If you cannot supply us with the information requested, it may be that you can tell us of someone who can.

STATE ENGINEERS OFFICE
Water Resources Survey

Code No. 385

Notice of Appropriation

1. County Stillwater Book 22 Page 68 Record Misc.
2. Name of Appropriator Holt, Willard Address Limestone, Montana
3. Date Appropriated Sept. 1, 1934 Date Filed July 24, 1937
Amount Appropriated, Miners Inches 360, Cubic Feet per second
4. Name of Stream Stillwater River (W. Fork) Tributary Basin
5. Point of Diversion at a point on its northwest bank at center NE $\frac{1}{4}$ of SW $\frac{1}{4}$ of
Sec. 32 Twp. 4 S. Rge. 15 E. Bank of Stream Northwest
thence runs over and upon said land.
6. Purpose Irrigation and other purposes.
7. Description of System By means of a ditch, 36 inches by 48 inches in size and conducts
360 inches of water.
8. Land Description of Intended Place of Use

| | | | | |
|------------------|------|------|-------|-----------|
| Subdivision | Sec. | Twp. | Rge. | Tot. Acr. |
| On Secs. 32 & 29 | | 4 S. | 15 E. | |
9. Remarks (Pertaining to Use, etc.)
not in use now

Decree

10. Case No. Date Amt. Decreed: M. I. C. F. S.
11. To Whom Decreed Address
12. Name of Ditch Maximum Capacity (C. F. S.)
13. Date of Priority Purpose
14. Land Description of Place of Use as Decreed
15. Remarks (Present Use Status, etc.)

STATE ENGINEERS OFFICE
Water Resources SurveyCode No. 231

Notice of Appropriation

1. County Stillwater Book 21 Page 390 Record Misc.
2. Name of Appropriator Herbert Russell Address Limestone, Montana
3. Date Appropriated Jan. 4, 1936 Date Filed Jan. 4, 1936
Amount Appropriated, Miners Inches 280, Cubic Feet per second.....
4. Name of Stream Lodge Pole Creek Tributary..... Basin.....
5. Point of Diversion at a point on its east bank and runs thence in a SE direction 300
feet then back into the creek.
Sec..... Twp..... Rge..... Bank of Stream east.
6. Purpose Irrigation, farm power and other purposes.
7. Description of System By means of a flume 36 inches by 10 inches in size.
8. Land Description of Intended Place of Use.....

| Subdivision | Sec. | Twp. | Rge. | Tot. Acr. | 1940 Owner | Address |
|--|-----------|-------------|--------------|-----------|-------------------------|------------------|
| <u>X SW$\frac{1}{4}$ SE$\frac{1}{4}$</u> | <u>20</u> | <u>4 S.</u> | <u>15 E.</u> | <u>40</u> | <u>Herbert Russell,</u> | <u>Limestone</u> |
9. ~~Remarks (Pertaining to Use, etc.)~~ Transfers of Land Ownership.
Herbert Russell - SW $\frac{1}{4}$ SE $\frac{1}{4}$ - Sec. 20 - Twp. 4 S., Rge. 15 E.
now lost to state.

Decree

10. Case No..... Date..... Amt. Decreed: M. I. C. F. S.
11. To Whom Decreed..... Address.....
12. Name of Ditch..... Maximum Capacity (C. F. S.).....
13. Date of Priority..... Purpose.....
14. Land Description of Place of Use as Decreed.....
15. Remarks (Present Use Status, etc.).....



STATE OF MONTANA
STATE ENGINEERS OFFICE
Water Resources Survey

324
Form WR-1-1M-11-44

Code No. 5 A, 6A, 7B, 8C
County Stillwater
T. 4 S. R. 15 E.

Name of Land Owner Ralph Southworth est. Address Dean, Montana
Name of Operator _____ Address _____

Part A

TO BE FILED BY THOSE OBTAINING IRRIGATION WATER FROM
A DITCH COMPANY OR IRRIGATION DISTRICT

1. Water is delivered by: Private ditch from Lodge Pole Creek
Name of Ditch, Ditch Company or District supplying water _____
2. State the number of acres you irrigate under this system 50 Shares you hold _____
3. If you obtain water from more than one Company, give the number of shares, acres irrigated and the name of the Company under "Remarks". If you obtain water from a Ditch Company and also have a private system fill in both Part A and Part B.

Part B

TO BE FILED BY THOSE WHO HAVE A PRIVATE DITCH, PUMP OR IRRIGATION SYSTEM
or those who have a private water right under a Ditch Company

4. In what year was this land first irrigated? Date _____
5. Give the name of the original appropriator (first user): Ed + Ann + Southworth
6. Give the date appropriated in 1898 Amount filed on: Miners Inches 200 C. F. S. _____
7. State the total number of acres irrigated under this system: 50
8. Give the point of diversion: _____ $\frac{1}{4}$ _____ $\frac{1}{4}$ Section _____ Township _____ Range _____

Part C

TO BE FILED BY ALL WATER USERS IN ADDITION TO PART A OR PART B

9. Source of Water: Lodge Pole Creek
Name of stream or lake from which water is originally diverted _____
10. Water is obtained by: (Check one) Gravity _____ Pumping _____ Other _____
11. What is the greatest number of acres you have irrigated? 50 Date _____
12. How many acres did you irrigate in 1944? (Crop and pasture) 35
13. State the total number of additional acres that could be irrigated by increasing the water supply, land leveling, etc. 15 This land is under what ditch? _____
14. How many acres of seeped land do you have which could be drained and put into production? _____
15. What is the condition of your irrigation system? Fair
16. Is your water supply adequate? Yes ✓ No _____ Explain _____
17. REMARKS: There is all hay land, some grain and
irrigated, in other parts of the area
depending on rainfall

OVER

-11-44
B.8C

NOTE: The foregoing questions apply only to irrigated land shown on this plat.

DESCRIPTION AND MAP OF FARM

18. Legal Description of this Farm Meets and bounds in sections 5, 6, 7, and 8 - Twp. 4 S., Rge. 15 E.



IRRIGATED LAND

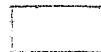

NON-IRRIGATED LAND

Farm Boundary.

This map is according to our records. Please change it if it is not correct. That is if we show more irrigated land than you have, & it out; if we have not enough, draw it in.

NORTH

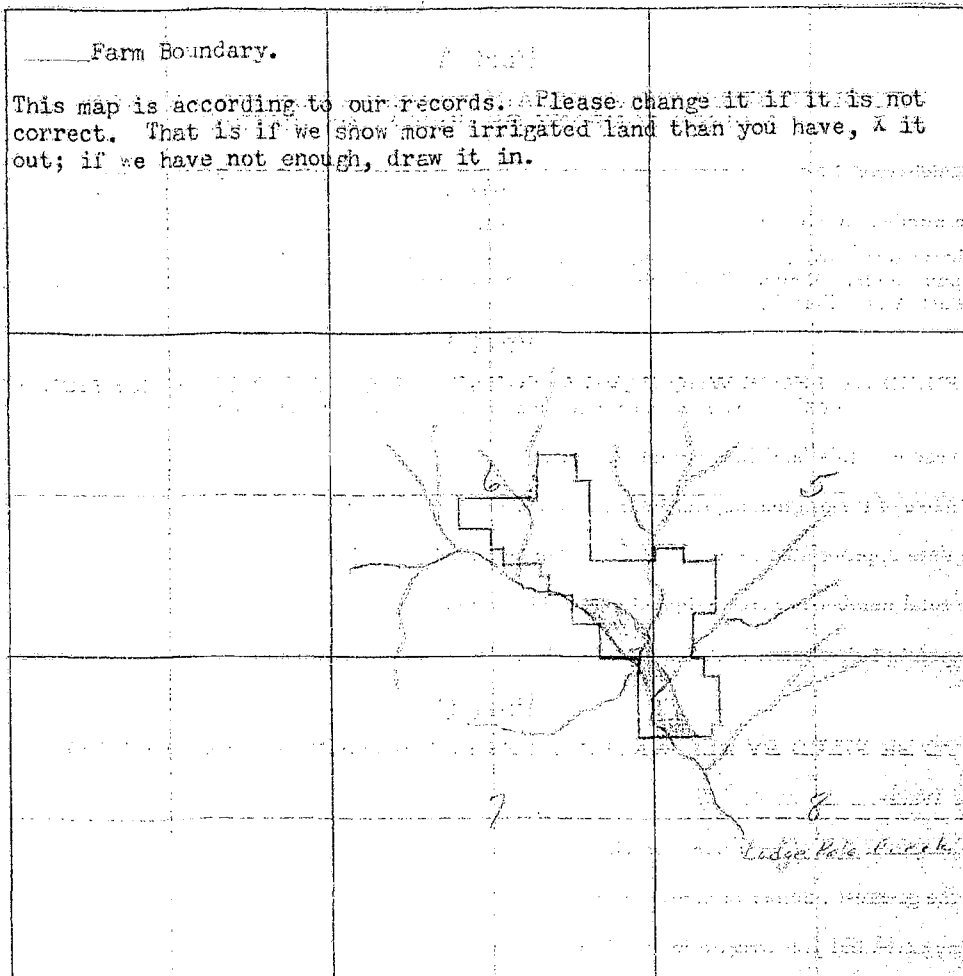

19. If the above land is irrigated from more than one ditch please give the acreage under each ditch in 19A and indicate the location of the land irrigated from each on the above map.

19A. Ditch: Private Ditch Acres: 35

Ditch: _____ Acres: _____

Information supplied by:

Name: E. J. Brant Address: _____ Date: 9-26-45

REMARKS: Information by field check to Mr. Geo. E.

McKinney and a water right appropriation
from nearby water

If you cannot answer all of the questions on this form answer as many as you can and return the form to us as soon as possible.

THURBER'S, HELENA

FORM SM-1a

STATE OF MONTANA WATER RESOURCES SURVEY

4515
4516

Sec. 15 E.

County Stillwater

Date _____

Name of Water User _____

Address _____

1. Do you own this land? Yes _____ No _____ If not give the owner's name below:

Owner's name Ralph Southworth et al

Address Dean

2. Source of Water _____

Water delivered by _____

3. Give point of Diversion _____

Section _____

Township _____

Range _____

4. Water is obtained by: (Check one) Gravity _____

Pumping _____

Other _____

5. Who first used water on this land? 667

Address _____

6. In what year was this land first irrigated? _____

Approximate Acres _____

7. What is the greatest number of acres you have irrigated? _____

Date _____

8. Present Use: Year _____

Acres Irrigated _____

9. If this land is not irrigated now give date of last use _____

10. State the total number of acres that could be irrigated _____

acres.

11. What is the condition of your irrigation system? _____

12. Land Description: _____

Twp. _____

Range _____

Remarks: _____

South of River

in T & R - 4515

(50)

Land then from

separate land

in 4516 is for

land & fence

Southworth

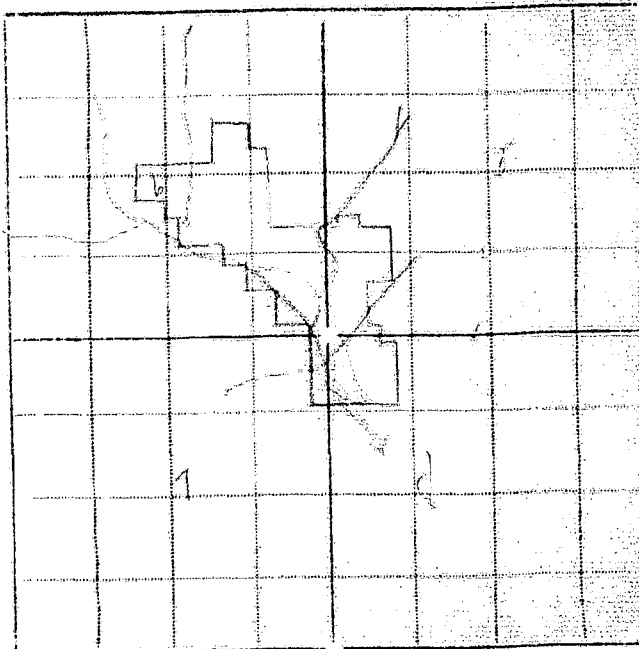

19A and

35

26-45

E.

as soon

Information by _____

Place _____

Date _____

63-155

Billings,
XXXXXXX

March 27, 1945

Ralph Southworth est.
Dean, Montana

Dear Sir:

On March 7th, this office sent you a letter asking for certain information pertaining to your irrigated land in township 4 south, range 15 east. To date we have not heard from you. With the vast post war water development in this area as now planned, it is essential that we have this information in order to show the extent of our water use in the Yellowstone Basin in Montana. This information is necessary to protect our present water users in the rights they have against future irrigation, navigation, power and flood control enterprises in this area. We are asking you for this information because we feel it is the democratic way; we also feel that you are more qualified to give us this information about your irrigated land than anyone else because it is part of your business. It may be that you were busy with your farm work or some unforeseen thing happened at the time our first letter was received, and you put it aside to be answered at some other time and have forgotten all about it. All information is strictly confidential and is only used to record and tabulate the water use in this area.

Water is as necessary to the farmer as the soil in which he plants. Without it no crops will grow; no living thing can survive. It is your water that we are trying to protect, so that you will have plenty now and in the future. We must keep Montana's water in Montana. The only way we can do this is by having the support of each and every water user so that we have a 100 percent representation of all water users. Remember: "United we stand, divided we fall".

In order to facilitate this work a branch office of the State Engineer has been established in Billings and is located in the Roosevelt School Building on 23rd Street and Fourth Avenue North. Anytime you are in Billings we would appreciate your calling on us.

Hoping to hear from you in the very near future, I am,

Very truly yours,

Gerald J. Oravetz
Assistant State Engineer

P.S. If you cannot supply us with the information requested, it may be that you can tell us of someone who can.

Our records show that you have an appropriation in Stillwater County, Book 25 Page 391, Record Misc., made by Fred R. Southworth and Frank G. Southworth appropriated 1698 or 1899 and filed Mar. 7, 1944 from Lodge Pole Creek for 200 miners inches. Is this appropriation now in use?

Billings,
XXXXXXXX

April 10, 1945

Ralph Southworth est.
Dean, Montana

Dear Mr. Southworth:

On March 7th we sent you a letter asking for certain information pertaining to your irrigated land in township 4 south range 15 east. On March 27th we sent you another letter asking you to submit the information to us as soon as possible. To date we have not heard from you regarding this matter.

It is hereby declared to be a policy of the State and necessary for the welfare of the State and its citizens, that the waters of this State, and especially interstate streams arising out of the State, be investigated. The State Engineer shall, either before or after the bringing of such action (to adjudicate the waters of any stream and its tributaries in any county traversed by said stream), upon the direction of the State Water Conservation Board, or upon the direction of the court, do all things, make all surveys, and perform all services required by said board in the securing of all necessary information and make the same available to said board or others who may be interested therein, including the courts of this State.

In order to protect the water rights of the water users in this state it is mandatory that the State Engineer have the information that we have asked you to submit to this office. If you have sold the piece of land about which we wrote you, will you please give us the name and address of the new owner.

We expect to hear from you in the very near future.

Very truly yours,

Gerald J. Oravetz
Assistant State Engineer

STATE ENGINEERS OFFICE
Water Resources Survey

Code No. 666

Notice of Appropriation

1. County Stillwater Book 25 Page 391 Record Misc.
G. Southworth.
2. Name of Appropriator Fred R. Southworth & / Address Dean, Montana
3. Date Appropriated 1898 or 1899 Date Filed Mar. 7, 1944
- Amount Appropriated, Miners Inches 200, Cubic Feet per second
4. Name of Stream Lodge Pole Creek Tributary Basin
5. Point of Diversion at a point on its north bank.

Sec. Twp. Rge. Bank of Stream

6. Purpose Stock, domestic and irrigation.
7. Description of System A flume and dam 12" x 72" which carries 200" of water from said stream to and upon said land or mining claim.

8. Land Description of Intended Place of Use

| Subdivision | Sec. | Twp. | Rge. | Tot. Acr. | 1940 Owner | Address |
|--|------|------|------|---|------------|---------|
| NWSW $\frac{1}{4}$ NWSW $\frac{1}{4}$, S $\frac{1}{2}$ SWNWSW $\frac{1}{4}$ | 5 | | | NWNWSESE $\frac{1}{4}$, NENESWSE $\frac{1}{4}$ | | |
| NWSWSW, W $\frac{1}{2}$ SWSWSW $\frac{1}{4}$ | 5 | | | S $\frac{1}{2}$ SENESE $\frac{1}{4}$, SESWNESE $\frac{1}{4}$ | | |
| SESESESE $\frac{1}{4}$, N $\frac{1}{2}$ SESESE $\frac{1}{4}$ | | | | W $\frac{1}{2}$ W $\frac{1}{2}$ NESE $\frac{1}{4}$, SWSWSENE $\frac{1}{4}$ | | |
| NESESE, E $\frac{1}{2}$ NWSESE $\frac{1}{4}$ | | | | SESWNE, E $\frac{1}{2}$ NWSE | | |

9. Remarks (Pertaining to Use, etc.)

E $\frac{1}{2}$ NWSE $\frac{1}{4}$, NWSWNWSE $\frac{1}{4}$
W $\frac{1}{2}$ NWSE $\frac{1}{4}$, E $\frac{1}{2}$ NENESW $\frac{1}{4}$ of Sec. 6
E $\frac{1}{2}$ ENE - Sec. 7, W $\frac{1}{2}$ NANW, W $\frac{1}{2}$ SENNW, SWNENWNW $\frac{1}{4}$, Sec. 8, T. 4 S., R. 15 E. containing 160 acres.

10. Case No. None Date Decree Amt. Decreed: M. I. C. F. S.
11. To Whom Decreed Address
12. Name of Ditch Maximum Capacity (C. F. S.)
13. Date of Priority Purpose
14. Land Description of Place of Use as Decreed

15. Remarks (Present Use Status, etc.) That Ralph Southworth (deceased) did by continuous use in 1898 or 1899 appropriate 200 miner's inches. All of the waters of Lodge Pole Creek and it's tributaries in said county and state.



STATE OF MONTANA
STATE ENGINEERS OFFICE
Water Resources Survey

331
Form WR-1-1M-11-41

Code No. 27 A, 28 A
County Stillwater
T. 4 S. R. 15 E.

Name of Land Owner Wm. R. Stafford Address Nye, Montana
Name of Operator _____ Address _____

Part A

TO BE FILED BY THOSE OBTAINING IRRIGATION WATER FROM
A DITCH COMPANY OR IRRIGATION DISTRICT

1. Water is delivered by: Grange Ditch Name of Ditch, Ditch Company or District supplying water
2. State the number of acres you irrigate under this system _____ Shares you hold _____
3. If you obtain water from more than one Company, give the number of shares, acres irrigated and the name of the Company under "Remarks". If you obtain water from a Ditch Company and also have a private system fill in both Part A and Part B.

Part B

TO BE FILED BY THOSE WHO HAVE A PRIVATE DITCH, PUMP OR IRRIGATION SYSTEM
or those who have a private water right under a Ditch Company

4. In what year was this land first irrigated? Date 50. 1895
5. Give the name of the original appropriator (first user): Robert Hudson
6. Give the date appropriated June 15 1895 Amount filed on: Miners Inches 200 in class 1st C. F. S.
7. State the total number of acres irrigated under this system: _____
8. Give the point of diversion: 1/4 Section _____ Township _____ Range _____

Part C

TO BE FILED BY ALL WATER USERS IN ADDITION TO PART A OR PART B

9. Source of Water: Sunweston Creek Name of stream or lake from which water is originally diverted
10. Water is obtained by: (Check one) Gravity ☒ Pumping _____ Other _____
11. What is the greatest number of acres you have irrigated? 120 Date _____
12. How many acres did you irrigate in 1944? (Crop and pasture) 100
13. State the total number of additional acres that could be irrigated by increasing the water supply, land leveling etc. None This land is under what ditch? _____
14. How many acres of seeped land do you have which could be drained and put into production? _____
15. What is the condition of your irrigation system? Good
16. Is your water supply adequate? Yes ☒ No _____ Explain _____
17. REMARKS: _____

OVER

NOTE: The foregoing questions apply only to irrigated land shown on this plat.

DESCRIPTION AND MAP OF FARM

18. Legal Description of this Farm NW $\frac{1}{4}$, S $\frac{1}{2}$ SE $\frac{1}{4}$, 1st ac NW $\frac{1}{4}$, No. of Co. rd. Sec. 27

SE $\frac{1}{4}$, NE $\frac{1}{4}$, N $\frac{1}{2}$ NW $\frac{1}{4}$, 1st ac NE $\frac{1}{4}$, 1st ac N $\frac{1}{2}$ SE $\frac{1}{4}$, No. of Co. rd., Sec. 28 - Twp. 4 S., R. 15 E.

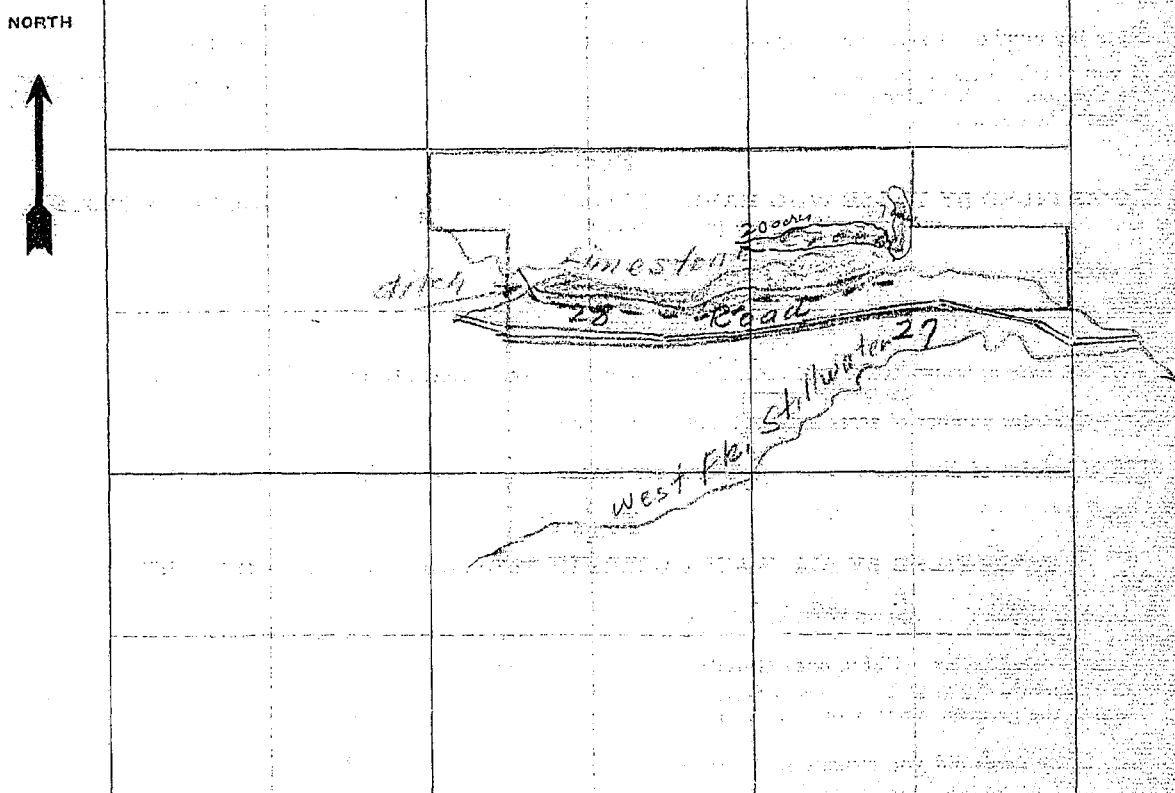
| <input type="checkbox"/> IRRIGATED LAND | <input type="checkbox"/> NON-IRRIGATED LAND |
|--|---|
| <p>— Farm boundary.</p> <p>This map is according to our records. Please change it if it is not correct. That is if we show more irrigated land than you have, X it out; if we have not enough, draw it in.</p> | |
| <p>NORTH</p>  | |

19. If the above land is irrigated from more than one ditch please give the acreage under each ditch in 19A and indicate the location of the land irrigated from each on the above map.

19A. Ditch: Private Ditch Acres: 100

Ditch: _____ Acres: _____

Information supplied by:

Name _____ Address _____ Date _____

REMARKS: _____

If you cannot answer all of the questions on this form answer as many as you can and return the form to us as soon as possible.

THURBER'S, HELENA

Our records show that you have an appropriation in Stillwater County, Book 23, Page 410, Record Misc., made by R. B. Hudson, appropriated June 15, 1895, and filed Aug. 6, 1940 from Limestone Creek for 200 miners inches.

also

Our records show that you have an appropriation in Stillwater County, Book 1, Page 250, Record Misc., made by Joseph Richard, appropriated June 1, 1912 and filed June 19, 1914 from Sheep Creek for 75 miners inches. Are these appropriations now in use?

27A
282
FORM SM-1a

STATE OF MONTANA WATER RESOURCES SURVEY

County Stillwater Date _____

Name of Water User _____ Address _____

1. Do you own this land? Yes _____ No _____ If not give the owner's name below:

Owner's name W. E. Stafford Address Nyc

2. Source of Water _____ Water delivered by _____

3. Give point of Diversion $\frac{1}{4}$ $\frac{1}{4}$ Section _____ Township _____ Range _____

4. Water is obtained by: (Check one) Gravity _____ Pumping _____ Other _____

5. Who first used water on this land? 675-470 Address _____

6. In what year was this land first irrigated? _____ Approximate Acres _____

7. What is the greatest number of acres you have irrigated? _____ Date _____

8. Present Use: Year _____ Acres Irrigated _____

9. If this land is not irrigated now give date of last use _____

10. State the total number of acres that could be irrigated _____ acres.

11. What is the condition of your irrigation system? _____

12. Land Description: _____, Twp. _____ Range _____

Remarks: Base

77W 5 NE 1/4 Sec 27

NE 1/4 NW 1/4 1/4 Sec 27

NE 1/4 NW 1/4 1/4 Sec 27

NE 1/4 NW 1/4 1/4 Sec 27

NE 1/4 NW 1/4 1/4 Sec 27

NE 1/4 NW 1/4 1/4 Sec 27

NE 1/4 NW 1/4 1/4 Sec 27

NE 1/4 NW 1/4 1/4 Sec 27

NE 1/4 NW 1/4 1/4 Sec 27

NE 1/4 NW 1/4 1/4 Sec 27

NE 1/4 NW 1/4 1/4 Sec 27

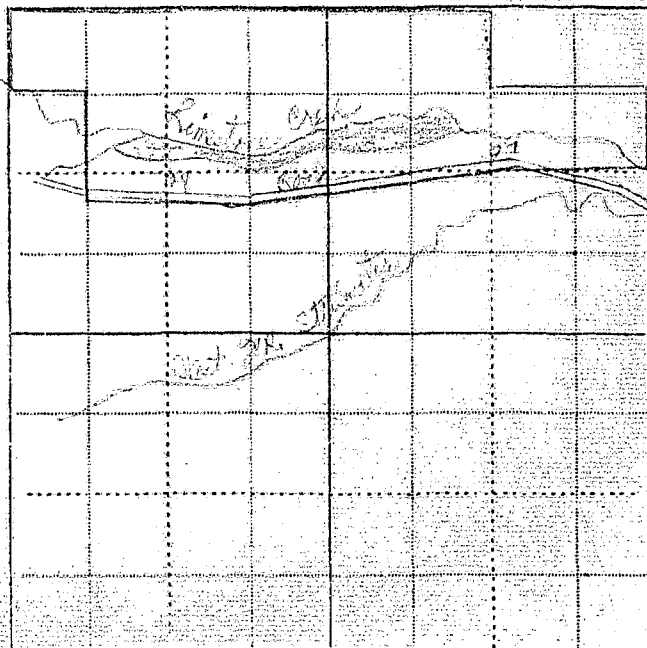

Our records show that you have an appropriation in Stillwater County, Book 23, Page 410, Record Misc., made by R. B. Hudson, appropriated June 15, 1895, and filed Aug. 6, 1940 from Limestone Creek for 200 miners inches.

also

Our records show that you have an appropriation in Stillwater County, Book 1, Page 260, Record Misc., made by Joseph Richard, appropriated June 1, 1912 and filed June 19, 1914 from Sheep Creek for 75 miners inches. Are these appropriations now in use?

1 Form Ap. 1-10M

STATE ENGINEERS OFFICE
Water Resources Survey

Code No. 470

Notice of Appropriation

1. County Stillwater Book 1 Page 260 Record Misc.
2. Name of Appropriator Richard, Joseph Address Nye, Montana
3. Date Appropriated June 1, 1912 Date Filed June 19, 1914
Amount Appropriated, Miners Inches 75, Cubic Feet per second
4. Name of Stream Sheep Creek Tributary of Limestone Basin Bas-
5. Point of Diversion Said ditch taps and diverts the water from said stream at a point upon west bank near SE corner of SE 1/4 SW 1/4 of
Sec. 22 Twp. 4 S. Rge. 15 E. Bank of Stream West.
or to run upon said land and through said described land.
6. Purpose Irrigation, domestic and other useful purposes.
7. Description of System Water is diverted by means of a ditch which said ditch is 18 inches by 24 inches in size and carries 75 inches of water.
8. Land Description of Intended Place of Use

| Subdivision | Sec. | Twp. | Rge. | Tot. Acr. | 1940 Owner | Address |
|-----------------------------|-----------|-------------|--------------|------------|----------------------|---------------------|
| <u>SE 1/4, E 1/4 NW 1/4</u> | <u>27</u> | <u>4 S.</u> | <u>15 E.</u> | <u>160</u> | <u>Robert Hudson</u> | <u>Nye, Montana</u> |
9. Remarks (Pertaining to Use, etc.) Transfer of Land Ownership.
Joseph Richards to Robert Hudson
SE 1/4, E 1/4 NW 1/4 - Sec. 27 - Twp. 4 S., Rge. 15 E.

Decree

10. Case No. Date Amt. Decreed: M. I. C. F. S.
11. To Whom Decreed Address
12. Name of Ditch Maximum Capacity (C. F. S.)
13. Date of Priority Purpose
14. Land Description of Place of Use as Decreed

STATE ENGINEERS OFFICE
Water Resources Survey

Code No. 675

Notice of Appropriation

1. County Stillwater Book 23 Page 410 Record Misc.
2. Name of Appropriator R. B. Hudson Address Limestone, Montana
3. Date Appropriated June 15, 1895 Date Filed Aug. 6, 1940
Amount Appropriated, Miners Inches 200, Cubic Feet per second
4. Name of Stream Limestone Creek Tributary Basin
5. Point of Diversion at a point on its south bank near the W line of Sec. 28, thence
running to and upon said land.
Sec. Twp. Rge. Bank of Stream
6. Purpose Domestic, irrigation and other purposes.
7. Description of System ditch 16" x 24" which carries and conducts 200" of water from
Limestone Creek.
8. Land Description of Intended Place of Use

| Subdivision | Sec. | Twp. | Rge. | Tot. Acr. | 1940 Owner | Address |
|-------------|------|------|-------|-----------|------------|---------|
| | 27 | 4 S. | 15 E. | | | |
| | 28 | 4 S. | 15 E. | | | |
9. Remarks (Pertaining to Use, etc.)
Water diverted

Decree

10. Case No. Date Amt. Decreed: M. I. C. F. S.
11. To Whom Decreed Address
12. Name of Ditch Maximum Capacity (C. F. S.)
13. Date of Priority Purpose
14. Land Description of Place of Use as Decreed
15. Remarks (Present Use Status, etc.)



STATE OF MONTANA
STATE ENGINEERS OFFICE
Water Resources Survey

Form ³³²WR-1-1M-11-41
Code No. 28C, 29C, 31A, 32A 33A
County Stillwater
T. 4 S. R. 15 E.

Name of Land Owner C. A. & Mary Stafford Address Nye, Montana
Name of Operator Same Address Same

Part A

TO BE FILED BY THOSE OBTAINING IRRIGATION WATER FROM
A DITCH COMPANY OR IRRIGATION DISTRICT

1. Water is delivered by: Private Ditch
Name of Ditch, Ditch Company or District supplying water _____
2. State the number of acres you irrigate under this system _____ Shares you hold _____
3. If you obtain water from more than one Company, give the number of shares, acres irrigated and the name of the Company under "Remarks". If you obtain water from a Ditch Company and also have a private system fill in both Part A and Part B.

Part B

TO BE FILED BY THOSE WHO HAVE A PRIVATE DITCH, PUMP OR IRRIGATION SYSTEM
or those who have a private water right under a Ditch Company

4. In what year was this land first irrigated? Date July 2-1919 - 7/15/37
5. Give the name of the original appropriator (first user): Wesley Holt - C. A. Stafford
6. Give the date appropriated July 2-1919 Amount filed on: Miners Inches _____ C. F. S. _____
7. State the total number of acres irrigated under this system: 158 acres
8. Give the point of diversion: 1/4 Section _____ Township _____ Range _____

Part C

TO BE FILED BY ALL WATER USERS IN ADDITION TO PART A OR PART B

9. Source of Water: Carter Creek - West Fork River
Name of stream or lake from which water is originally diverted _____
10. Water is obtained by: (Check one) Gravity ☒ Pumping _____ Other _____
11. What is the greatest number of acres you have irrigated? 109 Date _____
12. How many acres did you irrigate in 1944? (Crop and pasture) 77
13. State the total number of additional acres that could be irrigated by increasing the water supply, land leveling, etc. 158 This land is under what ditch? West Fork River
14. How many acres of seeped land do you have which could be drained and put into production? _____
15. What is the condition of your irrigation system? Good
16. Is your water supply adequate? Yes ☒ No _____ Explain _____
17. REMARKS: _____

This increase can be made by rebuilding ditch - which may be done this year

also returned this right Sept. 1, 1944 - to M. I. - West Fork River Co.

1A, 32A-
33A

fill

afford

NON-IRRIGATED LAND

eling,

This map is according to our records. Please change it if it is not correct. That is if we show more irrigated land than you have, X it out; if we have not enough, draw it in.

NORTH



20

28

Limestone

Ditch

W. S. Sturges

۱۱۱

3

19. If the above land is irrigated from more than one ditch please give the acreage under each ditch in 19A and indicate the location of the land irrigated from each on the above map.

19A. Ditch: Leas Fork } Acres: 1.5
Ditch: Carver Creek } Acres: 1.5

Information supplied by:

Name C. A. Stafford Address Wye Neck Date Dec 15/45

REMARKS:

If you cannot answer all of the questions on this form answer as many as you can and return the form to us as soon as possible.

THUNDER'S, MELENA 

202
202
202
202
202

[illegible]

- Owner's name C.A. + Mary Stafford Address N.Y.C.

2. Source of Water _____ Water delivered by _____

3. Give point of Diversion 1/2 1/4 Section Township Range

4. Water is obtained by: (Check one) Gravity _____ Pumping _____ Other _____

5. Who first used water on this land? 59-672-385 Address _____

6. In what year was this land first irrigated? _____ Approximate Acres _____

7. What is the greatest number of acres you have irrigated? _____ Date _____

| 8. Present Use: | Year | Acres Irrigated |
|-----------------|------|-----------------|
| | | |

9. If this land is not irrigated now give date of last use _____

10. State the total number of acres that could be irrigated _____ acres.

11. What is the condition of your irrigation system? _____

12. Land Description: _____, Twp. _____ Range _____

NENE, Sec 31, W2, N2E2, Frac E2NE4, Sec 32

254, 255, 256, 257

4515

n 19A and

15745

to us as soon
HELENA 

| Information by | Place | Date |
|----------------|-------|------|
|----------------|-------|------|

Our records show that you have an appropriation in Stillwater County, Book 8, Page 6, Record Misc., made by Willard Holt, appropriated July 2, 1919 and filed July 2, 1919 from Castle Creek for 100 miners inches.

also

Our records show that you have an appropriation in Stillwater County, Book 24, Page 134, Record Misc., made by C. A. Stafford et ux, appropriated Aug. 15, 1937 and filed May 17, 1941 from Castle Creek for 100 miners inches.

also

Our records show that you have an appropriation in Stillwater County, Book 22, Page 68, Record Misc., made by Willard Holt, appropriated Sept. 1, 1934 and filed July 24, 1937 from W. Fork Stillwater River for 360 miners inches. Are these appropriations now in use?

Our records show that you have an appropriation in Stillwater County, Book 8, Page 6, Record Misc., made by Willard Holt, appropriated July 2, 1919 and filed July 2, 1919 from Castle Creek for 100 miners inches.

also

Our records show that you have an appropriation in Stillwater County, Book 24, Page 134, Record Misc., made by C. A. Stafford et ux, appropriated Aug. 15, 1937 and filed May 17, 1941 from Castle Creek for 100 miners inches.

also

Our records show that you have an appropriation in Stillwater County, Book 22, Page 68, Record Misc., made by Willard Holt, appropriated Sept. 1, 1934 and filed July 21, 1937 from W. Fork Stillwater River for 360 miners inches. Are these appropriations now in use?

Form Ap. 1-10M 8

STATE ENGINEERS OFFICE
Water Resources Survey

Code No. 59

Notice of Appropriation

1. County Stillwater Book 8 Page 6 Record Misc.
2. Name of Appropriator Willard Holt Address Limestone, Montana
3. Date Appropriated July 2, 1919 Date Filed July 2, 1919
Amount Appropriated, Miners Inches 100, Cubic Feet per second _____
4. Name of Stream Castle Creek Tributary _____ Basin _____
5. Point of Diversion at a point on its ~~near~~ south bank, 13 rods south of center corner of
Sec. 30 Twp. 4 S. Rge. 15 E. Bank of Stream South
thence running to and upon said land.
6. Purpose Domestic, irrigation and other purposes.
7. Description of System By means of a ditch which is 3 feet wide on bottom by 12 inches in size and conducts 300 inches of water.
8. Land Description of Intended Place of Use
Subdivision Sec. Twp. Rge. Tot. Acr. 1940 Owner Address
W1/2SE1, NE1/4SE1, SW1/4SE1 29 4 S. 15 E. 160 C. A. & Mary Stafford,
Limestone.
9. Remarks (Pertaining to Use, etc.) Transfer of Land Ownership.
Willard Holt to C. A. & Mary Stafford
W1/2SE1, NE1/4SE1, SW1/4SE1, Sec. 29, Twp. 4 S., Rge. 15 E.

Decree

10. Case No. _____ Date _____ Amt. Decreed: M. I. _____ C. F. S. _____
11. To Whom Decreed _____ Address _____
12. Name of Ditch _____ Maximum Capacity (C. F. S.) _____
13. Date of Priority _____ Purpose _____

ed July

2,
filed July 21

59

na

corner

2 inches

Address
Stafford,
Limestone.

1 Form Ap. 1-10M 8

STATE ENGINEERS OFFICE
Water Resources Survey

Code No. 672

Notice of Appropriation

1. County Stillwater Book 24 Page 134 Record Misc.
2. Name of Appropriator C. A. Stafford et ux Address Nye, Montana
3. Date Appropriated Aug. 15, 1937 Date Filed May 17, 1941
- Amount Appropriated, Miners Inches 100 or, Cubic Feet per second 2 1/2
4. Name of Stream Castle Creek Tributary Basin
5. Point of Diversion at a point on its north bank in the SWNE 1/4 of
Sec. 29 Twp. 4 S. Rge. 15 E. Bank of Stream north.
6. Purpose Irrigating and other uses.
7. Description of System A ditch 19" x 24" which carries 100" of water to and upon said land.
8. Land Description of Intended Place of Use.
- | Subdivision | Sec. | Twp. | Rge. | Tot. Acr. | 1940 Owner | Address |
|-----------------|-----------|-------------|--------------|-----------|------------|---------|
| <u>SWNE 1/4</u> | <u>29</u> | <u>4 S.</u> | <u>15 E.</u> | | | |
9. Remarks (Pertaining to Use, etc.)
In paragraph V. it says: That the name of the appropriator of said water is
Willard Holt.
- none in use.

Decree

10. Case No. Date Amt. Decreed: M. I. C. F. S.
11. To Whom Decreed Address
12. Name of Ditch Maximum Capacity (C. F. S.)
13. Date of Priority Purpose
14. Land Description of Place of Use as Decreed
15. Remarks (Present Use Status, etc.)

STATE ENGINEERS OFFICE
Water Resources Survey

Code no. 385

Notice of Appropriation

1. County Stillwater Book 22 Page 68 Record Misc.
2. Name of Appropriator Holt, Willard Address Limestone, Montana
3. Date Appropriated Sept. 1, 1934 Date Filed July 24, 1937
Amount Appropriated, Miners Inches 360, Cubic Feet per second
4. Name of Stream Stillwater River (W. Fork) Tributary Basin
5. Point of Diversion at a point on its northwest bank at center NE 1/4 of SW 1/4 of
Sec. 32 Twp. 4 S. Rge. 15 E. Bank of Stream Northwest.
thence runs over and upon said land.
6. Purpose Irrigation and other purposes.
7. Description of System By means of a ditch, 36 inches by 48 inches in size and conducts
360 inches of water.
8. Land Description of Intended Place of Use
Subdivision Sec. Twp. Rge. Tot. Acr.
On Secs. 32 & 29 4 S. 15 E.
9. Remarks (Pertaining to Use, etc.)
None in use

Decree

10. Case No. Date Amt. Decreed: M. I. C. F. S.
11. To Whom Decreed Address
12. Name of Ditch Maximum Capacity (C. F. S.)
13. Date of Priority Purpose
14. Land Description of Place of Use as Decreed
15. Remarks (Present Use Status, etc.)



STATE OF MONTANA
STATE ENGINEERS OFFICE
Water Resources Survey

334
Form WR-1-1M-11-41

Code No. 29 D
County Stillwater
T. 4 S. R. 15 E.

Name of Land Owner Geo. L. Torian Jr. Address Limestone
Name of Operator _____ Address _____

Part A

TO BE FILED BY THOSE OBTAINING IRRIGATION WATER FROM
A DITCH COMPANY OR IRRIGATION DISTRICT

1. Water is delivered by: Private ditch
Name of Ditch, Ditch Company or District supplying water _____
2. State the number of acres you irrigate under this system _____ Shares you hold _____
3. If you obtain water from more than one Company, give the number of shares, acres irrigated and the name of the Company under "Remarks". If you obtain water from a Ditch Company and also have a private system fill in both Part A and Part B.

Part B 58-275

TO BE FILED BY THOSE WHO HAVE A PRIVATE DITCH, PUMP OR IRRIGATION SYSTEM
or those who have a private water right under a Ditch Company

4. In what year was this land first irrigated? Date George Herbert Torian, Sr.
5. Give the name of the original appropriator (first user): Geo L. Torian, Jr.
6. Give the date appropriated Oct 6-1917 Amount filed on: Miners Inches 160 C. F. S. _____
7. State the total number of acres irrigated under this system: _____
8. Give the point of diversion: 1/4 1/4 Section _____ Township _____ Range _____

Part C

TO BE FILED BY ALL WATER USERS IN ADDITION TO PART A OR PART B

9. Source of Water: Montele Creek & Head Fork Stillwater
Name of stream or lake from which water is originally diverted _____
10. Water is obtained by: (Check one) Gravity ☒ Pumping _____ Other _____
11. What is the greatest number of acres you have irrigated? 90 Date _____
12. How many acres did you irrigate in 1944? (Crop and pasture) 90
13. State the total number of additional acres that could be irrigated by increasing the water supply, land leveling, etc. _____ This land is under what ditch? ✓
14. How many acres of seeped land do you have which could be drained and put into production? _____
15. What is the condition of your irrigation system? Good
16. Is your water supply adequate? Yes ☒ No _____ Explain _____
17. REMARKS: _____
Also Geo L. Torian, Jr. July 2, 1919, 100 ft. Limestone Creek

OVER

NOTE: The foregoing questions apply only to irrigated land shown on this plat.

DESCRIPTION AND MAP OF FARM

18. Legal Description of this Farm S¹/₄ NW¹/₄, NE¹/₄, S¹/₂ SW¹/₄, Sec. 29

IRRIGATED LAND

NON-IRRIGATED LAND

— Farm boundary.

This map is according to our records. Please change it if it is not correct. That is if we show more irrigated land than you have, x it out; if we have not enough, draw it in.

NORTH

29

ditch

Road

Creek

29

ditch

29

19. If the above land is irrigated from more than one ditch please give the acreage under each ditch in 19A and indicate the location of the land irrigated from each on the above map.

19A. Ditch: Stillwater ditch (Private) from Acres: 90

Ditch: West of Highway 100 Acres: 1.00

Information supplied by:

Name Pro L. Toran Jr Address Linnestad Date 4/19/45

REMARKS: *See above*

If you cannot answer all of the questions on this form answer as many as you can and return the form to us as soon as possible.

THURBER'S, HELENA 

Our records show that you have an appropriation in Stillwater County, Book 8, Page 13, Record Misc., made by Geo. L. Torian, appropriated July 2, 1919 and filed July 11, 1919 from Castle Creek for 100 miners inches.

also

Our records show that you have an appropriation in Stillwater County, Book 7, Page 83, Record Misc., made by Geo. L. Torian Jr., appropriated Oct. 6, 1917 and filed May 31, 1918 from Picket Pin Cr. and Swamp Creek for 160 miners inches.

Are these appropriations now in use?

FORM SM-1a

STATE OF MONTANA WATER RESOURCES SURVEY

County Stillwater Date _____

Name of Water User _____ Address _____

1. Do you own this land? Yes _____ No _____ If not give the owner's name below:

Owner's name Geo. L. Torian Jr. Address Limestone

2. Source of Water _____ Water delivered by _____

3. Give point of Diversion $\frac{1}{4}$ $\frac{1}{4}$ Section _____ Township _____ Range _____

4. Water is obtained by: (Check one) Gravity _____ Pumping _____ Other _____

5. Who first used water on this land? 58-275 Address _____

6. In what year was this land first irrigated? _____ Approximate Acres _____

7. What is the greatest number of acres you have irrigated? _____ Date _____

8. Present Use: Year _____ Acres Irrigated _____

9. If this land is not irrigated now give date of last use _____

10. State the total number of acres that could be irrigated _____ acres.

11. What is the condition of your irrigation system? _____

12. Land Description: _____, Twp. _____ Range _____

Remarks: Same

SEND NESK, SPK, H,

Loc 29

50

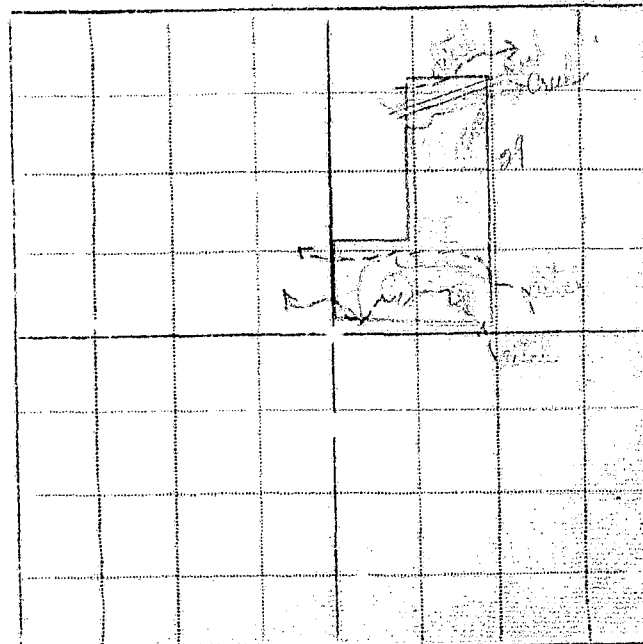

Billings,
XXXXXXXXXX

March 27, 1945

Geo. L. Torian, Jr.
Limestone, Montana

Dear Mr. Torian:

On March 7th, this office sent you a letter asking for certain information pertaining to your irrigated land in township 4 south, range 15 east. To date we have not heard from you. With the vast post war water development in this area now planned, it is essential that we have this information in order to show the extent of our water use in the Yellowstone Basin in Montana. This information is necessary to protect our present water users in the rights they have against future irrigation, navigation, power and flood control enterprises in this area. We are asking you for this information because we feel it is the democratic way; we also feel that you are more qualified to give us this information about your irrigated land than anyone else because it is part of your business. It may be that you were busy with your farm work or some unforeseen thing happened at the time our first letter was received, and you put it aside to be answered at some other time and have forgotten all about it. All information is strictly confidential and is only used to record and tabulate the water use in this area.

Water is as necessary to the farmer as the soil in which he plants. Without it no crops will grow; no living thing can survive. It is your water that we are trying to protect, so that you will have plenty now and in the future. We must keep Montana's water in Montana. The only way we can do this is by having the support of each and every water user so that we have a 100 percent representation of all water users. Remember: "United we stand, divided we fall".

In order to facilitate this work a branch office of the State Engineer has been established in Billings and is located in the Roosevelt School Building on 23rd Street and Fourth Avenue North. Anytime you are in Billings we would appreciate your calling on us.

Hoping to hear from you in the very near future, I am,

Very truly yours,

Gerald J. Oravetz
Assistant State Engineer

P.S. If you cannot supply us with the information requested, it may be that you can tell us of someone who can.

Billings,
XXXXXX

April 10, 1945

Geo. L. Torian Jr.
Limestone, Montana

Dear Mr. Torian:

On March 7th we sent you a letter asking for certain information pertaining to your irrigated land in township 4 south range 15 east. On March 27th we sent you another letter asking you to submit the information to us as soon as possible. To date we have not heard from you regarding this matter.

It is hereby declared to be a policy of the State and necessary for the welfare of the State and its citizens, that the waters of this State, and especially interstate streams arising out of the State, be investigated. The State Engineer shall, either before or after the bringing of such action (to adjudicate the waters of any stream and its tributaries in any county traversed by said stream), upon the direction of the State Water Conservation Board, or upon the direction of the court, do all things, make all surveys, and perform all services required by said board in the securing of all necessary information and make the same available to said board or others who may be interested therein, including the courts of this State.

In order to protect the water rights of the water users in this state it is mandatory that the State Engineer have the information that we have asked you to submit to this office. If you have sold the piece of land about which we wrote you, will you please give us the name and address of the new owner.

We expect to hear from you in the very near future.

Very truly yours,

Gerald J. Oravetz
Assistant State Engineer

STATE ENGINEERS OFFICE
Water Resources Survey

Code No. 58

Notice of Appropriation

1. County Stillwater Book 8 Page 13 Record Misc.
2. Name of Appropriator Geo. L. Torian Address Limestone, Montana
3. Date Appropriated July 2, 1919 Date Filed July 11, 1919
Amount Appropriated, Miners Inches 100, Cubic Feet per second
4. Name of Stream Castle Creek Tributary Basin
5. Point of Diversion at a point on its south bank 13 rods south of center corner of
Sec. 30 Twp. 4 S. Rge. 15 E. Bank of Stream south.
thence running to and upon said land.
6. Purpose Irrigation and other purposes.
7. Description of System By means of a ditch which is 3 feet wide on bottom by 12 inches in
size and conducts 300 inches of water.
8. Land Description of Intended Place of Use

| Subdivision | Sec. | Twp. | Rge. | Tot. Acr. | 1940 Owner | Address |
|-----------------------------|-----------|-------------|--------------|------------|------------------------------|-------------------|
| <u>S1SW1 - NESW1, SENW1</u> | <u>29</u> | <u>4 S.</u> | <u>15 E.</u> | <u>160</u> | <u>George L. Torian, Jr.</u> | <u>Limestone.</u> |
9. Remarks ~~(Pertaining to Use, etc.)~~ Transfer of Land Ownership.
(George L. Torian to George L. Torian Jr.)
S1SW1, NESW1, SENW1, Sec. 29 - Twp. 4 S., Rge. 15 E.

Decree

10. Case No. Date Amt. Decreed: M. I. C. F. S.
11. To Whom Decreed Address
12. Name of Ditch Maximum Capacity (C. F. S.)
13. Date of Priority Purpose
14. Land Description of Place of Use as Decreed
15. Remarks (Present Use Status, etc.)

Code No. 275

Notice of Appropriation

1. County Stillwater Book 7 Page 83 Record Misc.

2. Name of Appropriator Torian, Jr. Geo. L. Address Limestone, Montana

3. Date Appropriated Oct. 6, 1917 Date Filed May 31, 1918

Amount Appropriated, Miners Inches 160, Cubic Feet per second _____
Picket Pine & Swamp Creek

4. Name of Stream Picket Piner and Swamper Tributary _____ Basin _____

5. Point of Diversion at a point on its east bank running thence in a NE direction 1 mile
to SW corner SW $\frac{1}{4}$ of

Sec. 29 Twp. 4 S. Rge. 15 E. Bank of Stream East.
thence running to and upon said land.

6. Purpose Domestic, irrigation and other purposes.

7. Description of System By means of a ditch which is 36 inches by 24 inches in size.

8. Land Description of Intended Place of Use

| Subdivision | Sec. | Twp. | Rge. | Tot. Acr. | 1940 Owner | Address |
|---|-----------|-------------|--------------|------------|------------------------------|---------------------------|
| <u>SE$\frac{1}{4}$ NW$\frac{1}{4}$, E$\frac{1}{2}$ SW$\frac{1}{4}$, SW$\frac{1}{4}$ SW$\frac{1}{4}$</u> | <u>29</u> | <u>4 S.</u> | <u>15 E.</u> | <u>160</u> | <u>George L. Torian, Jr.</u> | <u>Limestone, Montana</u> |

9. -Remarks (Pertaining to Use, etc.) Transfer of Land Ownership.
George L. Torian, Jr. - SE $\frac{1}{4}$ NW $\frac{1}{4}$, SWSW $\frac{1}{4}$, E $\frac{1}{2}$ SW $\frac{1}{4}$, Sec. 29 - Twp. 4 S., Rge. 15 E.

Decree

10. Case No. Date Amt. Decreed: M. I. C. F. S.

11. To Whom Decreed Address

12. Name of Ditch Maximum Capacity (C. F. S.)

13. Date of Priority Purpose

14. Land Description of Place of Use as Decreed

.....

.....

.....

.....

.....

15. Remarks (Present Use Status, etc.)



STATE OF MONTANA
STATE ENGINEERS OFFICE
Water Resources Survey

333
Form WR-1-1M-11-41
Code No. 28 B, 29 A
County Stillwater
T. 4 S. R. 15 E.

Name of Land Owner Barry Wright Address Browesboro, Oregon
Name of Operator Herbert Russell Address Limestone, Montana

Part A

TO BE FILED BY THOSE OBTAINING IRRIGATION WATER FROM
A DITCH COMPANY OR IRRIGATION DISTRICT

1. Water is delivered by: Private Ditch
Name of Ditch, Ditch Company or District supplying water
2. State the number of acres you irrigate under this system. Shares you hold.
3. If you obtain water from more than one Company, give the number of shares, acres irrigated and the name of the Company under "Remarks". If you obtain water from a Ditch Company and also have a private system fill in both Part A and Part B.

Part B

TO BE FILED BY THOSE WHO HAVE A PRIVATE DITCH, PUMP OR IRRIGATION SYSTEM
or those who have a private water right under a Ditch Company

4. In what year was this land first irrigated? Date 1914
5. Give the name of the original appropriator (first user): Harry Wright
6. Give the date appropriated 1914 Amount filed on: Miners Inches 160 C. F. S.
7. State the total number of acres irrigated under this system: 90
8. Give the point of diversion: $\frac{1}{4}$ $\frac{1}{4}$ Section Township Range

Part C

TO BE FILED BY ALL WATER USERS IN ADDITION TO PART A OR PART B

9. Source of Water: Castle Creek
Name of stream or lake from which water is originally diverted
10. Water is obtained by: (Check one) Gravity ☒ Pumping ☐ Other ☐
11. What is the greatest number of acres you have irrigated? 90 Date 1919
12. How many acres did you irrigate in 1944? (Crop and pasture) 90
13. State the total number of additional acres that could be irrigated by increasing the water supply, land leveling, etc. None This land is under what ditch?
14. How many acres of seeped land do you have which could be drained and put into production? None
15. What is the condition of your irrigation system? Fair
16. Is your water supply adequate? Yes ☒ No ☐ Explain
17. REMARKS:

OVER

NOTE: The foregoing questions apply only to irrigated land shown on this plat.

DESCRIPTION AND MAP OF FARM

18. Legal Description of this Farm. E. 1/4 Sec. 29 - T. 36 N., R. 26 W., S. 15 E.



IRRIGATED LAND

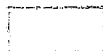

NON-IRRIGATED LAND

— Farm boundary.

This map is according to our records. Please change it if it is not correct. That is if we show more irrigated land than you have, X it out; if we have not enough, draw it in.

NORTH

29

Limestone Cr.

Road

28

19. If the above land is irrigated from more than one ditch please give the acreage under each ditch in 19A and indicate the location of the land irrigated from each on the above map.

19A. Ditch: Co

Spott

Acres: 70

Ditch: _____

Acres: _____

Information supplied by:

Name: Sammy Wright or Kenneth Russell

Address: Limestone, Mont.

Date: 3/28/45

REMARKS: _____

If you cannot answer all of the questions on this form answer as many as you can and return the form to us as soon as possible.

TURNER'S, HELENA

Our records show that you have an appropriation in Stillwater County, Book 1, Page 258, Record Misc., made by Harry W. Wright, appropriated June 19, 1914 and filed June 19, 1914 from Castle Creek for 160 miners inches. Is this appropriation now in use?

yes

Rge. 15

FORM SM-1a

STATE OF MONTANA WATER RESOURCES SURVEY

County Stillwater Date _____

Name of Water User Robert Russell Address Limestone

1. Do you own this land? Yes _____ No _____ If not give the owner's name below:

Owner's name Harry Wright Address Brownsville, Ark.

2. Source of Water _____ Water delivered by _____

3. Give point of Diversion 1/4 1/4 Section _____ Township _____ Range _____

4. Water is obtained by: (Check one) Gravity _____ Pumping _____ Other _____

5. Who first used water on this land? 60 Address _____

6. In what year was this land first irrigated? _____ Approximate Acres _____

7. What is the greatest number of acres you have irrigated? _____ Date _____

8. Present Use: Year _____ Acres Irrigated _____

9. If this land is not irrigated now give date of last use _____

10. State the total number of acres that could be irrigated _____ acres.

11. What is the condition of your irrigation system? _____

12. Land Description: _____, Twp. _____ Range _____

Remarks: Limestone

ENE, Sec 29

Stillwater, NE 1/4, Sec 29

1/4 Sec 29

operating the Wright

land you own

in the Stillwater

on the land

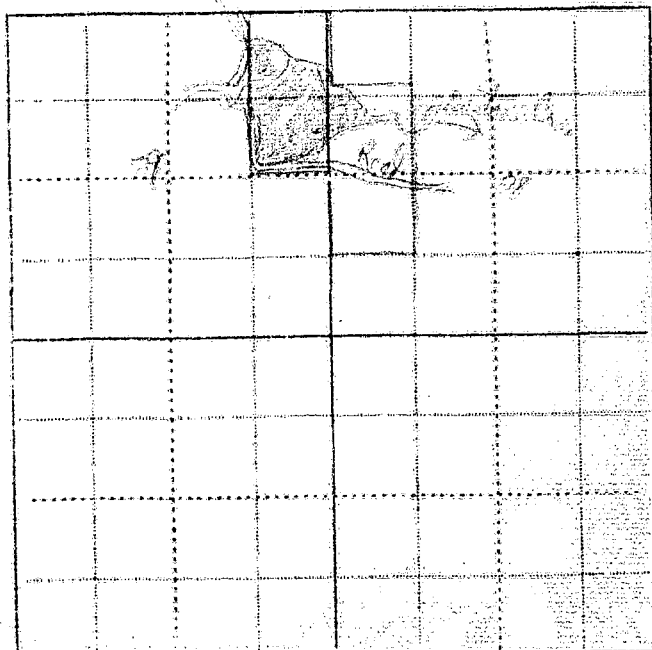

in 19A and

es: 50

es:

3/28/45

to us as soon
S. HELENA

Our records show that you have an appropriation in Stillwater County, Book 1, Page 258, Record Misc., made by Harry W. Wright, appropriated June 19, 1914 and filed June 19, 1914 from Castle Creek for 160 miners inches. Is this appropriation now in use?

Form Ap. 1-19M 8-

STATE ENGINEERS OFFICE
Water Resources Survey

Code No. 60

Notice of Appropriation

1. County Stillwater Book 1 Page 258 Record Misc.
2. Name of Appropriator Harry W. Wright Address Limestone, Montana
3. Date Appropriated June 19, 1914 Date Filed June 19, 1914
Amount Appropriated, Miners Inches 160, Cubic Feet per second
4. Name of Stream Castle Creek Tributary of Limestone Basin
5. Point of Diversion at a point upon its south bank about 200 yards south and three hundred yards east of the northwest corner of SE $\frac{1}{4}$ of NW $\frac{1}{4}$ of
Sec. 29 Twp. 4 S. Rge. 15 E. Bank of Stream South bank.
6. Purpose Domestic and irrigating and other purposes.
7. Description of System Ditch, two feet wide by one and one half deep in size and carries 160 inches of water.
8. Land Description of Intended Place of Use

| Subdivision | Sec. | Twp. | Rge. | Tot. Acr. | 1940 Owner | Address |
|---|------|------|-------|-----------|-----------------|------------------------|
| SW $\frac{1}{4}$ NW $\frac{1}{4}$, NW $\frac{1}{4}$ SW $\frac{1}{4}$ | 28 | 4 S. | 15 E. | 80 | Harry W. Wright | Brownstoro, Oregon. |
| E $\frac{1}{2}$ NE $\frac{1}{4}$ | 29 | 4 S. | 15 E. | 80 | | |
9. Remarks (Pertaining to Use, etc.)
That I (Harry W. Wright) took water 10th of July 1910 by means of ditch.
Transfers of Land Ownership.
NW $\frac{1}{4}$ SW $\frac{1}{4}$, SW $\frac{1}{4}$ NW $\frac{1}{4}$ - Sec. 28 - Twp. 4 S., Rge. 15 E.
E $\frac{1}{2}$ NE $\frac{1}{4}$, Sec. 29 - Twp. 4 S., Rge. 15 E.
now in use
10. Case No. Date Amt. Decreed: M. I. C. F. S.
11. To Whom Decreed Address
12. Name of Ditch Maximum Capacity (C. F. S.)
13. Date of Priority Purpose
14. Land Description of Place of Use as Decreed