

~~1/ The Cross Ditch ditches in the SE corner of the NE 1/4 of Sec. 18 making a very small area of potential which could be irrigated by Cummings if he had rights in the ditch.~~

2/ In the SW corner of this parcel there is a small amount of land around the base of a hill that is potential under the Sweet Grass Can. & Res. Co. Not irrigated because of lack of stock in the Company.

3. Two Cummings ditches divert out of Otter Creek in Sec 7 and run into the NW corner of the NE 1/4 of Sec 18 to irrigate land on the NE side of Otter Creek. The system is in fair condition and is in use at the present.

STATE OF MONTANA

State Engineer's Office

WATER RESOURCES SURVEY

FARM MAP

County Sweetgrass

Code No. 18 B

Twp. 3 N Rge. 15 E

Twp. \_\_\_\_\_ Rge. \_\_\_\_\_

Twp. \_\_\_\_\_ Rge. \_\_\_\_\_

Name of Land Owner Carney, Paul B. Address \_\_\_\_\_

Name of Operator Phil Cummings Address Big Timber

Legal Description \_\_\_\_\_

☐ Irrigated Land

☐ Non-Irrigated Land  
North

☒ Potential Land Under Existing Facilities



Code No. 12 B System Cummings Ditches Source of Water Other Creek

Basin Other Creek Present 76 Potential 0 Maximum 76 R. ☒ F. ☐ P. ☐ G. ☒ S. ☐

Code No. 18 B System Lower Canal S. & C. Co Source of Water Sweet Grass Creek

Basin Sweet Grass Present 0 Potential 6 Maximum 6 R. ☒ F. ☐ P. ☐ G. ☒ S. ☐

Code No. \_\_\_\_\_ System \_\_\_\_\_ Source of Water \_\_\_\_\_

Basin \_\_\_\_\_ Present \_\_\_\_\_ Potential \_\_\_\_\_ Maximum \_\_\_\_\_ R. ☐ F. ☐ P. ☐ G. ☐ S. ☐

Code No. \_\_\_\_\_ System \_\_\_\_\_ Source of Water \_\_\_\_\_

Basin \_\_\_\_\_ Present \_\_\_\_\_ Potential \_\_\_\_\_ Maximum \_\_\_\_\_ R. ☐ F. ☐ P. ☐ G. ☐ S. ☐

If under Ditch Company, Irrigation District, or Government Project, state the number of shares or inches, acre feet, as the case may be in said system.

NOTE: R—Denotes Regular Irrigation. F—Flood Irrigation. P—Water diverted by means of pumping. G—Water diverted by gravity. S—Stored Water.

Information from \_\_\_\_\_ Date \_\_\_\_\_

Farm Checked

By M.T. + B.B.

Area Sweet Grass

Date 8-18-50

Legal Land Owner

Operator

Water is delivered by:

Federal Project \_\_\_\_\_ Pres. \_\_\_\_\_ Pot. \_\_\_\_\_

Ditch Company Sweet Grass Res. + Canal Co. - Cramer lateral Pres. \_\_\_\_\_ Pot. \_\_\_\_\_

Irrigation District GLASS ditch Pres. \_\_\_\_\_ Pot. \_\_\_\_\_

Private System Adam ditch Pres. \_\_\_\_\_ Pot. \_\_\_\_\_

Totals \_\_\_\_\_

Flood \_\_\_\_\_ Pump \_\_\_\_\_ Reservoir \_\_\_\_\_ Gravity ☒

Size and Capacity, Pump, etc. (the Adam rights were sold to the Sweet Grass Res. + Canal Co.)

Original Appropriator, Company Late Adams; Ed & Emil App. No. (D-270, 267, 268,

Original Appropriator, Private Adams; Arthur J. Glass App. No. 269) 1984

Is the system an extension of another system? Yes \_\_\_\_\_ No \_\_\_\_\_

Is all land irrigated from one system? Yes \_\_\_\_\_ No \_\_\_\_\_

(If No, show break-down on map)

Source of Water Swamp Cr.; Flood water

Acres Irrigated 1950 \_\_\_\_\_ 0

Potential Acres 408 \_\_\_\_\_ Seeped \_\_\_\_\_

Explain \_\_\_\_\_

Condition of System \_\_\_\_\_

Adequate Supply \_\_\_\_\_ Yes \_\_\_\_\_ No \_\_\_\_\_

Explain \_\_\_\_\_

Topography \_\_\_\_\_

Information From Geo. Crum

Remarks - over -

FORM 7-1 - GAZETTE 1955-24-1-47

Code No. AA 11, 12, 13, 14B

County Sweet Grass

T. 3 N. R. 15 E. Sec. 13, 14

Photo No. MA 7A-150

Address 7A-151

Address \_\_\_\_\_

see attached map

Adam ditch out of Sweet Grass Co.

Point of diversion in NE<sup>1</sup>SW<sup>4</sup> Sec 29 T4N-R15E on south bank. Ditch in poor condition & not used by Geo. Crum. Lands that could be irrigated by this ditch lie in N<sup>1</sup> Sec 1 T3N-R15E.

Glass ditch out of upper reservoir Point of diversion - NE corner of Sec 8 T3N-R15E

The land under the Adam ditch can be irrigated by the Glass ditch.

Sweet Grass Res. & Canal Co. - Cremer lateral

The Cremer lateral comes out the connecting canal between Lake Adam & Lake Wolwood in center of S<sup>1</sup> Sec 11 T3N-R15E. Crum does not use water from this ditch, however, there is land in S<sup>1</sup>SE<sup>4</sup> Sec 11; S<sup>1</sup> Sec 12; N<sup>1</sup>NE<sup>4</sup> Sec 14; & NE<sup>1</sup>NW<sup>4</sup> Sec 13 T3N-R15E that could be irrigated from said ditch.

There is land in W<sup>1</sup> Sec 11 T3N-R15E that could be irrigated from the connecting canal between the two lakes.

STATE OF MONTANA  
**STATE ENGINEER'S OFFICE**  
 WATER RESOURCES SURVEY

Township 30 Range R15E County Sweet Grass

					A	VA
6	5	4	3	2		1
					A	A 3/4
7	8	9	10	11		12
					E	A
18	17	16	15	14		13
19	20	21	22	23		24
30	29	28	27	26		25
31	32	33	34	35		36

Gen. D. Quinn

Township 3 Range 15

STATE OF MONTANA

# State Engineer's Office

WATER RESOURCES SURVEY

FARM MAP

County Sweet Grass

Code No. 12-29-115-124-

124-124

Twp. 5N Rge. 15E

Twp. \_\_\_\_\_ Rge. \_\_\_\_\_

Twp. \_\_\_\_\_ Rge. \_\_\_\_\_

Name of Land Owner Corbin, John F. Address Montana

Name of Operator Corbin Address \_\_\_\_\_

Canal

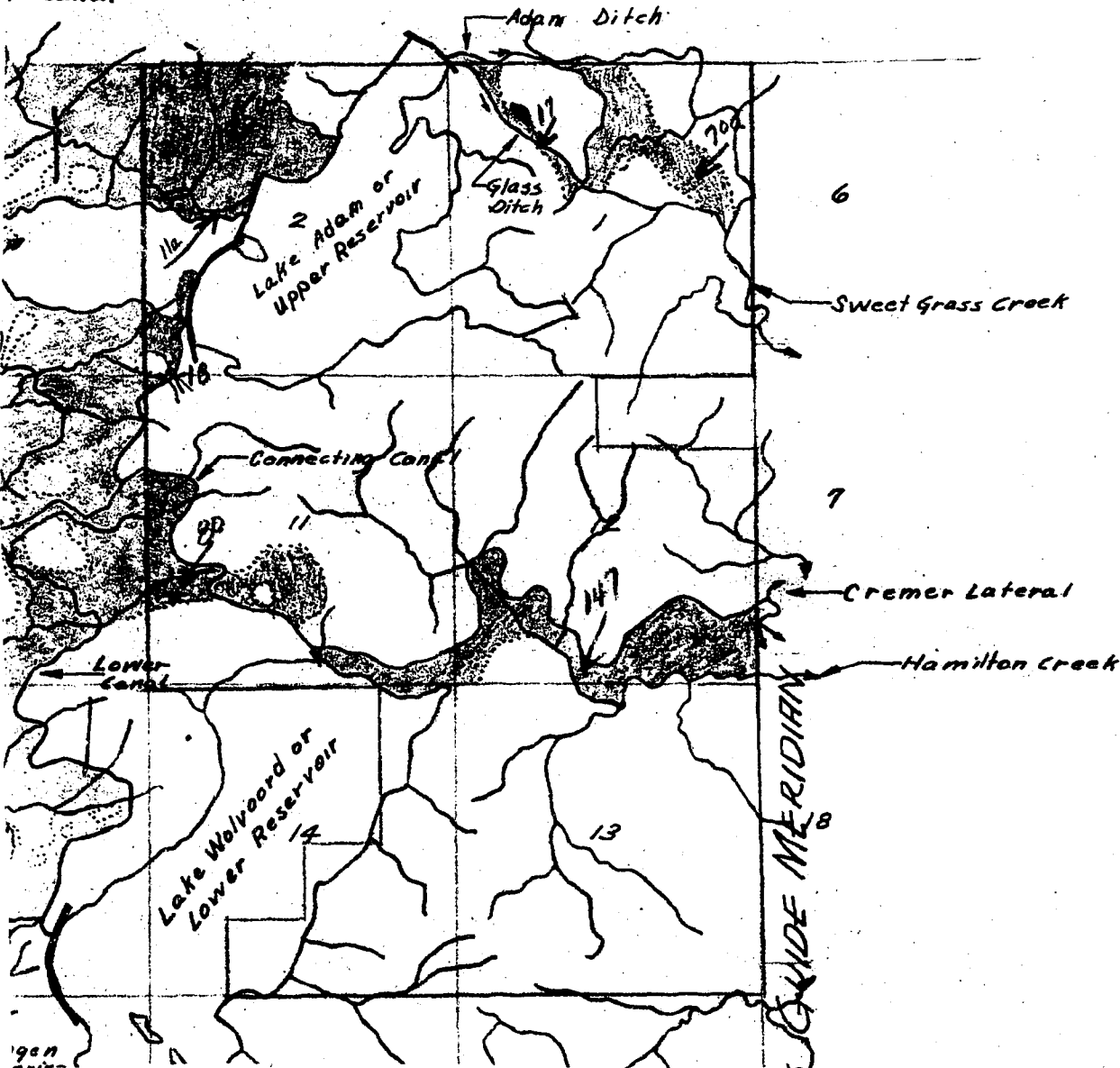

Code No. <u>124-124</u>	System <u>irrigation system in 1901</u>	Source of Water <u>Sweet Grass Creek</u>
Basin <u>124-124</u>	Present <u>11</u> Potential <u>11</u> Maximum <u>11</u>	R. <u>F</u> P. <u>G</u> S. <u>S</u>
Code No. <u>124-124</u>	System <u>irrigation system in 1901</u>	Source of Water <u>Sweet Grass Creek</u>
Basin <u>124-124</u>	Present <u>11</u> Potential <u>11</u> Maximum <u>11</u>	R. <u>F</u> P. <u>G</u> S. <u>S</u>
Code No. <u>124-124</u>	System <u>irrigation system in 1901</u>	Source of Water <u>Sweet Grass Creek</u>
Basin <u>124-124</u>	Present <u>11</u> Potential <u>11</u> Maximum <u>11</u>	R. <u>F</u> P. <u>G</u> S. <u>S</u>

If under Ditch Company, Irrigation District, or Government Project, state the number of shares or inches, acre feet, as the case may be in said system.

NOTE: R—Denotes Regular Irrigation. F—Flood Irrigation. P—Water diverted by means of pumping. G—Water diverted by gravity. S—Stored Water.

Information from \_\_\_\_\_ Date \_\_\_\_\_

STATE OF MONTANA

State Engineer's Office  
WATER RESOURCES SURVEY  
FARM MAP

County Sweet Grass

Code No. 1A-2A-11A-12A-

13A-14B

Name of Land Owner CRUM, GEO. B. Address Melville  
Name of Operator Same Address "

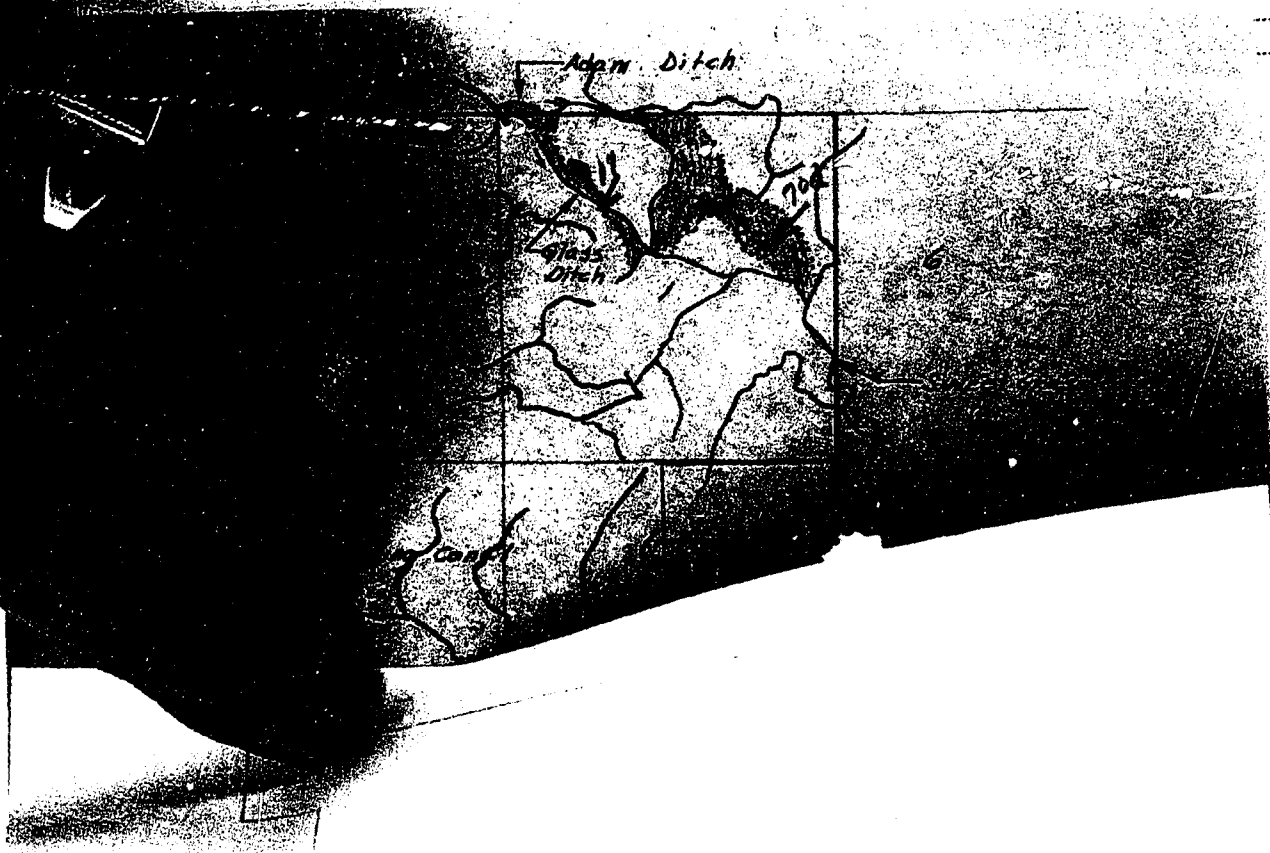

Code No. 11A System Main Ditch (not in use) Source of Water Sweet Grass Cr.  
Basin Sweet Grass Present 0 Potential 7.0 Maximum 7.0 R ✓ F ✓ P ✓ G ✓ S ✓  
Code No. 12A System Gage Ditch (not in use) Source of Water Sweet Grass Cr.  
Basin Sweet Grass Present 0 Potential 1.7 Maximum 1.7 R ✓ F ✓ P ✓ G ✓ S ✓  
Code No. 11A, 12A, 13A, 14A System Center Lateral (S.G. & R.C.) Source of Water Sweet Grass Cr.  
Basin Sweet Grass Present 0 Potential 14.7 Maximum 14.7 R ✓ F ✓ P ✓ G ✓ S ✓  
Code No. 11A System connecting lateral (S.G. & R.C.) Source of Water Sweet Grass Cr.  
Basin Sweet Grass Present 0 Potential 18 Maximum 18 R ✓ F ✓ P ✓ G ✓ S ✓

If under Ditch Company, Irrigation District, or Government Project, state the number of shares or inches, acre feet, as the case may be in said system.

NOTE: R—Denotes Regular Irrigation. F—Flood Irrigation. P—Water diverted by means of pumping. G—Water diverted by gravity. S—Stored Water.

Information from \_\_\_\_\_ Date \_\_\_\_\_

STATE OF MONTANA

State Engineer's Office

WATER RESOURCES SURVEY

FARM MAP

County Sweetgrass

Code No. 1A-2A-11A-12A-

13A-14B

Twp. 3N Rge. 15E

Twp. \_\_\_\_\_ Rge. \_\_\_\_\_

Twp. \_\_\_\_\_ Rge. \_\_\_\_\_

Name of Land Owner CRUM, GEO. B. Address Melville

Name of Operator Same Address \_\_\_\_\_

Code No. 24 System Upper Canal (S.G. & R. Co.) Source of Water Sweet Grass  
Basin Sweet Grass Present 0 Potential 11 Maximum 11 R. F P. G S. ✓  
Code No. 24 System Upper Canal Source of Water Sweet Grass Cr.  
Basin Sweet Grass Present 0 Potential 25 Maximum 14.5 R. ✓ F. P G. ✓ S. ✓  
Code No. \_\_\_\_\_ System \_\_\_\_\_ Source of Water \_\_\_\_\_  
Basin \_\_\_\_\_ Present \_\_\_\_\_ Potential \_\_\_\_\_ Maximum \_\_\_\_\_ R. \_\_\_\_\_ F. \_\_\_\_\_ P. \_\_\_\_\_ G. \_\_\_\_\_ S. \_\_\_\_\_  
Code No. \_\_\_\_\_ System \_\_\_\_\_ Source of Water \_\_\_\_\_  
Basin \_\_\_\_\_ Present \_\_\_\_\_ Potential \_\_\_\_\_ Maximum \_\_\_\_\_ R. \_\_\_\_\_ F. \_\_\_\_\_ P. \_\_\_\_\_ G. \_\_\_\_\_ S. \_\_\_\_\_

If under Ditch Company, Irrigation District, or Government Project, state the number of shares or inches, acre feet, as the case may be in said system.

NOTE: R—Denotes Regular Irrigation. F—Flood Irrigation. P—Water diverted by means of pumping. G—Water diverted by gravity. S—Stored Water.

Information from \_\_\_\_\_ Date \_\_\_\_\_



Farm Checked

By E. C. Smith

## STATE OF MONTANA

## STATE ENGINEER'S OFFICE

## WATER RESOURCES SURVEY.

Vernon M. Larson  
Tom DonlonCode No. 298321334County Sweet GrassT. 30 R. 15E Sec. 19, 32, 33Photo No. MA-12A-19Area Otter CreekDate July 27, 1950Legal Land Owner J. C. SwansonAddress Big TimberOperator Tom DonlonAddress "

Water is delivered by:

Federal Project \_\_\_\_\_ Pres. \_\_\_\_\_ Pot. \_\_\_\_\_

Ditch Company Sweet Grass Canal and Irr. Co. Pres. \_\_\_\_\_ Pot. \_\_\_\_\_

Irrigation District \_\_\_\_\_ Pres. \_\_\_\_\_ Pot. \_\_\_\_\_

Private System 3 private systems Pres. \_\_\_\_\_ Pot. \_\_\_\_\_

Totals \_\_\_\_\_

Flood \_\_\_\_\_ Pump \_\_\_\_\_ Reservoir \_\_\_\_\_ Gravity ✓

Size and Capacity, Pump, etc. \_\_\_\_\_

Original Appropriator, Company Emil Johnson et al. App. No. 111V134835842Original Appropriator, Private A. Stecker, Carl Fargen App. No. 427-A (601)Is the system an extension of another system? Yes ✓ No \_\_\_\_\_Is all land irrigated from one system? Yes \_\_\_\_\_ No ✓

(If No, show break down on map)

Source of Water Sweet Grass Can. FargenCan. Fargen Can. Otter Can.Acres Irrigated 19 50 374Potential Acres 88 Seeped \_\_\_\_\_

Explain \_\_\_\_\_

Condition of System Good where used, poor otherwiseAdequate Supply Yes ✓ No \_\_\_\_\_Explain Has water from three sourcesTopography Creek bottomInformation From Tom Donlon

Remarks \_\_\_\_\_

- OVER -

			A				
		29				28	
			A				A
		32				33	

1/ Donlon has 200 shares in Sw. Grass Can. & Res. Co. to irrigate any land of his but uses only a small portion of this in sec 29 pending renovation and repair of the main ditches and laterals.

2/ Webb ditch diverts near north line of Sec 29 on West side of Otter Cr. and is used to irrigate lands on west side of Otter Cr. in sections 29 and 32. Harold hold flood water rights on this ditch and uses this water to fill small reservoir in sec. 5. This system is in good condition and is in use at present.

3/ Swanson ditch diverts on south side of Tangen Coulee 300 yds west of east side of sec. 29. This ditch is used to irrigate land on east side of Otter creek in sections 29 and 32. below Tangen Coulee. The system is in good condition and is in use.

4/ The unnamed ditch diverts on east side of Otter creek near NE corner of the SW 1/4 of SE 1/4 of section 20 T.3N 15E and is used to irrigate two small fields on east side of Otter creek north of junction with Tangen Coulee in Sec 29

STATE OF MONTANA  
**State Engineer's Office**  
WATER RESOURCES SURVEY  
**FARM MAP**

County Sweetgrass  
Code No. 294-324-33A

Twp. 3N Rge. 15E  
Twp. \_\_\_\_\_ Rge. \_\_\_\_\_  
Twp. \_\_\_\_\_ Rge. \_\_\_\_\_

Name of Land Owner Danahy, Tom Address Big Timber  
Name of Operator Garrett Address " "  
Legal Description \_\_\_\_\_

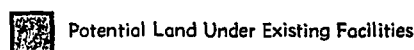
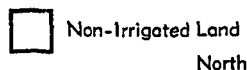

Code No. <u>294-324-33A</u>	System <u>Unnamed Ditch</u>	Source of Water <u>Otter Creek</u>
Basin <u>Otter Creek</u>	Present <u>39</u> Potential <u>0</u> Maximum <u>39</u>	R <u>✓</u> F <u>✓</u> P <u>✓</u> G <u>✓</u> S <u>✓</u>
Code No. <u>294-324-33A</u>	System <u>Swanson Ditch</u>	Source of Water <u>Tangen Coulee</u>
Basin <u>Otter Cr.</u>	Present <u>71</u> Potential <u>91</u> Maximum <u>91</u>	R <u>✓</u> F <u>✓</u> P <u>✓</u> G <u>✓</u> S <u>✓</u>
Code No. <u>294-324-33A</u>	System <u>Tangen or Webb Ditch</u>	Source of Water <u>Otter Creek</u>
Basin <u>Otter Creek</u>	Present <u>184</u> Potential <u>0</u> Maximum <u>184</u>	R <u>✓</u> F <u>✓</u> P <u>✓</u> G <u>✓</u> S <u>✓</u>
Code No. <u>294-324-33A</u>	System <u>Lower Canal (S.G. &amp; R.C.)</u>	Source of Water <u>Sweet Grass Cr.</u>
Basin <u>Sweet Grass</u>	Present <u>60</u> Potential <u>88</u> Maximum <u>148</u>	R <u>✓</u> F <u>✓</u> P <u>✓</u> G <u>✓</u> S <u>✓</u>

If under Ditch Company, Irrigation District, or Government Project, state the number of shares or inches, acre feet, as the case may be in said system. no shares in the Sweet Grass Canal & Reservoir Company

NOTE: R—Denotes Regular Irrigation. F—Flood Irrigation. P—Water diverted by means of pumping. G—Water diverted by gravity. S—Stored Water.

Information from \_\_\_\_\_ Date \_\_\_\_\_

Farm Checked

STATE OF MONTANA

Code No. 15A 14ABy MT & EC

## STATE ENGINEER'S OFFICE

County LincolnArea S.W. Gr. Can & Res Co. WATER RESOURCES SURVEYT. 3 N. R. 15 E Sec. 14, 15Date 7-1-50Photo No. MA-7A-150Legal Land Owner Harold LawAddress Big Timber

Operator \_\_\_\_\_ Address \_\_\_\_\_

Water is delivered by:

Federal Project \_\_\_\_\_ Pres. \_\_\_\_\_ Pot. \_\_\_\_\_

Ditch Company Sweet Grass Canal & Res. Co. Pres. \_\_\_\_\_ Pot. \_\_\_\_\_

Irrigation District \_\_\_\_\_ Pres. \_\_\_\_\_ Pot. \_\_\_\_\_

Private System \_\_\_\_\_ Pres. \_\_\_\_\_ Pot. \_\_\_\_\_

Totals \_\_\_\_\_

Flood \_\_\_\_\_ Pump \_\_\_\_\_ Reservoir \_\_\_\_\_ Gravity ☒

Size and Capacity, Pump, etc. \_\_\_\_\_

Original Appropriator, Company \_\_\_\_\_ App. No. \_\_\_\_\_

Original Appropriator, Private Alvin J. Glaser App. No. 1088Is the system an extension of another system? Yes ☒ No \_\_\_\_\_Is all land irrigated from one system? Yes ☒ No \_\_\_\_\_

(If No, show break down on map)

Source of Water Sweet Grass CreekAcres Irrigated 19 50 71Potential Acres 196 Seeped \_\_\_\_\_

Explain \_\_\_\_\_

Condition of System GoodAdequate Supply \_\_\_\_\_ Yes ☒ No \_\_\_\_\_

Explain \_\_\_\_\_

Topography \_\_\_\_\_

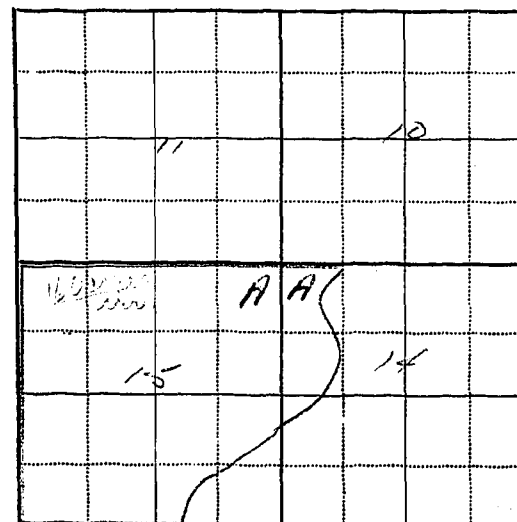
Information From Harold LawRemarks Over -

No irrigation or potential lands in Farr's holdings in Sec. 14

In Section 15, lands lying under Farr's lateral from the lower canal in the NW<sup>4</sup> are irrigated.

Considerable seeped areas (mapped in red) and potential lands are present, the source of water of which would be Lake Holwood, the lower Reservoir.

STATE OF MONTANA  
**State Engineer's Office**  
WATER RESOURCES SURVEY  
**FARM MAP**

County Sweetgrass  
Code No. 15A-14A

Twp. 3N Rge. 15E  
Twp. \_\_\_\_\_ Rge. \_\_\_\_\_  
Twp. \_\_\_\_\_ Rge. \_\_\_\_\_

Name of Land Owner FAW, HAROLD Address Big Timber  
Name of Operator SADUE Address " "  
Legal Description \_\_\_\_\_



Irrigated Land



Non-Irrigated Land



Potential Land Under Existing Facilities

North

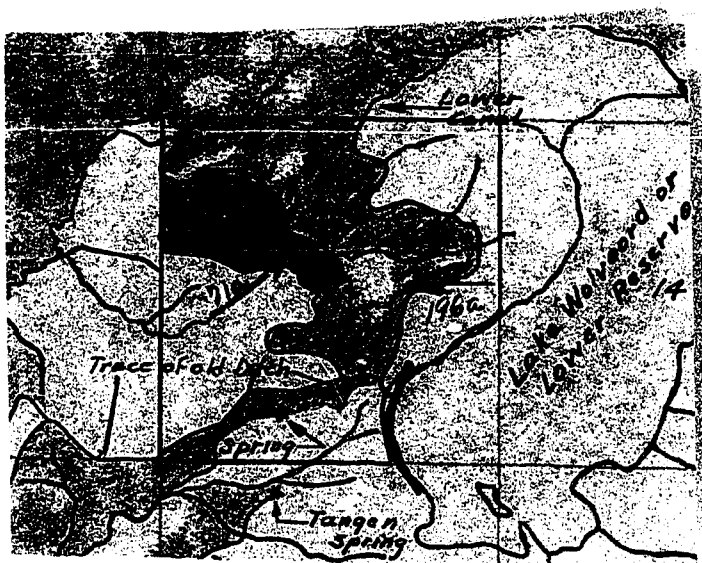

Code No. 15A System Lower Canal (S.G.C. & R.C.) Source of Water Sweet Grass Cr.  
Basin Sweet Grass Present 11 Potential 196 Maximum 2.67 R. F. P. G. S. V.  
Code No. \_\_\_\_\_ System \_\_\_\_\_ Source of Water \_\_\_\_\_  
Basin \_\_\_\_\_ Present \_\_\_\_\_ Potential \_\_\_\_\_ Maximum \_\_\_\_\_ R. F. P. G. S.  
Code No. \_\_\_\_\_ System \_\_\_\_\_ Source of Water \_\_\_\_\_  
Basin \_\_\_\_\_ Present \_\_\_\_\_ Potential \_\_\_\_\_ Maximum \_\_\_\_\_ R. F. P. G. S.  
Code No. \_\_\_\_\_ System \_\_\_\_\_ Source of Water \_\_\_\_\_  
Basin \_\_\_\_\_ Present \_\_\_\_\_ Potential \_\_\_\_\_ Maximum \_\_\_\_\_ R. F. P. G. S.

If under Ditch Company, Irrigation District, or Government Project, state the number of shares or inches, acre feet, as the case may be in said system.

NOTE: R—Denotes Regular Irrigation. F—Flood Irrigation. P—Water diverted by means of pumping. G—Water diverted by gravity. S—Stored Water.

Information from \_\_\_\_\_ Date \_\_\_\_\_

Farm Checked

By EC + MT

STATE OF MONTANA

Code No. 17E, 10H.Area Otter Cr.
**STATE ENGINEER'S OFFICE**  
 WATER RESOURCES SURVEY
County Sweet GrassDate Aug 3, 1950T. 3N R. 15E Sec. 12-10Photo No. MA-15A-18Legal Land Owner Wm. GlaserAddress Big TimberOperator Harold FauAddress "

Water is delivered by:

Federal Project \_\_\_\_\_ Pres. \_\_\_\_\_ Pot. \_\_\_\_\_

Ditch Company Sweet Grass Can. + Res. Co. Pres. \_\_\_\_\_ Pot. \_\_\_\_\_

Irrigation District \_\_\_\_\_ Pres. \_\_\_\_\_ Pot. \_\_\_\_\_

~~Private~~ System Cross Ditch Pres. \_\_\_\_\_ Pot. \_\_\_\_\_

Totals \_\_\_\_\_

Flood \_\_\_\_\_ Pump \_\_\_\_\_ Reservoir \_\_\_\_\_ Gravity ☒

Size and Capacity, Pump, etc. \_\_\_\_\_

Original Appropriator, Company \_\_\_\_\_ App. No. \_\_\_\_\_

Original Appropriator, Private Eugene Commission App. No. D-287Is the system an extension of another system? Yes ☒ No \_\_\_\_\_Is all land irrigated from one system? Yes \_\_\_\_\_ No ☒

(If No, show break down on map)

Source of Water Sweet Grass Cr.Acres Irrigated 1950 77Potential Acres 700 Seeped \_\_\_\_\_

Explain \_\_\_\_\_

Condition of System Good where usedAdequate Supply \_\_\_\_\_ Yes ☒ No \_\_\_\_\_Explain Supply from large res.Topography Rolling Hills and Creek bottomInformation From Harold FauRemarks - OVER -

Sec 17-<sup>1</sup> On west side of Otter Cr. in SE  $\frac{1}{4}$  of sec 17 there is a small parcel of land that could be irrigated by the Cross Ditch. No rights in this ditch are possessed by Harold Faw.

<sup>2</sup> Land on the east side of Otter Cr. in the SE  $\frac{1}{4}$  of Sec 17 is irrigated out of the Sweet Grass Can. & Res. Co. Other land in east  $\frac{1}{2}$  of Sec 17 is potential under Sweet Grass Can. & Res. Co. ditches. Seeped land on center line of east  $\frac{1}{2}$  of Sec 17 is colored in red.

Sec 10. Potential in Sec 10 is under Sweet Grass Can. & Res. Co. ditches. Seeped land in this section is colored in red



STATE OF MONTANA  
**STATE ENGINEER'S OFFICE**  
 WATER RESOURCES SURVEY

Township 30 Range 15E County Sweet Grass

6	5	4	3	2	1
7	8	9	10 <i>A</i>	11	12
18	17 <i>B</i>	16	15	14	13
19	20	21	22	23	24
30	29	28	27	26	25
31	32	33	34	35	36

*John G. Lewis*

\_\_\_\_\_

\_\_\_\_\_

\_\_\_\_\_

Township 3 Range 15

STATE OF MONTANA  
**State Engineer's Office**  
WATER RESOURCES SURVEY  
FARM MAP

County Bustergrass

Code No. \_\_\_\_\_

17P-104

Twp. 3 N Rge. 15 E

Twp. \_\_\_\_\_ Rge. \_\_\_\_\_

Twp. \_\_\_\_\_ Rge. \_\_\_\_\_

Name of Land Owner \_\_\_\_\_ Address \_\_\_\_\_

Name of Operator \_\_\_\_\_ Address \_\_\_\_\_

Legal Description \_\_\_\_\_



Irrigated Land



Non-Irrigated Land



Potential Land Under Existing Facilities

North

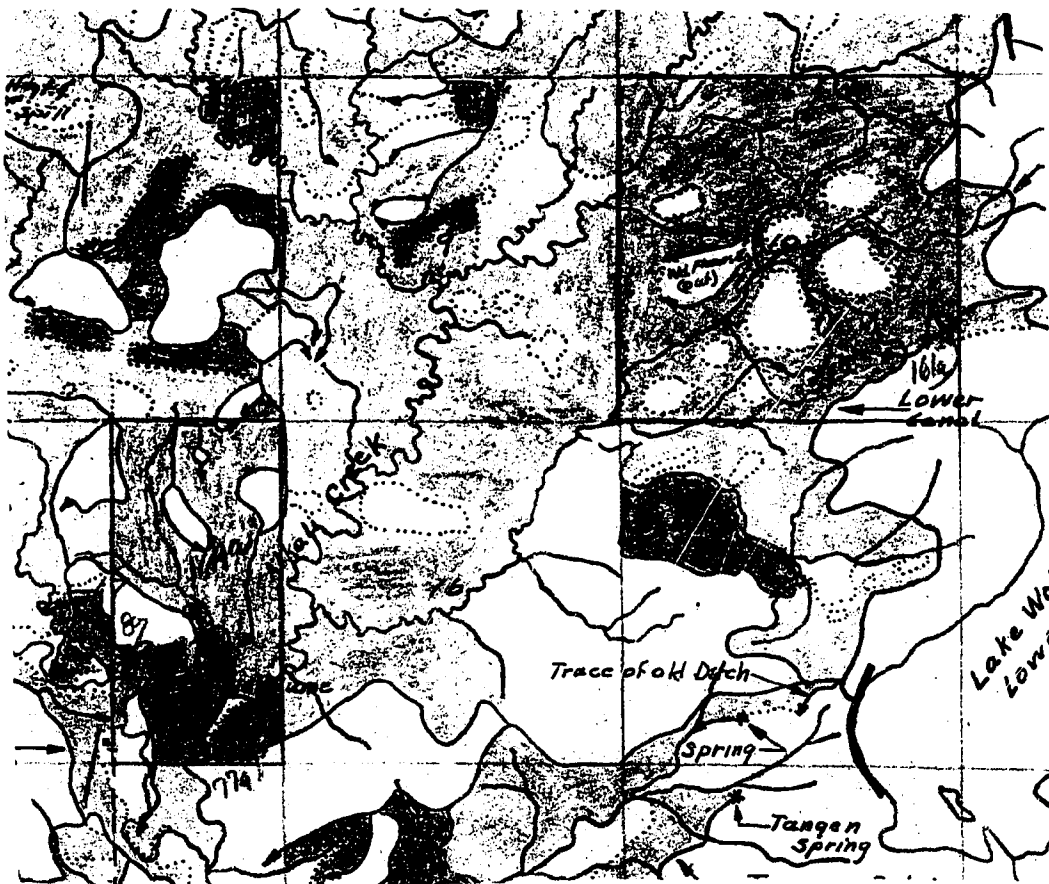

Code No. <u>17P-104</u>	System <u>gravity (ditch)</u>	Source of Water <u>Swamp Spring Cr.</u>
Basin <u>Swamp Spring</u>	Present <u>17</u> Potential <u>17</u> Maximum <u>259</u>	R. <u>✓</u> F. <u>✓</u> P. <u>✓</u> G. <u>✓</u> S. <u>✓</u>
Code No. <u>17P-104</u>	System <u>gravity (ditch)</u>	Source of Water <u>Swamp Spring Cr.</u>
Basin <u>Swamp Spring</u>	Present <u>17</u> Potential <u>17</u> Maximum <u>259</u>	R. <u>✓</u> F. <u>✓</u> P. <u>✓</u> G. <u>✓</u> S. <u>✓</u>
Code No. <u>17P-104</u>	System <u>gravity (ditch)</u>	Source of Water <u>Swamp Spring Cr.</u>
Basin <u>Swamp Spring</u>	Present <u>17</u> Potential <u>17</u> Maximum <u>259</u>	R. <u>✓</u> F. <u>✓</u> P. <u>✓</u> G. <u>✓</u> S. <u>✓</u>
Code No. <u>17P-104</u>	System <u>gravity (ditch)</u>	Source of Water <u>Swamp Spring Cr.</u>
Basin <u>Swamp Spring</u>	Present <u>17</u> Potential <u>17</u> Maximum <u>259</u>	R. <u>✓</u> F. <u>✓</u> P. <u>✓</u> G. <u>✓</u> S. <u>✓</u>

If under Ditch Company, Irrigation District, or Government Project, state the number of shares or inches, acre feet, as the case may be in said system.

NOTE: R—Denotes Regular Irrigation. F—Flood Irrigation. P—Water diverted by means of pumping. G—Water diverted by gravity. S—Stored Water.

Information from \_\_\_\_\_ Date \_\_\_\_\_

Farm Checked

By Jim & Bob

Area Sweet Grass Cr.

Date June 20, 1950

Legal Land Owner

Charles J. Harris

Operator

"

"

STATE OF MONTANA

STATE ENGINEER'S OFFICE

WATER RESOURCES SURVEY

FORM F-1 - GAZETTE 1945-2M-1-47

Code No.

12A-17A

County

Lincoln

T.

3N R. 15E Sec. 18, 19

Photo No.

11A-12A-18  
12A-19

Address

Big Timber

Address

Water is delivered by:

Federal Project

Pres.

Pot.

Ditch Company

Sweet Grass Cr. Canal & Res. Co.

Pres.

Pot.

Irrigation District

Pres.

Pot.

Private System

Pres.

Pot.

Totals

Flood

Pump

Reservoir

☒

Gravity

☒

Size and Capacity, Pump, etc.

Original Appropriator, Company

App. No.

Original Appropriator, Private

Charles J. Harris

App. No.

134

Is the system an extension of another system?

Yes

No

☒

Is all land irrigated from one system?

Yes

No

☒

(If No, show break down on map)

Source of Water

Big Timber Cr., Sweet Grass Cr.

Acres Irrigated 19 50

217

Potential Acres

12

Seeped

Explain

Condition of System

Good

Adequate Supply

Yes

No

☒

Explain

Topography

Creek bottom & bench land

Information From

Charles J. Harris

Remarks

Has 685 shares in Sweet Grass

Cr. Canal & Res. Co. in both T 3N-14 & 15E

	11				
	18			17	
A					
	19			20	

X5-  
+14+17

STATE OF MONTANA

**State Engineer's Office**  
**WATER RESOURCES SURVEY**  
**FARM MAP**

County Sweetgrass

Code No. \_\_\_\_\_

18A-19A

Twp. 3N Rge. 15E

Twp. \_\_\_\_\_ Rge. \_\_\_\_\_

Twp. \_\_\_\_\_ Rge. \_\_\_\_\_

Name of Land Owner HARMS, CHAS. J. Address Big Timber

Name of Operator Same Address " "

Legal Description \_\_\_\_\_

☐ Irrigated Land

☐ Non-Irrigated Land  
North

☒ Potential Land Under Existing Facilities

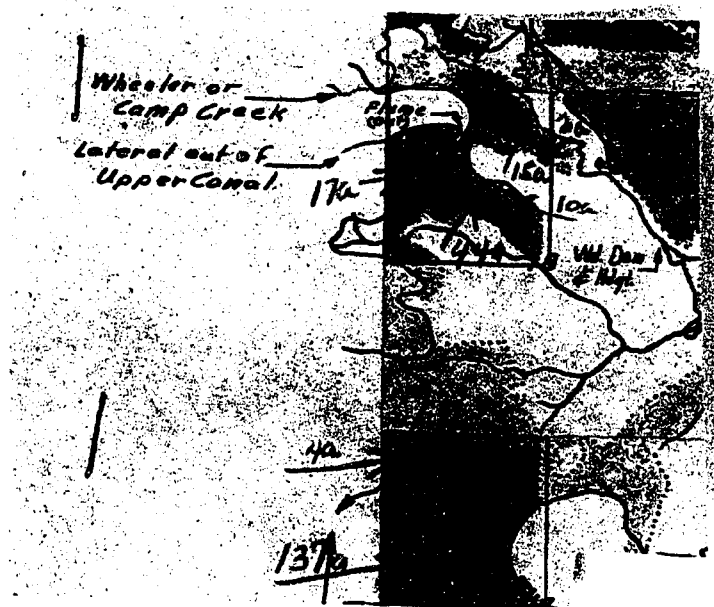

Code No. <u>18A, 19A</u>	System <u>Upper Canal (S.G.C. &amp; R.Co.)</u>	Source of Water <u>Sweet Grass Cr.</u>
Basin <u>Sweet Grass</u>	Present <u>21</u> Potential <u>2</u> Maximum <u>21</u>	R <u>✓</u> F <u>✓</u> P <u>✓</u> G <u>✓</u> S <u>✓</u>
Code No. <u>18A, 19A</u>	System <u>Lower Canal (S.G.C. &amp; R.Co.)</u>	Source of Water <u>Sweet Grass Cr.</u>
Basin <u>Sweet Grass</u>	Present <u>196</u> Potential <u>12</u> Maximum <u>208</u>	R <u>✓</u> F <u>✓</u> P <u>✓</u> G <u>✓</u> S <u>✓</u>
Code No. _____	System _____	Source of Water _____
Basin _____	Present _____ Potential _____ Maximum _____	R _____ F _____ P _____ G _____ S _____
Code No. _____	System _____	Source of Water _____
Basin _____	Present _____ Potential _____ Maximum _____	R _____ F _____ P _____ G _____ S _____

If under Ditch Company, Irrigation District, or Government Project, state the number of shares or inches, acre feet, as the case may be in said system. 685 Shares in Sweet Grass Canal & Reservoir Co.

NOTE: R—Denotes Regular Irrigation. F—Flood Irrigation. P—Water diverted by means of pumping. G—Water diverted by gravity. S—Stored Water.

Information from \_\_\_\_\_ Date \_\_\_\_\_

Farm Checked

## STATE OF MONTANA

Code No. 190 200 30 31

By \_\_\_\_\_

## STATE ENGINEER'S OFFICE

County Sweet Grass

Area \_\_\_\_\_

## WATER RESOURCES SURVEY

T. 3 N R. 15 E Sec. 19, 20, 31

Date \_\_\_\_\_

Photo No. MA-12A-19

Legal Land Owner \_\_\_\_\_

Address Big Timber

Operator \_\_\_\_\_

Address \_\_\_\_\_

Water is delivered by:

Federal Project \_\_\_\_\_ Pres. \_\_\_\_\_ Pot. \_\_\_\_\_

Ditch Company Sweet Grass \_\_\_\_\_ Pres. Sweet Grass Pot. \_\_\_\_\_

Irrigation District \_\_\_\_\_ Pres. \_\_\_\_\_ Pot. \_\_\_\_\_

Private System \_\_\_\_\_ Pres. \_\_\_\_\_ Pot. \_\_\_\_\_

Totals \_\_\_\_\_

Flood \_\_\_\_\_ Pump \_\_\_\_\_ Reservoir \_\_\_\_\_ Gravity \_\_\_\_\_

Size and Capacity, Pump, etc. \_\_\_\_\_

Original Appropriator, Company \_\_\_\_\_ App. No. \_\_\_\_\_

Original Appropriator, Private Stocker, Chas. E. App. No. 134Is the system an extension of another system? Yes \_\_\_\_\_ No ✓

Is all land irrigated from one system? Yes \_\_\_\_\_ No \_\_\_\_\_

(If No, show break down on map)

Source of Water Sweet GrassAcres Irrigated 19 362Potential Acres 243 Seeped \_\_\_\_\_

Explain \_\_\_\_\_

Condition of System Good

Adequate Supply \_\_\_\_\_ Yes \_\_\_\_\_ No \_\_\_\_\_

Explain \_\_\_\_\_

Topography Rolling hillsInformation From Stocker, Chas. E.Remarks 362 acres

15

STATE OF MONTANA  
**STATE ENGINEER'S OFFICE**  
 WATER RESOURCES SURVEY

Township 30 Range 15 E County Sweetgrass

6	5	4	3	2	1
7	8	9	10	11	12
18	17	16	15	14	13
19	20	21	22	23	24
D	C				
A					
30	29	28	27	26	25
A					
31	32	33	34	35	36

Dominic Spivey

Township 3 Range 15

STATE OF MONTANA

# State Engineer's Office

WATER RESOURCES SURVEY

FARM MAP

County Sweetgrass

Code No. \_\_\_\_\_

19D-200-30A-

31A

Twp. 3N Rge. 15E

Twp. \_\_\_\_\_ Rge. \_\_\_\_\_

Twp. \_\_\_\_\_ Rge. \_\_\_\_\_

Name of Land Owner McParadise, Dominica Address Big Timber

Name of Operator Same Address \_\_\_\_\_

Legal Description \_\_\_\_\_



Irrigated Land



Non-Irrigated Land



Potential Land Under Existing Facilities

North

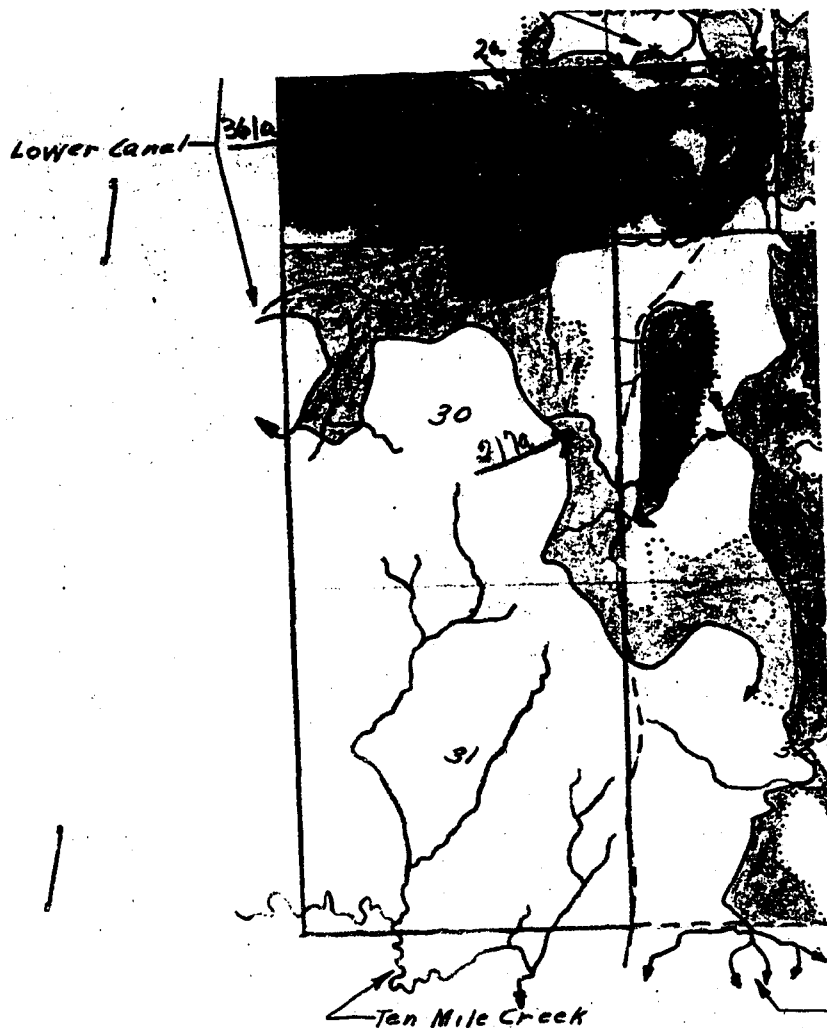

Code No. <u>200</u>	System <u>grass water in 100</u>	Source of Water <u>West Grass Cr.</u>
Basin <u>the same</u>	Present <u>1</u>	Potential <u>5</u> Maximum <u>6</u>
		R <u>✓</u> F <u>✓</u> P <u>✓</u> G <u>✓</u> S <u>✓</u>
Code No. _____	System _____	Source of Water _____
Basin _____	Present _____	Potential _____ Maximum _____
		R _____ F _____ P _____ G _____ S _____
Code No. _____	System _____	Source of Water _____
Basin _____	Present _____	Potential _____ Maximum _____
		R _____ F _____ P _____ G _____ S _____

If under Ditch Company, Irrigation District, or Government Project, state the number of shares or inches, acre feet, as the case may be in said system. 250 shares in Sweet Grass Canal & Reservoir Company

NOTE: R—Denotes Regular Irrigation. F—Flood Irrigation. P—Water diverted by means of pumping. G—Water diverted by gravity. S—Stored Water.

Information from \_\_\_\_\_ Date \_\_\_\_\_

STATE OF MONTANA

# State Engineer's Office

WATER RESOURCES SURVEY

FARM MAP

County Sweetgrass

Code No. 12D-200-30A

31A

Twp. 3N Rge. 15E

Twp. \_\_\_\_\_ Rge. \_\_\_\_\_

Twp. \_\_\_\_\_ Rge. \_\_\_\_\_

Name of Land Owner McCormick, Darrin Address Big Timber

Name of Operator Same Address \_\_\_\_\_

Local Description \_\_\_\_\_

☒ Irrigated Land

☐ Non-Irrigated Land

☒ Potential Land Under Existing Facilities

North

Code No. 12D-200-30A 31A System Canal (S.G. & P.C.) Source of Water Sweetgrass Cr.  
Basin Sweetgrass Present 361 Potential 238 Maximum 599 R. ✓ F. ✓ P. ✓ G. ✓ S. ✓  
Code No. 200 System Grass Ditch (not in use) Source of Water Other Creek  
Basin Other Creek Present 1 Potential 5 Maximum 6 R. ✓ F. ✓ P. ✓ G. ✓ S. ✓  
Code No. \_\_\_\_\_ System \_\_\_\_\_ Source of Water \_\_\_\_\_  
Basin \_\_\_\_\_ Present \_\_\_\_\_ Potential \_\_\_\_\_ Maximum \_\_\_\_\_ R. \_\_\_\_\_ F. \_\_\_\_\_ P. \_\_\_\_\_ G. \_\_\_\_\_ S. \_\_\_\_\_  
Code No. \_\_\_\_\_ System \_\_\_\_\_ Source of Water \_\_\_\_\_  
Basin \_\_\_\_\_ Present \_\_\_\_\_ Potential \_\_\_\_\_ Maximum \_\_\_\_\_ R. \_\_\_\_\_ F. \_\_\_\_\_ P. \_\_\_\_\_ G. \_\_\_\_\_ S. \_\_\_\_\_

If under Ditch Company, Irrigation District, or Government Project, state the number of shares or inches, acre feet, as the case may be in said system. 250 Shares in Sweet Grass Canal & Reservoir Company

NOTE: R—Denotes Regular Irrigation. F—Flood Irrigation. P—Water diverted by means of pumping. G—Water diverted by gravity. S—Stored Water.

Information from \_\_\_\_\_ Date \_\_\_\_\_



Farm Checked

By EC + MT

Area Otter Cr.

Date Aug 3, 1950

Legal Land Owner

State of Montana Address

Operator

Harold Faw Address Big Timber

Water is delivered by:

Federal Project Pres. Pot.

Ditch Company Sweet Grass Can. & Res. Co Pres. Pot.

Irrigation District Pres. Pot.

Private System Pres. Pot.

Totals

Flood Pump Reservoir Gravity ☒

Size and Capacity, Pump, etc.

Original Appropriator, Company App. No.

Original Appropriator, Private App. No.

Is the system an extension of another system? Yes ☒ No

Is all land irrigated from one system? Yes ☒ No

(If No, show break down on map)

Source of Water Sweet Grass Creek

Acres Irrigated 19.50, 0

Potential Acres 362 Seeped

Explain

Condition of System Good

Adequate Supply Yes ☒ No

Explain Large Res. is source of supply

Topography Hills and Creek bottom

Information From Harold Faw

Remarks — over —

FORM F-1 REPORTER IM 3-49 17380

Code No. 16A

County Sweet Grass

T. 3N R. 15E Sec. 16

Photo No. MA-12A-18

All the land in sec. 16 listed as potential  
is potential under the lower canal of the  
Sweet Grass Can. & Res. Co. None of the land  
is irrigated because of the lack of  
water rights to cover the land.

STATE OF MONTANA

State Engineer's Office

WATER RESOURCES SURVEY

FARM MAP

County Sweetgrass

Code No. 16A

Twp. 3N Rge. 15E

Twp. \_\_\_\_\_ Rge. \_\_\_\_\_

Twp. \_\_\_\_\_ Rge. \_\_\_\_\_

Name of Land Owner Montana State of Address \_\_\_\_\_

Name of Operator Harold Faw Address Big Timber

Legal Description \_\_\_\_\_

☐ Irrigated Land

☐ Non-Irrigated Land  
North

☒ Potential Land Under Existing Facilities



Code No. 16A System Lower Canal (S.G.C. & R. Co.) Source of Water Sweet Grass Creek  
Basin Sweet Grass Present 0 Potential 362 Maximum 362 R ✓ F ✓ P ✓ G ✓ S ✓  
Code No. \_\_\_\_\_ System \_\_\_\_\_ Source of Water \_\_\_\_\_  
Basin \_\_\_\_\_ Present \_\_\_\_\_ Potential \_\_\_\_\_ Maximum \_\_\_\_\_ R \_\_\_\_\_ F \_\_\_\_\_ P \_\_\_\_\_ G \_\_\_\_\_ S \_\_\_\_\_  
Code No. \_\_\_\_\_ System \_\_\_\_\_ Source of Water \_\_\_\_\_  
Basin \_\_\_\_\_ Present \_\_\_\_\_ Potential \_\_\_\_\_ Maximum \_\_\_\_\_ R \_\_\_\_\_ F \_\_\_\_\_ P \_\_\_\_\_ G \_\_\_\_\_ S \_\_\_\_\_  
Code No. \_\_\_\_\_ System \_\_\_\_\_ Source of Water \_\_\_\_\_  
Basin \_\_\_\_\_ Present \_\_\_\_\_ Potential \_\_\_\_\_ Maximum \_\_\_\_\_ R \_\_\_\_\_ F \_\_\_\_\_ P \_\_\_\_\_ G \_\_\_\_\_ S \_\_\_\_\_

If under Ditch Company, Irrigation District, or Government Project, state the number of shares or inches, acre feet, as the case may be in said system.

NOTE: R—Denotes Regular Irrigation. F—Flood Irrigation. P—Water diverted by means of pumping. G—Water diverted by gravity. S—Stored Water.

Information from \_\_\_\_\_ Date \_\_\_\_\_

**Farm Checked**

**STATE OF MONTANA**

Code No..

By \_\_\_\_\_

**STATE ENGINEER'S OFFICE**  
**WATER RESOURCES SURVEY**

County Sweet Grass

Area \_\_\_\_\_

T. 3N R. 15E Sec. 18

Date \_\_\_\_\_

Photo No. \_\_\_\_\_

Legal Land Owner Montana State et Address \_\_\_\_\_

Operator \_\_\_\_\_ Address \_\_\_\_\_

**Water is delivered by:**

Federal Project \_\_\_\_\_ Pres. \_\_\_\_\_ Pot. \_\_\_\_\_

Ditch Company Sweet Grass C. & R. Co. Pres. 12 Pot. 91

Irrigation District \_\_\_\_\_ Pres. \_\_\_\_\_ Pot. \_\_\_\_\_

Private System \_\_\_\_\_ Pres. \_\_\_\_\_ Pot. \_\_\_\_\_

Totals \_\_\_\_\_

Flood \_\_\_\_\_ Pump \_\_\_\_\_ Reservoir ☒ Gravity ☒

Size and Capacity, Pump, etc. \_\_\_\_\_

Original Appropriator, Company \_\_\_\_\_ App. No. \_\_\_\_\_

Original Appropriator, Private \_\_\_\_\_ App. No. \_\_\_\_\_

Is the system an extension of another system? Yes\_\_\_\_\_No\_\_\_\_\_

Is all land irrigated from one system? Yes\_\_\_\_\_No\_\_\_\_\_

(If No, show break down on map)

Source of Water Sweet Grass Cr

Acres Irrigated 19 50, 0

Potential Acres 91 Seeped                     

### Explain

Condition of System \_\_\_\_\_

Adequate Supply ..... Yes\_\_\_\_\_ No\_\_\_\_\_

### Explain

### Topography

Information From \_\_\_\_\_

Remarks \_\_\_\_\_

A 10x10 grid with a thick border. The letter 'D' is written in the 4th column and 5th row from the top-left corner.

STATE OF MONTANA  
**State Engineer's Office**  
WATER RESOURCES SURVEY  
FARM MAP

County Sweet Grass  
Code No. 18D

Twp. \_\_\_\_\_ Rge. \_\_\_\_\_  
Twp. \_\_\_\_\_ Rge. \_\_\_\_\_  
Twp. 3N Rge. 15E

Name of Land Owner Montana State of Address \_\_\_\_\_  
Name of Operator ? Address \_\_\_\_\_  
Legal Description \_\_\_\_\_

☐ Irrigated Land

☐ Non-Irrigated Land  
North

☐ Potential Land Under Existing Facilities

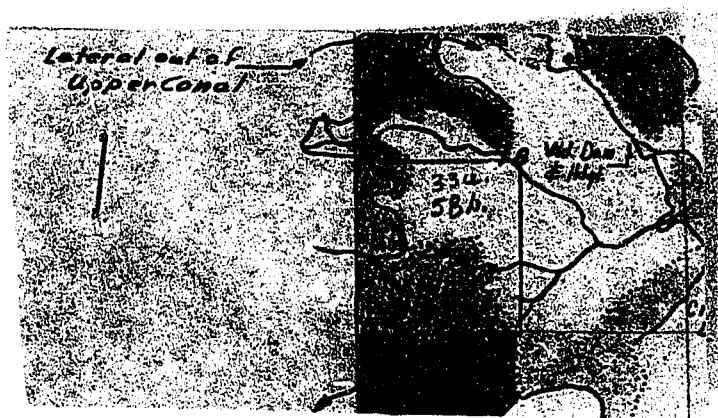

Code No. 18D System Upper Canal / S.G. & P. Co. Source of Water Sweet Grass Co.  
Basin Sweet Grass Present 0 Potential 33 Maximum 33 R ✓ F ✓ P ✓ G ✓ S ✓  
Code No. 18D System Lower Canal / S.G. & P. Co. Source of Water Sweet Grass Co.  
Basin Sweet Grass Present 0 Potential 58 Maximum 58 R ✓ F ✓ P ✓ G ✓ S ✓  
Code No. \_\_\_\_\_ System \_\_\_\_\_ Source of Water \_\_\_\_\_  
Basin \_\_\_\_\_ Present \_\_\_\_\_ Potential \_\_\_\_\_ Maximum \_\_\_\_\_ R \_\_\_\_\_ F \_\_\_\_\_ P \_\_\_\_\_ G \_\_\_\_\_ S \_\_\_\_\_  
Code No. \_\_\_\_\_ System \_\_\_\_\_ Source of Water \_\_\_\_\_  
Basin \_\_\_\_\_ Present \_\_\_\_\_ Potential \_\_\_\_\_ Maximum \_\_\_\_\_ R \_\_\_\_\_ F \_\_\_\_\_ P \_\_\_\_\_ G \_\_\_\_\_ S \_\_\_\_\_

If under Ditch Company, Irrigation District, or Government Project, state the number of shares or inches, acre feet, as the case may be in said system.

NOTE: R—Denotes Regular Irrigation. F—Flood Irrigation. P—Water diverted by means of pumping. G—Water diverted by gravity. S—Stored Water.

Information from \_\_\_\_\_ Date \_\_\_\_\_

Farm Checked

STATE OF MONTANA

Code No. 174, 180, 195, 204By BB, E. & MT

## STATE ENGINEER'S OFFICE

County SweetgrassArea 5, Can & Res Co.

WATER RESOURCES SURVEY

T. 3N R. 15E Sec. 12, 18, 19, 20Date 5-6-58Photo No. MA-12 A-18

Legal Land Owner

Amshelm OlinAddress Big Timber

Operator

Wayne LawAddress Big Timber

Water is delivered by:

Federal Project \_\_\_\_\_ Pres. \_\_\_\_\_ Pot. \_\_\_\_\_

Ditch Company Sweetgrass Canal & Res. Co. Pres. \_\_\_\_\_ Pot. \_\_\_\_\_

Irrigation District \_\_\_\_\_ Pres. \_\_\_\_\_ Pot. \_\_\_\_\_

Private System Cross Ditch Pres. \_\_\_\_\_ Pot. \_\_\_\_\_

Totals \_\_\_\_\_

Flood \_\_\_\_\_ Pump \_\_\_\_\_ Reservoir \_\_\_\_\_ Gravity ☒

Size and Capacity, Pump, etc.

Original Appropriator, Company Eugene Cummings; C. F. Stocker; App. No. \_\_\_\_\_Original Appropriator, Private E. (Dress); Danford Nevin App. No. 274, 134, 528,  
D-287, 574, 575,  
D-338.Is the system an extension of another system? Yes ☒ No \_\_\_\_\_Is all land irrigated from one system? Yes \_\_\_\_\_ No ☒

(If No, show break down on map)

Source of Water Cameron Cr.; Big Timber Cr.; MedicineBasin; Sweetgrass Cr.; Otter Cr.Acres Irrigated 19 50 99Potential Acres 213 Seeped \_\_\_\_\_

Explain \_\_\_\_\_

Condition of System GoodAdequate Supply Yes ☒ No \_\_\_\_\_

Explain \_\_\_\_\_

Topography \_\_\_\_\_

Information From Wayne Law

Remarks \_\_\_\_\_

				A	
	16		C		17
			B	A	
	17				20

15

over-

- ① The Cross ditch out of Otter Cr. is used and maintained by Wayne Faw and Merritt Sherod. This ditch is in good shape. The water is insufficient due to the fact that Otter Cr. dries up in late summer. Point of diversion is in S<sup>1</sup>/<sub>2</sub> NE<sup>1</sup>/<sub>4</sub> of Sec. 18 T3N-R15E on west bank. It irrigates lands in the SW<sup>1</sup>/<sub>4</sub> Sec 17 and the E<sup>1</sup>/<sub>2</sub> NW<sup>1</sup>/<sub>4</sub> Sec 20.
- ② Faw has a lateral out of the Sweetgrass Canal and Reservoir Co system. He irrigates lands in NE<sup>1</sup>/<sub>4</sub> SW<sup>1</sup>/<sub>4</sub> Sec 17 T3N-R15E from this source. He holds 100 shares in the company. The water is not apurtenant to any specific land parcel.
- ③ Lands lying in the W<sup>1</sup>/<sub>2</sub> of Sec. 17 above the draw running approximately N-S thru the center of the W<sup>1</sup>/<sub>2</sub> of Sec 17 and below the Cummings Ditch out of Otter Creek are potential under that ditch.

STATE OF MONTANA  
**State Engineer's Office**  
WATER RESOURCES SURVEY  
FARM MAP

County Sweetgrass  
Code No. 17A-19C-19B-  
20A

Twp. 3N Rge. 15E  
Twp. \_\_\_\_\_ Rge. \_\_\_\_\_  
Twp. \_\_\_\_\_ Rge. \_\_\_\_\_

Name of Land Owner Arshelvin Olin Address Big Timber  
Name of Operator Wayne Faw Address "  
Legal Description \_\_\_\_\_



Irrigated Land



Non-Irrigated Land



Potential Land Under Existing Facilities

North

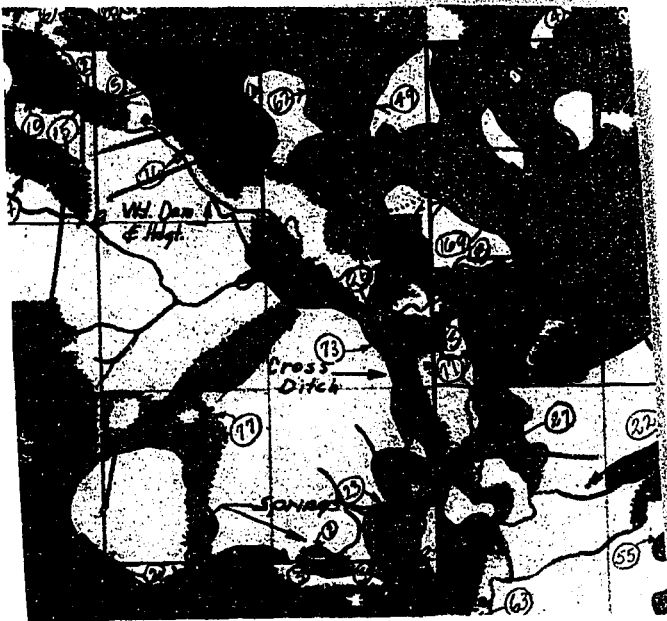

Code No. 17A, 18C, 19B System Lower Canal (S.G.C. & R.C.) Source of Water Sweet Grass Cr.  
Basin Sweet Grass Present 26 Potential 126 Maximum 152 R ✓ F ✓ P ✓ G ✓ S ✓  
Code No. 20A System Cross Ditch Source of Water Other Cr.  
Basin Other Present 13 Potential 25 Maximum 98 R ✓ F ✓ P ✓ G ✓ S ✓  
Code No. 17A System Cummings Ditches Source of Water Other Cr.  
Basin Other Present 0 Potential 62 Maximum 62 R ✓ F ✓ P ✓ G ✓ S ✓  
Code No. \_\_\_\_\_ System \_\_\_\_\_ Source of Water \_\_\_\_\_  
Basin \_\_\_\_\_ Present \_\_\_\_\_ Potential \_\_\_\_\_ Maximum \_\_\_\_\_ R \_\_\_\_\_ F \_\_\_\_\_ P \_\_\_\_\_ G \_\_\_\_\_ S \_\_\_\_\_

If under Ditch Company, Irrigation District, or Government Project, state the number of shares or inches, acre feet, as the case may be in said system.

NOTE: R—Denotes Regular Irrigation. F—Flood Irrigation. P—Water diverted by means of pumping. G—Water diverted by gravity.  
S—Stored Water.

Information from \_\_\_\_\_ Date \_\_\_\_\_



Farm Checked

## STATE OF MONTANA

## STATE ENGINEER'S OFFICE

## WATER RESOURCES SURVEY

Code No. 64County SweetgrassT. 3NR. 15ESec. 6Photo No. HA-12A-18By Wm. B. BickArea LandDate June 1950Legal Land Owner Albert OlsenAddress Big Timber

Operator \_\_\_\_\_

Address \_\_\_\_\_

Water is delivered by:

Federal Project \_\_\_\_\_

Pres. \_\_\_\_\_

Pot. \_\_\_\_\_

Ditch Company Sweet

Pres. \_\_\_\_\_

Pot. \_\_\_\_\_

Irrigation District \_\_\_\_\_

Pres. \_\_\_\_\_

Pot. \_\_\_\_\_

Private System \_\_\_\_\_

Pres. 0Pot. 0

Totals \_\_\_\_\_

Flood \_\_\_\_\_

Pump \_\_\_\_\_

Reservoir ✓Gravity ✓

Size and Capacity, Pump, etc. \_\_\_\_\_

Original Appropriator, Company \_\_\_\_\_

App. No. \_\_\_\_\_

Original Appropriator, Private Albert OlsenApp. No. 1045

Is the system an extension of another system?

Yes \_\_\_\_\_

No ✓

Is all land irrigated from one system?

Yes ✓

No \_\_\_\_\_

(If No show break down on map)

Source of Water Underground SpringAcres Irrigated 19 50Potential Acres 251

Seeped \_\_\_\_\_

Explain \_\_\_\_\_

Condition of System Good

Adequate Supply \_\_\_\_\_

Yes ✓

No \_\_\_\_\_

Explain \_\_\_\_\_

Topography Rolling to hilly land

Information From \_\_\_\_\_

Remarks See sketch on p. 2, 3, 4, 5, 6, 7, 8, 9, 10, 11, 12, 13, 14, 15, 16, 17, 18, 19, 20, 21, 22, 23, 24, 25, 26, 27, 28, 29, 30, 31, 32, 33, 34, 35, 36, 37, 38, 39, 40, 41, 42, 43, 44, 45, 46, 47, 48, 49, 50, 51, 52, 53, 54, 55, 56, 57, 58, 59, 60, 61, 62, 63, 64, 65, 66, 67, 68, 69, 70, 71, 72, 73, 74, 75, 76, 77, 78, 79, 80, 81, 82, 83, 84, 85, 86, 87, 88, 89, 90, 91, 92, 93, 94, 95, 96, 97, 98, 99, 100, 101, 102, 103, 104, 105, 106, 107, 108, 109, 110, 111, 112, 113, 114, 115, 116, 117, 118, 119, 120, 121, 122, 123, 124, 125, 126, 127, 128, 129, 130, 131, 132, 133, 134, 135, 136, 137, 138, 139, 140, 141, 142, 143, 144, 145, 146, 147, 148, 149, 150, 151, 152, 153, 154, 155, 156, 157, 158, 159, 160, 161, 162, 163, 164, 165, 166, 167, 168, 169, 170, 171, 172, 173, 174, 175, 176, 177, 178, 179, 180, 181, 182, 183, 184, 185, 186, 187, 188, 189, 190, 191, 192, 193, 194, 195, 196, 197, 198, 199, 200, 201, 202, 203, 204, 205, 206, 207, 208, 209, 210, 211, 212, 213, 214, 215, 216, 217, 218, 219, 220, 221, 222, 223, 224, 225, 226, 227, 228, 229, 230, 231, 232, 233, 234, 235, 236, 237, 238, 239, 240, 241, 242, 243, 244, 245, 246, 247, 248, 249, 250, 251, 252, 253, 254, 255, 256, 257, 258, 259, 260, 261, 262, 263, 264, 265, 266, 267, 268, 269, 270, 271, 272, 273, 274, 275, 276, 277, 278, 279, 280, 281, 282, 283, 284, 285, 286, 287, 288, 289, 290, 291, 292, 293, 294, 295, 296, 297, 298, 299, 300, 301, 302, 303, 304, 305, 306, 307, 308, 309, 310, 311, 312, 313, 314, 315, 316, 317, 318, 319, 320, 321, 322, 323, 324, 325, 326, 327, 328, 329, 330, 331, 332, 333, 334, 335, 336, 337, 338, 339, 340, 341, 342, 343, 344, 345, 346, 347, 348, 349, 350, 351, 352, 353, 354, 355, 356, 357, 358, 359, 360, 361, 362, 363, 364, 365, 366, 367, 368, 369, 370, 371, 372, 373, 374, 375, 376, 377, 378, 379, 380, 381, 382, 383, 384, 385, 386, 387, 388, 389, 390, 391, 392, 393, 394, 395, 396, 397, 398, 399, 400, 401, 402, 403, 404, 405, 406, 407, 408, 409, 410, 411, 412, 413, 414, 415, 416, 417, 418, 419, 420, 421, 422, 423, 424, 425, 426, 427, 428, 429, 430, 431, 432, 433, 434, 435, 436, 437, 438, 439, 440, 441, 442, 443, 444, 445, 446, 447, 448, 449, 450, 451, 452, 453, 454, 455, 456, 457, 458, 459, 460, 461, 462, 463, 464, 465, 466, 467, 468, 469, 470, 471, 472, 473, 474, 475, 476, 477, 478, 479, 480, 481, 482, 483, 484, 485, 486, 487, 488, 489, 490, 491, 492, 493, 494, 495, 496, 497, 498, 499, 500, 501, 502, 503, 504, 505, 506, 507, 508, 509, 510, 511, 512, 513, 514, 515, 516, 517, 518, 519, 520, 521, 522, 523, 524, 525, 526, 527, 528, 529, 530, 531, 532, 533, 534, 535, 536, 537, 538, 539, 540, 541, 542, 543, 544, 545, 546, 547, 548, 549, 550, 551, 552, 553, 554, 555, 556, 557, 558, 559, 560, 561, 562, 563, 564, 565, 566, 567, 568, 569, 570, 571, 572, 573, 574, 575, 576, 577, 578, 579, 580, 581, 582, 583, 584, 585, 586, 587, 588, 589, 590, 591, 592, 593, 594, 595, 596, 597, 598, 599, 600, 601, 602, 603, 604, 605, 606, 607, 608, 609, 610, 611, 612, 613, 614, 615, 616, 617, 618, 619, 620, 621, 622, 623, 624, 625, 626, 627, 628, 629, 630, 631, 632, 633, 634, 635, 636, 637, 638, 639, 640, 641, 642, 643, 644, 645, 646, 647, 648, 649, 650, 651, 652, 653, 654, 655, 656, 657, 658, 659, 660, 661, 662, 663, 664, 665, 666, 667, 668, 669, 670, 671, 672, 673, 674, 675, 676, 677, 678, 679, 680, 681, 682, 683, 684, 685, 686, 687, 688, 689, 690, 691, 692, 693, 694, 695, 696, 697, 698, 699, 700, 701, 702, 703, 704, 705, 706, 707, 708, 709, 710, 711, 712, 713, 714, 715, 716, 717, 718, 719, 720, 721, 722, 723, 724, 725, 726, 727, 728, 729, 730, 731, 732, 733, 734, 735, 736, 737, 738, 739, 740, 741, 742, 743, 744, 745, 746, 747, 748, 749, 750, 751, 752, 753, 754, 755, 756, 757, 758, 759, 760, 761, 762, 763, 764, 765, 766, 767, 768, 769, 770, 771, 772, 773, 774, 775, 776, 777, 778, 779, 780, 781, 782, 783, 784, 785, 786, 787, 788, 789, 790, 791, 792, 793, 794, 795, 796, 797, 798, 799, 800, 801, 802, 803, 804, 805, 806, 807, 808, 809, 810, 811, 812, 813, 814, 815, 816, 817, 818, 819, 820, 821, 822, 823, 824, 825, 826, 827, 828, 829, 830, 831, 832, 833, 834, 835, 836, 837, 838, 839, 840, 841, 842, 843, 844, 845, 846, 847, 848, 849, 850, 851, 852, 853, 854, 855, 856, 857, 858, 859, 860, 861, 862, 863, 864, 865, 866, 867, 868, 869, 870, 871, 872, 873, 874, 875, 876, 877, 878, 879, 880, 881, 882, 883, 884, 885, 886, 887, 888, 889, 890, 891, 892, 893, 894, 895, 896, 897, 898, 899, 900, 901, 902, 903, 904, 905, 906, 907, 908, 909, 910, 911, 912, 913, 914, 915, 916, 917, 918, 919, 920, 921, 922, 923, 924, 925, 926, 927, 928, 929, 930, 931, 932, 933, 934, 935, 936, 937, 938, 939, 940, 941, 942, 943, 944, 945, 946, 947, 948, 949, 950, 951, 952, 953, 954, 955, 956, 957, 958, 959, 960, 961, 962, 963, 964, 965, 966, 967, 968, 969, 970, 971, 972, 973, 974, 975, 976, 977, 978, 979, 980, 981, 982, 983, 984, 985, 986, 987, 988, 989, 990, 991, 992, 993, 994, 995, 996, 997, 998, 999, 1000, 1001, 1002, 1003, 1004, 1005, 1006, 1007, 1008, 1009, 1010, 1011, 1012, 1013, 1014, 1015, 1016, 1017, 1018, 1019, 1020, 1021, 1022, 1023, 1024, 1025, 1026, 1027, 1028, 1029, 1030, 1031, 1032, 1033, 1034, 1035, 1036, 1037, 1038, 1039, 1040, 1041, 1042, 1043, 1044, 1045, 1046, 1047, 1048, 1049, 1050, 1051, 1052, 1053, 1054, 1055, 1056, 1057, 1058, 1059, 1060, 1061, 1062, 1063, 1064, 1065, 1066, 1067, 1068, 1069, 1070, 1071, 1072, 1073, 1074, 1075, 1076, 1077, 1078, 1079, 1080, 1081, 1082, 1083, 1084, 1085, 1086, 1087, 1088, 1089, 1090, 1091, 1092, 1093, 1094, 1095, 1096, 1097, 1098, 1099, 1100, 1101, 1102, 1103, 1104, 1105, 1106, 1107, 1108, 1109, 1110, 1111, 1112, 1113, 1114, 1115, 1116, 1117, 1118, 1119, 1120, 1121, 1122, 1123, 1124, 1125, 1126, 1127, 1128, 1129, 1130, 1131, 1132, 1133, 1134, 1135, 1136, 1137, 1138, 1139, 1140, 1141, 1142, 1143, 1144, 1145, 1146, 1147, 1148, 1149, 1150, 1151, 1152, 1153, 1154, 1155, 1156, 1157, 1158, 1159, 1160, 1161, 1162, 1163, 1164, 1165, 1166, 1167, 1168, 1169, 1170, 1171, 1172, 1173, 1174, 1175, 1176, 1177, 1178, 1179, 1180, 1181, 1182, 1183, 1184, 1185, 1186, 1187, 1188, 1189, 1190, 1191, 1192, 1193, 1194, 1195, 1196, 1197, 1198, 1199, 1200, 1201, 1202, 1203, 1204, 1205, 1206, 1207, 1208, 1209, 1210, 1211, 1212, 1213, 1214, 1215, 1216, 1217, 1218, 1219, 1220, 1221, 1222, 1223, 1224, 1225, 1226, 1227, 1228, 1229, 1230, 1231, 1232, 1233, 1234, 1235, 1236, 1237, 1238, 1239, 1240, 1241, 1242, 1243, 1244, 1245, 1246, 1247, 1248, 1249, 1250, 1251, 1252, 1253, 1254, 1255, 1256, 1257, 1258, 1259, 1260, 1261, 1262, 1263, 1264, 1265, 1266, 1267, 1268, 1269, 1270, 1271, 1272, 1273, 1274, 1275, 1276, 1277, 1278, 1279, 1280, 1281, 1282, 1283, 1284, 1285, 1286, 1287, 1288, 1289, 1290, 1291, 1292, 1293, 1294, 1295, 1296, 1297, 1298, 1299, 1300, 1301, 1302, 1303, 1304, 1305, 1306, 1307, 1308, 1309, 1310, 1311, 1312, 1313, 1314, 1315, 1316, 1317, 1318, 1319, 1320, 1321, 1322, 1323, 1324, 1325, 1326, 1327, 1328, 1329, 1330, 1331, 1332, 1333, 1334, 1335, 1336, 1337, 1338, 1339, 1340, 1341, 1342, 1343, 1344, 1345, 1346, 1347, 1348, 1349, 1350, 1351, 1352, 1353, 1354, 1355, 1356, 1357, 1358, 1359, 1360, 1361, 1362, 1363, 1364, 1365, 1366, 1367, 1368, 1369, 1370, 1371, 1372, 1373, 1374, 1375, 1376, 1377, 1378, 1379, 1380, 1381, 1382, 1383, 1384, 1385, 1386, 1387, 1388, 1389, 1390, 1391, 1392, 1393, 1394, 1395, 1396, 1397, 1398, 1399, 1400, 1401, 1402, 1403, 1404, 1405, 1406, 1407, 1408, 1409, 1410, 1411, 1412, 1413, 1414, 1415, 1416, 1417, 1418, 1419, 1420, 1421, 1422, 1423, 1424, 1425, 1426, 1427, 1428, 1429, 1430, 1431, 1432, 1433, 1434, 1435, 1436, 1437, 1438, 1439, 1440, 1441, 1442, 1443, 1444, 1445, 1446, 1447, 1448, 1449, 1450, 1451, 1452, 1453, 1454, 1455, 1456, 1457, 1458, 1459, 1460, 1461, 1462, 1463, 1464, 1465, 1466, 1467, 1468, 1469, 1470, 1471, 1472, 1473, 1474, 1475, 1476, 1477, 1478, 1479, 1480, 1481, 1482, 1483, 1484, 1485, 1486, 1487, 1488, 1489, 1490, 1491, 1492, 1493, 1494, 1495, 1496, 1497, 1498, 1499, 1500, 1501, 1502, 1503, 1504, 1505, 1506, 1507, 1508, 1509, 1510, 1511, 1512, 1513, 1514, 1515, 1516, 1517, 1518, 1519, 1520, 1521, 1522, 1523, 1524, 1525, 1526, 1527, 1528, 1529, 1530, 1531, 1532, 1533, 1534, 1535, 1536, 1537, 1538, 1539, 1540, 1541, 1542, 1543, 1544, 1545, 1546, 1547, 1548, 1549, 1550, 1551, 1552, 1553, 1554, 1555, 1556, 1557, 1558, 1559, 1560, 1561, 1562, 1563, 1564, 1565, 1566, 1567, 1568, 1569, 1570, 1571, 1572, 1573, 1574, 1575, 1576, 1577, 1578, 1579, 1580, 1581, 1582, 1583, 1584, 1585, 1586, 1587, 1588, 1589, 1590, 1591, 1592, 1593, 1594, 1595, 1596, 1597, 1598, 1599, 1600, 1601, 1602, 1603, 1604, 1605, 1606, 1607, 1608, 1609, 1610, 1611, 1612, 1613, 1614, 1615, 1616, 1617, 1618, 1619, 1620, 1621, 1622, 1623, 1624, 1625, 1626, 1627, 1628, 1629, 1630, 1631, 1632, 1633, 1634, 1635, 1636, 1637, 1638, 1639, 1640, 1641, 1642, 1643, 1644, 1645, 1646, 1647, 1648, 1649, 1650, 1651, 1652, 1653, 1654, 1655, 1656, 1657, 1658, 1659, 1660, 1661, 1662, 1663, 1664, 1665, 1666, 1667, 1668, 1669, 1670, 1671, 1672, 1673, 1674, 1675, 1676, 1677, 1678, 1679, 1680, 1681, 1682, 1683, 1684, 1685, 1686, 1687, 1688, 1689, 1690, 1691, 1692, 1693, 1694, 1695, 1696, 1697, 1698, 1699, 1700, 1701, 1702, 1703, 1704, 1705, 1706, 1707, 1708, 1709, 1710, 1711, 1712, 1713, 1714, 1715, 1716, 1717, 1718, 1719, 1720, 1721, 1722, 1723, 1724, 1725, 1726, 1727, 1728, 1729, 1730, 1731, 1732, 1733, 1734, 1735, 1736, 1737, 1738, 1739, 1740, 1741, 1742, 1743, 1744, 1745, 1746, 1747, 1748, 1749, 1750, 1751, 1752, 1753, 1754, 1755, 1756, 1757, 1758, 1759, 1760, 1761, 1762, 1763, 1764, 1765, 1766, 1767, 1768, 1769, 1770, 1771, 1772, 1773, 1774, 1775, 1776, 1777, 1778, 1779, 1780, 1781, 1782, 1783, 1784, 1785, 1786, 1787, 1788, 1789, 1790, 1791, 1792, 1793, 1794, 1795, 1796, 1797, 1798, 1799, 1800, 1801, 1802, 1803, 1804, 1805, 1806, 1807, 1808, 1809, 1810, 1811, 1812, 1813, 1814, 1815, 1816, 1817, 1818, 1819, 1820, 1821, 1822, 1823, 1824, 1825, 1826, 1827, 1828, 1829, 1830, 1831, 1832, 1833, 1834, 1835, 1836, 1837, 1838, 1839, 1840, 1841, 1842, 1843, 1844, 1845, 1846, 1847, 1848, 1849, 1850, 1851, 1852, 1853, 1854, 1855, 1856, 1857, 1858, 1859, 1860, 1861, 1862, 1863, 1864, 1865, 1866, 1867, 1868, 1869, 1870, 1871, 1872, 1873, 1874, 1875, 1876, 1877, 18

STATE OF MONTANA

State Engineer's Office  
WATER RESOURCES SURVEY  
FARM MAP

County Sweetgrass  
Code No. 64

Twp. 3N Rge. 15E  
Twp. \_\_\_\_\_ Rge. \_\_\_\_\_  
Twp. \_\_\_\_\_ Rge. \_\_\_\_\_

Name of Land Owner JOHN, ALBERT Address Big Timber  
Name of Operator JOHN Address " "  
Legal Description \_\_\_\_\_

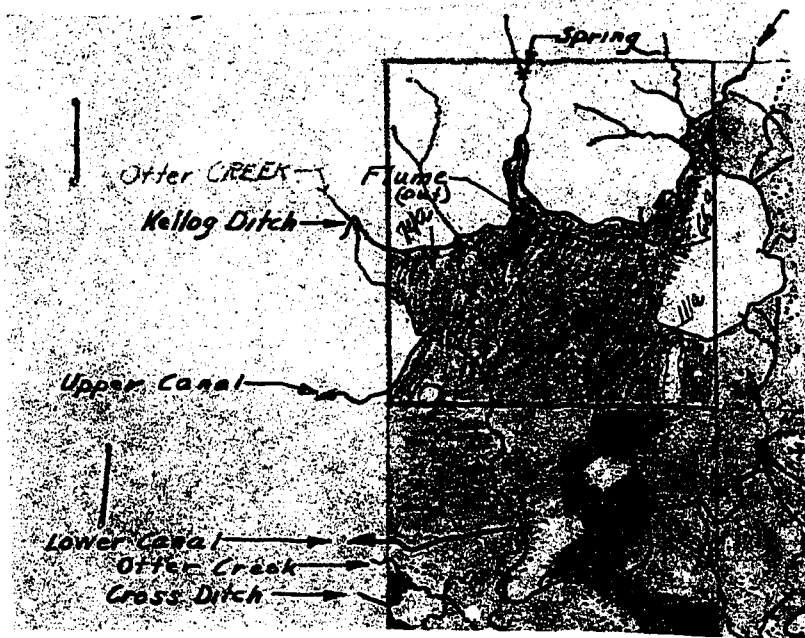
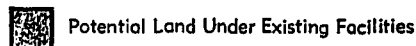

Code No. 64 System Upper Canal (S.G. C.D.P.C.) Source of Water Sweet Grass Cr.  
Basin Sweet Grass Present 0 Potential 111 Maximum 111 R ✓ F ✓ P ✓ G ✓ S ✓  
Code No. 64 System Kellogg Ditch (not in use) Source of Water Otter Creek  
Basin Otter Present 0 Potential 14 Maximum 14 R ✓ F ✓ P ✓ G ✓ S ✓  
Code No. 64 System Glass Ditch (not in use) Source of Water Sweet Grass Cr.  
Basin Sweet Grass Present 0 Potential 66 Maximum 66 R ✓ F ✓ P ✓ G ✓ S ✓  
Code No. \_\_\_\_\_ System \_\_\_\_\_ Source of Water \_\_\_\_\_  
Basin \_\_\_\_\_ Present \_\_\_\_\_ Potential \_\_\_\_\_ Maximum \_\_\_\_\_ R \_\_\_\_\_ F \_\_\_\_\_ P \_\_\_\_\_ G \_\_\_\_\_ S \_\_\_\_\_

If under Ditch Company, Irrigation District, or Government Project, state the number of shares or inches, acre feet, as the case may be in said system. 50 Shares in Sweet Grass Canal & Reservoir Co.

NOTE: R—Denotes Regular Irrigation. F—Flood Irrigation. P—Water diverted by means of pumping. G—Water diverted by gravity. S—Stored Water.

Information from \_\_\_\_\_ Date \_\_\_\_\_

**STATE OF MONTANA**

**STATE ENGINEER'S OFFICE**  
**WATER RESOURCES SURVEY**

Code No. 547284

By James J. [illegible]

County Indian Wells

Area \_\_\_\_\_

T. 34 R. 5E Sec. 528

Date 12/1/74

Photo No. MA-12A-18

Legal Land Owner.

Address 27th St. N. W.

### Operator

Address \_\_\_\_\_

**Water is delivered by:**

Federal Project \_\_\_\_\_ Pres. \_\_\_\_\_ Pot. \_\_\_\_\_

Ditch Company San Francisco Pres.                      Pot.                     

Irrigation District \_\_\_\_\_ Pres. \_\_\_\_\_ Pot. \_\_\_\_\_

Private System 1 Ditch from Otter Creek (Dana Cross ditch) Pres. \_\_\_\_\_ Pot. \_\_\_\_\_

[illegible]

Flood \_\_\_\_\_ Pump \_\_\_\_\_ Reservoir \_\_\_\_\_ Gravity \_\_\_\_\_

Size and Capacity, Pump, etc.....

Original Appropriator, Company \_\_\_\_\_ App. No. \_\_\_\_\_

Original Appropriator, Private None shown App. No. \_\_\_\_\_

Is the system an extension of another system? Yes \_\_\_\_\_ No ✓

Is all land irrigated from one system? Yes \_\_\_\_\_ No Y

(If No, show break down on map)

Source of Water: South Fork of Otter Creek

Acres Irrigated 19 319

Potential Acres 1326 Seeped \_\_\_\_\_

Explain

Condition of System Good

Adequate Supply — Yes \_\_\_\_\_ No \_\_\_\_\_

**Explain.** \_\_\_\_\_

Topography \_\_\_\_\_

Information From \_\_\_\_\_

Remarks From 2300 hrs. down to 3.00 PM

\_\_\_\_\_

A 4x4 grid with handwritten numbers and letters. The grid is divided into four quadrants by a vertical line between the second and third columns and a horizontal line between the second and third rows. The handwritten content is as follows:

			A
6		5	
	A		A
7		8	

[illegible]

7	→	
---	---	--

STATE OF MONTANA  
**State Engineer's Office**  
WATER RESOURCES SURVEY  
FARM MAP

County Sweetgrass

Code No. 5A-7A-8A

Twp. 3N Rge. 15E

Twp. \_\_\_\_\_ Rge. \_\_\_\_\_

Twp. \_\_\_\_\_ Rge. \_\_\_\_\_

Name of Land Owner J.C. CSEN Address Melville

Name of Operator James Address "

Legal Description \_\_\_\_\_



Irrigated Land



Non-Irrigated Land



Potential Land Under Existing Facilities

North

51 to Jan. 26, 1951

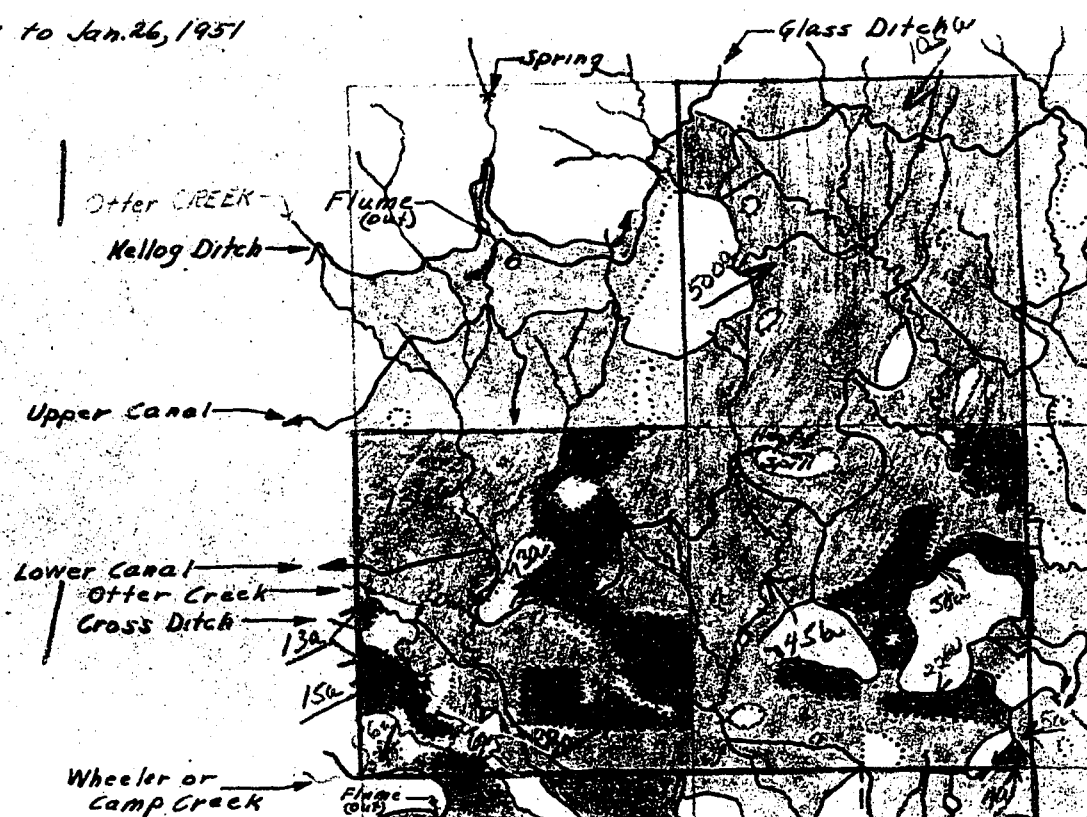

Code No. <u>71</u>	System <u>Glass Ditch (not in use)</u>	Source of Water <u>Sweet Grass Co.</u>
Basin <u>Sweet Grass</u>	Present <u>105</u> Potential <u>105</u> Maximum <u>105</u>	R. <u>X</u> F. <u></u> P. <u></u> G. <u>X</u> S. <u></u>
Code No. <u>51, 71, 81</u>	System <u>Upper Canal (S.G.C.R.C.)</u>	Source of Water <u>Sweet Grass Co.</u>
Basin <u>Sweet Grass</u>	Present <u>105</u> Potential <u>105</u> Maximum <u>105</u>	R. <u></u> F. <u></u> P. <u></u> G. <u>X</u> S. <u></u>
Code No. <u>51, 71, 81</u>	System <u>Lower Canal (S.G.C.R.C.)</u>	Source of Water <u>Sweet Grass Co.</u>
Basin <u>Sweet Grass</u>	Present <u>105</u> Potential <u>105</u> Maximum <u>105</u>	R. <u></u> F. <u></u> P. <u></u> G. <u>X</u> S. <u></u>
Code No. <u>71</u>	System <u>Wheeler or Camp Creek</u>	Source of Water <u>Otter Creek</u>
Basin <u>Otter</u>	Present <u>105</u> Potential <u>105</u> Maximum <u>105</u>	R. <u>X</u> F. <u></u> P. <u></u> G. <u>X</u> S. <u></u>

If under Ditch Company, Irrigation District, or Government Project, state the number of shares or inches, acre feet, as the case may be in said system. 100 shares in Sweet Grass Canal & Reservoir Company

NOTE: R—Denotes Regular Irrigation F—Flood Irrigation. P—Water diverted by means of pumping. G—Water diverted by gravity. S—Stored Water.

Information from \_\_\_\_\_ Date \_\_\_\_\_

**Farm Checked**

**STATE OF MONTANA**

Code No. 19c

By \_\_\_\_\_

# STATE ENGINEER'S OFFICE

County Sweet Grass

Area \_\_\_\_\_

## WATER RESOURCES SURVEY

T. 3N R. 15E Sec. 19

Date\_\_\_\_\_

Photo No. \_\_\_\_\_

Legal Land Owner. Delia Plagemeyer Address \_\_\_\_\_

Operator \_\_\_\_\_ Address \_\_\_\_\_

**Water is delivered by:**

Federal Project \_\_\_\_\_ Pres. \_\_\_\_\_ Pot. \_\_\_\_\_

Ditch Company Sweet Grass Canal & Res. Co Pres. \_\_\_\_\_ Pot. \_\_\_\_\_

Irrigation District \_\_\_\_\_ Pres. \_\_\_\_\_ Pot. \_\_\_\_\_

Private System \_\_\_\_\_ Pres. \_\_\_\_\_ Pot. \_\_\_\_\_

**Totals** \_\_\_\_\_

Flood \_\_\_\_\_ Pump \_\_\_\_\_ Reservoir \_\_\_\_\_ Gravity \_\_\_\_\_

Size and Capacity, Pump, etc. \_\_\_\_\_

Original Appropriator, Company \_\_\_\_\_ App. No. \_\_\_\_\_

Original Appropriator, Private \_\_\_\_\_ App. No. \_\_\_\_\_

Is the system an extension of another system? Yes\_\_\_\_\_No\_\_\_\_\_

Is all land irrigated from one system? Yes\_\_\_\_\_No\_\_\_\_\_

(If No, show break down on map)

Source of Water Sweet Grass Creek

Acres Irrigated 19 50, 72

Potential Acres 0 Seeped                     

### Explain

### Condition of System

Adequate Supply .... Yes..... No.....

**Explain**\_\_\_\_\_

### Topography

Information From \_\_\_\_\_

Remarks Holds 50 shares in the

A 10x10 grid with a 2x2 square in the bottom-left corner labeled 'c' and the number '19' in the center.

STATE OF MONTANA

State Engineer's Office  
WATER RESOURCES SURVEY  
FARM MAP

County Sweet Grass

Code No. 19C

Twp. 3N Rge. 15E

Twp. \_\_\_\_\_ Rge. \_\_\_\_\_

Twp. \_\_\_\_\_ Rge. \_\_\_\_\_

Name of Land Owner Delia Plaggemeyer Address \_\_\_\_\_

Name of Operator " Address \_\_\_\_\_

Legal Description \_\_\_\_\_



Irrigated Land



Non-Irrigated Land



Potential Land Under Existing Facilities

North

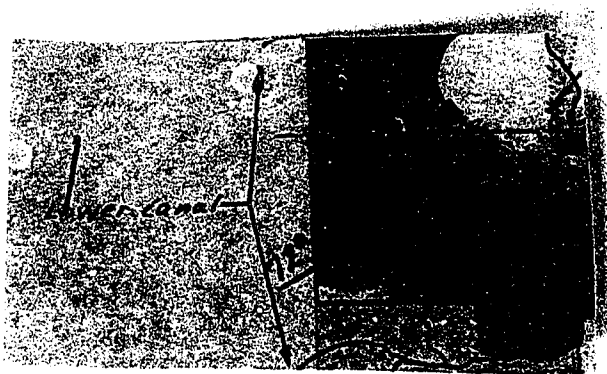

Code No. 19C System Lower Canal (S.G.C. & R.C.) Source of Water Sweet Grass

Basin Sweet Grass Present 70 Potential 0 Maximum 70 R. \_\_\_\_\_ F. \_\_\_\_\_ P. \_\_\_\_\_ G. ✓ S. ✓

Code No. \_\_\_\_\_ System \_\_\_\_\_ Source of Water \_\_\_\_\_

Basin \_\_\_\_\_ Present \_\_\_\_\_ Potential \_\_\_\_\_ Maximum \_\_\_\_\_ R. \_\_\_\_\_ F. \_\_\_\_\_ P. \_\_\_\_\_ G. \_\_\_\_\_ S. \_\_\_\_\_

Code No. \_\_\_\_\_ System \_\_\_\_\_ Source of Water \_\_\_\_\_

Basin \_\_\_\_\_ Present \_\_\_\_\_ Potential \_\_\_\_\_ Maximum \_\_\_\_\_ R. \_\_\_\_\_ F. \_\_\_\_\_ P. \_\_\_\_\_ G. \_\_\_\_\_ S. \_\_\_\_\_

Code No. \_\_\_\_\_ System \_\_\_\_\_ Source of Water \_\_\_\_\_

Basin \_\_\_\_\_ Present \_\_\_\_\_ Potential \_\_\_\_\_ Maximum \_\_\_\_\_ R. \_\_\_\_\_ F. \_\_\_\_\_ P. \_\_\_\_\_ G. \_\_\_\_\_ S. \_\_\_\_\_

If under Ditch Company, Irrigation District, or Government Project, state the number of shares or inches, acre feet, as the case may be in said system. 50 Shares in Sweet Grass Canal & Reservoir Co.

NOTE: R—Denotes Regular Irrigation. F—Flood Irrigation. P—Water diverted by means of pumping. G—Water diverted by gravity. S—Stored Water.

Information from \_\_\_\_\_ Date \_\_\_\_\_

Farm Checked

By BB + MT

Area Otter Creek

Date 7-6-50

Legal Land Owner

Operator

STATE OF MONTANA

STATE ENGINEER'S OFFICE

WATER RESOURCES SURVEY

FORM F-1 - GAZETTE 1965-24-1-47

Code No. 204A 21A 22A 28B

County Sweet Grass

T. 3 N R. 15 E Sec. 28 27

Photo No. 7A-150

Address Big Timber

Address

Water is delivered by:

Federal Project Pres. Pot.

Ditch Company Sweet Grass Canal & Res. Co. Pres. Pot.

Irrigation District Pres. Pot.

Private System Cross Ditch (mutual) Pres. Pot.

Tangen Ditch Totals

Flood Pump Reservoir Gravity ☒

Size and Capacity, Pump, etc.

Original Appropriator, Company Adaline E. Cross; David App. No. 574, 575, D-338

Original Appropriator, Private Mervin; Carl Tangen; App. No. 943, 956

Is the system an extension of another system? Yes ☒ No

Is all land irrigated from one system? Yes No ☒

(If No, show break down on map)

Source of Water Otter Cr. Sweet Grass Cr. Gust Run

Spring; Stocker & Tangen Spring

Acres Irrigated 19 50 140

Potential Acres 326 Seeped

Explain

Condition of System Good

Adequate Supply Yes No ☒

Explain Otter Creek dries in Summer

Topography Hills + Creek bed

Information From H. Shered

Remarks

(Good)



The Cross ditch out of Otter Cr. is used and maintained by Wayne Faw and Merritt Sherod. This ditch is in good shape. The water is insufficient due to the fact that Otter Cr. dries up in late summer. Point of diversion is in S<sup>2</sup>NW<sup>4</sup> of Sec 18 T3N-R15E on west bank.

Sherod has a lateral out of the Sweetgrass Canal & reservoir Co. system. This lateral is in good condition. Sherod had 300 M.T. out of the reservoir, however, he cut the quantity to 180 M.T. in 1950.

Springs in Sec 15 T3N-R15E apparently formed by seepage from Lake Wolwood produce sub-irrigation in S<sup>2</sup>S<sup>2</sup> Sec 15 & N<sup>2</sup>N<sup>2</sup> Sec 22 T3N-R15E. The sub-irrigation in Sec 21 is apparently produced by seepage from Sherod's lateral and the springs in Sec 15.

Traces of the Tanager Ditch, taking out of the Tanager Springs in the NE<sup>4</sup>NW<sup>4</sup> Sec 22, are still visible even after a considerable number of years of non-use. The water supply appears to be sufficient to irrigate all lands mapped as potential and lying under the ditch in Sections 21 and 22.

A small parcel of land lying in the S<sup>2</sup>SW<sup>4</sup>SE<sup>4</sup> of Sec. 30 is potential under an unnamed ditch now belonging to Tom Deuben.

STATE OF MONTANA  
STATE ENGINEER'S OFFICE  
WATER RESOURCES SURVEY

Township 3 N Range 15 E County Sweet Grass

6	5	4	3	2	1
7	8	9	10	11	12
18	17	16	15	14	13
19	20	21	22	23	24
30	29	28	27	26	25
31	32	33	34	35	36

*Handwritten notes on grid:*  
 Row 4: Section 20 has 'A' and 'x'. Section 21 has 'A' and 'x'. Section 22 has 'A'.  
 Row 5: Section 28 has 'B' and 'A'.  
 Section 28 also has a small square with 'x'.

Marvett C. Shorad

Township 3 Range 15

Twp. 3 N Rge. 15 E  
Twp. \_\_\_\_\_ Rge. \_\_\_\_\_  
Twp. \_\_\_\_\_ Rge. \_\_\_\_\_

Name of Land Owner \_\_\_\_\_  
Name of Operator \_\_\_\_\_  
Legal Description \_\_\_\_\_



Code No. \_\_\_\_\_  
Basin \_\_\_\_\_  
Code No. \_\_\_\_\_  
Basin \_\_\_\_\_  
Code No. \_\_\_\_\_  
Basin \_\_\_\_\_  
Code No. \_\_\_\_\_  
Basin \_\_\_\_\_  
If under \_\_\_\_\_  
in said system. \_\_\_\_\_  
NOTE: \_\_\_\_\_

Information from \_\_\_\_\_

STATE OF MONTANA

State Engineer's Office  
WATER RESOURCES SURVEY  
FARM MAP

County Sweetgrass  
Code No. 20A-21A-22A-23B-27A

Twp. 3N Rge. 15E  
Twp. \_\_\_\_\_ Rge. \_\_\_\_\_  
Twp. \_\_\_\_\_ Rge. \_\_\_\_\_

Name of Land Owner SHEROD, MERRITT C. Address Big Timber  
Name of Operator same Address " "  
Legal Description \_\_\_\_\_

☐ Irrigated Land ☐ Non-Irrigated Land ☒ Potential Land Under Existing Facilities  
North

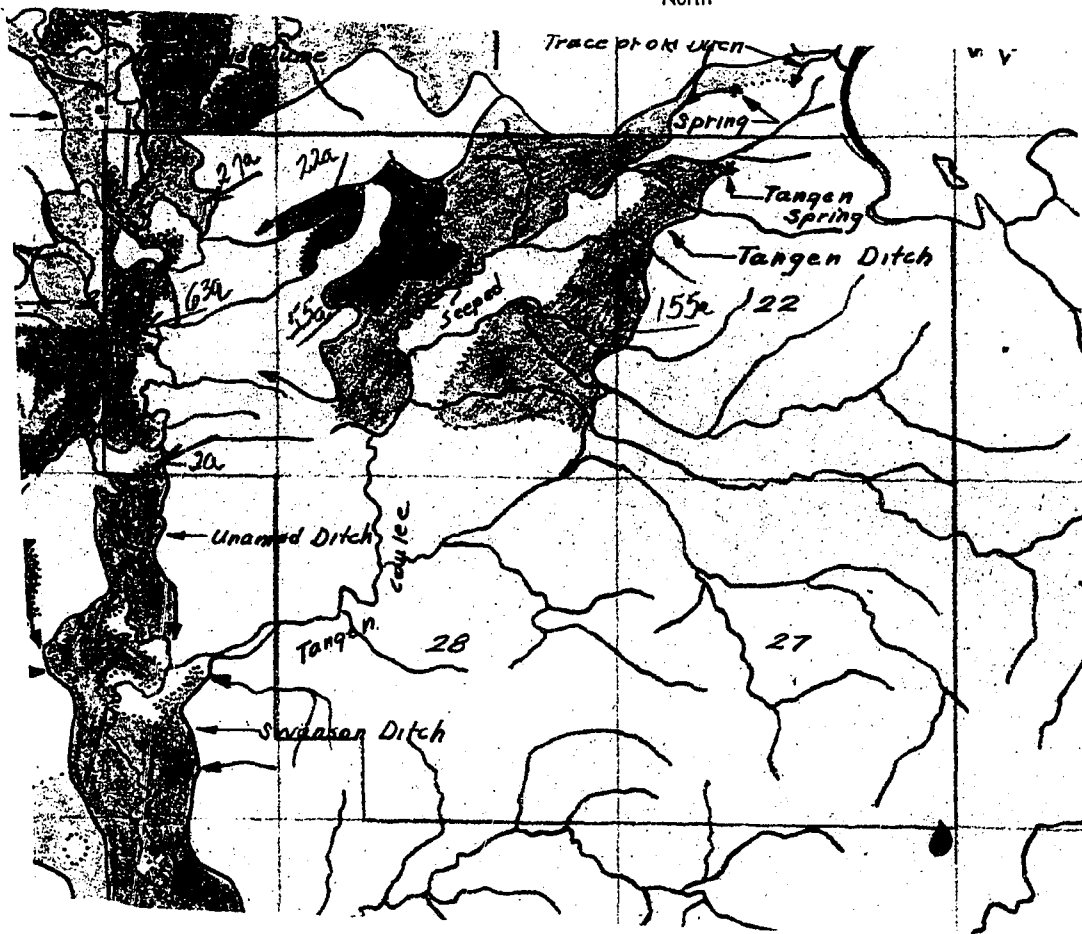

Code No. <u>144</u>	System <u>122a Ditch</u>	Source of Water <u>Other Creek</u>
Basin <u>Other</u>	Present <u>63</u> Potential <u>0</u> Maximum <u>63</u>	R <input checked="" type="checkbox"/> F <input type="checkbox"/> P <input type="checkbox"/> G <input checked="" type="checkbox"/> S <input type="checkbox"/>
Code No. <u>144</u>	System <u>122a Canal (R.G. &amp; P.C.)</u>	Source of Water <u>Sweet Grass Cr.</u>
Basin <u>Sweet Grass</u>	Present <u>77</u> Potential <u>171</u> Maximum <u>208</u>	R <input type="checkbox"/> F <input type="checkbox"/> P <input type="checkbox"/> G <input checked="" type="checkbox"/> S <input type="checkbox"/> <u>(R.G. &amp; P.C.)</u>
Code No. <u>144</u>	System <u>Tangen Ditch (not in use)</u>	Source of Water <u>Tangen Spring</u>
Basin <u>Other</u>	Present <u>0</u> Potential <u>155</u> Maximum <u>155</u>	R <input type="checkbox"/> F <input type="checkbox"/> P <input type="checkbox"/> G <input checked="" type="checkbox"/> S <input type="checkbox"/>
Code No. <u>144</u>	System <u>Unnamed Ditch</u>	Source of Water <u>Other Creek</u>
Basin <u>Other</u>	Present <u>0</u> Potential <u>2</u> Maximum <u>2</u>	R <input checked="" type="checkbox"/> F <input type="checkbox"/> P <input type="checkbox"/> G <input checked="" type="checkbox"/> S <input type="checkbox"/>

If under Ditch Company, Irrigation District, or Government Project, state the number of shares or inches, acre feet, as the case may be in said system. 200 shares in Sweet Grass Canal & Reservoir Co.

NOTE: R—Denotes Regular Irrigation. F—Flood Irrigation. P—Water diverted by means of pumping. G—Water diverted by gravity. S—Stored Water.

Information from \_\_\_\_\_ Date \_\_\_\_\_

FORM F-1 REPORTER 1M 3-49 1738C

Code No. 34 44 94

By 117 T 952

County: Street Pass

Area Sw. Gr. Can. & Res. Co

County: Street (pass)

## WATER RESOURCES SURVEY

T. 52 R. 117 Sec. 349

Date Aug. 3, 1950

Photo No. \_\_\_\_\_

**Legal Land Owner.**

Address 2319 Lumber

**Operator.**

Address Helville

**Water is delivered by:**

Federal Project \_\_\_\_\_ Pres. \_\_\_\_\_ Pot. \_\_\_\_\_

Ditch Company. Sweet Grass Land & Res. Co. Pres. 600 Pot.         

Irrigation District \_\_\_\_\_ Pres. \_\_\_\_\_ Pot. \_\_\_\_\_

Private System \_\_\_\_\_ Pres. \_\_\_\_\_ Pot. \_\_\_\_\_

Totals \_\_\_\_\_

Flood \_\_\_\_\_ Pump \_\_\_\_\_ Reservoir \_\_\_\_\_ Gravity ☒

Size and Capacity, Pump, etc. \_\_\_\_\_

Original Appropriator, Company \_\_\_\_\_ App. No. \_\_\_\_\_

Original Appropriator, Private: Edward G. Carol Adams App. No. D268, D267

Is the system an extension of another system?

Yes \_\_\_\_\_ No ✓

**Is all land irrigated from one system?**

Yes ✓ No       

(If No, show break down on map)

Source of Water Shawmut River - Shawmut Co.

Acres Irrigated 19 50, 60

Potential Acres 1420 Seeped                     

Explain \_\_\_\_\_

Condition of System \_\_\_\_\_

Adequate Supply..... Yes\_\_\_\_\_ No\_\_\_\_\_

Explain\_\_\_\_\_

Topography.

Information From \_\_\_\_\_

Remarks \_\_\_\_\_

	A		A
1		3	
	7		
9			

- All land colored Green in Sec. 3 + 9 is irrigated by the Sweet Grass Canal and Res. Co.
- All land colored Red in Sec. 3, 4, + 9 is sub-irrigated and seeped.
- The land colored Purple in Sec. 3, 4, + 9 is all potential under the Sweet Grass Canal and Res. Co. except small section in N<sup>2</sup> NW<sup>4</sup> of Sec. 4 which is under the old Glass Ditch and a small portion in NE<sup>4</sup> of Sec. 3 which is under the old Adams Ditch.
- Sec. 4 - No shares in Canal are owned by Carl Thompson for this section.
- Sec. 3 - 50 shares in Canal are owned by Carl Thompson for this section. At present he irrigates small field in NW<sup>4</sup> and next year plans to irrigate more land east of this in NW<sup>4</sup>.
- Sec. 9 - 100 shares in Canal are owned by Thompson for this section. At present he irrigates two small fields in N<sup>2</sup> and next year plans to irrigate other land between these two from same lateral.

STATE OF MONTANA  
**State Engineer's Office**  
WATER RESOURCES SURVEY  
FARM MAP

County Sweetgrass

Code No. \_\_\_\_\_

34-24-9A

Twp. 34 Rge. 15E

Twp. \_\_\_\_\_ Rge. \_\_\_\_\_

Twp. \_\_\_\_\_ Rge. \_\_\_\_\_

Name of Land Owner Philipson, W.A. Address Medicine

Name of Operator Same Address \_\_\_\_\_

Legal Description \_\_\_\_\_



Irrigated Land



Non-Irrigated Land



Potential Land Under Existing Facilities

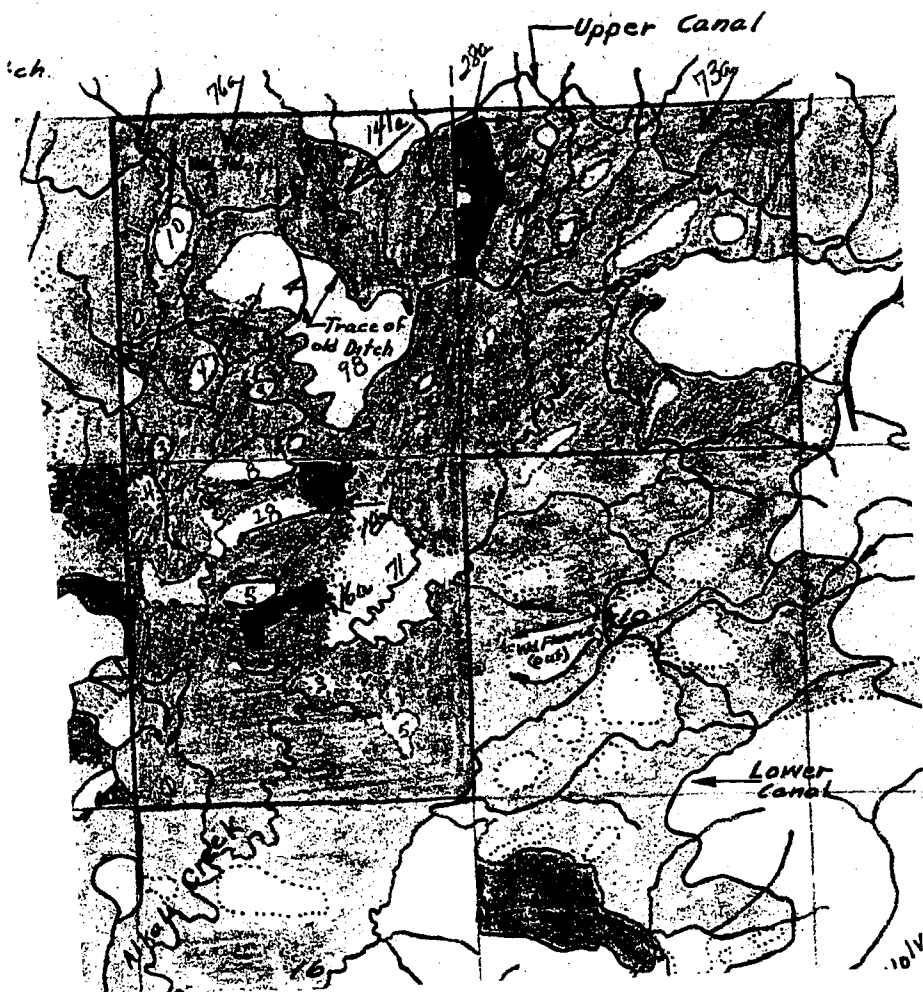

STATE OF MONTANA  
**State Engineer's Office**  
WATER RESOURCES SURVEY  
FARM MAP

County Sweetgrass

Code No. \_\_\_\_\_

3A-2A-2A

Twp. 3N Rge. 15E

Twp. \_\_\_\_\_ Rge. \_\_\_\_\_

Twp. \_\_\_\_\_ Rge. \_\_\_\_\_

Name of Land Owner THOMAS B. BULL, JR. Address \_\_\_\_\_

Operator SAUL C. Address \_\_\_\_\_

☐ Non-Irrigated Land

☒ Potential Land Under Existing Facilities

Upper Canal

1939

Code No. 3A System Windmill Mutual Ditch (not in use) Source of Water Sweet Grass Co.

Basin Sweet Grass Present \_\_\_\_\_ Potential \_\_\_\_\_ Maximum \_\_\_\_\_ R. X F. \_\_\_\_\_ P. \_\_\_\_\_ G. X S. \_\_\_\_\_

Code No. 3A System Connecting Can. (B. G. & R. Co.) Source of Water Sweet Grass Co.

Basin Sweet Grass Present \_\_\_\_\_ Potential 93 Maximum 93 R. X F. \_\_\_\_\_ P. \_\_\_\_\_ G. X S. X

Code No. \_\_\_\_\_ System \_\_\_\_\_ Source of Water \_\_\_\_\_

Basin \_\_\_\_\_ Present \_\_\_\_\_ Potential \_\_\_\_\_ Maximum \_\_\_\_\_ R. \_\_\_\_\_ F. \_\_\_\_\_ P. \_\_\_\_\_ G. \_\_\_\_\_ S. \_\_\_\_\_

Code No. \_\_\_\_\_ System \_\_\_\_\_ Source of Water \_\_\_\_\_

Basin \_\_\_\_\_ Present \_\_\_\_\_ Potential \_\_\_\_\_ Maximum \_\_\_\_\_ R. \_\_\_\_\_ F. \_\_\_\_\_ P. \_\_\_\_\_ G. \_\_\_\_\_ S. \_\_\_\_\_

Code No. \_\_\_\_\_ System \_\_\_\_\_ Source of Water \_\_\_\_\_

Basin \_\_\_\_\_ Present \_\_\_\_\_ Potential \_\_\_\_\_ Maximum \_\_\_\_\_ R. \_\_\_\_\_ F. \_\_\_\_\_ P. \_\_\_\_\_ G. \_\_\_\_\_ S. \_\_\_\_\_

Code No. \_\_\_\_\_ System \_\_\_\_\_ Source of Water \_\_\_\_\_

Basin \_\_\_\_\_ Present \_\_\_\_\_ Potential \_\_\_\_\_ Maximum \_\_\_\_\_ R. \_\_\_\_\_ F. \_\_\_\_\_ P. \_\_\_\_\_ G. \_\_\_\_\_ S. \_\_\_\_\_

Code No. \_\_\_\_\_ System \_\_\_\_\_ Source of Water \_\_\_\_\_

Basin \_\_\_\_\_ Present \_\_\_\_\_ Potential \_\_\_\_\_ Maximum \_\_\_\_\_ R. \_\_\_\_\_ F. \_\_\_\_\_ P. \_\_\_\_\_ G. \_\_\_\_\_ S. \_\_\_\_\_

Code No. \_\_\_\_\_ System \_\_\_\_\_ Source of Water \_\_\_\_\_

Basin \_\_\_\_\_ Present \_\_\_\_\_ Potential \_\_\_\_\_ Maximum \_\_\_\_\_ R. \_\_\_\_\_ F. \_\_\_\_\_ P. \_\_\_\_\_ G. \_\_\_\_\_ S. \_\_\_\_\_

Code No. \_\_\_\_\_ System \_\_\_\_\_ Source of Water \_\_\_\_\_

Basin \_\_\_\_\_ Present \_\_\_\_\_ Potential \_\_\_\_\_ Maximum \_\_\_\_\_ R. \_\_\_\_\_ F. \_\_\_\_\_ P. \_\_\_\_\_ G. \_\_\_\_\_ S. \_\_\_\_\_

Code No. \_\_\_\_\_ System \_\_\_\_\_ Source of Water \_\_\_\_\_

Basin \_\_\_\_\_ Present \_\_\_\_\_ Potential \_\_\_\_\_ Maximum \_\_\_\_\_ R. \_\_\_\_\_ F. \_\_\_\_\_ P. \_\_\_\_\_ G. \_\_\_\_\_ S. \_\_\_\_\_

If under Ditch Company, Irrigation District, or Government Project, state the number of shares or inches, acre feet, as the case may be in said system.

NOTE: R—Denotes Regular Irrigation. F—Flood Irrigation. P—Water diverted by means of pumping. G—Water diverted by gravity. S—Stored Water.

Information from \_\_\_\_\_ Date \_\_\_\_\_

Township 3 North - Range 16 East

(16)

Name of Owner	Township & Range
✓ 1. Arneson, Elmer	(16) 3N-16E (21) 2N-14E (22) 2N-15E (28) 1N-14E
2. Cremer, Leo J. et ux	" (8) 4N-14E (10) 4N-16E (11) 4N-17E
✓ 3. Crum, Geo. B.	" (9) 4N-15E (10) 4N-16E (15) 3N-15E
✓ 4. Farthing, Etta M.	"
✓ 5. Forewald, J. J.	"
✓ 6. Forewald, Mary R.	"
✓ 7. Nevin, Thos. H.	"
✓ 8. Neumayer, J.G.	"
✓ 9. <i>Lion, Anton Est.</i>	"



STATE OF MONTANA  
**STATE ENGINEER'S OFFICE**  
 WATER RESOURCES SURVEY

Township 3 North Range 16 East County Sweet Grass

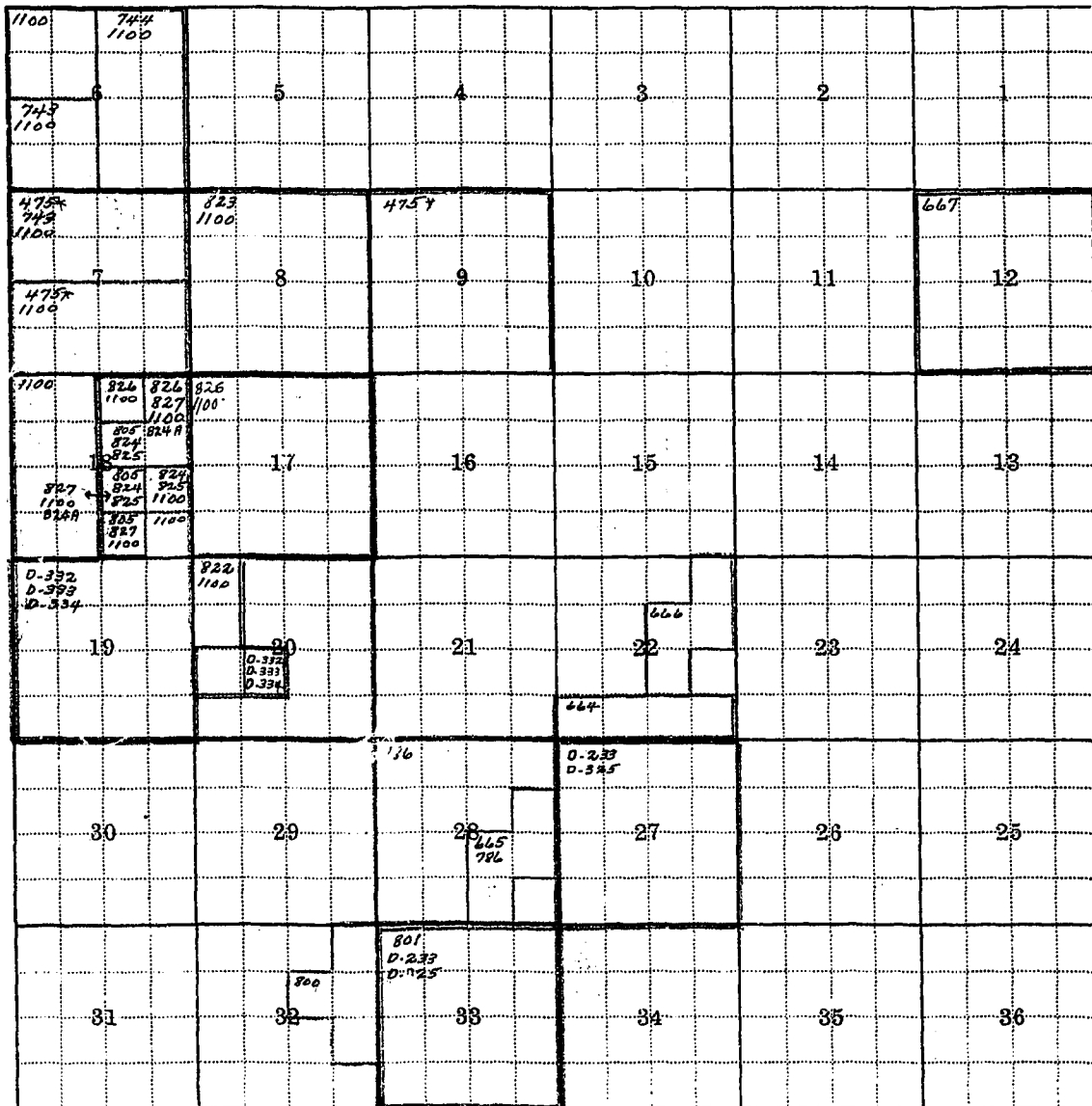

Township 3 North Range 16 East

Township\_\_\_\_\_ Range\_\_\_\_\_ County\_\_\_\_\_

Parcel Number	Name of Owner/Appropriator	Address
*Appropriation 475	Stocker, Matilda	Melville, Mont.
Appropriation records show this land to be in Sec 7 & 19 3N 16E rather than Sec 7 & 9 3N 16E.		
Appropriation 668	Stocker, Charles F. (200' MT)	Melville, Mont.
No legal description. Point of diversion on right bank of Lower Dough Creek.		

No.

475

-664

-665

-666

-667

-743

-744

786

-800

801

805

822

-823

-824

8241

825

826

626

^827

3104

-1100

-D-2

D-32

24 ת

U-3.

'D-32

D-32

Township 3 North, Range 16 East

<u>No.</u>	<u>Name of Appropriator</u>	<u>Name of Stream</u>	<u>Date App.</u>	<u>Date Filed</u>	<u>M.I.</u>
475	Stocker, Matilda	Hamilton Creek	2-12-86	2-18-86	100
664	Henry, John S.	Sour Dough Creek	8-19-11	8-19-11	160
665	Mahlon, Henry J.	Sour Dough Creek	9-22-02	9-22-02	200
666	Medley, James W.	Sour Dough Creek	6-14-99	6-15-99	200
667	Osborne, Roy	Sour Dough Creek	7-9-07	7-9-07	500 <sup>(no)</sup>
743	Adams, Emile Jr.	Sweetgrass Creek	10-26-89	10-30-89	500
744	Adams, Emil Jr.	Sweetgrass Creek	4-3-99	5-4-99	300
786	Gurney, Thomas M.	Sweetgrass Creek	12-11-03	12-11-03	400
800	Kelsey, Mary J.	Sweetgrass Creek	1-19-25	1-19-25	100
801	Kittle, P. F. and Wilkinson, A. F.	Sweetgrass Creek	2-10-03	2-10-03	400
805	Medley, Matilda S.	Sweetgrass Creek	5-8-93	5-8-93	1000
822	Stocker, Charles F.	Sweetgrass Creek	5-20-93	5-29-93	—
823	Stocker, Charles F.	Sweetgrass Creek	10-14-96	10-17-96	600
824	Stocker, Matilda A.	Sweetgrass Creek	2-12-86	2-18-86	1000
824H	Stocker, Matilda A.	Sweetgrass Creek	10-22-85	2-18-86	1000
825	Stocker, Matilda A.	Sweetgrass Creek	9-25-90	9-25-90	1000
826	Stocker, Matilda A.	Sweetgrass Creek	9-14-92	9-14-92	1000
827	Stocker, Matilda A.	Sweetgrass Creek	9-14-92	9-14-92	1000
1100	Gremer Rodeo L. & L. Co.	Swamp	7-18-44	7-25-44	600
D-233	Kittle, P. M. et al	Sour Dough Creek	7-1-02		40
D-325	Kittle, P. M. et al	Sweetgrass Creek	6-1-03		80
D-332	Medley, Matilda A.	Sweetgrass Creek	7-1-85		130
D-333	Medley, Matilda A.	Sweetgrass Creek	6-1-89		140
D-334	Medley, Matilda A.	Sweetgrass Creek	5-4-93		80

STATE OF MONTANA  
*State Engineer's Office*  
WATER RESOURCES SURVEY

Township 3N Range 16E County Sweet Grass

1659	6	5	4	3	2	1
861 1659						
861	7	8	9	10	11	12
1659						
	18	17	16	15	14	13
861						
	19	20	21	22	23	24
	30	29	28	27	26	25
	31	32	33	34	35	36

*Transcribed from Park County*

Township 3N Range 16E



**Farm Checked**

**STATE OF MONTANA**

Code No. 6B

By MT & EC

# STATE ENGINEER'S OFFICE

County Sweet Grass

Area 111 112 113

# WATER RESOURCES SURVEY

T. 34° N. E. 10 E Sec. 6

Date\_\_\_\_\_

Photo No. MA-7A-116

Legal Land Owner\_\_\_\_\_

Arneson, Elmer

Address Big Timber

Operator \_\_\_\_\_

Cum, Geo. B.

Address. 11 10

**Water is delivered by:**

Federal Project \_\_\_\_\_ Pres. \_\_\_\_\_ Pot. \_\_\_\_\_

Ditch Company. \_\_\_\_\_ Pres. \_\_\_\_\_ Pot. \_\_\_\_\_

Irrigation District \_\_\_\_\_ Pres. \_\_\_\_\_ Pot. \_\_\_\_\_

Private System \_\_\_\_\_ Pres. \_\_\_\_\_ Pot. \_\_\_\_\_

	<b>Totals</b>
--	---------------

Flood \_\_\_\_\_ Pump \_\_\_\_\_ Reservoir \_\_\_\_\_ Gravity \_\_\_\_\_

Size and Capacity, Pump, etc. \_\_\_\_\_

Original Appropriator, Company \_\_\_\_\_ App. No. \_\_\_\_\_

Original Appropriator, Private Adams, Emile Jr. App. No. 743,1100

Is the system an extension of another system? Yes \_\_\_\_\_ No \_\_\_\_\_

Is all land irrigated from one system? Yes\_\_\_\_\_No\_\_\_\_\_

(If No, show break down on map)

Source of Water Sweetgrass Creek, Swamp

Acres Irrigated 19 2 1

Potential Acres 0 Seeped                     

**Explain** \_\_\_\_\_

Condition of System \_\_\_\_\_

Adequate Supply ..... Yes ..... No .....

**Explain** \_\_\_\_\_

### Topography

Information From \_\_\_\_\_

Remarks:

over

Twp. 3 N - Rge. 16 E

A 10x10 grid with a horizontal line across the middle and a vertical line on the left. The letter 'B' is in the bottom-left cell, and the number '6' is in the center of the grid.

There is no irrigation in the  
SW<sup>1</sup>SW<sup>1</sup> Sec 6, T3N-R16E; however, a  
ditch belonging to Croner traverses  
the land, thus making a portion  
potential

STATE OF MONTANA

State Engineer's Office

WATER RESOURCES SURVEY

FARM MAP

County Sweetgrass

Code No. 6B

Twp. 3N Rge. 16E

Twp. \_\_\_\_\_ Rge. \_\_\_\_\_

Twp. \_\_\_\_\_ Rge. \_\_\_\_\_

Name of Land Owner ARNESON, ELMER Address Big Timber

Name of Operator CRUM, Geo. B. Address \_\_\_\_\_

Legal Description \_\_\_\_\_



Irrigated Land



Non-Irrigated Land



Potential Land Under Existing Facilities

North

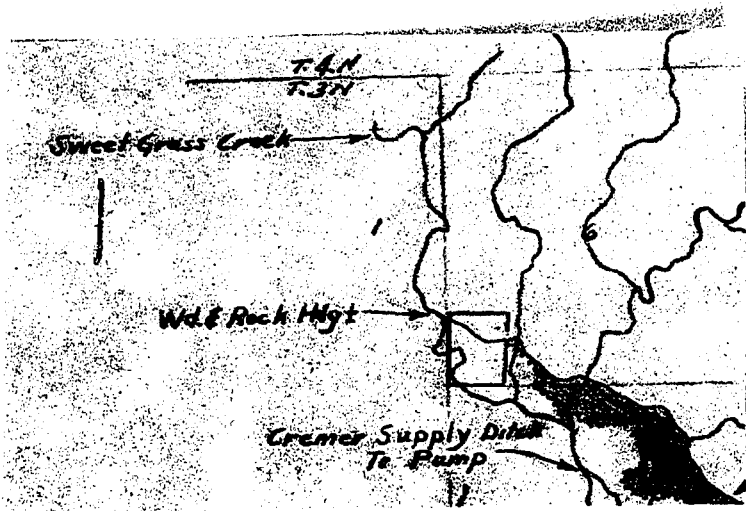

Code No. <u>6B</u>	System <u>Adams Ditch (not in use)</u>	Source of Water <u>Sweet Grass Creek</u>
Basin <u>Sweet Grass</u>	Present <u>0</u> Potential <u>0</u> Maximum <u>0</u>	R <u>✓</u> F <u> </u> P <u> </u> G <u> </u> S <u> </u>
Code No. _____	System _____	Source of Water _____
Basin _____	Present _____ Potential _____ Maximum _____	R <u> </u> F <u> </u> P <u> </u> G <u> </u> S <u> </u>
Code No. _____	System _____	Source of Water _____
Basin _____	Present _____ Potential _____ Maximum _____	R <u> </u> F <u> </u> P <u> </u> G <u> </u> S <u> </u>
Code No. _____	System _____	Source of Water _____
Basin _____	Present _____ Potential _____ Maximum _____	R <u> </u> F <u> </u> P <u> </u> G <u> </u> S <u> </u>

If under Ditch Company, Irrigation District, or Government Project, state the number of shares or inches, acre feet, as the case may be in said system.

NOTE: R—Denotes Regular Irrigation. F—Flood Irrigation. P—Water diverted by means of pumping. G—Water diverted by gravity. S—Stored Water.

Information from \_\_\_\_\_ Date \_\_\_\_\_



[illegible]

The only ditch not in use, yet visible, is a supply ditch to a pump-out which at one time was located in the SW<sup>1</sup>NE<sup>4</sup> Sec. 7 and pumped water into a ditch which covered a portion of the area now irrigated by water from the Cannon ditch out of the connecting canal of the Sweet Grass Canal & Res. Co.

No trace of ditches, which at one time literally covered the area, remain due to the present efficient coverage by power ditches.

Cremers has a 350 mt. right (decreed) out of the Sweet Grass Canal & Res. Co. which he diverts out of the connecting canal near the top of the lower reservoir. This Cremers lateral makes a considerable area of Cannon's land in Sec. 11 & 12 of 3N-15E potential. The Cremers lateral vents Sec. 7 of 3N-16E in the SW<sup>1</sup>SW<sup>4</sup> and irrigates land in the S<sup>1</sup> and SW<sup>1</sup>NE<sup>4</sup> of Sec. 7 lying on the west side of Sweet Grass Creek.

Two other ditches are located on the west side of Sweet Grass Creek.

① The Stocken ditch diverts water from the Sweet Grass Creek in the SE<sup>1</sup>SE<sup>4</sup> of Sec. 7-3N-16E and irrigates land in the E<sup>1</sup> of Sec. 18-3N-16E.

② The Stocken ditch out of Hamilton Creek diverts water in the NE<sup>1</sup>NW<sup>4</sup> of Sec. 18-3N-16E and traverses above the Stocken ditch out of the west side of Sweet Grass Creek.

Three ditches take out of the Sweet  
Grass Creek on the East bank

(1) The Adams ditch diverts  
near the East line in the NE<sup>4</sup> SE<sup>4</sup> of Sec  
1 - 3N-15E and irrigates land on the  
East side of Sweet Grass Creek in  
the SE<sup>2</sup> of Sec. 6, NE<sup>4</sup> NW<sup>4</sup>, E<sup>2</sup> of Sec. 7  
and W<sup>2</sup> W<sup>2</sup> of Sec 8 - 3N-16E

(2) The Stocken ditch diverts near  
the east line in the SE<sup>4</sup> SE<sup>4</sup> of Sec 7  
and irrigates land in the W<sup>2</sup> W<sup>2</sup> NW<sup>4</sup>  
of Sec 17 and E<sup>2</sup> E<sup>2</sup> NE<sup>4</sup> and E<sup>2</sup> NE<sup>4</sup> SE<sup>4</sup>  
of Sec 18 - 3N-16E

(3) The lower Stocken ditch diverts  
in the NE<sup>4</sup> SE<sup>4</sup> Sec. 18 and irrigates  
land in the E<sup>2</sup> SE<sup>4</sup> SE<sup>4</sup> Sec 18, N<sup>2</sup> SW<sup>4</sup> SW<sup>4</sup>  
Sec 17, NE<sup>4</sup> NE<sup>4</sup> Sec 19 and NW<sup>4</sup>  
Sec. 20 - 3N-16E

STATE OF MONTANA  
**State Engineer's Office**  
WATER RESOURCES SURVEY

Township 3 North Range 16 East County Sweet Grass

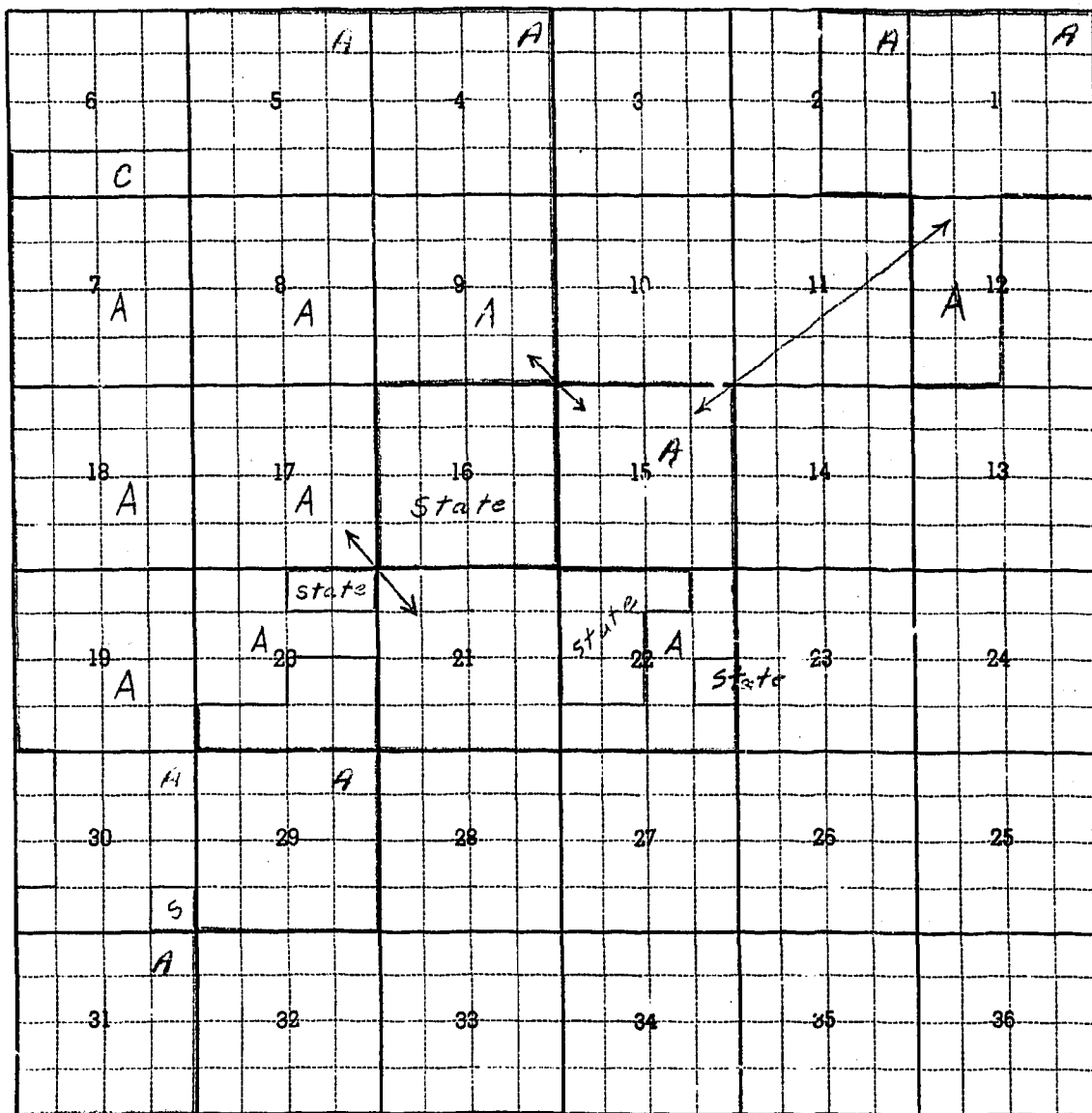

Township \_\_\_\_\_ Range \_\_\_\_\_