

Farm Checked

FORM F-1 REPORTER 1M 3-42 17380

By F.C. & D.B.

STATE OF MONTANA

State Engineer's Office

WATER RESOURCES SURVEY

Code No.

264

County

Lincoln

T.

3 N

R.

18 E

Sec.

24

Photo No.

100-94-24

Legal Land Owner

John W. Hoff et al

Address

Warden

Operator

Address

Water is delivered by:

Federal Project

Pres.

Pot.

Ditch Company

Pres.

Pot.

Irrigation District

Pres.

Pot.

Private System

Pres.

Pot.

Totals

Flood

Pump

Reservoir

Gravity

Size and Capacity, Pump, etc.

Original Appropriator, Company

App. No.

Original Appropriator, Private

Henry W. Warden

App. No.

937, 784-S

Is the system an extension of another system?

Yes

No

Is all land irrigated from one system?

Yes

No

(If No, show break down on map)

Source of Water

Unnamed Spring; Cedar Cr.

Acres Irrigated 19

None

Potential Acres

Seeped

Explain

Condition of System

Adequate Supply

Yes

No

Explain

Topography

Information From

Field Survey

Remarks

over

No trace of ditch in Sec 26 T3N-R5E  
land all under strip farming Trace of ditch  
for this land appears in Sec 27

AMERICAN OVERSIGHT SYSTEM

AMERICAN OVERSIGHT SYSTEM

AMERICAN OVERSIGHT SYSTEM

AMERICAN OVERSIGHT SYSTEM

By EL

Area Gibson

Date \_\_\_\_\_

Legal Land Owner\_\_\_\_\_

Operator\_\_\_\_\_

**Water is delivered by:**

STATE OF MONTANA

# STATE ENGINEER'S OFFICE

# WATER RESOURCES SURVEY

Code No. 6E 24

County Westmoreland

T. 30 R. 18 Sec. 2-6

Photo No. MA-9A-23

Press Big Iron 62-

Address 11

Federal Project \_\_\_\_\_ Pres. \_\_\_\_\_ Pot. \_\_\_\_\_

Ditch Company \_\_\_\_\_ Pres. \_\_\_\_\_ Pot. \_\_\_\_\_

Irrigation District \_\_\_\_\_ Pres. \_\_\_\_\_ Pot. \_\_\_\_\_

Private System \_\_\_\_\_ Pres. \_\_\_\_\_ Pot. \_\_\_\_\_

<u>Totals</u>	\$ 897.30
---------------	-----------

Flood Pump Reservoir Gravity

Size and Capacity, Pump, etc. \_\_\_\_\_

Original Appropriator, Company \_\_\_\_\_ App. No. \_\_\_\_\_

Original Appropriator, Private W. H. K. for S. H. K. App. No. 209

Is the system an extension of another system? Yes\_\_\_\_\_No\_\_\_\_\_

Is all land irrigated from one system? Yes\_\_\_\_\_No\_\_\_\_\_

(If No, show break down on map)

Source of Water Canal (W.)

Acres Irrigated 19 1900

Potential Acres \_\_\_\_\_ Seeped \_\_\_\_\_

### Explain

Condition of System.....

Adequate Supply ..... Yes..... No.....

**Explain** \_\_\_\_\_

## Topography

Information From G. J. Stands

Remarks *No trace of ditches are*

[illegible]

STATE OF MONTANA

# STATE ENGINEER'S OFFICE

## WATER RESOURCES SURVEY

Township 3N Range 18E County San Juan

6	5	4	3	2	1		
7	8	9	10	11	12		
18	17	16	15	14	13		
19	20	21	22	23	24		
30	29	28	27	26	25		
31	32	33	34	35	36		

*Martin Opland*

Township 3 Range 18



Township 2 North - Range 12E

(19)

Name of Owner	Township & Range
✓1. Cole, Jessie G.	(19) 2N-12E
✓2. Featherstone, Beatrice	"
✓3. Grosfield, Arne	" (20) 2N-13E <del>(20) 2N-13E</del>
✓3A Grosfield, Arthur	" (20) 2N-13E (27) 1N-13E
✓4. Gjerde, Marvin J.	" (27) 1N-13E
✓5. Morris, Sam and Jake	"
✓6. Prevost, F. N.	" (26) 1N-12E

**STATE OF MONTANA**

# STATE ENGINEER'S OFFICE

# WATER RESOURCES SURVEY

Township 2 North Range 12 East County Sweet Grass

[illegible]

Township 2 North Range 12 East



Township 2 North, Range 12 East

<u>No.</u>	<u>Name of Appropriator</u>	<u>Name of Stream</u>	<u>Date App.</u>	<u>Date Filed</u>	<u>M.I.</u>
295	Morris, Chester A.	Cort Creek	7-20-14	7-20-14	80
389	Davis, Mary B20-918	Duck Creek	5-28-15	5-28-15	320
480	Shook, Chas. H.	Henry Creek	11-11-01	11-11-10	200
510	Morris, Chester	Little Timber Creek	7-20-14	7-20-14	80
511	Morris, Dora M.	Little Timber Creek	11-1-05	11-1-05	200
512	Morris, Grover H. Arn	Little Timber Creek	11-17-10	11-17-10	200
513	Morris, Grover H.	Little Timber Creek	11-10-10	11-10-10	150
514	Morris, John B.	Little Timber Creek	5-28-03	5-28-03	300
1021	King, Nelson R.	Unnamed Springs	8-11-17	8-11-17	80
1031	Long, Ben F.	Unnamed Spring	8-3-14	8-3-14	20
1079	Long, G. B. and Morris, J. B.	Lake & Reservoir	7-29-19	7-29-19	1000
D-182	Davis, Florence E.	Duck Creek	5-28-15		210
D-215	Shook, Chas. H.	Henry Creek	10-1-05		80
D-216	Shook, Roy, Est.	Henry Creek	10-1-05		80

Farm Checked

STATE OF MONTANA

FORM F-1 - GAZETTE 1968-2N-1-47

By Jim Bob

Code No. 17A 20A 22A 26A 27A 28A 33A 34A

Area Springdale

**STATE ENGINEER'S OFFICE**  
WATER RESOURCES SURVEY

County Sweet Grass

Date July 27, 1950

T. 2N R. 10E Sec. 26, 27, 28, 33, 34

Legal Land Owner Jerome G. Cole

Photo No. HA-38-16

Operator Now owned by Paul Fetter

Address 38-05

Address Springdale

Water is delivered by:

Federal Project \_\_\_\_\_ Pres. \_\_\_\_\_ Pot. \_\_\_\_\_

Ditch Company \_\_\_\_\_ Pres. \_\_\_\_\_ Pot. \_\_\_\_\_

Irrigation District \_\_\_\_\_ Pres. \_\_\_\_\_ Pot. \_\_\_\_\_

Private System 2 Private ditches Pres. 30.0 Pot. \_\_\_\_\_

1 Diversion ditch in sec. 18-T2N-R12E (Pre 1905) Totals \_\_\_\_\_

Flood \_\_\_\_\_ Pump \_\_\_\_\_ Reservoir \_\_\_\_\_ Gravity ☒

Size and Capacity, Pump, etc. \_\_\_\_\_

Original Appropriator, Company Chas. H. Shank App. No. \_\_\_\_\_

Original Appropriator, Private Paul Shank, et al. App. No. D-216-D-215

Is the system an extension of another system? ☒ Yes ☒ No

Is all land irrigated from one system? ☒ Yes ☒ No

(If No, show break down on map)

Source of Water Henry Cui; Unnamed Springs

Acres Irrigated 19 50, 30.0

Potential Acres \_\_\_\_\_ Seeped \_\_\_\_\_

Explain \_\_\_\_\_

Condition of System Good

Adequate Supply ☒ Yes ☒ No

Explain Irrigates early and has plenty of water.

Topography Creek bottom a bench land

Information From Robert Cole

Remarks Information on back of sheet

See attached map

① Ditch takes out of Henry creek in SW corner of  
SW  $\frac{1}{4}$  on <sup>West</sup> south side of creek of Sec. 21. Shook Ditch  
Runs straight south on section line.

② Ditch runs out of Henry creek in SW corner of  
SW  $\frac{1}{4}$  on south side of creek of Sec. 21. Shook Ditch  
Runs straight south on section line. No ditch found.

③ Has ditch diverting East Duck Cr. to Alkali  
Creek of Sec. 18. T<sub>1</sub>N-R12E. Built by F. Clark.  
See also form #26

Presidents' diversion ditch from Henry Creek to  
Bailey Creek diverts on E bank near E line sec 20  
and runs S.E. across sec 21 into a canal ditch to Bailey  
Creek. This ditch has not been used for many years.

STATE OF MONTANA

# STATE ENGINEER'S OFFICE

## WATER RESOURCES SURVEY

Township 2N Range 12E County Sweet Grass

6	5	4	3	2	1
7	8	9	10	11	12
18	17	16	15	14	13
19	20	21	22	23	24
30	29	28	27	26	25
31	32	33	34	35	36

Handwritten annotations on the grid:

- Section 17: A
- Section 20: A
- Section 21: A
- Section 22: B
- Section 28: A
- Section 27: A
- Section 26: A
- Section 32: A
- Section 33: A
- Section 34: B

Jessie G. Cole

Township 2N Range 12E



STATE OF MONTANA

# State Engineer's Office

WATER RESOURCES SURVEY

## FARM MAP

County Sweetgrass

Code No. 17A-20A-21A-22B-

26A-27A-28A-22A-

33A-34B

Twp. 2N Rge. 12E

Twp. \_\_\_\_\_ Rge. \_\_\_\_\_

Twp. \_\_\_\_\_ Rge. \_\_\_\_\_

Name of Land Owner FETTER, JESSIE G. Address Spokane, Mont.

Address \_\_\_\_\_

☐ Non-Irrigated Land  
North

☒ Potential Land Under Existing Facilities

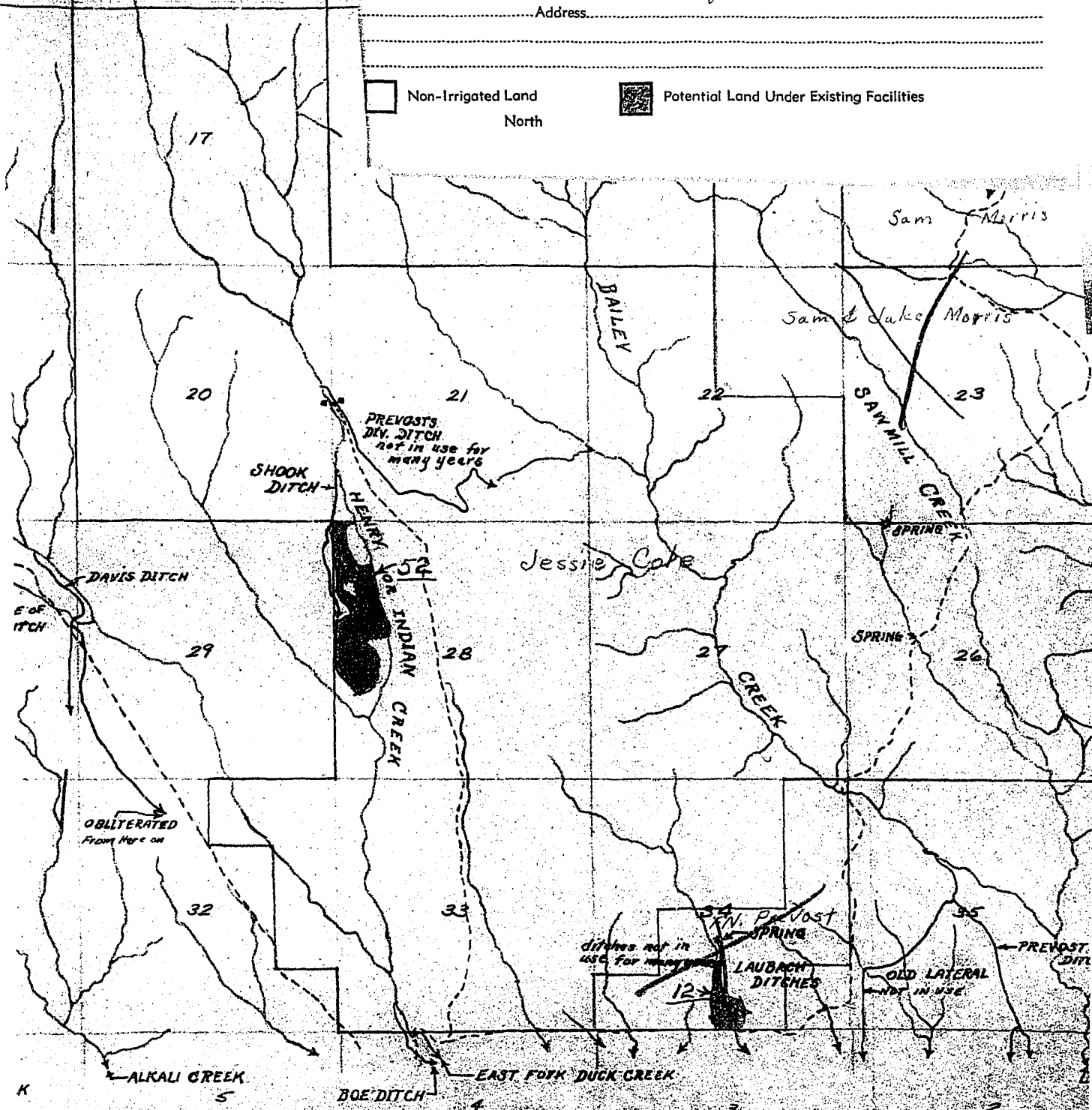

S—Stored Water.

Information from \_\_\_\_\_ Date July 3, 1951

State Engineer's Office

WATER RESOURCES SURVEY

FARM MAP

County Sweetgrass

Code No.

17A-20A-21A-22B-

26A-27A-28A-22A-

33A-34B

Twp 2N Rge 12E

Twp \_\_\_\_\_ Rge \_\_\_\_\_

Twp \_\_\_\_\_ Rge \_\_\_\_\_

of Land Owner FETTER, JESSIE G. Address Springdale Mont.

of Operator \_\_\_\_\_ Address \_\_\_\_\_

Description \_\_\_\_\_



Irrigated Land



Non-Irrigated Land

North



Potential Land Under Existing Facilities

No. 28A System Shook Ditch Source of Water Henry or Indian Creek  
Basin Yellowstone River Present 52 Potential 0 Maximum 52 R ✓ F ✓ P ✓ G ✓ S ✓  
No. \_\_\_\_\_ System \_\_\_\_\_ Source of Water \_\_\_\_\_  
Basin \_\_\_\_\_ Present \_\_\_\_\_ Potential \_\_\_\_\_ Maximum \_\_\_\_\_ R \_\_\_\_\_ F \_\_\_\_\_ P \_\_\_\_\_ G \_\_\_\_\_ S \_\_\_\_\_  
No. \_\_\_\_\_ System \_\_\_\_\_ Source of Water \_\_\_\_\_  
Basin \_\_\_\_\_ Present \_\_\_\_\_ Potential \_\_\_\_\_ Maximum \_\_\_\_\_ R \_\_\_\_\_ F \_\_\_\_\_ P \_\_\_\_\_ G \_\_\_\_\_ S \_\_\_\_\_  
No. \_\_\_\_\_ System \_\_\_\_\_ Source of Water \_\_\_\_\_  
Basin \_\_\_\_\_ Present \_\_\_\_\_ Potential \_\_\_\_\_ Maximum \_\_\_\_\_ R \_\_\_\_\_ F \_\_\_\_\_ P \_\_\_\_\_ G \_\_\_\_\_ S \_\_\_\_\_

If under Ditch Company, Irrigation District, or Government Project, state the number of shares or inches, acre feet, as the case may be said system.

NOTE: R—Denotes Regular Irrigation. F—Flood Irrigation. P—Water diverted by means of pumping. G—Water diverted by gravity. S—Stored Water.

Information from

J. E. Cook

Date

May 3, 1951

Farm Checked

STATE OF MONTANA

Code No.

By

## STATE ENGINEER'S OFFICE

County

Area

WATER RESOURCES SURVEY

T.

Sec.

Date

Photo No.

Legal Land Owner

Address

Operator

Address

Water is delivered by:

Federal Project

Pres.

Pot.

Ditch Company

Pres.

Pot.

Irrigation District

Pres.

Pot.

Private System

Pres.

Pot.

Totals

Flood

Pump

Reservoir

Gravity

Size and Capacity, Pump, etc.

Original Appropriator, Company

App. No.

Original Appropriator, Private

App. No.

Is the system an extension of another system?

Yes

No

Is all land irrigated from one system?

Yes

No

(If No, show break down on map)

Source of Water

Acres Irrigated 19

Potential Acres

Seeped

Explain

Condition of System

Adequate Supply

Yes

No

Explain

Topography

Information From

Remarks

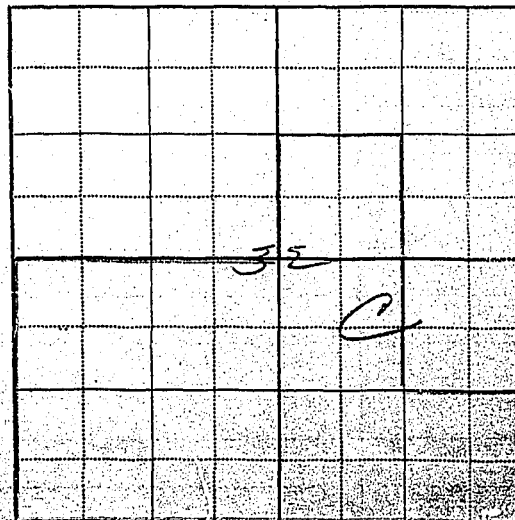

The Davis Ditch out of East Duck Cr takes  
out in NE "NE" Sec 30 T2N-R12E. This ditch  
is practically obliterated.

STATE OF MONTANA

State Engineer's Office

WATER RESOURCES SURVEY

FARM MAP

County Sweetgrass

Code No.

32C

Twp. 2N Rge. 12E

Twp. \_\_\_\_\_ Rge. \_\_\_\_\_

Twp. \_\_\_\_\_ Rge. \_\_\_\_\_

Name of Land Owner FEATHERSTONE, BEATRICE Address L. A. Calif.

Name of Operator \_\_\_\_\_ Address \_\_\_\_\_

Legal Description \_\_\_\_\_



Irrigated Land



Non-Irrigated Land



Potential Land Under Existing Facilities

North

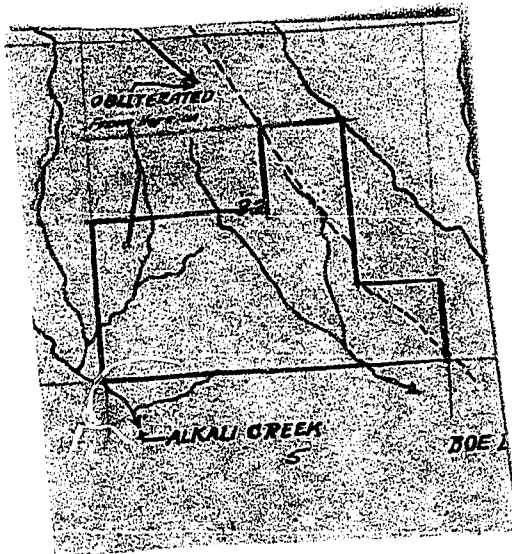

Code No. \_\_\_\_\_ System \_\_\_\_\_ Source of Water \_\_\_\_\_

Basin \_\_\_\_\_ Present \_\_\_\_\_ Potential \_\_\_\_\_ Maximum \_\_\_\_\_ R. \_\_\_\_\_ F. \_\_\_\_\_ P. \_\_\_\_\_ G. \_\_\_\_\_ S. \_\_\_\_\_

Code No. \_\_\_\_\_ System \_\_\_\_\_ Source of Water \_\_\_\_\_

Basin \_\_\_\_\_ Present \_\_\_\_\_ Potential \_\_\_\_\_ Maximum \_\_\_\_\_ R. \_\_\_\_\_ F. \_\_\_\_\_ P. \_\_\_\_\_ G. \_\_\_\_\_ S. \_\_\_\_\_

Code No. \_\_\_\_\_ System \_\_\_\_\_ Source of Water \_\_\_\_\_

Basin \_\_\_\_\_ Present \_\_\_\_\_ Potential \_\_\_\_\_ Maximum \_\_\_\_\_ R. \_\_\_\_\_ F. \_\_\_\_\_ P. \_\_\_\_\_ G. \_\_\_\_\_ S. \_\_\_\_\_

Code No. \_\_\_\_\_ System \_\_\_\_\_ Source of Water \_\_\_\_\_

Basin \_\_\_\_\_ Present \_\_\_\_\_ Potential \_\_\_\_\_ Maximum \_\_\_\_\_ R. \_\_\_\_\_ F. \_\_\_\_\_ P. \_\_\_\_\_ G. \_\_\_\_\_ S. \_\_\_\_\_

If under Ditch Company, Irrigation District, or Government Project, state the number of shares or inches, acre feet, as the case may be in said system.

NOTE: R—Denotes Regular Irrigation. F—Flood Irrigation. P—Water diverted by means of pumping. G—Water diverted by gravity. S—Stored Water.

Information from \_\_\_\_\_ Date \_\_\_\_\_

Farm Checked

STATE OF MONTANA

Code No. 18A 19A 30ABy B.S. 9 H

## STATE ENGINEER'S OFFICE

County LincolnArea Duck Cr

WATER RESOURCES SURVEY

T. 2N R. 12E Sec. 18, 19, 30Date 8-1-50Photo No. MA-38-16

Legal Land Owner

Maurice J. GinderAddress Bozeman

Operator

R. BerlandAddress Livingston

Water is delivered by:

Federal Project \_\_\_\_\_ Pres \_\_\_\_\_ Pot \_\_\_\_\_

Ditch Company \_\_\_\_\_ Pres \_\_\_\_\_ Pot \_\_\_\_\_

Irrigation District \_\_\_\_\_ Pres \_\_\_\_\_ Pot \_\_\_\_\_

Private System 1 ditch Pres \_\_\_\_\_ Pot \_\_\_\_\_No irrigation - no ditches Totals \_\_\_\_\_

Flood \_\_\_\_\_ Pump \_\_\_\_\_ Reservoir \_\_\_\_\_ Gravity \_\_\_\_\_

Size and Capacity, Pump, etc. \_\_\_\_\_

Original Appropriator, Company \_\_\_\_\_ App. No. \_\_\_\_\_

Original Appropriator, Private Melvin R. King App. No. 10211917-20

Is the system an extension of another system?

Yes ☒ No \_\_\_\_\_

Is all land irrigated from one system?

Yes \_\_\_\_\_ No \_\_\_\_\_

(If No, show break down on map)

Source of Water

Unmanned Springs

Acres Irrigated 19 \_\_\_\_\_

Potential Acres \_\_\_\_\_ Seeped \_\_\_\_\_

Explain \_\_\_\_\_

Condition of System \_\_\_\_\_

Adequate Supply \_\_\_\_\_ Yes \_\_\_\_\_ No \_\_\_\_\_

Explain \_\_\_\_\_

Topography \_\_\_\_\_

Information From R. Berland

Remarks \_\_\_\_\_

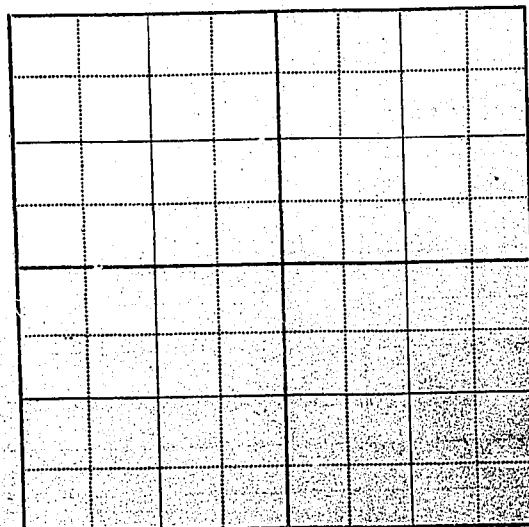
19 No Irr., No Ditches



① Ditch diverts in NE<sup>1</sup>/<sub>4</sub> NE<sup>1</sup>/<sub>4</sub> sec 30 from S bank of E. Ft. Duck Creek  
was used to irrigate land in SW<sup>1</sup>/<sub>4</sub> sec 29. also small amount  
in sec 30 near E fence line. Ditch is silted full and not in use.

UNITED STATES DEPARTMENT OF AGRICULTURE

OFFICE OF SOIL CONSERVATION



STATE OF MONTANA

# STATE ENGINEER'S OFFICE

WATER RESOURCES SURVEY

Township 2N Range 12E County Sweet Grass

6	5	4	3	2	1
7	8	9	10	11	12
A 18	17	16	15	14	13
A 19	20	21	22	23	24
A 30	29	28	27	26	25
31	32	33	34	35	36

Marvin J. Gjerde

Township 2N Range 12E

Farm Checked

STATE OF MONTANA

FORM F-1 - GAZETTE 1665-24-1-47

By

Area

Date

Legal Land Owner

Operator

**STATE ENGINEER'S OFFICE**  
WATER RESOURCES SURVEY

Code No.

County

T.

R.

Sec.

Photo No.

Address

Address

Water is delivered by:

Federal Project

Pres.

Pot.

Ditch Company

Pres.

Pot.

Irrigation District

Pres.

Pot.

Private System

Pres.

Pot.

Totals

Flood

Pump

Reservoir

Gravity

Size and Capacity, Pump, etc.

Original Appropriator, Company

App. No.

Original Appropriator, Private

App. No.

Is the system an extension of another system?

Yes

No

Is all land irrigated from one system?

Yes

No

(If No, show break down on map)

Source of Water

Acres Irrigated 19.50

300.0 (Same on other form)

Potential Acres

Seeped

Explain

Condition of System

Adequate Supply

Yes

No

Explain

Topography

Information From

Remarks

Dug W. R. in Morris ditch, diverting  
in Sec. 9.

- ① Some potential land under Johnson ditch in sec. 1 but does not have any W.R. in this ditch.
- ② Grosfield Ditch diverts in SE $\frac{1}{4}$  sec 33 T3N-R12E from S bank of Rick Creek runs E and S to irrigate land in secs. 1 & 2 T2N-R12E.
- ③ A. Grosfield sometimes uses the John Morris ditch out of Little Timber Creek. Ditch diverts on N Bank in E $\frac{1}{2}$ SW $\frac{1}{4}$  sec. 3 T2N-R12E, and runs E to land in sec. 2. Grosfield uses on land in SE $\frac{1}{4}$  sec. 2.
- ④ Grosfield has W.R. in Morris ditch which diverts from Main Little Timber Creek in SE $\frac{1}{4}$  sec. 9, and runs E to secs. 11, 14, & 15. According to the Morris's the lateral running NE thru sec 11 was only used to water stock and not for irrigation.
- ⑤ Ditch diverting from N Side of Little Timber Creek in sec. 10 (center) was built and used by John Morris to run his sawmill. Has not been used for many years.

STATE OF MONTANA  
**STATE ENGINEER'S OFFICE**  
 WATER RESOURCES SURVEY

Township 2N Range 1E E County Sweet Grass

				A		A
6	5	4	3	2	1	
7	8	9	10	11	12	
18	17	16	15	14	13	
19	20	21	22	23	24	
30	29	28	27	26	25	
31	32	33	34	35	36	

*Anne G. Masfield*

Township 2N Range 1E E

STATE OF MONTANA  
**State Engineer's Office**  
WATER RESOURCES SURVEY  
FARM MAP

County Sweetgrass  
Code No. 1A-2C-3A-10B-  
11A-12A-13A

Twp. 2N Rge. 12E

Twp. \_\_\_\_\_ Rge. \_\_\_\_\_

Twp. \_\_\_\_\_ Rge. \_\_\_\_\_

Name of Land Owner Grosfield, Arne Address Big Timber

Name of Operator Same Address "

Legal Description \_\_\_\_\_

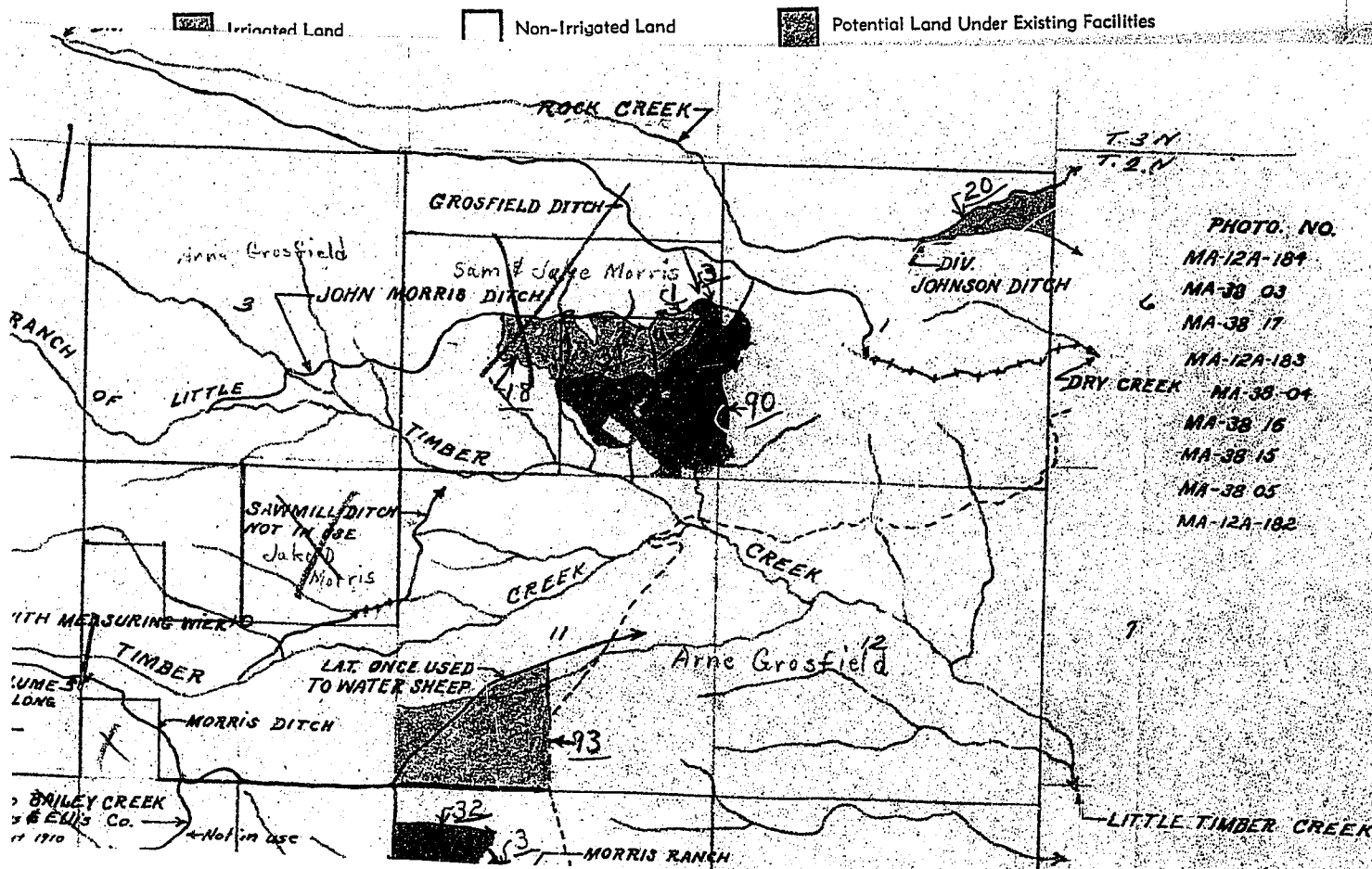

Code No. 1A System Johnson  
Basin Big Timber Creek Present 0 P  
Code No. 1A, 2C System Grosfield  
Basin Big Timber Creek Present 90 P  
Code No. 2C System John M  
Basin Yellowstone River Present 0 P  
Code No. 11A System Morris Ditch Source of Water A.U.  
Basin Yellowstone River Present 0 Potential 93 Maximum 93 R. V. F. P. G. V. S.

If under Ditch Company, Irrigation District, or Government Project, state the number of shares or inches, acre feet, as the case may be in said system.

NOTE: R—Denotes Regular Irrigation. F—Flood Irrigation. P—Water diverted by means of pumping. G—Water diverted by gravity. S—Stored Water.

Information from J. E. Cook Date May 3, 1951

Form WB-3  
Revised 20168 2M 12-41

STATE OF MONTANA  
**State Engineer's Office**  
WATER RESOURCES SURVEY  
FARM MAP

County Sweetgrass

Code No. 1A-2C-3A-10B  
11A-12A-13A

Twp. 2N Rge. 12E  
Twp. \_\_\_\_\_ Rge. \_\_\_\_\_  
Twp. \_\_\_\_\_ Rge. \_\_\_\_\_

Name of Land Owner Grasfield, Arnie Address Big Timber  
Name of Operator Same Address \_\_\_\_\_  
Legal Description \_\_\_\_\_



Irrigated Land



Non-Irrigated Land  
North



Potential Land Under Existing Facilities

Code No. <u>1A</u>	System <u>Johnson Ditch</u>	Source of Water <u>Rock Creek</u>
Basin <u>Big Timber Creek</u>	Present <u>0</u> Potential <u>20</u> Maximum <u>20</u>	R <input checked="" type="checkbox"/> F <input type="checkbox"/> P <input type="checkbox"/> G <input checked="" type="checkbox"/> S <input type="checkbox"/>
Code No. <u>1A, 2C</u>	System <u>Grasfield Ditch</u>	Source of Water <u>Rock Creek</u>
Basin <u>Big Timber Creek</u>	Present <u>90</u> Potential <u>9</u> Maximum <u>99</u>	R <input checked="" type="checkbox"/> F <input type="checkbox"/> P <input type="checkbox"/> G <input checked="" type="checkbox"/> S <input type="checkbox"/>
Code No. <u>2C</u>	System <u>John Morris Ditch</u>	Source of Water <u>Branch of Timber Creek</u>
Basin <u>Yellowstone River</u>	Present <u>0</u> Potential <u>31</u> Maximum <u>31</u>	R <input checked="" type="checkbox"/> F <input type="checkbox"/> P <input type="checkbox"/> G <input checked="" type="checkbox"/> S <input type="checkbox"/>
Code No. <u>11A</u>	System <u>Morris Ditch</u>	Source of Water <u>Little Timber Creek</u>
Basin <u>Yellowstone River</u>	Present <u>0</u> Potential <u>93</u> Maximum <u>93</u>	R <input checked="" type="checkbox"/> F <input type="checkbox"/> P <input type="checkbox"/> G <input checked="" type="checkbox"/> S <input type="checkbox"/>

If under Ditch Company, Irrigation District, or Government Project, state the number of shares or inches, acre feet, as the case may be in said system.

NOTE: R—Denotes Regular Irrigation. F—Flood Irrigation. P—Water diverted by means of pumping. G—Water diverted by gravity.  
S—Stored Water.

Information from

J. E. Cook

Date May 3, 1951



Farm Checked

STATE OF MONTANA

FORM F-1 REPORTER 1M 3-49-17380

By

Jim & Bob

Code No.

24A, 25A

Area

Little Timber

State Engineer's Office

County

Sweetgrass

WATER RESOURCES SURVEY

T.

2N

R. 12E

Sec. 24 & 25

Date

Aug. 17, 1950

Photo No.

MA-12A-183

Legal Land Owner

Arthur Grosfield

Address

Big Timber

Operator

Address

Water is delivered by:

Federal Project

Pres.

Pot.

Ditch Company

Pres.

Pot.

Irrigation District

Pres.

Pot.

Private System

2 Private ditches

Pres.

0

Pot.

Totals

Flood

Pump

Reservoir

Gravity

✓

Size and Capacity, Pump, etc.

Original Appropriator, Company

App. No.

Original Appropriator, Private

None shown

App. No.

Is the system an extension of another system?

Yes

No

✓

Is all land irrigated from one system?

Yes

No

✓

(If No, show break down on map)

Source of Water

West Fork Little Timber Creek

Acres Irrigated 1950, 0

Potential Acres

Seeped

Explain

Land never been irr. but some land pot. under ditches

Condition of System

Need repair

Adequate Supply

Yes

No

✓

Explain

Creek sometimes goes dry

Topography

Valley sides

Information From

Arthur Grosfield

Remarks

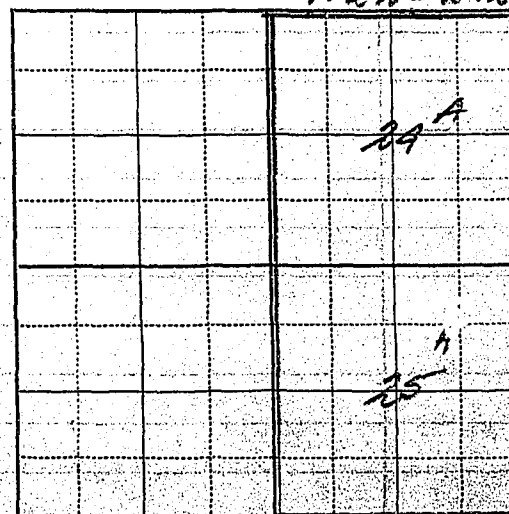

(19) Master Form in File No. 20



① Ditch diverting from Cort Creek, North bank, in the NW  $\frac{1}{4}$  NE  $\frac{1}{4}$  sec 28  
T2N-R12E, irr. land in T2N-R13E, some land potential in sec 24  
under this ditch

② Ditch diverts from S. side of W. Fork, Little Timber Creek near  
E. line of Sec 24, <sup>T2N-R12E</sup> runs S. and irrigates land in secs 19 & 30 T2N-R13E.

BY HENRIK R. POLAK

STATE ENGINEER & SURVEYOR

COMM. EXPIRES

DATE

STATE

STATE OF MONTANA

# State Engineer's Office

WATER RESOURCES SURVEY

## FARM MAP

County Sweetgrass

Code No. 24A-25A

Twp. 2N Rge. 12E

Twp. \_\_\_\_\_ Rge. \_\_\_\_\_

Twp. \_\_\_\_\_ Rge. \_\_\_\_\_

Name of Land Owner GROSFIELD, ARTHUR Address Big Timber

Name of Operator S. A. MUE Address " "

Legal Description \_\_\_\_\_

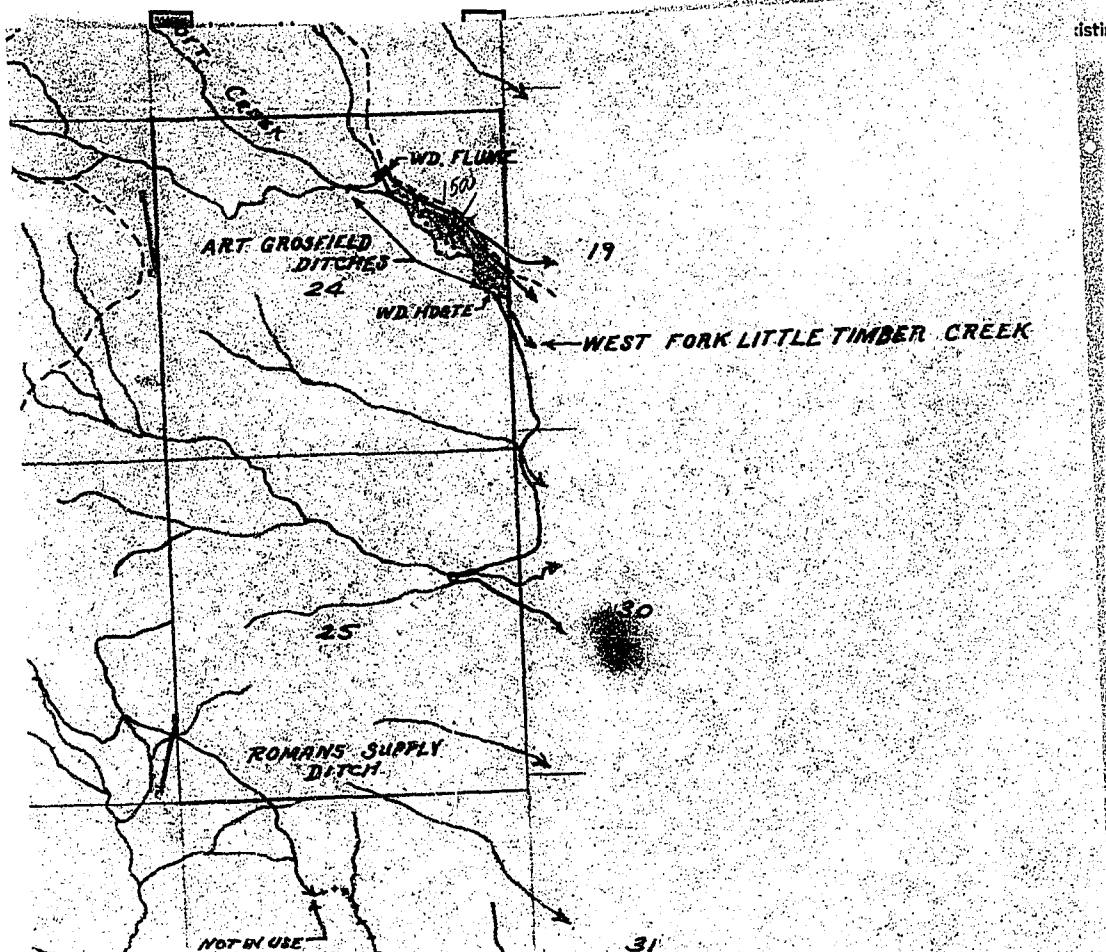

Code No. 24A System Art Grosfield Ditch Source of Water Cort Creek

Basin Yellowstone River Present 0 Potential 15 Maximum 15 R. Y F. P G. V S. S

Code No. \_\_\_\_\_ System \_\_\_\_\_ Source of Water \_\_\_\_\_

Basin \_\_\_\_\_ Present \_\_\_\_\_ Potential \_\_\_\_\_ Maximum \_\_\_\_\_ R. \_\_\_\_\_ F. \_\_\_\_\_ P. \_\_\_\_\_ G. \_\_\_\_\_ S. \_\_\_\_\_

Code No. \_\_\_\_\_ System \_\_\_\_\_ Source of Water \_\_\_\_\_

Basin \_\_\_\_\_ Present \_\_\_\_\_ Potential \_\_\_\_\_ Maximum \_\_\_\_\_ R. \_\_\_\_\_ F. \_\_\_\_\_ P. \_\_\_\_\_ G. \_\_\_\_\_ S. \_\_\_\_\_

Code No. \_\_\_\_\_ System \_\_\_\_\_ Source of Water \_\_\_\_\_

Basin \_\_\_\_\_ Present \_\_\_\_\_ Potential \_\_\_\_\_ Maximum \_\_\_\_\_ R. \_\_\_\_\_ F. \_\_\_\_\_ P. \_\_\_\_\_ G. \_\_\_\_\_ S. \_\_\_\_\_

If under Ditch Company, Irrigation District, or Government Project, state the number of shares or inches, acre feet, as the case may be in said system.

NOTE: R—Denotes Regular Irrigation. F—Flood Irrigation. P—Water diverted by means of pumping. G—Water diverted by gravity. S—Stored Water.

Information from L. E. Cook Date May 3, 1951

By \_\_\_\_\_

Area \_\_\_\_\_

Date \_\_\_\_\_

Legal Land Owner\_\_\_\_\_

Operator \_\_\_\_\_

Water is delivered by:

Federal Project \_\_\_\_\_ Pres. \_\_\_\_\_ Pot. \_\_\_\_\_

Ditch Company \_\_\_\_\_ Pres. \_\_\_\_\_ Pot. \_\_\_\_\_

Irrigation District \_\_\_\_\_ Pres. \_\_\_\_\_ Pot \_\_\_\_\_

Private System Morris Ditch Pres. \_\_\_\_\_ Pot. \_\_\_\_\_

Totals	
100	100

Flood \_\_\_\_\_ Pump \_\_\_\_\_ Reservoir \_\_\_\_\_ Gravity \_\_\_\_\_

Size and Capacity, Pump, etc. \_\_\_\_\_

Original Appropriator, Company \_\_\_\_\_ App. No. \_\_\_\_\_

Original Appropriator, Private \_\_\_\_\_ App. No. \_\_\_\_\_

Is the system an extension of another system? Yes\_\_\_\_\_No\_\_\_\_\_

Is all land irrigated from one system? Yes \_\_\_\_\_ No \_\_\_\_\_

(If No, show break down on map)

Source of Water. Cort Creek

Acres Irrigated 19\_\_\_\_\_

Potential Acres \_\_\_\_\_ Seeped \_\_\_\_\_

**Explain**\_\_\_\_\_

Condition of System \_\_\_\_\_

Adequate Supply ----- Yes ----- No -----

Explain

### Topography

Information From \_\_\_\_\_

Remarks \_\_\_\_\_

No 144

[illegible]

STATE OF MONTANA  
**State Engineer's Office**  
WATER RESOURCES SURVEY  
FARM MAP

County Sw. Grass  
Code No. 14A

Twp. 2N Rge. 17E  
Twp. \_\_\_\_\_ Rge. \_\_\_\_\_  
Twp. \_\_\_\_\_ Rge. \_\_\_\_\_

Name of Land Owner Sam J. Morris Address \_\_\_\_\_  
Name of Operator " Address \_\_\_\_\_  
Legal Description \_\_\_\_\_



Irrigated Land



Non-Irrigated Land



Potential Land Under Existing Facilities

North

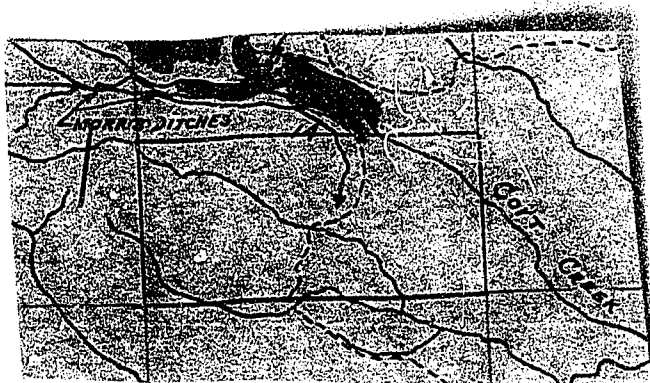

Code No. _____	System _____	Source of Water _____
Basin _____	Present _____ Potential _____	Maximum _____ R _____ F _____ P _____ G _____ S _____
Code No. _____	System _____	Source of Water _____
Basin _____	Present _____ Potential _____	Maximum _____ R _____ F _____ P _____ G _____ S _____
Code No. _____	System _____	Source of Water _____
Basin _____	Present _____ Potential _____	Maximum _____ R _____ F _____ P _____ G _____ S _____
Code No. _____	System _____	Source of Water _____
Basin _____	Present _____ Potential _____	Maximum _____ R _____ F _____ P _____ G _____ S _____

If under Ditch Company, Irrigation District, or Government Project, state the number of shares or inches, acre feet, as the case may be in said system.

NOTE: R—Denotes Regular Irrigation. F—Flood Irrigation. P—Water diverted by means of pumping. G—Water diverted by gravity. S—Stored Water.

Information from \_\_\_\_\_ Date \_\_\_\_\_

By James J. Baker

Area Little Lander, Co.

Date March 25, 1930

Legal Land Owner.

**Operator.**

Water is delivered by:

## STATE OF MONTANA

# STATE ENGINEER'S OFFICE

## WATER RESOURCES SURVEY

Code No. 210 14 A

County Franklin

T. 250 R. 1317 Sec. 2 14

Photo No. 38-04

Address (X) 4 Linden

Address \_\_\_\_\_

Federal Project \_\_\_\_\_ Pres. \_\_\_\_\_ Pot. \_\_\_\_\_

Ditch Company \_\_\_\_\_ Pres. \_\_\_\_\_ Pot. \_\_\_\_\_

Irrigation District \_\_\_\_\_ Pres. \_\_\_\_\_ Pot. \_\_\_\_\_

Private System 5 Station Private Pres. \_\_\_\_\_ Pot. \_\_\_\_\_

<b>Totals</b>	\$ 679,875 28,350		<b>\$ 708,225</b>
---------------	----------------------	--	-------------------

Flood \_\_\_\_\_ Pump \_\_\_\_\_ Reservoir \_\_\_\_\_ Gravity ☒

### Size and Capacity, Pump, etc.

Original Appropriator, Company \_\_\_\_\_ App. No. \_\_\_\_\_

Original Appropriator, Private James Lee C. Brown App. No. 295, 510

Is the system an extension of another system? Yes \_\_\_\_\_ No.       

Is all land irrigated from one system? Yes \_\_\_\_\_ No ✓ \_\_\_\_\_

(If No, show break down on map)

Source of Water South Cove, Little Ferry, New York

Acres Irrigated 19 50 60.0

Potential Acres 7 Seeped                     

Explain

Condition of System Good

Adequate Supply Yes No ☒

Explain Not enough water at different parts of

Topography Croc. 100 balloons & Kirsch Island

Information From Alfred Morris

Remarks Information on back of

Adm.

①

See attached

May

19

Cort-Creek or West

① Ditch takes out of Little Timber Cr. about 100 yards west of section line between sec. 14 & 15 of T. 2N-R 12E. On north side of cr.

or Cort Creek

② Ditch takes out of <sup>west</sup> Little Timber Cr. about 25 yds east of sec. line between 14 & 15 on south side of creek.

③ Ditch takes out of Little Timber Cr. about 100 yds. east of sec. line between 14 & 15 on south side of Timber Creek. Wood frame 1500' long. This ditch runs east to irrigate land in NW 1/4 Sec. 14. Lateral extended S.W. from Ditch near N line of sec 15 was built by Johnny King for the Briggs-Ellis Co. to supplement Bailey Creek - used only one year. Lateral extended N.E. from SW corner sec 11 was used by Grosfield to water stock - has not been used for many years but Anne Grosfield claims a right in the ditch.



STATE OF MONTANA

STATE ENGINEER'S OFFICE

WATER RESOURCES SURVEY

Township 2N Range 12E County Sweet Grass

6	5	4	3	2 <b>B</b>	1
7	8	9	10	11	12
18	17	16	15	14 <b>A</b>	13
19	20	21	22	23 <i>Building containing crops and water</i>	24
30	29	28	27	26	25
31	32	33	34	35	36

*Sam & Jack Morris*

Township 2N Range 12E



May 3, 1951

State Engineer's Office

WATER RESOURCES SURVEY

FARM MAP

County Sweetgrass

Code No. 2B-14A

Twp. 2N Rge. 13E

Twp. \_\_\_\_\_ Rge. \_\_\_\_\_

Twp. \_\_\_\_\_ Rge. \_\_\_\_\_

Name of Land Owner MORRIS, SAM & JAKE Address Big Timber

Name of Operator Sam Morris Address " "

Legal Description \_\_\_\_\_



Irrigated Land



Non-Irrigated Land



Potential Land Under Existing Facilities

North

Code No. 2B System John Morris Ditch Source of Water Branch of Little Timber Creek  
Basin Yellowstone River Present 0 Potential 18 Maximum 18 R ✓ F ✓ P ✓ G ✓ S ✓  
Code No. 2B System Grassfield Ditch Source of Water Rock Creek  
Basin Big Timber Creek Present 3 Potential 1 Maximum 4 R ✓ F ✓ P ✓ G ✓ S ✓  
Code No. 14A System Morris Ditches Source of Water Cort Creek  
Basin Yellowstone River Present 12 Potential 0 Maximum 12 R ✓ F ✓ P ✓ G ✓ S ✓  
Code No. 14A System Morris Ditch Source of Water Little Timber Cr.  
Basin Yellowstone River Present 50 Potential 0 Maximum 50 R ✓ F ✓ P ✓ G ✓ S ✓

If under Ditch Company, Irrigation District, or Government Project, state the number of shares or inches, acre feet, as the case may be in said system.

NOTE: R—Denotes Regular Irrigation. F—Flood Irrigation. P—Water diverted by means of pumping. G—Water diverted by gravity. S—Stored Water.

Information from J. E. Cook

Date May 3, 1951

Farm Checked

FORM F-1 REPORTER 1M 3-49 17380

STATE OF MONTANA

State Engineer's Office

WATER RESOURCES SURVEY

By Jim & Bob  
Area Little Timber Cr.

Code No. 34 A

County Sweetgrass

Date July 27, 1950

T. 2 N R. 12 E Sec. 34

Photo No. MA-38 0.5

Legal Land Owner Prevost, R. N.

Address Springdale

Operator

Address

Water is delivered by:

Federal Project \_\_\_\_\_ Pres. \_\_\_\_\_ Pot. \_\_\_\_\_

Ditch Company \_\_\_\_\_ Pres. \_\_\_\_\_ Pot. \_\_\_\_\_

Irrigation District \_\_\_\_\_ Pres. \_\_\_\_\_ Pot. \_\_\_\_\_

Private System 3 Private Ditches Pres. \_\_\_\_\_ Pot. \_\_\_\_\_

Totals \_\_\_\_\_

Flood \_\_\_\_\_ Pump \_\_\_\_\_ Reservoir \_\_\_\_\_ Gravity ☒

Size and Capacity, Pump, etc. \_\_\_\_\_

Original Appropriator, Company \_\_\_\_\_ App. No. \_\_\_\_\_

Original Appropriator, Private Lambach (no filing) App. No. \_\_\_\_\_

Is the system an extension of another system? Yes \_\_\_\_\_ No ☒

Is all land irrigated from one system? Yes \_\_\_\_\_ No ☒

(If No, show break down on map)

Source of Water Unmeasured springs

Acres Irrigated 1950, 0

Potential Acres \_\_\_\_\_ Seeped \_\_\_\_\_

Explain \_\_\_\_\_

Condition of System run down

Adequate Supply \_\_\_\_\_ Yes ☒ No \_\_\_\_\_

Explain Small area irr. Springs supply water

Topography Valley bottoms and sides

Information From F. M. Prevost

Remarks No filings shown.

Lambach built these ditches.

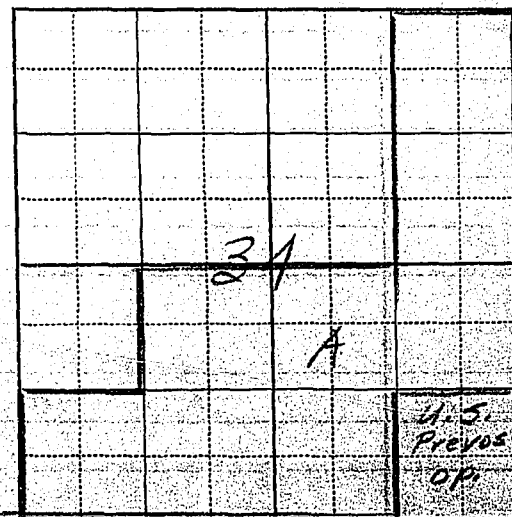

② 2 ditches diverting on north side  
of gulch out of springs in south half  
of Sec. 34. One out of spring and one  
out of gulch which carries spring water.

③ Ditch, diverts on opposite side of gulch  
from other ditch, uses spring water  
when available.

These ditches not in use for  
many years.

STATE OF MONTANA  
**State Engineer's Office**  
WATER RESOURCES SURVEY  
FARM MAP

County Sweetgrass

Code No. 34A

Twp. 2N Rge. 12E

Twp. \_\_\_\_\_ Rge. \_\_\_\_\_

Twp. \_\_\_\_\_ Rge. \_\_\_\_\_

Name of Land Owner PREVOST, J. N. Address \_\_\_\_\_

Name of Operator \_\_\_\_\_ Address \_\_\_\_\_

Legal Description \_\_\_\_\_

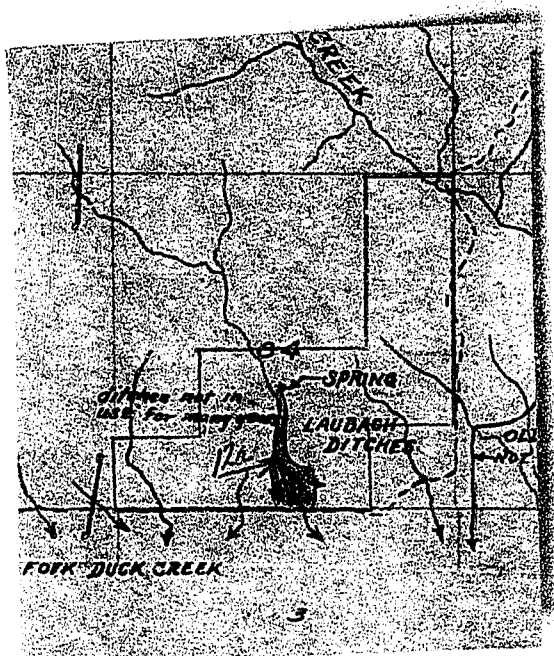
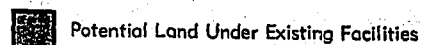
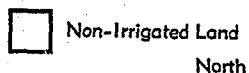
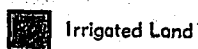

Code No. 34A System Laubach Ditches Source of Water unnamed spring trib. to E. Fork Duck Creek

Basin Yellowstone River Present 0 Potential 12 Maximum 12 R X F     P     G X S    

Code No. \_\_\_\_\_ System \_\_\_\_\_ Source of Water \_\_\_\_\_  
Basin \_\_\_\_\_ Present \_\_\_\_\_ Potential \_\_\_\_\_ Maximum \_\_\_\_\_ R     F     P     G     S    

Code No. \_\_\_\_\_ System \_\_\_\_\_ Source of Water \_\_\_\_\_  
Basin \_\_\_\_\_ Present \_\_\_\_\_ Potential \_\_\_\_\_ Maximum \_\_\_\_\_ R     F     P     G     S    

Code No. \_\_\_\_\_ System \_\_\_\_\_ Source of Water \_\_\_\_\_  
Basin \_\_\_\_\_ Present \_\_\_\_\_ Potential \_\_\_\_\_ Maximum \_\_\_\_\_ R     F     P     G     S    

Code No. \_\_\_\_\_ System \_\_\_\_\_ Source of Water \_\_\_\_\_  
Basin \_\_\_\_\_ Present \_\_\_\_\_ Potential \_\_\_\_\_ Maximum \_\_\_\_\_ R     F     P     G     S    

If under Ditch Company, Irrigation District, or Government Project, state the number of shares or inches, acre feet, as the case may be in said system.

NOTE: R—Denotes Regular Irrigation. F—Flood Irrigation. P—Water diverted by means of pumping. G—Water diverted by gravity. S—Stored Water.

Information from J. E. Cook Date May 3, 1955



Township 2 North - Range 13 E.

(20)

Name of Owner	Township & Range
✓ 1. Grosfield, Louis	(20) 2N-13E (21) 2N-14E (13) 3N-13E (7) 4N-13E
✓ 2. Grosfield, Arthur	" (27) 1N-13E (19) 2N-12E
✓ 3. Grosfield, Arne	" (19) 2N-12E
✓ 4. Hegdal, Ole	" (13) 3N-13E
✓ 5. Hauge, Bina	" (21) 2N-14E
✓ 6. Madill, John A.	" (21) 2N-14E (12) 3N-12E (13) 3N-13E (27) 1N-13E
✓ 7. Rudd, Alfred	"
✓ 8. Marie Ueland	Palmer Hauge
✓ 9. Freda Hauge	
✓ 10 John Pederson	

STATE OF MONTANA  
STATE ENGINEER'S OFFICE  
WATER RESOURCES SURVEY

Township 2 North Range 12 East County Sweet Grass

575 D-246 577	6 D-80 D-81 D-82 D-83 D-84 D-167 D-253 D-254 D-255 D-256 D-257 D-258	5 D-459 D-260 D-261 D-262	106 D-85 D-86 D-87 D-160	3 1059	13 87 111	13 111 D-115 D-116 D-117 D-164
7 76 377	D-163 D-265	76 375 729	D-80 D-81 D-82 D-83 D-84 D-167 D-253 D-254 D-255 D-256 D-257	10 1000	11 106 106 106 106 104 642 104 642 104 642 D-227 D-98	106 627 106 642 104 642 104 642 D-227 D-98
18 D-80 D-81 D-82 D-83 D-84 D-167 D-253 D-254 D-255 D-256 D-257	17 D-459 D-260 D-261 D-262	16 375	15 882	14 740 882	13 D-80 D-81 D-82 D-83 D-84 D-167 D-253 D-254 D-255 D-256 D-257	13 D-459 D-260 D-261 D-262
19 D-80 D-81 D-82 D-83 D-84 D-167 D-253 D-254 D-255 D-256 D-257	20 D-459 D-260 D-261 D-262	21 882	22 740 882	23 D-80 D-81 D-82 D-83 D-84 D-167 D-253 D-254 D-255 D-256 D-257	24 D-459 D-260 D-261 D-262	24 D-459 D-260 D-261 D-262
30 515	29 D-246	28 D-246	27 D-246	26 884 948	25 885	25 885
31 475 640 D-237 D-246 640 D-247 D-248 D-249 D-250	32 475 640 D-237 D-246 640 D-247 D-248 D-249 D-250	33 475 640 D-237 D-246 640 D-247 D-248 D-249 D-250	34 475 640 D-237 D-246 640 D-247 D-248 D-249 D-250	35 475 640 D-237 D-246 640 D-247 D-248 D-249 D-250	36 475 640 D-237 D-246 640 D-247 D-248 D-249 D-250	36 475 640 D-237 D-246 640 D-247 D-248 D-249 D-250

Township 2 North Range 12 East



Township 2 North, Range 13 East

No.	Name of Appropriator	Name of Stream	Date App.	Date Filed	M.I.
13	Magelson, Peter J.	Amalong Creek	12-9-04	12-20-04	200
76	Anderson, Anders O.	Big Timber Creek	2-14-06	2-14-06	300
87	Cavane, A. R. & Titinger, Fred & Nicholas	Big Timber Creek	5-23-96	5-23-96	1000
104	Hauge, Bina M.	Big Timber Creek	10-23-07	10-23-07	320
106	Hauge, Richard E.	Big Timber Creek	10-23-07	10-23-07	320
110	Iverson, Oleana	Big Timber Creek	6-9-02	6-9-02	200
111	Johnson, Emil et al <i>Big Dutch</i>	Big Timber Creek	3-3-03	3-3-03	2000
375	Grosfield, Mathias	Dry Creek	7-30-95	8-2-95	500
377	Larson, Osmond and Stole, Osmond	Dry Creek	9-22-04	10-1-04	400
379	Mosse, Osmond L.	Dry Creek	12-27-06	12-27-06	200
495	Davis, Minnie and King, May M.	King Creek	6-24-12	6-25-12	100
515	Mullen, James	Little Timber Creek	7-31-06	8-1-06	125
627	Hauge, Richard	Rock Creek	1-18-08	1-20-08	640
640	Davis, Minnie and King, May M.	Saw Mill Creek	6-24-12	6-25-12	200
642	Youmans, W. E.	School House Creek	4-27-01	4-27-01	111
729	Grosfield, Abraham	Swamp Creek	7-19-95	7-20-95	500
740	Youmans, H. E.	Swamp Creek	2-14-02	2-14-02	75
882	Arneson, Edward	White Tail Creek	10-30-02	10-31-02	100
884	Neeley, Mrs. Edna	White Tail Creek	9-20-17	9-20-17	60
885	Rudd, Christina	White Tail Creek	7-30-17	7-31-17	100
948	Neeley, Edna E.	Neeley Spring	9-20-17	9-20-17	30
1000	Grosfield, Abraham	Unnamed Spring	7-19-95	7-19-95	500
1059	Stole, Osmund P.	Unnamed Spring	10-3-95	10-3-95	200

Page Two.

<u>No.</u>	<u>To Whom Deeded</u>	<u>Name of Stream</u>	<u>Date Priority</u>	<u>M.I.</u>
D-80	Grosfield, A. M.	Big Timber Creek	6-15-89	160
D-81	Grosfield, A. M.	" "	9-15-89	20
D-82	Grosfield, A. M.	" "	5-23-96	22
D-83	Grosfield, A. M.	" "	1-1-03	278
D-84	Grosfield, A. M.	" "	6- -09	140
D-85	Hannah, Margaret L.	Big Timber Creek	6-1-00	40
D-86	Hannah, Margaret L.	" "	6-1-05	200
D-87	Hannah, Margaret L.	" "	6-1-07	250
D-98	Hauge, Bina	Big Timber Creek	11-22-04	100
D-115	Tintinger Bros.	Big Timber Creek	7-15-88	50
D-116	Tintinger Bros.	Big Timber Creek	5-23-96	250
D-117	Tintinger Bros.	Big Timber Creek	9-15-02	450
D-160	Hannah, Margaret	Devil Creek	6-25-08	120
D-164	Tintinger Bros.	Devil Creek	6-1-98	40
D-167	Grosfield, A. M.	Dry Creek <i>Rock Creek</i>	9-5-03	140
D-168	Mosse, O. L.	Dry Creek <i>Rock Creek</i>	9-5-03	145
D-227	Hauge, Bina	Rock Creek	1-17-08	150
D-231	King, May M.	Saw Mill Creek	6-6-12	100
D-246	Arneson, A. H.	Swamp Creek	<u>4-1-80</u>	<u>466</u>
D-253	Grosfield, A. M.	Swamp Creek	4-1-80	334
D-254	Grosfield, A. M.	Swamp Creek	6-15-84	160
D-255	Grosfield, A. M.	Swamp Creek	6-3-85	140
D-256	Grosfield, A. M.	Swamp Creek	4-21-90	50
D-257	Grosfield, A. M.	Swamp Creek	4-21-90	40
D-258	Grosfield, A. M.	Swamp Creek	6-12-95	60

Page Three

<u>No.</u>	<u>Name of Appropriator</u>	<u>Name of Stream</u>	<u>Date App.</u>	<u>Date Filed</u>	<u>M.I.</u>
D-259	Grosfield, A. M.	Swamp Creek	9-15-97		50
D-260	Grosfield, A. M.	Swamp Creek	9-15-03		80
D-261	Grosfield, A. M.	Swamp Creek	12-1-04		20
D-262	Grosfield, A. M.	Swamp Creek	8-1-06		220
D-265	Mossee, O. L.	Swamp Creek	4-21-90		40
D-246	Arneson, A. H.	Swamp Creek	4-1-80		466
D-247	Arneson, A. H.	Swamp Creek	9-14-89		100
D-248	"	"	4-21-90		60
D-249	"	"	6-1-91		60
D-250	"	"	7-1-93		40

*Sweet Grass*

FORM F-1 - GAZETTE 1965-24-1-47

1A-2A-3A-4A-4B, 5A, 9B

Farm Checked

STATE OF MONTANA

STATE ENGINEER'S OFFICE

WATER RESOURCES SURVEY

Code No. 10A-11A-12A-12C, 13A-14A

15A-17A-18A-20A-21A-22A

County 22D-23A-24A-25A-26A

By *JC + MT*

Area *Swamp Cr.*

Date *7-18-50*

Legal Land Owner *Louis Grosfield*  
*10A owned by State, off by Grosfield*

Operator

T. *2N* R. *13E* Sec. *184*

Photo No. *12A-183*

Address *12A-28*

Address *Big Jim Ben*

Water is delivered by:

Federal Project \_\_\_\_\_ Pres. \_\_\_\_\_ Pot. \_\_\_\_\_

Ditch Company \_\_\_\_\_ Pres. \_\_\_\_\_ Pot. \_\_\_\_\_

Irrigation District \_\_\_\_\_ Pres. \_\_\_\_\_ Pot. \_\_\_\_\_

Private System \_\_\_\_\_ Pres. \_\_\_\_\_ Pot. \_\_\_\_\_

*- OVER -* Totals \_\_\_\_\_

Flood \_\_\_\_\_ Pump \_\_\_\_\_ Reservoir \_\_\_\_\_ Gravity ☒

Size and Capacity, Pump, etc. \_\_\_\_\_

Original Appropriator, Company \_\_\_\_\_ App. No. \_\_\_\_\_

Original Appropriator, Private \_\_\_\_\_ App. No. *OVER ->*

Is the system an extension of another system? Yes ☒ No ☒

Is all land irrigated from one system? Yes \_\_\_\_\_ No ☒

(If No, show break down on map)

Source of Water *Next page*

Acres Irrigated 19 \_\_\_\_\_

Potential Acres \_\_\_\_\_ Seeped \_\_\_\_\_

Explain \_\_\_\_\_

Condition of System *see explanation*

Adequate Supply \_\_\_\_\_ Yes \_\_\_\_\_ No ☒

Explain *Cracks get low in late summer*

Topography *Valley bottom + sides + benchland*

Information From *Louis Grosfield*

Remarks *- OVER -*

(book page)

Two small ditches divert from springs west of  
Grossfield house these ditches combine to irrigate  
land south of road on Swamp cr. bottom.

② Swamp area of bottom.

and is used to irrigate lands on beach and

25 on A.M. Grossfield still in good condition

near section line between sections 8 & 9

Butch dwelling from north side of Sugar A.

Good condition

Sec 6 of 2N43E. This ditch is in use and is in

North side of Swamp Creek in NE 1/4 of NE 1/4 of

*A. M. Gross field dipah in Spad divers from*

was für ein Baum? - Kiefer

out of Grossfield and Tintner Counties pick up

For information: Lord W. 502 2-3-1-5. All rights reserved.

TiFinger-Covane difen is used by Grossing

76-50  
61-20

29, 4 (6029) (110)

4

500 225

23. 11. 1955

622

~~(10400) 81~~

5001047-83.1 (Fou. CH)

See 2. 1/9.9 0000 + 2

639

6186

174

[illegible]

Township

Range

County

<del>Parrot</del> APP. Number	Name of Owner	<del>Address</del> SOURCE OF WATER
- 13	Peter J. Madsen	Amelung Cr.
- 87	B. P. Candane & H. O. Mc. Tingen	Big Timber Cr.
- 110	Olga J. Madsen	"
- 111	Emil J. Madsen	"
(D-115-116)	Tain Tingen Bros.	"
- 117-164	"	"
* 104	Bina M. Hauge	"
- 627	Richard	Rock Cr.
- 642	W. E. Gammann	Schal house Cr.
1059	Samuel P. Stale	Unnamed Spring
(D-85-86-87)	Margaret Hannah	Big Timber Cr.
(D-80-84-106)	A. P. Grosfield	"
- D-167	"	"
(D-253-254-255)	"	Swamp Cr.
256-257-258-59-	"	"
60-61-62	"	"
375	Mathias Grosfield	Dry Cr.
729	Abraham	Swamp Cr.
- 740	H. E. Gammann	"
- 882	Edward Arneson	White Tail Cr.
884	Mrs. Edna Mearley	"
948	"	Mearley Spring
D-227, D-98	Hauge, Bina	Rock Creek
"	"	Big Timber Cr.



STATE OF MONTANA

STATE ENGINEER'S OFFICE

WATER RESOURCES SURVEY

Township 2N Range 13E County Sweet Grass

	A	A	A	A	A
6	5	4	3	2	1
		C	A	A	A
7	8	9	10	11	12
					C
A	A	State op by L. Grosfield	A	A	A
18	17	16	15	14	13
	A	A	D	A	A
19	20	21	22	23	24
				A	A
30	29	28	27	26	25
31	32	33	34	35	36

Laurie Grosfield

Township 2N Range 13E



Township

Range

County

Parcel Number	Name of Owner	Address
Sec 9	① small ditch diverts from north side of Swamp Cr. near north-south $\frac{1}{2}$ line of sec 9. It irrigate bottom land in SE $\frac{1}{4}$ of Sec 9.	
	② ditch diverting from south side of Swamp Cr. in NW corner of SW $\frac{1}{4}$ of SE $\frac{1}{4}$ irrigates land to the south line of section 9 only. This ditch at one time diverted water into Whitetail Cr. valley and irrigated lands on both sides of Whitetail Cr.	
Sec 14, 15, 23	① series of ditches out of north side of Swamp Cr. in sections 14, 15, 23 were used to irrigate rocky bottom land in these sections and have not been used for many years.	
9, 22, 24, 25	② ditches on south side of Swamp Cr. in sections 15, 22, 23 are silted and washed out	
	③ ditch diverting from south side of Swamp Cr. near sec. line between sections 15 & 16 is the Hannah Beley ditch which diverted water to Whitetail Cr. This ditch not in use.	
	④ ditch diverting from Swamp Cr. in SW $\frac{1}{4}$ of Sec 24 is in good condition and is used to irrigate land in the SE $\frac{1}{4}$ of Sec 24 and NE $\frac{1}{4}$ of NE $\frac{1}{4}$ of Sec 25	
	⑤ ditch diverting from south side of Swamp Cr. near center line of Sec 25 is the Amelia Beley ditch. Grossfield does not use this ditch.	
Sec 11 & 12	① ditch diverting from Long Gulch in sections 10 & 11 were built by Richard Hauge these ditches have not been used for many years.	
	② Old ditch diverting from south side of Grossfield Coulee was filled on by tinter. This ditch carried Big Timber Cr. water to top of bench in Sec 11. Water from this ditch was picked up by Anderson ditches in Sec. 12 to irrigate land in section 2 (3N13E), Sec. 6, 7, 8 (3N14E).	

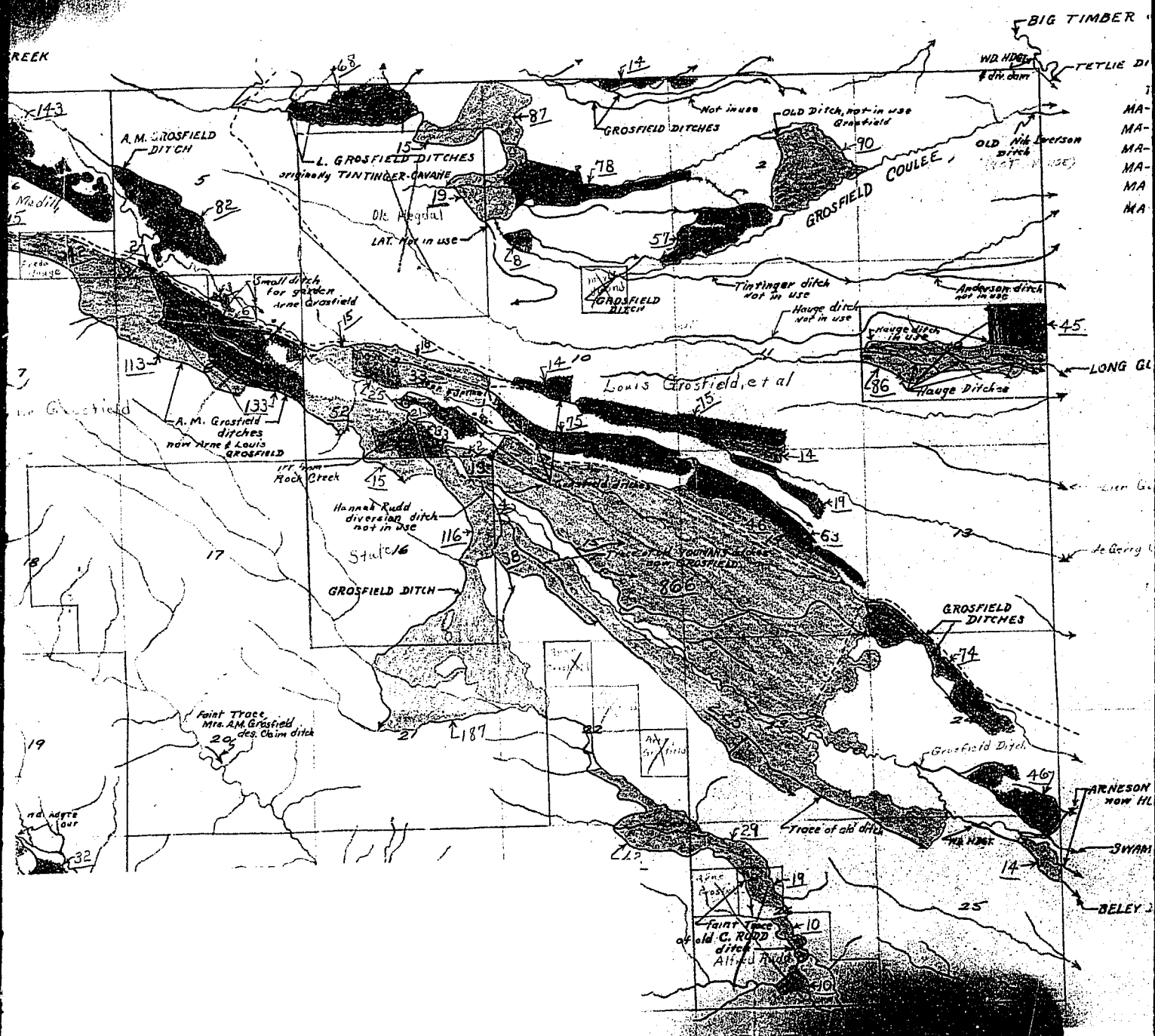

**State Engineer's Office**  
**WATER RESOURCES SURVEY**  
**FARM MAP**

County \_\_\_\_\_  
Code No. \_\_\_\_\_

Twp. 2N Rge. 13E  
Twp. 2N Rge. 14E  
Twp. 3N Rge. 13E  
" 4N " 13E

Name of Land Owner Grosfield, Louis Address Big Timber  
Name of Operator Same Address \_\_\_\_\_  
Legal Description \_\_\_\_\_



Irrigated Land



Non-Irrigated Land  
North



Potential Land Under Existing Facilities

21A, 22A, 22D, 23A, 24A, 25A  
Code No. 5A, 9B, 10A, 11A, 13A, 14A, 15A System Grosfield Ditches Source of Water Swamp Creek  
Basin Big Timber Creek Present 994 Potential 1410 Maximum 1904 R ☒ F ☐ P ☐ G ☒ S  
Code No. 1A, 2A, 3A, 4A, 5A System Tintinger-Cavane Ditch Source of Water So. Fk. Big Timber Creek  
Basin Big Timber Creek Present 225 Potential 177 Maximum 402 R ☒ F ☐ P ☐ G ☒ S  
Code No. 5A, 2B System Grosfield Ditch Source of Water Mingled Water  
Basin Big Timber Creek Present 35 Potential 60 Maximum 95 R ☒ F ☐ P ☐ G ☒ S  
Code No. 26A System Christina Rudd Ditch Source of Water Whitetail Creek  
Basin Yellowstone River Present 0 Potential 29 Maximum 29 R ☒ F ☐ P ☐ G ☒ S

If under Ditch Company, Irrigation District, or Government Project, state the number of shares or inches, acre feet, as the case may be in said system.

NOTE: R—Denotes Regular Irrigation. F—Flood Irrigation. P—Water diverted by means of pumping. G—Water diverted by gravity.  
S—Stored Water.

Information from

J. E. Cook

Date

May 4, 1951

FORM F-1 REPORTER 1M 3-49 173BC

Code No. 68

County SWIFT Grass

T. 2N R. 19E Sec. 6

Photo No. MA-12A-184

Address Bio Timber

Address

Ditch Company \_\_\_\_\_ Pres. \_\_\_\_\_ of \_\_\_\_\_

Irrigation District \_\_\_\_\_ Pres. \_\_\_\_\_ Pot. \_\_\_\_\_

Private System ☒ Pres. 0 Pot.       

[illegible]

Flood Pump Reservoir Gravity

Size and Capacity, Pump, etc. \_\_\_\_\_

Original Appropriator, Company \_\_\_\_\_ App. No. \_\_\_\_\_

Original Appropriator, Private No filing (Brookfield ditch) App. No. \_\_\_\_\_

Is the system an extension of another system? Yes \_\_\_\_\_ No \_\_\_\_\_

Is all land irrigated from one system? Yes ✓ No       

(If No, show break down on map)

Source of Water: Rock Creek, Dry Creek

Acres Irrigated 19 50, 0

Potential Acres \_\_\_\_\_ Seeped \_\_\_\_\_

Explain\_\_\_\_\_

Condition of System run down silted in

Adequate Supply..... Yes\_\_\_\_\_ No ☒

Explain No water right

Topography hillside

Information From: Field Survey of Arne Grosfield

Remarks land under Brookfield ditch is potential

but has no water right out of the ditch

Sec 6 T2N R13E

A 10x10 grid with a vertical line down the center. The letter 'G' is written in the 5th row, 5th column. The letter 'B' is written in the 8th row, 9th column.

STATE OF MONTANA  
**State Engineer's Office**  
WATER RESOURCES SURVEY  
**FARM MAP**

County Sweetgrass  
Code No. 10B

Twp. 2N Rge. 13E  
Twp. \_\_\_\_\_ Rge. \_\_\_\_\_  
Twp. \_\_\_\_\_ Rge. \_\_\_\_\_

Name of Land Owner Freda Hango Address Big Timber  
Name of Operator \_\_\_\_\_ Address \_\_\_\_\_  
Legal Description \_\_\_\_\_

☐ Irrigated Land

☐ Non-Irrigated Land  
North

☒ Potential Land Under Existing Facilities

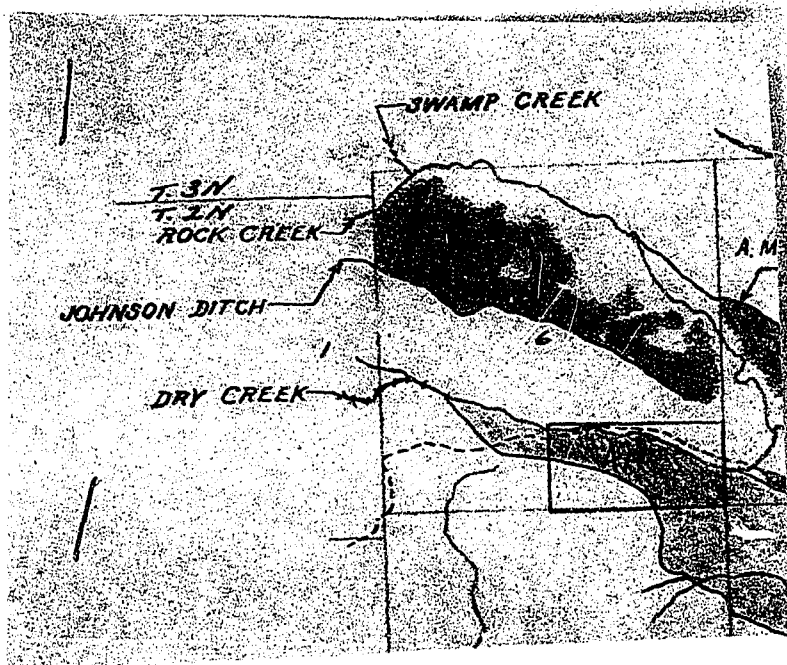

Code No. 6B System Grassfield Ditch Source of Water Rock Creek  
Basin Big Timber Creek Present 0 Potential 42 Maximum 42 R. ✓ F. ✓ P. ✓ G. ✓ S. ✓  
Code No. \_\_\_\_\_ System \_\_\_\_\_ Source of Water \_\_\_\_\_  
Basin \_\_\_\_\_ Present \_\_\_\_\_ Potential \_\_\_\_\_ Maximum \_\_\_\_\_ R. \_\_\_\_\_ F. \_\_\_\_\_ P. \_\_\_\_\_ G. \_\_\_\_\_ S. \_\_\_\_\_  
Code No. \_\_\_\_\_ System \_\_\_\_\_ Source of Water \_\_\_\_\_  
Basin \_\_\_\_\_ Present \_\_\_\_\_ Potential \_\_\_\_\_ Maximum \_\_\_\_\_ R. \_\_\_\_\_ F. \_\_\_\_\_ P. \_\_\_\_\_ G. \_\_\_\_\_ S. \_\_\_\_\_  
Code No. \_\_\_\_\_ System \_\_\_\_\_ Source of Water \_\_\_\_\_  
Basin \_\_\_\_\_ Present \_\_\_\_\_ Potential \_\_\_\_\_ Maximum \_\_\_\_\_ R. \_\_\_\_\_ F. \_\_\_\_\_ P. \_\_\_\_\_ G. \_\_\_\_\_ S. \_\_\_\_\_

If under Ditch Company, Irrigation District, or Government Project, state the number of shares or inches, acre feet, as the case may be in said system.

NOTE: R—Denotes Regular Irrigation. F—Flood Irrigation. P—Water diverted by means of pumping. G—Water diverted by gravity.  
S—Stored Water.

Information from J.E. Cook Date May 4, 1951

Farm Checked

STATE OF MONTANA

Code No. 4B, 9A.By J.C. + M.T.

## STATE ENGINEER'S OFFICE

County SeventeenArea Swamp Cr.

WATER RESOURCES SURVEY

T. E 1/2 R 13 S 49Date 7-18-50Photo No. KPA-12A-184Legal Land Owner Chas. HegdahlAddress Big TimberOperator J.Address J.

Water is delivered by:

Federal Project \_\_\_\_\_ Pres. \_\_\_\_\_ Pot. \_\_\_\_\_

Ditch Company \_\_\_\_\_ Pres. \_\_\_\_\_ Pot. \_\_\_\_\_

Irrigation District \_\_\_\_\_ Pres. \_\_\_\_\_ Pot. \_\_\_\_\_

Private System On one ditch (Tintinger-Cavane -- now Grosfield) Pres. R Pot. \_\_\_\_\_No Irrigation Totals \_\_\_\_\_Flood \_\_\_\_\_ Pump \_\_\_\_\_ Reservoir \_\_\_\_\_ Gravity ☒

Size and Capacity, Pump, etc. \_\_\_\_\_

Original Appropriator, Company \_\_\_\_\_ App. No. D-80-84, 106.Original Appropriator, Private Grosfield, Abraham App. No. D-167Is the system an extension of another system? Grosfield, Mathias Yes \_\_\_\_\_ No ✓

Is all land irrigated from one system? Yes \_\_\_\_\_ No \_\_\_\_\_

(If No, show break down on map)

Source of Water Big Timber Reservoir; Dry Cr.; Swamp Cr.Acres Irrigated 19 20 \_\_\_\_\_Potential Acres \_\_\_\_\_ Seeped 0

Explain \_\_\_\_\_

Condition of System \_\_\_\_\_

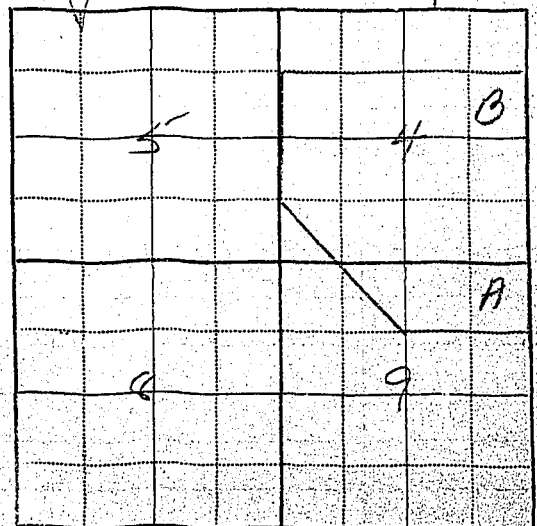
Adequate Supply \_\_\_\_\_ Yes \_\_\_\_\_ No ✓Explain Hegdahl has no right in T-C. ditchTopography HillsInformation From Arnold HegdahlRemarks Grosfields Tintinger-Cavane ditchcrosses this land but Hegdahl has20 no rights in it.



STATE OF MONTANA

State Engineer's Office  
WATER RESOURCES SURVEY  
FARM MAP

County Sweetgrass

Code No. 4B-9A

Twp. 2N Rge. 13E

Twp. \_\_\_\_\_ Rge. \_\_\_\_\_

Twp. \_\_\_\_\_ Rge. \_\_\_\_\_

Name of Land Owner HEGDAHL, OLE Address Big Timber

Name of Operator Same Address " "

Legal Description \_\_\_\_\_

☐ Irrigated Land

☐ Non-Irrigated Land  
North

☒ Potential Land Under Existing Facilities

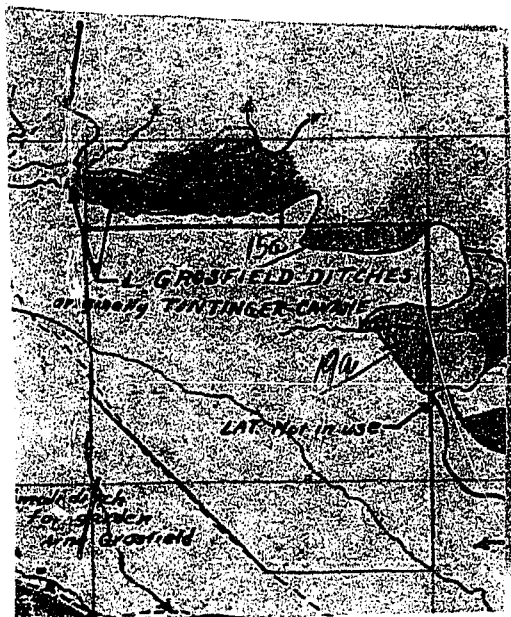

Code No. 4B System Tintinger - Cavane Ditch Source of Water S.E. of Big Timber Cr.  
Basin Big Timber Creek Present 0 Potential 34 Maximum 34 R ✓ F ✓ P ✓ G ✓ S ✓  
Code No. \_\_\_\_\_ System \_\_\_\_\_ Source of Water \_\_\_\_\_  
Basin \_\_\_\_\_ Present \_\_\_\_\_ Potential \_\_\_\_\_ Maximum \_\_\_\_\_ R \_\_\_\_\_ F \_\_\_\_\_ P \_\_\_\_\_ G \_\_\_\_\_ S \_\_\_\_\_  
Code No. \_\_\_\_\_ System \_\_\_\_\_ Source of Water \_\_\_\_\_  
Basin \_\_\_\_\_ Present \_\_\_\_\_ Potential \_\_\_\_\_ Maximum \_\_\_\_\_ R \_\_\_\_\_ F \_\_\_\_\_ P \_\_\_\_\_ G \_\_\_\_\_ S \_\_\_\_\_  
Code No. \_\_\_\_\_ System \_\_\_\_\_ Source of Water \_\_\_\_\_  
Basin \_\_\_\_\_ Present \_\_\_\_\_ Potential \_\_\_\_\_ Maximum \_\_\_\_\_ R \_\_\_\_\_ F \_\_\_\_\_ P \_\_\_\_\_ G \_\_\_\_\_ S \_\_\_\_\_

If under Ditch Company, Irrigation District, or Government Project, state the number of shares or inches, acre feet, as the case may be in said system.

NOTE: R—Denotes Regular Irrigation. F—Flood Irrigation. P—Water diverted by means of pumping. G—Water diverted by gravity. S—Stored Water.

Information from J.E. Cook Date May 4, 1951



Farm Checked

By Cook & Trask

STATE OF MONTANA

STATE ENGINEER'S OFFICE

WATER RESOURCES SURVEY

Area Swamp Creek

Date July 30, 1950

Legal Land Owner

John A. Smadill  
Huttop & Sons (buying)

Address

Operator

Address

Water is delivered by:

Federal Project \_\_\_\_\_ Pres. \_\_\_\_\_ Pot. \_\_\_\_\_

Ditch Company \_\_\_\_\_ Pres. \_\_\_\_\_ Pot. \_\_\_\_\_

Irrigation District \_\_\_\_\_ Pres. \_\_\_\_\_ Pot. \_\_\_\_\_

Private System 2 ditches \_\_\_\_\_ Pres. \_\_\_\_\_ Pot. \_\_\_\_\_

Totals

Flood \_\_\_\_\_ Pump \_\_\_\_\_ Reservoir \_\_\_\_\_ Gravity ☒

Size and Capacity, Pump, etc. \_\_\_\_\_

Original Appropriator, Company

A. H. Benson; Benson

App. No. \_\_\_\_\_

Original Appropriator, Private

Benson & Benson State, Ed.  
Benson

App. No. D-246, 377, 382

Is the system an extension of another system?

Yes \_\_\_\_\_ No \_\_\_\_\_

Is all land irrigated from one system?

Yes \_\_\_\_\_ No \_\_\_\_\_

(If No, show break down on map)

Source of Water

Swamp Cr.; Dry Cr.; Sub. in Fall Cr.  
Rock Cr.?

Acres Irrigated 19.50

Potential Acres \_\_\_\_\_ Seeped \_\_\_\_\_

Explain \_\_\_\_\_

Condition of System Fair (Rock Creek), Ruddy ditch nearly obliterated

Adequate Supply \_\_\_\_\_ Yes \_\_\_\_\_ No ☒

Explain Creek sometimes goes dry in late Summer

Topography Creek bottoms & Valley sides

Information From G. Irwin Hults

Remarks see other side

20 also in File No. 12, 13, 21, 27

① Ditch diverting from Rock Creek (South Side) in the NW 1/4 of the NE 1/4 of Sec 1 T2N R12E irrigates down up Creek bottom and valley side in sec 6 T2N R12E. Land is under Arneson Decreed right No. D-246. Ditch was probably built by Johnson.

② Old Christina Budd ditch diverting from S. side of Whitetail creek near center of Sec. 22. is silted and washed out, has not been used for many years. Ditch filled out originally by Edward Arneson, was supplemented by water from B.T. Creek

③

WATER INVESTIGATION OFFICE

U. S. DEPT. OF AGRICULTURE

STATE OF MONTANA  
**STATE ENGINEER'S OFFICE**  
 WATER RESOURCES SURVEY

Township 2N Range 13E County Sweet Grass

6	5	4	3	2	1
7	8	9	10	11	12
18	17	16	15	14	13
19	20	21	22	23	24
30	29	28	27	26	25
31	32	33	34	35	36

*Handwritten notes on grid:*  
 Section 6: A  
 Section 22: B  
 Sections 29, 28, 27: A  
 Sections 33, 34, 35: A  
 Section 36: Cult. to 200 ft. to

*John A. Madill*

Township 2N Range 13E

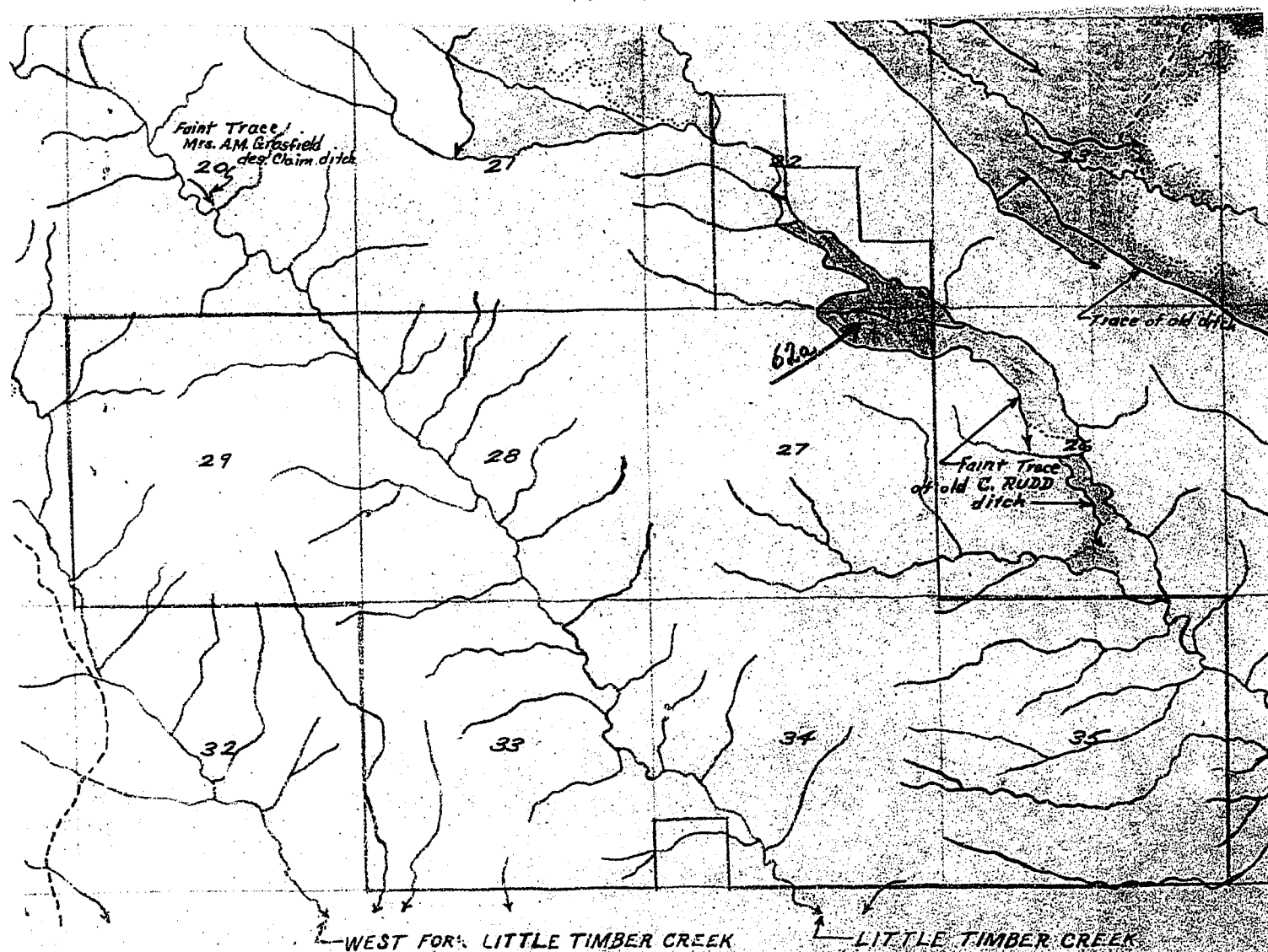
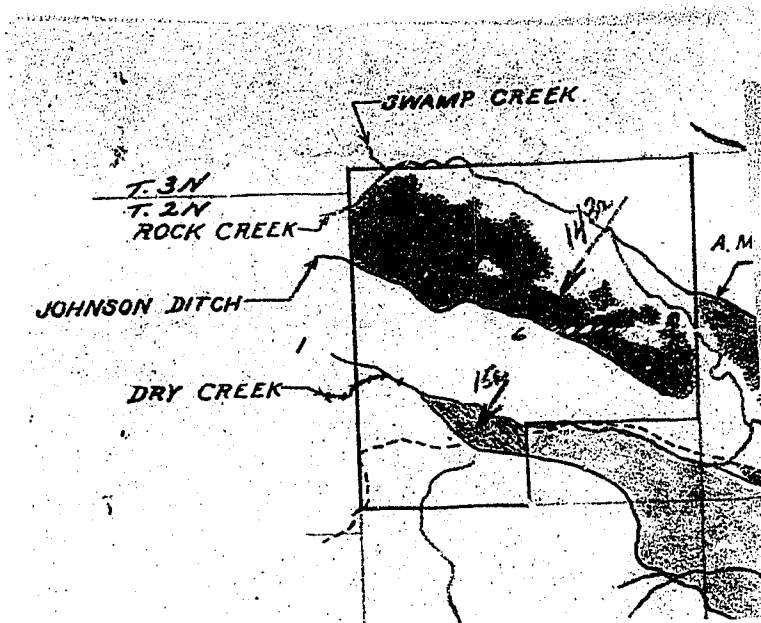

STATE OF MONTANA

State Engineer's Office  
WATER RESOURCES SURVEY  
FARM MAP

County Sweetgrass  
Code No. 6A-22B-27A-28A-29A-33A-34A-35A

Twp. 2N Rge. 13E

Twp. \_\_\_\_\_ Rge. \_\_\_\_\_

Twp. \_\_\_\_\_ Rge. \_\_\_\_\_

Name of Land Owner MADILL, JOHN A. Address \_\_\_\_\_

Name of Operator HULTS & SONS Address Big Timber

Legal Description \_\_\_\_\_



Irrigated Land



Non-Irrigated Land  
North



Potential Land Under Existing Facilities

Code No. 6A System Johnson Ditch Source of Water Rock Creek  
Basin Big Timber Creek Present 143 Potential 0 Maximum 143 R. ✓ F. ✓ P. ✓ G. ✓ S. ✓  
Code No. 6A System Grassfield Ditch Source of Water Rock Creek  
Basin Big Timber Creek Present 0 Potential 15 Maximum 15 R. ✓ F. ✓ P. ✓ G. ✓ S. ✓  
Code No. 22B, 27A System Christina Rudd Ditch Source of Water Whitetail Creek  
Basin Yellowstone River Present 0 Potential 62 Maximum 62 R. ✓ F. ✓ P. ✓ G. ✓ S. ✓  
Code No. \_\_\_\_\_ System \_\_\_\_\_ Source of Water \_\_\_\_\_  
Basin \_\_\_\_\_ Present \_\_\_\_\_ Potential \_\_\_\_\_ Maximum \_\_\_\_\_ R. \_\_\_\_\_ F. \_\_\_\_\_ P. \_\_\_\_\_ G. \_\_\_\_\_ S. \_\_\_\_\_

If under Ditch Company, Irrigation District, or Government Project, state the number of shares or inches, acre feet, as the case may be in said system.

NOTE: R—Denotes Regular Irrigation. F—Flood Irrigation. P—Water diverted by means of pumping. G—Water diverted by gravity. S—Stored Water.

Information from J. E. Carls Date May 1, 1951

**Farm Checked**

STATE OF MONTANA

Code No. 16A

By Bob E. Sims

# STATE ENGINEER'S OFFICE

County Sweet Grass

Area Swamp Creek

WATER RESOURCES SURVEY

T. 2N R. 13E Sec. 16

Date 7-18-50

Photo No. \_\_\_\_\_

Legal Land Owner. Montana State of Address \_\_\_\_\_

Operator L. Grasfield Address \_\_\_\_\_

Water is delivered by:

Federal Project \_\_\_\_\_ Pres. \_\_\_\_\_ Pot. \_\_\_\_\_

Ditch Company \_\_\_\_\_ Pres. \_\_\_\_\_ Pot. \_\_\_\_\_

Irrigation District \_\_\_\_\_ Pres. \_\_\_\_\_ Pot. \_\_\_\_\_

Private System Grosfield Ditch Pres. 0 Pot. 0

[illegible]

Flood \_\_\_\_\_ Pump \_\_\_\_\_ Reservoir \_\_\_\_\_ Gravity \_\_\_\_\_

Size and Capacity, Pump, etc. \_\_\_\_\_

Original Appropriator, Company\_\_\_\_\_App. No.\_\_\_\_\_

Original Appropriator, Private \_\_\_\_\_ App. No. \_\_\_\_\_

Is the system an extension of another system? Yes\_\_\_\_\_No.\_\_\_\_\_

Is all land irrigated from one system? Yes \_\_\_\_\_ No \_\_\_\_\_

(If No, show break down on map)

Source of Water. Swamp Cr.

Acres Irrigated 1950 0

Potential Acres \_\_\_\_\_ Seeped \_\_\_\_\_

Explain

Condition of System. out of use

Adequate Supply --- Yes \_\_\_\_\_ No ☒

Explain 730 right act of Swamp Pr.

Topography Valley sides

Information From Field Survey E L. Grosfield

Remarks \_\_\_\_\_

A 10x10 grid with a thick border. The letter 'A' is handwritten in the top right corner. The number '16' is handwritten in the center of the grid.



STATE OF MONTANA  
**State Engineer's Office**  
WATER RESOURCES SURVEY  
FARM MAP

County Sweet Grass  
Code No. 16A

Twp. 2N Rge. 13E  
Twp. \_\_\_\_\_ Rge. \_\_\_\_\_  
Twp. \_\_\_\_\_ Rge. \_\_\_\_\_

Name of Land Owner Montana State of Address \_\_\_\_\_  
Name of Operator L. Grosfield Address \_\_\_\_\_  
Legal Description \_\_\_\_\_



Irrigated Land



Non-Irrigated Land

North



Potential Land Under Existing Facilities

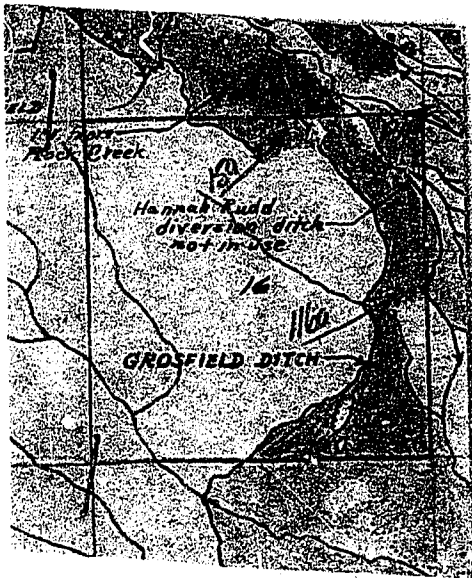

Code No. 16A System Grosfield Ditch Source of Water Swamp Creek  
Basin Big Timber Creek Present 0 Potential 129 Maximum 129 R ✓ F ✓ P ✓ G ✓ S ✓  
Code No. 16A System Grosfield Ditch Source of Water Rock Creek  
Basin Big Timber Creek Present 0 Potential 15 Maximum 15 R ✓ F ✓ P ✓ G ✓ S ✓  
Code No. \_\_\_\_\_ System \_\_\_\_\_ Source of Water \_\_\_\_\_  
Basin \_\_\_\_\_ Present \_\_\_\_\_ Potential \_\_\_\_\_ Maximum \_\_\_\_\_ R \_\_\_\_\_ F \_\_\_\_\_ P \_\_\_\_\_ G \_\_\_\_\_ S \_\_\_\_\_  
Code No. \_\_\_\_\_ System \_\_\_\_\_ Source of Water \_\_\_\_\_  
Basin \_\_\_\_\_ Present \_\_\_\_\_ Potential \_\_\_\_\_ Maximum \_\_\_\_\_ R \_\_\_\_\_ F \_\_\_\_\_ P \_\_\_\_\_ G \_\_\_\_\_ S \_\_\_\_\_

If under Ditch Company, Irrigation District, or Government Project, state the number of shares or inches, acre feet, as the case may be in said system.

NOTE: R—Denotes Regular Irrigation. F—Flood Irrigation. P—Water diverted by means of pumping. G—Water diverted by gravity. S—Stored Water.

Information from

J. E. Cook

Date

May 4, 1951