

Form WFR-B
Reporter 20188 2M 12-49

Twp. 4N Rge. 13E
Twp. _____ Rge. _____
Twp. _____ Rge. _____

STATE OF MONTANA
State Engineer's Office
WATER RESOURCES SURVEY
FARM MAP

County Sweetgrass
Code No. 7A-10B-12B-
13A-14A-15A-
17A-18A-19A-21A-22A
23A

Name of Land Owner Paul Van Cleve Jr. Address Melville
Name of Operator Same Address _____
Legal Description _____



Irrigated Land



Non-Irrigated Land
North



Potential Land Under Existing Facilities

Code No. 23A, 24A
13A, 14B, 15A, 17A, 21A, 22A System Van Cleve Ditches Source of Water Dry Creek
Basin Otter Creek Present 77.5 Potential 73.3 Maximum 120B R ✓ F ✓ P ✓ G ✓ S ✓
Code No. 13A, 14B, 15A System Hoff & Green Ditch Source of Water Sweet Grass Cr.
Basin Sweet Grass Cr. Present 0 Potential 14.5 Maximum 14.5 R ✓ F ✓ P ✓ G ✓ S ✓
Code No. 29A System Sandm Ditch Source of Water Otter Creek
Basin Otter Creek Present 0 Potential 6.5 Maximum 6.5 R ✓ F ✓ P ✓ G ✓ S ✓
Code No. 23A, 24A, 25A System Van Cleve Ditches Source of Water Otter Creek
Basin Otter Creek Present 396 Potential 1.8 Maximum 4.14 R ✓ F ✓ P ✓ G ✓ S ✓

If under Ditch Company, Irrigation District, or Government Project, state the number of shares or inches, acre feet, as the case may be in said system.

NOTE: R—Denotes Regular Irrigation. F—Flood Irrigation. P—Water diverted by means of pumping. G—Water diverted by gravity.
S—Stored Water.

Information from J. C. Cook Date April 27, 1951

Farm Checked

STATE OF MONTANA

Code No. 1B, 12BBy Dave & Joe

STATE ENGINEER'S OFFICE

County SweetgrassArea Melville

WATER RESOURCES SURVEY

T. 4N R. 13E Sec. 1, 12Date 8/17/50Photo No. MA-12A-33Legal Land Owner Ch. George & Leonard Yost Address MelvilleOperator Same Address _____

Water is delivered by:

Federal Project _____ Pres. _____ Pot. _____

Ditch Company _____ Pres. _____ Pot. _____

Irrigation District _____ Pres. _____ Pot. _____

Private System Private Ditch (Mutual) Pres. _____ Pot. _____

Totals _____

Flood _____ Pump _____ Reservoir _____ Gravity Regular

Size and Capacity, Pump, etc. _____

Original Appropriator, Company _____ App. No. _____

Original Appropriator, Private Andrew Davidson, et al; Julius Gunderson App. No. 270, D-310, D-315, D-316
Harry & Jack HartIs the system an extension of another system? Yes _____ No ✓Is all land irrigated from one system? Yes ✓ No _____

(If No, show break down on map)

Source of Water Sweetgrass CreekAcres Irrigated 10.32

Potential Acres _____ Seeped _____

Explain By draining Some land sec. 12 Pot. Private D.
(Mutual)Condition of System FairAdequate Supply _____ Yes ✓ No _____

Explain _____

Topography Slight SlopeInformation From Mr. Richards

Remarks _____

T 4N R 13E

(7)

STATE OF MONTANA
State Engineer's Office
WATER RESOURCES SURVEY
FARM MAP

County Sweetgrass

Code No. 1B-12B

Twp. 4N Rge. 13E

Twp. _____ Rge. _____

Twp. _____ Rge. _____

Name of Land Owner J. Geo. and Leonard Yost Address Melville

Name of Operator Same Address "

Legal Description _____



Irrigated Land



Non-Irrigated Land



Potential Land Under Existing Facilities

North

HART-PARKER DITCH

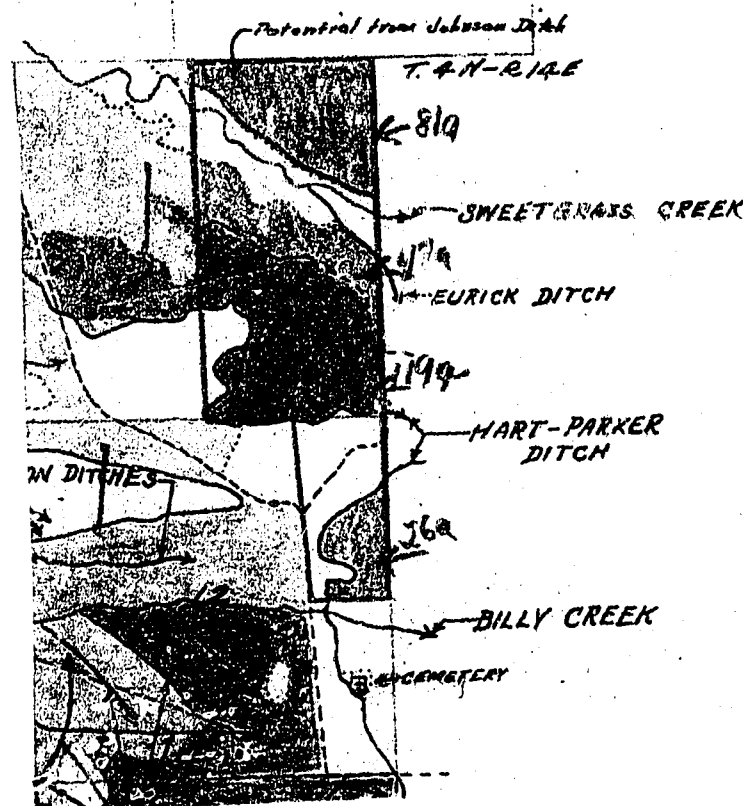

Code No. 1B-12B System Hart-Parker Ditch Source of Water Sweet Grass Cr.
Basin Sweet Grass Cr. Present 119 Potential 73 Maximum 192 R ✓ F ✓ P ✓ G ✓ S ✓
Code No. 1B System Johnson Ditch Source of Water Sweet Grass Cr.
Basin Sweet Grass Cr. Present 0 Potential 81 Maximum 81 R ✓ F ✓ P ✓ G ✓ S ✓
Code No. _____ System _____ Source of Water _____
Basin _____ Present _____ Potential _____ Maximum _____ R _____ F _____ P _____ G _____ S _____
Code No. _____ System _____ Source of Water _____
Basin _____ Present _____ Potential _____ Maximum _____ R _____ F _____ P _____ G _____ S _____

If under Ditch Company, Irrigation District, or Government Project, state the number of shares or inches, acre feet, as the case may be in said system.

NOTE: R—Denotes Regular Irrigation. F—Flood Irrigation. P—Water diverted by means of pumping. G—Water diverted by gravity. S—Stored Water.

Information from J. E. Cook Date April 26, 1951

County Sweet Grass

Farm Checked: Date.....8-21-50.....

By Jim & Bob

STATE OF MONTANA
STATE ENGINEERS OFFICE
Water Resources Survey

T. 4N. R. 14E. Plat No. 8.

Photo No MA-11A-210

Legal Land Owner.....Leif Anderson.....Address.....Melville, Mont.

Operator.....	Same	Address.....
---------------	------	--------------

Water is delivered by:— 1. Private System; 2. Ditch Company; 3. State Project; 4. Federal Project; 5. Irrigation District

[illegible]

NOTE: R—Denotes Regular Irrigation. F—Flood Irrigation.

Adequate Supply: Yes..... No..... Explain.....

Remarks:

(1) Old Wilson ditch takes out of Wheeler Creek on north side in NW 1/4 of Sec. 5 of T. 3N-R. 14E and flows through Sections 32, 33 & 34 T. 4N-R. 14E and ends there. This ditch not in use for many years. Two filings on this ditch.

(2) Forsythe Ditch takes out of Otter Creek on north side in Sec. 29 T. 4N-R. 14E near center of section. Wood headgate

(3) Forsythe Ditch takes out of Medicine Bow Creek on south side near Sec. line of 28 & 29 in Sec. 29 T. 4N-R. 14E.
Wood wing dam and heargate.

(4) Rye Ditch extends into Sec. 3 but is not used by Leif Anderson.

River Basin.....

Also in: Plat No. Twp. Rge.	Plat No. Twp. Rge.	Plat No. Twp. Rge.	Information From:
Plat No. Twp. Rge.	Plat No. Twp. Rge.	Plat No. Twp. Rge.	Leif Anderson

County.....Sweet Grass.....

Farm Checked: Date. 9-27-50

By.....Jim & Bob.....

STATE OF MONTANA
STATE ENGINEERS OFFICE
Water Resources Survey

T. 4N. R. 14E. Plat No. 8.

Photo No. MA-11A-211.....

Legal Land Owner.....Leo Gremer et ux.....Address.....Shawmut, Mont.

Operator	Same	Address
----------	------	---------

Water is delivered by:— 1. Private System; 2. Ditch Company; 3. State Project; 4. Federal Project; 5. Irrigation District

NOTE: R—Denotes Regular Irrigation. F—Flood Irrigation.

Adequate Supply: Yes..... No..... Explain.....

Remarks.....
(1) Land in Sec. 2 T. 4N-R. 14E is potential under the Cremer-Nollmeyer Ditch which gets water from Sweet Grass Creek and the ditch can also use Cayuse Creek if desired.

Only land near the house in NW $\frac{1}{4}$ Sec. 3 and NE $\frac{1}{4}$ NEP Sec. 4 is irrigated. Rest of land shown irrigated is sub-irrigated from ditches above these areas.

...River Basin.

Also in: Plat No. Twp. Rge.	Plat No. Twp. Rge.	Plat No. Twp. Rge.
Plat No. Twp. Rge.	Plat No. Twp. Rge.	Plat No. Twp. Rge.

Information From:
Ranch Foreman & Field Survey

County... Sweet Grass.....

Farm Checked: Date 9-7-50

By.....Jim & Bob.....

STATE OF MONTANA
STATE ENGINEERS OFFICE
Water Resources Survey

T. 4N R. 14E Plat No. 8

Photo No. MA-11A-211.....

Legal Land Owner Borddie J. Green Address Melville

[illegible]

Water is delivered by:— 1. Private System; 2. Ditch Company; 3. State Project; 4. Federal Project; 5. Irrigation District

[illegible]

NOTE: R—Denotes Regular Irrigation. F—Flood Irrigation.

Adequate Supply: Yes..... No..... Explain.....

Remarks.....

See other form.....

River Basin.....

Also in: Plat No. Twp. Rge.	Plat No. Twp. Rge.	Plat No. Twp. Rge.	Plat No. Twp. Rge.
Plat No. Twp. Rge.	Plat No. Twp. Rge.	Plat No. Twp. Rge.	Plat No. Twp. Rge.

Information From:

None shown

County..... Sweet Grass

Farm Checked: Date 8-4-50

By BS & BB

STATE OF MONTANA
STATE ENGINEERS OFFICE
Water Resources Survey



T 4N R 14E Plat No 8

Photo No. MA-12A-33

Legal Land Owner	Harry, Rob't. & Anna Hart	Address	Melville
------------------	---------------------------	---------	----------

Operator.....	Same.....	Address.....
---------------	-----------	--------------

Water is delivered by:— 1. Private System: 2. Ditch Company: 3. State Project: 4. Federal Project: 5. Irrigation District:

[illegible]

NOTE: R—Denotes Regular Irrigation. F—Flood Irrigation.

Adequate Supply: Yes..... No..... Explain.....

Remarks

River Basin

Also in: Plat No. Twp..... Rge.....	Plat No..... Twp. Rge.....	Plat No..... Twp..... Rge.....
Plat No..... Twp..... Rge.....	Plat No..... Twp..... Rge.....	Plat No..... Twp..... Rge.....

Information From:

John Hart

County.....Sweet Grass.....

Farm Checked: Date.....9-12-50.....

By Bob & Jim

STATE OF MONTANA
STATE ENGINEERS OFFICE
Water Resources Survey

T. 4N R. 14E..... Plat No. 8.....

Photo No. MA-11A-211

Legal Land Owner Minnie Wood et al Address 4174 Eldorado - Riverside, California

Operator.....?	Address.....
----------------	--------------

Water is delivered by:— 1. Private System; 2. Ditch Company; 3. State Project; 4. Federal Project; 5. Irrigation District

[illegible]

NOTE: R—Denotes Regular Irrigation. F—Flood Irrigation.

Adequate Supply: Yes..... No..... Explain.....

Remarks.....

Potential only under Thompson-Howe Ditch.

River Basin.....

Also in: Plat No. Twp. Rge.	Plat No. Twp. Rge.	Plat No. Twp. Rge.
Plat No. Twp. Rge.	Plat No. Twp. Rge.	Plat No. Twp. Rge.

Information From:

Field Survey

Township 4 North-Range 14 East

(8)

	Name of Owner	Township & Range
✓1.	Anderson, Leif	(8) 4N-14E
✓2.	Anderson, Thos.	"
✓3.	Grener, Leo Jr	" (3) 5N-14E
✓4.	Grener, Leo Jr. et ux	" (10) 4N-16E (11) 4N-17E (16) 3N-16E
✓5.	Essex, Ruth	"
✓6.	Eurick, Richard H.	"
✓7.	Franklin, W.P. (est.)	" (14) 3N-14E (9) 4N-15E
✓8.	Grande, Agnes	"
✓9.	Green, Borddie J.	"
✓10.	Green, Borddie J. et ux	"
✓11.	Hanson, S.O. & Pearl	"
✓12.	Hart, Harry, Robt. & Annie	" (7) 4N-13E
✓13.	Klceckner, Frank	" (9) 4N-15E
✓14.	Montana, State of	" (4) 5N-15E (29) 1N-13E (30) 1N-16E (34) 1S-14E (36) 1S-16E (39) 2S-13E (45) 3S-13E
✓15.	Neste, Peter (Est)	"
✓16.	Van Cleve, Helen	"
✓17.	Van Cleve, Paul III	"
✓18.	Vose, Eleanor	"
✓19.	Wood, Minnie et al	"
✓20.	Yost, Geo. J. & Lenard	" (2) 5N-13E (3) 5N-14E (7) 4N-13E

STATE OF MONTANA
STATE ENGINEER'S OFFICE
WATER RESOURCES SURVEY

Township 4 North Range 14 East County Sweet Grass

762 764 770	768 770 D-311	762 763 764		764 D-282	883 D-317	812 D-129	811 1087 D-335			812 D-129 D-335
D-287 D-289										
745 772 137 D-318 D-316	D-277 145 D-279 772 D-280 D-281 D-282 D-283	763 D-278 D-279 D-280 D-281	D-282 D-283 D-284	762 767 768 D-289 D-290 D-291		767 766 767 760 794		D-130 D-131 D-132	761 828 829 D-356 D-357 D-358	815 828 831
	145 772 785 D-326 D-327	D-279 D-279 D-280 D-281 D-282 D-283								
691 534 691 D-315 D-315		817 D-351 D-352				148 795 D-317			783 828	
	584		17	16	15					
D-277								D-228 D-301 D-305 D-306 D-307		
531 587 799 1018 D-324	755 818 817 536			D-228 D-301 D-302 D-305 D-306		775 D-229 D-229 D-303		637 775	776 775 814	D-227 D-301 D-305 D-306 D-307
D-324	19		20	D-302	21	638 775	22		776 775	858 783 828
		595							776 775	
578 578 581	427 569 D-351 D-352			582		638		777		
								638 777		
	30		29	28	27				26	25
580				D-59 869		869 870				
	31		869	32	33		34		35	36
869								871		

Township 4N Range 14E

Township _____ Range _____ County _____

[illegible]

Township 4 North, Range 14 East

<u>No.</u>	<u>Name of Appropriator</u>	<u>Name of Stream</u>	<u>Date App:</u>	<u>Date Filed</u>	<u>M. I.</u>
145	Clausen, Ole	Billy Creek	6-6-82	6-6-82	50
147	Hart, Hart & John	" "	2-5-91	2-5-91	250
148	Hickox, H. O.	Billy Creek	10-6-02	10-6-02	250
294	Howard, Frank W.	Corral Creek	5-7-88	5-11-88	200
279	Adam, Henry E.	Cayuse Creek	1-29-83	1-29-83	All
427	Fallong, Samuel	Fallong Creek	6-23-08	6-24-08	100
531	Hickox, H. O.	Medicine Bow	4-25-82	4-29-82	300
534	Hoyem, Iver H.	Medicine Bow	6-6-82	6-6-82	200
536	Rye, John	Medicine Bow	4-22-88	4-24-88	150
569	Anderson, Thos. W.	Otter Creek	6-22-16	6-22-16	80
578	Fallong, Inger	Otter Creek	8-25-04	10-6-04	320
579	Fallong, Oscar A.	Otter Creek	4-19-07	4-20-07	80
580	Fallong, Peter O.	Otter Creek	5-27-07	5-28-07	700
581	Fallong, Whitfield & Sarah	Otter Creek	4-13-12	4-13-12	160
582	Forsythe, Mary K.	Otter Creek	10-17-01	10-17-01	300
587	Johnson, Andrew	Otter Creek	4-18-89	4-18-89	400
595	Neste, Erik N.	Otter Creek	3-28-10	3-28-10	40
637	Franklin, Effie L.	Rye Creek	4-18-98	4-27-98	200
638	Franklin, W. P. & H. P.	Rye Creek	5-23-98	6-1-98	1000
691	Hart, J. W. and Hooper, J. B.	Spring Creek	3-30-88	4-2-88	200
697	McMahon, W.	Spring Creek	12-7-10	12-13-10	100
741	Adam, Edward	Sweetgrass Creek	4-20-97	4-21-97	200
760	Cook, George W.	Sweetgrass Creek	2-25-86	2-27-86	1000
761	Cook, John B. and Tessier, Prosper	Sweetgrass Cr.	4-7-87	4-11-87	—
762	Crest, Albert & Syver	Sweetgrass Creek	9-30-89	10-2-89	720
763	Crest, Albert & Syver	Sweetgrass Creek	11-29-90	11-29-90	720
764	Crest, Albert & Syver	Sweetgrass Creek	3-30-98	4-1-98	720
766	Dahl, Anne	Sweetgrass Creek	11-29-04	11-30-04	150
767	Dahl, Eddie H.	Sweetgrass Creek	9-25-02	11-29-02	1000

Page Two

<u>No.</u>	<u>Name of Appropriator</u>	<u>Name of Stream</u>	<u>Date App.</u>	<u>Date Filed</u>	<u>M.I.</u>
768	Dahl, Eddie H.	Sweetgrass Creek	12-10-03	12-10-03	400
770 ✓	Davidson, Andrew & Elliott, John -	Sweetgrass Creek	11-12-89	11-30-89	800
772	Ellingson, E. H. et al	Sweetgrass Creek	6-29-04	7-2-04	850
772R	Elliott, Alexander	Sweetgrass Creek	11-12-89	11-30-89	400
775	Franklin, H. P.	Sweetgrass Creek	8-2-89	8-7-89	1300
776	Franklin, H. P. & Wesley	Sweetgrass Creek	6-10-89	6-17-89	1000
777	Franklin, Hersel P.	Sweetgrass Creek	9-10-01	9-10-01	1000
783	Green, Earl and Hoff, John	Sweetgrass Creek	6-29-03	7-29-03	1500
785	David, B.S. et al	Sweetgrass Creek	3-24-98	3-24-98	1300
793	Hickox, Dollie M.	Sweetgrass Creek	9-25-06	9-27-06	40
794	Hickox, Herbert O. and Urner, Geo. P. -	Sweetgrass Cr.	3-7-87	3-8-87	1000
795	Hickox, H.O.	Sweetgrass Creek	7-29-04	7-30-04	200
799	Johnson, Andrew	Sweetgrass Creek	12-14-99	12-15-99	500
811	Parberry, William	Sweetgrass Creek	3-2-97	3-4-97	600
812	Parberry, William	Sweetgrass Creek	7-8-97	7-14-97	400
814	Pruett, Mary C.	Sweetgrass Creek	7-11-89	8-13-89	300
815	Pruetting, John F.	Sweetgrass Creek	3-3-00	3-3-00	150
817	Rye, John	Sweetgrass Creek	5-25-93	5-25-93	400
818	Rye, Lena	Sweetgrass Creek	5-25-93	5-25-93	100
828	Strong, Wm. G. & Weatherman, N.D. -	Sweetgrass Creek	3-10-83	3-17-83	3200
831	Tessier, Sophie	Sweetgrass Creek	7-13-01	7-13-01	200
833	Tucker, Walter	Sweetgrass Creek	9-10-00	9-10-00	200
858	Howard, Lester	Trout Creek	8-11-82	8-14-82	200
869	Stocker, Charles F.	Wheeler Creek	2-13-09	2-13-09	1000
870	Wilson, Delia	Wheeler Creek	9-15-14	9-17-14	300
871	Wilson, Frank J.	Wheeler Creek	9-15-14	9-17-14	200
1018	Johnson, Andrew	Unnamed Spring	4-18-89	4-20-89	300
1087	Elliott, Alexander	Flood Water	11-12-89	11-30-89	400

Page Three

No.	To Whom Decreed	Name of Stream	Date Priority	M.I.
D-59	Armstrong and Stocker	Big Timber Creek	5-3-03	300
D-129	Moore, George	Cayuse Creek	8-1-88	108
D-130	Nepstad, John Adm.	Cayuse Creek	2-1-83	40
D-131	Nepstad, John Adm.	Cayuse Creek	6-1-89	100
D-132	Nepstad, John Adm.	Cayuse Adm.	6-1-94	80
D-228	Franklin, H. P.	Rye Creek	9-1-88	150
D-229	Franklin, Effie	Rye Creek	9-1-88	150
D-277	Berg, Andrew	Sweetgrass Creek	6-1-92	250
D-278	Berg, Sam	Sweetgrass Creek	8-1-83	80
D-279	Berg, Sam	Sweetgrass Creek	7-30-88	300
D-280	Berg, Sam	Sweetgrass Creek	5-15-92	200
D-281	Berg, Sam	Sweetgrass Creek	7-1-94	80
D-282	Berg, Sam	Sweetgrass Creek	7-1-96	40
D-283	Berg, Sam	Sweetgrass Creek	6-30-98	300
D-288	Dahl, Anne Est.	" "	5-15-03	150
D-297	Elliott, John	Sweetgrass Creek	6-1-83	50
D-298	Elliott, John	Sweetgrass Creek	10-30-89	60
D-301	Franklin, H. P.	Sweetgrass Creek	6-1-80	100
D-302	" "	" "	9-1-88	700
D-303	Franklin, H. P.	Sweetgrass Creek	10-25-13	944
D-305	Franklin, W. P.	Sweetgrass Creek	4-1-88	400
D-306	Franklin, W. P.	Sweetgrass Creek	6-25-88	350
D-311	Gyland, Martin	Sweetgrass Creek	7-30-03	180
D-315	Hart, Harry & Jack	Sweetgrass Creek	10-1-89	350
D-316	Hart, Harry & Jack	Sweetgrass Creek	6-1-92	300
D-317	Hickox & Hickox Co.	Sweetgrass Creek	7-1-86	500
D-289	Dahl, E. H.	Sweetgrass Creek	6-3-93	100
D-290	" "	" "	3-31-95	80
D-291	" "	" "	8-1-04	200

Page Four

<u>No.</u>	<u>To Whom Deceased</u>	<u>Name of Stream</u>	<u>Date Priority</u>	<u>M.I.</u>
D-324	Johnson, Andrew	Sweetgrass Creek	6-14-00 400	400
D-335	Moore, George	Sweetgrass Creek	5-15-97	600
D-356	Tessier, Prosper	Sweetgrass Creek	7-2-87	125
D-357	Tessier, Prosper	Sweetgrass Creek	5-1-88	100
D-358	Tessier, Prosper	Sweetgrass Creek	6-1-90	100
D-359	Tucker, Walter <i>Green</i>	Sweetgrass Creek	8-21-00	150
D-351.	<i>Rye, John</i>	<i>Sweetgrass Creek</i>	<i>7-20-93</i>	<i>250</i>
D-352.	<i>Rye, John</i>	<i>Sweetgrass Creek</i>	<i>5-1-94</i>	<i>350</i>
D-326	Lavold, T.S.	Sweet Grass Creek	10-1-93	80
D-327	"	"	6-29-04	200

FORM D-1
REPORTER IM 3-48 17379

STATE OF MONTANA
State Engineer's Office
WATER RESOURCES SURVEY

Township 4N Range 14E County Sweet Grass

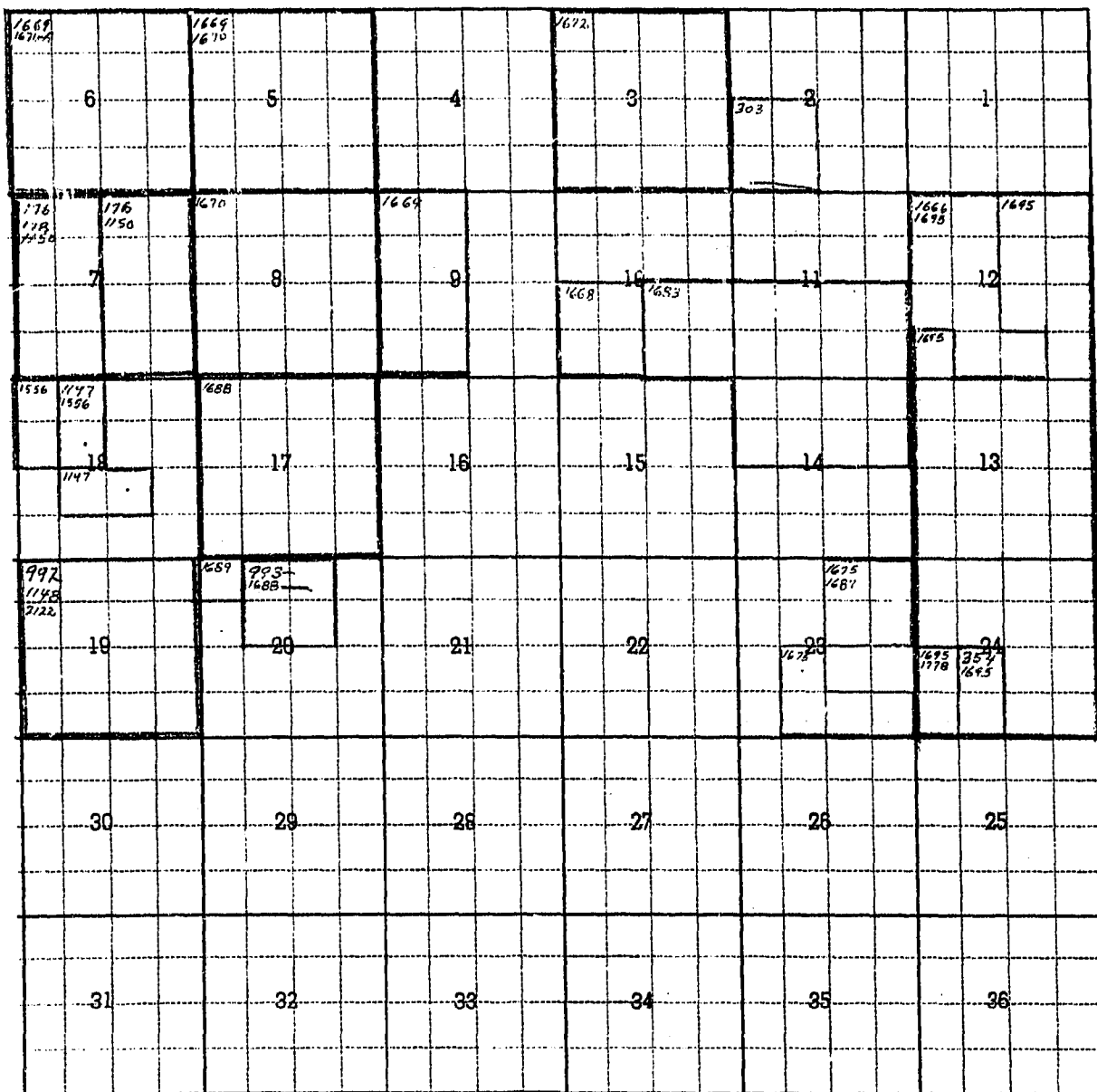

Transcribed from Park County

Township 4N Range 14E

Township _____ Range _____ County _____

Parcel Number	Name of Owner	Address	Filed	MT
176	Clauson, Ole	Billy Cr.	6-6-82	50
178	Hart Bros. & Hard, J.W.	" "	2-5-91	250
303	Adams, Henry E	Ciguco Cr.	1-29-83	811
354	Howard, Frank W.	Carroll Cr.	5-2-88	200
992	Hickox, Herbert J	Medicine Bow Cr.	4-25-82	300
992	Kye, John	" "	4-22-88	150
1147	Hoyem, T. H.	Other Cr.	6-6-82	-
1148	Johnson, Andrew	" "	4-15-89	400
1150	Rye, Peter & John	" "	5-26-83	300
1556	Hart, H. & John & Hooper, Joe B.	S. Spring Cr.	3-30-88	200
1666	Cox, John B. & Tessier, Prosper	Sweetgrass Cr.	4-2-87	1000
1668	Cook, Geo. W.	" "	2-25-86	1000
1669	Crest, Albert & Syver	" "	9-30-89	230
1670	" "	" "	11-29-90	720
1671-A	Davidson, Andrew & Elliott, John	" "	11-12-89	800
1672	Elliott, Alexander	" "	11-12-89	400
1675	Franklin, R. J. & sons	" "	6-10-89	1000
1683	Hickox, Herbert & Urner, G. B.	" "	3-7-87	1000
1687	Puett, Mary E.	" "	7-11-89	300
1688	Rye, John	" "	5-25-93	400
1689	Rye, Lena	" "	5-25-93	100
1695	Strong, Wm G. et al	" "	3-10-83	3200
1778	Howard, Lester M.	Trout Cr.	8-11-82	200
2123	Johnson, Andrew	Unimproved Spring	4-18-89	340

Farm Checked

STATE OF MONTANA

Code No. 25-340By James H. H. H.

STATE ENGINEER'S OFFICE

County SweetgrassArea 1000

WATER RESOURCES SURVEY

T. 4 N. R. 14 E Sec. 28, 34Date Aug 21, 1968Photo No. MA-11A-210Legal Land Owner ANDERSON, LEIFAddress MELVILLE, MONT.Operator "Address "

Water is delivered by:

Federal Project _____ Pres. _____ Pot. _____

Ditch Company _____ Pres. _____ Pot. _____

Irrigation District _____ Pres. _____ Pot. _____

Private System 3 1/2 miles from Melville Pres. 125.0 Pot. _____

Totals _____

Flood _____ Pump _____ Reservoir _____ Gravity ☒

Size and Capacity, Pump, etc. _____

Original Appropriator, Company _____ App. No. _____

Original Appropriator, Private Forsythe, Mary K. App. No. 582
Wilson, Della App. No. 876
Wilson, Frank Jr. App. No. 271Is the system an extension of another system? Yes _____ No ✓Is all land irrigated from one system? Yes ✓ No _____

(If No, show break down on map)

Source of Water Other Creek, Wheeler Cr.Acres Irrigated 19.50 125.0

Potential Acres _____ Seeped _____

Explain _____

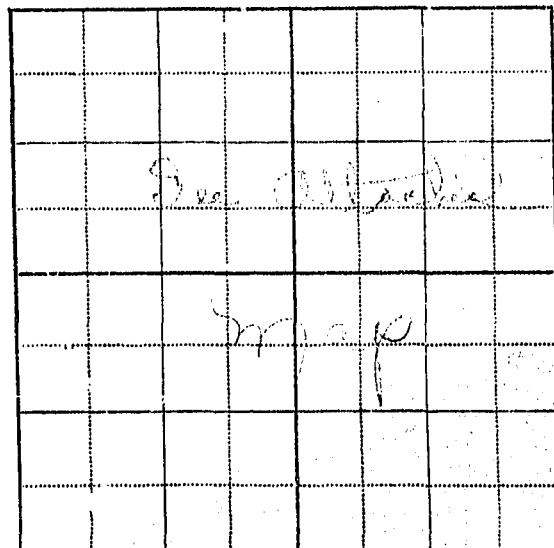
Condition of System GoodAdequate Supply Yes ✓ No ✓Explain See form in letter about 1/2 mileTopography Creek bottom and bench landInformation From Leif AndersonRemarks Find water on bench

① Old Wilson ditch takes out of Wheeler Creek on north side in NW $\frac{1}{4}$ of Sec. 5 of T. 3N-14E and flows through sections 32, 33 and 34 and T. 4N-14E and ends there. This ditch is in use for many years & Pillingson this ditch.

② Dorsythe ditch takes out of ~~Medicine Bow~~ ^{Older} creek on north side in Sec. 29-T. 4N-14E near center of section. Wood hdgt.

③ Dorsythe ditch takes out of Medicine Bow Creek on south side near sec line of 28 & 29 in Sec. 29-T. 4N-14E. Wood wing down and hdgt.

④ Rice ditch extends into sec. 25 but is not used by Sif Anderson.

STATE OF MONTANA
State Engineer's Office
WATER RESOURCES SURVEY

Township 4 NORTH Range 14 EAST County Sweetgrass

6	5	4	3	2	1
7	8	9	10	11	12
18	17	16	15	14	13
19	20	21	22	23	24
30	29	28 ^A	27	26	25
31	32	33	34 ^C	35	36

Township 4 N. Range 14 E.

Form WFR-B
Reporter 20188 2M 12-47

Twp. 4N Rge. 14E
Twp. _____ Rge. _____
Twp. _____ Rge. _____

STATE OF MONTANA
State Engineer's Office
WATER RESOURCES SURVEY
FARM MAP

County Sweetgrass
Code No. 28A-34C

Name of Land Owner Anderson, Leif Address Melville Mont.
Name of Operator Same Address _____
Legal Description _____



Irrigated Land



Non-Irrigated Land



Potential Land Under Existing Facilities

North

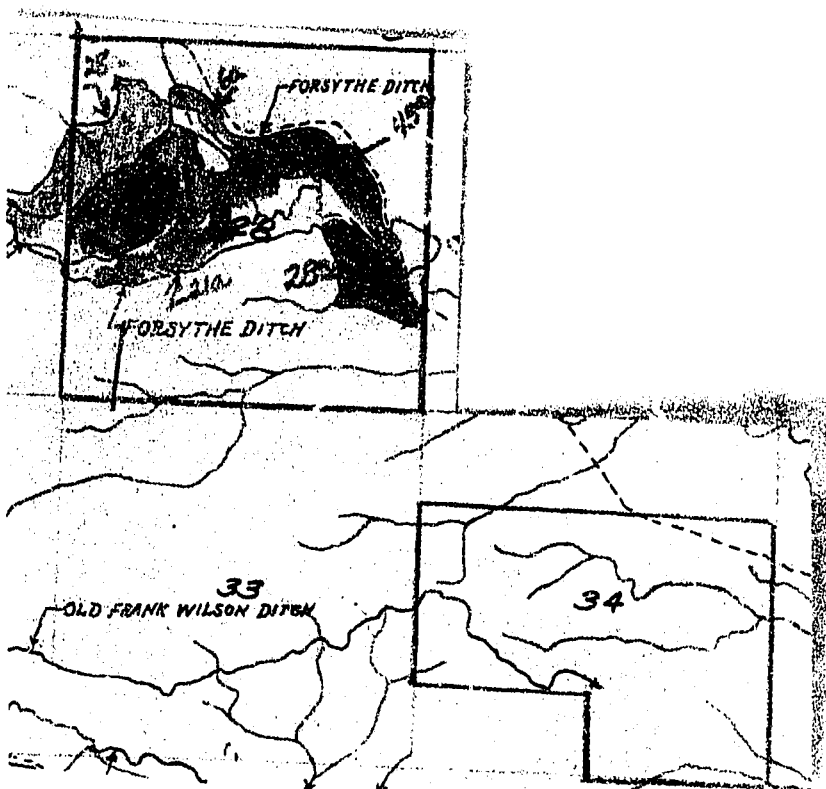

Code No. 28A System Rye Ditch Source of Water Otter Creek
Basin Otter Creek Present 0 Potential 28 Maximum 28 R ☒ F ☐ P ☐ G ☒ S ☐
Code No. 28A System Forsythe Ditches Source of Water Otter Creek
Basin Otter Creek Present 143 Potential 6 Maximum 149 R ☒ F ☐ P ☐ G ☒ S ☐
Code No. _____ System _____ Source of Water _____
Basin _____ Present _____ Potential _____ Maximum _____ R ☐ F ☐ P ☐ G ☐ S ☐
Code No. _____ System _____ Source of Water _____
Basin _____ Present _____ Potential _____ Maximum _____ R ☐ F ☐ P ☐ G ☐ S ☐

If under Ditch Company, Irrigation District, or Government Project, state the number of shares or inches, acre feet, as the case may be in said system.

NOTE: R—Denotes Regular Irrigation. F—Flood Irrigation. P—Water diverted by means of pumping. G—Water diverted by gravity. S—Stored Water.

Information from E. Cook Date May 1, 1951

Farm Checked

STATE OF MONTANA

Code No. 17-20-23 50A-32A-33-34ABy Jimmy Bob

STATE ENGINEER'S OFFICE

County SweetgrassArea Butler Creek

WATER RESOURCES SURVEY

T. 4N. R. 14E. Sec. Date Aug 21, 1950Photo No. MA-12A-32
MA-12A-33
MA-12A-34Legal Land Owner ANDERSON, THOS.Address MELVILLE, MONT.Operator "Address "

Water is delivered by:

Federal Project _____ Pres. _____ Pot. _____

Ditch Company _____ Pres. _____ Pot. _____

Irrigation District _____ Pres. _____ Pot. _____

Private System 4 Ditches Pres. 425.0 Pot. _____

Totals _____

Flood _____ Pump _____ Reservoir _____ Gravity ☒

Size and Capacity, Pump, etc. _____

Original Appropriator, Private Fallong, Samuel App. No. 437Original Appropriator, Company Anderson, Thos. W. App. No. 569Original Appropriator, Private Fallong, Roger App. No. 576Original Appropriator, Private Rye, John App. No. 817Original Appropriator, Private Stecher, Chas. E. App. No. 536Original Appropriator, Private Stecher, Chas. E. App. No. 869Is the system an extension of another system? Yes _____ No ☒Is all land irrigated from one system? Yes _____ No ☒

(If No, show break down on map)

Source of Water Fallong Cr., Otter Cr., Sweetgrass Cr., Medicine Bow Cr.,Wheeler Cr., Big Timber Cr.,Acres Irrigated 50 425.0

Potential Acres _____ Seeped _____

Explain _____

Condition of System GoodAdequate Supply Yes ☒ No _____Explain Some years run a little short of waterTopography Valley bottomInformation From Thos AndersonRemarks Information on backhas been used in the past

⑤

1/3rd interest in Anderson-Vose ditch.

(1) Two ditches out of Otter in Sec. 29 - 4N-14E
one diverting near north line of sec. 29
and one diverting ~~the~~ ^{the} 1/4 of sec. 29. Latter
ditch was built to irrigate land on
Anderson ranch.

(2) Two ditches out of Sweetgrass Creek.

(a) One Anderson claims to use Anderson-Vose
ditch.

Franklin ditch crosses land in sec.
17 & 20 - but Anderson only uses water
out of this ditch when water supply is
short. This ditch maybe Crest Bros.
ditch through which John Rye made
his filing out of Sweetgrass Creek.

FORM D-1
REPORTER IM 3-48 17379

STATE OF MONTANA
State Engineer's Office
WATER RESOURCES SURVEY

Township 4 NORTH Range 14 EAST County Sweet Grass

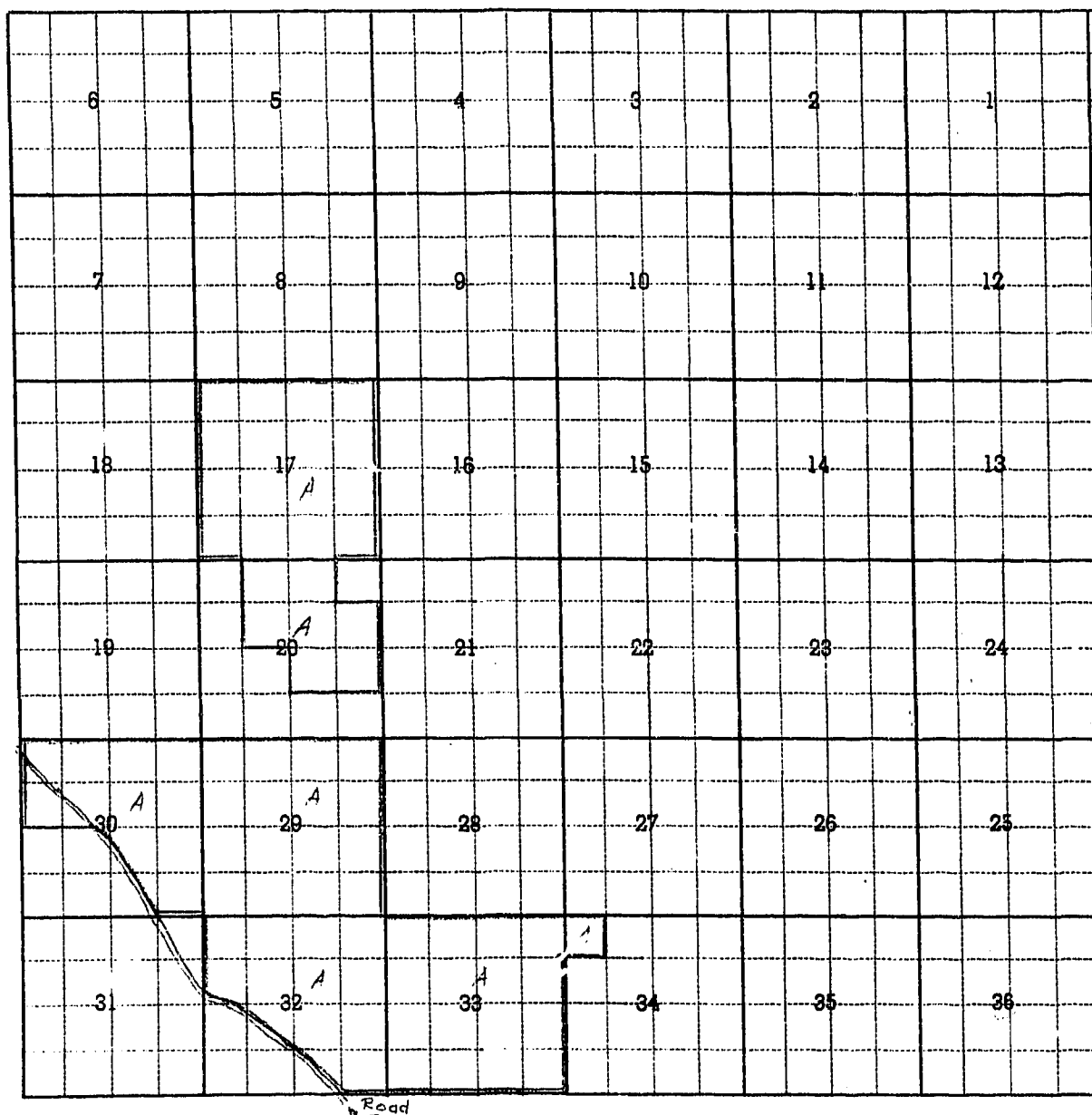

Township 4 N. Range 14 E.

69

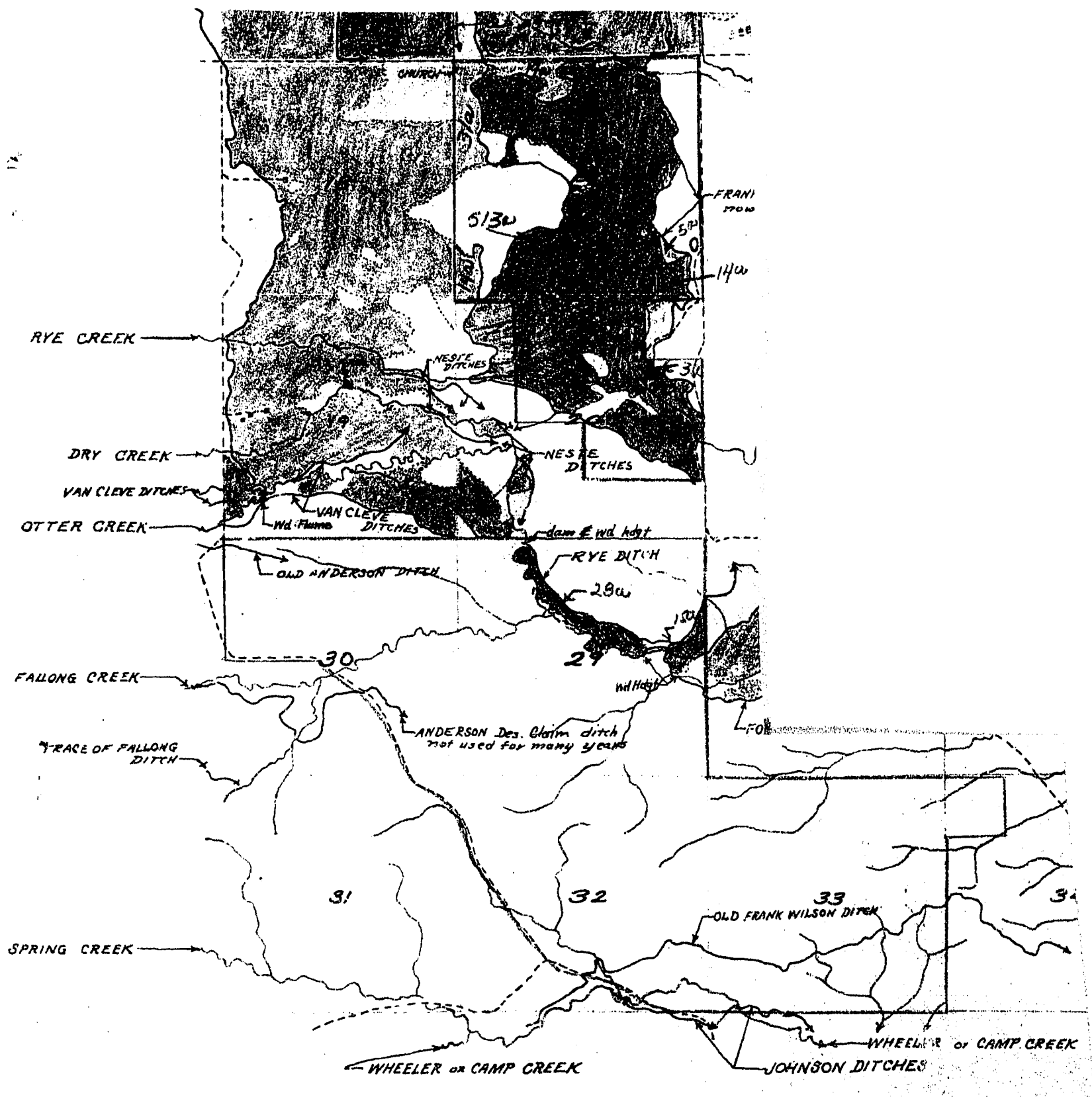

Form WR-B
Reporter 20188 2M 12-48

Twp. 4N Rge. 14E

Twp. _____ Rge. _____

Twp. _____ Rge. _____

STATE OF MONTANA
State Engineer's Office
WATER RESOURCES SURVEY
FARM MAP

County Sweetgrass

Code No. _____

17A-20A-29A-30A-

32A-33A-34A

Name of Land Owner Anderson, L. J. Address MELVILLE MONT.

Name of Operator Same Address " "

Legal Description _____



Irrigated Land



Non-Irrigated Land

North



Potential Land Under Existing Facilities

Code No. 17A System Hart-Parker Ditch Source of Water Sweet Grass Creek
Basin Sweet Grass Creek Present 0 Potential 45 Maximum 45 R. ✓ F. ✓ P. ✓ G. ✓ S. ✓
Code No. 17A, 20A System Anderson-Vase Ditch Source of Water Sweet Grass Creek
Basin Sweet Grass Cr. Present 513 Potential 19 Maximum 532 R. ✓ F. ✓ P. ✓ G. ✓ S. ✓
Code No. 17A, 20A System Franklin Ditch Source of Water Sweet Grass Creek
Basin Sweet Grass Cr. Present 26 Potential 8 Maximum 34 R. ✓ F. ✓ P. ✓ G. ✓ S. ✓
Code No. 29A System Rye Ditch Source of Water Otter Creek
Basin Otter Creek Present 43 Potential 0 Maximum 43 R. ✓ F. ✓ P. ✓ G. ✓ S. ✓

If under Ditch Company, Irrigation District, or Government Project, state the number of shares or inches, acre feet, as the case may be in said system.

NOTE: R—Denotes Regular Irrigation. F—Flood Irrigation. P—Water diverted by means of pumping. G—Water diverted by gravity.
S—Stored Water.

Information from J. E. Cook Date May 1, 1951

Farm Checked

STATE OF MONTANA

Code No. 2A-2C-3-4B-10BBy Jim & Bob

STATE ENGINEER'S OFFICE

County SweetgrassArea Melville

WATER RESOURCES SURVEY

T. 4 N. R. 14 E. Sec. 2, 3, 4, 10Date Sept. 27, 1950Photo No. MA-11A-211Legal Land Owner CREMER, LEO JR.Address SHAWMUT, MONT.Operator " " "Address " " "

Water is delivered by:

Federal Project _____ Pres. _____ Pot. _____

Ditch Company _____ Pres. _____ Pot. _____

Irrigation District Ormer - ~~Ormer~~ Ditch Pres. _____ Pot. _____Private System Ormer Ditch Pres. _____ Pot. _____

Totals _____

Flood ☒ Pump _____ Reservoir _____ Gravity ☒

Size and Capacity, Pump, etc. _____

Original Appropriator, Company APP Parberry, William App. No. 811Original Appropriator, Private Elliott, Alexander App. No. 1087Is the system an extension of another system? Yes _____ No ☒Is all land irrigated from one system? Yes ☒ No _____

(If No, show break down on map)

Source of Water Sweetgrass Cr., Flood water, Cayuse Cr.Acres Irrigated 19.50Potential Acres ? Seeped SomeExplain most land in this area is sub-irrigatedCondition of System GoodAdequate Supply Yes No _____

Explain _____

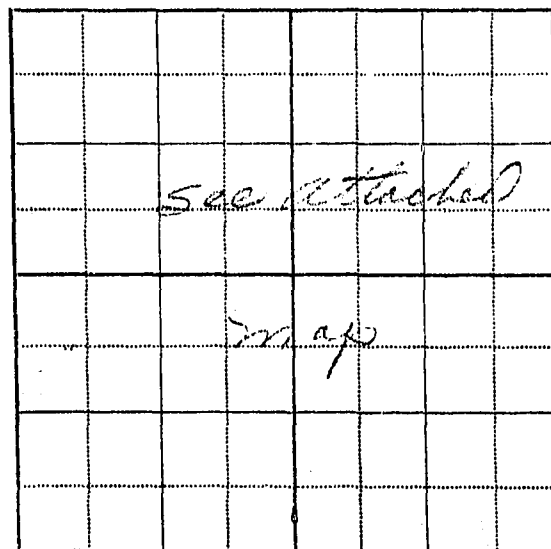
Topography Valley bottomInformation From Parberry former & field surveyRemarks See back of sheet for further information

1) Lateral ditch used to irrigate low meadow
west of ranch building is used by
Coyne. In Johnsons Canyon fields Sweetthorn
water comes from ^{100 ft deep or} ~~Johnson~~ ditch through
this lateral. Johnsons dumps his ~~own~~
privatized ditch water into lateral for use
on his land. Lateral takes out of ~~Coyne~~
~~Johnson~~ ditch on west section line of sec. 32-58-14
in S 4 1/4 and runs south westerly.

2) Green ditch runs into NW 1/4 of sec. 10 but
is not in sec. 10 ditch out of Sweetthorn cr.

3) All ditch out of Sweetthorn cr runs in sec. 34
but are not in line of main branch and irrigates
the low fields of Johnsons Ditch.

4) Two main ditches east of ranch pick up
runoff water and throw into Coyne cr.
It irrigates under these ditches.

Only land in NW 1/4 sec 3 and NE 1/4 sec 4 is irrigated
at present. Rest of land where as is is sub irr.
from ditches above these areas.

About half of west regularly irrigated ^{or 20 acres} hay land. The rest
is used as pasture.

STATE OF MONTANA

State Engineer's Office
WATER RESOURCES SURVEY

Township 4 NORTH Range 14 EAST County Sweetgrass

A 36x36 grid with a highlighted path and numbered cells. The path starts at cell 1 (row 1, column 35), goes left to cell 2 (row 1, column 34), then down to cell 3 (row 2, column 34), then left to cell 4 (row 2, column 33), then down to cell 5 (row 3, column 33), then left to cell 6 (row 3, column 32), then down to cell 7 (row 4, column 32), then left to cell 8 (row 4, column 31), then down to cell 9 (row 5, column 31), then left to cell 10 (row 5, column 30), then down to cell 11 (row 6, column 30), then left to cell 12 (row 6, column 29), then down to cell 13 (row 7, column 29), then left to cell 14 (row 7, column 28), then down to cell 15 (row 8, column 28), then left to cell 16 (row 8, column 27), then down to cell 17 (row 9, column 27), then left to cell 18 (row 9, column 26), then down to cell 19 (row 10, column 26), then left to cell 20 (row 10, column 25), then down to cell 21 (row 11, column 25), then left to cell 22 (row 11, column 24), then down to cell 23 (row 12, column 24), then left to cell 24 (row 12, column 23), then down to cell 25 (row 13, column 23), then left to cell 26 (row 13, column 22), then down to cell 27 (row 14, column 22), then left to cell 28 (row 14, column 21), then down to cell 29 (row 15, column 21), then left to cell 30 (row 15, column 20), then down to cell 31 (row 16, column 20), then left to cell 32 (row 16, column 19), then down to cell 33 (row 17, column 19), then left to cell 34 (row 17, column 18), then down to cell 35 (row 18, column 18), then left to cell 36 (row 18, column 17). The path is highlighted with a thick black line. The cells are numbered 1 through 36. The labels 'A', 'B', and 'C' are placed in the top right corner of the grid. 'A' is in cell 35 (row 1, column 35), 'B' is in cell 34 (row 1, column 34), and 'C' is in cell 33 (row 1, column 33).

Township 4 N. Range 14 E.

STATE OF MONTANA

State Engineer's Office
WATER RESOURCES SURVEY
FARM MAP

County Sweetgrass

Code No. 2A-2C-3A-4B-
10B

Twp. 44N Rge. 14E
Twp. _____ Rge. _____
Twp. _____ Rge. _____

Name of Land Owner Cramer, Leo Jr. Address Shawmut Mont.
Name of Operator Same Address _____
Legal Description _____



Irrigated Land



Non-Irrigated Land
North



Potential Land Under Existing Facilities

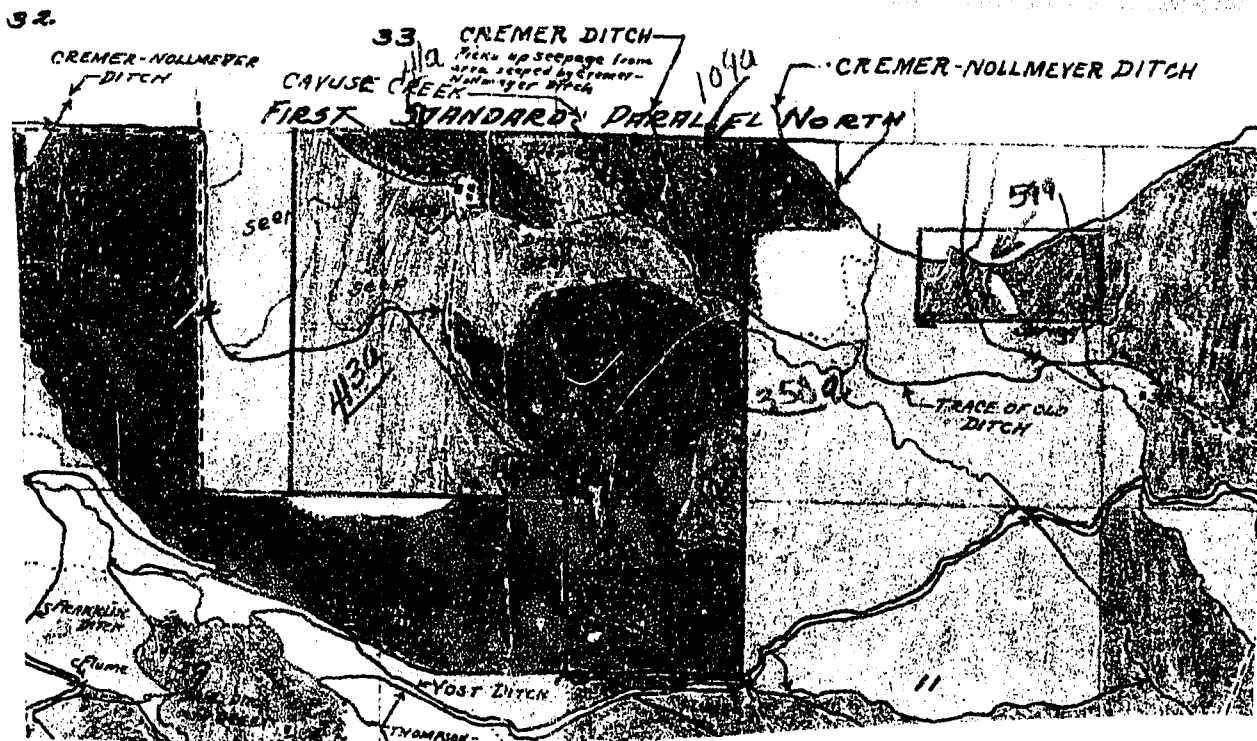

Code No. 2A-2C-3A-4B-10B System Cramer-Nollmeyer Ditch Source of Water Shawmut Canal Co.
Basin Shawmut Basin Present 905 Potential 903 Maximum _____ R. X F. _____ P. _____ G. X S. _____
Code No. _____ System _____ Source of Water _____
Basin _____ Present _____ Potential _____ Maximum _____ R. _____ F. _____ P. _____ G. _____ S. _____
Code No. _____ System _____ Source of Water _____
Basin _____ Present _____ Potential _____ Maximum _____ R. _____ F. _____ P. _____ G. _____ S. _____
Code No. _____ System _____ Source of Water _____
Basin _____ Present _____ Potential _____ Maximum _____ R. _____ F. _____ P. _____ G. _____ S. _____

If under Ditch Company, Irrigation District, or Government Project, state the number of shares or inches, acre feet, as the case may be in said system.

NOTE: R—Denotes Regular Irrigation. F—Flood Irrigation. P—Water diverted by means of pumping. G—Water diverted by gravity.
S—Stored Water.

Information from _____ Date 12-22-1951

Farm Checked

STATE OF MONTANA

Code No. 2BBy James & Bob

STATE ENGINEER'S OFFICE

County SweetgrassArea Melville

WATER RESOURCES SURVEY

T. 4 N. R. 14 E. Sec. 2Date Sept 27, 1950Photo No. MA-11A-211Legal Land Owner CREMER, LEO et uxAddress SHAWMUT, MONT.Operator " " "Address " "

Water is delivered by:

Federal Project _____ Pres. _____ Pot. _____

Ditch Company _____ Pres. _____ Pot. _____

Irrigation District _____ Pres. _____ Pot. _____

Private System Cremer - ^{Nollmeyer} ~~Clackman~~ Ditch Pres. _____ Pot. _____

Totals _____

Flood _____ Pump _____ Reservoir _____ Gravity ✓

Size and Capacity, Pump, etc. _____

Original Appropriator, Company _____ App. No. _____

Original Appropriator, Private _____ App. No. None?Is the system an extension of another system? Yes _____ No ✓Is all land irrigated from one system? Yes ✓ No _____

(If No, show break down on map)

Source of Water Sweet grass Cr. & Cayuse Creek,Acres Irrigated 19.50

Potential Acres _____ Seeped _____

Explain _____

Condition of System GoodAdequate Supply _____ Yes ✓ No _____

Explain _____

Topography Bench LandInformation From Real former field surveyRemarks See back of sheet for further information

① Land in sec. 2-4 N-14 E is potential under the Cremer ~~Stollmeyer~~ ditch ~~which~~ which gets water from Sweetgrass creek and the ditch can also use Coyase creek if desired.

only land near the house in NW 1/4 sec 3 and NE 1/4 sec 4 is irrigated. Rest of land shown irrigated is sub-irrigated from ditches above these areas.

STATE OF MONTANA

State Engineer's Office

WATER RESOURCES SURVEY

Township... 4 NORTH Range... 14 EAST County... Sweetgrass

A 36-point grid is shown, with points numbered 1 through 36. The grid is divided into four horizontal sections by three thick lines. A small box labeled 'B' is located at the top right, containing points 1 and 2. The points are arranged in a regular grid pattern, with the following coordinates (row, column) for each point:

Point	Row	Column
1	1	36
2	1	35
3	1	34
4	1	33
5	1	32
6	1	31
7	2	36
8	2	35
9	2	34
10	2	33
11	2	32
12	2	31
13	3	36
14	3	35
15	3	34
16	3	33
17	3	32
18	3	31
19	4	36
20	4	35
21	4	34
22	4	33
23	4	32
24	4	31
25	5	36
26	5	35
27	5	34
28	5	33
29	5	32
30	5	31
31	6	36
32	6	35
33	6	34
34	6	33
35	6	32
36	6	31

Township 4 N. Range 14 E.

Form WR-B
Reporter 20168 2M 12-49

Twp. 4N Rge. 17E
Twp. _____ Rge. _____
Twp. _____ Rge. _____

STATE OF MONTANA
State Engineer's Office
WATER RESOURCES SURVEY
FARM MAP

County Sweetgrass
Code No. 2B

Name of Land Owner CREMER, LEO. et ux Address SHAWMUT MONT.
Name of Operator Same Address _____
Legal Description _____



Irrigated Land



Non-Irrigated Land



Potential Land Under Existing Facilities

North

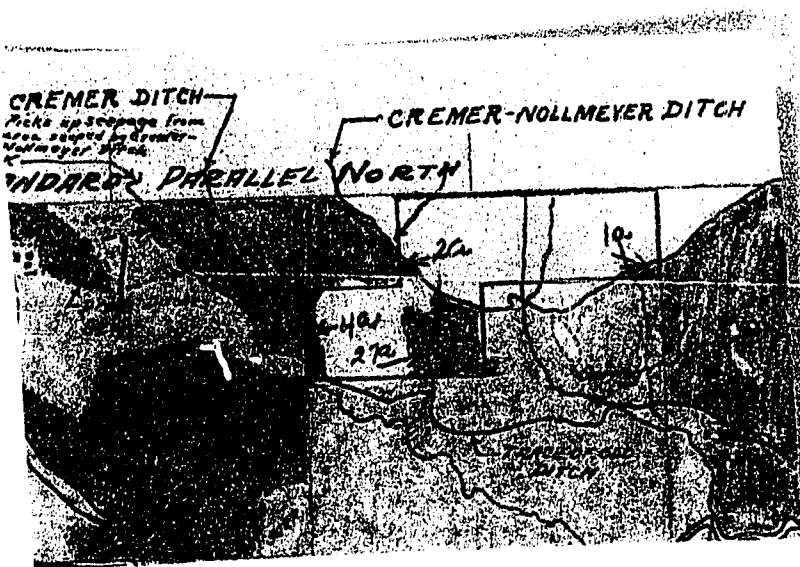

Code No. 2B System Cremer Nollmeyer Ditch Source of Water Sweet Grass Cr.
Basin Sweet Grass Cr. Present 6 Potential 28 Maximum 34 R X F P G X S
Code No. _____ System _____ Source of Water _____
Basin _____ Present _____ Potential _____ Maximum _____ R _____ F _____ P _____ G _____ S _____
Code No. _____ System _____ Source of Water _____
Basin _____ Present _____ Potential _____ Maximum _____ R _____ F _____ P _____ G _____ S _____
Code No. _____ System _____ Source of Water _____
Basin _____ Present _____ Potential _____ Maximum _____ R _____ F _____ P _____ G _____ S _____

If under Ditch Company, Irrigation District, or Government Project, state the number of shares or inches, acre feet, as the case may be in said system.

NOTE: R—Denotes Regular Irrigation. F—Flood Irrigation. P—Water diverted by means of pumping. G—Water diverted by gravity.
S—Stored Water.

Information from J. E. Clark Date April 27, 1951

Farm Checked

STATE OF MONTANA

Code No. 14B-21A-22A-23A-
26A-27ABy Line 4 Bob

STATE ENGINEER'S OFFICE

County Sweet GrassArea Sweet Grass Co.

WATER RESOURCES SURVEY

T. 4N. R. 14E Sec. Date Aug. 23, 1950Photo No. MA-11A-210
MA-11A-211Legal Land Owner ESSEX, RUTHAddress MELVILLEOperator " "Address " "

Water is delivered by:

Federal Project _____ Pres. _____ Pot. _____

Ditch Company _____ Pres. _____ Pot. _____

Irrigation District _____ Pres. _____ Pot. _____

Private System 2 Ditches out of Rye Creek
1 Private Ditch out of Sweetgrass Co. Pres. _____ Pot. _____2 - Franklin Ditches - Montana Totals _____1 Ditch (Dividahl) out of Sweetgrass Co. Flood _____ Pump _____ Reservoir _____ Gravity ☒Size and Capacity, Pump, etc. APP.Original Appropriator, Private Franklin, W. P. + H. P. Franklin, H. P. App. No. 637 D-228Original Appropriator, Private Franklin, H. P. Franklin, H. P. App. No. 638 D-229Franklin, H. P. + Wesley " " App. No. 775 D-301Franklin, H. P. " " App. No. 776 D-302Franklin, H. P. " " App. No. 777 D-303Franklin, H. P. " " App. No. 814 D-305Franklin, H. P. " " App. No. 814 D-306Is the system an extension of another system? Yes _____ No ☒Is all land irrigated from one system? Yes ☒ No _____

(If No, show break down on map)

Source of Water Rye Cr., Sweet Grass Co.Acres Irrigated 1950Potential Acres _____ Seeped Some under Dividahl ditch

Explain _____

Condition of System Good, need cleanedAdequate Supply _____ Yes ☒ No ☒Explain not when creek gets lowTopography Valley bottomInformation From Franklin, H. P.Remarks See other side

Has 100 MI W.R. in Divided Ditch out of Sweetgrass Creek.

Has 100 inches in upper Franklin Ditch that taken out of south side of Sweetgrass Creek.

- 100" 1887, June, 1st. Mutual on N side - Essex H.P. & E.P. Franklin jointly
- 700" April 1, 1888 S. side ditch, H.P. Franklin
- 300" 1888, Sept 1st off H.P. Franklin each 150 (Rye Creek)
- 700" 1888 in Franklin Mutual Ditch.
- 300-350" June 25, 1888. W. P. Franklin (Mutual) this right goes to Franklin est.
- 100" June 1, 1880 small ditch under hse H.P. Franklin
- 400 in in S. side ditch goes to W.P. Franklin est. April 1, 1888

Franklin Ditch which diverts from Sweet Grass Creek in S.W. corner sec 4 drops water into Rye Creek

The mingled water from this ditch and from Rye Creek is picked up by the Franklin Ditches in secs 21, 22, 23

The land under the Divided ditch is sub-irrigated from the Divided Ditch and from the Franklin Ditches above it.

FORM D-1
REPORTER IM 3-49 17379

STATE OF MONTANA
State Engineer's Office
WATER RESOURCES SURVEY

Township 4 NORTH Range 14 EAST County SHERIDAN

6	5	4	3	2	1
7	8	9	10	11	12
13	17	16	15	14	13
19	20	21 A	22 A	23 A	24
30	29	28	27 A	26	25
31	32	33	34	35	36

Township 4 N. Range 14 E.

Twp. 4N Rge. 14E
Twp. _____ Rge. _____
Twp. _____ Rge. _____

State Engineer's Office
WATER RESOURCES SURVEY
FARM MAP

County Douglas
Code No. 14A-21A-22A-
23A-26A-27A

Name of Land Owner Essex, Ruth Address MELVILLE
Name of Operator Same Address "
Legal Description _____

☒ Irrigated Land

☐ Non-Irrigated Land
North

☒ Potential Land Under Existing Facilities

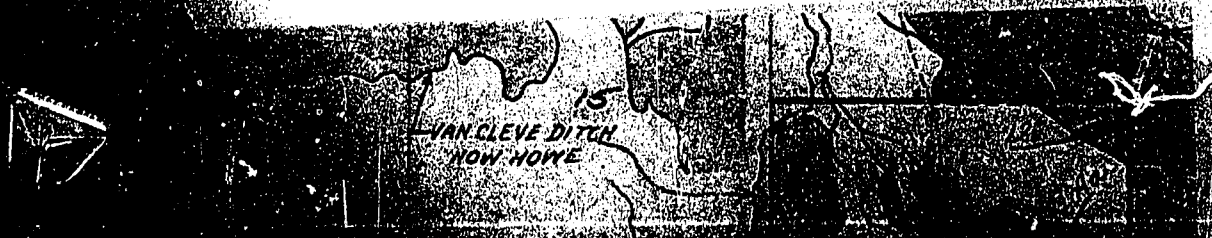

Code No. 14A System Franklin Ditches Source of Water Sweet Grass Cr.
Basin Sweet Grass Cr. Present 0 Potential 12 Maximum 12 R ✓ F ✓ P ✓ G ✓ S ✓
Code No. 14A, 22A, 23A System Franklin Ditches Source of Water Sweet Grass Cr.
Basin Sweet Grass Cr. Present 554 Potential 53 Maximum 607 R ✓ F ✓ P ✓ G ✓ S ✓
Code No. 21A, 22A, 23A, 26A, 27A System Franklin Ditches Source of Water Mingled Waters Ry Cr.
Basin Sweet Grass Cr. Present 793 Potential 303 Maximum 1096 R ✓ F ✓ P ✓ G ✓ S ✓
Code No. _____ System _____ Source of Water _____
Basin _____ Present _____ Potential _____ Maximum _____ R _____ F _____ P _____ G _____ S _____

If under Ditch Company, Irrigation District, or Government Project, state the number of shares or inches, acre feet, as the case may be in said system.

NOTE: R—Denotes Regular Irrigation. F—Flood Irrigation. P—Water diverted by means of pumping. G—Water diverted by gravity.
S—Stored Water.

Information from Franklin Date May 2, 1951

Farm Checked

STATE OF MONTANA

Code No. 68-7CBy Wm. S. Cole

STATE ENGINEER'S OFFICE

County SweetgrassArea Sweetgrass Co.

WATER RESOURCES SURVEY

T. 4N. R. 19E Sec. 9, 7Date Aug 23, 1950Photo No. MA-12A-33Legal Land Owner EURICH, RICHARD H.Address MELVILLE, MONT.Operator "Address "

Water is delivered by:

Federal Project _____ Pres. _____ Pot. _____

Ditch Company _____ Pres. _____ Pot. _____

Irrigation District _____ Pres. _____ Pot. _____

Private System Private Ditch Pres. 130.0 Pot. _____Grant - Parker Ditch - Mutual Totals _____Flood _____ Pump _____ Reservoir _____ Gravity ✓

Size and Capacity, Pump, etc. _____

Original Appropriator, Company APP. Deskre App. No. _____Original Appropriator, Private Elliott, John Davidson, Andrew App. No. 775 776 777 778 779 780 781 782 783 784 785 786 787 788 789 790Is the system an extension of another system? Yes _____ No ✓Is all land irrigated from one system? Yes ✓ No _____

(If No, show break down on map)

Source of Water Billy Co., Sweetgrass Co. (Biller Creek used as carrier for Sweetgrass Co. water)Acres Irrigated 1950 1300

Potential Acres _____ Seeped _____

Explain Some land is sub-irrigated from ditch & creeksCondition of System GoodAdequate Supply _____ Yes _____ No ✓Explain Some times gets short off later in seasonTopography Creek bottom & bench landInformation From St. EurichRemarks Information on backof sheet.

(8)

Diggs Hart Parker water (Eurich right)
into Billie Creek at point where Hart
Parker Ditch crosses Billie Creek. and
then take out ditch west of Billie Cr.
in S.E. 1/4 of Sec. 7, T4N-R14E to irrigate
land in S.E. 1/4 of Sec. 7. This water
is since to be conveyed in
Hart-Parker Ditch via Billie Cr.

D-297 - Elliot right ^{60 MI} is used out of Hart-Parker
Ditch

D-298 - Elliot right 60 MI is used out of private
ditch out of S. 1/4 Sec. 7 in S.W. 1/4 Sec. 6, T4N-R14E

Eurich has ^{100 MI} bought 100 MI of T.S. Savard right in Haystack
ditch on S.E. 1/4 of Sec. 7 bought from C. Rein.
Rein bought from Savard.

Eurich also bought the C.M. Rein Dredge right (D-346) to be used in the
Hart-Parker Ditch

Bought D-346 for Dredging work.

STATE OF MONTANA
State Engineer's Office
WATER RESOURCES SURVEY

Township 4 NORTH Range 14 EAST County Sandwich

6	5	4	3	2	1
B					
7	8	9	10	11	12
C					
18	17	16	15	14	13
19	20	21	22	23	24
30	29	28	27	26	25
31	32	33	34	35	36

Township 4 N Range 14 E

Form WR-B
Reporter 20188 2M 12-40

Twp. 4N Rge. 14E
Twp. _____ Rge. _____
Twp. _____ Rge. _____

STATE OF MONTANA
State Engineer's Office
WATER RESOURCES SURVEY
FARM MAP

County Sweetgrass

Code No. 6B-7C

Name of Land Owner EURICH, RICHARD H. Address MELVILLE MONT.
Name of Operator Same Address "
Legal Description _____

☐ Irrigated Land

☐ Non-Irrigated Land
North

☒ Potential Land Under Existing Facilities

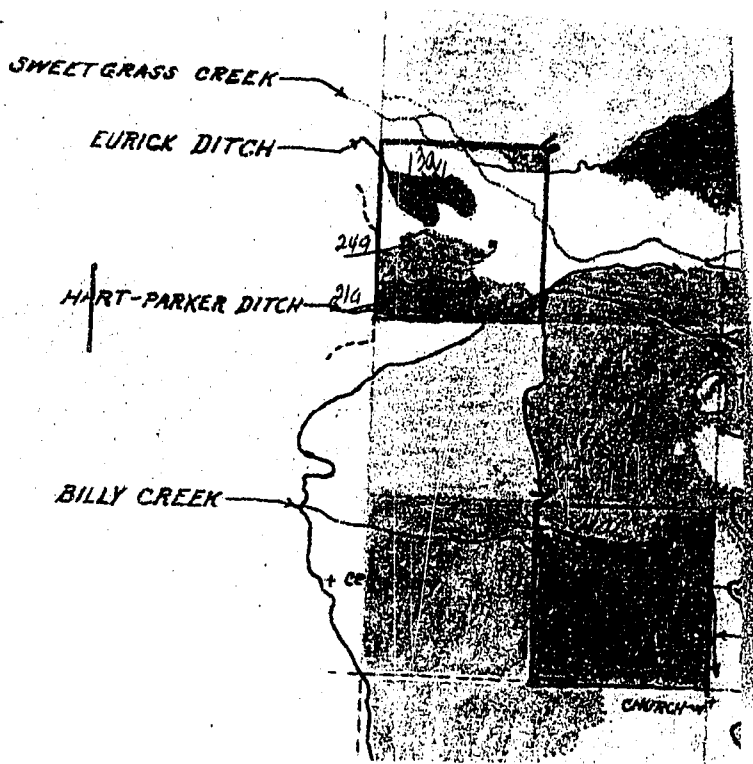

Code No. 6B System Eurick Ditches Source of Water Sweet Grass Cr.
Basin Sweet Grass Present 13 Potential 0 Maximum 13 R. X F. P. G. X S.
Code No. 6B, 7C System Hart-Parker Ditch Source of Water Sweet Grass Cr.
Basin Sweet Grass Cr. Present 21 Potential 45 Maximum 66 R. X F. P. G. X S.
Code No. 7C System Eurick Ditches Source of Water Sweet Grass Cr.
Basin Sweet Grass Cr. Present 128 Potential 0 Maximum 128 R. X F. P. G. X S.
Code No. _____ System _____ Source of Water _____
Basin _____ Present _____ Potential _____ Maximum _____ R. _____ F. _____ P. _____ G. _____ S. _____

If under Ditch Company, Irrigation District, or Government Project, state the number of shares or inches, acre feet, as the case may be in said system.

NOTE: R—Denotes Regular Irrigation. F—Flood Irrigation. P—Water diverted by means of pumping. G—Water diverted by gravity. S—Stored Water.

Information from _____ Date May 1, 1951

Farm Checked

STATE OF MONTANA

Code No. 24A-25A-34B-35ABy Jim & Bob

STATE ENGINEER'S OFFICE

County SweetgrassArea Sweetgrass Co.

WATER RESOURCES SURVEY

T. 4N. R. 14E Sec. Date Sept 12, 1950Photo No. MA-12A-17
MA-11A-210Legal Land Owner FRANKLIN, W. P. est (now deceased) Address MelvilleOperator 40 Essex, Ruth Address "

Water is delivered by:

Federal Project _____ Pres. _____ Pot. _____

Ditch Company _____ Pres. _____ Pot. _____

Irrigation District _____ Pres. _____ Pot. _____

Private System Upper Franklins Ditch Pres. _____ Pot. _____

Totals _____

Flood _____ Pump _____ Reservoir _____ Gravity ☒

Size and Capacity, Pump, etc. _____

Original Appropriator, Company APC Howard, Frank W. Dickel App. No. 244 D-228Original Appropriator, Private Strong, Wm. G. & Neelbeman, N.D. Franklin, W.P. App. No. 793 D-301Is the system an extension of another system? Yes _____ No ☒ App. No. 828 D-302Is all land irrigated from one system? Yes _____ No _____ App. No. 858 D-305

(If No, show break down on map)

Source of Water Corral Cr., Sweetgrass Co., Trout Cr., Rye Cr.,Acres Irrigated 19.50Potential Acres _____ Seeped Some

Explain _____

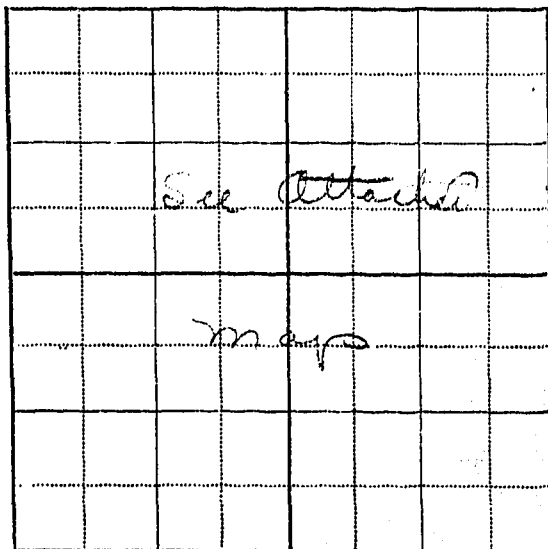
Condition of System GoodAdequate Supply Yes ☒ No _____Explain Except in dry seasonTopography Creek bottom and Valley bottomInformation From Survey recordsRemarks See back of sheet

FORM D-1
REPORTER IN 5-48 17379

STATE OF MONTANA
State Engineer's Office
WATER RESOURCES SURVEY

Township 4 North Range 14 East County Sweetgrass

6	5	4	3	2	1
7	8	9	10	11	12
18	17	16	15	14	13
19	20	21	22	23	24 <i>A</i>
30	29	28	27	26	25 <i>A</i>
31	32	33	34	<i>B</i>	35 <i>A</i>
					36

Township 7 N. Range 14 E.

STATE OF MONTANA
State Engineer's Office
WATER RESOURCES SURVEY
FARM MAP

County Sweetgrass
Code No. 24A-25A-24B-
35A

Twp. 4N Rge. 14E
Twp. _____ Rge. _____
Twp. _____ Rge. _____

Name of Land Owner FRANKLIN W. P. EST. Address MELVILLE MONT.
Name of Operator Dr. Essex Ruth Address _____
Legal Description _____

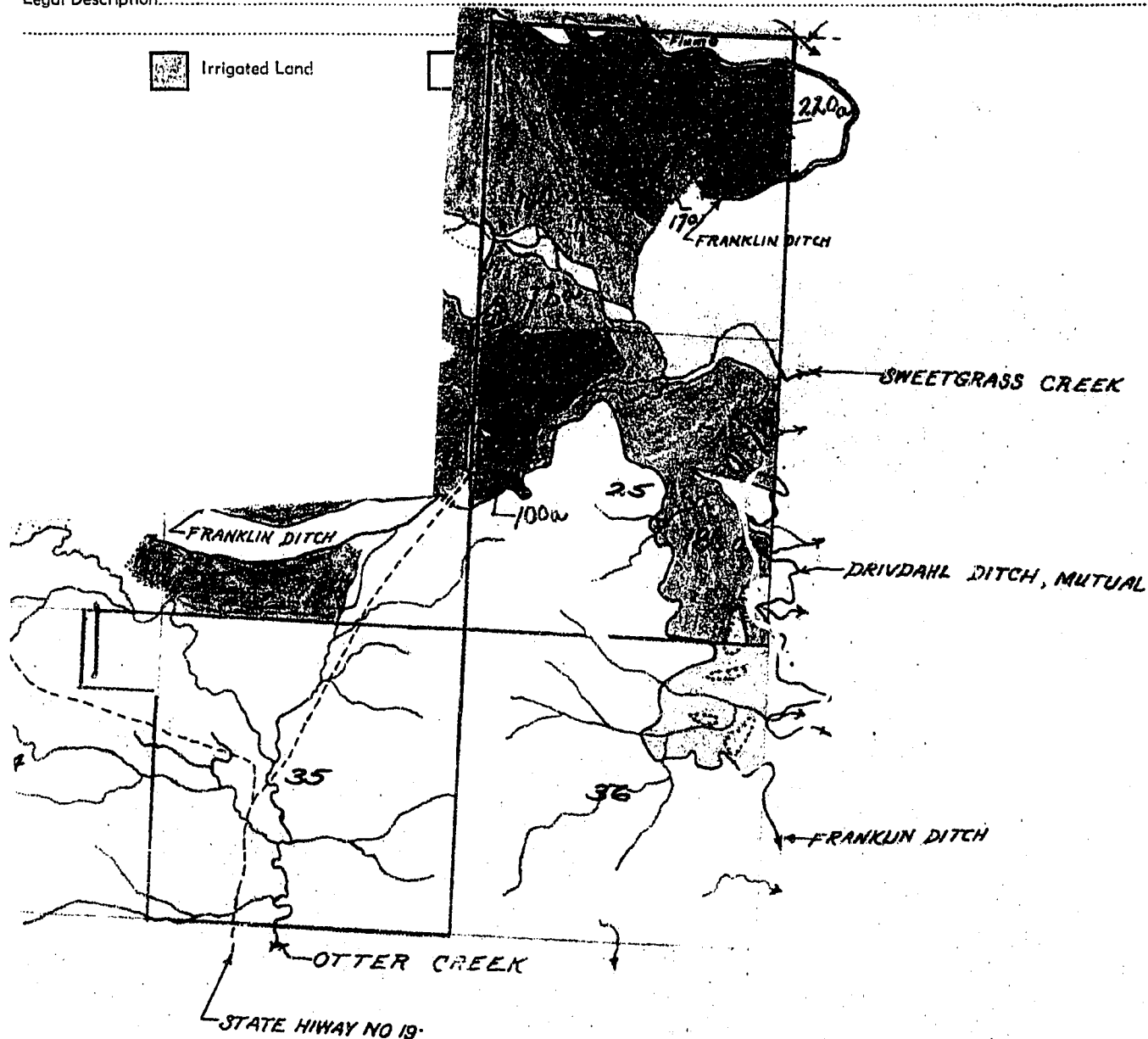

Basin Sweet Grass Present 550 Potential 23 Source of Water Sweet Grass
Code No. 24A-25A System Drivdahl Ditch
Basin Sweet Grass Present 6 Potential 90 Maximum 90 R ✓ F ✓ P ✓ G ✓ S ✓
Code No. 24A-25A System Franklin Ditch Source of Water Rye Creek Sweet Grass
Basin Sweet Grass Present 100 Potential 171 Maximum 271 R ✓ F ✓ P ✓ G ✓ S ✓
Code No. _____ System _____ Source of Water _____
Basin _____ Present _____ Potential _____ Maximum _____ R _____ F _____ P _____ G _____ S _____

If under Ditch Company, Irrigation District, or Government Project, state the number of shares or inches, acre feet, as the case may be in said system.

NOTE: R—Denotes Regular Irrigation. F—Flood Irrigation. P—Water diverted by means of pumping. G—Water diverted by gravity. S—Stored Water.

Information from _____ Date 8-11-75

Form WRS-5
Revised 12-20-48

STATE OF MONTANA
State Engineer's Office
WATER RESOURCES SURVEY
FARM MAP

County Sweetgrass
Code No. 24A-25A-34B-
35A

Land Owner FRANKLIN, W. P. & S. Address MELVILLE, MONT.
Operator Ruth Address "

Drained Area

Code No. 24A System Franklin Ditch Source of Water Sweet Grass Cr.
Basin Sweet Grass Cr. Present 220 Potential 157 Maximum 377 R ☒ F ☐ P ☐ G ☒ S ☐
Code No. 24A, 25A System Divdahl Ditch Source of Water Sweet Grass Cr.
Basin Sweet Grass Cr. Present 0 Potential 90 Maximum 90 R ☒ F ☐ P ☐ G ☒ S ☐
Code No. 24A, 25A System Franklin Ditch Source of Water Mingled water Rye Cr. & Sweet Grass Cr.
Basin Sweet Grass Cr. Present 100 Potential 191 Maximum 291 R ☒ F ☐ P ☐ G ☒ S ☐
Code No. _____ System _____ Source of Water _____
Basin _____ Present _____ Potential _____ Maximum _____ R ☐ F ☐ P ☐ G ☐ S ☐

If under Ditch Company, Irrigation District, or Government Project, state the number of shares or inches, acre feet, as the case may be in said system.

NOTE: R—Denotes Regular Irrigation. F—Flood Irrigation. P—Water diverted by means of pumping. G—Water diverted by gravity. S—Stored Water.

Information from Franklin Date May 2, 1951

Farm Checked

STATE OF MONTANA

Code No. 10CBy John B. B.

STATE ENGINEER'S OFFICE

County SweetgrassArea Sweetgrass Co.

WATER RESOURCES SURVEY

T. 4N. R. 14E Sec. 10Date Sept 4, 1958Photo No. MA-11A-211Legal Land Owner GREEN, BORDIE J.Address MelvilleOperator "Address "

Water is delivered by:

Federal Project _____ Pres. _____ Pot. _____

Ditch Company _____ Pres. _____ Pot. _____

Irrigation District _____ Pres. _____ Pot. _____

Private System _____ Pres. 0 Pot. _____

Totals _____

Flood _____ Pump _____ Reservoir _____ Gravity ✓

Size and Capacity, Pump, etc. _____

Original Appropriator, Company _____ App. No. _____

Original Appropriator, Private Good, George H. App. No. 262Is the system an extension of another system? Yes _____ No ✓Is all land irrigated from one system? Yes ✓ No _____

(If No, show break down on map)

Source of Water Sweetgrass Co.Acres Irrigated 50 0

Potential Acres _____ Seeped _____

Explain _____

Condition of System GoodAdequate Supply _____ Yes ✓ No _____

Explain _____

Topography Valley bottom

Information From _____

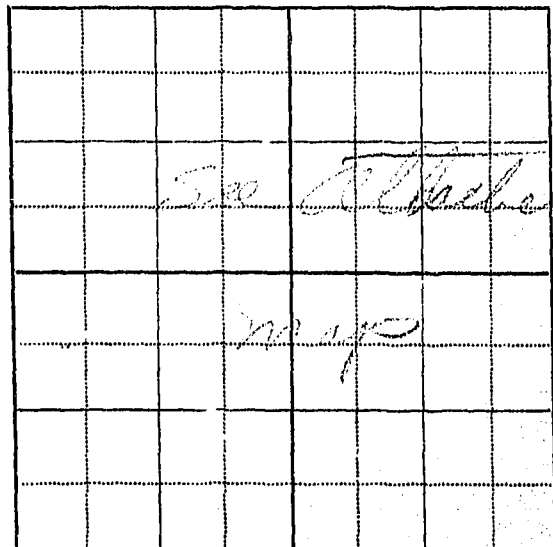
Remarks See back of sheet.(See other form)

STATE OF MONTANA
State Engineer's Office
WATER RESOURCES SURVEY

Township 1 NORTH Range 14 EAST County Sweetgrass

6	5	4	3	2	1
7	8	9	10 <i>C</i>	11	12
18	17	16	15	14	13
19	20	21	22	23	24
30	29	28	27	26	25
31	32	33	34	35	36

Township 2 N. Range 14 E.

Form WR-B
Reporter 20168 2M 12-45

STATE OF MONTANA
State Engineer's Office
WATER RESOURCES SURVEY
FARM MAP

County Sweetgrass

Code No. 100

Twp. 4 N Rge. 14 E

Twp. _____ Rge. _____

Twp. _____ Rge. _____

Name of Land Owner Green, Boddie J. Address Melville

Name of Operator Same Address "

Legal Description _____



Irrigated Land



Non-Irrigated Land



Potential Land Under Existing Facilities

North



Code No. 100 System Norris Ditch Source of Water Sweet Grass Cr.

Basin Sweet Grass Cr. Present 0 Potential 28 Maximum 28 R ✓ F ✓ P ✓ G ✓ S ✓

Code No. 100 System Thompson-Hawes Ditch Source of Water Sweet Grass Cr.

Basin Sweet Grass Cr. Present 0 Potential 10 Maximum 10 R ✓ F ✓ P ✓ G ✓ S ✓

Code No. 100 System Green Ditch Source of Water Sweet Grass Cr.

Basin Sweet Grass Cr. Present 0 Potential 15 Maximum 15 R ✓ F ✓ P ✓ G ✓ S ✓

Code No. _____ System _____ Source of Water _____

Basin _____ Present _____ Potential _____ Maximum _____ R _____ F _____ P _____ G _____ S _____

If under Ditch Company, Irrigation District, or Government Project, state the number of shares or inches, acre feet, as the case may be in said system.

NOTE: R—Denotes Regular Irrigation. F—Flood Irrigation. P—Water diverted by means of pumping. G—Water diverted by gravity. S—Stored Water.

Information from J. E. Paul Date April 30, 1951

Farm Checked

STATE OF MONTANA

Code No. 4A-9A-10ABy Valley

STATE ENGINEER'S OFFICE

WATER RESOURCES SURVEY

County SweetgrassArea SweetgrassT. 9N. R. 14E Sec. 9, 10Date Sept 7, 1986Photo No. MA-11A-211Legal Land Owner GREEN, RORDDIE et uxAddress MELVILLEOperator "Address "

Water is delivered by:

Federal Project _____ Pres. _____ Pot. _____

Ditch Company _____ Pres. _____ Pot. _____

Irrigation District _____ Pres. _____ Pot. _____

Private System 3 Private Ditches Pres. _____ Pot. _____

Totals _____

Flood _____ Pump _____ Reservoir _____ Gravity ☒

Size and Capacity, Pump, etc. _____

Original Appropriator, Private Company Cross, Albert & Sybert Deer 766 D-288

Original Appropriator, Private Dahl, Anne Dahl, Anne Est. 767 D-289

Dahl, Edlie H. Dahl, E. H. 768 D-290

Tucker, Walter Tucker, Walter 769 D-291

Is the system an extension of another system? Yes _____ No ☒Is all land irrigated from one system? Yes ☒ No _____

(If No, show break down on map)

Source of Water Sweetgrass Cr.Acres Irrigated 50

Potential Acres _____ Seeped _____

Explain _____

Condition of System Good

Adequate Supply _____ Yes _____ No _____

Explain _____

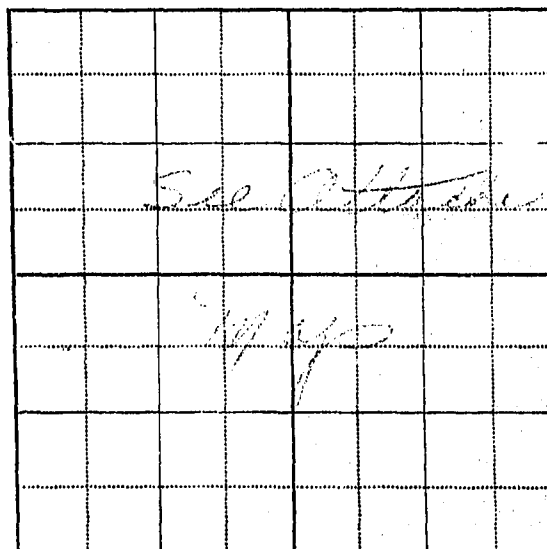
Topography Valley bottomInformation From Rorddie J. GreenRemarks See back of sheet

① Ditch in Sec. 4. From Ditch in Sec. 4.
(Ditch Cont. ditch) W. R. for this land orig.
decreased to above. Sub. test. (22-352).
Ditch Cont. Ditch decrees - D-289, 290 & 291

② On south side of river in Sec. 9 all land
is irrigated by means of two Ditch ditches.
Ditch from south side of Sweetgrass cr.
Ditch diverting S.W. 1/4 of Sec. 15 is also
used on sec. 15 by H. Green and on sec. 16
by H. Green. ~~See that no right in ditch.~~
H. Green & H. Green & H. Green can
decide right.

③ Ditch diverting north side of Sweetgrass
cr. in Sec. 4. Irrigated land
in N.W. 1/4 of Sec. 9 & N.W. 1/4 of Sec. 16.
Some land potential under H. Green ditch
in S.W. 1/4 of Sec. 17 but H. Green has more
right in this ditch.

STATE OF MONTANA
State Engineer's Office
WATER RESOURCES SURVEY

Township 4 NORTH Range 14 EAST County Sweet Grass

6	5	4 A	3	2	1
7	8	9 A	10 A	11	12
18	17	16	15	14	13
19	20	21	22	23	24
30	29	28	27	26	25
31	32	33	34	35	36

Township 4 N. Range 14 E.

STATE OF MONTANA
State Engineer's Office
WATER RESOURCES SURVEY
FARM MAP

County Sweetgrass

Code No. _____

74-94-104

Twp. 24N Rge. 10E

Twp. _____ Rge. _____

Twp. _____ Rge. _____

Name of Land Owner Green Paradise, et al Address Melville, Mont

Name of Operator Green Address _____

Legal Description _____



Irrigated Land



Non-Irrigated Land



Potential Land Under Existing Facilities

North

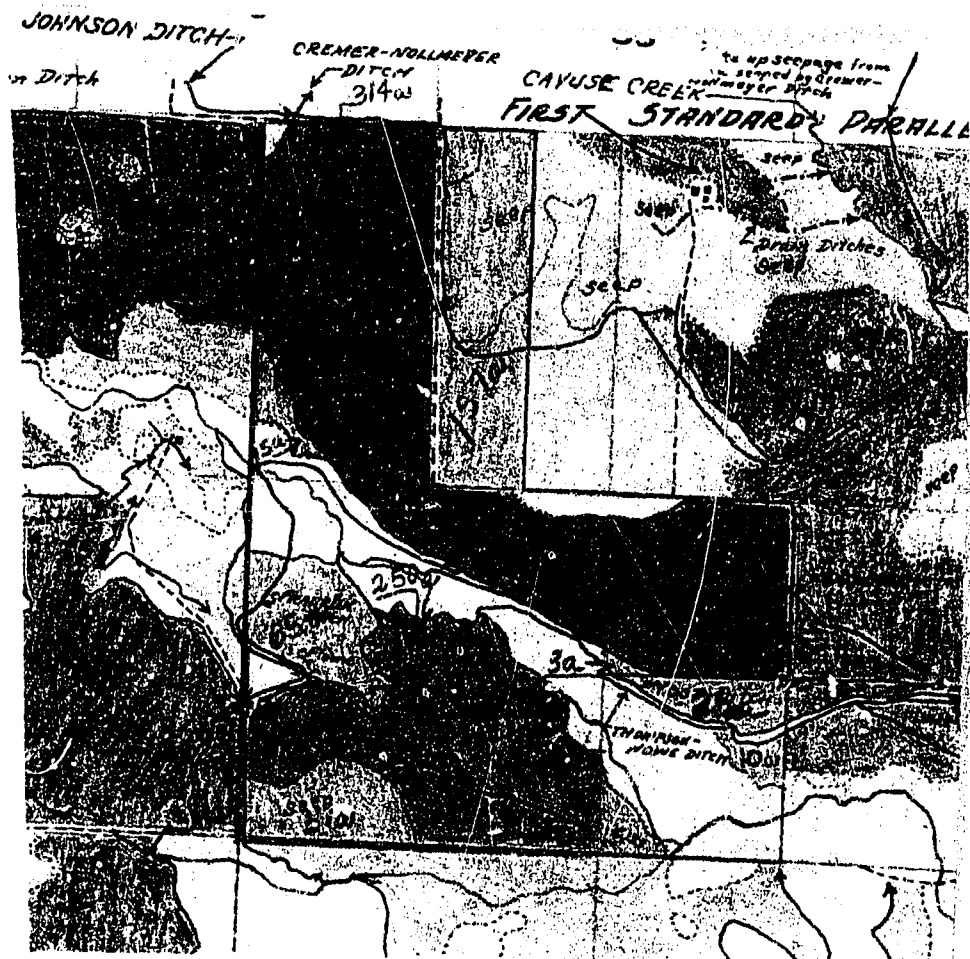

Code No. 24-104 System Green Ditch Source of Water Sweet Grass Cr.

Basin Sweet Grass Cr. Present 14 Potential 172 Maximum 486 R ✓ F ✓ P ✓ G ✓ S ✓

Code No. 24-104 System Green Ditches Source of Water Sweet Grass Cr.

Basin Sweet Grass Cr. Present 453 Potential 112 Maximum 542 R ✓ F ✓ P ✓ G ✓ S ✓

Code No. _____ System _____ Source of Water _____

Basin _____ Present _____ Potential _____ Maximum _____ R _____ F _____ P _____ G _____ S _____

Code No. _____ System _____ Source of Water _____

Basin _____ Present _____ Potential _____ Maximum _____ R _____ F _____ P _____ G _____ S _____

If under Ditch Company, Irrigation District, or Government Project, state the number of shares or inches, acre feet, as the case may be in said system.

NOTE: R--Denotes Regular Irrigation. F--Flood Irrigation. P--Water diverted by means of pumping. G--Water diverted by gravity. S--Stored Water.

Information from _____ Date Sept 1

Farm Checked

STATE OF MONTANA

Code No. 12ABy Jim & Bob**STATE ENGINEER'S OFFICE**County Sweet GrassArea Mcleville

WATER RESOURCES SURVEY

T. 4N R. 14E Sec. 12Date Sept. 12, 1950Photo No. MA-12A-16Legal Land Owner HANSON, J. O. & PearlAddress MclevilleOperator "Address "

Water is delivered by:

Federal Project _____ Pres. _____ Pot. _____

Ditch Company _____ Pres. _____ Pot. _____

Irrigation District _____ Pres. _____ Pot. _____

Private System Private Ditches Pres. 340.0 Pot. 7

Totals _____

Flood _____ Pump _____ Reservoir _____ Gravity ✓

Size and Capacity, Pump, etc. _____

Original Appropriator, Company APPL. Deer App. No. 761 D-356Original Appropriator, Private Prattins, John F. 815 D-357 D.Is the system an extension of another system? Yes _____ No ✓Is all land irrigated from one system? Yes ✓ No _____

(If No, show break down on map)

Source of Water Sweet Grass Co.Acres Irrigated 19 50 340.0Potential Acres _____ Seeped Some

Explain _____

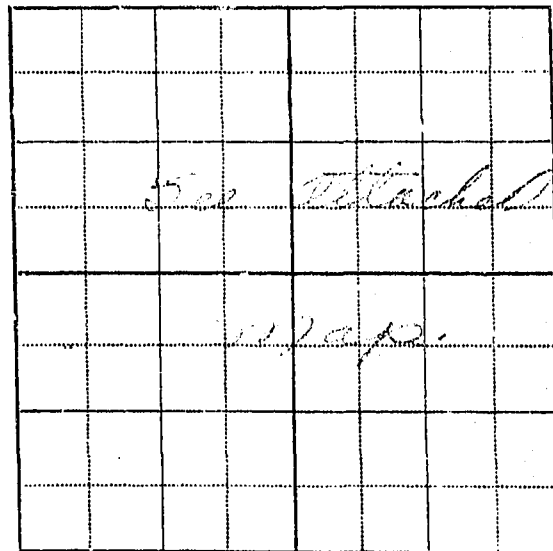
Condition of System GoodAdequate Supply Yes ✓ No _____Explain Good late in seasonTopography Valley bottomInformation From J. O. HansonRemarks Has 320" in Thompson Test inLetter. Received from R. Hanson.

③

9) Kenneth Hansen was born at Hill ca. 183 or 1834. Hansen
claims he & Hoyem are only ones who did any
maintenance on Ditch. J

3. Hanson uses Deeds 2-35, 357 and 3-8 but does not own Originally for this land but have income lost at the present time. Orig. Prosper Tesser rights.

③ K. name uses both Thompson & Newin Ditches
to irrigate land in Dec. 12.

2) Also has small ditches out of Coyuse Creek which run use the Coyuse Creek water & water from Yavin or Thompson ditches. Elling ditch is one of these.

⑤ Line above Yewin ditch is not under
Cresner - Hollmayer ditch but has no right
in this ditch.

(20) Classes to have used class right since 1908. $\left\{ \begin{array}{l} D-356 \\ D-357 \\ D-358 \end{array} \right.$

FORM D-1
REPORTER IM 3-49 17379

STATE OF MONTANA
State Engineer's Office
WATER RESOURCES SURVEY

Township 4 NORTH Range 14 EAST County Sweetgrass

6	5	4	3	2	1
7	8	9	10	11	12 A
18	17	16	15	14	13
19	20	21	22	23	24
30	29	28	27	26	25
31	32	33	34	35	36

Township 4 N Range 14 E

STATE OF MONTANA
State Engineer's Office
WATER RESOURCES SURVEY
FARM MAP

County Sweetgrass

Code No. 12A

Twp. 4 N Rge. 14 E

Twp. _____ Rge. _____

Twp. _____ Rge. _____

Name of Land Owner HANSON, S.O. and PEARL Address MELVILLE MONT.

Name of Operator SAME Address "

Legal Description _____



North

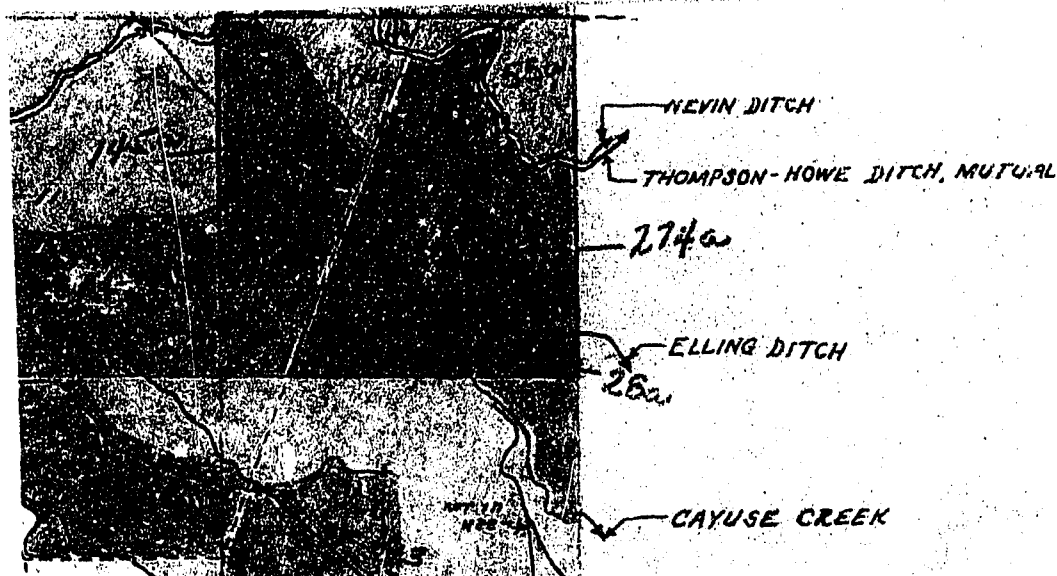

Code No. 12A System Crown-Hallmeyer Ditch Source of Water Sweet Grass Cr.

Basin Sweet Grass Cr. Present 0 Potential 59 Maximum 59 R ☒ F ☐ P ☐ G ☒ S ☐

Code No. 12A System Thompson-Howe Ditch Source of Water Sweet Grass Cr.

Basin Sweet Grass Cr. Present 419 Potential 43 Maximum 462 R ☒ F ☐ P ☐ G ☒ S ☐

Code No. 12A System Elling Ditch Source of Water Cayuse Creek

Basin Sweet Grass Cr. Present 28 Potential 0 Maximum 28 R ☒ F ☐ P ☐ G ☒ S ☐

Code No. _____ System _____ Source of Water _____

Basin _____ Present _____ Potential _____ Maximum _____ R ☐ F ☐ P ☐ G ☐ S ☐

If under Ditch Company, Irrigation District, or Government Project, state the number of shares or inches, acre feet, as the case may be in said system.

NOTE: R—Denotes Regular Irrigation. F—Flood Irrigation. P—Water diverted by means of pumping. G—Water diverted by gravity. S—Stored Water.

Information from _____ Date 1/19/51

Farm Checked

STATE OF MONTANA

Code No. 78-18ABy RS 188

STATE ENGINEER'S OFFICE

County SweetgrassArea 1.5

WATER RESOURCES SURVEY

T. 4 N. R. 14 E Sec. 7, 18Date 8-1-50Photo No. MA-12A-33Legal Land Owner HART, HARRY, ROBT & WIFEAddress MELVILLEOperator " " " "Address "

Water is delivered by:

Federal Project _____ Pres. _____ Pot. _____

Ditch Company _____ Pres. _____ Pot. _____

Irrigation District _____ Pres. _____ Pot. _____

Private System _____ Pres. _____ Pot. _____

Actual ditch _____ Totals _____Flood _____ Pump _____ Reservoir _____ Gravity ☒

Size and Capacity, Pump, etc. _____

Original Appropriator, Company APP. D-316 App. No. 125Original Appropriator, Private Hart, Harry & Jack App. No. 127 D-316Is the system an extension of another system? Yes _____ No ☒Is all land irrigated from one system? Yes ☒ No _____

(If No, show break down on map)

Source of Water Billy Co. Medicine Bow Spring Co., Sweetgrass Co.

Acres Irrigated 10 _____

Potential Acres _____ Seeped _____

Explain _____

Condition of System GoodAdequate Supply Yes ☒ No _____

Explain _____

Topography Back landInformation From John HartRemarks Over

(8)

STATE OF MONTANA
State Engineer's Office
WATER RESOURCES SURVEY

Township 4 NORTH Range 14 EAST County Sweetgrass

6	5	4	3	2	1
7	8	9	10	11	12
13	14	15	16	17	18
19	20	21	22	23	24
25	26	27	28	29	30
31	32	33	34	35	36

Township 4 N. Range 14 E.