

STATE OF MONTANA
State Engineer's Office
WATER RESOURCES SURVEY
FARM MAP

County Sweetgrass

Code No. _____

713-18A

Twp. 4N Rge. 14E

Twp. _____ Rge. _____

Twp. _____ Rge. _____

Name of Land Owner HART, HARRY, ROBT. & ANNA Address MELVILLE MONT

Name of Operator SAMIE Address " "

Legal Description _____

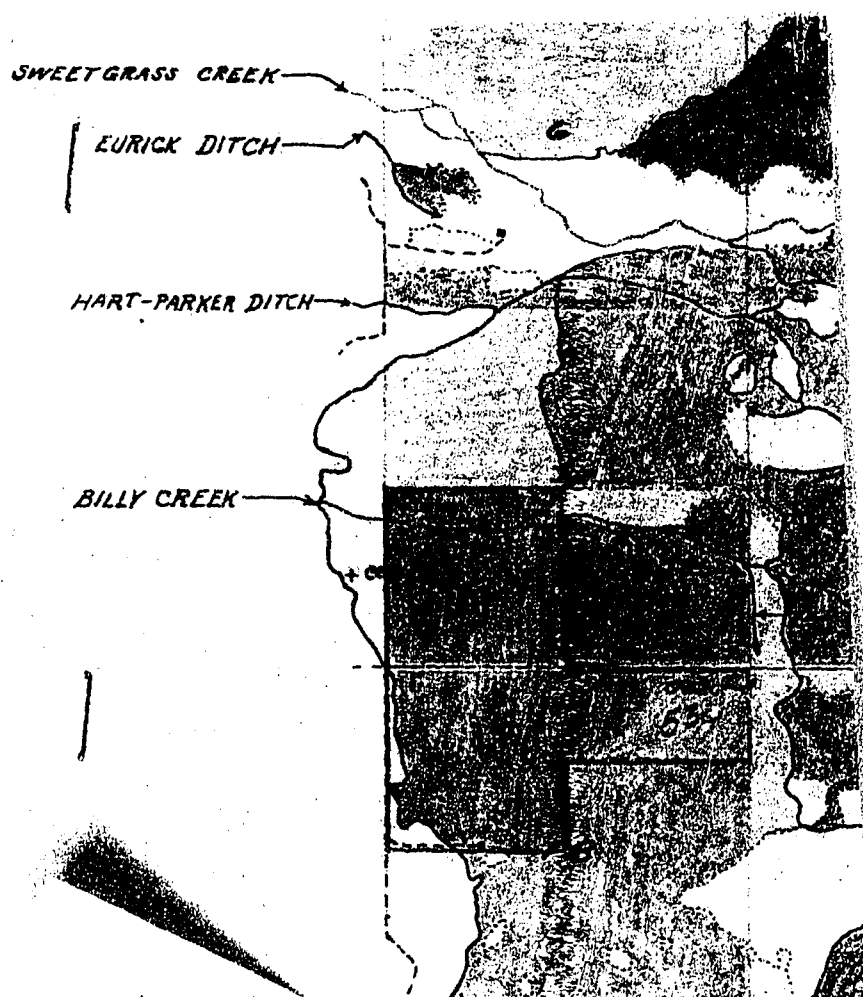
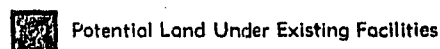
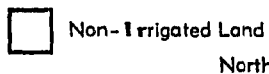

Code No. 713-18A System Hart-Parker Ditch Source of Water Sweet Grass

Basin Sweet Grass Present 306 Potential 53 Maximum 359 R. x F. P. G. x S.

Code No. _____ System _____ Source of Water _____

Basin _____ Present _____ Potential _____ Maximum _____ R. F. P. G. S.

Code No. _____ System _____ Source of Water _____

Basin _____ Present _____ Potential _____ Maximum _____ R. F. P. G. S.

Code No. _____ System _____ Source of Water _____

Basin _____ Present _____ Potential _____ Maximum _____ R. F. P. G. S.

If under Ditch Company, Irrigation District, or Government Project, state the number of shares or inches, acre feet, as the case may be in said system.

NOTE: R—Denotes Regular Irrigation. F—Flood Irrigation. P—Water diverted by means of pumping. G—Water diverted by gravity. S—Stored Water.

Information from Samie Hart Date May 1, 1951

Farm Checked

STATE OF MONTANA

Code No. 10E-11B-12A-13A-14A

By

Jim & Bob

STATE ENGINEER'S OFFICE

County Sweetgrass

Area

Melville

WATER RESOURCES SURVEY

T. 4N R. 14E Sec.

MA-11A-211

Date

Sept. 12, 1950

Photo No. MA-12A-16

Legal Land Owner

JESS HOBBS AND PARTNERS

Address

Melville

Operator

(Now sold - New Owner)

Address

"

Water is delivered by:

Federal Project

Pres.

Pot.

Ditch Company

Pres.

Pot.

Irrigation District

Pres.

Pot.

Private System

Pres.

Pot.

Totals

Flood

Pump

Reservoir

Gravity

Size and Capacity, Pump, etc.

Original Appropriator, Company

HICKOX, H. D.

Green, Earl & Hoff, John

HICKOX, Dollie M.

HICKOX, H. D. & Urner, Geo. B.

HICKOX, H. D.

Original Appropriator, Private

Stearns, Wm. C. & Weatherman, N. D.

Hickox & Hickox Co.

App. No.

App. No.

App. No.

Is the system an extension of another system?

Yes

No

Is all land irrigated from one system?

Yes

No

(If No, show break down on map)

Source of Water

Billy Co., Sweetgrass Co.

Acres Irrigated 19.50

Potential Acres

Seeped

Explain

Condition of System

Good

Adequate Supply

Yes

No

Explain

got enough water late in season

Topography

Valley bottom

Informatl.

From

Jesse Howe

Remarks

See back of sheet.

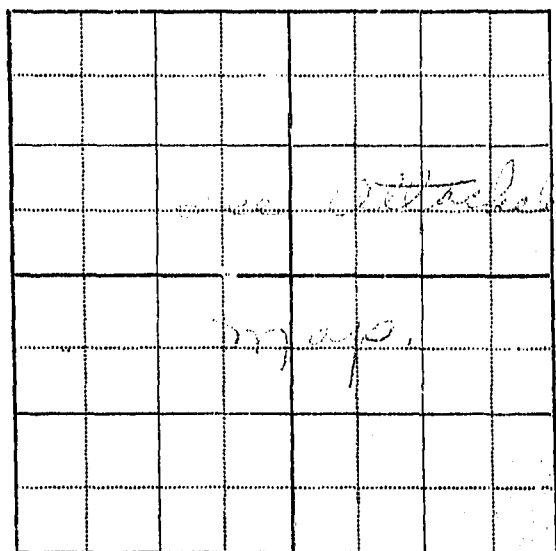

Thompson has in 1/2 interest in Thompson
Ed. & Howe has 1/2 interest in 500 ft.
Water right under both sides of Sweetgrass Cr.

- ① Private ditch all land irrigated on north
side of Sweetgrass creek is irrigated out
of it. No public ditch.

Section 15 covered by (Van Cleave
ditch) ^(now Howe) ditch. (River from south side
of Big Creek) in SE corner of sec. 5

Have bought 500 ft. of Hickox & Hickox 1886 W.R.
with church. (Van Cleave, Paul Jr.) had
previously turned over 200 ft. of their right
to his father. Van Cleave included 200 ft.
of an 1892 W.R. (Deeded to Sam Berg)
with the ranch to replace the 200 ft.
of the H. & H. right he gave his father.
(See p. 280)

The same land 1/2 sec. 11 and 14, 13 is potential under
Main ditch and foot ditch but has no W.R.
in these ditches.

Have intended to extend laterals to cover rest
of land in NE 1/4 of sec. 14 and NW 1/4 of sec. 13.

The water out of land out in from main ditch. Long road in
sec. 10.

FORM D-1
REPORTER IM 2-48 17379

STATE OF MONTANA
State Engineer's Office
WATER RESOURCES SURVEY

Township 4 NORTH Range 14 EAST County Sweetgrass

6	5	4	3	2	1
7	8	9	10 E	11 B	12 B
18	17	16	15 A	14 A	13 A
19	20	21	22	23	24
30	29	28	27	26	25
31	32	33	34	35	36

Township 4 N. Range 14 E.

STATE OF MONTANA
State Engineer's Office
WATER RESOURCES SURVEY
FARM MAP

County Sweetgrass
Code No. 10E-11A-12B-13A-14A-15A

Twp. 24 Rge. 14E
Twp. _____ Rge. _____
Twp. _____ Rge. _____

Name of Land Owner HOME FARM Address MEYVILLE MONT.
Name of Operator S. ANN Address _____
Legal Description _____

☐ Irrigated Land

☐ Non-Irrigated Land
North

☒ Potential Land Under Existing Facilities

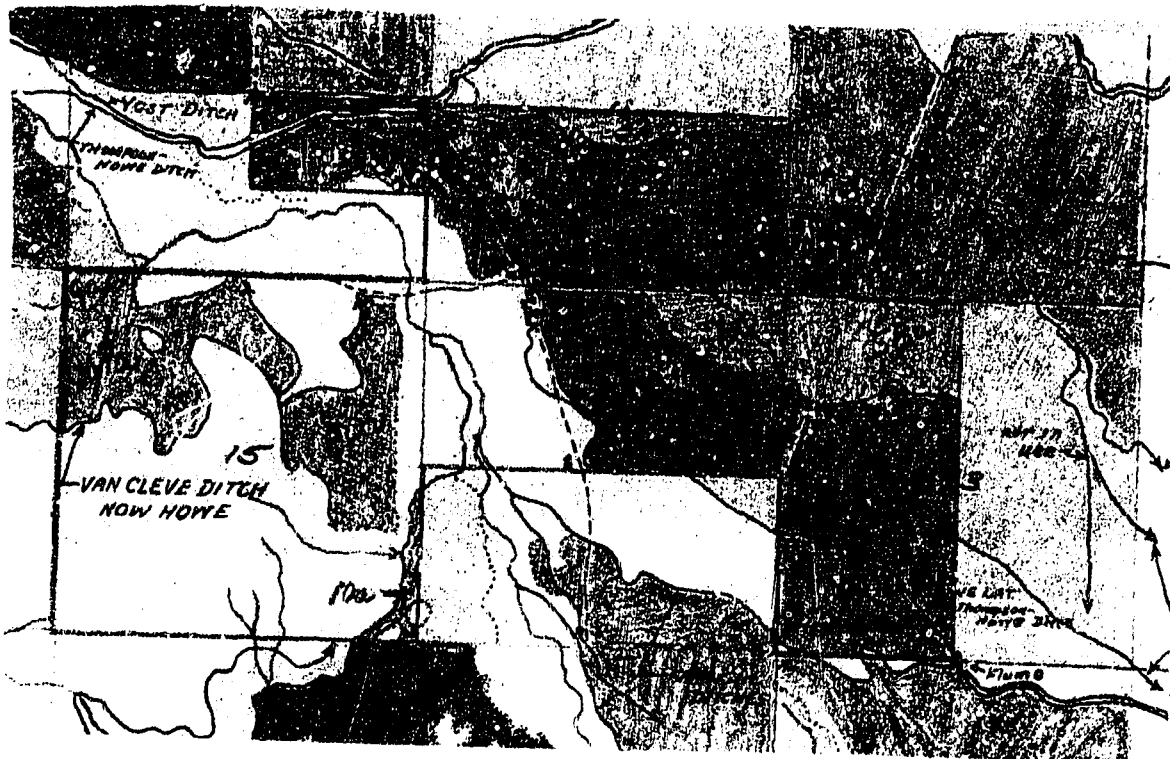

Code No. 11A System Home Ditch Source of Water Gravel Pit
Basin Home Ditch Present 1 Potential 9 Maximum 10 R ✓ F ✓ P ✓ G ✓ S ✓
Code No. 10E-11B-12B-13A System Home Ditch Source of Water Gravel Pit
Basin Home Ditch Present 704 Potential 150 Maximum 857 R ✓ F ✓ P ✓ G ✓ S ✓
Code No. 12A System Home Ditch Source of Water Gravel Pit
Basin Home Ditch Present 1 Potential 137 Maximum 187 R ✓ F ✓ P ✓ G ✓ S ✓
Code No. 15A System Home Ditch Source of Water Sweet Grass Co.
Basin Home Ditch Present 0 Potential 10 Maximum 10 R ✓ F ✓ P ✓ G ✓ S ✓

If under Ditch Company, Irrigation District, or Government Project, state the number of shares or inches, acre feet, as the case may be in said system.

NOTE: R—Denotes Regular Irrigation. F—Flood Irrigation. P—Water diverted by means of pumping. G—Water diverted by gravity. S—Stored Water.

Information from Home Farm Date July 2, 1951

STATE OF MONTANA

State Engineer's Office
WATER RESOURCES SURVEY
FARM MAP

County Sweetgrass

Code No. 10E-11A-12B-13A-14A-15A

Twp. 4N Rge. 14E

Twp. _____ Rge. _____

Twp. _____ Rge. _____

Name of Land Owner HOWE, JES Address MELVILLE MONT.

Name of Operator Same Address _____

Description _____

☒ Irrigated Land

☐ Non-Irrigated Land
North

☐ Potential Land Under Existing Facilities

Code No. 13A System Open Ditch Source of Water Sweet Grass Cr.
Basin Sweet Grass Present 0 Potential 1 Maximum ? R X F P G X S
Code No. _____ System _____ Source of Water _____
Basin _____ Present _____ Potential _____ Maximum _____ R _____ F _____ P _____ G _____ S _____
Code No. _____ System _____ Source of Water _____
Basin _____ Present _____ Potential _____ Maximum _____ R _____ F _____ P _____ G _____ S _____
Code No. _____ System _____ Source of Water _____
Basin _____ Present _____ Potential _____ Maximum _____ R _____ F _____ P _____ G _____ S _____

If under Ditch Company, Irrigation District, or Government Project, state the number of shares or inches, acre feet, as the case may be in said system.

NOTE: R—Denotes Regular Irrigation. F—Flood Irrigation. P—Water diverted by means of pumping. G—Water diverted by gravity. S—Stored Water.

Information from _____ Date _____

Farm Checked

STATE OF MONTANA

Code No. 1ABy W. G. Gable

STATE ENGINEER'S OFFICE

County SweetgrassArea Melville

WATER RESOURCES SURVEY

T. 4N R. 14E Sec. 1Date Sept. 21, 1950Photo No. MA-12A-15Legal Land Owner BLOECHNER, FRANKAddress MelvilleOperator Geo. NOLLMEYER, Jr.Address "

Water is delivered by:

Federal Project	Pres.	Pot.
Ditch Company	Pres.	Pot.
Irrigation District	Pres.	Pot.
Private System <u>Cramer Nollmeyer Ditch</u>	Pres. <u>400.0</u>	Pot.
Totals		
Flood	Pump	Reservoir
Gravity <input checked="" type="checkbox"/>		

Size and Capacity, Pump, etc.

Original Appropriator, Company

App. No.

Original Appropriator, Private Parberry, WilliamGeo. Moore, Geo.App. No. 812D-129D-335

Is the system an extension of another system?

Yes No ☒

Is all land irrigated from one system?

Yes No ☒

(If No, show break down on map)

Source of Water Cayuse Cr., Sweetgrass Cr.,Acres Irrigated 1950 400.0Potential Acres 7 Seeped None

Explain

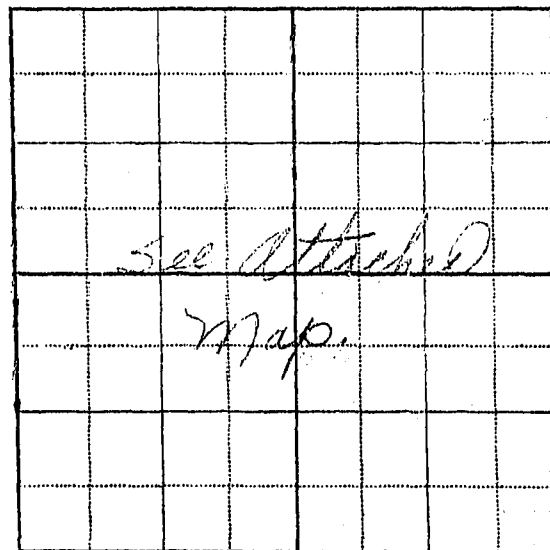
Condition of System GoodAdequate Supply Yes ☒ No ☒Explain Sept. 21, 1950 as by year.Topography Brush landInformation From Richard H. H. H.Remarks See back of sheet

⑧⑨

Vegetation gardens, lawn and trees around house
properly maintained in

Very much to be seen in the garden. The house is well
kept. Is not one of the things.

① Has irrigated and potential land under
ground. Hollister's Ditch which flows
eastward along the north side of section
1 of T4N-15E and sec. 6 of T4N-15E.

② Ditch out of canal in sec. 1 - T4N-15E - takes
out near west line of NW 1/4 of section
1 in sec. 1. Gets water from Channel Ditch.

③ Ditch out of Canal creek
takes out in NW corner of (SW 1/4 of
sec. 1 - T4N-15E).

STATE OF MONTANA
State Engineer's Office
WATER RESOURCES SURVEY

Township 4 NORTH Range 14 EAST County Sweetgrass

6	5	4	3	2	1 A
7	8	9	10	11	12
18	17	16	15	14	13
19	20	21	22	23	24
30	29	28	27	26	25
31	32	33	34	35	36

Township 4 N Range 14 E

(8)

Form TWR-2
Reporter 20188 2M 12-48

Twp. 4N Rge. 14E
Twp. _____ Rge. _____
Twp. _____ Rge. _____

STATE OF MONTANA
State Engineer's Office
WATER RESOURCES SURVEY
FARM MAP

County Sweetgrass

Code No. _____

1A

Name of Land Owner KLOECKNER, FRANK Address Melville

Name of Operator % NOLLMEYER, F. Address "

Legal Description _____



Irrigated Land



Non-Irrigated Land



Potential Land Under Existing Facilities

North

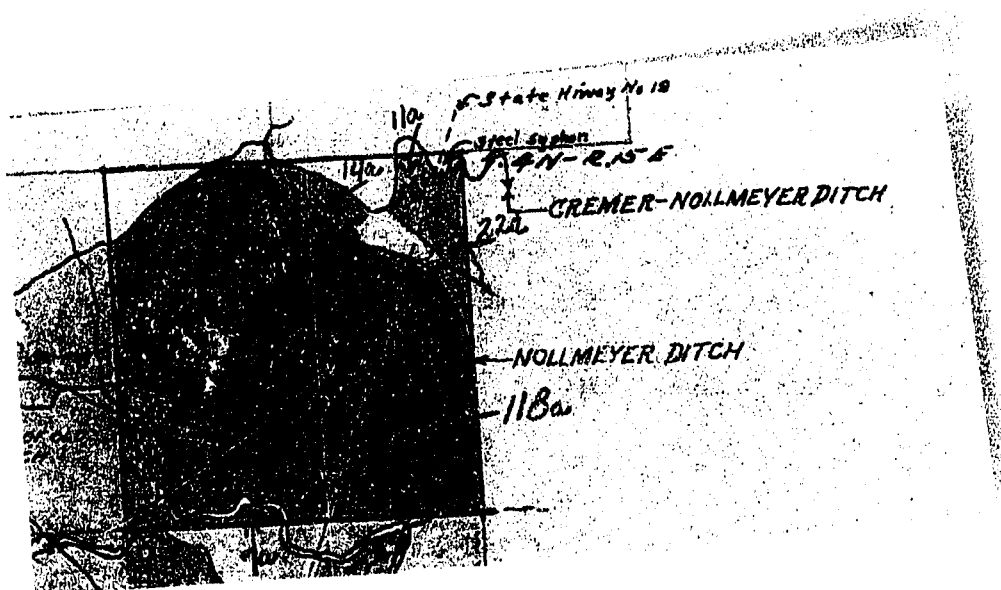

Code No. 1A System Cremer-Nollmeyer Ditch Source of Water Sweet Grass Cr.

Basin Sweet Grass Cr. Present 271 Potential 71 Maximum 542 R ☒ F ☐ P ☐ G ☒ S ☐

Code No. 1A System Thompson-Hawke Ditch Source of Water Sweet Grass Cr.

Basin Sweet Grass Cr. Present 0 Potential 7 Maximum 7 R ☒ F ☐ P ☐ G ☒ S ☐

Code No. _____ System _____ Source of Water _____

Basin _____ Present _____ Potential _____ Maximum _____ R ☐ F ☐ P ☐ G ☐ S ☐

Code No. _____ System _____ Source of Water _____

Basin _____ Present _____ Potential _____ Maximum _____ R ☐ F ☐ P ☐ G ☐ S ☐

If under Ditch Company, Irrigation District, or Government Project, state the number of shares or inches, acre feet, as the case may be in said system.

NOTE: R—Denotes Regular Irrigation. F—Flood Irrigation. P—Water diverted by means of pumping. G—Water diverted by gravity. S—Stored Water.

Information from J. C. Nollmeyer Date April 27, 1951

Farm Checked

STATE OF MONTANA

Code No. 16A-200-200-20E-342-34EBy Jim + Bob

STATE ENGINEER'S OFFICE

County SweetgrassArea Sweetgrass Co.

WATER RESOURCES SURVEY

T. 24N R. 18E Sec. 21Date Aug 30, 1950Photo No. 16A-12A-20Legal Land Owner STATE of MONTANAAddress ?Operator Address 223 1/2 miles

Water is delivered by:

Federal Project Pres. Pot. Ditch Company Pres. Pot. Irrigation District Van Cline Ditch (Montana) Pres. Pot. Private System Local Ditch Pres. Pot. Totals Flood Pump Reservoir Gravity Size and Capacity, Pump, etc. Original Appropriator, Company App. No. Original Appropriator, Private Rye, Lena App. No. 818Is the system an extension of another system? Yes No ✓Is all land irrigated from one system? Yes ✓ No

(If No, show break down on map)

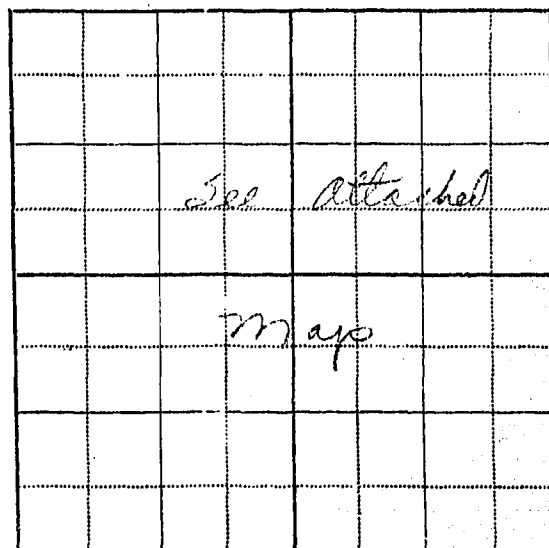
Source of Water Sweetgrass Cr.Acres Irrigated 19.50Potential Acres Seeped Explain Condition of System GoodAdequate Supply Yes No ✓Explain Topography Rolling land & creek bottomInformation From Remarks See back of sheet

⑧

(1) Land in sec. 16 is potential under
Franklin (from Howe) ditch.

(2) ~~Sec 16~~ ditch in sec. 20 has potential
under it.

(3) Ditch out of Sweetgrass Creek irrigate in
NW corner of NW 1/4 of sec. 20 - NW 1/4

20 C leased by Anderson

(1) Anderson in part of this 40 A from Anderson-Vase ditch

(2) Small amount pot under Hart-Parker ditch no right in this ditch

20 D leased by Anderson

(1) Anderson in small amount from Franklin ditch although he owns
no right in the ditch. Rest of this land under the E. ditch is potential

16 A leased by Vase

(1) land in NW 1/4 is potential under Geers waste ditch from Sweetgrass
Creek.

(2) land S. of Billy Creek is pot under Howe ditch out
of Billy Creek.

36 A leased by Harold

(1) some potential under Franklin ditch out of Sweetgrass Creek
& Rye Creek

STATE OF MONTANA
State Engineer's Office
WATER RESOURCES SURVEY

Township 4 NORTH Range 14 EAST County Sweetgrass

6	5	4	3	2	1
7	8	9	10	11	12
13	17	16 State A	15	14	13
19	C	20 State D	21	22	24
		E			
30	29	28	27	26	25
			D		
31	32	33	34 State E	35	36 A

Township _____ Range _____

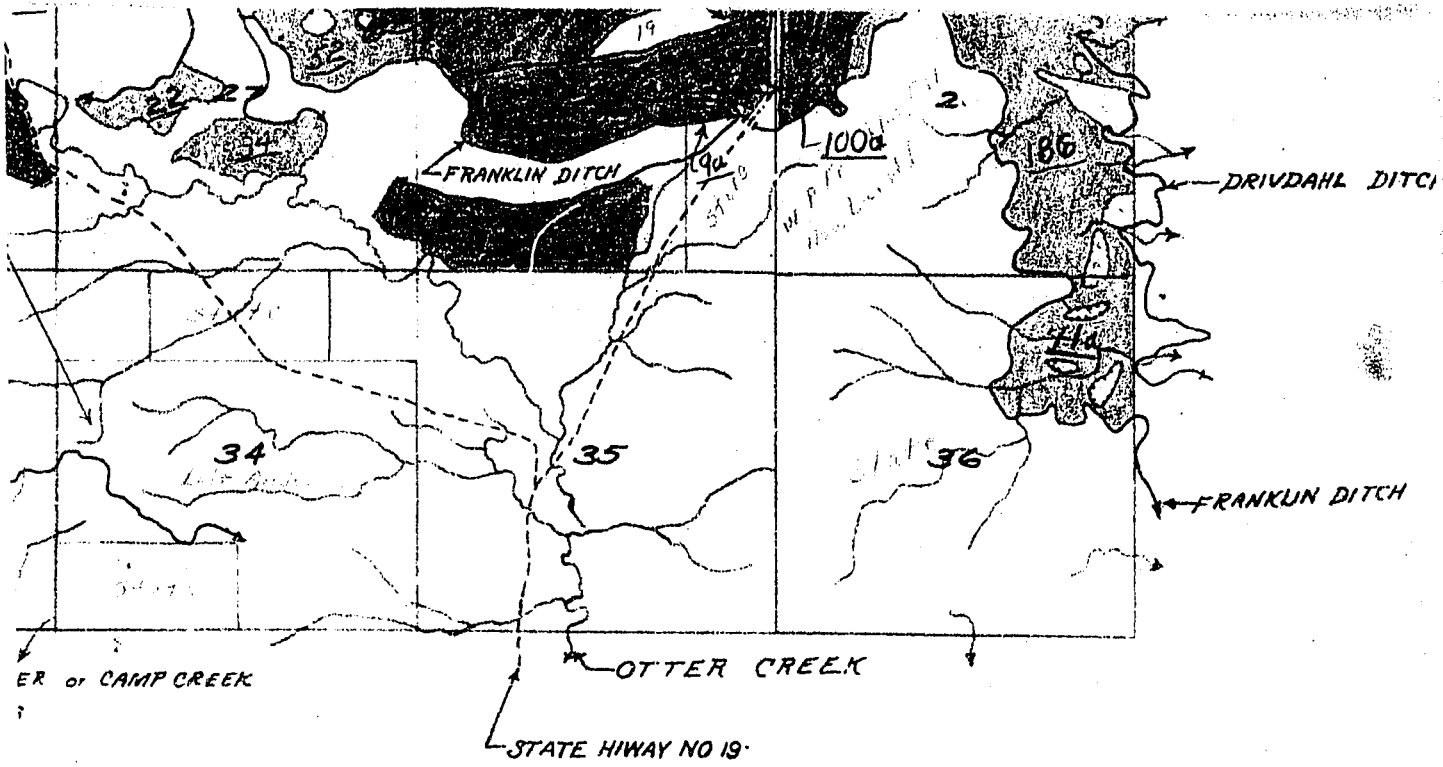
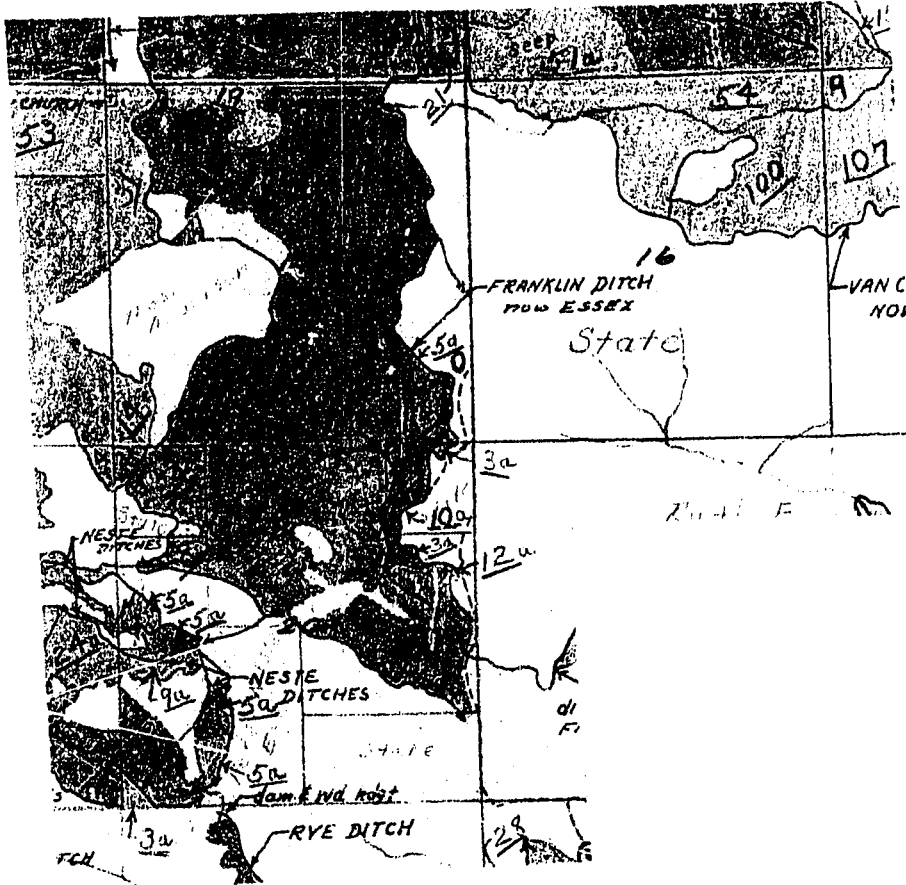

Form WR-B
Reporter 20168 2M 12-65

Twp. 4N Rge. 14E
Twp. _____ Rge. _____
Twp. _____ Rge. _____

STATE OF MONTANA
State Engineer's Office
WATER RESOURCES SURVEY
FARM MAP

County Sweetgrass
Code No. _____
16A-20C-20D-20E-
34D-34E-36A

Name of Land Owner MONTANA STATE OF Address _____
Name of Operator Vase Address MELVILLE
Legal Description _____



Irrigated Land



Non-Irrigated Land
North



Potential Land Under Existing Facilities

Code No. 20C System Hart-Parker Ditch Source of Water Sweet Grass Cr.
Basin Sweet Grass Cr. Present 0 Potential 4 Maximum 4 R ☒ F ☐ P ☐ G ☒ S ☐
Code No. 20C System Anderson-Vase Ditch Source of Water Sweet Grass Cr.
Basin Sweet Grass Cr. Present 24 Potential 0 Maximum 24 R ☒ F ☐ P ☐ G ☒ S ☐
Code No. 20D System Franklin Ditch Source of Water Sweet Grass Cr.
Basin Sweet Grass Cr. Present 3 Potential 10 Maximum 13 R ☒ F ☐ P ☐ G ☒ S ☐
Code No. 16A System Green Ditch Source of Water Sweet Grass Cr.
Basin Sweet Grass Cr. Present 0 Potential 54 Maximum 54 R ☒ F ☐ P ☐ G ☒ S ☐

If under Ditch Company, Irrigation District, or Government Project, state the number of shares or inches, acre feet, as the case may be in said system.

NOTE: R—Denotes Regular Irrigation. F—Flood Irrigation. P—Water diverted by means of pumping. G—Water diverted by gravity.
S—Stored Water.

Information from J. E. Cook Date May 1, 1951

Farm Checked

STATE OF MONTANA

Code No. 208By James K. B.

STATE ENGINEER'S OFFICE

County Sweet GrassArea 0.25 Sec.

WATER RESOURCES SURVEY

T. 4N. R. 14E Sec. 20Date Aug 22 1950Photo No. MA-12A-32Legal Land Owner NESTE, PETER estAddress MelvilleOperator JOE L. RUIST, TINALeased by Anderson Bros.Address "

Water is delivered by:

Federal Project

Pres.

Pot.

Ditch Company

Pres.

Pot.

Irrigation District

Pres.

Pot.

Private System 4 small ditches

Pres.

Pot.

Totals

Flood

Pump

Reservoir

Gravity ☒

Size and Capacity, Pump, etc.

Original Appropriator, Company

App. No.

Original Appropriator, Private Neste, Erik N.App. No. 595

Is the system an extension of another system?

Yes

No ☒

Is all land irrigated from one system?

Yes ☒

No

(If No, show break down on map)

Source of Water Glacier Co.Acres Irrigated 19.50

Potential Acres

Seeped 0

Explain

Condition of System poor

Adequate Supply

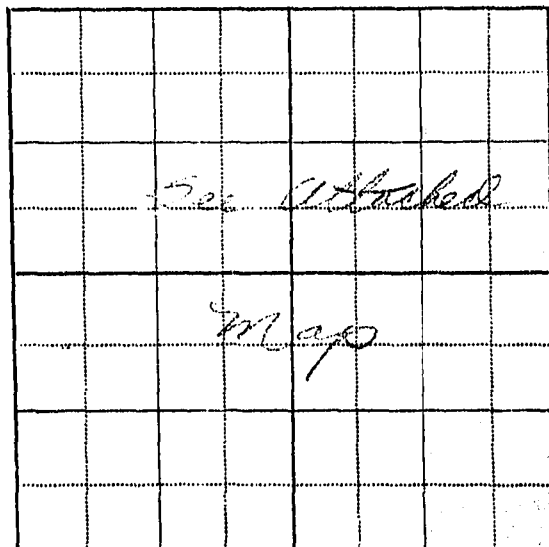
Yes ☒No ☒Explain smaller amount of land irrigatedTopography rock bottomInformation From Vertina AlquistRemarks no irrigation for last

1. 2 small ditches out of Dry Creek are diverting on the side of same in sec 19 and one diversion on the side near west line of sec 20. No filling.

2. Small ditches are on the creek bottom. One diverting from east side of Otter Creek and one from west side both in N.E. 1/4 sec 20 T4N R14E. No filling.

3. Ditch diverts from the side of Otter Creek near center of section 19. It irrigates land west of creek in SW 1/4 of sec 20 T4N R14E. It is filled in by Chick Creek.

4. One ditch out of creek, used for irrigation, flows in N.E. 1/4 sec 19 and runs into SW 1/4 NW 1/4 sec 20. but only a trace of the ditch is left in sec 20 and Nestle has no right in it.

FORM D-1
REPORTER IM 3-49 17379

STATE OF MONTANA
State Engineer's Office
WATER RESOURCES SURVEY

Township 4 NORTH Range 14 EAST County Sweetgrass

6	5	4	3	2	1
7	8	9	10	11	12
18	17	16	15	14	13
19	20	21	22	23	24
30	29	28	27	26	25
31	32	33	34	35	36

Township 4N. Range 14 E.

Form WR-11
Reporter 20188 2M 12-1

Twp. 4N Rge. 17E
Twp. _____ Rge. _____
Twp. _____ Rge. _____

STATE OF MONTANA
State Engineer's Office
WATER RESOURCES SURVEY
FARM MAP

County Sweetgrass

Code No. _____

20B

Name of Land Owner NESTE, PETER est Address Melville

Name of Operator SO ALLQUIST, TINA Address "

Legal Description _____



Irrigated Land



Non-Irrigated Land



Potential Land Under Existing Facilities

North



Code No. 20B System Anderson-Voss Ditch Source of Water Sweet Grass Cr.
Basin Sweet Grass Cr. Present 8 Potential 0 Maximum 8 R ☒ F ☐ P ☐ G ☒ S ☐
Code No. 20B System Neste Ditches Source of Water Dry Creek
Basin Otter Creek Present 10 Potential 14 Maximum 24 R ☒ F ☐ P ☐ G ☒ S ☐
Code No. 20B System Neste Ditch Source of Water Rye Creek
Basin Sweet Grass Cr. Present 2 Potential 5 Maximum 5 R ☒ F ☐ P ☐ G ☒ S ☐
Code No. 20B System Neste Ditch Source of Water Otter Creek
Basin Otter Creek Present 26 Potential 0 Maximum 26 R ☒ F ☐ P ☐ G ☒ S ☐

If under Ditch Company, Irrigation District, or Government Project, state the number of shares or inches, acre feet, as the case may be in said system.

NOTE: R—Denotes Regular Irrigation. F—Flood Irrigation. P—Water diverted by means of pumping. G—Water diverted by gravity.
S—Stored Water.

Information from J. E. Cook Date May 1, 1951

STATE OF MONTANA

State Engineer's Office

WATER RESOURCES SURVEY

FARM MAP

County Sweetgrass

Code No. _____

205

Twp. 4N Rge. 14E

Twp. _____ Rge. _____

Twp. _____ Rge. _____

Land Owner NESTE, PETER, EST. Address Melville

Owner ALLQUIST, TINA Address "



Non-Irrigated Land

North



Potential Land Under Existing Facilities

Code No. 205 System Van Dine Ditch Source of Water Cotton Creek

Basin Cotton Creek Present 0 Potential 3 Maximum 3 R ✓ F ✓ P ✓ G ✓ S ✓

Code No. _____ System _____ Source of Water _____

Basin _____ Present _____ Potential _____ Maximum _____ R _____ F _____ P _____ G _____ S _____

Code No. _____ System _____ Source of Water _____

Basin _____ Present _____ Potential _____ Maximum _____ R _____ F _____ P _____ G _____ S _____

Code No. _____ System _____ Source of Water _____

Basin _____ Present _____ Potential _____ Maximum _____ R _____ F _____ P _____ G _____ S _____

If under Ditch Company, Irrigation District, or Government Project, state the number of shares or inches, acre feet, as the case may be in said system.

NOTE: R—Denotes Regular Irrigation. F—Flood Irrigation. P—Water diverted by means of pumping. G—Water diverted by gravity. S—Stored Water.

Information from _____ Date _____

Farm Checked

STATE OF MONTANA

Code No. 18B-19A-303By Jim & Bob

STATE ENGINEER'S OFFICE

County SweetgrassArea Older Creek

WATER RESOURCES SURVEY

T. 4N. R. 14E Sec. 18, 19, 30Date Sept. 28, 1950

MA-12A-32

Photo No. MA-12A-83Legal Land Owner VAN CLEVE, HELENAddress McKillopOperator " " (wife - Paul VanCleve Jr.)Address "

Water is delivered by:

Federal Project _____ Pres. _____ Pot. _____

Ditch Company _____ Pres. _____ Pot. _____

Irrigation District _____ Pres. _____ Pot. _____

Private System Hand-Pumped ditch Pres. _____ Pot. _____3 private ditches Totals _____Flood _____ Pump _____ Reservoir _____ Gravity ☒Size and Capacity, Pump, etc. DecideOriginal Appropriator, Private Hickel, H.C. App. No. 531VCompany Hoyen, Iver H. App. No. 534VEdwards, T. Lee App. No. 518VFellows, W. H. & Sarah App. No. 581V D-277VJohnson, Andrew App. No. 587V D-324VLynd, B. S. et al App. No. 789V D-355VJohnson, Andrew App. No. 1018VHick, Harry & Jack App. No. _____Is the system an extension of another system? Yes _____ No ☒Is all land irrigated from one system? Yes _____ No ☒

(If No, show break down on map)

Source of Water Medicine Bow, Older Cr., Sweetgrass Cr., Unnamed SpringAcres Irrigated 19.50

Potential Acres _____ Seeped _____

Explain _____

Condition of System GoodAdequate Supply _____ Yes ☒ No ☒Explain except in extra dry yearsTopography Valley bottomInformation From J. Paul VanCleve Jr.

Remarks _____

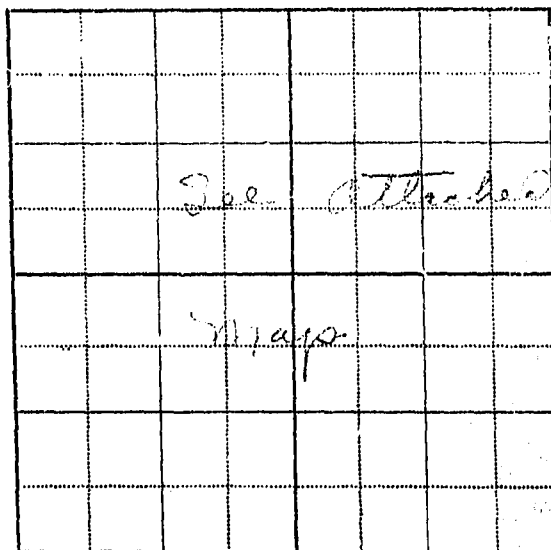

8

179
Drainage in sec 17¹⁸ from West-Parker ditch
Also 2 ditches out of Otter creek diverting
in south 1/2 of 19. Also some in out of
Waste ditch diverting in front of Otter can

STATE OF MONTANA
State Engineer's Office
WATER RESOURCES SURVEY

Township 4 NORTH Range 14 EAST County Sweetgrass

6	5	4	3	2	1
7	8	9	10	11	12
13	14	15	16	17	18
19	20	21	22	23	24
25	26	27	28	29	30
31	32	33	34	35	36

Road →

Handwritten notes on the grid:
- Section 18: B
- Section 19: A
- Section 30: B

Township 4 N. Range 14 E.

8

STATE OF MONTANA
State Engineer's Office
WATER RESOURCES SURVEY
FARM MAP

County Sweetgrass

Code No. 188-19A-30B

Twp. 4N Rge. 17E

Twp. _____ Rge. _____

Twp. _____ Rge. _____

Name of Land Owner VAN CLEVE, HELEN Address MELVILLE

Name of Operator PAUL VAN CLEVE JR. Address _____

Legal Description _____

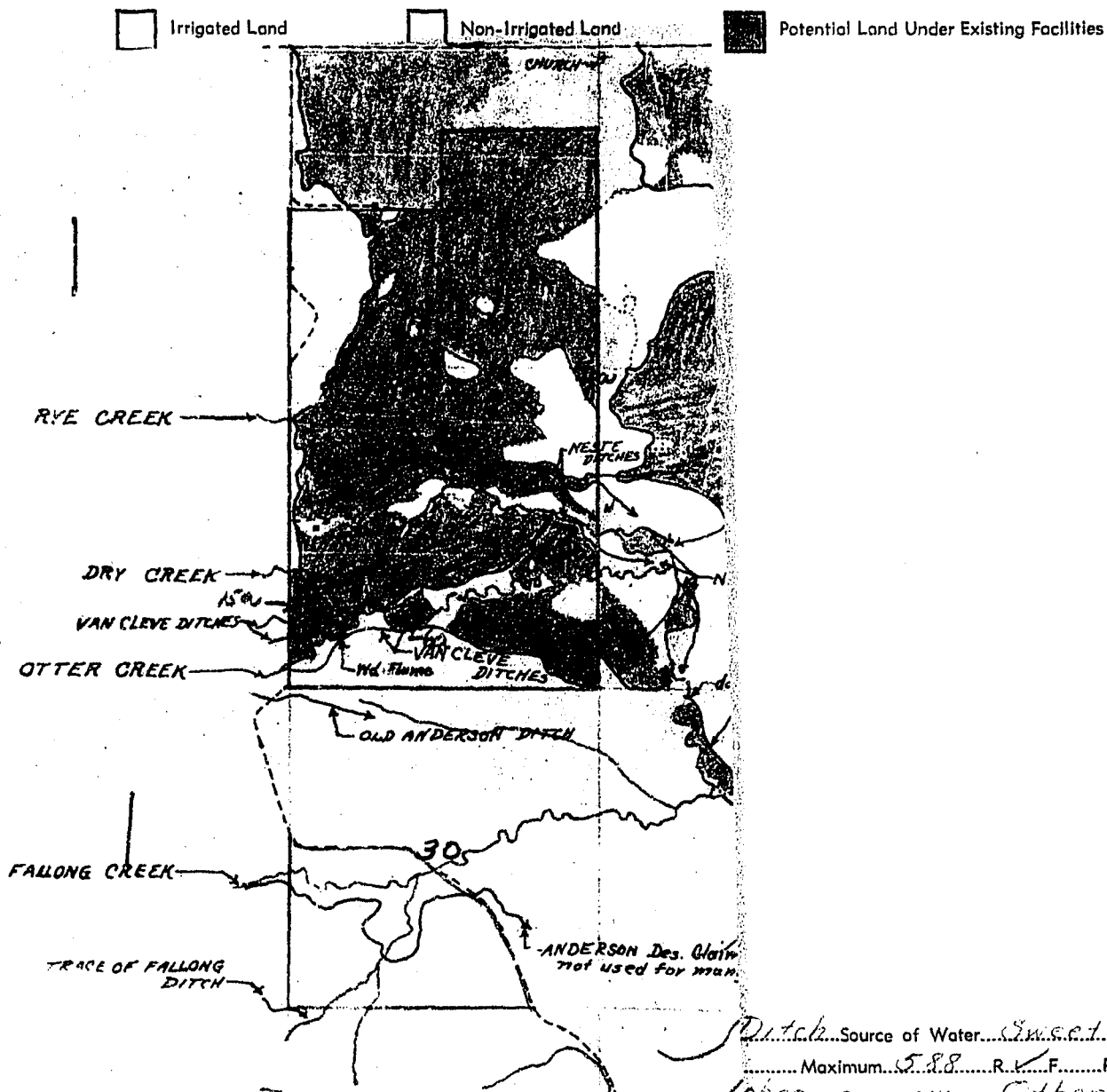

Basin Otter Creek Present 96 Potential 0 Maximum 96 R ☒ F ☐ P ☐ G ☒ S ☐
Code No. _____ System _____ Source of Water _____
Basin _____ Present _____ Potential _____ Maximum _____ R ☐ F ☐ P ☐ G ☐ S ☐
Code No. _____ System _____ Source of Water _____
Basin _____ Present _____ Potential _____ Maximum _____ R ☐ F ☐ P ☐ G ☐ S ☐

If under Ditch Company, Irrigation District, or Government Project, state the number of shares or inches, acre feet, as the case may be in said system.

NOTE: R—Denotes Regular Irrigation. F—Flood Irrigation. P—Water diverted by means of pumping. G—Water diverted by gravity. S—Stored Water.

Information from Paul Van Clevé Date May 1, 1951

STATE OF MONTANA

State Engineer's Office

WATER RESOURCES SURVEY

FARM MAP

County Sweetgrass

Code No. _____

18B-19A-30B

Twp. 4N Rge. 14E

Twp. _____ Rge. _____

Twp. _____ Rge. _____

Name of Land Owner VAN CLEVE, HELEN Address MELVILLE

Name of Operator PAUL VAN CLEVE, JR. Address _____

Legal Description _____

☐ Irrigated Land

☐ Non-Irrigated Land

☐ Potential Land Under Existing Facilities

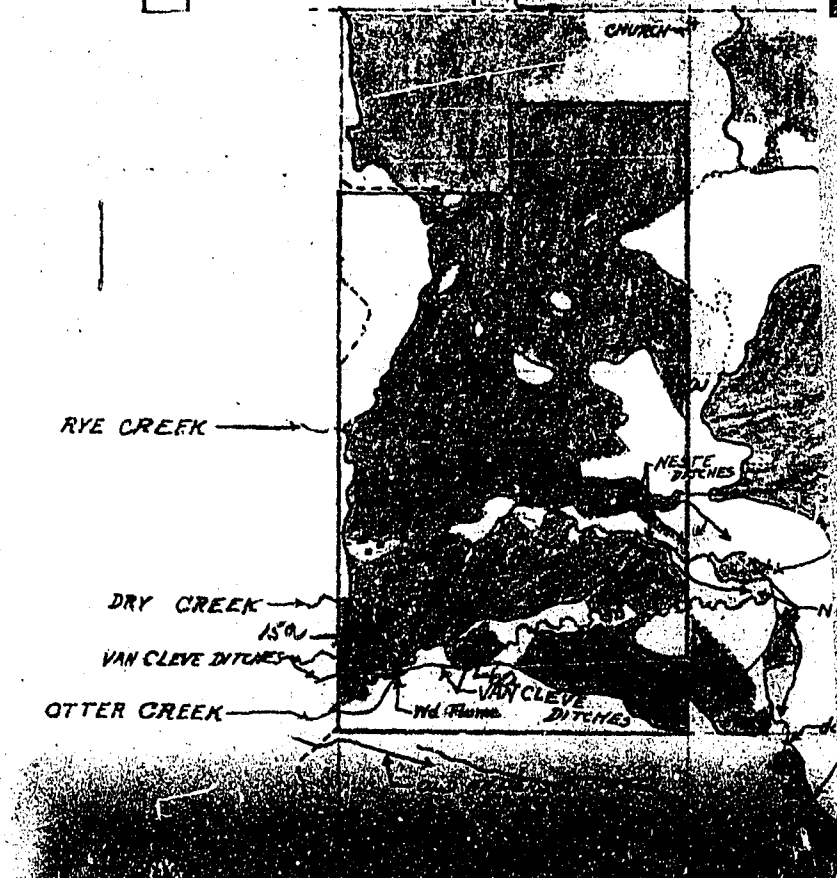

Code No. 18B-19A System Hart-Parker Ditch Source of Water Sweet Grass Cr.

Basin Sweet Grass Cr. Present 584 Potential 7 Maximum 588 R. ☒ F. ☐ P. ☐ G. ☒ S. ☐

Code No. 19A System Van Cleve Ditches Source of Water Otter Creek

Basin Otter Creek Present 96 Potential 0 Maximum 96 R. ☒ F. ☐ P. ☐ G. ☒ S. ☐

Code No. _____ System _____ Source of Water _____

Basin _____ Present _____ Potential _____ Maximum _____ R. ☐ F. ☐ P. ☐ G. ☐ S. ☐

Code No. _____ System _____ Source of Water _____

Basin _____ Present _____ Potential _____ Maximum _____ R. ☐ F. ☐ P. ☐ G. ☐ S. ☐

If under Ditch Company, Irrigation District, or Government Project, state the number of shares or inches, acre feet, as the case may be in said system.

NOTE: R—Denotes Regular Irrigation. F—Flood Irrigation. P—Water diverted by means of pumping. G—Water diverted by gravity. S—Stored Water.

Information from Van Cleve Date May 1, 1951

APP.	
145 ✓	Glaussen, Ole
- 279 ✓	Adam, Henry E. ✓
- 741 ✓	Adam, Edward ✓
- 762 ✓	Crest, Albert & Syvert ✓
- 763 ✓	" " " ✓
- 764 ✓	" " " ✓
- 770 ✓	Davidson, Andrew & Elliott, John ✓
- 772 ✓	Ellingson, E. H. et al ✓ (For old Hope ditch (old, 1850))

DECREES	
D-129 ✓	Moore, Geo.
D-130 ✓	Nepstad, John Adam
D-131 ✓	" " "
D-132 ✓	" " "
D-278 ✓	Berg, Sam
D-279 ✓	" "
D-280 ✓	" "
D-281 ✓	" "
D-282 ✓	" "
D-283 ✓	" "
D-311 ✓	Gyland, Martin
D-332 ✓	Moore, Geo.

- ① Business by Vose with Parker & Vose in sec. 6
1/2 interest
- ② Nepstad had ditches out of Payson Creek
when he had this ranch
- ③ Thus Anderson & Vose sh has 1/2 interest in Anderson.
(Orig. Gert) Vose ditch takes out on south bank near sec. line of 5 & 6.
- ④ Vose & Vose's ditch irrigates all land irr. in
Sec. 5 & 6 north of Sweetwater Cr. (Orig. Crest ditch)
- ⑤ Land in NE 1/4 of Sec. 7 & SE 1/4 of Sec. 6 irrigated
from Hart-Parker ditch.
- ⑥ Looking ditch runs thru SE 1/4 of Sec. 8
but not used by Vose.
- ⑦ also small ditch of SW 1/4 of Sec. 8. Not in use.
- ⑧ Also there is old ditch on south side
of Sweetwater Cr. in SE 1/4 of Sec. 5. Not in use.
- ⑨ Land in Sec. 2 & 11 is patented (under) Crown
Creek ditch but Vose has no right
in this ditch. (See next page)

FORM D-1
REPORTER IM 3-49 17379

STATE OF MONTANA
State Engineer's Office
WATER RESOURCES SURVEY

Township 4 NORTH Range 14 EAST County Sweet Grass

6	5	4	3	2	1
C	A			D	
7	8	9	10	11	12
	A			A	
18	17	16	15	14	13
19	20	21	22	23	24
30	29	28	27	26	25
31	32	33	34	35	36

Township 4 N. Range 14 E.

Township _____ Range _____ County _____

[illegible]

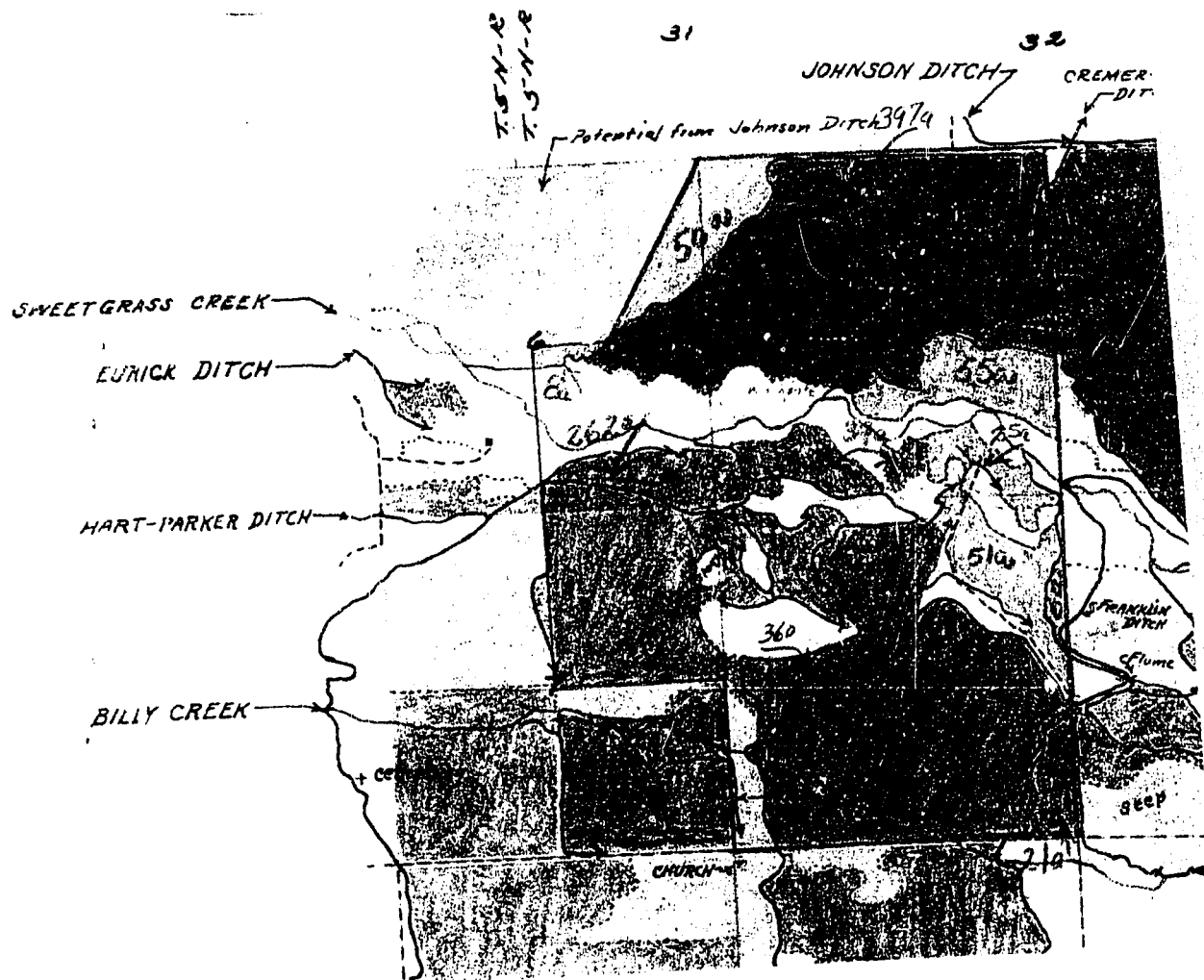
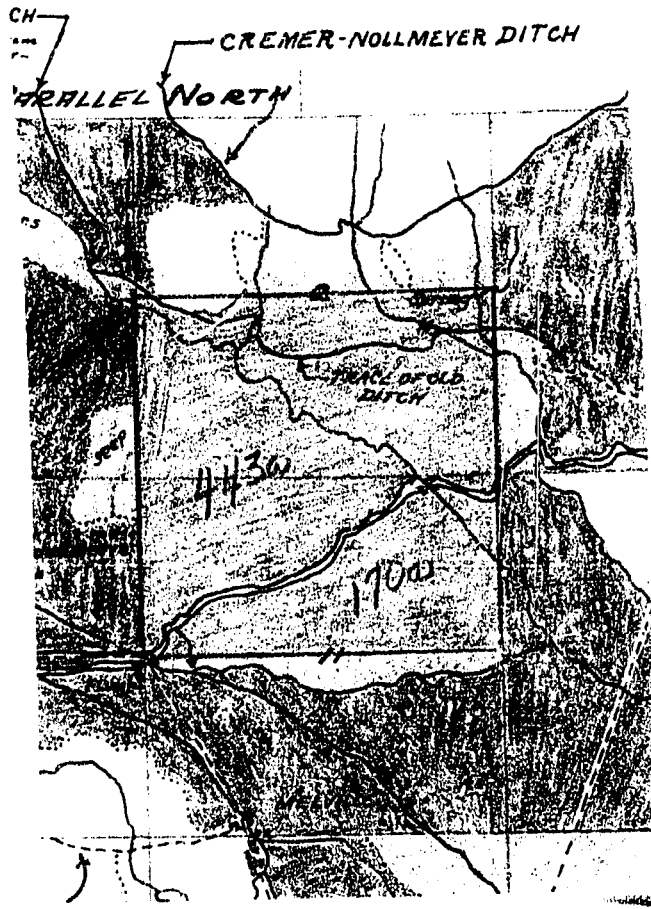

Form WR-B
Reporter 20168 2M 12-1

Twp. 4N Rge. 14E
Twp. _____ Rge. _____
Twp. _____ Rge. _____

STATE OF MONTANA
State Engineer's Office
WATER RESOURCES SURVEY
FARM MAP

County Sweetgrass
Code No. _____
2D-5A-6C-7B-
8A-11B

Name of Land Owner VOSE, ELEANOR Address MELVILLE MONT.
Name of Operator Same Address _____
Legal Description _____



Irrigated Land



Non-Irrigated Land
North



Potential Land Under Existing Facilities

Code No. 2D, 11A System Cremers-Mallmeyer Ditch Source of Water Sweet Grass Creek
Basin Sweet Grass Creek Present 0 Potential 443 Maximum 443 R ✓ F ✓ P ✓ G ✓ S ✓
Code No. 11A System Thompson-Howe Ditch Source of Water Sweet Grass Cr.
Basin Sweet Grass Cr. Present 0 Potential 170 Maximum 170 R ✓ F ✓ P ✓ G ✓ S ✓
Code No. 5A, 6C System Johnson Ditch Source of Water Sweet Grass Cr.
Basin Sweet Grass Cr. Present 0 Potential 58 Maximum 58 R ✓ F ✓ P ✓ G ✓ S ✓
Code No. 5A, 6C System Vose-Green Ditch Source of Water Sweet Grass Cr.
Basin Sweet Grass Cr. Present 39.7 Potential 55 Maximum 452 R ✓ F ✓ P ✓ G ✓ S ✓

If under Ditch Company, Irrigation District, or Government Project, state the number of shares or inches, acre feet, as the case may be in said system.

NOTE: R—Denotes Regular Irrigation. F—Flood Irrigation. P—Water diverted by means of pumping. G—Water diverted by gravity.
S—Stored Water.

Information from

Date

J. E. Cook

April 30, 1951

Form WR-B
Reporter 20188 2M 12-

STATE OF MONTANA
State Engineer's Office
WATER RESOURCES SURVEY
FARM MAP

County Sweetgrass
Code No. 2D-5A-6C-7A-
8A-11B

Twp. 4N Rge. 14E
Twp. _____ Rge. _____
Twp. _____ Rge. _____

Name of Land Owner JOSE, ELEANOR
Same

Address MELVILLE MONT.
Address _____



Non-Irrigated Land
North



Potential Land Under Existing Facilities

Code No. 306S-7E-SA System Green Ditch Source of Water Sweet Grass Creek
Basin Green Ditch Present 268 Potential 0 Maximum 268 R. 0 F. 0 P. 0 G. 0 S. 0
Code No. 306S-7E-SA System Green Ditch Source of Water Sweet Grass Creek
Basin Green Ditch Present 268 Potential 0 Maximum 268 R. 0 F. 0 P. 0 G. 0 S. 0
Code No. SA System Green Ditch Source of Water Sweet Grass Creek
Basin Green Ditch Present 0 Potential 0 Maximum 0 R. 0 F. 0 P. 0 G. 0 S. 0
Code No. _____ System _____ Source of Water _____
Basin _____ Present _____ Potential _____ Maximum _____ R. _____ F. _____ P. _____ G. _____ S. _____

If under Ditch Company, Irrigation District, or Government Project, state the number of shares or inches, acre feet, as the case may be in said system.

NOTE: R—Denotes Regular Irrigation. F—Flood Irrigation. P—Water diverted by means of pumping. G—Water diverted by gravity.
S—Stored Water.

Information from _____ Date 1941

Farm Checked

STATE OF MONTANA

Code No. 10 DBy Bob & Jim

STATE ENGINEER'S OFFICE

County SweetgrassArea Melville

WATER RESOURCES SURVEY

T. 4N R. 14E Sec. 10Date Sept 12, 1950Photo No. MA-11A-211Legal Land Owner WOOD, MINNIE et alAddress 4174 Eldorado
Riverside, CaliforniaOperator ?Address ?

Water is delivered by:

Federal Project _____ Pres. _____ Pot. _____

Ditch Company _____ Pres. _____ Pot. _____

Irrigation District _____ Pres. _____ Pot. _____

Private System _____ Pres. _____ Pot. _____

Totals _____

Flood _____ Pump _____ Reservoir _____ Gravity ☒

Size and Capacity, Pump, etc. _____

Original Appropriator, Company _____ App. No. _____

Original Appropriator, Private McMahon, W. App. No. 697
Hickox, Herbert O. & Winer, Geo. P. App. No. 294

Is the system an extension of another system? Yes _____ No _____

Is all land irrigated from one system? Yes _____ No _____

(If No, show break down on map)

Source of Water Spring Cr., Sweetgrass Cr.Acres Irrigated 1950, 0

Potential Acres _____ Seeped _____

Explain _____

Condition of System no water right no ditches

Adequate Supply _____ Yes _____ No _____

Explain _____

Topography _____

Information From Field SurveyRemarks Potential only (under Thompson-
Howe ditch)

8

STATE OF MONTANA
State Engineer's Office
WATER RESOURCES SURVEY

Township 4 NORTH Range 14 EAST County Sweetgrass

6	5	4	3	2	1
7	8	9	10	11	12
			D		
18	17	16	15	14	13
19	20	21	22	23	24
30	29	28	27	26	25
31	32	33	34	35	36

Township 4 N. Range 14 E.

Form WR-B
Reporter 20188 2M 12-8

Twp. 4N Rge. 14E
Twp. _____ Rge. _____
Twp. _____ Rge. _____

STATE OF MONTANA
State Engineer's Office
WATER RESOURCES SURVEY
FARM MAP

County Sweetgrass

Code No. 10D

Name of Land Owner WOOD, MINNIE et al. Address Riverside Calif.
Name of Operator ? Address ?
Legal Description _____

☐ Irrigated Land

☐ Non-Irrigated Land
North

☒ Potential Land Under Existing Facilities

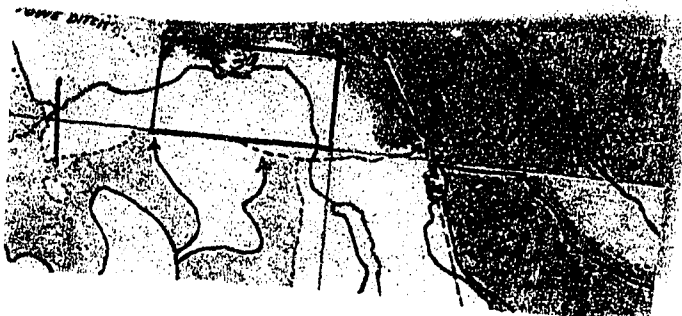

Code No. 10D System Thompson-Hawk Ditch Source of Water Sweet Grass Cr.
Basin Sweet Grass Cr. Present 0 Potential 3 Maximum 3 R ☒ F ☐ P ☐ G ☒ S ☐
Code No. _____ System _____ Source of Water _____
Basin _____ Present _____ Potential _____ Maximum _____ R ☐ F ☐ P ☐ G ☐ S ☐
Code No. _____ System _____ Source of Water _____
Basin _____ Present _____ Potential _____ Maximum _____ R ☐ F ☐ P ☐ G ☐ S ☐
Code No. _____ System _____ Source of Water _____
Basin _____ Present _____ Potential _____ Maximum _____ R ☐ F ☐ P ☐ G ☐ S ☐

If under Ditch Company, Irrigation District, or Government Project, state the number of shares or inches, acre feet, as the case may be in said system.

NOTE: R—Denotes Regular Irrigation. F—Flood Irrigation. P—Water diverted by means of pumping. G—Water diverted by gravity.
S—Stored Water.

Information from J. E. Cook Date May 1, 1951

Farm Checked

STATE OF MONTANA

Code No. 6A-7ABy Dave & Joe

STATE ENGINEER'S OFFICE

County Sweet GrassArea Sweet Grass Creek WATER RESOURCES SURVEYT. 4N R. 14E Sec. 6.2Date 8/17/50Photo No. MA-12A-33Legal Land Owner GEORGE, J. & YOST, LENARDAddress MELVILLE

Operator " " " " " "

Address " "

Water is delivered by:

Federal Project _____ Pres. _____ Pot. _____

Ditch Company _____ Pres. _____ Pot. _____

Irrigation District Yost Ditch Pres. 0 Pot. _____Private System Private Ditch (Mutual) Pres. _____ Pot. _____

Totals _____

Flood _____ Pump _____ Reservoir _____ Gravity ✓ RegularSize and Capacity, Pump, etc. APP. 145 vOriginal Appropriator, Private Company Clausen, Ole Hart, Harry & John Crest, Albert & Sylvester App. No. 147 v 768 vOriginal Appropriator, Private " Davidson, Andrew & Elliott, John Gyland, Martin Hart, Harry Jack App. No. 764 v 770 v 772 v D-311 v D-315 v D-316 vIs the system an extension of another system? Yes _____ No ✓Is all land irrigated from one system? Yes _____ No ✓

(If No, show break down on map)

Source of Water Billy Cr., Sweet Grass Cr.Acres Irrigated 19.50Potential Acres _____ Seeped 6Explain Some land sec. 7 & Pot. Private D. (Mutual)Condition of System goodAdequate Supply _____ Yes ✓ _____ No _____

Explain _____

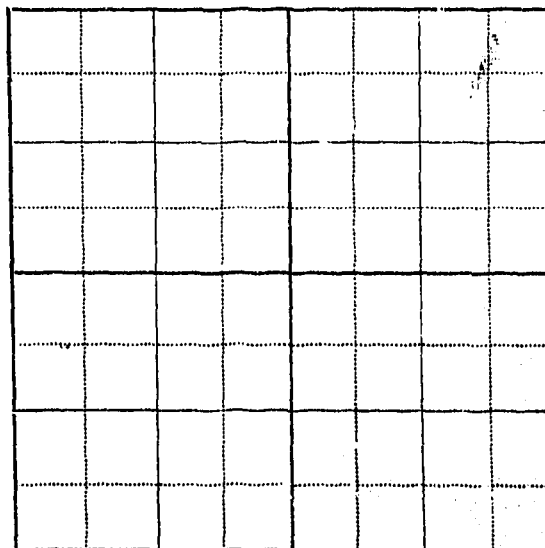
Topography Slight slopeInformation From Mr. RichardsRemarks For Yost Ditch see form (2) T. 5N - R. 13E

STATE OF MONTANA
State Engineer's Office
WATER RESOURCES SURVEY

Township 4 NORTH Range 14 EAST County Sweetgrass

6	5	4	3	2	1
7	8	9	10	11	12
18	17	16	15	14	13
19	20	21	22	23	24
30	29	28	27	26	25
31	32	33	34	35	36

Township 4 NORTH Range 14 EAST

Twp. 4N Rge. 14E
Twp. _____ Rge. _____
Twp. _____ Rge. _____

STATE OF MONTANA
State Engineer's Office
WATER RESOURCES SURVEY
FARM MAP

County Sweetgrass
Code No. 6A-7A

Name of Land Owner Yost, Geo. J. & Leonard Address Melville
Name of Operator Same Address _____
Legal Description _____



Irrigated Land



Non-Irrigated Land
North



Potential Land Under Existing Facilities

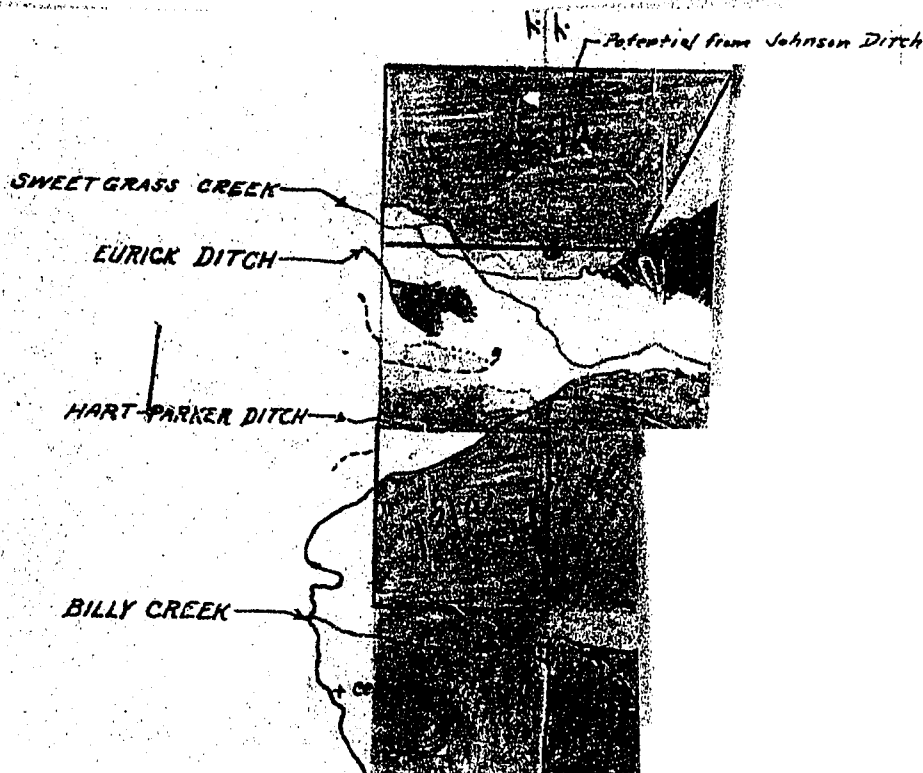

Code No. 7A System Hart-Parker Ditch Source of Water Sweet Grass Cr.
Basin Sweet Grass Cr. Present 0 Potential 131 Maximum 131 R ✓ F ✓ P ✓ G ✓ S ✓
Code No. 6A System Yost Ditch Source of Water Sweet Grass Cr.
Basin Sweet Grass Cr. Present 0 Potential 257 Maximum 257 R ✓ F ✓ P ✓ G ✓ S ✓
Code No. _____ System _____ Source of Water _____
Basin _____ Present _____ Potential _____ Maximum _____ R _____ F _____ P _____ G _____ S _____
Code No. _____ System _____ Source of Water _____
Basin _____ Present _____ Potential _____ Maximum _____ R _____ F _____ P _____ G _____ S _____

If under Ditch Company, Irrigation District, or Government Project, state the number of shares or inches, acre feet, as the case may be in said system.

NOTE: R—Denotes Regular Irrigation. F—Flood Irrigation. P—Water diverted by means of pumping. G—Water diverted by gravity. S—Stored Water.

Information from Geo. J. Yost Date April 30, 1951

Farm Checked

STATE OF MONTANA

Code No. 13BBy John Vost

STATE ENGINEER'S OFFICE

County SweetgrassArea 1000

WATER RESOURCES SURVEY

T. 4N. R. 14E Sec. 13Date Aug 1965Photo No. MA-12A-16Legal Land Owner GRANDE, AGNES [now Vost]Address LENNER, MONT.Operator John VostAddress ?

Water is delivered by:

Federal Project	Pres.	Pot.
Ditch Company <u>Elling Ditch (Mutual)</u>	Pres.	Pot.
Irrigation District <u>Thompson Home Ditch (Mutual)</u>	Pres.	Pot.
Private System <u>Private Ditches</u>	Pres.	Pot.
Totals		
Flood	Pump	Reservoir
Gravity <input checked="" type="checkbox"/>		

Size and Capacity, Pump, etc.

Original Appropriator, Company Greene, Earl & Hoff, John App. No. 283Original Appropriator, Private Stearns, Wm. G. & Weatherman, N.D. App. No. 828Is the system an extension of another system? Yes ☐ No ☐Is all land irrigated from one system? Yes ☐ No ☐

(If No, show break down on map)

Source of Water Sweetgrass Creek, Cayuse CreekAcres Irrigated 19 Potential Acres Seeped Explain Condition of System needs laterals to cover landAdequate Supply Yes ☐ No ☐Explain Topography Valley bottomInformation From John VostRemarks

STATE OF MONTANA
State Engineer's Office
WATER RESOURCES SURVEY

Township 4 NORTH Range 14 EAST County Sweetgrass

6		5		4		3		2		1
7		8		9		10		11		12
18		17		16		15		14		13 <i>B</i>
19		20		21		22		23		24
30		29		28		27		26		25
31		32		33		34		35		36

Township 4 N Range 14 E

Form WR-B
Reporter 20168 2M 12-49

Twp. 4N Rge. 12E
Twp. _____ Rge. _____
Twp. _____ Rge. _____

STATE OF MONTANA
State Engineer's Office
WATER RESOURCES SURVEY
FARM MAP

County Sweet Grass
Code No. 13B

Name of Land Owner John Yost Address _____
Name of Operator _____ Address _____
Legal Description _____



Irrigated Land



Non-Irrigated Land
North



Potential Land Under Existing Facilities

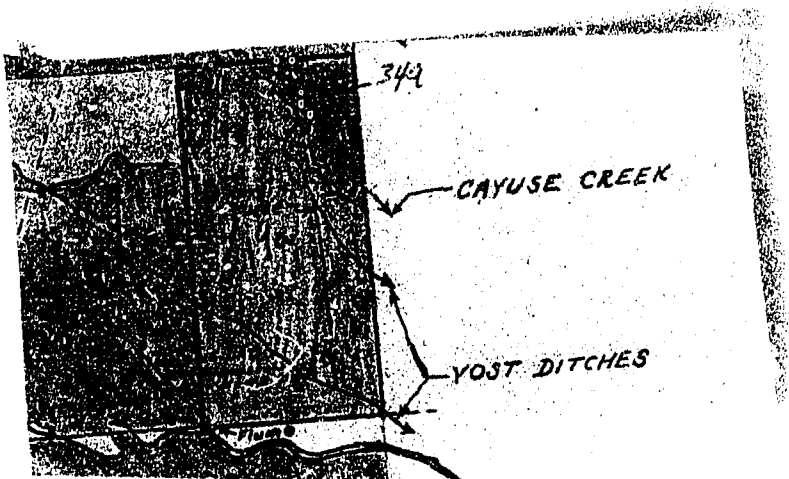

Code No. <u>136</u>	System <u>Filling Ditch</u>	Source of Water <u>Cayuse Creek</u>
Basin <u>Sweet Grass Cr.</u>	Present <u>34</u>	Potential <u>0</u> Maximum <u>34</u> R <input checked="" type="checkbox"/> F <input type="checkbox"/> P <input type="checkbox"/> G <input checked="" type="checkbox"/> S <input type="checkbox"/>
Code No. <u>13B</u>	System <u>Yost Ditch</u>	Source of Water <u>Cayuse Creek</u>
Basin <u>Sweet Grass Cr.</u>	Present <u>0</u>	Potential <u>53</u> Maximum <u>53</u> R <input checked="" type="checkbox"/> F <input type="checkbox"/> P <input type="checkbox"/> G <input checked="" type="checkbox"/> S <input type="checkbox"/>
Code No. <u>13B</u>	System <u>Thompson-Have Ditch</u>	Source of Water <u>Sweet Grass Cr.</u>
Basin <u>Sweet Grass Cr.</u>	Present <u>0</u>	Potential <u>219</u> Maximum <u>219</u> R <input checked="" type="checkbox"/> F <input type="checkbox"/> P <input type="checkbox"/> G <input checked="" type="checkbox"/> S <input type="checkbox"/>
Code No. _____	System _____	Source of Water _____
Basin _____	Present _____	Potential _____ Maximum _____ R <input type="checkbox"/> F <input type="checkbox"/> P <input type="checkbox"/> G <input type="checkbox"/> S <input type="checkbox"/>

If under Ditch Company, Irrigation District, or Government Project, state the number of shares or inches, acre feet, as the case may be in said system.

NOTE: R—Denotes Regular Irrigation. F—Flood Irrigation. P—Water diverted by means of pumping. G—Water diverted by gravity. S—Stored Water.

Information from L. E. Lusk Date July 2, 1951

County.....Sweet Grass.....

Farm Checked: Date.....8-23-50.....

By M.T. & E.B.

Legal Land Owner.....E. M. Adams.....

Operator.....John Adams...

Water is delivered by:— 1. Private System; 2. Ditch Company; 3. State Project. 4. Federal Project; 5. Irrigation District

T. 4N.....R. 15E..... Plat No. 9.....

Photo No.....MA-7A-154.....

Add. to ss. _____ Mel _____

Address.....

[illegible]

NOTE: R—Denotes Regular Irrigation. F—Flood Irrigation.

Adequate Supply: Yes..... No..... Explain.....
Remarks

[illegible]

...River Basin.

Also in: Plat No..... Twp..... Rge.....	Plat No..... Twp..... Rge.....	Plat No..... Twp..... Rge.....
Plat No..... Twp..... Rge.....	Plat No..... Twp..... Rge.....	Plat No..... Twp..... Rge.....

Information From:
John Adams

County..... Sweet Grass

Farm Checked: Date 8-21-50

Bv. MT & BB

STATE OF MONTANA
STATE ENGINEERS OFFICE
Water Resources Survey

T 4N R 15E Plat No. 9

Photo No. MA-12A-17

Legal Land Owner John Brenneman Address Hotel Perry - Peru, Ill.

Operator.....?	Address.....
----------------	--------------

Water is delivered by:— 1. Private System; 2. Ditch Company; 3. State Project; 4. Federal Project; 5. Irrigation District

[illegible]

NOTE: R—Denotes Regular Irrigation. F—Flood Irrigation.

Adequate Supply: Yes..... No..... Explain.....

Remarks.....
The potential on this land is under the Yost Ditch but no water rights are owned.

The NE $\frac{1}{4}$ has some land sub-irrigated from Cayuse Creek but there are no ditches or water rights for this land.

...River Basin.

Also in: Plat No.....	Twp.....	Rge.....	Plat No.....	Twp.....	Rge.....	Plat No.....	Twp.....	Rge.....
Plat No.....	Twp.....	Rge.....	Plat No.....	Twp.....	Rge.....	Plat No.....	Twp.....	Rge.....

Information From:

Observation

6	5	4	3	2	1
7	8	9	10	11	12
13	17	16	15	14	18
19	20	21	22	23	24
30	29	28	27	26	25
31	32	33	34	35	36

Land Ownership.

Leo Cremer

County.....Sweet Grass.....

Farm Checked: Date.....8-18-50.....

By M.T. & B. B.

Legal Land Owner.....Geo. B. Crum

Operator..... Same

Water is delivered by:— 1. Private System;

STATE OF MONTANA
STATE ENGINEERS OFFICE
Water Resources Survey

T 4N R 15E Plat No. 9

Photo No. MA-7A-152

Address.....Melville

Address.

4. Federal Project;

5. Irrigation District

[illegible]

NOTE: R—Denotes Regular Irrigation. F—Flood Irrigation.

Adequate Supply: Yes..... No..... Explain.

Remarks.

Remarks.....
Nevin Ditch out of Sweet Grass Creek.

Point of diversion in SW $\frac{1}{4}$ NE $\frac{1}{4}$ Sec. 9 T. 4N-R. 14E on north bank. This ditch is not used by Geo. Crum. There is a flume out over Rock Creek in center of Sec. 15 T. 4N-R. 15E. Lands that could be irrigated by this ditch are located in W $\frac{1}{2}$ Sec. 25 T. 4N-R. 15E.

.....River Basin

Also in: Plat No. Twp. Rge. Plat No. Twp. Rge. Plat No. Twp. Rge.
 Plat No. Twp. Rge. Plat No. Twp. Rge. Plat No. Twp. Rge.

Information From:

Geo. Crum

at No. 9

STATE OF MONTANA
STATE ENGINEERS OFFICE
Water Resources Survey

Photo No. MA-12A-17

By MT & BB

Address.....Melville.....

Address.....

tion District

[illegible][illegible]

Adequate Supply: Yes..... No..... Explain.....

Remarks.....

Drevdahl Ditch out of Sweet Grass Cr. Point of diversion in Sec. _____ T. 4N-R. 14E on south bank. This ditch in good condition. Used to irrigate lands in Sec. 32 T. 4N-R. 15E. Land in Sec. 34 T. 4N-R. 15E could be irrigated by this ditch. Oscar Drevdahl has a right for 200 M. I.

.....River Basin

Also in: Plat No..... Twp..... Rge.....	Plat No..... Twp..... Rge.....	Plat No..... Twp..... Rge.....
Plat No..... Twp..... Rge.....	Plat No..... Twp..... Rge.....	Plat No..... Twp..... Rge.....

Information From:

Oscar Drevdahl

County..... Sweet Grass

Farr. Checked: Date.....9-12-50.....

By.....Jim & Bob.....

STATE OF MONTANA
STATE ENGINEERS OFFICE
Water Resources Survey

T. 4N R. 15E Plat No. 9

Photo No. MA-12A-16

Legal Land Owner S. O. & Pearl Hanson Address Melville

[illegible]

Water is delivered by:— 1. Private System; 2. Ditch Company; 3. State Project; 4. Federal Project; 5. Irrigation District

[illegible]

NOTE: R—Denotes Regular Irrigation. F—Flood Irrigation.

Adequate Supply: Yes..... No..... Explain.....

Remarks.....
See Master Form in T. 4N-R. 14E.

River Basin.....

Also in: Plat No. Twp. Rge.	Plat No. Twp. Rge.	Plat No. Twp. Rge.
Plat No. Twp. Rge.	Plat No. Twp. Rge.	Plat No. Twp. Rge.

Information From:

S. O. Hanson

County..... Sweet Grass

Farm Checked: Date.....9-28-50.....

By Jim & Bob

STATE OF MONTANA
STATE ENGINEERS OFFICE
Water Resources Survey

T. 4N R. 15E Plat No. 2

Photo No. MA-12A-17

Legal Land Owner.....Vessie Howe.....Address.....Dig Timber.....

Operator	Same	Address

Water is delivered by:— 1. Private System; 2. Ditch Company; 3. State Project; 4. Federal Project; 5. Irrigation District

[illegible]

NOTE: R—Denotes Regular Irrigation. F—Flood Irrigation.

Adequate Supply: Yes..... No..... Explain.....

Remarks: _____

Has potential under Yost Ditch.

Just bought H. P. Franklin estate. Percy Lavold bought.

...River Basin.

Also in: Plat No.	Twp.	Rge.	Plat No.	Twp.	Rge.	Plat No.	Twp.	Rge.
Plat No.	Twp.	Rge.	Plat No.	Twp.	Rge.	Plat No.	Twp.	Rge.

Information From:

None shown

County.....Sweet Grass.....

Farm Checked: Date.....8-21-50.....

By.....M.T. & B. B.

STATE OF MONTANA
STATE ENGINEERS OFFICE
Water Resources Survey

T 4N R 15E Plat No. 9

Photo No. MA-12A-16

Legal Land Owner: Mike Hoyem Address: Melville

Operator.....Same.....Address.....

Water is delivered by— 1. Private System; 2. Ditch Company; 3. State Project; 4. Federal Project; 5. Irrigation District

[illegible]

NOTE: R—Denotes Regular Irrigation. F—Flood Irrigation.

Adequate Supply: Yes..... No..... Explain.....

Remarks.....

Remarks
Nevin Ditch out of Sweet Grass Creek: Point of diversion in SW $\frac{1}{4}$ NE $\frac{1}{4}$ Sec. 9 T. 4N-R. 14E on north bank. Water from this ditch is used to irrigate land in Sec. 17 T. 4N-R. 15E.

Water from this ditch is spilled into Gayuse Creek in Sec. 11 T. 4N-R. 14E and picked up by the Yost Ditch in Sec. 18 to irrigate land in Sec. 18 T. 4N-R. 15E. Water from the Nevin Ditch is also picked up by the Eling Ditch in Sec. 12 T. 4N-R. 14E to irrigate land in Sec. 18 T. 4N-R. 5.

...River Basin.

Also in: Plat No.....	Twp.....	Rge.....	Plat No.....	Twp.....	Rge.....	Plat No.....	Twp.....	Rge.....
Plat No.....	Twp.....	Rge.....	Plat No.....	Twp.....	Rge.....	Plat No.....	Twp.....	Rge.....

Information From:

Mike Hovem

Richard Nollmeyer

None shown

County Sweet Grass

Farm Checked: Date.....None...shown..

By BB & MT

STATE OF MONTANA
STATE ENGINEERS OFFICE
Water Resources Survey



T. 4N R. 15E Plat No. 9

Photo No. MA-12A-16

Legal Land Owner.....Montana, State of.....Address.....

Operator Chas. Crum Address

Water is delivered by:— 1. Private System; 2. Ditch Company; 3. State Project; 4. Federal Project; 5. Irrigation District

[illegible]

NOTE: R—Denotes Regular Irrigation. F—Flood Irrigation.

Adequate Supply: Yes..... No..... Explain.....

Remarks.....	
--------------	--

Nevin Ditch out of Sweet Grass Creek - Point of diversion in SW¹/₄NE¹/₄ Sec. 9 T. 4N-R. 14E on north bank. This ditch in poor condition & not used on this land. Land under this ditch classified as potential lie in S¹/₂ of Sec. 16 T. 4N-R. 15E.

...River Basin

Also in: Plat No.....	Twp.....	Rgc.....	Plat No.....	Twp.....	Rgc.....	Plat No.....	Twp.....	Rgc.....
Plat No.....	Twp.....	Rgc.....	Plat No.....	Twp.....	Rgc.....	Plat No.....	Twp.....	Rgc.....

Information From:

None shown

Geo. Crum

Township 4 North - Range 15 East

(9)

Name of Owner	Township and Range
✓1. Adams, E. M.	(9) 4N-15E (10) 4N-16E (5) 5N-16E
✓2. Brenneman, John	"
✓3. Cremer Rodeo Co. & Leo Cremer	" (18) 3N-18E
✓4. Crum, Chas. E.	"
✓5. Crum, Geo. B.	" (10) 4N-16E (15) 3N-15E (16) 3N-16E
✓6. Drivdahl, Louis	"
✓7. Drivdahl, Oscar	"
✓8. Franklin, W.P. est.	" (14) 3N-14E (8) 4N-14E
✓9. Hoyem, Mike	"
✓10. Kloeckner, Frank	" (8) 4N-14E
✓11. Lowry, Addie	"
✓12. Lavoie, Sigurd <i>Howe</i>	" (13) 3N-13E
✓13. Thompson, Mandius	"
✓14. Yost Farms Co.	"
✓15. <i>Richards, Don</i> <i>St. Louis, Mo.</i> <i>Manager</i>	"

STATE ENGINEER'S OFFICE

WATER RESOURCES SURVEY

Township 4 North Range 15 East County Lincoln

[illegible]

Township 4 North Range 15 East

Township

Range

County

[illegible]

Township 4 North, Range 15 East

No.	Name of Appropriator	Name of Stream	Date App.	Date	M.I.
230	Cook, George W.	Cayuse Creek	2-25-86	2-27-86	All
281	Cook, George W.	Cayuse Creek	10-14-92	10-15-92	1000
330	Bailey, J. W. & Clark, E.O.	Dead Beaver Creek	12-26-05	12-26-05	200
331	Bailey, J. W. and Clark, E.O.	Dead Beaver Creek	12-26-05	12-26-05	200
332	Strand, Anton A.	Dead Beaver Creek	8-28-00	8-28-00	200
628	Lowrey, H. T.	Rock Creek	10-31-88	11-1-88	200
756	Christensen, Chris	Sweetgrass Creek	10-15-04	10-17-04	200
760	Cook, George W.	Sweetgrass Creek	2-25-86	2-27-86	1000
761	Cook, John B. & Tessier, Prosper	Sweetgrass Creek	4-7-87	4-11-87	---
764	Crest, Albert + Syver				
769	Daniel, Roland & Maurine	Sweetgrass Creek Sweetgrass Creek	9-30-05 3-30-98	9-30-05 7-1-98	400 720
777	Franklin, Hersel P.	Sweetgrass Creek	9-10-01	9-10-01	1000
802	Lowery, Henry T.	Sweetgrass Creek	10-31-88	11-1-88	500
808	Nevin, Oswald B.	Sweetgrass Creek	6-17-02	6-17-02	1000
820	Schallock, W. Fred	Sweetgrass Creek	10-26-09	11-18-09	200
828	Strong, Wm. G. and Weatherman, N. D.	Sweetgrass Cr.	3-10-83	3-17-83	3200
829	Strong, Wm. G.	Sweetgrass Creek	11-18-01	11-19-01	1800
839	Whalen, Michael	Sweetgrass Creek	5-11-93	5-11-93	200
941	Hanson, E. B.	Cottonwood Springs	4-7-10	4-7-10	400
981	Cook, John B.	Unnamed Spring	8-10-82	8-14-82	All
986	Dravidahl, John	Unnamed Spring	11-6-08	11-10-08	100
988	Duff, Frank	Unnamed Spring	6-19-09	6-21-09	160
989	Duff, Lydia A.	Unnamed Spring	6-19-09	6-21-09	160
1030	Liebel, Clara	Unnamed Spring	5-14-10	5-14-10	100
1080	Tucker, Walter	Lake and Reservoir	4-22-10	4-22-10	200
1082	Briner, Geo. M.	Flood Water	10-26-03	10-26-03	200
1085	Cross, Frank J.	Flood Water	3-11-14	3-11-14	100
1101	Harris Cattle Co., In.	Swamp	10-28-46	10-28-46	500

Page Two

<u>No.</u>	<u>To Whom Decreed</u>	<u>Name of Stream</u>	<u>Date Priority</u>	<u>M.I.</u>
D-127	Cook, George W.	Cayuse Creek	6-1-79	200
D-128	Cook, George W.	Cayuse Creek	6-1-81	250
D-128	Franklin, H. P.	Rye Creek	9-1-88	150
D-284	Cook, George W.	Sweetgrass Creek	6-1-86	60
D-285	Cook, George W.	Sweetgrass Creek	6-1-04	60
D-292	Drevdahl, John	Sweetgrass Creek		200
D-293	Drevdahl, John	Sweetgrass Creek	7-8-11	160
D-294	Elling, Henry Est.	Sweetgrass Creek	7-2-87	270
D-295	Elling, Henry Est.	Sweetgrass Creek	6-1-89	120
D-301	Franklin, H. P.	Sweetgrass Creek	6-1-80	100
D-302	Franklin, H. P.	Sweetgrass Creek	4-1-88	700
D-305	Franklin, W. P.	Sweetgrass Creek	4-1-88	400
D-306	Franklin, W. P.	Sweetgrass Creek	6-25-88	350
D-323	Ingle, Mary	Sweetgrass Creek	----	200
D-328	McAllister, Charles & Seymour, Wm. -	Sweetgrass Creek	4-1-83	200
D-329	McAllister, Charles & Seymour, Wm. -	Sweetgrass Creek	5-28-02	675
D-351	Rye, John	Sweetgrass Creek	7-20-93	250
D-352	Rye, John	Sweetgrass Creek	5-1-94	350
D-364	Weatherman, V. F. & W. C.	Sweetgrass Creek	9-21-89	200
D-365	Whalen, William	Sweetgrass Creek	6-2-83	120
D-366	Whalen, William	Sweetgrass Creek	9-1-88	240
D-372	Elling, Henry Est.	Spring Creek	6-1-84	100