

A trace of the leader detail was
located; however, it is in extremely
poor condition and has not been
used for many years.

STATE OF MONTANA

State Engineer's Office

WATER RESOURCES SURVEY

Township 4 North Range 17 East County Sweet Grass

A 36x6 grid with numbered cells and labeled regions A and B.

The grid is divided into two main sections by a horizontal line. The top section contains cells numbered 1 through 12, and the bottom section contains cells numbered 13 through 36. The numbering is as follows:

- Row 1: 1, 2, 3, 4, 5, 6
- Row 2: 7, 8, 9, 10, 11, 12
- Row 3: 13, 14, 15, 16, 17, 18
- Row 4: 19, 20, 21, 22, 23, 24
- Row 5: 25, 26, 27, 28, 29, 30
- Row 6: 31, 32, 33, 34, 35, 36

Regions A and B are labeled as follows:

- Region A: A 2x2 square in the top-left corner, covering cells 1, 2, 7, and 8.
- Region B: A 2x2 square in the top-left corner, covering cells 3, 4, 9, and 10.

Township.....Range.....

Township 4 North Range 17 East County Sweet Grass

[illegible][illegible]

Form WR-B
Reporter 20108 2M 12-6

Twp. 4N Rge. 17E
Twp. _____ Rge. _____
Twp. _____ Rge. _____

STATE OF MONTANA
State Engineer's Office
WATER RESOURCES SURVEY
FARM MAP

County Sweetgrass
Code No. _____
6B-7A-20A

Name of Land Owner Cramer, Leo Address Shawmut
Name of Operator Same Address _____
Legal Description _____

☒ Irrigated Land ☐ Non-Irrigated Land ☒ Potential Land Under Existing Facilities
North

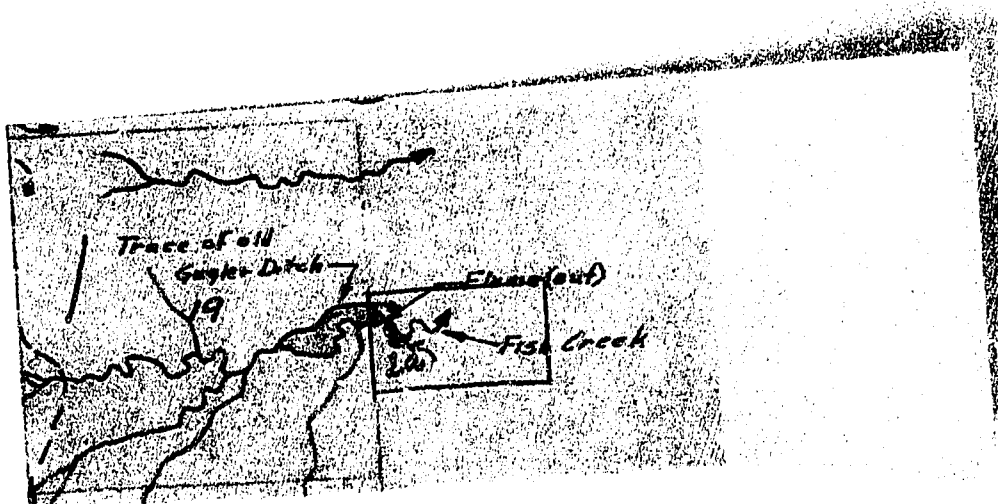

Code No. 20A System Gager Ditch (not in use) Source of Water Fish Creek
Basin Musselshell Present 2 Potential 2 Maximum 2 R ✓ F ✓ P ✓ G ✓ S ✓
Code No. _____ System _____ Source of Water _____
Basin _____ Present _____ Potential _____ Maximum _____ R _____ F _____ P _____ G _____ S _____
Code No. _____ System _____ Source of Water _____
Basin _____ Present _____ Potential _____ Maximum _____ R _____ F _____ P _____ G _____ S _____
Code No. _____ System _____ Source of Water _____
Basin _____ Present _____ Potential _____ Maximum _____ R _____ F _____ P _____ G _____ S _____

If under Ditch Company, Irrigation District, or Government Project, state the number of shares or inches, acre feet, as the case may be in said system.

NOTE: R—Denotes Regular Irrigation. F—Flood Irrigation. P—Water diverted by means of pumping. G—Water diverted by gravity. S—Stored Water.

Information from _____ Date _____

Farm Checked

By E.C. + BB

Area Gibson

Date 8-30-50

Legal Land Owner Dean, Mrs. A. C.

Operator ?

Water is delivered by:

Federal Project _____ Pres. _____ Pot. _____

Ditch Company _____ Pres. _____ Pot. _____

Irrigation District _____ Pres. _____ Pot. _____

Private System _____ Pres. _____ Pot. _____

No ditches - no irrigation Totals _____

Flood _____ Pump _____ Reservoir _____ Gravity _____

Size and Capacity, Pump, etc. _____

Original Appropriator, Company _____ App. No. _____

Original Appropriator, Private Wood, Samuel A. App. No. 1474, 1075

Is the system an extension of another system? Yes _____ No _____

Is all land irrigated from one system? Yes _____ No _____

(If No, show break down on map)

Source of Water Unnamed Spring

Acres Irrigated 19. _____

Potential Acres _____ Seeped _____

Explain _____

Condition of System _____

Adequate Supply Yes _____ No _____

Explain _____

Topography _____

Information From Field Survey

Remarks _____

(11)

STATE OF MONTANA

STATE ENGINEER'S OFFICE

WATER RESOURCES SURVEY

FORM F-1 - GAZETTE 1949-24-1-42

Corte No. 32A-33A

County Sweet Grass

T. 4N R. 17E Sec. 32, 33

MA-9A-178

Photo No. MA-14-184

435 - N. Elizabeth St.

Address St. Louis, 21, Mo.

Address _____

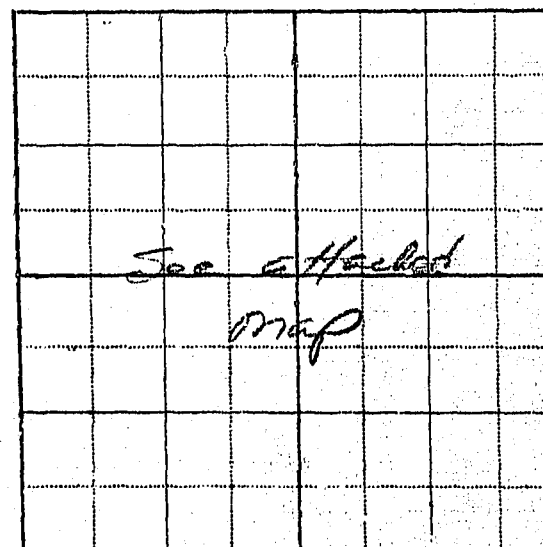

unable to locate any trace of a
kitch. No information available
as to the total appropriations
listed on the above card.

FORM D-1
REPORTER IN 3-48 17379

STATE OF MONTANA
State Engineer's Office
WATER RESOURCES SURVEY

Township 4 North Range 17 East County Sweet Grass

6	5	4	3	2	1
7	8	9	10	11	12
18	17	16	15	14	13
19	20	21	22	23	24
30	29	28	27	26	25
31	A 32	A 33	34	35	36

Township _____ Range _____

Township 4 North Range 17 East County Sweet Grass

[illegible][illegible]

Farm Checked

STATE OF MONTANA

Code No. 32 CBy E.C. & B.B.

STATE ENGINEER'S OFFICE

County Sweet GrassArea Gibson

WATER RESOURCES SURVEY

T. 4N R. 17E Sec. 32Date 8-30-50Photo No. MA-9A-178120-10th Ave.Legal Land Owner Thomas, Mary J.Address Huntington, West Va.Operator ?

Address

Water is delivered by:

Federal Project _____ Pres. _____ Pot. _____

Ditch Company _____ Pres. _____ Pot. _____

Irrigation District _____ Pres. _____ Pot. _____

Private System _____ Pres. _____ Pot. _____

Totals _____

Flood _____ Pump _____ Reservoir _____ Gravity ☒

Size and Capacity, Pump, etc. _____

Original Appropriator, Company Wood, Samuel A. App. No. 312, 1060, 1074, 1075Original Appropriator, Private Thomas, Mary J. App. No. 312, 1060, 1074, 1075Is the system an extension of another system? Yes _____ No ☒

Is all land irrigated from one system? Yes _____ No _____

(If No, show break down on map)

Source of Water Coulee Creek, unnamed Spring,Twp. 4N - Rge. 17EAcres Irrigated 19 None

Potential Acres _____ Seeped _____

Explain _____

Condition of System _____

Adequate Supply _____ Yes _____ No _____

Explain _____

Topography _____

Information From _____

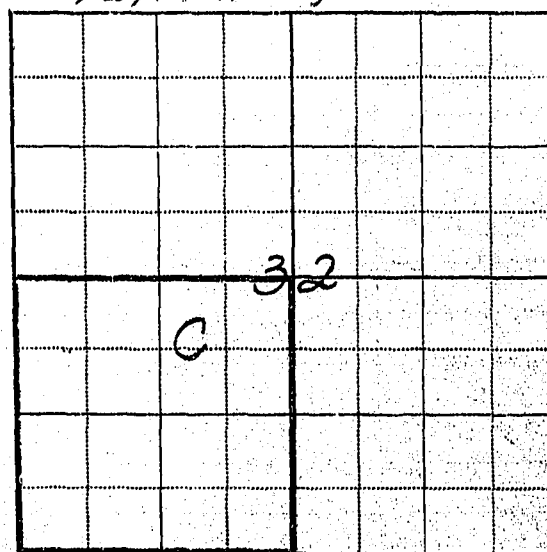
Remarks Over

A slight trace of a ditch in the
NW 1/4 SW 1/4 of Sec 32 T41N R5E is visible;
however, has not been used
for many years. Land under
the ditch would not total more
than 1/4 of an acre and no
water is available for irrigation.

Form WR-B
Reporter 20188 2M 12-41

Twp. 4N Rge. 17E
Twp. _____ Rge. _____
Twp. _____ Rge. _____

STATE OF MONTANA
State Engineer's Office
WATER RESOURCES SURVEY
FARM MAP

County Sweetgrass

Code No. _____

3212

Name of Land Owner Thomas, Mary J. Address Huntington West Va.
Name of Operator _____ Address _____
Legal Description _____



Irrigated Land



Non-Irrigated Land
North



Potential Land Under Existing Facilities

Code No. _____ System _____ Source of Water _____
Basin _____ Present _____ Potential _____ Maximum _____ R. _____ F. _____ P. _____ G. _____ S. _____
Code No. _____ System _____ Source of Water _____
Basin _____ Present _____ Potential _____ Maximum _____ R. _____ F. _____ P. _____ G. _____ S. _____
Code No. _____ System _____ Source of Water _____
Basin _____ Present _____ Potential _____ Maximum _____ R. _____ F. _____ P. _____ G. _____ S. _____
Code No. _____ System _____ Source of Water _____
Basin _____ Present _____ Potential _____ Maximum _____ R. _____ F. _____ P. _____ G. _____ S. _____

If under Ditch Company, Irrigation District, or Government Project, state the number of shares or inches, acre feet, as the case may be in said system.

NOTE: R—Denotes Regular Irrigation. F—Flood Irrigation. P—Water diverted by means of pumping. G—Water diverted by gravity. S—Stored Water.

Information from _____ Date _____

Farm Checked

STATE OF MONTANA

Code No. 191, 20, 3, 290, 328

By _____

STATE ENGINEER'S OFFICE

County Sweet Grass

Area _____

WATER RESOURCES SURVEY

T. 4N R. 17E Sec. 29, 32

Date _____

Photo No. _____

Legal Land Owner Sarah S. Tallefson Address _____Operator aw-ep Address _____

Water is delivered by:

Federal Project _____ Pres. _____ Pot. _____

Ditch Company _____ Pres. _____ Pot. _____

Irrigation District _____ Pres. _____ Pot. _____

Private System Gugler Ditch Pres. 0 Pot. _____

Totals _____

Flood _____ Pump _____ Reservoir _____ Gravity _____

Size and Capacity, Pump, etc. _____

Original Appropriator, Company _____ App. No. _____

Original Appropriator, Private _____ App. No. _____

Is the system an extension of another system? Yes _____ No ☒Is all land irrigated from one system? Yes ☒ No _____

(If No, show break down on map)

Source of Water Fish CreekAcres Irrigated 19.50 2Potential Acres 10 Seeped _____

Explain _____

Condition of System _____

Adequate Supply _____ Yes _____ No _____

Explain _____

Topography _____

Information From _____

Remarks Gugler Ditch not intended to irrigateland in Sec. 19 is potential only

(over)

STATE ENGINEER'S OFFICE

WATER RESOURCES SURVEY

Township 4N Range 17E County Sweet Grass

6	5	4	3	2	1
7	8	9	10	11	12
13	14	15	16	17	18
19	20	21	22	23	24
25	26	27	28	29	30
31	32	33	34	35	36

Township 4N Range 17E

Form-WR-B
Reporter 20168 2M 12-4

STATE OF MONTANA

State Engineer's Office
WATER RESOURCES SURVEY
FARM MAP

County San Juan

Code No. 191, 203

29B, 32B

Twp. 4N Rge. 17E

Twp. _____ Rge. _____

Twp. _____ Rge. _____

Name of Land Owner Sarah S. Tellefson Address _____

Name of Operator O.W. O.P. Address _____

Legal Description _____



Irrigated Land



Non-Irrigated Land



Potential Land Under Existing Facilities

North

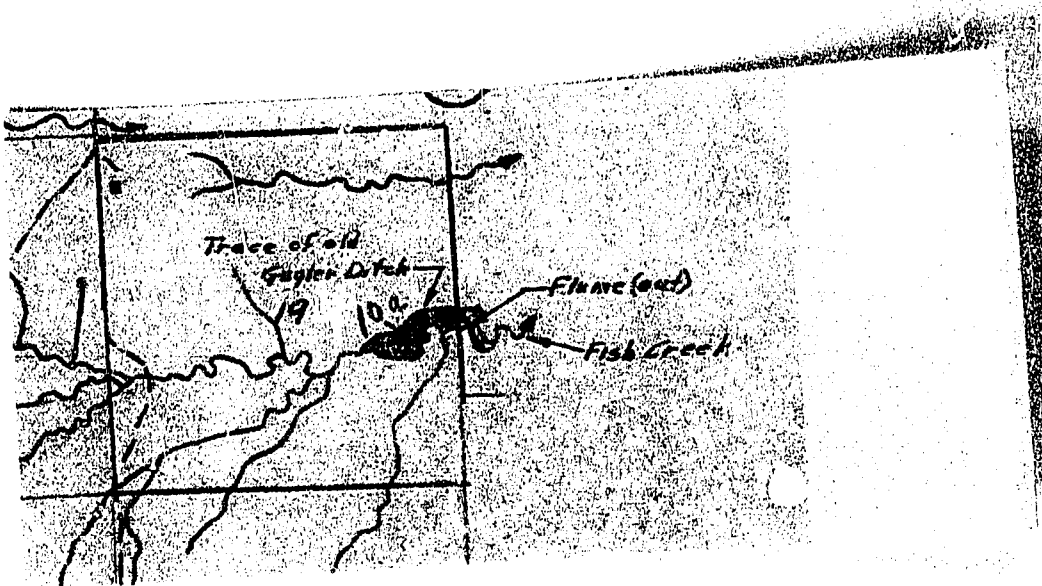

Code No. 191 System Gugler Ditch (not in use) Source of Water Fish Creek

Basin Mussekshell Present 0 Potential 10 Maximum 10 R ☒ F ☐ P ☐ G ☒ S ☐

Code No. _____ System _____ Source of Water _____

Basin _____ Present _____ Potential _____ Maximum _____ R ☐ F ☐ P ☐ G ☐ S ☐

Code No. _____ System _____ Source of Water _____

Basin _____ Present _____ Potential _____ Maximum _____ R ☐ F ☐ P ☐ G ☐ S ☐

Code No. _____ System _____ Source of Water _____

Basin _____ Present _____ Potential _____ Maximum _____ R ☐ F ☐ P ☐ G ☐ S ☐

If under Ditch Company, Irrigation District, or Government Project, state the number of shares or inches, acre feet, as the case may be in said system.

NOTE: R—Denotes Regular Irrigation. F—Flood Irrigation. P—Water diverted by means of pumping. G—Water diverted by gravity. S—Stored Water.

Information from _____ Date _____

County.....Sweet Grass.

Farin Checked: Date...7-20-50.....

By J.C. & M.T.

STATE OF MONTANA
STATE ENGINEERS OFFICE
Water Resources Survey

T3N.....R.12E..... Plat No.12.....

Photo No. MA-12A-185

Legal Land Owner.....John A. Madill.....

Address.....California

Operator..... Hults & Sons (Buying on contract)

Address..... Big Timber

Water is delivered by:— 1. Private System; 2. Ditch Company; 3. State Project; 4. Federal Project; 5. Irrigation District

NOTE: R—Denotes Regular Irrigation. F—Flood Irrigation.

Adequate Supply: Yes..... No..... Explain.....

Remarks..

System is for storage of flood waters. Consists of diversion ditch & res.
System and W.R. belong to Beleys but Hulst plans to rebuild and use it if he can get permission
to provide stock water.

...River Basin.

Also in: Plat No.....	Twp.....	Rge.....	Plat No.....	Twp.....	Rge.....	Plat No.....	Twp.....	Rge.....
Plat No.....	Twp.....	Rge.....	Plat No.....	Twp.....	Rge.....	Plat No.....	Twp.....	Rge.....

Information From:

G. Irwin Hults

County.....Sweet...Grass.....

Farm Checked: Date...None...shown

By Bob & Jim

STATE OF MONTANA
STATE ENGINEERS OFFICE
Water Resources Survey

T 3N R 12E Plat No. 12

Photo No. MA-12A-211

Legal Land Owner The Van Cleve Co. Address Melville

Operator	Same	Address

Water is delivered by:— 1. Private System; 2. Ditch Company; 3. State Project; 4. Federal Project; 5. Irrigation District

[illegible]

NOTE: R—Denotes Regular Irrigation. F—Flood Irrigation.

Adequate Supply: Yes..... No..... Explain.....

Remarks.....
Ditch diverts from B.T. Creek near W. line of Sec. 2 and runs E. to irr. small amount of land in center of Sec. 2.

River Basin.....

Also in: Plat No.....	Twp.....	Rge.....	Plat No.....	Twp.....	Rge.....	Plat No.....	Twp.....	Rge.....
Plat No.....	Twp.....	Rge.....	Plat No.....	Twp.....	Rge.....	Plat No.....	Twp.....	Rge.....

Information From:
Field Survey &
Paul Van Cleve, Sr.

Township 3 North - Range 12 East

(12)

	Name of Owner	Twp. & Rge.
✓ 1.	Madill, John A. <i>Madill</i>	(12) 3N-12E (20) 2N-13E (21) 2N-14E

STATE OF MONTANA
STATE ENGINEER'S OFFICE
 WATER RESOURCES SURVEY

Township 3 North Range 13 East County San Juan

6	5	4	3	2	
7	8	9	10	11	12
13	17	16	15	14	13
19	20	21	22	23	24
30	29	28	27	26	25
31	32	33	34	35	36

Township 3 North Range 13 East

Township _____ Range _____ County _____

Parcel Number	Name of Owner Appropriator	Address
Appropriation 74	Hmalong, Christopher (1400 M.T.)	Melville, Mont.
<p>Unsurveyed land. Lenses lying on both sides of North Fork of Big Timber Creek commencing at the mouth of a gulch at the foot of the mountains, running thence north along the foot of the Crazy Mts, one mile in length and eighty rods east - said strip of land being eighty rods wide and contains 160 Acres.</p>		
Appropriation 133	Securities Company Ltd. (20,000 M.T.)	
<p>Land undescribed. For the irrigation of lands & creation of a reservoir at or near the upper or main falls of the North Fork of Big Timber Creek at those certain lakes, three in number, adjacent to this point. The first 2 lakes to be known as Twin Lakes, the 3rd as Blue Lake and said system to be used for the irrigation of lands adjacent to the above named creek and elsewhere.</p>		

Township 3 North, Range 12 East

<u>No.</u>	<u>Name of Appropriator</u>	<u>Name of Stream</u>	<u>Date App.</u>	<u>Date Filed</u>	<u>M.I.</u>
80	Beley, Louis	Big Timber Creek	5-20-10	5-20-10	2500
724	Beley, Louis	Swamp Creek (N. Fork)	5-31-10	6-2-10	1000

Farm Checked

STATE OF MONTANA

Code No. 25A-26A-35ABy J.C. & M.T.

STATE ENGINEER'S OFFICE

County Sweet GrassArea Swamp Creek

WATER RESOURCES SURVEY

T. 3N R. 12E Sec 25, 26, 35Date July 20, 1950Photo No. MA-12A-185

Legal Land Owner

Madill, John A.Address California

Operator

Hults & Son's (Building on Contract)Address Big Timber

Water is delivered by:

Federal Project

Pres.

Pot.

Ditch Company

Pres.

Pot.

Irrigation District

Pres.

Pot.

Private System

System & water right owned by BeleyPres. D

Pot.

Totals

Flood

Pump

Reservoir ☒Gravity ☒

Size and Capacity, Pump, etc.

Original Appropriator, Company

App. No.

Original Appropriator, Private

Beley, LouisApp. No. 80, 724

Is the system an extension of another system?

Yes

No ☒

Is all land irrigated from one system?

Yes

No ☒

(If No, show break down on map)

Source of Water

Big Timber Creek, Swamp Creek (N. Fork)ditch diverts from Swamp Cr.Acres Irrigated 1950 2

Potential Acres

Seeped

Explain

Condition of System Poor, not used for many years

Adequate Supply

Yes ☒

No

Explain

System is for storage of flood waters
Consists of diversion ditch + Res.

Topography

Information From

L. Edwin Hults

Remarks

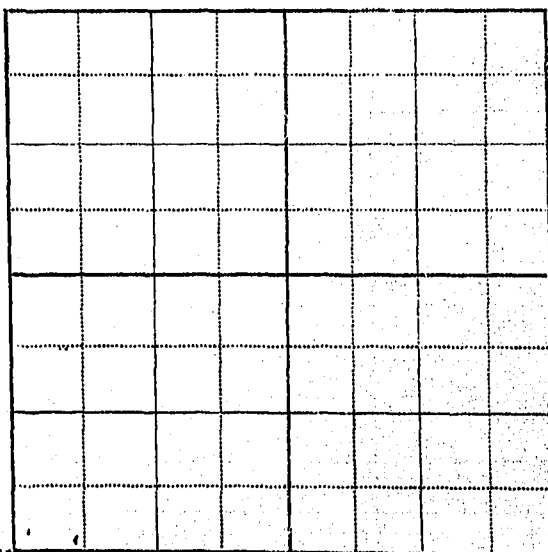
System and W.P. belong to Beley but
Hults plans to use it if he can get permission
to provide stock water.
also in the 13, 24, 25, 35No irr. land in this Twp. No Potential

STATE OF MONTANA
State Engineer's Office
WATER RESOURCES SURVEY

Township 3 North Range 12 East County Sweet Grass

6	5	4	3	2	1
7	8	9	10	11	12
18	17	16	15	14	13
19	20	21	22	23	24
30	29	28	27	26 A	25 A
31	32	33	34	35 A	36

Township _____ Range _____

Township 3 North Range 12 East County Sweet Grass

[illegible]

Form WR-3
Reporter 20108 2M 12-7

Twp. 3N Rge. 12E
Twp. _____ Rge. _____
Twp. _____ Rge. _____

STATE OF MONTANA
State Engineer's Office
WATER RESOURCES SURVEY
FARM MAP

County Sweetgrass
Code No. 25A-26A-35A

Name of Land Owner MADILL, JOHN A. Address Calif.
Name of Operator Hults and Sons (buying) Address Big Timber
Legal Description _____



Irrigated Land



Non-Irrigated Land

North



Potential Land Under Existing Facilities

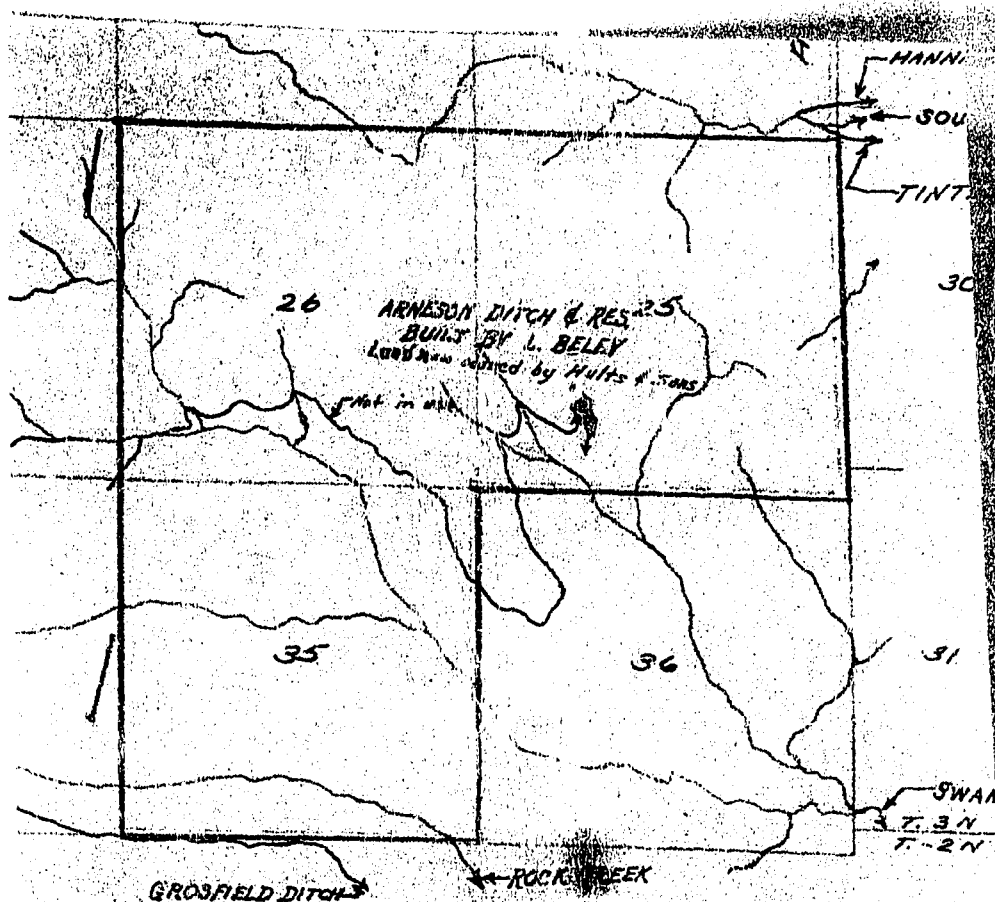

Code No.	System.	Source of Water.
Basin.	Present. Potential.	Maximum. R. F. P. G. S.
Code No.	System.	Source of Water.
Basin.	Present. Potential.	Maximum. R. F. P. G. S.
Code No.	System.	Source of Water.
Basin.	Present. Potential.	Maximum. R. F. P. G. S.
Code No.	System.	Source of Water.
Basin.	Present. Potential.	Maximum. R. F. P. G. S.

If under Ditch Company, Irrigation District, or Government Project, state the number of shares or inches, acre feet, as the case may be in said system.

NOTE: R—Regular Irrigation. F—Flood Irrigation. P—Water diverted by means of pumping. G—Water diverted by gravity. S—Stored Water.

Information from Date.

Farm Checked

STATE OF MONTANA

Code No. 24By Bob & Jim

STATE ENGINEER'S OFFICE

County SweetgrassArea N.E. Big Timber Creek

WATER RESOURCES SURVEY

T. 3N R. 12E Sec. 2

Date _____

Photo No. MA-12A-2Legal Land Owner The Van Cleave CoAddress MelvilleOperator Same

Address _____

Water is delivered by:

Federal Project _____ Pres. _____ Pot. _____

Ditch Company _____ Pres. _____ Pot. _____

Irrigation District _____ Pres. _____ Pot. _____

Private System ☒ _____ Pres. _____ Pot. _____

Totals _____

Flood _____ Pump _____ Reservoir _____ Gravity ☒

Size and Capacity, Pump, etc. _____

Original Appropriator, Company _____ App. No. _____

Original Appropriator, Private No Filing shown App. No. _____Is the system an extension of another system? Yes _____ No ☒Is all land irrigated from one system? Yes ☒ No _____

(If No, show break down on map)

Source of Water N.E. Big Timber CreekAcres Irrigated 1951 _____

Potential Acres _____ Seeped _____

Explain _____

Condition of System GoodAdequate Supply _____ Yes ☒ No _____E. main Creek runs all yearTopography Valley slopeInformation From Field Survey & Paul Van Cleave, Sr.

Remarks _____

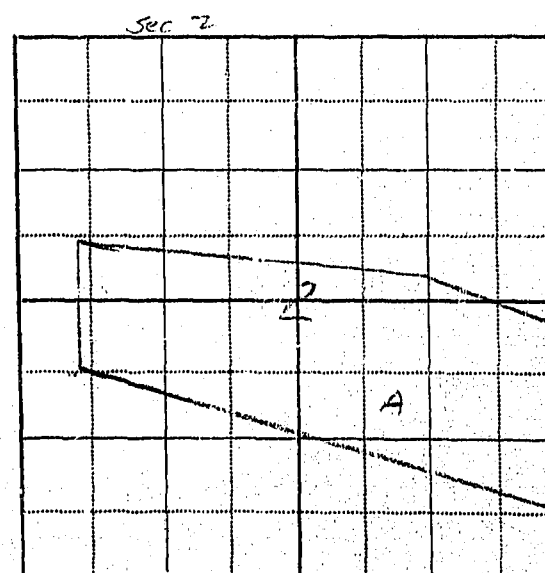

① ditch diverts from B.T. Creek near W line of sec 2
and runs E to the small amount of land in center of sec 2.

① Ditch Diverts from B.T. Creek near W line of sec 2
and runs E to irr small amount of land in center of sec 2.

Form WR-B
Reporter 20188 2M 12-4

Twp. 3N Rge. 12E
Twp. _____ Rge. _____
Twp. _____ Rge. _____

STATE OF MONTANA
State Engineer's Office
WATER RESOURCES SURVEY
FARM MAP

County Sweet Grass
Code No. 2A

Name of Land Owner. Van Cleave Co. Address. Melville
Name of Operator. _____ Address. _____
Legal Description. _____



Irrigated Land



Non-Irrigated Land
North



Potential Land Under Existing Facilities

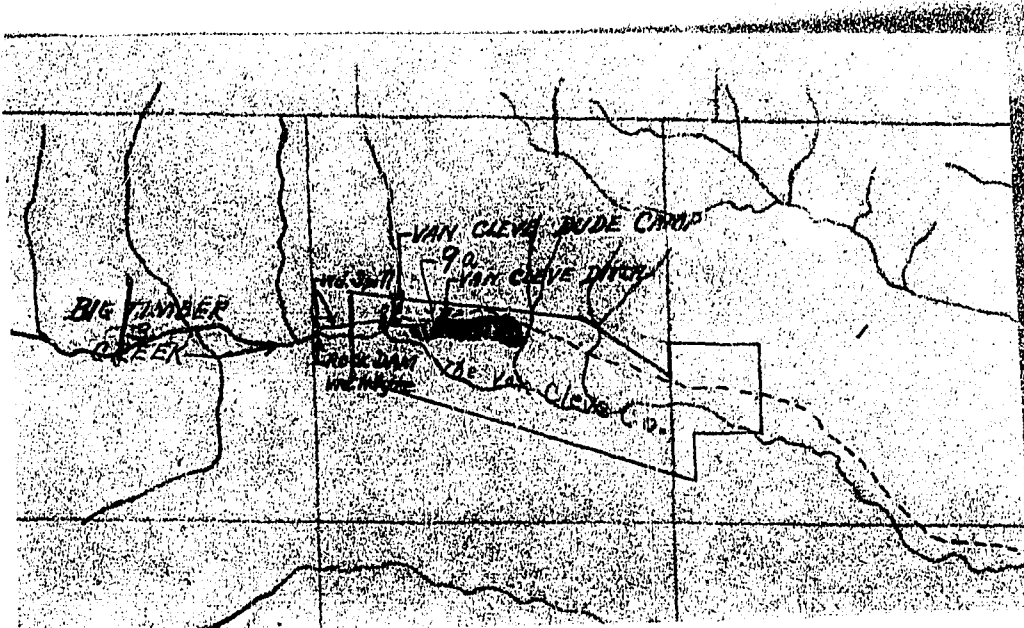

Code No. 2A System Van Cleave Ditch Source of Water N. Ek. Big Timber Cr.
Basin Big Timber Cr. Present 9 Potential 0 Maximum 9 R. ☒ F. ☐ P. ☐ G. ☒ S. ☐
Code No. _____ System _____ Source of Water _____
Basin _____ Present _____ Potential _____ Maximum _____ R. ☐ F. ☐ P. ☐ G. ☐ S. ☐
Code No. _____ System _____ Source of Water _____
Basin _____ Present _____ Potential _____ Maximum _____ R. ☐ F. ☐ P. ☐ G. ☐ S. ☐
Code No. _____ System _____ Source of Water _____
Basin _____ Present _____ Potential _____ Maximum _____ R. ☐ F. ☐ P. ☐ G. ☐ S. ☐

If under Ditch Company, Irrigation District, or Government Project, state the number of shares or inches, acre feet, as the case may be in said system.

NOTE: R—Denotes Regular Irrigation. F—Flood Irrigation. P—Water diverted by means of pumping. G—Water diverted by gravity. S—Stored Water.

Information from John P. Cook Date April 27, 1951

County Sweet Grass

Farm Checked: Date.....7-18-50.....

By J.C. & M.T.

STATE OF MONTANA
STATE ENGINEERS OFFICE
Water Resources Survey

T 3N R 13E Plat No. 13

Photo No. MA-12A-186

Legal Land Owner...Louis...Grosfield

Address.....Big Timber

Operator.....Same.

Address.

Water is delivered by:— 1. Private System;

2. Ditch Company;

3. State Project;

4. Federal Project;

5. Irrigation District

[illegible]

NOTE: R—Denotes Regular Irrigation. F—Flood Irrigation.

Adequate Supply: Yes..... .. No..... .. Explain

Remarks.

Trace of old ditch out of Analong Creek and possibly Big Timber Cr. on this land but no irrigation. Ditches silted full and nearly obliterated.

...River Basin.

Also in: Plat No..... Twp..... Rge.....	Plat No..... Twp..... Rge.....	Plat No..... Twp..... Rge.....
Plat No..... Twp..... Rge.....	Plat No..... Twp..... Rge.....	Plat No..... Twp..... Rge.....

Information From:

Louis Grossfield

Township 3 North - Range 13 East

(13)

	Name of Owner	Twp. & Rge.
✓ 1.	Grosfield, Louis et al	(13) 3N-13E
✓ 2.	Grosfield, Louis	" (21) 2N-14E (20) 2N-13E, 4N-13E
✓ 3.	Hegdal, Ole	" (20) 2N-13E
✓ 4.	Langhus, Ole	"
✓ 5.	Lavold, Sigurd	" (9) 4N-15E
✓ 6.	Madill, John	" (27) 1N-13E
✓ 7.	Plaggemeyer, John	"
✓ 8.	Ueland, Marie	"

*Not in folder
when I made
the cards
for summary*

STATE OF MONTANA
STATE ENGINEER'S OFFICE
WATER RESOURCES SURVEY

Township 3 North Range 13 East County Sweet Grass

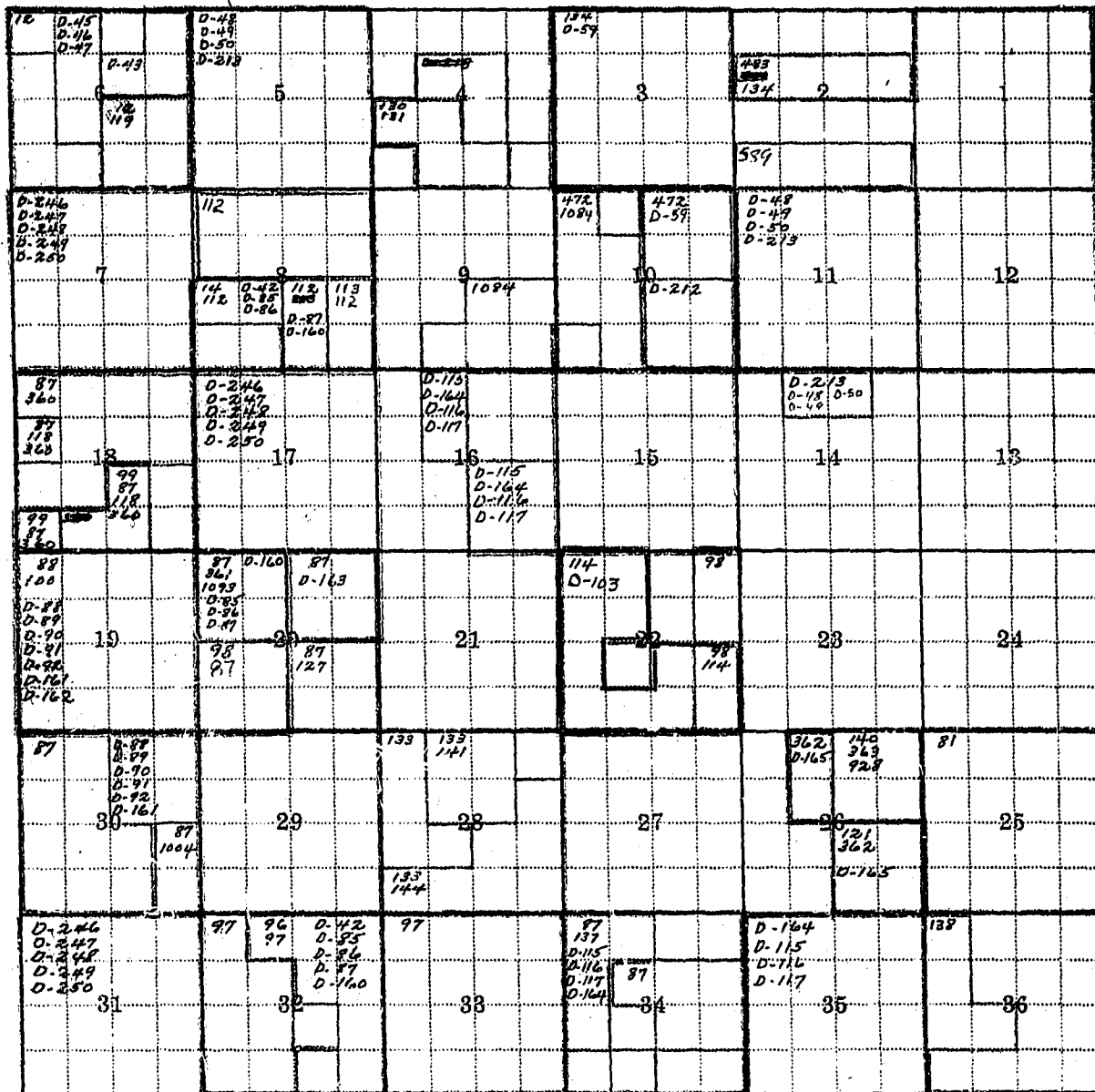

Township 3 North Range 13 East

Township

Range

County

Parcel Number	Name of Owner/Appropriator	Address
Appropriation 78	Arid Land Grant Commissioners	
	Certain lands in 3N 13E Point of diversion beginning at SE corner Sec 26 3N 13E on Big Timber Creek. A canal about 20 miles	
Appropriation 107	Holland Irrigation Canal Co.	Bozeman, Mont
	Land lying in 3N 13E Point of diversion on North Fork (now called the East Fork) of Big Timber Creek is 1024 feet north of the SW corner of the SE 1/4 Sec 27 3N, 13E on east bank of said stream.	
Appropriation 108	Holland Irrigation Canal Co.	Bozeman, Mont.
	Land lying in 3N 13E. Point of diversion on South Fork of Big Timber Creek is 955 feet NW of the SE corner of the SW 1/4 Sec 3N 13E on left bank of said stream.	
Appropriation 135	Sweet Grass Canal & Reservoir (3000 M.D.)	Big Timber, Mont
	Land situated in 3N 13E. Point of diversion on Big Timber Creek is at a point about 1002 feet north of the quarter corner on the south line of Sec 23 3N 13E on the east bank.	

Township 3 North, Range 13 East

<u>No.</u>	<u>Name of Appropriator</u>	<u>Name of Stream</u>	<u>Date App.</u>	<u>Date Filed</u>	<u>M.I.</u>
12	Hanson, Phillip W.	Amalong Creek	6-28-11	6-28-11	120
14	Parker, Thomas F.	Amalong Creek	6-24-93	7-3-93	250
81	Beley, Louis	Big Timber Creek	4-30-10	4-30-10	2500
87	Cavane, A. R. et al	Big Timber Creek	5-23-96	5-23-96	1000
88	Cavane, William et al	Big Timber Creek	6-14-93	6-16-93	400
96	Hannah, Margaret A.	Big Timber Creek	4-13-05	4-24-05	200
97	Hannah, Margaret A.	Big Timber Creek	9-9-07	9-13-07	1000
98	Hannah, W. J. et al	Big Timber Creek	6-1-09	6-15-09	400
99	Hannah, W. J.	Big Timber Creek	5-2-04	5-2-04	300
100	Hannah, W. J.	Big Timber Creek	11-22-04	11-22-04	320
112	Kelsey, James A.	Big Timber Creek	8-9-97	8-9-97	500
113	Kelsey, James A.	Big Timber Creek	11-15-05	11-17-05	100
114	Langhus, Ole et us	Big Timber Creek	7-20-17	7-27-17	300
118	Mitchell, Burt	Big Timber Creek	8-31-03	8-31-03	300
119	Mjolsness, John T.	Big Timber Creek	7-14-06	7-18-06	160
121	Nevin, Marion	Big Timber Creek	10-29-97	10-29-97	200
127	Roberts, Hulda	Big Timber Creek	5-27-12	5-29-12	160
130	Sanderson, Samuel	Big Timber Creek	3-22-94	3-23-94	1650
131	Sanderson, Samuel	Big Timber Creek	3-22-94	10-3-00	1650
133	Sjurson, Lisa	Big Timber Creek	5-9-07	5-15-07	250
134	Stocker, Chas. F.	Big Timber Creek	7-25-06	8-13-06	12,000
137	Tantinger, Maria	Big Timber Creek	11-14-06	11-15-06	320
138	Tintinger, Nicholas	Big Timber Creek	5-6-98	5-6-98	200
140	Vik, Oscar K.	Big Timber Creek	5-3-24	5-3-24	50

<u>No.</u>	<u>Name of Appropriator</u>	<u>Name of Stream</u>	<u>Date App.</u>	<u>Date Filed</u>	<u>M.I.</u>
141	Wilson, Wiley	Big Timber Creek	2-19-98	2-19-98	600
144	Youmans, Mary H.	Big Timber Creek	2-13-03	2-14-03	400
360	Corane, Wm. et al	Devils Creek	6-14-93	6-16-93	300
361	Roberts, Edward	Devils Creek	7-2-08	7-11-08	200
362	Tintinger, Nicholas	Devils Creek	4-3-96	4-7-96	200
363	Vik, Oscar K.	Devils Creek	5-3-24	5-3-24	50
472	Halstead, Wesley W.	Hailstone Creek	4-19-97	4-19-97	500
483	Rue, Karen	Horse Creek	11-27-09	12-17-09	100
589	Lavold, Sigurd	Otter Creek	10-17-11	10-18-11	160
928	Vik, Oscar K.	Zuill Creek	5-3-24	5-3-24	50
1004	Hannah, W. J.	Unnamed Spring	5-15-08	5-15-08	50
1084	Cobban, R. M.	Flood Water	8-17-11	8-30-11	500
1093	Roberts, Edward	Flood Water	8-26-08	8-27-08	100
D-42	Hannah, Margaret	Amlong Creek	8-1-97		40
D-43	Hanson, Phillip W.	Amlong Creek	4-6-14		60
D-45	Mjolsness, John	Amlong Creek	6-16-88		50
D-46	Mjolsness, John	Amlong Creek	7-3-93		20
D-47	Mjolsness, John	Amlong Creek	5-1-06		50
D-48	Sanderson, Carrie	^{orig. name long creek} Amlong Creek	6-15-88		160
D-49	Sanderson, Carrie	Amlong Creek	7-2-94		140
D-50	Sanderson, Carrie	Amlong Creek	6-1-06		240

Page Three

<u>No.</u>	<u>Name of Appropriator</u>	<u>Name of Stream</u>	<u>Date App.</u>	<u>Date Filed</u>	<u>M. I.</u>
D-59	Armstrong and Stocker	Big Timber Creek	5-3-03		300
D-85	Hannah, Margaret L.	Big Timber Creek	6-1-00		40
D-86	Hannah, Margaret L.	Big Timber Creek	6-1-05		200
D-87	Hannah, Margaret L.	Big Timber Creek	6-1-07		250
D-88	Hannah, W. J.	Big Timber Creek	7-15-87		120
D-89	Hannah, W. J.	Big Timber Creek	5-23-96		250
D-90	Hannah, W. J.	Big Timber Creek	5- -04		100
D-91	Hannah, W. J.	Big Timber Creek	11-22-04		120
D-92	Hannah, W. J.	Big Timber Creek	5- -05		60
D-103	Langhaus, Olet Guri	"	7-1-17		300
D-115	Tintinger Bros. -	Big Timber Creek	7-15-88		50
D-116	Tintinger Bros.	Big Timber Creek	5-23-96		250
D-117	Tintinger Bros.	Big Timber Creek	9-15-02		450
D-160	Hannah, Margaret	Devil Creek	6-25-08		120
D-161	Hannah, W. J.	Devil Creek	6-1-98		200
D-162	Hannah, W. J.	Devil Creek	6-1-98		200
D-163	Roberts, Edward	Devil Creek	6-25-08		120
D-164	Tintinger, Bros.	Devil Creek	6-1-98		40
D-165	Tintinger, N. J.	Devil Creek	6-1-98		40
D-212	Grant, Alexander (Langhaus)	Hailstone Creek	7- -98		70
D-213	Sanderson, Carrie (")	Hailstone Creek	7-2-93		40
D-246	Arneson, A. H.	Swamp Creek	4-1-80		466
D-247	Arneson, A. H.	Swamp Creek	9-14-89		100
D-248	Arneson, A. H.	Swamp Creek	4-21-90		60
D-249	Arneson, A. H.	Swamp Creek	6-1-91		60
D-250	Arneson, A. H.	Swamp Creek	7-1-93		40

FORM D-1
REPORTER IM 3-49 17379

STATE OF MONTANA
State Engineer's Office
WATER RESOURCES SURVEY

Township 3N Range 13E County Sweet Grass

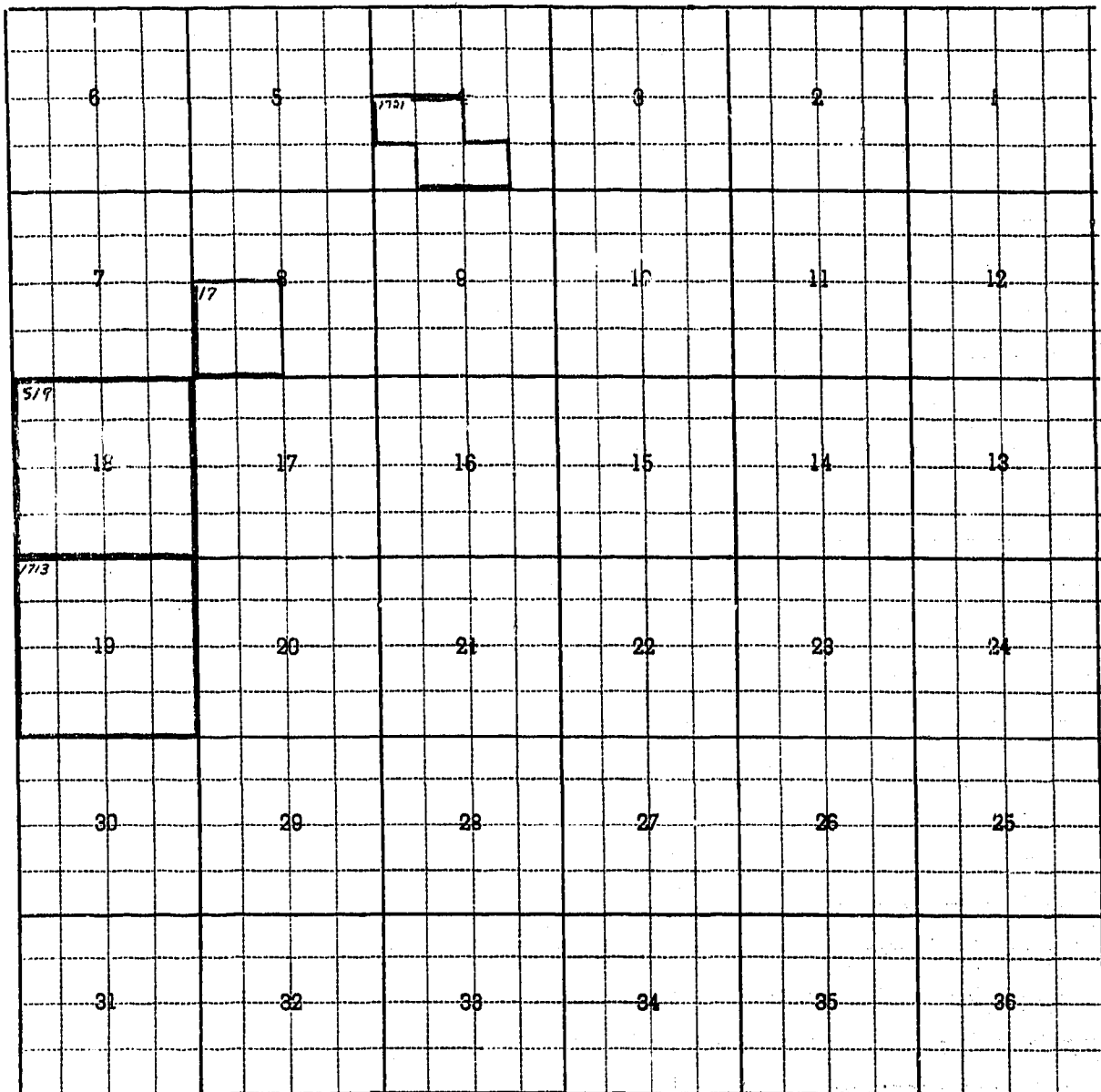

Transcribed from Park County

Township 3N Range 13E

County-

[illegible]

Farm Checked

STATE OF MONTANA

Code No. 8ABy JC + MT

STATE ENGINEER'S OFFICE

County Sweet GrassArea Big Timber Cr.

WATER RESOURCES SURVEY

T. 3 N R. 13 E Sec. 8Date 7-18-50Photo No. MA-124-186Legal Land Owner Grosfield, LouisAddress Big TimberOperator Same

Address " "

Water is delivered by:

Federal Project _____ Pres. _____ Pot. _____

Ditch Company _____ Pres. _____ Pot. _____

Irrigation District _____ Pres. _____ Pot. _____

Private System 1 old ditch _____ Pres. _____ Pot. _____

Totals _____

Flood _____ Pump _____ Reservoir _____ Gravity _____

Size and Capacity, Pump, etc. _____

Original Appropriator, Company _____ App. No. _____

Original Appropriator, Private Heisey, James A. App. No. 112Is the system an extension of another system? Yes ☒ No ☐Is all land irrigated from one system? Yes ☒ No ☐

(If No, show break down on map)

Source of Water Big Timber CreekAcres Irrigated 50 _____Potential Acres _____ Seeped 0

Explain _____

Condition of System Poor (silted Full)Adequate Supply _____ Yes _____ No ☒

Explain _____

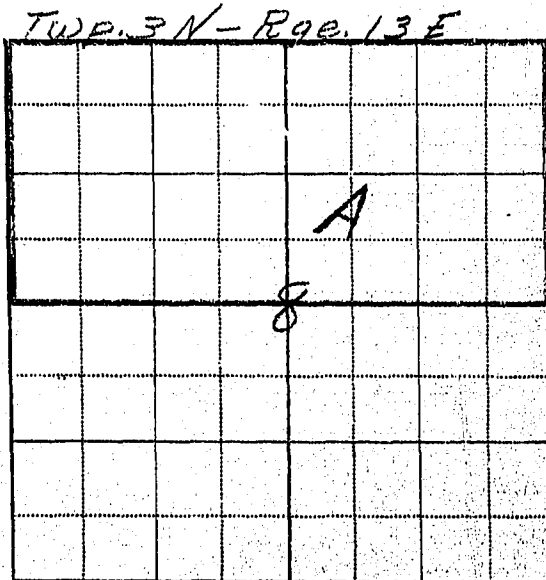
Topography Valley sides and bottomInformation From Louis GrosfieldRemarks Old ditch in south west corner

Trace of old ditch out of Amelona
creek and possibly Big Timber Cr. on
this land but no irrigation. Ditches
silted full and nearly obliterated.

Form WR-3
Reporter 20168 2M 12-49

STATE OF MONTANA
State Engineer's Office
WATER RESOURCES SURVEY
FARM MAP

County Sweet Grass

Code No. _____

Twp. 4N Rge. 13E

Twp. 3N Rge. 13E ✓

Twp. 2N Rge. 14E

2N 13E

Name of Land Owner Grosfield, Louis Address Big Timber

Name of Operator Same Address _____

Legal Description _____

☐ Irrigated Land

☐ Non-Irrigated Land
North

☐ Potential Land Under Existing Facilities



Code No. 8A System Old Ditch Source of Water M. F. K. Big Timber Cr.

Basin Big Timber Cr. Present 0 Potential 1 Maximum 1 R ✓ F ✓ P ✓ G ✓ S ✓

Code No. _____ System _____ Source of Water _____

Basin _____ Present _____ Potential _____ Maximum _____ R ✓ F ✓ P ✓ G ✓ S ✓

Code No. _____ System _____ Source of Water _____

Basin _____ Present _____ Potential _____ Maximum _____ R ✓ F ✓ P ✓ G ✓ S ✓

Code No. _____ System _____ Source of Water _____

Basin _____ Present _____ Potential _____ Maximum _____ R ✓ F ✓ P ✓ G ✓ S ✓

If under Ditch Company, Irrigation District, or Government Project, state the number of shares or inches, acre feet, as the case may be in said system.

NOTE: R—Denotes Regular Irrigation. F—Flood Irrigation. P—Water diverted by means of pumping. G—Water diverted by gravity. S—Stored Water.

Information from J. E. Cook Date May 2, 1951

Farm Checked

By

Area

Date

Legal Land Owner

Operator

Water is delivered by:

Federal Project

Pres.

Pot.

Ditch Company

Pres.

Pot.

Irrigation District

Pres.

Pot.

Private System

Pres.

Pot.

FORM F-1 REPORTER IM 3-49 17380
6A, 7A, 8B, 18A, 19A, 20A
Code No. 21A, 26A, 28A, 30B
32B, 33A, 34A, 35A, 36A
County, SWEET GRASS
T. 3N R. 13E Sec. 18
MA-12A-186-185
Photo No. 187 MA-12A-29, 30

STATE OF MONTANA
State Engineer's Office
WATER RESOURCES SURVEY

- OVER -

Flood Pump Reservoir Gravity

Size and Capacity, Pump, etc.

Original Appropriator, Company Tintinger, N.J. Bros. A.R. Cavane Wm. Mitchell, Furt. 112, 113, 121
Maria 362, D-116, D-115, D-117, D-164, 89, 350, 133
Original Appropriator, Private Hannah, W.J. - D-85, D-86, D-87, D-160 App. No. 96, 97, D-42, 99
Margaret, A. 100, D-88, D-89, D-90, D-91, D-92, D-161, D-162, 98
Is the system an extension of another system? Kevin, Marion Yes No 1004, D-42,
Roberts, Edward & Hulda - D-163, 127, 1093,
Is all land irrigated from one system? Yes No
Mjolsness, John - D-45, D-46, D-47, 119, D-43
(If No, show break down on map) Hanson, R.W., Parker, T.F. - 12, 14, D-246, D-247, D-248, D-249, D-250
Arneson, A.H. - Kelsey, James A. - Sjurson, Lisa.

Source of Water Big Timber Cr., Devil Cr., Amlong Cr., (Flood)

Acres Irrigated 19

Potential Acres Seeped

Explain

Condition of System see explanation

Adequate Supply Yes No

Explain Creeks get low in late summer

Topography Valley side bottom & bench land

Information From Louis Grosfield

Remarks

- OVER -

	Ditch in sec 2-2 out of Amelung Creek used to irrigate small amount of land in Sec. 8.	
	Sec. 2-2 100 acres	
	100 acres	
	Sec. 3-3 27 acres	
	Sec. 3-3 16 acres	
	95.4 (2000)	
	50	
	6.3	
	Sec. 3-3 23.7	
	25	
	6000*	
	Sec. 3-5 23.5 acres	
	18.7 acres	
	21.2 (2000)	
	6000 sample up to 1000 ft.	

Sec 6. To sec 6 old Sanderson ditch originally Amelung ditches in NW corner Sec 6. on north side of North Fork of Amelung Cr. this ditch is used as diversion ditch by Tanghaus Grossfield owns a water right in this ditch but has not used it for several years.

Sec 7-8 Old ditch diverts from Amelung Cr. in SE $\frac{1}{4}$ NE $\frac{1}{4}$ of Sec 7 - 3N 13E. This ditch irrigates small amount of land in sections 7 & 8 probably Mjolness ditch.

Sec 16-17-18 Old W. J. Hamrah ditch diverts on North side of Middle Fork of Big Timber Cr. (N. Fork of S. Fork) this ditch is washed out and has not been used for many years. Trace of old ditch out of Devil Cr. diverts out of south side of Creek at intersection between Sec 16 & Sec 17. Nearly obliterated

FORM D-1
REPORTER IM 3-48 1737R

STATE OF MONTANA
State Engineer's Office
WATER RESOURCES SURVEY

Township 3 North Range 13 East County Sweet Grass

11.5						
6 A	5	4	3	2	1	
7 A	8 B	9	10	11	12	
18 A	17 A	16 A	15	14	13	
19 A	20 A	21 A	22	23	24	
30 B	29	28 A	27	26 A	25	
		S	State			
31	32 B	33 A	34 A State	35 A	36 A	

Township _____ Range _____

Township 3 North Range 13 East County Sweet Grass

Parcel Number	Name of Owner	Address
Sec 8	Stocker on Big Timber Cr. near west line of Sec 8. Grossfield does not have right in or does not use this ditch.	
Sec 19-20-21 29, 32, 33, 34 35 (3N 13E)	① Old Wm. Cavane ditch diverts from south side of Middle Fork of Big Timber Cr. at north side of Sec. 19. Washed out and not in use.	
Sec 2, 3, 4 of 2N 13E	② W. J. Hannon ditch diverts from south fork of Big Timber Cr. on north side about 1/4 mile west of SW corner of Sec. 19. This ditch has not been used for about 12 years.	
	③ Grossfield-Langhaus ditch diverts from the north side of the south fork of Big Timber Cr. in SE 1/4 of SW 1/4 of Sec. 20. Grossfield uses this ditch to irrigate land in Sec. 21.	
	④ Ditch diverting from south side of the South Fork of Big Timber Cr. near SW corner of Sec. 19 is the Tintinger-Cavane ditch. Grossfield uses this ditch to irrigate lands in sections 29, 32, 33, 34, & 35 of 3N 13E and sections 2, 3, & 4 of 2N 13E. This ditch is in good condition and could irrigate a much larger area.	
Sec 22-23-26	Trace of old ditch out of Devil Creek	

Twp. Rge.
Twp. 3N Rge. 13E
Twp. Rge.

N
N
L

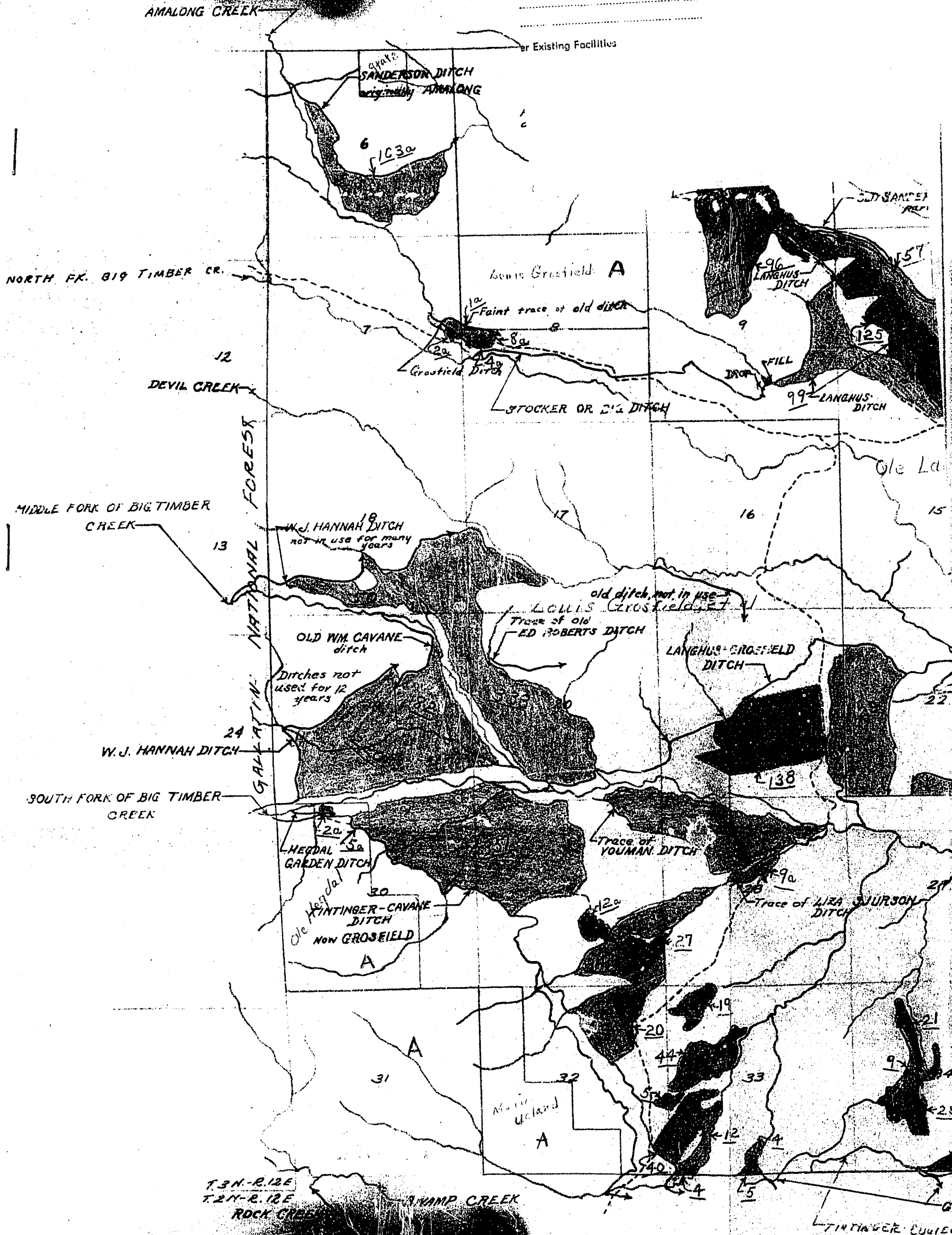

der Existing Facilities

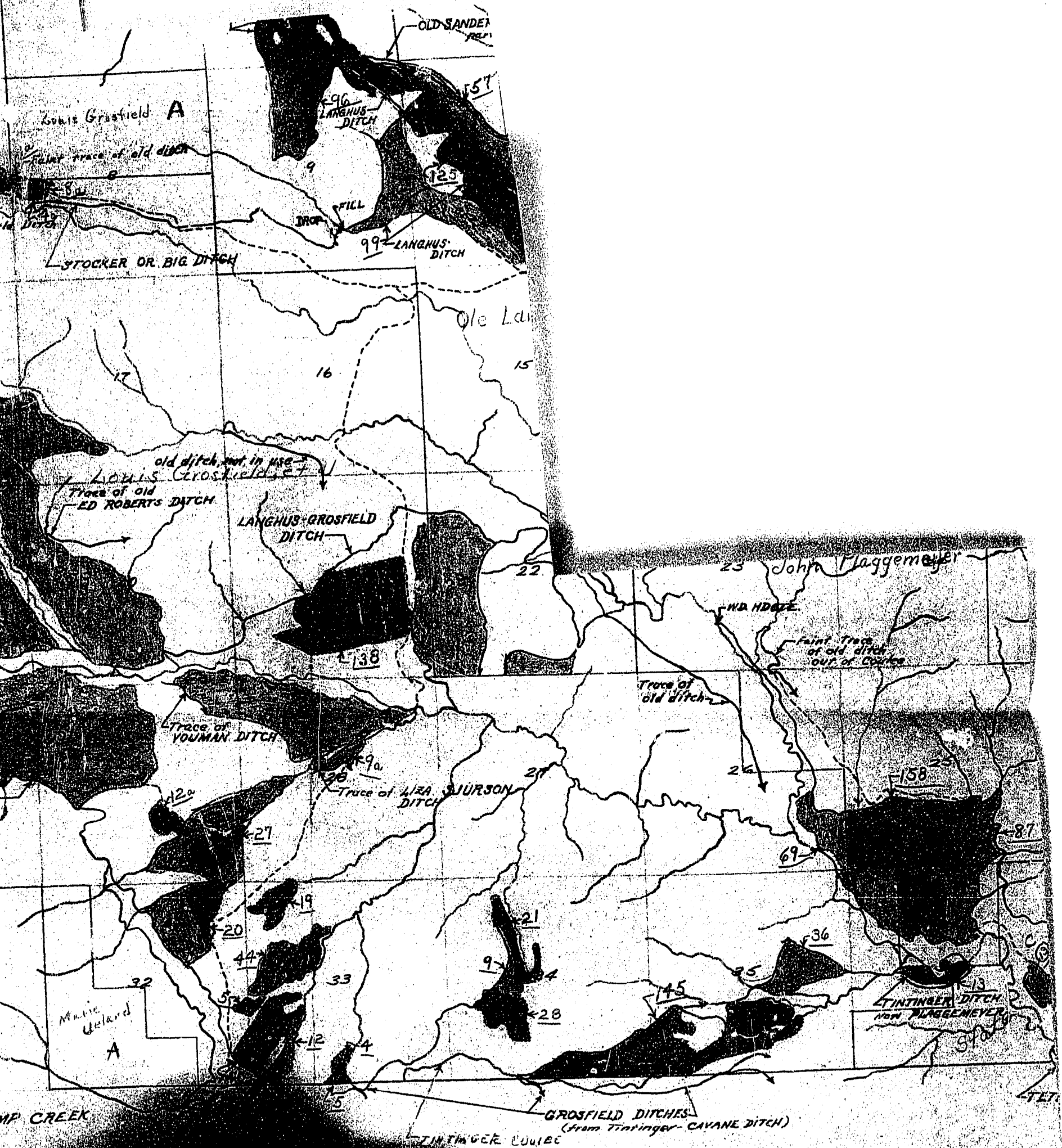

STATE OF MONTANA

State Engineer's Office

WATER RESOURCES SURVEY

FARM MAP

County _____

Code No. _____

Twp. _____ Rge. _____

Twp. 3N Rge. 13E

Twp. _____ Rge. _____

Land Owner Grosfield, Louis et al Address Big Timber

Operator Same Address _____

Location _____

☐ Irrigated Land

☐ Non-Irrigated Land
North

☐ Potential Land Under Existing Facilities

System <u>Sanderson Ditch</u>	Source of Water <u>Amalong Creek</u>
<u>Timber Cr.</u> Present <u>0</u> Potential <u>103</u> Maximum <u>103</u> R <input checked="" type="checkbox"/> F <input type="checkbox"/> P <input type="checkbox"/> G <input checked="" type="checkbox"/> S <input type="checkbox"/>	
System <u>Grasfield Ditch</u>	Source of Water <u>Amalong Creek</u>
<u>Timber Cr.</u> Present <u>6</u> Potential <u>8</u> Maximum <u>14</u> R <input checked="" type="checkbox"/> F <input type="checkbox"/> P <input type="checkbox"/> G <input checked="" type="checkbox"/> S <input type="checkbox"/>	
System <u>W. H. Hannah Ditch</u>	Source of Water <u>Middle Fk. Big T. Cr.</u>
<u>19A, 20A</u> Present <u>0</u> Potential <u>383</u> Maximum <u>383</u> R <input checked="" type="checkbox"/> F <input type="checkbox"/> P <input type="checkbox"/> G <input checked="" type="checkbox"/> S <input type="checkbox"/>	
System <u>Wm. Cavane Ditch</u>	Source of Water <u>Middle Fk. Big Timber Cr.</u>
<u>Timber Creek</u> Present <u>0</u> Potential <u>82</u> Maximum <u>82</u> R <input checked="" type="checkbox"/> F <input type="checkbox"/> P <input type="checkbox"/> G <input checked="" type="checkbox"/> S <input type="checkbox"/>	

Company, Irrigation District, or Government Project, state the number of shares or inches, acre feet, as the case may be

R—Denotes Regular Irrigation. F—Flood Irrigation. P—Water diverted by means of pumping. G—Water diverted by gravity.
S—Stored Water.

Information from J. E. Cook Date May 3, 1951

STATE OF MONTANA
State Engineer's Office
WATER RESOURCES SURVEY
FARM MAP

County _____
Code No. _____

Twp. _____ Rge. _____
Twp. 3N Rge. 13E
Twp. _____ Rge. _____

Land Owner Grosfield, Louis et al Address Big Timber
Operator Same Address _____
Location _____

☐ Irrigated Land

☐ Non-Irrigated Land
North

☐ Potential Land Under Existing Facilities

Code No. <u>6A</u>	System <u>Sanderson Ditch</u>	Source of Water <u>Amalong Creek</u>
Basin <u>Big Timber Cr.</u>	Present <u>0</u> Potential <u>103</u> Maximum <u>103</u>	R <input checked="" type="checkbox"/> F <input type="checkbox"/> P <input type="checkbox"/> G <input checked="" type="checkbox"/> S <input type="checkbox"/>
Code No. <u>7A, 8B</u>	System <u>Grosfield Ditch</u>	Source of Water <u>Amalong Creek</u>
Basin <u>Big Timber Cr.</u>	Present <u>6</u> Potential <u>8</u> Maximum <u>14</u>	R <input checked="" type="checkbox"/> F <input type="checkbox"/> P <input type="checkbox"/> G <input checked="" type="checkbox"/> S <input type="checkbox"/>
Code No. <u>17A, 18A, 19A, 20A</u>	System <u>Wash. Hannah Ditch</u>	Source of Water <u>Middle Fk. Big T. Cr.</u>
Basin <u>Big Timber Cr.</u>	Present <u>0</u> Potential <u>38.3</u> Maximum <u>38.3</u>	R <input checked="" type="checkbox"/> F <input type="checkbox"/> P <input type="checkbox"/> G <input checked="" type="checkbox"/> S <input type="checkbox"/>
Code No. <u>19A, 20A</u>	System <u>Wm. Cavane Ditch</u>	Source of Water <u>Middle Fk. Big Timber Cr.</u>
Basin <u>Big Timber Creek</u>	Present <u>0</u> Potential <u>8.2</u> Maximum <u>8.2</u>	R <input checked="" type="checkbox"/> F <input type="checkbox"/> P <input type="checkbox"/> G <input checked="" type="checkbox"/> S <input type="checkbox"/>

If under Ditch Company, Irrigation District, or Government Project, state the number of shares or inches, acre feet, as the case may be.

paid system _____
NOTE: R—Denotes Regular Irrigation. F—Flood Irrigation. P—Water diverted by means of pumping. G—Water diverted by gravity.
S—Stored Water.

Information from J. E. Cook Date May 3, 1951

II

D-161	Hannah, N.J.	Devil Creek	6-1-98	200
D-162	Hannah, N.J.	Devil Creek	6-1-98	200
D-164	Tintinger Bros.	Devil Creek	6-1-98	40
D-135	Tintinger, N.J.	Devil Creek	6-1-98	40
D-160	Hannah, Margaret	Devil Creek	6-25-08	120
D-163	Roberts, Edward	Devil Creek	6-25-08	120

D-167	Grosfield, A.M.	Dry Creek	9-5-03	140
-------	-----------------	-----------	--------	-----

^{Huffs} ^{Mudill} D-246	Arneson, A.H.	Swamp Creek	4-1-80	460
D-253	Grosfield, A.M.	Swamp Creek	4-1-80	334
D-254	Grosfield, A.M.	Swamp Creek	6-15-84	160
D-255	Grosfield, A.M.	Swamp Creek	6-3-85	140
^{Huffs} ^{Mudill} D-247	Arneson, A.H.	Swamp Creek	1-14-89	100
^{Huffs} ^{Mudill} D-248	Arneson, A.H.	Swamp Creek	4-21-90	60
D-256	Grosfield, A.M.	Swamp Creek	4-21-90	50
D-257	Grosfield, A.M.	Swamp Creek	4-21-90	40
^{Huffs} ^{Mudill} D-249	Arneson, A.H.	Swamp Creek	6-1-91	60
^{Huffs} ^{Mudill} D-250	Arneson, A.H.	Swamp Creek	7-1-93	40
D-258	Grosfield, A.M.	Swamp Creek	6-12-95	60
D-259	Grosfield, A.M.	Swamp Creek	9-13-97	50
D-260	Grosfield, A.M.	Swamp Creek	9-15-03	80
D-261	Grosfield, A.M.	Swamp Creek	12-1-04	20
D-262	Grosfield, A.M.	Swamp Creek	8-1-06	220

II					
TAN RISE					
Ditch out of B.T. Creek crosses Amalgam	13	Mayekason	Amalgam Cr.	12-9-04	12-30-04 200
110	Zverson, Cleona	and Ruckert Cr. Big Timber Cr. (Sofk)	using Tintinger & Carane ditch, which diverts in sec 24 TAN RISE (MA-12A-184)	6-9-02	6-9-02 200
Stacker Ditch at right	111	Tanger, Carl	Big Timber Cr.	3-3-03	3-3-03 2000
Same ditch as Tintinger & Carane	106	Hauge, Richard E.	Big Timber Cr. (Sofk)	10-23-07	10-23-07 320
no ditch found less wrong could be SE 1/4 Sec 6 (Sec 374)	375	Grasfield, Mathias	Dry Creek	7-32-95	8-2-95 500
Ditch diverts on W line sec 9	729	Grasfield, Abraham	Swamp Cr.	7-1-95	7-20-95 500
1000	"	"	mouth bank Springs near rise SW corner sec 9	-19-95	500
1059	Stole, Omand P.	"	"	10-3-95	200
627	Hauge, Richard E.	Rock Cr.		MA-12A-29	1-18-08
642	Younians, H. E.	Schoolhouse Cr.		MA-12A-28	4-27-01 4-27-01 All
State	375				
In sec 32	882	Arneson, Edward	Whitetail Cr.	10-30-02	10-30-02 100
In SW 1/4 Sec 23	384	Nesley, Mrs. Edna	Whitetail Cr.	9-20-17	9-20-17 60
748	"	"	Nesley Spring	9-20-17	9-20-17 50
740	Younians, H. E.	Swamp Cr.		2-14-02	2-14-02 75
SW 1/4	75	Anderson, A. O.	Big Timber Cr.	11-5-04	11-10-04 300
	77	Anderson, A. O.	Big T. Creek Cr. (Sofk) Tversen ditch	9-22-04	9-22-04 300
	1077	Mathias, A.	Spring	-01	25
378	Alex. Mero	Dry Cr.		3-2-01	3-2-01 300
379	Unter Mosse	Dry Cr.		12-27-06	12-27-06 200
Possible	768	Baker, F. L.	Dry Creek		
	372	Edwards	"		
	373				
	375				
Probably	377	A. Hansen & C. P. Stole	Dry Cr.	9-22-04	10-1-04 (MA-38-02) 400

No.	Name	Location	Acres	Year	Remarks
1	Parker, Thomas E.	Amalgam Cr.	6-24-91	6-24-93	200
2	Harrison, Philip W.	"	5-11-11	5-18-11	120
3	Middlemiss, John	N.E. Big T. Cr.	7-8-06	7-8-06	160
4	Kelsey, James A.	Big Timber Cr.	5-1-91	5-1-92	300
5	"	"	11-15-05	11-15-05	100
6	Cavane, A.R. et al	Big Timber Cr.	5-23-96	5-23-96	1000
7	Mitchell, Burt	N.E. Big T. Cr.	8-31-03	8-31-03	300
8	"	N.E. Big T. Cr.	5-3-09	5-2-09	100
9	Cavane, A.R. et al	Big T. Creek	6-14-93	6-16-93	400
10	Roberts, Edward	Waste Water from Hannah ditch	8-24-08	8-27-08	100
11	Hannah, W.D. & Claudine Roberts	Big T. Cr.	6-1-09	6-1-09	400
12	Roberts, Halda	Midco. B.T. Cr.	5-27-12	5-29-12	100
13	Kevin Marion	N.E. B.T. Creek	10-2-97	10-29-97	200
14	Sjogren, Lisa	B.T. Cr. & Springs	5-1-07	5-15-07	250
15	Wilcox, Wiley	S.F.K. B.T. Cr.	2-19-98	2-19-98	600
16	Yennans, Mary H.	"	2-14-03	2-14-03	400
17	Hannah, Elsie	Springs			
18	Margaret Hannah	B.T. Cr.	7-13-09	7-13-09	1000
19	"	"	4-1-07	4-24-05	200
20	Zindinger, Maria	S.F.K. B.T. Cr.	11-14-06	11-15-06	320
21	Zindinger, Nicholas	Big Timber Cr.	5-6-98	5-6-98	200

I					Decrease
Code No of Decree	Decreed to	Stream	Date of Priority	M.I.	
D-45	Mjolsness, John	Amalong Creek	6-16-88	50	
D-46	Mjolsness, John	Amalong Creek	7-3-93	20	
D-42	Hannah, Margaret	Amalong Creek	7-1-97	40	
D-47	Mjolsness, John	Amalong Creek	5-1-06	50	
D-43	Hanson, Phillip W.	Amalong Creek	4-6-14	60	
D-58	Anderson, Anders	Big Timber Cr.	-08	1	
D-88	Hannah, W. J.	Big Timber Cr.	7-15-87	120	
D-115	Tintinger Bros.	Big Timber Cr.	7-15-88	50	
D-80	Grosfield, A. M.	" " "	6-15-89	160	
D-81	Grosfield, A. M.	" " "	7-15-89	20	
D-82	Grosfield, A. M.	" " "	5-23-96	22	
D-89	Hannah, W. J.	" " "	5-23-96	250	
D-116	Tintinger Bros.	" " "	5-23-96	250	
D-85	Hannah, Margaret L.	" " "	6-1-00	40	
D-117	Tintinger Bros.	" " "	7-15-02	450	
D-83	Grosfield, A. M.	" " "	1-1-03	278	
D-90	Hannah, W. J.	" " "	5- -04	100	
D-91	Hannah, W. J.	" " "	1-22-04	120	
D-92	Hannah, W. J.	" " "	5- -05	60	
D-86	Hannah, Margaret L.	" " "	6-1-05	200	
D-87	Hannah, Margaret L.	" " "	6-1-07	250	
D-58	Anderson, A. O.	" " "	8-1-08	160	
D-84	Grosfield, A. M.	" " "	6- -09	140	

Farm Checked

STATE OF MONTANA

FORM F-1 REPORTER 1M 3-49 17380

By J.C. + M.T.

State Engineer's Office

Code No. 30A

Area Big Timber Cr.

WATER RESOURCES SURVEY

County Sweet Grass

Date 7-18-50

T. 3 N R. 13 E Sec. 30

Photo No. MA-12A-185

Legal Land Owner Hegdahl, Ole

Address Big Timber

Operator Same

Address " "

Water is delivered by:

Federal Project _____ Pres. _____ Pot. _____

Ditch Company _____ Pres. _____ Pot. _____

Irrigation District _____ Pres. _____ Pot. _____

Private System Cavane - Tintinger ditch Pres. 10 ac. Pot. _____

Hegdahl private ditch Totals 10 ac.

Flood _____ Pump _____ Reservoir _____ Gravity ☒

Size and Capacity, Pump, etc. _____

Original Appropriator, Company _____ App. No. _____

Original Appropriator, Private Cavane, A.R. et al App. No. 87

no filing for small ditch in NW corner Sec 30

Is the system an extension of another system? Yes _____ No ☒

Is all land irrigated from one system? Yes _____ No ☒

(If No, show break down on map)

Source of Water Big Timber Creek

Acres Irrigated 19.50, 10

Potential Acres _____ Seeped ☒

Explain _____

Condition of System Small ditch near, T-C ditch-gard

Adequate Supply _____ Yes ☒ No _____

Explain Small area irrigated

Topography Bottom of Creek

Information From Ole Hegdahl

Remarks _____

-OVER-

TWP. 3 N - R9E. 13 E

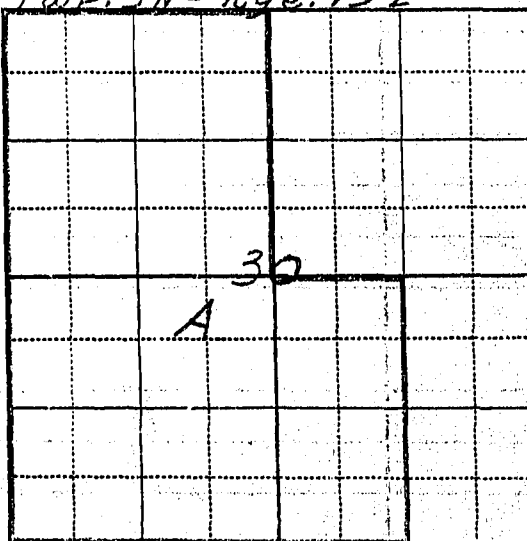

uses some ^{waste} water out of Cavane-tintinger ditch

to irrigate small garden

(5) also uses small private ditch out of Big timber creek

to irrigate small garden

1/ Some waste water from the Cavanaugh-Tintinger ditch is used to irrigate a small 10 acre garden plot although no rights are owned for this water.

2/ A small private ditch is taken out of Big Timber Creek to irrigate this same land and rights are ~~owned~~ ^{filed} for this water.

Form WR-B
Reporter 20168 2M 12-49

Twp. 2 N Rge. 13 E
Twp. _____ Rge. _____
Twp. _____ Rge. _____

STATE OF MONTANA
State Engineer's Office
WATER RESOURCES SURVEY
FARM MAP

County Sweetgrass
Code No. 30H

Name of Land Owner Hegdal, Ole Address Big Timber
Name of Operator Same Address "
Legal Description _____



Irrigated Land



Non-Irrigated Land



Potential Land Under Existing Facilities

North

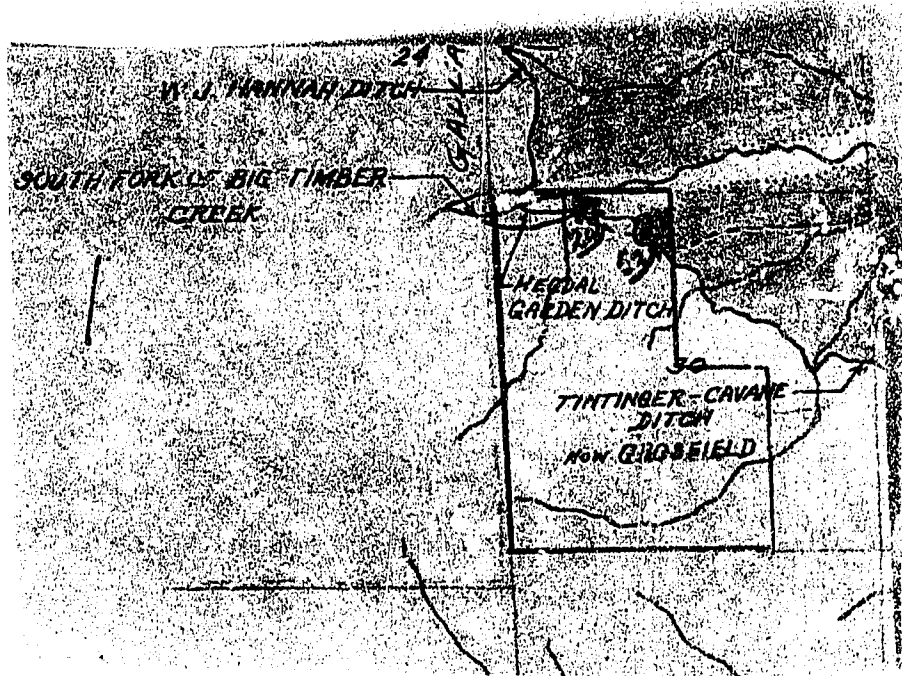

Code No. 30H System Hegdal Garden Ditch Source of Water S. F. K. Big Timber Co.
Basin Big Timber Co. Present 2 Potential 0 Maximum 2 R. F P. G S. S
Code No. 30H System Tintinger-Cavane Ditch Source of Water S. F. K. Big Timber Co.
Basin Big Timber Co. Present 0 Potential 3 Maximum 3 R. F P. G S. S
Code No. _____ System _____ Source of Water _____
Basin _____ Present _____ Potential _____ Maximum _____ R. F P. G S. S
Code No. _____ System _____ Source of Water _____
Basin _____ Present _____ Potential _____ Maximum _____ R. F P. G S. S

If under Ditch Company, Irrigation District, or Government Project, state the number of shares or inches, acre feet, as the case may be in said system.

NOTE: R—Denotes Regular Irrigation. F—Flood Irrigation. P—Water diverted by means of pumping. G—Water diverted by gravity. S—Stored Water.

Information from _____ Date June 2, 1951

Farm Checked

By JC + MT

Area Swamp Cr.

Date 7-18-50

Legal Land Owner.....

Operator _____

Water is delivered by:

Federal Project _____ Pres. _____ Pot. _____

Ditch Company _____ Pres. _____ Pot. _____

Irrigation District _____ Pres. _____ Pot. _____

Private System _____ Pres. _____ Pot. _____

No Irrigation	Totals
---------------	--------

Flood _____ **Pump** _____ **Reservoir** _____ **Gravity** _____

Size and Capacity, Pump, etc.....

Original Appropriator, Company _____ App. No. _____

Original Appropriator, Private Hannah, Margaret A. App. N 1

Is the system an extension of another system? Yes _____ No ✓

Is all land irrigated from one system? Yes_____No_____

(If No, show break down on map)

Source of Water. Big Timber Creek

Acres Irrigated 19_____

Potential Acres Seeped

Explain

Condition of System

Adequate Supply Yes No

Explain

Topography Hills

Information From David M. Hall

Remarks No water rights in use

No ditches according to Arnold Hegaballi

②

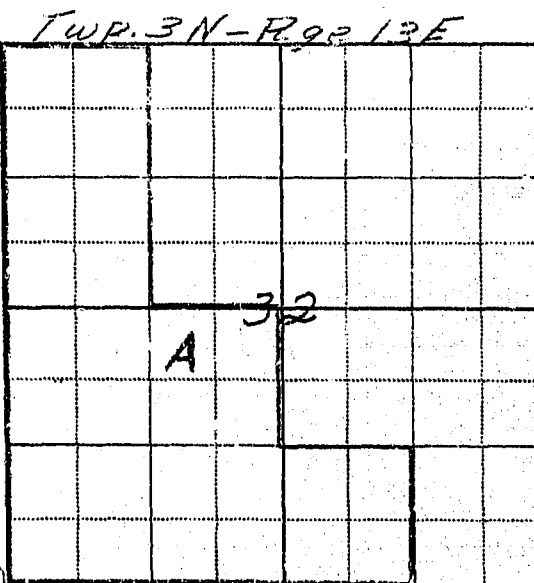

STATE OF MONTANA

FORM F-1 REPORTER IM 3-49 173BC

By James H. B. [Signature]

State Engineer's Office

Code No. 5A, 4A, 9A, 10A, 11A

Code No. 5A, 4A, 9A, 10A, 11A

Area Big Island

Courry Sweet Grass

Date June 27, 1950

T-3N R-15E Sec.

Legal Land Owner Langhus, Ole

Photo No. MA-12A-187-186

Operator Same

Address Big Timber

Water is delivered by:

Federal Project _____ Pres. _____ Pot _____

Ditch Company _____ Pres. _____ Pot. _____

Irrigation District _____ Pres. _____ Pot. _____

Private System	② Old Ditch (not in use)	Pres.	Pot.
----------------	--------------------------	-------	------

A Private Diskette Total 3

Flood _____ Pump _____ Reservoir _____ Gravity 

Size and Capacity, Pump, etc..

Original Appropriator, Company. _____ App. No. _____

Original Appropriator, Private Sanderson, Carrie Cobban, R.M. App. No. D-48, D-49, D-50

Is the system an extension of another system? Yes. _____ No. _____

Is all land irrigated from one system? ☒ Yes ☐ No
 (Grant Alexander) es. _____ No _____

(If No, show break down on map)

Source of Water: Antelope Cr. Big Timber Cr.

Acres Irrigated 19 50

Potential Acres _____ Seeped _____

Explain_____

Condition of System Good

Adequate Supply..... Yes ✓ No _____

Explain First part of season

Topography Creek bottoms + bench land

Information From Ed Arnold - 10/1/62

Remarks Information on truck

Chir 12/26/2011

③

See Attached
Map

① Land under Sanderson ditch was once irrigated and is now considered potential. This is Sec. 9 & 10 of T. 3N-R13E. Diversion out of Hailstone creek is out. Hasn't been in use for 5 years. Diverts in SE corner of Sec. 4 - T3N-R13E in Hailstone creek.

② Old ditch not in use in N 1/2 of Sec. 10. Partly obliterated.

Land in Sec. 22 used to be irrigated from 10-12 years ago. Ditch in Sec. 22 is extension another old ditch by Horsefield & Langhans.

③ Horsefield & Langhans ditch in Sec. 21 in middle of Section. Has not been used for irrigation for several years. Used only for bringing some stock water down.

④ Main ditch diverts from N. pk. of Arrolong Cr. into Hailstone cr. in N.W. cor. of Sec. 6. Water is picked up by 6 smaller spreader ditches out of Hailstone cr. and tribs. One of which is Grant ditch. Ditches diverting from Hailstone cr. below the point where the Big Ditch crosses said creek, depends partly on seepage from Big Ditch for supply.

FORM D-1
REPORTER 1M 3-49 17379

STATE OF MONTANA
State Engineer's Office
WATER RESOURCES SURVEY

Township 3 North Range 13 East County Sweet Grass

6	5	4	3	2	1
	A	A			
7	8	9	10	11	12
		A	A	A	
13	17	16	15	14	13
			A		
19	20	21	22	23	24
			A		
30	29	28	27	26	25
31	32	33	34	35	36

Township _____ Range _____

Township 3 North Range 13 East County Sweet Grass

[illegible]

Form WR-B
Reporter 20108 2M 12-40

Twp. 3 N Rge. 1 E

Twp. Rge.

Twp. Rge.

STATE OF MONTANA

State Engineer's Office

WATER RESOURCES SURVEY
FARM MAP

County San Diego

Code No. 5A-24-44-104

11A-128-154-224

