

County. Sweet Grass

Farin Checked: Date 4-6-51

By..... Bob & Jim .....

**STATE OF MONTANA**  
**STATE ENGINEERS OFFICE**  
**Water Resources Survey**

T. 5N.....R. 12E..... Plat No. 1.....

Photo No. MA-12A-209

Legal Land Owner.....Brannin Bros.....Address:.....None shown.....

Operator.....Same.....Address.....

Water is delivered by:— 1. Private System; 2. Ditch Company; 3. State Project; 4. Federal Project; 5. Irrigation District

[illegible]

**NOTE: R—Denotes Regular Irrigation. F—Flood Irrigation.**

Adequate Supply: Yes..... No...**X**... Explain.....  
Remarks.....

...River Basin

Also in: Plat No.....	Twp.....	Rge.....	Plat No.....	Twp.....	Rge.....	Plat No.....	Twp.....	Rge.....
Plat No.....	Twp.....	Rge.....	Plat No.....	Twp.....	Rge.....	Plat No.....	Twp.....	Rge.....

Information From:

Mr. Rein.

6	5	4	3	2	1
7	8	9	10	11	12
13	14	15	16	17	18
19	20	21	22	23	24
25	26	27	28	29	30
31	32	33	34	35	36

Land Ownership

---



---



---

(1)

Township 5 North, Range 12 East

Name of Owner

Township & Range

✓1.

American Fork Ranch

(1) 5N - 12E (2) 5N-13E

✓2.

Rein, Lloyd G.

"

✓3.

White, Mary M.

"

STATE OF MONTANA  
STATE ENGINEER'S OFFICE  
WATER RESOURCES SURVEY

Township 5 North Range 12 East County Sweet Grass

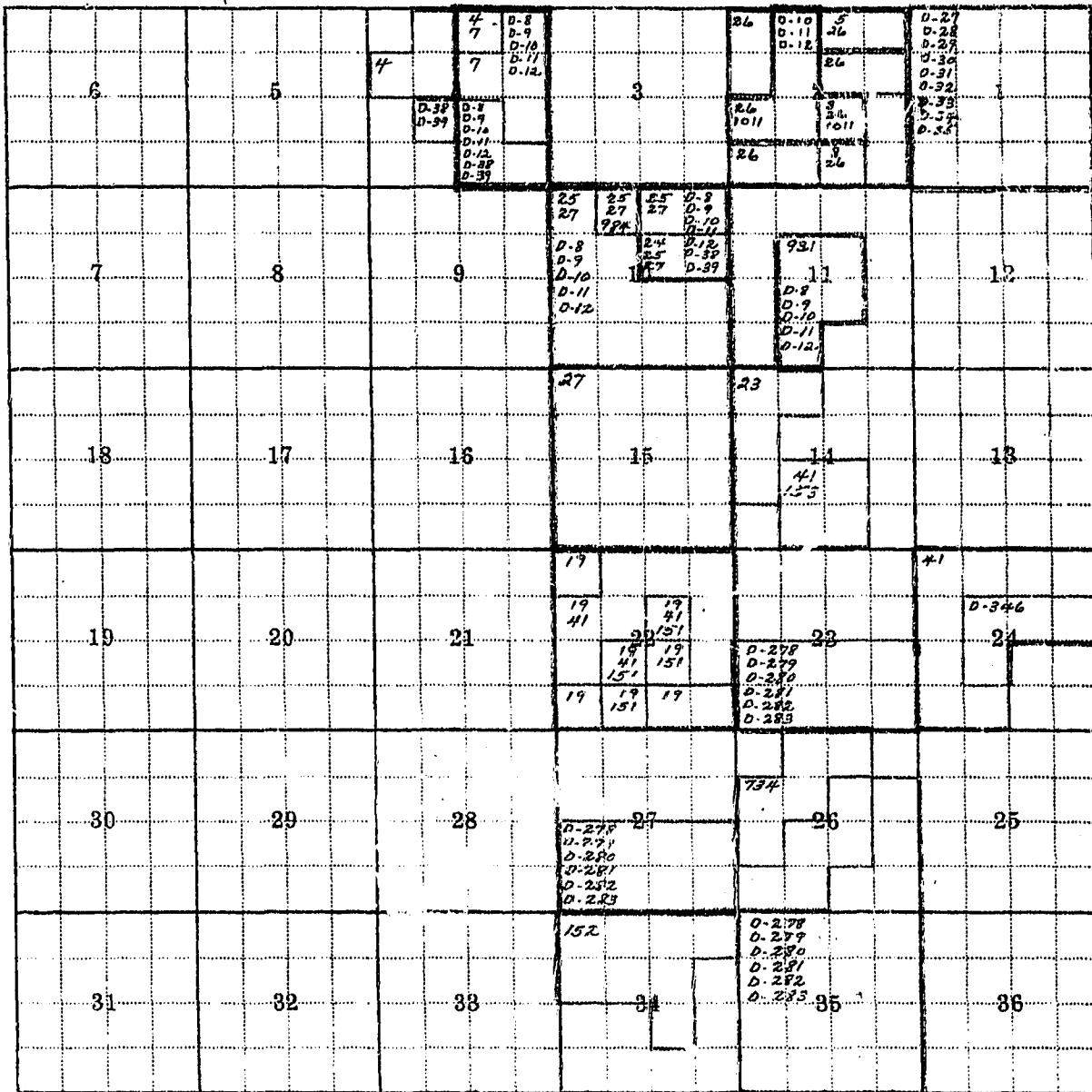

Township 5 North Range 12 East

Township \_\_\_\_\_ Range \_\_\_\_\_ County \_\_\_\_\_

Parcel Number	Name of Owner	Address
Appropriation 149	Arthur, John (1000 m.I.)	Melville, Mont.
	Land surveyed. Point of diversion on Bison Creek on north and south banks about 2 miles west of the west line of the lands now occupied by Edward Truesdell.	
Appropriation 150	Arthur, John (1000 m.I.)	Melville, Mont.
	Unsurveyed lands located west of the lands of John Hoff & Andrew Truesdell on the same stream (Bison Creek).	
Appropriation 17	Crooks, George H. (300 m.I.)	
	Point of diversion on left bank of American Fork Creek.	
Appropriation 837	Walwood, D.J. (40,000 m.I.)	Big Lake, Mont.
	Creation of a reservoir at or near the east line of Sec 24, S.N. 12 E.	
	No.	

Township 5 North, Range 12 East

<u>No.</u>	<u>Name of Appropriator</u>	<u>Name of Stream</u>	<u>Date App.</u>	<u>Date Filed</u>	<u>M.I.</u>
4	Hopkins, Joseph J.	A'Hern Creek	4-11-07	4-11-07	300
5	Hopkins, Josephine	A'Hern Creek	6-22-09	6-28-09	100
7	Hopkins, S. S.	A'Hern Creek	12-7-97	5-14-00	300
8	McDonnell, Elizabeth	A'Hern Creek	9-10-97	10-29-97	160
19	Eggen, Ole L.	American Fork Creek	7-18-07	10-3-07	100
23	Hiller, Albert	American Fork Creek	3-29-06	4-6-06	100
24	Hopkins, Aldis E.	American Fork Creek	11-21-92	11-25-92	500
25	Hopkins, Aldis E.	American Fork Creek	10-24-96	10-24-96	600
26	Hopkins, J. J.	American Fork Creek	10-28-98	10-28-98	500
27	Hopkins, Stillman	American Fork Creek	4-22-03	4-22-03	600
41	Rein, Cornelius M.	American Fork Creek	8-16-04	8-16-04	600
151	Hallstrom, Johannes	Blackby Creek	3-29-06	4-6-06	150
152	Muir, John A.	Blackby Creek	7-14-02	7-14-02	350
153	Rein, C. M.	Blackby Creek	6-10-02	6-11-02	400
734	Muir, Wm. G.	Swamp Creek	6-5-00	6-10-00	200
931	Hopkins, Aldis E.	Unnamed Stream	11-21-92	11-25-92	500
984	Crook, George H.	Unnamed Spring	1-22-01	3-1-01	200
1011	Hopkins, Josephine	Unnamed Spring	10-28-98	10-28-98	500

Page Two

<u>No.</u>	<u>To Whom Deceed</u>	<u>Name of Stream</u>	<u>Date Priority</u>	<u>M.I.</u>
D-8	Hopkins, S. I.	American Fork	5-31-87	100
D-9	Hopkins, S. I.	American Fork	5-31-87	160
D-10	Hopkins, S. I.	American Fork	5-31-87	40
D-11	Hopkins, S. I.	American Fork	6-1-96	280
D-12	Hopkins, S. I.	American Fork	5-31-99	100
D-27	McDonnell and Veasey	American Fork	6-10-83	30
D-28	McDonnell and Veasey	American Fork	5-1-82	40
D-29	McDonnell and Veasey	American Fork	5-30-82	100
D-30	McDonnell and Veasey	American Fork	5-1-82	80
D-31	McDonnell and Veasey	American Fork	6-1-84	60
D-32	McDonnell and Veasey	American Fork	12-9-86	1000
D-33	McDonnell and Veasey	American Fork	6-10-86	360
D-34	McDonnell and Veasey	American Fork	4-25-97	60
D-35	McDonnell and Veasey	American Fork	6-30-01	160
D-38	Raisland, S. B.	American Fork	7-1-00	50
D-39	Raisland, S. B.	American Fork	5-31-99	60
D-278	Berg, Sam	Sweetgrass Creek	8-1-83	80
D-279	Berg, Sam	Sweetgrass Creek	7-30-88	300
D-280	Berg, Sam	Sweetgrass Creek	5-15-92	200
D-281	Berg, Sam	Sweetgrass Creek	7-1-94	80
D-282	Berg, Sam	Sweetgrass Creek	7-1-96	40
D-283	Berg, Sam	Sweetgrass Creek	6-30-98	300
D-346	Rein, C. M.	Sweetgrass Creek	6-1-98	100

STATE OF MONTANA  
**STATE ENGINEER'S OFFICE**  
 WATER RESOURCES SURVEY

Township 5N Range 12E County Sweetgrass

6	5	4	3	2	1	14
7	8	9	10	11	12	13
18	17	16	15	14	13	
19	20	21	22	23	24	
30	29	28	27	26	25	
31	32	33	34	35	36	

American Fork Ranch

Township 5N Range 12E



**Firm Checked**

STATE OF MONTANA

Code No. 1A, 2B, 12A, 36A, 35A

By David W. Lee

# STATE ENGINEER'S OFFICE

County Sweetgrass

Area American Fork

WATER RESOURCES SURVEY

T. 51 R. 12 Sec. 12, 12, 26

Date 8/17/50

Photo No. MA-12A-207, 208, & 209

Legal Land Owner American Fock Ranch

Address Two B21

Operator Sam

Address \_\_\_\_\_

Water is delivered by:

Federal Project \_\_\_\_\_ Pres. \_\_\_\_\_ Pot. \_\_\_\_\_

Ditch Company \_\_\_\_\_ Pres. \_\_\_\_\_ Pot. \_\_\_\_\_

Irrigation-District Grande Dunes Pres. \_\_\_\_\_ Pot. \_\_\_\_\_

Private System American Fed. Highway Canal Pres. \_\_\_\_\_ Pot. \_\_\_\_\_

**Totals** \_\_\_\_\_

Flood \_\_\_\_\_ Pump \_\_\_\_\_ Reservoir \_\_\_\_\_ Gravity Regular

Size and Capacity, Pump, etc. \_\_\_\_\_

Original Appropriator, Company.....App. No.....

Original Appropriator, Private: Hopkins, J. J.; McDennell & Veasey App. No. 26; D-27 to D-35 incl;  
Miller, Wm. G.; Berg, Sam 734; D-278 to D-283 incl;

Is the system an extension of another system? Yes \_\_\_\_\_ No ☒

Is all land irrigated from one system? Yes \_\_\_\_\_ No ☒ \_\_\_\_\_

(If No, show break down on map)

Source of Water American Fork Creek, Sweetgrass Creek, Swamp Creek

Acres Irrigated 10,520

Potential Acres \_\_\_\_\_ Seeped \_\_\_\_\_

### Explain

Condition of System... Good

Adequate Supply . . . . . Yes ☒ No ☐

### Explain

Topography Slope to Creek

Information From Ranch Foreman

Remarks For American Ex. Canal see

① form (2) 7.5N-RISE

[illegible]

4. 11. 1936  
American Ex. Canal

Some land irrigated in Sec. 1 and 12

Springs ditched but not in use and  
trace of old ditch out of Sweet Grass  
Cr. for land in Sec. 35 (Not in use)

Trace of ditch out of Sweet Grass  
Cr. Sec. 26 (Not in use) Pot. land. Sec. 26

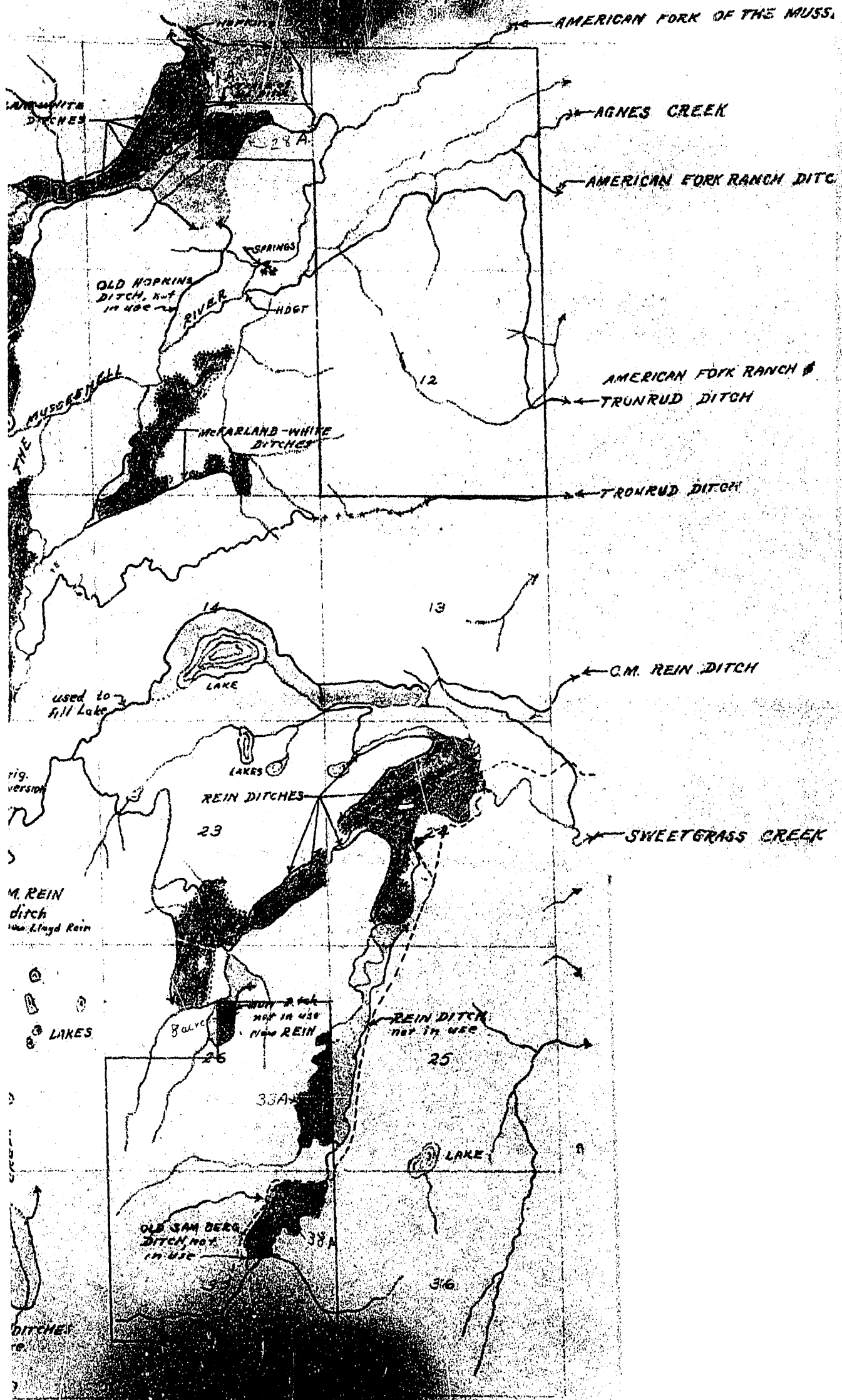

STATE OF MONTANA

State Engineer's Office

WATER RESOURCES SURVEY

FARM MAP

County Sweetgrass

Code No. \_\_\_\_\_

1A-2A-2A-26A-

35A

Twp. 5N Rge. 12E

Twp. \_\_\_\_\_ Rge. \_\_\_\_\_

Twp. \_\_\_\_\_ Rge. \_\_\_\_\_

Name of Land Owner American Fork Ranch Address Two Dot

Name of Operator Same Address " "

Legal Description \_\_\_\_\_



Irrigated Land



Non-Irrigated Land

North



Potential Land Under Existing Facilities

Code No. 213 System McFarland White Ditches Source of Water O'Hearn Creek  
Basin American Fork of the Missouri Present 1.7 Potential 2.8 Maximum 2.9 R ✓ F ✓ P ✓ G ✓ S ✓  
Code No. 26A System Wink Ditch Source of Water undammed Coulter trib. to Sweet Grass Creek  
Basin Sweet Grass Creek Present 0 Potential 8 Maximum 8 R ✓ F ✓ P ✓ G ✓ S ✓  
Code No. 26A System Rein. Ditch Source of Water Sweet Grass Creek  
Basin Sweet Grass Creek Present 0 Potential 3.3 Maximum 3.3 R ✓ F ✓ P ✓ G ✓ S ✓  
Code No. 35A System Sam Berg Ditch Source of Water Sweet Grass Creek  
Basin Sweet Grass Creek Present 0 Potential 3.8 Maximum 3.8 R ✓ F ✓ P ✓ G ✓ S ✓

If under Ditch Company, Irrigation District, or Government Project, state the number of shares or inches, acre feet, as the case may be in said system.

NOTE: R—Denotes Regular Irrigation. F—Flood Irrigation. P—Water diverted by means of pumping. G—Water diverted by gravity. S—Stored Water.

Information from J. E. Cook Date April 23, 1951

Farm Checked

STATE OF MONTANA

Code No. 34-BBy Bob & Jim

## STATE ENGINEER'S OFFICE

County Sweet GrassArea Melville

WATER RESOURCES SURVEY

T. 5N R. 12 Sec. 34Date 4/6/51Photo No. MA-12A-209Legal Land Owner Bradley Bros.

Address \_\_\_\_\_

Operator \_\_\_\_\_

Address \_\_\_\_\_

Water is delivered by:

Federal Project \_\_\_\_\_ Pres. \_\_\_\_\_ Pot. \_\_\_\_\_

Ditch Company \_\_\_\_\_ Pres. \_\_\_\_\_ Pot. \_\_\_\_\_

Irrigation District \_\_\_\_\_ Pres. \_\_\_\_\_ Pot. \_\_\_\_\_

Private System \_\_\_\_\_ Pres. \_\_\_\_\_ Pot. \_\_\_\_\_

Totals \_\_\_\_\_

Flood ☒ Pump \_\_\_\_\_ Reservoir \_\_\_\_\_ Gravity ☒

Size and Capacity, Pump, etc. \_\_\_\_\_

Original Appropriator, Company \_\_\_\_\_ App. No. \_\_\_\_\_

Original Appropriator, Private No Filing App. No. \_\_\_\_\_

Is the system an extension of another system? Yes \_\_\_\_\_ No \_\_\_\_\_

Is all land irrigated from one system? Yes \_\_\_\_\_ No \_\_\_\_\_

(If No, show break down on map)

Source of Water Blackby CreekAcres Irrigated 1950 0

Potential Acres \_\_\_\_\_ Seeped \_\_\_\_\_

Explain \_\_\_\_\_

Condition of System out of useAdequate Supply \_\_\_\_\_ Yes \_\_\_\_\_ No ☒Explain only in springTopography valley slopeInformation From Mr. Rein

Remarks \_\_\_\_\_

31

Form WR-B  
Reporter 20108 2M 12-49

Twp. 51V Rge. 12E (1)  
Twp. \_\_\_\_\_ Rge. \_\_\_\_\_  
Twp. \_\_\_\_\_ Rge. \_\_\_\_\_

STATE OF MONTANA  
**State Engineer's Office**  
WATER RESOURCES SURVEY  
FARM MAP

County Sweet Grass

Code No. 39 B

Name of Land Owner Brammer Bros Address Melville  
Name of Operator \_\_\_\_\_ Address \_\_\_\_\_  
Legal Description \_\_\_\_\_



Irrigated Land



Non-Irrigated Land



Potential Land Under Existing Facilities

North

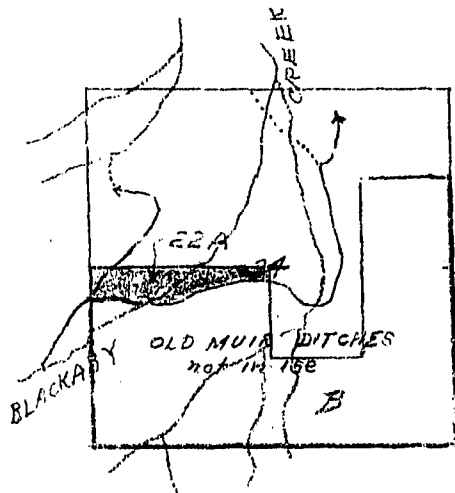

Code No. 39 B System (not in use) Old Muir Ditches Source of Water Blackburn Creek  
Basin Sweet Grass Creek Present 0 Potential 22 Maximum 22 R X F     P     G X S      
Code No. \_\_\_\_\_ System \_\_\_\_\_ Source of Water \_\_\_\_\_  
Basin \_\_\_\_\_ Present \_\_\_\_\_ Potential \_\_\_\_\_ Maximum \_\_\_\_\_ R     F     P     G     S      
Code No. \_\_\_\_\_ System \_\_\_\_\_ Source of Water \_\_\_\_\_  
Basin \_\_\_\_\_ Present \_\_\_\_\_ Potential \_\_\_\_\_ Maximum \_\_\_\_\_ R     F     P     G     S      
Code No. \_\_\_\_\_ System \_\_\_\_\_ Source of Water \_\_\_\_\_  
Basin \_\_\_\_\_ Present \_\_\_\_\_ Potential \_\_\_\_\_ Maximum \_\_\_\_\_ R     F     P     G     S    

If under Ditch Company, Irrigation District, or Government Project, state the number of shares or inches, acre feet, as the case may be in said system.

NOTE: R—Denotes Regular Irrigation. F—Flood Irrigation. P—Water diverted by means of pumping. G—Water diverted by gravity. S—Stored Water.

Information from \_\_\_\_\_ Date \_\_\_\_\_



11. 11. 11

- ① Trace of old main ditch out of Blackberry cr.  
Takes out on north side of creek in SW  $\frac{1}{4}$  of  
sec. 33 - T5 N-10 E and runs into sec. 24 & 27  
Not in use. Potential under this ditch.
- ② Also main ditch out of Blackberry cr. on south side  
in SW  $\frac{1}{4}$  of sec. 34. Not in use. Potential  
under this ditch.
- ③ Main ditch takes out of east side of Sweetgrass  
creek in SW corner of sec. 25. Has potential  
under ditch.
- ④ Main ditch out of course, takes to Sweetgrass cr.  
Diversion in center of sec. 26. Some  
potential under ditch. Not in use.
- ⑤ Ditch out of above course to sec. 23.  
Diversion ditch in SW  $\frac{1}{4}$  of sec. 23.
- ⑥ Rain ditch out of S. 24. American 24. creek  
irrigates land in sections 23 & 24.
- ⑦ Ditch out of course, takes to Sweetgrass cr.  
irrigates the west section line of 24 and  
irrigates west of Sweetgrass cr.
- ⑧ Ditch from lake in sec. 14 puts water into  
sec. 24. Diversion on sec. line between  
13 & 14 on the south side.
- ⑨ Rain ditch out of S. 24. American 24. cr.  
Has potential under it in sec. 13 & 14 & 22.



STATE OF MONTANA  
**STATE ENGINEER'S OFFICE**  
 WATER RESOURCES SURVEY

Township 5N Range 12E County Sweetgrass

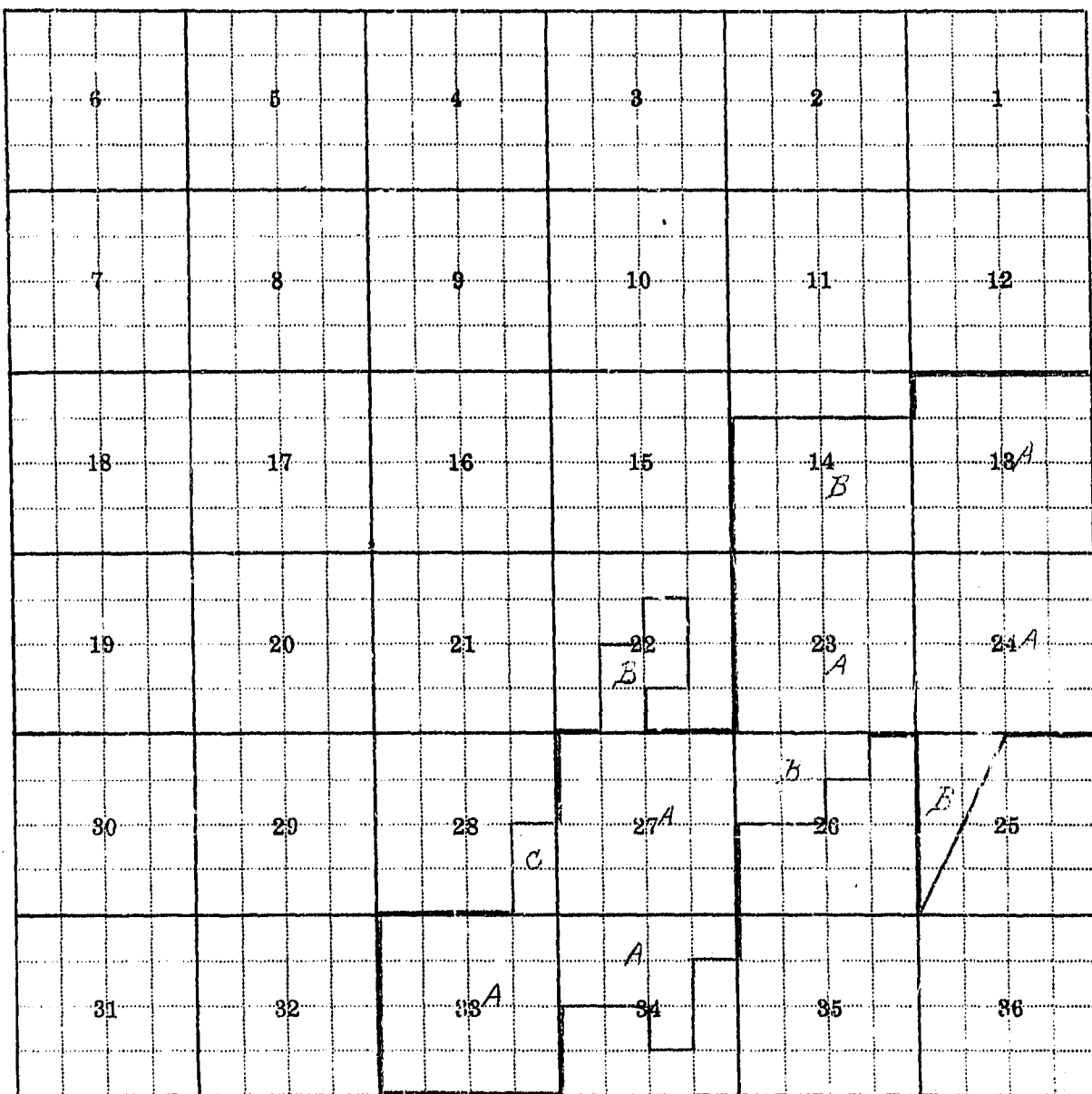

Lloyd G. Rein

Township 5N Range 12E

(1)

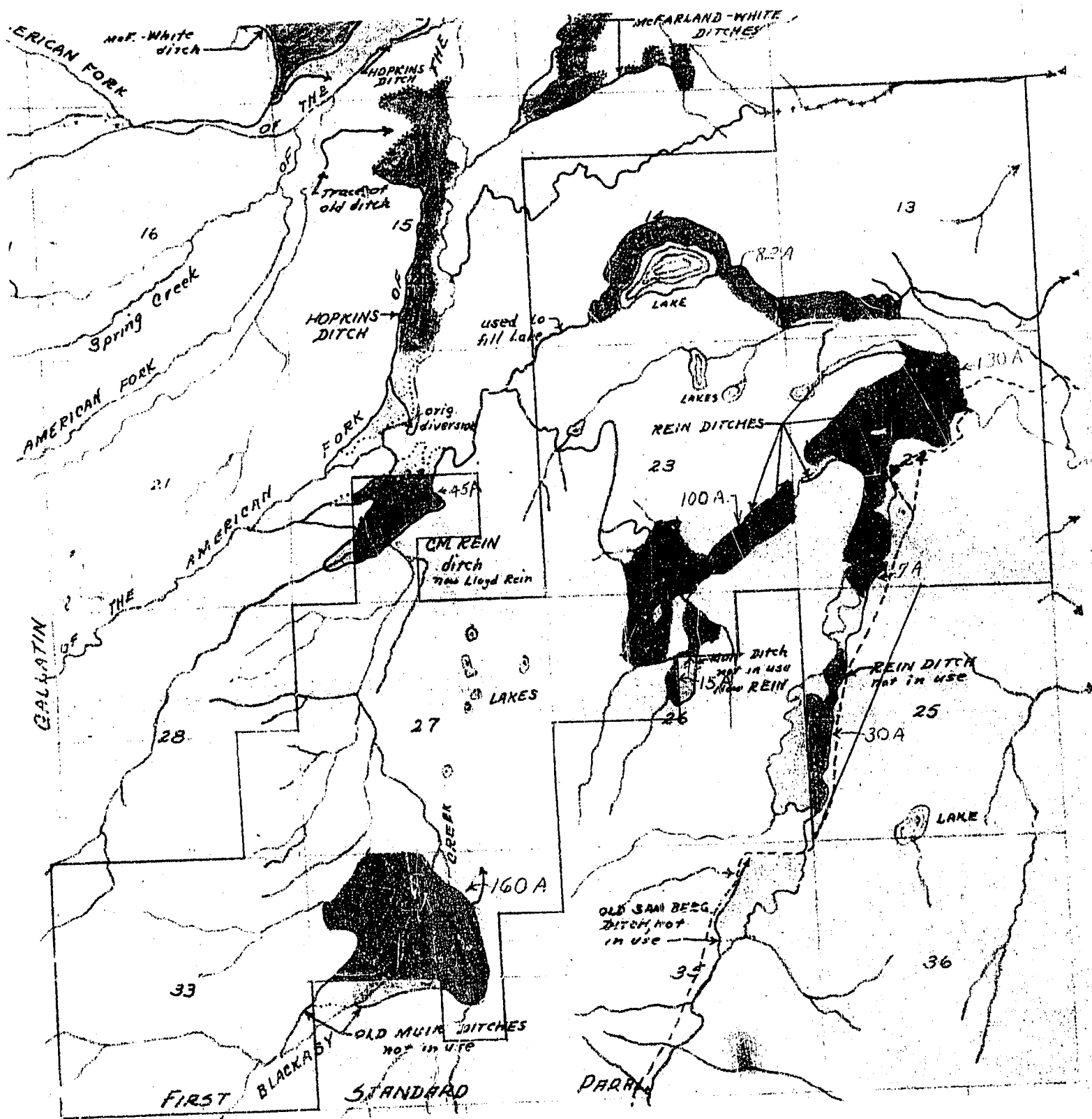

Form WA-5  
Reporter 20108 2M 12-49

STATE OF MONTANA

# State Engineer's Office

WATER RESOURCES SURVEY

## FARM MAP

County Sweet Grass

Code No. 13A-14A-

22B-23A-24A-25B-  
26B-27A-28C-33A-34B

Twp. 5N Rge. 12E

Twp.     Rge.    

Twp.     Rge.    

Name of Land Owner F. E. M. Lloyd G. Address Melville

Name of Operator Same Address "

Legal Description    



Irrigated Land



Non-Irrigated Land

North



Potential Land Under Existing Facilities

Code No. 13A, 14B, 22B, 23A, 24A, 26B System Rein. Ditch Source of Water So. Fl. of the American Fork

Basin Musselshell River Present 230 Potential 15 Maximum 357 R ✓ F     P     G ✓ S    

Code No. 24A System old Muir Ditches not in use Source of Water Blackaby Creek (not in use)

Basin Musselshell River Present 0 Potential 160 Maximum 160 R ✓ F     P     G ✓ S    

Code No. 26B System Muir Ditch (not in use) Source of Water unpaired Center trib. to Sweet Grass Creek

Basin Sweet Grass Creek Present 0 Potential 15 Maximum 15 R     F ✓ P     G ✓ S    

Code No. 25B, 24A System Rein. Ditch (not in use) Source of Water Sweet Grass Creek

Basin Sweet Grass Creek Present 0 Potential 30 Maximum 30 R ✓ F     P     G ✓ S    

If under Ditch Company, Irrigation District, or Government Project, state the number of shares or inches, acre feet, as the case may be in said system.

NOTE: R—Denotes Regular Irrigation. F—Flood Irrigation. P—Water diverted by means of pumping. G—Water diverted by gravity. S—Stored Water.

Information from J. E. Cook Date April 23, 1951

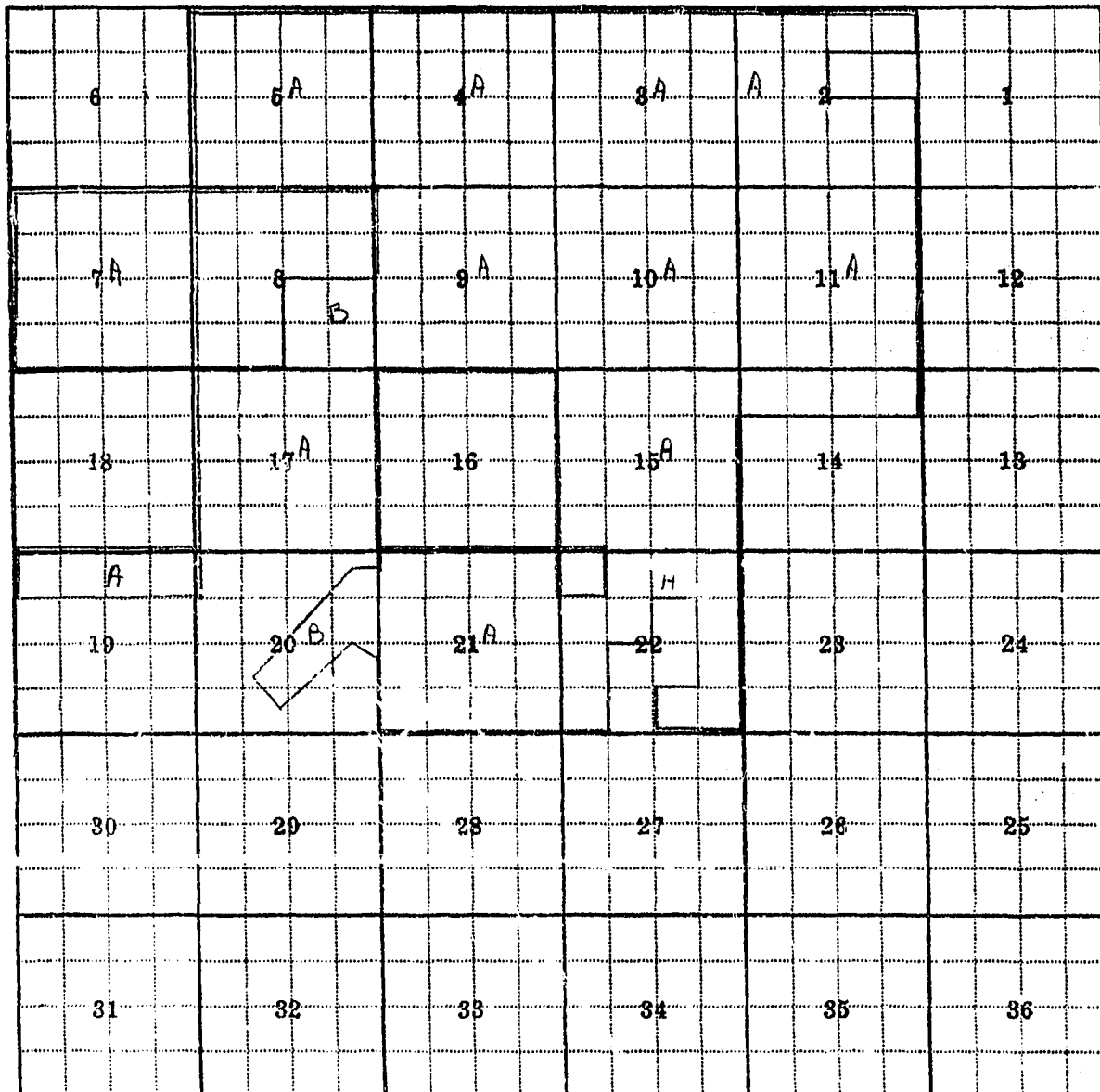

Land Ownership.....  
.....  
.....

2A, 3A, 4A, 5A 74, 8B, 9A, 10A

STATE OF MONTANA

# STATE ENGINEER'S OFFICE

Code No. 11A, 14A, 15A, 16A, 17A, 18A, 19A, 20A, 21A, 22A

County Sheridan

WATER RESOURCES SURVEY

T. 5N R. 12E Sec.       

MA-38 24 4-25

Photo No. MA-12A-2074205

Address Two Dot

Address Two Dot

**Water is delivered by:**

**Federal Project** \_\_\_\_\_ **Pres** \_\_\_\_\_ **Pot** \_\_\_\_\_

Ditch Company \_\_\_\_\_ Pres. \_\_\_\_\_ Pot. \_\_\_\_\_

Irrigation District \_\_\_\_\_ Pres. \_\_\_\_\_ Pot. \_\_\_\_\_

Private System 21 Private Members Pres. \_\_\_\_\_ Pot. \_\_\_\_\_

[illegible]

Flow 1 Pump \_\_\_\_\_ Reservoir \_\_\_\_\_ Gravity ✓

### Size and Capacity, Pump, etc.

Original Appropriator, Company Andis E. Hopkins; William Hopkins; Grenville M. Peim; George H. Crook App. No.                     

Original Appropriator, Private Joseph J. Hopkins; Josephine Hopkins; S.S. Hopkins Sp. No. 4, 5, 7, 8, 19, 23, 24, 25, 26  
Elizabeth McDonnell; Ole Eggen; Albert Hiller 27, 41, 931, 1011, 984

Is the system an extension of another system? Yes \_\_\_\_\_ No       

Is all land irrigated from one system? Yes. \_\_\_\_\_ No. 1

(If No, show break down on map)

Source of Water: Abern Creek; American Fork; & unnamed Springs

Acres Irrigated 19 50 400

Potential Acres \_\_\_\_\_ Seeped 2000

## Explain

Condition of System GoodAdequate Supply Yes No

Explain the difference between the two species

Topography Coastal flat topped by dunes

Information From William J. Clark

Remarks See back of sheet.

See Attached  
Map.

- ① Trace of old ditch, ditch south side of <sup>4000 ft</sup> ~~Shannon~~ creek. Diversion in middle of section line on north side of section 4. No irrigation.
- ② Ditch taken out in S.W. corner of sec. 11 on south side of ~~South American~~ creek, designated in sec. 11.
- ③ Ditch taken out in N.W. corner of sec. 14 on south side of South American Cr. and irr. in sec. 14 & 14.
- ④ Old ditch taken out in S.E. corner of NW 1/4 of sec. 11 on north side of ~~South American~~ Cr. Not in use.
- ⑤ Ditch taken out of N.W. ~~South American~~ Cr. on south side of creek, near middle of sec. line between 9 & 10 in sec. 10 and irrigation in sec. 10.
- ⑥ Ditch out of N.W. ~~South American~~ Cr. on north side of sec. in West 1/2 of SE 1/4 of sec. 12.
- ⑦ Ditch that runs both ways for a spring located in S.E. corner of NW 1/4 of sec. 10. Irrigated in sec. 10 and was potential in sec. 2.
- ⑧ Ditch out of ~~Shannon~~ creek on south side of creek in East 1/2 of SE 1/4 of sec. 2 and irr. in sec. 2.
- ⑨ Ditch taken out on south side of ~~Shannon~~ creek in S.E. corner of NW 1/4 of sec. 2. Some potential.
- ⑩ Trace of ditches out of creek in S.E. corner of SW 1/4 of sec. 25 - T 6 N - R 12 E of Wheatland County to Irrigate in sec. 2 of T 5 N - R 12 E of Sweetgrass Co.
- ⑪ Ditch of ~~Shannon~~ creek on north side of creek, ditch in NW corner of SW 1/4 of sec. 2. Irrigated in sec. 2.
- ⑫ Ditch taken out of north side of ~~Shannon~~ creek in NW corner of SE 1/4 of sec. 3 and irrigates in sec. 2 & 3.
- ⑬ Small ditch out of north side of creek, takes to ~~Shannon~~ creek in S.E. corner of NW 1/4 of sec. 2.
- ⑭ Small ditch out of south side of creek, takes to ~~Shannon~~ creek in center of NW 1/4 of sec. 2.
- ⑮ Small ditch out of <sup>South side of</sup> creek, takes to ~~Shannon~~ creek in NW corner of sec. 2 and irrigates in sec. 2.

(Cont. on next page.)

STATE OF MONTANA  
**STATE ENGINEER'S OFFICE**  
 WATER RESOURCES SURVEY

Township 5N Range 12E County Sweetgrass

6	5 <sup>A</sup>	4 <sup>A</sup>	3 <sup>A</sup>	2 <sup>A</sup>	1
7 <sup>A</sup>	8 <sup>E</sup>	9 <sup>A</sup>	10 <sup>A</sup>	11 <sup>A</sup>	12
18	17 <sup>A</sup>	16	15 <sup>A</sup>	14 <sup>A</sup>	13
19 <sup>A</sup>	20 <sup>E</sup>	21 <sup>A</sup>	22 <sup>A</sup>	23	24
30	29	28	27	26	25
31	32	33	34	35	36

.....Mary M. White et al - own.....

.....McFarland & White - op.....

(1)

Township 5N Range 12E

Township \_\_\_\_\_ Range \_\_\_\_\_ County \_\_\_\_\_

Parcel Number	Name of Owner	Address
(16)	Ditch out of north side of cañon, tube, to Chances,	
	in East $\frac{1}{2}$ of SE $\frac{1}{4}$ of sec. 9 to irr. in sec. 2.	
(17)	2 ditches out of spring on north $\frac{1}{2}$ of SE $\frac{1}{4}$	
	of sec. 3 to irrigate in sec. 18.	
(18)	Trace of old ditch in NE $\frac{1}{4}$ of sec. 2. Not in use.	
(19)	Ditch takes out of north side of So. 2d division	
	2d creek to irrigate in sec. 18 & 22. Ditch	
	in West $\frac{1}{2}$ of sec. 22.	
	Large potential under B. M. Bein ditch in	
	sec. 14 & 22.	
	Some water in East $\frac{1}{2}$ of sec. 10.	



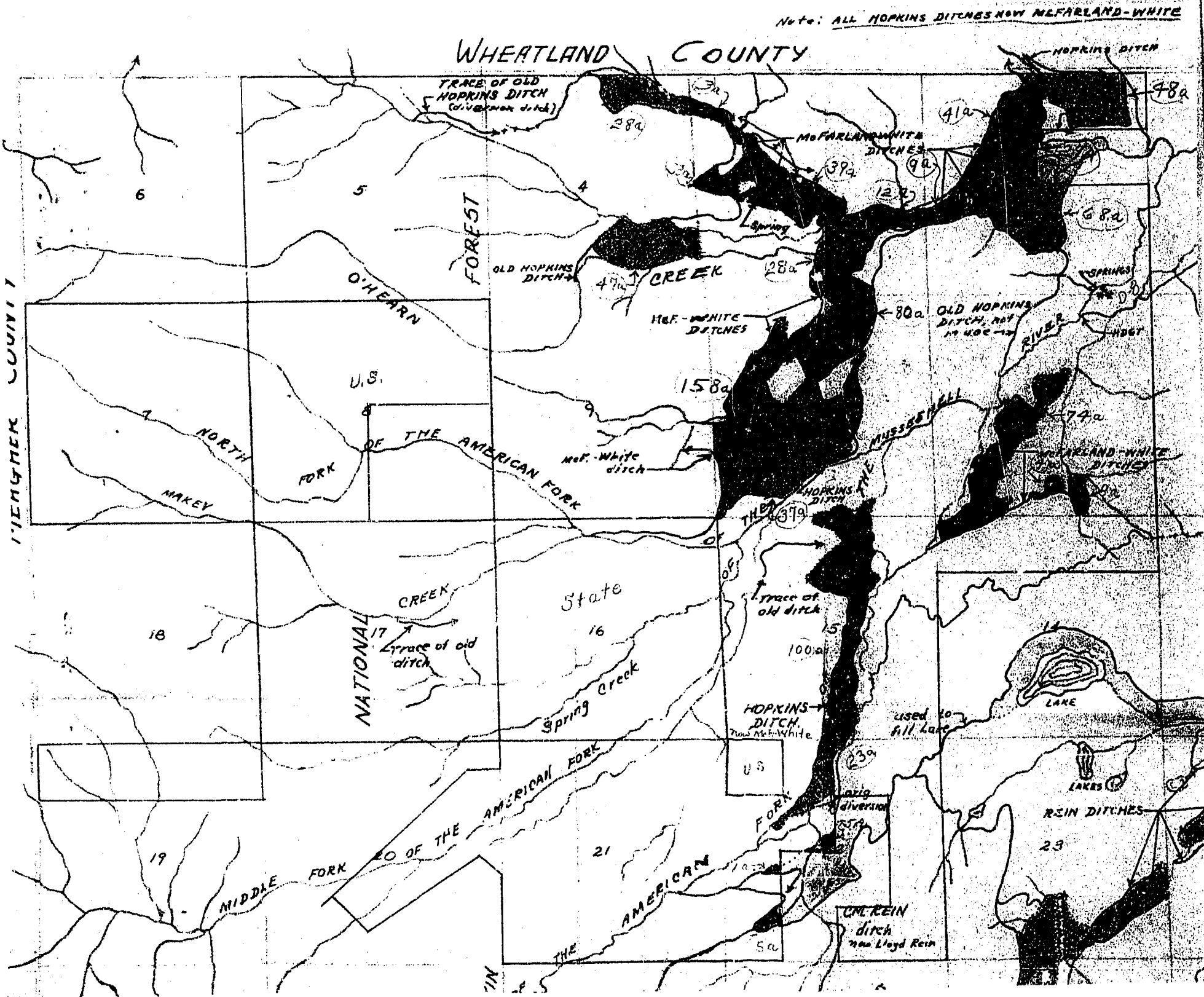

STATE OF MONTANA

State Engineer's Office

WATER RESOURCES SURVEY

FARM MAP

County Sweetgrass

Code No. 2A-3A-4A-

5A-7A-8B-9A-10A-11A-  
14A-15A-17A-19A-20B-21A-  
22A

Twp. 5N Rge. 12E

Twp. \_\_\_\_\_ Rge. \_\_\_\_\_

Twp. \_\_\_\_\_ Rge. \_\_\_\_\_

Name of Land Owner White, Mary M. Address Two Dot

Name of Operator McFarland & White Address \_\_\_\_\_

Legal Description \_\_\_\_\_



Irrigated Land



Non-Irrigated Land

North



Potential Land Under Existing Facilities

Code No. 2A, 3A, 4A System McFarland-White Ditches Source of Water O'Hearn Creek  
Basin Musselshell River Present 38 Potential 47 Maximum 85 R ✓ F ✓ P ✓ G ✓ S ✓  
Code No. 2A, 3A, 4A System McFarland-White Ditches Source of Water O'Hearn Creek  
Basin Musselshell River Present 128 Potential 76 Maximum 204 R ✓ F ✓ P ✓ G ✓ S ✓  
Code No. 2A, 3A, 10A System McFarland-White Ditches Source of Water North Fork of the American Rk.  
Basin Musselshell River Present 238 Potential 133 Maximum 371 R ✓ F ✓ P ✓ G ✓ S ✓  
Code No. 10A, 11A, 14A, 15A, 22A System McFarland-White Source of Water So. Fork of the American Rk.  
Basin Musselshell River Present 187 Potential 23 Maximum 210 R ✓ F ✓ P ✓ G ✓ S ✓

If under Ditch Company, Irrigation District or Government Project, state the number of shares or inches, acre feet, as the case may be in said system.

NOTE: R—Denotes Regular Irrigation. F—Flood Irrigation. P—Water diverted by means of pumping. G—Water diverted by gravity. S—Stored Water.

Information from \_\_\_\_\_ Date \_\_\_\_\_

STATE OF MONTANA

State Engineer's Office

WATER RESOURCES SURVEY

FARM MAP

County Sweetgrass

Code No. 2A-3A-4A-

5A-7A-8B-9A-10A-11A-

14A-15A-17A-19A-20B-21A-

22A

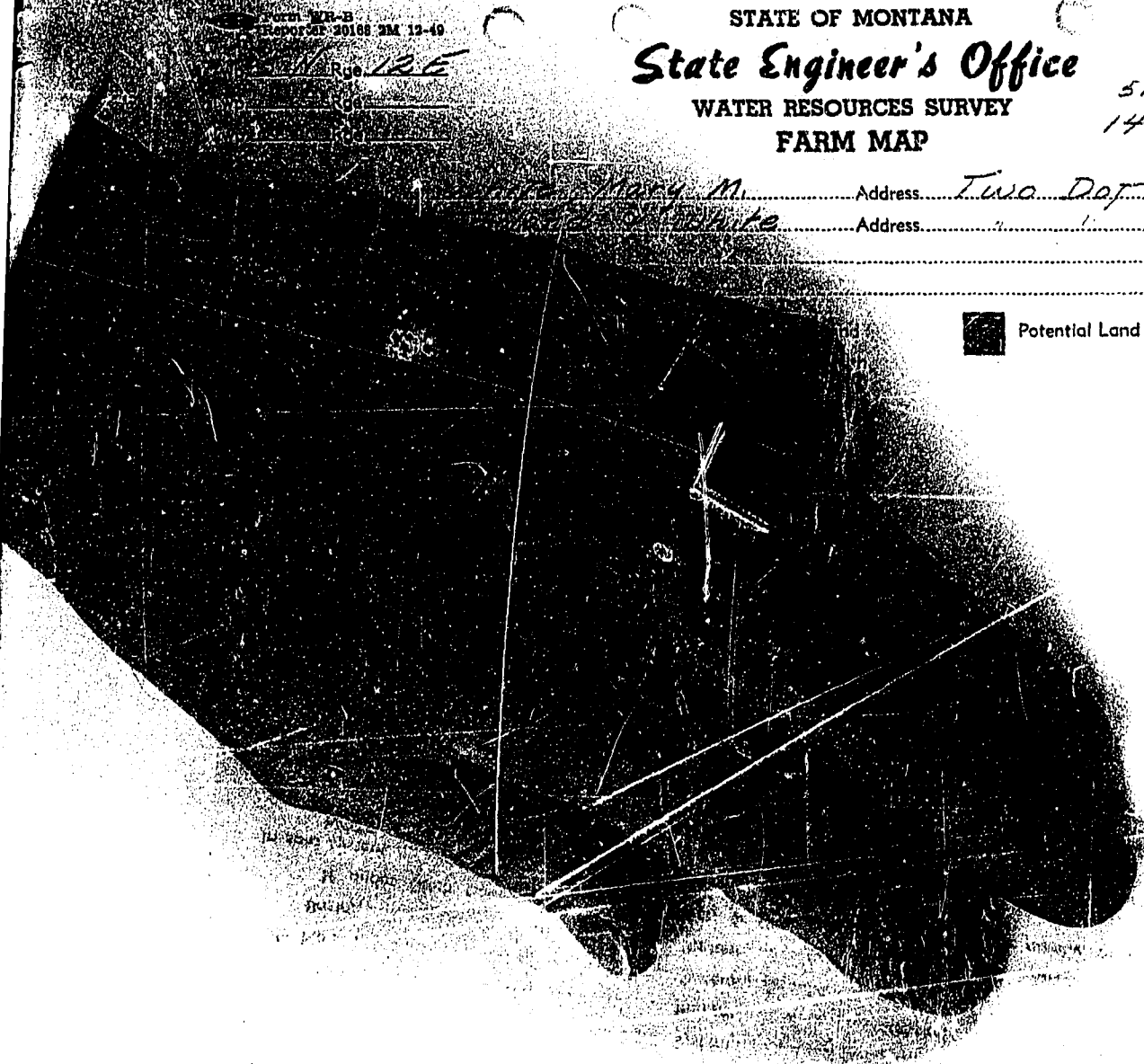

Potential Land Under Existing Facilities

Code No. 22A System C.M. Reim Ditch Source of Water South of the American Fork

Basin Muskegochell River Present C Potential 11 Maximum 11 R ✓ F ✓ P ✓ G ✓ S ✓

Code No. \_\_\_\_\_ System \_\_\_\_\_ Source of Water \_\_\_\_\_

Basin \_\_\_\_\_ Present \_\_\_\_\_ Potential \_\_\_\_\_ Maximum \_\_\_\_\_ R \_\_\_\_\_ F \_\_\_\_\_ P \_\_\_\_\_ G \_\_\_\_\_ S \_\_\_\_\_

Code No. \_\_\_\_\_ System \_\_\_\_\_ Source of Water \_\_\_\_\_

Basin \_\_\_\_\_ Present \_\_\_\_\_ Potential \_\_\_\_\_ Maximum \_\_\_\_\_ R \_\_\_\_\_ F \_\_\_\_\_ P \_\_\_\_\_ G \_\_\_\_\_ S \_\_\_\_\_

Code No. \_\_\_\_\_ System \_\_\_\_\_ Source of Water \_\_\_\_\_

Basin \_\_\_\_\_ Present \_\_\_\_\_ Potential \_\_\_\_\_ Maximum \_\_\_\_\_ R \_\_\_\_\_ F \_\_\_\_\_ P \_\_\_\_\_ G \_\_\_\_\_ S \_\_\_\_\_

If under Ditch Company, Irrigation District, or Government Project, state the number of shares or inches, acre feet, as the case may be in said system.

NOTE: R—Denotes Regular Irrigation. F—Flood Irrigation. P—Water diverted by means of pumping. G—Water diverted by gravity. S—Stored Water.

Information from \_\_\_\_\_ Date June 23, 1951

STATE OF MONTANA  
**STATE ENGINEER'S OFFICE**  
 WATER RESOURCES SURVEY

Township 5N Range 13E County Sweet Grass

6	5	4	3	2	1
7	8	9	10	11	12
				A	
				A	
18	17	16	15	14	13
				A	A
19	20	21	22	23	24
				A	A
30	29	28	27	26	25
				A	
31	32	33	34	35	36

Virginia Langston

Township 5N Range 13E

Farm Checked

STATE OF MONTANA

Code No. 1A, 2A, 3A, 10B, 11A, 12A, 13A, 14A

By Dave & Joe

**STATE ENGINEER'S OFFICE**

County San Juan

Area Am. Fork

WATER RESOURCES SURVEY

T. 5N R. 13E Sec. 1, 2, 3, 10, 11, 12, 13, 14

Date 8/17/50

Photo No. 12A-34

Legal Land Owner George G. Lawrence

Address Am. Fork, N.M.

Operator \_\_\_\_\_ Address \_\_\_\_\_

Water is delivered by:

Federal Project \_\_\_\_\_ Pres. \_\_\_\_\_ Pot. \_\_\_\_\_  
 Ditch Company \_\_\_\_\_ Pres. \_\_\_\_\_ Pot. \_\_\_\_\_  
 Irrigation District \_\_\_\_\_ Pres. \_\_\_\_\_ Pot. \_\_\_\_\_  
 Private System Range land Pres. \_\_\_\_\_ Pot. \_\_\_\_\_  
No irrigation Totals \_\_\_\_\_  
 Flood \_\_\_\_\_ Pump \_\_\_\_\_ Reservoir \_\_\_\_\_ Gravity \_\_\_\_\_

Size and Capacity, Pump, etc.

Original Appropriator, Company S.O. England & Henry State App. No. 36, 617, 87-37

Original Appropriator, Private McDonald & Edwards App. No. D-27, 28, 29, 30, 31, 32, 33, 34, 35

Is the system an extension of another system? Yes \_\_\_\_\_ No \_\_\_\_\_

Is all land irrigated from one system? Yes \_\_\_\_\_ No \_\_\_\_\_

(If No, show break down on map)

Source of Water Am. Fork; Pecos River Spg. Co.

Acres Irrigated 19 \_\_\_\_\_

Potential Acres \_\_\_\_\_ Seeped \_\_\_\_\_

Explain \_\_\_\_\_

Condition of System \_\_\_\_\_

Adequate Supply Yes \_\_\_\_\_ No \_\_\_\_\_

Explain \_\_\_\_\_

Topography Range land

Information From \_\_\_\_\_

Remarks \_\_\_\_\_

# STATE ENGINEER'S OFFICE

# WATER RESOURCES SURVEY

Township 52 Range 14E County Deer / 9-rod

A 6x6 grid with numbered cells and handwritten annotations. The grid is divided into four 3x3 quadrants by a vertical line between columns 3 and 4, and a horizontal line between rows 3 and 4. The top-left quadrant contains cells 6, 5, 4, 3, 2, 1. The top-right quadrant contains cells 3, 2, 1, 11, 12. The bottom-left quadrant contains cells 7, 8, 9, 10, 15, 16, 17, 18. The bottom-right quadrant contains cells 14, 13, 18, 23, 24, 25, 26, 27, 28, 29, 30, 31, 32, 33, 34, 35, 36. Handwritten annotations include 'A' in the top-right quadrant, 'B' in the bottom-left quadrant, and 'u = 5' in the top-right quadrant.

George Glennie

Township 5N Range 13E

FORM F-1 - GAZETTE 1665.2M-1-47

Code No. 44 54 64 74 84

County West Grand

T. 50 R. 134 Sec. 9567

Photo No. 44-124-170

<b>Operator:</b>	<b>Address</b>
------------------	----------------

W H

Federal Project \_\_\_\_\_ Pres. \_\_\_\_\_ Pot. \_\_\_\_\_

Ditch Company Pres. Pot.

\_\_\_\_\_ Irrigation District \_\_\_\_\_ Pres. \_\_\_\_\_ Pot. \_\_\_\_\_

Private System American Fr. Highline Canal Pres. \_\_\_\_\_ Pot. \_\_\_\_\_

Totals	
...	...

Flood \_\_\_\_\_ Pump \_\_\_\_\_ Reservoir \_\_\_\_\_ Gravity Regular

Size and Capacity, Pump, etc. \_\_\_\_\_

Original Appropriator, Company McDonnell, USAF, ED, App. No. 24, 25, 26, 27, 28, 29, 30, 31  
McDonnell, EDF, McDonnell & Company  
 Original Appropriator, Private Dec. 1955. App. No. 232, 233, 234, 235  
& 33.

Is the system an extension of another system? Yes \_\_\_\_\_ No ☒ \_\_\_\_\_

Is all land irrigated from one system? Yes ✓ No       

(If No, show break down on map)

Source of Water: Chlorinated feed

Acres Irrigated 19 30

Potential Acres \_\_\_\_\_ Sheep \_\_\_\_\_

## Explain

Condition of System Good

Adequate Supply ..... Yes                      No                     

### Explain

Topography Slight Slope

Information From Ranch Forman

Remarks Also land in T-3 N-11 12E

2 (1) See over

[illegible]

American Fork Highline Canal

Point of diversion on the east bank  
NW, NE  $\frac{1}{4}$ , Sec. 11 T. 5 N - R. 13 E

No headgate cut diversion from creek  
cut: across Agnes Cr.

Ditch about 6 miles in length.

A lateral in the NW, SE  $\frac{1}{4}$ , Sec 7.

for T 5 N - R 13 E

for Ironrod.

At one time had wooden headgate  
(New Out)

Irrigates land in Sec. 5, 6, & 7.



STATE OF MONTANA  
**STATE ENGINEER'S OFFICE**  
 WATER RESOURCES SURVEY

Township 5N Range 13E County Sweet Grass

6	A	5	A	4	A	3	2	1
7	A	8	9	10	11	12		
18		17	16	15	14	13		
19		20	21	22	23	24		
30		29	28	27	26	25		
31		32	33	34	35	36		

American Fork Ranch

Township 5N Range 13E

168 2M 12-49

STATE OF MONTANA  
**State Engineer's Office**  
 WATER RESOURCES SURVEY  
**FARM MAP**

County Sweetgrass  
 Code No. 4A-5A-6A-7A-8A

Twp. 5N Rge. 13E  
 Twp. 5N Rge. 12E  
 Twp. \_\_\_\_\_ Rge. \_\_\_\_\_

Name of Land Owner American Fork Ranch Address Melville  
 Name of Operator Same Address "  
 Legal Description \_\_\_\_\_

☐ Irrigated Land ☐ Non-Irrigated Land ☒ Potential Land Under Existing Facilities  
 North

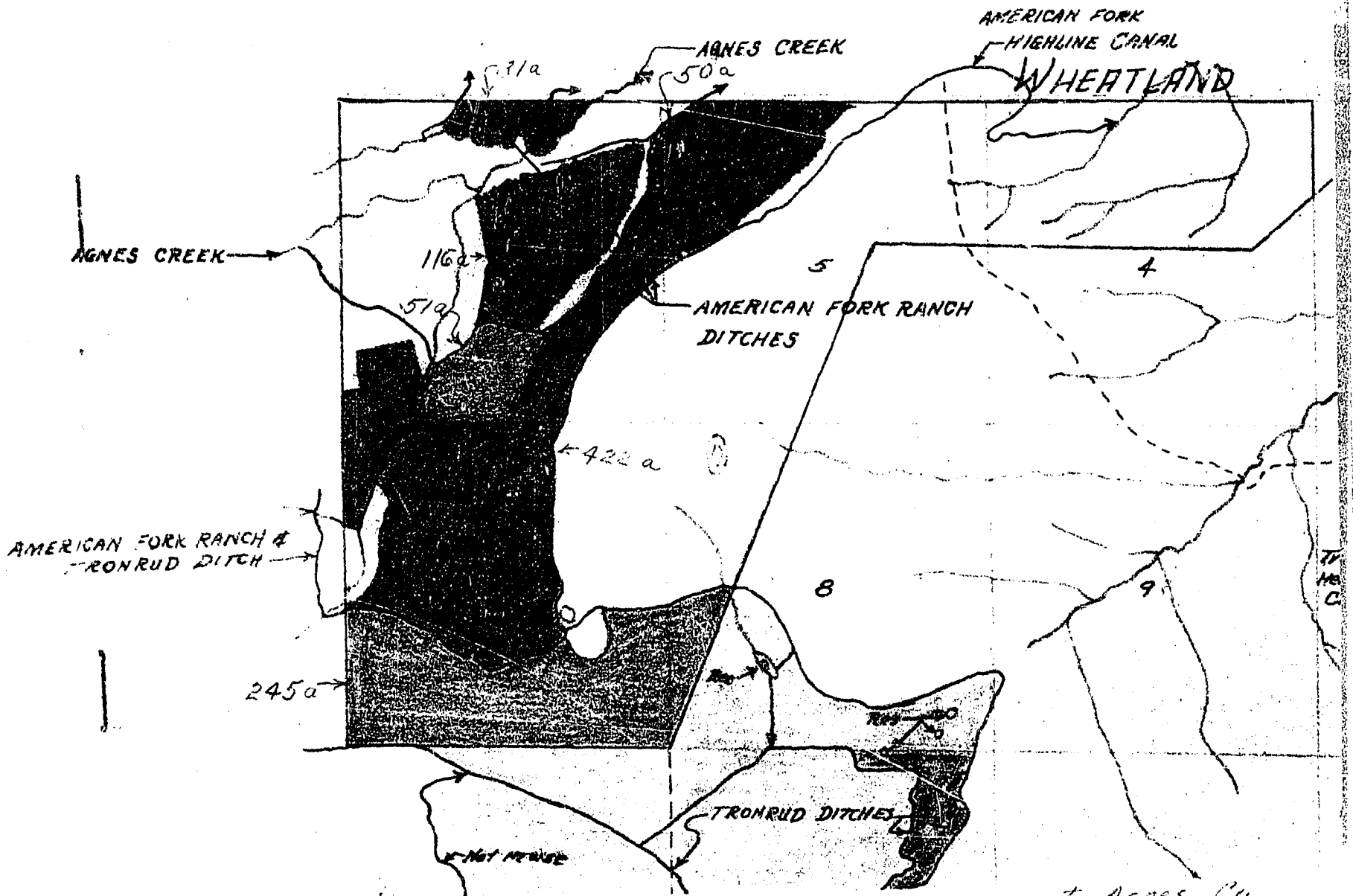

Code No. 6A System American Fork Ranch Ditch Source of Water Agnes Creek trib. to the American Fork River  
 Basin Missouri River Present 31 Potential 0 Maximum 31 R ☒ F ☐ P ☐ G ☒ S ☐  
 Code No. 5A-6A System American Fork Ranch Ditch Source of Water Agnes Creek (trib. to the American Fork)  
 Basin Missouri River Present 166 Potential 0 Maximum 166 R ☒ F ☐ P ☐ G ☒ S ☐  
 Code No. 5A-6A-7A-8A System American Fork Ranch & Tronrud Ditch Source of Water American Fork of Miss. River  
 Basin Missouri River Present 422 Potential 718 Maximum 718 R ☒ F ☐ P ☐ G ☒ S ☐  
 Code No. \_\_\_\_\_ System \_\_\_\_\_ Source of Water \_\_\_\_\_  
 Basin \_\_\_\_\_ Present \_\_\_\_\_ Potential \_\_\_\_\_ Maximum \_\_\_\_\_ R ☐ F ☐ P ☐ G ☐ S ☐

If under Ditch Company, Irrigation District, or Government Project, state the number of shares or inches, acre feet, as the case may be in said system.

NOTE: R—Denotes Regular Irrigation. F—Flood Irrigation. P—Water diverted by means of pumping. G—Water diverted by gravity. S—Stored Water.

Information from State Engineer's Office Date April 24 1951

Farm Checked

STATE OF MONTANA

Code No. 24B, 25B

By John + Bob

**STATE ENGINEER'S OFFICE**

County Sweet Grass

Area Sweet Grass Co.

**WATER RESOURCES SURVEY**

T. 5N R. 13E Sec. 24-25

Date Sept. 22, 1950

Photo No. MA-12A-35  
MA-12A-34

Legal Land Owner Alana Gasfield

Address Big Timber

Operator \_\_\_\_\_

Address \_\_\_\_\_

Water is delivered by:

Federal Project \_\_\_\_\_ Pres. \_\_\_\_\_ Pot. \_\_\_\_\_

Ditch Company \_\_\_\_\_ Pres. \_\_\_\_\_ Pot. \_\_\_\_\_

Irrigation District \_\_\_\_\_ Pres. \_\_\_\_\_ Pot. \_\_\_\_\_

Private System Nelson - Grosfield Ditch Pres. \_\_\_\_\_ Pot. \_\_\_\_\_

Totals \_\_\_\_\_

Flood \_\_\_\_\_ Pump \_\_\_\_\_ Reservoir ☒ Gravity ☒

Size and Capacity, Pump, etc. \_\_\_\_\_

Original Appropriator, Company \_\_\_\_\_

App. No. \_\_\_\_\_

Original Appropriator, Private \_\_\_\_\_

App. No. 835, 757, 759

Is the system an extension of another system?

Yes \_\_\_\_\_ No ☒

Is all land irrigated from one system?

Yes ☒ No \_\_\_\_\_

(If No, show break down on map)

Source of Water Sweet Grass Co.

Acres Irrigated 19 50

Potential Acres \_\_\_\_\_ Seeped Some

Explain \_\_\_\_\_

Condition of System Fair

Adequate Supply \_\_\_\_\_ Yes ☒ No ☒

Explain Except in extra dry years

Topography Valley bottom & bench land

Information From Alana Gasfield

Remarks \_\_\_\_\_

5N-R-13E

						B
	23				24	
						B
	26				25	

2 & 3 also in

Intend to drain bottom land in section 25.

Nelson - Grosfield Litch irrigate land in  
sec. 25 & 24. also potential in sec. 24 & 25.

STATE OF MONTANA  
**State Engineer's Office**  
WATER RESOURCES SURVEY  
FARM MAP

County Sweetgrass

Code No. 24B-25B

Twp. 5N Rge. 13E  
Twp. \_\_\_\_\_ Rge. \_\_\_\_\_  
Twp. \_\_\_\_\_ Rge. \_\_\_\_\_

Name of Land Owner Grosfield, Clara Address Big Timber  
Name of Operator \_\_\_\_\_ Address \_\_\_\_\_  
Legal Description \_\_\_\_\_



Irrigated Land



Non-Irrigated Land



Potential Land Under Existing Facilities

North

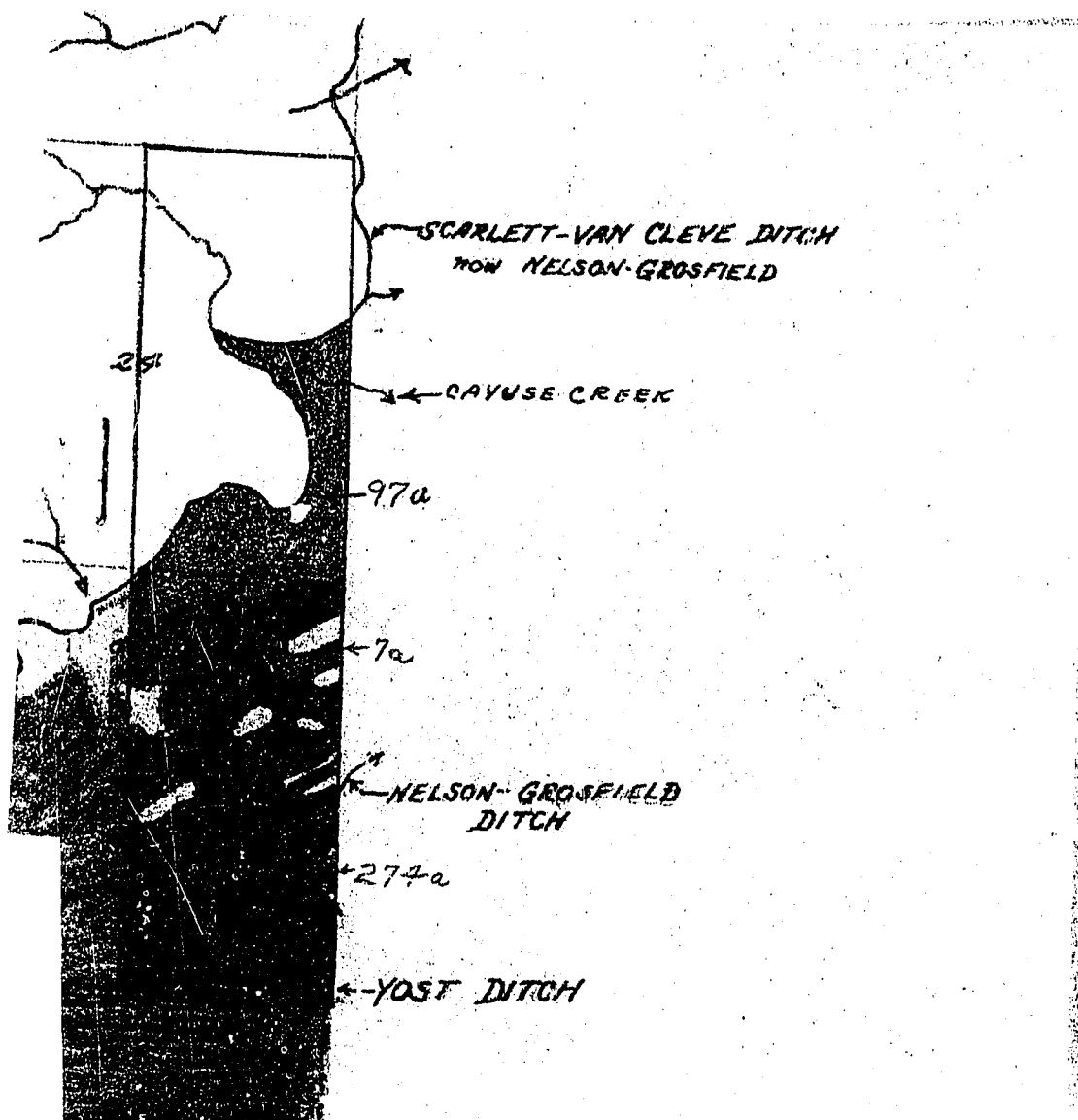

Code No. 24B-25B System Nelson-Grosfield Ditches Source of Water Sweet Grass Creek  
Basin Sweet Grass Creek Present 274 Potential 104 Maximum 378 R ✓ F ✓ P ✓ G ✓ S ✓  
Code No. \_\_\_\_\_ System \_\_\_\_\_ Source of Water \_\_\_\_\_  
Basin \_\_\_\_\_ Present \_\_\_\_\_ Potential \_\_\_\_\_ Maximum \_\_\_\_\_ R \_\_\_\_\_ F \_\_\_\_\_ P \_\_\_\_\_ G \_\_\_\_\_ S \_\_\_\_\_  
Code No. \_\_\_\_\_ System \_\_\_\_\_ Source of Water \_\_\_\_\_  
Basin \_\_\_\_\_ Present \_\_\_\_\_ Potential \_\_\_\_\_ Maximum \_\_\_\_\_ R \_\_\_\_\_ F \_\_\_\_\_ P \_\_\_\_\_ G \_\_\_\_\_ S \_\_\_\_\_  
Code No. \_\_\_\_\_ System \_\_\_\_\_ Source of Water \_\_\_\_\_  
Basin \_\_\_\_\_ Present \_\_\_\_\_ Potential \_\_\_\_\_ Maximum \_\_\_\_\_ R \_\_\_\_\_ F \_\_\_\_\_ P \_\_\_\_\_ G \_\_\_\_\_ S \_\_\_\_\_

If under Ditch Company, Irrigation District, or Government Project, state the number of shares or inches, acre feet, as the case may be in said system.

NOTE: R—Denotes Regular Irrigation. F—Flood Irrigation. P—Water diverted by means of pumping. G—Water diverted by gravity. S—Stored Water.

Information from W. B. Cook Date April 23, 1951

Code No. 555

County San Diego

T. 50 R. 134 Sec. 35

Photo No. 44-124-34

Address Belleair

Address McKsville

**Federal Project** \_\_\_\_\_ **Pres.** \_\_\_\_\_ **Pot.** \_\_\_\_\_

Ditch Company Pres. Pot.

Irrigation District \_\_\_\_\_ Pres. \_\_\_\_\_ Pot. \_\_\_\_\_

Private System \_\_\_\_\_ Pres. \_\_\_\_\_ Pot. \_\_\_\_\_

No irrigation ----- Totals -----

Flood \_\_\_\_\_ Pump \_\_\_\_\_ Reservoir \_\_\_\_\_ Gravity ☒ \_\_\_\_\_

Size and Capacity, Pump, etc. \_\_\_\_\_

Original Appropriator, Company \_\_\_\_\_ App. No. \_\_\_\_\_

Original Appropriator, Private Albert Cook & Vanlanderveer App. No. 757, D 35 a

Is the system an extension of another system? Yes. \_\_\_\_\_ No. \_\_\_\_\_

Is all land irrigated from one system? Yes \_\_\_\_\_ No \_\_\_\_\_

(If No, show break down on map)

Source of Water: Sweet Ground (w.)

Acres Irrigated 19 50, 0

**Potential Acres** \_\_\_\_\_ **Seeped** \_\_\_\_\_

Explain most of land is potential under Johnson's  
Vest Ditch and Oxbfield ditches

Condition of System.

Adequate Supply ----- Yes ----- No ✓

Explain has no right in ditches

Topography bench land

Information From Field Survey of A.M. Givensfield

Remarks \_\_\_\_\_

\_\_\_\_\_

Sec 50

A 10x10 grid with a 2x2 subgrid in the bottom right corner labeled 'B'.

168 2M 12-49

Iwp. 5N Rge. 13E  
Twp. \_\_\_\_\_ Rge. \_\_\_\_\_  
Twp. \_\_\_\_\_ Rge. \_\_\_\_\_

STATE OF MONTANA  
**State Engineer's Office**  
WATER RESOURCES SURVEY  
FARM MAP

County Sweetgrass  
Code No. 35B

Name of Land Owner Dr. Maude Gerdas Address Billings  
Name of Operator David & Leigh Address Melville  
Legal Description \_\_\_\_\_



Irrigated Land



Non-Irrigated Land



Potential Land Under Existing Facilities

North

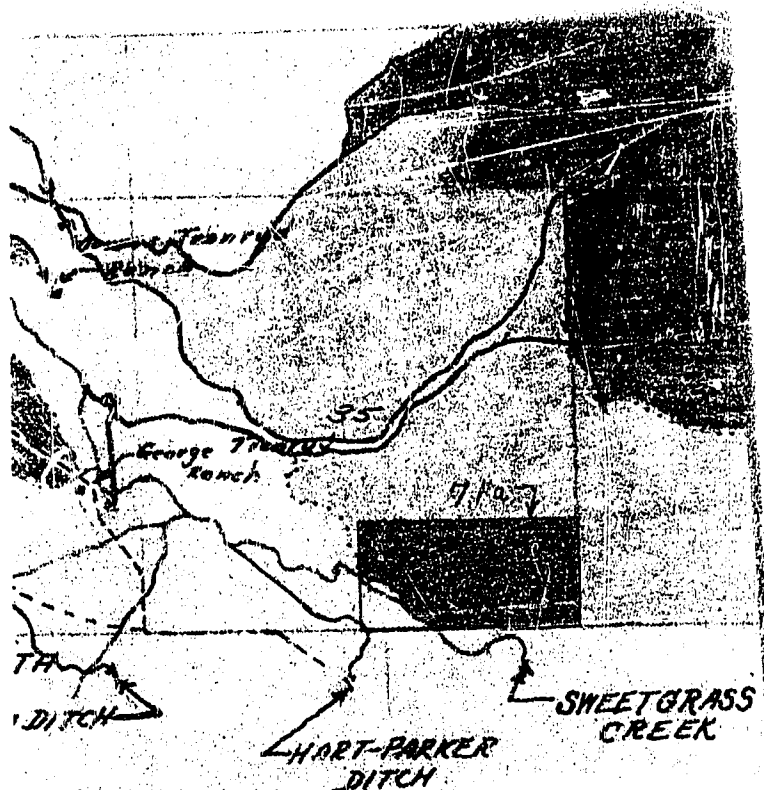

Code No. 35B System Johnson Ditch Source of Water Sweet Grass Creek  
Basin Sweet Grass Cr. Present 0 Potential 71 Maximum \_\_\_\_\_ R ✓ F \_\_\_\_\_ P \_\_\_\_\_ G ✓ S \_\_\_\_\_  
Code No. \_\_\_\_\_ System \_\_\_\_\_ Source of Water \_\_\_\_\_  
Basin \_\_\_\_\_ Present \_\_\_\_\_ Potential \_\_\_\_\_ Maximum \_\_\_\_\_ R \_\_\_\_\_ F \_\_\_\_\_ P \_\_\_\_\_ G \_\_\_\_\_ S \_\_\_\_\_  
Code No. \_\_\_\_\_ System \_\_\_\_\_ Source of Water \_\_\_\_\_  
Basin \_\_\_\_\_ Present \_\_\_\_\_ Potential \_\_\_\_\_ Maximum \_\_\_\_\_ R \_\_\_\_\_ F \_\_\_\_\_ P \_\_\_\_\_ G \_\_\_\_\_ S \_\_\_\_\_  
Code No. \_\_\_\_\_ System \_\_\_\_\_ Source of Water \_\_\_\_\_  
Basin \_\_\_\_\_ Present \_\_\_\_\_ Potential \_\_\_\_\_ Maximum \_\_\_\_\_ R \_\_\_\_\_ F \_\_\_\_\_ P \_\_\_\_\_ G \_\_\_\_\_ S \_\_\_\_\_

If under Ditch Company, Irrigation District, or Government Project, state the number of shares or inches, acre feet, as the case may be in said system.

NOTE: R—Denotes Regular Irrigation. F—Flood Irrigation. P—Water diverted by means of pumping. G—Water diverted by gravity. S—Stored Water.

Information from J. E. Gerdas Date April 29, 1951

(2)

Township 5N-Range 13E

	Name of Owner	Township & Range		
✓1.	American Fork Ranch	(2) 5N-13E	(1) 5N-12E	
✓2.	Grosfield, Clara	"	(21) 2N-14E	(3) 5N-14E
✓3.	Glennie, George	"		
✓4.	Gerdes, Dr. Maude	"		
✓5.	Langston, Virginia	"		
✓6.	Rein, Lloyd	"		
✓7.	Tronrud, Morris	"		
✓8.	Tronrud, Victor	"		
✓9.	Tronrud, Adolph	"	(7) 4N-13E	
✓10.	Tronrud, Anton	"	(7) 4N-13E	
✓11.	Tronrud, George	"		
✓12.	Yost, Geo. J. & Lenard	"	(8) 4N-14E	(7) 4N-13E (3) 5N-14E



STATE OF MONTANA  
**STATE ENGINEER'S OFFICE**  
 WATER RESOURCES SURVEY

Township 5 North Range 13 East County Sweet Grass

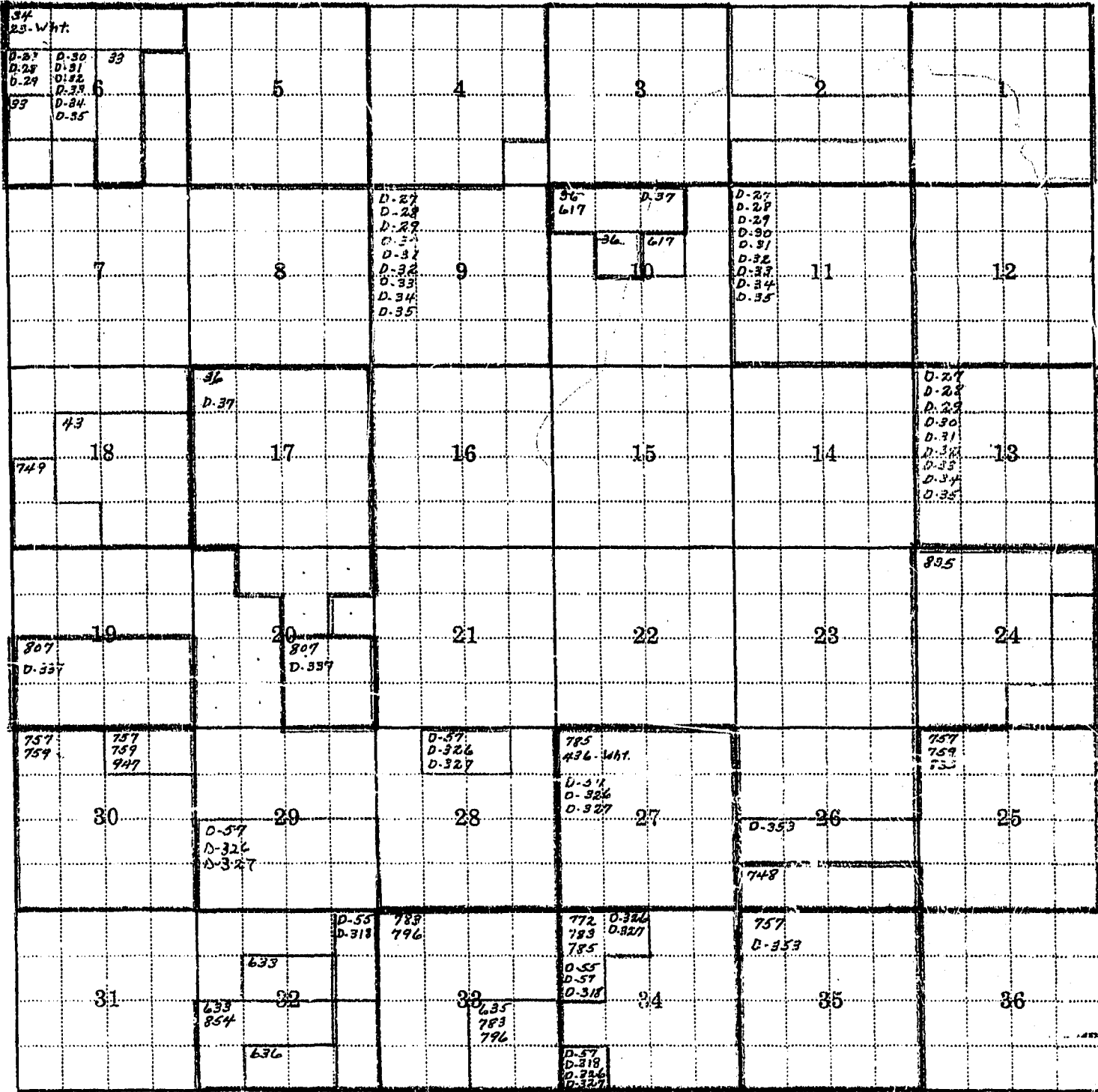

Township 5 North Range 13 East

Township

Range

County

Parcel  
Number

Name of Owner

Address

Appropriation  
735

Hart Bros. et al (2000 MI) White Co. Mont.

Point of diversion on right bank of Sweet Grass Creek. The main  
 crossing there and crossing the ditch known as the Canadian  
 ditch. Enlarged to a point of diversion at a distance of 1/2 mile or so  
 Canadian ditch.

Appropriation

836

Van Cleave Paul (7000 MI) Melville, Mont.

Point of diversion on east bank of Sweet Grass  
 Creek. Section 53<sup>rd</sup> 55<sup>th</sup> from N.W. corner Sec 35 5N 13E

Appropriation

835

Van Cleave, Paul L. (50,000 MI) Melville, Mont.

Point of diversion 5N 14-15 16E & 4N 13-14-15 16 17-18E;  
 3N 17-18E; 2N 17-18-19E.

Township 5 North, Range 13 East

<u>No.</u>	<u>Name of Appropriator</u>	<u>Name of Stream</u>	<u>Date App.</u>	<u>Date Filed</u>	<u>M.I.</u>
23 Wht.	McDonnell, Chas. & Veasey, Edward	American Fork	1-22-87	3-22-87	1500
33	McDonnell, Ed F.	American Fork Creek	1-13-03	1-13-03	300
34	McDonnell, Chas. & Veasey, Edward	American Fork Creek	1-27-87	9-6-99	1500
36	Mydland, S. O. <i>Transect Ditch</i>	American Fork Creek	9-1-04	9-1-04	700
43	Wold, Hilda M. <i>W. R. R. Ditch</i>	American Fork Creek	12-5-06	12-13-06	320
436 Wht.	Northey, W. H.	Sweetgrass Creek	10-15-21	12-10-21	40,000
617	Stole, Henry	Porcupine Spring Creek	9-24-09	9-24-09	160
633	Thompson, C. P.	Rough Gulch	12-7-03	12-7-03	200
635	Smith, Foster	Run-Away Creek	7-26-83	7-26-83	All
636	Thompson, Christian	Run-Away Creek	4-17-90	4-18-90	200
748	Benecke, Agnes et al	Sweetgrass Creek	3-20-05	3-20-05	1500
749	Berg, Annie	Sweetgrass Creek	7-1-04	8-22-04	200
757x	Cook, Albert and Van Cleve, Paul	Sweetgrass Creek	11-5-89	11-18-89	2000
759x	Cook, Albert and Van Cleve, P.L.	Sweetgrass Creek	5-5-88	5-16-88	1000
772	Ellingson, E. H. et al	Sweetgrass Creek	6-29-04	7-2-04	850
783	Green, Earl and Hoff, John	Sweetgrass Creek	6-29-03	7-29-03	1500
785	Gunderson, Julius et al	Sweetgrass Creek	3-24-98	3-24-98	1500
796	Hoff, John	Sweetgrass Creek	9-12-90	9-15-90	640
807	Mydland, Syvert	Sweetgrass Creek	1-3-03	1-3-03	300
835 836	VanCheve, Paul L.	Sweetgrass Creek	7-27-96 8-26-96	7-27-96 8-26-96	50,000 7000
854	Thompson, Christian	Thompson Creek	1-27-90	1-29-90	200
947x	Grosfield, Abraham	Mitchell's Spring	11-25-08	11-27-08	100

<u>No.</u>	<u>To Whom Decead</u>	<u>Name of Stream</u>	<u>Date Priority</u>	<u>M.I.</u>
-D-27°	McDonnell and Veasey	American Fork	6-10-83	30
-D-28°	McDonnell and Veasey	American Fork	5-1-82	40
-D-29°	McDonnell and Veasey	American Fork	5-30-82	100
-D-30°	McDonnell and Veasey	American Fork	5-1-82	80
-D-31°	McDonnell and Veasey	American Fork	6-1-84	60
-D-32°	McDonnell and Veasey	American Fork	12-9-86	1000
-D-33°	McDonnell and Veasey	American Fork	6-10-86	360
-D-34°	McDonnell and Veasey	American Fork	4-25-97	60
-D-35°	McDonnell and Veasey	American Fork	6-30-01	160
-D-37°	Mydland, S. O.	American Fork	6-15-07	300
-D-55	Hoff, John	Basin Creek	5-26-83	100
-D-57	Lavold, T. S.	Basin Creek	5-26-83	120
-D-318	Hoff, John	Sweetgrass Creek	10-1-04	800
-D-326	Lavold, T. S.	Sweetgrass Creek	10-1-93	80
-D-327	Lavold, T. S.	Sweetgrass Creek	6-29-04	300
-D-337	Mydland, Syvert	Sweetgrass Creek	7-1-95	145
-D-353	Scarlett, John H. & VanCleve, Paul	Sweetgrass Creek	7-15-87	1450

S. L. Hoggins

D. J. Hoggins

STATE OF MONTANA  
*State Engineer's Office*  
WATER RESOURCES SURVEY

Township 5 N Range 13 E County Sweet Grass

6	5	4	3	2	1
7	8	9	10	11	12
18	17	16	15	14	13
19	20	21	22	23	24
1684 1665	29	28	27	26	1684 1665
31	32	33	34	35	36

1703 1360 1703  
1703 1360  
1684 1359 1684  
1665

*Transcribed from Park County*

Township 5 N Range 13 E



F-1-A-5M-

County Sweet Grass

Farm Checked: Date 8-17-50

By Dave & Joe

Legal Land Owner George Glennie

Operator

Water is delivered by:— 1. Private System;

2. Ditch Company;

3. State Project;

4. Federal Project;

5. Irrigation District

STATE OF MONTANA  
STATE ENGINEERS OFFICE  
Water Resources Survey



T 5N R 13E Plat No. 2

Photo No. MA-12A-35, 12A-34

Address Harlowton

Address

App. No. Decree No.	NAME OF APPROPRIATOR TO WHOM DECREED	NAME OF STREAM	Date App. Date Priority	Miner's Inches	In Use	NAME OF DITCH (Water Delivered By)	No.	R/F	Present Irr. Acres	Irrigable Acres
A-36	S. O. Mydland	American Fork Creek	9-1-04	700						
A-617	Henry Stole	Porcupine Spring Cr.	9-24-09	160						
D-27	McDonnell & Veasey	American Fork	6-10-83	30						
D-28	McDonnell & Veasey	American Fork	5-1-82	40						
D-29	McDonnell & Veasey	American Fork	5-30-82	100						
D-30	McDonnell & Veasey	American Fork	5-1-82	80						
D-31	McDonnell & Veasey	American Fork	6-1-84	60						
D-32	McDonnell & Veasey	American Fork	12-9-86	1000						
D-33	McDonnell & Veasey	American Fork	6-10-86	360						
D-34	McDonnell & Veasey	American Fork	4-25-97	60						
D-35	McDonnell & Veasey	American Fork	6-30-01	160						
D-37	S. O. Mydland	American Fork	6-15-07	300						
		Range Land-No Irrigation								

NOTE: R—Denotes Regular Irrigation. F—Flood Irrigation.

Adequate Supply: Yes No Explain

Remarks

River Basin

Also in: Plat No. Twp. Rge.	Plat No. Twp. Rge.	Plat No. Twp. Rge.
Plat No. Twp. Rge.	Plat No. Twp. Rge.	Plat No. Twp. Rge.

Information From:

None shown

10-1-1	10-1-1
10-1-2	10-1-2
10-1-3	10-1-3
10-1-4	10-1-4
10-1-5	10-1-5
10-1-6	10-1-6
10-1-7	10-1-7
10-1-8	10-1-8
10-1-9	10-1-9
10-1-10	10-1-10
10-1-11	10-1-11
10-1-12	10-1-12
10-1-13	10-1-13
10-1-14	10-1-14
10-1-15	10-1-15
10-1-16	10-1-16
10-1-17	10-1-17
10-1-18	10-1-18
10-1-19	10-1-19
10-1-20	10-1-20
10-1-21	10-1-21
10-1-22	10-1-22
10-1-23	10-1-23
10-1-24	10-1-24
10-1-25	10-1-25
10-1-26	10-1-26
10-1-27	10-1-27
10-1-28	10-1-28
10-1-29	10-1-29
10-1-30	10-1-30
10-1-31	10-1-31
10-1-32	10-1-32
10-1-33	10-1-33
10-1-34	10-1-34
10-1-35	10-1-35
10-1-36	10-1-36
10-1-37	10-1-37
10-1-38	10-1-38
10-1-39	10-1-39
10-1-40	10-1-40
10-1-41	10-1-41
10-1-42	10-1-42
10-1-43	10-1-43
10-1-44	10-1-44
10-1-45	10-1-45
10-1-46	10-1-46
10-1-47	10-1-47
10-1-48	10-1-48
10-1-49	10-1-49
10-1-50	10-1-50
10-1-51	10-1-51
10-1-52	10-1-52
10-1-53	10-1-53
10-1-54	10-1-54
10-1-55	10-1-55
10-1-56	10-1-56
10-1-57	10-1-57
10-1-58	10-1-58
10-1-59	10-1-59
10-1-60	10-1-60
10-1-61	10-1-61
10-1-62	10-1-62
10-1-63	10-1-63
10-1-64	10-1-64
10-1-65	10-1-65
10-1-66	10-1-66
10-1-67	10-1-67
10-1-68	10-1-68
10-1-69	10-1-69
10-1-70	10-1-70
10-1-71	10-1-71
10-1-72	10-1-72
10-1-73	10-1-73
10-1-74	10-1-74
10-1-75	10-1-75
10-1-76	10-1-76
10-1-77	10-1-77
10-1-78	10-1-78
10-1-79	10-1-79
10-1-80	10-1-80
10-1-81	10-1-81
10-1-82	10-1-82
10-1-83	10-1-83
10-1-84	10-1-84
10-1-85	10-1-85
10-1-86	10-1-86
10-1-87	10-1-87
10-1-88	10-1-88
10-1-89	10-1-89
10-1-90	10-1-90
10-1-91	10-1-91
10-1-92	10-1-92
10-1-93	10-1-93
10-1-94	10-1-94
10-1-95	10-1-95
10-1-96	10-1-96
10-1-97	10-1-97
10-1-98	10-1-98
10-1-99	10-1-99
10-1-100	10-1-100

**Land Ownership**.....



County.....Sweet Grass.....

Farm Checked: Date.....8-16-50.....

By.....Dave & Joe.....

STATE OF MONTANA  
STATE ENGINEERS OFFICE  
Water Resources Survey

T 5N R 13E Plat No. 2

Photo No. MA-12A-190, 12A-34,.....

12A-35

Legal Land Owner.....Virginia Langston

Address. % Brown & Davis, Billings

Operator.....Nels Nelson

Address...Melville

Water is delivered by:— 1. Private System; 2. Ditch Company; 3. State Project; 4. Federal Project; 5. Irrigation District

NOTE: R—Denotes Regular Irrigation. F—Flood Irrigation.

Adequate Supply: Yes ... No ... Explain

Remarks.

Nelson-Grosfield Ditch: Point of diversion in SW, SE<sup>1</sup>, Sec. 27 - T. 5N-R. 13E. Irrigates land in Sec. 25 & 26.

...River Basin.

Information From:

Mr. Nels Nelson

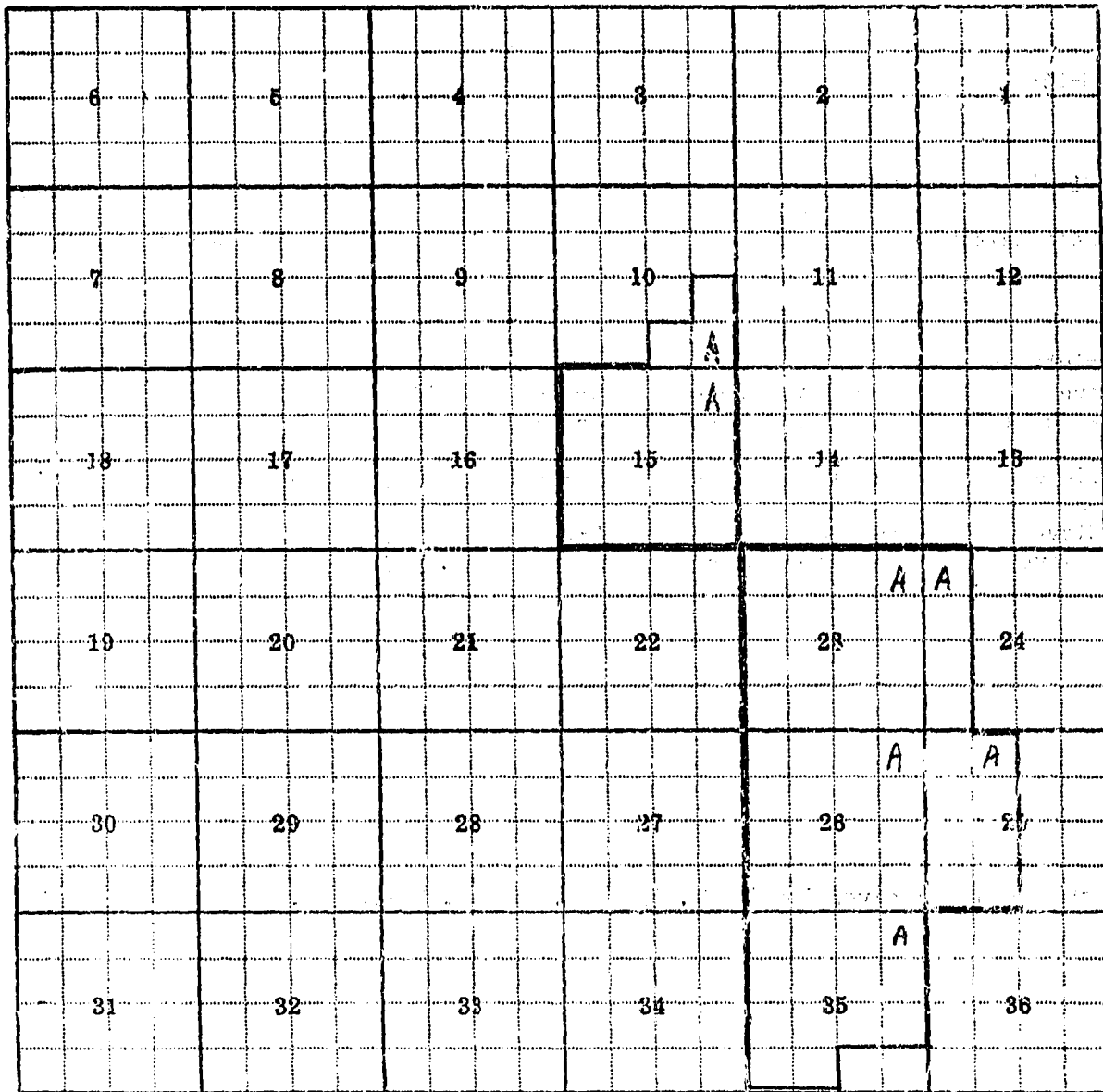

Land Ownership.....

.....

.....

County Sweet Grass

Father Checked: Date 9-22-50 .....

By..... Jim & Bob .....

**STATE OF MONTANA  
STATE ENGINEERS OFFICE  
Water Resources Survey**

T 5N.....R 13E..... Plat No....2.....

Photo No. MA-12A-35, MA-12A-34

Legal Land Owner Clara Grosfield Address Big Timber

Operator.....	Address .....
---------------	---------------

Water is delivered by:— 1. Private System; 2. Ditch Company; 3. State Project; 4. Federal Project; 5. Irrigation District

**NOTE: R—Denotes Regular Irrigation. F—Flood Irrigation.**

Adequate Supply: Yes ..... No ..... Explain.....

Remarks.....

Intends to drain bottom land in section 25.

Nessor-Grosfield Ditch irrigates land in Sec. 25 & 24. Also potential in Sec. 24 & 25.

...River Basin.....

Also in: Plat No. ....	Twp. ....	Rge. ....	Plat No. ....	Twp. ....	Rge. ....	Plat No. ....	Twp. ....	Rge. ....
Plat No. ....	Twp. ....	Rge. ....	Plat No. ....	Twp. ....	Rge. ....	Plat No. ....	Twp. ....	Rge. ....

Information From:

Clara Grosfield

6	5	4	3	2	1	
7	8	9	10	11	12	
13	17	16	15	14	13	
19	20	21	22	23	24	6
30	29	28	27	26	25	6
31	32	33	34	35	36	

Land Ownership.....

.....

.....

County. Sweet Grass

Farm Checked: Date 8-11-50

By BS & BD

STATE OF MONTANA  
STATE ENGINEERS OFFICE  
Water Resources Survey

T 5N R 13E Plat No. 2

Photo No. MA-12A-34

Legal Land Owner Dr. Maude Gerdes Address: Billings

Operator David & Leigh Address Melville

Water is delivered by:— 1. Private System; 2. Ditch Company 3. State Project; 4. Federal Project; 5. Irrigation District

[illegible]

**NOTE: R—Denotes Regular Irrigation. F—Flood Irrigation.**

Adequate Supply: Yes..... No..... Explain .....

Remarks

### River Basin

Also in: Plat No. ....	Twp. ....	Rge. ....	Plat No. ....	Twp. ....	Rge. ....	Plat No. ....	Twp. ....	Rge. ....
Plat No. ....	Twp. ....	Rge. ....	Plat No. ....	Twp. ....	Rge. ....	Plat No. ....	Twp. ....	Rge. ....

Information From:

Field Survey &  
A. M. Grosfield

6	5	4	3	2	1
7	8	9	10	11	12
18	17	16	15	14	13
19	20	21	22	23	24
30	29	28	27	26	25
31	32	33	34	35	36
				b	

Land Ownership \_\_\_\_\_

\_\_\_\_\_

\_\_\_\_\_

County Sweet Grass

Farm Checked: Date... 9-19-50

By..... Jim & Bob .....

STATE OF MONTANA  
STATE ENGINEERS OFFICE  
Water Resources Survey

T 5N R 13E Plat No. 2

Photo No. MA-12A-191

Legal Land Owner **Lloyd Rein** Address **Melville**

Operator.....	<b>Same</b>	Address.....
---------------	-------------	--------------

Water is delivered by:— 1. Private System; 2. Ditch Company; 3. State Project; 4. Federal Project; 5. Irrigation District

[illegible]

**NOTE: R—Denotes Regular Irrigation. F—Flood Irrigation.**

Adequate Supply: Yes. .... No. .... Explain.....

Remarks:

(1) Land in Sec. 18 potential under Tronrud Ditch in N.E. corner.

(2) Rein Ditch takes out of So. Fk. of American Fork Cr. on south side in SE $\frac{1}{4}$  in (and has potential under it in Sec. 18) Sec. 21 of T. 5N-R. 12E. Not in use. Runs into Ironrud Ditch.

...River Basin.

Also in: Plat No. .... Twp. .... Rge. ....	Plat No. .... Twp. .... Rge. ....	Plat No. .... Twp. .... Rge. ....
Plat No. .... Twp. .... Rge. ....	Plat No. .... Twp. .... Rge. ....	Plat No. .... Twp. .... Rge. ....

Information From:

Lloyd kein

	6		5		4		3		2		1
	7		8		9		10		11		12
U.S.		A									
	18		17		16		15		14		13
U.S.											
	19		20		21		22		23		24
	30		29		28		27		26		25
	31		32		33		34		35		36

Land Ownership.....

.....

.....



County..... Sweet Grass .....

Farm Checked: Date 8-8-50

By..... BS & RB

STATE OF MONTANA  
STATE ENGINEERS OFFICE  
Water Resources Survey

T. 5N R. 13E Plat No. 2

Photo No. MA-12A-190

Legal Land Owner.....Adolph Ironrud.....Address.....Melville.....

<b>Operator</b>	<b>Same</b>	<b>Address</b>
-----------------	-------------	----------------

Water is delivered by:— 1. Private System; 2. Ditch Company; 3. State Project; 4. Federal Project; 5. Irrigation District

[illegible]

**NOTE: P** ..otes Regular Irrigation. **F**—Flood Irrigation.

Adequate Supply: Yes..... No..... Explain.....

Remarks.....

River Basin.....

Also in: Plat No.....	Twp.....	Rge.....	Plat No.....	Twp.....	Rge.....	Plat No.....	Twp.....	Rge.....
Plat No.....	Twp.....	Rge.....	Plat No.....	Twp.....	Rge.....	Plat No.....	Twp.....	Rge.....

Information From:  
Adolph Tronrud

6	5	4	3	2	1
7	8	9	10	11	12
13	17	16	15	14	13
19	20	21	22	23	24
29	29	28	27	26	25
31	32	33	34	35	36

Land Ownership.....

.....

.....

unity.

FORM 1-; • GAZETTE 1685, 2N, 1-4

STATE OF MONTANA

By Duke & Co.

# STATE ENGINEER'S OFFICE

Area East Green Cove

WATER RESOURCES SURVEY

Date 9/14/50

Code No. 244/25-264

County Deer Creek

T. 50 R. 13 E Sec 24, 25, 26

Photo No. 24-34

Legal Land Owner. John J. O'Connell

12-17-30

Operator Michael J. Kelly

22-11-1947

Water is delivered by:

**Federal Project** \_\_\_\_\_ **Pres.** \_\_\_\_\_ **Put** \_\_\_\_\_

Ditch Company. Pres. Pot.

Irrigation District \_\_\_\_\_ Pres. \_\_\_\_\_ Pot. \_\_\_\_\_

Private System Wilson Co. 15400 1st St. Bldg Pres. \_\_\_\_\_ Pot. \_\_\_\_\_

Totals	
100	100

Floor \_\_\_\_\_ Pump \_\_\_\_\_ Reservoir \_\_\_\_\_ Gravity ☒ irregular

### Size and Capacity, Pump, etc.

Original Appropriator, Company: John, Van & Van Chemicals, Inc. App. No. 0-503,140

Original Appropriator, Private Edward J. [illegible] App. No. 100-100000

Is the system an extension of another system? Yes \_\_\_\_\_ No ✓

Is all land irrigated from one system? Yes ☒ No ☐

(If No, show break down on map)

Source of Water Well

Acres Irrigated 1950, \_\_\_\_\_

Potential Acres \_\_\_\_\_ Seeped \_\_\_\_\_

**Explain** \_\_\_\_\_

Condition of System GoodAdequate Supply ☒ Yes ☐ No

**Explain** \_\_\_\_\_

Tonography Shallow Slope

Information From Mr. Neils Neilsen

Remarks	
---------	--

[illegible]

Nelson-Grasfield Ditch

Point of diversion in SW, SE  $\frac{1}{4}$ ,

Sec. 21-T5N-R13E

Irrigates land in Sec. 25 & 26.

WATER RESOURCES DIVISION  
NORTH DAKOTA DEPARTMENT OF AGRICULTURE

DATE OF SURVEY