

Porter 1762 IM-2-a

Twp. Rge.

Twp. Twp.

Twp. Rge.

Code No. \_\_\_\_\_

10A-15A-23A-  
24A-25A-26A-35A

Name of Operator Kyle Nelson Address Melville

|                           |  |
|---------------------------|--|
| <b>Legal Description:</b> | W & E 1/4 Sec 36 T30N R9E S18W, McPherson County, SD |
|---------------------------|--|

Irrigated Land

Non-Irrigated Land

### Potential Land Under Existing Facilities

North

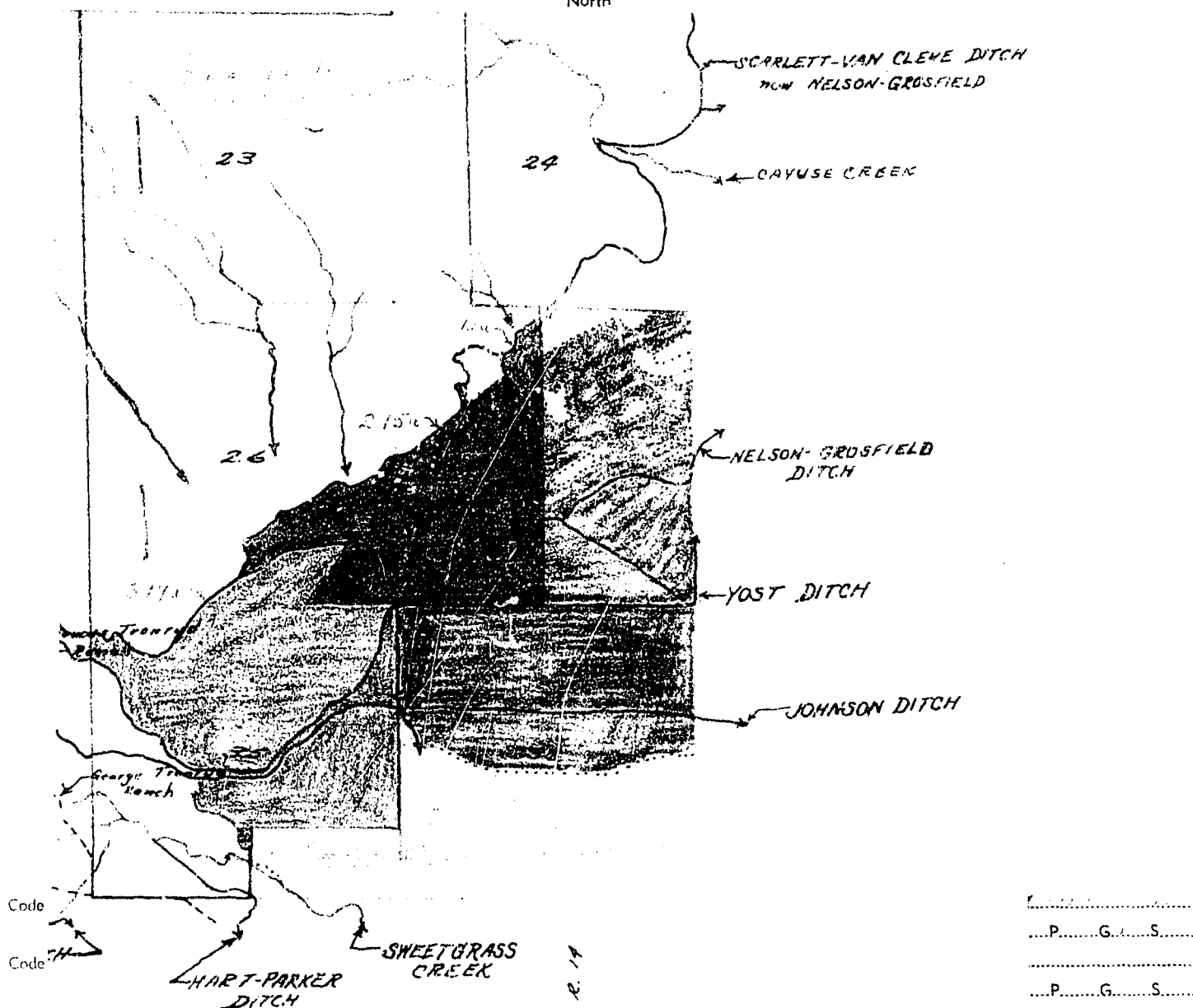

Code No. \_\_\_\_\_ System \_\_\_\_\_ Source of Water \_\_\_\_\_

| Basin | Present | Potential | Maximum | R | F | P | G | S |
|-------|---------|-----------|---------|---|---|---|---|---|
|-------|---------|-----------|---------|---|---|---|---|---|

Code No. .... System ..... Source of Water.....

| Basin | Present | Potential | Maximum | R | F | P | G | S |
|-------|---------|-----------|---------|---|---|---|---|---|
|-------|---------|-----------|---------|---|---|---|---|---|

If under Ditch Company, Irrigation District, or Government Project, state the number of shares or inches, acre feet, as the case may be in said system.

NOTE: R—Denotes Regular Irrigation. F—Flood Irrigation. P—Water diverted by means of pumping. G—Water diverted by gravity.  
S—Stored Water.

Information from ..... Date .....

STATE OF MONTANA  
State Engineer's Office  
WATER RESOURCES SURVEY  
MP

County Sweetgrass

Code No. 106-15A-23A-

24A-25A-26A-35A

Virginia  
Neis

Melville

Land Under Existing Facilities

Phone

Address

Address

Pres

Pol

Pol

Code No. 106-15A-23A System Nelsonville Field Source of Water Local Grass On  
Basin 106-15A-23A Present 15 Potential 4.11 Maximum 10.0 R. F. P. G. S.  
Code No. System Source of Water  
Basin Present Potential Maximum R. F. P. G. S.  
Code No. System Source of Water  
Basin Present Potential Maximum R. F. P. G. S.  
Code No. System Source of Water  
Basin Present Potential Maximum R. F. P. G. S.

If under Litch Company, Irrigation District, or Government Project, state the number of shares or inches, acre feet, as the case may be in said system.

NOTE: R—Denotes Regular Irrigation. F—Flood Irrigation. P—Water diverted by means of pumping. G—Water diverted by gravity. S—Stored Water.

Information from John Date April 29, 1941

FORM F-1 REPORTER IN 3-49 17390 e66

STATE OF MONTANA

Code No. \_\_\_\_\_

**State Engineer's Office**

County San Diego

WATER RESOURCES SURVEY

T. 100 R. 100 Sec. 100

Photo No. 126-10

Address 1234 Main St

Water is delivered by:

Federal Project \_\_\_\_\_ Pres. \_\_\_\_\_ Pot. \_\_\_\_\_

Ditch Company \_\_\_\_\_ Pres. \_\_\_\_\_ Pot. \_\_\_\_\_

Irrigation District \_\_\_\_\_ Pres. \_\_\_\_\_ Pot. \_\_\_\_\_

Private System \_\_\_\_\_ Pres. \_\_\_\_\_ Pot. \_\_\_\_\_

10 10/10/1912 Totals \_\_\_\_\_

Flood \_\_\_\_\_ Pump \_\_\_\_\_ Reservoir \_\_\_\_\_ Gravity \_\_\_\_\_

Size and Capacity, Pump, etc. \_\_\_\_\_

Original Appropriator, Company \_\_\_\_\_ App. No. \_\_\_\_\_

Original Appropriator, Private \_\_\_\_\_ App. No. \_\_\_\_\_

Is the system an extension of another system? Yes\_\_\_\_\_No\_\_\_\_\_

Is all land irrigated from one system? Yes \_\_\_\_\_ No \_\_\_\_\_

(If No, show break down on map)

Source of Water \_\_\_\_\_

Acres Irrigated 19\_\_\_\_\_

Potential Acres \_\_\_\_\_ Seeped \_\_\_\_\_

**Explain** \_\_\_\_\_

Condition of System: \_\_\_\_\_

Adequate Supply..... Yes..... No.....

**Explain** \_\_\_\_\_

Topography \_\_\_\_\_

Information From \_\_\_\_\_

Remarks \_\_\_\_\_

*Handwritten:* The old ground not water, ground high

[illegible]

FORM D-1 - GAZETTE 1944 11-1-47

STATE OF MONTANA  
**STATE ENGINEER'S OFFICE**  
 WATER RESOURCES SURVEY

Township 54 Range 12E County Beaverhead

|    |    |    |    |    |    |
|----|----|----|----|----|----|
| 6  | 5  | 4  | 3  | 2  | 1  |
| 7  | 8  | 9  | 10 | 11 | 12 |
| 13 | 17 | 16 | 15 | 14 | 13 |
| 19 | 20 | 21 | 22 | 23 | 24 |
| 25 | 26 | 27 | 28 | 29 | 30 |
| 31 | 32 | 33 | 34 | 35 | 36 |

Township 54 Range 12E

STATE OF MONTANA

Code No.

By \_\_\_\_\_

**STATE ENGINEER'S OFFICE**  
**WATER RESOURCES SURVEY**

County's

County San Diego

T. 50 R. 56 Sec. 18

Date.

Photo No. 112-1202-191

Legal Land Owner.

Address Philadelphia

Operator

**Address** \_\_\_\_\_

Water is delivered by:

**Federal Project** \_\_\_\_\_ **Pres.** \_\_\_\_\_ **Pot.** \_\_\_\_\_

Ditch Company \_\_\_\_\_ Pres. \_\_\_\_\_ Pot. \_\_\_\_\_

Irrigation District \_\_\_\_\_ Pres. \_\_\_\_\_ Pot. \_\_\_\_\_

Private System \_\_\_\_\_ Pres. \_\_\_\_\_ Pol. \_\_\_\_\_

| Totals |   | 1970 | 1971 | 1972 | 1973 | 1974 | 1975 | 1976 | 1977 | 1978 | 1979 | 1980 | 1981 | 1982 | 1983 | 1984 | 1985 | 1986 | 1987 | 1988 | 1989 | 1990 | 1991 | 1992 | 1993 | 1994 | 1995 | 1996 | 1997 | 1998 | 1999 | 2000 | 2001 | 2002 | 2003 | 2004 | 2005 | 2006 | 2007 | 2008 | 2009 | 2010 | 2011 | 2012 | 2013 | 2014 | 2015 | 2016 | 2017 | 2018 | 2019 | 2020 | 2021 | 2022 | 2023 | 2024 | 2025 | 2026 | 2027 | 2028 | 2029 | 2030 | 2031 | 2032 | 2033 | 2034 | 2035 | 2036 | 2037 | 2038 | 2039 | 2040 | 2041 | 2042 | 2043 | 2044 | 2045 | 2046 | 2047 | 2048 | 2049 | 2050 | 2051 | 2052 | 2053 | 2054 | 2055 | 2056 | 2057 | 2058 | 2059 | 2060 | 2061 | 2062 | 2063 | 2064 | 2065 | 2066 | 2067 | 2068 | 2069 | 2070 | 2071 | 2072 | 2073 | 2074 | 2075 | 2076 | 2077 | 2078 | 2079 | 2080 | 2081 | 2082 | 2083 | 2084 | 2085 | 2086 | 2087 | 2088 | 2089 | 2090 | 2091 | 2092 | 2093 | 2094 | 2095 | 2096 | 2097 | 2098 | 2099 | 2100 |
|--------|---|------|------|------|------|------|------|------|------|------|------|------|------|------|------|------|------|------|------|------|------|------|------|------|------|------|------|------|------|------|------|------|------|------|------|------|------|------|------|------|------|------|------|------|------|------|------|------|------|------|------|------|------|------|------|------|------|------|------|------|------|------|------|------|------|------|------|------|------|------|------|------|------|------|------|------|------|------|------|------|------|------|------|------|------|------|------|------|------|------|------|------|------|------|------|------|------|------|------|------|------|------|------|------|------|------|------|------|------|------|------|------|------|------|------|------|------|------|------|------|------|------|------|------|------|------|------|------|------|------|------|------|
| 1      | 2 | 3    | 4    | 5    | 6    | 7    | 8    | 9    | 10   | 11   | 12   | 13   | 14   | 15   | 16   | 17   | 18   | 19   | 20   | 21   | 22   | 23   | 24   | 25   | 26   | 27   | 28   | 29   | 30   | 31   | 32   | 33   | 34   | 35   | 36   | 37   | 38   | 39   | 40   | 41   | 42   | 43   | 44   | 45   | 46   | 47   | 48   | 49   | 50   | 51   | 52   | 53   | 54   | 55   | 56   | 57   | 58   | 59   | 60   | 61   | 62   | 63   | 64   | 65   | 66   | 67   | 68   | 69   | 70   | 71   | 72   | 73   | 74   | 75   | 76   | 77   | 78   | 79   | 80   | 81   | 82   | 83   | 84   | 85   | 86   | 87   | 88   | 89   | 90   | 91   | 92   | 93   | 94   | 95   | 96   | 97   | 98   | 99   | 100  |      |      |      |      |      |      |      |      |      |      |      |      |      |      |      |      |      |      |      |      |      |      |      |      |      |      |      |      |      |      |      |      |      |

Flood Pump Reservoir Gravity

**Size and Capacity, Pump, etc.**

Original Appropriator, Company General Electric Inc. No. 44-1111

Original Appropriator, Private Edna M. Webb App. No. 43,177

Is the system an extension of another system? Yes ☒ No ☐

Is all land irrigated from one system? Yes   /   No           

(If No, show break down on map)

Source of Water: Conifer Swampy Creek

Acres Irrigated 1950

Potential Acres Seeped

**Explain** \_\_\_\_\_

[illegible]

Adequate Supply — Yes. ☐ No. ☒

**Explain** \_\_\_\_\_

### Topography

Information From \_\_\_\_\_

[illegible]

1. The following information is being furnished to you for your information only. It is not to be used for any other purpose.

Also in File No 1

A 10x10 grid with a thick border. The top row is labeled with numbers 1 through 10. The left column is labeled with letters A through J. Handwritten in the top right cell (row 1, column 9) is the letter 'H'. Handwritten in the bottom left cell (row 10, column 2) is the text '27-5'.

1. *Stenopus* *scaber* *Stenopus* *scaber*  
Tropical Atlantic Ocean

2. *Stenopus* *scaber* *Stenopus* *scaber*  
Tropical Atlantic Ocean (and  
also in the Caribbean Sea)  
(see also *Stenopus* *scaber* 125. Not a new  
species)

WR-1  
Reborter 1702 IM-2-48

STATE OF MONTANA

State Engineer's Office

WATER RESOURCES SURVEY

FARM MAP

County Sweetgrass

Code No. 184

By

wp. SW Rge. 13E  
Twp. \_\_\_\_\_ Rge. \_\_\_\_\_  
Twp. \_\_\_\_\_ Rge. \_\_\_\_\_

Name of Land Owner. Rein, Lloyd Address Meiville

Name of Operator. Same Address Meiville

Legal Description \_\_\_\_\_



Irrigated Land



Non-Irrigated Land



Potential Land Under Existing Facilities

North

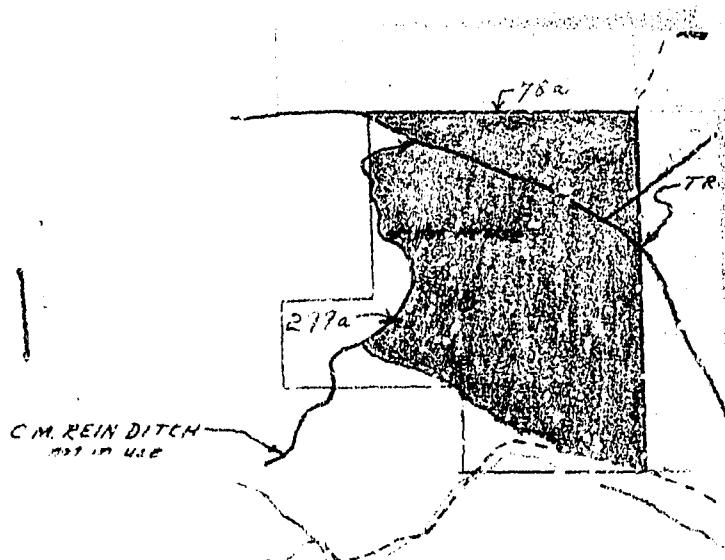

Code No. 184 System Rein Ditch Source of Water South American Fork

Basin Mountain Fork Present C Potential 78 Maximum 78 R ✓ F ✓ P ✓ G ✓ S ✓

Code No. 184 System C.M. Rein Ditch not in use Source of Water South American Fork

Basin Mountain Fork Present C Potential 299 Maximum 299 R ✓ F ✓ P ✓ G ✓ S ✓

Code No. \_\_\_\_\_ System \_\_\_\_\_ Source of Water \_\_\_\_\_

Basin \_\_\_\_\_ Present \_\_\_\_\_ Potential \_\_\_\_\_ Maximum \_\_\_\_\_ R \_\_\_\_\_ F \_\_\_\_\_ P \_\_\_\_\_ G \_\_\_\_\_ S \_\_\_\_\_

Code No. \_\_\_\_\_ System \_\_\_\_\_ Source of Water \_\_\_\_\_

Basin \_\_\_\_\_ Present \_\_\_\_\_ Potential \_\_\_\_\_ Maximum \_\_\_\_\_ R \_\_\_\_\_ F \_\_\_\_\_ P \_\_\_\_\_ G \_\_\_\_\_ S \_\_\_\_\_

If under Ditch Company, Irrigation District, or Government Project, state the number of shares or inches, acre feet, as the case may be in said system.

NOTE: R—Denotes Regular Irrigation. F—Flood Irrigation. P—Water diverted by means of pumping. G—Water diverted by gravity. S—Stored Water.

Information from \_\_\_\_\_ Date 7/22/1941

FORM 1-1 - GATE 111 1365-23-1-47

Code No. 2004 2005

County. San Diego

T. 50 R. 50 Sec. 29.32

Photo No. 44-24150

Address 1234 Main St, New York, NY 10001

| Operator | Address |
|----------|---------|
|          |         |

Federal Project \_\_\_\_\_ Pres. \_\_\_\_\_ Pot \_\_\_\_\_

Ditch Company. Pres. Pot.

Irrigation District \_\_\_\_\_ Pres. \_\_\_\_\_ Pot. \_\_\_\_\_

Private System \_\_\_\_\_ Pres. \_\_\_\_\_ Pot. \_\_\_\_\_

## Totals

**Flood** **Pump** **Reservoir** **Gravity**

### Size and Capacity, Pump, etc.

Original Appropriator, Company, Veracell, Inc. - Hq. - C.R. App. No. D-57-326-327

Original Appropriator, Private ..... App. No. 636, 757, 259

Is the system an extension of another system? Yes. . . . . No . . . . .

Is all land irrigated from one system? Yes.....No.....

(If No, show break down on map)

Source of Water: Ground Water - 1930s (C-1) (K-1) (L-1)

[illegible]

|                 |        |
|-----------------|--------|
| Potential Acres | Sceped |
|-----------------|--------|

**Explain** \_\_\_\_\_

|                             |  |
|-----------------------------|--|
| <b>Condition of System:</b> |  |
|-----------------------------|--|

|                 |     |    |  |
|-----------------|-----|----|--|
| Adequate Supply | Yes | No |  |
|-----------------|-----|----|--|

[illegible][illegible]

|                          |  |
|--------------------------|--|
| <b>Information From:</b> |  |
|--------------------------|--|

Remarks: \_\_\_\_\_

2

Sec detail map



11. High end of River 600 ft. point of diversion in  
NW 1/4 Sec 5 T24N R12E on north bank is used to  
direct water out of river. From there to a dam in SW 1/4 Sec 5  
Sec 32 T24N R12E. Hence through a wooden dam to  
irrigate land in NW 1/4 Sec 5 Sec 32 T24N R12E.

From there a right in the Trench 1/4 Sec 5  
NW 1/4 Sec 5 Sec 32 T24N R12E. From there to a dam in SW 1/4 Sec 5  
Sec 32 T24N R12E. Hence through a wooden dam to  
irrigate land in NW 1/4 Sec 5 Sec 32 T24N R12E.

STATE OF MONTANA  
STATE ENGINEER'S OFFICE  
WATER RESOURCES SURVEY

Township 50 Range 13E County Sandwich

|    |    |    |    |    |    |
|----|----|----|----|----|----|
| 6  | 5  | 4  | 3  | 2  | 1  |
| 7  | 8  | 9  | 10 | 11 | 12 |
| 18 | 17 | 16 | 15 | 14 | 13 |
| 19 | 20 | 21 | 22 | 23 | 24 |
| 30 | 29 | 28 | 27 | 26 | 25 |
| 31 | 32 | 33 | 34 | 35 | 36 |

Richard F. [Signature]

Township 50 Range 13E

Legal Land  
Operator  
Water is del  
F  
Di  
Irrig  
Priv  
Flood  
Size and Capacity, P  
Original Appropriato  
Original Appropriator,  
Is the system an exte  
Is all land irrigated fro  
(If No, show break  
Source of Water  
Acres Irrigated 19  
Potential Acres  
plain  
dition of System  
quate Supply Yes  
in  
raphy  
ation From

Information from ..... Date 4-1-57

Farm Checked

STATE OF MONTANA

FORM F-1 - GAZETTE 1965 - M 1-12

By B. Smith

**STATE ENGINEER'S OFFICE**

Code No. 317-204-202

County West Glacier

Area 1000 Acres

**WATER RESOURCES SURVEY**

T. 5N R. 13E Sec. 2, 28, 29, 34, 35

Date 8-11-50

Photo No. 4A-122-190

Legal Land Owner George T. Smith

Address Michell

Operator

Address

Water is delivered by:

Federal Project \_\_\_\_\_ Pres. \_\_\_\_\_ Pot. \_\_\_\_\_

Ditch Company \_\_\_\_\_ Pres. \_\_\_\_\_ Pot. \_\_\_\_\_

Irrigation District \_\_\_\_\_ Pres. \_\_\_\_\_ Pot. \_\_\_\_\_

Private System \_\_\_\_\_ Pres. \_\_\_\_\_ Pot. \_\_\_\_\_

Totals \_\_\_\_\_

Flood \_\_\_\_\_ Pump \_\_\_\_\_ Reservoir \_\_\_\_\_ Gravity ✓

Size and Capacity, Pump, etc. \_\_\_\_\_

Original Appropriator, Company T. E. Smith & Son, Inc. App. No. D-37-326-327

Original Appropriator, Private John E. Smith & Son, Inc. App. No. D-37-326-327

Is the system an extension of another system? Yes \_\_\_\_\_ No ✓

Is all land irrigated from one system? Yes \_\_\_\_\_ No ✓

(If No, show break down on map)

Source of Water San Juan River, Grand Coulee, River, Highway, etc.

Acres Irrigated 19 \_\_\_\_\_

Potential Acres \_\_\_\_\_ Seeped \_\_\_\_\_

Explain \_\_\_\_\_

Condition of System Good

Adequate Supply Yes \_\_\_\_\_ No \_\_\_\_\_

Explain \_\_\_\_\_

Topography Level

Information From George T. Smith

Remarks See attached map

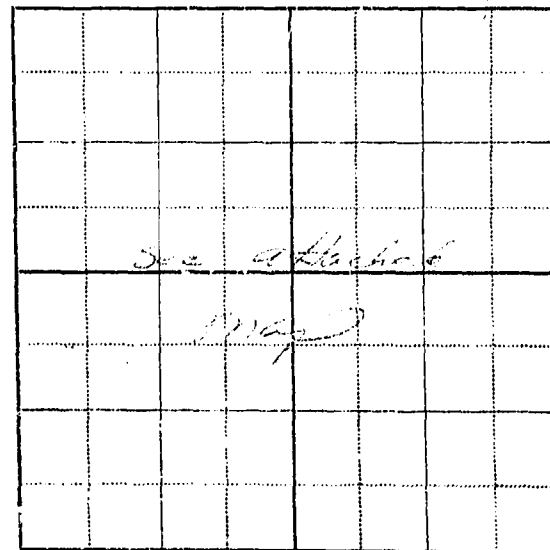

2

See Trunked irrigator land in Sec 34 T5N-R13E  
out of the Hayman River from Sweet Grass Cr.

The land in Sec 23 is all sub-irrigated

STATE OF MONTANA  
**STATE ENGINEER'S OFFICE**  
 WATER RESOURCES SURVEY

Township 5W Range 13E County San Juan

|    |    |    |    |    |    |
|----|----|----|----|----|----|
| 6  | 5  | 4  | 3  | 2  | 1  |
| 7  | 8  | 9  | 10 | 11 | 12 |
| 18 | 17 | 16 | 15 | 14 | 13 |
| 19 | 20 | 21 | 22 | 23 | 24 |
| 30 | 29 | 28 | 27 | 26 | 25 |
| 31 | 32 | 33 | 34 | 35 | 36 |

*Handwritten notes on grid:*  
 Section 21: A  
 Section 29: C  
 Section 28: B  
 Section 33: B  
 Section 34: C

Spring Township

Township 5W Range 13E



STATE OF MONTANA

State Engineer's Office

WATER RESOURCES SURVEY

FARM MAP

County Sweetgrass

Code No. \_\_\_\_\_

21A-284-600-330

33B-34B

Address \_\_\_\_\_

Melville

Address \_\_\_\_\_

Code No. 33B System Gravel Pit Source of Water Sweetgrass Co.  
Basin 1 Present 1 Potential 1 Maximum 1 R ✓ F ✓ P ✓ G ✓ S ✓  
Code No. 33B System Half Moon Ditch Source of Water Sweetgrass Co.  
Basin 2 Present 1 Potential 6.67 Maximum 6.07 R ✓ F ✓ P ✓ G ✓ S ✓  
Code No. 33B System Half Moon Ditch Source of Water Sweetgrass Co.  
Basin 3 Present 1 Potential 6.67 Maximum 6.07 R ✓ F ✓ P ✓ G ✓ S ✓  
Code No. \_\_\_\_\_ System \_\_\_\_\_ Source of Water \_\_\_\_\_  
Basin \_\_\_\_\_ Present \_\_\_\_\_ Potential \_\_\_\_\_ Maximum \_\_\_\_\_ R \_\_\_\_\_ F \_\_\_\_\_ P \_\_\_\_\_ G \_\_\_\_\_ S \_\_\_\_\_

If under Ditch Company, Irrigation District, or Government Project, state the number of shares or inches, acre feet, as the case may be in said system.

NOTE: R—Denotes Regular Irrigation. F—Flood Irrigation. P—Water diverted by means of pumping. G—Water diverted by gravity. S—Stored Water.

Information from \_\_\_\_\_ Date April 15, 1951





Marine Mammals Research Program, Sea 22434, NW-ABE  
in the Alouette Island, Santa Cruz Co.

M. Howard reports sent in Sep 27 & 30  
the following facts: 60000. Can you call  
back out of 50000.

The bond is \$20.32 is satisfied.

STATE OF MONTANA  
**STATE ENGINEER'S OFFICE**  
 WATER RESOURCES SURVEY

Township 50 Range 13E County Sandwich

|    |    |    |    |    |    |
|----|----|----|----|----|----|
| 6  | 5  | 4  | 3  | 2  | 1  |
| 7  | 8  | 9  | 10 | 11 | 12 |
| 18 | 17 | 16 | 15 | 14 | 13 |
| 19 | 20 | 21 | 22 | 23 | 24 |
| 30 | 29 | 28 | 27 | 26 | 25 |
| 31 | 32 | 33 | 34 | 35 | 36 |

*Surveyed*

Township 50 Range 13E

STATE OF MONTANA  
*State Engineer's Office*  
WATER RESOURCES SURVEY  
FARM MAP

County Sweetgrass

Code No. \_\_\_\_\_

22A-27A-34B-  
35A

Name of Land Owner.. Leonard Morris Address.. Melville

Name of Operator..... S. L. 1770 ..... Address..... 1 .....

Legal Description.....

7

Irrigated Land



### Non-Irrigated Land



### Potential Land Under Existing Facilities

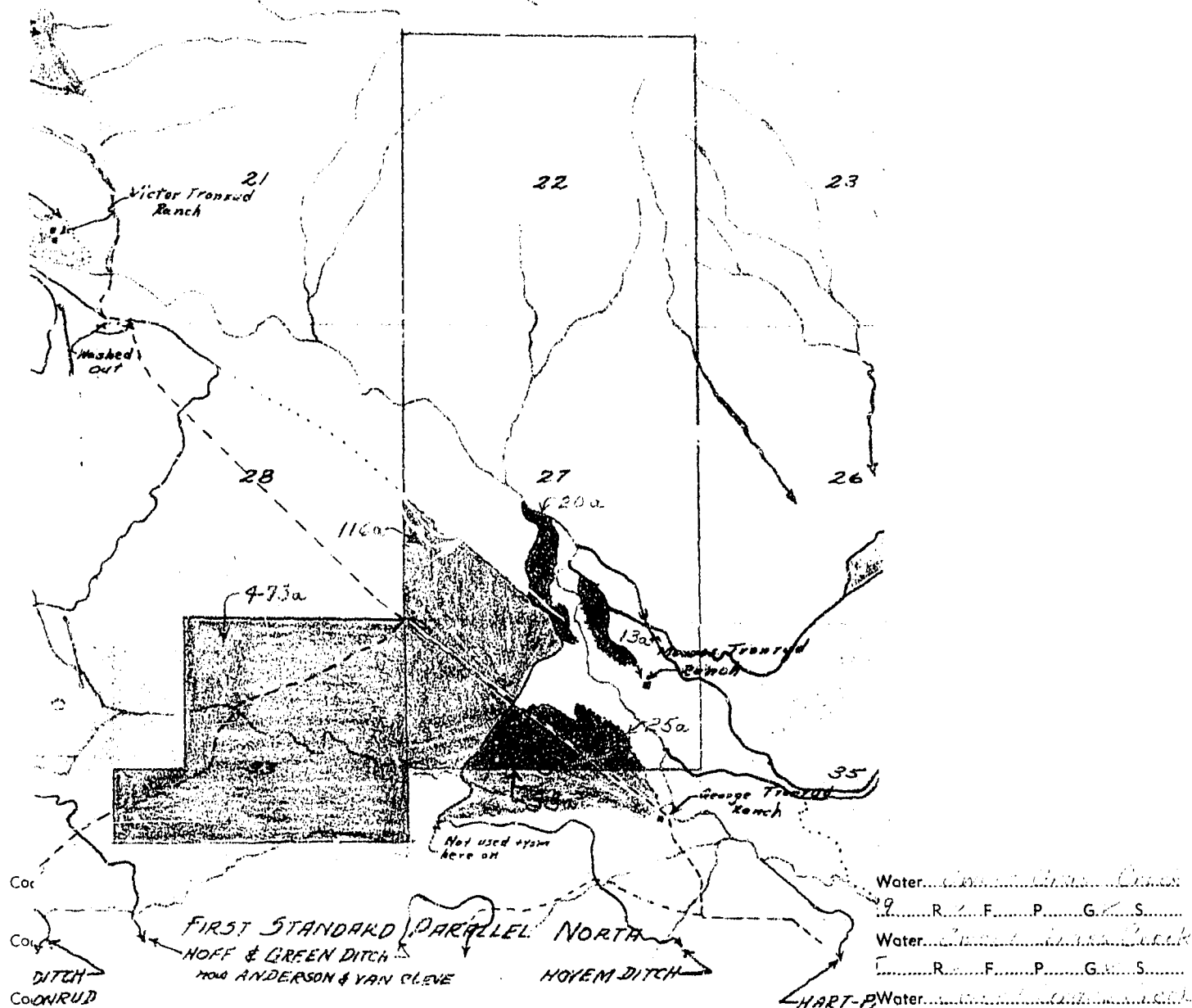

Basin..... Present..... *DITC*..... R..... F..... P..... G..... S.....

Code No. .... System ..... Source of Water .....

Basin.....Present.....Potential.....Maximum.....R.....F.....P.....G.....S.....

If under Ditch Company, Irrigation District, or Government Project, state the number of shares or inches, acre feet, as the case may be in said system.

NOTE: R—Denotes Regular Irrigation. F—Flood Irrigation. P—Water diverted by means of pumping. G—Water diverted by gravity.  
S—Stored Water.

Information from \_\_\_\_\_ Date \_\_\_\_\_

Form WR-B  
Reborter 17362 1M-2004

STATE OF MONTANA

# State Engineer's Office

WATER RESOURCES SURVEY

FARM MAP

County Sweetgrass

Code No. 274-27A-34A-

33A

Tranrud, Morris Address Melville  
Same Address "

Land



Non-Irrigated Land



Potential Land Under Existing Facilities

Code No. 274-27A-34A-33A System Tranrud Ditch Source of Water Sweet Grass Creek  
Basin Tranrud Ditch Present 1.5 Potential 1.5 Maximum 1.5 R. X F.  P.  G. X S.   
Code No. 274-27A-34A-33A System Hayden Ditch Source of Water Sweet Grass Creek  
Basin Hayden Ditch Present 1.5 Potential 1.5 Maximum 1.5 R. X F.  P.  G. X S.   
Code No. 274-27A-34A-33A System Hayden Ditch Source of Water Sweet Grass Creek  
Basin Hayden Ditch Present 1.5 Potential 1.5 Maximum 1.5 R. X F.  P.  G. X S.   
Code No. 274-27A-34A-33A System Hayden Ditch Source of Water Sweet Grass Creek  
Basin Hayden Ditch Present 1.5 Potential 1.5 Maximum 1.5 R. X F.  P.  G. X S.

If under Ditch Company, Irrigation District, or Government Project, state the number of shares or inches, acre feet, as the case may be in said system.

NOTE: R—Denotes Regular Irrigation. F—Flood Irrigation. P—Water diverted by means of pumping G—Water diverted by gravity. S—Stored Water.

Information from Tranrud, Morris Date 10/1/1907

Farm Checked

STATE OF MONTANA

FORM 7-1 - GAZETTE 1965-2M 1-47

By                     

Code No.                     

**STATE ENGINEER'S OFFICE**

County                     

Area                     

WATER RESOURCES SURVEY

T. 50 R. 3E Sec. 4, 5, 8, 9,

Date                     

112-122-191 17, 19, 20, 30

Photo No. 122-190

Legal Land Owner                     

Address                     

Operator                     

Address                     

Water is delivered by:

Federal Project                      Pres.                      Pot.                     

Ditch Company                      Pres.                      Pot.                     

Irrigation District                      Pres.                      Pot.                     

Private System                      Pres.                      Pot.                     

                     Totals                     

Flood                      Pump                      Reservoir                      Gravity                     

Size and Capacity, Pump, etc.                     

Original Appropriator, Company                      App. No.                     

Original Appropriator, Private                      App. No.                     

Is the system an extension of another system? Yes                      No                     

Is all land irrigated from one system? Yes                      No                     

(If No, show break down on map)

Source of Water                     

Acres Irrigated 19                     

Potential Acres                      Seeped                     

Explain                     

Condition of System                     

Adequate Supply                      Yes                      No                     

Explain                     

Topography                     

Information From                     

Remarks                     

|  |  |  |  |  |  |  |  |  |  |
|--|--|--|--|--|--|--|--|--|--|
|  |  |  |  |  |  |  |  |  |  |
|  |  |  |  |  |  |  |  |  |  |
|  |  |  |  |  |  |  |  |  |  |
|  |  |  |  |  |  |  |  |  |  |
|  |  |  |  |  |  |  |  |  |  |
|  |  |  |  |  |  |  |  |  |  |
|  |  |  |  |  |  |  |  |  |  |
|  |  |  |  |  |  |  |  |  |  |
|  |  |  |  |  |  |  |  |  |  |
|  |  |  |  |  |  |  |  |  |  |

Lower end of Trench ditch out of Raree Creek San American Fork possibly  
John Trencher has the San Hopkins right of Shore 8.5  
The Mt. from a ditch from spring at head of Raree  
Creek this ditch is also used by the American Fork  
each. Both were used to maintain a ditch. There is no  
claim of land on the ditch for maintenance.

Transcribed out of Mitchell

4. Found no other water in Sec 30 T5N-R33E. The  
only water found Mitchell Springs near center of said

Transit dated 22.11.1960. Back. Decree No 37.

This dish is one of South Facing American Food.

Training ... 337

|    |                                    |           |
|----|------------------------------------|-----------|
| 12 | 12-1-1950 To University of Chicago | 7-11-1950 |
|----|------------------------------------|-----------|

[illegible]

Point of diversion in course of Sec 19. T5N-R13E. Lands  
improved by this ditch are bounded SENE<sup>4</sup> Sec 19 + SWNW<sup>4</sup>  
Sec 20 T5N-R13E. This ditch was staked by settler  
Thomas B. Jones about 1880.

Greenish-brown. Small amount on a dark leaf.

Point of diversion in NE<sup>1</sup>SW<sup>1</sup> on south bank. This ditch  
was constructed in 1906. Some of the ditch was removed  
by road construction in SW<sup>1</sup>SW<sup>1</sup> Sec 21, T5N - R13E.

STATE OF MONTANA  
**STATE ENGINEER'S OFFICE**  
 WATER RESOURCES SURVEY

Township 52 Range 13E County San Juan

|    |    |    |    |    |    |
|----|----|----|----|----|----|
| 6  | 5  | 4  | 3  | 2  | 1  |
| 7  | 8  | 9  | 10 | 11 | 12 |
| 18 | 17 | 16 | 15 | 14 | 13 |
| 19 | 20 | 21 | 22 | 23 | 24 |
| 30 | 29 | 28 | 27 | 26 | 25 |
| 31 | 32 | 33 | 34 | 35 | 36 |

San Juan

Township 52 Range 13E



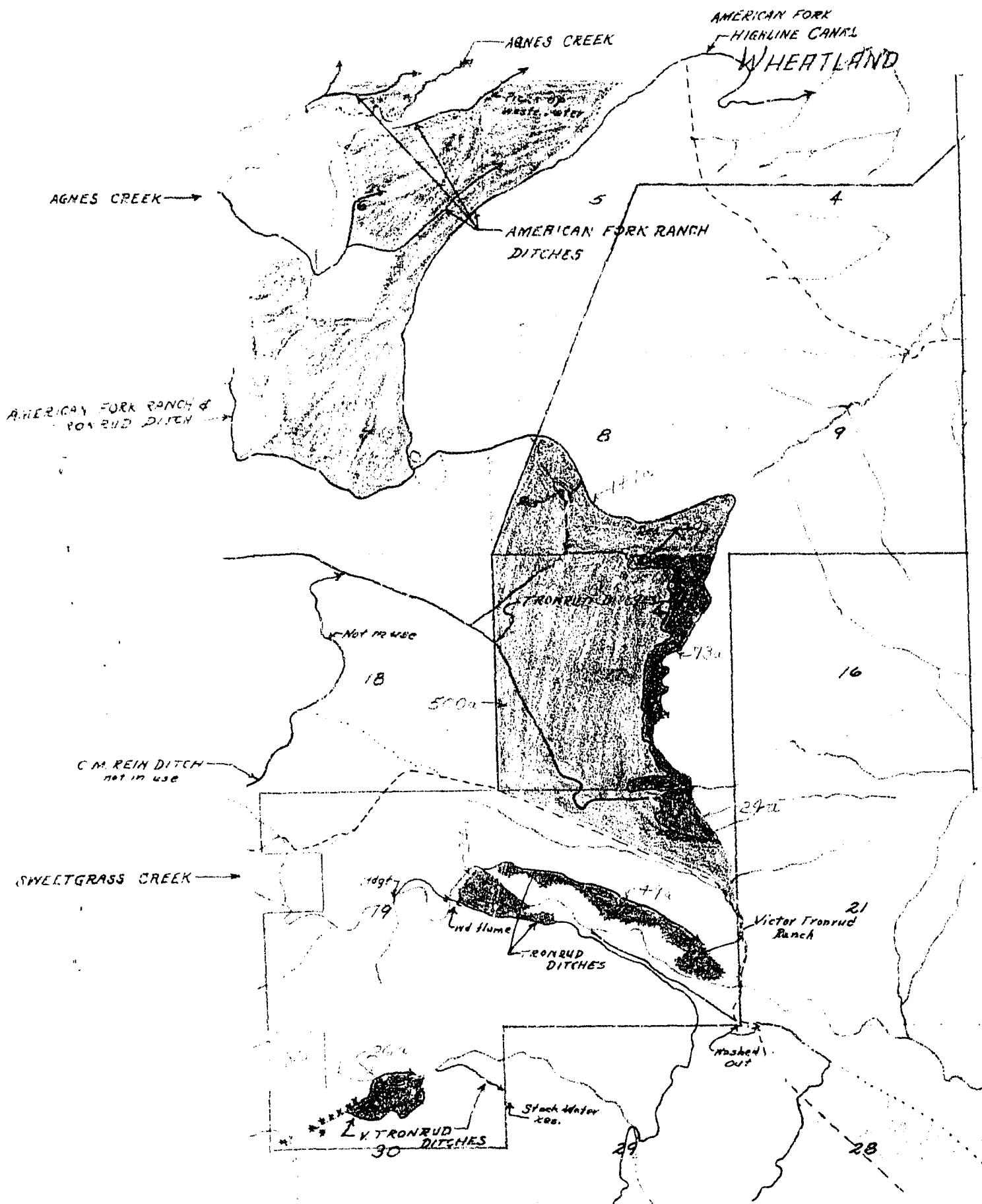

STATE OF MONTANA

**State Engineer's Office**  
WATER RESOURCES SURVEY  
FARM MAP

County Sweetgrass

Code No.

4B-5B-2E-9A-  
17A-19A-20A-30A

Twp. 5N Rge. 13E  
Twp. \_\_\_\_\_ Rge. \_\_\_\_\_  
Twp. \_\_\_\_\_ Rge. \_\_\_\_\_

Name of Land Owner Trenrud, Victor Address Melville  
Name of Operator Same Address \_\_\_\_\_  
Legal Description \_\_\_\_\_



Irrigated Land



Non-Irrigated Land  
North



Potential Land Under Existing Facilities

Code No. 2B, 11, 11A System Am. Fork River Source of Water Am. Fork River  
Basin Am. Fork River Present 73 Potential 147 Maximum 220 R. X F.  P.  G. X S.   
Code No. 11A, 5B, 6A System Trenrud Ditch Source of Water Am. Fork of the American Fork  
Basin Am. Fork River Present 24 Potential 500 Maximum 524 R. X F.  P.  G. X S.   
Code No. 11A, 6A System Trenrud Ditches Source of Water Sweet Grass Creek  
Basin Sweet Grass Creek Present 73 Potential 0 Maximum 73 R. X F.  P.  G. X S.   
Code No. 30A System Trenrud Ditches Source of Water Springs & Gulch Trib. to Sweet Grass Creek  
Basin Sweet Grass Creek Present 26 Potential 0 Maximum 26 R. X F.  P.  G. X S.

If under Ditch Company, Irrigation District, or Government Project, state the number of shares or inches, acre feet, as the case may be in said system.

NOTE: R—Denotes Regular Irrigation. F—Flood Irrigation. P—Water diverted by means of pumping. G—Water diverted by gravity. S—Stored Water.

Information from Victor Trenrud Date April 29, 1951

**Farm Checked**

STATE OF MONTANA

Code No. 36 E

By Dave L. Lee

# STATE ENGINEER'S OFFICE

County: DeKalb County

Area Wooded & Grassy Area

## WATER RESOURCES SURVEY

T. 5 R. 134 Sec. 36

Date 8/16/50

Sweetgrass Inc. - Chicago, Ill.

Photo No. 44-124-25

Legal Land Owner:

1. Edward G. (S. 13)

dress Black velvet

### Operator

K. Caudat + K. dyar

**Address** \_\_\_\_\_

**Water is delivered by:**

**Federal Project** \_\_\_\_\_ **Pres.** \_\_\_\_\_ **Pot.** \_\_\_\_\_

Ditch Company \_\_\_\_\_ Pres. \_\_\_\_\_ Post \_\_\_\_\_

**Irrigation District** \_\_\_\_\_ **Pres.** \_\_\_\_\_ **Pot.** \_\_\_\_\_

Private System Yost 2.000 Pres. 740 Pot. 0

**Totals**

Flood \_\_\_\_\_ Pump \_\_\_\_\_ Reservoir \_\_\_\_\_ Gravity ✓ Boiler

### Size and Capacity, Pump, etc..

Original Appropriator, Company \_\_\_\_\_ App. No. \_\_\_\_\_

Original Appropriator, Private App. No. \_\_\_\_\_

Is the system an extension of another system? Yes \_\_\_\_\_ No ☒

Is all land irrigated from one system? Yes ☒ No ☐

(If No, show break down on map)

Source of Water: \_\_\_\_\_

Acres Irrigated 1951 \_\_\_\_\_

Potential Agent \_\_\_\_\_ Scepter \_\_\_\_\_

## Explain

Condition of System: GoodAdequate Supply ☒ Yes ☐ No

**Explain**

Topograph: Mount. St. Helens to Mount

Information From: Mr. Richard S.

Remarks Unsettled land also 171

2000-10-31 7:30 AM

5

Sec. 36

[illegible]

West Brook (see wooden headstone)

Point of diversion on east bank

is the W. 5<sup>th</sup> 4, Sec. 27 - T. 3 N. R. 13 E.

Flower Nelson - Grosfield dirt about

100 yds. within Sec. 27 & 34.

Septoria south east to about center

of Sec. 35 then northeast to NW

corner of Sec. 36.

Impressions found in Sec. 36.

Form WR-B  
Reporter 173C (M)

STATE OF MONTANA

**State Engineer's Office**  
WATER RESOURCES SURVEY  
FARM MAP

County Sweetgrass

Code No. 364

Twp. 24N Rge. 3E

Twp. 24N Rge. 3E

Twp. 24N Rge. 3E

Name of Land Owner John H. Yost Address 100 Miles

Name of Operator Richard L. Yost Address 100 Miles

Legal Description



Irrigated Land



Non-Irrigated Land



Potential Land Under Existing Facilities

North

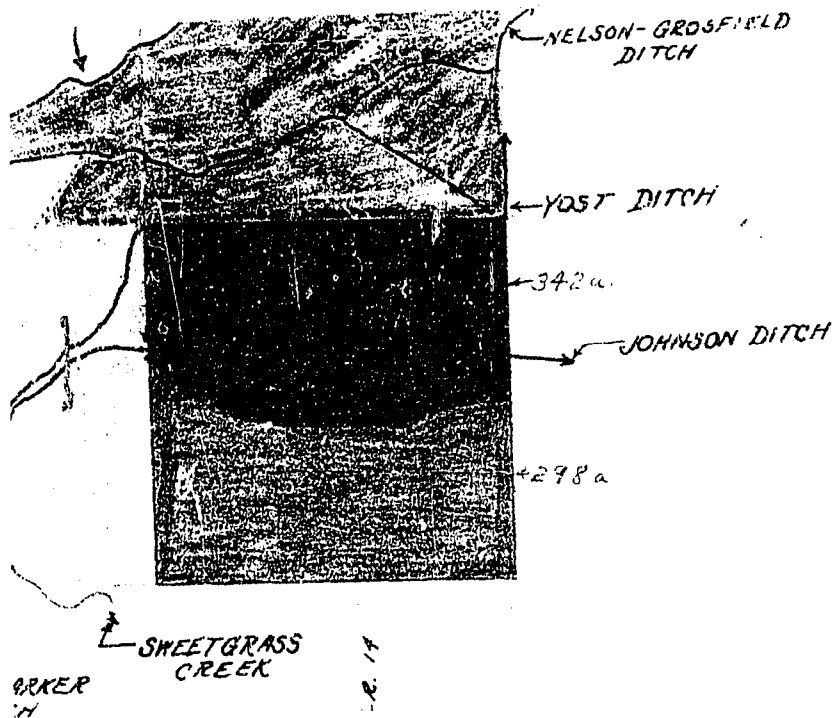

Code No. 364 System Yost Ditch Source of Water Sweet Grass Creek  
Basin Yost Present 342 Potential 4298 Maximum 30 R. x F.  P.  G. x S.   
Code No.  System  Source of Water   
Basin  Present  Potential  Maximum  R.  F.  P.  G.  S.   
Code No.  System  Source of Water   
Basin  Present  Potential  Maximum  R.  F.  P.  G.  S.   
Code No.  System  Source of Water   
Basin  Present  Potential  Maximum  R.  F.  P.  G.  S.

If under Ditch Company, Irrigation District, or Government Project, state the number of shares or inches, acre feet, as the case may be in said system.

NOTE: R--Denotes Regular Irrigation. F--Flood Irrigation. P--Water diverted by means of pumping. G--Water diverted by gravity. S--Stored Water.

Information from  Date 7-1-1951



Code No. 321342

County Sweet Grass

T. 5N R. 13E Sec. 32

Photo No. MA-124-190

| Operator | Address |
|----------|---------|
| ...      | ...     |

**Federal Project** \_\_\_\_\_ **Pres.** \_\_\_\_\_ **Pot.** \_\_\_\_\_

**Ditch Company** \_\_\_\_\_ **Pres.** \_\_\_\_\_ **Pot.** \_\_\_\_\_

Irrigation District \_\_\_\_\_ Pres. \_\_\_\_\_ Pot. \_\_\_\_\_

Private System Trained Clerk Pres.                      Pot.                     

**Totals**

Flood ☐ Pump ☐ Reservoir ☐ Gravity ☒

**Size and Capacity, Pump, etc.**

Original Appropriator, Company \_\_\_\_\_ App. No. \_\_\_\_\_

Original Appropriator, Private Thompson, Christian App. No. 636

Is the system an extension of another system? Yes \_\_\_\_\_ No \_\_\_\_\_

Is all land irrigated from one system? Yes \_\_\_\_\_ No \_\_\_\_\_

(If No, show break down on map)

Source of Water: Sweet Grass Creek, Runaway Creek

Acres Irrigated 19,200

Potential Acres Sheepd

## Explain.

Condition of System not in use

Adequate Supply ..... Yes ..... No .....

### Explain

Tonography Beach land

Information From John T. Howard

Remarks

|  |   |  |    |  |
|--|---|--|----|--|
|  | 6 |  |    |  |
|  |   |  |    |  |
|  |   |  | 37 |  |
|  |   |  |    |  |
|  | 2 |  |    |  |
|  |   |  |    |  |

Twp. 14N Rge. 12E

Twp. \_\_\_\_\_ Rge. \_\_\_\_\_

Twp. \_\_\_\_\_ Rge. \_\_\_\_\_

STATE OF MONTANA  
**State Engineer's Office**  
WATER RESOURCES SURVEY  
FARM MAP

County San Juan

Code No. 33-1-1

Name of Land Owner H. H. H. Address \_\_\_\_\_

Name of Operator \_\_\_\_\_ Address \_\_\_\_\_

Legal Description \_\_\_\_\_



Irrigated Land



Non-Irrigated Land



Potential Land Under Existing Facilities

North

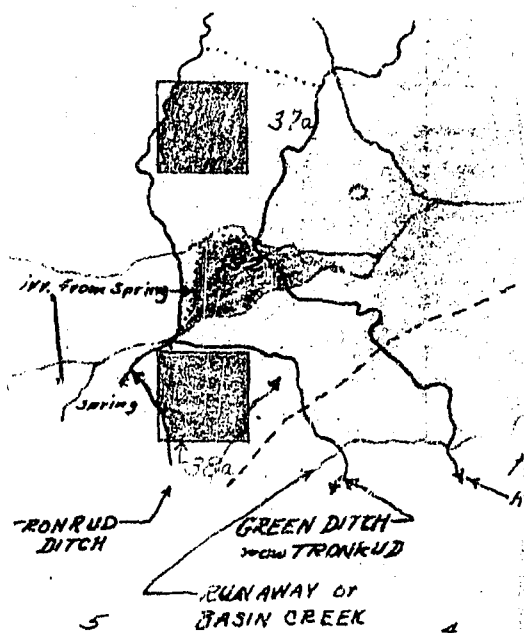

Code No. 33-1-1 System San Juan Basin Source of Water San Juan River

Basin San Juan Basin Present 12 Potential 12 Maximum 12 R 12 F 12 P 12 G 12 S 12

Code No. 33-1-1 System San Juan Basin Source of Water San Juan River

Basin San Juan Basin Present 12 Potential 12 Maximum 12 R 12 F 12 P 12 G 12 S 12

Code No. \_\_\_\_\_ System \_\_\_\_\_ Source of Water \_\_\_\_\_

Basin \_\_\_\_\_ Present \_\_\_\_\_ Potential \_\_\_\_\_ Maximum \_\_\_\_\_ R \_\_\_\_\_ F \_\_\_\_\_ P \_\_\_\_\_ G \_\_\_\_\_ S \_\_\_\_\_

Code No. \_\_\_\_\_ System \_\_\_\_\_ Source of Water \_\_\_\_\_

Basin \_\_\_\_\_ Present \_\_\_\_\_ Potential \_\_\_\_\_ Maximum \_\_\_\_\_ R \_\_\_\_\_ F \_\_\_\_\_ P \_\_\_\_\_ G \_\_\_\_\_ S \_\_\_\_\_

If under Ditch Company, Irrigation District, or Government Project, state the number of shares or inches, acre feet, as the case may be in said system.

NOTE: R—Denotes Regular Irrigation. F—Flood Irrigation. P—Water diverted by means of pumping. G—Water diverted by gravity. S—Stored Water.

Information from H. H. H. Date April 25, 1951

County..... Sweet Grass .....

Farm Checked: Date. 9-28-50

By..... Jim & Bob

STATE OF MONTANA  
STATE ENGINEERS OFFICE  
Water Resources Survey

T. 5N...R. 14E... Plat No. 3.....

Photo No. MA-11A-213, MA-12A-14

Legal Land Owner..... John P. Cooney.

Address..... Harlowton, Mont.

Operator.....Same

Address.

Water is delivered by:— 1. Private System; 2. Ditch Company; 3. State Project; 4. Federal Project; 5. Irrigation District

NOTE: R—Denotes Regular Irrigation. F—Flood Irrigation.

Adequate Supply: Yes . . . No . . . Explain

Remarks

Harper Ditch takes out of Fish Creek on east side of the NW 1/4 of sec. 10 on north side of cree. No irrigation. Has potential under ditch in sections 2,3, & 10. Wood flumes are out. Dam & wood headgate are also out.

River Basin.

|                   |      |      |          |      |      |          |      |      |
|-------------------|------|------|----------|------|------|----------|------|------|
| Also in: Plat No. | Twp. | Rge. | Plat No. | Twp. | Rge. | Plat No. | Twp. | Rge. |
| Plat No.          | Twp. | Rge. | Plat No. | Twp. | Rge. | Plat No. | Twp. | Rge. |

Information From:

## Field Survey



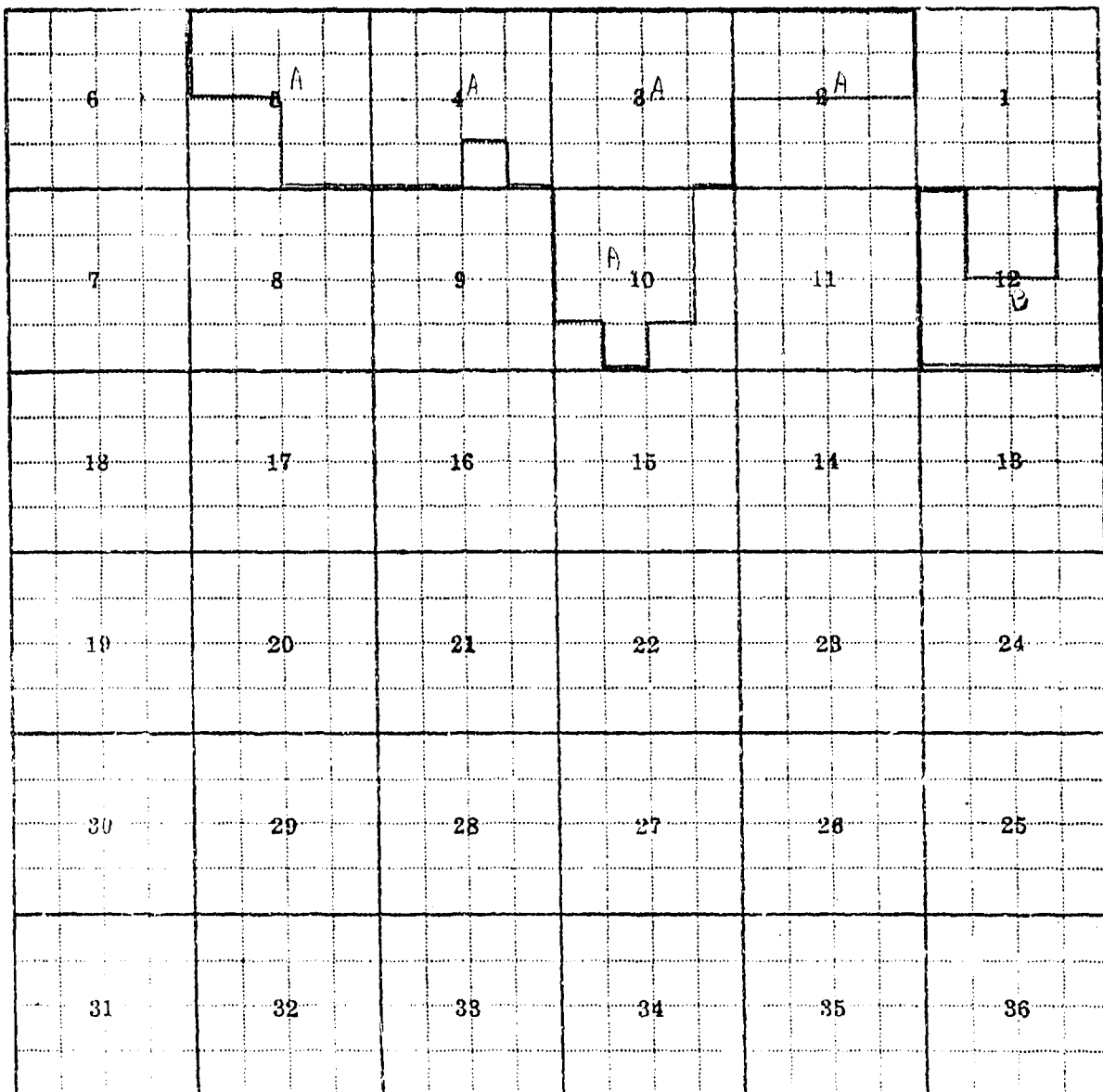

Land Ownership .....

.....

.....

County, Sweet Grass

Farm Checked: Date ..... None shown

By.....Jim & Bob.....

ॐ नमो भगवते वासुदेवाय ।

T 5N R 14E Plat No. 3

Photo No. MA-11A-212

Legal Land Owner. Leo J. Cremer, Jr. Address. Shawmut, Mont.

| Operator..... | Same..... | Address..... |
|---------------|-----------|--------------|
|               |           |              |

Water is delivered by:— 1. Private System; 2. Ditch Company; 3. State Project; 4. Federal Project; 5. Irrigation District

[illegible]

**NOTE: R—Denotes Regular Irrigation. F—Flood Irrigation.**

| Adequate Supply: | Yes | No | Explain |
|------------------|-----|----|---------|
|                  |     |    |         |

| Remarks |
|---------|
|         |

No irrigation by ditch is in practice at the present time in this twp. A considerable area in the SW portion is, however, sub-irrigated.

Some land sub-irrigated from Gremer-Nollmeyer ditch in S $\frac{1}{2}$  Sec. 34.

River Basin.

|                   |      |     |          |      |     |          |      |     |
|-------------------|------|-----|----------|------|-----|----------|------|-----|
| Also in: Plat No. | Twp. | Rge | Plat No. | Twp. | Rge | Plat No. | Twp. | Rge |
| Plat No.          | Twp. | Rge | Plat No. | Twp. | Rge | Plat No. | Twp. | Rge |

Information From:

Hired Hand

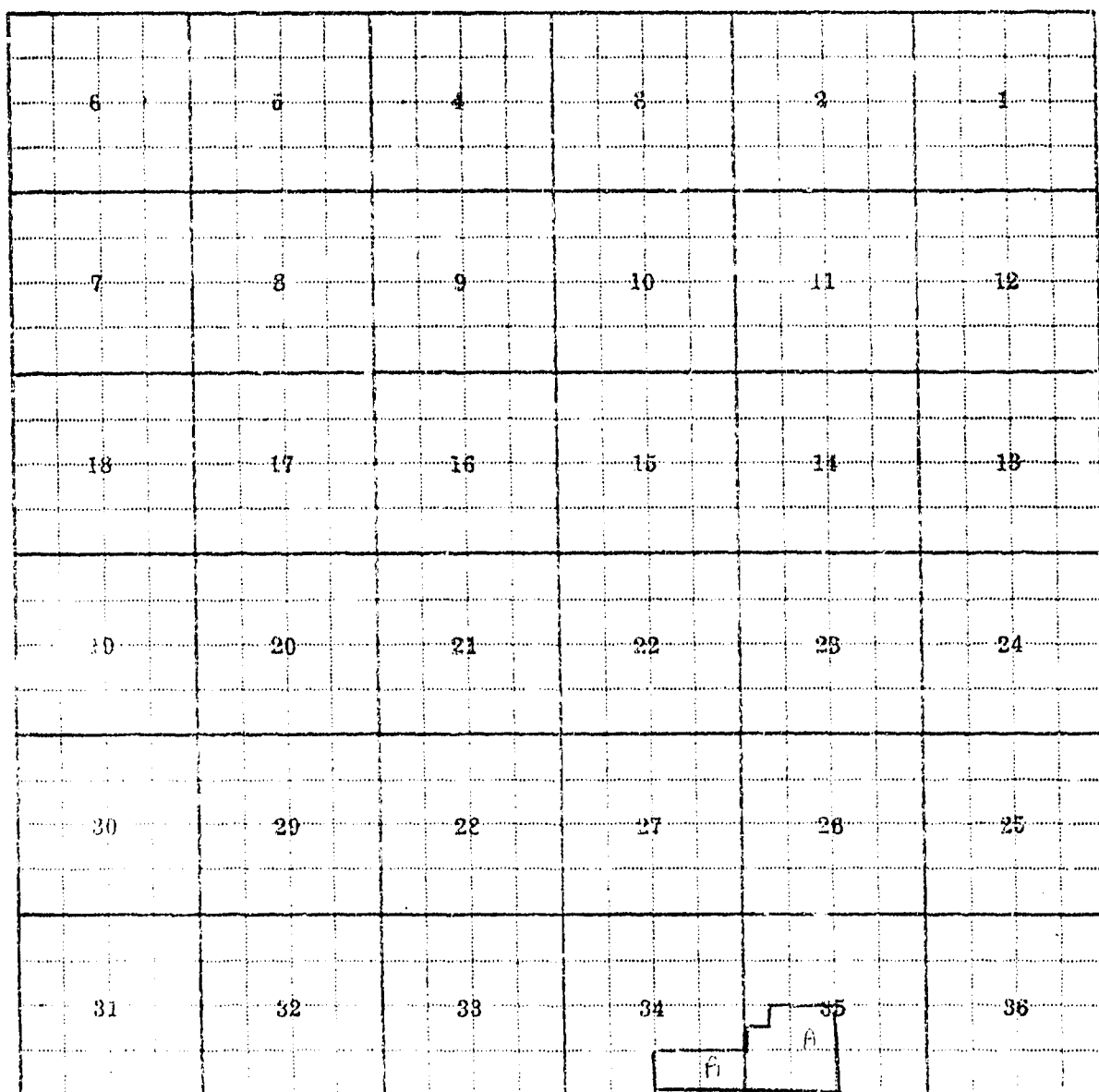

Land Ownership .....

.....

.....

F-1-A--5M--

County Sweet Grass

Farm Checked: Date 9-22-50

By Jim & Bob

STATE OF MONTANA  
STATE ENGINEERS OFFICE  
Water Resources Survey

T 5N R 14E Plat No. 3

Photo No. MA-12A-35, MA-12A-34

Legal Land Owner Clara Grosfield Address Big Timber, Mont.

Operator Same Address

Water is delivered by: 1. Private System; 2. Ditch Company; 3. State Project; 4. Federal Project; 5. Irrigation District

| App. No.<br>Deed No. | NAME OF APPROPRIATOR<br>TO WHOM DECREED | NAME OF STREAM    | Date App.<br>Date Priority | Miner's<br>Inches | In Use | NAME OF DITCH<br>(Water Delivered By) | No. | R/F | Present<br>Irr. Acres | Irrigable<br>Acres |
|----------------------|---|-------------------|----------------------------|-------------------|--------|---------------------------------------|-----|-----|-----------------------|--------------------|
| A-748                | Agnes Benecke et al                     | Sweet Grass Creek | 3-20-05                    | 1500              | }      | Nelson-Grosfield D.                   |     | R   | 172                   | 1043               |
| A-835                | Paul L. Van Cleve                       | Sweet Grass Creek | 7-27-96                    | 50,000            |        |                                       |     |     |                       |                    |
| D-363                | Alice Van Cleve                         | Sweet Grass Creek | 7-15-87                    | 300               |        |                                       |     |     |                       |                    |
| D-353                | John H. Scarlett &<br>Paul Van Cleve    | Sweet Grass Creek | 7-15-87                    | 1450              |        |                                       |     |     |                       |                    |
| D-27                 | McDonnell & Veasey                      | American Fork     | 6-10-83                    | 30                |        |                                       |     |     |                       |                    |
| D-28                 | McDonnell & Veasey                      | American Fork     | 5-1-82                     | 40                |        |                                       |     |     |                       |                    |
| D-29                 | McDonnell & Veasey                      | American Fork     | 5-30-82                    | 100               |        |                                       |     |     |                       |                    |
| D-30                 | McDonnell & Veasey                      | American Fork     | 5-1-82                     | 80                |        |                                       |     |     |                       |                    |
| D-31                 | McDonnell & Veasey                      | American Fork     | 5-1-84                     | 60                |        |                                       |     |     |                       |                    |
| D-32                 | McDonnell & Veasey                      | American Fork     | 12-9-85                    | 1000              |        |                                       |     |     |                       |                    |
| D-33                 | McDonnell & Veasey                      | American Fork     | 6-10-86                    | 360               |        |                                       |     |     |                       |                    |
| D-34                 | McDonnell & Veasey                      | American Fork     | 4-25-97                    | 60                |        |                                       |     |     |                       |                    |
| D-35                 | McDonnell & Veasey                      | American Fork     | 6-30-01                    | 160               |        |                                       |     |     |                       |                    |

NOTE: R--Denotes Regular Irrigation. F--Flood Irrigation.

Adequate Supply: Yes No Explain

Remarks

Nelson-Grosfield Ditches has irrigation in sections 19 & 30. Has potential in Sec. 18, 19, 20 & 30.  
Grosfield has  $\frac{1}{2}$  interest in ditch. Diversion is on east side of Sweet Grass Cr. in SE  $\frac{1}{4}$  of Sec. 27 T. 5N-R. 13E.

River Basin

|                   |      |      |          |      |      |          |      |      |
|-------------------|------|------|----------|------|------|----------|------|------|
| Also in: Plat No. | Twp. | Rge. | Plat No. | Twp. | Rge. | Plat No. | Twp. | Rge. |
| Plat No.          | Twp. | Rge. | Plat No. | Twp. | Rge. | Plat No. | Twp. | Rge. |

Information From:

Clara Grosfield



F-1-A-5M-

County Sweet GrassFarm Checked: Date 9-8-50By Jim & Bob

STATE OF MONTANA  
STATE ENGINEERS OFFICE  
Water Resources Survey

T. 5N F. 14E Plat No. 3Photo No. MA-12A-14, MA-12A-15,  
MA-11A-212, MA-11A-213,  
MA-12-A-34, MA-12A-35Legal Land Owner Lillian Johnson et alAddress Melville, Mont.Operator Same

Address

Water is delivered by:— 1. Private System; 2. Ditch Company; 3. State Project; 4. Federal Project; 5. Irrigation District

| App. No.<br>Decree No. | NAME OF APPEOPRIATOR<br>TO WHOM DECREED | NAME OF STREAM    | Date App.<br>Date Priority | Miner's<br>Inches | In Use | NAME OF DITCH<br>(Water Delivered By) | No | R/F | Present<br>Irr. Acres | Irrigable<br>Acres |
|------------------------|---|-------------------|----------------------------|-------------------|--------|---------------------------------------|----|-----|-----------------------|--------------------|
| A-283                  | Fred W. Schallock                       | Cayuse Creek      | 5-17-10                    | 200               |        |                                       |    |     |                       |                    |
| A-757                  | A. Cook & P. Van Cleve                  | Sweet Grass Creek | 11-5-89                    | 2000              |        |                                       |    |     |                       |                    |
| A-759                  | A. Cook & P. Van Cleve                  | Sweet Grass Creek | 5-5-88                     | 1000              |        |                                       |    |     |                       |                    |
| A-772A                 | Alexander Elliott                       | Sweet Grass Creek | 4-9-89                     | 400               |        |                                       |    |     |                       |                    |
| A-803                  | C. McDonnell & E. Veasey                | Sweet Grass Creek | 4-13-98                    | 1000              |        |                                       |    |     |                       |                    |
| A-804                  | Elizabeth McDonnell                     | Sweet Grass Creek | 11-2-04                    | 300               |        | Johnson Ditch                         |    | R   | 839                   | 661                |
| A-811                  | William Parberry                        | Sweet Grass Creek | 3-2-97                     | 600               |        |                                       |    |     |                       |                    |
| A-1054                 | Caroline Schallock                      | Unnamed Spring    | 5-17-10                    | 160               |        |                                       |    |     |                       |                    |
| A-1087                 | Alexander Elliott                       | Flood Water       | 11-12-89                   | 400               |        |                                       |    |     |                       |                    |
| A-1094                 | Fred W. Schallock                       | Flood Water       | 9-6-12                     | 200               |        |                                       |    |     |                       |                    |
| D-330                  | C. McDonnell & E. Veasey                | Sweet Grass Creek | 4-13-98                    | 750               |        |                                       |    |     |                       |                    |
| D-331                  | Elizabeth McDonnell                     | Sweet Grass Creek | 5-1-04                     | 200               |        |                                       |    |     |                       |                    |

NOTE: R—Denotes Regular Irrigation. F—Flood Irrigation.

Adequate Supply: Yes No Explain

Remarks

All irr. is from Johnson Ditch out of Sweet Grass Creek (McDonnell & Veasey decrees) ditch diverts from N. bank of Sweet Grass Creek in SE $\frac{1}{4}$ NE $\frac{1}{4}$  Sec. 34 T. 5N-R. 13E runs E. to secs. 28, 29, 32 & 33 T. 5N-R. 14E. The ditch can pick up water from Cayuse Creek where it crosses this stream.

River Basin

|                   |      |      |          |      |      |          |      |      |
|-------------------|------|------|----------|------|------|----------|------|------|
| Also in: Plat No. | Twp. | Rge. | Plat No. | Twp. | Rge. | Plat No. | Twp. | Rge. |
| Plat No.          | Twp. | Rge. | Plat No. | Twp. | Rge. | Plat No. | Twp. | Rge. |

Information From:

David Johnson

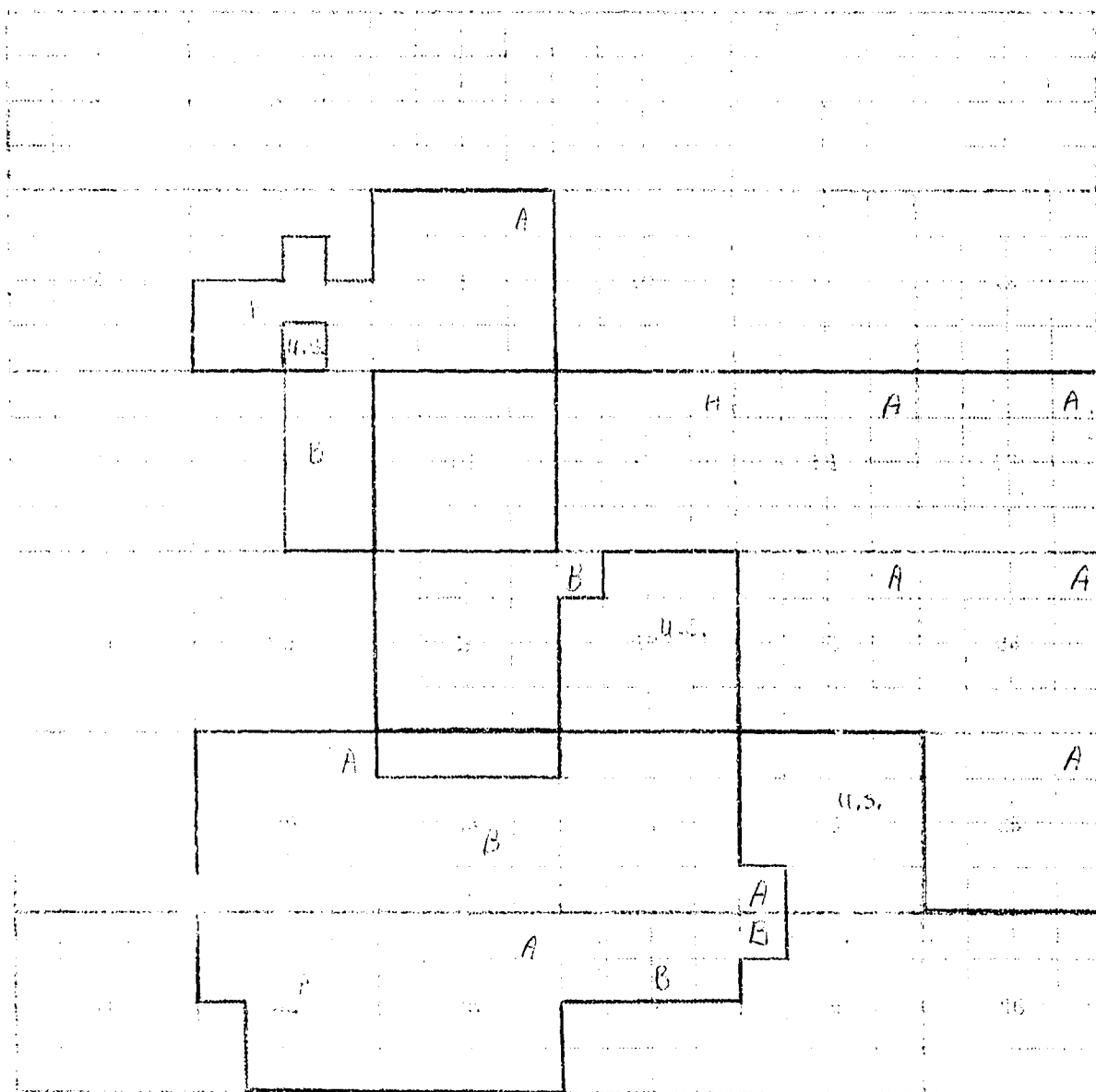

County..... Sweet Grass.....

Farm Checked: Date... 9-28-50

By Jim & Bob

STATE OF MONTANA  
STATE ENGINEERS OFFICE  
Water Resources Survey



T 5N R 14E Plat. No. 3

Photo No. MA-11A-213

Legal Land Owner..... Louis W. Miller ..... Address..... Big Timber, Mont.

| Operator | Address |
|----------|---------|
| ...      | ...     |

Water is delivered by:— 1. Private System; 2. Ditch Company; 3. State Project; 4. Federal Project; 5. Irrigation District

[illegible]

**NOTE: R—Denotes Regular Irrigation. F—Flood Irrigation.**

Adequate Supply: Yes ..... No ..... Explain.....  
Remarks .....

|         |  |
|---------|--|
| Remarks |  |
|---------|--|

[illegible][illegible]

.....

..... River Basin .....

[illegible]

| Also in: | Plot No. | Twp. | Rge. | Plot No. | Twp. | Rge. | Plot No. | Twp. | Rge. | Plot No. | Twp. | Rge. | Field Name |
|----------|----------|------|------|----------|------|------|----------|------|------|----------|------|------|------------|
|          | Plot No. | Twp. | Rge. | Plot No. | Twp. | Rge. | Plot No. | Twp. | Rge. | Plot No. | Twp. | Rge. | Field Name |

| Flat No. | Twp. | Rge. | Flat No. | Twp. | Rge. | Flat No. | Twp. | Rge. | Field Survey |
|----------|------|------|----------|------|------|----------|------|------|--------------|
|----------|------|------|----------|------|------|----------|------|------|--------------|



|    |    |    |    |    |    |
|----|----|----|----|----|----|
| 6  | 5  | 4  | 3  | 2  | 1  |
| 7  | 8  | 9  | 10 | 11 | 12 |
| 13 | 14 | 15 | 16 | 17 | 18 |
| 19 | 20 | 21 | 22 | 23 | 24 |
| 25 | 26 | 27 | 28 | 29 | 30 |
| 31 | 32 | 33 | 34 | 35 | 36 |

Land Ownership .....

.....

.....

County..... Sweet Grass

Farm Checked: Date 8-17-50

By Dave & Joe

STATE OF MONTANA  
STATE ENGINEERS OFFICE  
Water Resources Survey

T 5N R 14E Plat No. 3

Photo No. MA-12A-34

Legal Land Owner George J. & Lenard Yost Address Melville, Mont.

| Operator | Same | Address |
|----------|------|---------|
|          |      |         |

Water is delivered by:— 1. Private System; 2. Ditch Company; 3. State Project; 4. Federal Project; 5. Irrigation District

[illegible]

**NOTE: R—Denotes Regular Irrigation. F—Flood Irrigation.**

Adequate Supply: Yes..... No..... Explain.....

**Remarks**

...River Basin.

|                        |           |           |               |           |           |               |           |           |
|------------------------|-----------|-----------|---------------|-----------|-----------|---------------|-----------|-----------|
| Also in: Plat No. .... | Twp. .... | Rge. .... | Plat No. .... | Twp. .... | Rge. .... | Plat No. .... | Twp. .... | Rge. .... |
| Plat No. ....          | Twp. .... | Rge. .... | Plat No. .... | Twp. .... | Rge. .... | Plat No. .... | Twp. .... | Rge. .... |

Information From:

Mr. Richards

|    |    |    |    |    |    |
|----|----|----|----|----|----|
| 6  | 5  | 4  | 3  | 2  | 1  |
| 7  | 8  | 9  | 10 | 11 | 12 |
| 18 | 17 | 16 | 15 | 14 | 13 |
| 19 | 20 | 21 | 22 | 23 | 24 |
| 30 | 29 | 28 | 27 | 26 | 25 |
| 31 | 32 | 33 | 34 | 35 | 36 |

Land Ownership .....

.....

.....

(3) Township 5 North-Range 14 East

|     | Name of Owner           | Township & Range                   |
|-----|-------------------------|------------------------------------|
| ✓1. | Cooney, John P.         | (3) 5N-14E (4) 5N-13E              |
| 2.  | Gremer, Leo J. Jr.      | "                                  |
| ✓3. | Gresfield, Clara        | " (21) 2N-14E (2) 5N-13E           |
| ✓4. | Johnson, Lillian et al  | "                                  |
| ✓5. | Miller, Louis W.        | "                                  |
| ✓6. | Yost, Geo. J. & Leonard | " (2) 5N-13E (7) 4N-13E (8) 4N-14E |

STATE OF MONTANA  
**STATE ENGINEER'S OFFICE**  
 WATER RESOURCES SURVEY

Township 5 North Range 14 East County Sweet Grass

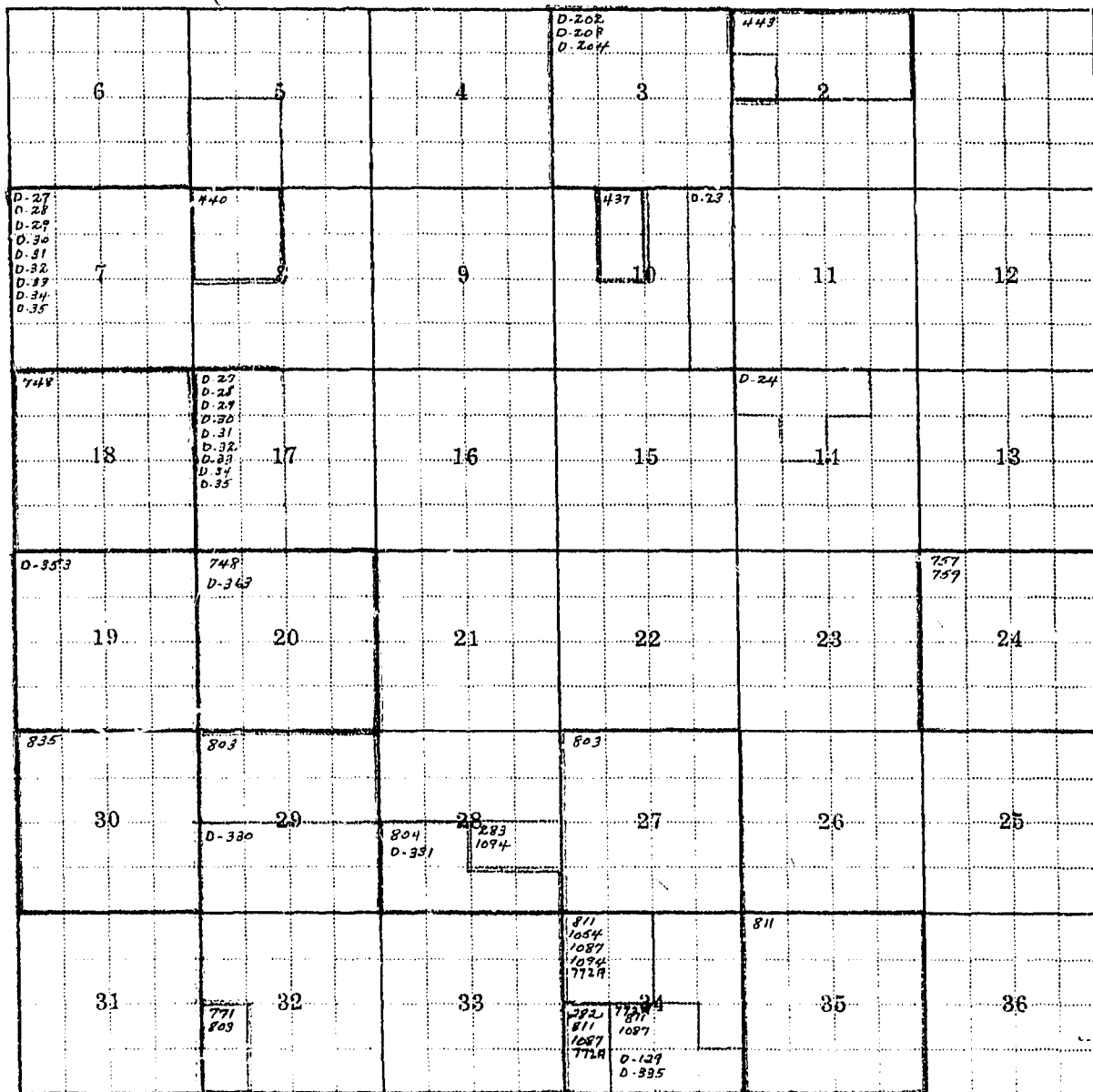

Township 5 North Range 14 East

Township.

Range

County

Deposition  
819

VanCleve, Ph. + Scarlett, J. H.

McNeill, Mont

lands lying in and all lying contiguous to Fish Creek in said Grant. There is about 2000 acres of diversion or Sweet Grass on lands, to be in Sec 27 5N 13E. (7500 M.T.)

836

Van Cleave, P. L.

McNeill, R. H.

Land in 5 N 14 E Part of Section on Sweet Grass Creek  
on east side of 51<sup>30</sup>/<sub>100</sub> ch. N. S. 3° 55' from NW corner of Sec 35 5 N 13 E

Township 5 North, Range 14 East

| <u>No.</u>  | <u>Name of Appropriator</u>  | <u>Name of Stream</u>                  | <u>Date App.</u>             | <u>Date Filed</u>              | <u>M.I.</u>            |
|-------------|--|--|------------------------------|--------------------------------|------------------------|
| 282         | Parberry, William  | Cavuse Creek                           | 12-26-96                     | 12-28-96                       | 100                    |
| 283         | Schallock, W. Fred   | Cavuse Creek                           | 5-17-10                      | 5-20-10                        | 200                    |
| 437         | Ferris, Alexander M.   | Fish Creek                             | 7-22-99                      | 7-22-99                        | 360                    |
| 440         | McClatchey, Lydia  | Fish Creek                             | 5-4-85                       | 5-13-85                        | 200                    |
| 443         | Morey, Will A.   | Fish Creek                             | 6-18-87                      | 6-21-87                        | 360                    |
| 748         | Benecke, Agnes et al   | Sweetgrass Creek                       | 3-20-05                      | 3-20-05                        | 1500                   |
| 757         | Cook, Albert & Van Cleve, Paul                                     | Sweetgrass Creek                       | 11-5-89                      | 11-18-89                       | 2000                   |
| 759         | Cook, Albert & Van Cleve, P.L.                                     | Sweetgrass Creek                       | 5-5-88                       | 5-16-88                        | 1000                   |
| 771         | Dugro, Alice   | Sweetgrass Creek                       | 3-30-12                      | 3-30-12                        | 80                     |
| 177A<br>803 | <del>Elliott, Alexander</del><br>McDonnell, Chas. & Veasey, Edward | <del>Sweetgrass Creek</del><br>" "     | <del>4-9-89</del><br>4-13-98 | <del>11-30-89</del><br>4-18-98 | <del>400</del><br>1000 |
| 804         | McDonnell, Elizabeth   | Sweetgrass Creek                       | 11-2-04                      | 11-2-04                        | 300                    |
| 811<br>819  | Parberry, William<br>Van Cleve, A. & Seale, J.                     | Sweetgrass Creek<br>Sweetgrass Creek   | 3-2-97<br>7-7-01             | 3-4-97<br>7-9-01               | 60<br>7000             |
| 835<br>836  | Van Cleve, Paul L.   | Sweetgrass Creek<br>"                  | 7-27-96<br>7-26-96           | 7-27-96<br>9-26-96             | 50,000<br>7,000        |
| 1054        | Schallock, Caroline  | Unnamed Spring                         | 5-17-10                      | 5-20-10                        | 160                    |
| 1087        | Elliott, Alexander   | Flood Water                            | 11-12-89                     | 11-30-89                       | 400                    |
| 1094        | Schallock, W. Fred   | Flood Water                            | 9-6-12                       | 9-6-12                         | 200                    |
| D-23        | Langston, James  | <del>Fish Creek</del><br>American Fork | - - - -                      | - - - -                        | 120                    |
| D-24        | Langston, Jesse  | American Fork                          | - - - -                      | - - - -                        | 12                     |
| D-27        | McDonnell and Veasey   | American Fork                          | 6-10-83                      |                                | 30                     |
| D-28        | McDonnell and Veasey   | American Fork                          | 5-1-82                       |                                | 40                     |
| D-29        | McDonnell and Veasey   | American Fork                          | 5-30-82                      |                                | 100                    |
| D-30        | McDonnell and Veasey   | American Fork                          | 5-1-82                       |                                | 80                     |
| D-31        | McDonnell and Veasey   | American Fork                          | 6-1-84                       |                                | 60                     |
| D-32        | McDonnell and Veasey   | American Fork                          | 12-9-86                      |                                | 1000                   |
| D-33        | McDonnell and Veasey   | American Fork                          | 6-10-86                      |                                | 360                    |

Page Two

| <u>No.</u> | <u>To Whom Decreed</u>                   | <u>Name of Stream</u> | <u>Date Priority</u> | <u>M.I.</u> |
|------------|--|-----------------------|----------------------|-------------|
| D-34       | McDonnell and Veasey                     | American Fork         | 4-25-97              | 60          |
| D-35       | McDonnell and Veasey                     | American Fork         | 6-30-01              | 160         |
| D-129      | Moore, George                            | Cayuse Creek          | 8-1-88               | 108         |
| D-202      | Harper, John                             | Fish Creek            | 7-1-86               | 50          |
| D-203      | Harper, John                             | Fish Creek            | 6-21-87              | 110         |
| D-204      | Harper, John                             | Fish Creek            | 6-2-02               | 68          |
| D-330      | McDonnell, Charles and<br>Veasey, Edward | Sweetgrass Creek      | 4-13-98              | 750         |
| D-331      | McDonnell, Elizabeth                     | Sweetgrass Creek      | 5-1-04               | 200         |
| D-335      | Moore, George                            | Sweetgrass Creek      | 5-15-97              | 600         |
| D-353      | Scarlett, John H. and Van Cleve, Paul    | " "                   | 7-15-87              | 1450        |
| D-363      | Van Cleve, Alice                         | Sweetgrass Creek      | 7-15-87              | 300         |



STATE OF MONTANA  
**State Engineer's Office**  
WATER RESOURCES SURVEY

Township 5 N Range 14 E County Sweet Grass

|    |    |    |    |    |    |
|----|----|----|----|----|----|
| 6  | 5  | 4  | 3  | 2  | 1  |
| 7  | 8  | 9  | 10 | 11 | 12 |
| 18 | 17 | 16 | 15 | 14 | 13 |
| 19 | 20 | 21 | 22 | 23 | 24 |
| 30 | 29 | 28 | 27 | 26 | 25 |
| 31 | 32 | 33 | 34 | 35 | 36 |

*Transcribed from Park County*

Township 5 N Range 14 E

Township \_\_\_\_\_ Range \_\_\_\_\_ County \_\_\_\_\_

[illegible]

Form Checked

STATE OF MONTANA

Code No. 3A-8-4-5A-10A-12B

By [Signature]

**STATE ENGINEER'S OFFICE**

County Sweetgrass Co.

Area [Signature]

**WATER RESOURCES SURVEY**

T. 5 N. R. 14 E. Sec. 3, 4, 5, 10, 12

D. [Signature]

Photo No. MA-11A-215  
MA-12A-1A

Legal Land Owner Caomey, John D.

Address HARLOWTON, MONT.

Operator " " "

Address " "

Water is delivered by:

Federal Project \_\_\_\_\_ Pres. \_\_\_\_\_ Pot. \_\_\_\_\_  
Ditch Company \_\_\_\_\_ Pres. \_\_\_\_\_ Pot. \_\_\_\_\_  
Irrigation District \_\_\_\_\_ Pres. \_\_\_\_\_ Pot. \_\_\_\_\_  
Private System [Signature] Pres. 0 Pot. \_\_\_\_\_  
Totals \_\_\_\_\_

Flood \_\_\_\_\_ Pump \_\_\_\_\_ Reservoir \_\_\_\_\_ Gravity ✓

Size and Capacity, Pump, etc. \_\_\_\_\_

Original Appropriator, Company \_\_\_\_\_ App. No. \_\_\_\_\_

Original Appropriator, Private Morey, Will A. App. No. 437 D-202  
Harper, John App. No. 443 D-203  
D-204

Is the system an extension of another system? Yes \_\_\_\_\_ No ✓

Is all land irrigated from one system? Yes ✓ No \_\_\_\_\_

(If No, show break down on map)

Source of Water Fish Creek

Acres Irrigated 1952 0

Potential Acres \_\_\_\_\_ Seeped \_\_\_\_\_

Explain \_\_\_\_\_

Condition of System Urbanized area

Adequate Supply Yes \_\_\_\_\_ No \_\_\_\_\_

Explain \_\_\_\_\_

Topography Urbanized area

Information From [Signature]

Remarks [Signature]

|  |  |  |  |  |  |  |  |
|--|--|--|--|--|--|--|--|
|  |  |  |  |  |  |  |  |
|  |  |  |  |  |  |  |  |
|  |  |  |  |  |  |  |  |
|  |  |  |  |  |  |  |  |
|  |  |  |  |  |  |  |  |
|  |  |  |  |  |  |  |  |
|  |  |  |  |  |  |  |  |
|  |  |  |  |  |  |  |  |

3

Lower part of the section is disturbed on east  
side of the gully. It is covered on north side  
of slope by talus from the contact in  
subdivisions 2, 3 & 4. The section is cut  
from the base of the section.

STATE OF MONTANA  
**State Engineer's Office**  
WATER RESOURCES SURVEY

Township 5 North Range 14 East County Sweetgrass

|    |    |    |    |    |    |
|----|----|----|----|----|----|
| 6  | 5  | 4  | 3  | 2  | 1  |
| 7  | 8  | 9  | 10 | 11 | 12 |
| 18 | 17 | 16 | 15 | 14 | 13 |
| 19 | 20 | 21 | 22 | 23 | 24 |
| 30 | 29 | 28 | 27 | 26 | 25 |
| 31 | 32 |    | 34 | 35 | 36 |

Township 5 N. Range 14 E.

STATE OF MONTANA

State Engineer's Office

WATER RESOURCES SURVEY

FARM MAP

County Sweet Grass

Code No. 2A-2B-4A-5A-08

228

Twp. 22N Rge. 22E

Twp. 22N Rge. 22E

Twp. 22N Rge. 22E

Name of Land Owner. Conroy, John R. Address. Harper, Mont.

Name of Operator. Same Address. "

Legal Description.



Irrigated Land



Non-Irrigated Land



Potential Land Under Existing Facilities

North

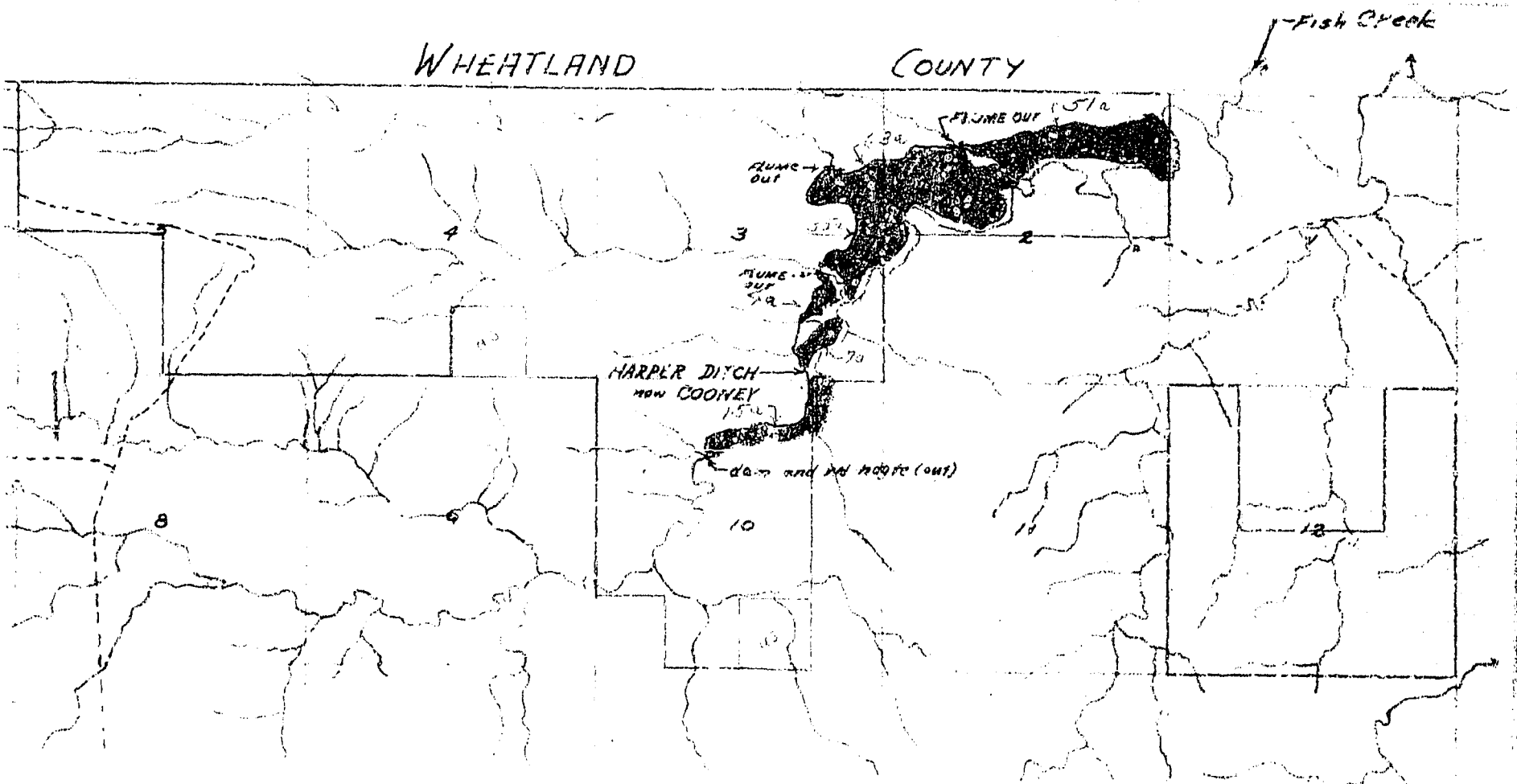

Code No. 2A-2B-4A-5A-08 System. Harper Ditch Source of Water. Harper Ditch

Basin. 22N 22E Present. 22N 22E Potential. 22N 22E Maximum. 22N 22E R. 22N 22E F. 22N 22E P. 22N 22E G. 22N 22E S. 22N 22E

Code No. 2A-2B-4A-5A-08 System. Harper Ditch Source of Water. Harper Ditch

Basin. 22N 22E Present. 22N 22E Potential. 22N 22E Maximum. 22N 22E R. 22N 22E F. 22N 22E P. 22N 22E G. 22N 22E S. 22N 22E

Code No. 2A-2B-4A-5A-08 System. Harper Ditch Source of Water. Harper Ditch

Basin. 22N 22E Present. 22N 22E Potential. 22N 22E Maximum. 22N 22E R. 22N 22E F. 22N 22E P. 22N 22E G. 22N 22E S. 22N 22E

Code No. 2A-2B-4A-5A-08 System. Harper Ditch Source of Water. Harper Ditch

Basin. 22N 22E Present. 22N 22E Potential. 22N 22E Maximum. 22N 22E R. 22N 22E F. 22N 22E P. 22N 22E G. 22N 22E S. 22N 22E

If under Ditch Company, Irrigation District, or Government Project, state the number of shares or inches, acre feet, as the case may be in said system.

NOTE: R—Denotes Regular Irrigation. F—Flood Irrigation. P—Water diverted by means of pumping. G—Water diverted by gravity. S—Stored Water.

Information from Harper Ditch Date 1928

FORM F-1 - GAZETTE 1685-2M-1-4/

STATE OF MONTANA

Code No. 34A-35A

# STATE ENGINEER'S OFFICE

County San Diego

WATER RESOURCES SURVEY

T. 2 N. R. 14 E. Sec. 5 1.35

Date \_\_\_\_\_

Photo No. 17A-11A-212

Legal Land Owner. CREMER, LEO J. JR.

Address SHAW-NUT, Mon. J.

Operator \_\_\_\_\_

Address \_\_\_\_\_

Water is delivered by:

**Federal Project** \_\_\_\_\_ **Pres** \_\_\_\_\_ **Pot** \_\_\_\_\_

Ditch Company \_\_\_\_\_ Pres. \_\_\_\_\_ Pot \_\_\_\_\_

Irrigation District \_\_\_\_\_ Pres. \_\_\_\_\_ Pot. \_\_\_\_\_

Private System Cremier - Hollinger Ditch Pres. \_\_\_\_\_ Pol. \_\_\_\_\_

| Totals |  | 1997 | 1998 | 1999 | 2000 | 2001 | 2002 | 2003 | 2004 | 2005 | 2006 | 2007 | 2008 | 2009 | 2010 | 2011 | 2012 | 2013 | 2014 | 2015 | 2016 | 2017 | 2018 | 2019 | 2020 | 2021 | 2022 | 2023 | 2024 | 2025 | 2026 | 2027 | 2028 | 2029 | 2030 | 2031 | 2032 | 2033 | 2034 | 2035 | 2036 | 2037 | 2038 | 2039 | 2040 | 2041 | 2042 | 2043 | 2044 | 2045 | 2046 | 2047 | 2048 | 2049 | 2050 | 2051 | 2052 | 2053 | 2054 | 2055 | 2056 | 2057 | 2058 | 2059 | 2060 | 2061 | 2062 | 2063 | 2064 | 2065 | 2066 | 2067 | 2068 | 2069 | 2070 | 2071 | 2072 | 2073 | 2074 | 2075 | 2076 | 2077 | 2078 | 2079 | 2080 | 2081 | 2082 | 2083 | 2084 | 2085 | 2086 | 2087 | 2088 | 2089 | 2090 | 2091 | 2092 | 2093 | 2094 | 2095 | 2096 | 2097 | 2098 | 2099 | 2100 | 2101 | 2102 | 2103 | 2104 | 2105 | 2106 | 2107 | 2108 | 2109 | 2110 | 2111 | 2112 | 2113 | 2114 | 2115 | 2116 | 2117 | 2118 | 2119 | 2120 | 2121 | 2122 | 2123 | 2124 | 2125 | 2126 | 2127 | 2128 | 2129 | 2130 | 2131 | 2132 | 2133 | 2134 | 2135 | 2136 | 2137 | 2138 | 2139 | 2140 | 2141 | 2142 | 2143 | 2144 | 2145 | 2146 | 2147 | 2148 | 2149 | 2150 | 2151 | 2152 | 2153 | 2154 | 2155 | 2156 | 2157 | 2158 | 2159 | 2160 | 2161 | 2162 | 2163 | 2164 | 2165 | 2166 | 2167 | 2168 | 2169 | 2170 | 2171 | 2172 | 2173 | 2174 | 2175 | 2176 | 2177 | 2178 | 2179 | 2180 | 2181 | 2182 | 2183 | 2184 | 2185 | 2186 | 2187 | 2188 | 2189 | 2190 | 2191 | 2192 | 2193 | 2194 | 2195 | 2196 | 2197 | 2198 | 2199 | 2200 | 2201 | 2202 | 2203 | 2204 | 2205 | 2206 | 2207 | 2208 | 2209 | 2210 | 2211 | 2212 | 2213 | 2214 | 2215 | 2216 | 2217 | 2218 | 2219 | 2220 | 2221 | 2222 | 2223 | 2224 | 2225 | 2226 | 2227 | 2228 | 2229 | 2230 | 2231 | 2232 | 2233 | 2234 | 2235 | 2236 | 2237 | 2238 | 2239 | 2240 | 2241 | 2242 | 2243 | 2244 | 2245 | 2246 | 2247 | 2248 | 2249 | 2250 | 2251 | 2252 | 2253 | 2254 | 2255 | 2256 | 2257 | 2258 | 2259 | 2260 | 2261 | 2262 | 2263 | 2264 | 2265 | 2266 | 2267 | 2268 | 2269 | 2270 | 2271 | 2272 | 2273 | 2274 | 2275 | 2276 | 2277 | 2278 | 2279 | 2280 | 2281 | 2282 | 2283 | 2284 | 2285 | 2286 | 2287 | 2288 | 2289 | 2290 | 2291 | 2292 | 2293 | 2294 | 2295 | 2296 | 2297 | 2298 | 2299 | 2300 | 2301 | 2302 | 2303 | 2304 | 2305 | 2306 | 2307 | 2308 | 2309 | 2310 | 2311 | 2312 | 2313 | 2314 | 2315 | 2316 | 2317 | 2318 | 2319 | 2320 | 2321 | 2322 | 2323 | 2324 | 2325 | 2326 | 2327 | 2328 | 2329 | 2330 | 2331 | 2332 | 2333 | 2334 | 2335 | 2336 | 2337 | 2338 | 2339 | 2340 | 2341 | 2342 | 2343 | 2344 | 2345 | 2346 | 2347 | 2348 | 2349 | 2350 | 2351 | 2352 | 2353 | 2354 | 2355 | 2356 | 2357 | 2358 | 2359 | 2360 | 2361 | 2362 | 2363 | 2364 | 2365 | 2366 | 2367 | 2368 | 2369 | 2370 | 2371 | 2372 | 2373 | 2374 | 2375 | 2376 | 2377 | 2378 | 2379 | 2380 | 2381 | 2382 | 2383 | 2384 | 2385 | 2386 | 2387 | 2388 | 2389 | 2390 | 2391 | 2392 | 2393 | 2394 | 2395 | 2396 | 2397 | 2398 | 2399 | 2400 | 2401 | 2402 | 2403 | 2 |
|--------|--|------|------|------|------|------|------|------|------|------|------|------|------|------|------|------|------|------|------|------|------|------|------|------|------|------|------|------|------|------|------|------|------|------|------|------|------|------|------|------|------|------|------|------|------|------|------|------|------|------|------|------|------|------|------|------|------|------|------|------|------|------|------|------|------|------|------|------|------|------|------|------|------|------|------|------|------|------|------|------|------|------|------|------|------|------|------|------|------|------|------|------|------|------|------|------|------|------|------|------|------|------|------|------|------|------|------|------|------|------|------|------|------|------|------|------|------|------|------|------|------|------|------|------|------|------|------|------|------|------|------|------|------|------|------|------|------|------|------|------|------|------|------|------|------|------|------|------|------|------|------|------|------|------|------|------|------|------|------|------|------|------|------|------|------|------|------|------|------|------|------|------|------|------|------|------|------|------|------|------|------|------|------|------|------|------|------|------|------|------|------|------|------|------|------|------|------|------|------|------|------|------|------|------|------|------|------|------|------|------|------|------|------|------|------|------|------|------|------|------|------|------|------|------|------|------|------|------|------|------|------|------|------|------|------|------|------|------|------|------|------|------|------|------|------|------|------|------|------|------|------|------|------|------|------|------|------|------|------|------|------|------|------|------|------|------|------|------|------|------|------|------|------|------|------|------|------|------|------|------|------|------|------|------|------|------|------|------|------|------|------|------|------|------|------|------|------|------|------|------|------|------|------|------|------|------|------|------|------|------|------|------|------|------|------|------|------|------|------|------|------|------|------|------|------|------|------|------|------|------|------|------|------|------|------|------|------|------|------|------|------|------|------|------|------|------|------|------|------|------|------|------|------|------|------|------|------|------|------|------|------|------|------|------|------|------|------|------|------|------|------|------|------|------|------|------|------|------|------|------|------|------|------|------|------|------|------|------|------|------|------|------|------|------|------|------|------|------|------|------|------|------|------|------|------|------|------|------|---|
|--------|--|------|------|------|------|------|------|------|------|------|------|------|------|------|------|------|------|------|------|------|------|------|------|------|------|------|------|------|------|------|------|------|------|------|------|------|------|------|------|------|------|------|------|------|------|------|------|------|------|------|------|------|------|------|------|------|------|------|------|------|------|------|------|------|------|------|------|------|------|------|------|------|------|------|------|------|------|------|------|------|------|------|------|------|------|------|------|------|------|------|------|------|------|------|------|------|------|------|------|------|------|------|------|------|------|------|------|------|------|------|------|------|------|------|------|------|------|------|------|------|------|------|------|------|------|------|------|------|------|------|------|------|------|------|------|------|------|------|------|------|------|------|------|------|------|------|------|------|------|------|------|------|------|------|------|------|------|------|------|------|------|------|------|------|------|------|------|------|------|------|------|------|------|------|------|------|------|------|------|------|------|------|------|------|------|------|------|------|------|------|------|------|------|------|------|------|------|------|------|------|------|------|------|------|------|------|------|------|------|------|------|------|------|------|------|------|------|------|------|------|------|------|------|------|------|------|------|------|------|------|------|------|------|------|------|------|------|------|------|------|------|------|------|------|------|------|------|------|------|------|------|------|------|------|------|------|------|------|------|------|------|------|------|------|------|------|------|------|------|------|------|------|------|------|------|------|------|------|------|------|------|------|------|------|------|------|------|------|------|------|------|------|------|------|------|------|------|------|------|------|------|------|------|------|------|------|------|------|------|------|------|------|------|------|------|------|------|------|------|------|------|------|------|------|------|------|------|------|------|------|------|------|------|------|------|------|------|------|------|------|------|------|------|------|------|------|------|------|------|------|------|------|------|------|------|------|------|------|------|------|------|------|------|------|------|------|------|------|------|------|------|------|------|------|------|------|------|------|------|------|------|------|------|------|------|------|------|------|------|------|------|------|------|------|------|------|------|------|------|------|------|------|------|------|------|------|------|------|---|

Flood \_\_\_\_\_ Pump \_\_\_\_\_ Reservoir \_\_\_\_\_ Gravity ☒

Size and Capacity, Pump, etc.

Original Appropriator, Company \_\_\_\_\_ App. No. \_\_\_\_\_

Original Appropriator, Private: Ellott, Alexander Moore, George App. No. 1067 100 D-335

Is the system an extension of another system? Yes \_\_\_\_\_ No \_\_\_\_\_

Is all land irrigated from one system? Yes \_\_\_\_\_ No \_\_\_\_\_

(If No, show break down on map)

Source of Water... Cayuse Creek, Sweetgrass Creek, Flood Water

Acres Irrigated 19 57

Potential Acres \_\_\_\_\_ Sceded \_\_\_\_\_

**Explain:** \_\_\_\_\_

Condition of System .....

Adequate Supply — Yes ☒ No ☐

**Explain** \_\_\_\_\_

Topography: Valley floor & bench mark

Information From: . . . . .

Remarks

400

A 10x10 grid with handwritten numbers. The number '34' is written in the bottom-left cell, and the number '35' is written in the bottom-right cell. The grid is composed of solid lines forming the outer border and dotted lines forming the internal grid.

No irrigation by ditch is in practice  
at the present time in this town.  
A considerable area in the SW portion  
is, however, sub-irrigated.

Some small areas in the SW portion of sec 34



STATE OF MONTANA

**State Engineer's Office**  
WATER RESOURCES SURVEY  
FARM MAP

County Sweetgrass

Code No. 344-35H

Twp. 5N Rge. 17E

Twp.      Rge.     

Twp.      Rge.     

Name of Land Owner. Greenleaf, J. Jr. Address Shawmut, Mont.

Name of Operator. Same Address     

Legal Description.     



Irrigated Land



Non-Irrigated Land



Potential Land Under Existing Facilities

North

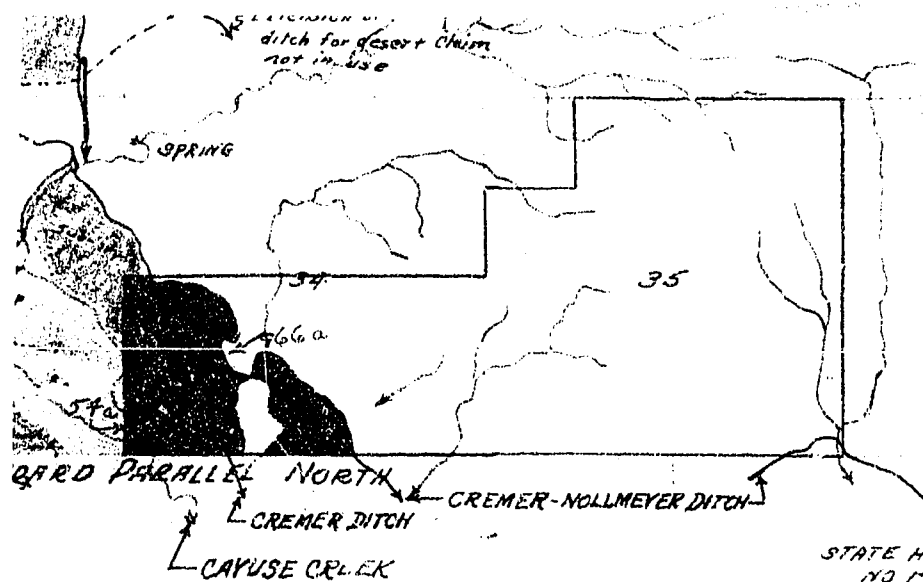

Code No. 344 System Shawmut Ditch Source of Water Shawmut Ditch

Basin      Present      Potential      Maximum      R ✓ F      P      G ✓ S     

Code No.      System      Source of Water     

Basin      Present      Potential      Maximum      R      F      P      G      S     

Code No.      System      Source of Water     

Basin      Present      Potential      Maximum      R      F      P      G      S     

Code No.      System      Source of Water     

Basin      Present      Potential      Maximum      R      F      P      G      S     

If under Ditch Company, Irrigation District, or Government Project, state the number of shares or inches, acre feet, as the case may be in said system.

NOTE: R—Denotes Regular Irrigation. F—Flood Irrigation. P—Water diverted by means of pumping. G—Water diverted by gravity. S—Stored Water.

Information from      Date 10/19/1961

Farm Checked

STATE OF MONTANA

Code No. 12A-18-19-20-30A

By \_\_\_\_\_

## STATE ENGINEER'S OFFICE

County Phillips

Area \_\_\_\_\_

WATER RESOURCES SURVEY

T. 5 N. R. 14 E. Sec. 17, 18, 20, 30Date April 10, 1960Photo No. MA-12A-35Legal Land Owner GROSFELD, C. L.Address Big Timber, Mont.

Operator \_\_\_\_\_

Address \_\_\_\_\_

Water is delivered by:

Federal Project \_\_\_\_\_ Pres. \_\_\_\_\_ Pot. \_\_\_\_\_

Ditch Company \_\_\_\_\_ Pres. \_\_\_\_\_ Pot. \_\_\_\_\_

Irrigation District \_\_\_\_\_ Pres. \_\_\_\_\_ Pot. \_\_\_\_\_

Private System Nelson, C. L. Pres. \_\_\_\_\_ Pot. \_\_\_\_\_

Totals \_\_\_\_\_

Flood \_\_\_\_\_ Pump \_\_\_\_\_ Reservoir ☒ Gravity ☒

Size and Capacity, Pump, etc. \_\_\_\_\_

Original Appropriator, Company Benecke, Agnes et al App. No. 245Original Appropriator, Private Kan. Cleve, Paul L. App. No. 255Is the system an extension of another system? Yes ☒ No ☐Is all land irrigated from one system? Yes ☒ No ☐

(If No, show break down on map)

Source of Water Sweetgrass Cr., American Fork,Acres Irrigated 50

Potential Acres \_\_\_\_\_ Seeped \_\_\_\_\_

Explain \_\_\_\_\_

Condition of System GoodAdequate Supply Yes ☒ No ☐

Explain \_\_\_\_\_

Topography Rolling hills, valley

Information From \_\_\_\_\_

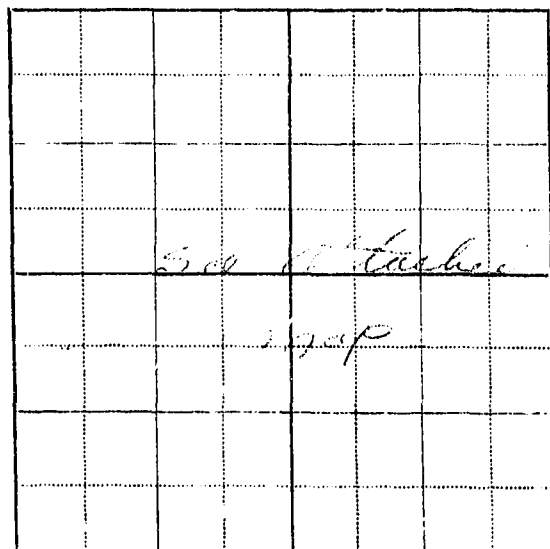
Remarks See map

7/1/30. Hospital ditcher has irrigated in  
ditch 17430. Has potential in areas 18, 19, 20  
V 30.

Unfilled 1/2 acre in S. 31.  
Reference on east side of section 31.  
E. 1/2 of section 31 - 17430 - 17431.

STATE OF MONTANA  
**State Engineer's Office**  
WATER RESOURCES SURVEY

Township 5 North Range 18 East County Sandwich

|         |         |    |    |    |    |
|---------|---------|----|----|----|----|
| 6       | 5       | 4  | 3  | 2  | 1  |
| 7       | 8       | 9  | 10 | 11 | 12 |
| 18<br>A | 17<br>A | 16 | 15 | 14 | 13 |
| 19<br>A | 20<br>A | 21 | 22 | 23 | 24 |
| 30<br>A | 29      | 28 | 27 | 26 | 25 |
| 31      | 32      | 33 | 34 | 35 | 36 |

Township 3 North Range 18 East