

Form WR-B
Reporter 17362 1M-3-46

STATE OF MONTANA

State Engineer's Office
WATER RESOURCES SURVEY
FARM MAP

County Sweetgrass

Code No. _____

17A-18A-19A-20A-

30A

Twp. 5N Rge. 14E

Twp. _____ Rge. _____

Twp. _____ Rge. _____

Name of Land Owner. Grosfield, Clara Address Big Timber Mont

Name of Operator. Same Address "

Legal Description. _____



Irrigated Land



Non-Irrigated Land



Potential Land Under Existing Facilities



Code No. 18A-19A-20A-30A System Nelson-Grosfield Ditch Source of Water Sweet Grass Creek

Basin Sweet Grass Creek Present 172 Potential 1043 Maximum 1215 R ✓ F ✓ P ✓ G ✓ S ✓

Code No. _____ System _____ Source of Water _____

Basin _____ Present _____ Potential _____ Maximum _____ R _____ F _____ P _____ G _____ S _____

Code No. _____ System _____ Source of Water _____

Basin _____ Present _____ Potential _____ Maximum _____ R _____ F _____ P _____ G _____ S _____

Code No. _____ System _____ Source of Water _____

Basin _____ Present _____ Potential _____ Maximum _____ R _____ F _____ P _____ G _____ S _____

If under Ditch Company, Irrigation District, or Government Project, state the number of shares or inches, acre feet, as the case may be in said system.

NOTE: R—Denotes Regular Irrigation. F—Flood Irrigation. P—Water diverted by means of pumping. G—Water diverted by gravity. S—Stored Water.

Information from W. C. Cook Date April 25, 1951

STATE OF MONTANA

State Engineer's Office

WATER RESOURCES SURVEY

FARM MAP

County Sweetgrass

Code No. 17A-18A-19A-20A-

30A

Twp 5N Rge 3E

Twp 5N Rge 3E

Twp 5N Rge 3E

Name of Land Owner Crossfield, Clara Address High Timber Road

Name of Operator Same Address "

Legal Description "



Irrigated Land



Non-Irrigated Land



Potential Land Under Existing Facilities

North

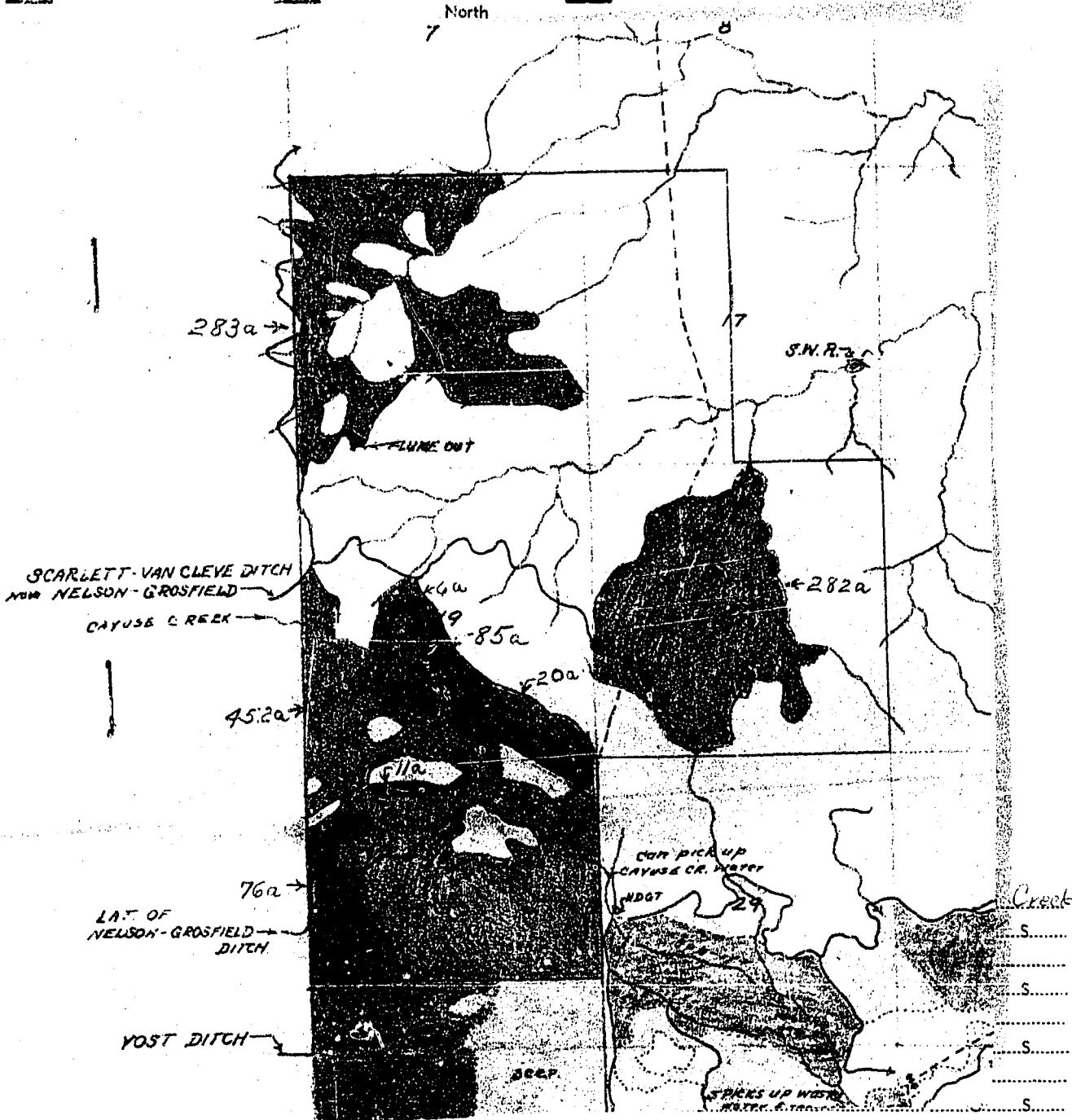

Code No.....

Basin.....

Code No.....

Basin.....

Code No.....

Basin.....

Code No.....

Basin.....

If u Company, Irrigation District, or Government Project, state the number of shares or inches, acre feet, as the case may be in said system.....

NOTE: R—Denotes Regular Irrigation. F—Flood Irrigation. P—Water diverted by means of pumping. G—Water diverted by gravity. S—Stored Water.

Information from Date 11/25/1951

Farm Checked

STATE OF MONTANA

FORM F-1 - GAZETTE 1958-2M-1-47
91-9A-18-15-17B-21A
825-25248260341-3728-
Code No. 29922A-37A34A-35A

By Jim & Bob

STATE ENGINEER'S OFFICE
WATER RESOURCES SURVEY

County Sweetgrass

Area Sweetgrass Cr.

T. 5N. R. 14E Sec.

Date Sept 8, 1950

Photo No. MA-12A-18
MA-12A-19
MA-12A-21
MA-12A-34
MA-12A-35

Legal Land Owner JOHNSON, LILLIAN et al

Address MELVILLE, MONT.

Operator "

Address "

Water is delivered by:

Federal Project _____ Pres. _____ Pot. _____
Ditch Company _____ Pres. _____ Pot. _____
Irrigation District _____ Pres. _____ Pot. _____
Private System Private Ditches Pres. 500.0 Pot. 500.0
Totals _____

Flood ☒ Pump _____ Reservoir _____ Gravity ☒

Size and Capacity, Pump, etc. _____
Original Appropriator, Private Schallack, W. Fred App. No. 803
Cook, Herbert & Van Cleave, Paul
McDonnell, C. & Keasey, Edward
McDonnell, Elizabeth
Garberry, William
Schallack, William
Ellis, Raymond
Schallack, W. Fred
Original Appropriator, Private McDonnell, C. & Keasey, Edward App. No. 1087
McDonnell, Elizabeth App. No. 1087
1094

Is the system an extension of another system? Yes _____ No ☒

Is all land irrigated from one system? Yes _____ No ☒

(If No, show break down on map)

Source of Water Cayuse Cr., Sweetgrass Cr., Unnamed Spring, Flood Water,

American Fork

Acres Irrigated 10 50 500.0 ac.

Potential Acres _____ Seeped Some

Explain _____

Condition of System Good

Adequate Supply _____ Yes ☒ No ☒

Explain Creek sometimes low

Topography Valley bottom

Information From Varied Person

Remarks See back of sheet

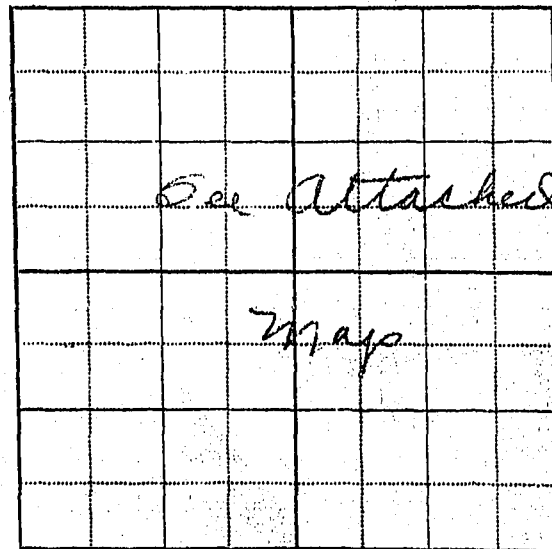

(1) All water from Johnson ditch out of Sweetgrass Creek
(McCormick & Vasey decrees) ditch diverts from N bank
of Sweetgrass Creek in SE 1/4 NE 1/4 sec 34 T5N R13E
runs E to Secs 28, 29, 32, 33 T5N R14E. The ditch can
pick up water from Oguse Creek where it crosses this
stream.

STATE OF MONTANA
State Engineer's Office
WATER RESOURCES SURVEY

Township 5 NORTH Range 14 EAST County Sweetgrass

6	5	4	3	2	1
7	8	9	10	11	12
	A	U.S.			
18	17	16	15	14	13
	B			A	A
19	20	21	22	23	24
			U.S.		
30	29	28	27	26	25
		B		U.S.	
31	32	33	34	35	36
	A	A	B		

Township 5 N. Range 14 E

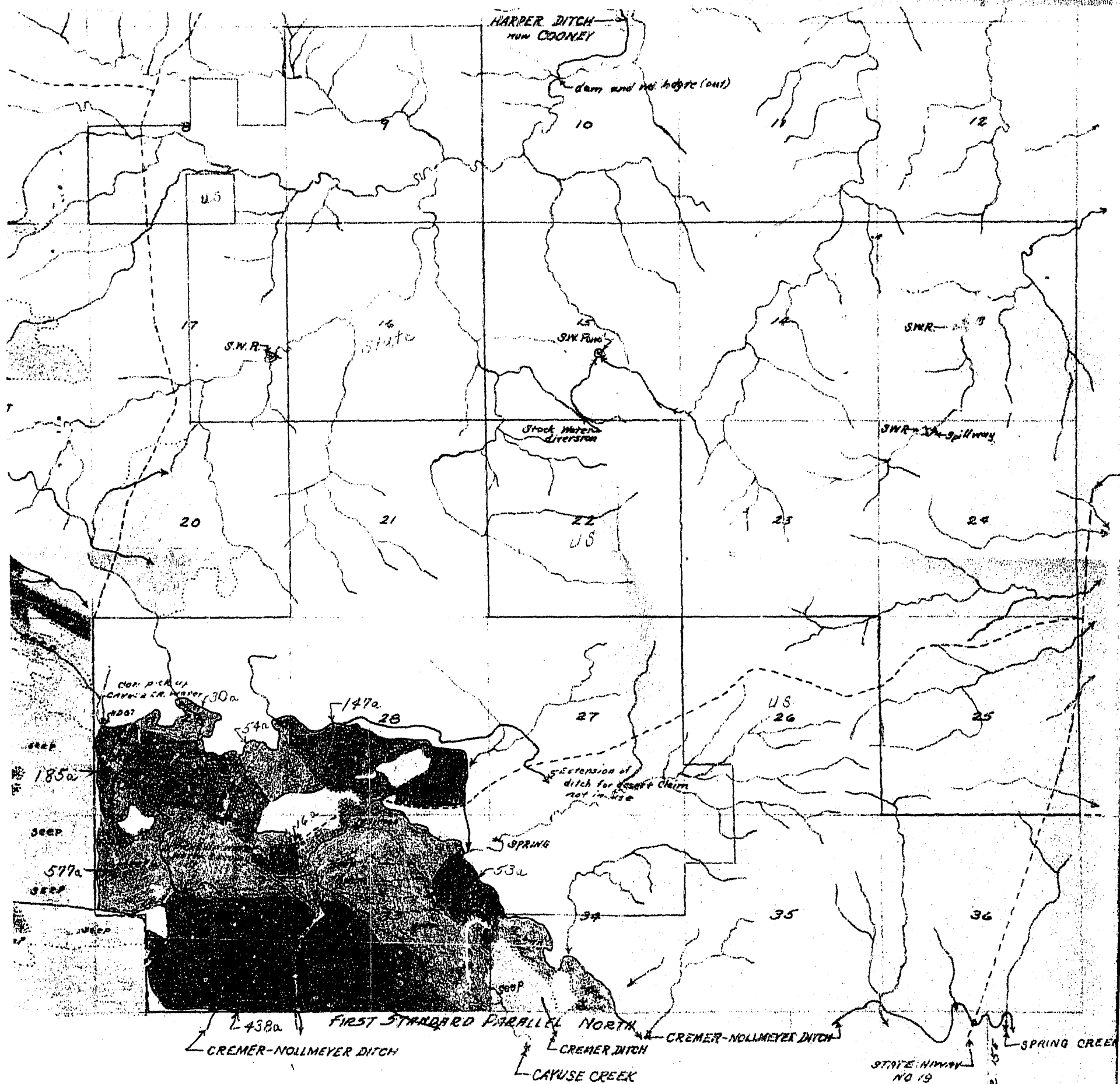

Form WR-B
Reporter 20188 2M 12-49

STATE OF MONTANA

State Engineer's Office
WATER RESOURCES SURVEY
FARM MAP

County Sweetgrass
Code No. _____

Twp. 5N Rge. 14E
Twp. _____ Rge. _____
Twp. _____ Rge. _____

Name of Land Owner Jackson, Lillian et al Address Melville
Name of Operator Same Address "
Legal Description _____



Irrigated Land



Non-Irrigated Land
North



Potential Land Under Existing Facilities

Code No. 28B, 29A, 32A, 33A, 34B System Jackson Ditch Source of Water Sweet Grass Creek
Basin Sweet Grass Creek Present 839 Potential 661 Maximum 1500 R. K F. P G. K S. S
Code No. _____ System _____ Source of Water _____
Basin _____ Present _____ Potential _____ Maximum _____ R. _____ F. _____ P. _____ G. _____ S. _____
Code No. _____ System _____ Source of Water _____
Basin _____ Present _____ Potential _____ Maximum _____ R. _____ F. _____ P. _____ G. _____ S. _____
Code No. _____ System _____ Source of Water _____
Basin _____ Present _____ Potential _____ Maximum _____ R. _____ F. _____ P. _____ G. _____ S. _____

If under Ditch Company, Irrigation District, or Government Project, state the number of shares or inches, acre feet, as the case may be in said system.

NOTE: R—Denotes Regular Irrigation. F—Flood Irrigation. P—Water diverted by means of pumping. G—Water diverted by gravity.
S—Stored Water.

Information from J. S. Cook Date April 26, 1951

Farm Checked

STATE OF MONTANA

Code No. 30A-31A-32B

By Dave & Joe

STATE ENGINEER'S OFFICE

County Sweetgrass

Area Sweet Grass Cr.

WATER RESOURCES SURVEY

T. 5N. R. 14E Sec. 30, 31, 32

Date 8/17/50

Photo No. MA-12A-34

Legal Land Owner YOST, GEORGE J. & LENARD

Address MELVILLE, MONT.

Operator

Address

Water is delivered by:

Federal Project _____ Pres. _____ Pot. _____

Ditch Company _____ Pres. _____ Pot. _____

Irrigation District _____ Pres. _____ Pot. _____

Private System Yost Ditch Pres. _____ Pot. _____

Totals _____

Flood _____ Pump _____ Reservoir _____ Gravity Regular

Size and Capacity, Pump, etc. _____

Original Appropriator, Company _____ App. No. _____

Original Appropriator, Private Dugro, Alice
McDonnell, Chas. & Neasey, Edward
Van Cleave, Paul L.
Scarlett, John H. & Van Cleave, Paul App. No. 835 D-353

Is the system an extension of another system? Yes _____ No ✓

Is all land irrigated from one system? Yes ✓ No _____

(If No, show break down on map)

Source of Water Sweetgrass Creek

Acres Irrigated 19.571

Potential Acres ? Seeped ?

Explain _____

Condition of System Good

Adequate Supply Yes ✓ No _____

Explain _____

Topography Slight Slope

Information From Mr. Richards

Remarks For Yost Ditch see form

(2) T. 5N - R. 13E

(3)

FORM D-1
REPORTER 1M 3-49 17379

STATE OF MONTANA
State Engineer's Office
WATER RESOURCES SURVEY

Township 5 NORTH Range 14 EAST County Sweetgrass

6	5	4	3	2	1
7	8	9	10	11	12
18	17	16	15	14	13
19	20	21	22	23	24
30	29	28	27	26	25
B					
31 A	B	32	33	34	35
					36

Township 5 N. Range 14 E.

(3)

Twp. 5N Rge. 14E
Twp. 5N Rge. 12E
Twp. _____ Rge. _____

STATE OF MONTANA
State Engineer's Office
WATER RESOURCES SURVEY
FARM MAP

County Sweetgrass
Code No. _____
30B-31A-32B

Name of Land Owner Yost, Geo. J. and Leonard Address Melville Mont
Name of Operator S.W.M.E. Address _____
Legal Description _____



Irrigated Land



Non-Irrigated Land



Potential Land Under Existing Facilities

North

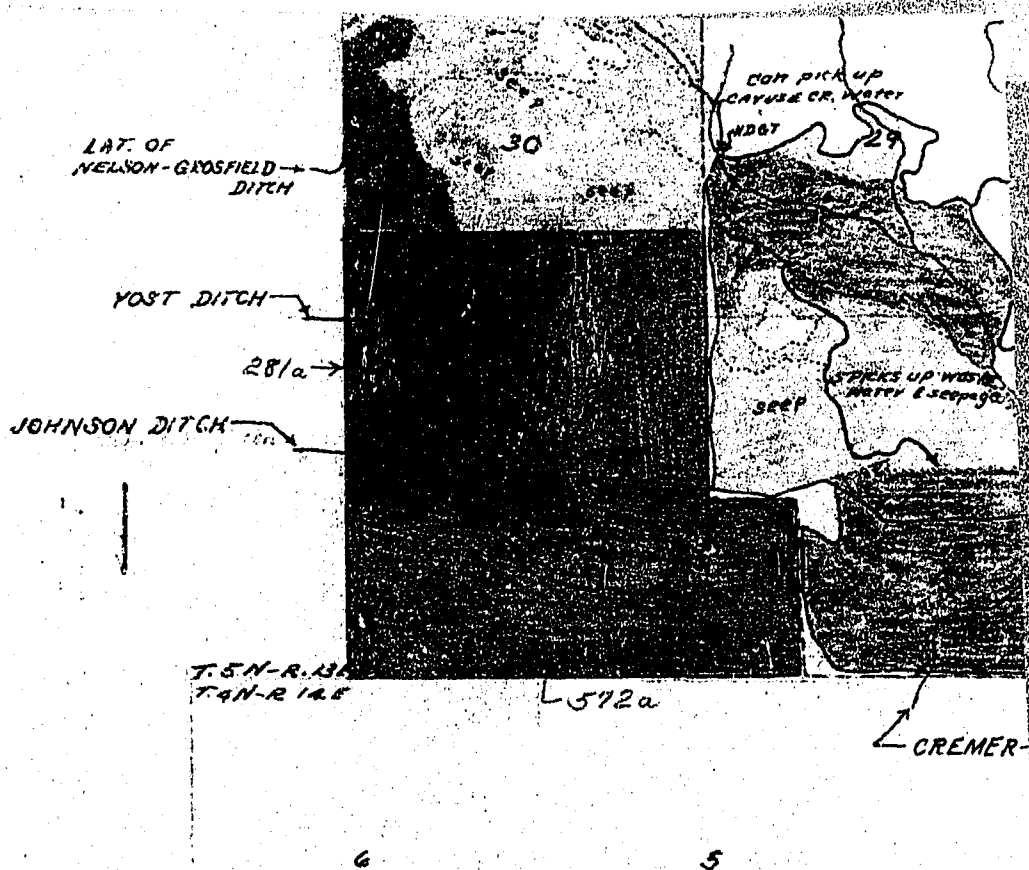

Code No. 30B-31A-32B System Yost Ditch Source of Water Sweet Grass Cr.
Basin Sweet Grass Creek Present 281 Potential 572 Maximum 553 R ✓ F _____ P _____ G ✓ S _____
Code No. _____ System _____ Source of Water _____
Basin _____ Present _____ Potential _____ Maximum _____ R _____ F _____ P _____ G _____ S _____
Code No. _____ System _____ Source of Water _____
Basin _____ Present _____ Potential _____ Maximum _____ R _____ F _____ P _____ G _____ S _____
Code No. _____ System _____ Source of Water _____
Basin _____ Present _____ Potential _____ Maximum _____ R _____ F _____ P _____ G _____ S _____

If under Ditch Company, Irrigation District, or Government Project, state the number of shares or inches, acre feet, as the case may be in said system.

NOTE: R—Denotes Regular Irrigation. F—Flood Irrigation. P—Water diverted by means of pumping. G—Water diverted by gravity. S—Stored Water.

Information from Geo. J. Yost Date April 25, 1951

Farm Checked

STATE OF MONTANA

FORM 7-1 - GAZETTE 1665-2M-1-47

By Jim Bob

STATE ENGINEER'S OFFICE
WATER RESOURCES SURVEY

Code No. EB-108

Area Fish Creek

County Sweetgrass

Date Sept. 28, 1950

T. 5N. R. 1E Sec. 2, 10

Photo No. MA-114-213

Legal Land Owner MILLER, LOUIS W.

Address BIG TIMBER, MONT.

Operator ??

Address ??

Water is delivered by:

Federal Project _____ Pres. _____ Pot. _____

Ditch Company _____ Pres. _____ Pot. _____

Irrigation District _____ Pres. _____ Pot. _____

Private System Harper Ditch Pres. 0 Pot. ?

Totals _____

Flood _____ Pump _____ Reservoir _____ Gravity ☒

Size and Capacity, Pump, etc. _____

Original Appropriator, Company _____ App. No. _____

Original Appropriator, Private Langston, James App. No. D-23

Is the system an extension of another system? Yes _____ No ☒

Is all land irrigated from one system? Yes ☒ No _____

(If No, show break down on map.)

Source of Water AMERICAN Fork Fish Creek

Acres Irrigated 50.0

Potential Acres ? Seeped _____

Explain _____

Condition of System Poor

Adequate Supply _____ Yes _____ No _____

Explain _____

Topography Creek bottom

Information From Field Survey

Remarks Small amount of land potential
under Harper D. now owned by John
Cooney

(3)

STATE OF MONTANA
State Engineer's Office
WATER RESOURCES SURVEY

Township 5 NORTH Range 14 EAST County Sweetgrass

6	5	4	3	2	1
				8	
7	8	9	10	11	12
				8	
18	17	16	15	14	13
19	20	21	22	23	24
30	29	28	27	26	25
31	32	33	34	35	36

Township 5 N. Range 14 E.

Form WR-B
Reporter 20188 2M 12-49

Twp. 5N Rge. 14E

Twp. _____ Rge. _____

Twp. _____ Rge. _____

STATE OF MONTANA
State Engineer's Office
WATER RESOURCES SURVEY
FARM MAP

County Sweetgrass

Code No. _____

2B-10B

Name of Land Owner Miller, Lewis W. Address Big Timber Mont.

Name of Operator _____ Address _____

Legal Description _____



Irrigated Land



Non-Irrigated Land

North



Potential Land Under Existing Facilities

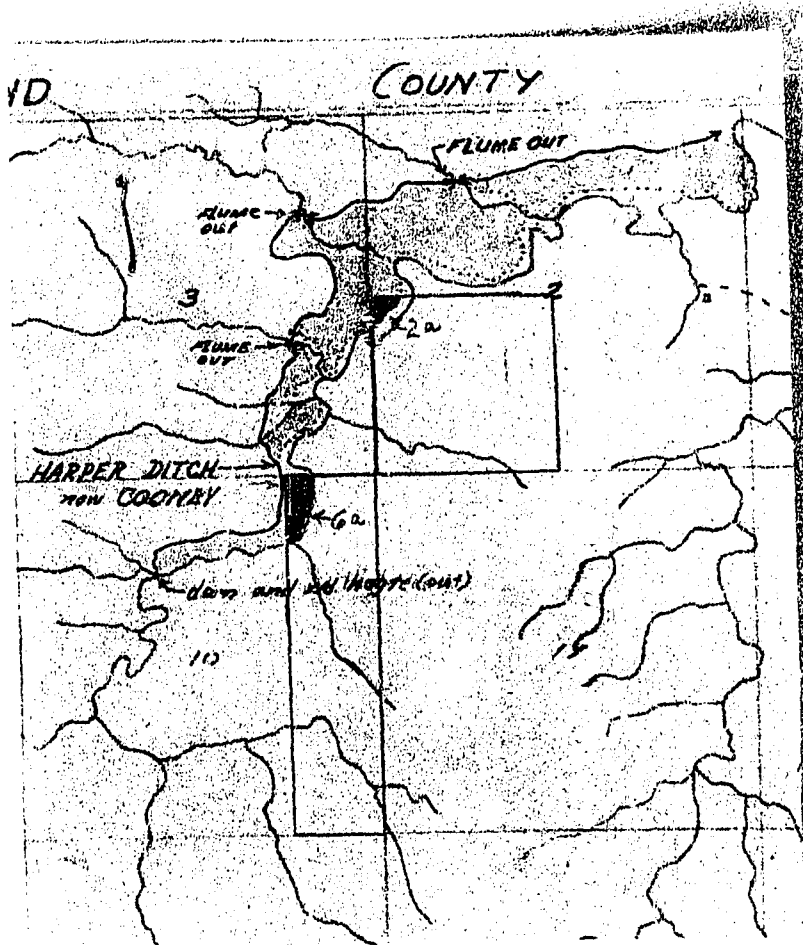

Code No. 2B-10B System Harper Ditch Source of Water Fish Creek

Basin Musselshell River Present 0 Potential 8 Maximum 8 R ✓ F ✓ P ✓ G ✓ S ✓

Code No. _____ System _____ Source of Water _____

Basin _____ Present _____ Potential _____ Maximum _____ R _____ F _____ P _____ G _____ S _____

Code No. _____ System _____ Source of Water _____

Basin _____ Present _____ Potential _____ Maximum _____ R _____ F _____ P _____ G _____ S _____

Code No. _____ System _____ Source of Water _____

Basin _____ Present _____ Potential _____ Maximum _____ R _____ F _____ P _____ G _____ S _____

If under Ditch Company, Irrigation District, or Government Project, state the number of shares or inches, acre feet, as the case may be in said system.

NOTE: R—Denotes Regular Irrigation. F—Flood Irrigation. P—Water diverted by means of pumping. G—Water diverted by gravity. S—Stored Water.

Information from Fish Creek Date April 25, 1951

Farm Checked

STATE OF MONTANA

Code No. 208By MT & EC

STATE ENGINEER'S OFFICE

County Sweet GrassArea Melville

WATER RESOURCES SURVEY

T. 5N R. 15E Sec. 20

Date _____

Photo No. MA-120-14Legal Land Owner State of Montana

Address _____

Operator _____

Address _____

Water is delivered by:

Federal Project _____ Pres. _____ Pot. _____

Ditch Company _____ Pres. _____ Pot. _____

Irrigation District _____ Pres. _____ Pot. _____

Private System No ditch - No irrigation Pres. _____ Pot. _____

Totals _____

Flood _____ Pump _____ Reservoir _____ Gravity _____

Size and Capacity, Pump, etc. _____

Original Appropriator, Company _____ App. No. _____

Original Appropriator, Private John Froehlich App. No. 938

Is the system an extension of another system? Yes _____ No _____

Is all land irrigated from one system? Yes _____ No _____

(If No, show break down on map)

Source of Water Unnamed Coulee

75N R 15E

Acres Irrigated 19 _____

Potential Acres _____ Seeped _____

Explain _____

Condition of System _____

Adequate Supply _____ Yes _____ No _____

Explain _____

Topography _____

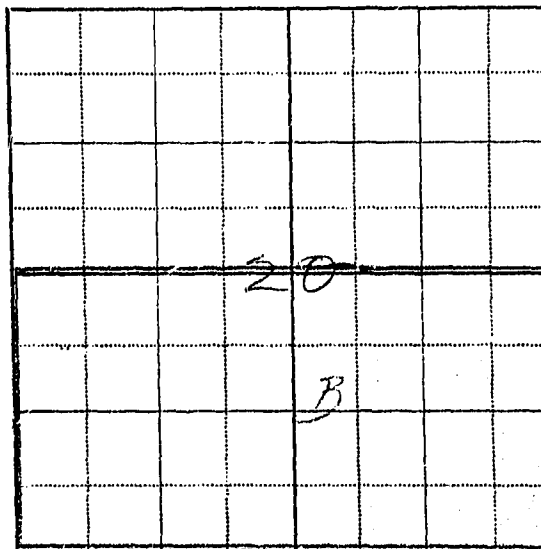
Information From Field SurveyRemarks entire area traversed -no trace of ditch

(7)

STATE OF MONTANA
STATE ENGINEER'S OFFICE
 WATER RESOURCES SURVEY

Township 5 North Range 15 East County Sweet Grass

6	5	4 1034	3	2 465 1003	1
7	8	9	10	11	12
18	17	16	15	14	13
19	20 938	21	22	23	24
30	29	28	27	26	25
31	32	33	34	35	36

Township 5 North Range 15 East

Township 5 North, Range 15 East

<u>No.</u>	<u>Name of Appropriator</u>	<u>Name of Stream</u>	<u>Date App.</u>	<u>Date Filed</u>	<u>M.I.</u>
465	Davis, Jeremiah	Gougley Creek	4-4-10	4-6-10	500
682	Duffy, Sadie M.	Spring Creek	8-9-27	8-9-27	150
695	Maney, Martin J.	Spring Creek	10-22-01	10-31-01	300
695A	Maney, Martin	Spring Creek	8-26-01	10-31-01	300
938	Frochlich, John	Unnamed Coulee	7-21-17	8-2-17	60
999	Graham, George	Unnamed Spring	5-6-10	5-9-10	200
1003	Gugler, Robert	Unnamed Spring	5-31-01	5-31-01	200
1034	Maney, Martin J.	Unnamed Spring	10-22-01	10-31-01	100

Code No. 1A, 2A, 3A, 4A, 5A, 6A, 7A, 8A

County West Grass

5N-15E 1,2,3,4,5,6,7
5N-15E 5,6,7,8,9,10,11,12,13,14,15

MA-7A-153

Address Harlowton

Federal Project _____ **Pres.** _____ **Pot.** _____

Ditch Company _____ Pres. _____ Pot. _____

Irrigation District..... Pres..... Pot.....

Private System ☒ Pres. ☐ Pot. ☐

Totals	
100	100

Flood _____ Pump _____ Reservoir _____ Gravity ☒

Size and Capacity, Pump, etc.

Original Appropriator, Company Sadie M. Zuffe, Martinich, Nancy App. No. 682, 695, 693, 54w

Original Appropriator, Private Robert Gugler; App. No. 1003, 1034

Is the system an extension of another system? Yes _____ No ✓

Is all land irrigated from one system? Yes ✓ No

(If No, show break down on map)

Source of Water..... Spring Creek, Unnamed Springs

Acres Irrigated 19 50 0

Potential Acres 44 Seeped _____

Explain.

Condition of System 100%

Adequate Supply Yes No ✓

Explain

Topography *5700 m. high*

Information From Field Survey

Remarks

Cover

the entire area was traversed

Findings -

only slight traces of the Maney ditch remain. This ditch diverted from a Spring Creek near the north quarter corner of Sec. 9 - 5N-15E and at one time irrigated a small parcel in the E²SW⁴ of Sec. 4 - 5N-15E. The water supply is insufficient for irrigation; the irrigable area is inaccessible and restricted to an extremely small area.

No other ditches remain

STATE OF MONTANA
STATE ENGINEER'S OFFICE
 WATER RESOURCES SURVEY

Township 5N Range 15E County Sweet Grass

1	2	3	4	5	6	7
8	9	10	11	12	13	14
15	16	17	18	19	20	21
22	23	24	25	26	27	28
29	30	31	32	33	34	35
36	37	38	39	40	41	42

John P. Cooney

Township 5N Range 15E

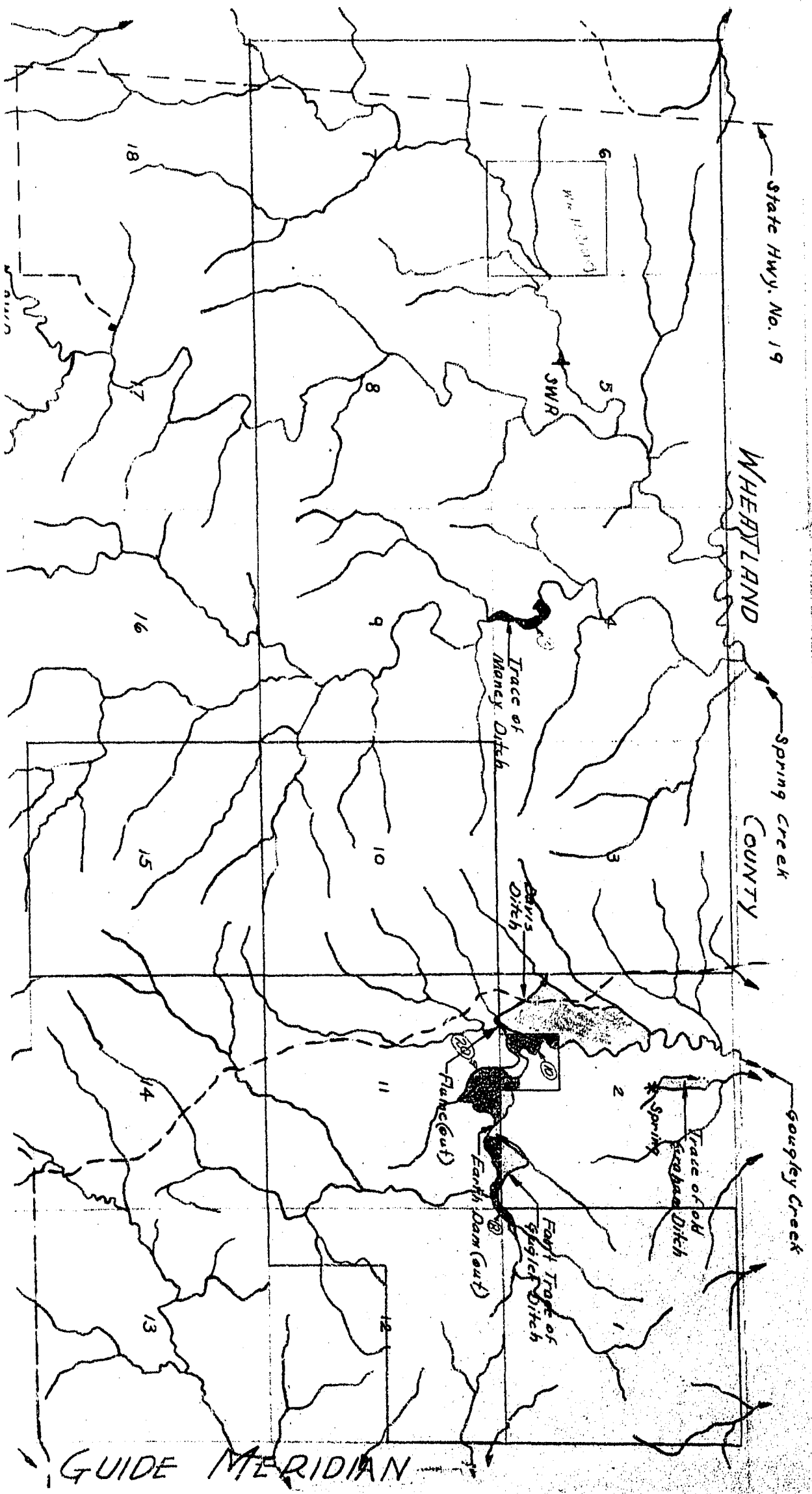

Form WR-B
Reporter 20168 2M 12-49

Twp. 5N Rge. 15E
Twp. _____ Rge. _____
Twp. _____ Rge. _____

STATE OF MONTANA
State Engineer's Office
WATER RESOURCES SURVEY
FARM MAP

County Sweetgrass
Code No. 1A-2B-3A-4A
5A-6A-7A-8A-9A-
11A-12A-13A

Name of Land Owner John P. Cooney Address Harlowton
Name of Operator Same Address "
Legal Description _____



Irrigated Land



Non-Irrigated Land
North



Potential Land Under Existing Facilities

Code No. 2A System Money Ditch (not in use) Source of Water Unnamed Caulee Spring Cr. ^{trib to}
Basin Musselshell Present 0 Potential 6 Maximum 6 R ✓ F ✓ P ✓ G ✓ S ✓
Code No. 2B, 11A System Davis Ditch (not in use) Source of Water Gaugley Cr.
Basin Musselshell Present 0 Potential 30 Maximum 30 R ✓ F ✓ P ✓ G ✓ S ✓
Code No. 11A, 12A System Gugler Ditch (not in use) Source of Water Unnamed Caulee Gaugley Cr. ^{trib to}
Basin Muhl Present 0 Potential 8 Maximum 8 R ✓ F ✓ P ✓ G ✓ S ✓
Code No. _____ System _____ Source of Water _____
Basin _____ Present _____ Potential _____ Maximum _____ R _____ F _____ P _____ G _____ S _____

If under Ditch Company, Irrigation District, or Government Project, state the number of shares or inches, acre feet, as the case may be in said system.

NOTE: R—Denotes Regular Irrigation. F—Flood Irrigation. P—Water diverted by means of pumping. G—Water diverted by gravity. S—Stored Water.

Information from _____ Date _____

Farm Checked

By EC + MT

Area Melville

Date Oct. 10, 1950

Legal Land Owner Wm. H. Cooney

Operator _____

Water is delivered by:

Federal Project _____ Pres. _____ Pot. _____

Ditch Company _____ Pres. _____ Pot. _____

Irrigation District _____ Pres. _____ Pot. _____

Private System Davis Ditch, Graham Ditch + Gogley Ditch Pres. _____ Pot. _____

Totals _____

Flood _____ Pump _____ Reservoir _____ Gravity ☒

Size and Capacity, Pump, etc. _____

Original Appropriator, Company _____ App. No. _____

Original Appropriator, Private Jeremiah Davis; George Graham; Robt. Gogley App. No. 145; 999; 1003

Is the system an extension of another system? Yes _____ No ☒

Is all land irrigated from one system? Yes _____ No ☒

(If No, show break down on map)

Source of Water Gogley Creek & unnamed Springs

Acres Irrigated 1950 None

Potential Acres 81 Seeped _____

Explain _____

Condition of System 220'

Adequate Supply Yes _____ No ☒

Explain Creek & spring have very little water

Topography Creek bottom + hill sides

Information From _____

Remarks _____

4

STATE OF MONTANA
STATE ENGINEER'S OFFICE
WATER RESOURCES SURVEY

FORM F-1 - GAZETTE 1685-2M-1-47

Code No. 2A (Dry land not shown)

County Sweet Grass

T. 5N R. 15E Sec. 2

Photo No. MM-14-155

Address Harlowton

Address _____

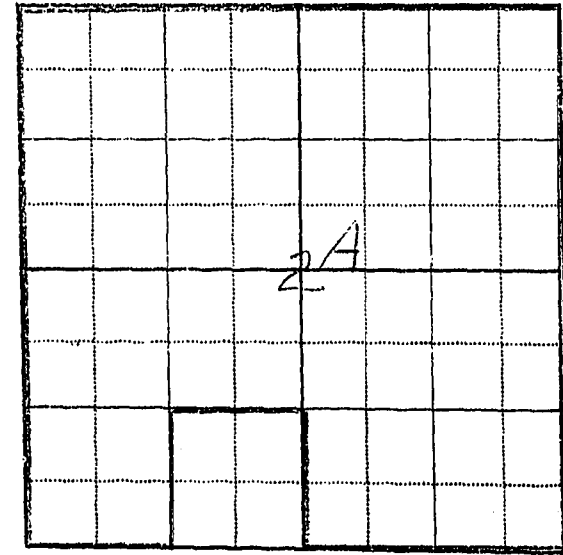

Twp. 5N Rge. 15E
Twp. _____ Rge. _____
Twp. _____ Rge. _____

STATE OF MONTANA
State Engineer's Office
WATER RESOURCES SURVEY
FARM MAP

County Sweetgrass

Code No. _____

24

Name of Land Owner Wm. H. Conroy Address Hurlburt

Name of Operator Conroy Address _____

Legal Description _____

☒ Irrigated Land ☐ Non-Irrigated Land ☐ Potential Land Under Existing Facilities

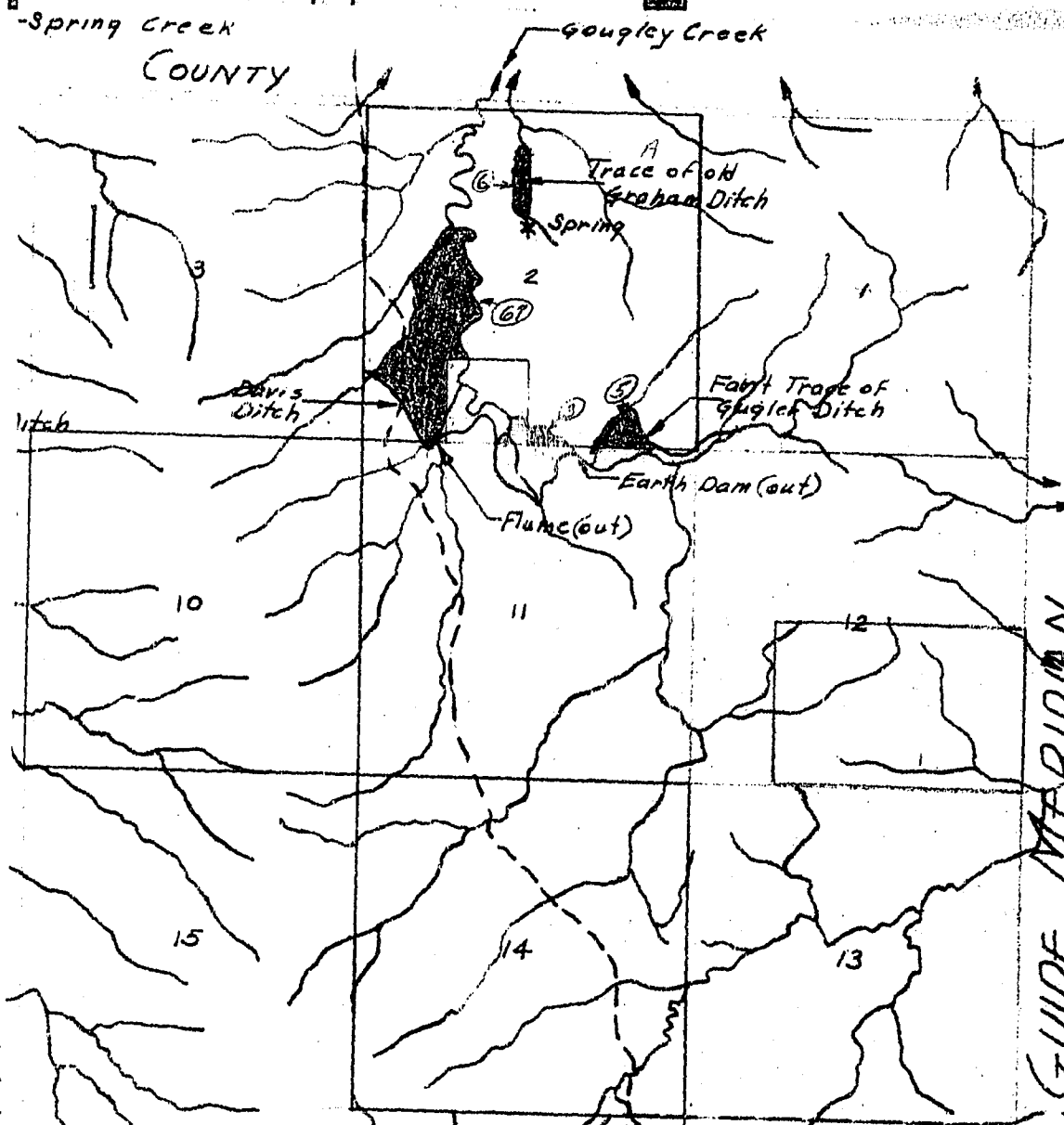

Code No. _____ Basin _____
Code No. _____ Basin _____
Code No. 24 System Gungley Irrigation Source of Water _____
Basin Wm. H. Conroy Present 12 Potential 8 Maximum 8 R. 1 F. 1 P. 1 G. 1 S. 1
Code No. _____ System _____ Source of Water _____
Basin _____ Present _____ Potential _____ Maximum _____ R. _____ F. _____ P. _____ G. _____ S. _____

If under Ditch Company, Irrigation District, or Government Project, state the number of shares or inches, acre feet, as the case may be in said system.

NOTE: R—Denotes Regular Irrigation. F—Flood Irrigation. P—Water diverted by means of pumping. G—Water diverted by gravity. S—Stored Water.

Information from _____ Date _____

STATE OF MONTANA
State Engineer's Office
WATER RESOURCES SURVEY
FARM MAP

County Sweetgrass
Code No. 2A

Owner James H. Austin
Address Lawton
Address Lawton

Potential and Source of Water

Code No. 2A System Davis Ditch (not in use) Source of Water Gaugley Cr.
Basin Musselshell Present 0 Potential 6.7 Maximum 6.7 R ☒ F ☐ P ☐ G ☐ S ☐
Code No. 2A System Graham Ditch (not in use) Source of Water Spring - trib. to Gaugley Cr.
Basin Musselshell Present 0 Potential 6 Maximum 6 R ☒ F ☐ P ☐ G ☐ S ☐
Code No. 2A System Gaugley Ditch (not in use) Source of Water Unnamed caulee - trib. to Gaugley Cr.
Basin Musselshell Present 0 Potential 8 Maximum 8 R ☒ F ☐ P ☐ G ☐ S ☐
Code No. 2A System 51 Source of Water 51
Basin Musselshell Present 0 Potential 51 Maximum 51 R ☐ F ☐ P ☐ G ☐ S ☐
If under Ditch Company, Irrigation District, or Government Project, state the number of shares or inches, acre feet, as the case may be
in said system.
NOTE: R—Denotes Regular Irrigation. F—Flood Irrigation. P—Water diverted by means of pumping. G—Water diverted by gravity.
S—Stored Water.
Information from _____ Date _____

- Gugler Ditch diverts in SW corner of Sec. 1 on North bank and is nearly obliterated.

- Graham Ditch diverts in SE⁴ NW⁴ and is not in use

- Davis Ditch diverts NW⁴ NE⁴ on south bank where there was an old collection res. but this is washed out, also a flume across a coulee is out therefore Ditch is not in use but makes land on west Bank in SW⁴ of sec 2 potential

All land colored Red is sub-irrigated

(4) Township 5 North - Range 15 East

	Name of Owner	Township & Range
1.	Cooney, John P.	(4) 5N-15E (3) 5N-14E
✓2.	Cooney, Wm. H.	"
✓3.	Montana, State of	" (8) 4N-14E (29) 1N-13E (30) 1N-16E (34) 1S-14E (36) 1S-16E (39) 2S-13E (45) 3S-13E

County...Sweet Grass.....

Farm Checked: Date.....None shown.

By.....MT & EC.....

STATE OF MONTANA
STATE ENGINEERS OFFICE
Water Resources Survey

T 5N.....R 15E..... Plat No....4.....

Photo No. MA-12A-14

Legal Land Owner Montana, State of Address

Operator.....	Address.....
---------------	--------------

Water is delivered by:— 1. Private System; 2. Ditch Company; 3. State Project; 4. Federal Project; 5. Irrigation District

[illegible]

NOTE: R—Denotes Regular Irrigation. F—Flood Irrigation.

Adequate Supply: Yes..... No..... Explain.....

Remarks.....

Entire area traversed-no trace of ditch.

...River Basin.....

Also in: Plat No..... Twp..... Rge.....	Plat No..... Twp..... Rge.....	Plat No..... Twp..... Rge.....
Plat No..... Twp..... Rge.....	Plat No..... Twp..... Rge.....	Plat No..... Twp..... Rge.....

Information From:

Field Survey

6	5	4	3	2	1
7	8	9	10	11	12
13	14	15	16	17	18
19	20 b	21	22	23	24
25	26	27	28	29	30
31	32	33	34	35	36

Land Ownership

County.....Sweet Grass.....

Farm Checked: Date.....10-10-50.....

By.....EC & MT.....

STATE OF MONTANA
STATE ENGINEERS OFFICE
Water Resources Survey

T 5N R 15E Plat No. 4

Photo No. MA-7A-155

Legal Land Owner Wm. H. Cooney Address Harlowton

Operator.....Same.....Address.....

Water is delivered by:— 1. Private System; 2. Ditch Company; 3. State Project; 4. Federal Project; 5. Irrigation District

[illegible]

NOTE: R—Denotes Regular Irrigation. F—Flood Irrigation.

Adequate Supply: Yes..... No..... Explain.....

Remarks.....

Gugler Ditch diverts in SW corner of Sec. 1 on north bank and is nearly obliterated.
Graham Ditch diverts in SE NW 1/4 and is not in use.

Davis Ditch diverts NW 1/4 on south bank where there was an old collection res. but this is washed out, also a flume across a coulee is out therefore ditch is not in use but makes land on west bank in 3/4 of Sec. 2 potential.

All land colored red is sub-irrigated.

River Basin.....

Also in: Plat No. Twp. Rge.	Plat No. Twp. Rge.	Plat No. Twp. Rge.
Plat No. Twp. Rge.	Plat No. Twp. Rge.	Plat No. Twp. Rge.

Information From:

None shown

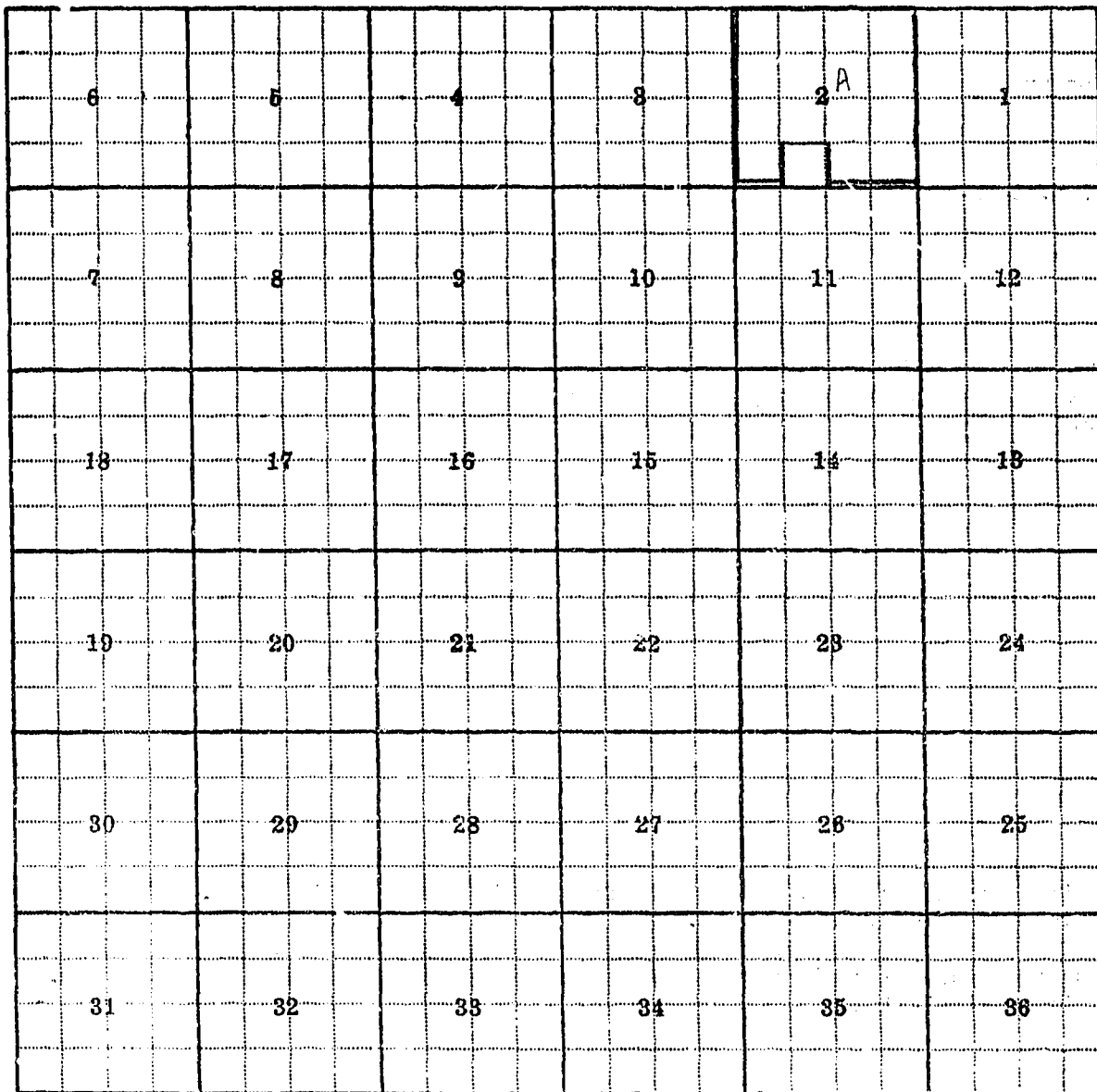

Land Ownership

STATE OF MONTANA
STATE ENGINEER'S OFFICE
 WATER RESOURCES SURVEY

Township 5 North Range 16 East County Sweet Grass

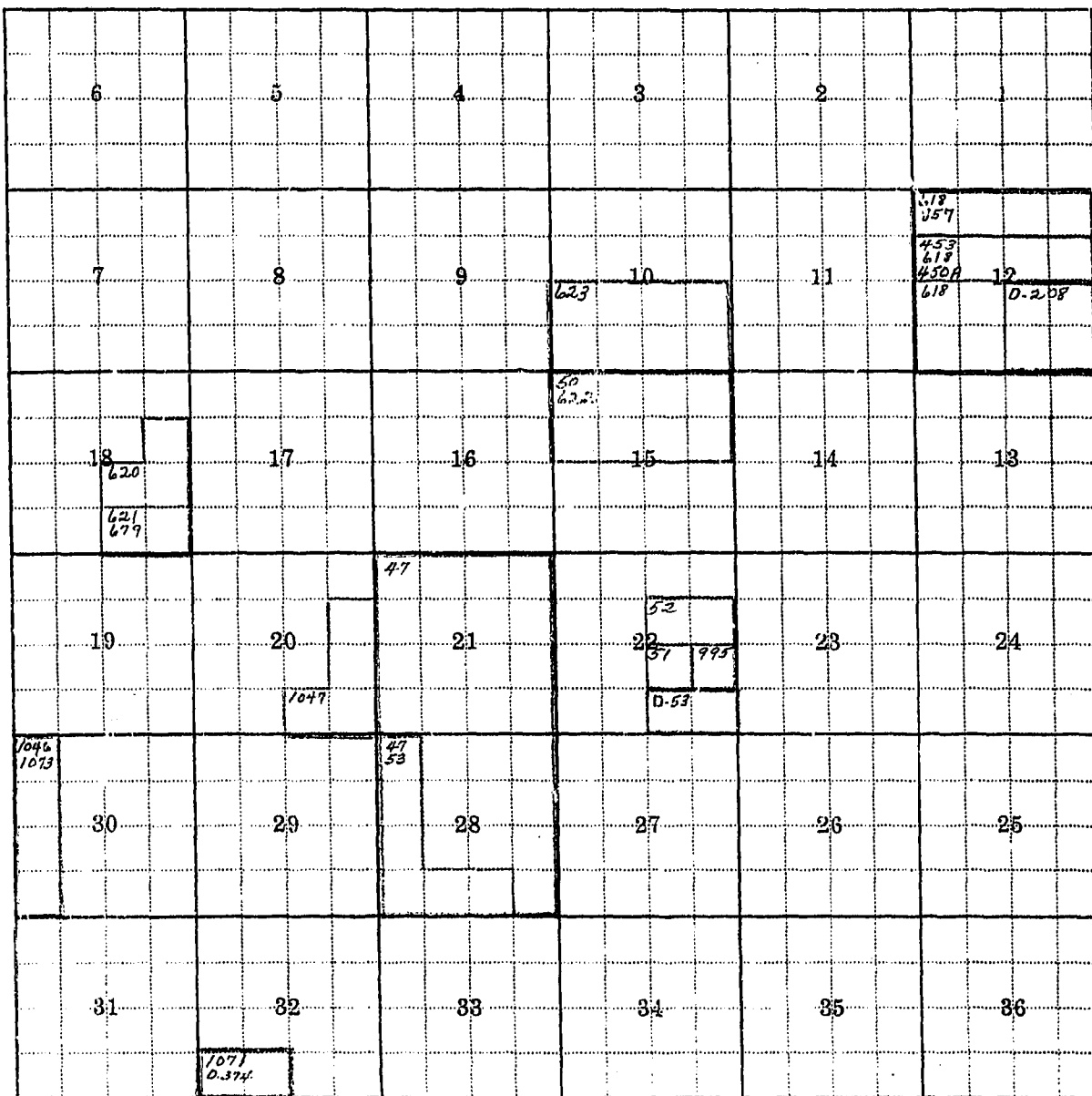

Township 5 North Range 16 East

Township _____ Range _____ County _____

Parcel Number	Name of Owner/Appropriator	Address
Appropriation 431	Cavill, Frederick H. (100 m. l.)	Shawmut, Mont.
	No Township or Range given. Land in NW 1/4 SW 1/4 of Sec 26. Point of diversion on Fish Creek on south bank at a point about 1/2 mile west of said creek.	
Appropriation 444	Northey, W. H. (40,000 m. l.)	Golden Valley Co.
	A proposed reservoir. Dam across Fish Creek in Sec 2 T5N R17E.	
Appropriation 449	Snyder, C. F. (40,000 m. l.)	Golden Valley Co.
	A proposed reservoir. Dam on Fish Creek Sec 2 T5N R17E.	

Township 5 North, Range 16 East

<u>No.</u>	<u>Name of Appropriator</u>	<u>Name of Stream</u>	<u>Date App.</u>	<u>Date Filed</u>	<u>M.I.</u>
47	Martin, Blanche W.	Andrews Creek	3-28-00	3-28-00	400
50	Crest, Albert & Syvert	Antelope Creek	11-29-90	11-29-90	300
51	Freeman, Hazel C.	Antelope Creek	9-4-13	10-27-13	40
52	Freeman, Roy E.	Antelope Creek	8-9-11	9-12-11	80
53	Nevin, Bertha S.	Antelope Creek	5-20-11	6-8-11	240
450A	Strand, Anton A.	Fish Creek - So. Fork	11-7-05	11-7-05	200
453	Widdicombe, James	Fish Creek	9-4-89	9-6-89	100
618	Strand, Anton A.	Potato Creek	8-16-03	8-18-03	100
620	Breck, Sivert M.	Pruett Creek	9-1-09	9-8-09	150
621	Crest, Albert	Pruett Creek	11-26-91	11-27-91	200
622	Crest, Albert & Syvert	Pruett Creek	11-29-90	11-29-90	500
623	Muir, Olga	Pruett Creek	8-2-09	8-2-09	300
679	Crest, Albert	Spring Creek	11-26-91	11-27-91	150
857	Lubman, Simon	Tony Creek	5-11-12	5-15-12	100
995	Freeman, Roy E.	Unnamed Spring	9-4-13	10-27-13	20
1046	Picken, Emily	Unnamed Spring	9-24-04	11-5-04	300
1047	Picken, Frances M.	Unnamed Spring	9-17-13	9-17-13	50
1071	Winsborough, Emily	Unnamed Spring	12-14-12	12-18-12	150
1073	Winsborough, John	Unnamed Spring	8-28-14	9-10-14	100
D-53	Freeman, Roy E.	Antelope Creek	8-8-11		80
D-208	Strand, Anton A.	Fish Creek	5-31-05		180
D-374	Winsborough, Emily	Spring Creek	12-14-12		150

FORM D-1
REPORTER IM 3-48 17378

STATE OF MONTANA
State Engineer's Office
WATER RESOURCES SURVEY

Township 5 N Range 16 E County Sweet Grass

6	5	4	3	2	
7	8	9	10	11	12
18	17	16	15	14	13
19	20	21	22	23	24
30	29	28	27	26	25
31	32	33	34	35	36

Handwritten annotations on the grid:

- Section 12: 754
- Section 15: 20 / 247
- Section 19: 244 / 543

Transcribed from Park County

Township 5 N Range 16 E

Township _____ Range _____ County _____

[illegible]

County..... Sweet Grass

Farm Checked: Date 8-24-50

By MT & BB

STATE OF MONTANA
STATE ENGINEERS OFFICE
Water Resources Survey

T. 5N R. 16E Plat No. 5

Photo No. MA-9A-175

Legal Land Owner.....Ansof. E. Hanson.....Address.....Melville, Mont.

Operator..... Same Address.....

Water is delivered by:— 1. Private System; 2. Ditch Company; 3. State Project; 4. Federal Project; 5. Irrigation District

[illegible]

NOTE: R—Denotes Regular Irrigation. F—Flood Irrigation.

Adequate Supply: Yes..... No..... Explain.....

Remarks

Strand Ditch out of Potato Cr. Hanson has the Strand right for water out of Potato Cr. This ditch is practically obliterated. However, Hanson plans to make this ditch usable ~~xxx~~ in 1951.

Hanson Ditch out of Tony Cr. This ditch comes out in Sec. 11 T. 5N-R. 15E on the north bank and flumes Tony Cr. in Sec. 12 to irrigate lands on south side of Tony Cr. in Sec. 12.

Hanson had installed a pump on the south side of Tony Cr. in SE 1/4 NW 1/4 Sec. 12. The pump is to be used latter in the summers when the stream flow is not sufficient to irrigate by gravity.

River Basin.....

Also in: Plat No. Twp. Rge.	Plat No. Twp. Rge.	Plat No. Twp. Rge.
Plat No. Twp. Rge.	Plat No. Twp. Rge.	Plat No. Twp. Rge.

Information From:

Albert Hanson

6	5	4	3	2	1
7	8	9	10	11	12 _A
13	17	16	15	14	13
19	20	21	22	23	24
29	29	28	27	26	25
31	32	33	34	35	36

Land Ownership.....

.....

.....

Ted DeCock

6		5	4	3	2	1
7 A		8 B	9 A	10	11	12
13 A		14 A	15 A	16	17	18
19	20	21	22	23	24	
26	27	28	29	30	31	32
33	34	35	36	37	38	39

Land Ownership _____

County Sweet Grass

Farm Checked: Date.....9-28-50.....

By EC & MT

STATE OF MONTANA
STATE ENGINEERS OFFICE
Water Resources Survey

T. 5N.....R. 16E..... Plat No.....5.....

Photo No.MA-9A-176.....

Legal Land Owner.....E. H. Christensen.....Address.....Shawmut.....

Operator	Address
-----------------	----------------

Water is delivered by:— 1. Private System; 2. Ditch Company; 3. State Project; 4. Federal Project; 5. Irrigation District

NOTE: R—Denotes Regular Irrigation. F—Flood Irrigation.

Mr. Christensen recently purchased this land from the state and this year constructed a ditch on the land taking out of Andrews Creek in the NW $\frac{1}{4}$ SE $\frac{1}{4}$ of Sec. 36. The ditch, at the present time, is good only for flood irrigation, however, it is Mr. Christensen's intention to uncover a spring at the head of the coulee and thus have a year-round water supply. Two large stock water reservoirs have also been constructed in the N $\frac{1}{2}$ NE $\frac{1}{4}$ of Sec. 36 T. 5N-R. 16E.

...River Basin

Information From:
Mr. E. H. Christensen

6	5	4	3	2	1
7	8	9	10	11	12
13	14	15	16	17	18
19	20	21	22	23	24
25	26	27	28	29	30
31	32	33	34	35	36

A

Land Ownership.....

.....

.....

(5)

Township 5 North - Range 16 East

	Name of Owner	Township & Range
✓1.	Adams, E. M.	(5) 5N-16E (9) 4N-15E (10) 4N-16E
✓2.	DeCock, Theo & Betsy	"
✓3.	Hanson, Ansof F.	"

Farm Checked

STATE OF MONTANA

FORM F-1 REPORTER 1M 3-49 17380

By EC & DIT

State Engineer's Office

Code No. 36 A

Area _____

County Sweet Grass

Date 7-28-50

WATER RESOURCES SURVEY

T. 5N R. 10E Sec. 36

Photo No. MA-9A-176

Legal Land Owner E H Christensen Address Shamout

Operator _____ Address _____

Water is delivered by:

Federal Project _____ Pres. _____ Pot. _____

Ditch Company _____ Pres. _____ Pot. _____

Irrigation District _____ Pres. _____ Pot. _____

Private System ✓ Pres. _____ Pot. _____

Totals _____

Flood _____ Pump _____ Reservoir _____ Gravity ✓

Size and Capacity, Pump, etc. _____

Original Appropriator, Company _____ App. No. _____

Original Appropriator, Private not filed as yet App. No. _____

Is the system an extension of another system? Yes _____ No ✓

Is all land irrigated from one system? Yes ✓ No _____

(If No, show break down on map)

Source of Water Andrews Creek

Acres Irrigated 19.50, none

Potential Acres 123 Seeped _____

Explain _____

Condition of System good

Adequate Supply _____ Yes not certain (over) No _____

Explain _____

Topography _____

Information From M. E. H. Christensen

Remarks over

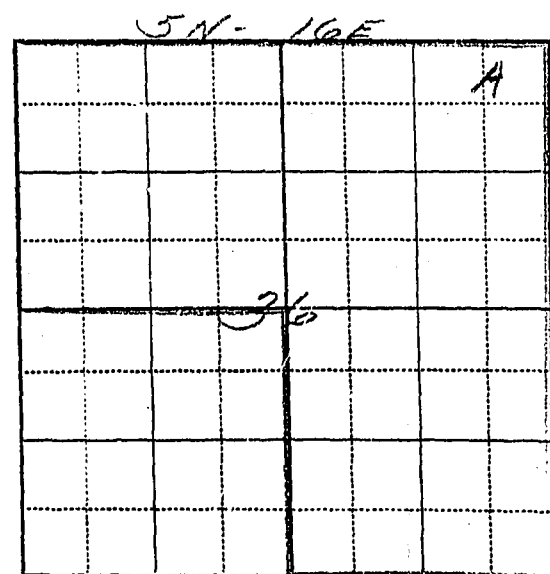

Mr. Christensen recently purchased this land from the state, and this year constructed a ditch on the land taking out of Andrews Creek in the NW¹ SE⁴ of Sec. 36. The ditch, at the present time, is good only for flood irrigation; however, it is Mr. Christensen's intention to uncover a spring at the head of the coulee and thus have a year-round water supply.

Two large stock water reservoirs have also been constructed in the N¹ NE⁴ of Sec 36-5N-16E

Form WR-B
Reporter 20168 2M 12

Twp. 5N Rge. 16E

Twp. _____ Rge. _____

Twp. _____ Rge. _____

STATE OF MONTANA

State Engineer's Office

WATER RESOURCES SURVEY

FARM MAP

County Sweetgrass

Code No. _____

36A

Name of Land Owner E. H. Christensen Address Summit

Name of Operator Same Address "

Legal Description _____



Irrigated Land



Non-Irrigated Land

North



Potential Land Under Existing Facilities

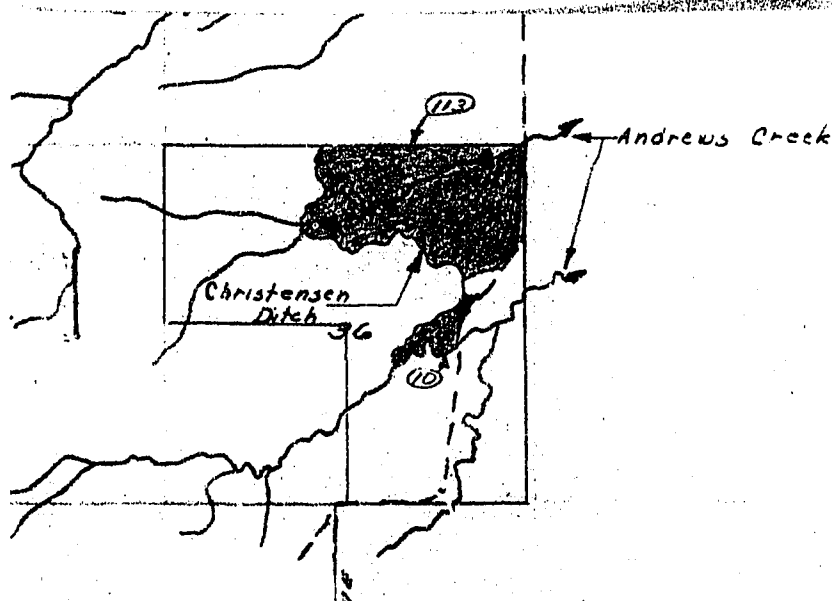

Code No. 36A System Christensen Ditch (not in use) Source of Water Andrews Creek

Basin Missoula Present P Potential 123 Maximum _____ R. _____ F. ✓ P. _____ G. ✓ S. _____

Code No. _____ System _____ Source of Water _____

Basin _____ Present _____ Potential _____ Maximum _____ R. _____ F. _____ P. _____ G. _____ S. _____

Code No. _____ System _____ Source of Water _____

Basin _____ Present _____ Potential _____ Maximum _____ R. _____ F. _____ P. _____ G. _____ S. _____

Code No. _____ System _____ Source of Water _____

Basin _____ Present _____ Potential _____ Maximum _____ R. _____ F. _____ P. _____ G. _____ S. _____

If under Ditch Company, Irrigation District, or Government Project, state the number of shares or inches, acre feet, as the case may be in said system.

NOTE: R—Denotes Regular Irrigation. F—Flood Irrigation. P—Water diverted by means of pumping. G—Water diverted by gravity. S—Stored Water.

Information from _____ Date _____

Farm Checked

STATE OF MONTANA

Code No. 12ABy M.T. B.B.

STATE ENGINEER'S OFFICE

County SweetgrassArea Fish Cr.

WATER RESOURCES SURVEY

T. 5N. R. 16E Sec. 12Date 1-24-50Photo No. MA-9A-175Legal Land Owner HANSON, ANSON E.Address MELVILLE, MONT.Operator "Address "

Water is delivered by:

Federal Project _____ Pres. _____ Pot. _____

Ditch Company _____ Pres. _____ Pot. _____

Irrigation District _____ Pres. _____ Pot. _____

Private System ✓ _____ Pres. _____ Pot. _____

Totals _____

Flood _____ Pump ✓ Reservoir _____ Gravity ✓

Size and Capacity, Pump, etc. _____

Original Appropriator, Company _____ App. No. _____

Original Appropriator, Private Waddecombe, James Strand, Anton A. Hubman, Simon Strand, Anton A. App. No. 618, 450A 857 D-208Is the system an extension of another system? Yes _____ No ✓Is all land irrigated from one system? Yes ✓ No _____

(If No, show break down on map)

Source of Water Fish Cr., Potato Cr., Tamy CreekAcres Irrigated 19 50 51Potential Acres 83 Seeped _____

Explain _____

Condition of System Ditch in use - goodAdequate Supply Yes ✓ No _____

Explain _____

Topography _____

Information From Albert HansonRemarks over

See attached

Strand ditch out of Potato Cr.
Hansen has the Strand right for water out of Potato Cr. This ditch is practically abandoned. However, Hansen plans to make this ditch usable in 1951.

Hansen ditch out of Tong Cr.
This ditch comes out in Sec 11 T5N-16E and the north bank and flows Tong Cr in Sec 12 & irrigate lands on south side of Tong Cr in Sec 12. Hansen had installed a pump on the south side of Tong Cr in SE 1/4 NW 1/4 Sec 12. The pump is to be used later in the summer when the stream flow is not sufficient to irrigate by gravity.

FORM D-1
REPORTER IM 3-49 17379

STATE OF MONTANA
State Engineer's Office
WATER RESOURCES SURVEY

Township 5 North Range 16 East County Sweetgrass

6	5	4	3	2	1
7	8	9	10	11	12 A
18	17	16	15	14	13
19	20	21	22	23	24
30	29	28	27	26	25
31	32	33	34	35	36

Township 5 N Range 16 E

Twp. 5N Rge. 16E
Twp. _____ Rge. _____
Twp. _____ Rge. _____

STATE OF MONTANA
State Engineer's Office
WATER RESOURCES SURVEY
FARM MAP

County Sweetgrass
Code No. 12A

Name of Land Owner Harrison, Arzso F. Address Melville
Name of Operator Same Address _____
Legal Description _____

☒ Irrigated Land ☐ Non-Irrigated Land ☒ Potential Land Under Existing Facilities
North

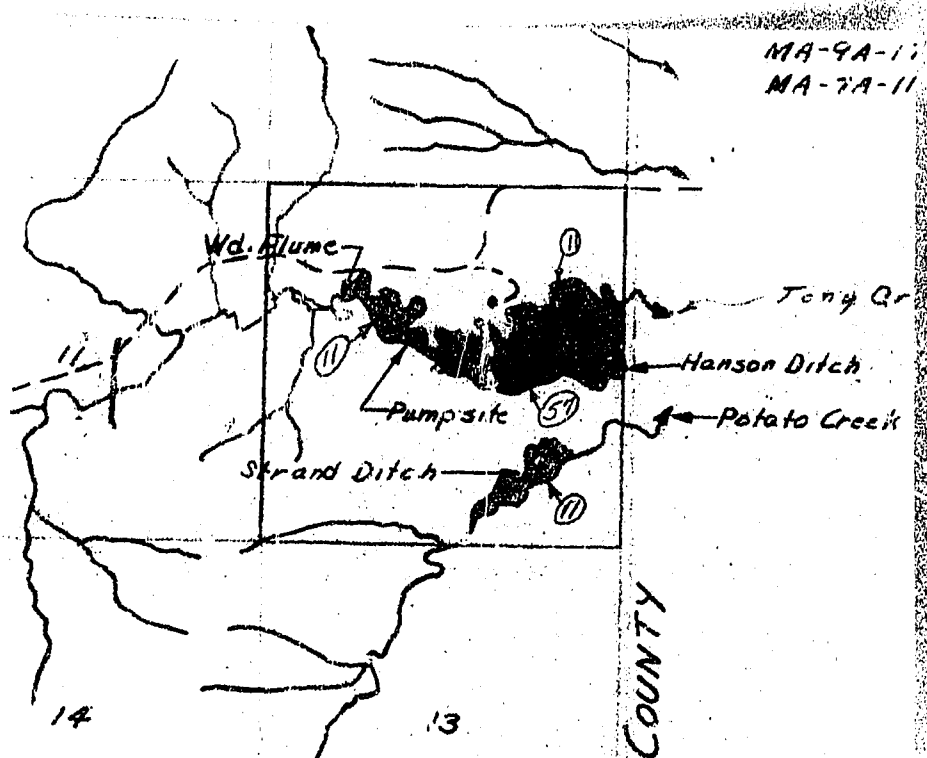

Code No. <u>12A</u>	System <u>Hanson Ditch</u>	Source of Water <u>Tony Creek</u>
Basin <u>Mussel shell</u>	Present <u>57</u> Potential <u>22</u> Maximum <u>79</u>	R <input checked="" type="checkbox"/> F <input type="checkbox"/> P <input type="checkbox"/> G <input checked="" type="checkbox"/> S <input type="checkbox"/>
Code No. <u>12A</u>	System <u>Strand Ditch (not used)</u>	Source of Water <u>Potato Creek</u>
Basin <u>Mussel shell</u>	Present <u>0</u> Potential <u>11</u> Maximum <u>11</u>	R <input checked="" type="checkbox"/> F <input type="checkbox"/> P <input type="checkbox"/> G <input checked="" type="checkbox"/> S <input type="checkbox"/>
Code No. _____	System _____	Source of Water _____
Basin _____	Present _____ Potential _____ Maximum _____	R <input type="checkbox"/> F <input type="checkbox"/> P <input type="checkbox"/> G <input type="checkbox"/> S <input type="checkbox"/>
Code No. _____	System _____	Source of Water _____
Basin _____	Present _____ Potential _____ Maximum _____	R <input type="checkbox"/> F <input type="checkbox"/> P <input type="checkbox"/> G <input type="checkbox"/> S <input type="checkbox"/>

If under Ditch Company, Irrigation District, or Government Project, state the number of shares or inches, acre feet, as the case may be in said system.

NOTE: R—Denotes Regular Irrigation. F—Flood Irrigation. P—Water diverted by means of pumping. G—Water diverted by gravity. S—Stored Water.

Information from _____ Date _____

Farm Checked

STATE OF MONTANA

FORM F-1 - PARETTE 1485-2M-1-42

Code No.

By M. V. 168

STATE ENGINEER'S OFFICE

County San Juan

Area Fish Cr.

WATER RESOURCES SURVEY

T. 5N R. 16E Sec. 11

Date 8-23-50

Photo No. MA-7A-175

Legal Land Owner ADAMS, E. M.

Address BIG TIMBER, MONT.

Operator ADAMS, JOHN

Address " " "

Water is delivered by:

Federal Project _____ Pres. _____ Pot. _____
Ditch Company _____ Pres. _____ Pot. _____
Irrigation District _____ Pres. _____ Pot. _____
Private System ✓ _____ Pres. _____ Pot. _____
Totals _____
Flood _____ Pump _____ Reservoir _____ Gravity ✓

Size and Capacity, Pump, etc.

Original Appropriator, Private Martin, Blanche W. App. No. 421
Company Crest, Albert & Syvert 561
Freeman, Hazel G. 521
Freeman, Roy E. 621
Original Appropriator, Private Crest, Albert & Syvert Freeman, Roy E. App. No. 231 D-531
Mull, Olga 9951
Freeman, Roy E.

Is the system an extension of another system? Yes _____ No ✓

Is all land irrigated from one system? Yes _____ No ✓

(If No, show break down on map)

Source of Water Andrews Creek, Antelope Creek, Pruett Cr., Unwarmed Spring,

Acres Irrigated 19 50 2
Potential Acres 503 Seeped _____
Explain _____
Condition of System poor - never used
Adequate Supply _____ Yes _____ No ✓
Explain Inadequate supply
Topography Barren land
Information From John Adams
Remarks over

Adams ditch from unnamed spring in NW¹/₄ NW¹/₄ Sec 23 T5N-R16E. This ditch is used to irrigate a garden of less than one acre.

Adam ditch out of Tony Cr. in SW¹/₄ SW¹/₄ Sec 19 T5N-R16E. ^(on west bank) There is barely a trace of this ditch. According to John Adams this ditch was never used.

Adam ditch out of Tony Cr. in SW¹/₄ SW¹/₄ Sec 19 on east bank. According to John Adams this ditch was never used.

Muir ditch out of Tony Cr. in SE¹/₄ NW¹/₄ Sec 16 T5N-R16E on north bank. According to John Adams this ditch was never used. Lands classified as potential under this ditch lies in Sec 9, 10, 15 & 16 T5N-R16E.

There are traces of two ditches apparently from SE fork of Applelope Cr. in Sec 27 T5N-R16E. Lands under these ditches lie in Sec 22 & 27 T5N-R16E.

Crest ditch out of Applelope Creek.

Nearby from E-W center line of Sec 15 on west side of crest and runs north to make lands in NW¹/₄ of Sec 15 potential. According to John Adams this ditch was used until soil became sour. Ditch is not in use now and is in very poor condition.

STATE OF MONTANA
State Engineer's Office
WATER RESOURCES SURVEY

Township 5 NORTH Range 16 EAST County Sweetgrass

6	5	4	3 <i>A</i>	2 <i>A</i>	1 <i>A</i>
7	8	9	10 <i>A</i>	11 <i>A</i>	12
18	17	16	15 <i>A</i>	14 <i>A</i>	13
19 <i>A</i>	<i>A</i>	20	21 <i>A</i>	22 <i>A</i>	24
30	29	28 <i>E</i>	27 <i>A</i>	26	25
31	32	33 <i>A</i>	34	35 <i>A</i>	36

Township 5 N. Range 16 E.

(5)

Twp. 5N Rge. 10E
Twp. _____ Rge. _____
Twp. _____ Rge. _____

STATE OF MONTANA
State Engineer's Office
WATER RESOURCES SURVEY
FARM MAP

County Deer Lodge

Code No. _____

Name of Land Owner Adams, E. M. Address Big Timber, Mont.

Name of Operator Adams, John Address _____

Local Description _____

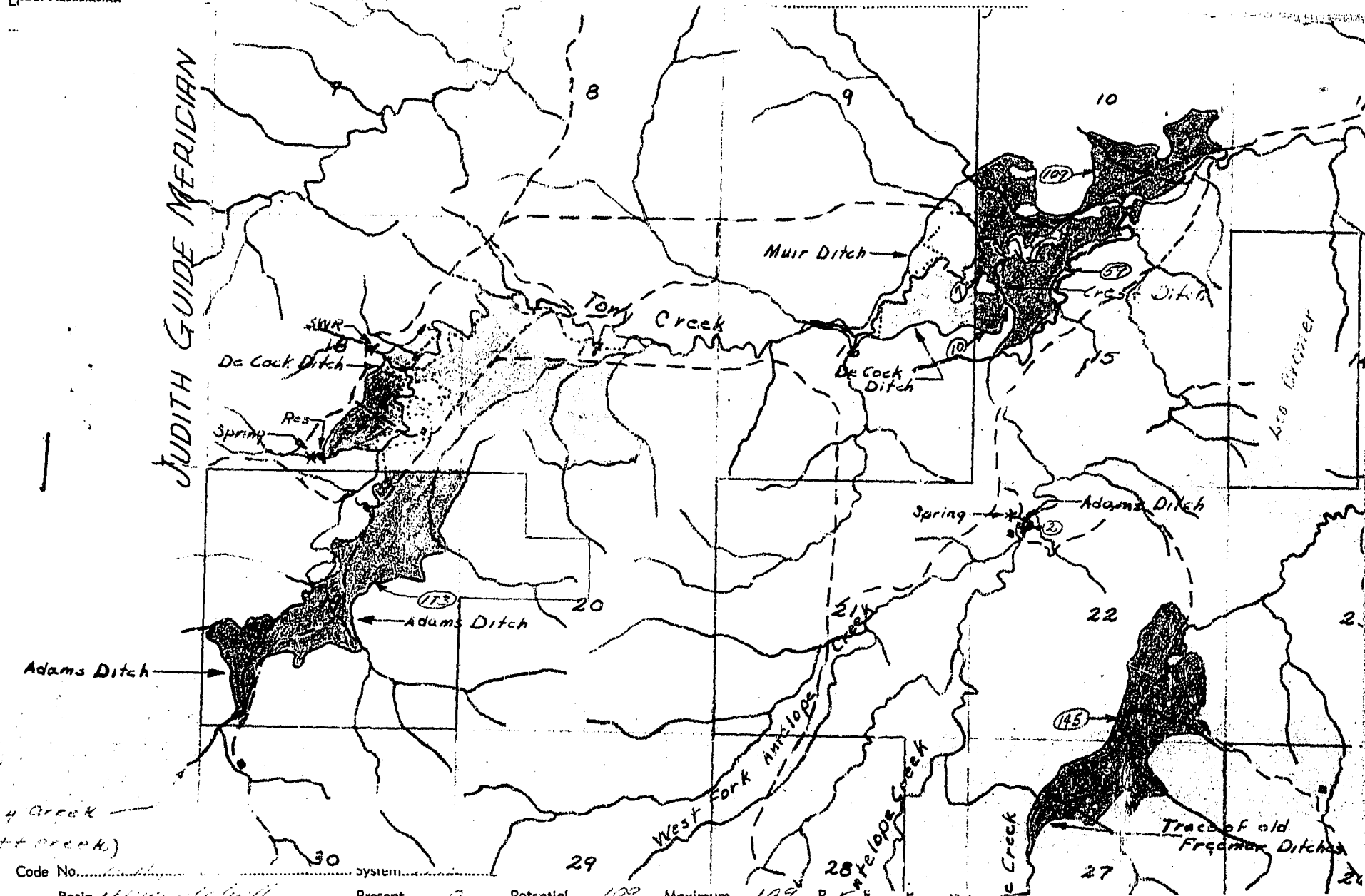

Code No. <u>113</u>	System <u>Adams Ditch</u>	Present <u>2</u>	Potential <u>102</u>	Maximum <u>102</u>	R. <u>✓</u>	F. <u>✓</u>	P. <u>✓</u>	G. <u>✓</u>	S. <u>✓</u>
Code No. <u>151</u>	System <u>Adams Ditch</u>	Present <u>2</u>	Potential <u>17</u>	Maximum <u>17</u>	R. <u>✓</u>	F. <u>✓</u>	P. <u>✓</u>	G. <u>✓</u>	S. <u>✓</u>
Code No. <u>152</u>	System <u>Adams Ditch</u>	Present <u>2</u>	Potential <u>59</u>	Maximum <u>59</u>	R. <u>✓</u>	F. <u>✓</u>	P. <u>✓</u>	G. <u>✓</u>	S. <u>✓</u>
Code No. <u>153</u>	System <u>Adams Ditch</u>	Present <u>2</u>	Potential <u>145</u>	Maximum <u>145</u>	R. <u>✓</u>	F. <u>✓</u>	P. <u>✓</u>	G. <u>✓</u>	S. <u>✓</u>

If under Ditch Company, Irrigation District, or Government Project, state the number of shares or inches, acre feet, as the case may be in said system.

NOTE: R—Denotes Regular Irrigation. F—Flood Irrigation. P—Water diverted by means of pumping. G—Water diverted by gravity. S—Stored Water.

Information from _____ Date 10/25/51

Form WR-B
Reporter 20168 2M 1

STATE OF MONTANA

State Engineer's Office

WATER RESOURCES SURVEY

FARM MAP

County Sweetgrass

Code No. _____

Twp. 5 N Rge. 16 E

Twp. _____ Rge. _____

Twp. _____ Rge. _____

Owner Adams, E. M. Address Big Timber Mont.

For Adams, John Address _____

☒ Irrigated Land

☐ Non-Irrigated Land
North

☒ Potential Land Under Existing Facilities

Code No. 100, 150 System Main Ditch (not in use) Source of Water Tony Creek
Basin Musselshell Present 0 Potential 100 Maximum 100 R ✓ F ✓ P ✓ G ✓ S ✓
Code No. 150 System De Bock Ditch (not in use) Source of Water Tony Creek
Basin Musselshell Present 0 Potential 17 Maximum 17 R ✓ F ✓ P ✓ G ✓ S ✓
Code No. 100, 150 System Crest Ditch (not in use) Source of Water W. H. Antelope Cr.
Basin Musselshell Present 0 Potential 59 Maximum 59 R ✓ F ✓ P ✓ G ✓ S ✓
Code No. 220, 230 System Freeman Ditch (not in use) Source of Water S. H. Antelope Cr.
Basin Musselshell Present 0 Potential 145 Maximum 145 R ✓ F ✓ P ✓ G ✓ S ✓

If under Ditch Company, Irrigation District, or Government Project, state the number of shares or inches, acre feet, as the case may be in said system.

NOTE: R—Denotes Regular Irrigation. F—Flood Irrigation. P—Water diverted by means of pumping. G—Water diverted by gravity. S—Stored Water.

Information from _____ Date 1905

Form WR-B
Reporter 20108 2M 1

STATE OF MONTANA
State Engineer's Office
WATER RESOURCES SURVEY
FARM MAP

County Sweetgrass
Code No. _____

Adams, F. M. Address Big Timber Mont.
Adams, John Address _____

Irrigated Land



Non-Irrigated Land
North



Potential Land Under Existing Facilities

Code No. 194 System Adams to Big Timber in use Source of Water Tracy Creek
Basin Adams to Big Timber Present 0 Potential 173 Maximum 173 R ✓ F ✓ P ✓ G ✓ S ✓
Code No. 224 System Adams to Big Timber Source of Water Spring - Trib. to Potomac Cr.
Basin Adams to Big Timber Present 0 Potential 0 Maximum 0 R ✓ F ✓ P ✓ G ✓ S ✓
Code No. _____ System _____ Source of Water _____
Basin _____ Present _____ Potential _____ Maximum _____ R _____ F _____ P _____ G _____ S _____
Code No. _____ System _____ Source of Water _____
Basin _____ Present _____ Potential _____ Maximum _____ R _____ F _____ P _____ G _____ S _____
If under Ditch Company, Irrigation District, or Government Project, state the number of shares or inches, acre feet, as the case may be in said system.
NOTE: R—Denotes Regular Irrigation. F—Flood Irrigation. P—Water diverted by means of pumping. G—Water diverted by gravity.
S—Stored Water.
Information from _____ Date _____

DeCook ditch from spring in S²S² Sec 18, T5N-R16E.
DeCook irrigated from this ditch and the ditch is in good
condition & the water supply, generally, is adequate.

Adams ditch out of Pruitt (Tony) Co in SW⁴ Sec 19
T5N-R16E on south bank. This ditch has never been
used. Lands under this ditch lie in Sec 17, 18, 19 & 20.
The water supply is inadequate.

DeCook ditch out of Pruitt (Tony) Co in NW⁴ Sec 16 on south
bank. This ditch is poor condition; water supply inadequate; and
supposedly never been used. Lands under this ditch lie in
Sec 16 T5N-R16E.

Pruitt ditch out of Pruitt (Tony) Co in NW⁴ Sec 16 on
north bank. Ditch in poor condition; water supply inadequate; and
supposedly never been used. Lands under this ditch lie in Sec
16 T5N-R16E.

STATE OF MONTANA
State Engineer's Office
WATER RESOURCES SURVEY

Township 5 NORTH Range 16 EAST County Sweetgrass

6	5	4	3	2	1
7 <i>A</i>	8 <i>B</i>	9 <i>A</i>	10	11	12
18 <i>A</i>	17 <i>A</i>	16 <i>A</i>	15	14	13
19	20	21	22	23	24
30	29	28	27	26	25
31	32	33	34	35	36

Township 5 N Range 16 E

STATE OF MONTANA

State Engineer's Office

WATER RESOURCES SURVEY

FARM MAP

County Sweetgrass

Code No. _____

7A-8B-9A-16A-

17A-18A

Twp. 5 N Rge. 16 E

Twp. _____ Rge. _____

Twp. _____ Rge. _____

Name of Land Owner De Cock, Theodore & Betsy Address Melville

Name of Operator Same Address _____

Legal Description _____



Irrigated Land



Non-Irrigated Land



Potential Land Under Existing Facilities

North

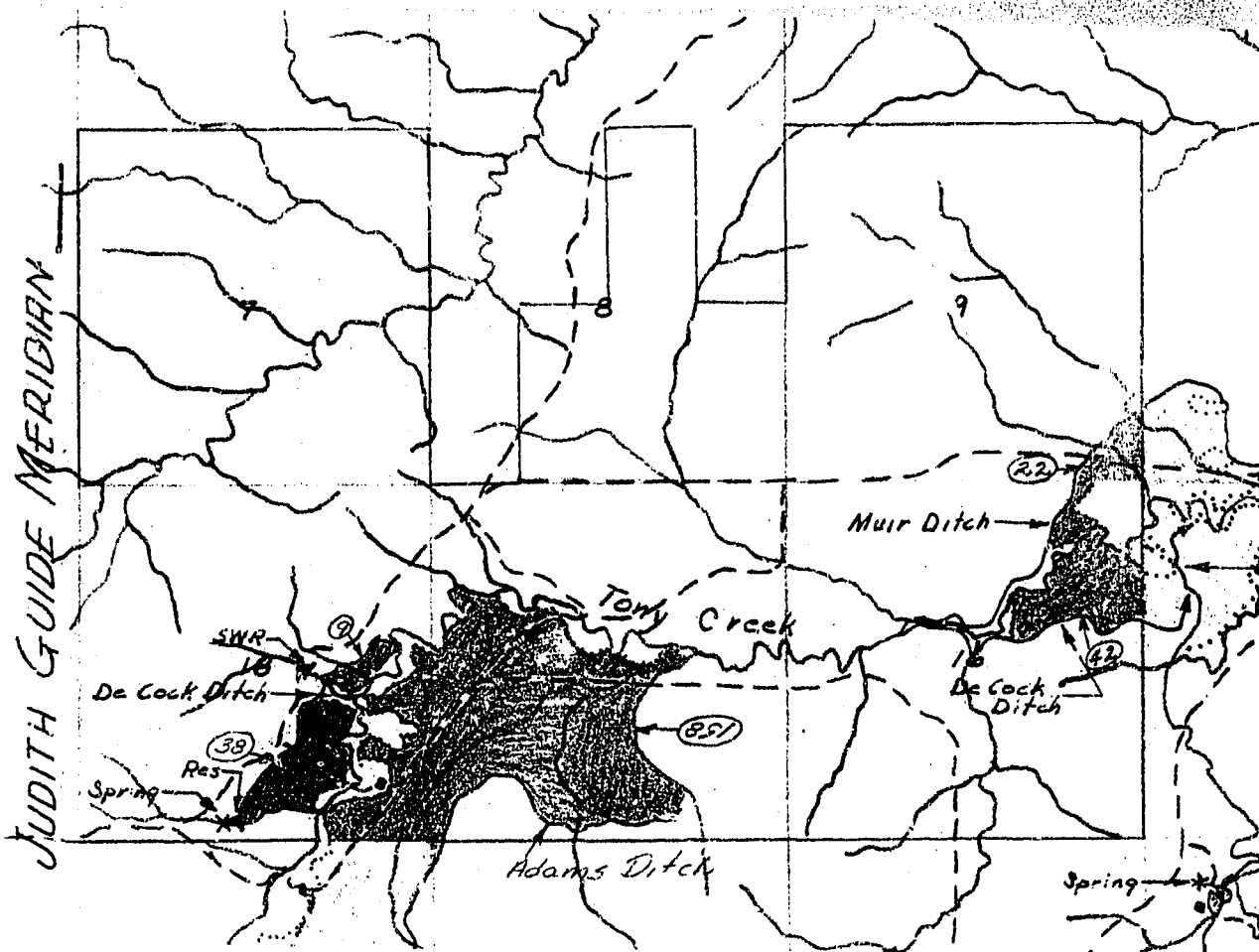

Code No. <u>1111</u>	System <u>De Cock Ditch</u>	Source of Water <u>Spring: tributary to Tommy Cr.</u>
Basin <u>1111-1111</u>	Present <u>32</u> Potential <u>9</u> Maximum <u>41</u>	R. <u>✓</u> F. <u>✓</u> P. <u>✓</u> G. <u>✓</u> S. <u>✓</u>
Code No. <u>1111-1111</u>	System <u>Adams Ditch (not in use)</u>	Source of Water <u>Tommy Creek</u>
Basin <u>1111-1111</u>	Present <u>0</u> Potential <u>158</u> Maximum <u>158</u>	R. <u>✓</u> F. <u>✓</u> P. <u>✓</u> G. <u>✓</u> S. <u>✓</u>
Code No. <u>1111</u>	System <u>De Cock Ditch (not in use)</u>	Source of Water <u>Tommy Creek</u>
Basin <u>1111-1111</u>	Present <u>0</u> Potential <u>42</u> Maximum <u>42</u>	R. <u>✓</u> F. <u>✓</u> P. <u>✓</u> G. <u>✓</u> S. <u>✓</u>
Code No. <u>1111-1111</u>	System <u>Adams Ditch (not in use)</u>	Source of Water <u>Tommy Creek</u>
Basin <u>1111-1111</u>	Present <u>0</u> Potential <u>22</u> Maximum <u>22</u>	R. <u>✓</u> F. <u>✓</u> P. <u>✓</u> G. <u>✓</u> S. <u>✓</u>

If under Ditch Company, Irrigation District, or Government Project, state the number of shares or inches, acre feet, as the case may be in said system.

NOTE: R—Denotes Regular Irrigation. F—Flood Irrigation. P—Water diverted by means of pumping. G—Water diverted by gravity. S—Stored Water.

Information from _____ Date _____

County Sweet Grass

Farm Checked: Date 8-3-50

By BS & BB

STATE OF MONTANA
STATE ENGINEERS OFFICE
Water Resources Survey

T 4N R 12E Plat No. 6

Photo No. MA-12A-209

Legal Land Owner Brannin Bros. Address Melville

Operator..... Same Address.....

Water is delivered by:— 1. Private System; 2. Ditch Company; 3. State Project; 4. Federal Project; 5. Irrigation District

[illegible]

NOTE: R—Denotes Regular Irrigation. F—Flood Irrigation.

Adequate Supply: Yes..... No..... Explain.....

Remarks.....
 Drannin Ditch takes water from Ramsey Cr., Beaver Cr., & Harrison Cr. There is contemplated use of the water from Shell
 Rock Springs for domestic purposes.....

The Brannin Ditch takes out of Harrison Creek; drops into Beaver Creek; takes out of Beaver Creek; drops into Ramsey Cr and then takes out.

River Basin.

Also in: Plat No.....	Twp.....	Rge.....	Plat No.....	Twp.....	Rge.....	Plat No.....	Twp.....	Rge.....
Plat No.....	Twp.....	Rge.....	Plat No.....	Twp.....	Rge.....	Plat No.....	Twp.....	Rge.....

Information From:

Barney Brannin