



NOTICE
These forms are the property of the State of Montana and must be returned.

STATE OF MONTANA
STATE ENGINEERS OFFICE
Water Resources Survey

FORM WR-1—2M 12-47
Code No. 2A
County Custer
T. 1N R. 47E

Name of Land Owner Bennie Carey Address Volborg, Mont.
Name of Operator _____ Address _____

Part A

TO BE FILED BY THOSE OBTAINING IRRIGATION WATER FROM A DITCH COMPANY OR IRRIGATION DISTRICT

1. Water is delivered by: _____
Name of Ditch, Ditch Company or District Supplying Water
2. State the number of acres you irrigate under this system _____ Shares you hold _____
3. If you obtain water from more than one Company, give the number of shares, acres irrigated and the name of the Company under "Remarks." If you obtain water from a Ditch Company and also have a private system fill in both Part A and Part B.

Part B

TO BE FILED BY THOSE WHO HAVE A PRIVATE DITCH, PUMP OR IRRIGATION SYSTEM or those who have a private water right under a Ditch Company

4. In what year was this land first irrigated? Date see attached filing
5. Give the name of the original appropriator (first user): Bennie S. Carey
6. Give the date appropriated 9/27/13 Amount filed on: Miners Inches 100 C. F. S. _____
7. State the total number of acres irrigated under this system: _____
8. Give the point of diversion: _____ $\frac{1}{4}$ _____ $\frac{1}{4}$ Section _____ Township _____ Range _____

Part C

TO BE FILED BY ALL WATER USERS IN ADDITION TO PART A OR PART B

9. Source of Water: Foster Creek
Name of stream or lake from which water is originally diverted
10. Water is obtained by: (Check one) Gravity Pumping _____ Other _____
11. What is the greatest number of acres you have irrigated? 38.0 Date 0
12. How many acres did you irrigate in 1947 (Crop and pasture) 0
13. State the total number of additional acres that could be irrigated by increasing the water supply, land leveling, etc. 38 This land is under what ditch? Carey ditch
14. How many acres of seeped land do you have which could be drained and put into production? _____
15. What is the condition of your irrigation system? Out of use
16. Is your water supply adequate? Yes _____ No Explain I had no
17. REMARKS: _____

NOTE: The foregoing questions apply only to irrigated land shown on this plat.

DESCRIPTION AND MAP OF FARM

18. Legal Description of this Farm S2NW4, N2SW4, NE4NW4, E2 Sec 2

None at Present
IRRIGATED LAND

NON-IRRIGATED LAND

Potential Land

North

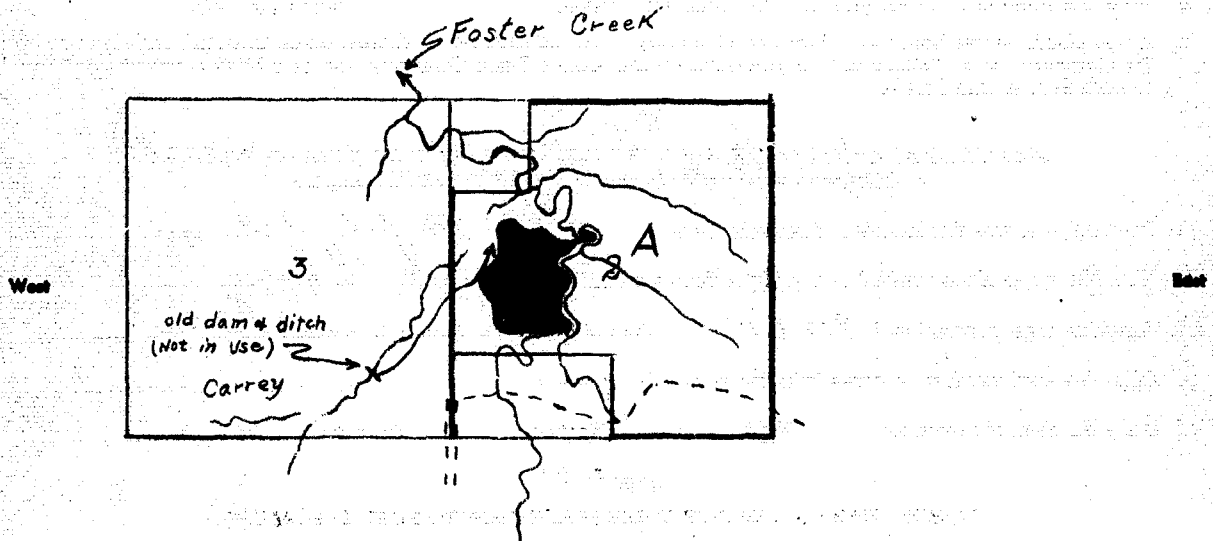

South

Ownership covers
only irrigated land.
All ownership for
dry land not shown.

19. If the above land is irrigated from more than one ditch please give the acreage under each ditch in 19A and indicate the location of the land irrigated from each on the above map.

19A. Ditch: Carrey ditch Acres: 0

Ditch: _____ Acres: _____

Information supplied by:

Name Field Survey Address _____ Date July 23-47

REMARKS: Johnson & J. Paulist

If you cannot answer all of the questions on this form answer as many as you can and return the form to us as soon as possible.

STATE ENGINEERS OFFICE
Water Resources Survey

COUNTY Custer

FILE NO. 75-T.1N-R.47E

Owner Carey, Bessie Address Valborg, Montana

AAA Owner Address

Operator ? Address ?

New Owner Address

New Operator Address

Assessment Record None

Assessed Acreage 0

Legal Description of This Farm S²NW⁴, N²S⁴W⁴, NE⁴NW⁴, E², Sec. 2; T.1N-R.47E

Total Acres in Farm ✓

Code Number 2A

Photo No. MA 13-169

AAA Contract No.

AAA Total Cropland Acreage

App. No. 716

Decree No.

Land is located in

Twp. 1N Rge. 47E Twp. 2N Rge. 47E

Twp. Rge. Twp. Rge.

Filed in Twp. 1N Rge. 47E

Remarks

Farm Map

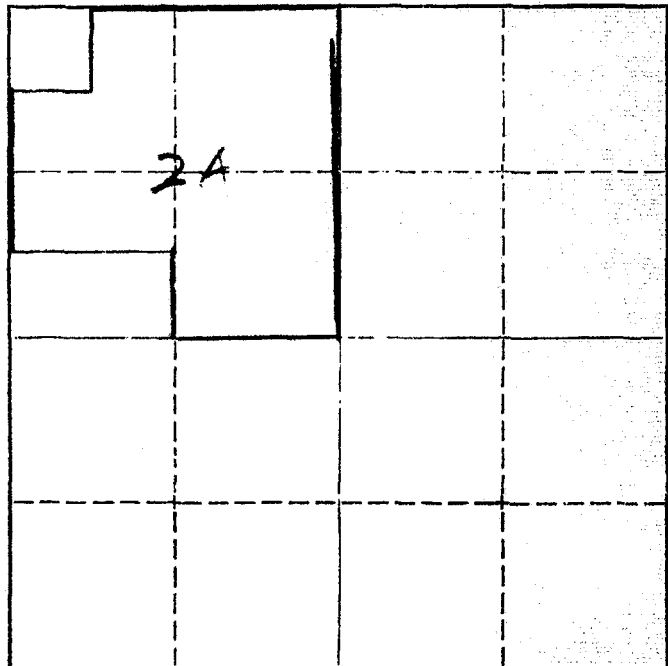

Ownership covers
only irrigated land.
All ownership for
dry land not shown.

Tongue River Basin



NOTICE
These forms are the
property of the State
Engineers Office and
should be returned
when required.

STATE OF MONTANA
STATE ENGINEERS OFFICE

Water Resources Survey

FORM WR-1-2M 12-57

Code No. 15A

County Custer

T. 1N R. 41E

Name of Land Owner: C. S. & Mollie, Holman Address Volborg, Montana

Name of Operator: _____ Address _____

Part A

**TO BE FILED BY THOSE OBTAINING IRRIGATION WATER FROM
A DITCH COMPANY OR IRRIGATION DISTRICT**

1. Water is delivered by: _____
Name of Ditch, Ditch Company or District Supplying Water
2. State the number of acres you irrigate under this system _____ Shares you hold _____
3. If you obtain water from more than one Company, give the number of shares, acres irrigated and the name of the Company under "Remarks." If you obtain water from a Ditch Company and also have a private system fill in both Part A and Part B.

Part B

**TO BE FILED BY THOSE WHO HAVE A PRIVATE DITCH, PUMP OR IRRIGATION SYSTEM
or those who have a private water right under a Ditch Company**

4. In what year was this land first irrigated? Date No. date
5. Give the name of the original appropriator (first user): see attached letter
6. Give the date appropriated _____ Amount filed on: Miners inches _____ C. F. S. _____
7. State the total number of acres irrigated under this system: _____
8. Give the point of diversion: _____ $\frac{1}{4}$ _____ $\frac{1}{2}$ Section _____ Township _____ Range _____

Part C

TO BE FILED BY ALL WATER USERS IN ADDITION TO PART A OR PART B

9. Source of Water: Foster Creek
Name of stream or lake from which water is originally diverted
10. Water is obtained by: (Check one) Gravity Pumping _____ Other _____
11. What is the greatest number of acres you have irrigated? ? Date _____
12. How many acres did you irrigate in 1947? (Crop and pasture) 210
13. State the total number of additional acres that could be irrigated by increasing the water supply, land leveling, etc. 0 This land is under what ditch? _____
14. How many acres of seeped land do you have which could be drained and put into production? _____
15. What is the condition of your irrigation system? fair
16. Is your water supply adequate? Yes _____ No Explain I had 0
17. REMARKS: _____

NOTE: The foregoing questions apply only to irrigated land shown on this plat.

DESCRIPTION AND MAP OF FARM

18. Legal Description of this Farm

See 15,



IRRIGATED LAND



NON-IRRIGATED LAND

North



West

East

South

Ownership shown
only irrigated land.
All ownership for
dry land not shown.

19. If the above land is irrigated from more than one ditch please give the acreage under each ditch in 19A and indicate the location of the land irrigated from each on the above map.

19A Ditch: Foster Cr. Flood Dam Acres: 21.0

Ditch: _____ Acres: _____

Information supplied by:

Name Field Survey Address _____ Date July 23-48

REMARKS: Johnson & J Paulist

If you cannot answer all of the questions on this form answer as many as you can and return the form to us as soon as possible.

STATE ENGINEERS OFFICE
Water Resources Survey

COUNTY Cluster

FILE NO. 75-T.1N-R.47E

Owner Holman, C. L. & Mollie

Address Velberg, Montana

AAA Owner

Address

Operator

Address

New Owner

Address

New Operator

Address

Assessment Record None

Assessed Acreage 0

Legal Description of This Farm all of Sec. 15, T. 1N-R. 47E

Total Acres in Farm

Code Number 15A

Farm Map

Photo No. Ma. 17-31

	15		

AAA Contract No.

AAA Total Cropland Acreage

App. No. Ne. Record by Discript

Decree No.

Land is located in

Twp. 1N Rge. 47E Twp. Rge.

Twp. Rge. Twp. Rge.

Filed in Twp. 1N Rge. 47E

Remarks

Tongue River Basin

Ownership covers only irrigated land. All ownership for dry land not shown.



STATE OF MONTANA

STATE ENGINEER

FRED E. BUCK, STATE ENGINEER
GERALD J. OPAVETZ, ASSISTANT

BILLINGS, MONTANA

February 11, 1948

C. L. & Mollie Holman
Volborg, Montana

Re: Flood Irrigation Foster Creek

Dear Sirs:

In accordance with the 1939 Session Law (Section 349.58 Montana Session Laws) requiring the State Engineer to investigate and prepare a complete record of all water rights in Montana, the State Engineer has been conducting a water resources survey in Custer County.

We are unable to find a recorded water filing for the land that you irrigate in Section 15, T. 1N., R. 47E. If a filing was made for this land we would like to have you send us the name of the appropriator, the date filed on, and the number of inches filed on. If no recorded filing was made we would like to have you send us the name of the first user and the date, or the approximate date, that the land was first irrigated so that we may establish a date of priority for this land.

We would like to have you make this a first on your agenda and send this information to us as soon as possible in the enclosed, stamped, self-addressed envelope.

Very truly yours,

Gerald J. O'pavetz
Assistant State Engineer

(over)

GJO/a
enc.

Yellowmond
Feb. 23, 1948

Dear Sir,

I have never ^{filed} a water right on
Foster Creek, nor do I know if any
body has filed a water right on Foster
Creek within ten miles of sec.
15-T one - R 47 E

C. L. Johnson

[Faint, illegible text, likely a carbon copy or bleed-through from the reverse side of the page.]

P. T. Bennett
S. 11/4



NOTICE
These forms are the
property of the State
of Montana and must
be returned.

STATE OF MONTANA
STATE ENGINEERS OFFICE

FORM WR-1-2M 12-47

Code No. 6A
County Custer
T. 14 R. 47E

Water Resources Survey

Name of Land Owner: William ^{John} Cook Address Barland, Montana
Name of Operator _____ Address _____

Part A

TO BE FILED BY THOSE OBTAINING IRRIGATION WATER FROM
A DITCH COMPANY OR IRRIGATION DISTRICT

1. Water is delivered by: _____
Name of Ditch, Ditch Company or District Supplying Water
2. State the number of acres you irrigate under this system _____ Shares you hold _____
3. If you obtain water from more than one Company, give the number of shares, acres irrigated and the name of the Company under "Remarks." If you obtain water from a Ditch Company and also have a private system fill in both Part A and Part B.

Part B

TO BE FILED BY THOSE WHO HAVE A PRIVATE DITCH, PUMP OR IRRIGATION SYSTEM
or those who have a private water right under a Ditch Company

4. In what year was this land first irrigated? Date No data
5. Give the name of the original appropriator (first user): see letter on IN R 46
6. Give the date appropriated _____ Amount filed on: Miners inches _____ C. F. S. _____
7. State the total number of acres irrigated under this system: _____
8. Give the point of diversion: _____ $\frac{1}{4}$ _____ $\frac{1}{4}$ Section _____ Township _____ Range _____

Part C

TO BE FILED BY ALL WATER USERS IN ADDITION TO PART A OR PART B

9. Source of Water: South Fork Foster Creek
Name of stream or lake from which water is originally diverted
10. Water is obtained by: (Check one) Gravity Pumping _____ Other _____
11. What is the greatest number of acres you have irrigated? ? Date _____
12. How many acres did you irrigate in 1947? (Crop and pasture) 15.0
13. State the total number of additional acres that could be irrigated by increasing the water supply, land leveling, etc. 0 This land is under what ditch? 0
14. How many acres of seeped land do you have which could be drained and put into production? 0
15. What is the condition of your irrigation system? Fair
16. Is your water supply adequate? Yes _____ No Explain Flowed over
17. REMARKS: _____

NOTE: The foregoing questions apply only to irrigated land shown on this plot.

DESCRIPTION AND MAP OF FARM

18. Legal Description of this Farm W², Sec 6

IRRIGATED LAND NON-IRRIGATED LAND

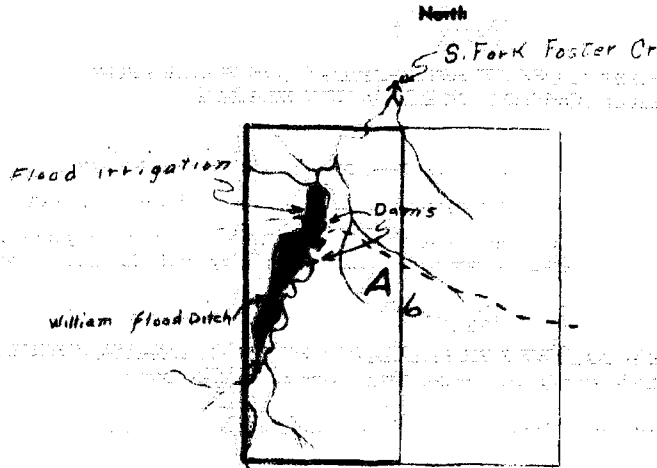

19. If the above land is irrigated from more than one ditch please give the acreage under each ditch in 19A and indicate the location of the land irrigated from each on the above map.

19A. Ditch: Williams flood ditch Acres: _____
Ditch: from S. Fork Foster Cr Acres: 15.0

Information supplied by:

Name Williams Co Address _____ Date July 23-47

REMARKS: Johnson + J. Parliat

If you cannot answer all of the questions on this form answer as many as you can and return the form to us as soon as possible.

STATE ENGINEERS OFFICE
Water Resources Survey

COUNTY Cluster

FILE NO. 75-T.1N-R.47E

Owner John Williams Ranch Address Garland, Montana?
(Former Owner Preston H. Wilson) Renton, Wash

AAA Owner Address

Operator " " Address " " "

New Owner Address

New Operator Address

Assessment Record None

Assessed Acreage 0

Legal Description of This Farm W² Sec. 6 - T.1N-R.47E

Total Acres in Farm

Code Number 6A

Photo No. MA 13-204

AAA Contract No.

AAA Total Cropland Acreage.....

App. No. No. Record by Discript

Decree No.

Land is located in

Twp. 1N Rge. 47E Twp. 1N Rge. 46E

Twp. Rge. Twp. Rge.

Filed in Twp. 1N Rge. 47E

Remarks also has some land

in T.1N-R.46E

Farm Map

	6		

Ownership covers
only irrigated land.
All ownership for
dry land not shown.

Tongue River Basin

9A and

50

23-47





NOTICE
These forms are the property of the State of Montana and must be returned.

STATE OF MONTANA
STATE ENGINEERS OFFICE
Water Resources Survey

Code No. 22A-27A
County Center
T. 1N R. 41E

Name of Land Owner Leon H. Willson Address Volborg, Mont
Name of Operator _____ Address _____

Part A

TO BE FILED BY THOSE OBTAINING IRRIGATION WATER FROM A DITCH COMPANY OR IRRIGATION DISTRICT

- Water is delivered by: _____ Name of Ditch, Ditch Company or District Supplying Water _____
- State the number of acres you irrigate under this system _____ Shares you hold _____
- If you obtain water from more than one Company, give the number of shares, acres irrigated and the name of the Company under "Remarks." If you obtain water from a Ditch Company and also have a private system fill in both Part A and Part B.

Part B

TO BE FILED BY THOSE WHO HAVE A PRIVATE DITCH, PUMP OR IRRIGATION SYSTEM or those who have a private water right under a Ditch Company

- In what year was this land first irrigated? Date (see attached filing)
- Give the name of the original appropriator (first user): _____
- Give the date appropriated _____ Amount filed on: Miners Inches _____ C. F. S. _____
- State the total number of acres irrigated under this system: _____
- Give the point of diversion: _____ $\frac{1}{4}$ _____ $\frac{1}{4}$ Section _____ Township _____ Range _____

Part C

TO BE FILED BY ALL WATER USERS IN ADDITION TO PART A OR PART B

- Source of Water: Foster Creek
Name of stream or lake from which water is originally diverted _____
- Water is obtained by: (Check one) Gravity Pumping _____ Other _____
- What is the greatest number of acres you have irrigated? ? Date _____
- How many acres did you irrigate in 1947? (Crop and pasture) 46.0
- State the total number of additional acres that could be irrigated by increasing the water supply, land leveling, etc. ? This land is under what di ?
- How many acres of seeped land do you have which could be drained and put into production? 0
- What is the condition of your irrigation system? fair
- Is your water supply adequate? Yes _____ No Explain Short on
- REMARKS: _____

NOTE: The foregoing questions apply only to irrigated land shown on this plat.

DESCRIPTION AND MAP OF FARM

18. Legal Description of this Farm Sec. 22, Sec 27,

 IRRIGATED LAND

 NON-IRRIGATED LAND

North

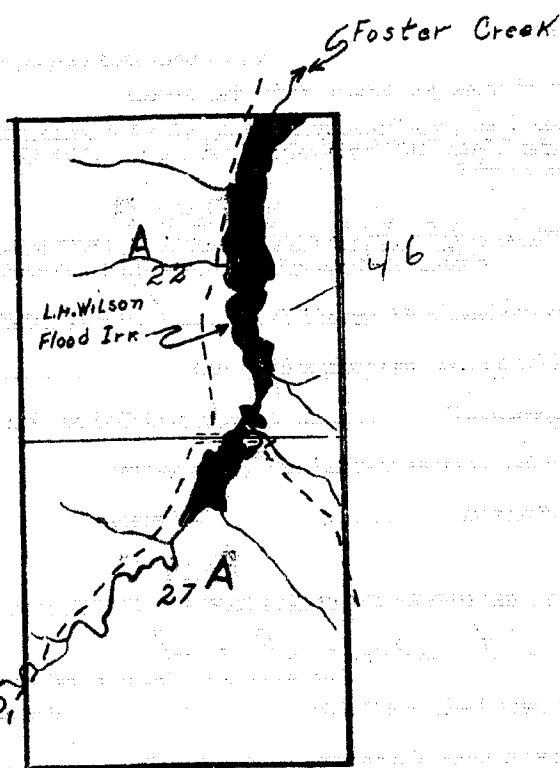

Ownership covers
only irrigated land.
All ownership for
dry land not shown.

19. If the above land is irrigated from more than one ditch please give the acreage under each ditch in 19A and indicate the location of the land irrigated from each on the above map.

19A. Ditch: L. H. Wilson Flood Irr Acres: 46.2

Ditch: _____ Acres: _____

Information supplied by:

Name Field Survey Address _____ Date July 23, 1947

REMARKS: Johnson & J. Paulist

If you cannot answer all of the questions on this form answer as many as you can and return the form to us as soon as possible.

