



NOTICE
These forms are the
property of the State
of Montana and must
be returned.

STATE OF MONTANA
STATE ENGINEERS OFFICE

Water Resources Survey

FORM WR-1--2M 12-47
193-203-29A-30B
Code No. 32C-31B
County Custer
T. 2N R. 4S

Name of Land Owner Bladys Whittier Coleman Address Montana Ave. Billings
Name of Operator R. L. Rhea Address Garland, Mont.

Part A

TO BE FILED BY THOSE OBTAINING IRRIGATION WATER FROM
A DITCH COMPANY OR IRRIGATION DISTRICT

1. Water is delivered by: _____ Name of Ditch, Ditch Company or District Supplying Water _____
2. State the number of acres you irrigate under this system _____ Shares you hold _____
3. If you obtain water from more than one Company, give the number of shares, acres irrigated and the name of the Company under "Remarks." If you obtain water from a Ditch Company and also have a private system fill in both Part A and Part B.

Part B

TO BE FILED BY THOSE WHO HAVE A PRIVATE DITCH, PUMP OR IRRIGATION SYSTEM
or those who have a private water right under a Ditch Company

4. In what year was this land first irrigated? Date See attached filings
5. Give the name of the original appropriator (first user): _____
6. Give the date appropriated _____ Amount filed on: Miners Inches _____ C. F. S. _____
7. State the total number of acres irrigated under this system: _____
8. Give the point of diversion: $\frac{1}{4}$ _____ $\frac{1}{4}$ Section _____ Township _____ Range _____

Part C

TO BE FILED BY ALL WATER USERS IN ADDITION TO PART A OR PART B

9. Source of Water: Tongue River, Laramie Co. & Garden Creek
Name of stream or lake from which water is originally diverted _____
10. Water is obtained by: (Check one) Gravity ☒ Pumping ☒ Other _____
11. What is the greatest number of acres you have irrigated? ? Date _____
12. How many acres did you irrigate in 1947? (Crop and pasture) 396.0
13. State the total number of additional acres that could be irrigated by increasing the water supply, land leveling, etc. 20.0 This land is under what ditch? Tongue R. Pump Ditch
14. How many acres of seeped land do you have which could be drained and put into production? _____
15. What is the condition of your irrigation system? Fair
16. Is your water supply adequate? Yes ☐ No ☒ Explain Not on Custer
17. REMARKS: Yp in Tongue R.

This form has Master Map for all
WR' forms attached. Filings attached
to individual forms

NOTE: The foregoing questions apply only to irrigated land shown on this plat.

DESCRIPTION AND MAP OF FARM

18. Legal Description of this Farm

Cover all land for attached farm - See code numbers for ownership break down



IRRIGATED LAND



NON-IRRIGATED LAND

Tongue River

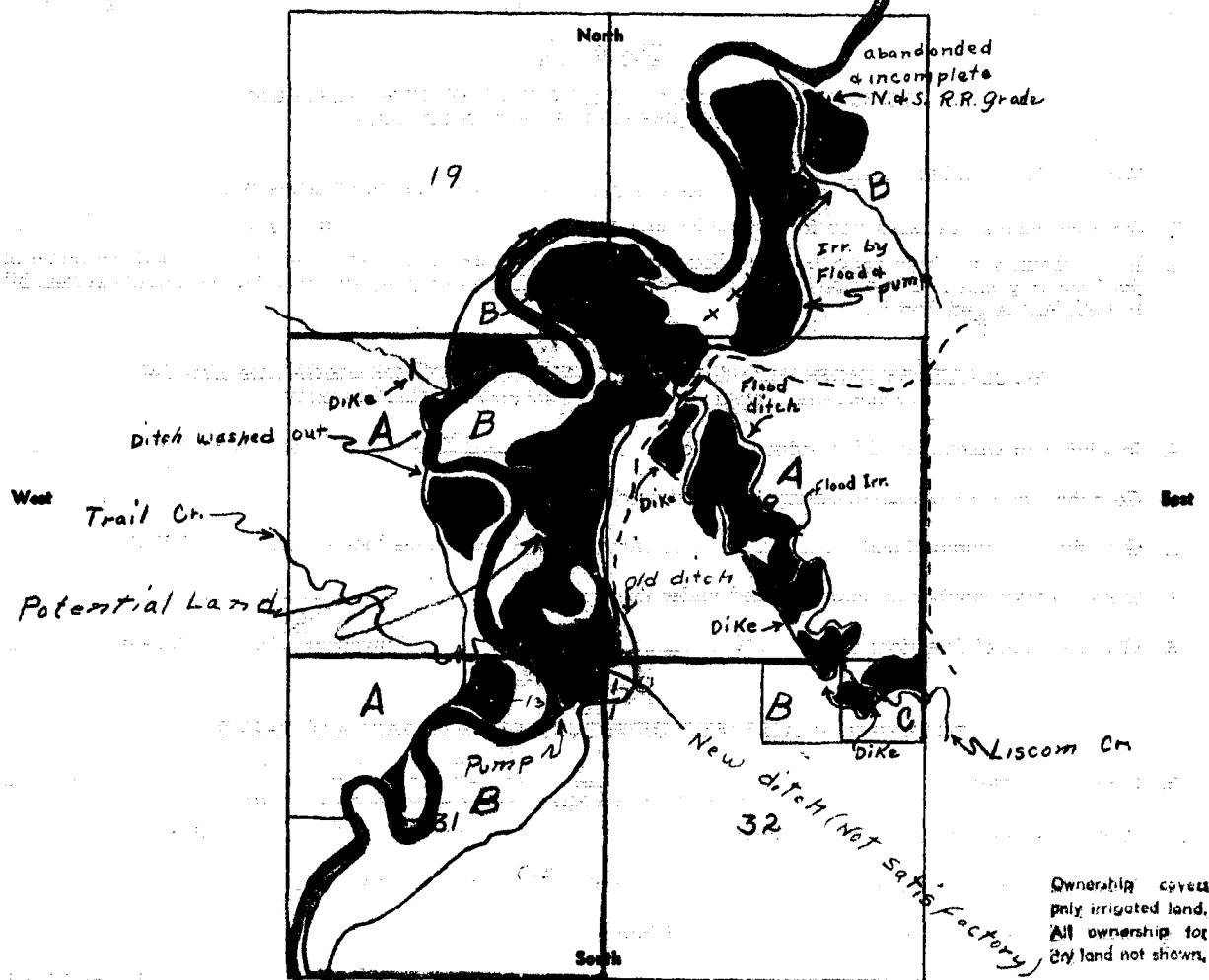

19. If the above land is irrigated from more than one ditch please give the acreage under each ditch in 19A and indicate the location of the land irrigated from each on the above map.

19A. Ditch: *For Code No. 5, 19B-20B-29A-30B* *32C-31B* Acres: _____
Ditch: *Flood + Pump* Acres: *396.0*

Information supplied by:

Name *See attached farm* Address _____ Date _____

REMARKS: _____

If you cannot answer all of the questions on this form answer as many as you can and return the form to us as soon as possible.

**STATE ENGINEER'S OFFICE
WATER RESOURCES SURVEY**

COUNTY CusterFILE NO. 66-T.2N-R.45EOwner Coleman, Gladys Whittier Address Montana Ave, Billings, Montana
90 E. H. Peters

AAA Owner Address

Operator Rhea, R. L. Address Garland, Montana

New Owner Address

New Operator Address

Assessment Record NoneAssessed Acreage 0Legal Description of This Farm Lat-6, Sec 19; Lots 1-5-6-7-9, SW*NE*, SE*,
Sec. 20; all of Sec 29; Lots 1, 4, 9, 10, SE*NE*, Sec 30; NE*NE*
Sec 32; T.2N-R.45ETotal Acres in Farm ✓Coc. Number 19B, 20B, 29A, 30B, 32C - 31BPhoto No. Ma-29-31

AAA Contract No.

AAA Total Cropland Acreage

App. No. 1003, 1932, 1933, 1950Decree No. 32A

Land is located in

Twp. 2N Rge. 45E Twp. Rge.

Twp. Rge. Twp. Rge.

Filed in Twp. 2N Rge. 45ERemarks Probably leased(325)
NW*NE* Sec 32 fromW.S.A.

19B-30.0	—	
20B-20.0	—	30
29A-40.0	—	20
30B-40.0	—	20
32C-75.0	—	90
31B-16.0	—	16
		<u>296</u>

Tongue River Basin

Ownership covers
only irrigated land.
All ownership for
dry land not shown.

Farm Checked

STATE OF MONTANA

Code No. See ownership (G.W. Coleman)By Dave, Joe, Jim

STATE ENGINEER'S OFFICE

County CusterArea Tongue River

WATER RESOURCES SURVEY

T. 2N R. 45E Sec. _____Date 4/3/1947Photo No. MA 29-304-31Legal Land Owner E. H. PetersAddress Billings, Mont.Operator R. L. RheaAddress Garland, Mont.

Water is delivered by:

Federal Project _____	Pres. _____	Pot. _____
Ditch Company _____	Pres. _____	Pot. _____
Irrigation District _____	Pres. _____	Pot. _____
Private System <input checked="" type="checkbox"/>	Pres. <u>396.0</u>	Pot. <u>20.0</u>
Totals _____		

Flood <input checked="" type="checkbox"/>	Pump <input checked="" type="checkbox"/>	Reservoir _____	Gravity _____
---	--	-----------------	---------------

Size and Capacity, Pump, etc. 8 inch, Centrifugal, 7' lift, tractor power

Original Appropriator, Company _____ App. No. _____

Original Appropriator, Private Pape & Howard App. No. 100341934
(Show date of appropriation under Remarks)Is the system an extension of another system? Yes _____ No ☒Is all land irrigated from one system? Yes ☒ No ☒

(If No, show break down on map)

Source of Water Tongue River, Wisconsin Crk & Garden CreekAcres Irrigated 19.46 ^PPotential Acres _____ ^P Seeped C

Explain _____

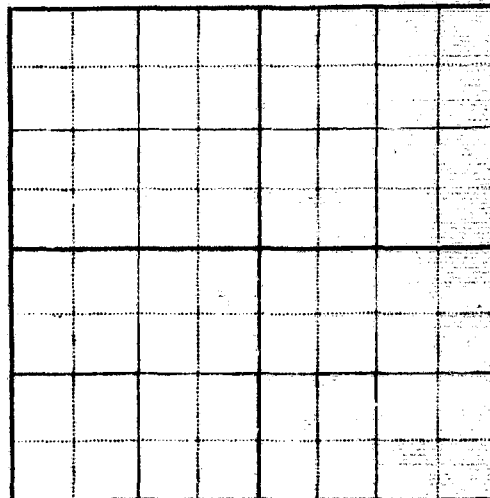
Condition of System Good, some work neededAdequate Supply Yes ☒ No _____
Land flooded by creek can also be irr. by pumpExplain Tongue River, Wisconsin & Garden Creek floodwater
supplemented by pump systemTopography Tongue River valley bottomInformation From R. L. RheaRemarks 1003- 2/20/07, 1934-11/17/10

ip (G. M. Coleman)

Sec.

4-31

Cont.

nt.

P
20.0

Water is taken from Tongue R. at site shown on pic. MA 29-30
originally was taken out farther up Tongue River & turned
across old River beds as shown on pic. until river changed
course to follow ditch. New raised ditch across field
breaks out easily and Mr. Rhea intends to use old
one ~~from~~ by building raised ditch (2' raise) from proposed
site to old ditch. Water from ~~the~~ hiscomb Crk floods area
in sec. 29 & 32, T2N R45E as shown in pics MA 29-30 & 31.
dike is used to divert some water from hiscomb Crk into
Garden Crk (near road) ~~which~~ which floods small area near ranch
buildings. This area is also irr. by pump system



NOTICE
These forms are the
property of the State
of Montana and must
be returned.

STATE OF MONTANA
STATE ENGINEERS OFFICE
Water Resources Survey

FORM WR-1—2M 12-47

Code No. 30A
County Custer
T. 2N R. 45

Name of Land Owner John F. Austin Address Barland, Mont
Name of Operator _____ Address _____

Part A

**TO BE FILED BY THOSE OBTAINING IRRIGATION WATER FROM
A DITCH COMPANY OR IRRIGATION DISTRICT**

1. Water is delivered by: _____
Name of Ditch, Ditch Company or District Supplying Water
2. State the number of acres you irrigate under this system. _____ Shares you hold _____
3. If you obtain water from more than one Company, give the number of shares, acres irrigated and the name of the Company under "Remarks." If you obtain water from a Ditch Company and also have a private system fill in both Part A and Part B.

Part B

**TO BE FILED BY THOSE WHO HAVE A PRIVATE DITCH, PUMP OR IRRIGATION SYSTEM
or those who have a private water right under a Ditch Company**

4. In what year was this land first irrigated? Date See attached filings
5. Give the name of the original appropriator (first user): _____
6. Give the date appropriated _____ Amount filed on: Miners Inches _____ C. F. S. _____
7. State the total number of acres irrigated under this system: _____
8. Give the point of diversion: _____ $\frac{1}{4}$ _____ $\frac{1}{4}$ Section _____ Township _____ Range _____

Part C

TO BE FILED BY ALL WATER USERS IN ADDITION TO PART A OR PART B

- Trail Creek trib Tongue River (Trail Creek)
9. Source of Water: _____
Name of stream or lake from which water is originally diverted
 10. Water is obtained by: (Check one) Gravity ☒ Pumping _____ Other _____
 11. What is the greatest number of acres you have irrigated? ? Date _____
 12. How many acres did you irrigate in 1946 (Crop and pasture) 63.0
 13. State the total number of additional acres that could be irrigated by increasing the water supply, land leveling, etc. 0 This land is under what ditch? _____
 14. How many acres of seeped land do you have which could be drained and put into production? 0
 15. What is the condition of your irrigation system? Good
 16. Is your water supply adequate? Yes _____ No ☒ Explain I have been
 17. REMARKS: Flood water from Trail Creek

Over

NOTE: The foregoing questions apply only to irrigated land shown on this plot.

DESCRIPTION AND MAP OF FARM

18. Legal Description of this Farm Secs. 1, 4, 9, 10, SE 1/4 NE 1/4, Sec 30



IRRIGATED LAND



NON-IRRIGATED LAND

North

see master Map
attached to this
group
operated by R. L. Rhea

West

South

Ownership given
only irrigated land.
All ownership for
dry land not shown.

19. If the above land is irrigated from more than one ditch please give the acreage under each ditch in 19A and indicate the location of the land irrigated from each on the above map.

19A. Ditch: Trail Creek flood Acres: 63.0

Ditch: _____ Acres: _____

Information supplied by:

Name See attached form Address _____ Date _____

REMARKS: _____

If you cannot answer all of the questions on this form answer as many as you can and return the form to us as soon as possible.

STATE ENGINEER'S OFFICE
WATER RESOURCES SURVEY

COUNTY Custer

FILE NO. 66-T.2N-R.45E

Owner Austin, John F. Address Garland, Montana

AAA Owner Address

Operator Rhea, R. L. Address Garland, Montana

New Owner Address

New Operator Address

Assessment Record Nana

Assessed Acreage 0

Legal Description of This Farm Lots 1, 4, 9, 10, SE¹NE⁴, Sec. 30;

Total Acres in Farm ✓

Code Number 30A,

Photo No. Ma-29-30, Ma-29-31

AAA Contract No.

AAA Total Cropland Acreage

App. No. 1903, 1934, 1950, 1957

Decree No. 2-3

Land is located in

Twp. 2N Rge. 45E Twp. Rge.

Twp. Rge. Twp. Rge.

Filed in Twp. 2N Rge. 45E

Remarks 310 also listed

field from land shown

by 2000

Tongue River Basin

Owning covers
only irrigated land.
All ownership for
dry land not shown.

*To be removed
with land shown
by R. L. Rhea*

*15.0
2.0
13.0
3.6*

Ownership covers
only irrigated land.
All ownership for
dry land not shown.

in 19A and

63.0

USGS 2000

Farm Checked

STATE OF MONTANA

FORM #1 - GAZETTE 1988-01-149

Oraland

STATE ENGINEER'S OFFICE
WATER RESOURCES SURVEY

Code No. 30431C

By Dave, Joe, Jim

County Custer

Area Tongue River

T. 2N R. 45E Sec. 30

Date 6/3/47

Photo No. MA-294304-31

Legal Land Owner Mc Austin

Address Kell, Iowa

Operator R. L. Rhea

Address Garland, Mont.

Water is delivered by:

Federal Project

Pres. Pot.

Ditch Company

Pres. Pot.

Irrigation District

Pres. Pot.

Private System ☒

Pres. R Pot. P

Totals

Flood ☒

Pump

Reservoir

Gravity

Size and Capacity, Pump, etc.

Original Appropriator, Company

App. No.

Original Appropriator, Private Thomas C. Bagby, E. J. Lamb
(Show date of appropriation under Remarks)

App. No. 1950, 1957

Is the system an extension of another system?

Yes No ☒

Is all land irrigated from one system?

Yes ☒ No ☒

(If No, show break down on map)

Source of Water Flood from Trail Crk. water from trail Crk is spread by use of old ditch, which is used as dikes.

Acres Irrigated 10.46 63

Potential Acres R Seeped D

Explain

Condition of System Fair flood sys.

Adequate Supply — Yes No ☒

Explain Supply adequate only during wet season depends on rain drainage from Trail Crk.

Topography T.R. Valley bottom

Information From R. L. Rhea

Remarks 1950-1952/50, 1957-7/5/95

1957 was for land in sec 16 & 18 R46E



NOTICE
These forms are the
property of the State
of Montana and must
be returned.

STATE OF MONTANA
STATE ENGINEERS OFFICE

Water Resources Survey

FORM WR-1-25 12-47

Code No. 31A
County Custer
T. 2N R. 45E

Name of Land Owner Ball Seacy Ranch Co. Address Miles City
Name of Operator R. L. Rhen Address Garland, Mont.

Part A

TO BE FILED BY THOSE OBTAINING IRRIGATION WATER FROM
A DITCH COMPANY OR IRRIGATION DISTRICT

1. Water is delivered by: _____ Name of Ditch, Ditch Company or District Supplying Water _____
2. State the number of acres you irrigate under this system _____ Shares you hold _____
3. If you obtain water from more than one Company, give the number of _____ res, acres irrigated and the name of the Company under "Remarks." If you obtain water from a Ditch Company and also have a private system fill in both Part A and Part B.

Part B

TO BE FILED BY THOSE WHO HAVE A PRIVATE DITCH, PUMP OR IRRIGATION SYSTEM
or those who have a private water right under a Ditch Company

4. In what year was this land first irrigated? Date See attached filings
5. Give the name of the original appropriator (first user): _____
6. Give the date appropriated _____ Amount filed on: Miners Inches _____ C. F. S. _____
7. State the total number of acres irrigated under this system: _____
8. Give the point of diversion: _____ $\frac{1}{4}$ _____ $\frac{1}{4}$ Section _____ Township _____ Range _____

Part C

TO BE FILED BY ALL WATER USERS IN ADDITION TO PART A OR PART B

9. Source of Water: Trail Creek
Name of stream or lake from which water is originally diverted _____
10. Water is obtained by: (Check one) Gravity ☒ Pumping _____ Other _____
11. What is the greatest number of acres you have irrigated? ? Date _____
12. How many acres did you irrigate in 1947? (Crop and pasture) 15.0
13. State the total number of additional acres that could be irrigated by increasing the water supply, land leveling, etc. 0 This land is under what ditch? _____
14. How many acres of seeped land do you have which could be drained and put into production? 0
15. What is the condition of your irrigation system? Poor
16. Is your water supply adequate? Yes _____ No ☒ Explain Flood Irr.
17. REMARKS: _____

Old ditch used as dyke

Over

2/A

15/25

R. 45E

27

d the name of
rate system fill

S.

age

ply, land level

2

NOTE: The foregoing questions apply only to irrigated land shown on this plat.

DESCRIPTION AND MAP OF FARM

18. Legal Description of this Farm Lot, 2, 3, 4, 5, & 6 Sec 31

T 2 N R 45 E



IRRIGATED LAND



NON-IRRIGATED LAND

North

West

East

South

*See master
map attached
showing all land
operated by R. L. Rhea*

Ownership covers
only irrigated land.
All ownership for
dry land not shown.

19. If the above land is irrigated from more than one ditch please give the acreage under each ditch in 19A and indicate the location of the land irrigated from each on the above map.

19A. Ditch: Trail Creek flood ditch Acres: 15.0

Ditch: _____ Acres: _____

Information supplied by:

Name Field Survey Address _____

Date 6/3-47

REMARKS: Johnson & Paulist
Information from Rhea.

If you cannot answer all of the questions on this form answer as many as you can and return the form to us as soon as possible.

STATE ENGINEER'S OFFICE
WATER RESOURCES SURVEY

Find Ownership

COUNTY CusterSeacy Ball Ranch Co. former owner FILE NO. 66-T.2N-R.15EOwner Unknown

Address

AAA Owner

Address

Operator Rhea, R. L.

Address

Garland, Montana

New Owner

Address

New Operator

Address

Assessment Record NoneAssessed Acreage 0Legal Description of This Farm lots 2, 3, 4, 5, & 6 Sec 31; T.2N-R.15ETotal Acres in Farm ✓Code Number 31APhoto No. MA-29-30

AAA Contract No.

AAA Total Cropland Acreage

App. No. 1929-1934-1993Decree No. 2

Land is located in

Twp. 2N Rge. 15E Twp. Rge.

Twp. Rge. Twp. Rge.

Filed in Twp. 2N Rge. 15E

Remarks

Notified after
land acquired by
R. L. Rhea

Tongue River Basin

Ownership covers
only irrigated land.
All ownership for
dry land not shown.



NOTICE
These forms are the
property of the State
of Montana and must
be returned.

STATE OF MONTANA
STATE ENGINEERS OFFICE
Water Resources Survey

FORM WR-1-2M 12-47

Code No. 328
County Custer
T. 2N R. 45

Name of Land Owner U.S.A. Address _____
Name of Operator E.L. Chea Address Garland, Mont.

Part A

TO BE FILED BY THOSE OBTAINING IRRIGATION WATER FROM
A DITCH COMPANY OR IRRIGATION DISTRICT

1. Water is delivered by: _____
Name of Ditch, Ditch Company or District Supplying Water
2. State the number of acres you irrigate under this system _____ Shares you hold _____
3. If you obtain water from more than one Company, give the number of shares, acres irrigated and the name of the Company under "Remarks." If you obtain water from a Ditch Company and also have a private system fill in both Part A and Part B.

Part B

TO BE FILED BY THOSE WHO HAVE A PRIVATE DITCH, PUMP OR IRRIGATION SYSTEM
or those who have a private water right under a Ditch Company

4. In what year was this land first irrigated? Date See attached filing
5. Give the name of the original appropriator (first user): _____
6. Give the date appropriated _____ Amount filed on: Miners Inches _____ C. F. S. _____
7. State the total number of acres irrigated under this system: _____
8. Give the point of diversion: _____ $\frac{1}{4}$ _____ $\frac{1}{4}$ Section _____ Township _____ Range _____

Part C

TO BE FILED BY ALL WATER USERS IN ADDITION TO PART A OR PART B

9. Source of Water: Liscomb Creek
Name of stream or lake from which water is originally diverted
10. Water is obtained by: (Check one) Gravity ☒ Pumping _____ Other _____
11. What is the greatest number of acres you have irrigated? 7 Date _____
12. w many acres did you irrigate in 1947 (Crop and pasture) 3.0
13. S e the total number of additional acres that could be irrigated by increasing the water supply, land leveling, etc. 0 This land is under what ditch? 0
14. How many acres of seeped land do you have which could be drained and put into production? _____
15. What is the condition of your irrigation system? Fair
16. Is your water supply adequate? Yes _____ No ☒ Explain I had no
17. REMARKS: Water spread by dykes from Liscomb Creek when water is available

Over

NOTE: The foregoing questions apply only to irrigated land shown on this plat.

DESCRIPTION AND MAP OF FARM

18. Legal Description of this Farm

NW 1/4 ME 4, Sec 32

T 2 N R 45 E



IRRIGATED LAND



NON-IRRIGATED LAND

North

*See Master
map attached*

West

East

South

Ownership covers
only irrigated land.
All ownership for
dry land not shown.

19. If the above land is irrigated from more than one ditch please give the acreage under each ditch in 19A and indicate the location of the land irrigated from each on the above map.

19A. Ditch:

Liscom Creek flood line

Acres:

3.0

Ditch:

Acres:

Information supplied by:

Name

R. L. Rhea

Address

Date

6/3/47

REMARKS:

*to field survey party
Paulist & Co.*

If you cannot answer all of the questions on this form answer as many as you can and return the form to us as soon as possible.

STATE ENGINEER'S OFFICE
WATER RESOURCES SURVEYCOUNTY CusterFILE NO. 66-T.2N-R.45EOwner U. S. A. Address Miles City, Mont.

AAA Owner Address

Operator Rhea, R. L. Address Garland, Mont.

New Owner Address

New Operator Address

Assessment Record NoneAssessed Acreage 0Legal Description of This Farm NW 4 NE 4 Sec. 32; T. 2N-R. 45ETotal Acres in Farm ✓Code Number 32BPhoto No. Ma-29-30

AAA Contract No.

AAA Total Cropland Acreage

App. No. 1003

Decree No.

Land is located in

Twp. 2N Rge. 45E Twp. Rge.

Twp. Rge. Twp. Rge.

Filed in Twp. 2N Rge. 45ERemarks This land ispartially leased byR. L. Rhea

*Should be mapped
with Gladys Coleman
land operated by
R. L. Rhea*

Tongue River Basin

Ownership - co. 25
only irrigated land.
All ownership for
dry land not shown.



NOTICE
These forms are the
property of the State
of Montana and must
be returned.

STATE OF MONTANA
STATE ENGINEERS OFFICE

Water Resources Survey

FORM WR-1-2M 12-27

Code No. 9A-10A

County Butter

T. 2N R. 45E

Name of Land Owner Sherman Chayum Address Barland, Mont.

Name of Operator _____ Address _____

Part A

**TO BE FILED BY THOSE OBTAINING IRRIGATION WATER FROM
A DITCH COMPANY OR IRRIGATION DISTRICT**

1. Water is delivered by: 5-H ditch not incorporated
Name of Ditch, Ditch Company or District supplying Water
2. State the number of acres you irrigate under this system _____ Shares you hold _____
3. If you obtain water from more than one Company, give the number of shares, acres irrigated and the name of the Company under "Remarks." If you obtain water from a Ditch Company and also have a private system fill in both Part A and Part B.

Part B

**TO BE FILED BY THOSE WHO HAVE A PRIVATE DITCH, PUMP OR IRRIGATION SYSTEM
or those who have a private water right under a Ditch Company**

4. In what year was this land first irrigated? Date No date
5. Give the name of the original appropriator (first user): (see attached letter)
6. Give the date appropriated _____ Amount filed on: Miners Inches _____ C. F. S. _____
7. State the total number of acres irrigated under this system: _____
8. Give the point of diversion: _____ $\frac{1}{4}$ _____ $\frac{1}{4}$ Section _____ Township _____ Range _____

Part C

TO BE FILED BY ALL WATER USERS IN ADDITION TO PART A OR PART B

9. Source of Water: Tongue River & flood from Coal Cr.
Name of stream or lake from which water is originally diverted
10. Water is obtained by: (Check one) Gravity ☒ Pumping ☒ Other _____
11. What is the greatest number of acres you have irrigated? ? Date _____
12. How many acres did you irrigate in 1948 (Crop and pasture) 112.0
13. State the total number of additional acres that could be irrigated by increasing the water supply, land leveling, etc. 0 This land is under what ditch? _____
14. How many acres of seeped land do you have which could be drained and put into production? 0
15. What is the condition of your irrigation system? Good
16. Is your water supply adequate? Yes _____ No ☒ Explain _____
17. REMARKS: _____

NOTE: The foregoing questions apply only to irrigated land shown on this plat.

DESCRIPTION AND MAP OF FARM

18. Legal Description of this Farm all of Sec. 9, W²N⁴W⁴, S²E⁴N⁴W⁴,
W²S⁴W⁴, NE⁴S⁴W⁴, Sec. 10, T2N R45E



IRRIGATED LAND



NON-IRRIGATED LAND

North

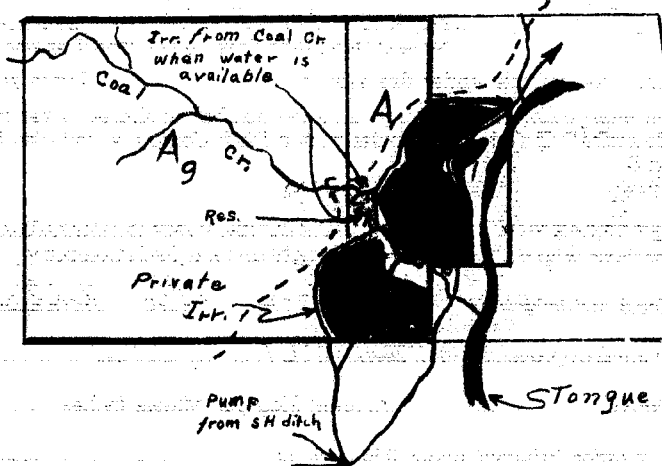

West

East

South

Ownership covers
only irrigated land.
All ownership for
dry land not shown.

19. If the above land is irrigated from more than one ditch please give the acreage under each ditch in 19A and indicate the location of the land irrigated from each on the above map.

19A. Ditch: S-H ditch (Chester Pump) Acres: 112.0

Ditch: _____ Acres: _____

Information supplied by:

Name See attached form Address _____ Date 6/3/47

REMARKS: Uses water from S-H ditch as possibly
right would be the same as S-H ditch
as long as agreeable to both parties

If you cannot answer all of the questions on this form answer as many as you can and return the form to us as soon as possible.

STATE ENGINEER'S OFFICE
WATER RESOURCES SURVEYCOUNTY CusterFILE NO. 66-T.2N-R.95EOwner Chezum, Sherman Address Garland, Montana

AAA Owner _____ Address _____

Operator " " Address _____New Owner _____ Address " "

New Operator _____ Address _____

Assessment Record NoneAssessed Acreage 0Legal Description of This Farm all of Sec. 9; W²NW⁴, SE⁴NW⁴, W²SW⁴, NE⁴SW⁴Sec. 10; T.2N-R.95ETotal Acres in Farm ✓Code Number 9A, 10APhoto No. Ma-29-56

AAA Contract No. _____

AAA Total Cropland Acreage _____

App. No. No Record by Discript

Decree No. _____

Land is located in

Twp. 2N Rge. 15E Twp. _____ Rge. _____

Twp. _____ Rge. _____ Twp. _____ Rge. _____

Filed in Twp. 2N Rge. 15E

Remarks _____

*See Map
on WR*Deposits cover
only irrigated land.
All ownership for
dry land not shown.

Tongue River Basin

Farm Checked

STATE OF MONTANA

Code No. 59, 89, 90, 100, 60By Dave, Joe, Jim

STATE ENGINEER'S OFFICE

County CusterArea Tongue River

WATER RESOURCES SURVEY

T. 2N R. 45E Sec. 9 & 10Date 6/3/47Photo No. MA 29-56Legal Land Owner Chezum, ShermanAddress Garland, MontOperator Same

Address

Water is delivered by:

Federal Project

Pres.

Pot.

Ditch Company

Pres.

Pot.

Irrigation District

Pres.

Pot.

Private System ☒

Pres.

Pot.

Totals

Flood ☒Pump ☒

Reservoir

Gravity

Size and capacity, Pump, etc. Winch Centrifugal, Tractor power, no lift (takes water from St ditch)

Original Appropriator, Company

App. No.

Original Appropriator, Private ☒ No App. shown from Coal Cr.
(Show the date of appropriation under Remarks)

App. No.

Is the system an extension of another system?

Yes ☒ No

Is all land irrigated from one system?

Yes No ☒

(If No, show break down on map)

Source of Water SH ditch from Tongue River, and Flood from Coal Crk.

Planim

Acres Irrigated 19.46

P

Potential Acres

Seeped 0

Explain

Condition of System Good

Adequate Supply

Yes ☒No ☒Explain Pump supplements flood from Coal CrkTopography Valley bottomInformation From R. L. Rhea

Remarks

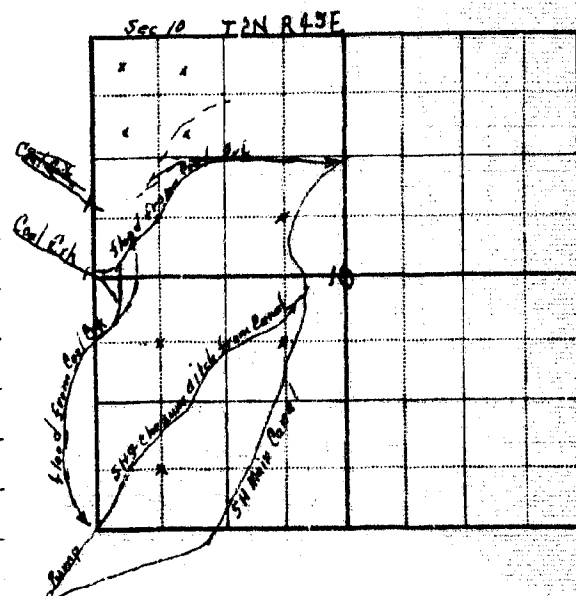

11-1-47

10A, 6A

56.8
Sec. 9 & 10

-56

Mont

Pot.

Pot.

Pot.

Pot.

H ditch)

Chezum has dam in Pool Creek which irr. land in wet seasons. He also uses water taken from SH ditch by pump. He pays for water by granting SH Canal right-of-way thru his land and by helping maintain ^{Canal} ditch on his land.

GEORGE W. FARR
ROLAND V. COLGROVE

FARR AND COLGROVE
ATTORNEYS AND COUNSELORS AT LAW
SUITES 4-6
JACKSON-ARNOLD BLOCK
MILES CITY, MONTANA

March 4, 1948

Mr. G. J. Oravetz,
Assistant State Engineer,
P. O. Box 873
Billings, Montana.

Dear Sir:

Re: Flood Irrigation Coal Creek

Mr. Sherman Chezum, ~~who~~ requested us to acknowledge your letter of February 12, 1948, with reference to your investigation of water rights in Custer County.

The records of Custer County discloses that a water right was filed on the following described property on May 16, 1897 by Horton Brothers: Section 10, Township 2 North, Range 45 East. We are unable to determine whether or not the records of Custer County have a recorded filing for the following described property: Sec. 9, W $\frac{1}{2}$ NW $\frac{1}{2}$, SE $\frac{1}{2}$ NW $\frac{1}{2}$, W $\frac{1}{2}$ SW $\frac{1}{2}$, NE $\frac{1}{2}$ SW $\frac{1}{2}$ Township 2 North, Range 45 East.

However, we are informed that a water right has long been established by continued use. It is our understanding that this use antedates the year 1911. It is hoped that this is the information you require.

Yours very truly,

FARR & COLGROVE

By *Roland V. Colgrove*

RVC:cm



NOTICE
These forms are the
property of the State
of Montana and must
be returned.

STATE OF MONTANA
STATE ENGINEERS OFFICE

Water Resources Survey

FORM WR-1-2N 12-47
1A-2A-10B-11A-12B
Code No. 15A

County Custer

T. 2N R. 45

Name of Land Owner Love & Hines Address 5-H Ranch Miles City - Billings
Name of Operator _____ Address _____

Part A

TO BE FILED BY THOSE OBTAINING IRRIGATION WATER FROM
A DITCH COMPANY OR IRRIGATION DISTRICT

1. Water is delivered by: _____ Name of Ditch, Ditch Company or District Supplying Water _____
2. State the number of acres you irrigate under this system _____ Shares you hold _____
3. If you obtain water from more than one Company, give the number of shares, acres irrigated and the name of the Company under "Remarks." If you obtain water from a Ditch Company and also have a private system fill in Part A and Part B.

Part B

TO BE FILED BY THOSE WHO HAVE A PRIVATE DITCH, PUMP OR IRRIGATION SYSTEM
or those who have a private water right under a Ditch Company

4. In what year was this land first irrigated? Date See attached filings & Deeds
5. Give the name of the original appropriator (first user): _____
6. Give the date appropriated _____ Amount filed on: Miners Inches _____ C. F. S. _____
7. State the total number of acres irrigated under this system: _____
8. Give the point of diversion: _____ $\frac{1}{4}$ Section _____ Township _____ Range _____

Part C

TO BE FILED BY ALL WATER USERS IN ADDITION TO PART A OR PART B

9. Source of Water: Tongue River Name of stream or lake from which water is originally diverted
10. Water is obtained by: (Check one) Gravity ☒ Pumping ☒ Other _____
11. What is the greatest number of acres you have irrigated? _____ Date _____
12. How many acres did you irrigate in 1947? (Crop and pasture) 482.0
13. State the total number of additional acres that could be irrigated by increasing the water supply, land leveling, etc. 160 This land is under what ditch? 5-H ditch
14. How many acres of seeped land do you have which could be drained and put into production? 0
15. What is the condition of your irrigation system? Good
16. Is your water supply adequate? Yes ☒ No _____ Explain _____
17. REMARKS: See attached form

Over

WA-1-2M 12-47
3-11A-120
A

the name of
the system fill

the name of
the system fill

the name of
the system fill

the name of
the system fill

the name of
the system fill

the name of
the system fill

the name of
the system fill

the name of
the system fill

the name of
the system fill

the name of
the system fill

the name of
the system fill

NOTE: The foregoing questions apply only to irrigated land shown on this plat.

DESCRIPTION AND MAP OF FARM

18. Legal Description of this Farm

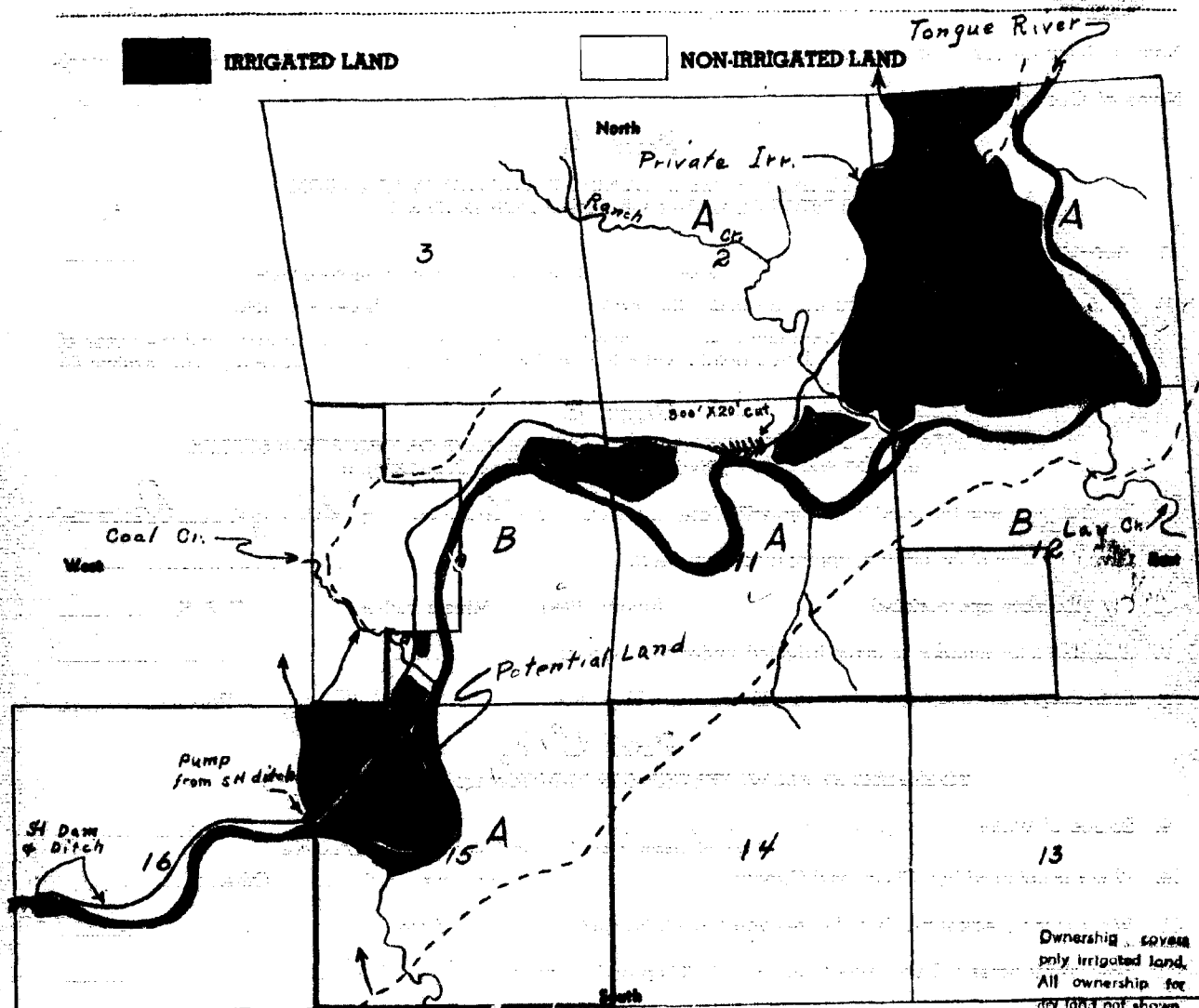

19. If the above land is irrigated from more than one ditch please give the acreage under each ditch in 19A and indicate the location of the land irrigated from each on the above map.

19A. Ditch: S-H ditch Acres: 482.0

Ditch: _____ Acres: _____

Information supplied by:

Name See signed form Address _____ Date _____

REMARKS: Field survey

If you cannot answer all of the questions on this form answer as many as you can and return the form to us as soon as possible.

STATE ENGINEER'S OFFICE
WATER RESOURCES SURVEYCOUNTY ClusterFILE NO. 66-T.2N-R.45EOwner Love & Hines, S-H Ranch Address Miles City - Billings,

AAA Owner _____ Address _____

Operator _____ Address _____

New Owner _____ Address _____

New Operator _____ Address _____

Assessment Record yes

Sec. 1 - 516.0 Ac.

Sec. 2 - 17.0 Ac.

Sec. 10 - 28.0 Ac.

Assessed Acreage Sec. 11 - 51.0 Ac.

Legal Description of This Farm all of Sections 12, 11, 15, lots 1-2-3-7, lot 6 less 2.00S²SE⁴, NE⁴SE⁴, N²NE⁴, NE⁴NW⁴, Section 10; N², SE⁴, Sec. 12;T.2N-R.45ETotal Acres in Farm ✓Code Number 1A, 2A, 10B, 11A, 12B, 15APhoto No. Ma-29-56; Ma-29-57

AAA Contract No. _____

AAA Total Cropland Acreage _____

App. No. 19263, 1917Decree No. 40

Land is located in

Twp. 2N Rge. 15E Twp. 3N Rge. 15ETwp. 3N Rge. 16E Twp. _____ Rge. _____Filed in Twp. 2N Rge. 15ERemarks Possibly leasedsome State of Montanaland; 16.0 in T.2N-R.45E.

Tongue River Basin

Ownership, assess
only irrigated land.
All ownership for
dry land not shown.

Farm Checked

STATE OF MONTANA

Code No. _____

By Dave, Joe, Jim

STATE ENGINEER'S OFFICE

County CusterArea Tongue

WATER RESOURCES SURVEY

T₃N 45E 300. 12, 9, 10, 11, 12, 15, 16
R. 46E 200. 25, 26
Sec. 22, 20Date 6/8/47Photo No. NA39-68, 66, 67Legal Land Owner Love & Hines St (formerly Dunn)Address Mill City, BillingsOperator Same

Address _____

Water is delivered by:

Federal Project _____ Pres. _____ Pot. _____
 Ditch Company _____ Pres. _____ Pot. _____
 Irrigation District _____ Pres. _____ Pot. _____
 Private System ✓ Closes under ditch system Pres. 1335 Pot. Plan.

Totals _____

Flood _____ Pump ✓ concrete dam _____ Reservoir ✓ Gravity ✓

Size and Capacity, Pump, etc. 6" cont. no lift, tractor power, concrete dam on Tongue
See other side

Original Appropriator, Company _____ App. No. _____

Original Appropriator, Private T. W. Crouch App. No. 1917, D-40
(Show date of appropriation under Remarks)Is the system an extension of another system? Yes _____ No ✓Is all land irrigated from one system? Yes ✓ No _____

(If No, show break down on map)

Source of Water Tongue River

974
Chin figure 1905 present 299 potential
50 acres more cleared +
 Acres Irrigated 19 46 1285 (irrigated in '47 - Total 1335)

Potential Acres Plan. m. Seeped 0

Explain _____

Condition of System GoodAdequate Supply Yes ✓ No _____

Explain _____

Topography BottomInformation From R. L. Rea. (319.)Remarks 1917, Dec. 10, 1900

974.0
We found 1285 irrigated in 47
with 299, potential (see other side)

COPY

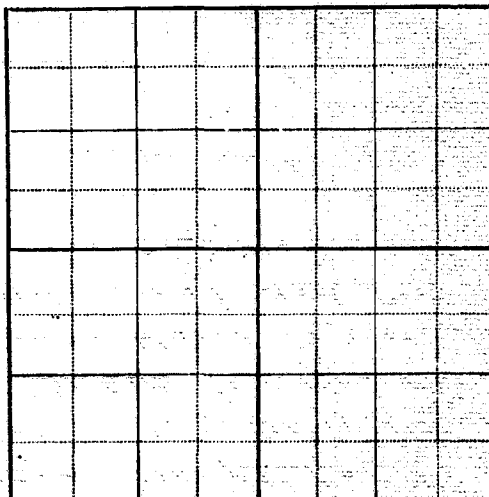
also filed in 3N-46E
3N-46E

irr. by grav. from dam in Tongue except for 50
A. piece irr. by pump from canal. Very little lift
required. Pump also used by Chezum to supplement
flood irr. on some of his land. Water is given to
him for right of way of Main Canal and for
helping to maintain canal on his land

In 1947 we found 974 irrigated with 299.0
potential making a maximum of 1273 under
S. H. ditch with present works, Ben says
there are 1335 acres under the ditch system

8/5/65
Sid Tietema

MSU - Ept 331

Called and wanted info. on
S-H Ranch and Dam.

Decree April, 1914 Case # 2809
gave Tongue River Irrigation
Co. 1781 miners inches
(must be S-H Ranch)

Water Board sells S-H Ranch
413.8 ac-ft on an annual
basis (no contracts).

DWR records show that
974 acres were irrigated in 1947.

Water Board charges are currently
 $\$1.30 + .42 (O+M) = \underline{\$1.72}$ ac-ft

EVD

7/15/63
Mr. Jerry Houghton, General Carter Hotel,
Billings (Ph. 245-5174), Room 504, called and
asked for the water rights and the buying of
water on Tongue River, T-2N, R-45E, S-16
and the S+H Dams. He said John Clay & Co. or
Matthews owned it. (Approx. 3,000 acres involved).

We informed Mr. Houghton that the S+H
Bench is owned by Mrs. John Wapcy, Pres.
Miles City State Bank but Mr. West is now
buying it. ^(4/15/14) On 7/20/1914 a decree was established
which granted the S+H Bench 1781 miners
inches of water under the 24th right on Tongue River
(Case No. 2809 - Tongue River Irrigation Co.) but
no water is usually available after the 2nd right.
The S+H Bench also has a right to 10,000
miners inches of flood water on Bench Creek.
Therefore, the S+H Bench has very poor surface
water rights. Mrs. Wapcy has been buying annually
400+ A.F. of water from the State Water Board
and irrigating about 2,000 acres of land (taking
water as needed). The Water Board wants
to sell a lot more water on a long term contract
at \$1.55/A.F.

END



NOTICE
These forms are the
property of the State
of Montana and must
be returned.

STATE OF MONTANA
STATE ENGINEERS OFFICE

Water Resources Survey

FORM WR-1—2M 12-47
Code No. 17A-20A
County Custer
T. 2N R. 45

Name of Land Owner J. E. Mahoney Address Barland, Mont
Name of Operator _____ Address _____

Part A

TO BE FILED BY THOSE OBTAINING IRRIGATION WATER FROM
A DITCH COMPANY OR IRRIGATION DISTRICT

1. Water is delivered by: _____
Name of Ditch, Ditch Company or District Supplying Water
2. State the number of acres you irrigate under this system _____ Shares you hold _____
3. If you obtain water from more than one Company, give the number of shares, acres irrigated and the name of the Company under "Remarks." If you obtain water from a Ditch Company and also have a private system fill in both Part A and Part B.

Part B

TO BE FILED BY THOSE WHO HAVE A PRIVATE DITCH, PUMP OR IRRIGATION SYSTEM
or those who have a private water right under a Ditch Company

4. In what year was this land first irrigated? Date See attached filings
5. Give the name of the original appropriator (first user): _____
6. Give the date appropriated _____ Amount filed on: Miners Inches _____ C. F. S. _____
7. State the total number of acres irrigated under this system: _____
8. Give the point of diversion: _____ $\frac{1}{4}$ _____ $\frac{1}{4}$ Section _____ Township _____ Range _____

Part C

TO BE FILED BY ALL WATER USERS IN ADDITION TO PART A OR PART B

9. Source of Water: Tongue River
Name of stream or lake from which water is originally diverted
10. Water is obtained by: (Check one) Gravity _____ Pumping ☒ Other _____
11. What is the greatest number of acres you have irrigated? 620 Date _____
12. How many acres did you irrigate in 1947? (Crop and pasture) 0
13. State the total number of additional acres that could be irrigated by increasing the water supply, land leveling, etc. 0 This land is under what ditch? _____
14. How many acres of seeped land do you have which could be drained and put into production? 0
15. What is the condition of your irrigation system? Run down
16. Is your water supply adequate? Yes ☒ No _____ Explain _____
17. REMARKS: _____

NOTE: The foregoing questions apply only to irrigated land shown on this plat.

DESCRIPTION AND MAP OF FARM

18. Legal Description of this Farm

*All of Sec. 17, Lots 2, 3, 4, & 8
NW 1/4 NW 1/4, Sec. 20, 2 N 45 E*



None at present
IRRIGATED LAND



NON-IRRIGATED LAND

North

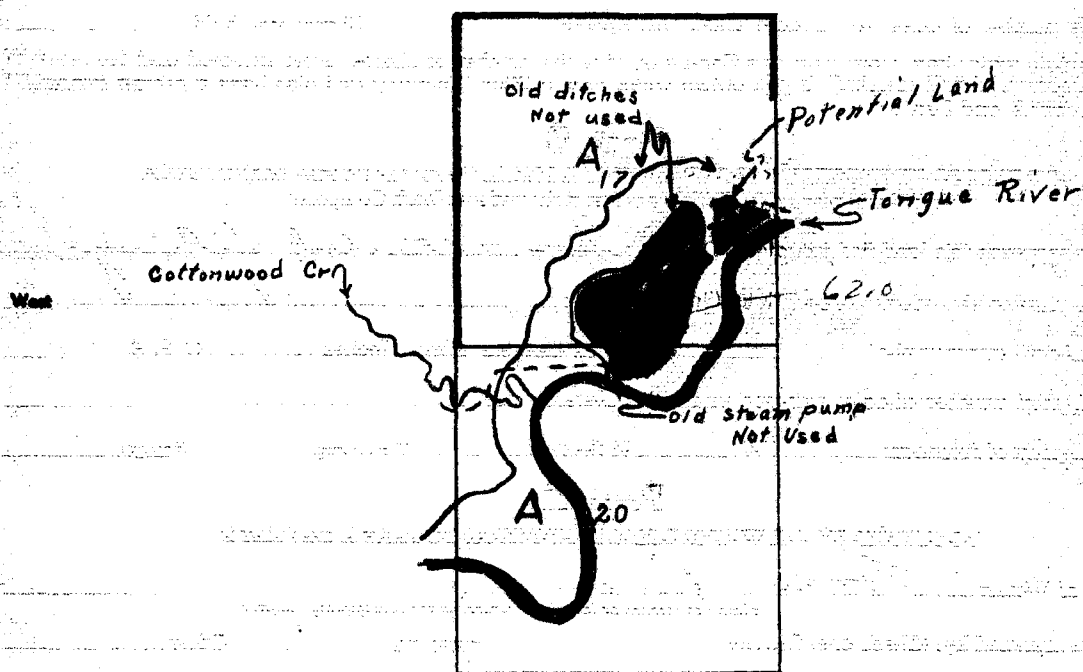

Ownership covers
only irrigated land.
All ownership for
dry land not shown.

South

19. If the above land is irrigated from more than one ditch please give the acreage under each ditch in 19A and indicate the location of the land irrigated from each on the above map.

19A. Ditch:

Mahoney Pump Ditch

Acre: *0*

Ditch:

Acre: *0*

Information supplied by:

Name

See attached form

Address

Date

REMARKS:

If you cannot answer all of the questions on this form answer as many as you can and return the form to us as soon as possible.

STATE ENGINEER'S OFFICE
WATER RESOURCES SURVEYCOUNTY CusterFILE NO. 66-TOwner Mahoney, J.E.Address Garland, Montana

AAA Owner

Address

Operator

Address

New Owner

Address

New Operator

Address

Assessment Record NoneAssessed Acreage 0Legal Description of This Farm all of Sec. 17, lots 2, 3, 4 & 8, NW "NW", Sec. 20,
T. 2N-R. 95ETotal Acres in Farm ✓Code Number 17A, 20APhoto No. MA-29-31

AAA Contract No.

AAA Total Cropland Acreage

App. No. 1903, 1924, 1932, 1934

Decree No.

Land is located in

Twp. 2N Rge. 95E Twp. Rge.

Twp. Rge. Twp. Rge.

Filed in Twp. 2N Rge. 95E

Remarks

Tongue River BasinOwnership covers
only irrigated land.
All ownership for
dry land not shown.

Farm Checked

By Dave, Joe, Jim

Area Tongue River

Date 4/3/47

Legal Land Owner Mr. Mahoney

Operator Same

Water is delivered by:

Federal Project _____ Pres. _____ Pot. _____

Ditch Company _____ Pres. _____ Pot. _____

Irrigation District _____ Pres. _____ Pot. _____

Private System ☒ _____ Pres. ☒ Pot. ☒

Totals _____

Flood ☒ Pump ☒ Reservoir _____ Gravity _____

Size and Capacity, Pump, etc. details on pump not known, system not used about 30 years

Original Appropriator, Company _____ App. No. _____

Original Appropriator, Private F. J. Lamb, George Miles
(Show date of appropriation under Remarks) App. No. _____

Is the system an extension of another system? Yes _____ No ☒

Is all land irrigated from one system? Yes ☒ No _____

(If No, show break down on map)

Source of Water Mr. Mahoney River

Acres Irrigated 10 46 _____

Potential Acres ? _____ Seeped 0 _____

Explain _____

Condition of System Rud. down

Adequate Supply — Yes ☒ No _____

Explain out of Tongue River

Topography valley bottom

Information From Mr. Mahoney

Remarks _____

FORM F-1 - GAZETTE 1968-24-1-47

Code No. 7A, 16B, 17A, 18A, 20A

County Custer

T. 2N R. 45E Sec. 7, 16, 17, 19, 20

Photo No. MA-29.31+57

Address Garland Mont

Address _____

Sec. 20;

ownership covers
irrigated land,
ownership for
and not shown.

17A, 17B, 20A

Sec. 7, 16, 17, 19, 20

157

int

years

System not used since before 1917 when
Mr. Mahoney first came. He doesn't seem to intend
to repair and use it or all.



NOTICE
These forms are the
property of the State
of Montana and must
be returned.

STATE OF MONTANA
STATE ENGINEERS OFFICE
Water Resources Survey

FORM WR-1—AM 12-47

Code No. 16 C
County Butte
T. 2 N R. 45

Name of Land Owner State of Montana Address Helena, Mont.
Name of Operator _____ Address _____

Part A

TO BE FILED BY THOSE OBTAINING IRRIGATION WATER FROM
A DITCH COMPANY OR IRRIGATION DISTRICT

1. Water is delivered by: _____ Name of Ditch, Ditch Company or District Supplying Water _____ Shares you hold _____
2. State the number of acres you irrigate under this system _____
3. If you obtain water from more than one Company, give the number of shares, acres irrigated and the name of the Company under "Remarks." If you obtain water from a Ditch Company and also have a private system fill in both Part A and Part B.

Part B

TO BE FILED BY THOSE WHO HAVE A PRIVATE DITCH, PUMP OR IRRIGATION SYSTEM
or those who have a private water right under a Ditch Company

4. In what year was this land first irrigated? Date See attached filing
5. Give the name of the original appropriator (first user): _____
6. Give the date appropriated _____ Amount filed on: Miners Inches _____ C. F. S. _____
7. State the total number of acres irrigated under this system: _____
8. Give the point of diversion: _____ $\frac{1}{4}$ _____ $\frac{1}{2}$ Section _____ Township _____ Range _____

Part C

TO BE FILED BY ALL WATER USERS IN ADDITION TO PART A OR PART B

9. Source of Water: Tongue River Name of stream or lake from which water is originally diverted _____
10. Water is obtained by: (Check one) Gravity ☒ Pumping ☒ Other _____
11. What is the greatest number of acres you have irrigated? _____ Date _____
12. How many acres did you irrigate in 1947? (Crop and pasture) 0
13. State the total number of additional acres that could be irrigated by increasing the water supply, land leveling, etc. 5.0 This land is under what ditch? S-H pump ditch
14. How many acres of seeped land do you have which could be drained and put into production? _____
15. What is the condition of your irrigation system? _____
16. Is your water supply adequate? Yes ☒ No _____ Explain _____
17. REMARKS: Water is pumped from S-H ditch to Sherman Cheyenne land, water council in ditch across state land patented Sherman and Lane + Hines from Hines

16. c
R. 45

and the name of
ivate system fill

EM

F. S.

large

upply, land level

?

ditch
canal
canal

NOTE: The foregoing questions apply only to irrigated land shown on this plot.

DESCRIPTION AND MAP OF FARM

18. Legal Description of this Farm LOTS 1, 2, 3, 4, 5, 7, N² NE⁴, S² SE⁴, SW⁴ SE⁴ Sec 16, 2 N, R 45 E

☐ None at Present
IRRIGATED LAND

☐ NON-IRRIGATED LAND

North

West

East

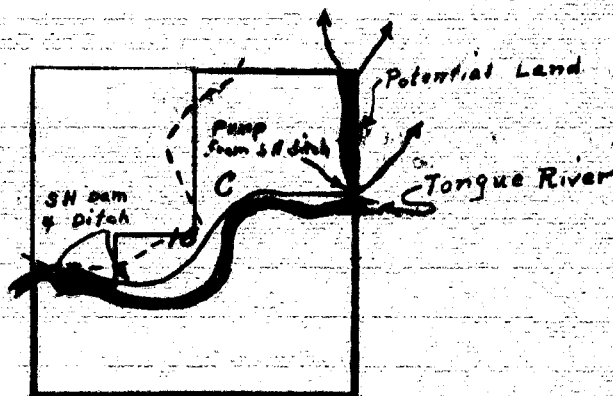

South

Ownership, extent
only irrigated land.
All ownership for
dry land not shown.

19. If the above land is irrigated from more than one ditch please give the acreage under each ditch in 19A and indicate the location of the land irrigated from each on the above map.

19A. Ditch: S-H. Pump ditch Acres: 0
Ditch: _____ Acres: _____

Information supplied by:

Name Joe - Dave - June Address _____ Date 6/3/47

REMARKS:

As Love & Hines operate this state land potential shown on their form

If you cannot answer all of the questions on this form answer as many as you can and return the form to us as soon as possible.

STATE ENGINEER'S OFFICE
WATER RESOURCES SURVEYCOUNTY ClusterFILE NO. 66-T.2N-R.45EOwner Montana, State ofAddress Helena, Montana

AAA Owner

Address

Operator Love & Hines - S.H. RanchAddress Miles City - Billings

New Owner

Address

New Operator

Address

Assessment Record NoneAssessed Acreage 0Legal Description of This Farm lots 1, 2, 3, 4, 5, 7, N¹NE¹, S¹SW¹, E¹SE¹,
SW¹SE¹, Sec 16, T.2N-R.45ETotal Acres in Farm ✓Code Number 16CPhoto No. Ma-29-57

AAA Contract No.

AAA Total Cropland Acreage

App. No. 353; 1923; 1931; 1932;

Decree No.

Land is located in

Twp. 2N Rge. 15E Twp. Rge.

rp. Rge. Twp. Rge.

Filed in Twp. 2N Rge. 15ERemarks This land is probablyleased by S.H. Ranch -Love & HinesTongue River Basin

Continued in
Love & Hines S.H. Ranch
ownership although this
land is owned by State
of Montana

Ownership covers
only irrigated land.
All ownership for
dry land not shown.Ownership covers
only irrigated land.
All ownership for
dry land not shown.

ditch in 19A and

Acres 0

Acres

6/3/47land

Return to us as soon



NOTICE
These forms are the
property of the State
of Montana and must
be returned.

STATE OF MONTANA
STATE ENGINEERS OFFICE
Water Resources Survey

FORM WM-1-28 12-47
Code No. 28B
County Butte
T. 2N R. 45E

Name of Land Owner Harold F. Pope Address Garland, Mont.
Name of Operator _____ Address _____

Part A

**TO BE FILED BY THOSE OBTAINING IRRIGATION WATER FROM
A DITCH COMPANY OR IRRIGATION DISTRICT**

1. Water is delivered by: _____ Name of Ditch, Ditch Company or District Supplying Water _____
2. State the number of acres you irrigate under this system _____ Shares you hold _____
3. If you obtain water from more than one Company, give the number of shares, acres irrigated and the name of the Company under "Remarks." If you obtain water from a Ditch Company and also have a private system fill in both Part A and Part B.

Part B

**TO BE FILED BY THOSE WHO HAVE A PRIVATE DITCH, PUMP OR IRRIGATION SYSTEM
or those who have a private water right under a Ditch Company**

4. In what year was this land first irrigated? Date See attached filings
5. Give the name of the original appropriator (first user): _____
6. Give the date appropriated _____ Amount filed on: Miners Inches _____ C. F. S. _____
7. State the total number of acres irrigated under this system: _____
8. Give the point of diversion: _____ $\frac{1}{4}$ _____ $\frac{1}{4}$ Section _____ Township _____ Range _____

Part C

TO BE FILED BY ALL WATER USERS IN ADDITION TO PART A OR PART B

9. Source of Water: Garden Creek (Trib. to Tongue)
Name of stream or lake from which water is originally diverted
10. Water is obtained by: (Check one) Gravity _____ Pumping _____ Other _____
11. What is the greatest number of acres you have irrigated? 55.0 Date 0
12. How many acres did you irrigate in 1947? (Crop and pasture) 0
13. State the total number of additional acres that could be irrigated by increasing the water supply, land leveling, etc. 55.0 This land is under what ditch? Head Irr.
14. How many acres of seeped land do you have which could be drained and put into production? _____
15. What is the condition of your irrigation system? Not in use
16. Is your water supply adequate? Yes _____ No X Explain Head Irr.
17. REMARKS: _____

NOTE: The foregoing questions apply only to irrigated land shown on this plat.

DESCRIPTION AND MAP OF FARM

18. Legal Description of this Farm

NW 1/4, S 2 NE 4, 8², Sec 28

T 2 N - R 45 E



None at Present
IRRIGATED LAND



NON-IRRIGATED LAND

North

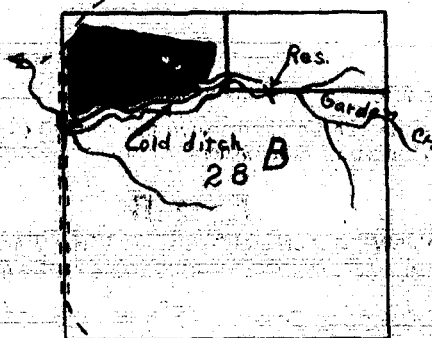

West

East

South

Ownership covers
only irrigated land.
All ownership for
dry land not shown.

19. If the above land is irrigated from more than one ditch please give the acreage under each ditch in 19A and indicate the location of the land irrigated from each on the above map.

19A. Ditch:

Garden Creek flood

Acre: 0

Ditch:

Acre:

Information supplied by:

Name

See attached form

Address

Date

REMARKS:

If you cannot answer all of the questions on this form answer as many as you can and return the form to us as soon as possible.

STATE ENGINEER'S OFFICE
WATER RESOURCES SURVEY

COUNTY Custer

FILE NO. 66-T-2N-R-45E

Owner Pope, Harold F. Address Garland, Montana

AAA Owner _____ Address _____

Operator " " Address " "

New Owner _____ Address _____

New Operator _____ Address _____

Assessment Record None

Assessed Acreage 0

Legal Description of This Farm NW 4, S 2 NE 4, S 2, Sec 28; T. 2N-R. 45E

Total Acres in Farm ✓

Code Number 28B

Photo No. Ma-29-58

AAA Contract No. _____

AAA Total Cropland Acreage _____

App. No. 739, 740, 1003, 741

Decrees No. _____

Land is located in _____

Twp. 2N Rge. 15E Twp. _____ Rge. _____

Twp. _____ Rge. _____ Twp. _____ Rge. _____

Filed in Twp. 2N Rge. 15

Remarks _____

Tongue River Basin

Ownership covers
only irrigated land.
All ownership for
dry land not shown.

Farm Checked

STATE OF MONTANA

Code No. 28BBy Joe, Dave, Jim

STATE ENGINEER'S OFFICE

County CusterArea Tongue River

WATER RESOURCES SURVEY

T. 2N R. 45E Sec. 28Date 6/4/67Photo No. MA-2958Legal Land Owner Pope, Harold F.Address Garland, Mont.Operator Samp

Address

Water is delivered by:

Federal Project	Pres	Pot
Ditch Company	Pres	Pot
Irrigation District	Pres	Pot
Private System <input checked="" type="checkbox"/>	Pres <input checked="" type="checkbox"/>	Pot <u>Plan</u>
Totals		

Flood <input checked="" type="checkbox"/>	Pump	Reservoir <input checked="" type="checkbox"/>	Gravity
---	------	---	---------

Size and Capacity, Pump, etc. ☒

Original Appropriator, Company App. No.

Original Appropriator, Private John Howard, Francis Pope, Lucy Pope App. No. 737, 740, 741
(Show date of appropriation under Remarks)Is the system an extension of another system? Yes No ☒Is all land irrigated from one system? Yes ☒ No

(If No, show break down on map)

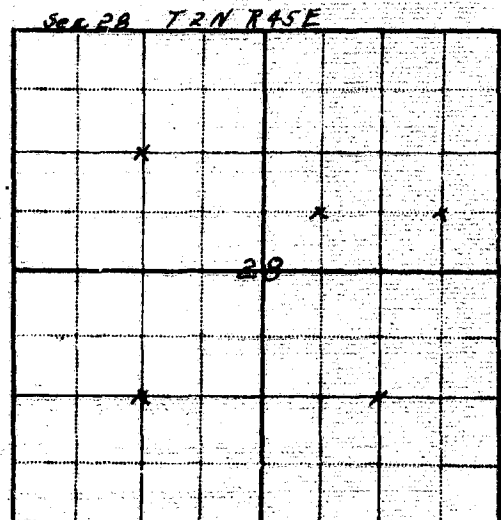
Source of Water Dam & Flood from GardenAcres Irrigated 18 47 0Potential Acres Plan Seeped 0Explain Has not been irrigated for many yearsCondition of System Original dam out new dam and dike put in last year but res. has not filled yet.Adequate Supply Yes No ☒Explain only available water is flood from Garden Creek.Topography ValleyInformation From Thelma V PopeRemarks 737-7/12/69, 740-4/14/65, 741-1/24/67

original place was desert claim and had water diverted
from dam in Garden Crk. Pope has just put in new dam and
dikes but reservoir has never filled yet because SH has
two dams in above him.

Sec. 28

nt.

Plan





NOTICE
These forms are the
property of the State
of Montana and must
be returned.

STATE OF MONTANA
STATE ENGINEERS OFFICE

FORM WR-1-28 12-47

Code No. 32A

County Buster

T. 2N R. 45E

Water Resources Survey

Name of Land Owner Thelma Pope

Address Barland, Mont.

Name of Operator

Address

Part A

TO BE FILED BY THOSE OBTAINING IRRIGATION WATER FROM
A DITCH COMPANY OR IRRIGATION DISTRICT

1. Water is delivered by: _____
Name of Ditch, Ditch Company or District Supplying Water
2. State the number of acres you irrigate under this system _____ Shares you hold _____
3. If you obtain water from more than one Company, give the number of shares, acres irrigated and the name of the Company under "Remarks." If you obtain water from a Ditch Company and also have a private system fill in both Part A and Part B.

Part B

TO BE FILED BY THOSE WHO HAVE A PRIVATE DITCH, PUMP OR IRRIGATION SYSTEM
or those who have a private water right under a Ditch Company

4. In what year was this land first irrigated? Date See attached filing
5. Give the name of the original appropriator (first user): Pope + Howard
6. Give the date appropriated 9/30/07 Amount filed on: Miners Inches 1000 C. F. S.
7. State the total number of acres irrigated under this system: _____
8. Give the point of diversion: _____ $\frac{1}{4}$ Section _____ Township _____ Range _____

Part C

TO BE FILED BY ALL WATER USERS IN ADDITION TO PART A OR PART B

9. Source of Water: Caullee Link to Tongue River
Name of stream or lake from which water is originally diverted
10. Water is obtained by: (Check one) Gravity ☒ Pumping _____ Other _____
11. What is the greatest number of acres you have irrigated? 9.0 Date _____
12. How many acres did you irrigate in 1947? (Crop and pasture) 0
13. State the total number of additional acres that could be irrigated by increasing the water supply, land leveling, etc. 9.0 This land is under what ditch? Pope flood ditch
14. How many acres of seeped land do you have which could be drained and put into production? _____
15. What is the condition of your irrigation system? Out of use like washed out
16. Is your water supply adequate? Yes _____ No ☒ Explain Flood loss
17. REMARKS: _____

Over

NOTE: The foregoing questions apply only to irrigated land shown on this plat.

DESCRIPTION AND MAP OF FARM

18. Legal Description of this Farm

NW 1/4, N 25 N 1/4, NW 1/4 SE 1/4, SW 1/4 NE 1/4

Sec 32 - 2 N, 4 SE.



None at Present
IRRIGATED LAND



NON-IRRIGATED LAND

North

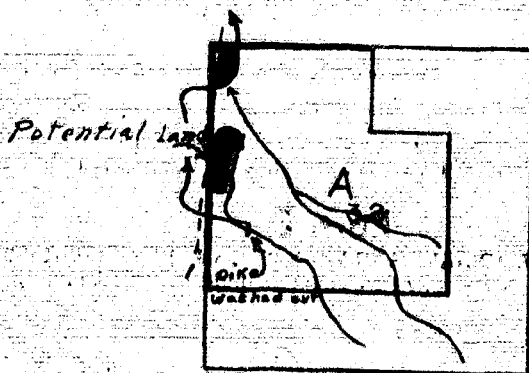

West

East

South

Remember: survey
only irrigated land.
All ownership for
dry land not shown.

19. If the above land is irrigated from more than one ditch please give the acreage under each ditch in 19A and indicate the location of the land irrigated from each on the above map.

19A. Ditch:

Pope Island ditch

Acre: 2

Ditch:

Acre:

Information supplied by:

Name

Field survey

Address

Date

6/3/47

REMARKS:

None, Joe, Jim Cash

If you cannot answer all of the questions on this form answer as many as you can and return the form to us as soon as possible.

STATE ENGINEER'S OFFICE
WATER RESOURCES SURVEYCOUNTY CusterFILE NO. 66-T.2N-R.45EOwner Pope, ThelmaAddress Garland, Montana

AAA Owner

Address

Operator

Address

New Owner

Address

New Operator

Address

Assessment Record NoneAssessed Acreage 0Legal Description of This Farm NW⁴, N²SW⁴, NW⁴SE⁴, SW⁴NE⁴, Sec. 32,T.2N-R.45ETotal Acres in Farm ✓Code Number 32APhoto No. Ma 29-30

AAA Contract No.

AAA Total Cropland Acreage

App. No. 1003

Decree No.

Land is located in

Twp. 2N Rge. 15 Twp. Rge.

Twp. Rge. Twp. Rge.

Filed in Twp. 2N Rge. 15ERemarks This land is ex-
pected by R.L. Rhea

Tongue River Basin

Demarcating lines
only irrigated land.
All owner up to
dry land not shown.see attached
WR. 2
for farm map.